



CONSTRUCTION SUMMARY

Lot: 8  
Model: 42.03 A FORESTCREST  
Project/Phase: Pine Valley Forevergreen / 1

APPLIANCES

Invoice	Qty.	Description
2505 72,282  22Dec20 **	1	ADDITIONAL 220V RECEPTACLE ON A SEPARATE CIRCUIT - FOR BUILT-IN WALL OVEN - APPLIANCE NOT INCLUDED - DOES NOT INCLUDE BREAKER THAT IS TO BE INSTALLED BY LICENSED ELECTRICIAN AND ARRANGED BY HOMEOWNER AFTER CLOSING
2583  16Mar21 NoCat	1	APPLIANCE SPECIFICATIONS ATTACHED - SIGNED COPY
2664  25Mar21 NoCat	1	SPICE KITCHEN HOOD FAN SPECIFICATION - SIGNED COPY

BASEMENT WINDOWS

Invoice	Qty.	Description
2505 72,351 22Dec20	2	BASEMENT WINDOWS - UPGRADE BASEMENT WINDOW SIZE TO 30 " X 24" - 8" FRAME

CERAMIC

Invoice	Qty.	Description
2583 19 16Mar21	1	FOYER: TILE, FLOOR - GROUT UPGRADE
2583 37 16Mar21	1	POWDER ROOM: TILE, FLOOR , LEVEL 5 - 12x24" LAID IN STRAIGHT, STACKED PATTERN. SEE PLAN FOR TILE DIRECTION
2583 19 16Mar21	1	POWDER ROOM: TILE, FLOOR - GROUT UPGRADE
2583 34 16Mar21	1	MASTER ENSUITE: TILE, FLOOR , LEVEL 2 - 8X8" LAID IN STRAIGHT, STACKED PATTERN.
2583 48 16Mar21	1	MASTER ENSUITE: TILE, WALL, LEVEL 2 - 8X24" LAID IN HORIZONTAL STACKED PATTERN.
2583 37 16Mar21	1	ENSUITE 3: TILE, FLOOR , LEVEL 5 - 12x24" LAID IN STRAIGHT, STACKED PATTERN. SEE PLAN FOR TILE DIRECTION
2583 19 16Mar21	1	ENSUITE 3: TILE, FLOOR - GROUT UPGRADE





CONSTRUCTION SUMMARY

Lot: 8  
Model: 42.03 A FORESTCREST  
Project/Phase: Pine Valley Forevergreen / 1

CERAMIC

Invoice	Qty.	Description
2583 21 16Mar21	1	ENSUITE 3: TILE GROUT UPGRADE, WALL, UPG GROUT
2583 36 16Mar21	1	FOYER: TILE, FLOOR , LEVEL 4 - 12x24" LAID IN STRAIGHT, STACKED PATTERN. SEE PLAN FOR DIRECTION
2583  16Mar21 NoCat	1	FYI - KITCHEN/BREAKFAST: (NOT SPICE KITCHEN) VINTAGE SERIES, 5" RED OAK, NSS ENGINEERED HARDWOOD, 3/4" THK, SCULPTED TEXTURE, UVF FINISH - LEVEL 4  DO NOT SUPPLY / INSTALL TILE (CREDIT)
2775  26May21 NoCat	1	ENSUITE 3: SHOWER TILE RE-SELECTION  PLEASE REFERENCE ATTACHED UPDATED COLOUR CHART FOR RE-SELECT

CONCRETE AND DRAIN

Invoice	Qty.	Description
2505  22Dec20 NoCat	1	BACKFLOW PREVENTER VALVE

CROWN MOULDING

Invoice	Qty.	Description
2505  22Dec20 NoCat	1	.GREAT ROOM: MODEL OPTIONS 42.03 - GREAT ROOM - OPT. WAFFLE CEILING, BEAM DETAIL AS PER PLAN (8 BOXES) OPTION #1 CTR-B07
2505  22Dec20 NoCat	1	.LIVING ROOM: MODEL OPTIONS 42.03 OPT. WAFFLE CEILING, BEAM DETAIL AS PER PLAN (4 BOXES) OPTION # 1 CTR-B07





CONSTRUCTION SUMMARY

Lot: 8  
Model: 42.03 A FORESTCREST  
Project/Phase: Pine Valley Forevergreen / 1

DRYWALL

Invoice	Qty.	Description
2505 72,351 22Dec20 **	2	BASEMENT WINDOWS - UPGRADE BASEMENT WINDOW SIZE TO 30 " X 24" - 8" FRAME
2505 72,484 22Dec20	1	GREAT ROOM: MODEL OPTIONS 42.03 - GREAT ROOM - OPT. COFFERED CEILING AS PER PLAN
2505 72,486 22Dec20	1	GREAT ROOM: MODEL OPTIONS 42.03 - GREAT ROOM - OPT. WAFFLE CEILING, BEAM DETAIL AS PER PLAN (8 BOXES) OPTION #1 CTR-B07
2505 72,498 22Dec20	1	LIVING ROOM: MODEL OPTIONS 42.03 - LIVING ROOM - OPT. COFFERED CEILING AS PER PLAN
2505 72,489 22Dec20	1	LIVING ROOM: MODEL OPTIONS 42.03 OPT. WAFFLE CEILING, BEAM DETAIL AS PER PLAN (4 BOXES) OPTION # 1 CTR-B07
2505 72,282 22Dec20 **	1	ADDITIONAL 220V RECEPTACLE ON A SEPARATE CIRCUIT - FOR BUILT-IN WALL OVEN - APPLIANCE NOT INCLUDED - DOES NOT INCLUDE BREAKER THAT IS TO BE INSTALLED BY LICENSED ELECTRICIAN AND ARRANGED BY HOMEOWNER AFTER CLOSING
2505  22Dec20 NoCat	1	.**CUSTOM LAYOUT** BEDROOM 2: DELETE 'HIS' WIC, RELOCATE DOOR TO CREATE WIC FOR BEDROOM 2 - SEE PLAN FOR LOCATION
2505  22Dec20 NoCat	1	.**CUSTOM LAYOUT** UPPER HALL - DELETE REACH-IN CLOSET FROM BEDROOM 2 - RELOCATE DOORS TO MAKE ACCESSIBLE FROM UPPER HALL. *LEAVE LINEN CLOSET* THIS WILL BE DOUBLE DOOR CLOSET *BESIDE LINEN CLOSET*
2505  22Dec20 NoCat	1	.***CUSTOM LAYOUT*** SPICE KITCHEN  INCLUDES POCKET DOORS + ELECTRICAL FOR COOKTOP+ COUNTER PLUGS + RELOCATE SINK - BASED ON STANDARD FINISHES (APPLIANCES AND HOOD FAN NOT INCLUDED)
2505  22Dec20 NoCat	1	.MASTER ENSUITE: SHOWER NICHE [SHAMPOO SHELF] - COMPLETE WITH MATCHING MARBLE JAMBS ON 4 SIDES, STANDARD TILE, APPROX. 12 X 18 INSTALLED VERTICALLY - SEE PLAN FOR LOCATION
2505  22Dec20 NoCat	1	.BREAKFAST ROOM: UPGRADE EXTERIOR GARDEN DOORS TO 96" *FRENCH DOOR* ASSEMBLY - BOTH DOORS OPEN
2505  22Dec20 NoCat	1	.**CUSTOM LAYOUT** ADD SIDE ENTRANCE DOOR TO GARAGE - COMPLETE WITH LIGHT AND STANDARD FINISHES





CONSTRUCTION SUMMARY

Lot: 8  
Model: 42.03 A FORESTCREST  
Project/Phase: Pine Valley Forevergreen / 1

ELECTRICAL

Invoice	Qty.	Description
2505 72,351 22Dec20 **	2	BASEMENT WINDOWS - UPGRADE BASEMENT WINDOW SIZE TO 30 " X 24" - 8" FRAME
2505 72,281 22Dec20	1	GREAT ROOM: INTERIOR WALL OUTLET: ADDITIONAL 110V WALL INTERIOR RECEPTACLE ON EXISTING CIRCUIT FOR WALL MOUNTED TV - LOCATE APPROX 66" A.F.F ABOVE FIREPLACE
2505 72,307 22Dec20	1	KITCHEN: FIXTURE: RELOCATE STANDARD CEILING MOUNT FIXTURE - LOCATE APPROX CENTERED ABOVE ISLAND
2505 72,289 22Dec20	6	KITCHEN: 4" E/S LED INTERIOR POT LIGHT - GROUND FLOOR - EACH - INCLUDES 1 SWITCH  INCLUDED IN APS
2505 72,273 22Dec20	1	KITCHEN: 110V WALL RECEPTACLE ON SEPARATE CIRCUIT - GAS FIRED COOKTOP - FOR AUX. EQUIPMENT - NOT A STOVE PLUG
2505 72,282 22Dec20	1	ADDITIONAL 220V RECEPTACLE ON A SEPARATE CIRCUIT - FOR BUILT-IN WALL OVEN - APPLIANCE NOT INCLUDED - DOES NOT INCLUDE BREAKER THAT IS TO BE INSTALLED BY LICENSED ELECTRICIAN AND ARRANGED BY HOMEOWNER AFTER CLOSING
2505  22Dec20 NoCat	1	.***CUSTOM LAYOUT*** SPICE KITCHEN  INCLUDES POCKET DOORS + ELECTRICAL FOR COOKTOP+ COUNTER PLUGS + RELOCATE SINK - BASED ON STANDARD FINISHES (APPLIANCES AND HOOD FAN NOT INCLUDED)
2505  22Dec20 NoCat	1	.GREAT ROOM: MODEL OPTIONS 42.03 - GREAT ROOM - OPT. WAFFLE CEILING, BEAM DETAIL AS PER PLAN (8 BOXES) OPTION #1 CTR-B07
2505  22Dec20 NoCat	1	.LIVING ROOM: MODEL OPTIONS 42.03 OPT. WAFFLE CEILING, BEAM DETAIL AS PER PLAN (4 BOXES) OPTION # 1 CTR-B07
2505  22Dec20 NoCat	1	.**CUSTOM LAYOUT** ADD SIDE ENTRANCE DOOR TO GARAGE - COMPLETE WITH LIGHT AND STANDARD FINISHES





CONSTRUCTION SUMMARY

Lot: 8  
Model: 42.03 A FORESTCREST  
Project/Phase: Pine Valley Forevergreen / 1

FORMING

Invoice	Qty.	Description
2504 72,483 03Nov20	1	MODEL OPTIONS 42.03 - KITCHEN - OPT. COVERED LOGGIA AS PER PLAN  NO COLD CELLAR BELOW
2505  22Dec20 NoCat	1	**CUSTOM LAYOUT** ADD SIDE ENTRANCE DOOR TO GARAGE - COMPLETE WITH LIGHT AND STANDARD FINISHES

FRAMING

Invoice	Qty.	Description
2505  22Dec20 NoCat	1	**CUSTOM LAYOUT** BEDROOM 2: DELETE 'HIS' WIC, RELOCATE DOOR TO CREATE WIC FOR BEDROOM 2 - SEE PLAN FOR LOCATION
2505  22Dec20 NoCat	1	**CUSTOM LAYOUT** UPPER HALL - DELETE REACH-IN CLOSET FROM BEDROOM 2 - RELOCATE DOORS TO MAKE ACCESSIBLE FROM UPPER HALL. *LEAVE LINEN CLOSET* THIS WILL BE DOUBLE DOOR CLOSET *BESIDE LINEN CLOSET*
2505  22Dec20 NoCat	1	***CUSTOM LAYOUT*** SPICE KITCHEN  INCLUDES POCKET DOORS + ELECTRICAL FOR COOKTOP+ COUNTER PLUGS + RELOCATE SINK - BASED ON STANDARD FINISHES (APPLIANCES AND HOOD FAN NOT INCLUDED)
2505 72,631 22Dec20	1	MASTER ENSUITE: SHOWER NICHE [SHAMPOO SHELF] - COMPLETE WITH MATCHING MARBLE JAMBS ON 4 SIDES, STANDARD TILE, APPROX. 12 X 18 INSTALLED VERTICALLY - SEE PLAN FOR LOCATION
2505  22Dec20 NoCat	1	.GREAT ROOM: MODEL OPTIONS 42.03 - GREAT ROOM - OPT. COFFERED CEILING AS PER PLAN
2505  22Dec20 NoCat	1	.GREAT ROOM: MODEL OPTIONS 42.03 - GREAT ROOM - OPT. WAFFLE CEILING, BEAM DETAIL AS PER PLAN (8 BOXES) OPTION #1 CTR-B07
2505  22Dec20 NoCat	1	.LIVING ROOM: MODEL OPTIONS 42.03 - LIVING ROOM - OPT. COFFERED CEILING AS PER PLAN
2505  22Dec20 NoCat	1	.LIVING ROOM: MODEL OPTIONS 42.03 OPT. WAFFLE CEILING, BEAM DETAIL AS PER PLAN (4 BOXES) OPTION # 1 CTR-B07
2505  22Dec20 NoCat	1	.BREAKFAST ROOM: UPGRADE EXTERIOR GARDEN DOORS TO 96" *FRENCH DOOR* ASSEMBLY - BOTH DOORS OPEN
2505  22Dec20 NoCat	1	**CUSTOM LAYOUT** ADD SIDE ENTRANCE DOOR TO GARAGE - COMPLETE WITH LIGHT AND STANDARD FINISHES





CONSTRUCTION SUMMARY

Lot: 8  
Model: 42.03 A FORESTCREST  
Project/Phase: Pine Valley Forevergreen / 1

GLASS AND MIRROR

Invoice	Qty.	Description
2583  16Mar21 NoCat	2	MASTER ENSUITE + ENSUITE 3: UPGRADE SHOWER DOOR HARDWARE - MT 6X6 - MATTE BLACK + HINGES
2583  16Mar21 NoCat	1	ENSUITE 4: UPGRADE HARDWARE TO MT6X6 - CHROME

GRANITE MARBLE QUARTZ

Invoice	Qty.	Description
2505  22Dec20 NoCat	1	.MASTER ENSUITE: SHOWER NICHE [SHAMPOO SHELF] - COMPLETE WITH MATCHING MARBLE JAMBS ON 4 SIDES, STANDARD TILE, APPROX. 12 X 18 INSTALLED VERTICALLY - SEE PLAN FOR LOCATION
2505  22Dec20 NoCat	1	.KITCHEN: ADD COMPLETE BAR SINK TO ISLAND (SINK/FAUCET/PLUMBING) AT ISLAND - COMPLETE WITH STANDARD FINISHES
2583  16Mar21 NoCat	1	POWDER ROOM: UPGRADE 6 QUARTZ COUNTER
2583  16Mar21 NoCat	1	KITCHEN: PERIMETER - UPGRADE 3 QUARTZ COUNTER ISLAND - UPGRADE 6 QUARTZ COUNTER
2583  16Mar21 NoCat	2	KITCHEN: ISLAND WATERFALL LEGS - UPGRADE 6
2583  16Mar21 NoCat	1	SPICE KITCHEN: ADD STANDARD LEVEL FULL HEIGHT BACKSPLASH AT COOKTOP + COOKTOP CUT OUT
2583  16Mar21 NoCat	1	ENSUITE 3: UPGRADE 1 QUARTZ COUNTER
2583  16Mar21 NoCat	1	KITCHEN: FULL HEIGHT QUARTZ SLAB BACKSPLASH - LEVEL 6
2696  14Apr21 NoCat	1	KITCHEN: EXTEND CABINET BASE + COUNTER BESIDE DISHWASHER + DELETE UPPERS AT LONG WALL  KITCHEN: EXTENDED COUNTER TOP - SEE ATTACHED REVISED PLANS





CONSTRUCTION SUMMARY

Lot: 8  
Model: 42.03 A FORESTCREST  
Project/Phase: Pine Valley Forevergreen / 1

HARDWOOD

Invoice	Qty.	Description
2583 7 16Mar21	1	THRU OUT - ALL STANDARD AREAS: MAIN HALL/LIVING ROOM/DINING ROOM/STUDY/GREAT ROOM/UPPER HALL/STUDY LOFT/MASTER BEDROOM/BEDROOM 2/BEDROOM 3/BEDROOM 4 - VINTAGE SERIES, 5" WHITE OAK, NSS ENGINEERED HARDWOOD, 3/4" THK, SCULPTED TEXTURE, UVF FINISH - LEVEL 4
2583 6 16Mar21	1	KITCHEN/BREAKFAST: (NOT SPICE KITCHEN) VINTAGE SERIES, 5" RED OAK, NSS ENGINEERED HARDWOOD, 3/4" THK, SCULPTED TEXTURE, UVF FINISH - LEVEL 4

HVAC

Invoice	Qty.	Description
2505 72,224 22Dec20	1	KITCHEN: GAS LINE ROUGH-IN - MAIN FLOOR FOR GAS COOKTOP - SEE PLAN FOR LOCATION

INTERIOR TRIM AND DOORS

Invoice	Qty.	Description
2505  22Dec20 NoCat	1	.**CUSTOM LAYOUT** BEDROOM 2: DELETE 'HIS' WIC, RELOCATE DOOR TO CREATE WIC FOR BEDROOM 2 - SEE PLAN FOR LOCATION
2505  22Dec20 NoCat	1	.**CUSTOM LAYOUT** UPPER HALL - DELETE REACH-IN CLOSET FROM BEDROOM 2 - RELOCATE DOORS TO MAKE ACCESSIBLE FROM UPPER HALL. *LEAVE LINEN CLOSET* THIS WILL BE DOUBLE DOOR CLOSET *BESIDE LINEN CLOSET*
2505  22Dec20 NoCat	1	.BREAKFAST ROOM: UPGRADE EXTERIOR GARDEN DOORS TO 96" *FRENCH DOOR* ASSEMBLY - BOTH DOORS OPEN
2505  22Dec20 NoCat	1	.**CUSTOM LAYOUT** ADD SIDE ENTRANCE DOOR TO GARAGE - COMPLETE WITH LIGHT AND STANDARD FINISHES





CONSTRUCTION SUMMARY

Lot: 8  
Model: 42.03 A FORESTCREST  
Project/Phase: Pine Valley Forevergreen / 1

KITCHEN AND BATH CABINETRY

Invoice	Qty.	Description
2505 72,282 22Dec20 **	1	ADDITIONAL 220V RECEPTACLE ON A SEPARATE CIRCUIT - FOR BUILT-IN WALL OVEN - APPLIANCE NOT INCLUDED - DOES NOT INCLUDE BREAKER THAT IS TO BE INSTALLED BY LICENSED ELECTRICIAN AND ARRANGED BY HOMEOWNER AFTER CLOSING
2505  22Dec20 NoCat	1	.***CUSTOM LAYOUT*** SPICE KITCHEN  INCLUDES POCKET DOORS + ELECTRICAL FOR COOKTOP+ COUNTER PLUGS + RELOCATE SINK - BASED ON STANDARD FINISHES (APPLIANCES AND HOOD FAN NOT INCLUDED)
2583  16Mar21 NoCat	1	SEE ATTACHED CABINETRY SCHEDULE
2583  16Mar21 NoCat	1	FYI - KITCHEN: ISLAND WATERFALL LEGS - UPGRADE 6
2696 101,930 14Apr21	1	KITCHEN: EXTEND CABINET BASE + COUNTER BESIDE DISHWASHER + DELETE UPPERS AT LONG WALL  SEE ATTACHED FOR REVSIED PLAN

NETWORK AND WIRING

Invoice	Qty.	Description
2505 72,258 22Dec20	1	GREAT ROOM: ADDITIONAL CAT6 ETHERNET OUTLET - EACH SEE PLAN FOR LOCATION
2505 72,259 22Dec20	1	GREAT ROOM: CONDUIT PIPE - FOR WALL MOUNT TV - LOCATE APPROX 66" A.F.F. ABOVE FIREPLACE, THRU BASEMENT, TERMINATE AT CABLE LOCATION - SEE PLAN
2505 72,258 22Dec20	2	MASTER BEDROOM / BEDROOM 2: ADDITIONAL CAT6 ETHERNET OUTLET - EACH SEE PLAN FOR LOCATION





CONSTRUCTION SUMMARY

Lot: 8  
Model: 42.03 A FORESTCREST  
Project/Phase: Pine Valley Forevergreen / 1

PAINT

Invoice	Qty.	Description
2505  22Dec20 NoCat	1	.**CUSTOM LAYOUT** BEDROOM 2: DELETE 'HIS' WIC, RELOCATE DOOR TO CREATE WIC FOR BEDROOM 2 - SEE PLAN FOR LOCATION
2505  22Dec20 NoCat	1	.**CUSTOM LAYOUT** UPPER HALL - DELETE REACH-IN CLOSET FROM BEDROOM 2 - RELOCATE DOORS TO MAKE ACCESSIBLE FROM UPPER HALL. *LEAVE LINEN CLOSET* THIS WILL BE DOUBLE DOOR CLOSET *BESIDE LINEN CLOSET*
2505  22Dec20 NoCat	1	.***CUSTOM LAYOUT*** SPICE KITCHEN  INCLUDES POCKET DOORS + ELECTRICAL FOR COOKTOP+ COUNTER PLUGS + RELOCATE SINK - BASED ON STANDARD FINISHES (APPLIANCES AND HOOD FAN NOT INCLUDED)
2505  22Dec20 NoCat	1	.GREAT ROOM: MODEL OPTIONS 42.03 - GREAT ROOM - OPT. COFFERED CEILING AS PER PLAN
2505  22Dec20 NoCat	1	.GREAT ROOM: MODEL OPTIONS 42.03 - GREAT ROOM - OPT. WAFFLE CEILING, BEAM DETAIL AS PER PLAN (8 BOXES) OPTION #1 CTR-B07
2505  22Dec20 NoCat	1	.LIVING ROOM: MODEL OPTIONS 42.03 - LIVING ROOM - OPT. COFFERED CEILING AS PER PLAN
2505  22Dec20 NoCat	1	.LIVING ROOM: MODEL OPTIONS 42.03 OPT. WAFFLE CEILING, BEAM DETAIL AS PER PLAN (4 BOXES) OPTION # 1 CTR-B07
2505  22Dec20 NoCat	1	.BREAKFAST ROOM: UPGRADE EXTERIOR GARDEN DOORS TO 96" *FRENCH DOOR* ASSEMBLY - BOTH DOORS OPEN
2505  22Dec20 NoCat	1	.**CUSTOM LAYOUT** ADD SIDE ENTRANCE DOOR TO GARAGE - COMPLETE WITH LIGHT AND STANDARD FINISHES
2583  16Mar21 NoCat	2	MAIN STAIRS - 2ND FLOOR TO BASEMENT - STAIN STAIRS AND LANDINGS  STAIRS AND LANDINGS WILL NOT MATCH HARDWOOD FLOORS IN COLOUR/TEXTURE/SPECIES





CONSTRUCTION SUMMARY

Lot: 8  
Model: 42.03 A FORESTCREST  
Project/Phase: Pine Valley Forevergreen / 1

PLUMBING

Invoice	Qty.	Description
2505  22Dec20 NoCat	1	KITCHEN: ADD COMPLETE BAR SINK TO ISLAND (SINK/FAUCET/PLUMBING) AT ISLAND - COMPLETE WITH STANDARD FINISHES
2505  22Dec20 NoCat	1	.BACKFLOW PREVENTER VALVE
2505  22Dec20 NoCat	1	***CUSTOM LAYOUT*** SPICE KITCHEN  INCLUDES POCKET DOORS + ELECTRICAL FOR COOKTOP+ COUNTER PLUGS + RELOCATE SINK - BASED ON STANDARD FINISHES (APPLIANCES AND HOOD FAN NOT INCLUDED)
2583  16Mar21 NoCat	1	KITCHEN ISLAND: UPGRADE SINK BLANCO PRECIS U 3/4 BAR SINK  SEE ATTACHED
2583  16Mar21 NoCat	1	KITCHEN SINK: BLANCO PRECIS CASCADE U/M  SEE ATTACHED
2583  16Mar21 NoCat	1	SPICE KITCHEN: KITCHEN SINK - 'BLANCO QUATRUS R15 U MEDIUM' - STAINLESS STEEL  SEE ATTACHED
2583 101,930 16Mar21	1	SPICE KITCHEN: MOEN 'SLEEK' FAUCET - CHROME





CONSTRUCTION SUMMARY

Lot: 8  
Model: 42.03 A FORESTCREST  
Project/Phase: Pine Valley Forevergreen / 1

STAIR AND RAILINGS

Invoice	Qty.	Description
2583 93,800 16Mar21	2	MAIN STAIRS: UPGRADE - EURONLINE (ALL PLAIN) PICKET, 3" HALF-ROUND W/V-GROOVE HANDRAIL, 3 1/2" ALL SQUARE POST WITH PYRAMID TOP POST CAP - PACKAGE A-2

WINDOWS AND DOORS

Invoice	Qty.	Description
2505  22Dec20 NoCat	1	BREAKFAST ROOM: UPGRADE EXTERIOR GARDEN DOORS TO 96" *FRENCH DOOR* ASSEMBLY - BOTH DOORS OPEN
2505  22Dec20 NoCat	1	.**CUSTOM LAYOUT** ADD SIDE ENTRANCE DOOR TO GARAGE - COMPLETE WITH LIGHT AND STANDARD FINISHES
2505 72,351 22Dec20 **	2	BASEMENT WINDOWS - UPGRADE BASEMENT WINDOW SIZE TO 30 " X 24" - 8" FRAME



Scheduled Closing Date: May 20, 2021

Purchasers: SUKHJITPAL SINGH & JASKARAN SINGH Property: 8 of Plan -

Telephone Res. / Bus: / (647) 703-9131

Project: Pine Valley Forevergreen - Phase 1

Decor Advisor: Yolande Somerville

Model and Elevation: 42.03 A FORESTCREST

Layout Changes: ☒ Yes ☐ No

Sketch Attached: ☒ Yes ☐ No

Exterior Colour Scheme:

### 1. Cabinetry

	Style and Colour	Counter	Hardware
Kitchen / Breakfast	*2-TONE	*2-TONE	attached
Laundry Room	Wexford 'Tan'	P-Lam: Standard White	attached
Powder Room	Chesapeake 'Classic White'	*Quartz: Nordic Loft	attached
SPICE KITCHEN	Chesapeake 'Classic White'	*Quartz: Arctic White HP	attached
Master Ensuite Bathroom	Alban Oak 'Storm Grey'	Quartz: Ice Snow	attached
Second Ensuite Bathroom (If Applicable)	Chesapeake 'Pewter'	*Quartz: Ice Snow	attached
Ensuite 3	Alban oak 'Storm Grey'	Quartz: Jet Black	attached

#### Comment

Kitchen Perimeter: Medio 6 'Pitch Black' + Quartz: Pure White // Kitchen Island: Medio 6 'Oyster' + Quartz: Eternal Noir // Ensuite 4: Wexford 'Tan' + Quartz: Nordic Loft // Mud Room: Wexford 'Tan' + P-Lam std white

### 2. Floor Tile

	Selection
Entrance Vestibule	*12x24" Reve 'Nuit' + charcoal grout
Main Hall	
Kitchen / Breakfast	hardwood
Laundry Room	13x13" Venus 'Brown'
Powder Room	*12x24" Marmorea matte 'Port Laurent' + charcoal grout
Spice Kitchen	13x13" New Reeds 'Taupe'
Master Ensuite Bathroom	8x8" Marakesh Decor Mix 1 Matte
Second Ensuite Bathroom (If Applicable)	13x13" Cambridge 'White' Matte
Lower Landing (If Applicable)	13x13" New Reeds 'Taupe' (basement foyer)
Ensuite 3	12x24" Marmorea 'Port Laurent' matte + charcoal grout

#### Comment

Mud Room: 13x13" New Reeds 'Taupe' // Ensuite 4: 13x13" Serpentine 'Beyaz' white // Shower Floors thru out: Standard 2x2" white

\*REVISED\*

May 26, 2021

attach

### 3. Wall Tile

	Selection	Listello/Inserts	Describe
Ensuite 3	8x10" Weave 'White' + chrcoal grou	<input type="radio"/> Yes <input checked="" type="radio"/> No	
Master Ensuite Bathroom			
Tub Deck		<input type="radio"/> Yes <input checked="" type="radio"/> No	
Shower Stall	8x24" Laguna 'White-Wave'	<input type="radio"/> Yes <input checked="" type="radio"/> No	
Bathroom Walls	→ Lindt 'White' Matte	<input type="radio"/> Yes <input checked="" type="radio"/> No	
Second Ensuite Bathroom (If Applicable)	8x10" Weave 'White'	<input type="radio"/> Yes <input checked="" type="radio"/> No	
Ensuite 4	8x10" Weave 'White'	<input type="radio"/> Yes <input checked="" type="radio"/> No	
Kitchen Backsplash	<input checked="" type="radio"/> Yes <input type="radio"/> No	Backsplash Behind Fridge	

#### Comment

SPICE KITCHEN BACKSPLASH: FHBS same as spice kitchen counter: Arctic White

KS

\*Revised\* March 17, 2021

attach



Scheduled Closing Date: May 20, 2021

Purchasers: SUKHJITPAL SINGH &amp; JASKARAN SINGH Property: 8 of Plan -

Telephone Res. / Bus: / (647) 703-9131

Project: Pine Valley Forevergreen - Phase 1

Decor Advisor: Yolande Somerville

Model and Elevation: 42.03 A FORESTCREST

## 4. Plumbing Fixtures

<input type="checkbox"/>	Second Ensuite	<input type="checkbox"/>	Powder Room	<input type="checkbox"/>	
Master Ensuite Bathroom	<input type="checkbox"/>	Other Room - Specify	<input type="checkbox"/>	Other Washroom	<input type="checkbox"/>

Comment

see extras

## 5. Hardwood Flooring

	Type and Stain		Type and Stain
Main Hall	<input type="text"/>	Upper Landing	<input type="text"/>
Kitchen / Breakfast	*3/4x5" White oak sculpted 'Apollo'	Upper Hall	<input type="text"/>
Living Room	<input type="text"/>	Master Bedroom	<input type="text"/>
Dining Room	<input type="text"/>	Bedroom #2	<input type="text"/>
Family Room	<input type="text"/>	Bedroom #3	<input type="text"/>
Den/Library	<input type="text"/>	Bedroom #4	<input type="text"/>
Entrance Vestibule	<input type="text"/>	Bedroom #5	<input type="text"/>
Lower Landing (If Applicable)	<input type="text"/>	Other Room - Specify	<input type="text"/>
		Thru out standard areas	*3/4x5" White oak sculpted 'Apollo'

Comment

## 6. Carpeting

	Upgrade	Description
Ground Floor	<input type="checkbox"/>	<input type="text"/>
Second Floor	<input type="checkbox"/>	<input type="text"/>
<input type="text"/>	<input type="checkbox"/>	<input type="text"/>

Upgrade Underpad

Type

Area

Carpet on Stairs

Capped

Runner - \*Upgrade

Comment

## 7. Fireplace

	Living Room			Family Room			Other Room - Specify		
	Purchased	As Per Plan	N/A	Purchased	As Per Plan	N/A	Purchased	As Per Plan	N/A
Fireplace Type	<input type="radio"/>	<input type="radio"/>	<input checked="" type="radio"/>	<input type="radio"/>	<input checked="" type="radio"/>	<input type="radio"/>	<input type="radio"/>	<input type="radio"/>	<input checked="" type="radio"/>
Mantle Type	<input type="text"/>			Standard Gas			<input type="text"/>		
Colour / Stain	<input type="text"/>			Mediterranean			<input type="text"/>		
Surround	<input type="text"/>			Arctic White			<input type="text"/>		
Hearth	<input type="text"/>			n/a			<input type="text"/>		
	<input type="text"/>			none			<input type="text"/>		

Comment

15

attach

March 17, 2021



Scheduled Closing Date: May 20, 2021

Purchasers: SUKHJITPAL SINGH &amp; JASKARAN SINGH Property: 8 of Plan -

Telephone Res. / Bus: / (647) 703-9131

Project: Pine Valley Forevergreen - Phase 1

Decor Advisor: Yolande Somerville

Model and Elevation: 42.03 A FORESTCREST

## 8. Trim Carpentry

Interior Doors Carrara std Front Door Glass Inserts standard Door Handles standard  
Interior Trim standard  
Comment

## 9. Plaster Mouldings and Medallions

Standard Throughout ☐ Yes ☐ No ☒ N/A

Entrance Vestibule			Kitchen/Breakfast		
Main Hall			Den/Library		
Living Room			Lower Landing		
Dining Room			Other Room - Specify		
Family Room					

Comment

## 10. Railings and Spindles

Railing Package A-2 package  
Railing Colour Hopscotch  
Stringer / Riser Hopscotch  
Spindle Colour Black  
Treads Hopscotch  
Oak Stairs ☒ Yes ☐ No ☐ N/A

Comment

## 11. Wall Paint / Ceilings

Throughout Finished Areas Cool White

Trim Paint White

## Smooth Ceilings

Ground Floor ☒Second Floor ☒

Note

Comment



March 17, 2021

May 26, 2021





Purchasers: SUKHJITPAL SINGH & JASKARAN SINGH Property: 8 of Plan -

Telephone Res. / Bus: / (647) 703-9131

Project: Pine Valley Forevergreen - Phase 1

Decor Advisor: Yolande Somerville

Model and Elevation: 42.03 A FORESTCREST

### 12. Electrical

Hood Fan ☐ White ☐ Stainless ☐ N/A

Above Kitchen Cabinet Light ☐ Yes ☒ No

Standard Appliances ☐

Below Kitchen Cabinet Light ☐ Yes ☒ No

Over The Range Microwave ☐

Chimney Style Fan ☐

Comment

### 13. Heating and Air Conditioning

Air Conditioning

Gas Provisions Stove

Gas Provisions Dryer

Gas Provisions Barbecue

Comment

### 14. Additional Comments

### 15. Disclaimers and Notes

- Colours of all materials are as close as possible to builder's selection, but not necessarily identical due to variances in manufacturing.
- Any extras listed above are null and void unless accompanied by a separate invoice/amendment. Said invoice must be paid in full.
- The Purchaser acknowledges that after Interior Colour Selection form is signed and dated, no further changes will be permitted other than re-selection due to unavailability.  Purchaser's Initials
- The Purchaser acknowledges reading and accepting the "Gold Park Homes Decor Centre Disclaimers" form. This document contains other miscellaneous disclaimers.

This Interior Colour Selection is final and approved by:

Signature: 

Date: March 15, 2021

March 17, 2021

May 26, 2021



## Yolande Somerville

---

**From:** Sukhjital Singh <sukhjital.singh@icloud.com>  
**Sent:** Wednesday, May 26, 2021 9:55 AM  
**To:** Yolande Somerville  
**Subject:** Re: PV- 8 Shower tile Reselection

Hi,

I like Selection 1 for replacement of shower tile.

Thank you,  
Sukhjital.  
Sent from my iPhone

On May 25, 2021, at 12:42 PM, Yolande Somerville <YSomerville@goldparkhomes.com> wrote:

Hi Sukhjital,

We have just received word that the shower tile you've selected for your Master Ensuite is unavailable and a reselection is required. Please photo attached of a replacement option we have put together for you with your original selections for the room.

Thank you,

**Goldpark Homes Design Studio**  
55 Siltan Road, Unit 3  
Woodbridge, ON  
L4L 7Z8

<lot 8.png>

---

This email has been scanned for spam and viruses by Proofpoint Essentials. Click [here](#) to report this email as spam.



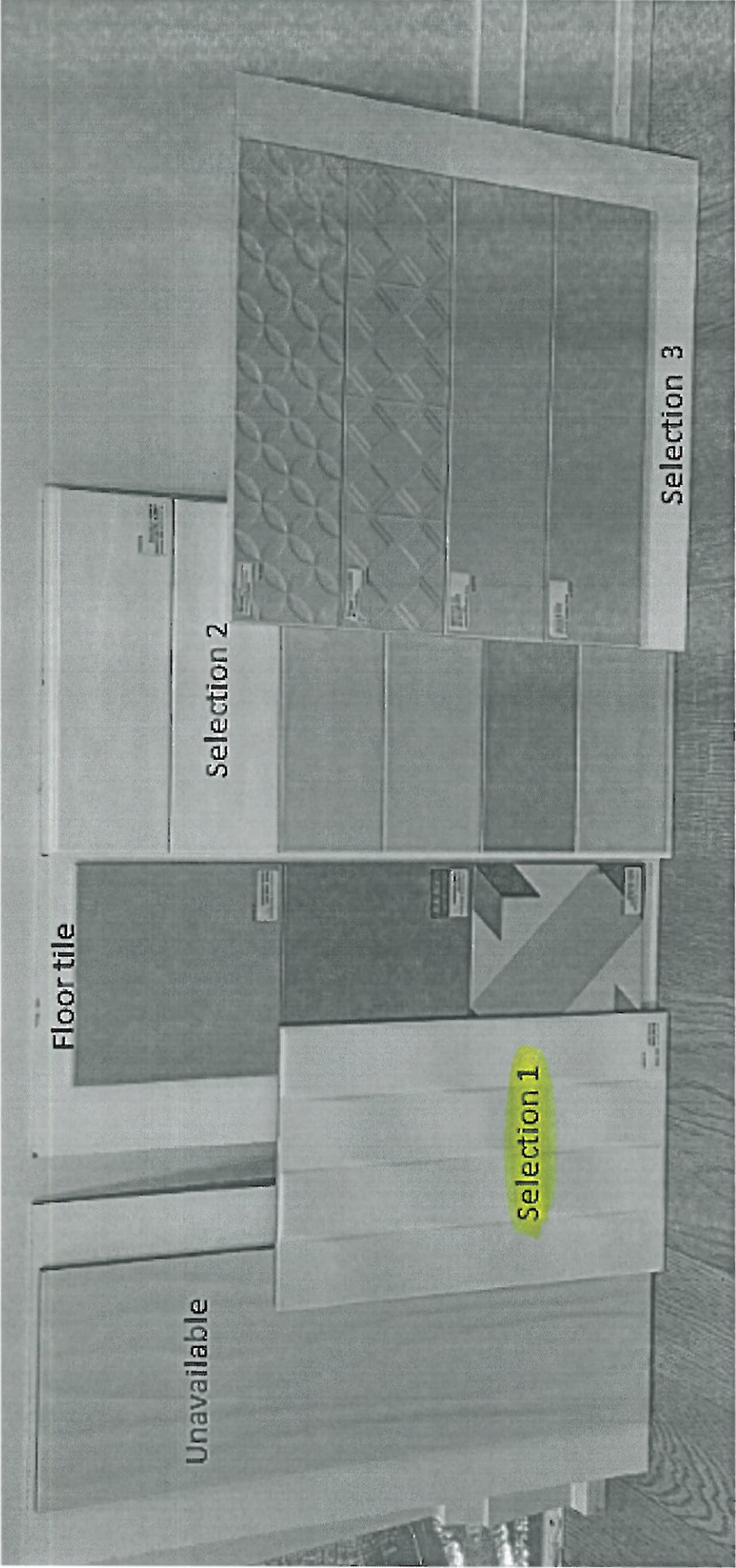



Prices, figures, illustrations, sizes, features and finishes are subject to change without notice. Areas and dimensions are approximate and actual usable floor space may vary from the stated area. Layout may be reverse of the unit purchased. E. & O.E. 4203



SCHEDULE 'F'



PV-8  
DEC 14 2020  
PV-8  
March, 15, 2021  
April 13, 2021

\* See attach \*

# The Forestcrest

## 42' SERIES

→ Elevation A • 3,800 sq.ft.  
Elevation B • 3,785 sq.ft.  
Elevation C • 3,800 sq.ft.

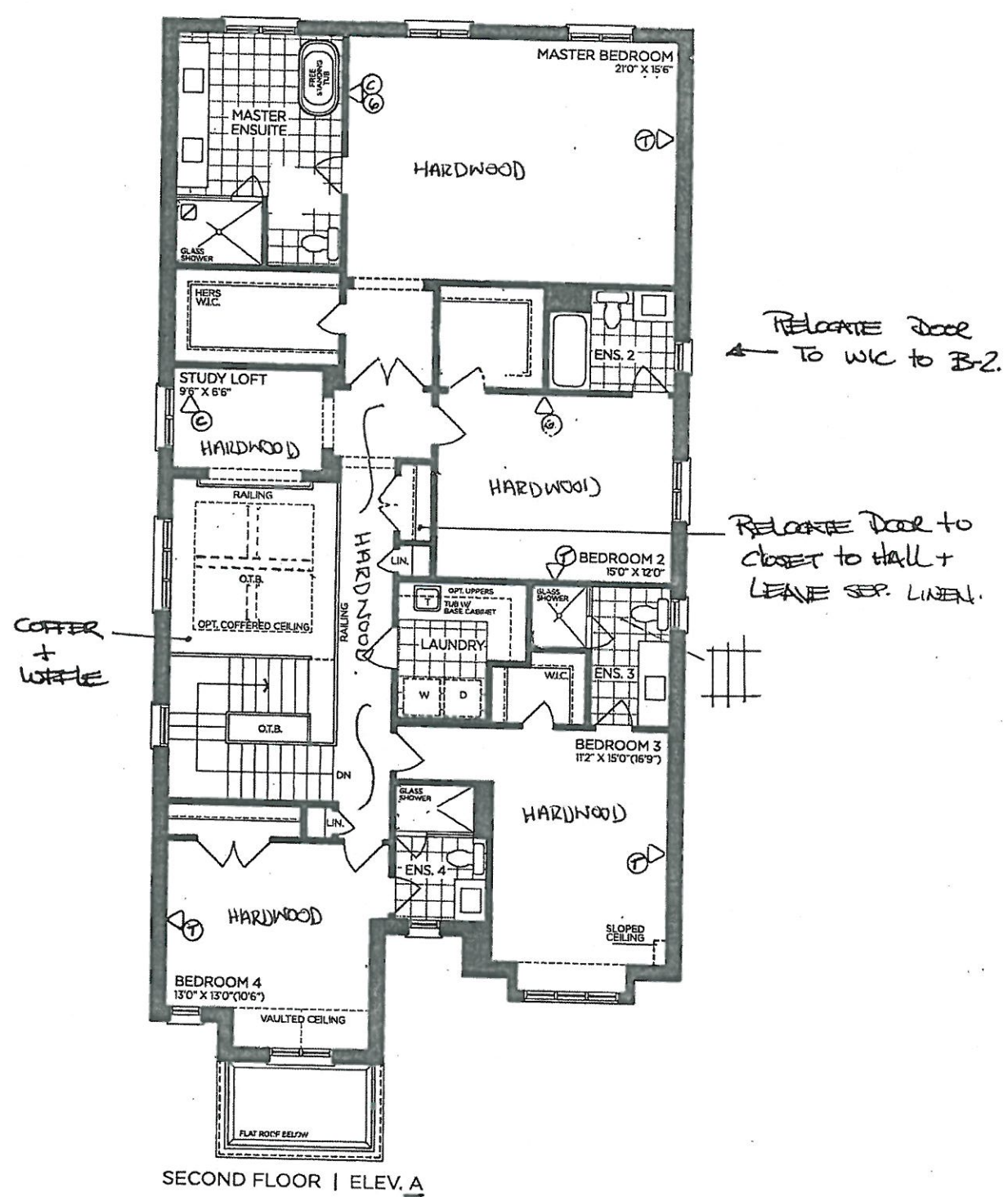

VENDOR

PURCHASER

PURCHASER

# GOLDPARK

WORTH MORE™

Prices, figures, illustrations, sizes, features and finishes are subject to change without notice. Areas and dimensions are approximate and actual usable floor space may vary from the stated area. Layout may be reverse of the unit purchased. E. & O.E. 4203



SCHEDULE 'F'



PV-8  
DEC 14 2020  
PV-8  
March 15, 2021  
April 13, 2021

fsa  
attach  
K

# The Forestcrest 42' SERIES

→ Elevation A • 3,800 sq.ft.  
Elevation B • 3,785 sq.ft.  
Elevation C • 3,800 sq.ft.

WOB (LOGS/H)

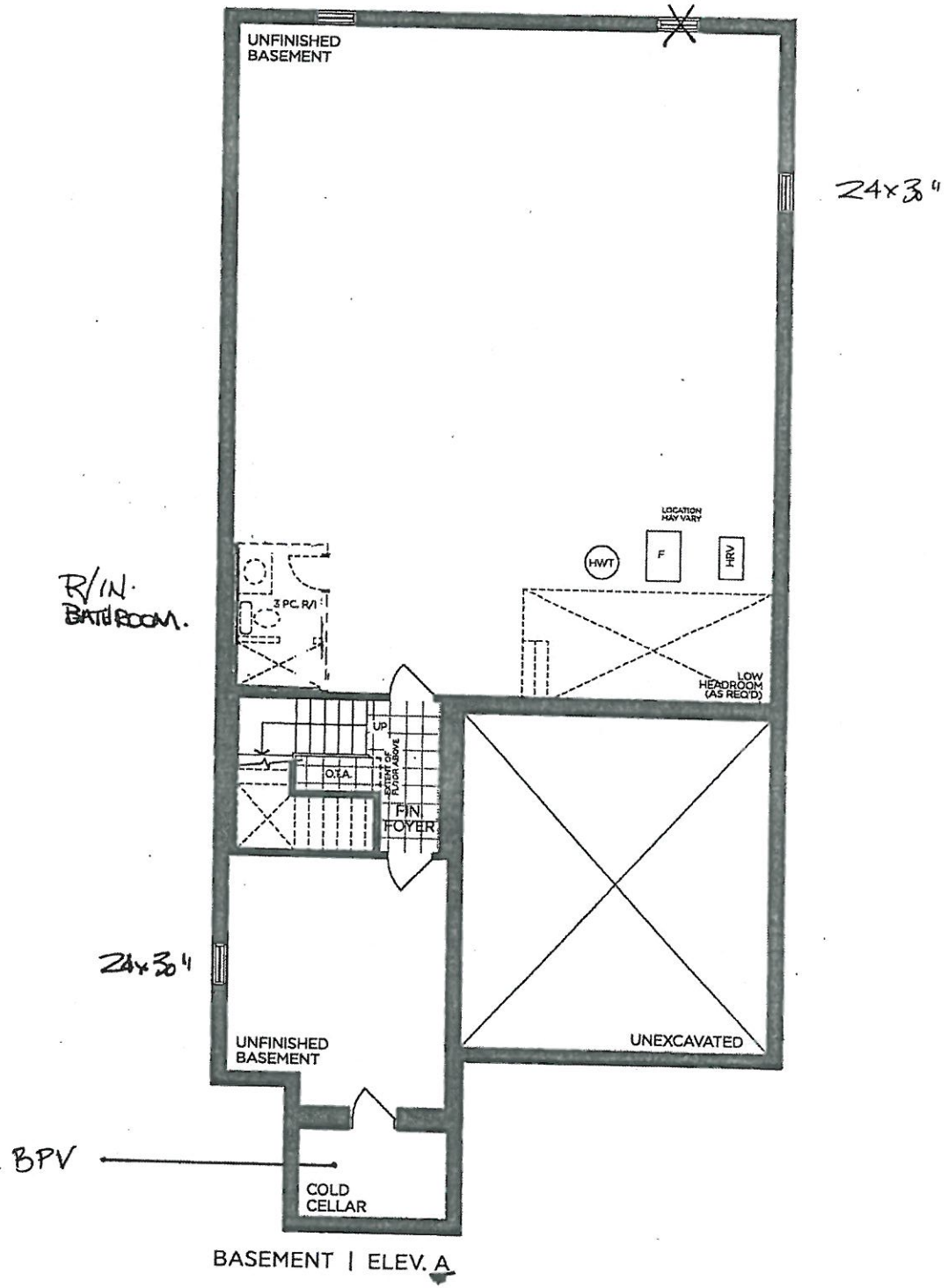

VENDOR

PURCHASER

PURCHASER

**GOLDPARK**  
WORTH MORE™

Prices, figures, illustrations, sizes, features and finishes are subject to change without notice. Areas and dimensions are approximate and actual usable floor space may vary from the stated area. Layout may be reverse of the unit purchased. E. & O.E. 4203



SCHEDULE 'F'

PINE VALLEY  
FRANCHISE

PV-8

DEC 14 2020

PV-8

MARCH 15, 2021

\* Revised \*  
April 13, 2021

The  
Forestcrest  
42' SERIES

Elevation A - 3,800 sq.ft.  
Elevation B - 3,785 sq.ft.  
Elevation C - 3,800 sq.ft.

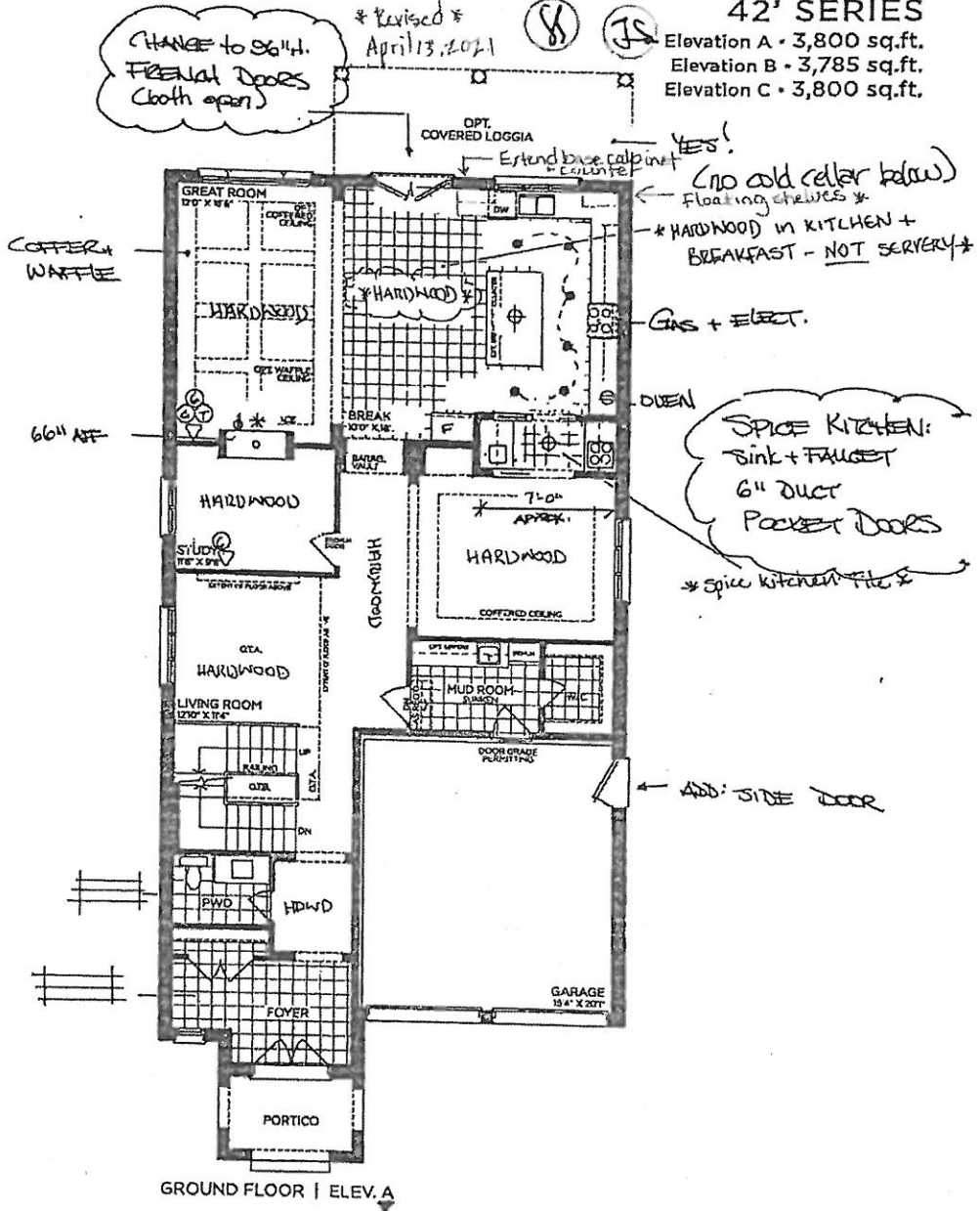

VENDOR

PURCHASER

PURCHASER

GOLDPARK  
WORTH MORE

Prices, figures, illustrations, sizes, features and finishes are subject to change without notice. Areas and dimensions are approximate and actual usable floor space may vary from the stated area. Layout may be reverse of the unit purchased. E & OE 4203



# AVG

AVV-309S  
30" under cabinet hood - MSRP: \$879.00

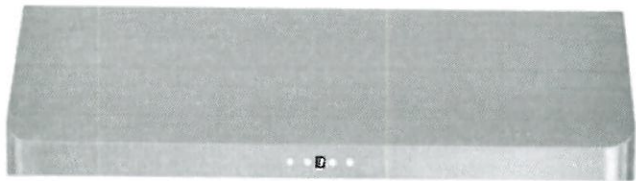

Model		AVV-309S
Dimensions		
Dimensions	29 1/2" (W) x 22" (D) x 9 13/16" (H)	
Exterior Appearance		
Stainless steel grade	201	
Features		
Control	Soft touch with LED display	
Lighting	2 bulbs, 3W LED (bulbs included)	
Blower type	900 CFM , 4-speeds	
Blower performance	Speed 1, 1.5 sones	
	Speed 4, 7.5 sones	
Filter type	2 Stainless steel baffle filters (included)	
Duct transition	8" round (top)	
Ducting	Ducted	
Electrical Requirements		
Electrical requirements	120V / 60Hz / 2.7 Amps	
Warranty		
1-year Warranty	Parts and labour, in-home service	

Spice Kitchen  
PV-8      ~~See email~~  
March 19, 2021

The information contained herein is based on sources that we believe to be reliable, but is not guaranteed by us, may be incomplete or may change without notice



Spice Kitchen  
PV-8 ~~see~~ email  
March, 19, 2021

AVV-309S/AVV-369S

Dimensions

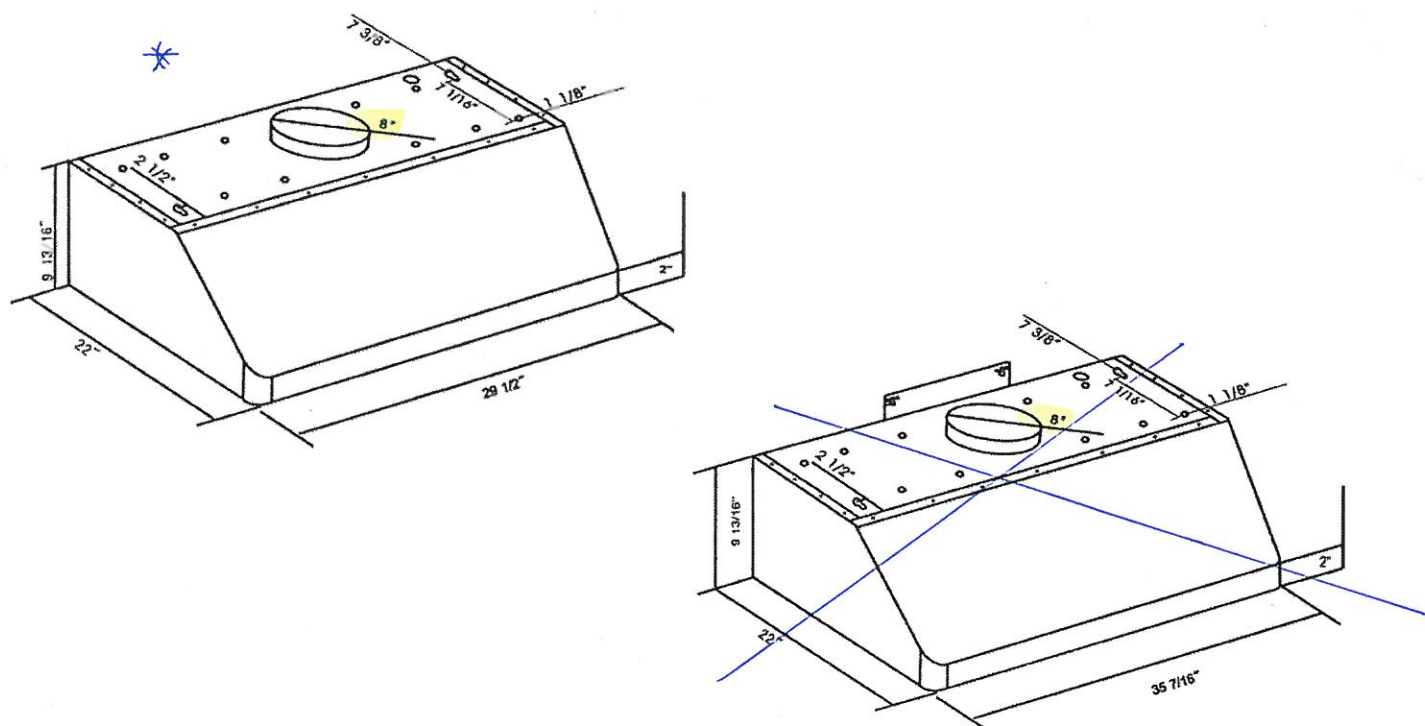

Installation

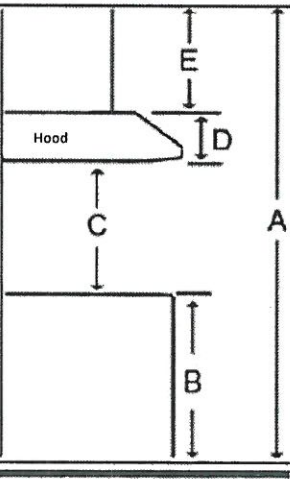

A	Floor to ceiling height	variable
B	Floor to counter top height (standard)	36"
C	Recommended height between cooking surface and bottom of the hood	28" to 30"
D	Hood height	9 13/16"
E	Chimney height	N/A

Duct transition

8" Top round



The information contained herein is based on sources that we believe to be reliable, but is not guaranteed by us, may be incomplete and/or may change without notice.

Need technical support? 1(888) 651-2534



## Yolande Somerville

---

**From:** Sukhjital Singh <sukhjital.singh@icloud.com>  
**Sent:** March 15, 2021 8:42 PM  
**To:** Yolande Somerville  
**Subject:** Fwd: AVG Under The Cabinet Specs 30"  
**Attachments:** avg-avv-309s.pdf; ATT00001.htm

Hello,

Please see attached under cabinet hood for spice kitchen.

Thanks  
Sukhjital.

**From:** Gunjan Mehandru <gunjan1834@gmail.com>  
**Date:** March 15, 2021 at 7:18:20 PM EDT  
**To:** sukhjital.singh@icloud.com  
**Subject:** AVG Under The Cabinet Specs 30"

Hello,

Please see the attached copy of cut out dimensions for your reference.

Thanks & Regards  
GUNJAN MEHANDRU |SALES MANAGER|  
GUNJAN1834@GMAIL.COM  
905-450-2828  
BRAMPTON TV & APPLIANCES

---



This email has been scanned for spam and viruses by Proofpoint Essentials. Click [here](#) to report this email as spam.



**PV-8 Cabinetry Schedule**

ROOM	DESCRIPTION	PRICE	QTY	TOTAL
KITCHEN	UPGRADE PERIMETER FROM SERIES 2 TO SERIES 6 - <i>MEDIO 6 PITCH BLACK</i>		1	
	ADD 4-BIN RECYCLING PULL-OUT ACCESSORY TO BASE CABINET		1	
	DELETE UPPER ON WINDOW WALL (N/C)		1	
	CONVERT STD. CABINETRY INTO A TALL DEEP BUILT-IN OVEN UNIT WITH 3/4" EXTENSION WHITE POT DRAWER BELOW		1	
	ADD RANGETOP POTS & PANS DRAWERS CABINET IN STOVE LOCATION WITH 3/4" EXTENSION WHITE DRAWERS		1	
	REDUCE FRIDGE WALL CABINETRY TO ACCOMMODATE MODIFIED BACKING SPICE KITCHEN		1	
	ADJUST 36"W FRIDGE OPENING FOR A 48"W FRIDGE (N/C)		1	
	DECOR PANELS FOR FRIDGE/FREEZER		1	
	ADD 2" T FLOATING SHELVES FLANKING WINDOW (24"x9"x2" - APPROX 24" AFC. + APPROX 16" ABOVE THAT)		1	
	UPGRADE HARDWARE - BH-052-09		1	
	RETURN TRIP FOR KICKPLATE ADJUSTMENTS		1	
	ADD FLIP UP CABINETS ABOVE FRIDGE		1	
	ADD DECOR PANEL FOR DISHWASHER		1	
ISLAND	UPGRADE ISLAND FROM SERIES 2 TO SERIES 5 - <i>MEDIO 6 OYSTER</i>		1	
	RELOCATE STD. BANK OF FOUR DRAWERS TO ISLAND (N/C)		1	
	ADD CAMDEN STYLE FLUSH KICK PLATE TO BACKSIDE OF ISLAND		1	
	ADD PUSH-TO-OPEN HARDWARE TO BACKSIDE OF ISLAND		1	
SPICE KITCHEN	FLAT FURRING PANEL THERMOFOIL IN LIEU OF CROWN IN SPICE KITCHEN			
	SERVERY BASE CABINETS INCLUDING BAR SINK SUPPLIED IN STD. SERIES 2 'CHESAPEAKE CLASSIC WHITE' AND RE-LOCATED ACROSS ROOM BACKING FRIDGE WALL (N/C)		1	
	SUPPLY OPT. SERVERY UPPER CABINETS IN STD. SERIES 2 'CHESAPEAKE CLASSIC WHITE' (INCLUDED IN PE #2505)		1	
	RE-LOCATE SERVERY UPPERS ACROSS ROOM BACKING FRIDGE WALL (N/C)		1	
	ADD FULL-DOOR BASE CABINET TO FORMER SERVERY WALL (INCLUDED IN PE #2505)		1	
	ADD 30"H STOVE UPPER TO FORMER SERVERY WALL (INCLUDED IN PE #2505)		1	
	ADD 45"H UPPER TO FORMER SERVERY WALL (INCLUDED IN PE #2505)		1	
	CONVERT FULL-DOOR BASE INTO COOKTOP CABINET WITH 3/4" EXTENSION WHITE POT DRAWERS BELOW - COOKTOP LOCATION AS PER KITCHEN DESIGNERS DISCRETION		1	
ENSUITE 3	ADD VANITY BANK OF DRAWERS		1	
<b>CABINETRY TOTAL:</b>				

\*\*\*HANDLE PLACEMENT: AT INSTALLERS DISCRETION\*\*\*

LOT #: <b>PV-8</b>	DATE: <b>March 15, 2021</b>
SIGNATURE: 	
SIGNATURE: 	

*\* Revised \* March 17, 2021* 

**GOLD PARK**  
WOODEN HILLS

REVISED:  
2021-03-15





PV-8 Cabinetry Schedule

ROOM	DESCRIPTION	QTY	PRICE
KITCHEN	UPGRADE PERIMETER FROM SERIES 2 TO SERIES 6 - MEDIO 6 PITCH BLACK	1	
	ADD 1-DOOR WICHOW FULL-OUT ACCESSORY TO BASE CABINET	1	
	DELETE UPPER CH WINDOW WALL (N/C)	1	
	CONVERT STD. CABINETS INTO A TALL DEEP BUILT-IN OVEN UNIT WITH 1/4" EXTENSION WHITE POT DRAWER BELOW	1	
	ADD RANGERTOP POTS & PANI DRAWERS CABINET IN 1-DOOR LOCATION WITH 3/4" EXTENSION WHITE DRAWERS	1	
	REDUCE FRIDGE WALL CABINETS TO ACCOMMODATE MATCHED BACKING SPACE KITCHEN	1	
	ADJUST 36" W FRIDGE OPENING FOR A 48" W FRIDGE (N/C)	1	
	DECON PANELS FOR FRIDGE/ICEBER	1	
	ADD 2" T FLYING SHELVES FLANKING WINDOW (24" X 24" - 48" X 24" - APPROX 16" ABOVE THAT)	1	
	UPGRADE HARDWARE - BA-B55-09	1	
	RETURN TRIP FOR KICKPLATE ADJUSTMENTS	2	
	ADD FLIP-UP CABINET ABOVE FRIDGE	1	
	ADD DECOR PANEL FOR DISHWASHER	2	
		1	
		1	
		1	
		1	
		1	
ISLAND	UPGRADE ISLAND FROM SERIES 2 TO SERIES 6 - MEDIO 6 OYSTER	1	
	RELOCATE STD. BANK OF FOUR DRAWERS TO ISLAND (N/C)	2	
	ADD CAMDEN STYLE FLUSH PICK PLATE TO BACKSIDE OF ISLAND	1	
STICK KITCHEN	FLAT FURNISH PANEL THERMOFILL IN LIEU OF CROWN IN STICK KITCHEN	1	
	SERVING BASE CABINETS INCLUDING SINK SUPPLIED IN STD. SERIES 2 CHESAPEAKE CLASSIC WHITE AND RE-LOCATED ACROSS ROOM BACKING FRIDGE WALL (N/C)	1	
	SUPPLY OPT. SERVING UPPER CABINETS IN STD. SERIES 3 CHESAPEAKE CLASSIC WHITE (INCLUDED IN PRICED)	1	
	RE-LOCATE SERVING UPPER ACROSS ROOM BACKING FRIDGE WALL (N/C)	1	
	ADD FULL-DOOR BAKE CABINET TO FORMER SERVING WALL (INCLUDED IN PRICED)	1	
	ADD 48" H STOVE UPPER TO FORMER SERVING WALL (INCLUDED IN PRICED)	1	
	ADD 45" H UPPER TO FORMER SERVING WALL (INCLUDED IN PRICED)	1	
	CONVERT FULL-DOOR BAKE INTO COUNTERTOP CABINET WITH 3/4" EXTENSION WHITE POT DRAWERS BELOW - COUNTERTOP LOCATION AS PER KITCHEN DESIGNERS SPECIFICATION	1	
		1	
		1	
ENDNOTE 3	ADD VANITY BANK OF DRAWERS	1	
CABINETS TOTAL:			

\*\*\*HARDWARE PLACEMENT: AT INSTALLERS DISCRETION\*\*\*

LOT #:	PV-8	DATE:	March 15, 2021
SIGNATURE:			
SIGNATURE:			

\*Revised\* March 17, 2021



GOLD

REVISED:  
2011-03-27



# GOLDPARK

WORTH MORE™

TO: Gold Park Homes

DATE: March 15, 2021

SITE: Fine Valley

LOT: 8

I/We the undersigned, hereby authorize Sukhjotpal Singh  
to act on my/our behalf in all matters relating to colour selection and the selection of upgrades  
and extras for the above mentioned Lot, including, without limitation, signing of all documents  
relating to these matters. Any and all acts carried out by Sukhjotpal Singh  
on my/our behalf shall have the same effect as acts of my/our own and are irrevocable.  
The authorization is valid under further written notice from the undersigned.

\_\_\_\_\_  
WITNESS

Name:

\_\_\_\_\_  
WITNESS

Name:

Jasvinder Singh  
PURCHASER

Name:

\_\_\_\_\_  
PURCHASER

Name:





STONE COUNTERTOP EDGE PROFILES



STANDARD 2CM EASED EDGE

LOCATION: THRU-OUT

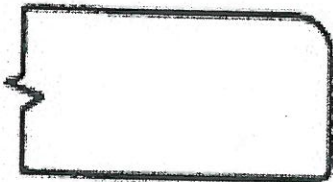

UPGRADE 3CM EASED EDGE

LOCATION:

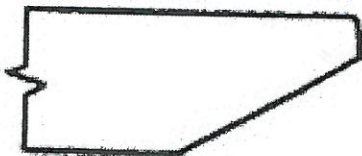

UPGRADE 4CM MITRED EDGE

LOCATION:

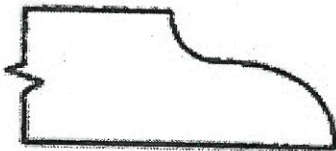

UPGRADE 2CM OGEE EDGE

LOCATION:

LOT #: PV-8

DATE: March 15, 2021

SIGNATURE:

SIGNATURE:



STANDARD HARDWARE / KNOBS



K002-02



K002-03



K002-04



K002-06

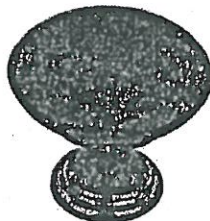

K002-05

→ Powder Room

→ Mud Room

→ Laundry

→ Ensuite 2

→ Ensuite 4



K002-14



K024-03



\*NO HARDWARE

LOT # PV-8

DATE: March 15, 2021

SIGNATURE:



SIGNATURE:





STANDARD HARDWARE / HANDLES



H001-02

→ Ensuite 3



H001-03



H001-04

→ Master Ensuite



H009-03



H009-09



H011-03



H011-05



H011-06

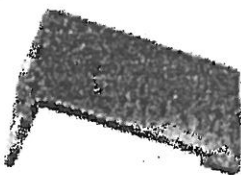

H033-01



H039-03



\*NO HARDWARE

LOT #

PV-8

DATE:

March 15, 2021

SIGNATURE:

*SS*

SIGNATURE:



UPGRADE HARDWARE

BH-052-09

Pull - 'Brushed Gold'





LOCATION:

Kitchen

LOT # *PV-8*

DATE: *March 15, 2021*

SIGNATURE: 

SIGNATURE: 





PINE VALLEY  
FOREVERGREEN

## UPGRADE KITCHEN SINK

### BLANCO - PRECIS CASCADE

Silgranit - Undermount Sink

28" x 18" x 7 7/8" - 5 1/2"



Anthracite

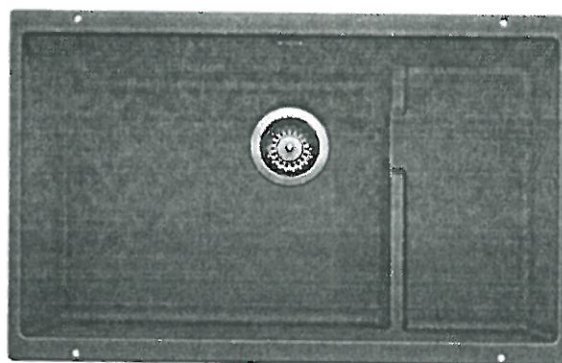

Concrete Grey

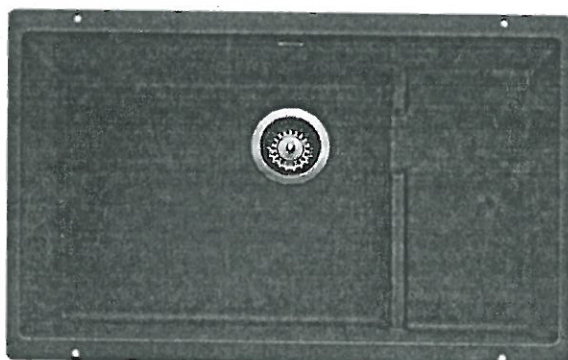

Metallic Grey

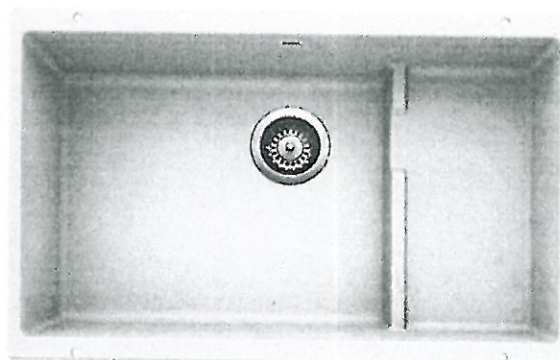

White

- ☒ ANTHRACITE  
☐ CONCRETE GREY  
☐ METALLIC GREY  
☐ WHITE

MODEL 401445 Anthracite / 402268 Concrete Grey / 401684 Metallic Grey / 401482 White

Lot#  
PV-8

Room:  
Kitchen

Signature:

Date:  
March 15, 2021

Signature:

GOLDPARK  
WORTH MORE™



## UPGRADE BAR SINK



PINE VALLEY

FOREVERGREEN

### BLANCO - PRECIS U 3/4

Silgranit - Undermount Sink

13 3/4" x 18 1/8" x 7 1/2"

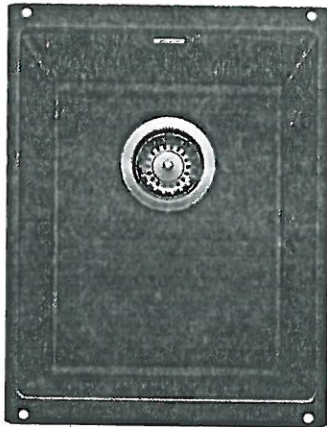

Anthracite

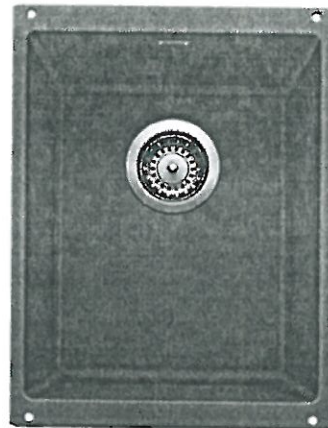

Concrete Grey

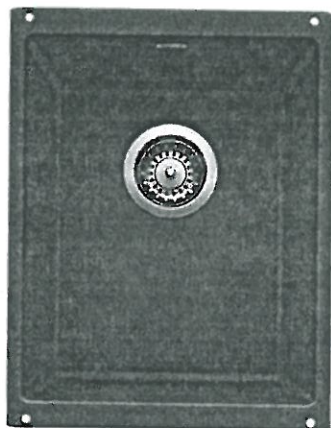

Metallic Grey



White

- ☒ ANTHRACITE  
☐ CONCRETE GREY  
☐ METALLIC GREY  
☐ WHITE

MODEL 400827 Anthracite / 402270 Concrete Grey / 401679 Metallic Grey / 401703 White /

LOT #  
PV-8

ROOM: Kitchen Island

DATE: March 15, 2021

SIGNATURE:

SIGNATURE:





PINE VALLEY  
FOREVERGREEN

## UPGRADE KITCHEN FAUCET

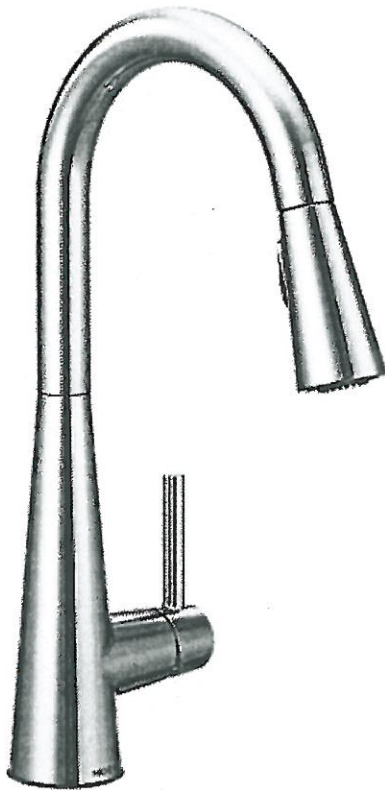

MOEN - SLEEK

One-Handle Pulldown Kitchen Faucet



- ☒ CHROME  
☐ MATTE BLACK (BL)  
☐ STAINLESS (SRS)

MODEL: 7864 (BL, SRS) Kitchen Faucet

Lot# <u>PV-8</u>	Date: <u>March 15, 2021</u>	Room: <u>Spice Kitchen</u>
Signature: <u></u>		
Signature: <u></u>		

GOLDPARK  
WORTH MORE





PINE VALLEY  
FOREVERGREEN

## UPGRADE KITCHEN SINK

### BLANCO - QUATRUS R15 U 1 MEDIUM

Stainless Steel - Undermount  
25" x 18" x 9"

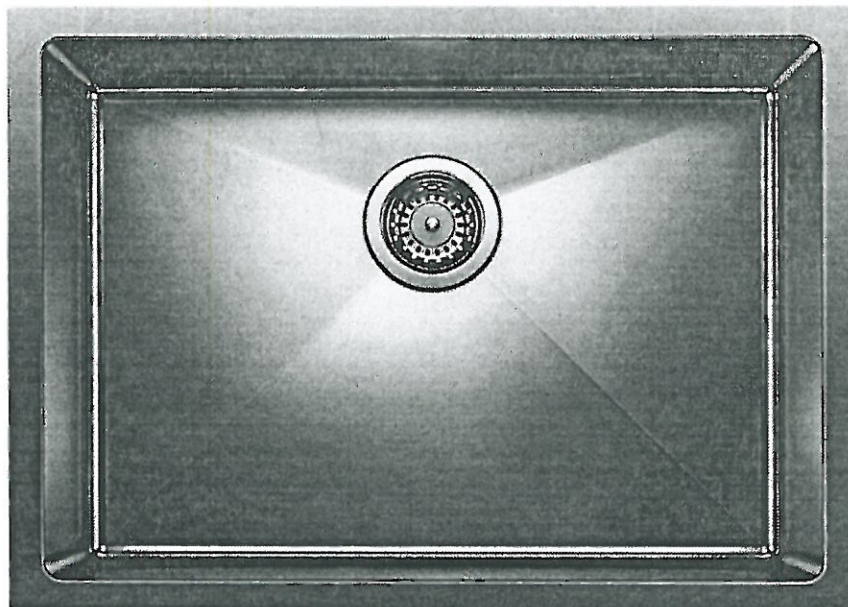

Stainless Steel

MODEL 401517 Stainless

Lot# PV-8

Room: Spice Kitchen

Signature:

Date: March 15, 2021

Signature:

GOLDPARK  
WORTH MORE





PINE VALLEY  
FOREVERGREEN

## UPGRADE SHOWER HARDWARE

MT6X6

Shower Door Handle

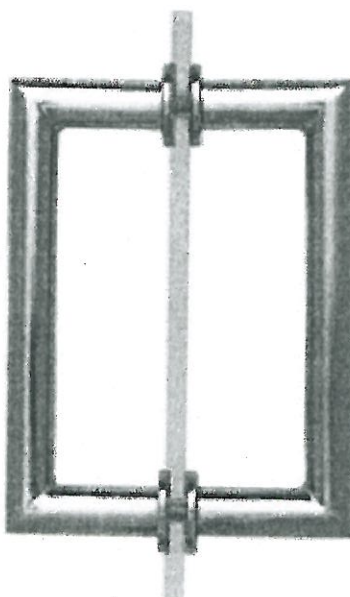

MT6X6  
Shower Door Handle

6" x 6" back-to-back  
3/4" dia. tube  
Cut and mitred corners with  
washers  
(Also available single sided)

- ☒ CHROME → *Ensuite 4*  
☒ MATTE BLACK → *Master Ensuite + Ensuite 3*

Lot#

*PR-8*

Date:

*March 15, 2021*

Room:

*\* see above \**

Signature:

*[Signature]*

Signature:

*[Signature]*



## BATHROOM ACCESSORIES



PINE VALLEY

FOREVERGREEN

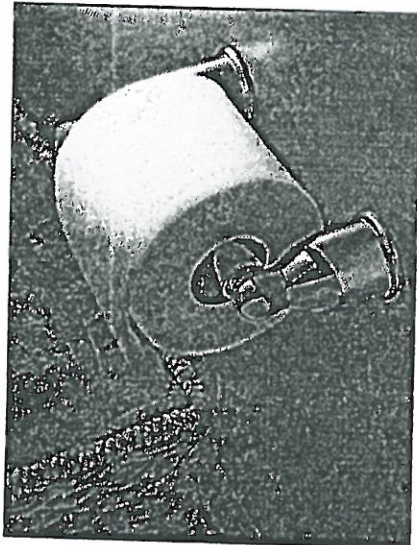

Tissue Holder  
Mason - Chrome

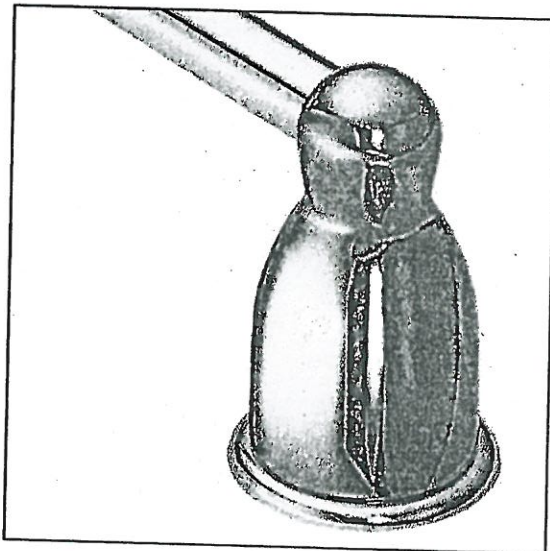

Towel Bar  
Mason - Chrome

**Please select one of the following:**

☒ INSTALL STANDARD BATHROOM ACCESSORIES THRU OUT  
(tissue holder + towel bar) *\*location as per vendors discretion\**

☐ **\*DO NOT\*** INSTALL STANDARD BATHROOM ACCESSORIES  
THRU OUT *\*tissue holder + towel bar will not be provided\**

LOT # PV-8

DATE: March 15, 2021

SIGNATURE:

[Signature]

SIGNATURE:

[Signature]





Project: Pine Valley

Lot: 8

Purchaser(s): Sukhjotpal Singh + Jaskeeran Singh

Standard Hood Fan Deletion

We acknowledge that the builder's standard hood fan will not be installed.  
Do not supply, install and/or credit. We will install our own hood fan after closing.

Signature: 

Signature: 

Date: March 15, 2021





PV-8 SS  
March 15, 2021  
Main Kitchen

# INSTALLATION INSTRUCTIONS

COMMERCIAL-STYLE GAS COOKTOPS  
30" (76.2 cm), 36" (91.4 cm) AND 48" (121.9 cm)  
For residential use only

## INSTRUCTIONS D'INSTALLATION

TABLE DE CUISSON AU GAZ DE STYLE COMMERCIAL DE  
30 PO (76,2 cm), 36 PO (91,4 cm) ET 48 PO (121,9 cm)  
Pour utilisation résidentielle uniquement

### Table of Contents/Table des matières

<b>COOKTOP SAFETY</b> .....	<b>2</b>	<b>SÉCURITÉ DE LA TABLE DE CUISSON</b> .....	<b>19</b>
<b>INSTALLATION REQUIREMENTS</b> .....	<b>3</b>	<b>EXIGENCES D'INSTALLATION</b> .....	<b>20</b>
Tools and Parts.....	3	Outils et pièces.....	20
Location Requirements.....	4	Exigences d'emplacement.....	21
Electrical Requirements .....	9	Spécifications électriques.....	26
Gas Supply Requirements.....	9	Spécifications de l'alimentation en gaz .....	26
<b>INSTALLATION INSTRUCTIONS</b> .....	<b>10</b>	<b>INSTRUCTIONS D'INSTALLATION</b> .....	<b>28</b>
Install Cooktop .....	10	Installation de la table de cuisson.....	28
Make Gas Connection .....	11	Effectuer le raccordement au gaz.....	28
Install Griddle Tray.....	12	Installer le plateau d'égouttement .....	30
Complete Installation .....	12	Terminer l'installation.....	30
<b>GAS CONVERSIONS</b> .....	<b>13</b>	<b>CONVERSIONS POUR CHANGEMENT DE GAZ</b> .....	<b>31</b>
Propane Gas Conversion.....	13	Conversion pour l'alimentation au propane .....	31
Natural Gas Conversion .....	16	Conversion pour l'alimentation au gaz naturel .....	34

#### IMPORTANT:

**Installer:** Leave installation instructions with the homeowner.

**Homeowner:** Keep installation instructions for future reference.

#### IMPORTANT :

**Installateur :** Remettre les instructions d'installation au propriétaire.

**Propriétaire :** Conserver les instructions d'installation pour référence ultérieure.



36" (91.4 cm) models

PR-8

88

March 15, 2021

Main kitchen

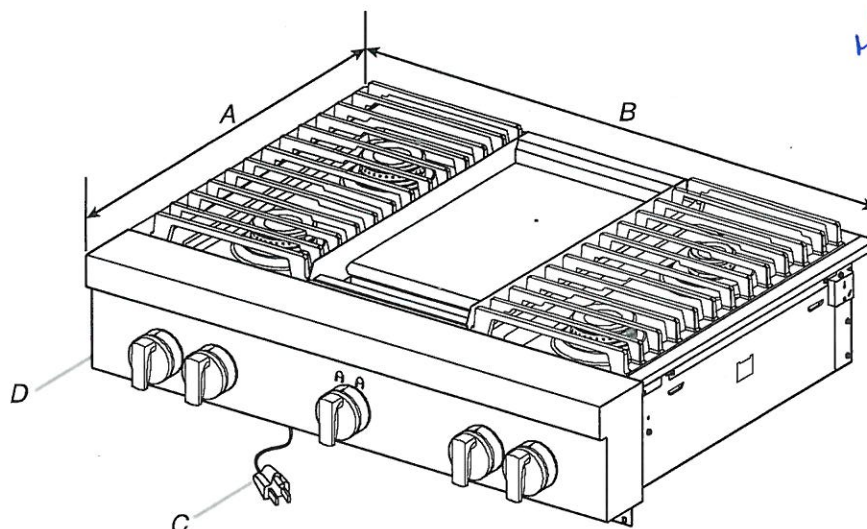

A.  $27\frac{1}{8}$ " (68.9 cm)  
B.  $35\frac{3}{4}$ " (90.8 cm)

C. 3 prong grounding-type power supply cord  
D. Model/serial/rating plate (located on the underside of the cooktop burner base)

#### Side View of Cooktop

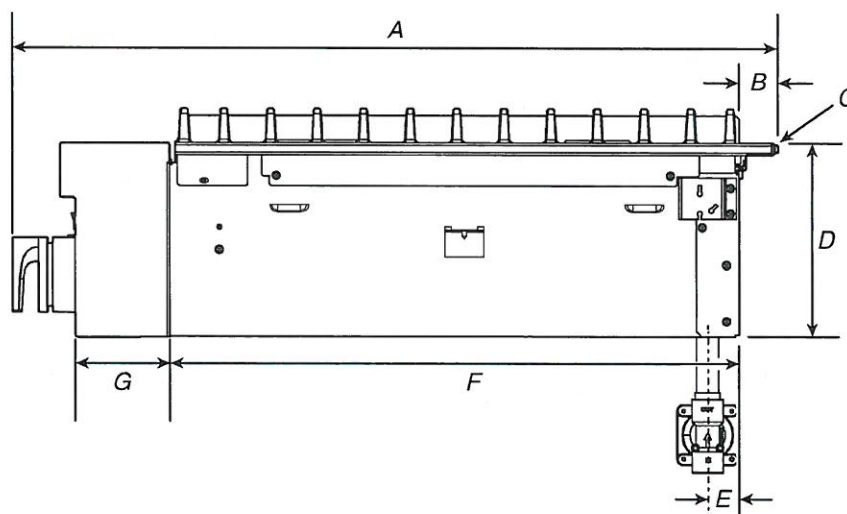

A.  $27\frac{3}{8}$ " (69.5 cm)  
B.  $1\frac{1}{4}$ " (3.2 cm)  
C. Island trim or optional backguard  
D.  $7\frac{7}{16}$ " (18.8 cm)

E. Gas inlet is located  $1\frac{7}{8}$ " (4.8 cm) from the back of the cooktop burner base and  $4\frac{7}{8}$ " (12.4 cm) in from left-hand side of the cooktop burner base.  
F. 22" (55.9 cm)  
G.  $3\frac{5}{16}$ " (8.4 cm)



## Gas and Electric Connection Locations

PV-8 

March 15, 2021

Main Kitchen

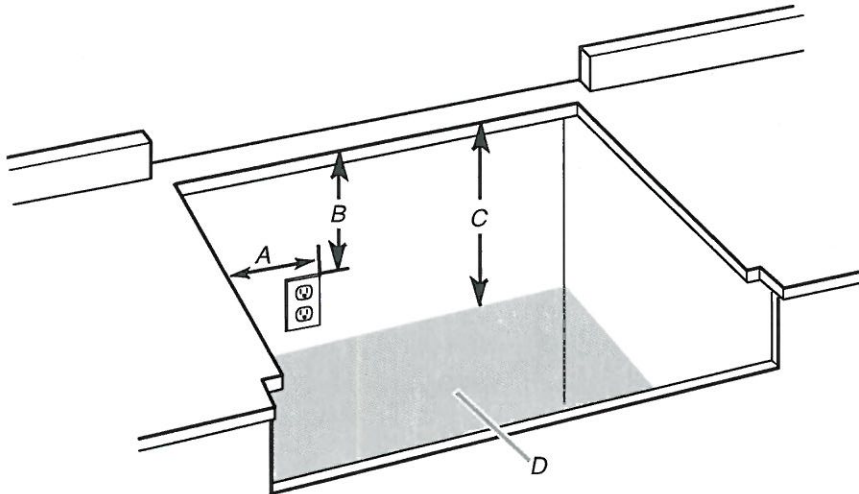

- A. Grounded 3 prong outlet should be located on left-hand side of the cutout 16" (40.6 cm) max. from enclosure sidewall
  - B. 10" (25.4 cm) min. clearance from countertop to top of the outlet
  - C. 14" (35.6 cm) countertop to the gas supply line
  - D. Gas supply line should be located in this area on rear or side walls or the supply line can come up through the floor.
- NOTE:** Solid side and bottom of cutout enclosure not shown.

## Cabinet Requirements

**IMPORTANT:** If installing a range hood or microwave hood combination above the cooking surface, follow the range hood or microwave hood combination installation instructions for dimensional clearances above the cooktop surface.

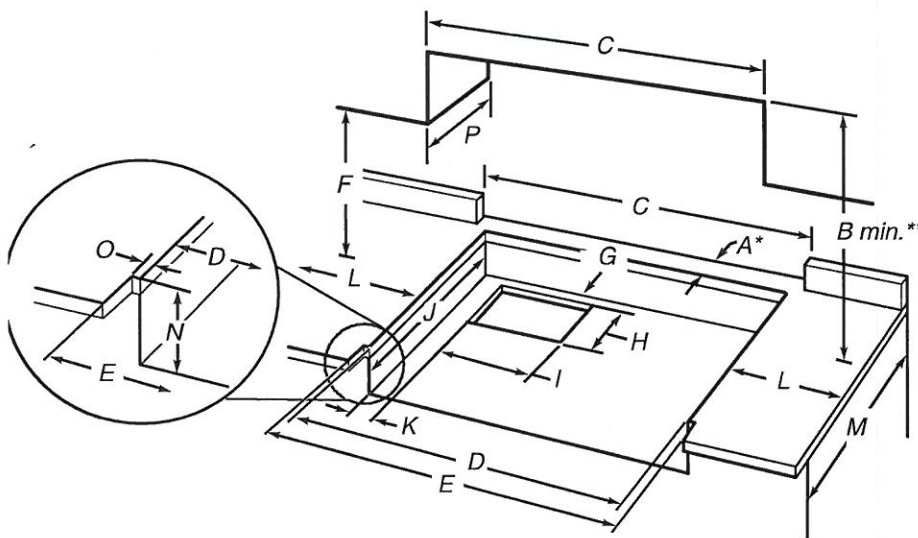

- A. See chart.
- B. See chart.
- C. See chart.
- D. See chart.
- E. See chart.
- F. 18" (45.7 cm) min. clearance upper cabinet to countertop
- G. 3/4" (19 mm) back of cabinet cutout to gas opening cutout
- H. 6 7/8" (16.1 cm) gas opening cutout depth
- I. 12 1/2" (31.7 cm) gas opening cutout width
- J. 22 1/4" (56.5 cm) cabinet cutout depth
- K. 2" (5.1 cm) cabinet side to gas cutout
- L. 6" (15.2 cm) min. distance on both sides of the cooktop to the side wall or other combustible material above cooking surface
- M. 24" (61.0 cm) cabinet depth
- N. 7 1/4" (18.4 cm) cabinet depth to countertop
- O. Notch to be equal on both sides
- P. 13" (33.0 cm) upper cabinet depth

Size	A* Cooktop Cutout to Back Wall	B** Cooktop to Cabinet	C Optional Backguard and Upper Cabinet Opening	D Cabinet and Countertop	E Countertop Only
30" (76.2 cm)	1 3/4" (4.4 cm)*	42" (106.7 cm)	30" (76.2 cm)	29 1/4" (74.3 cm)	29 7/8" (75.9 cm) for zero clearance
36" (91.4 cm)	1 3/4" (4.4 cm)*	58" (147.3 cm)	36" (91.4 cm)	35 1/4" (89.5 cm)	35 3/4" (90.8 cm) for zero clearance
48" (121.9 cm)	1 3/4" (4.4 cm)*	58" (147.3 cm)	48" (121.9 cm)	47 1/4" (120.0 cm)	47 7/8" (121.6 cm) for zero clearance

\* **NOTE:** If back wall is constructed of a combustible material and a backguard is not installed, a minimum clearance of dimension A + 6" (15.2 cm) is required for all models.

\*\* **NOTES:** Dimension "B" can be reduced by 6" (15.2 cm) when bottom of wood or metal cabinet is covered by not less than 0.25" (6.4 mm) flame retardant millboard covered with not less than No. 28 MSG sheet metal, 0.015" (0.4 mm) stainless steel, 0.024" (0.6 mm) aluminum, or 0.020" (0.5 mm) copper.

If installing a range hood above the cooktop, follow the range hood instructions for dimensional clearances above the cooktop surface.

**NOTE:** Due to manufacturing factory tolerances, these are nominal dimensions. You may need to readjust to meet your clearance.



please confirm  
size (27" or 30")  
↓



PV-8 88  
March, 15, 2021  
(Kitchen)

## INSTALLATION INSTRUCTIONS

27" (68.6 CM) AND 30" (76.2 CM) ELECTRIC BUILT-IN  
CONVECTION MICROWAVE OVEN

## INSTRUCTIONS D'INSTALLATION

FOUR À MICRO-ONDES ENCASTRÉ ÉLECTRIQUE À  
CONVECTION DE 27" (68,6 CM) ET 30" (76,2 CM)

---

### Table of Contents/Table des matières

<b>BUILT-IN MICROWAVE OVEN SAFETY</b> .....	<b>2</b>	<b>SÉCURITÉ DU FOUR À MICRO-ONDES ENCASTRÉ</b> .....	<b>8</b>
<b>INSTALLATION REQUIREMENTS</b> .....	<b>3</b>	<b>EXIGENCES D'INSTALLATION</b> .....	<b>8</b>
Tools and Parts .....	3	Outils et pièces .....	8
Location Requirements .....	3	Exigences d'emplacement .....	8
Electrical Requirements .....	4	Spécifications électriques .....	10
<b>INSTALLATION INSTRUCTIONS</b> .....	<b>5</b>	<b>INSTRUCTIONS D'INSTALLATION</b> .....	<b>11</b>
Spacer Kit Installation .....	5	Installation de la trousse d'entretoise .....	11
Prepare Built-In Microwave Oven .....	5	Préparation du four à micro-ondes encastré .....	11
Make Electrical Connection .....	6	Raccordement électrique .....	11
Install Microwave Oven .....	6	Installation du four à micro-ondes .....	12
Complete Installation .....	7	Achever l'installation .....	13

---

#### IMPORTANT:

Save for local electrical inspector's use.

#### IMPORTANT:

À conserver pour consultation par l'inspecteur local des installations électriques.



# INSTALLATION REQUIREMENTS

pr-8 88  
March 15, 2021  
(Kitchen)

## Tools and Parts

Gather the required tools and parts before starting installation. Read and follow the instructions provided with any tools listed here.

### Tools Needed

- Phillips screwdriver
- Flat-blade screwdriver
- Measuring tape
- Level
- Drill (for wall cabinet installations)
- 1/8" (3 mm) drill bit (for wall cabinet installations)
- 1" (2.5 cm) drill bit (for wall cabinet installations)

### Parts Needed

- UL listed or CSA approved conduit connector
- UL listed wire connectors

### Parts Needed – Flush Installation

- W10801485 Stainless steel flush installation kit for 27" (68.6 cm) models
- W10801486 Stainless steel flush installation kit for 30" (76.2 cm) models
- W10801487 Black flush installation kit for 30" (76.2 cm) models

To order, see the "Assistance or Service" section of the Use and Care Guide.

### Parts Supplied

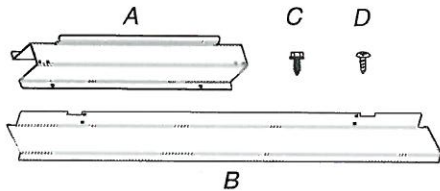

- A. Spacer bars (2)
- B. Bottom vent (1)
- C. 3/8" (9.5 mm) hex-head washer screws (4)
- D. 3/4" (1.9 cm) pan-head screws (4)

Check local codes. Check existing electrical supply. See "Electrical Requirements."

It is recommended that all electrical connections be made by a licensed, qualified electrical installer.

## Location Requirements

**IMPORTANT:** Observe all governing codes and ordinances.

- Cabinet opening dimensions that are shown must be used. Given dimensions provide minimum clearance with microwave oven.
- Recessed installation area must provide complete enclosure around the recessed portion of the microwave oven.
- Grounded electrical supply is required. See "Electrical Requirements" section.
- Electrical supply junction box should be located 3" (7.6 cm) maximum below the support surface when the microwave oven is installed in a wall cabinet. A 1" (2.5 cm) minimum diameter hole should have been drilled in the left rear corner of the support surface to pass the appliance cable through to the junction box.

- For installation above single built-in oven, the junction box must located inside upper cabinet.
- If you are installing the junction box on rear wall behind the microwave oven, the junction box must be recessed and located in the upper or lower right or left corner of the cabinet; otherwise, the microwave oven will not fit into the cabinet opening.
- Microwave oven support surface must be solid, level, and flush with bottom of cabinet cutout. Floor must be able to support a weight of 108 lbs (49.0 kg).

**IMPORTANT:** To avoid damage to your cabinets, check with your builder or cabinet supplier to make sure that the materials used will not discolor, delaminate, or sustain other damage. This oven has been designed in accordance with the requirements of UL and CSA International and complies with the maximum allowable wood cabinet temperatures of 194°F (90°C).

### Product Dimensions

#### 27" (68.6 cm) and 30" (76.2 cm) Microwave Ovens

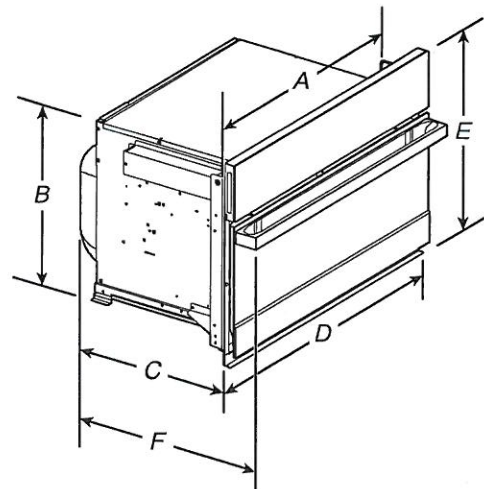

#### 27" (68.6 cm) models

- A. 25<sup>3</sup>/<sub>8</sub>" (64.5 cm)
- B. 17<sup>3</sup>/<sub>8</sub>" (44.1 cm)
- C. 22<sup>11</sup>/<sub>16</sub>" (57.7 cm)
- D. 26<sup>3</sup>/<sub>4</sub>" (68.0 cm) overall width
- E. 19<sup>7</sup>/<sub>8</sub>" (50.3 cm) overall height
- F. JMC2427IM: 25<sup>9</sup>/<sub>16</sub>" (64.9 cm)  
JMC2427IL: 24<sup>3</sup>/<sub>4</sub>" (62.9 cm)

#### 30" (76.2 cm) models

- A. 28<sup>3</sup>/<sub>8</sub>" (72.1 cm)
- B. 17<sup>3</sup>/<sub>8</sub>" (44.1 cm)
- C. 22<sup>11</sup>/<sub>16</sub>" (57.7 cm)
- D. 29<sup>3</sup>/<sub>4</sub>" (75.6 cm) overall width
- E. 19<sup>7</sup>/<sub>8</sub>" (50.3 cm) overall height
- F. JMC2430IM: 25<sup>9</sup>/<sub>16</sub>" (64.9 cm)  
JMC2430IL: 24<sup>3</sup>/<sub>4</sub>" (62.9 cm)

#### 27" (68.6 cm) and 30" (76.2 cm) Microwave Oven Spacer Kit

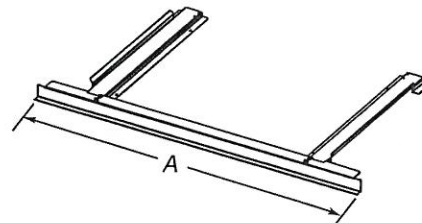

#### 27" (68.6 cm) models

- A. 26<sup>3</sup>/<sub>4</sub>" (67.9 cm) overall width

#### 30" (76.2 cm) models

- A. 29<sup>3</sup>/<sub>4</sub>" (75.6 cm) overall width

**NOTE:** The microwave oven spacer kit will allow the microwave oven to be installed in a 17<sup>3</sup>/<sub>8</sub>" to 17<sup>3</sup>/<sub>4</sub>" (44.1 to 45.1 cm) maximum cutout height.



A microwave oven spacer kit is available from your dealer that will allow the microwave oven to be installed in a 19" to 19<sup>13/16</sup>" (48.3 to 50.2 cm) maximum cutout height. Match the oven size to the following kits:

■ 27" (68.6 cm) Stainless Steel – Model W10469901

■ 30" (76.2 cm) Stainless Steel – Model W10469903

To order, see the "Assistance or Service" section of the Use and Care Guide.

### Cabinet Dimensions

#### 27" (68.6 cm) and 30" (76.2 cm) Microwave Ovens

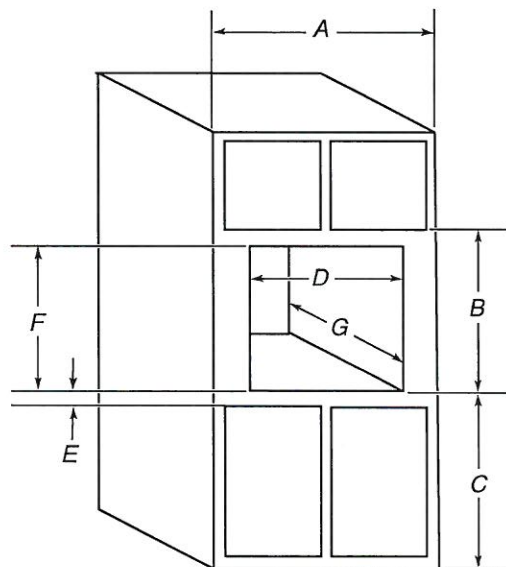

#### 27" (68.6 cm) models

- A. 27" (68.6 cm) min. cabinet width
- B. 19<sup>7/8</sup>" (50.3 cm) from bottom of cutout to bottom of upper cabinet door
- C. 40" (101.6 cm) bottom of cutout to floor (recommended)
- D. 25<sup>1/2</sup>" (64.8 cm) cutout width
- E. 1<sup>1/2</sup>" (3.8 cm) min. bottom of cutout to top of cabinet door
- F. 17<sup>5/8</sup>" (44.7 cm) recommended cutout height (will fit cutout height from 17<sup>3/8</sup>" [44.1 cm] to 17<sup>3/4</sup>" [45.1 cm])
- G. 21<sup>7/8</sup>" (55.5 cm) min. cutout depth

#### 30" (76.2 cm) models

- A. 30" (76.2 cm) min. cabinet width
- B. 19<sup>7/8</sup>" (50.3 cm) from bottom of cutout to bottom of upper cabinet door
- C. 40" (101.6 cm) bottom of cutout to floor (recommended)
- D. 28<sup>1/2</sup>" (72.4 cm) cutout width
- E. 1<sup>1/2</sup>" (3.8 cm) min. bottom of cutout to top of cabinet door
- F. 17<sup>5/8</sup>" (44.7 cm) recommended cutout height (will fit cutout height from 17<sup>3/8</sup>" [44.1 cm] to 17<sup>3/4</sup>" [45.1 cm])
- G. 21<sup>7/8</sup>" (55.5 cm) min. cutout depth

### Minimum Installation Clearances

For proper installation, the following minimum clearances must exist above and below the cabinet opening.

### Installation Above Single Built-In Oven

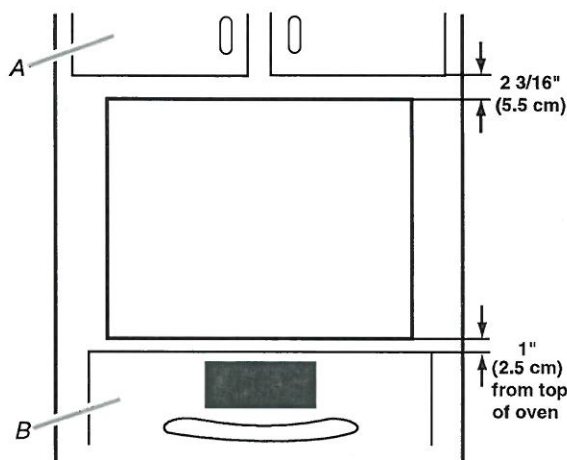

A. Upper cabinet  
B. Lower single oven

### Electrical Requirements

#### GROUNDING INSTRUCTIONS

##### For a permanently connected microwave oven:

The microwave oven must be connected to a grounded, metallic, permanent wiring system, or an equipment grounding conductor should be run with the circuit conductors and connected to the equipment grounding terminal or lead on the microwave oven.

#### SAVE THESE INSTRUCTIONS

If codes permit and a separate ground wire is used, it is recommended that a qualified electrical installer determine that the ground path and wire gauge are in accordance with local codes.

Check with a qualified electrical installer if you are not sure the oven is properly grounded.

This oven must be connected to a grounded metal, permanent wiring system.

Be sure that the electrical connection and wire size are adequate and in conformance with the National Electrical Code, ANSI/NFPA 70 – latest edition or CSA Standards C22.1-94, Canadian Electrical Code, Part 1 and C22.2 No. O-M91 – latest edition, and all local codes and ordinances.

A copy of the above code standards can be obtained from:

National Fire Protection Association  
1 Batterymarch Park  
Quincy, MA 02169-7471  
CSA International  
8501 East Pleasant Valley Road  
Cleveland, OH 44131-5575

#### Electrical Connection

To properly install your microwave oven, you must determine the type of electrical connection you will be using and follow the instructions provided for it here.

PV-8 (8)  
March 15, 2021  
(kitchen)



- Microwave oven must be connected to the proper electrical voltage and frequency as specified on the model/serial/rating plate. The model/serial/rating plate is located underneath the control panel along the oven vent.

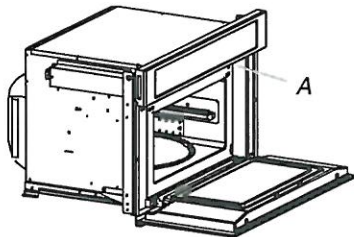

A. Model/serial/rating plate

- The microwave oven rated 120/240 V, 20 A, has 4 wires (L1, L2, N, and G) in the flex conduit, and should be connected to a 20 A maximum-rated circuit, overcurrent protected on both the L1 and L2 circuits.
- A time-delay fuse or circuit breaker is recommended.
- Flexible cable from the microwave oven should be connected directly to the junction box.

- Do not cut the conduit. The length of conduit provided is for serviceability of the microwave oven.
- A UL listed or CSA approved conduit connector must be provided.
- If the house has aluminum wiring, follow the procedure below:

Connect the aluminum wiring using special connectors and/or tools designed and UL listed for joining copper to aluminum.

Follow the electrical connector manufacturer's recommended procedure. Aluminum/copper connection must conform with local codes and industry accepted wiring practices.

For power requirements, refer to the following table:

Voltage	Microwave With Convection Oven
120/240 VAC	15 A
120/208 VAC	15 A

PV-8 (85)  
March 15, 2021  
(Kitchen)

## INSTALLATION INSTRUCTIONS

### Spacer Kit Installation

#### NOTES:

- The microwave oven spacer kit allows the microwave oven to be installed in an  $17\frac{7}{16}$ " to  $17\frac{7}{8}$ " (44.1 cm to 45.3 cm) maximum cutout height.
- If your cabinet cutout height is more than  $17\frac{7}{16}$ " (44.1 cm), you must install the spacer kit. Proceed to "Assemble Spacer Kit."
- If your cabinet cutout height is less than  $17\frac{7}{16}$ " (44.1 cm), you do not have to install the spacer kit. Proceed to "Prepare Built-In Microwave Oven."

#### Assemble Spacer Kit

1. Attach the bottom vent to spacer bars using four  $\frac{3}{8}$ " (9.5 mm) hex-head washer screws.

**NOTE:** Spacer bar flanges should be facing out.

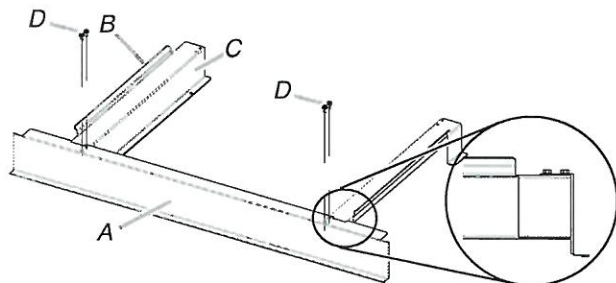

- A. Bottom vent  
B. Spacer bar flange  
C. Spacer bars  
D.  $\frac{3}{8}$ " (9.5 mm) hex-head washer screws

#### Install Spacer Kit

1. Center assembled microwave oven spacer kit against lower front edge of the cabinet cutout.
2. Using an  $\frac{1}{8}$ " (3.2 mm) drill bit, drill through the mounting holes in the spacer bars to create pilot holes.

3. Attach the assembled spacer kit to the cabinet using four  $\frac{3}{4}$ " (1.9 cm) (flat-head screws. Do not overtighten screws.

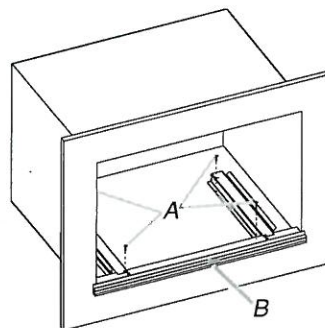

- A.  $\frac{3}{4}$ " (1.9 cm) flat-head screws  
B. Spacer kit assembly

### Prepare Built-In Microwave Oven

1. Locate existing wiring to avoid drilling into or severing wiring during installation.

## ⚠ WARNING

#### Excessive Weight Hazard

Use two or more people to move and install microwave oven.

Failure to do so can result in back or other injury.

2. To avoid floor damage, set the microwave oven onto cardboard prior to installation. Do not use handle or any portion of the front frame for lifting.
3. Remove the shipping materials and tape from the microwave oven.
4. Remove and set aside racks and other items from inside the microwave oven.
5. Remove the hardware package from inside the bag containing literature.
6. Move the microwave oven and cardboard close to the microwave oven's final location.



confirm size  
(27" or 30")



PR-8 ~~8~~  
March 15, 2021  
(kitchen.)

## INSTALLATION INSTRUCTIONS

27" (68.6 CM) AND 30" (76.2 CM) ELECTRIC SINGLE AND  
DOUBLE BUILT-IN OVEN

## INSTRUCTIONS D'INSTALLATION

FOUR ÉLECTRIQUE ENCASTRÉ  
27" (68,6 CM) ET 30" (76,2 CM) - SIMPLE ET DOUBLE

### Table of Contents/Table des matières

<b>BUILT-IN OVEN SAFETY.....</b>	<b>2</b>	<b>SÉCURITÉ DE LA TABLE DE CUISSON.....</b>	<b>17</b>
<b>INSTALLATION REQUIREMENTS.....</b>	<b>3</b>	<b>EXIGENCES D'INSTALLATION .....</b>	<b>17</b>
Tools and Parts.....	3	Outillage et pièces.....	17
Location Requirements.....	3	Exigences d'emplacement.....	17
Electrical Requirements.....	6	Spécifications électriques.....	20
<b>INSTALLATION INSTRUCTIONS.....</b>	<b>7</b>	<b>INSTRUCTIONS D'INSTALLATION.....</b>	<b>21</b>
Prepare Built-In Oven.....	7	Préparation du four encastré.....	21
Remove Oven Door(s).....	7	Dépose de la/des porte(s) du four.....	21
Replace Oven Door(s).....	7	Réinstallation de la/des porte(s) du four.....	22
Positioning Oven Feet for Multiple Cabinet Cutout Heights.....	8	Positionnement des pieds du four pour des ouvertures d'encastrement de hauteur différente.....	23
Make Electrical Connection.....	13	Raccordement électrique.....	27
Install Oven.....	14	Installation du four.....	28
Install Warming Drawer Deflector Kit (Only for Ovens Installed above Warming Drawers).....	15	Installation de l'ensemble de déflecteur du tiroir-réchaud (uniquement pour les fours installés au-dessus d'un tiroir-réchaud).....	30
Complete Installation.....	16	Achever l'installation.....	30

#### IMPORTANT:

Save for local electrical inspector's use.

#### IMPORTANT:

À conserver pour consultation par l'inspecteur local des installations électriques.



PV-8 (85)  
March 15, 2021  
(kitchen)

## Product Dimensions - Single Ovens

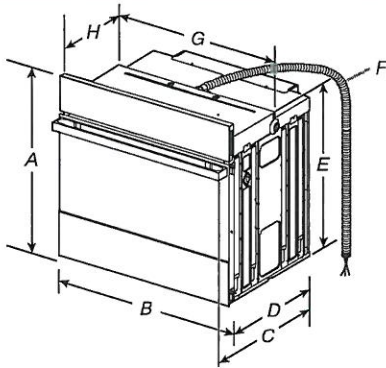

### 27" (68.6 cm) models

- A. 29<sup>7</sup>/<sub>16</sub>" (75.8 cm) max. overall height
- B. 27" (68.6 cm) overall width
- C. JJW2427IM - 26<sup>3</sup>/<sub>16</sub>" (67 cm)  
JJW2427IL - 27<sup>9</sup>/<sub>16</sub>" (69 cm)
- D. 23<sup>1</sup>/<sub>4</sub>" (59.1 cm) max. recessed depth
- E. 26<sup>3</sup>/<sub>4</sub>" (67.9 cm) recessed height
- F. 48" (121.9 cm) flexible conduit length
- G. 25<sup>7</sup>/<sub>16</sub>" (64.6 cm) max. recessed width
- H. 12" (30.5 cm) from back of control panel to start of strain relief

### 30" (76.2 cm) models

- A. 29<sup>7</sup>/<sub>16</sub>" (75.8 cm) max. overall height
- B. 30" (76.2 cm) overall width
- C. JJW2430IM - 26<sup>3</sup>/<sub>16</sub>" (67 cm)  
JJW2430IL - 27<sup>9</sup>/<sub>16</sub>" (69 cm)
- D. 23<sup>1</sup>/<sub>4</sub>" (59.1 cm) max. recessed depth
- E. 26<sup>3</sup>/<sub>4</sub>" (67.9 cm) recessed height
- F. 48" (121.9 cm) flexible conduit length
- G. 28<sup>7</sup>/<sub>16</sub>" (72.2 cm) max. recessed width
- H. 12" (30.5 cm) from back of control panel to start of strain relief

## Single Ovens Installed in Cabinet

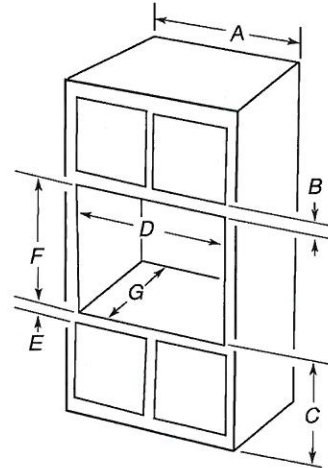

### 27" (68.6 cm) models

- A. 27" (68.6 cm) min. cabinet width
- B. 2<sup>9</sup>/<sub>16</sub>" (5.5 cm) top of cutout to bottom of upper cabinet door
- C. 32" (81.3 cm) bottom of cutout to floor
- D. 25<sup>1</sup>/<sub>2</sub>" (64.8 cm) cutout width
- E. 1<sup>1</sup>/<sub>2</sub>" (3.8 cm) min. bottom of cutout to top of cabinet door
- F. 28" (71.2 cm)\* recommended cutout height
- G. 24" (60.7 cm) cutout depth

### 30" (76.2 cm) models

- A. 30" (76.2 cm) min. cabinet width
- B. 2<sup>9</sup>/<sub>16</sub>" (5.5 cm) top of cutout to bottom of upper cabinet door
- C. 32" (81.3 cm) bottom of cutout to floor
- D. 28<sup>1</sup>/<sub>2</sub>" (72.4 cm) cutout width
- E. 1<sup>1</sup>/<sub>2</sub>" (3.8 cm) min. bottom of cutout to top of cabinet door
- F. 28" (71.2 cm)\* recommended cutout height
- G. 24" (60.7 cm) cutout depth

\*NOTE: The cutout height can be between 26<sup>15</sup>/<sub>16</sub>" and 29<sup>7</sup>/<sub>16</sub>" (68.4 cm and 74.8 cm) for single ovens.

## Cabinet Dimensions - Single Ovens

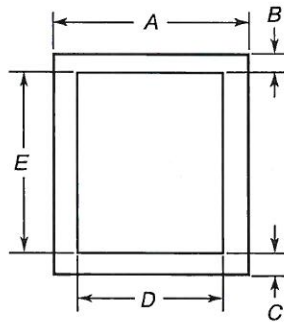

### 27" (68.6 cm) models

- A. 27" (68.6 cm) min. cabinet width
- B. 1<sup>1</sup>/<sub>2</sub>" (3.8 cm) min. top of cutout to underside of countertop
- C. 5<sup>1</sup>/<sub>4</sub>" (13.3 cm) bottom of cutout to floor
- D. 25<sup>1</sup>/<sub>2</sub>" (64.8 cm) cutout width
- E. 28" (71.2 cm) min. cutout height

### 30" (76.2 cm) models

- A. 30" (76.2 cm) min. cabinet width
- B. 1<sup>1</sup>/<sub>2</sub>" (3.8 cm) min. top of cutout to underside of countertop
- C. 5<sup>1</sup>/<sub>4</sub>" (13.3 cm) bottom of cutout to floor
- D. 28<sup>1</sup>/<sub>2</sub>" (72.4 cm) cutout width
- E. 28" (71.2 cm) min. cutout height



PV-8   
 March 15, 2021  
 (kitchen)

## Product Dimensions - Double Ovens

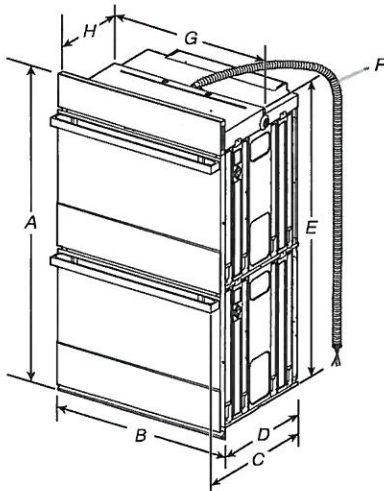

### 27" (68.6 cm) models

- A. 52 $\frac{3}{8}$ " (133 cm) max. overall height
- B. 27" (68.6 cm) overall width
- C. JJW2827IM - 26 $\frac{3}{8}$ " (67 cm)  
JJW2827IL - 27 $\frac{3}{16}$ " (69 cm)
- D. 23 $\frac{1}{4}$ " (59.1 cm) max. recessed depth
- E. 48 $\frac{13}{16}$ " (124 cm) recessed height
- F. 66" (167.6 cm) flexible conduit length
- G. 25 $\frac{7}{16}$ " (64.6 cm) max. recessed width
- H. 12" (30.5 cm) from back of control panel to start of strain relief

### 30" (76.2 cm) models

- A. 52 $\frac{3}{8}$ " (133 cm) max. overall height
- B. 30" (76.2 cm) overall width
- C. JJW2830IM - 26 $\frac{3}{8}$ " (67 cm)  
JJW2830IL - 27 $\frac{3}{16}$ " (69 cm)
- D. 23 $\frac{1}{4}$ " (59.1 cm) max. recessed depth
- E. 48 $\frac{13}{16}$ " (124 cm) recessed height
- F. 66" (167.6 cm) flexible conduit length
- G. 28 $\frac{7}{16}$ " (72.2 cm) max. recessed width
- H. 12" (30.5 cm) from back of control panel to start of strain relief

## Cabinet Dimensions - Double Ovens

### Double Ovens Installed in Cabinet

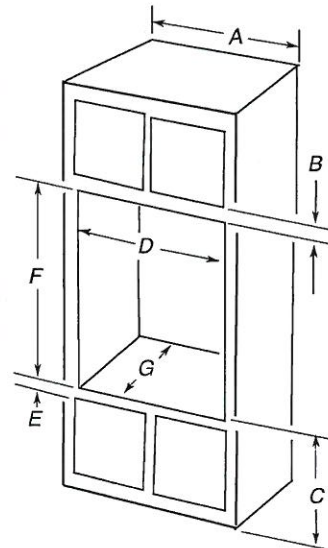

### 27" (68.6 cm) models

- A. 27" (68.6 cm) min. cabinet width
- B. 2 $\frac{3}{16}$ " (5.5 cm) top of cutout to bottom of upper cabinet door
- C. 14 $\frac{3}{4}$ " (37.5 cm) bottom of cutout to floor is recommended.  
4"-14 $\frac{3}{4}$ " (10.2-37.5 cm) bottom of cutout to floor is acceptable.
- D. 25 $\frac{1}{2}$ " (64.8 cm) cutout width
- E. 1 $\frac{1}{2}$ " (3.8 cm) min. bottom of cutout to top of cabinet door
- F. 50 $\frac{1}{4}$ " (127.6 cm)\* recommended cutout height
- G. 24" (60.7 cm) cutout depth

### 30" (76.2 cm) models

- A. 30" (76.2 cm) min. cabinet width
- B. 2 $\frac{3}{16}$ " (5.5 cm) top of cutout to bottom of upper cabinet door
- C. 14 $\frac{3}{4}$ " (37.5 cm) bottom of cutout to floor is recommended.  
4"-14 $\frac{3}{4}$ " (10.2-37.5 cm) bottom of cutout to floor is acceptable.
- D. 28 $\frac{1}{2}$ " (72.4 cm) cutout width
- E. 1 $\frac{1}{2}$ " (3.8 cm) min. bottom of cutout to top of cabinet door
- F. 50 $\frac{1}{4}$ " (127.6 cm)\* recommended cutout height
- G. 24" (60.7 cm) cutout depth

**\*NOTE:** The cutout height can be between 48 $\frac{7}{8}$ " and 52 $\frac{3}{16}$ " (124.1 cm and 132.6 cm) for double ovens.



PV-8 88  
 March 15, 2021  
 (kitchen)

## Electrical Requirements

If codes permit and a separate ground wire is used, it is recommended that a qualified electrical installer determine that the ground path and the wire gauge are in accordance with local codes.

Check with a qualified electrical installer if you are not sure the oven is properly grounded.

This oven must be connected to a grounded metal, permanent wiring system.

Be sure that the electrical connection and wire size are adequate and in conformance with the National Electrical Code, ANSI/NFPA 70-latest edition or CSA Standards C22.1-94, Canadian Electrical Code, Part 1 and C22.2 No. 0-M91-latest edition, and all local codes and ordinances.

A copy of the above code standards can be obtained from:

National Fire Protection Association  
 1 Batterymarch Park  
 Quincy, MA 02169-7471  
 CSA International  
 8501 East Pleasant Valley Road  
 Cleveland, OH 44131-5575

### Electrical Connection

To properly install your oven, you must determine the type of electrical connection you will be using and follow the instructions provided for it here.

- Oven must be connected to the proper electrical voltage and frequency as specified on the model/serial/rating plate. The model/serial/rating plate is located under the control panel on single ovens and under the control panel on the upper oven cavity on double ovens. See the following illustrations.

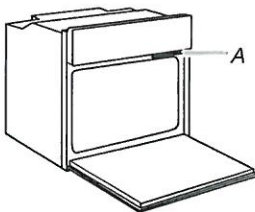

**Single Oven**  
 A. Model/serial/rating plate

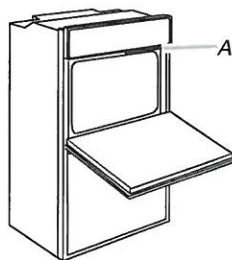

**Double Oven**  
 A. Model/serial/rating plate

- Models rated from 7.3 to 9.6 kW at 240 V (5.4 to 7.4 kW at 208 V) require a separate 40 A circuit. Models rated at 4.8 kW and below at 240 V (3.6 kW and below at 208 V) require a separate 20 A circuit.
- A circuit breaker is recommended.
- Connect directly to the circuit breaker box (or fused disconnect) through flexible, armored or nonmetallic sheathed, copper cable (with grounding wire). See "Make Electrical Connection" section.
- Flexible conduit from the oven should be connected directly to the junction box.
- Fuse both sides of the line.
- Do not cut the conduit. The length of conduit provided is for serviceability of the oven.
- A UL listed or CSA approved conduit connector must be provided.
- If the house has aluminum wiring, follow the procedure below:

Connect the aluminum wiring using special connectors and/or tools designed and UL listed for joining copper to aluminum.

Follow the electrical connector manufacturer's recommended procedure. Aluminum/copper connection must conform with local codes and industry accepted wiring practices.

For power requirements for models JJW2430I, JJW2427I, JJW2830I, and JJW2827I refer to the following table.

	240 VAC	208 VAC
Model	kW	kW
JJW2430I	4.1	3.1
JJW2427I	4.1	3.1
JJW2830I	8.7	6.5
JJW2827I	8.7	6.5



# KitchenAid®

FOR THE WAY IT'S MADE.®

## Side By Side Built-In Refrigerator

### PRODUCT MODEL NUMBERS

KBSD602E KBSD606E KBSD608E KBSN602E **KBSN608E**  
KBSD612E KBSD618E

**Electrical:** A 115 volt, 60 Hz., AC only, 15- or 20-amp fused, grounded electrical supply is required. It is recommended that a separate circuit serving only your refrigerator be provided. Use an outlet that cannot be turned off by a switch. Do not use an extension cord.

**Water Pressure:** A cold water supply with water pressure between 30 and 120 psi (207 and 827 kPa) is required to operate the water dispenser and ice maker. If you have questions about your water pressure, call a licensed, qualified plumber.

#### Reverse Osmosis Water Supply:

**IMPORTANT:** The pressure of the water supply coming out of a reverse osmosis system going to the water inlet valve of the refrigerator needs to be between 30 and 120 psi (207 and 827 kPa).

#### IMPORTANT:

- It is recommended that you do not install the refrigerator near an oven, radiator, or other heat source.
- Do not install in a location where the temperature will fall below 55°F (13°C).
- Floor must support the refrigerator weight, more than 600 lbs (272 kg), door panels and contents of the refrigerator.

### PRODUCT DIMENSIONS

- The depth from the front of the top grille to the back of the refrigerator cabinet is 5 $\frac{3}{8}$ " (64.5 cm).
- The power cord is 84" (213 cm) long.
- Height dimensions are shown with leveling legs extended  $\frac{1}{8}$ " (3 mm) below the rollers.

#### SIDE VIEW

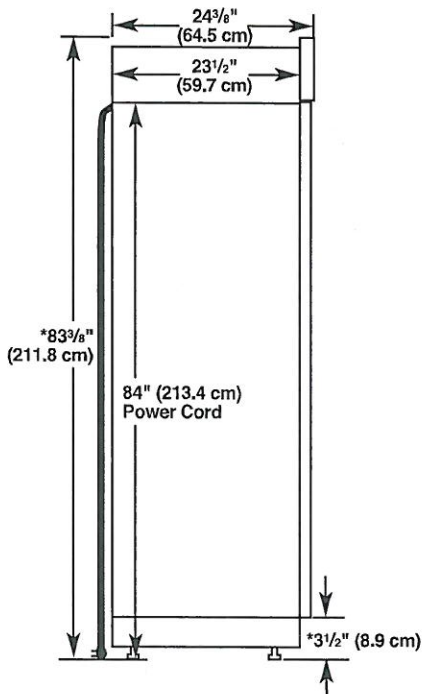

\*When leveling legs are fully extended to 1 $\frac{1}{4}$ " (3.2 cm) below rollers, add 1 $\frac{1}{8}$ " (2.9 cm) to the height dimensions.

Because Whirlpool Corporation policy includes a continuous commitment to improve our products, we reserve the right to change materials and specifications without notice.

### OPENING DIMENSIONS

To avoid tipping during use, the solid soffit must be within 1" (2.5 cm) maximum above the refrigerator. If the solid soffit is higher than 1" (2.5 cm) or one is not available, then the refrigerator must be braced. If the anti-tip boards are needed, they must be attached to the rear wall studs 80" to 90" (203 cm to 229 cm) above the floor. See "Install Anti-Tip Boards" for more information.

**NOTE:** A clearance of  $\frac{1}{2}$ " (1.3 cm) above the top grille must be maintained in order for the top grille to be removed.

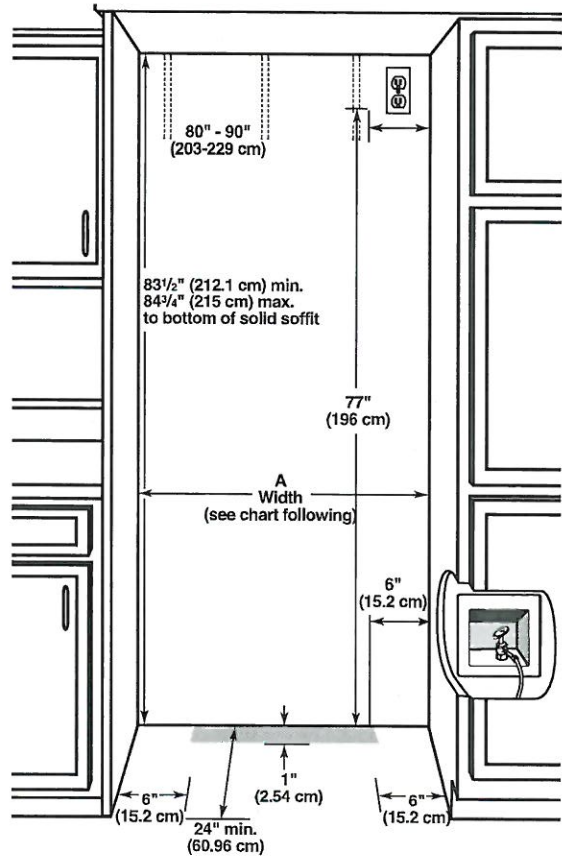

Model	Width A (as shown above)	Dimension B (as shown above)
36	35 $\frac{1}{2}$ " to 35 $\frac{3}{4}$ " (90.2 cm to 90.8 cm)	4" (10.2 cm)
42	41 $\frac{1}{2}$ " to 41 $\frac{3}{4}$ " (105.4 cm to 106.1 cm)	7 $\frac{1}{2}$ " (19.1 cm)
<b>48</b>	47 $\frac{1}{2}$ " to 47 $\frac{3}{4}$ " (120.7 cm to 121.3 cm)	13 $\frac{1}{2}$ " (34.3 cm)

**NOTE:** Flooring under refrigerator must be at same level as the room. Face of cabinetry must be plumb.



PR-8  
March 15, 2021  
(Kitchen)

## TOP VIEW

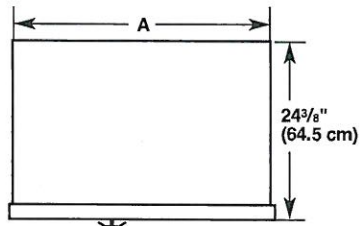

Model	Width A
36	35" (88.9 cm)
42	41" (104.1 cm)
48	47" (119.4 cm)

## FRONT VIEW

- Width dimensions were measured from trim edge to trim edge.
- Height dimensions are shown with leveling legs extended  $\frac{1}{8}$ " (3 mm) below the rollers.

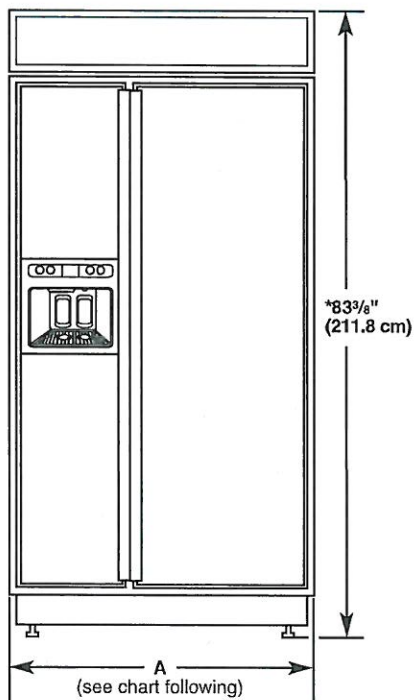

Model	Width A (Trim edge to trim edge)
36	36 1/2" (92.3 cm)
42	42 1/2" (107.5 cm)
48	48 1/2" (122.8 cm)

\*When leveling legs are fully extended to  $1\frac{1}{4}$ " (3.2 cm) below rollers, add  $1\frac{1}{8}$ " (2.9 cm) to the height dimensions.

## DOOR SWING DIMENSIONS

The location must permit both doors to open to a minimum of 90°. Allow 5" (12.7 cm) minimum space between the side of the refrigerator and a corner wall.

**NOTE:** More clearance may be required if you are using overlay panels, custom handles, or extended handles on a Classic model.

To adjust the door swings, see "Adjust Doors."

### 36" (91.4 cm) Models

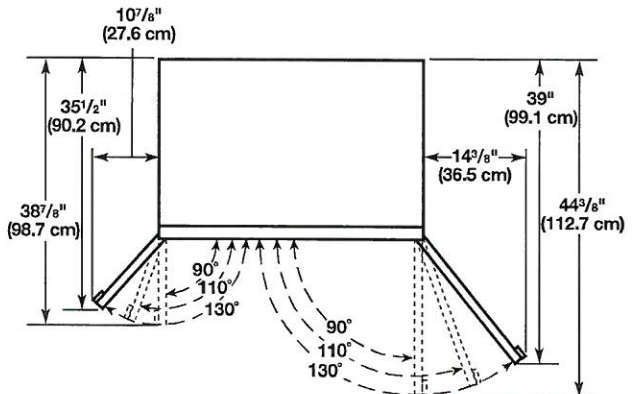

### 42" (106.7 cm) Models

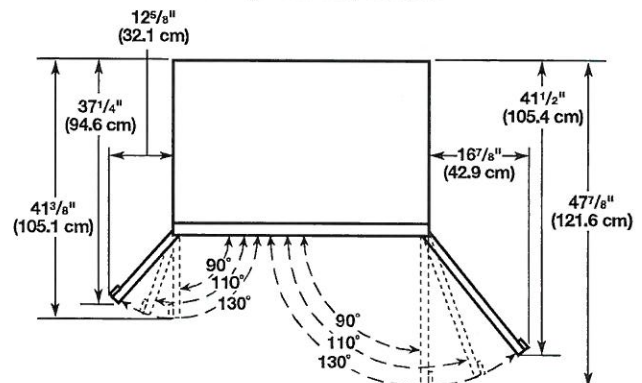

### 48" (121.9 cm) Models

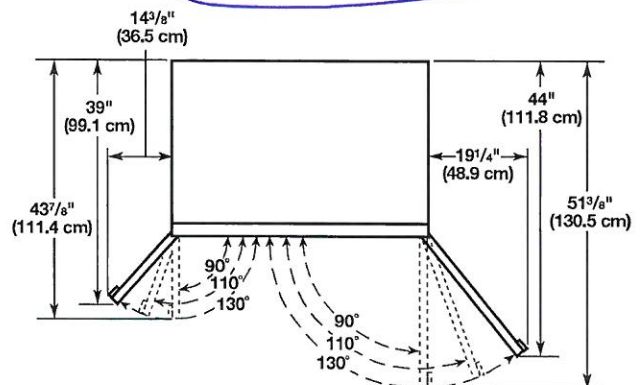



# Electric Cooktop

10 Series – Black Frameless NEM5466UC

PV-8 (S)  
March 15, 2021  
→ (Spice Kitchen)



**BOSCH**  
Invented for

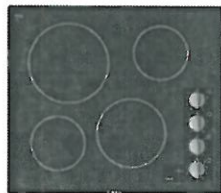

**NEM5466UC**  
Black

The 24" electric cooktop, sleek in design, features optimal temperature control and is ideal for kitchens with a smaller footprint.

## Features & Benefits

Precise temperature control for better cooking results.

Ceramic glass surface makes cooking and cleaning especially easy.

Residual heat indicator – warns if cooktop is warm or hot.

Push-to-turn control knobs.

Ideal for kitchens with a small footprint.

## General Properties

Knob material Plastic

## Element Performance

Power of Front Left heating element 1,850 W

Power of Back Left heating element 2,200 W

Power of Back Right heating element 1,200 W

Power of Front Right heating element 1,800 W

## Element Size

Dimension of Front Left heating element 6"

Dimension of Back Left heating element 8"

Dimension of Back Right heating element 6"

Dimension of Front Right heating element 7"

## Technical Details

Watts 6,600 W

Circuit breaker 30 A

Volts 208-240 V

Frequency 60 Hz

Plug type No plug

Energy source Electric

## Dimensions & Weight

Overall appliance dimensions (HxWxD) 1/8" + 4 1/3" x 23" x 20 1/5"

Required cutout size (HxWxD) 4 1/3" x 22" x 19 1/4"

Minimum distance from counter front 2 1/4"

Minimum distance from rear wall 2"

Net weight 24 lbs

## Accessories—Optional



**HEZ390210**  
8" AutoChef® pan



**HEZ390220**  
9" AutoChef® pan



**HEZ390230**  
10" AutoChef® pan



For help and assistance with Bosch accessories please call 1-800-944-2904 Mon-Fri 8am to 6pm EST

Notes: All height, width and depth dimensions are shown in inches. BSH reserves the absolute and unrestricted right to change product materials and specifications, at any time, without notice. Consult the product's installation instructions for final dimensional data and other details prior to making cutout. Applicable product warranty can be found in accompanying product literature or you may contact your account manager for further details.

Warranties: Bosch warrants that the Product is free from defects in materials and workmanship for a period of three hundred and sixty-five (365) days from the date of purchase. The foregoing warranty begins to run upon the date of purchase, and shall not be stalled, tolled, extended, or suspended, for any reason whatsoever. This Product is also warranted to be free from cosmetic defects in material and workmanship (such as scratches of stainless steel, paint/porcelain blemishes, chip, dents, or other damage) to the finish of the Product, for a period of thirty (30) days from the date of purchase or closing date for new construction. This cosmetic warranty excludes slight color variations due to inherent differences in painted and porcelain parts, as well as color differences caused by kitchen lighting, product location, or other similar factors. This cosmetic warranty specifically excludes any display, floor, "As Is", or "B" stock appliances.

For more information on our entire line of products, go to [www.bosch-home.ca](http://www.bosch-home.ca) or call 1-800-944-2904





## Installation Details

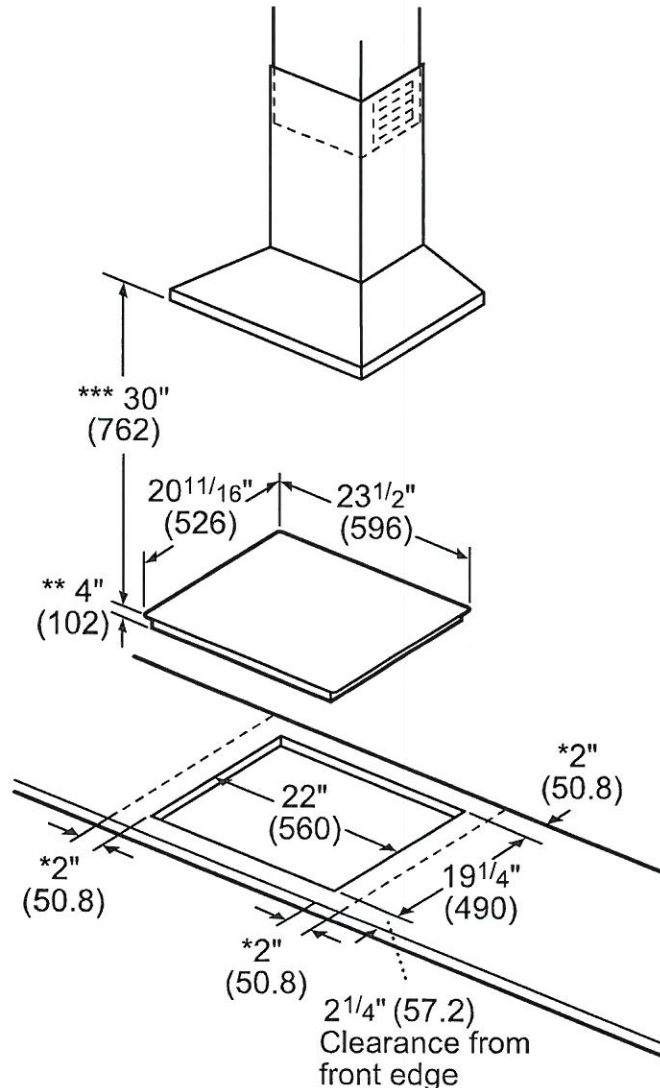

- \* Minimum clearance from the cooktop cutout to the wall
- \*\* Maximum cutout depth
- \*\*\* Minimum clearance between the cooktop surface and lower edge of the exhaust hood.

measurements in inches (mm)

## Installation above Wall Ovens

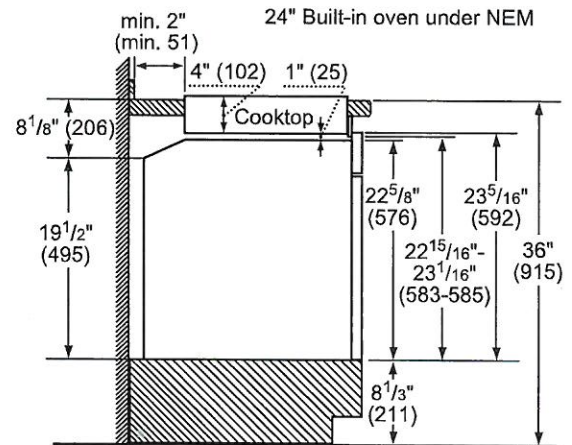

Notes: Dimensions based on standard countertop height (36" with 4 3/4" toe kick including base plate).

The built-in oven can be installed below the cooktop as long as there is at least 1" (25) of space between the bottom flat surface of the cooktop and the top of the oven.

Please allow at least 2" (51) from the countertop front edge to the edge of the cutout.

measurements in inches (mm)

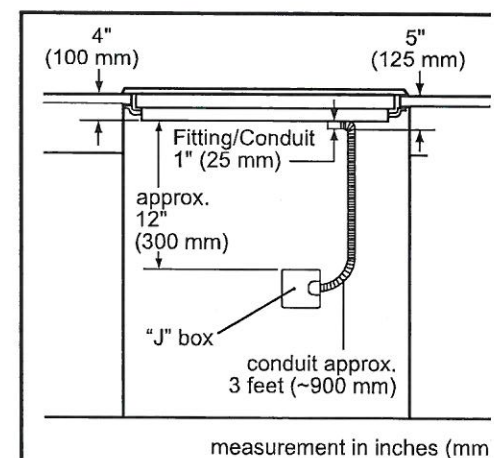

measurement in inches (mm)

For help and assistance with Bosch accessories please call 1-800-944-2904 Mon-Fri 8am to 6pm EST

Notes: All height, width and depth dimensions are shown in inches. BSH reserves the absolute and unrestricted right to change product materials and specifications, at any time, without notice. Consult the product's installation instructions for final dimensional data and other details prior to making cutout. Applicable product warranty can be found in accompanying product literature or you may contact your account manager for further details.

Warranties: Bosch warrants that the Product is free from defects in materials and workmanship for a period of three hundred and sixty-five (365) days from the date of purchase. The foregoing warranty begins to run upon the date of purchase, and shall not be stalled, tolled, extended, or suspended, for any reason whatsoever. This Product is also warranted to be free from cosmetic defects in material and workmanship (such as scratches of stainless steel, paint/porcelain blemishes, chip, dents, or other damage) to the finish of the Product, for a period of thirty (30) days from the date of purchase or closing date for new construction. This cosmetic warranty excludes slight color variations due to inherent differences in painted and porcelain parts, as well as discolorations caused by kitchen lighting, product location, or other similar factors. This cosmetic warranty specifically excludes any display, floor, "As Is", or "B" stock appliances.

For more information on our entire line of products, go to [www.bosch-home.ca](http://www.bosch-home.ca) or call 1-800-944-2904





## WARNING

**Avoid Scalding or Electrical Shock Hazard!**  
Make sure the water supply and electrical supply are shut off before installation or service.

PV-8   
March 15, 2021

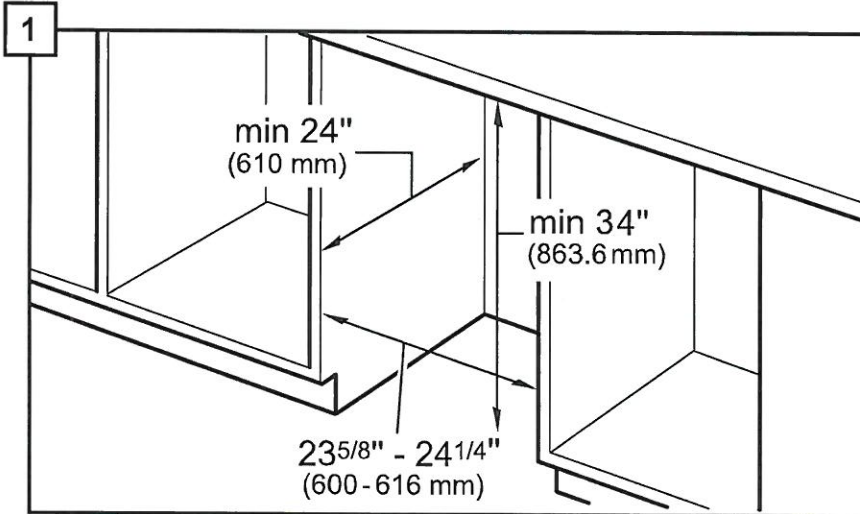

*Note: This dishwasher is designed to be enclosed on the top, back and both sides by standard residential kitchen cabinetry.*

**Select a location** as close to the sink as possible for easy access to water supply and drain lines.

**For proper dishwasher operation** and appearance, ensure that the enclosure is square and has the dimensions shown.

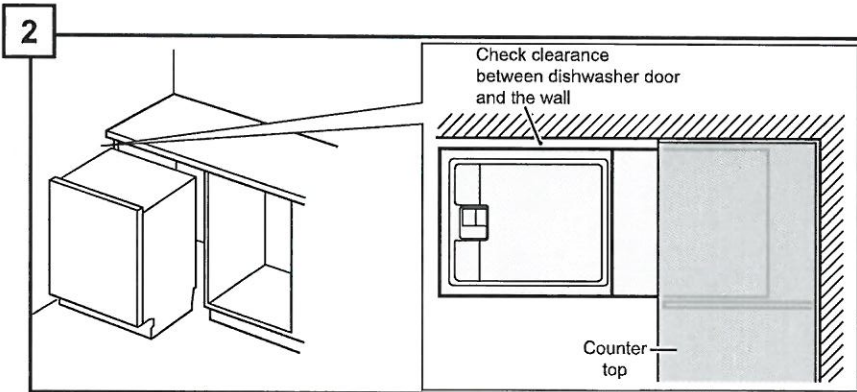

**If the dishwasher is to be installed in a corner**, ensure that there is adequate clearance to open the door as shown.



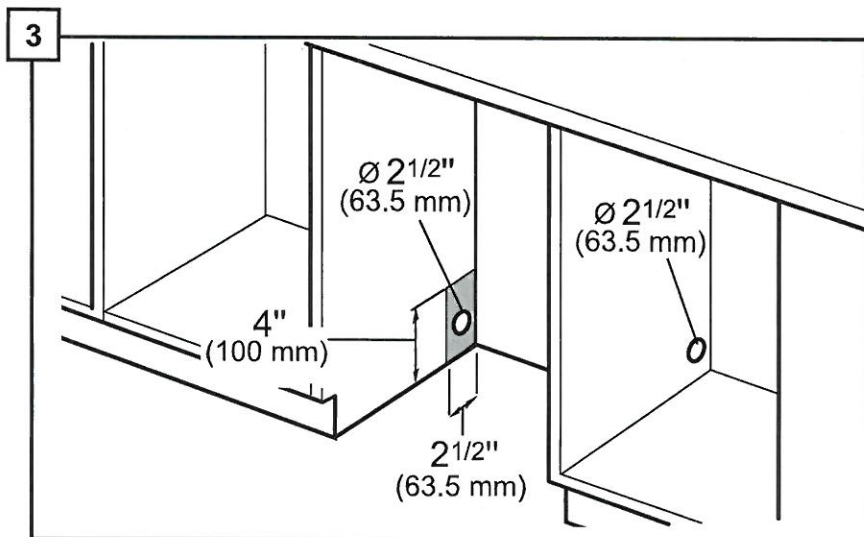

After locating the proper place for your dishwasher, create required openings in your cabinets in order to allow for water, drain and electrical lines on the appropriate side. The holes should be cut within the 4x2.5" area shown.

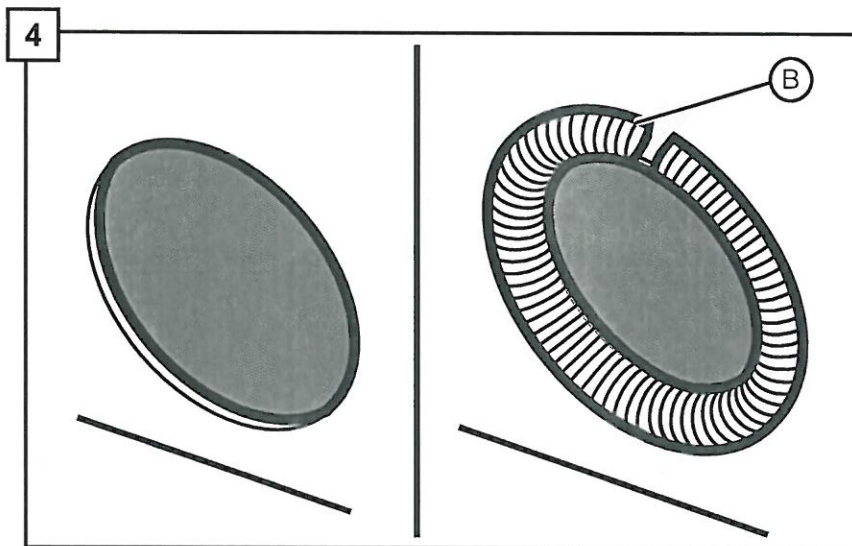

If the opening is made through wood, sand it smooth. If the opening is made through metal, use the provided edge protector (B) or other approved method to protect wiring from damage.

PV-8   
March 15, 2021



# GTW840CPN/CSN

GE® 5.2 Cu. Ft. Capacity Washer with SmartDispense

## DIMENSIONS AND INSTALLATION INFORMATION (IN INCHES)

**CIRCUIT REQUIREMENTS:** An individual, properly-grounded branch circuit, with a three-prong grounding-type receptacle, protected by a 15 or 20 amp circuit breaker or a time-delay fuse, is required.

**ELECTRICAL RATING:** 120V, 60Hz, 10A

**NOTE:** Washer wall outlet must be located within 36" of service code entry. Wall outlet must not be located behind dryer.

**INSTALLATION INFORMATION:** Before installing, consult installation instructions packed with product for current dimensional data.

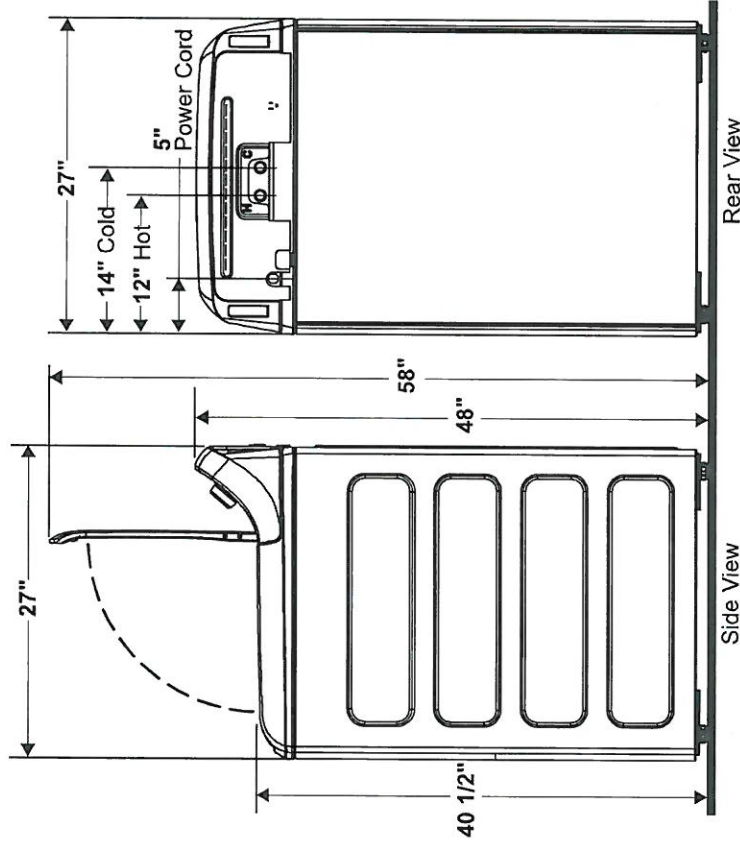

For answers to your Monogram, GE Café™ Series, GE Profile™ Series or GE Appliances product questions, visit our website at [geappliances.com](http://geappliances.com) or call GE Answer Center® Service, 800.626.2000.



Specification Revised 01/20

PV-8 8  
March 15, 2021