



CONSTRUCTION SUMMARY

Lot: 155  
Model: 40.00 B BRIARWOOD  
Project/Phase: Pine Valley Forevergreen / 1

APPLIANCES

| Invoice                      | Qty. | Description                                     |
|------------------------------|------|---|
| 2644<br><br>17Mar21<br>NoCat | 1    | APPLIANCE SPECIFICATIONS ATTACHED - SIGNED COPY |

BASEMENT WINDOWS

| Invoice                   | Qty. | Description  |
|---------------------------|------|--|
| 2488<br>72,351<br>21Oct20 | 2    | BASEMENT WINDOWS - UPGRADE BASEMENT WINDOW SIZE TO 30 " X 24" - 8" FRAME |

CERAMIC

| Invoice                      | Qty. | Description   |
|------------------------------|------|---|
| 2543<br><br>08Jan21<br>NoCat | 1    | .MASTER ENSUITE: SHOWER NICHE [SHAMPOO SHELF] - COMPLETE WITH MATCHING MARBLE JAMBS ON 4 SIDES, STANDARD TILE, APPROX. 12 X 18 INSTALLED VERTICALLY |
| 2543<br><br>08Jan21<br>NoCat | 1    | .SHARED BATH: SHOWER NICHE [SHAMPOO SHELF] - COMPLETE WITH MATCHING MARBLE JAMBS ON 4 SIDES, STANDARD TILE, APPROX. 12 X 18 INSTALLED VERTICALLY    |
| 2644<br>37<br>17Mar21        | 1    | FRONT FOYER: TILE, FLOOR , LEVEL 5 - 12X24" LAID IN STRAIGHT, STACKED PATTERN. SEE PLAN FOR TILE DIRECTION  |
| 2644<br>37<br>17Mar21        | 1    | POWDER ROOM: TILE, FLOOR , LEVEL 5 - 12X24" LAID IN STRAIGHT, STACKED PATTERN. SEE PLAN FOR TILE DIRECTION  |
| 2644<br>37<br>17Mar21        | 1    | KITCHEN: TILE, FLOOR , LEVEL 5 - 12X24" LAID IN STRAIGHT, STACKED PATTERN. SEE PLAN FOR TILE DIRECTION  |
| 2644<br>19<br>17Mar21        | 1    | FRONT FOYER: TILE GROUT UPGRADE, FLOOR , UPG GROUT - FRONT FOYER - UPG GROUT  |
| 2644<br>19<br>17Mar21        | 1    | POWDER ROOM: TILE GROUT UPGRADE, FLOOR , UPG GROUT - POWDER ROOM - UPG GROUT  |
| 2644<br>19<br>17Mar21        | 1    | KITCHEN: TILE GROUT UPGRADE, FLOOR , UPG GROUT - KITCHEN - UPG GROUT  |
| 2644<br>37<br>17Mar21        | 1    | MASTER ENSUITE: TILE, FLOOR , LEVEL 5 - 12X24" LAID IN STRAIGHT, STACKED PATTERN. SEE PLAN FOR TILE DIRECTION                                       |
| 2644<br>21<br>17Mar21        | 1    | MASTER ENSUITE: TILE GROUT UPGRADE, WALL, UPG GROUT - MASTER ENSUITE, ALT. GROUND FLOOR - UPG GROUT   |



CONSTRUCTION SUMMARY

Lot: 155  
Model: 40.00 B BRIARWOOD  
Project/Phase: Pine Valley Forevergreen / 1

CERAMIC

| Invoice                      | Qty. | Description  |
|------------------------------|------|--|
| 2644<br>37<br>17Mar21        | 1    | SHARED BATH: TILE, FLOOR , LEVEL 5 - 12X24" LAID IN STRAIGHT, STACKED PATTERN. SEE PLAN FOR TILE DIRECTION                   |
| 2644<br>19<br>17Mar21        | 1    | SHARED BATH: TILE GROUT UPGRADE, FLOOR , UPG GROUT - SHARED BATH - UPG GROUT   |
| 2644<br>48<br>17Mar21        | 1    | MASTER ENSUITE: TILE, WALL, LEVEL 2 - 10X16" LAID IN VERTICAL, STACKED PATTERN.  |
| 2644<br>48<br>17Mar21        | 1    | SHARED BATH: TILE, WALL, LEVEL 2 - 10X16" LAID IN VERTICAL, STACKED PATTERN.   |
| 2647<br><br>17Mar21<br>NoCat | 1    | MASTER ENSUITE: ADD SHOWER BENCH COMPLETE WITH STANDARD TILE AND MATCHING MARBLE JAMB COLOUR SEAT TOP<br><br>INCLUDED IN APS |

CONCRETE AND DRAIN

| Invoice                      | Qty. | Description               |
|------------------------------|------|---------------------------|
| 2488<br><br>21Oct20<br>NoCat | 1    | BACK-FLOW PREVENTER VALVE |



CONSTRUCTION SUMMARY

Lot: 155  
Model: 40.00 B BRIARWOOD  
Project/Phase: Pine Valley Forevergreen / 1

DRYWALL

| Invoice                         | Qty. | Description  |
|---------------------------------|------|--|
| 2488<br>72,351<br>21Oct20<br>** | 2    | BASEMENT WINDOWS - UPGRADE BASEMENT WINDOW SIZE TO 30 " X 24" - 8" FRAME   |
| 2543<br>72,373<br>08Jan21       | 1    | MASTER ENSUITE: MODEL OPTIONS 40.00 - MASTER BEDROOM - OPT. 11 FOOT TRAY CEILING   |
| 2543<br><br>08Jan21<br>NoCat    | 1    | **CUSTOM LAYOUT** MASTER ENSUITE - REDUCE DEPTH OF LINEN CLOSET IN ENSUITE TO ALLOW FOR PANTRY ACCESSIBLE FROM KITCHEN - SEE PLAN FOR LOCATION<br><br>BASED ON STANDARD FINISHES |
| 2543<br><br>08Jan21<br>NoCat    | 1    | .MASTER ENSUITE: SHOWER NICHE [SHAMPOO SHELF] - COMPLETE WITH MATCHING MARBLE JAMBS ON 4 SIDES, STANDARD TILE, APPROX. 12 X 18 INSTALLED VERTICALLY                              |
| 2543<br><br>08Jan21<br>NoCat    | 1    | .SHARED BATH: SHOWER NICHE [SHAMPOO SHELF] - COMPLETE WITH MATCHING MARBLE JAMBS ON 4 SIDES, STANDARD TILE, APPROX. 12 X 18 INSTALLED VERTICALLY                                 |
| 2543<br><br>08Jan21<br>NoCat    | 8    | .THRU OUT 2ND FLOOR: INCREASE HEIGHT OF DOOR TO 8FT SECOND FLOOR - PER DOOR  |
| 2647<br>17Mar21<br>NoCat        | 1    | **CUSTOM LAYOUT** 2ND FLOOR MEDIA ROOM - INSTALL FULL WALL IN LIEU OF RAILING ABOVE GREAT ROOM. ADD 8' DOUBLE DOORS - SEE PLAN FOR LOCATION<br><br>INCLUDED IN APS               |
| 2647<br>17Mar21<br>NoCat        | 1    | MASTER ENSUITE: ADD SHOWER BENCH COMPLETE WITH STANDARD TILE AND MATCHING MARBLE JAMB COLOUR SEAT TOP<br><br>INCLUDED IN APS   |



CONSTRUCTION SUMMARY

Lot: 155  
Model: 40.00 B BRIARWOOD  
Project/Phase: Pine Valley Forevergreen / 1

ELECTRICAL

| Invoice                         | Qty. | Description  |
|---------------------------------|------|--|
| 2488<br>72,351<br>21Oct20<br>** | 2    | BASEMENT WINDOWS - UPGRADE BASEMENT WINDOW SIZE TO 30 " X 24" - 8" FRAME   |
| 2543<br>72,281<br>08Jan21       | 1    | GREAT ROOM: INTERIOR WALL OUTLET: ADDITIONAL 110V WALL INTERIOR RECEPTACLE ON EXISTING CIRCUIT FOR WALL MOUNTED TV - LOCATE ABOVE FIREPLACE, APPROX 66" A.F.F.   |
| 2543<br>72,289<br>08Jan21       | 6    | KITCHEN: 4" E/S LED INTERIOR POT LIGHT - GROUND FLOOR - EACH - INCLUDES 1 SWITCH<br><br>INCLUDED IN APS  |
| 2543<br>72,282<br>08Jan21       | 1    | KITCHEN: ADDITIONAL 220V RECEPTACLE ON A SEPARATE CIRCUIT - FOR BUILT-IN WALL OVEN - APPLIANCE NOT INCLUDED - DOES NOT INCLUDE BREAKER THAT IS TO BE INSTALLED BY LICENSED ELECTRICIAN AND ARRANGED BY HOMEOWNER AFTER CLOSING |
| 2543<br>72,280<br>08Jan21       | 1    | KITCHEN: CEILING OUTLET: ADDITIONAL REINFORCED CEILING OUTLET - APPROX CENTERED ABOVE ISLAND<br><br>USE SAME SWITCH AS STANDARD LIGHT  |
| 2543<br>72,307<br>08Jan21       | 1    | KITCHEN: FIXTURE: RELOCATE STANDARD CEILING MOUNT FIXTURE - APPROX CENTERED ABOVE ISLAND   |
| 2543<br>72,289<br>08Jan21       | 6    | MAIN HALL: 4" E/S LED INTERIOR POT LIGHT - GROUND FLOOR - EACH<br><br>USE STANDARD SWITCHES  |
| 2543<br>72,290<br>08Jan21       | 8    | GREAT ROOM: 4" E/S LED INTERIOR POT LIGHT (INSULATED CEILING) - SECOND FLOOR - EACH  |
| 2543<br>72,278<br>08Jan21       | 1    | GREAT ROOM: ADDITIONAL INTERIOR SWITCH<br><br>FOR POTLIGHTS  |
| 2543<br>72,290<br>08Jan21       | 6    | FORMAL ROOM: 4" E/S LED INTERIOR POT LIGHT (INSULATED CEILING) - SECOND FLOOR - EACH   |
| 2543<br>72,278<br>08Jan21       | 1    | FORMAL ROOM: ADDITIONAL INTERIOR SWITCH<br><br>FOR POTLIGHTS   |
| 2543<br>72,290<br>08Jan21       | 6    | MASTER BEDROOM: 4" E/S LED INTERIOR POT LIGHT (INSULATED CEILING) - SECOND FLOOR - EACH  |
| 2543<br>72,289<br>08Jan21       | 5    | MASTER ENSUITE: 4" E/S LED INTERIOR POT LIGHT - GROUND FLOOR - EACH  |



CONSTRUCTION SUMMARY

Lot: 155  
Model: 40.00 B BRIARWOOD  
Project/Phase: Pine Valley Forevergreen / 1

ELECTRICAL

| Invoice                      | Qty. | Description  |
|------------------------------|------|--|
| 2543<br>72,280<br>08Jan21    | 1    | MASTER ENSUITE: CEILING OUTLET: ADDITIONAL REINFORCED CEILING OUTLET - LOCATE APPROX CENTRED ABOVE TUB   |
| 2543<br>72,278<br>08Jan21    | 1    | MASTER ENSUITE: ADDITIONAL INTERIOR SWITCH<br><br>FOR POTLIGHTS + TUB LIGHT  |
| 2543<br>72,290<br>08Jan21    | 7    | UPPER HALL: 4" E/S LED INTERIOR POT LIGHT (INSULATED CEILING) - SECOND FLOOR - EACH<br><br>USE STANDARD SWITCH   |
| 2543<br>72,278<br>08Jan21    | 1    | MASTER BEDROOM: ADDITIONAL INTERIOR SWITCH<br><br>FOR POTLIGHTS  |
| 2644<br>72,285<br>17Mar21    | 1    | MASTER ENSUITE: INTERIOR WALL OUTLET: ADDITIONAL INTERIOR GFI RECEPTACLE - LOCATE ABOVE WATER SUPPLY BEHIND TOILET<br><br>FOR FUTURE BIDET SEAT                    |
| 2644<br>72,272<br>17Mar21    | 1    | LAUNDRY: DEDICATED 110V WALL RECEPTACLE ON SEPARATE CIRCUIT - FOR FUTURE FRIDGE - APPLIANCE NOT INCLUDED   |
| 2644<br>72,303<br>17Mar21    | 1    | KITCHEN: FIXTURE: UNDER CABINET FLUORESCENT LIGHT FIXTURES - DOES NOT INCLUDE (AND REQUIRES) LIGHT VALANCE<br><br>PRICE INCLUDED IN CABINETRY SCHEDULE             |
| 2644<br><br>17Mar21<br>NoCat | 1    | KITCHEN: RELOCATE STANDARD COUNTER PLUGS TO INSIDE UPPER CABINETS - BOX WILL BE NOTICABLE IN REAR CORNER OF CABINET(S)<br><br>PRICE INCLUDED IN CABINETRY SCHEDULE |
| 2644<br><br>17Mar21<br>NoCat | 1    | **CHANGE TO LAYOUT** ADD SWITCH FOR POTLIGHTS AT MEDIA ROOM (1 SWITCH OUTSIDE ROOM TO CONTROL 2 POTLIGHTS IN MEDIA ROOM)<br><br>SEE PLAN FOR LOCATION              |
| 2647<br><br>17Mar21<br>NoCat | 1    | **CUSTOM LAYOUT** 2ND FLOOR MEDIA ROOM - INSTALL FULL WALL IN LIEU OF RAILING ABOVE GREAT ROOM. ADD 8' DOUBLE DOORS - SEE PLAN FOR LOCATION<br><br>INCLUDED IN APS |

EXTERIOR COLOURS

| Invoice                      | Qty. | Description                   |
|------------------------------|------|-------------------------------|
| 2644<br><br>17Mar21<br>NoCat | 1    | EXTERIOR COLOURS PACKAGE: BR9 |



CONSTRUCTION SUMMARY

Lot: 155  
Model: 40.00 B BRIARWOOD  
Project/Phase: Pine Valley Forevergreen / 1

FORM - FORMING

| Invoice                         | Qty. | Description  |
|---------------------------------|------|--|
| 2488<br>72,351<br>21Oct20<br>** | 2    | BASEMENT WINDOWS - UPGRADE BASEMENT WINDOW SIZE TO 30 " X 24" - 8" FRAME |

FRAMING

| Invoice                      | Qty. | Description  |
|------------------------------|------|--|
| 2543<br><br>08Jan21<br>NoCat | 1    | **CUSTOM LAYOUT** MASTER ENSUITE - REDUCE DEPTH OF LINEN CLOSET IN ENSUITE TO ALLOW FOR PANTRY ACCESSIBLE FROM KITCHEN - SEE PLAN FOR LOCATION<br><br>BASED ON STANDARD FINISHES |
| 2543<br>72,631<br>08Jan21    | 1    | MASTER ENSUITE: SHOWER NICHE [SHAMPOO SHELF] - COMPLETE WITH MATCHING MARBLE JAMBS ON 4 SIDES, STANDARD TILE, APPROX. 12 X 18 INSTALLED VERTICALLY                               |
| 2543<br>72,631<br>08Jan21    | 1    | SHARED BATH: SHOWER NICHE [SHAMPOO SHELF] - COMPLETE WITH MATCHING MARBLE JAMBS ON 4 SIDES, STANDARD TILE, APPROX. 12 X 18 INSTALLED VERTICALLY                                  |
| 2543<br><br>08Jan21<br>NoCat | 1    | .MASTER ENSUITE: MODEL OPTIONS 40.00 - MASTER BEDROOM - OPT. 11 FOOT TRAY CEILING  |
| 2543<br><br>08Jan21<br>NoCat | 8    | .THRU OUT 2ND FLOOR: INCREASE HEIGHT OF DOOR TO 8FT SECOND FLOOR - PER DOOR  |
| 2647<br><br>17Mar21<br>NoCat | 1    | **CUSTOM LAYOUT** 2ND FLOOR MEDIA ROOM - INSTALL FULL WALL IN LIEU OF RAILING ABOVE GREAT ROOM. ADD 8' DOUBLE DOORS - SEE PLAN FOR LOCATION<br><br>INCLUDED IN APS               |
| 2647<br>72,671<br>17Mar21    | 1    | MASTER ENSUITE: ADD SHOWER BENCH COMPLETE WITH STANDARD TILE AND MATCHING MARBLE JAMB COLOUR SEAT TOP<br><br>INCLUDED IN APS   |

GLASS AND MIRROR

| Invoice                      | Qty. | Description   |
|------------------------------|------|---|
| 2644<br><br>17Mar21<br>NoCat | 2    | MASTER ENSUITE + SHARED ENSUITE: UPGRADE SHOWER DOOR HANDLE AND HINGES - MT6X6 BRUSHED NICKEL |



CONSTRUCTION SUMMARY

Lot: 155  
Model: 40.00 B BRIARWOOD  
Project/Phase: Pine Valley Forevergreen / 1

GRANITE MARBLE QUARTZ

| Invoice                      | Qty. | Description   |
|------------------------------|------|---|
| 2644<br>101,930<br>17Mar21   | 1    | KITCHEN: UPGRADE QUARTZ COUNTERTOP UPGRADE 5          |
| 2644<br><br>17Mar21<br>NoCat | 1    | POWDER ROOM: UPGRADE 1 QUARTZ COUNTER TOP             |
| 2644<br><br>17Mar21<br>NoCat | 1    | KITCHEN: UPGRADE THICKNESS TO 3CM                     |
| 2644<br><br>17Mar21<br>NoCat | 1    | KITCHEN: FULL HEIGHT SLAB BACKSPLASH - LEVEL 5 QUARTZ |
| 2644<br><br>17Mar21<br>NoCat | 1    | MASTER ENSUITE: UPGRADE 1 QUARTZ COUNTER              |

HARDWOOD

| Invoice              | Qty. | Description  |
|----------------------|------|--|
| 2644<br>4<br>17Mar21 | 1    | THRU OUT STANDARD AREAS - MAIN HALL/FORMAL ROOM/ GREAT ROOM/ UPPER HALL/ LOFT/ MEDIA ROOM/ MASTER BEDROOM/ BEDROOM 2/ BEDROOM 3/ BEDROOM4: VINTAGE SERIES, 5" WHITE OAK, NSS ENGINEERED HARDWOOD, 3/4" THK, WIREBRUSH TEXTURE, UV OIL FINISH - LEVEL 3 |

HVAC

| Invoice                   | Qty. | Description   |
|---------------------------|------|---|
| 2543<br>72,224<br>08Jan21 | 1    | KITCHEN: GAS LINE ROUGH-IN - MAIN FLOOR FOR GAS COOKTOP |

INTERIOR DOORS

| Invoice                      | Qty. | Description   |
|------------------------------|------|---|
| 2543<br><br>08Jan21<br>NoCat | 1    | .**CUSTOM LAYOUT** MASTER ENSUITE - REDUCE DEPTH OF LINEN CLOSET IN ENSUITE TO ALLOW FOR PANTRY ACCESSIBLE FROM KITCHEN - SEE PLAN FOR LOCATION<br><br>BASED ON STANDARD FINISHES |

INTERIOR DOORS AND TRIM

| Invoice                   | Qty. | Description  |
|---------------------------|------|--|
| 2543<br>72,644<br>08Jan21 | 8    | THRU OUT 2ND FLOOR: INCREASE HEIGHT OF DOOR TO 8FT SECOND FLOOR - PER DOOR |



CONSTRUCTION SUMMARY

Lot: 155  
Model: 40.00 B BRIARWOOD  
Project/Phase: Pine Valley Forevergreen / 1

INTERIOR TRIM /MOULDINGS

| Invoice                         | Qty. | Description  |
|---------------------------------|------|--|
| 2488<br>72,351<br>21Oct20<br>** | 2    | BASEMENT WINDOWS - UPGRADE BASEMENT WINDOW SIZE TO 30 " X 24" - 8" FRAME |

INTERIOR TRIM AND DOORS

| Invoice                      | Qty. | Description  |
|------------------------------|------|--|
| 2543<br><br>08Jan21<br>NoCat | 1    | .GREAT ROOM: 96" GARDEN DOOR ASSEMBLY  |
| 2644<br>155,857<br>17Mar21   | 1    | THRU OUT: ADD FOR HINGES 3X3 SQUARE FLAT TIP THROUGHOUT<br><br>UPGRADE       |
| 2644<br>153,777<br>17Mar21   | 1    | THRU OUT: HALIFAX LEVER, IRON BLACK INTERIOR DOOR HARDWARE<br><br>UPGRADE    |
| 2644<br>153,237<br>17Mar21   | 1    | THRU OUT; UPGRADE 3 1/2" STEP BEVEL CASING, 7 1/4" BASE BOARD<br><br>UPGRADE |

KITCHEN AND BATH CABINETRY

| Invoice                      | Qty. | Description  |
|------------------------------|------|--|
| 2644<br><br>17Mar21<br>NoCat | 1    | THRU OUT: SEE ATTACHED CABINETRY SCHEDULE  |
| 2644<br><br>17Mar21<br>NoCat | 1    | FYI - KITCHEN: FIXTURE: UNDER CABINET FLUORESCENT LIGHT FIXTURES - DOES NOT INCLUDE (AND REQUIRES) LIGHT VALANCE             |
| 2644<br><br>17Mar21<br>NoCat | 1    | FYI - KITCHEN: RELOCATE STANDARD COUNTER PLUGS TO INSIDE UPPER CABINETS - BOX WILL BE NOTICABLE IN REAR CORNER OF CABINET(S) |

MASONRY

| Invoice                      | Qty. | Description                           |
|------------------------------|------|---------------------------------------|
| 2543<br><br>08Jan21<br>NoCat | 1    | .GREAT ROOM: 96" GARDEN DOOR ASSEMBLY |





CONSTRUCTION SUMMARY

Lot: 155  
Model: 40.00 B BRIARWOOD  
Project/Phase: Pine Valley Forevergreen / 1

NETWORK AND WIRING

| Invoice                   | Qty. | Description   |
|---------------------------|------|---|
| 2543<br>72,259<br>08Jan21 | 1    | GREAT ROOM: CONDUIT PIPE - FOR WALL MOUNT TV - LOCATE ABOVE FIREPLACE, APPROX 66" A.F.F.,<br>TERMINATING AT CABLE |
| 2543<br>72,258<br>08Jan21 | 1    | GREAT ROOM: ADDITIONAL CAT6 ETHERNET OUTLET - EACH  |
| 2644<br>72,260<br>17Mar21 | 1    | CONDUIT PIPE - FROM ATTIC FROM BY ELECTRICAL PANEL IN BASEMENT TO APPROX CENTER OF ATTIC                          |
| 2644<br>72,258<br>17Mar21 | 1    | MEDIA ROOM: ADDITIONAL CAT6 ETHERNET OUTLET - EACH SEE PLAN FOR ELECT   |
| 2644<br>72,256<br>17Mar21 | 3    | MEDIA ROOM + BEDROOM 3 + BEDROOM 4: ADDITIONAL RG6 HIGH SPEED TV / INTERNET OUTLETS SEE PLAN<br>FOR LOCATION      |
| 2644<br>72,258<br>17Mar21 | 1    | BEDROOM 4: ADDITIONAL CAT6 ETHERNET OUTLET - EACH SEE PLAN FOR LOCATION   |

PAINT

| Invoice                      | Qty. | Description  |
|------------------------------|------|--|
| 2543<br><br>08Jan21<br>NoCat | 1    | .**CUSTOM LAYOUT** MASTER ENSUITE - REDUCE DEPTH OF LINEN CLOSET IN ENSUITE TO ALLOW FOR<br>PANTRY ACCESSIBLE FROM KITCHEN - SEE PLAN FOR LOCATION<br><br>BASED ON STANDARD FINISHES |
| 2543<br><br>08Jan21<br>NoCat | 1    | .MASTER ENSUITE: MODEL OPTIONS 40.00 - MASTER BEDROOM - OPT. 11 FOOT TRAY CEILING  |
| 2543<br><br>08Jan21<br>NoCat | 1    | .GREAT ROOM: 96" GARDEN DOOR ASSEMBLY  |
| 2543<br><br>08Jan21<br>NoCat | 8    | .THRU OUT 2ND FLOOR: INCREASE HEIGHT OF DOOR TO 8FT SECOND FLOOR - PER DOOR  |
| 2644<br><br>17Mar21<br>NoCat | 2    | MAIN STAIRS: 2ND FLOOR TO BASEMENT - STAIN STAIRS & LANDINGS<br><br>STAIN STAIRS AND LANDINGS WILL NOT MATCH HARDWOOD FLOORS IN COLOUR/TEXTURE/SPECIES                               |
| 2647<br><br>17Mar21<br>NoCat | 1    | .**CUSTOM LAYOUT** 2ND FLOOR MEDIA ROOM - INSTALL FULL WALL IN LIEU OF RAILING ABOVE GREAT<br>ROOM. ADD 8' DOUBLE DOORS - SEE PLAN FOR LOCATION<br><br>INCLUDED IN APS               |



CONSTRUCTION SUMMARY

Lot: 155  
Model: 40.00 B BRIARWOOD  
Project/Phase: Pine Valley Forevergreen / 1

PAINTING

| Invoice                         | Qty. | Description  |
|---------------------------------|------|--|
| 2488<br>72,351<br>21Oct20<br>** | 2    | BASEMENT WINDOWS - UPGRADE BASEMENT WINDOW SIZE TO 30 " X 24" - 8" FRAME |

PANL - FRAMING

| Invoice                         | Qty. | Description  |
|---------------------------------|------|--|
| 2488<br>72,351<br>21Oct20<br>** | 2    | BASEMENT WINDOWS - UPGRADE BASEMENT WINDOW SIZE TO 30 " X 24" - 8" FRAME |

PLUMBING

| Invoice                      | Qty. | Description  |
|------------------------------|------|--|
| 2543<br>72,346<br>08Jan21    | 1    | KITCHEN: MOEN 'MODERN' POT FILLER - STAINLESS STEEL<br><br>ROUGH-IN INCLUDED   |
| 2543<br>72,332<br>08Jan21    | 1    | KITCHEN: ROUGH-IN 1/4" COLD WATER LINE TO FRIDGE   |
| 2543<br><br>08Jan21<br>NoCat | 1    | MASTER ENSUITE: MOEN 'FLARA' TUB FILLER + HAND SHOWER CROSS HANDLE 'BRUSHED NICKEL'<br><br>TUB DRAIN HALF KIT INCLUDED |
| 2543<br><br>08Jan21<br>NoCat | 2    | MASTER ENSUITE: MOEN 'FLARA' 8" CC LAV FAUCET - CROSS HANDLE BRUSHED NICKEL  |
| 2543<br><br>08Jan21<br>NoCat | 1    | MASTER ENSUITE: MOEN 'FLARA' RAIN SHOWER (from wall) + HAND SHOWER/SLIDE BAR 'BRUSHED NICKEL                           |
| 2644<br><br>17Mar21<br>NoCat | 2    | MASTER ENSUITE + SHARED ENSUITE: ADD TOE TESTER AT SHOWERS - APPROX 18" A.F.F.   |

PLUMBING FIXTURES

| Invoice                    | Qty. | Description   |
|----------------------------|------|---|
| 2644<br>101,930<br>17Mar21 | 1    | KITCHEN: **APRON FRONT SINK** - BLANCO QUATRUS R15 U - STAINLESS<br><br>SEE ATTCHED |

ROUGH CARPENTRY

| Invoice                         | Qty. | Description  |
|---------------------------------|------|--|
| 2488<br>72,351<br>21Oct20<br>** | 2    | BASEMENT WINDOWS - UPGRADE BASEMENT WINDOW SIZE TO 30 " X 24" - 8" FRAME |



CONSTRUCTION SUMMARY

Lot: 155  
Model: 40.00 B BRIARWOOD  
Project/Phase: Pine Valley Forevergreen / 1

STAIR AND RAILINGS

| Invoice                   | Qty. | Description   |
|---------------------------|------|---|
| 2644<br>93,776<br>17Mar21 | 2    | MAIN STAIRS: 2ND FLOOR TO BASEMENT; UPGRADE - EURONLINE (ALL PLAIN) PICKET, 3" HALF-ROUND W/V-GROOVE HANDRAIL, 3 1/2" ALL SQUARE POST WITH PYRAMID TOP POST CAP - PACKAGE A-2 |

STAIRS AND RAILINGS

| Invoice                      | Qty. | Description  |
|------------------------------|------|--|
| 2647<br><br>17Mar21<br>NoCat | 1    | **CUSTOM LAYOUT** 2ND FLOOR MEDIA ROOM - INSTALL FULL WALL IN LIEU OF RAILING ABOVE GREAT ROOM. ADD 8' DOUBLE DOORS - SEE PLAN FOR LOCATION<br><br>DELETE RAILING ABOVE GREAT ROOM |

SUB FLOOR

| Invoice                      | Qty. | Description  |
|------------------------------|------|--|
| 2647<br><br>17Mar21<br>NoCat | 1    | **CUSTOM LAYOUT** 2ND FLOOR MEDIA ROOM - INSTALL FULL WALL IN LIEU OF RAILING ABOVE GREAT ROOM. ADD 8' DOUBLE DOORS - SEE PLAN FOR LOCATION<br><br>INCLUDED IN APS |

WINDOWS - BASEMENT

| Invoice                         | Qty. | Description  |
|---------------------------------|------|--|
| 2488<br>72,351<br>21Oct20<br>** | 2    | BASEMENT WINDOWS - UPGRADE BASEMENT WINDOW SIZE TO 30 " X 24" - 8" FRAME |

WINDOWS AND DOORS

| Invoice                      | Qty. | Description                          |
|------------------------------|------|--------------------------------------|
| 2543<br><br>08Jan21<br>NoCat | 1    | GREAT ROOM: 96" GARDEN DOOR ASSEMBLY |

PV - 155 Cabinetry Schedule

| ROOM            | DESCRIPTION   | PRICE | QTY | TOTAL |
|-----------------|---|-------|-----|-------|
| KITCHEN         | UPGRADE PERIMETER, ISLAND, AND PANTRIES FROM SERIES 2 TO SERIES 3 - CHELSEA |       | 1   | \$    |
|                 | HI GLOSS WHITE  |       | 1   | \$    |
|                 | ADD 2-BIN RECYCLE CENTRE TO ISLAND  |       | 1   | \$    |
|                 | ADJUST CABINETS FOR 36" COOKTOP (N/C)                                       |       | 1   | \$    |
|                 | LEAVE 42" SPACE IN UPPER CABINETS FOR HOOD FAN (N/C)                        |       | 1   | \$    |
|                 | ADJUST CABINETS FOR APRON FRONT SINK  |       | 1   | \$    |
|                 | ADD FLUORESCENT LIGHT BUNDLE + CABINETS VALANCE                             |       | 1   | \$    |
|                 | HIDDEN RECEPTICLE BELOW UPPER CABINET - LOCATED IN UPPER CORNER             |       | 1   | \$    |
|                 | ADD SPICE PULL OUT ACCESSORY TO CABINETS FLANKING COOKTOP                   |       | 2   | \$    |
|                 | ADD POTS AND PANS DRAWERS BELOW COOKTOP                                     |       | 1   | \$    |
|                 | CONVERT CABINETS TO BUILT IN WALL OVEN UNIT WITH POT DRAWER BELOW           |       | 1   | \$    |
|                 | ADD FLUSH CAMDEN FURNITURE KICK TO BACKSIDE OF ISLAND                       |       | 1   | \$    |
|                 |   |       |     | \$    |
| SHARED ENSUITE  | ADD BANK OF 4 DRAWERS   |       | 1   | \$    |
| CABINETS TOTAL: |   |       |     | \$    |

\*\*\*HANDLE PLACEMENT: AT INSTALLERS DISCRETION\*\*\*

LOT #: PV-155

DATE: March 16, 2021

SIGNATURE:

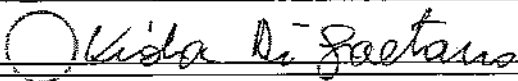

SIGNATURE:





PINE VALLEY  
FOREVERGREEN

STONE COUNTERTOP EDGE PROFILES



STANDARD 2CM EASED EDGE

LOCATION:

*\* Turn-out \**

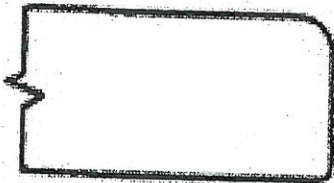

UPGRADE 3CM EASED EDGE

LOCATION:

*\* Kitchen \**



UPGRADE 4CM MITRED EDGE

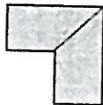

LOCATION:

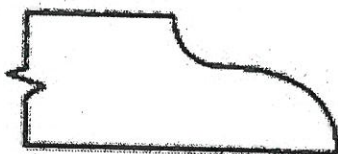

UPGRADE 2CM OGEE EDGE

LOCATION:

LOT #: *PV-155*

DATE: *May 20.2021*

SIGNATURE: *see attach.*

SIGNATURE:



PINE VALLEY  
FOREVERGREEN

## STANDARD HARDWARE / HANDLES

☐

H001-02

☐

H001-03

☐

H001-04

☐

H009-03

☐

H009-09

☐

H011-03

☒

H011-05

→ shared Ensuite  
→ Master Ensuite

☐

H011-06

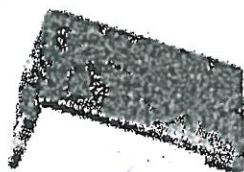
☒

H033-01

→ Kitchen

☐

H039-03

☐

\*NO HARDWARE

LOT # PV-155

DATE: May 20, 2021

SIGNATURE:



See  
attach.

SIGNATURE:





PINE VALLEY

FOREVERGREEN

STANDARD HARDWARE / KNOBS

☐

K002-02

☐

K002-03

☐

K002-04

☐

K002-06

☐

K002-05

☐

K008-14

☒

K024-03

→ Powder Room  
→ Laundry

☐

\*NO HARDWARE

☐

\*TOUCH-LATCH

LOT #

PV-155

DATE:

May 20, 2021

SIGNATURE:



See  
attach.

SIGNATURE:





## BATHROOM ACCESSORIES

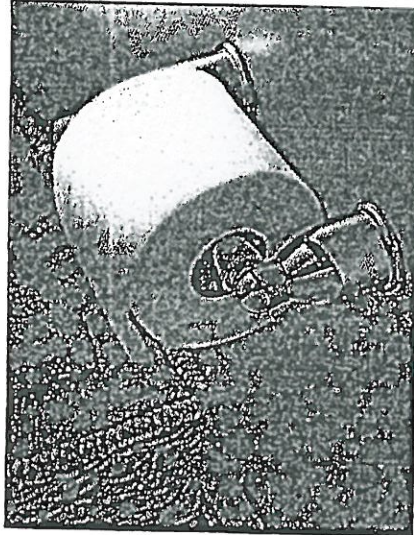

Tissue Holder  
Mason - Chrome

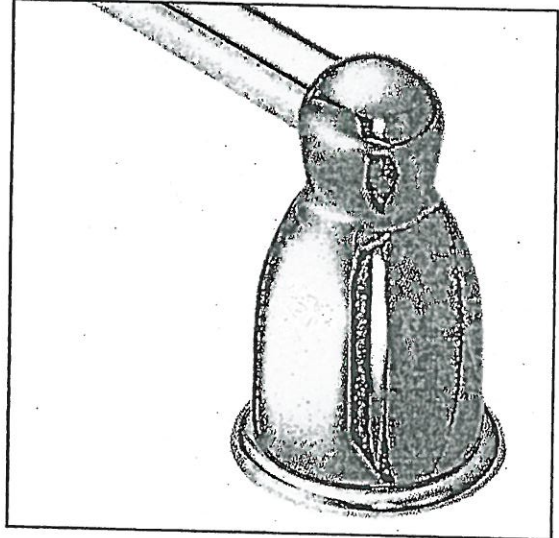

Towel Bar  
Mason - Chrome

**Please select one of the following:**

- ☐ INSTALL STANDARD BATHROOM ACCESSORIES THRU OUT  
(tissue holder + towel bar) *\*location as per vendors discretion\**
- ☐ **\*DO NOT\*** INSTALL STANDARD BATHROOM ACCESSORIES  
THRU OUT *\*tissue holder + towel bar will not be provided\**

LOT # PV-155

DATE: May 20, 2021

SIGNATURE:  see attach.

SIGNATURE: 





Project: Pine Valley

Lot: 155

Purchaser(s): Violanda DiGaetano & Loredana Di Gaetano

Standard Hood Fan Deletion

We acknowledge that the builder's standard hood fan will not be installed.  
Do not supply, install and/or credit. We will install our own hood fan after closing.

Signature:  See attach.

Signature: 

Date: May 20, 2021

**STONE COUNTERTOP EDGE PROFILES**

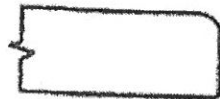

STANDARD 2CM EASED EDGE

LOCATION:

\* *turn-out* \*



UPGRADE 3CM EASED EDGE

LOCATION:

\* *Kitchen* \*



UPGRADE 4CM MITRED EDGE



LOCATION:



UPGRADE 2CM OGEE EDGE

LOCATION:

LOT #: *PV-155*

DATE: *May 20, 2021*

SIGNATURE:

SIGNATURE:

# STANDARD HARDWARE / HANDLES



☐ H001-02



☐ H001-03



☐ H001-04



☐ H009-03



☐ H009-09



☐ H011-03



☒ H011-05  
→ Shared Ensuite  
→ Master Ensuite



☐ H011-06

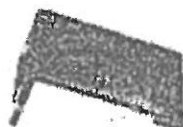

☒ H033-01  
→ Kitchen



☐ H039-03

☐ \*NO HARDWARE

LOT # TV-155

DATE: May 20, 2021

SIGNATURE:

*[Signature]*

SIGNATURE:

*[Signature]*

GOLDPARK

STANDARD HARDWARE / KNOBS



☐ K002-02



☐ K002-03



☐ K002-04



☐ K002-06



☐ K002-05

☐ K008-14



☒ K024-03

→ Powder Room  
→ Laundry

☐ \*NO HARDWARE

☐ \*TOUCH-LATCH

LOT # PV-165

DATE: May 20, 2021

SIGNATURE:

SIGNATURE:

GOLDPARK

## BATHROOM ACCESSORIES

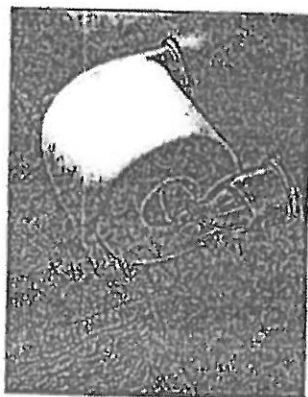

Tissue Holder  
Mason - Chrome

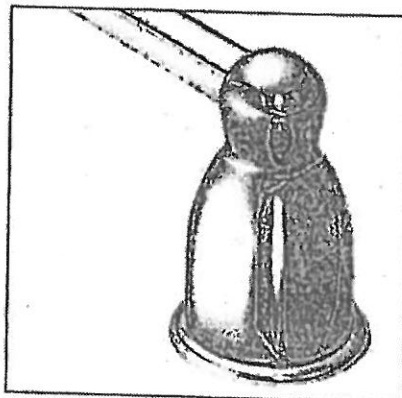

Towel Bar  
Mason - Chrome

Please select one of the following:

☒ INSTALL STANDARD BATHROOM ACCESSORIES THRU OUT  
(tissue holder + towel bar) *\*location as per vendors discretion\**

☐ **\*DO NOT\*** INSTALL STANDARD BATHROOM ACCESSORIES  
THRU OUT *\*tissue holder + towel bar will not be provided\**

LOT # PV-165

DATE: May 20, 2021

SIGNATURE:

*[Signature]*

SIGNATURE:

*[Signature]*

GOLDPARK  
OFFICE SUPPLY



Project: Pine Valley

Lot: 155

Purchaser(s): Violanda Di Gaetano & Landano Di Gaetano

**Standard Hood Fan Deletion**

We acknowledge that the builder's standard hood fan will not be installed.  
Do not supply, install and/or credit. We will install our own hood fan after closing.

Signature: \_\_\_\_\_

A handwritten signature in dark ink, appearing to be "V. Di Gaetano", written over a horizontal line.

Signature: \_\_\_\_\_

A handwritten signature in dark ink, appearing to be "L. Di Gaetano", written over a horizontal line.

Date: \_\_\_\_\_

May 20, 2021

\*\*\* NOTE: This is not an approved document. Document must be locked \*\*\*

Scheduled Closing Date: June 30, 2021

Purchasers: LOREDANA DI GAETANO & VIOLANDA DIGAE Property: 155 of Plan -

Telephone Res. / Bus: / Project: Pine Valley Forevergreen - Phase 1

Decor Advisor: Angela Phim Model and Elevation: 40.00 B BRIARWOOD

Layout Changes: ☒ Yes ☐ No Sketch Attached: ☒ Yes ☐ No Exterior Colour Scheme:

### 1. Cabinetry

|   | Style and Colour          | Counter                 | Hardware |
|---|---------------------------|-------------------------|----------|
| Kitchen / Breakfast                     | *Chelsea'Wht PET HiGloss' | *Quartz: 'Empira White' | attach   |
| Laundry Room                            | Modena 'Classic White'    | P-Lam 'White'           | attach   |
| Powder Room                             | Modena 'Classic White'    | *Quartz: 'Jet Black'    | attach   |
|   |                           |                         |          |
| Master Ensuite Bathroom                 | Modena 'Classic White'    | *Quartz: 'Jet Black'    | attach   |
| Second Ensuite Bathroom (If Applicable) | n/a                       | n/a                     | n/a      |
| Shared Bath                             | Modena 'Classic White'    | *Quartz: 'Snow White'   | attach   |

Comment

### 2. Floor Tile

|   | Selection  |
|---|--|
| Entrance Vestibule                      | *12x24" Marmorea 'Port Laurent' matte + *Grout: 'Charcoal' |
| Main Hall                               |  |
| Kitchen / Breakfast                     | *12x24" Marmorea 'Port Laurent' matte + *Grout: 'Charcoal' |
| Laundry Room                            | 13x13" Costa 'White'                                       |
| Powder Room                             | *12x24" Marmorea 'Port Laurent' matte + *Grout: 'Charcoal' |
|   |  |
| Master Ensuite Bathroom                 | *12x24" Marmorea 'Port Laurent' matte + *Grout: 'Charcoal' |
| Second Ensuite Bathroom (If Applicable) | n/a  |
| Lower Landing (If Applicable)           | 13x13" Costa 'White' (Basement Foyer)                      |
| Shared Bath                             | *12x24" Marmorea 'Port Laurent' matte + *Grout: 'Charcoal' |

Comment

Master Ensuite + Shared Bath: Standard Shower Floor - 2x2" 'White'

### 3. Wall Tile

|   | Selection   | Listello/Inserts                                   | Describe |
|---|---|--|----------|
|   |   | <input type="radio"/> Yes <input type="radio"/> No |          |
| Master Ensuite Bathroom                 |   |  |          |
| Tub Deck                                |   | <input type="radio"/> Yes <input type="radio"/> No |          |
| Shower Stall                            | *10x16" Lindt 'White Glossy'                                  | <input type="radio"/> Yes <input type="radio"/> No |          |
| Bathroom Walls                          |   | <input type="radio"/> Yes <input type="radio"/> No |          |
| Second Ensuite Bathroom (If Applicable) | n/a   | <input type="radio"/> Yes <input type="radio"/> No |          |
| Shared Bath                             | *10x16" Lindt 'White Glossy'                                  | <input type="radio"/> Yes <input type="radio"/> No |          |
| Kitchen Backsplash                      | <input checked="" type="radio"/> Yes <input type="radio"/> No | Backsplash Behind Fridge                           |          |
|   | FHBS same as counter  |  |          |

Comment

6/06

### 4. Plumbing Fixtures

Master Ensuite Bathroom  Second Ensuite  Powder Room   
Other Room - Specify  Other Washroom

Comment

see upgrades

### 5. Hardwood Flooring

| Type and Stain                                     | Type and Stain                            |
|--|---|
| Main Hall <input type="text"/>                     | Upper Landing <input type="text"/>        |
| Kitchen / Breakfast <input type="text"/>           | Upper Hall <input type="text"/>           |
| Living Room <input type="text"/>                   | Master Bedroom <input type="text"/>       |
| Dining Room <input type="text"/>                   | Bedroom #2 <input type="text"/>           |
| Family Room <input type="text"/>                   | Bedroom #3 <input type="text"/>           |
| Den/Library <input type="text"/>                   | Bedroom #4 <input type="text"/>           |
| Entrance Vestibule <input type="text"/>            | Bedroom #5 <input type="text"/>           |
| Lower Landing (If Applicable) <input type="text"/> | Other Room - Specify <input type="text"/> |

thru-out standard areas: 5x3/4" WhtOak Wirebrush 'Atlantis'

Comment

### 6. Carpeting

| Upgrade                               | Description          |
|---------------------------------------|----------------------|
| Ground Floor <input type="checkbox"/> | <input type="text"/> |
| Second Floor <input type="checkbox"/> | <input type="text"/> |
| <input type="checkbox"/>              | <input type="text"/> |

| Type                                  | Area                 |
|---------------------------------------|----------------------|
| Upgrade Underpad <input type="text"/> | <input type="text"/> |
| Capped                                | Runner - *Upgrade    |
| Carpet on Stairs <input type="text"/> | <input type="text"/> |

Comment

### 7. Fireplace

|                | Living Room           |                       |                       | Family Room           |                       |                       | Other Room - Specify  |                                  |                       | Great Room    |
|----------------|-----------------------|-----------------------|-----------------------|-----------------------|-----------------------|-----------------------|-----------------------|----------------------------------|-----------------------|---------------|
|                | Purchased             | As Per Plan           | N/A                   | Purchased             | As Per Plan           | N/A                   | Purchased             | As Per Plan                      | N/A                   |               |
| Fireplace Type | <input type="radio"/> | <input type="radio"/> | <input type="radio"/> | <input type="radio"/> | <input type="radio"/> | <input type="radio"/> | <input type="radio"/> | <input checked="" type="radio"/> | <input type="radio"/> | Gas           |
| Mantle Type    | <input type="text"/>  | <input type="text"/>  | <input type="text"/>  | <input type="text"/>  | <input type="text"/>  | <input type="text"/>  | <input type="text"/>  | <input type="text"/>             | <input type="text"/>  | Mediterranean |
| Colour / Stain | <input type="text"/>  | <input type="text"/>  | <input type="text"/>  | <input type="text"/>  | <input type="text"/>  | <input type="text"/>  | <input type="text"/>  | <input type="text"/>             | <input type="text"/>  | Arctic        |
| Surround       | <input type="text"/>  | <input type="text"/>  | <input type="text"/>  | <input type="text"/>  | <input type="text"/>  | <input type="text"/>  | <input type="text"/>  | <input type="text"/>             | <input type="text"/>  | n/a           |
| Hearth         | <input type="text"/>  | <input type="text"/>  | <input type="text"/>  | <input type="text"/>  | <input type="text"/>  | <input type="text"/>  | <input type="text"/>  | <input type="text"/>             | <input type="text"/>  | none          |

Comment

VDC



Purchasers: LOREDANA DI GAETANO & VIOLANDA DIGAE Property: 155 of Plan -

Telephone Res. / Bus: /

Project: Pine Valley Forevergreen - Phase 1

Decor Advisor: Angela Phim

Model and Elevation: 40.00 B BRIARWOOD

### 8. Trim Carpentry

Interior Doors Flat Front Door Glass Inserts Std Door Handles halifax blk + hinges  
Interior Trim Board 4\*  
Comment

### 9. Plaster Mouldings and Medallions

Standard Throughout ☐ Yes ☐ No ☐ N/A

|                    |  |  |                      |  |  |
|--------------------|--|--|----------------------|--|--|
| Entrance Vestibule |  |  | Kitchen/Breakfast    |  |  |
| Main Hall          |  |  | Den/Library          |  |  |
| Living Room        |  |  | Lower Landing        |  |  |
| Dining Room        |  |  | Other Room - Specify |  |  |
| Family Room        |  |  |                      |  |  |

Comment

### 10. Railings and Spindles

Railing Package A2 Package  
Railing Colour Hopscotch  
Stringer / Riser Hopscotch  
Spindle Colour Black  
Treads Hopscotch  
Oak Stairs ☒ Yes ☐ No ☐ N/A

Comment

### 11. Wall Paint / Ceilings

Throughout Finished Areas Warm Grey

Trim Paint White

Smooth Ceilings

Ground Floor ☒

Second Floor ☒

Note

Comment



Purchasers: LOREDANA DI GAETANO & VIOLANDA DIGAE Property: 155 of Plan -

Telephone Res. / Bus: /

Project: Pine Valley Forevergreen - Phase 1

Decor Advisor: Angela Phim

Model and Elevation: 40.00 B BRIARWOOD

### 12. Electrical

Hood Fan ☐ White ☐ Stainless ☐ N/A

Above Kitchen Cabinet Light ☐ Yes ☐ No

Below Kitchen Cabinet Light ☒ Yes ☐ No

Standard Appliances ☐

Over The Range Microwave ☐

Chimney Style Fan ☒

Comment

### 13. Heating and Air Conditioning

Air Conditioning

Gas Provisions Stove

Gas Provisions Dryer

Gas Provisions Barbecue

Comment

### 14. Additional Comments

### 15. Disclaimers and Notes

- Colours of all materials are as close as possible to builder's selection, but not necessarily identical due to variances in manufacturing.
- Any extras listed above are null and void unless accompanied by a separate invoice/amendment. Said invoice must be paid in full.
- The Purchaser acknowledges that after Interior Colour Selection form is signed and dated, no further changes will be permitted other than re-selection due to unavailability.  Purchaser's Initials
- The Purchaser acknowledges reading and accepting the "Gold Park Homes Decor Centre Disclaimers" form. This document contains other miscellaneous disclaimers.

This Interior Colour Selection is final and approved by:

Signature: Viola Di Gaetano Date: March 16, 2021



PV-155  
OCT. 19 2020  
DEC 28 2020  
PV-165  
March 16, 2021

The Briarwood  
40' Series  
Elevation B - 2,860 sq.ft.

THIS PLAN  
Shows OPT  
Ground  
Floor

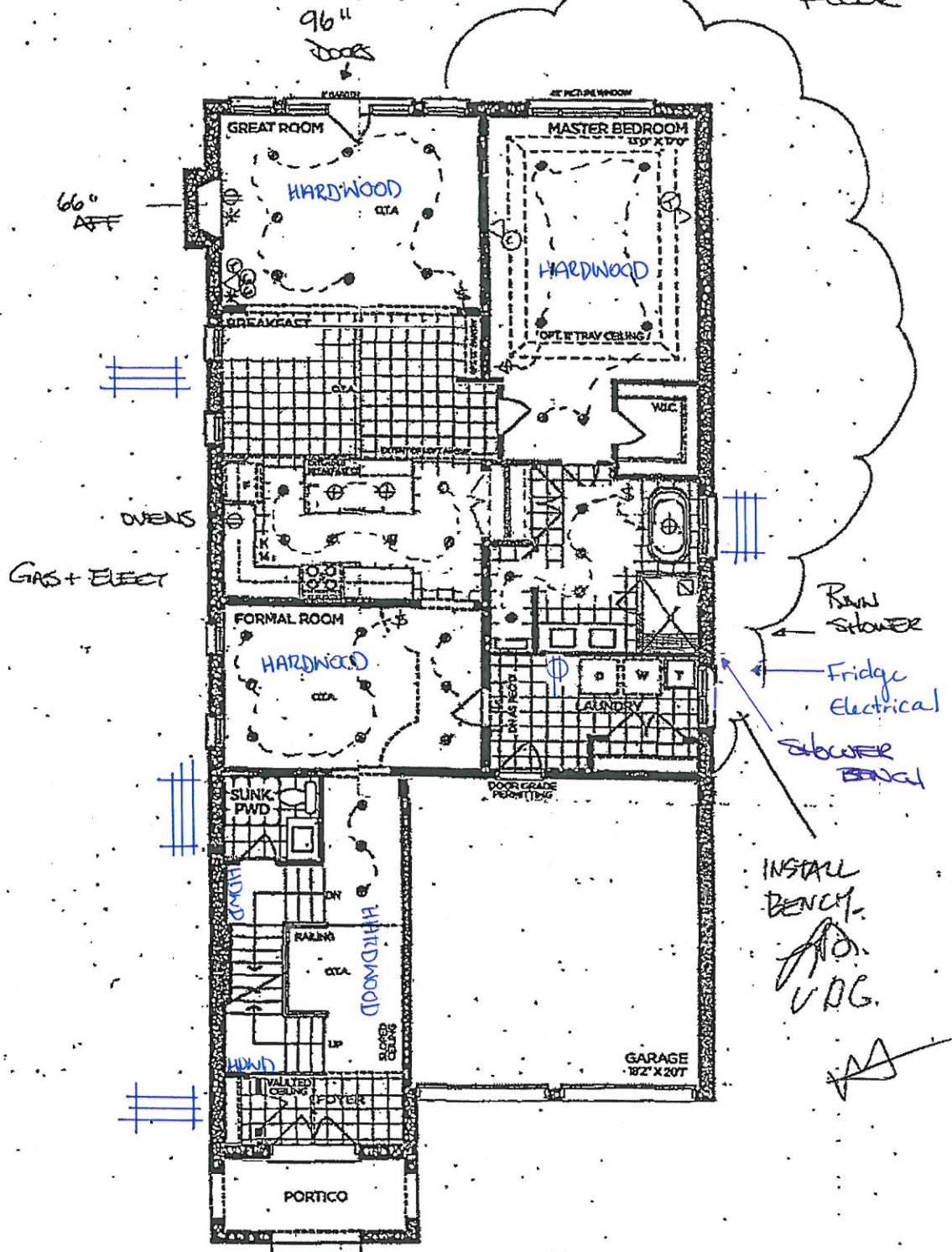

GROUND FLOOR | ELEV. A-  
Elev. B

|           |  |
|-----------|--|
| VENDOR    |  |
| PURCHASER |  |
| PURCHASER |  |

GOLDPARK  
WORTH MORE

Prices, figures, illustrations, sizes, features and finishes are subject to change without notice. Areas and dimensions are approximate and actual usable floor space may vary from the stated area. Layout may be reverse of the unit purchased. E. & C.E. 400

SCHEDULE 'F'



PV-155  
Oct 19 2020  
Dec 28 2020

PV-155  
March 16, 2021 *WVG*

The  
**Briarwood**  
40' SERIES  
Elevation A • 2,870 sq.ft.  
→ Elevation B • 2,860 sq.ft.

8' Doors  
Flu out

\* Media Room Lights  
→ Separate Switch \*

INSTALL Full  
Wall in lieu  
of railing &  
install DBL  
Door (8 FT).  
*WVG*

*WVG*

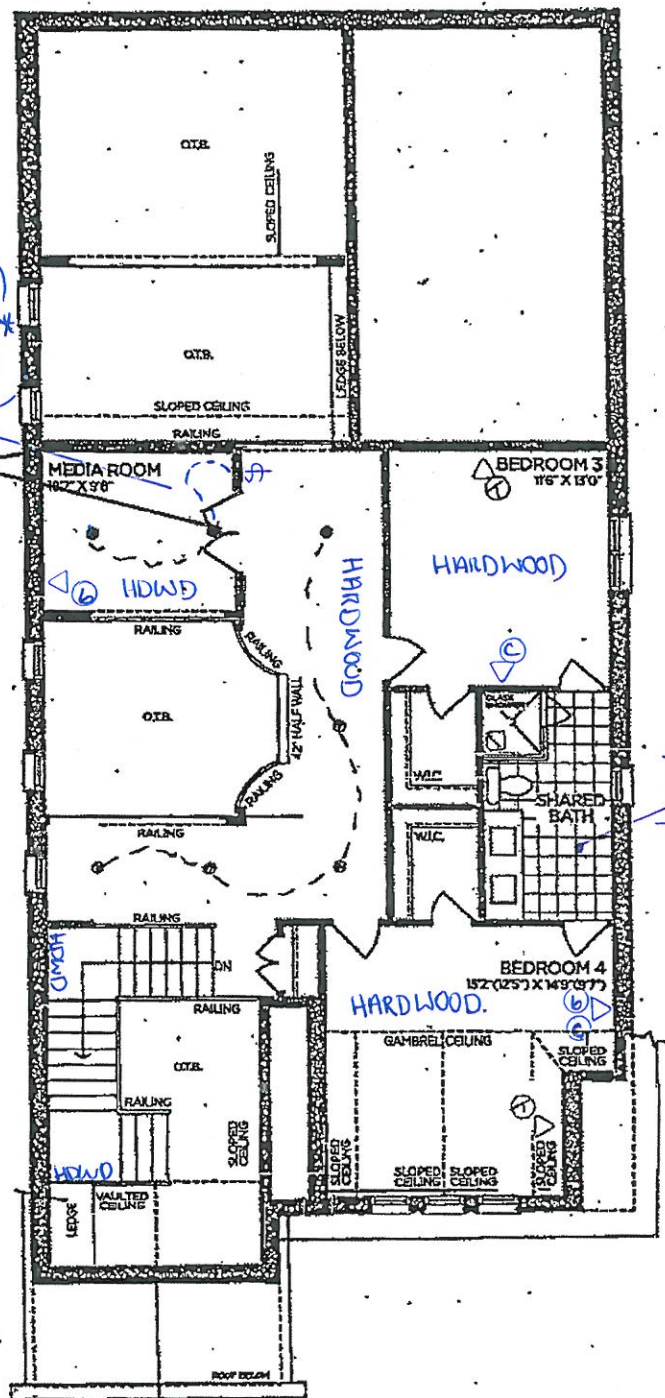

LOFT FLOOR | ELEV. A

|           |            |
|-----------|------------|
| VENDOR    |            |
| PURCHASER | <i>WVG</i> |
| PURCHASER | <i>WVG</i> |

**GOLDPARK**  
WORTH MOR

Prices, figures, illustrations, sizes, features and finishes are subject to change with notice. Areas and dimensions are approximate and actual usable floor space may vary from the stated area. Layout may be reverse of the unit purchased, E. & O.E. 40



SCHEDULE 'F'



FV-155  
Oct 19 22  
Dec 28 22

PV-155  
March 16, 2021



# The Briarwood

40' SERIES

Elevation A - 2,870 sq.ft.

Elevation B - 2,860 sq.ft.

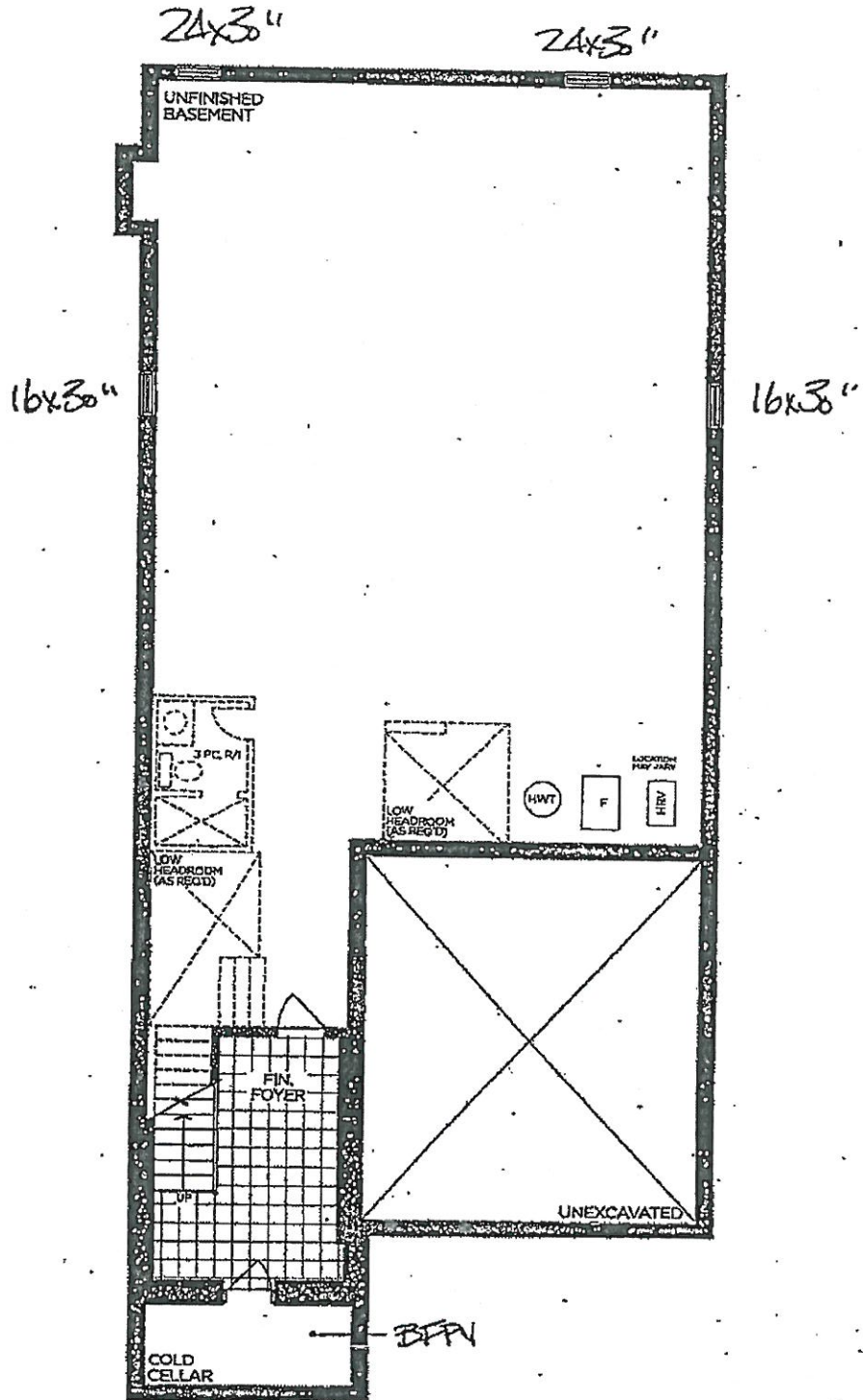

BASEMENT | ELEV. A & B

VENDOR

PURCHASER

PURCHASER

GOLDPARK

WORTH MORE™

Prices, figures, illustrations, sizes, features and finishes are subject to change without notice. Areas and dimensions are approximate and actual usable floor space may vary from the stated area. Layout may be reverse of the unit purchased. E. & D.E. 4000

PV-155 Grout Schedule

| ROOM           | LOCATION | COLOUR   |
|----------------|----------|----------|
| FOYER          | FLOOR    | CHARCOAL |
|                |          |          |
| POWDER ROOM    | FLOOR    | CHARCOAL |
|                |          |          |
| KITCHEN        | FLOOR    | CHARCOAL |
|                |          |          |
| MASTER ENSUITE | FLOOR    | CHARCOAL |
|                |          |          |
| SHARED ENSUITE | FLOOR    | CHARCOAL |

LOT #: PV-155

DATE: March 16, 2021

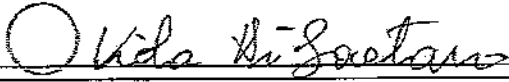
SIGNATURE: 

SIGNATURE: 

PV-155  
March 16, 2021

CHELSEA HI GLOSS WHITE  
H033-01

OPT. BREAKFAST  
PANTRIES

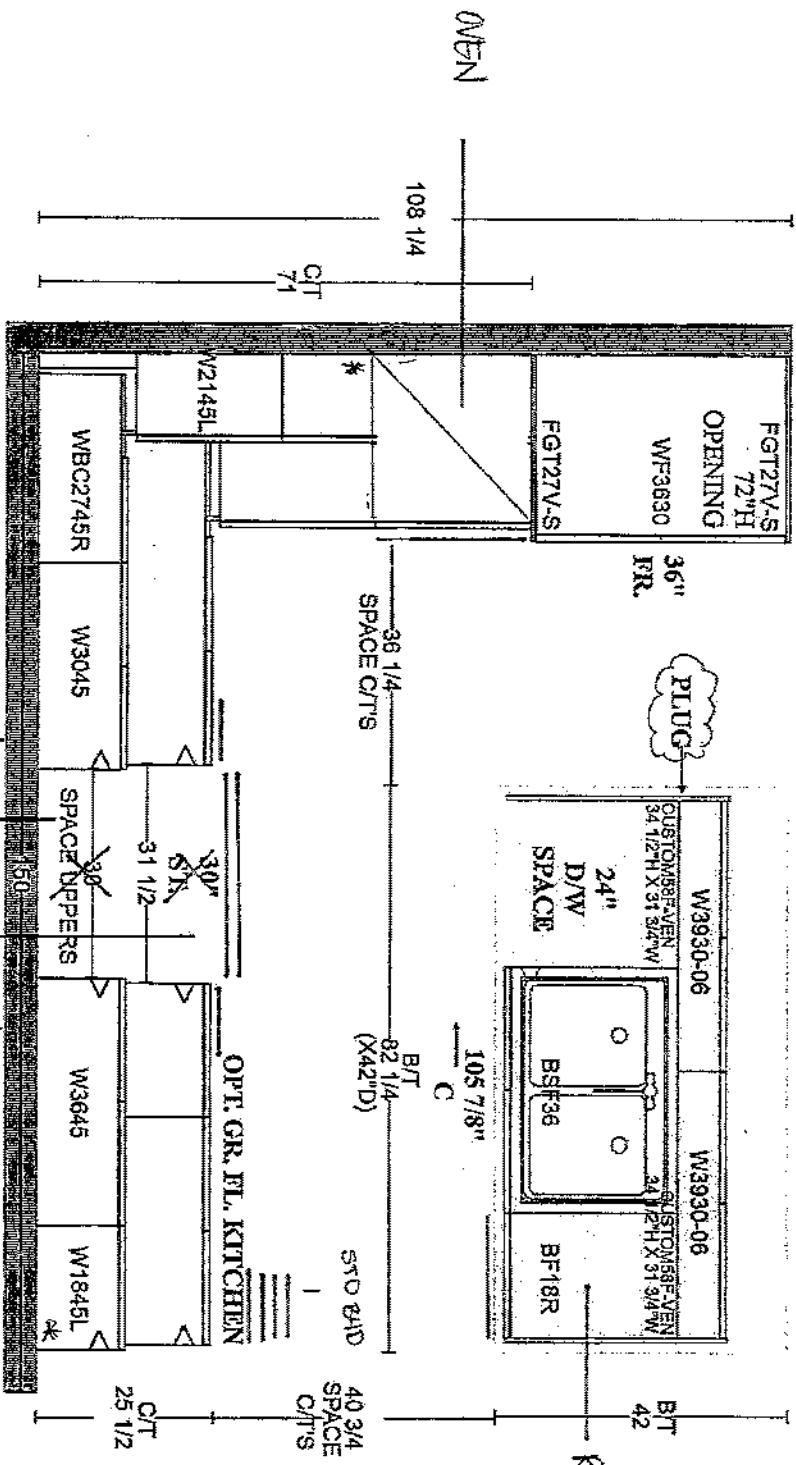
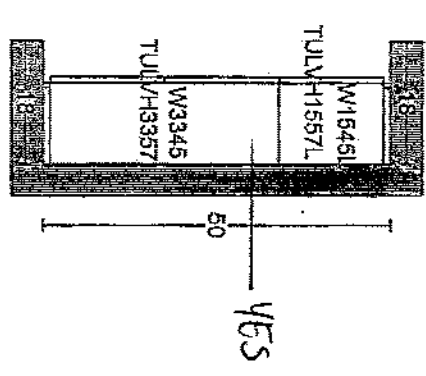

GOLDPARK HOMES  
PINE VALLEY  
VAUGHAN, ONTARIO  
MODEL: (4000 OPT.)  
BRIARWOOD

SITE STANDARD: WHITE 3/4" EXTENSION  
SOFT-CLOSE DRAWERS & SOFT-CLOSE  
HINGES TO KITCHEN AREA  
10' CEILING - 12" H COFFERED CEILING -  
M.H. = 102" + 3/4" H CONTEMPORARY  
MOLDING + 5 1/4" H FURRING RAIL  
+ LARGE CORNICE MOLDING TO  
UNDERSIDE OF BOX

PLAN VIEW

UPGRADE KITCHEN SINK



BLANCO - QUATRUS R15 U 2 APRON  
Stainless Steel - Undermount  
32" x 19" x 9"

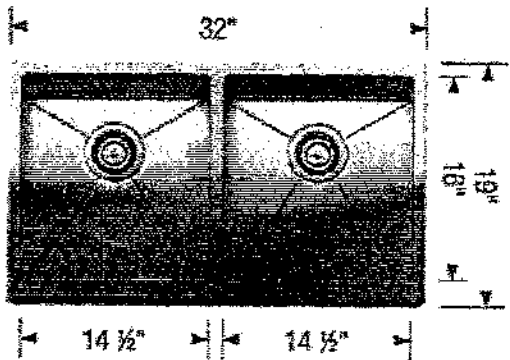
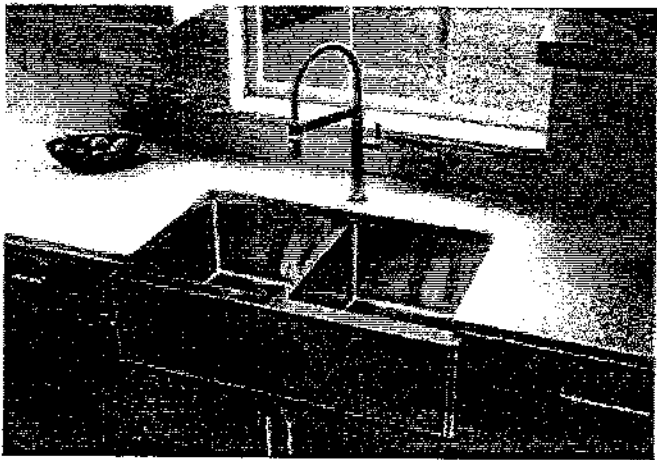
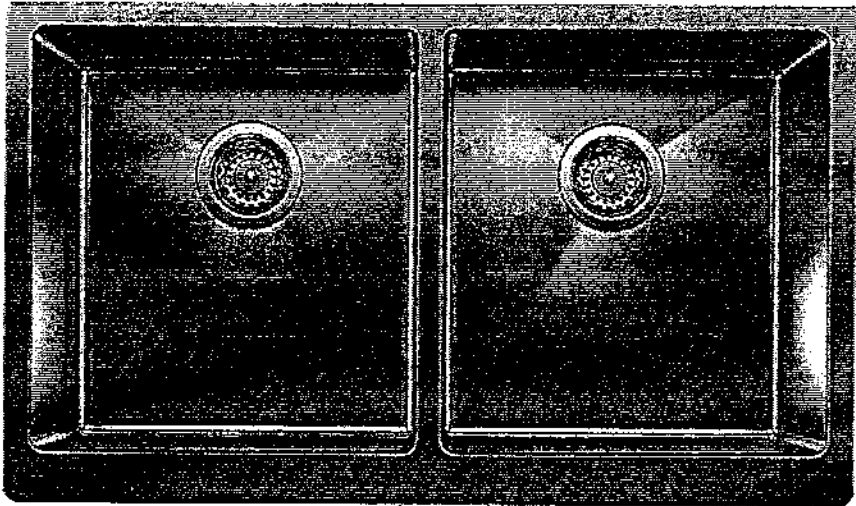

Stainless Steel



MODEL 401867 Stainless Steel / 406454 Grid

Lot# PV-155

Room: Kitchen

Signature: *Olivia Di Gaetano*

Date: March 16, 2021

Signature: *[Signature]*



UPGRADE SHOWER HARDWARE



MT6X6

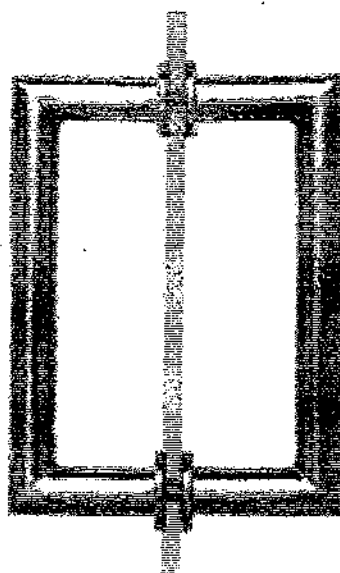

Shower Door Handle + Hinges



MT6X6  
Shower Door Handle

6" x 6" back-to-back  
3/4" dia. tube  
Cut and mitred corners with  
washers  
(Also available single sided)

- ☐ CHROME  
☐ MATTE BLACK  
☐ BRUSHED GOLD  
☒ BRUSHED NICKEL

|  |                      |                                      |
|--|----------------------|--------------------------------------|
| Lot# PV-155  | Date: March 16, 2021 | Room: Master Ensuite, Shared Ensuite |
| Signature:  |                      |                                      |
| Signature:  |                      |                                      |

PV-155  
March 16, 2024

GOLDPARK HOMES  
PINE VALLEY  
VAUGHAN, ONTARIO  
MODEL: (4000 OPT.) BRIARWOOD

SITE STANDARD: WHITE 3/4" EXTENSION  
SOFT-CLOSE DRAWERS & STANDARD SLAM DOOR HINGES  
TO VANITIES

ONE TOP DRAWER WHERE POSSIBLE THROUGHOUT EACH  
VANITY, ONE BANK OF DRAWERS WHERE POSSIBLE  
THROUGHOUT EACH MASTER ENSUITE VANITY

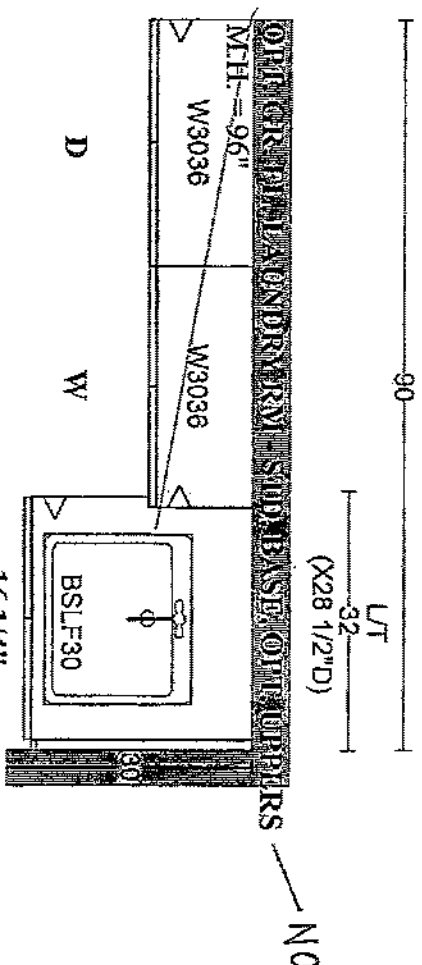
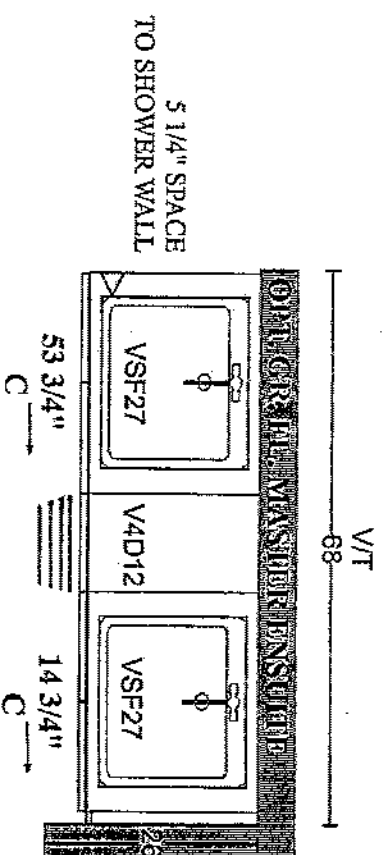

PLAN VIEW

MODENA CLASSIC WHITE

K024 - 03

PV-155  
March 16, 2021

GOLDPARK HOMES  
PINE VALLEY  
VAUGHAN, ONTARIO  
MODEL: (4000) BRIARWOOD

SITE STANDARD: WHITE 3/4" EXTENSION  
SOFT-CLOSE DRAWERS & STANDARD SLAM DOOR HINGES  
TO VANITIES

ONE TOP DRAWER WHERE POSSIBLE THROUGHOUT EACH  
VANITY, ONE BANK OF DRAWERS WHERE POSSIBLE  
THROUGHOUT EACH MASTER ENSUITE VANITY

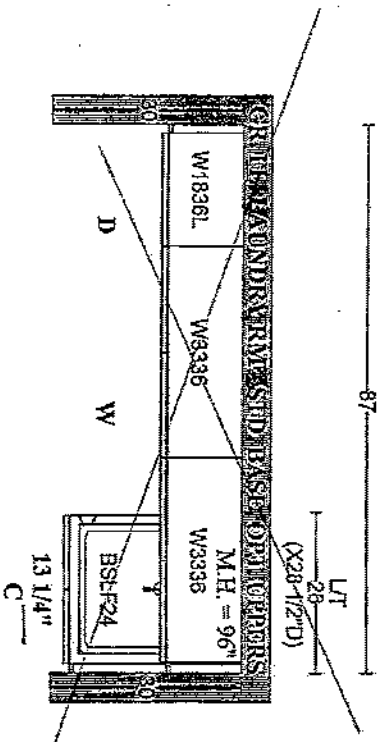
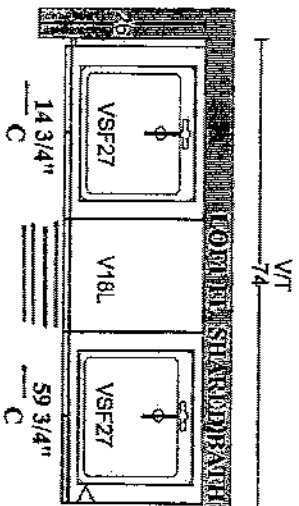
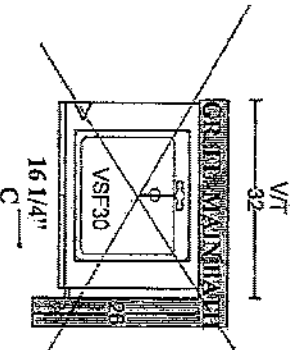
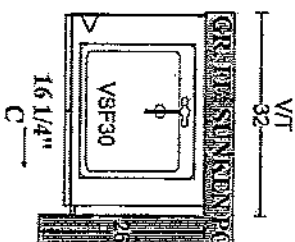
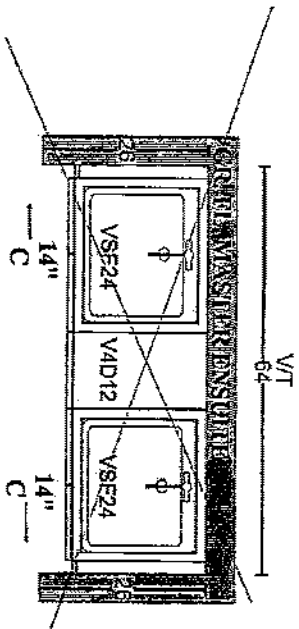

PLAN VIEW

MODENA CLASSIC WHITE  
K024 - 03

# GOLDPARK

WORTH MORE™

TO: Gold Park Homes

DATE: March 16, 2021

SITE: Pine Valley

LOT: 155

I/We the undersigned, hereby authorize Vince DiGaetano  
to act on my/our behalf in all matters relating to colour selection and the selection of upgrades  
and extras for the above mentioned Lot, including, without limitation, signing of all documents  
relating to these matters. Any and all acts carried out by Vince DiGaetano  
on my/our behalf shall have the same effect as acts of my/our own and are irrevocable.  
The authorization is valid under further written notice from the undersigned.

\_\_\_\_\_  
WITNESS

Name:

\_\_\_\_\_  
WITNESS

Name:

  
\_\_\_\_\_  
PURCHASER

Name: Loredana DiGaetano

\_\_\_\_\_  
PURCHASER

Name:

## Stainless Chimney Wall-Mount Hood

RH36WC55G S

**Electrolux**

PV-155

March 16 2021

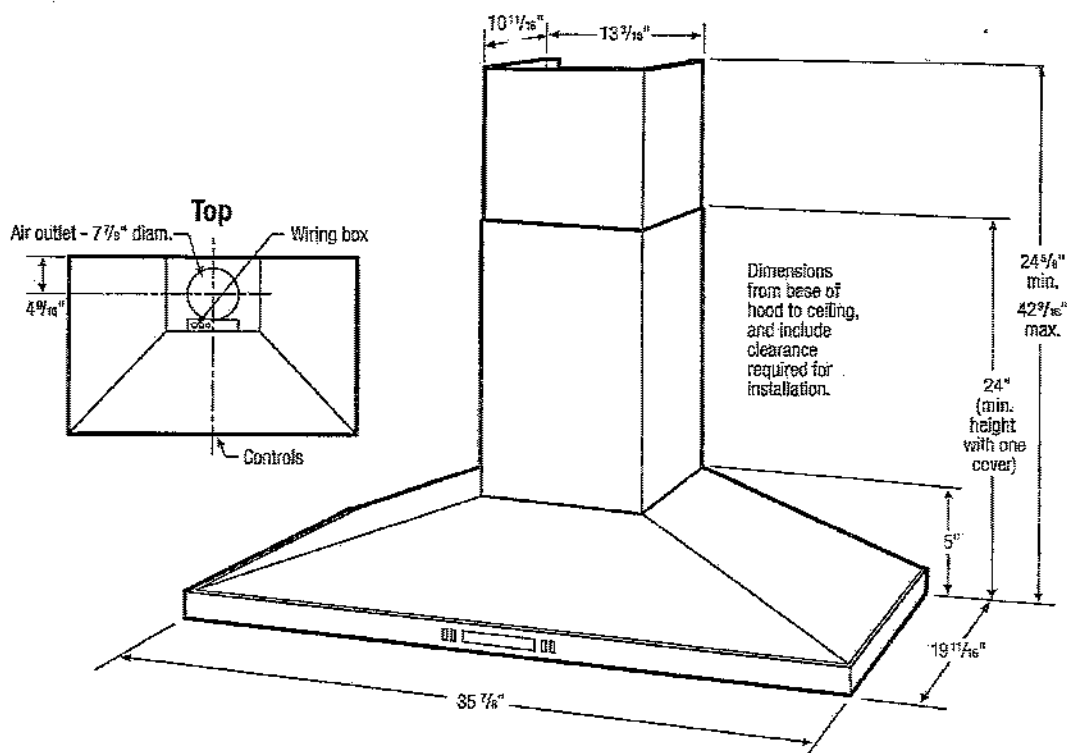

### 36" Stainless Chimney Wall-Mount Hood Specifications

- Product Weight – 39 Lbs.
- Wall-Mount Installation
- Ventilation system is preset to exhaust air outside. If outside ducting is not possible, optional Duct-Free Kit (PN# RHDFW60GS) is available to convert ventilation to allow air to recirculate inside. (Refer to Ducted Option Specifications for outside ventilation.)
- Sones Rating – 9.0
- Voltage Rating – 120V/60 Hz/15 Amps
- Connected Load (kW Rating) @ 120 Volts = 0.475kW (For use on adequately wired 120V, dedicated circuit having 2-wire service with a separate ground wire. Appliance must be grounded for safe operation.)
- Amps @ 120 Volts = 3.84 Amps
- Always consult local and national electric codes. Check local building codes for installation requirements, as they may vary per locale.
- Minimum installation height allowed from bottom of hood to cooking surface is 24"–30" for electric and 30" for gas. (NOT more than 36" recommended.)
- To prepare mounting surface, adequate structure and support must be provided, capable of supporting 100 lbs.

### Ducted Option Specifications

- For outside ventilation.
- Exhaust Duct Required – 8" round
- For most efficient airflow exhaust, use a straight run or as few elbows as possible.
- Use metallic flex ducting only to connect rigid duct directly to transitions (if allowed by code).
- Thermal breaks such as short section of nonmetallic duct, should be used in areas of extreme cold.
- Cold weather installations should have additional backdraft damper installed.
- Refer to installation instructions on web for detailed exhaust duct preparation and converting vent blower system for recirculating inside.

*Note: For planning purposes only. Refer to Product Installation Guide on the web at [electroluxappliances.com](http://electroluxappliances.com) for detailed instructions.*

### Optional Accessories

- Charcoal Filter – (PN# RHCFW60GS).
- Duct-Free Kit (Single Pack) – (PN# RHDFW60GS).
- 52" Flue Extension – (PN# RHCFW55GS).

### Electrolux Major Appliances, N.A.

USA • 10200 David Taylor Drive • Charlotte, NC 28262 • 1-877-4electrolux (1-877-435-3287) • [electroluxappliances.com](http://electroluxappliances.com)  
CANADA • 5855 Terry Fox Way • Mississauga, ON L5V 3E4 • 1-800-265-8352 • [electroluxappliances.ca](http://electroluxappliances.ca)

RH36WC55G 04/11

© 2011 Electrolux Home Products, Inc.

High standards of quality at Electrolux Home Products, Inc. mean we are constantly working to improve our products. We reserve the right to change specifications or discontinue models without notice.

Printed in the U.S.A.





Electrolux

# GAS COOKTOPS

EW36GC55P S/B

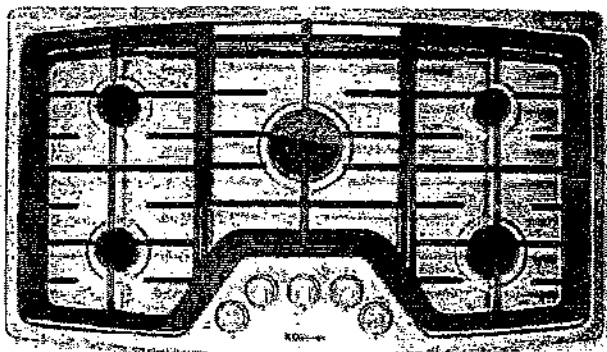

## PRODUCT DIMENSIONS

|   |             |
|---|-------------|
| Width   | 36"         |
| Depth   | 24 1/2" S/A |
| Height (Excluding Height to Underside of Cooktop) | 4 3/4"      |

## MORE EASY-TO-USE FEATURES

### PERFECT OVER-A-WALL OVEN

Mounts above a single wall oven for additional installation options.

### DISHWASHER-SAFE GRATES

For easy cleanup.

### A.D.A. COMPLIANT

When properly installed, this model is A.D.A. qualified based on the United States Access Board's A.D.A./A.B.A. Accessibility Guidelines and the Department of Justice's 2010 A.D.A. Standards for Accessible Design.

Available in:



Stainless  
(S)



Black  
(B)

## SIGNATURE FEATURES

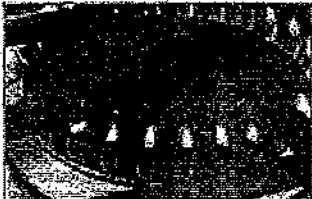

### MIN-2-MAX® GAS BURNER

Designed with a dual-flame sealed burner, this cooktop offers the widest range of BTU performance in the industry for the utmost versatility — from a roaring 20,000-BTU boil to a 1,100-BTU simmer.



### PROFESSIONAL-GRADE CONTROL KNOBS

Professional grade control knobs are designed to provide you with pinpoint precision control.



### DEEP-WELL DESIGN

Keeps spills contained for easy cleanup and lowers the cooking surface to countertop-level, which makes moving oversized pots and pans onto and off of the cooking surface much easier.

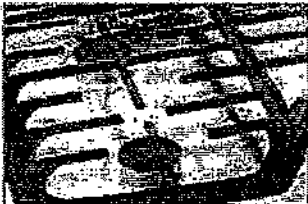

### CONTINUOUS GRATES

Designed for cooking multiple dishes at varying temperatures on a single cooktop. These grates allow easy movement of even the heaviest pots and pans from burner to burner — without lifting.

| BURNER                             | BTU            |
|------------------------------------|----------------|
| Min-2-Max Dual-Flame Sealed Burner | 20,000 - 1,100 |
| Sealed Power Burner                | 15,000         |
| Sealed Power Burner                | 15,000         |
| Sealed Power Burner                | 15,000         |
| Sealed Power Burner                | 15,000         |

Handwritten signature and date: 11/16/2011

ELECTROLUXAPPLIANCES.COM

## EW36005P S/B

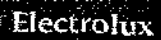

## FEATURES

|  |     |
|--|-----|
| Diesel-Water Pumped Combustor                                | Yes |
| Preheated Air/Fuel/Gas/Exhaust                               | Yes |
| Combustion in Series   | Yes |
| Min. 2 m/s - Dual Phase Staged Burner - 20,000 - 11 (mg COU) |     |
| Partial Pump Burner - 14,000 BTU                             |     |
| Staged Preburn Burner - 9,500 BTU                            | 2   |
| Staged Preburn Burner - 5,000 - 260 BTU                      |     |
| Lowest Flow Burner Nozzle                                    | Yes |
| Electrically Heated Nozzle                                   | Yes |
| AFA Extension*   |     |

## ACCESSORIES

|  |             |
|--|-------------|
| Crash Conversion Kit (Baker, 70) - P/NF 603100-010 | Impeller    |
| Oil/Water - P/NF 318251000                         | End in Card |
| LP Gas Conversion Kit                              | Included    |

## SPECIFICATIONS

|  |                |
|--|----------------|
| 100' Stainless Steel                                 | 8              |
| 100' PVC   | 8              |
| One 1/2" x 1/2" Supply Connection Fitting            | 1              |
| Voltage Rating                                       | 120V/60Hz/1-Ph |
| Connected Load (kW Rating @ 240 Volts)               | 10             |
| Electrical Cable                                     | Yes            |
| Approved for Simultaneous Combination Installation** | Yes            |

[illegible]

### PRODUCT DIMENSIONS

|   |         |
|---|---------|
| Width                                   | 21 3/4" |
| Length                                  | 41 1/8" |
| Height (From Seams to Inside of Crotch) | 41 1/8" |

\*Approved by the Board of the City of Chicago, Single Seal System

USA • 10200 David Taylor Drive • Charlotte, NC 28262 • 1-877-4electrolux (1-877-435-3287) • [electroluxappliances.com](http://electroluxappliances.com)  
CANADA • 5855 Terry Fox Way • Mississauga, ON L5V 3E4 • 1-800-265-6352 • [electroluxappliances.ca](http://electroluxappliances.ca)  
EW366C5P 12/14 © 2014 Electrolux Home Products, Inc.

High standards of quality is essential from products, for  
mean the are constantly working to increase our products  
we reserve the right to change specifications of  
anytime without notice.

© 2014 Electrolux Home Products, Inc.

# GAS COOKTOPS

EW36GC55P S/B



Electrolux

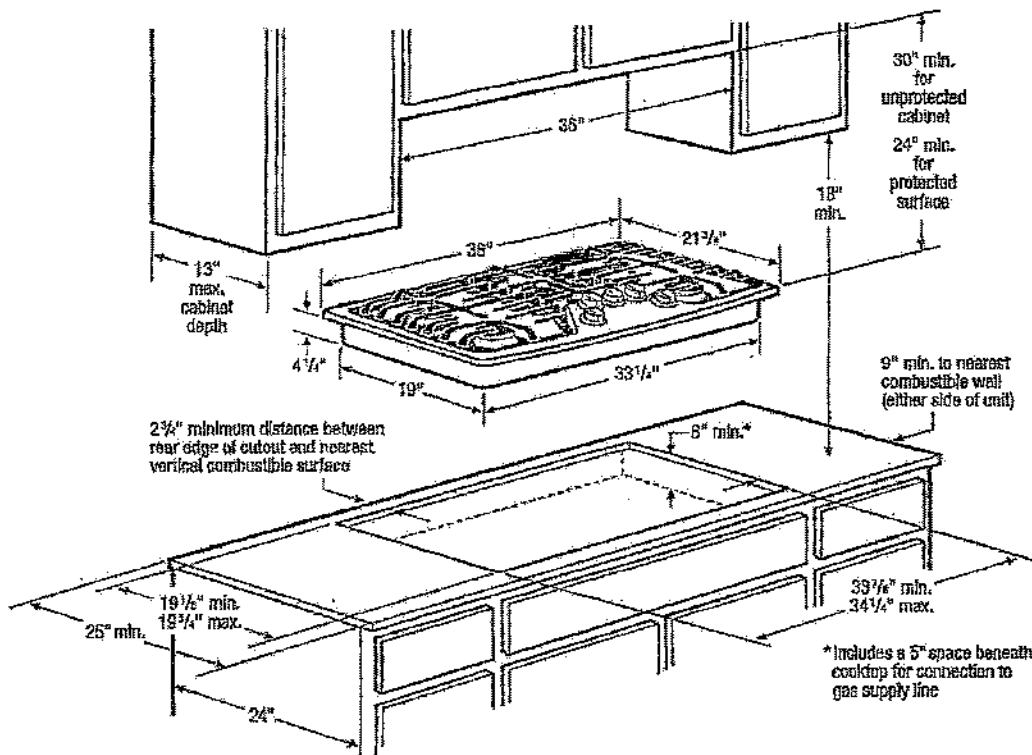

## 36" Gas Cooktop Specifications

- Product Weight – 53 Lbs.
- Voltage Rating – 120V/60Hz/15 Amps
- Connected Load (kW Rating) @120 Volts = .12kW (For use on adequately wired 120V, dedicated circuit having 2-wire service with a separate ground wire. Appliance must be grounded for safe operation.)
- Amps @120 Volts = 1.0 Amps
- Always consult local and national electric and gas codes.
- Recommended location for grounded 120V outlet is on rear wall in an 8" wide by 10" high area, positioned 22" above floor surface and 4" from right side of cooktop centerline. Access to underside of cooktop and junction box must be provided for inspection and service.
- Cooktop ships with 3/4" factory regulator.
- LP Gas conversion kit supplied.
- Overhead cabinetry should not exceed a 13" maximum depth.
- Allow 30" minimum clearance between top of cooktop and bottom of unprotected wood or metal overhead cabinetry.
- Absolute minimum horizontal distance between overhead cabinets installed to either side of appliance must be no less than 36".
- Allow 24" minimum clearance when bottom of wood or metal overhead cabinet is protected by not less than 1/8" flame-retardant millboard covered with not less than No. 28 MSG sheet steel, 0.015" stainless steel, 0.024" aluminum or 0.020" copper.

- Allow 2-3/4" minimum distance between rear edge of cutout and nearest combustible surface above countertop.
- Allow 9" minimum clearance from edge of cooktop to nearest combustible wall on either side of unit.
- Installation of drawers beneath cooktop requires minimum 6-1/2" clearance beneath countertop surface and assured clearance for gas and electrical connections.
- To reduce risk of fire when using overhead cabinetry, install range hood that projects horizontally a recommended minimum of 5" beyond bottom of cabinets.
- Gas Cooktop model EW36GC55P is approved to be used over any Electrolux Electric Single Wall Oven. (Refer to Gas Cooktop Installation Over 30"/27" Electric Single Wall Oven Specifications page on web.)

*Note: For planning purposes only. Refer to Product Installation Guide on the web at [electroluxappliances.com](http://electroluxappliances.com) for detailed instructions.*

## Optional Accessories

- Granite Countertop Installation Kit – (PN# 903103-9010).

## Electrolux Major Appliances, N.A.

USA • 10200 David Taylor Drive • Charlotte, NC 28262 • 1-877-4electrolux (1-877-435-3287) • [electroluxappliances.com](http://electroluxappliances.com)  
CANADA • 5855 Terry Fox Way • Mississauga, ON L5V 3E4 • 1-800-265-8352 • [electroluxappliances.ca](http://electroluxappliances.ca)

EW36GC55P 12/14

© 2014 Electrolux Home Products, Inc.



High standards of quality at Electrolux Home Products, Inc. assure we are constantly working to improve our products. We reserve the right to change specifications or equipment models without notice.

PV-155  
May 16, 2021

KDG JPS



# GAS COOKTOP INSTALLATION OVER 30"/27" ELECTRIC SINGLE WALL OVEN

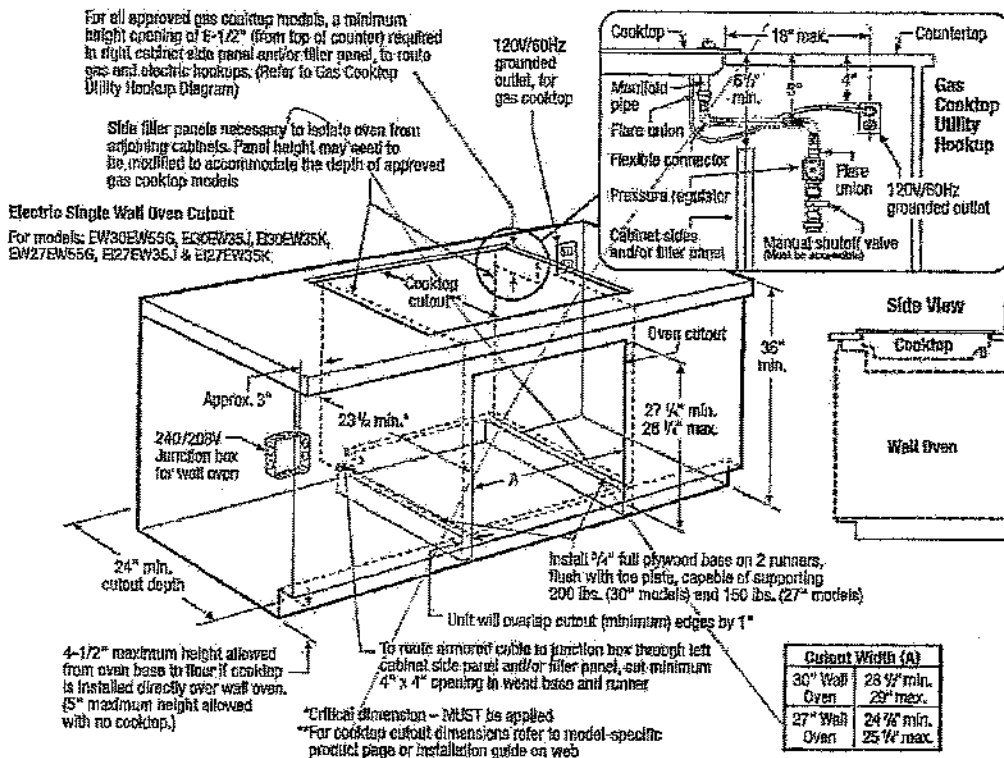

## 30" & 27" Electric Single Wall Ovens Under-Counter Installation Specifications

- Product Weights -- (EW30EW55G, E30EW35J and E30EW35K) 200 Lbs. / (EW27EW55G, E27EW35J and E27EW35K) 150 Lbs.
- Single phase 3- or 4-wire cable, 120/240 or 120/208 Volt, 60 Hertz AC only electrical supply with ground required on separate circuit fused on both sides of line.
- Connected Load (kW Rating) @ 240/208 Volts = (30") 4.0/3.0kW / (27") 3.4/2.6kW
- Amps @ 240/208 Volts = (30") 17.0/14.5 Amps / (27") 14.2/12.6 Amps
- Recommended Circuit Breaker -- 20 Amps
- Always consult local and national electric codes.
- Minimum 21" clearance for oven door depth when open.
- Minimum 23-1/2" deep cutout dimension is critical for proper installation, to ensure that oven's faceplate will fit flush against cabinet front.
- Full oven base of solid plywood or similar material required, capable of supporting 200 Lbs. (30" models) or 150 Lbs. (27" models). Install over two runners and flush with toe plate.
- Base must be level and cabinet front must be square.
- Allow 5" maximum height from oven base to floor, if NO cooktop is installed directly over wall oven.

## Gas Cooktop Installation Over 30"/27" Electric Single Wall Oven Specifications

Electrolux Single Wall Oven models EW30EW55G, E30EW35J, E30EW35K, EW27EW55G, E27EW35J and E27EW35K are approved to be used beneath Electrolux cooktop models EW30GC55G, EW30GC55G and EW30GC50L.

For detailed Gas Cooktop Installation, refer to model-specific product page and installation guide on web.

- Side filler panels necessary to isolate oven from adjoining cabinets. Panel height may need to be modified to accommodate the depth of approved gas cooktop models.
- Minimum height opening of 6-1/2" (from top of counter) required in right cabinet side panel and/or filler panel, to route gas and electric hookups.
- Allow 4-1/2" maximum height from oven base to floor, if cooktop is installed directly over wall oven.

*Note: For planning purposes only. Refer to Product Installation Guide on the web at [electroluxappliances.com](http://electroluxappliances.com) for detailed instructions.*

PR-155  
Mar. 16, 2021

RDC [Signature]

## Electrolux Major Appliances, N.A.

USA • 10200 David Taylor Drive • Charlotte, NC 28262 • 1-877-4electrolux (1-877-435-9287) • [electroluxappliances.com](http://electroluxappliances.com)  
CANADA • 5855 Terry Fox Way • Mississauga, ON L5V 3E4 • 1-800-265-3352 • [electroluxappliances.ca](http://electroluxappliances.ca)

60\_EW INST EL 02/14

© 2014 Electrolux Home Products, Inc.

High standards of quality at Electrolux Home Products, Inc. mean we are constantly working to improve our products. We reserve the right to change specifications or discontinue models without notice.



# MICROWAVE COMBINATION OVEN

EW30MC65PS

Featuring Wave-Touch® Electronic Controls

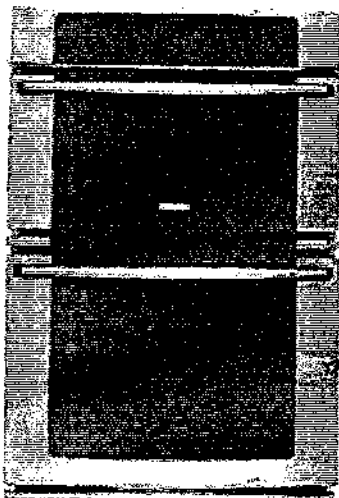

## SIGNATURE FEATURES



### PERFECT TASTE™ DUAL-FAN CONVECTION

For consistently delicious taste and texture, home chefs rely on our dual-fan convection heat, which circulates air evenly with two variable speeds that work in tandem with three heating elements.

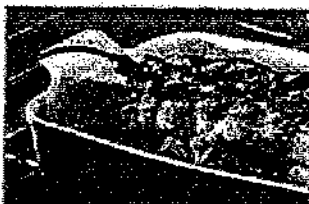

### PERFECT TASTE™ TEMP PROBE

The Perfect Taste™ Temp Probe does more than measure temperature. — It keeps an active eye on your dishes by alerting you when food is at the peak of perfection and automatically adjusting to the Keep Warm setting.



### MULTI-STAGE COOKING

Conveniently program your recipes that require multiple cooking stages for optimally prepared dishes.

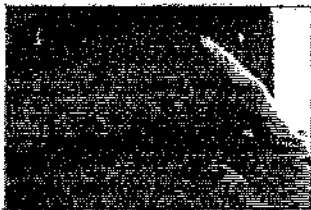

### WAVE-TOUCH® CONTROLS

One simple touch on your microwave or oven and the control panel activates, showing the virtually endless cooking options. After you make your choices, all but the option selected will fade away, returning to an elegant display.

## PRODUCT DIMENSIONS

|        |         |
|--------|---------|
| Height | 45-1/4" |
| Width  | 30" *   |
| Depth  | 24-1/2" |

## MORE EASY-TO-USE FEATURES

### PERFECT TURKEY®

New and Improved Perfect Turkey® button works to precisely time your convection roast for turkey that is perfectly done — crispy on the outside and juicy on the inside. And now, it even counts down the time remaining, so you can prepare your other dishes and have them all ready to serve at the same time, perfectly hot.

### FRESH CLEAN™ TECHNOLOGY

Exclusive Fresh Clean self-cleaning technology virtually eliminates odors and smoke to keep the room smelling fresh.

### SELF-CLEANING PORCELAIN RACKS

Bake, roast, broil, sauté — the cleaning's on us. Our porcelain racks are safe to stay inside of the oven during the self-clean cycle, eliminating the mess and inconvenience of removing and cleaning racks by hand.

### EASY-TO-CLEAN INTERIORS

Premium non-stick coating for easy cleanup.

### 900 WATTS

### CERAMIC TURNTABLE

### SIX AUTO COOK FEATURES

### HIGH AND LOW METAL RACKS

### LUXURY-GLIDE® OVEN RACK

With a ball bearing system, the oven rack is so smooth it extends effortlessly.

Available in:



Stainless Steel

PA-155  
Mar. 16 2021

VOC - RFP

ELECTROLUXAPPLIANCES.COM

# MICROWAVE COMBINATION OVEN

EW30MCC6SPS

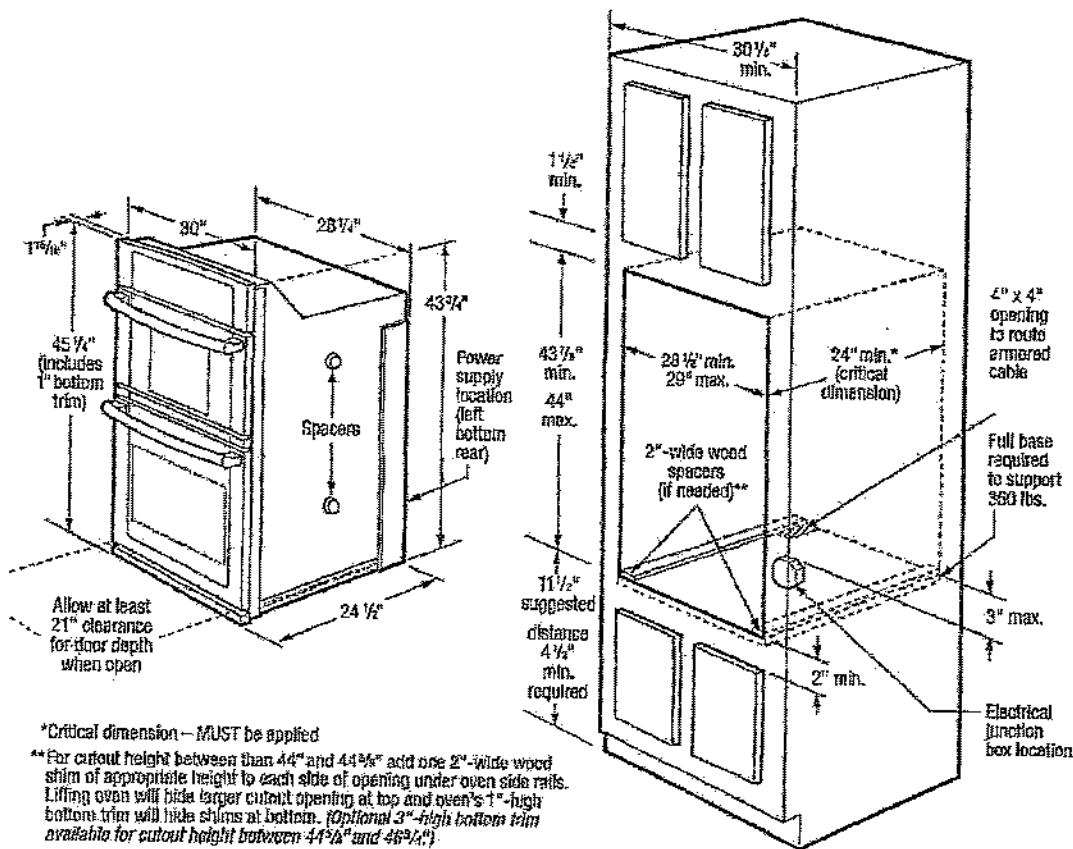

## 30" Microwave Combination Oven Specifications

- Product Weight - 250 Lbs.
- Single phase 3- or 4-wire cable, 120 / 240 or 120 / 208 VAC, 60 Hertz AC only electrical supply with ground required on separate circuit fused on both sides of line.
- Connected Load (kW Rating) @ 240 / 208 Volts = 8.5 / 6.4 kW
- Amps @ 240 / 208 Volts = 35.4 / 30.8 Amps
- Recommended Circuit Breaker - 40 Amps
- Always consult local and national electric codes.
- Minimum 21" clearance for oven door depth when open.
- Suggested distance from floor is 11-1/2". Minimum required distance is 4-1/2".
- To adapt Microwave Combination Oven to fit cutout height between 44" and 44-5/8", add one 2"-wide wood shim of appropriate height to each side of opening under oven side rails. Lifting oven will hide larger cutout opening at top and oven's 1"-high bottom trim will hide shims at bottom. (Standard 1"-High Bottom Trim included.)

- To adapt Microwave Combination Oven to fit cutout height between 44-5/8" and 46-3/8", optional 3"-High Bottom Trim available.
- Minimum 24" deep cutout dimension is critical for proper installation, to ensure that oven's faceplate will fit flush against cabinet front.
- Full oven base of solid plywood or similar material required, capable of supporting 350 Lbs.
- Base must be level and cabinet front must be square.
- Microwave Combination Oven is NOT approved to be used in stackable or side-by-side installation.

*Notes: For planning purposes only. Refer to Product Installation Guide on the web at [electroluxappliances.com](http://electroluxappliances.com) for detailed instructions.*

### Optional Accessories

- 3"-High Bottom Trim S - (PN # 908114-9110).

PV-155  
Mar. 16, 2021

VDB



## Electrolux Major Appliances, N.A.

USA • 10200 David Taylor Drive • Charlotte, NC 28262 • 1-877-4electrolux (1-877-435-3267) • [electroluxappliances.com](http://electroluxappliances.com)  
CANADA • 8855 Terry Fox Way • Mississauga, ON L5V 3E4 • 1-800-265-8352 • [electroluxappliances.ca](http://electroluxappliances.ca)

EW30MCC6SP 12/16

© 2016 Electrolux Home Products, Inc.

High standards of quality at Electrolux Home Products, Inc. never were more importantly working to improve our products. We reserve the right to change specifications or discontinue models without notice.



# FRENCH DOOR REFRIGERATOR

EI23BC82SS

Featuring IQ-Touch™ Electronic Controls

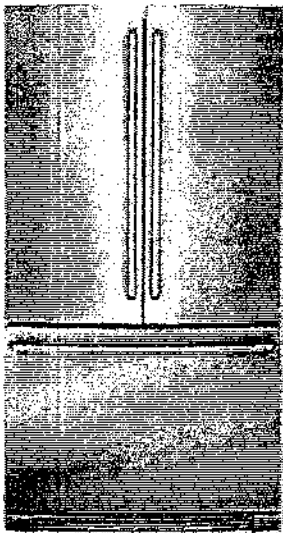

## SIGNATURE FEATURES



### PERFECT TEMP® DRAWER KEEPS FAVORITES AT THEIR IDEAL TEMPERATURE

Delight your guests by serving everything at its ideal temperature — the Perfect Temp® Drawer offers a customizable range of 28-38 degrees and preset options for favorites, such as wine and cheese.



### CRISPER DRAWERS KEEP FRUITS AND VEGGIES AT THEIR MOST DELICIOUS

Veggies and fruits retain their just-picked taste with our Adjustable Humidity-Controlled Crisper Drawers that lock in freshness longer.



### COUNTER-DEPTH DESIGN

Gives you a sleek built-in look.

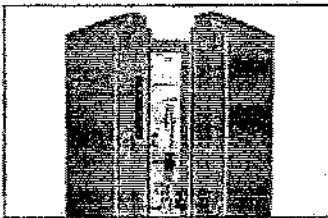

### SELF-CLOSING DOORS GIVE YOU PEACE OF MIND

Maintain your desired temperature in the refrigerator while never worrying about accidentally leaving the door open.

## PRODUCT DIMENSIONS

|        |         |
|--------|---------|
| Height | 69 7/8" |
| Width  | 36 1/2" |
| Depth  | 28 1/2" |

## MORE EASY-TO-USE FEATURES

### IQ-TOUCH™ CONTROLS DISPLAY ALL YOUR OPTIONS

For those who like to have their options always visible, the IQ-Touch™ control panel displays all of your options, at all times.

### PLATINUM STAR® LIMITED WARRANTY

Our exclusive limited warranty that includes three years coverage on parts and one year on labor.\*

### LUXURY-DESIGN® GLASS SHELVES

Fit even large entertaining platters with sleek, spacious glass shelves.

### LUXURY-DESIGN® LIGHTING

Our designer LED lighting ramps up and is as beautiful as it is functional.

### LUXURY-GLIDE® FREEZER DRAWERS FOR EFFORTLESS ACCESS TO ITEMS

Access it all — our Luxury-Glide® Freezer drawers glide out smoothly and fully extend, letting you see every last item inside.

### PUREADVANTAGE® FILTRATION SYSTEMS

Our filtration system keeps clean, filtered air circulated throughout and our 3M® water filter keeps fresh, clean water and ice at your fingertips.

### STAY INFORMED WITH THE REFRIGERATION ALARM SYSTEM

Rest assured with our Refrigeration Alarm System, which alerts you to important changes, including power failures, an open door and elevated freezer temperatures.

### FULL-EXTENSION FREEZER BASKETS

Baskets give you additional functional space to organize and store more.

Available in:



Stainless Steel

\*Warranty (years) on parts: 3 years on parts with limited warranty. See Electrolux website for details. Products sold after 10/1/2015. Coverage includes 3 years on parts for 3 years and labor for 1 year.

ELECTROLUXAPPLIANCES.COM

## F123858255



## PARATIPS

|                         |             |
|-------------------------|-------------|
| Total Capacity          | 22.9 Cu Ft  |
| Trench Pools Volume     | 16.46 Cu Ft |
| Trench Volume           | 6.82 Cu Ft  |
| Total Spoil Area        | 20.4 Sq Ft  |
| Trench Pools Spoil Area | 21.77 Sq Ft |
| Present Spoil Area      | 5.57 Sq Ft  |

## EXTREME

|  |          |
|--|----------|
| Signature Soft-Acrylic Door and Window Designs | Yes      |
| Electronic Controls                            | NO-Touch |
| High-End Home Decor Design                     | Yes      |

## PROS AND CONS

|   |                 |
|---|-----------------|
| Paint/Schmaltz® Water & Ice                       | Yes             |
| Penetration: Air Filtration/Water Filter Location | Yes (Top Right) |
| Jump Alarm System/Door War Alarm                  | Yes (Yes)       |
| Power Failure Alarm                               | Yes             |
| Emergency-Designated Glass Shatters               | Emil, Left Wall |
| Humidity-Controlled Left Chiller                  | Emergency-Glass |
| Humidity-Controlled Right Chiller                 | Emergency-Glass |
| Parted-Door System                                | Emergency-Glass |
| Water and Beverage Fountains                      | Yes             |
| Glass/Gallen Door Bars (Adjustable)               | 2               |
| Glass 1/2-Inch Door Bar (Adjustable)              | 2               |
| Glass-Calculation Air                             | 2               |
| Glass/CPU Can Run Repairs                         | 2               |
| Emergency-Designated Ramp-Up Multiple Emergency   | Yes             |
| Emergency-Designated                              |                 |

FREEZER COMPARTMENT

|   |        |
|---|--------|
| Automatic Ice Maker                           | Yes    |
| Energy-Save Self-Clean Drawer                 | Yes    |
| Spacious Freezer Basket                       | Yes    |
| Self-Freeze 8in/White Pizza Slot              | No/Yes |
| Plastic Basket Tray                           | Yes    |
| Luxury Design LED Ramp-Up Multilayer Lighting | Yes    |

## ADDITIONAL FEATURES

ENERGY STAR® U.S. EPA  
 Chain Mark Paper Condon

## SPECIFICATIONS

|  |                 |
|--|-----------------|
| Chainless Glow                           | \$              |
| Power Supply, Cooling, and Location      | Right Bottom    |
| Water Inlet Location                     | Left Bottom     |
| Cooling Rating                           | 1120/160 hp     |
| Customer Load (kW, Rating, 48-120 volts) | 1.62, 1000/1200 |
| Minimum Circuit Breaker Rating           | 15              |
| Shipping Weight (Approx.)                | 347 Lbs.        |

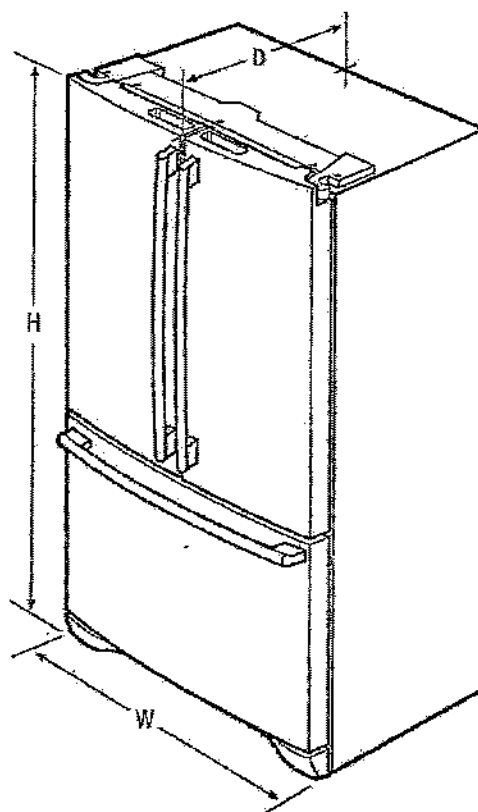

TAKE THE TIME TO MEET WITH PROGRESSIVE THINKING BUSINESS LEADERS. LET THEM KNOW ABOUT YOUR BUSINESS AND YOUR NEEDS. BUILD A RELATIONSHIP WITH STRONG LINES OF COMMUNICATION. YOUR FUTURE WILL BE BUILT ON THE FOUNDATION OF A STRONG RELATIONSHIP WITH PROGRESSIVE THINKING BUSINESS LEADERS. THEY WILL BE YOUR BEST FRIENDS IN BUSINESS. THEY WILL BE YOUR BEST FRIENDS IN BUSINESS. THEY WILL BE YOUR BEST FRIENDS IN BUSINESS.



| PRODUCT DIMENSIONS                   |         |
|--------------------------------------|---------|
| Height (Including Door)              | 70-1/8" |
| Width                                | 35"     |
| Depth (Including Door)               | 28-1/2" |
| Depth (Floor to Top of Cabinet)      | 47-1/2" |
| Depth (Cabinet Only) (Excludes Door) | 15"     |

EL23BCR2S 10/16

© 2015 Electrolux Home Products, Inc.



  
 PR-155  
 Mar 16, 2021



High standards of quality at Chemtronics Home Products, Inc. mean we are constantly working to improve our products. We reserve the right to change specifications of this product without notice.

# FRENCH DOOR REFRIGERATOR

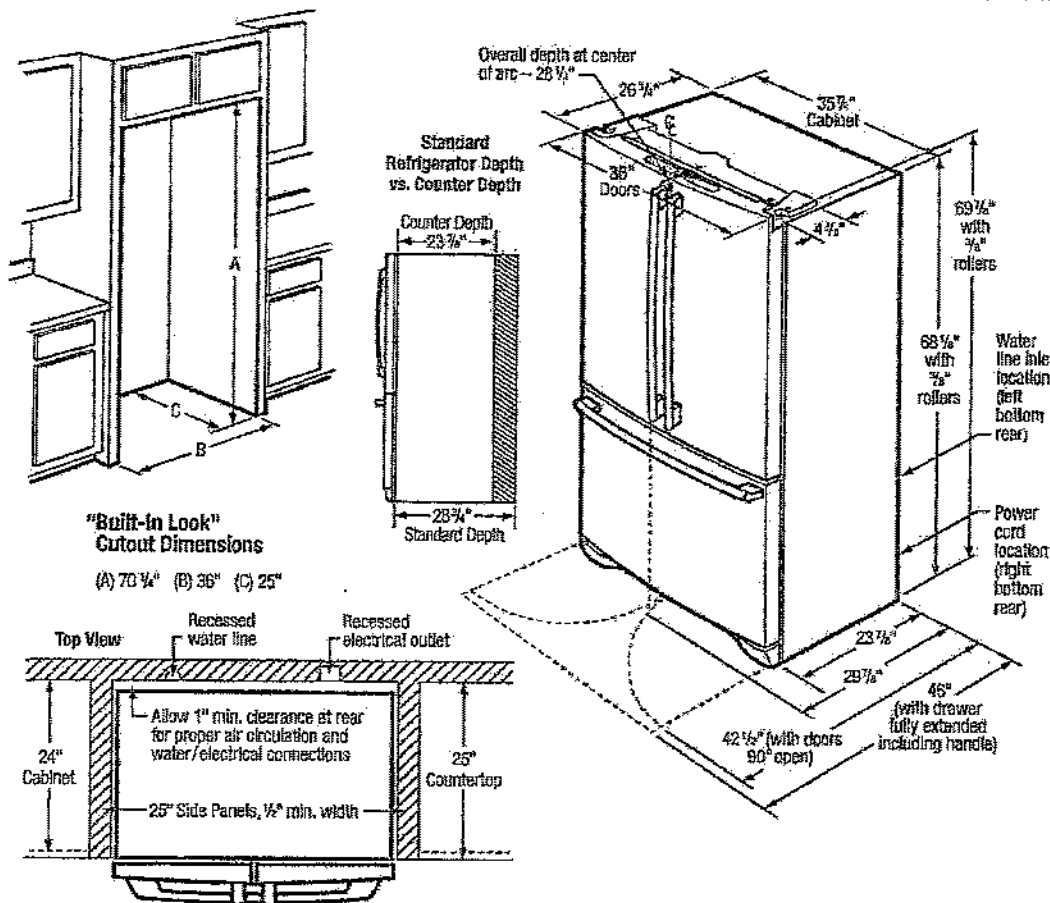
E1235C625S



## Counter-Depth French Door Refrigerator Specifications

- Product Weight – 342 lbs.
- An electrical supply with grounded three-prong receptacle is required. The power supply circuit must be installed in accordance with current edition of National Electrical Code (NFPA 70) and local codes & ordinances.
- Voltage Rating – 120V/60 Hz
- Connected Load (kW Rating) @ 120 Volts = 1.02 kW
- Amps @ 120 Volts = 15 Amps
- Always consult local and national electric & plumbing codes.
- Floor should be level surface of hard material, capable of supporting fully loaded refrigerator.
- When installing refrigerator adjacent to wall, cabinet or other appliance that extends beyond front edge of unit, 20" minimum clearance recommended to allow for optimum 120° to 180° door swing, providing complete drawer/crisper access and removal. (Absolute 4-1/2" minimum clearance will ONLY allow for 90° door swing which will provide drawer/crisper access with restricted removal.)
- To ensure optimum performance, avoid installing in direct sunlight or close proximity to range, dishwasher or other heat source.

- For proper ventilation, front grills MUST remain unobstructed.
- Recess electrical outlet when possible.
- Water recess on rear wall recommended to prevent water line damage.
- Water Pressure – Cold water line must provide between 30 and 100 pounds per square inch (psi).
- Copper tubing with 1/4" O.D. recommended for water supply line with length equal to distance from rear of unit to household water supply line plus 7 additional feet. Optional Water Supply Installation Kits available.
- Adjustable front rollers to assist with door alignment.

## "Built-In Look" Specifications

- Minimum opening of 70-1/4" H x 36" W x 25" D required to allow for ease of installation, proper air circulation, and plumbing/electrical connections.
- Remove all wall/floor molding prior to installation.

Note: For planning purposes only. Refer to Product Installation Guide on the web at [electroluxappliances.com](http://electroluxappliances.com) for detailed instructions.

DY-155  
Mar. 16, 2021

WOK



## Electrolux Major Appliances, N.A.

USA • 10200 David Taylor Drive • Charlotte, NC 28262 • 1-877-4electrolux (1-877-435-3287) • [electroluxappliances.com](http://electroluxappliances.com)  
CANADA • 5555 Terry Fox Way • Mississauga, ON L5V 3E4 • 1-800-265-8352 • [electroluxappliances.ca](http://electroluxappliances.ca)

E1235C625S 10/16

© 2016 Electrolux Home Products, Inc.

High standards of quality at Electrolux Home Products, Inc. mean we are constantly working to improve our products. We reserve the right to change specifications or discontinue models without notice.



EDSH4944AS

Available Colors : Stainless Steel

Version : 02/20

Dishwasher

24" Built-In Dishwasher

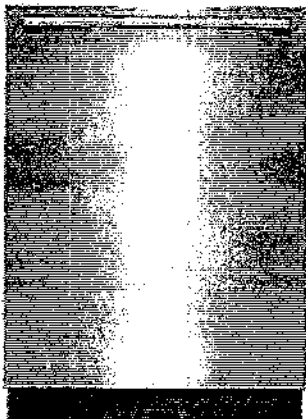

### Product Specifications

#### Certifications & Approvals

|                        |     |
|------------------------|-----|
| ENERGY STAR® Certified | Yes |
| NSF® Certified         | Yes |

#### Dishwasher: Options

|                |     |
|----------------|-----|
| Hi-Temp Wash   | Yes |
| Max Dry        | Yes |
| NSF® Certified | Yes |

#### Dishwasher

|                             |                 |
|-----------------------------|-----------------|
| ApnaLux Direct Delivery     | Yes             |
| Beam on Floor - Clean Light | Yes             |
| Antibacterial Dispenser     | Yes             |
| Drying System               | Perfect Dry     |
| Interior                    | Stainless Steel |
| Luxury-Glide® System        | Yes             |
| Luxury-Hold Door            | Yes             |
| Rinse Aid Dispenser         | Yes             |
| Smart Soil Sensor           | Yes             |
| Tub Design                  | Tall-Tub        |
| Wash Levels                 | 6               |
| Wash System                 | Pro-Clean       |
| Water Pressure - PSI        | 20-90           |
| Water Usage (Gallons)       | 4.0-6.0         |

#### General Specifications

|                   |     |
|-------------------|-----|
| Leveling Legs     | 3   |
| Prop 65 Label     | Yes |
| Sound Level (dBA) | 45  |

#### Electrical Specifications

|                       |           |
|-----------------------|-----------|
| Amps @ 120 Volts      | 15        |
| Connected Load @ 120V | 1.44      |
| Voltage Rating        | 120V 60Hz |

#### Dishwasher: Cycles

|                    |     |
|--------------------|-----|
| Auto Wash          | Yes |
| Eco-Wash           | Yes |
| Fast               | Yes |
| Favorite           | Yes |
| Heavy              | Yes |
| Normal             | Yes |
| Perfect Steamware? | Yes |
| Rinse Only         | Yes |

#### Controls

|                     |                  |
|---------------------|------------------|
| Control Panel       | Fully Integrated |
| Control Type        | IQ Touch         |
| Delay Start - hours | 1-24 Hours       |

#### Dishwasher: Rack Upper

|                   |            |
|-------------------|------------|
| Cup Clips         | 2          |
| Height (Eltux)    | Yes        |
| Perfect Steamware | 8          |
| Rack Handles      | Yes        |
| Rack Type         | Adjustable |
| Third Level Rack  | Yes        |

#### Dimensions: Exterior

|                          |                   |
|--------------------------|-------------------|
| Depth                    | 24 1/4"           |
| Depth (w/ 80° Door Open) | 60 1/4"           |
| Height                   | 33 3/4" - 35 3/4" |
| Width                    | 23 3/4"           |

#### Dimensions: Cut-Out

|        |               |
|--------|---------------|
| Height | 34" - 35 3/4" |
| Width  | 24"           |

#### Exterior

|             |      |
|-------------|------|
| Door Design | Flat |
|-------------|------|

#### Dishwasher: Rack Lower

|                   |                 |
|-------------------|-----------------|
| Silverware Basket | 3-pc Splittable |
| Special Item Cove | 2               |
| Steamware Holder  | 2               |

#### Electrolux Major Appliances, N.A.

USA • 10200 David Taylor Drive • Charlotte, NC 28262 • 1-877-Electrolux (1-877-455-3297) • [electroluxappliances.com](http://electroluxappliances.com)  
CANADA • 8855 Terry Fox Way • Mississauga, ON L5V 3E4 • 1-800-265-8952 • [electroluxappliances.ca](http://electroluxappliances.ca)

Electrolux and the Electrolux logo are registered trademarks of Electrolux Appliances, Inc. in the U.S. and other countries. ©2020 Electrolux Appliances, Inc. All rights reserved. The model number is located on the bottom right of the door.

PV-155  
Mar 16, 2021





EDSH4944AS

✂ Available Colors : Stainless Steel ✂

Version : 02/20

Dishwasher

✂ 24" Built-In Dishwasher ✂

## Installation Drawing

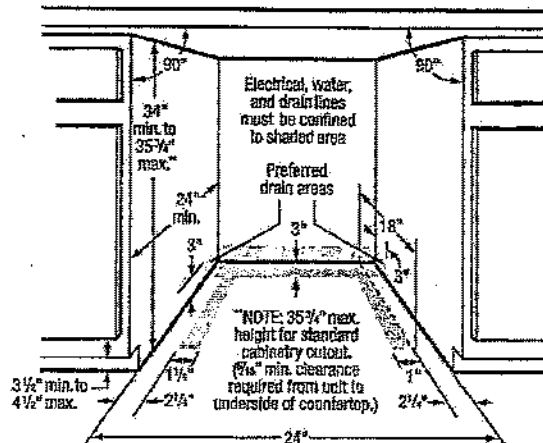
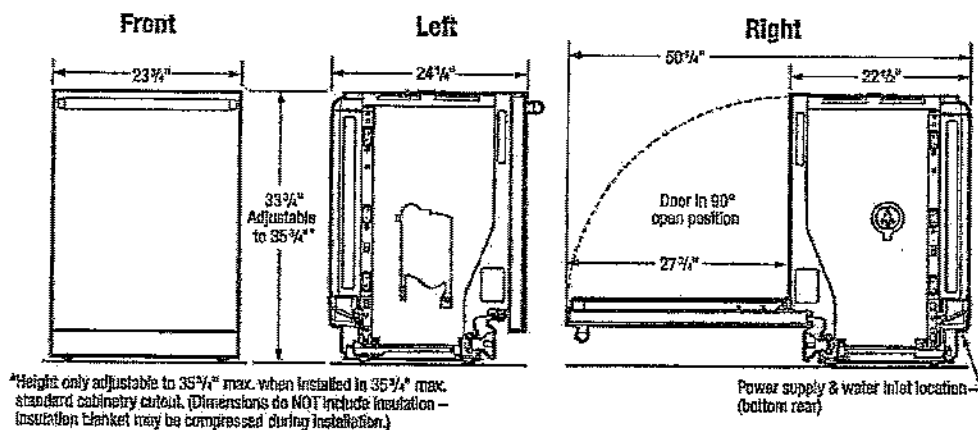

PR-155  
Mar 16, 2021.

WAB

*[Signature]*

Electrolux Major Appliances, N.A.

USA • 10200 David Taylor Drive • Charlotte, NC 28262 • 1-877-4electrolux (1-877-435-3267) • [electroluxappliances.com](http://electroluxappliances.com)  
CANADA • 5855 Terry Fox Way • Mississauga, ON L5V 3E4 • 1-800-265-8332 • [electroluxappliances.ca](http://electroluxappliances.ca)

High standards of quality of Electrolux Home Products Inc. cannot be met consistently without the cooperation of our customers. We request that you please inform us of any defects or problems you encounter so we can correct them.





# FRONT LOAD WASHERS

4.3 Cu. Ft.

EFLS527U TT/IW

Perfect Steam™ Washer with LuxCare® Wash and IQ-Touch™ Controls

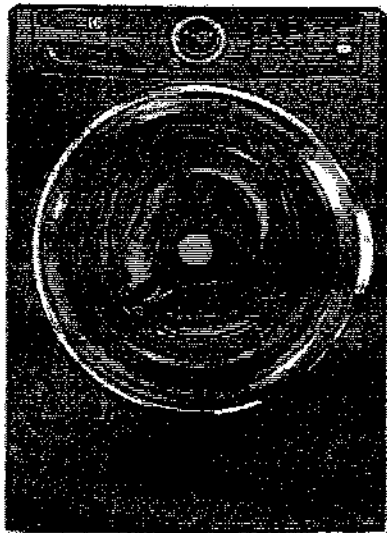

## SIGNATURE FEATURES



### WORLD'S 1<sup>ST</sup> ADAPTIVE DISPENSER™ DESIGNED TO ACCEPT PODS®

Get the ultimate clean no matter what type of detergent you prefer with the Adaptive Dispenser™.

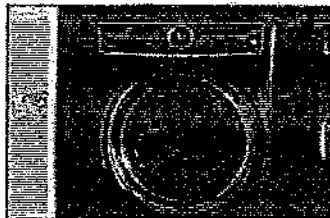

### PERFECT STEAM™ REMOVES TOUGH STAINS

Unlike many washers, our Perfect Steam™ rises from the bottom, gently lifting dirt and stains from fibers.



### THOROUGH CLEANING WITH LUXCARE® WASH SYSTEM

Our LuxCare® Wash System offers a thorough clean with improved wash actions, temperature control, and smart load sensing.



### 18-MINUTE FAST WASH¹

Quickly deep cleans the items you need most.

## PRODUCT DIMENSIONS

|        |     |
|--------|-----|
| Height | 38" |
| Width  | 27" |
| Depth  | 32" |

## MORE EASY-TO-USE FEATURES

### SANITIZE OPTION

Certified to kill and remove 99% of bacteria and 95% of allergens.\*

### STAIN TREAT™ II OPTION REMOVES SET-IN STAINS

Optimizes the temperature, tumbling action, and cycle time based on the stain you select.

### ENERGY STAR® CERTIFIED

Electrolux washers meet strict criteria to guarantee high-quality energy efficient performance — without sacrificing clean.

### ACTIVWEAR CYCLE

Takes care of delicate and expensive activewear garments.

### 10-YEAR MOTOR WARRANTY PLUS LIFETIME TUB WARRANTY

Rest easy knowing your washer is backed by a 10-year motor and lifetime tub warranty.

### PERFECT BALANCE® SYSTEM & SECOND FLOOR GUARANTEE

Balances loads for smooth, quiet operation. So quiet you can even run your washer on the second floor or near bedrooms without noticing it.\*

### FITS MORE ROOMS WITH REVERSIBLE WASHER DOOR

With reversible washer door, four-way venting, and a standard 27" platform, our products are designed to fit just about anywhere you want to put them.

### SPACIOUS CAPACITY

Easily cleans a king-sized comforter with spacious 4.3 cu. ft. drum.

### EXTENDED REFRESH

Adds a rinse and spin after the wash cycle to keep garments fresh until you can switch them to the dryer.

### 9 CYCLES TO CARE FOR EVERY FABRIC

Clean all your special items with tailored cycles for delicates, heavy duty, whitest whites, and more.

Available in:



Titanium  
(TT)



Island White  
(IW)

¹Fast Wash limited to 2 lbs. 100° wash.

\*See product's user manual for NSF® testing standards.

We warrant our appliances will perform their intended use with proper care and handling.

ELECTROLUXAPPLIANCES.COM

PV-155  
Mac 16, 2022

# FRONT LOAD WASHERS

EELS527U TT / IW



## 27" FRONT LOAD WASHER

Capacity 6.0 cu ft

CS Color

### FEATURES

|  |                  |
|--|------------------|
| Full-Size Open Door                              | Yes              |
| Hi-Tech™ Control                                 | Yes              |
| Perfect Steam™ Wash System                       | Yes              |
| Balance System                                   | Perfect Balance™ |
| Silent System                                    | Yes              |
| Lighting   | Luxury Display™  |
| Adaptive Dispenser                               | Yes              |
| Wash System                                      | LongCare™        |
| Integrated Water Heater                          | Yes              |
| Wash Drum  | Stainless Steel  |
| Automatic Temperature Control                    | Yes              |
| Automatic Water Level Adjustment                 | Yes              |
| Auto Prewash Detergent Dispenser (Liquid/Powder) | Yes              |
| Auto Bleach Dispenser (Liquid Only)              | Yes              |
| Auto Detergent Dispenser (Liquid/Powder/PODS™)   | Yes              |
| Auto Fabric Softener Dispenser (Liquid Only)     | Yes              |
| Tumble Speed (RPM)                               | Variable         |
| Spin Speed (RPM)                                 | 1,500            |
| Reversible Door                                  | Yes              |
| Adjustable Loading Legs                          | Yes              |
| ENERGY STAR®                                     | Yes              |
| NSF® Certified for Ice                           | Yes              |

### CYCLES

Heavy Duty, Whisker Whites, Normal, All-in-One, Colors, 96-Min Fast Wash, Deep Clean Rinse & Spin, Clean Washer

### OPTIONS

|                                     |        |
|-------------------------------------|--------|
| Wash/Rinse Temperature Combinations | 7      |
| Temperature Selections              | 5      |
| Add Steam                           | Yes    |
| Spin Speed Selections               | 5      |
| Soil Level Selections               | 5      |
| Delay Start                         | Yes    |
| End-of-Cycle Chime                  | On/Off |

### INSTALLATION OPTIONS

Freestanding Under Counter, Stacked Under Dryer, Pedestal, In-Cabinet, Second Floor Down

### ACCESSORIES

|  |          |
|--|----------|
| Luxury Glass® Reveal with Stainless Storage Drawer | Optional |
| Discs - PN 437025701                               | Optional |
| End-of-Cycle Chime - PN 437025701                  | Optional |
| Dryer Stacking Kit - PN 437025701                  | Optional |
| Drain Hose Extension Kit - PN 437025701            | Optional |

### SPECIFICATIONS

|  |                 |
|--|-----------------|
| Color                                  | Stainless Steel |
| Finish                                 | Brushed         |
| Power Supply Location                  | Top Right Rear  |
| Water Inlet Location                   | Top Left Rear   |
| Voltage Rating                         | 120V/60Hz       |
| Connected Load (kW Rating @ 120 Volts) | 1.2 kW          |
| Watts @ 120 Volts                      | 1,200 W         |
| Amps @ 120 Volts                       | 12 A            |
| Shipping Weight (Approx.)              | 247 lbs         |

Always use proper care and maintenance instructions for your machine. Read and follow the user manual. Adjusted pressure (pounds) shown in this manual is approximate. The power supply (voltage) shown in this manual is approximate. Always use proper care and maintenance instructions for your machine. Read and follow the user manual. Always use proper care and maintenance instructions for your machine. Read and follow the user manual.

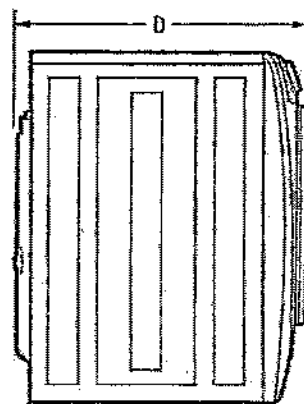
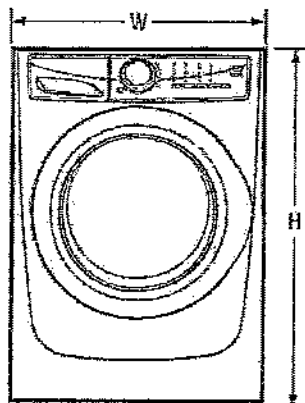

### PRODUCT DIMENSIONS

|   |         |
|---|---------|
| Height (without Pedestal)                         | 33 1/2" |
| Height (with Pedestal)                            | 48 1/2" |
| Width   | 27 1/2" |
| Depth (to Center of Aperture Not Including Hoses) | 22"     |
| Depth (to Center of Aperture Including Hoses)     | 24 1/2" |

PV-155  
Mar. 16, 2021  
VAB

Electrolux Major Appliances, N.A.

USA • 10200 David Taylor Drive • Charlotte, NC 28262 • 1-877-4electrolux (1-877-435-3287) • [electroluxappliances.com](http://electroluxappliances.com)  
CANADA • 5855 Terry Fox Way • Mississauga, ON L5V 3E4 • 1-800-265-8382 • [electroluxappliances.ca](http://electroluxappliances.ca)

EELS527U 02/18

© 2018 Electrolux Home Products, Inc.



High standards of quality at Electrolux Home Products, Inc. mean we are constantly working to improve our products. We reserve the right to change specifications or discontinue models without notice.

# FRONT LOAD WASHERS

EFLS527U TT/WW

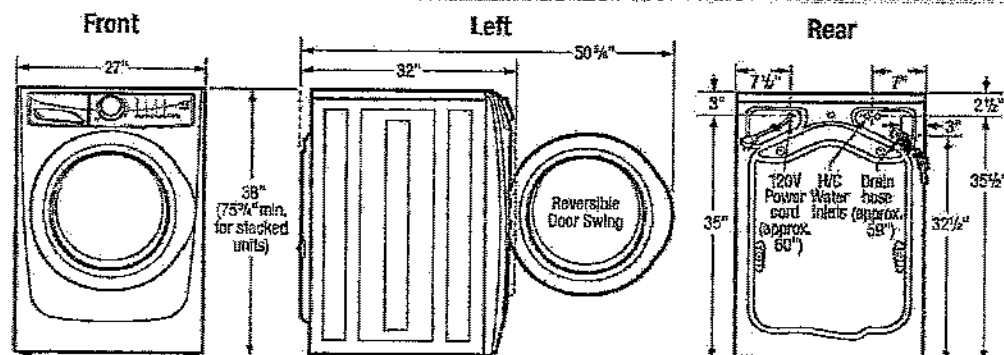

## 15" Pedestal Drawer Installation

Elevates washer height to 53 3/4". For detailed pedestal installation, refer to instructions included with pedestal or on web. Pedestal installation may require modified utility hookup locations. For details, refer to Product Installation Guide on web.

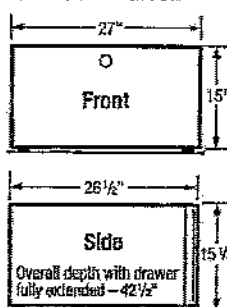

## Built-In Installations

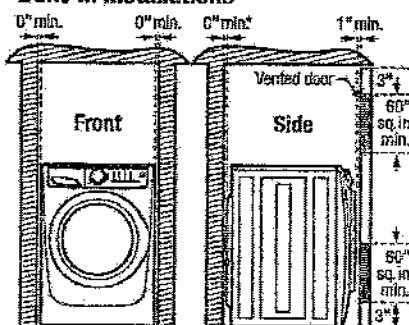

\*Installation with steam dryer requires additional 3/4" hose clearance.

### Closet Installation:

If washer and dryer are installed in same closet, door(s) MUST be vented with 120 sq. in. minimum louvered opening, equally divided, located 3" from top and bottom of door. Louvered door(s) with equivalent air openings for full-length of door is acceptable. Air openings MUST remain unobstructed with door(s) installed.

### Installation Clearances:

Washer can be built in alone or with dryer (side by side or stacked) in closet, recess or under counter installation with 0" minimum clearance required around sides and back of unit(s). To achieve 0" minimum rear clearance when installed with dryer, dryer MUST be vented straight back or with quick-turn 90° elbow. Steam dryer requires additional 3/4" steam hose clearance at back of unit(s). Installation of closet door(s) requires additional 1" minimum clearance between front of unit(s) and door(s). Location of plumbing, exhaust and utility hookups MUST be considered when planning any built-in installation. For additional installation details, refer to Product Installation Guides on web.

### Under Counter Installation:

Installation of washer alone or side by side with dryer under counter, requires custom-built countertop and/or cabinetry to accommodate unit(s) height.

### Stacking Units:

Stacking dryer above washer requires use of optional Stacking Kit (PN# STACKIT7X) with modified utility hookup locations for dryer. For complete installation details, refer to instructions included with Stacking Kit or on web.

## Front Load Washer Specifications

- Product Weight – 237 Lbs. / Shipping Weight – 247 Lbs.
- An electrical supply with grounded three-prong receptacle is required. The power supply circuit must be installed in accordance with current edition of National Electrical Code (ANSI/NFPA 70) and local codes & ordinances. (Do not use same circuit as dryer.)
- Voltage Rating – 120V/60Hz
- Connected Load (kW Rating) @ 120 Volts = 1.2 kW
- Amps @ 120V = 12A
- Equipped with 120V 3-wire power supply cord, approx. 60" long.
- Always consult local and national electric & plumbing codes.
- To maximize detergent effectiveness, ambient temperature should never be below 60°F.
- Can be installed alone, with or without optional 15" pedestal drawer, or stacked beneath matching Electrolux Dryer, which requires installation of optional dryer stacking kit. (For installation details, refer to instructions included with optional pedestal or stacking kit or on web.)
- Can be built in alone or with matching Electrolux Dryer (side by side or stacked) in closet, recess or under counter installation with 0" minimum clearance required around sides and back of unit(s). To achieve 0" minimum rear clearance when installed with dryer, dryer MUST be vented straight back or with quick-turn 90° elbow. Steam dryer requires additional 3/4" steam hose clearance at back of unit(s). Installation of closet door(s) requires additional 1" minimum clearance between front of unit(s) and door(s). Location of plumbing, exhaust and utility hookups MUST be considered when planning any built-in installation.
- Under-counter installation requires custom-built countertop and/or cabinetry to accommodate unit(s) height.

- Do NOT install in area exposed to dripping water or outdoor weather conditions, or where gasoline or other flammables, including automobiles, are kept or stored.
- For garage installation, washer MUST be located minimum 18" above floor.
- Floor MUST be solid with 1" maximum slope. To ensure vibration or movement does not occur, reinforcement of floor may be necessary. Do NOT install on carpeted surface.
- Leveling legs supplied to level washer properly and reduce excessive noise and vibration.
- H/C water faucets MUST be installed within 42" of washer's water inlet and MUST be 3/4" garden hose type, to connect to 48-1/2" inlet hoses.
- Water pressure MUST be between 20 and 120 psi with NOT more than 10 psi pressure difference between hot and cold.
- Drain required with standpipe diameter of 1-1/4" min. and height of 24" min./96" max. above floor, capable of eliminating 17 gallons per minute. Attached 59" drain hose can reach 79"-high standpipe.

Note: For planning purposes only. Refer to Product Installation Guide on the web at [electroluxappliances.com](http://electroluxappliances.com) for detailed instructions.

## Optional Accessories

- Pedestal Drawers – Titanium (PN# EPWD257UTT), Island White (PN# EPWD257IWW).
- Dryer Stacking Kit – (PN# STACKIT7X).
- Drain Hose Extension Kit – (PN# 137038000).

## Electrolux Major Appliances, N.A.

USA • 10200 David Taylor Drive • Charlotte, NC 28262 • 1-877-4electrolux (1-877-435-3287) • [electroluxappliances.com](http://electroluxappliances.com)  
CANADA • 5955 Terry Fox Way • Mississauga, ON L5V 3E4 • 1-800-265-8352 • [electroluxappliances.ca](http://electroluxappliances.ca)

EFLS527U 02/18

© 2018 Electrolux Home Products, Inc.



High standards of quality at Electrolux Home Products, Inc. mean we are constantly working to improve our products. We reserve the right to change specifications or reconfigure models without notice.

PV-155  
Mar 16, 2021  
VOC



# ELECTRIC FRONT LOAD DRYER

8.0 Cu. Ft.

EFMC527U TT/IW

Perfect Steam™ Dryer with Instant Refresh™ and IQ-Touch™ Controls

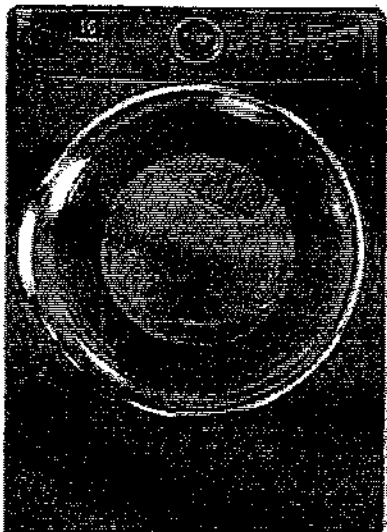

## SIGNATURE FEATURES



### HELP PREVENT OVER- OR UNDER- DRYING WITH LUXCARE® DRY SYSTEM

A more precise sensor for a better dry to protect your clothes from over-drying, but also to help make sure you don't have wet clothes left in the load.



### INSTANT REFRESH™ CYCLE REVIVES FABRICS

Remove wrinkles and quickly refresh items with steam in 10 minutes.



### 18-MINUTE FAST DRY¹

Quickly dry the items you need most.



### ENERGY STAR®-CERTIFIED

Rigorously tested to do more with less. Electrolux dryers meet strict criteria to guarantee high-quality energy efficient performance.

## PRODUCT DIMENSIONS

|        |         |
|--------|---------|
| Height | 38"     |
| Width  | 27"     |
| Depth  | 31-1/2" |

## MORE EASY-TO-USE FEATURES

### PERFECT STEAM™, WRINKLE RELEASE OPTION

Gently releases wrinkles and reduces static to keep clothes looking their best.

### EXTENDED TUMBLE OPTION KEEPS CLOTHES TANGLE-FREE

Gently tumbles your clothes without heat to keep them tangle-free — perfect for when you cannot remove clothes right after the cycle ends.

### LUXCARE® LINT SHIELD HELPS AVOID MESSSES

Traps lint so it doesn't make a mess, even if you empty it while there are clothes in the dryer.

### ACTIVWEAR CYCLE

Takes care of delicate and expensive activewear garments.

### EXTRA-LARGE CAPACITY DRYER

Dry more in each load with our 8.0 cu. ft. dryers.

### PLATINUM STAR® LIMITED WARRANTY

Our exclusive limited warranty that includes three-year coverage on parts and one year on labour.\*

### 8 CYCLES TO CARE FOR EVERY FABRIC

Perfectly dry every item with tailored cycles for towels, delicates, and more.

### FITS MORE ROOMS WITH REVERSIBLE DOOR

Enjoy easy loading no matter how your washer and dryer are configured.

### OPTIONAL PEDESTALS AND STACKING KIT FOR MORE INSTALLATION OPTIONS

Raise your units with optional pedestal drawers that provide extra storage. Or use the optional stacking kit for convenient placement in small spaces.

### LUXURY-DESIGN® LIGHTING

Conveniently find any article of clothing with premium LED lighting that provides visibility inside your dryer.

Available in:



Titanium  
(TT)



Island White  
(IW)

\*Platinum Star® Limited Warranty: 3 years on parts, 1 year on labour. See Electrolux website for details. †Optional pedestal drawers and stacking kit sold separately. ‡Optional LED lighting sold separately. †††Optional LED lighting sold separately. ††††Optional LED lighting sold separately. †††††Optional LED lighting sold separately.

ELECTROLUXAPPLIANCES.CA

# ELECTRIC FRONT LOAD DRYER

EFMC527U TT/1W



| 27" ELECTRIC FRONT LOAD DRYER                       |   |
|---|---|
| FEATURES  |   |
| Power-to-Open Door                                  | Yes   |
| Up-Touch Controls                                   | Yes   |
| Perfect Steam Dry System                            | Yes   |
| Dry System  | LogicDry  |
| Steam System  | LogicSteam  |
| Lighting  | LogicDry LED  |
| Tumble System                                       | Genie Tumble  |
| Shutlure Sensor                                     | Yes   |
| Dryer Drum  | Painted Steel   |
| Tumble Speed (RPM)                                  | 50  |
| Reversible Door                                     | Yes   |
| Adjustable Leveling Legs                            | Yes   |
| CYCLES  |   |
| Timed Dry (30, 45, 60, 75)                          | Heavy Duty/Tumble Dry                                 |
| 18-Min. Fast Dry                                    | ActiveWash, Speed Load, Delicates, Extra Dry, Refresh |
| OPTIONS   |   |
| Temperature Selections                              | 5   |
| Add Steam   | Yes   |
| Electronic Auto Dry System                          | Yes   |
| Manual Steam Dry Selection                          | Yes   |
| Delay Start (Hours)                                 | 12  |
| End-of-Cycle Chime                                  | On/Off  |
| Extended Cycle (Hours)                              | Yes   |
| Auto-Sense  | Yes   |
| Like Dry  | Yes   |
| Dryness Levels                                      | 5   |
| INSTALLATION OPTIONS                                |   |
| Freestanding, Under Counter, Stacked (Above Washer) | Yes   |
| Freestanding, Second Floor                          | Yes   |
| 4-Way Dryer Venting                                 | Yes   |
| ACCESSORIES   |   |
| Library Glide® Pedestal with Storage Drawer         | Optional  |
| Ironing Board - PN # EPW0257U/1T                    | Optional  |
| Steam System - PN # EPW0257U/1W                     | Optional  |
| Dryer Stacking Kit - PN # S1A3317X                  | Optional  |
| Drying Rack - PN # AD4640701                        | Optional  |
| Assembly Hose Kit - PN # S30491300                  | Optional  |
| SPECIFICATIONS                                      |   |
| Colour  |   |
| Black   | 11  |
| White   | 19  |
| Adjustable Exhaust Duct Length (ft.)                | 125   |
| Power Supply Connection Location                    | Rear  |
| Voltage Rating (V)                                  | 240V/60Hz/30A   |
| Connected Load (kW Rating) to 240 Volts             | 6.5   |
| Amperage @ 240 Volts                                | 25  |
| Heating Element @ 240 Volts (Wattage)               | 5,400   |
| Shipping Weight (Approx.)                           | 140 lbs.  |

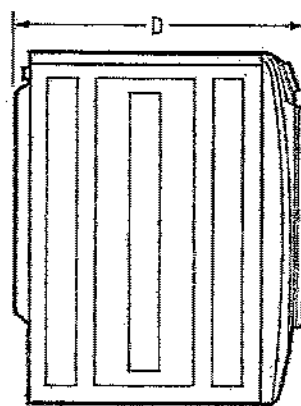
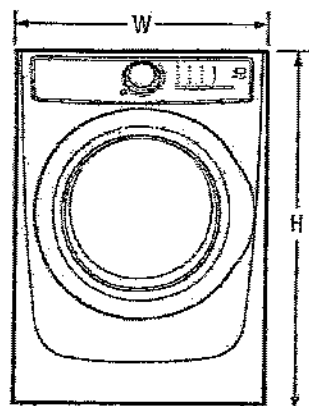

| PRODUCT DIMENSIONS                                   |         |
|--|---------|
| Height (Front Panel) (inches)                        | 33 1/4" |
| Width (inches)                                       | 27 1/2" |
| Depth (to Centre of Air Mat Including Hose) (inches) | 31 1/2" |
| Depth (to Back of Cabinet) (inches)                  | 30 1/2" |

Electrolux Major Appliances, N.A.

CANADA • 5855 Terry Fox Way • Mississauga, ON L5V 3E4 • 1-800-265-8352 • [electroluxappliances.ca](http://electroluxappliances.ca)

EFMC527U 05/18

© 2018 Electrolux Major Appliances, N.A.

High standards of quality at Electrolux Home Products, Inc. mean we are constantly working to improve our products. We reserve the right to change specifications or discontinue models without notice.

Printed in Canada

PV-155  
Mar, 16, 2021  
WDB [Signature]



# ELECTRIC FRONT LOAD DRYER

EFMC527U1T/1W

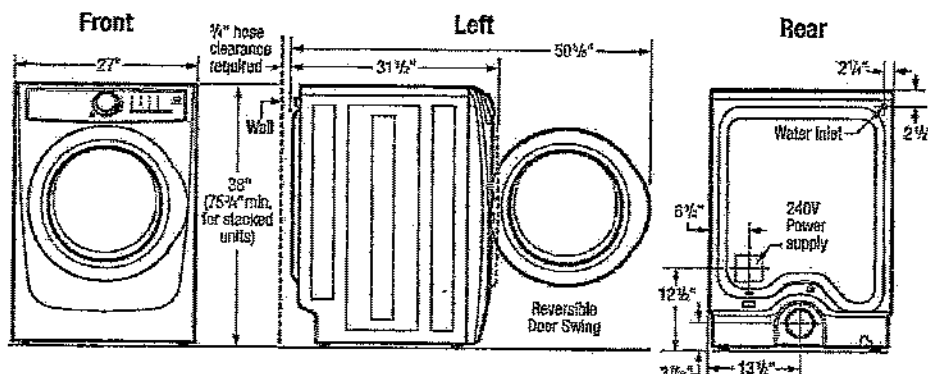

## 15" Pedestal Drawer Installation

Elevates dryer height to 53 1/4". For detailed pedestal installation, refer to instructions included with pedestal or on web. Pedestal installation may require modified utility hookup locations. For details, refer to Product Installation Guide on web.

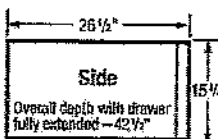
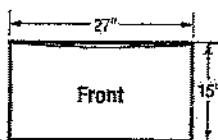

## Built-In Installations

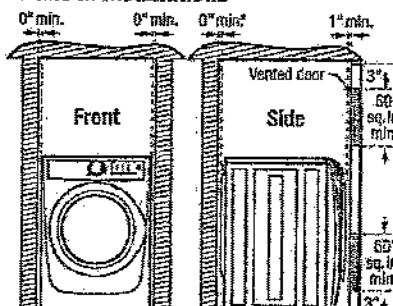

\*Steam dryer requires additional 3/4" hose clearance.

**Closet Installation:**  
If washer and dryer are installed in same closet, door(s) MUST be vented with 120 sq. in. minimum lowered opening, equally divided, located 3" from top and bottom of door. Lowered door(s) with equivalent air openings for full length of door is acceptable. Air openings MUST remain unobstructed with door(s) installed.

## Installation Clearances

Dryer can be built in alone or with washer (side by side or stacked) in closet, recess or under counter installation with 0" minimum clearance required around sides and back of unit(s). To achieve 0" minimum rear clearance, dryer MUST be vented straight back or with quick-turn 90° elbow. Steam dryer requires additional 3/4" steam hose clearance at back of unit(s). Installation of closet door(s) requires additional 1" minimum clearance between front of unit(s) and door(s). Location of plumbing, exhaust and utility hookups MUST be considered when planning any built-in installation. For additional installation details, refer to Product Installation Guides on web.

**Under Counter Installation:**  
Installation of dryer alone or side by side with washer under counter, requires custom-built countertop and/or cabinetry to accommodate unit(s) height.

**Stacking Units:**  
Stacking dryer above washer requires use of optional Stacking Kit (PN# STACKIT7X) with modified utility hookup locations for dryer. For complete installation details, refer to instructions included with Stacking Kit or on web.

## Electric Dryer Specifications

- Product Weight – 130 Lbs. / Shipping Weight – 140 Lbs.
- Voltage Rating – 240/60 Hz/30A
- Single phase 3- or 4-wire cable, 240 Volt, 60 Hertz AC only electrical supply with ground required on separate circuit fused on both sides of line. (Do not use same circuit as washer.)
- Connected Load (kW Rating) @ 240 Volts = 6.0 kW
- Amps @ 240V = 25A
- Dryer MUST employ a 3-conductor NEMA 10-30 type SRDT or 4-conductor NEMA 14-30 type SRDT or ST (as required), rated at 240 volt AC minimum, 30 amp power supply cord marked for use with clothes dryers (not supplied).
- Grounding through neutral link prohibited in specific applications and certain locales, requiring use of 4-wire system. (For detailed electrical requirements, refer to Product Installation Guide on web.)
- Always consult local and national electric & plumbing codes.
- Can be installed alone, with or without optional 15" pedestal drawer, or stacked above matching Electrolux Washer, which requires installation of optional dryer stacking kit. (For installation details, refer to instructions included with optional pedestal or stacking kit or on web.)
- Can be built in alone or with matching Electrolux Washer (side by side or stacked) in closet, recess or under counter installation with 0" minimum clearance required around sides and back of unit(s). To achieve 0" minimum rear clearance, dryer MUST be vented straight back or with quick-turn 90° elbow. Steam dryer requires additional 3/4" steam hose clearance at back of unit(s). Installation of closet door(s) requires additional 1" minimum clearance between front of unit(s) and door(s). Location of plumbing, exhaust and utility hookups MUST be considered when planning any built-in installation.
- Under-counter installation requires custom-built countertop and/or cabinetry to accommodate unit(s) height.

- Do NOT install in area exposed to dripping water or outdoor weather conditions, or where gasoline or other flammables, including automobiles, are kept or stored.
- For garage installation, dryer MUST be located minimum 18" above floor.
- Floor MUST be solid with 1" maximum slope. To ensure vibration or movement does not occur, reinforcement of floor may be necessary. Do NOT install on carpeted surface.
- Dryer MUST exhaust to outside of building, NOT into any concealed space.
- Dryer equipped for 4-way venting and approved for up to 125-foot-equivalent of duct length, determined by length of run and number of elbows needed.
- Exhaust installation requires minimum 4"-diameter rigid or semi-rigid metal duct with approved, unobstructed vent hood having swing-out damper(s). If installing rigid metal duct (preferred), do not exceed MAXIMUM venting run length of 125 ft., allow deductions for elbows and vents. If installing semi-rigid metal duct, do not exceed MAXIMUM venting run length of 8 ft., always allow deductions for elbows and vents (Refer to Product Installation Guide on web for additional information). Do NOT use flexible plastic or metal foil duct and use shortest run possible.
- Leveling legs supplied to level dryer properly and reduce excessive noise and vibration.
- Water inlet hose for steam setting connects to cold water supply with 3/4" connector and requires 3/4" clearance between back of unit and wall.

**Note:** For planning purposes only. Refer to Product Installation Guide on the web at [electroluxappliances.ca](http://electroluxappliances.ca) for detailed instructions.

## Optional Accessories

- Pedestal Drawers – Titanium (PN# EPWD257UTT), Island White (PN# EPWD257UIW).
- Dryer Stacking Kit – (PN# STACKIT7X).
- Drying Rack – (PN# A04840701).
- Assembly Hose Kit – (PN# 5304495002).



High standards of quality at Electrolux Home Profiles, Inc. mean we are constantly working to improve our products. We reserve the right to change specifications or discontinue models without notice.

Printed in Canada

## Electrolux Major Appliances, N.A.

CANADA • 5855 Terry Fox Way • Mississauga, ON L5V 3E4 • 1-800-265-8352 • [electroluxappliances.ca](http://electroluxappliances.ca)

EFMC527U 05/18

© 2018 Electrolux Major Appliances, N.A.