



CONSTRUCTION SUMMARY

Lot: 111  
Model: 40.07 A SUNCREST  
Project/Phase: Pine Valley Forevergreen / 1

APPLIANCES

Invoice	Qty.	Description
2296  23Oct20 NoCat	1	APPLIANCE SPECIFICATIONS ATTACHED - SIGNED

CERAMIC

Invoice	Qty.	Description
2463 35 10Dec20	1	FRONT FOYER: TILE, FLOOR , LEVEL 3 - FRONT FOYER - 12X24" LAID IN STRAIGHT, STACKED PATTERN. SEE PLAN FOR TILE DIRECTION
2463 35 10Dec20	1	POWDER ROOM: TILE, FLOOR , LEVEL 3 - POWDER ROOM - 12X24" LAID IN STRAIGHT, STACKED PATTERN. SEE PLAN FOR TILE DIRECTION
2463 35 10Dec20	1	LAUNDRY: TILE, FLOOR , LEVEL 3 - LAUNDRY - 12X24" LAID IN STRAIGHT, STACKED PATTERN. SEE PLAN FOR TILE DIRECTION
2463 43 10Dec20	1	MASTER ENSUTIE: TILE, SHOWER FLOOR, LEVEL 2 - MASTER ENSUITE - 2"
2463 43 10Dec20	1	SHARED BATH: TILE, SHOWER FLOOR, LEVEL 2 - SHARED BATH - 2"
2463  10Dec20 NoCat	1	MAIN HALL: UPGRADE TO LEVEL 3 TILE (IN LIEU OF HARDWOOD)
2726  23Apr21 NoCat	1	MASTER ENSUITE & SHARED BATH: TILE RESELECTION, SHOWER FLOOR  REFERENCE REVISED COLOUR CHART ATTACHED FOR RESELECTION

CONCRETE AND DRAIN

Invoice	Qty.	Description
2209  23Oct20 NoCat	1	.BACK-FLOW PREVENTER VALVE

CROWN MOULDING

Invoice	Qty.	Description
2296  23Oct20 NoCat	1	.GREAT ROOM - OPT. COFFERED CEILING AS PER PLAN



CONSTRUCTION SUMMARY

Lot: 111  
Model: 40.07 A SUNCREST  
Project/Phase: Pine Valley Forevergreen / 1

DRYWALL

Invoice	Qty.	Description
2296  23Oct20 NoCat	1	.GREAT ROOM - OPT. COFFERED CEILING AS PER PLAN
2296  23Oct20 NoCat	1	.GREAT ROOM - OPT. WAFFLE CEILING, BEAM DETAIL AS PER PLAN (9 BOXES) OPTION # 1 CTR-B07



CONSTRUCTION SUMMARY

Lot: 111  
Model: 40.07 A SUNCREST  
Project/Phase: Pine Valley Forevergreen / 1

ELECTRICAL

Invoice	Qty.	Description
2296 72,281 23Oct20	1	.GREAT ROOM: INTERIOR WALL OUTLET: ADDITIONAL 110V WALL INTERIOR RECEPTACLE ON EXISTING CIRCUIT FOR WALL MOUNTED TV - LOCATE APPROX. 66" A.F.F. ABOVE FIREPLACE
2296 72,289 23Oct20	2	.POWDER ROOM: 4" E/S LED INTERIOR POT LIGHT - GROUND FLOOR - EACH  USE SAME SWITCH AS VANITY LIGHT
2296 72,309 23Oct20	1	.MAIN HALL: UPGRADE STANDARD CEILING MOUNT FIXTURE TO (1) LED POT LIGHT - GROUND FLOOR - SEE PLAN FOR LOCATION
2296 72,289 23Oct20	4	.MAIN HALL: 4" E/S LED INTERIOR POT LIGHT - GROUND FLOOR - EACH  USE SAME SWITCH AS STANDARD
2296 72,309 23Oct20	6	.GREAT ROOM: UPGRADE STANDARD CEILING MOUNT FIXTURE TO (1) LED POT LIGHT - GROUND FLOOR - SEE PLAN FOR LOCATION  INCLUDED IN APS
2296 72,289 23Oct20	3	.GREAT ROOM: 4" E/S LED INTERIOR POT LIGHT - GROUND FLOOR - EACH  USE SAME SWITCH AS STANDARD
2296 72,289 23Oct20	5	.LAUNDRY: 4" E/S LED INTERIOR POT LIGHT - GROUND FLOOR - EACH
2296 72,309 23Oct20	1	.LAUNDRY: UPGRADE STANDARD CEILING MOUNT FIXTURE TO (1) LED POT LIGHT - GROUND FLOOR - SEE PLAN FOR LOCATION
2296 72,278 23Oct20	1	.LAUNDRY: ADD HINGE-ACTIVATED INTERIOR SWITCH  FOR POTLIGHT IN CLOSET
2296 72,289 23Oct20	7	.KITCHEN: 4" E/S LED INTERIOR POT LIGHT - GROUND FLOOR - EACH
2296 72,309 23Oct20	1	.KITCHEN: UPGRADE STANDARD CEILING MOUNT FIXTURE TO (1) LED POT LIGHT - GROUND FLOOR - LOCATE ABOVE ISLAND
2296 72,289 23Oct20	1	.KITCHEN: 4" E/S LED INTERIOR POT LIGHT - GROUND FLOOR - EACH LOCATE ABOVE ISLAND, SAME SWITCH AS STANDARD
2296 72,278 23Oct20	1	.KITCHEN: ADDITIONAL INTERIOR SWITCH  SWITCH FOR POTLIGHTS



CONSTRUCTION SUMMARY

Lot: 111  
Model: 40.07 A SUNCREST  
Project/Phase: Pine Valley Forevergreen / 1

ELECTRICAL

Invoice	Qty.	Description
2296 72,289 23Oct20	4	.BREAKFAST: 4" E/S LED INTERIOR POT LIGHT - GROUND FLOOR - EACH
2296 72,278 23Oct20	1	.BREAKFAST: ADDITIONAL INTERIOR SWITCH  FOR POTLIGHTS
2296 72,303 23Oct20	1	.KITCHEN: FIXTURE: UNDER CABINET FLUORESCENT LIGHT FIXTURES - DOES NOT INCLUDE (AND REQUIRES) LIGHT VALANCE
2641 72,275 17Mar21	1	240V WALL RECEPTACLE ON SEPARATE CIRCUIT - FOR COOKTOP

EXTERIOR COLOURS

Invoice	Qty.	Description
2296  23Oct20 NoCat	1	EXTERIOR COLOUR PACKAGE # BR.1

FRAMING

Invoice	Qty.	Description
2296 72,445 23Oct20	1	.GREAT ROOM - OPT. COFFERED CEILING AS PER PLAN
2296 72,444 23Oct20	1	.GREAT ROOM - OPT. WAFFLE CEILING, BEAM DETAIL AS PER PLAN (9 BOXES) OPTION # 1 CTR-B07

GRANITE MARBLE QUARTZ

Invoice	Qty.	Description
2463  10Dec20 NoCat	1	POWDER ROOM: UPGRADE 5 QUARTZ COUNTER
2463  10Dec20 NoCat	1	KITCHEN: UPGRADE 5 QUARTZ COUNTER TOP
2463  10Dec20 NoCat	1	KITCHEN: COOKTOP CUT OUT
2463  10Dec20 NoCat	1	KITCHEN: UPGRADE SINK TO BLANCO QUATRUS R15 U 1-3/4



CONSTRUCTION SUMMARY

Lot: 111  
Model: 40.07 A SUNCREST  
Project/Phase: Pine Valley Forevergreen / 1

HARDWOOD

Invoice	Qty.	Description
2463 12 10Dec20	1	THRU OUT ALL STANDARD AREAS: GREAT ROOM/DINING ROOM/ UPPER HALL/ MASTER BEDROOM/ BEDROOM 2/ BEDROOM 3/ BEDROOM 4: MIRAGE, 5" RED OAK, TRUE BALANCE ENGINEERED HARDWOOD, 3/4" THK, IMAGINE TEXTURE, DURAMATT FINISH - GREAT ROOM/DINING ROOM - LEVEL 5
2463 12 10Dec20	1	KITCHEN/BREAKFAST: MIRAGE, 5" RED OAK, TRUE BALANCE ENGINEERED HARDWOOD, 3/4" THK, IMAGINE TEXTURE, DURAMATT FINISH - KITCHEN/BREAKFAST - LEVEL 5
2463  10Dec20 NoCat	1	MAIN HALL: UPGRADE TO LEVEL 3 TILE (IN LIEU OF HARDWOOD)  HARDWOOD FLOORING MAIN HALL ONLY - DO NOT SUPPLY / DO NOT INSTALL

INTERIOR TRIM AND DOORS

Invoice	Qty.	Description
2296  23Oct20 NoCat	1	.GREAT ROOM - OPT. COFFERED CEILING AS PER PLAN
2296  23Oct20 NoCat	1	.GREAT ROOM - OPT. WAFFLE CEILING, BEAM DETAIL AS PER PLAN (9 BOXES) OPTION # 1 CTR-B07
2463 155,374 10Dec20	1	UPGRADE INTERIOR DOORS TO LINCOLN PARK,  UPGRADE

KITCHEN AND BATH CABINETRY

Invoice	Qty.	Description
2296  23Oct20 NoCat	1	APPLIANCE SPECIFICATIONS ATTACHED - SIGNED
2463  10Dec20 NoCat	1	THRU OUT: SEE ATTACHED CABINETRY SCHEDULE
2463  10Dec20 NoCat	1	KITCHEN: UPGRADE SINK TO BLANCO QUATRUS R15 U 1-3/4



CONSTRUCTION SUMMARY

Lot: 111  
Model: 40.07 A SUNCREST  
Project/Phase: Pine Valley Forevergreen / 1

NETWORK AND WIRING

Invoice	Qty.	Description
2296 72,259 23Oct20	1	.GREAT ROOM: CONDUIT PIPE - FOR WALL MOUNT TV - LOCATE APPROX. 66" A.F.F. ABOVE FIREPLACE, TERMINATING AT CABLE -SEE PLAN
2296 72,258 23Oct20	1	.GREAT ROOM: ADDITIONAL CAT6 ETHERNET OUTLET - EACH SEE PLAN FOR LOCATION
2296 72,261 23Oct20	1	KITCHEN: INSTALL VAC PAN UNDER KITCHEN SINK.
2296 72,260 23Oct20	1	.CONDUIT PIPE - FROM ATTIC TO BASEMENT - AT ELECTRICAL PANEL TO APPROX CENTER OF ATTIC

PAINT

Invoice	Qty.	Description
2296  23Oct20 NoCat	1	.GREAT ROOM - OPT. COFFERED CEILING AS PER PLAN
2296  23Oct20 NoCat	1	.GREAT ROOM - OPT. WAFFLE CEILING, BEAM DETAIL AS PER PLAN (9 BOXES) OPTION # 1 CTR-B07
2463  10Dec20 NoCat	2	MAIN STAIRS: 2ND FLOOR TO BASEMENT - STAIN STAIRS AND LANDINGS  STAIRS AND LANDINGS WILL NOT MATCH HARDWOOD IN COLOUR OR TEXTURE

PLUMBING

Invoice	Qty.	Description
2296  23Oct20 NoCat	1	.GARAGE: UPGRADE TO HOT/COLD HOSE BIB (FROM STANDARD COLD ONLY)
2463  10Dec20 NoCat	1	KITCHEN: UPGRADE SINK TO BLANCO QUATRUS R15 U 1-3/4  BOTTOM GRID NOT INCLUDED / SEE ATTACHED

PV-111 Cabinetry Schedule

ROOM	DESCRIPTION	PRICE	QTY	TOTAL
POWDER ROOM	UPGRADE SERIES 2 TO SERIES 5 - WILLIS OYSTER		1	
KITCHEN	UPGRADE KITCHEN FROM SERIES 2 TO SERIES 5 - WILLIS OYSTER		1	
	UPGRADE ISLAND FROM SERIES 2 TO SERIES 5 - WILLIS OYSTER		1	
	FLAT VALANCE		1	
	POTS AND PANS DRAWERS CONVERSION WITH 3/4" EXTENSION		1	
	OPTIONAL DEEP PANTRY IN LIEU OF STANDARD CABINETRY		1	
	30" COOKTOP + BUILT IN OVEN BELOW STOVE LOCATION		1	
	RETURN TRIP		1	
	ADD SMALL FURRING RAIL IN LIEU OF CROWN MOULDING		1	
CABINETRY TOTAL:				

LOT #: PV-111

DATE: December 7, 2020

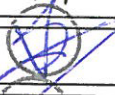
SIGNATURE: 

SIGNATURE: 

Purchasers: Vanessa Smith & Bradley, James Smith

Property: 111 of Plan -

Telephone Res. / Bus: / (416) 315-3107

Project: Pine Valley Forevergreen - Phase 1

Decor Advisor: Yolande Somerville

Model and Elevation: 40.07 A SUNCREST

Layout Changes: ☐ Yes ☒ No

Sketch Attached: ☒ Yes ☐ No

Exterior Colour Scheme:

## 1. Cabinetry

	Style and Colour	Counter	Hardware
Kitchen / Breakfast	*Willis 'Oyster'	*Quartz: Statuario Maximus	h03301
Laundry Room	Modena 'Classic White'	P-Lam: Std White	h01106
Powder Room	*Willis 'Oyster'	*Quartz: Statuario Maximus	h03301
Main Bath	Modena 'Classic White'	Quartz: 'Ice Snow'	h01106
Master Ensuite Bathroom	Modena 'Classic White'	Quartz: 'Ice Snow'	h01106
Second Ensuite Bathroom (If Applicable)	n/a	n/a	n/a
Shared Bath	Modena 'Classic White'	Quartz: 'Ice Snow'	h01106

Comment

## 2. Floor Tile

	Selection
Entrance Vestibule	*12x24" Carrara X polished 'White'
Main Hall	*12x24" Carrara X polished 'White'
Kitchen / Breakfast	see hardwood*
Laundry Room	*12x24" Carrara X polished 'White'
Powder Room	*12x24" Carrara X polished 'White'
Shared Ensuite	13x13" Sempre 'White'
Master Ensuite Bathroom	13x13" Sempre 'White'
Second Ensuite Bathroom (If Applicable)	n/a
Lower Landing (If Applicable)	13x13" Sempre 'White' (basement landing)
Main Bath	13x13" Sempre 'White'

Comment

Master Ensuite Shower Floor + Shared Bath Shower Floor: ~~2" Ontario 'taupe'~~

ontario taupe hex  
\*reselection\*  
April 22, 2021

## 3. Wall Tile

	Selection	Listello/Inserts	Describe
Main Bath	8x10" Uniwall 'Tender Grey'	<input type="radio"/> Yes <input checked="" type="radio"/> No	
Master Ensuite Bathroom			
Tub Deck	n/a	<input type="radio"/> Yes <input checked="" type="radio"/> No	
Shower Stall	8x10" Uniwall 'Tender Grey'	<input type="radio"/> Yes <input checked="" type="radio"/> No	
Bathroom Walls	n/a	<input type="radio"/> Yes <input checked="" type="radio"/> No	
Second Ensuite Bathroom (If Applicable)	n/a	<input type="radio"/> Yes <input checked="" type="radio"/> No	
Shared Bath	8x10" Uniwall 'Tender Grey'	<input type="radio"/> Yes <input checked="" type="radio"/> No	
Kitchen Backsplash	<input type="radio"/> Yes <input checked="" type="radio"/> No	Backsplash Behind Fridge	

Comment

Scheduled Closing Date: Thursday, November 26, 2020

Purchasers: Vanessa Smith & Bradley, James Smith

Property: 111 of Plan -

Telephone Res. / Bus: / (416) 315-3107

Project: Pine Valley Forevergreen - Phase 1

Decor Advisor: Yolande Somerville

Model and Elevation: 40.07 A SUNCREST

#### 4. Plumbing Fixtures

Master Ensuite Bathroom  Second Ensuite  Powder Room   
Other Room - Specify  Other Washroom

Comment

std thru out except kitchen sink

#### 5. Hardwood Flooring

	Type and Stain		Type and Stain
Main Hall	see tile*	Upper Landing	
Kitchen / Breakfast	*3/4x5" red oak brushed 'Driftwood'	Upper Hall	
Living Room		Master Bedroom	
Dining Room		Bedroom #2	
Family Room		Bedroom #3	
Den/Library		Bedroom #4	
Entrance Vestibule		Bedroom #5	
Lower Landing (If Applicable)		Other Room - Specify	*3/4x5" red oak brushed 'Driftwood'
		Thru out standard areas	

Comment

#### 6. Carpeting

	Upgrade	Description
Ground Floor	<input type="checkbox"/>	
Second Floor	<input type="checkbox"/>	
	<input type="checkbox"/>	

	Type	Area
Upgrade Underpad		
	Capped	Runner - *Upgrade
Carpet on Stairs		

Comment

#### 7. Fireplace

	Living Room			Family Room			Other Room - Specify		
	Purchased	As Per Plan	N/A	Purchased	As Per Plan	N/A	Purchased	As Per Plan	N/A
Fireplace Type	<input type="radio"/>	<input type="radio"/>	<input checked="" type="radio"/>	<input type="radio"/>	<input checked="" type="radio"/>	<input type="radio"/>	<input type="radio"/>	<input type="radio"/>	<input checked="" type="radio"/>
Mantle Type				Standard Gas					
Colour / Stain				Mediterranean					
Surround				Arctic White					
Hearth				n/a					
				none					

Comment

Purchasers: Vanessa Smith & Bradley, James Smith

Property: 111 of Plan -

Telephone Res. / Bus: / (416) 315-3107

Project: Pine Valley Forevergreen - Phase 1

Decor Advisor: Yolande Somerville

Model and Elevation: 40.07 A SUNCREST

## 8. Trim Carpentry

Interior Doors \*Lincoln Park Front Door Glass Inserts standard Door Handles Standard

Interior Trim Standard

Comment

## 9. Plaster Mouldings and Medallions

Standard Throughout ☐ Yes ☐ No ☒ N/A

Entrance Vestibule			Kitchen/Breakfast		
Main Hall			Den/Library		
Living Room			Lower Landing		
Dining Room			Other Room - Specify		
Family Room					

Comment

## 10. Railings and Spindles

Railing Package Standard 2 oak

Railing Colour \*Graphite

Stringer / Riser \*Graphite

Spindle Colour \*Graphite

Treads \*Graphite

Comment

Oak Stairs ☒ Yes ☐ No ☐ N/A

## 11. Wall Paint / Ceilings

Throughout Finished Areas Warm Grey

Trim Paint White

Smooth Ceilings

Ground Floor ☒

Second Floor ☒

Note

Comment

Purchasers: Vanessa Smith & Bradley, James Smith

Property: 111 of Plan -

Telephone Res. / Bus: / (416) 315-3107

Project: Pine Valley Forevergreen - Phase 1

Decor Advisor: Yolande Somerville

Model and Elevation: 40.07 A SUNCREST

## 12. Electrical

Hood Fan ☐ White ☒ Stainless ☐ N/A

Above Kitchen Cabinet Light ☐ Yes ☒ No

Below Kitchen Cabinet Light ☐ Yes ☒ No

Standard Appliances ☐

Over The Range Microwave ☐

Chimney Style Fan ☒

Comment

## 13. Heating and Air Conditioning

Air Conditioning

Gas Provisions Stove

Gas Provisions Dryer

Gas Provisions Barbecue

Comment

## 14. Additional Comments

## 15. Disclaimers and Notes

- 1) Colours of all materials are as close as possible to builder's selection, but not necessarily identical due to variances in manufacturing.
- 2) Any extras listed above are null and void unless accompanied by a separate invoice/amendment. Said invoice must be paid in full.
- 3) The Purchaser acknowledges that after Interior Colour Selection form is signed and dated, no further changes will be permitted other than re-selection due to unavailability. \_\_\_\_\_ Purchaser's Initials
- 4) The Purchaser acknowledges reading and accepting the "Gold Park Homes Decor Centre Disclaimers" form. This document contains other miscellaneous disclaimers.

This Interior Colour Selection is final and approved by:

Signature:  Date: \_\_\_\_\_

## INTERIOR COLOUR SCHEME

\*\*\* NOTE: This is not an approved document. Document must be locked \*\*\*

Scheduled Closing Date: Thursday, November 26, 2020

Purchasers: Vanessa Smith &amp; Bradley, James Smith

Property: 111 of Plan -

Telephone Res. / Bus: / (416) 315-3107

Project: Pine Valley Forevergreen - Phase 1

Decor Advisor: Yolande Somerville

Model and Elevation: 40.07 A SUNCREST

Layout Changes: ☐ Yes ☒ NoSketch Attached: ☒ Yes ☐ No

Exterior Colour Scheme: \_\_\_\_\_

## 1. Cabinetry

	Style and Colour	Counter	Hardware
Kitchen / Breakfast	*Willis 'Oyster'	*Quartz: Statuario Maximus	h03301
Laundry Room	Modena 'Classic White'	P-Lam: Std White	h01106
Powder Room	*Willis 'Oyster'	*Quartz: Statuario Maximus	h03301
Main Bath	Modena 'Classic White'	Quartz: 'Ice Snow'	h01106
Master Ensuite Bathroom	Modena 'Classic White'	Quartz: 'Ice Snow'	h01106
Second Ensuite Bathroom (If Applicable)	n/a	n/a	n/a
Shared Bath	Modena 'Classic White'	Quartz: 'Ice Snow'	h01106

Comment

## 2. Floor Tile

	Selection
Entrance Vestibule	*12x24" Carrara X polished 'White'
Main Hall	*12x24" Carrara X polished 'White'
Kitchen / Breakfast	see hardwood*
Laundry Room	*12x24" Carrara X polished 'White'
Powder Room	*12x24" Carrara X polished 'White'
Shared Ensuite	13x13" Sempre 'White'
Master Ensuite Bathroom	13x13" Sempre 'White'
Second Ensuite Bathroom (If Applicable)	n/a
Lower Landing (If Applicable)	13x13" Sempre 'White' (basement landing)
Main Bath	13x13" Sempre 'White'

Comment

Master Ensuite Shower Floor + Shared Bath Shower Floor: 2" Ontario 'taupe'

ontario taupe hex  
\*reselection\*  
April 22, 2021

## 3. Wall Tile

	Selection	Listello/Inset	Describe
Main Bath	8x10" Uniwall 'Tender Grey'	<input type="radio"/> Yes <input checked="" type="radio"/> No	
Master Ensuite Bathroom			
Tub Deck	n/a	<input type="radio"/> Yes <input checked="" type="radio"/> No	
Shower Stall	8x10" Uniwall 'Tender Grey'	<input type="radio"/> Yes <input checked="" type="radio"/> No	
Bathroom Walls	n/a	<input type="radio"/> Yes <input checked="" type="radio"/> No	
Second Ensuite Bathroom (If Applicable)	n/a	<input type="radio"/> Yes <input checked="" type="radio"/> No	
Shared Bath	8x10" Uniwall 'Tender Grey'	<input type="radio"/> Yes <input checked="" type="radio"/> No	
Kitchen Backsplash	<input type="radio"/> Yes <input checked="" type="radio"/> No	Backsplash Behind Fridge	

Comment

**GOLDPARK**

WORTH MORE

**INTERIOR COLOUR SCHEME**

\*\*\* NOTE: This is not an approved document. Document must be locked \*\*\*

Scheduled Closing Date: Thursday, November 26, 2020

Purchasers: Vanessa Smith & Bradley, James Smith

Property: 111 of Plan -

Telephone Res. / Bus: / (416) 315-3107

Project: Pine Valley Forevergreen - Phase 1

Decor Advisor: Yolande Somerville

Model and Elevation: 40.07 A SUNCREST

**4. Plumbing Fixtures**

Master Ensuite Bathroom ☐ Second Ensuite ☐ Powder Room ☐  
Other Room - Specify ☐ Other Washroom ☐

**Comment**

std thru out except kitchen sink

**5. Hardwood Flooring**

	Type and Stain		Type and Stain
Main Hall	see tile*	Upper Landing	
Kitchen / Breakfast	3/4x5" red oak brushed 'Driftwood'	Upper Hall	
Living Room		Master Bedroom	
Dining Room		Bedroom #2	
Family Room		Bedroom #3	
Den/Library		Bedroom #4	
Entrance Vestibule		Bedroom #5	
Lower Landing (If Applicable)		Other Room - Specify	
		Thru out standard areas	3/4x5" red oak brushed 'Driftwood'

**Comment**

**6. Carpeting**

	Upgrade	Description
Ground Floor	<input type="checkbox"/>	
Second Floor	<input type="checkbox"/>	

**Upgrade Underpad**

Type	Area
Capped	
Runner - Upgrade	

**Carpet on Stairs**

**Comment**

**7. Fireplace**

	Living Room			Family Room			Other Room - Specify		
	Purchased	As Per Plan	N/A	Purchased	As Per Plan	N/A	Purchased	As Per Plan	N/A
Fireplace Type	<input type="radio"/>	<input type="radio"/>	<input checked="" type="radio"/>	<input type="radio"/>	<input checked="" type="radio"/>	<input type="radio"/>	<input type="radio"/>	<input type="radio"/>	<input checked="" type="radio"/>
Mantle Type				Standard Gas					
Colour / Stain				Mediterranean					
Surround				Arctic White					
Hearth				n/a					
				none					

**Comment**

**GOLD PARK**

WORTH MORE

**INTERIOR COLOUR SCHEME**

\*\*\* NOTE: This is not an approved document. Document must be locked \*\*\*

Scheduled Closing Date: Thursday, November 26, 2020

Purchasers: Vanessa Smith & Bradley, James Smith

Property: 111 of Plan -

Telephone Res. / Bus: / (416) 315-3107

Project: Pine Valley Forevergreen - Phase 1

Decor Advisor: Yolande Somerville

Model and Elevation: 40.07 A SUNCREST

**8. Trim Carpentry**

Interior Doors  Front Door Glass Inserts  Door Handles

Interior Trim

Comment

**9. Plaster Mouldings and Medallions**

Standard Throughout ☐ Yes ☐ No ☒ N/A

Entrance Vestibule	<input type="text"/>	<input type="text"/>	Kitchen/Breakfast	<input type="text"/>	<input type="text"/>
Main Hall	<input type="text"/>	<input type="text"/>	Den/Library	<input type="text"/>	<input type="text"/>
Living Room	<input type="text"/>	<input type="text"/>	Lower Landing	<input type="text"/>	<input type="text"/>
Dining Room	<input type="text"/>	<input type="text"/>	Other Room - Specify	<input type="text"/>	<input type="text"/>
Family Room	<input type="text"/>	<input type="text"/>			

Comment

**10. Railings and Spindles**

Railing Package	<input type="text" value="Standard 2 oak"/>		
Railing Colour	<input type="text" value="Graphite"/>	Spindle Colour	<input type="text" value="Graphite"/>
Stringer / Riser	<input type="text" value="Graphite"/>	Treads	<input type="text" value="Graphite"/>
		Oak Stairs	<input checked="" type="radio"/> Yes <input type="radio"/> No <input type="radio"/> N/A

Comment

**11. Wall Paint / Ceilings**

Throughout Finished Areas

Trim Paint

Smooth Ceilings

Ground Floor ☒

Second Floor ☒

Note

Comment

**GOLD PARK**

WORTH MORE

**INTERIOR COLOUR SCHEME**

\*\*\* NOTE: This is not an approved document. Document must be locked \*\*\*

Scheduled Closing Date: Thursday, November 26, 2020

Purchasers: Vanessa Smith & Bradley, James Smith

Property: 111 of Plan -

Telephone Res. / Bus: / (416) 315-3107

Project: Pine Valley Forevergreen - Phase 1

Decor Advisor: Yolande Somerville

Model and Elevation: 40.07 A SUNCREST

**12. Electrical**

Hood Fan ☐ White ☒ Stainless ☐ N/A

Above Kitchen Cabinet Light ☐ Yes ☒ No

Below Kitchen Cabinet Light ☐ Yes ☒ No

Standard Appliances ☐

Over The Range Microwave ☐

Chimney Style Fan ☒

Comment

**13. Heating and Air Conditioning**

Air Conditioning

Gas Provisions Stove

Gas Provisions Dryer

Gas Provisions Barbecue

Comment

**14. Additional Comments**

**15. Disclaimers and Notes**

- 1) Colours of all materials are as close as possible to builder's selection, but not necessarily identical due to variances in manufacturing.
- 2) Any extras listed above are null and void unless accompanied by a separate invoice/amendment. Said Invoice must be paid in full.
- 3) The Purchaser acknowledges that after Interior Colour Selection form is signed and dated, no further changes will be permitted other than re-selection due to unavailability. \_\_\_\_\_ Purchaser's Initials
- 4) The Purchaser acknowledges reading and accepting the "Gold Park Homes Decor Centre Disclaimers" form. This document contains other miscellaneous disclaimers.

This Interior Colour Selection is final and approved by:

Signature:  Date: \_\_\_\_\_

# SCHEDULE 'F'



PV-III  
APRIL 24 2020

PV-III  
Dec. 7, 2020.

see attached  
see attached

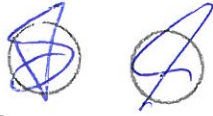

## The Suncrest 40' SERIES

Elevation A • 2,520 sq.ft.  
Elevation B • 2,535 sq.ft.

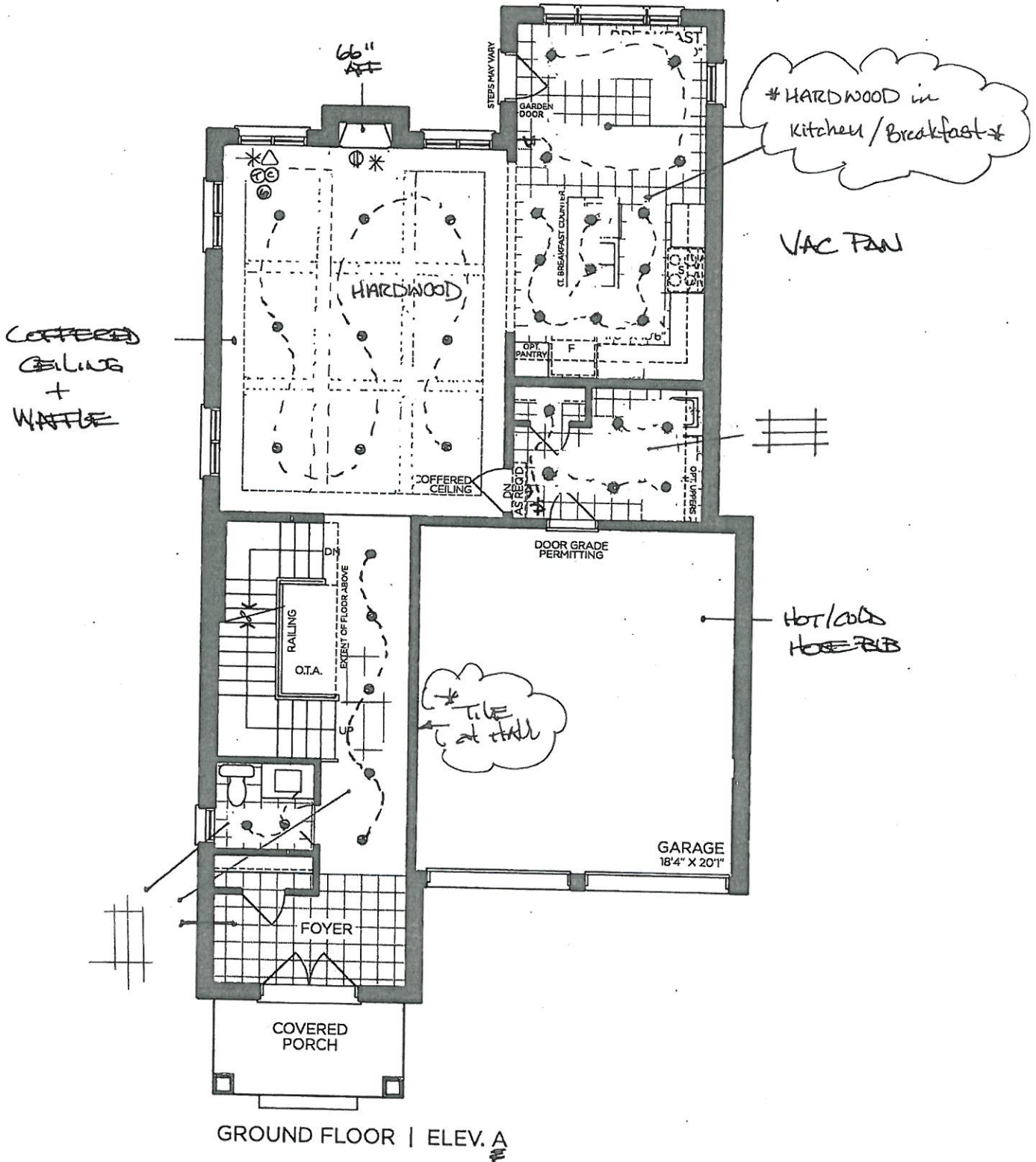

GROUND FLOOR | ELEV. A

VENDOR

PURCHASER

PURCHASER

**GOLDPARK**  
WORTH MORE™

Prices, figures, illustrations, sizes, features and finishes are subject to change without notice. Areas and dimensions are approximate and actual usable floor space may vary from the stated area. Layout may be reverse of the unit purchased. E. & O.E. 4007

SCHEDULE 'F'



PV-III ~~see attached~~ ~~see attached~~  
APRIL 24 2020  
PV-III ~~see attached~~ ~~see attached~~  
Dec. 7, 2020.

The Suncrest  
40' SERIES

Elevation A • 2,520 sq.ft.  
Elevation B • 2,535 sq.ft.

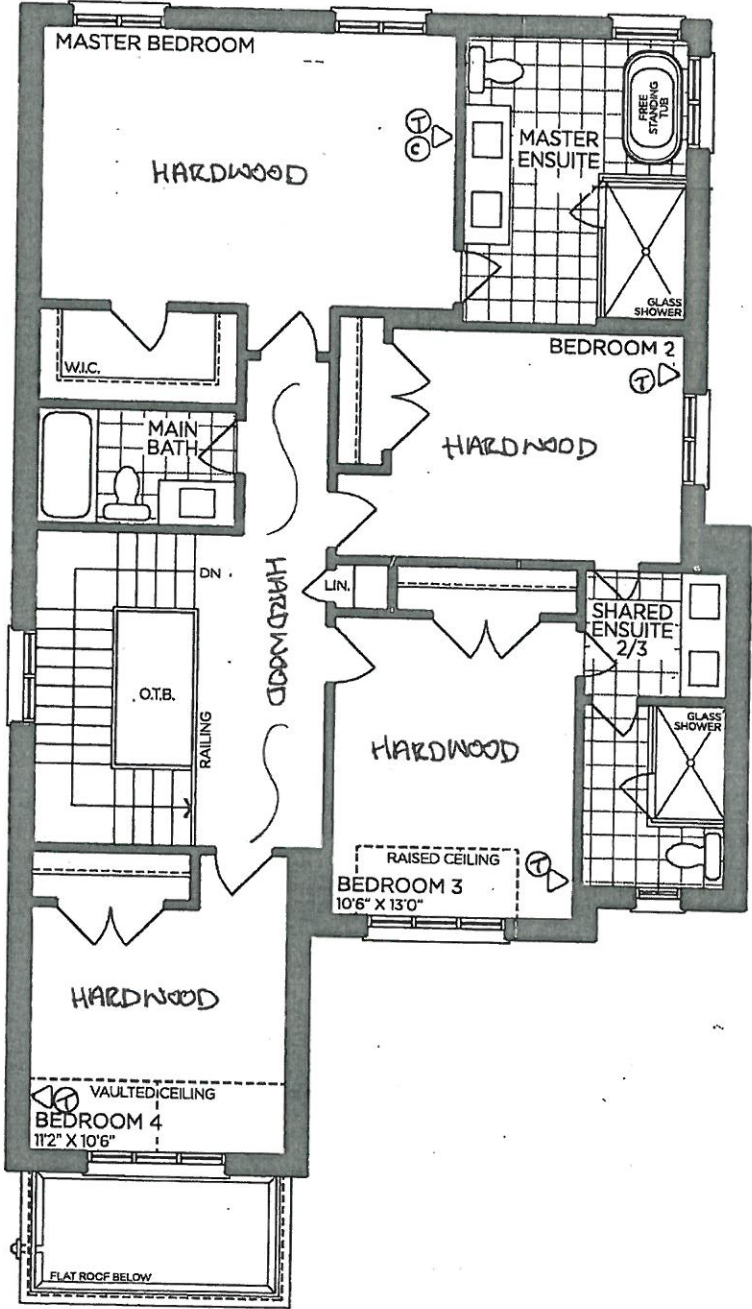

SECOND FLOOR | ELEV. A

VENDOR

PURCHASER

PURCHASER

GOLDPARK  
WORTH MORE™

Prices, figures, illustrations, sizes, features and finishes are subject to change without notice. Areas and dimensions are approximate and actual usable floor space may vary from the stated area. Layout may be reverse of the unit purchased. E. & O.E. 4007

SCHEDULE 'F'



PV- III  
April 24 2020  
PV- III  
December 7, 2020.

*See attached -*

The  
Suncrest  
40' SERIES

→ Elevation A • 2,520 sq.ft.  
Elevation B • 2,535 sq.ft.

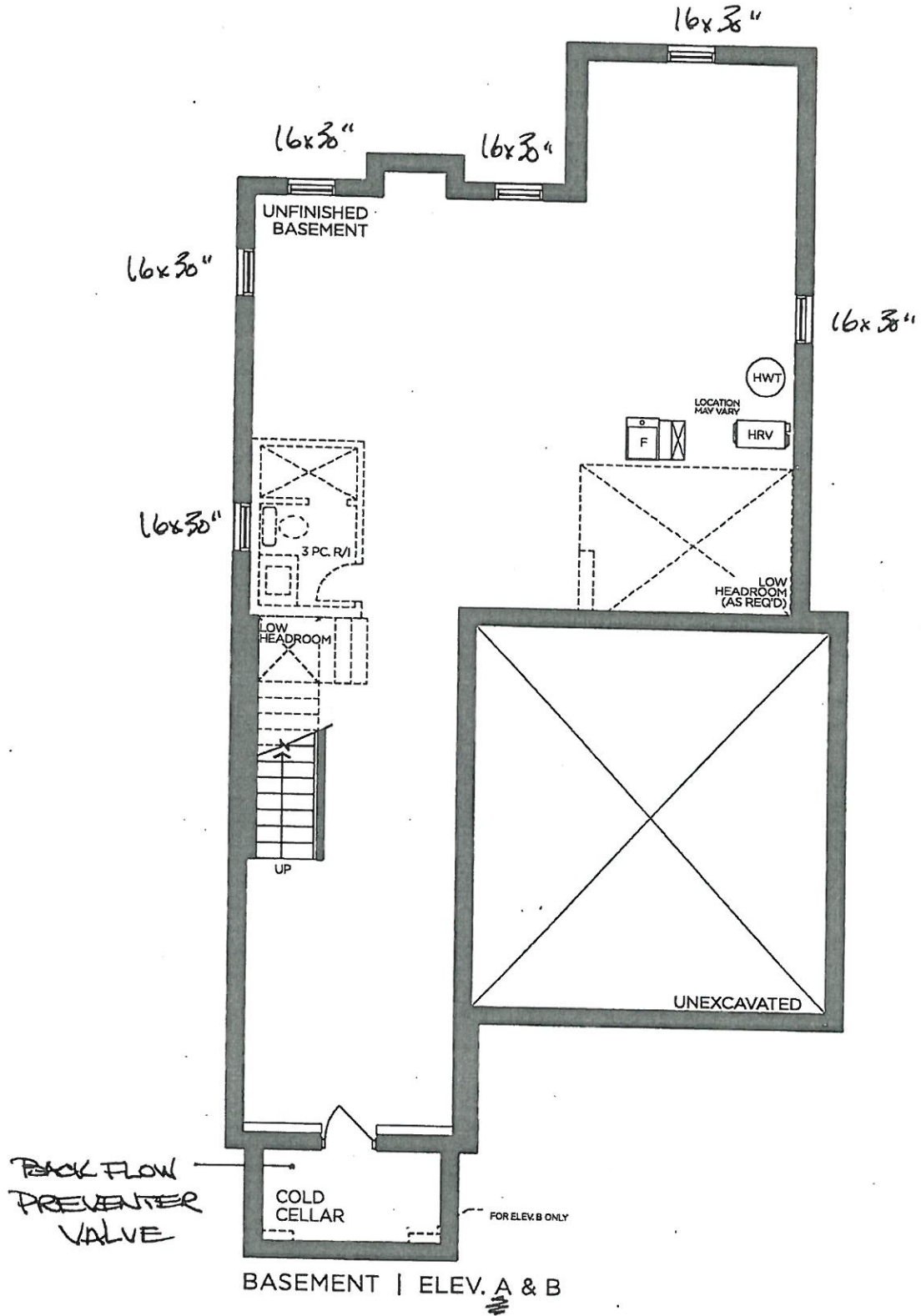

VENDOR

PURCHASER

PURCHASER

GOLDPARK  
WORTH MORE™

Prices, figures, illustrations, sizes, features and finishes are subject to change without notice. Areas and dimensions are approximate and actual usable floor space may vary from the stated area. Layout may be reverse of the unit purchased. E. & O.E. 4007

PV-III  
 Dec. 7, 2020

GOLDPARK HOMES  
 PINE VALLEY  
 VAUGHAN, ONTARIO  
 MODEL: (4007)

SITE STANDARD: WHITE 3/4" EXTENSION  
 SOFT-CLOSE DRAWERS & SOFT-CLOSE  
 HINGES TO KITCHEN AREA

10' CEILING - 12"H COFFERED CEILING -  
 M.H. = 102" + 3/4"H CONTEMPORARY  
 MOLDING + 5 1/4"H FURRING RAIL  
 + LARGE CORNICE MOLDING TO  
 UNDERSIDE OF BOX

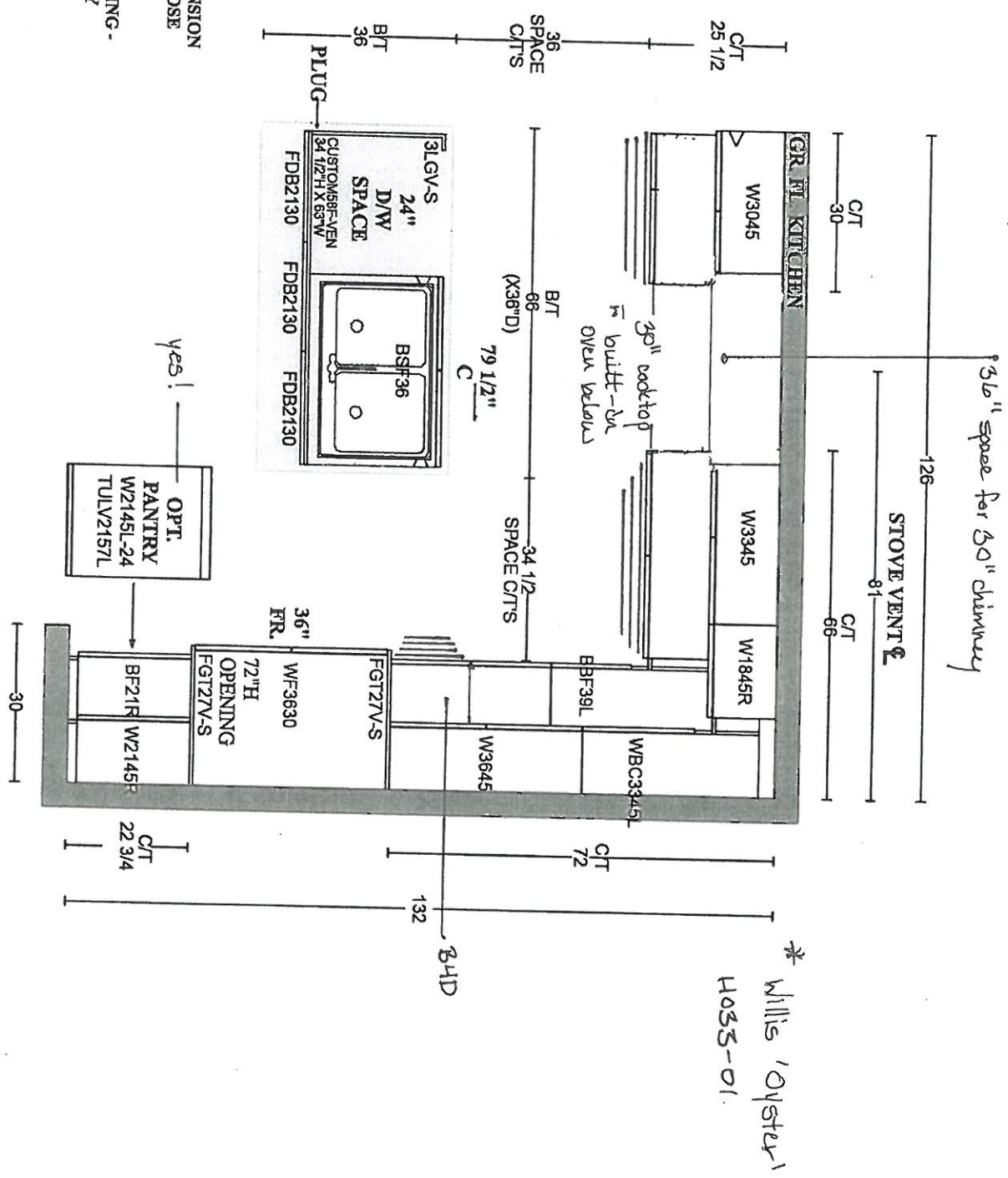

PV-111  
Dec 7, 2020

GOLDPARK HOMES  
PINE VALLEY  
VAUGHAN, ONTARIO  
MODEL: (4007)

SITE STANDARD: WHITE 3/4" EXTENSION  
SOFT-CLOSE DRAWERS & STANDARD SLAM DOOR HINGES  
TO VANITIES  
ONE TOP DRAWER WHERE POSSIBLE THROUGHOUT EACH  
VANITY, ONE BANK OF DRAWERS WHERE POSSIBLE  
THROUGHOUT EACH MASTER ENSUITE VANITY

Moderna 'Classic White'  
H04-06

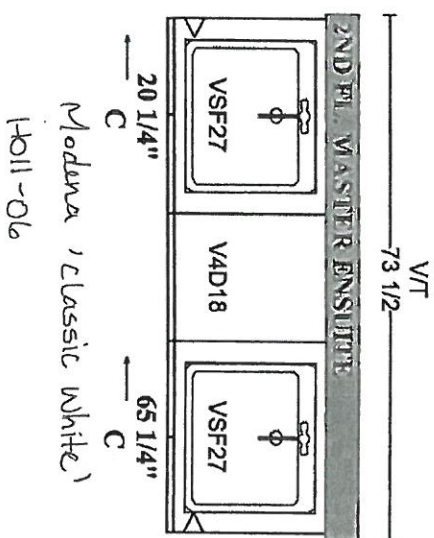
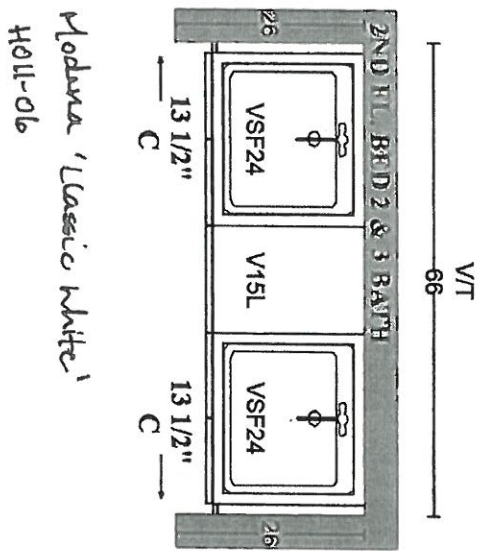
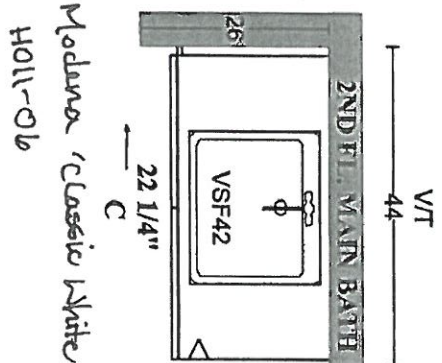
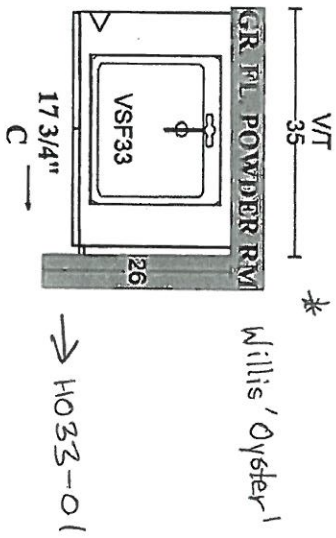
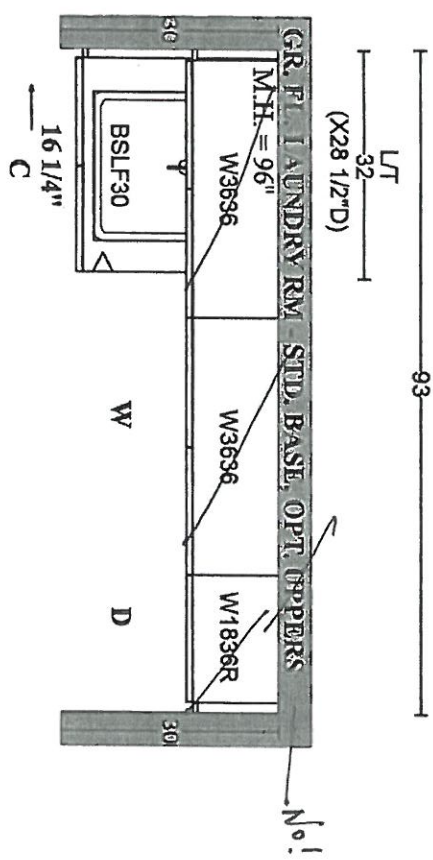



PINE VALLEY  
FOREVERGREEN

STONE COUNTERTOP EDGE PROFILES



2CM EASED EDGE

LOCATION:

THRU-OUT



3CM EASED EDGE

LOCATION:



4CM MITRED EDGE

LOCATION:



2CM OGEE EDGE

LOCATION:

LOT #: PY-LL1

DATE: Dec. 7, 2020

SIGNATURE

SIGNATURE

GOLD PARK  
WORTH MORE

# STANDARD HARDWARE



☐ H001-02



☐ H001-03



☐ H001-04



☐ H009-03



☐ H009-09



☐ H011-03



☐ H011-05



☒ H011-06

- Laundry
- Main Bath
- Shared Bath
- Master Ensuite



☒ H033-01  
→ Kitchen  
→ Powder Room.



☐ H039-03

LOT #  
PV-111

DATE:  
Dec. 7, 2020

SIGNATURE:

SIGNATURE:

UPGRADE KITCHEN SINK



BLANCO - QUATRUS R15 U 1-3/4  
Stainless Steel - Undermount  
33" x 18" x 9"

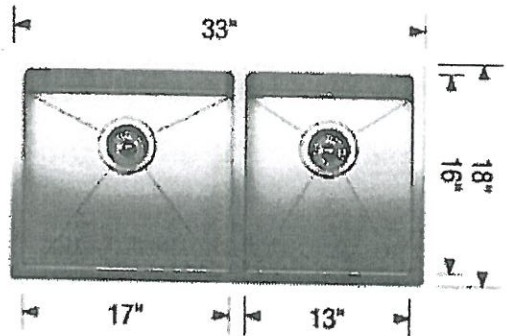
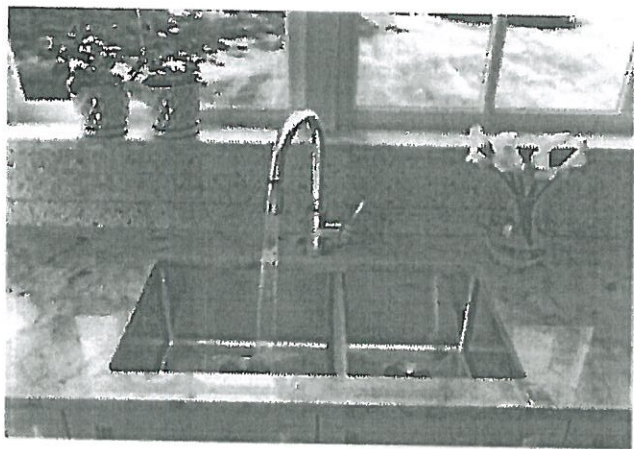
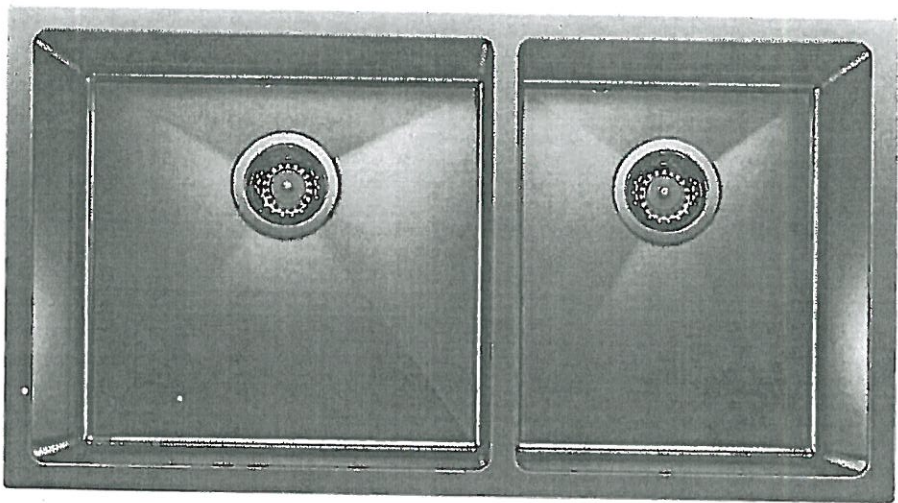

Stainless Steel

☐ GRID (LB)

☐ GRID (SB)

MODEL 401520 Stainless Steel / ~~406451 Grid (LB)~~ / ~~406450 Grid (SB)~~

Lot#  
PV-111

Room: Kitchen

Signature:

Date: December 7, 2020.

Signature:

STANDARD SHOWER HARDWARE



SDK106

Shower Door Knob

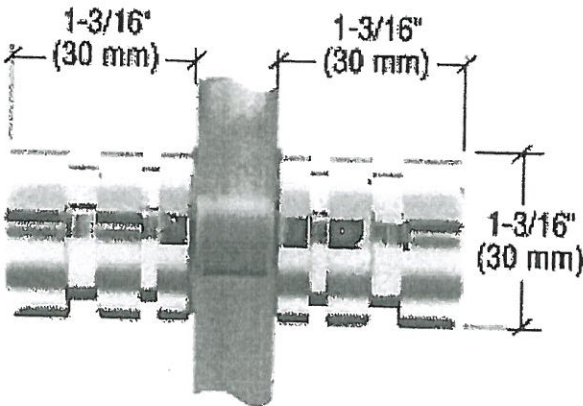

SDK106  
Shower Door Knob

1-3/16" dia.  
Contemporary Style  
(Also available single sided)

\* THRU-OUT.

LOT #  
PV-111

DATE:  
December 7, 2020

SIGNATURE:

SIGNATURE:

## BATHROOM ACCESSORIES

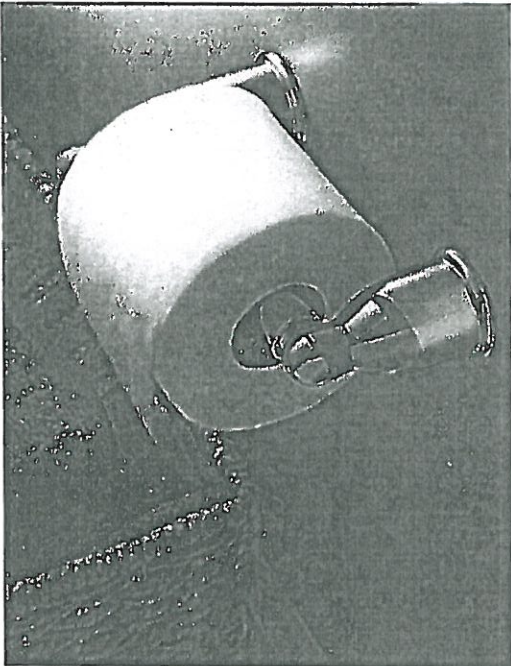

Tissue Holder  
Mason - Chrome

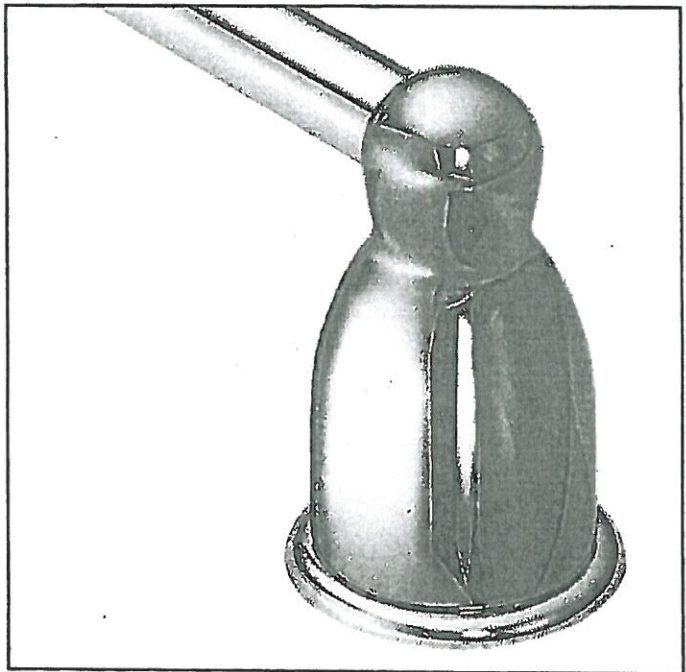

Towel Bar  
Mason - Chrome

*\*Please select one below \**

☐ INSTALL STANDARD BATHROOM ACCESSORIES THRU OUT  
(tissue holder + towel bar) *\*location as per vendors discretion\**

☒ **\*DO NOT\*** INSTALL STANDARD BATHROOM ACCESSORIES  
THRU OUT *\*tissue holder + towel bar will not be provided\**

LOT #  
PV-111

DATE:  
December 7, 2020

SIGNATURE:

SIGNATURE:

30" Induction Cooktop

800 Series – Black NIT8069UC

PV-111 ~~see attached~~  
October 16, 2020



NIT8069UC  
Black

Also available in:  
Black with NIT8069SUC  
Stainless  
Steel Frame

The 800 Series induction cooktop is sleek in design, and features AutoChef® technology which maintains precise cooking temperatures.

Features & Benefits

Induction – faster than gas and electric cooktops. Precise cooking, easy cleaning and more efficient

AutoChef® – regulates temperatures continuously during frying and adjusts them as needed

11" cooking zone for larger pots and pans

Home Connect™ – the easy way to connect your smart device with your Bosch cooktop

Hood Control – convenient operation of the Home Connect™ enabled ventilation via your cooktop

Element Performance	
Power of Front Left heating element	1,400 W
Power of Front Left heating element (in boost)	2,200 W
Power of Back Left heating element	2,200 W
Power of Back Left heating element (in boost)	3,700 W
Power of Back Right heating element	2,600 W
Power of Back Right heating element (in boost)	3,700 W
Power of Front Right heating element	1,400 W
Power of Front Right heating element (in boost)	2,200 W
Burners with booster	All
Element Size	
Dimension of Front Left heating element	6"
Dimension of Back Left heating element	9"
Dimension of Back Right heating element	11"
Dimension of Front Right heating element	6"

General Properties	
Home Connect™ (Wi-Fi Enabled)	Yes
Controls	PreciseSelect® Touch
Technical Details	
Watts	7,200 W
Circuit breaker	30 A
Volts	208-240 V
Frequency	60 Hz
Plug type	No plug
Power cord length	37"
Energy source	Electric
Dimensions & Weight	
Overall appliance dimensions (HxWxD)	1/4" +4 1/8" x 31" x 21 1/4"
Required cutout size (HxWxD)	4 1/8" x 28 7/8" x 20"
Minimum distance from counter front	2 1/4"
Minimum distance from rear wall	2"
Net weight	41 lbs
Accessories—Optional	



HEZ390210  
8" AutoChef® pan



HEZ390220  
9" AutoChef® pan



HEZ390230  
10" AutoChef® pan



Accessories: To purchase Bosch accessories, cleaners & parts please visit [www.bosch-home.com/us/store](http://www.bosch-home.com/us/store) or call 1-800-944-2904 (Mon to Fri 5 am to 6 pm PST, Sat 6 am to 3 pm PST).  
Notes: All height, width and depth dimensions are shown in inches. BSH reserves the absolute and unrestricted right to change product materials and specifications, at any time, without notice. Consult the product's installation instructions for final dimensional data and other details prior to making cutout.  
Warranties: Please see Use & Care manual or Bosch website for statement of limited warranty.  
For more information on our entire line of products, go to [www.bosch-home.com/us](http://www.bosch-home.com/us) or call 1-800-944-2904  
© BSH Home Appliances Corporation. All rights reserved. Bosch is a registered trademark of Robert Bosch GmbH.

# 30" Induction Cooktop

800 Series – Black NIT8069UC

PV-111 \*see attached\*  **BOSCH**  
Invented for life  
October 16, 2020

## Installation Details

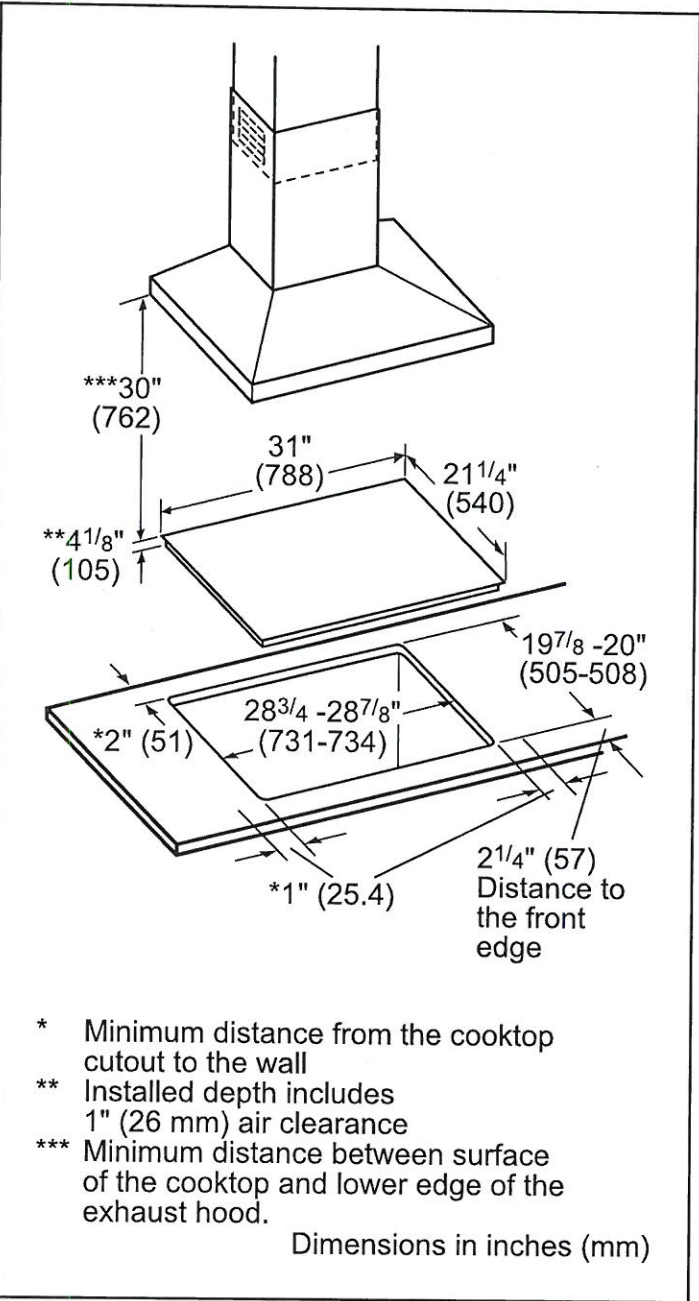

## Installation above Wall Ovens

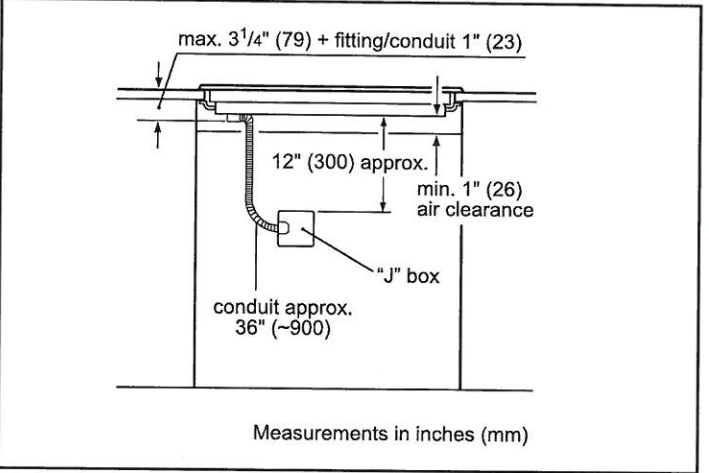
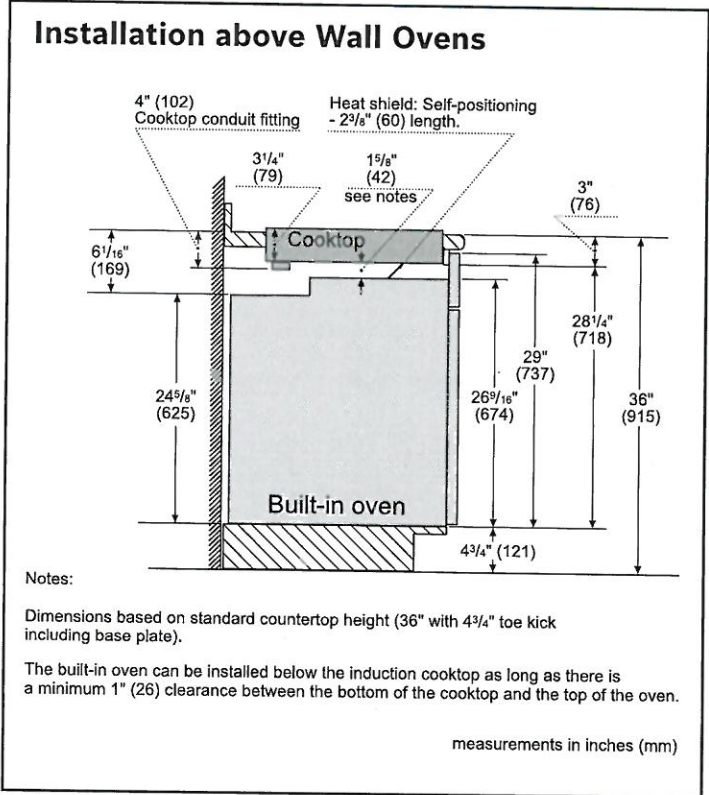

**Accessories:** To purchase Bosch accessories, cleaners & parts please visit [www.bosch-home.com/us/store](http://www.bosch-home.com/us/store) or call 1-800-944-2904 (Mon to Fri 5 am to 6 pm PST, Sat 6 am to 3 pm PST).

**Notes:** All height, width and depth dimensions are shown in inches. BSH reserves the absolute and unrestricted right to change product materials and specifications, at any time, without notice. Consult the product's installation instructions for final dimensional data and other details prior to making cutout.

**Warranties:** Please see Use & Care manual or Bosch website for statement of limited warranty.

**For more information on our entire line of products, go to [www.bosch-home.com/us](http://www.bosch-home.com/us) or call 1-800-944-2904**

© BSH Home Appliances Corporation. All rights reserved. Bosch is a registered trademark of Robert Bosch GmbH.

30" Single Wall Oven

800 Series – Stainless Steel HBL8453UC

PV-111 \*see attached\*  
October 16, 2020



HBL8453UC  
Stainless Steel

Also available in:  
Black HBL8463UC  
Black Stainless HBL8443UC  
Steel

Using Genuine European Convection Roast, you can create a juicy, tender roast up to 25% faster than non-convection modes.

Features & Benefits

Get the oven up to temperature in less time using Fast Preheat™, so meals are ready sooner.

Whether cooking poultry, beef or pork, use the Temperature Meat Probe to monitor the internal temperature and get perfect results every time.

Serve dinner on time with tools like an oven timer, delay cook feature, and digital kitchen timer.

Oven is equipped with a self-cleaning cycle that easily cleans itself via 2, 3, and 4 hour cycle options.

Download the Home Connect app to remotely monitor and control your Bosch wall oven with your smart phone or tablet.

General Properties	
Home Connect™ (WiFi enabled)	Yes
Oven modes	Bake, Variable Broil (hi & low), Roast, Warm, Sabbath, Proof Dough, Convection Bake, Convection Broil, Convection Roast, Pizza, Multi Rack Genuine European Convection, Convection Conversion, Temperature Probe, Fast Preheat
Cleaning type	Self Clean
Telescopic rack	1
Illumination type	Incandescent
Interior lights	2
Oven Performance	
Bake / broil element wattages	2,400 / 3,800 W
Convection element wattages	2,000 W
Technical Details	
Watts (W)	6,325 W
Circuit breaker (A)	30 A
Volts (V)	240 / 208 V
Frequency (Hz)	60 Hz
Power cord length (in)	50"
Plug type	Fixed Connection, No Plug
Energy source	Electric

Dimensions & Weight	
Overall appliance dimensions (HxWxD) (in)	29" x 29 3/4" x 24 1/2"
Required cutout size (HxWxD) (in)	27" – 28 5/8" x 28 1/2" x 23 1/2"
Oven cavity size (cu. ft.)	4.6
Overall oven interior dimensions (HxWxD) (in)	17 13/16" x 24 1/8" x 18"
Usable oven interior dimensions (HxWxD) (in)	12 1/4" x 23 1/4" x 15 1/4"
Net weight (lbs)	149 lbs
Accessories – Included	
Included	1 Telescopic and 2 Standard Oven Racks, Temperature Probe
Accessories – Optional	



HEZTR301  
30" Telescopic Rack



**Accessories:** To purchase Bosch accessories, cleaners & parts please visit [www.bosch-home.com/us/store](http://www.bosch-home.com/us/store) or call 1-800-944-2904 (Mon to Fri 5 am to 6 pm PST, Sat 6 am to 3 pm PST).

**Notes:** All height, width and depth dimensions are shown in inches. BSH reserves the absolute and unrestricted right to change product materials and specifications, at any time, without notice. Consult the product's installation instructions for final dimensional data and other details prior to making cutout.

**Warranties:** Please see Use & Care manual or Bosch website for statement of limited warranty.

**For more information on our entire line of products, go to [www.bosch-home.com/us](http://www.bosch-home.com/us) or call 1-800-944-2904**

© BSH Home Appliances Corporation. All rights reserved. Bosch is a registered trademark of Robert Bosch GmbH.

# 30" Single Wall Oven

800 Series – Stainless Steel HBL8453UC

PV-III ~~\*see attached\*~~  **BOSCH**  
Invented for life  
October 16, 2020

## Installation Details

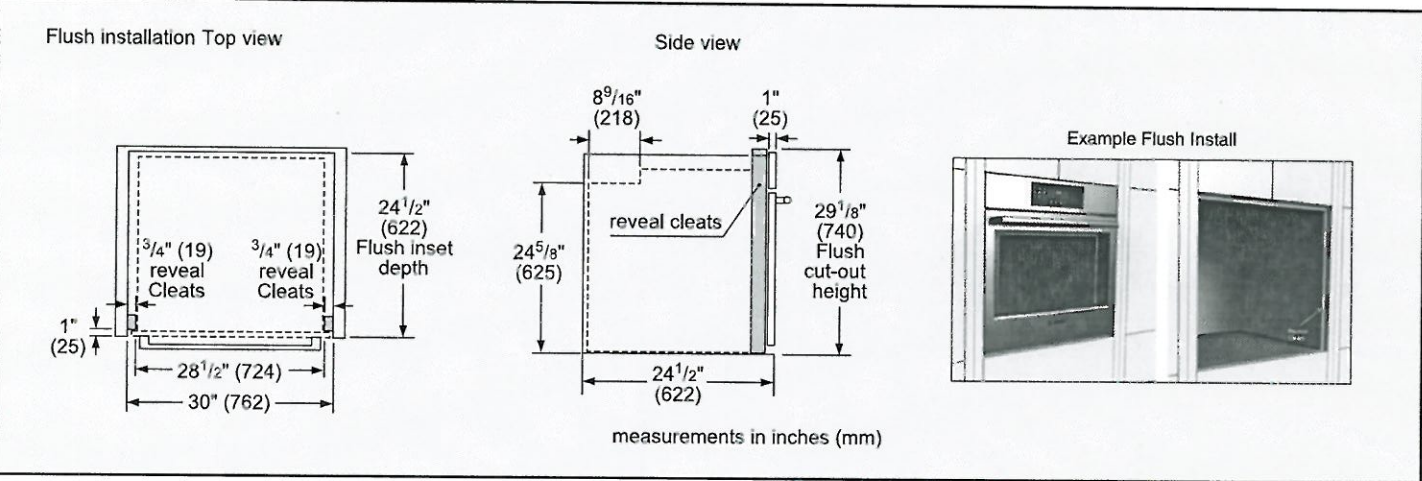
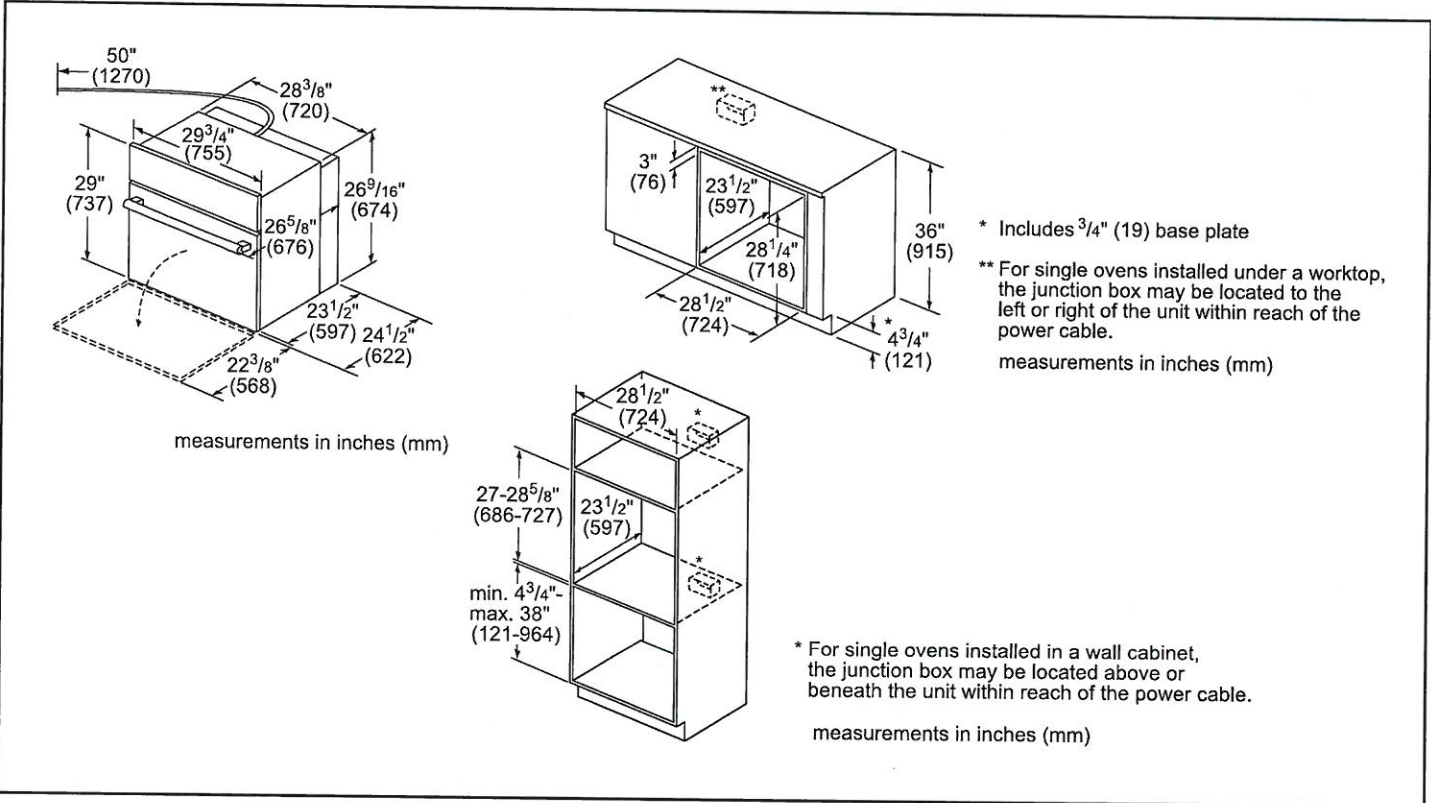

**Accessories:** To purchase Bosch accessories, cleaners & parts please visit [www.bosch-home.com/us/store](http://www.bosch-home.com/us/store) or call 1-800-944-2904 (Mon to Fri 5 am to 6 pm PST, Sat 6 am to 3 pm PST).

**Notes:** All height, width and depth dimensions are shown in inches. BSH reserves the absolute and unrestricted right to change product materials and specifications, at any time, without notice. Consult the product's installation instructions for final dimensional data and other details prior to making cutout.

**Warranties:** Please see Use & Care manual or Bosch website for statement of limited warranty.

**For more information on our entire line of products, go to [www.bosch-home.com/us](http://www.bosch-home.com/us) or call 1-800-944-2904**

© BSH Home Appliances Corporation. All rights reserved. Bosch is a registered trademark of Robert Bosch GmbH.