



CONSTRUCTION SUMMARY

Lot: BLOCK 160  
Model: 38-6 Elev.B SCARLATTI OPT- GFA1  
Project/Phase: Brampton Encore / 2

CERAMIC

Invoice	Qty.	Description
2622 11Mar21 NoCat	1	FOYER / POWDER / GROUND FLOOR FOYER: UPGRADE 4 FLOOR TILE - 12X24" LAID IN STRAIGHT, STACKED PATTERN. SEE PLAN FOR TILE DIRECTION
2622 11Mar21 NoCat	1	MASTER ENSUITE: UPGRADE 4 FLOOR + SHOWER WALL TILE - 12X24" LAID IN STRAIGHT, STACKED PATTERN - HORIZONTAL ON WALLS
2622 11Mar21 NoCat	1	MASTER ENSUITE: UPGRADE TO FREE STANDING TUB - MIROLIN 'BROOKE'  FLOOR TILE REQUIRED WALL TO WALL

CONCRETE AND DRAIN

Invoice	Qty.	Description
2549 28,894 27Jan21 **	1	ROUGH-IN - 3PC BASEMENT ROUGH-IN  INCLUDED IN APS
2549 27Jan21 NoCat	1	.ROUGH-IN - 3PC BASEMENT ROUGH-IN  INCLUDED IN APS

DRYWALL

Invoice	Qty.	Description
2549 27Jan21 NoCat	1	.SIDE DOOR- HOME TO EXTERIOR- AS PER PLAN AND GRADE PERMITTING  Included in APS
2549 27Jan21 NoCat	1	.MANDOOR - GARAGE TO HOUSE- AS PER PLAN AND GRADE PERMITTING  INCLUDED IN APS
2549 27Jan21 NoCat	3	.MAIN FLOOR: EXTENDED HEIGHT ARCHWAY (PRICE PER DOORWAY) - 96"
2549 27Jan21 NoCat	4	.MAIN FLOOR: STANDARD DOOR EXTENDED HEIGHT 96" (PRICE PER DOOR) MAIN FLOOR 3 STOREY MODELS
2622 11Mar21 NoCat	1	FYI - MASTER ENSUITE: UPGRADE TO FREE STANDING TUB - MIROLIN 'BROOKE'

ELECTRICAL

Invoice	Qty.	Description
2549 27Jan21 NoCat	1	KITCHEN: SINGLE POLE SWITCH  FOR PENINSULA LIGHT
2549 28,822 27Jan21	1	KITCHEN: ROUGH - IN CEILING OUTLET ON SAME SWITCH - DOES NOT INCLUDE FIXTURE - LOCATE APPROX CENTERED ABOVE PENINSULA
2549 28,811 27Jan21	1	200 AMP ELECTRICAL SERVICE
2549 28,810 27Jan21	1	KITCHEN: 220V WALL RECEPTICAL ON DEDICATED CIRCUIT- FOR 4 WIRE BUILT-IN WALL OVEN - SEE PLAN FOR LOCATION
2549 28,808 27Jan21	1	KITCHEN: 110V WALL RECEPTACLE ON DEDICATED CIRCUIT - GAS FIRED APPLIANCE - FOR AUX. EQUIPMENT - NOT A STOVE PLUG

EXTERIOR COLOURS

Invoice	Qty.	Description
2549 27Jan21 NoCat	1	COLOUR PACKAGE #4

FORMING

Invoice	Qty.	Description
2549 28,841 27Jan21	1	SIDE DOOR- HOME TO EXTERIOR- AS PER PLAN AND GRADE PERMITTING  INCLUDED IN APS
2549 28,842 27Jan21 **	1	MANDOOR - GARAGE TO HOUSE- AS PER PLAN AND GRADE PERMITTING  INCLUDED IN APS
2549 28,916 27Jan21 **	4	BASEMENT WINDOWS - UPGRADE EXISTING BASEMENT WINDOW TO 30 INCH X 24 INCH - MAY REQUIRE INSTALLATION OF WINDOW WELL
2549 27Jan21 NoCat	1	.MANDOOR - GARAGE TO HOUSE- AS PER PLAN AND GRADE PERMITTING  INCLUDED IN APS
2549 27Jan21 NoCat	4	.BASEMENT WINDOWS - UPGRADE EXISTING BASEMENT WINDOW TO 30 INCH X 24 INCH - MAY REQUIRE INSTALLATION OF WINDOW WELL



CONSTRUCTION SUMMARY

Lot: BLOCK 160  
Model: 38-6 Elev.B SCARLATTI OPT- GFA1  
Project/Phase: Brampton Encore / 2

FRAMING

Invoice	Qty.	Description
2549 28,842 27Jan21	1	MANDOOR - GARAGE TO HOUSE- AS PER PLAN AND GRADE PERMITTING  INCLUDED IN APS
2549  27Jan21 NoCat	1	.SIDE DOOR- HOME TO EXTERIOR- AS PER PLAN AND GRADE PERMITTING  INCLUDED IN APS
2549  27Jan21 NoCat	4	.BASEMENT WINDOWS - UPGRADE EXISTING BASEMENT WINDOW TO 30 INCH X 24 INCH - MAY REQUIRE INSTALLATION OF WINDOW WELL
2549  27Jan21 NoCat	3	.MAIN FLOOR: EXTENDED HEIGHT ARCHWAY (PRICE PER DOORWAY) - 96"
2549  27Jan21 NoCat	4	.MAIN FLOOR: STANDARD DOOR EXTENDED HEIGHT 96" (PRICE PER DOOR) MAIN FLOOR 3 STOREY MODELS
2622  11Mar21 NoCat	1	FYI - MASTER ENSUITE: UPGRADE TO FREE STANDING TUB - MIROLIN 'BROOKE'

GRANITE MARBLE QUARTZ

Invoice	Qty.	Description
2622  11Mar21 NoCat	1	KITCHEN: UPGRADE 3 QUARTZ COUNTER TOP
2622  11Mar21 NoCat	1	KITCHEN: FLUSH BREAKFAST BAR
2622  11Mar21 NoCat	1	KITCHEN: FULL HEIGHT SLAB BACKSPLASH - LEVEL 3 QUARTZ
2622  11Mar21 NoCat	1	KITCHEN: COOKTOP CUT OUT



HARDWOOD

Invoice	Qty.	Description
2622  11Mar21 NoCat	1	FAMILY / LIVING/ DINING/ MAIN HALL / LANDNGS / UPPER HALL / KITCHEN: UPGRADE 3 HARDWOOD - 3/4X5" VINTAGE WHITE OAK WIRE BRUSHED  HARDWOOD FLOORS WILL NOT MATCH STAIRS IN COLOUR/TEXTURE/SPECIES
2622  11Mar21 NoCat	1	FYI - KITCHEN: RAISE CABINETRY 3/4" FOR HARDWOOD FLOOR INSTALL

HVAC

Invoice	Qty.	Description
2549 28,872 27Jan21	1	KITCHEN: GAS LINE ROUGH - 2ND FLOOR- (3-STOREY MODELS) FOR GAS COOKTOP OR RANGE TOP

INTERIOR TRIM AND DOORS

Invoice	Qty.	Description
2549 28,841 27Jan21 **	1	SIDE DOOR- HOME TO EXTERIOR- AS PER PLAN AND GRADE PERMITTING  INCLUDED IN APS
2549 28,885 27Jan21	3	MAIN FLOOR: EXTENDED HEIGHT ARCHWAY (PRICE PER DOORWAY) - 96"
2549 28,884 27Jan21	4	MAIN FLOOR: STANDARD DOOR EXTENDED HEIGHT 96" (PRICE PER DOOR) MAIN FLOOR 3 STOREY MODELS
2549  27Jan21 NoCat	1	.SIDE DOOR- HOME TO EXTERIOR- AS PER PLAN AND GRADE PERMITTING  Included in APS
2549  27Jan21 NoCat	1	.MANDOOR - GARAGE TO HOUSE- AS PER PLAN AND GRADE PERMITTING  INCLUDED IN APS
2549  27Jan21 NoCat	4	.BASEMENT WINDOWS - UPGRADE EXISTING BASEMENT WINDOW TO 30 INCH X 24 INCH - MAY REQUIRE INSTALLATION OF WINDOW WELL
2622  11Mar21 NoCat	1	MASTER ENSUITE: UPGRADE TO FREE STANDING TUB - MIROLIN 'BROOKE'



CONSTRUCTION SUMMARY

Lot: BLOCK 160  
Model: 38-6 Elev.B SCARLATTI OPT- GFA1  
Project/Phase: Brampton Encore / 2

KITCHEN AND BATH CABINETRY

Invoice	Qty.	Description
2622 11Mar21 NoCat	1	KITCHEN: UPGRADE 2 CABINETRY PROFILE + SPRAY STAIN
2622 11Mar21 NoCat	1	KITCHEN: DOUBLE APPLIANCE CABINET WITH POT DRAWER BELOW OVENS
2622 11Mar21 NoCat	3	KITCHEN: POTS AND PANS DRAWERS BELOW COOKTOP - 1 SHALLOW TOP DRAWER (dummy at cooktop) + 2 DEEP DRAWERS BELOW
2622 11Mar21 NoCat	1	KITCHEN: FINISHED GABLE AT OVENS
2622 11Mar21 NoCat	1	KITCHEN: L-SHAPED CANOPY - INCLUDES 600CFM FAN
2622 11Mar21 NoCat	1	KITCHEN: UPGRADE HARDWARE
2622 11Mar21 NoCat	1	KITCHEN: RAISE CABINETRY 3/4" FOR HARDWOOD FLOOR INSTALL
2622 11Mar21 NoCat	1	FYI - KITCHEN: FULL HEIGHT SLAB BACKSPLASH - LEVEL 3 QUARTZ

PAINT

Invoice	Qty.	Description
2549 28,842 27Jan21 **	1	MANDOOR - GARAGE TO HOUSE- AS PER PLAN AND GRADE PERMITTING  INCLUDED IN APS
2549  27Jan21 NoCat	1	.SIDE DOOR- HOME TO EXTERIOR- AS PER PLAN AND GRADE PERMITTING  Included in APS
2549  27Jan21 NoCat	1	.MANDOOR - GARAGE TO HOUSE- AS PER PLAN AND GRADE PERMITTING  INCLUDED IN APS
2549  27Jan21 NoCat	3	.MAIN FLOOR: EXTENDED HEIGHT ARCHWAY (PRICE PER DOORWAY) - 96"
2549  27Jan21 NoCat	4	.MAIN FLOOR: STANDARD DOOR EXTENDED HEIGHT 96" (PRICE PER DOOR) MAIN FLOOR 3 STOREY MODELS
2622  11Mar21 NoCat	1	MAIN STAIRS: STAIN STAIRS
2622  11Mar21 NoCat	1	MASTER ENSUITE: UPGRADE TO FREE STANDING TUB - MIROLIN 'BROOKE'
2622  11Mar21 NoCat	1	FYI - MAIN STAIRS: EUROLINE 0 PICKETS + SQUARE NEWELL POSTS + STANDARD HAND RAIL

PLUMBING

Invoice	Qty.	Description
2549 28,894 27Jan21	1	ROUGH-IN - 3PC BASEMENT ROUGH-IN  INCLUDED IN APS
2622  11Mar21 NoCat	1	KITCHEN: UPGRADE SINK TO BLANCO QATRUS R15 U SUPER SINGLE
2622 28,898 11Mar21	1	MASTER ENSUITE: UPGRADE TO FREE STANDING TUB - MIROLIN 'BROOKE'



CONSTRUCTION SUMMARY

Lot: BLOCK 160  
Model: 38-6 Elev.B SCARLATTI OPT- GFA1  
Project/Phase: Brampton Encore / 2

STAIRS AND RAILINGS

Invoice	Qty.	Description
2622  11Mar21 NoCat	1	MAIN STAIRS: EUROLINE 0 PICKETS + SQUARE NEWELL POSTS + STANDARD HAND RAIL

WINDOWS - BASEMENT

Invoice	Qty.	Description
2549 28,916 27Jan21	4	BASEMENT WINDOWS - UPGRADE EXISTING BASEMENT WINDOW TO 30 INCH X 24 INCH - MAY REQUIRE INSTALLATION OF WINDOW WELL

WINDOWS AND DOORS

Invoice	Qty.	Description
2549 28,841 27Jan21 **	1	SIDE DOOR- HOME TO EXTERIOR- AS PER PLAN AND GRADE PERMITTING  INCLUDED IN APS
2549 28,842 27Jan21 **	1	MANDOOR - GARAGE TO HOUSE- AS PER PLAN AND GRADE PERMITTING  INCLUDED IN APS
2549  27Jan21 NoCat	1	.SIDE DOOR- HOME TO EXTERIOR- AS PER PLAN AND GRADE PERMITTING  Included in APS



Scheduled Closing Date:

Purchaser: Inventory Lot\_BLOCK 160

Property: BLOCK 160

Telephone Res. / Bus: (905) 760-9595

Project: Brampton Encore - Phase 2

Decor Advisor: Yolande Somerville

Model and Elevation: 38-6 Elev.B SCARLATTI OPT- GFA1

Layout Changes: ☐ Yes ☒ No Sketch Attached: ☒ Yes ☐ No Exterior Colour Scheme:

### 1. Cabinetry

	Style and Colour	Counter	Hardware
Kitchen / Breakfast	*Florentine oak 'Slate'	*Quartz: Misty Carrara	*CH-45
Laundry Room	n/a	n/a	n/a
Powder Room	n/a	n/a	n/a
Ground Floor Bath	Varese pvc 'White Crystal'	P-Lam #6698-46	cs1-23
Master Ensuite Bathroom	Siena oak 'Greystone'	P-Lam #4971-52	cs1-24
Second Ensuite Bathroom (If Applicable)	Siena oak 'Slate'	P-Lam #6698-46	cs1-23
Shared Ensuite	Siena oak 'Slate'	P-Lam #6698-46	cs1-23

Comment

### 2. Floor Tile

	Selection
Entrance Vestibule	*12x24" Eterna polished 'Imperial Grey'
Main Hall	
Kitchen / Breakfast	see hardwood
Laundry Room	13x13" New Reeds 'Taupe'
Powder Room	*12x24" Eterna polished 'Imperial Grey'
Ground Floor Bath	13x13" Costa matte 'White'
Master Ensuite Bathroom	*12x24" Eterna polished 'Imperial Grey'
Second Ensuite Bathroom (If Applicable)	13x13" Costa matte 'White'
Lower Landing (If Applicable)	*12x24" Eterna polished 'Imperial Grey'
Shared Bath	13x13" New Reeds 'Taupe'

Comment

### 3. Wall Tile

	Selection	Listello/Inserts	Describe
Ground Floor Bath	8x10" Weave 'White'	<input type="radio"/> Yes <input checked="" type="radio"/> No	
Master Ensuite Bathroom			
Tub Deck		<input type="radio"/> Yes <input checked="" type="radio"/> No	
Shower Stall	*12x24" Eterna pol 'Imperial Grey'	<input type="radio"/> Yes <input checked="" type="radio"/> No	
Bathroom Walls		<input type="radio"/> Yes <input checked="" type="radio"/> No	
Second Ensuite Bathroom (If Applicable)	8x10" Weave 'White'	<input type="radio"/> Yes <input checked="" type="radio"/> No	
Shared Bath	8x10" Weave 'Tender Grey'	<input type="radio"/> Yes <input checked="" type="radio"/> No	
Kitchen Backsplash	<input checked="" type="radio"/> Yes <input type="radio"/> No	Backsplash Behind Fridge	
	*FHBS slab - same as counter		

Comment



Scheduled Closing Date:

Purchaser: Inventory Lot\_BLOCK 160

Property: BLOCK 160

Telephone Res. / Bus: (905) 760-9595

Project: Brampton Encore - Phase 2

Decor Advisor: Yolande Somerville

Model and Elevation: 38-6 Elev.B SCARLATTI OPT- GFA1

## 4. Plumbing Fixtures

<input type="text"/>	Second Ensuite	<input type="text"/>	Powder Room	<input type="text"/>	
Master Ensuite Bathroom	<input type="text"/>	Other Room - Specify	<input type="text"/>	Other Washroom	<input type="text"/>

Comment

See extras

## 5. Hardwood Flooring

	Type and Stain		Type and Stain
Main Hall	<input type="text"/>	Upper Landing	<input type="text"/>
Kitchen / Breakfast	*3/4x5" wht oak wirebrush 'Atlantis'	Upper Hall	*3/4x5" wht oak wirebrush 'Atlantis'
Living Room	<input type="text"/>	Master Bedroom	<input type="text"/>
Dining Room	<input type="text"/>	Bedroom #2	<input type="text"/>
Family Room	<input type="text"/>	Bedroom #3	<input type="text"/>
Den/Library	<input type="text"/>	Bedroom #4	<input type="text"/>
Entrance Vestibule	<input type="text"/>	Bedroom #5	<input type="text"/>
Lower Landing (If Applicable)	<input type="text"/>	Other Room - Specify	<input type="text"/>
		Thru out standard areas	*3/4x5" wht oak wirebrush 'Atlantis'

Comment

## 6. Carpeting

	Upgrade	Description
Ground Floor	<input type="checkbox"/>	Std: 4002-20 with std u/pad
Second Floor	<input type="checkbox"/>	Std: 4002-20 with std u/pad
<input type="text"/>	<input type="checkbox"/>	<input type="text"/>

Upgrade Underpad	Type	Area
	<input type="text"/>	<input type="text"/>
Carpet on Stairs	Capped	Runner - *Upgrade
	<input type="text"/>	<input type="text"/>

Comment

## 7. Fireplace

	Living Room			Family Room			Other Room - Specify		
	Purchased	As Per Plan	N/A	Purchased	As Per Plan	N/A	Purchased	As Per Plan	N/A
Fireplace Type	<input type="radio"/>	<input type="radio"/>	<input checked="" type="radio"/>	<input type="radio"/>	<input checked="" type="radio"/>	<input type="radio"/>	<input type="radio"/>	<input type="radio"/>	<input checked="" type="radio"/>
Mantle Type	<input type="text"/>			Standard Gas			<input type="text"/>		
Colour / Stain	<input type="text"/>			NF-23			<input type="text"/>		
Surround	<input type="text"/>			White			<input type="text"/>		
Hearth	<input type="text"/>			Nero Marquina			<input type="text"/>		
	<input type="text"/>			none			<input type="text"/>		

Comment

Scheduled Closing Date:

Purchaser: Inventory Lot\_BLOCK 160

Property: BLOCK 160

Telephone Res. / Bus: (905) 760-9595

Project: Brampton Encore - Phase 2

Decor Advisor: Yolande Somerville

Model and Elevation: 38-6 Elev.B SCARLATTI OPT- GFA1

## 8. Trim Carpentry

Interior Doors \*Standard Front Door Glass Inserts Standard Door Handles Standard

Interior Trim Standard Package

Comment

## 9. Plaster Mouldings and Medallions

Standard Throughout ☐ Yes ☐ No ☒ N/A

Entrance Vestibule Kitchen/Breakfast

Main Hall Den/Library

Living Room Lower Landing

Dining Room Other Room - Specify

Family Room

Comment

## 10. Railings and Spindles

Railing Package \*Euroline 0 with standard hand rail + square Newell posts

Railing Colour \*Graphite

Spindle Colour \*Black

Stringer / Riser \*Graphite

Treads \*Graphite

Comment

Oak Stairs ☒ Yes ☐ No ☐ N/A

## 11. Wall Paint / Ceilings

Throughout Finished Areas Warm Grey

Trim Paint White

Smooth Ceilings

Ground Floor ☐Second Floor ☐

Note Standard smooth ceiling on Main Floor

Comment

Scheduled Closing Date:

Purchaser: Inventory Lot\_BLOCK 160

Property: BLOCK 160

Telephone Res. / Bus: (905) 760-9595

Project: Brampton Encore - Phase 2

Decor Advisor: Yolande Somerville

Model and Elevation: 38-6 Elev.B SCARLATTI OPT- GFA1

## 12. Electrical

Hood Fan ☐ White ☐ Stainless ☐ N/A

Above Kitchen Cabinet Light ☐ Yes ☒ No

Below Kitchen Cabinet Light ☐ Yes ☒ No

Standard Appliances ☐

Over The Range Microwave ☐

Chimney Style Fan ☐

Comment

## 13. Heating and Air Conditioning

Air Conditioning

Gas Provisions Stove

Gas Provisions Dryer

Gas Provisions Barbecue

Comment

## 14. Additional Comments

## 15. Disclaimers and Notes

- 1) Colours of all materials are as close as possible to builder's selection, but not necessarily identical due to variances in manufacturing.
- 2) Any extras listed above are null and void unless accompanied by a separate invoice/amendment. Said invoice must be paid in full.
- 3) The Purchaser acknowledges that after Interior Colour Selection form is signed and dated, no further changes will be permitted other than re-selection due to unavailability. \_\_\_\_\_ Purchaser's Initials
- 4) The Purchaser acknowledges reading and accepting the "Gold Park Homes Decor Centre Disclaimers" form. This document contains other miscellaneous disclaimers.

This Interior Colour Selection is final and approved by:

Signature: \_\_\_\_\_ Date: \_\_\_\_\_



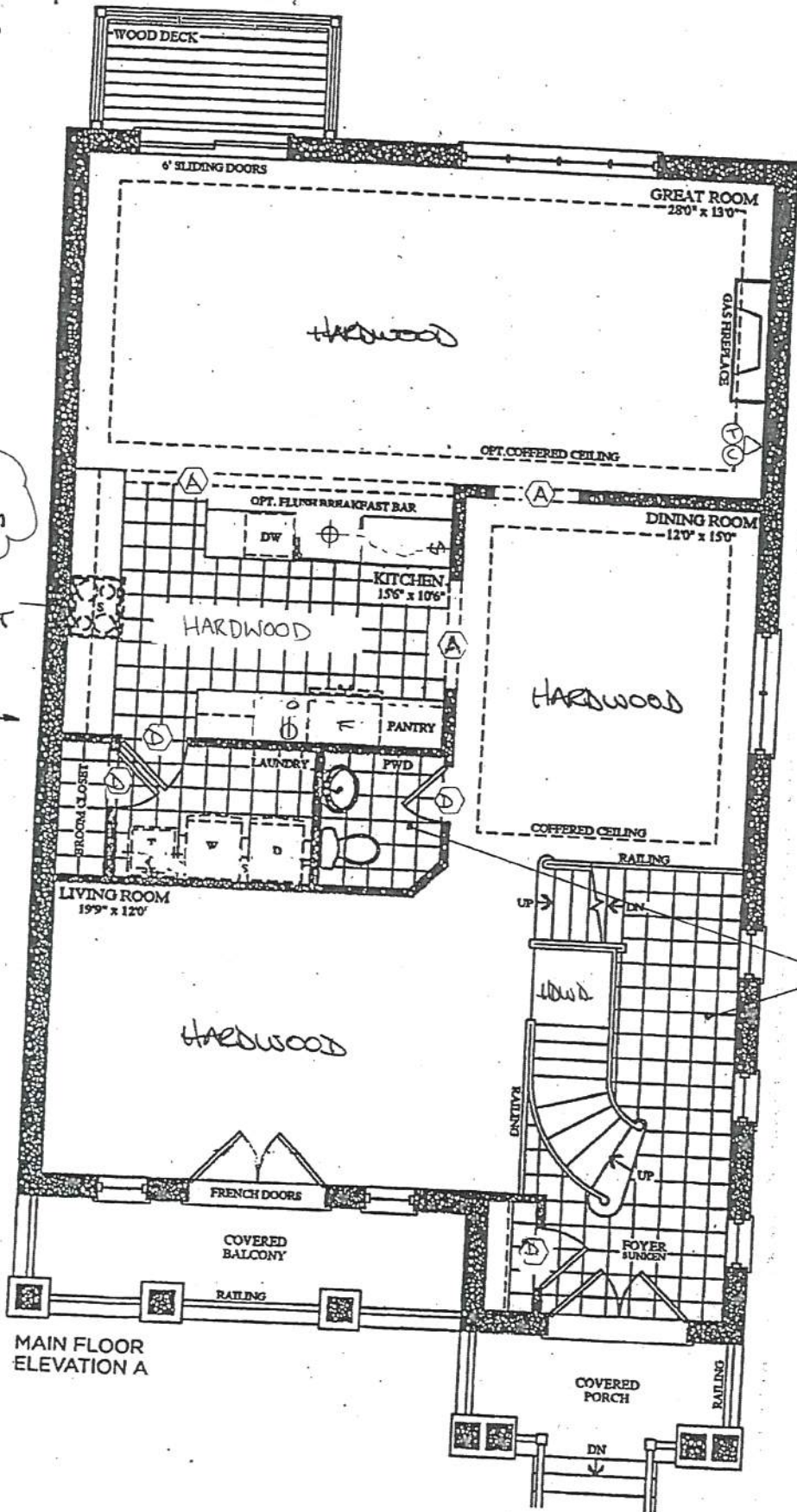

BF2-160  
JAN. 8 2021

REVISED:  
MARCH 10 2021

# The Scarlatti

Elevation A • 3,591 sq.ft.

Elevation B • 3,578 sq.ft.

Pricing, figures, illustrations, sizes, features and finishes are subject to change without notice. E.A.O.E. Areas and dimensions are approximate and actual usable floor space may vary from the stated area. Layout may be reverse of the unit purchased. E. & O.E.

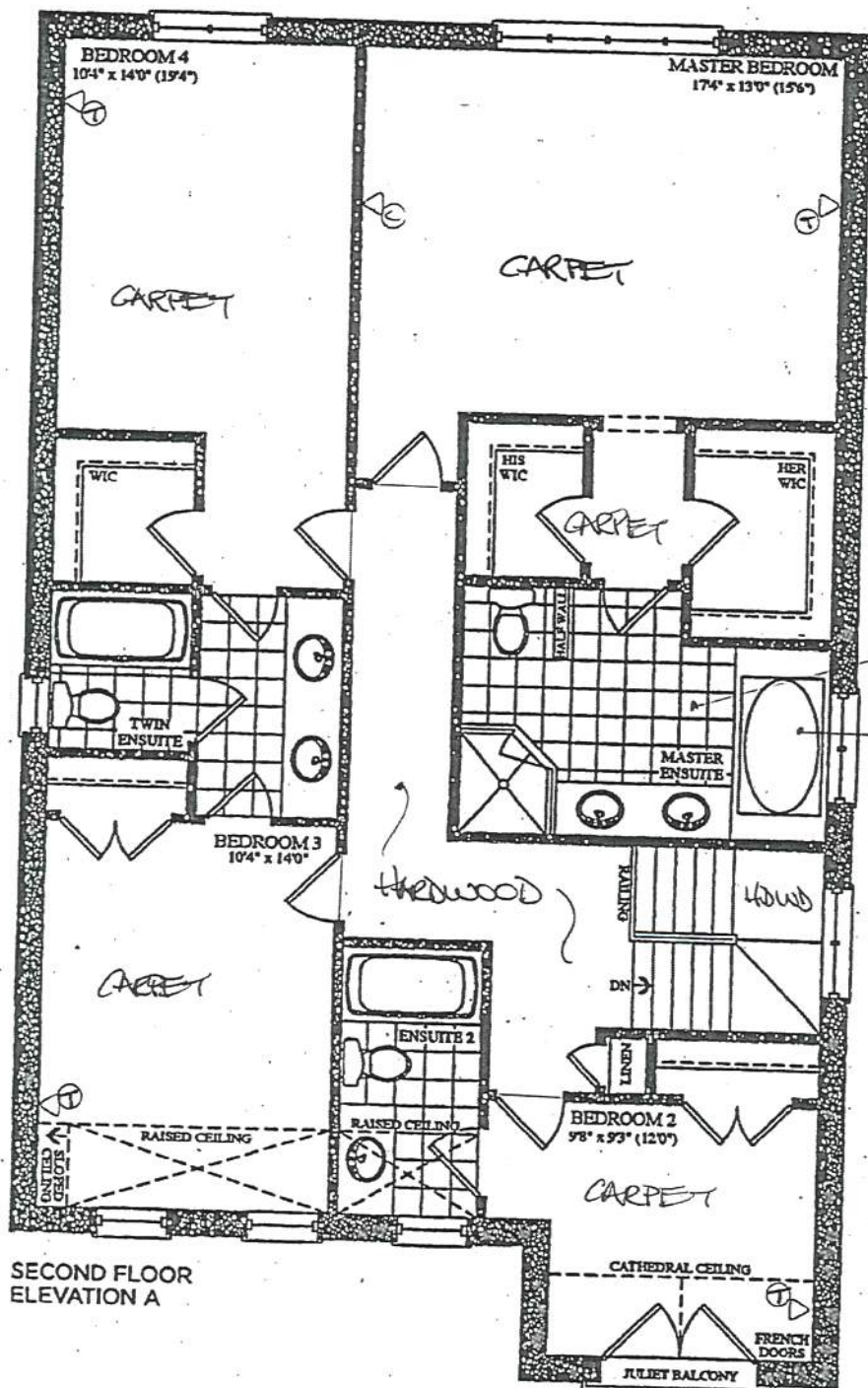

SECOND FLOOR  
ELEVATION A

BEZ-160  
JAN 8 2021

REVISED:  
MAR 10 2021

# The Scarlatti

Elevation A • 3,591 sq.ft. Elevation B • 3,578 sq.ft.

Prices, figures, illustrations, sizes, features and finishes are subject to change without notice. E.A.O.E. Areas and dimensions are approximate and actual usable floor space may vary from the stated area. Layout may be reverse of the unit purchased. E. & O.E.

BE2-160  
JAN 8 2021

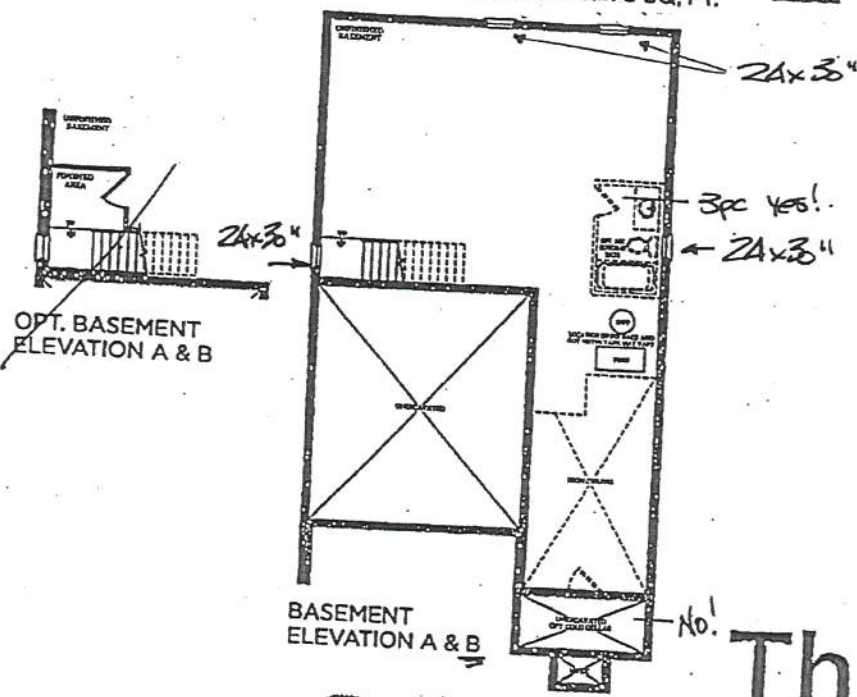
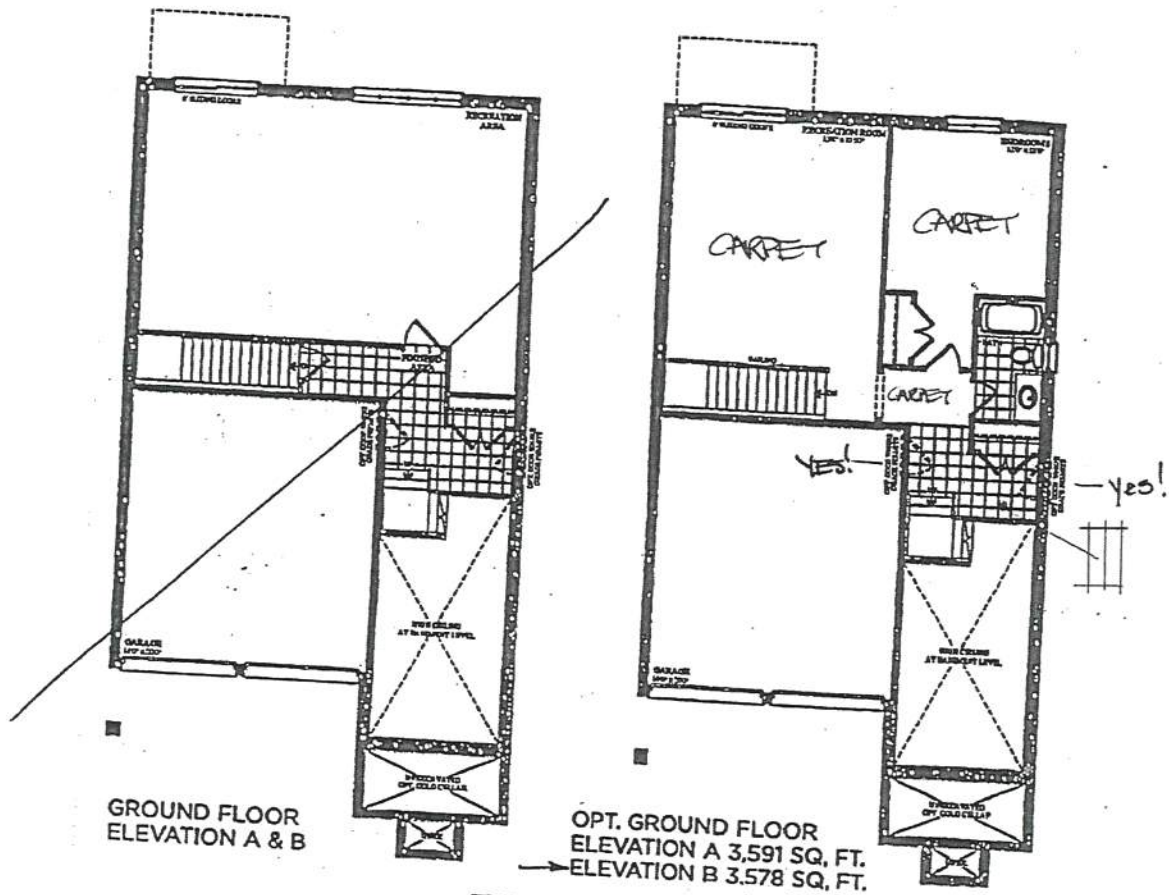

# The Scarlatti

Elevation A • 3,591 sq.ft. Elevation B • 3,578 sq.ft.

Prices, figures, illustrations, sizes, features and finishes are subject to change without notice. E&O.E. Areas and dimensions are approximate and actual usable floor space may vary from the stated area. Layout may be reverse of the unit purchased. E. & O.E.



This layout has been explained to the purchaser by Cortina Kitchens Inc. and is understood by the purchaser.

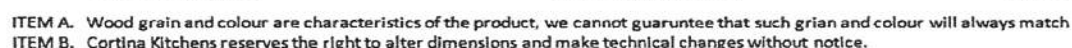

BE2-1160

March 10, 2021



20mm 1 3/4" Profiles

Kitchen

30mm 1 3/4" Profiles

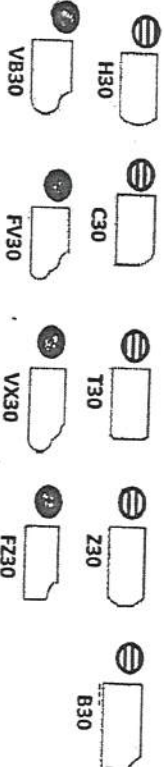
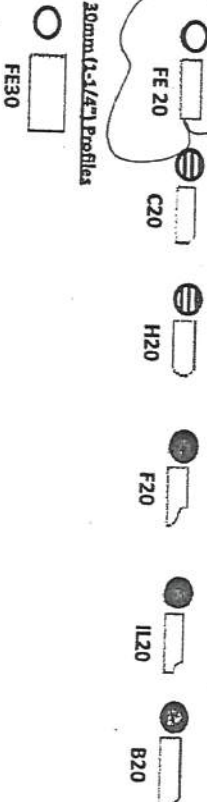

40mm 1 3/4" Profiles

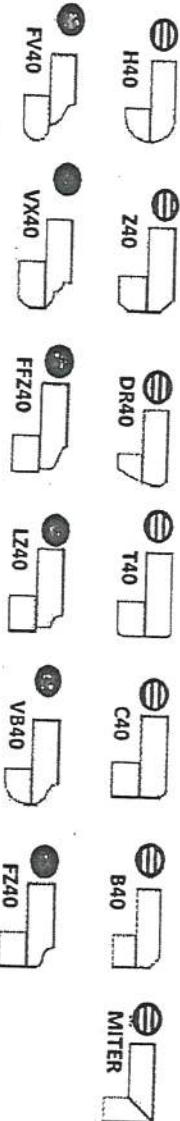

Note: All colours may not be available in 30mm at time ordered. Vendor reserves the right to use 40 mm edges (by lamination process).

\*Mitre edge is available in Upgrade 1 for an overall thickness of 2". All other Mitre edge options will be an Upgrade 2 Edge.



# ARTINA STANDARD HARDWARE

B62-160  
March 10, 2021

MODIFIED: 19/05/18

STANDARD HARDWARE



CSI-6



CSI-10



CSI-14



CSI-16

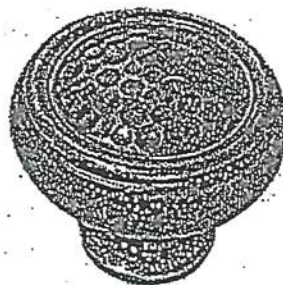

CSI-18

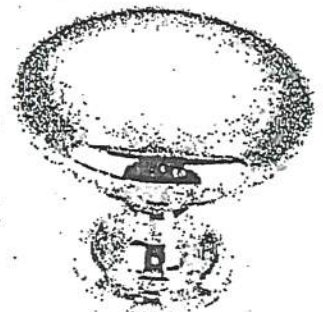

CSI-19



CSI-20

1. Ground Floor Bath
2. Ensuite 2
3. Shared Ensuite



CSI-21



CSI-22

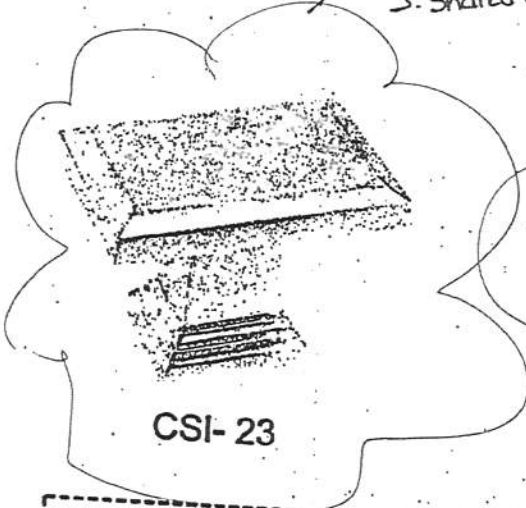

CSI-23

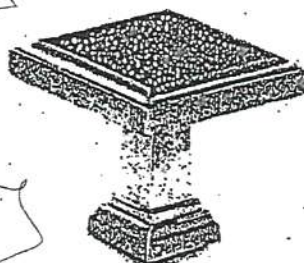

CSI-24

Master Ensuite

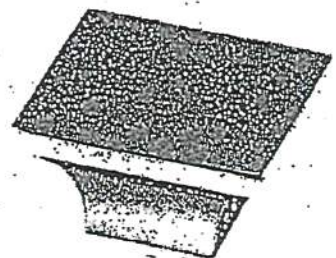

CSI-25

## \*NOTES:

- IMAGES ARE FOR QUICK REFERENCE PURPOSES ONLY
- ACTUAL SIZES AND FINISHES AS PER HARDWARE SAMPLE BOARD PROVIDED TO DECOR CENTRE





CH-32



CH-38

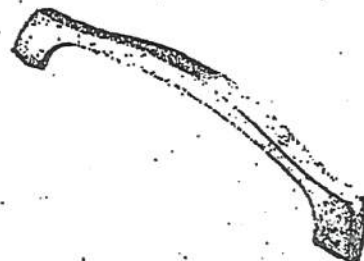

CH-44

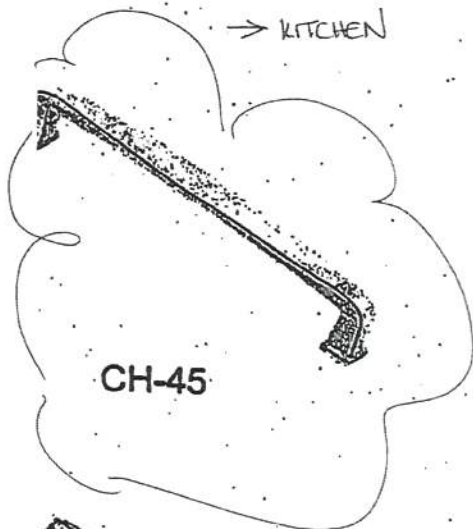

CH-45

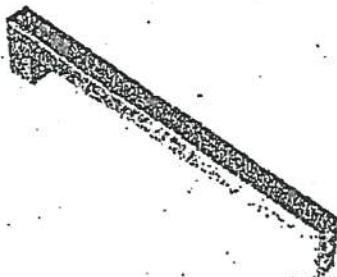

CH-46

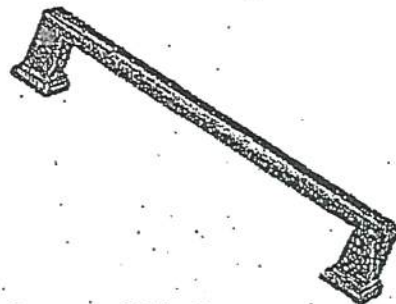

CH-47

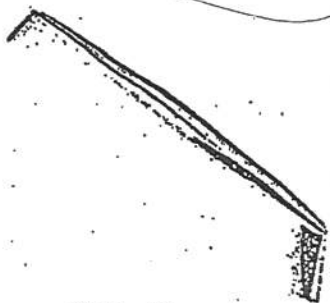

CH-48



CH-49

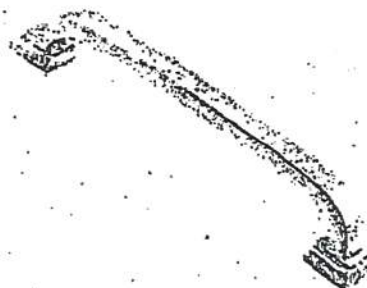

CH-50

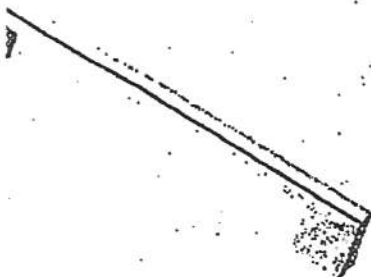

CH-51

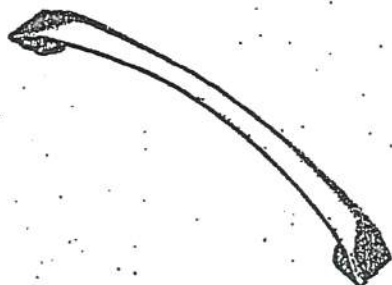

CH-52

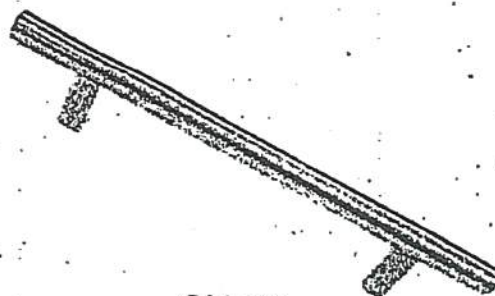

CH-53

### NOTES:

IMAGES ARE FOR QUICK REFERENCE PURPOSES ONLY  
ACTUAL SIZES AND FINISHES AS PER HARDWARE  
SAMPLE BOARD PROVIDED TO DECOR CENTRE

UPGRADE KITCHEN SINK



BLANCO - QUATRUS R15 U SUPER SINGLE

Stainless Steel - Undermount  
32" x 18" x 9"

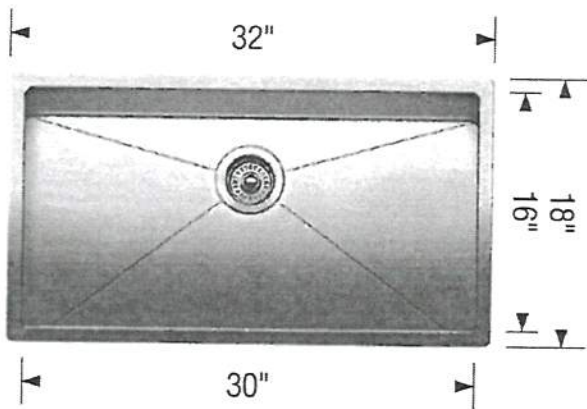
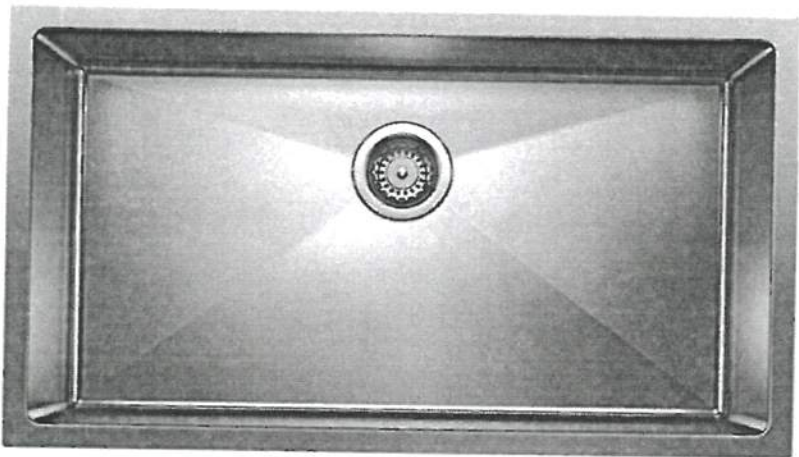

Stainless Steel

MODEL 401518 Stainless Steel

Lot# 160	Date: March 10, 2021	Room: Kitchen
Signature:		
Signature:		

UPGRADE TUB



MIROLIN - BROOKE  
Freestanding Tub  
68" x 36"  
CF2002



Lot# 160	Date: March 10, 2021	Room: Master Ensuite
Signature:		
Signature:		





## BATHROOM ACCESSORIES

PROJECT: ENCORE 2

LOT: 160

---

INSTALL STANDARD BATHROOM ACCESSORIES  
THRU OUT (TOWEL BAR, SOAP DISH, TISSUE  
HOLDER) \*\*location as per vendors discretion



**DO \*NOT\*** INSTALL STANDARD BATHROOM  
ACCESSORIES THRU OUT (TOWEL BAR, SOAP  
DISH, TISSUE HOLDER)



SIGNATURE: \_\_\_\_\_

SIGNATURE: \_\_\_\_\_

DATE: March 10, 2021