



DRYWALL

Invoice	Qty.	Description
2212  03Nov20 NoCat	1	.PINE VALLEY MODEL 42.01 MAPLEWOOD ELEV A OR B - 9 FOOT BASEMENT CEILING HEIGHT IN LIEU OF STANDARD 8 FOOT CEILING.
2242  03Nov20 NoCat	1	.**CUSTOM LAYOUT** DELETE 2-SIDED FIREPLACE - INSTALL APPX 96" FIN. WALL. INSTALL (breakfast side) TALL PANTRY CABINETS (approx. 5.5') + BASE CABINET TO HOUSE FUTURE WINE FRIDGE + COUNTER TOP (NO UPPER CABINET ABOVE COUNTER) BASED ON STANDARD FINISHES
2242  03Nov20 NoCat	1	.***CUSTOM***DELETE GROUND FLOOR ENSUITE 2 BATH RELOCATE LAUNDRY *from mudroom* TO FORMER ENSUITE 2, COMPLETE WITH WASHER/DRYER ROUGH-IN AND ADD STD LAUNDRY TUB. LAUNDRY BECOMES MUD ROOM (OPEN SPACE) - INCLUSIVE OF BUILDERS STANDARD FINISHES **SEE REVISED DOOR LOCATIONS FOR LAUNDRY AND BEDROOM 2-- RELOCATE PLUMBING/ELECTRICAL/HVAC **
2242  03Nov20 NoCat	1	.DELETE KITCHEN BULKHEAD, IF POSSIBLE, SITE APPROVAL REQUIRED
2242  03Nov20 NoCat	1	.**CUSTOM LAYOUT** REDUCE SIZE OF MUDROOM BY APPROX 1', INCREASE SIZE OF LAUNDRY ROOM BY 1'-- SEE PLAN FOR LOCATION



**Lot: 102****Model: 42.01 A MAPLEWOOD****Project/Phase: Pine Valley Forevergreen / 1**

# ELECTRICAL

Invoice	Qty.	Description
2242 03Nov20 NoCat	1	.KITCHEN: ADD ELECTRICAL OUTLET WITH USB TO ISLAND
2242 72,272 03Nov20	1	.BREAKFAST: 110V WALL RECEPTACLE ON SEPARATE CIRCUIT - FOR WINE FRIDGE - APPLIANCE NOT INCLUDED
2242 72,665 03Nov20	1	.KITCHEN: 240v WALL RECEPTACLE ON SEPARATE CIRCUIT FOR BUILT-IN OVEN. - APPROX. LOCATION AS PER ATTACHED DRAWINGS
2242 03Nov20 NoCat	1	.**CUSTOM LAYOUT** DELETE 2-SIDED FIREPLACE - INSTALL APPX 96" FIN. WALL. INSTALL (breakfast side) TALL PANTRY CABINETS (approx. 5.5') + BASE CABINET TO HOUSE FUTURE WINE FRIDGE + COUNTER TOP (NO UPPER CABINET ABOVE COUNTER) BASED ON STANDARD FINISHES
2242 03Nov20 NoCat	1	.***CUSTOM***DELETE GROUND FLOOR ENSUITE 2 BATH RELOCATE LAUNDRY *from mudroom* TO FORMER ENSUITE 2, COMPLETE WITH WASHER/DRYER ROUGH-IN AND ADD STD LAUNDRY TUB. LAUNDRY BECOMES MUD ROOM (OPEN SPACE) - INCLUSIVE OF BUILDERS STANDARD FINISHES **SEE REVISED DOOR LOCATIONS FOR LAUNDRY AND BEDROOM 2-- RELOCATE PLUMBING/ELECTRICAL/HVAC **
2242 03Nov20 NoCat	1	.DELETE KITCHEN BULKHEAD, IF POSSIBLE, SITE APPROVAL REQUIRED

## EXTERIOR COLOURS

Invoice	Qty.	Description
2242	1	EXTERIOR COLOUR PACKAGE # BR.5
03Nov20 NoCat		

## FORMING

Invoice	Qty.	Description
2212 72,351 03Nov20	2	.BASEMENT WINDOWS - UPGRADE BASEMENT WINDOW SIZE TO 30 " X 24" - 8" FRAME
2212 03Nov20 NoCat	1	.PINE VALLEY MODEL 42.01 MAPLEWOOD ELEV A OR B - 9 FOOT BASEMENT CEILING HEIGHT IN LIEU OF STANDARD 8 FOOT CEILING.

















CONSTRUCTION SUMMARY

Lot: 102

Model: 42.01 A MAPLEWOOD

Project/Phase: Pine Valley Forevergreen / 1

STAIRS AND RAILINGS

Invoice	Qty.	Description
2552	2	MAIN STAIRS: BASEMENT TO 2ND FLOOR: STAIN STAIRS AND LANDINGS
17Feb21 NoCat		STAIRS AND LANDINGS WILL NOT MATCH HARDWOOD FLOORS IN COLOUR/TEXTURE/SPECIES
2604 101,930 24Feb21	1	**NOTE** UPPER HALL HAS CURVED STAIR OPENING - INSTALL SMALLER GLASS PANELS THAT WILL FOLLOW THE CURVE. STAINLESS SUPPORTS MAY FALL OUTSIDE THE STAIR NOSING

WINDOWS - BASEMENT

Invoice	Qty.	Description
2212	2	.BASEMENT WINDOWS - UPGRADE BASEMENT WINDOW SIZE TO 30 " X 24" - 8" FRAME
03Nov20 NoCat		



ROOM	DESCRIPTION	PRICE	QTY	TOTAL
KITCHEN	UPGRADE FROM SERIES 2 TO SERIES 3 - <b>MANHATTAN OYSTER</b>		1	\$
	ADD 36"W COOKTOP POTS AND PANS DRAWERS IN STOVE LOCATION		1	\$
	ADD MINI STACKED UPPER LINE TO STD KITCHEN		1	\$
	ADD TOUCH LATCH HARDWARE TO MINI STACKED UPPERS		1	\$
	ADD DECORATIVE PANEL FOR FRIDGE/FREEZER		1	\$
	CONVERT FULL DOOR BASE CABINET TO BASE POTS AND PANS		2	\$
	ADD DECORATIVE HOOD CANOPY - MITRED MODERN		1	\$
	ADJUST BASE CABINETS FOR 36" COOKTOP (N/C)		1	\$
	CONVERT STD CABINET INTO TALL DEEP BUILT IN OVEN UNIT WITH POT DRAWER BELOW		1	\$
	CONVERT STD UPPER CABINET TO NOTCHED UPPER CABINET FOR FINGER PULL - NO HARDWARE ON UPPERS		1	\$
	RETURN TRIP FOR HARDWOOD		1	\$
	ADD 30"H BASE DUMMY DOOR APPLIED AGAINST END BASE		1	\$
	ADD APPLIANCE PULLS AT FRIDGE, PANTRY + COORDINATING HARDWARE AT BASE DRAWERS AND DOORS - CONTEMPORARY 806MM METAL PULL 7191		1	\$
	ADD CABINETRY VALANCE		1	\$
ISLAND	UPGRADE FROM SERIES 2 TO SERIES 3 - <b>MANHATTAN OYSTER</b>		1	\$
	ADD 2-BIN RECYCLE CENTRE TO ISLAND		1	\$
	RELOCATE STD BANK OF DRAWERS TO ISLAND (N/C)		1	\$
	ADD DECORATIVE PANEL FOR DISHWASHER		1	\$
	ADD TOUCH LATCH HARDWARE TO BACK OF ISLAND		1	\$
BREAKFAST PANTRIES	ADD 117"H BASE LINE FULL-HEIGHT PANTRY WITH MINI STACKED UPPER RUN. ADD SEAM GABLES. ADD BASE SUPPORT GABLES FOR BEVERAGE FRIDGE. ADD 9"W SKINNY FULL- DOOR BASE CABINET BESIDE BEVERAGE FRIDGE. ADD FURRING TO 10' CEILING. (DIFFERENCE FROM STD IN STRUCTURAL ORDER)		1	\$
	ADD TOUCH LATCH HARDWARE TO MINI STACKED UPPERS		1	\$
POWDER ROOM	UPGRADE FROM SERIES 2 TO SERIES 3 - <b>BROADWAY II WHITE HI GLOSS PET</b>		1	\$
	UPGRADE HARDWARE - <b>BAH-083-03</b>		1	\$
	CONVERT VANITY INTO 21"H OR 24"H FLOATING VANITY		1	\$
	CONVERT FLOATING VANITY INTO U-SHAPED TWO DRAWER VANITY		1	\$
	ADD SKIRT BELOW FLOATING VANITY FOR UNFORSEEN PLUMBING		1	\$
LOFT BATH	CONVERT STD VANITY CABINET INTO VANITY BANK OF DRAWERS		1	\$
LAUNDRY ROOM	ADD FULL-DOOR BASE CABINET		1	\$
	ADD LAMINATE TOP		1	\$
MASTER ENSUITE	UPGRADE FROM SERIES 2 TO SERIES 3 - <b>MANHATTAN OYSTER</b>		1	\$
	UPGRADE HARDWARE - <b>BAH-083-03</b>		1	\$
	CONVERT VANITY INTO 21"H OR 24"H FLOATING VANITY		1	\$
	CONVERT FLOATING VANITY INTO U-SHAPED TWO DRAWER VANITY		1	\$
	ADD SKIRT BELOW FLOATING VANITY FOR UNFORSEEN PLUMBING		1	\$
<b>CABINETRY TOTAL:</b>				<b>\$</b>

LOT #:	PR-102	DATE:	Feb 11, 2021
SIGNATURE:			
✧ See attach ✧			
SIGNATURE:			



\*\*\* NOTE: This is not an approved document. Document must be locked \*\*\*

Scheduled Closing Date: Tuesday, May 4, 2021

Purchaser: ERMENZIANA SIMONE

Property: 102 of Plan -

Telephone Res. / Bus: / (647) 627-0981

Project: Pine Valley Forevergreen - Phase 1

Decor Advisor: Yolande Somerville

Model and Elevation: 42.01 A MAPLEWOOD

Layout Changes: ☒ Yes ☐ No

Sketch Attached: ☒ Yes ☐ No

Exterior Colour Scheme:

### 1. Cabinetry

	Style and Colour	Counter	Hardware
Kitchen / Breakfast	*Manhattan 'Oyster'	*2-tone	attached
Laundry Room	Modena 'Classic White'	P-Lam: Std White	attached
Powder Room	*BroadwayII pet hi-gloss white	*Quartz: Desert Silver	attached
Master Ensuite Bathroom	*Manhattan 'Oyster'	Quartz: Ice Snow	attached
Second Ensuite Bathroom (If Applicable)	n/a	n/a	n/a
Shared Ensuite	Modena 'Classic White'	Quartz: Ice Snow	attached

#### Comment

Kitchen Perimeter + Pantry Wall Countertop: \*Quartz: Vivid White' // Island Countertop: \*Quartz: 'Bianco Calacatta'

### 2. Floor Tile

	Selection
Entrance Vestibule	*24x24" Volkas 'White' polished
Main Hall	
Kitchen / Breakfast	see hardwood
Laundry Room	*12x24" Volkas 'White' polished
Powder Room	*12x24" Volkas 'White' polished
Mud Room	<del>13x13" Sempre 'White' matte</del> 13" x 13" Capri White
Master Ensuite Bathroom	*12x24" Regal matte 'Shell White'
Second Ensuite Bathroom (If Applicable)	n/a
Lower Landing (If Applicable)	<del>13x13" Sempre 'White' matte</del> 13" x 13" Capri White
Shared Ensuite	<del>13x13" Sempre 'White' matte</del> 13" x 13" Capri White

#### Comment

Master Ensuite: Shower Floor: \*2x2" Quebec 'Arctic White' // Shared Ensuite: std 2x2" white

\*REVISED\*  
PV-102 skeemail  
Feb. 22, 2021

### 3. Wall Tile

	Selection	Listello/Inserts	Describe
Master Ensuite Bathroom		<input type="radio"/> Yes <input checked="" type="radio"/> No	
Tub Deck		<input type="radio"/> Yes <input checked="" type="radio"/> No	
Shower Stall	*4x12" Piccadilly (Ivory) Glossy	<input type="radio"/> Yes <input checked="" type="radio"/> No	
Bathroom Walls		<input type="radio"/> Yes <input checked="" type="radio"/> No	
Second Ensuite Bathroom (If Applicable)		<input type="radio"/> Yes <input checked="" type="radio"/> No	
Shared Ensuite	8x10" Splendour 'White'	<input type="radio"/> Yes <input checked="" type="radio"/> No	
Kitchen Backsplash	<input type="radio"/> Yes <input checked="" type="radio"/> No	Backsplash Behind Fridge	

#### Comment

\*see attach.\*

Purchaser: ERMENZIANA SIMONE

Property: 102 of Plan -

Telephone Res. / Bus: / (647) 627-0981

Project: Pine Valley Forevergreen - Phase 1

Decor Advisor: Yolande Somerville

Model and Elevation: 42.01 A MAPLEWOOD

### 4. Plumbing Fixtures

Master Ensuite Bathroom  Second Ensuite  Powder Room   
Other Room - Specify  Other Washroom

Comment

Standard except kitchen + Master

### 5. Hardwood Flooring

	Type and Stain		Type and Stain
Main Hall	<input type="text"/>	Upper Landing	<input type="text"/>
Kitchen / Breakfast	*3/4x5" wht oak wirebrush 'Atlantis'	Upper Hall	<input type="text"/>
Living Room	<input type="text"/>	Master Bedroom	<input type="text"/>
Dining Room	<input type="text"/>	Bedroom #2	<input type="text"/>
Family Room	<input type="text"/>	Bedroom #3	<input type="text"/>
Den/Library	<input type="text"/>	Bedroom #4	<input type="text"/>
Entrance Vestibule	<input type="text"/>	Bedroom #5	<input type="text"/>
Lower Landing (If Applicable)	<input type="text"/>	Other Room - Specify	<input type="text"/>
		Thru out standard areas	*3/4x5" wht oak wirebrush 'Atlantis'

Comment

### 6. Carpeting

	Upgrade	Description
Ground Floor	<input type="checkbox"/>	<input type="text"/>
Second Floor	<input type="checkbox"/>	<input type="text"/>
<input type="text"/>	<input type="checkbox"/>	<input type="text"/>

	Type	Area
Upgrade Underpad	<input type="text"/>	<input type="text"/>
	Capped	Runner - *Upgrade
Carpet on Stairs	<input type="text"/>	<input type="text"/>

Comment

### 7. Fireplace

	Living Room			Family Room			Other Room - Specify		
	Purchased	As Per Plan	N/A	Purchased	As Per Plan	N/A	Purchased	As Per Plan	N/A
Fireplace Type	<input type="radio"/>	<input type="radio"/>	<input checked="" type="radio"/>	<input type="radio"/>	<input checked="" type="radio"/>	<input type="radio"/>	<input type="radio"/>	<input type="radio"/>	<input checked="" type="radio"/>
Mantle Type	<input type="text"/>	<input type="text"/>	<input type="text"/>	<input type="text"/>	<input type="text"/>	<input type="text"/>	<input type="text"/>	<input type="text"/>	<input type="text"/>
Colour / Stain	<input type="text"/>	<input type="text"/>	<input type="text"/>	<input type="text"/>	<input type="text"/>	<input type="text"/>	<input type="text"/>	<input type="text"/>	<input type="text"/>
Surround	<input type="text"/>	<input type="text"/>	<input type="text"/>	<input type="text"/>	<input type="text"/>	<input type="text"/>	<input type="text"/>	<input type="text"/>	<input type="text"/>
Hearth	<input type="text"/>	<input type="text"/>	<input type="text"/>	<input type="text"/>	<input type="text"/>	<input type="text"/>	<input type="text"/>	<input type="text"/>	<input type="text"/>

Comment

PV-102  
Feb. 22, 2021

\* see attach. x

see email



Purchaser: ERMENZIANA SIMONE

Property: 102 of Plan -

Telephone Res. / Bus: / (647) 627-0981

Project: Pine Valley Forevergreen - Phase 1

Decor Advisor: Yolande Somerville

Model and Elevation: 42.01 A MAPLEWOOD

### 8. Trim Carpentry

Interior Doors  Front Door Glass Inserts  Door Handles   
 Interior Trim

Comment

### 9. Plaster Mouldings and Medallions

Standard Throughout ☐ Yes ☐ No ☒ N/A

Entrance Vestibule	<input type="text"/>	<input type="text"/>	Kitchen/Breakfast	<input type="text"/>	<input type="text"/>
Main Hall	<input type="text"/>	<input type="text"/>	Den/Library	<input type="text"/>	<input type="text"/>
Living Room	<input type="text"/>	<input type="text"/>	Lower Landing	<input type="text"/>	<input type="text"/>
Dining Room	<input type="text"/>	<input type="text"/>	Other Room - Specify	<input type="text"/>	<input type="text"/>
Family Room	<input type="text"/>	<input type="text"/>			

Comment

### 10. Railings and Spindles

Railing Package   
 Railing Colour   
 Stringer / Riser

Spindle Colour   
 Treads

Comment

Oak Stairs ☒ Yes ☐ No ☐ N/A

### 11. Wall Paint / Ceilings

Throughout Finished Areas

Trim Paint

Smooth Ceilings

Ground Floor ☒

Second Floor ☒

Note

Comment

PV-102  
Feb. 22, 2021

\* see attach \*

see email

Scheduled Closing Date: Tuesday, May 4, 2021

Purchaser: ERMENZIANA SIMONE

Property: 102 of Plan -

Telephone Res. / Bus: / (647) 627-0981

Project: Pine Valley Forevergreen - Phase 1

Decor Advisor: Yolande Somerville

Model and Elevation: 42.01 A MAPLEWOOD

### 12. Electrical

Hood Fan ☐ White ☐ Stainless ☒ N/A

Above Kitchen Cabinet Light ☐ Yes ☒ No

Standard Appliances ☐

Below Kitchen Cabinet Light ☒ Yes ☐ No

Over The Range Microwave ☐

Chimney Style Fan ☐

Comment

### 13. Heating and Air Conditioning

Air Conditioning

Gas Provisions Stove

Gas Provisions Dryer

Gas Provisions Barbecue

Comment

### 14. Additional Comments

### 15. Disclaimers and Notes

- Colours of all materials are as close as possible to builder's selection, but not necessarily identical due to variances in manufacturing.
- Any extras listed above are null and void unless accompanied by a separate invoice/amendment. Said invoice must be paid in full.
- The Purchaser acknowledges that after Interior Colour Selection form is signed and dated, no further changes will be permitted other than re-selection due to unavailability. \_\_\_\_\_ Purchaser's Initials
- The Purchaser acknowledges reading and accepting the "Gold Park Homes Decor Centre Disclaimers" form. This document contains other miscellaneous disclaimers.

This Interior Colour Selection is final and approved by:

Signature: \*see attach \* Date: Feb. 11, 2021

see email Feb. 22, 2021



SCHEDULE 'F'



PV-102

MAY 25, 2020

PV-102

Feb 11, 2021

\* see attach. \*

# The Maplewood

## 42' SERIES

Elevation A • 2,770 sq.ft.

Elevation B • 2,725 sq.ft.

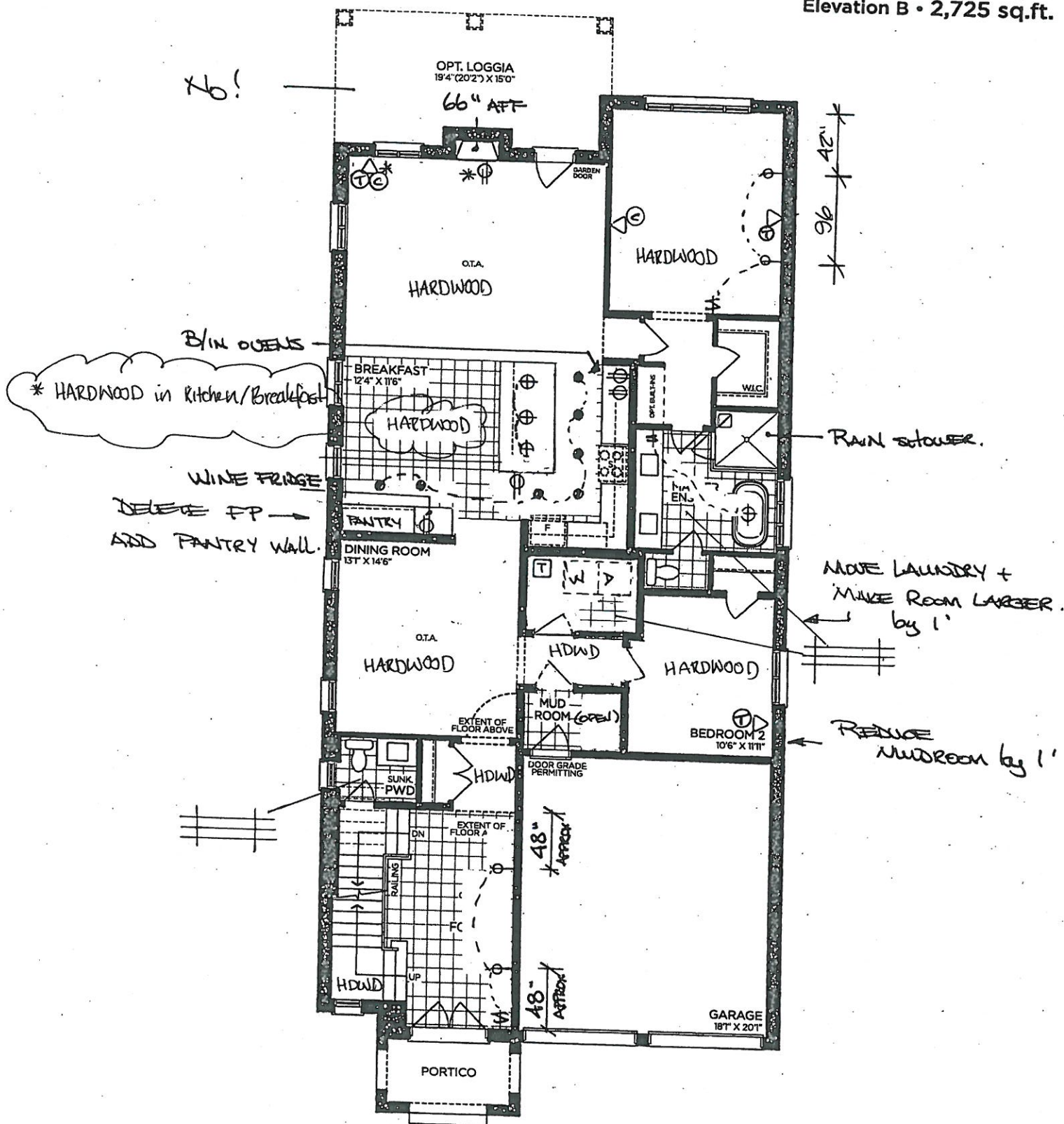

GROUND FLOOR | ELEV. A

PV-102

Feb. 23, 2021

see attached

VENDOR

PURCHASER

PURCHASER

**GOLDPARK**  
WORTH MORE™

Prices, figures, illustrations, sizes, features and finishes are subject to change without notice. Areas and dimensions are approximate and actual usable floor space may vary from the stated area. Layout may be reverse of the unit purchased. E. & O.E. 4201

# SCHEDULE 'F'



PV-102

May 25 2020

PV-102.

Feb 11, 2021

see attached

\* see attach \*

## The Maplewood 42' SERIES

→ Elevation A • 2,770 sq.ft.  
Elevation B • 2,725 sq.ft.

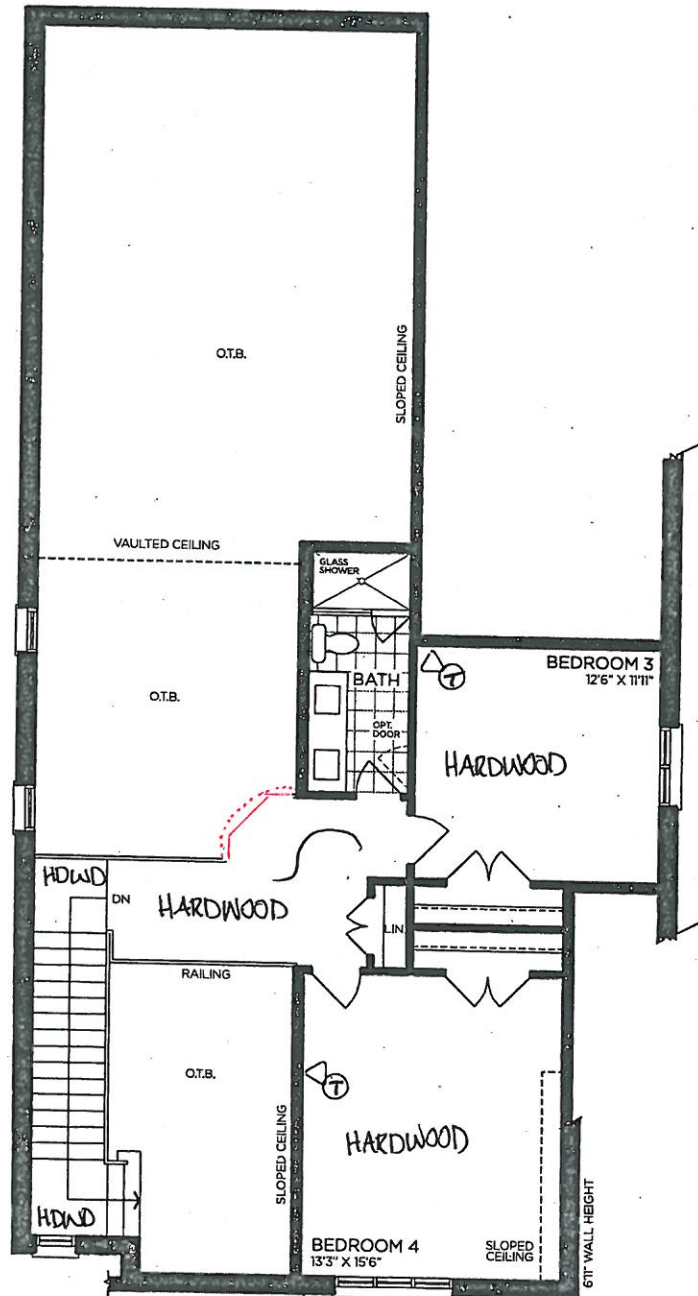

LOFT | ELEV. A

see attached

\* Revised \*

PV-102

Feb. 23, 2021

VENDOR

PURCHASER

PURCHASER

**GOLDPARK**  
WORTH MORE™

Prices, figures, illustrations, sizes, features and finishes are subject to change without notice. Areas and dimensions are approximate and actual usable floor space may vary from the stated area. Layout may be reverse of the unit purchased. E. & O.E. 4201

SCHEDULE 'F'



PV-102. *see attached*  
 MAY 25 2020  
 PV-102  
 Feb 11, 2021 *\* see attach \**

The  
**Maplewood**  
 42' SERIES  
 Elevation A • 2,770 sq.ft.  
 Elevation B • 2,725 sq.ft.

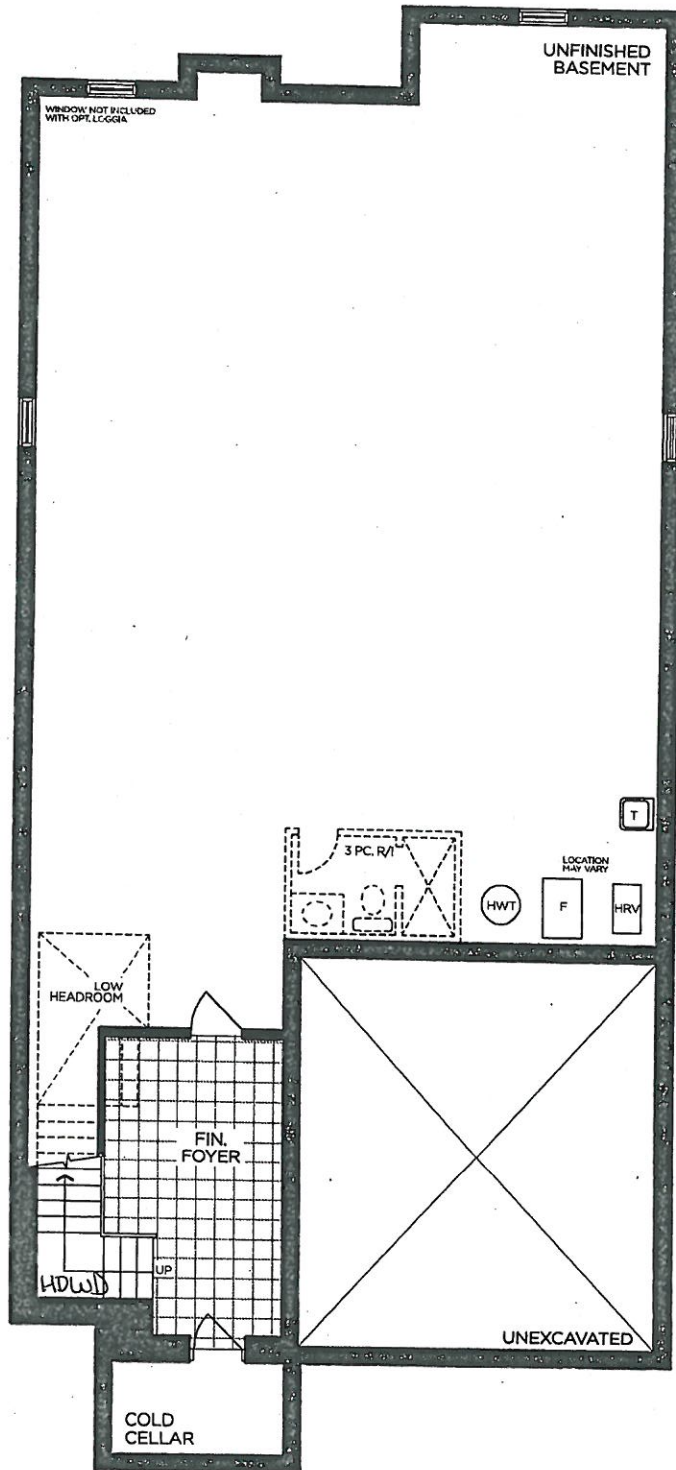

BASEMENT | ELEV. A

*see attached*

PV-102  
 Feb 23, 2021

VENDOR

PURCHASER

PURCHASER

**GOLDPARK**  
 WORTH MORE™

Prices, figures, illustrations, sizes, features and finishes are subject to change without notice. Areas and dimensions are approximate and actual usable floor space may vary from the stated area. Layout may be reverse of the unit purchased. E. & O.E. 4201



# GOLDPARK HOMES PINE VALLEY VAUGHAN, ONTARIO MODEL: (4201) MAPLEWOOD

SITE STANDARD: WHITE 3/4" EXTENSION  
SOFT-CLOSE DRAWERS & SOFT-CLOSE  
HINGES TO KITCHEN AREA  
  
10' CEILING - 12"H COFFERED CEILING -  
M.H. = 102" + 3/4"H CONTEMPORARY  
MOLDING + 5 1/4"H FURRING RAIL  
+ LARGE CORNICE MOLDING TO  
UNDERSIDE OF BOX

• Manhattan 'Oyster'

- \* Mini stacked uppers to ceiling
- \* No valance
- \* Return trip for hardwood.

→ See painting at breakfast.

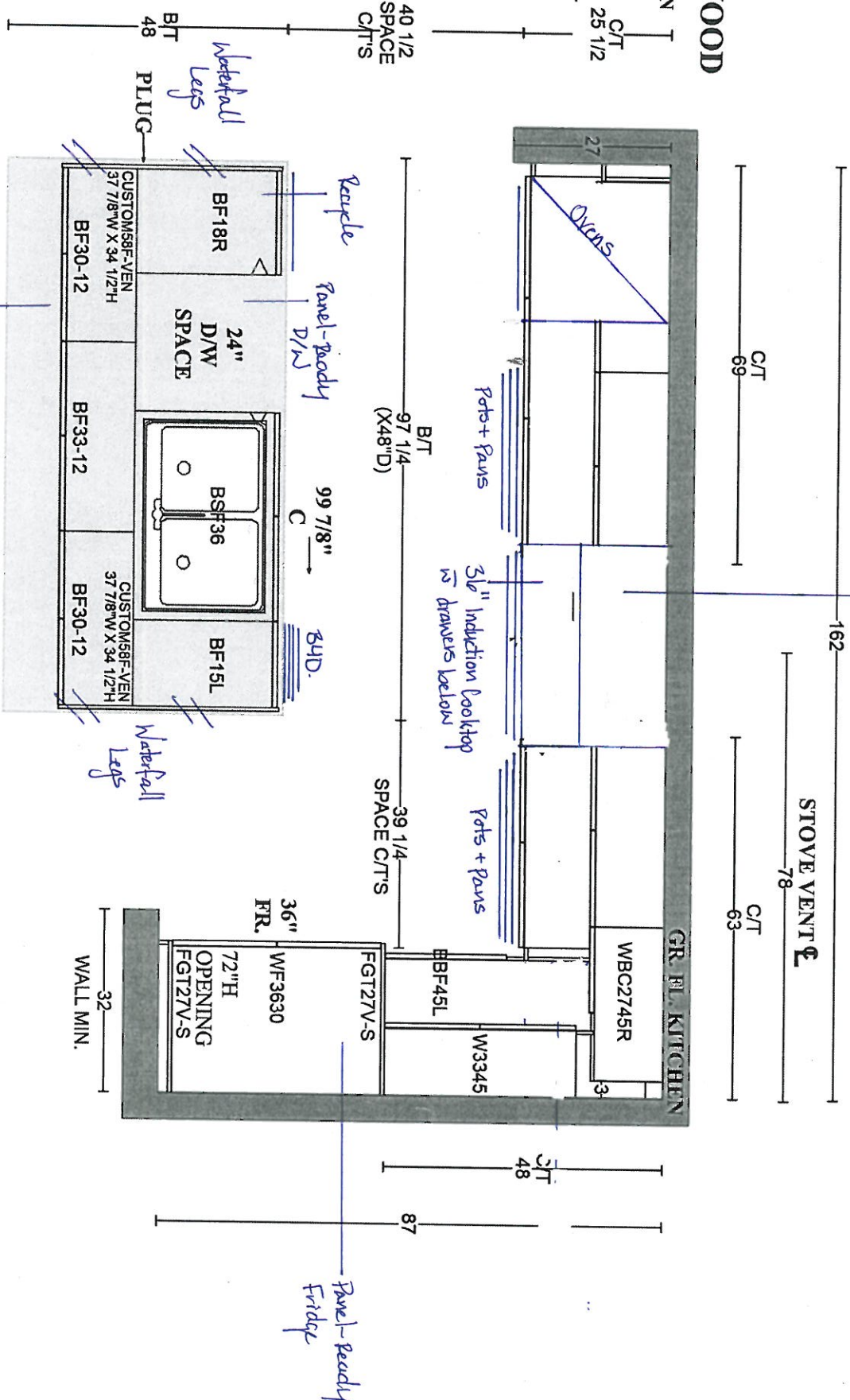

PLAN VIEW



\* See attach \*

RV-102

Pantry at Breakfast

Feb 11, 2021

Manhattan 'Oyster'

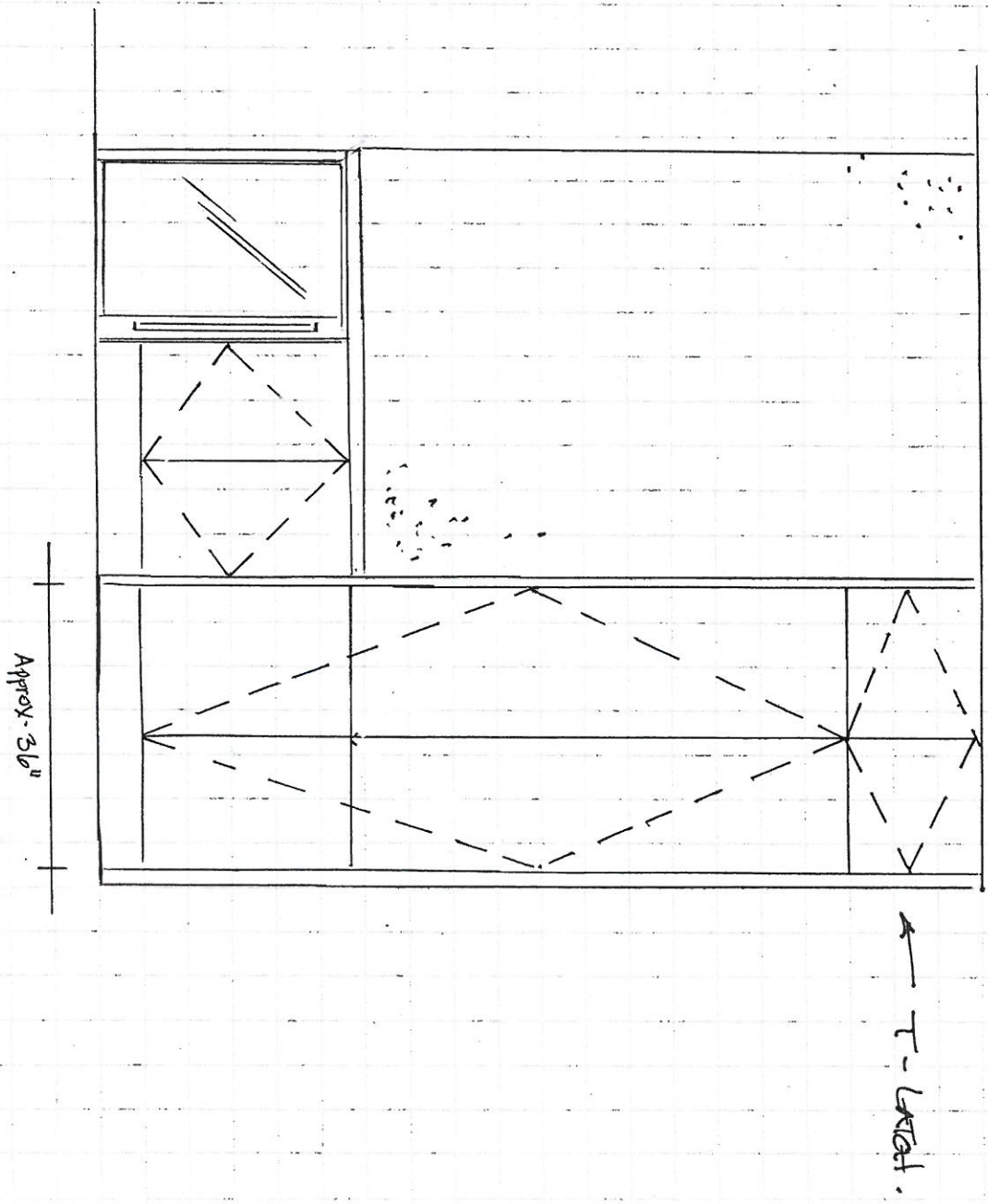

PV-102  
Feb. 11, 2021

\* See attach. \*

**GOLDPARK HOMES  
PINE VALLEY  
VAUGHAN, ONTARIO  
MODEL: (4201) MAPLEWOOD**

SITE STANDARD: WHITE 3/4" EXTENSION  
SOFT-CLOSE DRAWERS & STANDARD SLAM DOOR HINGES  
TO VANITIES

ONE TOP DRAWER WHERE POSSIBLE THROUGHOUT EACH  
VANITY, ONE BANK OF DRAWERS WHERE POSSIBLE  
THROUGHOUT EACH MASTER ENSUITE VANITY

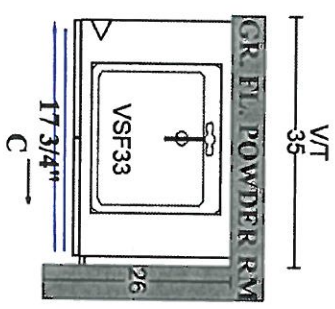
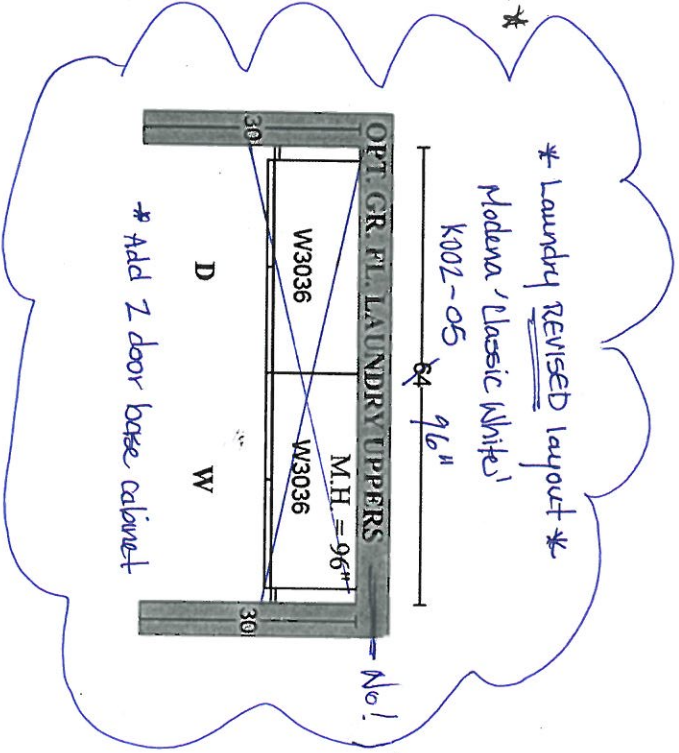

Broadway 11' PET Hi-gloss white  
BATH-083-03  
\* Floating vanity

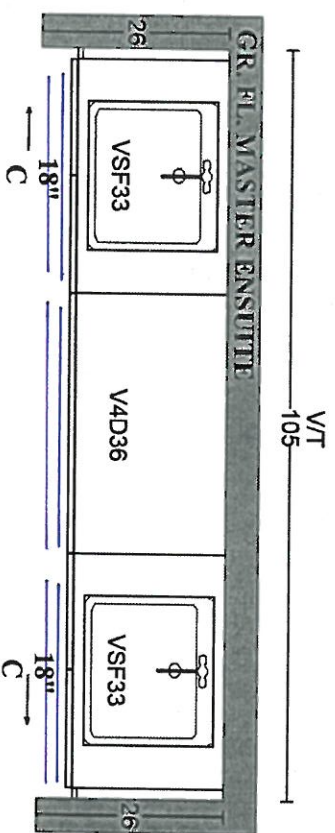

Modena 'Oyster' BATH-083-03  
\* Floating vanity

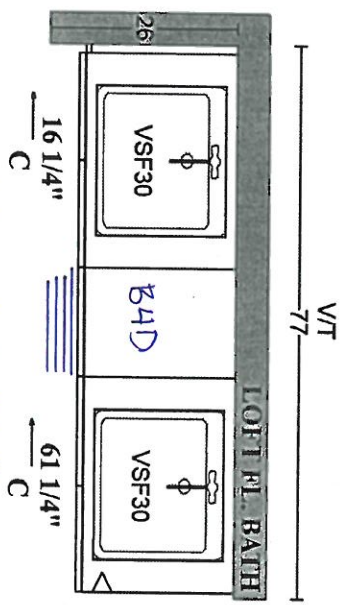
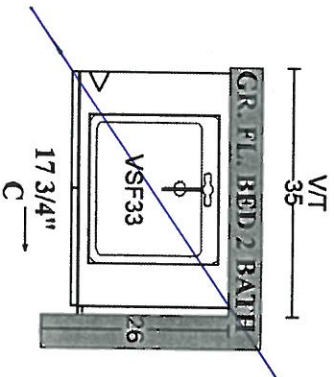

Modena 'Classic White' H039-03



PLAN VIEW



PINE VALLEY  
FOREVERGREEN

STONE COUNTERTOP EDGE PROFILES



STANDARD 2CM EASED EDGE

LOCATION:

~~\*THRU-OUT\*~~

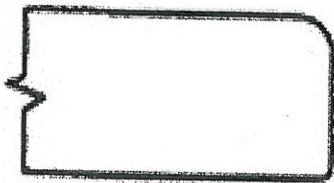

UPGRADE 3CM EASED EDGE

LOCATION:



UPGRADE 4CM MITRED EDGE

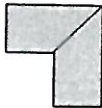

LOCATION:

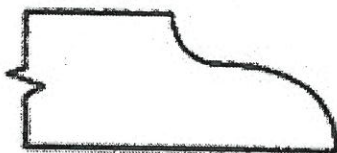

UPGRADE 2CM OGEE EDGE

LOCATION:

LOT #: PV-102

DATE: Feb 11, 2021

SIGNATURE: \*see attach.\*

SIGNATURE:

CONTEMPORARY METAL PULL

806mm - 7191



LOCATION:

→ kitchen

LOT # PY-102

DATE: Feb 11, 2021

SIGNATURE:

 \* see attach. \*

SIGNATURE:

UPGRADE HARDWARE



BAH-083-03

'Brushed Nickel'

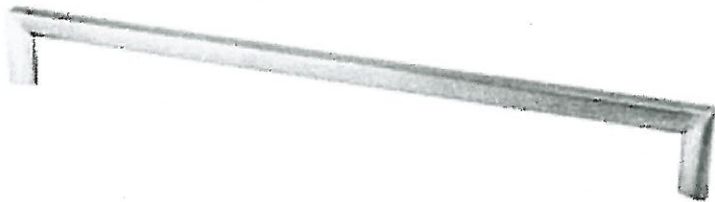

LOCATION:

→ Powder Room  
→ Master ensuite

LOT #  
PV-102

DATE:  
Feb 11, 2021

SIGNATURE: \*see attach.\*

SIGNATURE:



STANDARD HARDWARE / HANDLES



☐ H001-02



☐ H001-03



☐ H001-04



☐ H009-03



☐ H009-09



☐ H011-03



☐ H011-05



☐ H011-06

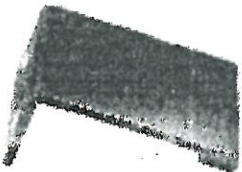

☐ H033-01



☒ H039-03  
→ loft bath.

☐ \*NO HARDWARE

LOT # PV-102

DATE: Feb. 11 2021

SIGNATURE:  \*see attach \*

SIGNATURE:

STANDARD HARDWARE / KNOBS

☐

K002-02

☐

K002-03

☐

K002-04

☐

K002-06

☒

K002-05

→ Laundry

☐

K002-14

☐

K024-03

☐

\*NO HARDWARE

LOT # PV-102

DATE: Feb 11 2021

SIGNATURE:



\* see attach. \*

SIGNATURE:



PINE VALLEY

FOREVERGREEN

## UPGRADE KITCHEN SINK

### BLANCO - QUATRUS R15 U SUPER SINGLE

Stainless Steel - Undermount

32" x 18" x 9"

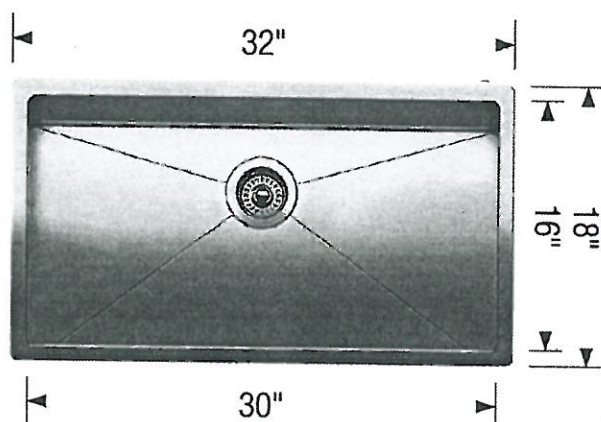
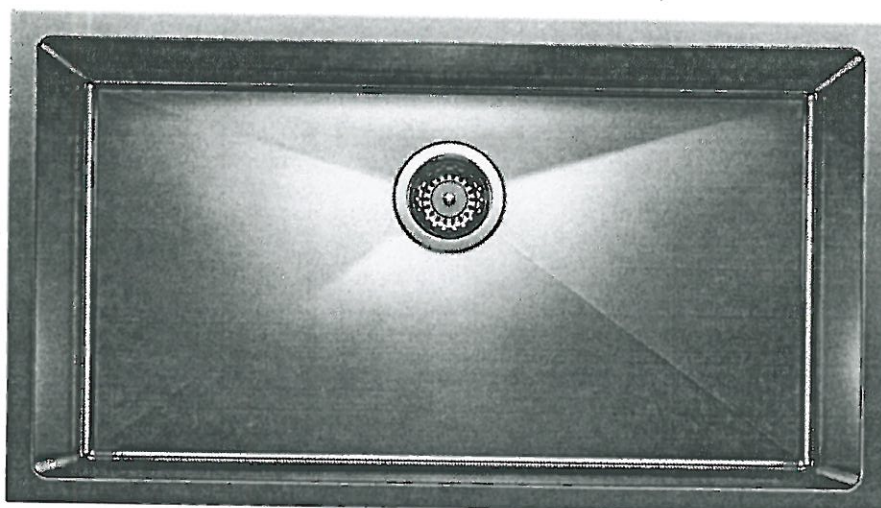

Stainless Steel

MODEL 401518 Stainless Steel

Lot#  
TV-102

Room:  
kitchen

Signature: \*see attach\*

Date:  
Feb 11, 2021

Signature:

GOLDPARK  
WORTH MORE





PINE VALLEY  
FOREVERGREEN

## UPGRADE SHOWER HARDWARE

MT6X6

Shower Door Handle

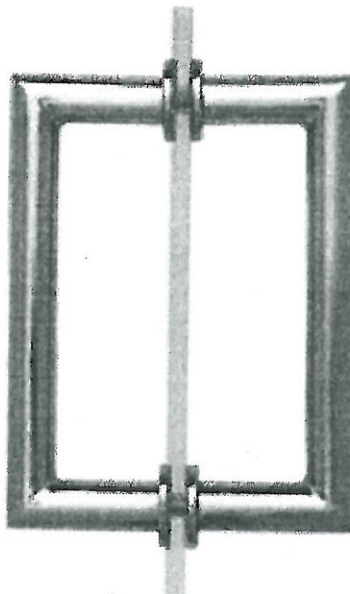

MT6X6

Shower Door Handle

6" x 6" back-to-back

3/4" dia. tube

Cut and mitred corners with  
washers

(Also available single sided)



CHROME



MATTE BLACK



BRUSHED GOLD

Lot#

PV-102

Date:

Feb 11, 2021

Room:

Master Ensuite + Loft Bath

Signature:

\*see attach. \*

Signature:



PINE VALLEY  
FOREVERGREEN

## BATHROOM ACCESSORIES

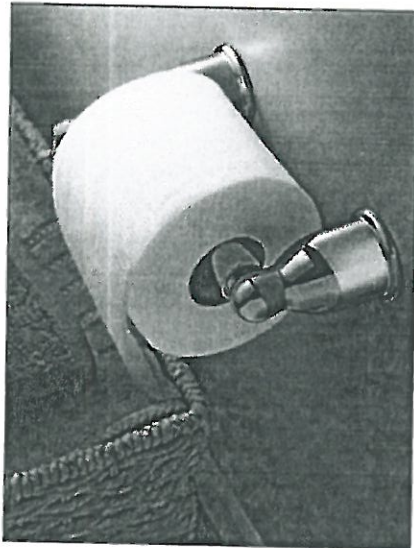

Tissue Holder  
Mason - Chrome

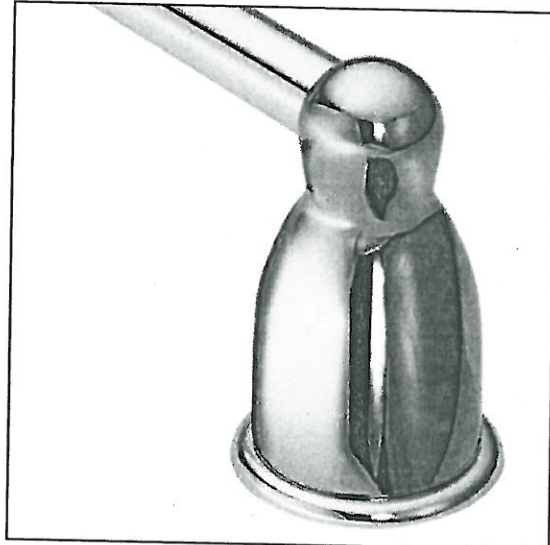

Towel Bar  
Mason - Chrome

**Please select one of the following:**

☐ INSTALL STANDARD BATHROOM ACCESSORIES THRU OUT  
(tissue holder + towel bar) *\*location as per vendors discretion\**

☐ **\*DO NOT\*** INSTALL STANDARD BATHROOM ACCESSORIES  
THRU OUT *\*tissue holder + towel bar will not be provided\**

LOT #  
PV-102

DATE:  
Feb 11, 2021

SIGNATURE: ✱ see attach. ✱

SIGNATURE:



Project: Pine Valley

Lot: 102

Purchaser(s): Ermenziana Simone

#### Standard Hood Fan Deletion

We acknowledge that the builder's standard hood fan will not be installed.  
Do not supply, install and/or credit. We will install our own hood fan after closing.

Signature:  \* see attach \*

Signature: \_\_\_\_\_

Date: February 11 2021



PINE VALLEY

FOREVERGREEN

Range Hood - Mitred Square

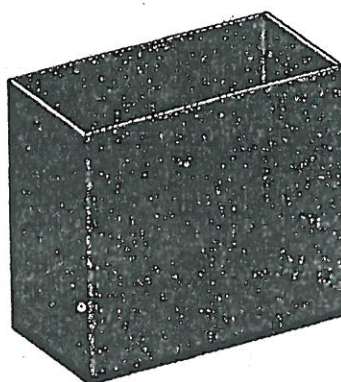

Lot#  
PV-102

Room:  
Kitchen

Signature:  \* see attach. \*

Date:  
Feb 11, 2021

Signature:

GOLDPARK  
WORTH MORE

POSI-TEMP SHOWER ONLY\* W/ 3 FUNCTION TRANSFER  
VALVE/TRIM AND SLIDE BAR WITH HAND SHOWER

MOEN - 90 DEGREE

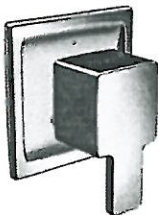

☒ CHROME

☐ BRUSHED NICKEL

☐ from WALL

☒ from CEILING

MODEL TS2712EP / 3372 / TS4172 / 62320 / S3879EP / A721

Lot#  
102.

Room:  
MASTER ENSUITE

Signature: *see attached*

Date:  
MAY 25 2020

Signature: *see attached*

PLUMBING UPGRADES



POST-TEMP SHOWER ONLY\* W/ 3 FUNCTION TRANSFER VALVE/TRIM AND SLIDE BAR WITH HAND SHOWER

MOEN - 90 DEGREE

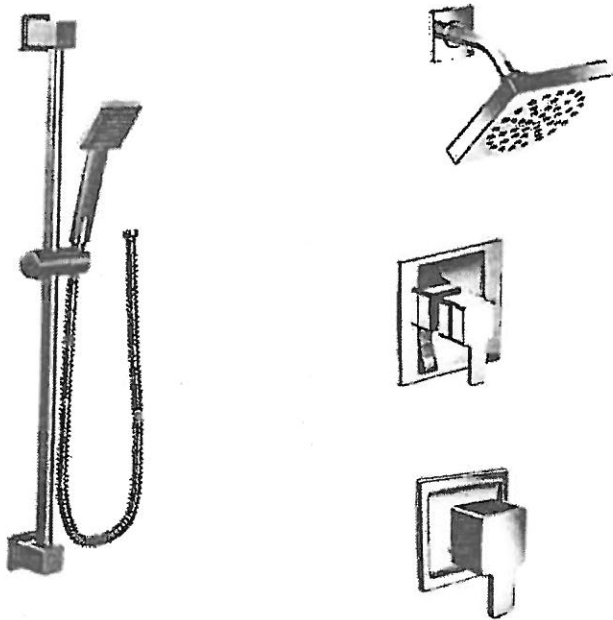

- ☒ CHROME
- ☐ BRUSHED NICKEL
- ☐ from WALL
- ☒ from CEILING

MODEL TS2712EP / 3372 / TS4172 / 62320 / S3879EP / A721

Lot# 102.	
Room: MASTER ENSUITE	Signature: [Signature]
Date: MAY 25 2020	Signature: [Signature]





## My Reveal Project

For help with questions about the specifications provided for your configuration, call us toll-free between 8am-5pm CST at [\(866\) 689-9653](tel:8666899653).

Disclaimer: We strongly recommend saving all Reveal configurations to "My Sub-Zero Account" to ensure the most up-to-date specification information is reflected on your shared documents as product specifications are subject to change without notice. Otherwise, we suggest that this configuration be recreated prior to finalizing your cabinetry enclosures. The reveal listed in this configuration is the minimum reveal suggested by the manufacturer. After extensive research, Sub-Zero simplified the naming of our refrigeration product lines to be more descriptive and distinct for our consumers. Built-In is now referred to as Classic, and Integrated is now referred to as Designer. Model numbers currently remain unchanged.

## BI-36UFD/O: Opening and Panel Specs, Flush Inset Installation, Custom Panels, 83" Finished Height

### Specifications:

[Specifications Summary](#)

[Front View](#)

[Side View](#)

[Top View](#)

[Top View Detail](#)

[Panel Specifications](#)

[Panel Planning Notes](#)

[Panel Offsets](#)

[Templates](#)

[Additional Requirements](#)



BI-36UFD/O

36" Classic French Door Refrigerator/Freezer - Panel Ready

Notes : Additional accessories are available for this installation. Please ask your local retailer for more information.



## Specifications Summary

Single Model: BI-36UFD/O

MODEL	OVERALL DIMENSIONS	WEIGHT	FLUSH INSET OPENING DIMENSIONS
BI-36UFD/O <a href="#">3D Studio Max (3DS)</a> <a href="#">3D AutoCad (DWG)</a> <a href="#">2D AutoCad (DWG)</a> <a href="#">AutoCad (DXF)</a> <a href="#">ArchiCad (GSM)</a> <a href="#">3D Studio Max (MAX)</a> <a href="#">Wavefront 3D (OBJ)</a> <a href="#">Revit Files (RFA)</a> <a href="#">SketchUp (SKP)</a> <a href="#">QR SHEET</a> <a href="#">Subzero Design Guide</a> <a href="#">Model Detail</a>	36" <small>W</small> 84" <small>H</small> 24" <small>D</small>	529 lbs	38" <small>W</small> 83 <sup>1</sup> / <sub>8</sub> " <small>H</small> 26 <sup>3</sup> / <sub>16</sub> " <small>D</small>

## Front View

Single Model: BI-36UFD/O

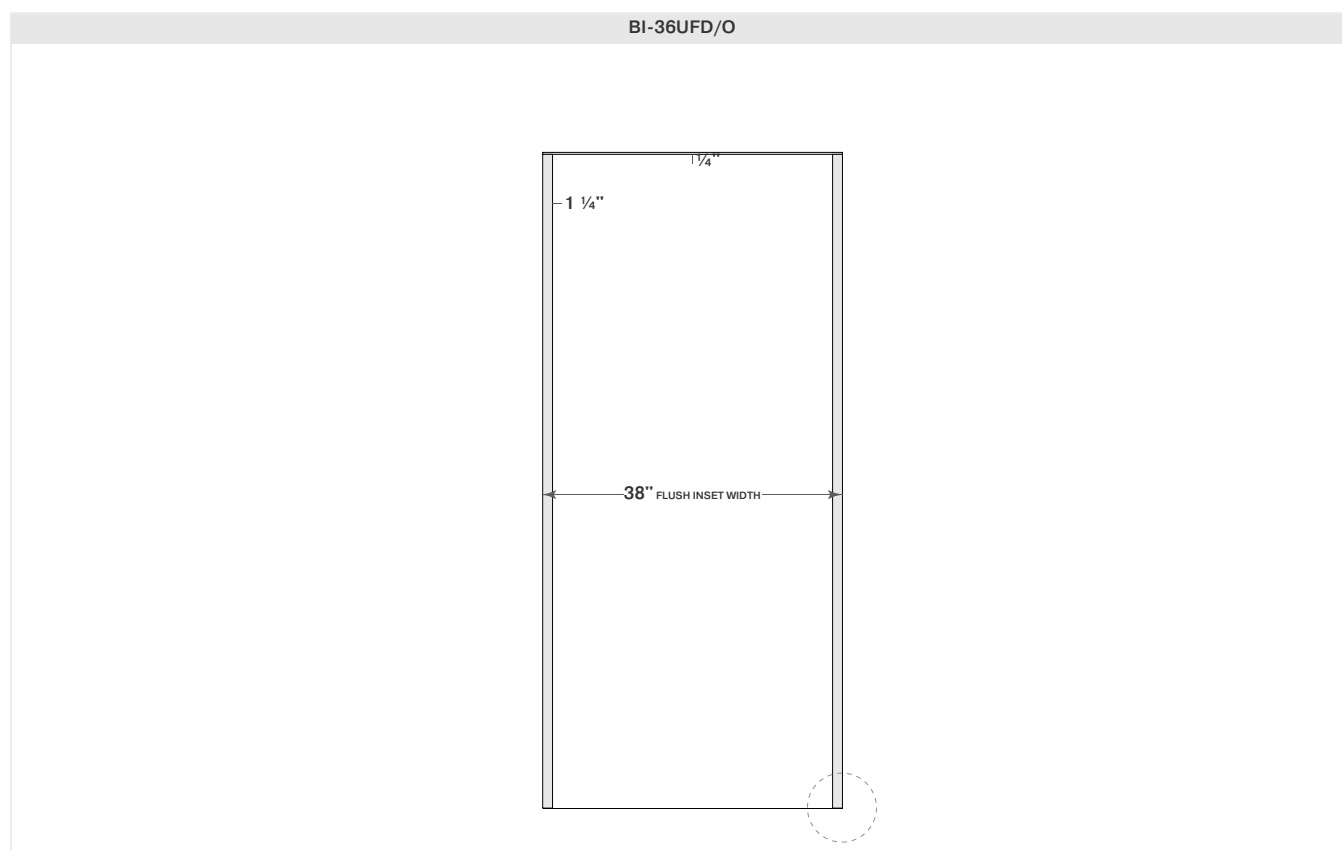

## Top View

Single Model: BI-36UFD/O

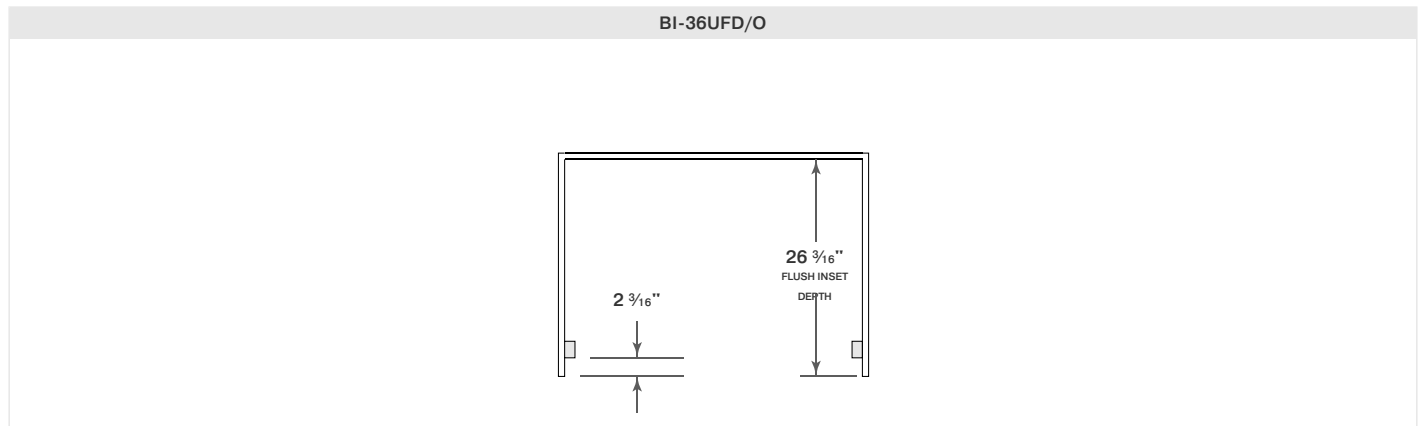

## Top View Detail

Single Model: BI-36UFD/O

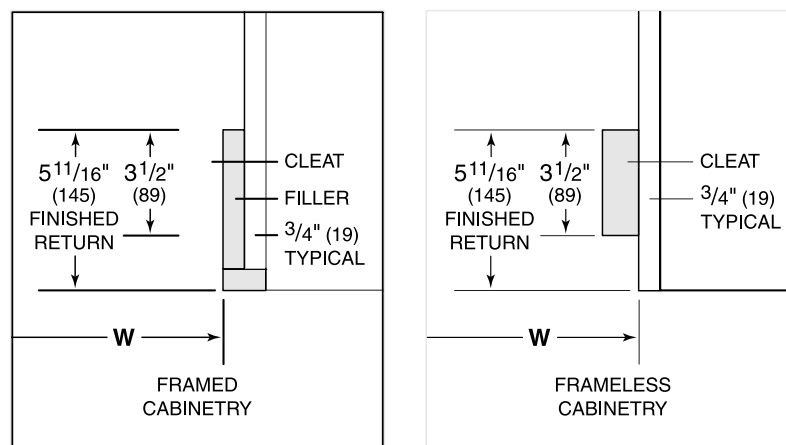

Shaded areas will be visible and should be finished to match cabinetry.

## Side View

Single Model: BI-36UFD/O

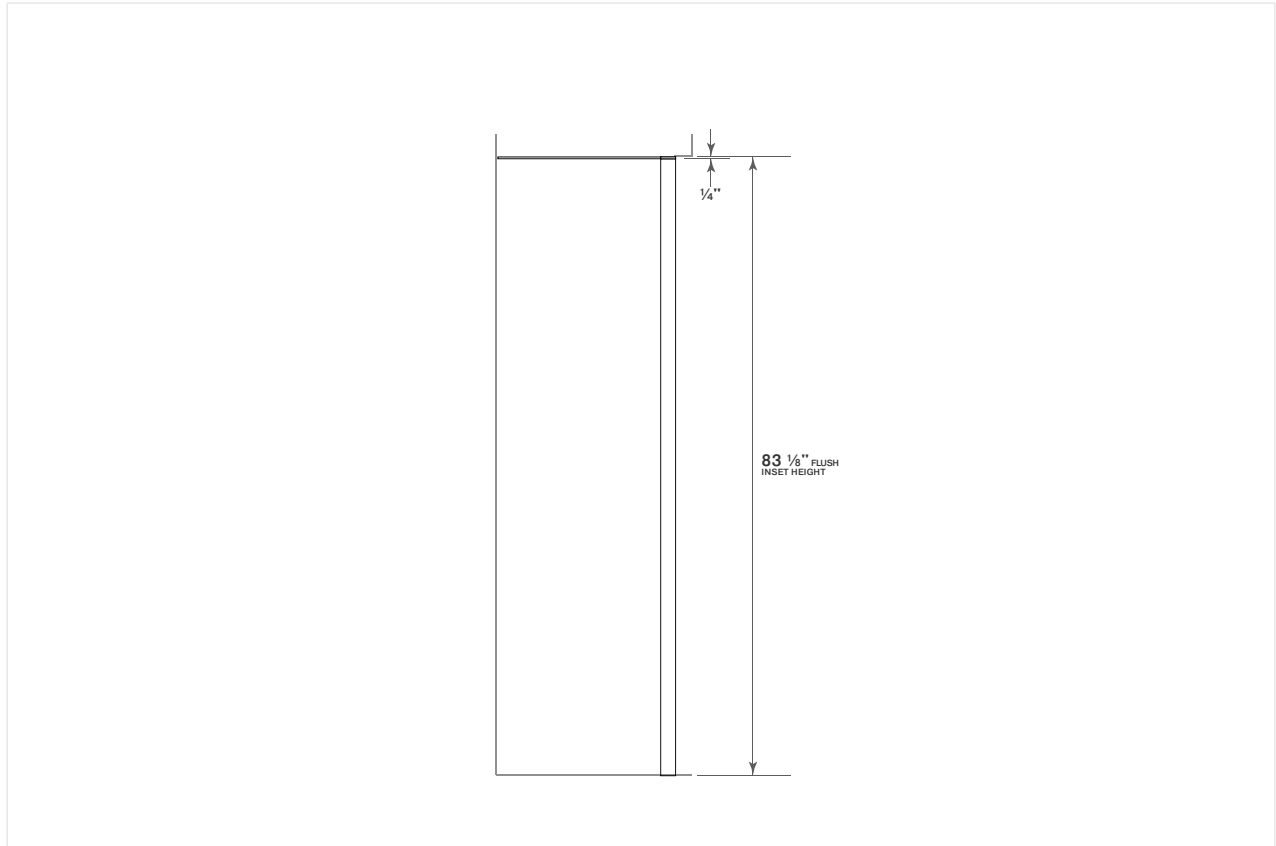

## Panel Specifications

Single Model: BI-36UFD/O

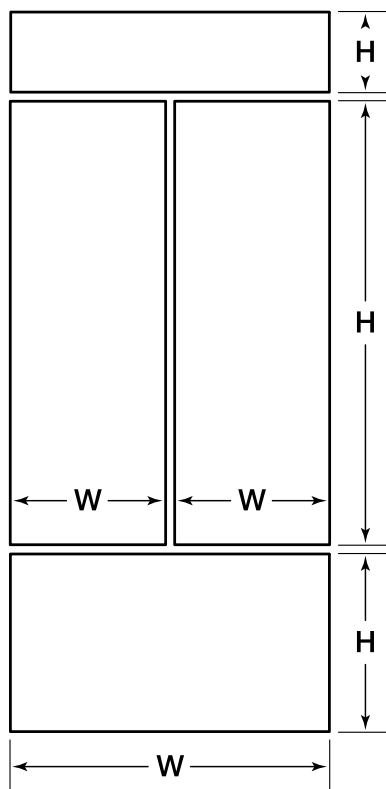

PANEL	FRONT	SPACER	BACKER	MAX WEIGHT
Door (2)	$18 \frac{3}{8}"$ <small>W</small> $50 \frac{1}{8}"$ <small>H</small>	$17"$ <small>W</small> $49 \frac{5}{16}"$ <small>H</small>	$17 \frac{5}{8}"$ <small>W</small> $49 \frac{15}{16}"$ <small>H</small>	50 lbs
Drawer	$37"$ <small>W</small> $19"$ <small>H</small>	$35 \frac{1}{8}"$ <small>W</small> $18 \frac{1}{16}"$ <small>H</small>	$35 \frac{3}{4}"$ <small>W</small> $18 \frac{11}{16}"$ <small>H</small>	50 lbs
Grille	$37"$ <small>W</small> $8 \frac{1}{4}"$ <small>H</small>	$35 \frac{1}{8}"$ <small>W</small> $7 \frac{5}{16}"$ <small>H</small>	$35 \frac{3}{4}"$ <small>W</small> $7 \frac{15}{16}"$ <small>H</small>	13 lbs

## Panel Planning Notes

Single Model: BI-36UFD/O

The flush inset application is an overlay model with flush inset panels. It is not a separate model.

The flush inset design allows custom panels to be installed flush with adjacent cabinets. Similar to overlay, flush inset panels are typically created by combining a 3/4" (19) custom panel, a .10" (3) spacer panel and a 1/4" (6) backer panel.

For flush inset panels thicker than 3/4" (19), a 90° door stop may be required to prevent interference with adjacent cabinets.

### Minimum Panel Thickness

5/8"

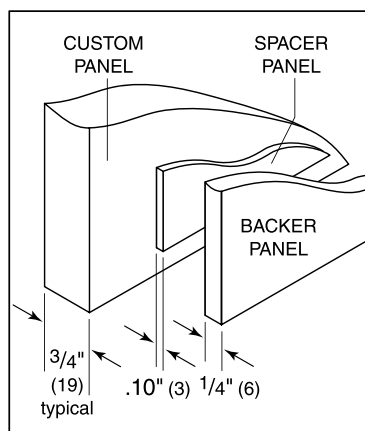

Panel assembly (rear view).

### Standard Handle Lengths (Optional)

HANDLE	TUBULAR	PRO
BI-36UFD/O Door	44 1/4"	37 1/2"
BI-36UFD/O Drawer	30 5/16"	23 5/8"

## Panel Offsets

Single Model: BI-36UFD/O

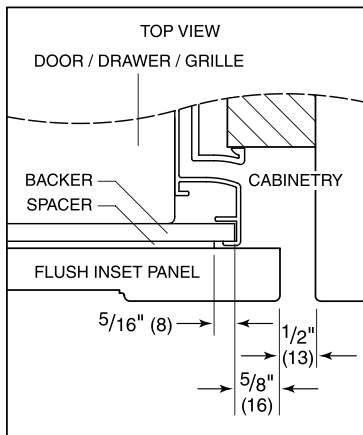

Door (hinge) / Drawer / Grille Sides

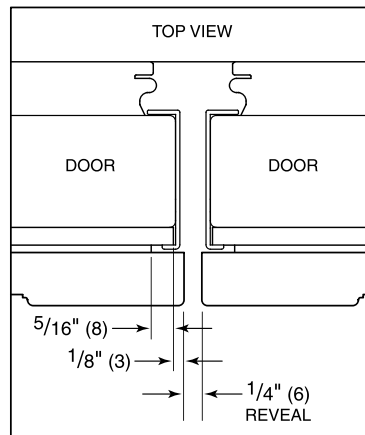

Doors (handle) Sides

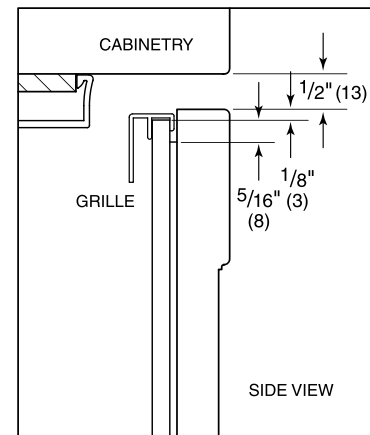

Grille Top

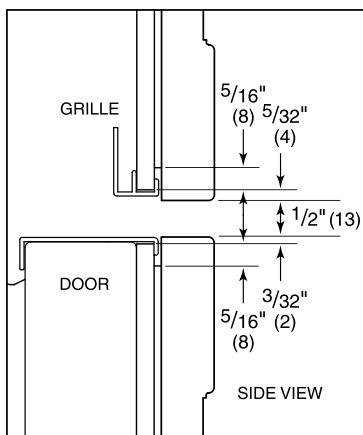

Grille Bottom / Door Top

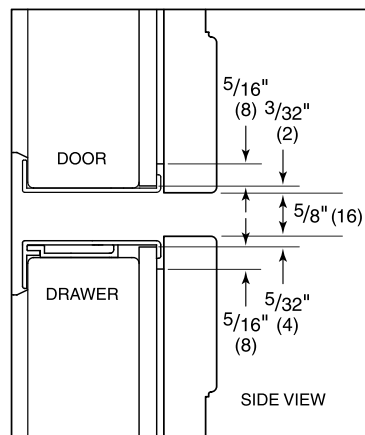

Door Bottom / Drawer Top

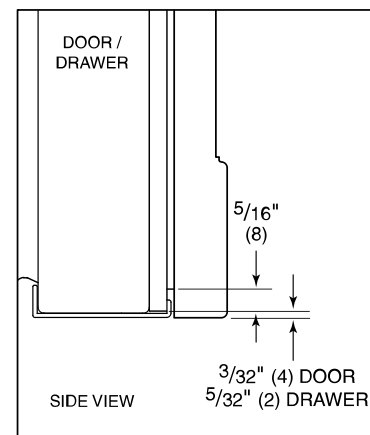

Door/Drawer Bottom

## Templates

Single Model: BI-36UFD/O

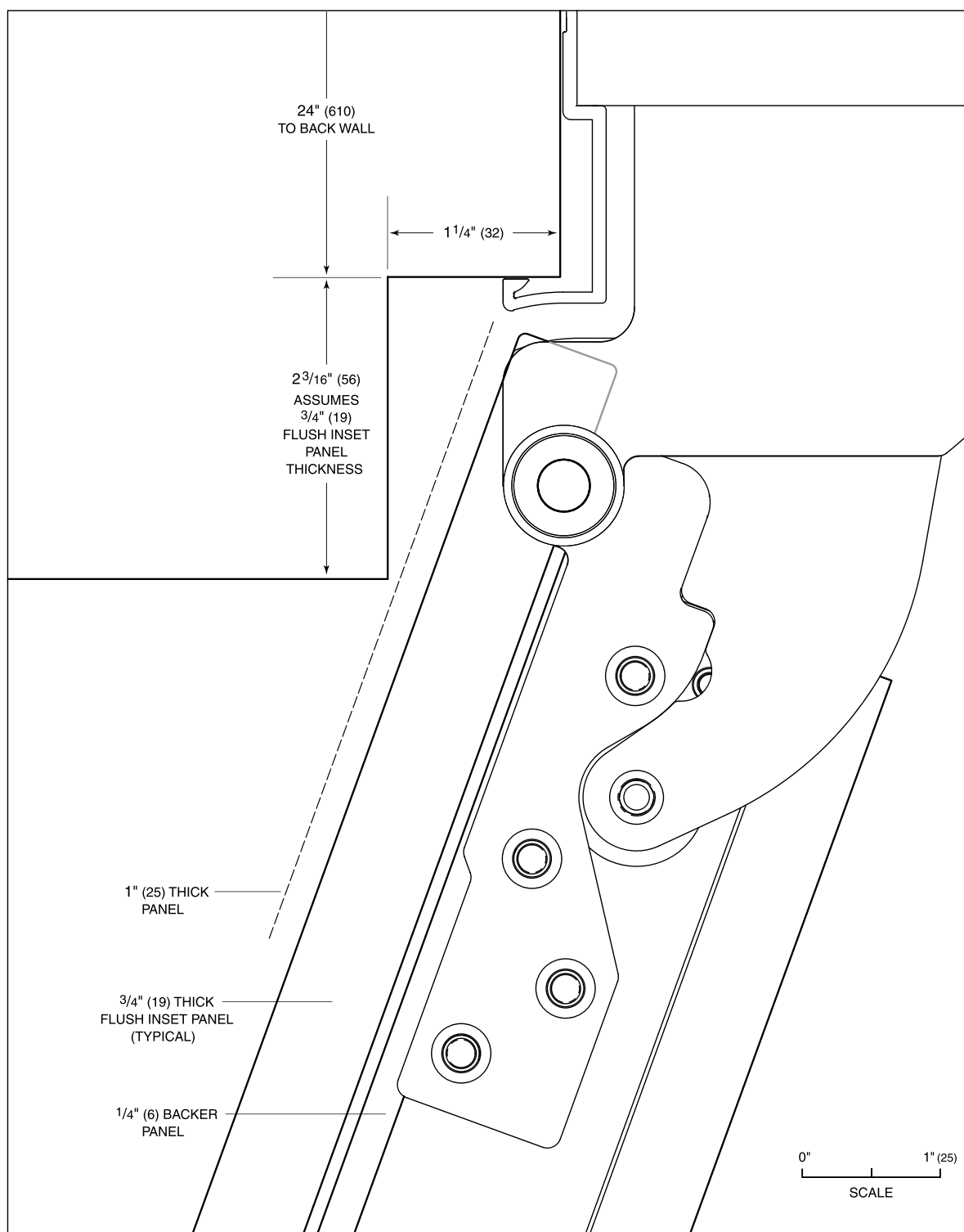

Flush inset application—110° door opening (top view).

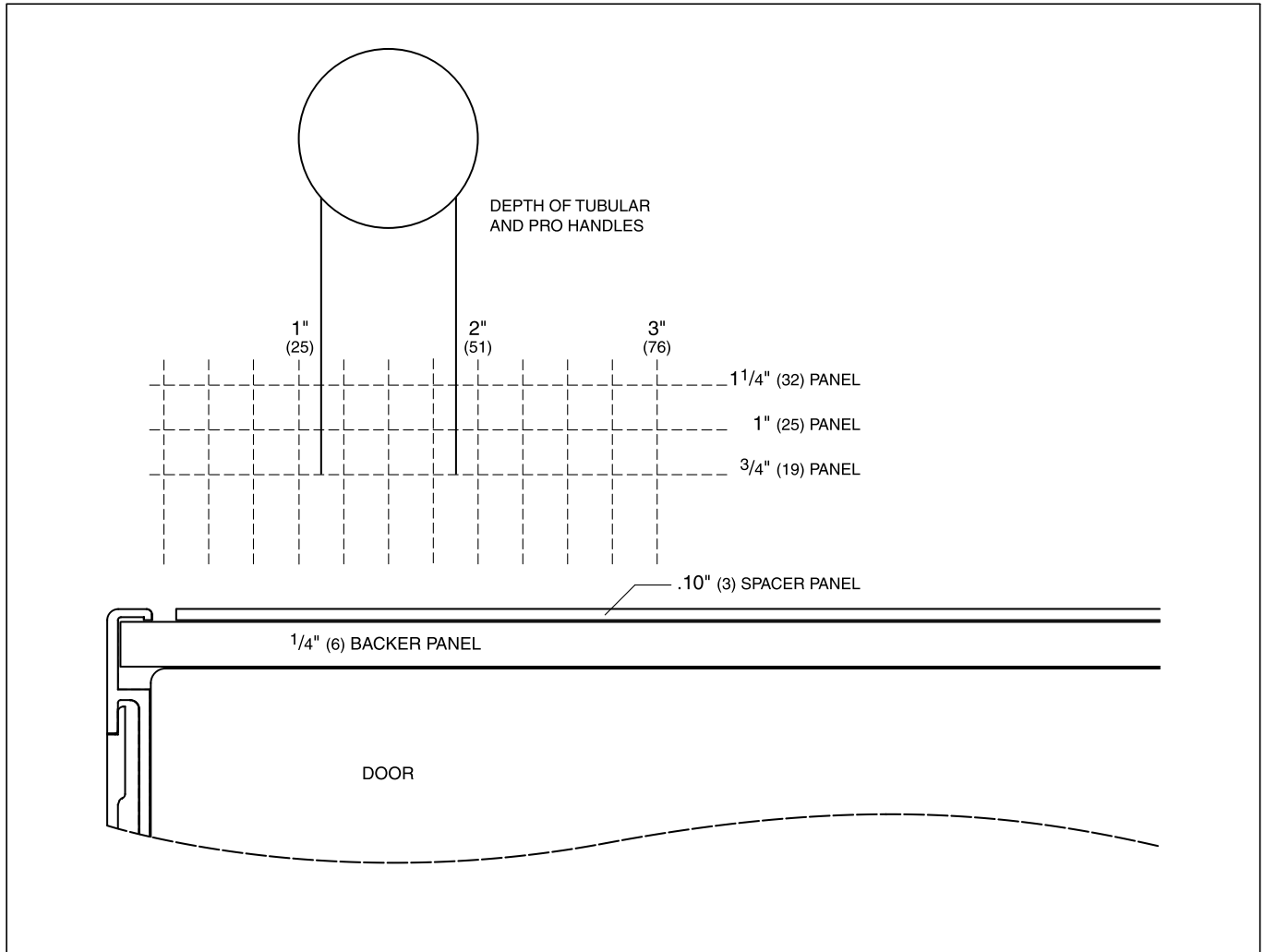

Overlay and flush inset panel thickness.



## Overall Dimensions

Single Model: BI-36UFD/O

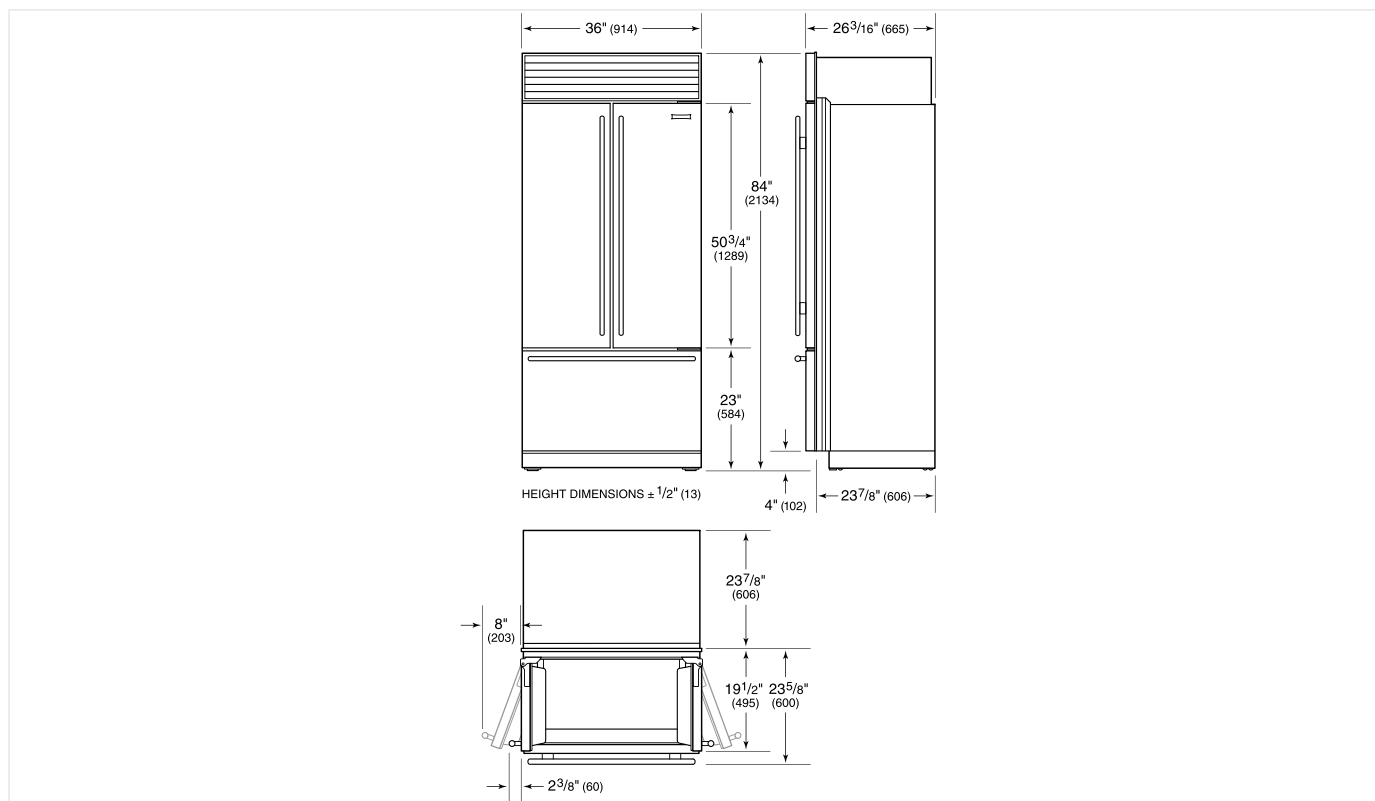

## Electrical

Single Model: BI-36UFD/O

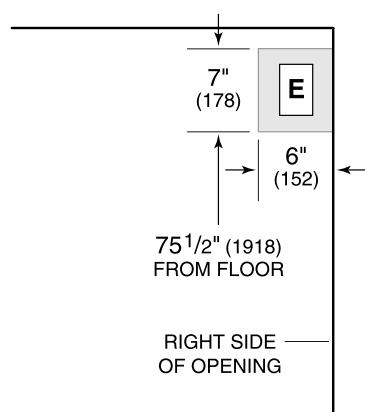

&gt;

Electrical Supply	grounded, 115 VAC, 60 Hz
Electrical Service	15 amp dedicated circuit
Receptacle	3-prong grounding-type

**WARNING**

Installation must comply with all applicable electrical codes.

A separate circuit, servicing only this appliance is required. A ground fault circuit interrupter (GFCI) is not recommended and may cause interruption of operation. Installation must comply with all applicable electrical codes.

## Plumbing

Single Model: BI-36UFD/O

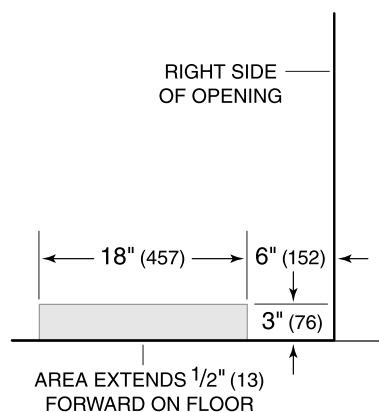

Water Supply	1/4" OD copper, braided stainless steel or PEX tubing
Excess Line For Connection	36"

The water supply line should be connected to the house supply with an easily accessible shut-off valve. Do not use self-piercing valves. The water supply line must not interfere with installation of the anti-tip brackets. A reverse osmosis system can be used provided there is constant water pressure of 35–120 psi (2.4–8.3 bar) supplied to the unit at all times. A copper line is not recommended for this application. Installation must comply with all applicable plumbing codes.

# GOEMANS APPLIANCES

*Expect More. Get More.*

## APPLIANCE SPECIFICATIONS

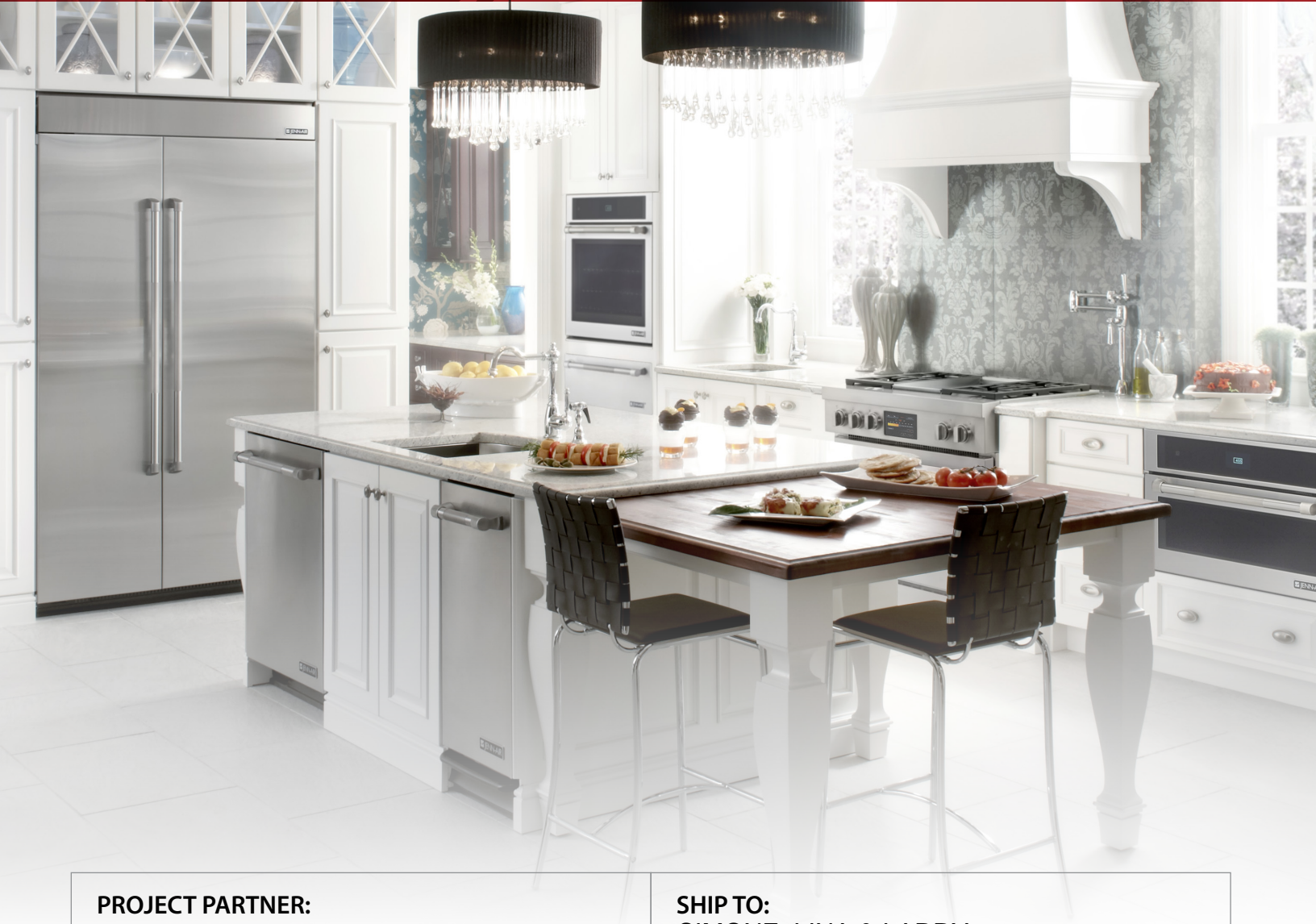

**PROJECT PARTNER:**

**SHIP TO:**  
**SIMONE, LINA & LARRY**

LOT TBD - WOODBRIDGE  
WOODBRIDGE, ON L4L 3N9

### REMINDER:

To ensure a smooth project it is the responsibility of the homeowner / purchaser of appliances to share all the attached specifications with their cabinet provider, contractor, or any other tradesperson so they have the information required to complete their work accurately. Product specifications are for planning purposes only and are subject to change without notice. Refer to installation instructions shipped with the product before cutting cabinets, counters, panels, etc.

Goemans Appliances assumes no liability for product specifications.

**SIMONE, LINA & LARRY**

LOT TBD - WOODBRIDGE  
WOODBRIDGE, ON L4L 3N9

**Goemans Appliances**

goemans.com

**Chantelle Hope**

Appliance Sales  
(905) 264-1771

Document **QU00189878**

Version 1.1

Fri, Feb 26, 2021

1:46 PM EST



enterprise.steelcod.com/sp/goem/IB6WD44C

<i>Models</i>	<i>Pages</i>
<b>SU90934X</b> Sirius Ventilation	3-4
<b>CIT36XWB</b> Thermador Cooktop	5-7
<b>JJW3430IM</b> Jenn-Air Wall Oven	8-10
<b>W10837579</b> Jenn-Air Accessory	11-14
<b>JMC2430IM</b> Jenn-Air Wall Oven	15-23
<b>SHVM78Z53N</b> Bosch Dishwasher	24-26
<b>MLWC224-SG01A</b> Marvel Refrigeration	27-28

**Note about page numbers:**

Because the original manufacturer's documents are not altered in any way, the page numbers displayed on the page may not correspond to the page number within this package.

**All specifications are intended for initial planning purposes only.**

Manufacturers reserve the right to change specifications at any time without notice. Always consult the installation instructions found on the manufacturer's website or included with the appliances before installation.





**SU 909**  
stainless steel AISI 430

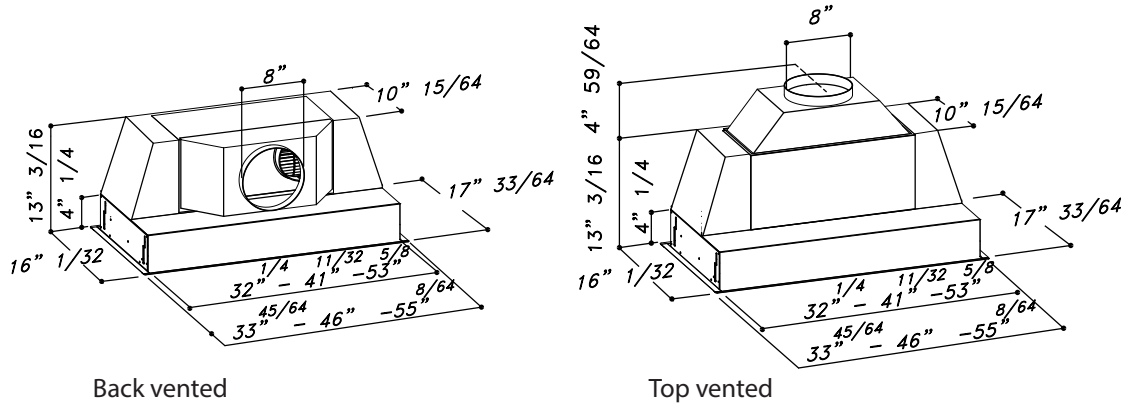

<b>MOTOR</b>	Dual Motor Aluminium die-cast housing 1100 CFM Pressure: 800 Pa Noise level: 66 dBA/5.1 sones
<b>LIGHTING</b>	2x1W Led spot for 34" and 46" 4x1W Led spot for 55"
<b>CONTROL PANEL</b>	Chromed push button 4 Speeds + timer +light
<b>GREASE FILTER</b>	Commercial style baffle filters
<b>AIR OUTLET</b>	8"
<b>DISCHARGE</b>	Vertical and horizontal
<b>CUT OUT</b>	32"15/32 x 16" 1/8 SU909 34" version 44" 23/32 x 16" 1/8 SU909 46" version 53" 3/4 x 16" 1/8 SU909 55" version
<b>ACCESSORIES</b>	Charcoal filters: KF7 (Order 2 pcs for SU909 34" version) KF7 (Order 3 pcs for SU909 46"/55" version) Cod. 60080477002

# CIT36XWB

## 36-INCH FREEDOM® INDUCTION COOKTOP

MASTERPIECE® SERIES, DARK GRAY WITH STAINLESS STEEL FRAME



### ALSO AVAILABLE:

CIT36XWBB – Dark Gray, Frameless

### FEATURES & BENEFITS

- ★ - Largest 36" fully usable cooking surface on the market within it's class
- ★ - 56 inductor elements combined with pot detection automatically recognizes the size, shape and position of your cookware on the cooktop
- ★ - Wi-Fi connectivity allows the cooktop and matching hood to communicate with one another to synchronize turning on task lighting and ventilation
- ★ - Sapphire Glow™ LED embedded surface lights along the sides of cooktop provide visual feedback when a pot is moved or whether a pot is heated or not
- ★ - TeppanyakiPro® function divides a teppanyaki griddle into one heated and one non-heated area

### GENERAL PROPERTIES

Home Connect™ (Wi-Fi Enabled)	Yes
Controls	Full Color Touch Screen Display

### ELEMENT PERFORMANCE

Power of Full Surface Heating Element	3,500 W
Power of Full Surface Heating Element (In Boost)	5,500 W
Burners With Booster	All

### COOKWARE SIZE (UP TO 6 POTS HEATED)

Minimum Cookware Size*	3 1/2" x 3 1/2"
Maximum Cookware Size*	13" x 21"

### TECHNICAL DETAILS

Watts (W)	7,200 W
Circuit Breaker (A)	30 A
Volts (V)	208 / 240 V
Frequency (Hz)	50 / 60 Hz
Plug Type	No Plug
Conduit	39" Flexible 3-Wire
Energy Source	Electric

### DIMENSIONS & WEIGHT

Overall Appliance Dimensions (HxWxD) (in)	4 1/8" x 37" x 21 1/4"
Required Cutout Size (HxWxD) (in)	4 1/8" x 34 3/4" x 19 7/8"
Minimum Distance From Counter Front (in)	2 1/2"
Minimum Distance From Rear Wall (in)	2"
Net Weight (lbs)	79 lbs

### WARRANTY

Limited Warranty, Entire Appliance, Parts and Labor	2 Year
---	--------

\*Cookware must have a flat bottom in order to utilize the full surface. Only use ferromagnetic cookware for induction cooking.

### ACCESSORIES (OPTIONAL)



CHEFSPAN08  
10" Stainless Steel Pan



CHEFSPAN13  
16" Round Skillet



TCOOKSENSW  
Wireless Cooking Sensor



TGRILLPANX  
Non-Stick Induction Grill  
9" x 17"



TROASTERT  
Stainless Steel  
Roaster Pan  
10" x 16"



TEPPAN1013  
Griddle Style Teppanyaki  
10" x 13"



TEPPAN1321  
Griddle Style Teppanyaki  
13" x 21"



TEPPAN1314  
Griddle Style  
Teppanyaki  
13" x 14"



TEPPAN1016  
Griddle Style Teppanyaki  
10" x 16"

# CIT36XWB

## 36-INCH FREEDOM® INDUCTION COOKTOP

MASTERPIECE® SERIES, DARK GRAY WITH STAINLESS STEEL FRAME



### 36-INCH COOKTOP AND CUTOUT DIMENSIONS

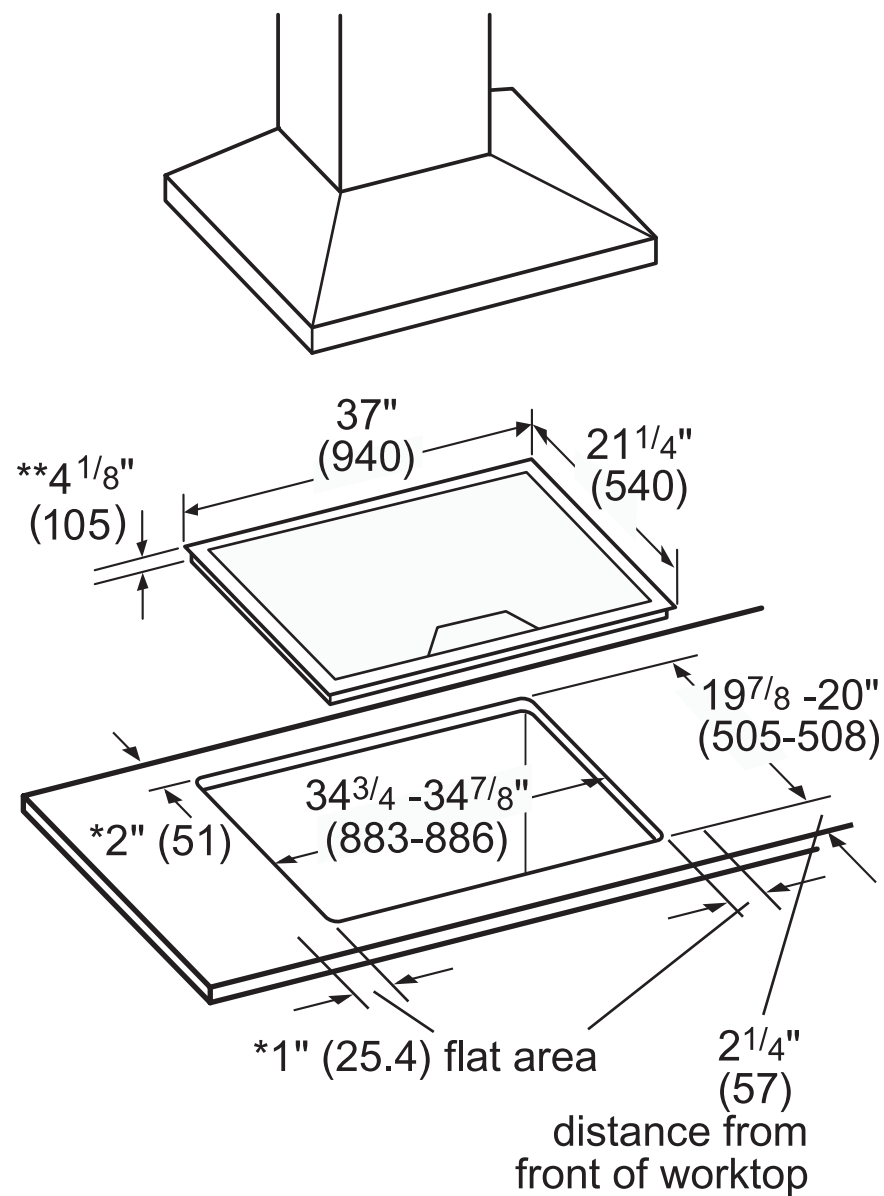

- \* Minimum distance from cutout to the wall
- \*\* Recessed depth (includes 1" air clearance)

Measurements in inches (mm in brackets)

**NOTE:** The work surface should be horizontal and level. The stability of the countertop should be confirmed even after making the cutout.



# CIT36XWB

## 36-INCH FREEDOM® INDUCTION COOKTOP

MASTERPIECE® SERIES, DARK GRAY WITH STAINLESS STEEL FRAME



### INSTALLATION ABOVE A THERMADOR WALL OVEN

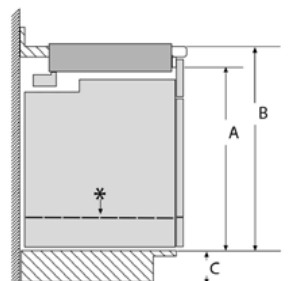

Product Type	A Inches (mm)	B min. Inches (mm)	C max. Inches (mm)
Conventional Oven	28 1/4 (718)	31 1/4 (794) min.	4 3/4 (121)
Steam Oven	25 1/16 (636)	28 1/16 (713)	7 15/16 (202)
Steam Oven with 4" Storage Drawer*	28 1/4 (718)	31 1/4 (794) min.	4 3/4 (121)
Microwave / Speed Oven	19 1/4 (488)	24 (609) min.	12" (306)
Microwave / Speed Oven with Warming drawer*	28 1/4 (718)	31 1/4 (794) min.	4 3/4 (121)

When installing an oven or oven with a drawer in combination with a cooktop, a minimum distance between the cabinet floor and countertop (B) is required. Reference the table for dimensions. Refer to the oven installation guide for all other measurements.

These warranties give you specific legal rights and you may have other rights that vary from state to state. Limited warranty from date of purchase. For complete warranty details, refer to your Use & Care manual, or ask your dealer.

Specifications are for planning purposes only. Refer to installation instructions and consult your countertop supplier prior to making counter opening. Consult with a heating and ventilation engineer for your specific ventilation requirements. For the most detailed information, refer to installation instructions accompanying product or write to Thermador indicating the model number. Specifications are correct at time of printing. Thermador reserves the right to change product specifications or design without notice. Some models are certified for use in Canada. Thermador is not responsible for products that are transported from the U.S. for use in Canada.



# 30" SINGLE WALL OVEN WITH V2™ VERTICAL DUAL-FAN CONVECTION SYSTEM

## Signature Features

### V2™ VERTICAL DUAL-FAN CONVECTION

Dual counter-rotating vertical fans work in tandem, helping you wield your cooking prowess with everything from mouthwatering fillets to irresistible roasts.

### MY CREATIONS

My Creations allows you to seamlessly combine up to three cooking modes and save the settings for your favorite recipes.

### IRRESISTIBLE INTERIOR

Captivation cloaked in black. Beyond a dark glass expanse, cinematic lighting illuminates smooth racks, flat tines, and an enticing jet black interior.

## Feature Listing

### DESIGN & CRAFTSMANSHIP

#### Irresistible Interior

##### 7-Inch Full Color LCD Display

Cinematic Lighting  
Seamless Touches  
Glide Rack  
Smooth Close Door  
5.0 Cu. Ft. Capacity

### PERFORMANCE

#### V2™ Vertical Dual-Fan Convection

#### My Creations

Closed Door Broiling  
Versatile Modes  
3,400-Watt Convection Element  
2,800-Watt Hidden Bake Element  
4,000-Watt Broil Element  
8-Pass Reflective Broil Element  
Connected Temperature Probe

### ADDITIONAL FEATURES

Keep Warm™ Option  
Auto Convection Conversion  
Auto Convection Modes  
Manual Convection Modes  
Rapid Preheat  
Proofing Option  
Control Lock  
Sabbath Mode  
ADA Compliant  
Badasses at the Ready  
Serviced by a Select Few

## Specifications

Shipping Weight (lbs) 184  
Volts 240  
Amps 20  
Capacity (Cu. Ft.) 5.0

## Dimensions

Overall Dimensions 30" x 29(7/8)" x 25(5/16)"  
Opening / Clearance Dimensions (Traditional Installation) 28(1/2)" x 28" x 24"  
Opening / Clearance Dimensions (Flush Installation) 30(1/4)" x 30(7/16)" x 25"

**Do not make any cutouts based on this information**

JJW3430I



## Style Options

### RISE™

JJW3430IL

### NOIR™

JJW3430IM



Bold = Top Features

JENNAIR®

## SINGLE WALL OVENS

JJW2427I – 27" x 29-7/8" x 25-5/16"

JJW2430I, JJW3430I – 30" x 29-7/8" x 25-5/16"

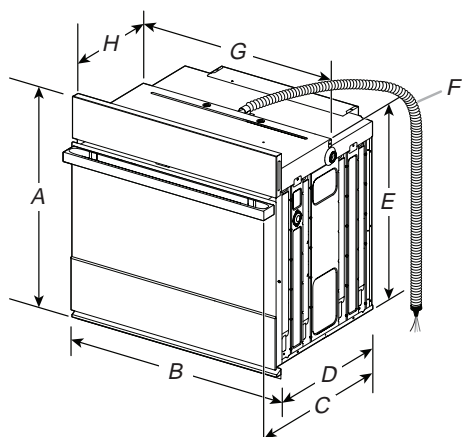

## PRODUCT DIMENSIONS – SINGLE OVENS

## 27" (68.6 CM) MODELS

- A. 29-7/8" (75.8 cm) max. overall height
- B. 27" (68.6 cm) overall width
- C. JJW2427IM – 26-3/8" (67 cm)  
JJW2427IL – 27-3/16" (69 cm)
- D. 23-1/4" (59.1 cm) max. recessed depth
- E. 27-3/16" (69 cm) recessed height
- F. 48" (121.9 cm) flexible conduit length
- G. 25-7/16" (64.6 cm) max. recessed width
- H. 12" (30.5 cm) from back of control panel to start of strain relief

## 30" (76.2 CM) MODELS

- A. 29-7/8" (75.8 cm) max. overall height
- B. 30" (76.2 cm) overall width
- C. JJW2430IM – 26-3/8" (67 cm)  
JJW2430IL – 27-3/16" (69 cm)  
JJW3430IM – 26-3/8" (67 cm)  
JJW3430IL – 27-3/16" (69 cm)
- D. 23-1/4" (59.1 cm) max. recessed depth
- E. 27-3/16" (69 cm)
- F. 48" (121.9 cm) flexible conduit length
- G. 28-7/16" (72.2 cm) max. recessed width
- H. 12" (30.5 cm) from back of control panel to start of strain relief

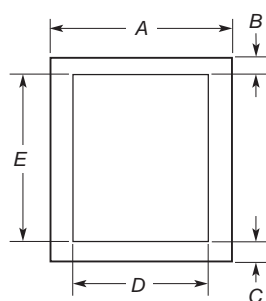

## UNDERCOUNTER CABINET DIMENSIONS – SINGLE OVENS

## 27" (68.6 CM) MODELS

- A. 27" (68.6 cm) min. cabinet width
- B. 1-1/2" (3.8 cm) min. top of cutout to underside of countertop
- C. 5-1/4" (13.3 cm) bottom of cutout to floor
- D. 25-1/2" (64.8 cm) cutout width
- E. 28" (71.2 cm) min. cutout height

## 30" (76.2 CM) MODELS

- A. 30" (76.2 cm) min. cabinet width
- B. 1-1/2" (3.8 cm) min. top of cutout to underside of countertop
- C. 5-1/4" (13.3 cm) bottom of cutout to floor
- D. 28-1/2" (72.4 cm) cutout width
- E. 28" (71.2 cm) min. cutout height

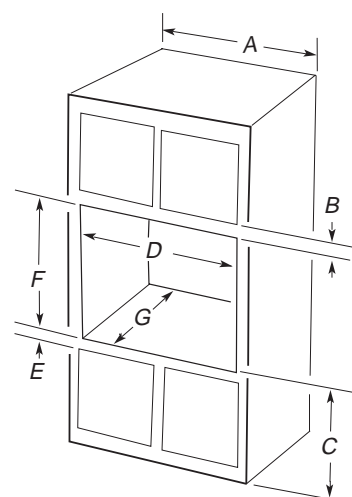

## SINGLE OVENS INSTALLED IN CABINET

## 27" (68.6 CM) MODELS

- A. 27" (68.6 cm) min. cabinet width
- B. 2-3/16" (5.5 cm) top of cutout to bottom of upper cabinet door
- C. 32" (81.3 cm) bottom of cutout to floor
- D. 25-1/2" (64.8 cm) cutout width
- E. 1-1/2" (3.8 cm) min. bottom of cutout to top of cabinet door
- F. 28" (71.2 cm)\* recommended cutout height
- G. 24" (60.7 cm) cutout depth

**\*NOTE:** The cutout height can be between 27-1/4" (69.2cm) and 29-7/16" (74.8 cm) for 27" single ovens.

## 30" (76.2 CM) MODELS

- A. 30" (76.2 cm) min. cabinet width
- B. 2-3/16" (5.5 cm) top of cutout to bottom of upper cabinet door
- C. 32" (81.3 cm) bottom of cutout to floor
- D. 28-1/2" (72.4 cm) cutout width
- E. 1-1/2" (3.8 cm) min. bottom of cutout to top of cabinet door
- F. 28" (71.2 cm)\* recommended cutout height
- G. 24" (60.7 cm) cutout depth

**\*NOTE:** The cutout height can be between 27-1/4" (69.2 cm) and 29-7/16" (74.8 cm) for 30" single ovens.

**IMPORTANT:** Dimensional specifications are provided for planning purposes only.

**Do not make any cutouts based on this information.** Refer to the Installation or Use & Care Guide before selecting cabinetry, verifying electrical/gas connections, making cutouts or beginning installation.

All JennAir® appliances are appropriately UL, CUL or CSA approved.



## SINGLE WALL OVENS

JJW2427I – 27" x 29-7/8" x 25-5/16"

JJW2430I, JJW3430I – 30" x 29-7/8" x 25-5/16"

## ELECTRICAL REQUIREMENTS

If codes permit and a separate ground wire is used, it is recommended that a qualified electrical installer determine that the ground path and the wire gauge are in accordance with local codes.

Check with a qualified electrical installer if you are not sure the oven is properly grounded.

This oven must be connected to a grounded metal, permanent wiring system.

Be sure that the electrical connection and wire size are adequate and in conformance with the National Electrical Code, ANSI/NFPA 70-latest edition or CSA Standards C22.1-94, Canadian Electrical Code, Part 1 and C22.2 No. 0-M91-latest edition, and all local codes and ordinances.

A copy of the above code standards can be obtained from:

National Fire Protection Association  
1 Batterymarch Park  
Quincy, MA 02169-7471

CSA International  
8501 East Pleasant Valley Road  
Cleveland, OH 44131-5575

- Models rated from 7.3 to 9.6 kW at 240 V (5.4 to 7.4 kW at 208 V) require a separate 40 A circuit. Models rated at 4.8 kW and below at 240 V (3.6 kW and below at 208 V) require a separate 20 A circuit.
- A circuit breaker is recommended.
- Connect directly to the circuit breaker box (or fused disconnect) through flexible, armored, or nonmetallic sheathed, copper cable (with grounding wire).
- Flexible conduit from the oven should be connected directly to the junction box.
- Fuse both sides of the line.
- Do not cut the conduit. The length of conduit provided is for serviceability of the oven.
- A UL listed or CSA approved conduit connector must be provided.
- If the house has aluminum wiring, follow the procedure below: Connect the aluminum wiring using special connectors and/or tools designed and UL listed for joining copper to aluminum. Follow the electrical connector manufacturer's recommended procedure. Aluminum/copper connection must conform with local codes and industry accepted wiring practices.

For power requirements for models JJW2427I, JJW2430I and JJW3430I, refer to the following table.

	240 VAC	208 VAC
Model	kW	kW
JJW2427I	4.1	3.1
JJW2430I	4.1	3.1
JJW3430I	4.5	3.4

## ELECTRICAL CONNECTION

To properly install your oven, you must determine the type of electrical connection you will be using and follow the instructions provided for it here.

- Oven must be connected to the proper electrical voltage and frequency as specified on the model/serial/rating plate. The model/serial/rating plate is located under the control panel on single ovens. See the following illustration

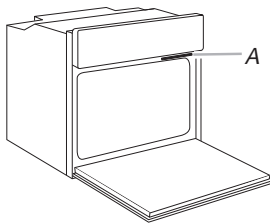

A. Model/Serial/Rating Plate

**IMPORTANT:** Dimensional specifications are provided for planning purposes only.

**Do not make any cutouts based on this information.** Refer to the Installation or Use & Care Guide *before* selecting cabinetry, verifying electrical/gas connections, making cutouts or beginning installation.

All JennAir® appliances are appropriately UL, CUL or CSA approved.



# INSTALLATION INSTRUCTIONS 27" (68.6 CM) AND 30" (76.2 CM) ELECTRIC SINGLE AND DOUBLE BUILT-IN OVEN FLUSH INSTALLATION KIT

## INSTRUCTIONS D'INSTALLATION ENSEMBLE D'INSTALLATION EN AFFLEUREMENT POUR FOUR ÉLECTRIQUE ENCASTRÉ SIMPLE ET DOUBLE DE 27" (68,6 CM) ET 30" (76,2 CM)

27" (68.6 cm) Flush Installation Kits  
Ensembles d'installation en affleurement de 27" (68,6 cm)

	Black Noir	Stainless Steel Acier inoxydable	Stainless Steel/ Acier inoxydable, RISE™/NOIR™
Model# Modèle n°	Kit PN/ Ensemble référence: W10791232	Kit PN/ Ensemble référence: W10791228	Kit PN/ Ensemble référence: W11357761
JJW2427DB, JJW2827DB	★★	*	*
JJW2427DS, JJW2827DS, JJW2727DS	*	★★	*
JJW2427IM, JJW2427IL, JJW2827IM, JJW2827IL	*	*	★★

30" (76.2 cm) Flush Installation Kits  
Ensembles d'installation en affleurement de 30" (76,2 cm)

	Black Noir		Stainless Steel Acier inoxydable		Stainless Steel/ Acier inoxydable, RISE™/NOIR™	
Model# Modèle n°	Kit PN Ensemble référence: W10791233	Kit PN Ensemble référence: W10837578	Kit PN Ensemble référence: W10791229	Kit PN Ensemble référence: W10837579	Kit PN Ensemble référence: W11357756	Kit PN Ensemble référence: W11357769
JJW2430DS, JJW2430DP, JJW2830DS, JJW2830DP, JJW2730DS	*		★★		*	
JJW2430DB, JJW2830DB	★★		*		*	
JJW2430IM, JJW2430IL, JJW2830IM, JJW2830IL	*		*		★★	
JJW3430DS, JJW3430DP, JJW3830DS, JJW3830DP		*		★★		*
JJW3430IM, JJW3430IL, JJW3830IM, JJW3830IL		*		*		★★
JJW3430DB, JJW3830DB		★★		*		*

★ Approved for use.

★★ Recommended color and approved for use.

★ Approuvé pour l'utilisation.

★★ Couleur recommandée et approuvé pour l'utilisation.

### IMPORTANT:

Save for local electrical inspector's use.

### IMPORTANT:

À conserver pour consultation par l'inspecteur local des installations électriques.

W11356314A

In some European factories the letter "W" of the part code mentioned herein will be automatically replaced by the number "4000" (e.g. "W12345678" becomes "400012345678")



## Table of Contents/Table des matières

<b>BUILT-IN OVEN SAFETY</b> .....	<b>2</b>	<b>SÉCURITÉ DU FOUR ENCASTRÉ</b> .....	<b>11</b>
<b>INSTALLATION REQUIREMENTS</b> .....	<b>2</b>	<b>EXIGENCES D'INSTALLATION</b> .....	<b>12</b>
Tools and Parts.....	2	Outillage et pièces.....	12
Location Requirements.....	3	Exigences d'emplacement.....	12
<b>INSTALLATION INSTRUCTIONS</b> .....	<b>5</b>	<b>INSTRUCTIONS D'INSTALLATION</b> .....	<b>15</b>
Prepare Built-In Oven.....	5	Préparation du four encastré.....	15
Remove Oven Door(s).....	5	Dépose de la/des porte(s) du four.....	15
Replace Oven Door(s).....	6	Réinstallation de la/des porte(s) du four.....	16
Positioning Oven Feet.....	7	Positionnement des pieds du four.....	17
Replace Plastic Spacers.....	8	Remplacement des cales d'espacement en plastique.....	18
Install Oven.....	9	Installation du four.....	19
Install Deflector Kit Bracket.....	9	Installation du support de la trousse du déflecteur.....	19
Complete Installation.....	10	Achever l'installation.....	20

## BUILT-IN OVEN SAFETY

### Your safety and the safety of others are very important.

We have provided many important safety messages in this manual and on your appliance. Always read and obey all safety messages.



This is the safety alert symbol.

This symbol alerts you to potential hazards that can kill or hurt you and others.

All safety messages will follow the safety alert symbol and either the word "DANGER" or "WARNING."

These words mean:

**! DANGER**

**You can be killed or seriously injured if you don't immediately follow instructions.**

**! WARNING**

**You can be killed or seriously injured if you don't follow instructions.**

All safety messages will tell you what the potential hazard is, tell you how to reduce the chance of injury, and tell you what can happen if the instructions are not followed.

## INSTALLATION REQUIREMENTS

### Tools and Parts

Gather the required tools and parts before starting installation. Read and follow the instructions provided.

#### Tools Needed

- Phillips screwdriver
- Measuring tape
- Drill (for wall cabinet installations)
- 1/8" (3.1 mm) drill bit (for wall cabinet installations)
- Level
- Flat-blade screwdriver

#### Parts Supplied With Your Built-In Oven

- #8-14 x 1" (2.5 cm) screws - (2) single ovens, (4) double ovens included with built-in oven
- (2) #8-18 x 3/8" (9.5 mm) screws - bottom vent included with built-in oven
- (4) #8-18 x 3/8" (9.5 mm) screws - included with built-in oven
- Bottom vent included with built-in oven
- (2) Feet double oven included with built-in oven
- (2) Front feet double oven included with built-in oven

Parts Supplied

- Deflector bracket
- Plastic spacers - (4) single ovens, (6) double ovens
- #8-18 x 1/4" (6.3 mm) screws - (2) for 27" (68.6 cm) models; (4) for 30" (76.2 cm) models

Location Requirements

- IMPORTANT:** Observe all governing codes and ordinances.
- NOTE:** Refer to the following "Location Requirements" and the "Location Requirements" section of the Installation Instructions provided with your built-in oven.
- Cabinet opening dimensions that are shown must be used. Given dimensions provide minimum clearance with oven.
  - Recessed installation area must provide complete enclosure around the recessed portion of the oven.
  - Oven support surface must be solid, level, and flush with bottom of the cabinet cutout.
  - Floor must be able to support a single oven weight of 180 lbs (82 kg).
  - Floor must be able to support a double oven weight of 357 lbs (162 kg).
- IMPORTANT:** To avoid damage to your cabinets, check with your builder or cabinet supplier to make sure that the materials used will not discolor, delaminate, or sustain other damage. This oven has been designed in accordance with the requirements of UL and CSA International and complies with the maximum allowable wood cabinet temperatures of 194°F (90°C).

Deflector Bracket Dimensions

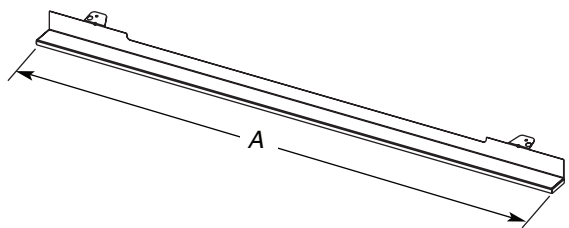

- |   |   |
|---|---|
| <b>27" (68.6 cm) Models</b>                                   | <b>30" (76.2 cm) Models</b>                                   |
| A. 26 <sup>15</sup> / <sub>16</sub> " (68.4 cm) overall width | A. 29 <sup>15</sup> / <sub>16</sub> " (76.0 cm) overall width |

Cabinet Dimensions - Single Ovens, Flush Installations

A 25" (63.5 cm) minimum cutout depth is required.

These dimensions will result in a 1/4" (6.3 mm) reveal on the top, a 1/4" (6.3 mm) reveal on the sides, and a 1/8" (3.1 mm) reveal on the bottom of the wall oven.

The front face of the cleats and platform will be visible and should be treated as a finished surface.

Single Ovens Installed in Cabinet - Flush Installation

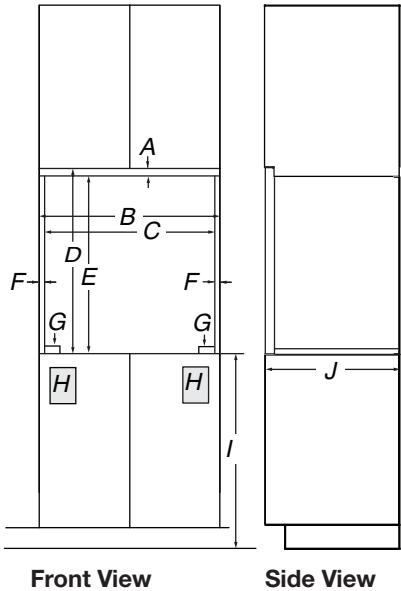

- | <b>27" (68.6 cm) Models</b>   | <b>30" (76.2 cm) Models</b>  |
|---|--|
| A. 3/4" (19 mm) top cleat*  | A. 3/4" (19 mm) top cleat*   |
| B. 27 <sup>1</sup> / <sub>4</sub> " (69.2 cm) minimum width of flush inset cutout     | B. 30 <sup>1</sup> / <sub>4</sub> " (76.8 cm) minimum width of flush inset cutout      |
| C. 25 <sup>7</sup> / <sub>8</sub> " (65.7 cm) minimum width of opening                | C. 28 <sup>7</sup> / <sub>8</sub> " (73.3 cm) minimum width of opening                 |
| D. 30 <sup>7</sup> / <sub>16</sub> " (77.3 cm) minimum height of flush inset cutout   | D. 30 <sup>7</sup> / <sub>16</sub> " (77.3 cm) minimum height of flush inset cutout    |
| E. 29 <sup>11</sup> / <sub>16</sub> " (75.4 cm) recommended cutout height             | E. 29 <sup>11</sup> / <sub>16</sub> " (75.4 cm) recommended cutout height              |
| F. 11/16" (1.7 cm) side cleat*  | F. 11/16" (1.7 cm) side cleat*   |
| G. 1/2" x 2" (1.3 cm x 5.1 cm) spacer the entire depth of the cutout*                 | G. 1/2" x 2" (1.3 cm x 5.1 cm) spacer the entire depth of the cutout*                  |
| H. Recommended junction box location  | H. Recommended junction box location   |
| I. 4 <sup>5</sup> / <sub>8</sub> " - 32" (11.7 cm- 81.3 cm) bottom of cutout to floor | I. 4 <sup>5</sup> / <sub>8</sub> " - 32" (11.7 cm - 81.3 cm) bottom of cutout to floor |
| J. 25" (63.5 cm) minimum depth of cutout  | J. 25" (63.5 cm) minimum depth of cutout   |

\*Cleats and spacers must be recessed 1<sup>3</sup>/<sub>8</sub>" (3.5 cm) from the front of the cabinet.

## Single Ovens Undercounter - Flush Installations (without cooktop installed above)

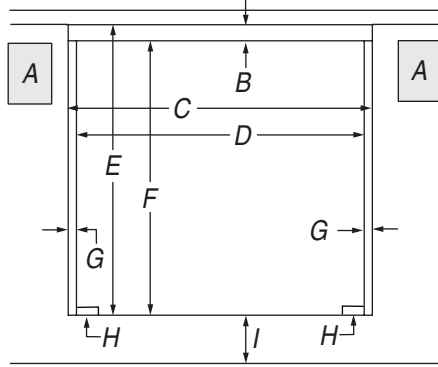

Front View

### 27" (68.6 cm) Models

- A. Recommended junction box location
- B. 3/4" (1.9 cm) top cleat\*
- C. 27 1/4" (69.2 cm) minimum width of flush inset cutout
- D. 25 7/8" (65.7 cm) minimum width of opening
- E. 30 7/16" (77.3 cm) minimum height of flush inset cutout
- F. 29 11/16" (75.4 cm) recommended cutout height
- G. 11/16" (1.7 cm) side cleat\*
- H. 1/2" x 2" (1.3 cm x 5.1 cm) spacer the entire depth of the cutout\*
- I. 4 1/16" (10.3 cm) bottom of cutout to floor

### 30" (76.2 cm) Models

- A. Recommended junction box location
- B. 3/4" (1.9 cm) top cleat\*
- C. 30 1/4" (76.8 cm) minimum width of flush inset cutout
- D. 28 7/8" (73.3 cm) minimum width of opening
- E. 30 7/16" (77.3 cm) minimum height of flush inset cutout
- F. 29 11/16" (75.4 cm) recommended cutout height
- G. 11/16" (1.7 cm) side cleat\*
- H. 1/2" x 2" (1.3 cm x 5.1 cm) spacer the entire depth of the cutout\*
- I. 4 1/16" (10.3 cm) bottom of cutout to floor

\*Cleats and spacers must be recessed 1 3/8" (3.5 cm) from the front of the cabinet.

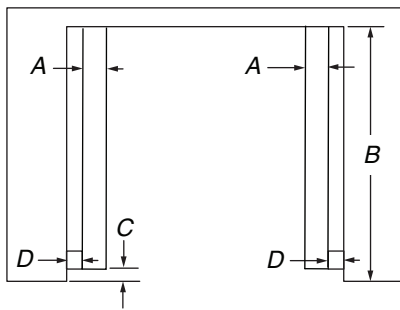

Top View

### 27" (68.6 cm) Models

- A. 1/2" x 2" (1.3 cm x 5.1 cm) spacer the entire depth of the cutout\*
- B. 25" (63.5 cm) depth of cutout
- C. 1 3/8" (3.5 cm) recess from front of cabinet
- D. 11/16" (1.7 cm) side cleat\*

### 30" (76.2 cm) Models

- A. 1/2" x 2" (1.3 cm x 5.1 cm) spacer the entire depth of the cutout\*
- B. 25" (63.5 cm) depth of cutout
- C. 1 3/8" (3.5 cm) recess from front of cabinet
- D. 11/16" (1.7 cm) side cleat\*

\*Cleats and spacers must be recessed 1 3/8" (3.5 cm) from the front of the cabinet.

## Cabinet Dimensions - Double Ovens, Flush Installations

A 25" (63.5 cm) minimum cutout depth is required.

These dimensions will result in a 1/4" (6.3 mm) reveal on the top, a 1/4" (6.3 mm) reveal on the sides, and a 1/8" (3.1 mm) reveal on the bottom of the wall oven.

The front face of the cleats and platform will be visible and should be treated as a finished surface.

## Double Ovens Installed in Cabinet - Flush Installations

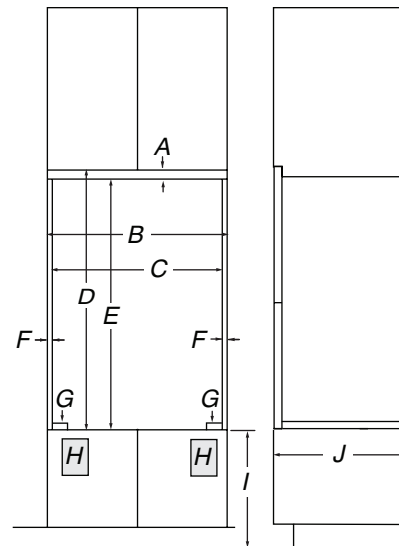

Front View

Side View

### 27" (68.6 cm) Models

- A. 9/16" (1.4 cm) top cleat\*
- B. 27 1/4" (69.2 cm) minimum width of flush inset cutout
- C. 25 7/8" (65.7 cm) minimum width of opening
- D. 53 3/16" (135.1 cm) minimum height of flush inset cutout
- E. 52 5/8" (133.6 cm) recommended cutout height
- F. 11/16" (1.7 cm) side cleat\*
- G. 1/2" x 2" (1.3 cm x 5.1 cm) spacer the entire depth of the cutout\*
- H. Recommended junction box location
- I. 4 5/8" - 14 3/4" (11.7 - 37.5 cm) bottom of cutout to floor
- J. 25" (63.5 cm) minimum depth of cutout

### 30" (76.2 cm) Models

- A. 9/16" (1.4 cm) top cleat\*
- B. 30 1/4" (76.8 cm) minimum width of flush inset cutout
- C. 28 7/8" (73.3 cm) minimum width of opening
- D. 53 3/16" (135.1 cm) minimum height of flush inset cutout
- E. 52 5/8" (133.6 cm) recommended cutout height
- F. 11/16" (1.7 cm) side cleat\*
- G. 1/2" x 2" (1.3 cm x 5.1 cm) spacer the entire depth of the cutout\*
- H. Recommended junction box location
- I. 4 5/8" - 14 3/4" (11.7 - 37.5 cm) bottom of cutout to floor
- J. 25" (63.5 cm) minimum depth of cutout

\*Cleats and spacers must be recessed 1 3/8" (3.5 cm) from the front of the cabinet.

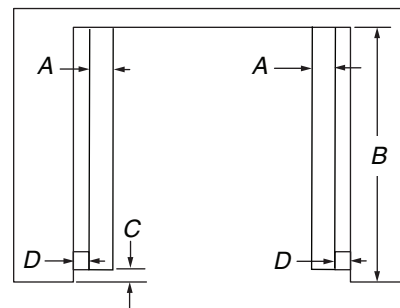

Top View

### 27" (68.6 cm) Models

- A. 1/2" x 2" (1.3 cm x 5.1 cm) spacer the entire depth of the cutout\*
- B. 25" (63.5 cm) depth of cutout
- C. 1 3/8" (3.5 cm) recess from front of cabinet
- D. 11/16" (1.7 cm) side cleat\*

### 30" (76.2 cm) Models

- A. 1/2" x 2" (1.3 cm x 5.1 cm) spacer the entire depth of the cutout\*
- B. 25" (63.5 cm) depth of cutout
- C. 1 3/8" (3.5 cm) recess from front of cabinet
- D. 11/16" (1.7 cm) side cleat\*

\*Cleats and spacers must be recessed 1 3/8" (3.5 cm) from the front of the cabinet.

# JennAir® NOIR™ 30" BUILT-IN MICROWAVE OVEN WITH SPEED-COOK

JMC2430IM

Available Finishes/Colours



JMC2430IM  
FA



Let your appetite run wild with microwave and convection energy. With curated recipes and full-color doneness images, an intelligent culinary experience awaits your touch.

## Top Features

4.3-Inch Full Color LCD Display

Seamless Touches

Stainless Steel Microwave Interior

## Manuals & Literature:



[Use and Care](#)



[Installation Instructions](#)



[Warranty](#)

# INSTALLATION REQUIREMENTS

## Tools and Parts

Gather the required tools and parts before starting installation. Read and follow the instructions provided with any tools listed here.

### Tools Needed

- Phillips screwdriver
- Flat-blade screwdriver
- Measuring tape
- Level
- Drill (for wall cabinet installations)
- 1/8" (3 mm) drill bit (for wall cabinet installations)
- 1" (2.5 cm) drill bit (for wall cabinet installations)

### Parts Needed

- UL listed or CSA approved conduit connector
- UL listed wire connectors

### Parts Needed – Flush Installation

- W10801485 Stainless steel flush installation kit for 27" (68.6 cm) models
- W10801486 Stainless steel flush installation kit for 30" (76.2 cm) models
- W10801487 Black flush installation kit for 30" (76.2 cm) models

To order, see the "Assistance or Service" section of the Use and Care Guide.

### Parts Supplied

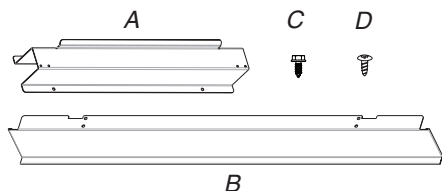

- A. Spacer bars (2)
- B. Bottom vent (1)
- C. 3/8" (9.5 mm) hex-head washer screws (4)
- D. 3/4" (1.9 cm) pan-head screws (4)

Check local codes. Check existing electrical supply. See "Electrical Requirements."

It is recommended that all electrical connections be made by a licensed, qualified electrical installer.

## Location Requirements

**IMPORTANT:** Observe all governing codes and ordinances.

- Cabinet opening dimensions that are shown must be used. Given dimensions provide minimum clearance with microwave oven.
- Recessed installation area must provide complete enclosure around the recessed portion of the microwave oven.
- Grounded electrical supply is required. See "Electrical Requirements" section.
- Electrical supply junction box should be located 3" (7.6 cm) maximum below the support surface when the microwave oven is installed in a wall cabinet. A 1" (2.5 cm) minimum diameter hole should have been drilled in the left rear corner of the support surface to pass the appliance cable through to the junction box.

- For installation above single built-in oven, the junction box must be located inside upper cabinet.
- If you are installing the junction box on rear wall behind the microwave oven, the junction box must be recessed and located in the upper or lower right or left corner of the cabinet; otherwise, the microwave oven will not fit into the cabinet opening.
- Microwave oven support surface must be solid, level, and flush with bottom of cabinet cutout. Floor must be able to support a weight of 108 lbs (49.0 kg).

**IMPORTANT:** To avoid damage to your cabinets, check with your builder or cabinet supplier to make sure that the materials used will not discolor, delaminate, or sustain other damage. This oven has been designed in accordance with the requirements of UL and CSA International and complies with the maximum allowable wood cabinet temperatures of 194°F (90°C).

## Product Dimensions

### 27" (68.6 cm) and 30" (76.2 cm) Microwave Ovens

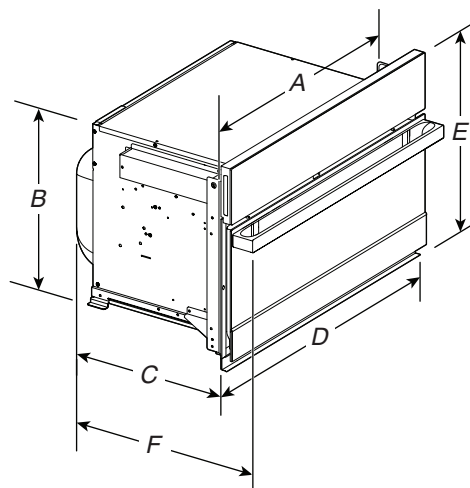

#### 27" (68.6 cm) models

- A. 25<sup>3</sup>/<sub>8</sub>" (64.5 cm)
- B. 17<sup>3</sup>/<sub>8</sub>" (44.1 cm)
- C. 22<sup>11</sup>/<sub>16</sub>" (57.7 cm)
- D. 26<sup>3</sup>/<sub>4</sub>" (68.0 cm) overall width
- E. 19<sup>7</sup>/<sub>8</sub>" (50.3 cm) overall height
- F. JMC2427IM: 25<sup>9</sup>/<sub>16</sub>" (64.9 cm)  
JMC2427IL: 24<sup>3</sup>/<sub>4</sub>" (62.9 cm)

#### 30" (76.2 cm) models

- A. 28<sup>3</sup>/<sub>8</sub>" (72.1 cm)
- B. 17<sup>3</sup>/<sub>8</sub>" (44.1 cm)
- C. 22<sup>11</sup>/<sub>16</sub>" (57.7 cm)
- D. 29<sup>3</sup>/<sub>4</sub>" (75.6 cm) overall width
- E. 19<sup>7</sup>/<sub>8</sub>" (50.3 cm) overall height
- F. JMC2430IM: 25<sup>9</sup>/<sub>16</sub>" (64.9 cm)  
JMC2430IL: 24<sup>3</sup>/<sub>4</sub>" (62.9 cm)

### 27" (68.6 cm) and 30" (76.2 cm) Microwave Oven Spacer Kit

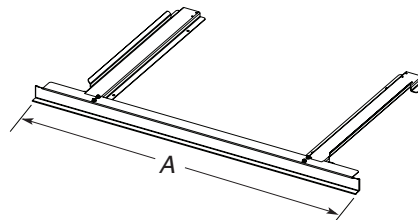

#### 27" (68.6 cm) models

- A. 26<sup>3</sup>/<sub>4</sub>" (67.9 cm) overall width

#### 30" (76.2 cm) models

- A. 29<sup>3</sup>/<sub>4</sub>" (75.6 cm) overall width

**NOTE:** The microwave oven spacer kit will allow the microwave oven to be installed in a 17<sup>3</sup>/<sub>8</sub>" to 17<sup>3</sup>/<sub>4</sub>" (44.1 to 45.1 cm) maximum cutout height.



# INSTALLATION INSTRUCTIONS 27" (68.6 CM) AND 30" (76.2 CM) ELECTRIC BUILT-IN MICROWAVE OVEN FLUSH INSTALLATION KIT

## INSTRUCTIONS D'INSTALLATION POUR ENSEMBLE D'INSTALLATION EN AFFLEUREMENT DE FOUR À MICRO-ONDES ÉLECTRIQUE ENCASTRÉ DE 27" (68,6 CM) ET 30" (76,2 CM)

### 27" (68.6 cm) Flush Installation Kits Ensembles d'installation en affleurement de 27" (68,6 cm)

	Stainless Steel Acier inoxydable	Stainless Steel/ Acier inoxydable, RISE™/NOIR™
Model#/ Modèle n°	Kit PN/ Ensemble référence: W10801485	Kit PN/ Ensemble référence: W11358283
JMC2427DS	★★	*
JMC2427IM, JMC2427IL	*	★★

### 30" (76.2 cm) Flush Installation Kits Ensembles d'installation en affleurement de 30" (76,2 cm)

	Black Noir	Stainless Steel/ Acier inoxydable	Stainless Steel/ Acier inoxydable, RISE™/NOIR™
Model#/ Modèle n°	Kit PN/ Ensemble référence: W10801487	Kit PN/ Ensemble référence: W10801486	Kit PN/ Ensemble référence: W11358282
JMC2430DB	★★	*	*
JMC2430DP, JMC2430DS	*	★★	*
JMC2430IM, JMC2430IL	*	*	★★

\* Approved for use.

★★ Recommended color and approved for use.

\* Approuvé pour l'utilisation.

★★ Couleur recommandée et approuvé pour l'utilisation.

### Table of Contents/Table des matières

<b>BUILT-IN MICROWAVE OVEN SAFETY</b> .....	2	<b>SÉCURITÉ DU FOUR À MICRO-ONDES ENCASTRÉ</b> .....	5
<b>INSTALLATION REQUIREMENTS</b> .....	2	<b>EXIGENCES D'INSTALLATION</b> .....	5
Tools and Parts.....	2	Outillage et pièces.....	5
Location Requirements .....	2	Exigences d'emplacement.....	5
<b>INSTALLATION INSTRUCTIONS</b> .....	4	<b>INSTRUCTIONS D'INSTALLATION</b> .....	7
Prepare Built-In Oven.....	4	Assemblage de la trousse d'entretoise .....	7
Install Spacer Kit .....	4	Installation de la trousse d'entretoise .....	7
Install Microwave Oven .....	4	Installation du four à micro-ondes .....	7
Complete Installation .....	4	Achever l'installation .....	7

#### IMPORTANT:

Save for local electrical inspector's use.

#### IMPORTANT:

À conserver pour consultation par l'inspecteur local des installations électriques.

W11356316A

In some European factories the letter "W" of the part code mentioned herein will be automatically replaced by the number "4000" (e.g. "W12345678" becomes "400012345678")

# BUILT-IN MICROWAVE OVEN SAFETY

## Your safety and the safety of others are very important.

We have provided many important safety messages in this manual and on your appliance. Always read and obey all safety messages.



This is the safety alert symbol.

This symbol alerts you to potential hazards that can kill or hurt you and others.

All safety messages will follow the safety alert symbol and either the word "DANGER" or "WARNING."

These words mean:

**⚠ DANGER**

You can be killed or seriously injured if you don't immediately follow instructions.

**⚠ WARNING**

You can be killed or seriously injured if you don't follow instructions.

All safety messages will tell you what the potential hazard is, tell you how to reduce the chance of injury, and tell you what can happen if the instructions are not followed.

## INSTALLATION REQUIREMENTS

### Tools and Parts

Gather the required tools and parts before starting installation. Read and follow the instructions provided with any tools listed here.

#### Tools Needed

- Phillips screwdriver
- 1/4" (6.3 mm) nut driver
- Measuring tape
- Level
- Drill
- 1/8" (3.1 mm) drill bit

#### Parts Needed

- (2) Spacer bars - included with built-in microwave oven
- (4) Hex-head washer screws - included with built-in microwave oven
- (4) Pan-head screws - included with built-in microwave oven

#### Parts Supplied

- Bottom vent

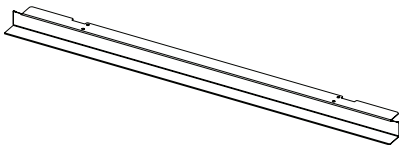

### Location Requirements

**IMPORTANT:** Observe all governing codes and ordinances.

- Cabinet opening dimensions that are shown must be used. Given dimensions provide minimum clearance with the microwave oven.
- Recessed installation area must provide complete enclosure around the recessed portion of the microwave oven.
- Microwave oven support surface must be solid, level and flush with the bottom of the cabinet cutout. Floor must be able to support a weight of 108 lbs (49 kg).

**IMPORTANT:** To avoid damage to your cabinets, check with your builder or cabinet supplier to make sure that the materials used will not discolor, delaminate or sustain other damage. This oven has been designed in accordance with the requirements of UL and CSA International and complies with the maximum allowable wood cabinet temperatures of 194°F (90°C).

### Bottom Vent Dimensions

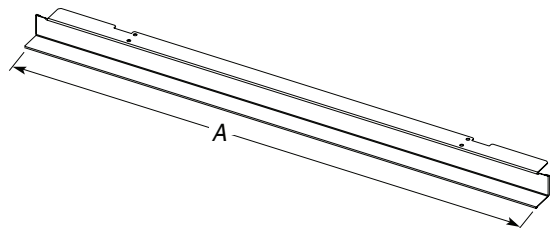

**27" (68.6 cm) Models**

A. 26<sup>3</sup>/<sub>4</sub>" (67.9 cm) overall width

**30" (76.2 cm) Models**

A. 29<sup>3</sup>/<sub>4</sub>" (75.6 cm) overall width

## Cabinet Dimensions - Flush Installation

A 23<sup>1</sup>/<sub>4</sub>" (59 cm) minimum cutout depth is required. These dimensions will result in a 1/4" (6.3 mm) reveal on the top, a 1/4" (6.3 mm) reveal on the sides, and a 1/8" (3.1 mm) reveal on the bottom of the microwave oven. The front face of the cleats and platform will be visible and should be treated as a finished surface.

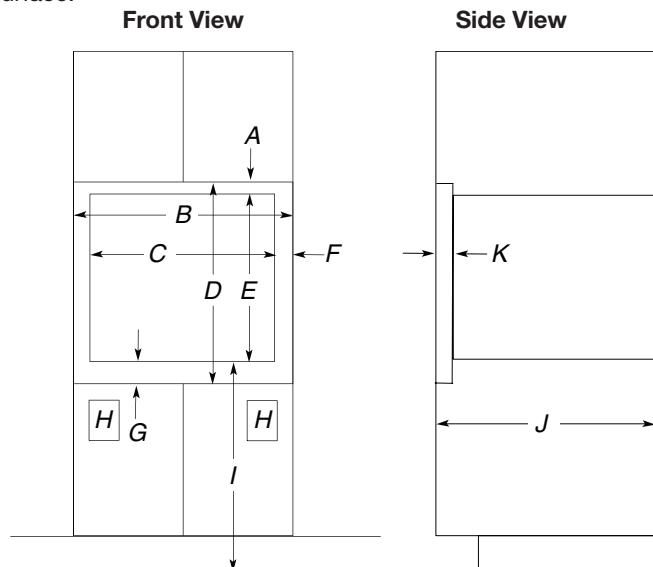

## Minimum Installation Clearances

For proper installation, the following minimum clearances must exist below the cabinet opening.

### Installation Above Single Built-In Oven

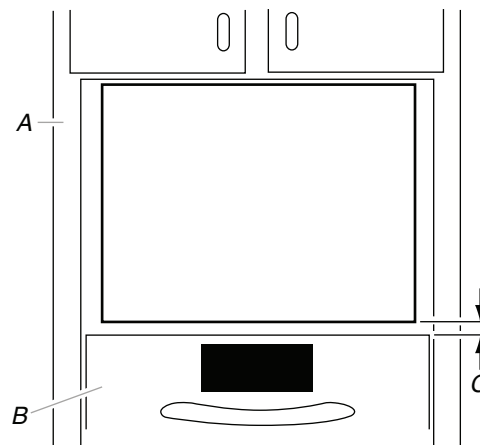

- A. Upper cabinet
- B. Lower single oven\*
- C. 1" (2.5 cm) from top of oven

#### 27" (68.6 cm) Models

- A. 1<sup>13</sup>/<sub>16</sub>" (4.7 cm) top cleat\*
- B. 27<sup>1</sup>/<sub>4</sub>" (69.2 cm) minimum width of flush inset cutout
- C. 25<sup>7</sup>/<sub>8</sub>" (65.7 cm) minimum width of opening
- D. 20<sup>3</sup>/<sub>16</sub>" (51.3 cm) minimum height of flush inset cutout
- E. 17<sup>5</sup>/<sub>8</sub>" (44.7 cm) recommended cutout height
- F. 11/16" (1.7 cm) side cleat\*
- G. 3/4" (1.9 cm) bottom cleat\*
- H. Recommended junction box location
- I. 40" (101.6 cm) bottom of cutout to floor (recommended)
- J. 23<sup>1</sup>/<sub>4</sub>" (59.0 cm) minimum depth of cutout
- K. 1<sup>3</sup>/<sub>8</sub>" (3.5 cm) recess from front of cabinet

#### 30" (76.2 cm) Models

- A. 1<sup>13</sup>/<sub>16</sub>" (4.7 cm) top cleat\*
- B. 30<sup>1</sup>/<sub>4</sub>" (76.8 cm) minimum width of flush inset cutout
- C. 28<sup>7</sup>/<sub>8</sub>" (70.8 cm) minimum width of opening
- D. 20<sup>3</sup>/<sub>16</sub>" (51.3 cm) minimum height of flush inset cutout
- E. 17<sup>5</sup>/<sub>8</sub>" (44.7 cm) recommended cutout height
- F. 11/16" (1.7 cm) side cleat\*
- G. 3/4" (1.9 cm) bottom cleat\*
- H. Recommended junction box location
- I. 40" (101.6 cm) bottom of cutout to floor (recommended)
- J. 23<sup>1</sup>/<sub>4</sub>" (59.0 cm) minimum depth of cutout
- K. 1<sup>3</sup>/<sub>8</sub>" (3.5 cm) recess from front of cabinet

\*Cleats must be recessed 1<sup>3</sup>/<sub>8</sub>" (3.5 cm) from the front of the cabinet.

# INSTALLATION INSTRUCTIONS

## Prepare Built-In Oven

1. Attach bottom vent to spacer bars using four 3/8" (9.5 mm) hexhead washer screws.

**NOTE:** Spacer bar flanges should be facing out.

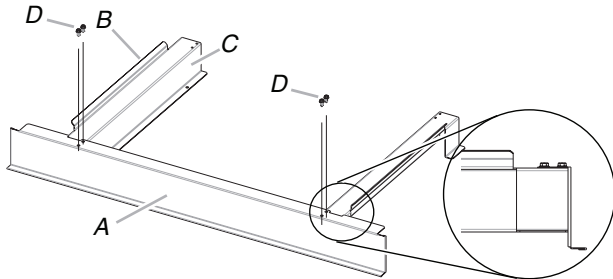

- A. Bottom vent
- B. Spacer bar flange
- C. Spacer bars
- D. 3/8" (9.5 mm) hex-head washer screws

## Install Spacer Kit

1. Center assembled microwave oven spacer kit against lower, front edge of the cabinet cutout.
2. Using an 1/8" (3.1 mm) drill bit, drill through the mounting holes in the spacer bars to create pilot holes.
3. Attach the assembled spacer kit to the cabinet using four 3/4" (1.9 cm) pan-head screws provided. Do not overtighten screws.

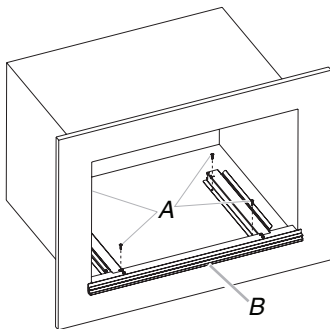

- A. 3/4" (1.9 cm) pan-head screws
- B. Spacer kit assembly

## Install Microwave Oven

Follow the instructions below along with the instructions in the Electric Built-In Microwave Oven Installation Instructions.

Read the "Electrical Requirements" and "Electrical Connection" sections, along with all other sections of the Installation Instructions, before installing the microwave oven.

### **⚠ WARNING**

#### **Excessive Weight Hazard**

**Use two or more people to move and install microwave oven.**

**Failure to do so can result in back or other injury.**

1. Using 2 or more people, lift the microwave oven partially into the cabinet cutout above the spacer kit. Place microwave oven in between the spacer bar flanges.

**NOTE:** When pushing the microwave oven into the cabinet, open the microwave oven door and push against the seal area on the front frame. Do not push against the outside edges.

2. Push against the front frame of the microwave oven to push oven into cabinet. Push microwave oven completely into cabinet and center in cabinet cutout.

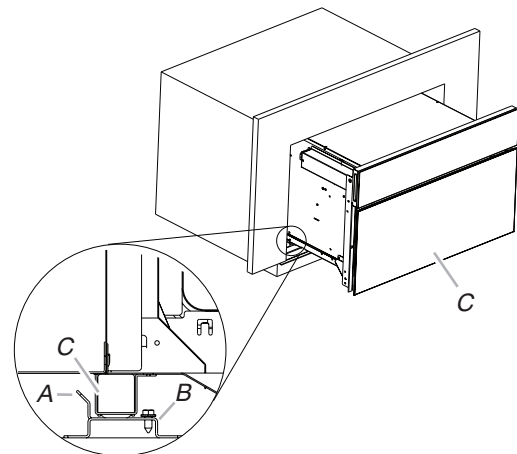

- A. Spacer bar flange
- B. Spacer bar
- C. Microwave oven

## Complete Installation

1. Check that all parts are now installed. If there is an extra part, go back through the steps to see which step was skipped.
2. Check that you have all of your tools.
3. Dispose of/recycle all packaging materials.

### **If you need Assistance or Service:**

Please reference the "Assistance or Service" section of the Use and Care Guide or contact the dealer from whom you purchased your built-in microwave oven spacer kit.

# INSTALLATION REQUIREMENTS

## Tools and Parts

Gather the required tools and parts before starting installation. Read and follow the instructions provided with any tools listed here.

### Tools Needed

- Phillips screwdriver
- Flat-blade screwdriver
- Measuring tape
- Level
- Drill (for wall cabinet installations)
- 1/8" (3 mm) drill bit (for wall cabinet installations)
- 1" (2.5 cm) drill bit (for wall cabinet installations)

### Parts Needed

- UL listed or CSA approved conduit connector
- UL listed wire connectors

### Parts Needed – Flush Installation

- W10801485 Stainless steel flush installation kit for 27" (68.6 cm) models
- W10801486 Stainless steel flush installation kit for 30" (76.2 cm) models
- W10801487 Black flush installation kit for 30" (76.2 cm) models

To order, see the "Assistance or Service" section of the Use and Care Guide.

### Parts Supplied

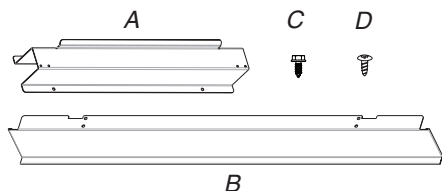

- A. Spacer bars (2)
- B. Bottom vent (1)
- C. 3/8" (9.5 mm) hex-head washer screws (4)
- D. 3/4" (1.9 cm) pan-head screws (4)

Check local codes. Check existing electrical supply. See "Electrical Requirements."

It is recommended that all electrical connections be made by a licensed, qualified electrical installer.

## Location Requirements

**IMPORTANT:** Observe all governing codes and ordinances.

- Cabinet opening dimensions that are shown must be used. Given dimensions provide minimum clearance with microwave oven.
- Recessed installation area must provide complete enclosure around the recessed portion of the microwave oven.
- Grounded electrical supply is required. See "Electrical Requirements" section.
- Electrical supply junction box should be located 3" (7.6 cm) maximum below the support surface when the microwave oven is installed in a wall cabinet. A 1" (2.5 cm) minimum diameter hole should have been drilled in the left rear corner of the support surface to pass the appliance cable through to the junction box.

- For installation above single built-in oven, the junction box must be located inside upper cabinet.
- If you are installing the junction box on rear wall behind the microwave oven, the junction box must be recessed and located in the upper or lower right or left corner of the cabinet; otherwise, the microwave oven will not fit into the cabinet opening.
- Microwave oven support surface must be solid, level, and flush with bottom of cabinet cutout. Floor must be able to support a weight of 108 lbs (49.0 kg).

**IMPORTANT:** To avoid damage to your cabinets, check with your builder or cabinet supplier to make sure that the materials used will not discolor, delaminate, or sustain other damage. This oven has been designed in accordance with the requirements of UL and CSA International and complies with the maximum allowable wood cabinet temperatures of 194°F (90°C).

## Product Dimensions

### 27" (68.6 cm) and 30" (76.2 cm) Microwave Ovens

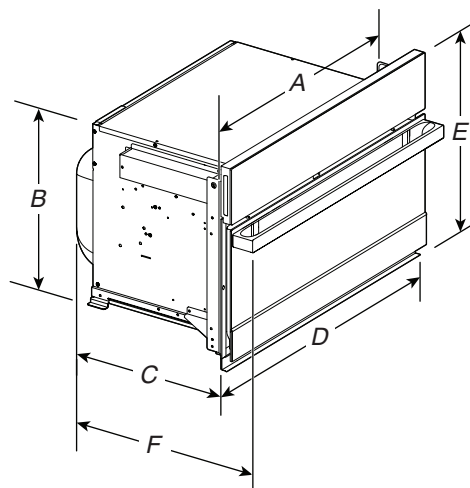

#### 27" (68.6 cm) models

- A. 25<sup>3</sup>/<sub>8</sub>" (64.5 cm)
- B. 17<sup>3</sup>/<sub>8</sub>" (44.1 cm)
- C. 22<sup>11</sup>/<sub>16</sub>" (57.7 cm)
- D. 26<sup>3</sup>/<sub>4</sub>" (68.0 cm) overall width
- E. 19<sup>7</sup>/<sub>8</sub>" (50.3 cm) overall height
- F. JMC2427IM: 25<sup>9</sup>/<sub>16</sub>" (64.9 cm)  
JMC2427IL: 24<sup>3</sup>/<sub>4</sub>" (62.9 cm)

#### 30" (76.2 cm) models

- A. 28<sup>3</sup>/<sub>8</sub>" (72.1 cm)
- B. 17<sup>3</sup>/<sub>8</sub>" (44.1 cm)
- C. 22<sup>11</sup>/<sub>16</sub>" (57.7 cm)
- D. 29<sup>3</sup>/<sub>4</sub>" (75.6 cm) overall width
- E. 19<sup>7</sup>/<sub>8</sub>" (50.3 cm) overall height
- F. JMC2430IM: 25<sup>9</sup>/<sub>16</sub>" (64.9 cm)  
JMC2430IL: 24<sup>3</sup>/<sub>4</sub>" (62.9 cm)

### 27" (68.6 cm) and 30" (76.2 cm) Microwave Oven Spacer Kit

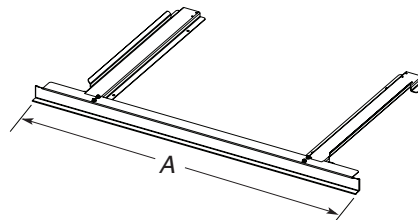

#### 27" (68.6 cm) models

- A. 26<sup>3</sup>/<sub>4</sub>" (67.9 cm) overall width

#### 30" (76.2 cm) models

- A. 29<sup>3</sup>/<sub>4</sub>" (75.6 cm) overall width

**NOTE:** The microwave oven spacer kit will allow the microwave oven to be installed in a 17<sup>3</sup>/<sub>8</sub>" to 17<sup>3</sup>/<sub>4</sub>" (44.1 to 45.1 cm) maximum cutout height.



A microwave oven spacer kit is available from your dealer that will allow the microwave oven to be installed in a 19" to 19<sup>13/16</sup>" (48.3 to 50.2 cm) maximum cutout height. Match the oven size to the following kits:

■ 27" (68.6 cm) Stainless Steel – Model W10469901

■ 30" (76.2 cm) Stainless Steel – Model W10469903

To order, see the "Assistance or Service" section of the Use and Care Guide.

## Cabinet Dimensions

### 27" (68.6 cm) and 30" (76.2 cm) Microwave Ovens

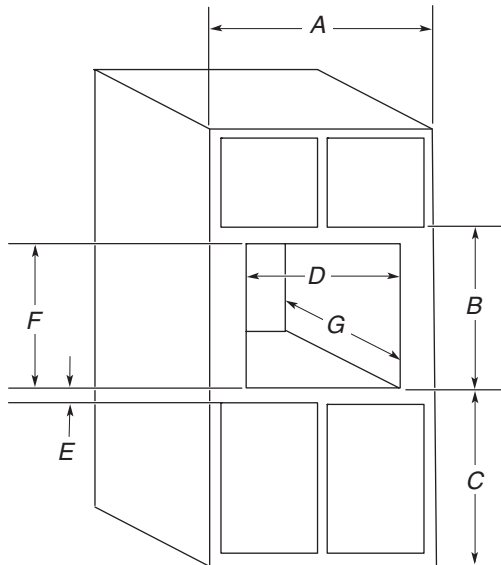

#### 27" (68.6 cm) models

- A. 27" (68.6 cm) min. cabinet width
- B. 19<sup>7/8</sup>" (50.3 cm) from bottom of cutout to bottom of upper cabinet door
- C. 40" (101.6 cm) bottom of cutout to floor (recommended)
- D. 25<sup>1/2</sup>" (64.8 cm) cutout width
- E. 1<sup>1/2</sup>" (3.8 cm) min. bottom of cutout to top of cabinet door
- F. 17<sup>5/8</sup>" (44.7 cm) recommended cutout height (will fit cutout height from 17<sup>3/8</sup>" [44.1 cm] to 17<sup>3/4</sup>" [45.1 cm])
- G. 21<sup>7/8</sup>" (55.5 cm) min. cutout depth

#### 30" (76.2 cm) models

- A. 30" (76.2 cm) min. cabinet width
- B. 19<sup>7/8</sup>" (50.3 cm) from bottom of cutout to bottom of upper cabinet door
- C. 40" (101.6 cm) bottom of cutout to floor (recommended)
- D. 28<sup>1/2</sup>" (72.4 cm) cutout width
- E. 1<sup>1/2</sup>" (3.8 cm) min. bottom of cutout to top of cabinet door
- F. 17<sup>5/8</sup>" (44.7 cm) recommended cutout height (will fit cutout height from 17<sup>3/8</sup>" [44.1 cm] to 17<sup>3/4</sup>" [45.1 cm])
- G. 21<sup>7/8</sup>" (55.5 cm) min. cutout depth

## Minimum Installation Clearances

For proper installation, the following minimum clearances must exist above and below the cabinet opening.

## Installation Above Single Built-In Oven

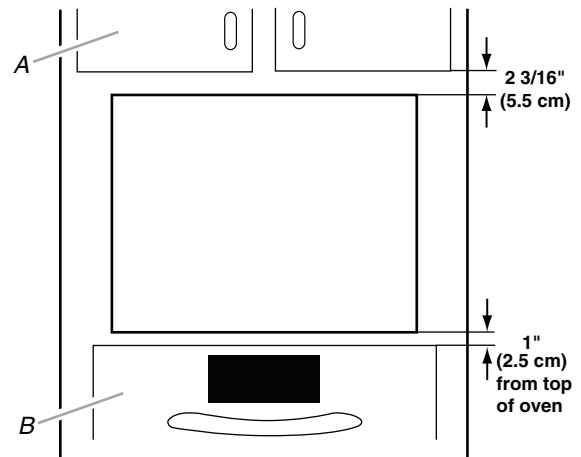

A. Upper cabinet  
B. Lower single oven

## Electrical Requirements

### GROUNDING INSTRUCTIONS

#### For a permanently connected microwave oven:

The microwave oven must be connected to a grounded, metallic, permanent wiring system, or an equipment grounding conductor should be run with the circuit conductors and connected to the equipment grounding terminal or lead on the microwave oven.

### SAVE THESE INSTRUCTIONS

If codes permit and a separate ground wire is used, it is recommended that a qualified electrical installer determine that the ground path and wire gauge are in accordance with local codes.

Check with a qualified electrical installer if you are not sure the oven is properly grounded.

This oven must be connected to a grounded metal, permanent wiring system.

Be sure that the electrical connection and wire size are adequate and in conformance with the National Electrical Code, ANSI/NFPA 70 – latest edition or CSA Standards C22.1-94, Canadian Electrical Code, Part 1 and C22.2 No. O-M91 – latest edition, and all local codes and ordinances.

A copy of the above code standards can be obtained from:

National Fire Protection Association  
1 Batterymarch Park  
Quincy, MA 02169-7471  
CSA International  
8501 East Pleasant Valley Road  
Cleveland, OH 44131-5575

### Electrical Connection

To properly install your microwave oven, you must determine the type of electrical connection you will be using and follow the instructions provided for it here.

- Microwave oven must be connected to the proper electrical voltage and frequency as specified on the model/serial/rating plate. The model/serial/rating plate is located underneath the control panel along the oven vent.

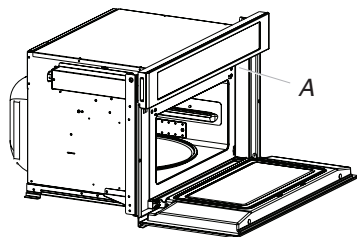

A. Model/serial/rating plate

- The microwave oven rated 120/240 V, 20 A, has 4 wires (L1, L2, N, and G) in the flex conduit, and should be connected to a 20 A maximum-rated circuit, overcurrent protected on both the L1 and L2 circuits.
- A time-delay fuse or circuit breaker is recommended.
- Flexible cable from the microwave oven should be connected directly to the junction box.

- Do not cut the conduit. The length of conduit provided is for serviceability of the microwave oven.
- A UL listed or CSA approved conduit connector must be provided.
- If the house has aluminum wiring, follow the procedure below:

Connect the aluminum wiring using special connectors and/or tools designed and UL listed for joining copper to aluminum.

Follow the electrical connector manufacturer's recommended procedure. Aluminum/copper connection must conform with local codes and industry accepted wiring practices.

For power requirements, refer to the following table:

Voltage	Microwave With Convection Oven
120/240 VAC	15 A
120/208 VAC	15 A

## INSTALLATION INSTRUCTIONS

### Spacer Kit Installation

#### NOTES:

- The microwave oven spacer kit allows the microwave oven to be installed in an  $17\frac{7}{16}$ " to  $17\frac{7}{8}$ " (44.1 cm to 45.3 cm) maximum cutout height.
- If your cabinet cutout height is more than  $17\frac{7}{16}$ " (44.1 cm), you must install the spacer kit. Proceed to "Assemble Spacer Kit."
- If your cabinet cutout height is less than  $17\frac{7}{16}$ " (44.1 cm), you do not have to install the spacer kit. Proceed to "Prepare Built-In Microwave Oven."

#### Assemble Spacer Kit

1. Attach the bottom vent to spacer bars using four  $\frac{3}{8}$ " (9.5 mm) hex-head washer screws.

**NOTE:** Spacer bar flanges should be facing out.

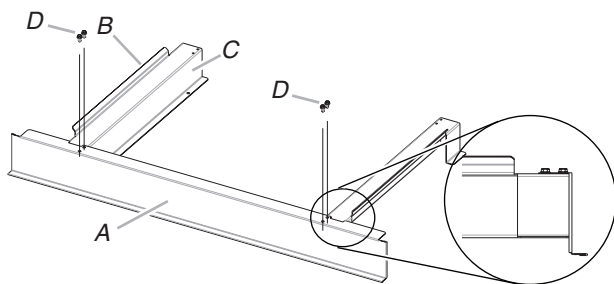

A. Bottom vent  
B. Spacer bar flange  
C. Spacer bars  
D.  $\frac{3}{8}$ " (9.5 mm) hex-head washer screws

#### Install Spacer Kit

1. Center assembled microwave oven spacer kit against lower front edge of the cabinet cutout.
2. Using an  $\frac{1}{8}$ " (3.2 mm) drill bit, drill through the mounting holes in the spacer bars to create pilot holes.

3. Attach the assembled spacer kit to the cabinet using four  $\frac{3}{4}$ " (1.9 cm) ( flat-head screws. Do not overtighten screws.

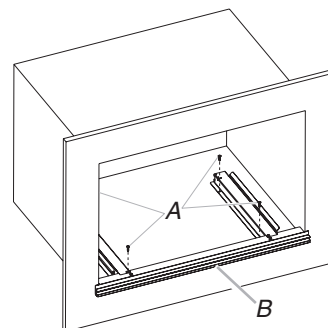

A.  $\frac{3}{4}$ " (1.9 cm) flat-head screws  
B. Spacer kit assembly

### Prepare Built-In Microwave Oven

1. Locate existing wiring to avoid drilling into or severing wiring during installation.

## ⚠ WARNING

#### Excessive Weight Hazard

**Use two or more people to move and install microwave oven.**

**Failure to do so can result in back or other injury.**

2. To avoid floor damage, set the microwave oven onto cardboard prior to installation. Do not use handle or any portion of the front frame for lifting.
3. Remove the shipping materials and tape from the microwave oven.
4. Remove and set aside racks and other items from inside the microwave oven.
5. Remove the hardware package from inside the bag containing literature.
6. Move the microwave oven and cardboard close to the microwave oven's final location.

# 24" Custom Panel Dishwasher

800 Series – Custom Panel SHVM78Z53N



**BOSCH**  
Invented for life



**SHVM78Z53N**  
Custom Panel

**Patented CrystalDry™ technology transforms moisture into heat to get dishes, including plastics, 60% drier.<sup>1</sup>**

## Features & Benefits

42 dBA: dishwasher runs quietly so your kitchen conversations aren't interrupted.

The Flexible 3rd Rack with fold down sides adds 30% more<sup>2</sup> loading area, perfect for utensils and ramekins.

Touch Control Technology allows for quick cycle programming.

The AquaStop® leak protection system contains leaks through a precisely engineered system. If a leak occurs, the system contains it by shutting down operation and pumping out water. So you have the ultimate peace of mind whether you are away or at home.



<sup>1</sup>Based on aggregate average drying performance of Bosch Dishwashers with CrystalDry on combined household load including plastics, glass, steel, and porcelain as compared to Bosch Dishwashers with PureDry. Drying performance may vary by dish type.

<sup>2</sup>Compared to a Bosch dishwasher with 2 racks.

<sup>3</sup>Certification to NSF/ANSI Standard 184 for residential dishwashers.

<sup>4</sup>September 2020 running production change to remove adhesive routing clips for power cord. These clips and the edge protector are now included in the dishwasher accessory kit # SMZEPCC1UC.

General Properties	
Number of wash cycles	6
Number of options	5
dBA	42
Drying system	CrystalDry™ option
Third rack	Flexible 3rd Rack
Rack adjustability	Rackmatic®
Tub material	Stainless Steel
Control type	Touch Control
Concealed water heating element	Yes
Leak protection system	24/7 AquaStop®
NSF®-certified <sup>3</sup> sanitize option	Yes
Water softener	No
Five-level wash	Yes
ChildLock	No
Special features	InfoLight®
Efficiency	
Water usage per cycle	3.5
Energy efficiency class	Tier 1
ENERGY STAR® qualified	Yes
Total annual energy consumption (kWh)	269
Total annual water consumption (g)	623.5
Capacity	
Number of place settings	16

Technical Details	
Watts (W)	1440 W
Current (A)	12 Amps
Volts (V)	120 V
Frequency (Hz)	60 Hz
Power cord full length	67"
Power cord install length from edge of unit when facing the door (in) <sup>4</sup>	Left – 45" Right – 56"
Minimum water pressure (lb/sin)	14
Length outlet hose (in)	79"

Dimensions & Weight	
Overall appliance dimensions (HxWxD) (in)	33 7/8" x 23 9/16" x 23 1/16"
Required cutout size (HxWxD) (in)	33 7/8" x 23 5/8" x 24"
Adjustable feet	Yes
Net weight (lbs)	99 lbs

Accessories—Optional	
Junction Box	SMZPCJB1UC
Bosch Dishwasher Water Supply Hose	SMZSH002UC
Drain Hose Extension Kit	SGZ1010UC
Dishwasher Accessory Kit	SMZ5000
Anti-Tarnish Silverware Cassette	SMZ5002UC
Edge Protector + Power Cord Clip Install Kit	SMZEPCC1UC
Stainless Steel Straight Bosch Bar Handle	SMZ1007UC



**Accessories:** To purchase Bosch accessories, cleaners & parts please visit [www.bosch-home.com/us/store](http://www.bosch-home.com/us/store) or call 1-800-944-2904 (Mon to Fri 5 am to 6 pm PST, Sat 6 am to 3 pm PST).

**Notes:** All height, width and depth dimensions are shown in inches. BSH reserves the absolute and unrestricted right to change product materials and specifications, at any time, without notice. Consult the product's installation instructions for final dimensional data and other details prior to making cutout.

**Warranties:** Please see Use & Care manual or Bosch website for statement of limited warranty.

**For more information on our entire line of products, go to [www.bosch-home.com/us](http://www.bosch-home.com/us) or call 1-800-944-2904**

© BSH Home Appliances Corporation. All rights reserved. Bosch is a registered trademark of Robert Bosch GmbH.

# 24" Custom Panel Dishwasher

800 Series – Custom Panel SHVM78Z53N



**BOSCH**  
Invented for life

## Installation Details

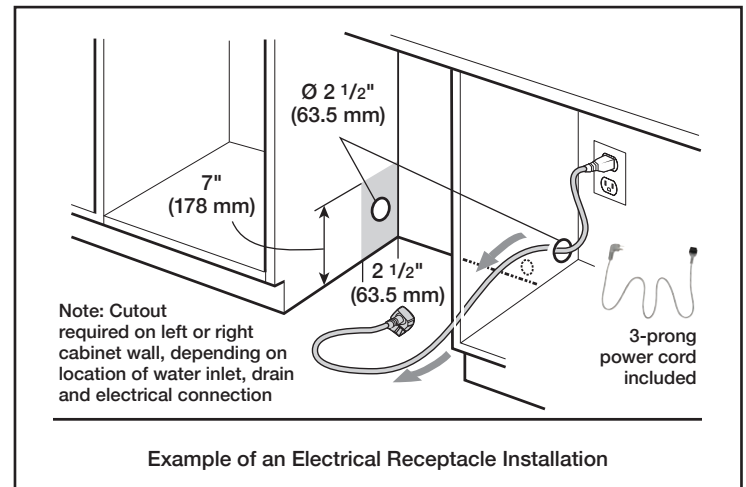
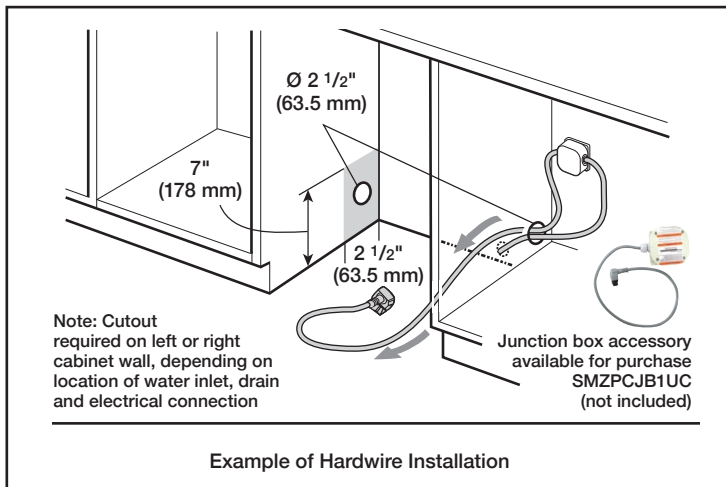
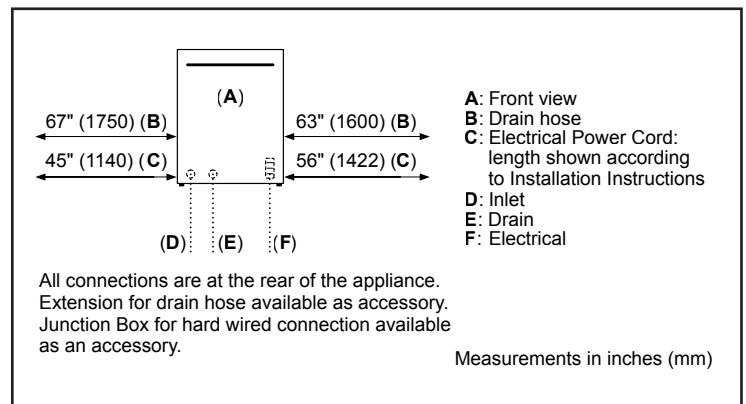
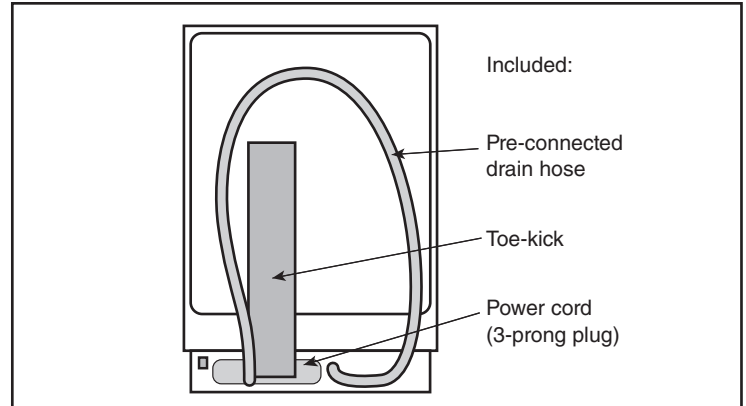
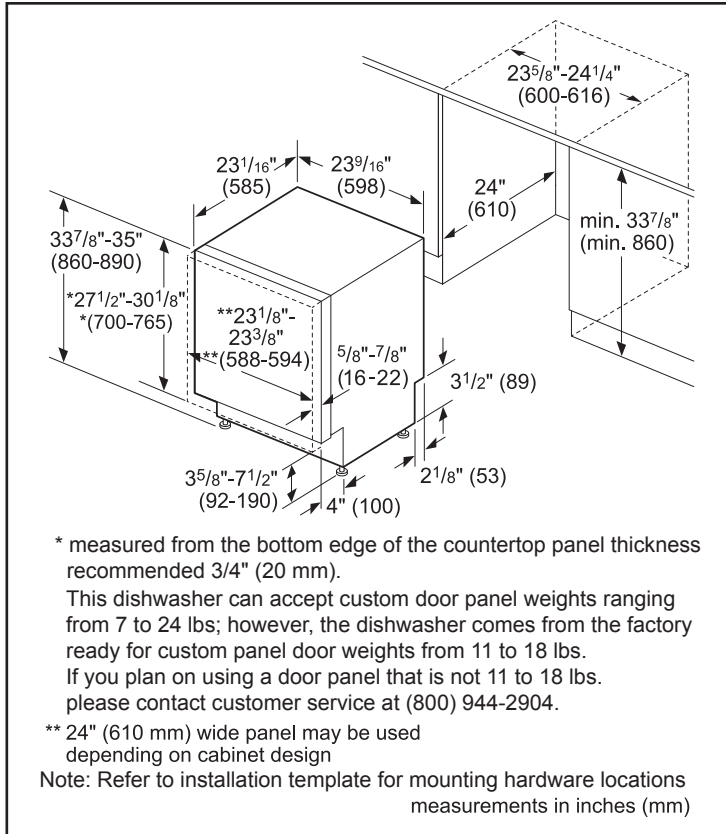

**Accessories:** To purchase Bosch accessories, cleaners & parts please visit [www.bosch-home.com/us/store](http://www.bosch-home.com/us/store) or call 1-800-944-2904 (Mon to Fri 5 am to 6 pm PST, Sat 6 am to 3 pm PST).

**Notes:** All height, width and depth dimensions are shown in inches. BSH reserves the absolute and unrestricted right to change product materials and specifications, at any time, without notice. Consult the product's installation instructions for final dimensional data and other details prior to making cutout.

**Warranties:** Please see Use & Care manual or Bosch website for statement of limited warranty.

**For more information on our entire line of products, go to [www.bosch-home.com/us](http://www.bosch-home.com/us) or call 1-800-944-2904**

© BSH Home Appliances Corporation. All rights reserved. Bosch is a registered trademark of Robert Bosch GmbH.

# 24" Custom Panel Dishwasher

800 Series – Custom Panel SHVM78Z53N



**BOSCH**  
Invented for life

## Installation Details

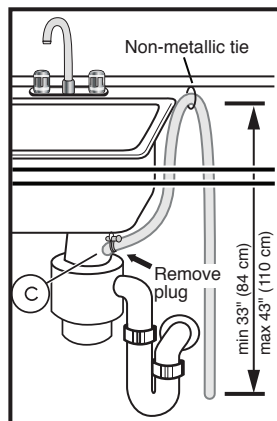
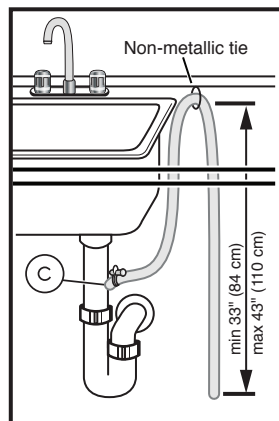

Note: Plumbing installations will vary - refer to local codes. Drain hose included is 79" (201 cm) and can be extended to a maximum of 155 3/4" (396 cm).

Always use the approved drain hose extension kit (SGZ1010UC).

Ensure a portion of the drain hose is raised between min. 33" (84 cm) and max. 43" (110 cm) above the cabinet floor.

**Accessories:** To purchase Bosch accessories, cleaners & parts please visit [www.bosch-home.com/us/store](http://www.bosch-home.com/us/store) or call 1-800-944-2904 (Mon to Fri 5 am to 6 pm PST, Sat 6 am to 3 pm PST).

**Notes:** All height, width and depth dimensions are shown in inches. BSH reserves the absolute and unrestricted right to change product materials and specifications, at any time, without notice. Consult the product's installation instructions for final dimensional data and other details prior to making cutout.

**Warranties:** Please see Use & Care manual or Bosch website for statement of limited warranty.

**For more information on our entire line of products, go to [www.bosch-home.com/us](http://www.bosch-home.com/us) or call 1-800-944-2904**

© BSH Home Appliances Corporation. All rights reserved. Bosch is a registered trademark of Robert Bosch GmbH.



## Fresh Living Tip

Proud of the special vintages in your wine collection? You'll like the Marvel Gallery Wine Refrigerator for the way it displays your favorite labels like a gallery art collection.

## FINISH OPTIONS



# 24" Marvel High-Efficiency Single Zone Gallery Display Wine Refrigerator

MLWC224

### Storage Adaptability

- 5.3 cu. ft. capacity stores 27 bottles of wine
- (2) 7-bottle gallery display racks to display your best wine, (1) 8-bottle wine tray and (1) 5-bottle gallery display rack
- Accommodates a variety of bottle sizes including champagne and magnum bottles
- $\frac{3}{4}$  extension smooth-glide ball-bearing tray shelving provides easy access to your collection

### Performance

- Dynamic cooling technology delivers precise temperature stability and frost-free operation for an optimal wine preservation environment
- Proprietary shelving design allows temperature-controlled air to circulate throughout cabinet for consistency from top to bottom
- Thermal-efficient cabinet ensures optimum wine preservation and energy efficiency while maximizing capacity
- Argon-filled, UV-resistant tinted dual pane glass door protects contents from damaging ultraviolet light and helps conserve energy
- Sound-buffering design

### Convenient Controls

- Multifunction controls allow you to select a precise temperature from 34° F to 60° F
- Features easy-to-use settings and options

### Fit & Finish

- Elegant midnight black interior and arctic white LED interior lighting
- Solid natural maple shelf fronts, stainable to match cabinetry
- Reversible door allows for right or left swing for adaptable installation
- Black toe kick adjustable to 4" with leveling legs

### Warranty

- 1-year parts and labor warranty and 5-year sealed system parts warranty



*For the wine collector, the Marvel Gallery Wine Refrigerator elegantly and securely displays bottles of all shapes and sizes from slim dessert wine bottles to extra-large champagne and magnum bottles. And the angled gallery-style display makes finding your favorite labels even easier.*



*Even holds champagne bottles!*

### DOOR STYLE

Stainless Steel Frame Glass

### MODEL NUMBER

MLWC224-SG01A



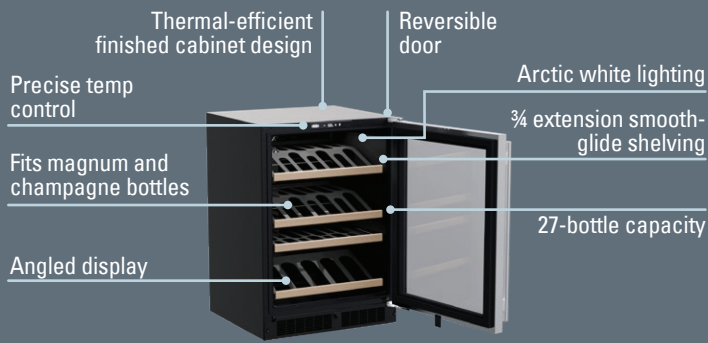

H: 33 3/4" W: 23 7/8" D: 26 7/32" (with handle)

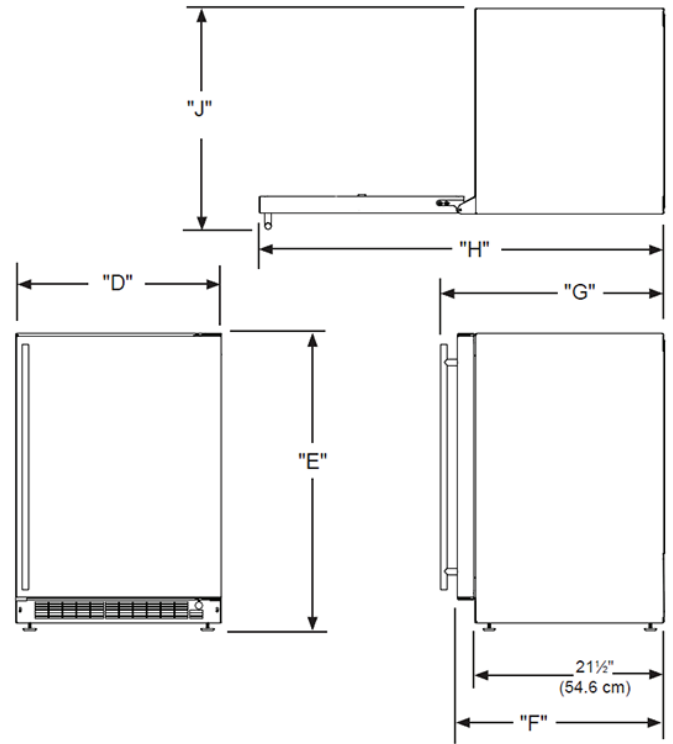
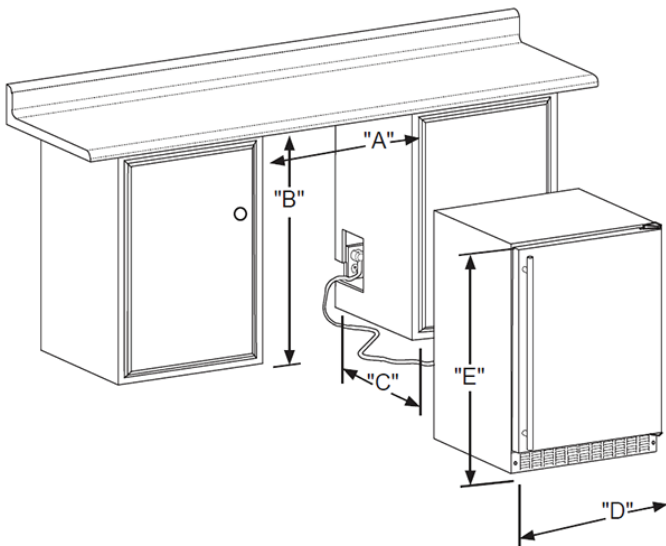

#### Rough In Dimensions

"A"	"B"	"C"
24"	34-1/4" to 35-1/4"	24"
(61 CM)	(87 CM to 89.5 CM)	(61 CM)

#### Cabinet Dimensions

"D"	"E"	"F"	"G"	"H"	"J"
23-7/8"	33-5/8" TO 34-5/8"	23-5/8"*	26-1/8"*	47-3/4"*	26-1/2"*
(60.7 CM)	(85.4 CM TO 87.9 CM)	(60 CM)	(66.3 CM)	(146.6 CM)	(67.3 CM)

<b>Capacity</b>	5.3 CU. FT.
<b>Control Type</b>	Electronic
<b>Sabbath Mode</b>	Yes
<b>Temperature Range</b>	34°F to 60°F
<b>Handle Style</b>	Slim
<b>Hinge Type</b>	Reversible
<b>Interior Lighting</b>	White LED
<b>Shelving System</b>	3/4 Extension Smooth-Glide Wire Shelving
<b>Toe Grille Finish</b>	Black

<b>Lock</b>	No
<b>Electrical Requirements</b>	115V / 60 Hz / 15A
<b>Cord Length</b>	6 FT.
<b>Shipping Dimensions</b>	28" W x 31" D x 37" H
<b>Shipping Weight</b>	160 LBS
<b>Agency Approval</b>	UL
<b>Refrigerant Type</b>	R600a

For comprehensive installation instructions, please visit [marvelrefrigeration.com](http://marvelrefrigeration.com) to access the owner's guide.

