

APPLIANCES

Invoice	Qty.	Description
2556  27Jan21 NoCat	1	Appliance specifications attached - signed copies

CERAMIC

Invoice	Qty.	Description
2556 37 27Jan21	1	FRONT FOYER: TILE, FLOOR , LEVEL 9 - 30x60" LAID IN STRAIGHT, STACKED PATTERN. SEE PLAN FOR TILE DIRECTION
2556 37 27Jan21	1	MUD ROOM: TILE, FLOOR , LEVEL 5 - 12X24" LAID IN STRAIGHT, STACKED PATTERN. SEE PLAN FOR TILE DIRECTION
2556 37 27Jan21	1	POWDER ROOM: TILE, FLOOR , LEVEL 5 - 12X24" LAID IN STRAIGHT, STACKED PATTERN. SEE PLAN FOR TILE DIRECTION
2556 35 27Jan21	1	MASTER ENSUITE: TILE, FLOOR , LEVEL 3 - 12X24" LAID IN STRAIGHT, STACKED PATTERN. SEE PLAN FOR TILE DIRECTION
2556  27Jan21 NoCat	1	MASTER ENSUITE: ADD TILE TO SHOWER CEILING - SAME AS WALL TILE - LEVEL 3
2556 49 27Jan21	1	MASTER ENSUITE: TILE, WALL, LEVEL 3 - 12X24" LAID IN HORIZONTAL, STACKED PATTERN.
2556 45 27Jan21	1	MASTER ENSUITE: TILE, SHOWER FLOOR, LEVEL 3 -2X2"
2556 48 27Jan21	1	ENSUITE 2: TILE, WALL, LEVEL 2 - 8X24" LAID IN HORIZONTAL STACKED PATTERN.
2556 32 27Jan21	1	SHARED ENSUITE: TILE, FLOOR , LEVEL 1 - 12X24" LAID IN STRAIGHT, STACKED PATTERN. SEE PLAN FOR TILE DIRECTION
2556 48 27Jan21	1	SHARED ENSUITE: TILE, WALL, LEVEL 3 - 12X24" LAID IN HORIZONTAL STACKED PATTERN
2556 43 27Jan21	1	SHARED ENSUITE: TILE, SHOWER FLOOR, LEVEL 2 - 2X2"



DRYWALL

Invoice	Qty.	Description
2338  02Feb21 NoCat	18	- 2ND FLOOR: INCREASE HEIGHT OF DOOR TO 8FT SECOND FLOOR - PER DOOR  INCLUDED IN APS
2338  02Feb21 NoCat	5	- MAIN FLOOR: UPGRADE TO 9' DOORS **EXCLUDING** MUD ROOM AND MUDROOM WIC  INCLUDED IN APS
2338  02Feb21 NoCat	1	- GREAT ROOM - OPT. COFFERED CEILING AS PER PLAN  INCLUDED IN APS
2338  02Feb21 NoCat	1	- LIBRARY - OPT. WAFFLE CEILING, BEAM DETAIL AS PER PLAN (4 BOXES) OPTION #1 CTR-B07  INCLUDED IN APS
2338  02Feb21 NoCat	1	- GREAT ROOM/KITCHEN: REDUCE WIDTH OF ARCHWAY - LEAVE NIBB WALLS EVEN ON BOTH SIDES - APPROX. 30" - SEE PLAN FOR LOCATION  INCLUDED IN APS
2338  02Feb21 NoCat	1	- MASTER BEDROOM - OPT. 10 FOOT TRAY CEILING AS PER PLAN - SQUARE OFF LIKE ELEVATION C  INCLUDED IN APS
2338  02Feb21 NoCat	1	- DRESSING ROOM: SUN TUNNEL EXTENSION, 6 FOOT RIGID TUNNEL EXTENSION [2TR 6 FOOT ] - UP TO 6 FOOT MAX.  INCLUDED IN APS
2338 72,303 02Feb21 **	1	FIXTURE: UNDER CABINET FLUORESCENT LIGHT FIXTURES - DOES NOT INCLUDE (AND REQUIRES) LIGHT VALANCE  INCLUDED IN APS



ELECTRICAL

Invoice	Qty.	Description
2556  27Jan21 NoCat	1	FYI - KITCHEN: FULL HEIGHT SLAB BACKSPLASH - QUARTZ LEVEL 6
2338 72,273 02Feb21	1	KITCHEN:110V WALL RECEPTACLE ON SEPARATE CIRCUIT - GAS FIRED APPLIANCE - FOR AUX. EQUIPMENT - NOT A STOVE PLUG  INCLUDED IN APS
2338 72,282 02Feb21	1	KITCHEN: ADDITIONAL 220V RECEPTACLE ON A SEPARATE CIRCUIT - FOR BUILT-IN WALL OVEN - APPLIANCE NOT INCLUDED - DOES NOT INCLUDE BREAKER THAT IS TO BE INSTALLED BY LICENSED ELECTRICIAN AND ARRANGED BY HOMEOWNER AFTER CLOSING  INCLUDED IN APS
2338 72,307 02Feb21	1	KITCHEN FIXTURE: RELOCATE STANDARD CEILING MOUNT FIXTURE ABOVE ISLAND  INCLUDED IN APS
2338 72,280 02Feb21	1	KITCHEN CEILING OUTLET: ADDITIONAL REINFORCED CEILING OUTLET ABOVE ISLAND  INCLUDED IN APS
2338 72,303 02Feb21	1	FIXTURE: UNDER CABINET FLUORESCENT LIGHT FIXTURES - DOES NOT INCLUDE (AND REQUIRES) LIGHT VALANCE  INCLUDED IN APS
2338 72,289 02Feb21	8	KITCHEN: 4" E/S LED INTERIOR POT LIGHT - GROUND FLOOR QTY 8  INCLUDED IN APS
2338 72,290 02Feb21	3	UPPER HALL: 4" E/S LED INTERIOR POT LIGHT (INSULATED CEILING) - QTY 3  INCLUDED IN APS
2338 72,289 02Feb21	1	UPPER HALL: UPGRADE STANDARD CEILING MOUNT FIXTURE TO (1) - 4" E/S LED INTERIOR POT LIGHT  INCLUDED IN APS
2338 72,273 02Feb21	1	GREAT ROOM: ADDITIONAL INTERIOR RECEPTACLE ON EXISTING CIRCUIT FOR WALL MOUNT TV ABOVE FIREPLACE  INCLUDED IN APS
2338 72,289 02Feb21	5	MAIN HALL: 4" E/S LED INTERIOR POT LIGHT - GROUND FLOOR QTY 5  INCLUDED IN APS
2338 72,289 02Feb21	1	MAIN HALL: UPGRADE STANDARD CEILING MOUNT FIXTURE TO (1) 4" E/S LED INTERIOR POT LIGHT  INCLUDED IN APS
2338 72,289 02Feb21	1	LIBRARY: 4" E/S LED INTERIOR POT LIGHT - QYT 3  INCLUDED IN APS





**Lot: 124**

**Model: 40.06 A LILAC**

**Project/Phase: Pine Valley Forevergreen / 1**

## FRAMING

Invoice	Qty.	Description
2338 02Feb21 NoCat	1	- GREAT ROOM - OPT. COFFERED CEILING AS PER PLAN  INCLUDED IN APS
2338 02Feb21 NoCat	1	- LIBRARY - OPT. LIBRARY COFFERED CEILING AS PER PLAN  INCLUDED IN APS
2338 02Feb21 NoCat	1	- GREAT ROOM/KITCHEN: REDUCE WIDTH OF ARCHWAY - LEAVE NIBB WALLS EVEN ON BOTH SIDES - APPROX. 30" - SEE PLAN FOR LOCATION  INCLUDED IN APS
2338 02Feb21 NoCat	1	- MASTER BEDROOM - OPT. 10 FOOT TRAY CEILING AS PER PLAN - SQUARE OFF LIKE ELEVATION C  INCLUDED IN APS
2338 02Feb21 NoCat	1	- DRESSING ROOM: SUN TUNNEL EXTENSION, 6 FOOT RIGID TUNNEL EXTENSION [2TR 6 FOOT ] - UP TO 6 FOOT MAX.  INCLUDED IN APS
2338 02Feb21 NoCat	18	- 2ND FLOOR: INCREASE HEIGHT OF DOOR TO 8FT SECOND FLOOR - 18 DOORS TOTAL  INCLUDED IN APS
2338 02Feb21 NoCat	5	- MAIN FLOOR: UPGRADE TO 9' DOORS **EXCLUDING** MUD ROOM AND MUDROOM WIC  INCLUDED IN APS
2338 72,631 02Feb21	1	MASTER ENSUITE: SHOWER NICHE [SHAMPOO SHELF] - COMPLETE WITH MATCHING MARBLE JAMBS ON 4 SIDES, STANDARD TILE, APPROX. 12 X 18 INSTALLED VERTICALLY  INCLUDED IN APS

## GLASS AND MIRROR

Invoice	Qty.	Description
2556 27Jan21 NoCat	1	MASTER ENSUITE: UPGRADE SHOWER HINGES + SHOWER DOOR HARDWARE TO BRUSHED NICKEL
2556 27Jan21 NoCat	1	SHARED ENSUITE: UPGRADE SHOWER HINGES + SHOWER DOOR HARDWARE TO MATTE BLACK



**Lot: 124**

**Model: 40.06 A LILAC**

**Project/Phase: Pine Valley Forevergreen / 1**

## GRANITE MARBLE QUARTZ

Invoice	Qty.	Description
2556 27Jan21 NoCat	1	POWDER ROOM: UPGRADE 5 QUARTZ COUNTER
2556 27Jan21 NoCat	1	KITCHEN: UPGRADE 6 QUARTZ COUNTER TOP
2556 27Jan21 NoCat	1	KITCHEN: FULL HEIGHT SLAB BACKSPLASH - QUARTZ LEVEL 6
2556 27Jan21 NoCat	1	KITCHEN: UPGRADE COUNTER TOP THICKNESS TO 3CM
2556 27Jan21 NoCat	1	KITCHEN: COOKTOP CUT OUT
2556 27Jan21 NoCat	1	MASTER ENSUITE: UPGRADE 1 QUARTZ COUNTER
2556 27Jan21 NoCat	1	ENSUITE 2: UPGRADE 1 QUARTZ COUNTER TOP
2556 27Jan21 NoCat	1	SHARED ENSUITE: UPGRADE 1 QUARTZ COUNTER TOP

## HARDWOOD

Invoice	Qty.	Description
2556 10 27Jan21	1	THRU OUT - STANDARD AREAS - MAIN HALL/ GREAT ROOM/ LIBRARY/ DINING/ UPPER HALL/ MASTER BEDROOM/ BEDROOM 2/ BEDROOM 3/ BEDROOM 4: MIRAGE, 5" RED OAK, TRUE BALANCE ENGINEERED HARDWOOD, 3/4", SWEET MEMORIES TEXTURE DURAMATT FINISH - CORNER - LEVEL 5
2556 10 27Jan21	1	KITCHEN/BREAKFAST: MIRAGE, 5" RED OAK, TRUE BALANCE ENGINEERED HARDWOOD, 3/4", SWEET MEMORIES TEXTURE DURAMATT FINISH - CORNER - LEVEL 5

## HVAC

invoice	Qty.	Description
2338	1	- KITCHEN: GAS LINE ROUGH-IN - MAIN FLOOR FOR GAS COOKTOP.- SEE PLAN FOR LOCATION
02Feb21 NoCat		INCLUDED IN APS



INTERIOR TRIM AND DOORS

Invoice	Qty.	Description
2556 155,876 27Jan21	1	THRU OUT: ADD FOR HINGES 3X3 SQUARE FLAT TIP THROUGHOUT  UPGRADE
2556 153,798 27Jan21	1	THRU OUT: HALIFAX LEVER, IRON BLACK INTERIOR DOOR HARDWARE  UPGRADE
2556 155,300 27Jan21	1	THRU OUT: UPGRADE INTERIOR DOORS TO LIVINGSTON  UPGRADE
2556 153,286 27Jan21	1	THRU OUT: UPGRADE 3 1/4" STEP BEVEL BB CASING, 5 1/2" BASE BOARD  UPGRADE
2338 02Feb21 NoCat	1	GREAT ROOM/KITCHEN: REDUCE WIDTH OF ARCHWAY - LEAVE NIBB WALLS EVEN ON BOTH SIDES - APPROX. 30" - SEE PLAN FOR LOCATION
2338 02Feb21 NoCat	1	- GREAT ROOM - OPT. COFFERED CEILING AS PER PLAN  INCLUDED IN APS
2338 02Feb21 NoCat	1	- GREAT ROOM/KITCHEN: REDUCE WIDTH OF ARCHWAY - LEAVE NIBB WALLS EVEN ON BOTH SIDES - APPROX. 30" - SEE PLAN FOR LOCATION  INCLUDED IN APS
2338 02Feb21 NoCat	1	- MASTER BEDROOM - OPT. 10 FOOT TRAY CEILING AS PER PLAN - SQUARE OFF LIKE ELEVATION C  INCLUDED IN APS
2338 02Feb21 NoCat	1	- DRESSING ROOM: SUN TUNNEL EXTENSION, 6 FOOT RIGID TUNNEL EXTENSION [2TR 6 FOOT ] - UP TO 6 FOOT MAX.  INCLUDED IN APS
2338 02Feb21 NoCat	18	- 2ND FLOOR: INCREASE HEIGHT OF DOOR TO 8FT SECOND FLOOR - 18 DOORS TOTAL  INCLUDED IN APS
2338 02Feb21 NoCat	5	- MAIN FLOOR: UPGRADE TO 9' DOORS **EXCLUDING** MUD ROOM AND MUDROOM WIC  INCLUDED IN APS
2338 02Feb21 NoCat	1	LIBRARY: OPT. 9FT. HIGH DOUBLE FRENCH DOORS WITH FLAT CLEAR GLASS COMPLETE WITH BUILDERS STANDARD FINISHES.  INCLUDED IN APS



PAINT

Invoice	Qty.	Description
2338  02Feb21 NoCat	1	- GREAT ROOM - OPT. COFFERED CEILING AS PER PLAN  INCLUDED IN APS
2338  02Feb21 NoCat	1	- LIBRARY - OPT. WAFFLE CEILING, BEAM DETAIL AS PER PLAN (4 BOXES) OPTION #1 CTR-B07  INCLUDED IN APS
2338  02Feb21 NoCat	1	- GREAT ROOM/KITCHEN: REDUCE WIDTH OF ARCHWAY - LEAVE NIBB WALLS EVEN ON BOTH SIDES - APPROX. 30" - SEE PLAN FOR LOCATION  INCLUDED IN APS
2338  02Feb21 NoCat	1	- MASTER BEDROOM - OPT. 10 FOOT TRAY CEILING AS PER PLAN - SQUARE OFF LIKE ELEVATION C  INCLUDED IN APS
2338  02Feb21 NoCat	18	- 2ND FLOOR: INCREASE HEIGHT OF DOOR TO 8FT SECOND FLOOR - 18 DOORS TOTAL  INCLUDED IN APS
2338  02Feb21 NoCat	5	- MAIN FLOOR: UPGRADE TO 9' DOORS **EXCLUDING** MUD ROOM AND MUDROOM WIC  INCLUDED IN APS
2338  02Feb21 NoCat	1	LIBRARY: OPT. 9FT. HIGH DOUBLE FRENCH DOORS WITH FLAT CLEAR GLASS COMPLETE WITH BUILDERS STANDARD FINISHES.  INCLUDED IN APS

PAINTING

Invoice	Qty.	Description
2556  27Jan21 NoCat	2	MAIN STAIRS - BASEMENT TO 2ND FLOOR: STAIN STAIRS AND LANDINGS  STAIRS WILL NOT MATCH HARDWOOD FLOORS IN COLOUR/TEXTURE

PANL - FRAMING

Invoice	Qty.	Description
2338 72,303 02Feb21 **	1	FIXTURE: UNDER CABINET FLUORESCENT LIGHT FIXTURES - DOES NOT INCLUDE (AND REQUIRES) LIGHT VALANCE  INCLUDED IN APS





**Lot: 124**

**Model: 40.06 A LILAC**

**Project/Phase: Pine Valley Forevergreen / 1**

## PLUMBING

Invoice	Qty.	Description
2556 27Jan21 NoCat	1	POWDER ROOM: MOEN 'ALIGN' 8" CC LAV FAUCET - MATTE BLACK
2556 27Jan21 NoCat	1	KITCHEN: UPGRADE SINK TO BLANCO QUATRUS R15 U 2 - STAINLESS STEEL  BOTTOM GRID NOT INCLUDED
2556 27Jan21 NoCat	1	KITCHEN: MOEN 'NIO' KITCHEN FAUCET - BLACK WITH GOLD HANDLE
2556 27Jan21 NoCat	1	MASTER ENSUITE: UPGRADE SHOWER SYSTEM TO MOEN 'ALIGN' RAIN SHOWER (from ceiling) + HAND SHOWER W/ SLIDE BAR - BRUSHED NICKEL
2556 27Jan21 NoCat	2	MASTER ENSUITE: MOEN 'ALIGN' 8" cc LAV FAUCET - BRUSHED NICKEL
2556 27Jan21 NoCat	1	MASTER ENSUITE: MOEN 'ALIGN' TUB FILLER + HAND SHOWER - BRUSHED NICKEL
2556 27Jan21 NoCat	1	ENSUITE 2: UPGRADE TUB/SHOWER FAUCET + 8" cc LAV FAUCET TO MOEN 'ARRIS' MATTE BLACK
2556 27Jan21 NoCat	1	SHARED ENSUITE: UPGRADE SHOWER FAUCET + (2x) 8" cc LAV FAUCET TO MOEN 'ARRIS' MATTE BLACK
2338 02Feb21 NoCat	1	MASTER ENSUITE: MOEN ARRIS POSI-TEMP 3-FUNCTION RAIN SHOWER (FROM WALL) + HAND SHOWER + SLIDE BAR IN CHROME FINISH  INCLUDED IN APS

## STAIR AND RAILINGS

Invoice	Qty.	Description
2556 94,074 27Jan21	2	MAIN STAIRS: UPGRADE - EUROLINE CONTEMPORARY, 3" RECTANGULAR HANDRAIL, 3 1/2" ALL SQUARE POST WITH SQUARE STYLE W/BAND POST CAP - PACKAGE F



\* Included in Schedule M. - ARS.



# 40' DETACHED

## INVENTORY SERIES COLLECTION

LOT # 124

MODEL	ELEVATION	SF	PRICE
The Lilac	A	3425	

### Inclusive of Structural Extra's :

- ✓ Basement – upgrade basement windows 30 x 24 x 8" Frame + Egress window 47 x 35 x 8
- ✓ Back-Flow preventer valve
- ✓ Windows – upgrade to black interior windows thruout
- ✓ Kitchen – relocate standard ceiling mount fixture above island
- ✓ Kitchen – Additional reinforced ceiling outlet above island
- ✓ Kitchen – Gas line rough-in for cooktop (appliance not included)
- ✓ Kitchen – under cabinet fluorescent light fixtures (light valance not included)
- ✓ Kitchen – 240V wall receptacle on separate circuit for wall oven appliance ( appliance not included)
- ✓ Kitchen – 110V wall receptacle on separate circuit for gas fired appliance for AUX. equipment (appliance not included)
- ✓ Kitchen – 4" E/S Led interior pot lights (quantity 8)
- ✓ Master Bedroom – optional 10ft tray ceiling
- ✓ Upper Hall – upgrade standard ceiling mount fixture to (1) LED pot light
- ✓ Upper Hall – 4" E/s Led interior pot lights (quantity 3)
- ✓ Master Ensuite – Shower Niche (shampoo shelf), complete with matching marble jambs on 4 sides, standard tile, approx., 12 x 18 installed vertically
- ✓ Master Bedroom – Sun Tunnel Extension, 6ft. rigid tunnel. Approx.
- ✓ Main floor increase height of doors to 9ft., excluding mudroom & mudroom WIC
- ✓ 2<sup>nd</sup> Floor- increase height of doors to 8ft
- ✓ Master Ensuite – Moen ARRIS posi-temp 3-function rain shower (from wall) + hand shower + slide bar in chrome finish
- ✓ Great Room – additional interior receptacle on existing circuit for wall mount TV above fireplace
- ✓ Great Room – Conduit pipe for wall mount TV above fireplace
- ✓ Great Room – optional coffered ceiling as per plan
- ✓ Great room/Kitchen – Reduce width of Archway, leaving Nibb walls even on both sides
- Great Room – optional waffle ceiling, beam detail, as per plan (9 boxes) CTR-B07
- Study – optional coffered ceiling as per plan
- ✓ Study – optional waffle ceiling, beam detail, as per plan (4 boxes) CTR-B07
- ✓ Study – optional 9ft high double French Doors with flat clear glass complete with builders standard finishes.
- ✓ Main Hall (ground floor) - 4" E/s Led interior pot lights (quantity 5)
- ✓ Main Hall – upgrade standard ceiling mount fixture to (1) Led pot light
- ✓ Study - 4" E/s Led interior pot lights (quantity 3)
- ✓ Study – upgrade standard ceiling mount fixture to (1) Led pot light
- ✓ Main Hall @ Study - 4" E/s Led interior pot lights (quantity 2)
- ✓ Main Hall @ Study – upgrade standard ceiling mount fixture to (1) Led pot light
- ✓ Library – optional coffered ceiling as per plan

GOLDPARK  
WORTH MORE™



PV - 124 Cabinetry Schedule

ROOM	DESCRIPTION	PRICE	QTY	TOTAL
KITCHEN	UPGRADE FROM SERIES 2 TO SERIES 4 - WINDERMERE OYSTER	1175.00	1	\$
	UPGRADE FROM SERIES 2 TO SERIES 4 - WINDERMERE CLAY		1	\$
	UPGRADE HARDWARE: BH-051-09 (GOLD)		1	\$
	UPGRADE HARDWARE: BAH-053-09 (GOLD)		1	\$
	COOKTOP CABINET WITH POTS AND PANS BELOW		1	\$
	2 BIN RECYCLE CENTRE		1	\$
	WALL OVEN CABINET WITH DRAWER BELOW		1	\$
	BASE CORNER "MAGIC CORNER"		1	\$
	POTS AND PANS DRAWERS		4	\$
	2 TIER SPICE PULL OUT		2	\$
	ADJUST FOR 36" COOKTOP		1	\$
	DISHWASHER PANEL		1	\$
	FRIDGE/FREEZER PANELS		1	\$
	RETURN TRIP FOR HARDWOOD		1	\$
	LEAVE APPROX 42" SPACE FOR FUTURE 36" CHIMNEY STYLE HOOD FAN		1	\$
	DECORATIVE RECESSED END GABLE AT ISLAND		2	\$
	DECORATIVE PROUD FURNITURE KICK		2	\$
	TOUCH LATCH AT REAR OF ISLAND		1	\$
	STRAIGHT VALANCE		1	\$
				\$
				\$
POWDER ROOM	UPGRADE FROM SERIES 2 TO SERIES 4 - WINDERMERE OYSTER		1	\$
				\$
LAUNDRY ROOM	ADD OPTIONAL UPFERS		1	\$
				\$
MASTER ENSUITE	UPGRADE FROM SERIES 2 TO SERIES 3 - MANHATTAN ANTHRACITE		1	\$
	ADD BANK OF DRAWERS		2	\$
				\$
ENSUITE 2	ADD ADDITIONAL TOP DRAWER		1	\$
				\$
SHARED BATH	ADD VANITY BANK OF DRAWERS		1	\$
				\$
CABINETRY TOTAL:				\$

LOT #: PV-124

DATE: Jan 26, 2021

SIGNATURE: 

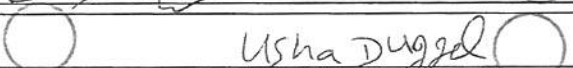
SIGNATURE: Usha Duggal 

Purchasers: AMIT DUGAL / PUNEET DUGAL & MEGHA DUC Property: 124 of Plan -

Telephone Res. / Bus: /

Project: Pine Valley Forevergreen - Phase 1

Decor Advisor: Yolande Somerville

Model and Elevation: 40.06 A LILAC

Layout Changes: ☐ Yes ☒ No

Sketch Attached: ☒ Yes ☐ No

Exterior Colour Scheme:

### 1. Cabinetry

	Style and Colour	Counter	Hardware
Kitchen / Breakfast	2-TONE	*Quartz: Bianco Calacatta	attached
Laundry Room	Modena 'Classic White'	P-Lam: White	attached
Powder Room	*Windermere 'Oyster'	*Quartz: Empira Black	attached
Master Ensuite Bathroom	*Manhattan 'Anthracite'	*Quartz: N-Boost Marengo	attached
Second Ensuite Bathroom (If Applicable)	Modena 'Classic White'	*Quartz: N-Boost Marengo	attached
Shared Ensuite	Modena 'Tan'	*Quartz: N-Boost Marengo	attached

#### Comment

Kitchen Perimeter: \*Windermere 'Oyster' // Island: \*Windermere 'Clay'

### 2. Floor Tile

	Selection
Entrance Vestibule	*30x60" Marmorea polished 'Port Laurent'
Main Hall	
Kitchen / Breakfast	hardwood
Laundry Room	13x13" Sempre 'White'
Powder Room	*12x24" Marmorea polished 'Port Laurent'
Mud Room	*12x24" Marmorea polished 'Port Laurent'
Master Ensuite Bathroom	*12x24" Carrara X polished 'White'
Second Ensuite Bathroom (If Applicable)	13x13" Sempre 'White'
Lower Landing (If Applicable)	13x13" Reflex 'Espresso' (basement foyer)
Shared Bath	*12x24" Land 'Grigio'

#### Comment

Master Ensuite Shower Floor: 2x2" Carrara X 'White' matte // Shared Ensuite Shower Floor: 2x2" Quebec 'Black' unglazed

### 3. Wall Tile

	Selection	Listello/Inserts	Describe
Master Ensuite Bathroom		<input type="radio"/> Yes <input checked="" type="radio"/> No	
Tub Deck		<input type="radio"/> Yes <input checked="" type="radio"/> No	
Shower Stall	*12x24" Carrara X pol 'White'	<input type="radio"/> Yes <input checked="" type="radio"/> No	
Bathroom Walls		<input type="radio"/> Yes <input checked="" type="radio"/> No	
Second Ensuite Bathroom (If Applicable)	*8x24" Laguna Wave 'White'	<input type="radio"/> Yes <input checked="" type="radio"/> No	
Shared Ensuite	*12x24" Carrara X pol 'White'	<input type="radio"/> Yes <input checked="" type="radio"/> No	
Kitchen Backsplash	<input checked="" type="radio"/> Yes <input type="radio"/> No	Backsplash Behind Fridge	

#### Comment

FHBS - same as counter



Purchasers: AMIT DUGAL / PUNEET DUGAL & MEGHA DUC Property: 124 of Plan -

Telephone Res. / Bus: /

Project: Pine Valley Forevergreen - Phase 1

Decor Advisor: Yolande Somerville

Model and Elevation: 40.06 A LILAC

### 4. Plumbing Fixtures

Master Ensuite Bathroom  Second Ensuite  Powder Room   
Other Room - Specify  Other Washroom

Comment

Upgraded thru out - see extras

### 5. Hardwood Flooring

	Type and Stain		Type and Stain
Main Hall	<input type="text"/>	Upper Landing	<input type="text"/>
Kitchen / Breakfast	*3/4x5" red oak brush 'Hopscotch'	Upper Hall	<input type="text"/>
Living Room	<input type="text"/>	Master Bedroom	<input type="text"/>
Dining Room	<input type="text"/>	Bedroom #2	<input type="text"/>
Family Room	<input type="text"/>	Bedroom #3	<input type="text"/>
Den/Library	<input type="text"/>	Bedroom #4	<input type="text"/>
Entrance Vestibule	<input type="text"/>	Bedroom #5	<input type="text"/>
Lower Landing (If Applicable)	<input type="text"/>	Other Room - Specify	<input type="text"/>
		Thru out standard areas	*3/4x5" red oak brush 'Hopscotch'

Comment

Stairs & Landings will not match hardwood floors in colour/texture

### 6. Carpeting

	Upgrade	Description
Ground Floor	<input type="checkbox"/>	<input type="text"/>
Second Floor	<input type="checkbox"/>	<input type="text"/>
<input type="text"/>	<input type="checkbox"/>	<input type="text"/>

	Type	Area
Upgrade Underpad	<input type="text"/>	<input type="text"/>
Carpet on Stairs	Capped <input type="text"/>	Runner - *Upgrade <input type="text"/>

Comment

### 7. Fireplace

	Living Room			Family Room			Other Room - Specify		
	Purchased	As Per Plan	N/A	Purchased	As Per Plan	N/A	Purchased	As Per Plan	N/A
Fireplace Type	<input type="radio"/>	<input type="radio"/>	<input checked="" type="radio"/>	<input type="radio"/>	<input checked="" type="radio"/>	<input type="radio"/>	<input type="radio"/>	<input type="radio"/>	<input checked="" type="radio"/>
Mantle Type	<input type="text"/>	<input type="text"/>	<input type="text"/>	<input type="text"/>	<input type="text"/>	<input type="text"/>	<input type="text"/>	<input type="text"/>	<input type="text"/>
Colour / Stain	<input type="text"/>	<input type="text"/>	<input type="text"/>	<input type="text"/>	<input type="text"/>	<input type="text"/>	<input type="text"/>	<input type="text"/>	<input type="text"/>
Surround	<input type="text"/>	<input type="text"/>	<input type="text"/>	<input type="text"/>	<input type="text"/>	<input type="text"/>	<input type="text"/>	<input type="text"/>	<input type="text"/>
Hearth	<input type="text"/>	<input type="text"/>	<input type="text"/>	<input type="text"/>	<input type="text"/>	<input type="text"/>	<input type="text"/>	<input type="text"/>	<input type="text"/>

Comment



Purchasers: AMIT DUGAL / PUNEET DUGAL & MEGHA DUC Property: 124 of Plan -

Telephone Res. / Bus: /

Project: Pine Valley Forevergreen - Phase 1

Decor Advisor: Yolande Somerville

Model and Elevation: 40.06 A LILAC

## 8. Trim Carpentry

Interior Doors \*Livingston Front Door Glass Inserts Standard Door Handles \*Halifax blk + hinge  
Interior Trim \*Board 5  
Comment

## 9. Plaster Mouldings and Medallions

Standard Throughout ☐ Yes ☐ No ☒ N/A

Entrance Vestibule			Kitchen/Breakfast		
Main Hall			Den/Library		
Living Room			Lower Landing		
Dining Room			Other Room - Specify		
Family Room					

Comment

## 10. Railings and Spindles

Railing Package \*Package F  
Railing Colour \*Graphite Mirage Spindle Colour \*Black  
Stringer / Riser \*Graphite Mirage Treads \*Graphite Mirage  
Oak Stairs ☒ Yes ☐ No ☐ N/A  
Comment

## 11. Wall Paint / Ceilings

Throughout Finished Areas Warm Grey  
Trim Paint White  
Smooth Ceilings  
Ground Floor ☒  
Second Floor ☒  
Note  
Comment

Scheduled Closing Date: Thursday, November 25, 2021

Purchasers: AMIT DUGAL / PUNEET DUGAL & MEGHA DUC Property: 124 of Plan -

Telephone Res. / Bus: /

Project: Pine Valley Forevergreen - Phase 1

Decor Advisor: Yolande Somerville

Model and Elevation: 40.06 A LILAC

## 12. Electrical

Hood Fan ☐ White ☐ Stainless ☒ N/A

Above Kitchen Cabinet Light ☐ Yes ☒ No

Below Kitchen Cabinet Light ☒ Yes ☐ No

Standard Appliances ☐

Over The Range Microwave ☐

Chimney Style Fan ☒

Comment

## 13. Heating and Air Conditioning

Air Conditioning

Gas Provisions Stove

Gas Provisions Dryer

Gas Provisions Barbecue

Comment

## 14. Additional Comments

## 15. Disclaimers and Notes

- 1) Colours of all materials are as close as possible to builder's selection, but not necessarily identical due to variances in manufacturing.
- 2) Any extras listed above are null and void unless accompanied by a separate invoice/amendment. Said invoice must be paid in full.
- 3) The Purchaser acknowledges that after Interior Colour Selection form is signed and dated, no further changes will be permitted other than re-selection due to unavailability. \_\_\_\_\_ Purchaser's Initials
- 4) The Purchaser acknowledges reading and accepting the "Gold Park Homes Decor Centre Disclaimers" form. This document contains other miscellaneous disclaimers.

This Interior Colour Selection is final and approved by:

Signature:  Date: Jan 26, 2021

 Usha Duggal

**PV-124 Grout Schedule**

ROOM	LOCATION	COLOUR
FOYER	FLOOR	CHARCOAL
MUD ROOM	FLOOR	CHARCOAL
POWDER ROOM	FLOOR	CHARCOAL
BASEMENT FOYER	FLOOR	CHARCOAL
SHARED ENSUITE	SHOWER FLOOR	CHARCOAL

LOT #: <u>PV-124</u>	DATE: <u>Jan 26, 2021</u>
SIGNATURE: <u>[Signature]</u>	
SIGNATURE: <u>Usha Duggal</u>	



# SCHEDULE 'F'



PV-124  
MAY 8 2020  
PV-124  
Jan 26, 2021

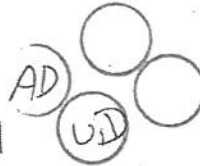

## The Lilac 40' SERIES

Elevation A • 3,425 sq.ft.  
Elevation B • 3,385 sq.ft.

BLACK INTERIOR  
Windows

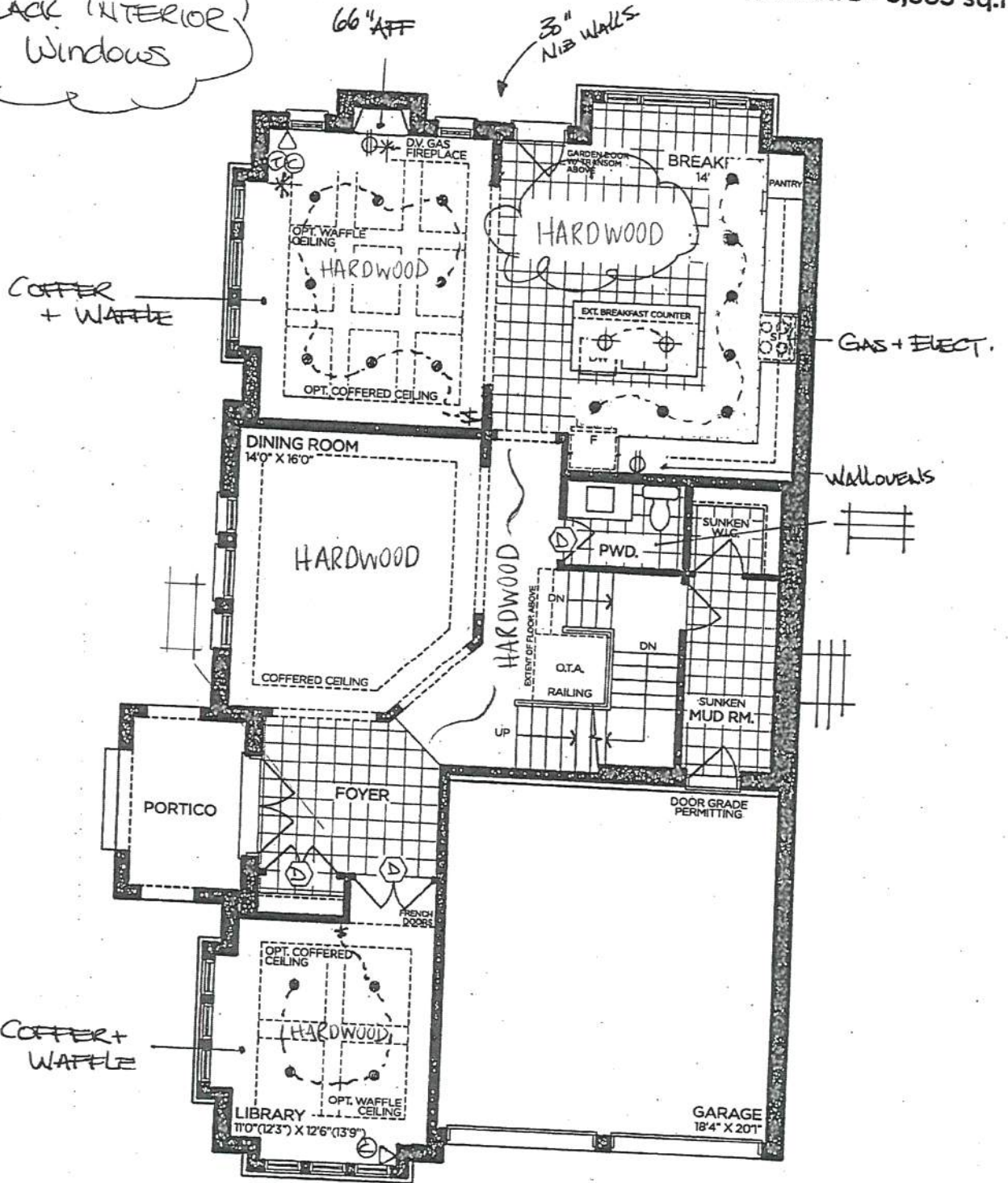

GROUND FLOOR | ELEV. A

VENDOR

PURCHASER

PURCHASER

**GOLDPARK**  
WORTH MORE™

Prices, figures, illustrations, sizes, features and finishes are subject to change without notice. Areas and dimensions are approximate and actual usable floor space may vary from the stated area. Layout may be reverse of the unit purchased. E. & O.E. 4006

Prices, figures, illustrations, sizes, features and finishes are subject to change without notice. Areas and dimensions are approximate and actual usable floor space may vary from the stated area. Layout may be reverse of the unit purchased. E. & O.E. 4006

SCHEDULE 'F'



The Lilac  
40' SERIES

Elevation A • 3,425 sq.ft.  
Elevation B • 3,385 sq.ft.

PV-124  
March 30 2020  
May 8 2020  
PV-124  
Jan 26, 2021

AD  
UD

35x47"

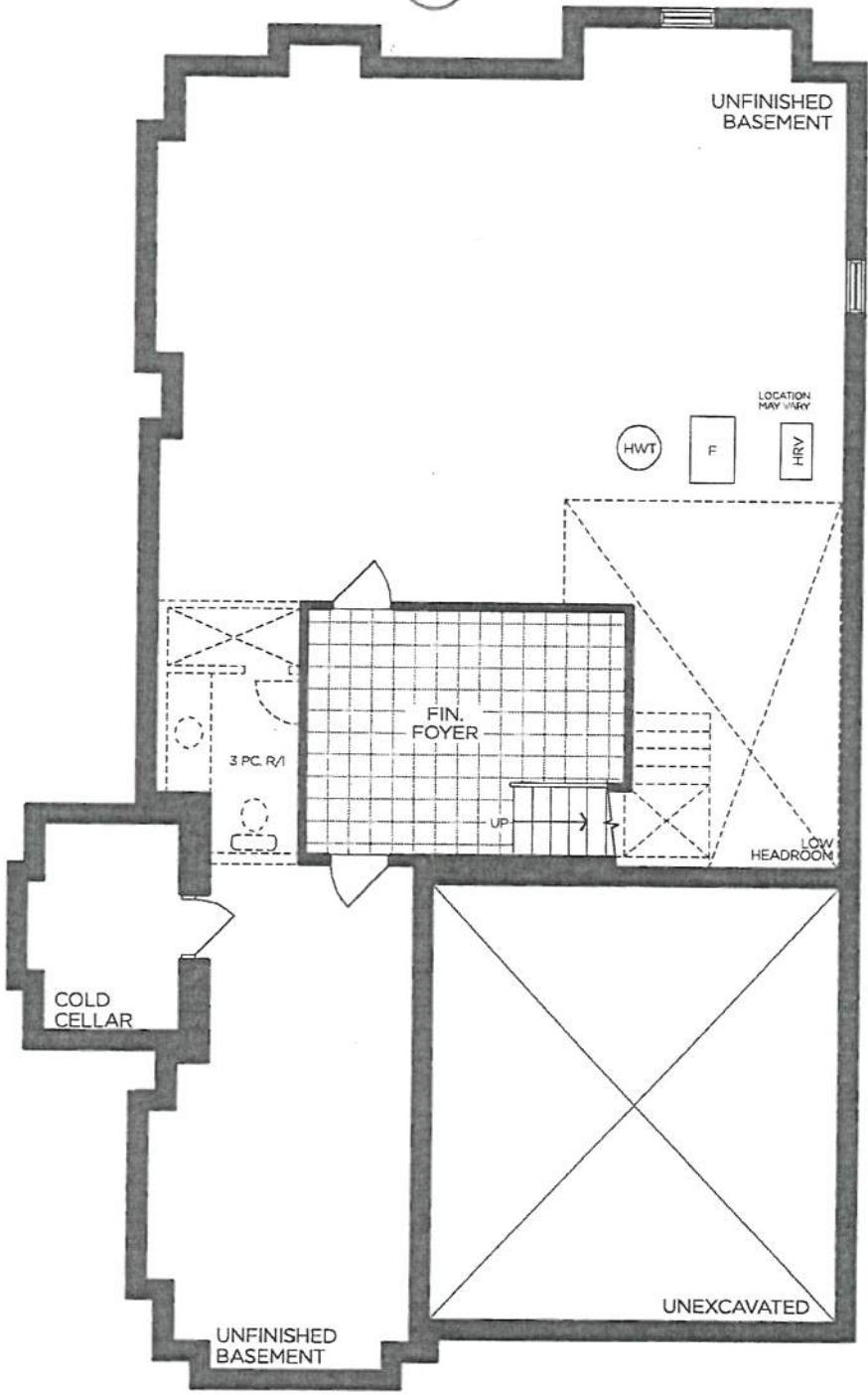

BASEMENT | ELEV. A

VENDOR

PURCHASER

PURCHASER

GOLDPARK  
WORTH MORE™

Prices, figures, illustrations, sizes, features and finishes are subject to change without notice. Areas and dimensions are approximate and actual usable floor space may vary from the stated area. Layout may be reverse of the unit purchased. E. & O.E. 4006



Jan. 28, 2021

→ Perimeter: Windermere  
(Oyster)

→ Island: Nindermere 'Clay'  
B4-051-09 (GOLD)  
BAH-053-09 (GOLD)

\* return trip for hardwood  
x Light value

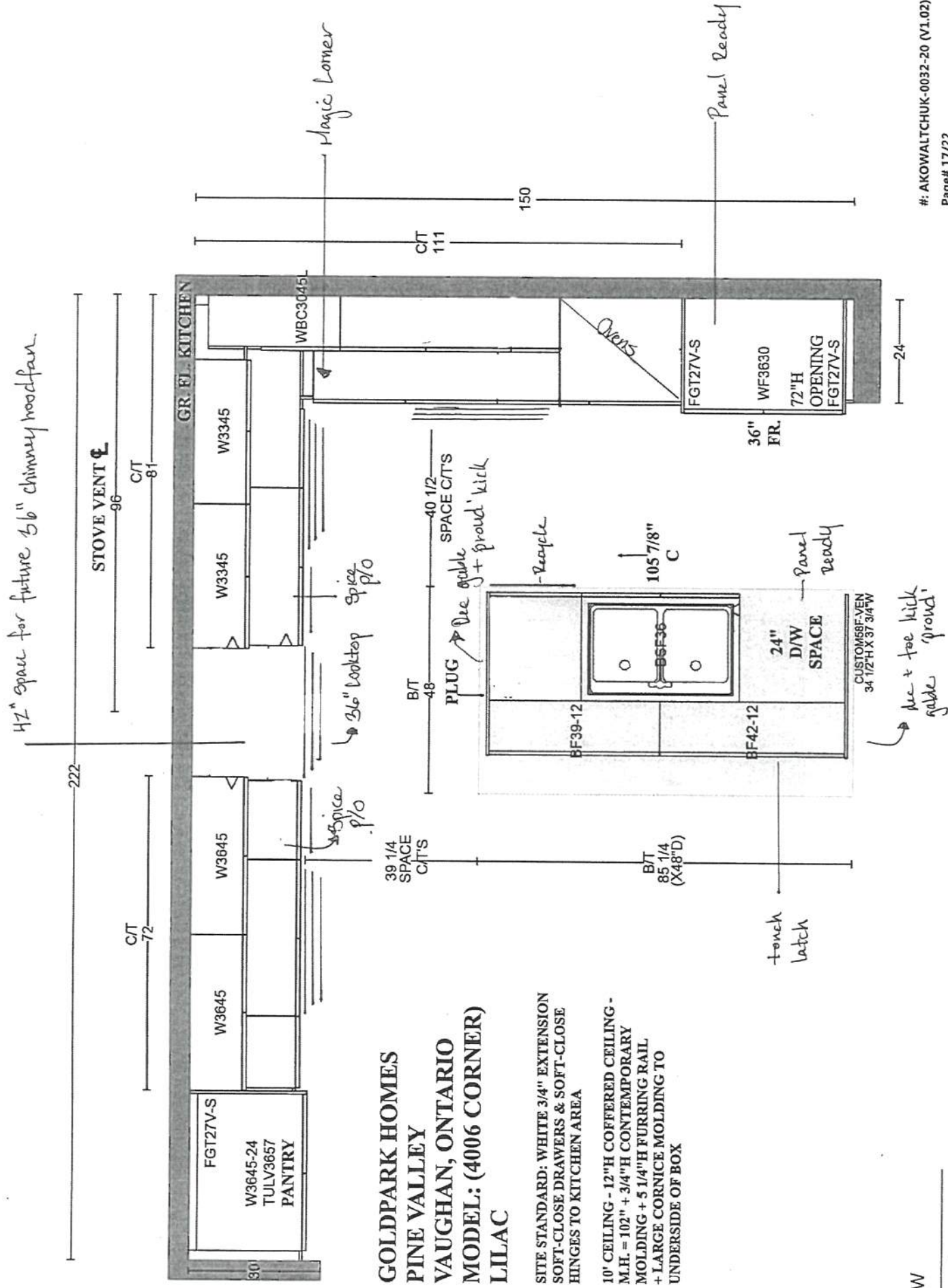

PV-124

Jan 26, 2021

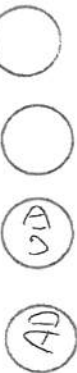

Windermere "Oyster"  
K002-05

Manhattan "Anthracite"  
H039-03

**GOLDPARK HOMES  
PINE VALLEY  
VAUGHAN, ONTARIO  
MODEL: (4006 CORNER) LILAC**

SITE STANDARD: WHITE 3/4" EXTENSION  
SOFT-CLOSE DRAWERS & STANDARD SLAM DOOR HINGES  
TO VANITIES

ONE TOP DRAWER WHERE POSSIBLE THROUGHOUT EACH  
VANITY, ONE BANK OF DRAWERS WHERE POSSIBLE  
THROUGHOUT EACH MASTER ENSUITE VANITY

92" ————  
L/T 32"  
(X28 1/2"D)

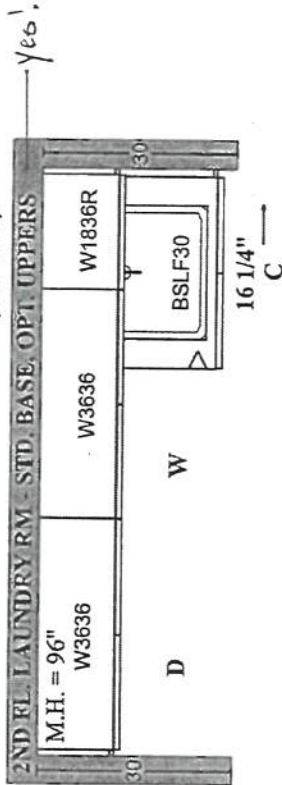

Modena "Classic White"  
K002-05

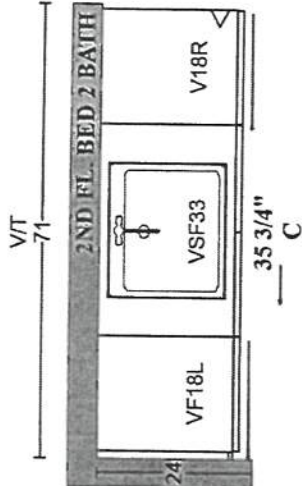
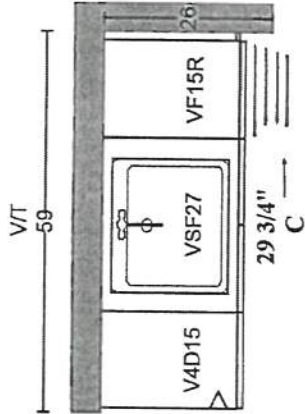
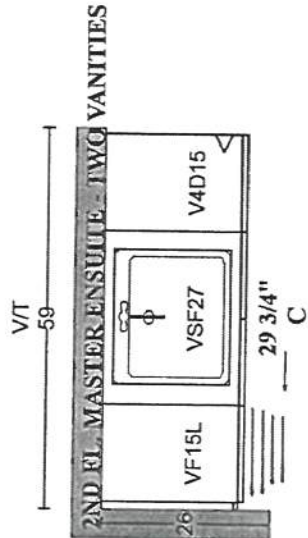
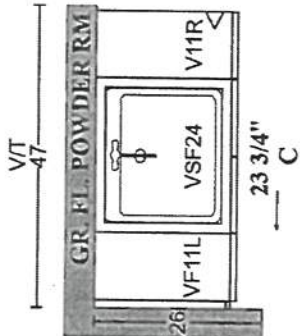

Modena "Classic White"  
H011-05

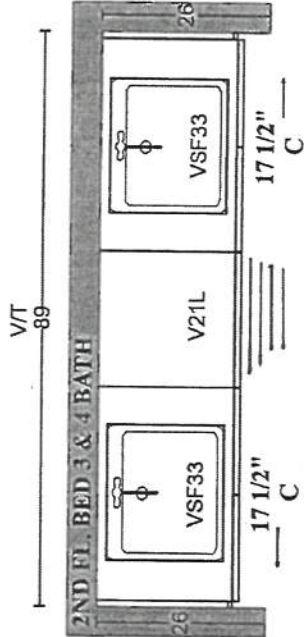

Modena "Tan"  
H011-05



PINE VALLEY  
FOREVERGREEN

STONE COUNTERTOP EDGE PROFILES



STANDARD 2CM EASED EDGE

LOCATION:

THRU-OUT



UPGRADE 3CM EASED EDGE

LOCATION:

Kitchen



UPGRADE 4CM MITRED EDGE



LOCATION:

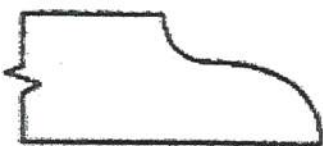

UPGRADE 2CM OGEE EDGE

LOCATION:

LOT #: PV-124

DATE: Jan. 26, 2021

SIGNATURE:



*[Signature]*

SIGNATURE:



Usha Duggal

GOLDPARK  
WORTH MORE



STANDARD HARDWARE / HANDLES



☐ H001-02



☐ H001-03



☐ H001-04



☐ H009-03



☐ H009-09



☐ H011-03



☒ H011-05

→ Ensuite 2  
→ Shared Ensuite



☐ H011-06



☐ H033-01



☒ H039-03  
→ Master Ensuite

☐ \*NO HARDWARE

LOT # PV-124

DATE: Jan 26 12021

SIGNATURE:



SIGNATURE:



Usha Duggal

STANDARD HARDWARE / KNOBS



☐ K002-02



☐ K002-03



☐ K002-04



☐ K002-06

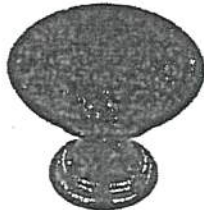

☒ K002-05  
→ Powder Room  
→ Laundry Room



☐ K002-14



☐ K024-03

☐ \*NO HARDWARE

LOT # PV-124

DATE: Jan 26, 2021

SIGNATURE:



*[Signature]*

SIGNATURE:



*Usha Duzzol*

UPGRADE HARDWARE



BH-051-09

Pull - 'Brushed Gold'



LOCATION:

Kitchen

LOT # PV-124

DATE: Jan 26, 2021

SIGNATURE:



*Usha Duggal*

SIGNATURE:



Usha Duggal

GOLDPARK  
WORTH MORE



UPGRADE HARDWARE



BAH-053-09

Appliance Pull - 'Brushed Gold'



LOCATION:

Kitchen (appliances)

LOT # PV-124	DATE: Jan 26, 2021
SIGNATURE: 	
SIGNATURE: 	Usha Duggal

UPGRADE KITCHEN FAUCET



MOEN - NIO

One-Handle Pulldown Kitchen Faucet

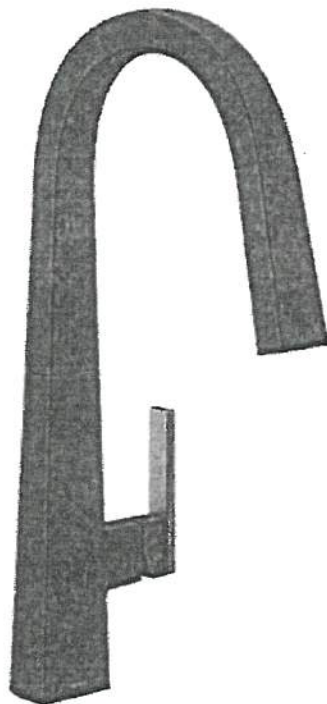

- ☐ CHROME
- ☒ MATTE BLACK / BRUSHED GOLD (BL)
- ☐ SPOT RESIST STAINLESS (SRS)

MODEL: S75005 Chrome / S75005BL Matte Black / S75005SRS Spot Resist Stainless

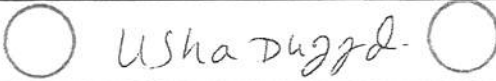
Lot# PV-124	Date: Jan 26, 2021	Room: Kitchen
Signature: 		
Signature: 		

UPGRADE KITCHEN SINK



**BLANCO - QUATRUS R15 U 2**  
Stainless Steel - Undermount  
32" x 18" x 9"

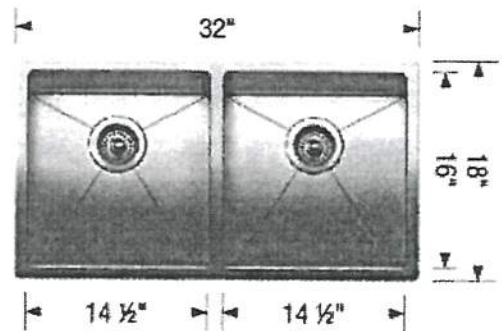
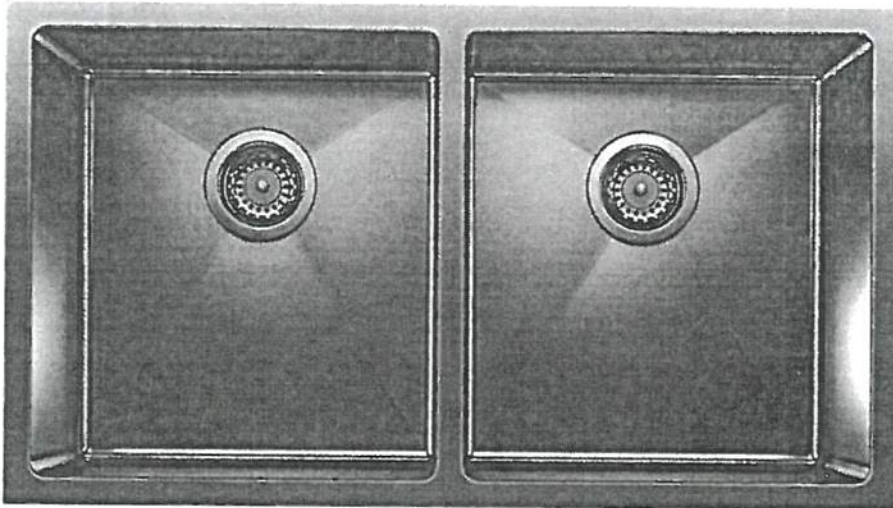

Stainless Steel

☐ GRID

MODEL 401519 Stainless Steel / 406454 Grid

Lot# PV-124

Room: Kitchen

Signature:

Date: Jan 26, 2021

Signature:

**GOLDPARK**  
WORTH MORE™



PLUMBING UPGRADES





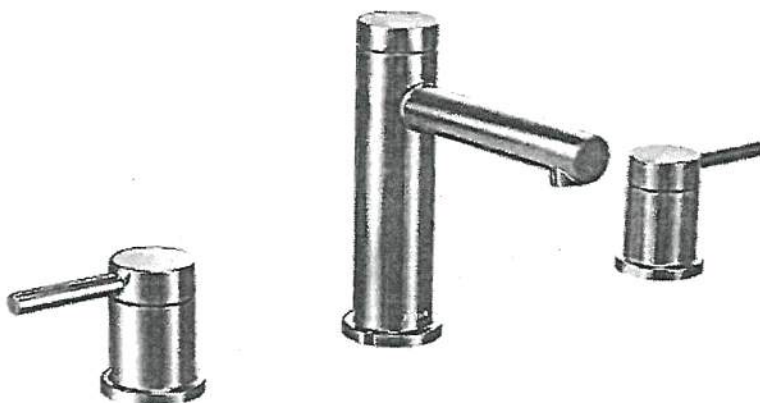

MOEN - ALIGN

Two-Handle Adjustable Widespread Lav Faucet with Lift Rod Drain



- ☐ CHROME
- ☐ BRUSHED NICKEL (BN)
- ☒ MATTE BLACK (BL)
- ☐ BRUSHED GOLD (BG)

MODEL: T6193 Lav Faucet / 69000 Valve

Lot# PV-124	Date: Jan 26, 2021	Room: Powder Room
Signature: 	 Usha Duggal	
Signature: 		

PLUMBING UPGRADES





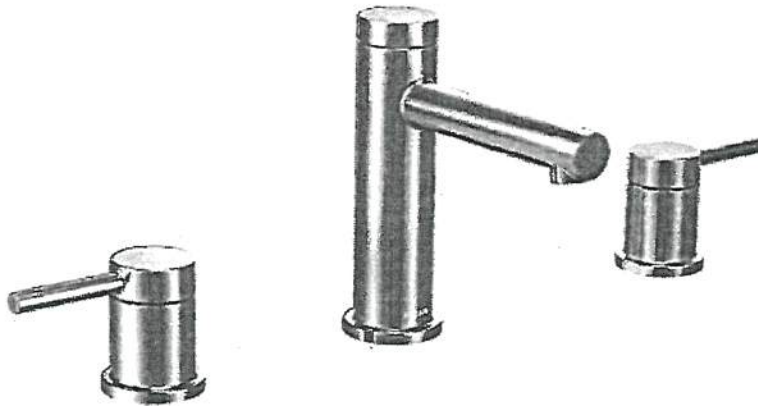

MOEN - ALIGN

Two-Handle Adjustable Widespread Lav Faucet with Lift Rod Drain



- ☐ CHROME
- ☒ BRUSHED NICKEL (BN)
- ☐ MATTE BLACK (BL)
- ☐ BRUSHED GOLD (BG)

MODEL: T6193 Lav Faucet / 69000 Valve

Lot# PV-124	Date: Jan 26, 2021	Room: Master Ensuite x 2
Signature: 		Usha Jugal
Signature: 		

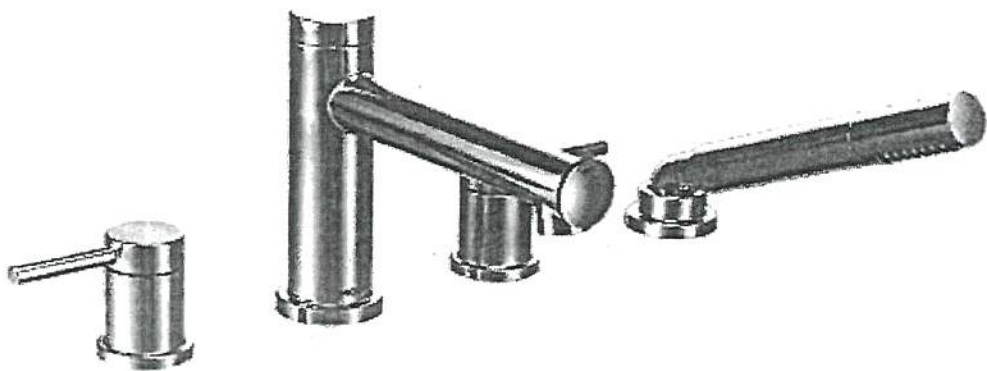

MOEN - ALIGN

Two-Handle Roman Tub Faucet with Hand Shower

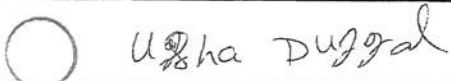

- ☐ CHROME
- ☒ BRUSHED NICKEL (BN)
- ☐ BRUSHED GOLD (BG)

MODEL: T394 Tub Faucet / 9796 Valve / T90331 + 140680 Tub Drain Half Kit

Lot# PV-124	Date: Jan 26, 2021	Room: Master Ensuite
Signature:  		
Signature:  		



PLUMBING UPGRADES



MOEN - ALIGN



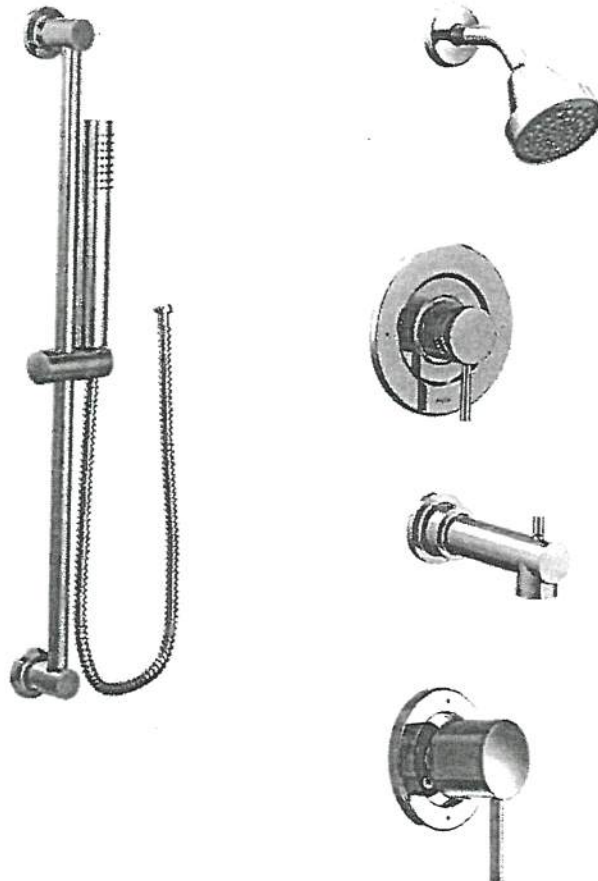

Posi-Temp Tub/Shower Faucet with 3 Function Transfer Valve/Trim and Slide Bar with Handshower



- ☐ CHROME
- ☒ BRUSHED NICKEL (BN)
- ☐ MATTE BLACK (BL)
- ☐ BRUSHED GOLD (BG)

- ☐ from WALL
- ☒ from CEILING

MODEL: T2193EP Tub/Shower Trim / 62320 1/2" CC Valve / T4191 Transfer Trim + 3372 Transfer Valve / 128284 Twin El Valve / 3887EP Handshower + A725 Drop El / 226651 (BN, WR, BG) Shower Arm

Lot# PV-124	Date: Jan 26, 2021	Room: Master Ensuite
Signature: 	 Lisha Duggal	
Signature: 		

PLUMBING UPGRADES



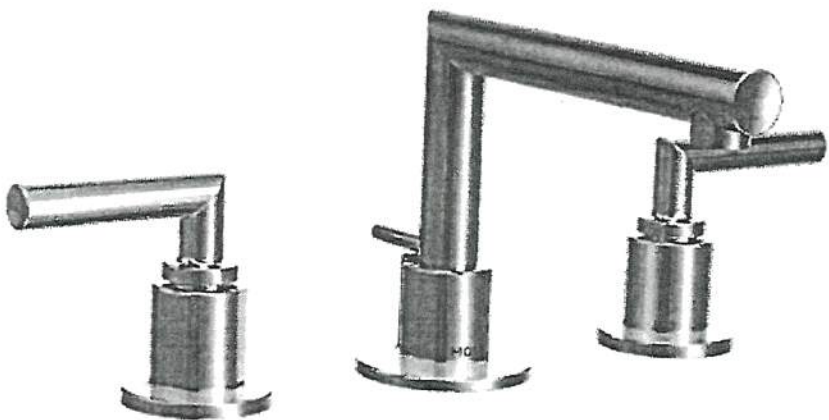

MOEN - ARRIS

Two-Handle Adjustable Widespread Lav Faucet with Drain Assembly



- ☐ CHROME
- ☐ BRUSHED NICKEL (BN)
- ☒ MATTE BLACK (BL)

MODEL: TS43002 Lav Faucet / 69000 Valve

Lot# PV-124	Date: Jan 26, 2021	Room: Ensuite 2
Signature:  Usha Duggal.		
Signature:  		

PLUMBING UPGRADES

MOEN - ARRIS

Eco-Performance Posi-Temp Tub/Shower Faucet

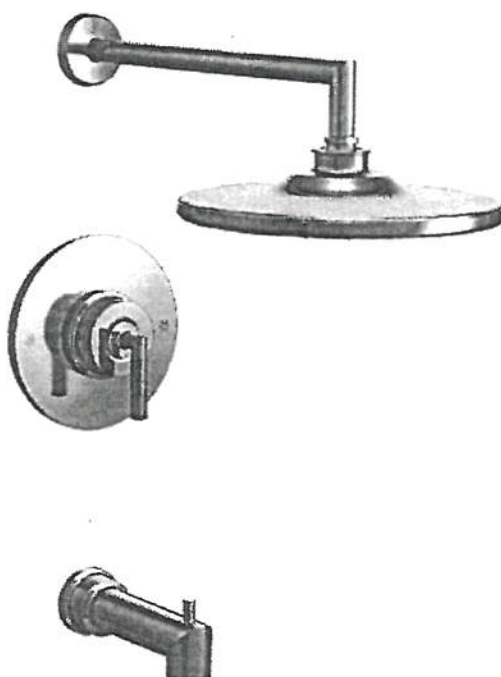

☐ CHROME



☐ BRUSHED NICKEL (BN)

☒ MATTE BLACK (BL)

☒ from WALL

☐ from CEILING

MODEL: TS22003EP Tub/Shower Trim / 62320 1/2" CC Valve / 116651 Shower Arm (from Ceiling)

Lot# PV-124	Date: Jan 26, 2021	Room: Ensuite 2
Signature:  Usha Duggal		
Signature: 		



PLUMBING UPGRADES





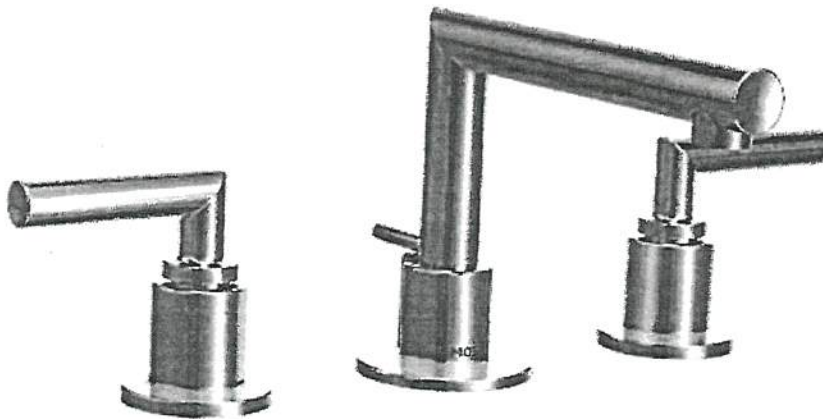

MOEN - ARRIS

Two-Handle Adjustable Widespread Lav Faucet with Drain Assembly



- ☐ CHROME
- ☐ BRUSHED NICKEL (BN)
- ☒ MATTE BLACK (BL)

MODEL: TS43002 Lav Faucet / 69000 Valve

Lot# PV-124	Date: Jan 26, 2021	Room: Shared Ensuite x2
Signature: 		Usha Duggal
Signature: 		

PLUMBING UPGRADES



MOEN - ARRIS

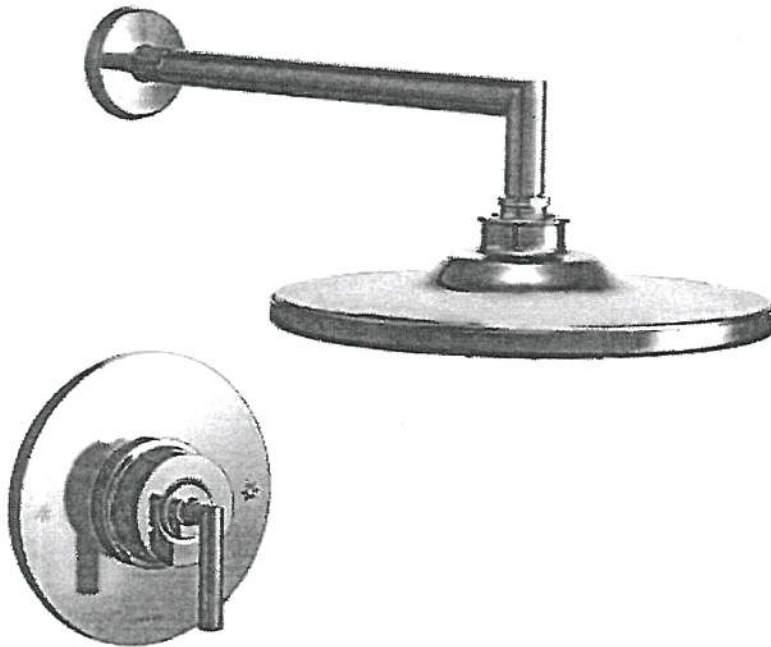

Eco-Performance Posi-Temp SHOWER ONLY\*



- ☐ CHROME
- ☐ BRUSHED NICKEL (BN)
- ☒ MATTE BLACK (BL)

- ☒ from WALL
- ☐ from CEILING

MODEL: TS22002EP Shower ONLY\* Trim / 62320 1/2" CC Valve / 116651 Shower Arm (from Ceiling)

Lot# PV-124	Date: Jan 26, 2021	Room: Shared Ensuite
Signature: 	Usha Duggal.	
Signature: 		

UPGRADE SHOWER HARDWARE



MT6X6

Shower Door Handle + hinges

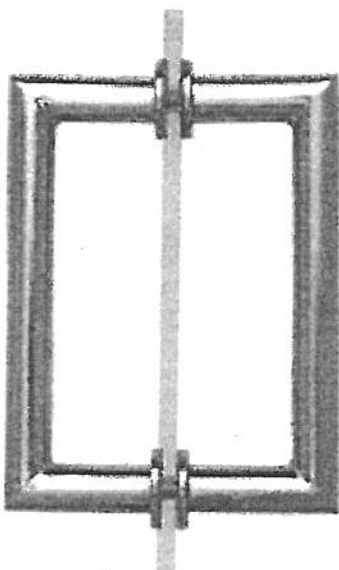

MT6X6  
Shower Door Handle





6" x 6" back-to-back  
3/4" dia. tube  
Cut and mitred corners with  
washers  
(Also available single sided)

☐ CHROME

☒ MATTE BLACK → Shared Ensuite

☐ BRUSHED GOLD

☒ BRUSHED NICKEL → Master Ensuite

Lot# PV-124	Date: Jan 26, 2021	Room: Master Ensuite, Shared Ensuite
Signature: 		Usha Duggal
Signature: 		



## BATHROOM ACCESSORIES

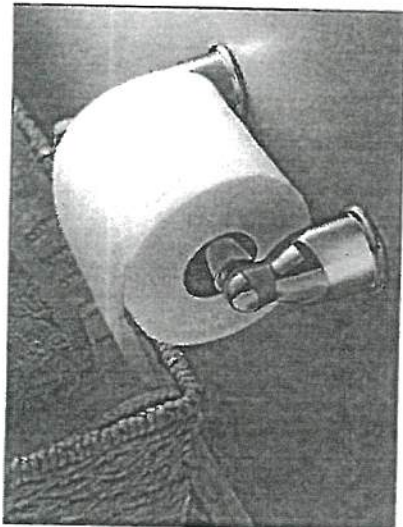

Tissue Holder  
Mason - Chrome

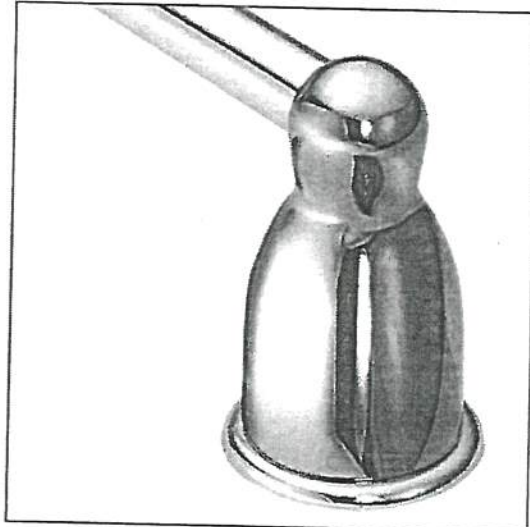

Towel Bar  
Mason - Chrome

**Please select one of the following:**

☒ INSTALL STANDARD BATHROOM ACCESSORIES THRU OUT  
(tissue holder + towel bar) *\*location as per vendors discretion\**

☐ **\*DO NOT\*** INSTALL STANDARD BATHROOM ACCESSORIES  
THRU OUT *\*tissue holder + towel bar will not be provided\**

LOT # PV-124

DATE: Jan 26, 2021

SIGNATURE:



W. Ha Duggal

SIGNATURE:





Project: Pine Valley

Lot: 124

Purchaser(s): Amit Duggal, Puneet Duggal, Megha Duggal, Usha Duggal

Standard Hood Fan Deletion

We acknowledge that the builder's standard hood fan will not be installed.  
Do not supply, install and/or credit. We will install our own hood fan after closing.

Signature: 

Signature: 

Date: January 26, 2021

PV-124

Jan 26, 2021

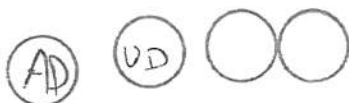

# **INSTALLATION INSTRUCTIONS** **27" (68.6 CM) AND 30" (76.2 CM) ELECTRIC** **BUILT-IN MICROWAVE OVEN FLUSH** **INSTALLATION KIT** **INSTRUCTIONS D'INSTALLATION** **POUR ENSEMBLE D'INSTALLATION EN** **AFFLEUREMENT DE FOUR À MICRO-ONDES** **ÉLECTRIQUE ENCASTRÉ DE 27" (68,6 CM)** **ET 30" (76,2 CM)**

## 27" (68.6 cm) Flush Installation Kits Ensembles d'installation en affleurement de 27" (68,6 cm)

	Stainless Steel Acier inoxydable	Stainless Steel/ Acier inoxydable, RISE™/NOIR™
Model#/ Modèle n°	Kit PN/ Ensemble référence: W10801485	Kit PN/ Ensemble référence: W11358283
JMC2427DS	★★	*
JMC2427IM, JMC2427IL	*	★★

## 30" (76.2 cm) Flush Installation Kits Ensembles d'installation en affleurement de 30" (76,2 cm)

	Black Noir	Stainless Steel/ Acier inoxydable	Stainless Steel/ Acier inoxydable, RISE™/NOIR™
Model#/ Modèle n°	Kit PN/ Ensemble référence: W10801487	Kit PN/ Ensemble référence: W10801486	Kit PN/ Ensemble référence: W11358282
JMC2430DB	★★	*	*
JMC2430DP, JMC2430DS	*	★★	*
JMC2430IM, JMC2430IL	*	*	★★

\* Approved for use.

★★ Recommended color and approved for use.

\* Approuvé pour l'utilisation.

★★ Couleur recommandée et approuvé pour l'utilisation.

## **Table of Contents/Table des matières**

<b>BUILT-IN MICROWAVE OVEN SAFETY</b> .....	2	<b>SÉCURITÉ DU FOUR À MICRO-ONDES ENCASTRÉ</b> .....	5
<b>INSTALLATION REQUIREMENTS</b> .....	2	<b>EXIGENCES D'INSTALLATION</b> .....	5
Tools and Parts.....	2	Outillage et pièces.....	5
Location Requirements.....	2	Exigences d'emplacement.....	5
<b>INSTALLATION INSTRUCTIONS</b> .....	4	<b>INSTRUCTIONS D'INSTALLATION</b> .....	7
Prepare Built-In Oven.....	4	Assemblage de la trousse d'entretoise.....	7
Install Spacer Kit.....	4	Installation de la trousse d'entretoise.....	7
Install Microwave Oven.....	4	Installation du four à micro-ondes.....	7
Complete Installation.....	4	Achever l'installation.....	7

### **IMPORTANT:**

Save for local electrical inspector's use.

### **IMPORTANT:**

À conserver pour consultation par l'inspecteur local des installations électriques.

W11356316A



PV-124  
Jan 26, 2021

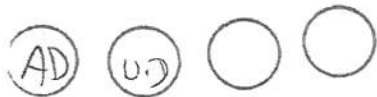

### Cabinet Dimensions - Flush Installation

A 23<sup>3</sup>/<sub>4</sub>" (59 cm) minimum cutout depth is required. These dimensions will result in a 1/4" (6.3 mm) reveal on the top, a 1/4" (6.3 mm) reveal on the sides, and a 1/8" (3.1 mm) reveal on the bottom of the microwave oven. The front face of the cleats and platform will be visible and should be treated as a finished surface.

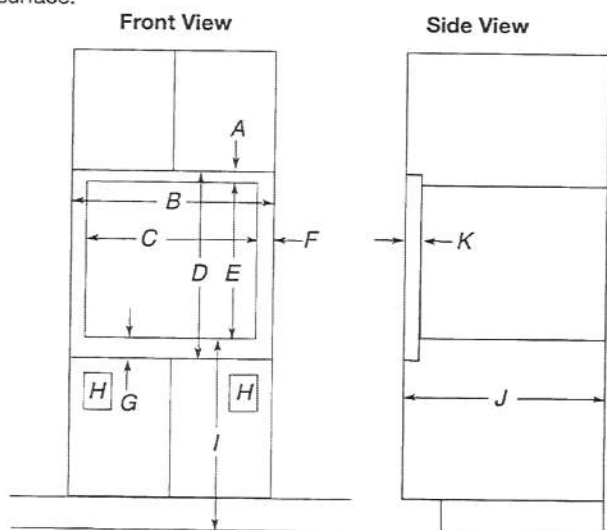

### Minimum Installation Clearances

For proper installation, the following minimum clearances must exist below the cabinet opening.

### Installation Above Single Built-In Oven

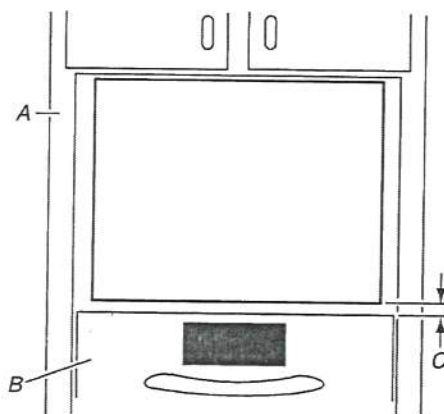

- A. Upper cabinet
- B. Lower single oven\*
- C. 1" (2.5 cm) from top of oven

### 30" (76.2 cm) Models

- A. 1<sup>3</sup>/<sub>16</sub>" (4.7 cm) top cleat\*
- B. 30<sup>1</sup>/<sub>4</sub>" (76.8 cm) minimum width of flush inset cutout
- C. 28<sup>7</sup>/<sub>16</sub>" (70.8 cm) minimum width of opening
- D. 20<sup>3</sup>/<sub>16</sub>" (51.3 cm) minimum height of flush inset cutout
- E. 17<sup>3</sup>/<sub>16</sub>" (44.7 cm) recommended cutout height
- F. 11/16" (1.7 cm) side cleat\*
- G. 3/4" (1.9 cm) bottom cleat\*
- H. Recommended junction box location
- I. 40" (101.6 cm) bottom of cutout to floor (recommended)
- J. 23<sup>1</sup>/<sub>4</sub>" (59.0 cm) minimum depth of cutout
- K. 1<sup>3</sup>/<sub>16</sub>" (3.5 cm) recess from front of cabinet

\*Cleats must be recessed 1<sup>3</sup>/<sub>16</sub>" (3.5 cm) from the front of the cabinet.

PV-124

Jan 26, 2021

AD

U.D

## INSTALLATION INSTRUCTIONS

### Prepare Built-In Oven

1. Attach bottom vent to spacer bars using four 3/8" (9.5 mm) hexhead washer screws.

**NOTE:** Spacer bar flanges should be facing out.

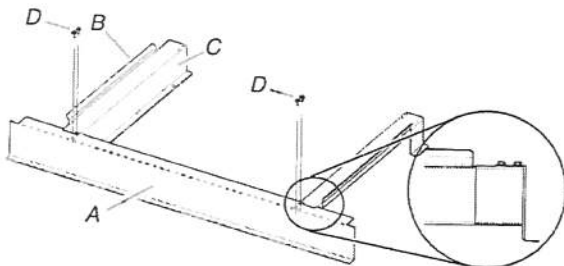

A. Bottom vent  
B. Spacer bar flange  
C. Spacer bars  
D. 3/8" (9.5 mm) hex-head washer screws

### Install Spacer Kit

1. Center assembled microwave oven spacer kit against lower, front edge of the cabinet cutout.
2. Using an 1/8" (3.1 mm) drill bit, drill through the mounting holes in the spacer bars to create pilot holes.
3. Attach the assembled spacer kit to the cabinet using four 3/4" (1.9 cm) pan-head screws provided. Do not overtighten screws.

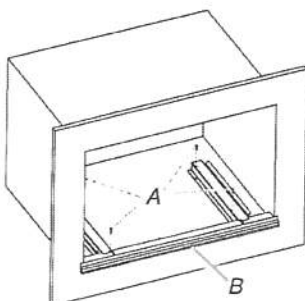

A. 3/4" (1.9 cm) pan-head screws  
B. Spacer kit assembly

### Install Microwave Oven

Follow the instructions below along with the instructions in the Electric Built-In Microwave Oven Installation Instructions.

Read the "Electrical Requirements" and "Electrical Connection" sections, along with all other sections of the Installation Instructions, before installing the microwave oven.

### WARNING

#### Excessive Weight Hazard

Use two or more people to move and install microwave oven.

Failure to do so can result in back or other injury.

1. Using 2 or more people, lift the microwave oven partially into the cabinet cutout above the spacer kit. Place microwave oven in between the spacer bar flanges.

**NOTE:** When pushing the microwave oven into the cabinet, open the microwave oven door and push against the seal area on the front frame. Do not push against the outside edges.

2. Push against the front frame of the microwave oven to push oven into cabinet. Push microwave oven completely into cabinet and center in cabinet cutout.

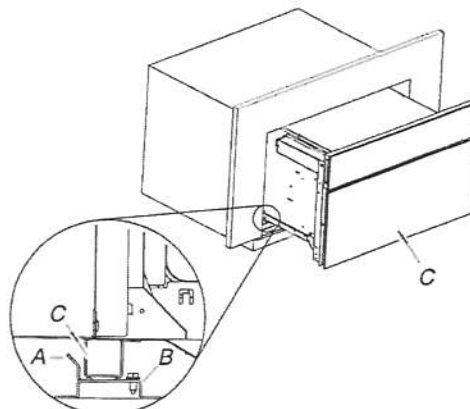

A. Spacer bar flange  
B. Spacer bar  
C. Microwave oven

### Complete Installation

1. Check that all parts are now installed. If there is an extra part, go back through the steps to see which step was skipped.
2. Check that you have all of your tools.
3. Dispose of/recycle all packaging materials.

#### If you need Assistance or Service:

Please reference the "Assistance or Service" section of the Use and Care Guide or contact the dealer from whom you purchased your built-in microwave oven spacer kit.



PV-124

Jan. 26, 2021



## INSTALLATION REQUIREMENTS

### Tools and Parts

Gather the required tools and parts before starting installation. Read and follow the instructions provided with any tools listed here.

#### Tools Needed

- Level
- Drill with 1/4" (3 cm), 3/8" (9.5 mm) and 5/16" (7.9 mm) drill bits
- Pencil
- Wire stripper or utility knife
- Tape measure or ruler
- Pliers
- Caulking gun and weatherproof caulking compound
- Vent clamps
- Jigsaw or keyhole saw
- Flat-blade screwdriver
- Metal snips
- Phillips screwdriver

#### Parts Needed

- Home power supply cable
- 1/2" (12.7 mm) UL listed or CSA approved strain relief
- 3 UL listed wire connectors

#### For Vented Installations, you will also need:

- 1 wall or roof cap
- Metal vent system

#### For Non-Vented (Recirculating) Installations, you will also need:

- Recirculation Kit for non-vented (recirculating) installations only. See "Assistance or Service" section to order.
- 6" (15.2 cm) diameter round metal vent duct - length required is determined by ceiling height.

#### Parts supplied

Remove parts from packages. Check that all parts are included.

- Hood canopy assembly with ventilator and LED lights installed
- Vent transition with back draft dampers
- Metal grease filter - depending on model and size
- Vent cover support bracket
- Mounting template
- 2-piece vent cover
- 4 - 4.2 x 8 mm screws
- 6 - 5 x 45 mm mounting screws
- 2 - D6.4 x 18 mm washers
- 2 - 8 x 40 mm wall anchors
- 4 - 10 x 60 mm wall anchors
- 4 - 5.4 x 75 mm screws (for 10 x 60 mm wall anchors)
- 2 - 3.5 x 9.5 mm sheet metal screws
- T10 TORX®† adapter

†®TORX is a registered trademarks of Acument Intellectual Properties, LLC.

### Location Requirements

**IMPORTANT:** Observe all governing codes and ordinances.

Have a qualified technician install the range hood. It is the installer's responsibility to comply with installation clearances specified on the model/serial/rating plate. The model/serial/rating plate is located behind the left filter on the rear wall of the vent hood.

Canopy hood location should be away from strong draft areas, such as windows, doors and strong heating vents.

Cabinet opening dimensions that are shown must be used. Given dimensions provide minimum clearance.

This range hood is recommended for use with cooktops with a maximum total rating of 65,000 BTUs or less.

Grounded electrical outlet is required. See "Electrical Requirements" section.

The canopy hood is factory-set for venting through the roof or wall. For non-vented (recirculating) installation see "For Non-Vented (Recirculating) Installation Only" in the "Connect Vent System" section. Recirculation Kit Part Number W10692908 is available from your dealer or an authorized parts distributor.

All openings in ceiling and wall where canopy hood will be installed must be sealed.

### For Mobile Home Installations

The installation of this range hood must conform to the Manufactured Home Construction Safety Standards, Title 24 CFR, Part 328 (formerly the Federal Standard for Mobile Home Construction and Safety, Title 24, HUD, Part 280) or when such standard is not applicable, the standard for Manufactured Home Installation 1982 (Manufactured Home Sites, Communities and Setups) ANSI A225.1/NFPA 501A, or latest edition, or with local codes.

### Product Dimensions

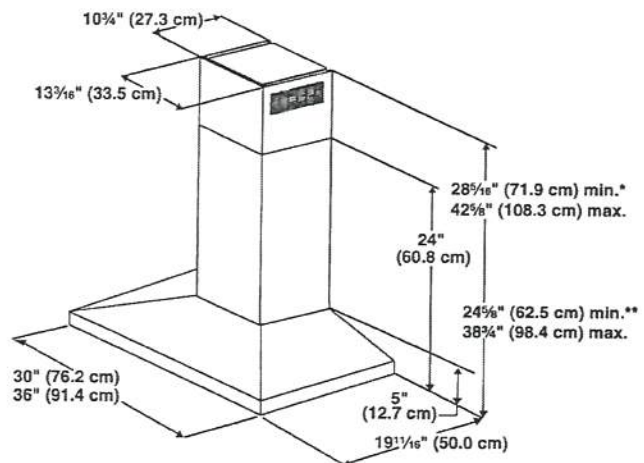

\*For non-vented (recirculating) installations

\*\*For vented installations

PR-124  
Jan 26, 2021



### Cabinet Dimensions

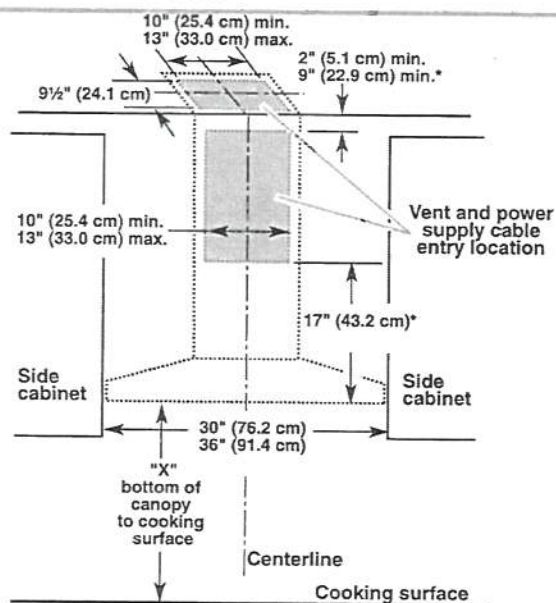

\*For non-vented (recirculating) installations

#### IMPORTANT:

- Minimum distance "X": 24" (61.0 cm) from electric cooking surface.
- Minimum distance "X": 27" (68.6 cm) from gas cooking surfaces.
- Suggested maximum distance "X": 36" (91.4 cm)

The chimneys can be adjusted for different ceiling heights. See the following chart.

Vented Installations		
	Min. ceiling height	Max. ceiling height
Electric cooking surface	7' 1" (2.16 m)	9' 2" (2.79 m)
Gas cooking surface	7' 4" (2.23 m)	9' 2" (2.79 m)

Non-Vented (Recirculating) Installations		
	Min. ceiling height	Max. ceiling height
Electric cooking surface	7' 1" (2.16 m)	9' 6" (2.9 m)
Gas cooking surface	7' 4" (2.23 m)	9' 6" (2.9 m)

\*NOTE: The range hood chimneys are adjustable and designed to meet varying ceiling or soffit heights depending on the distance "X" between the bottom of the range hood and the cooking surface. For higher ceilings, a Stainless Steel Chimney Extension Kit Part Number W10272075 is available from your dealer or an authorized parts distributor. The chimney extension replaces the chimney shipped with the range hood.

### Venting Requirements (vented models only)

- Vent system must terminate to the outdoors, except for non-vented (recirculating) installations.
- Do not terminate the vent system in an attic or other enclosed area.
- Do not use 4" (10.2 cm) laundry-type wall cap.
- Use metal vent only. Rigid metal vent is recommended. Plastic or metal foil vent is not recommended.
- The length of vent system and number of elbows should be kept to a minimum to provide efficient performance.

#### For the most efficient and quiet operation:

- Use no more than three 90° elbows.
- Make sure there is a minimum of 24" (61 cm) of straight vent between the elbows, if more than 1 elbow is used.
- Do not install 2 elbows together.
- Use clamps to seal all joints in the vent system.
- The vent system must have a damper. If the roof or wall cap has a damper, do not use the damper supplied with the range hood.
- Use caulking to seal exterior wall or roof opening around the cap.
- The size of the vent should be uniform.

### Cold Weather Installations

An additional back draft damper should be installed to minimize backward cold airflow and a thermal break should be installed to minimize conduction of outside temperatures as part of the vent system. The damper should be on the cold air side of the thermal break.

The break should be as close as possible to where the vent system enters the heated portion of the house.

### Makeup Air

Local building codes may require the use of makeup air systems when using ventilation systems greater than specified CFM of air movement. The specified CFM varies from locale to locale. Consult your HVAC professional for specific requirements in your area.

### Venting Methods

This canopy hood is factory-set for venting through the roof or wall.

A 6" (15.2 cm) round vent system is needed for installation (not included). The hood exhaust opening is 6" (15.2 cm) round.

**NOTE:** Flexible vent is not recommended. Flexible vent creates back pressure and air turbulence that greatly reduce performance.

Vent system can terminate either through the roof or wall. To vent through a wall, a 90° elbow is needed.

### Rear discharge

A 90° elbow may be installed immediately above the hood.



Pr-124

Jan. 26, 2021

AD



### For Non-Vented (Recirculating) Installations

If it is not possible to vent cooking fumes and vapors to the outside, the hood can be used in the non-vented (recirculating) version, fitting a charcoal filter and the deflector. Fumes and vapors are recycled through the top grille.

Roof Venting

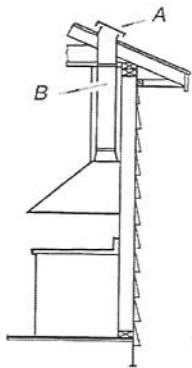

A. Roof cap  
B. 6" (15.2 cm)  
round vent

Wall Venting

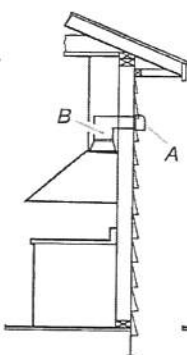

A. Wall cap  
B. 6" (15.2 cm)  
round vent

Non-Vented  
(Recirculating)

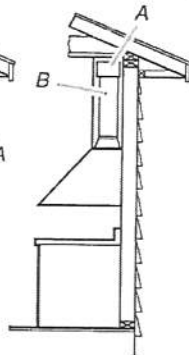

A. Deflector  
B. 6" (15.2 cm)  
round vent

### Calculating Vent System Length

To calculate the length of the system you need, add the equivalent feet (meters) for each vent piece used in the system.

Vent Piece	6" (15.2 cm) Round
------------	--------------------

45° elbow	2.5 ft (0.8 m)
-----------	----------------



90° elbow	5.0 ft (1.5 m)
-----------	----------------



Maximum equivalent vent length is 35 ft (10.7 m).

### Example vent system

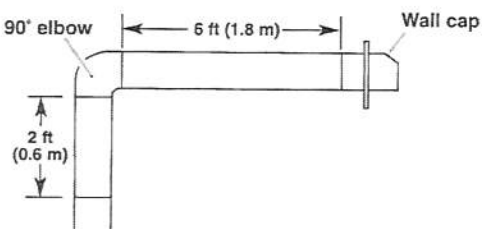

The following example falls within the maximum recommended vent length of 35 ft (10.7 m).

1 - 90° elbow	= 5.0 ft (1.5 m)
1 - wall cap	= 0.0 ft (0.0 m)
8 ft (2.4 m) straight	= 8.0 ft (2.4 m)
Length of system	= 13.0 ft (3.9 m)

### Electrical Requirements

Observe all governing codes and ordinances.

Ensure that the electrical installation is adequate and in conformance with National Electrical Code, ANSI/NFPA 70 (latest edition), or CSA Standards C22.1-94, Canadian Electrical Code, Part 1 and C22.2 No. 0-M91 (latest edition) and all local codes and ordinances.

If codes permit and a separate ground wire is used, it is recommended that a qualified electrician determine that the ground path is adequate.

A copy of the above code standards can be obtained from:

National Fire Protection Association  
1 Batterymarch Park  
Quincy, MA 02169-7471  
CSA International  
8501 East Pleasant Valley Road  
Cleveland, OH 44131-5575

- A 120 V, 60 Hz, AC only, 15 A, fused electrical circuit is required.

- If the house has aluminum wiring, follow the procedure below:

Connect the aluminum wiring using special connectors and/or tools designed and UL listed for joining copper to aluminum.

Follow the electrical connector manufacturer's recommended procedure. Aluminum/copper connection must conform with local codes and industry accepted wiring practices.

- Wire sizes and connections must conform with the rating of the appliance as specified on the model/serial/rating plate. The model/serial/rating plate is located behind the left filter on the rear wall of the range hood.
- Wire sizes must conform to the requirements of the National Electrical Code, ANSI/NFPA 70 (latest edition), or CSA Standards C22.1-94, Canadian Electrical Code, Part 1 and C22.2 No. 0-M91 (latest edition) and all local codes and ordinances.

PV-124  
Jan 26, 2021

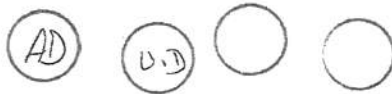

## JENN-AIR® DETAILED PLANNING DIMENSIONS

1 of 2

### 36" GAS COOKTOP

JGC7636B – 36" x 5 1/4" x 21"

#### PRODUCT DIMENSIONS

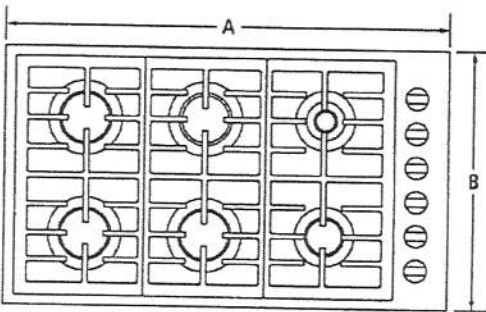

TOP VIEW

MODEL #		JGC7636B	
		in	cm
A	Overall width	36	91.4
B	Depth of cooktop	21	53.3
C	Center of cooktop to center of gas inlet	13 1/4	34.3
D	Width of recessed cooktop	35 1/4	89.5
E	Height of recessed cooktop	3 1/4	8.3
F	Height from gas inlet to countertop	5 1/4	13.3
G	Height with grates	1 1/4	3.2
H	Depth of recessed cooktop	20 1/4	51.4

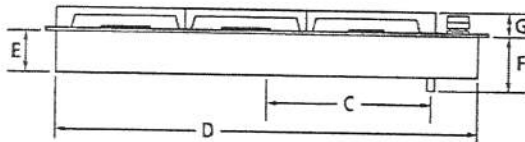

FRONT VIEW

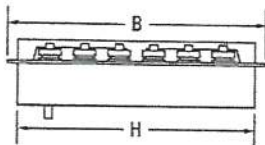

SIDE VIEW

**IMPORTANT:** Dimensional specifications are provided for planning purposes only.  
Do not make any cutouts based on this information. Refer to the Installation Guide before selecting cabinetry, verifying electrical/gas connections, making cutouts or beginning installation.  
All Jenn-Air® appliances are appropriately UL, CUL or CSA approved.

 JENN-AIR®

8658AdZw1015

PV-124  
Jan 26, 2021

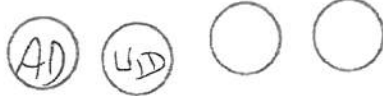

## JENN-AIR® DETAILED PLANNING DIMENSIONS

2 of 2

### 36" GAS COOKTOP

JGC7636B – 36" x 5¼" x 21"

#### OPENING/CLEARANCE DIMENSIONS

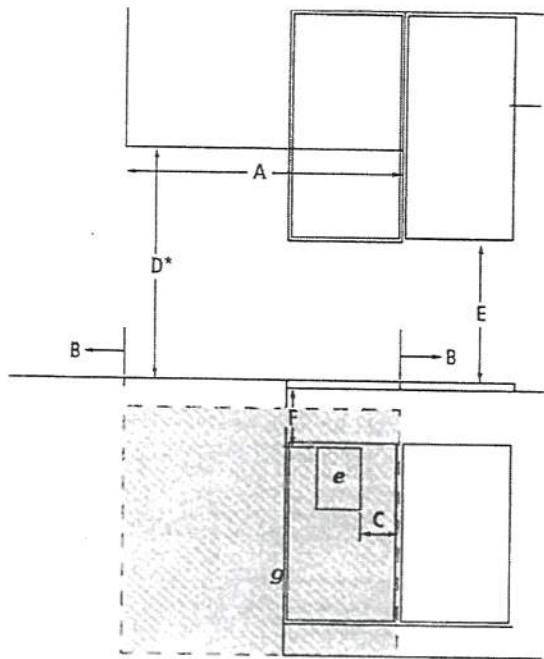

FRONT VIEW

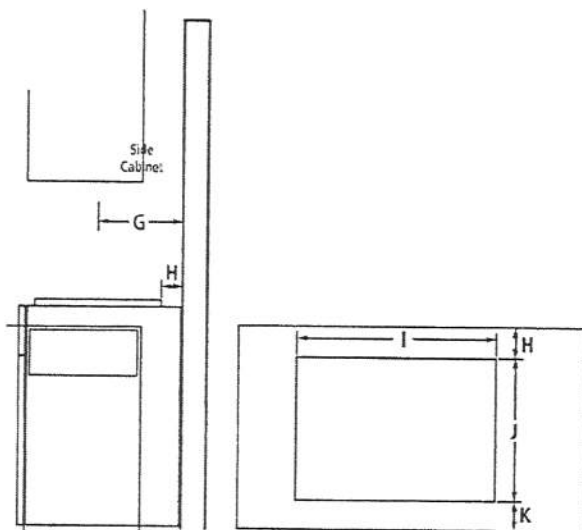

SIDE VIEW

TOP VIEW – CUTOUT

MODEL #		JGC7636B	
		in	cm
A	Width of combustible area above cooking surface (min.)	36	91.4
B	Width from cooktop to fixed wall or other combustible material (min.)	6	15.2
C	Width to outer edge of outlet (max.)	24	61.0
D*	Height to bottom of uncovered wood or metal cabinet above cooking surface (min.)	30	76.2
E	Height to bottom of uncovered wood or metal cabinet (min.)	18	45.7
F	Height to top edge of outlet (min.)	5½"	14.0
G	Depth of upper cabinet (recommended)	13	33.0
H	Depth from cutout to wall (min.)	2½"	5.9
I	Width of cutout	35¾"	89.9
J	Depth of cutout	20¾"	51.8
K	Depth from cutout to front of countertop	2½"	5.9
e	Recommended electrical access location		
g	Recommended gas supply line location		

\*Dimension can be reduced by 6" (15.2 cm) when bottom of wood or metal cabinet is covered by not less than ½" (0.6 cm) flame retardant millboard covered with not less than No. 28 MSG sheet metal, 0.015" (0.4 mm) stainless steel, 0.024" (0.6 mm) aluminum or 0.020" (0.5 mm) copper. If installing a hood or microwave hood combination above the cooktop, follow the hood or microwave hood combination instructions for dimensional clearances above the cooking surface.

#### GAS REQUIREMENTS

##### Natural Gas

This cooktop is factory-set for use with natural gas.

##### LP Gas Conversion

Conversion must be done by a qualified service technician. To convert to LP gas, use an LP gas conversion kit.

#### ELECTRICAL REQUIREMENTS

120 volt, 60 Hz, AC only, 15-amp fused, electrical circuit is required. A time-delay fuse or dedicated circuit is recommended.

#### LOCATION REQUIREMENTS

- To ensure cooktop base clearance, cabinet side walls need to be wider than the cutout.
- If cabinet has a drawer, allow a 4" (10.2 cm) minimum clearance between countertop and top of drawer. Drawer depth may need to be shortened to avoid interfering with the regulator.

**IMPORTANT:** Dimensional specifications are provided for planning purposes only. Do not make any cutouts based on this information. Refer to the Installation Guide before selecting cabinetry, verifying electrical/gas connections, making cutouts or beginning installation. All Jenn-Air® appliances are appropriately UL, CUL or CSA approved.

**JENN-AIR®**

8658AdZw1015



Pr-124  
Jan 26, 2021

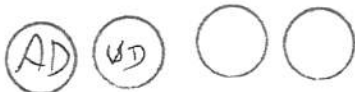

## JENNAIR® DETAILED PLANNING DIMENSIONS

1 of 2

### SINGLE WALL OVENS

JJW2427I – 27" x 29-7/8" x 25-5/16"

JJW2430I, JJW3430I – 30" x 29-7/8" x 25-5/16"

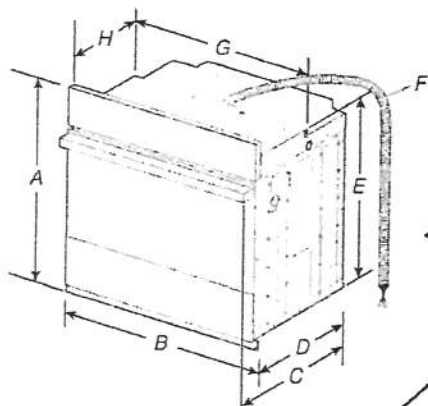

#### PRODUCT DIMENSIONS SINGLE OVENS

##### 27" (68.6 CM) MODELS

- A. 29-7/8" (75.8 cm) max. overall height
- B. 27" (68.6 cm) overall width
- C. JJW2427IM – 26-3/8" (67 cm)  
JJW2427IL – 27-3/16" (69 cm)
- D. 23-1/4" (59.1 cm) max. recessed depth
- E. 27-3/16" (69 cm) recessed height
- F. 48" (121.9 cm) flexible conduit length
- G. 25-7/16" (64.6 cm) max. recessed width
- H. 12" (30.5 cm) from back of control panel to start of strain relief

##### 30" (76.2 CM) MODELS

- A. 29-7/8" (75.8 cm) max. overall height
- B. 30" (76.2 cm) overall width
- C. JJW2430IM – 26-3/8" (67 cm)  
JJW2430IL – 27-3/16" (69 cm)  
JJW3430IM – 26-3/8" (67 cm)  
JJW3430IL – 27-3/16" (69 cm)
- D. 23-1/4" (59.1 cm) max. recessed depth
- E. 27-3/16" (69 cm)
- F. 48" (121.9 cm) flexible conduit length
- G. 28-7/16" (72.2 cm) max. recessed width
- H. 12" (30.5 cm) from back of control panel to start of strain relief

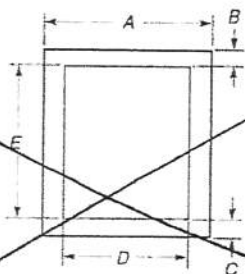

#### UNDERCOUNTER CABINET DIMENSIONS SINGLE OVENS

##### 27" (68.6 CM) MODELS

- A. 27" (68.6 cm) min. cabinet width
- B. 1-1/2" (3.8 cm) min. top of cutout to underside of countertop
- C. 5-1/4" (13.3 cm) bottom of cutout to floor
- D. 25-1/2" (64.8 cm) cutout width
- E. 28" (71.2 cm) min. cutout height

##### 30" (76.2 CM) MODELS

- A. 30" (76.2 cm) min. cabinet width
- B. 1-1/2" (3.8 cm) min. top of cutout to underside of countertop
- C. 5-1/4" (13.3 cm) bottom of cutout to floor
- D. 28-1/2" (72.4 cm) cutout width
- E. 28" (71.2 cm) min. cutout height

#### SINGLE OVENS INSTALLED IN CABINET

##### 27" (68.6 CM) MODELS

- A. 27" (68.6 cm) min. cabinet width
- B. 2-3/16" (5.5 cm) top of cutout to bottom of upper cabinet door
- C. 32" (81.3 cm) bottom of cutout to floor
- D. 25-1/2" (64.8 cm) cutout width
- E. 1-1/2" (3.8 cm) min. bottom of cutout to top of cabinet door
- F. 28" (71.2 cm) recommended cutout height
- G. 24" (60.7 cm) cutout depth

\*NOTE: The cutout height can be between 27-1/4" (69.2 cm) and 29-7/16" (74.8 cm) for 27" single ovens.

##### 30" (76.2 CM) MODELS

- A. 30" (76.2 cm) min. cabinet width
- B. 2-3/16" (5.5 cm) top of cutout to bottom of upper cabinet door
- C. 32" (81.3 cm) bottom of cutout to floor
- D. 28-1/2" (72.4 cm) cutout width
- E. 1-1/2" (3.8 cm) min. bottom of cutout to top of cabinet door
- F. 28" (71.2 cm) recommended cutout height
- G. 24" (60.7 cm) cutout depth

\*NOTE: The cutout height can be between 27-1/4" (69.2 cm) and 29-7/16" (74.8 cm) for 30" single ovens.

IMPORTANT: Dimensional specifications are provided for planning purposes only.  
Do not make any cutouts based on this information. Refer to the Installation or Use & Care Guide  
BEFORE selecting cabinetry, verifying electrical/gas connections, making cutouts or beginning installation.  
All JennAir® appliances are appropriately UL, CUL or CSA approved.





PV-124  
Jan. 26, 2021

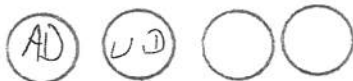

## JENNAIR® DETAILED PLANNING DIMENSIONS

2 of 2

### SINGLE WALL OVENS

JJW2427I – 27" x 29-7/8" x 25-5/16"

JJW2430I, JJW3430I – 30" x 29-7/8" x 25-5/16"

### ELECTRICAL REQUIREMENTS

If codes permit and a separate ground wire is used, it is recommended that a qualified electrical installer determine that the ground path and the wire gauge are in accordance with local codes.

Check with a qualified electrical installer if you are not sure the oven is properly grounded.

This oven must be connected to a grounded metal, permanent wiring system.

Be sure that the electrical connection and wire size are adequate and in conformance with the National Electrical Code, ANSI/NFPA 70-latest edition or CSA Standards C22.1-94, Canadian Electrical Code, Part 1 and C22.2 No. 0-M91-latest edition, and all local codes and ordinances.

A copy of the above code standards can be obtained from:

National Fire Protection Association  
1 Batterymarch Park  
Quincy, MA 02169-7471

CSA International  
8501 East Pleasant Valley Road  
Cleveland, OH 44131-5575

### ELECTRICAL CONNECTION

To properly install your oven, you must determine the type of electrical connection you will be using and follow the instructions provided for it here.

- Oven must be connected to the proper electrical voltage and frequency as specified on the model/serial/rating plate. The model/serial/rating plate is located under the control panel on single ovens. See the following illustration

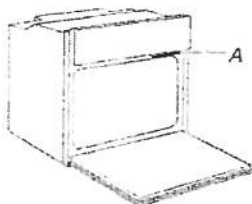

A. Model/Serial/Rating Plate

- Models rated from 7.3 to 9.6 kW at 240 V (5.4 to 7.4 kW at 208 V) require a separate 40 A circuit. Models rated at 4.8 kW and below at 240 V (3.6 kW and below at 208 V) require a separate 20 A circuit.

A circuit breaker is recommended.

- Connect directly to the circuit breaker box (or fused disconnect) through flexible, armored, or nonmetallic sheathed, copper cable (with grounding wire).
- Flexible conduit from the oven should be connected directly to the junction box.
- Fuse both sides of the line.
- Do not cut the conduit. The length of conduit provided is for serviceability of the oven.
- A UL listed or CSA approved conduit connector must be provided.
- If the house has aluminum wiring, follow the procedure below:  
Connect the aluminum wiring using special connectors and/or tools designed and UL listed for joining copper to aluminum.  
Follow the electrical connector manufacturer's recommended procedure. Aluminum/copper connection must conform with local codes and industry accepted wiring practices.

For power requirements for models JJW2427I, JJW2430I and JJW3430I, refer to the following table.

MODEL	240 VAC	208 VAC
	kW	kW
JJW2427I	4.1	3.1
JJW2430I	4.1	3.1
JJW3430I	4.5	3.4

**IMPORTANT:** Dimensional specifications are provided for planning purposes only.

**Do not make any cutouts based on this information.** Refer to the Installation or Use & Care Guide

**BEFORE** selecting cabinetry, verifying electrical/gas connections, making cutouts or beginning installation.

All JennAir® appliances are appropriately UL, CUL or CSA approved.



PR-124

AD VCD

Jan 26, 2021

#### Parts Supplied

- Deflector bracket



- Plastic spacers - (4) single ovens, (6) double ovens



- #8-18 x 1/4" (6.3 mm) screws - (2) for 27" (68.6 cm) models; (4) for 30" (76.2 cm) models

#### Location Requirements

**IMPORTANT:** Observe all governing codes and ordinances.

**NOTE:** Refer to the following "Location Requirements" and the "Location Requirements" section of the Installation Instructions provided with your built-in oven.

- Cabinet opening dimensions that are shown must be used. Given dimensions provide minimum clearance with oven.
- Recessed installation area must provide complete enclosure around the recessed portion of the oven.
- Oven support surface must be solid, level, and flush with bottom of the cabinet cutout.
- ■ Floor must be able to support a single oven weight of 180 lbs (82 kg).
- Floor must be able to support a double oven weight of 367 lbs (162 kg)

**IMPORTANT:** To avoid damage to your cabinets, check with your builder or cabinet supplier to make sure that the materials used will not discolor, delaminate, or sustain other damage. This oven has been designed in accordance with the requirements of UL and CSA International and complies with the maximum allowable wood cabinet temperatures of 194°F (90°C).

#### Deflector Bracket Dimensions

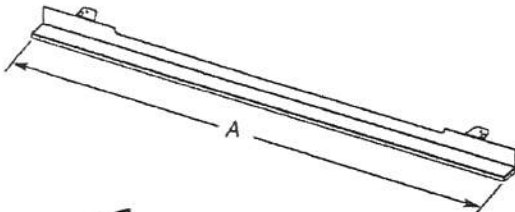

~~27" (68.6 cm) Models~~

~~A. 26 1/8" (66.4 cm) overall width~~

~~30" (76.2 cm) Models~~

~~A. 29 15/16" (76.0 cm) overall width~~

#### Cabinet Dimensions - Single Ovens, Flush Installations

A 25" (63.5 cm) minimum cutout depth is required.

These dimensions will result in a 1/4" (6.3 mm) reveal on the top, a 1/4" (6.3 mm) reveal on the sides, and a 1/8" (3.1 mm) reveal on the bottom of the wall oven.

The front face of the cleats and platform will be visible and should be treated as a finished surface.

#### Single Ovens Installed in Cabinet - Flush Installation

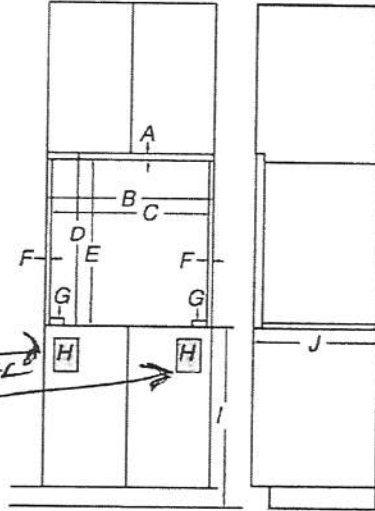

Front View

Side View

#### 27" (68.6 cm) Models

- ~~A. 3/4" (19 mm) top cleat\*~~
- ~~B. 27 1/4" (69.2 cm) minimum width of flush inset cutout~~
- ~~C. 25 1/8" (65.7 cm) minimum width of opening~~
- ~~D. 30 1/16" (77.3 cm) minimum height of flush inset cutout~~
- ~~E. 29 11/16" (75.4 cm) recommended cutout height~~
- ~~F. 1 11/16" (1.7 cm) side cleat\*~~
- ~~G. 1/2" x 2" (1.3 cm x 5.1 cm) spacer the entire depth of the cutout\*~~
- ~~H. Recommended junction box location~~
- ~~I. 4 5/8" - 32" (11.7 cm - 81.3 cm) bottom of cutout to floor~~
- ~~J. 25" (63.5 cm) minimum depth of cutout~~

#### 30" (76.2 cm) Models

- ~~A. 3/4" (19 mm) top cleat\*~~
- ~~B. 30 1/4" (76.8 cm) minimum width of flush inset cutout~~
- ~~C. 28 7/8" (73.3 cm) minimum width of opening~~
- ~~D. 30 1/16" (77.3 cm) minimum height of flush inset cutout~~
- ~~E. 29 11/16" (75.4 cm) recommended cutout height~~
- ~~F. 1 11/16" (1.7 cm) side cleat\*~~
- ~~G. 1/2" x 2" (1.3 cm x 5.1 cm) spacer the entire depth of the cutout\*~~
- ~~H. Recommended junction box location~~
- ~~I. 4 5/8" - 32" (11.7 cm - 81.3 cm) bottom of cutout to floor~~
- ~~J. 25" (63.5 cm) minimum depth of cutout~~

\*Cleats and spacers must be recessed 1 3/8" (3.5 cm) from the front of the cabinet.



PV-124

Jan 26, 2021

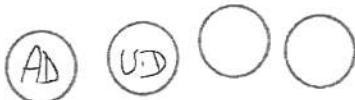

## Gas Supply Requirements

### ⚠ WARNING



#### Explosion Hazard

Use a new CSA International approved gas supply line.

Install a shut-off valve.

Securely tighten all gas connections.

If connected to LP, have a qualified person make sure gas pressure does not exceed 14" (36 cm) water column.

Examples of a qualified person include:

licensed heating personnel,  
authorized gas company personnel, and  
authorized service personnel.

Failure to do so can result in death, explosion, or fire.

Observe all governing codes and ordinances.

**IMPORTANT:** This installation must conform with all local codes and ordinances. In the absence of local codes, installation must conform with American National Standard, National Fuel Gas Code ANSI Z223.1 - latest edition or CAN/CGA B149 - latest edition.

**IMPORTANT:** Leak testing of the range must be conducted according to the manufacturer's instructions.

#### Type of Gas

##### Natural Gas:

- This cooktop is factory-set for use with Natural gas. To convert to LP gas, see the Gas Conversion instructions provided in the package containing the literature. The model/serial rating plate located on the underside of the burner box has information on the types of gas that can be used. If the types of gas listed do not include the type of gas available, check with the local gas supplier.

##### LP Gas conversion:

Conversion must be done by a qualified service technician.

No attempt shall be made to convert the appliance from the gas specified on the model/serial rating plate for use with a different gas without consulting the serving gas supplier. See the Gas Conversion instructions provided in the package containing the literature.

#### Gas Supply Line

- Provide a gas supply line of 3/4" (1.9 cm) rigid pipe to the cooktop location. A smaller size pipe on longer runs may result in insufficient gas supply. Pipe-joint compounds that resist the action of LP gas must be used. Do not use TEFLON<sup>®</sup> tape. With LP gas, piping or tubing size can be 1/2" minimum. Usually, LP gas suppliers determine the size and materials used in the system.

#### Flexible metal appliance connector:

- If local codes permit, use a 3/8" flexible stainless steel tubing gas connector, designed by CSA to connect the cooktop to the rigid gas supply line.



- A 1/2" (1.3 cm) male pipe thread is needed for connection to the female pipe threads of the inlet to the appliance pressure regulator.
- Do not kink or damage the flexible metal tubing when moving the cooktop.

#### Rigid pipe connection:

The rigid pipe connection requires a combination of pipe fittings to obtain an in-line connection to the cooktop. The rigid pipe must be level with the cooktop connection. All strains must be removed from the supply and fuel lines so cooktop will be level and in line.

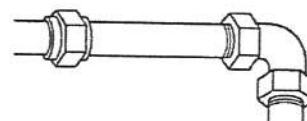

- Must include a shutoff valve:  
The supply line must be equipped with a manual shutoff valve. This valve should be located in the same room but external to the cooktop opening, such as an adjacent cabinet. It should be in a location that allows ease of opening and closing. Do not block access to shutoff valve. The valve is for turning on or shutting off gas to the cooktop.

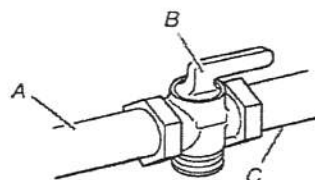

A. Gas supply line  
B. Shutoff valve "open" position  
C. To cooktop

#### Gas Pressure Regulator

The gas pressure regulator supplied with this cooktop must be used. The inlet pressure to the regulator should be as follows for proper operation:

##### Natural Gas:

Minimum pressure: 6" (15.2 cm) WCP

Maximum pressure: 14" (35.5 cm) WCP

##### LP Gas:

Minimum pressure: 11" (27.9 cm) WCP

Maximum pressure: 14" (35.5 cm) WCP

Contact local gas supplier if you are not sure about the inlet pressure.

†TEFLON is a registered trademark of E.I. Du Pont De Nemours and Company.

PV-124  
Jan. 26, 2021 (AD) (VD) ○ ○

## JENN-AIR® DETAILED PLANNING DIMENSIONS

1 of 6

### 48" FULLY INTEGRATED SIDE-BY-SIDE REFRIGERATOR

(BASE UNIT REQUIRES SUITE-COORDINATING PANEL KIT OR CUSTOM PANELS AND HANDLES)

JS48NXFXDW – 47<sup>7</sup>/<sub>8</sub>" x 83<sup>1</sup>/<sub>8</sub>" x 24"

#### PRODUCT DIMENSIONS

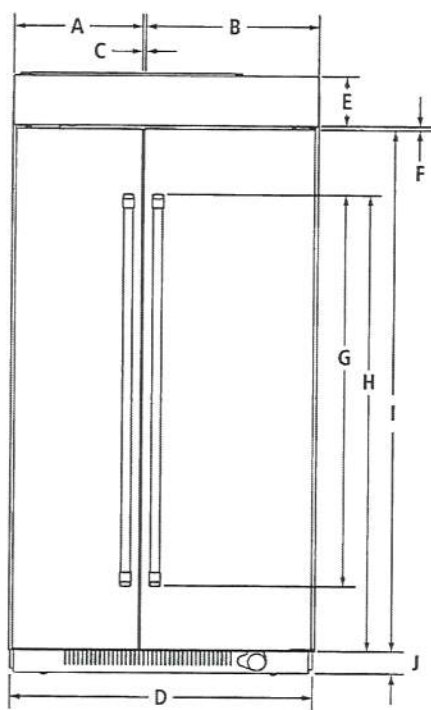

FRONT VIEW

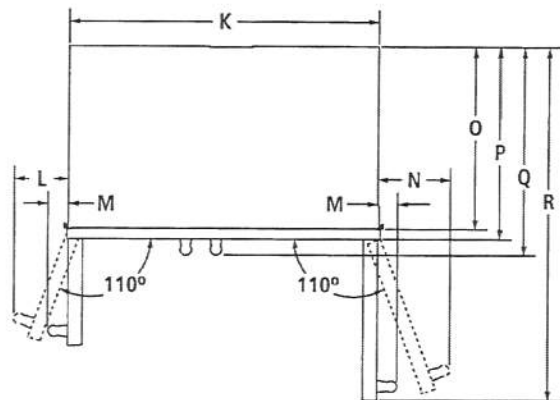

TOP VIEW

MODEL #		JS48NXFXDW	
		in	cm
A	Width of freezer door	20 <sup>1</sup> / <sub>8</sub>	51.2
B	Width of refrigerator door	27 <sup>1</sup> / <sub>8</sub>	68.9
C	Space between doors	<sup>1</sup> / <sub>8</sub>	0.3
D	Overall width	47 <sup>7</sup> / <sub>8</sub>	121.7
E	Height of top grille and bracket	6 <sup>1</sup> / <sub>2</sub>	16.5
F	Space between doors and top grille	<sup>3</sup> / <sub>8</sub>	0.8
G	Height of door handles Pro-Style® Stainless	63	160
	Euro-Style Stainless	50	127.1
H	Height to top of door handles Pro-Style® Stainless	67	170.3
	Euro-Style Stainless	66 <sup>5</sup> / <sub>8</sub>	169.1
I	Height of doors	74 <sup>1</sup> / <sub>4</sub>	188.6
J	Height of bottom grille	3	7.6
K	Width of recessed refrigerator	47 <sup>7</sup> / <sub>8</sub>	121.6
L	Width from side of refrigerator to freezer door handle – door fully open 110° Pro-Style® Stainless	8 <sup>3</sup> / <sub>8</sub>	21.3
	Euro-Style Stainless	8	20.3
M	Width from side of refrigerator to handle – doors open 90° Pro-Style® Stainless	2	5.1
	Euro-Style Stainless	1 <sup>1</sup> / <sub>2</sub>	3.9
N	Width from side of refrigerator to refrigerator door handle – door fully open 110° Pro-Style® Stainless	9 <sup>5</sup> / <sub>8</sub>	24.4
	Euro-Style Stainless	9 <sup>1</sup> / <sub>8</sub>	23.1
O	Depth without door panel kit	24	61.0
P	Depth with doors Pro-Style® Stainless panel kit	24 <sup>3</sup> / <sub>4</sub>	62.9
	Euro-Style Stainless panel kit	24 <sup>3</sup> / <sub>4</sub>	62.9
	Custom panel (¾"/1.9 cm)	24 <sup>3</sup> / <sub>4</sub>	62.9
Q	Depth with handles Pro-Style® Stainless	27 <sup>3</sup> / <sub>8</sub>	69.5
	Euro-Style Stainless	26 <sup>7</sup> / <sub>8</sub>	68.3
R	Depth with refrigerator door open 90°	50 <sup>3</sup> / <sub>4</sub>	128.8

Product dimension, cutout and installation specifications are provided for planning purposes only. Before installing any product, be sure to verify cutout dimensions and electrical/gas connections as actual product dimensions may vary.

**JENN-AIR®**

JRC120073A 07/2012



PV-124  
Jan. 26, 2021

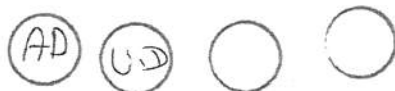

## JENN-AIR® DETAILED PLANNING DIMENSIONS

2 of 6

### 48" FULLY INTEGRATED SIDE-BY-SIDE REFRIGERATOR

(BASE UNIT REQUIRES SUITE-COORDINATING PANEL KIT OR CUSTOM PANELS AND HANDLES)

JS48NXFXDW – 47 $\frac{7}{8}$ " x 83 $\frac{1}{8}$ " x 24"

#### DIMENSIONS AS INSTALLED

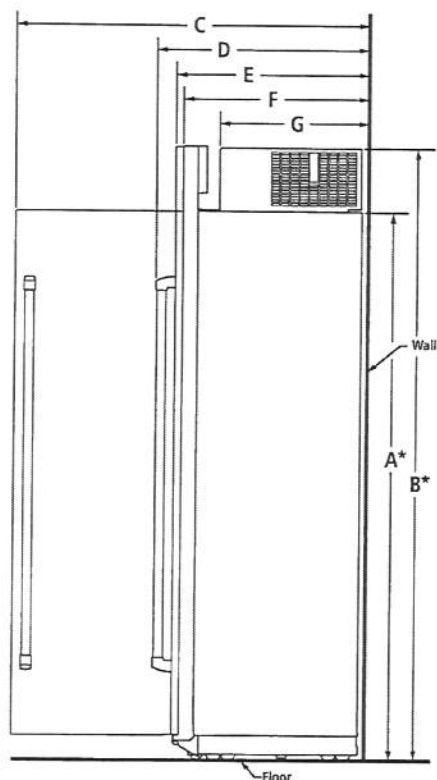

SIDE VIEW

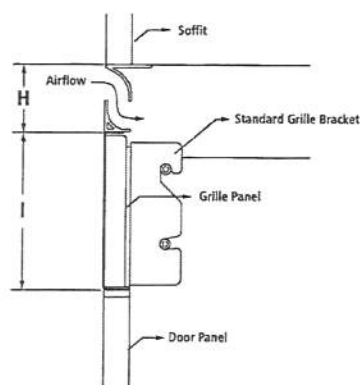

SIDE VIEW – PANEL KIT

MODEL #		JS48NXFXDW	
		in	cm
A*	Height without compressor (min.)	74 $\frac{3}{8}$	188.9
B*	Height of recessed refrigerator (min.)	83 $\frac{1}{8}$	211.1
C	Depth with refrigerator door open 90° (min.)	50 $\frac{3}{4}$	128.8
D	Depth with handles (min.)		
	Pro-Style® Stainless	27 $\frac{3}{8}$	69.5
	Euro-Style Stainless	26 $\frac{7}{8}$	68.3
E	Depth with doors (min.)		
	Pro-Style® Stainless panel kit	24 $\frac{3}{4}$	62.9
	Euro-Style Stainless panel kit	24 $\frac{3}{4}$	62.9
	Custom panel (3/4"/1.9 cm)	24 $\frac{3}{4}$	62.9
F	Depth without door panel kit (min.)	24	61.0
G	Depth of compressor (min.)	19 $\frac{7}{8}$	50.5
H	Space between top grille and soffit	1	2.5
I	Height of top grille	5 $\frac{1}{2}$	14.0

\*Add 1 $\frac{1}{8}$ " (2.9 cm) to the height dimension when leveling legs are fully extended.

Product dimension, cutout and installation specifications are provided for planning purposes only. Before installing any product, be sure to verify cutout dimensions and electrical/gas connections as actual product dimensions may vary.

 JENN-AIR®

JRC120073A 07/2012

PV-124  
Jan. 26, 2021

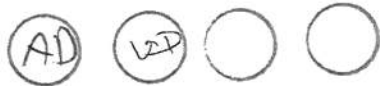

## JENN-AIR® DETAILED PLANNING DIMENSIONS

3 of 6

### 48" FULLY INTEGRATED SIDE-BY-SIDE REFRIGERATOR

(BASE UNIT REQUIRES SUITE-COORDINATING PANEL KIT OR CUSTOM PANELS AND HANDLES)

JS48NXFXDW – 47<sup>7</sup>/<sub>8</sub>" x 83<sup>1</sup>/<sub>8</sub>" x 24"

#### STANDARD INSTALLATION REQUIREMENTS – FLUSH GRILLE PANEL

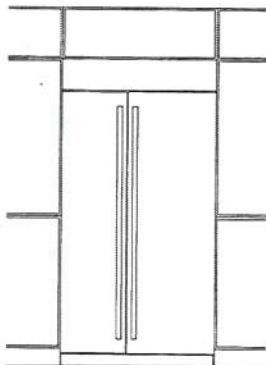

FRONT VIEW

- Attach the standard grille with the provided standard grille bracket.
- This bracket allows for the required minimum air gap between the refrigerator and the grille.

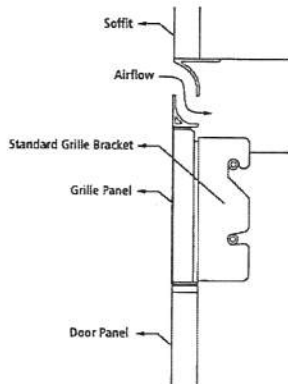

SIDE VIEW – PANEL KIT

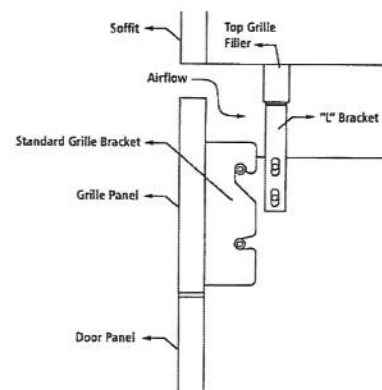

SIDE VIEW – CUSTOM PANEL

#### STANDARD INSTALLATION – FLUSH GRILLE CUSTOM OVERLAY PANEL DIMENSIONS

MODEL #		JS48NXFXDW	
		in	cm
REVEAL*		3/8	1.0
A	Width of top grille panel	47 <sup>1</sup> / <sub>4</sub>	120.0
B	Width of freezer door panel	20 <sup>1</sup> / <sub>16</sub>	51.0
C	Width of refrigerator door panel	27 <sup>1</sup> / <sub>16</sub>	68.7
D	Height of top grille filler	1	2.5
E**	Height of top grille panel	5 <sup>3</sup> / <sub>4</sub>	14.6
F	Height of door panels	74 <sup>1</sup> / <sub>4</sub>	188.6
REVEAL*		1/8	0.3
A	Width of top grille panel	47 <sup>3</sup> / <sub>4</sub>	121.3
B	Width of freezer door panel	20 <sup>5</sup> / <sub>16</sub>	51.6
C	Width of refrigerator door panel	27 <sup>5</sup> / <sub>16</sub>	69.4
D	Height of top grille filler	1	2.5
E**	Height of top grille panel	5 <sup>3</sup> / <sub>4</sub>	14.6
F	Height of door panels	74 <sup>1</sup> / <sub>4</sub>	188.6

\*Gap between door panel and adjacent cabinet.

\*\*Grille panel height allows for an air gap critical to refrigerator performance.

NOTE: The required thickness for all panels is 3/4" (1.9 cm). This installation does not require filler or backer panels.

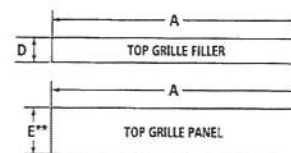

Maximum Weight: 8 lb (3.6 kg)

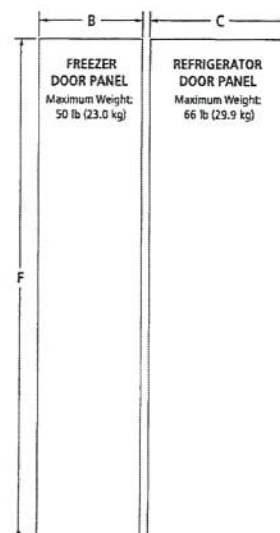

**JENN-AIR®**

JRC120073A 07/2012

Product dimension, cutout and installation specifications are provided for planning purposes only. Before installing any product, be sure to verify cutout dimensions and electrical/gas connections as actual product dimensions may vary.

PV-124  
Jan. 26, 2021 AD U.B

# JENN-AIR® DETAILED PLANNING DIMENSIONS

48" FULLY INTEGRATED SIDE-BY-SIDE REFRIGERATOR  
(BASE UNIT REQUIRES SUITE-COORDINATING PANEL KIT OR CUSTOM PANELS AND HANDLES)  
JS48NFXDW – 47<sup>7</sup>/<sub>8</sub>" x 83<sup>1</sup>/<sub>8</sub>" x 24"

## INTEGRATED INSTALLATION REQUIREMENTS – FULL-HEIGHT GRILLE ~~PANEL~~

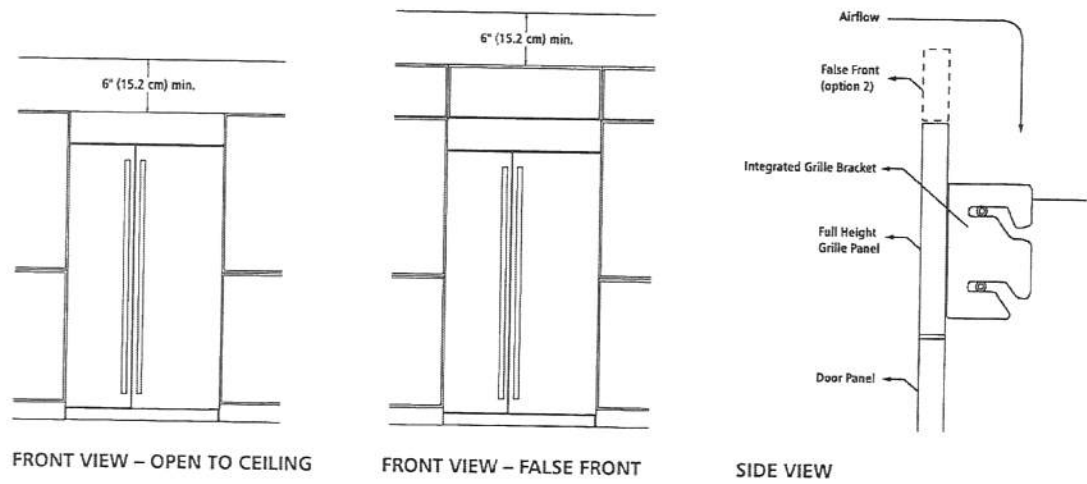

- Attach the full-height grille with the provided integrated grille bracket.
- Requires a minimum of 6" (15.2 cm) of open space above the refrigerator, which must not be blocked in any way, including soffits.

## INTEGRATED INSTALLATION – FULL-HEIGHT GRILLE CUSTOM OVERLAY PANEL DIMENSIONS

### Airflow Venting Requirements

Fully integrated installations require a minimum of 6" (15.2 cm) of open space above the refrigerator. This space must not be blocked in any way, including soffits.

MODEL #		JS48NFXDW	
		in	cm
REVEAL*		3/8	1.0
A	Width of top grille panel	47 1/4	120.0
B	Width of freezer door panel	20 1/16	51.0
C	Width of refrigerator door panel	27 1/16	68.7
D	Height of top grille panel	6 5/8	16.8
E	Height of door panels	74 1/4	188.6
REVEAL*		1/8	0.3
A	Width of top grille panel	47 3/4	121.3
B	Width of freezer door panel	20 5/16	51.6
C	Width of refrigerator door panel	27 5/16	69.4
D	Height of top grille panel	6 5/8	16.8
E	Height of door panels	74 1/4	188.6

\*Gap between door panel and adjacent cabinet.  
NOTE: The required thickness for all panels is 3/4" (1.9 cm). This installation does not require filler or backer panels.

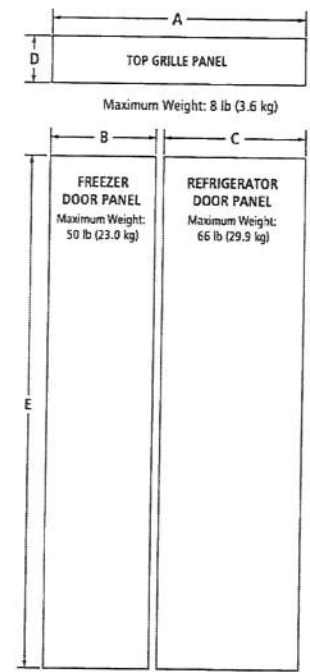

Product dimension, cutout and installation specifications are provided for planning purposes only. Before installing any product, be sure to verify cutout dimensions and electrical/gas connections as actual product dimensions may vary.



PR-124  
Jan. 26, 2021

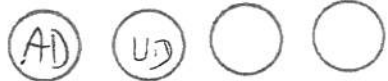

JENN-AIR® DETAILED PLANNING DIMENSIONS 5 of 6

48" FULLY INTEGRATED SIDE-BY-SIDE REFRIGERATOR  
(BASE UNIT REQUIRES SUITE-COORDINATING PANEL KIT OR CUSTOM PANELS AND HANDLES)  
JS48NXFXDW – 47<sup>7</sup>/<sub>8</sub>" x 83<sup>1</sup>/<sub>8</sub>" x 24"

INTEGRATED INSTALLATION REQUIREMENTS – ARMOIRE-STYLE PANEL KIT

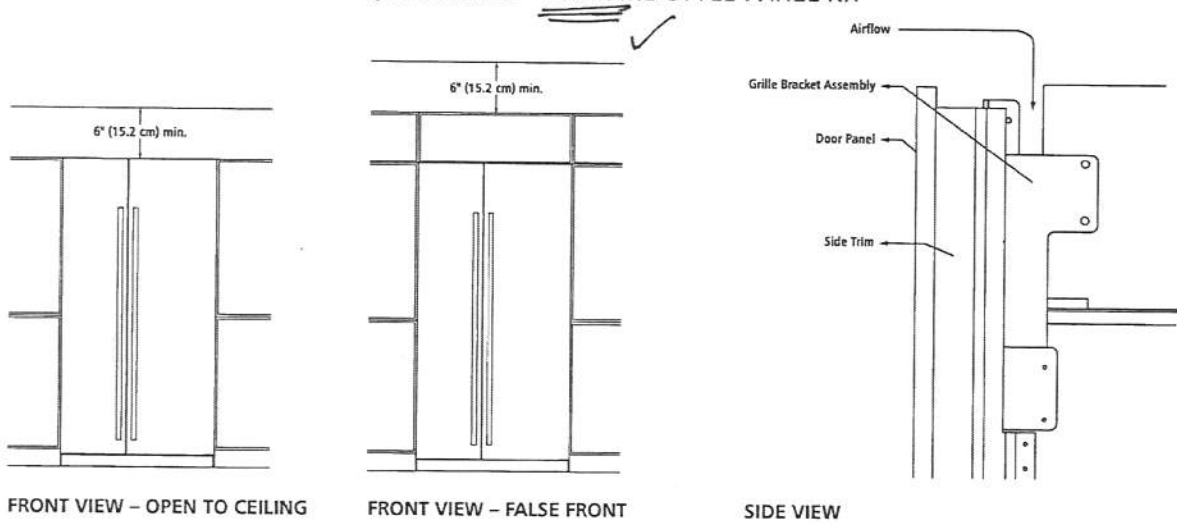

- Attach the grille bracket assembly and grille panel provided in the armoire-style panel kit.
- Requires a minimum of 6" (15.2 cm) of open space above the refrigerator, which must not be blocked in any way, including soffits.

ARMOIRE KIT  
ADDED TO  
ORDER FOR THIS  
INSTALL. USE  
THESE SPECS

INTEGRATED INSTALLATION –  
ARMOIRE-STYLE CUSTOM OVERLAY PANEL DIMENSIONS

The armoire-style door panel kit for Jenn-Air® fully integrated built-in refrigerators enables full-height custom door panels with a hidden top panel for the ultimate in integrated design.

MODEL #		JS48NXFXDW	
		in	cm
REVEAL*		3/8	1.0
A	Width of freezer door panel	20 1/16	51.0
B	Width of refrigerator door panel	27 1/16	68.7
C	Height of door panels	81	205.7
REVEAL*		1/8	0.3
A	Width of freezer door panel	20 5/16	51.6
B	Width of refrigerator door panel	27 5/16	69.3
C	Height of door panels	81	205.7

\*Gap between door panel and adjacent cabinet.  
NOTE: The required thickness for all panels is 3/4" (1.9 cm). This installation does not require filler or backer panels.

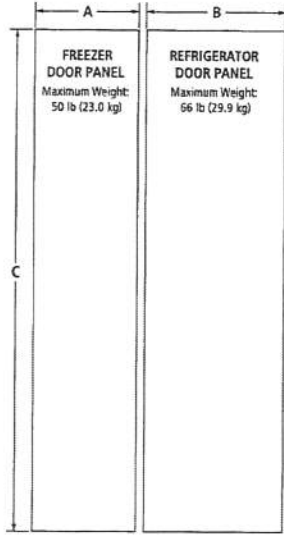

Product dimension, cutout and installation specifications are provided for planning purposes only. Before installing any product, be sure to verify cutout dimensions and electrical/gas connections as actual product dimensions may vary.



PV-124  
Jan. 26, 2021

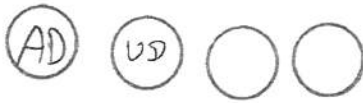

## JENN-AIR® DETAILED PLANNING DIMENSIONS

6 of 6

### 48" FULLY INTEGRATED SIDE-BY-SIDE REFRIGERATOR

(BASE UNIT REQUIRES SUITE-COORDINATING PANEL KIT OR CUSTOM PANELS AND HANDLES)

JS48NXFXDW – 47<sup>7</sup>/<sub>8</sub>" x 83<sup>1</sup>/<sub>8</sub>" x 24"

#### OPENING/CLEARANCE DIMENSIONS

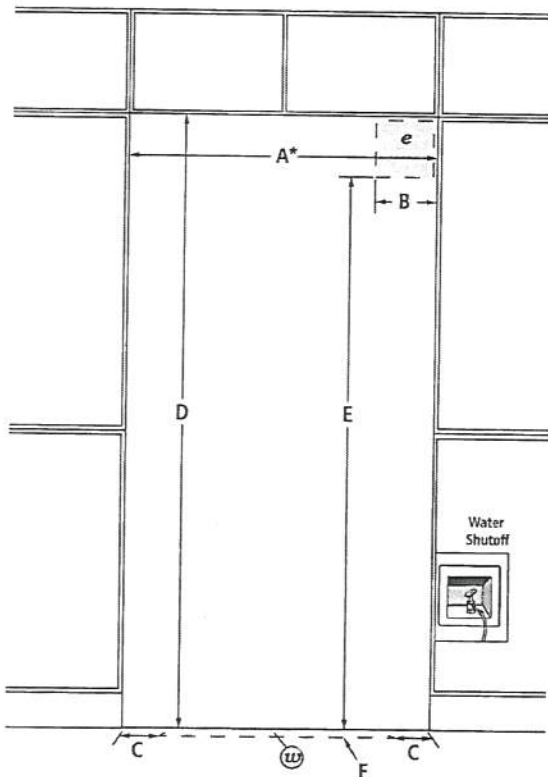

FRONT VIEW

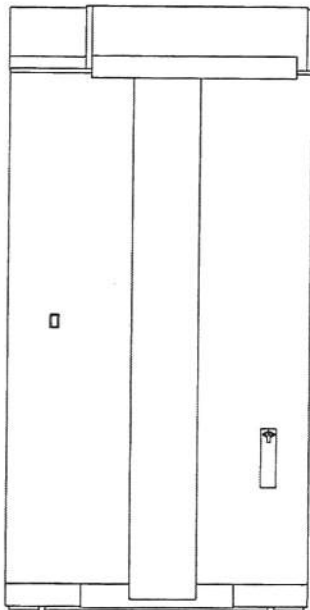

BACK VIEW

MODEL #		JS48NXFXDW	
		in	cm
A*	Width (min.)	48	121.9
B	Width of recommended electrical location	4	10.2
C	Distance from side of cabinet to recommended water connection location	6	15.2
D	Height (min.)	84 <sup>1</sup> / <sub>4</sub>	214.0
E	Height to recommended electrical location	77	195.6
F	Depth of recommended water connection location (max.)	1	2.5
e	Recommended electrical connection location		
w	Recommended water connection location		

\*Minimum width must extend behind the face of the cabinet for at least 2" (5.1 cm).

#### ELECTRICAL REQUIREMENTS

115 volt, 60 Hz, AC only, 15- or 20-amp fused, grounded circuit is required. A dedicated circuit is recommended. Use an outlet that cannot be turned off by a switch. Do not use an extension cord.

#### WATER PRESSURE REQUIREMENTS

A cold water supply with water pressure between 30 and 120 psi (207 and 827 kPa) is required to operate the ice maker. Call a licensed, qualified plumber with any questions about the water pressure.

#### Reverse Osmosis Water Supply

**IMPORTANT:** The pressure of the water coming out of a reverse osmosis system going to the water inlet valve of the refrigerator needs to be between 30 and 120 psi (207 and 827 kPa).

If a reverse osmosis water filtration system is connected to the cold water supply, the water pressure to the reverse osmosis system needs to be a minimum of 40 to 60 psi (276 to 414 kPa).

#### LOCATION REQUIREMENTS

Floor must be able to support refrigerator (more than 600 lb [272 kg]), door panels and contents of the refrigerator and must be at the same level as flooring in the room.

Product dimension, cutout and installation specifications are provided for planning purposes only. Before installing any product, be sure to verify cutout dimensions and electrical/gas connections as actual product dimensions may vary.

**JENN-AIR®**

JRC120073A 07/2012



## 24" DISHWASHER DETAILED PLANNING DIMENSIONS GUIDE

JDTSS246G, JDTSS244G, JDTSS245G, JDTSS243G, JDTSS247HS  
23<sup>7</sup>/<sub>8</sub>" (W) x 33<sup>1</sup>/<sub>2</sub>" (H) x 24" (Depth without door panel/handles)

### PRODUCT DIMENSIONS

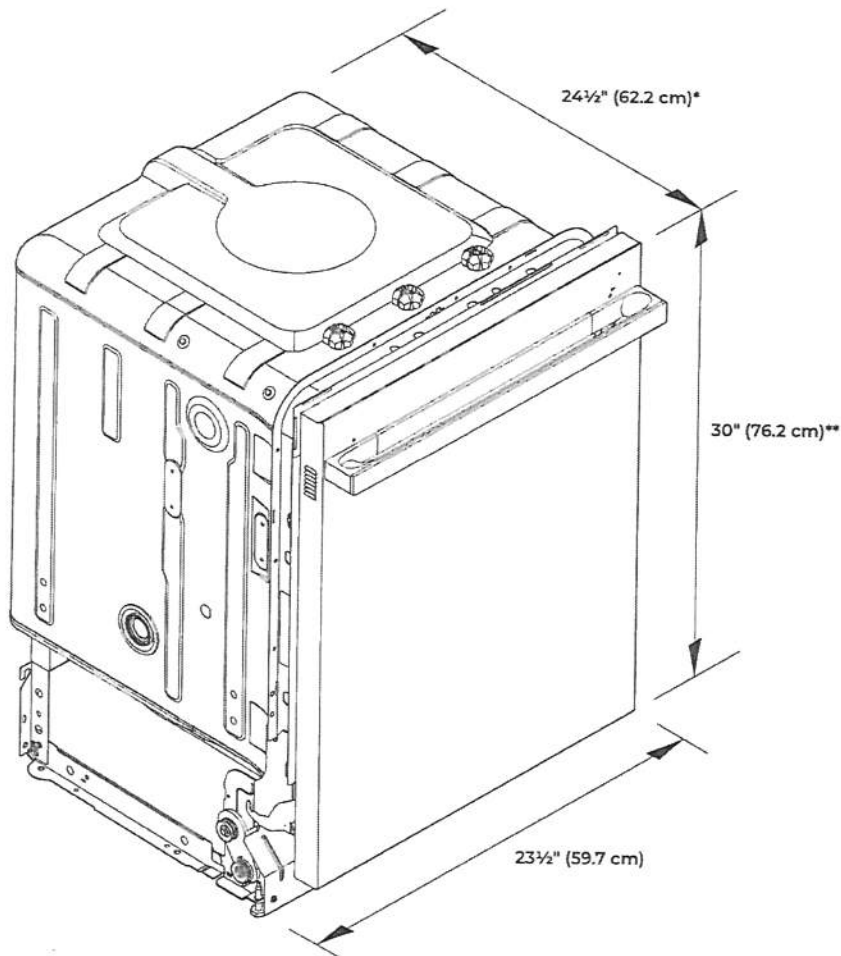

US  
PV-124 AD  
Jan 26, 2021

\*For custom panel models, this value may change.

\*\*With wheels removed. Add up to 1" (2.5 cm) to height with wheels and leg levelers fully extended.

Because Whirlpool Corporation policy includes a continuous commitment to improve our products, we reserve the right to change materials and specifications without notice.

Dimensions are for planning purposes only. For complete details, see Installation Instructions packed with product. Specifications subject to change without notice.

PV-124 (AD) (U.D)   
Jan 26, 2021



# 24" DISHWASHER

## DETAILED PLANNING DIMENSIONS GUIDE

JDTSS246G, JDTSS244G, JDTSS245G, JDTSS243G, JDTSS247HS  
23<sup>7</sup>/<sub>8</sub>" (W) x 33<sup>1</sup>/<sub>2</sub>" (H) x 24" (Depth without door panel/handles)

PRODUCT DIMENSIONS (CONTD.)

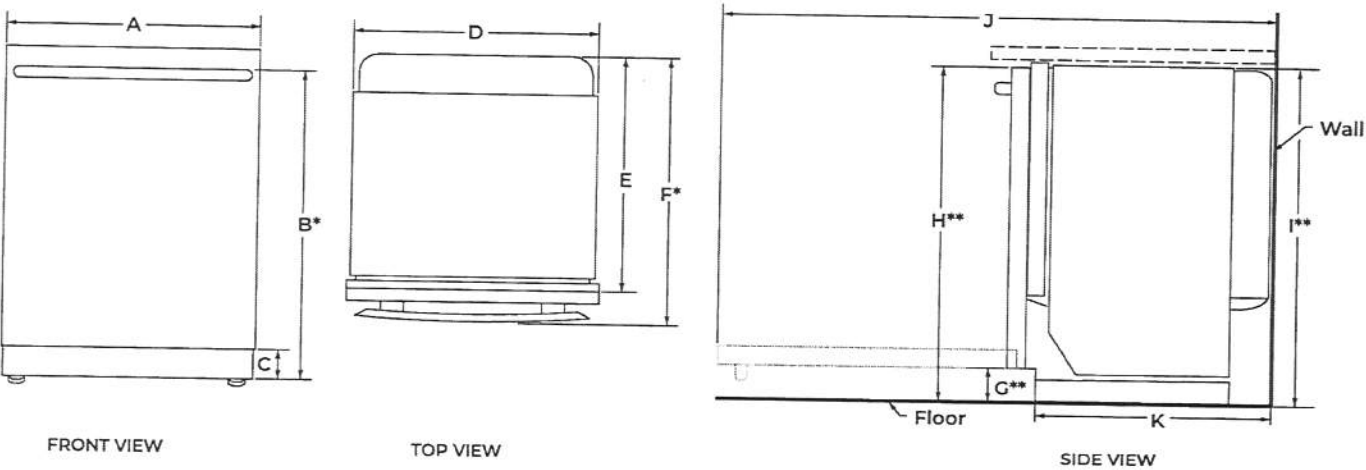

	DESCRIPTION	JDTSS246G, JDTSS244G	JDTSS245G, JDTSS243G	JDTSS247HS
A	Width of door	23 <sup>7</sup> / <sub>8</sub> " (60.6 cm)	23 <sup>7</sup> / <sub>8</sub> " (60.6 cm)	23 <sup>7</sup> / <sub>8</sub> " (60.6 cm)
B*	Height to top of handle	31 <sup>1</sup> / <sub>16</sub> " (80.1 cm)	-	-
C	Height of adjustable toe kick	3 <sup>1</sup> / <sub>2</sub> " (8.8 cm) - min. 4 <sup>1</sup> / <sub>4</sub> " (10.6 cm) - max.	3 <sup>1</sup> / <sub>2</sub> " (8.8 cm) - min. 4 <sup>1</sup> / <sub>4</sub> " (10.6 cm) - max.	3 <sup>1</sup> / <sub>2</sub> " (8.8 cm) - min. 4 <sup>1</sup> / <sub>4</sub> " (10.6 cm) - max.
D	Width of recessed dishwasher	23 <sup>7</sup> / <sub>8</sub> " (60.6 cm)	23 <sup>7</sup> / <sub>8</sub> " (60.6 cm)	23 <sup>7</sup> / <sub>8</sub> " (60.6 cm)
E*	Depth without handle	22 <sup>5</sup> / <sub>8</sub> " (57.4 cm)	22 <sup>5</sup> / <sub>8</sub> " (57.4 cm)	22 <sup>5</sup> / <sub>8</sub> " (57.4 cm)
F*	Depth with handle	29 <sup>1</sup> / <sub>16</sub> " (73.9 cm)	-	-
	Pro-Style® Stainless			
	Euro-Style Stainless	28 <sup>9</sup> / <sub>16</sub> " (72.6 cm)	-	-
	RISE™ Stainless	28 <sup>5</sup> / <sub>8</sub> " (72.7 cm)	-	-
	NOIR™ Stainless	28 <sup>9</sup> / <sub>16</sub> " (72.6 cm)	-	-
G**	Height to bottom of door	3 <sup>5</sup> / <sub>8</sub> " (9.4 cm)	3 <sup>5</sup> / <sub>8</sub> " (9.4 cm)	3 <sup>5</sup> / <sub>8</sub> " (9.4 cm)
H**	Height to top of door (min.)	33 <sup>3</sup> / <sub>4</sub> " (85.7 cm)	33 <sup>3</sup> / <sub>4</sub> " (85.7 cm)	33 <sup>1</sup> / <sub>2</sub> " (85.1 cm)
I**	Height of recessed dishwasher (min.)	33 <sup>5</sup> / <sub>8</sub> " (85.5 cm)	33 <sup>5</sup> / <sub>8</sub> " (85.5 cm)	-
J	Depth with door fully open (min.)	49 <sup>1</sup> / <sub>2</sub> " (125.7 cm)	49 <sup>1</sup> / <sub>2</sub> " (125.7 cm)	-
K	Depth with toe kick (min.)	20 <sup>7</sup> / <sub>8</sub> " (52.9 cm)	20 <sup>7</sup> / <sub>8</sub> " (52.9 cm)	21" (533 mm)

Because Whirlpool Corporation policy includes a continuous commitment to improve our products, we reserve the right to change materials and specifications without notice.

Dimensions are for planning purposes only. For complete details, see Installation Instructions packed with product. Specifications subject to change without notice.



PV-124

Jan 26, 2021

AD

VD



## 24" DISHWASHER

### DETAILED PLANNING DIMENSIONS GUIDE

JDTSS246G, JDTSS244G, JDTSS245G, JDTSS243G, JDTSS247HS  
23<sup>7</sup>/<sub>8</sub>" (W) x 33<sup>1</sup>/<sub>2</sub>" (H) x 24" (Depth without door panel/handles)

#### OPENING/CLEARANCE DIMENSIONS

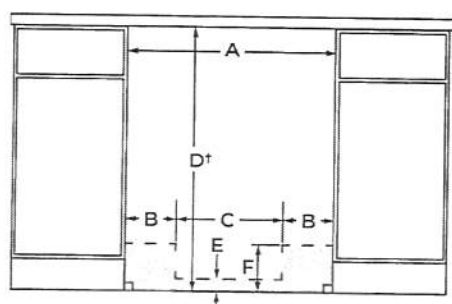

FRONT VIEW

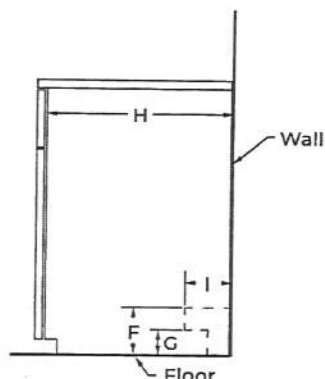

SIDE VIEW

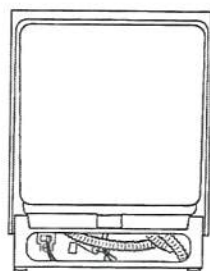

BACK VIEW

	DESCRIPTION	JDTSS246G, JDTSS244G, JDTSS245G, JDTSS243G, JDTSS247HS
A	Width (min.)	24" (61 cm)
B	Width of possible utility installation area (back wall)	6 <sup>3</sup> / <sub>4</sub> " (17.2 cm)
C	Width of clear area (back wall)	10 <sup>1</sup> / <sub>2</sub> " (26.7 cm)
D+	Height with wheels removed (min.)	34" (86.4 cm)
E	Height of possible utility installation area (back wall)	2 <sup>1</sup> / <sub>4</sub> " (6.4 cm)
F	Height of possible utility installation area (back/side wall)	6 <sup>1</sup> / <sub>4</sub> " (15.9 cm)
G	Height of clear area (side wall)	3" (7.6 cm)
H	Depth (min.)	24" (61 cm)
I	Depth of utility location (side wall)	4" (10.2 cm)
Recommended drain connection location - closest to sink		1 <sup>1</sup> / <sub>2</sub> " (3.8 cm) dia.
Recommended electrical connection location - right-hand side or back wall		1 <sup>1</sup> / <sub>2</sub> " (3.8 cm) dia.
Recommended water connection location - left-hand side or back wall		1/2" (1.3 cm) dia.

†Measured from the lowest point on the underside of countertop.

**NOTE:** Shaded areas indicate recommended locations of electrical, water and drain connections.

#### LOCATION REQUIREMENTS

Corner locations require a 2" (5.1 cm) minimum clearance between the side of the dishwasher door and the wall or cabinet.

Because Whirlpool Corporation policy includes a continuous commitment to improve our products, we reserve the right to change materials and specifications without notice.

Dimensions are for planning purposes only. For complete details, see Installation Instructions packed with product. Specifications subject to change without notice.



PV-124

Jan 26, 2021



24" DISHWASHER

DETAILED PLANNING DIMENSIONS GUIDE

JDTSS246G, JDTSS244G, JDTSS245G, JDTSS243G, JDTSS247HS  
23<sup>5</sup>/<sub>8</sub>" (W) x 33<sup>1</sup>/<sub>2</sub>" (H) x 24" (Depth without door panel/handles)

WOOD PANEL GUIDE

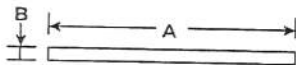

WOOD PANEL - TOP VIEW

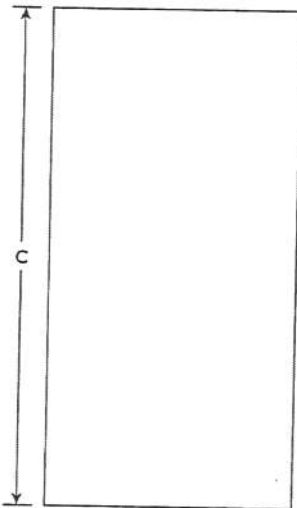

WOOD PANEL - FRONT VIEW

	DESCRIPTION	JDTSS245G, JDTSS243G
A	Width	23 <sup>5</sup> / <sub>8</sub> " (60 cm)
B	Thickness	3/4" (1.91 cm)
C	Height	29 <sup>15</sup> / <sub>16</sub> " (76 cm)

INSTALLATION NOTES

- Overlay panel thickness is 3/4" (1.90 cm).
- Maximum panel weight (including handle) is 14.7 lbs (6.7 kg).
- Panel dimensions shown are the minimum size to cover the appliance door. The resulting top and side reveals are 3/16". Panels can be made taller/wider to match surrounding cabinetry.
- Minimum opening height: 34" (86.36 cm).

Because Whirlpool Corporation policy includes a continuous commitment to improve our products, we reserve the right to change materials and specifications without notice.

Dimensions are for planning purposes only. For complete details, see Installation Instructions packed with product. Specifications subject to change without notice.