

APPLIANCES

Invoice	Qty.	Description
2434 18Sep20 NoCat	1	APPLIANCE SPECIFICATIONS ATTACHED - SIGNED

CERAMIC

Invoice	Qty.	Description
2344 23Jul20 NoCat	1	.MASTER ENSUITE: SHOWER BENCH COMPLETE WITH STANDARD TILE AND MATCHING MARBLE JAMB COLOUR SEAT TOP
2344 23Jul20 NoCat	1	.SHARED BATH: SHOWER BENCH COMPLETE WITH STANDARD TILE AND MATCHING MARBLE JAMB COLOUR SEAT TOP
2344 23Jul20 NoCat	1	.SHARED BATH: SHOWER NICHE [SHAMPOO SHELF] - COMPLETE WITH MATCHING MARBLE JAMBS ON 4 SIDES, STANDARD TILE, APPROX. 12 X 18 INSTALLED VERTICALLY - SEE PLAN FOR LOCATION
2344 23Jul20 NoCat	1	.MASTER ENSUITE: SHOWER NICHE [SHAMPOO SHELF] - COMPLETE WITH MATCHING MARBLE JAMBS ON 4 SIDES, STANDARD TILE, APPROX. 12 X 18 INSTALLED VERTICALLY - SEE PLAN FOR LOCATION
2434 35 18Sep20	1	FRONT FOYER: TILE, FLOOR , LEVEL 3 - FRONT FOYER, ALT. GROUND FLOOR - 12X24" LAID IN STRAIGHT, STACKED PATTERN. SEE PLAN FOR TILE DIRECTION
2434 35 18Sep20	1	LAUNDRY ROOM: TILE, FLOOR , LEVEL 3 - LAUNDRY, ALT. GROUND FLOOR - 12X24" LAID IN STRAIGHT, STACKED PATTERN. SEE PLAN FOR TILE DIRECTION
2434 35 18Sep20	1	POWDER ROOM: TILE, FLOOR , LEVEL 3 - POWDER ROOM, ALT. GROUND FLOOR - 12X24" LAID IN STRAIGHT, STACKED PATTERN. SEE PLAN FOR TILE DIRECTION
2434 35 18Sep20	1	KITCHEN: TILE, FLOOR , LEVEL 3 - KITCHEN, ALT. GROUND FLOOR - 12X24" LAID IN STRAIGHT, STACKED PATTERN. SEE PLAN FOR TILE DIRECTION
2434 35 18Sep20	1	MASTER ENSUITE: TILE, FLOOR , LEVEL 3 - MASTER ENSUITE, ALT. GROUND FLOOR - 12X24" LAID IN STRAIGHT, STACKED PATTERN. SEE PLAN FOR TILE DIRECTION
2434 43 18Sep20	1	MASTER ENSUITE: TILE, SHOWER FLOOR, LEVEL 2 - MASTER ENSUITE - 2" HEX
2434 50 18Sep20	1	MASTER ENSUITE SHOWER WALL TILE: TILE, WALL, LEVEL 4 - MASTER ENSUITE, ALT. GROUND FLOOR - 10X30" LAID IN VERTICAL STACKED PATTERN

CERAMIC

Invoice	Qty.	Description
2434 32 18Sep20	1	SHARED BATH: TILE, FLOOR , LEVEL 1 - SHARED BATH, ALT. GROUND FLOOR - 12X24" LAID IN STRAIGHT, STACKED PATTERN - SEE PLAN FOR TILE DIRECTION
2434 43 18Sep20	1	SHARED BATH: TILE, SHOWER FLOOR, LEVEL 2 - SHARED BATH - HEX
2434 18Sep20 NoCat	1	KITCHEN: UPGRADE 8 MARBLE MOSAIC BACKSPLASH

CONCRETE AND DRAIN

Invoice	Qty.	Description
2216 23Jul20 NoCat	1	.BACK-FLOW PREVENTER VALVE

CROWN MOULDING

Invoice	Qty.	Description
2344 23Jul20 NoCat	1	.**CUSTOM LAYOUT** COFFERED CEILING IN MASTER BEDROOM

DRYWALL

Invoice	Qty.	Description
2344 23Jul20 NoCat	1	.**CUSTOM LAYOUT** COFFERED CEILING IN MASTER BEDROOM
2344 23Jul20 NoCat	1	.GREAT ROOM: RAISED HEARTH - APPROX 4"
2344 23Jul20 NoCat	1	.MASTER ENSUITE: SINGLE POCKET DOOR 800 SERIES COMPLETE WITH BUILDERS STANDARD OFFERINGS
2344 23Jul20 NoCat	1	.LAUNDRY ROOM: SINGLE POCKET DOOR 800 SERIES COMPLETE WITH BUILDERS STANDARD OFFERINGS
2344 23Jul20 NoCat	1	.**CUSTOM LAYOUT** ADD GARAGE SIDE ENTRANCE DOOR - SITE APPROVAL AND GRADE PERMITTING
2344 23Jul20 NoCat	1	.THRU OUT *INCLUDING CLOSETS* - UPGRADED TO SOLID CORE DOORS (ADDITIONAL FOR SAFE & SOUND)

ELECTRICAL

Invoice	Qty.	Description
2344 72,667 23Jul20	1	.KITCHEN:ROUGH-IN FOR CAPPED CEILING OUTLET (FUTURE LIGHT FIXTURE) - EACH LOCATE APPROX. CENTER ABOVE ISLAND
2344 72,278 23Jul20	1	.KITCHEN: ADDITIONAL INTERIOR SWITCH FOR LIGHT ABOVE ISLAND
2344 72,289 23Jul20	2	.MASTER ENSUITE *WATER CLOSET*: ADD (2) 4" E/S LED INTERIOR POT LIGHT - GROUND FLOOR - EACH - INCLUDED IN APS IN LIEU OF STANDARD CEILING LIGHT
2344 72,289 23Jul20	4	.MASTER ENSUITE: 4" E/S LED INTERIOR POT LIGHT - GROUND FLOOR - EACH - INCLUDED IN APS IN LIEU OF STANDARD CEILING LIGHT
2344 72,292 23Jul20	1	.FRONT PORTICO: ADDITIONAL EXTERIOR COACH LIGHT ON SAME SWITCH (BUILDERS STANDARD FIXTURE) - AT REAR OR SIDE ELEVATION ONLY LOCATE ON OTHER SIDE OF FRONT DOOR (SAME HEIGHT AS STANDARD)
2344 72,303 23Jul20	1	.KITCHEN: FIXTURE: UNDER CABINET FLUORESCENT LIGHT FIXTURES - DOES NOT INCLUDE (AND REQUIRES) LIGHT VALANCE
2344 72,291 23Jul20	2	.FRONT ELEVATION *ABOVE GARAGE DOOR*: EXTERIOR LED SOFFIT POT LIGHT - EACH - IN LIEU OF STANDARD COACH LIGHTS ABOVE GARAGE DOORS
2344 72,286 23Jul20	1	.FRONT PORTICO: ADD EXTERIOR RECEPTACLE: ADDITIONAL EXTERIOR GFI RECEPTACLE WITH COVER - LOCATE ON OTHER SIDE OF FRONT DOOR
2344 72,282 23Jul20	1	.KITCHEN: ADDITIONAL 220V RECEPTACLE ON A SEPARATE CIRCUIT - FOR BUILT-IN WALL OVEN - APPLIANCE NOT INCLUDED - DOES NOT INCLUDE BREAKER THAT IS TO BE INSTALLED BY LICENSED ELECTRICIAN AND ARRANGED BY HOMEOWNER AFTER CLOSING
2344 72,298 23Jul20	1	.MASTER ENSUITE: BATHROOM FAN DELAY - ONE UNIT
2434 18Sep20 NoCat	1	MASTER ENSUITE: ELECTRICAL FOR WHIRLPOOL

EXTERIOR COLOURS

Invoice	Qty.	Description
2344 23Jul20 NoCat	1	.EXTERIOR COLOUR PACKAGE # BR.1
2344 23Jul20 NoCat	1	EXTERIOR COLOUR PACKAGE # BR.1

FORMING

Invoice	Qty.	Description
2216 23Jul20 NoCat	2	.BASEMENT WINDOWS - UPGRADE BASEMENT WINDOW SIZE TO 30 " X 24" - 8" FRAME
2216 23Jul20 NoCat	2	.BASEMENT WINDOWS - UPGRADE BASEMENT WINDOW SIZE TO 30 " X 24" - 8" FRAME
2344 23Jul20 NoCat	1	**CUSTOM LAYOUT** INCREASE SIZE OF DECK TO APPROX 10x18' - PRESSURE TREATED DECKING SEE ATTACHED SKETCH FOR LAYOUT
2344 23Jul20 NoCat	1	**CUSTOM LAYOUT** ADD GARAGE SIDE ENTRANCE DOOR - SITE APPROVAL AND GRADE PERMITTING

FRAMING

Invoice	Qty.	Description
2216 23Jul20 NoCat	2	.BASEMENT WINDOWS - UPGRADE BASEMENT WINDOW SIZE TO 30 " X 24" - 8" FRAME
2344 72,671 23Jul20	1	.MASTER ENSUITE: SHOWER BENCH COMPLETE WITH STANDARD TILE AND MATCHING MARBLE JAMB COLOUR SEAT TOP
2344 23Jul20 NoCat	1	.**CUSTOM LAYOUT** COFFERED CEILING IN MASTER BEDROOM
2344 23Jul20 NoCat	1	.GREAT ROOM: RAISED HEARTH - APPROX 4"
2344 23Jul20 NoCat	1	.**CUSTOM LAYOUT** INCREASE SIZE OF DECK TO APPROX 10x18' - PRESSURE TREATED DECKING SEE ATTACHED SKETCH FOR LAYOUT BASED ON PERMIT APPROVAL
2344 72,640 23Jul20	1	.MASTER ENSUITE: SINGLE POCKET DOOR 800 SERIES COMPLETE WITH BUILDERS STANDARD OFFERINGS
2344 72,640 23Jul20	1	.LAUNDRY ROOM: SINGLE POCKET DOOR 800 SERIES COMPLETE WITH BUILDERS STANDARD OFFERINGS
2344 23Jul20 NoCat	1	.**CUSTOM LAYOUT** ADD GARAGE SIDE ENTRANCE DOOR - SITE APPROVAL AND GRADE PERMITTING STEP MAY BE REQUIRED
2344 72,671 23Jul20	1	.SHARED BATH: SHOWER BENCH COMPLETE WITH STANDARD TILE AND MATCHING MARBLE JAMB COLOUR SEAT TOP
2344 72,631 23Jul20	1	.SHARED BATH: SHOWER NICHE [SHAMPOO SHELF] - COMPLETE WITH MATCHING MARBLE JAMBS ON 4 SIDES, STANDARD TILE, APPROX. 12 X 18 INSTALLED VERTICALLY - SEE PLAN FOR LOCATION
2344 72,631 23Jul20	1	.MASTER ENSUITE: SHOWER NICHE [SHAMPOO SHELF] - COMPLETE WITH MATCHING MARBLE JAMBS ON 4 SIDES, STANDARD TILE, APPROX. 12 X 18 INSTALLED VERTICALLY - SEE PLAN FOR LOCATION
2344 72,645 23Jul20	19	.THRU OUT *INCLUDING CLOSETS* - UPGRADED TO SOLID CORE DOORS (ADDITIONAL FOR SAFE & SOUND)
2434 72,671 18Sep20	-1	.**DELETE** SHARED BATH: SHOWER BENCH COMPLETE WITH STANDARD TILE AND MATCHING MARBLE JAMB COLOUR SEAT TOP DELETE FROM ORDER PE.2344 DUE TO SITE CONDITION

GARAGE DOORS

Invoice	Qty.	Description
2344 72,324 23Jul20	2	.GARAGE DOOR OPENER (CHAMBERLAIN BELT DRIVE) - WITH 1 REMOTE - PRICE IS PER DOOR
2344 72,323 23Jul20	2	.WIRELESS KEYPAD GARAGE DOOR ENTRY 877LM

GLASS AND MIRROR

Invoice	Qty.	Description
2434 18Sep20 NoCat	1	MASTER ENSUITE: SHOWER DOOR HANDLE SQ6X6
2434 18Sep20 NoCat	1	SHARED BATH: UPGRADE SHOWER DOOR HANDLE SQ6X6

GRANITE MARBLE QUARTZ

Invoice	Qty.	Description
2434 18Sep20 NoCat	1	POWDER ROOM: UPGRADE EDGE PROFILE TO 4CM
2434 18Sep20 NoCat	1	KITCHEN: UPGRADE 4 QUARTZ COUNTER TOP
2434 18Sep20 NoCat	1	KITCHEN: UPGRADE KITCHEN EDGE PROFILE TO 4CM
2434 18Sep20 NoCat	1	MASTER ENSUITE: UPGRADE 3 QUARTZ COUNTER TOP
2434 18Sep20 NoCat	1	MASTER ENSUITE: UPGRADE VANITY COUNTER TOP PROFILE TO 4CM
2434 18Sep20 NoCat	1	SHARED BATH: UPGRADE COUNTERTOP EDGE PROFILE TO 4CM
2434 18Sep20 NoCat	1	LAUNDRY ROOM: UPGRADE 1 QUARTZ COUNTER TOP + ADD ABOVE MACHINES

HARDWOOD

Invoice	Qty.	Description
2434 2 18Sep20	1	FORMAL ROOM / MAIN HALL: VINTAGE SERIES, 4 3/8" RED OAK, NSS ENGINEERED HARDWOOD, 3/4" THK, SMOOTH TEXTURE, PEARL FINISH - OPT. GROUND FL, FORMAL ROOM/ MAIN HALL - LEVEL 2
2434 2 18Sep20	1	GREAT ROOM: VINTAGE SERIES, 4 3/8" RED OAK, NSS ENGINEERED HARDWOOD, 3/4" THK, SMOOTH TEXTURE, PEARL FINISH - OPT. GROUND FL, GREAT ROOM - LEVEL 2
2434 2 18Sep20	1	MASTER BEDROOM: VINTAGE SERIES, 4 3/8" RED OAK, NSS ENGINEERED HARDWOOD, 3/4" THK, SMOOTH TEXTURE, PEARL FINISH - OPT. GROUND FL, MASTER BEDROOM - LEVEL 2
2434 2 18Sep20	1	MEDIA ROOM / LOFT: VINTAGE SERIES, 4 3/8" RED OAK, NSS ENGINEERED HARDWOOD, 3/4" THK, SMOOTH TEXTURE, PEARL FINISH - OPT. GROUND FL, MEDIA ROOM / LOFT - LEVEL 2
2434 2 18Sep20	1	BEDROOM 3: VINTAGE SERIES, 4 3/8" RED OAK, NSS ENGINEERED HARDWOOD, 3/4" THK, SMOOTH TEXTURE, PEARL FINISH - OPT. GROUND FL, BEDROOM 3 - LEVEL 2
2434 2 18Sep20	1	BEDROOM 4: VINTAGE SERIES, 4 3/8" RED OAK, NSS ENGINEERED HARDWOOD, 3/4" THK, SMOOTH TEXTURE, PEARL FINISH - OPT. GROUND FL, BEDROOM 4 - LEVEL 2

HVAC

Invoice	Qty.	Description
2344 72,321 23Jul20	1	.GREAT ROOM: FIREPLACE - ADD HEAT ACTIVATED FAN
2344 72,247 23Jul20	1	HUMIDIFER - LENNOX MODEL WB3-17 (2000 UP TO 3000 SQ.FT.)

INTERIOR TRIM AND DOORS

Invoice	Qty.	Description
2344 23Jul20 NoCat	1	.**CUSTOM LAYOUT** COFFERED CEILING IN MASTER BEDROOM
2344 23Jul20 NoCat	1	.GREAT ROOM: RAISED HEARTH - APPROX 4"
2344 23Jul20 NoCat	1	.MASTER ENSUITE: SINGLE POCKET DOOR 800 SERIES COMPLETE WITH BUILDERS STANDARD OFFERINGS
2344 23Jul20 NoCat	1	.LAUNDRY ROOM: SINGLE POCKET DOOR 800 SERIES COMPLETE WITH BUILDERS STANDARD OFFERINGS
2344 23Jul20 NoCat	1	.THRU OUT *INCLUDING CLOSETS* - UPGRADED TO SOLID CORE DOORS (ADDITIONAL FOR SAFE & SOUND)
2434 155,134 18Sep20	1	THRU OUT: UPGRADE INTERIOR DOORS TO ROMAN UPGRADE
2434 153,704 18Sep20	1	THRU OUT: HALIFAX LEVER, SATIN NICKLE INTERIOR DOOR HARDWARE UPGRADE
2434 155,782 18Sep20	1	THRU OUT: ADD FOR HINGES 3X3 RADIUS STEEPLE TIP THROUGHOUT UPGRADE
2434 100,610 18Sep20	1	THRU OUT: UPGRADE 3 1/2" STEP BB CASING, 7 1/4" BASE BOARD - UPGRADE

KITCHEN AND BATH CABINetry

Invoice	Qty.	Description
2434 18Sep20 NoCat	1	KITCHEN: SEE ATTACHED SCHEDULE FOR EXTRAS

NETWORK AND WIRING

Invoice	Qty.	Description
2344 72,264 23Jul20	2	MUD ROOM & LAUNDRY: ROUGH - IN FOR EXTRA SECURITY KEY PAD

PAINT

Invoice	Qty.	Description
2344 23Jul20 NoCat	1	.**CUSTOM LAYOUT** COFFERED CEILING IN MASTER BEDROOM
2344 23Jul20 NoCat	1	.GREAT ROOM: RAISED HEARTH - APPROX 4"
2344 23Jul20 NoCat	1	.MASTER ENSUITE: SINGLE POCKET DOOR 800 SERIES COMPLETE WITH BUILDERS STANDARD OFFERINGS
2344 23Jul20 NoCat	1	.LAUNDRY ROOM: SINGLE POCKET DOOR 800 SERIES COMPLETE WITH BUILDERS STANDARD OFFERINGS
2344 23Jul20 NoCat	1	.**CUSTOM LAYOUT** ADD GARAGE SIDE ENTRANCE DOOR - SITE APPROVAL AND GRADE PERMITTING
2344 23Jul20 NoCat	1	.THRU OUT *INCLUDING CLOSETS* - UPGRADED TO SOLID CORE DOORS (ADDITIONAL FOR SAFE & SOUND)
2434 18Sep20 NoCat	2	MAIN STAIRS - 2ND FLOOR TO BASEMENT: STAIN STAIRS AND LANDINGS STAIRS AND LANDINGS WILL NOT MATCH HARDWOOD FLOORS

PLUMBING

Invoice	Qty.	Description
2344 72,332 23Jul20	1	.KITCHEN: ROUGH-IN 1/4" COLD WATER LINE TO FRIDGE
2344 72,335 23Jul20	1	.GARAGE: HOT AND COLD WATER SUPPLY LINES IN GARAGE IN LIEU OF STANDARD OFFERING
2344 23Jul20 NoCat	1	**NOTE** MASTER ENSUITE: SEE PLAN FOR PREFERRED VALVE LOCATION (IF POSSIBLE)
2434 18Sep20 NoCat	3	POWDER / MASTER BATH / SHARED BATH: CONTRAC 'KIERA' COMFORT HEIGHT 1 PIECE TOILET
2434 18Sep20 NoCat	1	MASTER ENSUITE: MAAX 'JAZZ' FREE-STANDING WHIRLPOOL TUB
2434 18Sep20 NoCat	2	MASTER ENSUITE: UPGRADE FAUCETS TO MOEN 8"CC 'FLARA' CHROME CROSS HANDLE #TS6985
2548 01Feb21 NoCat	1	LAUNDRY: UPGRADE FAUCET TO MOEN 'SLEEK' - CHROME
2548 01Feb21 NoCat	-1	*REVISED* MASTER ENSUITE: *DELETE* 'FLARA' RAIN SHOWER FROM CEILING + DIVERTER (from pe# 2434) INSTALL MOEN 'FLARA' VALVE + ECO-PERFORMANCE 5 FUNCTION HANDSHOWER + SLIDE BAR INSTEAD DIFFERENCE IN PRICE

PLUMBING FIXTURES

Invoice	Qty.	Description
2434 18Sep20 NoCat	1	MASTER ENSUITE: MOEN 'FLARA' 3-FUNCTION SHOWER FAUCET WITH RAIN SHOWER (from ceiling) + HAND SHOWER - CHROME #TS2912EP
2434 18Sep20 NoCat	1	MASTER ENSUITE: MOEN 'FLARA' ROMAN TUB FILLER - DECK MOUNT WITH HAND SPRAY - CHROME #TS929
2434 18Sep20 NoCat	1	LAUNDRY ROOM: UPGRADE TO STAINLESS STEEL LAUNDRY SINK - BLANCO QUATRUS R15 LAUNDRY #401519 (NO LAUNDRY RACK/GRID)
2434 18Sep20 NoCat	1	KITCHEN: MOEN 'NIO' SINGLE HANDLE PULLDOWN KITCHEN FAUCET - SPOT RESISTANT STAINLESS #S75005SRS
2434 18Sep20 NoCat	1	KITCHEN: BLANCO QUATRUS R15 U 1-3/4 UNDERMOUNT SINK #401520 / 406451 / 406450 BOTTOM GRIDS *INCLUDED*
2434 18Sep20 NoCat	1	POWDER ROOM: MOEN 'ARRIS' 8"CC LAV FAUCET CHROME #TS43002 / 69000

STAIR AND RAILINGS

Invoice	Qty.	Description
2434 93,946 18Sep20	2	MAIN STAIRS: BASEMENT TO 2ND FLOOR: UPGRADE - EURONLINE # 1, 3" HALF-ROUND W/V-GROOVE HANDRAIL, 3 1/2" ALL SQUARE POST WITH PYRAMID TOP POST CAP - PACKAGE D

STAIRS AND RAILINGS

Invoice	Qty.	Description
2344 23Jul20 NoCat	1	**CUSTOM LAYOUT** REAR DECK - GLASS RAILING AT FLOOR AREA - 42" HEIGHT PICKET RAILING ALONG STAIRS

WINDOWS - BASEMENT

Invoice	Qty.	Description
2216 72,351 23Jul20	2	.BASEMENT WINDOWS - UPGRADE BASEMENT WINDOW SIZE TO 30 " X 24" - 8" FRAME

WINDOWS AND DOORS

Invoice	Qty.	Description
2344 23Jul20 NoCat	1	**CUSTOM LAYOUT** ADD GARAGE SIDE ENTRANCE DOOR - SITE APPROVAL AND GRADE PERMITTING

*** NOTE: This is not an approved document. Document must be locked ***

Scheduled Closing Date: Thursday, March 4, 2021

Purchasers: Alberto Francesco Puchiele & Annamaria V. Ober Property: 101 of Plan -

Telephone Res. / Bus: /

Project: Pine Valley Forevergreen - Phase 1

Decor Advisor: Laura Di Pede

Model and Elevation: 40.00 A BRIARWOOD

Layout Changes: Yes No Sketch Attached: Yes No Exterior Colour Scheme:

1. Cabinetry

	Style and Colour	Counter	Hardware
Kitchen / Breakfast	*Brill 6 'Cherry Barley'	*Quartz: 'Bianco Drift'	bh081.3
Laundry Room	Bowery 'Ello-I'	*Quartz: 'Blanco Maple'	h039-03
Powder Room	*Vermont 'storm grey maple'	*Quartz: 'Nordic Loft'	bh080.3
Master Ensuite Bathroom	*Pacifica 'storm grey maple'	*Quartz: 'White Arabesque'	bh081.3
Second Ensuite Bathroom (If Applicable)	n/a	n/a	n/a
Shared Bath	Tribeca 'Stello'	Quartz: 'Nordic Loft'	h039-03

Comment

2. Floor Tile

	Selection
Entrance Vestibule	*12x24" Volkas matte 'White'
Main Hall	n/a
Kitchen / Breakfast	*12x24" Volkas matte 'White'
Laundry Room	*12x24" Volkas matte 'White'
Powder Room	*12x24" Volkas matte 'White'
Shared Bathroom	*12x24" Land 'Beige'
Master Ensuite Bathroom	*12x24" Eterna matte 'Dark Grey'
Second Ensuite Bathroom (If Applicable)	n/a
Lower Landing (If Applicable)	n/a
Basement Foyer	13x13" New Byzantine 'Azzuro Blue'

Comment

M. Ens shower floor: Ontario Hex 'Dark Grey' Shared Bath shower floor: Ontario Hex 'Tender Grey'

3. Wall Tile

	Selection	Listello/Inserts	Describe
Master Ensuite Bathroom		<input type="radio"/> Yes <input checked="" type="radio"/> No	
Tub Deck		<input type="radio"/> Yes <input checked="" type="radio"/> No	
Shower Stall	*10x30" Roma Filo 'Statuario Decor'	<input type="radio"/> Yes <input checked="" type="radio"/> No	
Bathroom Walls		<input type="radio"/> Yes <input checked="" type="radio"/> No	
Second Ensuite Bathroom (If Applicable)		<input type="radio"/> Yes <input checked="" type="radio"/> No	
Shared Bath	8x10" Venus 'Grey'	<input type="radio"/> Yes <input checked="" type="radio"/> No	
Kitchen Backsplash	<input checked="" type="radio"/> Yes <input type="radio"/> No	Backsplash Behind Fridge	<input type="text"/>
Comment	*marble 'Verona blend' Herringbone		

Scheduled Closing Date: Thursday, March 4, 2021

Purchasers: Alberto Francesco Puchiele & Annamaria V. Ober Property: 101 of Plan -

Telephone Res. / Bus: /

Project: Pine Valley Forevergreen - Phase 1

Decor Advisor: Laura Di Pede

Model and Elevation: 40.00 A BRIARWOOD

4. Plumbing Fixtures

<input type="checkbox"/>	<input type="checkbox"/>	<input type="checkbox"/>	<input type="checkbox"/>
Master Ensuite Bathroom	Second Ensuite	Powder Room	Other Room - Specify
<input type="checkbox"/>	<input type="checkbox"/>	<input type="checkbox"/>	<input type="checkbox"/>
<input type="checkbox"/>	<input type="checkbox"/>	Other Washroom	<input type="checkbox"/>

Comment

Standard at Shared bath, upgraded kitchen/laundry/master ensuite

5. Hardwood Flooring

	Type and Stain		Type and Stain
Main Hall	<input type="text"/>	Upper Landing	<input type="text"/>
Kitchen / Breakfast	<input type="text"/>	Upper Hall	<input type="text"/>
Living Room	<input type="text"/>	Master Bedroom	<input type="text"/>
Dining Room	<input type="text"/>	Bedroom #2	<input type="text"/>
Family Room	<input type="text"/>	Bedroom #3	<input type="text"/>
Den/Library	<input type="text"/>	Bedroom #4	<input type="text"/>
Entrance Vestibule	<input type="text"/>	Bedroom #5	<input type="text"/>
Lower Landing (If Applicable)	<input type="text"/>	Other Room - Specify	<input type="text"/>
		thru out standard areas	*3/4x4-3/8" Red oak smth 'Walnut'

Comment

6. Carpeting

	Upgrade	Description
Ground Floor	<input type="checkbox"/>	<input type="text"/>
Second Floor	<input type="checkbox"/>	<input type="text"/>
<input type="text"/>	<input type="checkbox"/>	<input type="text"/>

Upgrade Underpad	Type	Area
<input type="text"/>	<input type="text"/>	<input type="text"/>
Carpet on Stairs	Capped	Runner - *Upgrade
<input type="text"/>	<input type="text"/>	<input type="text"/>

Comment

7. Fireplace

	Living Room			Family Room			Other Room - Specify		
	Purchased	As Per Plan	N/A	Purchased	As Per Plan	N/A	Purchased	As Per Plan	N/A
	<input type="radio"/>	<input type="radio"/>	<input checked="" type="radio"/>	<input type="radio"/>	<input checked="" type="radio"/>	<input type="radio"/>	<input type="radio"/>	<input type="radio"/>	<input checked="" type="radio"/>
Fireplace Type	<input type="text"/>			Standard Gas			<input type="text"/>		
Mantle Type	<input type="text"/>			Mediterranean			<input type="text"/>		
Colour / Stain	<input type="text"/>			Arctic White			<input type="text"/>		
Surround	<input type="text"/>			n/a			<input type="text"/>		
Hearth	<input type="text"/>			**raised hearth**			<input type="text"/>		

Comment

Scheduled Closing Date: Thursday, March 4, 2021

Purchasers: Alberto Francesco Puchiele & Annamaria V. Obel Property: 101 of Plan -

Telephone Res. / Bus: /

Project: Pine Valley Forevergreen - Phase 1

Decor Advisor: Laura Di Pede

Model and Elevation: 40.00 A BRIARWOOD

8. Trim Carpentry

Interior Doors *Roman Front Door Glass Inserts Standard Door Handles *Halifax satin nickel

Interior Trim *Board 1 - 3-1/2" casing + 7-1/4" baseboard

Comment

*Hinges: steeple satin nickel

9. Plaster Mouldings and Medallions

Standard Throughout Yes No N/A

Entrance Vestibule	<input type="text"/>	<input type="text"/>	Kitchen/Breakfast	<input type="text"/>	<input type="text"/>
Main Hall	<input type="text"/>	<input type="text"/>	Den/Library	<input type="text"/>	<input type="text"/>
Living Room	<input type="text"/>	<input type="text"/>	Lower Landing	<input type="text"/>	<input type="text"/>
Dining Room	<input type="text"/>	<input type="text"/>	Other Room - Specify	<input type="text"/>	<input type="text"/>
Family Room	<input type="text"/>	<input type="text"/>		<input type="text"/>	<input type="text"/>

Comment

10. Railings and Spindles

Railing Package *Package D

Railing Colour *Havana

Stringer / Riser *Havana

Spindle Colour *Black

Treads *Havana

Comment

Oak Stairs Yes No N/A

11. Wall Paint / Ceilings

Throughout Finished Areas Warm Grey

Trim Paint White

Smooth Ceilings

Ground Floor

Second Floor

Note

Comment

*** NOTE: This is not an approved document. Document must be locked ***

Scheduled Closing Date: Thursday, March 4, 2021

Purchasers: Alberto Francesco Puchiele & Annamaria V. Obel Property: 101 of Plan -

Telephone Res. / Bus: /

Project: Pine Valley Forevergreen - Phase 1

Decor Advisor: Laura Di Pede

Model and Elevation: 40.00 A BRIARWOOD

12. Electrical

Hood Fan White Stainless N/A

Above Kitchen Cabinet Light Yes No

Below Kitchen Cabinet Light Yes No

Standard Appliances

Over The Range Microwave

Chimney Style Fan

Comment

13. Heating and Air Conditioning

Air Conditioning

Gas Provisions Stove

Gas Provisions Dryer

Gas Provisions Barbecue

Comment

14. Additional Comments

15. Disclaimers and Notes

- 1) Colours of all materials are as close as possible to builder's selection, but not necessarily identical due to variances in manufacturing.
- 2) Any extras listed above are null and void unless accompanied by a separate invoice/amendment. Said invoice must be paid in full.
- 3) The Purchaser acknowledges that after Interior Colour Selection form is signed and dated, no further changes will be permitted other than re-selection due to unavailability. _____ Purchaser's Initials
- 4) The Purchaser acknowledges reading and accepting the "Gold Park Homes Decor Centre Disclaimers" form. This document contains other miscellaneous disclaimers.

This Interior Colour Selection is final and approved by:

Signature:  _____ Date: _____

PV-101
July 9 2020

[Signature]
PV-101

September 15 2020

THIS PLAN SHOWS
OPT G/F LAYOUT

REAR DECK
10x18' approx.
w/ Glass
Railing

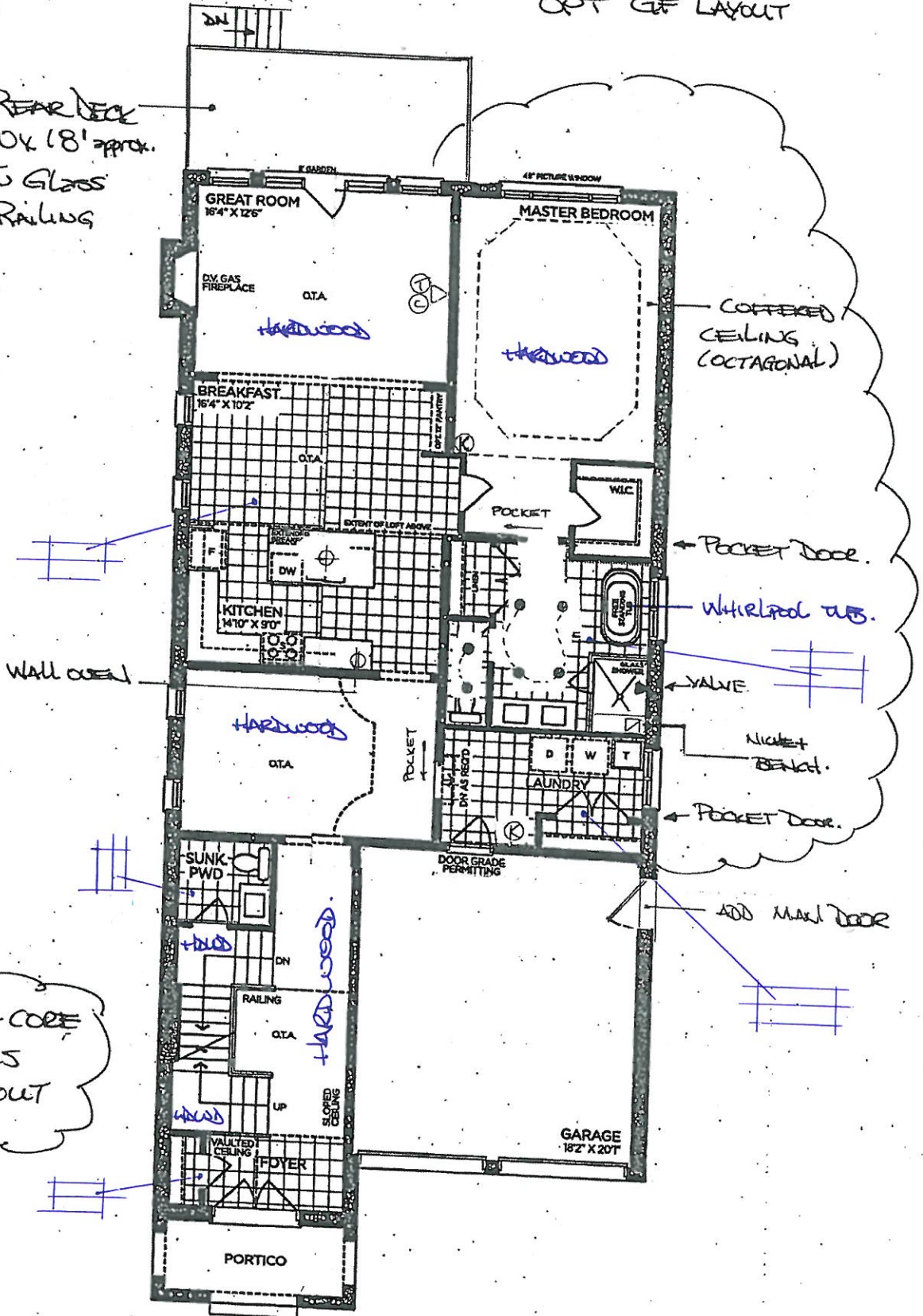

Solid-Core
Doors
Thru Out

GROUND FLOOR | ELEV. A

VENDOR

PURCHASER

PURCHASER

GOLDPARK
WORTH MORE™

Prices, figures, illustrations, sizes, features and finishes are subject to change without notice. Areas and dimensions are approximate and actual usable floor space may vary from the stated area. Layout may be reverse of the unit purchased. E. & O.E. 4000

2
SCHEDULE 'F'



AV-101
July 9 2020

September 15, 2020

(Handwritten initials and signatures)

The Briarwood

40' SERIES

→ Elevation A • 2,870 sq.ft.
Elevation B • 2,860 sq.ft.

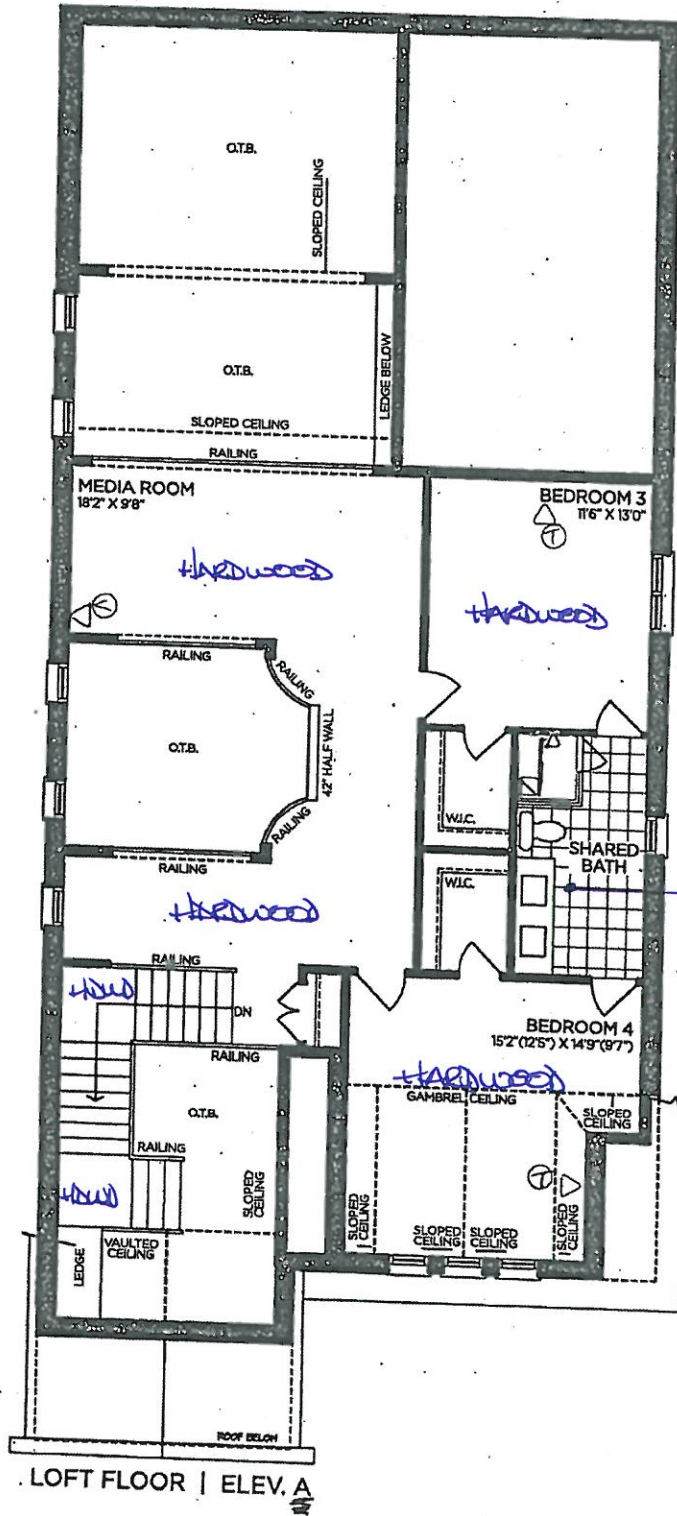

LOFT FLOOR | ELEV. A

VENDOR

PURCHASER

PURCHASER

GOLDPARK
WORTH MORE™

Prices, figures, illustrations, sizes, features and finishes are subject to change without notice. Areas and dimensions are approximate and actual usable floor space may vary from the stated area. Layout may be reverse of the unit purchased. E. & O.E. 4000

SCHEDULE 'F'



PV-101
July 9 2020

September 15 2020

[Handwritten signatures and initials]

The Briarwood

40' SERIES

→ Elevation A • 2,870 sq.ft.
Elevation B • 2,860 sq.ft.

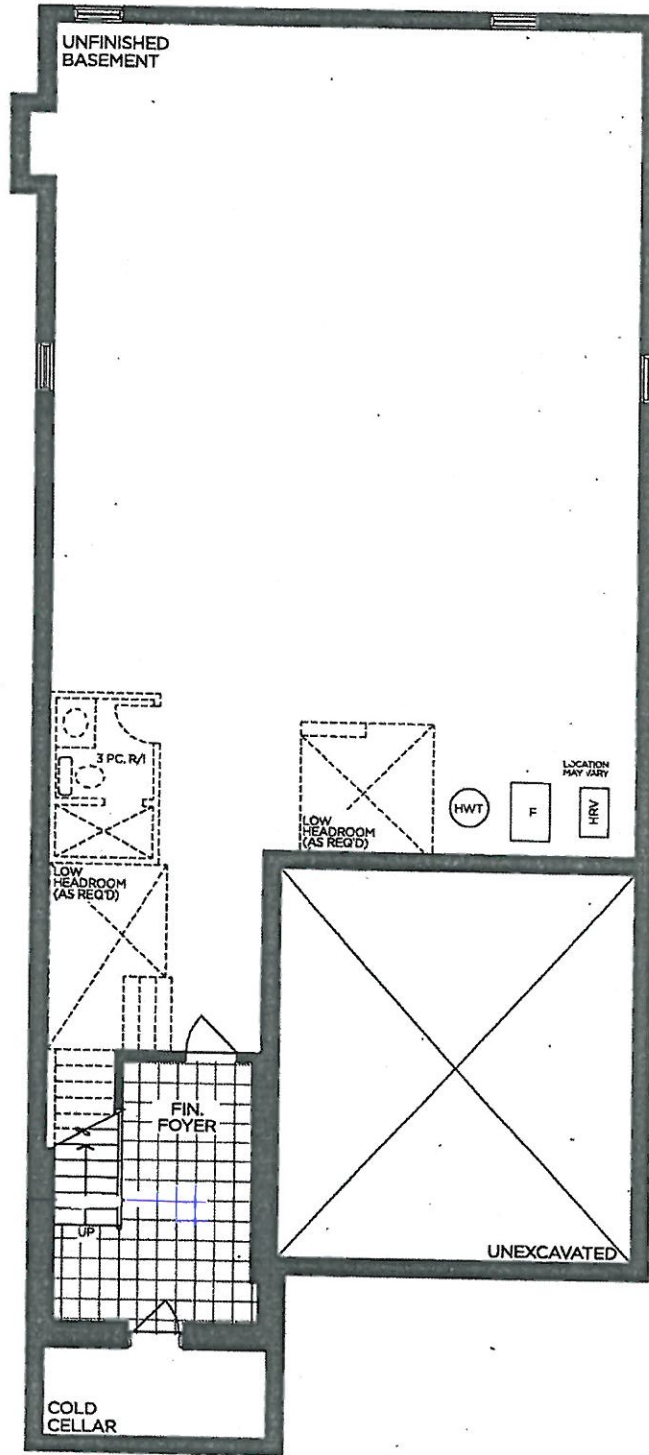

BASEMENT | ELEV. A & B

VENDOR

PURCHASER

PURCHASER

GOLDPARK

WORTH MORE™

Prices, figures, illustrations, sizes, features and finishes are subject to change without notice. Areas and dimensions are approximate and actual usable floor space may vary from the stated area. Layout may be reverse of the unit purchased. E. & O.E. 4000

PN-101

OPT. BREAKFAST PANTRIES
Cab: SA-BRILL
CHERRY 'PARLEY'
HAWK: BH 081-03
PINE VALLEY

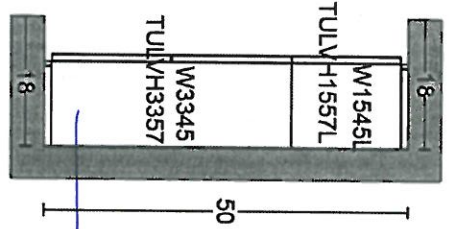

18" deep pantries

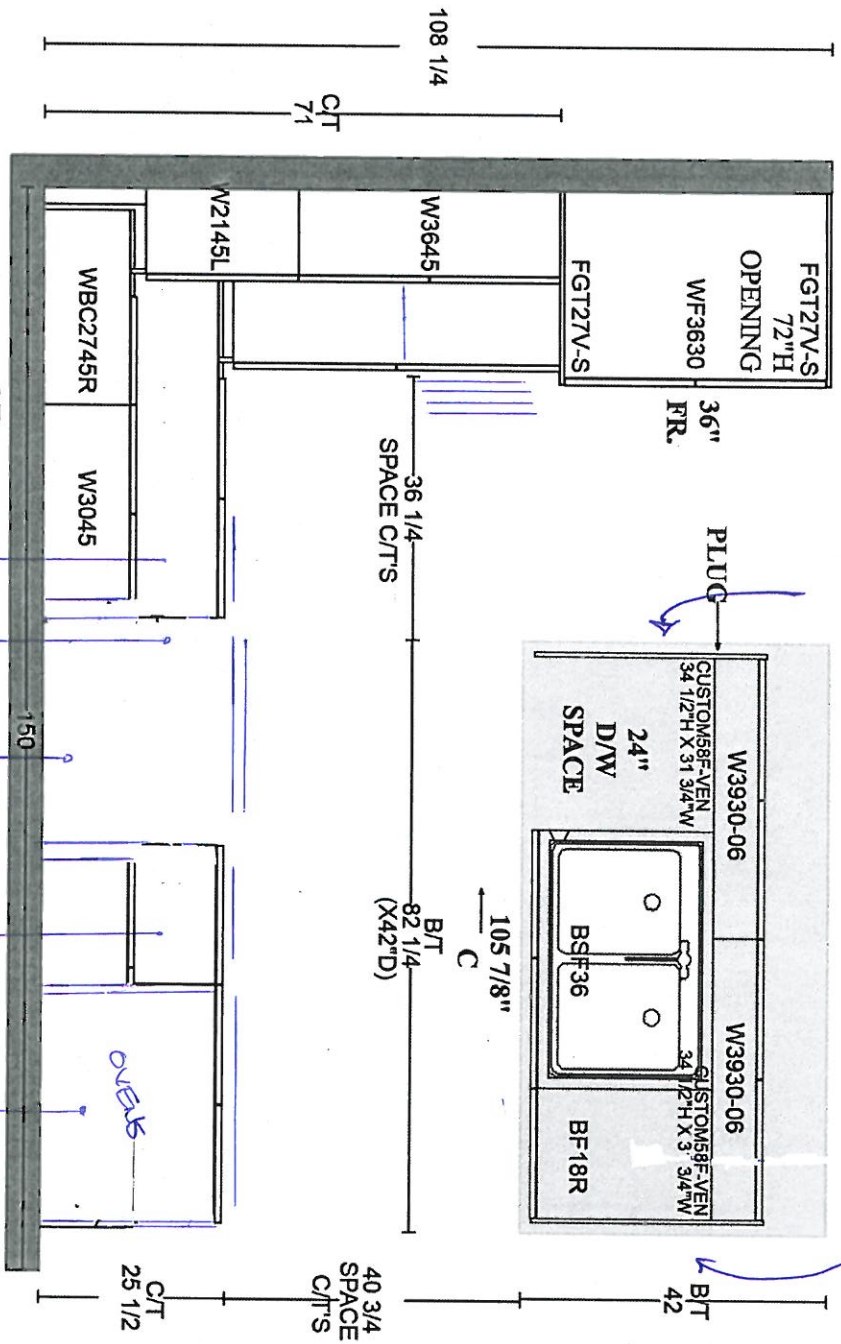

(LARGE DUMMY)

(LARGE DUMMY)

2-TIER SPIKE
36" COOKTOP + POTS below
42" space for 36" chiming
2-tier spike
OVERS + POT DRAWER

PLAN VIEW

**GOLDPARK HOMES
PINE VALLEY
VAUGHAN, ONTARIO
MODEL: (4000 OPT.)
BRIARWOOD**

[Signature]
PR-101

2020

SITE STANDARD: WHITE 3/4" EXTENSION
SOFT-CLOSE DRAWERS & SOFT-CLOSE
HINGES TO KITCHEN AREA
10' CEILING - 12"H COFFERED CEILING -
M.H. = 102" + 3/4"H CONTEMPORARY
MOLDING + 5 1/4"H FURRING RAIL
+ LARGE CORNICE MOLDING TO
UNDERSIDE OF BOX

PV-101

~~PV-101~~
2020.

**GOLDPARK HOMES
PINE VALLEY
VAUGHAN, ONTARIO
MODEL: (4000) BRIARWOOD**

SITE STANDARD: WHITE 3/4" EXTENSION
SOFT-CLOSE DRAWERS & STANDARD SLAM DOOR HINGES
TO VANITIES

ONE TOP DRAWER WHERE POSSIBLE THROUGHOUT EACH
VANITY, ONE BANK OF DRAWERS WHERE POSSIBLE
THROUGHOUT EACH MASTER ENSUITE VANITY

S3 - VANITY
STORM GRAY WASTE
E4-081-03

* All Vanities Raised

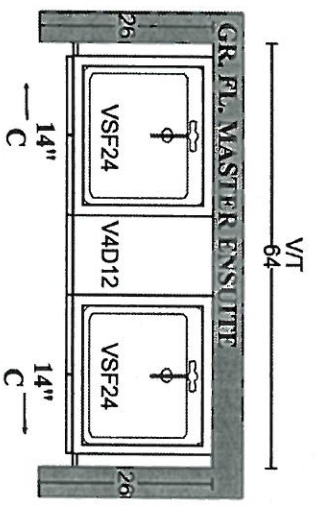

S4 - PACECA

STORM GRAY MAPLE
E4-081-03.

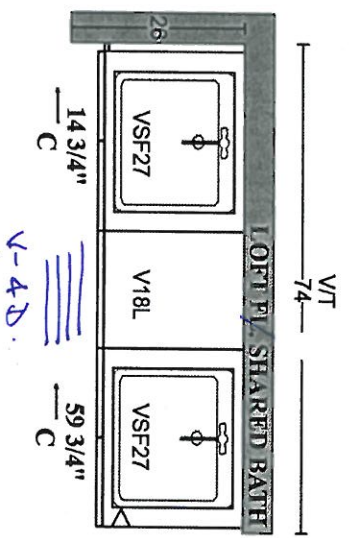
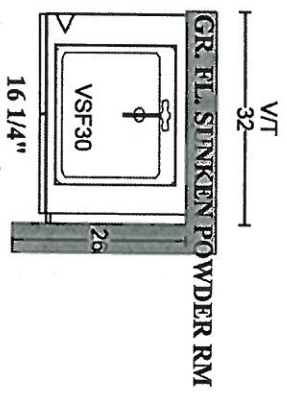

TRIBECA. STELLA
H280-03.

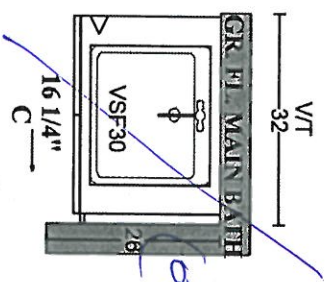

(OPT G.F.)

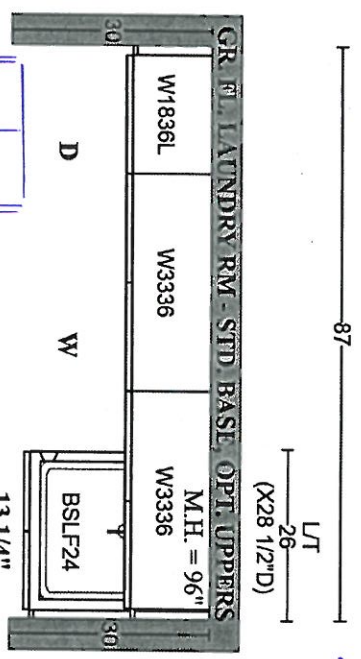

Buany-Elb1
H280-03.

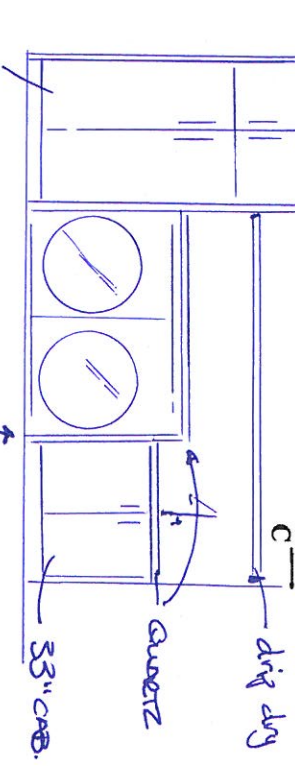

PLAN VIEW



SOLID SURFACE COUNTERTOP EDGE DETAIL

STANDARD - 2CM EDGE

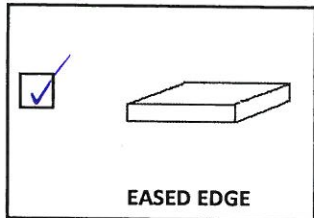

LAUNDRY

LEVEL 1 (UPGRADE) - 2CM EDGE

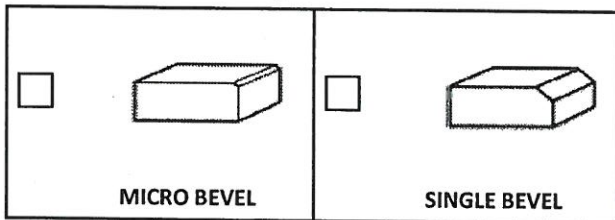

LEVEL 2 (UPGRADE) - 2CM EDGE

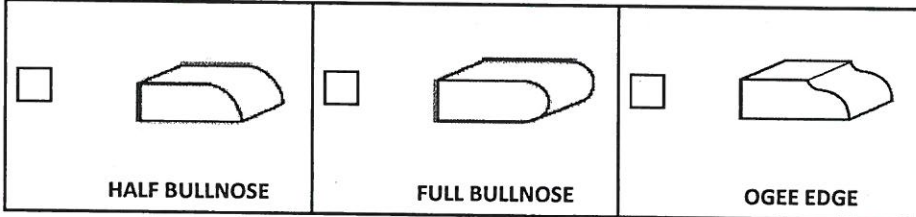

LEVEL 3 (UPGRADE) - 4CM EDGE - SEAMS WILL BE VISIBLE

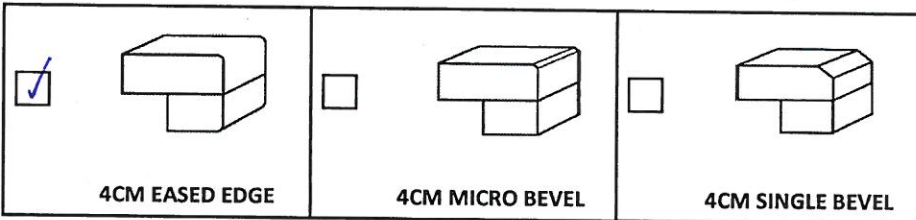

POWDER
KITCHEN
MASTER ENSUITE
SHARED BATH.

LEVEL 4 (UPGRADE) - 4CM EDGE - SEAMS WILL BE VISIBLE

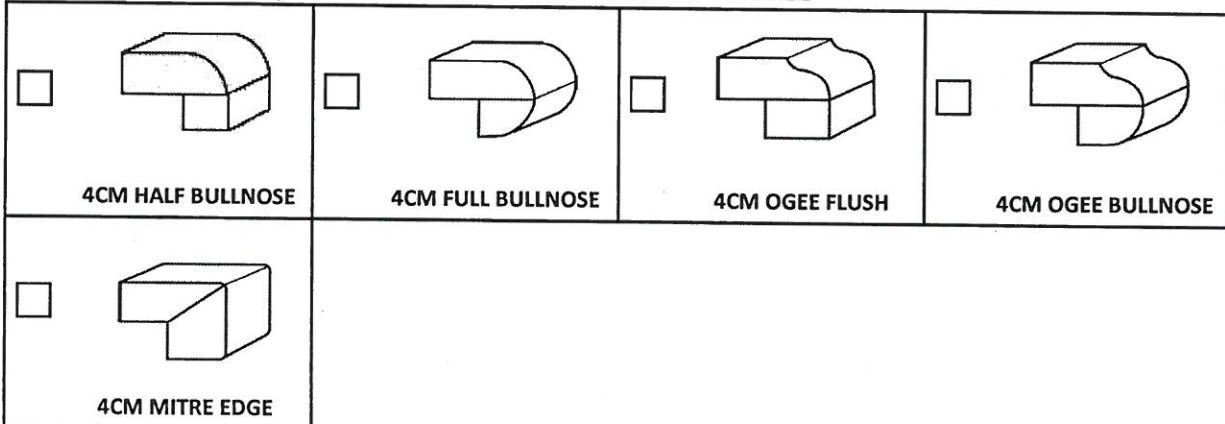

LEVEL 5 (UPGRADE) - 4CM EDGE - SEAMS WILL BE VISIBLE

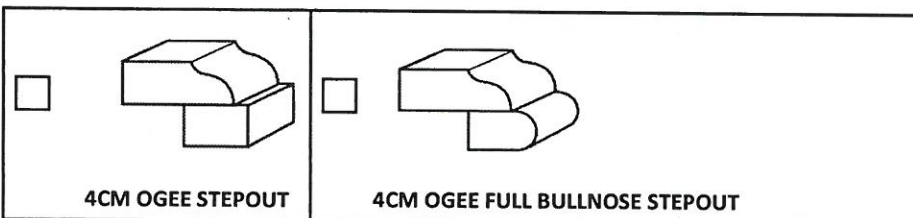

3CM UPGRADE EDGE DETAIL IN LIEU OF 2CM EDGE

LOT #	101
AREA:	
DATE:	September 15, 2020.

SIGNATURE:	
SIGNATURE:	



STANDARD HARDWARE



H001-02



H001-03



H001-04



H009-03



H009-09



H011-03



H011-05



H011-06



H033-01



H039-03 • shared bath
• laundry

LOT #
PV. 101

DATE:
September 15, 2020

SIGNATURE:

SIGNATURE:

UPGRADE HARDWARE

BH-081-03

Brushed Nickel - Pull
160mm C/C

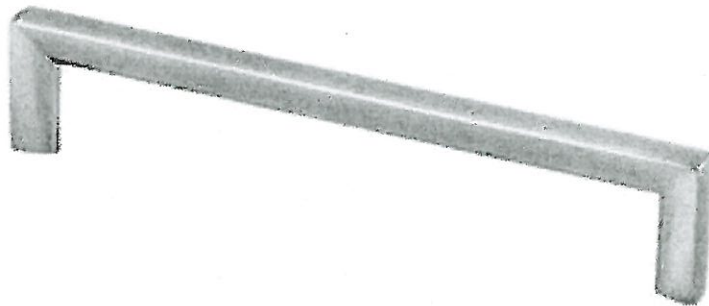



LOCATION:

<ul style="list-style-type: none">• Kitchen• Master Ensuite
--

LOT # 101

DATE: Sept. 16, 2020

SIGNATURE:	
------------	---

SIGNATURE:	
------------	---

UPGRADE HARDWARE

BH-080-03

Brushed Nickel - Pull
128mm C/C

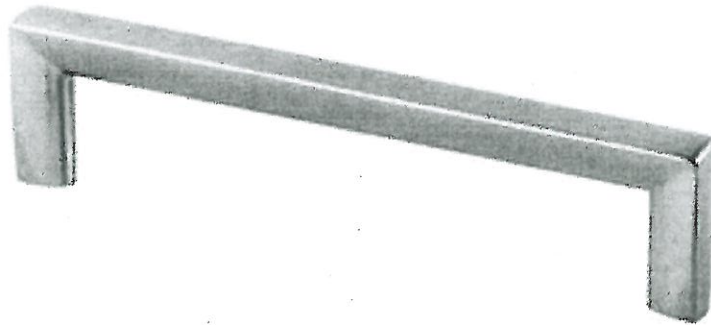

LOCATION:

· Powder Room.

LOT # 101

DATE: Sept. 16, 2020.

SIGNATURE: 

SIGNATURE: 

UPGRADE FAUCET

Moen - NIO

One Handle Pulldown Kitchen Faucet

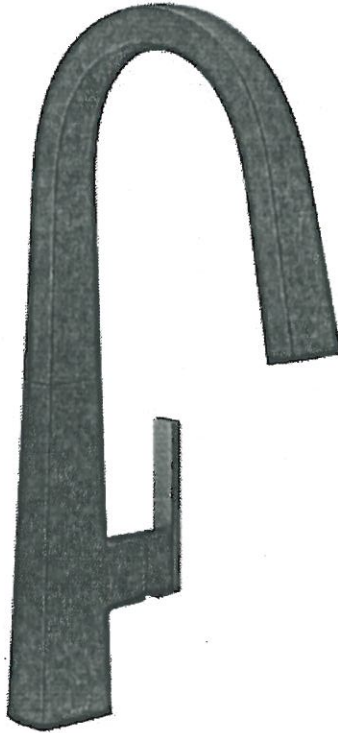

- CHROME
- MATTE BLACK / BRUSHED GOLD
- SPOT RESISTANT STAINLESS

MODEL S75005 Chrome / S75005BL Matte Black / S75005SRS Spot Resistant Stainless

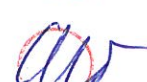
LOT # PV-101	ROOM: Kitchen	DATE: September 15 2020
SIGNATURE: 		
SIGNATURE: 		



PINE VALLEY
FOREVERGREEN

UPGRADE KITCHEN SINK

BLANCO - QUATRUS R15 U 1-3/4
Stainless Steel - Undermount
33" x 18" x 9"

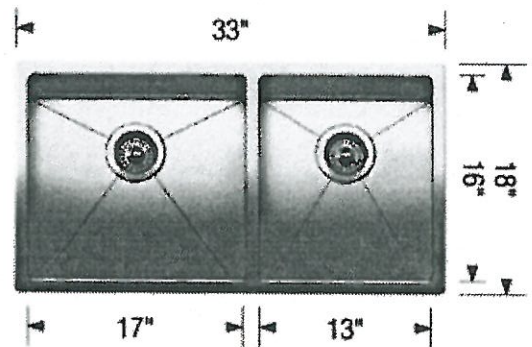
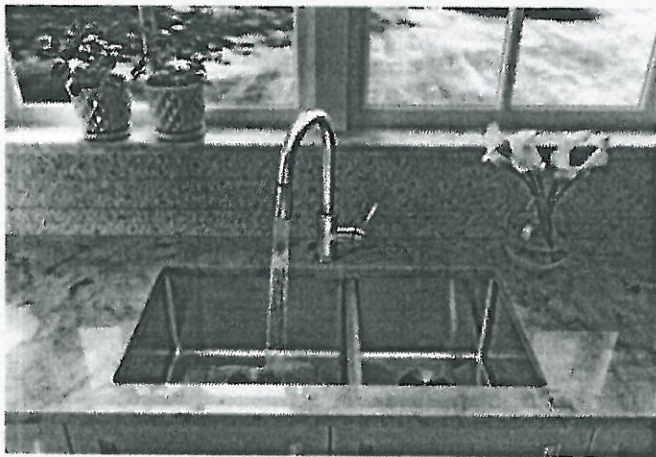
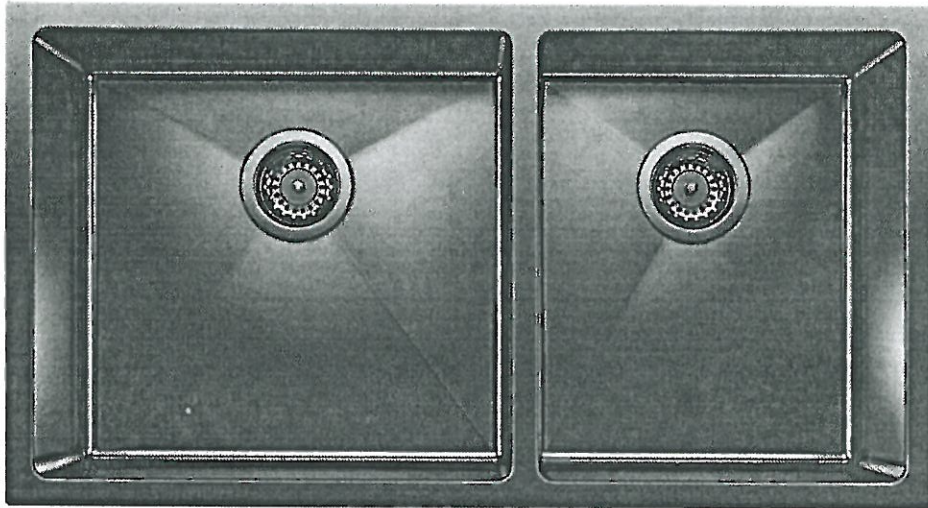

Stainless Steel

GRID (LB)

GRID (SB)

MODEL 401520 Stainless Steel / 406451 Grid (LB) / 406450 Grid (SB)

Lot#
PV-101

Room:
Kitchen

Signature:

Date:
September 15 2020

Signature:



PLUMBING UPGRADES

TWO HANDLE ADJUSTABLE WIDESPREAD (8"-16") LAV FAUCET
WITH DRAIN ASSEMBLY

MOEN - ARRIS

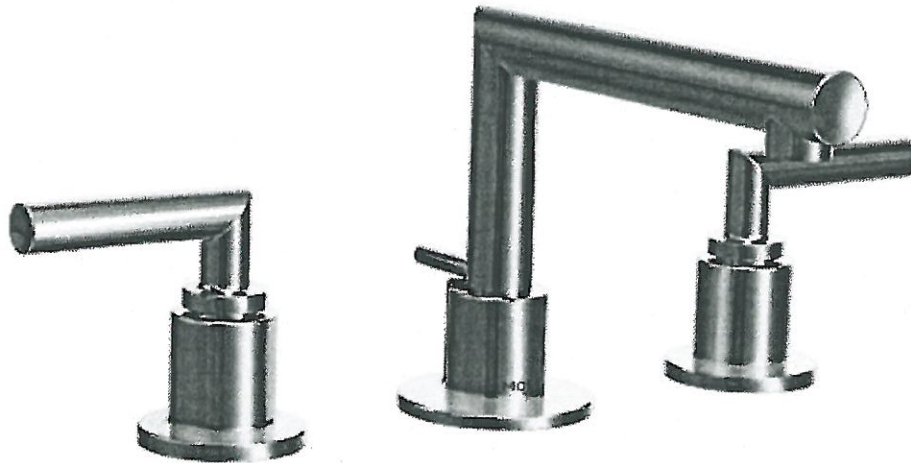

- CHROME
- BRUSHED NICKEL
- MATTE BLACK

MODEL TS43002 / 69000

Lot# PV-101	
Room: Powder Room	Signature:
Date: September 15 2020	Signature:



UPGRADE TOILET

CONTRAC - KIERA

1 Piece Elongated Bowl w/ concealed skirted trapway

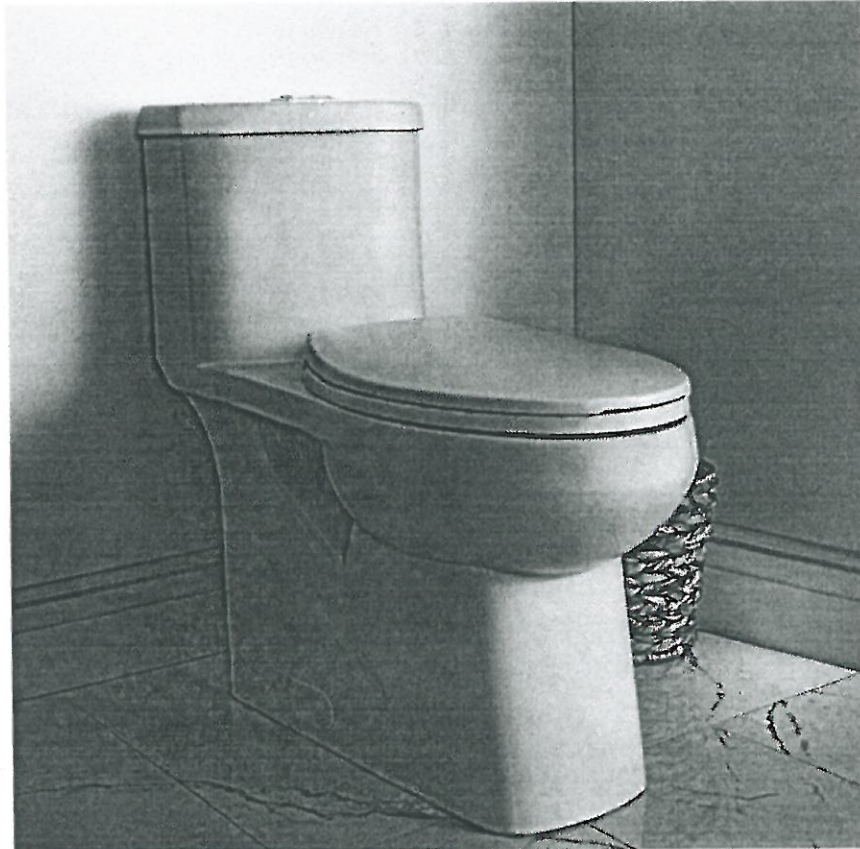

Soft White

17" plus height for greater comfort
White and chrome top push button

15" W x 28 1/2" D x 30 1/8" H

MODEL 4710BNWU

LOT # 101	ROOM: • Master Ensuite: Powder / Shared Bath.	DATE: September 15 2020
SIGNATURE:		
SIGNATURE:		



UPGRADE FAUCET

Moen - FLARA

Two-Handle High Arc Bathroom Faucet

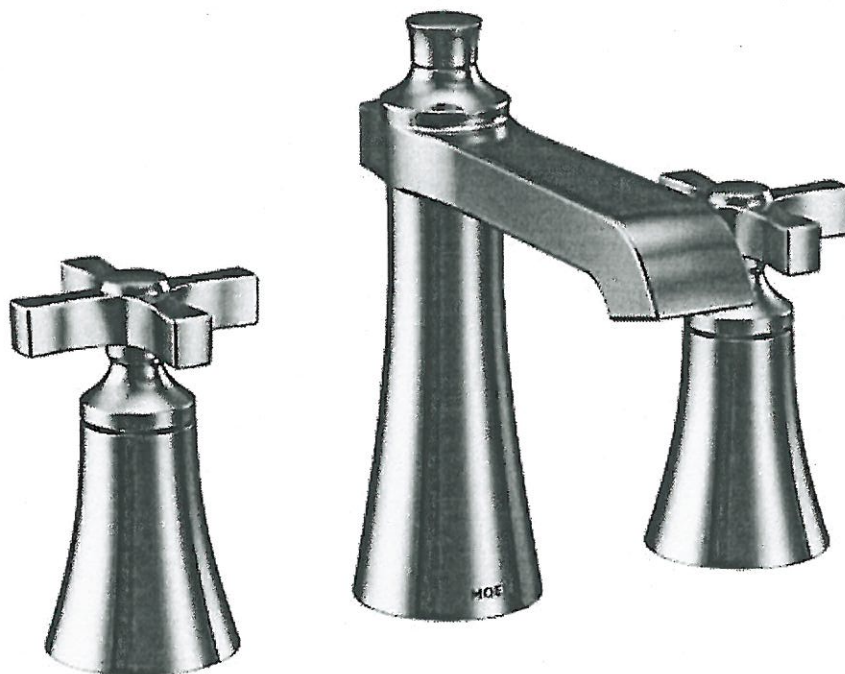

- CHROME
- POLISHED NICKEL
- BRUSHED NICKEL
- BRUSHED GOLD

MODEL TS6985 Chrome / TS6985NL Polished Nickel / TS6985BN Brushed Nickel / TS6985BG
Brushed Gold

LOT # 101	ROOM: Master Ensuite (x2.)	DATE: September 15 2020
-----------	-------------------------------	-------------------------

SIGNATURE:

SIGNATURE:



TUB UPGRADES

Maax Tubs - JAZZ
Free-Standing w/ JET

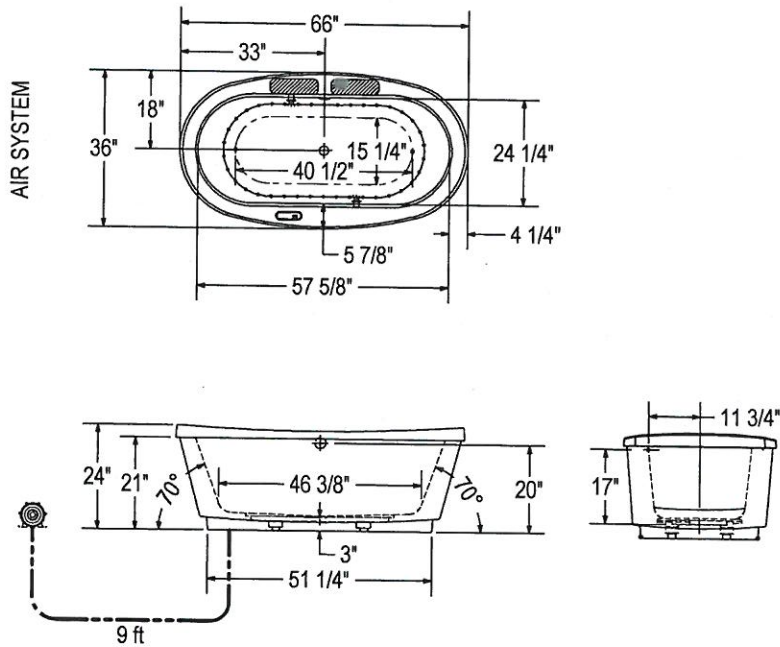
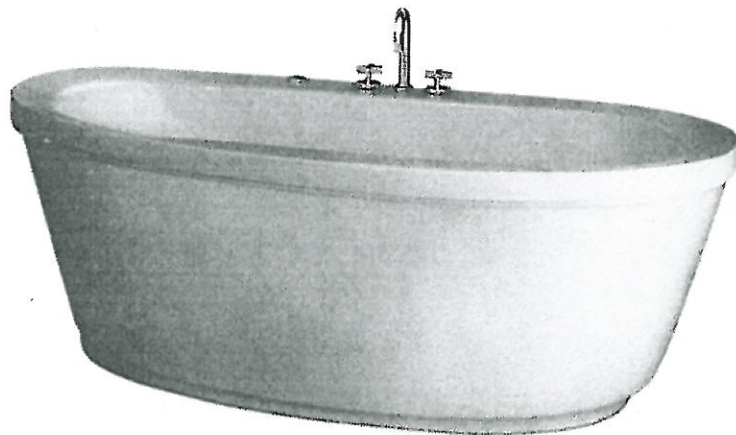

Lot#
PV-101

Room:
Master Ensuite

Signature:

Date:
September 15 2020

Signature:

Moen - FLARA

Posi-Temp Shower Faucet ONLY w/ 3 Function Transfer Valve/Trim &
Slide Bar w/ Hand Shower



CHROME

POLISHED NICKEL

BRUSHED NICKEL

BRUSHED GOLD

From WALL

From CEILING
Ceiling Shower Arm:
Chrome

MODEL TS2912EP Chrome / TS2912EPNL Polished Nickel / TS2912EPBN Brushed Nickel /
TS2912EPBG Brushed Gold / 62380 / 3372 / TS4912 / 3558EP / A725 / 151380

LOT # 101

ROOM: MASTER
ENQUITE

DATE: September 15 2020

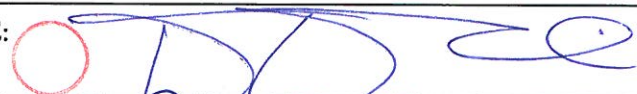
SIGNATURE: 

SIGNATURE: 



PLUMBING UPGRADE

Moen - FLARA

Deck-mounted Tub Filler and Handshower



- CHROME
- POLISHED NICKEL
- BRUSHED NICKEL
- BRUSHED GOLD

MODEL TS929 Chrome / TS929NL Polished Nickel / TS929BN Brushed Nickel / TS929BG Brushed Gold / 9797

LOT # 101	ROOM: MASTER ENSUITE	DATE: September 15 2020
SIGNATURE:		
SIGNATURE:		



UPGRADE SHOWER HARDWARE



SQ6X6

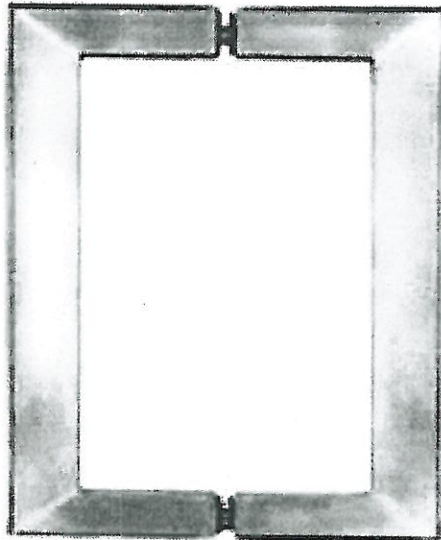

Shower Door Handle



SQ6X6
Shower Door Handle
6" x 6" back-to-back
3/4" square tube
(Also available single sided)

LOT # PV-101	ROOM: Master Ensuite, Shared bath	DATE: September 15 2020
-----------------	--------------------------------------	----------------------------

SIGNATURE:  

SIGNATURE:  



PINE VALLEY
FOREVERGREEN

UPGRADE KITCHEN SINK

BLANCO - QUATRUS R15 U 2
Stainless Steel - Undermount
32" x 18" x 9"

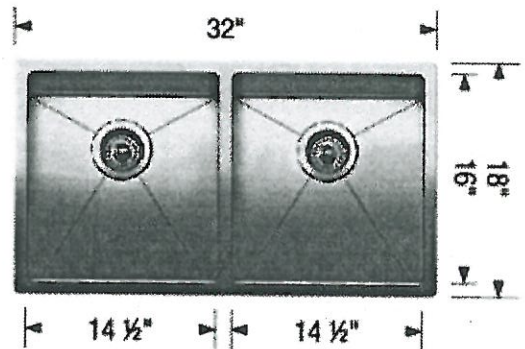
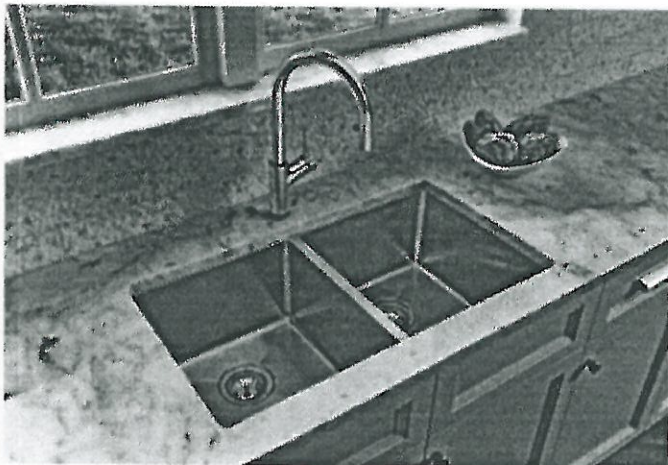
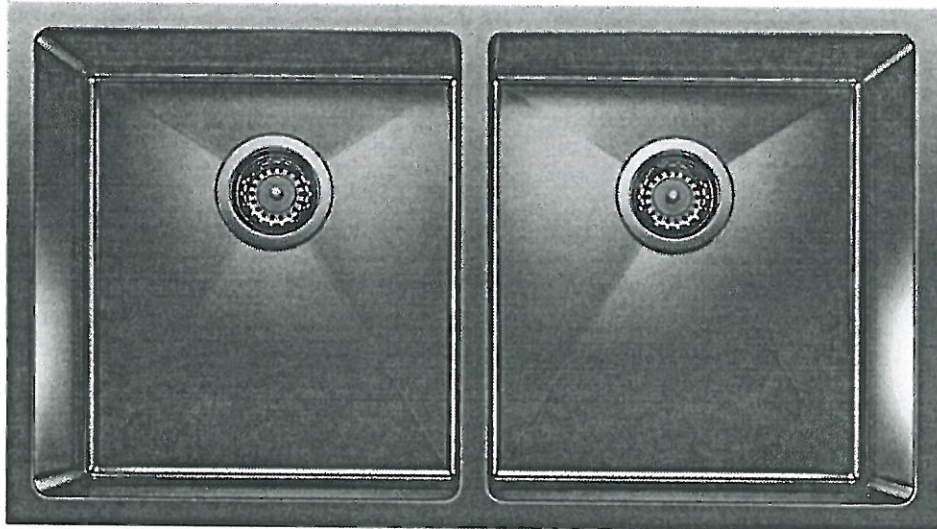

Stainless Steel

GRID

MODEL 401519 Stainless Steel / 406454 Grid

Lot# 101

Room: LAUNDRY ROOM

Signature: *[Handwritten Signature]*

Date: September 15 2020

Signature: *[Handwritten Signature]*

BATHROOM ACCESSORIES



Tissue Holder
Mason - Chrome



Towel Bar
Mason - Chrome

**Please select one:*

INSTALL STANDARD BATHROOM ACCESSORIES THRU OUT
(tissue holder + towel bar) **location as per vendors discretion**

DO NOT INSTALL STANDARD BATHROOM ACCESSORIES
THRU OUT **tissue holder + towel bar will not be provided**

LOT # 101

DATE: September 15, 2020

SIGNATURE: 

SIGNATURE: 



UPGRADE KITCHEN FAUCET

MOEN - SLEEK

One-Handle Pulldown Kitchen Faucet

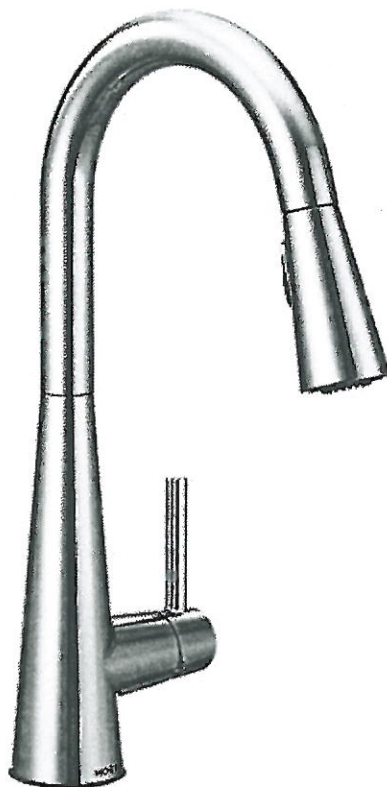

- CHROME
- MATTE BLACK (BL)
- STAINLESS (SRS)

MODEL: 7864 (BL, SRS) Kitchen Faucet

Lot# PV-101	Date: Jan 27, 2021	Room: Laundry
----------------	-----------------------	------------------

Signature: *see attach.*

Signature:



PLUMBING UPGRADES

SHOWER RAIL + VALVE

Annex Shower Rail + Flara Valve



CHROME

MODEL: TS2911 + 2520 Transfer Valve / TS3661NH + S6310 + 164929 + 62320 Shower Rail

Lot#	Date:	Room:
------	-------	-------

Signature: *see attach.*

Signature:

PURCHASER'S EXTRA ORDER
Pine Valley Contractors - Phase 3



PINE VALLEY
FOREVERGREEN

UPGRADE KITCHEN FAUCET

MOEN - SLEEK

One-Handle Pulldown Kitchen Faucet

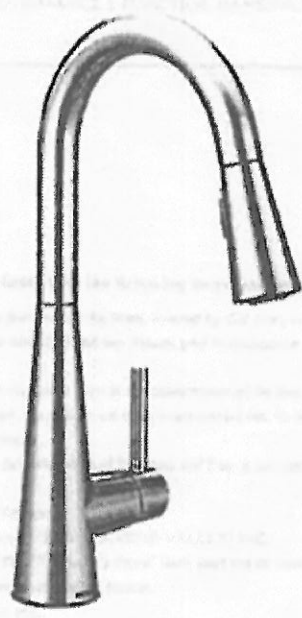

- CHROME
- MATTE BLACK (BL)
- STAINLESS (SRS)

MODEL: 7864 (BL, SRS) Kitchen Faucet

Lot# PY-101	Date: Jan 27, 2021	Room: Laundry
Signature: <i>[Handwritten Signature]</i>		
Signature: <i>[Handwritten Signature]</i>		

GOLDPARK

GOLD PARK



PINE VALLEY

FOREVERGREEN

PLUMBING UPGRADES

SHOWER RAIL + VALVE

Annex Shower Rail + Flara Valve

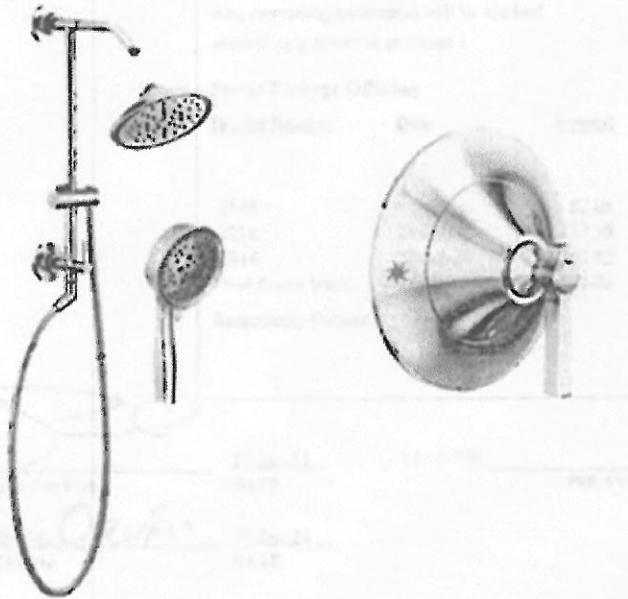

CHROME

MODEL: TS2911 + 2520 Transfer Valve / TS3661NH + S6310 + 164929 + 62320 Shower Rail

Lot# PY-101	Date: Jan 27, 2021	Room: Master Ensuite
----------------	-----------------------	-------------------------

Signature:

Signature:

GOLD PARK
WORTH ABSTRACT

PREPARED BY: [Faint text]
DATE: [Faint text]

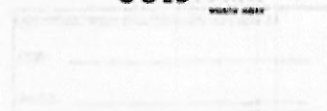

PV-Lol
Sept. 15, 2020

300 / 500 Series 36" Chimney Wall Hoods



36" 300 Series
Pyramid Canopy Chimney Hood
HCP36E52UC

- 300 CFM
- ENERGY STAR® Qualified
- 2 LED Lights
- Aluminum Mesh Filters
- 9 ft.–11.5 ft. Duct Cover Extension Accessory



36" 500 Series
Pyramid Canopy Chimney Hood
HCP56652UC

- + 600 CFM
- + 2 LED Lights
- + Home Connect
- Aluminum Mesh Filters
- 9 ft.–11.5 ft. Duct Cover Extension Accessory



36" 500 Series
Box Canopy Chimney Hood
HCB56651UC

- + 600 CFM
- + 2 Halogen Lights
- + Stainless Steel Filters with Metal Latch
- 9 ft.–11.5 ft. Duct Cover Extension Accessory

+ Indicates a step-up feature

36" Pyramid Canopy 300 Series	36" Pyramid Canopy 500 Series	36" Box Canopy 500 Series
Stainless Steel – HCP36E52UC	Stainless Steel – HCP56652UC	Stainless Steel – HCB56651UC

General Properties			
Operating mode	Convertible: ducted / recirculating	Convertible: ducted / recirculating	Convertible: ducted / recirculating
Maximum CFM	300 CFM	600 CFM	600 CFM
Sones	5.5 HS / 1.3 WS	10.8 HS / 2.5 WS	8.6 HS / 1.7 WS
Number of speed settings	3-stage	4-stage	4-stage
Motor location	Integrated motor in hood chimney	Integrated motor in hood chimney	Integrated motor in hood chimney
Number and type of lights	2 LED	2 LED	2 Halogen
Light lumens	500	100 – 150	360
Light color (°K)	3000	3500 – 4000	3000
Total power of the lamps (W)	13 W	3 W	80 W
Damper included	Yes	Yes	Yes
Grease filter material	Aluminum	Aluminum	Washable stainless steel
Grease filter type	Multilayer cassette	Multilayer cassette	Multilayer cassette
Technical Details			
Volts (V)	120 V	120 V	120 V
Frequency (Hz)	60 Hz	60 Hz	60 Hz
Plug type	No plug	No plug	No plug
Dimensions & Weight			
Overall appliance dimensions (width of canopy included) (HxWxD) (in.)	24 9/16" – 38 7/8" / 28 1/4" – 42 9/16" x 36" x 19 11/16"	25" – 39 1/2" / 29" – 43 1/2" x 36" x 19 11/16"	27 1/16" x 42 1/8" / 27 1/16" x 45 13/16" / 36" x 19 11/16"
Height of the chimney (in.)	19 9/16" – 33 7/8" / 23 1/4" – 42 9/16"	19 9/16" – 33 7/8" / 23 1/4" – 42 9/16"	25 1/2" x 40 9/16" / 25 1/2" x 44 1/4"
Required distance above cooktop / range cooking surface	Min. 24" electric / 27" gas	Min. 30" electric / 30" gas	Min. 24" electric / 27" gas
Diameter of air duct (in.) top	8"	8"	8"
Net weight (lbs)	53 lbs	53 lbs	54 lbs

Optional Accessories



HCPEXT5UC
Chimney extension for 9–11.5 ft. ceilings for use with HCP36E52UC and HCP56652UC



HCBEXT5UC
Chimney extension for 9–11.5 ft. ceilings for use with HCB56651UC



HCIFILTUC
Filter Kit

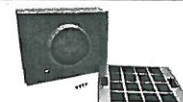

HCREC5UC
Recirculation Kit

300 / 500 Series 36" Chimney Wall Hoods

PV-L01
Sept. 15, 2020
[Signature]

36" HCP36E52UC
 Pyramid Canopy Chimney Hood

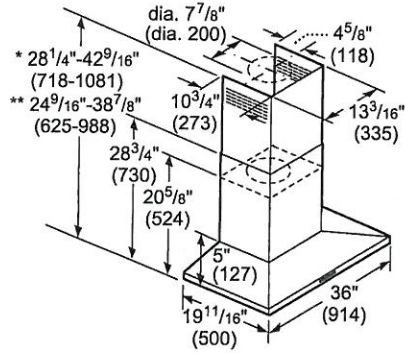

* Recirculating installation
 ** Installation with exhaust air duct
 Installation height above cooking surface:
 24"-34" (610 mm-864 mm) for electric
 27"-34" (686 mm-864 mm) for gas

measurements in inches (mm)

36" HCP56652UC
 Pyramid Canopy Chimney Hood

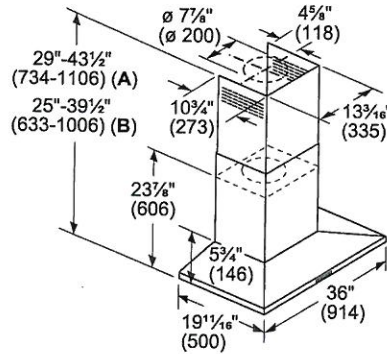

A: Recirculating installation
 B: Ducted installation
 Installation height above cooking surface:
 30"-36" (762 mm-914 mm) to Electric
 30"-36" (762 mm-914 mm) to Gas

measurements in inches (mm)

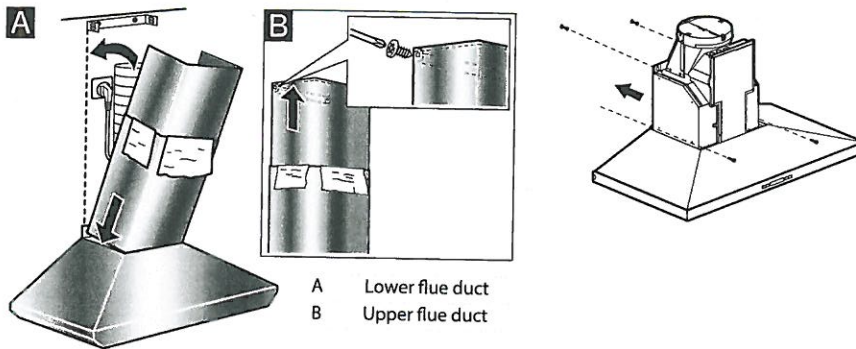

A Lower flue duct
 B Upper flue duct

36" HCB56651UC
 Box Canopy Chimney Hood

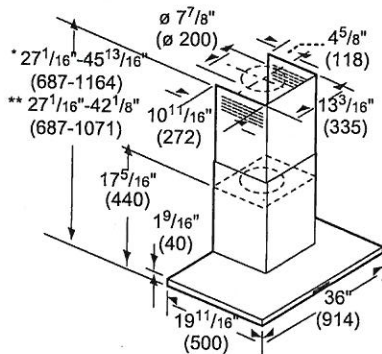

* Recirculating installation
 ** Ducted installation
 Installation height above cooking surface:
 24"-34" (610 mm-864 mm) to Electric
 27"-34" (686 mm-864 mm) to Gas

measurements in inches (mm)

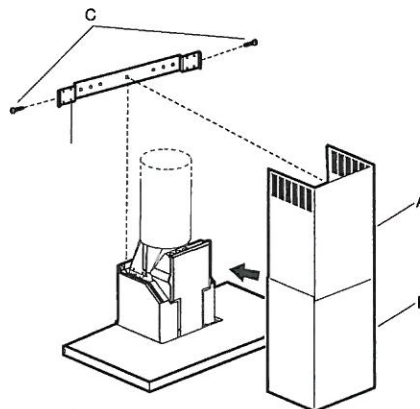

A Upper flue duct
 B Lower flue duct
 C Screws
 D Angle bracket

500 / 800 Series 36" Induction Cooktops

Set *

PV-101
Sept. 15, 2020.

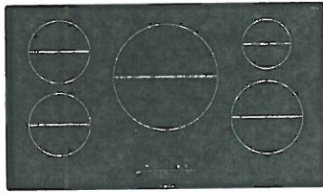

36" 500 Series
NIT5668UC

- 12" Dual-Ring Center Cooking Zone
- 17 Power Levels
- Each Cooking Zone Has an Independent Countdown Timer
- SpeedBoost*



36" 800 Series
NIT8669UC (Frameless)
NIT8669SUC (Frame)

- + AutoChef®
- + Home Connect™
- + Hood Control
- + PreciseSelect® Control
- + Framed and Frameless Options



+ Indicates a step-up feature

	500 Series	800 Series
	Black - NIT5668UC	Black - NIT8669UC Black with Stainless Steel Frame - NIT8669SUC
General Properties		
Home Connect™ (Wi-Fi Enabled)	No	Yes
Controls	Touch	PreciseSelect® Touch
Element Performance		
Power of front left heating element (in boost)	1,800 W (3,100 W)	1,800 W (3,100 W)
Power of back left heating element (in boost)	1,800 W (3,100 W)	1,800 W (3,100 W)
Power of center heating element (in boost)	3,300 / 2,200 W (5,400 / 3,700 W)	3,300 / 2,200 W (5,400 / 3,700 W)
Power of back right heating element (in boost)	1,400 W (2,200 W)	1,400 W (2,200 W)
Power of front right heating element (in boost)	2,200 W (3,700 W)	2,200 W (3,700 W)
Burners with booster	All	All
Element Size		
Dimension of front left heating element	7"	7"
Dimension of back left heating element	7"	7"
Dimension of center heating element	12", 9"	12", 9"
Dimension of back right heating element	6"	6"
Dimension of front right heating element	9"	9"
Technical Details		
Watts	9,600 W	9,600 W
Circuit breaker	40 A	40 A
Volts	208 - 240 V	208 - 240 V
Frequency	60 Hz	60 Hz
Plug type	No plug	No plug
Power cord length	37"	37"
Energy source	Electric	Electric
Dimensions & Weight		
Overall appliance dimensions (HxWxD)	5/16" + 4 1/8" x 37" x 21 1/4"	5/16" + 4 1/8" x 37" x 21 1/4"
Required cutout size (HxWxD)	4 1/8" x 34 7/8" x 20"	4 1/8" x 34 7/8" x 20"
Minimum distance from counter front	2 1/4"	2 1/4"
Minimum distance from rear wall	2"	2"
Net weight	53 lbs	53 lbs

Optional Accessories



HEZ390210
8" AutoChef® pan
for 6" element



HEZ390220
9" AutoChef® pan
for 7" element



HEZ390230
10" AutoChef® pan
for 8" and 9" elements

500 / 800 Series 36" Induction Cooktops

36" Cooktop and Cutout Dimensions

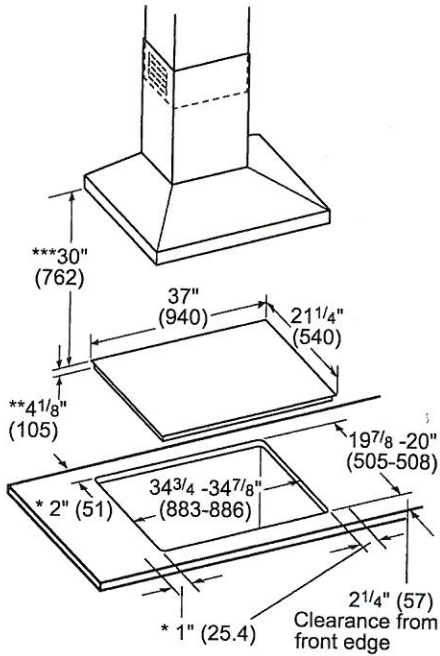

- * Minimum clearance from the cooktop cutout to the wall
- ** Installed depth includes gap of 1" (26 mm) to the ventilation
- *** Minimum clearance between surface of the cooktop and lower edge of the exhaust hood.

measurements in inches (mm)

36" Cooktop Installation Above Wall Oven

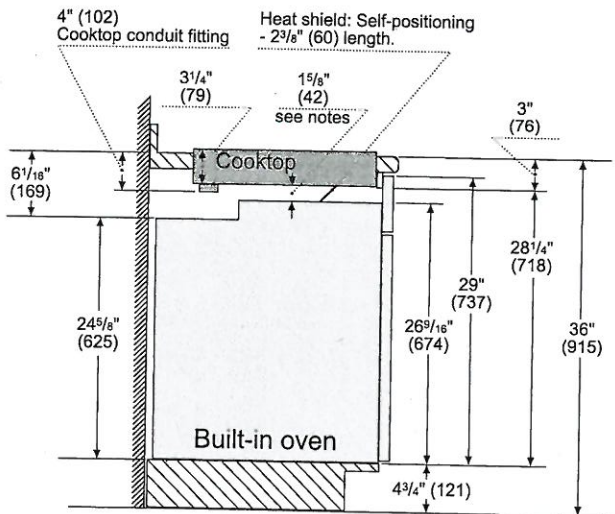

Notes:

Dimensions based on standard countertop height (36" with 4 3/4" toe kick including base plate).

The built-in oven can be installed below the induction cooktop as long as there is a minimum 1" (26) clearance between the bottom of the cooktop and the top of the oven.

PV-101
Sept. 15, 2020.

(Handwritten initials)

Electrical Location

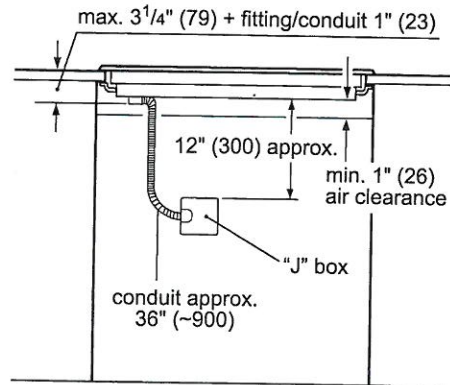

Measurements in inches (mm)

500 / 800 Series Combination Ovens

PV-01
Sept. 15, 2020



- 30" 500 Series**
HBL57M52UC
- 120V Microwave Oven (U)
 - 4.6 cu. ft. (L)
 - European Convection (L)
 - Stainless Steel Knobs (L)



- 30" 800 Series**
HBL87M53UC
- 120V Microwave Oven (U)
 - 4.6 cu. ft. (L)
 - + QuietClose® Door (L)
 - + Extension Rack (L)
 - + Meat Probe (L)
 - + Home Connect (L)
 - + LED Light (U)



- 30" 800 Series**
HBL8753UC
HBL8743UC
- 240V Speed Oven (U)
 - 4.6 cu. ft. (L)
 - + 12 Auto Programs (U)
 - + 1000 W Microwave (U)
 - Home Connect (L)

Black
Stainless Steel

+ Indicates a step-up feature
U=Upper; L=Lower

500 Series	800 Series	800 Series
Stainless Steel – HBL57M52UC	Stainless Steel – HBL87M53UC	Stainless Steel – HBL8753UC Black Stainless Steel – HBL8743UC

General Properties			
Cooking modes – upper cavity	Microwave; 10 Sensor Cooking Programs (Including Baked Potato, Sweet Potato, Fresh Vegetable, Frozen Vegetable, Ground Meat, Fish/Seafood, Brown Rice, White Rice, Frozen Entrées, Reheat), Popcorn, Beverage, Melt/Soften, Defrost	Microwave; 10 Sensor Cooking Programs (Including Baked Potato, Sweet Potato, Fresh Vegetable, Frozen Vegetable, Ground Meat, Fish/Seafood, Brown Rice, White Rice, Frozen Entrées, Reheat), Popcorn, Beverage, Melt/Soften, Defrost	Speed Oven; 12 Auto Programs (Including Auto Defrost, Melt Butter, Soften Ice Cream, Pizza), 9 Sensor Cook Programs, 9 SpeedChef® Programs, Hi & Lo Broil, European Convection, Keep Warm, Frozen Foods
Cooking modes – lower cavity	Bake, Variable Broil (Hi & Low), Roast, Warm, Sabbath, Proof Dough, Convection Bake, Convection Broil, Convection Roast, Pizza, Multi Rack Genuine European Convection, Convection Conversion	Bake, Variable Broil (Hi & Low), Roast, Warm, Sabbath, Proof Dough, Convection Bake, Convection Broil, Convection Roast, Pizza, Multi Rack Genuine European Convection, Convection Conversion, Temperature Probe, Fast Preheat	Bake, Variable Broil (Hi & Low), Roast, Warm, Sabbath, Proof Dough, Convection Bake, Convection Broil, Convection Roast, Pizza, Multi Rack Genuine European Convection, Convection Conversion, Temperature Probe, Fast Preheat
Cleaning type – lower cavity	Self clean	Self clean	Self clean
Telescopic rack	0	1	1
Illumination type	Incandescent (upper and lower)	LED (upper) / Incandescent (lower)	LED (upper) / Incandescent (lower)
Interior lights – upper / lower cavity	1 / 1	1 / 2	1 / 2
Oven Performance			
Microwave power – upper cavity	950 W	950 W	1000 W
Bake / broil element wattages – upper	N/A	N/A	600 / 1,750 W
Convection element wattages – upper	N/A	N/A	1,700 W
Bake / broil element wattages – lower	2,400 / 3,800 W	2,400 / 3,800 W	2,400 / 3,800 W
Convection element wattages – lower	2,000 W	2,000 W	2,000 W
Technical Details			
Watts (W)	9,600 W	9,600 W	9,600 W
Circuit breaker (A)	40 A	40 A	40 A
Volts (V); Frequency (Hz)	240 / 208 V, 60 Hz	240 / 208 V, 60 Hz	240 / 208 V, 60 Hz
Power cord length (in)	50"	50"	50"
Plug type	Fixed connection, no plug	Fixed connection, no plug	Fixed connection, no plug
Energy source	Electric	Electric	Electric
Dimensions & Weight			
Overall appliance dimensions (HxWxD) (in)	49" x 29 3/4" x 24 1/2"	49" x 29 3/4" x 24 1/2"	49" x 29 3/4" x 24 1/2"
Required cutout size – standard (HxWxD) (in)	48 5/8" x 28 1/2" x 23 1/2"	48 5/8" x 28 1/2" x 23 1/2"	48 5/8" x 28 1/2" x 23 1/2"
Required cutout size – flush (HxWxD) (in)	49 1/8" x 30" x 24 1/2"	49 1/8" x 30" x 24 1/2"	49 1/8" x 30" x 24 1/2"
Overall upper oven interior (HxWxD) (in.)	9 7/8" x 16 1/2" x 16 1/2"	9 7/8" x 16 1/2" x 16 1/2"	9 7/8" x 16 1/2" x 16 1/2"
Turntable – glass max. cookware – upper	14 1/8" dia.	14 1/8" dia.	N/A
Turntable – metal max. cookware – upper	N/A	N/A	14 1/8" dia.
Turntable – ceramic tray max. – upper	N/A	N/A	13 3/4" dia.
Rack – rectangular cookware max. – upper	N/A	N/A	15" x 12"
Oven cavity size – upper / lower cavity (cu. ft.)	1.6 / 4.6 cu. ft.	1.6 / 4.6 cu. ft.	1.6 / 4.6 cu. ft.
Overall lower oven interior (HxWxD) (in)	17 13/16" x 24 1/8" x 18"	17 13/16" x 24 1/8" x 18"	17 13/16" x 24 1/8" x 18"
Usable lower oven interior (HxWxD) (in)	12 5/16" x 23 1/4" x 15 1/4"	12 1/4" x 23 1/4" x 15 1/4"	12 1/4" x 23 1/4" x 15 1/4"
Net weight (lbs)	259 lbs	259 lbs	259 lbs

500 / 800 Series Combination Ovens

PV-LO1
 Sept. 15, 2020

Product Dimensions

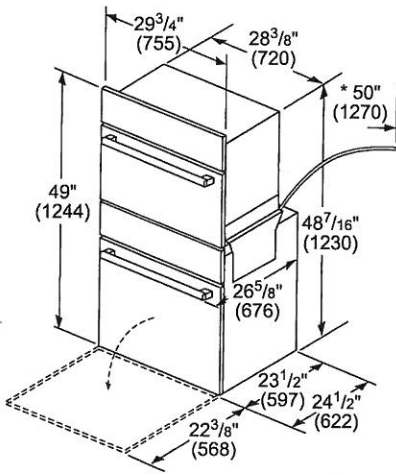

* Power cable 50" (1270 mm) from the lower oven.

Cutout Dimensions

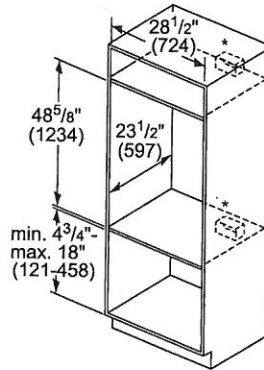

* Junction box may be installed above, below, or to the left or right of the unit within reach of the power cable

measurements in inches (mm)

Flush Installation

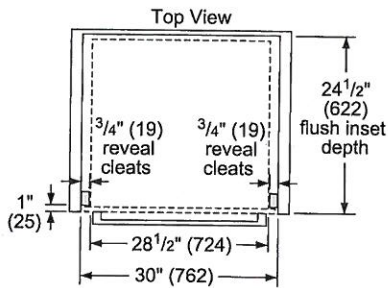

Side View

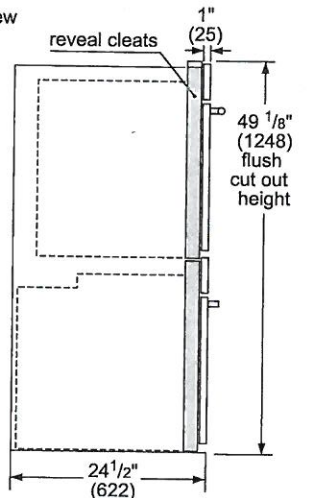

measurements in inches (mm)

NOTE: Bosch combination wall ovens can be installed in combination with other Bosch cooking products. See page 52 for details.

500 Series	800 Series	800 Series
Stainless Steel – HBL57M52UC	Stainless Steel – HBL87M53UC	Stainless Steel – HBL8753UC Black Stainless Steel – HBL8743UC

Accessories – Included

Included	500 Series	800 Series	800 Series
	Upper oven: metal turntable, square rack, ceramic cooking tray; Lower oven: 2 standard oven racks	Upper Oven: Glass Turntable Lower Oven: 1 Telescopic and 2 Standard Oven Racks, Meat Probe	Upper oven: metal turntable, square rack, ceramic cooking tray; Lower oven: 1 telescopic and 2 standard oven racks, meat probe

Optional Accessories



HEZTR301
 30" Telescopic rack

800 Series Freestanding French Door Refrigerator

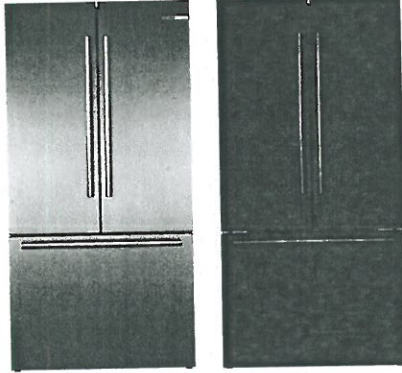

800 Series
 B36CT80SNS (Stainless)
 B36CT80SNB (Black Stainless Steel)
 French Door

- Dual Compressor and Dual Evaporator
- Counter-Depth
- FarmFresh System™
- VitaFreshPro™ Freshness Settings
- Interior Water Dispenser
- FlexBar™ Flexible Storage Bar
- Home Connect™



Pr-L01
 Sept. 15, 2020
 (Handwritten initials and date)

800 Series 36" Counter-Depth

Stainless Steel – B36CT80SNS
 Black Stainless Steel – B36CT80SNB

General Properties

Full 72" height and true counter depth for built-in appearance	Yes
Easy Clean Stainless Steel	Yes
Lighting	Recessed LED light bars
Number of compressors / evaporators	2 / 2
Defrost process refrigerator section	Frost-free
Adjustable glass shelves – refrigerator	4 half-width
Flexible storage bar	FlexBar™
Automatic temp. & humidity controlled drawer	VitaFreshPro™
Water dispenser, freezer ice maker, water filter	Yes (internal), yes, UltraClarityPro™
AirFresh® filter, MultiAirFlow™	Yes, yes
FreshProtect™ ethylene filter	Yes
Stainless steel back wall	Yes
Number of drawers – freezer	3
Wi-Fi enabled	Yes, Home Connect™ app

Capacity

Total capacity (cu. ft.)	20.8 cu. ft.
Refrigerator capacity (cu. ft.)	14.8 cu. ft.
Freezer capacity (cu. ft.)	6.0 cu. ft.

Technical Details

Current (A)	15 A
Volts (V)	115 V
Frequency (Hz)	60 Hz
Power cord length (in.)	91"
Plug type	120V-3 prong

Dimensions & Weight

Appliance dimensions with hinges, handles and doors (HxWxD) (in.)	72** x 35 5/8" x 31 1/8"
Appliance dimensions without hinges and doors (HxWxD) (in.)	71 1/2" x 35 5/8" x 24****
Appliance dimensions with hinges and doors, no handles (HxWxD) (in.)	72** x 35 5/8" x 28 3/4"
Required cutout size (HxWxD) (in.)	72" x 36" x 25"
Net weight (lbs)	350 lbs

Efficiency

ENERGY STAR® qualified	Yes – Tier 1
Energy consumption (kWh / yr)	570 kWh

*When leveling legs are fully extended, add 5/8" to overall height, total 72 5/8".
 **The cutout depth of 25" includes the required 1" airflow. The electrical covers on the back of unit do not require additional depth.

800 Series Freestanding French Door Refrigerator

36" Freestanding Dimensions

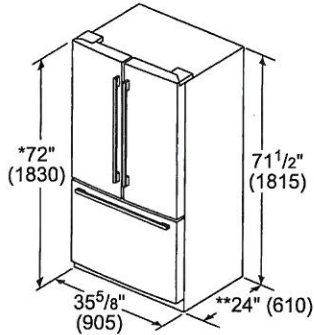

*Add 5/8" (17) with front levelling feet fully extended
 **Add 1" (25) for fixed spacers on back measurements in inches (mm)

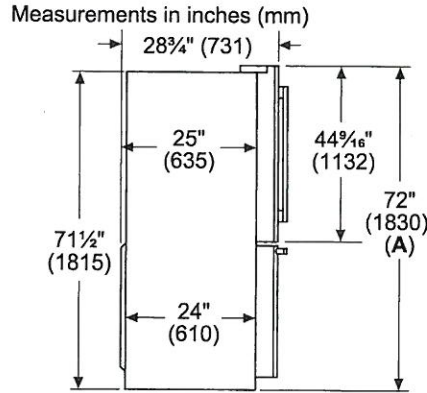

A: Add 5/8" (17) with front levelling feet fully extended

PV-101
Sept. 15, 2020

36" Freestanding Dimensions (Overhead Views)

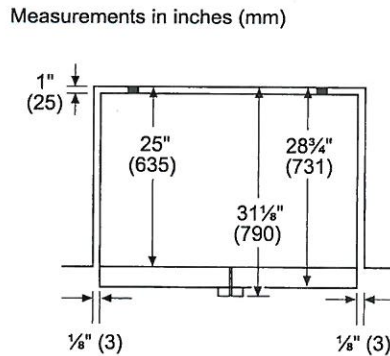
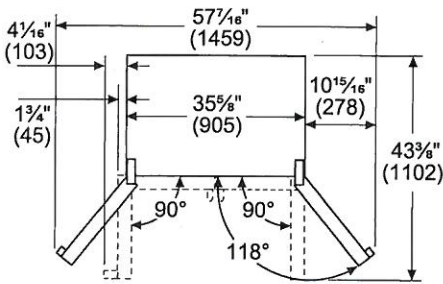

Drawers can be pulled out with door open to 90°. Drawers can be taken out with door completely opened.

36" Freestanding Installation

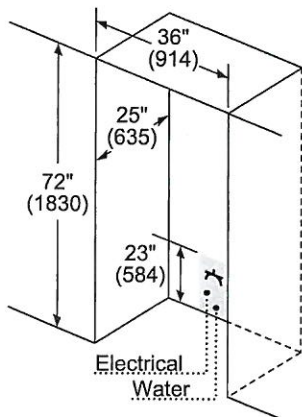

Leave 1/2" (12.7) gap at the top and 1" (25.4) behind the refrigerator for proper ventilation. It is recommended that you do not install the refrigerator near a heat source such as an oven or a range. Maximum receptacle and waterline height 23" (584).

measurements in inches (mm)

Accessories

BORPLFTR50 UltraClarityPro™ Water Filter	BOETHSCV10 FreshProtect™ Ethylene Filter Kit	BOFRSRF FreshProtect™ Ethylene Filter Refill	BOFLEXBOTL FlexBar™ Bottle Holder	BOFLEXLGSB FlexBar™ Deep Shelf	BOFLEXSMBSH FlexBar™ Shallow Shelf	BOFLEXEGG FlexBar™ Egg Tray
--	--	--	---	--------------------------------------	--	-----------------------------------

800 Series Dishwasher



- 800 Series with Home Connect™
- SHEM78ZH5N
- 42 dBA
- Flexible 3rd Rack
- + Home Connect™
- + 24/7 AquaStop® Plus
- CrystalDry™

PV-001
 Sept. 15, 2020.
 JF WA

+ Indicates a step-up feature

800 Series with Home Connect™

Recessed Handle – SHEM78ZH5N

General Properties

Number of wash cycles / options	6 / 6
dBA	42
Drying system	CrystalDry™
Third rack	Flexible 3rd rack
Rack adjustability	RackMatic®
Tub material	Stainless steel
Control type	Touch control
Concealed water heating element	Yes
Leak protection system	24/7 AquaStop® Plus
Water softener	No
Five-level wash	Yes
ChildLock	No
InfoLight®	No
Special features	Home Connect™ (WiFi enabled)

Efficiency and Capacity

Water usage per cycle	3.5
Energy efficiency class	Tier 1
ENERGY STAR® qualified	Yes
Total annual energy / water consumption	269 kWh / 623.5 g
Number of place settings	16

Technical Data

Watts (W)	1440 W
Current (A) / Volts (V) / Frequency (Hz)	12 A / 120 V / 60 Hz
Power cord length	67"
- Install length from corner of unit	45"
Minimum water pressure (lb / sin)	14
Length outlet hose (in)	79"

Dimensions & Weight

Overall appliance dimensions (HxWxD) (in)	33 7/8" x 23 9/16" x 23 3/4"
Required cutout size (HxWxD) (in)	33 7/8" x 23 5/8" x 24"
Adjustable feet	Yes
Net weight (lbs)	102 lbs

Optional Accessories

SMZPCJB1UC Junction Box	SMZSH002UC Bosch Dishwasher Water Supply Hose	SGZ1010UC Drain Hose Extension 76 3/4"	SMZ5000 Accessory Kit: Extra Tall Item Sprinkler, Vase and Bottle Holder, 3 Plastic Item Clips and Small Item Basket	SMZ5002UC Anti-Tarnish Silverware Cassette	SMZEP001UC Edge Protector
----------------------------	---	--	---	--	------------------------------

800 Series Dishwasher

Pr-LO1
Sept. 15, 2020.
gh

Dimensions and Cutout

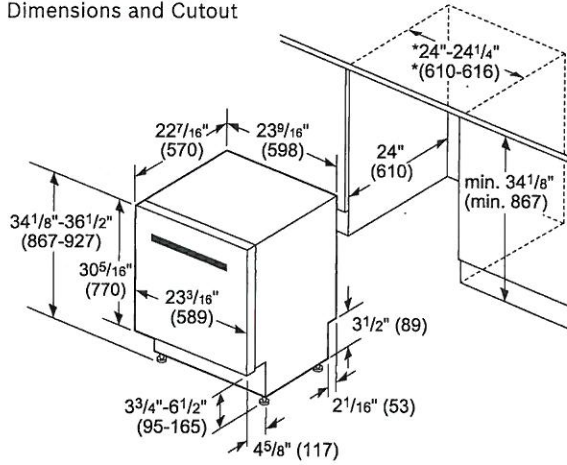

*23 5/8" (600) without decor strips measurements in inches (mm)

Plumbing

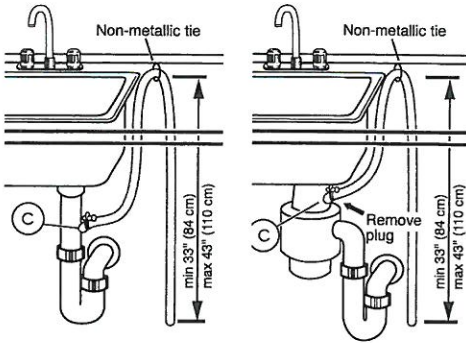

Note: Plumbing installations will vary - refer to local codes. Drain hose included is 79" (201 cm) and can be extended to a maximum of 155 3/4" (396 cm).

Always use the approved drain hose extension kit (SGZ1010UC).

Ensure a portion of the drain hose is raised between min. 33" (84 cm) and max. 43" (110 cm) above the cabinet floor.

Included Parts & Accessories

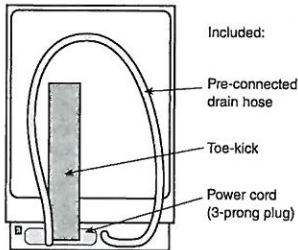

Example of Hardwire Installation

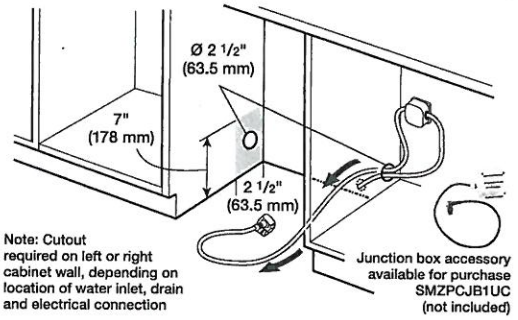

Example of Electrical Receptacle Installation

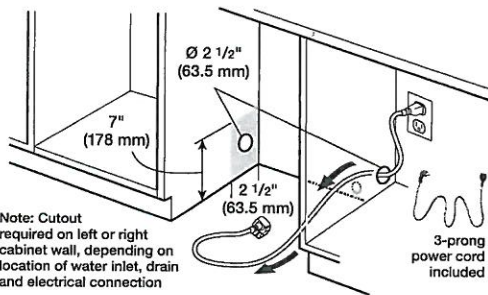

Water and Electrical Locations

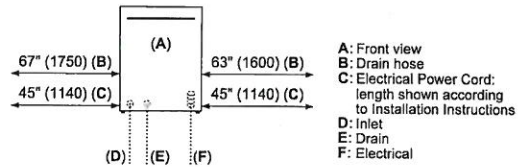

All connections are at the rear of the appliance. Extension for drain hose available as accessory. Junction Box for hard wired connection available as an accessory.

measurements in inches (mm)

24" Washers and Dryers Installed in Enclosure

PV-101
Sept. 15, 2020

Enclosure Dimensions

Under Counter: (Preferred)

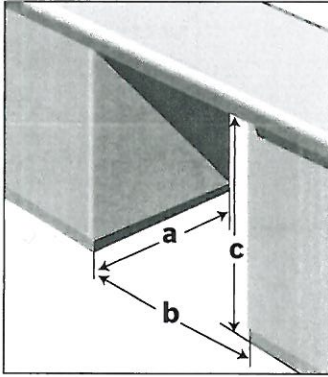

Front of the appliance fully open. No doors or coverings.

Under Counter: (Less Preferred)

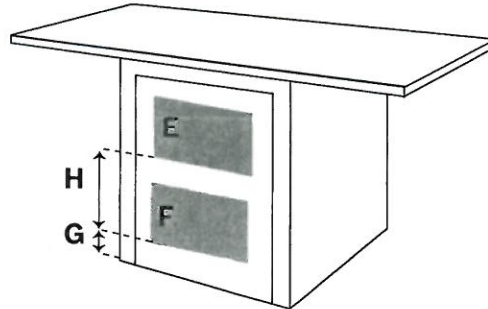

If the front of the appliance is covered, ventilation openings must be installed as shown and front/rear clearances adhered to according to closet installations.

Minimum opening dimensions

a	28 in.
b	23 7/8 in.
c	34 1/2 in.

E & F are minimum area sizes

E	63 sq. in.
F	63 sq. in.

G & H actual spacing dimensions for min. open area sizes

G	3 in.
H	14 in.

Closet: Stacked

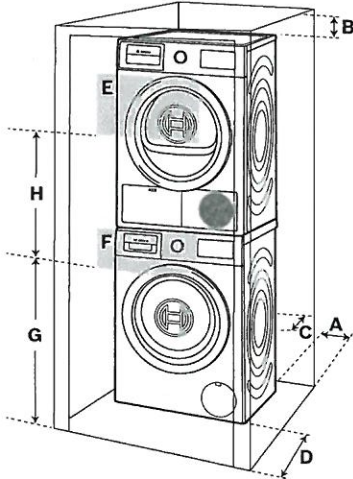

Closet: Stand Alone (shown) or Side by Side

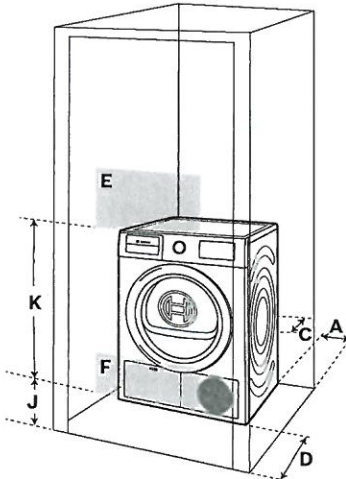

Clearance requirements (Minimum)

A Both Sides	5/8 in.
B Top	6 1/4 in.
C Rear	2 1/2 in.
D Front	2 1/2 in.

Ventilation Area (Minimum)

E Top	63 sq. in.
F Bottom	63 sq. in.

Vent Spacing

G	37 in.
H	26 in.
J	3 in.
K	29 in.

Enclosure Dimensions

RY-001
Sept. 15, 2020

(Handwritten initials and marks)

24" Compact Washers



300 Series
WAT28400UC

- SpeedPerfect® Provides Up to 40% Faster Washing Time*
- EcoSilence Motor Delivers Quiet, Efficient Performance
- Anti-vibration Circular Side Walls Reduce Vibration
- ENERGY STAR® Qualified



500 Series
WAT28401UC

- + AquaShield® Provides Protection Against Water Damage
- + Sanitize Cycle Heats Water to Kill Bacteria
- + Lower Noise 52 / 72 dBA (Washing / Spinning)



+ Indicates a step-up feature

	300 Series White - WAT28400UC	500 Series White - WAT28401UC
General Properties		
Drum material	Stainless steel	Stainless steel
Maximum spin speed (rpm)	1,400	1,400
Interior light	No	No
Leak protection systems	Reinforced hose	AquaShield® hose
Internal water heater	Yes	Yes
Stackable	Yes	Yes
Silence level - washing (dBA)	54	52
Silence level - spinning (dBA)	73	72
Programs (No.), [Special]	(15), [Allergen, Jeans, Heavy Duty]	(15), [Bulky / Large Items, Towels]
Options (No.), [Special]	(6), [SpeedPerfect®, PreWash]	(6), [SpeedPerfect®, PreWash]
Energy consumption (kWh / yr)	84	84
Water consumption (gal / yr)	2,294	2,294
ENERGY STAR® qualified	Yes	Yes
Capacity		
Capacity (cu. ft.)	2.2	2.2
Design Elements		
Door ring	White	Silver
Control type	Touch	Touch
Dial	White	Silver ring with white center
Bosch logo on door glass	No	Yes
Technical Details		
Watts (W)	2,520	2,520
Circuit breaker if plugged into an individual circuit (A)	20	20
Volts (V)	208 / 220 - 240	208 / 220 - 240
Current (A)	10.5	10.5
Frequency (Hz)	60	60
Plug type	240V, NEMA 6 - 15 (3 prong)	240V; NEMA 6 - 15 (3 prong)
Included power cord length (in)	63" (Full length)	63" (Full length)
Drain / inlet hose length (in)	57" / 47" (Full length)	57" / 59" (Full length)
Door hinge	Left side (not reversible)	Left side (not reversible)
Dimensions & Weight		
Overall dimensions (HxWxD) (in)	33 1/4" x 23 1/2" x 24 1/4"	33 1/4" x 23 1/2" x 25"
Net weight (lbs)	158	160
Minimum stack height (in)	67 3/4"	67 3/4"
ADA compliance	Meets ADA height and access requirements <i>when installed on pedestal.</i> Meets ADA operable parts requirements for controls and detergent dispenser	

* As compared to Perm Press Heavy Soil cycle without SpeedPerfect

24" Compact Washers



800 Series
WAW285H2UC

Home
CONNECT

- + Home Connect™ Controls
Washer Remotely
- + Premium LED Controls with
Enhanced Text and Icons
- + Illuminated Selection Jog Dial
- + Stains Program
- + EcoPerfect



PV-LO1
Sept. 15, 2020.
AF AW

+ Indicates a step-up feature

800 Series

White – WAW285H2UC

General Properties	
Drum material	Stainless steel
Maximum spin speed (rpm)	1,400
Interior light	Yes (LED)
Leak protection systems	AquaStop® Plus (AquaStop® base + AquaShield® hose)
Internal water heater	Yes
Stackable	Yes
Silence level – washing (dBA)	50
Silence level – spinning (dBA)	71
Programs (No.), [Special]	(14), [Super Quick 15, Whitest Whites]
Options (No.), [Special]	(9), [Remote Start, EcoPerfect, Stains]
Energy consumption (kWh / yr)	84
Water consumption (gal / yr)	2,358
ENERGY STAR® qualified	Yes
Capacity	
Capacity (cu. ft.)	2.2
Design Elements	
Door ring	Chrome
Control type	Premium LED Touch
Dial	Illuminated jog dial
Bosch logo on door glass	Yes
Technical Details	
Watts (W)	2,520
Circuit breaker if plugged into an individual circuit (A)	20
Volts (V)	208 / 220 – 240
Current (A)	10.5
Frequency (Hz)	60
Plug type	240V; NEMA 6 – 15 (3 prong)
Included power cord length (in)	63" (Full length)
Drain / inlet hose length (in)	57" / 59" (Full length)
Door hinge	Left side (not reversible)
Dimensions & Weight	
Overall dimensions (HxWxD) (in)	33 1/4" x 23 1/2" x 25"
Net weight (lbs)	160
Minimum stack height (in)	67 3/4"
ADA compliance	Meets ADA height and access requirements when installed on pedestal. Meets ADA operable parts requirements for controls and detergent dispenser.

PV-LO1
 Sept. 15, 2020.

24" Compact Washers

300 Series Dimensions and Installation

300 Series, 500 Series and 800 Series

Dimensions in inches

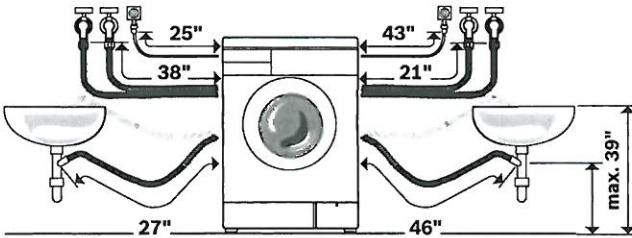
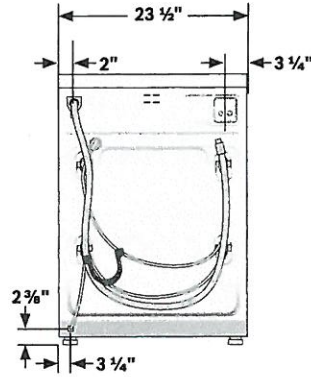
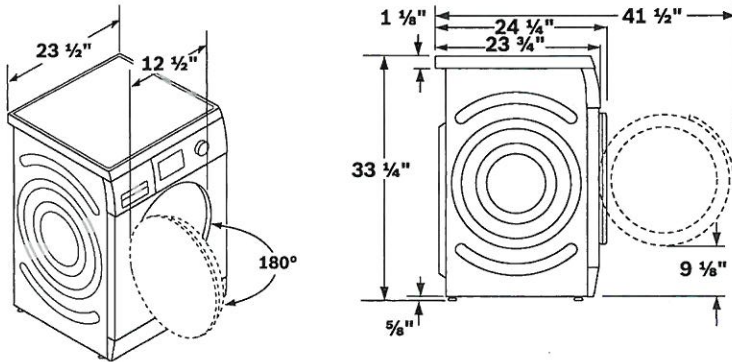

300 Series, 500 Series and 800 Series
 Washer plugs into the dryer or properly installed 240V NEMA 6-15 wall receptacle.

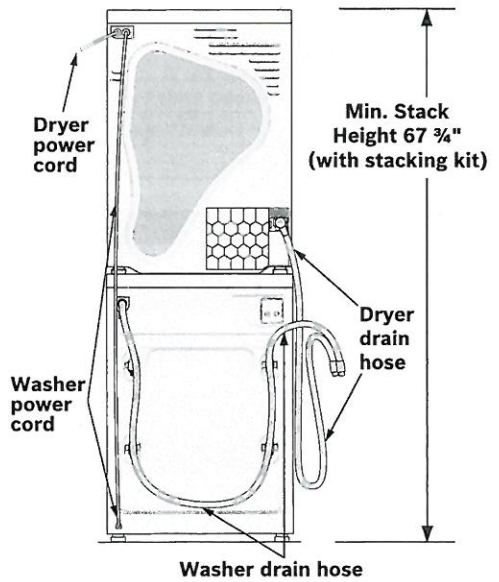

500 Series and 800 Series Dimensions and Installation

Dimensions in inches

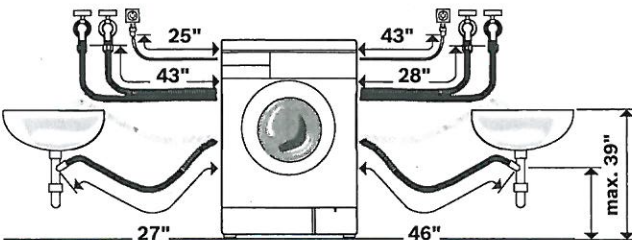
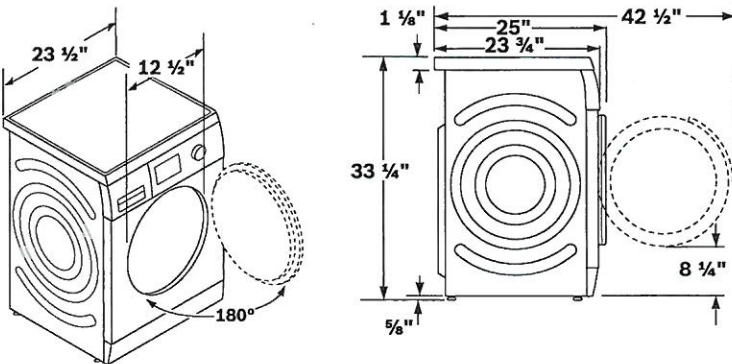

Optional Accessories
 P/N 645787 (500 & 800 Series)
 Short Stainless Steel Hose (If Needed for
 Plumbing Box Clearance with AQS Hose)

NOTE: See page 158 for details on installing under counter or in a closet.

24" Compact Dryers

PV-L01
 Sept. 15, 2020.

(Handwritten initials and signature)



300 Series
 WTG86400UC

- Washer Plugs into Dryer for Easy Installation
- Intelligent Sensors Prevent Over Drying
- Anti-vibration Circular Side Walls Reduce Vibration
- Low Noise 67 dBA



500 Series
 WTG86401UC

- + Reversible Door
- + Stainless Steel Drum
- + ENERGY STAR® Qualified
- + Lower Noise 65 dBA
- + Bulky / Large Items Cycle



+ Indicates a step-up feature

	300 Series	500 Series
	White – WTG86400UC	White – WTG86401UC
General Properties		
Dryer type	Condensing	Condensing
Drum material	Galvalume	Stainless steel
Interior light	No	No
Ventless drying (no ducting)	Yes	Yes
Stackable	Yes	Yes
Silence level (dBA)	67	65
Programs (No.), [Special]	(15), [Jeans, Heavy Duty]	(15), [Bulky / Large Items, Towels]
Options (No.), [Special]	(6), [Dry Level, Finished In]	(6), [Dry Level, Finished In]
Energy consumption (kWh / yr)	320	311
ENERGY STAR® qualified	No	Yes
Capacity		
Capacity (cu. ft.)	4.0	4.0
Design Elements		
Door ring	White	Silver
Control type	Touch	Touch
Dial	White	Silver ring with white center
Bosch logo on door glass	No	Yes
Technical Details		
Energy source	Electric	Electric
Watts (W)	2,520	2,520
Circuit breaker (A)	30	30
Volts (V)	208 / 220 – 240	208 / 220 – 240
Current (A)	10.5	10.5
Frequency (Hz)	60	60
Plug type	240V; NEMA 14 – 30 (4 prong)	240V; NEMA 14 – 30 (4 prong)
Included power cord length (in)	63" (full length)	63" (full length)
Drain hose length (in)	78" (full length)	78" (full length)
Door hinge	Right side (not reversible)	Right side (reversible)
Dimensions & Weight		
Overall dimensions (HxWxD) (in)	33 1/4" x 23 1/2" x 25"	33 1/4" x 23 1/2" x 25"
Net weight (lbs)	99	99
Minimum stack height (in)	67 3/4"	67 3/4"
ADA compliance	Meets ADA height and access requirements <i>when installed on pedestal</i> . Meets ADA operable parts requirements for controls and lint filter.	

24" Compact Dryers



800 Series
WTG865H3UC Home connect

- + Home Connect™ Controls
Dryer Remotely
- + Premium LED Controls with
Enhanced Text and Icons
- + Illuminated Selection Jog Dial
- + Easy Start
- + Dry Level Adjust
- + ENERGY STAR® Qualified



(Handwritten notes)
 PV-LO1
 Sept. 15, 2020.

+ Indicates a step-up feature

800 Series

White – WTG865H3UC

General Properties

Dryer type	Condensing
Drum material	Stainless steel
Interior light	Yes (LED)
Ventless drying (no ducting)	Yes
Stackable	Yes
Silence level (dBA)	63
Programs (No.), [Special]	(14), [Super Quick 15, Anti Shrink]
Options (No.), [Special]	(8), [Remote Start, Dry level adjust]
Energy consumption (kWh / yr)	311
ENERGY STAR® qualified	Yes

Capacity

Capacity (cu. ft.)	4.0
--------------------	-----

Design Elements

Door ring	Chrome
Control type	Premium LED Touch
Dial	Illuminated jog dial
Bosch logo on door glass	Yes

Technical Details

Energy source	Electric
Watts (W)	2,520
Circuit breaker (A)	30
Volts (V)	208 / 220 – 240
Current (A)	10.5
Frequency (Hz)	60
Plug type	240V; NEMA 14 – 30 (4 prong)
Included power cord length (in)	63" (full length)
Drain hose length (in)	78" (full length)
Door hinge	Right side (reversible)

Dimensions & Weight

Overall dimensions (HxWxD) (in)	33 1/4" x 23 1/2" x 25"
Net weight (lbs)	99
Minimum stack height (in)	67 3/4"
ADA compliance	Meets ADA height and access requirements <i>when installed on pedestal.</i> Meets ADA operable parts requirements for controls and lint filter.

24" Compact Dryers

Dryer Dimensions

Dimensions in inches

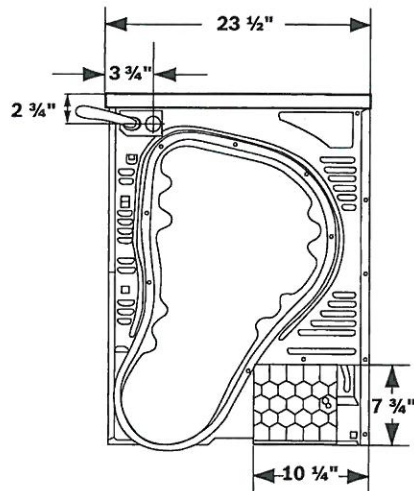
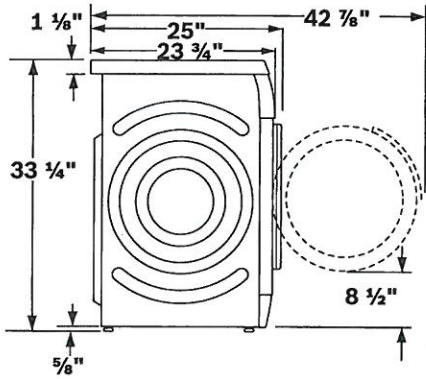
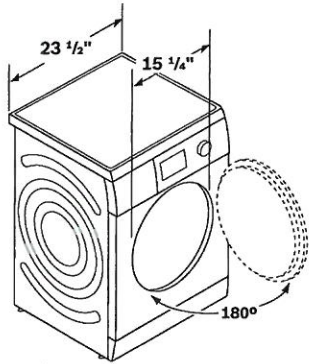

300 Series, 500 Series and 800 Series
 Washer plugs into the dryer or properly installed 240V NEMA 6-15 wall receptacle.

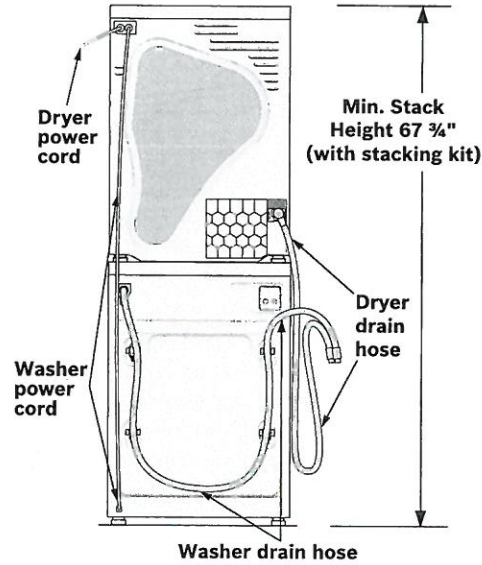

(Handwritten initials)

PV-L01

Sept. 15, 2020.

Optional Accessories

- | | | |
|----------------------------|-------------------------|-------------|
| WTZ20410UC | WTZ11400UC | WMZ20600 |
| Stacking Kit Without Shelf | Stacking Kit with Shelf | Drying Rack |

NOTE: See page 158 for details on installing under counter or in a closet.