



CONSTRUCTION SUMMARY

Lot: 150
Model: 40.00 A BRIARWOOD
Project/Phase: Pine Valley Forevergreen / 1

APPLIANCES

Invoice	Qty.	Description
2331	1	See attached signed appliance specifications. Fridge/bottom mount freezer, double electric free standing range, beverage fridge, dishwasher, washer/dryer with pedestals.
15Sep20 NoCat		**See attached signed appliance specifications**

CERAMIC

Invoice	Qty.	Description
2331	1	.MASTER ENSUITE: DELETE WALL AND DOOR AT WATER CLOSET
15Sep20 NoCat		
2331	1	.MASTER ENSUITE: SHOWER NICHE [SHAMPOO SHELF] - COMPLETE WITH MATCHING MARBLE JAMBS ON 4 SIDES, STANDARD TILE, APPROX. 12 X 18 INSTALLED VERTICALLY - SEE PLAN
15Sep20 NoCat		
2516 43 28Jan21	1	MASTER ENSUITE: TILE, SHOWER FLOOR, LEVEL 2 - MASTER ENSUITE - HEX
2516 37 28Jan21	1	FRONT FOYER: TILE, FLOOR , LEVEL 5 - 24X24" LAID IN STRAIGHT, STACKED PATTERN.
2516 37 28Jan21	1	KITCHEN: TILE, FLOOR , LEVEL 5 - KITCHEN - 24X24" LAID IN STRAIGHT, STACKED PATTERN.
2516 37 28Jan21	1	POWDER ROOM: TILE, FLOOR , LEVEL 5 - 24X24" LAID IN STRAIGHT, STACKED PATTERN.
2516 37 28Jan21	1	MASTER ENSUITE: TILE, FLOOR , LEVEL 5 - ALT. GROUND FLOOR - 24X24" LAID IN STRAIGHT, STACKED PATTERN.
2516 37 28Jan21	1	LAUNDRY: TILE, FLOOR , LEVEL 5 - LAUNDRY, ALT. GROUND FLOOR - 24X24" LAID IN STRAIGHT, STACKED PATTERN.

CONCRETE AND DRAIN

Invoice	Qty.	Description
2304	1	.BACK-FLOW PREVENTER VALVE
24Jul20 NoCat		



CONSTRUCTION SUMMARY

Lot: 150
Model: 40.00 A BRIARWOOD
Project/Phase: Pine Valley Forevergreen / 1

DRYWALL

Invoice	Qty.	Description
2304 24Jul20 NoCat	4	.BASEMENT WINDOWS - UPGRADE BASEMENT WINDOW SIZE TO 30 " X 24" - 8" FRAME (QTY:4)
2331 15Sep20 NoCat	1	.MASTER ENSUITE: DELETE WALL AND DOOR AT WATER CLOSET
2331 15Sep20 NoCat	1	.GREAT ROOM: FIREPLACE
2331 15Sep20 NoCat	1	.**CUSTOM LAYOUT** CHANGE LINEN CLOSET TO 1/2 LINEN + HALF PANTRY WITH 2 DOORS ACCESSIBLE FROM KITCHEN, COMPLETE WITH 4 FIXED SHELVES ON PANTRY SIDE
2331 15Sep20 NoCat	1	MASTER BEDROOM: RELOCATE DOOR TO ENSUITE TO CREATE LARGER WALK-IN CLOSET (7` closet, if possible - REDUCE SIZE OF ENSUITE DOOR, IF NECESSARY)
2331 15Sep20 NoCat	1	.**CUSTOM LAYOUT** INCREASE NIBB WALLS TO APPROX. 30" WIDE AT BREAKFAST / GREAT ROOM + SERVERY- -SEE PLAN FOR LOCATION



CONSTRUCTION SUMMARY

Lot: 150
Model: 40.00 A BRIARWOOD
Project/Phase: Pine Valley Forevergreen / 1

ELECTRICAL

Invoice	Qty.	Description
2331 72,281 15Sep20	1	.GREAT ROOM: INTERIOR WALL OUTLET: ADDITIONAL 110V WALL INTERIOR RECEPTACLE ON EXISTING CIRCUIT FOR WALL MOUNTED TV - LOCATE APPROX. 66" A.F.F. ABOVE FIREPLACE
2331 72,307 15Sep20	1	.KITCHEN: FXITURE: RELOCATE STANDARD CEILING MOUNT FIXTURE (TO APPROX CENTER ABOVE ISLAND)
2331 72,303 15Sep20	1	.KITCHEN: FIXTURE: UNDER CABINET FLUORESCENT LIGHT FIXTURES - DOES NOT INCLUDE (AND REQUIRES) LIGHT VALANCE
2331 72,309 15Sep20	1	.MAIN HALL:UPGRADE STANDARD CEILING MOUNT FIXTURE TO (1) LED POT LIGHT - GROUND FLOOR - MAIN HALL TO HAVE POTLIGHTS ONLY
2331 72,289 15Sep20	2	.MAIN HALL: 4" E/S LED INTERIOR POT LIGHT - GROUND FLOOR - EACH SAME SWITCH AS STANDARD
2331 72,291 15Sep20	2	.EXTERIOR LED SOFFIT POT LIGHT - EACH 2 AT FRONT ELEVATION AT GARAGE SOFFIT
2331 72,278 15Sep20	1	.FOYER: ADDITIONAL INTERIOR SWITCH FOR EXTERIOR SOFFIT LIGHTS
2331 72,268 15Sep20	1	.BASEMENT: INTERIOR WALL OUTLET: 110V WALL INTERIOR RECEPTACLE ON EXISTING CIRCUIT
2331 72,272 15Sep20	1	.BREAKFAST: 110V WALL RECEPTACLE ON SEPARATE CIRCUIT - FOR FUTURE BAR FRIDGE AT `SERVERY`, APPLIANCE NOT INCLUDED
2331 72,284 15Sep20	1	.BREAKFAST: INTERIOR WALL OUTLET: ADDITIONAL SPLIT CIRCUIT RECEPTACLE (IN KITCHEN ABOVE COUNTER) - AT SERVERY
2331 72,289 15Sep20	6	.KITCHEN & MAIN HALL: 4" E/S LED INTERIOR POT LIGHT - GROUND FLOOR - EACH INCLUDES 1 SWITCH INCLUDED IN APS
2331 72,289 15Sep20	1	.MAIN HALL AT FORMAL ROOM: 4" E/S LED INTERIOR POT LIGHT - GROUND FLOOR - EACH
2331 72,309 15Sep20	1	.MAIN HALL AT FORMAL ROOM: UPGRADE STANDARD CEILING MOUNT FIXTURE TO (1) LED POT LIGHT - GROUND FLOOR - SEE PLAN FOR LOCATION



CONSTRUCTION SUMMARY

Lot: 150
Model: 40.00 A BRIARWOOD
Project/Phase: Pine Valley Forevergreen / 1

ELECTRICAL

Invoice	Qty.	Description
2331 72,310 15Sep20	2	.UPPER HALL: UPGRADE STANDARD CEILING MOUNT FIXTURE TO (1) LED POT LIGHT - SECOND FLOOR - SEE PLAN FOR LOCATION
2331 72,290 15Sep20	6	.UPPER HALL: 4" E/S LED INTERIOR POT LIGHT (INSULATED CEILING) - SECOND FLOOR - EACH USE STANDARD SWITCHES
2331 15Sep20 NoCat	1	.GREAT ROOM: FIREPLACE - ADD HEAT ACTIVATED FAN
2516 72,291 28Jan21	1	FRONT ELEVATION: EXTERIOR LED SOFFIT POT LIGHT - EACH - LOCATE LEFT OF FRONT PORTICO - SWITCHED WITH OTHERS

EXTERIOR COLOURS

Invoice	Qty.	Description
2331 15Sep20 NoCat	1	EXTERIOR COLOUR PACKAGE # BR.1

FIREPLACE

Invoice	Qty.	Description
2331 15Sep20 NoCat	1	.GREAT ROOM: FIREPLACE - ADD HEAT ACTIVATED FAN

FORMING

Invoice	Qty.	Description
2304 24Jul20 NoCat	4	.BASEMENT WINDOWS - UPGRADE BASEMENT WINDOW SIZE TO 30 " X 24" - 8" FRAME (QTY:4)



CONSTRUCTION SUMMARY

Lot: 150
Model: 40.00 A BRIARWOOD
Project/Phase: Pine Valley Forevergreen / 1

FRAMING

Invoice	Qty.	Description
2304 24Jul20 NoCat	4	.BASEMENT WINDOWS - UPGRADE BASEMENT WINDOW SIZE TO 30 " X 24" - 8" FRAME (QTY:4)
2331 15Sep20 NoCat	1	.MASTER ENSUITE: DELETE WALL AND DOOR AT WATER CLOSET
2331 72,631 15Sep20	1	.MASTER ENSUITE: SHOWER NICHE [SHAMPOO SHELF] - COMPLETE WITH MATCHING MARBLE JAMBS ON 4 SIDES, STANDARD TILE, APPROX. 12 X 18 INSTALLED VERTICALLY - SEE PLAN
2331 15Sep20 NoCat	1	.**CUSTOM LAYOUT** CHANGE LINEN CLOSET TO 1/2 LINEN + HALF PANTRY WITH 2 DOORS ACCESSIBLE FROM KITCHEN, COMPLETE WITH 4 FIXED SHELVES ON PANTRY SIDE
2331 15Sep20 NoCat	1	MASTER BEDROOM: RELOCATE DOOR TO ENSUITE TO CREATE LARGER WALK-IN CLOSET (7` closet, if possible - REDUCE SIZE OF ENSUITE DOOR, IF NECESSARY)
2331 15Sep20 NoCat	1	.**CUSTOM LAYOUT** INCREASE NIBB WALLS TO APPROX. 30" WIDE AT BREAKFAST / GREAT ROOM + SERVERY- -SEE PLAN FOR LOCATION
2331 15Sep20 NoCat	1	.GREAT ROOM: FIREPLACE

GRANITE MARBLE QUARTZ

Invoice	Qty.	Description
2516 101,930 28Jan21	1	KITCHEN: UPGRADE 5 QUARTZ COUNTERTOP
2516 101,930 28Jan21	1	BREAKFAST: UPGRADE 5 QUARTZ COUNTERTOP
2516 101,930 28Jan21	1	MASTER ENSUITE: UPGRADE 2 QUARTZ COUNTERTOP
2516 28Jan21 NoCat	1	POWDER ROOM: UPGRADE 2 QUARTZ COUNTER
2516 28Jan21 NoCat	1	.KITCHEN: BLANCO - QUATRUS R15 U SUPER SINGLE 'STAINLESS' #401518



CONSTRUCTION SUMMARY

Lot: 150
Model: 40.00 A BRIARWOOD
Project/Phase: Pine Valley Forevergreen / 1

HARDWOOD

Invoice	Qty.	Description
2516 101,930 28Jan21	1	THRU-OUT ALL STANDARD AREAS: MAIN HALL/FORMAL ROOM/GREAT ROOM/MASTER BEDROOM/UPPER HALL/MEDIA ROOM/BEDROOM 3/BEDROOM 4: VINTAGE SERIES, 5" WHITE OAK, NSS ENGINEERED HARDWOOD, 3/4" THK, SCULPTED TEXTURE, UVF FINISH LEVEL 4

HVAC

Invoice	Qty.	Description
2331 72,321 15Sep20	1	.GREAT ROOM: FIREPLACE - ADD HEAT ACTIVATED FAN

INTERIOR TRIM AND DOORS

Invoice	Qty.	Description
2304 24Jul20 NoCat	4	.BASEMENT WINDOWS - UPGRADE BASEMENT WINDOW SIZE TO 30 " X 24" - 8" FRAME (QTY:4)
2331 15Sep20 NoCat	1	.MASTER ENSUITE: DELETE WALL AND DOOR AT WATER CLOSET
2331 15Sep20 NoCat	1	.GREAT ROOM: FIREPLACE
2331 15Sep20 NoCat	1	.**CUSTOM LAYOUT** CHANGE LINEN CLOSET TO 1/2 LINEN + HALF PANTRY WITH 2 DOORS ACCESSIBLE FROM KITCHEN, COMPLETE WITH 4 FIXED SHELVES ON PANTRY SIDE
2331 15Sep20 NoCat	1	MASTER BEDROOM: RELOCATE DOOR TO ENSUITE TO CREATE LARGER WALK-IN CLOSET (7` closet, if possible - REDUCE SIZE OF ENSUITE DOOR, IF NECESSARY)
2331 15Sep20 NoCat	1	.**CUSTOM LAYOUT** INCREASE NIBB WALLS TO APPROX. 30" WIDE AT BREAKFAST / GREAT ROOM + SERVERY- -SEE PLAN FOR LOCATION

KITCHEN AND BATH CABINETRY

Invoice	Qty.	Description
2331 15Sep20 NoCat	1	.**CUSTOM LAYOUT** CHANGE LINEN CLOSET TO 1/2 LINEN + HALF PANTRY WITH 2 DOORS ACCESSIBLE FROM KITCHEN, COMPLETE WITH 4 FIXED SHELVES ON PANTRY SIDE
2516 101,930 28Jan21	1	THRU-OUT: SEE ATTACHED CABINETRY SCHEDULE
2516 28Jan21 NoCat	1	UPDATED KITCHEN DRAWINGS - JAN 28, 2021



CONSTRUCTION SUMMARY

Lot: 150
Model: 40.00 A BRIARWOOD
Project/Phase: Pine Valley Forevergreen / 1

MASONRY

Invoice	Qty.	Description
2516 28Jan21 NoCat	1	.FRONT ELEVATION: EXTERIOR LED SOFFIT POT LIGHT - EACH - LOCATE LEFT OF FRONT PORTICO - SWITCHED WITH OTHERS

NETWORK AND WIRING

Invoice	Qty.	Description
2331 72,259 15Sep20	1	.GREAT ROOM: CONDUIT PIPE - FOR WALL MOUNT TV - LOCATE APPROX. 66" A.F.F. ABOVE FIREPLACE, THRU BASEMENT, TERMINATING AT CABLE. SEE PLAN FOR LOCATION
2331 72,264 15Sep20	1	.LAUNDRY: ROUGH - IN FOR EXTRA SECURITY KEY PAD
2331 72,256 15Sep20	1	.BASEMENT: ADDITIONAL RG6 HIGH SPEED TV / INTERNET OUTLETS - SEE PLAN FOR LOCATION
2331 72,260 15Sep20	1	.CONDUIT PIPE - FROM ATTIC TO BASEMENT - FROM BASEMENT BY ELECTRICAL PANEL TO APPROX CENTER OF ATTIC
2331 15Sep20 NoCat	1	2nd level loft floor - telephone outlet in bedroom 3



CONSTRUCTION SUMMARY

Lot: 150
Model: 40.00 A BRIARWOOD
Project/Phase: Pine Valley Forevergreen / 1

PAINT

Invoice	Qty.	Description
2331 15Sep20 NoCat	1	.MASTER ENSUITE: DELETE WALL AND DOOR AT WATER CLOSET
2331 15Sep20 NoCat	1	.GREAT ROOM: FIREPLACE
2331 15Sep20 NoCat	1	.**CUSTOM LAYOUT** CHANGE LINEN CLOSET TO 1/2 LINEN + HALF PANTRY WITH 2 DOORS ACCESSIBLE FROM KITCHEN, COMPLETE WITH 4 FIXED SHELVES ON PANTRY SIDE
2331 15Sep20 NoCat	1	MASTER BEDROOM: RELOCATE DOOR TO ENSUITE TO CREATE LARGER WALK-IN CLOSET (7` closet, if possible - REDUCE SIZE OF ENSUITE DOOR, IF NECESSARY)
2331 15Sep20 NoCat	1	.**CUSTOM LAYOUT** INCREASE NIBB WALLS TO APPROX. 30" WIDE AT BREAKFAST / GREAT ROOM + SERVERY- -SEE PLAN FOR LOCATION
2516 28Jan21 NoCat	2	MAIN STAIRS - 2ND FLOOR TO BASEMENT: STAIN STAIRS AND LANDINGS STAIRS AND LANDINGS WILL NOT MATCH HARDWOOD FLOORS IN COLOUR/TEXTURE/SPECIES

PLUMBING

Invoice	Qty.	Description
2304 24Jul20 NoCat	1	.BACK-FLOW PREVENTER VALVE
2331 72,332 15Sep20	1	.KITCHEN: ROUGH-IN 1/4" COLD WATER LINE TO FRIDGE
2331 15Sep20 NoCat	1	.MASTER ENSUITE: DELETE WALL AND DOOR AT WATER CLOSET

PLUMBING FIXTURES

Invoice	Qty.	Description
2516 101,930 28Jan21	1	KITCHEN: BLANCO - QUATRUS R15 U SUPER SINGLE 'STAINLESS' #401518

STAIR AND RAILINGS

Invoice	Qty.	Description
2516 93,775 28Jan21	2	BASEMENT TO 2ND FLOOR: UPGRADE - EURONLINE (ALL PLAIN) PICKET, 3" HALF-ROUND W/V-GROOVE HANDRAIL, 3 1/2" ALL SQUARE POST WITH PYRAMID TOP POST CAP - PACKAGE A-2



CONSTRUCTION SUMMARY

Lot: 150
Model: 40.00 A BRIARWOOD
Project/Phase: Pine Valley Forevergreen / 1

WINDOWS - BASEMENT

Invoice	Qty.	Description
2304 72,351 24Jul20	4	.BASEMENT WINDOWS - UPGRADE BASEMENT WINDOW SIZE TO 30 " X 24" - 8" FRAME (QTY:4)



PV-150 Cabinetry Schedule

ROOM	DESCRIPTION	PRICE	QTY	TOTAL
KITCHEN	UPGRADE KITCHEN FROM SERIES 2 TO SERIES 3 - MONTEREY STORM GREY MAPLE		1	
	UPGRADE ISLAND FROM SERIES 2 TO SERIES 3 - MONTEREY STORM GREY MAPLE		1	
	ADD DECORATIVE RANGE HOOD CABINET - 'CLASSIC' STYLE		1	
	CONVERT FULL DOOR BASE CAB INTO BASE POTS AND PANS DRAWERS W/ 3/4" EXT WHITE DRAWERS		2	
	UPGRADE HARDWARE: H050-06		1	
	ADD FULL-DOOR 2-BIN FULL-OUT RECYCLING CENTRE (18"-21"W)		1	
	LIGHT VALANCE "FLAT"		1	
	ADD FULL-DOOR BASE TO FORMER OPTIONAL BREAKFAST PANTRY AREA		1	
	CONVERT FULL-DOOR BASE CAB TO BASE DOOR & TOP DRAWER CAB W/ 3/4" WHITE EXT DRAWER		1	
	ADD BASE SUPPORT GABLE BESIDE BUILT-IN WINE FRIDGE SIDEWALL		1	
	LIGHT VALANCE "FLAT"		1	
	ADD FLAT LIGHT VALANCE @ BREAKFAST		1	
	ADD LARGE TRADITIONAL CORNICE MOULDING @ BREAKFAST		1	
	ADD 3/4" CONTEMPORARY MOULDING @ BREAKFAST		1	
	ADD FURRING RAIL @ BREAKFAST		1	
	ADD 45"H UPPER TO FORMER OPTIONAL BREAKFAST PANTRY AREA		1	
	UPGRADE PANTRY FROM SERIES 2 TO SERIES 3		1	
LOFT SHARED BATH	RAISE VANITY TO COMFORT/KITCHEN HEIGHT		1	
	STANDARD HARDWARE: H039-03		1	
MASTER ENSUITE	UPGRADE FROM SERIES 2 TO SERIES 3- MONTEREY STORM GREY MAPLE		1	
	RAISE VANITY TO COMFORT/KITCHEN HEIGHT		1	
	STANDARD HARDWARE: H001-04	-	1	
LAUNDRY ROOM	STANDARD DOOR: CHESAPEAKE CLASSIC WHITE	-	1	
	STANDARD HARDWARE: H039-03	-	1	
CABINETS TOTAL:				

LOT #: PV-150	DATE: Dec. 14, 2020
SIGNATURE:	
SIGNATURE:	

*** NOTE: This is not an approved document. Document must be locked ***

Scheduled Closing Date: Thursday, January 14, 2021

Purchasers: Domenico Dell'Aquila & Addolorata Dell'Aquila Property: 150 of Plan -

Telephone Res. / Bus: / (647) 295-6509

Project: Pine Valley Forevergreen - Phase 1

Decor Advisor: Yolande Somerville

Model and Elevation: 40.00 A BRIARWOOD

Layout Changes: ☒ Yes ☐ No

Sketch Attached: ☒ Yes ☐ No

Exterior Colour Scheme:

1. Cabinetry

	Style and Colour	Counter	Hardware
Kitchen / Breakfast	*Monterey 'Storm Grey Maple'	*Quartz: 'Eternal Statuario'	H05006
Laundry Room	Chesapeake 'Classic White II'	P-Lam 'White'	H03903
Powder Room	Bowery 'Ello'	Quartz: 'Misty Carrara'	H03903
Master Ensuite Bathroom	*Monterey 'Storm Grey Maple'	Quartz: 'Misty Carrara'	H00104
Second Ensuite Bathroom (If Applicable)	n/a	n/a	n/a
Shared Ensuite	Chesapeake 'Classic White II'	Quartz: Ice Snow	H03903

Comment

2. Floor Tile

	Selection
Entrance Vestibule	*24x24" Carrara X 'White polished'
Main Hall	n/a
Kitchen / Breakfast	*24x24" Carrara X 'White polished'
Laundry Room	*24x24" Carrara X 'White polished'
Powder Room	*24x24" Carrara X 'White polished'
Master Ensuite Bathroom	*24x24" Carrara X 'White polished'
Second Ensuite Bathroom (If Applicable)	n/a
Lower Landing (If Applicable)	13x13" Sempre 'White matte' (basement foyer)
Shared Ensuite	13x13" Sempre 'White matte'

Comment

Master Ensuite Shower Floor: *Quebec hex. 'Black' / Shared Ensuite Shower Floor: 2x2" Standard White

3. Wall Tile

	Selection	Listello/Inserts	Describe
Master Ensuite Bathroom		<input type="radio"/> Yes <input checked="" type="radio"/> No	
Tub Deck		<input type="radio"/> Yes <input checked="" type="radio"/> No	
Shower Stall	8x10" Weave 'White'	<input type="radio"/> Yes <input checked="" type="radio"/> No	
Bathroom Walls		<input type="radio"/> Yes <input checked="" type="radio"/> No	
Second Ensuite Bathroom (If Applicable)	n/a	<input type="radio"/> Yes <input checked="" type="radio"/> No	
Shared Ensuite	8x10" Weave 'White'	<input type="radio"/> Yes <input checked="" type="radio"/> No	
Kitchen Backsplash	<input type="radio"/> Yes <input checked="" type="radio"/> No	Backsplash Behind Fridge	

Comment

AD

*** NOTE: This is not an approved document. Document must be locked ***

Scheduled Closing Date: Thursday, January 14, 2021

Purchasers:

Domenico Dell'Aquila & Addolorata Dell'Aquila

Property: 150 of Plan -

Telephone Res. / Bus: / (647) 295-6509

Project: Pine Valley Forevergreen - Phase 1

Decor Advisor: Yolande Somerville

Model and Elevation: 40.00 A BRIARWOOD

4. Plumbing Fixtures

<input type="checkbox"/>	Second Ensuite	<input type="checkbox"/>	Powder Room	<input type="checkbox"/>
Master Ensuite Bathroom <input type="checkbox"/>	Other Room - Specify <input type="checkbox"/>	<input type="checkbox"/>	Other Washroom	<input type="checkbox"/>

Comment

*Upgrade Kitchen Sink

5. Hardwood Flooring

	Type and Stain		Type and Stain
Main Hall	<input type="text"/>	Upper Landing	<input type="text"/>
Kitchen / Breakfast	<input type="text"/>	Upper Hall	<input type="text"/>
Living Room	<input type="text"/>	Master Bedroom	<input type="text"/>
Dining Room	<input type="text"/>	Bedroom #2	<input type="text"/>
Family Room	<input type="text"/>	Bedroom #3	<input type="text"/>
Den/Library	<input type="text"/>	Bedroom #4	<input type="text"/>
Entrance Vestibule	<input type="text"/>	Bedroom #5	<input type="text"/>
Lower Landing (If Applicable)	<input type="text"/>	Other Room - Specify thru-out standard areas	<input type="text"/>

*3/4x5" wht oak sculpted 'Apollo'

Comment

6. Carpeting

	Upgrade	Description
Ground Floor	<input type="checkbox"/>	<input type="text"/>
Second Floor	<input type="checkbox"/>	<input type="text"/>
<input type="text"/>	<input type="checkbox"/>	<input type="text"/>

Upgrade Underpad	Type <input type="text"/>	Area <input type="text"/>
Carpet on Stairs	Capped <input type="text"/>	Runner - *Upgrade <input type="text"/>

Comment

7. Fireplace

	Living Room			Family Room			Other Room - Specify			Great Room
	Purchased	As Per Plan	N/A	Purchased	As Per Plan	N/A	Purchased	As Per Plan	N/A	
Fireplace Type	<input type="radio"/>	<input type="radio"/>	<input checked="" type="radio"/>	<input type="radio"/>	<input type="radio"/>	<input checked="" type="radio"/>	<input type="radio"/>	<input checked="" type="radio"/>	<input type="radio"/>	Standard Gas
Mantle Type	<input type="text"/>	<input type="text"/>	<input type="text"/>	<input type="text"/>	<input type="text"/>	<input type="text"/>	<input type="text"/>	<input type="text"/>	<input type="text"/>	Mediterranean
Colour / Stain	<input type="text"/>	<input type="text"/>	<input type="text"/>	<input type="text"/>	<input type="text"/>	<input type="text"/>	<input type="text"/>	<input type="text"/>	<input type="text"/>	Arctic White
Surround	<input type="text"/>	<input type="text"/>	<input type="text"/>	<input type="text"/>	<input type="text"/>	<input type="text"/>	<input type="text"/>	<input type="text"/>	<input type="text"/>	n/a
Hearth	<input type="text"/>	<input type="text"/>	<input type="text"/>	<input type="text"/>	<input type="text"/>	<input type="text"/>	<input type="text"/>	<input type="text"/>	<input type="text"/>	none

Comment

Scheduled Closing Date: Thursday, January 14, 2021

Purchasers: Domenico Dell'Aquila & Addolorata Dell'Aquila Property: 150 of Plan -
Telephone Res. / Bus: / (647) 295-6509 Project: Pine Valley Forevergreen - Phase 1
Decor Advisor: Yolande Somerville Model and Elevation: 40.00 A BRIARWOOD

8. Trim Carpentry

Interior Doors Front Door Glass Inserts Door Handles
Interior Trim

Comment

9. Plaster Mouldings and Medallions

Standard Throughout ☐ Yes ☐ No ☒ N/A

Entrance Vestibule	<input type="text"/>	<input type="text"/>	Kitchen/Breakfast	<input type="text"/>	<input type="text"/>
Main Hall	<input type="text"/>	<input type="text"/>	Den/Library	<input type="text"/>	<input type="text"/>
Living Room	<input type="text"/>	<input type="text"/>	Lower Landing	<input type="text"/>	<input type="text"/>
Dining Room	<input type="text"/>	<input type="text"/>	Other Room - Specify	<input type="text"/>	<input type="text"/>
Family Room	<input type="text"/>	<input type="text"/>		<input type="text"/>	<input type="text"/>

Comment

10. Railings and Spindles

Railing Package
Railing Colour Spindle Colour
Stringer / Riser Treads

Comment

*NOTE: Stairs and landings will not match hardwood in colour/texture/species.

11. Wall Paint / Ceilings

Throughout Finished Areas

Trim Paint

Smooth Ceilings

Ground Floor ☒

Second Floor ☒

Note

Comment

Handwritten signatures and initials in blue ink.

Purchasers:

Domenico Dell'Aquila & Addolorata Dell'Aquila

Property: 150 of Plan -

Telephone Res. / Bus:

/ (647) 295-6509

Project: Pine Valley Forevergreen - Phase 1

Decor Advisor:

Yolande Somerville

Model and Elevation: 40.00 A BRIARWOOD

12. Electrical

Hood Fan ☐ White ☐ Stainless ☒ N/A

Above Kitchen Cabinet Light ☐ Yes ☒ No

Below Kitchen Cabinet Light ☒ Yes ☐ No

Standard Appliances ☐

Over The Range Microwave ☐

Chimney Style Fan ☐

Comment

13. Heating and Air Conditioning

Air Conditioning

Gas Provisions Stove

Gas Provisions Dryer

Gas Provisions Barbecue

Comment

14. Additional Comments

15. Disclaimers and Notes

- Colours of all materials are as close as possible to builder's selection, but not necessarily identical due to variances in manufacturing.
- Any extras listed above are null and void unless accompanied by a separate invoice/amendment. Said invoice must be paid in full.
- The Purchaser acknowledges that after Interior Colour Selection form is signed and dated, no further changes will be permitted other than re-selection due to unavailability. _____ Purchaser's Initials
- The Purchaser acknowledges reading and accepting the "Gold Park Homes Decor Centre Disclaimers" form. This document contains other miscellaneous disclaimers.

This Interior Colour Selection is final and approved by:

Signature:





Date:

Dec. 14-20

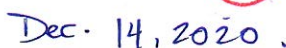

This Plan shows
opt GROUND FLOOR.

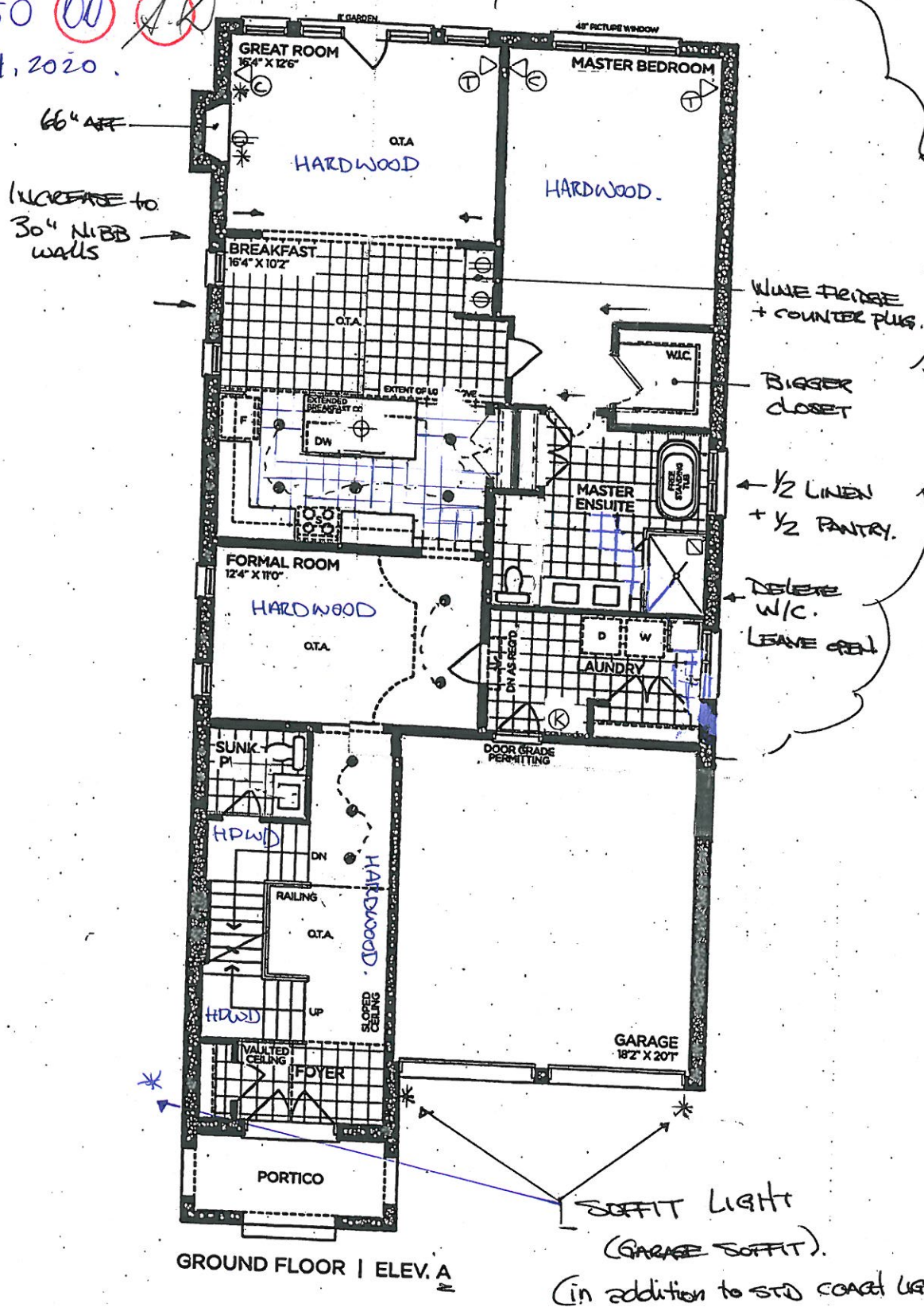
**PURCHASER**

GOLDPARK
WORTH MORE

Prices, figures, illustrations, sizes, features and finishes are subject to change without notice. Areas and dimensions are approximate and actual usable floor space may vary from the stated area. Layout may be reverse of the unit purchased. E. & O.E. 4000

2
SCHEDULE 'F'



PV-150 *[Signature]*
 MAY 28 2020
 PV-150 *[Signature]* See attached.
 June 2, 2020
 PV-150 *[Signature]*
 Dec. 14, 2020

The Briarwood

40' SERIES

→ Elevation A • 2,870 sq.ft.
 Elevation B • 2,860 sq.ft.

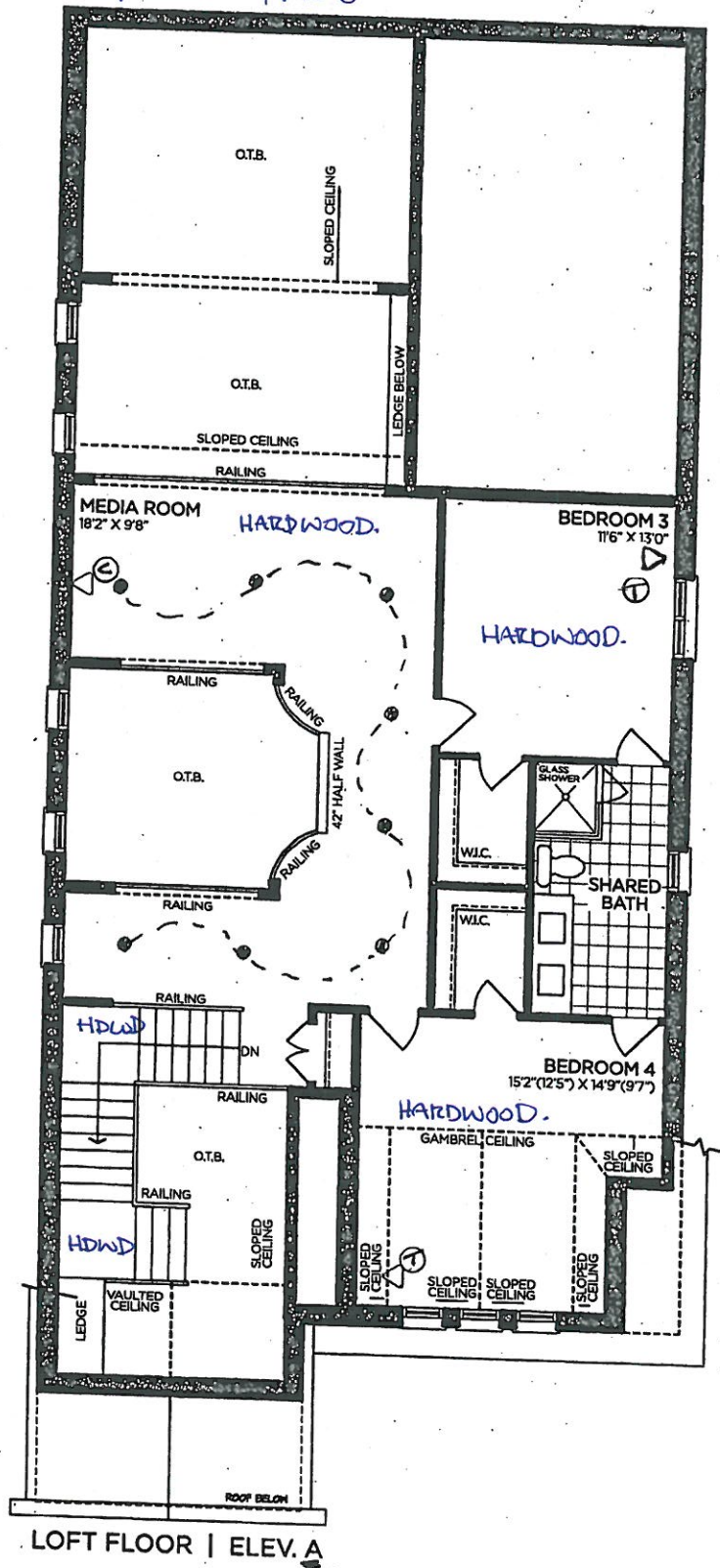

VENDOR

PURCHASER

PURCHASER

GOLDPARK
 WORTH MORE™

Prices, figures, illustrations, sizes, features and finishes are subject to change without notice. Areas and dimensions are approximate and actual usable floor space may vary from the stated area. Layout may be reverse of the unit purchased. E. & O.E. 4000

SCHEDULE 'F'



PV-150

MAY 28 2020

PV-150

Dec. 14, 2020

24x30"

The Briarwood

40' SERIES

→ Elevation A • 2,870 sq.ft.

Elevation B • 2,860 sq.ft.

24x30"

24x30"

24x30"

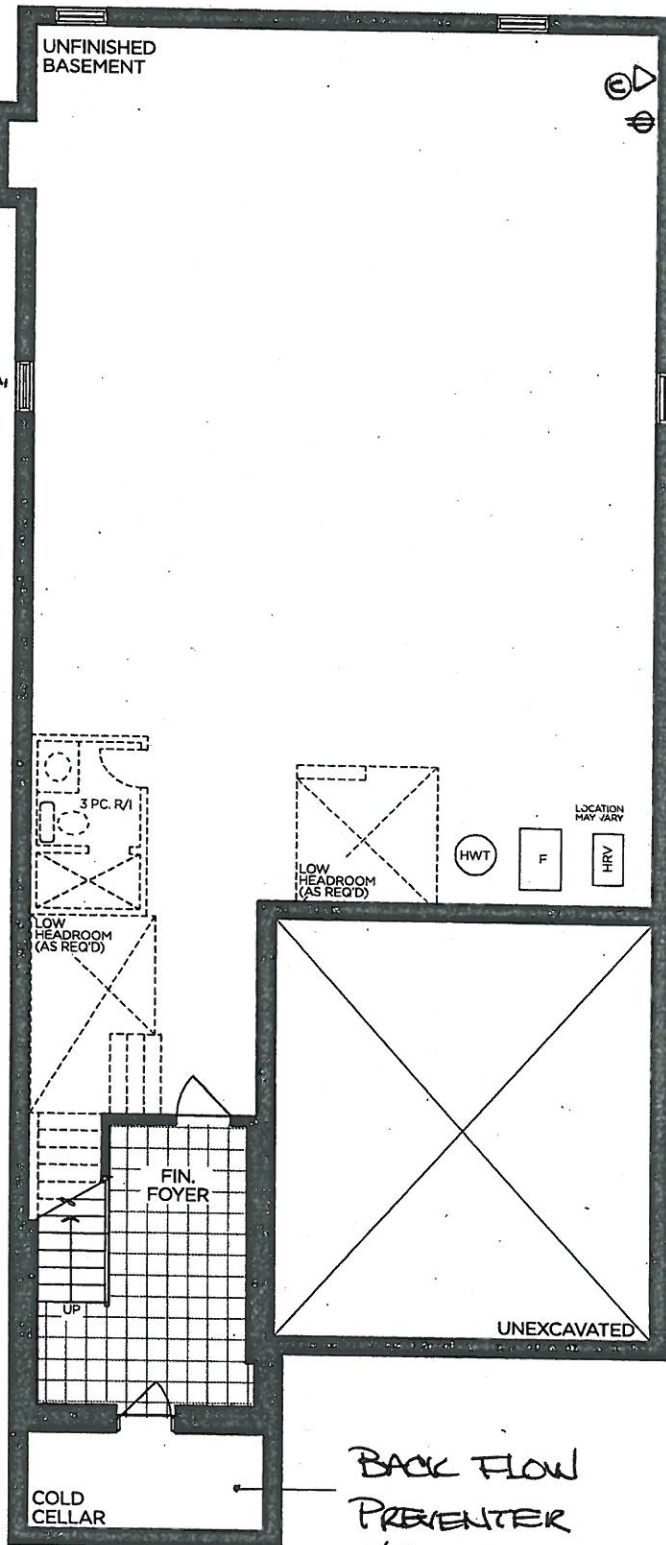

BASEMENT | ELEV. A & B

VENDOR

PURCHASER

PURCHASER

GOLDPARK
WORTH MORE™

Prices, figures, illustrations, sizes, features and finishes are subject to change without notice. Areas and dimensions are approximate and actual usable floor space may vary from the stated area. Layout may be reverse of the unit purchased. E. & O.E. 4000

PV-150

Dec. 14, 2020.

**GOLDPARK HOMES
PINE VALLEY
VAUGHAN, ONTARIO
MODEL: (4000) BRIARWOOD**

SITE STANDARD: WHITE 3/4" EXTENSION
SOFT-CLOSE DRAWERS & STANDARD SLAM DOOR HINGES
TO VANITIES

ONE TOP DRAWER WHERE POSSIBLE THROUGHOUT EACH
VANITY, ONE BANK OF DRAWERS WHERE POSSIBLE
THROUGHOUT EACH MASTER ENSUITE VANITY

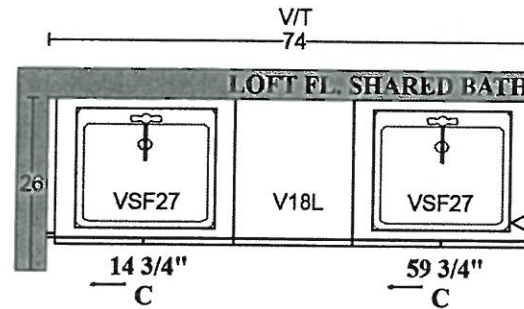
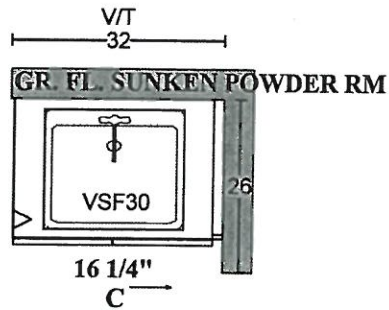
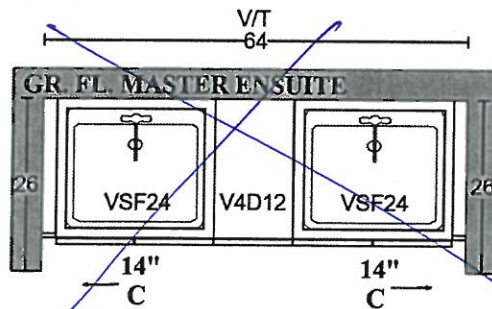

*CHESAPEAKE 'Classic White'

H039-03

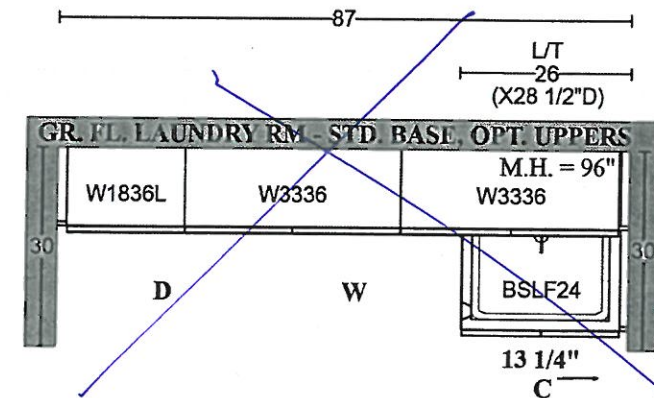
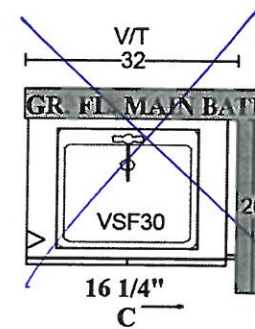

PLAN VIEW

#: AKOWALTCHUK-0032-20 (V1.02)

Page# 2/22

**GOLDPARK HOMES
PINE VALLEY
VAUGHAN, ONTARIO
MODEL: (4000 OPT.) BRIARWOOD**

**SITE STANDARD: WHITE 3/4" EXTENSION
SOFT-CLOSE DRAWERS & STANDARD SLAM DOOR HINGES
TO VANITIES**

**ONE TOP DRAWER WHERE POSSIBLE THROUGHOUT EACH
VANITY, ONE BANK OF DRAWERS WHERE POSSIBLE
THROUGHOUT EACH MASTER ENSUITE VANITY**

PV-150 *AD*
Dec. 14, 2020.

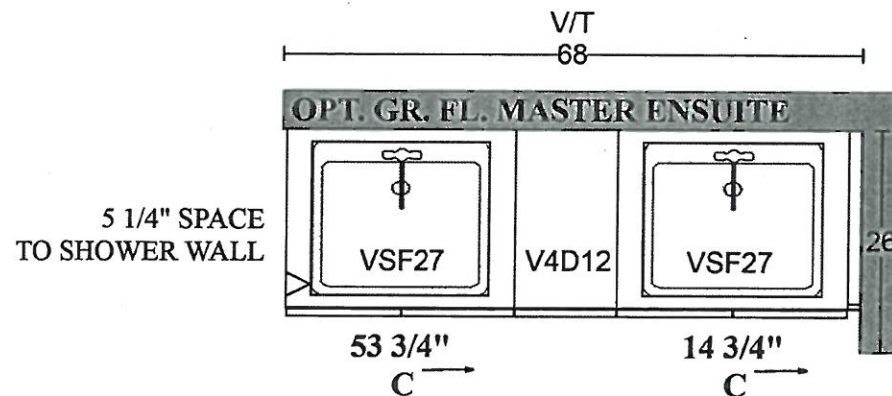

* Monterey 'Storm Grey - Maple'
H001-04

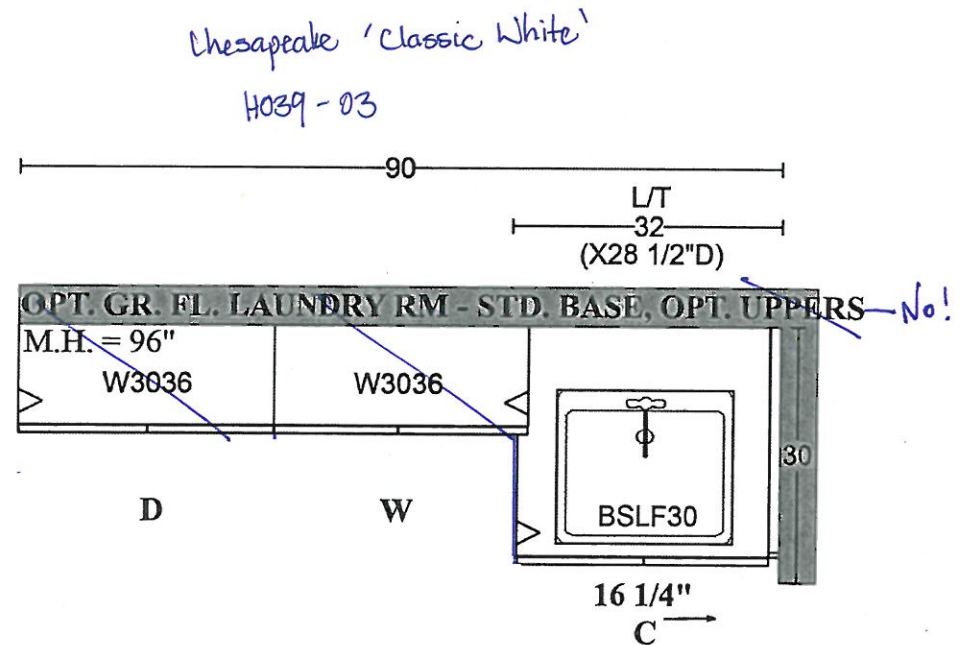

UPDATE JAN 28.2021
KITCHEN DRAWINGS

* Monterey 'STORM GREY MATE' + * includes pantry doors on plan.
* H050-06

* see attach.
Dec. 17, 2020.
PV-150

Add: shallow Pantry (Master Linen).

* Breakfast: Base Cabinetry + Uppers.

OPT. BREAKFAST PANTRIES — No!

← extended nibb.

Base Cabinet + Top drawer.

* see attach.*
PV-150
Jan 25, 2021

Built-in Wine Fridge

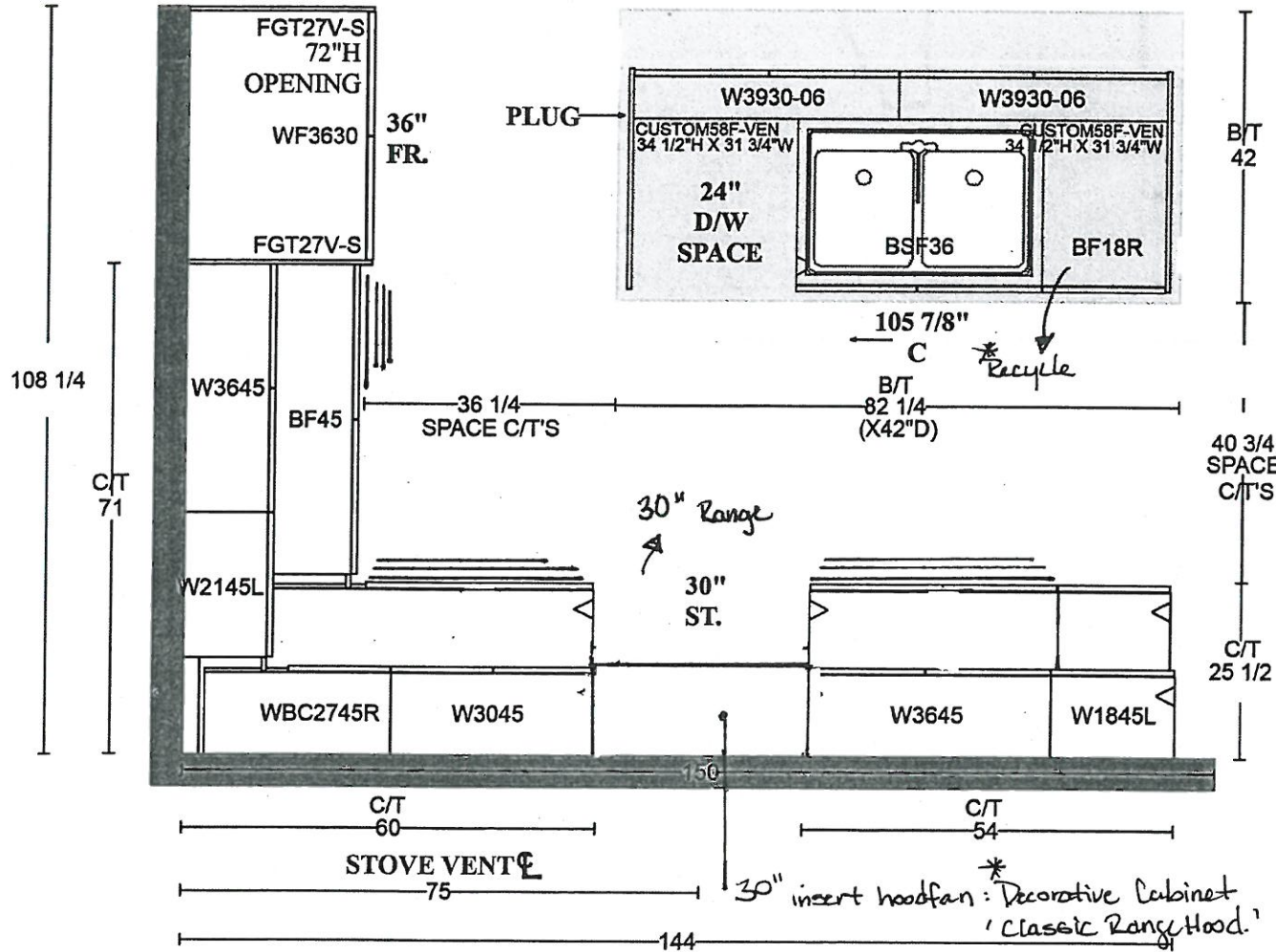

GOLDPARK HOMES
PINE VALLEY
VAUGHAN, ONTARIO
MODEL: (4000 OPT.)
BRIARWOOD

PV-150

Dec. 14, 2020.

SITE STANDARD: WHITE 3/4" EXTENSION
SOFT-CLOSE DRAWERS & SOFT-CLOSE
HINGES TO KITCHEN AREA

10' CEILING - 12"H COFFERED CEILING -
M.H. = 102" + 3/4"H CONTEMPORARY
MOLDING + 5 1/4"H FURRING RAIL
+ LARGE CORNICE MOLDING TO
UNDERSIDE OF BOX



PLAN VIEW

UPDATE JAN 28, 2021
KITCHEN DRAWINGS

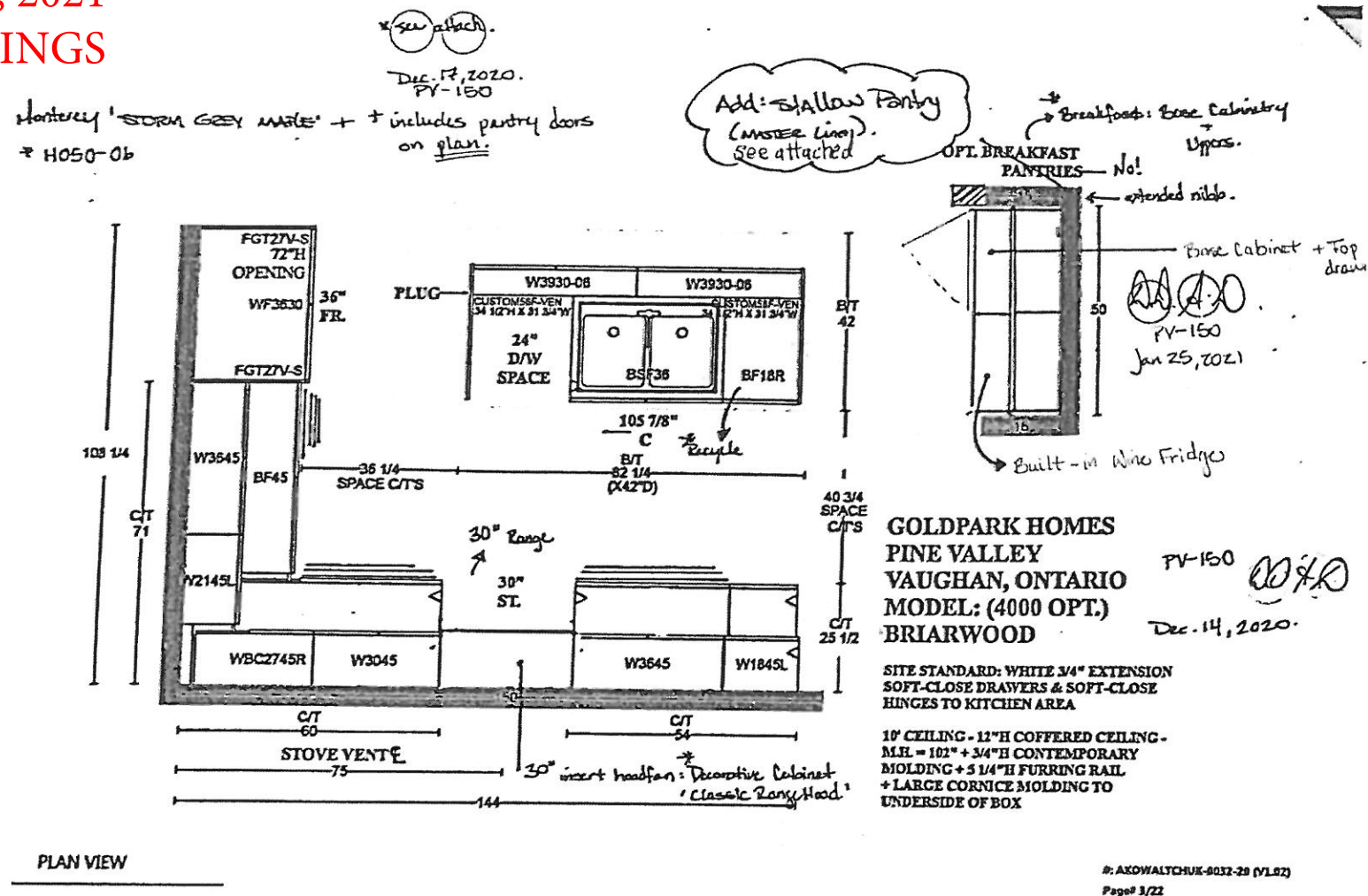

UPDATE JAN 28, 2021

**GOLDPARK HOMES
PINE VALLEY
VAUGHAN, ONTARIO
MODEL: (4000 OPT.) BRIARWOOD**

**SITE STANDARD: WHITE 3/4" EXTENSION
SOFT-CLOSE DRAWERS & STANDARD SLAM DOOR HINGES
TO VANITIES**

**ONE TOP DRAWER WHERE POSSIBLE THROUGHOUT EACH
VANITY, ONE BANK OF DRAWERS WHERE POSSIBLE
THROUGHOUT EACH MASTER ENSUITE VANITY**

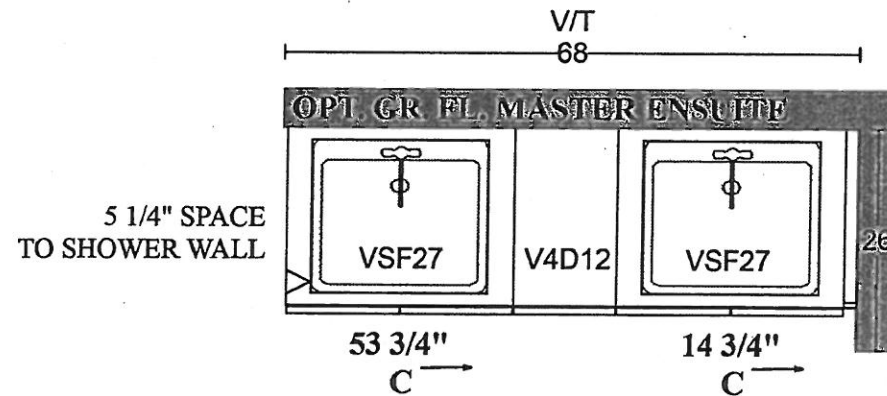

* Monterey 'Storm Grey - Maple'
H001-04

PV-150 *AD*
Dec. 14, 2020.

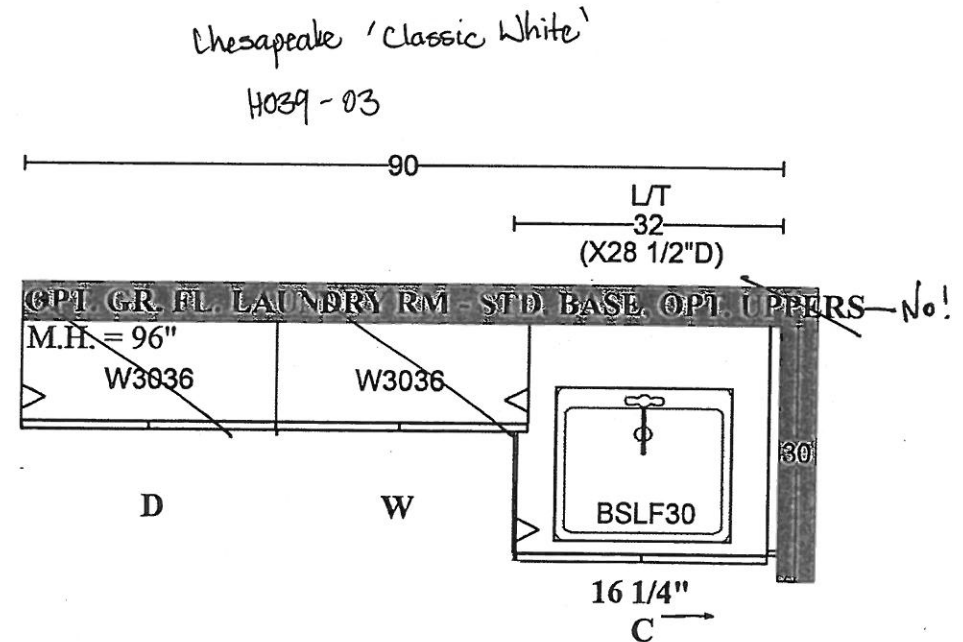

PLAN VIEW

#: AKOWALTCHUK-0032-20 (V1.02)

Page# 4/22

UPDATE JAN 28, 2021

PV-150 *[Signature]*
Dec. 14, 2020.

**GOLDPARK HOMES
PINE VALLEY
VAUGHAN, ONTARIO
MODEL: (4000) BRIARWOOD**

**SITE STANDARD: WHITE 3/4" EXTENSION
SOFT-CLOSE DRAWERS & STANDARD SLAM DOOR HINGES
TO VANITIES**

**ONE TOP DRAWER WHERE POSSIBLE THROUGHOUT EACH
VANITY, ONE BANK OF DRAWERS WHERE POSSIBLE
THROUGHOUT EACH MASTER ENSUITE VANITY**

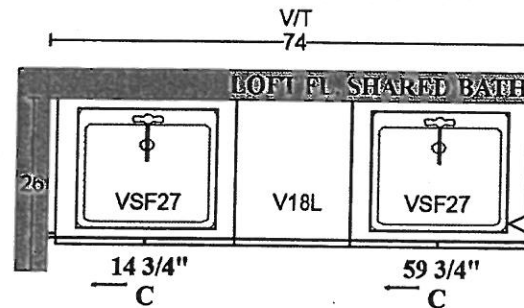
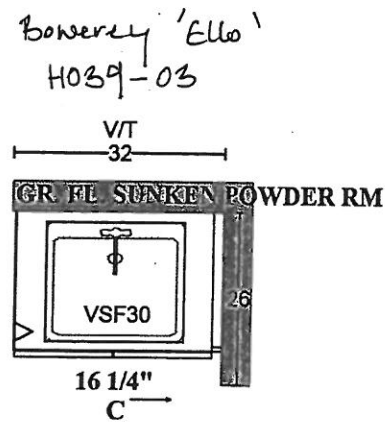
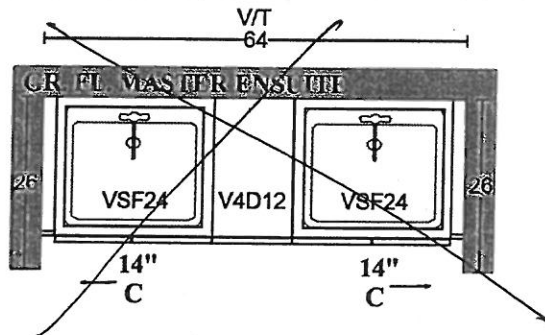

*CLEARANCE 'Classic White'
H039-03

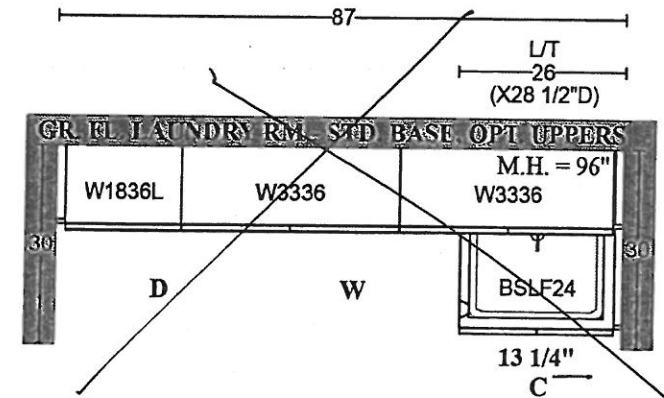
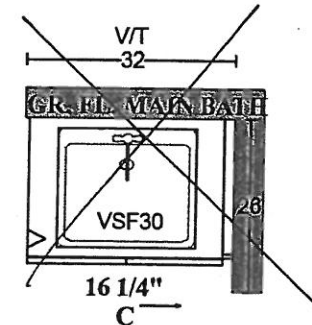

PLAN VIEW

UDPATE JAN 28, 2021

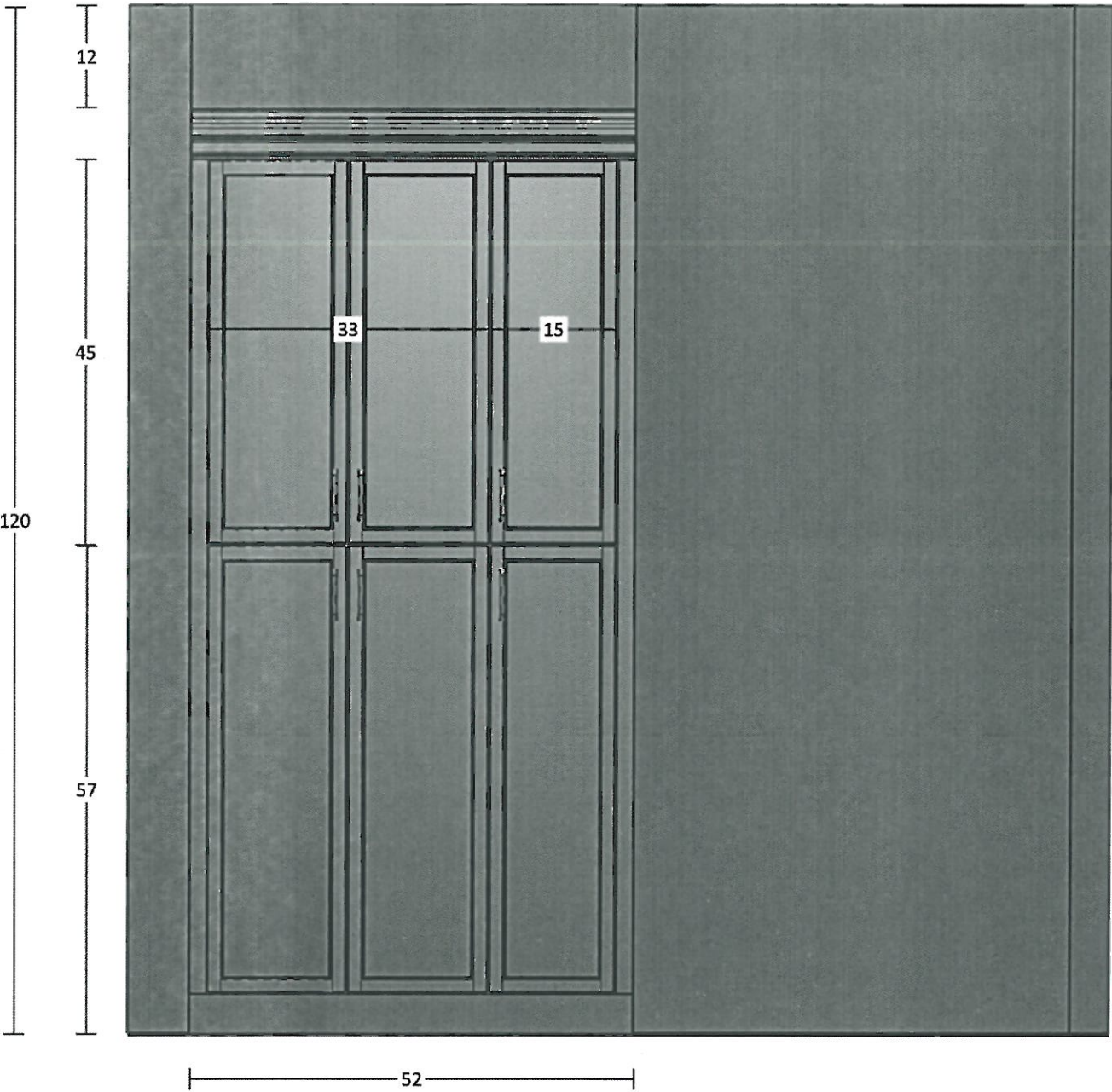

TV-150
Jan 25, 2021

* see attach *

UPDATE JAN 28, 2021

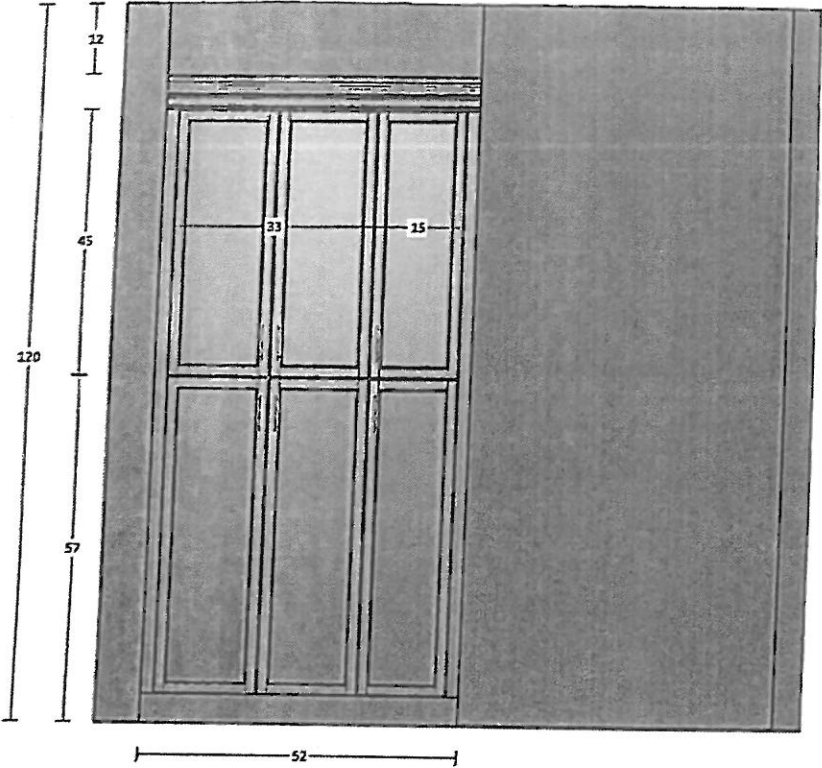

TV-150
Jan 25, 2021



PINE VALLEY

FOREVERGREEN

STONE COUNTERTOP EDGE PROFILES



STANDARD 2CM EASED EDGE

LOCATION:

THRU-OUT.

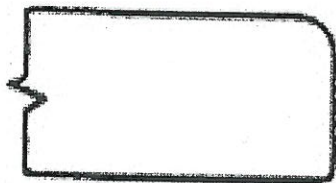

UPGRADE 3CM EASED EDGE

LOCATION:

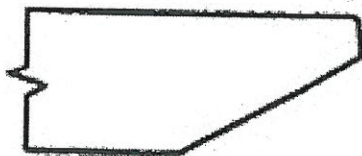

UPGRADE 4CM MITRED EDGE

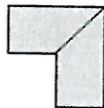

LOCATION:



UPGRADE 2CM OGEE EDGE

LOCATION:

LOT #: PV-150

DATE: December 14, 2020

SIGNATURE:

SIGNATURE:

STANDARD HARDWARE / HANDLES

☐

H001-02

☐

H001-03

☒

H001-04

→ Master Ensuite

☐

H009-03

☐

H009-09

☐

H011-03

☐

H011-05

☐

H011-06

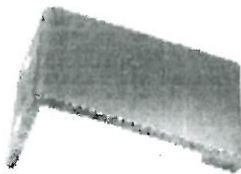
☐

H033-01

☒

H039-03

→ shared Bath
→ Laundry
→ Powder Room

☐

*NO HARDWARE

LOT # PV-150

DATE: Dec. 14, 2020

SIGNATURE:

SIGNATURE:

UPGRADE KITCHEN SINK



BLANCO - QUATRUS R15 U SUPER SINGLE
Stainless Steel - Undermount
32" x 18" x 9"

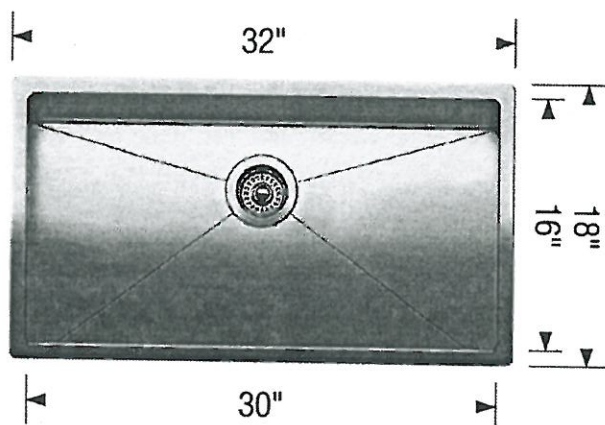
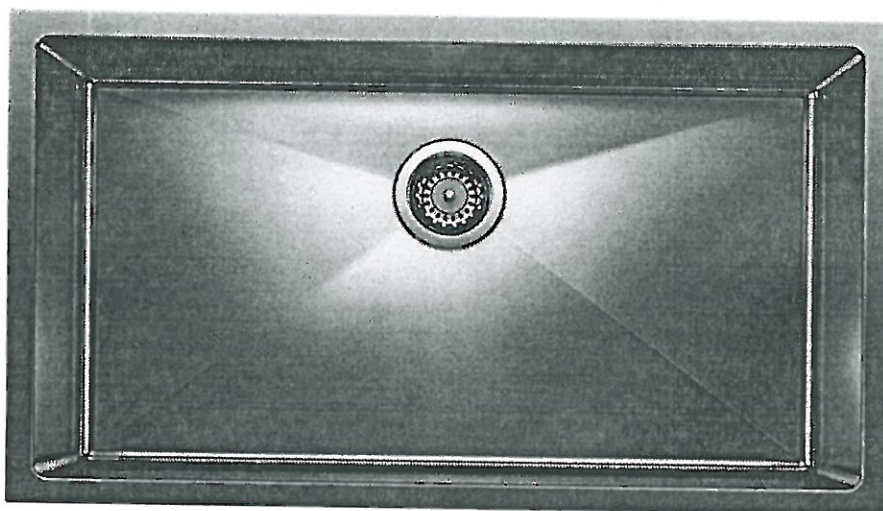

Stainless Steel

☐ GRID

MODEL 401518 Stainless Steel / 406347 Grid

Lot#
PV-150

Room: kitchen

Signature:

Date: Dec. 14, 2020.

Signature:

STANDARD SHOWER HARDWARE



SDK106

Shower Door Knob

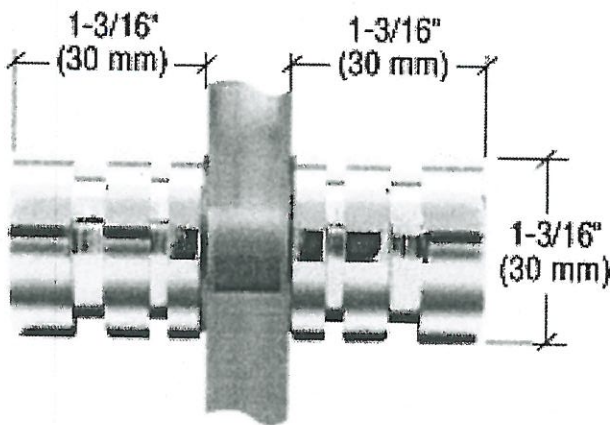

SDK106
Shower Door Knob

1-3/16" dia.
Contemporary Style
(Also available single sided)

CHROME

Lot# PV-150	Date: Dec. 14, 2020	Room: Thru-out.
Signature:		
Signature:		

BATHROOM ACCESSORIES

**PLEASE SELECT ONE OF THE FOLLOWING:*

☒ INSTALL STANDARD BATHROOM ACCESSORIES THRU-OUT (tissue holder + towel bar) **location as per vendors discretion**

☐ **DO NOT** INSTALL STANDARD BATHROOM ACCESSORIES THRU-OUT
tissue holder + towel bar will not be provided

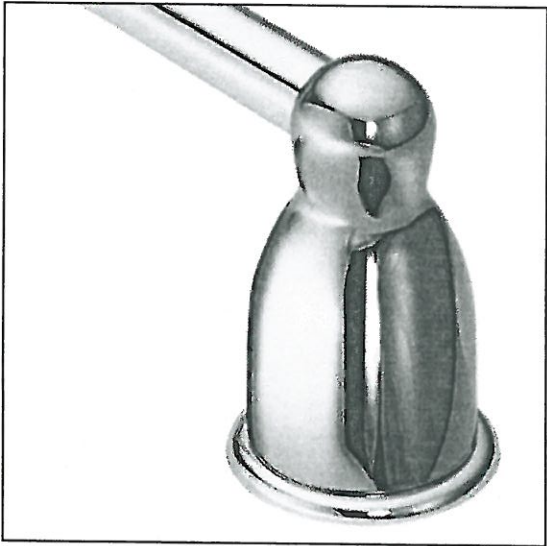
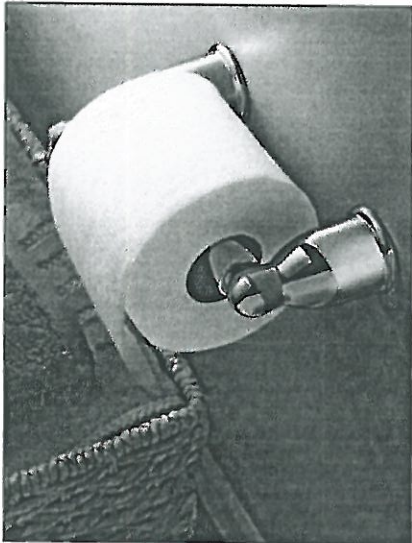

LOT # PV-150

DATE: Dec. 14, 2020

SIGNATURE: 



SIGNATURE: 

UPGRADE KITCHEN EXTRA

CLASSIC RANGE HOOD

(Insert fan not included)



LOT # PV-150	ROOM: Kitchen	DATE: Dec. 14, 2020.
SIGNATURE: 		
SIGNATURE: 		



Project: Pine Valley

Lot: 150

Purchaser(s): Domenico Dell'Aquila & Addolorata Dell'Aquila

Standard Hood Fan Deletion

We acknowledge that the builder's standard hood fan will not be installed.
Do not supply, install and/or credit. We will install our own hood fan after closing.

Signature: _____

A handwritten signature in blue ink, consisting of a stylized 'D' and 'A', is circled in red.

Signature: _____

A handwritten signature in blue ink, consisting of a stylized 'A' and 'A', is circled in red.

Date: December 14 2020



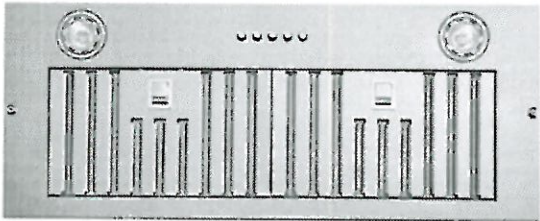

AVM-278PS
30" Insert hood - MSRP: \$569.00



PV-150
Dec. 14, 2020.  

Model		AVM-278PS
Features		
Control	Mechanical push buttons	
Lighting	2 bulbs, 3W LED (bulbs included)	
Blower type	860 CFM, 3-Speed	
Blower performance	Speed 1, 0.7 sones	
	Speed 3, 4.0 sones	
Filter type	2 aluminium superior micro hole filters and stainless steel baffle filters included	
Duct transition	6" Round (Top)	
Ducting	Ducted	
Exterior Appearance		
Stainless steel grade	201	
Electrical Requirements		
Electrical requirements	120V / 60Hz / 2.7 Amps	
Dimensions		
Dimensions	27 3/8" (W) x 11 3/8" (D) x 13 1/2" (H)	
Warranty		
1-year Warranty	Parts and labour, in-home service	

The information contained herein is based on sources that we believe to be reliable, but is not guaranteed by us, may be incomplete or may change without notice

PV-150
Dec. 14, 2020.
 

AVM-278/368PS

Dimensions

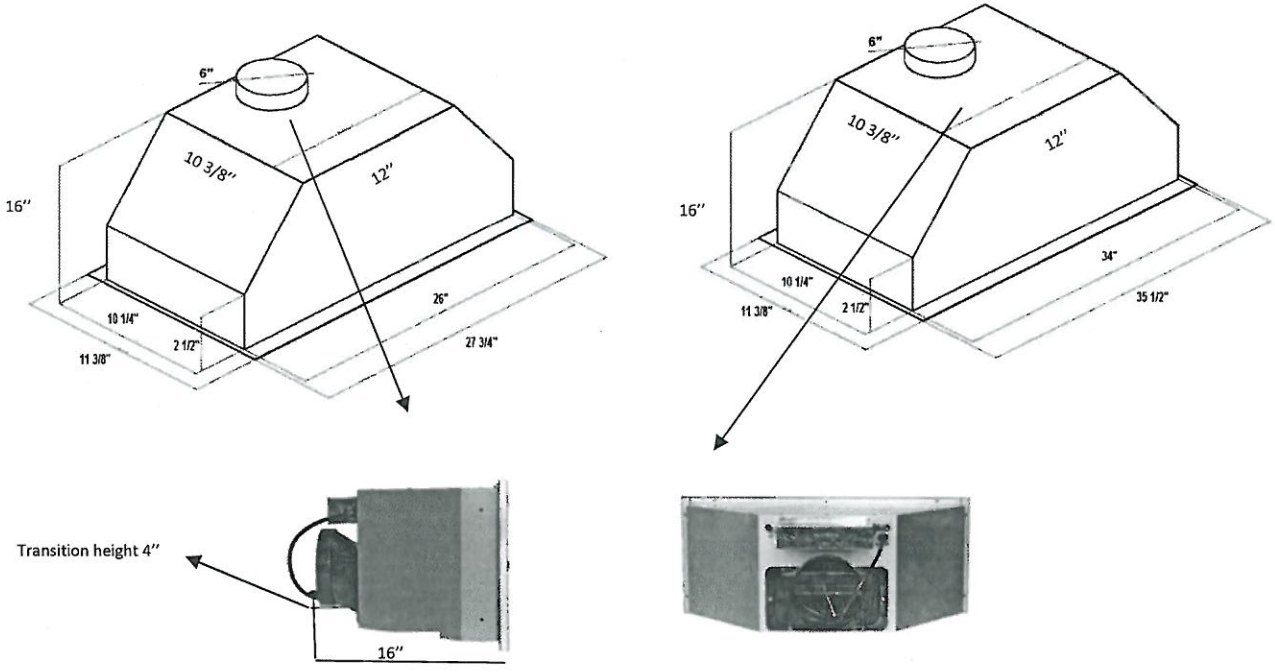

Installation

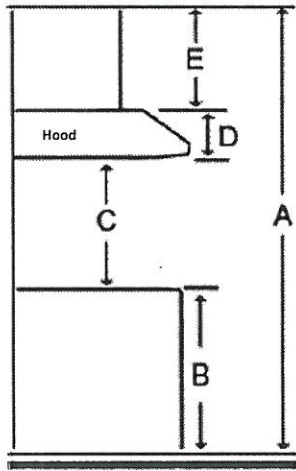

A	Floor to ceiling height	variable
B	Floor to counter top height (standard)	36"
C	Recommended height between cooking surface and bottom of the hood	28" to 30"
D	Hood height (including transition height (4"))	16"
E	Cabinet height	N/A

Duct transition

Top 6" Round



The information contained herein is based on sources that we believe to be reliable, but is not guaranteed by us, may be incomplete and/or may change without notice.

PV-150
Dec. 14, 2020.



PREPARING THE CUT-OUT

1. Using a jigsaw or reciprocal saw cut an opening in the bottom of the cabinet, inside the frame.

NOTE: For frameless cupboards, a $\frac{3}{4}$ " (1.9 cm) front and rear edge is required to form a frame in the bottom of the cabinet. A $\frac{3}{4}$ " (1.9 cm) thick support rod (not included) may be required for certain types of cabinets.

OPENING DIMENSIONS

Model AVM-278PS

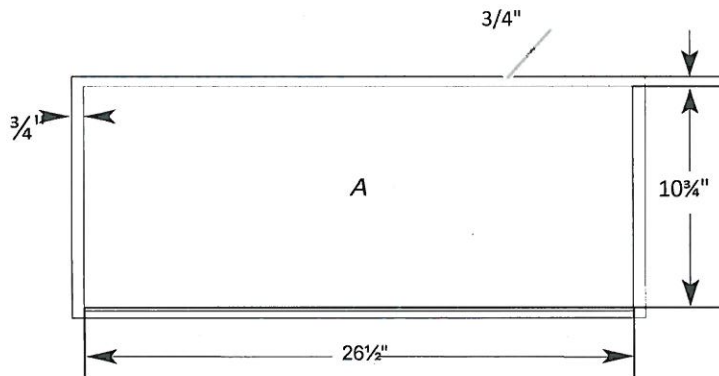

A = Opening in the cupboard

Model AVM-368PS

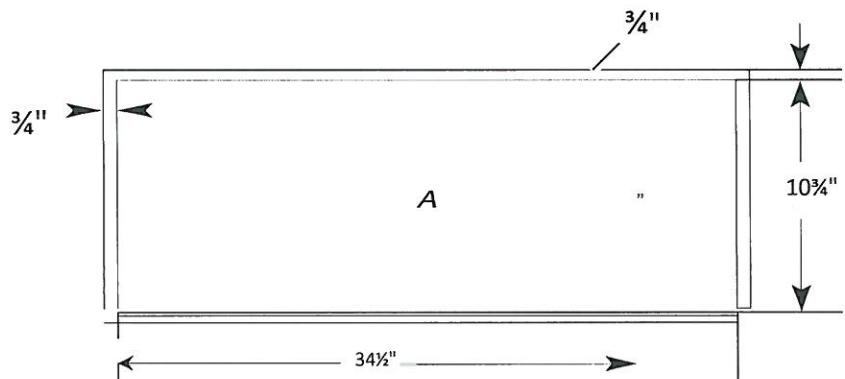

- Remove the decorative panel from the range hood.
 - Cut a hole in the bottom of the cabinet, using the dimensions shown in the table above, according to the model.
 - Insert the hood in the cabinet and secure with the (4) mounting screws from the inner side of the range hood. Make certain that the hood is secure before releasing.
Note: Wood blocking might be necessary if there is no frame to secure the mounting screws.
 - Replace the decorative panel.
2. Complete the closet preparation according to the instructions for the type of home evacuation. Determine the location of the ventilation openings and cut out the openings in the cupboards, walls and / or soffits.