



**Lot: 13**

**Model: 42.02 A ROSEDALE**

**Project/Phase: Pine Valley Forevergreen / 1**

## APPLIANCES

Invoice	Qty.	Description
2560	1	Appliance specifications attached - signed copy
26Jan21 NoCat		

## BASEMENT WINDOWS

Invoice	Qty.	Description
2471 72,675 05Oct20	2	BASEMENT WINDOWS - UPGRADE BASEMENT WINDOW SIZE TO 30 " X 24" - 10" FRAME

## CERAMIC

Invoice	Qty.	Description
2560 37 26Jan21	1	FRONT FOYER: TILE, FLOOR , LEVEL 5 - 24X24" LAID IN STRAIGHT, STACKED PATTERN
2560 35 26Jan21	1	MUD ROOM: TILE, FLOOR , LEVEL 3 - 12X24" LAID IN STRAIGHT, STACKED PATTERN. SEE PLAN FOR TILE DIRECTION
2560 35 26Jan21	1	POWDER ROOM: TILE, FLOOR , LEVEL 3 - 12X24" LAID IN STRAIGHT, STACKED PATTERN. SEE PLAN FOR TILE DIRECTION
2560 38 26Jan21	1	MASTER ENSUITE: TILE, FLOOR , LEVEL 5 - 12X24" LAID IN STRAIGHT, STACKED PATTERN. SEE PLAN FOR TILE DIRECTION
2560 50 26Jan21	1	MASTER ENSUITE: TILE, WALL, LEVEL 4 - 10X30" LAID VERTICAL STACKED PATTERN
2560 43 26Jan21	1	MASTER ENSUITE: TILE, SHOWER FLOOR, LEVEL 2 - 2" HEX
2560 34 26Jan21	1	LAUNDRY: TILE, FLOOR , LEVEL 2 - LAUNDRY - 8X8" LAID STRAIGHT STACKED TO MAKE DESIGN

## CONCRETE AND DRAIN

Invoice	Qty.	Description
2471	1	BACK-FLOW PREVENTER VALVE
05Oct20		
NoCat		



CONSTRUCTION SUMMARY

Lot: 13  
Model: 42.02 A ROSEDALE  
Project/Phase: Pine Valley Forevergreen / 1

ELECTRICAL

Invoice	Qty.	Description
2471 72,281 05Oct20	1	GREAT ROOM: INTERIOR WALL OUTLET: ADDITIONAL 110V WALL INTERIOR RECEPTACLE ON EXISTING CIRCUIT FOR WALL MOUNTED TV - LOCATE APPROX 66" A.F.F. ABOVE FIREPLACE
2471 72,289 05Oct20	6	KITCHEN: 4" E/S LED INTERIOR POT LIGHT - GROUND FLOOR - EACH - INCLUDES 1 SWITCH  INCLUDED IN APS
2471 72,307 05Oct20	1	KITCHEN: FIXTURE: RELOCATE STANDARD CEILING MOUNT FIXTURE APPROX CENTER ABOVE ISLAND
2471 72,272 05Oct20	1	KITCHEN ISLAND: 110V WALL RECEPTACLE ON SEPARATE CIRCUIT - FOR MICROWAVE - MICROWAVE NOT INCLUDED
2560 72,303 26Jan21	1	KITCHEN: FIXTURE: UNDER CABINET FLUORESCENT LIGHT FIXTURES - DOES NOT INCLUDE (AND REQUIRES) LIGHT VALANCE
2560  26Jan21 NoCat	1	KITCHEN: RELOCATE STANDARD COUNTER PLUGS INTO BOTTOM OF UPPER CABINETS

FORMING

Invoice	Qty.	Description
2471 72,205 05Oct20	1	PINE VALLEY MODEL 42.02 ROSEDALE ELEV A - 9 FOOT BASEMENT CEILING HEIGHT IN LIEU OF STANDARD 8 FOOT CEILING.

FRAMING

Invoice	Qty.	Description
2471  05Oct20 NoCat	1	**CUSTOM LAYOUT** DELETE REACH IN CLOSETS IN LAUNDRY AND BEDROOM 4. CREATE 1 LARGE WIC FROM ACCESSIBLE BEDROOM 4, COMPLETE WITH STANDARD FINISHES - SEE PLAN FOR LOCATION

GLASS AND MIRROR

Invoice	Qty.	Description
2560  26Jan21 NoCat	1	THRU OUT: PLEASE DO NOT SUPPLY/INSTALL MIRRORS
2560  26Jan21 NoCat	3	MASTER ENSUITE / ENSUITE 2 / ENSUITE 4 - UPGRADE SHOWER DOOR HANDLE TO MT6X6 - CHROME

**GRANITE MARBLE QUARTZ**

Invoice	Qty.	Description
2560 26Jan21 NoCat	1	POWDER ROOM: UPGRADE 6 MARBLE COUNTER TOP
2560 26Jan21 NoCat	1	KITCHEN: UPGRADE 4 QUARTZ COUNTER TOP
2560 26Jan21 NoCat	1	KITCHEN: FULL HEIGHT SLAB BACKSPLASH
2560 26Jan21 NoCat	1	MASTER ENSUITE: UPGRADE 4 QUARTZ COUNTER TOP
2560 26Jan21 NoCat	1	LAUNDRY: UPGRADE 1 QUARTZ COUNTER AT CABINET + OVER MACHINES

**HARDWOOD**

Invoice	Qty.	Description
2560 4 26Jan21	1	THRU OUT - MAIN HALL/ GREAT ROOM/ DINING/ UPPER HALL/ STUDY LOFT/ MASTER BEDROOM/ BEDROOM 2/ BEDROOM 3/ BEDROOM 4:VINTAGE SERIES, 5" WHITE OAK, NSS ENGINEERED HARDWOOD, 3/4" THK, WIREBRUSH TEXTURE, UV OIL FINISH - LEVEL 3
2560 4 26Jan21	1	KITCHEN/BREAKFAST: VINTAGE SERIES, 5" WHITE OAK, NSS ENGINEERED HARDWOOD, 3/4" THK, WIREBRUSH TEXTURE, UV OIL FINISH - LEVEL 3

**INTERIOR TRIM AND DOORS**

Invoice	Qty.	Description
2471 05Oct20 NoCat	1	**CUSTOM LAYOUT** DELETE REACH IN CLOSETS IN LAUNDRY AND BEDROOM 4. CREATE 1 LARGE WIC FROM ACCESSIBLE BEDROOM 4, COMPLETE WITH STANDARD FINISHES - SEE PLAN FOR LOCATION
2560 153,422 26Jan21	1	THRU OUT: UPGRADE 3 1/4" STEP BEVEL BB CASING, 7 1/4" BASE BOARD  UPGRADE
2560 153,806 26Jan21	1	HALIFAX LEVER, IRON BLACK INTERIOR DOOR HARDWARE  UPGRADE
2560 155,884 26Jan21	1	ADD FOR HINGES 3X3 SQUARE FLAT TIP THROUGHOUT  UPGRADE



**KITCHEN AND BATH CABINETRY**

Invoice	Qty.	Description
2560  26Jan21 NoCat	1	THRU OUT: SEE ATTACHED CABINETRY SCHEDULE
2560  26Jan21 NoCat	1	Appliance specifications attached - signed copy

**NETWORK AND WIRING**

Invoice	Qty.	Description
2471 72,259 05Oct20	1	GREAT ROOM: CONDUIT PIPE - FOR WALL MOUNT TV - LOCATE APPROX 66" A.F.F. ABOVE FIREPLACE, THRU BASEMENT, TERMINATING AT CABLE - SEE PLAN FOR LOCATION
2471 72,260 05Oct20	1	CONDUIT PIPE - FROM ATTIC TO BASEMENT - FROM BASEMENT NEAR ELECTRICAL PANEL TO APPROX CENTER OF ATTIC
2471 72,264 05Oct20	1	MUD ROOM: ROUGH - IN FOR EXTRA SECURITY KEY PAD

**PAINT**

Invoice	Qty.	Description
2471  05Oct20 NoCat	1	**CUSTOM LAYOUT** DELETE REACH IN CLOSETS IN LAUNDRY AND BEDROOM 4. CREATE 1 LARGE WIC FROM ACCESSIBLE BEDROOM 4, COMPLETE WITH STANDARD FINISHES - SEE PLAN FOR LOCATION

**PAINTING**

Invoice	Qty.	Description
2560  26Jan21 NoCat	2	MAIN STAIRS - BASEMENT TO 2ND FLOOR - STAIN STAIRS AND LANDINGS  WILL NOT MATCH HARDWOOD FLOOR IN COLOUR/TEXTURE/FINISH

**PLUMBING**

Invoice	Qty.	Description
2560  26Jan21 NoCat	1	LAUNDRY: UPGRADE SINK TO SS UNDERMOUNT + SINGLE HOLE FAUCET - CHROME
2560  26Jan21 NoCat	1	KITCHEN: UPGRADE SINK TO BLANCO SUPER SINGLE - STAINLESS
2560  26Jan21 NoCat	1	KITCHEN: MOEN 'NIO' BLACK FAUCET WITH GOLD HANDLE



CONSTRUCTION SUMMARY

Lot: 13  
Model: 42.02 A ROSEDALE  
Project/Phase: Pine Valley Forevergreen / 1

PLUMBING FIXTURES

Invoice	Qty.	Description
2471  05Oct20 NoCat	1	MASTER ENSUITE: UPGRADE TO MOEN 'ALIGN' RAIN SHOWER (from ceiling) + HAND SHOWER WITH SLIDE BAR CHROME #T219EP/3372/T4191/62320/3887EP/A725/116651

Purchasers: FERNANDO R BETTENCOURT & KRISTINA G, Property: 13 of Plan -

Telephone Res. / Bus: / (416) 565-7509

Project: Pine Valley Forevergreen - Phase 1

Decor Advisor: Yolande Somerville

Model and Elevation: 42.02 A ROSEDALE

Layout Changes: ☐ Yes ☒ No Sketch Attached: ☒ Yes ☐ No Exterior Colour Scheme:

### 1. Cabinetry

	Style and Colour	Counter	Hardware
Kitchen / Breakfast	*Medio 6 'Oyster'	*Quartz: Frosty Carina	attached
Laundry Room	Bowery 'Ello'	*Quartz: Nordic Loft	attached
Powder Room	*Pacifica 'Slate Grey Maple'	*Marble: Collemantina	attached
Ensuite 3	Chesapeake 'Classic White'	Quartz: Ice Snow	attached
Master Ensuite Bathroom	*Medio 6 'Oyster'	*Quartz: Organic White	attached
Second Ensuite Bathroom (If Applicable)	Tribeca 'Stello'	Quartz: Nordic Loft	attached
Ensuite 4	Tribeca 'Stello'	Quartz: Nordic Loft	attached

Comment

### 2. Floor Tile

	Selection
Entrance Vestibule	*24x24" Volkas polished 'White'
Main Hall	
Kitchen / Breakfast	hardwood
Laundry Room	*8x8" Marakesh matte 'Mix 2'
Powder Room	*12x24" Volkas polished 'White' + Mud Room
Ensuite 3	13x13" Sempre 'White'
Master Ensuite Bathroom	*12x24" Pisentina semi pol 'White'
Second Ensuite Bathroom (If Applicable)	13x13" Costa matte 'White'
Lower Landing (If Applicable)	13x13" Costa matte 'White'
Ensuite 4	13x13" Costa matte 'White'

Comment

Shower floor: Master 2" Hex Quebec Arctic White - all others standard 2x2" white

### 3. Wall Tile

	Selection	Listello/Inserts	Describe
Ensuite 3	8x10" Weave 'White'	<input type="radio"/> Yes <input checked="" type="radio"/> No	
Master Ensuite Bathroom			
Tub Deck		<input type="radio"/> Yes <input checked="" type="radio"/> No	
Shower Stall	*10x30" Roma Filo Dec 'Statuario'	<input type="radio"/> Yes <input checked="" type="radio"/> No	
Bathroom Walls		<input type="radio"/> Yes <input checked="" type="radio"/> No	
Second Ensuite Bathroom (If Applicable)	8x10" Uniwall 'White'	<input type="radio"/> Yes <input checked="" type="radio"/> No	
Ensuite 4	8x10" Uniwall 'White'	<input type="radio"/> Yes <input checked="" type="radio"/> No	
Kitchen Backsplash	<input checked="" type="radio"/> Yes <input type="radio"/> No	Backsplash Behind Fridge	
	*FHBS - slab, same as counter		

Comment



Purchasers: FERNANDO R BETTENCOURT & KRISTINA G, Property: 13 of Plan -

Telephone Res. / Bus: / (416) 565-7509

Project: Pine Valley Forevergreen - Phase 1

Decor Advisor: Yolande Somerville

Model and Elevation: 42.02 A ROSEDALE

#### 4. Plumbing Fixtures

Master Ensuite Bathroom ☐ Second Ensuite ☐ Powder Room ☐  
Other Room - Specify ☐ Other Washroom ☐

Comment

Upgrade kitchen + laundry

#### 5. Hardwood Flooring

	Type and Stain		Type and Stain
Main Hall	<input type="text"/>	Upper Landing	<input type="text"/>
Kitchen / Breakfast	*3/4x5" wht oak wirebrush 'Gotham'	Upper Hall	<input type="text"/>
Living Room	<input type="text"/>	Master Bedroom	<input type="text"/>
Dining Room	<input type="text"/>	Bedroom #2	<input type="text"/>
Family Room	<input type="text"/>	Bedroom #3	<input type="text"/>
Den/Library	<input type="text"/>	Bedroom #4	<input type="text"/>
Entrance Vestibule	<input type="text"/>	Bedroom #5	<input type="text"/>
Lower Landing (If Applicable)	<input type="text"/>	Other Room - Specify	<input type="text"/>
		Thru out standar areas	*3/4x5" wht oak wirebrush 'Gotham'

Comment

#### 6. Carpeting

	Upgrade	Description
Ground Floor	<input type="checkbox"/>	<input type="text"/>
Second Floor	<input type="checkbox"/>	<input type="text"/>
<input type="text"/>	<input type="checkbox"/>	<input type="text"/>

Upgrade Underpad	Type <input type="text"/>	Area <input type="text"/>
Carpet on Stairs	Capped <input type="text"/>	Runner - *Upgrade <input type="text"/>

Comment

#### 7. Fireplace

	Living Room			Family Room			Other Room - Specify		
	Purchased	As Per Plan	N/A	Purchased	As Per Plan	N/A	Purchased	As Per Plan	N/A
Fireplace Type	<input type="radio"/>	<input type="radio"/>	<input checked="" type="radio"/>	<input type="radio"/>	<input checked="" type="radio"/>	<input type="radio"/>	<input type="radio"/>	<input type="radio"/>	<input checked="" type="radio"/>
Mantle Type	<input type="text"/>	<input type="text"/>	<input type="text"/>	Gas Fireplace	<input type="text"/>	<input type="text"/>	<input type="text"/>	<input type="text"/>	<input type="text"/>
Colour / Stain	<input type="text"/>	<input type="text"/>	<input type="text"/>	Mediterranean	<input type="text"/>	<input type="text"/>	<input type="text"/>	<input type="text"/>	<input type="text"/>
Surround	<input type="text"/>	<input type="text"/>	<input type="text"/>	Arctic White	<input type="text"/>	<input type="text"/>	<input type="text"/>	<input type="text"/>	<input type="text"/>
Hearth	<input type="text"/>	<input type="text"/>	<input type="text"/>	n/a	<input type="text"/>	<input type="text"/>	<input type="text"/>	<input type="text"/>	<input type="text"/>
	<input type="text"/>	<input type="text"/>	<input type="text"/>	none	<input type="text"/>	<input type="text"/>	<input type="text"/>	<input type="text"/>	<input type="text"/>

Comment

*[Handwritten Signature]*

Purchasers: FERNANDO R BETTENCOURT & KRISTINA G, Property: 13 of Plan -

Telephone Res. / Bus: / (416) 565-7509

Project: Pine Valley Forevergreen - Phase 1

Decor Advisor: Yolande Somerville

Model and Elevation: 42.02 A ROSEDALE

## 8. Trim Carpentry

Interior Doors  Front Door Glass Inserts  Door Handles   
Interior Trim   
Comment

## 9. Plaster Mouldings and Medallions

Standard Throughout ☐ Yes ☐ No ☒ N/A

Entrance Vestibule	<input type="text"/>	<input type="text"/>	Kitchen/Breakfast	<input type="text"/>	<input type="text"/>
Main Hall	<input type="text"/>	<input type="text"/>	Den/Library	<input type="text"/>	<input type="text"/>
Living Room	<input type="text"/>	<input type="text"/>	Lower Landing	<input type="text"/>	<input type="text"/>
Dining Room	<input type="text"/>	<input type="text"/>	Other Room - Specify	<input type="text"/>	<input type="text"/>
Family Room	<input type="text"/>	<input type="text"/>			

Comment

## 10. Railings and Spindles

Railing Package   
Railing Colour  Spindle Colour   
Stringer / Riser  Treads   
Oak Stairs ☒ Yes ☐ No ☐ N/A  
Comment

## 11. Wall Paint / Ceilings

Throughout Finished Areas   
  
Trim Paint   
Smooth Ceilings  
Ground Floor ☒  
Second Floor ☒  
Note

Comment



Purchasers: FERNANDO R BETTENCOURT & KRISTINA G, Property: 13 of Plan -

Telephone Res. / Bus: / (416) 565-7509

Project: Pine Valley Forevergreen - Phase 1

Decor Advisor: Yolande Somerville

Model and Elevation: 42.02 A ROSEDALE

## 12. Electrical

Hood Fan ☐ White ☐ Stainless ☒ N/A

Above Kitchen Cabinet Light ☐ Yes ☒ No

Below Kitchen Cabinet Light ☒ Yes ☐ No

Standard Appliances ☐

Over The Range Microwave ☐

Chimney Style Fan ☐

Comment

## 13. Heating and Air Conditioning

Air Conditioning

Gas Provisions Stove

Gas Provisions Dryer

Gas Provisions Barbecue

Comment

## 14. Additional Comments

## 15. Disclaimers and Notes

- Colours of all materials are as close as possible to builder's selection, but not necessarily identical due to variances in manufacturing.
- Any extras listed above are null and void unless accompanied by a separate invoice/amendment. Said invoice must be paid in full.
- The Purchaser acknowledges that after Interior Colour Selection form is signed and dated, no further changes will be permitted other than re-selection due to unavailability. \_\_\_\_\_ Purchaser's Initials
- The Purchaser acknowledges reading and accepting the "Gold Park Homes Decor Centre Disclaimers" form. This document contains other miscellaneous disclaimers.

This Interior Colour Selection is final and approved by:

Signature:  Date: \_\_\_\_\_

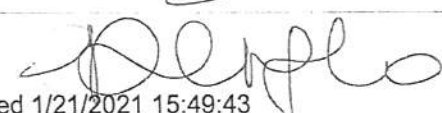

PV - 13 Cabinetry Schedule

ROOM	DESCRIPTION	PRICE	QTY	TOTAL
KITCHEN	UPGRADE FROM SERIES 2 TO SERIES 5 - <i>MEDIO 6 OYSTER</i>		1	\$
	UPGRADE HARDWARE - BH-081-03 (MATTE BLACK)		1	\$
	ADD CHATEAU HOOD CANOPY		1	\$
	CONVERT FULL DOOR BASE CABINET INTO BASE POTS AND PANS		2	\$
	CONVERT BASE CABINET TO BOTTOM DRAWER W/ M/W SHELF		1	\$
	ADJUST CABINETRY FOR 36" RANGE (N/C)		1	\$
	RETURN TRIP FOR HARDWOOD IN KITCHEN		1	\$
	CABINETRY VALANCE		1	\$
	HIDDEN RECEPTICLE BELOW UPPER CABINET - BUILT IN BOX REQUIRED INSIDE UPPER CABINET TO CON			
	WIRING		1	\$
ISLAND	UPGRADE FROM SERIES 2 TO SERIES 5 - <i>MEDIO 6 OYSTER</i>		1	\$
	ADD FULL DOOR 2-BIN PULL OUT RECYCLING CENTRE		1	\$
	ADD DECORATIVE PANELS TO SIDES OF ISLAND		1	\$
	FURNITURE KICK		1	\$
	ADD TOUCH LATCH TO BACK OF ISLAND		1	\$
				\$
MASTER ENSUITE	UPGRADE FROM SERIES 2 TO SERIES 5 - <i>MEDIO 6 OYSTER</i>		1	\$
ENSUITE 4	ADD BANK OF DRAWERS		2	\$
POWDER ROOM	UPGRADE FROM SERIES 2 TO SERIES 3 - <i>PACIFICA SLATE GREY MAPLE</i>		1	\$
LAUNDRY	ADD BUILT IN WASHER/DRYER WITH LAUNDRY GABLE		1	\$
CABINETRY TOTAL:				\$

LOT #:
PV-13

DATE:
Jan 21, 2021

SIGNATURE:

SIGNATURE:



PV-13

Oct 5 2020

PV-13

Jan 21, 2021



## SCHEDULE 'F'

# The Rosedale 42' SERIES

→ Elevation A • 3,655 sq.ft.  
Elevation B • 3,605 sq.ft.  
Elevation C • 3,590 sq.ft.

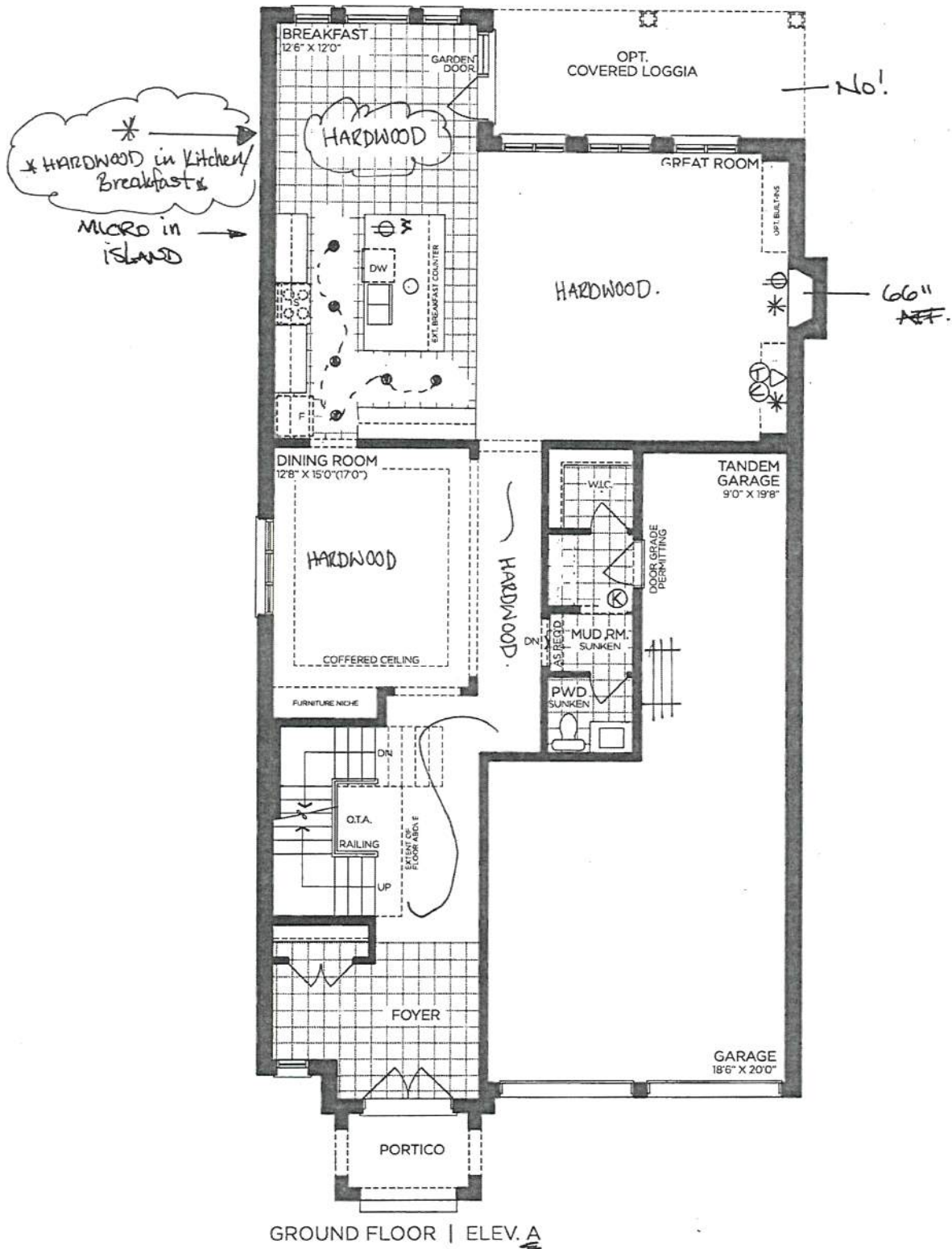

VENDOR

PURCHASER

PURCHASER

**GOLDPARK**  
WORTH MORE™

Prices, figures, illustrations, sizes, features and finishes are subject to change without notice. Areas and dimensions are approximate and actual usable floor space may vary from the stated area. Layout may be reverse of the unit purchased. E. & O.E. 4202



SCHEDULE 'F'



PV-13  
Oct 5 2020  
PV-13  
Jan 21, 2021

The  
Rosedale  
42' SERIES

→ Elevation A • 3,655 sq.ft.  
Elevation B • 3,605 sq.ft.  
Elevation C • 3,590 sq.ft.

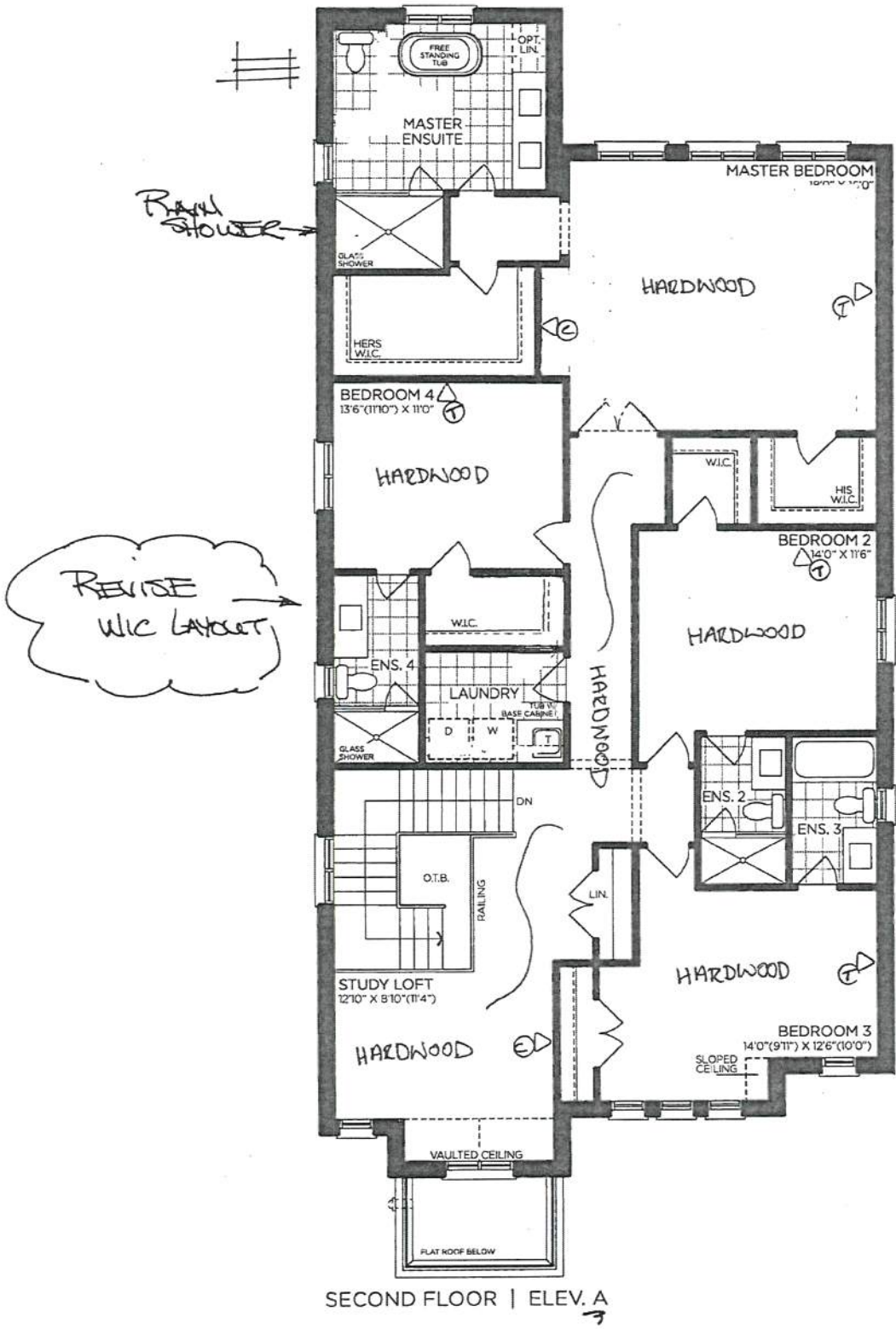

SECOND FLOOR | ELEV. A  
7

VENDOR

PURCHASER

PURCHASER

GOLDPARK  
WORTH MORE™

Prices, figures, illustrations, sizes, features and finishes are subject to change without notice. Areas and dimensions are approximate and actual usable floor space may vary from the stated area. Layout may be reverse of the unit purchased. E. & O.E. 4202

SCHEDULE 'F'



PV-13  
Oct 5 2020  
PV-13  
Jan 21, 2021

# The Rosedale

## 42' SERIES

- Elevation A • 3,655 sq.ft.  
Elevation B • 3,605 sq.ft.  
Elevation C • 3,590 sq.ft.

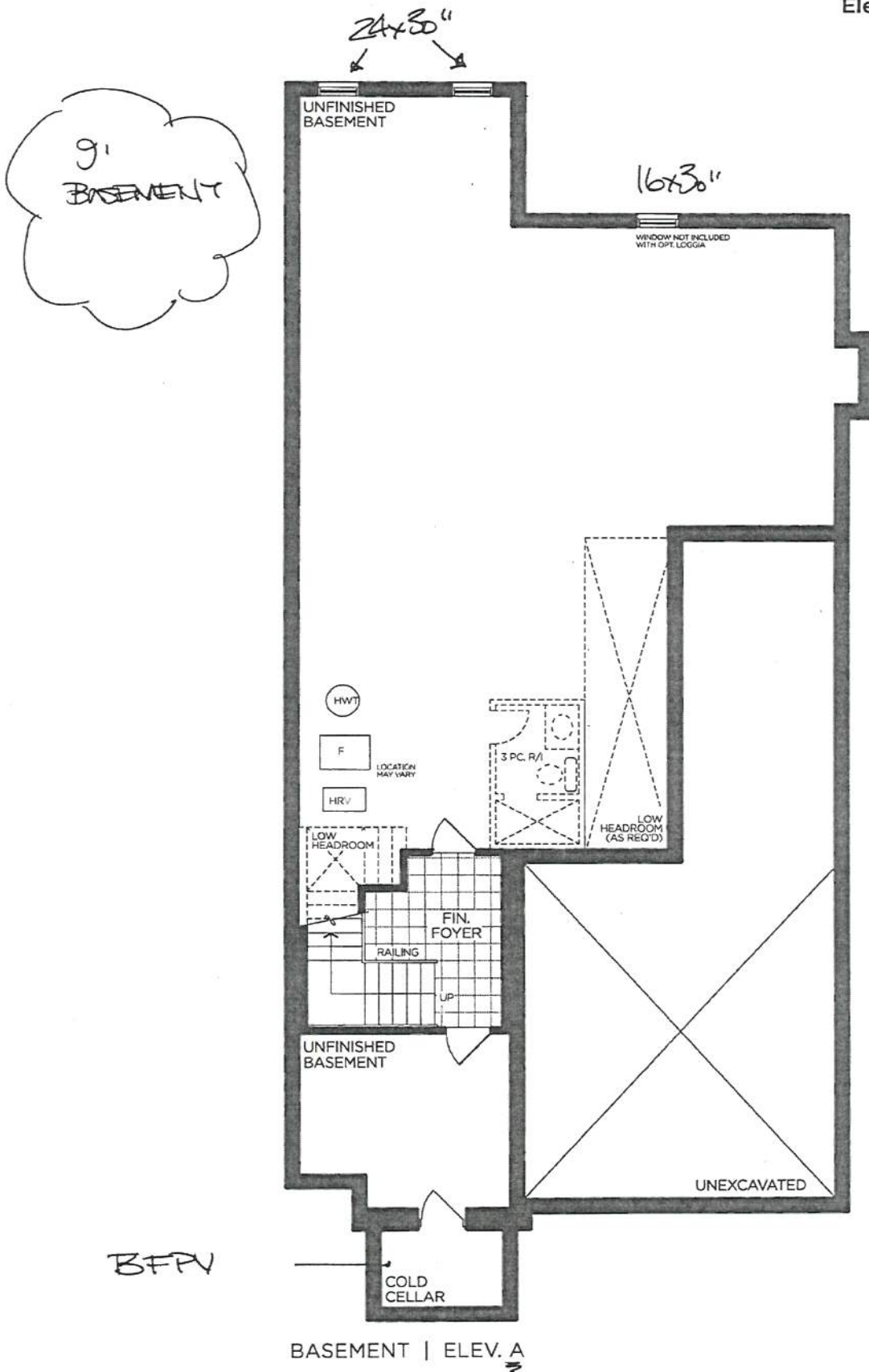

VENDOR

PURCHASER

PURCHASER

**GOLDPARK**  
WORTH MORE™

Prices, figures, illustrations, sizes, features and finishes are subject to change without notice. Areas and dimensions are approximate and actual usable floor space may vary from the stated area. Layout may be reverse of the unit purchased. E. & O.E. 4202

Jan 21, 2021

Medio b - 'Oyster'

DH-081-03 (but black)

\* Light Valve

Handwritten: Handwritten:

vertically on doors  
horizontally on drawers  
+ on Reaple.

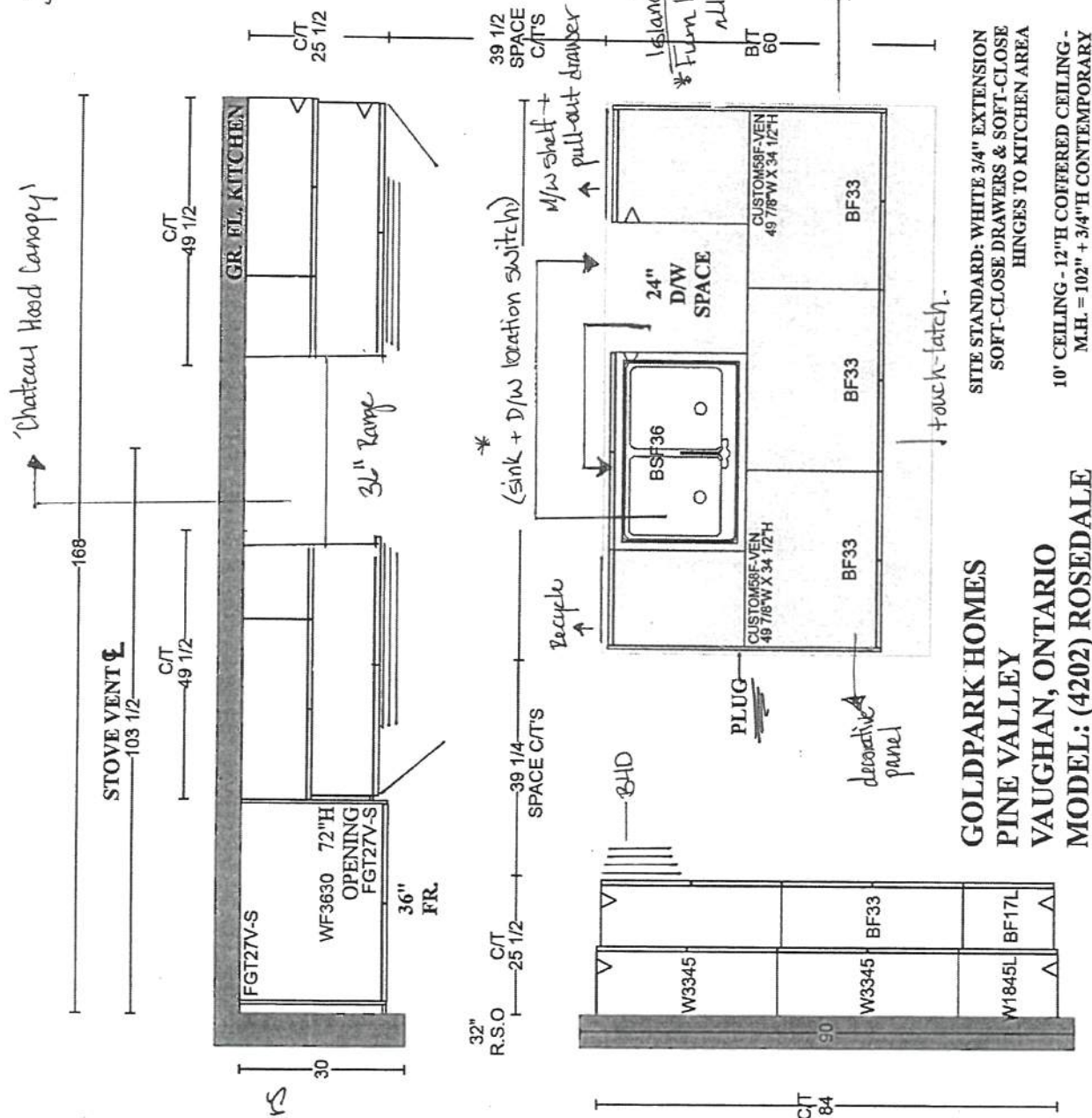

**GOLDPARK HOMES  
PINE VALLEY  
VAUGHAN, ONTARIO  
MODEL: (4202) ROSEDALE**

**SITE STANDARD: WHITE 3/4" EXTENSION  
SOFT-CLOSE DRAWERS & SOFT-CLOSE  
HINGES TO KITCHEN AREA**

**10' CEILING - 12"H COFFERED CEILING -  
M.H. = 102" + 3/4"H CONTEMPORARY  
MOLDING + 5 1/4"H FURRING RAIL  
+ LARGE CORNICE MOLDING TO  
UNDERSIDE OF BOX**



RV-13  
 Jun 21, 2021

Bowery - 'Ello'  
 H039-03

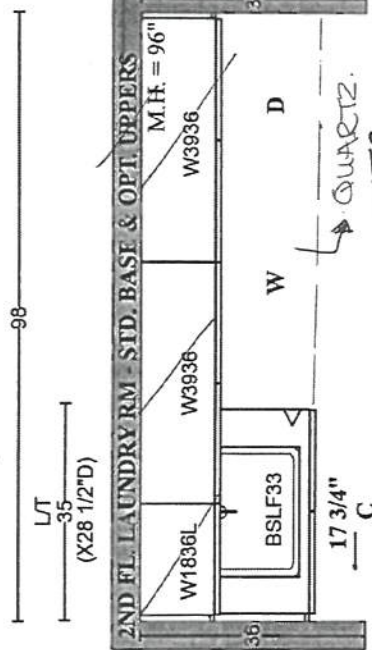

No!

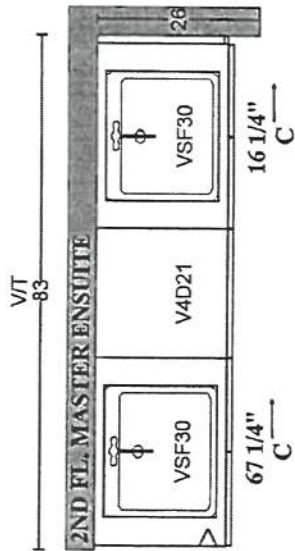

Nedie - 'Oyster'  
 K002-03

**GOLDPARK HOMES  
 PINE VALLEY  
 VAUGHAN, ONTARIO  
 MODEL: (4202) ROSEDALE**

SITE STANDARD: WHITE 3/4" EXTENSION  
 SOFT-CLOSE DRAWERS & STANDARD SLAM DOOR HINGES  
 TO VANITIES  
 ONE TOP DRAWER WHERE POSSIBLE THROUGHOUT EACH  
 VANITY, ONE BANK OF DRAWERS WHERE POSSIBLE  
 THROUGHOUT EACH MASTER ENSUITE VANITY

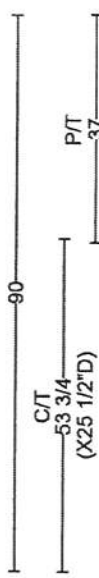

No!

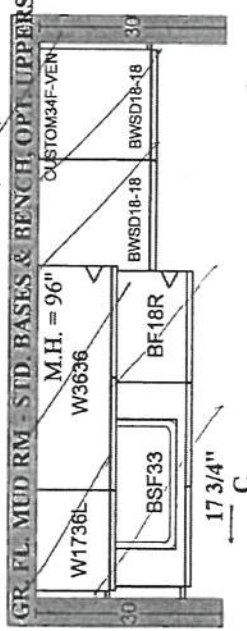

Pacific - 'Slate Grey Maple'  
 K002-05

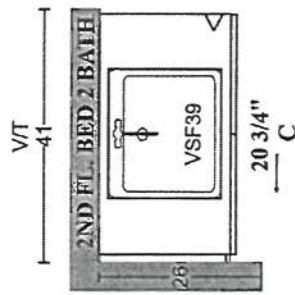

Tribeca Stello  
 H039-03

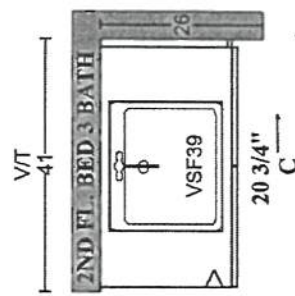

Chesapeake 'Classic White'  
 K002-05

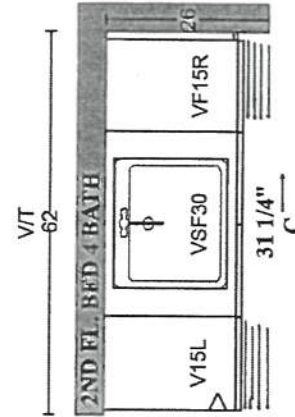

Tribeca 'Stello'  
 H039-03

PLAN VIEW





PINE VALLEY  
FOREVERGREEN

STONE COUNTERTOP EDGE PROFILES

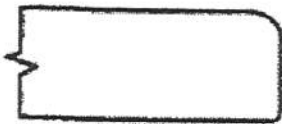

STANDARD 2CM EASED EDGE

LOCATION:

\*THRU-OUT\*



UPGRADE 3CM EASED EDGE

LOCATION:

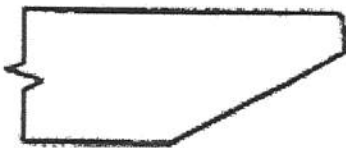

UPGRADE 4CM MITRED EDGE

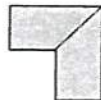

LOCATION:

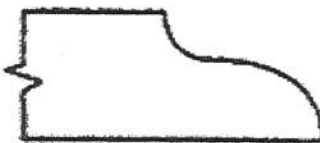

UPGRADE 2CM OGEE EDGE

LOCATION:

LOT #: PV-13

DATE: Jan 21, 2021

SIGNATURE:

SIGNATURE:

GOLDPARK  
WORTH MORE

STANDARD HARDWARE / KNOBS

☐

K002-02

☒

K002-03

→ Master ensuite

☐

K002-04

☐

K002-06

☒

K002-05

→ Powder Room

→ Mud Room

→ Ensuite 3

☐

K008-14

☐

K024-03

☐

\*NO HARDWARE

LOT # PV-13

DATE: Jan 21, 2021

SIGNATURE:

SIGNATURE:





PINE VALLEY  
FOREVERGREEN

STANDARD HARDWARE / HANDLES

☐

H001-02

☐

H001-03

☐

H001-04

☐

H009-03

☐

H009-09

☐

H011-03

☐

H011-05

☐

H011-06

☐

H033-01

☒

H039-03

→ Laundry  
→ Ensuite 2  
→ ensuite 4

☐

\*NO HARDWARE

LOT # PV-13

DATE: Jan 21, 2021

SIGNATURE:

SIGNATURE:

GOLDPARK  
WORTH MORE

UPGRADE HARDWARE



BH-081-03

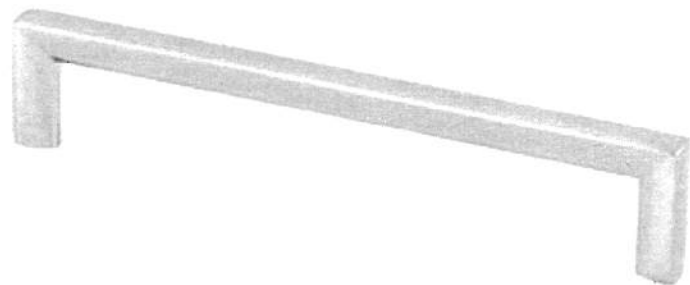

- ☐ BRUSHED NICKEL
- ☒ MATTE BLACK

LOCATION:

→ kitchen

LOT # PV-13	DATE: Jan 21, 2021
----------------	-----------------------

SIGNATURE:

SIGNATURE:

UPGRADE KITCHEN FAUCET



MOEN - NIO

One-Handle Pulldown Kitchen Faucet

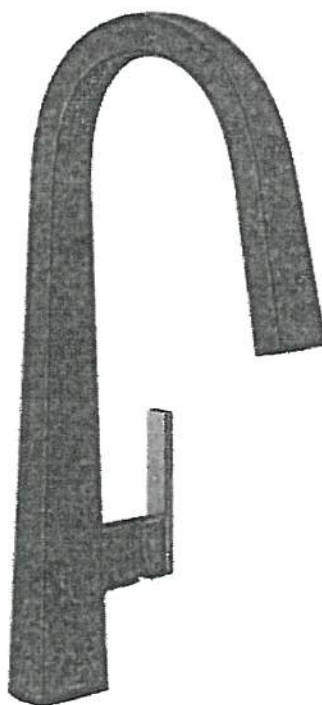

- ☐ CHROME
- ☒ MATTE BLACK / BRUSHED GOLD (BL)
- ☐ SPOT RESIST STAINLESS (SRS)

MODEL: S75005 Chrome / S75005BL Matte Black / S75005SRS Spot Resist Stainless

Lot# PV-13	Date: Jan 21, 2021	Room: Kitchen
Signature: 		
Signature: 		

GOLDPARK  
WORTH MORE



UPGRADE KITCHEN SINK



**BLANCO - QUATRUS R15 U SUPER SINGLE**  
Stainless Steel - Undermount  
32" x 18" x 9"

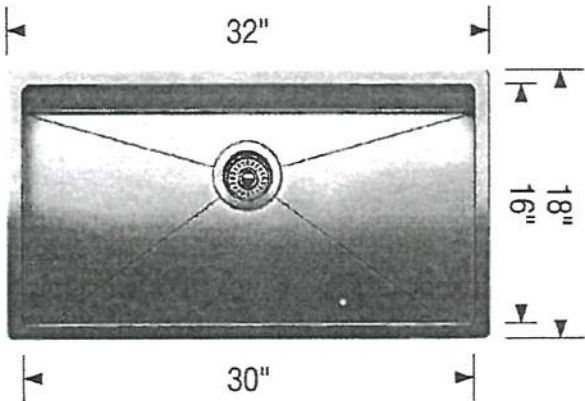
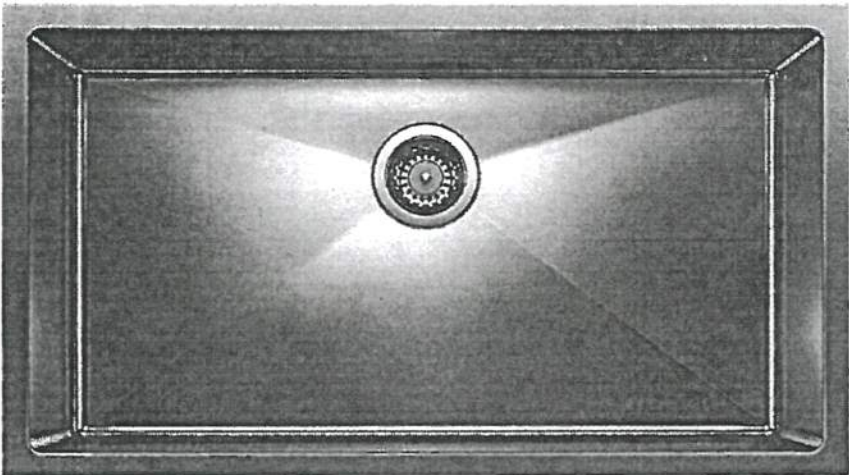

Stainless Steel

MODEL 401518 Stainless Steel

Lot# PV-13
---------------

Room: Kitchen
------------------

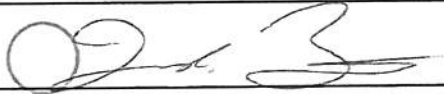
Signature: 
--

Date: Jan 21, 2021
-----------------------

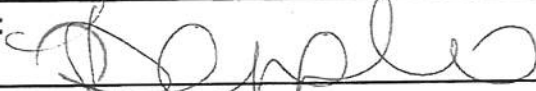
Signature: 
--

UPGRADE KITCHEN FAUCET



MOEN - SLEEK

One-Handle Pulldown Kitchen Faucet

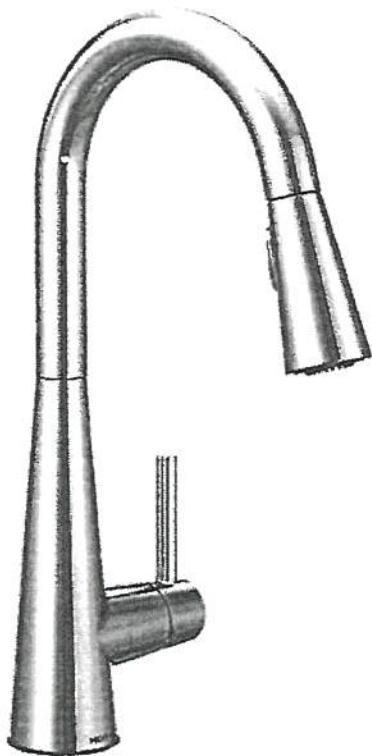

- ☒ CHROME
- ☐ MATTE BLACK (BL)
- ☐ STAINLESS (SRS)

MODEL: 7864 (BL, SRS) Kitchen Faucet

Lot# FV-13	Date: Jan 21, 2021	Room: Laundry
Signature: 		
Signature: 		

UPGRADE KITCHEN SINK



**BLANCO - QUATRUS R15 U 1 MEDIUM**  
Stainless Steel - Undermount  
25" x 18" x 9"

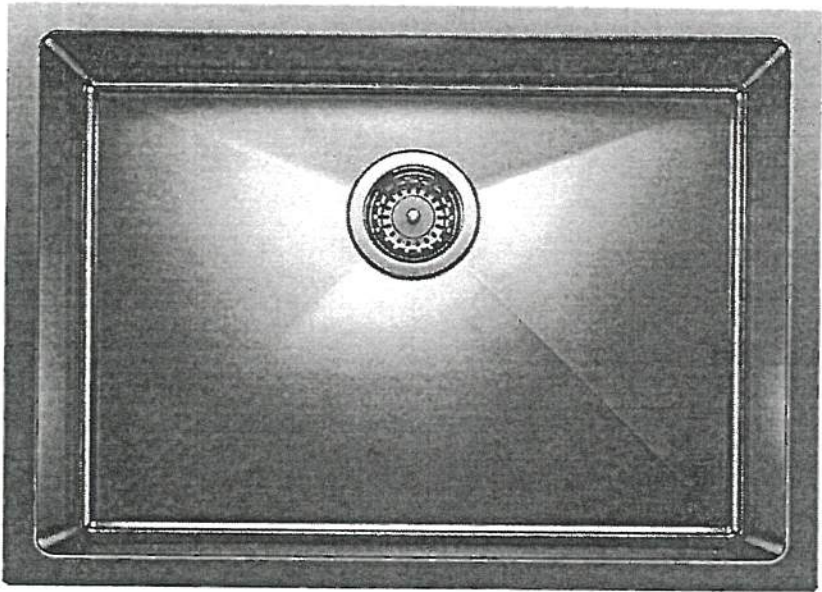

Stainless Steel

MODEL 401517 Stainless

Lot# *PV-13*

Room: *Laundry*

Signature: *[Signature]*

Date: *Jan 21, 2021*

Signature: *[Signature]*



UPGRADE SHOWER HARDWARE



MT6X6

Shower Door Handle

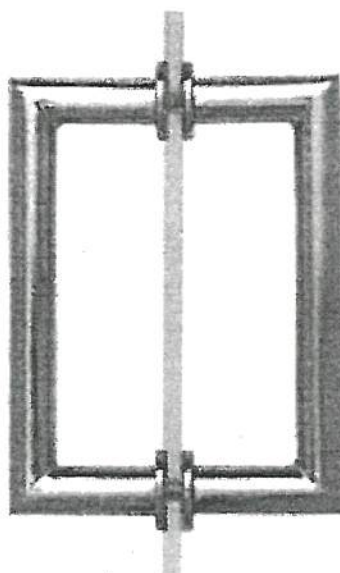

MT6X6  
Shower Door Handle

6" x 6" back-to-back  
3/4" dia. tube  
Cut and mitred corners with  
washers  
(Also available single sided)

- ☒ CHROME  
☐ MATTE BLACK  
☐ BRUSHED GOLD

Lot# PV-13	Date: Jan 21, 2021	Room: Master Ensuite, Ensuite 2, Ensuite 4
Signature:		
Signature:		

## BATHROOM ACCESSORIES



Tissue Holder  
Mason - Chrome



Towel Bar  
Mason - Chrome

**Please select one of the following:**

- ☐ INSTALL STANDARD BATHROOM ACCESSORIES THRU OUT  
(tissue holder + towel bar) *\*location as per vendors discretion\**
- ☒ **\*DO NOT\*** INSTALL STANDARD BATHROOM ACCESSORIES  
THRU OUT *\*tissue holder + towel bar will not be provided\**

LOT # PV-13

DATE: Jan 21 12021

SIGNATURE:

A handwritten signature in cursive script, appearing to read "John Z.", written over a circular stamp.

SIGNATURE:

A handwritten signature in cursive script, appearing to read "K. Apple", written over a circular stamp.



Project: Pine Valley

Lot: 13

Purchaser(s): Fernando R. Bettencourt & Kristina G. V. Dangelo

Standard Hood Fan Deletion

We acknowledge that the builder's standard hood fan will not be installed.  
Do not supply, install and/or credit. We will install our own hood fan after closing.

Signature: [Handwritten Signature]

Signature: [Handwritten Signature]

Date: January 21, 2021



UPGRADE KITCHEN EXTRA



## CHATEAU RANGE HOOD

(Insert fan not included)

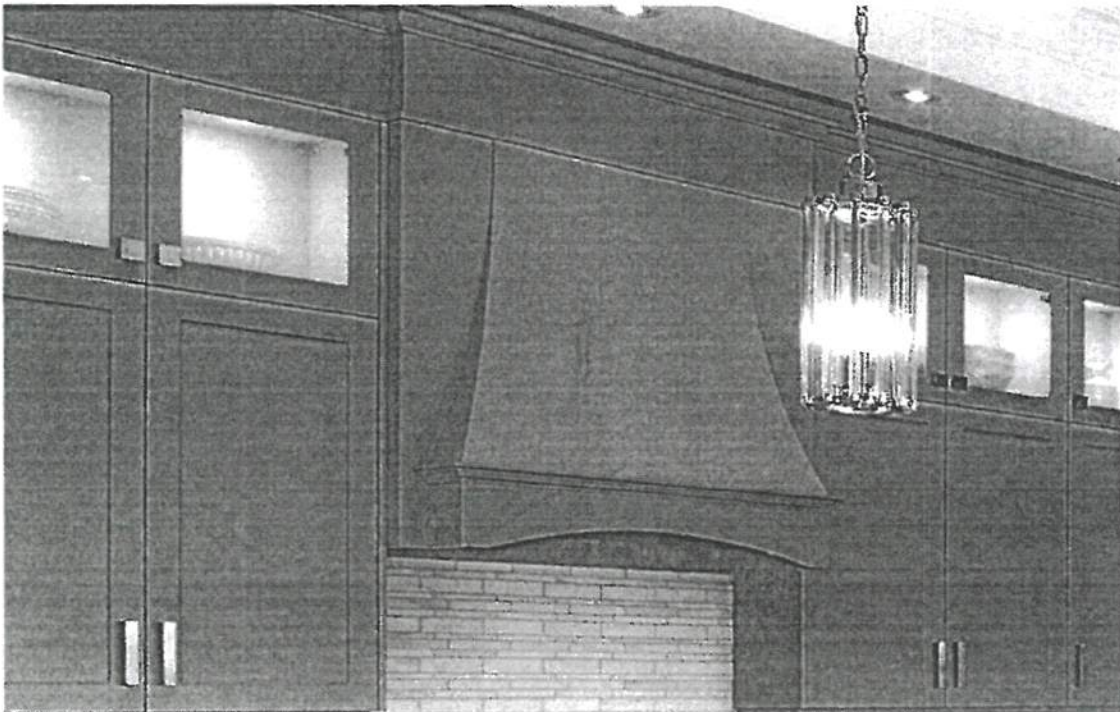

LOT # PV-13

DATE: Jan. 21, 2021

ROOM: kitchen

SIGNATURE:

A handwritten signature in dark ink, appearing to be "John [unclear]".

SIGNATURE:

A handwritten signature in dark ink, appearing to be "O. [unclear]".

GOLDPARK  
WORTH MORE

PV-13

Jan 21, 2021



# MONOGRAM 36" DUAL-FUEL PROFESSIONAL RANGE WITH 6 BURNERS

ZDP366NNSS (NATURAL GAS)



## THE MONOGRAM STATEMENT COLLECTION

Edge-to-edge handles, polished stainless steel, smoothly finished edges and large electronic control knobs offer an authentic professional appearance.

## SEALED, DUAL-FLAME STACKED BURNERS

Deliver a full spectrum of heat settings, from an ultra-low 140° F simmer to an intense 18,000 BTU

## MONOGRAM PROFESSIONAL OVEN SYSTEM

Combines European, reverse-air convection technology and six heating elements to provide superb baking results

## HEAVY-DUTY, FULL-EXTENSION RACKS

Glide smoothly in and out on stainless steel ball bearings for easy access, and are designed to remain in the oven during the self-clean cycle

## LED TASK LIGHTS

Below the bullnose, provide a functional and theatrical touch

## ELECTRONIC IGNITION WITH AUTOMATIC REIGNITION

Ensures a continuous flame and reignites automatically if accidentally extinguished

## STAR-K CERTIFICATION

Allows Monogram ranges to operate in Sabbath mode

## OPTIONAL FULL-WIDTH STAINLESS STEEL TOEKICK

Is included with the range

## LARGE TEMPERATURE AND TIME DISPLAYS

Make it easy to monitor cooking progress

## HALOGEN LIGHT COLUMNS

Provide a clear view, regardless of rack position

## REVERSIBLE BURNER GRATES

Flat on one side and uniquely contoured on the other to accommodate round-bottom woks

\*Natural Gas Model

For questions about your appliance, please call 1-800-626-2000.

PAGE 1 OF 4

Product Specification Revised 11/20

7V-13

Jan 21, 2021



#### SPECIFICATIONS

Overall Width	35 7/8" (911 cm)
Overall Height	35 1/4" (89.5 cm)
Overall Depth	30 7/8" (78.4 cm)
Door Clearance	48 1/4" (122.5 cm)
Cutout Width	36" (91.4 cm)
Cutout Height	35 1/4" - 36 3/4" (89.5 - 93.3 cm)
Shipping Weight	462 lbs (209.5 kg)

#### ATTENTION ELECTRICIAN:

Electrical requirements: Ranges must be supplied with 208/240V, 60Hz, and connected to an individual, properly grounded branch circuit protected by a circuit breaker or time-delay fuse. Install a 30-amp circuit for 36" ranges. The receptacle must be a NEMA 14-50R device to accept the four-prong plug on the range.

#### OVERALL DIMENSIONS

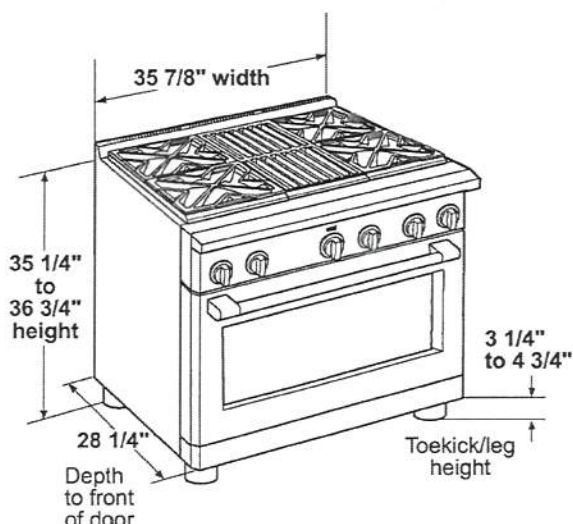

#### SIDE VIEW WITH A BACKSPLASH

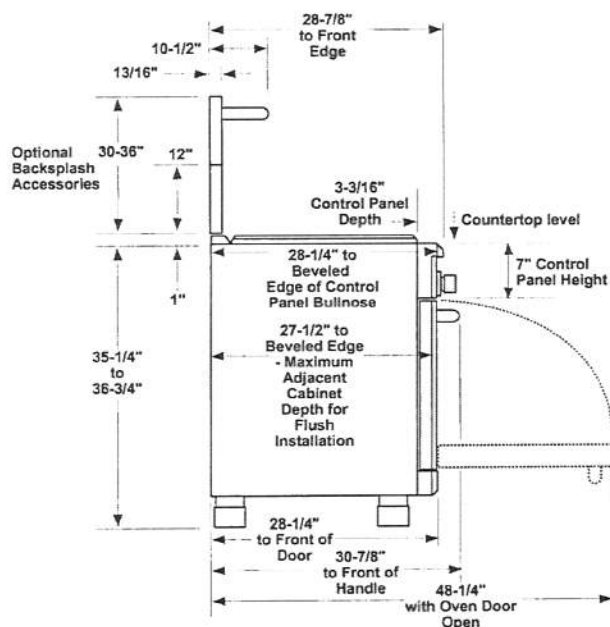



7V-13  
Jan. 21, 2021



DIMENSIONS AND INSTALLATION  
INFORMATION (IN INCHES)

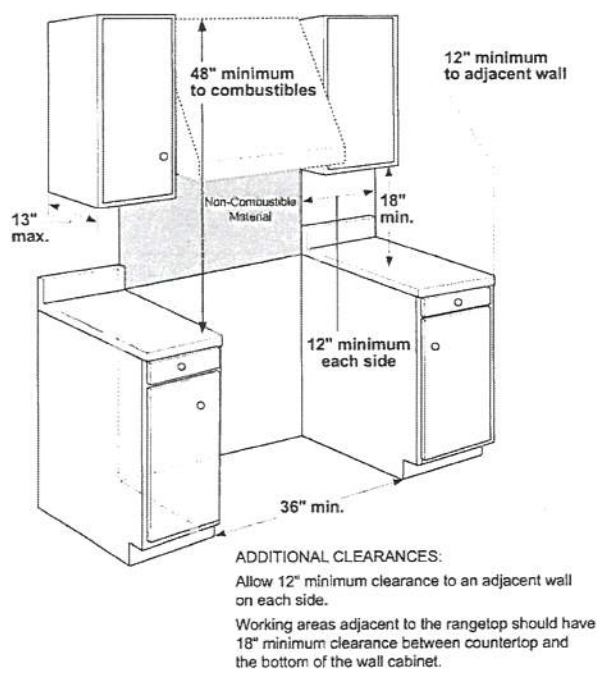

HELPFUL TIPS

Professional ranges offer a number of choices in size and cooktop configurations.  
All Dual-Fuel Professional Ranges are factory set for natural gas.

**NOTE**  
A propane conversion kit is included with the range. High Altitude kit, WB28K10553 for operation above 6,000 feet (for Natural and L.P. gas models), is also available. The kits must be installed by a qualified service technician at additional cost.

INSTALLATION INFORMATION

Before installing, consult installation instructions packed with product or online at [Monogram.com](http://Monogram.com) for current dimensional data. A suitable overhead vent hood is required for models with a grill and is recommended for all other models.

ADVANCE PLANNING

Refer to dimensional drawings for appropriate placement and necessary clearances when planning the installation.

- Working areas adjacent to the range should have 18" minimum clearance between countertop and cabinet bottom.
- Clearance between range and side wall or combustible material must be at least 12" on each side.
- Installation must conform with local codes. In the absence of local codes, the range must comply with the National Fuel Gas Code, ANSI Z223.1-1990.

**WARNING**

Installations without a hood require 48" minimum to combustibles. A custom hood installation with exposed horizontal combustible surfaces must have an Auto-On feature. Refer to hood installation instructions for specific hood clearances.

The surface of the entire back wall above the range and below the hood must be covered with a non-combustible material such as metal, ceramic tile, brick, marble or other stone.

PV-13

Jan 21, 2021

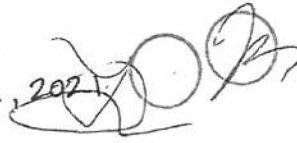

## DIMENSIONS AND INSTALLATION INFORMATION (IN INCHES)

### UTILITY LOCATIONS

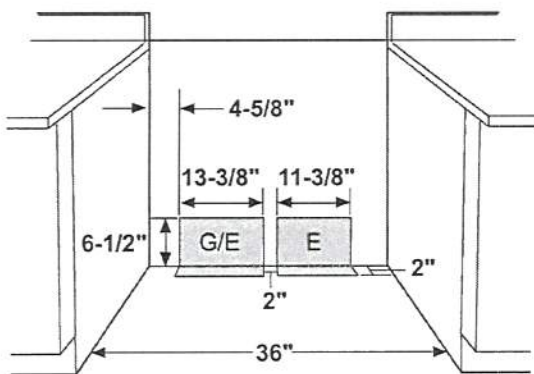

Locate gas and electric as shown

12" min. to combustibles or 0" to a non-combustible material above the cooking surface

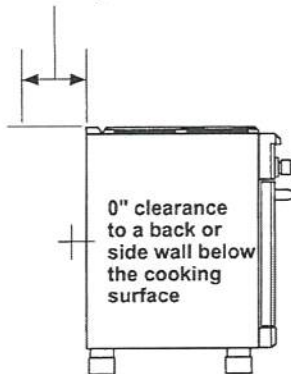

### HELPFUL TIPS

#### GAS SUPPLY

- The natural gas models are designed to operate at 5" water column pressure. For proper operation, the pressure of the natural gas supplied to the regulator must be between 7" and 13" water column.
- The LP models are designed to operate at 10" water column pressure. For proper operation, the pressure of the LP gas supplied to the regulator must be between 11" and 13" water column.

#### OPTIONAL BACKSPLASH ACCESSORIES

- The range requires a 12" minimum clearance to a vertical combustible surface at the rear. A backsplash is required for installations with less than 12" clearance. The following backsplash accessories are available, or a custom, non-combustible backsplash can be used.
- Order one with a 36"-wide range backsplash:
  - UX12B36PSS-12"-height backsplash
  - UXADJB36PSS-30"-36" adjustable-height backsplash with warming shelf

1/4/2019

PV-13  
Jan 21, 2021



Microwave Ovens    Countertop

### Countertop NN-SD765S

#### MODEL & SIZE

#### PANASONIC TECHNOLOGY

#### DESIGN

#### STYLE

#### PERFORMANCE PROGRAMMABLE FEATURES

Model Number	NN-SD765S
Type	Family-size
Installation	Countertop or built-in
Oven Capacity	1.6 cu. ft.
Cooking Power	1200W
Turntable Diameter	380mm
Panasonic Inverter	Cyclonic Inverter
Genius Sensor	Genius®
Color	Stainless Steel
Control Panel	Solid Dial + Button
Display Panel	New 6 Digit LCD / Green
Door Window	Smoked Glass
Door Release	Push Open
Oven Interior	Paint White
Multi-stage Cooking	3 stage
Sensor Cook	Yes
Sensor Reheat	Yes
Auto Cook/Reheat	Yes
More / Less Control	Yes
Inverter Turbo Defrost	Yes
Keep Warm Button	Yes
Popcorn Button	Yes
Quick Minute	

PV-13  
Jan 21, 2021

Copyright ©Panasonic Canada Inc.



WFW6620HC

LOCATION REQUIREMENTS

Proper installation is your responsibility.

You will need:

- A water heater set to 120°F (49°C).
- A grounded electrical outlet located within 6 ft (1.8 m) of power cord on back of washer.
- Hot and cold water faucets located within 4 ft (1.2 m) of hot and cold water fill valves on washer, and water pressure of 20–100 psi (137.9–689.6 kPa).
- A level floor with maximum slope of 1" (25 mm) under entire washer. Installing on carpet or surfaces with foam backing is not recommended.
- Floor must support washer's total weight (with water and load) of 315 lbs (143 kgs).

**IMPORTANT:** Do not install, store, or operate washer where it will be exposed to weather or in temperatures below 32°F (0°C). Water remaining in washer after use may cause damage in low temperatures. See "Washer Care" in your Use and Care Guide for winterizing information.

Whirlpool Models\*

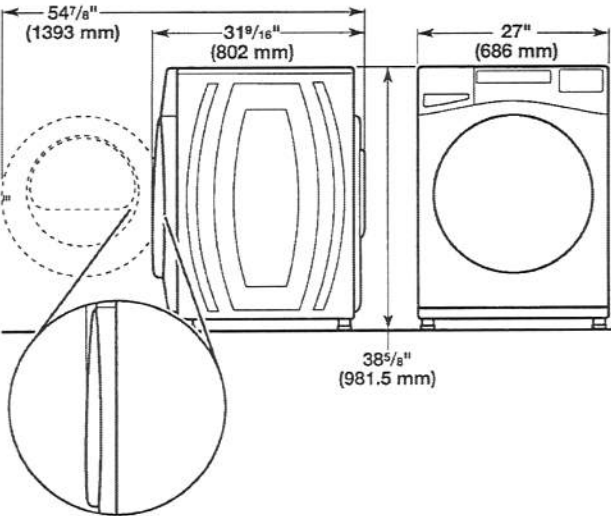
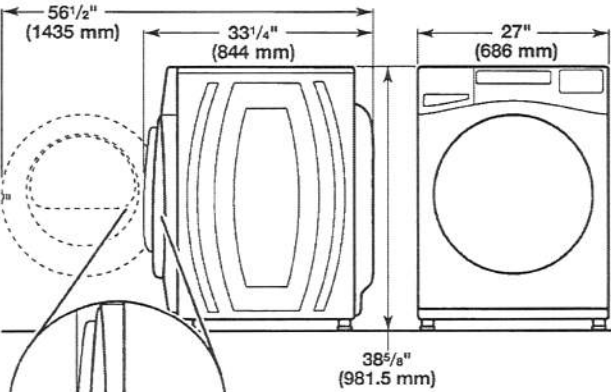

\*For additional details (or information) specific to your model, refer to the 'Dimensions' listed for your model at [www.whirlpool.com](http://www.whirlpool.com).

PV-13  
Jan 21, 2021

Maytag Models

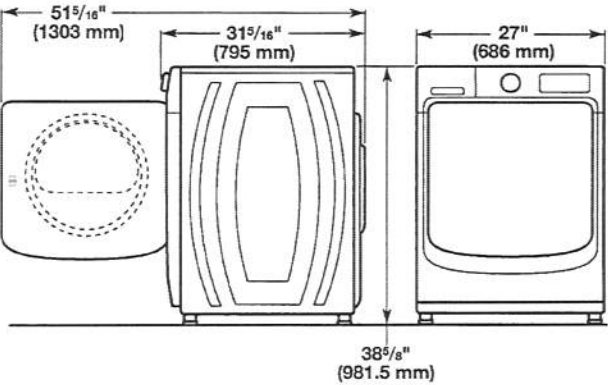
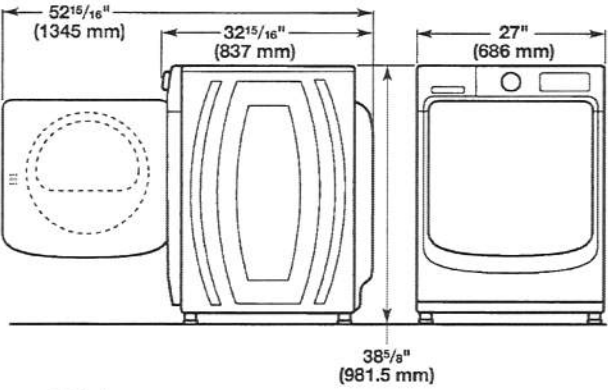

All dimensions show minimum spacing allowed. For each arrangement, consider allowing more space for ease of installation and servicing, and spacing for companion appliances and clearances for walls, doors, and floor moldings. Space must be large enough to allow door to fully open. Add spacing of 1" (25 mm) on all sides of washer to reduce noise transfer. If a closet door or louvered door is installed, top and bottom air openings in door are required.

Recessed area or closet installation (stacked washer and dryer):

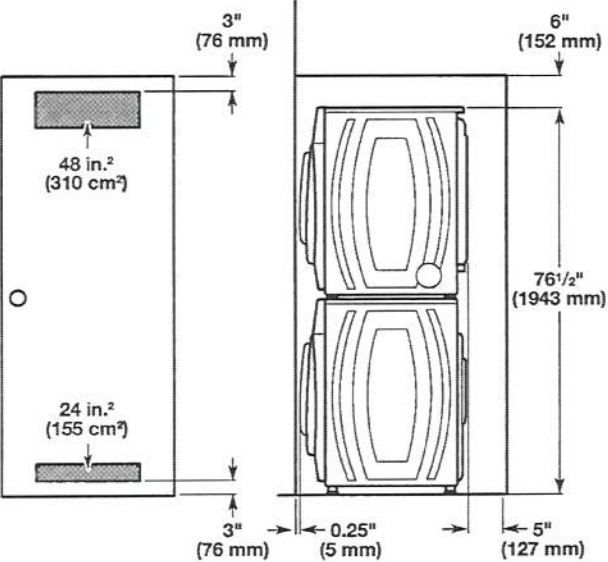

Jan 21, 2021

The technical drawings show the front and side views of the washing machine with the following dimensions:

- Front View:**
  - Top panel width: 1" (25 mm)
  - Door width: 1" (25 mm)
  - Door height: 1" (25 mm)
  - Bottom panel width: 1" (25 mm)
  - Bottom panel height: 1" (25 mm)
- Side View:**
  - Top panel depth: 0.25" (5 mm)
  - Door depth: 1" (25 mm)
  - Bottom panel depth: 1" (25 mm)
  - Bottom panel height: 1" (25 mm)

The drain system can be installed using a floor drain, wall standpipe, floor standpipe, or laundry tub. Select the method you need.

**IMPORTANT:** To avoid siphoning, only 4.5" (114 mm) of drain hose should be inside standpipe. Always secure drain hose with cable tie.

Minimum diameter for a standpipe drain: 2" (51 mm). Minimum carry-away capacity: 17 gal. (64 L) per minute. A 1/4" (6 mm) diameter to 1" (25 mm) diameter Standpipe Adapter Kit is available (Part Number 3363920). Top of standpipe must be at least 30" (762 mm) high; install no higher than 96" (2.44 m) from bottom of washer. If you have an overhead sewer and need to pump higher than 96" (2.44 m), a sump pump and associated hardware are needed. See "Alternate parts."

See requirements for floor standpipe drain system.

Minimum capacity: 20 gal. (76 L). Top of laundry tub must be at least 30" (762 mm) above floor; install no higher than 96" (2.44 m) from bottom of washer.



PV-13  
Jan 21, 2021

#### Floor drain system

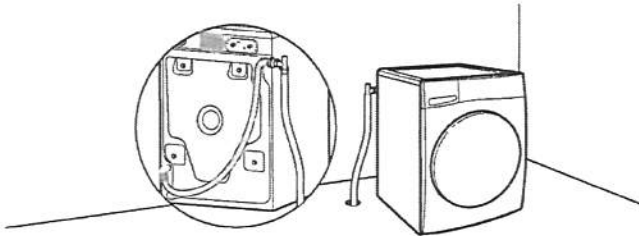

Floor drain system requires a Siphon Break Kit, two Connector Kits, and an Extension Drain Hose that may be purchased separately. Please contact your retailer for ordering information, or see the "Assistance or Service" page on the back of your Use and Care Guide. Minimum siphon break height: 28" (710 mm) from bottom of washer. (Additional hoses may be needed.)

#### ELECTRICAL REQUIREMENTS

##### ⚠ WARNING



##### Electrical Shock Hazard

Plug into a grounded 3 prong outlet.

Do not remove ground prong.

Do not use an adapter.

Do not use an extension cord.

Failure to follow these instructions can result in death, fire, or electrical shock.

- A 120 V, 60 Hz., AC only, 15 or 20 A, fused electrical supply is required. A time-delay fuse or circuit breaker is recommended. It is recommended that a separate circuit breaker serving only this appliance be provided.
- This washer is equipped with a power supply cord having a 3 prong grounding plug.
- To minimize possible shock hazard, the cord must be plugged into a mating, 3 prong, grounding-type outlet, grounded in accordance with local codes and ordinances. If a mating outlet is not available, it is the personal responsibility and obligation of the customer to have the properly grounded outlet installed by a qualified electrician.
- If codes permit and a separate ground wire is used, it is recommended that a qualified electrician determine that the ground path is adequate.
- Do not ground to a gas pipe.
- Check with a qualified electrician if you are not sure the washer is properly grounded.
- Do not have a fuse in the neutral or ground circuit.

#### GROUNDING INSTRUCTIONS

##### For a grounded, cord-connected washer:

This washer must be grounded. In the event of a malfunction or breakdown, grounding will reduce the risk of electrical shock by providing a path of least resistance for electric current. This washer is equipped with a cord having an equipment-grounding conductor and a grounding plug. The plug must be plugged into an appropriate outlet that is properly installed and grounded in accordance with all local codes and ordinances.

**WARNING:** Improper connection of the equipment-grounding conductor can result in a risk of electric shock. Check with a qualified electrician or serviceman if you are in doubt as to whether the appliance is properly grounded.

Do not modify the plug provided with the appliance – if it will not fit the outlet, have a proper outlet installed by a qualified electrician.

#### INSTALLATION INSTRUCTIONS

##### ⚠ WARNING

##### Excessive Weight Hazard

Use two or more people to move and install washer.

Failure to do so can result in back or other injury.

**NOTE:** To avoid floor damage, set washer onto cardboard before moving it.

##### 1. Move washer

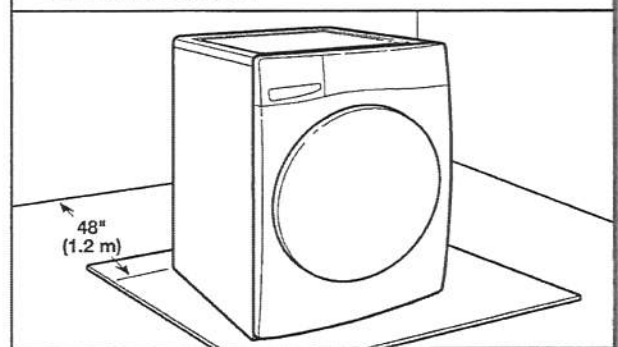

It is necessary to remove all shipping materials for proper operation and to avoid excessive noise from washer.

Move washer to within 4 ft (1.2 m) of its final location. It must be in a fully upright position.

PV-13

Jan 21, 2021



Additional parts may be required, depending on your installation. Check local codes. Check existing electrical supply and venting. Read "Electrical Requirements" and "Venting Requirements" before purchasing parts.

#### If using a power supply cord:

Use a UL Listed power supply cord kit marked for use with clothes dryers. The kit should contain:

- A UL Listed 30 amp power supply cord, rated 120/240 volt minimum. The cord should be type SRD or SRDT and be at least 4 ft. (1.22 m) long. The wires that connect to the dryer must end in ring terminals or spade terminals with upturned ends.
- A UL Listed strain relief.

#### Optional Equipment (not supplied with dryer):

Refer to your Use and Care Guide for information about accessories available for your dryer.

## LOCATION REQUIREMENTS

Check code requirements. Some codes limit, or do not permit, installing dryer in garages, closets, mobile homes, or sleeping quarters. Contact your local building inspector.

**⚠ WARNING**



**Explosion Hazard**

Keep flammable materials and vapors, such as gasoline, away from dryer.

Place dryer at least 18 inches (460 mm) above the floor for a garage installation.

Failure to do so can result in death, explosion, or fire.

#### You will need:

- A location allowing for proper exhaust installation. See "Venting Requirements."
- A separate 15 or 20 amp circuit for a gas dryer or 30 amp circuit for an electric dryer.
- If using power supply cord, a grounded electrical outlet located within 2 ft. (610 mm) of either side of dryer. See "Electrical Requirements."
- Floor must support dryer weight of 200 lbs. (90.7 kg). Also consider weight of companion appliance.
- Cold water faucets located within 4 ft. (1.2 m) of the water fill valves, and water pressure of 20–120 psi (138–827 kPa). You may use your washer's water supply by purchasing the necessary parts noted in "Parts needed."
- Level floor with maximum slope of 1" (25 mm) under entire dryer. If slope is greater than 1" (25 mm), install Extended Dryer Feet Kit, Part Number 279810. If not level, clothes may not tumble properly and automatic sensor cycles may not operate correctly.
- For garage installation, place dryer at least 18" (460 mm) above floor. If using a pedestal, you will need 18" (460 mm) to bottom of dryer.
- The dryer must not be installed or stored in an area where it will be exposed to water and/or weather.

**IMPORTANT:** Do not operate, install, or store dryer where it will be exposed to water, weather, or at temperatures below 40°F (4°C). Lower temperatures may cause dryer not to shut off at end of automatic sensor cycles, resulting in longer drying times.

## DRYER DIMENSIONS

Front view:

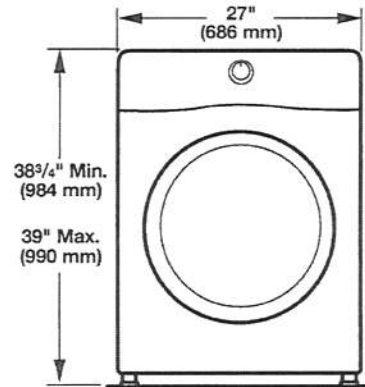

Side view:

Whirlpool Models

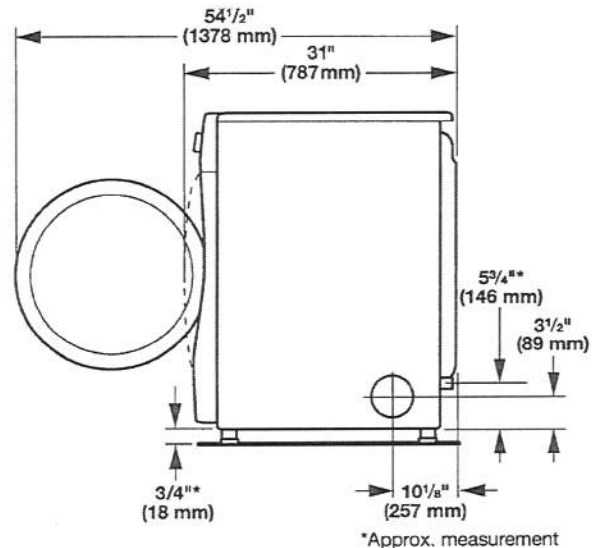

\*Approx. measurement

Maytag Models

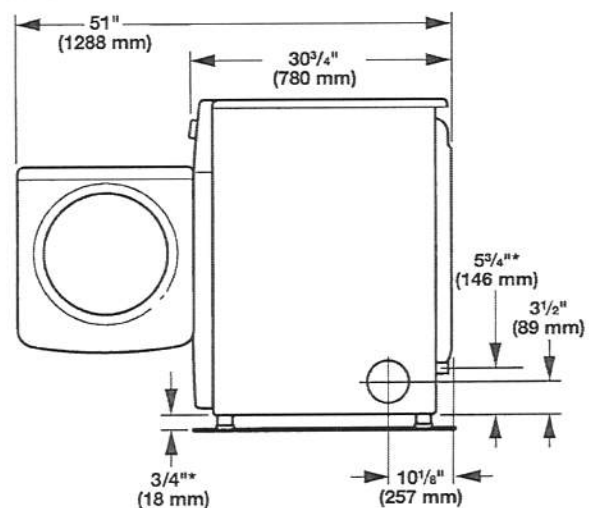

\*Approx. measurement



PV-13  
Jan 21, 2021

#### Back view:

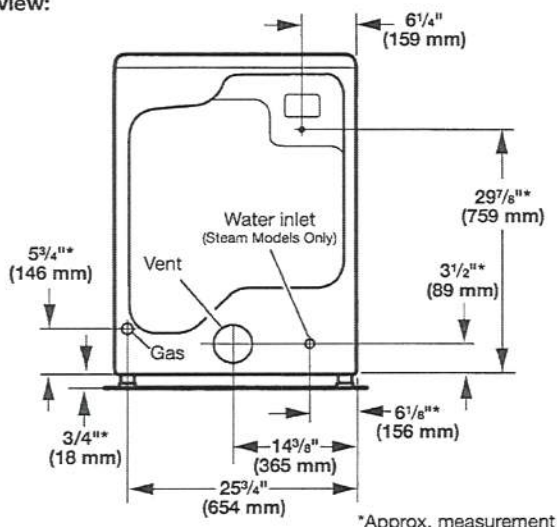

**NOTE:** Most installations require a minimum of 5" (127 mm) clearance behind dryer for exhaust vent with elbow. See "Venting Requirements."

#### Installation Clearances

For each arrangement, consider allowing more space for ease of installation and servicing, spacing for companion appliances, and clearances for walls, doors, and floor moldings. Space must be large enough to allow door to fully open. Add spacing on all sides of dryer to reduce noise transfer. If a closet door or louvered door is installed, top and bottom air openings in door are required.

Check code requirements. Some codes limit, or do not permit, installation of the dryer in garages, closets, mobile homes, or sleeping quarters. Contact your local building inspector.

**NOTE:** No other fuel-burning appliance can be installed in the same closet as a dryer.

#### Installation spacing for recessed area or closet installation

All dimensions show recommended and minimum spacing allowed.

- Additional spacing should be considered for ease of installation and servicing.
- Additional clearances might be required for wall, door, floor moldings, dryer venting, and gas line.
- Additional spacing should be considered on all sides of the dryer to reduce noise transfer.
- For closet installation with a door, minimum ventilation openings in the top and bottom of the door are required. Louvered doors with equivalent ventilation openings are acceptable.
- Companion appliance spacing should also be considered.

#### Recommended installation clearances (dryer only):

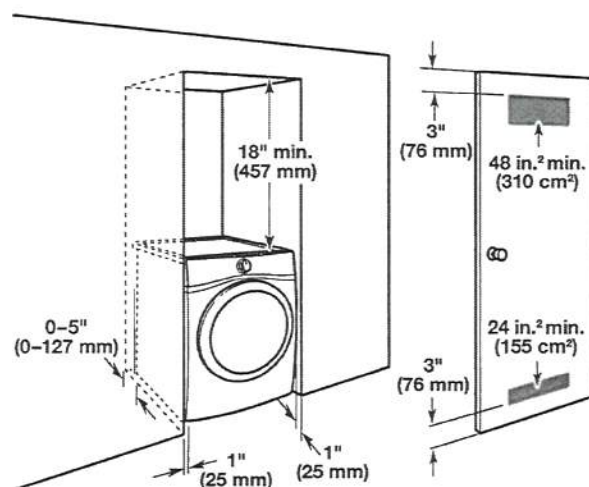

0" (0 mm) rear spacing is allowed for straight back venting only. For steam models only, inlet hose must not be kinked.

#### Custom under-counter installation:

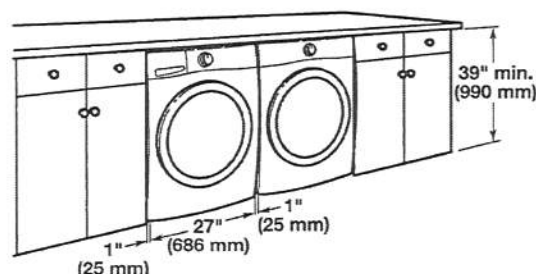

#### Mobile home – Additional installation requirements:

This dryer is suitable for mobile home installations. The installation must conform to the Manufactured Home Construction and Safety Standard, Title 24 CFR, Part 3280 (formerly the Federal Standard for Mobile home construction and Safety, Title 24, HUD Part 280) or Standard CAN/CSA-Z240 MH.

#### Mobile home installations require:

- Metal exhaust system hardware, available for purchase from your dealer. For further information, see "Assistance or Service" in your Use and Care Guide.
- Special provisions must be made in mobile homes to introduce outside air into dryer. Openings (such as a nearby window) should be at least twice as large as dryer exhaust opening.

#### For mobile home installation of gas dryers:

- Mobile Home Installation Hold-down Kit Part Number 346764 is available to order. For further information, see "Assistance or Service" in your Use and Care Guide.

PV-13

Jan 21, 2021



MONOGRAM 24" FULLY  
INTEGRATED DISHWASHER  
ZDT985SPNSS



**THE MONOGRAM STATEMENT COLLECTION**

Polished stainless steel, and hand-finished edges convey a sense of solidity and beauty

**ADVANCED WASH SYSTEM**

Designed to achieve the ultimate clean, this advanced wash system with over 90 powerful jets delivers complete washing coverage to every corner of the dishwasher

**FULL-EXTENSION, ADJUSTABLE THIRD RACK WITH PREMIUM SLIDES**

Convenient and adjustable, this expansive third rack easily accommodates an entire flatware collection, plus carving knives, soup ladles and other cooking/serving tools for the ultimate clean

**STEAM + SANITIZATION**

Eliminate the need to pre-wash dishes at the end of every meal, thanks to a Steam + Sani feature that easily loosens lingering traces of food with an added bonus of complete sanitization, removing 99.999% of bacteria

**39 DBA QUIET OPERATION**

Is made possible by advancing sound-absorbing materials and a smooth-running motor

**HARD FOOD DISPOSER**

Designed to maintain a kitchen's cleanliness and efficiency, the hard food disposer with stainless steel blades grinds food into tiny particles that wash away with ease

**MAX DRY SYSTEM**

This precise and efficient drying system delivers beautifully dry dishes every time and is perfect for hard-to-dry items like your favorite champagne flutes

**BOTTLE JETS**

Hard-to-reach areas inside tall items get completely clean with four dedicated jets integrated into the upper rack that shower water deep inside for the ultimate clean

**LED LIGHTING**

Illuminates the entire interior, leaving no question as to whether or not dishes have been cleaned

**DEEP CLEAN SILVERWARE JETS**

Powerful jets blast away stuck-on food for silverware that's always spotless

**FLUSH INSTALLATION CAPABILITY**

Enables the dishwasher to be installed flush, even with inset cabinetry, without any additional parts

For questions about your  
appliance, please call 1-800-626-2000.

PV-13  
Jan 21, 2021

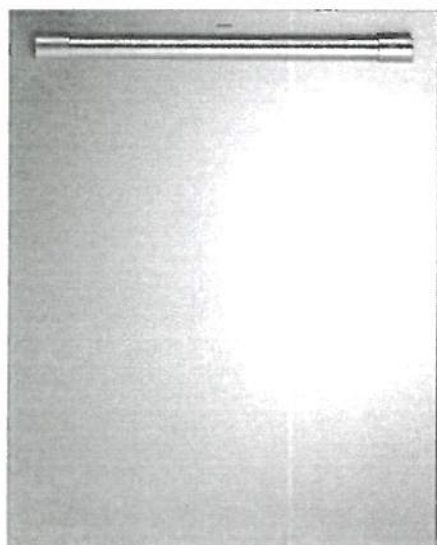

#### SPECIFICATIONS

Overall Width	23 3/4" (60.3 cm)
Overall Height	33 3/8" (84.8 cm) Min 34 5/8" (88.0 cm) Max
Overall Depth	24" (61 cm)
Door Clearance	25 1/2" (64.8 cm)
Overall Dishwasher Capacity	16 Place Settings
Minimum Cabinet Width	24" (61 cm)
Minimum Cabinet Depth	24" (61 cm)
Cutout Width	24" (61 cm)
Cutout Height	33 1/2" (85.1 cm) Min 34 3/4" (88.3 cm) Max
Electrical Requirements	10.2 A
Hose Length	No more than 12' (3.7 m)
Voltz/Hertz/Amps	115 V, 60 Hz, 15 or 20 amp circuit
Shipping Weight	139 lb (63 kg)

#### OVERALL DIMENSIONS

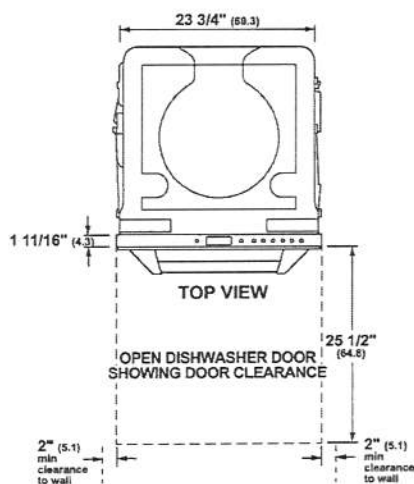
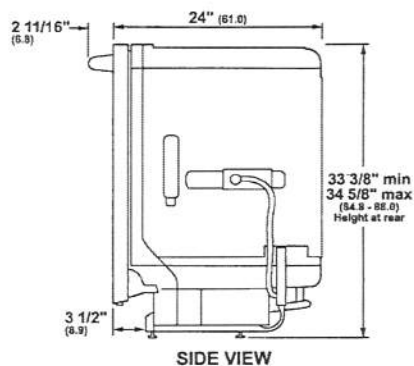
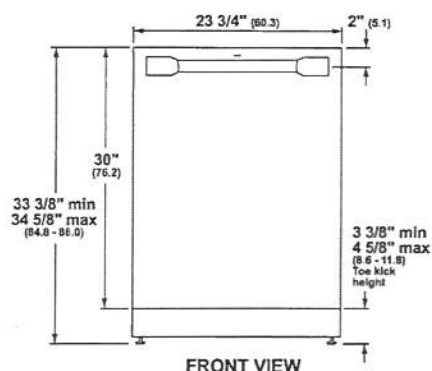

Dimensions in parentheses are in centimeters unless otherwise noted.  
Actual product dimensions may vary due to manufacturing tolerances.

PR-13  
Jan 21, 2021



## FLUSH CUTOUT INSTALLATION

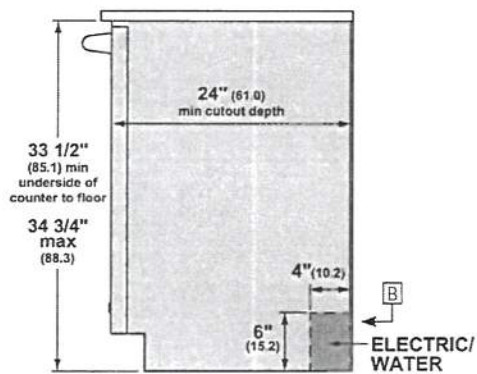

## INSTALLATION CUTOUT FRONT VIEW

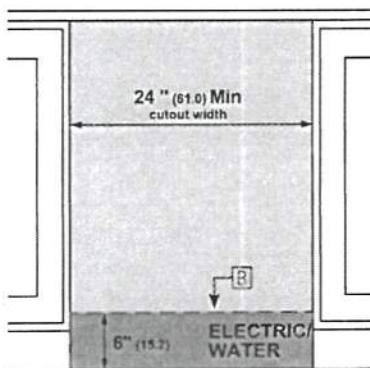

## SPECIAL NOTES

- A The dishwasher drain hose must be no more than 12 feet in length for proper drainage.
- B Electrical connections are at the right front of the dishwasher and water connections are on the left. The hot water line should extend forward 30" to 40" from the rear wall. The electrical must extend forward at least 24" to reach the junction box.
- C To prevent siphoning, an air gap or high drain loop must be used.

For more details, refer to the installation instructions for this product on [Monogram.com](http://Monogram.com). Dimensions in parentheses are in centimeters unless otherwise noted.



PV-13  
Jan 21, 2021

36" FREE-STANDING FRENCH-DOOR  
REFRIGERATOR  
ZWE23PSNSS

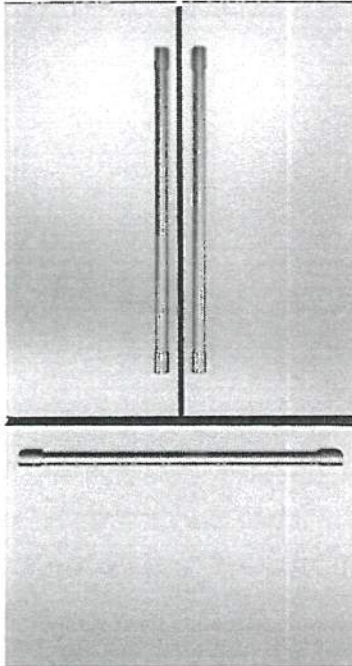

**THE MONOGRAM STATEMENT COLLECTION**  
Edge-to-edge handles, polished stainless steel and hand finished edges convey a sense of solidity and beauty

**TWINCHILL™ EVAPORATORS**  
Separate climates in the fresh food and freezer sections help keep foods fresh

**SHOWCASE LED LIGHTING**  
Positioned throughout the interior and under fresh food doors to spotlight foods inside the refrigerator and in the freezer

**FULL-WIDTH ELECTRONIC TEMPERATURE-CONTROLLED DRAWER WITH LED LIGHTS**  
3 accurate settings deliver the optimal temperature for your favorite foods, while lights indicate the chosen setting

**DROP-DOWN TRAY**  
Allows for extra door storage when you need it and tucks away when you don't

**QUICK SPACE SHELF**  
Functions as a normal full-sized shelf when needed and easily slides down for instant storage flexibility

**ADVANCED WATER FILTRATION USES RPWF REPLACEMENT FILTER**  
Reduces trace pharmaceuticals from water and ice\*

\* Removes 98% of ibuprofen, atenolol, fluoxetine, progesterone and trimethoprim. These pharmaceuticals are not necessarily in all users' water

RV-13  
Jan 21, 2021

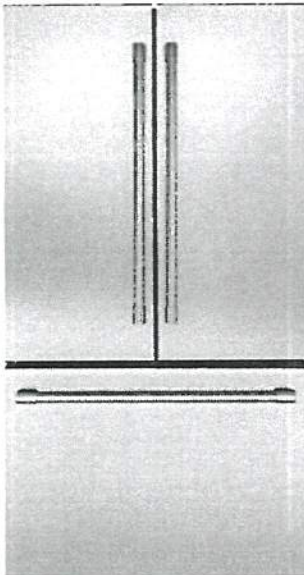

#### SPECIFICATIONS

Overall Width	36" (91.4 cm)
Overall Height	70 1/2" (179.1 cm)
Overall Depth	31 5/16" (79.5 cm)
Drawer Clearance	21 15/16" (55.7 cm)
Cutout Width	36 1/4" (92.1 cm)
Cutout Height	71" (180.3 cm)
Cutout Depth	26 3/8" (67 cm)
Plumbing Requirements	1/4" OD copper tubing or GE SmartConnect kit
Shipping Weight	400 lb (181.4 kg)

#### ATTENTION ELECTRICIAN:

A 115 volt 60Hz, 15 or 20 amp power supply is required. An individual properly grounded branch circuit or circuit breaker is recommended. Install a properly grounded 3-prong electrical receptacle recessed into the back wall.

#### OVERALL DIMENSIONS

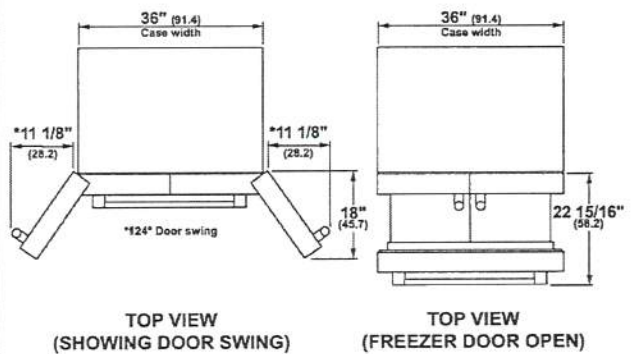
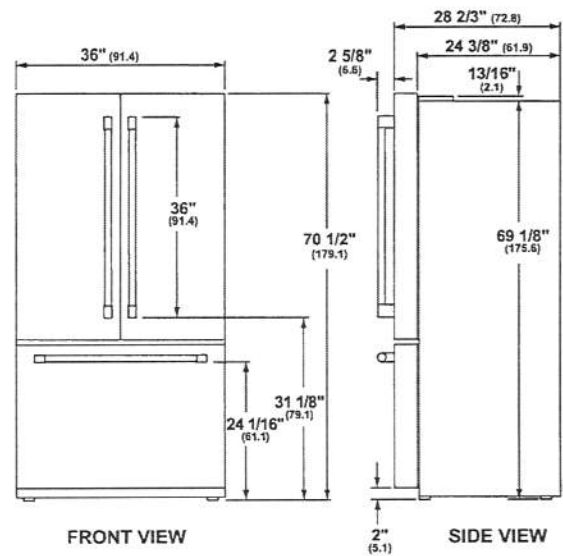

Dimensions in parentheses are in centimeters unless otherwise noted. Actual product dimensions may vary due to manufacturing tolerances.

*[Handwritten signature]*  
PV-13

Jan 21, 2021



## ANTI-TIP BRACKET INSTALLATION

### A Attachment to Wall and Floor

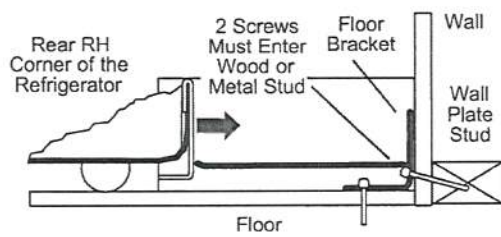

## AIR GAP INSTALLATION DIMENSIONS

Each Side 1/8" (3 cm)  
Top 1" (2.5 cm)  
Back 2" (5.1 cm)

## HELPFUL TIPS

- A The refrigerator is top heavy and must be secured to prevent the possibility of tilting forward.

### ⚠ WARNING:

#### Wood Wall and Floor Construction:

- Drill the appropriate number of 1/8" (3 mm) pilot holes in the center of each floor bracket hole being used (a nail or awl may be used if a drill is not available) AND remove the locator template from the floor.
- Mount the anti-tip floor bracket by fastening the 2, or recommended 4, #10-16 hex-head screws tightly into place as illustrated in figure 3.