

**Lot: 111****Model: 40.07 A SUNCREST****Project/Phase: Pine Valley Forevergreen / 1**

APPLIANCES

Invoice	Qty.	Description
2296	1	APPLIANCE SPECIFICATIONS ATTACHED - SIGNED
23Oct20 NoCat		

CERAMIC

Invoice	Qty.	Description
2463 35 10Dec20	1	FRONT FOYER: TILE, FLOOR , LEVEL 3 - FRONT FOYER - 12X24" LAID IN STRAIGHT, STACKED PATTERN. SEE PLAN FOR TILE DIRECTION
2463 35 10Dec20	1	POWDER ROOM: TILE, FLOOR , LEVEL 3 - POWDER ROOM - 12X24" LAID IN STRAIGHT, STACKED PATTERN. SEE PLAN FOR TILE DIRECTION
2463 35 10Dec20	1	LAUNDRY: TILE, FLOOR , LEVEL 3 - LAUNDRY - 12X24" LAID IN STRAIGHT, STACKED PATTERN. SEE PLAN FOR TILE DIRECTION
2463 43 10Dec20	1	MASTER ENSUTIE: TILE, SHOWER FLOOR, LEVEL 2 - MASTER ENSUITE - 2"
2463 43 10Dec20	1	SHARED BATH: TILE, SHOWER FLOOR, LEVEL 2 - SHARED BATH - 2"
2463 10Dec20 NoCat	1	MAIN HALL: UPGRADE TO LEVEL 3 TILE (IN LIEU OF HARDWOOD)

CONCRETE AND DRAIN

Invoice	Qty.	Description
2209	1	.BACK-FLOW PREVENTER VALVE
23Oct20		
NoCat		

CROWN MOULDING

Invoice	Qty.	Description
2296	1	.GREAT ROOM - OPT. COFFERED CEILING AS PER PLAN
23Oct20 NoCat		



CONSTRUCTION SUMMARY

Lot: 111

Model: 40.07 A SUNCREST

Project/Phase: Pine Valley Forevergreen / 1

DRYWALL

Invoice	Qty.	Description
2296 23Oct20 NoCat	1	.GREAT ROOM - OPT. COFFERED CEILING AS PER PLAN
2296 23Oct20 NoCat	1	.GREAT ROOM - OPT. WAFFLE CEILING, BEAM DETAIL AS PER PLAN (9 BOXES) OPTION # 1 CTR-B07

PV-111 Cabinetry Schedule

ROOM	DESCRIPTION	PRICE	QTY	TOTAL
POWDER ROOM	UPGRADE SERIES 2 TO SERIES 5 - WILLIS OYSTER		1	
KITCHEN	UPGRADE KITCHEN FROM SERIES 2 TO SERIES 5 - WILLIS OYSTER		1	
	UPGRADE ISLAND FROM SERIES 2 TO SERIES 5 - WILLIS OYSTER		1	
	FLAT VALANCE		1	
	POTS AND PANS DRAWERS CONVERSION WITH 3/4" EXTENSION		1	
	OPTIONAL DEEP PANTRY IN LIEU OF STANDARD CABINETRY		1	
	30" COOKTOP + BUILT IN OVEN BELOW STOVE LOCATION		1	
	RETURN TRIP		1	
	ADD SMALL FURRING RAIL IN LIEU OF CROWN MOULDING		1	
CABINETRY TOTAL:				

LOT #: PV-111

DATE: December 7, 2020

SIGNATURE: 

SIGNATURE: 

*** NOTE: This is not an approved document. Document must be locked ***

Scheduled Closing Date: Thursday, November 26, 2020

Purchasers: Vanessa Smith & Bradley, James Smith

Property: 111 of Plan -

Telephone Res. / Bus: / (416) 315-3107

Project: Pine Valley Forevergreen - Phase 1

Decor Advisor: Yolande Somerville

Model and Elevation: 40.07 A SUNCREST

Layout Changes: ☐ Yes ☒ No

Sketch Attached: ☒ Yes ☐ No

Exterior Colour Scheme:

1. Cabinetry

	Style and Colour	Counter	Hardware
Kitchen / Breakfast	*Willis 'Oyster'	*Quartz: Statuario Maximus	h03301
Laundry Room	Modena 'Classic White'	P-Lam: Std White	h01106
Powder Room	*Willis 'Oyster'	*Quartz: Statuario Maximus	h03301
Main Bath	Modena 'Classic White'	Quartz: 'Ice Snow'	h01106
Master Ensuite Bathroom	Modena 'Classic White'	Quartz: 'Ice Snow'	h01106
Second Ensuite Bathroom (If Applicable)	n/a	n/a	n/a
Shared Bath	Modena 'Classic White'	Quartz: 'Ice Snow'	h01106

Comment

2. Floor Tile

	Selection
Entrance Vestibule	*12x24" Carrara X polished 'White'
Main Hall	*12x24" Carrara X polished 'White'
Kitchen / Breakfast	see hardwood*
Laundry Room	*12x24" Carrara X polished 'White'
Powder Room	*12x24" Carrara X polished 'White'
Shared Ensuite	13x13" Sempre 'White'
Master Ensuite Bathroom	13x13" Sempre 'White'
Second Ensuite Bathroom (If Applicable)	n/a
Lower Landing (If Applicable)	13x13" Sempre 'White' (basement landing)
Main Bath	13x13" Sempre 'White'

Comment

Master Ensuite Shower Floor + Shared Bath Shower Floor: 2" Ontario 'taupe'

3. Wall Tile

	Selection	Listello/Inserts	Describe
Main Bath	8x10" Uniwall 'Tender Grey'	<input type="radio"/> Yes <input checked="" type="radio"/> No	
Master Ensuite Bathroom			
Tub Deck	n/a	<input type="radio"/> Yes <input checked="" type="radio"/> No	
Shower Stall	8x10" Uniwall 'Tender Grey'	<input type="radio"/> Yes <input checked="" type="radio"/> No	
Bathroom Walls	n/a	<input type="radio"/> Yes <input checked="" type="radio"/> No	
Second Ensuite Bathroom (If Applicable)	n/a	<input type="radio"/> Yes <input checked="" type="radio"/> No	
Shared Bath	8x10" Uniwall 'Tender Grey'	<input type="radio"/> Yes <input checked="" type="radio"/> No	
Kitchen Backsplash	<input type="radio"/> Yes <input checked="" type="radio"/> No	Backsplash Behind Fridge	<input type="text"/>

Comment

Scheduled Closing Date: Thursday, November 26, 2020

Purchasers: Vanessa Smith & Bradley, James Smith

Property: 111 of Plan -

Telephone Res. / Bus: / (416) 315-3107

Project: Pine Valley Forevergreen - Phase 1

Decor Advisor: Yolande Somerville

Model and Elevation: 40.07 A SUNCREST

4. Plumbing Fixtures

Master Ensuite Bathroom Second Ensuite Powder Room
Other Room - Specify Other Washroom

Comment

std thru out except kitchen sink

5. Hardwood Flooring

Main Hall Kitchen / Breakfast Living Room Dining Room Family Room Den/Library Entrance Vestibule Lower Landing (If Applicable)
Type and Stain see tile* *3/4x5" red oak brushed 'Driftwood'
Upper Landing Upper Hall Master Bedroom Bedroom #2 Bedroom #3 Bedroom #4 Bedroom #5 Other Room - Specify
Type and Stain *3/4x5" red oak brushed 'Driftwood'
Thru out standard areas

Comment

6. Carpeting

Ground Floor Second Floor
Upgrade Description

Upgrade Underpad Type Area
Carpet on Stairs Capped Runner - *Upgrade

Comment

7. Fireplace

Living Room Family Room Other Room - Specify
Purchased As Per Plan N/A
Fireplace Type Standard Gas
Mantle Type Mediterranean
Colour / Stain Arctic White
Surround n/a
Hearth none

Comment

Scheduled Closing Date: Thursday, November 26, 2020

Purchasers: Vanessa Smith & Bradley, James Smith

Property: 111 of Plan -

Telephone Res. / Bus: / (416) 315-3107

Project: Pine Valley Forevergreen - Phase 1

Decor Advisor: Yolande Somerville

Model and Elevation: 40.07 A SUNCREST

8. Trim Carpentry

Interior Doors *Lincoln Park Front Door Glass Inserts standard Door Handles Standard

Interior Trim Standard

Comment

9. Plaster Mouldings and Medallions

Standard Throughout ☐ Yes ☐ No ☒ N/A

Entrance Vestibule Kitchen/Breakfast

Main Hall Den/Library

Living Room Lower Landing

Dining Room Other Room - Specify

Family Room

Comment

10. Railings and Spindles

Railing Package Standard 2 oak

Railing Colour *Graphite Spindle Colour *Graphite

Stringer / Riser *Graphite Treads *Graphite

Comment

Oak Stairs ☒ Yes ☐ No ☐ N/A

11. Wall Paint / Ceilings

Throughout Finished Areas Warm Grey

Trim Paint White

Smooth Ceilings

Ground Floor ☒Second Floor ☒

Note

Comment

Scheduled Closing Date: Thursday, November 26, 2020

Purchasers: Vanessa Smith & Bradley, James Smith

Property: 111 of Plan -

Telephone Res. / Bus: / (416) 315-3107

Project: Pine Valley Forevergreen - Phase 1

Decor Advisor: Yolande Somerville

Model and Elevation: 40.07 A SUNCREST

12. Electrical

Hood Fan ☐ White ☒ Stainless ☐ N/A

Above Kitchen Cabinet Light ☐ Yes ☒ No

Below Kitchen Cabinet Light ☐ Yes ☒ No

Standard Appliances ☐

Over The Range Microwave ☐

Chimney Style Fan ☒

Comment

13. Heating and Air Conditioning

Air Conditioning

Gas Provisions Stove

Gas Provisions Dryer

Gas Provisions Barbecue

Comment

14. Additional Comments

15. Disclaimers and Notes

- 1) Colours of all materials are as close as possible to builder's selection, but not necessarily identical due to variances in manufacturing.
- 2) Any extras listed above are null and void unless accompanied by a separate invoice/amendment. Said invoice must be paid in full.
- 3) The Purchaser acknowledges that after Interior Colour Selection form is signed and dated, no further changes will be permitted other than re-selection due to unavailability. _____ Purchaser's Initials
- 4) The Purchaser acknowledges reading and accepting the "Gold Park Homes Decor Centre Disclaimers" form. This document contains other miscellaneous disclaimers.

This Interior Colour Selection is final and approved by:

Signature:  Date: _____

SCHEDULE 'F'



PV-III
APRIL 24 2020

PV-III
Dec. 7, 2020.

see attached
see attached

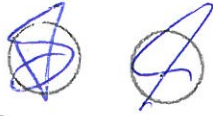

The Suncrest 40' SERIES

Elevation A • 2,520 sq.ft.
Elevation B • 2,535 sq.ft.

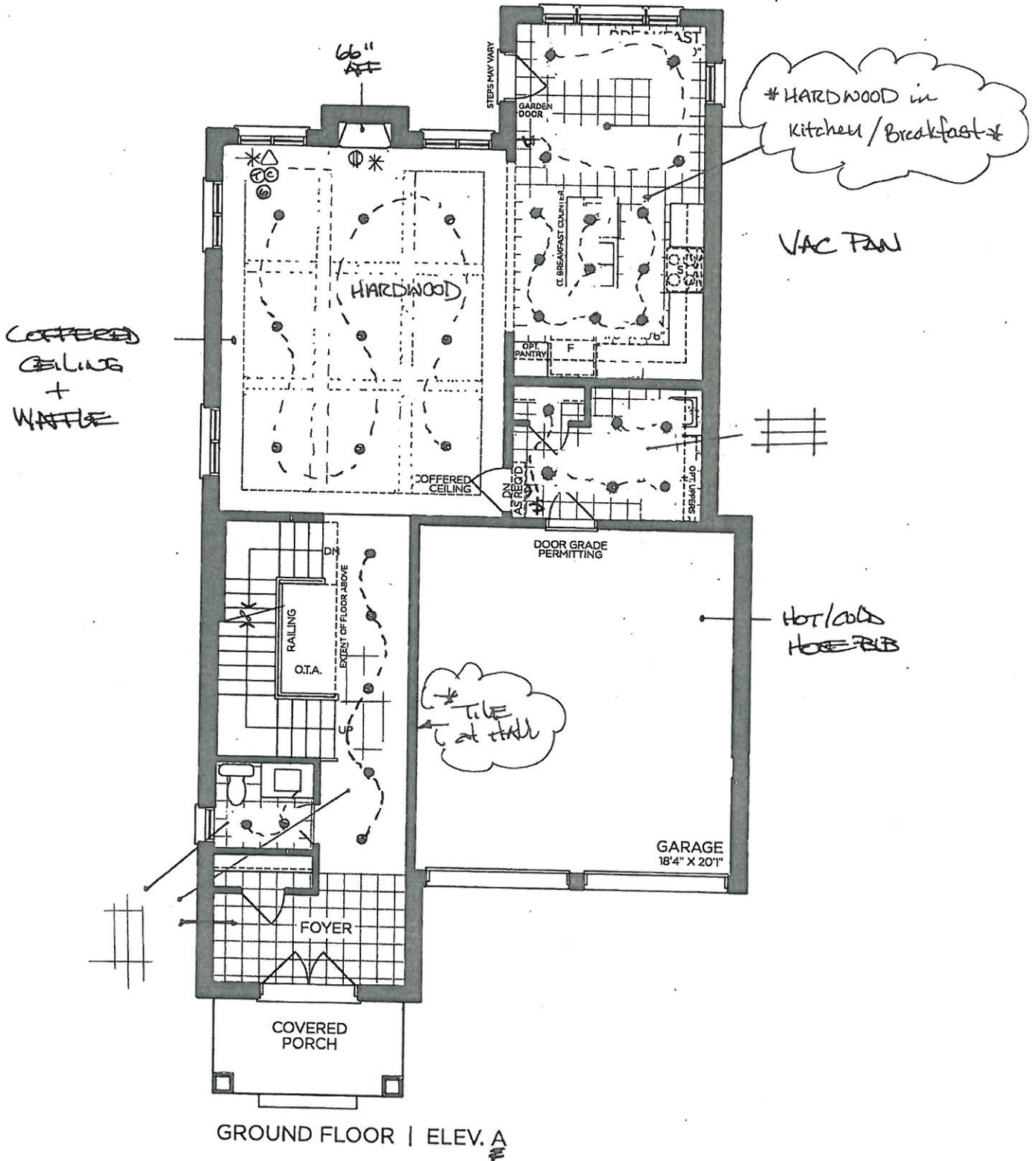

GROUND FLOOR | ELEV. A

VENDOR

PURCHASER

PURCHASER

GOLDPARK
WORTH MORE™

Prices, figures, illustrations, sizes, features and finishes are subject to change without notice. Areas and dimensions are approximate and actual usable floor space may vary from the stated area. Layout may be reverse of the unit purchased. E. & O.E. 4007

SCHEDULE 'F'



PV-III *see attached*
APRIL 24 2020
PV-III *see attached*
Dec. 7, 2020.

The Suncrest
40' SERIES

Elevation A • 2,520 sq.ft.
Elevation B • 2,535 sq.ft.

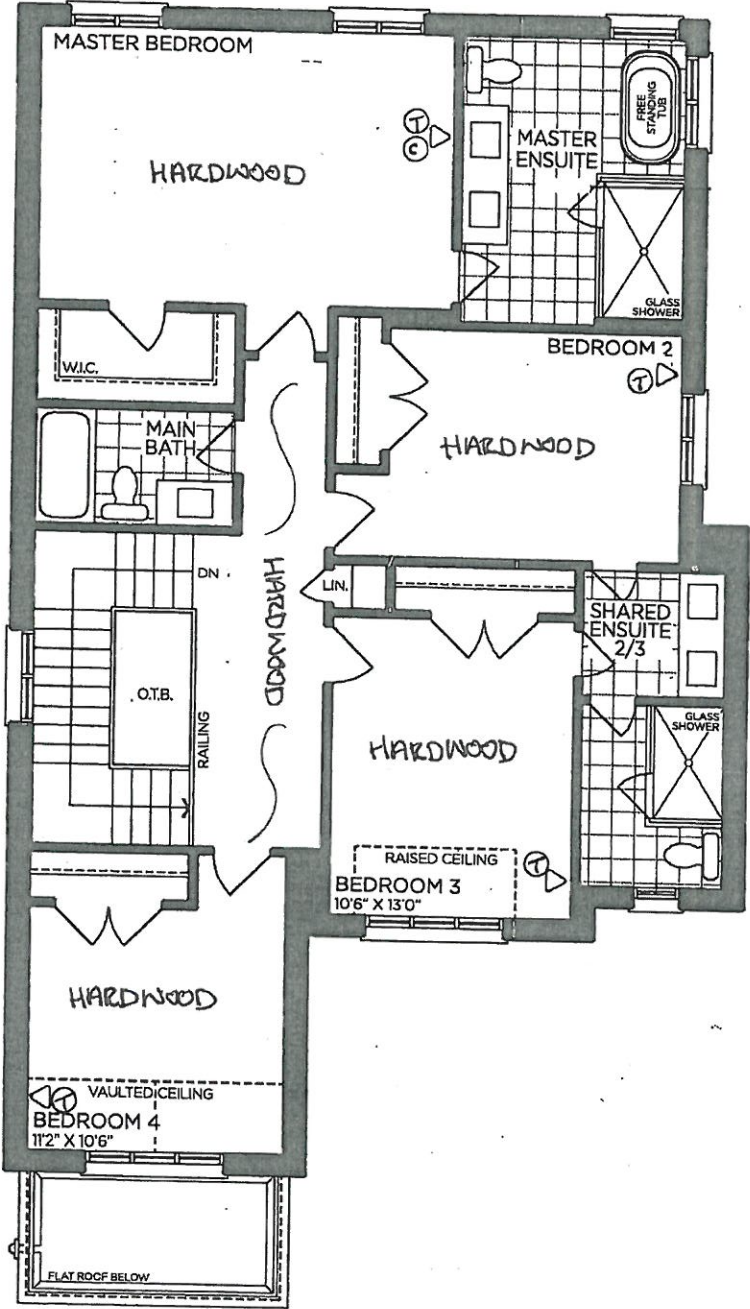

SECOND FLOOR | ELEV. A

VENDOR

PURCHASER

PURCHASER

GOLDPARK
WORTH MORE™

Prices, figures, illustrations, sizes, features and finishes are subject to change without notice. Areas and dimensions are approximate and actual usable floor space may vary from the stated area. Layout may be reverse of the unit purchased. E. & O.E. 4007

SCHEDULE 'F'



PV- III
April 24 2020
PV- III
December 7, 2020.

See attached -

The
Suncrest
40' SERIES

→ Elevation A • 2,520 sq.ft.
Elevation B • 2,535 sq.ft.

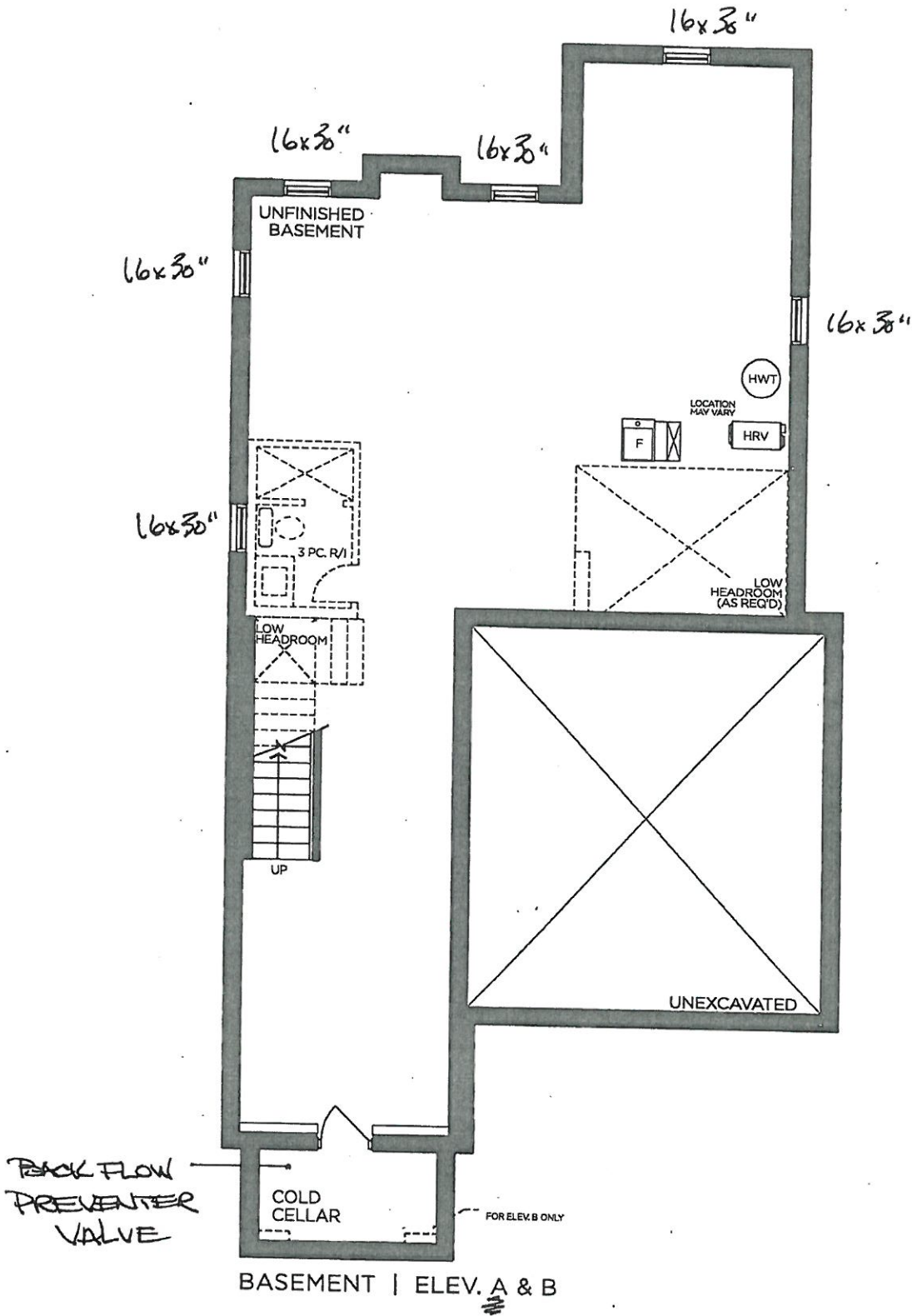

VENDOR

PURCHASER

PURCHASER

GOLDPARK
WORTH MORE™

Prices, figures, illustrations, sizes, features and finishes are subject to change without notice. Areas and dimensions are approximate and actual usable floor space may vary from the stated area. Layout may be reverse of the unit purchased. E. & O.E. 4007



36" space for 30" chimney

—87—

126
STOVE VENT
81
C/T
66

$$\frac{B/T}{66} \quad (X36"D)$$

○

3 LGVS
24"
D/W
SPACE
CUSTOMER-VEN
34 1/2" H X 65" W

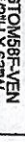

BSF36

FR. 36.

**GOLDPARK HOMES
PINE VALLEY
VAUGHAN, ONTARIO
MODEL: (4007)**

yes!

10" CEILING - 12"H COFFERED CEILING -
M.H. = 102" + 3/4"H CONTEMPORARY
MOLDING + 5 1/4"H FURRING RAIL
+ LARGE CORNICE MOLDING TO
UNDERSIDE OF BOX

BF21R W2145R

FG12V-S

* Willis 'Oyster'
H033-01.

PLAN VIEW

PV-111
Dec 7, 2020

GOLDPARK HOMES
PINE VALLEY
VAUGHAN, ONTARIO
MODEL: (4007)

SITE STANDARD: WHITE 3/4" EXTENSION
SOFT-CLOSE DRAWERS & STANDARD SLAM DOOR HINGES
TO VANITIES
ONE TOP DRAWER WHERE POSSIBLE THROUGHOUT EACH
VANITY, ONE BANK OF DRAWERS WHERE POSSIBLE
THROUGHOUT EACH MASTER ENSUITE VANITY

Moderna 'Classic White'
H04-06

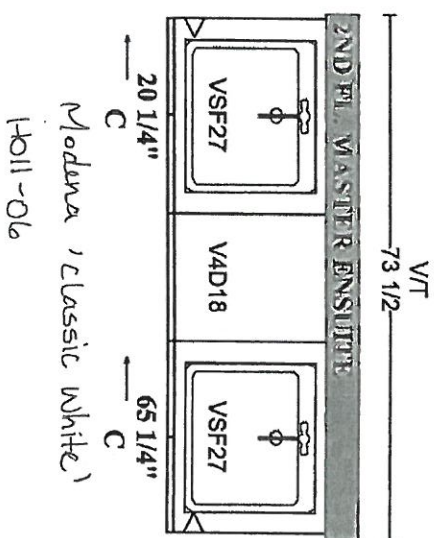
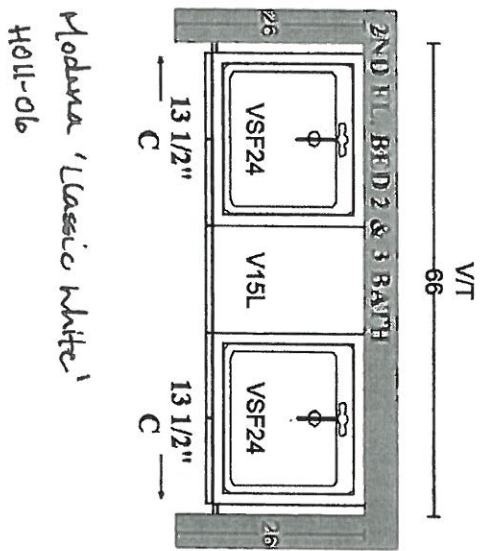
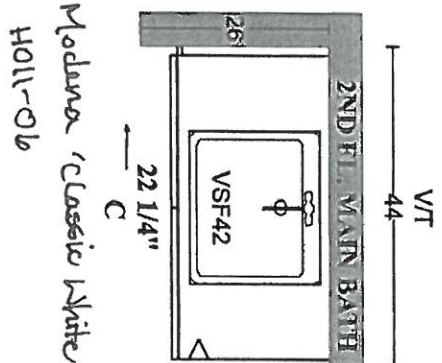
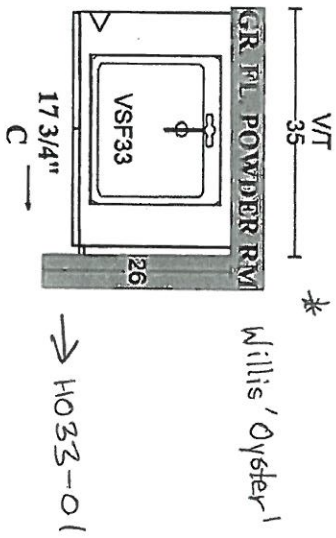
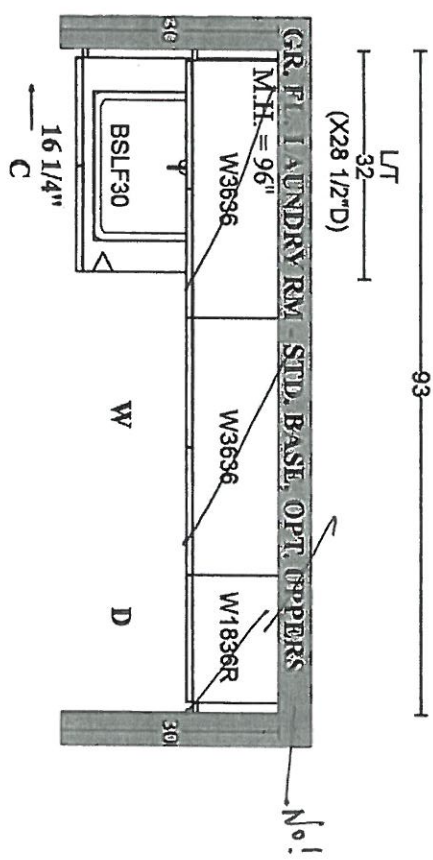



PINE VALLEY
FOREVERGREEN

STONE COUNTERTOP EDGE PROFILES



2CM EASED EDGE

LOCATION:

THRU-OUT

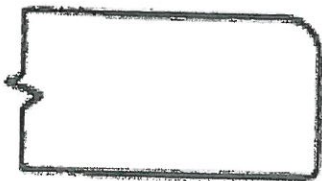

3CM EASED EDGE

LOCATION:



4CM MITRED EDGE

LOCATION:



2CM OGEE EDGE

LOCATION:

LOT #: PY-LL1

DATE: Dec. 7, 2020

SIGNATURE

SIGNATURE

GOLD PARK
WORTH MORE

STANDARD HARDWARE



☐ H001-02



☐ H001-03



☐ H001-04



☐ H009-03



☐ H009-09



☐ H011-03



☐ H011-05



☒ H011-06

- Laundry
- Main Bath
- Shared Bath
- Master Ensuite



☒ H033-01
→ Kitchen
→ Powder Room.



☐ H039-03

LOT #
PV-111

DATE:
Dec. 7, 2020

SIGNATURE:

SIGNATURE:

UPGRADE KITCHEN SINK



BLANCO - QUATRUS R15 U 1-3/4
Stainless Steel - Undermount
33" x 18" x 9"

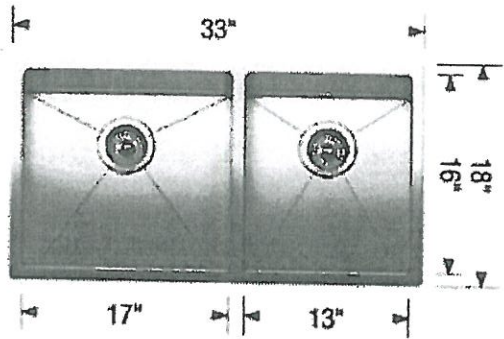
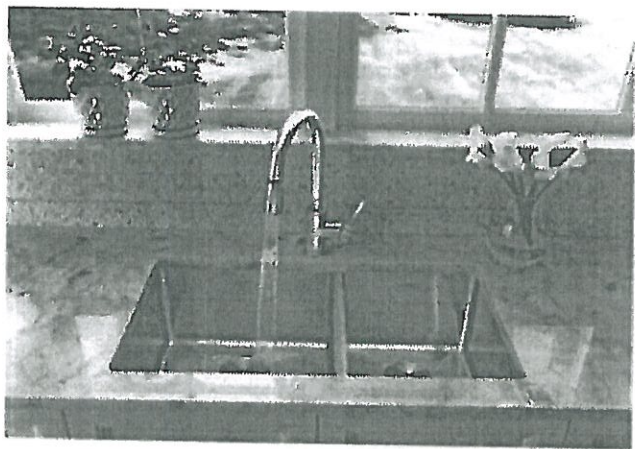
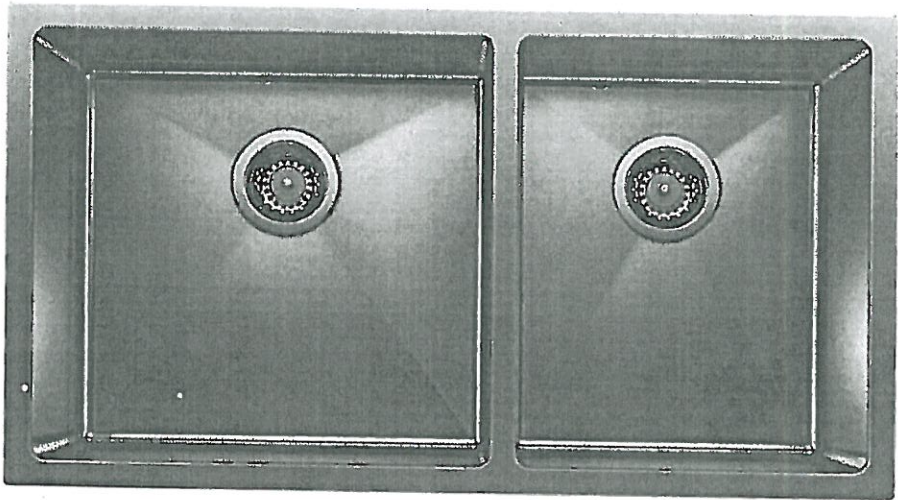

Stainless Steel

☐ GRID (LB)

☐ GRID (SB)

MODEL 401520 Stainless Steel / ~~406451 Grid (LB)~~ / ~~406450 Grid (SB)~~

Lot#
PV-111

Room: Kitchen

Signature:

Date: December 7, 2020.

Signature:

STANDARD SHOWER HARDWARE



SDK106

Shower Door Knob

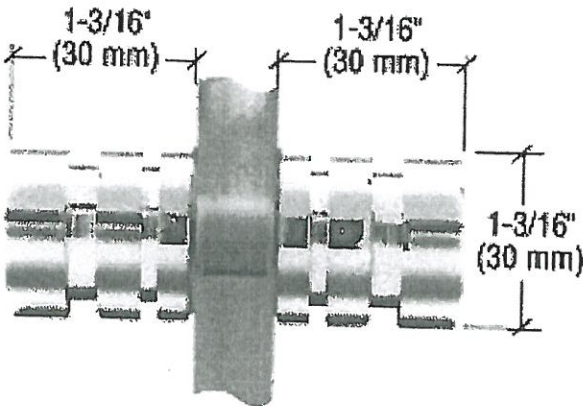

SDK106
Shower Door Knob

1-3/16" dia.
Contemporary Style
(Also available single sided)

* THRU-OUT.

LOT #
PV-111

DATE:
December 7, 2020

SIGNATURE:

SIGNATURE:

BATHROOM ACCESSORIES

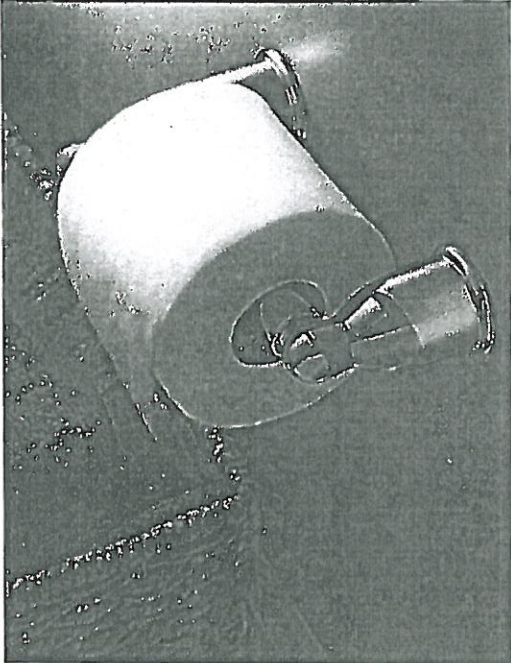

Tissue Holder
Mason - Chrome

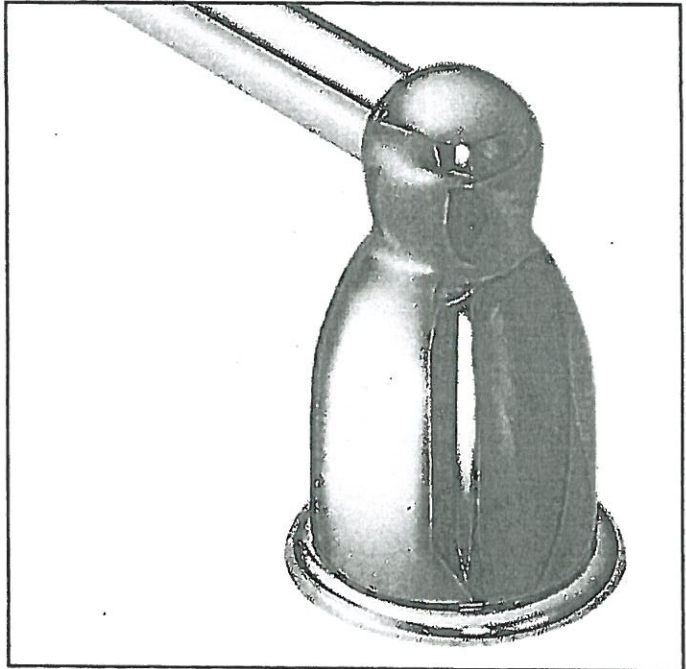

Towel Bar
Mason - Chrome

**Please select one below **

☐ INSTALL STANDARD BATHROOM ACCESSORIES THRU OUT
(tissue holder + towel bar) **location as per vendors discretion**

☒ ***DO NOT*** INSTALL STANDARD BATHROOM ACCESSORIES
THRU OUT **tissue holder + towel bar will not be provided**

LOT #
PV-111

DATE:
December 7, 2020

SIGNATURE:

SIGNATURE:

30" Induction Cooktop

800 Series – Black NIT8069UC

PV-111 ~~see attached~~
October 16, 2020



NIT8069UC
Black

Also available in:
Black with NIT8069SUC
Stainless
Steel Frame

The 800 Series induction cooktop is sleek in design, and features AutoChef® technology which maintains precise cooking temperatures.

- Features & Benefits
- Induction – faster than gas and electric cooktops. Precise cooking, easy cleaning and more efficient
- AutoChef® – regulates temperatures continuously during frying and adjusts them as needed
- 11" cooking zone for larger pots and pans
- Home Connect™ – the easy way to connect your smart device with your Bosch cooktop
- Hood Control – convenient operation of the Home Connect™ enabled ventilation via your cooktop

Element Performance	
Power of Front Left heating element	1,400 W
Power of Front Left heating element (in boost)	2,200 W
Power of Back Left heating element	2,200 W
Power of Back Left heating element (in boost)	3,700 W
Power of Back Right heating element	2,600 W
Power of Back Right heating element (in boost)	3,700 W
Power of Front Right heating element	1,400 W
Power of Front Right heating element (in boost)	2,200 W
Burners with booster	All
Element Size	
Dimension of Front Left heating element	6"
Dimension of Back Left heating element	9"
Dimension of Back Right heating element	11"
Dimension of Front Right heating element	6"

General Properties	
Home Connect™ (Wi-Fi Enabled)	Yes
Controls	PreciseSelect® Touch
Technical Details	
Watts	7,200 W
Circuit breaker	30 A
Volts	208-240 V
Frequency	60 Hz
Plug type	No plug
Power cord length	37"
Energy source	Electric
Dimensions & Weight	
Overall appliance dimensions (HxWxD)	1/4" +4 1/8" x 31" x 21 1/4"
Required cutout size (HxWxD)	4 1/8" x 28 7/8" x 20"
Minimum distance from counter front	2 1/4"
Minimum distance from rear wall	2"
Net weight	41 lbs
Accessories—Optional	



Accessories: To purchase Bosch accessories, cleaners & parts please visit www.bosch-home.com/us/store or call 1-800-944-2904 (Mon to Fri 5 am to 6 pm PST, Sat 6 am to 3 pm PST).

Notes: All height, width and depth dimensions are shown in inches. BSH reserves the absolute and unrestricted right to change product materials and specifications, at any time, without notice. Consult the product's installation instructions for final dimensional data and other details prior to making cutout.

Warranties: Please see Use & Care manual or Bosch website for statement of limited warranty.

For more information on our entire line of products, go to www.bosch-home.com/us or call 1-800-944-2904

© BSH Home Appliances Corporation. All rights reserved. Bosch is a registered trademark of Robert Bosch GmbH.

30" Induction Cooktop

800 Series – Black NIT8069UC

PV-111 *see attached*  **BOSCH**
Invented for life
October 16, 2020

Installation Details

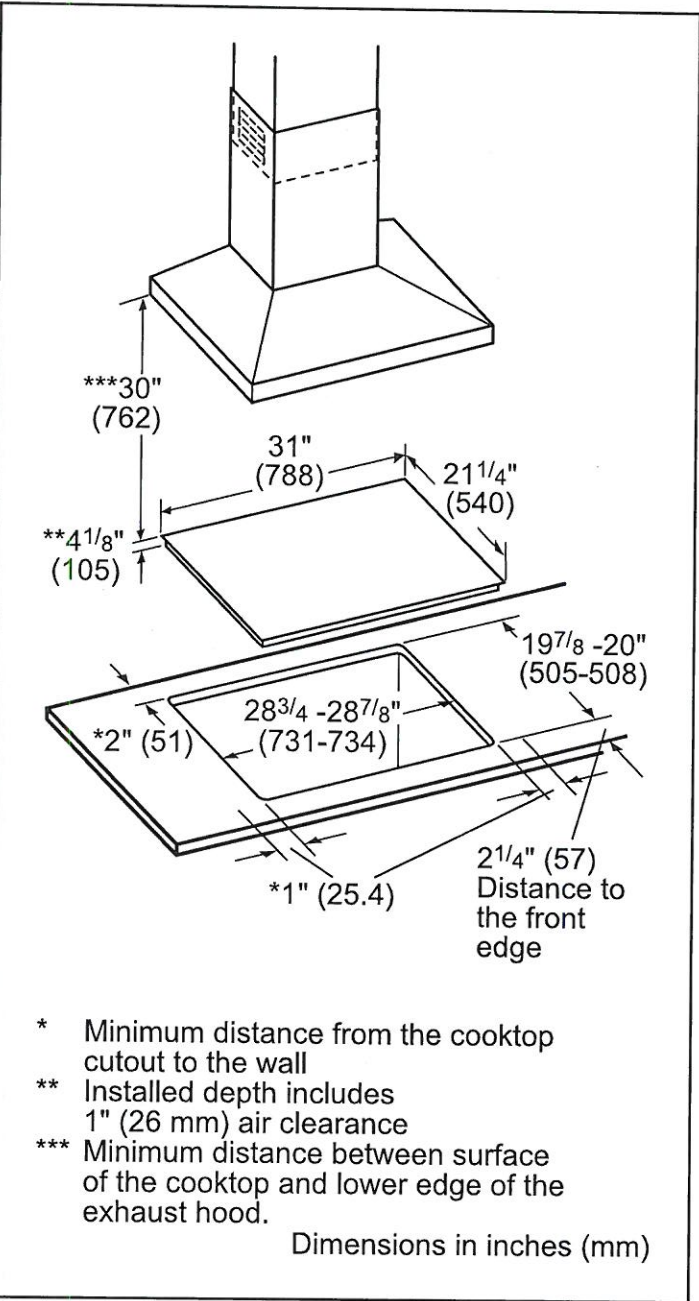

Installation above Wall Ovens

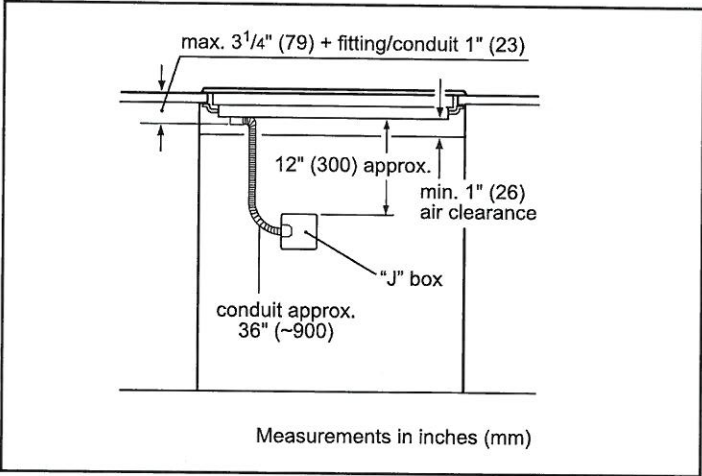
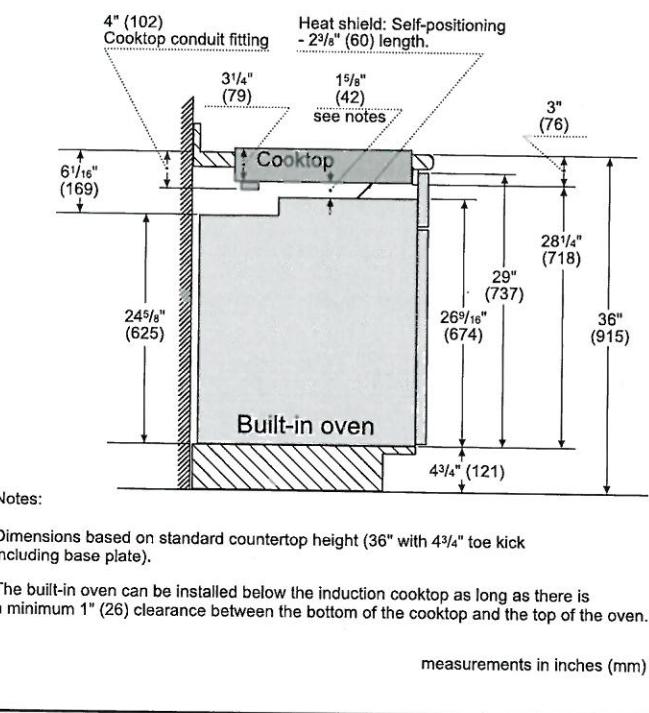

Accessories: To purchase Bosch accessories, cleaners & parts please visit www.bosch-home.com/us/store or call 1-800-944-2904 (Mon to Fri 5 am to 6 pm PST, Sat 6 am to 3 pm PST).

Notes: All height, width and depth dimensions are shown in inches. BSH reserves the absolute and unrestricted right to change product materials and specifications, at any time, without notice. Consult the product's installation instructions for final dimensional data and other details prior to making cutout.

Warranties: Please see Use & Care manual or Bosch website for statement of limited warranty.

For more information on our entire line of products, go to www.bosch-home.com/us or call 1-800-944-2904

© BSH Home Appliances Corporation. All rights reserved. Bosch is a registered trademark of Robert Bosch GmbH.

30" Single Wall Oven

800 Series – Stainless Steel HBL8453UC

PV-111 *see attached*
October 16, 2020



HBL8453UC
Stainless Steel

Also available in:
Black HBL8463UC
Black Stainless HBL8443UC
Steel

Using Genuine European Convection Roast, you can create a juicy, tender roast up to 25% faster than non-convection modes.

Features & Benefits

- Get the oven up to temperature in less time using Fast Preheat™, so meals are ready sooner.
- Whether cooking poultry, beef or pork, use the Temperature Meat Probe to monitor the internal temperature and get perfect results every time.
- Serve dinner on time with tools like an oven timer, delay cook feature, and digital kitchen timer.
- Oven is equipped with a self-cleaning cycle that easily cleans itself via 2, 3, and 4 hour cycle options.
- Download the Home Connect app to remotely monitor and control your Bosch wall oven with your smart phone or tablet.

General Properties	
Home Connect™ (WiFi enabled)	Yes
Oven modes	Bake, Variable Broil (hi & low), Roast, Warm, Sabbath, Proof Dough, Convection Bake, Convection Broil, Convection Roast, Pizza, Multi Rack Genuine European Convection, Convection Conversion, Temperature Probe, Fast Preheat
Cleaning type	Self Clean
Telescopic rack	1
Illumination type	Incandescent
Interior lights	2
Oven Performance	
Bake / broil element wattages	2,400 / 3,800 W
Convection element wattages	2,000 W
Technical Details	
Watts (W)	6,325 W
Circuit breaker (A)	30 A
Volts (V)	240 / 208 V
Frequency (Hz)	60 Hz
Power cord length (in)	50"
Plug type	Fixed Connection, No Plug
Energy source	Electric

Dimensions & Weight	
Overall appliance dimensions (HxWxD) (in)	29" x 29 3/4" x 24 1/2"
Required cutout size (HxWxD) (in)	27" – 28 5/8" x 28 1/2" x 23 1/2"
Oven cavity size (cu. ft.)	4.6
Overall oven interior dimensions (HxWxD) (in)	17 13/16" x 24 1/8" x 18"
Usable oven interior dimensions (HxWxD) (in)	12 1/4" x 23 1/4" x 15 1/4"
Net weight (lbs)	149 lbs
Accessories – Included	
Included	1 Telescopic and 2 Standard Oven Racks, Temperature Probe
Accessories – Optional	



HEZTR301
30" Telescopic Rack



Accessories: To purchase Bosch accessories, cleaners & parts please visit www.bosch-home.com/us/store or call 1-800-944-2904 (Mon to Fri 5 am to 6 pm PST, Sat 6 am to 3 pm PST).

Notes: All height, width and depth dimensions are shown in inches. BSH reserves the absolute and unrestricted right to change product materials and specifications, at any time, without notice. Consult the product's installation instructions for final dimensional data and other details prior to making cutout.

Warranties: Please see Use & Care manual or Bosch website for statement of limited warranty.

For more information on our entire line of products, go to www.bosch-home.com/us or call 1-800-944-2904

© BSH Home Appliances Corporation. All rights reserved. Bosch is a registered trademark of Robert Bosch GmbH.

30" Single Wall Oven

800 Series – Stainless Steel HBL8453UC

PV-III ~~*see attached*~~  **BOSCH**
Invented for life
October 16, 2020

Installation Details

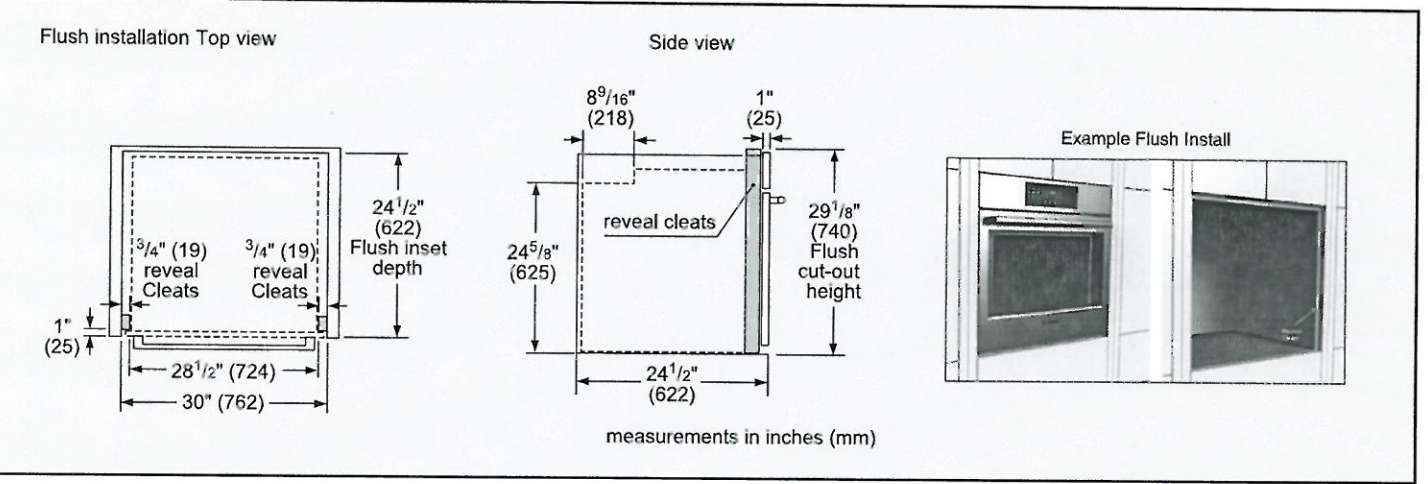
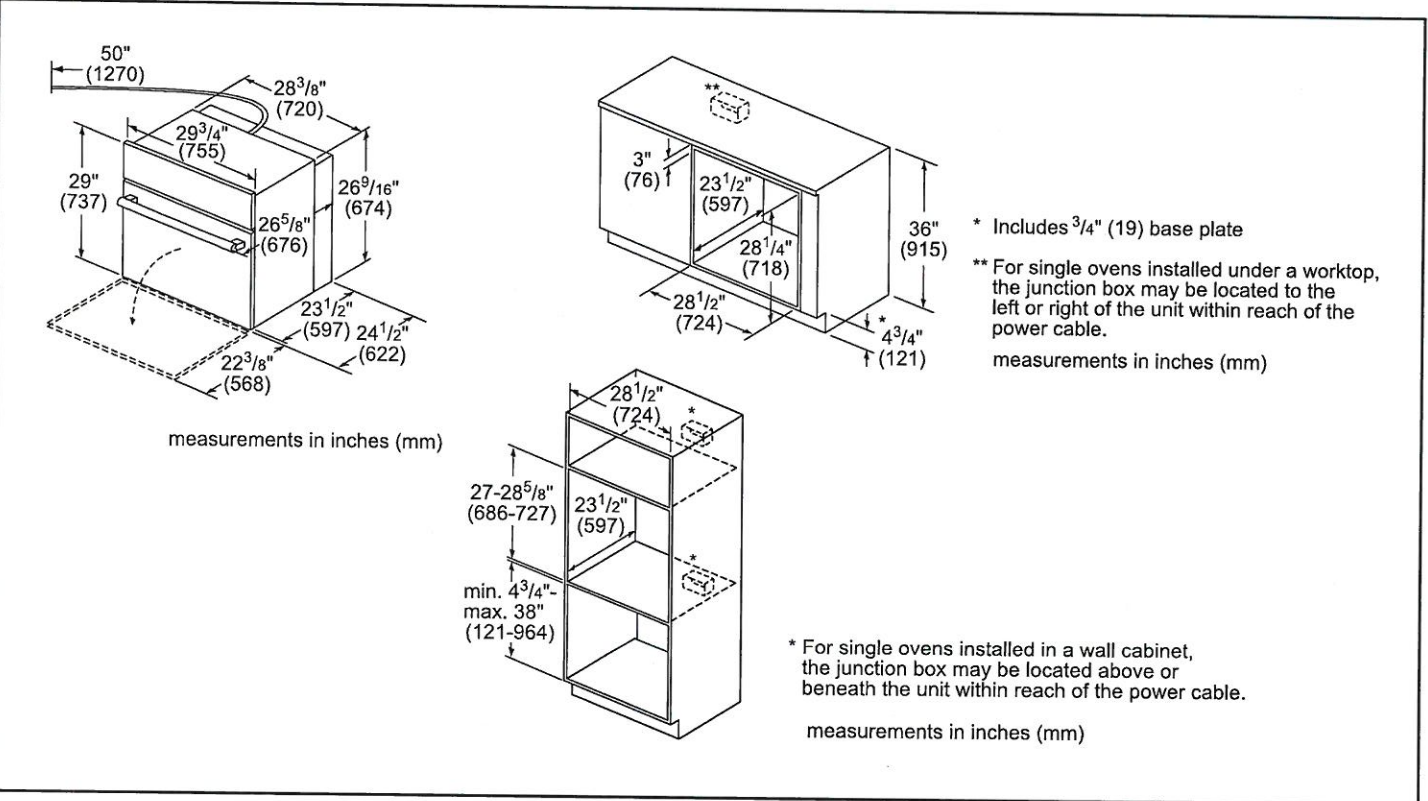

Accessories: To purchase Bosch accessories, cleaners & parts please visit www.bosch-home.com/us/store or call 1-800-944-2904 (Mon to Fri 5 am to 6 pm PST, Sat 6 am to 3 pm PST).

Notes: All height, width and depth dimensions are shown in inches. BSH reserves the absolute and unrestricted right to change product materials and specifications, at any time, without notice. Consult the product's installation instructions for final dimensional data and other details prior to making cutout.

Warranties: Please see Use & Care manual or Bosch website for statement of limited warranty.

For more information on our entire line of products, go to www.bosch-home.com/us or call 1-800-944-2904

© BSH Home Appliances Corporation. All rights reserved. Bosch is a registered trademark of Robert Bosch GmbH.