





**Model: 42.03 A FORESTCREST****Project/Phase: Pine Valley Forevergreen / 1**

## ELECTRICAL APPLIANCES

Invoice	Qty.	Description
2320 72,273 30Sep20	1	KITCHEN: 110V WALL RECEPTACLE ON SEPARATE CIRCUIT - GAS FIRED COOKTOP- FOR AUX. EQUIPMENT - NOT A STOVE PLUG
2320 72,273 30Sep20	1	KITCHEN: 110V WALL RECEPTACLE ON SEPARATE CIRCUIT - FUTURE FREEZER BESIDE FRIDGE
2320 72,272 30Sep20	1	SERVERY: 110V WALL RECEPTACLE ON SEPARATE CIRCUIT - FOR FUTURE WINE FRIDGE - APPLIANCE NOT INCLUDED
2320 72,282 30Sep20	1	KITCHEN: ADDITIONAL 220V RECEPTACLE ON A SEPARATE CIRCUIT - FOR BUILT-IN WALL OVEN - APPLIANCE NOT INCLUDED - DOES NOT INCLUDE BREAKER THAT IS TO BE INSTALLED BY LICENSED ELECTRICIAN AND ARRANGED BY HOMEOWNER AFTER CLOSING

## ELECTRICAL INTERIOR

Invoice	Qty.	Description
2320 72,281 30Sep20	1	GREAT ROOM: INTERIOR WALL OUTLET: ADDITIONAL 110V WALL INTERIOR RECEPTACLE ON EXISTING CIRCUIT FOR WALL MOUNTED TV - LOCATE APPROX. 66" A.F.F. ABOVE FIREPLACE
2320 72,280 30Sep20	1	LIVING ROOM: CEILING OUTLET: ADDITIONAL REINFORCED CEILING OUTLET - LOCATE APPROX. CENTER IN OTA
2320 72,307 30Sep20	1	KITCHEN: FIXTURE: RELOCATE STANDARD CEILING MOUNT FIXTURE - LOCATE APPROX. CENTER ABOVE ISLAND

## ELECTRICAL SWITCH

Invoice	Qty.	Description
2320 72,278 30Sep20	1	LIVING ROOM: ADDITIONAL INTERIOR SWITCH  FOR CEILING LIGHT

## FORM - FORMING

Invoice	Qty.	Description
2236 72,351 30Sep20 **	2	BASEMENT WINDOWS - UPGRADE BASEMENT WINDOW SIZE TO 30 " X 24" - 8" FRAME

## FORMING

Invoice	Qty.	Description
2236 72,208 30Sep20	1	PINE VALLEY MODEL 42.03 FORESTCREST ELEV A - 9 FOOT BASEMENT CEILING HEIGHT IN LIEU OF STANDARD 8 FOOT CEILING.

GOLDPARK

WORTH MORE™

CONSTRUCTION SUMMARY

Lot: 100

Model: 42.03 A FORESTCREST

Project/Phase: Pine Valley Forevergreen / 1

FRAMING

Invoice	Qty.	Description
2320 72,631 30Sep20	1	MASTER ENSUITE: SHOWER NICHE [SHAMPOO SHELF] - COMPLETE WITH MATCHING MARBLE JAMBS ON 4 SIDES, STANDARD TILE, APPROX. 12 X 18 INSTALLED VERTICALLY - SEE PLAN FOR PREFERRED LOCATION
2320 72,690 30Sep20	1	DELETE KITCHEN BULKHEAD, IF POSSIBLE, SITE APPROVAL REQUIRED
2320  30Sep20 NoCat	1	***CUSTOM LAYOUT*** DELETE LINEN CLOSET FROM UPPER HALL, USE IT TO MAKE CLOSET LARGER IN BEDROOM 2
2320  30Sep20 NoCat	1	***CUSTOM LAYOUT***DELETE STUDY LOFT, CLOSE WALL/RAILING AT OTB TO CREATE LARGER HERS WIC. SEE PLAN FOR LAYOUT. INCLUDES STANDARD INTERIOR ROD AND SHELVING. ISLAND TO BE PURCHASED AT COLOUR APPOINTMENT

GARAGE DOORS

Invoice	Qty.	Description
2320 72,324 30Sep20	2	GARAGE DOOR OPENER (CHAMBERLAIN BELT DRIVE) - WITH 1 REMOTE - PRICE IS PER DOOR
2320 72,323 30Sep20	1	GARAGE: WIRELESS KEYPAD GARAGE DOOR ENTRY   877LM

GLASS AND MIRROR

Invoice	Qty.	Description
2450  16Nov20 NoCat	1	MASTER ENSUITE: UPGRADE TO SHOWER DOOR HANDLE/TOWEL BAR #MT6X18 CHROME
2450  16Nov20 NoCat	1	ENSUITE 3: UPGRADE SHOWER DOOR HARDWARE TO HANDLE/TOWEL BAR #SQ6X18 CHROME
2450  16Nov20 NoCat	1	ENSUITE 4: UPGRADE SHOWER DOOR HARDWARE TO HANDLE/TOWEL BAR #SQ6X18 CHROME

DisciplineMS.rpt 26jun20

Page 4 of 8  
Printed and Sent: 16-Nov-20





GOLDPARK

WORTH MORE™

CONSTRUCTION SUMMARY

Lot: 100

Model: 42.03 A FORESTCREST

Project/Phase: Pine Valley Forevergreen / 1

PAINT		
Invoice	Qty.	Description
2450	2	MAIN STAIRS: BASEMENT TO 2ND FLOOR: STAIN STAIRS AND LANDINGS
16Nov20 NoCat		STAIRS AND LANDINGS WILL NOT MATCH HARDWOOD FLOORS IN COLOUR/TEXTURE/SPECIES

PAINTING		
Invoice	Qty.	Description
2320 72,690 30Sep20 **	1	DELETE KITCHEN BULKHEAD, IF POSSIBLE, SITE APPROVAL REQUIRED
2320 72,498 30Sep20 **	1	LIVING ROOM - OPT. COFFERED CEILING AS PER PLAN
2236 72,351 30Sep20 **	2	BASEMENT WINDOWS - UPGRADE BASEMENT WINDOW SIZE TO 30 " X 24" - 8" FRAME

PANL - FRAMING		
Invoice	Qty.	Description
2320 72,690 30Sep20 **	1	DELETE KITCHEN BULKHEAD, IF POSSIBLE, SITE APPROVAL REQUIRED
2320 72,498 30Sep20 **	1	LIVING ROOM - OPT. COFFERED CEILING AS PER PLAN
2320 72,324 30Sep20 **	2	GARAGE DOOR OPENER (CHAMBERLAIN BELT DRIVE) - WITH 1 REMOTE - PRICE IS PER DOOR
2236 72,351 30Sep20 **	2	BASEMENT WINDOWS - UPGRADE BASEMENT WINDOW SIZE TO 30 " X 24" - 8" FRAME

PLUMBING		
Invoice	Qty.	Description
2320 72,332 30Sep20	1	KITCHEN: ROUGH-IN 1/4" COLD WATER LINE TO FRIDGE
2450 16Nov20 NoCat	1	KITCHEN: UPGRADE SINK TO BLANCO QUATRUS R15 U SUPER SINGLE STAINLESS STEEL #401518
		BOTTOM GRID NOT INCLUDED
2450 16Nov20 NoCat	1	KITCHEN: ADD SOAP DISPENSER - MOEN CHROME #S3947C
		LOCATE LEFT OF KITCHEN FAUCET

DisciplineMS.rpt 26jun20

Page 7 of 8  
Printed and Sent: 16-Nov-20





PV-100 Cabinetry Schedule

ROOM	DESCRIPTION	PRICE	QTY	TOTAL
LAUNDRY ROOM	ADD LAUNDRY UPPERS		1	
MUD ROOM	ADD UPPERS		1	
MASTER ENSUITE	CONVERT TO COMFORT HEIGHT		1	
BED 2 BATH	UPGRADE FROM SERIES 2 TO SERIES 5		1	
BED 3 BATH	TOP DRAWER CONVERSION		1	
BED 4 BATH	UPGRADE FROM SERIES 2 TO SERIES 5		1	
POWDER ROOM	UPGRADE FROM SERIES 2 TO SERIES 6		1	
ISLAND	UPGRADE FROM SERIES 2 TO SERIES 5		1	
	TOUCH-LATCH HARDWARE TO BACKSIDE OF ISLAND DRILLED INTO CABINET GABLE		1	
SERVERY	UPGRADE FROM SERIES 2 TO SERIES 5		1	
	SUPPLY OPTIONAL SERVERY UPPERS SERIES 5		1	
	LEAVE OPEN SPACE FOR WINE COOLER		1	
KITCHEN	UPGRADE KITCHEN CABINET FROM SERIES 2 TO SERIES 5		1	
	SPICE PULL-OUT 9"W - FULL-HEIGHT		1	
	ADD 12"D STOVE UPPER 18"H		1	
	ADD FLIP-UP HARDWARE TO 18"H/21"H STOVE UPPER		1	
	BUILT-IN TALL & DEEP M/W CABINET CONVERSION IN LIEU OF STD. CABINETRY		1	
	POTS & PANS DRAWERS CONVERSION BELOW TALL BUILT-IN M/W UNIT		1	
	21"W 2-BIN RECYCLING CENTRE RIGHT OF SINK CABINET		1	
	RETURN TRIP FOR KICK PLATE ADJUSTMENTS		1	
CABINETRY TOTAL:				

LOT #: 100

DATE: Nov. 11 2020

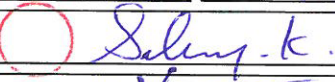
SIGNATURE: 

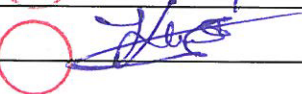
SIGNATURE: 

Purchasers: Thiruchchelvy Kanagalingam & Elamaran Thirun Property: 100 of Plan -

Telephone Res. / Bus: / (416) 567-3204

Project: Pine Valley Forevergreen - Phase 1

Decor Advisor: Yolande Somerville

Model and Elevation: 42.03 A FORESTCREST

Layout Changes: ☒ Yes ☐ No

Sketch Attached: ☒ Yes ☐ No

Exterior Colour Scheme: ☒ See attach

### 1. Cabinetry

	Style and Colour	Counter	Hardware
Kitchen / Breakfast	2 - tone	*Quartz: N Boost Marengo	k00205
Laundry Room	Chesapeake 'Classic White'	P-Lam: White	h03903
Powder Room	*Manhattan 'Midnight Blue'	Quartz: Ice Snow	h00102
Mud Room	Modena 'Pewter'	P-Lam: White	h01105
Master Ensuite Bathroom	Alban oak 'Storm Grey'	Quartz: Ice Snow	k00205
Second Ensuite Bathroom (If Applicable)	*Alban 'Winter Green'	Quartz: Ice Snow	k00203
Ensuite 3	Chesapeake 'Pewter'	Quartz: Ice Snow	k00203

#### Comment

KITCHEN: PERIMETER + SERVERY: Medio 6 'Clay' // ISLAND: Medio 6 'Oyster' // Ensuite 4: \*Manhattan: Wenge 'storm grey' Quartz: Ice Snow h00104

### 2. Floor Tile

	Selection
Entrance Vestibule	*12x24" New Byzantine 'Azzuro Blue'
Main Hall	n/a
Kitchen / Breakfast	see hardwood
Laundry Room	12x12" Construct 'Dark Grey' matte
Powder Room	*12x24" New Byzantine 'Azzuro Blue'
Ensuite 3	13x13" Costa 'White' matte
Master Ensuite Bathroom	*18x18" Madison matte 'white'
Second Ensuite Bathroom (If Applicable)	13x13" New Byzantine 'Azzuro Blue'
Lower Landing (If Applicable)	13x13" New Byzantine 'Azzuro Blue' (basement foyer)
Ensuite 4	13x13" Construct 'Light Grey'

#### Comment

Master Ensuite Shower Floor: 2x2" Quebec 'White' // Ensuite 3 + Ensuite 4 shower floor: std 2" white // MUDROOM: 13x13" New Byzantine 'Azzuro Blue'

### 3. Wall Tile

	Selection	Listello/Inserts	Describe
Ensuite 3	8x10" Weave 'White'	<input type="radio"/> Yes <input checked="" type="radio"/> No	
Master Ensuite Bathroom			
Tub Deck		<input type="radio"/> Yes <input checked="" type="radio"/> No	
Shower Stall	*8x24" Laguna 'Grey wave'	<input type="radio"/> Yes <input checked="" type="radio"/> No	
Bathroom Walls	n/a	<input type="radio"/> Yes <input checked="" type="radio"/> No	
Second Ensuite Bathroom (If Applicable)	8x10" Weave 'White'	<input type="radio"/> Yes <input checked="" type="radio"/> No	
Ensuite 4	8x10" Reflection 'Expresso'	<input type="radio"/> Yes <input checked="" type="radio"/> No	
Kitchen Backsplash	<input type="radio"/> Yes <input checked="" type="radio"/> No	Backsplash Behind Fridge	

#### Comment



Purchasers: Thiruchchelvy Kanagalingam & Elamaran Thirun; Property: 100 of Plan -

Telephone Res. / Bus: / (416) 567-3204

Project: Pine Valley Forevergreen - Phase 1

Decor Advisor: Yolande Somerville

Model and Elevation: 42.03 A FORESTCREST

### 4. Plumbing Fixtures

<input type="checkbox"/>	Second Ensuite	<input type="checkbox"/>	Powder Room	<input type="checkbox"/>
Master Ensuite Bathroom	<input type="checkbox"/>	Other Room - Specify	<input type="checkbox"/>	Other Washroom
<input type="checkbox"/>		<input type="checkbox"/>		

Comment

Standard thru out except master ensuite + kitchen sink + soap

### 5. Hardwood Flooring

	Type and Stain		Type and Stain
Main Hall	<input type="text"/>	Upper Landing	<input type="text"/>
Kitchen / Breakfast	5" white oak Sculpted 'Baroque'	Upper Hall	<input type="text"/>
Living Room	<input type="text"/>	Master Bedroom	<input type="text"/>
Dining Room	<input type="text"/>	Bedroom #2	<input type="text"/>
Family Room	<input type="text"/>	Bedroom #3	<input type="text"/>
Den/Library	<input type="text"/>	Bedroom #4	<input type="text"/>
Entrance Vestibule	<input type="text"/>	Bedroom #5	<input type="text"/>
Lower Landing (If Applicable)	<input type="text"/>	Other Room - Specify	<input type="text"/>
		Thru out standard areas	5" white oak Sculpted 'Baroque'

Comment

Vintage 3/4x5" White oak Sculpted 'Baroque'

### 6. Carpeting

	Upgrade	Description
Ground Floor	<input type="checkbox"/>	<input type="text"/>
Second Floor	<input type="checkbox"/>	<input type="text"/>
<input type="text"/>	<input type="checkbox"/>	<input type="text"/>

Upgrade Underpad	Type	Area
	<input type="text"/>	<input type="text"/>
Carpet on Stairs	Capped	Runner - *Upgrade
	<input type="text"/>	<input type="text"/>

Comment

### 7. Fireplace

	Living Room			Family Room			Other Room - Specify		
	Purchased	As Per Plan	N/A	Purchased	As Per Plan	N/A	Purchased	As Per Plan	N/A
Fireplace Type	<input type="radio"/>	<input type="radio"/>	<input checked="" type="radio"/>	<input type="radio"/>	<input checked="" type="radio"/>	<input type="radio"/>	<input type="radio"/>	<input type="radio"/>	<input checked="" type="radio"/>
Mantle Type	<input type="text"/>	<input type="text"/>	<input type="text"/>	Standard Gas	<input type="text"/>	<input type="text"/>	<input type="text"/>	<input type="text"/>	<input type="text"/>
Colour / Stain	<input type="text"/>	<input type="text"/>	<input type="text"/>	Mediterranean	<input type="text"/>	<input type="text"/>	<input type="text"/>	<input type="text"/>	<input type="text"/>
Surround	<input type="text"/>	<input type="text"/>	<input type="text"/>	Arctic White	<input type="text"/>	<input type="text"/>	<input type="text"/>	<input type="text"/>	<input type="text"/>
Hearth	<input type="text"/>	<input type="text"/>	<input type="text"/>	n/a	<input type="text"/>	<input type="text"/>	<input type="text"/>	<input type="text"/>	<input type="text"/>
	<input type="text"/>	<input type="text"/>	<input type="text"/>	none	<input type="text"/>	<input type="text"/>	<input type="text"/>	<input type="text"/>	<input type="text"/>

Comment

\*see attach.\*

PV-600  
Nov. 12, 2020.

Purchasers: Thiruchchelvy Kanagalingam & Elamaran Thirun; Property: 100 of Plan -

Telephone Res. / Bus: / (416) 567-3204

Project: Pine Valley Forevergreen - Phase 1

Decor Advisor: Yolande Somerville

Model and Elevation: 42.03 A FORESTCREST

### 8. Trim Carpentry

Interior Doors  Front Door Glass Inserts  Door Handles

Interior Trim

Comment

### 9. Plaster Mouldings and Medallions

Standard Throughout ☐ Yes ☐ No ☒ N/A

Entrance Vestibule   Kitchen/Breakfast

Main Hall   Den/Library

Living Room   Lower Landing

Dining Room   Other Room - Specify

Family Room

Comment

### 10. Railings and Spindles

Railing Package

Railing Colour  Spindle Colour

Stringer / Riser  Treads

Comment Oak Stairs ☒ Yes ☐ No ☐ N/A

### 11. Wall Paint / Ceilings

Throughout Finished Areas

Trim Paint

Smooth Ceilings

Ground Floor ☒

Second Floor ☒

Note

Comment

\*See attach.\*

PV-600  
Nov. 12, 2020



Scheduled Closing Date: Tuesday, March 9, 2021

Purchasers: Thiruchchelvay Kanagalingam & Elamaram Thirun: Property: 100 of Plan -

Telephone Res. / Bus: / (416) 567-3204

Project: Pine Valley Forevergreen - Phase 1

Decor Advisor: Yolande Somerville

Model and Elevation: 42.03 A FORESTCREST

### 12. Electrical

Hood Fan ☐ White ☐ Stainless ☒ N/A

Above Kitchen Cabinet Light ☐ Yes ☒ No

Below Kitchen Cabinet Light ☐ Yes ☒ No

Standard Appliances ☐

Over The Range Microwave ☐

Chimney Style Fan ☐

Comment

### 13. Heating and Air Conditioning

Air Conditioning

Gas Provisions Stove

Gas Provisions Dryer

Gas Provisions Barbecue

Comment

### 14. Additional Comments

### 15. Disclaimers and Notes

- 1) Colours of all materials are as close as possible to builder's selection, but not necessarily identical due to variances in manufacturing.
- 2) Any extras listed above are null and void unless accompanied by a separate invoice/amendment. Said invoice must be paid in full.
- 3) The Purchaser acknowledges that after Interior Colour Selection form is signed and dated, no further changes will be permitted other than re-selection due to unavailability. \_\_\_\_\_ Purchaser's Initials
- 4) The Purchaser acknowledges reading and accepting the "Gold Park Homes Decor Centre Disclaimers" form. This document contains other miscellaneous disclaimers.

This Interior Colour Selection is final and approved by:

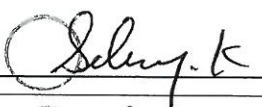
Signature:  Date: \_\_\_\_\_

# SCHEDULE 'F'

PINE VALLEY  
FOREVLAAGEN

PV-100  
MAR 22 2020

PV-100  
MAY 11 2020

SK ET

PV-100

Nov. 11, 2020

## The Forestcrest 42' SERIES

Elevation A • 3,800 sq.ft.  
Elevation B • 3,785 sq.ft.  
Elevation C • 3,800 sq.ft.

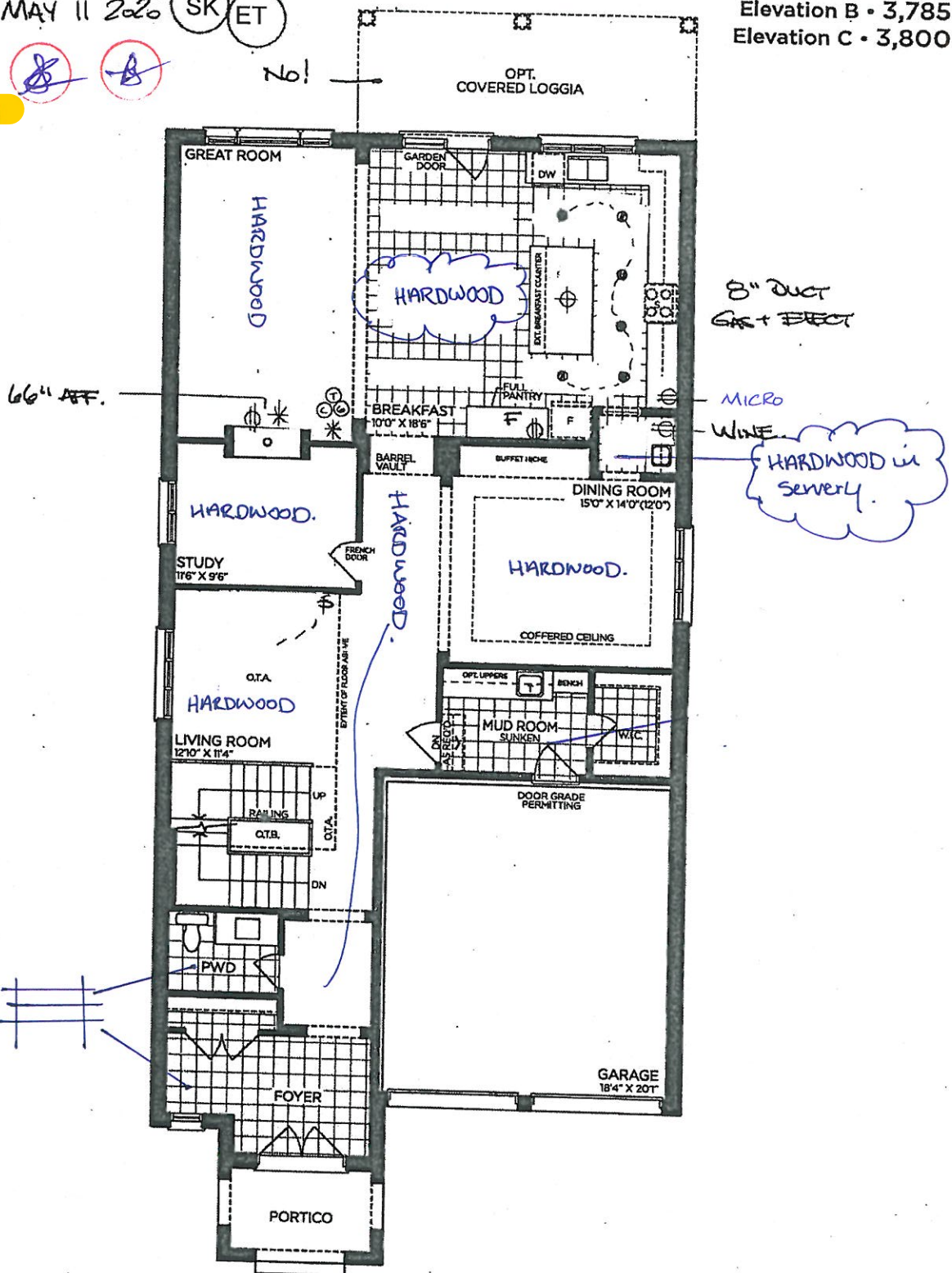

GROUND FLOOR | ELEV. A

VENDOR   
PURCHASER   
PURCHASER

GOLDPARK  
WORTH MORE™

Prices, figures, illustrations, sizes, features and finishes are subject to change without notice. Areas and dimensions are approximate and actual usable floor space may vary from the stated area. Layout may be reverse of the unit purchased. E. & O.E. 4203



# SCHEDULE 'F'



PV-100 (SK) (ET)  
MAY 11 2020

PV-100  
Nov. 11, 2020

## The Forestcrest 42' SERIES

→ Elevation A • 3,800 sq.ft.  
Elevation B • 3,785 sq.ft.  
Elevation C • 3,800 sq.ft.

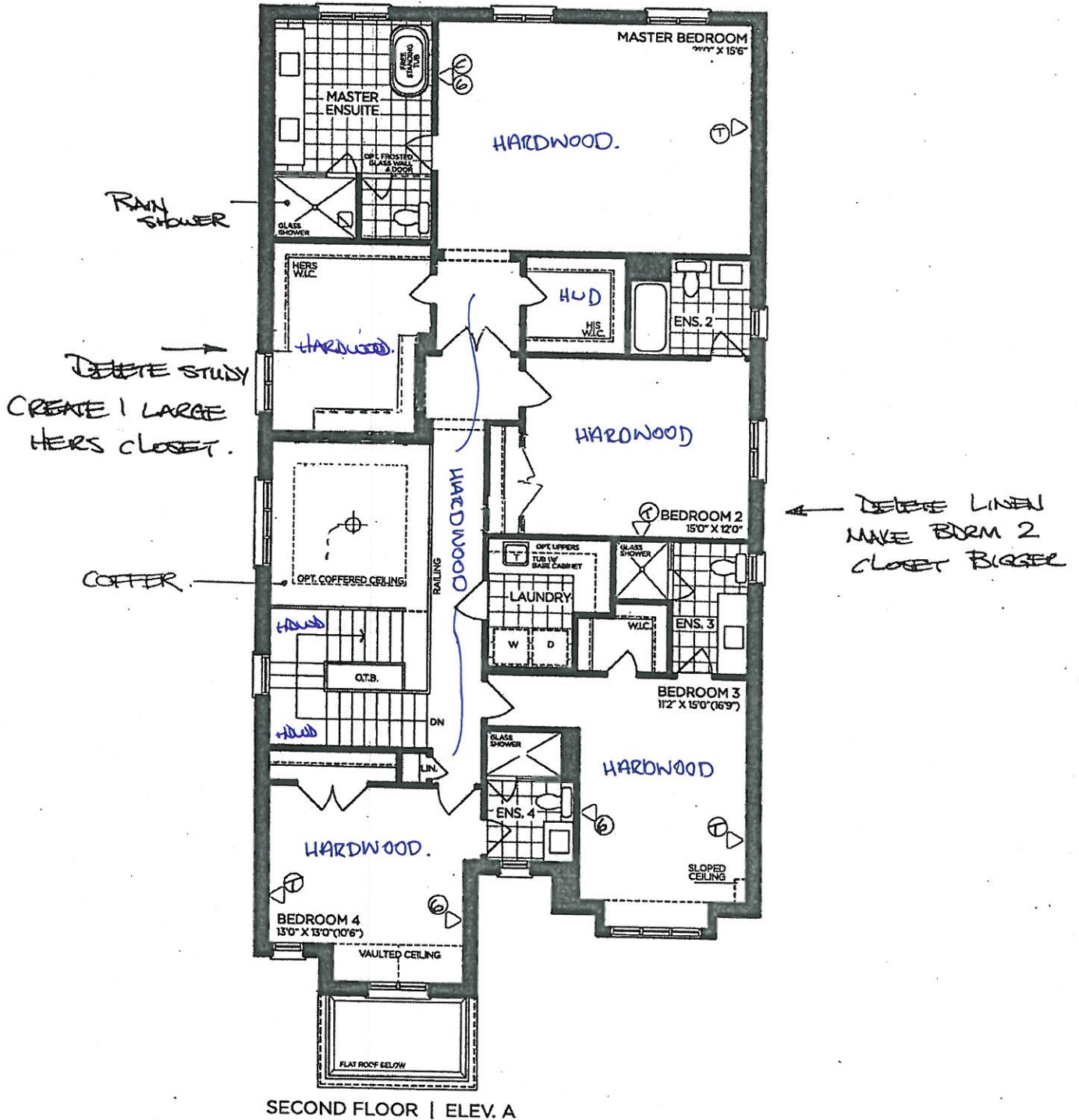

VENDOR

PURCHASER

PURCHASER

**GOLDPARK**  
WORTH MORE™

Prices, figures, illustrations, sizes, features and finishes are subject to change without notice. Areas and dimensions are approximate and actual usable floor space may vary from the stated area. Layout may be reverse of the unit purchased. E. & O.E. 4203

SCHEDULE 'F'



PV-100 *see attached*  
March 22 2020

PV-100  
May 11 2020 (SK) (ET)

PV-100  
Nov. 11, 2020

# The Forestcrest

## 42' SERIES

→ Elevation A • 3,800 sq.ft.  
Elevation B • 3,785 sq.ft.  
Elevation C • 3,800 sq.ft.

LOS

Back Flow  
Preventer Valve

9' CEILING  
in BASEMENT

24x30"

24x30"

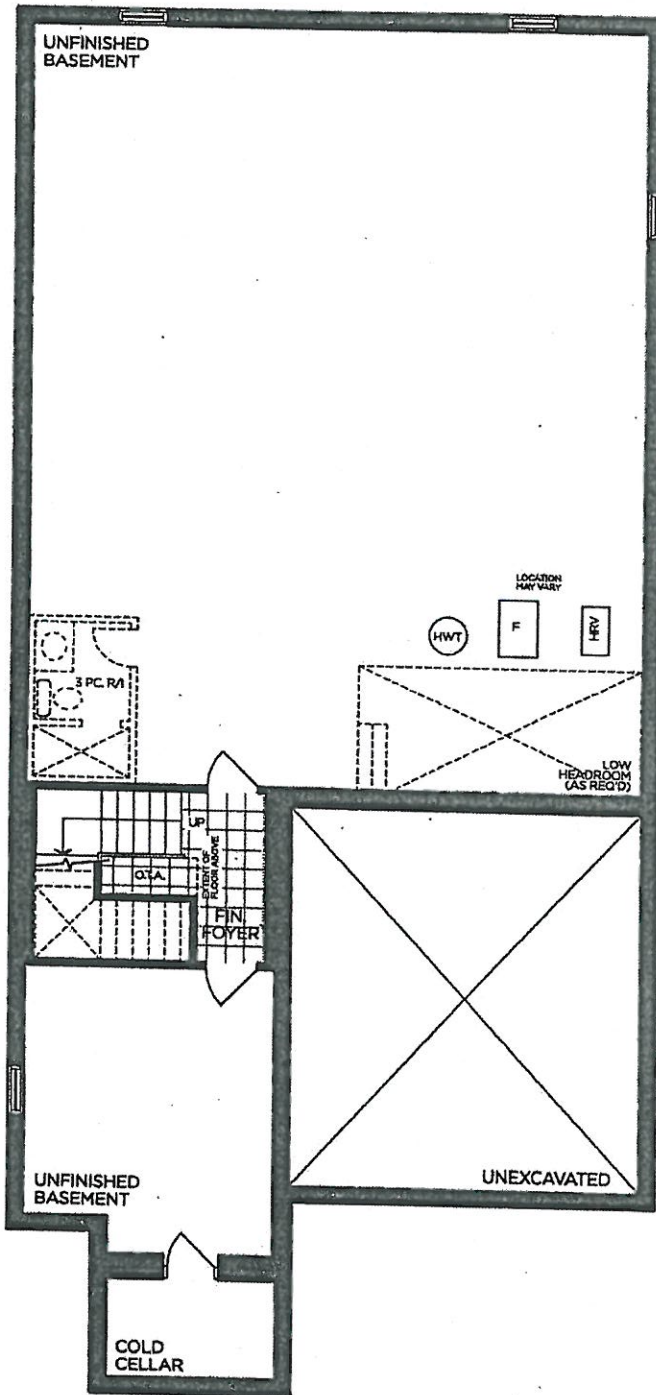

BASEMENT | ELEV. A

VENDOR	
PURCHASER	
PURCHASER	

## GOLDPARK

WORTH MORE™

Prices, figures, illustrations, sizes, features and finishes are subject to change without notice. Areas and dimensions are approximate and actual usable floor space may vary from the stated area. Layout may be reverse of the unit purchased. E. & O.E. 4203





**SITE STANDARD: WHITE 3/4" EXTENSION  
SOFT-CLOSE DRAWERS & SOFT-CLOSE  
HINGES TO KITCHEN AREA**

**10' CEILING - 12"H COFFERED CEILING -  
M.H. = 102" + 3/4"H CONTEMPORARY  
MOLDING + 5 1/4"H FURRING RAIL  
+ LARGE CORNICE MOLDING TO  
UNDERSIDE OF BOX**

PERIMETER:  
Mediog 'Clay'

ISLAND:  
Medina to 'oyster'

HARDWARE: K002-05.

island: Touch Lstch

Recycle P/O

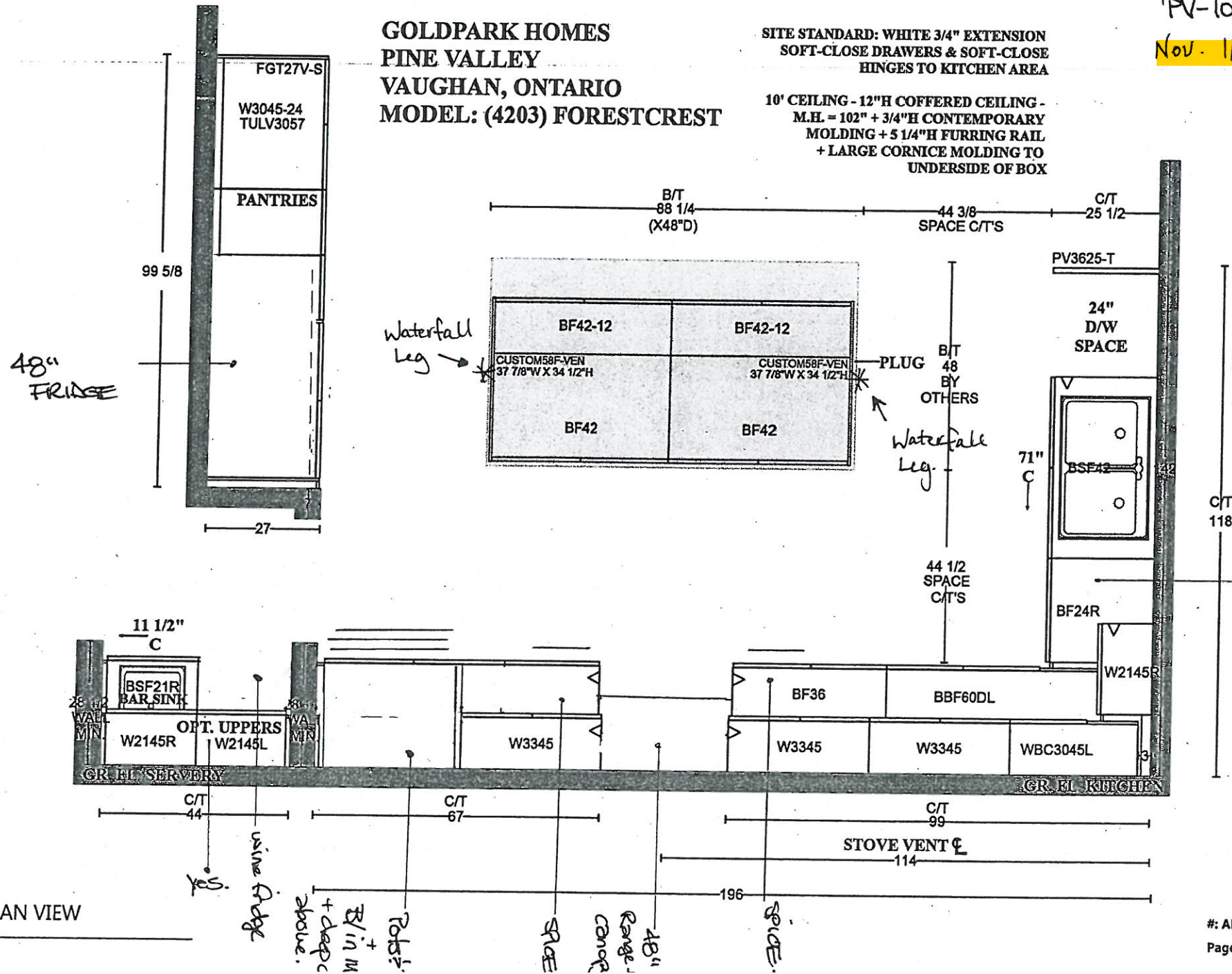

PR-LOO  
Nov. 11, 2020.

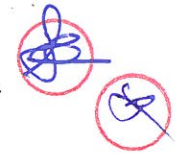

Manhattan  
'Midnight Blue'  
Hool-02.

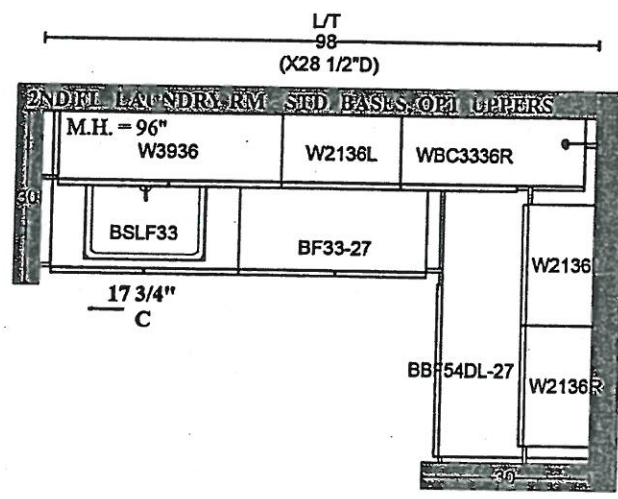
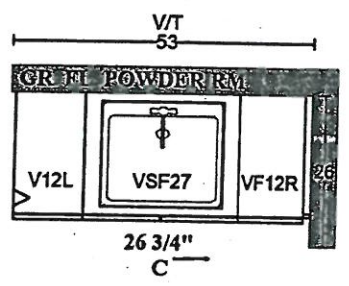
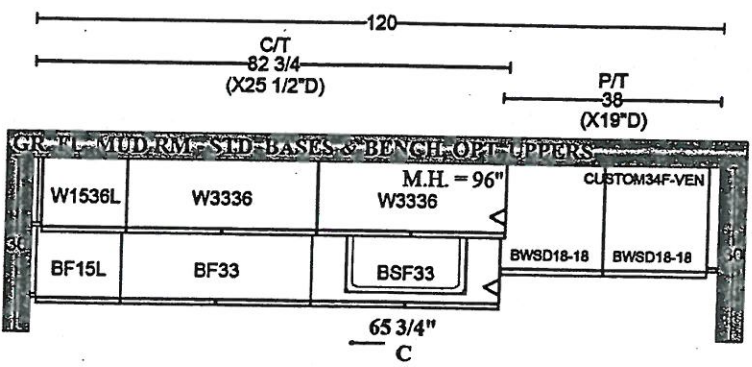

Chesapeake  
'Classic White'  
H039-03.  
P-Lam 'white'

**GOLDPARK HOMES  
PINE VALLEY  
VAUGHAN, ONTARIO  
MODEL: (4203) FORESTCREST**  
SITE STANDARD: WHITE 3/4" EXTENSION  
SOFT-CLOSE DRAWERS & STANDARD SLAM DOOR HINGES  
TO VANITIES  
ONE TOP DRAWER WHERE POSSIBLE THROUGHOUT EACH  
VANITY, ONE BANK OF DRAWERS WHERE POSSIBLE  
THROUGHOUT EACH MASTER ENSUITE VANITY

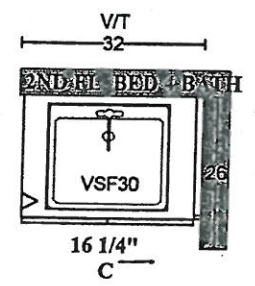
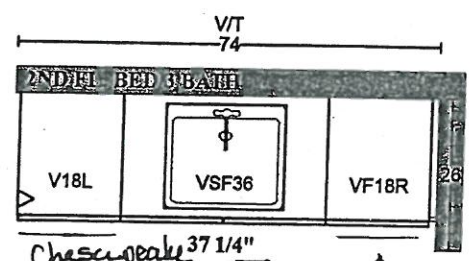
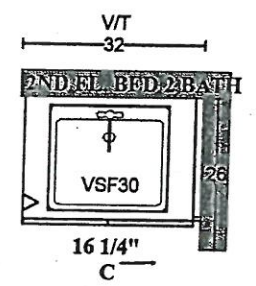
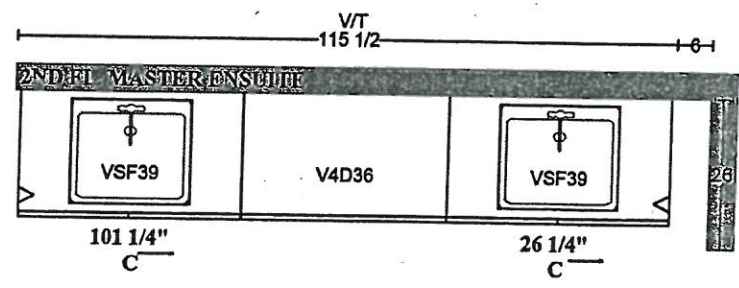

Manhattan  
'Storm Grey Wenge'  
Hool-04.

Chesapeake  
'Pewter'  
K002-03  
Add top  
drawers

opt 4 pps →  
Modena  
'Pewter'  
Hool: H011-05.  
P-Lam: 'white'

Alban oak  
'Storm Grey'  
K002-05  
\* → 'comfort height'

Alban  
'Winter Green'  
K002-03



PLAN VIEW



PINE VALLEY

FOREVERGREEN

STONE COUNTERTOP EDGE PROFILES

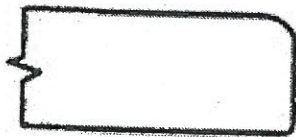

2CM EASED EDGE

LOCATION:

TRUV-OVT.

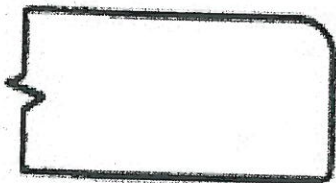

3CM EASED EDGE

LOCATION:



4CM MITRED EDGE

LOCATION:



2CM OGEE EDGE

LOCATION:

LOT #: PV-600

DATE: Nov. 11, 2020.

SIGNATURE: 

SIGNATURE: 





PINE VALLEY  
FOREVERGREEN

## STANDARD HARDWARE / KNOBS



☐ K002-02



☒ K002-03  
→ Ensuite 2 + 3



☐ K002-04



☐ K002-06



☒ K002-05  
→ Kitchen  
→ Master Ensuite



☐ K002-14



☐ K024-03

LOT #  
PV-100

DATE:  
Nov. 11, 2020

SIGNATURE:

 *Selena K*

SIGNATURE:

 *JAS*

GOLDPARK  
WORTH MORE™



PINE VALLEY  
FOREVERGREEN

## STANDARD HARDWARE



H001-02

→ Powder Room



H001-03



H001-04

→ Ensuite 4



H009-03



H009-09



H011-03



H011-05

→ Mudroom



H011-06



H033-01



H039-03

→ Laundry

LOT #

PV-100

DATE:

Nov. 11, 2020

SIGNATURE:

 *Schuyler*

SIGNATURE:

 *[Signature]*

GOLDPARK  
WORTH MORE™



PINE VALLEY  
FOREVERGREEN

## UPGRADE KITCHEN SINK

### BLANCO - QUATRUS R15 U SUPER SINGLE

Stainless Steel - Undermount

32" x 18" x 9"

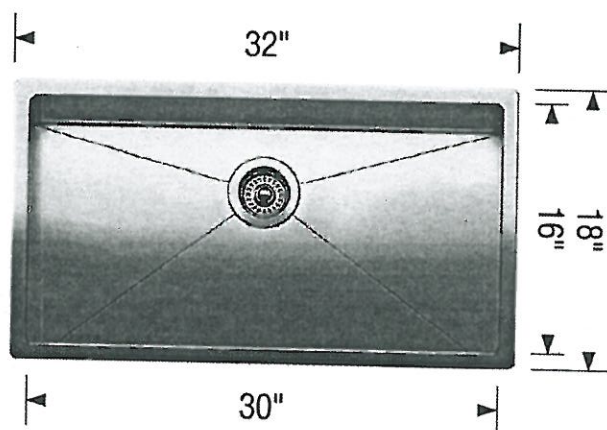

Stainless Steel

☐ GRID

MODEL 401518 Stainless Steel / ~~406347 Grid~~

Lot#

PV-100

Room:

Kitchen

Signature:

 Seluy. k

Date:

Nov. 11, 2020

Signature:

GOLDPARK  
WORTH MORE™

UPGRADE KITCHEN EXTRA



MOEN - MODERN

Soap/Lotion Dispenser



- ☒ CHROME (C)  
☐ STAINLESS (SRS)  
☐ BRUSHED GOLD (BG)  
☐ MATTE BLACK (BL)

MODEL: S3947 (C, SRS, BG, BL) Soap Dispenser

Lot# <i>PV-100</i>	Date: <i>Nov. 11, 2020</i>	Room: <i>Kitchen</i>
Signature:  <i>Selma K</i>		
Signature:  <i>[Signature]</i>		





PINE VALLEY  
FOREVERGREEN

## UPGRADE SHOWER HARDWARE

### MT6X18

Shower Door Handle / Towel Bar

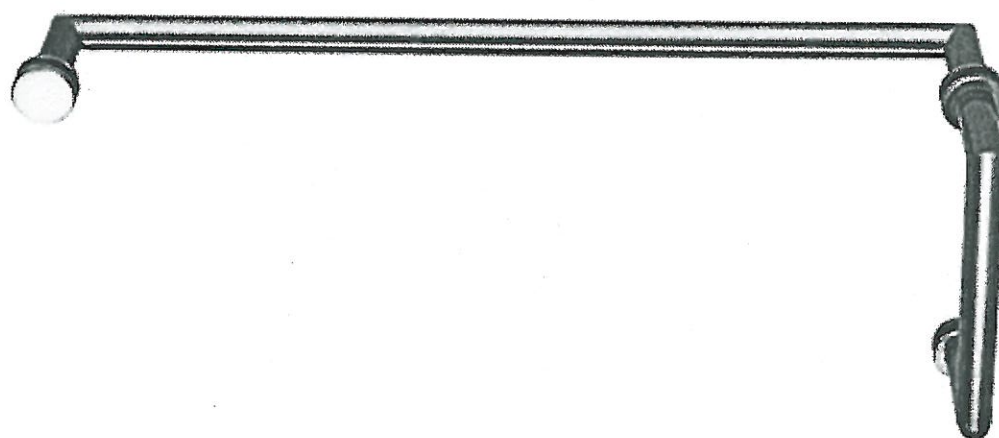

MT6X18  
Shower Door Handle / Towel  
Bar

6" x 18" back-to-back  
3/4" dia. tube  
Cut and miltred corners with  
washers

☒ CHROME

☐ MATTE BLACK

LOT #  
PV-100

DATE:  
Nov. 11, 2020.

ROOM: Master Ensuite

SIGNATURE:  Selmy. k.

SIGNATURE:  [Signature]





PINE VALLEY  
FOREVERGREEN

## UPGRADE SHOWER HARDWARE

### SQ6X18

Shower Door Handle / Towel Bar

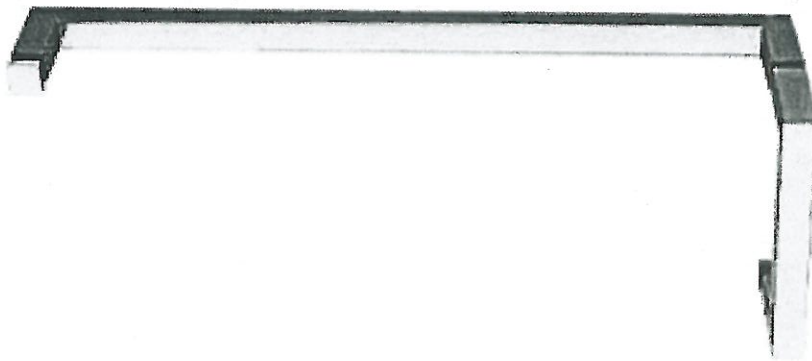

SQ6X18  
Shower Door Handle / Towel  
Bar

6" x 18" back-to-back  
3/4" square tube

☒ CHROME

☐ MATTE BLACK

LOT #  
PV-600

DATE: Nov. 11, 2020.

ROOM: Ensuite 3 + 4

SIGNATURE:  Selwyn, K.

SIGNATURE:  [Signature]



Project: Pine Valley

Lot: 100

Purchaser(s): Thiruchchelv Kanagalingam + Elamaram  
Thirunavukkarasu

#### Standard Hood Fan Deletion

We acknowledge that the builder's standard hood fan will not be installed.  
Do not supply, install and/or credit. We will install our own hood fan after closing.

Signature:  Selva K

Signature:  [Signature]

Date: November 11, 2020

## BATHROOM ACCESSORIES



Tissue Holder  
Mason - Chrome

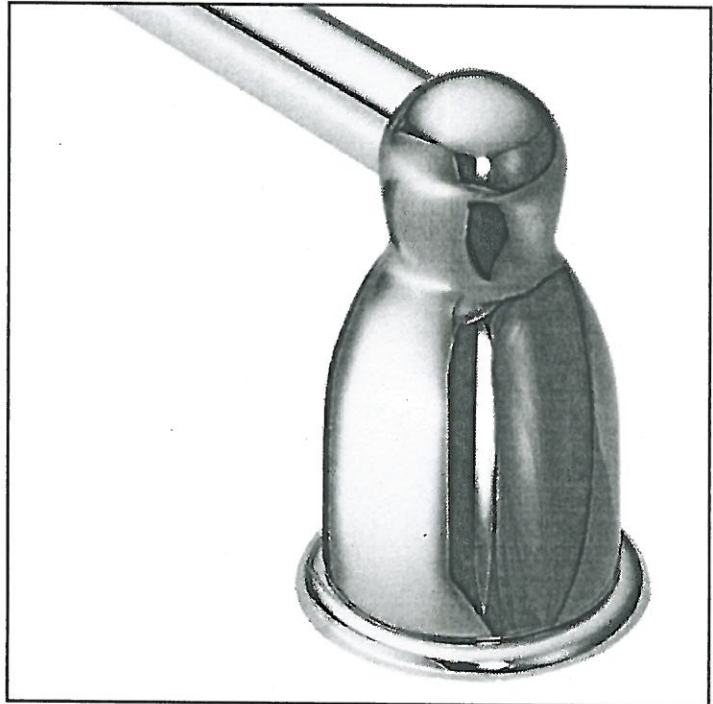

Towel Bar  
Mason - Chrome

*\*PLEASE SELECT ONE\* ;*

☐ INSTALL STANDARD BATHROOM ACCESSORIES THRU OUT  
(tissue holder + towel bar) *\*location as per vendors discretion\**

☒ **\*DO NOT\*** INSTALL STANDARD BATHROOM ACCESSORIES  
THRU OUT *\*tissue holder + towel bar will not be provided\**

LOT #  
PV-100

DATE:  
Nov. 11, 2020

SIGNATURE: 

SIGNATURE: 