

Brampton Encore - 125 - 2 - 38-7 Elev.B SCHUBERT OPT - GFA1  
CERAMIC

Inv.2,127	1 - KITCHEN/FOYER/POWDER ROOM: UPGRADE 4 FLOOR TILE - 12X24" LAID IN STRAIGHT, STACKED PATTERN. SEE PLAN FOR TILE DIRECTION
Line30240	Note:
3Dec19 / 16Mar20	
Inv.2,165	1 - GROUND FLOOR: EXTEND FOYER 'STANDARD TILES' TO KITCHENETTE - SEE PLAN FOR LOCATION
Line30721	Note:
28Jan20 / 16Mar20	

CONCRETE AND DRAIN

Inv.2,127	1 - ROUGH-IN - 3PC BASEMENT ROUGH-IN
Line31457	Note:
3Dec19 / 16Mar20	

ELECTRICAL

Inv.2,127	1 - BEDROOM 3: CAT 6 WIRING - SEE PLAN FOR LOCATION
Line30208	Note:
3Dec19 / 16Mar20	
Inv.2,127	1 - 200 AMP ELECTRICAL SERVICE
Line30214	Note:
3Dec19 / 16Mar20	
Inv.2,127	1 - KITCHEN: CAPPED CEILING OUTLET, COMPLETE WITH SWITCH
Line30215	Note: LOCATE APPROX CENTER ABOVE ISLAND
3Dec19 / 16Mar20	
Inv.2,127	1 - LIVING ROOM: ADD CAPPED CEILING OUTLET, COMPLETE WITH SWITCH.
Line30216	Note:
3Dec19 / 16Mar20	
Inv.2,127	1 - KITCHEN: 110V WALL RECEPTACLE ON DEDICATED CIRCUIT - GAS FIRED APPLIANCE - FOR AUX. EQUIPMENT - NOT A STOVE PLUG
Line30218	Note:
3Dec19 / 16Mar20	
Inv.2,165	1 - GROUND FLOOR: 110V WALL RECEPTACLE ON DEDICATED CIRCUIT-LOCATE AT END OF "WET BAR" FOR FUTURE FRIDGE. SEE PLAN FOR LOCATION.
Line30722	Note:
28Jan20 / 16Mar20	

EXTERIOR COLOURS

Inv.2,127	1 - EXTERIOR COLOUR PKG# 4
Line31464	Note:
3Dec19 / 16Mar20	

FORMING

Inv.2,127	1 - SIDE DOOR- HOME TO EXTERIOR- AS PER PLAN AND GRADE PERMITTING
Line30205	Note:
3Dec19 / 16Mar20	
Inv.2,127	1 - MANDOOR - GARAGE TO HOUSE- AS PER PLAN AND GRADE PERMITING
Line31455	Note:
3Dec19 / 16Mar20	



CONSTRUCTION SUMMARY

Brampton Encore - 125 - 2 - 38-7 Elev.B SCHUBERT OPT - GFA1  
FRAMING

Inv.2,127	1 - MANDOOR - GARAGE TO HOUSE- AS PER PLAN AND GRADE PERMITTING
Line30203	Note: Included in aps
3Dec19 / 16Mar20	
Inv.2,127	1 - BEDROOM 6: RELOCATE DOOR TO BEDROOM. SEE PLAN FOR LOCATION
Line30207	Note:
3Dec19 / 16Mar20	
Inv.2,127	1 - UPPER HALL: 2X4' SKYLIGHT - FIXED
Line30221	Note: LOCATION TO BE DETERMINED BY VENDOR
3Dec19 / 16Mar20	
Inv.2,127	1 - SIDE DOOR- HOME TO EXTERIOR- AS PER PLAN AND GRADE PERMITTING
Line31456	Note:
3Dec19 / 16Mar20	

GRANITE MARBLE QUARTZ

Inv.2,127	1 - KITCHEN: FLUSH BREAKFAST BAR
Line30238	Note:
3Dec19 / 16Mar20	

HVAC

Inv.2,127	1 - KITCHEN: GAS LINE ROUGH - 2ND FLOOR- (3-STOREY MODELS)
Line30217	Note:
3Dec19 / 16Mar20	

INTERIOR TRIM AND DOORS

Inv.2,127	1 - BEDROOM 6: RELOCATE DOOR TO BEDROOM. SEE PLAN FOR LOCATION
Line31462	Note:
3Dec19 / 16Mar20	
Inv.2,127	1 - MAN DOOR- AS PER PLAN & GRADE PERMITTING
Line31465	Note:
3Dec19 / 16Mar20	

KITCHEN AND BATH CABINETRY

Inv.2,127	1 - KITCHEN: DELETE UPPERS, FINISH SIDES OF CABINETS - LEAVE APPROX. 36" FOR FUTURE 30" CHIMNEY-HOOD FAN.
Line30236	Note:
3Dec19 / 16Mar20	
Inv.2,127	1 - KITCHEN: SLIDE IN STOVE PREP
Line30237	Note:
3Dec19 / 16Mar20	
Inv.2,127	1 - KITCHEN: PREMIUM SPRAY STAIN
Line30239	Note:
3Dec19 / 16Mar20	
Inv.2,127	1 - REC ROOM: **ADD WET BAR** APPROX. 6' BASE CABINETS (NO UPPERS) COMPLETE WITH LAMINATE COUNTER TOP + SS DROP IN BAR SINK AND BAR FAUCET (CHROME) BASED ON STANDARD FINISHES.
Line31459	Note:
3Dec19 / 16Mar20	

Brampton Encore - 125 - 2 - 38-7 Elev.B SCHUBERT OPT - GFA1

MISC.

Inv.2,127	1 - Purchaser has attended an appointment at the Decor Centre & has DECLINED any additional upgrades and accepts and acknowledges that there will be no further changes/additions/deletions to be made upon signing on December 20, 2019
Line30234	Note:
3Dec19 / 16Mar20	
Inv.2,127	1 - BONUS PACKAGE: \$10,000.00 (INCLUDING TAXES) WORTH OF UPGRADES FROM GOLD PARK HOMES DÉCOR CENTRE IS BEING APPLIED TOWARD THIS ORDER. PURCHASER HAS A REMAINING AMOUNT OF \$00 (INCLUDING TAXES).
Line30235	Note:
3Dec19 / 16Mar20	
Inv.2,165	1 - There will be no further changes/additions/deletions to be made upon signing January 28 2020
Line30723	Note: A \$500 fee to re-opn file will apply.
28Jan20 / 16Mar20	

PAINT

Inv.2,127	1 - SIDE DOOR & MAN DOOR- AS PER PLAN & GRADE PERMITTING
Line31463	Note:
3Dec19 / 16Mar20	

PLUMBING

Inv.2,127	1 - REC ROOM: **ADD WET BAR** APPROX. 6' BASE CABINETS (NO UPPERS) COMPLETE WITH LAMINATE COUNTER TOP + SS DROP IN BAR SINK AND BAR FAUCET (CHROME) BASED ON STANDARD FINISHES.
Line30206	Note: SINK TO BE LOCATED AT ONE END (NOT IN CENTER)
3Dec19 / 16Mar20	
Inv.2,127	1 - ROUGH-IN - 3PC BASEMENT ROUGH-IN
Line30219	Note:
3Dec19 / 16Mar20	
Inv.2,127	1 - KITCHEN: ROUGH-IN - WATERLINE FOR FIRDGE
Line30226	Note:
3Dec19 / 16Mar20	

PLUMBING FIXTURES

Inv.2,127	1 - REC ROOM: **ADD WET BAR** APPROX. 6' BASE CABINETS (NO UPPERS) COMPLETE WITH LAMINATE COUNTER TOP + SS DROP IN BAR SINK AND BAR FAUCET (CHROME) BASED ON STANDARD FINISHES.
Line31460	Note:
3Dec19 / 16Mar20	

WINDOWS - BASEMENT

Inv.2,127	2 - BASEMENT WINDOWS - UPGRADE EXISTING BASEMENT WINDOW TO 30 INCH X 24 INCH - MAY REQUIRE INSTALLATION OF WINDOW WELL
Line30225	Note: REAR WINDOWS ONLY
3Dec19 / 16Mar20	

WINDOWS AND DOORS

Inv.2,127	1 - BEDROOM 6: RELOCATE DOOR TO BEDROOM. SEE PLAN FOR LOCATION
Line31461	Note:
3Dec19 / 16Mar20	



\*\*\* NOTE: This is not an approved document. Document must be locked \*\*\*

Scheduled Closing Date:

Purchasers: Nancy Manuel Parmar & Nicholas Manuel P Property: 125

Telephone Res. / Bus:

Project: Brampton Encore - Phase 2

Decor Advisor: Yolande Somerville

Model and Elevation: 38-7 Elev.B SCHUBERT OPT - GFA1

Layout Changes: ☐ Yes ☒ No

Sketch Attached: ☒ Yes ☐ No

Exterior Colour Scheme:

1. Cabinetry

	Style and Colour	Counter	Hardware
Kitchen / Breakfast	*Siena oak 'Graphite'	Granite: Uba Tuba	cs1-23
Laundry Room	n/a	n/a	n/a
Powder Room	n/a	n/a	n/a
Twin Bath	Venice pvc 'Mystic'	P-Lam #6698-46	cs1-23
Master Ensuite Bathroom	Toscana pvc 'Crystal White'	P-Lam #6698-46	cs1-19
Second Ensuite Bathroom (If Applicable)	Venice pvc 'Mystic'	P-Lam #6698-46	cs1-23
Ground floor bath	Venice pvc 'Mystic'	P-Lam #6698-46	cs1-23

Comment

Wet Bar in Rec Room: Cabinet Venice pvc 'Mystic' P-Lam #6698-46 cs1-23

2. Floor Tile

	Selection
Entrance Vestibule	*12x24" Eterna polished London 'Beach Grey'
Main Hall	n/a
Kitchen / Breakfast	*12x24" Eterna polished London 'Beach Grey' ***kitchen only***
Laundry Room	13x13" Costa matte 'white'
Powder Room	*12x24" Eterna polished London 'Beach Grey'
Twin Bath	13x13" New Reeds 'Brown'
Master Ensuite Bathroom	13x13" Serpentine 'Charcoal'
Second Ensuite Bathroom (If Applicable)	13x13" New Reeds 'Brown'
Lower Landing (If Applicable)	n/a
Ground Floor Bath	13x13" New Reeds 'Brown'

Comment

GROUND FLOOR FOYER + 'WET BAR' : 13x13" NEW REEDS 'BROWN'

REVISED JAN 28 2020



3. Wall Tile

	Selection	Listello/Inserts	Describe
M.Ens. Tub skirt/splash	8x10" Weave 'White'	<input type="radio"/> Yes <input checked="" type="radio"/> No	
Master Ensuite Bathroom			
Tub Deck	8x10" Weave 'White'	<input type="radio"/> Yes <input checked="" type="radio"/> No	
Shower Stall	8x10" Weave 'White'	<input type="radio"/> Yes <input checked="" type="radio"/> No	
Bathroom Walls		<input type="radio"/> Yes <input checked="" type="radio"/> No	
Second Ensuite Bathroom (If Applicable)	8x10" Weave 'White'	<input type="radio"/> Yes <input checked="" type="radio"/> No	
Twin Bath	8x10" Weave 'White'	<input type="radio"/> Yes <input checked="" type="radio"/> No	
Kitchen Backsplash	<input type="radio"/> Yes <input checked="" type="radio"/> No	Backsplash Behind Fridge	

Comment

Ground Floor Bath: 8x10" Weave 'White'





\*\*\* NOTE: This is not an approved document. Document must be locked \*\*\*

Scheduled Closing Date:

Purchasers: Nancy Manuel Parmar & Nicholas Manuel P Property: 125

Telephone Res. / Bus:

Project: Brampton Encore - Phase 2

Decor Advisor: Yolande Somerville

Model and Elevation: 38-7 Elev.B SCHUBERT OPT - GFA1

#### 4. Plumbing Fixtures

Master Ensuite Bathroom ☐ Second Ensuite ☐ Powder Room ☐  
Other Room - Specify ☐ Other Washroom ☐

Comment

Standard Thru Out

#### 5. Hardwood Flooring

	Type and Stain		Type and Stain
Main Hall	STD 'Natural' 3/4 x 4-3/8" red oak	Upper Landing	STD 'Natural' 3/4 x 4-3/8" red oak
Kitchen / Breakfast	STD 'Natural' *bfst only*	Upper Hall	n/a
Living Room	STD 'Natural' 3/4 x 4-3/8" red oak	Master Bedroom	n/a
Dining Room	STD 'Natural' 3/4 x 4-3/8" red oak	Bedroom #2	n/a
Family Room	STD 'Natural' 3/4 x 4-3/8" red oak	Bedroom #3	n/a
Den/Library	n/a	Bedroom #4	n/a
Entrance Vestibule	n/a	Bedroom #5	n/a
Lower Landing (If Applicable)	STD 'Natural' 3/4 x 4-3/8" red oak	Other Room - Specify	n/a

Comment

#### 6. Carpeting

	Upgrade	Description
Ground Floor	<input type="checkbox"/>	Std 'Pearl White' with std u/pad
Second Floor	<input type="checkbox"/>	Std 'Pearl White' with std u/pad
	<input type="checkbox"/>	

Upgrade Underpad

Type  Area

Carpet on Stairs



Capped  Runner - \*Upgrade

Comment

#### 7. Fireplace

	Living Room			Family Room			Other Room - Specify		
	Purchased	As Per Plan	N/A	Purchased	As Per Plan	N/A	Purchased	As Per Plan	N/A
Fireplace Type	<input type="radio"/>	<input type="radio"/>	<input checked="" type="radio"/>	<input type="radio"/>	<input checked="" type="radio"/>	<input type="radio"/>	<input type="radio"/>	<input type="radio"/>	<input checked="" type="radio"/>
Mantle Type	<input type="text"/>			Standard Gas			<input type="text"/>		
Colour / Stain	<input type="text"/>			NF-23			<input type="text"/>		
Surround	<input type="text"/>			White			<input type="text"/>		
Hearth	<input type="text"/>			Nero Marquina			<input type="text"/>		
	<input type="text"/>			none			<input type="text"/>		

Comment

Jan 28 2020  

Purchasers:

Nancy Manuel Parmar & Nicholas Manuel P

Property: 125

Telephone Res. / Bus:

Project: Brampton Encore - Phase 2

Decor Advisor:

Yolande Somerville

Model and Elevation: 38-7 Elev.B SCHUBERT OPT - GFA1

## 8. Trim Carpentry

Interior Doors

Front Door Glass Inserts

Door Handles

Interior Trim

Comment

## 9. Plaster Mouldings and Medallions

Standard Throughout ☐ Yes ☐ No ☒ N/A

Entrance Vestibule

Main Hall

Living Room

Dining Room

Family Room

Comment

Kitchen/Breakfast

Den/Library

Lower Landing

Other Room - Specify

## 10. Railings and Spindles

Railing Package

Railing Colour

Stringer / Riser

Comment

Spindle Colour

Treads

Oak Stairs ☒ Yes ☐ No ☐ N/A

## 11. Wall Paint / Ceilings

Throughout Finished Areas

Trim Paint

Smooth Ceilings

Ground Floor ☐

Second Floor ☐

Note

Comment

Jan 28 2020

R P



\*\*\* NOTE: This is not an approved document. Document must be locked \*\*\*

Purchasers: Nancy Manuel Parmar & Nicholas Manuel P

Telephone Res. / Bus:

Decor Advisor: Yolande Somerville

Scheduled Closing Date:

Property: 125

Project: Brampton Encore - Phase 2

Model and Elevation: 38-7 Elev.B SCHUBERT OPT - GFA1

### 12. Electrical

Hood Fan ☐ White ☐ Stainless ☒ N/A

Above Kitchen Cabinet Light ☐ Yes ☒ No

Below Kitchen Cabinet Light ☐ Yes ☒ No

Standard Appliances ☐

Over The Range Microwave ☐

Chimney Style Fan ☒

Comment

### 13. Heating and Air Conditioning

Air Conditioning

Gas Provisions Dryer

Gas Provisions Stove

Gas Provisions Barbecue

Comment

### 14. Additional Comments

### 15. Disclaimers and Notes

- Colours of all materials are as close as possible to builder's selection, but not necessarily identical due to variances in manufacturing.
- Any extras listed above are null and void unless accompanied by a separate invoice/amendment. Said invoice must be paid in full.
- The Purchaser acknowledges that after Interior Colour Selection form is signed and dated, no further changes will be permitted other than re-selection due to unavailability.  Purchaser's Initials
- The Purchaser acknowledges reading and accepting the "Gold Park Homes Decor Centre Disclaimers" form. This document contains other miscellaneous disclaimers.

This Interior Colour Selection is final and approved by:

Signature: N. Parmar Date: Jan 28 2020

BE2-125  
JEE 20 2019

The  
Schubert  
38' SERIES

Elevation A • 3,665 sq.ft. | Elevation B • 3,683 sq.ft.

JAN 28 2020

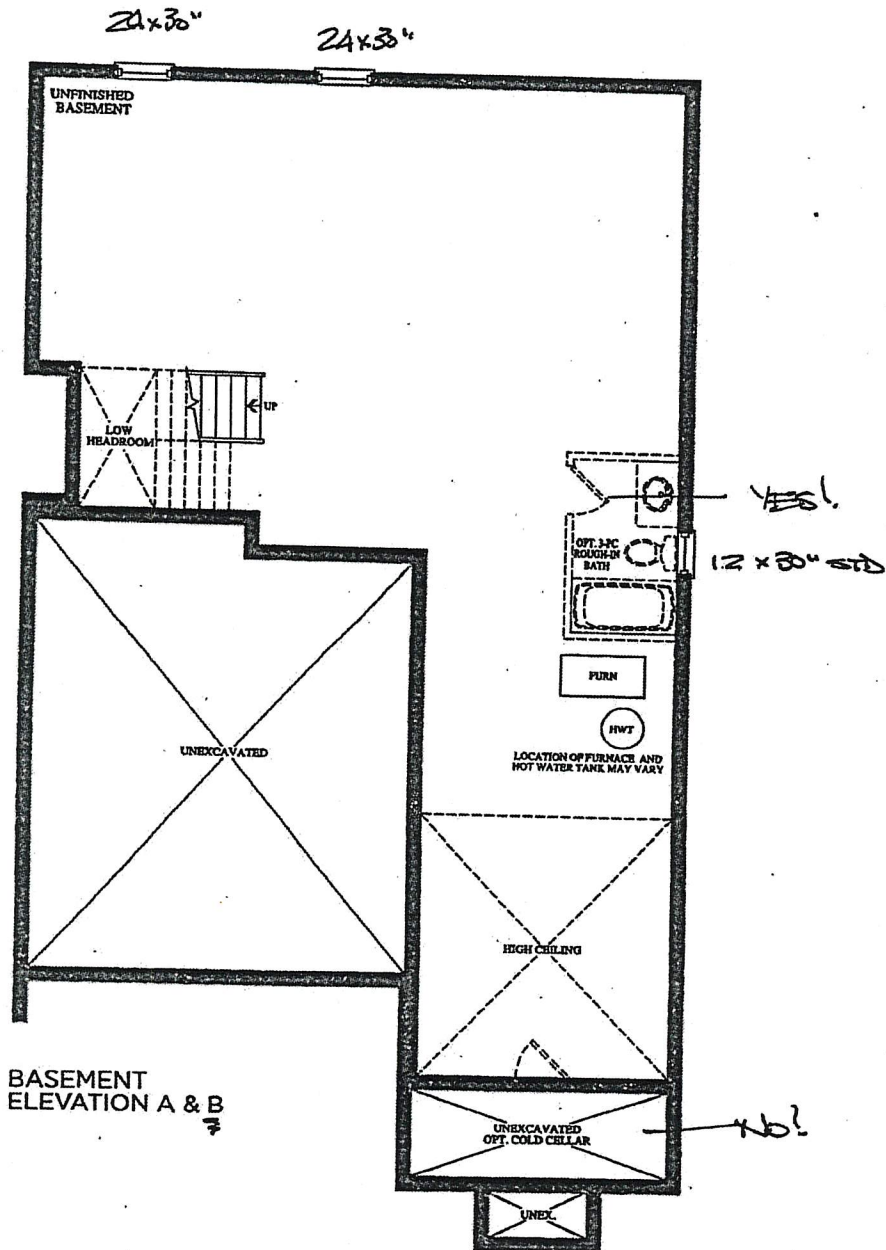



encore  
BRAMPTON

BE2-125  
DEC 20 2019



# The Schubert 38' SERIES

Elevation A • 3,665 sq.ft. | Elevation B • 3,683 sq.ft.

\*REVISION  
JAN 28 2020

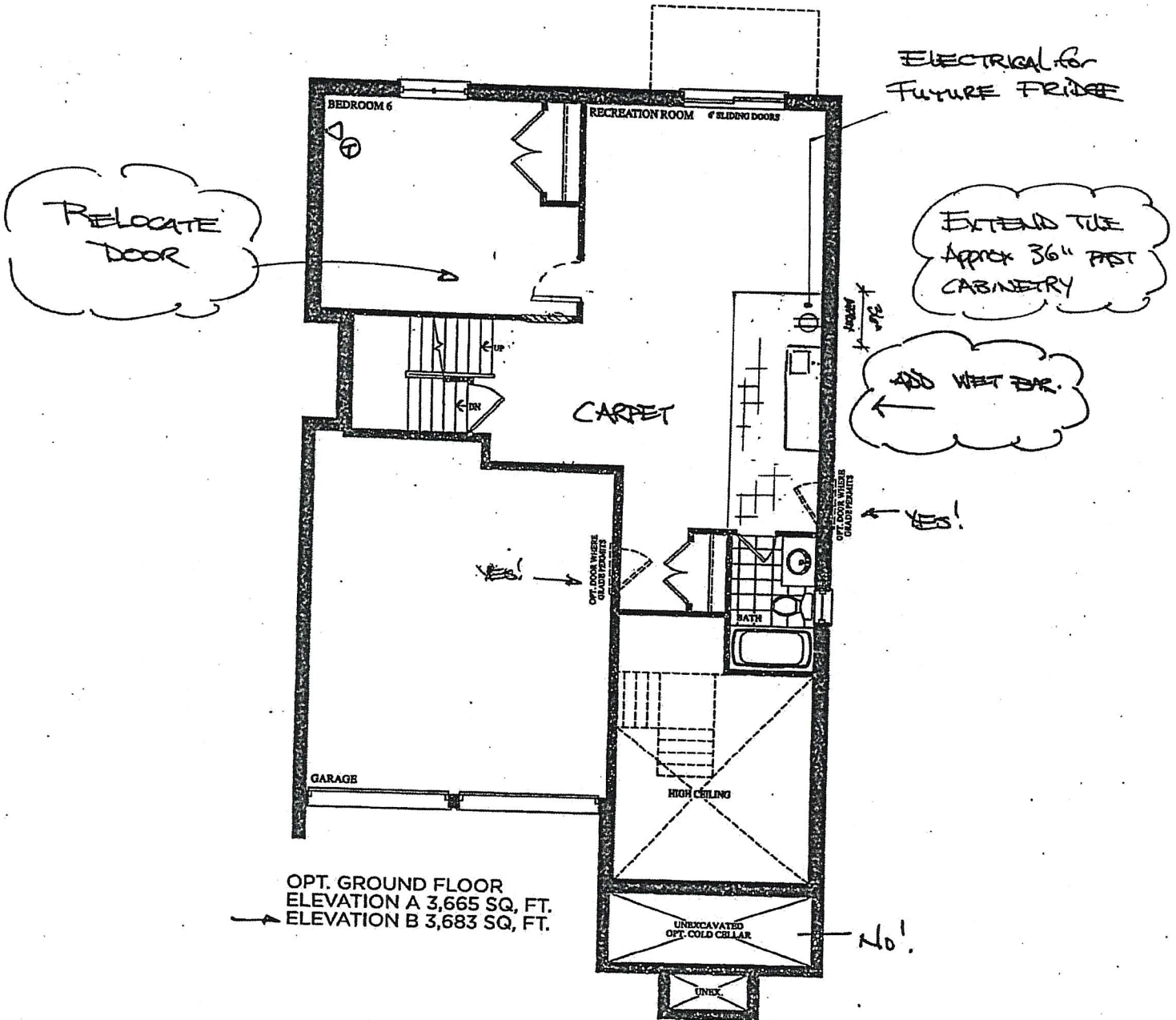

Prices, figures, illustrations, sizes, features and finishes are subject to change without notice. E.&O.E. Areas and dimensions are approximate and actual usable floor space may vary from the stated area. Layout may be reverse of the unit purchased. E. & O.E.

GOLDPARK  
HOMES

encore  
BRAMPTON

FE2-125  
DEC 26 2019

JAN 28 2020

# The Schubert 38' SERIES

Elevation A • 3,665 sq.ft. | Elevation B • 3,683 sq.ft.

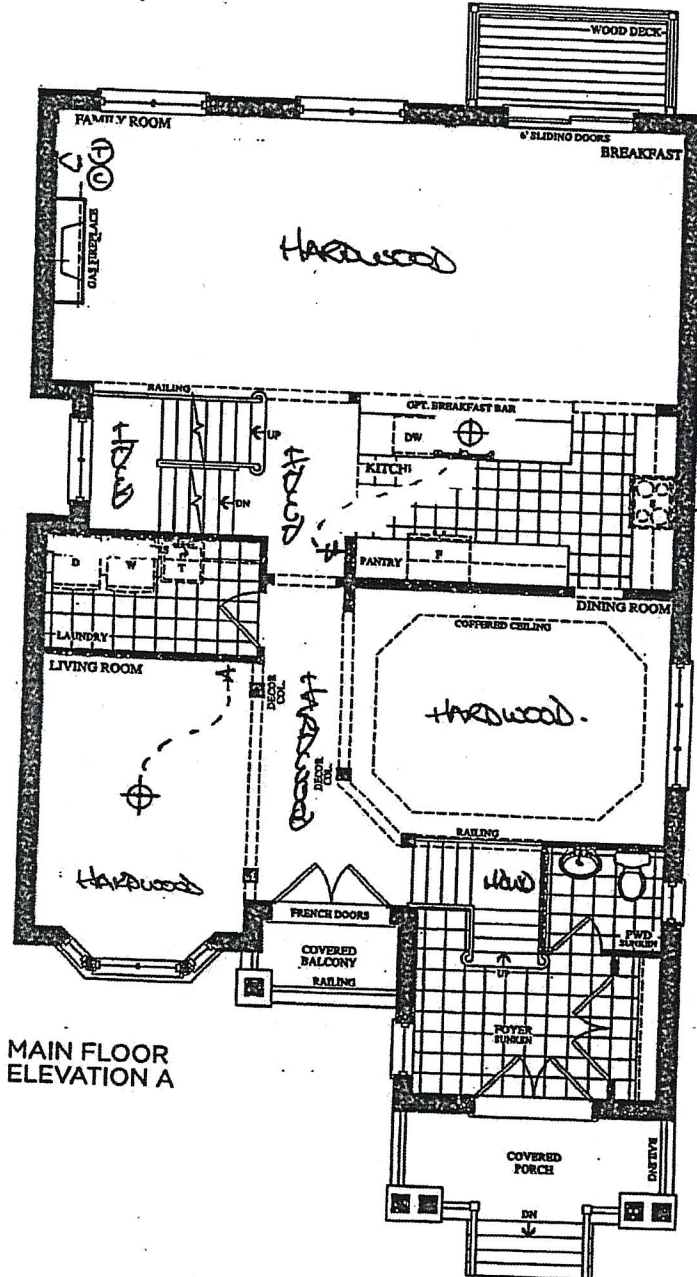

MAIN FLOOR  
ELEVATION A

TILE  
DIRECTION  
THRU OUT

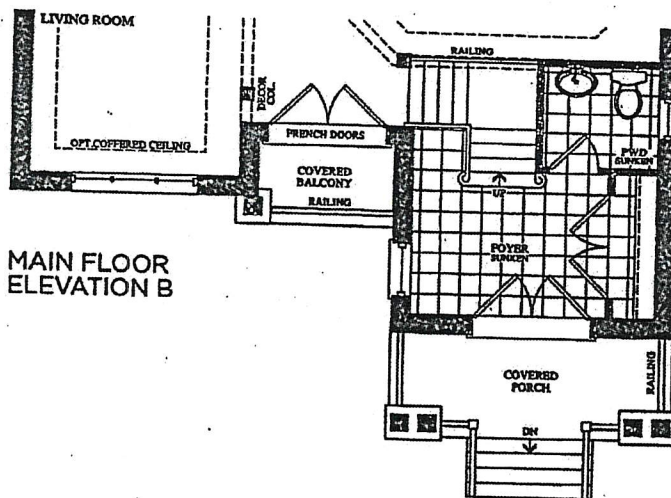

MAIN FLOOR  
ELEVATION B

Prices, figures, illustrations, sizes, features and finishes are subject to change without notice. E.&O.E. Areas and dimensions are approximate and actual usable floor space may vary from the stated area. Layout may be reverse of the unit purchased. E. & O.E.

GOLDPARK  
HOMES



Elevation A • 3,665 sq.ft. | Elevation B • 3,683 sq.ft.

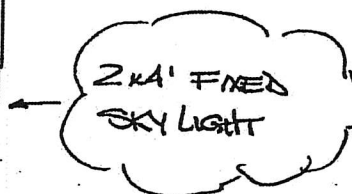

BEDROOM 4

CATHEDRAL CEILING

BEDROOM 3

CATHEDRAL CEILING

SECOND FLOOR  
ELEVATION B

**GOLDPARK**  
HOMES



**BATHROOM ACCESSORIES**

PROJECT: ENCORE 2



LOT: 125

INSTALL STANDARD BATHROOM ACCESSORIES  
THRU OUT (TOWEL BAR, SOAP DISH, TISSUE  
HOLDER) \*\*location as per vendor's discretion



**DO \*NOT\*** INSTALL STANDARD BATHROOM  
ACCESSORIES THRU OUT (TOWEL BAR, SOAP  
DISH, TISSUE HOLDER)



SIGNATURE:  

SIGNATURE:  

DATE: Dec 20 2019





Project: Encore 2

Lot: 125

Purchaser(s): Nancy & Nicholas Parmar

Standard Hood Fan Deletion

We acknowledge that the builder's standard hood fan will not be installed.  
Do not supply, install and/or credit. We will install our own hood fan after closing.

Signature:  

Signature:  

Date: Dec 20 2019



BE2-125 Nov.2 2020



**AVN-308CS**

30" Wall mount hood - Professional design - MSRP: \$819.00



Selected Model	
Model number	AVN-308CS
Dimensions	
Dimensions	29 1/2" (W) x 19 3/4" (D) x 7 1/3" (H)
Exterior Appearance	
Stainless steel grade	201
Features	
Control	Soft touch with LED display
Lighting	2 bulbs, 3W LED (bulbs included)
Blower type	860 CFM, 6-Speed
Blower performance	Speed 1, 0.7 sones Speed 6, 6.5 sones
Filter type	2 Stainless steel baffle filters (included)
Duct transition	6" Round (Top)
Ducting	Ducted
Electrical Requirements	
Electrical requirements	120V / 60Hz / 2.7 Amps
Accessories (optional)	
Optional duct covers	AD-884S (884mm, AVN-AVH compatible)
Warranty	
1-year Warranty	Parts and labour, in-home service



## Dimensions

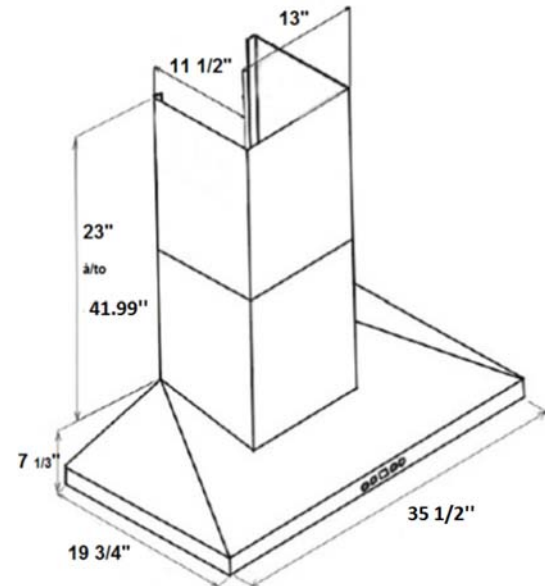
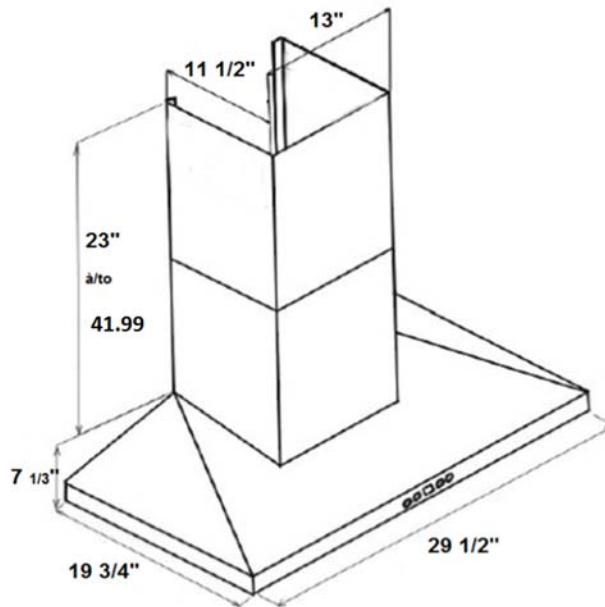

## Installation

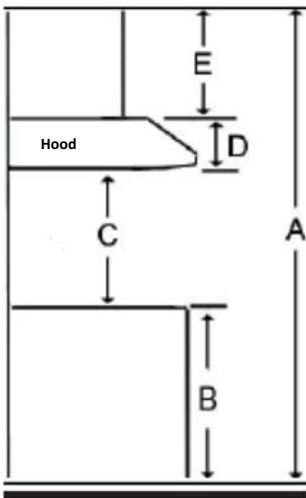

A	Floor to ceiling height	variable
B	Floor to counter top height (standard)	36"
C	Recommended height between cooking surface and bottom of the hood	28" to 30"
D	Hood height	7 1/3"
E	Chimney height	19" to 41.99"

## Duct transition

Top 6" round



*The information contained herein is based on sources that we believe to be reliable, but is not guaranteed by us, may be incomplete and/or may change without notice.*

# NX60T8511SS

BE2-125 Nov.2 2020

SAMSUNG

## 6.0 cu. ft. Slide-In Gas Range

### Installation Specifications

**BEFORE YOU BEGIN** to install this appliance, refer to the following information, dimensions, and clearances. **Do not locate the range where it may be subject to strong drafts.** Provide adequate clearances between the range and adjacent combustible surfaces. These dimensions must be met for safe use of the range. The location of the electrical outlet and gas piping may be adjusted to meet the following dimensions and clearances. **For installation in Canada, a free-standing range is not to be installed closer than 4.7 in (12 cm) from any adjacent surface.**

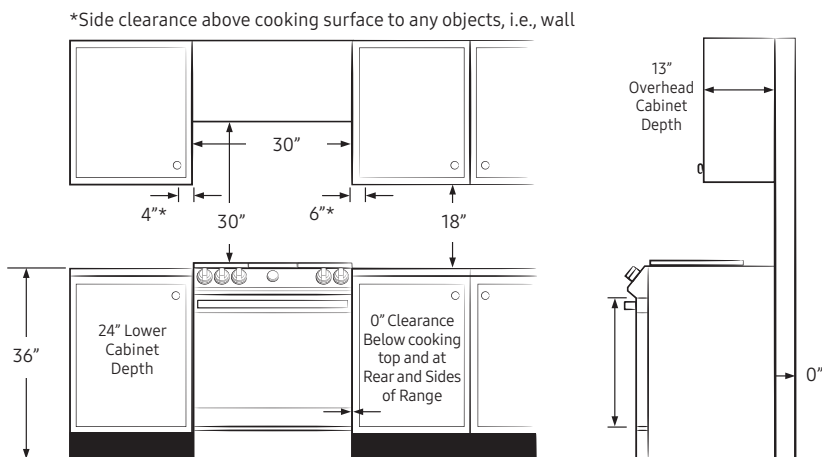

### Dimensions

**CAUTION:** This range has been designed to comply with the maximum allowable wood cabinet temperature of 194 °F (90 °C). Make sure the wall covering, countertops, and cabinets around the range can withstand the heat (up to 194 °F [90 °C]) generated by the range. If not, discoloration, delamination, or melting may occur.

### SLIDE-IN CUTOUT

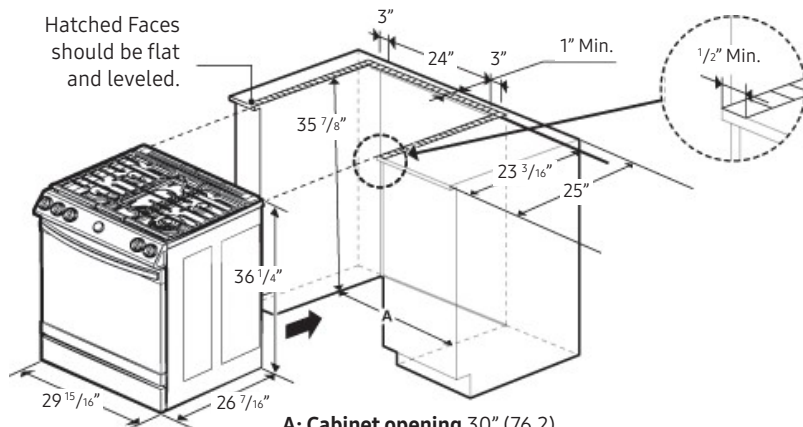

**A: Cabinet opening 30" (76.2)**

**IMPORTANT:** If your cabinet have height over 36 1/4", this range cannot be installed without supporting unit like hard block.

### Total Power

58.5K BTU

### Power Source

120V/60Hz/40A

### 5-Burner Cooktop

- Right Front: 18K BTU
- Left Front: 16K BTU
- Right Rear: 5K BTU
- Left Rear: 9.5K BTU
- Centre (Oval): 10K BTU

### Oven: 6.0 cu. ft. Capacity

- Bake: 175°F–550°F
- Bake Burner: 18K BTU
- Broil Burner: 16.5K BTU
- Variable Broil: Low/High (375°F–480°F)
- Sabbath Mode

### Storage Drawer

- Capacity: 1.0 cu. ft.

### Warranty

One (1) Year Parts and Labour

### Product Dimensions & Weight (WxHxD)

Outside Net Dimensions: 29 15/16" x 36 1/4"-37" x 28 11/16"

Weight: 208.1 lbs (94.4 Kg)

### Shipping Dimensions & Weight (WxHxD)

Dimensions: 33 1/16" x 41 3/4" x 30 5/16"

Weight: 233.7 lbs (106 Kg)

### Colour

Stainless Steel

### Model #

NX60T8511SS

### UPC Code

887276409245

Black Stainless Steel

NX60T8511SG

887276409238

### Recommended Locations for Gas Piping and Electrical Outlets

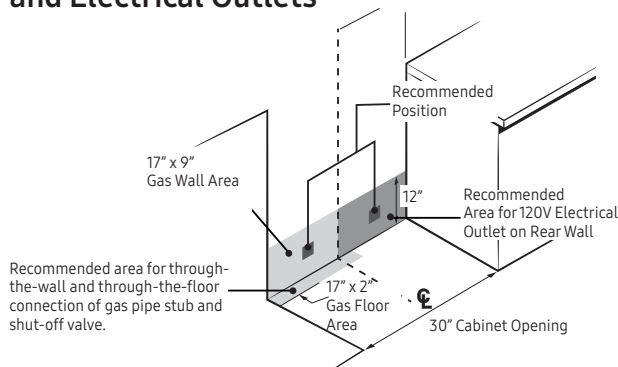

# RF28R6201SR

**SAMSUNG**

## 28 cu. ft. 3-Door French Door Refrigerator with CoolSelect Pantry™

### Installation Specifications

1. Measure the height, width and depth of the opening, making sure to include baseboards, molding tile, countertop overhang, etc. Check to be sure there is enough room to open the door (consider walls, islands or other obstacles when measuring).
2. Refer to illustration below to determine dimensions.
3. Allow 2.5" of clearance on hinge side of refrigerator when installing next to a wall where handle may make contact.
4. Allow 1" minimum clearance at rear for proper air circulation and water/electrical connections. Allow a 3/8" minimum clearance at sides and top for ease of installation.
5. Ensure each door and entryway in the home is wide enough for the refrigerator to be moved through easily.

For optimal usage and to be able to open refrigerator doors completely, do not install next to a wall.

Please note: The following dimension and cutout information is for planning purposes only. For complete installation details, consult manual packed with product, or download manual online at [samsung.com](http://samsung.com).

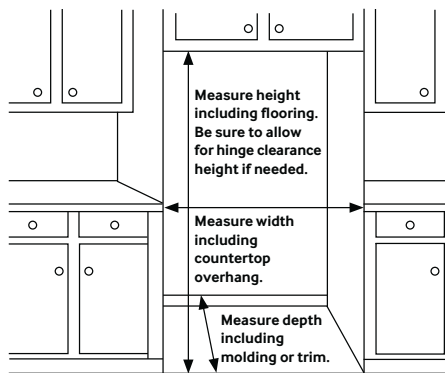

### Dimensions

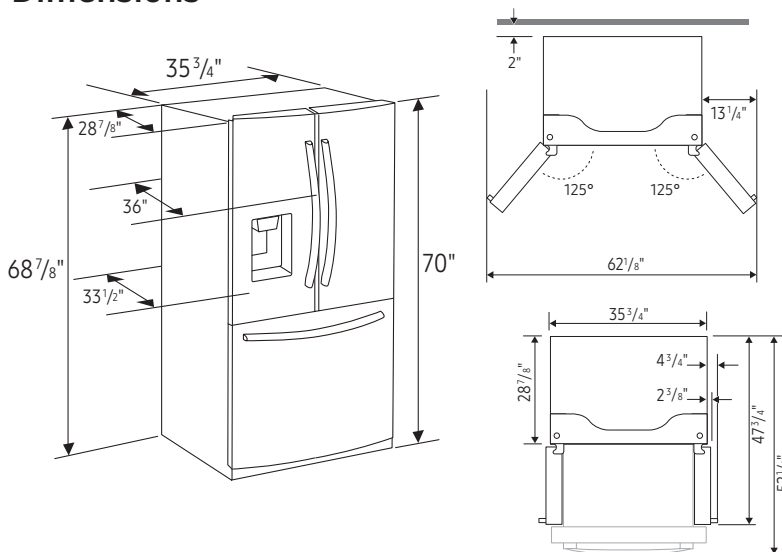

**Total Capacity: 28 cu. ft.**

**Refrigerator: 19.1 cu. ft.**

- Premium External Filtered Water and Ice Dispenser
  - Crushed or Cubed Ice
- Ice Max
- CoolSelect Pantry™ with Temperature Control – Deli (41°C), Fresh (38°F) and Chilled (32°F) Options
- Pantry Divider
- 2 Humidity-Controlled Crispers
- 5 Tempered Glass Spill-Proof Shelves:
  - 1 Slide-In
  - 1 Foldable Half
  - 3 Fixed
- 6 Clear Door Bins
  - Right Door: 3 Gallon Bins
  - Left Door: 3 Regular Bins
- Adjustable Shelves for Tall Oversized Items
- High Efficiency Top LED Lighting

**Freezer: 8.9 cu. ft.**

- EZ-Open Handle™
- 2 Drawer Dividers
- High Efficiency LED Lighting

### Accessories

Water Filter: HAF-QIN

### Warranty

One (1) Year Parts and Labor on Refrigerator

Five (5) Years Parts and Labor on Sealed Refrigeration System Only\*

Ten (10) Years Parts and Five (5) Years Labor on Digital Inverter Compressor

\*Compressor, evaporator, condenser, drier and connecting tubing.

### Product Dimensions & Weight

Dimensions (WxHxD with hinges, handles and doors): 35 3/4" x 70" x 36"

Dimensions (WxHxD without hinges and door): 35 3/4" x 68 7/8" x 28 7/8"

Dimensions (WxHxD with hinge and door, no handle): 35 3/4" x 70" x 33 1/2"

Weight: 311 lbs

### Shipping Dimensions & Weight (WxHxD)

Dimensions: 38 5/8" x 76 5/8" x 36 1/8"

Weight: 320 lbs

Color	Model #	UPC Code
Fingerprint Resistant Stainless Steel	RF28R6201SR	887276341330
Fingerprint Resistant Black Stainless Steel	RF28R6201SG	887276341323
Fingerprint Resistant Tuscan Stainless Steel	RF28R6201DT	887276341316
White	RF28R6202WW	887276341347



DW80R9950US

## Specifications

Power supply	120 V, 15 A, 60 Hz AC
Water pressure	20~120 psi (140 ~ 830 kPa)
Dimensions (Width×Depth×Height)	23 <sup>7</sup> / <sub>8</sub> x 25 x 33 <sup>7</sup> / <sub>8</sub> in. (605 x 636 x 860 mm)
Minimum inlet water temperature	120 °F (49 °C)

### NOTE

Specifications are subject to change without notice for quality improvement purposes.  
The actual appearance of the dishwasher may differ from the illustrations in this manual.

# Installation

If this is a new installation, follow these steps:

1. Using a 2<sup>1</sup>/<sub>2</sub> inch hole saw, cut a hole into the side of the cabinet that holds the sink as shown in **Figure 1-1** below.
2. If the base inside the sink cabinet is raised above the kitchen floor and is higher than the connections on the dishwasher, make a hole in the base inside the cabinet and in the cabinet side as shown in **Figure 1-2**.

## NOTE

Depending on where your electrical outlet is, you may need to cut a hole in the opposite cabinet side.

**Figure 1-1**

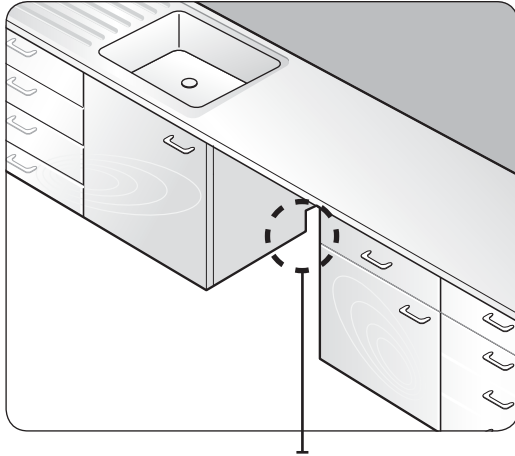

The hole for the water supply line, drain hose and power cables.

**Figure 1-2**

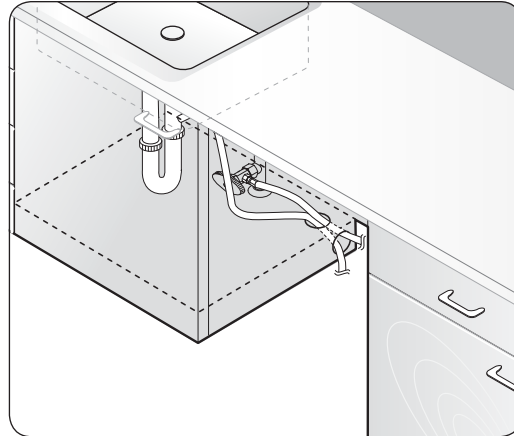

## CAUTION

Make sure the cabinet hole is smoothened before you insert the drain hose through the hole. A sharp edge of the cabinet hole may cause damage to the drain hose, resulting in a leak of the hose.

## Product dimensions

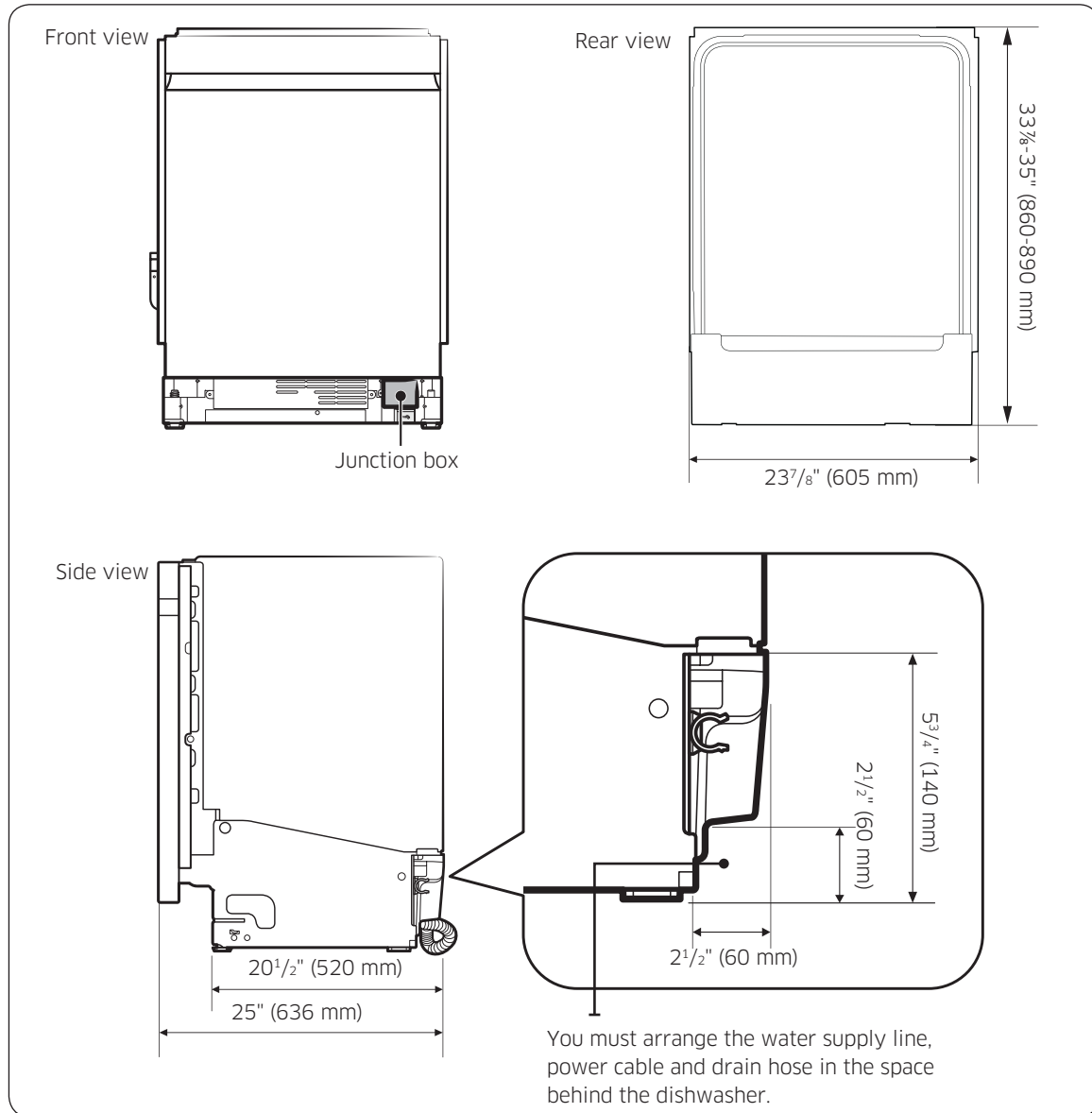

Installation



# Installation

## Cabinet dimensions

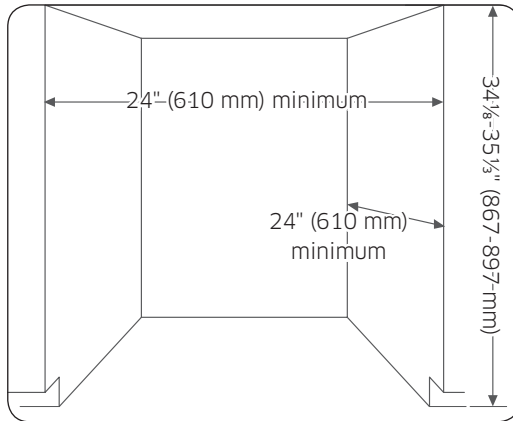

### NOTE

This dishwasher is designed to be enclosed on the top and on both sides by a standard residential kitchen cabinet unit.

The installation cabinet must be clean and free of any obstructions.

The cabinet must be at least 24 inches wide, 24 inches deep, and 34 1/8 inches high.

For the front door of the dishwasher to be flush with the leading edge of the counter top, the counter top must be at least 25 inches deep.