

APPLIANCES		
Invoice	Qty.	Description
2386	1	APPLIANCE PACKAGE: FRIDGE/STOVE/DISHWASHER - STAINLESS STEEL + WASHER/DRYER - WHITE
15Sep20 NoCat		INCLUDED IN APS

CARPET		
Invoice	Qty.	Description
2412	1	MASTER BEDROOM / BEDROOM 2 / BEDROOM 3 / BEDROOM 4 / BEDROOM 5 / REC ROOM: UPGRADE CARPET TO BERBER STYLE WITH STANDARD UNDERPAD
28Sep20 NoCat		

CENTRAL VAC AND WIRING		
Invoice	Qty.	Description
2412 28,799 28Sep20	1	GREAT ROOM: CONDUIT PIPE- FOR TELEVISION- LOCATE ABOVE FIREPLACE, APPROX 66" A.F.F.TERMINATING AT CABLE LOCATION
2412 28,794 28Sep20	1	GREAT ROOM / REC ROOM / MASTER BEDROOM / BEDROOM 2 / BEDROOM 4: CAT 6 WIRING - UPGRADE AN OUTLET TO CAT 6- SEE PLAN FOR LOCATION PACKAGE PRICE
2412 28Sep20 NoCat	1	GARAGE: CENTRAL VAC ROUGH OUT TO BASEMENT
2412 28,792 28Sep20	1	KITCHEN: INSTALL VAC PAN UNDER KITCHEN SINK

CERAMIC		
Invoice	Qty.	Description
2412 28Sep20 NoCat	1	FOYER / POWDER / KITCHEN / LAUNDRY: UPGRADE 2 TILE - 12X24" LAID IN STRAIGHT STACKED PATTERN, SEE PLAN FOR TILE DIRECTION
2412 28Sep20 NoCat	1	.TWIN BATH: UPGRADED SHOWER IN LIEU OF TUB - INCLUDES FRAMED GLASS SHOWER ENCLOSURE + POTLIGHT IN SHOWER

CONCRETE AND DRAIN		
Invoice	Qty.	Description
2386 28,894 15Sep20 **	1	ROUGH-IN - 3PC BASEMENT ROUGH-IN INCLUDED IN APS
2412 28Sep20 NoCat	1	BACK-FLOW PREVENTER VALVE

CROWN MOULDING		
Invoice	Qty.	Description
2412	3	.MAIN FLOOR; EXTENDED HEIGHT ARCHWAY (PRICE PER DOORWAY) - 96"
28Sep20 NoCat		

DRYWALL		
Invoice	Qty.	Description
2386	1	.MANDOOR - GARAGE TO HOUSE- AS PER PLAN AND GRADE PERMITING
15Sep20 NoCat		
2386	1	.SIDE DOOR- HOME TO EXTERIOR- AS PER PLAN AND GRADE PERMITTING
15Sep20 NoCat		INCLUDED IN APS
2412	1	.TWIN BATH: UPGRADED SHOWER IN LIEU OF TUB - INCLUDES FRAMED GLASS SHOWER ENCLOSURE + POTLIGHT IN SHOWER
28Sep20 NoCat		
2412	4	.MAIN FLOOR: STANDARD DOOR EXTENDED HEIGHT 96" (PRICE PER DOOR) MAIN FLOOR 3 STOREY MODELS
28Sep20 NoCat		
2412	3	.MAIN FLOOR; EXTENDED HEIGHT ARCHWAY (PRICE PER DOORWAY) - 96"
28Sep20 NoCat		

ELECTRICAL

Invoice	Qty.	Description
2412 28,804 28Sep20	1	GREAT ROOM: 110V WALL RECEPTACLE ON DEDICATED CIRCUIT- LOCATE ABOVE FIREPLACE, APPROX 66" A.F.F.
2412 28Sep20 NoCat	3	KITCHEN: CAPPED CEILING ROUGH IN - 3 CENTERED ABOVE PENINSULA
2412 28Sep20 NoCat	1	KITCHEN: SWITCH FOR PENDANTS
2412 28Sep20 NoCat	2	LIVING ROOM: CAPPED CEILING ROUGH IN **CENTERED TO ROOM, NOT FRENCH DOORS**
2412 28Sep20 NoCat	1	LIVING ROOM: SINGLE POLE SWITCH FOR CAPPED CEILING LIGHTS
2412 28Sep20 NoCat	2	GREAT ROOM: CAPPED CEILING OUTLET USE SAME SWITCH AS STANDARD
2412 28,808 28Sep20	1	KITCHEN: 110V WALL RECEPTACLE ON DEDICATED CIRCUIT - GAS FIRED APPLIANCE - FOR AUX. EQUIPMENT - NOT A STOVE PLUG
2412 28,811 28Sep20	1	200 AMP ELECTRICAL SERVICE
2412 28Sep20 NoCat	1	TWIN BATH: UPGRADED SHOWER IN LIEU OF TUB - INCLUDES FRAMED GLASS SHOWER ENCLOSURE + POTLIGHT IN SHOWER

EXTERIOR COLOURS

Invoice	Qty.	Description
2412 28Sep20 NoCat	1	EXTERIOR COLOUR PACKAGE # 6

FIREPLACE

Invoice	Qty.	Description
2412 28Sep20 NoCat	1	.GREAT ROOM: 110V WALL RECEPTACLE ON DEDICATED CIRCUIT- LOCATE ABOVE FIREPLACE, APPROX 66" A.F.F.

PAINT

Invoice	Qty.	Description
2386 28,842 15Sep20 **	1	MANDOOR - GARAGE TO HOUSE- AS PER PLAN AND GRADE PERMITING INCLUDED IN APS
2412 28Sep20 NoCat	1	MAIN STAIRS: STAIN STAIRS TO MATCH HARDWOOD FLOORS, AS CLOSE AS POSSIBLE
2412 28Sep20 NoCat	4	.MAIN FLOOR: STANDARD DOOR EXTENDED HEIGHT 96" (PRICE PER DOOR) MAIN FLOOR 3 STOREY MODELS

PLUMBING

Invoice	Qty.	Description
2386 28,894 15Sep20	1	ROUGH-IN - 3PC BASEMENT ROUGH-IN INCLUDED IN APS
2412 28,897 28Sep20	1	TWIN BATH: UPGRADED SHOWER IN LIEU OF TUB - INCLUDES FRAMED GLASS SHOWER ENCLOSURE + POTLIGHT IN SHOWER
2412 28,903 28Sep20	1	KITCHEN: ROUGH-IN - WATERLINE FOR FRIDGE
2412 28Sep20 NoCat	1	KITCHEN: BLANCO QUATRUS R15 U SUPER SINGLE #401518 BOTTOM GRID NOT INCLUDED

STAIRS AND RAILINGS

Invoice	Qty.	Description
2412 28Sep20 NoCat	1	MAIN STAIRS: EUROLINE 1 + V GROOVE

WINDOWS - BASEMENT

Invoice	Qty.	Description
2386 28,915 15Sep20	2	BASEMENT WINDOWS - UPGRADE EXISTING BASEMENT WINDOW TO 30 INCH X 16 INCH INCLUDED IN APS
2412 28,909 28Sep20	1	BASEMENT WINDOWS - EXTRA BASEMENT WINDOW 30 INCH X 16 INCH
2412 28,919 28Sep20	1	BASEMENT WINDOWS - UPGRADE EXISTING BASEMENT WINDOW TO 53 INCH X 16 INCH - MAY REQUIRE INSTALLATION OF WINDOW WELL



CONSTRUCTION SUMMARY

Lot: 140
Model: 38-6 Elev.B SCARLATTI OPT- GFA1
Project/Phase: Brampton Encore / 2

WINDOWS AND DOORS

Invoice	Qty.	Description
2386 28,842 15Sep20 **	1	MANDOOR - GARAGE TO HOUSE- AS PER PLAN AND GRADE PERMITTING INCLUDED IN APS
2386 28,841 15Sep20 **	1	SIDE DOOR- HOME TO EXTERIOR- AS PER PLAN AND GRADE PERMITTING INCLUDED IN APS

Scheduled Closing Date: Thursday, January 21, 2027

Purchasers: Ajaykumar K. Thakar & Parth Thakar

Property: 140

Telephone Res. / Bus: (416) 785-5566

Project: Brampton Encore - Phase 2

Decor Advisor: Yolande Somerville

Model and Elevation: 38-6 Elev.B SCARLATTI OPT- GFA1

Layout Changes: Yes No

Sketch Attached: Yes No

Exterior Colour Scheme:

1. Cabinetry

	Style and Colour	Counter	Hardware
Kitchen / Breakfast	*Florentine Maple **Graphite'	*Quartz 'White Shadow'	cs1-24
Laundry Room	*Varese pvc 'White Crystal'	n/a	cs1-24
Powder Room	n/a	n/a	n/a
Ground Floor Bath	Siena oak 'Greystone'	P-Lam #6697-46	cs1-25
Master Ensuite Bathroom	Varese pvc 'White Crystal'	P-Lam #4926k-07	cs1-25
Second Ensuite Bathroom (If Applicable)	Siena oak 'Greystone'	P-Lam #6697-46	cs1-25
Twin Bath	Siena oak 'Greystone'	P-Lam #4925k-07	cs1-25

Comment

2. Floor Tile

	Selection
Entrance Vestibule	*12x24" New Byzentine 'Azzuro Blue'
Main Hall	n/a
Kitchen / Breakfast	*12x24" New Byzentine 'Azzuro Blue'
Laundry Room	*12x24" New Byzentine 'Azzuro Blue'
Powder Room	*12x24" New Byzentine 'Azzuro Blue'
Ground floor Bath	13x13" Costa 'White' matte
Master Ensuite Bathroom	13x13" Serpentine 'Grey'
Second Ensuite Bathroom (If Applicable)	13x13" Costa 'White' matte
Lower Landing (If Applicable)	13x13" Serpentine 'Grey'
Twin Bath	13x13" Serpentine 'Grey'

Comment

3. Wall Tile

	Selection	Listello/Inserts	Describe
M. Ens. tub skirt/splash	8x10" Weave 'White'	Yes No	
Master Ensuite Bathroom			
Tub Deck	8x10" Weave 'White'	Yes No	
Shower Stall	8x10" Weave 'White'	Yes No	
Bathroom Walls	n/a	Yes No	
Second Ensuite Bathroom (If Applicable)	8x10" Weave 'White'	Yes No	
Twin Bath	8x10" Weave 'White'	Yes No	
Kitchen Backsplash	Yes No	Backsplash Behind Fridge	

Comment

Ground Floor Bath: 8x10" Weave 'White'

BF2-140

Sept. 4, 2020

AT

PT

Scheduled Closing Date: Thursday, January 21, 2027

Purchasers: Ajaykumar K. Thakar & Parth Thakar

Property: 140

Telephone Res. / Bus: (416) 785-5566

Project: Brampton Encore - Phase 2

Decor Advisor: Yolande Somerville

Model and Elevation: 38-6 Elev.B SCARLATTI OPT- GFA1

4. Plumbing Fixtures

Master Ensuite Bathroom Second Ensuite Powder Room
Other Room - Specify Other Washroom

Comment

Standard except kitchen sink

5. Hardwood Flooring

Main Hall Kitchen / Breakfast Living Room Dining Room Family Room Den/Library Entrance Vestibule Lower Landing (If Applicable)
Type and Stain: *3/4x5" white oak 'Apollo', n/a
Upper Landing Upper Hall Master Bedroom Bedroom #2 Bedroom #3 Bedroom #4 Bedroom #5 Other Room - Specify
Type and Stain: *3/4x5" white oak 'Apollo', n/a

Comment

6. Carpeting

Ground Floor Second Floor
Upgrade Description: *Cityview 'Downtown' with std u/pad

Upgrade Underpad Type Area
Carpet on Stairs Capped Runner - *Upgrade

Comment

7. Fireplace

Living Room Family Room Other Room - Specify
Purchased As Per Plan N/A
Fireplace Type Mantle Type Colour / Stain Surround Hearth
Standard Gas NF-20 White Nero Marquina none

Comment

BE2-140
Sept. 4, 2020
AT PT

Purchasers: Ajaykumar K. Thakar & Parth Thakar

Property: 140

Telephone Res. / Bus: (416) 785-5566

Project: Brampton Encore - Phase 2

Decor Advisor: Yolande Somerville

Model and Elevation: 38-6 Elev.B SCARLATTI OPT- GFA1

8. Trim Carpentry

Interior Doors Front Door Glass Inserts Door Handles

Interior Trim

Comment

9. Plaster Mouldings and Medallions

Standard Throughout ☐ Yes ☐ No ☒ N/A

Entrance Vestibule Kitchen/Breakfast

Main Hall Den/Library

Living Room Lower Landing

Dining Room Other Room - Specify

Family Room

Comment

10. Railings and Spindles

Railing Package

Railing Colour

Stringer / Riser

Spindle Colour

Treads

Comment

Oak Stairs ☒ Yes ☐ No ☐ N/A

11. Wall Paint / Ceilings

Throughout Finished Areas

Trim Paint

Smooth Ceilings

Ground Floor ☐

Second Floor ☐

Note

Comment

BEA-140

Sept. 4, 2020

AT

PT

Scheduled Closing Date: Thursday, January 21, 2027

Purchasers: Ajaykumar K. Thakar & Parth Thakar

Property: 140

Telephone Res. / Bus: (416) 785-5566

Project: Brampton Encore - Phase 2

Decor Advisor: Yolande Somerville

Model and Elevation: 38-6 Elev.B SCARLATTI OPT- GFA1

12. Electrical

Hood Fan ☐ White ☒ Stainless ☐ N/A

Above Kitchen Cabinet Light ☐ Yes ☒ No

Standard Appliances ☐

Below Kitchen Cabinet Light ☐ Yes ☒ No

Over The Range Microwave ☐

Chimney Style Fan ☐

Comment

13. Heating and Air Conditioning

Air Conditioning

Gas Provisions Stove

Gas Provisions Dryer

Gas Provisions Barbecue

Comment

14. Additional Comments

15. Disclaimers and Notes

- 1) Colours of all materials are as close as possible to builder's selection, but not necessarily identical due to variances in manufacturing.
- 2) Any extras listed above are null and void unless accompanied by a separate invoice/amendment. Said invoice must be paid in full.
- 3) The Purchaser acknowledges that after Interior Colour Selection form is signed and dated, no further changes will be permitted other than re-selection due to unavailability. _____ Purchaser's Initials
- 4) The Purchaser acknowledges reading and accepting the "Gold Park Homes Decor Centre Disclaimers" form. This document contains other miscellaneous disclaimers.

This Interior Colour Selection is final and approved by:

Signature: AT Parth Date: Sept. 4, 2020

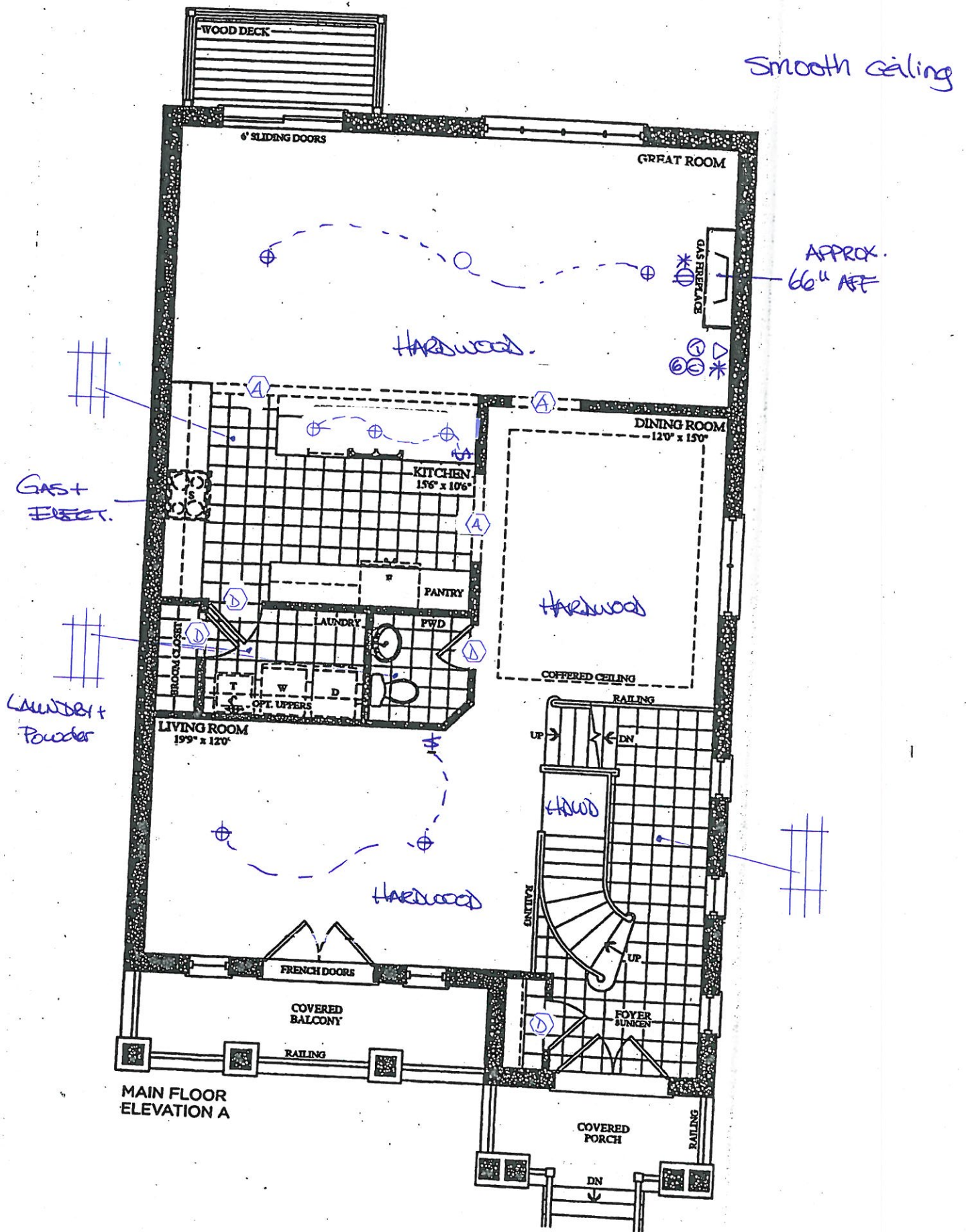

The Scarlatti

BE2-140

AT

PT

Sept. 4 2020

Elevation A • 3,591 sq.ft. Elevation B • 3,578 sq.ft.

Prices, figures, illustrations, sizes, features and finishes are subject to change without notice. E&O.E. Areas and dimensions are approximate and actual usable floor space may vary from the stated area. Layout may be reverse of the unit purchased. E. & O.E.

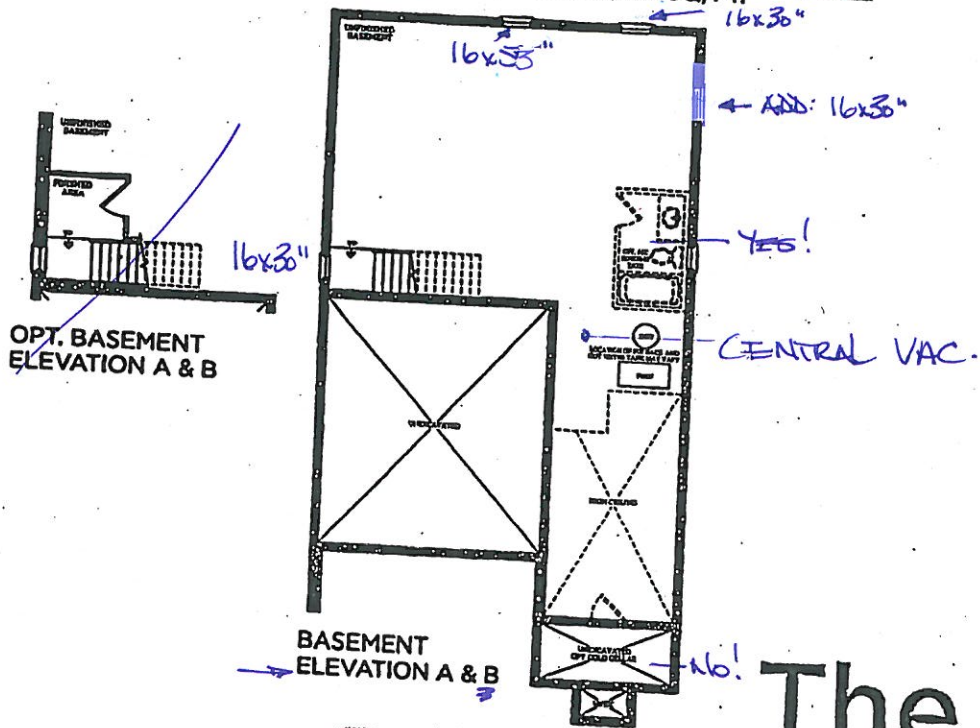
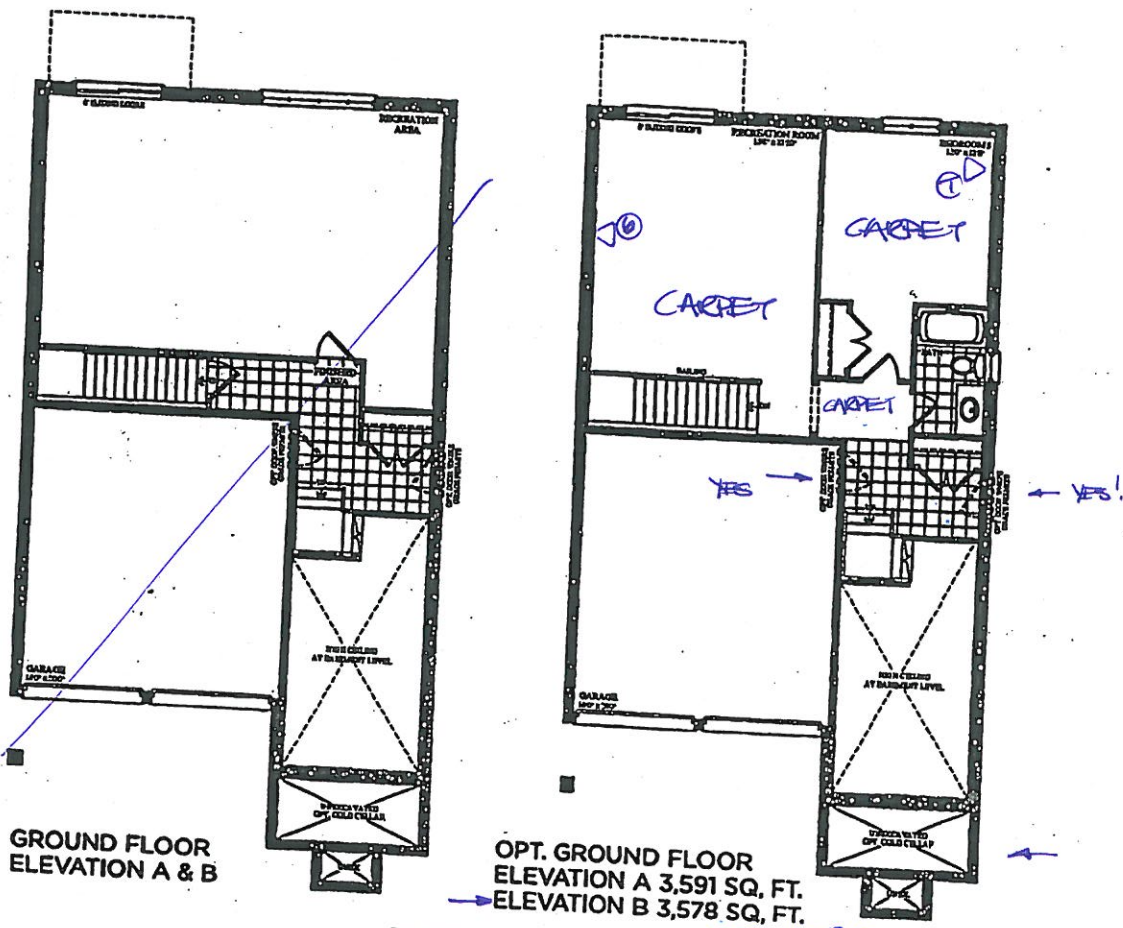

The Scarlatti

Elevation A • 3,591 sq.ft. Elevation B • 3,578 sq.ft.

Prices, figures, illustrations, sizes, features and finishes are subject to change without notice. E.&O.E. Areas and dimensions are approximate and actual usable floor space may vary from the stated area. Layout may be reverse of the unit purchased. E. & O.E.

BEZ-140

Sept. 4 2020

AT

PT

Trade Name: Gold Park Homes

Site location: Brampton

Model: 38-6

Address:

Project: Encore

Phase:

This layout has been explained to the purchaser by Cortina Kitchens Inc. and is understood by the purchaser.

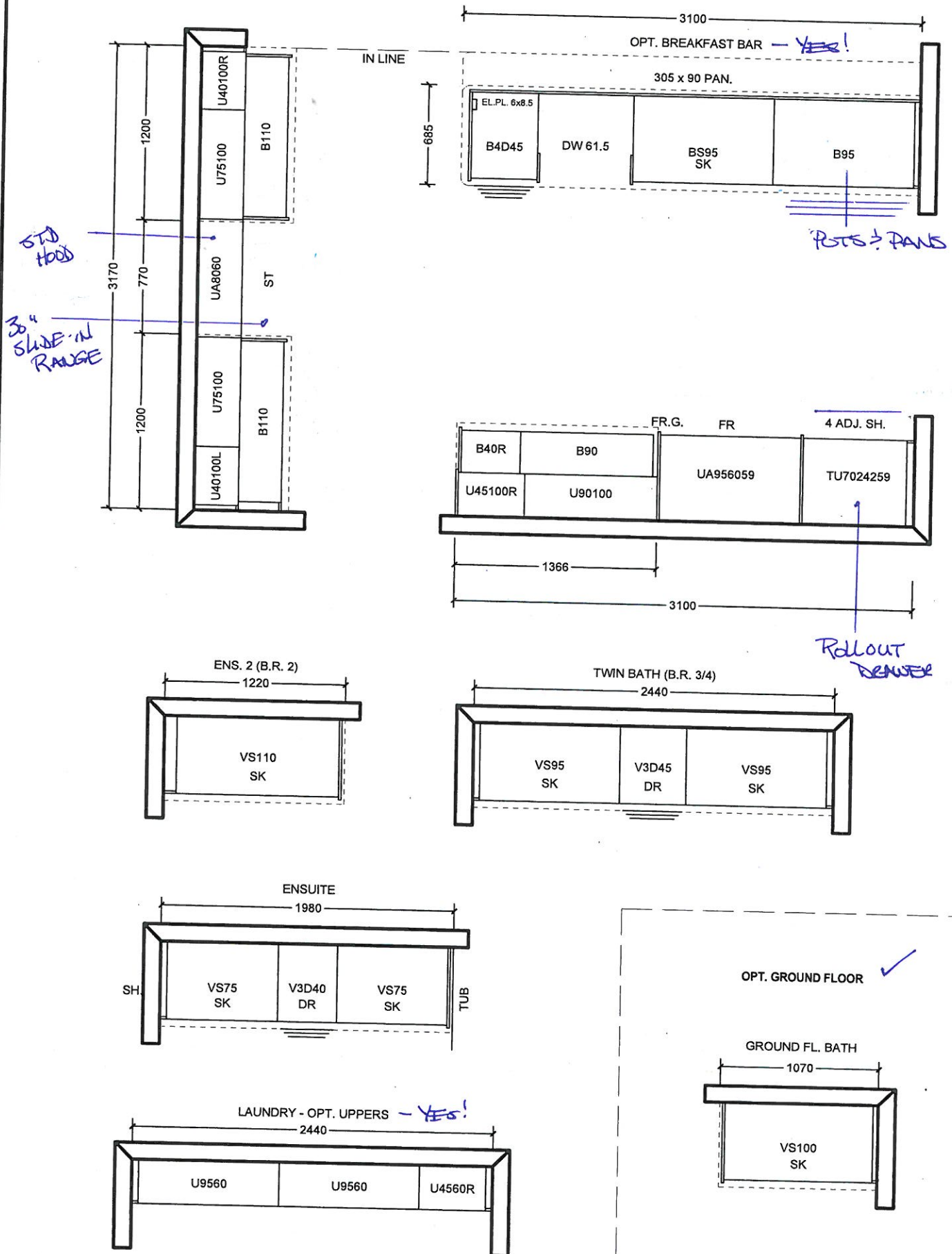

All prices subject to confirmation from head office.
This quotation is subject to the terms & conditions set out
in Cortina's Agreement of Purchase and Sale

All agreements are contingent upon strikes, accidents, and delay beyond our control.
Please provide our installer with template for sinkholes or \$150.00 will be charged for callback.

ACCEPTED DATE: _____

CUSTOMER SIGNATURE _____

SALESPERSON SIGNATURE _____

CORTINA HEAD OFFICE APPROVAL _____

ITEM A. Wood grain and colour are characteristics of the product, we cannot guarantee that such grain and colour will always match
ITEM B. Cortina Kitchens reserves the right to alter dimensions and make technical changes without notice.

GOLDPARK
HOMES



Granite, Marble,
Engineered Surfaces

- Standard 2CM & 3CM
- ⊖ Upgrade 1 2CM & 3CM
- ⊗ Upgrade 1 4 CM
- Upgrade 2

20mm (3/4") Profiles

Kitchen

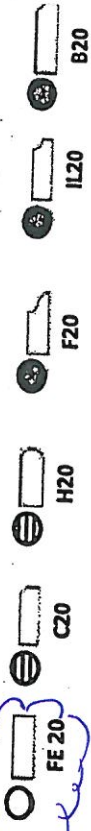

30mm (1 1/4") Profiles

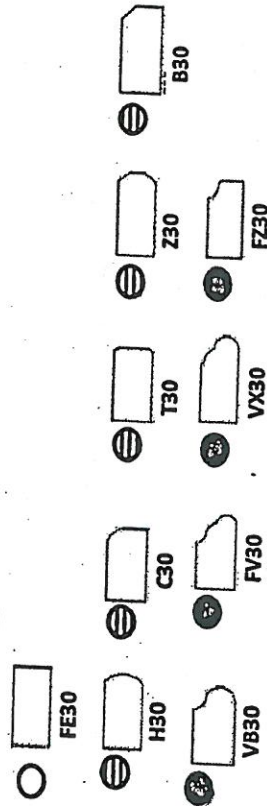

40mm (1 1/2") Profiles

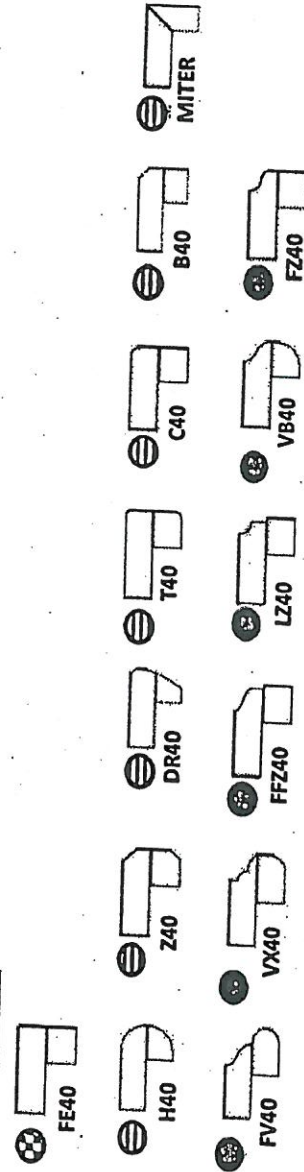

Note: All colours may not be available in 30mm at time ordered. Vendor reserves the right to use 40 mm edges (by lamination process).

*Mitre edge is available in Upgrade 1 for an overall thickness of 2". All other Mitre edge options will be an Upgrade 2 Edge.

2-140 AT PT
Sept. 4 2020

RTINA

STANDARD HARDWARE

BEZ-140

Sept. 4

2020

PT

MODIFIED: 19/05/18 R

STANDARD HARDWARE



CSI-6



CSI-10



CSI-14



CSI-16



CSI-18

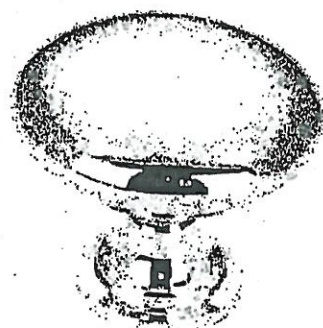

CSI-19

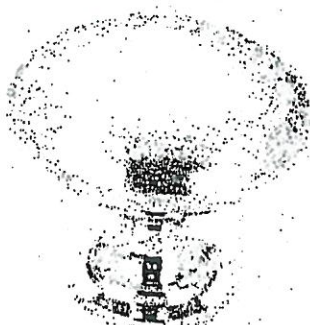

CSI-20



CSI-21



CSI-22

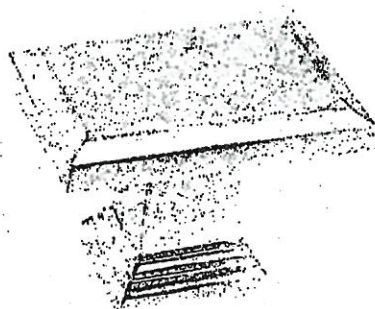

CSI-23

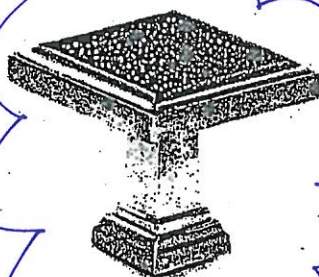

CSI-24

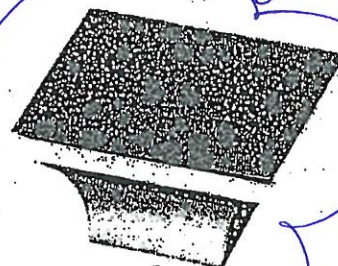

CSI-25

*NOTES:

- IMAGES ARE FOR QUICK REFERENCE PURPOSES ONLY
- ACTUAL SIZES AND FINISHES AS PER HARDWARE SAMPLE BOARD PROVIDED TO DECOR CENTRE

GOLD PARK

WORTH MORE™

BATHROOM ACCESSORIES

PROJECT: ENCORE 2

LOT: 140

**Please select one of the following:*

INSTALL STANDARD BATHROOM ACCESSORIES
THRU OUT (TOWEL BAR, SOAP DISH, TISSUE
HOLDER) **location as per vendors discretion



DO *NOT* INSTALL STANDARD BATHROOM
ACCESSORIES THRU OUT (TOWEL BAR, SOAP
DISH, TISSUE HOLDER)



SIGNATURE: _____

AT

AT

SIGNATURE: _____

PT

PT

DATE: _____

Sept. 4

2020

Gold Park Homes Décor

Centre Disclaimers

GOLDPARK

WORTH MORE™

Through years of doing business, we at Gold Park Homes have encountered issues beyond our control. The following disclaimers apply to all instances of Purchaser's Extras forms and all Interior Colour Scheme forms.

FIREPLACES

Fireplace Marble: Due to the many variables that can affect the pattern and/or design, frequently the marble installed on the fireplace will not be identical to the samples. We will make every attempt to come as close to the samples as possible, but cannot be responsible for results which differ from the samples.

CERAMIC FLOOR TILE

Many variables including variegation can affect tile colour, pattern and/or design which mean installed tiles may not be identical to the samples. We will make every attempt to come as close as possible, but cannot be responsible for results which differ from the samples.

HARDWOOD FLOORING

The purchaser is advised that cupping and shrinkage are characteristics of hardwood flooring normally appearing after installation, especially when humidity levels are not regulated, and no warranty is provided by the flooring supplier with respect to such cupping and shrinkage. Furthermore, hardwood floors may also heave and warp when located at or close to entrance points of the home, where rain could make its way to the flooring. The vendor agrees to install any hardwood flooring ordered by the purchaser in a good and workmanlike manner, but shall not be responsible for, and is hereby released by the purchaser from responsibility and liability for cupping, shrinkage, heaving and warping of hardwood flooring in the above mentioned circumstances.

STAIRCASE VS FLOORING WOOD SPECIES DIFFERENCE

The purchaser is aware and therefore accepts and acknowledges that the wood species of the staircase and flooring chosen do not match. This difference might result in an undesirable colour variance

The purchaser is aware and therefore accepts and acknowledges that though the flooring is of the same species as the staircase the difference in product finishing may result in a stain colour variance.

The purchaser agrees that the vendor is to be exempt from any and all claims by the purchaser regarding this colour variance.

RAILINGS

All railings, pickets, posts, nosing's and stairs come from solid wood and veneered wood materials sourced from multiple locations and sources. As such there will be variations in grains and shades between the various natural components beyond our control. Due to this variance in material, all components will stain with colour or natural finish differently.

Iron pickets are wrought in nature and depending on the manufacturing process will have differences from picket to picket which is normal. Also the finish of the iron pickets is of a powder coated nature. This process can produce minor colour variations or tones. Furthermore, the assembly of the metal pickets can develop a natural rattle over time from vibration in the railing. Minor rattling is normal and is a part of the wrought iron picket assembly.

HOUSE EXTERIORS

Variations in subcontractors across different sites and varying site conditions may result in house exteriors that differ from the artist renderings. We cannot be responsible for results which differ from the artists renderings of elevations.

PLASTER MOULDINGS AND MEDALLIONS

Plaster mouldings will not be installed in open to above areas or areas with 2 storey elements.

STAIN COLOURS

Due to the many variables that can affect the outcome of a stain colour on wood, staircases, railings, and fireplaces, the colour may not be identical to samples. Factors such as density, age, humidity, air temperature, and the uniqueness of each piece of wood can result in wide variations in darkness or lightness. We will make every attempt to come as close to the sample as possible, but cannot be responsible for results which differ from the samples.

Stain on pre-finished hardwood floors will not be an exact match to the stain colours available on stairs, pickets and rails. The purchaser is responsible for choosing the stain on these areas to their satisfaction.

IN-WALL CONDUIT FOR AUDIO/VIDEO CABLES

It is important to note that due to the variation in framing requirements in different parts of your home, conduit lengths and routing can vary. In virtually all instances of ground floor installation (i.e. above a fireplace), conduit will first travel down into the basement below the floor joists, over to the termination point and back up into the main floor. As a result, it is best to measure the length of the conduit after occupancy with a "pull wire" before

AT

PT

purchasing your cables. For above-fireplace installations, the conduit wall plate will be installed approximately 10" above the Fireplace Mantle, unless otherwise specified in the Construction Summary.

APPLIANCE SPECIFICATIONS

All appliance openings are set to builder's standard openings. Please advise Décor Centre at time of your structural appointment if custom-sizing of cabinets is required for any built-in appliances. The purchaser is responsible for costs and fees associated with changes to pre-manufactured kitchens made subsequent to colour appointments.

Purchaser accepts & acknowledges that in order to accommodate upgraded appliances, all appliance specifications should be provided at the time of their structural appointment, should this not occur they must be provided to the Décor Center within one (1) week of completion of structural chart. Failure to do so may result in the need to revert to the standard appliance openings or in a delay in construction of your dwelling, as well as a cost of \$500 to re-open your structural file should changes be required. As a result we may be forced to extend the closing of your transaction. Due to failure to complete the above-mentioned selections and at no fault of our own, we reserve our right to hold you responsible for this delayed closing, including charging extra administration cost and interest on the balance due on closing.

Purchasers Accept Standard Appliance Openings (unless otherwise specified):
Fridge - 37-1/2"W x 73-1/2" High Approx.
Range - 30-1/2"D x 31-1/2"W Approx.
Dishwasher - 24" W Approx.

DELETION OF HOODFAN & CABINETS ABOVE STOVE:

The purchasers are aware that in requesting NOT TO INSTALL builder's standard hood fan and standard cabinets above stove they will receive NO STANDARD HOOD FAN and NO CREDIT. Purchasers are installing their own hood fan after closing and accept that it may waive any warranty associated with such a change.

Purchasers accept and acknowledge that the exhaust fan duct hole may be off-centered with the stove in the kitchen due to purchasers installing their own hood fan after closing. The vendor is exempt from adjusting such openings for the purchasers range hood.

ELECTRICAL FOR APPLIANCES

Pricing is subject to change based on the appliance specifications provided. Purchasers should provide proper appliance specifications and cut-out sheets in order for Gold Park to price extras accordingly.

KITCHEN CABINETS

The kitchen you order/purchase will undoubtedly contain slight colour variations. The degree of these variations is virtually impossible to determine before the kitchen is installed in its intended location. The amount of and type of lighting will also affect various highlights in the finish. Note: No two pieces of wood are identical. Variations in colour tone and grain patterns make a perfect colour match virtually impossible. It is generally agreed that these variations add to the natural beauty of a wood kitchen.

STAIN

Charcoal is a spray stain applied to Oak and Maple products with several characteristics that are important to be aware of when purchasing this product.

1. Shadow lines may be visible at the interior profile edges of a door or drawer front. If movement occurs shadow lines may increase or decrease, depending on the style and/or size of a door or drawer front.
2. Variation and unevenness may be visible in the finish.
3. Hairline cracks at the joints are created over time due to the nature of natural wood, caused by usage, humidity**, or dryness. They tend to be more visible to darker stains, than lighter wood stains.

** Relative humidity is recommended to be between 45% and 55%. Please refer to Cortina Kitchens "Cleaning, Care, Maintenance, & Warranty Information" guide.

Please be advised that Cortina Kitchens will not replace doors and/or parts that exhibit the above characteristics associated with this finish. These characteristics are not avoidable and are a result of the natural characteristics of wood and wood veneer, and the characteristics of darker stains on wood. The Charcoal stain is not available on doors in Group IV, Group IVA, Group V and Group VA.

Cortina Kitchens offers a wide variety of finishes, applied to oak and maple products. The subject finishes include the spray stains Cocoa, Espresso, Graphite as well as wiping stain Ebony.

Due to the very dark stains applied on natural maple and oak doors and joints, several characteristics are important to be noted when purchasing these products.

1. Shadow lines may be visible at the interior profile edges of a door or drawer front. If movement occurs shadow lines may increase or decrease, depending on the style and/or size of a door or drawer front.
2. Variation and unevenness may be visible in the finish.
3. Hairline cracks at the joints are created over time due to the nature of natural wood, caused by usage, humidity, or dryness. They tend to be more visible to darker stains, than lighter wood stains.

Please be advised that Cortina Kitchens will not replace doors nor parts that exhibit the above characteristics associated with this finish. These characteristics are not avoidable and are a result of the natural characteristics of wood and wood veneer, and the characteristics of darker stains on wood.

AP

PT

CABINETRY DOOR HARDWARE

Cortina Kitchens' cabinetry doors and drawer fronts will be drilled to accept a standard knob or handle selected from Cortina's hardware boards. This drilling comes standard with the order, and is done ONLY in our shop, not on the job site.

For those not wanting Cortina's hardware drilling, the following applies:
No holes to be drilled on the doors and drawer fronts should be specified in writing on the colour chart and the P.O. If while in production, Cortina Kitchens misses this request, Cortina Kitchens and the Builder will not be held responsible to replace any or all doors and drawer fronts affected, and the customer agrees to accept the product as is. No hardware will be supplied or credited by Cortina Kitchens with this request. No charge will apply for this request.

PVC DOORS

All cabinets with PVC (Thermofoil) Doors come with melamine gables, panels and kick. The doors, crown moulding and light valance are PVC wrapped. Open shelves incorporated in design will only be available with melamine interiors. There will be variations in colour shades between the PVC parts (doors, crown and Light valance) and the melamine parts (open shelves, Gables, Panels and Kick) due to the difference in material.

Furring Panel with crown moulding to the ceiling is not available on all PVC door styles due to subtle variations in colour shades between the PVC parts (moulding) and the melamine parts (furring panel) due to the difference in material. Grain directions in wood grain pattern melamine, vary between the furring panel, crown moulding (horizontal) and the PVC doors (vertical).

GRANITE, MARBLE ENGINEERED SURFACES WAIVER

Granite and marble are naturally occurring products, and due to the many variables that can affect the pattern, colour and/or design and "pitting" of natural products slabs installed will not be identical to the samples displayed. We will make every attempt to come as close to the samples as possible, but cannot be responsible for results which differ from the samples. Every effort is made to provide granite counter tops as close as possible but the vendor is not responsible for results which differ from the sample displayed. All countertop surfaces may have seams & product pattern & shade can change in areas containing seams.

RESELECTIONS

It is not uncommon for flooring, such as tile, to become discontinued prior to its installation. Therefore it may be necessary to make a reselection of certain materials sometime during the build process. We cannot assure you that another choice approximating your selection will be available.

PLANS

Plans are subject to change without notice. Actual usable floor space may vary from the stated floor area. Layout for kitchen, furnace, HWT and laundry tub may vary from plan. Vertical and horizontal bulkhead, which are not shown on plan, may be required for plumbing and heating runs. E.& O.E.

PLEASE NOTE:

In the event the work on the house has progressed beyond the point where the items covered by these invoices cannot be installed without entailing any unusual expense, then this order is to be cancelled and any deposit paid in connection with the same is to be refunded to the purchaser.
The vendor will undertake to incorporate the work covered by the sales extra in the construction of the house but will not be liable to the purchaser in any way, if for any reason the work covered by the extra is not carried out. In that event, any monies paid in connection with the same shall be returned to the purchaser.
It is understood and agreed that if for any reason whatsoever the transaction of Purchase and Sale is not completed, the total cost of extras ordered are not refundable to the Purchaser(s).
Extras or changes will not be processed unless signed by the Vendor.
These extras may not be amended without the written consent of Gold Park Homes.
The purchaser(s) and the builder acknowledge and agree that this "Purchaser's Extra" form shall not be deemed to be part of the agreement of purchase and sale entered into between them, nor an addendum thereto.
No postdated cheques will be accepted.
No estimates or orders will be accepted once construction has commenced.
Should a refund be requested on any extras purchased, an 80% reimbursement of the purchase price will be given. (a \$50.00 minimum charge and a maximum \$250.00 charge will apply)
Estimates will only be considered when resubmitted on a signed Purchaser Extras form, accompanied by payment in full.

All prices are estimates only and may be subject to change. Should a change in price occur Gold Park Homes reserves the right to request from the purchaser an adjustment of the price or a refund limited to that item.

Purchasers are aware & accept that ANY changes made to upgrades after signing the Purchasers Extra Form are subject to a minimum administration fee of \$500. PLUS a 10% holdback fee.

Purchasers are aware that any request to add a percentage of upgrades from the purchaser's extras form will be processed only after the builder receives approval letter from the bank.

AT PT

Please be advised that your failure to finalize your structural or colour selections may result in a delay in construction of your dwelling and we may have to extend closing of your transaction. Due to failure to complete the above-mentioned selections and at no fault of us, we reserve our right to hold you responsible for a delayed closing, including charging extra administration cost and interest on the balance due on closing.

Purchaser has attended a Colour appointment at the Decor Centre & has DECLINED any additional upgrades and accepts and acknowledges that there will be no further structural changes/additions/deletions to be made upon signing.

I hereby acknowledge reading and understanding the above copy and will not hold Gold Park Homes responsible for any issues in relation to above.

Purchasers Signatures

AT

[Signature]

PT

[Signature]

Date AUG 31 2016

BE2-140

Blanco Quatrus R15U Super Single kitchen sink #401518 (stainless)

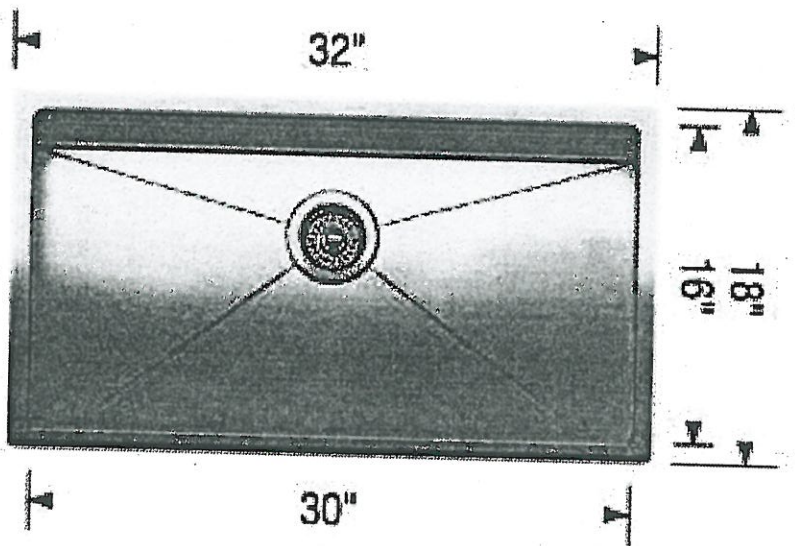
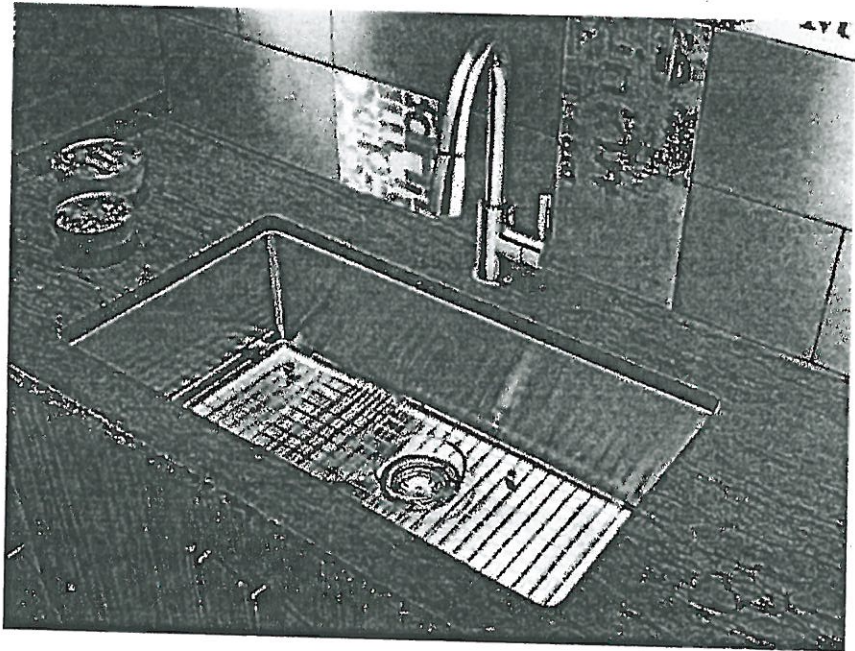

LOT # 140		
ROOM: Kitchen	SIGNATURE: AT <i>Attacher</i>	
DATE: Sept. 4 - 2020	SIGNATURE: PT <i>Paxth</i>	