

Brampton Encore - 99 - 2 - 38-4 Elev.B VIVALDI  
CARPET

Inv.2,022	1 - MASTER BEDROOM / BEDROOM 2 / BEDROOM 3 / BEDROOM 4: UPGRADE CARPET TO BERBER STYLE CARPET
Line28705	Note:
15Jul19 / 9Sep19	

CERAMIC

Inv.2,022	1 - FOYER / POWDER / KITCHEN / BREAKFAST: UPGRADE 2 TILE - 12X24" LAID IN STRAIGHT, STACKED PATTERN. SEE PLAN FOR TILE DIRECTION
Line28701	Note:
15Jul19 / 9Sep19	

ELECTRICAL

Inv.2,022	1 - KITCHEN: SINGLE POLE SWITCH FOR ROUGH-IN CEILING LIGHTS ABOVE ISLAND
Line28676	Note:
15Jul19 / 9Sep19	
Inv.2,022	2 - KITCHEN: ROUGH - IN CEILING OUTLET ON SAME SWITCH - DOES NOT INCLUDE FIXTURE - LOCATE ABOVE ISLAND
Line28675	Note: SEE PLAN FOR LOCATION
15Jul19 / 9Sep19	
Inv.2,022	1 - KITCHEN; 220V WALL RECEPTICAL ON DEDICATED CIRCUIT- FOR 4 WIRE BUILT-IN WALL OVEN - SEE PLAN FOR LOCATION
Line28679	Note:
15Jul19 / 9Sep19	
Inv.2,022	1 - KITCHEN: 110V WALL RECEPTACLE ON DEDICATED CIRCUIT- FOR WARMING DRAWER - LOCATE *BELOW* BUILT-IN OVEN, BUT ABOVE POTS AND PANS DRAWER
Line28680	Note:
15Jul19 / 9Sep19	

FORMING

Inv.2,051	1 - SIDE DOOR- HOME TO EXTERIOR- AS PER PLAN AND GRADE PERMITTING
Line29113	Note:
16Aug19 / 17Aug19	

FRAMING

Inv.2,051	1 - MANDOOR - GARAGE TO HOUSE- AS PER PLAN AND GRADE PERMITING
Line29114	Note:
16Aug19 / 17Aug19	

GRANITE MARBLE QUARTZ

Inv.2,022	1 - KITCHEN: COOKTOP CUT OUT
Line28714	Note:
15Jul19 / 9Sep19	
Inv.2,022	1 - KITCHEN: UPGRADE 1 QUARTZ COUNTER TOP
Line28697	Note:
15Jul19 / 9Sep19	
Inv.2,022	1 - ISLAND: FLUSH BREAKFAST BAR
Line28698	Note:
15Jul19 / 9Sep19	

Brampton Encore - 99 - 2 - 38-4 Elev.B VIVALDI

Inv.2,022	1 - KITCHEN ISLAND: WATERFALL LEG - 1 SIDE ONLY
Line28700	Note: install on breakfast room side *only*
15Jul19 / 9Sep19	

HARDWOOD

Inv.2,022	1 - MAIN FLOOR: FAMILY / DINING / MAIN HALL / LANDING: UPGRADE 1 HARDWOOD - VINTAGE RED OAK SMOOTH 3/4 X 4-3/8"
Line28703	Note:
15Jul19 / 9Sep19	
Inv.2,022	1 - UPPER HALL: UPGRADE 1 HARDWOOD - VINTAGE RED OAK SMOOTH 3/4 X 4-3/8"
Line28704	Note:
15Jul19 / 9Sep19	

KITCHEN AND BATH CABINETRY

Inv.2,022	1 - KITCHEN: DOUBLE APPLIANCE CABINET FOR COOKTOP
Line28715	Note: BUILT-IN OVEN WITH SPACE FOR WARMING DRAWER BELOW OVEN. POTS AND PANS DRAWER TO BE BELOW WARMING DRAWER
15Jul19 / 9Sep19	
Inv.2,022	1 - KITCHEN: FINISHED GABLE BESIDE OVENS
Line28716	Note:
15Jul19 / 9Sep19	
Inv.2,022	1 - KITCHEN: DELETE UPpers ABOVE STOVE, FINISH SIDES OF CABINETS. LEAVE APPROX. 36" SPACE FOR (future) 30" CHIMNEY-STYLE HOOD FAN
Line28692	Note:
15Jul19 / 9Sep19	
Inv.2,022	1 - KITCHEN: RELOCATE STANDARD BANK OF DRAWERS TO ISLAND
Line28694	Note: SEE PLAN FOR LOCATION
15Jul19 / 9Sep19	
Inv.2,022	1 - KITCHEN: MOVE COOKTOP CABINET TO BE CENTERED TO BASE CABINETS
Line28695	Note:
15Jul19 / 9Sep19	
Inv.2,022	1 - KITCHEN: UPGRADE HARDWARE
Line28696	Note:
15Jul19 / 9Sep19	
Inv.2,058	1 - KITCHEN: REDESIGN KITCHEN TO ACCOMMODATE 36" COOK TOP AND 42" SPACE FOR FUTURE 36" CHIMNEY STYLE HOOD.
Line29128	Note:
9Sep19 / 12Sep19	

MISC.

Inv.2,022	1 - Purchaser has attended an appointment at the Decor Centre & has DECLINED any additional upgrades and accepts and acknowledges that there will be no further changes/additions/deletions to be made upon signing on JULY 17, 2019.
Line28709	Note:
15Jul19 / 9Sep19	
Inv.2,022	1 - Purchasers are aware & accepts that ANY changes made to upgrades after signing this Purchasers Extra Form are subject to a minimum administration fee of \$500. PLUS a 10% holdback fee.
Line28710	Note:
15Jul19 / 9Sep19	



Brampton Encore - 99 - 2 - 38-4 Elev.B VIVALDI

Inv.2,022	1 - BONUS PACKAGE: \$15,000.00 (INCLUDING TAXES) WORTH OF UPGRADES FROM GOLD PARK HOMES DÉCOR CENTRE IS BEING APPLIED TOWARD THIS ORDER. PURCHASER HAS A REMAINING AMOUNT OF \$00 (INCLUDING TAXES).
Line28711	Note:
15Jul19 / 9Sep19	
Inv.2,022	1 - DELETE HOODFAN & CABINETS ABOVE STOVE: KITCHEN -Purchasers request to NOT INSTALL builder's standard hood fan and standard cabinets above stove. DELETE. Do not supply, install, and/or credit. Purchasers are installing their own hood fan after closing
Line28713	Note:
15Jul19 / 9Sep19	
Inv.2,022	1 - KITCHEN - Purchaser accepts & acknowledges that in order to either complete or install built-in appliances and accommodate for cook-top, all appliance specifications must be provided within one (1) week of completion of colour chart.
Line28744	Note:
15Jul19 / 9Sep19	

PAINT

Inv.2,022	1 - MAIN STAIRS: STAIN STAIRS TO MATCH HARDWOOD, AS CLOSE AS POSSIBLE
Line28708	Note:
15Jul19 / 9Sep19	

PLUMBING

Inv.2,022	1 - ROUGH-IN - 3PC BASEMENT ROUGH-IN
Line28683	Note:
15Jul19 / 9Sep19	
Inv.2,022	1 - ROUGH-IN - WATERLINE FOR FRIDGE
Line28689	Note:
15Jul19 / 9Sep19	

PLUMBING FIXTURES

Inv.2,022	1 - KITCHEN SINK: BLANCO QUATRUS R-15 U 1-3/4" #401520
Line28742	Note:
15Jul19 / 9Sep19	

WINDOWS - BASEMENT

Inv.2,022	2 - BASEMENT WINDOWS - UPGRADE EXISTING BASEMENT WINDOW TO 30 INCH X 24 INCH - MAY REQUIRE INSTALLATION OF WINDOW WELL
Line28684	Note: REAR WINDOWS *ONLY*
15Jul19 / 9Sep19	

CORTINA  
KITCHENS INC.  
70 Regatta Road, Woodbridge, Ontario L4L 6L8  
Tel: 905-264-4444 Fax: 905-264-0864  
www.CortinaKitchens.com

BEZ-99.

JULY 17 2019

\*REVISION\*  
#1 #2

SEPT 9 2019

QUOTATION

Date: 05/23/16

Trade Name: Gold Park Homes

Site location: Brampton

Model: 38-4

Address:

Project: Encore

Phase:

This layout has been explained to the purchaser by Cortina Kitchens Inc. and is understood by the purchaser.

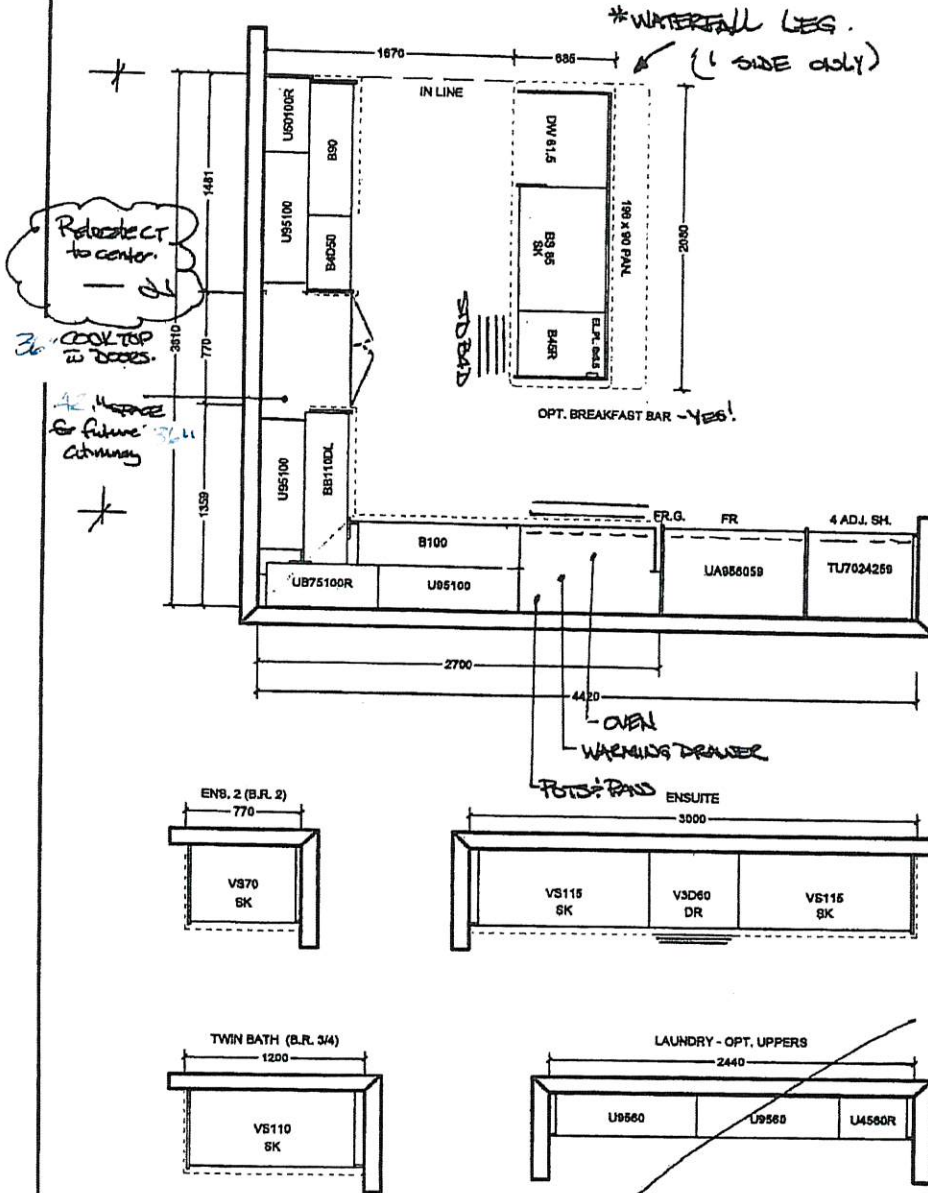

All prices subject to confirmation from head office.  
This quotation is subject to the terms & conditions set out  
in Cortina's Agreement of Purchase and Sale

ACCEPTED DATE: \_\_\_\_\_

CUSTOMER SIGNATURE \_\_\_\_\_

SALESPERSON SIGNATURE \_\_\_\_\_

CORTINA HEAD OFFICE APPROVAL \_\_\_\_\_

ITEM A. Wood grain and colour are characteristics of the product; we cannot guarantee that such grain and colour will always match  
ITEM B. Cortina Kitchens reserves the right to alter dimensions and make technical changes without notice.

All agreements are contingent upon strikes, accidents, and delay beyond our control.  
Please provide our installer with template for sinkholes or \$150.00 will be charged for callback.