

Brampton Encore - 147 - 2 - 38-4 Elev.A VIVALDI
CERAMIC

Inv.1,575	1 - KITCHEN / FOYER / POWDER: UPGRADE 5 FLOOR TILE - 24X24"
Line29004	Note:
20Sep17 / 16Aug19	

FORMING

Inv.1,575	1 - SIDE DOOR- HOME TO EXTERIOR- AS PER PLAN AND GRADE PERMITTING
Line28984	Note: INCLUDED IN APS
20Sep17 / 16Aug19	

FRAMING

Inv.1,575	1 - MANDOOR - GARAGE TO HOUSE- AS PER PLAN AND GRADE PERMITING
Line28983	Note: INCLUDED IN APS
20Sep17 / 16Aug19	
Inv.1,575	4 - MAIN FLOOR: *NOTE* FRAME MAIN FLOOR DOORS AT 96" - ADDED WITH THE ADDITION OF TALLER INTERIOR DOORS
Line28985	Note:
20Sep17 / 16Aug19	
Inv.1,575	4 - MAIN FLOOR: *NOTE* FRAME MAIN FLOOR DOORS AT 96" - ADDED WITH THE ADDITION OF TALLER INTERIOR DOORS
Line28986	Note:
20Sep17 / 16Aug19	
Inv.1,575	1 - TWIN 3/4" SHOWER IN LIEU OF TUB- INCLUDES FRAMED GLASS SHOWER ENCLOSURE
Line28991	Note:
20Sep17 / 16Aug19	

GARAGE DOORS

Inv.1,575	1 - GARAGE: DIGITAL ENTRY KEYPAD
Line28992	Note:
20Sep17 / 16Aug19	
Inv.1,575	2 - GARAGE DOOR OPENER - WITH 1 REMOTE- PRICE IS PER DOOR **BELT DRIVE**
Line28993	Note:
20Sep17 / 16Aug19	

GRANITE MARBLE QUARTZ

Inv.1,575	1 - KITCHEN: FLUSH BREAKFAST BAR
Line29002	Note:
20Sep17 / 16Aug19	
Inv.1,575	1 - KITCHEN: UPGRADE 1 QUARTZ COUNTERS
Line29001	Note:
20Sep17 / 16Aug19	
Inv.1,575	1 - KITCHEN: 4CM BUILT UP EDGE PROFILE
Line29003	Note:
20Sep17 / 16Aug19	

HARDWOOD

Brampton Encore - 147 - 2 - 38-4 Elev.A VIVALDI

Inv.1,575	1 - MAIN FLOOR: FAMLY / DINING / MAIN HALL / UPPER LANDING: UPGRADE 1 HARDWOOD - VINTAGE RED OAK SMOOTH 3/4 X 4-3/8"
Line29005	Note:
20Sep17 / 16Aug19	

Inv.1,575	1 - UPPER HALL: UPGRADE 1 HARDWOOD - VINTAGE RED OAK SMOOTH 3/4 X 4-3/8"
Line29010	Note:
20Sep17 / 16Aug19	

HVAC

Inv.1,575	1 - KITCHEN: DO *not* INSTALL STANDARD HOOD FAN, PURCHASER WILL INSTALL OWN CHIMNEY HOOD AFTER CLOSING
Line28997	Note:
20Sep17 / 16Aug19	

INTERIOR TRIM AND DOORS

Inv.1,575	4 - MAIN FLOOR: STANDARD DOOR EXTENDED HEIGHT 96" (PRICE PER DOOR)- GROUND FLOOR 2 STOREY MODELS
Line28987	Note:
20Sep17 / 16Aug19	

Inv.1,575	4 - MAIN FLOOR: EXTENDED HEIGHT ARCHWAY (PRICE PER DOORWAY)
Line28988	Note:
20Sep17 / 16Aug19	

KITCHEN AND BATH CABINETRY

Inv.1,575	2 - KITCHEN: POTS AND PANS DRAWERS - SHALLOW TOP DRAWER + 2 DEEP DRAWERS BELOW
Line29000	Note:
20Sep17 / 16Aug19	

Inv.1,575	1 - KITCHEN: UPGRADE TO SPRAY STAIN
Line28995	Note:
20Sep17 / 16Aug19	

Inv.1,575	1 - KITCHEN: DELETE UPPERS ABOVE STOVE, FINISH SIDES OF CABINETS. LEAVE APPROX. 36" SPACE FOR *FUTURE* 30" CHIMNEY HOOD FAN
Line28996	Note:
20Sep17 / 16Aug19	

Inv.1,575	1 - KITCHEN: SLIDE IN STOVE PREP - 30"
Line28998	Note: IF PURCHASER DOES NOT PROVIDE SLIDE IN RANGE SPECS WITHIN 2 WEEKS OF COLOUR APPOINTMENT, THE BUILDER WILL PROCEED WITH 'TYPICAL' 30" SLIDE IN RANGE OPENING. *IF* THE RANGE DOES NOT FIT BECAUSE NO SPECS WERE PROVIDED, THE **PURCHASER MUST PAY** TO REMAKE COUNTERS.
20Sep17 / 16Aug19	

Inv.1,575	1 - KITCHEN: UPGRADE HARDWARE
Line29017	Note:
20Sep17 / 16Aug19	

Inv.2,052	2 - KITCHEN: MATCHING INTERIOR (DOUBLE DOOR CABINET)
Line29120	Note:
26Aug19 / 27Aug19	

Inv.2,052	4 - KITCHEN: CLEAR GLASS BEVELLED DOOR
Line29119	Note: UPPER CABINETS EITHER SIDE OF STOVE
26Aug19 / 27Aug19	

MISC.

Brampton Encore - 147 - 2 - 38-4 Elev.A VIVALDI

Inv.1,575	1 - Purchaser has attended an appointment at the Decor Centre & has DECLINED any additional upgrades and accepts and acknowledges that there will be no further changes/additions/deletions to be made upon signing on AUGUST 13, 2019.
Line29011	Note:
20Sep17 / 16Aug19	
Inv.1,575	1 - Purchasers are aware & accepts that ANY changes made to upgrades after signing this Purchasers Extra Form are subject to a minimum administration fee of \$500. PLUS a 10% holdback fee.
Line29012	Note:
20Sep17 / 16Aug19	
Inv.1,575	1 - BONUS PACKAGE: \$10,000.00 (INCLUDING TAXES) WORTH OF UPGRADES FROM GOLD PARK HOMES DÉCOR CENTRE IS BEING APPLIED TOWARD THIS ORDER. PURCHASER HAS A REMAINING AMOUNT OF \$00 (INCLUDING TAXES).
Line29013	Note:
20Sep17 / 16Aug19	

PAINT

Inv.1,575	1 - MAIN STAIRS: STAIN STAIRS TO MATCH HARDWOOD AS CLOSE AS POSSIBLE
Line29016	Note:
20Sep17 / 16Aug19	

PLUMBING

Inv.1,575	1 - ROUGH-IN - 3PC BASEMENT ROUGH-IN
Line28989	Note:
20Sep17 / 16Aug19	
Inv.1,575	1 - TWIN 3/4": *NOTE* SHOWER IN LIEU OF TUB- INCLUDES FRAMED GLASS SHOWER ENCLOSURE
Line28999	Note:
20Sep17 / 16Aug19	

PLUMBING FIXTURES

Inv.1,575	1 - KITCHEN SINK: UPGRADE TO BLANCO QUATRUS #401520
Line29014	Note:
20Sep17 / 16Aug19	

STAIRS AND RAILINGS

Inv.1,575	1 - MAIN STAIRS: 1-3/4" COLONIAL RAILING + V GROOVE
Line29015	Note:
20Sep17 / 16Aug19	

WINDOWS - BASEMENT

Inv.2,052	4 - ***REVISED AUGUST 26 2019***BASEMENT WINDOWS - UPGRADE EXISTING BASEMENT WINDOW TO 30 INCH X 24 INCH - MAY REQUIRE INSTALLATION OF WINDOW WELL
Line29118	Note:
26Aug19 / 27Aug19	

CORTINA KITCHENS INC.

70 Regina Road, Woodbridge, Ontario L4L 8L6
Tel: 905-294-0464 Fax: 905-294-0804
www.CortinaKitchens.com

B2-147
AUG 13 2019



QUOTATION

Date: 06/23/16

Trade Name: Gold Park Homes

Site location: Brampton

Model: 38-4

Address:

Project: Encore

Phase:

This layout has been explained to the purchaser by Cortina Kitchens Inc. and is understood by the purchaser.

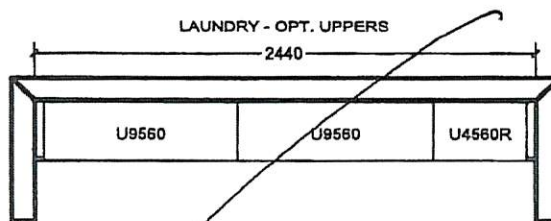
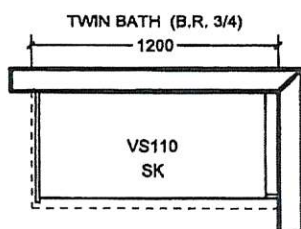
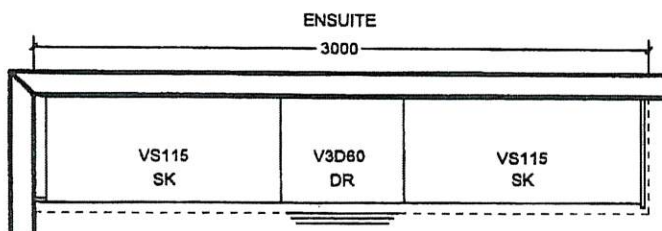
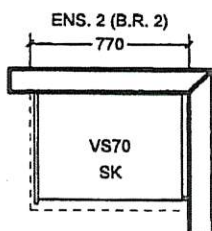
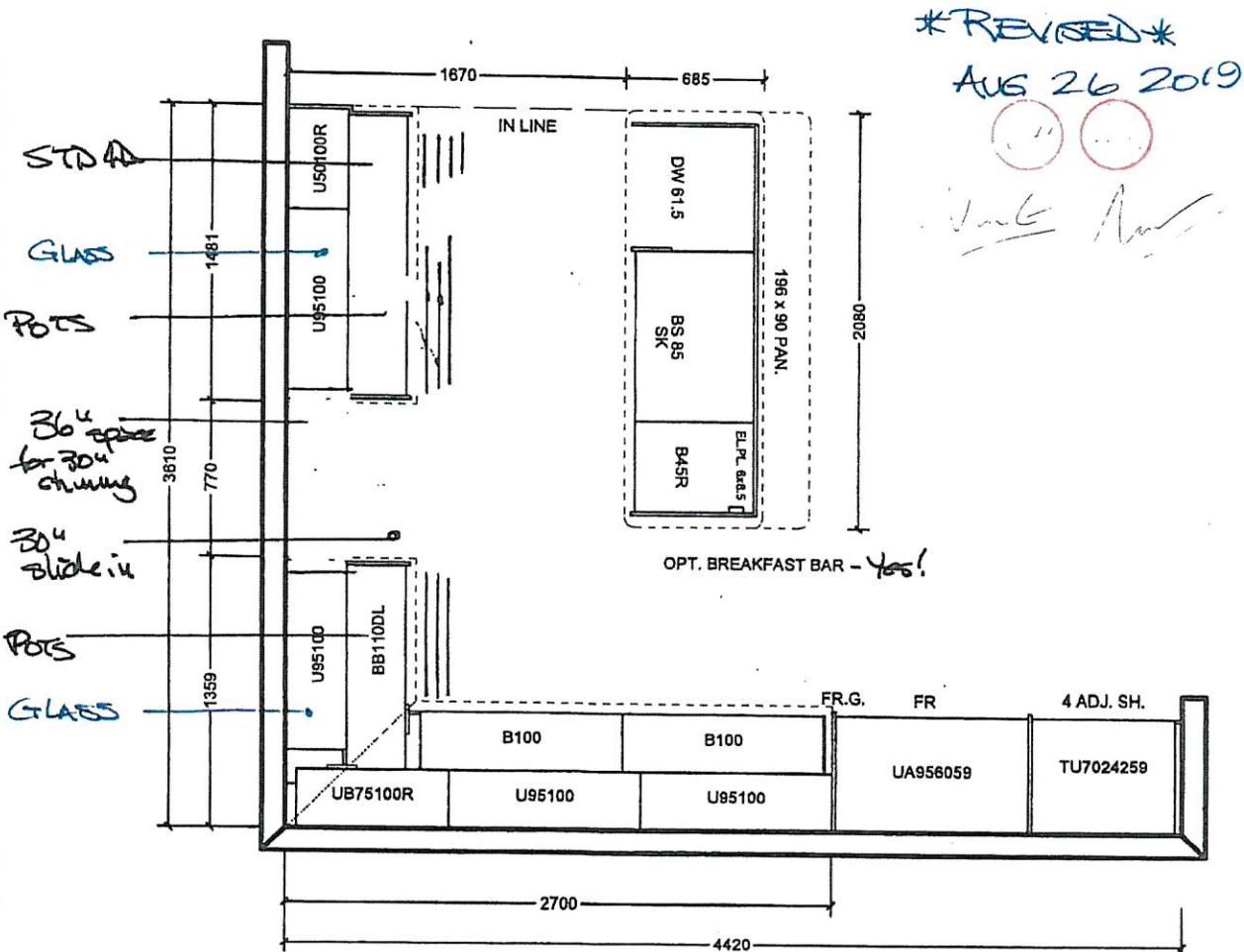

All prices subject to confirmation from head office.
This quotation is subject to the terms & conditions set out
in Cortina's Agreement of Purchase and Sale

All agreements are contingent upon strikes, accidents, and delay beyond our control.
Please provide our Installer with template for sinkholes or \$150.00 will be charged for callback.

ACCEPTED DATE: _____

CUSTOMER SIGNATURE

SALESPERSON SIGNATURE

CORTINA HEAD OFFICE APPROVAL

ITEM A. Wood grain and colour are characteristics of the product, we cannot guarantee that such grain and colour will always match
ITEM B. Cortina Kitchens reserves the right to alter dimensions and make technical changes without notice.

