

IC-24FI



FEATURES

Ready to be fitted with custom panels and handles to blend with cabinetry

Water-filtration system for ice reduces contaminants, chlorine taste and odor

Nano-coated spill-proof shelves for easy clean-up

Smart-touch controls for streamlined access to more settings

Soft-on LED lights for varying degrees of brightness

Uniform 84" height

Automatic ice maker with "max ice" feature

All-freezer storage solves capacity problems

Rigorously tested to ensure decades of use

Exceptional support from Madison, WI-based Customer Care team

ACCESSORIES

Dual Installation Kit Handle to Handle

Dual Installation Kit Hinge to Handle

Dual Installation Kit Hinge to Hinge

Press-to-Open - Left Hinge

Reduced Toekick Divider

Stainless Steel Side Panel

Stainless Steel Top Panel

Water Filler 4204490

Stainless Steel Tubular Handles

Stainless Steel Pro Handles

Accessories are available through an authorized dealer.
For local dealer information, visit subzero-wolf.com/locator



HANDLE ACCESSORIES

PRO



TUBULAR



PRODUCT DETAILS

FREEZER

- Three adjustable wire shelves
- Two storage drawers
- Five adjustable door shelves
- Ice drawer
- Automatic ice maker

PRODUCT SPECIFICATIONS

Model	IC-24FI
Dimensions	24"W x 84"H x 24"D
Door Clearance	22 1/2"
Weight	340 lbs
Freezer Capacity	12.3 cu. ft.
Electrical Supply	115 VAC, 60 Hz
Electrical Service	15 amp dedicated circuit
Receptacle	3-prong grounding-type

ELECTRICAL

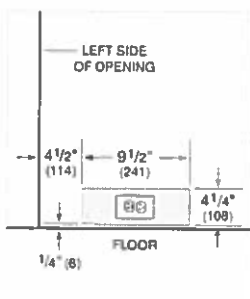

PLUMBING

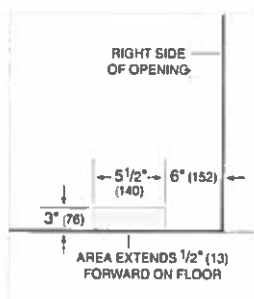

PANEL SPECIFICATIONS For complete panels specifications including width/height, weight requirements and thickness requirements visit subzero-wolf.com/revqa

NOTE: Dimensions in parenthesis are in millimeters unless otherwise specified

INTERIOR VIEW

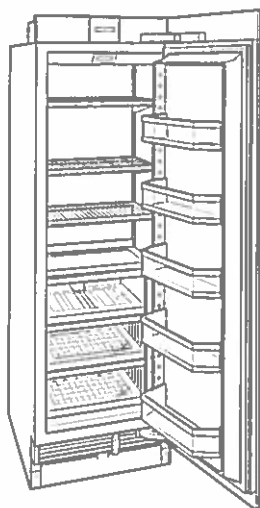

This illustration is intended for interior reference only and may not represent the exterior of the model being specified.

DIMENSIONS

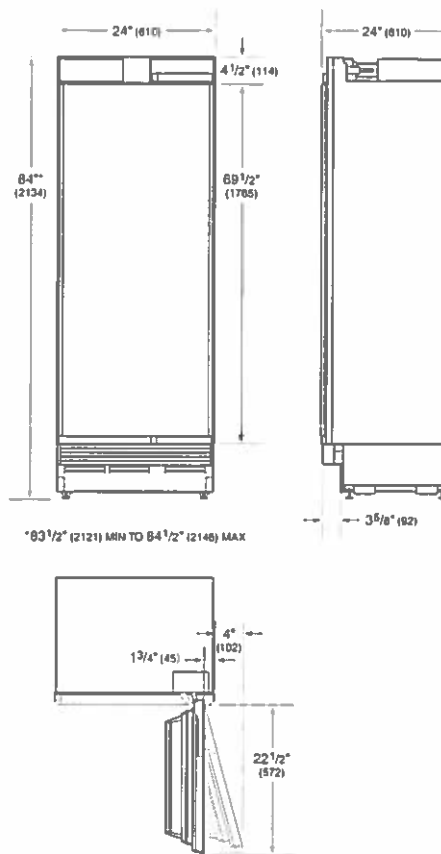

STANDARD INSTALLATION

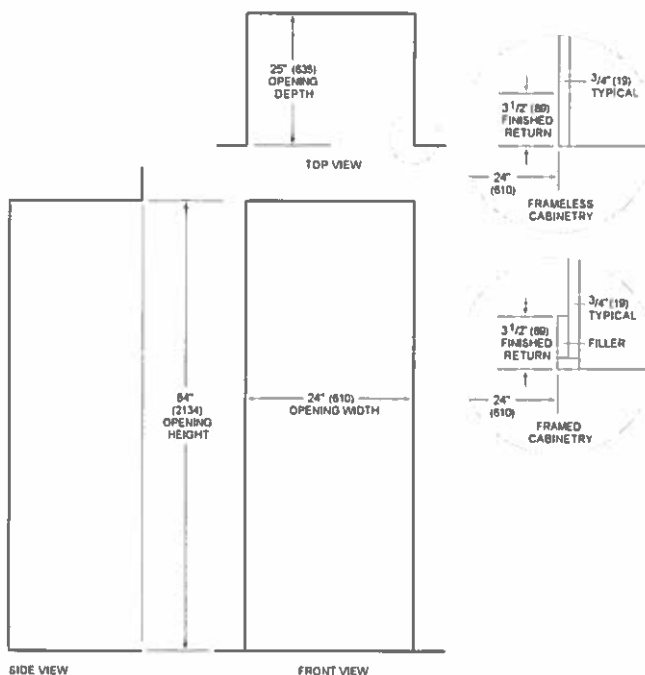

NOTE 3 1/2" (89) finished returns will be visible and should be finished to match cabinetry

IW-24



FEATURES

- Custom front panel and hardware allow for infinite design options.
- Dual evaporators for constant, moderate humidity so corks don't dry out
- Two independent temperature zones hold reds and whites at proper serving temperature
- Bronze-tinted, UV-resistant glass protects against light exposure
- Soft-on LED lighting illuminates gradually
- Home security system connection
- Wine racks accommodate 750 ml bottles, half-bottles and magnums.
- Intuitive touch control panel keeps temps within one degree of set point
- Rigorously tested to ensure decades of use
- Exceptional support from Madison, WI-based Customer Care team
- Illuminated display rack for prized bottles of wine.
- Full-extension, easy-glide racks provide access without agitating wine
- New inventory tiles system lets you label wine racks for easy ID

ACCESSORIES

- 24" Bulk Storage Drawer
- Dessert Wine Rack
- Door Lock Kit
- Dual Installation Kit Handle to Handle
- Dual Installation Kit Hinge to Handle
- Dual Installation Kit Hinge to Hinge
- Press-to-Open - Left Hinge
- Press-to-Open - Right Hinge
- Reduced Toekick Divider
- Stainless Steel Side Panel
- Stainless Steel Top Panel
- Wine inventory tiles
- Wine inventory tiles-writable
- Stainless steel pro handles
- Stainless steel tubular handles

Accessories are available through an authorized dealer.
For local dealer information, visit subzero-wolf.com/locator

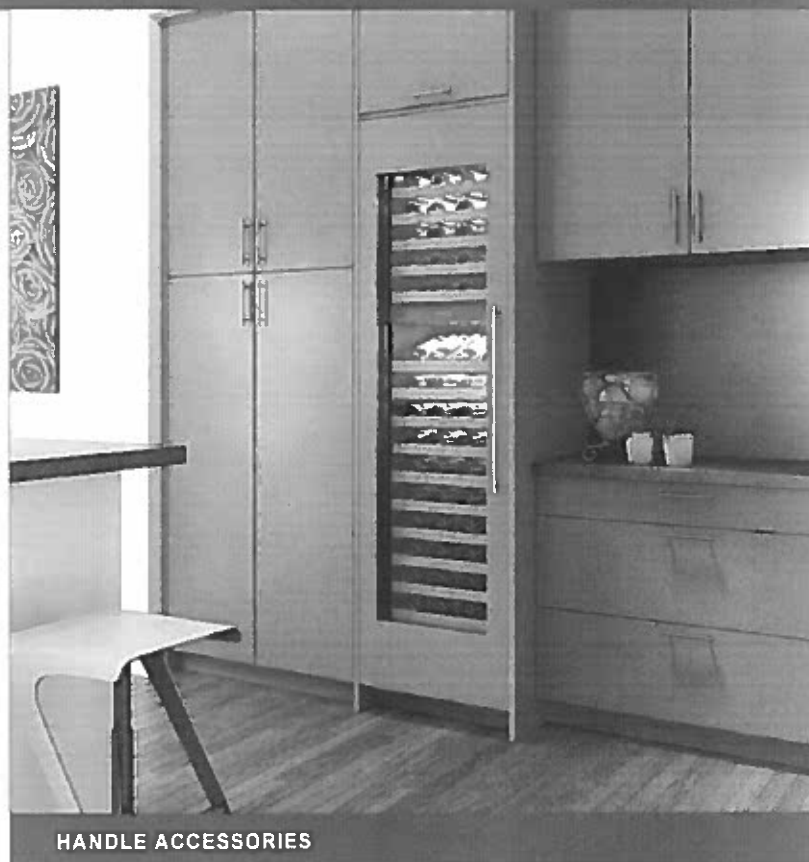

HANDLE ACCESSORIES

PRO



TUBULAR



PRODUCT SPECIFICATIONS

Model	IW-24
Dimensions	24"W x 84"H x 24"D
Door Clearance	22 1/2"
Weight	410 lbs
Electrical Supply	115 VAC, 60 Hz
Electrical Service	15 amp dedicated circuit
Wine Storage Capacity	102 Bottles
Receptacle	3-prong grounding-type

ELECTRICAL

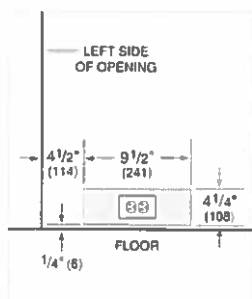

NOTE: Dimensions in parenthesis are in millimeters unless otherwise specified

INTERIOR VIEW

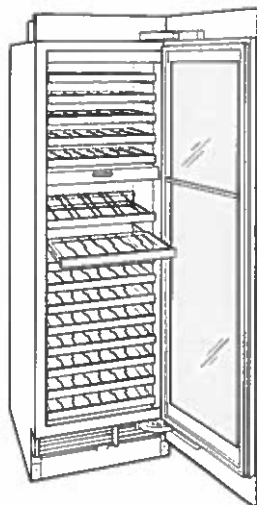

This illustration is intended for interior reference only and may not represent the exterior of the model being specified.

DIMENSIONS

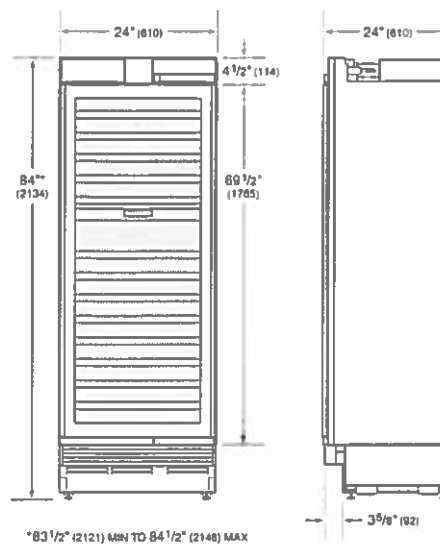

STANDARD INSTALLATION

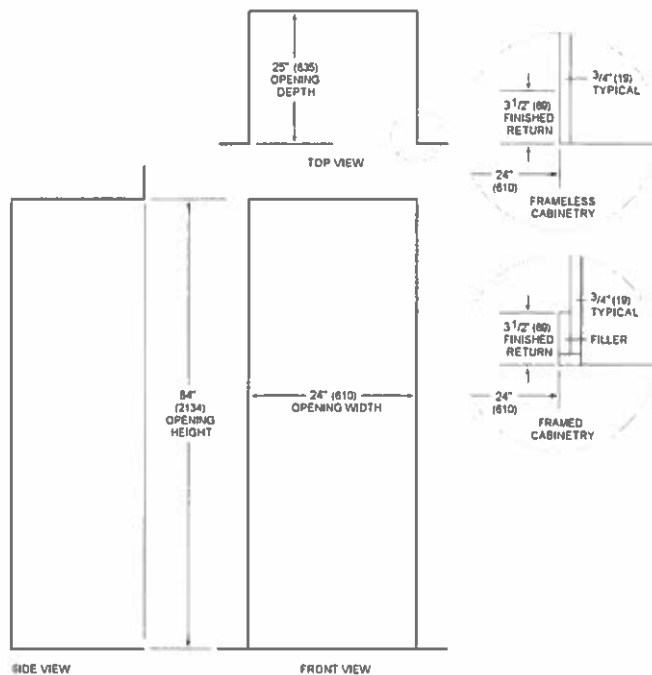

NOTE: 3 1/2" (89 mm) finished returns will be visible and should be finished to match cabinetry

UW-24/O



FEATURES

Panel ready for your custom cabinetry

Two independent temperature zones hold reds and whites at proper serving temperature

Dual evaporators for constant, moderate humidity so corks don't dry out

Textured roller-glide shelves for access without agitating wine

UV-resistant glass door protects against premature wine aging

Intuitive control panel keeps temps within one degree of set point

Brighter LED lighting makes finding bottles easy

Inventory tile system for better organization

Rigorously tested to ensure decades of use

Exceptional support from Madison, WI-based Customer Care team

ACCESSORIES

Dessert Wine Rack

Dual Installation Kit

Undercounter Black Dual Kickplate

Undercounter Door Lock Kit

Undercounter Dual Lock Kit

Undercounter Silver Dual Kickplate

Undercounter Silver Kickplate

Undercounter Solid Overlay Door

Wine inventory tiles

Wine inventory tiles-writable

Stainless steel pro handles

Stainless steel tubular handles

Accessories are available through an authorized dealer.
For local dealer information visit subzero-wolf.com/locator.



HANDLE ACCESSORIES

PRO



TUBULAR



PRODUCT SPECIFICATIONS

Model	UW-24/O
Dimensions	23 7/8"W x 34"H x 24"D
Door Clearance	25 3/8"
Weight	195 lbs
Electrical Supply	115 VAC, 60 Hz
Electrical Service	15 amp dedicated circuit
Wine Storage Capacity	46 Bottles
Receptacle	3-prong grounding-type

ELECTRICAL

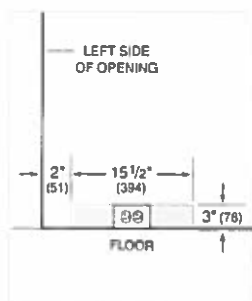

NOTE: Dimensions in parenthesis are in millimeters unless otherwise specified

INTERIOR VIEW

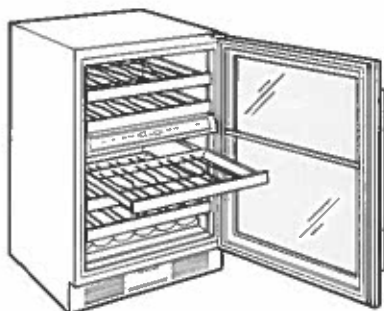

This illustration is intended for interior reference only and may not represent the exterior of the model being specified.

DIMENSIONS

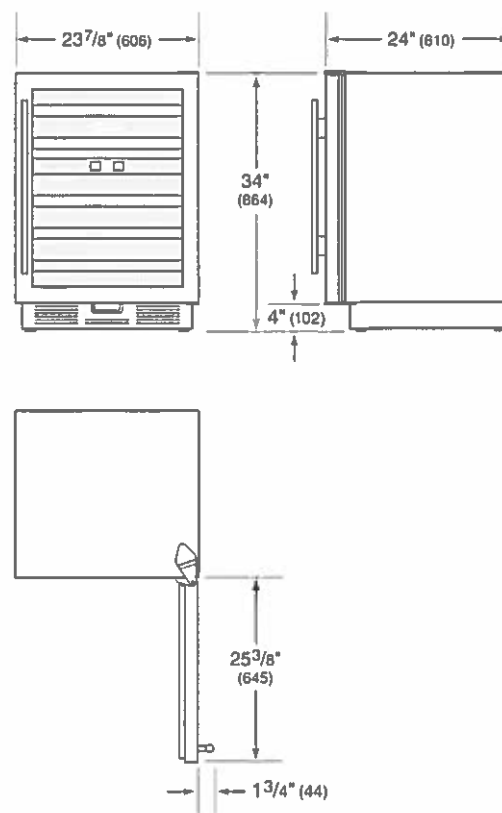

STANDARD INSTALLATION

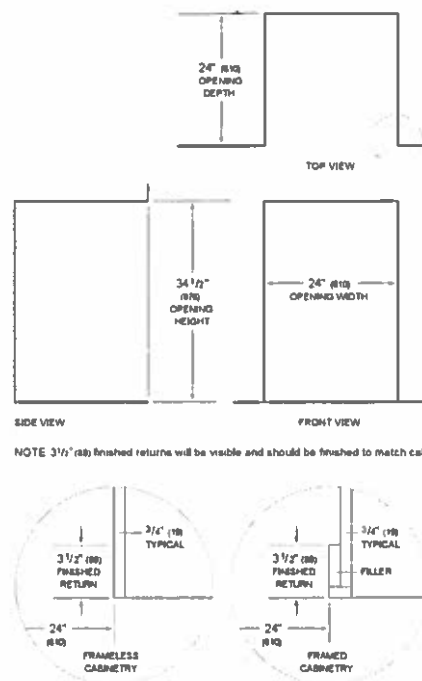

IC-30RID



FEATURES

All-refrigerator storage solves capacity problems

Ready to be fitted with custom panels and handles to blend with cabinetry

Air purification system fights spoilage, odors

Internal water dispenser works with seamless design

Water-filtration system reduces contaminants, chlorine taste and odor

Nano-coated spill-proof shelves for easy clean-up

Smart-touch controls for streamlined access to more settings

Rigorously tested to ensure decades of use

Exceptional support from Madison, WI-based Customer Care team

Soft-close doors and drawers

Soft-on LED lights for varying degrees of brightness

Uniform 84" height

ACCESSORIES

Air Purification Cartridge

Dual Installation Kit Handle to Handle

Dual Installation Kit Hinge to Handle

Dual Installation Kit Hinge to Hinge

Egg Container

Press-to-Open - Left Hinge

Press-to-Open Internal Dispenser- Right Hinge

Reduced Toekick Divider

Stainless Steel Side Panel

Stainless Steel Top Panel

Water Filter 4204490

Stainless Steel Tubular Handles

Stainless Steel Pro Handles

Accessories are available through an authorized dealer.
For local dealer information, visit subzero-wolf.com/locator.



HANDLE ACCESSORIES



PRODUCT DETAILS

REFRIGERATOR

- Three adjustable glass shelves
- Two crisper drawers with dividers
- Deli drawer with dividers
- Three adjustable door shelves
- Two stationary door shelves
- Adjustable dairy compartment
- Air purification system

PRODUCT SPECIFICATIONS

Model	IC-30RID
Dimensions	30"W x 84"H x 24"D
Door Clearance	28 1/2"
Weight	400 lbs
Refrigerator Capacity	17.3 cu. ft.
Electrical Supply	115 VAC, 60 Hz
Electrical Service	15 amp dedicated circuit
Receptacle	3-prong grounding-type

ELECTRICAL

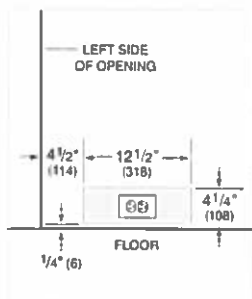

PLUMBING

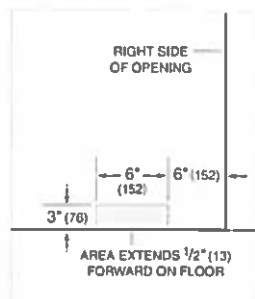

PANEL SPECIFICATIONS For complete panels specifications including width/height, weight requirements and thickness requirements visit subzero-wolf.com/reveal

NOTE: Dimensions in parenthesis are in millimeters unless otherwise specified

INTERIOR VIEW



This illustration is intended for interior reference only and may not represent the exterior of the model being specified.

DIMENSIONS

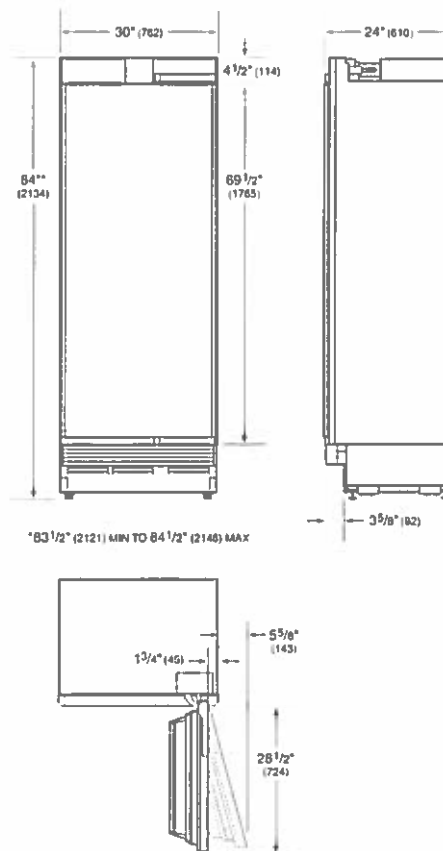

STANDARD INSTALLATION

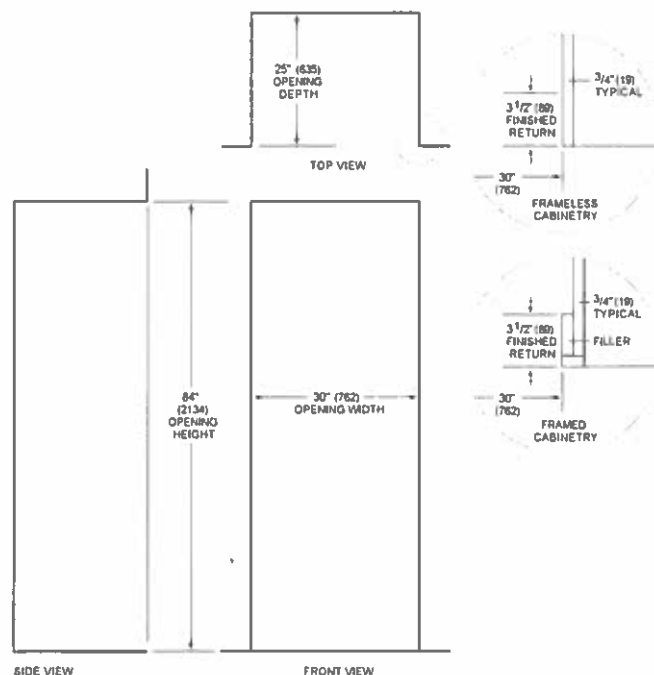

NOTE 3 1/2 inch (89 mm) finished return will be visible and should be finished to match cabinetry

CG365C/S



FEATURES

- 20,000 Btu burner for faster boils
- Lower tier of dual-stacked burner lets you simmer and melt
- Continuous cast-iron grates for easy movement of pots and pans
- Spark ignition system re-ignites if flame goes out
- Dual-stacked, sealed burners for higher highs, lower lows
- Easy-clean seamless burner pan
- Illuminated control knobs
- Stunning minimalist design sits virtually flush to countertop
- Rigorously tested for decades of use
- Exceptional support from our Customer Care team in Madison

ACCESSORIES

- Center burner wok grate
- High altitude conversion kit
- Signature red, black or brushed stainless control knobs

Accessories available through an authorized dealer.
For local dealer information, visit subzero-wolf.com/locator.



KNOB OPTIONS



COOKTOP SPECIFICATIONS

- 2 - 9,200 Btu Burner
- 2 - 12,000 Btu Burner
- 1 - 20,000 Btu Burner

PRODUCT SPECIFICATIONS

Model	CG365C/S
Dimensions	36"W x 6 3/4"H x 21"D
Weight	100 lbs
Electrical Supply	120 VAC 60 Hz
Electrical Service	15 amp dedicated circuit
Gas Supply	3/4" ID line
Gas Inlet	1/2" NPT female

ELECTRICAL

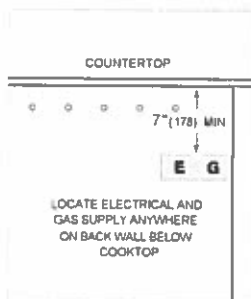

GAS

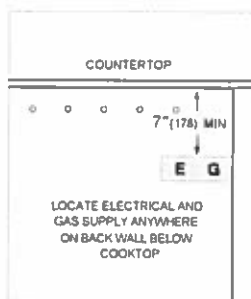

NOTE: Dimensions in parenthesis are in millimeters unless otherwise specified

DIMENSIONS

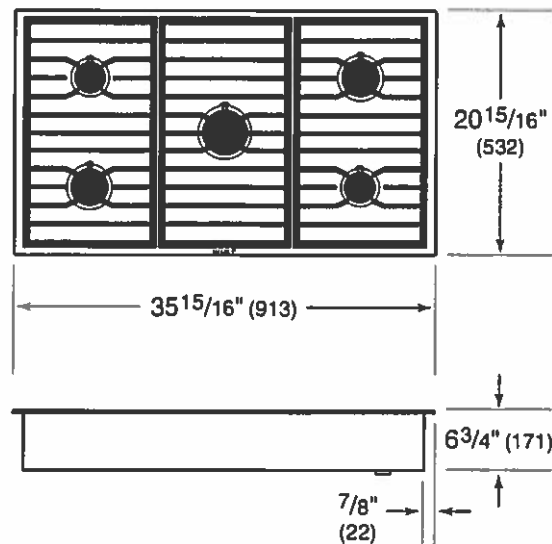

STANDARD INSTALLATION

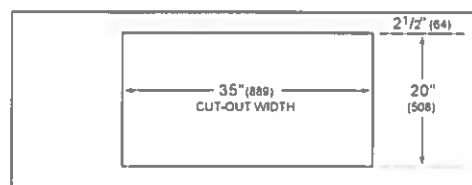

COUNTERTOP CUT-OUT

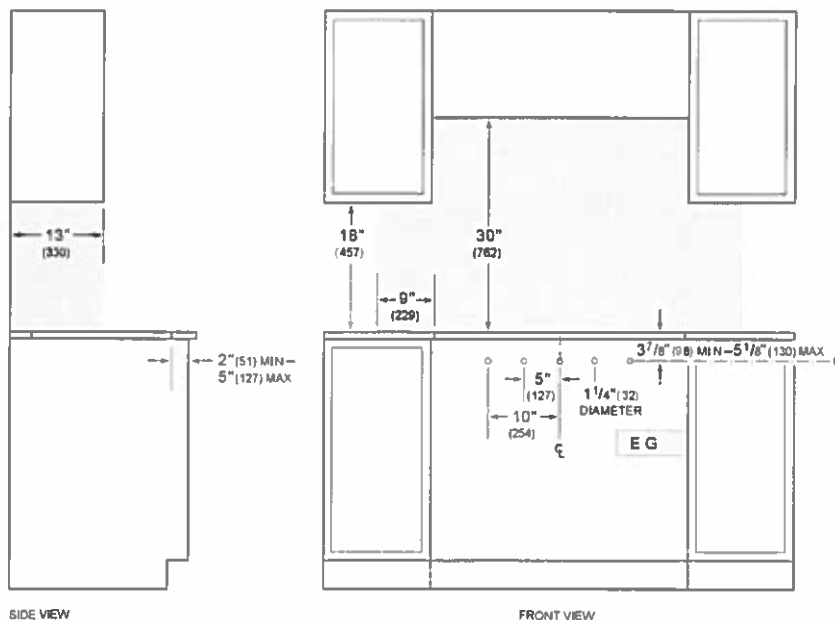

SIDE VIEW

FRONT VIEW

NOTE Shaded area above countertop indicates minimum clearance to combustible surfaces, combustible materials cannot be located within this area. Maximum facade thickness (25 1/2" (649 mm)) thickness extends 17 1/2" (443 mm) left and right and 25 1/2" (649 mm) above and below centerlines.

DD36

FEATURES

- Rises 14 inches to whisk away smoke and odors
- Heavy-gauge stainless steel
- Lowers when not in use
- Remote control operation from up to 9' away
- Blower required (internal, in-line or remote blowers available)
- Adjustable discharge lets you negotiate around ducting
- Delay-off feature
- Delay-off feature shuts off blower after approximately 5 minutes
- Reversible motor box can be installed on either side of the downdraft
- Rigorously tested for decades of use
- Exceptional support from our Customer Care team in Madison

ACCESSORIES

- 10" Round Inline Damper
- 1200 CFM Remote Blower
- 600 CFM Internal Blower
- 8" Round Inline Damper
- Contemporary Cooktop/Downdraft Trim
- Make-Up Air Damper
- Recirculating Filter
- Recirculating Kit
- SRT Downdraft Trim

Accessories available through an authorized dealer
For local dealer information, visit subzero-wolf.com/locator



BLOWER OPTIONS

- 600 CFM Internal
- 600 CFM Inline
- 600 CFM Remote
- 1200 CFM Remote

PRODUCT SPECIFICATIONS

Model	DD36
Dimensions	36"W x 14"H x 2"D
Weight	80 lbs
Electrical Supply	110/120 VAC, 60 Hz
Electrical Service	15 amp dedicated circuit
Discharge Location	Vertical or Horizontal
Discharge Dimensions	6" round internal or 10" round inline or remote
Receptacle	3-prong grounding-type

ELECTRICAL

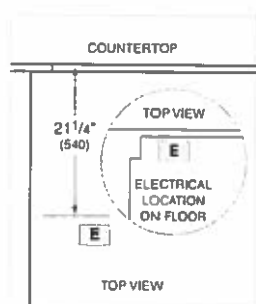

NOTE: Dimensions in parenthesis are in millimeters unless otherwise specified

DIMENSIONS

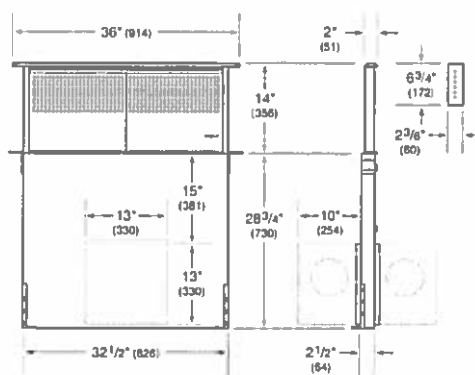

NOTE: Shown with front mounted internal blower with 6" (152) round discharge, dashed line represents rear mount.

STANDARD INSTALLATION

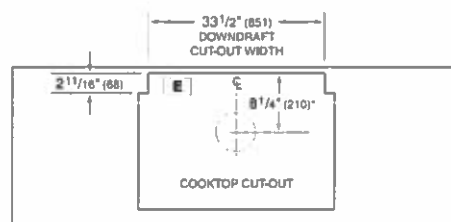

TOP VIEW

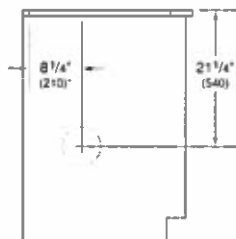

SIDE VIEW

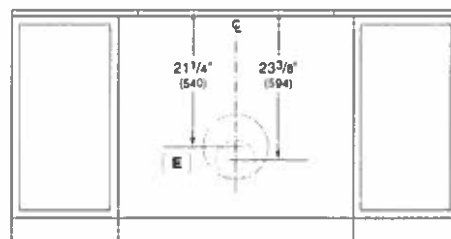

FRONT VIEW

*6" (152) back from countertop cut-out when internal blower is rear mounted.

NOTE: Internal blower 6" (152) round, side, rear or bottom discharge. In-line and remote blower 10" (254) round, rear discharge. Centerline indicates center of downdraft cut-out.

SO30CE/B/TH



FEATURES

10 cooking modes make meals easy

Three adjustable oven racks

Cobalt blue porcelain interior

Self clean, delayed start, timed cook, Sabbath mode and more

Installs flush with surrounding cabinetry

Dual convection oven for faster, more consistent cooking

Temperature probe cooks to ideal doneness and lets you know when it's ready

Rigorously tested for decades of use

Exceptional support from our Customer Care team in Madison

Hidden bake element and recessed broil element

ACCESSORIES

30" Bake Stone Kit

30" Broiler Pan

Dehydration Kit

Full-Extension Ball Bearing Rack

Premier Baking Sheet

Standard Oven Rack

Temperature Probe

Accessories available through an authorized dealer

For local dealer information, visit subzero-wolf.com/locator



PRODUCT SPECIFICATIONS

Model	SO30CE/B/TH
Dimensions	29 7/8"W x 27 7/8"H x 23 3/4"D
Oven 1 Interior Dimensions	25"W x 16 1/2"H x 19"D
Overall Capacity	4.5 cu. ft.
Usable Capacity	2.8 cu. ft.
Door Clearance	22"
Weight	273 lbs
Electrical Supply	240/208 VAC, 60 Hz
Electrical Service	30 amp dedicated circuit
Conduit Length	4 Feet

ELECTRICAL

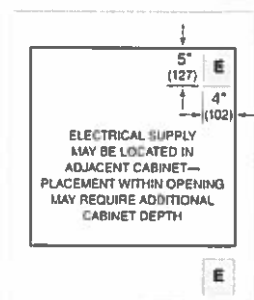

NOTE: Dimensions in parenthesis are in millimeters unless otherwise specified

DIMENSIONS

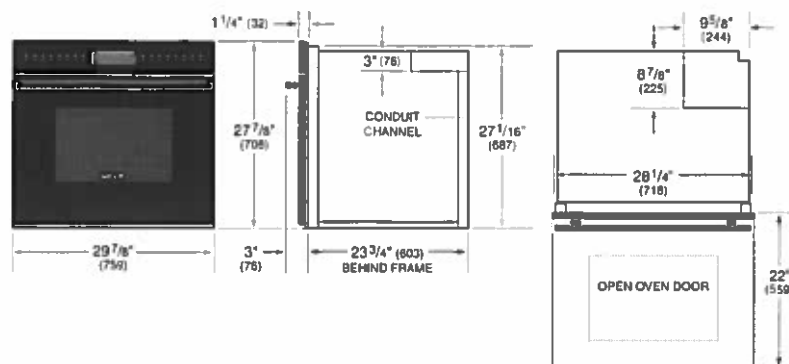

STANDARD INSTALLATION

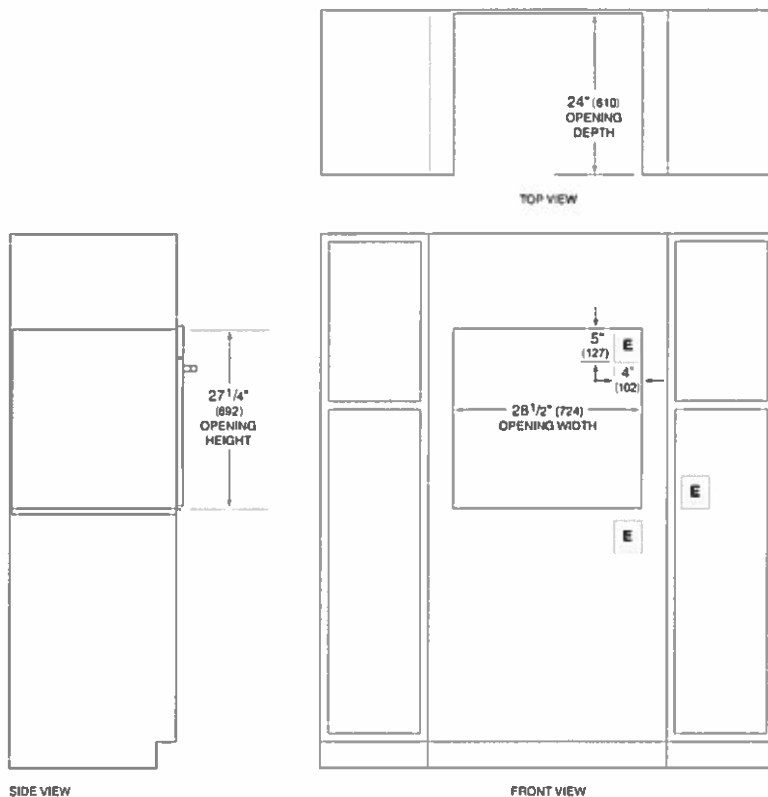

NOTE: Location of electrical supply within opening may require additional cabinet depth.

30" M SERIES CONTEMPORARY BLACK GLASS CONVECTION STEAM OVEN WITH RETRACTABLE HANDLE

WOLF

CSO30CM/B



FEATURES

- 10 cooking modes make meals easy
- Full steam for sous vide and flaky, crispy crusts
- Gourmet mode adjusts time, temperature, humidity for perfect results
- Larger than similar units, can make multiple dishes at once
- Installs flush with cabinetry or integrated into your kitchen design
- Program in when you want your dish to be ready
- Temperature probe cooks to ideal doneness and lets you know when it's ready
- Easy-access water tank provides 90 minutes of steam cooking
- Rigorously tested for decades of use
- Exceptional support from our Customer Care team in Madison

ACCESSORIES

- Descaling Solution
- Full Extension Rack Guides
- Oven Rack
- Perforated Pan 12 3/4" x 1 1/2" x 7"
- Perforated Pan 12 3/4" x 2 1/2" x 7"
- Perforated Pan 17 3/4" x 1 1/4" x 15"
- Porcelain Baking Sheet
- Solid Pan 12 3/4" x 1 1/2" x 7"
- Solid Pan 12 3/4" x 1 1/4" x 14"
- Solid Pan 17 3/4" x 1 1/4" x 15"

Accessories available through an authorized dealer.
For local dealer information, visit subzero-wolf.com/locator



30" M SERIES CONTEMPORARY BLACK GLASS CONVECTION STEAM OVEN WITH RETRACTABLE HANDLE



PRODUCT SPECIFICATIONS

Model	CSO30CM/B
Dimensions	29 7/8"W x 17 7/8"H x 21 1/2"D
Oven Interior Dimensions	17 7/8"W x 11"H x 15 3/4"D
Capacity	1.8 cu. ft.
Door Clearance	14 3/16"
Weight	80 lbs
Electrical Supply	240/208 VAC, 60 Hz
Electrical Service	20 amp dedicated circuit
Power Cord Length	6 Feet
Receptacle	NEMA 6-20R grounding-type

ELECTRICAL



NOTE: Dimensions in parenthesis are in millimeters unless otherwise specified

DIMENSIONS

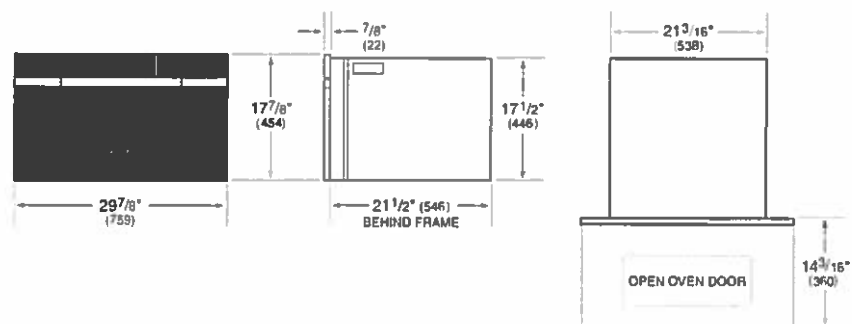

STANDARD INSTALLATION

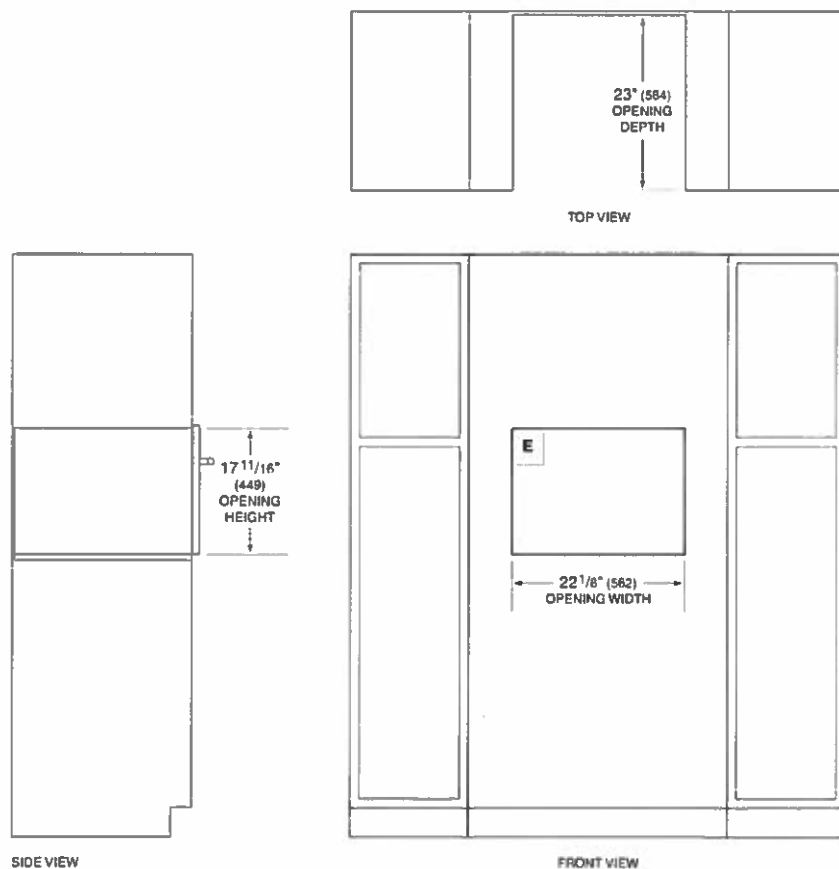

NOTE: 24" (610) and 30" (762) models require the same opening dimensions.

30" M SERIES CONTEMPORARY DROP-DOWN DOOR MICROWAVE OVEN

WOLF

MDD30CM/B/TH

FEATURES

Integrates into any kitchen

Matches M series ovens, coffee systems, convection steam oven

900 watts of power

Generous 1.6 cu. ft. capacity

Quick-start controls for popular items

Gourmet mode cooks automatically from preset recipes

"Keep Warm" mode

Rigorously tested for decades of use

Exceptional support from our Customer Care team in Madison

ACCESSORIES

3/4" Black Tubular Handle

Accessories available through an authorized dealer

For local dealer information, visit subzero-wolf.com/locator.



PRODUCT SPECIFICATIONS

Model	MDD30CM/B/TH
Dimensions	29 7/8"W x 17 7/8"H x 20"D
Capacity	1.6 cu. ft.
Door Clearance	14 3/16"
Weight	80 lbs
Electrical Supply	120 VAC, 60 Hz
Electrical Service	15 amp dedicated circuit
Power Cord Length	4 Feet
Receptacle	3-prong grounding-type

ELECTRICAL

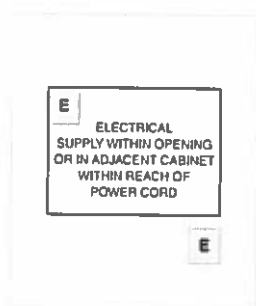

NOTE: Dimensions in parenthesis are in millimeters unless otherwise specified

DIMENSIONS

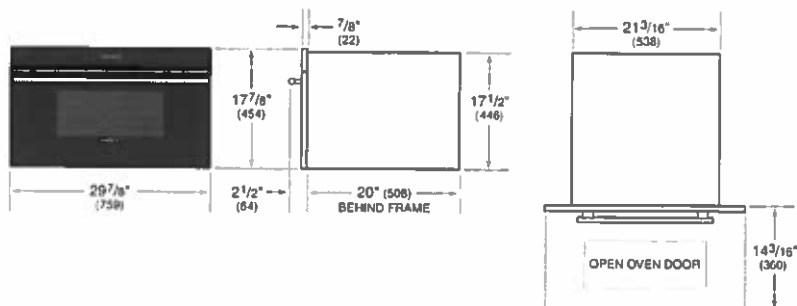

STANDARD INSTALLATION

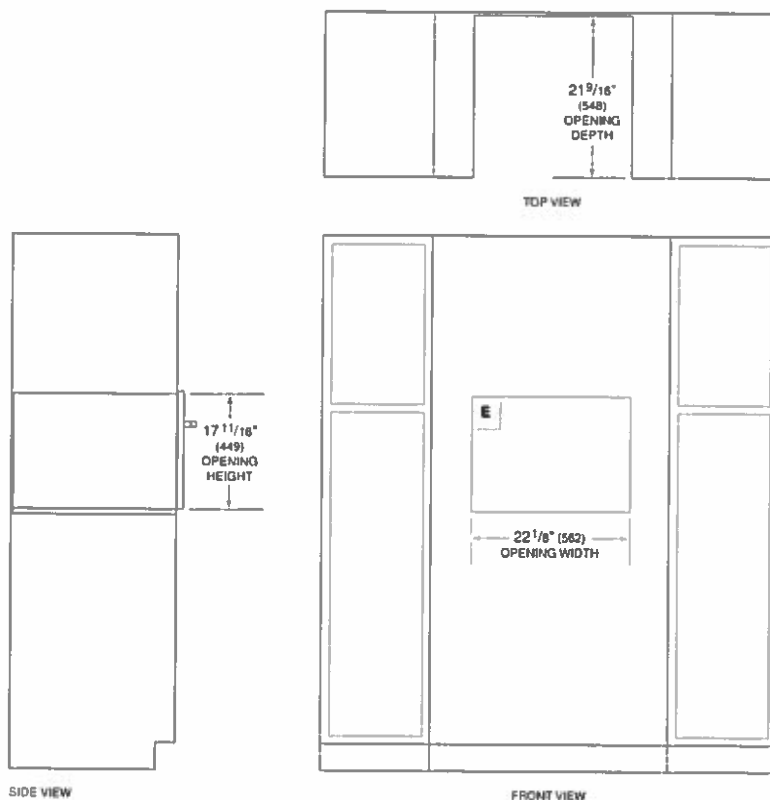

CW24/B



FEATURES

Gentle heat warms cups, dishes

50 lb. capacity - room for 40 cups!

Hidden interior control panel

Removable non-slip mat

Push to open

Black glass and stainless steel options

Rigorously tested for decades of use

Exceptional support from our Customer Care team in Madison

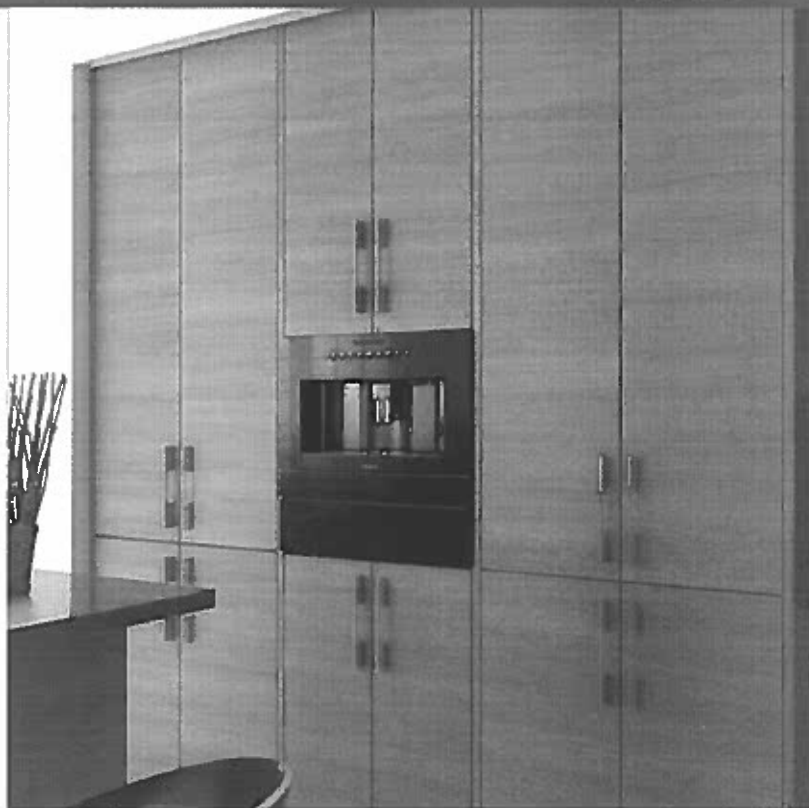

PRODUCT SPECIFICATIONS

Model	CW24/B
Dimensions	23 1/2"W x 5 1/2"H x 21"D
Capacity	0.8 cu. ft.
Weight	60 lbs
Electrical Supply	120 VAC, 60 Hz
Electrical Service	10 amp dedicated circuit
Power Cord Length	3 Feet
Receptacle	3-prong grounding-type

ELECTRICAL



NOTE: Dimensions in parenthesis are in millimeters unless otherwise specified

DIMENSIONS

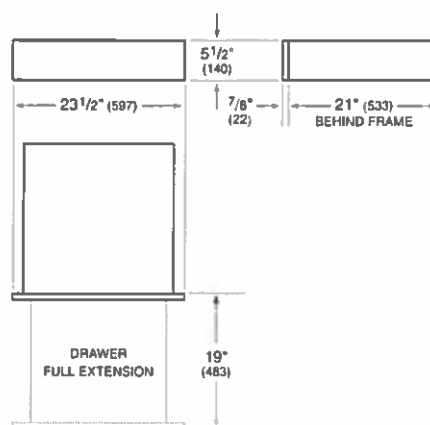

STANDARD INSTALLATION

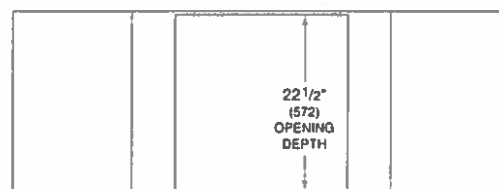

TOP VIEW

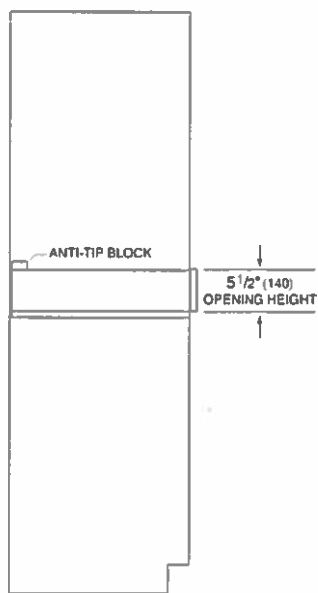

SIDE VIEW

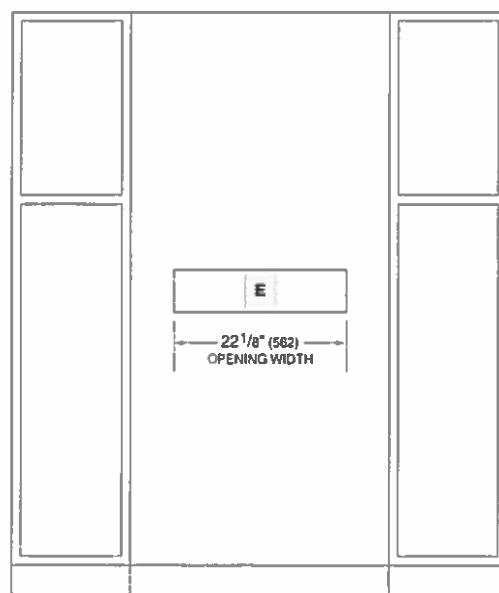

FRONT VIEW

EC 24/B

FEATURES

Make all your favorite coffee drinks

Uses whole-bean and pre-ground coffee

Coffee made to size, from 1 oz. to 12 oz.

Built-in burr grinder with 13 grind settings

No plumbing needed

Rigorously tested for decades of use

Exceptional support from our Customer Care team in Madison

Auto-descale reminders

Five strength settings

Hot water on demand

Press Double Coffee button for two identical cups

Removable milk carafe for freshness

ACCESSORIES

Care Kit

Descaling Solution

30" Trim Kits - M Series

30" Trim Kits - E Series

Accessories available through an authorized dealer.
For local dealer information, visit subzero-wolf.com/locator.

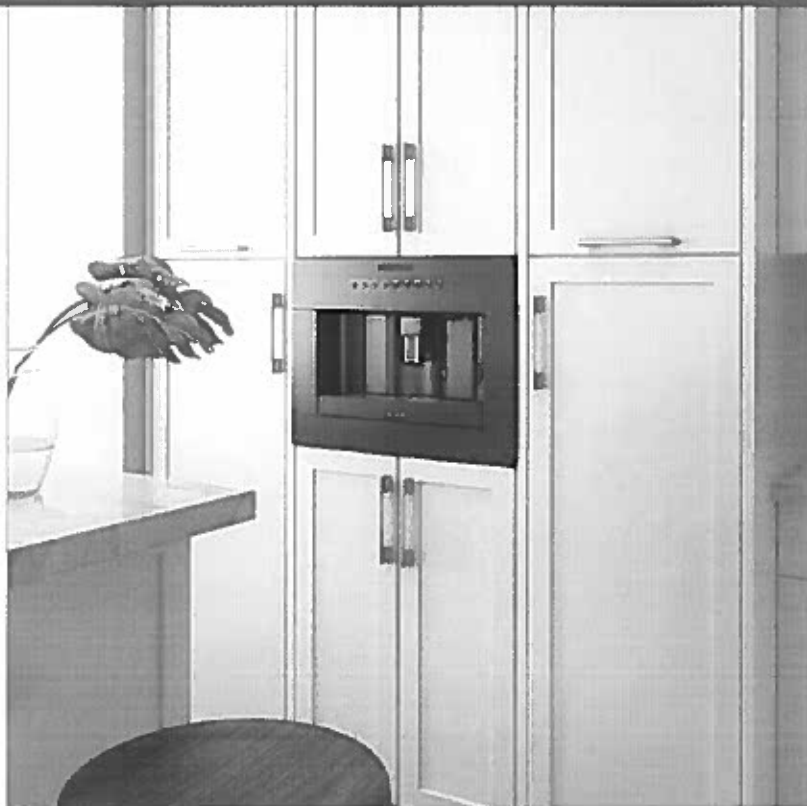

30" TRIM OPTIONS



E SERIES TRANSITIONAL



E SERIES PROFESSIONAL



M SERIES TRANSITIONAL



M SERIES PROFESSIONAL



M AND E SERIES CONTEMPORARY

PRODUCT SPECIFICATIONS

Model	EC24/B
Dimensions	23 1/2"W x 17 7/8"H x 18"D
Weight	80 lbs
Electrical Supply	120 VAC, 60 Hz
Electrical Service	15 amp dedicated circuit
Power Cord Length	6 Feet
Receptacle	3-prong grounding-type

ELECTRICAL



LOCATE ELECTRICAL
SUPPLY ANYWHERE ON
BACK WALL OF OPENING

INSTALLATIONS WITH ACCESSORY TRIM Accessory trim may affect overall product dimensions and opening dimensions. Refer to [Reveal](#) for more information: subzero-wolf.com/reveal

NOTE: Dimensions in parenthesis are in millimeters unless otherwise specified

DIMENSIONS

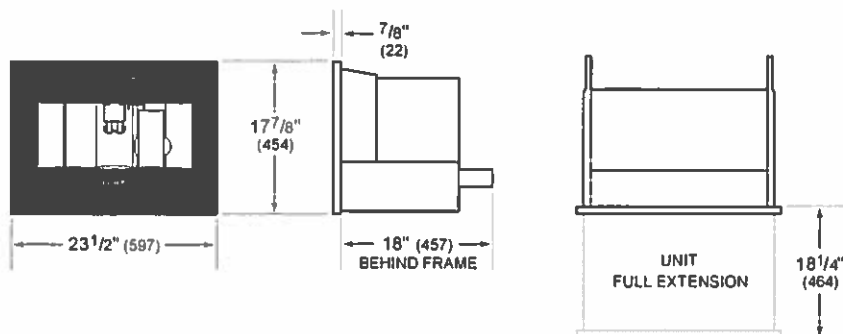

STANDARD INSTALLATION



DW2450WS**FEATURES**

Built-in water softener to reduce hard water spots on dishes and ensure optimal performance

Custom wash and dry options and three separate spray arms to ensure optimal cleaning performance

Height-adjustable middle rack and fold-down tines adjust to any size or combination of dishes

Accepts cabinet panels for a custom look or stainless panels and handles to match Sub-Zero and Wolf products

Near-silent operation never interrupts the conversation

Easy-to-use, touch controls and display are hidden to maintain clean lines and a status floor light indicates cycle status

Rigorously tested in our U.S. manufacturing facilities to ensure decades of use

Exceptional support from Madison, WI-based Customer Care team

ACCESSORIES

24" Door Panels

24" Door Panels

24" Door Panels

24" Door Panels

4" Stainless Kickplate - 24" Opening

4" Stainless Kickplate - 60cm Opening

6" Stainless Kickplate - 24" Opening

6" Stainless Kickplate - 60cm Opening

60cm Door Panels

60cm Door Panels

60cm Door Panels

60cm Door Panels

Pro Handle

Tubular Handle

Accessories are available through an authorized dealer.
For local dealer information, visit subzero-wolf.com/locator.

**HANDLE ACCESSORIES**

PRO



TUBULAR



PRODUCT SPECIFICATIONS

Model	DW2450WS
Dimensions	23 5/8"W x 34 1/2"H x 23 1/4"D
Door Clearance	26 3/4"
Electrical Supply	115 VAC, 60 Hz
Electrical Service	15 amp dedicated circuit
Receptacle	3-prong grounding-type
cord-length	3'
Water Connection	5' braided tubing with 3/8" female compression fitting
Drain Connection	5' (1.5 m) corrugated tubing
Plumbing Pressure	30–140 psi

ELECTRICAL

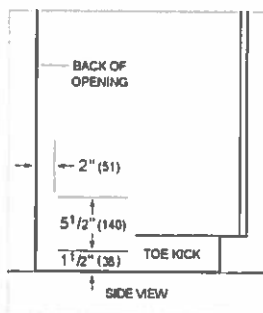

PLUMBING

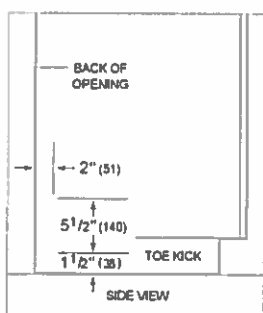

NOTE: Dimensions in parenthesis are in millimeters unless otherwise specified

PANEL SPECIFICATIONS For complete panels specifications including width/height, weight requirements and thickness requirements visit subzero-wolf.com/reveal.

INTERIOR VIEW

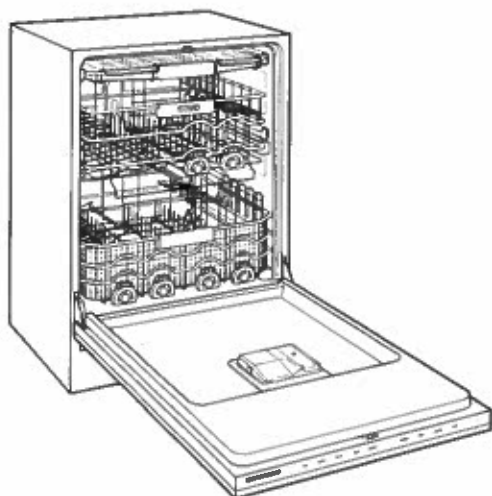

This illustration is intended for interior reference only and may not represent the exterior of the model being specified.

DIMENSIONS

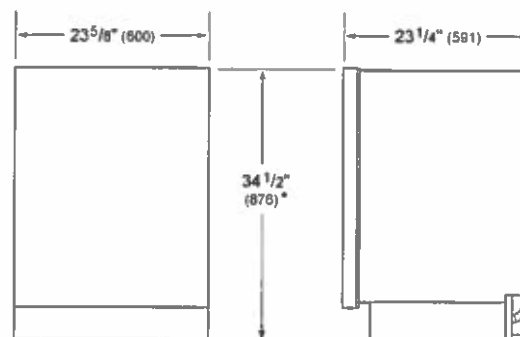

*34" (864) MIN TO 34 5/8" (880) MAX

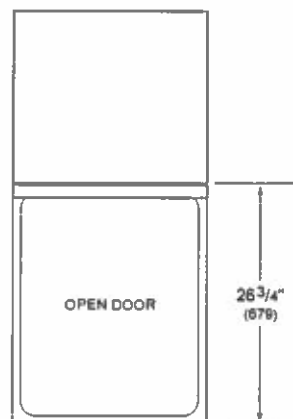

STANDARD INSTALLATION

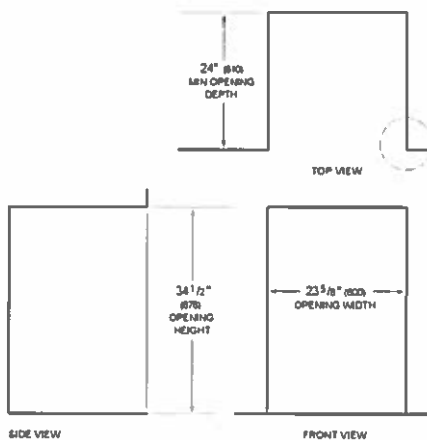

NOTE: 3 1/2" (89) finished returns will be visible and should be finished to match cabinetry

