

Brampton Encore - 102 - 2 - 38-5 Elev.B HANDEL

CENTRAL VAC AND WIRING

Inv.2,040	1 - GREAT ROOM: CONDUIT PIPE- FOR TELEVISION- LOCATE APPROX. 66" A.F.F. ABOVE FIREPLACE, TERMINATING AT CABLE
Line28848	Note:
8Aug19 / 17Aug19	

CERAMIC

Inv.2,040	1 - MAIN FLOOR:FOYER / POWDER/ HALL AT GARAGE ENTRANCE / KITCHEN/BREAKFAST / LAUNDRY ROOM FLOOR TILE: UPGRADE 4 - 12X24" LAID IN STRAIGHT STACKED PATTERN. SEE PLAN FOR TILE ENTRANCE
Line28857	Note:
8Aug19 / 17Aug19	
Inv.2,040	1 - MASTER ENSUITE/ENSUITE 2 / TWIN BATH: FLOOR TILE: UPGRADE 4 - 12X24" LAID IN STRAIGHT STACKED PATTERN. SEE PLAN FOR TILE ENTRANCE
Line28858	Note:
8Aug19 / 17Aug19	
Inv.2,040	1 - MASTER ENSUITE: SHOWER WALL AND CEILING - UPGRADE 2 WALL TILE - 8X24" LAID IN HORIZONTAL STACKED PATTERN
Line28863	Note:
8Aug19 / 17Aug19	

ELECTRICAL

Inv.2,040	1 - GREAT ROOM: 110V WALL RECEPTACLE ON DEDICATED CIRCUIT- LOCATE 66" A.F.F. ABOVE FIREPLACE
Line28849	Note:
8Aug19 / 17Aug19	
Inv.2,040	1 - KITCHEN: ROUGH - IN CEILING OUTLET ON SAME SWITCH - DOES NOT INCLUDE FIXTURE - LOCATE APPROX. CENTER ABOVE ISLAND, USE SAME SWITCH AS STANDARD LIGHT
Line28850	Note:
8Aug19 / 17Aug19	
Inv.2,040	1 - KITCHEN: 110V WALL RECEPTACLE ON DEDICATED CIRCUIT - GAS FIRED APPLIANCE - FOR AUX. EQUIPMENT - NOT A STOVE PLUG
Line28853	Note:
8Aug19 / 17Aug19	
Inv.2,040	1 - KITCHEN: CYCLONE CHIMNEY-STYLE HOOD FAN #SCB50130
Line28875	Note:
8Aug19 / 17Aug19	

FORMING

Inv.2,040	1 - SIDE DOOR- HOME TO EXTERIOR- AS PER PLAN AND GRADE PERMITTING
Line29111	Note:
8Aug19 / 17Aug19	

FRAMING

Inv.2,040	1 - MANDOOR - GARAGE TO HOUSE - AS PER PLAN AND GRADE PERMITING
Line29117	Note: INCLUDED IN APS
8Aug19 / 17Aug19	

GARAGE DOORS

Brampton Encore - 102 - 2 - 38-5 Elev.B HANDEL

Inv.2,040	2 - GARAGE DOOR OPENER - WITH 1 REMOTE- PRICE IS PER DOOR *BELT DRIVE*
Line28851	Note:
8Aug19 / 17Aug19	

GLASS AND MIRROR

Inv.2,040	1 - ENSUITE 2: SHOWER IN LIEU OF TUB- FRAMED SHOWER ENCLOSURE WITH POTLIGHT
Line28871	Note:
8Aug19 / 17Aug19	

GRANITE MARBLE QUARTZ

Inv.2,040	1 - MASTER ENSUITE: UPGRADE 1 QUARTZ
Line28864	Note:
8Aug19 / 17Aug19	

HARDWOOD

Inv.2,040	1 - MAIN FLOOR: FAMILY / DINING/ MAIN HALL / LANDING: UPGRADE 3 HARDWOOD - 3/4 X 5" VINTAGE RED OAK WIREBRUSHED
Line28859	Note:
8Aug19 / 17Aug19	

Inv.2,040	1 - UPPER HALL: UPGRADE 3 HARDWOOD - 3/4 X 5" VINTAGE RED OAK WIREBRUSHED
Line28860	Note:
8Aug19 / 17Aug19	

HVAC

Inv.2,040	1 - KITCHEN: GAS LINE ROUGH - MAIN FLOOR OF 2 STORY HOME
Line28852	Note:
8Aug19 / 17Aug19	

Inv.2,040	1 - KITCHEN: CYCLONE CHIMNEY-STYLE HOOD FAN #SCB50130
Line29112	Note:
8Aug19 / 17Aug19	

KITCHEN AND BATH CABINETRY

Inv.2,040	1 - LAUNDRY: OPTIONAL UPPER CABINETS - STANDARD LEVEL
Line28866	Note:
8Aug19 / 17Aug19	

Inv.2,040	1 - KITCHEN: FLUSH BREAKFAST BAR
Line28870	Note:
8Aug19 / 17Aug19	

Inv.2,040	1 - KITCHEN: DELETE UPPERS FINISH SIDES OF CABINETS - LEAVE APPROX. 36" FOR 30" CHIMNEY HOOD FAN
Line28872	Note:
8Aug19 / 17Aug19	

Inv.2,040	1 - KITCHEN: SLIDE IN STOVE PREP FOR "TYPICAL" 30" SLIDE-IN RANGE **APPLIANCE SPECS WILL NOT BE PROVIDED**
Line28873	Note: Purchaser acknowledges/accept that by not providing appliance specs, IF the stove does not fit they will be liable to pay for any adjustments to cabinet/counter top.
8Aug19 / 17Aug19	

Inv.2,040	2 - KITCHEN: POTS AND PANS DRAWERS - 1 SHALLOW TOP DRAWER + 2 DEEP DRAWERS BELOW
Line28874	Note:
8Aug19 / 17Aug19	



Brampton Encore - 102 - 2 - 38-5 Elev.B HANDEL

Inv.2,040	1 - KITCHEN: RELOCATE STANDARD BANK OF 4 DRAWERS TO ISLAND
Line28876	Note:
8Aug19 / 17Aug19	

MISC.

Inv.2,040	1 - Purchaser has attended an appointment at the Decor Centre & has DECLINED any additional upgrades and accepts and acknowledges that there will be no further changes/additions/deletions to be made upon signing on AUGUST 8, 2019.
Line28867	Note:
8Aug19 / 17Aug19	
Inv.2,040	1 - Purchasers are aware & accepts that ANY changes made to upgrades after signing this Purchasers Extra Form are subject to a minimum administration fee of \$500. PLUS a 10% holdback fee.
Line28868	Note:
8Aug19 / 17Aug19	
Inv.2,040	1 - BONUS PACKAGE: \$10,000.00 (INCLUDING TAXES) WORTH OF UPGRADES FROM GOLD PARK HOMES DÉCOR CENTRE IS BEING APPLIED TOWARD THIS ORDER. PURCHASER HAS A REMAINING AMOUNT OF \$00 (INCLUDING TAXES) .
Line28869	Note:
8Aug19 / 17Aug19	

PAINT

Inv.2,040	1 - MAIN STAIRS: STAIN STAIRS TO MATCH HARDWOOD AS CLOSE AS POSSIBLE
Line28862	Note: stairs will NOT match hardwood floors in colour, texture or species
8Aug19 / 17Aug19	

PLUMBING

Inv.2,040	1 - KITCHEN: ROUGH-IN - WATERLINE FOR FRIDGE
Line28854	Note:
8Aug19 / 17Aug19	
Inv.2,040	1 - MASTER ENSUITE: UPGRADE TO FREE STANDING TUB - MIROLIN 'BROOKE'
Line28856	Note:
8Aug19 / 17Aug19	

PLUMBING FIXTURES

Inv.2,040	2 - MASTER ENSUITE: CONTRAC 'CALVIN' OVAL UNDER MOUNT SINK
Line28865	Note:
8Aug19 / 17Aug19	

STAIRS AND RAILINGS

Inv.2,040	1 - MAIN STAIRS: EUROLINE 1 + V GROOVE
Line28861	Note:
8Aug19 / 17Aug19	

WINDOWS - BASEMENT

Inv.2,040	3 - BASEMENT WINDOWS - UPGRADE EXISTING BASEMENT WINDOW TO 30 INCH X 24 INCH - MAY REQUIRE INSTALLATION OF WINDOW WELL
Line28855	Note:
8Aug19 / 17Aug19	

\*\*\* NOTE: This is not an approved document. Document must be locked \*\*\*  
Scheduled Closing Date:

Purchaser: Sukhbir Singh

Property: 102

Telephone Res. / Bus:

Project: Brampton Encore - Phase 2

Decor Advisor: Yolande Somerville

Model and Elevation: 38-5 Elev.B HANDEL

Layout Changes: ☐ Yes ☒ No      Sketch Attached: ☒ Yes ☐ No      Exterior Colour Scheme:

1. Cabinetry

	Style and Colour	Counter	Hardware
Kitchen / Breakfast	M500 melamine 'Mystic'	Grigio Sardo	*CH-53
Laundry Room	M500 melamine 'Mystic'	n/a	cs1-23
Powder Room	n/a		
Twin Bath	M500 melamine 'Mystic'	P-Lam #4925K-07	cs1-23
Master Ensuite Bathroom	M500 melamine 'Mystic'	*Quartz 'Silky White'	cs1-23
Second Ensuite Bathroom (If Applicable)	M500 melamine 'Mystic'	P-Lam #4925K-07	cs1-23

Comment

2. Floor Tile

	Selection
Entrance Vestibule	*12x24" Carrara X polished 'White'
Main Hall	
Kitchen / Breakfast	*12x24" Carrara X polished 'White'
Laundry Room	*12x24" Carrara X polished 'White'
Powder Room	*12x24" Carrara X polished 'White'
Garage Entrance	*12x24" Carrara X polished 'White'
Master Ensuite Bathroom	*12x24" Carrara X polished 'White'
Second Ensuite Bathroom (If Applicable)	*12x24" Carrara X polished 'White'
Lower Landing (If Applicable)	

Comment

3. Wall Tile

	Selection	Listello/Inserts	Describe
		<input type="radio"/> Yes <input checked="" type="radio"/> No	
Master Ensuite Bathroom			
Tub Deck	n/a	<input type="radio"/> Yes <input checked="" type="radio"/> No	
Shower Stall	*8x24" Laguna 'white' (horiz stack)	<input type="radio"/> Yes <input checked="" type="radio"/> No	
Bathroom Walls	n/a	<input type="radio"/> Yes <input checked="" type="radio"/> No	
Second Ensuite Bathroom (If Applicable)	8x10" Weave 'White'	<input type="radio"/> Yes <input checked="" type="radio"/> No	
Twin Bath	8x10" Weave 'White'	<input type="radio"/> Yes <input checked="" type="radio"/> No	
Kitchen Backsplash	<input type="radio"/> Yes <input checked="" type="radio"/> No	Backsplash Behind Fridge	
Comment			





Scheduled Closing Date:

Purchaser: Sukhbir Singh
Telephone Res. / Bus:
Decor Advisor: Yolande Somerville

Property: 102
Project: Brampton Encore - Phase 2
Model and Elevation: 38-5 Elev.B HANDEL

4. Plumbing Fixtures

Master Ensuite Bathroom Second Ensuite Powder Room
Other Room - Specify Other Washroom

Comment
Standard except bathroom sink and tub

5. Hardwood Flooring

Main Hall Kitchen / Breakfast Living Room Dining Room Family Room Den/Library Entrance Vestibule Lower Landing (If Applicable)
Type and Stain
\*5" Red oak wire brush 'Gryphon'
n/a
n/a
\*5" Red oak wire brush 'Gryphon'
\*5" Red oak wire brush 'Gryphon'
n/a
n/a
n/a
n/a

Comment

6. Carpeting

Ground Floor Second Floor
Upgrade
Description
STD 'Winter Grey' with std u/pad

Upgrade Underpad
Type
Area
Capped
Runner - \*Upgrade

Comment

7. Fireplace

Living Room Family Room Other Room - Specify
Purchased As Per Plan N/A
Fireplace Type Mantle Type Colour / Stain Surround Hearth

Comment

Scheduled Closing Date:

Purchaser: Sukhbir Singh

Property: 102

Telephone Res. / Bus:

Project: Brampton Encore - Phase 2

Decor Advisor: Yolande Somerville

Model and Elevation: 38-5 Elev.B HANDEL

8. Trim Carpentry

Interior Doors Standard Front Door Glass Inserts Standard Door Handles Standard
Interior Trim Standard
Comment

9. Plaster Mouldings and Medallions

Standard Throughout Yes No N/A
Entrance Vestibule Kitchen/Breakfast
Main Hall Den/Library
Living Room Lower Landing
Dining Room Other Room - Specify
Family Room
Comment

10. Railings and Spindles

Railing Package Euroline 1 + V Groove
Railing Colour Gryphon Spindle Colour Black
Stringer / Riser Gryphon Treads Gryphon
Oak Stairs Yes No N/A
Comment

11. Wall Paint / Ceilings

Throughout Finished Areas Warm Grey
Trim Paint White
Smooth Ceilings
Ground Floor
Second Floor
Note
Comment



Scheduled Closing Date:

Purchaser: Sukhbir Singh

Property: 102

Telephone Res. / Bus:

Project: Brampton Encore - Phase 2

Decor Advisor: Yolande Somerville

Model and Elevation: 38-5 Elev.B HANDEL

12. Electrical

Hood Fan ☐ White ☒ Stainless ☐ N/A

Above Kitchen Cabinet Light ☐ Yes ☒ No

Below Kitchen Cabinet Light ☐ Yes ☒ No

Standard Appliances ☒

Over The Range Microwave ☐

Chimney Style Fan ☐

Comment

13. Heating and Air Conditioning

Air Conditioning

Gas Provisions Stove

Gas Provisions Dryer

Gas Provisions Barbecue

Comment

14. Additional Comments

15. Disclaimers and Notes

- 1) Colours of all materials are as close as possible to builder's selection, but not necessarily identical due to variances in manufacturing.
- 2) Any extras listed above are null and void unless accompanied by a separate invoice/amendment. Said invoice must be paid in full.
- 3) The Purchaser acknowledges that after Interior Colour Selection form is signed and dated, no further changes will be permitted other than re-selection due to unavailability. \_\_\_\_\_ Purchaser's Initials
- 4) The Purchaser acknowledges reading and accepting the "Gold Park Homes Decor Centre Disclaimers" form. This document contains other miscellaneous disclaimers.

This Interior Colour Selection is final and approved by:

Signature:  Date: \_\_\_\_\_



BEZ-102.55  
Aug 8 2019

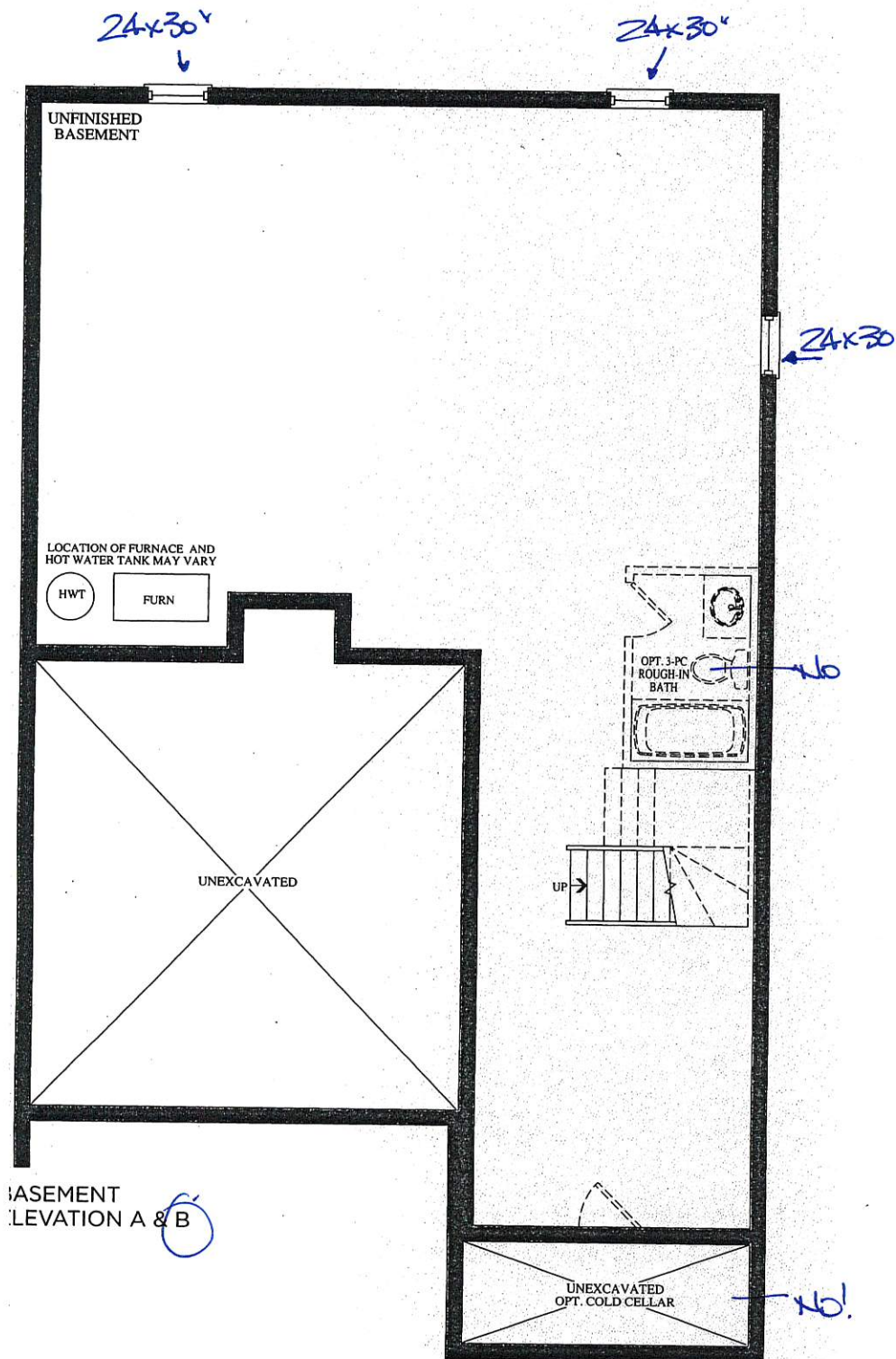



BEZ-102  
AUG 8 2009 S.S

HANDEL B.  
38-5.

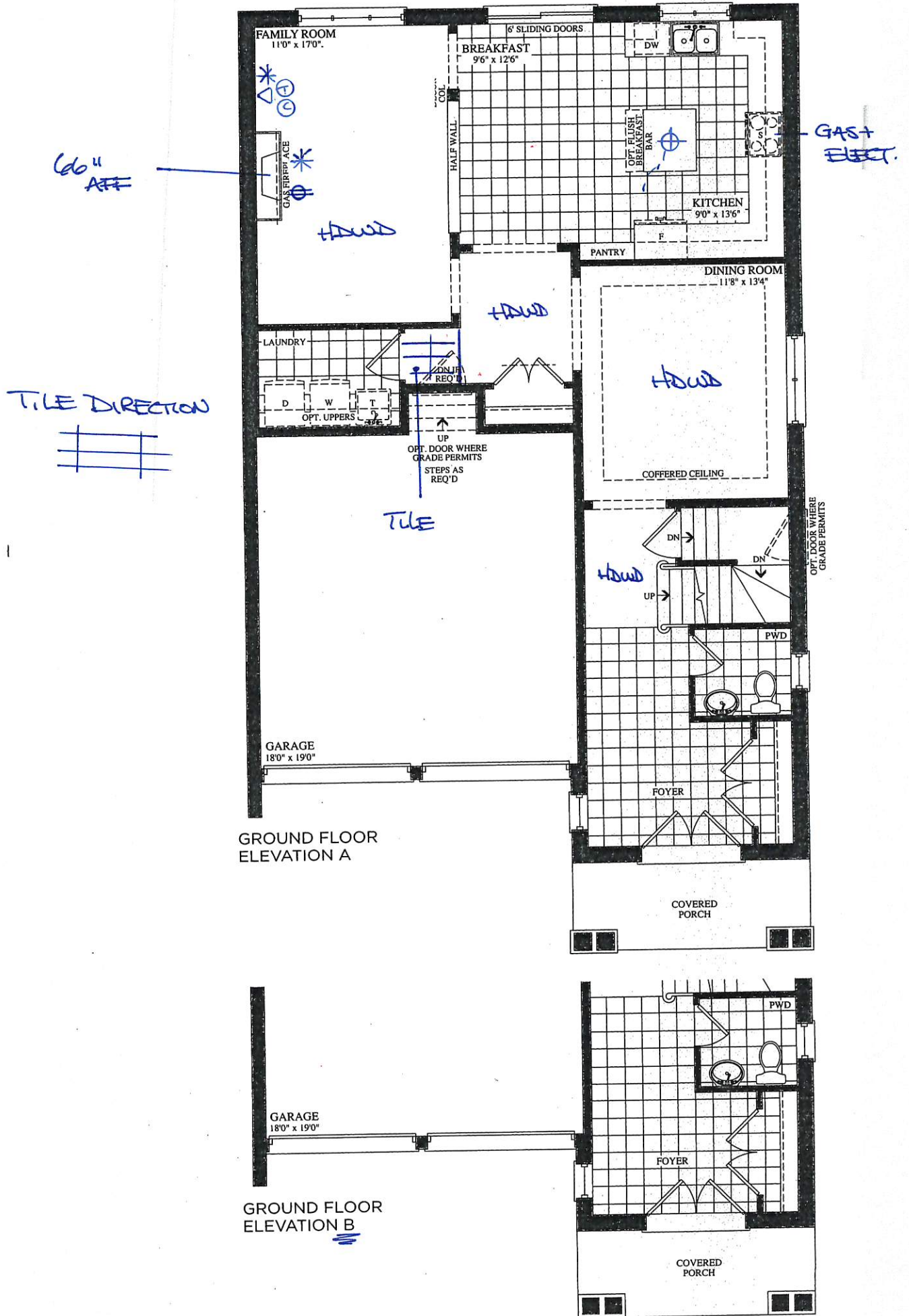

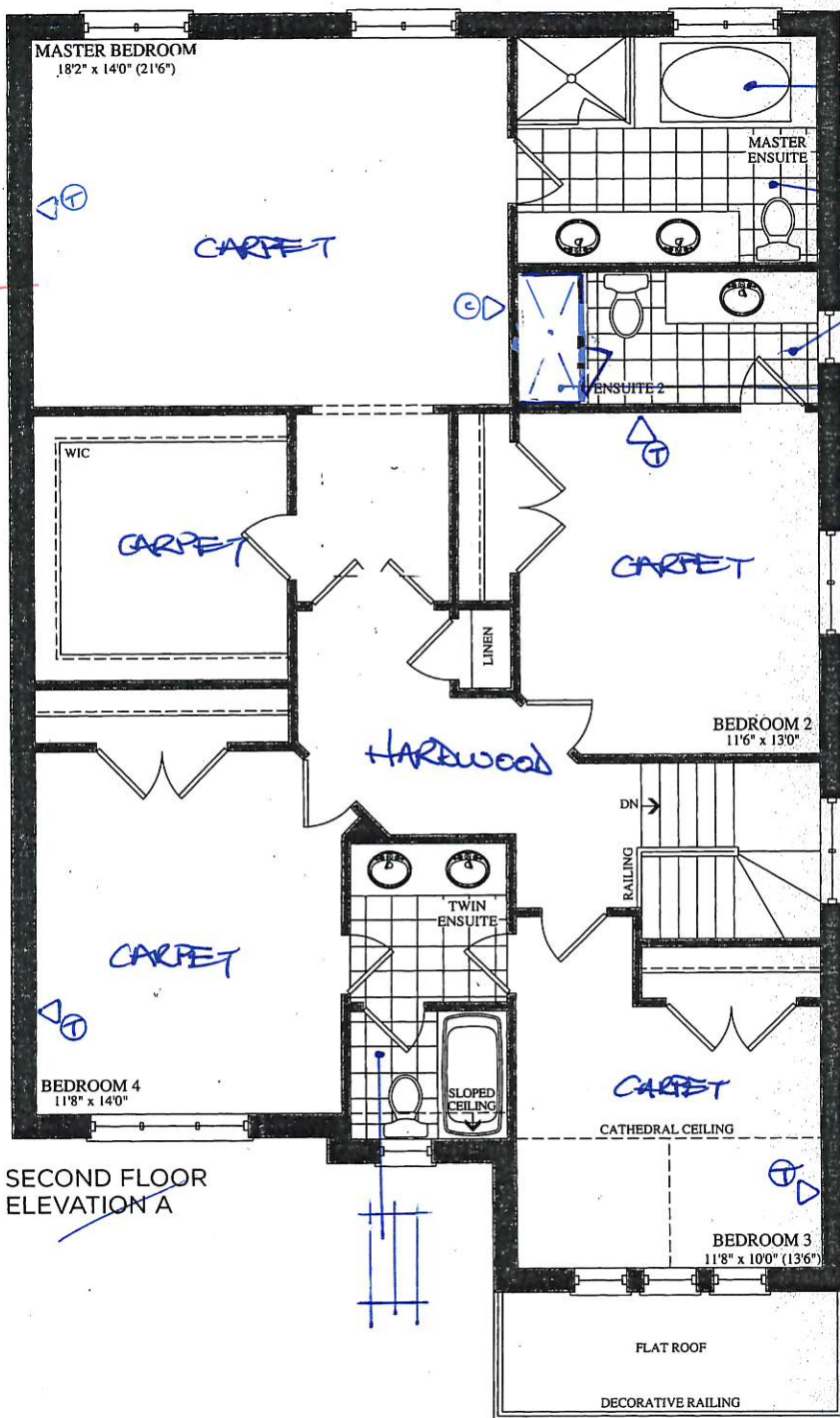

SECOND FLOOR  
ELEVATION A

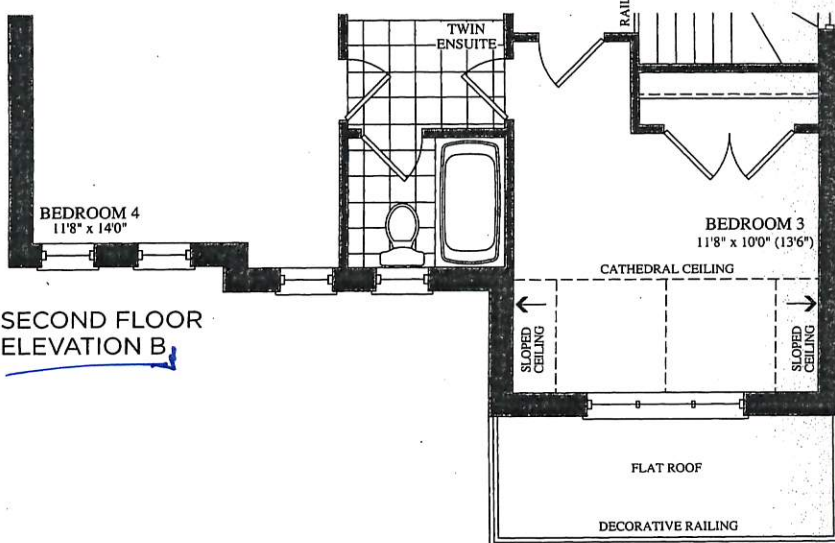

SECOND FLOOR  
ELEVATION B

55

BEZ-102  
AUG 8 2009



BE2-102  
AUG 8 2019



QUOTATION

Date: 06/23/16

Trade Name: Gold Park Homes

Site location: Brampton

Model: 38-5

Address:

Project: Encore

Phase:

This layout has been explained to the purchaser by Cortina Kitchens Inc. and is understood by the purchaser.

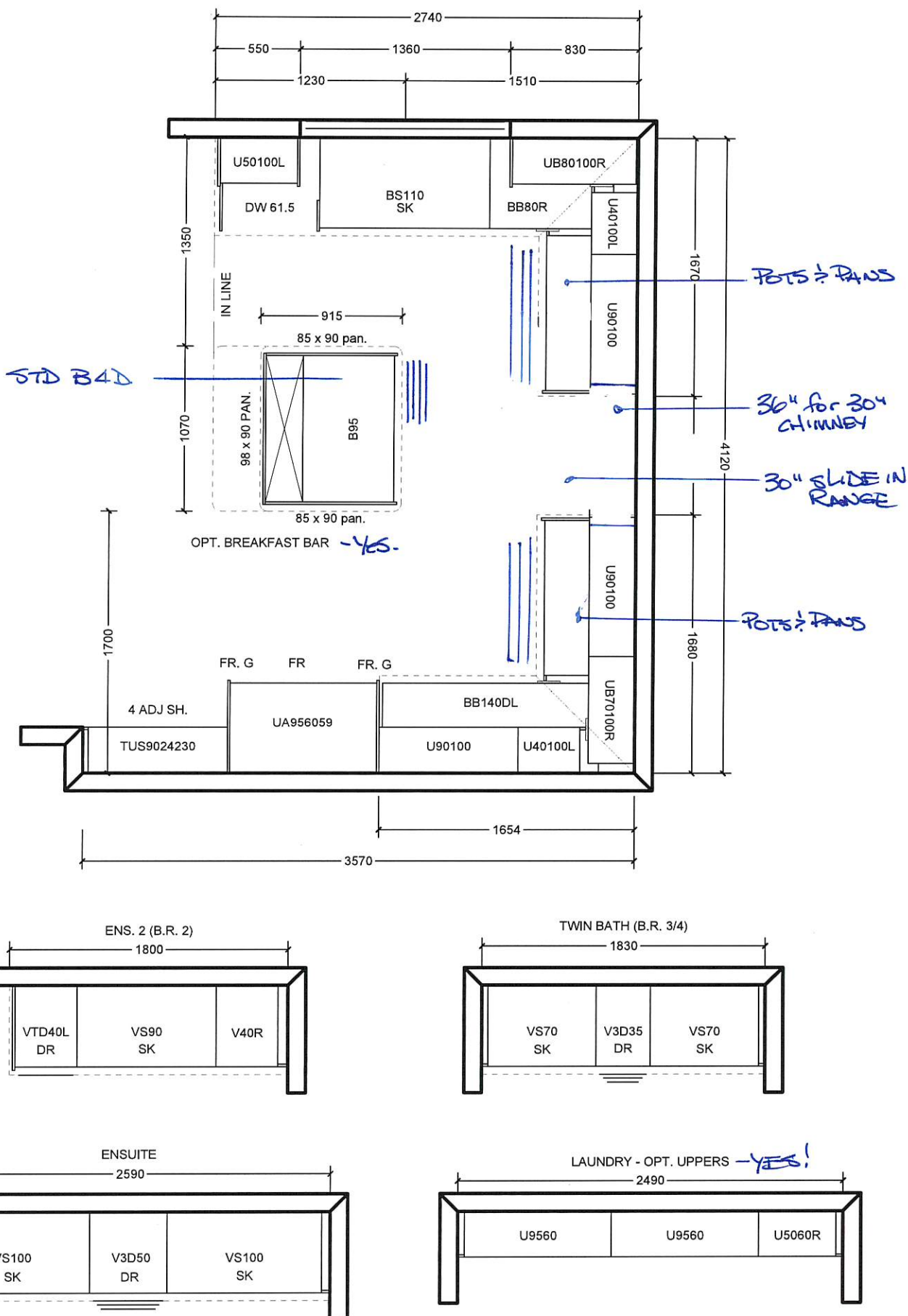

All prices subject to confirmation from head office.  
This quotation is subject to the terms & conditions set out  
in Cortina's Agreement of Purchase and Sale

All agreements are contingent upon strikes, accidents, and delay beyond our control.  
Please provide our installer with template for sinkholes or \$150.00 will be charged for callback.

ACCEPTED DATE: \_\_\_\_\_

\_\_\_\_\_  
CUSTOMER SIGNATURE

\_\_\_\_\_  
SALESPERSON SIGNATURE

\_\_\_\_\_  
CORTINA HEAD OFFICE APPROVAL

ITEM A. Wood grain and colour are characteristics of the product, we cannot guarantee that such grain and colour will always match  
ITEM B. Cortina Kitchens reserves the right to alter dimensions and make technical changes without notice.



SC(B)501

ALITO COLLECTION

# Cyclone®

Innovation by Design - Since 1991

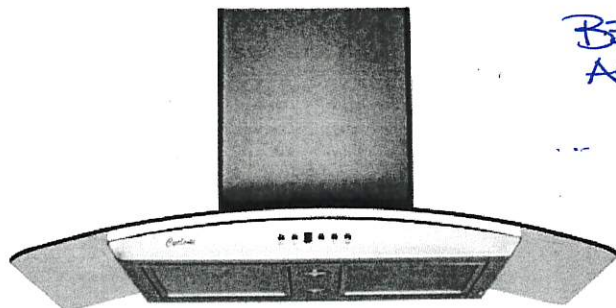

Mesh Filter

BEZ-102  
August 8 2019

5.5

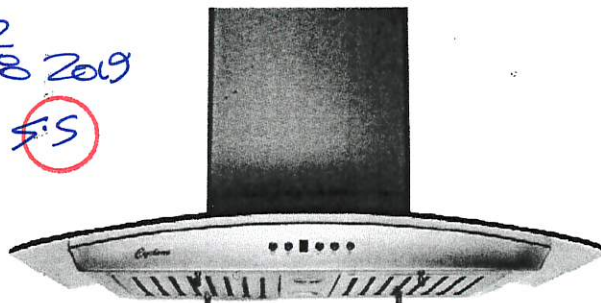

Baffle Filter

## Wall Mount

A very stylish exhaust fan, it is the perfect balance of substance and style. The graceful contour of the arched glass canopy coupled with the brilliant shine of the stainless steel body give an impression that is at once both modern and classic. The hood features a digital three-speed control panel, button controlled LED lights, two mesh or baffle filter screens, and a quiet, efficient motor. Fitted with time-delay "OFF" options up to nine minutes.

## Specifications

Air Flow Volume: 550 CFM

Electrical Connection: 120V/60Hz

Electrical Consumption: 200 Watts

Fan Speed: 1599 RPM

Finishes: Stainless Steel

Venting: 6" Round - Top Only

Dimensions: Width: 30"/36"

Height: 44 1/2"

Depth: 19 3/4"

Sones: Min. 2  
Max. 6

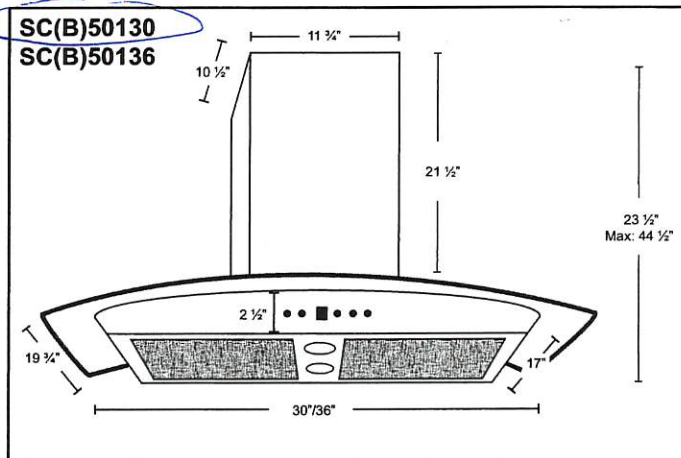

\* B in the model name denotes a model with baffle filters.

SC501 - Mesh Filters

SCB501 - Baffle Filters

Model	Colour	Venting	Size
→ SC(B)50130	Stainless Steel	6"	30"
✗ SC(B)50136	Stainless Steel	6"	36"

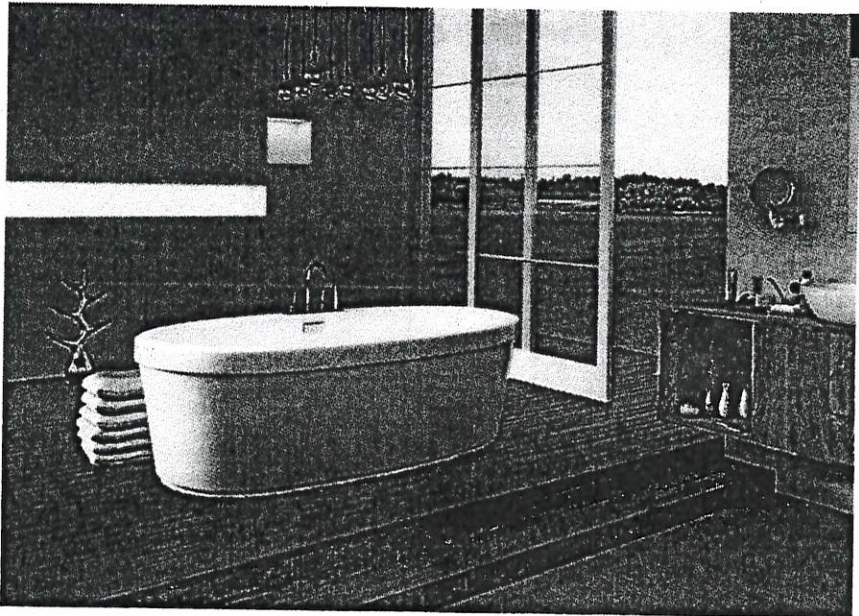

Mirolin Brooke Freestanding Tub  
68" x 36"  
#CF2002

LOT # 102		
ROOM: MASTER ENSUITE	SIGNATURE:  Surinder Singh	
DATE: Aug 8 2019	SIGNATURE:	



BE2-102  
Aug 8 2019

S.S

UPGRADE HARDWARE



CH-32



CH-38

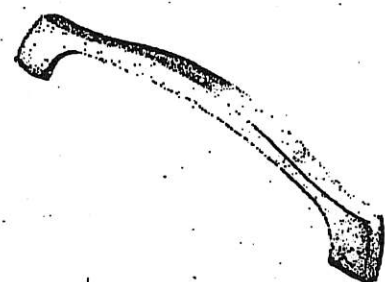

CH-44



CH-45

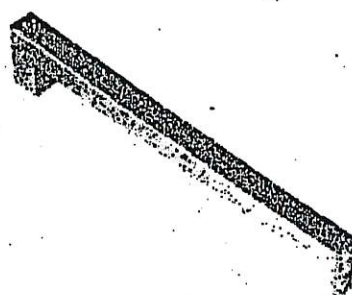

CH-46

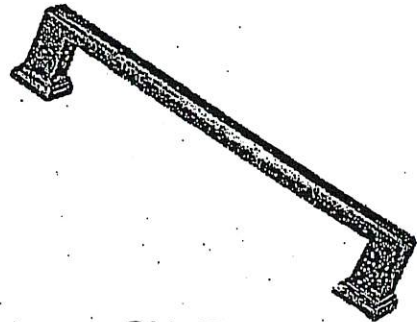

CH-47

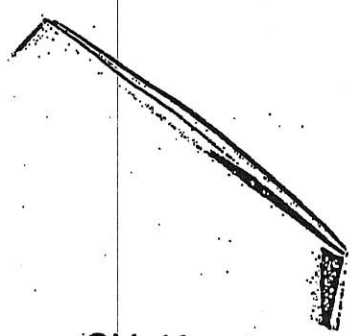

CH-48

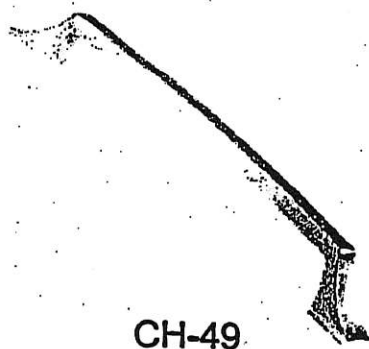

CH-49

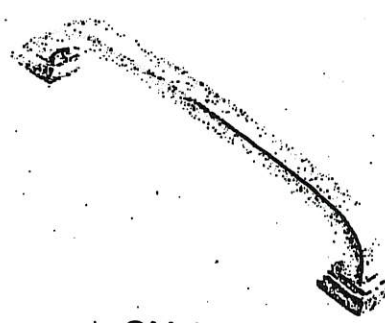

CH-50

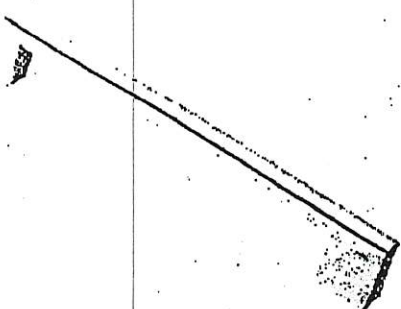

CH-51

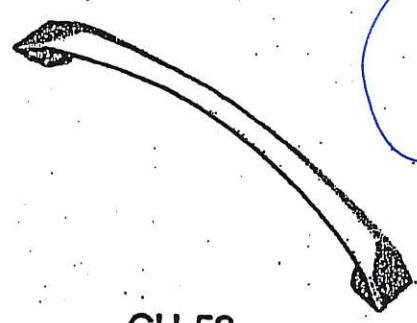

CH-52

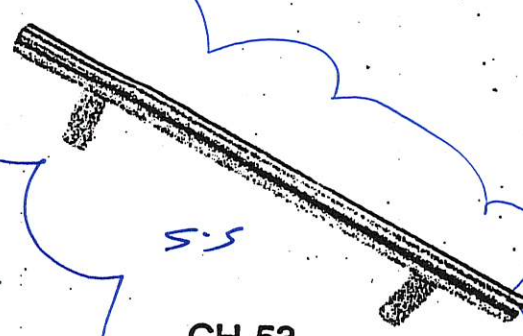

CH-53

NOTES:  
IMAGES ARE FOR QUICK REFERENCE PURPOSES ONLY  
ACTUAL SIZES AND FINISHES AS PER HARDWARE  
SAMPLE BOARD PROVIDED TO DECOR CENTRE



# Calvin

19 1/4" Oval  
4220CFY Undermount Sink

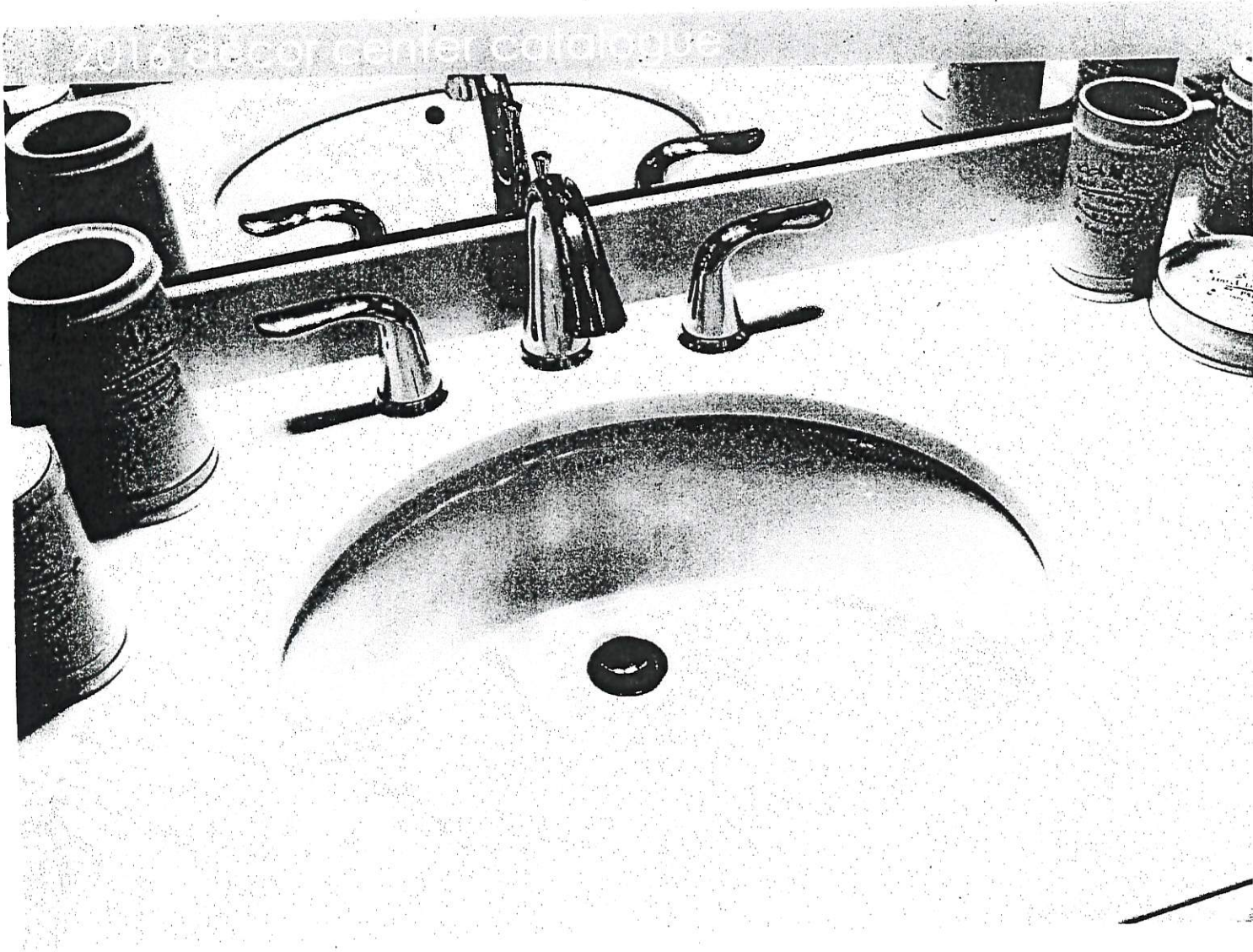

FEATURES

- Vitreous china
- Front overflow hole
- Template and mounting hardware supplied
- Overall dimensions (W x D x H):  
(OD): 19 1/4" x 16 1/2" x 7 1/2"  
(ID): 17" x 13 3/4" x 5 3/4"

CERTIFICATIONS

- IAPMO cUPC
- ASME A112.19.2 / CSA B45.1-2008

COLOUR

Soft white

LOT #
102

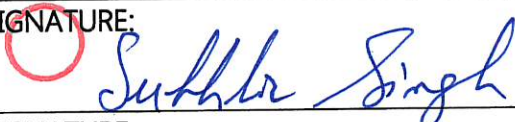
ROOM: MASTER ENSUITE	SIGNATURE: 
DATE: AUG. 8 2019	SIGNATURE:



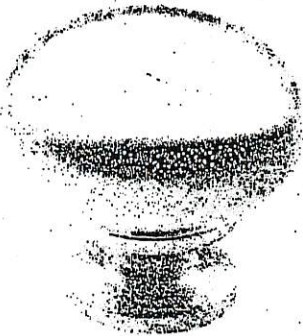

CSI-6

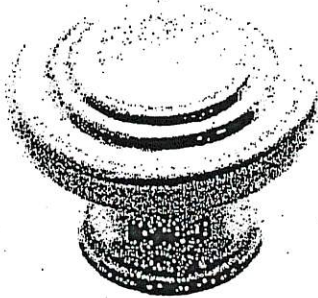

CSI-10



CSI-14

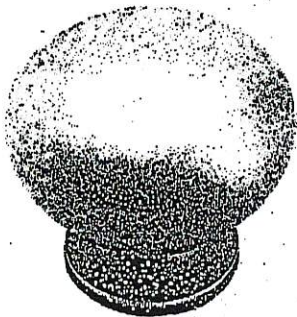

CSI-16

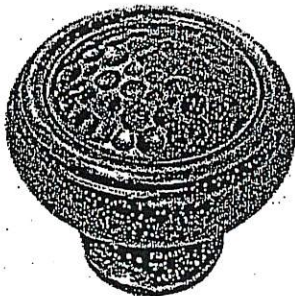

CSI-18

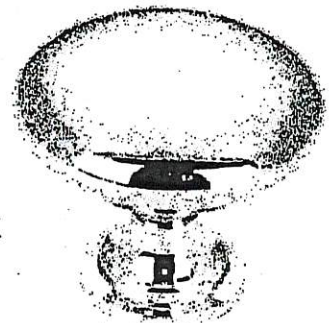

CSI-19

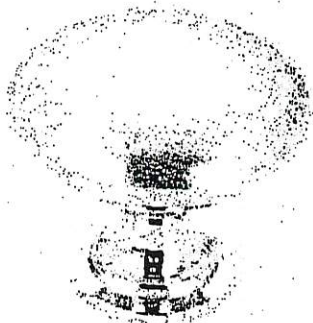

CSI-20



CSI-21



CSI-22

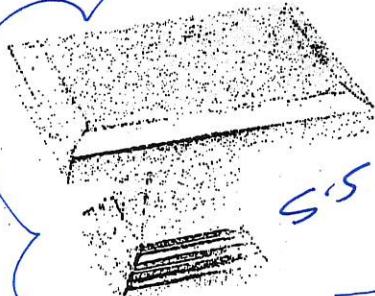

CSI-23

THRU OUT  
\*EXCEPT\*  
KITCHEN

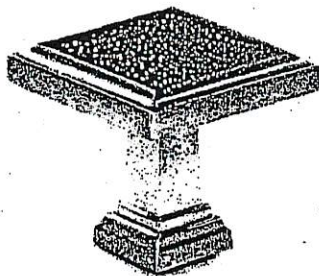

CSI-24

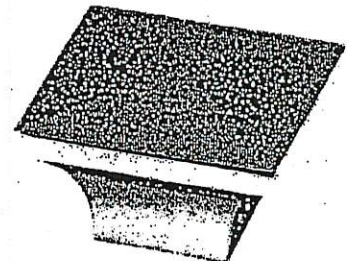

CSI-25

**\*NOTES:**

- IMAGES ARE FOR QUICK REFERENCE PURPOSES ONLY
- ACTUAL SIZES AND FINISHES AS PER HARDWARE SAMPLE BOARD PROVIDED TO DECOR CENTRE

GOLDPARK

WORTH MORE

encore  
BRAMPTON



Granite, Marble,  
Engineered Surfaces

- Standard 2CM & 3CM
- ⊖ Upgrade 1 2CM & 3CM
- ⊗ Upgrade 1 & 4 CM
- ⊕ Upgrade 2

20mm (3/4") Profiles

KITCHEN

+

MARBLE  
ENDSUITE

20mm (3/4") Profiles

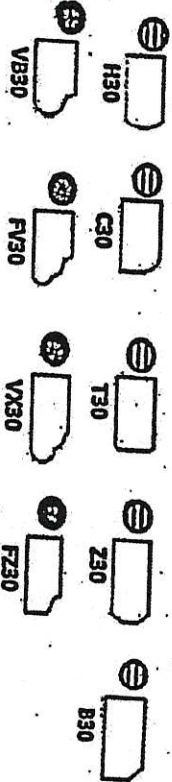

40mm (1 1/2") Profiles

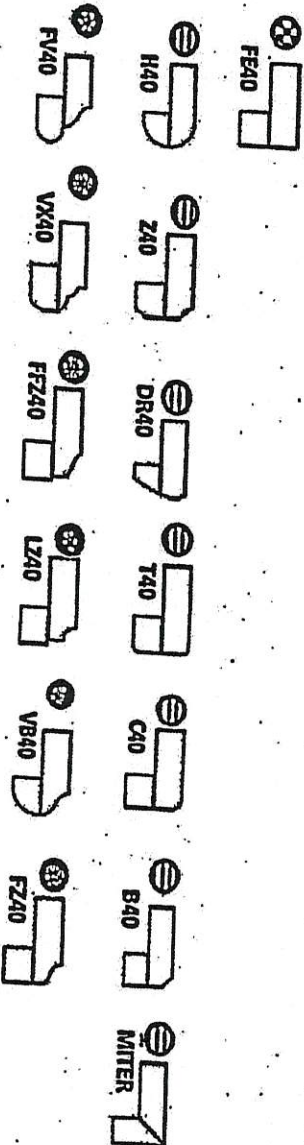

Note: All colours may not be available in 30mm at time ordered. Vendor reserves the right to use 40mm edges (by lamination process).

\*Mitre edge is available in Upgrade 1 for an overall thickness of 2". All other Mitre edge options will be an Upgrade 2 Edge.

FE2-102  
Aug 8 2019

55