

Brampton Encore - 159 - 2 - 38-6 Elev.A SCARLATTI OPT - OPTG  
CENTRAL VAC AND WIRING

Inv.1,362	1 - SECURITY UPGRADE- 1 X KEY PAD IN MASTER BDRM, 1 X MOTION DETECTOR ON SECOND FLOOR, 1 X GLASSBRAKE DETECTOR ON MAIN FLOOR, 1 X MOISTURE SENSOR IN BASEMENT
Line21425	Note:
15May17 / 31Oct17	
Inv.1,362	1 - TELEPHONE AND CABLE ROUGH-IN LOCATIONS
Line21424	Note:
15May17 / 31Oct17	

CONCRETE AND DRAIN

Inv.1,362	1 - BASEMENT: INSTALL ROUGH-IN - 3PC BASEMENT ROUGH-IN
Line21429	Note:
15May17 / 31Oct17	
Inv.1,362	1 - BASEMENT: INSTALL BACKFLOW PREVENTOR VALVE
Line21439	Note:
15May17 / 31Oct17	

ELECTRICAL

Inv.1,362	1 - LIVING ROOM: INSTALL ROUGH - IN CEILING OUTLET & SWITCH (WITH COVER PLATE) - DOES NOT INCLUDE FIXTURE - MUST SPECIFY LOCATION, IN ADDITION TO SWITCH CONTROLLED RECEPTICLE
Line21427	Note:
15May17 / 31Oct17	
Inv.1,362	1 - KITCHEN: INSTALL 220V WALL RECEPTICAL ON DEDICATED CIRCUIT- FOR 4 WIRE BUILT-IN WALL OVEN - MUST SPECIFY LOCATION PURCHASER IS AWARE THAT THEY NEED TO PURCHASE ADDITIONAL CABINETRY AT THE TIME OF COLOURS
Line23398	Note:
15May17 / 31Oct17	
Inv.1,362	1 - KITCHEN: INSTALL 110V WALL RECEPTACLE ON DEDICATED CIRCUIT - FOR MICROWAVE - MICROWAVE NOT INCLUDED
Line23397	Note:
15May17 / 31Oct17	
Inv.1,362	1 - KITCHEN: INSTALL GAS LINE ROUGH - 2ND FLOOR- (3-STOREY MODELS) INCLUDES ELECTRICAL, 110 V
Line24592	Note:
15May17 / 31Oct17	

Exterior Colours

Inv.1,362	1 - EXTERIOR COLOUR PACKAGE #1
Line24591	Note:
15May17 / 31Oct17	

FORMING

Inv.1,362	1 - EXTERIOR: INSTALL SIDE DOOR- HOME TO EXTERIOR- AS PER PLAN AND GRADE PERMITTING
Line21430	Note:
15May17 / 31Oct17	

FRAMING

Brampton Encore - 159 - 2 - 38-6 Elev.A SCARLATTI OPT - OPTG

Inv.1,362	1 - MANDOOR- GARAGE TO HOUSE
Line21431	Note:
15May17 / 31Oct17	
Inv.1,362	1 - EXTERIOR: INSTALL SIDE DOOR- HOME TO EXTERIOR- AS PER PLAN AND GRADE PERMITTING
Line24588	Note:
15May17 / 31Oct17	
Inv.1,362	1 - MASTER ENSUITE: INSTALL ROUGH-IN FOR RAINSHOWER HEAD- SHOWER HEAD NOT INCLUDED AND MUST BE PURCHASED
Line24590	Note:
15May17 / 31Oct17	

HARDWOOD

Inv.1,665	1 - UPPER HALL: INSTALL STANDARD VINTAGE RED OAK 4 3/8" NATURAL FINISH ON UPPER HALL
Line24952	Note:
4Dec17 / 7Mar18	

HVAC

Inv.1,362	1 - KITCHEN: RELOCATE STANDARD BBQ GAS LINE TO THE KITCHEN DECK.
Line21433	Note:
15May17 / 31Oct17	
Inv.1,362	1 - KITCHEN: INSTALL GAS LINE ROUGH - 2ND FLOOR- (3-STOREY MODELS) INCLUDES ELECTRICAL, 110 V
Line21434	Note:
15May17 / 31Oct17	

KITCHEN AND BATH CABINETRY

Inv.1,665	1 - Oak PVC 125 Built in wall oven and microwave unit 242cm
Line24953	Note:
4Dec17 / 7Mar18	
Inv.1,665	1 - Oak PVC 169 Fridge Gable 61x220 61x242
Line24954	Note:
4Dec17 / 7Mar18	
Inv.1,665	1 - LAUNDRY ROOM: INSTALL STANDARD UPPER CABINETS IN LAUNDRY ROOM
Line24955	Note:
4Dec17 / 7Mar18	

MISC.

Inv.1,362	1 - BONUS PACKAGE: \$9107.80 (INCLUDING TAXES) WORTH OF UPGRADES FROM GOLD PARK HOMES DÉCOR CENTRE IS BEING APPLIED TOWARD THE STRUCTURAL APPOINTMENT. PURCHASER HAS A REMAINING AMOUNT OF \$892.20 (INCLUDING TAXES) TO BE USED TOWARD THE COLOUR APPOINTMENT
Line21440	Note:
15May17 / 31Oct17	
Inv.1,362	1 - Purchaser has attended a Structural appointment at the Decor Centre & has DECLINED any additional upgrades and accepts and acknowledges that there will be no further structural changes/additions/deletions to be made upon signing on May 15, 2017
Line21441	Note:
15May17 / 31Oct17	

Brampton Encore - 159 - 2 - 38-6 Elev.A SCARLATTI OPT - OPTG

Inv.1,362	1 - Purchasers are aware & accepts that ANY changes made to upgrades after signing this Purchasers Extra Form are subject to a minimum administration fee of \$500. PLUS a 10% holdback fee
Line21442	Note:
15May17 / 31Oct17	
Inv.1,665	1 - BONUS PACKAGE: \$892.20 (INCLUDING TAXES) WORTH OF UPGRADES FROM GOLD PARK HOMES DÉCOR CENTRE IS BEING APPLIED TOWARD THE COLOUR APPOINTMENT.
Line24956	Note:
4Dec17 / 7Mar18	
Inv.1,665	1 - Purchasers are aware & accepts that ANY changes made to upgrades after signing this Purchasers Extra Form are subject to a minimum administration fee of \$500. PLUS a 10% holdback fee
Line24957	Note:
4Dec17 / 7Mar18	
Inv.1,665	1 - Purchaser has attended a Colour appointment at the Decor Centre & has DECLINED any additional upgrades and accepts and acknowledges that there will be no further structural changes/additions/deletions to be made upon signing on December 4, 2017
Line24958	Note:
4Dec17 / 7Mar18	

PLUMBING

Inv.1,362	1 - MASTER ENSUITE: INSTALL ROUGH-IN FOR RAINSHOWER HEAD- SHOWER HEAD NOT INCLUDED AND MUST BE PURCHASED
Line21436	Note:
15May17 / 31Oct17	
Inv.1,665	1 - MASTER ENSUITE: MASTER ENSUITE SHOWER ENCLOSURE- INSTALL RAIN SHOWER + DIVERTER- RAINCAN 8" HEAD + 6" CEILING MOUNT ARM
RP70172/RP61058/R110000/T11900 (CHROME)	
Line24951	Note:
4Dec17 / 7Mar18	

WINDOWS - BASEMENT

Inv.1,362	2 - BASEMENT: INSTALL TWO (X2) BASEMENT WINDOWS - UPGRADE EXISTING BASEMENT WINDOW TO 30 INCH X 24 INCH - MAY REQUIRE INSTALLATION OF WINDOW WELL
Line21432	Note:
15May17 / 31Oct17	

WINDOWS AND DOORS

Inv.1,362	1 - EXTERIOR: INSTALL SIDE DOOR- HOME TO EXTERIOR- AS PER PLAN AND GRADE PERMITTING
Line24587	Note:
15May17 / 31Oct17	
Inv.1,362	1 - MANDOOR- GARAGE TO HOUSE
Line24589	Note:
15May17 / 31Oct17	

Scheduled Closing Date: March-22-18

Purchaser: Stephen Uchenna Nnamdi  
Telephone Res. / Bus: (438) 879-6773  
Decor Advisor: Terri Parisani

Property: 159  
Project: Brampton Encore - Phase 2  
Model and Elevation: 38-6 Elev.A SCARLATTI OPT - OPTG

Layout Changes: ☒ Yes ☐ No      Sketch Attached: ☒ Yes ☐ No      Exterior Colour Scheme:

1. Cabinetry

	Style and Colour	Counter	Hardware
Kitchen / Breakfast	Varese (pvc) White Crystal	Grigio Sardo Granite Standard Edge	CS1-24
Laundry Room	*Varese (pvc) White Crystal	-	CS1-24
Powder Room	-	-	-
TWIN BATH	Varese (pvc) White Crystal	1877K-52 Autumn Carnival	CS1-24
Master Ensuite Bathroom	Varese (pvc) White Crystal	1877K-52 Autumn Carnival	CS1-24
Second Ensuite Bathroom (If Applicable)	Varese (pvc) White Crystal	1877K-52 Autumn Carnival	CS1-24
GROUND FL ENSUITE	Varese (pvc) White Crystal	1877K-52 Autumn Carnival	CS1-24

Comment

2. Floor Tile

	Selection
Entrance Vestibule	NEW ALBION GREY 13 X 13
Main Hall	-
Kitchen / Breakfast	NEW ALBION GREY 13 X 13
Laundry Room	NEW ALBION GREY 13 X 13
Powder Room	NEW ALBION GREY 13 X 13
TWIN BATH	Costa Series 13 x 13 Ivory Matte
Master Ensuite Bathroom	Costa Series 13 x 13 Ivory Matte
Second Ensuite Bathroom (If Applicable)	Costa Series 13 x 13 Ivory Matte
Lower Landing (If Applicable)	Costa Series 13 x 13 Ivory Matte (ground floor)
GROUND FL ENSUITE	Costa Series 13 x 13 Ivory Matte

Comment

3. Wall Tile

	Selection	Listello/Inserts	Describe
TWIN BATH	Weave Ivory 8 x 10	<input type="radio"/> Yes <input checked="" type="radio"/> No	
Master Ensuite Bathroom			
Tub Deck	Weave Ivory 8 x 10	<input type="radio"/> Yes <input checked="" type="radio"/> No	
Shower Stall	Weave Ivory 8 x 10	<input type="radio"/> Yes <input checked="" type="radio"/> No	
Bathroom Walls	Weave Ivory 8 x 10	<input type="radio"/> Yes <input checked="" type="radio"/> No	
Second Ensuite Bathroom (If Applicable)	Weave Ivory 8 x 10	<input type="radio"/> Yes <input checked="" type="radio"/> No	
GROUND FL ENSUITE	Weave Ivory 8 x 10	<input type="radio"/> Yes <input checked="" type="radio"/> No	
Kitchen Backsplash	<input type="radio"/> Yes <input checked="" type="radio"/> No	Backsplash Behind Fridge	

Comment

S.N

\*\*\* NOTE: This is not an approved document. Document must be locked \*\*\*

Scheduled Closing Date: March-22-18

Purchaser: Stephen Uchenna Nnamdi

Property: 159

Telephone Res. / Bus: (438) 879-6773

Project: Brampton Encore - Phase 2

Decor Advisor: Terri Parisani

Model and Elevation: 38-6 Elev.A SCARLATTI OPT - OPTG

4. Plumbing Fixtures

<input type="checkbox"/>	Second Ensuite	<input type="checkbox"/>	Powder Room	<input type="checkbox"/>
Master Ensuite Bathroom	<input type="checkbox"/>	Other Room - Specify	<input type="checkbox"/>	Other Washroom
Comment	<input type="text"/>			

\*\* MASTER ENSUITE SHOWER: INSTALL RAINSHOWER HEAD, DIVERTER AND CEILING MOUNT ARM: #RP70172/RP61058/T11900 (CHROME). SEE SHEET ATTACHED FOR REFERENCE

5. Hardwood Flooring

	Type and Stain		Type and Stain
Main Hall	Std.Vintage 4 3/8"RedOak,Natural	Upper Landing	Std.Vintage 4 3/8"RedOak,Natural
Kitchen / Breakfast	Std.Vintage 4 3/8"RedOak,Natural	Upper Hall	**Vintage 4 3/8"RedOak,Natural
Living Room	Std.Vintage 4 3/8"RedOak,Natural	Master Bedroom	<input type="text"/>
Dining Room	Std.Vintage 4 3/8"RedOak,Natural	Bedroom #2	<input type="text"/>
Family Room	Std.Vintage 4 3/8"RedOak,Natural	Bedroom #3	<input type="text"/>
Den/Library	<input type="text"/>	Bedroom #4	<input type="text"/>
Entrance Vestibule	<input type="text"/>	Bedroom #5	<input type="text"/>
Lower Landing (If Applicable)	Std.Vintage 4 3/8"RedOak,Natural	Other Room - Specify	<input type="text"/>

Comment  
\*NOTE THAT ONLY THE BREAKFAST ROOM HAD HARDWOOD, NOT THE KITCHEN

6. Carpeting

	Upgrade	Description
Ground Floor	<input type="checkbox"/>	11077 Templar
Second Floor	<input type="checkbox"/>	11077 Templar (does not include upper hall)
<input type="text"/>	<input type="checkbox"/>	<input type="text"/>

Upgrade Underpad	Type STANDARD	Area <input type="text"/>
Carpet on Stairs	Capped 11077 Templar (Ground Fl to Bsmnt)	Runner - *Upgrade <input type="text"/>

Comment

7. Fireplace

	Living Room			Family Room			Other Room - Specify		
	Purchased	As Per Plan	N/A	Purchased	As Per Plan	N/A	Purchased	As Per Plan	N/A
	<input type="radio"/>	<input type="radio"/>	<input checked="" type="radio"/>	<input type="radio"/>	<input checked="" type="radio"/>	<input type="radio"/>	<input type="radio"/>	<input type="radio"/>	<input checked="" type="radio"/>
Fireplace Type	<input type="text"/>			STANDARD			<input type="text"/>		
Mantle Type	<input type="text"/>			NF 23			<input type="text"/>		
Colour / Stain	<input type="text"/>			WHITE PAINT GRADE			<input type="text"/>		
Surround	<input type="text"/>			NERO MARQUINA			<input type="text"/>		
Hearth	<input type="text"/>			NONE			<input type="text"/>		

Comment

Scheduled Closing Date: March-22-18

Purchaser: Stephen Uchenna Nnamdi

Property: 159

Telephone Res. / Bus: (438) 879-6773

Project: Brampton Encore - Phase 2

Decor Advisor: Terri Parisani

Model and Elevation: 38-6 Elev.A SCARLATTI OPT - OPTG

### 8. Trim Carpentry

Interior Doors  Front Door Glass Inserts  Door Handles

Interior Trim

Comment

### 9. Plaster Mouldings and Medallions

Standard Throughout ☐ Yes ☒ No ☐ N/A

Entrance Vestibule	<input type="text"/>	<input type="text"/>	Kitchen/Breakfast	<input type="text"/>	<input type="text"/>
Main Hall	<input type="text"/>	<input type="text"/>	Den/Library	<input type="text"/>	<input type="text"/>
Living Room	<input type="text"/>	<input type="text"/>	Lower Landing	<input type="text"/>	<input type="text"/>
Dining Room	<input type="text"/>	<input type="text"/>	Other Room - Specify	<input type="text"/>	<input type="text"/>
Family Room	<input type="text"/>	<input type="text"/>		<input type="text"/>	<input type="text"/>

Comment

### 10. Railings and Spindles

Railing Package

Railing Colour

Stringer / Riser

Spindle Colour

Treads

Comment

Oak Stairs ☒ Yes ☐ No ☐ N/A

STAIRS FROM GROUND FLOOR TO BASEMENT ARE PAINT GRADE

### 11. Wall Paint / Ceilings

Throughout Finished Areas

Trim Paint

Smooth Ceilings

Ground Floor ☐

Second Floor ☐

Note

Comment

Scheduled Closing Date: March-22-18

Purchaser: Stephen Uchenna Nnamdi

Property: 159

Telephone Res. / Bus: (438) 879-6773

Project: Brampton Encore - Phase 2

Decor Advisor: Terri Parisani

Model and Elevation: 38-6 Elev.A SCARLATTI OPT - OPTG

12. Electrical

Hood Fan ☐ White ☒ Stainless ☐ N/A

Above Kitchen Cabinet Light ☐ Yes ☒ No

Standard Appliances ☐

Below Kitchen Cabinet Light ☐ Yes ☒ No

Over The Range Microwave ☐

Chimney Style Fan ☐

Comment

MICROWAVE/ WALL OVEN UNIT

13. Heating and Air Conditioning

Air Conditioning

Gas Provisions Stove

Gas Provisions Dryer

Gas Provisions Barbecue

Comment

14. Additional Comments

15. Disclaimers and Notes

- 1) Colours of all materials are as close as possible to builder's selection, but not necessarily identical due to variances in manufacturing.
- 2) Any extras listed above are null and void unless accompanied by a separate invoice/amendment. Said invoice must be paid in full.
- 3) The Purchaser acknowledges that after Interior Colour Selection form is signed and dated, no further changes will be permitted other than re-selection due to unavailability. SUN Purchaser's Initials
- 4) The Purchaser acknowledges reading and accepting the "Gold Park Homes Decor Centre Disclaimers" form. This document contains other miscellaneous disclaimers.

This Interior Colour Selection is final and approved by:

Signature: [Signature] Date: Dec 4, 17

encore  
BRAMPTON

Cable (C)  
Telephone (T)  
Electrical (E)

The  
**Scarlatti**  
38' SERIES

Elevation A • 3,591 sq.ft. | Elevation B • 3,578 sq.ft.

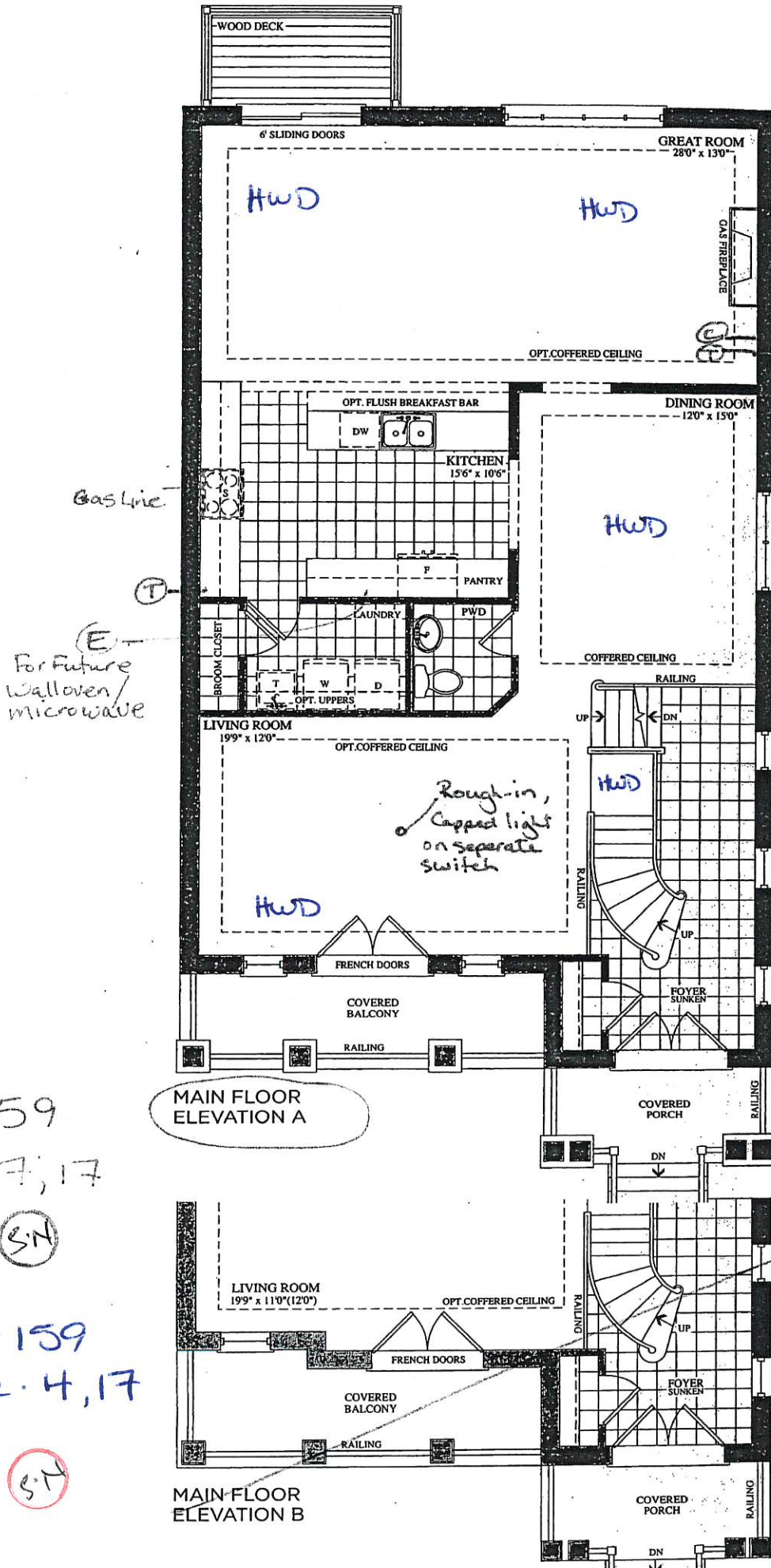

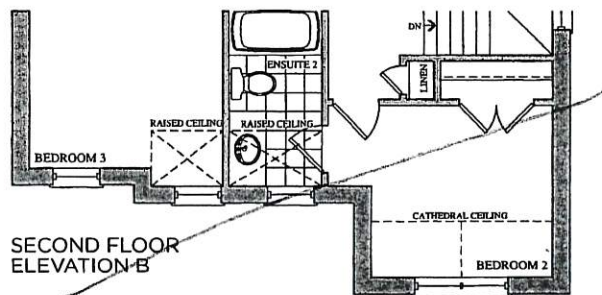
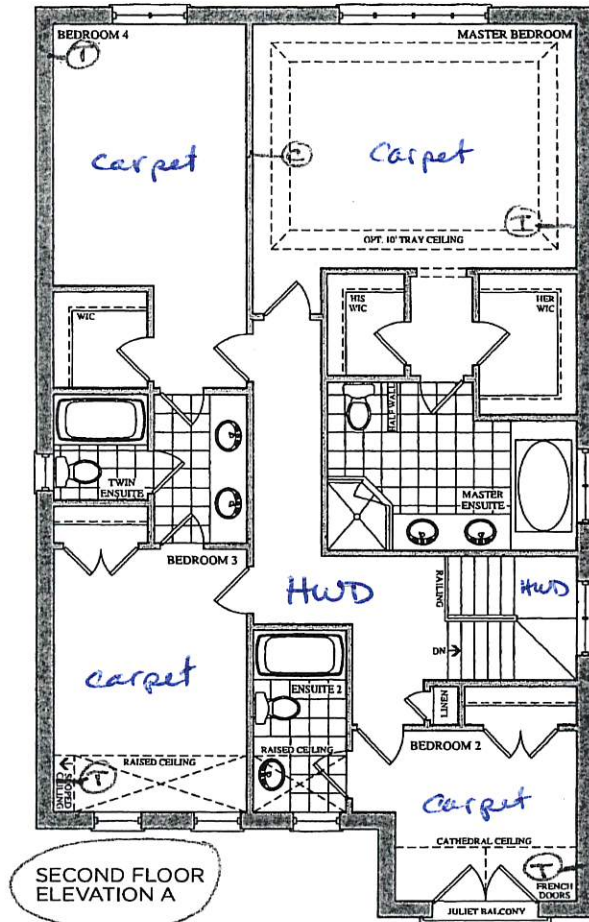

Prices, figures, illustrations, sizes, features and finishes are subject to change without notice. E.&O.E. Areas and dimensions are approximate and actual usable floor space may vary from the stated area. Layout may be reverse of the unit purchased. E. & O.E.

**GOLDPARK**  
H O M E S

Lot 159  
July 17, 17

Lot 159  
Dec. 4, 17

SN

SN

BSMNT WINDOWS  
2 x 30" x 24"

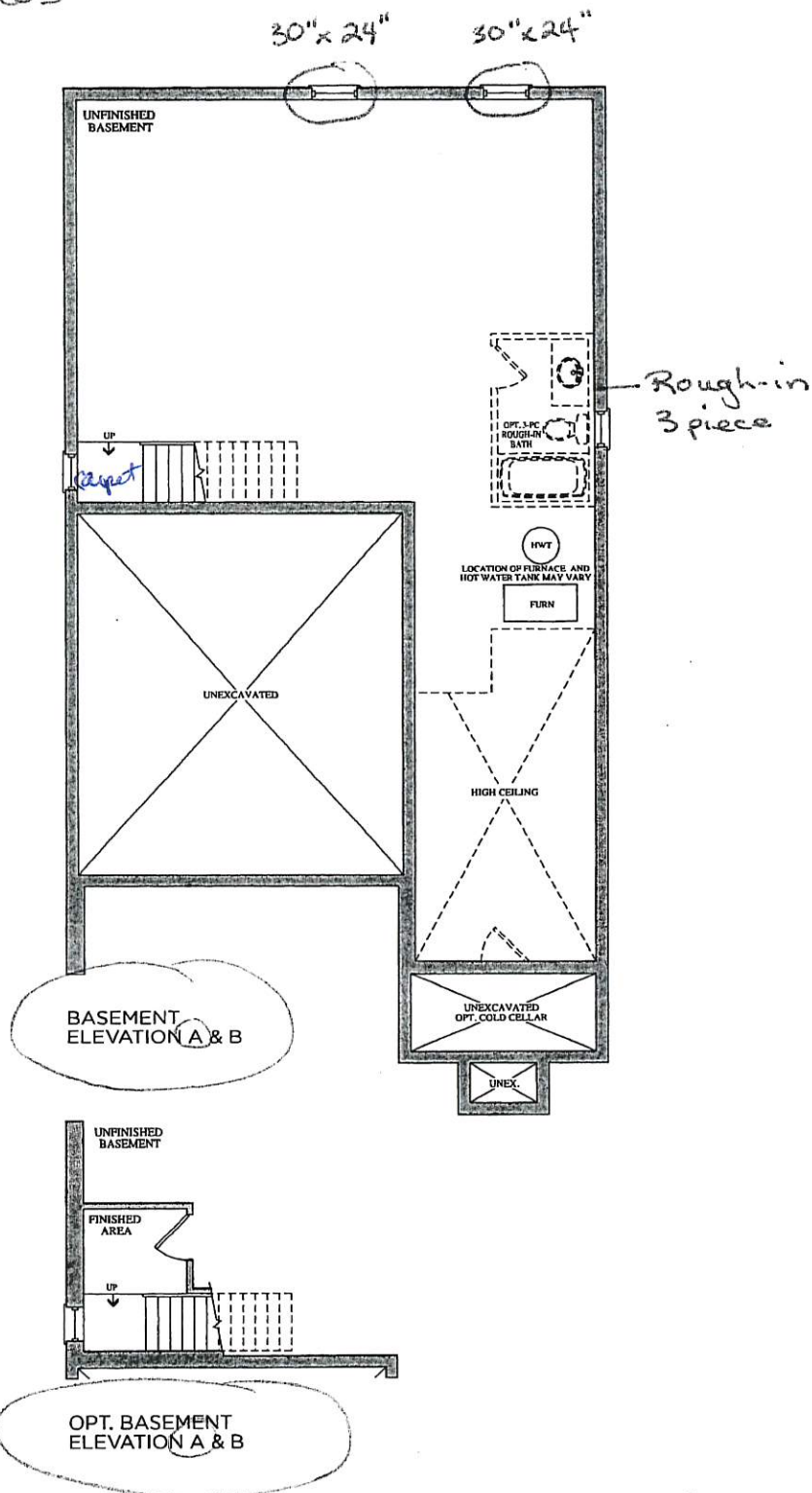

Prices, figures, illustrations, sizes, features and finishes are subject to change without notice. E.&O.E. Areas and dimensions are approximate and actual usable floor space may vary from the stated area. Layout may be reverse of the unit purchased. E. & O.E.

GOLDPARK  
HOMES

Lot 159  
July 17, 17

SN

Lot 159  
Dec. 4, 17

SN

ITEM A. Wood grain and colour are characteristics of the product, we cannot guarantee that such grain and colour will always match  
ITEM B. Cortina Kitchens reserves the right to alter dimensions and make technical changes without notice.

STANDARD HARDWARE

Lot 159

Dec. 4, 17

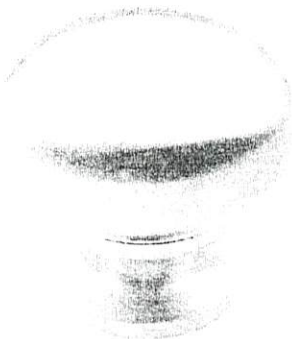

CSI-6



CSI-10



CSI-14

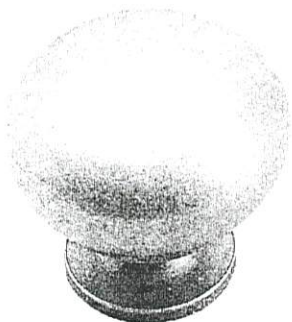

CSI-16



CSI-18

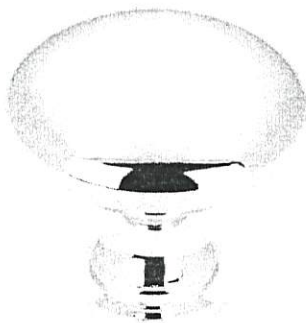

CSI-19

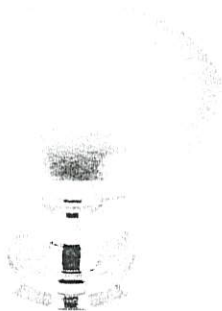

CSI-20



CSI-21



CSI-22

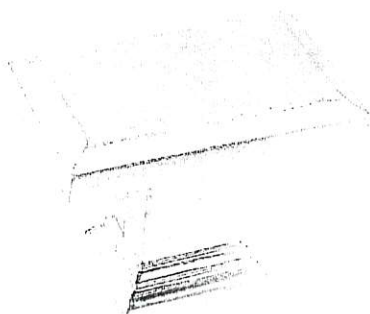

CSI-23

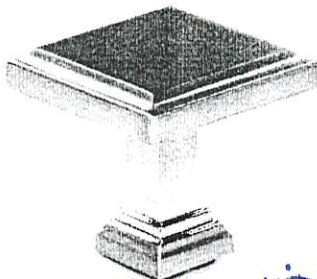

CSI-24

Kitchen  
Powder  
Ens. 2  
Twin  
master  
Ground Fl.

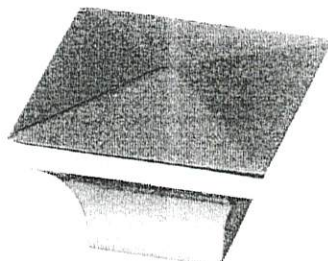

CSI-25

\*NOTES:

- IMAGES ARE FOR QUICK REFERENCE PURPOSES ONLY
- ACTUAL SIZES AND FINISHES AS PER HARDWARE SAMPLE BOARD PROVIDED TO DECOR CENTRE

# CORTINA

KITCHENS INC.

70 Regina Road Woodbridge ON L4L 8L6  
905-264-6464

## INFORMATION - PVC DOORS

Builder: Gold Park Homes Project: Encore ..... Lot #: 159 .....

All cabinets with PVC (Thermofoil) Doors come with melamine gables, panels and kick. The doors, crown moulding and light valance are PVC wrapped. Open shelves incorporated in design will only be available with melamine interiors. There will be variations in colour shades between the PVC parts (doors, crown and Light valance) and the melamine parts (open shelves, Gables, Panels and Kick) due to the difference in material.

Furring Panel with crown moulding to the ceiling is not available on all PVC door styles due to subtle variations in colour shades between the PVC parts (moulding) and the melamine parts (furring panel) due to the difference in material. Grain directions in wood grain pattern melamine, vary between the furring panel, crown moulding (horizontal) and the PVC doors (vertical).

Thank you for your understanding.

---

I am well informed of this information, and agree to the purchase of the above.

Purchaser: Samir

Date: Dec 4, 17

# GOLD PARK

WORTH MORE™



## Granite, Marble, Engineered Surfaces

- Standard 2CM & 3CM
- Upgrade 1 2CM & 3CM
- Upgrade 1.4 CM
- Upgrade 2

### 20 mm (3/4") Profiles



### 30mm (1-1/4") Profiles

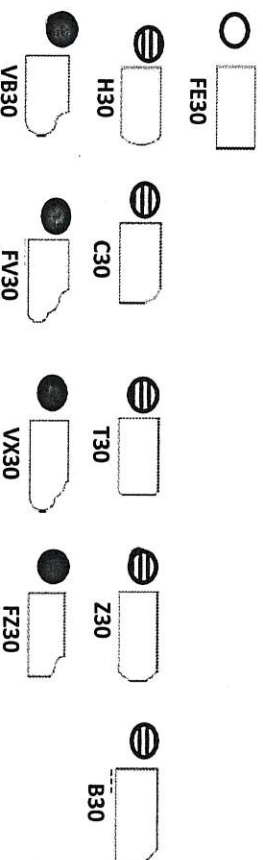

### 40mm (1-1/2") Profiles

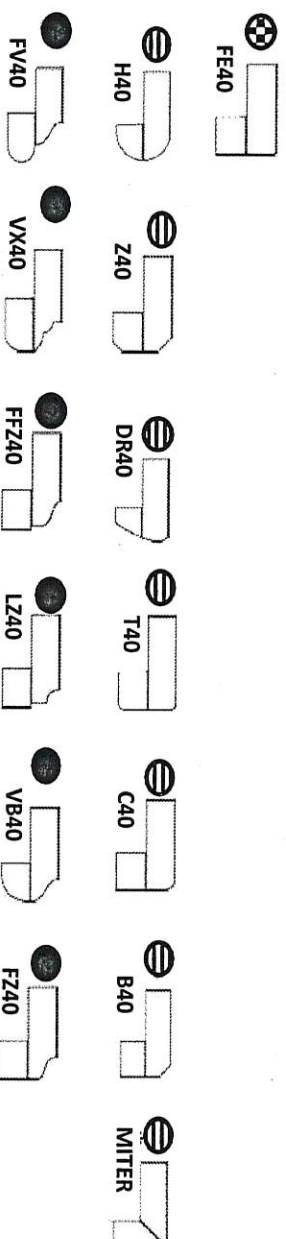

Note: All colours may not be available in 30mm at time ordered. Vendor reserves the right to use 40 mm edges (by lamination process).

\*Mitre edge is available in Upgrade 1 for an overall thickness of 2". All other Mitre edge options will be an Upgrade 2 Edge.

Oct 159  
Dec. 4, 17  
N.S.

PLUMBING UPGRADES



Rain Shower + Diverter - RainCan 8" Head + 6" ceiling mount arm  
#RP70172/RP61058/R110000/T11900 (chrome)  
\$615.00



RP70172▲

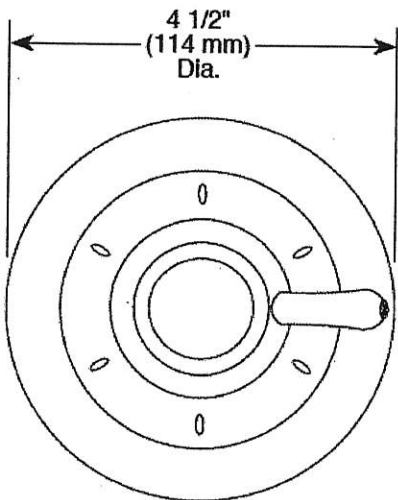
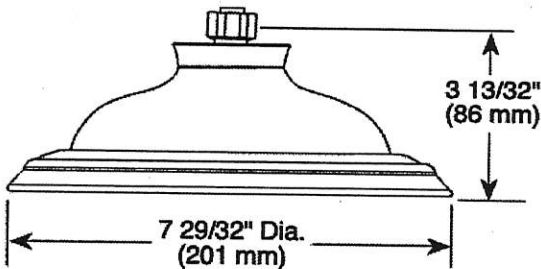
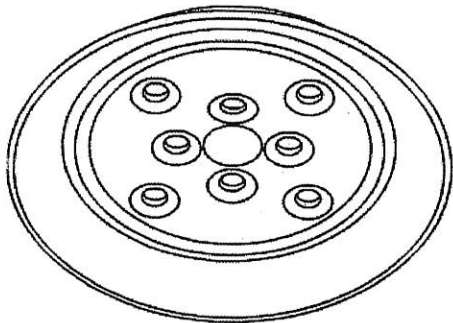
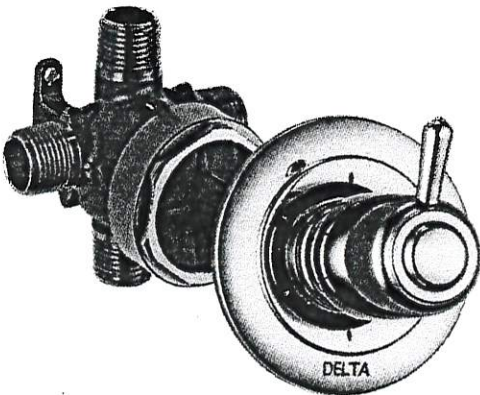

T11900▲

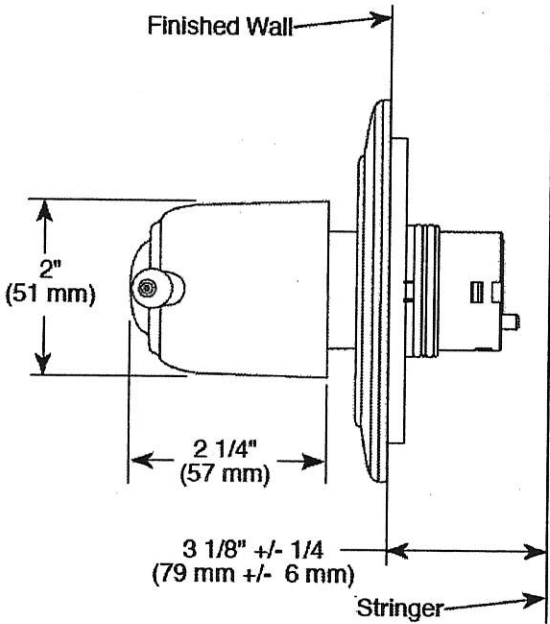

LOT # 159	
ROOM: Master Ensuite	SIGNATURE: X [Signature]
DATE: Dec. 4, 17	SIGNATURE:

*Gold Park Homes Décor*

**GOLD PARK**  
WORTH MORE™

## ***Centre Disclaimers***

*Through years of doing business, we at Gold Park Homes have encountered issues beyond our control. The following disclaimers apply to all instances of Purchaser's Extras forms and all Interior Colour Scheme forms.*

### **FIREPLACES**

Fireplace Marble: Due to the many variables that can affect the pattern and/or design, frequently the marble installed on the fireplace will not be identical to the samples. We will make every attempt to come as close to the samples as possible, but cannot be responsible for results which differ from the samples.

### **CERAMIC FLOOR TILE**

Many variables including variegation can affect tile colour, pattern and/or design which mean installed tiles may not be identical to the samples. We will make every attempt to come as close as possible, but cannot be responsible for results which differ from the samples.

### **HARDWOOD FLOORING**

The purchaser is advised that cupping and shrinkage are characteristics of hardwood flooring normally appearing after installation, especially when humidity levels are not regulated, and no warranty is provided by the flooring supplier with respect to such cupping and shrinkage. Furthermore, hardwood floors may also heave and warp when located at or close to entrance points of the home, where rain could make its way to the flooring. The vendor agrees to install any hardwood flooring ordered by the purchaser in a good and workmanlike manner, but shall not be responsible for, and is hereby released by the purchaser from responsibility and liability for cupping, shrinkage, heaving and warping of hardwood flooring in the above mentioned circumstances.

### **STAIRCASE VS FLOORING WOOD SPECIES DIFFERENCE**

The purchaser is aware and therefore accepts and acknowledges that the wood species of the staircase and flooring chosen do not match. This difference might result in an undesirable colour variance

The purchaser is aware and therefore accepts and acknowledges that though the flooring is of the same species as the staircase the difference in product finishing may result in a stain colour variance.

The purchaser agrees that the vendor is to be exempt from any and all claims by the purchaser regarding this colour variance.

### **RAILINGS**

All railings, pickets, posts, nosing's and stairs come from solid wood and veneered wood materials sourced from multiple locations and sources. As such there will be variations in grains and shades between the various natural components beyond our control. Due to this variance in material, all components will stain with colour or natural finish differently.

Iron pickets are wrought in nature and depending on the manufacturing process will have differences from picket to picket which is normal. Also the finish of the iron pickets is of a powder coated nature. This process can produce minor colour variations or tones. Furthermore, the assembly of the metal pickets can develop a natural rattle over time from vibration in the railing. Minor rattling is normal and is a part of the wrought iron picket assembly.

### **HOUSE EXTERIORS**

Variations in subcontractors across different sites and varying site conditions may result in house exteriors that differ from the artist renderings. We cannot be responsible for results which differ from the artists renderings of elevations.

### **PLASTER MOULDINGS AND MEDALLIONS**

Plaster mouldings will not be installed in open to above areas or areas with 2 storey elements.

### **STAIN COLOURS**

Due to the many variables that can affect the outcome of a stain colour on wood, staircases, railings, and fireplaces, the colour may not be identical to samples. Factors such as density, age, humidity, air temperature, and the uniqueness of each piece of wood can result in wide variations in darkness or lightness. We will make every attempt to come as close to the sample as possible, but cannot be responsible for results which differ from the samples.

Stain on pre-finished hardwood floors will not be an exact match to the stain colours available on stairs, pickets and rails. The purchaser is responsible for choosing the stain on these areas to their satisfaction.

### **IN-WALL CONDUIT FOR AUDIO/VIDEO CABLES**

It is important to note that due to the variation in framing requirements in different parts of your home, conduit lengths and routing can vary. In virtually all instances of ground floor installation (I.e. above a fireplace), conduit will first travel down into the basement below the floor joists, over to the termination point and back up into the main floor. As a result, it is best to measure the length of the conduit after occupancy with a "pull wire" before

purchasing your cables. For above-fireplace installations, the conduit wall plate will be installed approximately 10" above the Fireplace Mantle, unless otherwise specified in the Construction Summary.

#### **APPLIANCE SPECIFICATIONS**

All appliance openings are set to builder's standard openings. Please advise Décor Centre at time of your structural appointment if custom sizing of cabinets is required for any built-in appliances. The purchaser is responsible for costs and fees associated with changes to pre-manufactured kitchens made subsequent to colour appointments.

Purchaser accepts & acknowledges that in order to accommodate upgraded appliances, all appliance specifications should be provided at the time of their structural appointment, should this not occur they must be provided to the Décor Center within one (1) week of completion of structural chart. Failure to do so may result in the need to revert to the standard appliance openings or in a delay in construction of your dwelling, as well as a cost of \$500 to re-open your structural file should changes be required. As a result we may be forced to extend the closing of your transaction. Due to failure to complete the above-mentioned selections and at no fault of our own, we reserve our right to hold you responsible for this delayed closing, including charging extra administration cost and interest on the balance due on closing.

Purchasers Accept Standard Appliance Openings (unless otherwise specified):

Fridge - 37-1/2"W x 73-1/2" High Approx.

Range - 30-1/2"D x 31-1/2"W Approx.

Dishwasher - 24" W Approx.

#### **DELETION OF HOODFAN & CABINETS ABOVE STOVE:**

The purchasers are aware that in requesting NOT TO INSTALL builder's standard hood fan and standard cabinets above stove they will receive NO STANDARD HOOD FAN and NO CREDIT. Purchasers are installing their own hood fan after closing and accept that it may waive any warranty associated with such a change.

Purchasers accept and acknowledge that the exhaust fan duct hole may be off-centered with the stove in the kitchen due to purchasers installing their own hood fan after closing. The vendor is exempt from adjusting such openings for the purchasers range hood.

#### **ELECTRICAL FOR APPLIANCES**

Pricing is subject to change based on the appliance specifications provided. Purchasers should provide proper appliance specifications and cut-out sheets in order for Gold Park to price extras accordingly.

#### **KITCHEN CABINETS**

The kitchen you order/purchase will undoubtedly contain slight colour variations. The degree of these variations is virtually impossible to determine before the kitchen is installed in its intended location. The amount of and type of lighting will also affect various highlights in the finish. Note: No two pieces of wood are identical. Variations in colour tone and grain patterns make a perfect colour match virtually impossible. It is generally agreed that these variations add to the natural beauty of a wood kitchen.

#### **STAIN**

Charcoal is a spray stain applied to Oak and Maple products with several characteristics that are important to be aware of when purchasing this product.

1. Shadow lines may be visible at the interior profile edges of a door or drawer front. If movement occurs shadow lines may increase or decrease, depending on the style and/or size of a door or drawer front.
2. Variation and unevenness may be visible in the finish.
3. Hairline cracks at the joints are created over time due to the nature of natural wood, caused by usage, humidity\*\*, or dryness. They tend to be more visible to darker stains, than lighter wood stains.

\*\* Relative humidity is recommended to be between 45% and 55%. Please refer to Cortina Kitchens "Cleaning, Care, Maintenance, & Warranty Information" guide.

Please be advised that Cortina Kitchens will not replace doors and/or parts that exhibit the above characteristics associated with this finish. These characteristics are not avoidable and are a result of the natural characteristics of wood and wood veneer, and the characteristics of darker stains on wood. The Charcoal stain is not available on doors in Group IV, Group IVA, Group V and Group VA.

Cortina Kitchens offers a wide variety of finishes, applied to oak and maple products. The subject finishes include the spray stains Cocoa, Espresso, Graphite as well as wiping stain Ebony.

Due to the very dark stains applied on natural maple and oak doors and joints, several characteristics are important to be noted when purchasing these products.

1. Shadow lines may be visible at the interior profile edges of a door or drawer front. If movement occurs shadow lines may increase or decrease, depending on the style and/or size of a door or drawer front.
2. Variation and unevenness may be visible in the finish.
3. Hairline cracks at the joints are created over time due to the nature of natural wood, caused by usage, humidity, or dryness. They tend to be more visible to darker stains, than lighter wood stains.

Please be advised that Cortina Kitchens will not replace doors nor parts that exhibit the above characteristics associated with this finish. These characteristics are not avoidable and are a result of the natural characteristics of wood and wood veneer, and the characteristics of darker stains on wood.

### **CABINETRY DOOR HARDWARE**

Cortina Kitchens' cabinetry doors and drawer fronts will be drilled to accept a standard knob or handle selected from Cortina's hardware boards. This drilling comes standard with the order, and is done ONLY in our shop, not on the job site.

For those not wanting Cortina's hardware drilling, the following applies:

No holes to be drilled on the doors and drawer fronts should be specified in writing on the colour chart and the P.O. If while in production, Cortina Kitchens misses this request, Cortina Kitchens and the Builder will not be held responsible to replace any or all doors and drawer fronts affected, and the customer agrees to accept the product as is. No hardware will be supplied or credited by Cortina Kitchens with this request. No charge will apply for this request.

### **PVC DOORS**

All cabinets with PVC (Thermofoil) Doors come with melamine gables, panels and kick.

The doors, crown moulding and light valance are PVC wrapped. Open shelves incorporated in design will only be available with melamine interiors. There will be variations in colour shades between the PVC parts (doors, crown and Light valance) and the melamine parts (open shelves, Gables, Panels and Kick) due to the difference in material.

Furring Panel with crown moulding to the ceiling is not available on all PVC door styles due to subtle variations in colour shades between the PVC parts (moulding) and the melamine parts (furring panel) due to the difference in material. Grain directions in wood grain pattern melamine, vary between the furring panel, crown moulding (horizontal) and the PVC doors (vertical).

### **GRANITE, MARBLE ENGINEERED SURFACES WAIVER**

Granite and marble are naturally occurring products, and due to the many variables that can affect the pattern, colour and/or design and "pitting" of natural products slabs installed will not be identical to the samples displayed. We will make every attempt to come as close to the samples as possible, but cannot be responsible for results which differ from the samples. Every effort is made to provide granite counter tops as close as possible but the vendor is not responsible for results which differ from the sample displayed. All countertop surfaces may have seams & product pattern & shade can change in areas containing seams.

### **RESELECTIONS**

It is not uncommon for flooring, such as tile, to become discontinued prior to its installation. Therefore it may be necessary to make a reselection of certain materials sometime during the build process. We cannot assure you that another choice approximating your selection will be available.

### **PLANS**

Plans are subject to change without notice. Actual usable floor space may vary from the stated floor area. Layout for kitchen, furnace, HWT and laundry tub may vary from plan. Vertical and horizontal bulkhead, which are not shown on plan, may be required for plumbing and heating runs. E.& O.E.

### **PLEASE NOTE:**

In the event the work on the house has progressed beyond the point where the items covered by these invoices cannot be installed without entailing any unusual expense, then this order is to be cancelled and any deposit paid in connection with the same is to be refunded to the purchaser.

The vendor will undertake to incorporate the work covered by the sales extra in the construction of the house but will not be liable to the purchaser in any way, if for any reason the work covered by the extra is not carried out. In that event, any monies paid in connection with the same shall be returned to the purchaser.

It is understood and agreed that if for any reason whatsoever the transaction of Purchase and Sale is not completed, the total cost of extras ordered are not refundable to the Purchaser(s).

Extras or changes will not be processed unless signed by the Vendor.

These extras may not be amended without the written consent of Gold Park Homes.

The purchaser(s) and the builder acknowledge and agree that this "Purchaser's Extra" form shall not be deemed to be part of the agreement of purchase and sale entered into between them, nor an addendum thereto.

No postdated cheques will be accepted.

No estimates or orders will be accepted once construction has commenced.

Should a refund be requested on any extras purchased, an 80% reimbursement of the purchase price will be given. (a \$50.00 minimum charge and a maximum \$250.00 charge will apply)

Estimates will only be considered when resubmitted on a signed Purchaser Extras form, accompanied by payment in full.

All prices are estimates only and may be subject to change. Should a change in price occur Gold Park Homes reserves the right to request from the purchaser an adjustment of the price or a refund limited to that item.

Purchasers are aware & accept that ANY changes made to upgrades after signing the Purchasers Extra Form are subject to a minimum administration fee of \$500. PLUS a 10% holdback fee.

Purchasers are aware that any request to add a percentage of upgrades from the purchaser's extras form will be processed only after the builder receives approval letter from the bank.

Please be advised that your failure to finalize your structural or colour selections may result in a delay in construction of your dwelling and we may have to extend closing of your transaction. Due to failure to complete the above-mentioned selections and at no fault of us, we reserve our right to hold you responsible for a delayed closing, including charging extra administration cost and interest on the balance due on closing.

Purchaser has attended a Colour appointment at the Decor Centre & has DECLINED any additional upgrades and accepts and acknowledges that there will be no further structural changes/additions/deletions to be made upon signing.

I hereby acknowledge reading and understanding the above copy and will not hold Gold Park Homes responsible for any issues in relation to above.

Purchasers Signatures Samir Date Dec. 4, 17

\_\_\_\_\_