

**Kleinburg Glen - 37 - 2 - 42-1 Elev.A ROYALTON**  
**CENTRAL VAC AND WIRING**

Inv.1,249	1 - MASTER BEDROOM (APPROX. 55" AFF) / BEDROOM 3 / DEN (APPROX. 55" AFF) / GREAT ROOM (APPROX. 55" AFF): ROUGH IN- 4X- CAT 6 CONNECTIONS
Line19066	Note: Please see floorplan for locations
16Mar17 / 16Aug17	
Inv.1,249	1 - INSTALL VAC PAN UNDER KITCHEN SINK
Line19067	Note:
16Mar17 / 16Aug17	
Inv.1,249	1 - NILFISK CENTRAL VACCUM KIT SE 150 WITH MA10M ELECTRIC POWER HEAD
Line19080	Note:
16Mar17 / 16Aug17	
Inv.1,249	1 - SECURITY UPGRADE- ROUGH-IN FOR: 1 KEYPAD IN MASTER BEDROOM, 1 MOTION DETECTOR ON 2ND FLOOR, 1 GLASSBREAK DETECTOR ON MAIN FLOOR, 1 MOISTURE SENSOR IN BASEMENT
Line19083	Note: See floorplan for keypad location in Master Bedroom
16Mar17 / 16Aug17	

**CERAMIC**

Inv.1,249	1 - MASTER ENSUITE SHOWER: ADD SHOWER STALL SHAMPOO SHELF- 12 inch x 16 inch
Line23843	Note:
16Mar17 / 16Aug17	
Inv.1,249	1 - MASTER ENSUITE: DELETE ANGLE OF SHOWER AND MAKE SQUARE. PLEASE SEE FLOORPLAN FOR DETAIL
Line23844	Note:
16Mar17 / 16Aug17	
Inv.1,249	1 - SHOWER STALL SEAT- 12 inch x 30 inch- Linear
Line23855	Note:
16Mar17 / 16Aug17	
Inv.1,293	1 - TWIN BATH FLOOR TILE: UPG 2, 12x24
Line20222	Note:
2Apr17 / 24Jan18	
Inv.1,293	1 - FOYER: Custom inlay. 4-24x24" Volkas White Polished tiles in center, approx 3.5" boarder of Marble Mosaic Polished Tuana Herringbone 0.6x1.3 Code GM. TUANA.HER.BON
Line20252	Note: See sketch attached
2Apr17 / 24Jan18	
Inv.1,293	1 - MAIN FLOOR TILE Foyer: UPG 5, 24x24"
Line20179	Note:
2Apr17 / 24Jan18	
Inv.1,293	1 - MAIN FLOOR Tile Main Hall: UPG 5, 24x24"
Line20184	Note:
2Apr17 / 24Jan18	
Inv.1,293	1 - MAIN FLOOR TILE Laundry: UPG 5, 24x24"
Line20182	Note:
2Apr17 / 24Jan18	
Inv.1,293	1 - MAIN FLOOR TILE Powder Room: UPG 5, 24x24"
Line20183	Note:
2Apr17 / 24Jan18	

**Kleinburg Glen - 37 - 2 - 42-1 Elev.A ROYALTON**

Inv.1,293	1 - MASTER ENSUITE FLOOR TILE: UPG 5, 24x24"
Line20189	Note:
2Apr17 / 24Jan18	
Inv.1,293	2 - MASTER ENSUITE Shower Floor & Ceiling Tile: UPG 5 Marble Mosaic
Line20190	Note:
2Apr17 / 24Jan18	
Inv.1,293	1 - ENSUITE 2 FLOOR TILE: UPG 4, 12x24"
Line20191	Note:
2Apr17 / 24Jan18	
Inv.1,293	1 - ENSUITE 2 Shower Wall Tile: UPG 1, 2x12 Cristallo
Line20192	Note:
2Apr17 / 24Jan18	
Inv.1,293	1 - ENSUITE 2 Shower Floor Tile: UPG 4, Marble Mosaic
Line20193	Note:
2Apr17 / 24Jan18	
Inv.1,293	1 - TWIN BATH TUB WALL TILE: UPG 2, Cristallo Glass
Line20223	Note:
2Apr17 / 24Jan18	
Inv.1,293	1 - MASTER ENSUITE Shower Wall Tile: UPG 4, 12x24"
Line20235	Note:
2Apr17 / 24Jan18	

**CONCRETE AND DRAIN**

Inv.1,249	1 - BASEMENT: BACKFLOW PREVENTER VALVE
Line19068	Note:
16Mar17 / 16Aug17	

**DRYWALL**

Inv.1,249	1 - SMOOTH CEILINGS - (2 - Story Design) 2ND FLOOR
Line19082	Note:
16Mar17 / 16Aug17	
Inv.1,249	1 - OPTIONAL 10 FOOT TRAY CEILING - MASTER BEDROOM
Line23835	Note:
16Mar17 / 16Aug17	
Inv.1,249	1 - MAIN FLOOR CEILING 10FT, 8FT TALLER INTERIOR DOORS, TALLER FLAT ARCHES, REAR AND FRONT WINDOWS WITH TRANSOM, TALLER KITCHEN CABINETS WITH CROWN AND FURRING PANEL, ADDED STAIRS AND PICKETS
Line23840	Note:
16Mar17 / 16Aug17	
Inv.1,249	1 - MASTER ENSUITE SHOWER: ADD SHOWER STALL SHAMPOO SHELF- 12 inch x 16 inch
Line23842	Note:
16Mar17 / 16Aug17	
Inv.1,249	1 - SHOWER STALL SEAT- 12 inch x 30 inch- Linear
Line23856	Note:
16Mar17 / 16Aug17	

**ELECTRICAL**

Kleinburg Glen - 37 - 2 - 42-1 Elev.A ROYALTON

Inv.1,417	1 - FOYER: Additional Interior Receptacle (not separate circuit), LOCATE IN APPROX. CENTER OF WALL. SEE PLAN FOR LOCATION.
Line22188	Note:
5Jun17 / 29Nov17	
Inv.1,249	3 - MASTER BEDROOM / DEN / GREAT ROOM: Additional Interior Receptacle (not separate circuit). Approx 55" AFF next to CAT 6 Wire
Line19079	Note: Please see floorplan for locations
16Mar17 / 16Aug17	
Inv.1,249	1 - KITCHEN: Additional 240V Receptacle for future Steam oven.
Line19090	Note: Please see floorplan for location. Right of Fridge
16Mar17 / 16Aug17	
Inv.1,249	1 - KITCHEN: 240V Wall Receptacle on dedicated circuit for double wall oven.
Line19093	Note: Please see floorplan for location
16Mar17 / 16Aug17	
Inv.1,249	1 - ENSUITE 2: Add 4 in. Potlight in Shower
Line20245	Note:
16Mar17 / 16Aug17	
Inv.1,249	1 - KITCHEN: GAS LINE ROUGH - MAIN FLOOR - (2 STOREY MODELS) FOR GAS STOVE- INCLUDES 110V PLUG ON SEPARATE CIRCUIT
Line23846	Note:
16Mar17 / 16Aug17	
Inv.1,249	1 - KITCHEN: Relocate sink location and dishwasher due to Island turned 90 degrees. See floorplan for location
Line23851	Note:
16Mar17 / 16Aug17	

Exterior Colours

Inv.1,249	1 - EXTERIOR COLOUR PACKAGE 4
Line23863	Note:
16Mar17 / 16Aug17	

FRAMING

Inv.1,417	1 - FOYER: DELETE FOYER CLOSET
Line22183	Note:
5Jun17 / 29Nov17	
Inv.1,417	1 - LAUNDRY ROOM: MOVE DOOR TO LAUNDRY ROOM (from hallway) TO OTHER SIDE OF CLOSET, SEE PLAN FOR LOCATION.
Line22187	Note:
5Jun17 / 29Nov17	
Inv.1,249	1 - SHOWER STALL SEAT- 12 inch x 30 inch- Linear
Line20227	Note:
16Mar17 / 16Aug17	
Inv.1,249	1 - 2ND FLOOR - Extended doors and archway
Line20232	Note:
16Mar17 / 16Aug17	
Inv.1,249	1 - OPTIONAL 10 FOOT TRAY CEILING - MASTER BEDROOM
Line19064	Note:
16Mar17 / 16Aug17	

**Kleinburg Glen - 37 - 2 - 42-1 Elev.A ROYALTON**

Inv.1,249	1 - MAIN FLOOR CEILING 10FT, 8FT TALLER INTERIOR DOORS, TALLER FLAT ARCHES, REAR AND FRONT WINDOWS WITH TRANSOM, TALLER KITCHEN CABINETS WITH CROWN AND FURRING PANEL, ADDED STAIRS AND PICKETS
Line19065	Note:
16Mar17 / 16Aug17	
Inv.1,249	1 - MASTER ENSUITE SHOWER: ADD SHOWER STALL SHAMPOO SHELF- 12 inch x 16 inch
Line19077	Note: Please see floorplan for location
16Mar17 / 16Aug17	
Inv.1,249	1 - MASTER BEDROOM: Relocate Walk-in closet door. Add double door - please see floorplan for location
Line19086	Note:
16Mar17 / 16Aug17	
Inv.1,249	1 - GREAT ROOM / DINING ROOM: Add archway - 8ft wide and 8ft high. Leave 4ft on either side.
Line19088	Note: Please see floorplan for location
16Mar17 / 16Aug17	
Inv.1,249	1 - MASTER ENSUITE: Delete door to Water Closet
Line19092	Note:
16Mar17 / 16Aug17	
Inv.1,249	1 - MASTER ENSUITE: DELETE ANGLE OF SHOWER AND MAKE SQUARE. PLEASE SEE FLOORPLAN FOR DETAIL
Line23845	Note:
16Mar17 / 16Aug17	
Inv.1,249	1 - KITCHEN: UPGRADE VENTING FOR STOVE TO 8 INCH PIPE EXTERIOR WALL
Line23847	Note:
16Mar17 / 16Aug17	
Inv.1,249	1 - STANDARD DOOR EXTENDED HEIGHT 96 INCH (PRICE PER DOOR) - SECOND FLOOR 2 STOREY MODELS
Line23852	Note:
16Mar17 / 16Aug17	
Inv.1,249	1 - EXTENDED HEIGHT ARCHWAY (PRICE PER DOORWAY) - 2ND FLOOR
Line23853	Note:
16Mar17 / 16Aug17	
Inv.1,293	1 - BREAKFAST ROOM: INSTALL FRENCH DOORS IN LIEU OF GARDEN DOORS
Line25582	Note:
2Apr17 / 24Jan18	

**GLASS AND MIRROR**

Inv.1,249	1 - ENSUITE 2: CONVERT FRAMED SHOWER TO 10MM FRAMELESS SHOWER ENCLOSURE WITH DOOR AND 10MM SIDE PANEL
Line19073	Note:
16Mar17 / 16Aug17	
Inv.1,249	1 - MASTER ENSUITE SHOWER: CONVERT FRAMED SHOWER TO 10MM FRAMLESS SHOWER ENCLOSURE WITH DOOR AND 10MM SIDE PANEL
Line19074	Note:
16Mar17 / 16Aug17	
Inv.1,249	1 - MASTER ENSUITE: DELETE ANGLE OF SHOWER AND MAKE SQUARE. PLEASE SEE FLOORPLAN FOR DETAIL
Line19078	Note:
16Mar17 / 16Aug17	

**Kleinburg Glen - 37 - 2 - 42-1 Elev.A ROYALTON**

**HARDWOOD**

Inv.1,293	1 - MAIN FLOOR HARDWOOD Kitchen: UPG 5
Line20185	Note:
2Apr17 / 24Jan18	
Inv.1,293	1 - MAIN FLOOR HARDWOOD Great Room: UPG 5
Line20186	Note:
2Apr17 / 24Jan18	
Inv.1,293	1 - MAIN FLOOR HARDWOOD Dining Room: UPG 5
Line20187	Note:
2Apr17 / 24Jan18	
Inv.1,293	1 - MAIN FLOOR HARDWOOD Den: UPG 5
Line20188	Note:
2Apr17 / 24Jan18	

**HVAC**

Inv.1,249	1 - KITCHEN: GAS LINE ROUGH - MAIN FLOOR - (2 STOREY MODELS) FOR GAS STOVE- INCLUDES 110V PLUG ON SEPARATE CIRCUIT
Line19084	Note:
16Mar17 / 16Aug17	
Inv.1,249	1 - KITCHEN: UPGRADE VENTING FOR STOVE TO 8 INCH PIPE EXTERIOR WALL
Line19085	Note:
16Mar17 / 16Aug17	
Inv.1,249	1 - HUMIDIFIER: WB3 - 17 (UP TO 3,000 SQ.FT.)
Line19087	Note:
16Mar17 / 16Aug17	

**INTERIOR TRIM AND DOORS**

Inv.1,249	1 - EXTENDED HEIGHT ARCHWAY (PRICE PER DOORWAY) - 2ND FLOOR
Line20231	Note: See floorplan for location
16Mar17 / 16Aug17	
Inv.1,249	19 - STANDARD DOOR EXTENDED HEIGHT 96 INCH (PRICE PER DOOR) - SECOND FLOOR 2 STOREY MODELS
Line19091	Note:
16Mar17 / 16Aug17	
Inv.1,249	1 - MAIN FLOOR CEILING 10FT, 8FT TALLER INTERIOR DOORS, TALLER FLAT ARCHES, REAR AND FRONT WINDOWS WITH TRANSOM, TALLER KITCHEN CABINETS WITH CROWN AND FURRING PANEL, ADDED STAIRS AND PICKETS
Line23837	Note:
16Mar17 / 16Aug17	
Inv.1,249	1 - MASTER BEDROOM: Relocate Walk-in closet door. Add double door - please see floorplan for location
Line23848	Note:
16Mar17 / 16Aug17	
Inv.1,249	1 - GREAT ROOM / DINING ROOM: Add archway - 8ft wide and 8ft high. Leave 4ft on either side.
Line23849	Note:
16Mar17 / 16Aug17	

**Kleinburg Glen - 37 - 2 - 42-1 Elev.A ROYALTON**

Inv.1,249	1 - MASTER ENSUITE: Delete door to Water Closet
Line23854	Note:
16Mar17 / 16Aug17	

**KITCHEN AND BATH CABINETRY**

Inv.1,249	1 - MAIN FLOOR CEILING 10FT, 8FT TALLER INTERIOR DOORS, TALLER FLAT ARCHES, REAR AND FRONT WINDOWS WITH TRANSOM, TALLER KITCHEN CABINETS WITH CROWN AND FURRING PANEL, ADDED STAIRS AND PICKETS
Line23838	Note:
16Mar17 / 16Aug17	
Inv.1,249	1 - KITCHEN: Relocate sink location and dishwasher due to Island turned 90 degrees. See floorplan for location
Line23850	Note:
16Mar17 / 16Aug17	
Inv.1,293	1 - KITCHEN: Integrated Steam Oven (Flush Mount)
Line20254	Note: Purchaser to supply cabinetry for double wall oven at own expense and warranty after closing
2Apr17 / 24Jan18	
Inv.1,293	1 - KITCHEN: Built in fridge enclosure. Purchaser to supply and install own fridge doors & handles at own expense and warranty after closing
Line20256	Note: See spec sheet attached
2Apr17 / 24Jan18	
Inv.1,293	1 - KITCHEN: Cabinet Steam oven and cooktop
Line20253	Note:
2Apr17 / 24Jan18	
Inv.1,293	1 - KITCHEN: Redraw kitchen layout to accommodate 36" cooktop and 48" fridge
Line20255	Note: See spec sheets attached
2Apr17 / 24Jan18	

**MISC.**

Inv.1,417	1 - Admin fee to re-open file
Line22181	Note:
5Jun17 / 29Nov17	
Inv.1,249	1 - BONUS PACKAGE: \$20,000.00 (INCLUDING TAXES) WORTH OF UPGRADES FROM GOLD PARK HOMES DÉCOR CENTRE IS BEING APPLIED TOWARD THE STRUCTURAL APPOINTMENT. PURCHASER HAS A REMAINING AMOUNT OF \$00 (INCLUDING TAXES) TO BE USED TOWARD THE COLOUR APPOINTMENT.
Line19094	Note:
16Mar17 / 16Aug17	
Inv.1,249	1 - TOTAL AFTER CREDIT: \$53,190.10 Applied to Colour Order
Line19095	Note:
16Mar17 / 16Aug17	
Inv.1,249	1 - Purchaser has attended a Structural appointment at the Decor Centre & has DECLINED any additional upgrades and accepts and acknowledges that there will be no further structural changes/additions/deletions to be made upon signing.
Line19096	Note:
16Mar17 / 16Aug17	
Inv.1,249	1 - Purchasers are aware & accepts that ANY changes made to upgrades after signing this Purchasers Extra Form are subject to a minimum administration fee of \$500. PLUS a 10% holdback fee.
Line19097	Note:
16Mar17 / 16Aug17	

**Kleinburg Glen - 37 - 2 - 42-1 Elev.A ROYALTON**

Inv.1,293	1 - TOTAL Structural \$53,190.10 + TOTAL Colours: \$65,878.90 = \$119,069.00 50% Deposit: \$59,534.50 50% On Closing: \$59,534.50
Line20257	Note:
2Apr17 / 24Jan18	

**PAINT**

Inv.1,293	1 - STAIRS & RAILING: UPG Stain Colour - Generation Cobalt
Line20221	Note:
2Apr17 / 24Jan18	

**PAINTING**

Inv.1,249	1 - MAIN FLOOR CEILING 10FT, 8FT TALLER INTERIOR DOORS, TALLER FLAT ARCHES, REAR AND FRONT WINDOWS WITH TRANSOM, TALLER KITCHEN CABINETS WITH CROWN AND FURRING PANEL, ADDED STAIRS AND PICKETS
Line23839	Note:
16Mar17 / 16Aug17	

**PLUMBING**

Inv.1,249	1 - KITCHEN: INSTALL WATERLINE FOR FRIDGE
Line19069	Note: Please see floorplan for location
16Mar17 / 16Aug17	
Inv.1,249	1 - REAR OF HOUSE: HOSE BIB - STANDARD TO UPGRADED WITH HOT AND COLD WATER VALVE
Line19070	Note:
16Mar17 / 16Aug17	
Inv.1,249	1 - MASTER ENSUITE: WATER SERVICE - INCREASE WATER SERVICE TO 3/4 INCH
Line19072	Note:
16Mar17 / 16Aug17	
Inv.1,249	1 - ENSUITE 2: TRENCH DRAIN APPROX 24 INCH LINEAR TRENCH DRAIN GRATE - ACO 37245/93871 - UPG 1
Line19075	Note:
16Mar17 / 16Aug17	
Inv.1,249	1 - MASTER ENSUITE SHOWER: TRENCH DRAIN APPROX 6 INCH SQUARE - DRAIN
Line19076	Note:
16Mar17 / 16Aug17	
Inv.1,249	1 - KITCHEN: Relocate sink location and dishwasher due to Island turned 90 degrees. See floorplan for location
Line19089	Note:
16Mar17 / 16Aug17	
Inv.1,249	1 - BASEMENT: BACKFLOW PREVENTER VALVE
Line23841	Note:
16Mar17 / 16Aug17	

**PLUMBING FIXTURES**

Inv.1,293	1 - MASTER ENSUITE TUB FAUCET: UPG to Arzo 4 Piece Roman Tub Faucet chrome - #T4786/R4716
Line20248	Note: See spec sheet attached
2Apr17 / 24Jan18	

Kleinburg Glen - 37 - 2 - 42-1 Elev.A ROYALTON

Inv.1,293	1 - MASTER ENSUITE TUB: UPG to Mirolin Beacon Freestanding Tub #CF2001 - 67"x36"
Line20247	Note:
2Apr17 / 24Jan18	

STAIRS AND RAILINGS

Inv.1,293	1 - STAIRS & RAILING: Euroline 2 with V-Groove handrail
Line20246	Note:
2Apr17 / 24Jan18	

Inv.1,293	1 - STAIRS & RAILINGS: UPG TO Euroline 2 with V-Groove handrail
Line20233	Note:
2Apr17 / 24Jan18	

TRIM AND DOORS

Inv.1,293	1 - BASEBOARDS & CASING: UPG 2 Main & Second Floor
Line20234	Note:
2Apr17 / 24Jan18	

WINDOWS AND DOORS

Inv.1,249	1 - BREAKFAST ROOM: FRENCH DOORS In Lieu of Garden Doors
Line20228	Note:
16Mar17 / 16Aug17	

Inv.1,249	1 - MAIN FLOOR CEILING 10FT, 8FT TALLER INTERIOR DOORS, TALLER FLAT ARCHES, REAR AND FRONT WINDOWS WITH TRANSOM, TALLER KITCHEN CABINETS WITH CROWN AND FURRING PANEL, ADDED STAIRS AND PICKETS
Line23836	Note:
16Mar17 / 16Aug17	



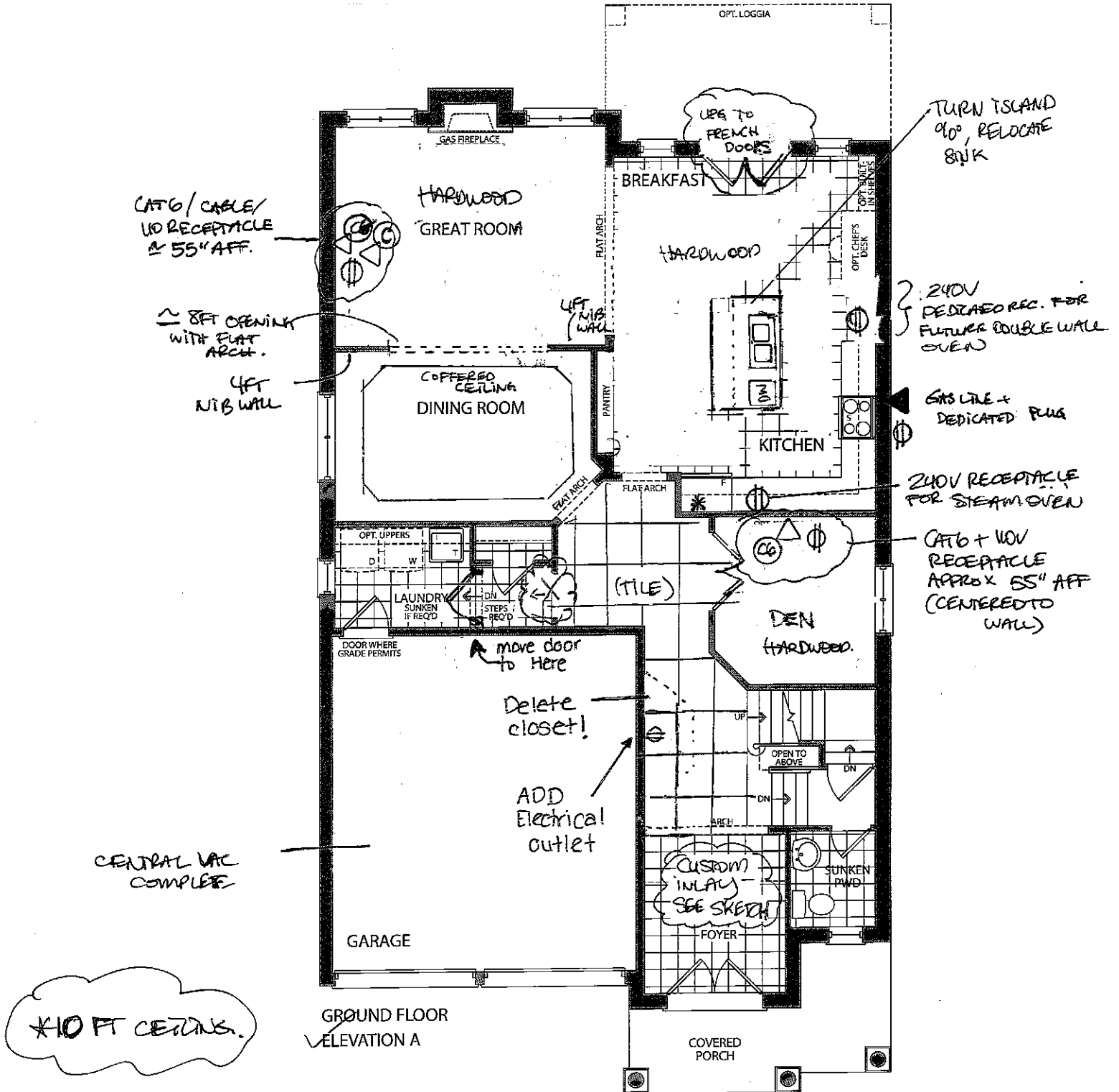

LEGEND

- ⊗ - 96" DOOR
- \* - WATER LINE
- ⊕ - RECEPTACLE
- ⬮ - GAS LINE
- ⊙ - CABLE
- Ⓣ - TELEPHONE

⬮ - CAT 6

Prices, figures, illustrations, sizes, features and finishes are subject to change without notice. E.&O.E. Areas and dimensions are approximate and actual usable floor space may vary from the stated area. Layout may be reverse of the unit purchased. E & O.E.

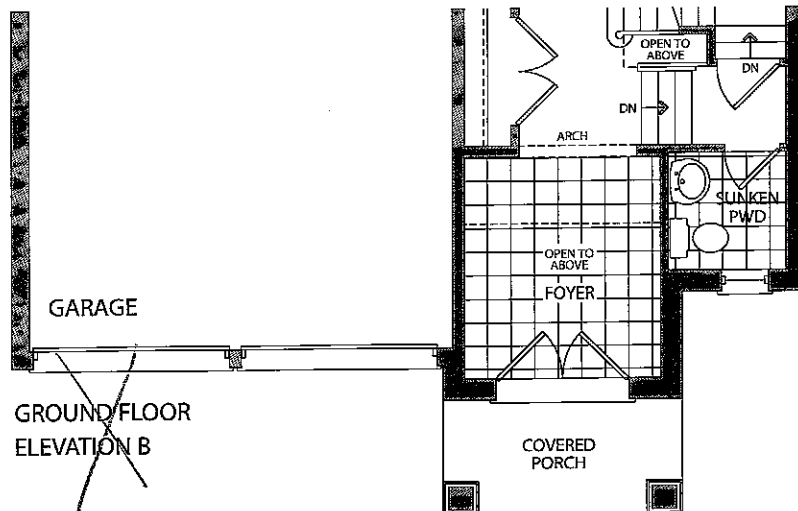

KG2-37  
STRUCTURAL

MARCH 16, 2017

COLOURS

APRIL 2 2017

Elevation A • 3,016 sq.ft.

Elevation B • 3,043 sq.ft.

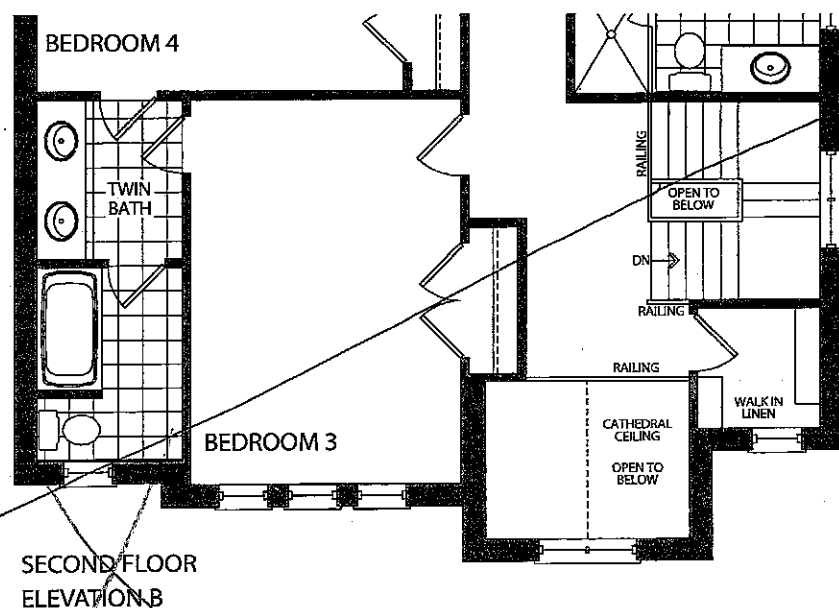
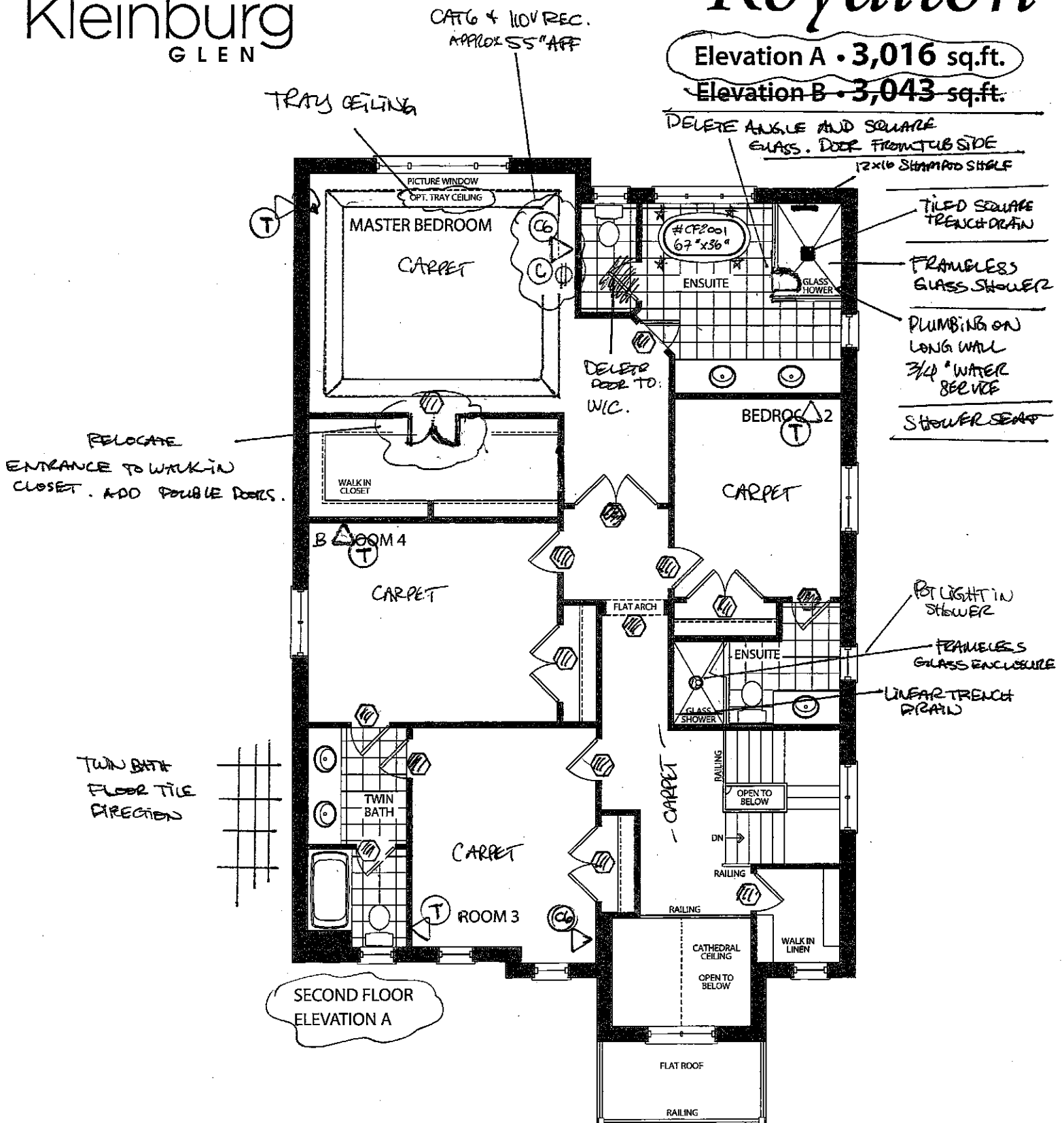

KG.2-37  
STRUCTURAL

MARCH 16, 2017

COLOURS

April 2, 2017

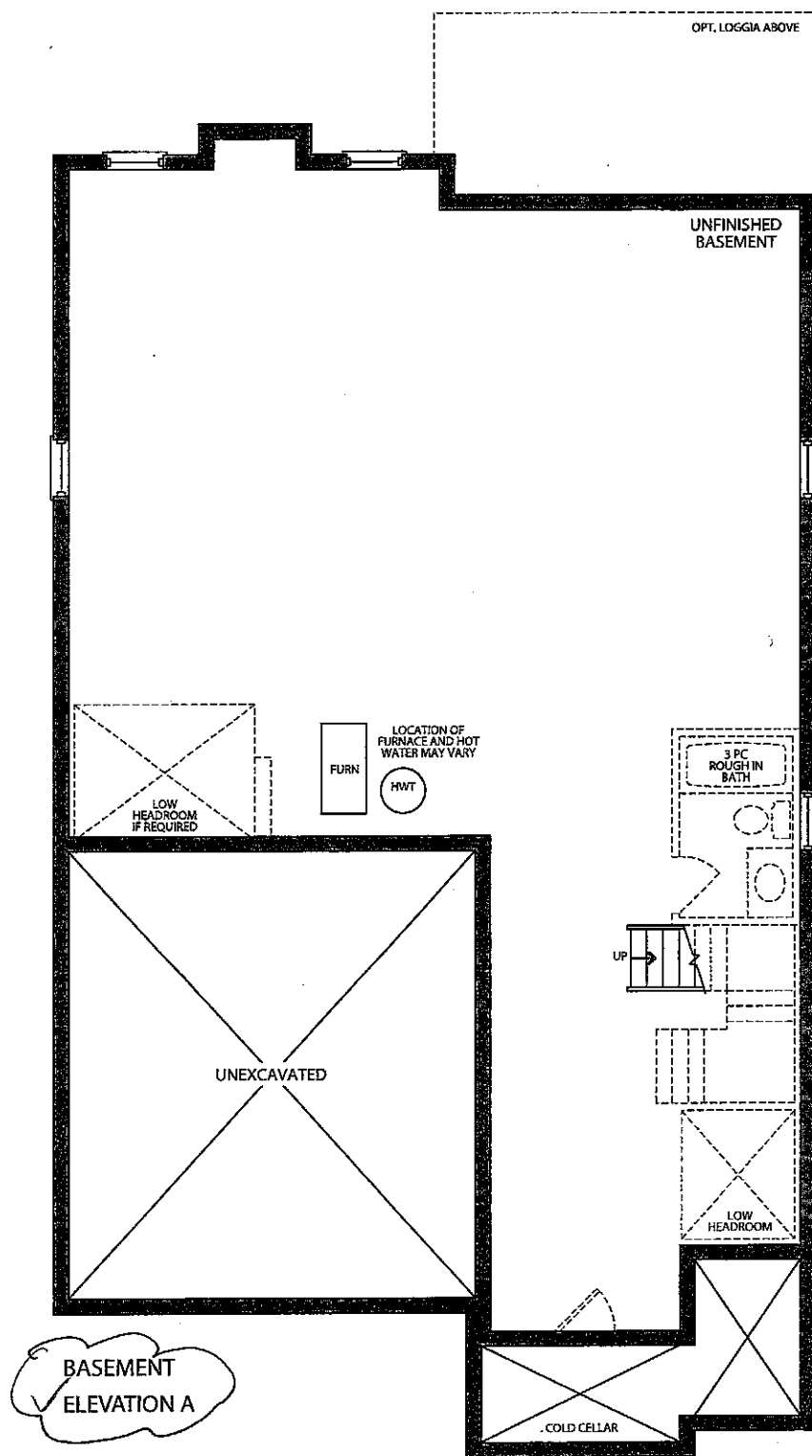

BASEMENT  
ELEVATION A

BACKFLOW  
PREVENTER

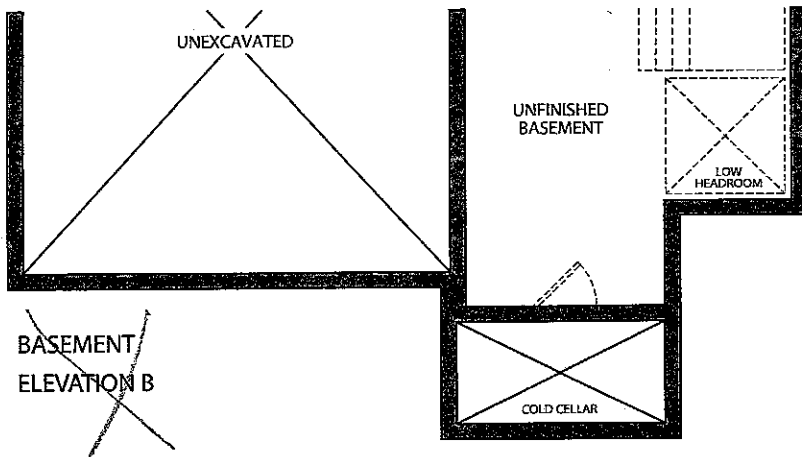

BASEMENT  
ELEVATION B

K62-37  
STRUCTURAL  
CM  
March 16, 2017  
Colours  
CM  
April 2, 2017

## CORTINA

70 Regina Road, Woodbridge, Ontario L4L 6L6  
Tel: 905-294-8484 Fax: 905-294-0804  
www.CortinaKitchens.com

## QUOTATION

Date: 28/06/16

Trade Name: Gold Park Homes

Site location:

Model: 42-1

Address:

Project: Kleinburg Glen

Phase:

This layout has been explained to the purchaser by Cortina Kitchens Inc. and is understood by the purchaser.

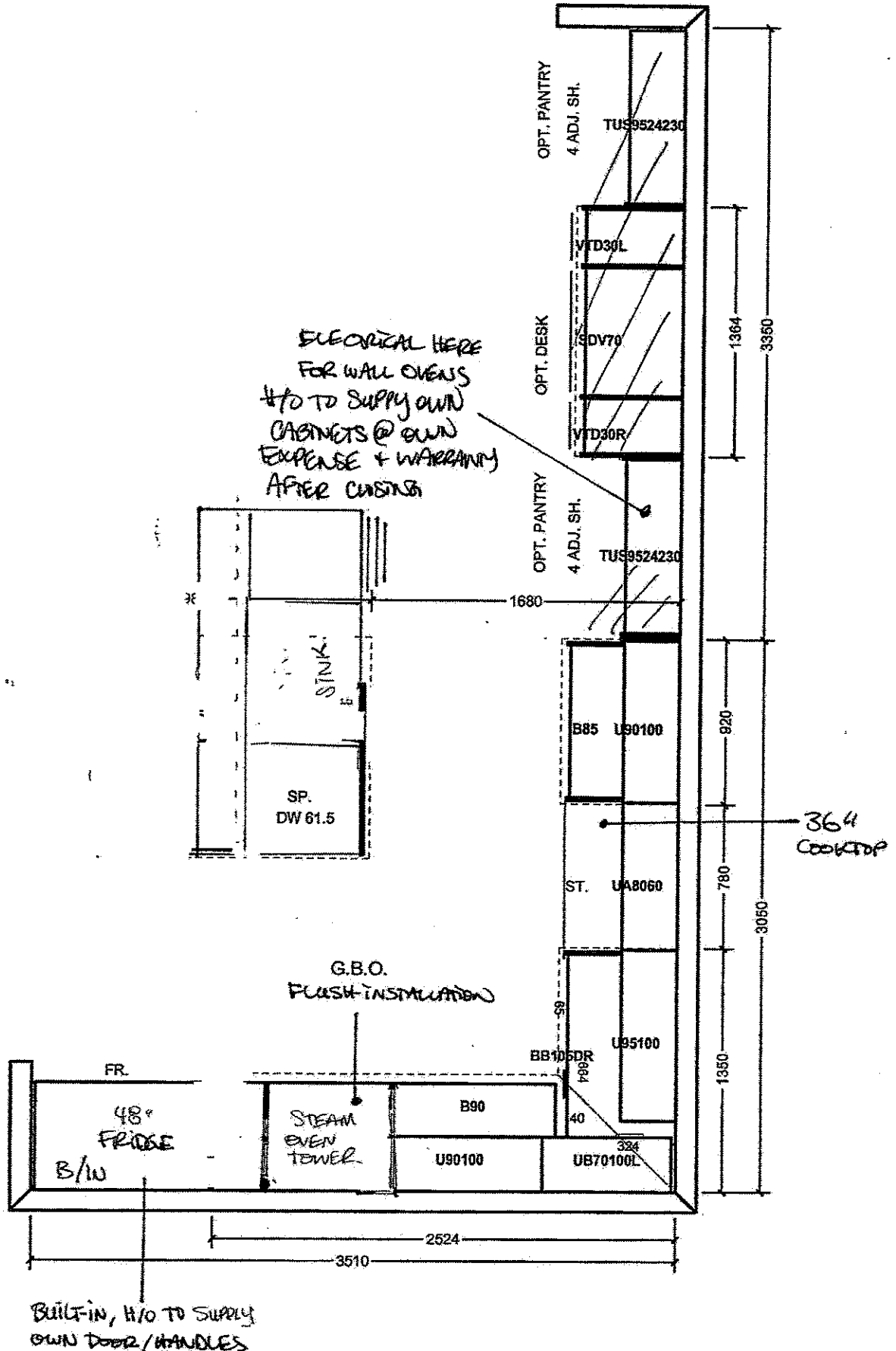

All prices subject to confirmation from head office.  
This quotation is subject to the terms & conditions set out

ACCEPTED DATE: Apr-13-2017

All agreements are contingent upon strikes, accidents, and delays beyond our control.  
Please provide our installer with template for sinkholes or \$150.00 will be charged for callback.

KG2-37

DocuSigned by:

X

dm

097EB0262A834ED

Item A. Wood grain and colour are characteristics of the product. We cannot guarantee that such grain and colour will always match.  
Item B. Cortina Kitchens Inc. reserves the right to alter dimensions and make technical changes without notice.

Date: 28/06/16

Trade Name: Gold Park Homes

Site location:

Model: 42-1

Address:

Project: Kleinburg Glen

Phase:

This layout has been explained to the purchaser by Cortina Kitchens Inc. and is understood by the purchaser.

ENSUITE 2(BD. 2)

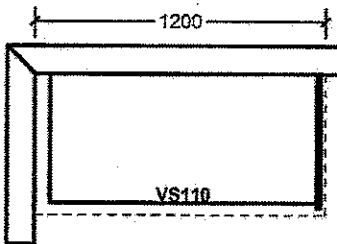

ENSUITE

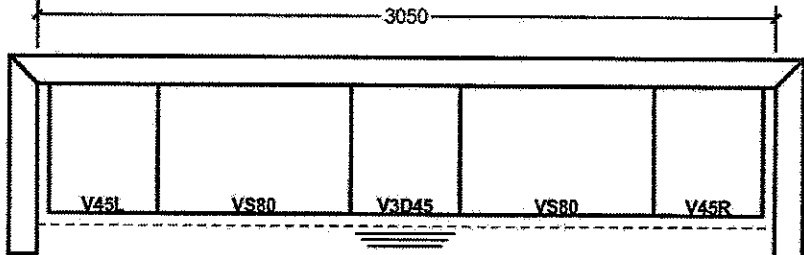

TWIN BATH(BD. 3/4)

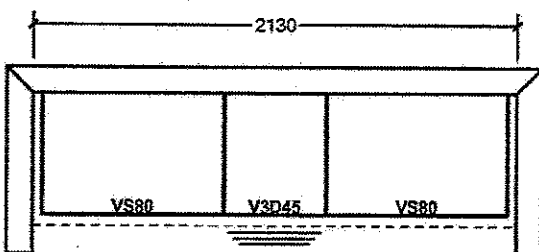

LAUNDRY

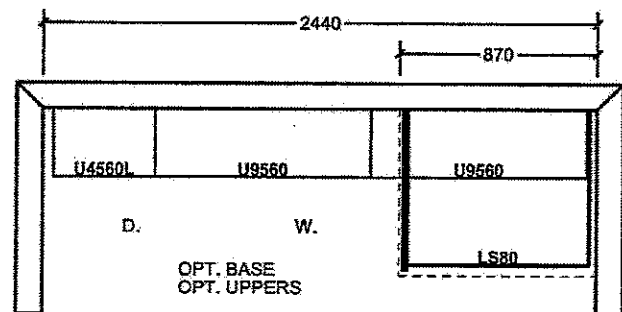

OPT. 5 BED. SECOND FLOOR

TWIN BATH( BD. 2/3)

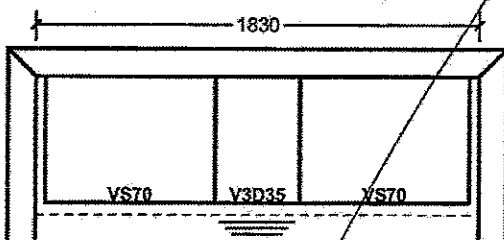

TWIN BATH(BD. 4/5)

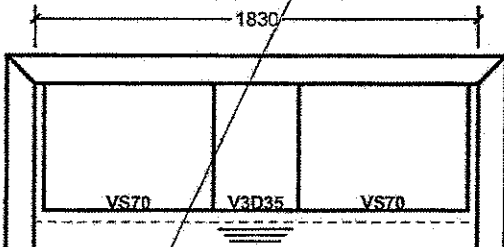

ENSUITE

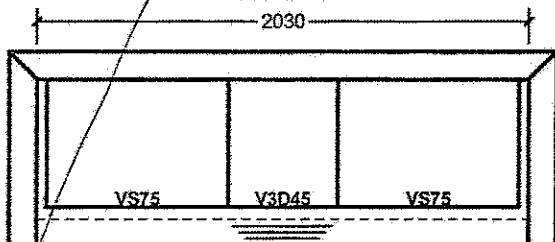

PART OPT. 5 BED. SECOND FLOOR

TWIN BATH 2(BD. 4/5)

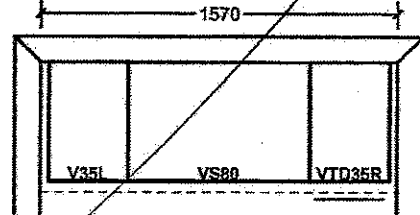

PART SECOND FL. ELV. B

TWIN BATH(BD. 3/4)

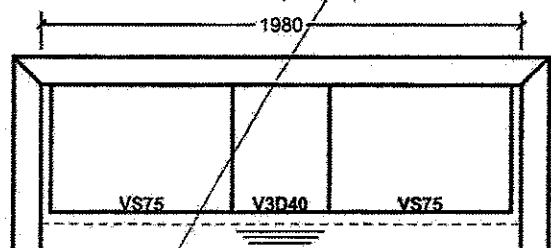
All prices subject to confirmation from head office.  
This quotation is subject to the terms & conditions set out

ACCEPTED DATE: Apr-13-2017

All agreements are contingent upon strikes, accidents, and delays beyond our control.  
Please provide our installer with template for sinkholes or \$150.00 will be charged for callback.

K62-37

DocuSigned by:

x

c/m

097FD0202A034FD

Arzo 4 Piece Roman Tub faucet (chrome) #T4786/R4716

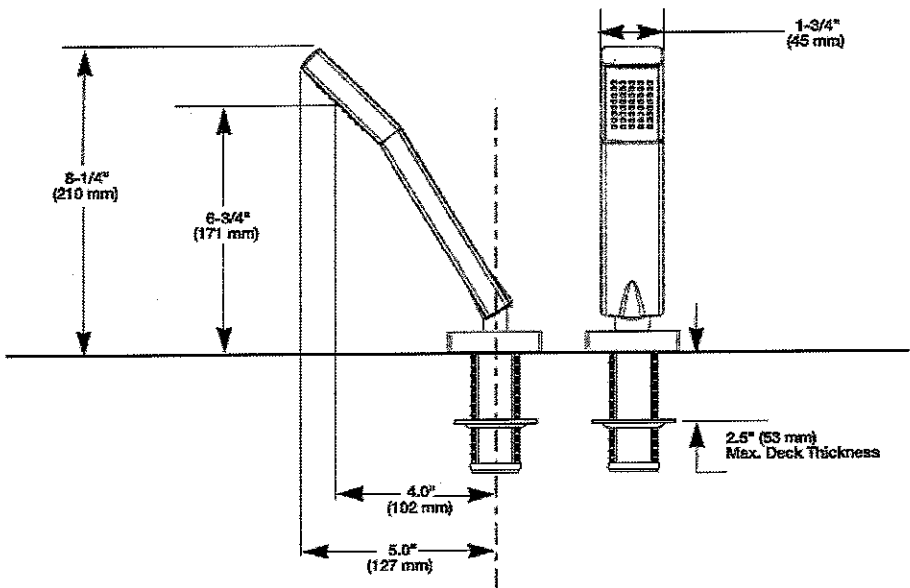
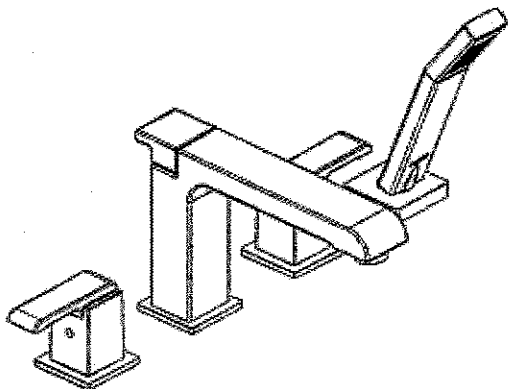
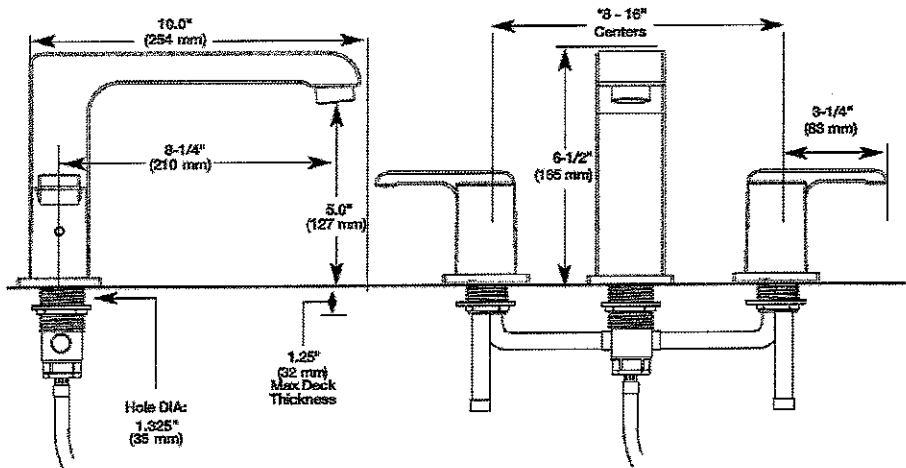
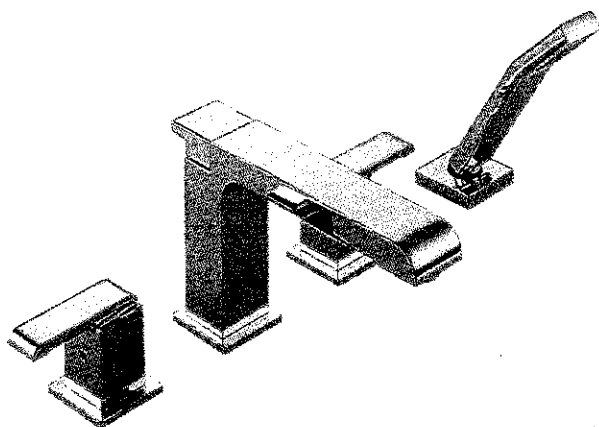

T4786

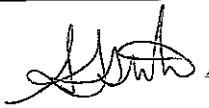
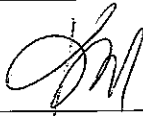
LOT # KG2-37	
ROOM: MASTER ENSUITE	SIGNATURE: 
DATE: April 2, 2017	SIGNATURE: 

\*\*\* NOTE: This is not an approved document. Document must be locked \*\*\*

Scheduled Closing Date:

Purchaser: KEVIN MACH & Amy SSUTU
Telephone Res. / Bus: 416.357.9156
Decor Advisor: Laura Lofaro

Property: 37
Project: Kleinburg Glen - Phase 2
Model and Elevation: ROYALTON - SLEU-A.

Layout Changes: Yes No Sketch Attached: Yes No Exterior Colour Scheme:

1. Cabinetry

Table with 4 columns: Room, Style and Colour, Counter, Hardware. Rows include Kitchen / Breakfast, Laundry Room, Powder Room, Master Ensuite Bathroom, Second Ensuite Bathroom, and Twin Bath.

Comment

2. Floor Tile

Table with 2 columns: Room, Selection. Rows include Entrance Vestibule, Main Hall, Kitchen / Breakfast, Laundry Room, Powder Room, Master Ensuite Bathroom, Second Ensuite Bathroom, Lower Landing, and Twin Bath.

Comment

\*Second Ensuite Shower Floor Tile: Marble Mosaics Pol. Milas Pearl Herringbone 0.6x1.3
\*Master Ensuite Shower Floor & Ceiling: Marble Hexagon Polished Oriental White 1.2" Hex. Sheet 11.8x11.3 code: GM.ORT.WHITE.HEX.
\*\*\*\*SHOWER SEAT AND JAMB GREY & WHITE PLEASE\*\*\*\*

3. Wall Tile

Table with 4 columns: Room, Selection, Listello/Inserts, Describe. Rows include Master Ensuite Bathroom (Tub Deck, Shower Stall, Bathroom Walls), Second Ensuite Bathroom, and Twin Bath.

Comment

Master Ensuite Shower Wall Tile: Installed horizontally stacked
\*\*\*\*SHOWER SEAT AND JAMB GREY & WHITE PLEASE\*\*\*\*



Scheduled Closing Date:

Purchaser: KEVIN MARCH & AMY SUTU

Property: 37

Telephone Res. / Bus: 416. 367. 9056

Project: Kleinburg Glen - Phase 2

Decor Advisor: Laura Lofaro

Model and Elevation: ROYALTON - ELEVATION A

4. Plumbing Fixtures

<input type="checkbox"/>	Second Ensuite	<input type="checkbox"/>	Powder Room	<input type="checkbox"/>
Master Ensuite Bathroom <input type="checkbox"/>	Other Room - Specify <input type="checkbox"/>	<input type="checkbox"/>	Other Washroom	<input type="checkbox"/>

Comment

Master Ensuite Tub - Mirolin Beacon Freestanding Tub 67"x36"  
Master Ensuite Tub Faucet: Arzo 4 piece Roman Tub Faucet Chrome #T4786 / R4716  
Everywhere else Standard

5. Hardwood Flooring

Main Hall	Type and Stain N/A	Upper Landing	Type and Stain N/A
Kitchen / Breakfast	*Prev.White Oak Tahoe 7"	Upper Hall	N/A
Living Room	N/A	Master Bedroom	N/A
Dining Room	*Prev.White Oak Tahoe 7"	Bedroom #2	N/A
Family Room	N/A	Bedroom #3	N/A
Den/Library	*Prev.White Oak Tahoe 7"	Bedroom #4	N/A
Entrance Vestibule	N/A	Bedroom #5	N/A
Lower Landing (If Applicable)	N/A	Other Room - Specify Great Room	*Prev.White Oak Tahoe 7"

Comment

\*Preverco White Oak Tahoe Variation with Knots / Variations Edge 7"

6. Carpeting

Ground Floor	Upgrade <input type="checkbox"/>	Description N/A
Second Floor	<input type="checkbox"/>	Throughout - T04
<input type="checkbox"/>	<input type="checkbox"/>	<input type="checkbox"/>

Upgrade Underpad	Type N/A	Area <input type="checkbox"/>
Carpet on Stairs	Capped N/A	Runner - *Upgrade <input type="checkbox"/>

Comment

7. Fireplace

	Living Room			Family Room			Other Room - Specify			Great Room
	Purchased	As Per Plan	N/A	Purchased	As Per Plan	N/A	Purchased	As Per Plan	N/A	
	<input type="radio"/>	<input type="radio"/>	<input type="radio"/>	<input type="radio"/>	<input type="radio"/>	<input type="radio"/>	<input type="radio"/>	<input checked="" type="radio"/>	<input type="radio"/>	
Fireplace Type	<input type="checkbox"/>			<input type="checkbox"/>			STD Gas			<input type="checkbox"/>
Mantle Type	<input type="checkbox"/>			<input type="checkbox"/>			STD			<input type="checkbox"/>
Colour / Stain	<input type="checkbox"/>			<input type="checkbox"/>			STD			<input type="checkbox"/>
Surround	<input type="checkbox"/>			<input type="checkbox"/>			N/A			<input type="checkbox"/>
Hearth	<input type="checkbox"/>			<input type="checkbox"/>			STD			<input type="checkbox"/>

Comment





Scheduled Closing Date:

Purchaser: KEVIN MATH & AMY SEOM

Property: 37

Telephone Res. / Bus: 410. 357. Q056

Project: Kleinburg Glen - Phase 2

Decor Advisor: Laura Lofaro

Model and Elevation: ROYALTON - ELEV. A

8. Trim Carpentry

Interior Doors STD Front Door Glass Inserts STD Door Handles STD

Interior Trim MAIN & SECOND: UPG 2

Comment

8ft Doors throughout

9. Plaster Mouldings and Medallions

Standard Throughout ☐ Yes ☐ No ☒ N/A

Entrance Vestibule N/A Kitchen/Breakfast N/A

Main Hall N/A Den/Library N/A

Living Room N/A Lower Landing N/A

Dining Room N/A Other Room - Specify N/A

Family Room N/A

Comment

10. Railings and Spindles

Railing Package \*Euroline 2 with V-Groove handrail

Railing Colour \*Generation Cobalt Spindle Colour Black

Stringer / Riser \*Generation Cobalt Treads \*Generation Cobalt

Comment

Oak Stairs ☒ Yes ☐ No ☐ N/A

11. Wall Paint / Ceilings

Throughout Finished Areas Warm Grey

Trim Paint White

Smooth Ceilings

Ground Floor ☒

Second Floor ☒

Note

Comment



\*\*\* NOTE: This is not an approved document. Document must be locked \*\*\*

Scheduled Closing Date:

Purchaser:                    Unsold - 37    Unsold - 37

Property: 37

Telephone Res. / Bus: (905) 760-9595

Project: Kleinburg Glen - Phase 2

Decor Advisor:              Laura Lofaro

Model and Elevation: Unknown

12. Electrical

Hood Fan    ☐ White    ☒ Stainless    ☐ N/A

Above Kitchen Cabinet Light    ☐ Yes    ☒ No

Below Kitchen Cabinet Light    ☐ Yes    ☒ No

Standard Appliances    ☐

Over The Range Microwave    ☐

Chimney Style Fan    ☐

Comment

STD SS Hood fan / Double Wall Oven / Gas cooktop / steam oven

13. Heating and Air Conditioning

Air Conditioning   

Gas Provisions Stove   

Gas Provisions Dryer   

Gas Provisions Barbecue   

Comment

14. Additional Comments

15. Disclaimers and Notes

- 1) Colours of all materials are as close as possible to builder's selection, but not necessarily identical due to variances in manufacturing.
- 2) Any extras listed above are null and void unless accompanied by a separate invoice/amendment. Said invoice must be paid in full.
- 3) The Purchaser acknowledges that after Interior Colour Selection form is signed and dated, no further changes will be permitted other than re-selection due to unavailability.  Purchaser's Initials
- 4) The Purchaser acknowledges reading and accepting the "Gold Park Homes Decor Centre Disclaimers" form. This document contains other miscellaneous disclaimers.

This Interior Colour Selection is final and approved by:

Signature: 

Date: 14/11/17

*Gold Park Homes Décor*

**GOLDPARK**  
WORTH MORE™

## **Centre Disclaimers**

*Through years of doing business, we at Gold Park Homes have encountered issues beyond our control. The following disclaimers apply to all instances of Purchaser's Extras forms and all Interior Colour Scheme forms.*

### **FIREPLACES**

Fireplace Marble: Due to the many variables that can affect the pattern and/or design, frequently the marble installed on the fireplace will not be identical to the samples. We will make every attempt to come as close to the samples as possible, but cannot be responsible for results which differ from the samples.

### **CERAMIC FLOOR TILE**

Many variables including variegation can affect tile colour, pattern and/or design which mean installed tiles may not be identical to the samples. We will make every attempt to come as close as possible, but cannot be responsible for results which differ from the samples.

### **HARDWOOD FLOORING**

The purchaser is advised that cupping and shrinkage are characteristics of hardwood flooring normally appearing after installation, especially when humidity levels are not regulated, and no warranty is provided by the flooring supplier with respect to such cupping and shrinkage. Furthermore, hardwood floors may also heave and warp when located at or close to entrance points of the home, where rain could make its way to the flooring. The vendor agrees to install any hardwood flooring ordered by the purchaser in a good and workmanlike manner, but shall not be responsible for, and is hereby released by the purchaser from responsibility and liability for cupping, shrinkage, heaving and warping of hardwood flooring in the above mentioned circumstances.

### **STAIRCASE VS FLOORING**

#### **WOOD SPECIES DIFFERENCE**

The purchaser is aware and therefore accepts and acknowledges that the wood species of the staircase and flooring chosen do not match. This difference might result in an undesirable colour variance

The purchaser is aware and therefore accepts and acknowledges that though the flooring is of the same species as the staircase the difference in product finishing may result in a stain colour variance.

The purchaser agrees that the vendor is to be exempt from any and all claims by the purchaser regarding this colour variance.

### **RAILINGS**

All railings, pickets, posts, nosing's and stairs come from solid wood and veneered wood materials sourced from multiple locations and sources. As such there will be variations in grains and shades between the various natural components beyond our control. Due to this variance in material, all components will stain with colour or natural finish differently.

Iron pickets are wrought in nature and depending on the manufacturing process will have differences from picket to picket which is normal. Also the finish of the iron pickets is of a powder coated nature. This process can produce minor colour variations or tones. Furthermore, the assembly of the metal pickets can develop a natural rattle over time from vibration in the railing. Minor rattling is normal and is a part of the wrought iron picket assembly.

### **HOUSE EXTERIORS**

Variations in subcontractors across different sites and varying site conditions may result in house exteriors that differ from the artist renderings. We cannot be responsible for results which differ from the artists renderings of elevations.

### **PLASTER MOULDINGS AND MEDALLIONS**

Plaster mouldings will not be installed in open to above areas or areas with 2 storey elements.

### **STAIN COLOURS**

Due to the many variables that can affect the outcome of a stain colour on wood, staircases, railings, and fireplaces, the colour may not be identical to samples. Factors such as density, age, humidity, air temperature, and the uniqueness of each piece of wood can result in wide variations in darkness or lightness. We will make every attempt to come as close to the sample as possible, but cannot be responsible for results which differ from the samples.

Stain on pre-finished hardwood floors will not be an exact match to the stain colours available on stairs, pickets and rails. The purchaser is responsible for choosing the stain on these areas to their satisfaction.

### **IN-WALL CONDUIT FOR AUDIO/VIDEO CABLES**

It is important to note that due to the variation in framing requirements in different parts of your home, conduit lengths and routing can vary. In virtually all instances of ground floor installation (I.e. above a fireplace), conduit will first travel down into the basement below the floor joists, over to the termination point and back up into the main floor. As a result, it is best to measure the length of the conduit after occupancy with a "pull wire" before

K62-37



purchasing your cables. For above-fireplace installations, the conduit wall plate will be installed approximately 10" above the Fireplace Mantle, unless otherwise specified in the Construction Summary.

#### **APPLIANCE SPECIFICATIONS**

All appliance openings are set to builder's standard openings. Please advise Décor Centre at time of your structural appointment if custom sizing of cabinets is required for any built - in appliances. The purchaser is responsible for costs and fees associated with changes to pre-manufactured kitchens made subsequent to colour appointments.

Purchaser accepts & acknowledges that in order to accommodate upgraded appliances, all appliance specifications should be provided at the time of their structural appointment, should this not occur they must be provided to the Décor Center within one (1) week of completion of structural chart. Failure to do so may result in the need to revert to the standard appliance openings or in a delay in construction of your dwelling, as well as a cost of \$500 to re-open your structural file should changes be required. As a result we may be forced to extend the closing of your transaction. Due to failure to complete the above-mentioned selections and at no fault of our own, we reserve our right to hold you responsible for this delayed closing, including charging extra administration cost and interest on the balance due on closing.

Purchasers Accept Standard Appliance Openings (unless otherwise specified):

Fridge - 37-1/2"W x 73-1/2" High Approx.

Range - 30-1/2"D x 31-1/2"W Approx.

Dishwasher - 24" W Approx.

#### **DELETION OF HOODFAN & CABINETS ABOVE STOVE:**

The purchasers are aware that in requesting NOT TO INSTALL builder's standard hood fan and standard cabinets above stove they will receive NO STANDARD HOOD FAN and NO CREDIT. Purchasers are installing their own hood fan after closing and accept that it may waive any warranty associated with such a change.

Purchasers accept and acknowledge that the exhaust fan duct hole may be off-centered with the stove in the kitchen due to purchasers installing their own hood fan after closing. The vendor is exempt from adjusting such openings for the purchasers range hood.

#### **ELECTRICAL FOR APPLIANCES**

Pricing is subject to change based on the appliance specifications provided. Purchasers should provide proper appliance specifications and cut-out sheets in order for Gold Park to price extras accordingly.

#### **KITCHEN CABINETS**

The kitchen you order/purchase will undoubtedly contain slight colour variations. The degree of these variations is virtually impossible to determine before the kitchen is installed in its intended location. The amount of and type of lighting will also affect various highlights in the finish. Note: No two pieces of wood are identical. Variations in colour tone and grain patterns make a perfect colour match virtually impossible. It is generally agreed that these variations add to the natural beauty of a wood kitchen.

#### **STAIN**

Charcoal is a spray stain applied to Oak and Maple products with several characteristics that are important to be aware of when purchasing this product.

1. Shadow lines may be visible at the interior profile edges of a door or drawer front. If movement occurs shadow lines may increase or decrease, depending on the style and/or size of a door or drawer front.
2. Variation and unevenness may be visible in the finish.
3. Hairline cracks at the joints are created over time due to the nature of natural wood, caused by usage, humidity\*\*, or dryness. They tend to be more visible to darker stains, than lighter wood stains.

\*\* Relative humidity is recommended to be between 45% and 55%. Please refer to Cortina Kitchens "Cleaning, Care, Maintenance, & Warranty Information" guide.

Please be advised that Cortina Kitchens will not replace doors and/or parts that exhibit the above characteristics associated with this finish. These characteristics are not avoidable and are a result of the natural characteristics of wood and wood veneer, and the characteristics of darker stains on wood. The Charcoal stain is not available on doors in Group IV, Group IVA, Group V and Group VA.

Cortina Kitchens offers a wide variety of finishes, applied to oak and maple products. The subject finishes include the spray stains Cocoa, Espresso, Graphite as well as wiping stain Ebony.

Due to the very dark stains applied on natural maple and oak doors and joints, several characteristics are important to be noted when purchasing these products.

1. Shadow lines may be visible at the interior profile edges of a door or drawer front. If movement occurs shadow lines may increase or decrease, depending on the style and/or size of a door or drawer front.
2. Variation and unevenness may be visible in the finish.
3. Hairline cracks at the joints are created over time due to the nature of natural wood, caused by usage, humidity, or dryness. They tend to be more visible to darker stains, than lighter wood stains.

Please be advised that Cortina Kitchens will not replace doors nor parts that exhibit the above characteristics associated with this finish. These characteristics are not avoidable and are a result of the natural characteristics of wood and wood veneer, and the characteristics of darker stains on wood.

KG-2-37



### **CABINETRY DOOR HARDWARE**

Cortina Kitchens' cabinetry doors and drawer fronts will be drilled to accept a standard knob or handle selected from Cortina's hardware boards. This drilling comes standard with the order, and is done ONLY in our shop, not on the job site.

For those not wanting Cortina's hardware drilling, the following applies:

No holes to be drilled on the doors and drawer fronts should be specified in writing on the colour chart and the P.O. If while in production, Cortina Kitchens misses this request, Cortina Kitchens and the Builder will not be held responsible to replace any or all doors and drawer fronts affected, and the customer agrees to accept the product as is. No hardware will be supplied or credited by Cortina Kitchens with this request. No charge will apply for this request.

### **PVC DOORS**

All cabinets with PVC (Thermofoil) Doors come with melamine gables, panels and kick. The doors, crown moulding and light valance are PVC wrapped. Open shelves incorporated in design will only be available with melamine interiors. There will be variations in colour shades between the PVC parts (doors, crown and Light valance) and the melamine parts (open shelves, Gables, Panels and Kick) due to the difference in material.

Furring Panel with crown moulding to the ceiling is not available on all PVC door styles due to subtle variations in colour shades between the PVC parts (moulding) and the melamine parts (furring panel) due to the difference in material. Grain directions in wood grain pattern melamine, vary between the furring panel, crown moulding (horizontal) and the PVC doors (vertical).

### **GRANITE, MARBLE ENGINEERED SURFACES WAIVER**

Granite and marble are naturally occurring products, and due to the many variables that can affect the pattern, colour and/or design and "pitting" of natural products slabs installed will not be identical to the samples displayed. We will make every attempt to come as close to the samples as possible, but cannot be responsible for results which differ from the samples. Every effort is made to provide granite counter tops as close as possible but the vendor is not responsible for results which differ from the sample displayed. All countertop surfaces may have seams & product pattern & shade can change in areas containing seams.

### **RESELECTIONS**

It is not uncommon for flooring, such as tile, to become discontinued prior to its installation. Therefore it may be necessary to make a reselection of certain materials sometime during the build process. We cannot assure you that another choice approximating your selection will be available.

### **PLANS**

Plans are subject to change without notice. Actual usable floor space may vary from the stated floor area. Layout for kitchen, furnace, HWT and laundry tub may vary from plan. Vertical and horizontal bulkhead, which are not shown on plan, may be required for plumbing and heating runs. E.& O.E.

### **PLEASE NOTE:**

In the event the work on the house has progressed beyond the point where the items covered by these invoices cannot be installed without entailing any unusual expense, then this order is to be cancelled and any deposit paid in connection with the same is to be refunded to the purchaser.

The vendor will undertake to incorporate the work covered by the sales extra in the construction of the house but will not be liable to the purchaser in any way, if for any reason the work covered by the extra is not carried out. In that event, any monies paid in connection with the same shall be returned to the purchaser.

It is understood and agreed that if for any reason whatsoever the transaction of Purchase and Sale is not completed, the total cost of extras ordered are not refundable to the Purchaser(s).

Extras or changes will not be processed unless signed by the Vendor.

These extras may not be amended without the written consent of Gold Park Homes.

The purchaser(s) and the builder acknowledge and agree that this "Purchaser's Extra" form shall not be deemed to be part of the agreement of purchase and sale entered into between them, nor an addendum thereto.

No postdated cheques will be accepted.

No estimates or orders will be accepted once construction has commenced.

Should a refund be requested on any extras purchased, an 80% reimbursement of the purchase price will be given. (a \$50.00 minimum charge and a maximum \$250.00 charge will apply)

Estimates will only be considered when resubmitted on a signed Purchaser Extras form, accompanied by payment in full.

All prices are estimates only and may be subject to change. Should a change in price occur Gold Park Homes reserves the right to request from the purchaser an adjustment of the price or a refund limited to that item.

Purchasers are aware & accept that ANY changes made to upgrades after signing the Purchasers Extra Form are subject to a minimum administration fee of \$500. PLUS a 10% holdback fee.

Purchasers are aware that any request to add a percentage of upgrades from the purchaser's extras form will be processed only after the builder receives approval letter from the bank.

KG2-37  
JP KW

Please be advised that your failure to finalize your structural or colour selections may result in a delay in construction of your dwelling and we may have to extend closing of your transaction. Due to failure to complete the above-mentioned selections and at no fault of us, we reserve our right to hold you responsible for a delayed closing, including charging extra administration cost and interest on the balance due on closing.

Purchaser has attended a Colour appointment at the Decor Centre & has DECLINED any additional upgrades and accepts and acknowledges that there will be no further structural changes/additions/deletions to be made upon signing.

I hereby acknowledge reading and understanding the above copy and will not hold Gold Park Homes responsible for any issues in relation to above.

Purchasers Signatures

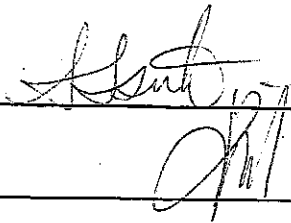
  
\_\_\_\_\_

Date March 16, 2017

KG2-37

STANDARD HARDWARE



CSI-6



CSI-10



CSI-14

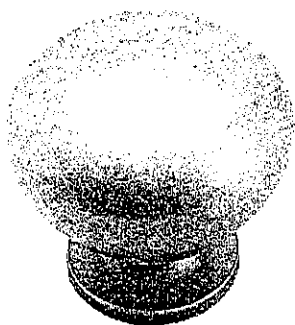

CSI-16

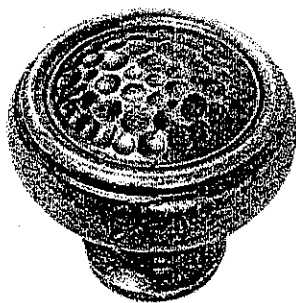

CSI-18

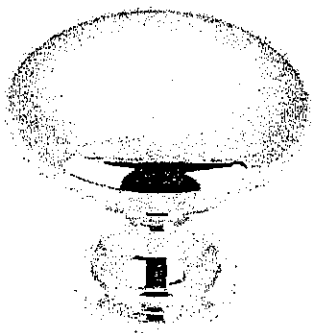

CSI-19

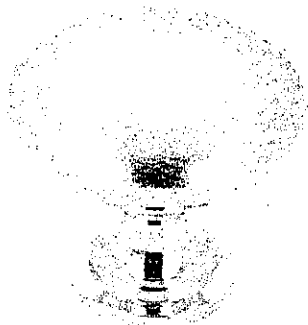

CSI-20

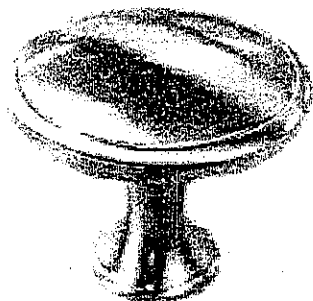

CSI-21

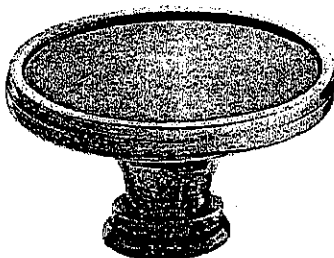

CSI-22

▶ KITCHEN / MASTER ENS. / ENS 2 / TWIN BATH

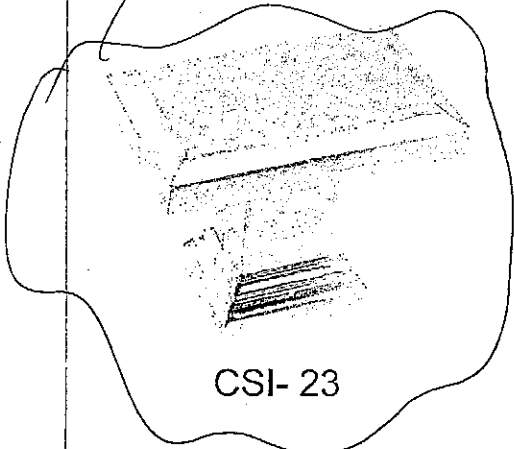

CSI-23

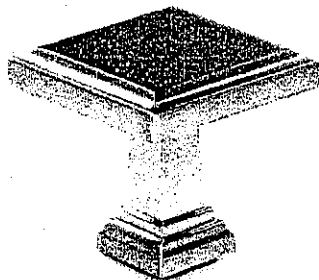

CSI-24

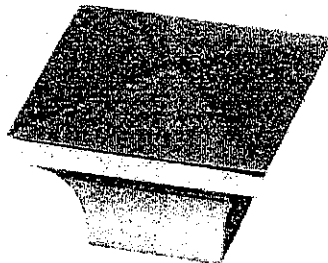

CSI-25

**\*NOTES:**  
- IMAGES ARE FOR QUICK REFERENCE PURPOSES ONLY  
- ACTUAL SIZES AND FINISHES AS PER HARDWARE  
SAMPLE BOARD PROVIDED TO DECOR CENTRE

K62-37

KM AS

APRIL 2, 2017

GOLDPARK  
HOMES

Kleinburg

Granite, Marble,  
Engineered Surfaces

- Standard 2CM & 3CM
- Upgrade 1 2CM & 3CM
- Upgrade 2 4 CM
- Upgrade 2

20mm (3/4") Profiles



20mm (3/4") Profiles

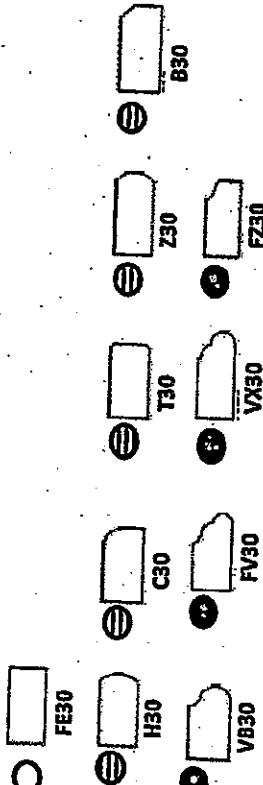

40mm (1 1/2") Profiles

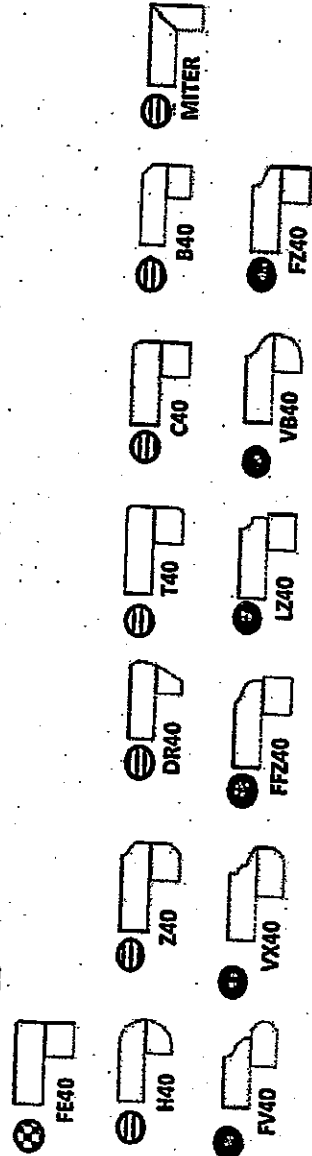

Note: All colours may not be available in 30mm at time ordered. Vendor reserves the right to use 40 mm edges (by lamination process).

\*Mitre edge is available in Upgrade 1 for an overall thickness of 2". All other Mitre edge options will be an Upgrade 2 Edge.

K62-37



APRIL 2, 2017

KURZEN  
(SOD SINK)



Foyer

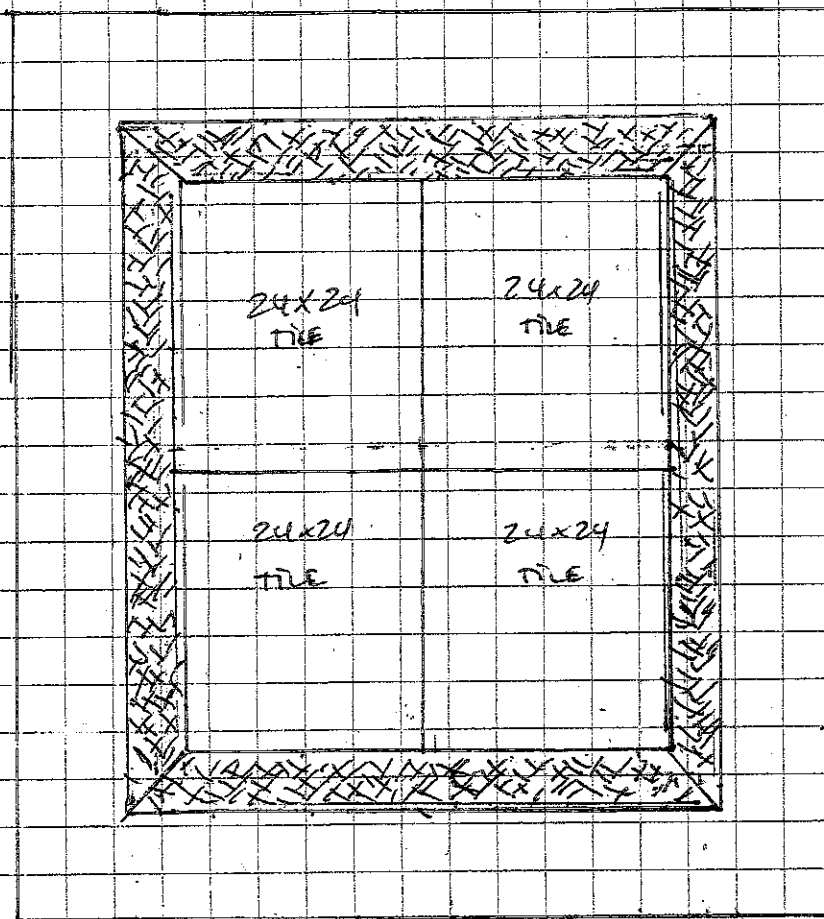

APPROX 3.5 inch Inlay Border.

- \* MARBLE MOSAIC - POLISHED TUNIA  
HERINGBONE 0.6x1.3  
(CODE # GR. TUNIA HER. BON)
- \* 4 full 24x24" TILES  
IN THE CENTER  
(24x24 VOLKAS WHITE POL.)

K62-37



APRIL 2, 2007

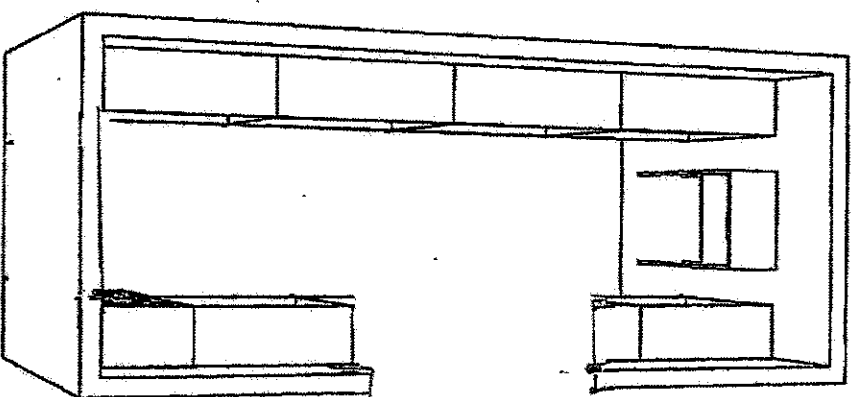

REVISED  
CUBES/LANGUET

The Home Organizer		GPH MODEL 42-1		Perspective	
<YOUR ADDRESS>					
<YOUR CITY AND STATE>		GPH MODEL 42-1 Room 1			
PHONE <YOUR PHONE NUMBER> FAX <YOUR FAX NUMBER>				Current Date: Feb 07, 2017	
				Scale: NTS	

K62-37



Designed by:

ofm

097FB0262A834FD...

DATE:

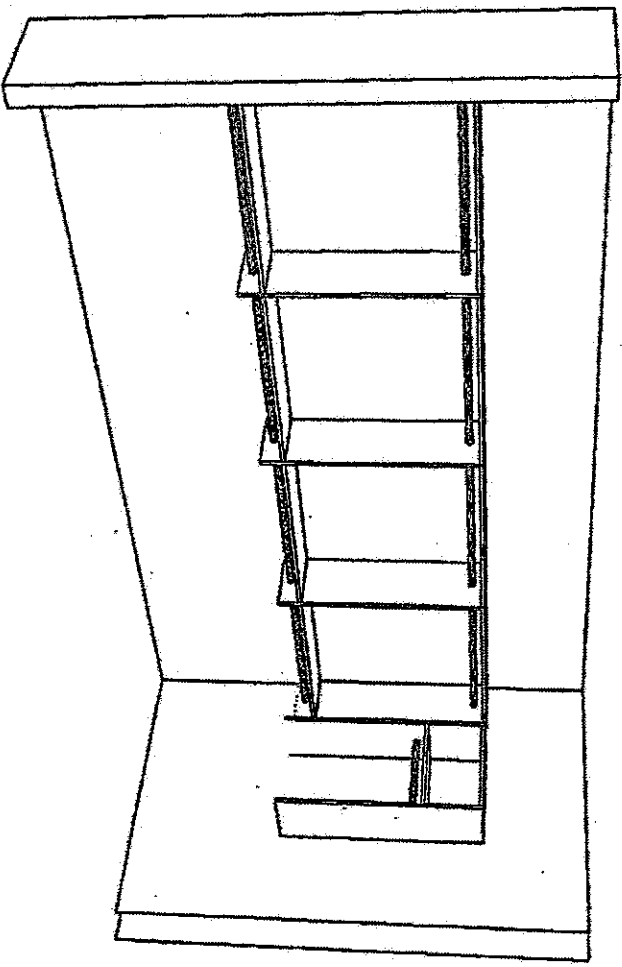

Revised  
CLOSET  
LAYOUT

SEE PLAN VIEW

The Home Organizer		GPH MODEL 42 - 1		Perspective	
<YOUR ADDRESS>					
<YOUR CITY AND STATE>		GPH MODEL 42 - 1 Room 1			
<PHONE> <YOUR PHONE NUMBER> Ext. <YOUR FAX NUMBER>				Current Date: Feb 07, 2017	
				Scale: NTS	



KG2-37

DATE: APR-13-2017

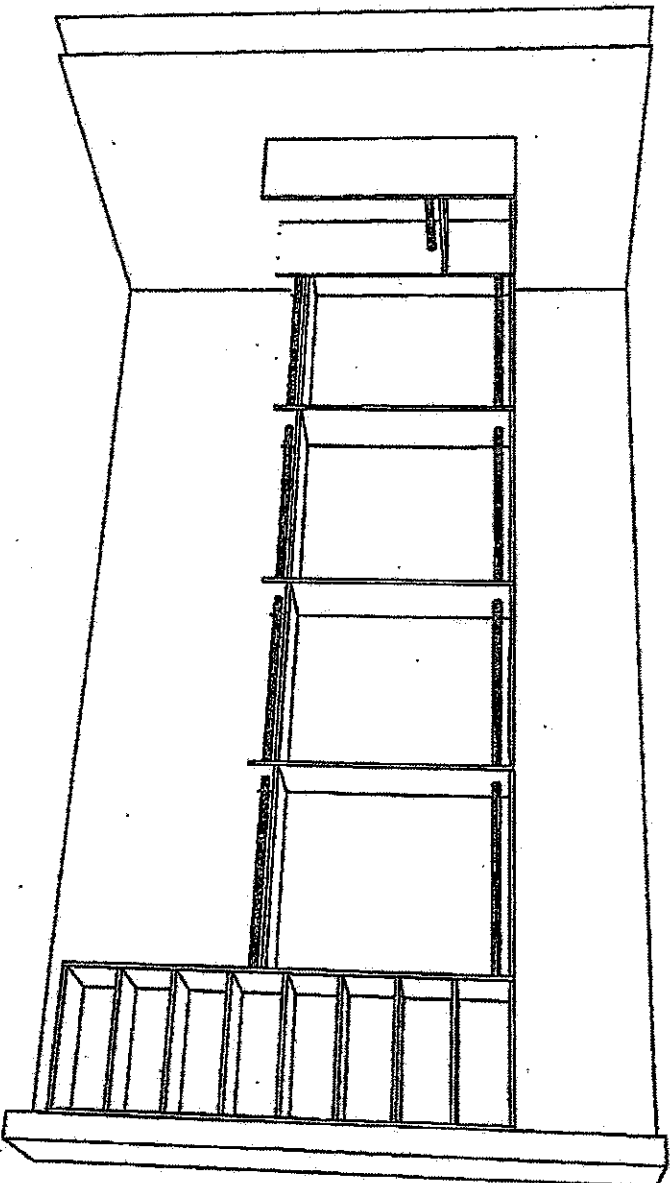

REUSED  
CLOSET LAYOUT  
SEE PLANS VIEW D

K62-37



DME, Apr-13-2017

The Home Organizer		Perspective	
<YOUR ADDRESS>			
<YOUR CITY AND STATE>			
Phone: <YOUR PHONE NUMBER> Fax: <YOUR FAX NUMBER>			
GPH MODEL 42 - 1		Current Date: Feb 07, 2017	
GPH MODEL 42 - 1 Room 1		Scale: NTS	

# FOYER INLAY

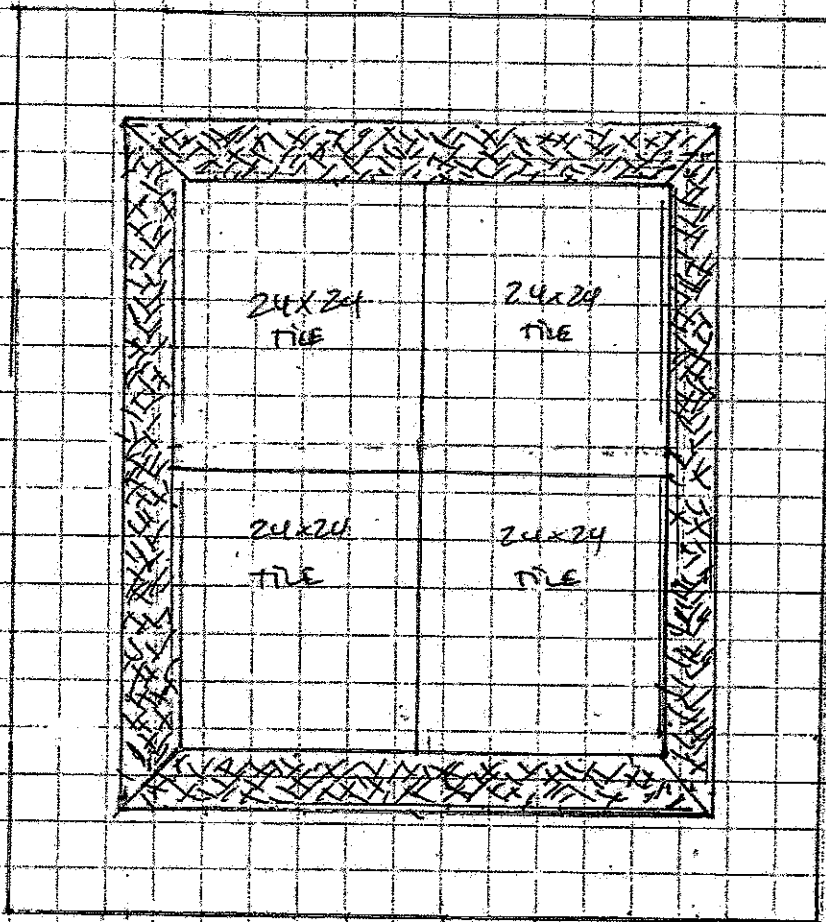

APPROX 3.5 inch Inlay Border.

\* MARBLE MOSAIC - POLISHED TURNA HERMIONENSE 0.6 x 1.3  
(CODE H GR. TURNA HER. BON)

\* 4 full 24x24" TILES  
IN THE CENTER  
(24x24 VOLKAS WHITE POL.)

K62-37

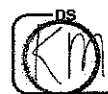

DATE: Apr-13-2017

# 30" Speed Combination Oven

800 Series – Stainless Steel HBL8752UC



KGZ 37

MADE IN GERMANY  
16.2017

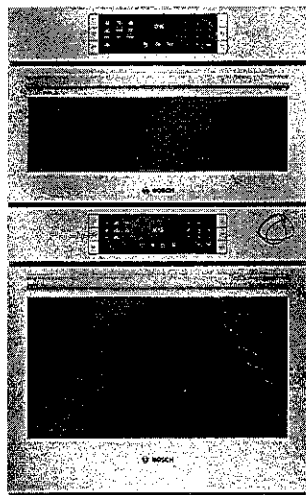

**HBL8752UC**  
Stainless Steel

The Bosch speed combination oven allows for faster cooking results and features a QuietClose® door.

## Features & Benefits

Cooks faster than a traditional oven and can be used as a microwave.

Dampened hinges softly and quietly guide the QuietClose® door shut.

A full-extension telescopic rack offers safe access to the oven cavity.

The wall oven is designed to be installed flush with cabinetry.

## General Properties

**Cooking modes – upper cavity** Speed oven; 12 Auto Programs (including Auto Defrost, Melt Butter, Soften Ice Cream, Pizza), 9 Sensor Cook Programs, 9 SpeedChef™ Programs, Hi & Lo Broil, European Convection, Keep Warm, Frozen Foods

**Cooking modes – lower cavity** Bake, Variable Broil (hi & low), Roast, Warm, Sabbath, Proof Dough, Convection Bake, Convection Broil, Convection Roast, Pizza, Multi Rack Genuine European Convection, Convection Conversion, Temperature Probe, Fast Preheat

**Cleaning type – lower** Self Clean

**Telescopic rack** 1

**Illumination type** Halogen (Upper and Lower)

**Interior lights** 1 Upper / 2 Lower

## Oven Performance

**Microwave power – upper cavity** 1000 W

**Bake / broil element wattages – upper cavity** 600 / 1,750 W

**Convection element wattages – upper cavity** 1,700 W

**Bake / broil element wattages – lower cavity** 2,400 / 3,800 W

**Convection element wattages – lower cavity** 2,000 W

## Technical Details

**Watts (W)** 9,600 W

**Circuit breaker (A)** 40 A

**Volts (V); Frequency (Hz)** 240 / 208 V; 60 Hz

**Power cord length (in)** 50"

**Plug type** Hardwired 240 V

**Energy source** Electric

## Dimensions & Weight

**Overall appliance dimensions (HxWxD)(in)** 49" x 29 3/4" x 24 1/2"

**Required cutout size – Standard (HxWxD) (in)** 48 5/8" x 28 1/2" x 23 1/2"

**Required cutout size – Flush (HxWxD) (in)** 49 1/8" x 30" x 24 1/2"

**Oven cavity size – upper** 1.6 cu. ft.

**Overall upper oven interior dimensions (HxWxD) (in.)** 9 7/8" x 16 1/2" x 16 1/2"

**Turntable – Metal Max. Cookware – upper** 12 3/4" dia.

**Turntable – Ceramic Max. Cookware – upper** 12 1/2" dia.

**Rack – Rectangular Cookware Max. – upper** 15" x 12"

**Oven cavity size – lower** 4.6 cu. ft.

**Overall lower oven interior dimensions (HxWxD) (in)** 17 13/16" x 24 1/8" x 18"

**Usable lower oven interior dimensions (HxWxD) (in)** 12 5/16" x 23 1/4" x 15 1/4"

**Net weight (lbs)** 259 lbs

## Accessories—Included

Upper Oven: Metal Turntable, Square rack, Ceramic Cooking Tray  
Lower Oven: 1 Telescopic and 2 Standard Oven Racks, Meat Probe

## Accessories—Optional

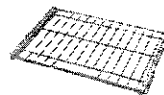

**HEZTR301**  
30" Telescopic Rack



\*Wall oven only

For help and assistance with Bosch accessories please call 1-800-944-2904 Mon-Fri 8am to 6pm EST

Notes: All height, width and depth dimensions are shown in inches. BSH reserves the absolute and unrestricted right to change product materials and specifications, at any time, without notice. Consult the product's installation instructions for final dimensional data and other details prior to making cutout. Applicable product warranty can be found in accompanying product literature or you may contact your account manager for further details.

Warranties: Bosch warrants that the Product is free from defects in materials and workmanship for a period of three hundred and sixty-five (365) days from the date of purchase. The foregoing timeline begins to run upon the date of purchase, and shall not be stalled, tolled, extended, or suspended, for any reason whatsoever. This Product is also warranted to be free from cosmetic defects in material and workmanship (such as scratches of stainless steel, paint/porcelain blemishes, chip, dents, or other damage) to the finish of the Product, for a period of thirty (30) days from the date of purchase or closing date for new construction. This cosmetic warranty excludes slight color variations due to inherent differences in painted and porcelain parts, as well as differences caused by kitchen lighting, product location, or other similar factors. This cosmetic warranty specifically excludes any display, floor, "As Is", or "B" stock appliances.

For more information on our entire line of products, go to [www.bosch-home.ca](http://www.bosch-home.ca) or call 1-800-944-2904

© BSH Home Appliances Limited. All rights reserved. Bosch is a registered trademark of Robert Bosch GmbH.

# 30" Speed Combination Oven

800 Series – Stainless Steel HBL8752UC



K62-37

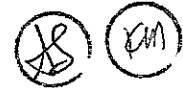

MAR 16, 2017

## Installation Details

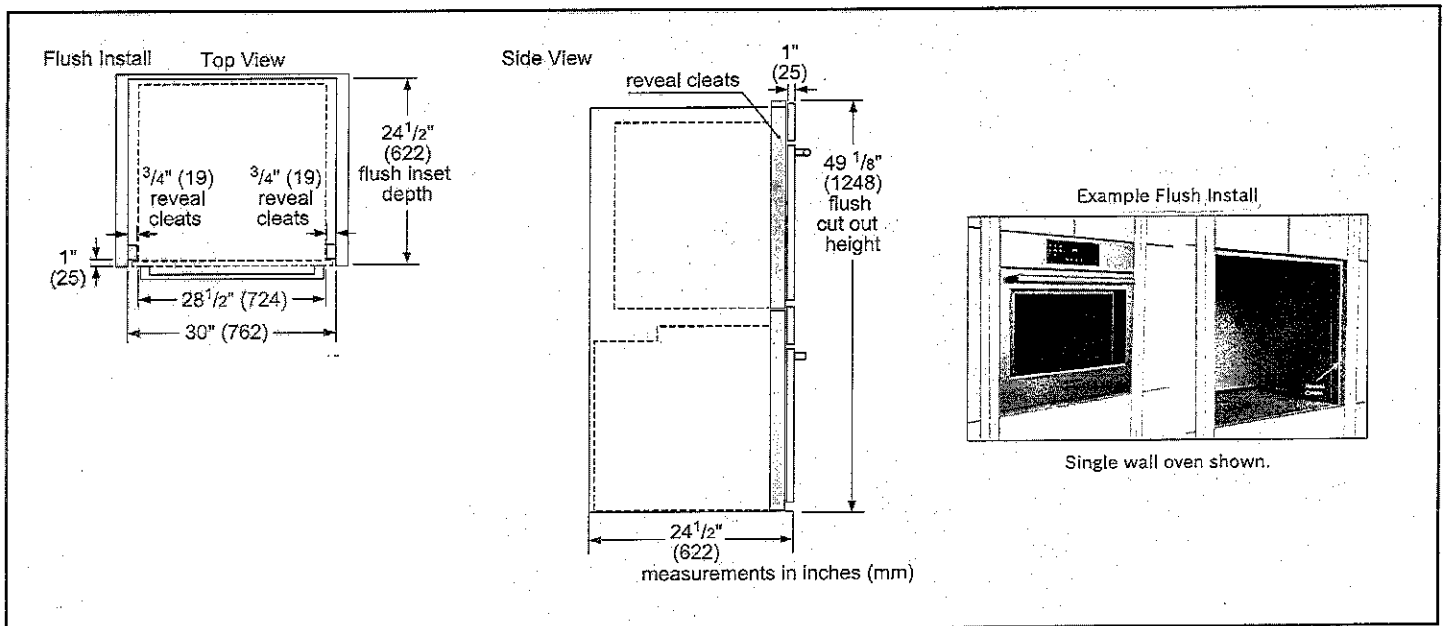
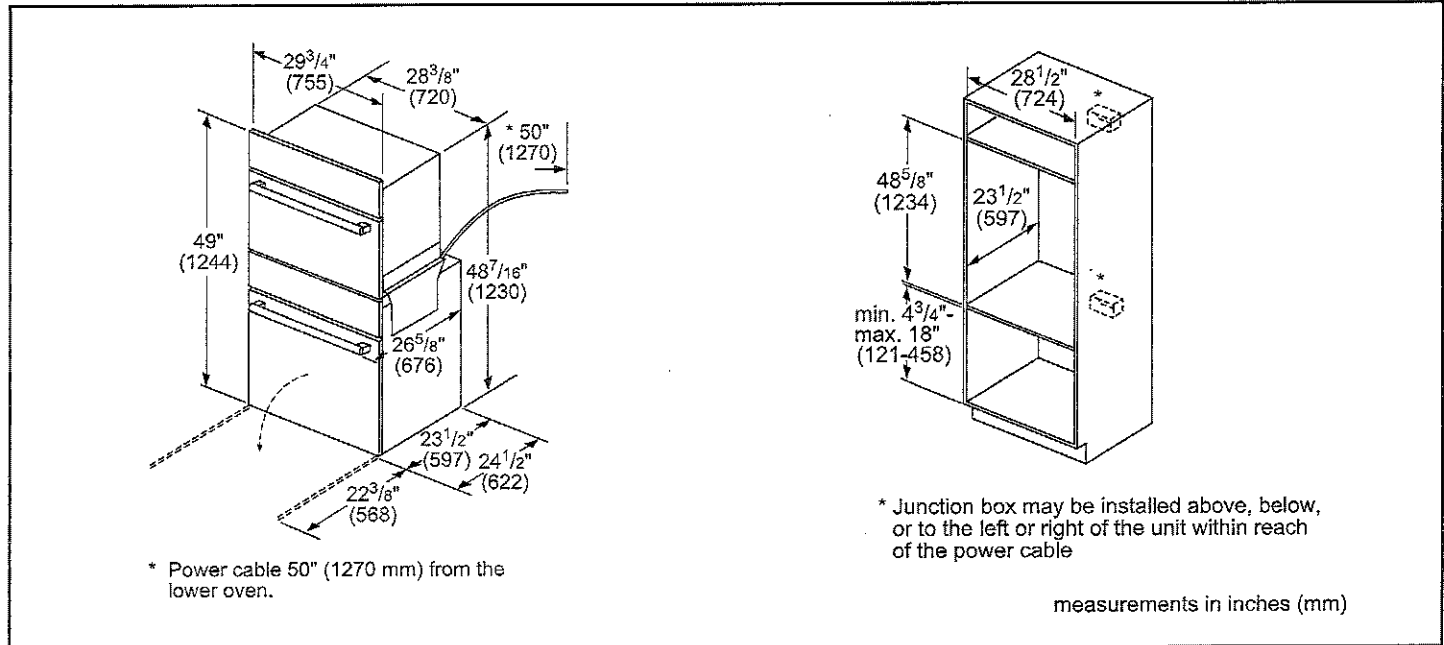

For help and assistance with Bosch accessories please call 1-800-944-2904 Mon-Fri 8am to 6pm EST

Notes: All height, width and depth dimensions are shown in inches. BSH reserves the absolute and unrestricted right to change product materials and specifications, at any time, without notice. Consult the product's installation instructions for final dimensional data and other details prior to making cutout. Applicable product warranty can be found in accompanying product literature or you may contact your account manager for further details.

Warranties: Bosch warrants that the Product is free from defects in materials and workmanship for a period of three hundred and sixty-five (365) days from the date of purchase. The foregoing timeline begins to run upon the date of purchase, and shall not be stalled, tolled, extended, or suspended, for any reason whatsoever. This Product is also warranted to be free from cosmetic defects in material and workmanship (such as scratches of stainless steel, paint/porcelain blemishes, chip, dents, or other damage) to the finish of the Product, for a period of thirty (30) days from the date of purchase or closing date for new construction. This cosmetic warranty excludes slight color variations due to inherent differences in painted and porcelain parts, as well as differences caused by kitchen lighting, product location, or other similar factors. This cosmetic warranty specifically excludes any display, floor, "As Is", or "B" stock appliances.

For more information on our entire line of products, go to [www.bosch-home.com/us](http://www.bosch-home.com/us) or call 1-800-944-2904

© BSH Home Appliances Limited. All rights reserved. Bosch is a registered trademark of Robert Bosch GmbH.

# 30" Speed Combination Oven

800 Series – Stainless Steel HBL8752UC



K2-37



MAR. 16. 2017

## Installation Details

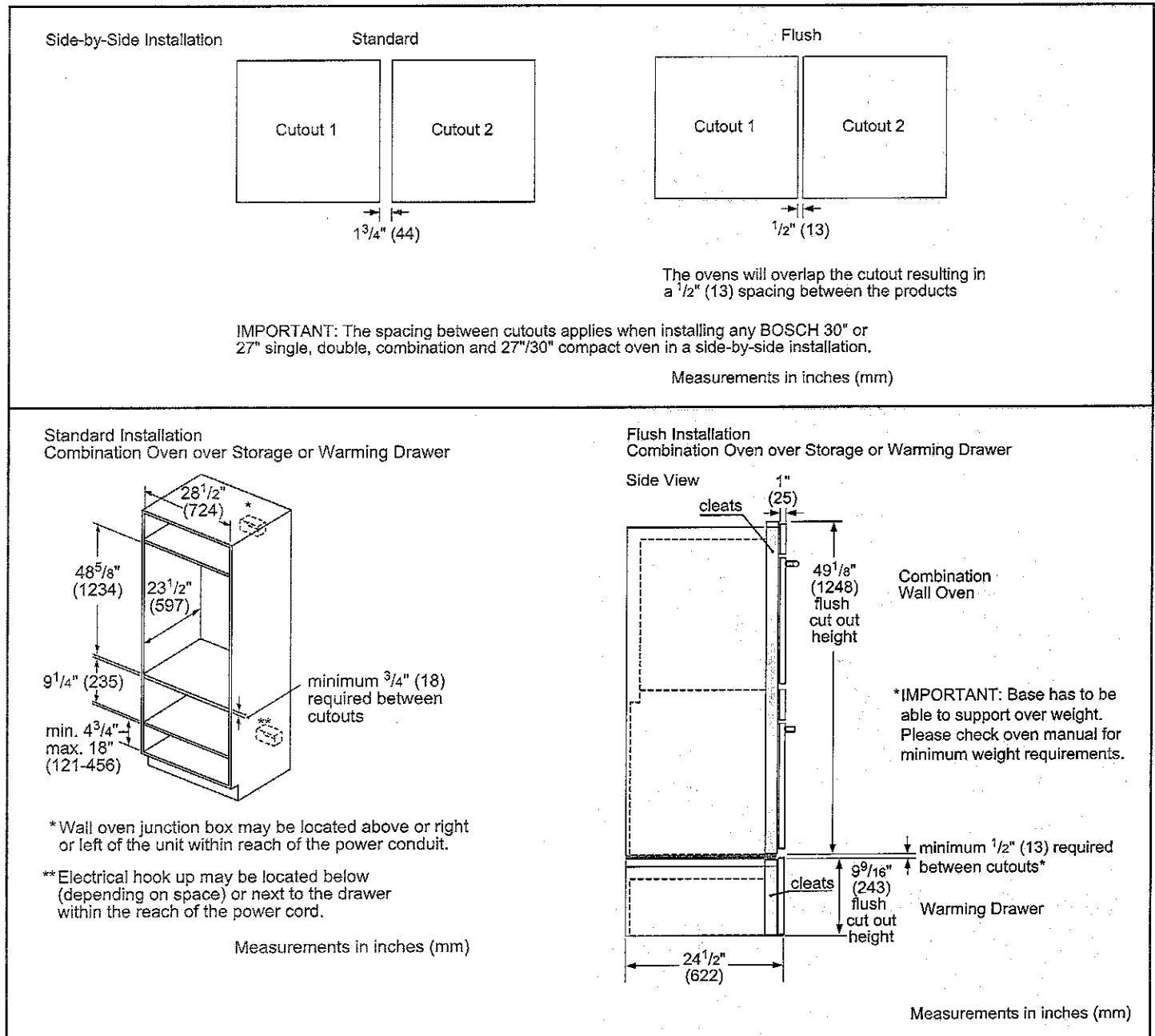

For help and assistance with Bosch accessories please call 1-800-944-2904 Mon-Fri 8am to 6pm EST

Notes: All height, width and depth dimensions are shown in inches. BSH reserves the absolute and unrestricted right to change product materials and specifications, at any time, without notice. Consult the product's installation instructions for final dimensional data and other details prior to making cutout. Applicable product warranty can be found in accompanying product literature or you may contact your account manager for further details.

Warranties: Bosch warrants that the Product is free from defects in materials and workmanship for a period of three hundred and sixty-five (365) days from the date of purchase. The foregoing timeline begins to run upon the date of purchase, and shall not be stalled, tolled, extended, or suspended, for any reason whatsoever. This Product is also warranted to be free from cosmetic defects in material and workmanship (such as scratches of stainless steel, paint/porcelain blemishes, chip, dents, or other damage) to the finish of the Product, for a period of thirty (30) days from the date of purchase or closing date for new construction. This cosmetic warranty excludes slight color variations due to inherent differences in painted and porcelain parts, as well as differences caused by kitchen lighting, product location, or other similar factors. This cosmetic warranty specifically excludes any display, floor, "As Is", or "B" stock appliances.

For more information on our entire line of products, go to [www.bosch-home.ca](http://www.bosch-home.ca) or call 1-800-944-2904

© BSH Home Appliances Limited. All rights reserved. Bosch is a registered trademark of Robert Bosch GmbH.



SECTION 1

STANDARD INSTALLATION

1/4" FRAMED PANELS

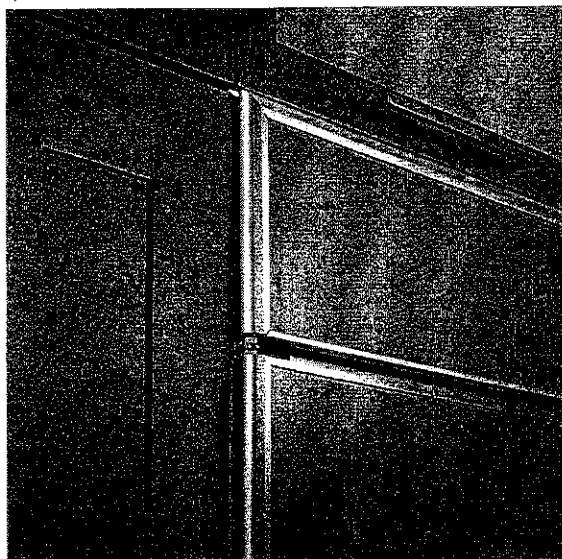

3/4" OVERLAY PANELS

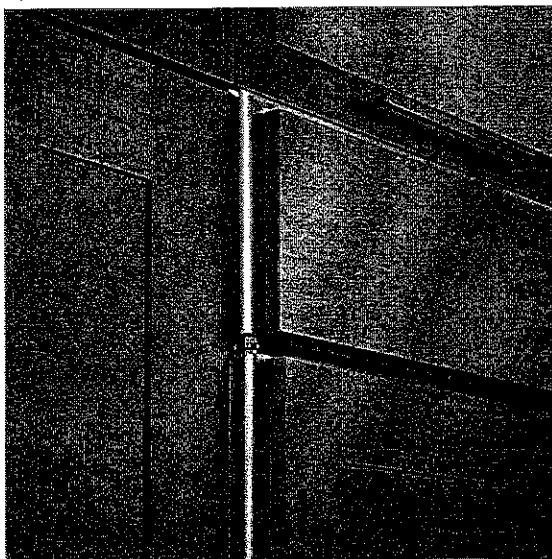

SECTION 2

FLUSH INSET INSTALLATION

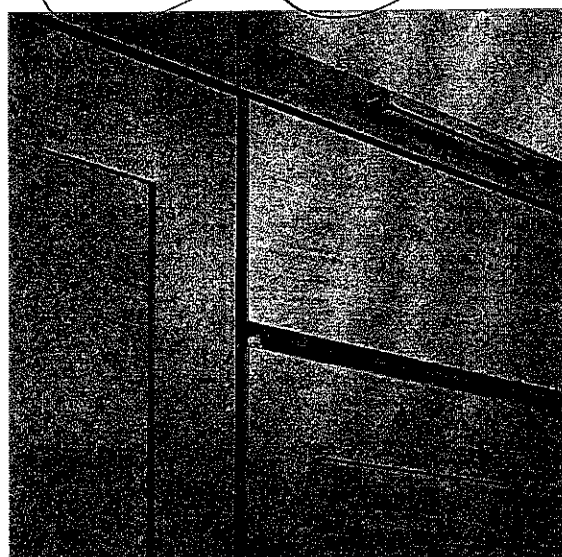

K6-2-37

AS KM

MAR. 16. 2017

MONOGRAM

# MONOGRAM 48" BUILT-IN SIDE-BY-SIDE REFRIGERATOR

ZISB480DK

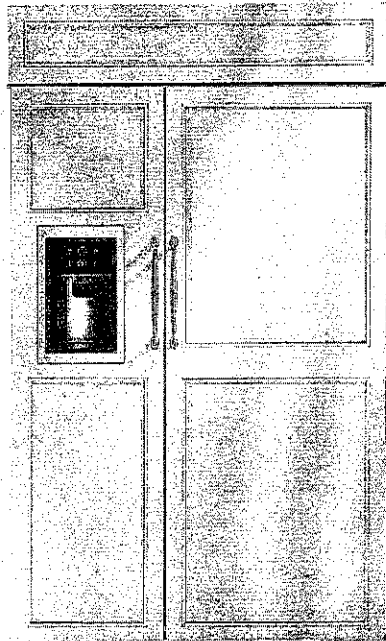

## SPECIFICATIONS

Overall Width	50" (127.0 cm) <sup>†</sup>
Overall Height	84 1/2" (214.6 cm) <sup>†</sup>
Overall Depth	26" (66.0 cm) <sup>†</sup>
Door Clearance	28 5/8" (72.1 cm)
Cutout Width	51" (129.5 cm)
Cutout Height	85" (215.9 cm)
Cutout Depth	26 3/16" (66.5 cm)
Plumbing Requirements	1/4" OD copper tubing or GE SmartConnect kit
Shipping Weight	775 lb (351.5 kg)

<sup>†</sup> Dimensions include 3/4" custom cabinet panel

## ATTENTION ELECTRICIAN:

A 115 volt 60Hz., 15 or 20 amp power supply is required. An individual properly grounded branch circuit or circuit breaker is recommended. Install a properly grounded 3-prong electrical receptacle recessed into the back wall.

## OVERALL DIMENSIONS AFTER PANEL INSTALL

## FLUSH INSET INSTALLATION

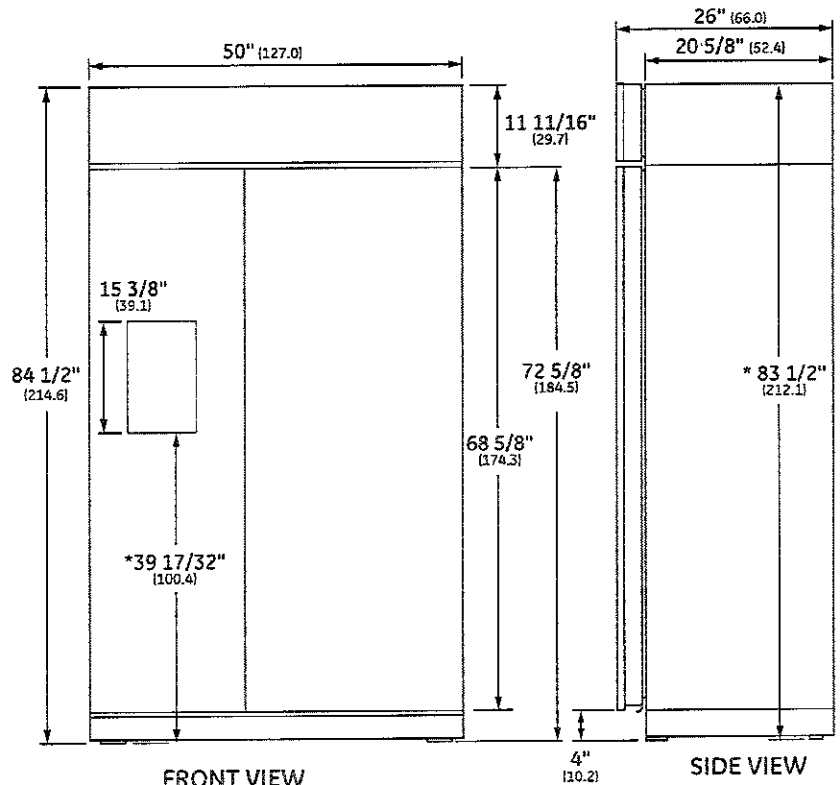

Use leveling legs and wheels for maximum 1" height adjustment from shipping height. Nominal installation height is 84"

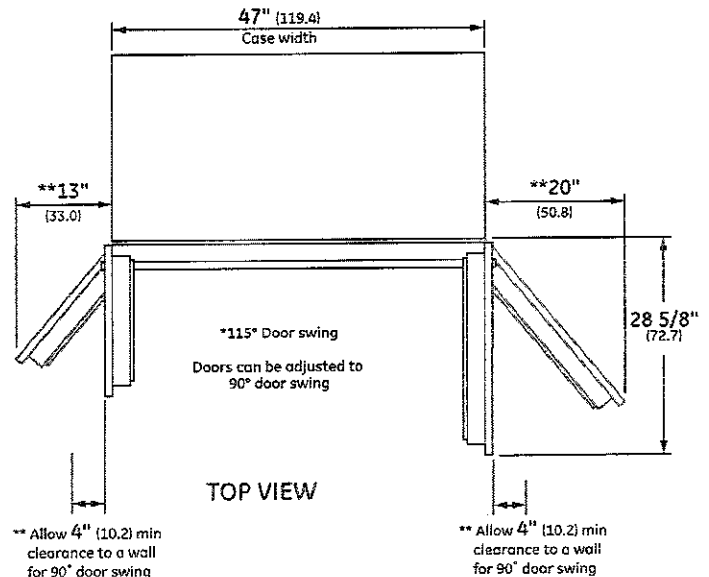

\*\* These refrigerators are equipped with a 2-position door stop. The factory-set 115° door swing can be adjusted to 90° if clearances to adjacent cabinets or walls is restricted. Allow a 15" minimum clearance to wall for pan removal. If the 90° door stop position is used, pan access is maintained, but pan removal is restricted.

Dimensions in parentheses are in centimeters unless otherwise noted. Actual product dimensions may vary due to manufacturing tolerances.

**MONOGRAM**

K62-37



MARCH 16, 2017

Product Specification Revised 10/16

## FLUSH INSET INSTALLATION 1/2" PANELS

## FLUSH INSET INSTALLATION

### NOTES

**A** Mounting the junction box in this location will also allow for front accessibility through access panel.

**B** Water supply area.

### ⚠ WARNING:

The refrigerator is top heavy and must be secured to prevent the possibility of tipping forward. Failure to do so may result in death or serious injury.

The information below is for cabinet design only. When installing the anti-tip system you must use the product installation instructions.

Determine your installation construction and required anti-tip configuration:

**C** Cut a 1" x 4" block 35" long. Measure and mark under the soffit, 5 3/8" from the front edge of the cabinet. Secure the wood block under the soffit. From the bottom of the block to the finished floor should measure 84".

**D** Wooden Wall Studs and No Soffit

- Cut a 2" x 4" block and secure to brackets provided.
- Secure brackets to back wall of opening at 84" or your installation height from the floor.

See Installation Instructions for detailed instructions.

K62-37

*(Handwritten signatures)*

MARCH 10, 2017

Product Specification Revised 10/16

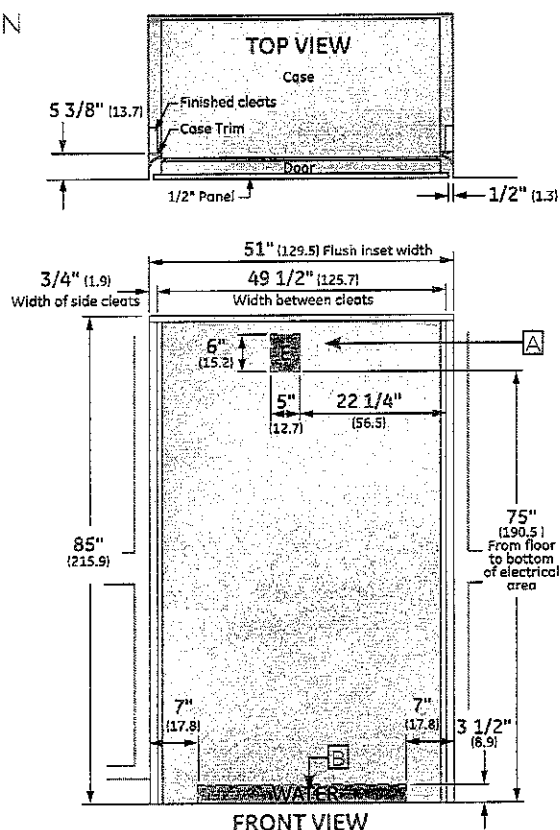

## ANTI-TIP BRACKET

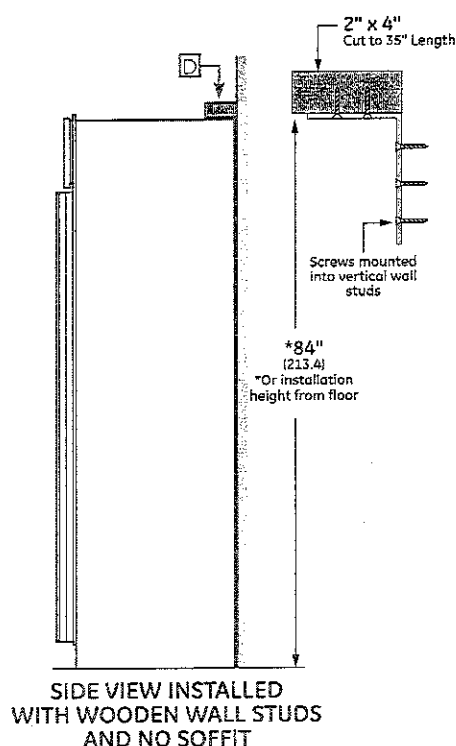
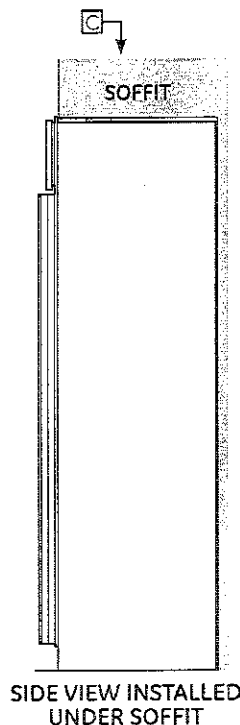

MONOGRAM

## 3/4" RAISED GRILLE PANEL ROUTING

NOTE: Routed areas should be finished as they may be visible when assembled.

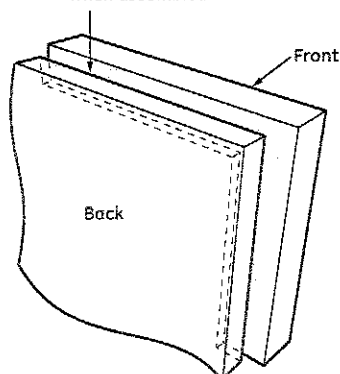

CORNER VIEW SHOWING "PICTURE FRAME" ROUTING

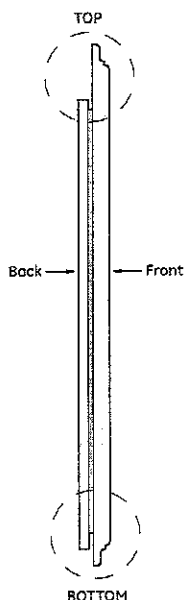
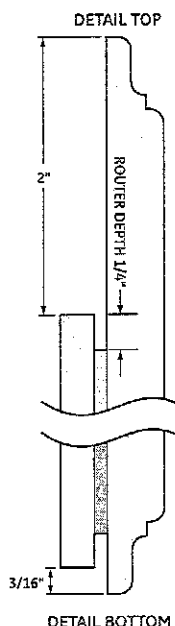

3/4" PANEL SIDE VIEW (AFTER ROUTING)

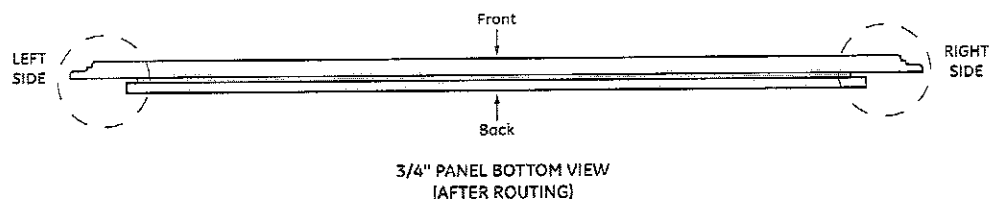
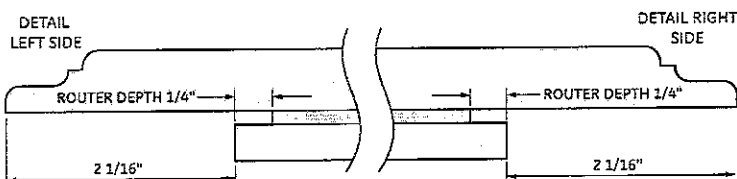

3/4" PANEL BOTTOM VIEW (AFTER ROUTING)

## FLUSH INSET INSTALLATION

### NOTES

Trimmed refrigerators are designed to be customized with decorative panels. Field-installed 1/2" or 3/4" custom door and grille panels are required. For 3/4" raised door and grille panels, routing is required. The router depth is 1/4" all the way around the panel's backs. Additional panel width reductions are required per the diagrams shown. This will create "picture frame" routing allowing the panels to slide into the attached door and grille trims.

Maximum total panel weight:

- Fresh food door panels - 75 lbs.
- Freezer drawer panel - 53 lbs.
- Grille panel - 18 lbs.

Door Handles

Door handle not included. A custom handle supplied by your cabinet maker may be used.

ZKHPSS1: Professional tubular stainless steel handle designed to fit 3/4" panels. Kit includes one handle - 30 1/2" long.

ZKHSS2: European tubular stainless steel handle designed to fit 3/4" panels. Kit includes one handle - 64 1/4" long.

FLUSH INSET 1/2" PANEL DIMENSIONS

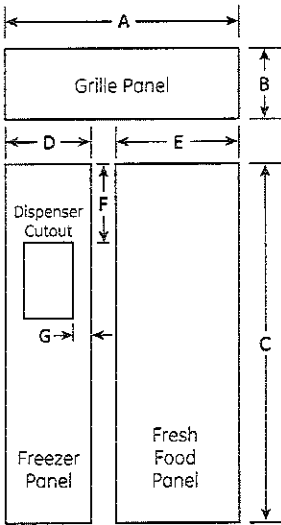

PANEL DIMENSIONS

	A	B	C	D	E
1/4" Backer Panel	45 7/8"	9 1/2"	68 3/8"	18 9/16"	29 9/16"
.10" Space Panel	45"	8 5/8"	67"	17 9/16"	25 9/16"
1/2" Overlay Panel	50"	11 3/16"	68 5/8"	20 7/8"	28 7/8"

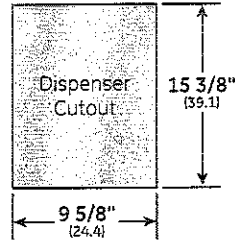

DISPENSER CUTOUT POSITION

F	G
17 23/32"	5 3/8"

FLUSH INSET INSTALLATION

NOTES

The 1/2" overlay panel must be secured to a .10" spacer panel and a 1/4" thick backer panel, which slides into the trim.

Assemble the panels with glue and screws:

- Center the spacer panel on the backer panel, left to right and top to bottom. Secure the panels with glue.
- Refer to the chart for locating the backer panel to the overlay panel. Secure the overlay panel to the backer panel with glue and screws. Screws must be countersunk into the backer panel.

Maximum total panel weight:

- Fresh food door panel - 75 lbs.
- Freezer drawer panel - 53 lbs.
- Grille panel - 18 lbs.

1/4" BACKER ASSEMBLY ROUTING DIMENSIONS

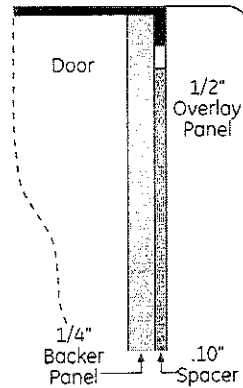
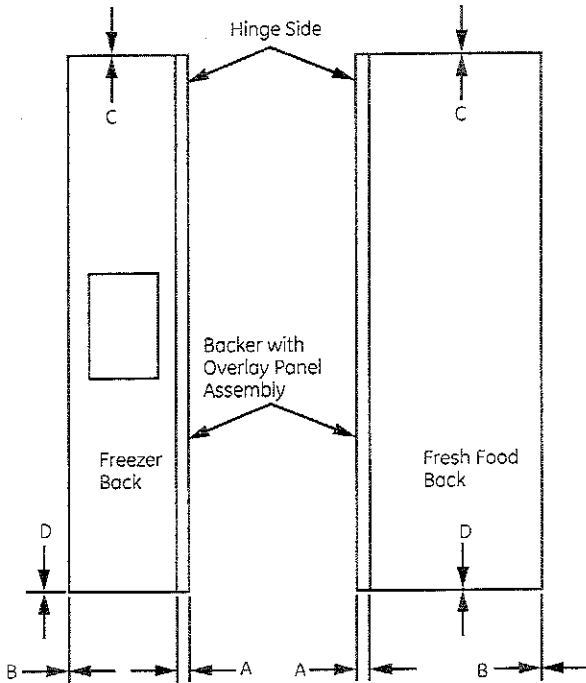

PANEL DIMENSIONS

	A	B	C	D
Fresh Food Panel	2 1/16"	1/16"	1/8"	1/8"
Freezer Panel	2 1/16"	1/16"	1/8"	1/8"
Grille Panel	2 1/16"	2 1/16"	1 15/32"	7/32"

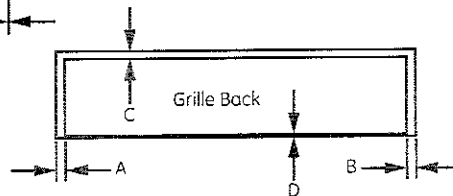

KG2-37

MA 10, 2017

Product Specification Revised 10/16

MONOGRAM

**MONOGRAM**

ZISB480DK

## Monogram 48" Built-In Side-by-Side Refrigerator with Dispenser

### Specifications

#### APPROXIMATE DIMENSIONS (HxWxD)

84 in x 48 in x 25 3/8 in

#### CAPACITY

Total Capacity (cubic feet)	30.10 cu ft
Fresh Food Capacity	17.60 cu ft
Freezer Capacity	12.50 cu ft

#### FEATURES

Temperature Management Features	Electronic Sensors; Multi-Shelf Air Management Tower
Control Type	Upfront Electronic Digital Temperature Display
Defrost Type	Auto
Icemaker	Factory-Installed
Dispenser	Extra-Tall w/ Cubes, Crushed Ice & Chilled Water
Dispenser Features	Child Lock; Disappearing Electronic Glass Touch with Proximity Sensor; Dispenser Light; Door Alarm; Water Filter Indicator Light
Water Filtration	GE Water Filtration 1 Year
Fresh Food Cabinet Shelves	4 Total
Fresh Food Cabinet Shelf Features	Adjustable
Fresh Food Door Bins	4
Fresh Food Door Features	Adjustable; Gallon Storage
Climate Control Drawer	Express Chill, Express Thaw, Select Temp
Deli Drawer	Adjustable Sealed w/ Full Extension Slides
Produce Drawer	High-Humidity Sealed w/ Full Extension Slides
Freezer Cabinet Shelves	5 Adjustable; 5 Total; Wire
Freezer Door Bins	3 Total
Freezer Utility Baskets	2
Clear Lexan Bins and Pans	Yes
Interior Lighting	LED Light Towers, Top LED and Pan LED Lighting
Leveling System	4 Point
Sabbath Mode Kit	Optional - ZSAB1
Exterior Style	Built-In

#### ECONOMICAL

Quiet Features	Black Sealed Adjustable Toe Kick
----------------	----------------------------------

#### APPEARANCE

Color Appearance	Custom Panels Required
Design Style	Custom Panel

monogram.ca

662-37

(B) (RM)

MARCH 16, 2017

# PRODUCT SPECIFICATIONS

Model	SRT366
Dimensions	35 7/8"W x 8 1/2"H x 28 1/2"D
Weight	220 lbs
Electrical Supply	110/120 VAC, 60 Hz
Electrical Service	15 amp dedicated circuit
Gas Supply	3/4" rigid pipe
Gas Inlet	1/2" NPT female
Receptacle	3-prong grounding-type

# ELECTRICAL AND GAS

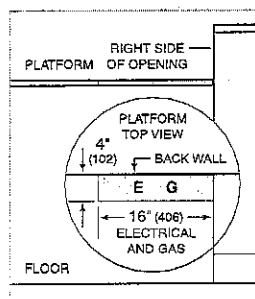

# DIMENSIONS

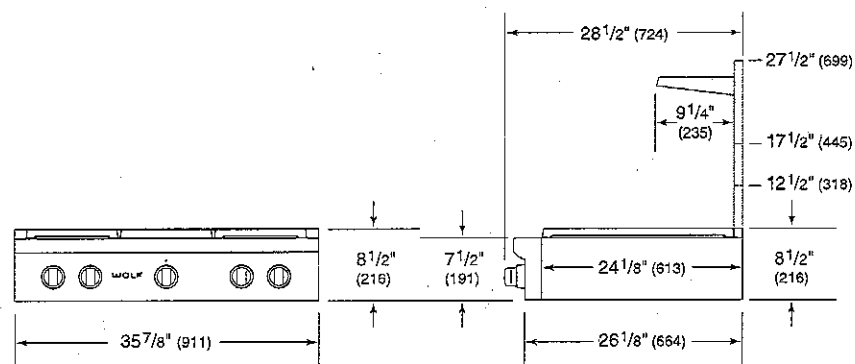

# STANDARD INSTALLATION

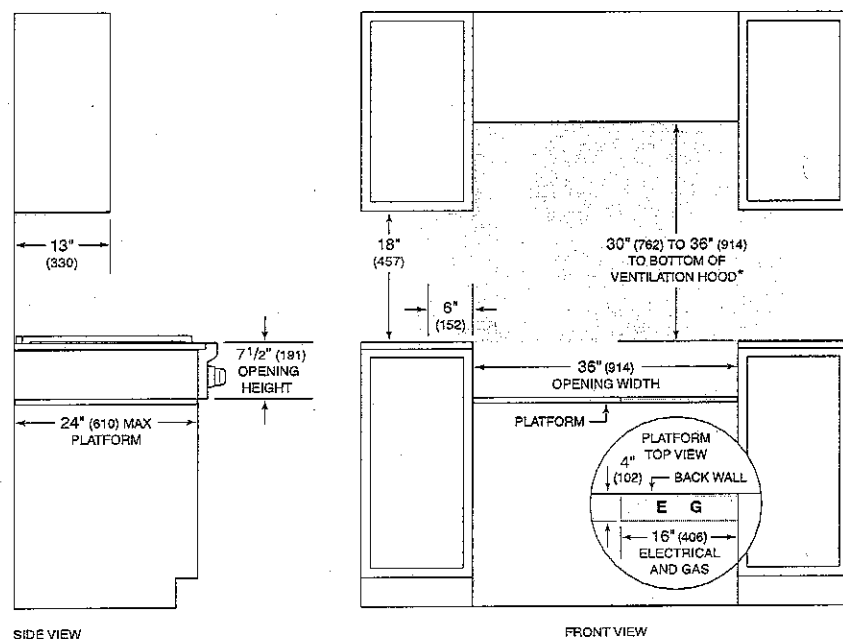

SIDE VIEW

FRONT VIEW

\*Without ventilation hood, 36" (914) minimum clearance countertop to combustible materials, 44" (118) for charbroiler.

NOTE: Shaded area above countertop indicates minimum clearance to combustible surfaces, combustible materials cannot be located within this area.

Electrical and gas supply located through bottom of platform.

For island installation, 12" (305) minimum clearance back of range to combustible rear wall above countertop.

**Miele**

PureLine  
Combi-Steam Oven

DGC 6800 XL



KG2-37

AS UM

MARCH 16, 2007



# PureLine Combi-Steam Oven DGC 6800 XL



## PRODUCT VIEWS

Isometric View

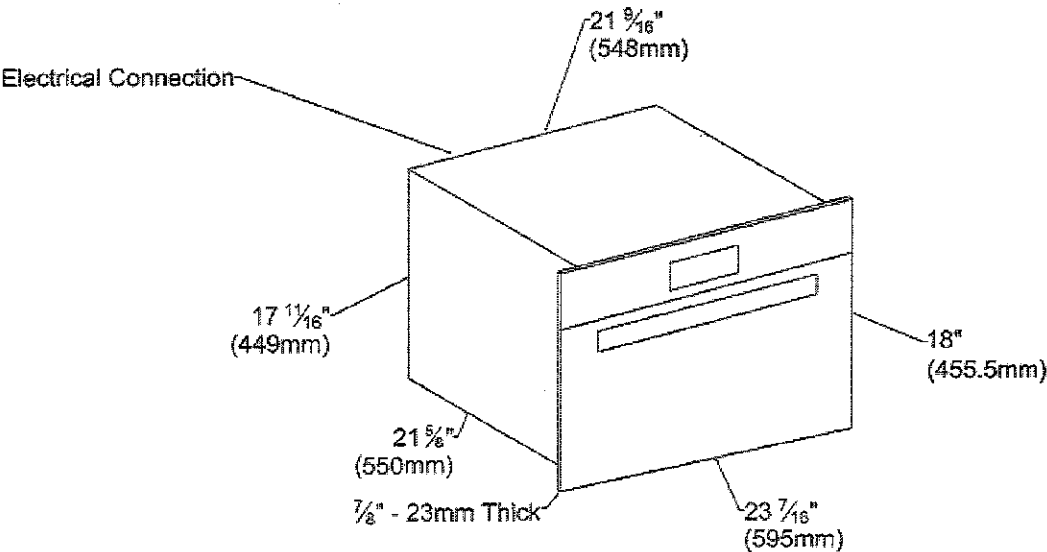

Front View

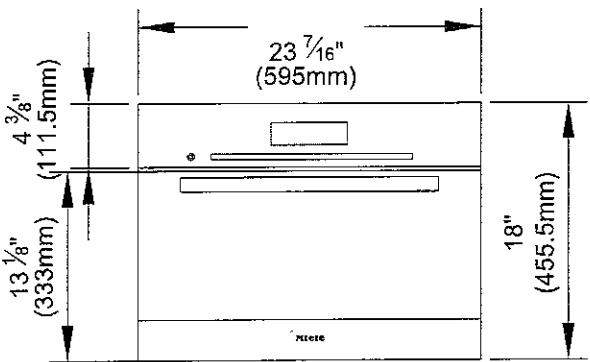

# PureLine Combi-Steam Oven DGC 6800 XL



## INSTALLATION SPECIFICATIONS

Top View, Door Open

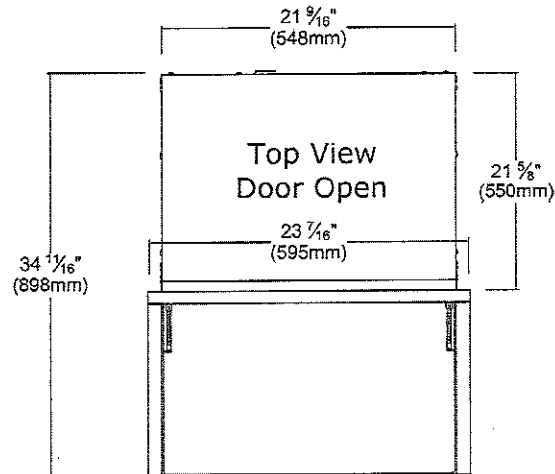

Side View

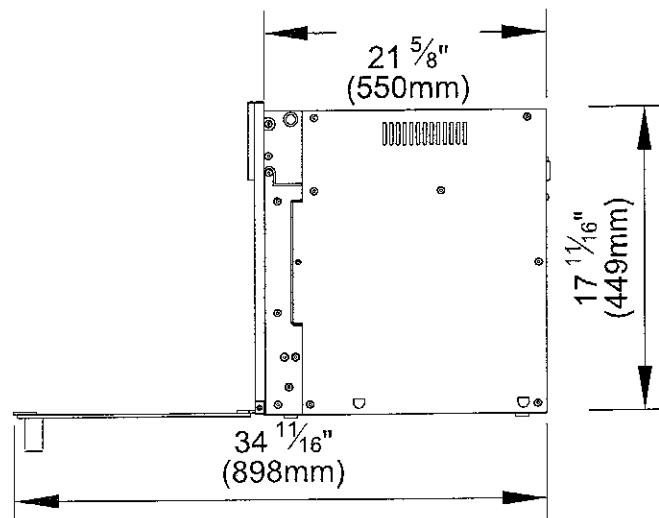

KG2-37



MARCH 16, 2017

# PureLine Combi-Steam Oven DGC 6800 XL



## INSTALLATION SPECIFICATIONS

### Tall Cabinet Installation

- ① Combi Steam Oven
- ② Installation niche
- ③ Power supply to the appliance
- ④ Recommended location for electrical connection
- ⑤ Power cord

\* Appliances with glass front  
\*\* Appliances with metal front

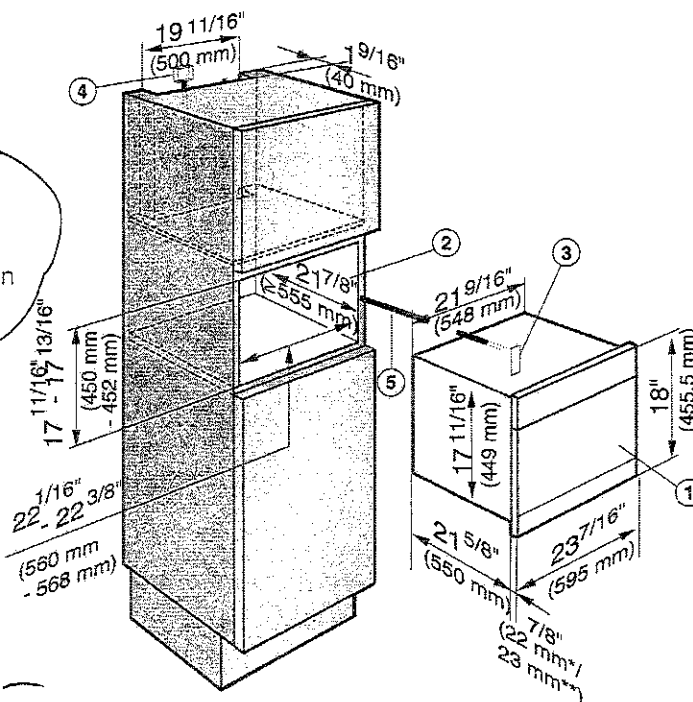

FLUSH INSTALLATION

### Tall Cabinet Installation — Venting Requirements

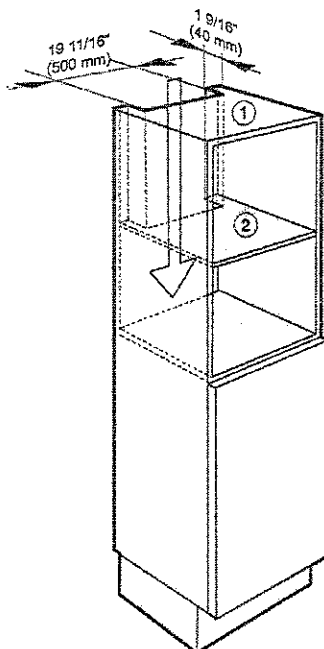

KG2-37



Wrote: 16. 2017

To ensure that the Combi Steam Oven has adequate ventilation, the following cut-outs measuring 19 11/16" x 1 9/16" (500 x 40 mm) must be made:

- ① in the top of the cabinet
- ② in the center shelf above the installation niche

The cabinet housing must not have a back panel fitted behind the installation niche.

# PureLine Combi-Steam Oven DGC 6800 XL



## INSTALLATION SPECIFICATIONS

Installation Above Warming Drawer

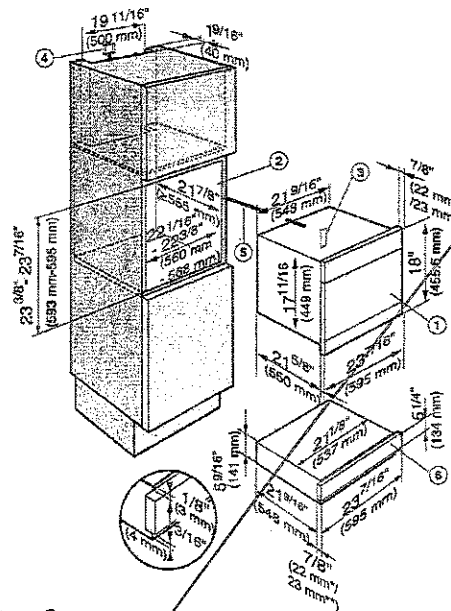

- ① Combi Steam Oven
- ② Installation niche
- ③ Power supply to the appliance
- ④ Recommended location for electrical connection
- ⑤ Power cord
- ⑥ Warming drawer

Installation Above Warming Drawer —  
Venting Requirements

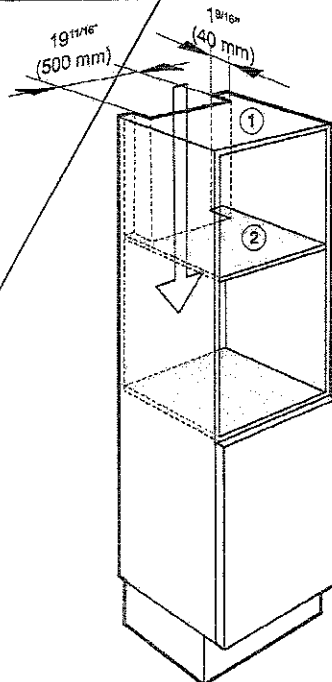

To ensure that the Combi Steam Oven has adequate ventilation, the following cut-outs measuring 19 11/16" x 1 9/16" (500 x 40 mm) must be made:

- ① in the top of the cabinet
- ② in the center shelf above the installation niche.

The cabinet housing must not have a back panel fitted behind the installation niche.

K6237

AS km

MARCH 16, 2017