



CONSTRUCTION SUMMARY

Kleinburg Glen - 37 - 2 - 42-1 Elev.A ROYALTON
CENTRAL VAC AND WIRING

Inv.1,249	1 - MASTER BEDROOM (APPROX. 55" AFF) / BEDROOM 3 / DEN (APPROX. 55" AFF) / GREAT ROOM (APPROX. 55" AFF): ROUGH IN- 4X- CAT 6 CONNECTIONS
Line19066	Note: Please see floorplan for locations
16Mar17 / 16Aug17	
Inv.1,249	1 - INSTALL VAC PAN UNDER KITCHEN SINK
Line19067	Note:
16Mar17 / 16Aug17	
Inv.1,249	1 - NILFISK CENTRAL VACCUM KIT SE 150 WITH MA10M ELECTRIC POWER HEAD
Line19080	Note:
16Mar17 / 16Aug17	
Inv.1,249	1 - SECURITY UPGRADE- ROUGH-IN FOR: 1 KEYPAD IN MASTER BEDROOM, 1 MOTION DETECTOR ON 2ND FLOOR, 1 GLASSBREAK DETECTOR ON MAIN FLOOR, 1 MOISTURE SENSOR IN BASEMENT
Line19083	Note: See floorplan for keypad location in Master Bedroom
16Mar17 / 16Aug17	

CERAMIC

Inv.1,249	1 - MASTER ENSUITE SHOWER: ADD SHOWER STALL SHAMPOO SHELF- 12 inch x 16 inch
Line23843	Note:
16Mar17 / 16Aug17	
Inv.1,249	1 - MASTER ENSUITE: DELETE ANGLE OF SHOWER AND MAKE SQUARE. PLEASE SEE FLOORPLAN FOR DETAIL
Line23844	Note:
16Mar17 / 16Aug17	
Inv.1,249	1 - SHOWER STALL SEAT- 12 inch x 30 inch- Linear
Line23855	Note:
16Mar17 / 16Aug17	

CONCRETE AND DRAIN

Inv.1,249	1 - BASEMENT: BACKFLOW PREVENTER VALVE
Line19068	Note:
16Mar17 / 16Aug17	

DRYWALL

Inv.1,249	1 - SMOOTH CEILINGS - (2 - Story Design) 2ND FLOOR
Line19082	Note:
16Mar17 / 16Aug17	
Inv.1,249	1 - OPTIONAL 10 FOOT TRAY CEILING - MASTER BEDROOM
Line23835	Note:
16Mar17 / 16Aug17	
Inv.1,249	1 - MAIN FLOOR CEILING 10FT, 8FT TALLER INTERIOR DOORS, TALLER FLAT ARCHES, REAR AND FRONT WINDOWS WITH TRANSOM, TALLER KITCHEN CABINETS WITH CROWN AND FURRING PANEL, ADDED STAIRS AND PICKETS
Line23840	Note:
16Mar17 / 16Aug17	
Inv.1,249	1 - MASTER ENSUITE SHOWER: ADD SHOWER STALL SHAMPOO SHELF- 12 inch x 16 inch
Line23842	Note:
16Mar17 / 16Aug17	



CONSTRUCTION SUMMARY

Kleinburg Glen - 37 - 2 - 42-1 Elev.A ROYALTON

Inv.1,249	1 - SHOWER STALL SEAT- 12 inch x 30 inch- Linear
Line23856	Note:
16Mar17 / 16Aug17	

ELECTRICAL

Inv.1,249	3 - MASTER BEDROOM / DEN / GREAT ROOM: Additional Interior Receptacle (not separate cicuit). Approx 55" AFF next to CAT 6 Wire
Line19079	Note: Please see floorplan for locations
16Mar17 / 16Aug17	

Inv.1,249	1 - KITCHEN: Additional 240V Receptacle for future Steam oven.
Line19090	Note: Please see floorplan for location. Right of Fridge
16Mar17 / 16Aug17	

Inv.1,249	1 - KITCHEN: 240V Wall Receptacle on dedicated circuit for double wall oven.
Line19093	Note: Please see floorplan for location
16Mar17 / 16Aug17	

Inv.1,249	1 - ENSUITE 2: Add 4 in. Potlight in Shower
Line20245	Note:
16Mar17 / 16Aug17	

Inv.1,249	1 - KITCHEN: GAS LINE ROUGH - MAIN FLOOR - (2 STOREY MODELS) FOR GAS STOVE- INCLUDES 110V PLUG ON SEPARATE CIRCUIT
Line23846	Note:
16Mar17 / 16Aug17	

Inv.1,249	1 - KITCHEN: Relocate sink location and dishwasher due to Island turned 90 degrees. See floorplan for location
Line23851	Note:
16Mar17 / 16Aug17	

Inv.1,417	1 - FOYER: Additional Interior Receptacle (not separate circuit), LOCATE IN APPROX. CENTER OF WALL. SEE PLAN FOR LOCATION.
Line22188	Note:
5Jun17 / 29Nov17	

Exterior Colours

Inv.1,249	1 - EXTERIOR COLOUR PACKAGE 4
Line23863	Note:
16Mar17 / 16Aug17	

FRAMING

Inv.1,249	1 - SHOWER STALL SEAT- 12 inch x 30 inch- Linear
Line20227	Note:
16Mar17 / 16Aug17	

Inv.1,249	1 - 2ND FLOOR - Extended doors and archway
Line20232	Note:
16Mar17 / 16Aug17	

Inv.1,249	1 - OPTIONAL 10 FOOT TRAY CEILING - MASTER BEDROOM
Line19064	Note:
16Mar17 / 16Aug17	



CONSTRUCTION SUMMARY

Kleinburg Glen - 37 - 2 - 42-1 Elev.A ROYALTON

Inv.1,249	1 - MAIN FLOOR CEILING 10FT, 8FT TALLER INTERIOR DOORS, TALLER FLAT ARCHES, REAR AND FRONT WINDOWS WITH TRANSOM, TALLER KITCHEN CABINETS WITH CROWN AND FURRING PANEL, ADDED STAIRS AND PICKETS
Line19065	Note:
16Mar17 / 16Aug17	
Inv.1,249	1 - MASTER ENSUITE SHOWER: ADD SHOWER STALL SHAMPOO SHELF- 12 inch x 16 inch
Line19077	Note: Please see floorplan for location
16Mar17 / 16Aug17	
Inv.1,249	1 - MASTER BEDROOM: Relocate Walk-in closet door. Add double door - please see floorplan for location
Line19086	Note:
16Mar17 / 16Aug17	
Inv.1,249	1 - GREAT ROOM / DINING ROOM: Add archway - 8ft wide and 8ft high. Leave 4ft on either side.
Line19088	Note: Please see floorplan for location
16Mar17 / 16Aug17	
Inv.1,249	1 - MASTER ENSUITE: Delete door to Water Closet
Line19092	Note:
16Mar17 / 16Aug17	
Inv.1,249	1 - MASTER ENSUITE: DELETE ANGLE OF SHOWER AND MAKE SQUARE. PLEASE SEE FLOORPLAN FOR DETAIL
Line23845	Note:
16Mar17 / 16Aug17	
Inv.1,249	1 - KITCHEN: UPGRADE VENTING FOR STOVE TO 8 INCH PIPE EXTERIOR WALL
Line23847	Note:
16Mar17 / 16Aug17	
Inv.1,249	1 - STANDARD DOOR EXTENDED HEIGHT 96 INCH (PRICE PER DOOR) - SECOND FLOOR 2 STOREY MODELS
Line23852	Note:
16Mar17 / 16Aug17	
Inv.1,249	1 - EXTENDED HEIGHT ARCHWAY (PRICE PER DOORWAY) - 2ND FLOOR
Line23853	Note:
16Mar17 / 16Aug17	
Inv.1,417	1 - FOYER: DELETE FOYER CLOSET
Line22183	Note: *NEW*
5Jun17 / 29Nov17	
Inv.1,417	1 - LAUNDRY ROOM: MOVE DOOR TO LAUNDRY ROOM (from hallway) TO OTHER SIDE OF CLOSET, SEE PLAN FOR LOCATION.
Line22187	Note: *NEW*
5Jun17 / 29Nov17	

GLASS AND MIRROR

Inv.1,249	1 - ENSUITE 2: CONVERT FRAMED SHOWER TO 10MM FRAMELESS SHOWER ENCLOSURE WITH DOOR AND 10MM SIDE PANEL
Line19073	Note:
16Mar17 / 16Aug17	
Inv.1,249	1 - MASTER ENSUITE SHOWER: CONVERT FRAMED SHOWER TO 10MM FRAMLESS SHOWER ENCLOSURE WITH DOOR AND 10MM SIDE PANEL
Line19074	Note:
16Mar17 / 16Aug17	



CONSTRUCTION SUMMARY

Kleinburg Glen - 37 - 2 - 42-1 Elev.A ROYALTON

Inv.1,249	1 - MASTER ENSUITE: DELETE ANGLE OF SHOWER AND MAKE SQUARE. PLEASE SEE FLOORPLAN FOR DETAIL
Line19078	Note:
16Mar17 / 16Aug17	

HVAC

Inv.1,249	1 - KITCHEN: GAS LINE ROUGH - MAIN FLOOR - (2 STOREY MODELS) FOR GAS STOVE- INCLUDES 110V PLUG ON SEPARATE CIRCUIT
Line19084	Note:
16Mar17 / 16Aug17	

Inv.1,249	1 - KITCHEN: UPGRADE VENTING FOR STOVE TO 8 INCH PIPE EXTERIOR WALL
Line19085	Note:
16Mar17 / 16Aug17	

Inv.1,249	1 - HUMIDIFIER: WB3 - 17 (UP TO 3,000 SQ.FT.)
Line19087	Note:
16Mar17 / 16Aug17	

INTERIOR TRIM AND DOORS

Inv.1,249	1 - EXTENDED HEIGHT ARCHWAY (PRICE PER DOORWAY) - 2ND FLOOR
Line20231	Note: See floorplan for location
16Mar17 / 16Aug17	

Inv.1,249	19 - STANDARD DOOR EXTENDED HEIGHT 96 INCH (PRICE PER DOOR) - SECOND FLOOR 2 STOREY MODELS
Line19091	Note:
16Mar17 / 16Aug17	

Inv.1,249	1 - MAIN FLOOR CEILING 10FT, 8FT TALLER INTERIOR DOORS, TALLER FLAT ARCHES, REAR AND FRONT WINDOWS WITH TRANSOM, TALLER KITCHEN CABINETS WITH CROWN AND FURRING PANEL, ADDED STAIRS AND PICKETS
Line23837	Note:
16Mar17 / 16Aug17	

Inv.1,249	1 - MASTER BEDROOM: Relocate Walk-in closet door. Add double door - please see floorplan for location
Line23848	Note:
16Mar17 / 16Aug17	

Inv.1,249	1 - GREAT ROOM / DINING ROOM: Add archway - 8ft wide and 8ft high. Leave 4ft on either side.
Line23849	Note:
16Mar17 / 16Aug17	

Inv.1,249	1 - MASTER ENSUITE: Delete door to Water Closet
Line23854	Note:
16Mar17 / 16Aug17	

KITCHEN AND BATH CABINETRY

Inv.1,249	1 - MAIN FLOOR CEILING 10FT, 8FT TALLER INTERIOR DOORS, TALLER FLAT ARCHES, REAR AND FRONT WINDOWS WITH TRANSOM, TALLER KITCHEN CABINETS WITH CROWN AND FURRING PANEL, ADDED STAIRS AND PICKETS
Line23838	Note:
16Mar17 / 16Aug17	

Inv.1,249	1 - KITCHEN: Relocate sink location and dishwasher due to Island turned 90 degrees. See floorplan for location
Line23850	Note:
16Mar17 / 16Aug17	



CONSTRUCTION SUMMARY

Kleinburg Glen - 37 - 2 - 42-1 Elev.A ROYALTON

MISC.

Inv.1,249	1 - BONUS PACKAGE: \$20,000.00 (INCLUDING TAXES) WORTH OF UPGRADES FROM GOLD PARK HOMES DÉCOR CENTRE IS BEING APPLIED TOWARD THE STRUCTURAL APPOINTMENT. PURCHASER HAS A REMAINING AMOUNT OF \$00 (INCLUDING TAXES) TO BE USED TOWARD THE COLOUR APPOINTMENT.
Line19094	Note:
16Mar17 / 16Aug17	
Inv.1,249	1 - TOTAL AFTER CREDIT: \$53,190.10 Applied to Colour Order
Line19095	Note:
16Mar17 / 16Aug17	
Inv.1,249	1 - Purchaser has attended a Structural appointment at the Decor Centre & has DECLINED any additional upgrades and accepts and acknowledges that there will be no further structural changes/additions/deletions to be made upon signing.
Line19096	Note:
16Mar17 / 16Aug17	
Inv.1,249	1 - Purchasers are aware & accepts that ANY changes made to upgrades after signing this Purchasers Extra Form are subject to a minimum administration fee of \$500. PLUS a 10% holdback fee.
Line19097	Note:
16Mar17 / 16Aug17	
Inv.1,417	1 - Admin fee to re-open file
Line22181	Note:
5Jun17 / 29Nov17	

PAINTING

Inv.1,249	1 - MAIN FLOOR CEILING 10FT, 8FT TALLER INTERIOR DOORS, TALLER FLAT ARCHES, REAR AND FRONT WINDOWS WITH TRANSOM, TALLER KITCHEN CABINETS WITH CROWN AND FURRING PANEL, ADDED STAIRS AND PICKETS
Line23839	Note:
16Mar17 / 16Aug17	

PLUMBING

Inv.1,249	1 - KITCHEN: INSTALL WATERLINE FOR FRIDGE
Line19069	Note: Please see floorplan for location
16Mar17 / 16Aug17	
Inv.1,249	1 - REAR OF HOUSE: HOSE BIB - STANDARD TO UPGRADED WITH HOT AND COLD WATER VALVE
Line19070	Note:
16Mar17 / 16Aug17	
Inv.1,249	1 - MASTER ENSUITE: WATER SERVICE - INCREASE WATER SERVICE TO 3/4 INCH
Line19072	Note:
16Mar17 / 16Aug17	
Inv.1,249	1 - ENSUITE 2: TRENCH DRAIN APPROX 24 INCH LINEAR TRENCH DRAIN GRATE - ACO 37245/93871 - UPG 1
Line19075	Note:
16Mar17 / 16Aug17	
Inv.1,249	1 - MASTER ENSUITE SHOWER: TRENCH DRAIN APPROX 6 INCH SQUARE - DRAIN
Line19076	Note:
16Mar17 / 16Aug17	



CONSTRUCTION SUMMARY

Kleinburg Glen - 37 - 2 - 42-1 Elev.A ROYALTON

Inv.1,249	1 - KITCHEN: Relocate sink location and dishwasher due to Island turned 90 degrees. See floorplan for location
Line19089	Note:
16Mar17 / 16Aug17	
Inv.1,249	1 - BASEMENT: BACKFLOW PREVENTER VALVE
Line23841	Note:
16Mar17 / 16Aug17	

WINDOWS AND DOORS

Inv.1,249	1 - BREAKFAST ROOM: FRENCH DOORS In Lieu of Garden Doors
Line20228	Note:
16Mar17 / 16Aug17	
Inv.1,249	1 - MAIN FLOOR CEILING 10FT, 8FT TALLER INTERIOR DOORS, TALLER FLAT ARCHES, REAR AND FRONT WINDOWS WITH TRANSOM, TALLER KITCHEN CABINETS WITH CROWN AND FURRING PANEL, ADDED STAIRS AND PICKETS
Line23836	Note:
16Mar17 / 16Aug17	

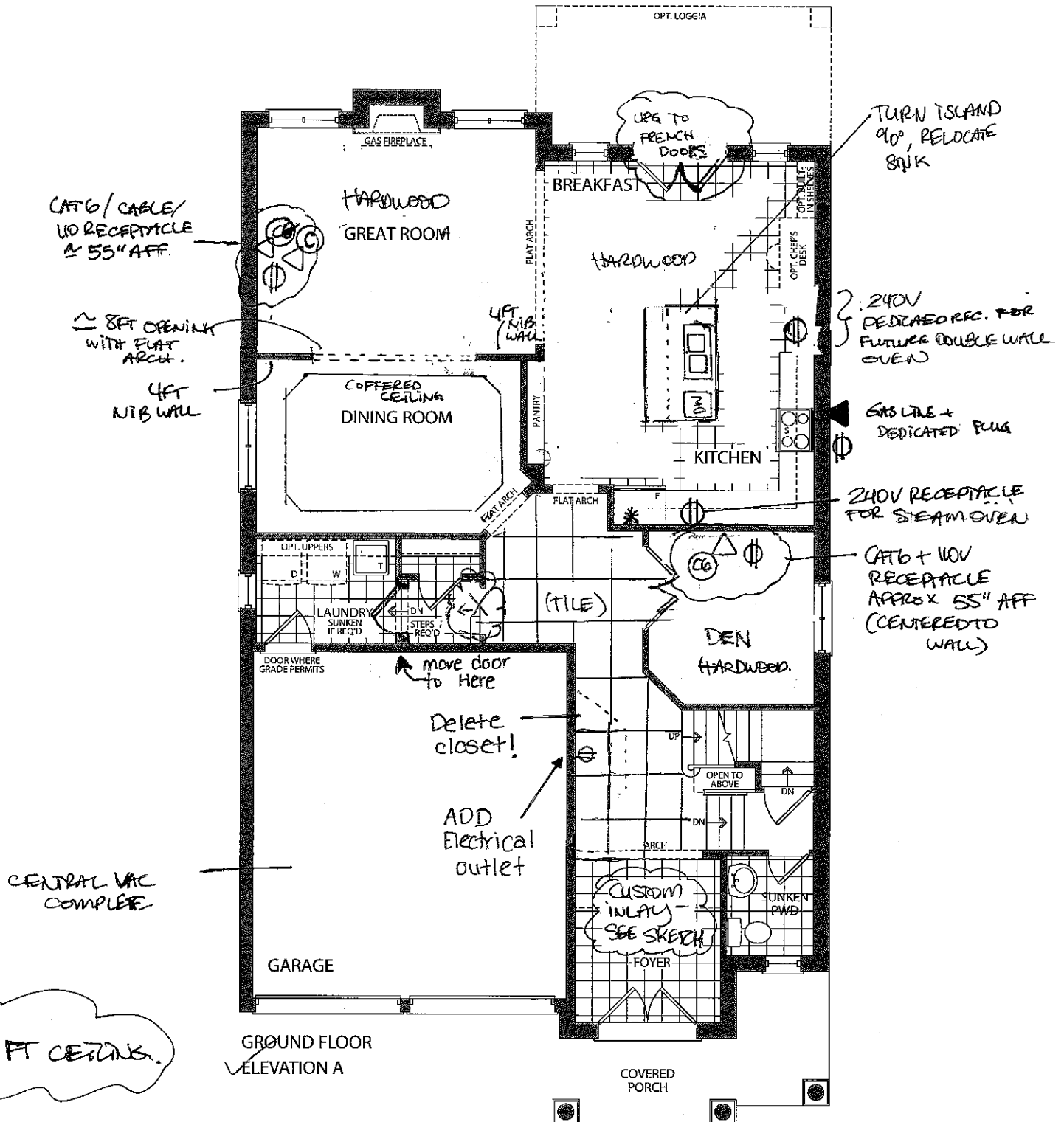

LEGEND

- ⊗ - 96" DOOR
- * - WATER LINE
- ⊕ - RECEPTACLE
- ◀ - GAS LINE
- ⊙ - CABLE
- Ⓣ - TELEPHONE
- ⊙ - CAT 6

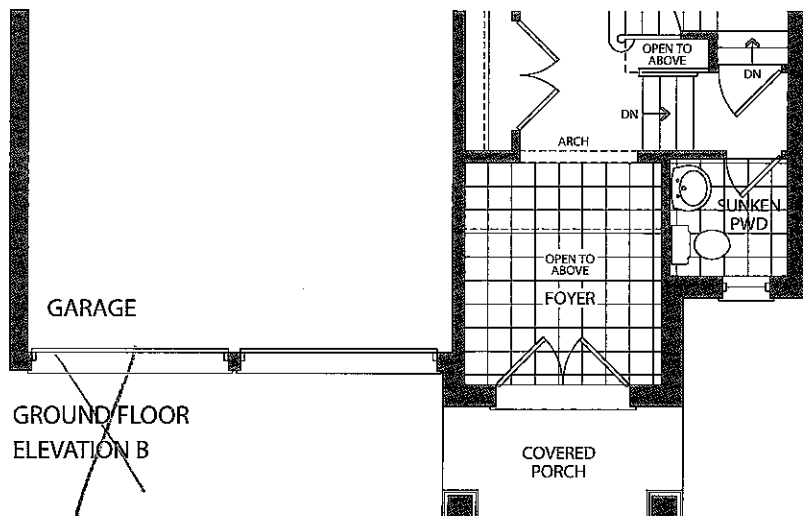

K62-37
STRUCTURAL

MARCH 16, 2017

COLOURS

APRIL 2 2017

Elevation A • 3,016 sq.ft.

Elevation B • 3,043 sq.ft.

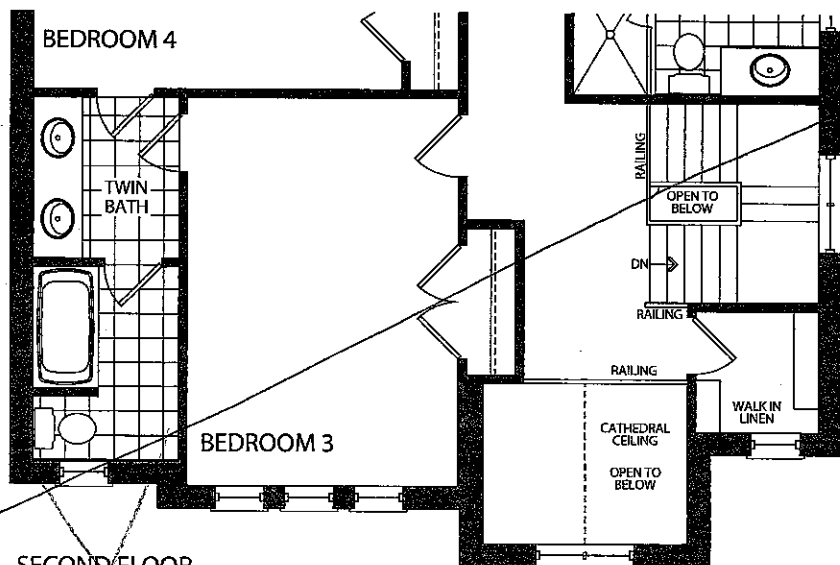
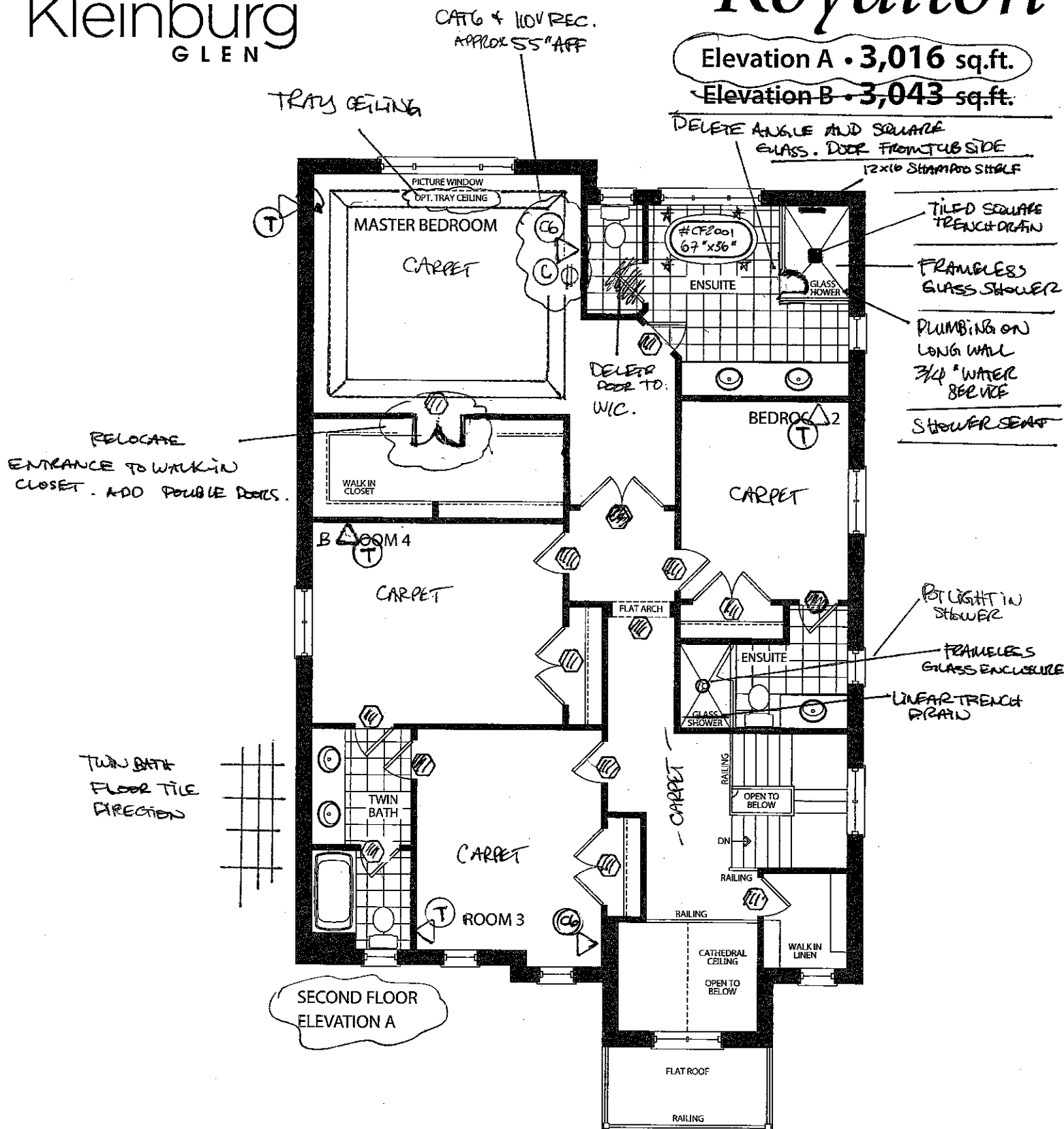

KG2-37
STRUCTURAL

MARCH 16, 2017

COLOURS

April 2, 2017

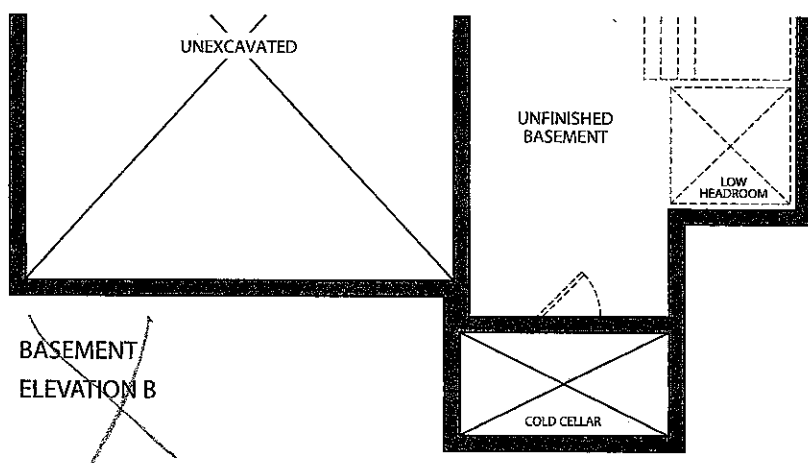
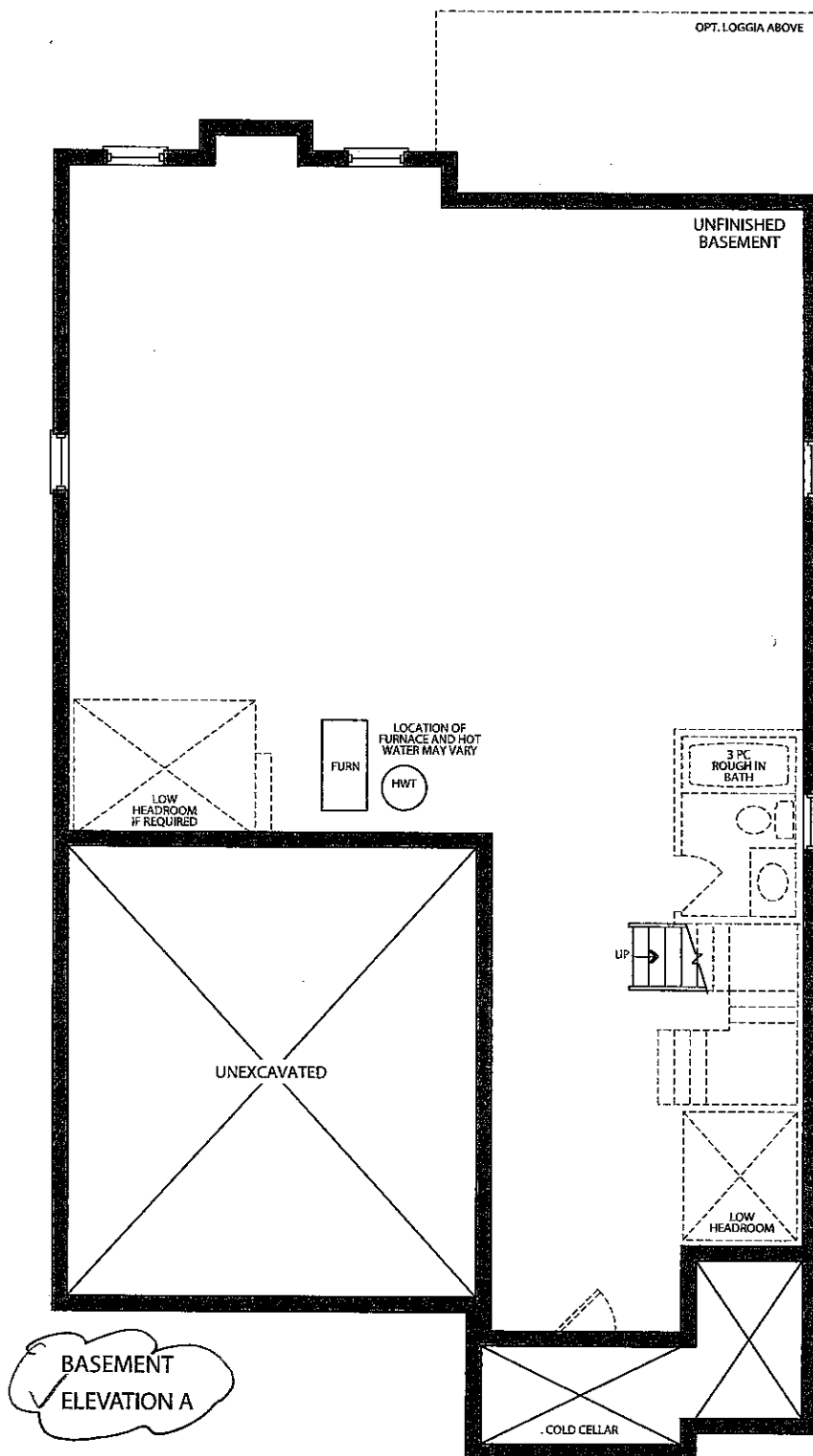

K62-37
STRUCTURAL

CM

MARCH 16, 2017

COLOURS

CM

April 2, 2017

CORTINA

70 Regline Road, Woodbridge, Ontario L4L 8L8
Tel: 905-284-8484 Fax: 905-284-0884
www.CortinaKitchens.com

QUOTATION

Date: 28/06/16

Trade Name: Gold Park Homes

Site location:

Model: 42-1

Address:

Project: Kleinburg Glen

Phase:

This layout has been explained to the purchaser by Cortina Kitchens Inc. and is understood by the purchaser.

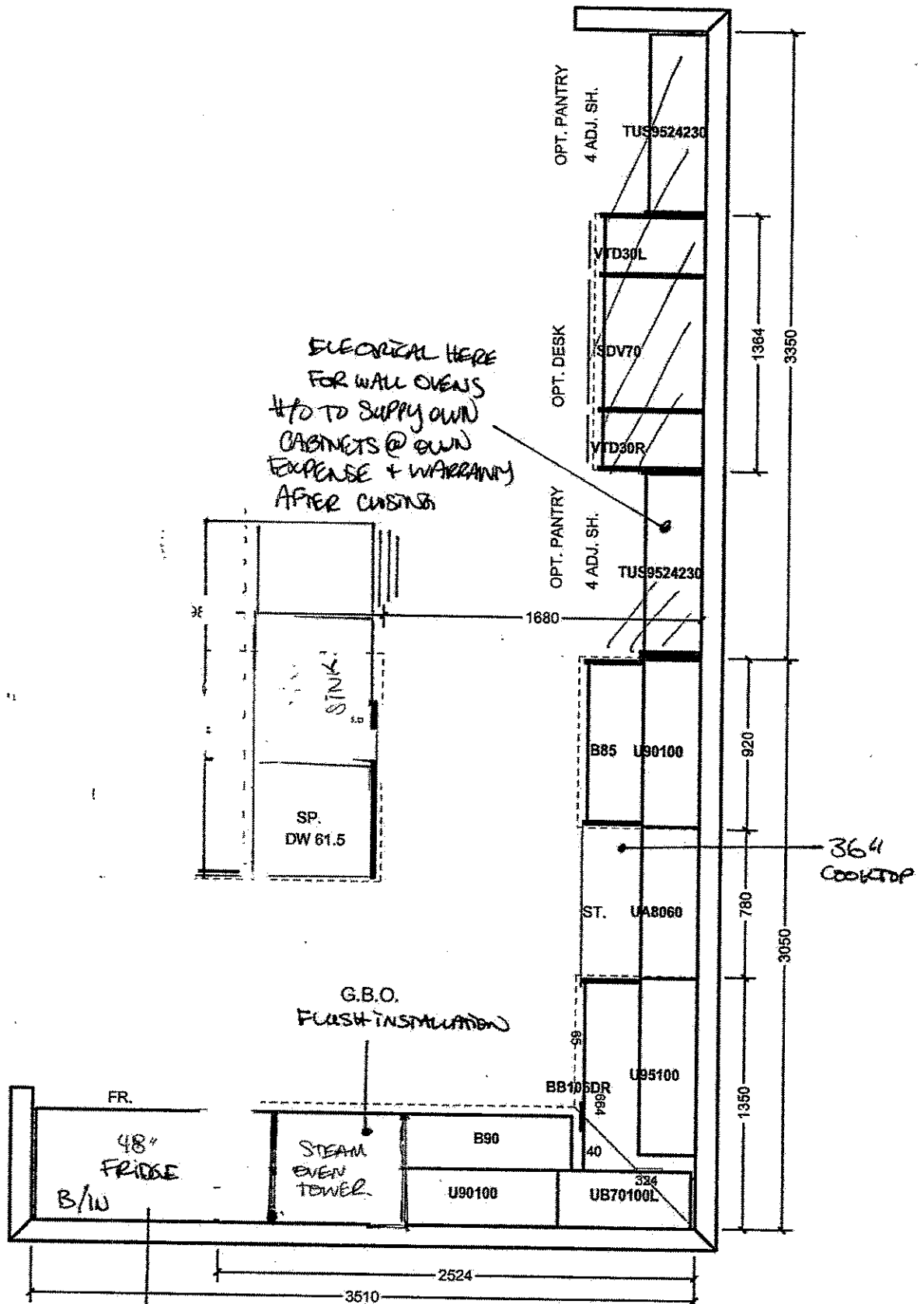

All prices subject to confirmation from head office.
This quotation is subject to the terms & conditions set out

ACCEPTED DATE: Apr-13-2017

All agreements are contingent upon strikes, accidents, and delays beyond our control.
Please provide our installer with template for sinkholes or \$150.00 will be charged for callback.

DocuSigned by:

097E90262A834ED

Item A. Wood grain and colour are characteristics of the product. We cannot guarantee that such grain and colour will always match.
Item B. Cortina Kitchens Inc. reserves the right to alter dimensions and make technical changes without notice.

CORTINA

70 Regina Road, Woodbridge, Ontario L4L 8L6
Tel: 905-204-6484 Fax: 905-284-0604
www.CortinaKitchens.com

QUOTATION

Date: 28/06/16

Trade Name: Gold Park Homes

Site location:

Model: 42-1

Address:

Project: Kleinburg Glen

Phase:

This layout has been explained to the purchaser by Cortina Kitchens Inc. and is understood by the purchaser.

ENSUITE 2(BD. 2)

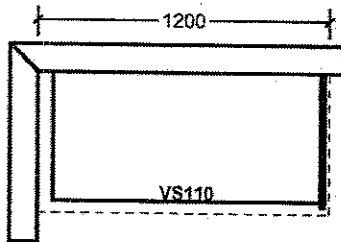

ENSUITE

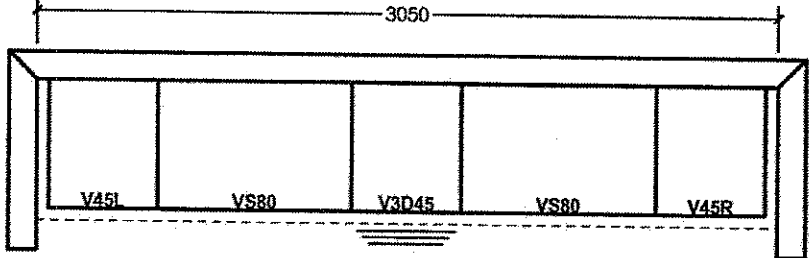

TWIN BATH(BD. 3/4)

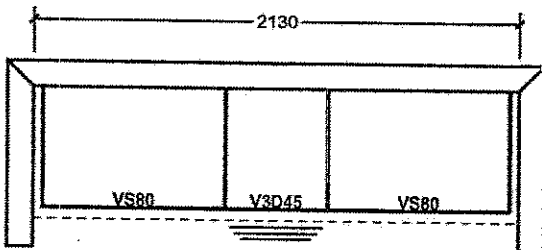

LAUNDRY

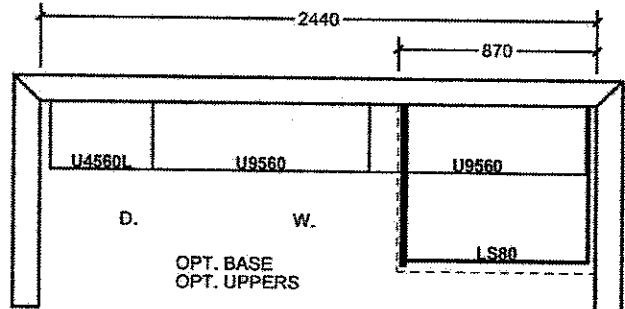

OPT. 5 BED. SECOND FLOOR

TWIN BATH(BD. 2/3)

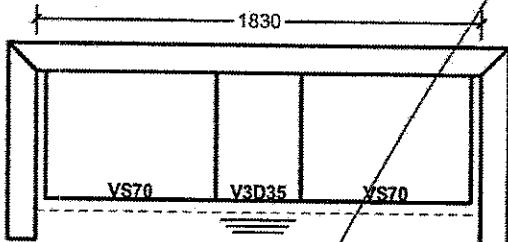

TWIN BATH(BD. 4/5)

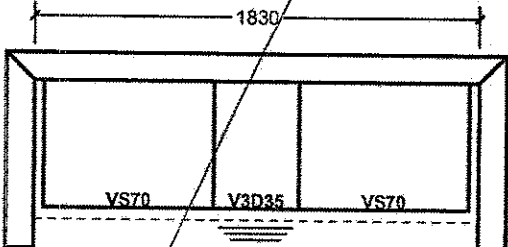

ENSUITE

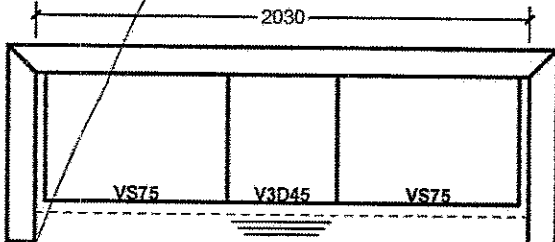

PART OPT. 5 BED. SECOND FLOOR

TWIN BATH 2(BD. 4/5)

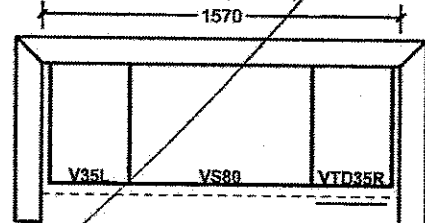

PART SECOND FL. ELV. B

TWIN BATH(BD. 3/4)

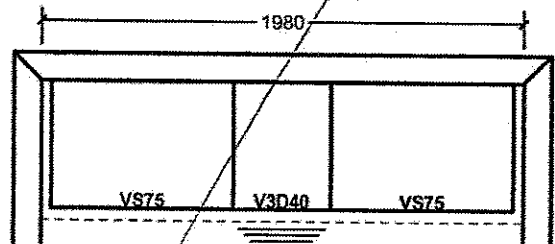

All prices subject to confirmation from head office.
This quotation is subject to the terms & conditions set out

All agreements are contingent upon strikes, accidents, and delays beyond our control.
Please provide our installer with template for sinkholes or \$150.00 will be charged for callback.

ACCEPTED DATE: Apr-13-2017

DocuSigned by:

x  697F-B0262A034FD...

Item A. Wood grain and colour are characteristics of the product. We cannot guarantee that such grain and colour will always match.
Item B. Cortina Kitchens Inc. reserves the right to alter dimensions and make technical changes without notice.

Arzo 4 Piece Roman Tub faucet (chrome) #T4786/R4716

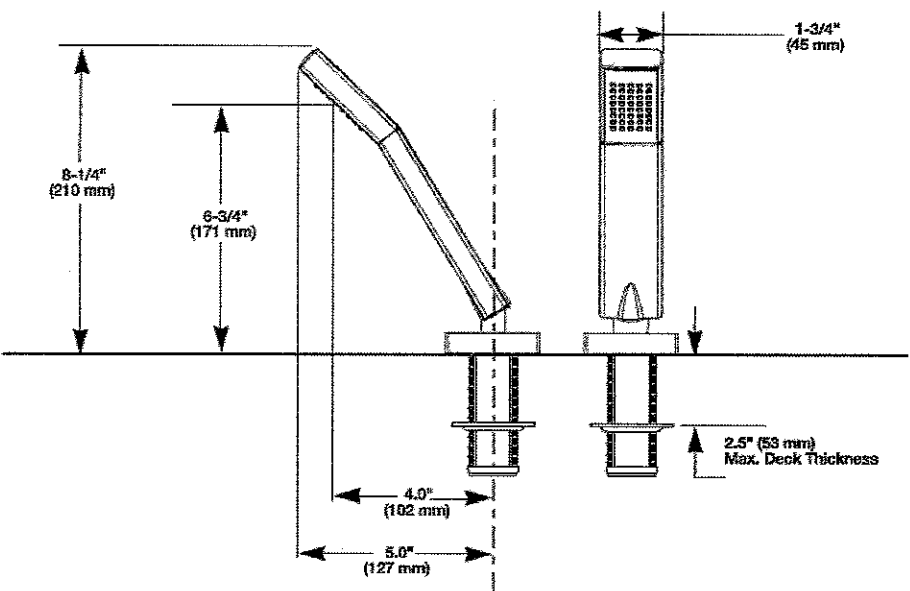
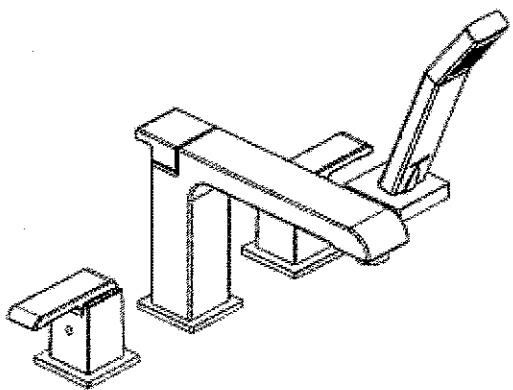
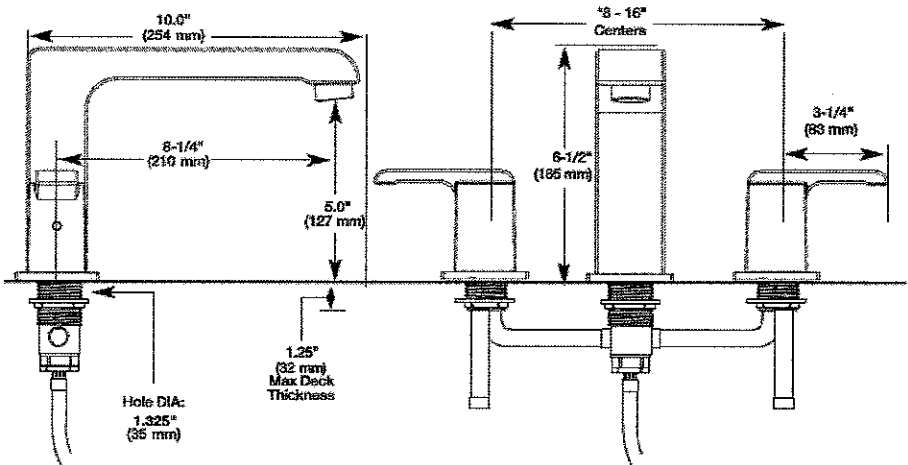
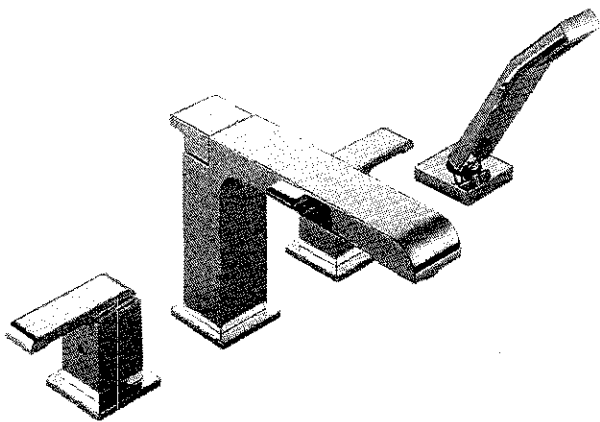

T4786

LOT # KG2-37	
ROOM: MASTER ENSUITE	SIGNATURE: 
DATE: April 2, 2017	SIGNATURE: 