



CONSTRUCTION SUMMARY

Kleinburg Glen - 26 - 2 - 42-1 Elev.B ROYALTON
CENTRAL VAC AND WIRING

Inv.1,627 *NEW*	1 - DELETE NILFISK CENTRAL VACUUME KIT SE 150 WITH MA10M ELECTRIC POWER HEAD. FROM INVOICE #1202 ITEM #21
Line24541	Note:
27Oct17 / 20Nov17	
Inv.1,202	1 - ROUGH IN- 4X- CAT 6 CONNECTIONS- LOCATION TO BE MARKED ON FLOORPLAN
Line17871	Note: See floorplan for locations
21Feb17 / 26Oct17	
Inv.1,202	1 - NILFISK CENTRAL VACCUM KIT SE 150 WITH MA10M ELECTRIC POWER HEAD
Line19230	Note:
21Feb17 / 26Oct17	
Inv.1,202	1 - INSTALL VAC PAN UNDER KITCHEN SINK
Line19231	Note:
21Feb17 / 26Oct17	
Inv.1,256	1 - GREAT ROOM: CONDUIT PIPE - FOR TELEVISION - Above fireplace, next to receptacle. Approx 66" aff. Terminating at standard height, under window at left side of fireplace.
Line21219	Note: See floorplan for location
19Mar17 / 26Oct17	

CERAMIC

Inv.1,627	1 - ENSUITE 2 & TWIN BATH: CHANGE WALL TILES TO UPG 1, 4X12" CHESS ARCTIC WHITE
Line24542	Note:
27Oct17 / 20Nov17	
Inv.1,256	1 - FOYER FLOOR TILE: UPG 5 24x24"
Line19244	Note:
19Mar17 / 26Oct17	
Inv.1,256	1 - ENSUITE 2 Floor Tile: UPG 5 12x24"
Line19243	Note: See Floorplan for tile direction. Parallel to Vanity
19Mar17 / 26Oct17	
Inv.1,256	1 - POWDER FLOOR TILE: UPG 5 12x24"
Line19245	Note: See floorplan for tile direction. Parallel to door
19Mar17 / 26Oct17	
Inv.1,256	1 - ENSUITE 2 Shower Wall Tile: UPG 1
Line19252	Note: Installed Horiztally stacked
19Mar17 / 26Oct17	
Inv.1,256	1 - TWIN BATH Floor Tile: UPG 2 12x24
Line19253	Note: See floorplan for tile for tile direction. Parrallel to vanity.
19Mar17 / 26Oct17	
Inv.1,256	1 - TWIN BATH Tub Wall Tile: UPG 1
Line19254	Note: Installed Horizontally stacked
19Mar17 / 26Oct17	
Inv.1,256	1 - LAUNDRY ROOM Floor Tile: UPG 5 - 24x24", straight stacked installation
Line19255	Note:
19Mar17 / 26Oct17	



CONSTRUCTION SUMMARY

Kleinburg Glen - 26 - 2 - 42-1 Elev.B ROYALTON

Inv.1,256	1 - MASTER ENSUITE Floor Tile: UPG 5, 24"x24 straight stacked installation
Line19256	Note:
19Mar17 / 26Oct17	
Inv.1,256	1 - MASTER ENSUITE Shower Floor Tile: UPG 4, hex marble mosaic
Line19257	Note:
19Mar17 / 26Oct17	
Inv.1,256	1 - MASTER ENSUITE Shower Wall Tile: UPG 5 - 12x24"
Line19258	Note: Installed Horizontally stacked
19Mar17 / 26Oct17	

CONCRETE AND DRAIN

Inv.1,202	1 - BASEMENT: Add backflow preventer
Line17887	Note:
21Feb17 / 26Oct17	

DRYWALL

Inv.1,202	1 - SMOOTH CEILINGS - (2 - Story Design) 2ND FLOOR
Line17875	Note:
21Feb17 / 26Oct17	
Inv.1,202	1 - MAIN FLOOR CEILING 10FT, 8FT TALLER INTERIOR DOORS, TALLER FLAT ARCHES, REAR AND FRONT WINDOWS WITH TRANSOM, TALLER KITCHEN CABINETS WITH CROWN AND FURRING PANEL, ADDED STAIRS AND PICKETS
Line23694	Note:
21Feb17 / 26Oct17	
Inv.1,202	1 - OPTIONAL 10 FOOT TRAY CEILING - MASTER BEDROOM
Line24524	Note:
21Feb17 / 26Oct17	

ELECTRICAL

Inv.1,627 *NEW*	1 - KITCHEN: DELETE UNDER CABINET LIGHT ROUGH-IN FROM INVOICE #1202 ITEM #3
Line24540	Note:
27Oct17 / 20Nov17	
Inv.1,202	1 - KITCHEN: Add 240V Wall Recepticle on dedicated circuit for future wall oven
Line17860	Note: See floorplan for location. Left of Fridge
21Feb17 / 26Oct17	
Inv.1,202	1 - KITCHEN: Rough-In ONLY Under Cabinet Valance Lighting - DOES NOT INCLUDE VALANCE
Line17863	Note:
21Feb17 / 26Oct17	
Inv.1,202	1 - KITCHEN: Additional Interior Dedicated electrical for future Microwave
Line17864	Note: Please see floorplan for location
21Feb17 / 26Oct17	
Inv.1,202	1 - 200 AMP Service
Line17876	Note:
21Feb17 / 26Oct17	



CONSTRUCTION SUMMARY

Kleinburg Glen - 26 - 2 - 42-1 Elev.B ROYALTON

Inv.1,202	1 - DINING ROOM: Additional Interior Receptacle (not separate cicuit) to ceiling
Line17878	Note: See floorplan for location
21Feb17 / 26Oct17	
Inv.1,202	1 - MASTER WALK-IN CLOSET: Additional Interior Receptacle (not separate cicuit)
Line19235	Note: Please see floorplan for location
21Feb17 / 26Oct17	
Inv.1,202	1 - KITCHEN: GAS LINE ROUGH - MAIN FLOOR - (2 STOREY MODELS) FOR GAS STOVE- INCLUDES 110V PLUG ON SEPARATE CIRCUIT
Line23690	Note:
21Feb17 / 26Oct17	
Inv.1,202	1 - HUMIDIFIER: WB3 - 17 (UP TO 3,000 SQ.FT.)
Line24529	Note:
21Feb17 / 26Oct17	
Inv.1,256	1 - GREAT ROOM: Additional Interior Receptacle (not separate cicuit) above fireplace, next to conduit. Approx 66" aff.
Line21220	Note: See floorplan for location
19Mar17 / 26Oct17	

Exterior Colours

Inv.1,202	1 - EXTERIOR COLOUR PACKAGE 1
Line23696	Note:
21Feb17 / 26Oct17	

FRAMING

Inv.1,256	1 - KITCHEN: UPG Add Furring panel & Crown
Line24530	Note:
19Mar17 / 26Oct17	
Inv.1,416 *NEW*	1 - FOYER: DELETE FOYER CLOSET
Line22077	Note:
5Jun17 / 20Nov17	
Inv.1,416 *NEW*	1 - DEN: DELETE WALL AND DOOR AT DEN - REMOVE HEADER *IF POSSIBLE*
Line22078	Note:
5Jun17 / 20Nov17	
Inv.1,202	1 - DINING / GREAT ROOM: OPEN WALL approx 8ft. Leave 4ft on either side of wall.
Line19228	Note: See floorplan for details / location
21Feb17 / 26Oct17	
Inv.1,202	1 - MAIN FLOOR CEILING 10FT, 8FT TALLER INTERIOR DOORS, TALLER FLAT ARCHES, REAR AND FRONT WINDOWS WITH TRANSOM, TALLER KITCHEN CABINETS WITH CROWN AND FURRING PANEL, ADDED STAIRS AND PICKETS
Line17869	Note:
21Feb17 / 26Oct17	
Inv.1,202	1 - OPTIONAL 10 FOOT TRAY CEILING - MASTER BEDROOM
Line17879	Note:
21Feb17 / 26Oct17	
Inv.1,202	1 - MASTER WALK-IN CLOSET: Please see new layout for
Line19234	Note:
21Feb17 / 26Oct17	



CONSTRUCTION SUMMARY

Kleinburg Glen - 26 - 2 - 42-1 Elev.B ROYALTON

Inv.1,202	1 - ROUGH-IN FOR RAINSHOWER HEAD- DOES NOT INCLUDE SHOWER HEAD AND DIVERTER AND MUST BE PURCHASED THROUGH GOLDPARK
Line24526	Note:
21Feb17 / 26Oct17	
Inv.1,202	1 - UPGRADE VENTING FOR STOVE TO 8 INCH PIPE EXTERIOR WALL
Line24527	Note:
21Feb17 / 26Oct17	

GLASS AND MIRROR

Inv.1,202	1 - MASTER ENSUITE: Delete angled shower door - squared shower encolusure. Relocate Shower door.
Line19232	Note: See floorplan for location
21Feb17 / 26Oct17	
Inv.1,202	1 - MASTER ENSUITE: CONVERT FRAMED SHOWER TO 10MM FRAMLESS SHOWER ENCLOSURE WITH DOOR AND 10MM SIDE PANEL
Line17880	Note:
21Feb17 / 26Oct17	
Inv.1,202	1 - ENSUITE 2: CONVERT FRAMED SHOWER TO 10MM FRAMLESS SHOWER ENCLOSURE WITH DOOR AND 10MM SIDE PANEL
Line17881	Note:
21Feb17 / 26Oct17	

HARDWOOD

Inv.1,256	1 - MAIN FLOOR HARDWOOD - Main Hall: UPG 5
Line19246	Note:
19Mar17 / 26Oct17	
Inv.1,256	1 - MAIN FLOOR HARDWOOD - Den: UPG 5
Line19248	Note:
19Mar17 / 26Oct17	
Inv.1,256	1 - MAIN FLOOR HARDWOOD - Dining: UPG 5
Line19247	Note:
19Mar17 / 26Oct17	
Inv.1,256	1 - MAIN FLOOR HARDWOOD - Great Room UPG 5
Line19249	Note:
19Mar17 / 26Oct17	
Inv.1,256	1 - MAIN FLOOR HARDWOOD - Kitchen: UPG 5
Line19250	Note:
19Mar17 / 26Oct17	

HVAC

Inv.1,256	1 - KITCHEN: UPG Add Furring panel & Crown
Line24531	Note:
19Mar17 / 26Oct17	
Inv.1,202	1 - KITCHEN: GAS LINE ROUGH - MAIN FLOOR - (2 STOREY MODELS) FOR GAS STOVE- INCLUDES 110V PLUG ON SEPARATE CIRCUIT
Line17861	Note:
21Feb17 / 26Oct17	



CONSTRUCTION SUMMARY

Kleinburg Glen - 26 - 2 - 42-1 Elev.B ROYALTON

Inv.1,202	1 - UPGRADE VENTING FOR STOVE TO 8 INCH PIPE EXTERIOR WALL
Line19227	Note:
21Feb17 / 26Oct17	
Inv.1,202	1 - HUMIDIFIER: WB3 - 17 (UP TO 3,000 SQ.FT.)
Line19237	Note:
21Feb17 / 26Oct17	

INTERIOR TRIM AND DOORS

Inv.1,416	*NEW* 1 - DEN: DELETE WALL AND DOOR AT DEN - REMOVE HEADER *IF POSSIBLE*
Line24698	Note:
5Jun17 / 20Nov17	
Inv.1,416	*NEW* 1 - FOYER: DELETE FOYER CLOSET
Line24699	Note:
5Jun17 / 20Nov17	
Inv.1,202	19 - STANDARD DOOR EXTENDED HEIGHT 96 INCH (PRICE PER DOOR) - SECOND FLOOR 2 STOREY MODELS
Line19236	Note:
21Feb17 / 26Oct17	
Inv.1,202	1 - MAIN FLOOR CEILING 10FT, 8FT TALLER INTERIOR DOORS, TALLER FLAT ARCHES, REAR AND FRONT WINDOWS WITH TRANSOM, TALLER KITCHEN CABINETS WITH CROWN AND FURRING PANEL, ADDED STAIRS AND PICKETS
Line23692	Note:
21Feb17 / 26Oct17	

KITCHEN AND BATH CABINETRY

Inv.1,256	1 - KITCHEN: Add custom dishwasher panel
Line21225	Note: See spec sheet attached
19Mar17 / 26Oct17	
Inv.1,256	2 - KITCHEN: Add 2 receptacles (not on separate circuit) at backsplash of pantry. Approx 4ft aff.
Line21229	Note: See sketch attached for details
19Mar17 / 26Oct17	
Inv.1,202	1 - MAIN FLOOR CEILING 10FT, 8FT TALLER INTERIOR DOORS, TALLER FLAT ARCHES, REAR AND FRONT WINDOWS WITH TRANSOM, TALLER KITCHEN CABINETS WITH CROWN AND FURRING PANEL, ADDED STAIRS AND PICKETS
Line23693	Note:
21Feb17 / 26Oct17	
Inv.1,256	1 - KITCHEN: Raise kitchen to accommodate for hardwood floors
Line19251	Note:
19Mar17 / 26Oct17	
Inv.1,256	1 - KITCHEN Cabinetry: UPG 6
Line19260	Note:
19Mar17 / 26Oct17	
Inv.1,256	1 - KITCHEN: UPG Add Furring panel & Crown
Line19261	Note:
19Mar17 / 26Oct17	
Inv.1,256	1 - KITCHEN: Soft Close cabinets / drawers throughout
Line19263	Note:
19Mar17 / 26Oct17	



CONSTRUCTION SUMMARY

Kleinburg Glen - 26 - 2 - 42-1 Elev.B ROYALTON

Inv.1,256	1 - KITCHEN: UPG - 2 tone Kitchen
Line19264	Note: Perimeter Cabinets Windsor MDF White /Matte. Island and Pantry Windsor Maple Greystone
19Mar17 / 26Oct17	
Inv.1,256	4 - KITCHEN: Add 4 overlay doors to back of island
Line19318	Note:
19Mar17 / 26Oct17	
Inv.1,256	1 - KITCHEN: Add Vetrina 148cm height x 30cm deep double doors with plain clear glass (white interior), with double drawers below
Line19319	Note: Please see kitchen drawing for location. Added to end of Kitchen, left of range
19Mar17 / 26Oct17	
Inv.1,256	1 - KITCHEN: Built-in fridge enclosure with Integrated installation.
Line19322	Note: Flush Installation. See spec sheet attached
19Mar17 / 26Oct17	
Inv.1,256	1 - KITCHEN: Wall Oven / Microwave Tower with integrated installation
Line19324	Note: Flush Installation. See spec sheet attached
19Mar17 / 26Oct17	
Inv.1,256	1 - KITCHEN: Adjust cabinets for 36" range
Line19325	Note:
19Mar17 / 26Oct17	
Inv.1,256	1 - KITCHEN: Delete Upper cabinets above range and finish sides for 42" Hood. Please leave 46" opening
Line19327	Note: Add bottom panel with crown & furring above fan. See spec sheet attached
19Mar17 / 26Oct17	
Inv.1,256	2 - KITCHEN: Add pots and pans drawers on either side of range
Line19341	Note: See kitchen drawing for location
19Mar17 / 26Oct17	
Inv.1,256	1 - KITCHEN: Add light valance
Line19358	Note: Includes extra piece under glass cabinets at new pantry configuration
19Mar17 / 26Oct17	
Inv.1,256	1 - KITCHEN: UPG HARDWARE, CH-47
Line21226	Note:
19Mar17 / 26Oct17	
Inv.1,256	1 - KITCHEN: CUSTOM PANTRY Configuration
Line21227	Note: 4 Clear Glass doors (Uppers), Extra Granite, Base Cabinets - See sketch attached for details
19Mar17 / 26Oct17	
Inv.1,256	1 - KITCHEN: Add custom Fridge / Freezer Panels.
Line21221	Note: See spec sheet attached. Purchaser to supply & Install own handles at own expense and warranty after closing.
19Mar17 / 26Oct17	

MISC.

Inv.1,416	1 - ADMIN - FEE TO RE-OPEN FILE
Line22079	Note:
5Jun17 / 20Nov17	
Inv.1,627	1 - PURCHASER ACCEPTS AND ACKNOWLEDGES CREDIT TO BE APPLIED AT CLOSING.
Line24543	Note:
27Oct17 / 20Nov17	



CONSTRUCTION SUMMARY

Kleinburg Glen - 26 - 2 - 42-1 Elev.B ROYALTON

Inv.1,202	1 - Purchaser has attended a Structural appointment at the Decor Centre & has DECLINED any additional upgrades and accepts and acknowledges that there will be no further structural changes/additions/deletions to be made upon signing.
Line19238	Note:
21Feb17 / 26Oct17	
Inv.1,202	1 - Purchasers are aware & accepts that ANY changes made to upgrades after signing this Purchasers Extra Form are subject to a minimum administration fee of \$500. PLUS a 10% holdback fee.
Line19239	Note:
21Feb17 / 26Oct17	
Inv.1,202	1 - BONUS PACKAGE: \$20,000.00 (INCLUDING TAXES) WORTH OF UPGRADES FROM GOLD PARK HOMES DÉCOR CENTRE IS BEING APPLIED TOWARD THE STRUCTURAL APPOINTMENT. PURCHASER HAS A REMAINING AMOUNT OF \$00 (INCLUDING TAXES) TO BE USED TOWARD THE COLOUR APPOINTMENT.
Line19240	Note:
21Feb17 / 26Oct17	
Inv.1,202	1 - Purchaser request that all upgrades from this purchaser's extras form to be added to the purchase price. Purchaser is aware that upgrades will be processed only after the builder receives approval letter from the bank.
Line19241	Note:
21Feb17 / 26Oct17	
Inv.1,202	1 - TOTAL AFTER BONUS: \$69,236.10 Deposit: \$35,143.50 On Closing: \$34,092.60
Line19242	Note:
21Feb17 / 26Oct17	
Inv.1,256	1 - TOTAL: \$89,424.98 1st Deposit: \$35,186.59 2nd Deposit: \$9,525.90 50% On Closing \$44,712,49
Line19366	Note:
19Mar17 / 26Oct17	
Inv.1,256	1 - Purchasers are aware & accepts that ANY changes made to upgrades after signing this Purchasers Extra Form are subject to a minimum administration fee of \$500. PLUS a 10% holdback fee.
Line19364	Note:
19Mar17 / 26Oct17	
Inv.1,256	1 - Purchaser has attended a Colour appointment at the Decor Centre & has DECLINED any additional upgrades and accepts and acknowledges that there will be no further structural changes/additions/deletions to be made upon signing.
Line19363	Note:
19Mar17 / 26Oct17	
Inv.1,256	1 - Purchaser request that all upgrades from this purchaser's extras form to be added to the purchase price. Purchaser is aware that upgrades will be processed only after the builder receives approval letter from the bank.
Line19365	Note:
19Mar17 / 26Oct17	

PAINTING

Inv.1,202	1 - MAIN FLOOR CEILING 10FT, 8FT TALLER INTERIOR DOORS, TALLER FLAT ARCHES, REAR AND FRONT WINDOWS WITH TRANSOM, TALLER KITCHEN CABINETS WITH CROWN AND FURRING PANEL, ADDED STAIRS AND PICKETS
Line23695	Note:
21Feb17 / 26Oct17	
Inv.1,202	1 - OPTIONAL 10 FOOT TRAY CEILING - MASTER BEDROOM
Line24525	Note:
21Feb17 / 26Oct17	



CONSTRUCTION SUMMARY

Kleinburg Glen - 26 - 2 - 42-1 Elev.B ROYALTON

Inv.1,256	1 - STAIRS & RAILINGS: UPG Stain to Preverco Mirabel
Line19262	Note:
19Mar17 / 26Oct17	

PLUMBING

Inv.1,202	1 - KITCHEN ROUGH - IN - WATERLINE FOR FRIDGE
Line17866	Note:
21Feb17 / 26Oct17	
Inv.1,202	1 - ROUGH-IN FOR RAINSHOWER HEAD- DOES NOT INCLUDE SHOWER HEAD AND DIVERTER AND MUST BE PURCHASED THROUGH GOLDPARK
Line17883	Note:
21Feb17 / 26Oct17	
Inv.1,202	1 - ROUGH - IN SHOWER BODY JETS - INCLUDES ROUGH-IN FOR TWO JETS- CLIENT MUST PURCHASE JETS FROM GOLDPARK HOMES
Line17885	Note:
21Feb17 / 26Oct17	
Inv.1,202	1 - TRENCH DRAIN APPROX 27 INCH LINEAR TRENCH DRAIN TILED - ACO 3705/93871 - UPG 1
Line17886	Note:
21Feb17 / 26Oct17	
Inv.1,202	1 - HUMIDIFIER: WB3 - 17 (UP TO 3,000 SQ.FT.)
Line24528	Note:
21Feb17 / 26Oct17	
Inv.1,256	1 - MASTER ENSUITE SHOWER: WATER SERVICE - INCREASE WATER SERVICE TO 3/4 INCH
Line21224	Note:
19Mar17 / 26Oct17	

PLUMBING FIXTURES

Inv.1,256	1 - MASTER ENSUITE: Master Ensuite Shower: Delta Temp Assure Shower system wtih 6 function diverter & body sprays & high flow rough-in 1.0GPM Chrome Finish. #T17T26 / 50570 / 51567 / T11967 / R1100 / 50150 x3 / R10000-UNBXHF. See spec sheet attached
Line19359	Note: With 6" Straight arm from ceiling for rain shower head.
19Mar17 / 26Oct17	

STAIRS AND RAILINGS

Inv.1,256	1 - STAIRS & RAILINGS: UPG to Euroline 1 with V-Groove handrail
Line21233	Note:
19Mar17 / 26Oct17	

TRIM AND DOORS

Inv.1,256	1 - TRIM & BASEBOARDS: SECOND FLOOR - UPG 1
Line21223	Note:
19Mar17 / 26Oct17	
Inv.1,256	1 - TRIM & BASEBOARDS: FIRST FLOOR - UPG 2
Line21222	Note:
19Mar17 / 26Oct17	

WINDOWS AND DOORS



CONSTRUCTION SUMMARY

Kleinburg Glen - 26 - 2 - 42-1 Elev.B ROYALTON

Inv.1,202	1 - BREAKFAST ROOM: Delete STD Garden door and 2 side windows and install UPG Line-1 Sitrine
Line19229	Outswing Folding Door Product Clau Auralast Pine, Bottom Rolling 4 PNL (3L-1R)
	Note: See spec sheet attached and floorplan for location
21Feb17 / 26Oct17	
Inv.1,202	1 - MAIN FLOOR CEILING 10FT, 8FT TALLER INTERIOR DOORS, TALLER FLAT ARCHES,
	REAR AND FRONT WINDOWS WITH TRANSOM, TALLER KITCHEN CABINETS WITH CROWN
Line23691	AND FURRING PANEL, ADDED STAIRS AND PICKETS
	Note:
21Feb17 / 26Oct17	

Scheduled Closing Date:

Purchaser: Jason Vuong
Telephone Res. / Bus: (416) 716-0000
Decor Advisor: Laura Lofaro

Property: 26
Project: Kleinburg Glen - Phase 2
Model and Elevation: 42-1 Elev.B ROYALTON

8. Trim Carpentry

Interior Doors	*STD	Front Door Glass Inserts	STD	Door Handles	STD
Interior Trim	*First Floor - UPG 2 / Second Floor UPG 1				
Comment	*8ft doors throughout				

9. Plaster Mouldings and Medallions

Standard Throughout ☐ Yes ☒ No ☐ N/A

Entrance Vestibule			Kitchen/Breakfast		
Main Hall			Den/Library		
Living Room			Lower Landing		
Dining Room			Other Room - Specify		
Family Room					
Comment					

10. Railings and Spindles

Railing Package	*Euroline 1, with Vgroove handrail		
Railing Colour	*Generation Cobalt	Spindle Colour	*Black
Stringer / Riser	*Generation Cobalt	Treads	*Generation Cobalt
Comment	Oak Stairs <input checked="" type="radio"/> Yes <input type="radio"/> No <input type="radio"/> N/A		

11. Wall Paint / Ceilings

Throughout Finished Areas	
Thru-out	Warm Grey COOL WHITE
Trim Paint	White
Smooth Ceilings	
Ground Floor	<input type="checkbox"/>
Second Floor	<input type="checkbox"/>
Note	
Comment	

Scheduled Closing Date:

Purchaser: Jason Vuong
Telephone Res. / Bus: (416) 716-0000
Decor Advisor: Laura Lofaro

Property: 26
Project: Kleinburg Glen - Phase 2
Model and Elevation: 42-1 Elev.B ROYALTON

Layout Changes: ☐ Yes ☐ No Sketch Attached: ☐ Yes ☐ No Exterior Colour Scheme:

1. Cabinetry

	Style and Colour	Counter	Hardware
Kitchen / Breakfast	*SEE COMMENT	Granite Pol. Crema Caramel STD FE20 Edge	*CH-47
Laundry Room	N/A		
Powder Room	N/A		
Master Ensuite Bathroom	Varese PVC WhtCrys	Formica Paloma Polar 6698-46	CS1-24
Second Ensuite Bathroom (If Applicable)	Varese PVC WhtCrys	Wilsonart Pearl Soapstone 4886-38	CS1-24
Twin Bath	Varese PVC WhtCrys	Wilsonart Pearl Soapstone 4886-38	CS1-24

Comment

*Perimeter Cabinets Windsor MDF & Pantry White Matte / Island Windsor Maple Greystone

2. Floor Tile

	Selection
Entrance Vestibule	*24x24 Volkas Series White Pol.
Main Hall	
Kitchen / Breakfast	(See Hardwood)
Laundry Room	*24x24 Volkas Series White Pol.
Powder Room	*12x24 Techmarble Series Mud Semi-Pol
Master Ensuite Bathroom	*24x24 Volkas Series White Pol.
Second Ensuite Bathroom (If Applicable)	*12x24 Creation Series Matte Grey
Lower Landing (If Applicable)	(Hardwood)
Twin Bath	*12x24 Trento Series Light Grey

Comment

3. Wall Tile

	Selection	Listello/Inserts	Describe
Master Ensuite Bathroom		<input type="radio"/> Yes <input type="radio"/> No	
Tub Deck	N/A	<input type="radio"/> Yes <input type="radio"/> No	
Shower Stall	*12x24 Volkas Series White Pol.	<input type="radio"/> Yes <input type="radio"/> No	
Bathroom Walls	N/A	<input type="radio"/> Yes <input type="radio"/> No	
Second Ensuite Bathroom (If Applicable)	*4x12 CDC Arctic White Bright	<input type="radio"/> Yes <input checked="" type="radio"/> No	
Twin Bath	*4x12 CDC Sterling Grey Bright	<input type="radio"/> Yes <input checked="" type="radio"/> No	
Kitchen Backsplash	<input type="radio"/> Yes <input checked="" type="radio"/> No	Backsplash Behind Fridge	

Comment

*Master Ensuite Shower Wall Tile: Installed horizontally stacked

(N)

Scheduled Closing Date:

Purchaser: Jason Vuong
Telephone Res. / Bus: (416) 716-0000
Decor Advisor: Laura Lofaro

Property: 26
Project: Kleinburg Glen - Phase 2
Model and Elevation: 42-1 Elev.B ROYALTON

Layout Changes: ☐ Yes ☐ No Sketch Attached: ☐ Yes ☐ No Exterior Colour Scheme:

1. Cabinetry

	Style and Colour	Counter	Hardware
Kitchen / Breakfast	*SEE COMMENT	Granite Pol. Crema Caramel STD FE20 Edge	*CH-47
Laundry Room	N/A		
Powder Room	N/A		
Master Ensuite Bathroom	Varese PVC WhtCrys	Formica Paloma Polar 6698-46	CS1-24
Second Ensuite Bathroom (If Applicable)	Varese PVC WhtCrys	Wilsonart Pearl Soapstone 4886-38	CS1-24
Twin Bath	Varese PVC WhtCrys	Wilsonart Pearl Soapstone 4886-38	CS1-24

Comment

*Perimeter Cabinets Windsor MDF & Pantry White Matte / Island Windsor Maple Greystone

2. Floor Tile

	Selection
Entrance Vestibule	*24x24 Volkas Series White Pol. upg 5
Main Hall	
Kitchen / Breakfast	(See Hardwood)
Laundry Room	*24x24 Volkas Series White Pol. upg 5
Powder Room	*12x24 Techmarble Series Mud Semi-Pol upg 4
Master Ensuite Bathroom	*24x24 Volkas Series White Pol. upg 5
Second Ensuite Bathroom (If Applicable)	*12x24 Creation Series Matte Grey
Lower Landing (If Applicable)	(Hardwood)
Twin Bath	*12x24 Trento Series Light Grey upg 2

Comment

3. Wall Tile

	Selection	Listello/Inserts	Describe
Master Ensuite Bathroom		<input type="radio"/> Yes <input type="radio"/> No	
Tub Deck	N/A	<input type="radio"/> Yes <input type="radio"/> No	
Shower Stall	*12x24 Volkas Series White Pol. upg 3	<input type="radio"/> Yes <input type="radio"/> No	
Bathroom Walls	N/A	<input type="radio"/> Yes <input type="radio"/> No	
Second Ensuite Bathroom (If Applicable)	*4x12 CDC Arctic White Bright upg 2	<input type="radio"/> Yes <input checked="" type="radio"/> No	
Twin Bath	*4x12 CDC Sterling Grey Bright upg 2	<input type="radio"/> Yes <input checked="" type="radio"/> No	
Kitchen Backsplash	<input type="radio"/> Yes <input checked="" type="radio"/> No	Backsplash Behind Fridge	

Comment

*Master Ensuite Shower Wall Tile: Installed horizontally stacked



Scheduled Closing Date:

Purchaser: Jason Vuong
Telephone Res. / Bus: (416) 716-0000
Decor Advisor: Laura Lofaro

Property: 26
Project: Kleinburg Glen - Phase 2
Model and Elevation: 42-1 Elev.B ROYALTON

4. Plumbing Fixtures

<input type="checkbox"/>	<input type="checkbox"/>	Second Ensuite	<input type="checkbox"/>	Powder Room	<input type="checkbox"/>
Master Ensuite Bathroom	<input type="checkbox"/>	Other Room - Specify	<input type="checkbox"/>	Other Washroom	<input type="checkbox"/>
<div>Comment</div> <div>Master Ensuite Shower: Delta Temp Assure Shower system with 6 function diverter & body sprays & high flow rough-in 1.0GPM Chrome Finish. #T17T26 / 50570 / 51567 / T11967 / R1100 / 50150 x3 / R10000-UNBXHF. See spec sheet attached</div>					

5. Hardwood Flooring

	Type and Stain		Type and Stain
Main Hall	*See Comment	Upper Landing	N/A
Kitchen / Breakfast	*See Comment	Upper Hall	N/A
Living Room	N/A	Master Bedroom	N/A
Dining Room	*See Comment	Bedroom #2	N/A
Family Room	N/A	Bedroom #3	N/A
Den/Library	*See Comment	Bedroom #4	N/A
Entrance Vestibule	N/A	Bedroom #5	N/A
Lower Landing (If Applicable)	N/A	Other Room - Specify	*See Comment
		Great Room	

Comment

*Preverco White Oak Edge Meribel Variations with Knots 7"

6. Carpeting

	Upgrade	Description
Ground Floor	<input type="checkbox"/>	
Second Floor	<input type="checkbox"/>	T04, standard underpad
	<input type="checkbox"/>	

	Type	Area
Upgrade Underpad	N/A	
	Capped	Runner - *Upgrade
Carpet on Stairs	N/A	

Comment

7. Fireplace

	Living Room			Family Room			Other Room - Specify			Great Room
	Purchased	As Per Plan	N/A	Purchased	As Per Plan	N/A	Purchased	As Per Plan	N/A	
	<input type="radio"/>	<input type="radio"/>	<input type="radio"/>	<input type="radio"/>	<input type="radio"/>	<input type="radio"/>	<input type="radio"/>	<input type="radio"/>	<input type="radio"/>	
Fireplace Type							STD Gas			
Mantle Type							STD			
Colour / Stain							STD			
Surround							N/A			
Hearth							STD			

Comment



Scheduled Closing Date:

Purchaser: Jason Vuong
Telephone Res. / Bus: (416) 716-0000
Decor Advisor: Laura Lofaro

Property: 26
Project: Kleinburg Glen - Phase 2
Model and Elevation: 42-1 Elev.B ROYALTON

8. Trim Carpentry

Interior Doors Front Door Glass Inserts Door Handles

Interior Trim

Comment

*8ft doors throughout

9. Plaster Mouldings and Medallions

Standard Throughout ☐ Yes ☒ No ☐ N/A

Entrance Vestibule	<input type="text"/>	<input type="text"/>	Kitchen/Breakfast	<input type="text"/>	<input type="text"/>
Main Hall	<input type="text"/>	<input type="text"/>	Den/Library	<input type="text"/>	<input type="text"/>
Living Room	<input type="text"/>	<input type="text"/>	Lower Landing	<input type="text"/>	<input type="text"/>
Dining Room	<input type="text"/>	<input type="text"/>	Other Room - Specify	<input type="text"/>	<input type="text"/>
Family Room	<input type="text"/>	<input type="text"/>		<input type="text"/>	<input type="text"/>

Comment

10. Railings and Spindles

Railing Package
Railing Colour Spindle Colour
Stringer / Riser Treads

Comment

Oak Stairs ☒ Yes ☐ No ☐ N/A

11. Wall Paint / Ceilings

Throughout Finished Areas

Thru-out

Trim Paint

Smooth Ceilings

Ground Floor ☐

Second Floor ☐

Note

Comment

Scheduled Closing Date:

Purchaser: Jason Vuong
Telephone Res. / Bus: (416) 716-0000
Decor Advisor: Laura Lofaro

Property: 26
Project: Kleinburg Glen - Phase 2
Model and Elevation: 42-1 Elev.B ROYALTON

12. Electrical

Hood Fan ☐ White ☐ Stainless ☐ N/A

Above Kitchen Cabinet Light ☐ Yes ☒ No

Below Kitchen Cabinet Light ☒ Yes ☐ No

Standard Appliances ☐

Over The Range Microwave ☐

Chimney Style Fan ☐

Comment

Hood fan supplied and installed by homeowner. 600CFM / See appliance specs for details

13. Heating and Air Conditioning

Air Conditioning

Gas Provisions Stove

Gas Provisions Dryer

Gas Provisions Barbecue

Comment

*Humidifier

14. Additional Comments

15. Disclaimers and Notes

- 1) Colours of all materials are as close as possible to builder's selection, but not necessarily identical due to variances in manufacturing.
- 2) Any extras listed above are null and void unless accompanied by a separate invoice/amendment. Said invoice must be paid in full.
- 3) The Purchaser acknowledges that after Interior Colour Selection form is signed and dated, no further changes will be permitted other than re-selection due to unavailability.  Purchaser's Initials
- 4) The Purchaser acknowledges reading and accepting the "Gold Park Homes Decor Centre Disclaimers" form. This document contains other miscellaneous disclaimers.

This Interior Colour Selection is final and approved by:

Signature: 

Date: May 2 / 17

~~Elevation A - 3.016 sq ft~~

Elevation B • 3,043 sq.ft.

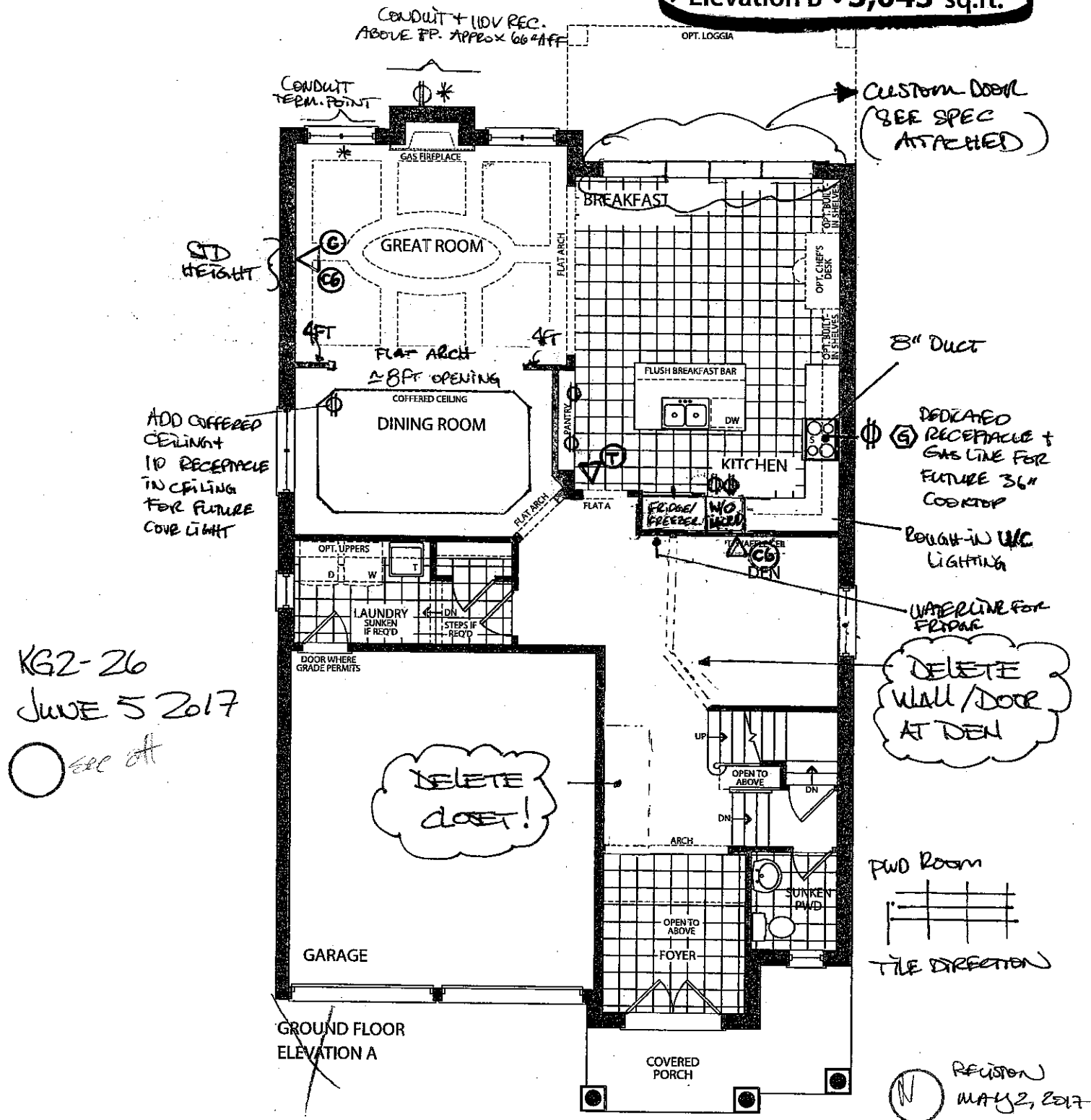

* 10FT CEILINGS

- * - CONDUIT
- ▽ (C6) - CAT 6
- ▽ (C) - CABLE
- ⌘ - RECEPTACLE
- ▽ (T) - TELEPHONE
- ▽ (G) - GAS LINE

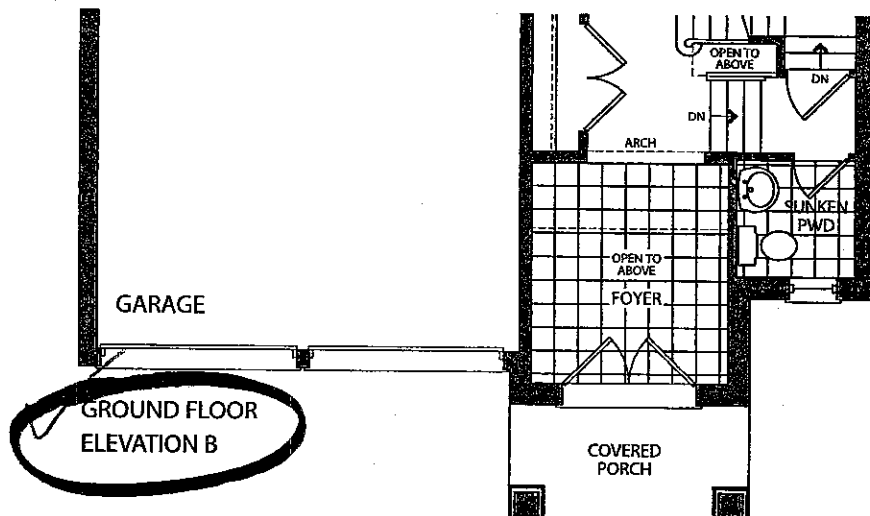

K62-26
STRUCTURAL

DATE: 03/19/12

Colours

DATE: 03/19/12

Elevation A • 3,016 sq.ft.
Elevation B • 3,043 sq.ft.

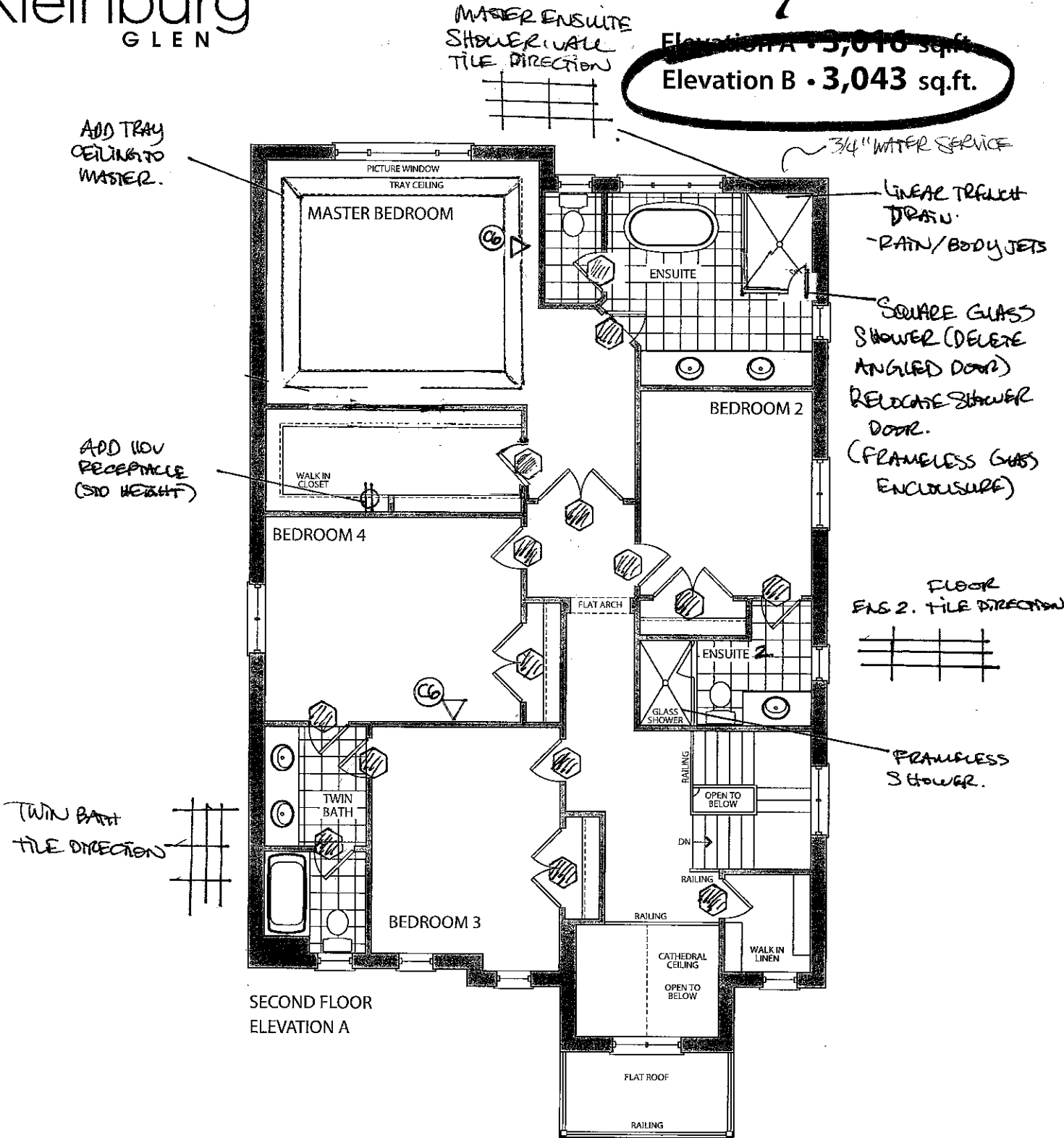

SECOND FLOOR
ELEVATION A

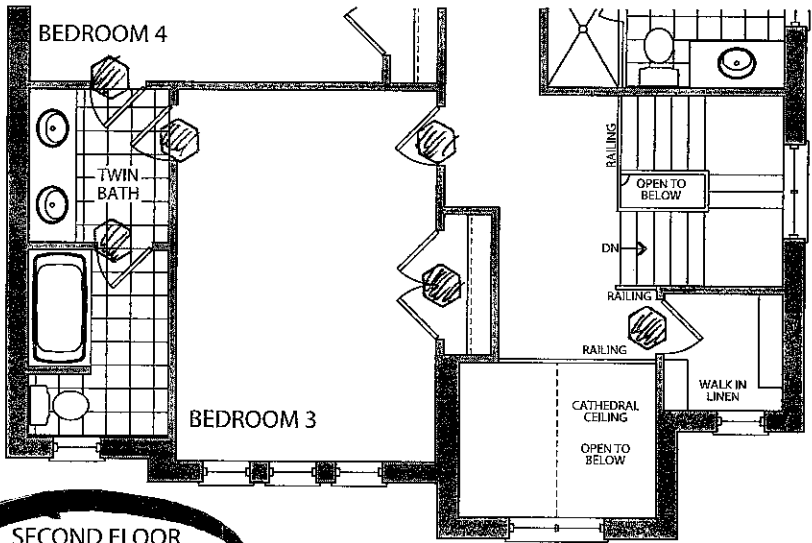

SECOND FLOOR
ELEVATION B

REVISION
MAY 2, 2017

KS2-26
STRUCTURAL

DATE: 03/19/17

COLOURS

DATE: 03/19/17

~~Elevation A • 3,016 sq.ft.~~

Elevation B • 3,043 sq.ft.

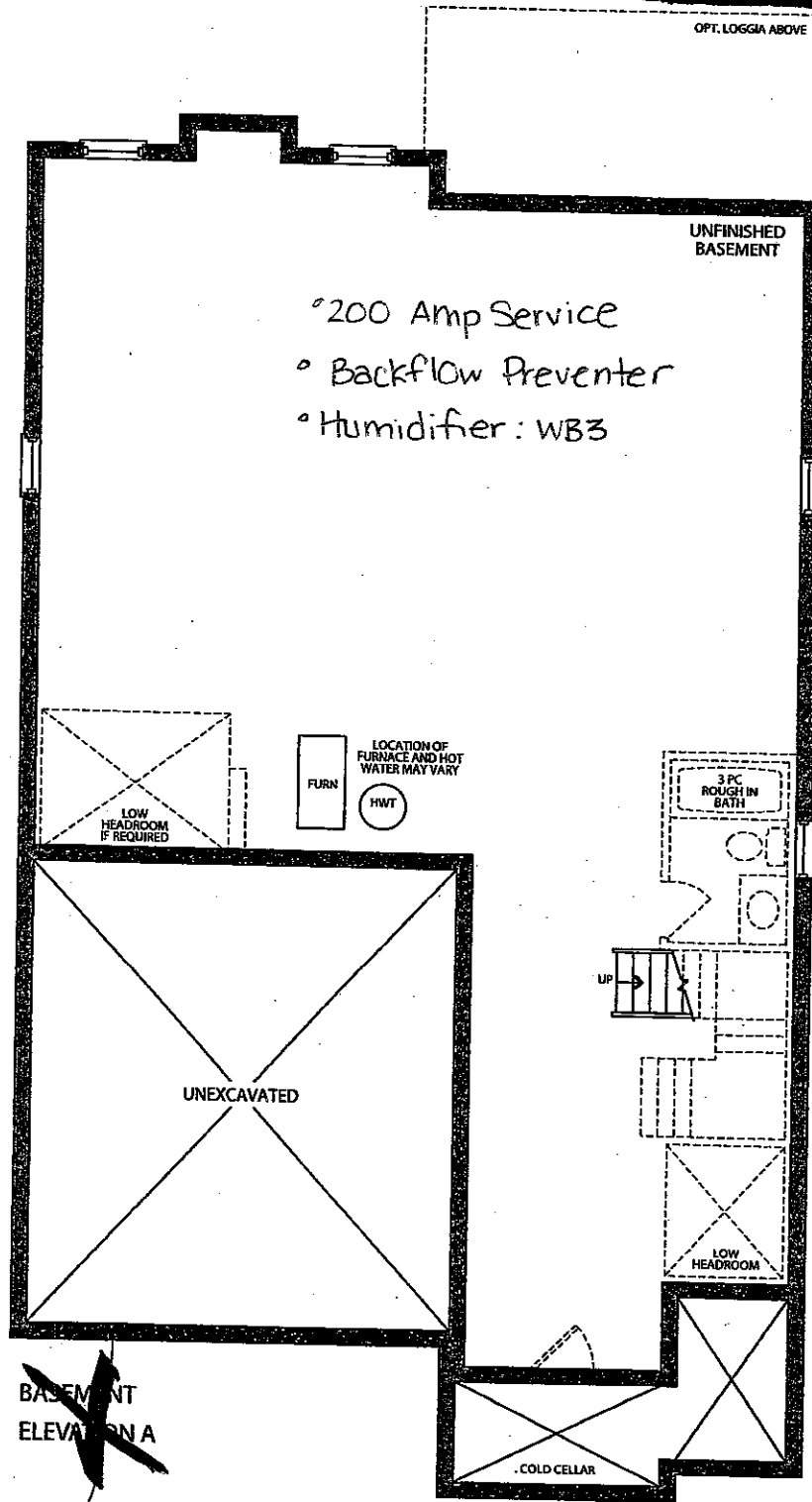

KG2-26
JUNE 5 2017

* BACKFLOW
* HUMIDIFIER

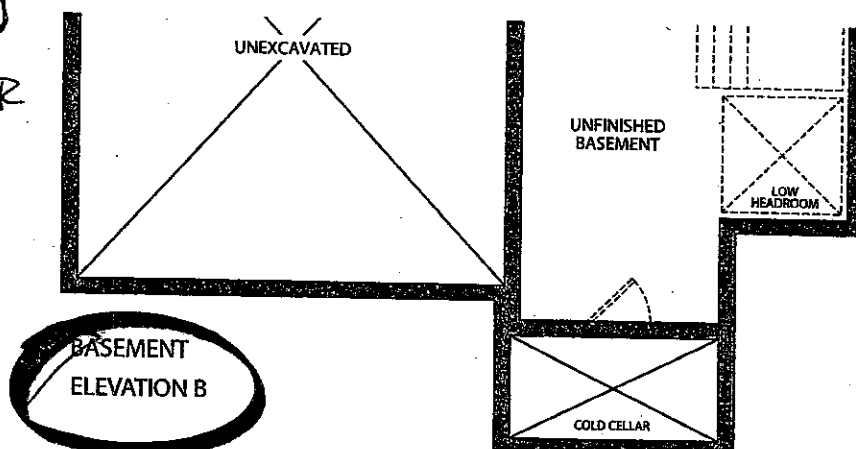

KG2-26
STRUCTURAL

DATE 03/19/17

COLOURS

DATE 03/19/17

GOLDPARK
H O M E S

Kleinbaur

**Granite, Marble,
Engineered Surfaces**

- Standard 2CM & 3CM
- ⊖ Upgrade 1 2CM & 3CM
- ⊗ Upgrade 1 & 4 CM
- Upgrade 2

20mm (3/4") Profiles

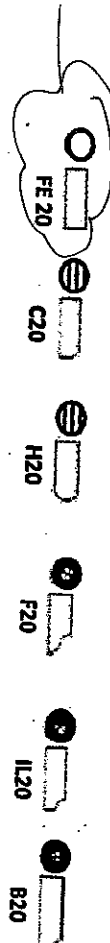

STD
KITCHEN
EDGE

30mm (1 1/4") Profiles

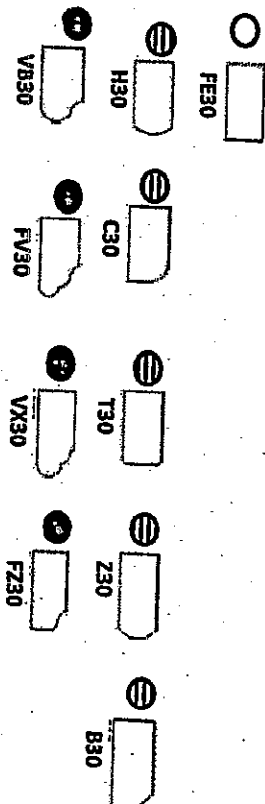

40mm (1 1/2") Profiles

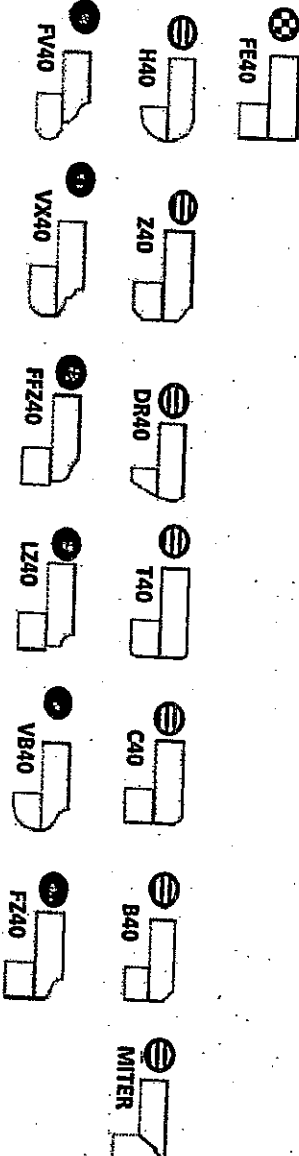

Note: All colours may not be available in 30mm at time ordered. Vendor reserves the right to use 40 mm edges (by lamination process).

*Mitre edge is available in Upgrade 1 for an overall thickness of 2". All other Mitre edge options will be an Upgrade 2 Edge.

W62-26

12

March 19, 2017

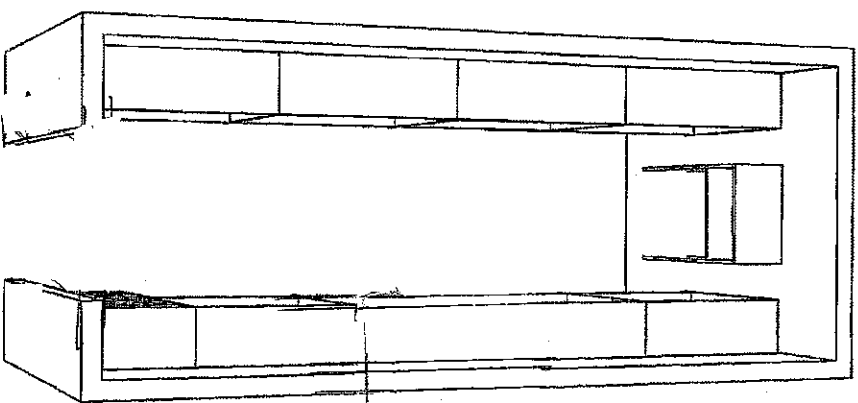

 MAY 2, 2017

The Home Organizer

<YOUR ADDRESS>
<YOUR CITY AND STATE>
PHONE: <YOUR PHONE NUMBER> FAX: <YOUR FAX NUMBER>

GPH MODEL 42 - 1

GPH MODEL 42 - 1 Room 1

Perspective

Current Date: Feb 07, 2017

Scale: NTS

W62-240



MAR. 19, 2017

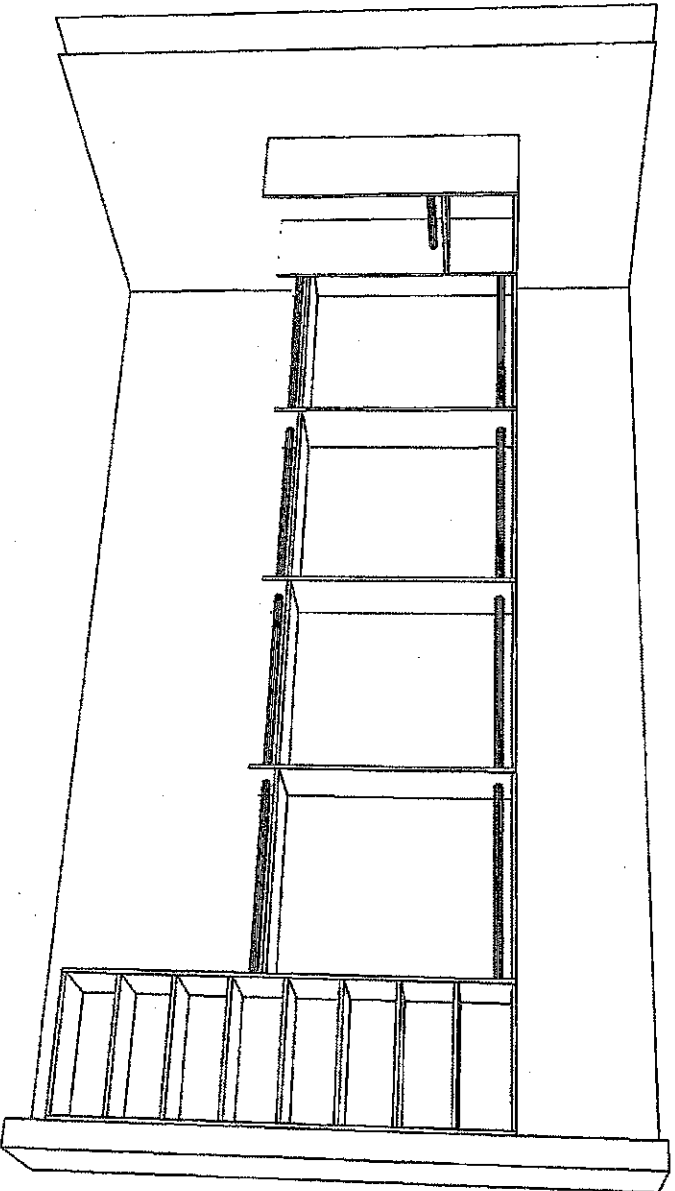

The Home Organizer		Perspective	
<YOUR ADDRESS>			
<YOUR CITY AND STATE>			
Phone: <YOUR PHONE NUMBER> Fax: <YOUR FAX NUMBER>			
GPH MODEL 42 - 1			
GPH MODEL 42 - 1 Room 1			
Current Date: Feb 07, 2017		Scale: NTS	

MA 2-26
MATH 19. 2017

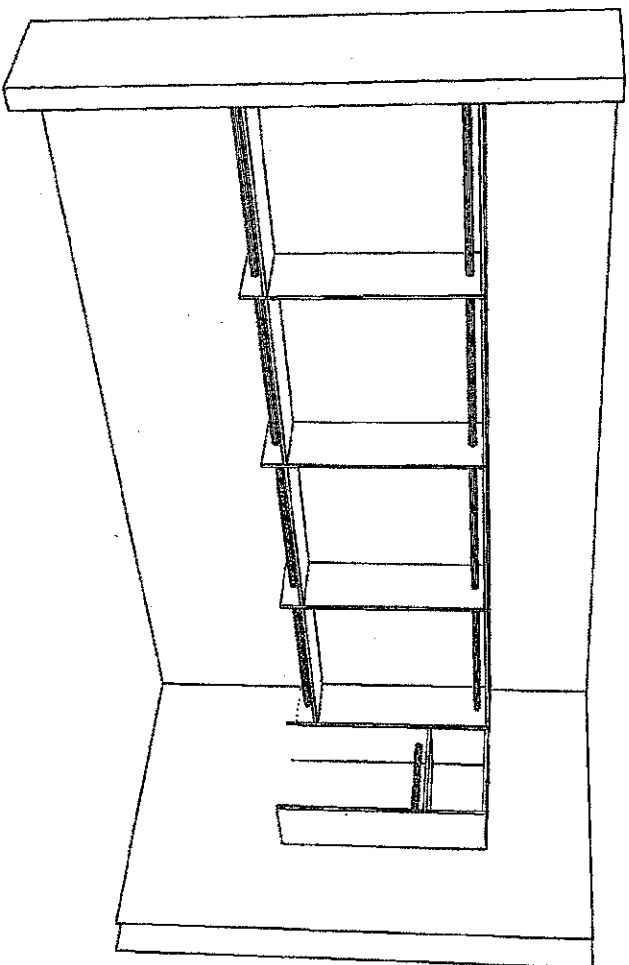

The Home Organizer

<YOUR ADDRESS>
<YOUR CITY AND STATE>
Phone: <YOUR PHONE NUMBER> Fax: <YOUR FAX NUMBER>

GPH MODEL 42 - 1

GPH MODEL 42 - 1 Room 1

Perspective

Current Date: Feb 07, 2017

Scale: NTS

MS2-26

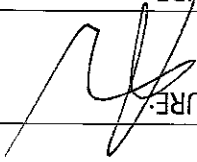

March 29, 2017

LOT # K62-26		ROOM: MASTER ENSUITE SHOWER	DATE: MARCH 19, 2017
SIGNATURE: 		SIGNATURE:	

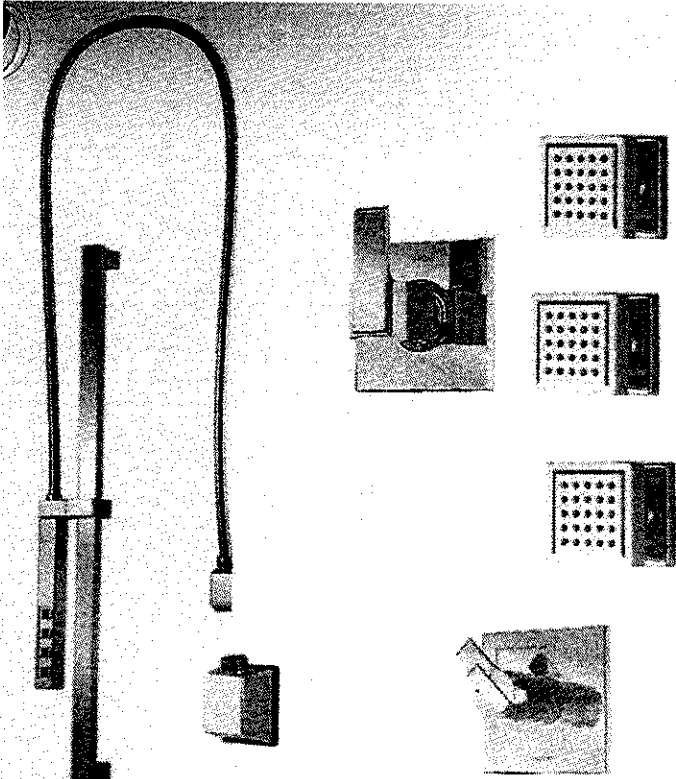

STRAIGHT ARM FROM
 CEILING FOR
 RAIN
 SHOWER

Delta Temp Assure Shower system with 6 function diverter & body sprays & high flow rough-in 1.0GPM
 Chrome Finish. #T117126 / 50570 / 51567 / T11967 / R1100 / 50150 x3 / R10000-UNBXHF

PLUMBING UPGRADES

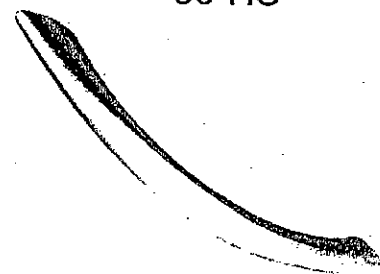

CH-32



CH-38

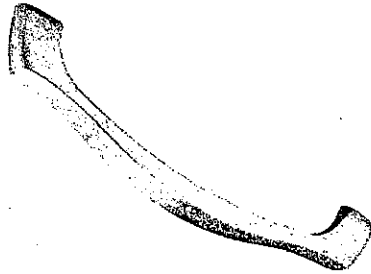

CH-44

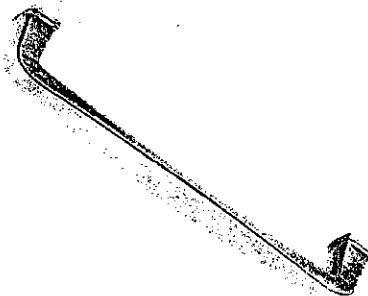

CH-45

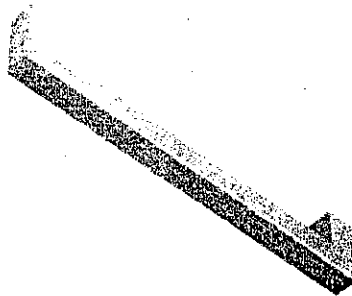

CH-46

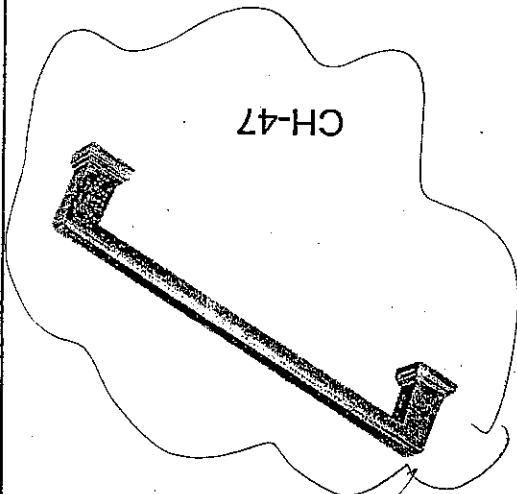

CH-47

to be used

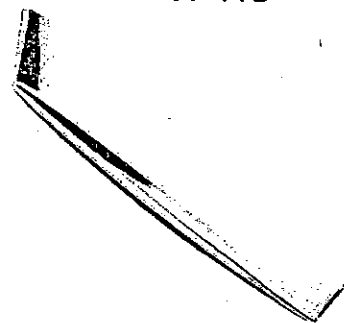

CH-48

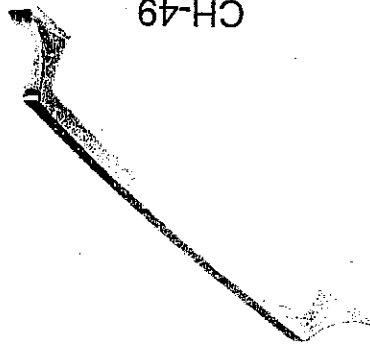

CH-49

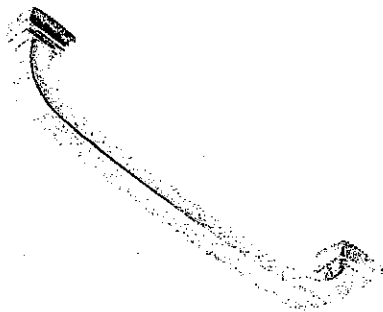

CH-50

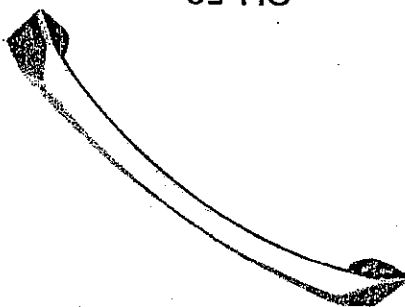

CH-52

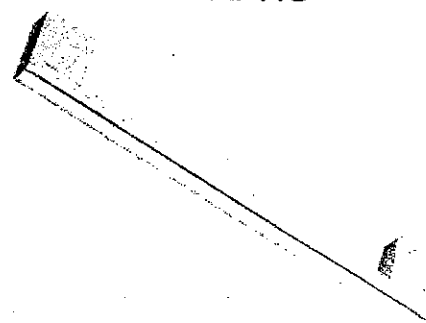

CH-51

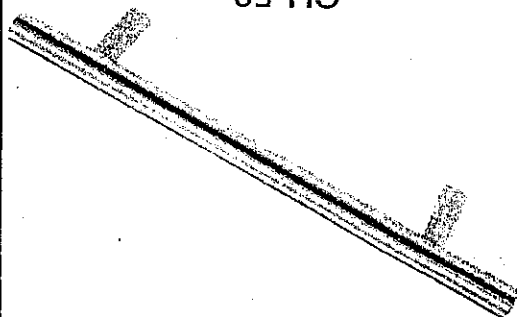

CH-53

NOTES:
- IMAGES ARE FOR QUICK REFERENCE PURPOSES ONLY
- ACTUAL SIZES AND FINISHES AS PER HARDWARE
- SAMPLE BOARD PROVIDED TO DECOR CENTRE



K62-26

MAY 2, 2017

K62-210

11

MAY 2 2017

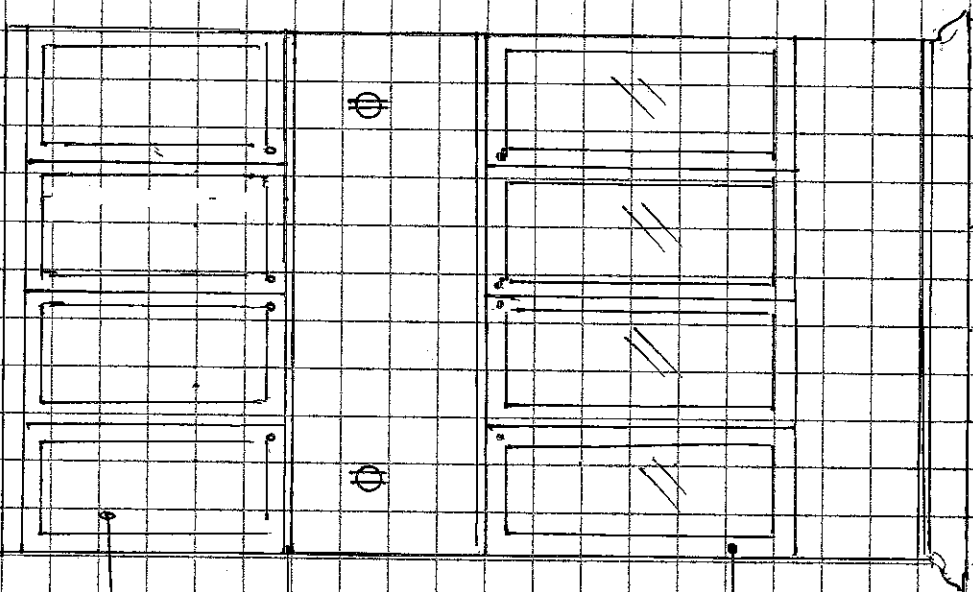

WHITE FRAMED GLASS DOORS

SINK GRANITE

WHITE CABINETS
WINDOW SEAT

Trade Name: Gold Park Homes

Site location:

Model: 42-1

Project: Kleinburg Glen

Phase:

This layout has been explained to the purchaser by Cortina Kitchens Inc. and is understood by the purchaser.

NEW PANTRY
Layout - SEE SKETCH
ATT'D.

ADD 2FT VETRINA
(DOUBLE DOOR - CLEAR GLASS)
WITH STANDARD CABINET DOUBLE
DOORS BELOW

ADD 4 OVERLAY
(BUNNY) DOORS AT
BACK OF ISLAND
ONLY.

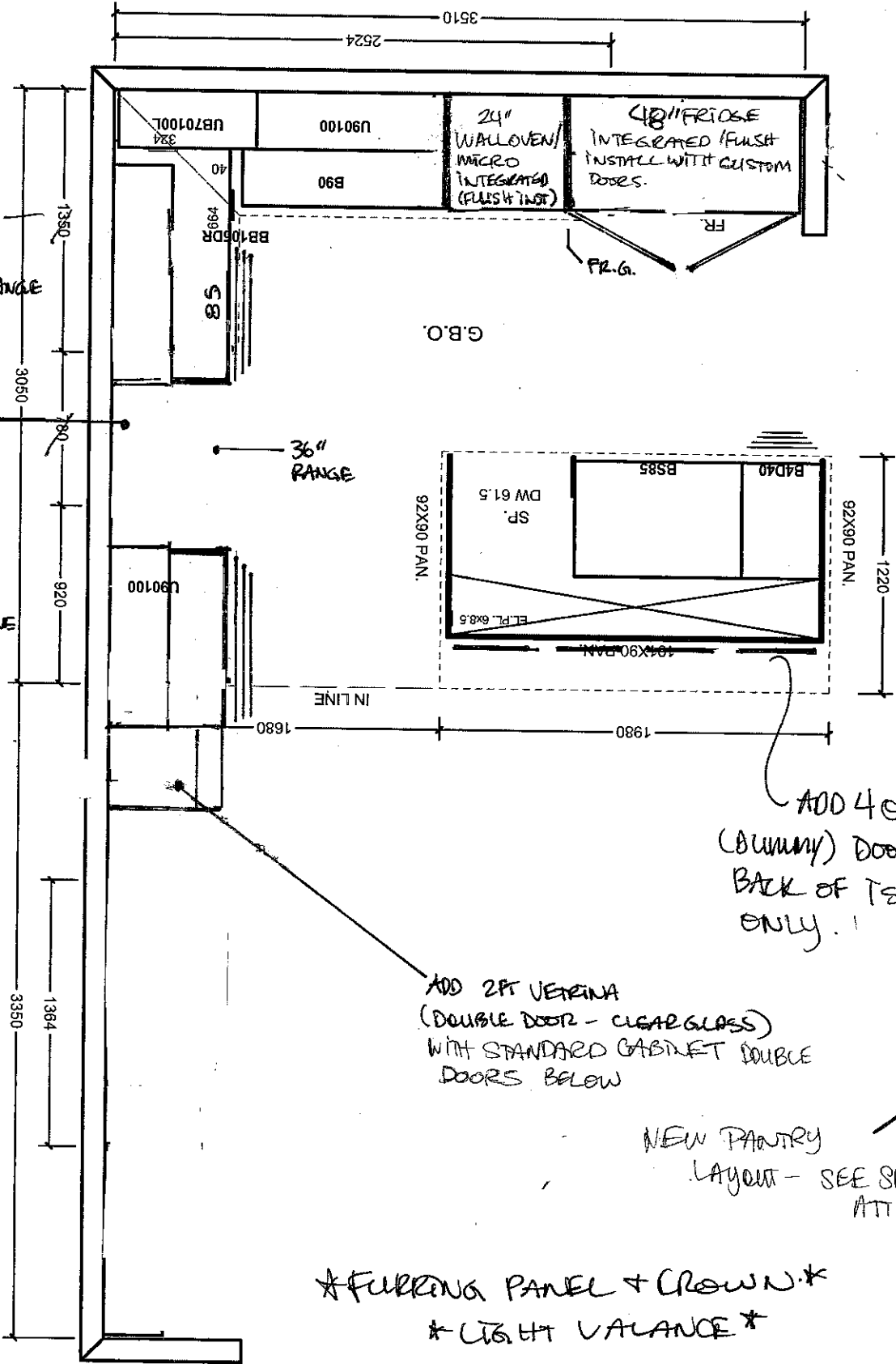

All prices subject to confirmation from head office.
This quotation is subject to the terms & conditions set out

All agreements are contingent upon strikes, accidents, and delays beyond our control.
Please provide our installer with template for sinkholes or \$150.00 will be charged for callback.

MAY 2, 2017

K62-26

ACCEPTED DATE: MARCH 19, 2017

Item A. Wood grain and colour are characteristics of the product. We cannot guarantee that such grain and colour will always match.
Item B. Cortina Kitchens Inc. reserves the right to alter dimensions and make technical changes without notice.

STANDARD HARDWARE

STANDARD HARDWARE

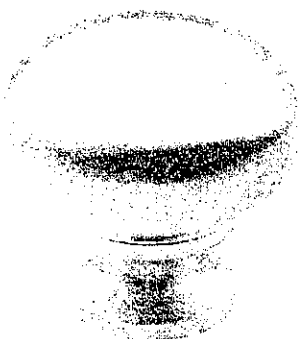

CSI-6



CSI-10



CSI-14

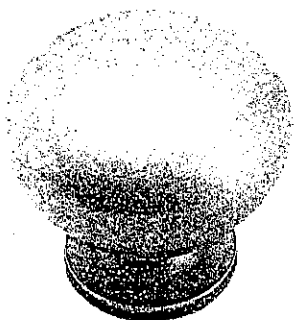

CSI-16



CSI-18

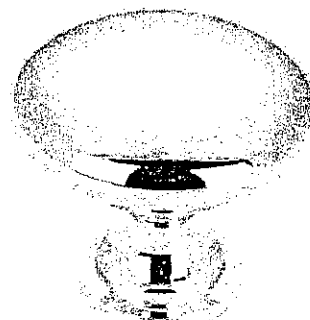

CSI-19



CSI-20

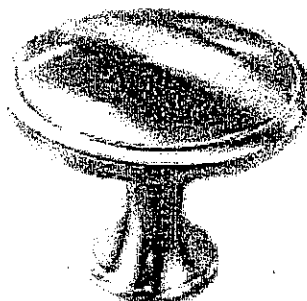

CSI-21

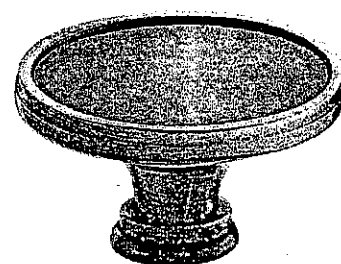

CSI-22

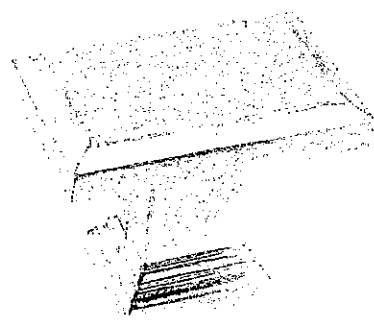

CSI-23

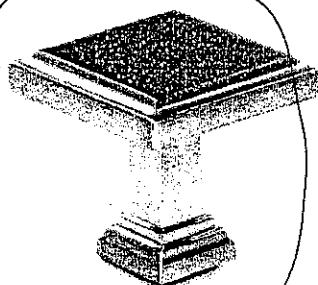

CSI-24

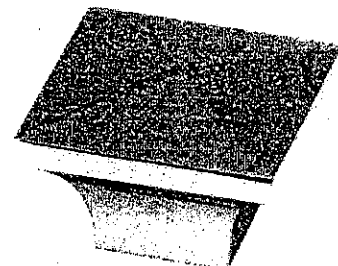

CSI-25

*NOTES:

- IMAGES ARE FOR QUICK REFERENCE PURPOSES ONLY
- ACTUAL SIZES AND FINISHES AS PER HARDWARE SAMPLE BOARD PROVIDED TO DECOR CENTRE

MASTER ENSUITE / ENSUITE 2 /
TWIN BATH

K62-26

March 19, 2017

(30" WIDE)(24" HIEGHT)(12" DEPTH) STAINLESS WALL MOUNT DUCT COVER:

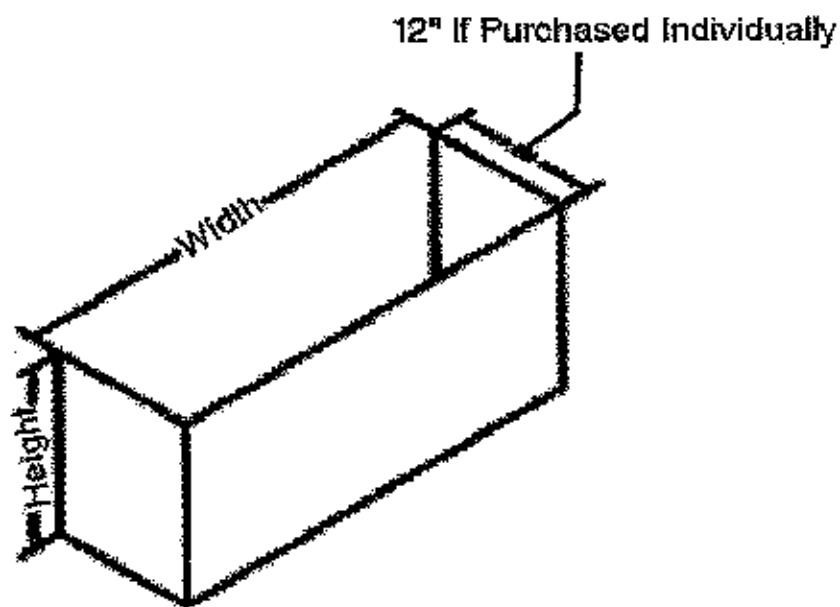

K62-26



MARCH 23, 2017

K52-24

40

March 23, 2017

VERANDA
2 CUBIC
GUASS
DOORS

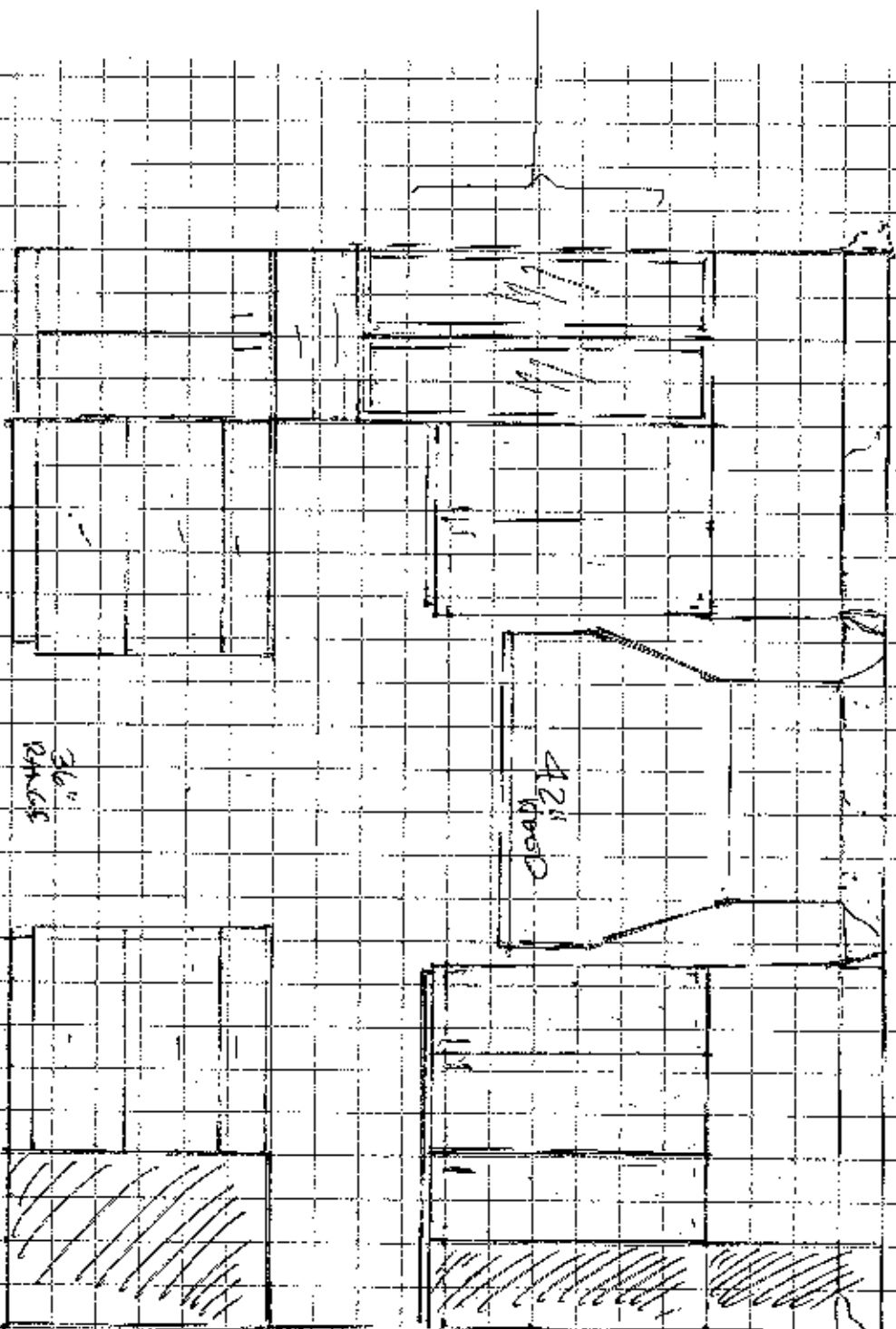

R62-26a

(2)
PROJECT 19, 2017

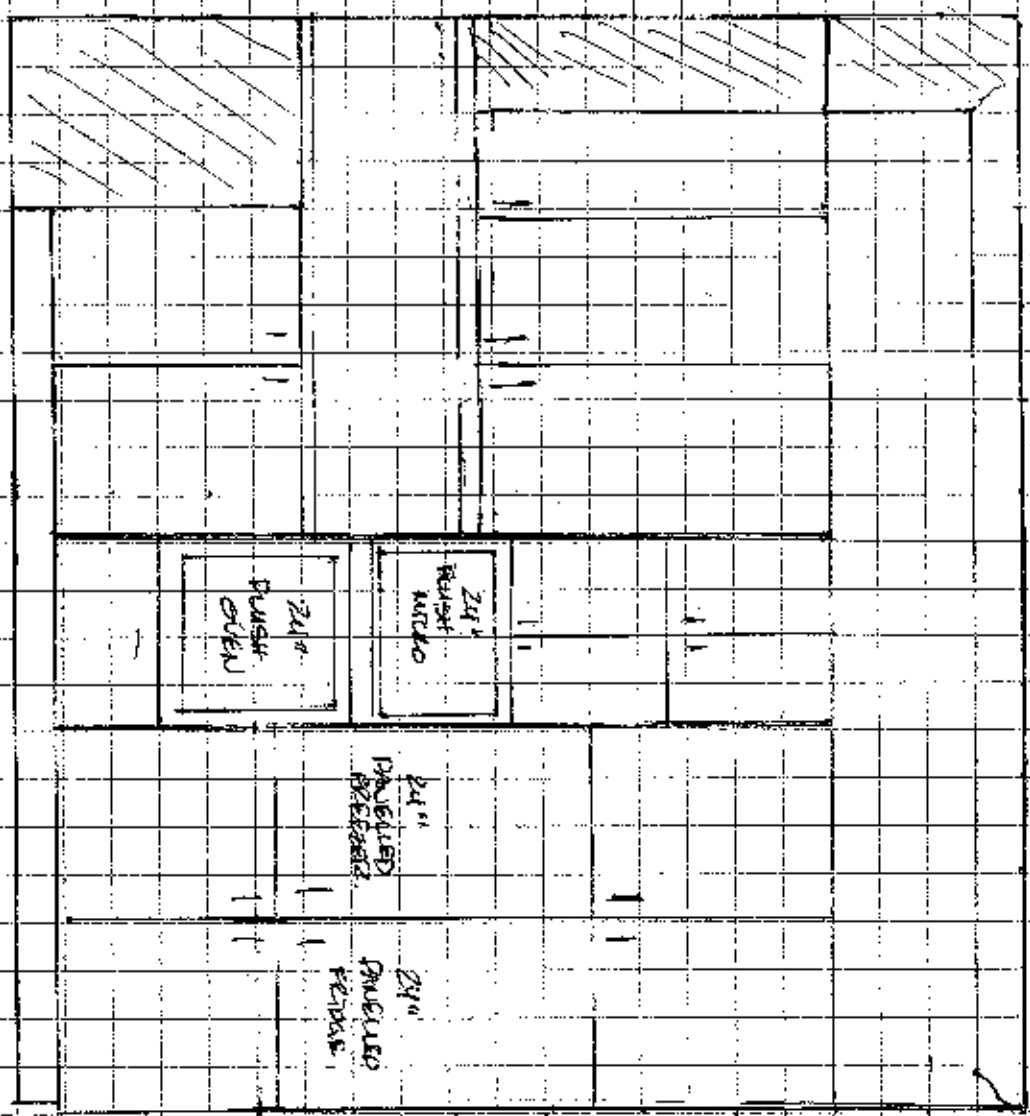

104
CERIMOS

Trade Name: Gold Park Homes

Site location:

Model: 42-1

Project: Kiehnburg Glen

Phase:

This layout has been explained to the purchaser by Cortina Kitchens Inc. and is understood by the purchaser.

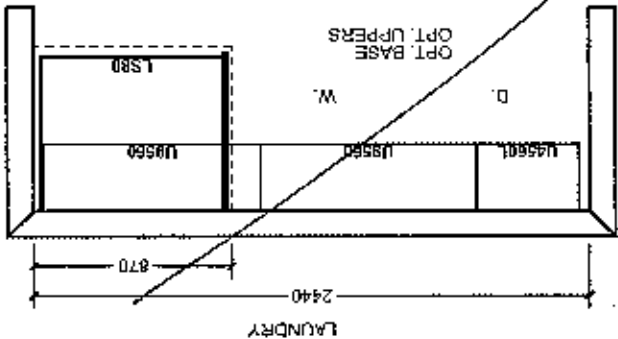
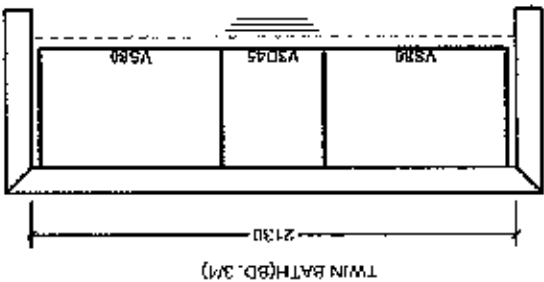
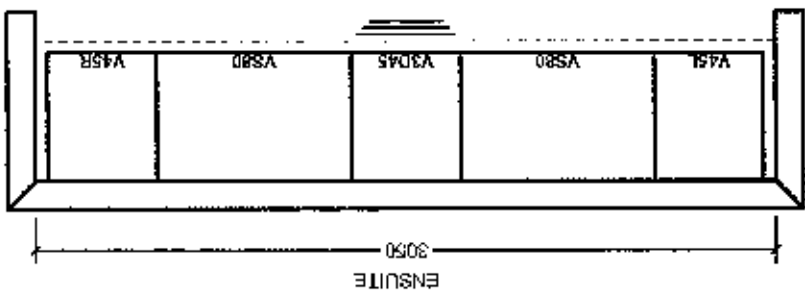
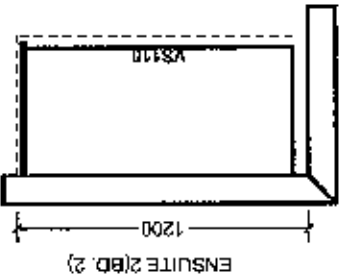

OPT. 5 BED. SECOND FLOOR

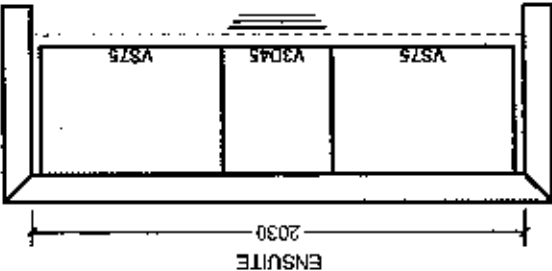
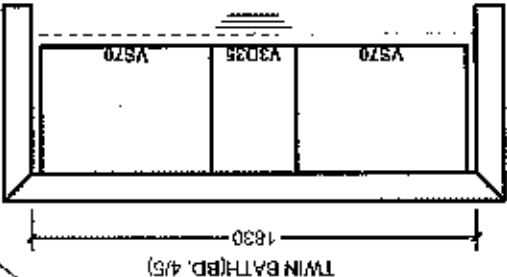
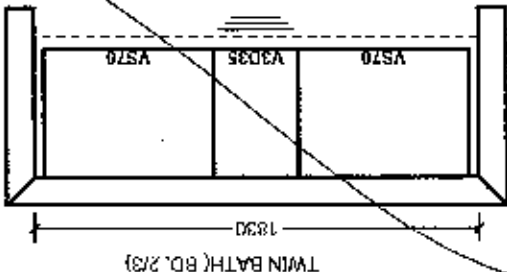

PART SECOND FL. ELV. B

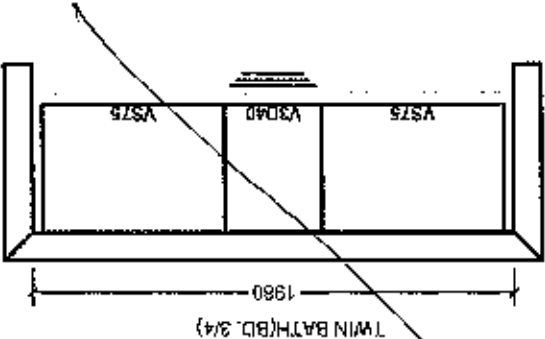

PART OPT. 5 BED. SECOND FLOOR

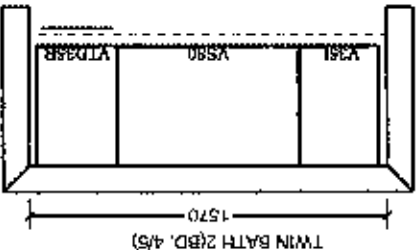

All prices subject to confirmation from head office.
This quotation is subject to the terms & conditions set out

All agreements are contingent upon strikes, accidents, and delays beyond our control. Please provide our installer with template for sinkholes or \$150.00 will be charged for callback.

ACCEPTED DATE:

11/07/19, 2017

162226

LINE NO.	LOCATION	BOOK CODE	NET UNIT PRICE	QTY	EXTENDED PRICE
SIZE INFO	DESCRIPTION				

Line-1

Rough Opening: 148 15/16 X 97 1/8

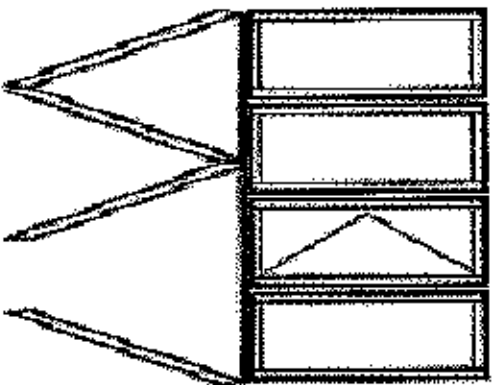

Viewed from Exterior. Scale: 1/8" = 1'

Main Line Item

Siteline - Outswing Folding Door Product, Clad Aurilast Pine, Bottom Rolling 4 PNL (3L-1R)

Black Exterior,

Water Penetration Resistance 260 Air Level A2

Natural Interior, 3 — BLACK OR STEEL IF POSSIBLE (PREFERRED) * 1

No Drip Cap/No Nail Fin,

Bronze Sill, Black Weirp, 6 9/16 Jamb,

Panel 3 Active, Narrow Sill, Extruded Clad Pnl,

5th Nkl Hdr Stainless Hrg/Flush Bolts, w/Magnet Catches, Bronze,

Contemporary Multi-pt Hd Set Active Only,

, Ashagal Installed,

Insulated Low-E Tempered Glass, Preserve Film, Argon Filled,

Canada-NAFS 08 & 11/CSA A440, PG 35,

No Screen,

Contact dealer to discuss how unit will ship knocked down and sill options.

U-Factor: 1.62, SHGC: 0.27, VLT: 0.49, Energy Rating: 15.00, CPD:

JEL-N-851-00010-00001

REV 2016.12.13/19/20 6.277 (03/03/16) RP

1

K62-26

NO

MARCH 19, 2017



K52-26



March 19, 2010

Gold Park Homes Décor

GOLDPARK
WORTH MORE™

Centre Disclaimers

Through years of doing business, we at Gold Park Homes have encountered issues beyond our control. The following disclaimers apply to all instances of Purchaser's Extras forms and all Interior Colour Scheme forms.

FIREPLACES

Fireplace Marble: Due to the many variables that can affect the pattern and/or design, frequently the marble installed on the fireplace will not be identical to the samples. We will make every attempt to come as close to the samples as possible, but cannot be responsible for results which differ from the samples.

CERAMIC FLOOR TILE

Many variables including variegation can affect tile colour, pattern and/or design which mean installed tiles may not be identical to the samples. We will make every attempt to come as close as possible, but cannot be responsible for results which differ from the samples.

HARDWOOD FLOORING

The purchaser is advised that cupping and shrinkage are characteristics of hardwood flooring normally appearing after installation, especially when humidity levels are not regulated, and no warranty is provided by the flooring supplier with respect to such cupping and shrinkage. Furthermore, hardwood floors may also heave and warp when located at or close to entrance points of the home, where rain could make its way to the flooring. The vendor agrees to install any hardwood flooring ordered by the purchaser in a good and workmanlike manner, but shall not be responsible for, and is hereby released by the purchaser from responsibility and liability for cupping, shrinkage, heaving and warping of hardwood flooring in the above mentioned circumstances.

STAIRCASE VS FLOORING WOOD SPECIES DIFFERENCE

The purchaser is aware and therefore accepts and acknowledges that the wood species of the staircase and flooring chosen do not match. This difference might result in an undesirable colour variance.

The purchaser is aware and therefore accepts and acknowledges that though the flooring is of the same species as the staircase the difference in product finishing may result in a stain colour variance.

The purchaser agrees that the vendor is to be exempt from any and all claims by the purchaser regarding this colour variance.

RAILINGS

All railings, pickets, posts, nosing's and stairs come from solid wood and veneered wood materials sourced from multiple locations and sources. As such there will be variations in grains and shades between the various natural components beyond our control. Due to this variance in material, all components will stain with colour or natural finish differently.

Iron pickets are wrought in nature and depending on the manufacturing process will have differences from picket to picket which is normal. Also the finish of the iron pickets is of a powder coated nature. This process can produce minor colour variations or tones. Furthermore, the assembly of the metal pickets can develop a natural rattle over time from vibration in the railing. Minor rattling is normal and is a part of the wrought iron picket assembly.

HOUSE EXTERIORS

Variations in subcontractors across different sites and varying site conditions may result in house exteriors that differ from the artist renderings. We cannot be responsible for results which differ from the artists renderings of elevations.

PLASTER MOULDINGS AND MEDALLIONS

Plaster mouldings will not be installed in open to above areas or areas with 2 storey elements.

STAIN COLOURS

Due to the many variables that can affect the outcome of a stain colour on wood, staircases, railings, and fireplaces, the colour may not be identical to samples. Factors such as density, age, humidity, air temperature, and the uniqueness of each piece of wood can result in wide variations in darkness or lightness. We will make every attempt to come as close to the sample as possible, but cannot be responsible for results which differ from the samples.

Stain on pre-finished hardwood floors will not be an exact match to the stain colours available on stairs, pickets and rails. The purchaser is responsible for choosing the stain on these areas to their satisfaction.

IN-WALL CONDUIT FOR AUDIO/VIDEO CABLES

It is important to note that due to the variation in framing requirements in different parts of your home, conduit lengths and routing can vary. In virtually all instances of ground floor installation (i.e. above a fireplace), conduit will first travel down into the basement below the floor joists, over to the termination point and back up into the main floor. As a result, it is best to measure the length of the conduit after occupancy with a "pull wire" before

K62-26

MAR. 19, 2017

purchasing your cables. For above-fireplace installations, the conduit wall plate will be installed approximately 10" above the Fireplace Mantle, unless otherwise specified in the Construction Summary.

APPLIANCE SPECIFICATIONS

All appliance openings are set to builder's standard openings. Please advise Décor Centre at time of your structural appointment if custom sizing of cabinets is required for any built-in appliances. The purchaser is responsible for costs and fees associated with changes to pre-manufactured kitchens made subsequent to colour appointments.

Purchaser accepts & acknowledges that in order to accommodate upgraded appliances, all appliance specifications should be provided at the time of their structural appointment, should this not occur they must be provided to the Décor Center within one (1) week of completion of structural chart. Failure to do so may result in the need to revert to the standard appliance openings or in a delay in construction of your dwelling, as well as a cost of \$500 to re-open your structural file should changes be required. As a result we may be forced to extend the closing of your transaction. Due to failure to complete the above-mentioned selections and at no fault of our own, we reserve our right to hold you responsible for this delayed closing, including charging extra administration cost and interest on the balance due on closing.

Purchasers Accept Standard Appliance Openings (unless otherwise specified):

Fridge - 37-1/2"W x 73-1/2" High Approx.

Range - 30-1/2"D x 31-1/2"W Approx.

Dishwasher - 24" W Approx.

DELETION OF HOODFAN & CABINETS ABOVE STOVE:

The purchasers are aware that in requesting NOT TO INSTALL builder's standard hood fan and standard cabinets above stove they will receive NO STANDARD HOOD FAN and NO CREDIT. Purchasers are installing their own hood fan after closing and accept that it may waive any warranty associated with such a change.

Purchasers accept and acknowledge that the exhaust fan duct hole may be off-centered with the stove in the kitchen due to purchasers installing their own hood fan after closing. The vendor is exempt from adjusting such openings for the purchasers range hood.

ELECTRICAL FOR APPLIANCES

Pricing is subject to change based on the appliance specifications provided. Purchasers should provide proper appliance specifications and cut-out sheets in order for Gold Park to price extras accordingly.

KITCHEN CABINETS

The kitchen you order/purchase will undoubtedly contain slight colour variations. The degree of these variations is virtually impossible to determine before the kitchen is installed in its intended location. The amount of and type of lighting will also affect various highlights in the finish. Note: No two pieces of wood are identical. Variations in colour tone and grain patterns make a perfect colour match virtually impossible. It is generally agreed that these variations add to the natural beauty of a wood kitchen.

STAIN

Charcoal is a spray stain applied to Oak and Maple products with several characteristics that are important to be aware of when purchasing this product.

1. Shadow lines may be visible at the interior profile edges of a door or drawer front. If movement occurs shadow lines may increase or decrease, depending on the style and/or size of a door or drawer front.
2. Variation and unevenness may be visible in the finish.
3. Hairline cracks at the joints are created over time due to the nature of natural wood, caused by usage, humidity**, or dryness. They tend to be more visible to darker stains, than lighter wood stains.

** Relative humidity is recommended to be between 45% and 55%. Please refer to Cortina Kitchens "Cleaning, Care, Maintenance, & Warranty Information" guide.

Please be advised that Cortina Kitchens will not replace doors and/or parts that exhibit the above characteristics associated with this finish. These characteristics are not avoidable and are a result of the natural characteristics of wood and wood veneer, and the characteristics of darker stains on wood. The Charcoal stain is not available on doors in Group IV, Group IVA, Group V and Group VA.

Cortina Kitchens offers a wide variety of finishes, applied to oak and maple products. The subject finishes include the spray stains Cocoa, Espresso, Graphite as well as wiping stain Ebony.

Due to the very dark stains applied on natural maple and oak doors and joints, several characteristics are important to be noted when purchasing these products.

1. Shadow lines may be visible at the interior profile edges of a door or drawer front. If movement occurs shadow lines may increase or decrease, depending on the style and/or size of a door or drawer front.
2. Variation and unevenness may be visible in the finish.
3. Hairline cracks at the joints are created over time due to the nature of natural wood, caused by usage, humidity, or dryness. They tend to be more visible to darker stains, than lighter wood stains.

Please be advised that Cortina Kitchens will not replace doors nor parts that exhibit the above characteristics associated with this finish. These characteristics are not avoidable and are a result of the natural characteristics of wood and wood veneer, and the characteristics of darker stains on wood.

1462-26



MARCH 4, 2014

CABINETRY DOOR HARDWARE

Cortina Kitchens' cabinetry doors and drawer fronts will be drilled to accept a standard knob or handle selected from Cortina's hardware boards. This drilling comes standard with the order, and is done ONLY in our shop, not on the job site.

For those not wanting Cortina's hardware drilling, the following applies:

No holes to be drilled on the doors and drawer fronts should be specified in writing on the colour chart and the P.O. If while in production, Cortina Kitchens misses this request, Cortina Kitchens and the Builder will not be held responsible to replace any or all doors and drawer fronts affected, and the customer agrees to accept the product as is. No hardware will be supplied or credited by Cortina Kitchens with this request. No charge will apply for this request.

PVC DOORS

All cabinets with PVC (Thermofoil) Doors come with melamine gables, panels and kick.

The doors, crown moulding and light valance are PVC wrapped. Open shelves incorporated in design will only be available with melamine interiors. There will be variations in colour shades between the PVC parts (doors, crown and Light valance) and the melamine parts (open shelves, Gables, Panels and Kick) due to the difference in material.

Furring Panel with crown moulding to the ceiling is not available on all PVC door styles due to subtle variations in colour shades between the PVC parts (moulding) and the melamine parts (furring panel) due to the difference in material. Grain directions in wood grain pattern melamine, vary between the furring panel, crown moulding (horizontal) and the PVC doors (vertical).

GRANITE, MARBLE ENGINEERED SURFACES WAIVER

Granite and marble are naturally occurring products, and due to the many variables that can affect the pattern, colour and/or design and "pitting" of natural products slabs installed will not be identical to the samples displayed. We will make every attempt to come as close to the samples as possible, but cannot be responsible for results which differ from the samples. Every effort is made to provide granite counter tops as close as possible but the vendor is not responsible for results which differ from the sample displayed. All countertop surfaces may have seams & product pattern & shade can change in areas containing seams.

RESELECTIONS

It is not uncommon for flooring, such as tile, to become discontinued prior to its installation. Therefore it may be necessary to make a reselection of certain materials sometime during the build process. We cannot assure you that another choice approximating your selection will be available.

PLANS

Plans are subject to change without notice. Actual usable floor space may vary from the stated floor area. Layout for kitchen, furnace, HWT and laundry tub may vary from plan. Vertical and horizontal bulkhead, which are not shown on plan, may be required for plumbing and heating runs. E.& O.E.

PLEASE NOTE:

In the event the work on the house has progressed beyond the point where the items covered by these invoices cannot be installed without entailing any unusual expense, then this order is to be cancelled and any deposit paid in connection with the same is to be refunded to the purchaser.

The vendor will undertake to incorporate the work covered by the sales extra in the construction of the house but will not be liable to the purchaser in any way, if for any reason the work covered by the extra is not carried out. In that event, any monies paid in connection with the same shall be returned to the purchaser.

It is understood and agreed that if for any reason whatsoever the transaction of Purchase and Sale is not completed, the total cost of extras ordered are not refundable to the Purchaser(s).

Extras or changes will not be processed unless signed by the Vendor.

These extras may not be amended without the written consent of Gold Park Homes.

The purchaser(s) and the builder acknowledge and agree that this "Purchaser's Extra" form shall not be deemed to be part of the agreement of purchase and sale entered into between them, nor an addendum thereto.

No postdated cheques will be accepted.

No estimates or orders will be accepted once construction has commenced.

Should a refund be requested on any extras purchased, an 80% reimbursement of the purchase price will be given. (a \$50.00 minimum charge and a maximum \$250.00 charge will apply)

Estimates will only be considered when resubmitted on a signed Purchaser Extras form, accompanied by payment in full.

All prices are estimates only and may be subject to change. Should a change in price occur Gold Park Homes reserves the right to request from the purchaser an adjustment of the price or a refund limited to that item.

Purchasers are aware & accept that ANY changes made to upgrades after signing the Purchasers Extra Form are subject to a minimum administration fee of \$500. PLUS a 10% holdback fee.

Purchasers are aware that any request to add a percentage of upgrades from the purchaser's extras form will be processed only after the builder receives approval letter from the bank.

1962-26

(11)

MAR. 19, 2017

Please be advised that your failure to finalize your structural or colour selections may result in a delay in construction of your dwelling and we may have to extend closing of your transaction. Due to failure to complete the above-mentioned selections and at no fault of us, we reserve our right to hold you responsible for a delayed closing, including charging extra administration cost and interest on the balance due on closing.

Purchaser has attended a Colour appointment at the Decor Centre & has DECLINED any additional upgrades and accepts and acknowledges that there will be no further structural changes/additions/deletions to be made upon signing.

I hereby acknowledge reading and understanding the above copy and will not hold Gold Park Homes responsible for any issues in relation to above.

Purchasers Signatures



Date

March 13/17

K62-26



MARCH 19, 2017

48" BUILT-IN SIDE-BY-SIDE REFRIGERATOR/FREEZER WITH INTERNAL DISPENSER PANEL READY

Sub-Zero

81-4851010



FEATURES

- LED lighting for brighter interior
- Overlay design accepts cabinet panels of all kinds
- Ice and chilled water dispenser inside the refrigerator makes convenience and aesthetics
- Dual refrigeration keeps food fresher longer
- Air purification system fights spoilage, odors
- Crisper and dairy drawers in low-temp, high-humidity zones for optimum freshness
- Microprocessor control ensures peak performance
- Water-filtration system reduces contaminants, chlorine taste and odor
- Freshness cards for maximum food preservation
- Rigorously tested in our U.S. manufacturing facilities to ensure decades of use
- Exceptional 24/7 support from Madison, WI-based Customer Care team
- Magnetic door seal system locks in cold air
- Automatic ice maker with "max ice" feature
- Adjustable shelves for maximum convenience
- Ice and chilled water dispenser inside the refrigerator makes convenience and aesthetics

ACCESSORIES

- Stainless Steel Side Panel
- White Side Panel
- Air Purification Cartridge
- Egg Container
- Stainless steel kickplate
- Grilles for 60" or 66" finished height (64" is standard)
- Side panel mounting kit
- Flush inset panels in stainless steel with tubular or pro handles
- Full-length standard and extended framed handles
- Framed front panels in white or stainless steel
- Custom front panel mounting kit
- Stainless steel pro handles
- Stainless steel tubular handles

Accessories are available through an authorized Sub-Zero dealer
• Contact dealer information: visit subzero.com/dealer

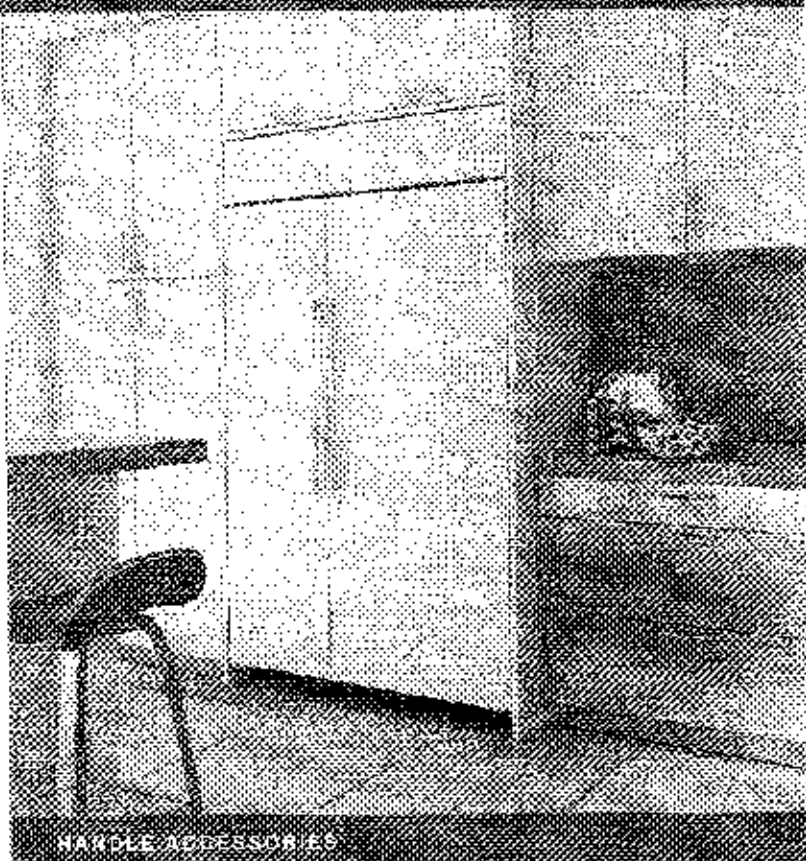

HANDLE ACCESSORIES

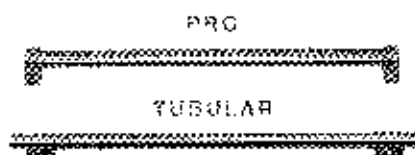

PRODUCT DETAILS

REFRIGERATOR

- Internal ice and water dispenser
- 4 Adjustable glass shelves
- 1 Stationary glass shelf
- 1 High-humidity drawer with divider
- 2 Storage drawers with divider
- 3 Adjustable door shelves
- 2 Stationary door shelves
- Adjustable dairy compartment

FREEZER

- 3 Adjustable wire shelves
- 1 Stationary solid shelf
- 3 Storage drawers
- 5 Adjustable door shelves
- Automatic ice maker

K6 2-26



May 2, 2017

48" BUILT-IN SIDE-BY-SIDE REFRIGERATOR/FREEZER WITH INTERNAL DISPENSER PANEL READY

ENERGY STAR

PRODUCT SPECIFICATIONS

Model	BI-48SID10
Dimensions	48"W x 64"H x 24"D
Door Clearance	30"
Weight	555 lbs
Refrigerator Capacity	18.5 cu. ft.
Freezer Capacity	9.5 cu. ft.
Electrical Supply	115 VAC, 60 Hz
Electrical Service	15 amp dedicated circuit
Plumbing Supply	1/4" OD copper, braided stainless steel or PEX tubing
Plumbing Pressure	35-120 psi
Receptacle	3-prong grounding-type

ELECTRICAL

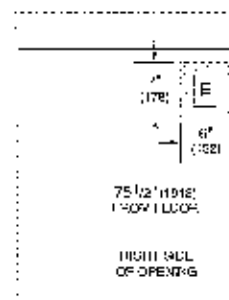

PLUMBING

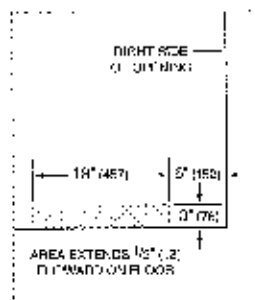

INTERIOR VIEW

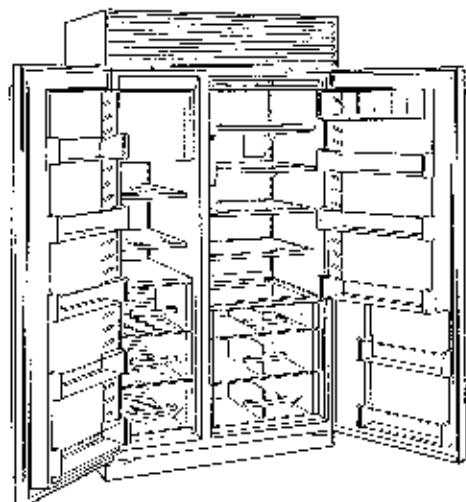

This illustration is intended for interior reference only and may not represent the exterior of the model being specified.

DIMENSIONS

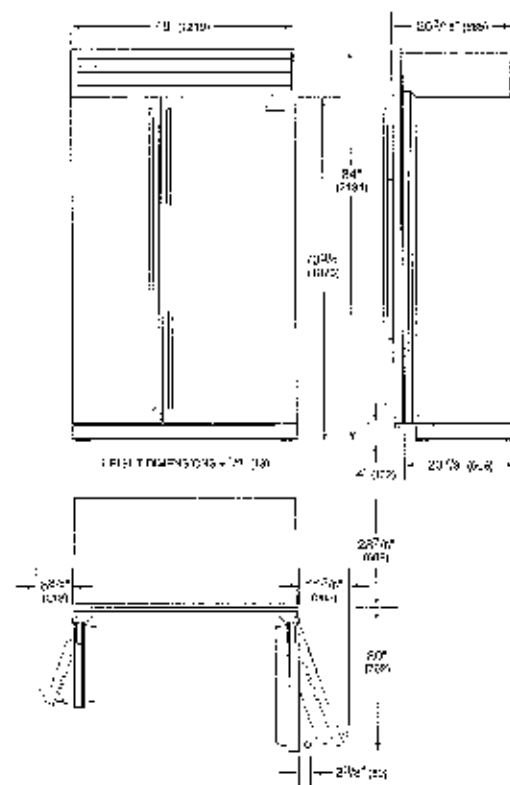

FLUSH INSET INSTALLATION

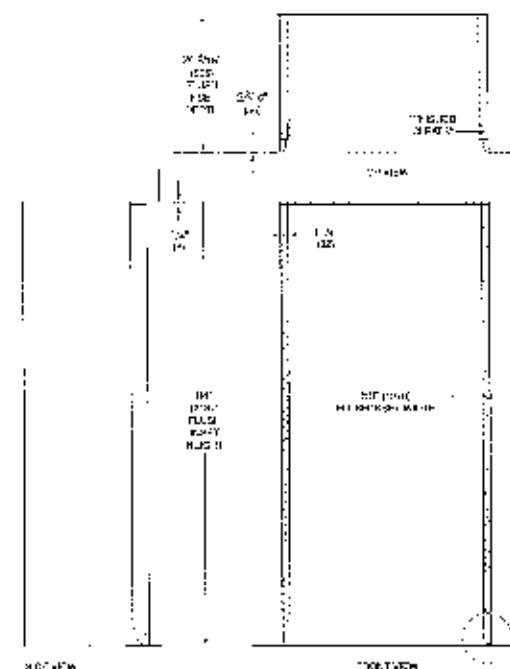

For flush inset installation, the cabinet must be constructed and finished to match exterior. No additional doors or hardware are required for flush inset installation.

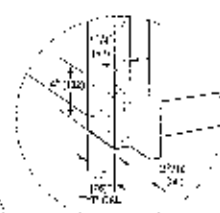

K62-26
N
MAY 2, 2017

Flush Inset Panel Dimensions

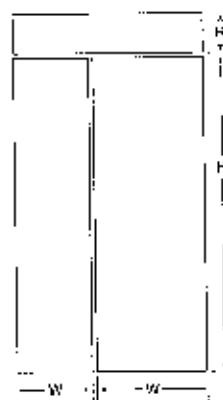
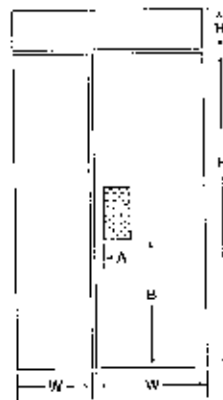
BI-36S, BI-42SD(10),
BI-48S(10)

BI-42SD, BI-48SD

MODEL BI-12S, BI-42SD, BI-42SD

REFRIGERATOR	W	H
Flush Inset Panel	25 5/8" (643)	69 3/4" (1772)
Spacer Panel	24 3/16" (614)	68 15/16" (1751)
Backer Panel	24 13/16" (630)	69 3/16" (1767)
FREEZER	W	H
Flush Inset Panel	17 3/16" (437)	69 3/4" (1772)
Spacer Panel	15 19/16" (407)	68 15/16" (1751)
Backer Panel	16 7/16" (418)	69 3/16" (1767)
GRILLE	W	H
Flush Inset Panel	43" (1092)	9 1/4" (235)
Spacer Panel	41 1/8" (1045)	8 5/16" (211)
Backer Panel	41 3/4" (1060)	8 15/16" (227)
BI-42SD	W	H
Dispenser Cut-Out	57 5/8" (146)	127 5/8" (316)
Cut-Out Location	2" (51)	28 13/16" (732)

MODEL BI-42UPD(10)

REFRIGERATOR (2 PANELS)	W	H
Flush Inset Panel	21 3/8" (543)	50 1/8" (1273)
Spacer Panel	20" (508)	49 5/8" (1253)
Backer Panel	20 5/8" (524)	49 13/16" (1260)
FREEZER	W	H
Flush Inset Panel	43" (1092)	18" (457)
Spacer Panel	41 1/8" (1045)	18 1/16" (459)
Backer Panel	41 3/4" (1060)	18 11/16" (475)
GRILLE	W	H
Flush Inset Panel	43" (1092)	9 1/4" (235)
Spacer Panel	41 1/8" (1045)	8 5/16" (211)
Backer Panel	41 3/4" (1060)	8 15/16" (227)

MODEL BI-36S

REFRIGERATOR	W	H
Flush Inset Panel	20 5/16" (522)	69 3/4" (1772)
Spacer Panel	19 3/16" (507)	68 15/16" (1751)
Backer Panel	19 13/16" (505)	69 3/16" (1767)
FREEZER	W	H
Flush Inset Panel	16 3/16" (411)	69 3/4" (1772)
Spacer Panel	14 3/16" (376)	68 15/16" (1751)
Backer Panel	15 7/16" (392)	69 3/16" (1767)
GRILLE	W	H
Flush Inset Panel	37" (940)	9 1/4" (235)
Spacer Panel	35 1/8" (892)	8 5/16" (211)
Backer Panel	35 3/4" (908)	8 15/16" (227)

MODEL BI-36S, BI-48SD, BI-48SD

REFRIGERATOR	W	H
Flush Inset Panel	29 1/4" (743)	89 1/2" (1772)
Spacer Panel	27 1/16" (708)	88 15/16" (1751)
Backer Panel	28 1/8" (724)	89 3/16" (1767)
FREEZER	W	H
Flush Inset Panel	19 1/2" (495)	69 3/4" (1772)
Spacer Panel	18 1/8" (460)	68 15/16" (1751)
Backer Panel	18 3/4" (476)	69 3/16" (1767)
GRILLE	W	H
Flush Inset Panel	49" (1245)	9 1/4" (235)
Spacer Panel	47 1/8" (1107)	8 5/16" (211)
Backer Panel	47 3/4" (1213)	8 15/16" (227)
BI-48SD	W	H
Dispenser Cut-Out	57 5/8" (146)	127 5/8" (316)
Cut-Out Location	2" (51)	28 13/16" (732)

Grille panel dimensions are for standard 84" (2146) overall unit height. For 83" (2109) height, subtract 1" (25) from grille panel height dimensions and for 82" (2083) height, subtract 4" (102). A specific panel grille must be ordered for an 82" or 83" overall unit height.

K6Z-26

N

MAY 3, 2017

MODEL D6626XXLF1



FEATURES

Asko's custom panel and handle to integrate with surrounding cabinetry

Hidden controls

Condensation drying system

15 place-setting capacity

Quiet operation—48 dBA

18-in.³ wash system; separate spray arm, clean pot & wine and non-toxic spray cutlery basket

8 wash programs

Heavy-duty stainless steel construction with nylon-coated glass rack

LED display

Apex handles 4" or 6" for 48" height

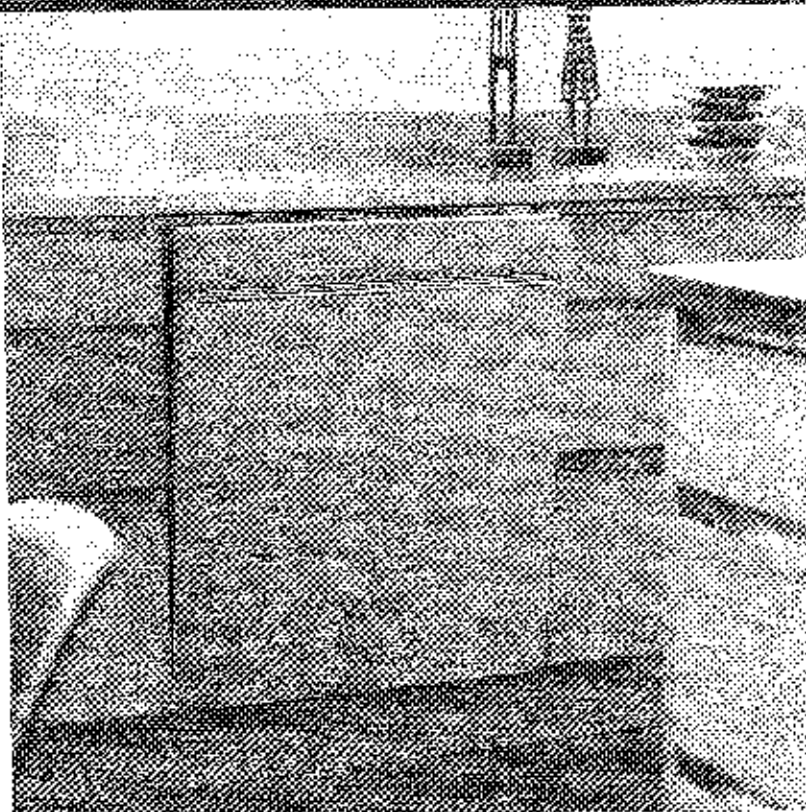

ACCESSORIES

Stainless steel front panel with tubular or pin handle

Stainless steel tubular and pin handles

Accessories available through an authorized Asko dealer. For local dealer information, visit the find a showroom section of our website, www.asko.com.

INTERIOR FEATURES

- Standard upper rack
- Standard lower rack

PROGRAMS

- Sensor or Wash
- Normal Wash
- Heavy Wash
- Quick Wash
- Hygiene
- Delicate Wash
- Eco Wash
- Rinse and Hold

462-26

MAY 2, 2017

PRODUCT SPECIFICATIONS

Model	DB52B0XL1
Width	23 5/8"
Height	34 1/2" (850 mm)
Depth	22 7/8"
Door Clearance	24 1/2"
Weight	115 lb
Min Loading Height Upper Rack	0"
Max Loading Height Lower Rack	18 1/2"
Heating System	115 VAC, 50 Hz
Electrical Service	10 amp circuit
Plumbing Supply	1/2" OD copper, braided stainless steel or PEX tubing
Pressure	4.2 - 140 psi

Product dimensions do not include panel and handle. Unit dimensions will vary with panel thickness.

Electrical supply, plumbing supply and drain should be installed in an accessible, dry location. All must be installed and sealed according to applicable codes and the instructions below.

ELECTRICAL | PLUMBING

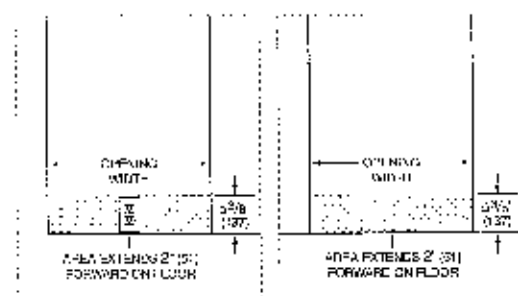

DIMENSIONS

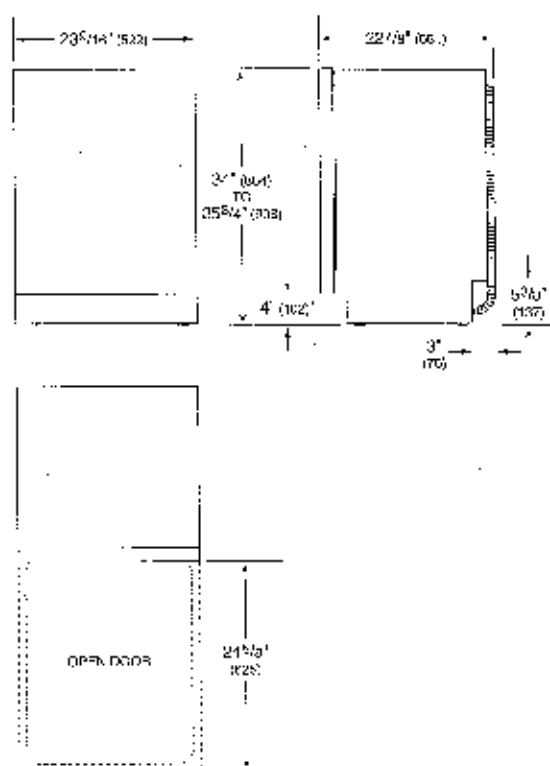

*Dimensions will vary with product design.

INSTALLATION

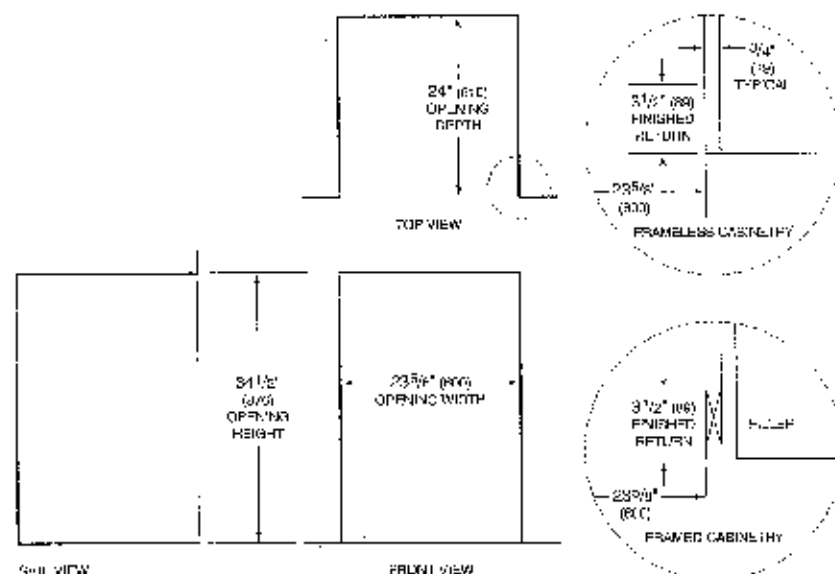

NOTE: The predrilled source will be double ended and be finished in match countertop.

262-26

(N)

MAY 2, 2017

STEP 2. ATTACHING THE ACCESSORY DOOR OR CUSTOM PANEL

Follow the separate instructions supplied with the dishwasher to attach the chosen accessory door or custom panel to the front of the machine.

NOTE

Once you have fitted the accessory door or custom panel to the dishwasher, the door springs may need adjusting. Check that the door stays in the position in which it is placed. If the door drops down when you open it, the springs need to be tightened. If the door shuts on its own, the springs need to be loosened. See step 3 for further instructions.

NOTE

The custom panel must not cover the air nozzle and thereby block the flow of air.

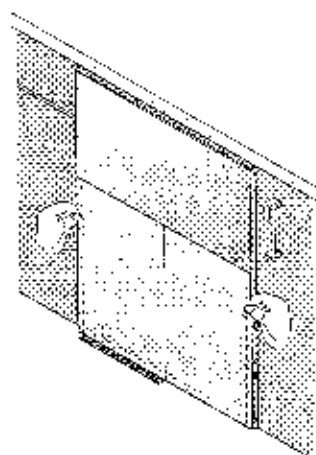
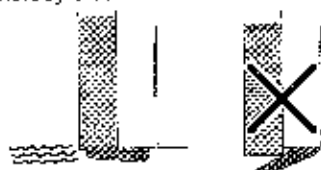

Custom Panel Dimensions

	XXL DISHWASHERS	ADA AND XL DISHWASHERS
Width	24" (610 mm) minimum to cabinet width minus 1/4" reveal	24" (610 mm) minimum to cabinet width minus 1/4" reveal
Height	28-1/8" (714 mm) for 6" toe kick to 30-1/8" (765 mm) for 4" toe kick	28-1/8" (714 mm) for 4" toe kick
Thickness	3/4" (19 mm)	3/4" (19 mm)

462-26

N

MAY 2, 2017

36" GAS RANGE - 4 BURNERS AND INFRARED GRIDDLE

2101

GR364G



FEATURES

- 4 dual-stacked burners plus 15,000 Btu infrared griddle
- Convection oven for faster, more consistent cooking
- Dual-stacked, scalloped burners for higher highs, lower lows
- Infrared broiler inside oven sears quickly and evenly
- Heavy gauge stainless steel
- Continuous cast-iron grates for easy movement of pots and pans
- Rigorously tested in our U.S. manufacturing facilities for decades of use
- Exceptional 24/7 support from our Customer Care team in Madison
- Signature red infinite control knobs
- Sense ignition system re-ignites if flame goes out
- Adjustable legs for stability, plus rear casters

ACCESSORIES

- 1" Cutting Board
- Buko stone kitchen scale (rock and peel)
- Stainless steel, brass or chrome bezels
- High altitude conversion kit
- Full extension easy glide oven rack
- Cam lock S-grates and wok grate
- Stainless steel kickplate
- Signature red, black or stainless steel control knobs
- Front leg covers
- 6" and 10" stainless steel doors, and 24" door with shelf

Accessories available through an authorized Sub-Zero dealer.
For local dealer information, visit www.subzero.com/location.

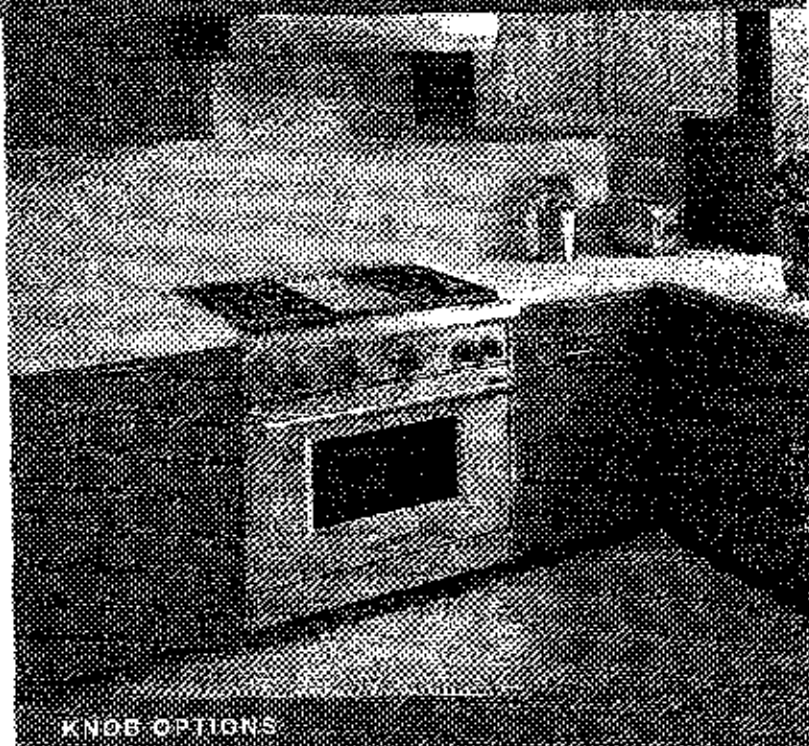

KNOB OPTIONS



TOP CONFIGURATION

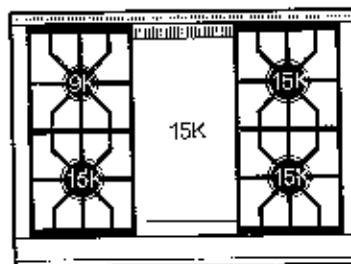

RANGETOP SPECIFICATIONS

- 1 - 9,200 Btu burner
- 2 - 15,000 Btu burners
- 1 - 15,000 Btu (12,000 Btu LP) Griddle

H62-26

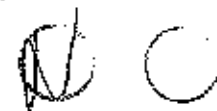

MAR. 19. 2017

36" GAS RANGE - 4 BURNERS AND INFRARED GRIDDLE

101

PRODUCT SPECIFICATIONS

Model	GR391G
Dimensions	36 7/8" W x 37" H x 28 3/8" D
Oven Interior Dimensions	30" W x 18 5/8" H x 17" D
Oven 1 Usable Capacity	3.7 cu. ft.
Oven 1 Overall Capacity	5.5 cu. ft.
Door Clearance	19 1/2"
Weight	470 lbs
Electrical Supply	110/120 VAC, 50/60 Hz
Electrical Service	15 amp dedicated circuit
Gas Supply	3/4" rigid pipe
Gas Inlet	1/2" NPT female
Receptacle	3-prong grounding-type

DIMENSIONS

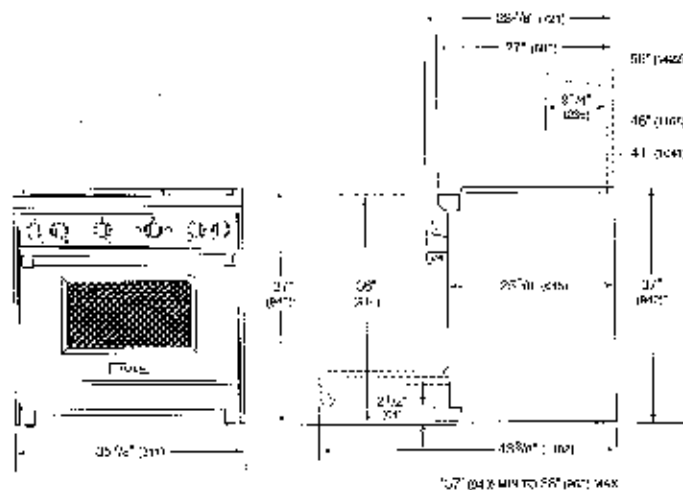

ELECTRICAL

GAS

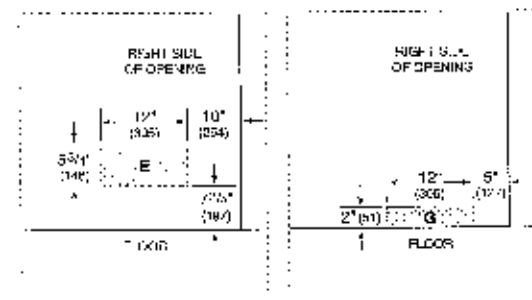

STANDARD INSTALLATION

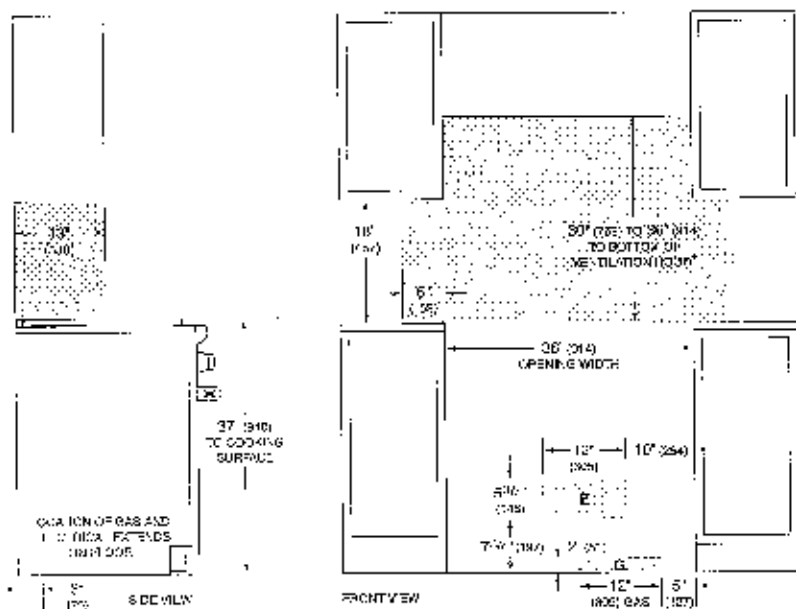

1/2" (12.7 mm) minimum clearance between opening in combustible material, when other requires non-combustible material.
 NOTE: Shown above countertop indicates minimum clearance in combustible surfaces.
 combustible materials covered by groundable wire.
 1/2" (12.7 mm) minimum clearance back of range to combustible wall and above countertop.

K62126
 MAR. 19, 2017

MDD24TE/S/TH

FEATURES

Integrates into any kitchen

Matches E Series ovens, coffee systems, convection steam oven

900 watts of power

Generous 1.9 cu. ft. capacity

Quick-start controls for popular items

Guaranteed cooks automatically from preset recipes

"Keep Warm" mode

Rigorously tested in our U.S. manufacturing facilities for decades of use

Exceptional 24/7 support from our Customer Care team in Hudson



ACCESSORIES

Pro Handle

Accessories available through an authorized Frig-Zero dealer.
For more dealer information, visit frigzero.com/dealers.

662-26

WFO

MAR. 19, 2017

PRODUCT SPECIFICATIONS

Model	MD024TE/STH
Dimensions	23 1/2"W x 17 7/8"H x 20"D
Door Clearance	14 3/16"
Weight	80 lbs
Electrical Supply	120 VAC, 60 Hz
Electrical Service	15 amp dedicated circuit
Overall Capacity	1.6 cu. ft.
Power Cord Length	4 Feet
Receptacle	3-prong grounding-type

DIMENSIONS

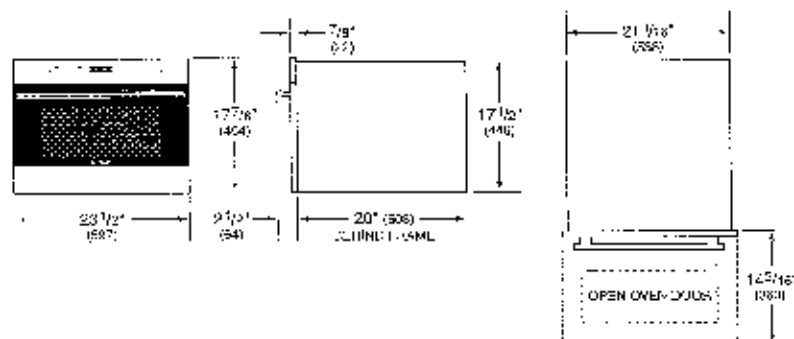

ELECTRICAL



FLUSH INSTALLATION

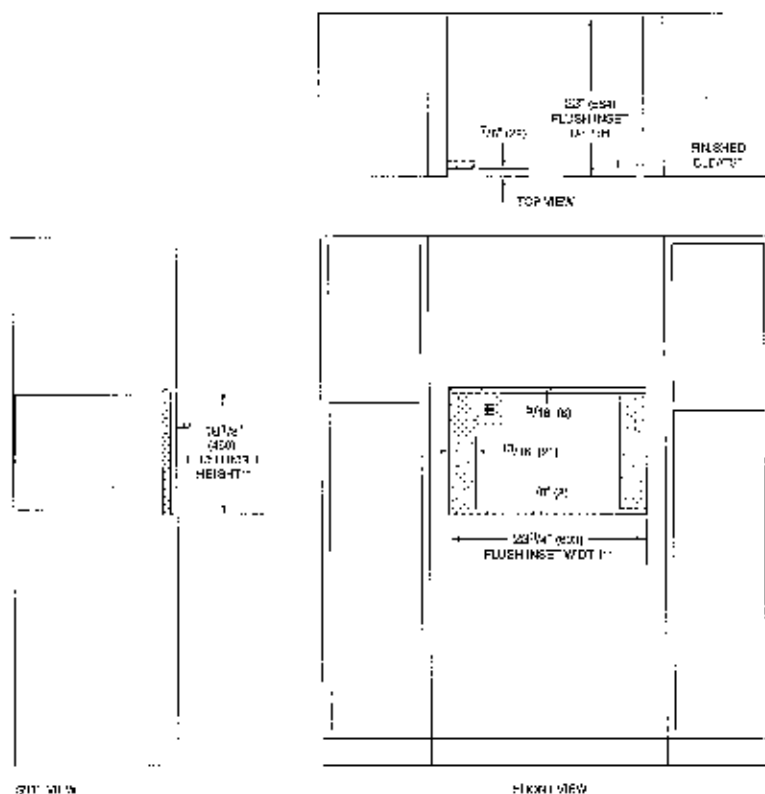

91" (230)

91" (230)

15A Power Cord and should be attached to metal cabinets.
15A receptacle should be installed in cabinets.

KG2-26
V

MAR. 19. 2017

SO24TE/S/TH



FEATURES

- 11 cooking modes make meals easy
- Black porcelain interior
- Installs flush or proud with surrounding cabinetry
- Self clean, delayed start, timed cook and more
- Single convection oven for fast, consistent cooking
- Quicker preheat for faster meal prep
- Adjustable oven rack plus porcelain-coated pan
- Hidden bake element and recessed broil element
- Rigorously tested in our U.S. manufacturing facilities for decades of use
- Exceptional 24/7 support from our Customer Care team in Madison
- Temperature probe lets you know when it's done
- Dual halogen lights for better interior views

ACCESSORIES

- Solid Pan 13 3/4" x 1 1/2" x 7"
- Solid Pan 12 3/4" x 1 1/4" x 14"
- Solid Pan 17 3/4" x 1 1/4" x 15"
- Full Extension Rack Guides
- Porcelain Baking Sheet
- Oven Rack
- Pro Handle

Accessories available through an authorized Sub-Zero dealer.
For local dealer information, visit subzero-pro.com/dealers.

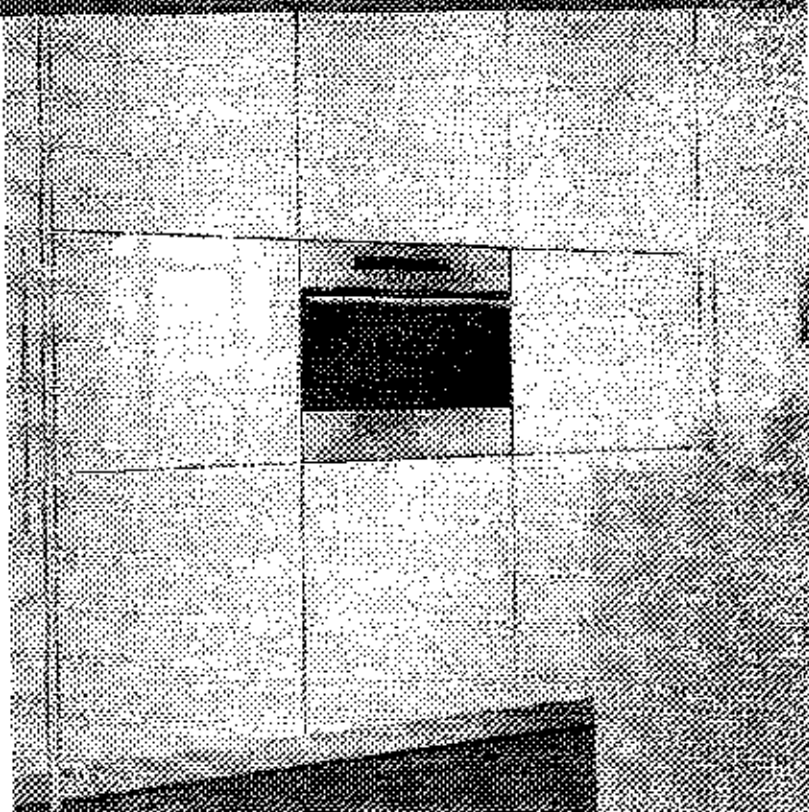

K62-26



MAR. 19. 2017

March 19, 2017

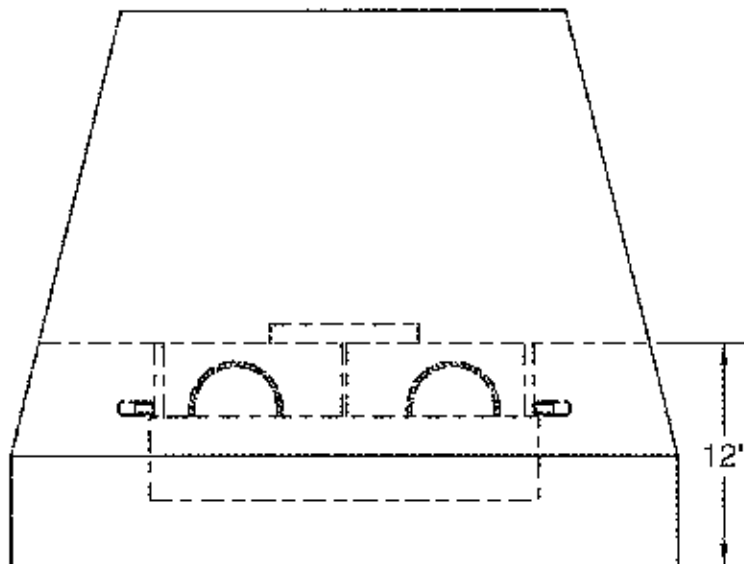

(Front View)

ELECTRICAL/MECHANICAL SPECIFICATIONS FOR BLOWER UNIT

Model	Volts	Amps+	Hz	RPM	CFM SP@0.0"	Equiv. CFM\$	CFM SP@0.1"	CFM SP@0.2"	CFM SP@0.3"	Min. Round Duct Size	Sones#
B200 Dual	115	4.0	60	1550	600	900	531	480	430	8" (50 sq. in.)	6.5

+ This model is equipped with LED lighting: (2 lights: 30" - 41", 3 lights: 42" - 53", 4 lights: 54" - 66").

\$ Because the Magic Lung® blower uses centrifugal filtration rather than conventional baffle or mesh filters, the Magic Lung® blower can handle cooking equipment with higher cubic feet per minute (CFM) requirements and can deliver equivalent CFM much more efficiently than other filtration systems. When comparing the Magic Lung® with other blower units made by other manufacturers, use the "Equivalent CFM".

Ratings in accordance with the Standard Test Code by the Energy Systems Laboratory of the Texas Engineering Experiment Station.

162-26



MAR. 19. 2017

General Remarks

II. Electrical Requirements & Safety

A 115 Volt, 60 Hz, 15 Amp (20 Amp for side-by-side installation) fused electrical supply is required. Connect an undercounter wine cabinet to a 115 VAC, 10 amp (15 Amp for side-by-side installations) circuit that is controlled by a circuit breaker or fuse.

We recommend using a dedicated circuit for these appliances to prevent electrical overload. Comply with the National Electrical Code as well as local codes and ordinances when installing the receptacle.



WARNING

Do not ground to a gas pipe. Check with a qualified electrician if you are not sure the appliance is properly grounded. Do not have a fuse in the neutral or grounding circuit.



WARNING

ELECTROCUTION HAZARD

Electrical Grounding Required. This appliance is equipped with a three-prong(grounding) polarized plug for your protection against possible shock hazards.

- DO NOT remove the round grounding prong from the plug.
- DO NOT use a two-prong grounding adapter.
- DO NOT use an extension cord to connect power to the unit.
- DO NOT use a power cord that is frayed or damaged.

III. IceMaker (if equipped)

The icemaker is located in the freezer compartment. It must be connected to the water supply to function properly. The appliance must be level for the icemaker to function properly.

The water pressure must be between 21.8-87.0 psi (1.5-6 bar). Use a 1/4" OD copper line (not supplied) to connect the water supply to the solenoid valve.

If you have hard water, we recommend you install a water softener. Also, a filter must be installed if the water contains solids such as sand. All equipment and devices used to supply the water to the appliance must comply with the current regulations for your geographical area.

Safety Instructions and Warnings

- Do not attach the water source while the appliance is connected to an electrical outlet.
- A shut-off valve, must be installed between the hose line and the main water supply so that the water supply can be stopped if necessary. Do not install the shut-off valve behind the refrigeration unit.
- The connection to the water supply may only be made by a trained and licensed plumber.
- The water quality must comply with the drinking water regulations for the geographical area where the appliance is located.
- The icemaker is designed exclusively to make ice cubes in quantities needed by a household and may only be operated with water appropriate for this purpose.
- All repairs and work on the icemaker may only be done by customer service personnel or other trained personnel.
- The manufacturer cannot accept liability for damage caused by equipment or water lines between the solenoid valve and the water supply.

K62-26

PO

MAR. 19. 2007

| [PRINT](#) | [CLOSE](#) |

Vent-A-Hood

MODEL NUMBER: JPH242/C1

DESIGNER SERIES WALL MOUNTED SPECIFICATIONS

Special Notes: LED lights. This model is not available with heat lamps.

WIDTH :	42"
DEPTH :	24"
HEIGHT :	30"
CFM :	600
SONES :	6.5
Amps :	4.0
Num. Lights :	3

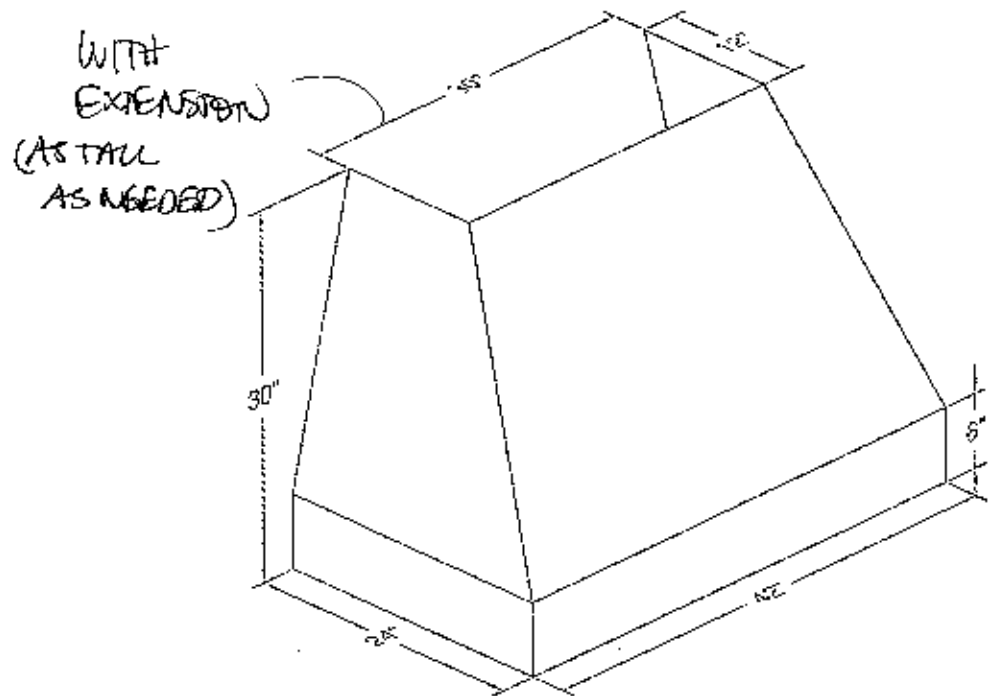

CONNECTION DIAGRAM

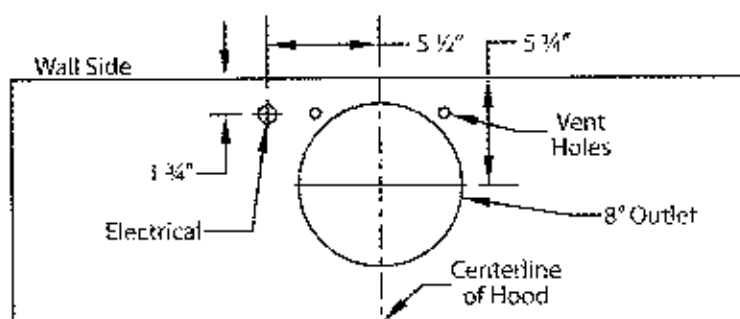

600 CFM B200 Dual Blower (Top View)

REC. MOUNTING HEIGHT

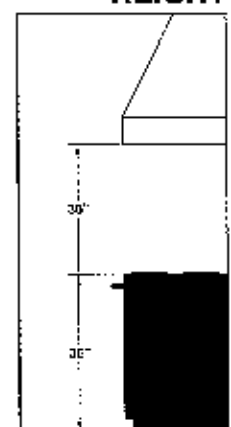

*Exceeding recommended mounting height may compromise performance.

262-26



MARCH 19, 2017