

## Kleinburg Glen - 26 - 2 - 42-1 Elev.B ROYALTON

### CENTRAL VAC AND WIRING

Inv.1,202	1 - ROUGH IN- 4X- CAT 6 CONNECTIONS- LOCATION TO BE MARKED ON FLOORPLAN
Line17871	Note: See floorplan for locations
21Feb17 / 26Oct17	
Inv.1,202	1 - NILFISK CENTRAL VACCUM KIT SE 150 WITH MA10M ELECTRIC POWER HEAD
Line19230	Note:
21Feb17 / 26Oct17	
Inv.1,202	1 - INSTALL VAC PAN UNDER KITCHEN SINK
Line19231	Note:
21Feb17 / 26Oct17	
Inv.1,256	1 - GREAT ROOM: CONDUIT PIPE - FOR TELEVISION - Above fireplace, next to receptacle. Approx 66" aff. Terminating at standard height, under window at left side of fireplace.
Line21219	Note: See floorplan for location
19Mar17 / 26Oct17	

### CERAMIC

Inv.1,256	1 - FOYER FLOOR TILE: UPG 5 24x24"
Line19244	Note:
19Mar17 / 26Oct17	
Inv.1,256	1 - ENSUITE 2 Floor Tile: UPG 5 12x24"
Line19243	Note: See Floorplan for tile direction. Parallel to Vanity
19Mar17 / 26Oct17	
Inv.1,256	1 - POWDER FLOOR TILE: UPG 5 12x24"
Line19245	Note: See floorplan for tile direction. Parallel to door
19Mar17 / 26Oct17	
Inv.1,256	1 - ENSUITE 2 Shower Wall Tile: UPG 1
Line19252	Note: Installed Horizontally stacked
19Mar17 / 26Oct17	
Inv.1,256	1 - TWIN BATH Floor Tile: UPG 2 12x24
Line19253	Note: See floorplan for tile for tile direction. Parrallel to vanity.
19Mar17 / 26Oct17	
Inv.1,256	1 - TWIN BATH Tub Wall Tile: UPG 1
Line19254	Note: Installed Horizontally stacked
19Mar17 / 26Oct17	
Inv.1,256	1 - LAUNDRY ROOM Floor Tile: UPG 5 - 24x24", straight stacked installation
Line19255	Note:
19Mar17 / 26Oct17	
Inv.1,256	1 - MASTER ENSUITE Floor Tile: UPG 5, 24"x24 straight stacked installation
Line19256	Note:
19Mar17 / 26Oct17	
Inv.1,256	1 - MASTER ENSUITE Shower Floor Tile: UPG 4, hex marble mosaic
Line19257	Note:
19Mar17 / 26Oct17	
Inv.1,256	1 - MASTER ENSUITE Shower Wall Tile: UPG 5 - 12x24"
Line19258	Note: Installed Horizontally stacked
19Mar17 / 26Oct17	

**CONCRETE AND DRAIN**

Inv.1,202	<b>1 - BASEMENT: Add backflow preventer</b>
Line17887	Note:
21Feb17 / 26Oct17	

**DRYWALL**

Inv.1,202	<b>1 - SMOOTH CEILINGS - (2 - Story Design) 2ND FLOOR</b>
Line17875	Note:
21Feb17 / 26Oct17	

Inv.1,202	<b>1 - MAIN FLOOR CEILING 10FT, 8FT TALLER INTERIOR DOORS, TALLER FLAT ARCHES, REAR AND FRONT WINDOWS WITH TRANSOM, TALLER KITCHEN CABINETS WITH CROWN AND FURRING PANEL, ADDED STAIRS AND PICKETS</b>
Line23694	Note:
21Feb17 / 26Oct17	

Inv.1,202	<b>1 - OPTIONAL 10 FOOT TRAY CEILING - MASTER BEDROOM</b>
Line24524	Note:
21Feb17 / 26Oct17	

**ELECTRICAL**

Inv.1,202	<b>1 - KITCHEN: Add 240V Wall Recepticle on dedicated circuit for future wall oven</b>
Line17860	Note: See floorplan for location. Left of Fridge
21Feb17 / 26Oct17	

Inv.1,202	<b>1 - KITCHEN: Rough-In ONLY Under Cabinet Valance Lighting - DOES NOT INCLUDE VALANCE</b>
Line17863	Note:
21Feb17 / 26Oct17	

Inv.1,202	<b>1 - KITCHEN: Additional Interior Dedicated electrical for future Microwave</b>
Line17864	Note: Please see floorplan for location
21Feb17 / 26Oct17	

Inv.1,202	<b>1 - 200 AMP Service</b>
Line17876	Note:
21Feb17 / 26Oct17	

Inv.1,202	<b>1 - DINING ROOM: Additional Interior Receptacle (not separate cicuit) to ceiling</b>
Line17878	Note: See floorplan for location
21Feb17 / 26Oct17	

Inv.1,202	<b>1 - MASTER WALK-IN CLOSET: Additional Interior Receptacle (not separate cicuit)</b>
Line19235	Note: Please see floorplan for location
21Feb17 / 26Oct17	

Inv.1,202	<b>1 - KITCHEN: GAS LINE ROUGH - MAIN FLOOR - (2 STOREY MODELS) FOR GAS STOVE- INCLUDES 110V PLUG ON SEPARATE CIRCUIT</b>
Line23690	Note:
21Feb17 / 26Oct17	

Inv.1,202	<b>1 - HUMIDIFIER: WB3 - 17 (UP TO 3,000 SQ.FT.)</b>
Line24529	Note:
21Feb17 / 26Oct17	

## Kleinburg Glen - 26 - 2 - 42-1 Elev.B ROYALTON

Inv.1,256	1 - GREAT ROOM: Additional Interior Receptacle (not separate circuit) above fireplace, next to conduit. Approx 66" aff.
Line21220	Note: See floorplan for location
19Mar17 / 26Oct17	

### Exterior Colours

Inv.1,202	1 - EXTERIOR COLOUR PACKAGE 1
Line23696	Note:
21Feb17 / 26Oct17	

### FRAMING

Inv.1,256	1 - KITCHEN: UPG Add Furring panel & Crown
Line24530	Note:
19Mar17 / 26Oct17	

Inv.1,202	1 - DINING / GREAT ROOM: OPEN WALL approx 8ft. Leave 4ft on either side of wall.
Line19228	Note: See floorplan for details / location
21Feb17 / 26Oct17	

Inv.1,202	1 - MAIN FLOOR CEILING 10FT, 8FT TALLER INTERIOR DOORS, TALLER FLAT ARCHES, REAR AND FRONT WINDOWS WITH TRANSOM, TALLER KITCHEN CABINETS WITH CROWN AND FURRING PANEL, ADDED STAIRS AND PICKETS
Line17869	Note:
21Feb17 / 26Oct17	

Inv.1,202	1 - OPTIONAL 10 FOOT TRAY CEILING - MASTER BEDROOM
Line17879	Note:
21Feb17 / 26Oct17	

Inv.1,202	1 - MASTER WALK-IN CLOSET: Please see new layout for
Line19234	Note:
21Feb17 / 26Oct17	

Inv.1,202	1 - ROUGH-IN FOR RAINSHOWER HEAD- DOES NOT INCLUDE SHOWER HEAD AND DIVERTER AND MUST BE PURCHASED THROUGH GOLDPARK
Line24526	Note:
21Feb17 / 26Oct17	

Inv.1,202	1 - UPGRADE VENTING FOR STOVE TO 8 INCH PIPE EXTERIOR WALL
Line24527	Note:
21Feb17 / 26Oct17	

### GLASS AND MIRROR

Inv.1,202	1 - MASTER ENSUITE: Delete angled shower door - squared shower enclosure. Relocate Shower door.
Line19232	Note: See floorplan for location
21Feb17 / 26Oct17	

Inv.1,202	1 - MASTER ENSUITE: CONVERT FRAMED SHOWER TO 10MM FRAMLESS SHOWER ENCLOSURE WITH DOOR AND 10MM SIDE PANEL
Line17880	Note:
21Feb17 / 26Oct17	

Inv.1,202	1 - ENSUITE 2: CONVERT FRAMED SHOWER TO 10MM FRAMLESS SHOWER ENCLOSURE WITH DOOR AND 10MM SIDE PANEL
Line17881	Note:
21Feb17 / 26Oct17	

### HARDWOOD

**Kleinburg Glen - 26 - 2 - 42-1 Elev.B ROYALTON**

Inv.1,256	1 - MAIN FLOOR HARDWOOD - Main Hall: UPG 5
Line19246	Note:
19Mar17 / 26Oct17	

Inv.1,256	1 - MAIN FLOOR HARDWOOD - Den: UPG 5
Line19248	Note:
19Mar17 / 26Oct17	

Inv.1,256	1 - MAIN FLOOR HARDWOOD - Dining: UPG 5
Line19247	Note:
19Mar17 / 26Oct17	

Inv.1,256	1 - MAIN FLOOR HARDWOOD - Great Room UPG 5
Line19249	Note:
19Mar17 / 26Oct17	

Inv.1,256	1 - MAIN FLOOR HARDWOOD - Kitchen: UPG 5
Line19250	Note:
19Mar17 / 26Oct17	

**HVAC**

Inv.1,256	1 - KITCHEN: UPG Add Furring panel & Crown
Line24531	Note:
19Mar17 / 26Oct17	

Inv.1,202	1 - KITCHEN: GAS LINE ROUGH - MAIN FLOOR - (2 STOREY MODELS) FOR GAS STOVE- INCLUDES 110V PLUG ON SEPARATE CIRCUIT
Line17861	Note:
21Feb17 / 26Oct17	

Inv.1,202	1 - UPGRADE VENTING FOR STOVE TO 8 INCH PIPE EXTERIOR WALL
Line19227	Note:
21Feb17 / 26Oct17	

Inv.1,202	1 - HUMIDIFIER: WB3 - 17 (UP TO 3,000 SQ.FT.)
Line19237	Note:
21Feb17 / 26Oct17	

**INTERIOR TRIM AND DOORS**

Inv.1,202	19 - STANDARD DOOR EXTENDED HEIGHT 96 INCH (PRICE PER DOOR) - SECOND FLOOR 2 STOREY MODELS
Line19236	Note:
21Feb17 / 26Oct17	

Inv.1,202	1 - MAIN FLOOR CEILING 10FT, 8FT TALLER INTERIOR DOORS, TALLER FLAT ARCHES, REAR AND FRONT WINDOWS WITH TRANSOM, TALLER KITCHEN CABINETS WITH CROWN AND FURRING PANEL, ADDED STAIRS AND PICKETS
Line23692	Note:
21Feb17 / 26Oct17	

**KITCHEN AND BATH CABINETRY**

Inv.1,256	1 - KITCHEN: Add custom dishwasher panel
Line21225	Note: See spec sheet attached
19Mar17 / 26Oct17	

## Kleinburg Glen - 26 - 2 - 42-1 Elev.B ROYALTON

Inv.1,256	2 - KITCHEN: Add 2 receptacles (not on separate circuit) at backsplash of pantry. Approx 4ft aff.
Line21229	Note: See sketch attached for details
19Mar17 / 26Oct17	
Inv.1,202	1 - MAIN FLOOR CEILING 10FT, 8FT TALLER INTERIOR DOORS, TALLER FLAT ARCHES, REAR AND FRONT WINDOWS WITH TRANSOM, TALLER KITCHEN CABINETS WITH CROWN AND FURRING PANEL, ADDED STAIRS AND PICKETS
Line23693	Note:
21Feb17 / 26Oct17	
Inv.1,256	1 - KITCHEN: Raise kitchen to accommodate for hardwood floors
Line19251	Note:
19Mar17 / 26Oct17	
Inv.1,256	1 - KITCHEN Cabinetry: UPG 6
Line19260	Note:
19Mar17 / 26Oct17	
Inv.1,256	1 - KITCHEN: UPG Add Furring panel & Crown
Line19261	Note:
19Mar17 / 26Oct17	
Inv.1,256	1 - KITCHEN: Soft Close cabinets / drawers throughout
Line19263	Note:
19Mar17 / 26Oct17	
Inv.1,256	1 - KITCHEN: UPG - 2 tone Kitchen
Line19264	Note: Perimeter Cabinets Windsor MDF White /Matte. Island and Pantry Windsor Maple Greystone
19Mar17 / 26Oct17	
Inv.1,256	4 - KITCHEN: Add 4 overlay doors to back of island
Line19318	Note:
19Mar17 / 26Oct17	
Inv.1,256	1 - KITCHEN: Add Vetrina 148cm height x 30cm deep double doors with plain clear glass (white interior), with double drawers below
Line19319	Note: Please see kitchen drawing for location. Added to end of Kitchen, left of range
19Mar17 / 26Oct17	
Inv.1,256	1 - KITCHEN: Built-in fridge enclosure with Integrated installation.
Line19322	Note: Flush Installation. See spec sheet attached
19Mar17 / 26Oct17	
Inv.1,256	1 - KITCHEN: Wall Oven / Microwave Tower with integrated installation
Line19324	Note: Flush Installation. See spec sheet attached
19Mar17 / 26Oct17	
Inv.1,256	1 - KITCHEN: Adjust cabinets for 36" range
Line19325	Note:
19Mar17 / 26Oct17	
Inv.1,256	1 - KITCHEN: Delete Upper cabinets above range and finish sides for 42" Hood. Please leave 46" opening
Line19327	Note: Add bottom panel with crown & furring above fan. See spec sheet attached
19Mar17 / 26Oct17	
Inv.1,256	2 - KITCHEN: Add pots and pans drawers on either side of range
Line19341	Note: See kitchen drawing for location
19Mar17 / 26Oct17	

**Kleinburg Glen - 26 - 2 - 42-1 Elev.B ROYALTON**

Inv.1,256	1 - KITCHEN: Add light valance
Line19358	Note: Includes extra piece under glass cabinets at new pantry configuration
19Mar17 / 26Oct17	
Inv.1,256	1 - KITCHEN: UPG HARDWARE, CH-47
Line21226	Note:
19Mar17 / 26Oct17	
Inv.1,256	1 - KITCHEN: CUSTOM PANTRY Configuration
Line21227	Note: 4 Clear Glass doors (Uppers), Extra Granite, Base Cabinets - See sketch attached for details
19Mar17 / 26Oct17	
Inv.1,256	1 - KITCHEN: Add custom Fridge / Freezer Panels.
Line21221	Note: See spec sheet attached. Purchaser to supply & Install own handles at own expense and warranty after closing.
19Mar17 / 26Oct17	

**MISC.**

Inv.1,202	1 - Purchaser has attended a Structural appointment at the Decor Centre & has DECLINED any additional upgrades and accepts and acknowledges that there will be no further structural changes/additions/deletions to be made upon signing.
Line19238	Note:
21Feb17 / 26Oct17	
Inv.1,202	1 - Purchasers are aware & accepts that ANY changes made to upgrades after signing this Purchasers Extra Form are subject to a minimum administration fee of \$500. PLUS a 10% holdback fee.
Line19239	Note:
21Feb17 / 26Oct17	
Inv.1,202	1 - BONUS PACKAGE: \$20,000.00 (INCLUDING TAXES) WORTH OF UPGRADES FROM GOLD PARK HOMES DÉCOR CENTRE IS BEING APPLIED TOWARD THE STRUCTURAL APPOINTMENT. PURCHASER HAS A REMAINING AMOUNT OF \$00 (INCLUDING TAXES) TO BE USED TOWARD THE COLOUR APPOINTMENT.
Line19240	Note:
21Feb17 / 26Oct17	
Inv.1,202	1 - Purchaser request that all upgrades from this purchaser's extras form to be added to the purchase price. Purchaser is aware that upgrades will be processed only after the builder receives approval letter from the bank.
Line19241	Note:
21Feb17 / 26Oct17	
Inv.1,202	1 - TOTAL AFTER BONUS: \$69,236.10 Deposit: \$35,143.50 On Closing: \$34,092.60
Line19242	Note:
21Feb17 / 26Oct17	
Inv.1,256	1 - TOTAL: \$89,424.98 1st Deposit: \$35,186.59 2nd Deposit: \$9,525.90 50% On Closing \$44,712.49
Line19366	Note:
19Mar17 / 26Oct17	
Inv.1,256	1 - Purchasers are aware & accepts that ANY changes made to upgrades after signing this Purchasers Extra Form are subject to a minimum administration fee of \$500. PLUS a 10% holdback fee.
Line19364	Note:
19Mar17 / 26Oct17	

## Kleinburg Glen - 26 - 2 - 42-1 Elev.B ROYALTON

Inv.1,256	1 - Purchaser has attended a Colour appointment at the Decor Centre & has DECLINED any additional upgrades and accepts and acknowledges that there will be no further structural changes/additions/deletions to be made upon signing.
Line19363	Note:
19Mar17 / 26Oct17	

Inv.1,256	1 - Purchaser request that all upgrades from this purchaser's extras form to be added to the purchase price. Purchaser is aware that upgrades will be processed only after the builder receives approval letter from the bank.
Line19365	Note:
19Mar17 / 26Oct17	

### PAINTING

Inv.1,202	1 - MAIN FLOOR CEILING 10FT, 8FT TALLER INTERIOR DOORS, TALLER FLAT ARCHES, REAR AND FRONT WINDOWS WITH TRANSOM, TALLER KITCHEN CABINETS WITH CROWN AND FURRING PANEL, ADDED STAIRS AND PICKETS
Line23695	Note:
21Feb17 / 26Oct17	

Inv.1,202	1 - OPTIONAL 10 FOOT TRAY CEILING - MASTER BEDROOM
Line24525	Note:
21Feb17 / 26Oct17	

Inv.1,256	1 - STAIRS & RAILINGS: UPG Stain to Preverco Mirabel
Line19262	Note:
19Mar17 / 26Oct17	

### PLUMBING

Inv.1,202	1 - KITCHEN ROUGH - IN - WATERLINE FOR FRIDGE
Line17866	Note:
21Feb17 / 26Oct17	

Inv.1,202	1 - ROUGH-IN FOR RAINSHOWER HEAD- DOES NOT INCLUDE SHOWER HEAD AND DIVERTER AND MUST BE PURCHASED THROUGH GOLDPARK
Line17883	Note:
21Feb17 / 26Oct17	

Inv.1,202	1 - ROUGH - IN SHOWER BODY JETS - INCLUDES ROUGH-IN FOR TWO JETS- CLIENT MUST PURCHASE JETS FROM GOLDPARK HOMES
Line17885	Note:
21Feb17 / 26Oct17	

Inv.1,202	1 - TRENCH DRAIN APPROX 27 INCH LINEAR TRENCH DRAIN TILED - ACO 3705/93871 - UPG
Line17886	Note:
21Feb17 / 26Oct17	

Inv.1,202	1 - HUMIDIFIER: WB3 - 17 (UP TO 3,000 SQ.FT.)
Line24528	Note:
21Feb17 / 26Oct17	

Inv.1,256	1 - MASTER ENSUITE SHOWER: WATER SERVICE - INCREASE WATER SERVICE TO 3/4 INCH
Line21224	Note:
19Mar17 / 26Oct17	

### PLUMBING FIXTURES

**Kleinburg Glen - 26 - 2 - 42-1 Elev.B ROYALTON**

Inv.1,256	<b>1 - MASTER ENSUTTE:</b> Master Ensuite Shower: Delta Temp Assure Shower system wtih 6 function diverter & body sprays & high flow rough-in 1.0GPM Chrome Finish. #T17T26 / 50570 / 51567 / T11967 / R1100 / 50150 x3 / R10000-UNBXHF. See spec sheet attached
Line19359	Note: With 6" Straight arm from ceiling for rain shower head.
19Mar17 / 26Oct17	

**STAIRS AND RAILINGS**

Inv.1,256	<b>1 - STAIRS &amp; RAILINGS:</b> UPG to Euroline 1 with V-Groove handrail
Line21233	Note:
19Mar17 / 26Oct17	

**TRIM AND DOORS**

Inv.1,256	<b>1 - TRIM &amp; BASEBOARDS:</b> SECOND FLOOR - UPG 1
Line21223	Note:
19Mar17 / 26Oct17	

Inv.1,256	<b>1 - TRIM &amp; BASEBOARDS:</b> FIRST FLOOR - UPG 2
Line21222	Note:
19Mar17 / 26Oct17	

**WINDOWS AND DOORS**

Inv.1,202	<b>1 - BREAKFAST ROOM:</b> Delete STD Garden door and 2 side windows and install UPG Line-1 Sitrine Outswing Folding Door Product Clau Auralast Pine, Bottom Rolling 4 PNL (3L-1R)
Line19229	Note: See spec sheet attached and floorplan for location
21Feb17 / 26Oct17	

Inv.1,202	<b>1 - MAIN FLOOR CEILING 10FT, 8FT TALLER INTERIOR DOORS, TALLER FLAT ARCHES, REAR AND FRONT WINDOWS WITH TRANSOM, TALLER KITCHEN CABINETS WITH CROWN AND FURRING PANEL, ADDED STAIRS AND PICKETS</b>
Line23691	Note:
21Feb17 / 26Oct17	



\*\*\* NOTE: This is not an approved document. Document must be locked \*\*\*

Scheduled Closing Date:

Purchaser: Jason Vuong  
Telephone Res. / Bus: (416) 716-0000  
Decor Advisor: Laura Lofaro

Property: 26  
Project: Kleinburg Glen - Phase 2  
Model and Elevation: 42-1 Elev.B ROYALTON

Layout Changes:  Yes  No    Sketch Attached:  Yes  No    Exterior Colour Scheme:

**1. Cabinetry**

	Style and Colour	Counter	Hardware
Kitchen / Breakfast	*SEE COMMENT	Granite Pol. Crema Caramel STD FE20 Edge	*CH-47
Laundry Room	N/A		
Powder Room	N/A		
Master Ensuite Bathroom	Varese PVC WhtCrys	Formica Paloma Polar 6698-46	CS1-24
Second Ensuite Bathroom (If Applicable)	Varese PVC WhtCrys	Wilsonart Pearl Soapstone 4886-38	CS1-24
Twin Bath	Varese PVC WhtCrys	Wilsonart Pearl Soapstone 4886-38	CS1-24

**Comment**

\*Perimeter Cabinets Windsor MDF & Pantry White Matte / Island Windsor Maple Greystone

**2. Floor Tile**

	Selection
Entrance Vestibule	*24x24 Volkas Series White Pol. <i>upg 5</i>
Main Hall	
Kitchen / Breakfast	(See Hardwood)
Laundry Room	*24x24 Volkas Series White Pol. <i>upg 5</i>
Powder Room	*12x24 Techmarble Series Mud Semi-Pol <i>upg 4</i>
Master Ensuite Bathroom	*24x24 Volkas Series White Pol. <i>upg 5</i>
Second Ensuite Bathroom (If Applicable)	*12x24 Creation Series Matte Grey
Lower Landing (If Applicable)	(Hardwood)
Twin Bath	*12x24 Trento Series Light Grey <i>upg 2</i>

**Comment**

**3. Wall Tile**

	Selection	Listello/Inserts	Describe
Master Ensuite Bathroom		<input type="radio"/> Yes <input type="radio"/> No	
Tub Deck	N/A	<input type="radio"/> Yes <input type="radio"/> No	
Shower Stall	*12x24 Volkas Series White Pol. <i>upg 3</i>	<input type="radio"/> Yes <input type="radio"/> No	
Bathroom Walls	N/A	<input type="radio"/> Yes <input type="radio"/> No	
Second Ensuite Bathroom (If Applicable)	*4x12 CDC Arctic White Bright <i>upg 2</i>	<input type="radio"/> Yes <input checked="" type="radio"/> No	
Twin Bath	*4x12 CDC Sterling Grey Bright <i>upg 2</i>	<input type="radio"/> Yes <input checked="" type="radio"/> No	
Kitchen Backsplash	<input type="radio"/> Yes <input checked="" type="radio"/> No	Backsplash Behind Fridge	<input type="text"/>

**Comment**

\*Master Ensuite Shower Wall Tile: Installed horizontally stacked

*N*

Scheduled Closing Date:

Purchaser: Jason Vuong  
Telephone Res. / Bus: (416) 716-0000  
Decor Advisor: Laura Lofaro

Property: 26  
Project: Kleinburg Glen - Phase 2  
Model and Elevation: 42-1 Elev.B ROYALTON

**4. Plumbing Fixtures**

<input type="checkbox"/>	<input type="checkbox"/>	<b>Second Ensuite</b>	<input type="checkbox"/>	<b>Powder Room</b>	<input type="checkbox"/>
<b>Master Ensuite Bathroom</b>	<input type="checkbox"/>	<b>Other Room - Specify</b>	<input type="checkbox"/>	<b>Other Washroom</b>	<input type="checkbox"/>

Comment

Master Ensuite Shower: Delta Temp Assure Shower system with 6 function diverter & body sprays & high flow rough-in 1.0GPM Chrome Finish. #T17T26 / 50570 / 51567 / T11967 / R1100 / 50150 x3 / R10000-UNBXHF. See spec sheet attached

**5. Hardwood Flooring**

	Type and Stain		Type and Stain
Main Hall	*See Comment	Upper Landing	N/A
Kitchen / Breakfast	*See Comment	Upper Hall	N/A
Living Room	N/A	Master Bedroom	N/A
Dining Room	*See Comment	Bedroom #2	N/A
Family Room	N/A	Bedroom #3	N/A
Den/Library	*See Comment	Bedroom #4	N/A
Entrance Vestibule	N/A	Bedroom #5	N/A
Lower Landing (If Applicable)	N/A	Other Room - Specify	*See Comment
		Great Room	

Comment

\*Preverco White Oak Edge Meribel Variations with Knots 7"

**6. Carpeting**

	Upgrade	Description
Ground Floor	<input type="checkbox"/>	
Second Floor	<input type="checkbox"/>	T04, standard underpad
	<input type="checkbox"/>	

Upgrade Underpad	Type	Area
	N/A	
Carpet on Stairs	Capped	Runner - *Upgrade
	N/A	

Comment

**7. Fireplace**

	Living Room			Family Room			Other Room - Specify			Great Room
	Purchased	As Per Plan	N/A	Purchased	As Per Plan	N/A	Purchased	As Per Plan	N/A	
Fireplace Type	<input type="radio"/>	<input type="radio"/>	<input type="radio"/>	<input type="radio"/>	<input type="radio"/>	<input type="radio"/>	<input type="radio"/>	<input type="radio"/>	<input type="radio"/>	STD Gas
Mantle Type										STD
Colour / Stain										STD
Surround										N/A
Hearth										STD

Comment



Scheduled Closing Date:

Purchaser: Jason Vuong  
Telephone Res. / Bus: (416) 716-0000  
Decor Advisor: Laura Lofaro

Property: 26  
Project: Kleinburg Glen - Phase 2  
Model and Elevation: 42-1 Elev.B ROYALTON

**8. Trim Carpentry**

Interior Doors \*STD  Front Door Glass Inserts STD  Door Handles STD

Interior Trim \*First Floor - UPG 2 / Second Floor UPG 1

**Comment**

\*8ft doors throughout

**9. Plaster Mouldings and Medallions**

Standard Throughout  Yes  No  N/A

Entrance Vestibule	<input type="text"/>	<input type="text"/>	Kitchen/Breakfast	<input type="text"/>	<input type="text"/>
Main Hall	<input type="text"/>	<input type="text"/>	Den/Library	<input type="text"/>	<input type="text"/>
Living Room	<input type="text"/>	<input type="text"/>	Lower Landing	<input type="text"/>	<input type="text"/>
Dining Room	<input type="text"/>	<input type="text"/>	Other Room - Specify	<input type="text"/>	<input type="text"/>
Family Room	<input type="text"/>	<input type="text"/>		<input type="text"/>	<input type="text"/>

**Comment**

**10. Railings and Spindles**

Railing Package \*Euroline 1, with Vgroove handrail

Railing Colour \*Generation Cobalt

Spindle Colour \*Black

Stringer / Riser \*Generation Cobalt

Treads \*Generation Cobalt

**Comment**

Oak Stairs  Yes  No  N/A

**11. Wall Paint / Ceilings**

Throughout Finished Areas

Thru-out Warm Grey

Trim Paint White

**Smooth Ceilings**

Ground Floor

Second Floor

Note

**Comment**



**Scheduled Closing Date:**

**Purchaser:** Jason Vuong  
**Telephone Res. / Bus:** (416) 716-0000  
**Decor Advisor:** Laura Lofaro

**Property:** 26  
**Project:** Kleinburg Glen - Phase 2  
**Model and Elevation:** 42-1 Elev.B ROYALTON

**12. Electrical**

**Hood Fan**  White  Stainless  N/A

**Above Kitchen Cabinet Light**  Yes  No

**Below Kitchen Cabinet Light**  Yes  No

**Standard Appliances**

**Over The Range Microwave**

**Chimney Style Fan**

**Comment**

Hood fan supplied and installed by homeowner. 600CFM / See appliance specs for details

**13. Heating and Air Conditioning**

**Air Conditioning**

**Gas Provisions Stove**

**Gas Provisions Dryer**

**Gas Provisions Barbecue**

**Comment**

\*Humidifier

**14. Additional Comments**

**15. Disclaimers and Notes**

- 1) Colours of all materials are as close as possible to builder's selection, but not necessarily identical due to variances in manufacturing.
- 2) Any extras listed above are null and void unless accompanied by a separate invoice/amendment. Said invoice must be paid in full.
- 3) The Purchaser acknowledges that after Interior Colour Selection form is signed and dated, no further changes will be permitted other than re-selection due to unavailability.  Purchaser's Initials
- 4) The Purchaser acknowledges reading and accepting the "Gold Park Homes Decor Centre Disclaimers" form. This document contains other miscellaneous disclaimers.

**This Interior Colour Selection is final and approved by:**

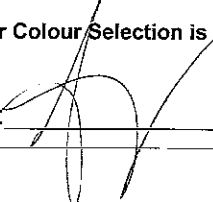
Signature:  Date: May 2 / 17

Elevation A - 3,016 sq. ft.

**Elevation B - 3,043 sq. ft.**

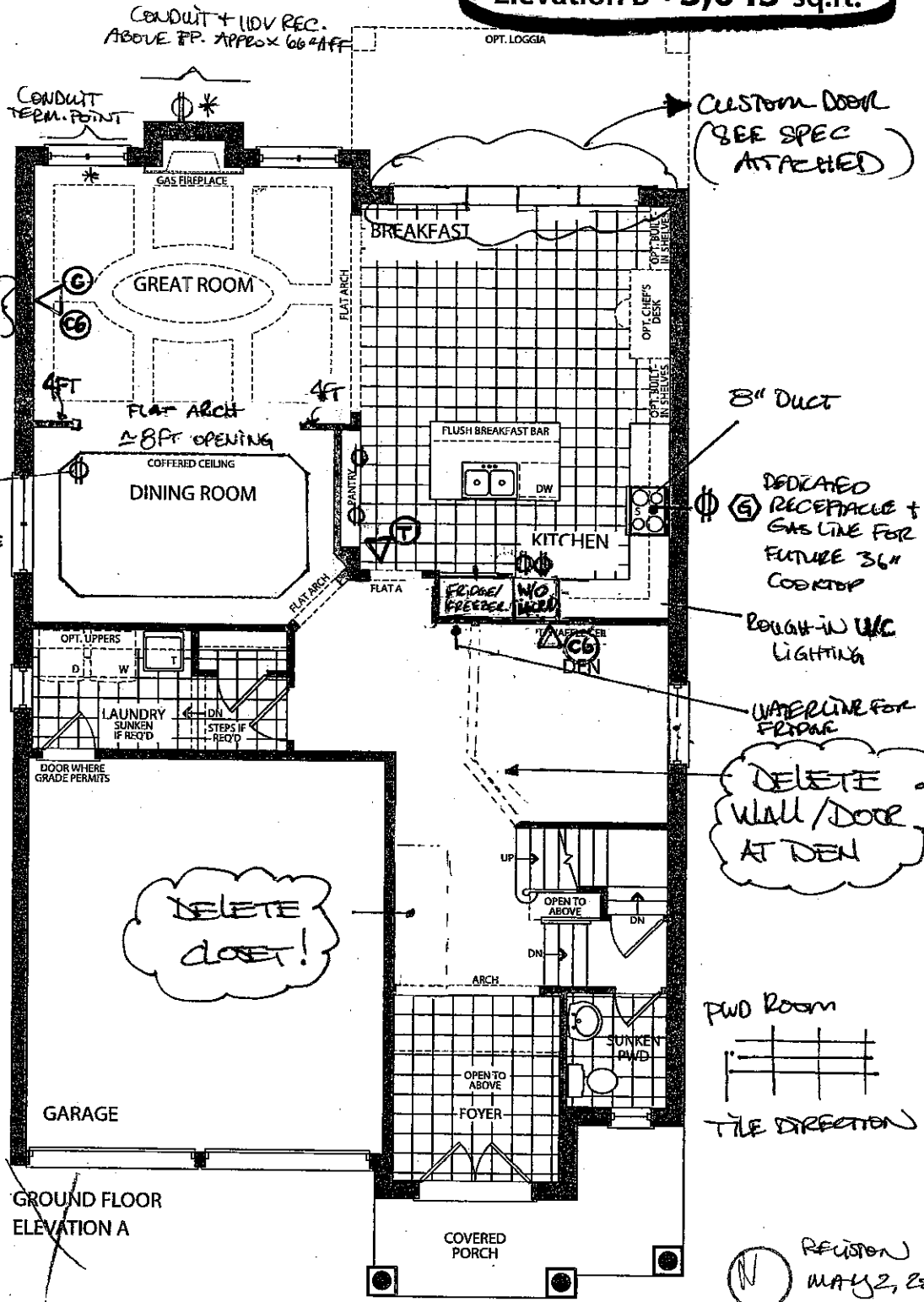

KG2-26  
JUNE 5 2017

○ see off

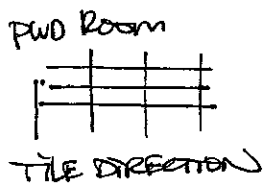

\* 10FT CEILINGS

- \* - CONDUIT
- ⊖ - CAT 6
- ⊖ - CABLE
- ⊖ - RECEPTACLE
- ⊖ - TELEPHONE
- ⊖ - GAS LINE

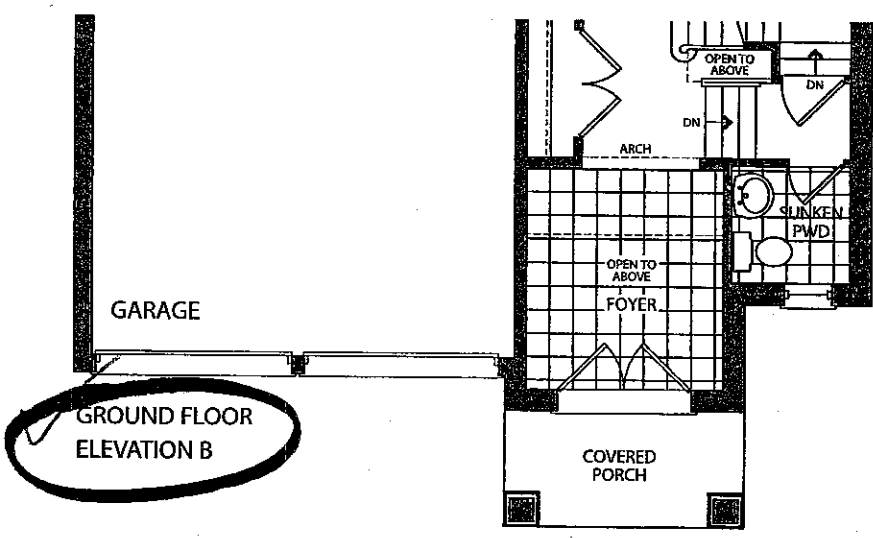

KG2-26  
STRUCTURAL

DATE: 03/19/12

COLOURS

DATE: 03/19/12

Prices, figures, illustrations, sizes, features and finishes are subject to change without notice. E.&O.E. Areas and dimensions are approximate and actual usable floor space may vary from the stated area. Layout may be reverse of the unit purchased. E. & O.E.

Elevation A • 3,016 sq.ft.  
Elevation B • 3,043 sq.ft.

MASTER ENSUITE  
SHOWER WALL  
TILE DIRECTION

ADD TRAY  
CEILING TO  
MASTER.

ADD 110V  
RECEPTACLE  
(SID HEIGHT)

TWIN BATH  
TILE DIRECTION

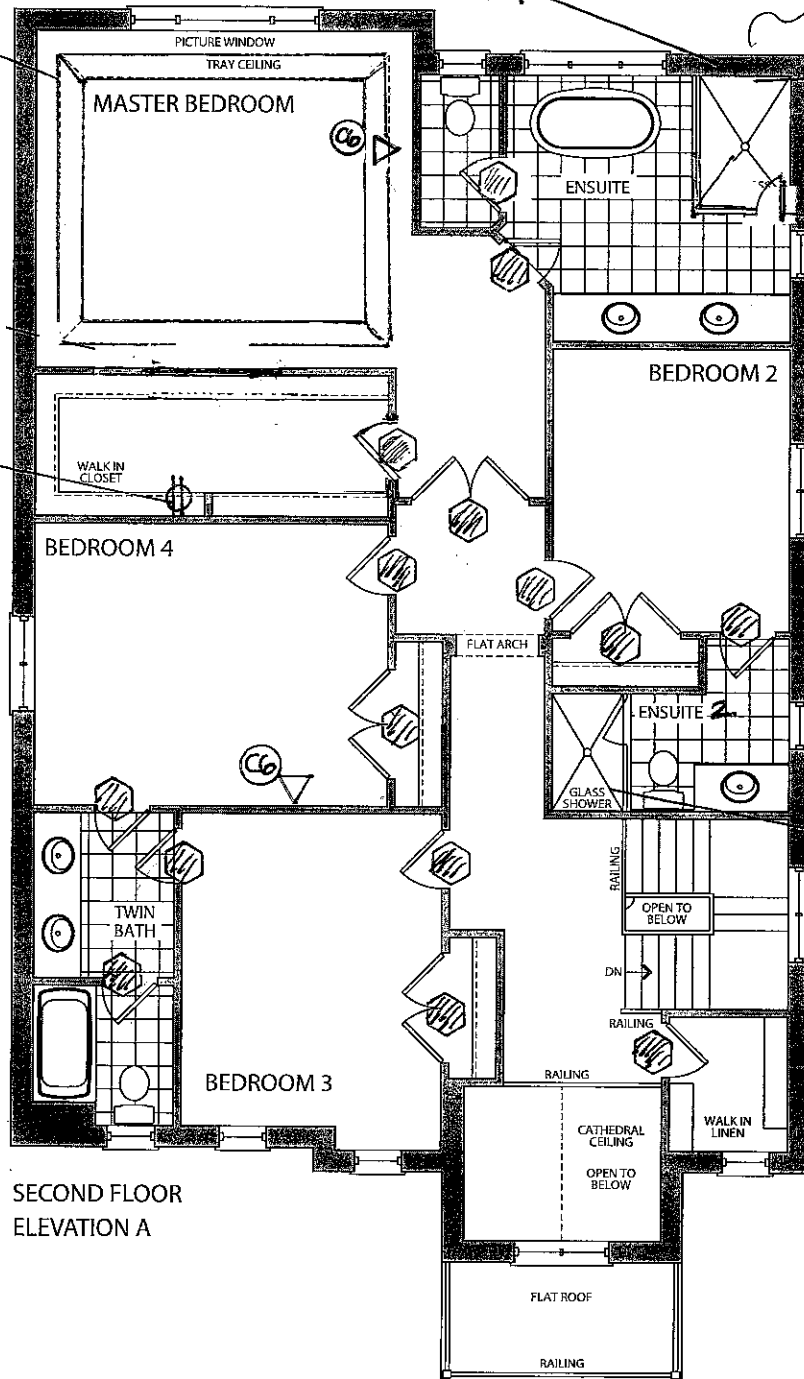

SECOND FLOOR  
ELEVATION A

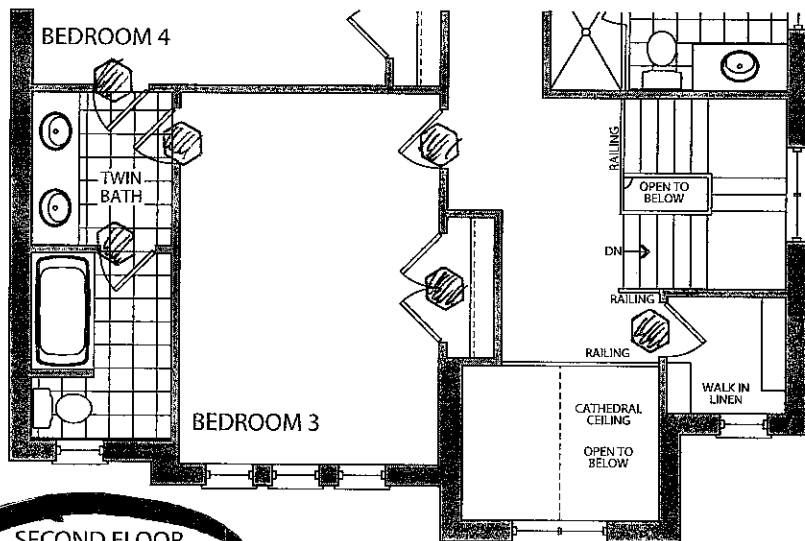

SECOND FLOOR  
ELEVATION B

REVISION  
MAY 2, 2017

KS2-26  
STRUCTURAL

DATE: 03/19/17

COLOURS

DATE: 03/19/17

\* SMOOTH CEILING

96" DOORS

~~Elevation A • 3,016 sq.ft.~~  
Elevation B • 3,043 sq.ft.

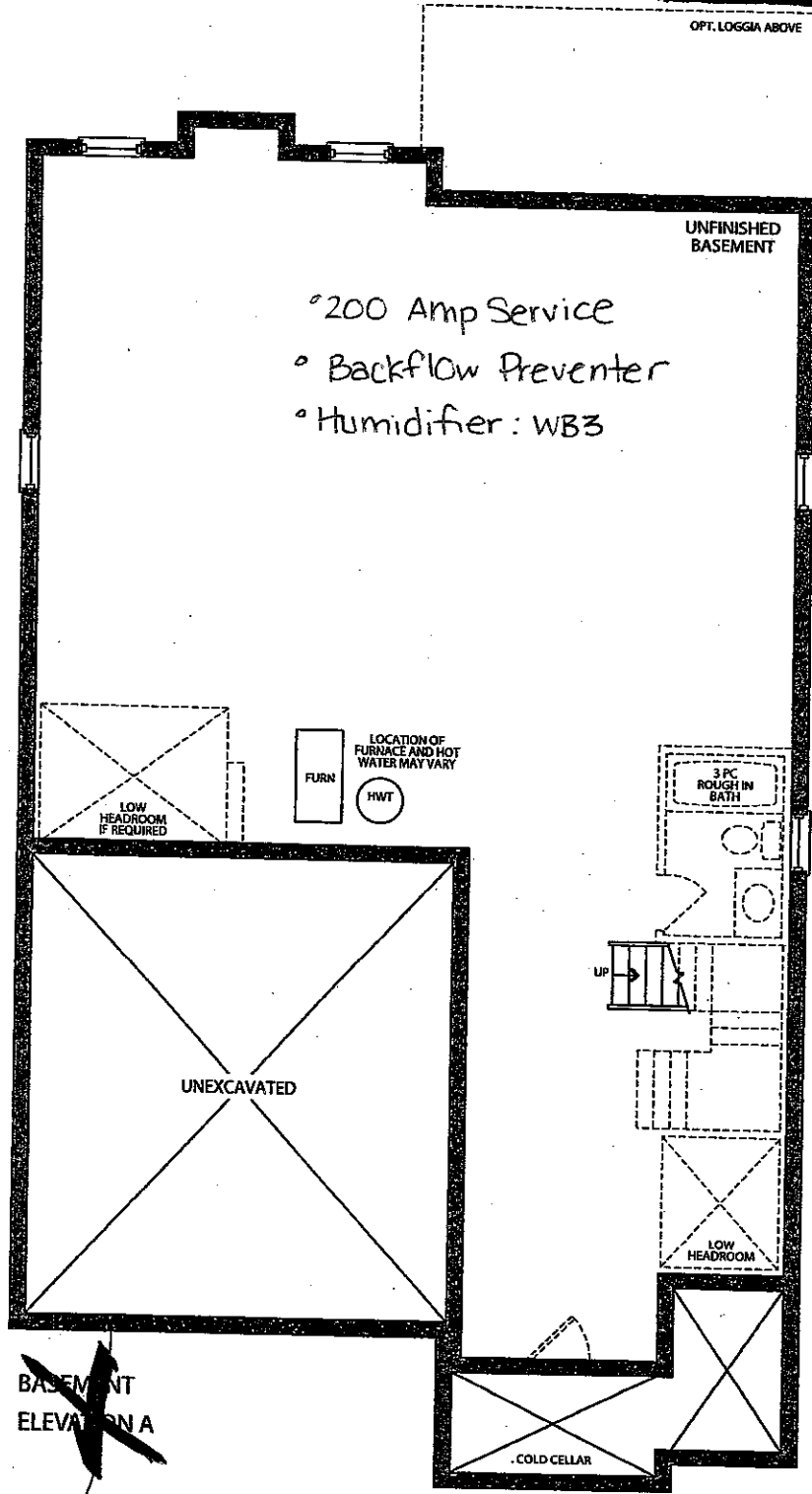

see it  
KG2-26  
JUNE 5 2017

~~BASEMENT  
ELEVATION A~~

\* BACKFLOW  
\* HUMIDIFIER

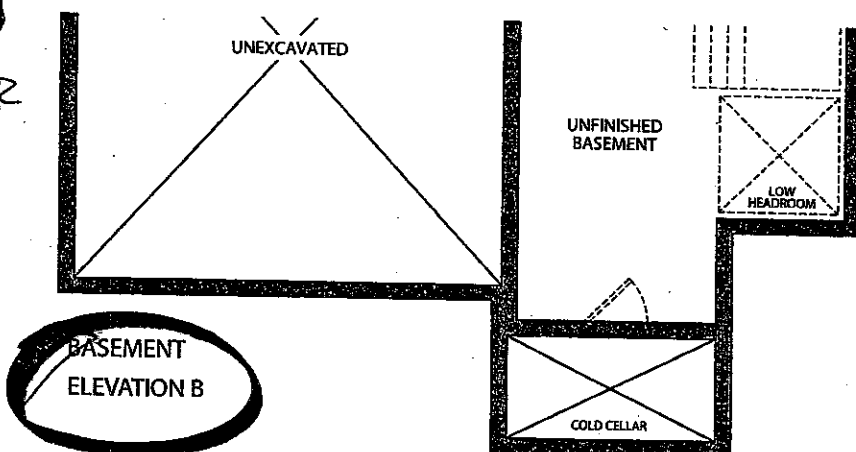

KG2-26  
STRUCTURAL  
DATE 03/19/17  
COLOURS  
DATE 03/19/17

- Standard 2CM & 3CM
- Upgrade 1 2CM & 3CM
- Upgrade 1 & CM
- Upgrade 2

**20mm (3/4") Profiles**

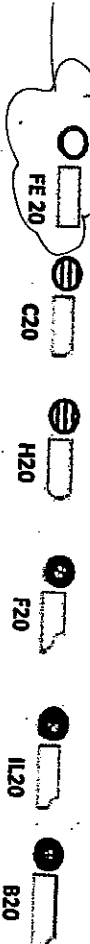

STO  
KUTTEN  
EDGE

**30mm (1 1/4") Profiles**

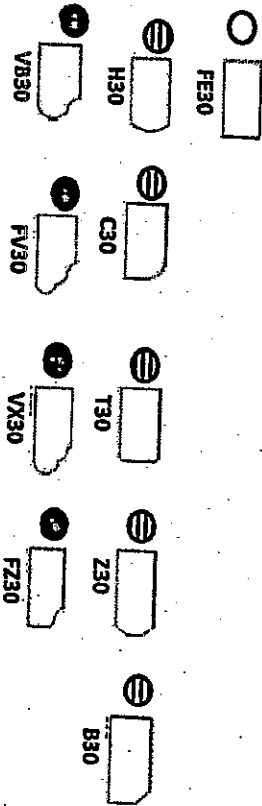

**40mm (1 1/2") Profiles**

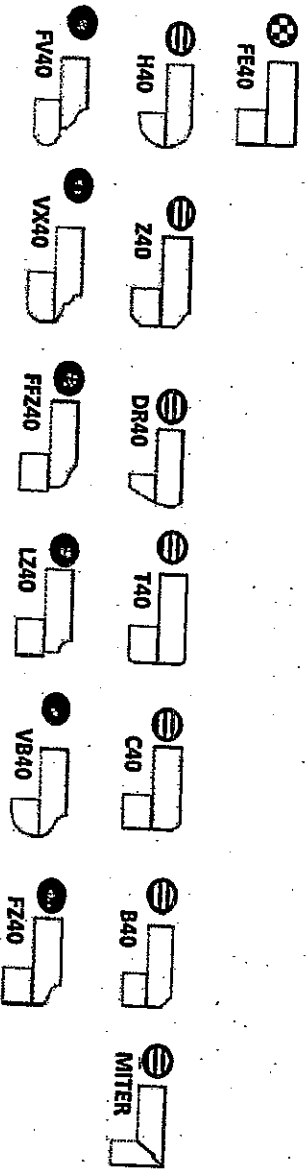

Note: All colours may not be available in 30mm at time ordered. Vendor reserves the right to use 40mm edges (by lamination process).

\*Mitre edge is available in Upgrade 1 for an overall thickness of 2". All other Mitre edge options will be an Upgrade 2 Edge.

W62-26

12

MARCH 19, 2017



The Home Organizer  
<YOUR ADDRESS>  
<YOUR CITY AND STATE>  
Phone: <YOUR PHONE NUMBER> Fax: <YOUR FAX NUMBER>

GPH MODEL 42 - 1  
GPH MODEL 42 - 1 Room 1

Perspective  
Current Date: Feb 07, 2017  
Scale: NTS

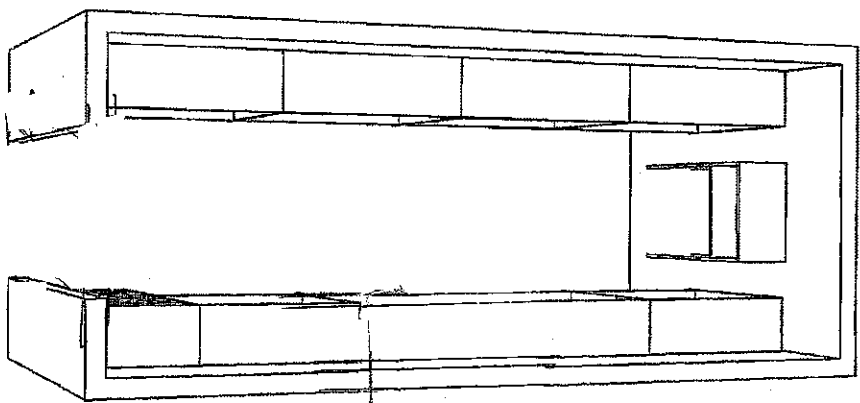

~~Q~~ MAY 2, 2017

WAL. 19, 2017

~~Q~~

W62-26

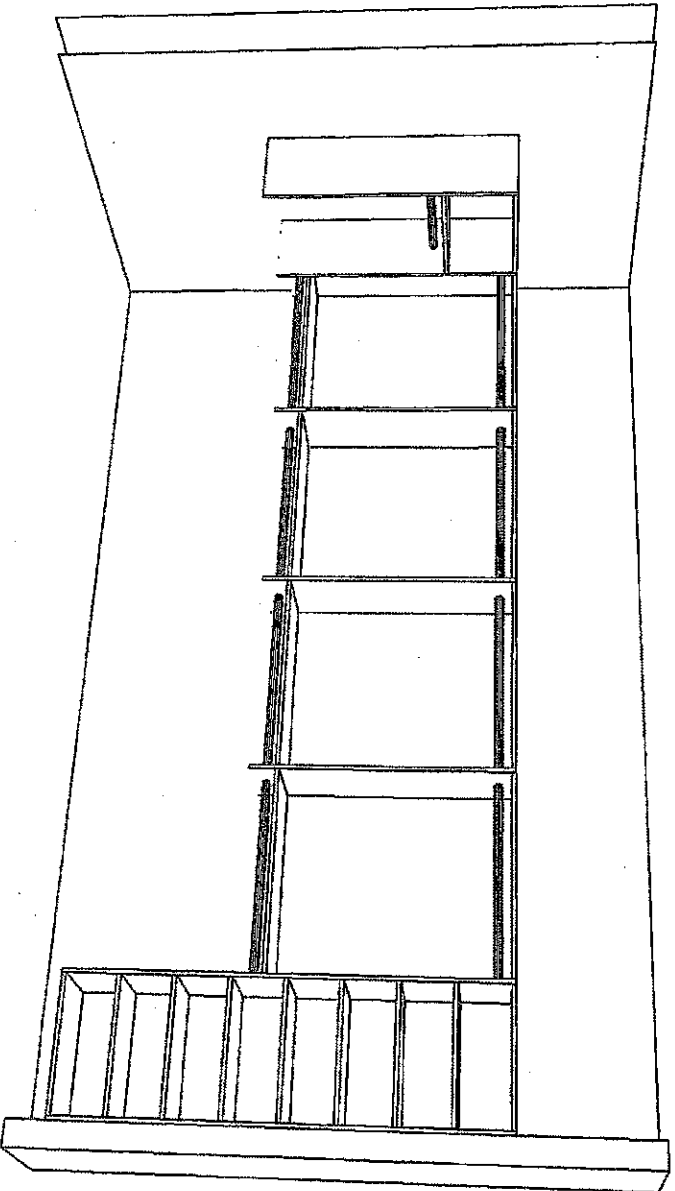

**The Home Organizer**

<YOUR ADDRESS>  
<YOUR CITY AND STATE>  
PHONE: <YOUR PHONE NUMBER> FAX: <YOUR FAX NUMBER>

**GPH MODEL 42 - 1**

GPH MODEL 42 - 1 Room 1

**Perspective**

Current Date: Feb 07, 2017

Scale: NTS

KA 2-26  
MATH 19. 2017

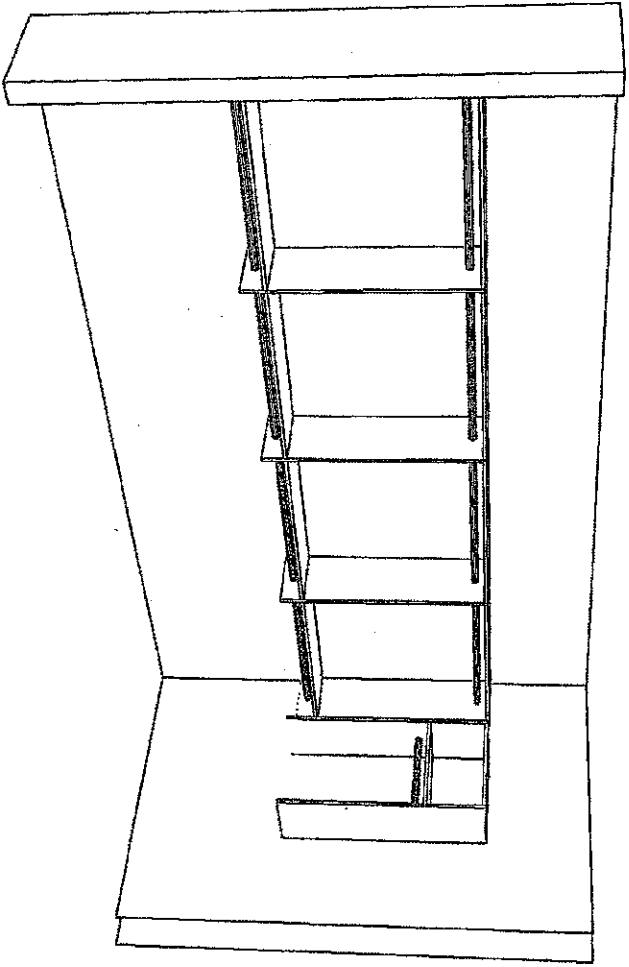

**The Home Organizer**

<YOUR ADDRESS>  
<YOUR CITY AND STATE>  
Phone: <YOUR PHONE NUMBER> Fax: <YOUR FAX NUMBER>

**GPH MODEL 42 - 1**

GPH MODEL 42 - 1 Room 1

**Perspective**

Current Date: Feb 07, 2017

Scale: NTS

MS2-26

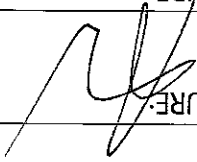

MARKOT 29, 2017

SIGNATURE: 		DATE: MARCH 19, 2017
SIGNATURE:		ROOM: MASTER ENSUITE SHOWER
		LOT # K62-26

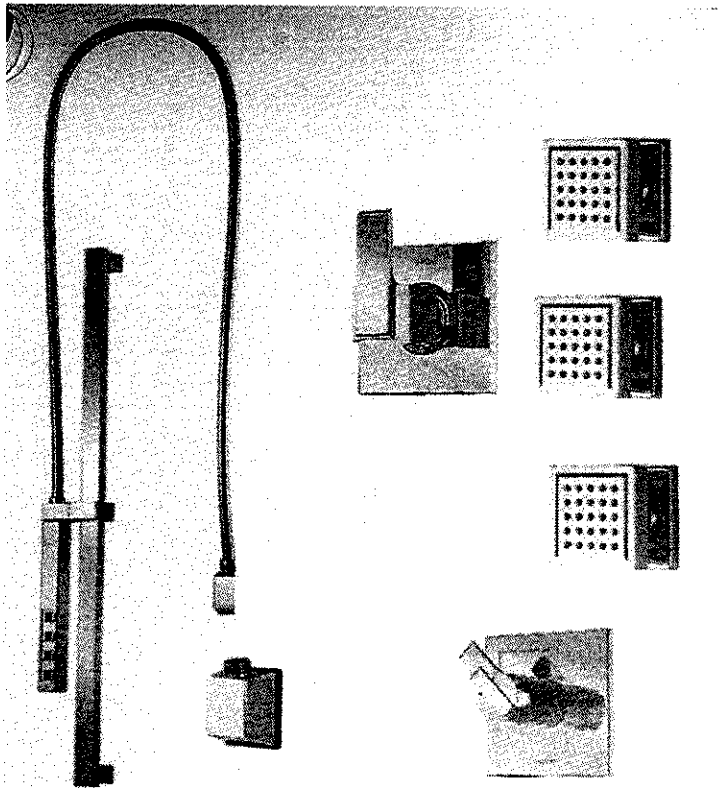

STRAIGHT ARM FROM  
 CEILING FOR  
 RAIN  
 SHOWER

Delta Temp Assure Shower system with 6 function diverter & body sprays & high flow rough-in 1.0GPM  
 Chrome Finish. #T117126 / 50570 / 51567 / T11967 / R1100 / 50150 x3 / R10000-UNBXHF

PLUMBING UPGRADES

**GOLDPARK**  
 WORTH MORE

**Kleinburg**  
 GLEN

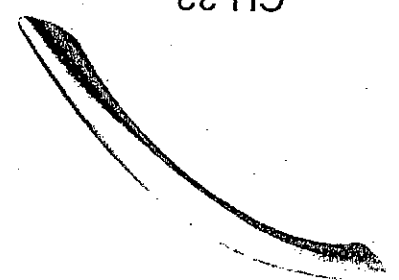

CH-32

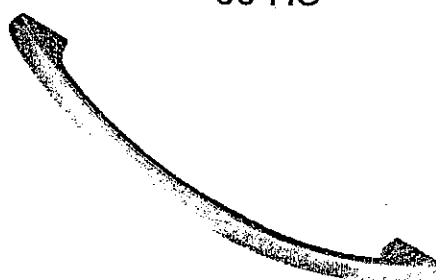

CH-38

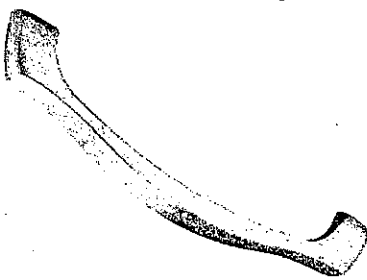

CH-44

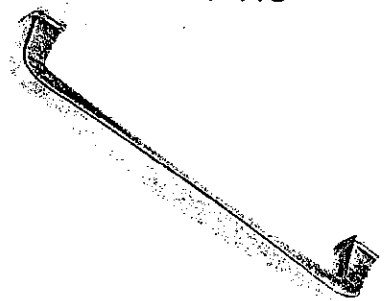

CH-45

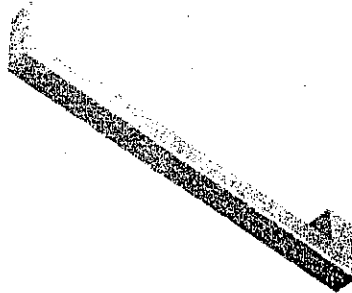

CH-46

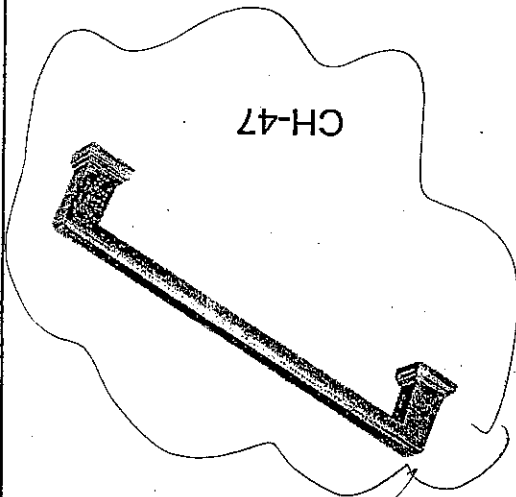

CH-47

→ (KURZEN)

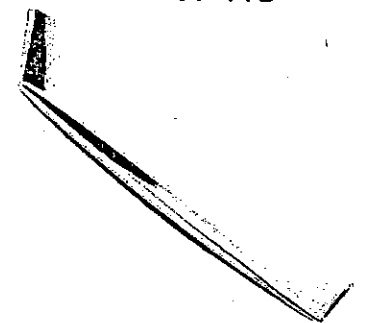

CH-48

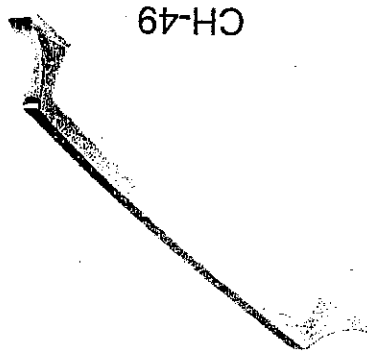

CH-49



CH-50

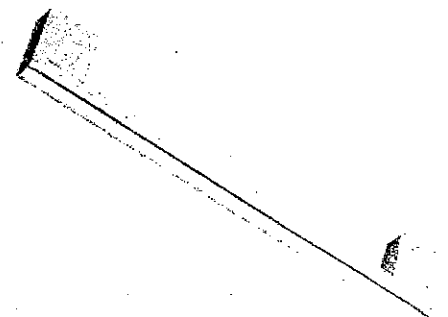

CH-51

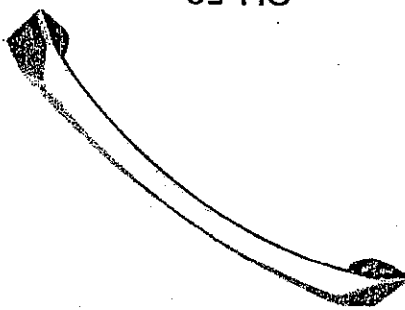

CH-52

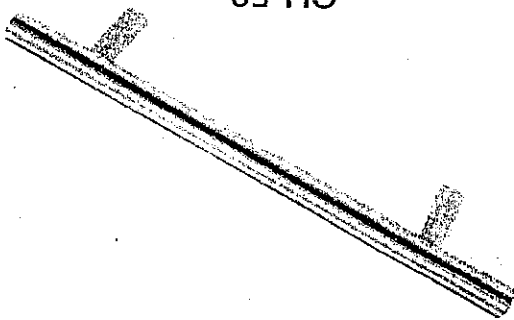

CH-53

NOTES:  
- IMAGES ARE FOR QUICK REFERENCE PURPOSES ONLY  
- ACTUAL SIZES AND FINISHES AS PER HARDWARE  
- SAMPLE BOARD PROVIDED TO DECOR CENTRE



K62-26

MAY 2, 2017

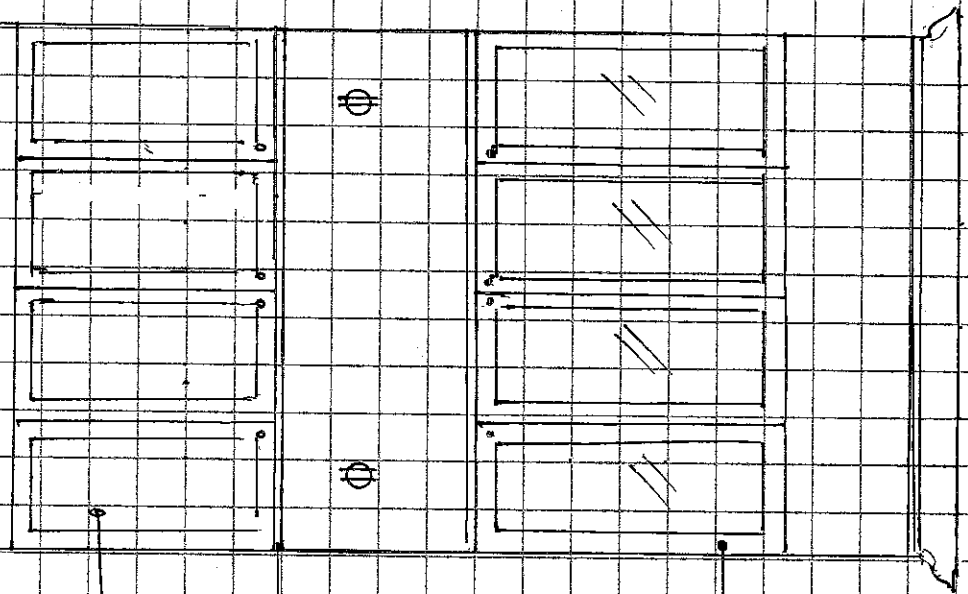

WHITE FRAMED GLASS DOOR

SINK GRANITE

WHITE CABINETS  
WINDOW W/DP

K62-210

(1)

MAY 2 2017

Trade Name: Gold Park Homes	Site location:	Model: 42-1
Address:	Project: Kleinburg Glen	Phase:

This layout has been explained to the purchaser by Cortina Kitchens Inc. and is understood by the purchaser.

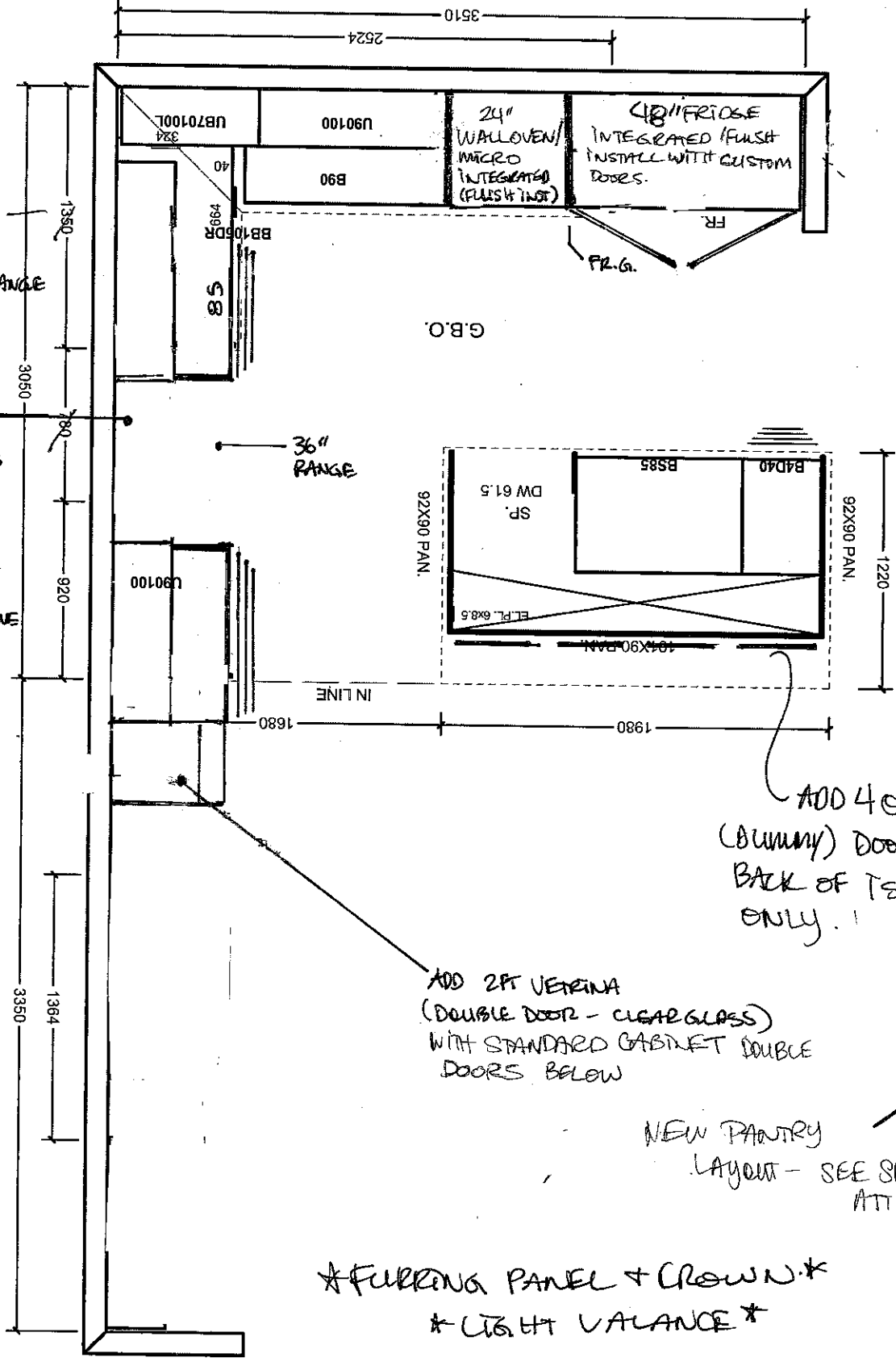

MAKE BASE CAB. ON EITHER SIDE OF RANGE EVEN 85

DELETE UPPIERS, FINISH SIDES LEAVE 48" OPENING. ADD BOTTOM PANEL WITH CROWN + FURRING ABOVE PAN.

ADD 4 OVERLAY (BUNNY) DOORS AT BACK OF ISLAND ONLY.

ADD 2FT VETRINA (DOUBLE DOOR - CLEAR GLASS) WITH STANDARD CABINET DOUBLE DOORS BELOW

NEW PANTRY LAYOUT - SEE SKETCH ATT'D.

\* FURRING PANEL + CROWN \*  
\* LIGHT VALANCE \*

ACCEPTED DATE: MARCH 19, 2017  
This quotation is subject to confirmation from head office. All prices subject to confirmation from head office. out

All agreements are contingent upon strikes, accidents, and delays beyond our control. Please provide our installer with template for sinkholes or \$150.00 will be charged for callback.

MAY 2, 2017

K62-26

Item A. Wood grain and colour are characteristics of the product. We cannot guarantee that such grain and colour will always match. Item B. Cortina Kitchens Inc. reserves the right to alter dimensions and make technical changes without notice.

STANDARD HARDWARE

STANDARD HARDWARE

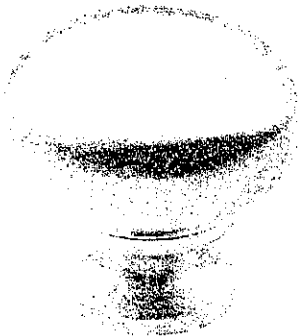

CSI-6

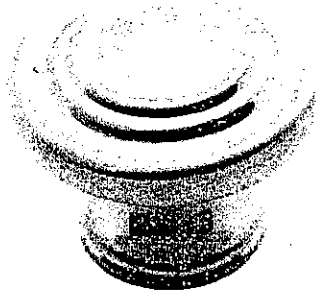

CSI-10

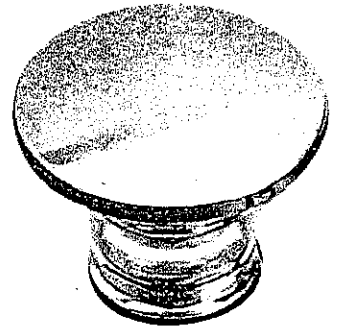

CSI-14



CSI-16



CSI-18

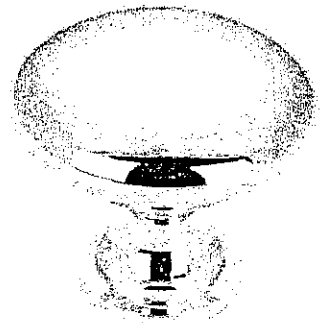

CSI-19



CSI-20

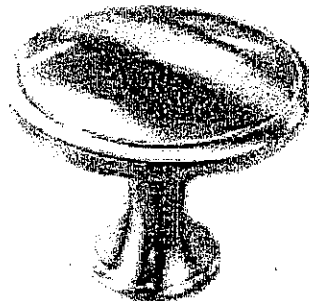

CSI-21

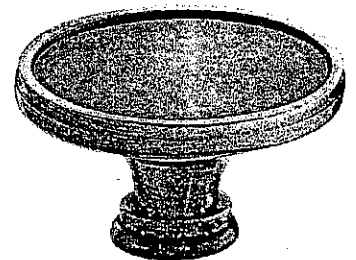

CSI-22

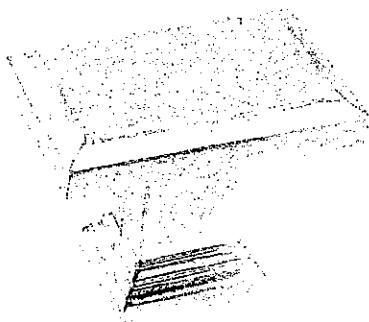

CSI-23

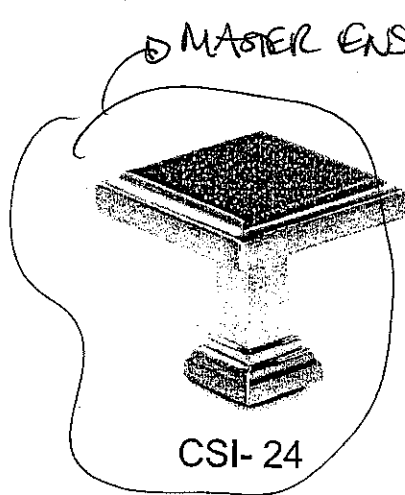

CSI-24

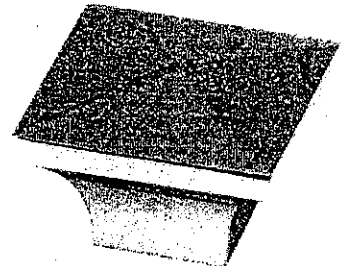

CSI-25

K62-26

Ⓟ

March 19, 2017

\*NOTES:

- IMAGES ARE FOR QUICK REFERENCE PURPOSES ONLY
- ACTUAL SIZES AND FINISHES AS PER HARDWARE
- SAMPLE BOARD PROVIDED TO DECOR CENTRE