

Kleinburg Glen - 33 - 2 - 42-3 Elev.A CARLTON
CENTRAL VAC AND WIRING

Inv.1,222	1 - GREAT ROOM / DEN / MASTER BEDROOM / DEN: ROUGH IN- 4X- CAT 6 CONNECTIONS- See plan for location.
Line18444	Note:
1Mar17 / 8Aug17	

CERAMIC

Inv.1,222	1 - KITCHEN FLOOR TILE: Upgrade 2 - 12x24" laid in straight, stacked pattern. See plan for tile direction.
Line18467	Note:
1Mar17 / 8Aug17	
Inv.1,222	1 - FOYER FLOOR TILE: Upgrade 2 - 12x24" laid in straight, stacked pattern. See plan for tile direction.
Line18468	Note:
1Mar17 / 8Aug17	
Inv.1,222	1 - POWDER ROOM FLOOR TILE: Upgrade 2 - 12x24" laid in straight, stacked pattern. See plan for tile direction.
Line18469	Note:
1Mar17 / 8Aug17	
Inv.1,222	1 - MUDROOM FLOOR TILE: Upgrade 2 - 12x24" laid in straight, stacked pattern. See plan for tile direction.
Line18470	Note:
1Mar17 / 8Aug17	
Inv.1,222	1 - 2ND FLOOR LAUNDRY: Move laundry to basement - space will be unfinished - no floor tiles, no drywall
Line23814	Note:
1Mar17 / 8Aug17	

DRYWALL

Inv.1,222	1 - 2ND FLOOR: SMOOTH CEILINGS - (2 - Story Design) 2ND FLOOR
Line18455	Note:
1Mar17 / 8Aug17	

ELECTRICAL

Inv.1,222	2 - GREAT ROOM: Additional Interior Receptacle (not separate cicuit) - Locate above fireplace box for tv components, see sketch for location.
Line18445	Note:
1Mar17 / 8Aug17	
Inv.1,222	1 - KITCHEN: 240V Wall Recepticle on dedicated circuit - for wall oven
Line18446	Note:
1Mar17 / 8Aug17	
Inv.1,222	1 - KITCHEN: Additional Separate Circuit Receptacle - for microwave
Line18447	Note:
1Mar17 / 8Aug17	
Inv.1,222	1 - KITCHEN: Additional Separate Circuit Receptacle for future 600+ cfm hood fan.
Line18449	Note:
1Mar17 / 8Aug17	
Inv.1,222	1 - KITCHEN: Relocate standard ceiling light above island, see plan for location.
Line18452	Note:
1Mar17 / 8Aug17	

Kleinburg Glen - 33 - 2 - 42-3 Elev.A CARLTON

Inv.1,222	1 - KITCHEN: Rough in light on existing switch- Capped (doesn't include fixture) -Locate above island, use same switch as standard light
Line18453	Note:
1Mar17 / 8Aug17	
Inv.1,222	1 - Living Room: Rough in light on separate switch- Capped (doesn't include fixture). See plan for location.
Line18454	Note:
1Mar17 / 8Aug17	
Inv.1,222	1 - 2ND FLOOR LAUNDRY: Move laundry to basement - space will be unfinished - no floor tiles, no drywall
Line23815	Note:
1Mar17 / 8Aug17	
Inv.1,222	1 - BASEMENT: TANKLESS HWT CONNECTION - HWT ON RENTAL BASIS / TANK NOT INCLUDED
Line23820	Note:
1Mar17 / 8Aug17	
Inv.1,222	1 - KITCHEN: GAS LINE ROUGH - MAIN FLOOR - (2 STOREY MODELS) FOR GAS STOVE- INCLUDES 110V PLUG ON SEPARATE CIRCUIT
Line23822	Note:
1Mar17 / 8Aug17	

Exterior Colours

Inv.1,222	1 - EXTERIOR COLOUR PACKAGE 4
Line23810	Note:
1Mar17 / 8Aug17	

FRAMING

Inv.1,222	1 - KITCHEN: UPGRADE VENTING FOR STOVE TO 8 INCH PIPE EXTERIOR WALL
Line23811	Note:
1Mar17 / 8Aug17	
Inv.1,222	1 - MAIN FLOOR & 2ND FLOOR: EXTENDED HEIGHT ARCHWAY (PRICE PER DOORWAY) - 96"
Line23812	Note:
1Mar17 / 8Aug17	
Inv.1,222	1 - 2ND FLOOR - FORMER LAUNDRY ROOM: rotate close and enlarge to double door closet. Remove door, create tall arch. Finish floor with standard carpet.
Line23816	Note:
1Mar17 / 8Aug17	
Inv.1,222	1 - KITCHEN: Crown moulding and Furring Panel
Line23817	Note:
1Mar17 / 8Aug17	
Inv.1,544	1 - MANDOOR- GARAGE TO HOUSE
Line23824	Note:
8Aug17 / 8Aug17	

GRANITE MARBLE QUARTZ

Inv.1,222	1 - KITCHEN COUNTER TOP: Upgrade 3 Granite - Edge FE-20
Line18466	Note:
1Mar17 / 8Aug17	

HARDWOOD

Kleinburg Glen - 33 - 2 - 42-3 Elev.A CARLTON

Inv.1,222	1 - UPPER HALL: Preverco Red Oak 3/4 x 4-1/4" smooth 'Komodo'
Line18472	Note:
1Mar17 / 8Aug17	

HVAC

Inv.1,222	1 - KITCHEN: UPGRADE VENTING FOR STOVE TO 8 INCH PIPE EXTERIOR WALL
Line18451	Note:
1Mar17 / 8Aug17	
Inv.1,222	1 - BASEMENT: TANKLESS HWT CONNECTION - HWT ON RENTAL BASIS / TANK NOT INCLUDED
Line18524	Note:
1Mar17 / 8Aug17	
Inv.1,222	1 - KITCHEN: GAS LINE ROUGH - MAIN FLOOR - (2 STOREY MODELS) FOR GAS STOVE- INCLUDES 110V PLUG ON SEPARATE CIRCUIT
Line18525	Note:
1Mar17 / 8Aug17	
Inv.1,222	1 - BASEMENT: Upgrade to 2-stage Lennox furnace, in lieu of standard
Line19386	Note:
1Mar17 / 8Aug17	
Inv.1,222	1 - 2ND FLOOR LAUNDRY: Move laundry to basement - space will be unfinished - no floor tiles, no drywall
Line23813	Note:
1Mar17 / 8Aug17	
Inv.1,222	1 - KITCHEN: Crown moulding and Furring Panel
Line23818	Note:
1Mar17 / 8Aug17	

INTERIOR TRIM AND DOORS

Inv.1,222	9 - MAIN FLOOR & 2ND FLOOR: EXTENDED HEIGHT ARCHWAY (PRICE PER DOORWAY) - 96"
Line18456	Note:
1Mar17 / 8Aug17	
Inv.1,222	1 - 2ND FLOOR - FORMER LAUNDRY ROOM: rotate close and enlarge to double door closet. Remove door, create tall arch. Finish floor with standard carpet.
Line18458	Note:
1Mar17 / 8Aug17	

KITCHEN AND BATH CABINETRY

Inv.1,222	1 - KITCHEN CABINETRY: Upgrade 2 profile - maple
Line18459	Note:
1Mar17 / 8Aug17	
Inv.1,222	1 - KITCHEN: Crown moulding and Furring Panel
Line18460	Note:
1Mar17 / 8Aug17	
Inv.1,222	1 - KITCHEN CABINETRY: dark spray stain premium
Line18461	Note:
1Mar17 / 8Aug17	

Kleinburg Glen - 33 - 2 - 42-3 Elev.A CARLTON

Inv.1,222	1 - KITCHEN: Double appliance cabinet with drawer below
Line18462	Note:
1Mar17 / 8Aug17	
Inv.1,222	1 - KITCHEN: Pots and Pans Drawers below cooktop. Top Drawer is false + 2 deep drawers below.
Line18463	Note:
1Mar17 / 8Aug17	
Inv.1,222	1 - KITCHEN: Waste/recycle center - pullout with 2 bins
Line18464	Note:
1Mar17 / 8Aug17	
Inv.1,222	1 - KITCHEN: Delete uppers above cooktop, finish sides of cabinets. Leave approx. 36" between uppers for future 30" chimney-style hood fan.
Line18465	Note:
1Mar17 / 8Aug17	
Inv.1,222	1 - POWDER ROOM CABINET: Upgrade 2 maple - price includes premium for dark spray stain
Line18471	Note:
1Mar17 / 8Aug17	

MISC.

Inv.1,222	1 - Purchaser has attended an appointment at the Decor Centre & has DECLINED any additional upgrades and accepts and acknowledges that there will be no further changes/additions/deletions to be made upon signing on March 8 2017.
Line18475	Note:
1Mar17 / 8Aug17	
Inv.1,222	1 - Purchasers are aware & accepts that ANY changes made to upgrades after signing this Purchasers Extra Form are subject to a minimum administration fee of \$500. PLUS a 10% holdback fee.
Line18476	Note:
1Mar17 / 8Aug17	
Inv.1,222	1 - BONUS PACKAGE: \$20,000.00 (INCLUDING TAXES) WORTH OF UPGRADES FROM GOLD PARK HOMES DÉCOR CENTRE IS BEING APPLIED TOWARD THIS APPOINTMENT. PURCHASER HAS A REMAINING AMOUNT OF \$00 (INCLUDING TAXES).
Line18477	Note:
1Mar17 / 8Aug17	

PAINTING

Inv.1,222	1 - MAIN STAIRS: Stain stairs to match hardwood, as close as possible
Line18474	Note: stair landings to be stained on site
1Mar17 / 8Aug17	

PLUMBING

Inv.1,222	1 - 2ND FLOOR LAUNDRY: Move laundry to basement - space will be unfinished - no floor tiles, no drywall
Line18457	Note:
1Mar17 / 8Aug17	
Inv.1,222	1 - KITCHEN: Crown moulding and Furring Panel
Line23819	Note:
1Mar17 / 8Aug17	
Inv.1,222	1 - BASEMENT: TANKLESS HWT CONNECTION - HWT ON RENTAL BASIS / TANK NOT INCLUDED
Line23821	Note:
1Mar17 / 8Aug17	

Kleinburg Glen - 33 - 2 - 42-3 Elev.A CARLTON

PLUMBING FIXTURES

Inv.1,318	1 - KITCHEN: SOAP DISPENSER # RP1002 (chrome) - LOCATE LEFT OF KITCHEN FAUCET.
Line20853	Note:
11Apr17 / 8Aug17	

STAIRS AND RAILINGS

Inv.1,222	1 - MAIN STAIRS: R6 + V GROOVE
Line18473	Note:
11Mar17 / 8Aug17	

WINDOWS AND DOORS

Inv.1,544	1 - MANDOOR- GARAGE TO HOUSE
Line23825	Note:
8Aug17 / 8Aug17	

*** NOTE: This is not an approved document. Document must be locked ***

Scheduled Closing Date:

Purchasers: Hinakumari P Gandhi & Piyushkumar B Gandhi Property: 33

Telephone Res. / Bus: (416) 357-6747

Project: Burkshire Holdings Inc.

Decor Advisor: Yolande Somerville

Model and Elevation: 42-3 Elev.A CARLTON

Layout Changes: ☒ Yes ☐ NoSketch Attached: ☒ Yes ☐ No

Exterior Colour Scheme:

1. Cabinetry

	Style and Colour	Counter	Hardware
Kitchen / Breakfast	*Varese maple 'Cocoa'	*Granite: Bianco Antico Edge:FE-20	cs1-23
Laundry Room	n/a	n/a	n/a
Powder Room	*Varese maple 'Cocoa'	P-Lam #1877k-52 'Autumn Carnival'	cs1-23
n/a	n/a	n/a	n/a
Master Ensuite Bathroom	varese pvc 'mystic'	P-Lam #P-345 'Inukshuk Taupe'	cs1-23
Second Ensuite Bathroom (If Applicable)	varese pvc 'mystic'	P-Lam #P-344 'Inukshuk Grey'	cs1-23
Twin Bathroom	varese pvc 'mystic'	P-Lam #P-344 'Inukshuk Grey'	cs1-23
Dishwasher Cabinet	n/a		

Comment

2. Floor Tile

	Selection	Grout	Threshold
Entrance Vestibule	*12x24" Land 'Bianco' upg 2	n/a	n/a
Main Hall	n/a	n/a	n/a
Kitchen / Breakfast	*12x24" Land 'Bianco' upg 2	n/a	n/a
Laundry Room	n/a	n/a	n/a
Powder Room	*12x24" Land 'Bianco' upg 2	n/a	n/a
Mud Room	*12x24" Land 'Bianco' upg 2	n/a	n/a
Master Ensuite Bathroom	13x13" New Reeds 'Taupe'	n/a	n/a
Second Ensuite Bathroom (If Applicable)	13x13" Serpentine 'Beyaz-white'	n/a	n/a
Lower Landing (If Applicable)	n/a	n/a	n/a
Twin Bathroom	13x13" Serpentine 'Beyaz-white'	n/a	n/a

Comment

*Laundry has moved to basement - unfinished space

3. Wall Tile

	Selection	Listello/Inserts	Describe
M. Ens. Tub skirt/splash	8x10" Weave 'Tender Grey'	<input type="radio"/> Yes <input checked="" type="radio"/> No	
Master Ensuite Bathroom			
Tub Deck	8x10" Weave 'Tender Grey'	<input type="radio"/> Yes <input checked="" type="radio"/> No	
Shower Stall	8x10" Weave 'Tender Grey'	<input type="radio"/> Yes <input checked="" type="radio"/> No	
Bathroom Walls	n/a	<input type="radio"/> Yes <input checked="" type="radio"/> No	
Second Ensuite Bathroom (If Applicable)	8x10" Weave 'White'	<input type="radio"/> Yes <input checked="" type="radio"/> No	
Twin Bathroom	8x10" Weave 'White'	<input type="radio"/> Yes <input checked="" type="radio"/> No	

Kitchen Backsplash ☐ Yes ☒ No

Backsplash Behind Fridge n/a

Comment

none

Scheduled Closing Date:

Purchasers: Hinakumari P Gandhi & Piyushkumar B Gandhi Property: 33

Telephone Res. / Bus: (416) 357-6747

Project: Burkshire Holdings Inc.

Decor Advisor: Yolande Somerville

Model and Elevation: 42-3 Elev.A CARLTON

4. Plumbing Fixtures

Master Ensuite Bathroom Second Ensuite Powder Room
Other Room - Specify Other Washroom

Comment

Standard plumbing thru out

5. Hardwood Flooring

	Type and Stain		Type and Stain
Main Hall	Preverco Rd Oak 'Komodo'	Upper Landing	n/a
Kitchen / Breakfast	n/a	Upper Hall	Preverco Rd Oak 'Komodo'
Living Room	Preverco Rd Oak 'Komodo'	Master Bedroom	n/a
Dining Room	Preverco Rd Oak 'Komodo'	Bedroom #2	n/a
Family Room	Preverco Rd Oak 'Komodo'	Bedroom #3	n/a
Den/Library	Preverco Rd Oak 'Komodo'	Bedroom #4	n/a
Entrance Vestibule	n/a	Bedroom #5	n/a
Lower Landing (If Applicable)	n/a	Other Room - Specify	n/a

Comment

Hardwood Selection: Preverco 3/4 x 4-1/4" Red Oak (smooth) "Komodo"

6. Carpeting

	Upgrade	Description
Main Hall	<input type="checkbox"/>	n/a
Living Room	<input type="checkbox"/>	n/a
Dining Room	<input type="checkbox"/>	n/a
Family Room	<input type="checkbox"/>	n/a
Den/Library	<input type="checkbox"/>	n/a
Upper Hall	<input type="checkbox"/>	n/a
Master Bedroom	<input type="checkbox"/>	T-15
Bedroom #2	<input type="checkbox"/>	T-15
Bedroom #3	<input type="checkbox"/>	T-15
Bedroom #4	<input type="checkbox"/>	T-15
Bedroom #5	<input type="checkbox"/>	n/a
Former Laundry	<input type="checkbox"/>	T-15
Upper Landing (If Applicable)	<input type="checkbox"/>	n/a
Lower Landing (If Applicable)	<input type="checkbox"/>	n/a

	Type	Area
Upgrade Underpad	n/a	n/a
	Capped	Runner - *Upgrade
Carpet on Stairs	n/a	n/a

Comment

Standard Underpad

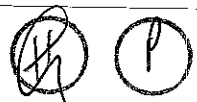

Scheduled Closing Date:

Purchasers: Hinakumari P Gandhi & Piyushkumar B Gandhi Property: 33

Telephone Res. / Bus: (416) 357-6747

Project: Burkshire Holdings Inc.

Decor Advisor: Yolande Somerville

Model and Elevation: 42-3 Elev.A CARLTON

7. Fireplace

Living Room

Purchased ☐ As Per Plan ☐ N/A ☒

Family Room

Purchased ☐ As Per Plan ☒ N/A ☐

Other Room - Specify

Purchased ☐ As Per Plan ☐ N/A ☒

Fireplace Type

Standard Gas

Mantle Type

Standard Mediterranean

Colour / Stain

Standard

Surround

none

Hearth

none

Comment

8. Trim Carpentry

Interior Doors Standard

Front Door Glass Inserts Standard

Door Handles Standard

Interior Trim Standard

Comment

9. Plaster Mouldings and Medallions

Entrance Vestibule

Kitchen/Breakfast

Main Hall

Den/Library

Living Room

Lower Landing

Dining Room

Other Room - Specify

none

Family Room

Thru Out

Comment

10. Railings and Spindles

Railing Package *R6 + V Groove

Railing Colour *Komodo

Stringer / Riser *Komodo

Spindle Colour *Black

Treads *Komodo

Oak Stairs ☒ Yes ☐ No

Comment

11. Wall Paint

Main & Upper Hall

Living Room

Dining Room

Kitchen / Breakfast

Family Room

Powder Room

Laundry Room

Den/Library

Trim Paint

Comment

Smooth Ceilings First Floor

Master Bedroom

Bedroom #2

Bedroom #3

Bedroom #4

Bedroom #5

Master Ensuite

Second Ensuite

Thru Out

Thru Out

Warm Grey



Scheduled Closing Date:

Purchasers: Hinakumari P Gandhi & Piyushkumar B Gandhi Property: 33

Telephone Res. / Bus: (416) 357-6747

Project: Burkshire Holdings Inc.

Decor Advisor: Yolande Somerville

Model and Elevation: 42-3 Elev.A CARLTON

12. Electrical

Plugs and Switches ☒ White ☐ Ivory

Hood Fan ☐ White ☐ Ivory

Appliances Built in Cooktop

☒ Yes ☐ No

Built in Oven

☒ Yes ☐ No

Above Kitchen Cabinet Light ☐ Yes ☒ No

Below Kitchen Cabinet Light ☐ Yes ☒ No

Gas Stove

☒ Yes ☐ No

Microwave

☒ Yes ☐ No

Comment

13. Heating and Air Conditioning

Air Conditioning

Gas Provisions Dryer

Comment

Standard Gas BBQ Line

Gas Provisions Stove

Gas Provisions Barbecue

14. Additional Comments

15. Disclaimers and Notes

- 1) Colours of all materials are as close as possible to builder's selection, but not necessarily identical due to variances in manufacturing.
- 2) Any extras listed above are null and void unless accompanied by a separate invoice/amendment. Said invoice must be paid in full.
- 3) The Purchaser acknowledges that after Interior Colour Selection form is signed and dated, no further changes will be permitted other than re-selection due to unavailability. Purchaser's Initials
- 4) The Purchaser acknowledges reading and accepting the "Gold Park Homes Decor Centre Disclaimers" form. This document contains other miscellaneous disclaimers.

This Interior Colour Selection is final and approved by:

Signature:

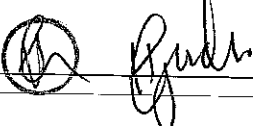

Date: 03/20/16

Signature:

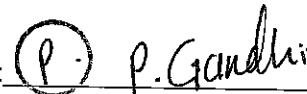

Date: 03/20/16

KG2-33
March 20 2017
(P) (P)

the Carlton

Elevation A • 3,354 sq.ft.

Elevation B • 3,361 sq.ft.

• Kitchen
crown + furring panel

SEE SKETCH
for location.

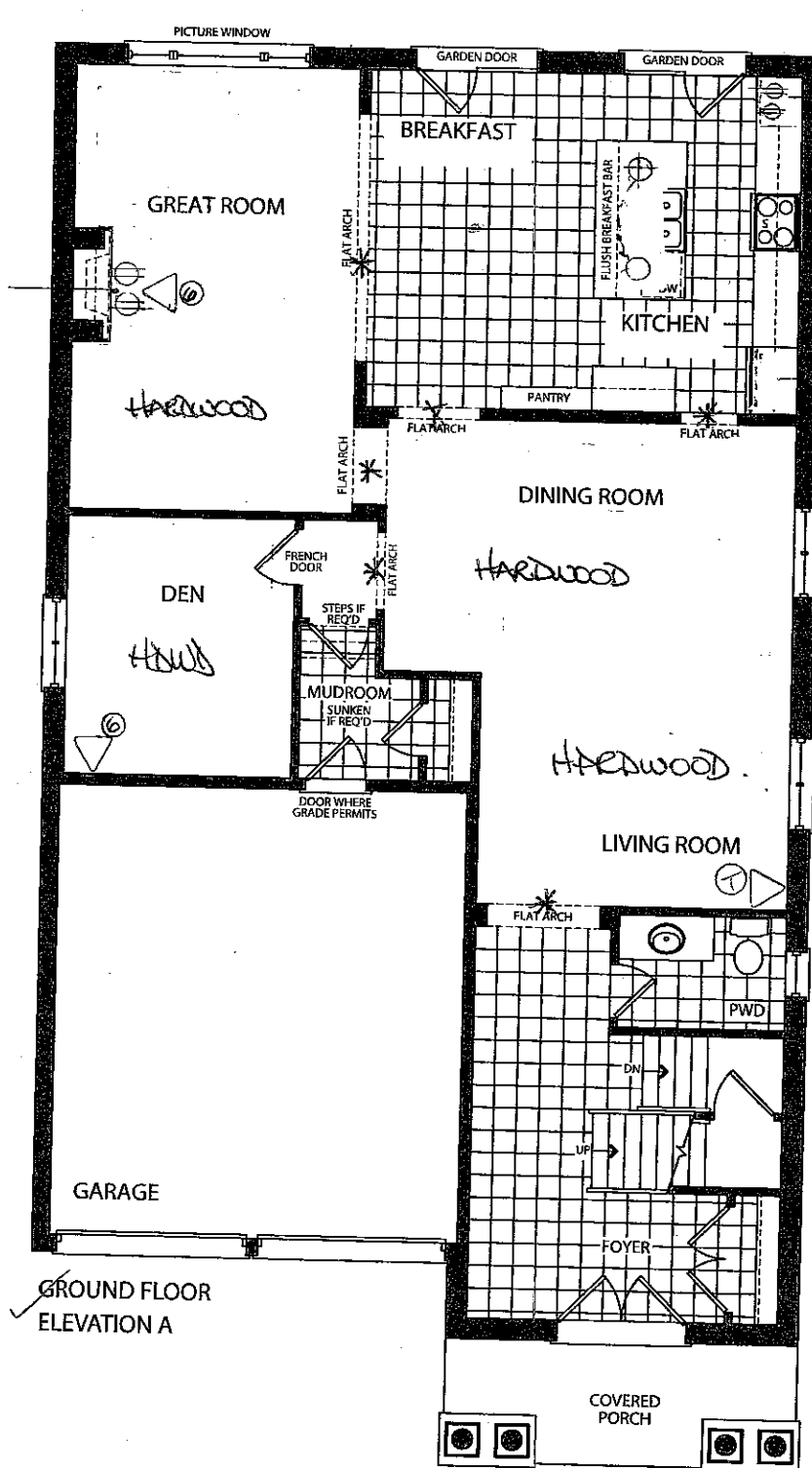

110v for micro
240v for wall ovens

OVENS

110v & gasline

No PANOPE
in KITCHEN

110v on
separate
receptacle
for hood

upg 8" vent pipe

PR

* 96" ARCHES
MAIN FLOOR

TILE DIRECTION
MAIN FLOOR

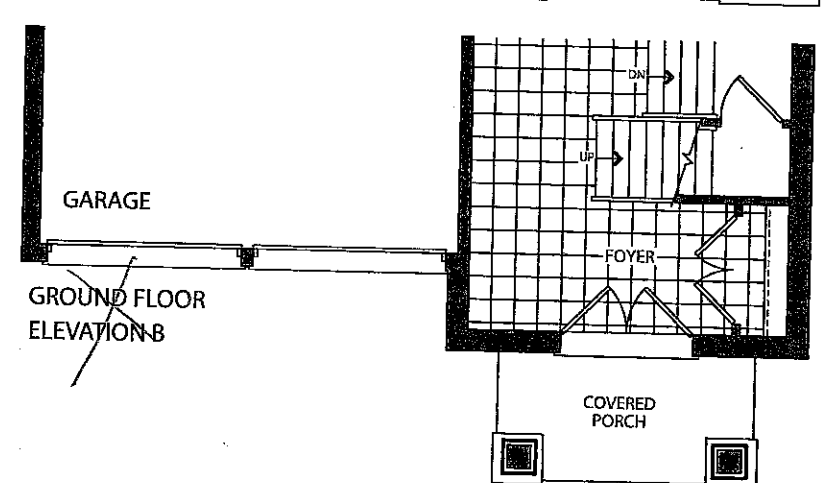
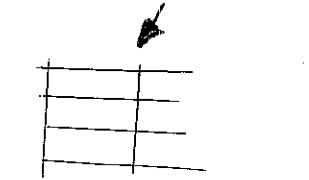

KG2-33

MARCH 20 2017



the Carlton

Elevation A • 3,354 sq.ft.

~~Elevation B • 3,361 sq.ft.~~

smooth ceiling

* 96" ARCHES
on 2nd FLOOR

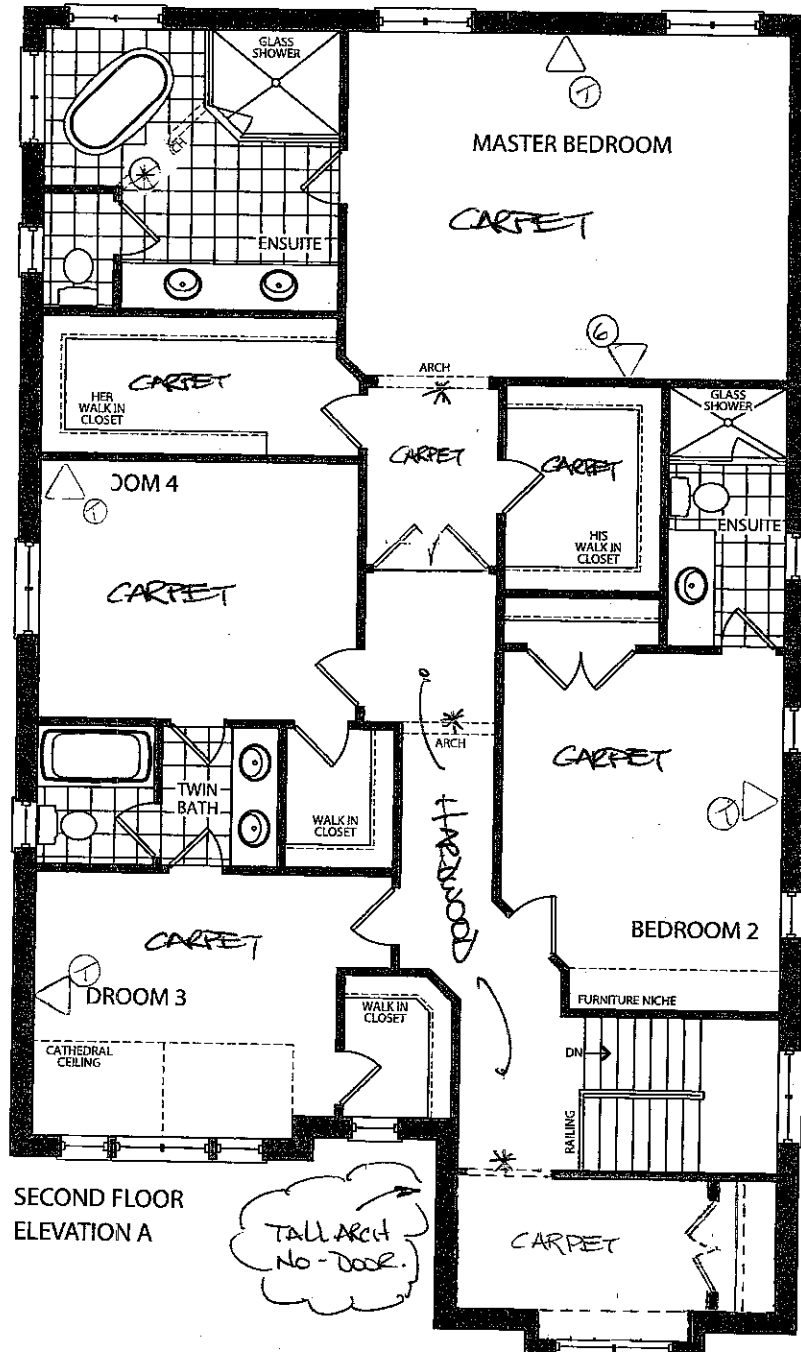

SECOND FLOOR
ELEVATION A

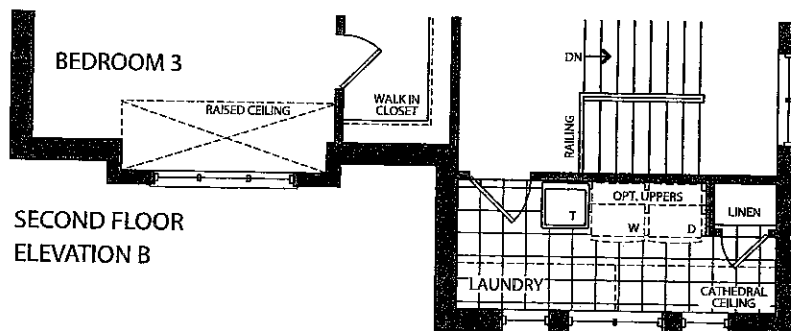

SECOND FLOOR
ELEVATION B

KG2-33
MARCH 20 2017
(A) (P)

the *Carlton*

✓ Elevation A • 3,354 sq.ft.
~~Elevation B • 3,361 sq.ft.~~

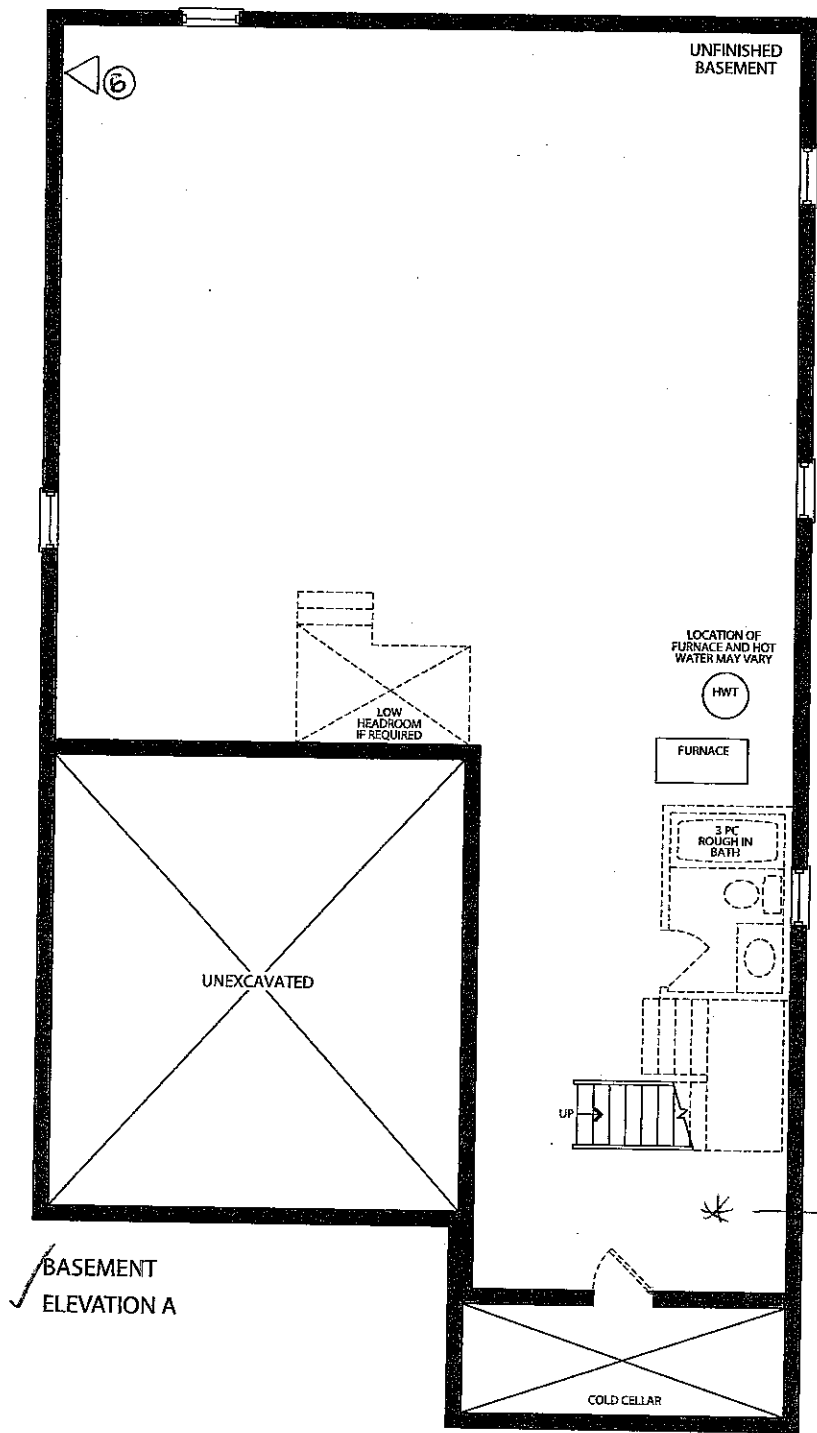

- 2 stage
UPGRADED
FURNACE
+
- WATER HEATER
Tankless

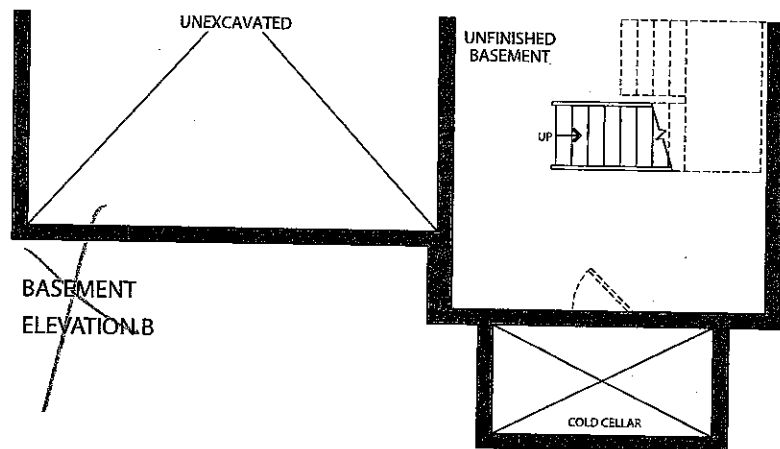

Trade Name: Gold Park Homes

Site location: Kleinburg

Model: 42-3

Address:

Project: Kleinburg Glen

Phase:

This layout has been explained to the purchaser by Cortina Kitchens Inc. and is understood by the purchaser.

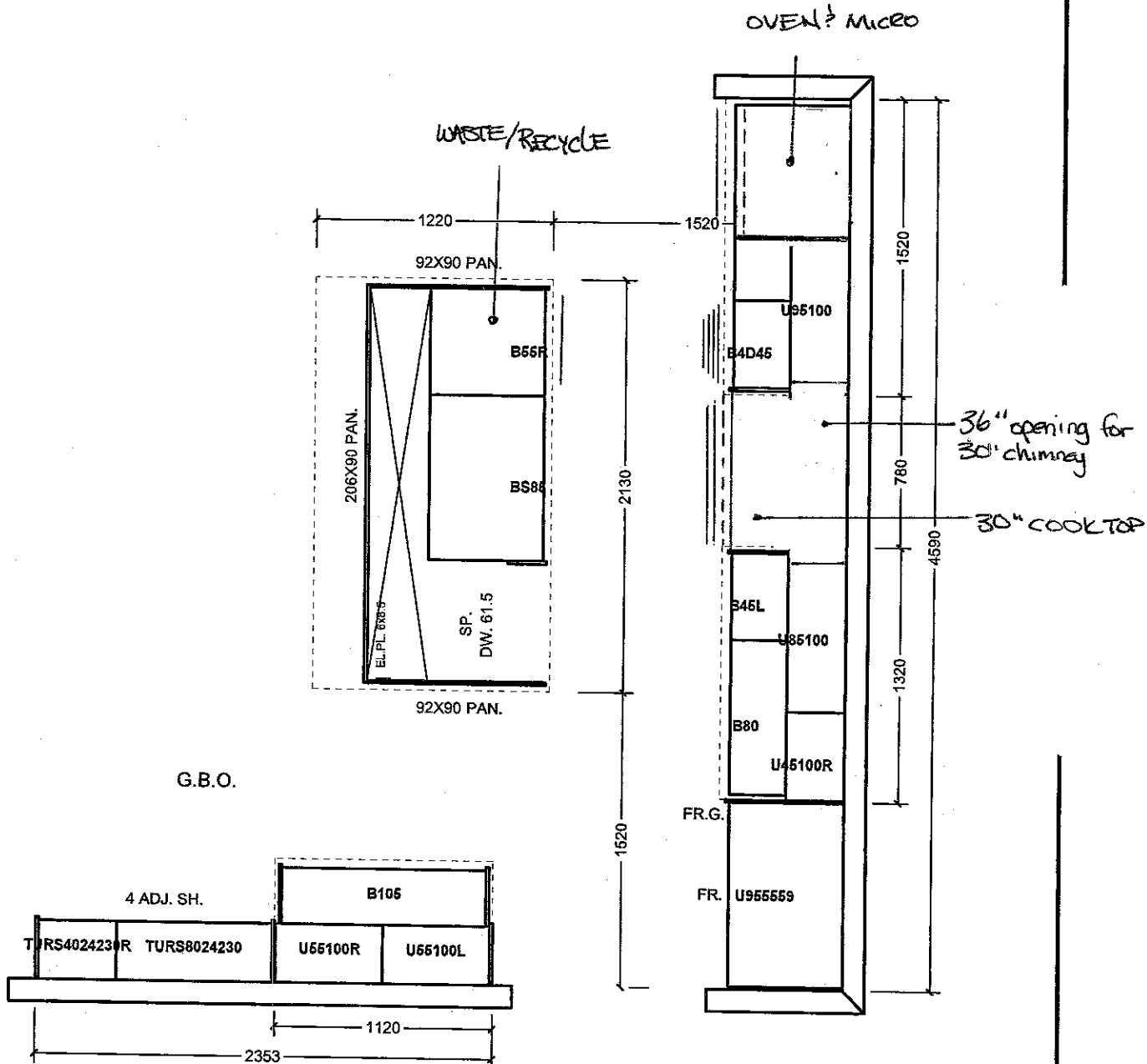

All prices subject to confirmation from head office.
This quotation is subject to the terms & conditions set out

ACCEPTED DATE: _____

All agreements are contingent upon strikes, accidents, and delays beyond our control.
Please provide our installer with template for sinkholes or \$150.00 will be charged for callback.

Item A. Wood grain and colour are characteristics of the product. We cannot guarantee that such grain and colour will always match.
Item B. Cortina Kitchens Inc. reserves the right to alter dimensions and make technical changes without notice.

CORTINA

70 Regina Road, Woodbridge, Ontario L4L 8L6
Tel: 905-264-0464 Fax: 905-264-0064
www.CortinaKitchens.com

KG2-33

MARCH 20 2017



QUOTATION

Date: 29/06/16

Trade Name: Gold Park Homes

Site location:

Model: 42-3

Address:

Project: Kleinburg Glen

Phase:

This layout has been explained to the purchaser by Cortina Kitchens Inc. and is understood by the purchaser.

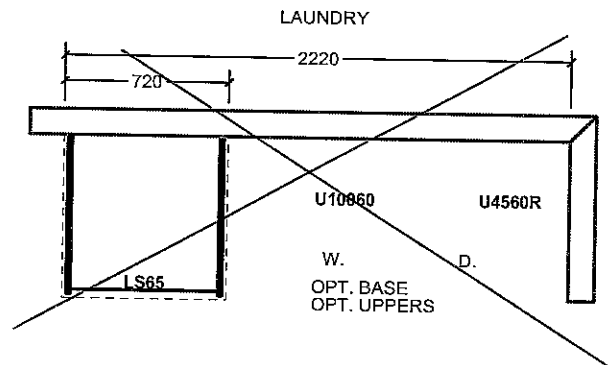
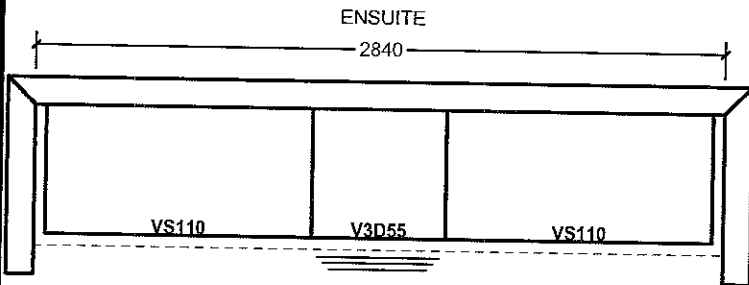
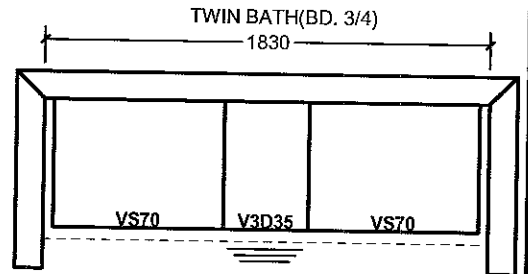
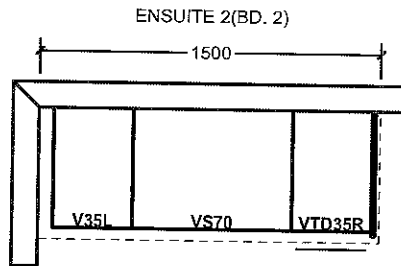
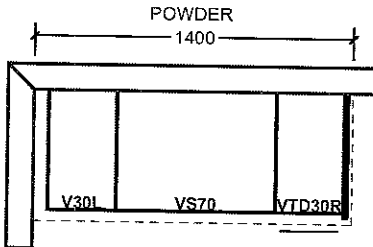

OPT. SECOND FLOOR

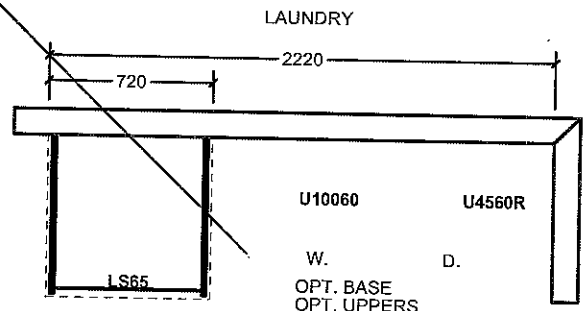
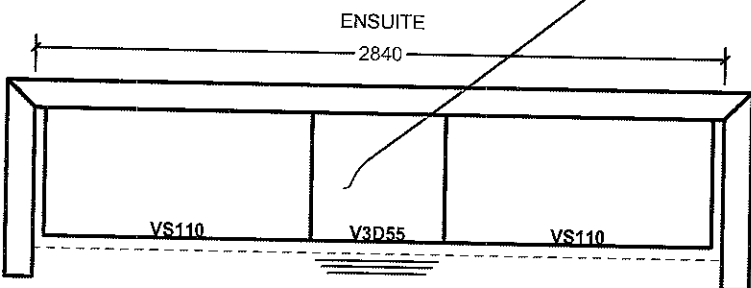
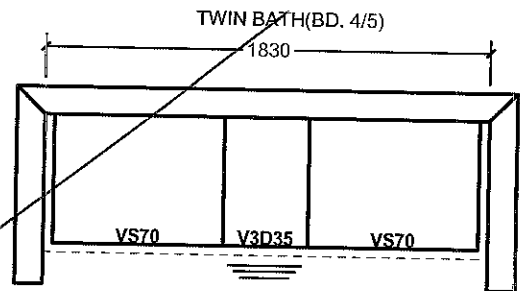
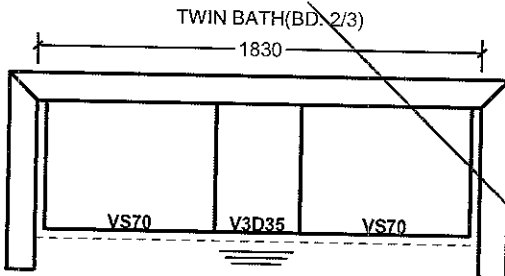

All prices subject to confirmation from head office.
This quotation is subject to the terms & conditions set out

ACCEPTED DATE: _____

All agreements are contingent upon strikes, accidents, and delays beyond our control.
Please provide our installer with template for sinkholes or \$150.00 will be charged for callback.

Item A. Wood grain and colour are characteristics of the product. We cannot guarantee that such grain and colour will always match.
Item B. Cortina Kitchens Inc. reserves the right to alter dimensions and make technical changes without notice.

STANDARD HARDWARE

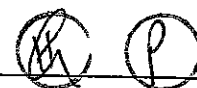
KG2-33
March 7 2017

STANDARD HARDWARE



CSI-6



CSI-10



CSI-14



CSI-16



CSI-18

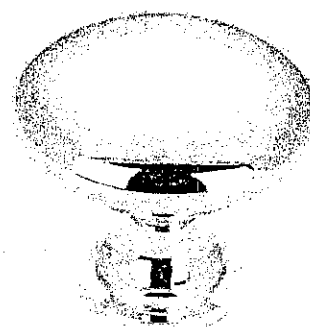

CSI-19

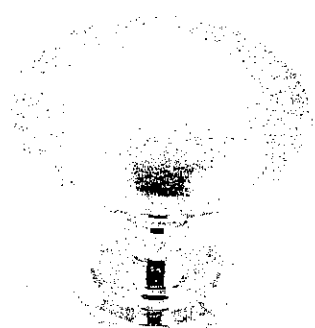

CSI-20

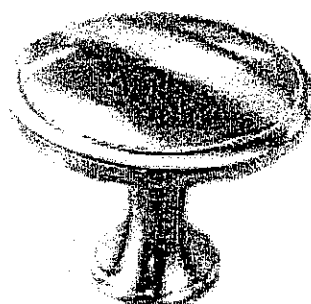

CSI-21



CSI-22

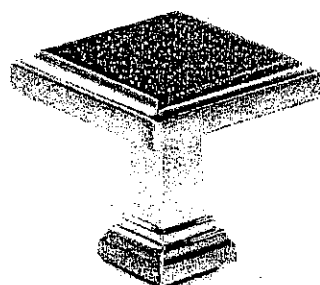

CSI-24

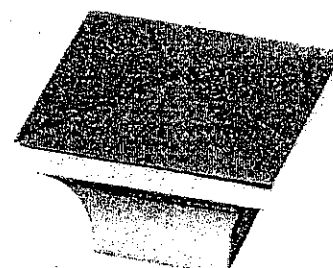

CSI-25

CSI-23

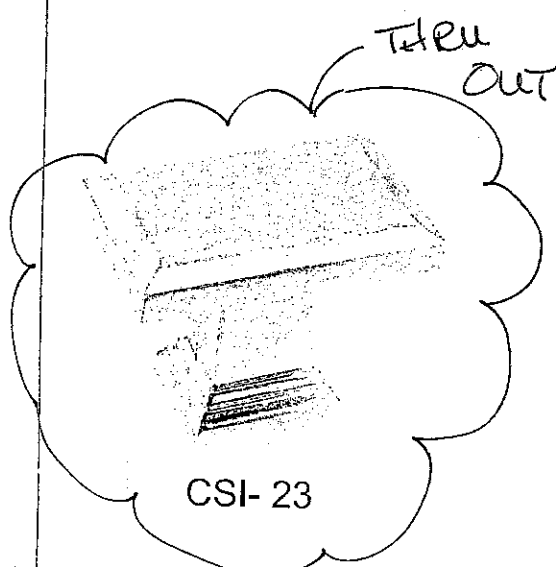

*NOTES:

- IMAGES ARE FOR QUICK REFERENCE PURPOSES ONLY
- ACTUAL SIZES AND FINISHES AS PER HARDWARE SAMPLE BOARD PROVIDED TO DECOR CENTRE

- Standard 2CM & 3CM
- Upgrade 1 2CM & 3CM
- Upgrade 1 4 CM
- Upgrade 2

KG2-33

March 7 2017

20mm (3/4") Profiles

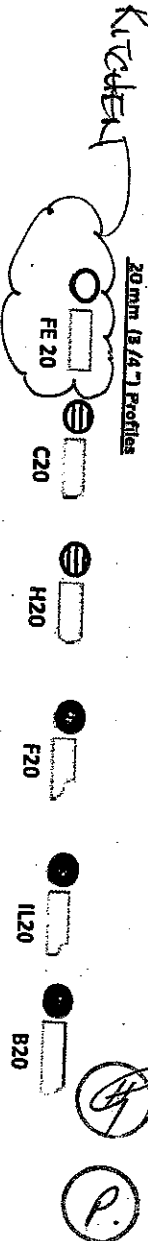

30mm (1 1/4") Profiles

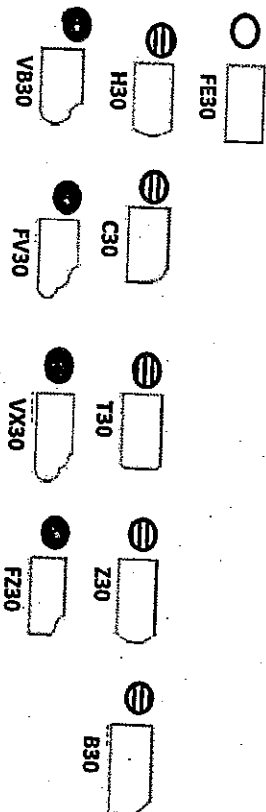

40mm (1 1/2") Profiles

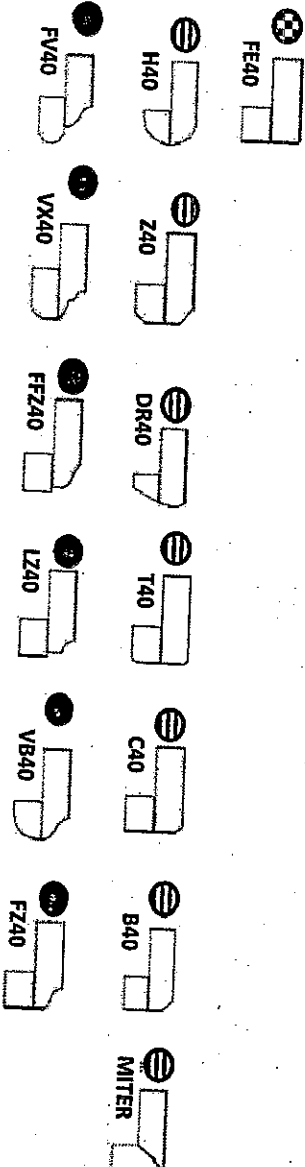

Note: All colours may not be available in 30mm at time ordered. Vendor reserves the right to use 40 mm edges (by lamination process).

*Mitre edge is available in Upgrade 1 for an overall thickness of 2". All other Mitre edge options will be an Upgrade 2 Edge.

STANDARD SINK & FAUCET

CORTINA

KITCHENS INC.

70 Regina Road Woodbridge ON L4L 8L6
905-264-6464

INFORMATION - PVC DOORS

Builder: Gold Park Homes Project: KG 2 Lot #: 33

All cabinets with PVC (Thermofoil) Doors come with melamine gables, panels and kick. The doors, crown moulding and light valance are PVC wrapped. Open shelves incorporated in design will only be available with melamine interiors. There will be variations in colour shades between the PVC parts (doors, crown and Light valance) and the melamine parts (open shelves, Gables, Panels and Kick) due to the difference in material.

Furring Panel with crown moulding to the ceiling is not available on all PVC door styles due to subtle variations in colour shades between the PVC parts (moulding) and the melamine parts (furring panel) due to the difference in material. Grain directions in wood grain pattern melamine, vary between the furring panel, crown moulding (horizontal) and the PVC doors (vertical).

Thank you for your understanding.

I am well informed of this information, and agree to the purchase of the above.

Purchaser:  

Date: March 7 2017

CORTINA

30 Regina Road Woodbridge ON L4L 8L6
905-264-6464

DARK STAIN INFORMATION

Builder GOLD PARK Project KG 2 Lot # 33

Cortina Kitchens offers a wide variety of finishes, applied to oak and maple products. The subject finishes include the spray stains **Cocoa**, **Espresso**, **Graphite** as well as wiping stain **Ebony**.

Due to the very dark stains applied on natural maple and oak doors and joints, several characteristics are important to be noted when purchasing these products.

1. Shadow lines may be visible at the interior profile edges of a door or drawer front. If movement occurs shadow lines may increase or decrease, depending on the style and/or size of a door or drawer front.
2. Variation and unevenness may be visible in the finish.
3. Hairline cracks at the joints are created over time due to the nature of natural wood, caused by usage, humidity, or dryness. They tend to be more visible to darker stains, than lighter wood stains.

Please be advised that Cortina Kitchens will not replace doors nor parts that exhibit the above characteristics associated with this finish. These characteristics are not avoidable and are a result of the natural characteristics of wood and wood veneer, and the characteristics of darker stains on wood.

Thank you for your understanding.

I am well informed of this information, and agree to the purchase of any of the subject finishes listed above.

Purchaser:

Date: MARCH 7 2017

LOOKIE ELECTRICAL
ABOVE FIREPLACE
BOX for future
TV / COMPONENTS.

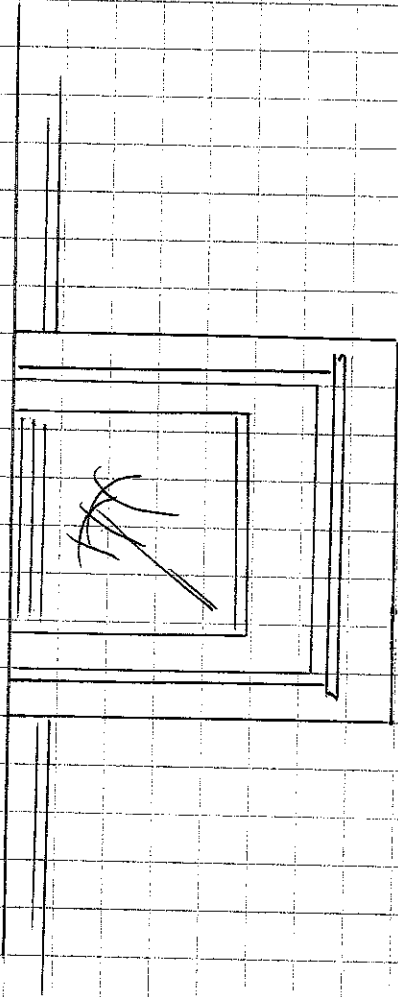

APPROX 50" AFF

APPROX 60" AFF

K62-33

MARCH 7 2017

GEART ROOM

ELECTRICAL ABOVE FIREPLACE.



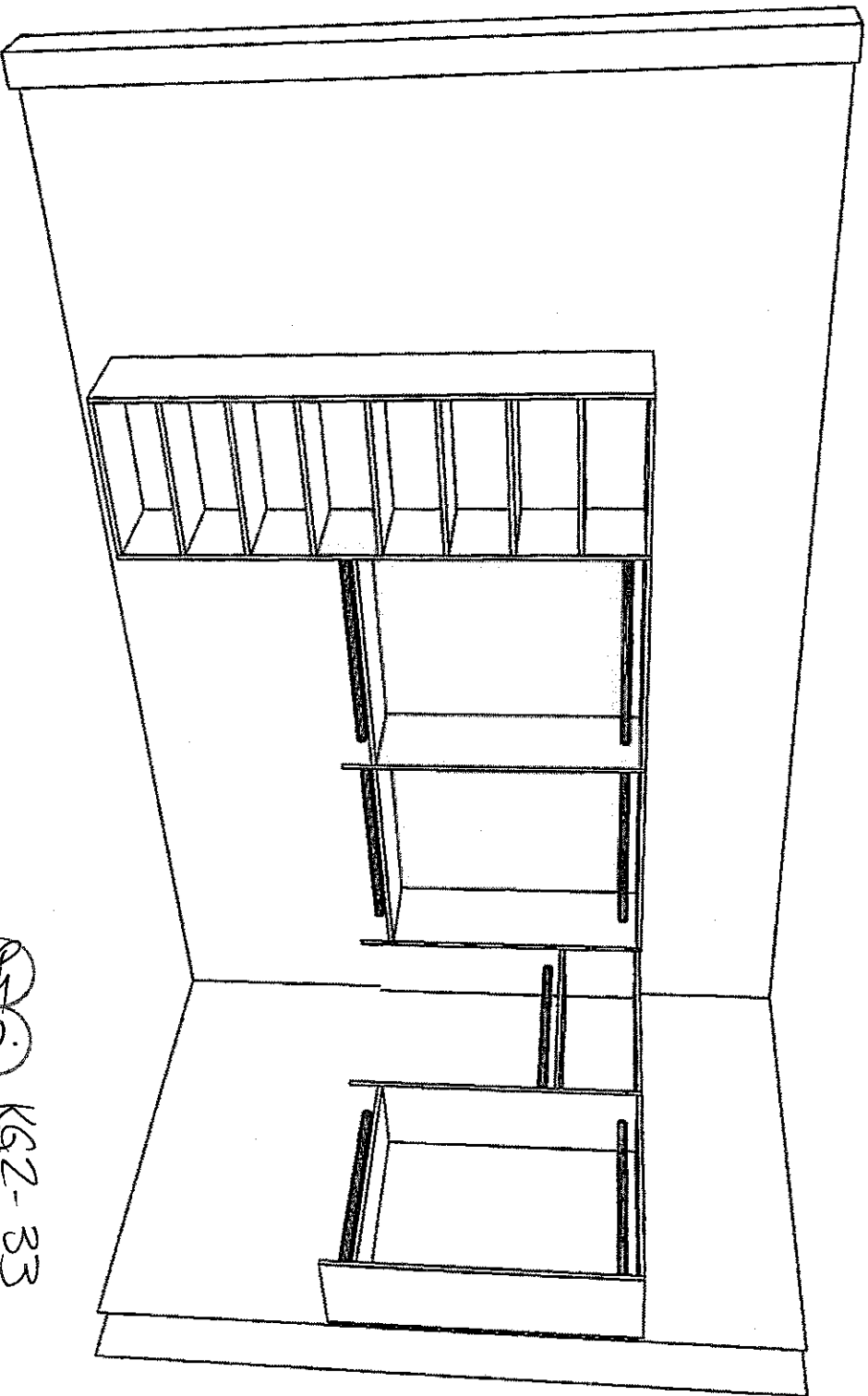

KGZ-33

March 6 2017

The Home Organizer

<YOUR ADDRESS>
<YOUR CITY AND STATE>
Phone: <YOUR PHONE NUMBER> Fax: <YOUR FAX NUMBER>

GPH MODEL 42-3 MAST

GPH MODEL 42-3 MAST Room 1

Perspective

Current Date: Mar 06, 2017

Scale: NTS

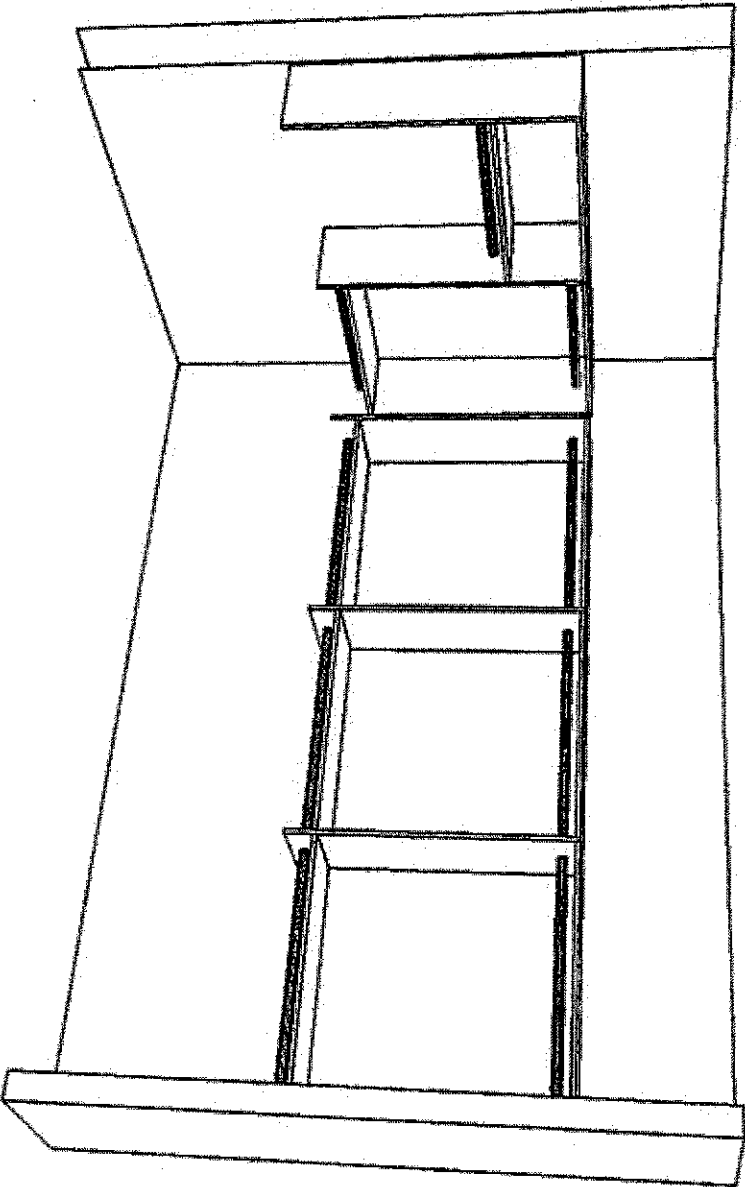

KG2-33

March 6
2017



The Home Organizer
<YOUR ADDRESS>
<YOUR CITY AND STATE>
Phone: <YOUR PHONE NUMBER> Fax: <YOUR FAX NUMBER>

GPH MODEL 42-3 5 BDR
GPH MODEL 42-3 5 BDR Room 1

Perspective
Current Date: Mar 06, 2017
Scale: NTS

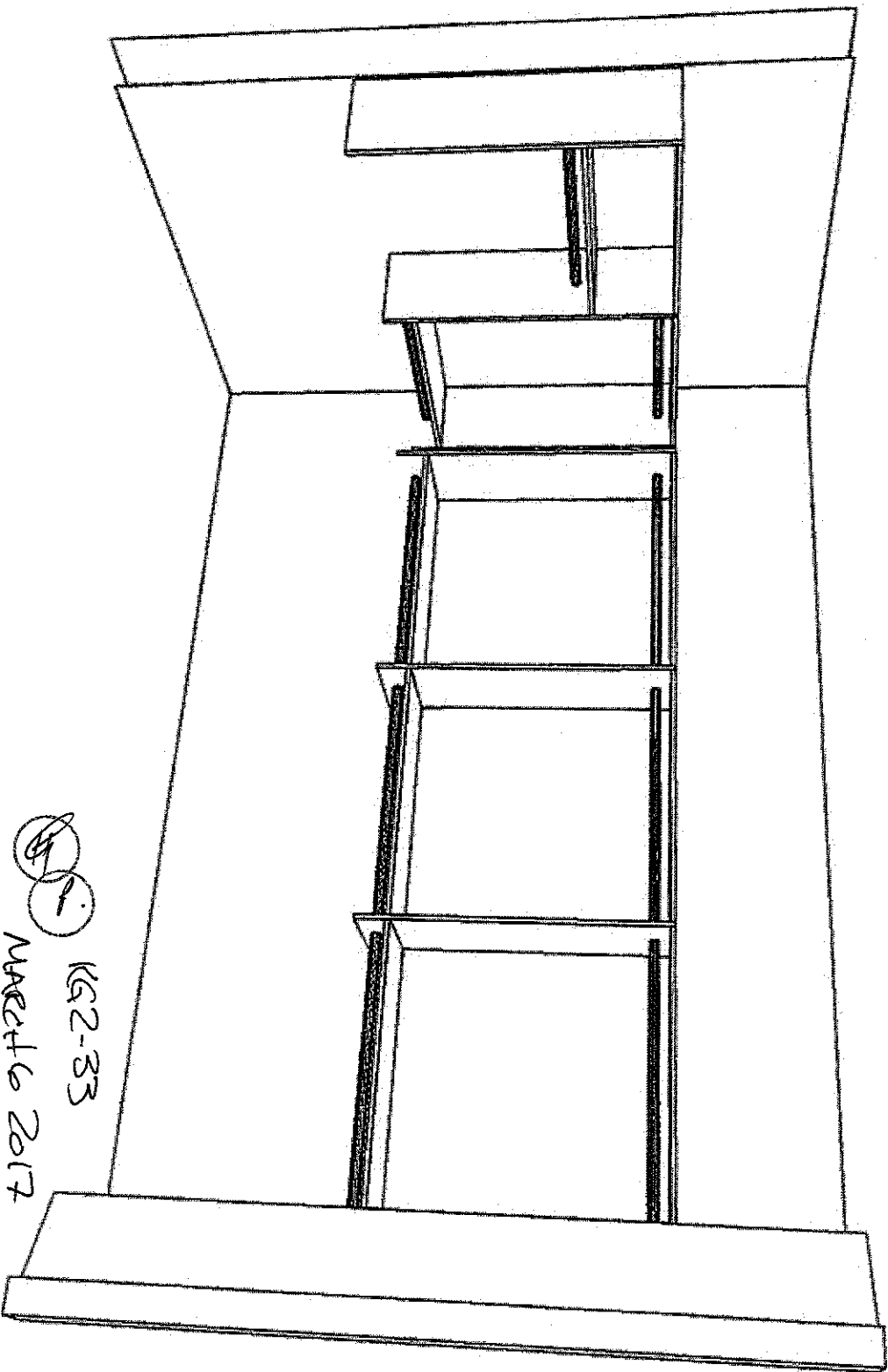

KG2-33
March 6 2017

The Home Organizer

<YOUR ADDRESS>
<YOUR CITY AND STATE>
Phone: <YOUR PHONE NUMBER> Fax: <YOUR FAX NUMBER>

GPH MODEL 42-3 MAST

GPH MODEL 42-3 MAST Room 1

Perspective

Current Date: Mar 06, 2017

Scale: NTS

KG2-33

KitchenAid®**French Door w/Ice Dispenser Refrigerator****PRODUCT MODEL NUMBERS****KRFC704F KRFC604F**

Electrical: A 115-volt, 60 Hz, AC-only 15- or 20-amp fused, grounded electrical supply is required. It is recommended that a separate circuit serving only your refrigerator and approved accessories be provided. Use an outlet that cannot be turned off by a switch. Do not use an extension cord.

Water: A cold water supply with water pressure between 35 and 120 psi (241 and 827 kPa) is required to operate the water dispenser and ice maker. If you have questions about your water pressure, call a licensed, qualified plumber.

NOTE: If the water pressure is less than what is required, the flow of water from the water dispenser could decrease or ice cubes could be hollow or irregular shaped.

Reverse Osmosis Water Supply:
IMPORTANT: The pressure of the water supply coming out of a reverse osmosis system going to the water inlet valve of the refrigerator needs to be between 35 and 120 psi (241 and 827 kPa).

If a reverse osmosis water filtration system is connected to your cold water supply, the water pressure to the reverse osmosis system needs to be a minimum of 40 to 60 psi (276 to 414 kPa).

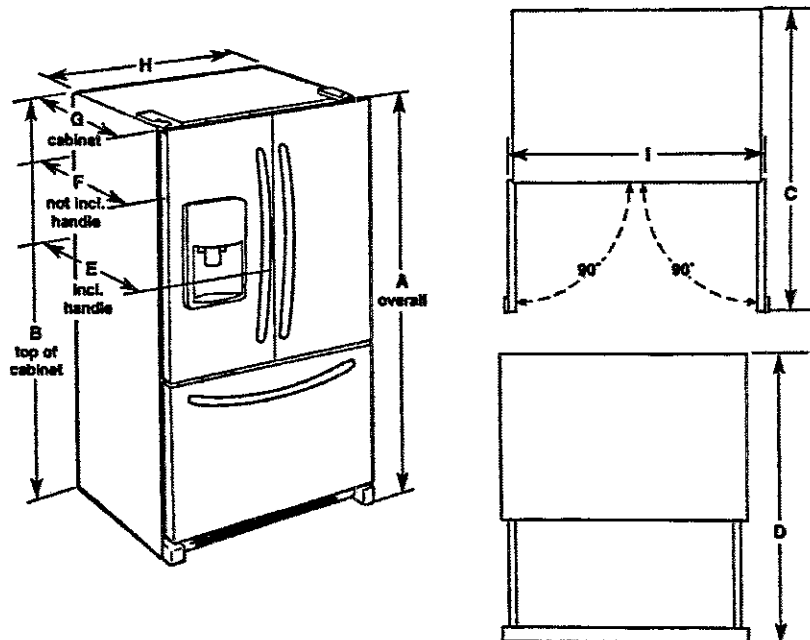
PRODUCT DIMENSIONS

Model Size	Height - Overall "A"	Height - Top of Cabinet "B"	Depth - Door Open 90° "C"	Depth - Drawer Open "D"	Depth - With Handles "E"	Depth - Without Handles "F"	Depth - Cabinet Only "G"	Width - Cabinet "J"	Width - Door Open 90° "T"
23.8 cu. ft.	71 1/4" (182.6 cm)	70 1/4" (180.0 cm)	43 1/4" (111.1 cm)	45 1/4" (116.5 cm)	31 1/2" (80.0 cm)	28 1/4" (73.3 cm)	24 1/4" (61.9 cm)	35 1/4" (90.5 cm)	43 1/4" (110.8 cm)

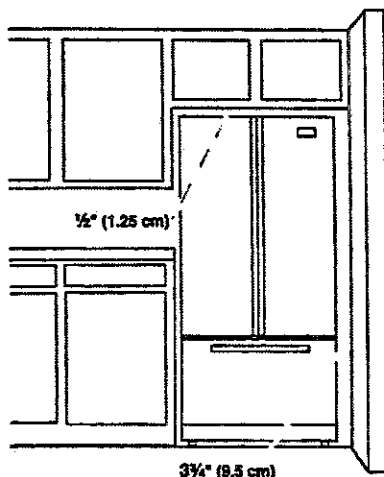
LOCATION REQUIREMENTS

IMPORTANT: This refrigerator is designed for indoor, household use only.

To ensure proper ventilation for your refrigerator, allow for a 1/2" (1.25 cm) of space on each side and at the top. Allow for a 1" (2.54 cm) space behind the refrigerator. If your refrigerator has an ice maker, allow extra space at the back for the water line connections. When installing your refrigerator next to a fixed wall, leave a 3 3/4" (9.5 cm) minimum space between the refrigerator and wall to allow the door to swing open.

NOTE: This refrigerator is intended for use in a location where the temperature ranges from a minimum of 55°F (13°C) to a maximum of 110°F (43°C). The preferred room temperature range for optimum performance, which reduces electricity usage and provides superior cooling, is between 60°F (15°C) and 90°F (32°C). It is recommended that you do not install the refrigerator near a heat source, such as an oven or radiator.

KRFC 704 FBS

30" (76.2 CM) AND 36" (91.4 CM) GAS BUILT-IN COOKTOP

KG2-33

(H-P)

PRODUCT MODEL NUMBERS

KCGS350E	KCGS950E	MGC9530D	WCG75US0D
KCGS356E	KCGS956E	MGC9536D	WCG97US0D
KCGS550E	MGC7430D	WCG51US0D	WCG97US6D
KCGS556E	MGC7536D	WCG51US6D	

GAS SUPPLY REQUIREMENTS

Type of Gas

Natural Gas:

- This cooktop is factory set for use with Natural gas. If converting to LP gas, see the "LP Gas Conversion" instructions provided in the package containing literature. The model/serial rating plate located on the underside of the cooktop base has information on the types of gas that can be used. If the types of gas listed do not include the type of gas available, check with the local gas supplier.

LP Gas Conversion:

Conversion must be done by a qualified service technician.

No attempt shall be made to convert the cooktop from the gas specified on the model/serial rating plate for use with a different gas without consulting the serving gas supplier. See the Gas Conversion instructions provided in the package containing literature.

Gas Supply Line

- Provide a gas supply line of 1/2" (1.9 cm) rigid pipe to the cooktop location. A smaller size pipe on longer runs may result in insufficient gas supply. Pipe-joint compounds that resist the action of LP gas must be used. Do not use TEFLON™ tape. With LP gas, piping or tubing size should be 1/2" minimum. Usually, LP gas suppliers determine the size and materials used in the system.

Flexible metal appliance connector:

- If local codes permit, use a 1/2" or 3/4" I.D. flexible stainless steel tubing gas connector, designed by CSA to connect the cooktop to the rigid gas supply line.

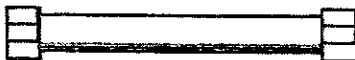

- A 1/2" male pipe thread is needed for connection to the female pipe threads of the inlet to the cooktop pressure regulator.
- Do not kink or damage the flexible metal tubing when moving the cooktop.

• Must include a shutoff valve:

The supply line must be equipped with a manual shutoff valve. This valve should be located in the same room but external to the cooktop opening, such as an adjacent cabinet. It must be accessible without removing the cooktop, and it should be in a location that allows ease of opening and closing. Do not block access to shutoff valve. The valve is for turning on or shutting off gas to the cooktop.

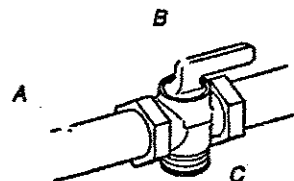

A. Gas supply line
B. Shutoff valve "open" position
C. To cooktop

™TEFLON is a registered trademark of E.I. Du Pont De Nemours and Company.

ELECTRICAL REQUIREMENTS

- A 120 volt, 60 Hz, AC only, 15-amp, fused electrical circuit is required. A time-delay fuse or circuit breaker is also recommended. It is recommended that a separate circuit serving only this cooktop be provided.
- Electronic ignition systems operate within wide voltage limits, but proper grounding and polarity are necessary. Check that the outlet provides 120-volt power and is correctly grounded.

KCGS950ESS

PRODUCT DIMENSIONS

KG2-33 

KCGS550ESS and KCGS950ESS Models

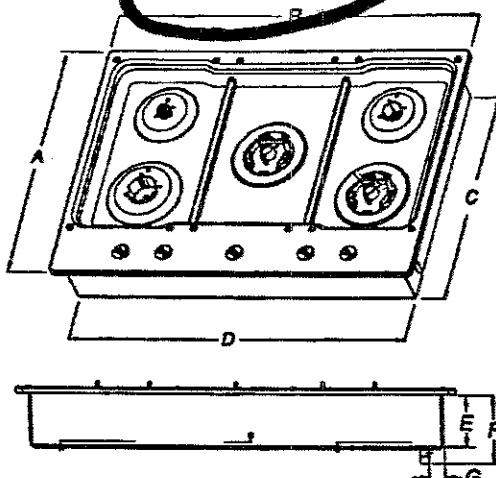

A. 21" (53.3 cm) E. 3 3/8" (9.2 cm)
 B. 30" (76.2 cm) F. 4 1/8" (11.6 cm)
 C. 19 3/8" (49.2 cm) G. 1 3/8" (3.4 cm)
 D. 28 3/8" (72.1 cm)

KCGS556ESS and KCGS956ESS Models

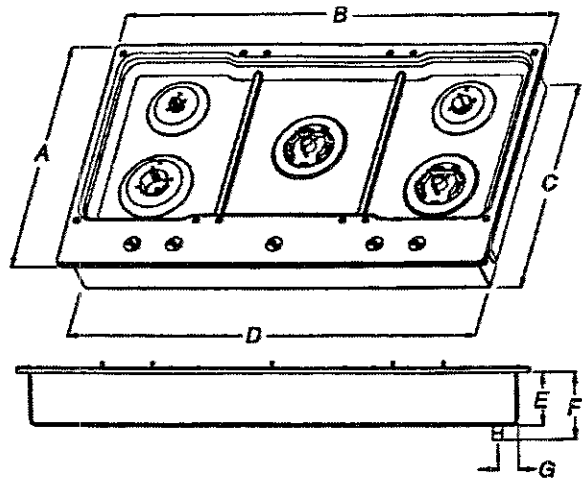

A. 21" (53.3 cm) E. 3 3/8" (9.2 cm)
 B. 36 1/2" (92.0 cm) F. 4 1/8" (11.6 cm)
 C. 19 3/8" (49.2 cm) G. 1 1/8" (3.6 cm)
 D. 34 3/8" (88.1 cm)

All Other 30" (76.2 cm) Models

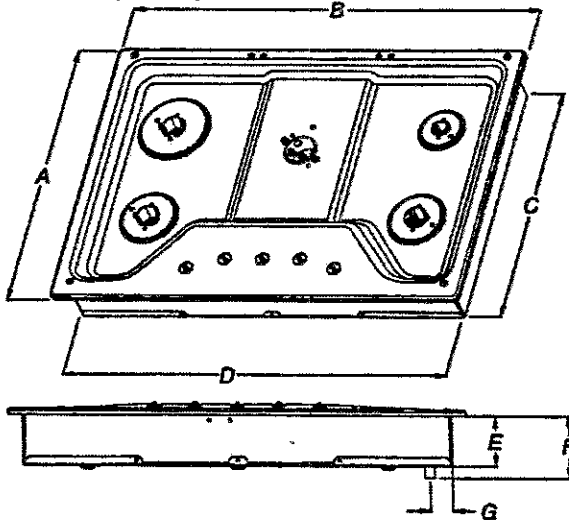

A. 21" (53.3 cm) E. 3 3/8" (8.6 cm)
 B. 30" (76.2 cm) F. 4 1/8" (10.5 cm)
 C. 18 3/8" (48.0 cm) G. 1 1/8" (3.8 cm)
 D. 28 3/8" (72.1 cm)

All Other 36" (91.4 cm) Models

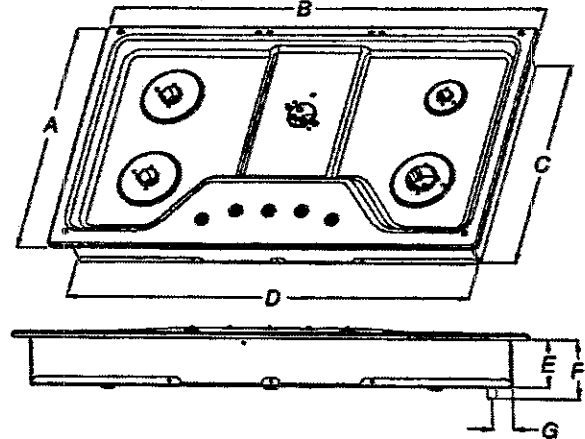

A. 21" (53.3 cm) E. 3 3/8" (8.6 cm)
 B. 36" (91.4 cm) F. 4 1/8" (10.5 cm)
 C. 18 3/8" (48.0 cm) G. 1 1/8" (3.8 cm)
 D. 33 3/8" (85.7 cm)

KCGS 950 ESS

CABINET DIMENSIONS

KG2-33

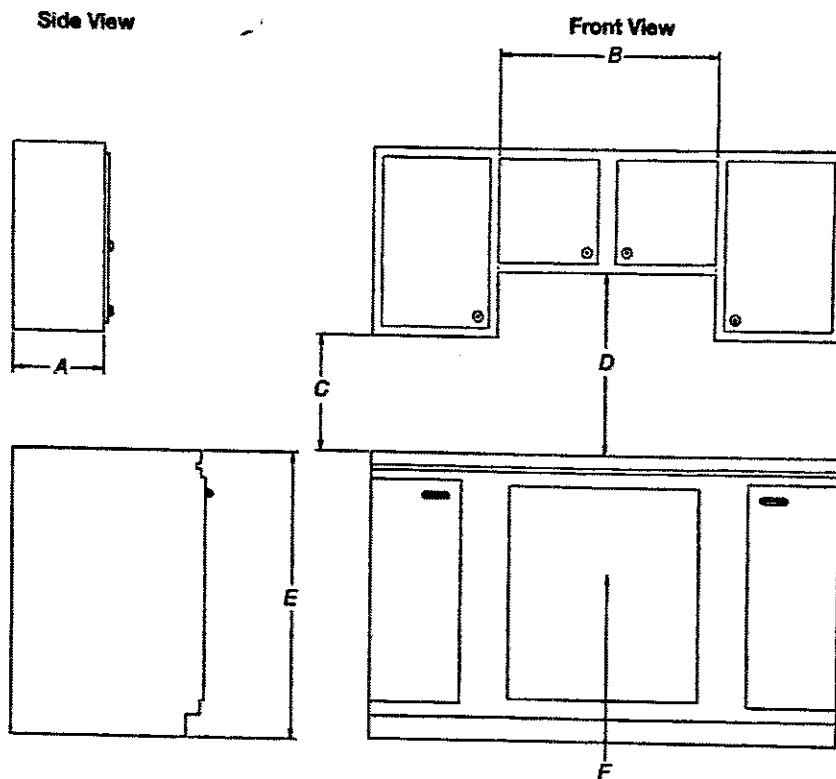

(H-P)

- A. 13" (33.0 cm) recommended upper cabinet depth.
- B. 30" (76.2 cm) for 30" models; 36" (91.4 cm) for 36" models.
- C. 18" (45.7 cm) minimum clearance from upper cabinet to countertop within minimum horizontal clearances to cooktop.
- D. 30" (76.2 cm) minimum clearance between top of cooktop platform and bottom of uncovered wood or metal cabinet. 24" (61 cm) minimum clearance if bottom of wood or metal cabinet is covered by not less than 1/4" (0.6 cm) flame retardant millboard covered with not less than No. 28 MSG sheet steel, 0.015" (0.04 cm) stainless steel, or 0.024" (0.06 cm) aluminum or 0.020" (0.05 cm) copper.
- E. 36" (91.4 cm) top of countertop to floor.
- F. Gas line opening - Wall: anywhere 5" (12.7 cm) below underside of countertop. Cabinet floor: anywhere within 6" (15.2 cm) of rear wall is recommended.

CABINET DIMENSIONS (cont.)

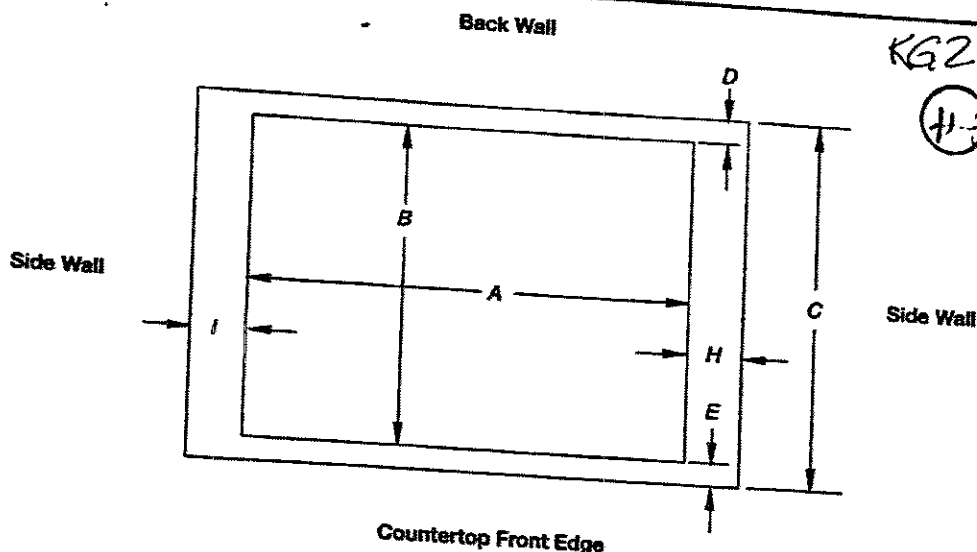

Cutout (Product Opening) Dimensions						
30" (76.2 cm) Models						
Models	A			B		
	Min	Recommended	Max	Min	Recommended	Max
KGSS550 and KCGS950 All Other 30" (76.2 cm) Models	28 1/2" (72.4 cm) 28 1/2" (72.4 cm)	28 7/8" (73.4 cm) 28 7/8" (73.4 cm)	29 3/8" (74.3 cm) 29 3/8" (74.3 cm)	19 1/2" (49.5 cm) 19" (48.3 cm)	19 7/8" (50.2 cm) 19 1/2" (49.5 cm)	20" (50.8 cm) 20" (50.8 cm)
36" (91.4 cm) Models						
KGSS556 and KCGS956 All Other 36" (91.4 cm) Models	34 7/8" (88.4 cm) 33 7/8" (86.0 cm)	35 1/4" (89.4 cm) 34 3/4" (87.0 cm)	35 3/8" (90.3 cm) 35 1/2" (89.5 cm)	19 1/2" (49.5 cm) 19" (48.3 cm)	19 7/8" (50.2 cm) 19 1/2" (49.5 cm)	20" (50.8 cm) 20" (50.8 cm)

Side Walls (Combustible Surfaces)	
Models	H and I
KCGS5 and KCGS9	H and I added together must be at least 48" (122.0 cm), with each side individually being at least 8" (20.3 cm).
KCGS350, KCGS356, MGC9536, WCG97US0, WCG97US6	H and I added together must be at least 48" (122.0 cm), with each side individually being at least 12" (30.5 cm).
All Other Models	Both have to be 8" (20.3 cm) or more.

Back Wall and Countertop Front Dimensions			
Models	C	D	E
KCGS550 and KCGS950	25" (63.5 cm)	2 1/8" (7.3 cm)	2 3/4" (6.9 cm)
All Other Models			3 1/8" (7.9 cm)

NOTES: After making the countertop cutout, some installations may require notching down the base cabinet side walls to clear the cooktop base. To avoid this modification, use a base cabinet with sidewalls wider than the cutout.

If cabinet has a drawer, a 4" (10.2 cm) depth clearance from the countertop to the top of the drawer (or other obstruction) in base cabinet is required. The drawer depth may need to be shortened to avoid interfering with the regulator.

IMPORTANT: If a built-in wall oven is to be installed below this cooktop, the grounded outlet and gas supply piping must be located in an adjacent cabinet.

This cooktop and its gas and electrical supply sources must be installed before the undercounter built-in wall oven is installed.

KitchenAid®

FOR THE WAY IT'S MADE.®

Undercounter Dishwasher

KG2-33



PRODUCT MODEL NUMBERS

KDFE104D, KDFE304D, KDTE204D, KDTE404D, KDTE704D, KDTM354D, KDFE204E, KDFE454C, KDTE104E, KDTE204E, KDTE254E, KDTM354E, KDTM384E, **KDTM404E**, KDTM504E, KDTM704E, KDTM804E

Electrical Requirements: 120-volt, 60 Hz, AC-only, 15- or 20-amp. fused electrical supply. Copper wire only. A time delay fuse or circuit breaker and separate circuit is recommended.

If direct wiring dishwasher: Use flexible, armored or nonmetallic, sheathed copper wire with grounding wire that meets the wiring requirements for your home and local codes and ordinances.

Use a UL Listed or CSA Approved conduit connector.

If connecting dishwasher with a power supply cord:

Use power supply cord kit (Part Number 4317824) marked for use with dishwashers. Follow the kit instructions for installing the power supply cord.

Power supply cord must plug into a grounded 3 prong outlet located in the cabinet next to the dishwasher opening. Outlet must meet all local codes and ordinances.



Water Supply Requirements: A hot water line with 20 to 120 psi (138 to 862 kPa) water pressure. Water temperature must be 120°F (49°C) water at dishwasher. Use 3/4" O.D. copper tubing with compression fitting or flexible braided water supply line.

Note: 1/2" minimum plastic tubing is not recommended.

Use a 90° elbow with 3/4" hose connection with rubber washer (Part Number W10273460). Do not solder within 6" (15.2 cm) from water inlet valve.

Drain Requirements: A new drain hose is supplied with your dishwasher. If this is not long enough, use a new drain hose with a maximum length of 12' (3.7 m) (Part Number 3385556) that meets all current AHAM/IAPMO test standards, is resistant to heat and detergent, and fits the 1" (2.5 cm) drain connector of the dishwasher.

Make sure to connect the drain hose to waste tee or disposer inlet above drain trap in house plumbing and 20" (50.8 cm) minimum above the floor. It is recommended

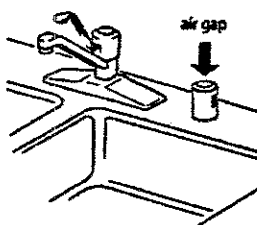

that the drain hose either be looped up and securely fastened to the underside of the counter or be connected to an air gap.

Make sure to use an air gap if the drain hose is connected to house plumbing lower than 20" (50.8 cm) above subfloor or floor.

Use 1/2" (1.3 cm) minimum I.D. drain line fittings.

If required, the air gap should be installed in accordance with the air gap installation instructions. When connecting the air gap, a rubber hose (not provided) will be needed to connect to the waste tee or disposer inlet.

PRODUCT DIMENSIONS

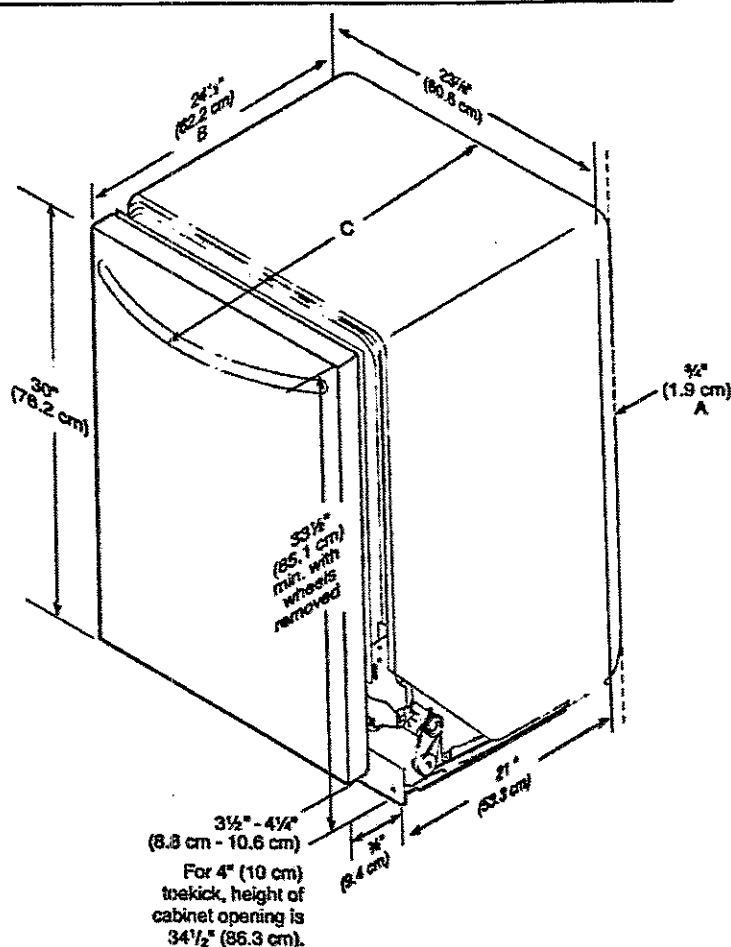

A. Insulation may be compressed (not used on all models).

B. For panel-ready models, dishwasher depth is 24" (60 cm) not including the 3/4" (1.9 cm) custom door panel.

C. Door handles may protrude forward of the face of the dishwasher; varies by model.

KDTM404EBS

CABINET CUTOUT DIMENSIONS

NOTE: Shaded areas of cabinet walls show where utility connections may be installed.

*Measure from the lowest point on the underside of the countertop. May be reduced to 33½" (85.1 cm) by removing the rear leveling legs from dishwasher.

**Minimum, measured from narrowest point of opening.

K62-33

H.P.

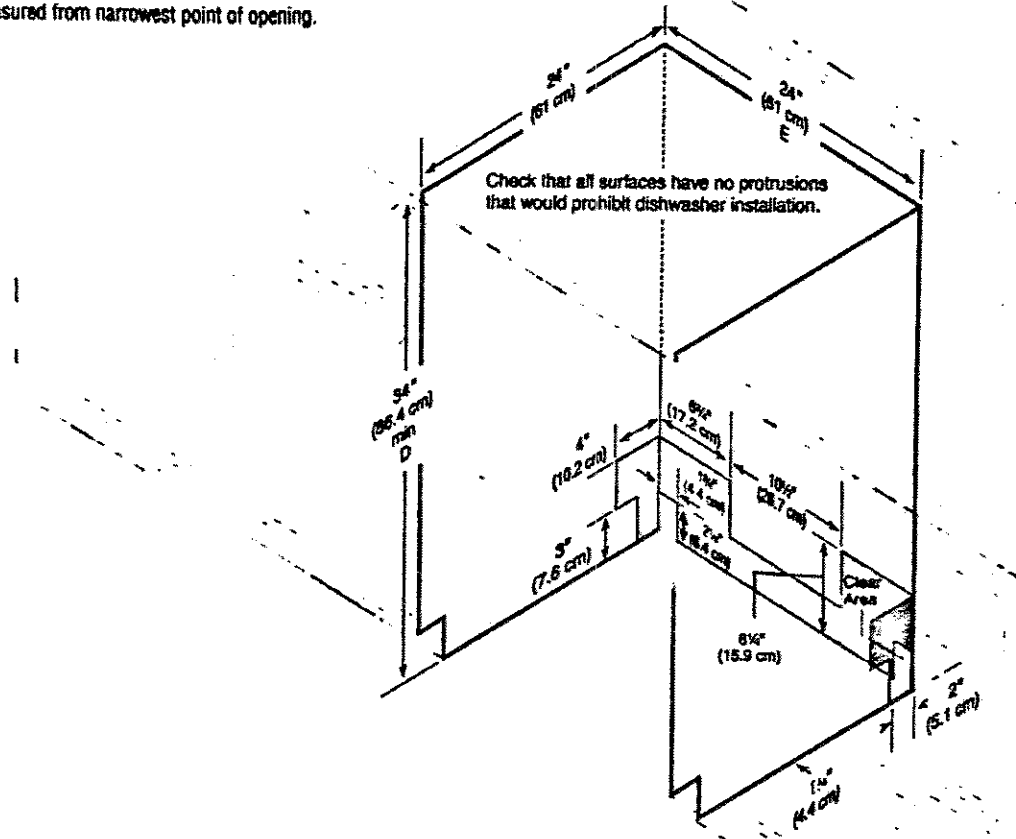

KG2-33



KitchenAid® 27" (68.6 cm) and 30" (76.2 cm) Electric Built-In Microwave/Oven Combination

PRODUCT MODEL NUMBERS

KEMS309E

KOCE500E

KOCE507E

ELECTRICAL CONNECTION

If codes permit and a separate ground wire is used, it is recommended that a qualified electrical installer determine that the ground path and the wire gauge are in accordance with local codes. Check with a qualified electrical installer if you are not sure the oven is properly grounded.

This oven must be connected to a grounded metal, permanent wiring system.

Be sure that the electrical connection and wire size are adequate and in conformance with the National Electrical Code, ANSI/NFPA 70-latest edition or CSA Standards C22.1-94, Canadian Electrical Code, Part 1 and C22.2 No. 0-M91-latest edition, and all local codes and ordinances.

To properly install your oven, you must determine the type of electrical connection you will be using and follow the instructions provided for it here.

- Oven must be connected to the proper electrical voltage and frequency as specified on the model/serial/rating plate. See the following illustration.

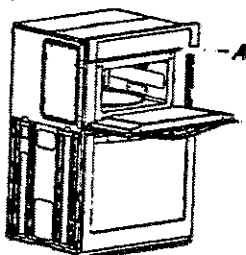

A. Model/serial/rating plate

- Models rated from 7.3 to 9.6 kW at 240 volts (5.4 to 7.4 kW at 208 volts) require a separate 40-amp circuit. Models rated at 4.8 kW and below at 240 volts (3.6 kW and below at 208 volts) require a separate 30-amp circuit.
- A circuit breaker is recommended.
- Connect directly to the fused disconnect (or circuit breaker box) through flexible, armored or nonmetallic sheathed, copper cable (with grounding wire). See "Make Electrical Connection" section.
- Flexible conduit from the oven should be connected directly to the junction box.
- Do not cut the conduit. The length of conduit provided is for serviceability of the oven.
- A UL listed or CSA approved conduit connector must be provided.
- If the house has aluminum wiring, follow the procedure below:
 1. Connect a section of solid copper wire to the pigtail leads.
 2. Connect the aluminum wiring to the added section of copper wire using special connectors and/or tools designed and UL listed for joining copper to aluminum.

Follow the electrical connector manufacturer's recommended procedure. Aluminum/copper connection must conform with local codes and industry accepted wiring practices.

For power requirements, refer to the following table.

Model	Voltage	Amperage (L1)*	Amperage (L2)*	Rating (W)
KOCE507E/KOCE500E	120/240	32	30	8000
KOCE507E/KOCE500E	120/208	30	28	6600

*Amperage values noted above are for information purposes only; the units are rated in watts.

PRODUCT DIMENSIONS

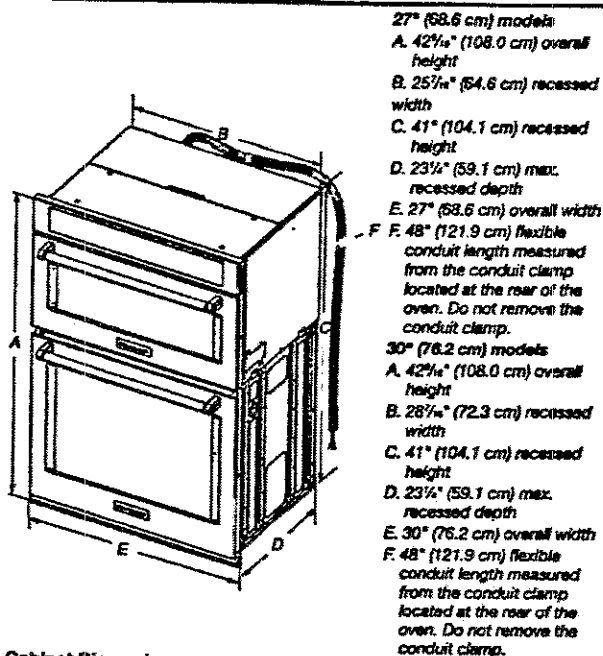

Cabinet Dimensions

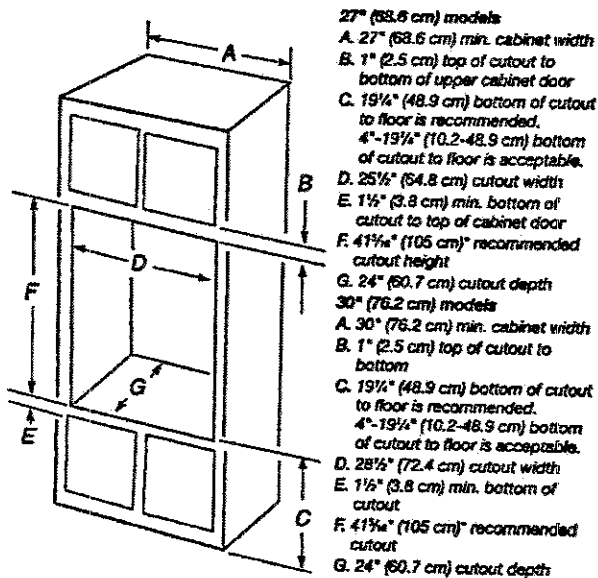

* NOTE: The cabinet height can be between 41" (104.1 cm) and 41 1/2" (105.6 cm) for microwave/oven combination.

KOCE500EBs

KitchenAid®

FOR THE WAY IT'S MADE.™

PRODUCT MODEL NUMBERS

KVWB600D

KVWB606D

Electrical: A 120 volt, 60 Hz., AC only, 15-amp, fused electrical circuit is required.

VENTING METHODS

This canopy range hood is factory set for venting through the roof or through the wall.

A 6" (15.2 cm) round vent system is needed for installation (not included). The hood exhaust opening is 6" (15.2 cm) round.

NOTE: Flexible vent is not recommended. Flexible vent creates back pressure and air turbulence that greatly reduce performance.

Vent system can terminate either through the roof or wall. To vent through a wall, a 90° elbow is needed.

Rear Discharge

A 90° elbow may be installed immediately above the hood.

For Non-Vented (Recirculating) Installations

If it is not possible to vent cooking fumes and vapors to the outside, the hood can be used in the non-vented (recirculating) version, using a Recirculation Kit (which includes charcoal filters and a deflector). To order, see the "Assistance or Service" section.

Roof Venting

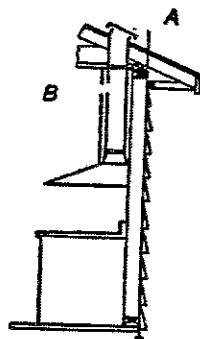

A. Roof cap
B. 6" (15.2 cm)
round vent

Wall Venting

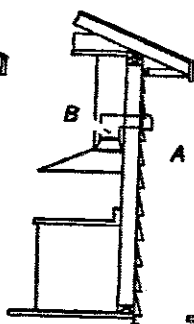

A. Wall cap
B. 6" (15.2 cm)
round vent

Non-Vented (Recirculating)

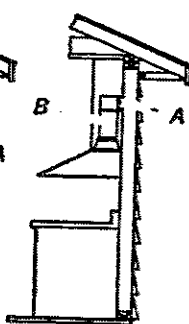

A. Diverter
B. 6" (15.2 cm)
round vent

Calculating Vent System Length

To calculate the length of the system you need, add the equivalent feet (meters) for each vent piece used in the system.

Vent System

Vent Piece	6" (15.2 cm) Round
45° elbow	2.5 ft (0.8 m)
90° elbow	5.0 ft (1.5 m)



Maximum equivalent vent length is 35 ft (10.7 m).

KG2-33

H. P.

Example Vent System

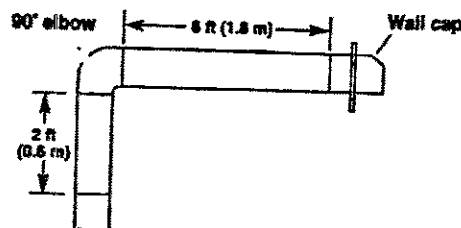

The following example falls within the maximum recommended vent length of 35 ft (10.7 m).

1 - 90° elbow	= 5.0 ft (1.5 m)
1 - wall cap	= 0.0 ft (0.0 m)
8 ft (2.4 m) straight	= 8.0 ft (2.4 m)
Length of system	= 13.0 ft (3.9 m)

PRODUCT DIMENSIONS

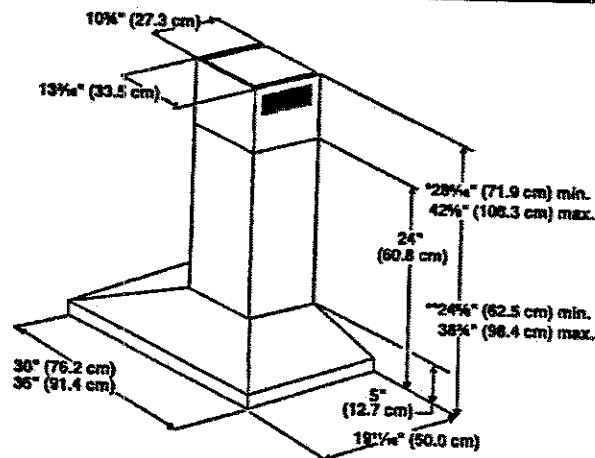

*For non-vented (recirculating) installations

**For vented installations

KVWB600DBS

CABINET DIMENSIONS

KG2-33 (H.P.)

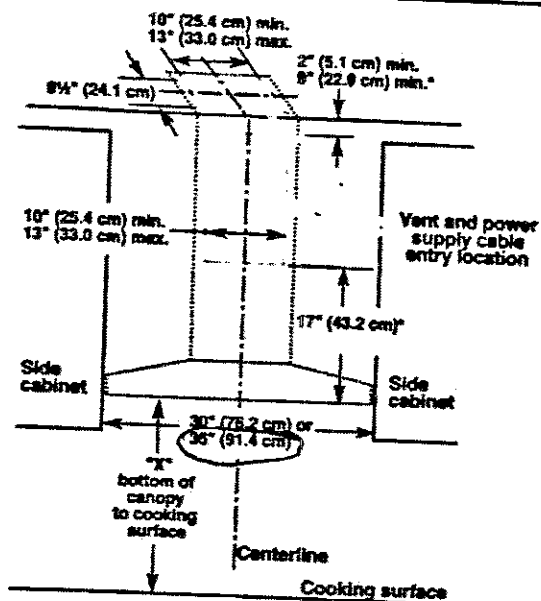

*For non-vented (recirculating) installations

IMPORTANT:

Minimum distance "X": 24" (61.0 cm) from electric cooking surface.

Minimum distance "X": 27" (68.6 cm) from gas cooking surfaces.

Suggested maximum distance "X": 36" (91.4 cm)

The chimneys can be adjusted for different ceiling heights. See the following chart.

Vented Installations		
	Min. ceiling height	Max. ceiling height
Electric cooking surface	7' 1" (2.16 m)	9' 2" (2.79 m)
Gas cooking surface	7' 4" (2.23 m)	9' 2" (2.79 m)
Non-vented (recirculating) Installations		
	Min. ceiling height	Max. ceiling height
Electric cooking surface	7' 1" (2.16 m)	9' 6" (2.9 m)
Gas cooking surface	7' 4" (2.23 m)	9' 6" (2.9 m)

***NOTE:** The range hood chimneys are adjustable and designed to meet varying ceiling or soffit heights depending on the distance "X" between the bottom of the range hood and the cooking surface. For higher ceilings, a Chimney Extension Kit is available from your dealer or an authorized parts distributor. The chimney extension replaces the chimney shipped with the range hood. To order, see the "Assistance or Service" section.

PLUMBING UPGRADES



Soap Dispenser #RP1002 (chrome)

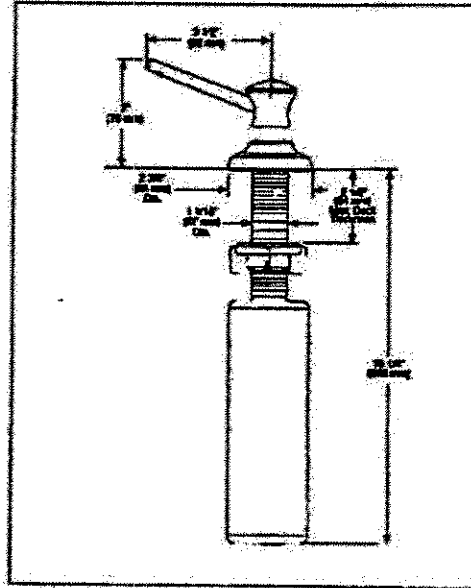
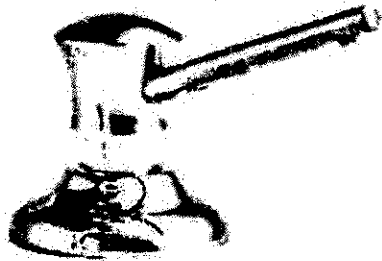

LOT # 2-33	
ROOM: KITCHEN	SIGNATURE: <i>P. Gandhi</i>
DATE: APRIL 11 2017	SIGNATURE: <i>P. Gandhi</i>

Centre Disclaimers

Through years of doing business, we at Gold Park Homes have encountered issues beyond our control. The following disclaimers apply to all instances of Purchaser's Extras forms and all Interior Colour Scheme forms.

FIREPLACES

Fireplace Marble: Due to the many variables that can affect the pattern and/or design, frequently the marble installed on the fireplace will not be identical to the samples. We will make every attempt to come as close to the samples as possible, but cannot be responsible for results which differ from the samples.

CERAMIC FLOOR TILE

Many variables including variegation can affect tile colour, pattern and/or design which mean installed tiles may not be identical to the samples. We will make every attempt to come as close as possible, but cannot be responsible for results which differ from the samples.

HARDWOOD FLOORING

The purchaser is advised that cupping and shrinkage are characteristics of hardwood flooring normally appearing after installation, especially when humidity levels are not regulated, and no warranty is provided by the flooring supplier with respect to such cupping and shrinkage. Furthermore, hardwood floors may also heave and warp when located at or close to entrance points of the home, where rain could make its way to the flooring. The vendor agrees to install any hardwood flooring ordered by the purchaser in a good and workmanlike manner, but shall not be responsible for, and is hereby released by the purchaser from responsibility and liability for cupping, shrinkage, heaving and warping of hardwood flooring in the above mentioned circumstances.

**STAIRCASE VS FLOORING
WOOD SPECIES DIFFERENCE**

The purchaser is aware and therefore accepts and acknowledges that the wood species of the staircase and flooring chosen do not match. This difference might result in an undesirable colour variance

The purchaser is aware and therefore accepts and acknowledges that though the flooring is of the same species as the staircase the difference in product finishing may result in a stain colour variance.

The purchaser agrees that the vendor is to be exempt from any and all claims by the purchaser regarding this colour variance.

RAILINGS

All railings, pickets, posts, nosing's and stairs come from solid wood and veneered wood materials sourced from multiple locations and sources. As such there will be variations in grains and shades between the various natural components beyond our control. Due to this variance in material, all components will stain with colour or natural finish differently.

Iron pickets are wrought in nature and depending on the manufacturing process will have differences from picket to picket which is normal. Also the finish of the iron pickets is of a powder coated nature. This process can produce minor colour variations or tones. Furthermore, the assembly of the metal pickets can develop a natural rattle over time from vibration in the railing. Minor rattling is normal and is a part of the wrought iron picket assembly.

HOUSE EXTERIORS

Variations in subcontractors across different sites and varying site conditions may result in house exteriors that differ from the artist renderings. We cannot be responsible for results which differ from the artists renderings of elevations.

PLASTER MOULDINGS AND MEDALLIONS

Plaster mouldings will not be installed in open to above areas or areas with 2 storey elements.

STAIN COLOURS

Due to the many variables that can affect the outcome of a stain colour on wood, staircases, railings, and fireplaces, the colour may not be identical to samples. Factors such as density, age, humidity, air temperature, and the uniqueness of each piece of wood can result in wide variations in darkness or lightness. We will make every attempt to come as close to the sample as possible, but cannot be responsible for results which differ from the samples.

Stain on pre-finished hardwood floors will not be an exact match to the stain colours available on stairs, pickets and rails. The purchaser is responsible for choosing the stain on these areas to their satisfaction.

IN-WALL CONDUIT FOR AUDIO/VIDEO CABLES

It is important to note that due to the variation in framing requirements in different parts of your home, conduit lengths and routing can vary. In virtually all instances of ground floor installation (i.e. above a fireplace), conduit will first travel down into the basement below the floor joists, over to the termination point and back up into the main floor. As a result, it is best to measure the length of the conduit after occupancy with a "pull wire" before

purchasing your cables. For above-fireplace installations, the conduit wall plate will be installed approximately 10" above the Fireplace Mantle, unless otherwise specified in the Construction Summary.

APPLIANCE SPECIFICATIONS

All appliance openings are set to builder's standard openings. Please advise Décor Centre at time of your structural appointment if custom sizing of cabinets is required for any built-in appliances. The purchaser is responsible for costs and fees associated with changes to pre-manufactured kitchens made subsequent to colour appointments.

Purchaser accepts & acknowledges that in order to accommodate upgraded appliances, all appliance specifications should be provided at the time of their structural appointment, should this not occur they must be provided to the Décor Center within one (1) week of completion of structural chart. Failure to do so may result in the need to revert to the standard appliance openings or in a delay in construction of your dwelling, as well as a cost of \$500 to re-open your structural file should changes be required. As a result we may be forced to extend the closing of your transaction. Due to failure to complete the above-mentioned selections and at no fault of our own, we reserve our right to hold you responsible for this delayed closing, including charging extra administration cost and interest on the balance due on closing.

Purchasers Accept Standard Appliance Openings (unless otherwise specified):

Fridge - 37-1/2"W x 73-1/2" High Approx.

Range - 30-1/2"D x 31-1/2"W Approx.

Dishwasher - 24" W Approx.

DELETION OF HOODFAN & CABINETS ABOVE STOVE:

The purchasers are aware that in requesting NOT TO INSTALL builder's standard hood fan and standard cabinets above stove they will receive NO STANDARD HOOD FAN and NO CREDIT. Purchasers are installing their own hood fan after closing and accept that it may waive any warranty associated with such a change.

Purchasers accept and acknowledge that the exhaust fan duct hole may be off-centered with the stove in the kitchen due to purchasers installing their own hood fan after closing. The vendor is exempt from adjusting such openings for the purchasers range hood.

ELECTRICAL FOR APPLIANCES

Pricing is subject to change based on the appliance specifications provided. Purchasers should provide proper appliance specifications and cut-out sheets in order for Gold Park to price extras accordingly.

KITCHEN CABINETS

The kitchen you order/purchase will undoubtedly contain slight colour variations. The degree of these variations is virtually impossible to determine before the kitchen is installed in its intended location. The amount of and type of lighting will also affect various highlights in the finish. Note: No two pieces of wood are identical. Variations in colour tone and grain patterns make a perfect colour match virtually impossible. It is generally agreed that these variations add to the natural beauty of a wood kitchen.

STAIN

Charcoal is a spray stain applied to Oak and Maple products with several characteristics that are important to be aware of when purchasing this product.

1. Shadow lines may be visible at the interior profile edges of a door or drawer front. If movement occurs shadow lines may increase or decrease, depending on the style and/or size of a door or drawer front.
2. Variation and unevenness may be visible in the finish.
3. Hairline cracks at the joints are created over time due to the nature of natural wood, caused by usage, humidity**, or dryness. They tend to be more visible to darker stains, than lighter wood stains.

** Relative humidity is recommended to be between 45% and 55%. Please refer to Cortina Kitchens "Cleaning, Care, Maintenance, & Warranty Information" guide.

Please be advised that Cortina Kitchens will not replace doors and/or parts that exhibit the above characteristics associated with this finish. These characteristics are not avoidable and are a result of the natural characteristics of wood and wood veneer, and the characteristics of darker stains on wood. The Charcoal stain is not available on doors in Group IV, Group IVA, Group V and Group VA.

Cortina Kitchens offers a wide variety of finishes, applied to oak and maple products. The subject finishes include the spray stains Cocoa, Espresso, Graphite as well as wiping stain Ebony.

Due to the very dark stains applied on natural maple and oak doors and joints, several characteristics are important to be noted when purchasing these products.

1. Shadow lines may be visible at the interior profile edges of a door or drawer front. If movement occurs shadow lines may increase or decrease, depending on the style and/or size of a door or drawer front.
2. Variation and unevenness may be visible in the finish.
3. Hairline cracks at the joints are created over time due to the nature of natural wood, caused by usage, humidity, or dryness. They tend to be more visible to darker stains, than lighter wood stains.

Please be advised that Cortina Kitchens will not replace doors nor parts that exhibit the above characteristics associated with this finish. These characteristics are not avoidable and are a result of the natural characteristics of wood and wood veneer, and the characteristics of darker stains on wood.

 P

CABINETRY DOOR HARDWARE

Cortina Kitchens' cabinetry doors and drawer fronts will be drilled to accept a standard knob or handle selected from Cortina's hardware boards. This drilling comes standard with the order, and is done ONLY in our shop, not on the job site.

For those not wanting Cortina's hardware drilling, the following applies:

No holes to be drilled on the doors and drawer fronts should be specified in writing on the colour chart and the P.O. If while in production, Cortina Kitchens misses this request, Cortina Kitchens and the Builder will not be held responsible to replace any or all doors and drawer fronts affected, and the customer agrees to accept the product as is. No hardware will be supplied or credited by Cortina Kitchens with this request. No charge will apply for this request.

PVC DOORS

All cabinets with PVC (Thermofoil) Doors come with melamine gables, panels and kick. The doors, crown moulding and light valance are PVC wrapped. Open shelves incorporated in design will only be available with melamine interiors. There will be variations in colour shades between the PVC parts (doors, crown and Light valance) and the melamine parts (open shelves, Gables, Panels and Kick) due to the difference in material.

Furring Panel with crown moulding to the ceiling is not available on all PVC door styles due to subtle variations in colour shades between the PVC parts (moulding) and the melamine parts (furring panel) due to the difference in material. Grain directions in wood grain pattern melamine, vary between the furring panel, crown moulding (horizontal) and the PVC doors (vertical).

GRANITE, MARBLE ENGINEERED SURFACES WAIVER

Granite and marble are naturally occurring products, and due to the many variables that can affect the pattern, colour and/or design and "pitting" of natural products slabs installed will not be identical to the samples displayed. We will make every attempt to come as close to the samples as possible, but cannot be responsible for results which differ from the samples. Every effort is made to provide granite counter tops as close as possible but the vendor is not responsible for results which differ from the sample displayed. All countertop surfaces may have seams & product pattern & shade can change in areas containing seams.

RESELECTIONS

It is not uncommon for flooring, such as tile, to become discontinued prior to its installation. Therefore it may be necessary to make a reselection of certain materials sometime during the build process. We cannot assure you that another choice approximating your selection will be available.

PLANS

Plans are subject to change without notice. Actual usable floor space may vary from the stated floor area. Layout for kitchen, furnace, HWT and laundry tub may vary from plan. Vertical and horizontal bulkhead, which are not shown on plan, may be required for plumbing and heating runs. E.& O.E.

PLEASE NOTE:

In the event the work on the house has progressed beyond the point where the items covered by these invoices cannot be installed without entailing any unusual expense, then this order is to be cancelled and any deposit paid in connection with the same is to be refunded to the purchaser.

The vendor will undertake to incorporate the work covered by the sales extra in the construction of the house but will not be liable to the purchaser in any way, if for any reason the work covered by the extra is not carried out. In that event, any monies paid in connection with the same shall be returned to the purchaser.

It is understood and agreed that if for any reason whatsoever the transaction of Purchase and Sale is not completed, the total cost of extras ordered are not refundable to the Purchaser(s).

Extras or changes will not be processed unless signed by the Vendor.

These extras may not be amended without the written consent of Gold Park Homes.

The purchaser(s) and the builder acknowledge and agree that this "Purchaser's Extra" form shall not be deemed to be part of the agreement of purchase and sale entered into between them, nor an addendum thereto.

No postdated cheques will be accepted.

No estimates or orders will be accepted once construction has commenced.

Should a refund be requested on any extras purchased, an 80% reimbursement of the purchase price will be given. (a \$50.00 minimum charge and a maximum \$250.00 charge will apply)

Estimates will only be considered when resubmitted on a signed Purchaser Extras form, accompanied by payment in full.

All prices are estimates only and may be subject to change. Should a change in price occur Gold Park Homes reserves the right to request from the purchaser an adjustment of the price or a refund limited to that item.

Purchasers are aware & accept that ANY changes made to upgrades after signing the Purchasers Extra Form are subject to a minimum administration fee of \$500. PLUS a 10% holdback fee.

Purchasers are aware that any request to add a percentage of upgrades from the purchaser's extras form will be processed only after the builder receives approval letter from the bank.

 P.

Please be advised that your failure to finalize your structural or colour selections may result in a delay in construction of your dwelling and we may have to extend closing of your transaction. Due to failure to complete the above-mentioned selections and at no fault of us, we reserve our right to hold you responsible for a delayed closing, including charging extra administration cost and interest on the balance due on closing.

Purchaser has attended a Colour appointment at the Decor Centre & has DECLINED any additional upgrades and accepts and acknowledges that there will be no further structural changes/additions/deletions to be made upon signing.

I hereby acknowledge reading and understanding the above copy and will not hold Gold Park Homes responsible for any issues in relation to above.

Purchasers Signatures

_____

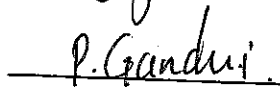
_____

Date 03/20/17