

Kleinburg Glen - 89 - 1 - 38-5 Elev.B ROSEMONT

CERAMIC

Inv.1,033	1 - KITCHEN FLOOR TILE: Upgrade 2 - 12x24" -Laid in straight, stacked pattern. See plan for tile direction.
Line14954	Note:
5Dec16 / 20Dec16	
Inv.1,033	1 - FOYER FLOOR TILE: Upgrade 2 - 12x24" -Laid in straight, stacked pattern. See plan for tile direction.
Line14955	Note:
5Dec16 / 20Dec16	
Inv.1,033	1 - POWDER ROOM FLOOR TILE: Upgrade 2 - 12x24" -Laid in straight, stacked pattern. See plan for tile direction.
Line14956	Note:
5Dec16 / 20Dec16	
Inv.1,033	1 - LAUNDRY ROOM FLOOR TILE: Upgrade 2 - 12x24" -Laid in straight, stacked pattern. See plan for tile direction.
Line14957	Note:
5Dec16 / 20Dec16	

ELECTRICAL

Inv.597	1 - FAMILY ROOM: Install a 110V WALL RECEPTACLE ON NORMAL CIRCUIT - Locate approx. 60" A.F.F. above fireplace (NOTE: conduit NOT purchased)
Line7324	Note:
21Jun16 / 11Nov16	
Inv.597	1 - KITCHEN: Install a 110V WALL RECEPTACLE ON DEDICATED CIRCUIT - FOR MICROWAVE - MICROWAVE NOT INCLUDED. Cabinetry customization to be purchased at colour appointment. See plan for location.
Line7325	Note:
21Jun16 / 11Nov16	
Inv.597	1 - KITCHEN: Install a 220V WALL RECEPTICAL ON DEDICATED CIRCUIT - FOR 4 WIRE BUILT - IN WALL OVEN. Cabinetry customization to be purchased at colour appointment. See plan for location.
Line7327	Note:
21Jun16 / 11Nov16	
Inv.597	1 - **REQUEST** Electrical panel to be located near furnace, if possible.
Line7336	Note:
21Jun16 / 11Nov16	
Inv.1,033	1 - KITCHEN - Purchasers request to NOT INSTALL builder's standard hood fan and standard cabinets above stove. DELETE. Do not supply, install, and/or credit. Purchasers are installing their own hood fan after closing.
Line14967	Note: Purchasers accept and acknowledge that the exhaust fan duct hole may be off-centered with stove in kitchen due to purchasers installing their own hood fan after closing. The vendor is exempt.
5Dec16 / 20Dec16	
Inv.1,033	1 - 110V WALL RECEPTACLE ON DEDICATED CIRCUIT - GAS FIRED APPLIANCE - FOR AUX. EQUIPMENT - NOT A STOVE PLUG
Line14970	Note:
5Dec16 / 20Dec16	

EXTERIOR COLOURS

Inv.597	1 - EXTERIOR COLOUR PACKAGE 2
Line13836	Note:
21Jun16 / 11Nov16	

FIREPLACE AND MANTLE

Kleinburg Glen - 89 - 1 - 38-5 Elev.B ROSEMONT

Inv.1,033	1 - GREAT ROOM: Add raised hearth to standard fireplace mantle.
Line14963	Note:
5Dec16 / 20Dec16	

FORMING

Inv.597	1 - WALK-UP BASEMENT
Line7323	Note:
21Jun16 / 11Nov16	

FRAMING

Inv.597	1 - WALK-UP BASEMENT
Line13834	Note:
21Jun16 / 11Nov16	
Inv.597	1 - MANDOOR - GARAGE TO HOUSE - AS PER PLAN AND GRADE PERMITING
Line13838	Note: AS PER APS
21Jun16 / 11Nov16	

GRANITE MARBLE QUARTZ

Inv.1,033	1 - KITCHEN GRANITE COUNTER TOP: Add granite for cooktop
Line14952	Note:
5Dec16 / 20Dec16	
Inv.1,033	1 - KITCHEN GRANITE COUNTER TOP: Upgrade 1 Edge profile 4cm
Line14953	Note:
5Dec16 / 20Dec16	

HARDWOOD

Inv.1,033	1 - GREAT ROOM / DINING ROOM / DEN / MAIN HALL-HARDWOOD FLOOR: Upgrade 1 - Preverco 3/4 x 4-1/4" Red Oak (smooth) **NOTE: hardwood floors will not match stairs.
Line14958	Note:
5Dec16 / 20Dec16	
Inv.1,033	1 - UPPER HALL HARDWOOD FLOOR: Upgrade 1 - Preverco 3/4 x 4-1/4" Red Oak (smooth) **NOTE: hardwood floors will not match stairs.
Line14960	Note:
5Dec16 / 20Dec16	*New*
Inv.1,348	1 - MASTER BEDROOM- UPG 1 HARDWOOD 3/4" X 4 1/4" RED OAK INOX
Line21260	Note:
8May17 / 11May17	* New *
Inv.1,348	1 - BEDROOM 2-UPG 1 HARDWOOD 3/4" X 4 1/4" RED OAK INOX
Line21261	Note:
8May17 / 11May17	* New*
Inv.1,348	1 - BEDROOM 3- UPG 1 HARDWOOD 3/4" X 4 1/4" RED OAK INOX
Line21262	Note:
8May17 / 11May17	* New*
Inv.1,348	1 - BEDROOM 4- UPG 1 HARDWOOD 3/4" X 4 1/4" RED OAK INOX
Line21263	Note:
8May17 / 11May17	*New *

HVAC

**Kleinburg Glen - 89 - 1 - 38-5 Elev.B ROSEMONT**

Inv.597	1 - KITCHEN: Install a GAS LINE ROUGH - GROUND FLOOR for future gas cook top
Line7329	Note:
21Jun16 / 11Nov16	
Inv.597	1 - KITCHEN: UPGRADE VENTING FOR STOVE TO 8 INCH PIPE EXTERIOR WALL
Line7330	Note:
21Jun16 / 11Nov16	
Inv.597	1 - HUMIDIFIER: WB3 - 17 (UP TO 3,000 SQ.FT.)
Line7331	Note:
21Jun16 / 11Nov16	

**KITCHEN AND BATH CABINETRY**

Inv.1,033	1 - KITCHEN CABINETRY: Upgrade 2 profile - maple
Line14946	Note:
5Dec16 / 20Dec16	
Inv.1,033	1 - KITCHEN CABINETRY: Double appliance cabinet with drawer below. See plan for location.
Line14947	Note: *PLEASE NOTE: PRICE ABOVE MAY CHANGE. PURCHASER(S) TO PROVIDE PROPER APPLIANCE SPECIFICATIONS TO PRICE APPLICABLE ELECTRICAL ACCORDINGLY
5Dec16 / 20Dec16	
Inv.1,033	1 - KITCHEN CABINETRY: Pots and Pans drawers below cooktop
Line14948	Note:
5Dec16 / 20Dec16	
Inv.1,033	1 - KITCHEN CABINETRY: Delete uppers above cooktop, finish sides - for future 36" chimney-style hood fan.
Line14949	Note:
5Dec16 / 20Dec16	
Inv.1,033	1 - KITCHEN CABINETRY: Adjust cabinetry for 36" cooktop and hood fan.
Line14950	Note:
5Dec16 / 20Dec16	

**MISC.**

Inv.597	1 - Purchasers are aware & accepts that ANY changes made to upgrades after signing this Purchasers Extra Form are subject to a minimum administration fee of \$500. PLUS a 10% holdback fee.
Line7334	Note:
21Jun16 / 11Nov16	
Inv.597	1 - Purchaser has attended a Structural appointment at the Decor Centre & has DECLINED any additional upgrades and accepts and acknowledges that there will be no further structural changes/additions/deletions to be made upon signing on June 21, 2016.
Line7333	Note:
21Jun16 / 11Nov16	
Inv.597	1 - BONUS PACKAGE: \$7500.00 (INCLUDING TAXES) WORTH OF UPGRADES FROM GOLD PARK HOMES DÉCOR CENTRE IS BEING APPLIED TOWARD THE STRUCTURAL APPOINTMENT. PURCHASER HAS A REMAINING AMOUNT OF \$00 (INCLUDING TAXES) TO BE USED TOWARD THE COLOUR APPOINTMENT.
Line7335	Note:
21Jun16 / 11Nov16	
Inv.1,033	1 - Purchaser has attended a Colour appointment at the Decor Centre & has DECLINED any additional upgrades and accepts and acknowledges that there will be no further changes/additions/deletions to be made upon signing on December 5, 2016.
Line14964	Note:
5Dec16 / 20Dec16	

Kleinburg Glen - 89 - 1 - 38-5 Elev.B ROSEMONT

Inv.1,033	1 - Purchasers are aware & accepts that ANY changes made to upgrades after signing this Purchasers Extra Form are subject to a minimum administration fee of \$500. PLUS a 10% holdback fee.
Line14965	Note:
5Dec16 / 20Dec16	
Inv.1,033	1 - STAIRCASE - The purchaser was advised and therefore accepts and acknowledges that the wood species of the staircase and flooring chosen do not match. This difference may result in a stain colour variance.
Line14966	Note: The purchaser agrees that the vendor is to be exempt from any and all claims by the purchaser regarding this colour variance.
5Dec16 / 20Dec16	
Inv.1,033	1 - Purchaser Accepts Standard Appliance Openings, unless otherwise noted: Fridge - 37-1/2"W x 73-1/2" High Approx. Range - 30-1/2"D x 31-1/2"W Approx. Dishwasher - 24" W Approx.
Line14968	Note:
5Dec16 / 20Dec16	
Inv.1,033	1 - KITCHEN - Purchaser accepts & acknowledges that in order to either complete or install built-in appliances and accommodate for cook-top, all appliance specifications must be provided to the Décor Center within one (1) week of completion of colour chart.
Line14969	Note:
5Dec16 / 20Dec16	
Inv.1,348	1 - CREDIT TO BE APPLIED IN LIEU OF TARION COMPENSATION FOR 60 DAY EXTENSION. MOVING CLOSING DATE OF HOME FROM JULY 6 2017 TO SEPTEMBER 7TH 2017. PURCHASER TO PAY DIFFERENCE
Line21264	Note:
8May17 / 11May17	

PAINTING

Inv.1,033	1 - MAIN STAIRS: Stain stairs and landings Vintage "Pewter"
Line14962	Note: **NOTE: Stairs and landings will not match hardwood floors**
5Dec16 / 20Dec16	

PLUMBING

Inv.597	1 - KITCHEN: Install a ROUGH - IN - WATERLINE FOR FRIDGE
Line7332	Note:
21Jun16 / 11Nov16	

STAIRS AND RAILINGS

Inv.1,033	1 - MAIN STAIRS: Euroline 2+ V Groove
Line14961	Note:
5Dec16 / 20Dec16	

WINDOWS AND DOORS

Inv.597	1 - WALK-UP BASEMENT
Line13835	Note:
21Jun16 / 11Nov16	
Inv.597	1 - MAN DOOR GARAGE TO HOUSE - OPTIONAL - IF GRADE PERMITS
Line13837	Note: AS PER APS
21Jun16 / 11Nov16	

Purchasers: Ilknur Atay & Atilla Atay

Property: 89

Telephone Res. / Bus: (416) 735-0043

Project: Burkshire Holdings Inc.

Decor Advisor: Yolande Somerville

Model and Elevation: 38-5 Elev.B ROSEMONT

Layout Changes: ☐ Yes ☒ No

Sketch Attached: ☒ Yes ☐ No

Exterior Colour Scheme:

## 1. Cabinetry

	Style and Colour	Counter	Hardware
Kitchen / Breakfast	*Florentin mpl 'Greyston'	Granite: Grigio Sardo *Edge: H-40	cs1-24
Laundry Room	n/a	n/a	n/a
Powder Room	n/a	n/a	n/a
n/a	n/a	n/a	n/a
Master Ensuite Bathroom	Varese pvc 'ANTQ. WHITE' AA IA	P-Lam #P-345-LM 'Inukshuk Taupe'	cs1-24
Second Ensuite Bathroom (If Applicable)	Varese pvc 'Antiq White'	P-Lam #P-344-LM 'Inukshuk Grey'	cs1-24
Twin Bathroom	Varese pvc 'Antq. White'	P-Lam #P-344-LM 'Inukshuk Grey'	cs1-24
Dishwasher Cabinet	n/a		

Comment

## 2. Floor Tile

	Selection	Grout	Threshold
Entrance Vestibule	*12x24" Allure 'Grey'	n/a	n/a
Main Hall	n/a	n/a	n/a
Kitchen / Breakfast	*12x24" Allure 'Grey'	n/a	n/a
Laundry Room	*12x24" Allure 'Grey'	n/a	n/a
Powder Room	*12x24" Allure 'Grey'	n/a	n/a
n/a	n/a	n/a	n/a
Master Ensuite Bathroom	13x13" New Reeds 'Brown'	n/a	n/a
Second Ensuite Bathroom (If Applicable)	13x13" Milieu 'Fog'	n/a	n/a
Lower Landing (If Applicable)	n/a	n/a	n/a

Comment

## 3. Wall Tile

	Selection	Listello/Inserts	Describe
M. Ens Tub skirt/deck	8x10" New Reeds 'Brown'	<input type="radio"/> Yes <input checked="" type="radio"/> No	
Master Ensuite Bathroom			
Tub Deck	8x10" New Reeds 'Brown'	<input type="radio"/> Yes <input checked="" type="radio"/> No	
Shower Stall	8x10" New Reeds 'Brown'	<input type="radio"/> Yes <input checked="" type="radio"/> No	
Bathroom Walls	n/a	<input type="radio"/> Yes <input checked="" type="radio"/> No	
Second Ensuite Bathroom (If Applicable)	8x10" Weave 'White'	<input type="radio"/> Yes <input checked="" type="radio"/> No	
Twin Bathroom	8x10" Weave 'White'	<input type="radio"/> Yes <input checked="" type="radio"/> No	

Kitchen Backsplash ☐ Yes ☒ No

Backsplash Behind Fridge

Comment

AA IA

Purchasers: Ilknur Atay & Atilla Atay

Property: 89

Telephone Res. / Bus: (416) 735-0043

Project: Burkshire Holdings Inc.

Decor Advisor: Yolande Somerville

Model and Elevation: 38-5 Elev.B ROSEMONT

#### 4. Plumbing Fixtures

Master Ensuite Bathroom ☐ Second Ensuite ☐ Powder Room ☐  
Other Room - Specify ☐ Other Washroom ☐

Comment

Standard plumbing thru out!

#### 5. Hardwood Flooring

	Type and Stain		Type and Stain
Main Hall	*3/4x4-1/4" Red Oak 'Inox'	Upper Landing	**natural oak - stained stair colour
Kitchen / Breakfast	n/a	Upper Hall	*3/4x4-1/4" Red Oak 'Inox'
Living Room	n/a	Master Bedroom	*3/4x4-1/4" Red Oak 'Inox'
Dining Room	*3/4x4-1/4" Red Oak 'Inox'	Bedroom #2	*3/4x4-1/4" Red Oak 'Inox'
Family Room	*3/4x4-1/4" Red Oak 'Inox'	Bedroom #3	*3/4x4-1/4" Red Oak 'Inox'
Den/Library	*3/4x4-1/4" Red Oak 'Inox'	Bedroom #4	*3/4x4-1/4" Red Oak 'Inox'
Entrance Vestibule	n/a	Bedroom #5	n/a
Lower Landing (If Applicable)	**natural oak - stained stair colour	Other Room - Specify	

Comment

#### 6. Carpeting

	Upgrade	Description
Main Hall	<input type="checkbox"/>	n/a
Living Room	<input type="checkbox"/>	n/a
Dining Room	<input type="checkbox"/>	n/a
Family Room	<input type="checkbox"/>	n/a
Den/Library	<input type="checkbox"/>	n/a
Upper Hall	<input type="checkbox"/>	n/a
Master Bedroom	<input type="checkbox"/>	T-15
Bedroom #2	<input type="checkbox"/>	T-15
Bedroom #3	<input type="checkbox"/>	T-15
Bedroom #4	<input type="checkbox"/>	T-15
Bedroom #5	<input type="checkbox"/>	n/a
	<input type="checkbox"/>	n/a
Upper Landing (If Applicable)	<input type="checkbox"/>	n/a
Lower Landing (If Applicable)	<input type="checkbox"/>	n/a

Upgrade Underpad	Type n/a	Area n/a
Carpet on Stairs	Capped n/a	Runner - *Upgrade n/a

Comment

Standard carpet with standard underpad in bedrooms

AA 1/2

Purchasers: Ilknur Atay & Atilla Atay

Property: 89

Telephone Res. / Bus: (416) 735-0043

Project: Burkshire Holdings Inc.

Decor Advisor: Yolande Somerville

Model and Elevation: 38-5 Elev.B ROSEMONT

## 7. Fireplace

	Living Room			Family Room			Other Room - Specify		
	Purchased	As Per Plan	N/A	Purchased	As Per Plan	N/A	Purchased	As Per Plan	N/A
Fireplace Type	<input type="radio"/>	<input type="radio"/>	<input checked="" type="radio"/>	<input type="radio"/>	<input checked="" type="radio"/>	<input type="radio"/>	<input type="radio"/>	<input type="radio"/>	<input checked="" type="radio"/>
Mantle Type				Standard Gas					
Colour / Stain				Standard Mediterranean					
Surround				Standard					
Hearth				n/a					
				*raised hearth					

### Comment

\*Add raised hearth to standard fireplace mantle

## 8. Trim Carpentry

Interior Doors	Standard	Front Door Glass Inserts	Standard	Door Handles	Standard
Interior Trim	Standard				

### Comment

## 9. Plaster Mouldings and Medallions

Entrance Vestibule			Kitchen/Breakfast		
Main Hall			Den/Library		
Living Room			Lower Landing		
Dining Room			Other Room - Specify	none	
Family Room			Thru out		

### Comment

## 10. Railings and Spindles

Railing Package	*Eurline 2 + V Groove		
Railing Colour	*Vintage 'Pewter'	Spindle Colour	*Black
Stringer / Riser	*Vintage 'Pewter'	Treads	*Vintage 'Pewter'
Comment		Oak Stairs	<input checked="" type="radio"/> Yes <input type="radio"/> No

## 11. Wall Paint

Main & Upper Hall		Master Bedroom	
Living Room		Bedroom #2	
Dining Room		Bedroom #3	
Kitchen / Breakfast		Bedroom #4	
Family Room		Bedroom #5	
Powder Room		Master Ensuite	
Laundry Room		Second Ensuite	
Den/Library		Thru out	Warm Grey
Trim Paint			
Comment	Smooth Ceilings First Floor		

A-A 17A

Scheduled Closing Date: Wednesday, November 09, 2016

Purchasers: Ilknur Atay & Atilla Atay

Property: 89

Telephone Res. / Bus: (416) 735-0043

Project: Burkshire Holdings Inc.

Decor Advisor: Yolande Somerville

Model and Elevation: 38-5 Elev.B ROSEMONT

12. Electrical

Plugs and Switches ☒ White ☐ Ivory

Hood Fan ☐ White ☐ Ivory

Appliances Built in Cooktop

☒ Yes ☐ No

Built in Oven

☒ Yes ☐ No

Above Kitchen Cabinet Light ☐ Yes ☒ No

Below Kitchen Cabinet Light ☐ Yes ☒ No

Gas Stove

☒ Yes ☐ No

Microwave

☒ Yes ☐ No

Comment

Chimney-style hood fan

13. Heating and Air Conditioning

Air Conditioning

Gas Provisions Dryer

Comment

Standard Gas BBQ Line

Gas Provisions Stove

Gas Provisions Barbecue

14. Additional Comments

15. Disclaimers and Notes

- 1) Colours of all materials are as close as possible to builder's selection, but not necessarily identical due to variances in manufacturing.
- 2) Any extras listed above are null and void unless accompanied by a separate invoice/amendment. Said invoice must be paid in full.
- 3) The Purchaser acknowledges that after Interior Colour Selection form is signed and dated, no further changes will be permitted other than re-selection due to unavailability. Purchaser's Initials
- 4) The Purchaser acknowledges reading and accepting the "Gold Park Homes Decor Centre Disclaimers" form. This document contains other miscellaneous disclaimers.

This Interior Colour Selection is final and approved by:

Signature:

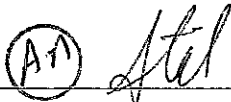

Date:

Signature:



Date:

KITCHEN  
TILE  
DIRECTION



# the Rosemont

Elevation A • 2,861 sq.ft.

Elevation B • 2,861 sq.ft.

LOT 89  
JUNE 21 2016

(A-A) (I-A)

8" DUCT  
+ GAS LINE

MICRO  
WALL OVEN

KG-89  
DEC 5 2016

(A-F) (I-A)

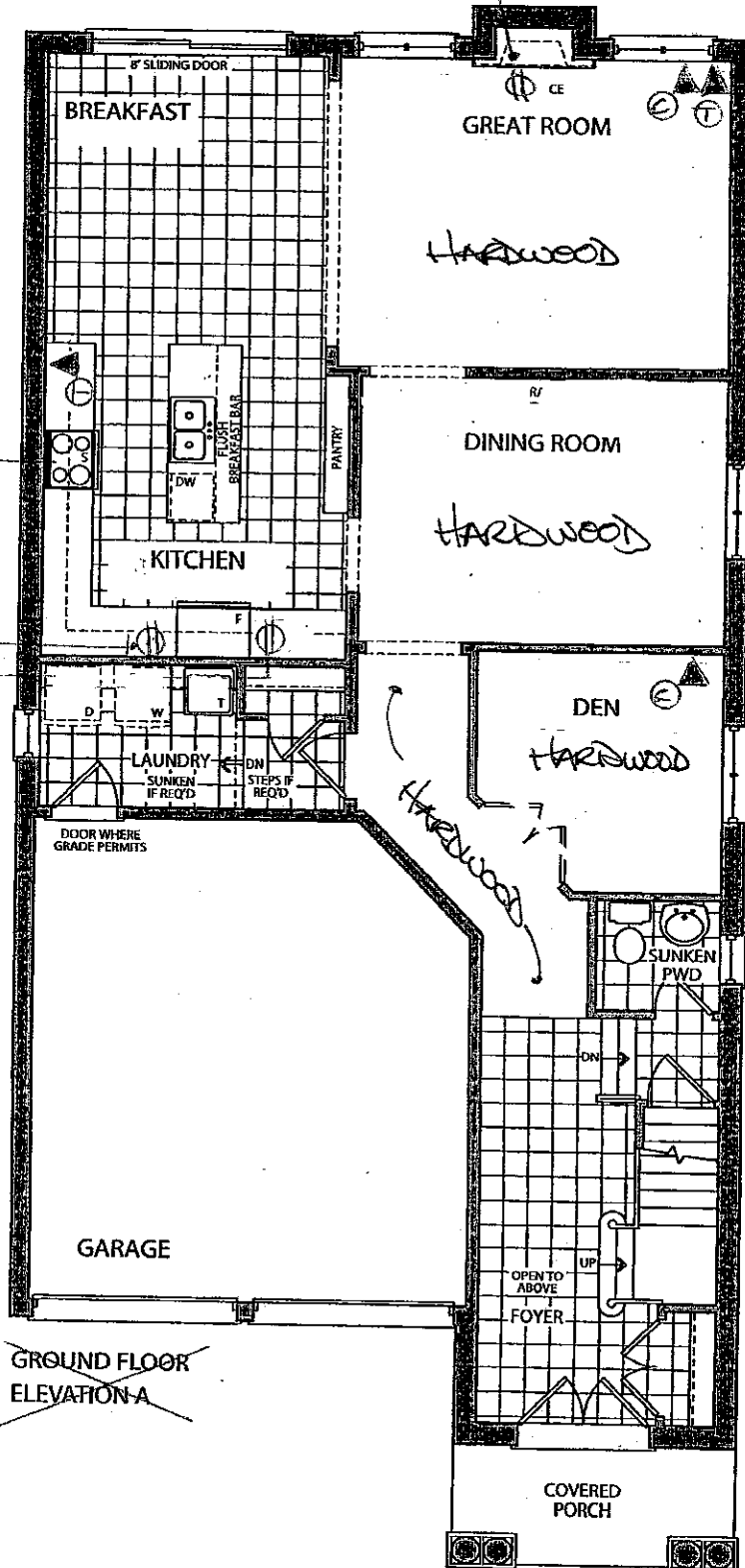

~~GROUND FLOOR  
ELEVATION A~~

Foyer + Powder  
TILE DIRECTION

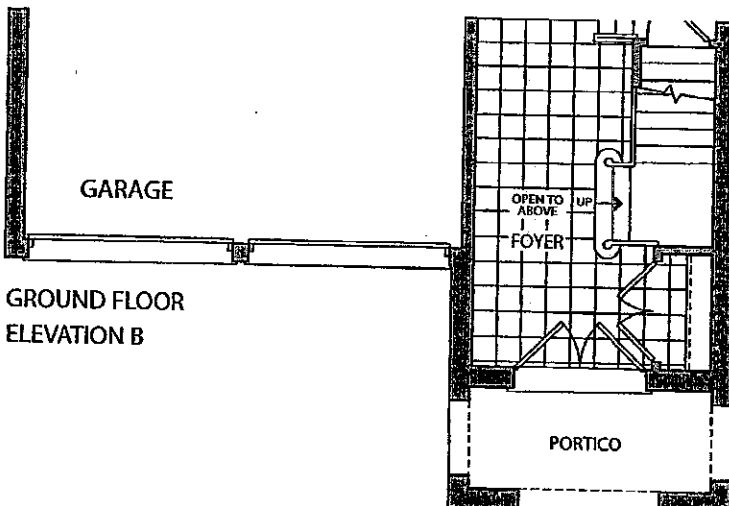

\* GROUND FLOOR  
ELEVATION B

Elevation A • 2,861 sq.ft.

Elevation B • 2,861 sq.ft.

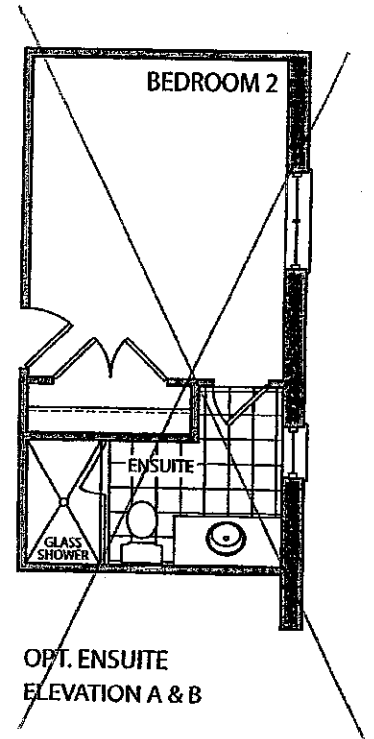
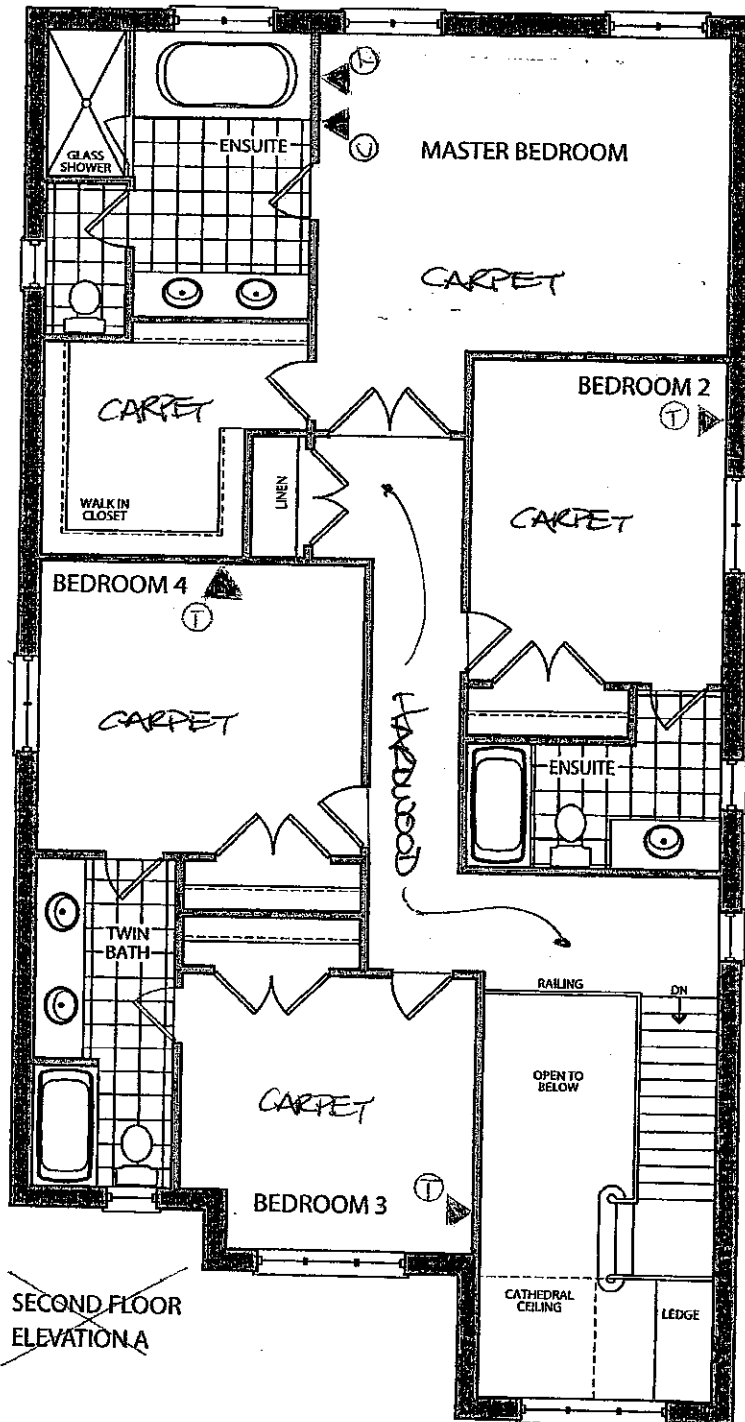

LOT 89  
JUNE 21 2016  
(AA) (1A)

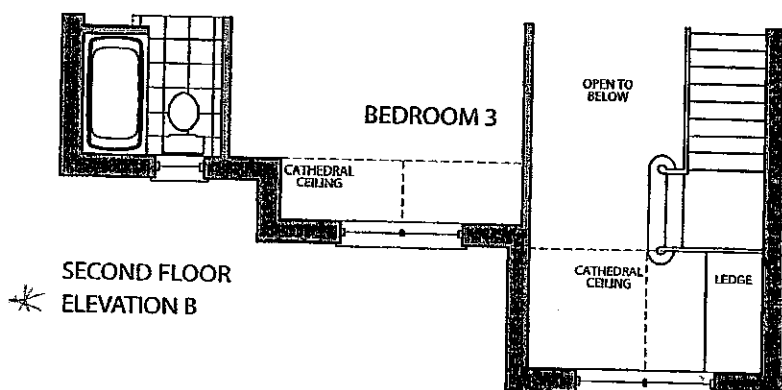

KG-89  
DEC 5 2016  
(AA) (1A)

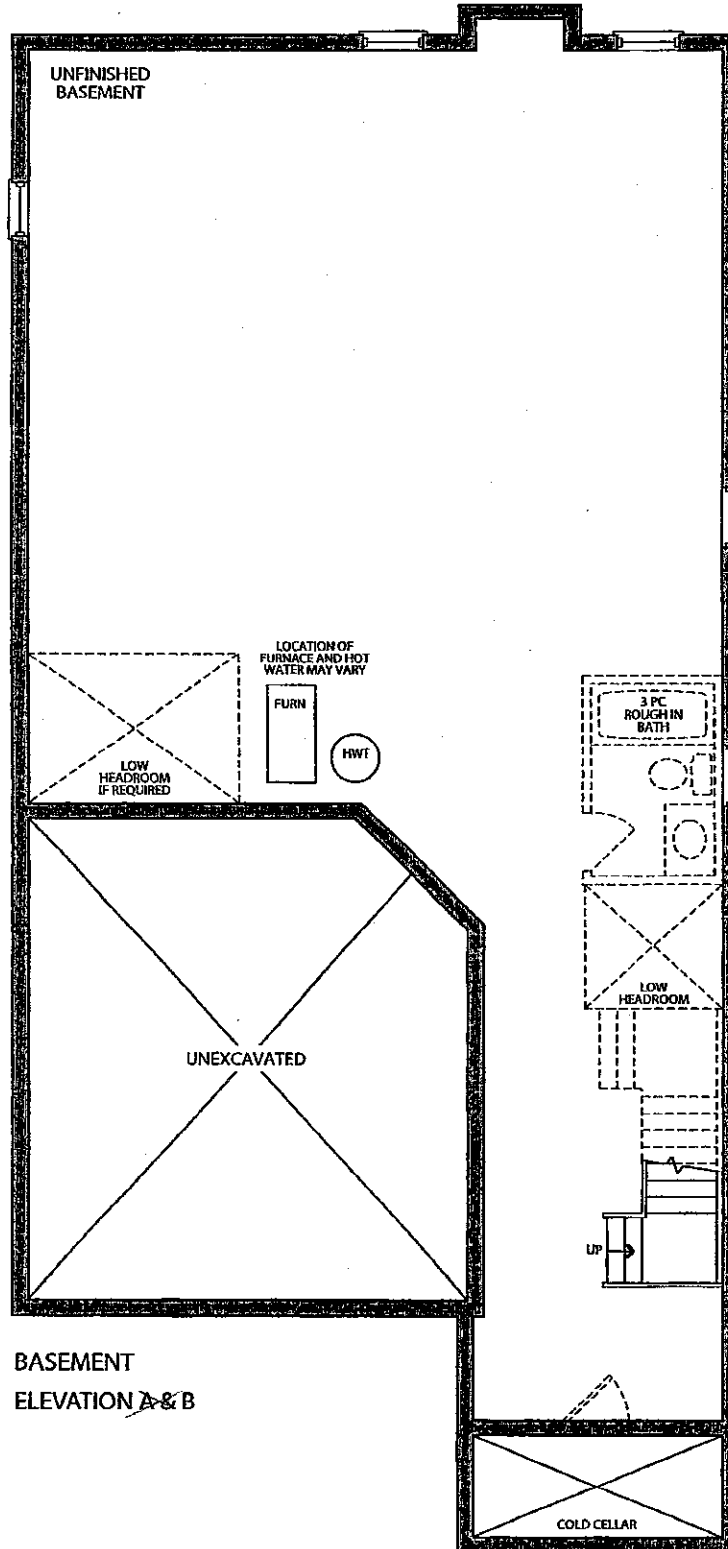

LOT 89

JUNE 21 2016

(AA) (LA)

KG-89

Dec 5 2016

(AA) (IA)

CORTINA

70 Regina Road, Woodbridge, Ontario L4L 8L8  
Tel: 905-264-6464 Fax: 905-264-0664  
www.CortinaKitchens.com

KG-89

Dec. 5 2016

A-A (A)

QUOTATION

Date: 28/06/16

Trade Name: Gold Park Homes

Site location:

Model: 38-5

Address:

Project: Kleinburg Glen

Phase:

This layout has been explained to the purchaser by Cortina Kitchens Inc. and is understood by the purchaser.

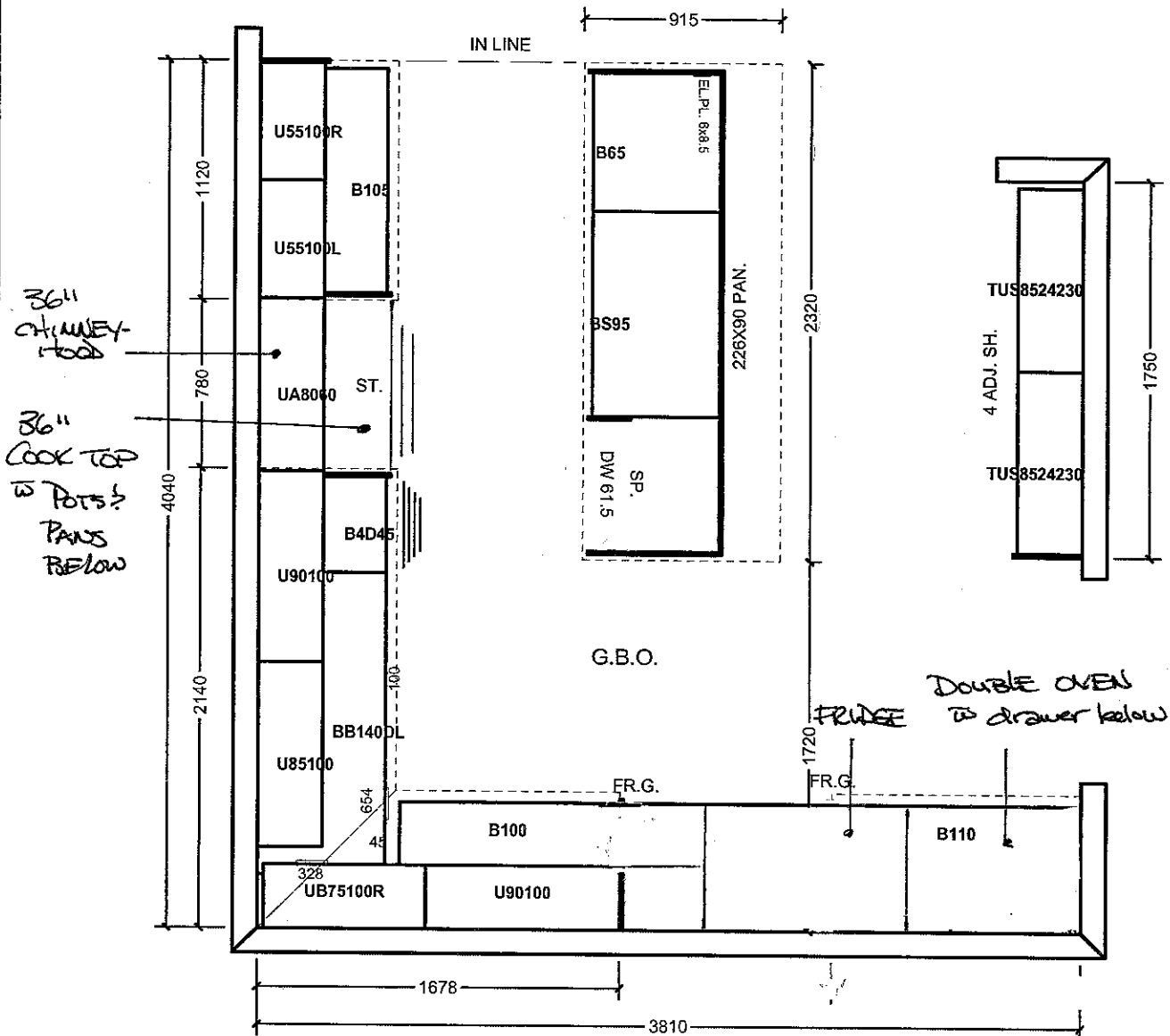

All prices subject to confirmation from head office.  
This quotation is subject to the terms & conditions set out

ACCEPTED DATE: \_\_\_\_\_

All agreements are contingent upon strikes, accidents, and delays beyond our control.  
Please provide our installer with template for sinkholes or \$150.00 will be charged for callback.

Item A. Wood grain and colour are characteristics of the product. We cannot guarantee that such grain and colour will always match.  
Item B. Cortina Kitchens Inc. reserves the right to alter dimensions and make technical changes without notice.

Trade Name: Gold Park Homes	Site location:	Model: 38-4
Address:	Project: Kleinburg Glen	Phase:

This layout has been explained to the purchaser by Cortina Kitchens Inc. and is understood by the purchaser.

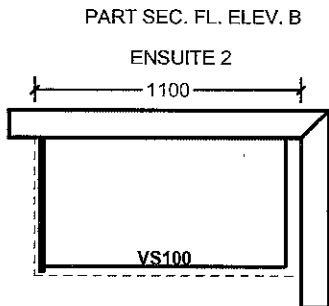
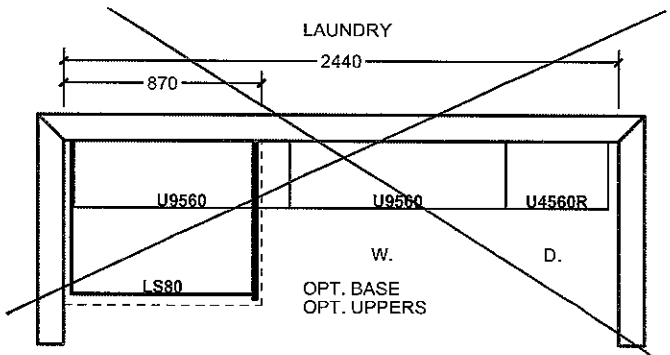
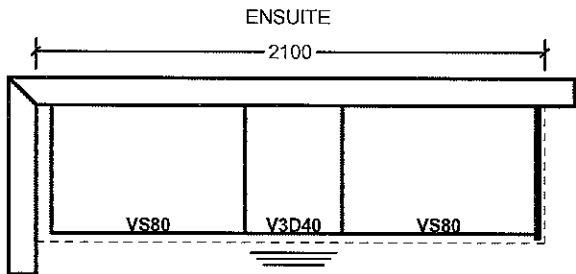
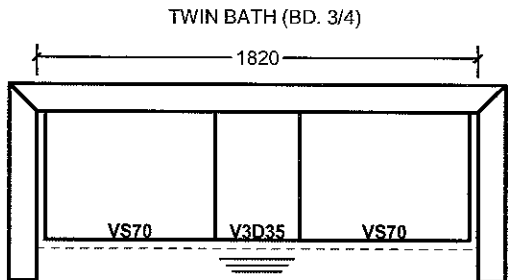
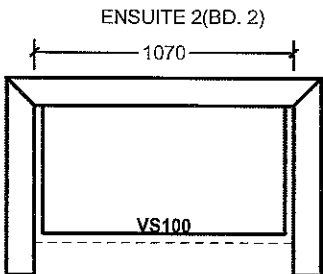

All prices subject to confirmation from head office.  
This quotation is subject to the terms & conditions set out

All agreements are contingent upon strikes, accidents, and delays beyond our control.  
Please provide our installer with template for sinkholes or \$150.00 will be charged for callback.

ACCEPTED DATE: \_\_\_\_\_

## STANDARD HARDWARE

KG-89

DEC 5 2016

AA

1A



CSI-6

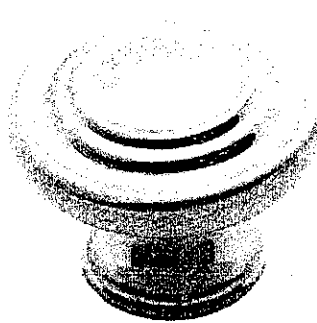

CSI-10



CSI-14

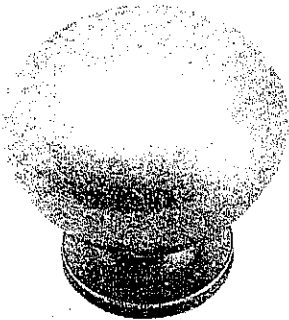

CSI-16

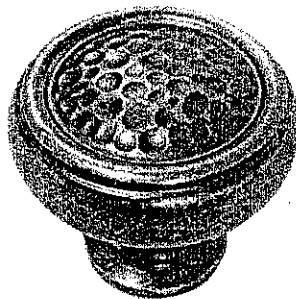

CSI-18

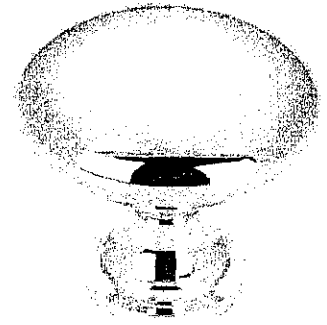

CSI-19

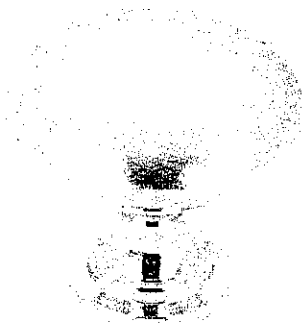

CSI-20

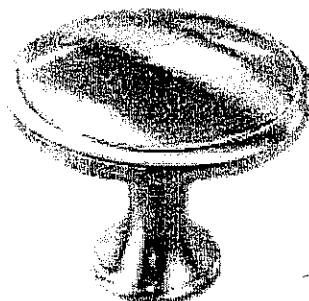

CSI-21

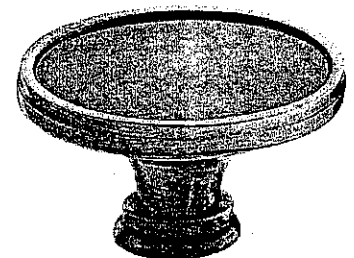

CSI-22

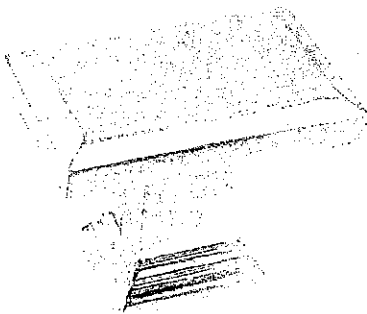

CSI-23

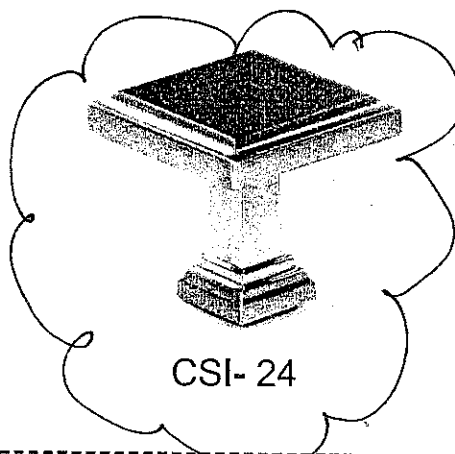

CSI-24

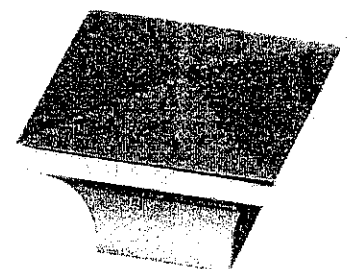

CSI-25

**\*NOTES:**

- IMAGES ARE FOR QUICK REFERENCE PURPOSES ONLY
- ACTUAL SIZES AND FINISHES AS PER HARDWARE SAMPLE BOARD PROVIDED TO DECOR CENTRE

KG-89  
DEC 5 2016

AA

**20mm (3/4") Profiles**

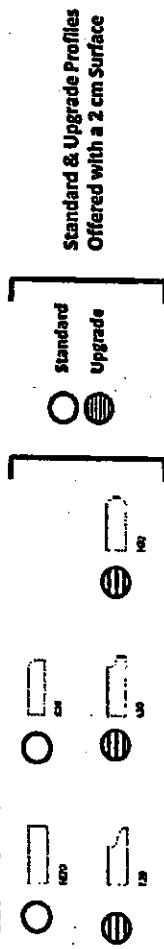

**30mm (1 1/4") Profiles**

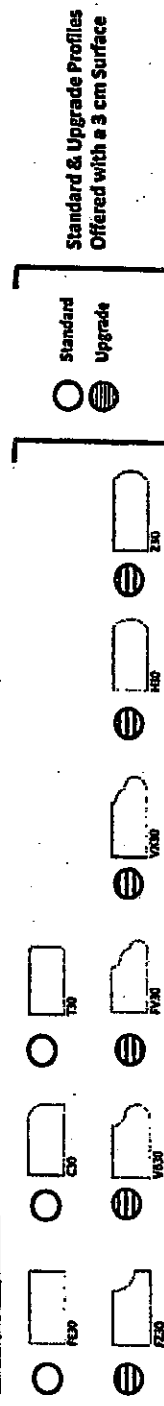

**40mm (1 1/2") Profiles**

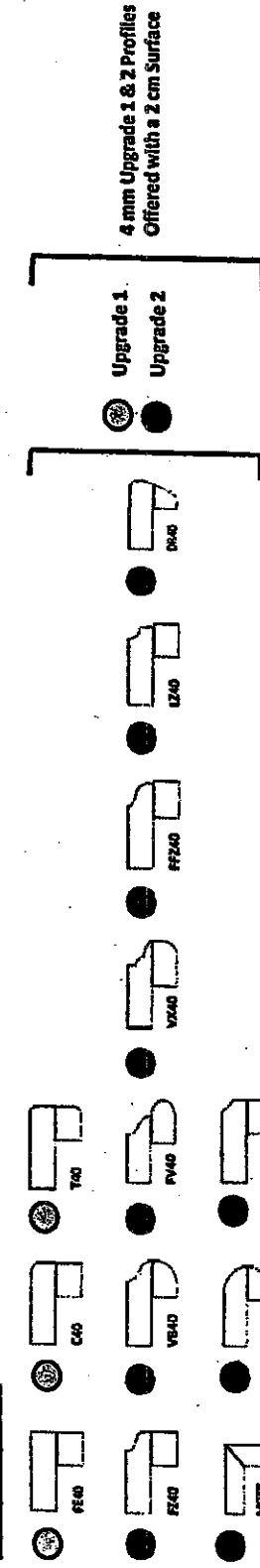

Note: All colours may not be available in 30mm at time ordered.  
Vendor reserves the right to use 40mm edges (by limitation process).

H-40

KG-89

FRIGIDAIRE → upl oven 18254 - FG EW 3865 PF✓  
→ Cool top 36" 749889 - 18984  
FRGC 3845 Q S✓  
1298

MAX AIR MWO 136173 NVSD 797 S. 3584  
- NV-TK 7295F - TRAM 127

→ Range hood. MXR-B02-36 646.6

D/W 498132 SHP 651554c

21  
Y  
3  
ne  
31

KG-89

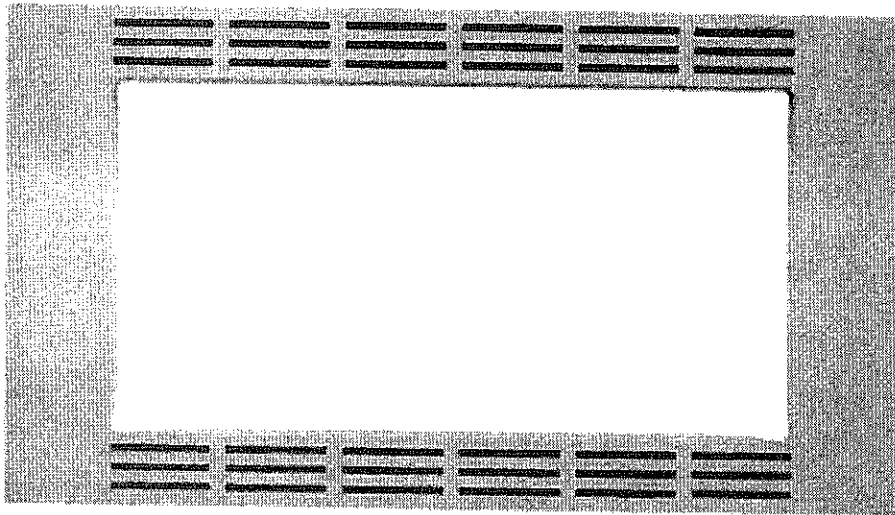

KG-89



Glass Cooking Tray  
A06014A00AP

In Stock

4.8 (15 Reviews)



27" Trim Kit for select  
Microwaves NN-  
TK722SS

NN-TK722SS

In Stock

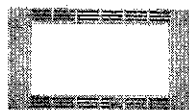

30" Trim Kit for select  
Microwaves NN-  
TK732SS

NN-TK732SS

In Stock

5.0 (1 Reviews)

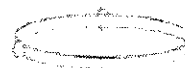

Roller Ring  
F290D9330AP

In Stock

4.9 (22 Reviews)

Visit Dealer

ADD TO CART

ADD TO CART

Visit Dealer

## Replacement Accessories

### Trim Kits

SEE ALL ACCESSORIES

2.4	Write a review	Pros	Cons
Quality	2.3	Easy to use (9)	Poor quality (12)
Value	2.5	Convenient (8)	Did not meet expectations (9)
Ease of Use	3.7	Exceeded expectations (6)	Expensive (3)
Features	3.7	Durable (4)	dangerous (1)
		Inexpensive (3)	door latch problems are common across models (1)
		+ see more Pros	+ see more Cons

### My Product Experience:

Negative ☐ Positive ☐

### My Customer Support Experience:

Negative ☐ Positive ☐

5 of 18 (28%) reviewers would recommend this product to a friend.

1

Date: January 29, 2016

Cons: Poor quality, Did not meet expectations, Difficult to use

" Like apparently every other consumer who trusted the Panasonic brand, I have a broken door latch and a non functioning microwave after a few short years. Hoping Panasonic will offer to remedy its design shortcomings. No one budgets for having to replace a basic core kitchen appliance which has had light use every 4 years...."

1 of 1 people found this review helpful.

Was this review helpful to you? Yes No (Report Inappropriate Review)

Response from Panasonic:

By AM, Social Media, February 2, 2016

Thank you for taking the time to leave a review. Our microwaves have a 1 year warranty. If something is broken on your model then we recommend you use the below link to locate an authorized service center.

<http://bit.ly/1uRyflE>

Quality

Value

Ease of Use

Features

### My Product Experience:

Negative ☐ Positive ☐

### My Customer Support Experience:

Negative ☐ Positive ☐

yetanotherfailedlatch

KG-89.

BULK ORDERS LOGIN SUPPORT ORDER STATUS

ABOUT FOR BUSINESS FOR INDUSTRY

Enter model, category or keyword

CAMERAS + CAMCORDERS

AUDIO + VIDEO

MICROWAVE + KITCHEN

TELEPHONES

PERSONAL CARE

MASSAGE

HOME + OFFICE

NEW!

DEALS

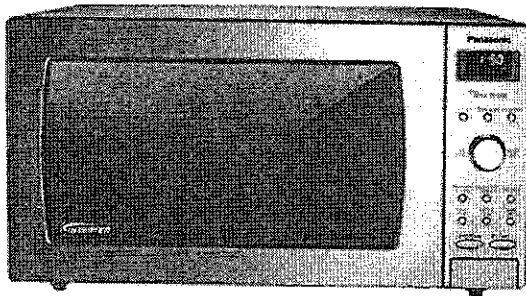
**FREE SHIPPING ON ALL ORDERS**[Home](#) [Get Support](#) [NN-SD797S](#)

## 1.6 Cu. Ft. Built-In/Countertop Microwave Oven with Inverter Technology™ - Stainless Steel - NN-SD797S

NN-SD797S

2.4 [Read Customer Reviews](#) | [Write a review](#)

### Features

- Enjoy faster cooking times with 1250 watts high power
- Microwave Inverter technology delivers a seamless stream of cooking power
- Advanced Inverter Turbo Defrost speeds up defrosting time
- Automatic sensor adjusts power and times for different foods
- High-end, neon blue LED dial and display complement any decor
- Choose countertop or built-in installation, trim kit sold separately
- Dimensions: Outside - 11 15/16" x 21 7/8" x 19 15/16"

See similar model: [NN-SD775S](#)

### Specifications

### Accessories

### Reviews

### Support

[PDF](#) [VIEW FULL SPECS](#)

### MORE DETAILS

MODEL NO.	NN-SD797S
Capacity	1.6cft
Exterior Dimensions HxWxD"	11 15/16" x 21 7/8" x 19 15/16"
POWER	
Microwave Type	
Microwave (Technology)	1250W / Normal wave
Power Consumption	1460W
Power Supply	Inverter
Cooking Power	1250W
DESIGN	

# GAS COOKTOP INSTALLATION INSTRUCTIONS

(For 30" & 36" Models)



**INSTALLATION AND SERVICE MUST BE PERFORMED BY A QUALIFIED INSTALLER.**  
**IMPORTANT: SAVE FOR LOCAL ELECTRICAL INSPECTOR'S USE.**  
**READ AND SAVE THESE INSTRUCTIONS FOR FUTURE REFERENCE.**



**! WARNING** If the information in this manual is not followed exactly, a fire or explosion may result causing property damage, personal injury or death.

## FOR YOUR SAFETY:

- Do not store or use gasoline or other flammable vapors and liquids in the vicinity of this or any other appliance.
- **WHAT TO DO IF YOU SMELL GAS:**
  - Do not try to light any appliance.
  - Do not touch any electrical switch; do not use any phone in your building.
  - Immediately call your gas supplier from a neighbor's phone.
- Follow the gas supplier's instructions.
- If you cannot reach your gas supplier, call the fire department.
- Installation and service must be performed by a qualified installer, service agency or the gas supplier.

## Appliances Installed in the state of Massachusetts:

This Appliance can only be installed in the state of Massachusetts by a Massachusetts licensed plumber or gas fitter. This appliance must be installed with a three (3) foot / 36 in. long flexible gas connector. A "T" handle type manual gas valve must be installed in the gas supply line to this appliance.

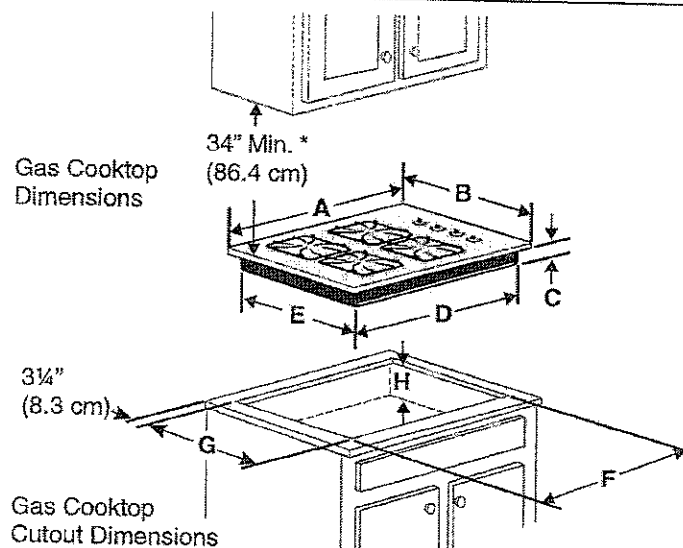

Figure 1

PRODUCT DIMENSIONS					
MODEL	A. WIDTH	B. DEPTH	C. HEIGHT	D. BOX WIDTH	E. BOX DEPTH
30" Gas Cooktop	30 (76.2)	21 <sup>3</sup> / <sub>8</sub> (55.2)	4 <sup>1</sup> / <sub>4</sub> (10.8)	28 (71.1)	19 <sup>3</sup> / <sub>8</sub> (49.2)
36" Gas Cooktop	36 (91.4)	21 <sup>3</sup> / <sub>8</sub> (55.2)	4 <sup>1</sup> / <sub>4</sub> (10.8)	33 <sup>7</sup> / <sub>8</sub> (85.4)	19 (48.3)
CUTOUT DIMENSIONS					
MODEL	F. WIDTH		G. DEPTH		H. HEIGHT BELOW COOKTOP
	MINIMUM	MAXIMUM	MINIMUM	MAXIMUM	
30" Gas Cooktop	28 <sup>1</sup> / <sub>4</sub> (71.8)	28 <sup>5</sup> / <sub>8</sub> (72.7)	19 <sup>3</sup> / <sub>8</sub> (49.2)	19 <sup>3</sup> / <sub>8</sub> (50.2)	8 (20.3)
36" Gas Cooktop	33 <sup>7</sup> / <sub>8</sub> (86)	34 <sup>1</sup> / <sub>4</sub> (87)	19 <sup>3</sup> / <sub>8</sub> (49.2)	19 <sup>3</sup> / <sub>8</sub> (50.2)	8 (20.3)

All dimensions are stated in inches and (cm).

Dimension H includes a 5" (12.7 cm) space underneath the cooktop for connection to gas supply line.

**NOTE: Wiring diagrams for this cooktop are enclosed in this booklet**

Printed in China

A01705101 (1406) Rev. A

English - pages 1-9

Español - páginas 10-18

Français - pages 19-26

Wiring Diagram 27-28

KG-89

# ELECTRIC WALL OVEN INSTALLATION INSTRUCTIONS

(and Optional Electric or Gas Cooktop Combination)

INSTALLATION AND SERVICE MUST BE PERFORMED BY A QUALIFIED INSTALLER.  
 IMPORTANT: SAVE FOR LOCAL ELECTRICAL INSPECTOR'S USE.  
 READ AND SAVE THESE INSTRUCTIONS FOR FUTURE REFERENCE.

United States  
and Canada



**WARNING** FOR YOUR SAFETY: Do not store or use gasoline or other flammable vapors and liquids in the vicinity of this or any other appliance.

Your new wall oven has been designed to fit a limited variety of cutout sizes to make the job of installing easier. The first step of your installation should be to measure your current cutout dimensions and compare them to the cutout dimensions chart below for your model. You may find little or no cabinet work being necessary.

**WARNING** Do not remove spacers (if equipped) on the side walls of the built-in oven. These spacers center the oven in the space provided. The oven must be centered to prevent excess heat buildup that may result in heat damage or fire.

## NOTES:

1. Base must be capable of supporting 150 pounds (68 kg) for 27" models and 200 pounds (90 kg) for 30" models.
2. Allow at least 21" (53.3 cm) clearance in front of oven for door depth when it is open.
3. Dimension G (cutout depth) is critical to the proper installation of the built-in oven. If the oven decorative trim does not butt against the cabinet, or if noise is heard on convection models, verify dimension G to assure it is the required depth.
4. For a cutout height greater than 28 1/4" (71.8 cm) add one 2" (5 cm) wide wood shim of appropriate height to each side of the opening under the appliance side rails.
5. For a cutout height (H) greater than 28 1/4" (71.8 cm) you can order a larger bottom trim through a Service Center.

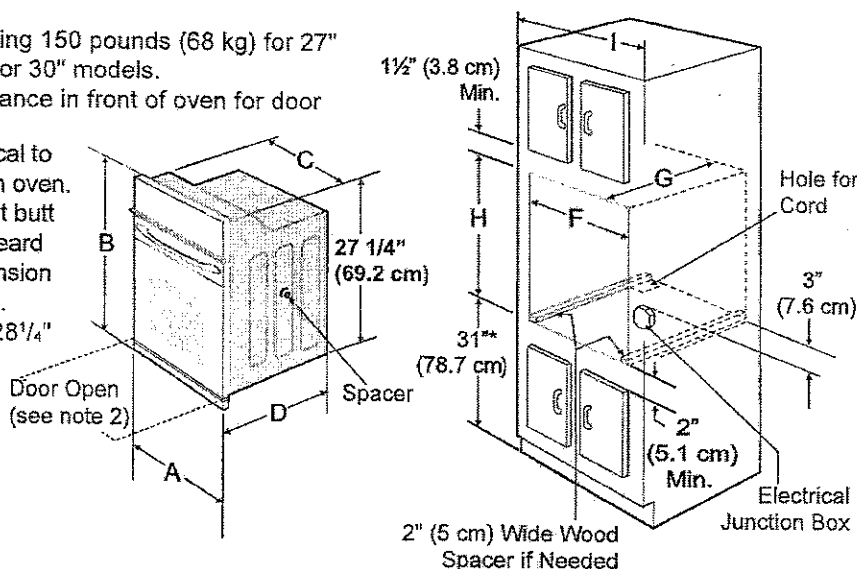

\* Suggested distance from floor is 31" (78.7cm).  
 Minimum required distance is 4 1/2" (11.4cm).

Figure 1  
 27" and 30" Single Wall Ovens (Double ovens see Figure 2)

PRODUCT DIMENSIONS						
MODEL	A		B	C		D
27" (68.6 cm) Wall Oven	27 (68.6)		29 (73.7)	24 <sup>5</sup> / <sub>8</sub> (62.5)		24 <sup>3</sup> / <sub>4</sub> (62.9)
30" (76.2 cm) Wall Oven	30 (76.2)		29 (73.7)	28 <sup>1</sup> / <sub>4</sub> (71.8)		24 <sup>3</sup> / <sub>4</sub> (62.9)
CUTOUT DIMENSIONS AND CABINET WIDTH						
MODEL	F		G (Min.)	H. Standard Height (**Others, see notes 4 & 5)		I
	Min.	Max.		Min.	Max.	
27" (68.6 cm) Wall Oven	24 <sup>7</sup> / <sub>8</sub> (63.2)	25 <sup>1</sup> / <sub>4</sub> (64.1)	24 (61.0)	27 <sup>1</sup> / <sub>4</sub> (69.2)	28 <sup>1</sup> / <sub>4</sub> (71.8)	27 <sup>1</sup> / <sub>8</sub> (68.9) Min
30" (76.2 cm) Wall Oven	28 <sup>1</sup> / <sub>2</sub> (72.4)	29 (73.7)	24 (61.0)	27 <sup>1</sup> / <sub>4</sub> (69.2)	28 <sup>1</sup> / <sub>4</sub> (71.8)	30 <sup>1</sup> / <sub>8</sub> (76.5) Min

All dimensions are in inches (cm).  
 Printed in U.S.A.

PN 807153701 Rev. D (16/05)  
 English – pages 1-8  
 Español – páginas 9-16  
 Français – pages 17-24

KG-89

## Similar Items At Lowe's Canada



**SAVE THE TAVERN**  
Steel Wall Mounted Range  
\$670.00



**IN STORE AND ONLINE**  
Maxair MXR-B01-30 Wall  
Mounted Range Hood  
\$617.00



Maxair MXR-203-30 Wall  
Mounted Range Hood  
\$617.00  
☆☆☆  
(1)



Discount reflected in cart  
Maxair MXR-B02-36 Wall  
Mounted Range Hood  
\$702.00

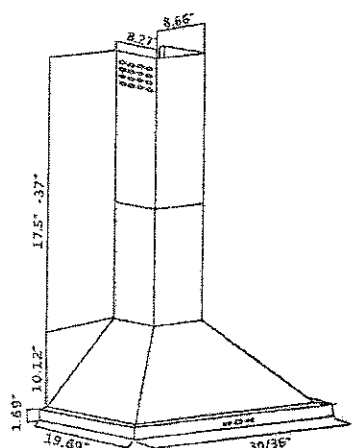

12929991S

## Maxair MXR-B02-36 Wall Mounted Range Hood

by Maxair

★★★★★ 5.0 (1) [Write a review](#) [Ask a question](#)Price **\$646.00** (Price includes Shipping)

Get 32 AIR MILES® Reward Miles

Estimated ship date Dec 29th - Jan 9th

Online Exclusive

Vendor Direct Shipping



Quantity

1

[Add to Cart](#)[Add to Compare](#)[Add to Wish List](#)[Shipping & Pick-up Policy](#) | [Return Policy](#)[View Larger](#) | [Share your images](#)[Description](#)[Dimensions](#)[Reviews](#)[Questions](#)

## Product Description

## Wall Mounted Range Hood

- Mounting version: Wall Mount
- Voltage: 120V @ 60 Hz (USA & Canada Standard)
- Speeds: 6 Speeds
- Motor: 360W Ultra Quiet Dual Chamber Motor
- Keypad: Buttons
- Lighting: 2 x 3.5W LED lights
- Venting Size: 6-in round duct vent
- Filters: Dishwasher Safe Stainless Steel Baffle Filters
- Material: Heavy Duty 19 Gauge Brushed Stainless Steel
- Features: Ultra-Slim
- Warranty: 1 year parts
- Amperage: 12A
- Wattage: 300W
- Dimensions: 35 7/8-in x 19.7-in x 28-39.5-in, (W x D x H)
- Airflow Max: 720 CFM
- Noise Level: Low Speed: 35dB to Max Speed: 67dB