

**Kleinburg Glen - 83L - 1 - 25-2 Elev.A HUDSON**  
**CERAMIC**

Inv.1,112	1 - MAIN BATH FLOOR TILE: UPG 5
Line17059	Note:
19Jan17 / 19Apr17	
Inv.1,112	1 - MAIN BATH WALL TILE: UPG 2
Line17060	Note:
19Jan17 / 19Apr17	
Inv.1,112	1 - MASTER ENSUITE FLOOR TILE: UPG 5
Line17061	Note: Floor / Tub Skirt / Tub Deck / Tub Splash
19Jan17 / 19Apr17	
Inv.1,112	1 - MASTER ENSUITE Shower Wall Tile: UPG 2
Line17068	Note:
19Jan17 / 19Apr17	
Inv.1,112	2 - MASTER ENSUITE SHOWER Floor & Ceiling Tile: UPG 1
Line17088	Note:
19Jan17 / 19Apr17	
Inv.1,112	1 - MASTER ENSUITE, MAIN BATH & POWDER ROOM: PLEASE DELETE ALL MIRRORS / ACCESSORIES / DELETE ALL VANITY LIGHT FIXTURES & HARDWARE
Line21052	Note:
19Jan17 / 19Apr17	

**ELECTRICAL**

Inv.791	1 - KITCHEN: 110V WALL RECEPTACLE ON DEDICATED CIRCUIT - FOR MICROWAVE - MICROWAVE NOT INCLUDED. See plan for location.
Line10687	Note:
29Aug16 / 14Nov16	
Inv.1,112	1 - KITCHEN: PLEASE LEAVE MICROWAVE PLUG ON BACKSPLASH, LEFT OF FRIDGE
Line17070	Note:
19Jan17 / 19Apr17	
Inv.1,112	1 - MASTER ENSUITE, MAIN BATH & POWDER ROOM: PLEASE DELETE ALL MIRRORS / ACCESSORIES / DELETE ALL VANITY LIGHT FIXTURES & HARDWARE
Line21053	Note:
19Jan17 / 19Apr17	

**EXTERIOR COLOURS**

Inv.791	1 - EXTERIOR COLOUR PACKAGE 4
Line13876	Note:
29Aug16 / 14Nov16	

**GLASS AND MIRROR**

Inv.791	1 - THRU OUT: DO *NOT* INSTALL MIRRORS
Line10686	Note:
29Aug16 / 14Nov16	
Inv.1,112	1 - MASTER ENSUITE, MAIN BATH & POWDER ROOM: PLEASE DELETE ALL MIRRORS / ACCESSORIES / DELETE ALL VANITY LIGHT FIXTURES & HARDWARE
Line17056	Note: Purchaser to supply and install all at own expense and warranty after closing
19Jan17 / 19Apr17	

**Kleinburg Glen - 83L - 1 - 25-2 Elev.A HUDSON**

Inv.1,112	1 - MASTER ENSUITE: FRAMELESS GLASS SHOWER IN LIEU OF FRAMED SHOWER
Line17062	Note:
19Jan17 / 19Apr17	

**GRANITE MARBLE QUARTZ**

Inv.1,112	1 - MAIN BATH COUNTERTOP: UPG 2 Marble
Line17057	Note:
19Jan17 / 19Apr17	

**KITCHEN AND BATH CABINETRY**

Inv.1,112	1 - MASTER ENSUITE, MAIN BATH & POWDER ROOM: PLEASE DELETE ALL CABINETRY DOOR HARDWARE
Line21054	Note:
19Jan17 / 19Apr17	

**MISC.**

Inv.791	1 - Purchaser has attended a Structural appointment at the Decor Centre & has DECLINED any additional upgrades and accepts and acknowledges that there will be no further structural changes/additions/deletions to be made upon signing on August 30, 2016.
Line10690	Note:
29Aug16 / 14Nov16	

Inv.791	1 - Purchasers are aware & accepts that ANY changes made to upgrades after signing this Purchasers Extra Form are subject to a minimum administration fee of \$500. PLUS a 10% holdback fee.
Line10691	Note:
29Aug16 / 14Nov16	

Inv.791	1 - BONUS PACKAGE: \$5,000.00 (INCLUDING TAXES) WORTH OF UPGRADES FROM GOLD PARK HOMES DÉCOR CENTRE IS BEING APPLIED TOWARD THE STRUCTURAL APPOINTMENT. PURCHASER HAS A REMAINING AMOUNT OF \$4293.75 (INCLUDING TAXES) TO BE USED TOWARD THE COLOUR APPOINTMENT.
Line10692	Note:
29Aug16 / 14Nov16	

Inv.1,112	1 - Purchasers are aware & accepts that ANY changes made to upgrades after signing this Purchasers Extra Form are subject to a minimum administration fee of \$500. PLUS a 10% holdback fee.
Line17091	Note:
19Jan17 / 19Apr17	

Inv.1,112	1 - Purchaser has attended a Colour appointment at the Decor Centre & has DECLINED any additional upgrades and accepts and acknowledges that there will be no further structural changes/additions/deletions to be made upon signing.
Line17090	Note:
19Jan17 / 19Apr17	

Inv.1,112	1 - Purchaser Accepts Standard Appliance Openings: Fridge - 37-1/2"W x 73-1/2" High Approx. Range - 30-1/2"D x 31-1/2"W Approx. Dishwasher - 24" W Approx
Line17094	Note:
19Jan17 / 19Apr17	

Inv.1,112	1 - REMAINING BONUS PACKAGE: \$4,293.75 (INCLUDING TAXES) WORTH OF UPGRADES FROM GOLD PARK HOMES DÉCOR CENTRE IS BEING APPLIED TOWARD THE STRUCTURAL APPOINTMENT. PURCHASER HAS A REMAINING AMOUNT OF \$00 (INCLUDING TAXES)
Line17092	Note:
19Jan17 / 19Apr17	

Kleinburg Glen - 83L - 1 - 25-2 Elev.A HUDSON

Inv.1,112	1 - Due to the many variables that can affect the pattern, colour and/or design and "pitting" of natural products, granite installed will not be identical to the samples displayed.
Line17095	Note: Every effort is made to provide granite counter tops as close as possible but the vendor is not responsible for results which differ from the sample displayed. All countertop surfaces may have seems & product pattern & shade can change in areas containing seems.
19Jan17 / 19Apr17	

PLUMBING

Inv.791	1 - KITCHEN: ROUGH - IN - WATERLINE FOR FRIDGE
Line10688	Note:
29Aug16 / 14Nov16	

PLUMBING FIXTURES

Inv.1,112	1 - MAIN BATH: UPG Vanity Sink Camden 16" Square 4210CHY
Line17058	Note: Includes polished cut out for undermount sink. See spec sheet attached
19Jan17 / 19Apr17	

Purchasers: Viaqas Ahmad & Sadeef Ahmad

Property: 83L

Telephone Res. / Bus: (647) 408-2481

Project: Burkshire Holdings Inc.

Decor Advisor: Laura Lofaro

Model and Elevation: 25-2 Elev.A HUDSON

Layout Changes: ☐ Yes ☐ No Sketch Attached: ☐ Yes ☐ No Exterior Colour Scheme:

**1. Cabinetry**

	Style and Colour	Counter	Hardware
Kitchen / Breakfast	Varese PVC WhtCrystal	Granite Pol. Grigio Sardo STD FE20 Edge	CS1-25
Laundry Room	N/A		
Powder Room	N/A		
Master Ensuite Bathroom	Varese PVC WhtCrystal	Wilsonart Pearl Soapstone 4886-38	N/A
Second Ensuite Bathroom (If Applicable)			
Main Bath	Varese PVC WhtCrystal	*Marble Pol. Volakis STD FE20 Edge	N/A
Dishwasher Cabinet			

Comment

**2. Floor Tile**

	Selection	Grout	Threshold
Entrance Vestibule	13x13 Carrera X Series White/Grey		
Main Hall	13x13 Carrera X Series White/Grey		
Kitchen / Breakfast	13x13 Carrera X Series White/Grey		
Laundry Room	13x13 Carrera X Series White/Grey		
Powder Room	13x13 Carrera X Series White/Grey		
Master Ensuite Bathroom	*24x24 Himalyan Series Grey		
Second Ensuite Bathroom (If Applicable)	N/A		
Lower Landing (If Applicable)	N/A		
Main Bath	*24x24 Timeless Series Light Grey Pol.		

Comment

MASTER ENSUITE: Floor / Tub Skirt / Tub Deck / Tub Splash

**3. Wall Tile**

	Selection	Listello/Inserts	Describe
		<input type="radio"/> Yes <input checked="" type="radio"/> No	
Master Ensuite Bathroom			
Tub Deck	*SEE Floor Tile	<input type="radio"/> Yes <input checked="" type="radio"/> No	
Shower Stall	*See Comments	<input type="radio"/> Yes <input checked="" type="radio"/> No	
Bathroom Walls	SHOWER FLOOR-See Comments	<input type="radio"/> Yes <input checked="" type="radio"/> No	
Second Ensuite Bathroom (If Applicable)	N/A	<input type="radio"/> Yes <input checked="" type="radio"/> No	
Main Bath	*3x6 Chess Bevelled Tender Grey	<input type="radio"/> Yes <input checked="" type="radio"/> No	*WHITE GROUT PLEASE**

Kitchen Backsplash ☐ Yes ☒ No

Backsplash Behind Fridge

Comment

MASTER ENSUITE SHOWER WALL: Cristallo Glass Tile Interlock (Brick) Design - Blend DOVE GREY 0,6"x1,9" CODE KV.CR.DGY.0,6X1,9BL  
MASTER ENSUITE Shower Floor & Ceiling - Ontario Hexagon Glossy Snow White 11,9"x10,7" OD.ON.SWT.02.HEX.GL

VA SA

Purchasers: Viaqas Ahmad & Sadeef Ahmad

Property: 83L

Telephone Res. / Bus: (647) 408-2481

Project: Burkshire Holdings Inc.

Decor Advisor: Laura Lofaro

Model and Elevation: 25-2 Elev.A HUDSON

#### 4. Plumbing Fixtures

<input type="text"/>	<b>Second Ensuite</b>	<input type="text"/>	<b>Powder Room</b>	<input type="text"/>
<b>Master Ensuite Bathroom</b>	<input type="text"/>	<b>Other Room - Specify</b>	<input type="text"/>	<b>Other Washroom</b>
<input type="text"/>	<input type="text"/>	<input type="text"/>	<input type="text"/>	<input type="text"/>

##### Comment

STD Plumbing fixtures throughout Except Main Bathroom Vanity sink - Contrac Camden 16" 4210CHY

#### 5. Hardwood Flooring

	Type and Stain		Type and Stain
Main Hall	<input type="text" value="N/A"/>	Upper Landing	<input type="text" value="N/A"/>
Kitchen / Breakfast	<input type="text" value="N/A"/>	Upper Hall	<input type="text" value="N/A"/>
Living Room	<input type="text" value="Preverco Natural Oak 4-1/4"/>	Master Bedroom	<input type="text" value="N/A"/>
Dining Room	<input type="text" value="Preverco Natural Oak 4-1/4"/>	Bedroom #2	<input type="text" value="N/A"/>
Family Room	<input type="text" value="Preverco Natural Oak 4-1/4"/>	Bedroom #3	<input type="text" value="N/A"/>
Den/Library	<input type="text" value="N/A"/>	Bedroom #4	<input type="text" value="N/A"/>
Entrance Vestibule	<input type="text" value="N/A"/>	Bedroom #5	<input type="text" value="N/A"/>
Lower Landing (If Applicable)	<input type="text" value="Preverco Natural Oak 4-1/4"/>	Other Room - Specify	<input type="text" value="N/A"/>

##### Comment

#### 6. Carpeting

	Upgrade	Description
Main Hall	<input type="checkbox"/>	<input type="text" value="N/A"/>
Living Room	<input type="checkbox"/>	<input type="text" value="N/A"/>
Dining Room	<input type="checkbox"/>	<input type="text" value="N/A"/>
Family Room	<input type="checkbox"/>	<input type="text" value="N/A"/>
Den/Library	<input type="checkbox"/>	<input type="text" value="N/A"/>
Upper Hall	<input type="checkbox"/>	<input type="text" value="T15"/>
Master Bedroom	<input type="checkbox"/>	<input type="text" value="T15"/>
Bedroom #2	<input type="checkbox"/>	<input type="text" value="T15"/>
Bedroom #3	<input type="checkbox"/>	<input type="text" value="T15"/>
Bedroom #4	<input type="checkbox"/>	<input type="text" value="N/A"/>
Bedroom #5	<input type="checkbox"/>	<input type="text" value="N/A"/>
<input type="text"/>	<input type="checkbox"/>	<input type="text"/>
Upper Landing (If Applicable)	<input type="checkbox"/>	<input type="text" value="N/A"/>
Lower Landing (If Applicable)	<input type="checkbox"/>	<input type="text" value="N/A"/>

<b>Upgrade Underpad</b>	<b>Type</b>	<b>Area</b>
	<input type="text" value="STD"/>	<input type="text"/>
<b>Carpet on Stairs</b>	<b>Capped</b>	<b>Runner - *Upgrade</b>
	<input type="text" value="N/A"/>	<input type="text"/>

##### Comment

SAVIA

Purchasers: Viaqas Ahmad & Sadeef Ahmad

Property: 83L

Telephone Res. / Bus: (647) 408-2481

Project: Burkshire Holdings Inc.

Decor Advisor: Laura Lofaro

Model and Elevation: 25-2 Elev.A HUDSON

## 7. Fireplace

Living Room			Family Room			Other Room - Specify		
Purchased	As Per Plan	N/A	Purchased	As Per Plan	N/A	Purchased	As Per Plan	N/A
<input type="radio"/>	<input checked="" type="radio"/>	<input type="radio"/>	<input type="radio"/>	<input type="radio"/>	<input type="radio"/>	<input type="radio"/>	<input type="radio"/>	<input type="radio"/>

Fireplace Type	STD Gas		
Mantle Type	STD		
Colour / Stain	STD		
Surround	STD		
Hearth	Declined		

Comment

## 8. Trim Carpentry

Interior Doors	STD	Front Door Glass Inserts	STD	Door Handles	STD
Interior Trim	STD				

Comment

## 9. Plaster Mouldings and Medallions

Entrance Vestibule	N/A		Kitchen/Breakfast	N/A	
Main Hall	N/A		Den/Library	N/A	
Living Room	N/A		Lower Landing	N/A	
Dining Room	N/A		Other Room - Specify	N/A	
Family Room	N/A				

Comment

## 10. Railings and Spindles

Railing Package	STD Oak	Spindle Colour	Natural Oak - SA VA
Railing Colour	STD Natural Oak	Treads	STD Natural Oak
Stringer / Riser	STD Natural Oak	Oak Stairs	<input checked="" type="radio"/> Yes <input type="radio"/> No

Comment

## 11. Wall Paint

Main & Upper Hall		Master Bedroom	
Living Room		Bedroom #2	
Dining Room		Bedroom #3	
Kitchen / Breakfast		Bedroom #4	
Family Room		Bedroom #5	
Powder Room		Master Ensuite	
Laundry Room			
Den/Library		Second Ensuite	
Trim Paint	White	Thru-Out	Cool White

Comment

Smooth Ceilings First Floor

Scheduled Closing Date: February-13-17

Purchasers: Viaqas Ahmad & Sadeef Ahmad

Property: 83L

Telephone Res. / Bus: (647) 408-2481

Project: Burkshire Holdings Inc.

Decor Advisor: Laura Lofaro

Model and Elevation: 25-2 Elev.A HUDSON

## 12. Electrical

Plugs and Switches ☒ White ☐ Ivory

Hood Fan ☐ White ☐ Ivory

Appliances

Built in Cooktop

Built in Oven

Gas Stove

Microwave

☐ Yes ☒ No

☐ Yes ☒ No

☐ Yes ☒ No

☒ Yes ☐ No

Comment

~~SS HOOD FAN. Purchaser to supply hood fan at own expense and liability of closing.~~

SS HOOD FAN

SA: V.A

## 13. Heating and Air Conditioning

Air Conditioning

Gas Provisions Dryer

Gas Provisions Stove

Gas Provisions Barbecue

Comment

## 14. Additional Comments

## 15. Disclaimers and Notes

- 1) Colours of all materials are as close as possible to builder's selection, but not necessarily identical due to variances in manufacturing.
- 2) Any extras listed above are null and void unless accompanied by a separate invoice/amendment. Said invoice must be paid in full.
- 3) The Purchaser acknowledges that after Interior Colour Selection form is signed and dated, no further changes will be permitted other than re-selection due to unavailability. SA Purchaser's Initials
- 4) The Purchaser acknowledges reading and accepting the "Gold Park Homes Decor Centre Disclaimers" form. This document contains other miscellaneous disclaimers.

This Interior Colour Selection is final and approved by:

Signature:

Date:

Feb 2/17

Signature:

Date:

Feb 2/17

# Camden

4210CHY 16" Square Undermount Sink

2016 decor center catalogue

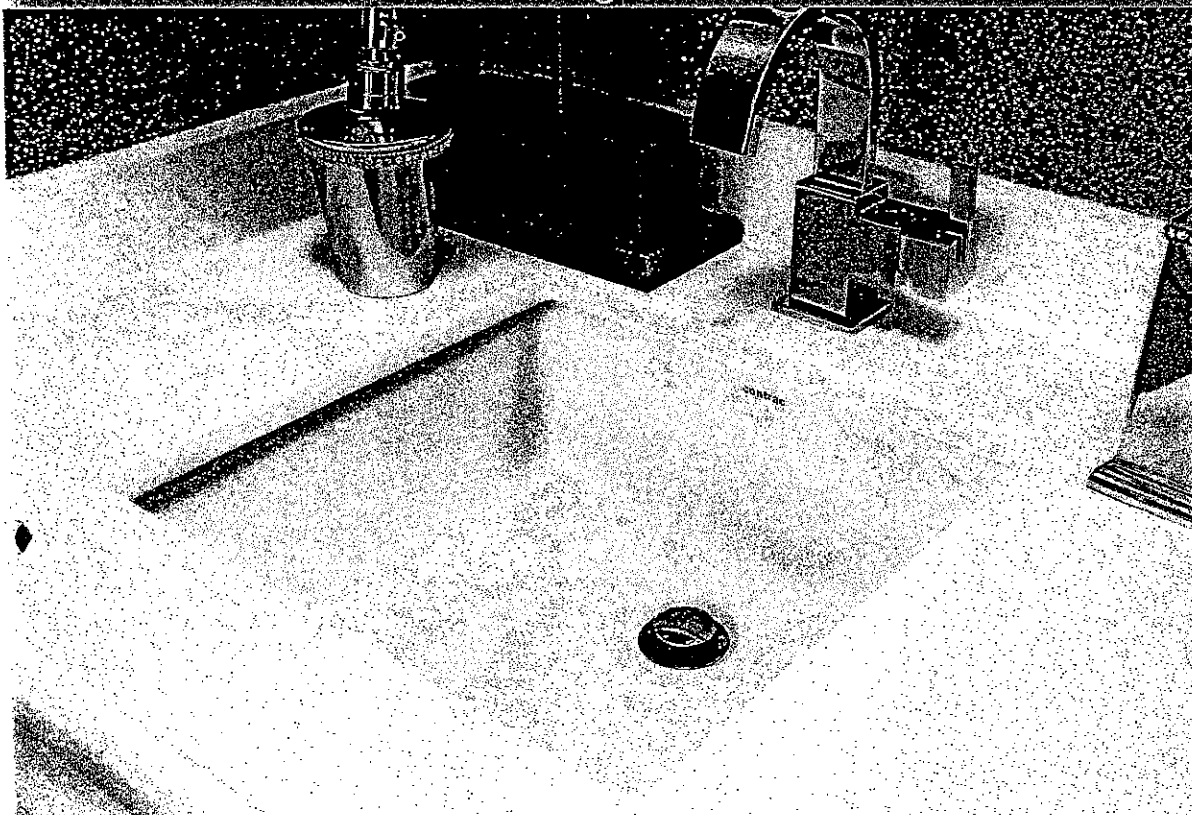

## FEATURES

Vitreous china  
Front overflow hole  
Template and mounting hardware supplied  
Overall dimensions (W x D x H):  
(OD) 16" x 16" x 7 1/4"  
(ID) 13 3/8" x 13 3/8" x 5 1/2"

## CERTIFICATIONS

IAPMO cUPC  
ASME A112.19.2 / CSA B45.1-2008

## COLOUR

Soft white

LOT No.: 83L

ROOM: MAIN BATH

DATE: FEB. 2. 2017

SIGNATURE: SA VA

Kleinforg

GOLDPARK

WORTH MORE



# CORTINA

KITCHENS INC.

70 Regina Road Woodbridge ON L4L 8L6  
905-264-6464

## INFORMATION - PVC DOORS

Builder Gold Park Homes Project KLEINBURG GLEN Lot # 83L

All cabinets with PVC (Thermofoil) Doors come with melamine gables, panels and kick. The doors, crown moulding and light valance are PVC wrapped. Open shelves incorporated in design will only be available with melamine interiors. There will be variations in colour shades between the PVC parts (doors, crown and Light valance) and the melamine parts (open shelves, Gables, Panels and Kick) due to the difference in material.

Furring Panel with crown moulding to the ceiling is not available on all PVC door styles due to subtle variations in colour shades between the PVC parts (moulding) and the melamine parts (furring panel) due to the difference in material. Grain directions in wood grain pattern melamine, vary between the furring panel, crown moulding (horizontal) and the PVC doors (vertical).

Thank you for your understanding.

I am well informed of this information, and agree to the purchase of the above.

Purchaser: 

Date: FEB- 2 2017

Purchaser: 

Date: FEB 2/17

## STANDARD HARDWARE



CSI-6



CSI-10



CSI-14



CSI-16



CSI-18

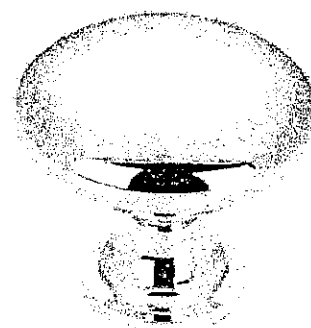

CSI-19

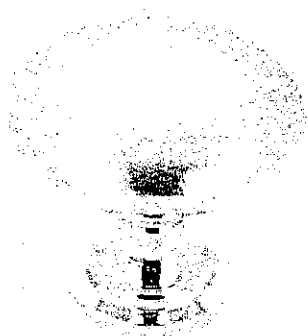

CSI-20

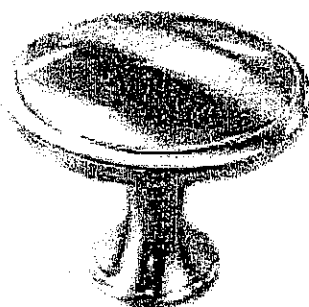

CSI-21



CSI-22

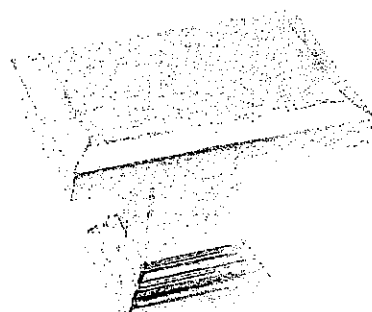

CSI-23

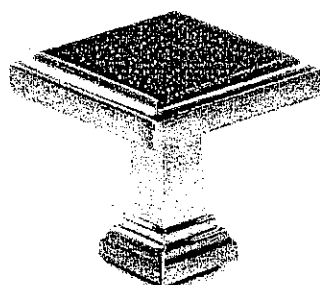

CSI-24

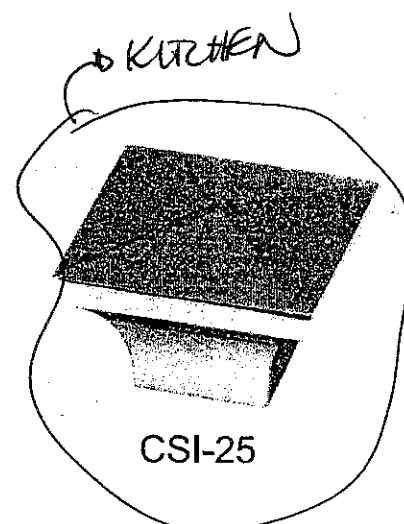

CSI-25

**\*NOTES:**

- IMAGES ARE FOR QUICK REFERENCE PURPOSES ONLY
- ACTUAL SIZES AND FINISHES AS PER HARDWARE SAMPLE BOARD PROVIDED TO DECOR CENTRE

V6-83L

SA-VA

FEB. 2. 2017

# CORTINA

KITCHENS INC.

70 Regina Road, Woodbridge, ON L4L 8L6  
Tel:(905) 264-6464 Fax:(905) 264-0664

December, 2008

## MASTER ENSUITE & MAIN BATH POLICY MEMO FOR BUILDERS

### DRILLING FOR KNOB AND HANDLE HARDWARE

Builder: GOLDPARK HOMES

Project: KLEINBURG GLEN

Lot #: 83L

Date: FEB. 2. 2017

Cortina Kitchens' cabinetry doors and drawer fronts will be drilled to accept a standard knob or handle selected from Cortina's hardware boards. This drilling comes standard with the order, and is done ONLY in our shop, not on the job site.

For those not wanting Cortina's standard drilling, the following applies:

No holes to be drilled on the doors and drawer fronts should be specified in writing on the order. If while in production, Cortina Kitchens misses this request, Cortina Kitchens and the Builder will not be held responsible to replace any or all doors and drawer fronts affected, and the customer agrees to accept the product as is. No hardware will be supplied or credited by Cortina Kitchens. No charge will apply for this request.

I, Sadat, Vignos, have read and agree to the above information.

Customer Signature:

[Signature]

Date:

FEB 21 17

**GOLDPARK**  
H O M E S

**Kleinburg**

**Granite, Marble,  
Engineered Surfaces**

- Standard 2CM & 3CM
- ⊖ Upgrade 1 2CM & 3CM
- ⊗ Upgrade 1 4 CM
- Upgrade 2

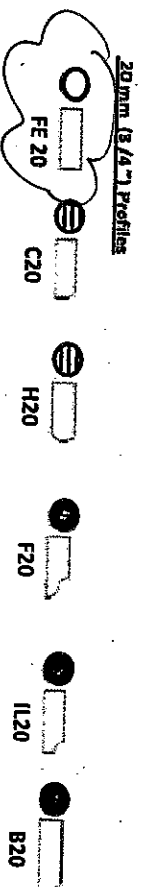

KITCHEN +  
MAIN BATH  
EDGE

**30mm (1 1/4") Profiles**

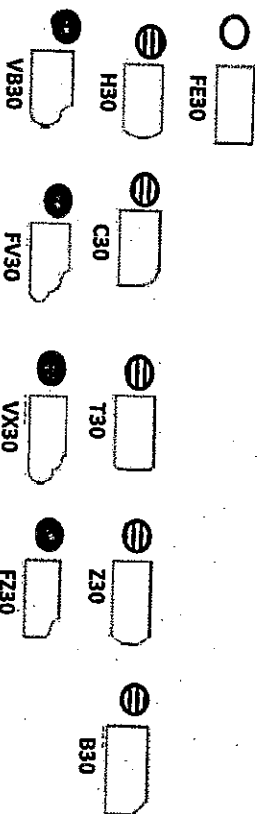

**40mm (1 1/2") Profiles**

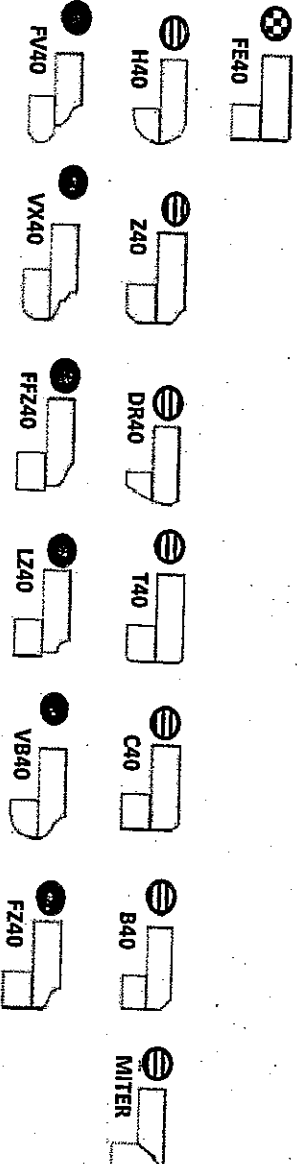

Note: All colours may not be available in 30mm at time ordered. Vendor reserves the right to use 40 mm edges (by lamination process).

\*Mitre edge is available in Upgrade 1 for an overall thickness of 2". All other Mitre edge options will be an Upgrade 2 Edge.

46-83L

NA

FEB. 2. 2017

<b>Trade Name:</b> Gold Park Homes	<b>Site location:</b>	<b>Model:</b> 25-2
<b>Address:</b>	<b>Project:</b> Kleinburg Glen	<b>Phase:</b>

This layout has been explained to the purchaser by Cortina Kitchens Inc. and is understood by the purchaser.

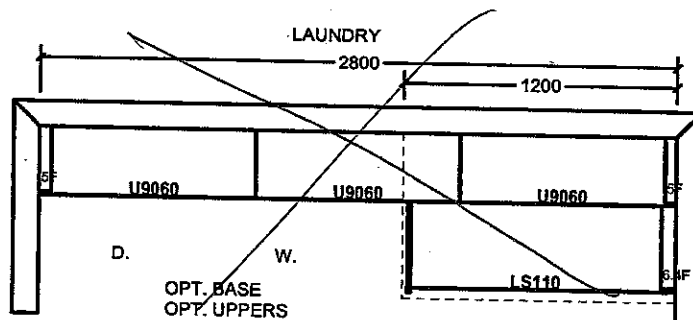
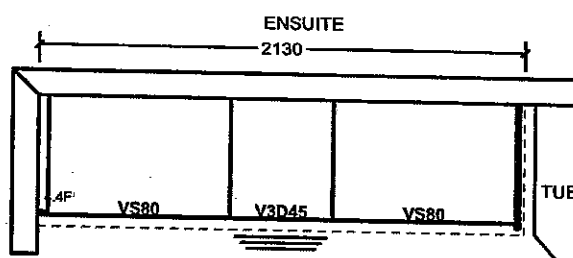
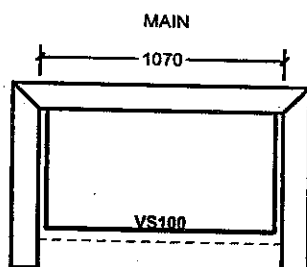
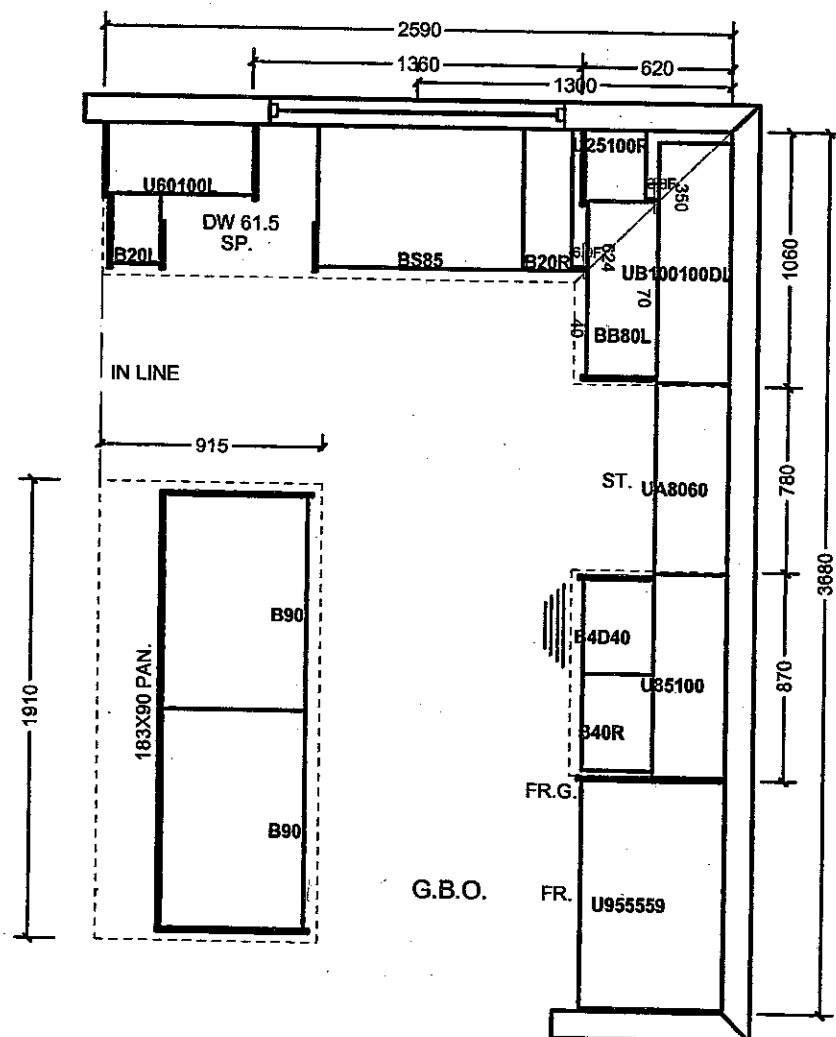

**All prices subject to confirmation from head office.  
This quotation is subject to the terms & conditions set  
out**

ACCEPTED DATE:

**All agreements are contingent upon strikes, accidents, and delays beyond our control. Please provide our installer with template for sinkholes or \$150.00 will be charged for callback.**

Item A. Wood grain and colour are characteristics of the product. We cannot guarantee that such grain and colour will always match.  
Item B. Corfina Kitchens Inc. reserves the right to alter dimensions and make technical changes without notice.

Elevation A • 1,898 sq.ft.

Elevation B • 1,898 sq.ft.

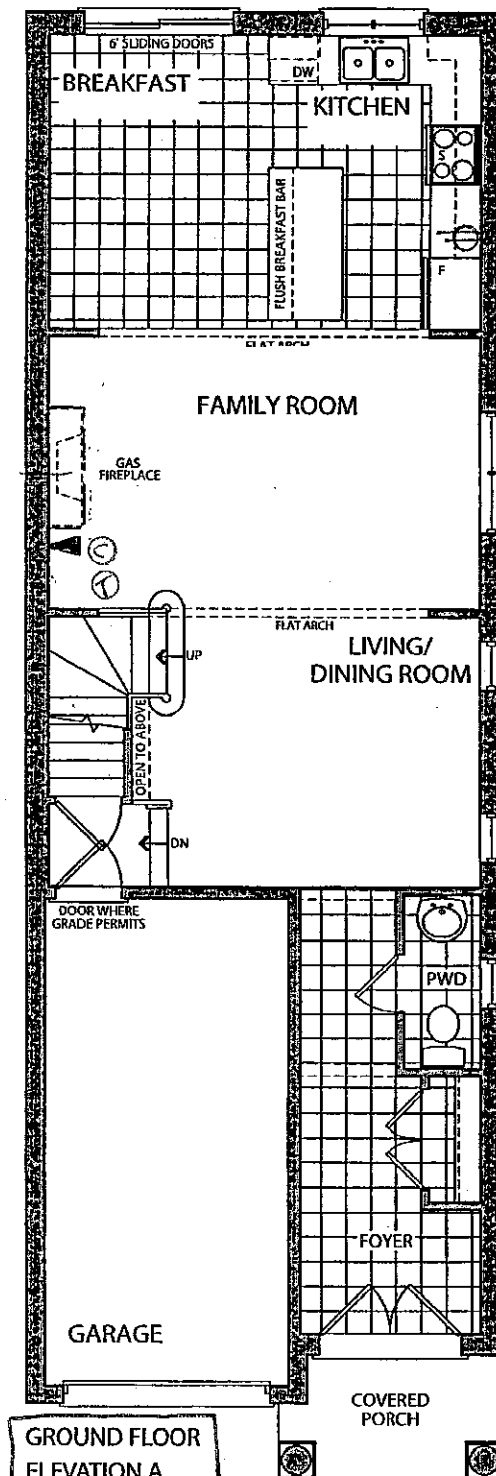

GROUND FLOOR  
ELEVATION A

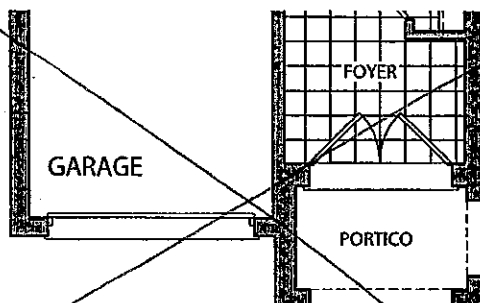

GROUND FLOOR  
ELEVATION B

No PHONE  
in KITCHEN.

MICRO

STRUCTURAL

August 30 2016

LOT 83L

(S.A.) (V.A.)

Colours

SA VA

FEB 2, 2017

Elevation A • 1,898 sq.ft.

Elevation B • 1,898 sq.ft.

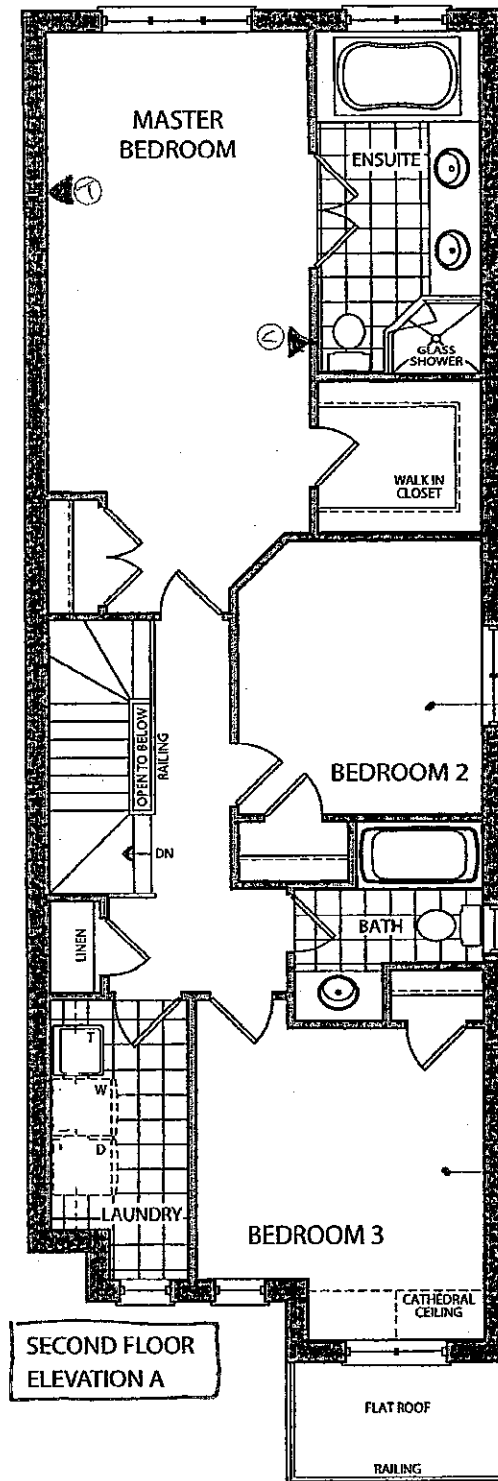

No PHONE!

No PHONE!

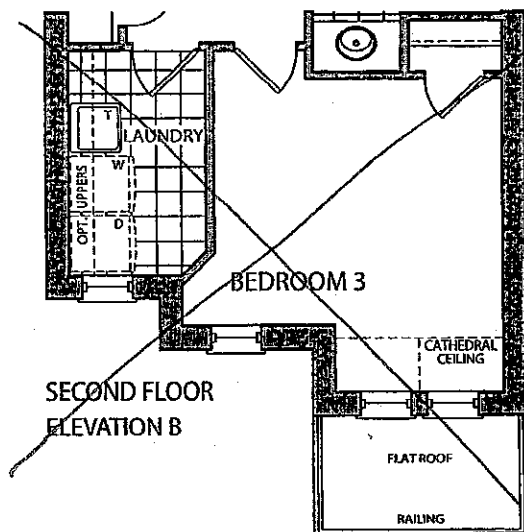

STRUCTURAL

AUGUST 30 2016

LOT 83L

SA. VA.

COLOURS

SA. VA.

FEB. 2. 2017

Elevation A • 1,898 sq.ft.

Elevation B • 1,898 sq.ft.

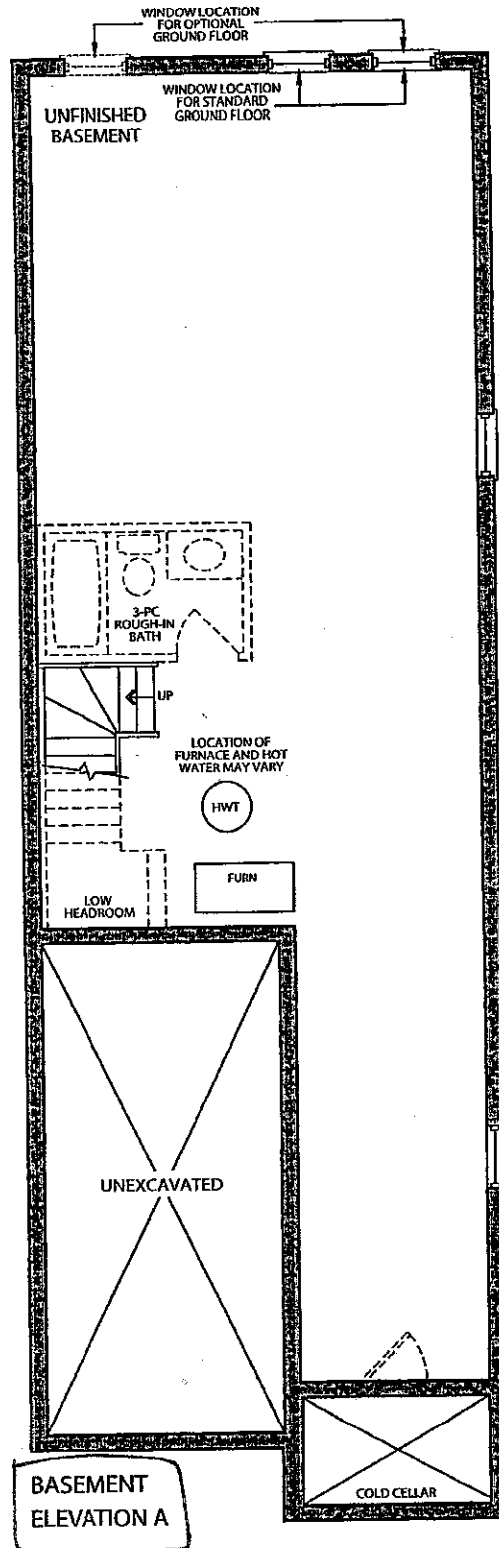

BASEMENT  
ELEVATION A

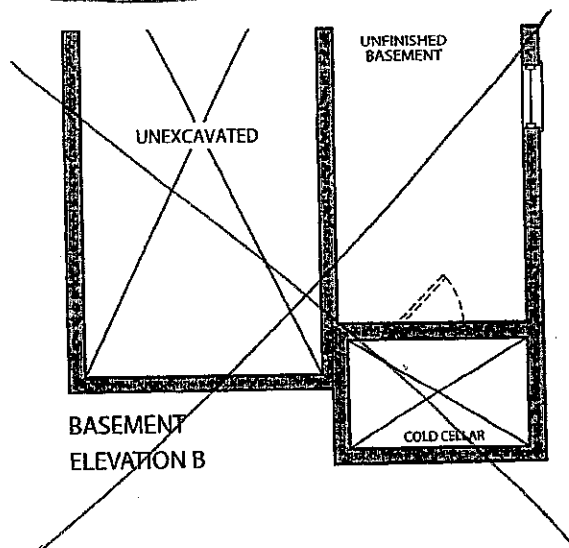

BASEMENT  
ELEVATION B

Structural  
 August 30 2016

LOT 83L

SA      VA

Columns

SA VA

FEB. 2. 2017