

**Kleinburg Glen - 61 - 1 - 42-3 Elev.B CARLTON**
**CERAMIC**

Inv.1,103	<b>1 - KITCHEN FLOOR TILE: Upgrade 5 - 24x24" Regal Polished</b>
Line16628	Note:
16Jan17 / 24Feb17	
Inv.1,103	<b>1 - Thru out: Grout lines as small as possible, please!</b>
Line16629	Note:
16Jan17 / 24Feb17	
Inv.1,103	<b>1 - POWDER ROOM: Upgrade 5 - 24x24" Regal polished</b>
Line16631	Note:
16Jan17 / 24Feb17	
Inv.1,103	<b>1 - MASTER ENSUITE: Upgrade 4 floor tile - 18x18" Must polished - laid in straight, stacked pattern</b>
Line16639	Note:
16Jan17 / 24Feb17	
Inv.1,103	<b>1 - ENSUITE 2: SHOWER WALL TILE - upgrade 1 - 4x16" CDC- laid in horizontal, stacked pattern.</b>
Line16648	Note:
16Jan17 / 24Feb17	
Inv.1,103	<b>1 - TWIN BATH: TUB/SHOWER WALL TILE - upgrade 1 - 2X8" CDC- laid in horizontal, stacked pattern.</b>
Line16713	Note:
16Jan17 / 24Feb17	
Inv.1,103	<b>1 - ENSUITE 2 SHOWER: DO *not* DROP CEILING ABOVE SHOWER - Shower jambs to be applied to ceiling. Price includes taller glass fixed panels and taller, full height glass door (for future steam shower). Price per Sergio Jan 26 2017</b>
Line18133	Note:
16Jan17 / 24Feb17	
Inv.1,103	<b>1 - MASTER ENSUITE SHOWER: DO *not* DROP CEILING ABOVE SHOWER - Shower jambs to be applied to ceiling. Price includes taller glass fixed panels and taller, full height glass door (for future steam shower). Price per Sergio Jan 26 2017</b>
Line18134	Note:
16Jan17 / 24Feb17	

**DRYWALL**

Inv.602	<b>1 - SMOOTH CEILINGS - (2 - Story Design) 2ND FLOOR</b>
Line7392	Note:
23Jun16 / 13Oct16	
Inv.1,103	<b>1 - MASTER ENSUITE SHOWER: DO *not* DROP CEILING ABOVE SHOWER - Shower jambs to be applied to ceiling. Price includes taller glass fixed panels and taller, full height glass door (for future steam shower). Price per Sergio Jan 26 2017</b>
Line18136	Note: *PURCHASER HAS RAINSHOWER HEAD
16Jan17 / 24Feb17	

**ELECTRICAL**

Inv.602	<b>1 - 200 AMP ELECTRICAL SERVICE</b>
Line7390	Note:
23Jun16 / 13Oct16	
Inv.602	<b>1 - KITCHEN: Single pole switch for puck lights in upper cabinets</b>
Line9492	Note:
23Jun16 / 13Oct16	

**Kleinburg Glen - 61 - 1 - 42-3 Elev.B CARLTON**

Inv.602	<b>1 - KITCHEN: ROUGH - IN CEILING OUTLET ON SAME SWITCH - DOES NOT INCLUDE FIXTURE - Locate above island, on same switch as standard light. See plan for location.</b>
Line9490	Note:
23Jun16 / 13Oct16	
Inv.602	<b>1 - KITCHEN: Install a 110V WALL RECEPTACLE ON DEDICATED CIRCUIT - FOR future 600+cfm hood fan.</b>
Line7409	Note:
23Jun16 / 13Oct16	
Inv.602	<b>1 - KITCHEN: 240v / 50a Outlet for future micro/oven combo unit.</b>
Line9486	Note:
23Jun16 / 13Oct16	
Inv.602	<b>1 - KITCHEN: 110V WALL RECEPTACLE ON DEDICATED CIRCUIT - GAS FIRED APPLIANCE - FOR AUX. EQUIPMENT - NOT A STOVE PLUG</b>
Line9487	Note:
23Jun16 / 13Oct16	
Inv.602	<b>1 - KITCHEN: RELOCATE STANDARD FIXTURE - Locate above island, see plan for location.</b>
Line9489	Note:
23Jun16 / 13Oct16	
Inv.602	<b>2 - KITCHEN: KITCHEN CABINET INTERIOR CABINET LIGHT - EACH PUCK LIGHT - DOES NOT INCLUDE (AND REQUIRES) KITCHEN UPGRADE PRICING -locate 1 in each upper cabinet either side of cook top.</b>
Line9491	Note:
23Jun16 / 13Oct16	
Inv.602	<b>1 - MASTER ENSUITE: RELOCATE STANDARD FIXTURE - Locate above sink</b>
Line9716	Note:
23Jun16 / 13Oct16	
Inv.602	<b>1 - REAR EXTERIOR: ADDITIONAL EXTERIOR COACH LIGHT ON SAME SWITCH (BUILDER STANDARD FIXTURE) - In addition to builders standard light, add 1 light - locate 1 on either side of double doors - See plan for location.</b>
Line9541	Note:
23Jun16 / 13Oct16	
Inv.602	<b>1 - MASTER ENSUITE: ROUGH - IN WALL OUTLET ON SAME SWITCH - DOES NOT INCLUDE FIXTURE - LOCATE approx. center above sink. See plan for location.</b>
Line9715	Note:
23Jun16 / 13Oct16	
Inv.1,103	<b>1 - KITCHEN: Add 110V WALL RECEPTACLE ON NORMAL CIRCUIT - for future wine fridge. See plan for location.</b>
Line17970	Note:
16Jan17 / 24Feb17	
Inv.1,103	<b>1 - Add potlight built-in to cabinet, price includes cut outs and 1 transformer</b>
Line18131	Note:
16Jan17 / 24Feb17	

**EXTERIOR COLOURS**

Inv.602	<b>1 - EXTERIOR COLOUR PACKAGE 2</b>
Line12599	Note:
23Jun16 / 13Oct16	

**FRAMING**

**Kleinburg Glen - 61 - 1 - 42-3 Elev.B CARLTON**

Inv.602	<b>1 - MAIN FLOOR CEILING 10FT- INCLUDES: TALLER FRONT DOOR WITH TRANSOM, TALLER FRONT AND REAR ELEVATION WINDOWS OR WITH TRANSOM, EXTRA TALL FLAT ARCHES, 8' TALL INTERIOR DOORS, WITH KITCHEN CROWN AND FURRING PANEL,</b>
Line7391	Note:
23Jun16 / 13Oct16	
Inv.602	<b>1 - OPTIONAL 10 FOOT TRAY CEILING - MASTER BEDROOM</b>
Line9496	Note:
23Jun16 / 13Oct16	
Inv.602	<b>1 - KITCHEN: *REDUCE* BULKHEADS AS MUCH AS POSSIBLE. TO ALLOW FOR FUTURE FURRING PANEL AND CROWN MOULDING TO HIDE BULKHEADS. (all cabinets to be same height)</b>
Line9485	Note:
23Jun16 / 13Oct16	
Inv.602	<b>1 - STANDARD DOOR EXTENDED HEIGHT 96 INCH (PRICE PER DOOR) - SECOND FLOOR 2 STOREY 38 FOOT AN 42 FOOT MODELS ONLY</b>
Line12597	Note:
23Jun16 / 13Oct16	
Inv.602	<b>1 - UPPER HALL &amp; MASTER BEDROOM: Increase Archway to 8' height (PRICE PER DOORWAY) See plan for location.</b>
Line12598	Note:
23Jun16 / 13Oct16	
Inv.1,103	<b>1 - MASTER ENSUITE SHOWER: DO *not* DROP CEILING ABOVE SHOWER - Shower jambs to be applied to ceiling. Price includes taller glass fixed panels and taller, full height glass door (for future steam shower). Price per Sergio Jan 26 2017</b>
Line16710	Note:
16Jan17 / 24Feb17	
Inv.1,103	<b>1 - KITCHEN NOTE: **DELETE** BULKHEAD thru out kitchen. Cabinetry to be stacked to ceiling at cooktop. Cabinets will touch ceiling above pantry wall.</b>
Line16748	Note:
16Jan17 / 24Feb17	
Inv.1,103	<b>1 - ENSUITE 2 SHOWER: DO *not* DROP CEILING ABOVE SHOWER - Shower jambs to be applied to ceiling. Price includes taller glass fixed panels and taller, full height glass door (for future steam shower). Price per Sergio Jan 26 2017</b>
Line17889	Note:
16Jan17 / 24Feb17	
Inv.1,103	<b>1 - GREAT ROOM: Standard Fireplace to be centered on wall.</b>
Line17980	Note:
16Jan17 / 24Feb17	
Inv.1,137	<b>1 - MAIN FLOOR: Remove side windows, reframe and install taller windows</b>
Line18849	Note:
26Jan17 / 13Mar17	

**GLASS AND MIRROR**

Inv.602	<b>1 - CONVERT FRAMED SHOWER TO 10MM FRAMELESS SHOWER ENCLOSURE WITH DOOR AND 10MM SIDE PANEL</b>
Line7395	Note:
23Jun16 / 13Oct16	
Inv.1,103	<b>1 - ENSUITE 2 SHOWER: DO *not* DROP CEILING ABOVE SHOWER - Shower jambs to be applied to ceiling. Price includes taller glass fixed panels and taller, full height glass door (for future steam shower). Price per Sergio Jan 26 2017</b>
Line18132	Note:
16Jan17 / 24Feb17	

**Kleinburg Glen - 61 - 1 - 42-3 Elev.B CARLTON**

Inv.1,103	1 - MASTER ENSUITE SHOWER: DO *not* DROP CEILING ABOVE SHOWER - Shower jambs to be applied to ceiling. Price includes taller glass fixed panels and taller, full height glass door (for future steam shower). Price per Sergio Jan 26 2017
Line18135	Note:
16Jan17 / 24Feb17	

**HARDWOOD**

Inv.1,103	1 - GREAT ROOM / DEN / LIVING/DINING HARDWOOD FLOOR: 3/4 x 3-1/2" Vintage Red Oak (Smooth)
Line16632	Note:
16Jan17 / 24Feb17	

Inv.1,103	1 - UPPER HALL HARDWOOD FLOOR: 3/4 x 3-1/2" Vintage Red Oak (Smooth)
Line16633	Note:
16Jan17 / 24Feb17	

**HVAC**

Inv.602	1 - TANKLESS HWT CONNECTION - HWT ON RENTAL BASIS / TANK NOT INCLUDED
Line7405	Note:
23Jun16 / 13Oct16	

Inv.602	1 - KITCHEN: GAS LINE ROUGH - GROUND FLOOR (for future gas cook top)
Line9488	Note:
23Jun16 / 13Oct16	

Inv.602	1 - KITCHEN: UPGRADE VENTING FOR STOVE TO 10" INCH PIPE EXTERIOR WALL
Line7410	Note:
23Jun16 / 13Oct16	

Inv.1,137	1 - *DELETE* ITEM #13 from order PE-502-1 **do not install 10" duct, homeowner bought hood fan thru Cortina kitchens - it is not required.
Line18508	Note:
26Jan17 / 13Mar17	

**INTERIOR TRIM AND DOORS**

Inv.602	2 - UPPER HALL & MASTER BEDROOM: Increase Archway to 8' height (PRICE PER DOORWAY) See plan for location.
Line7400	Note:
23Jun16 / 13Oct16	

Inv.602	18 - STANDARD DOOR EXTENDED HEIGHT 96 INCH (PRICE PER DOOR) - SECOND FLOOR 2 STOREY 38 FOOT AN 42 FOOT MODELS ONLY
Line7406	Note:
23Jun16 / 13Oct16	

Inv.602	1 - MAIN FLOOR CEILING 10FT- INCLUDES: TALLER FRONT DOOR WITH TRANSOM, TALLER FRONT AND REAR ELEVATION WINDOWS OR WITH TRANSOM, EXTRA TALL FLAT ARCHES, 8' TALL INTERIOR DOORS, WITH KITCHEN CROWN AND FURRING PANEL,
Line12595	Note:
23Jun16 / 13Oct16	

Inv.1,103	1 - MAIN FLOOR + 2ND FLOOR: Upgrade package 2
Line16650	Note:
16Jan17 / 24Feb17	

**KITCHEN AND BATH CABINETS**

## Kleinburg Glen - 61 - 1 - 42-3 Elev.B CARLTON

Inv.602	1 - MAIN FLOOR CEILING 10FT- INCLUDES: TALLER FRONT DOOR WITH TRANSOM, TALLER FRONT AND REAR ELEVATION WINDOWS OR WITH TRANSOM, EXTRA TALL FLAT ARCHES, 8' TALL INTERIOR DOORS, WITH KITCHEN CROWN AND FURRING PANEL,
Line12593	Note:
23Jun16 / 13Oct16	
Inv.1,103	1 - KITCHEN CABINETRY: Upgrade 4 profile (maple) Price includes spray stain premium
Line16136	Note:
16Jan17 / 24Feb17	
Inv.1,103	1 - KITCHEN CABINETRY: Stacked uppers *Cooktop Wall *
Line16618	Note:
16Jan17 / 24Feb17	
Inv.1,103	6 - KITCHEN CABINETRY: Plain, Clear Glass doors in upper stacked cabinets *Note: interior of cabinets to be standard white finish)
Line16619	Note: Cooktop wall only!
16Jan17 / 24Feb17	
Inv.1,103	1 - KITCHEN CABINETRY: L-shaped hood canopy, complete with 600cfm fan.-36"wide
Line16621	Note: Cabinet to be 40cm deep + 40cm deep stacked upper - per Paolo Feb 23 2017
16Jan17 / 24Feb17	
Inv.1,103	1 - KITCHEN CABINETRY: Double appliance cabinet for built-in wall ovens, complete with bottom drawer (standard appliance installation, not flush)
Line16622	Note:
16Jan17 / 24Feb17	
Inv.1,103	3 - KITCHEN CABINETRY: Pots and Pans drawers (1 shallow top drawer + 2 deep drawers) *top drawer is false at cooktop
Line16623	Note:
16Jan17 / 24Feb17	
Inv.1,103	1 - KITCHEN CABINETRY: Panel-ready fridge - door overlay (2 doors) **hardware to be supplied by homeowner & must be on site at time of installation**
Line16624	Note:
16Jan17 / 24Feb17	
Inv.1,103	1 - KITCHEN CABINETRY: Leave minimum 24" space for backsplash
Line16625	Note:
16Jan17 / 24Feb17	
Inv.1,103	1 - KITCHEN CABINETRY: Adjust cabinets for 36" cooktop
Line16627	Note:
16Jan17 / 24Feb17	
Inv.1,103	1 - POWDER ROOM CABINETRY: Upgrade 2 profile (maple)
Line16634	Note:
16Jan17 / 24Feb17	
Inv.1,103	1 - MASTER ENSUITE CABINETRY: Upgrade 2 profile (maple) (price includes spray stain premium)
Line16638	Note:
16Jan17 / 24Feb17	
Inv.1,103	3 - MASTER ENSUITE: Raise vanity to 36"
Line16641	Note:
16Jan17 / 24Feb17	
Inv.1,103	1 - ENSUITE 2 CABINETRY: Upgrade: spray stain premium
Line16647	Note:
16Jan17 / 24Feb17	

**Kleinburg Glen - 61 - 1 - 42-3 Elev.B CARLTON**

Inv.1,103	1 - TWIN BATH CABINETRY: Upgrade to spray stain premium
Line16649	Note:
16Jan17 / 24Feb17	
Inv.1,103	1 - KITCHEN CABINETRY: Built-in fridge (regular installation)
Line16673	Note:
16Jan17 / 24Feb17	
Inv.1,103	1 - KITCHEN CABINETRY: Add potlight built-in to cabinet, price includes cut outs and 1 transformer
Line16747	Note:
16Jan17 / 24Feb17	
Inv.1,103	2 - KITCHEN CABINETRY: Clear glass door with matching interior - 1 on either side of hood fan.
Line16746	Note:
16Jan17 / 24Feb17	
Inv.1,103	1 - KITCHEN CABINETRY: Stacked uppers above pantry wall (no glass)
Line17888	Note:
16Jan17 / 24Feb17	
Inv.1,103	1 - KITCHEN: Do NOT install hardware, do not drill holes for kitchen cabinetry.
Line17890	Note:
16Jan17 / 24Feb17	
Inv.1,103	1 - KITCHEN CABINETRY: Add soft-close hardware in kitchen
Line17905	Note:
16Jan17 / 24Feb17	
Inv.1,103	1 - KITCHEN CABINETRY: Leave space for future wine fridge. See plan for location.
Line17972	Note:
16Jan17 / 24Feb17	
Inv.1,103	1 - KITCHEN: Add pull out waste/recycle cabinet with 2 bins in island. See plan for location.
Line17977	Note:
16Jan17 / 24Feb17	
Inv.1,103	1 - KITCHEN: Upgrade standard shallow pantry to deep pantry.
Line17978	Note:
16Jan17 / 24Feb17	
Inv.1,103	1 - KITCHEN: Add pull-out spice beside pantry. See plan for location.
Line17979	Note:
16Jan17 / 24Feb17	
Inv.1,267	1 - KITCHEN: *DELETE* ITEMS 1, 2, 3, 4, 5, 6, 7, 8, 9, 30, 31, 36, 37 FROM ORDER PE 1.103-3 **INSTALL STANDARD KITCHEN**
Line19649	Note:
23Mar17 / 13Apr17	
Inv.1,267	3 - POWDER ROOM: RAISE VANITY HEIGHT TO 36" (price per box)
Line20011	Note:
23Mar17 / 13Apr17	

**MISC.**

Inv.602	1 - THRU OUT: *DELETE* ACCESSORIES THRU OUT - INSTALL STANDARD MIRRORS THRU OUT.
Line9497	Note:
23Jun16 / 13Oct16	

**Kleinburg Glen - 61 - 1 - 42-3 Elev.B CARLTON**

Inv.602	<b>1 - MASTER ENSUITE: DELETE ARCH BY TUB</b>
Line9495	Note:
23Jun16 / 13Oct16	
Inv.602	<b>1 - Purchaser has attended a Structural appointment at the Decor Centre &amp; has DECLINED any additional upgrades and accepts and acknowledges that there will be no further structural changes/additions/deletions to be made upon signing on August 2, 2016.</b>
Line9537	Note:
23Jun16 / 13Oct16	
Inv.602	<b>1 - Purchasers are aware &amp; accepts that ANY changes made to upgrades after signing this Purchasers Extra Form are subject to a minimum administration fee of \$500. PLUS a 10% holdback fee.</b>
Line9538	Note:
23Jun16 / 13Oct16	
Inv.602	<b>1 - BONUS PACKAGE: \$10,000.00 (INCLUDING TAXES) WORTH OF UPGRADES FROM GOLD PARK HOMES DÉCOR CENTRE IS BEING *DEFERRED* THE COLOURS APPOINTMENT. PURCHASER HAS A REMAINING AMOUNT OF \$10,000 (INCLUDING TAXES) TO BE USED TOWARD THE COLOUR APPOINTMENT.</b>
Line9539	Note:
23Jun16 / 13Oct16	
Inv.1,103	<b>1 - *CREDIT* rear basement window credit due to WOB condition.</b>
Line16749	Note:
16Jan17 / 24Feb17	
Inv.1,103	<b>1 - Purchasers are aware &amp; accepts that ANY changes made to upgrades after signing this Purchasers Extra Form are subject to a minimum administration fee of \$500. PLUS a 10% holdback fee.</b>
Line16715	Note:
16Jan17 / 24Feb17	
Inv.1,103	<b>1 - Purchaser has attended a Colour appointment at the Decor Centre &amp; has DECLINED any additional upgrades and accepts and acknowledges that there will be no further changes/additions/deletions to be made upon signing on January 26 2017.</b>
Line16714	Note:
16Jan17 / 24Feb17	
Inv.1,137	<b>1 - BASEMENT: Adjust credit for basement windows (should have credited \$290, only credited \$250)</b>
Line18275	Note:
26Jan17 / 13Mar17	
Inv.1,267	<b>2 - DELETE** MASTER ENSUITE AND ENSUITE 2:*DELETE* ITEMS #28 AND #37 - shower ceiling must be dropped.</b>
Line19648	Note:
23Mar17 / 13Apr17	
Inv.1,267	<b>2 - CHANGE ORDER FEE: OPEN LOCKED FILE - ORDER PE.1.103-3 AND COLOUR CHART</b>
Line20243	Note:
23Mar17 / 13Apr17	

**PAINTING**

Inv.1,103	<b>1 - MAIN STAIRS: Stain stairs to match hardwood, as close as possible. Note, price includes landings stained on site.</b>
Line16653	Note:
16Jan17 / 24Feb17	

**PLUMBING**

Inv.602	<b>1 - KITCHEN: ROUGH - IN - WATERLINE FOR FRIDGE</b>
Line7402	Note:
23Jun16 / 13Oct16	

**Kleinburg Glen - 61 - 1 - 42-3 Elev.B CARLTON**

Inv.602	<b>1 - MASTER ENSUITE: ROUGH - IN FOR RAINSHOWER HEAD - SHOWER HEAD NOT INCLUDED AND MUST BE PURCHASED</b>
Line7403	Note:
23Jun16 / 13Oct16	

Inv.602	<b>1 - MASTER ENSUITE: Plumbing wall in shower to be on bedroom wall, see plan for location.</b>
Line9714	Note:
23Jun16 / 13Oct16	

Inv.1,103	<b>1 - MASTER ENSUITE AND ENSUITE 2: DELETE TOE TESTER on standard shower faucet</b>
Line17891	Note:
16Jan17 / 24Feb17	

Inv.1,103	<b>1 - MASTER ENSUITE: Install standard shower head from ceiling (in lieu of upgraded rain shower head) with standard control valve (please delete toe-tester). Homeowner to delete/alter all tile and plumbing to master ensuite shower after closing.</b>
Line17906	Note: Purchaser accepts and acknowledges that warranty is void on Master Ensuite plumbing.
16Jan17 / 24Feb17	

**PLUMBING FIXTURES**

Inv.1,103	<b>1 - MASTER ENSUITE: Upgrade free-standing tub to Mirolin Brook #CF2002</b>
Line16642	Note:
16Jan17 / 24Feb17	

Inv.1,103	<b>1 - MASTER ENSUITE TUB FILLER: Delta Arzo 3 piece tub filler #T2786/R2709 (chrome)</b>
Line16646	Note:
16Jan17 / 24Feb17	

**STAIRS AND RAILINGS**

Inv.1,103	<b>1 - MAIN STAIRS: Euroline 2 + V Groove</b>
Line16651	Note:
16Jan17 / 24Feb17	

**WINDOWS - BASEMENT**

Inv.602	<b>5 - BASEMENT WINDOWS - UPGRADE EXISTING BASEMENT WINDOW TO 30 INCH X 24 INCH - MAY REQUIRE INSTALLATION OF WINDOW WELL- ONLY 4 WINDOWS UPG</b>
Line7397	Note: REFUND FOR ONE REAR WINDOW UPG-DUE TO WOB CONDITION PE:875
23Jun16 / 13Oct16	

Inv.602	<b>1 - BASEMENT WINDOWS - EXTRA BASEMENT WINDOW 30 INCH X 24 INCH - MAY REQUIRE INSTALLATION OF WINDOW WELL</b>
Line9713	Note:
23Jun16 / 13Oct16	

**WINDOWS AND DOORS**

Inv.602	<b>1 - MAIN FLOOR CEILING 10FT- INCLUDES: TALLER FRONT DOOR WITH TRANSOM, TALLER FRONT AND REAR ELEVATION WINDOWS OR WITH TRANSOM, EXTRA TALL FLAT ARCHES, 8' TALL INTERIOR DOORS, WITH KITCHEN CROWN AND FURRING PANEL,</b>
Line12594	Note:
23Jun16 / 13Oct16	

Inv.1,137	<b>1 - MAIN FLOOR: Remove side windows, reframe and install taller windows</b>
Line18488	Note: As per Bruno Pricing by Martina
26Jan17 / 13Mar17	



\*\*\* NOTE: This is not an approved document. Document must be locked \*\*\*

Purchaser: Pearl Mingle  
Telephone Res. / Bus: (416) 274-6267  
Decor Advisor: Yolande Somerville

Scheduled Closing Date: Thursday, November 03, 2016

Property: 61

Project: Berkshire Holdings Inc.

Model and Elevation: 42-3 Elev.B CARLTON

APRIL 13  
2017

Layout Changes:  Yes  No Sketch Attached:  Yes  No Exterior Colour Scheme: \_\_\_\_\_

**1. Cabinetry**

	Style and Colour	Counter	Hardware
Kitchen / Breakfast	Hampton maple 'cocoa'	Granite: Crema Caramel Edge: FE-20	cs1-22
Laundry Room	n/a	n/a	n/a
Powder Room	Florentine maple 'cocoa'	P-Lam #7264-58 'Limestone'	cs1-22
n/a	n/a	n/a	n/a
Master Ensuite Bathroom	Florentine maple 'cocoa'	P-Lam #7267-58 'Concrete Stone'	cs1-21
Second Ensuite Bathroom (If Applicable)	Siena oak 'cocoa'	P-Lam #7267-58 'Concrete Stone'	cs1-24
Twin 3/4	Siena oak 'cocoa'	P-Lam #7264-58 'Concrete Stone'	cs1-23
Dishwasher Cabinet	n/a		
Comment	STANDARD: P-400 pvc 'mythic'		

**2. Floor Tile**

	Selection	Grout	Threshold
Entrance Vestibule	13x13" Venus 'Ivory'	n/a	n/a
Main Hall	n/a	n/a	n/a
Kitchen / Breakfast	24x24" Regal polished 'Taupe'	n/a	n/a
Laundry Room	13x13" Venus 'Ivory'	n/a	n/a
Powder Room	24x24" Regal polished 'Taupe'	n/a	n/a
Mud Room	13x13" Venus 'Ivory'	n/a	n/a
Master Ensuite Bathroom	18x18" Must 'Ivory'	n/a	n/a
Second Ensuite Bathroom (If Applicable)	13x13" Carrara 'White/Grey'	n/a	n/a
Lower Landing (If Applicable)	n/a	n/a	n/a
Twin Bathroom	13x13" New Reeds 'Taupe'	n/a	n/a
Comment	**Grout lines as small as possible** M. Ens. Shower Floor - Ontario Hex 'Tender Grey'		

**3. Wall Tile**

	Selection	Listello/inserts	Describe
Master Ensuite Bathroom		<input type="radio"/> Yes <input checked="" type="radio"/> No	
Tub Deck	n/a	<input type="radio"/> Yes <input checked="" type="radio"/> No	
Shower Stall	4x16" CDC 'Tender Grey' Bright	<input type="radio"/> Yes <input checked="" type="radio"/> No	
Bathroom Walls	n/a	<input type="radio"/> Yes <input checked="" type="radio"/> No	
Second Ensuite Bathroom (If Applicable)	4x16" CDC 'Tender Grey' Bright	<input type="radio"/> Yes <input checked="" type="radio"/> No	
Twin Bathroom	2x8" CDC 'Taupe' Bright	<input type="radio"/> Yes <input checked="" type="radio"/> No	
Kitchen Backsplash		<input type="radio"/> Yes <input checked="" type="radio"/> No	Backsplash Behind Fridge: none
Comment			

\*\*\* NOTE: This is not an approved document. Document must be locked \*\*\*

Purchaser: Pearl Mingle  
Telephone Res. / Bus: (416) 274-6267  
Decor Advisor: Yolande Somerville

Scheduled Closing Date: Thursday, November 03, 2016

Property: 61

Project: Berkshire Holdings Inc.

Model and Elevation: 42-3 Elev.B CARLTON

**4. Plumbing Fixtures**

Master Ensuite Bathroom  Second Ensuite  Powder Room   
Other Room - Specify  Other Washroom

Comment

Standard Thru out, except Master Ensuite Shower + Tub

**5. Hardwood Flooring**

	Type and Stain		Type and Stain
Main Hall	n/a	Upper Landing	n/a
Kitchen / Breakfast	n/a	Upper Hall	*3-1/2" Vintage Baroque (smooth)
Living Room	*3-1/2" Vintage Baroque (smooth)	Master Bedroom	n/a
Dining Room	*3-1/2" Vintage Baroque (smooth)	Bedroom #2	n/a
Family Room	*3-1/2" Vintage Baroque (smooth)	Bedroom #3	n/a
Den/Library	*3-1/2" Vintage Baroque (smooth)	Bedroom #4	n/a
Entrance Vestibule	n/a	Bedroom #5	n/a
Lower Landing (If Applicable)	n/a	Other Room - Specify	

Comment

Hardwood Selection: Vintage 3/4 x 3-1/2" Red Oak smooth 'Baroque'

**6. Carpeting**

	Upgrade	Description
Main Hall	<input type="checkbox"/>	n/a
Living Room	<input type="checkbox"/>	n/a
Dining Room	<input type="checkbox"/>	n/a
Family Room	<input type="checkbox"/>	n/a
Den/Library	<input type="checkbox"/>	n/a
Upper Hall	<input type="checkbox"/>	n/a
Master Bedroom	<input type="checkbox"/>	T-15
Bedroom #2	<input type="checkbox"/>	T-15
Bedroom #3	<input type="checkbox"/>	T-15
Bedroom #4	<input type="checkbox"/>	T-15
Bedroom #5	<input type="checkbox"/>	n/a
Upper Landing (If Applicable)	<input type="checkbox"/>	n/a
Lower Landing (If Applicable)	<input type="checkbox"/>	n/a

Upgrade Underpad

Type

n/a

Area

n/a

Carpet on Stairs

Capped

n/a

Runner - \*Upgrade

n/a

Comment

Standard Carpet and Standard Underpad in bedrooms

Revised

LL

P.M.

\*\*\* NOTE: This is not an approved document. Document must be locked \*\*\*

Purchaser: Pearl Mingle  
Telephone Res. / Bus: (416) 274-6267  
Decor Advisor: Yolande Somerville

Scheduled Closing Date: Thursday, November 03, 2016

Property: 61

Project: Berkshire Holdings Inc.

Model and Elevation: 42-3 Elev.B CARLTON

**7. Fireplace**

	Living Room			Family Room			Other Room - Specify		
	Purchased	As Per Plan	N/A	Purchased	As Per Plan	N/A	Purchased	As Per Plan	N/A
Fireplace Type	<input type="radio"/>	<input type="radio"/>	<input checked="" type="radio"/>	<input type="radio"/>	<input checked="" type="radio"/>	<input type="radio"/>	<input type="radio"/>	<input type="radio"/>	<input checked="" type="radio"/>
Mantle Type	Standard Gas								
Colour / Stain	Standard Mediterranean								
Surround	Standard								
Hearth	none								
Comment	none								

**8. Trim Carpentry**

Interior Doors  Front Door Glass Inserts  Door Handles

Interior Trim

Comment

**9. Plaster Mouldings and Medallions**

Entrance Vestibule	<input type="text"/>	<input type="text"/>	Kitchen/Breakfast	<input type="text"/>	<input type="text"/>
Main Hall	<input type="text"/>	<input type="text"/>	Den/Library	<input type="text"/>	<input type="text"/>
Living Room	<input type="text"/>	<input type="text"/>	Lower Landing	<input type="text"/>	<input type="text"/>
Dining Room	<input type="text"/>	<input type="text"/>	Other Room - Specify	<input type="text" value="none"/>	<input type="text"/>
Family Room	<input type="text"/>	<input type="text"/>	Thru out	<input type="text"/>	<input type="text"/>

Comment

**10. Railings and Spindles**

Railing Package

Railing Colour

Stringer / Riser

Spindle Colour

Treads

Oak Stairs  Yes  No

Comment

**11. Wall Paint**

Main & Upper Hall	<input type="text"/>	Master Bedroom	<input type="text"/>
Living Room	<input type="text"/>	Bedroom #2	<input type="text"/>
Dining Room	<input type="text"/>	Bedroom #3	<input type="text"/>
Kitchen / Breakfast	<input type="text"/>	Bedroom #4	<input type="text"/>
Family Room	<input type="text"/>	Bedroom #5	<input type="text"/>
Powder Room	<input type="text"/>	Master Ensuite	<input type="text"/>
Laundry Room	<input type="text"/>	Second Ensuite	<input type="text"/>
Den/Library	<input type="text"/>	Thru Out	<input type="text" value="Warm Grey"/>
Trim Paint	<input type="text"/>		

Comment

Revised

(L.L.)

(P.M.)

\*\*\* NOTE: This is not an approved document. Document must be locked \*\*\*

Purchaser: Pearl Mingle  
Telephone Res. / Bus: (416) 274-6267  
Decor Advisor: Yolande Somerville

Scheduled Closing Date: Thursday, November 03, 2016

Property: 61

Project: Burkshire Holdings Inc.

Model and Elevation: 42-3 Elev.B CARLTON

**12. Electrical**

Plugs and Switches  White  Ivory   
Hood Fan  White  Ivory  Above Kitchen Cabinet Light  Yes  No  
Appliances Built in Cooktop  Yes  No Built in Oven  Yes  No  
Gas Stove  Yes  No Microwave  Yes  No  
Below Kitchen Cabinet Light  Yes  No

Comment

Built-in chimney hood fan

**13. Heating and Air Conditioning**

Air Conditioning   
Gas Provisions Dryer  Gas Provisions Stove   
Comment Gas Provisions Barbecue

Standard Gas BBQ Line

**14. Additional Comments**

[Empty box for additional comments]

**15. Disclaimers and Notes**

- 1) Colours of all materials are as close as possible to builder's selection, but not necessarily identical due to variances in manufacturing.
- 2) Any extras listed above are null and void unless accompanied by a separate invoice/amendment. Said invoice must be paid in full.
- 3) The Purchaser acknowledges that after Interior Colour Selection form is signed and dated, no further changes will be permitted other than re-selection due to unavailability. \_\_\_\_\_ Purchaser's initials
- 4) The Purchaser acknowledges reading and accepting the "Gold Park Homes Decor Centre Disclaimers" form. This document contains other miscellaneous disclaimers.

This interior Colour Selection is final and approved by:

Signature: 

Date: 13/04/2017

Revised 

Elevation A • 3,354 sq.ft.

✓ Elevation B • 3,361 sq.ft.

LOT 61  
AUGUST 2, 2016

PM

KG-61  
JANUARY 24  
2017 PM

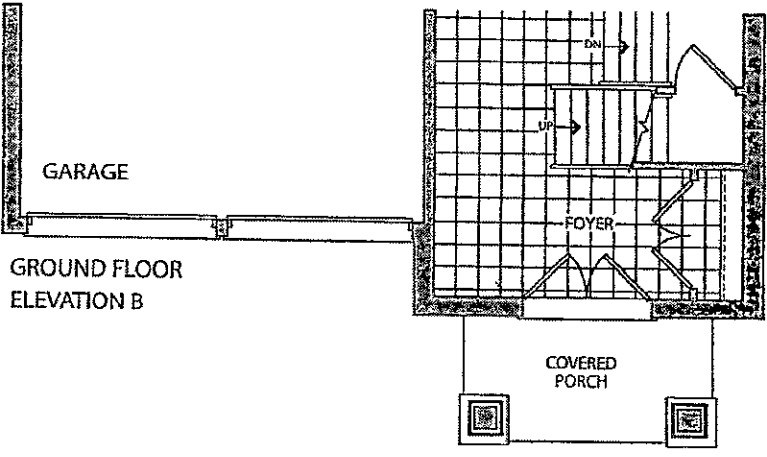
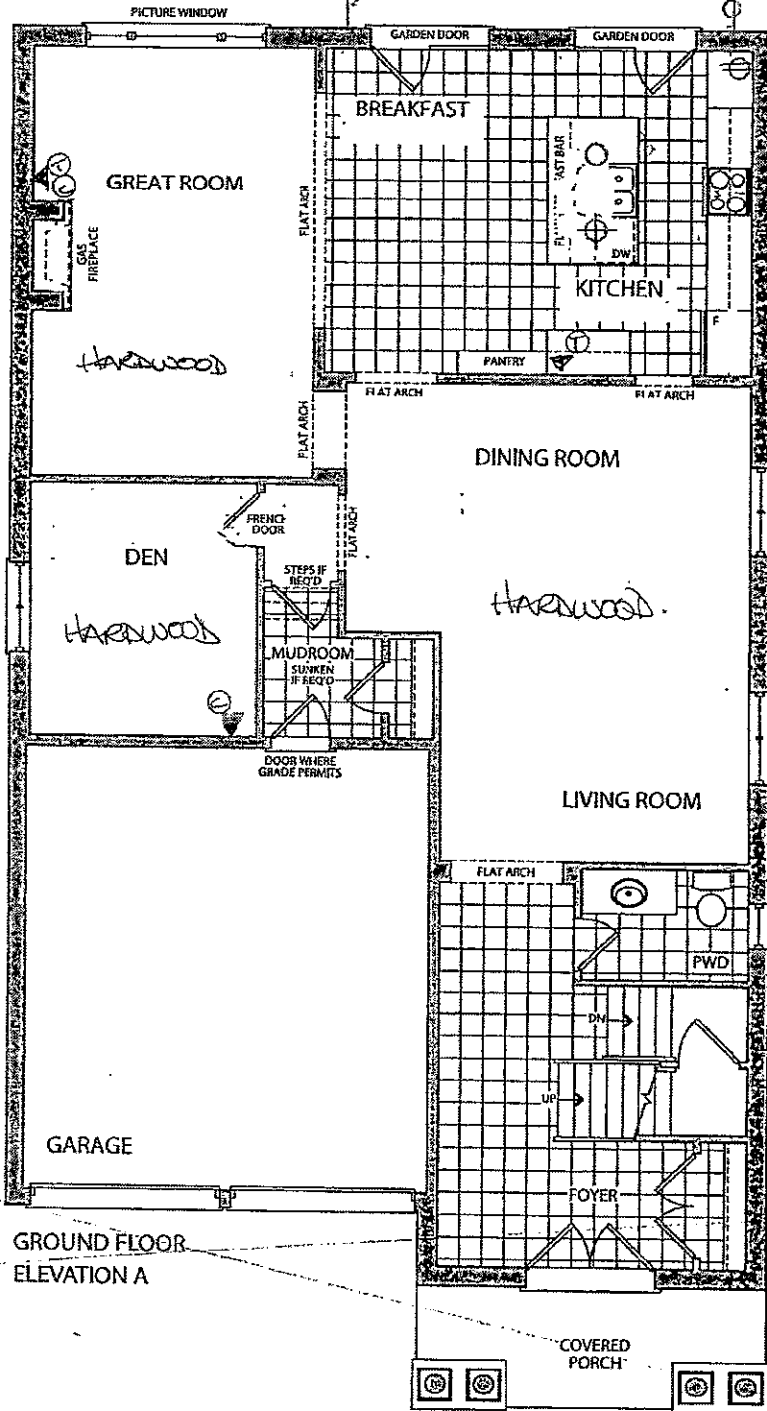

Prices, figures, illustrations, sizes, features and finishes are subject to change without notice. E.&O.E. Areas and dimensions are approximate and actual usable floor space may vary from the stated area. Layout may be reverse of the unit purchased. E. & O.E.

LS-7 61  
AUGUST 2 2016

PM

JAN. 26 2017  
KG-61

PM

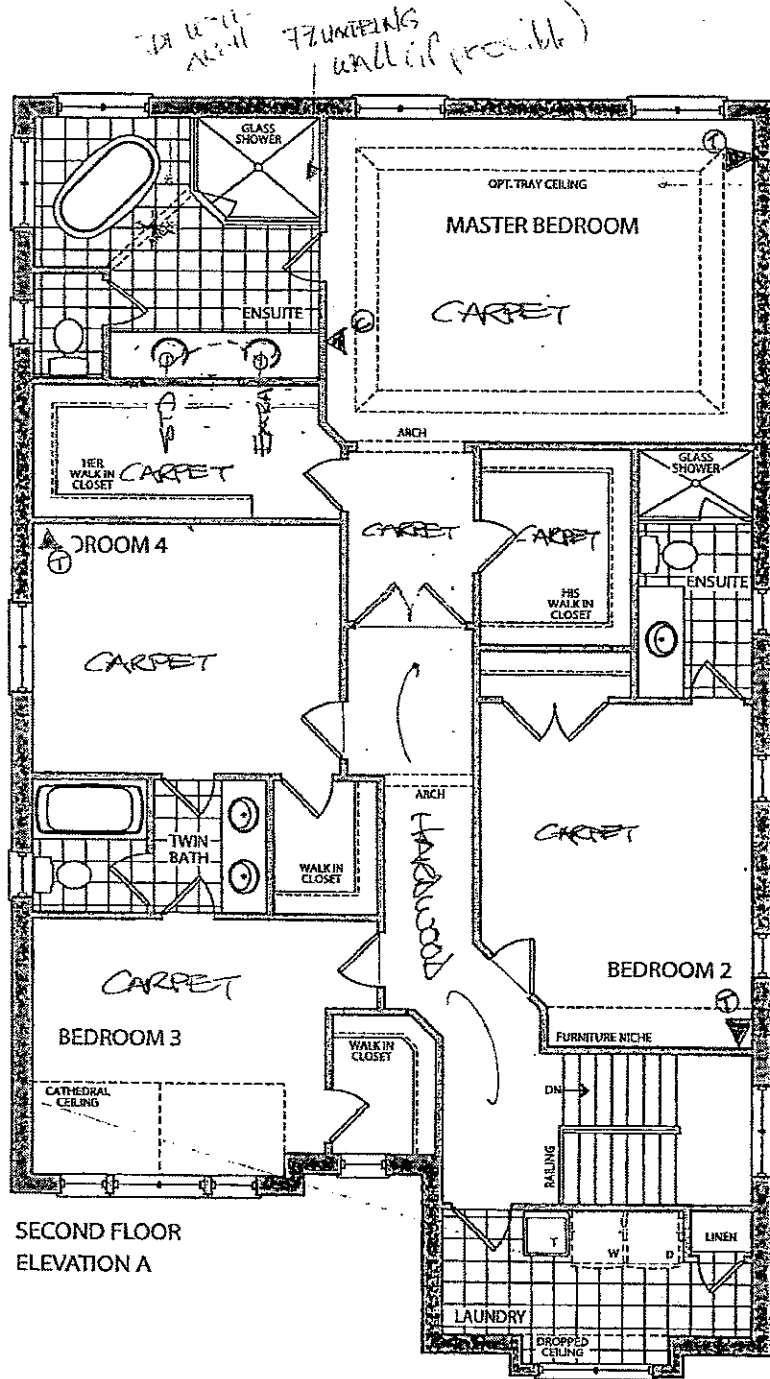

SECOND FLOOR  
ELEVATION A

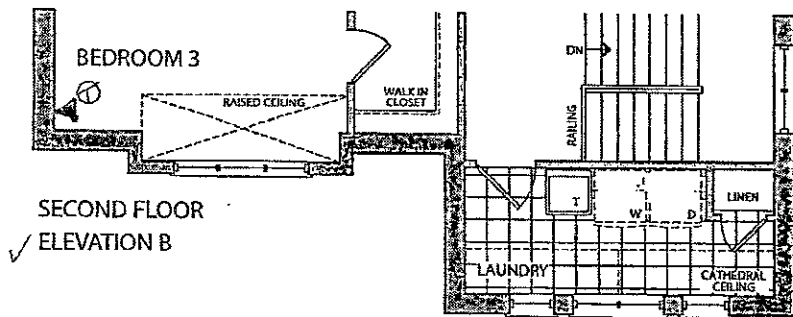

SECOND FLOOR  
ELEVATION B

Prices, figures, illustrations, sizes, features and finishes are subject to change without notice. E.&O.E. Areas and dimensions are approximate and actual usable floor space may vary from the stated area. Layout may be reverse of the unit purchased. E. & O.E.

— Elevation A • 3,354 sq.ft. —

✓ Elevation B • 3,361 sq.ft.

lot 61

AUGUST 2 2016

PM

ADD:  
30x24" →

KG-61 PM  
JANUARY 24 2017

URG  
30x24"

URG.  
30x24"

\* WALK CLOS  
- MEASUREMENT

URG.  
30x24"

URG.  
30x24"

URG.  
30x24"

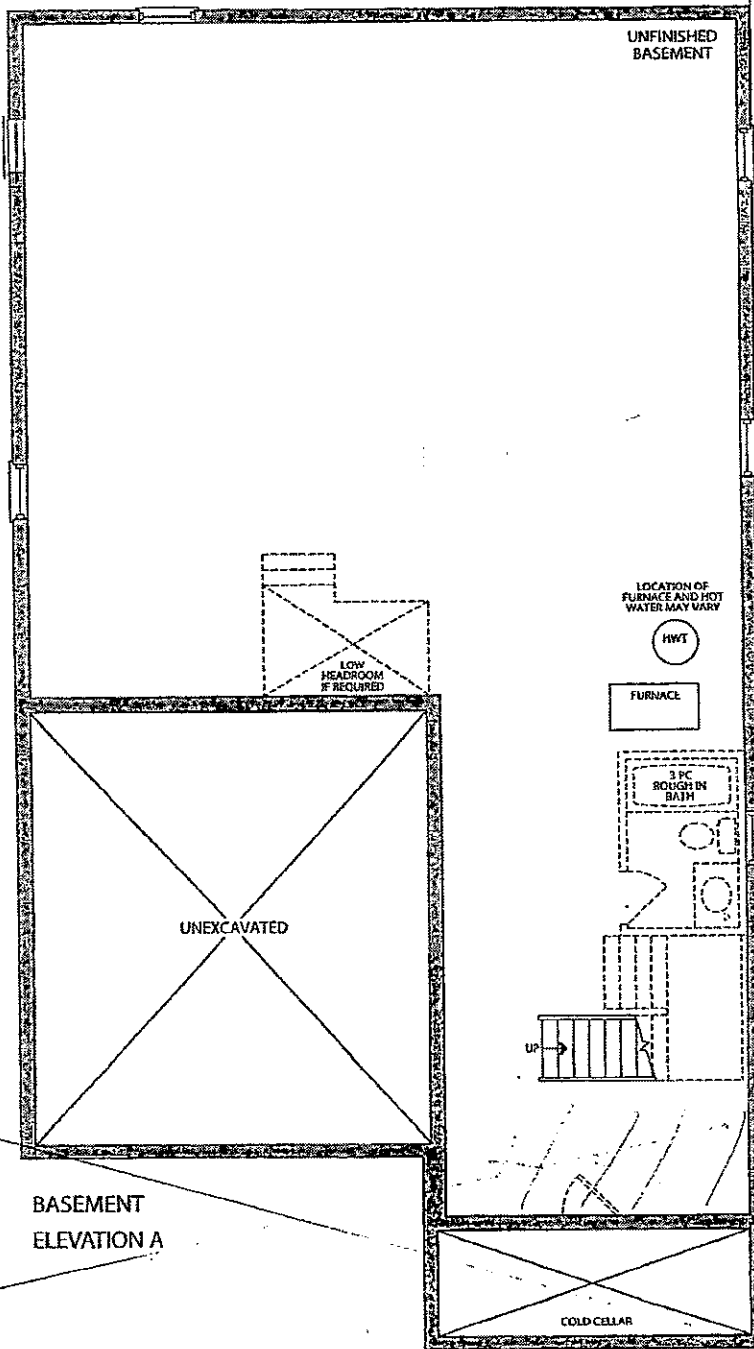

BASEMENT  
ELEVATION A

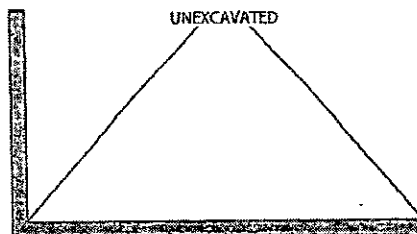

BASEMENT  
ELEVATION B

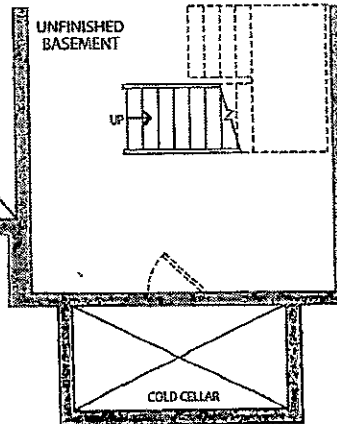

Prices, figures, illustrations, sizes, features and finishes are subject to change without notice. C.&O.E. Areas and dimensions are approximate and actual usable floor space may vary from the stated area. Layout may be reverse of the unit purchased. E. & O.E.

<b>Trade Name:</b> Gold Park Homes	<b>Site location:</b>	<b>Model:</b> 42-3
<b>Address:</b>	<b>Project:</b> Kleinburg Glen	<b>Phase:</b>

This layout has been explained to the purchaser by Cortina Kitchens Inc. and is understood by the purchaser.

Purchaser has decided to DELETE all extras from previous summary and proceed with a Standard Kitchen

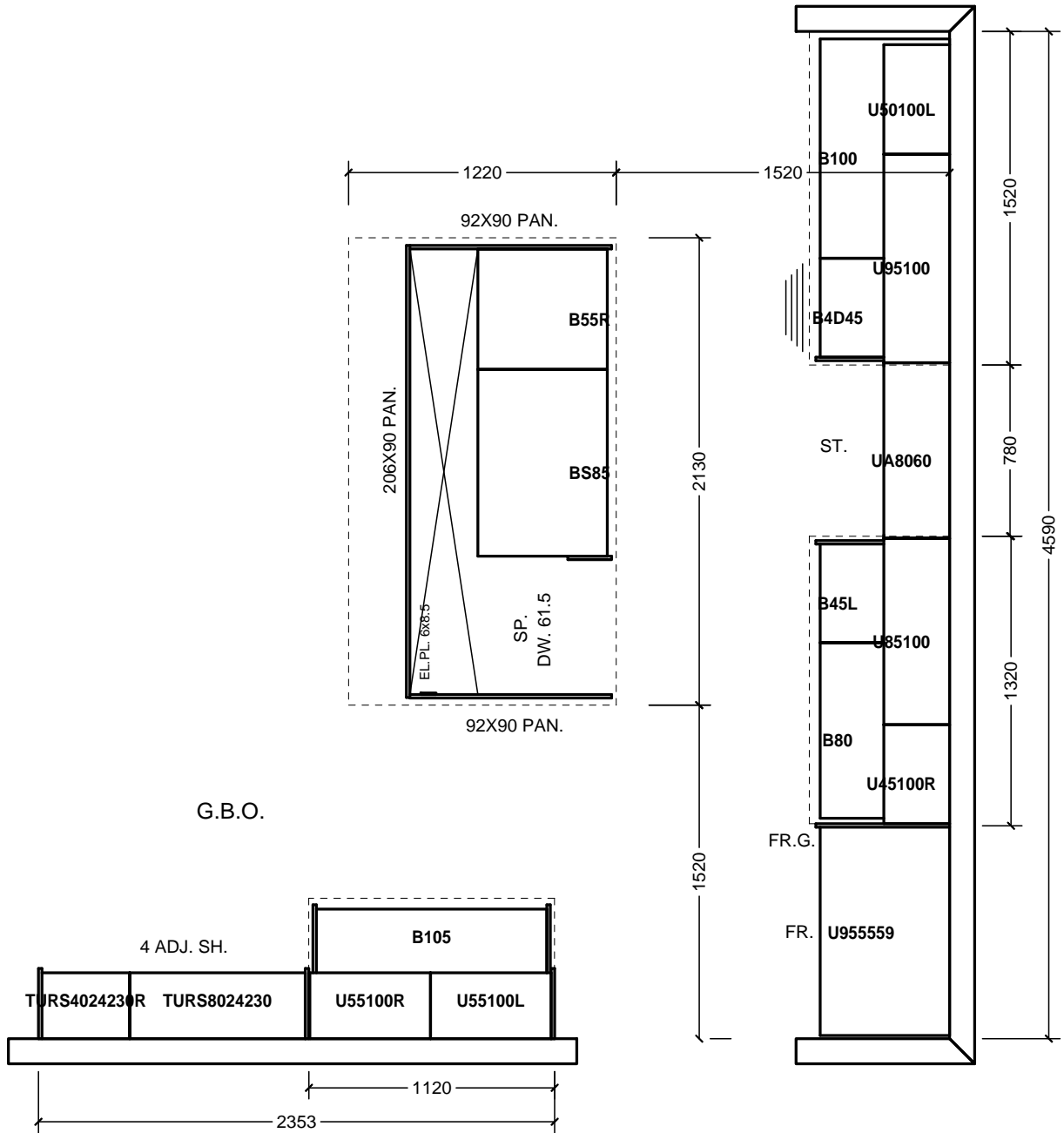

All prices subject to confirmation from head office.  
 This quotation is subject to the terms & conditions set out

All agreements are contingent upon strikes, accidents, and delays beyond our control.  
 Please provide our installer with template for sinkholes or \$150.00 will be charged for callback.

ACCEPTED DATE: \_\_\_\_\_

Item A. Wood grain and colour are characteristics of the product. We cannot guarantee that such grain and colour will always match.  
 Item B. Cortina Kitchens Inc. reserves the right to alter dimensions and make technical changes without notice.



Trade Name: Gold Park Homes	Site location:	Model: 42-3
Address:	Project: Kleinburg Glen	Phase:

This layout has been explained to the purchaser by Cortina Kitchens Inc. and is understood by the purchaser.

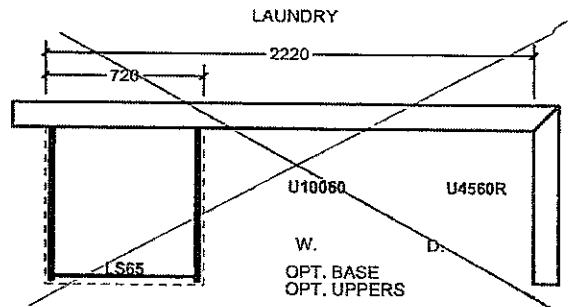
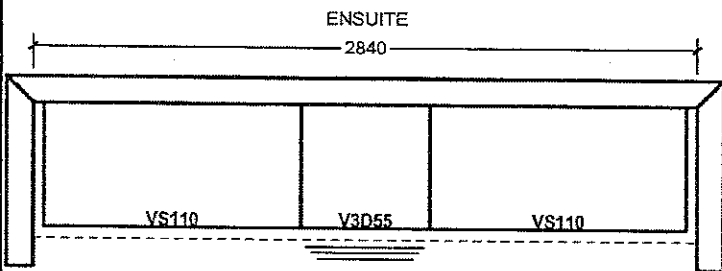
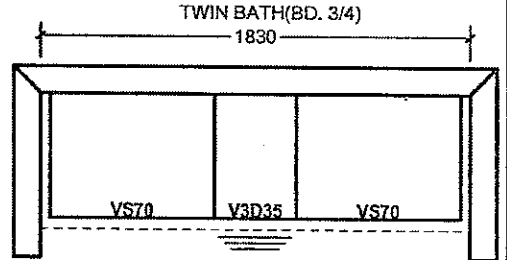
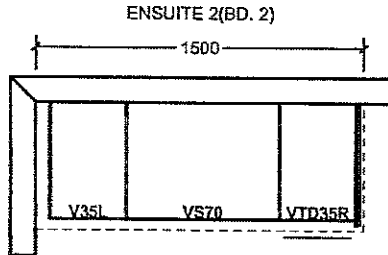
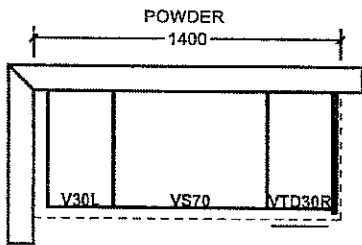

### OPT. SECOND FLOOR

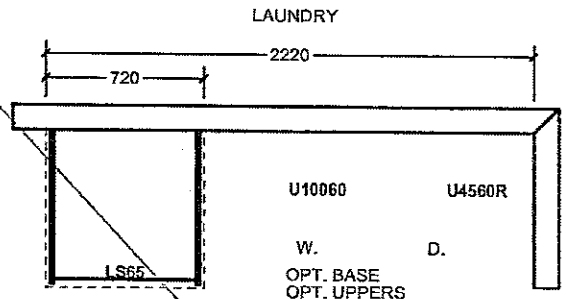
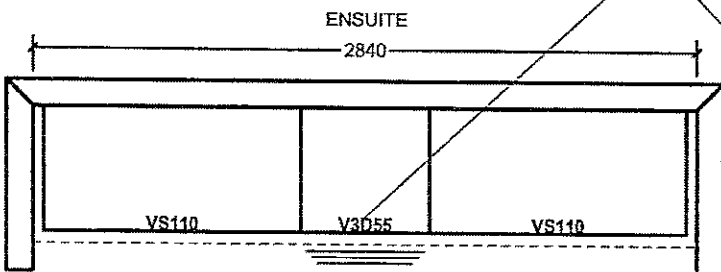
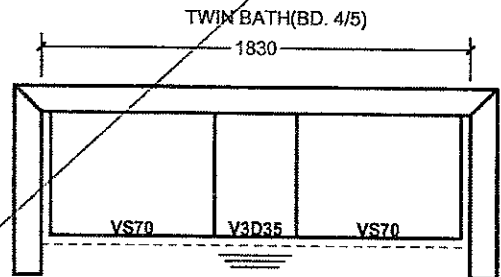
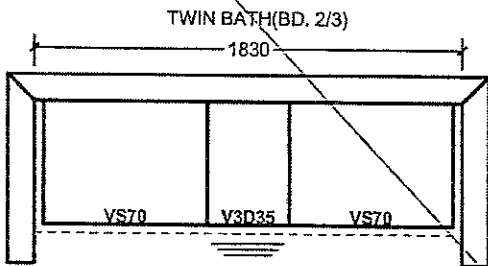

All prices subject to confirmation from head office.  
This quotation is subject to the terms & conditions set out



All agreements are contingent upon strikes, accidents, and delays beyond our control.  
Please provide our installer with template for sinkholes or \$150.00 will be charged for callback.

ACCEPTED DATE: \_\_\_\_\_

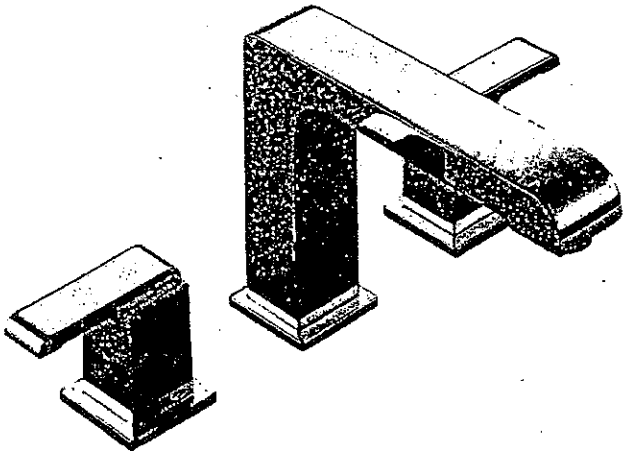
Arzo® Collection



Roman Tub - 3 Piece  
Chrome Finish  
# T2786 / # R2709

LOT No.: 61	
ROOM: MASTER ENSUITE	
DATE: JAN. 26 2016	SIGNATURE: 
	GOLDPARK <small>WORTH MORE</small>

\* MASTER ENSUITE  
LAV IS STANDARD

# CORTINA

MODIFIED: 19/05/16 fd

## STANDARD HARDWARE

KG-61  
JAN. 26 2017 *PM*

STANDARD HARDWARE

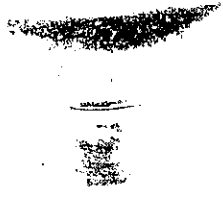

CSI-6

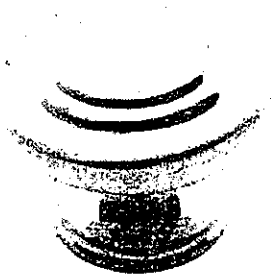

CSI-10



CSI-14



CSI-16



CSI-18

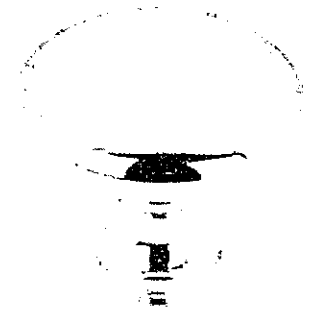

CSI-19

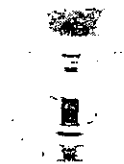

CSI-20

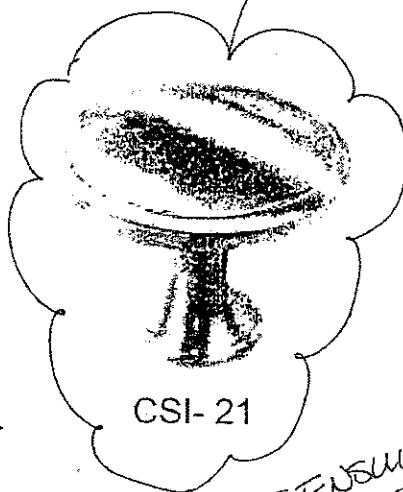

CSI-21

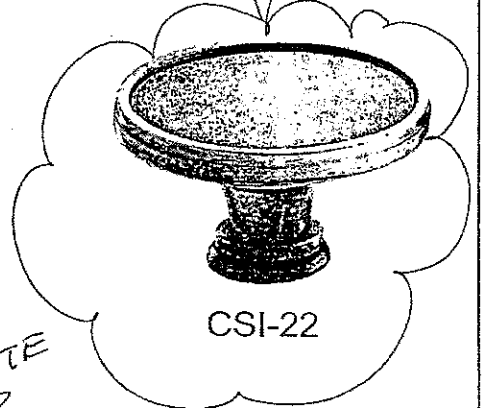

CSI-22

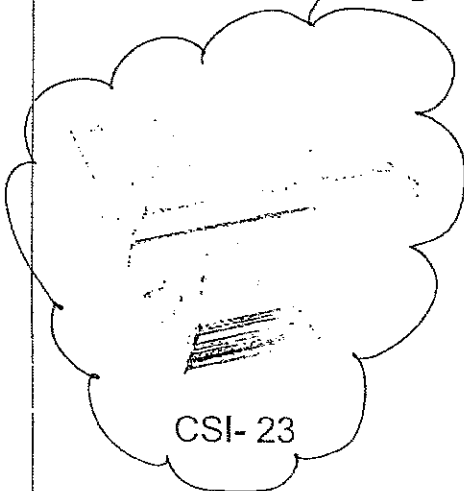

CSI-23

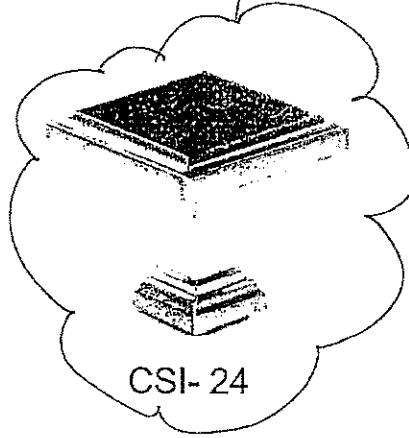

CSI-24

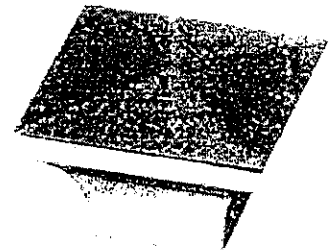

CSI-25

*MASTER  
ENSUITE*

*POWDER ROOM  
KITCHEN*

*TWIN  
BATH.*

*ENSUITE  
2.*

**\*NOTES:**

- IMAGES ARE FOR QUICK REFERENCE PURPOSES ONLY
- ACTUAL SIZES AND FINISHES AS PER HARDWARE SAMPLE BOARD PROVIDED TO DECOR CENTRE

*\* KITCHEN - NO  
HARDWARE \**

- Standard 2CM & 3CM
- Upgrade 1 2CM & 3CM
- Upgrade 1 4 CM
- Upgrade 2

20mm (3/4") Profiles



30mm (1 1/4") Profiles

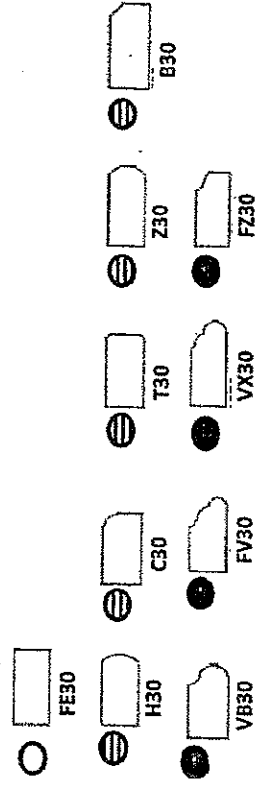

40mm (1 1/2") Profiles

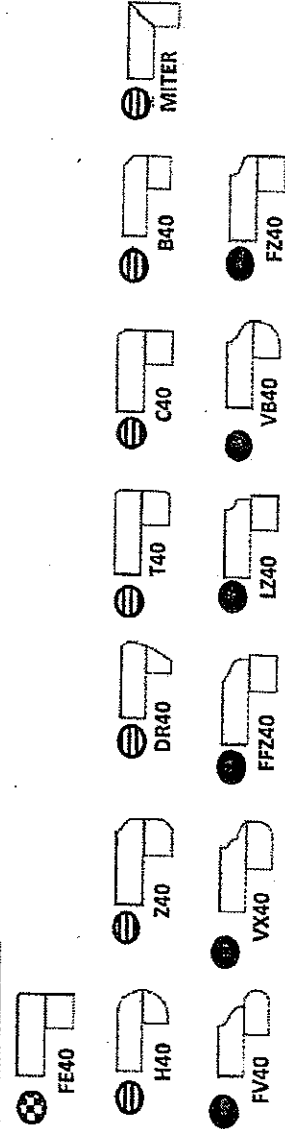

JAN. 26 2017

KG-61

\* STANDARD SINK ? FAUCET

KITCHEN

Note: All colours may not be available in 30mm at time ordered. Vendor reserves the right to use 40 mm edges (by lamination process).

\*Mitre edge is available in Upgrade 1 for an overall thickness of 2". All other Mitre edge options will be an Upgrade 2 Edge.