

APPLIANCES

Inv.1,041	1 - Purchaser Accepts Standard Appliance Openings: Fridge - 37-1/2"W x 73-1/2" High Approx. Dishwasher - 24" W Approx
Line15209	Note:
8Dec16 / 25Jan17	

CENTRAL VAC AND WIRING

Inv.735	1 - FAMILY ROOM: CONDUIT PIPE - FOR TELEVISION - ABOVE FIREPLACE APPROX. 66" AFF. NEXT TO STANDARD CABLE. TERMINATING LEFT OF FIREPLACE AT STANDARD HEIGHT. PLEASE SEE FLOORPLAN FOR LOCATION.
Line9962	Note:
10Aug16 / 17Oct16	
Inv.735	1 - CONDUIT PIPE - FROM ATTIC TO ELECTRICAL PANEL - PLEASE RUN A STRAIGHT RUN FROM ELECTRICAL PANEL TO ATTIC.
Line9972	Note:
10Aug16 / 17Oct16	
Inv.735	1 - MASTER BEDROOM: ROUGH - IN FOR EXTRA SECURITY KEY PAD. PLEASE SEE FLOORPLAN FOR LOCATION
Line9974	Note:
10Aug16 / 17Oct16	
Inv.735	1 - KITCHEN: INSTALL VAC PAN UNDER KITCHEN SINK
Line9975	Note:
10Aug16 / 17Oct16	

CERAMIC

Inv.1,041	1 - MAIN FLOOR TILE: UPG 3 Foyer / Powder Room / Kitchen
Line15145	Note: Installed in a vertical stacked pattern. Parallel to island. See floorplan for tile direction.
8Dec16 / 25Jan17	
Inv.1,041	1 - MASTER ENSUITE FLOOR TILE: UPG 2
Line15189	Note:
8Dec16 / 25Jan17	
Inv.1,041	1 - MASTER ENSUITE TUB TILE: Tub Skirt / Tub Deck / Tub Splash
Line15190	Note:
8Dec16 / 25Jan17	

DRYWALL

Inv.735	1 - SMOOTH CEILINGS - (2 - Story Design) SECOND FLOOR
Line9973	Note:
10Aug16 / 17Oct16	

ELECTRICAL

Inv.735	1 - FAMILY ROOM: 110V WALL RECEPTACLE ON NORMAL CIRCUIT - ABOVE FIREPLACE APPROX. 66" AFF. NEXT TO STANDARD CABLE. PLEASE SEE FLOORPLAN FOR LOCATION.
Line9963	Note:
10Aug16 / 17Oct16	
Inv.735	10 - MAIN FLOOR: POT LIGHT: 4 INCH HALOGEN POT LIGHT - 440 WH - PRICED PER LIGHT - x4 in Kitchen (on a separate switch), x4 in Family Room (on a separate switch), x2 in Hallway on same switch as Foyer Light.
Line9964	Note:
10Aug16 / 17Oct16	

Kleinburg Glen - 31L - 1 - 25-2 Elev.B HUDSON

Inv.735	2 - MAIN FLOOR: POT LIGHT SWITCHES (WITH COVER PLATE) - x1 for Kitchen Pot lights, x1 for Family Room Pot lights. Please see floorplan for locations
Line9965	Note:
10Aug16 / 17Oct16	
Inv.735	1 - KITCHEN: RELOCATE STANDARD KITCHEN CEILING LIGHT TO CENTER OVER ISLAND.
Line9966	Note:
10Aug16 / 17Oct16	
Inv.735	4 - FRONT ELEVATION: SOFFIT POT LIGHTS: 4 INCH LINE VOLTAGE POT LIGHT - (EXTERIOR) - X4. Please see sketch attached for locations
Line9967	Note:
10Aug16 / 17Oct16	
Inv.1,041	1 - KITCHEN - Purchasers request to NOT INSTALL builder's standard hood fan and standard cabinets above stove. DELETE. Do not supply, install, and/or credit. Purchasers are installing their own hood fan after closing.
Line15152	Note: Purchasers accept and acknowledge that the exhaust fan duct hole may be off-centered with stove in kitchen due to purchasers installing their own hood fan after closing. The vendor is exempt.
8Dec16 / 25Jan17	

EXTERIOR COLOURS

Inv.735	1 - EXTERIOR COLOUR PACKAGE 10
Line12709	Note:
10Aug16 / 17Oct16	

FRAMING

Inv.735	1 - MAIN FLOOR: EXTENDED HEIGHT ARCHWAY (PRICE PER DOORWAY)
Line12407	Note:
10Aug16 / 17Oct16	
Inv.735	1 - MAIN FLOOR: STANDARD DOOR EXTENDED HEIGHT 96 INCH (PRICE PER DOOR)
Line12408	Note:
10Aug16 / 17Oct16	

GLASS AND MIRROR

Inv.735	1 - MASTER ENSUITE: CONVERT FRAMED SHOWER TO 10MM FRAMLESS SHOWER ENCLOSURE WITH DOOR AND 10MM SIDE PANEL
Line9978	Note:
10Aug16 / 17Oct16	

GRANITE MARBLE QUARTZ

Inv.1,041	1 - KITCHEN COUNTERTOP: Adjust countertop to accommodate slide-in-range.
Line15151	Note: See Spec sheet attached
8Dec16 / 25Jan17	

HARDWOOD

Inv.1,041	1 - MAIN FLOOR HARDWOOD: UPG 1 Living/Dining Room / Family Room / Lower Landing
Line15144	Note:
8Dec16 / 25Jan17	
Inv.1,041	1 - 2ND FLOOR HALLWAY: Hardwood UPG 1
Line15156	Note:
8Dec16 / 25Jan17	

HVAC

Kleinburg Glen - 31L - 1 - 25-2 Elev.B HUDSON

Inv.735	1 - HUMIDIFIER: WB3 - 12 (UP TO 2,000 SQ.FT.)
Line9976	Note:
10Aug16 / 17Oct16	
Inv.735	1 - TANKLESS HWT CONNECTION - HWT ON RENTAL BASIS / TANK NOT INCLUDED
Line9977	Note:
10Aug16 / 17Oct16	

INTERIOR TRIM AND DOORS

Inv.735	2 - MAIN FLOOR: EXTENDED HEIGHT ARCHWAY (PRICE PER DOORWAY)
Line9968	Note:
10Aug16 / 17Oct16	
Inv.735	4 - MAIN FLOOR: STANDARD DOOR EXTENDED HEIGHT 96 INCH (PRICE PER DOOR)
Line9969	Note:
10Aug16 / 17Oct16	

KITCHEN AND BATH CABINETRY

Inv.1,041	1 - KITCHEN: Slide-In Stove customizations
Line15150	Note: See spec sheet attached
8Dec16 / 25Jan17	
Inv.1,041	1 - KITCHEN: UPG Cabinetry Stain - Cocoa
Line15147	Note:
8Dec16 / 25Jan17	
Inv.1,041	1 - KITCHEN: Delete Upper cabinets above Stove to accommodate future chimney hood fan, with finished sides
Line15149	Note:
8Dec16 / 25Jan17	
Inv.1,041	1 - KITCHEN: UPG 2 Cabinetry
Line15146	Note:
8Dec16 / 25Jan17	
Inv.1,041	1 - KITCHEN: UPG - Add Furring Panel and Crown Moulding at top perimeter of cabinetry
Line15148	Note:
8Dec16 / 25Jan17	
Inv.1,041	4 - KITCHEN: Add 2 Clear Glass doors to upper cabinets. Either side of future Chimney hoodfan.
Line15153	Note: See kitchen drawing for location
8Dec16 / 25Jan17	
Inv.1,041	2 - KITCHEN: UPG to Matching interior to clear glass doors (either side of future chimney hoodfan)
Line15154	Note: See kitchen drawing for location
8Dec16 / 25Jan17	

MISC.

Inv.735	1 - Purchaser has attended a Structural appointment at the Decor Centre & has DECLINED any additional upgrades and accepts and acknowledges that there will be no further structural changes/additions/deletions to be made upon signing on August 10, 2016.
Line9979	Note:
10Aug16 / 17Oct16	

Kleinburg Glen - 31L - 1 - 25-2 Elev.B HUDSON

Inv.735	1 - Purchasers are aware & accepts that ANY changes made to upgrades after signing this Purchasers Extra Form are subject to a minimum administration fee of \$500. PLUS a 10% holdback fee.
Line9980	Note:
10Aug16 / 17Oct16	
Inv.735	1 - BONUS PACKAGE: \$5,000.00 (INCLUDING TAXES) WORTH OF UPGRADES FROM GOLD PARK HOMES DÉCOR CENTRE IS BEING APPLIED TOWARD THE STRUCTURAL APPOINTMENT. PURCHASER HAS A REMAINING AMOUNT OF \$00 (INCLUDING TAXES) TO BE USED TOWARD THE COLOUR APPOINTMENT.
Line9981	Note:
10Aug16 / 17Oct16	
Inv.735	1 - BALANCE AFTER CREDIT: \$11,413.25
	50% DEPOSIT PAID BY CHEQUE: \$5,706.63
	50% ADDED TO CLOSING: \$5,706.63
Line9983	Note:
10Aug16 / 17Oct16	
Inv.1,041	1 - Purchasers are aware & accepts that ANY changes made to upgrades after signing this Purchasers Extra Form are subject to a minimum administration fee of \$500. PLUS a 10% holdback fee.
Line15207	Note:
8Dec16 / 25Jan17	
Inv.1,041	1 - Purchaser has attended a Colour appointment at the Decor Centre & has DECLINED any additional upgrades and accepts and acknowledges that there will be no further structural changes/additions/deletions to be made upon signing.
Line15206	Note:
8Dec16 / 25Jan17	
Inv.1,041	1 - STAIRCASE - The purchaser was advised and therefore accepts and acknowledges that the stain of the staircase and flooring chosen do not match. This difference might result in an undesirable colour variance.
Line15208	Note: The purchaser agrees that the vendor is to be exempt from any and all claims by the purchaser regarding this colour variance.
8Dec16 / 25Jan17	
Inv.1,041	1 - Paid by Debit: \$22,401.57
	Correction on Glass Cabinet door: \$587.60 Paid by credit card
Line15211	Note:
8Dec16 / 25Jan17	

PAINTING

Inv.1,041	1 - STAIRS: UPG Stain colour to Preverco Cappuccino
Line15155	Note:
8Dec16 / 25Jan17	

PLUMBING

Inv.1,041	2 - MASTER ENSUITE SINKS: UPG to Contrac Minuet Square Vessel
Line15199	Note: See spec sheet attached
8Dec16 / 25Jan17	

STAIRS AND RAILINGS

Inv.1,041	1 - STAIRS AND RAILINGS: UPG to Euroline 2 with V-Groove Handrail
Line15205	Note: With Black Wrought Iron Pickets
8Dec16 / 25Jan17	

WINDOWS - BASEMENT

Inv.735	1 - BASEMENT WINDOWS - UPGRADE EXISTING BASEMENT WINDOW TO 53 INCH X 12 INCH. Please see floorplan for location.
Line9982	Note:
10Aug16 / 17Oct16	

Scheduled Closing Date: January-11-17

Purchasers: Marvin Monterroso & Indra Delcarmen Cortez Alf Property: 31L

Telephone Res. / Bus: (647) 400-7419

Project: Burkshire Holdings Inc.

Decor Advisor: Laura Lofaro

Model and Elevation: 25-2 Elev.B HUDSON

Layout Changes: ☐ Yes ☐ No Sketch Attached: ☐ Yes ☐ No Exterior Colour Scheme:

1. Cabinetry

	Style and Colour	Counter	Hardware
Kitchen / Breakfast	*Romana Maple *Cocoa	Crema Caramel STD Edge FE20	CS1-24
Laundry Room	N/A		
Powder Room	N/A		
Master Ensuite Bathroom	Varese PVC ChocMpl	Wilsonart Bronzite 4971K-52	CS1-20
Second Ensuite Bathroom (If Applicable)	N/A		
Main Bath	Varese PVC ChocMpl	Arborite P-345 LM Inukshuk Taupe	CS1-20
Dishwasher Cabinet	N/A		

Comment

2. Floor Tile

	Selection	Grout	Threshold
Entrance Vestibule	*12x24 Concrete Matte Brown		
Main Hall	*12x24 Concrete Matte Brown		
Kitchen / Breakfast	*12x24 Concrete Matte Brown		
Laundry Room	13x13 Serpentine Beyaz White		
Powder Room	*12x24 Concrete Matte Brown		
Master Ensuite Bathroom	*18x18 Antikas Series Grigio (Grey)		
Second Ensuite Bathroom (If Applicable)	N/A		
Lower Landing (If Applicable)	N/A		
Main Bath	13x13 Serpentine Beyaz White		

Comment

Master Ensuite Floor Tile / Tub Skirt / Tub Deck / Tub Splash - *18x18 Antikas Series Grigio (Grey)

3. Wall Tile

	Selection	Listello/Inserts	Describe
		<input type="radio"/> Yes <input checked="" type="radio"/> No	
Master Ensuite Bathroom			
Tub Deck	*See floor	<input type="radio"/> Yes <input checked="" type="radio"/> No	
Shower Stall	8x10 Serpentine Beyaz White	<input type="radio"/> Yes <input checked="" type="radio"/> No	
Bathroom Walls	N/A	<input type="radio"/> Yes <input checked="" type="radio"/> No	
Second Ensuite Bathroom (If Applicable)	N/A	<input type="radio"/> Yes <input checked="" type="radio"/> No	
Main Bath	8x10 Serpentine Beyaz White	<input type="radio"/> Yes <input checked="" type="radio"/> No	

Kitchen Backsplash ☒ Yes ☐ No

Backsplash Behind Fridge N/A

Comment

IC mm

Scheduled Closing Date: January-11-17

Purchasers: Marvin Monterroso & Indra Delcarmen Cortez Alf
Telephone Res. / Bus: (647) 400-7419
Decor Advisor: Laura Lofaro
Property: 31L
Project: Burkshire Holdings Inc.
Model and Elevation: 25-2 Elev.B HUDSON

4. Plumbing Fixtures

<input type="text"/>	Second Ensuite	<input type="text"/>	Powder Room	<input type="text"/>	
Master Ensuite Bathroom	<input type="text"/>	Other Room - Specify	<input type="text"/>	Other Washroom	<input type="text"/>

Comment

STD Throughout except Master ensuite sinks - Minuet Square Vessel. See spec sheet attached

5. Hardwood Flooring

	Type and Stain		Type and Stain
Main Hall	N/A	Upper Landing	N/A
Kitchen / Breakfast	N/A	Upper Hall	*Preverco Red Oak Capp.Pro 4-1/4
Living Room	*Preverco Red Oak Capp.Pro 4-1/4	Master Bedroom	N/A
Dining Room	*Preverco Red Oak Capp.Pro 4-1/4	Bedroom #2	N/A
Family Room	*Preverco Red Oak Capp.Pro 4-1/4	Bedroom #3	N/A
Den/Library	N/A	Bedroom #4	N/A
Entrance Vestibule	N/A	Bedroom #5	N/A
Lower Landing (If Applicable)	*Preverco Red Oak Capp.Pro 4-1/4	Other Room - Specify	N/A

Comment

6. Carpeting

	Upgrade	Description
Main Hall	<input type="checkbox"/>	N/A
Living Room	<input type="checkbox"/>	N/A
Dining Room	<input type="checkbox"/>	N/A
Family Room	<input type="checkbox"/>	N/A
Den/Library	<input type="checkbox"/>	N/A
Upper Hall	<input type="checkbox"/>	N/A
Master Bedroom	<input type="checkbox"/>	T15
Bedroom #2	<input type="checkbox"/>	T15
Bedroom #3	<input type="checkbox"/>	T15
Bedroom #4	<input type="checkbox"/>	N/A
Bedroom #5	<input type="checkbox"/>	N/A
<input type="text"/>	<input type="checkbox"/>	<input type="text"/>
Upper Landing (If Applicable)	<input type="checkbox"/>	N/A
Lower Landing (If Applicable)	<input type="checkbox"/>	N/A

Upgrade Underpad	Type N/A	Area
Carpet on Stairs	Capped N/A	Runner - *Upgrade

Comment

50 mm

Scheduled Closing Date: January-11-17

Purchasers: Marvin Monterroso & Indra Delcarmen Cortez Alf Property: 31L

Telephone Res. / Bus: (647) 400-7419

Project: Burkshire Holdings Inc.

Decor Advisor: Laura Lofaro

Model and Elevation: 25-2 Elev.B HUDSON

7. Fireplace

	Living Room			Family Room			Other Room - Specify		
	Purchased	As Per Plan	N/A	Purchased	As Per Plan	N/A	Purchased	As Per Plan	N/A
	<input type="radio"/>	<input type="radio"/>	<input type="radio"/>	<input type="radio"/>	<input checked="" type="radio"/>	<input type="radio"/>	<input type="radio"/>	<input type="radio"/>	<input type="radio"/>
Fireplace Type				STD					
Mantle Type				STD Cast Stone					
Colour / Stain				STD					
Surround				STD					
Hearth				Declined					

Comment

8. Trim Carpentry

Interior Doors	STD	Front Door Glass Inserts	STD	Door Handles	STD
Interior Trim	STD				

Comment

9. Plaster Mouldings and Medallions

Entrance Vestibule	N/A		Kitchen/Breakfast	N/A	
Main Hall	N/A		Den/Library	N/A	
Living Room	N/A		Lower Landing	N/A	
Dining Room	N/A		Other Room - Specify	N/A	
Family Room	N/A				

Comment

10. Railings and Spindles

Railing Package	*Euroline 2 With V-Groove Handrail		
Railing Colour	*Preverco Cappuccino Pro	Spindle Colour	Black Wrought Iron
Stringer / Riser	*Preverco Cappuccino Pro	Treads	*Preverco Cappuccino Pro
Comment		Oak Stairs	<input checked="" type="radio"/> Yes <input type="radio"/> No

11. Wall Paint

Main & Upper Hall		Master Bedroom	
Living Room		Bedroom #2	
Dining Room		Bedroom #3	
Kitchen / Breakfast		Bedroom #4	
Family Room		Bedroom #5	
Powder Room		Master Ensuite	
Laundry Room			
Den/Library		Second Ensuite	
Trim Paint	White		
Comment	Smooth Ceilings First Floor		

Warm Grey Throughout

IC MM

Scheduled Closing Date: January-11-17

Purchasers: Marvin Monterroso & Indra Delcarmen Cortez Alf Property: 31L

Telephone Res. / Bus: (647) 400-7419

Project: Burkshire Holdings Inc.

Decor Advisor: Laura Lofaro

Model and Elevation: 25-2 Elev.B HUDSON

12. Electrical

Plugs and Switches ☒ White ☐ Ivory

Hood Fan ☐ White ☐ Ivory

Appliances

Built in Cooktop

Built in Oven

Gas Stove

Microwave

Comment

Chimney Hood Fan - Home owner to supply and install own Chimney hood fan at own expense and warranty after closing

Above Kitchen Cabinet Light ☐ Yes ☒ No

Below Kitchen Cabinet Light ☐ Yes ☒ No

☐ Yes ☒ No

☐ Yes ☒ No

☐ Yes ☒ No

☐ Yes ☒ No

13. Heating and Air Conditioning

Air Conditioning

Gas Provisions Dryer

Comment

Gas Provisions Stove

Gas Provisions Barbecue

14. Additional Comments

15. Disclaimers and Notes

- Colours of all materials are as close as possible to builder's selection, but not necessarily identical due to variances in manufacturing.
- Any extras listed above are null and void unless accompanied by a separate invoice/amendment. Said invoice must be paid in full.
- The Purchaser acknowledges that after Interior Colour Selection form is signed and dated, no further changes will be permitted other than re-selection due to unavailability. J.C. Purchaser's Initials
- The Purchaser acknowledges reading and accepting the "Gold Park Homes Decor Centre Disclaimers" form. This document contains other miscellaneous disclaimers.

This Interior Colour Selection is final and approved by:

Signature:

Date: Dec 9/16

Signature:

Date: Dec 9, 2016

Elevation A • 1,898 sq.ft.

Elevation B • 1,898 sq.ft.

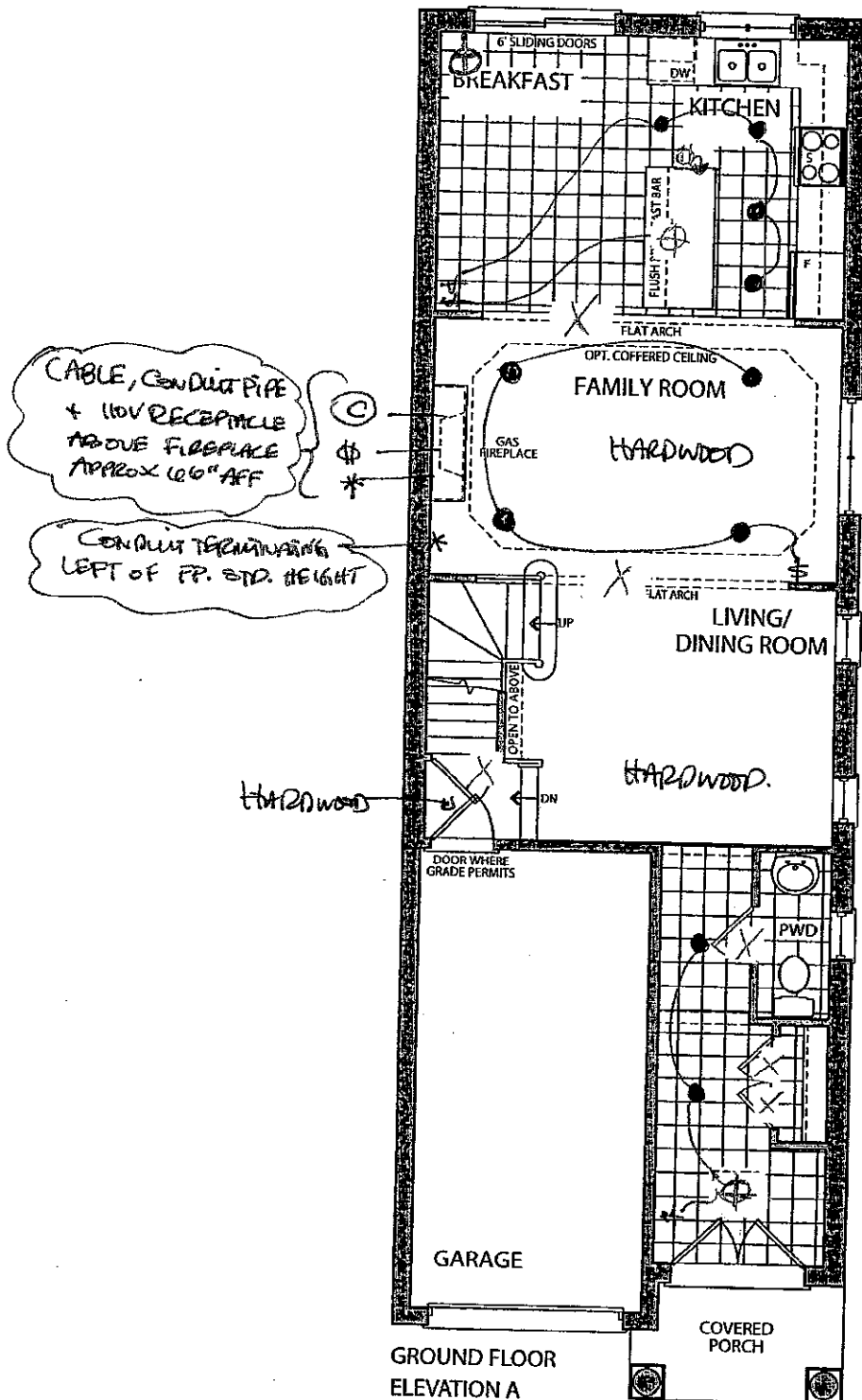

110V RECEPTACLE
TO ISLAND FACING
DISHWASHER

CABLE, CONDUIT PIPE
+ 110V RECEPTACLE
ABOVE FIREPLACE
APPROX 126" AFF

CONDUIT TERMINATING
LEFT OF FP. STD. HEIGHT

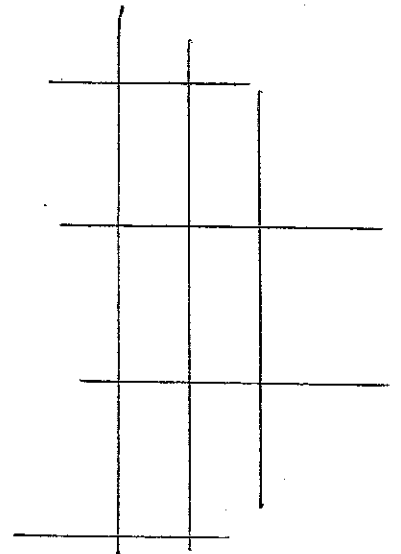

* VERTICALLY STACKED
TILE DIRECTION
FOR FOYER/POWDER
ROOM / KITCHEN *

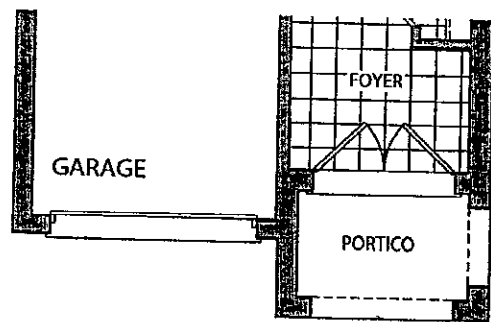

GROUND FLOOR
ELEVATION B

- © - CABLE
- Ⓣ - TELEPHONE
- ⊕ - 110V RECEPTACLE
- * - CONDUIT PIPE
- - POT LIGHT
- ⊙ - CEILING LIGHT
- X - EXTEND DOORWAY
+ ARCHWAYS
- \$ - SWITCH

COLOURS

IC MM

DATE:
Dec 18/16

STRUCTURAL

LOT 31L

FC MM

AUGUST 10, 2016

Elevation A • 1,898 sq.ft.

Elevation B • 1,898 sq.ft.

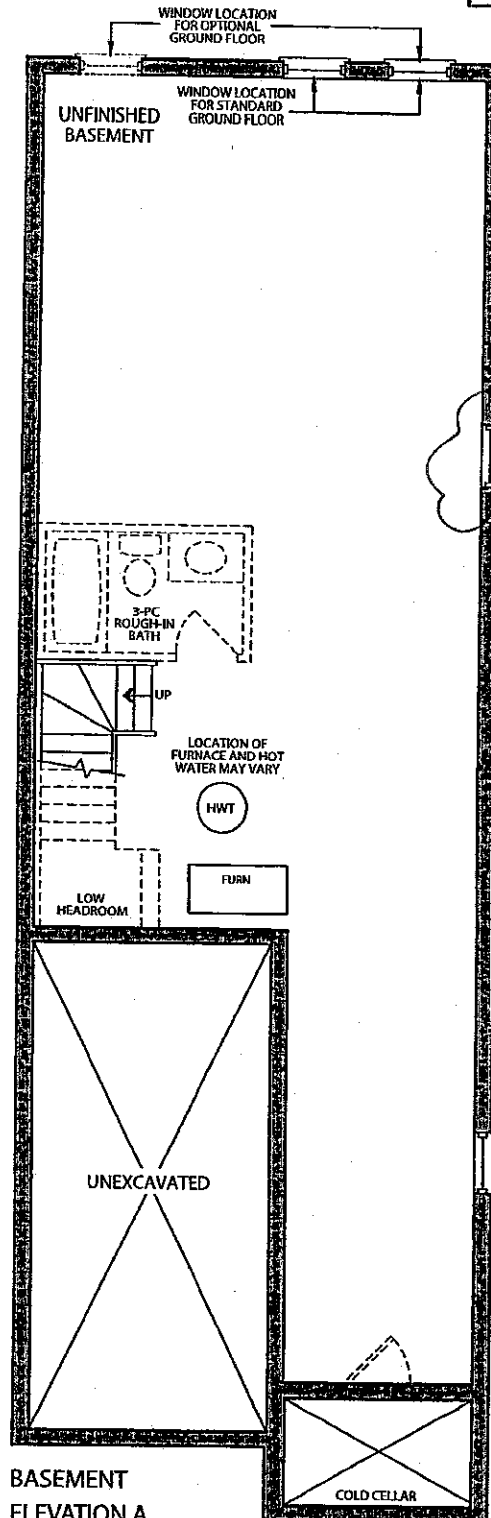

BASEMENT
ELEVATION A

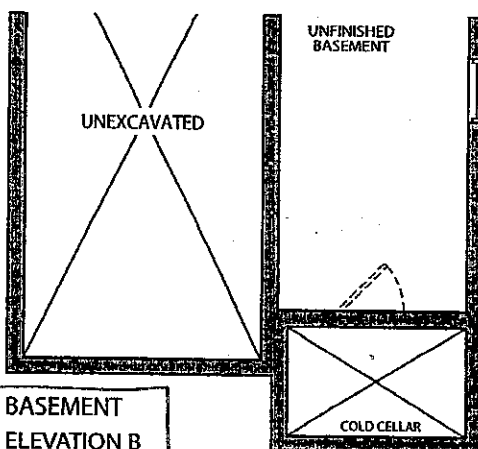

BASEMENT
ELEVATION B

- UP6 TO
53" x 12"
WINDOW
WHITE FRAME

COLOURS

IC MM

DATE: Dec 08/2016

STRUCTURAL

LOT 31L

IC MM

AUGUST 10, 2016



Attention: Building Department

Re: Lot # 31L
DEC 8, 2016

This is to acknowledge that as the purchaser of the above noted lot, I have asked Gold Park Homes not to install the standard builder's kitchen exhaust hood, as I will be installing my own unit after closing.

A handwritten signature in dark ink, appearing to be "J. M. [unclear]", is written over a horizontal line.

Purchaser

A solid horizontal line intended for a signature.

Vendor

Dated this _____ day of _____, 20____.

CORTINA

KITCHENS INC.

70 Regina Road Woodbridge ON L4L 8L6
905-264-6464

INFORMATION - PVC DOORS

Builder: Gold Park Homes Project: KLEINBURG GREEN Lot #: 31L

All cabinets with PVC (Thermofoil) Doors come with melamine gables, panels and kick. The doors, crown moulding and light valance are PVC wrapped. Open shelves incorporated in design will only be available with melamine interiors. There will be variations in colour shades between the PVC parts (doors, crown and Light valance) and the melamine parts (open shelves, Gables, Panels and Kick) due to the difference in material.

Furring Panel with crown moulding to the ceiling is not available on all PVC door styles due to subtle variations in colour shades between the PVC parts (moulding) and the melamine parts (furring panel) due to the difference in material. Grain directions in wood grain pattern melamine, vary between the furring panel, crown moulding (horizontal) and the PVC doors (vertical).

Thank you for your understanding.

I am well informed of this information, and agree to the purchase of the above.

Purchaser: J.C. M.M.

Date: DEC 8, 2016

CORTINA

30 Regina Road Woodbridge ON L4L 8L6
905-264-6464

DARK STAIN INFORMATION

Builder GOLD PARK HOMES Project KLEINBURG GLEN Lot # 31L

Cortina Kitchens offers a wide variety of finishes, applied to oak and maple products. The subject finishes include the spray stains Cocoa, Espresso, Graphite as well as wiping stain **Ebony**.

Due to the very dark stains applied on natural maple and oak doors and joints, several characteristics are important to be noted when purchasing these products.

1. Shadow lines may be visible at the interior profile edges of a door or drawer front. If movement occurs shadow lines may increase or decrease, depending on the style and/or size of a door or drawer front.
2. Variation and unevenness may be visible in the finish.
3. Hairline cracks at the joints are created over time due to the nature of natural wood, caused by usage, humidity, or dryness. They tend to be more visible to darker stains, than lighter wood stains.

Please be advised that Cortina Kitchens will not replace doors nor parts that exhibit the above characteristics associated with this finish. These characteristics are not avoidable and are a result of the natural characteristics of wood and wood veneer, and the characteristics of darker stains on wood.

Thank you for your understanding.

I am well informed of this information, and agree to the purchase of any of the subject finishes listed above.

Purchaser: JO MM

Date: Dec 8, 2016

CORTINA

70 Regina Road, Woodbridge, Ontario L4L 6L6
Tel: 905-284-6404 Fax: 905-284-0804
www.CortinaKitchens.com

QUOTATION

Date: 28/06/16

Trade Name: Gold Park Homes

Site location:

Model: 25-2

Address:

Project: Kleinburg Glen

Phase:

This layout has been explained to the purchaser by Cortina Kitchens Inc. and is understood by the purchaser.

* ADD FURRING
PANEL +
CROWN MOULDING

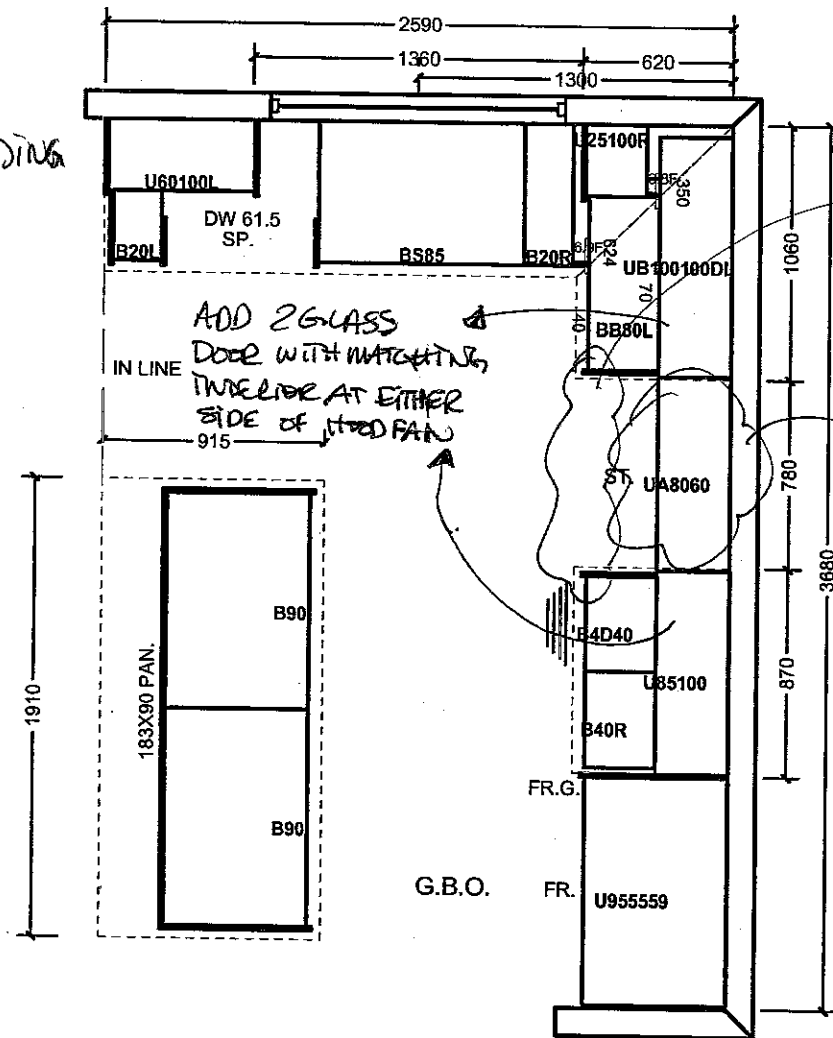

ADJUST
CABINETS
FOR SLIDE-
IN RANGE.

DELETE UPPER
STOVE CABINETS
+ FINISH SIDES
FOR FUTURE
CHIMNEY
HOOD.

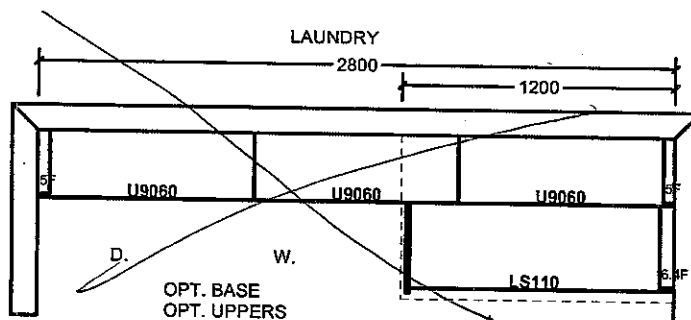
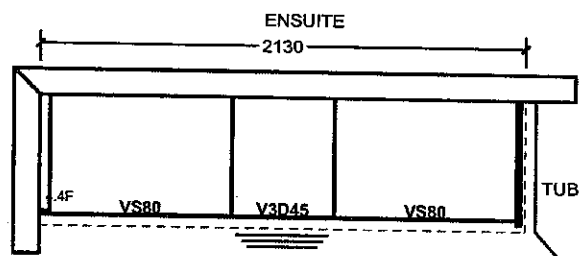
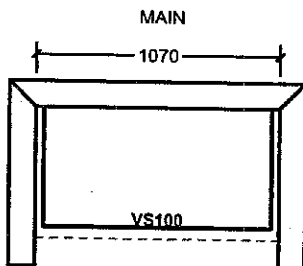

All prices subject to confirmation from head office.
This quotation is subject to the terms & conditions set out

All agreements are contingent upon strikes, accidents, and delays beyond our control.
Please provide our installer with template for sinkholes or \$150.00 will be charged for callback.

ACCEPTED DATE: DEC. 8. 2016

x *[Signature]*

LOT 31L

[Signature]

Item A. Wood grain and colour are characteristics of the product. We cannot guarantee that such grain and colour will always match.
Item B. Cortina Kitchens Inc. reserves the right to alter dimensions and make technical changes without notice.

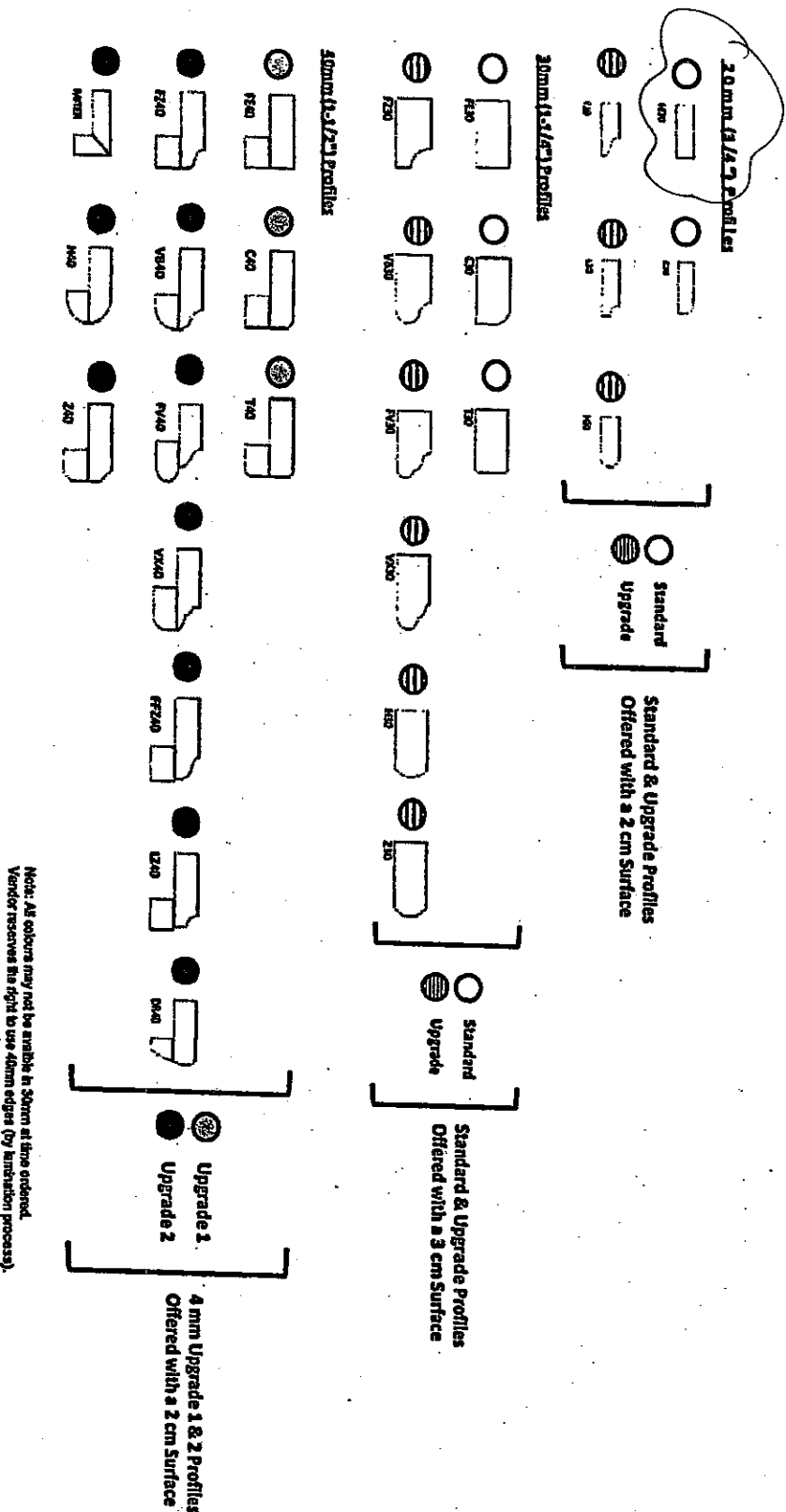

- WPS - SLIDE-IN RAUSE
- STD KITCHEN SINK

WARRANTS GIVEN
Lot 31L

IC 01/11/19

DATE: Dec. 08/2016

STANDARD HARDWARE

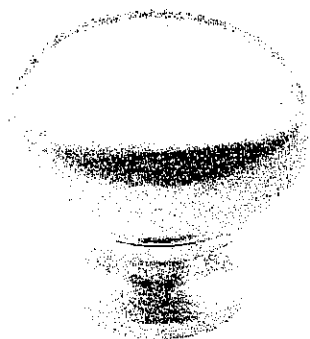

CSI-6

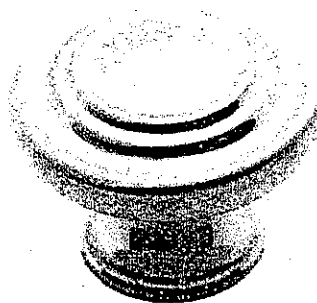

CSI-10

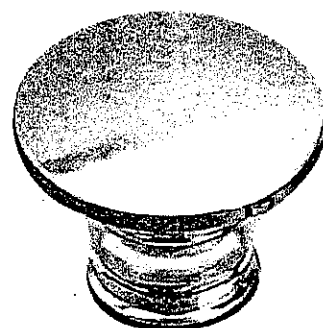

CSI-14



CSI-16

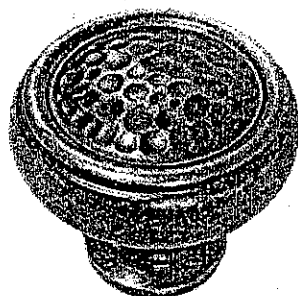

CSI-18

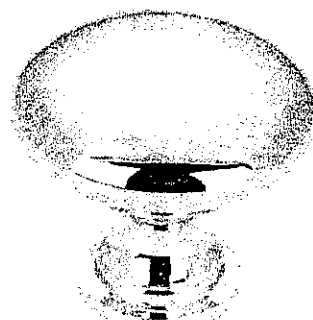

CSI-19

→ MASTER ENSUITE
+ MAIN BATH

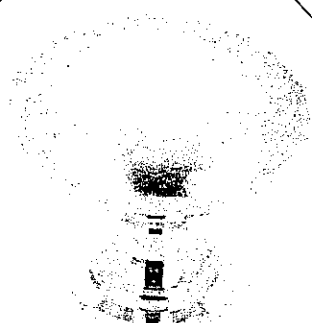

CSI-20

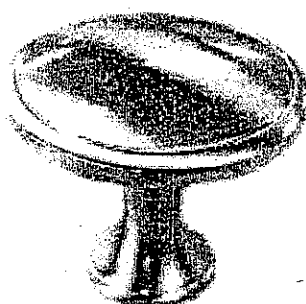

CSI-21



CSI-22

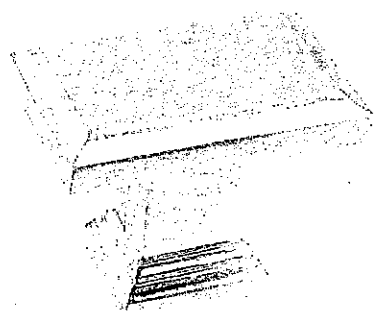

CSI-23

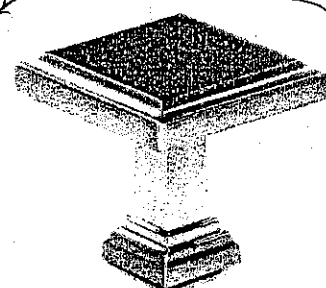

CSI-24

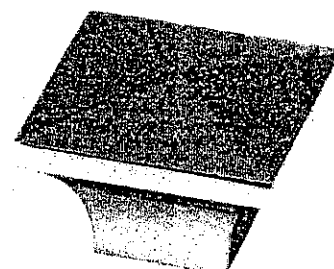

CSI-25

*NOTES:

- IMAGES ARE FOR QUICK REFERENCE PURPOSES ONLY
- ACTUAL SIZES AND FINISHES AS PER HARDWARE SAMPLE BOARD PROVIDED TO DECOR CENTRE

KLEINBURG GLEN
LOT 31L

JO MM

DATE: Dec 08/2016

13-0024-W



Finish
Soft white vitreous china
Nano easy clean glaze



Overflow
Rear



Template
Supplied



Faucet drilling
Single hole



Dimensions
19" (W) x 15 1/4" (D) x 6 1/4" (H)

Minuet

rectangular vessel lavatory

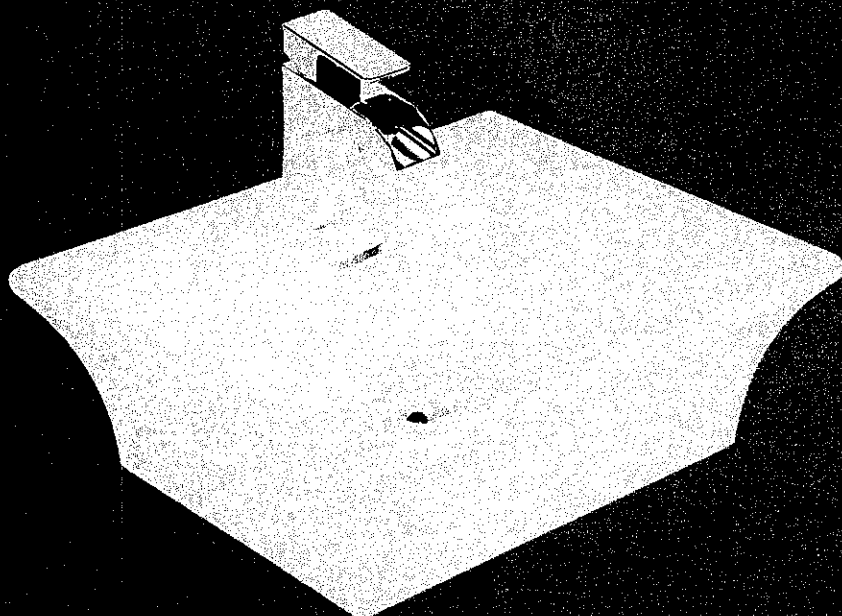

www.foremostcanada.com

(KLEINBURG GLEN)

LOT 31L

(JC) (mm)

DATE: Dec. 08/2016

MASTER ENSUITE X2

Laura Lofaro

From: Marvin Monterroso <marvin.monterroso09@gmail.com>
Sent: December-09-16 1:20 AM
To: Laura Lofaro
Subject: slide in specs

KLEINBURG GLEN
LOT 31L

Overview Model # PCS940SFSS Store SKU # 1000788526

6.6 cu. ft. Slide-in Electric Self-Cleaning Convection Range in Stainless Steel

GE slide-in ranges offer a custom built-in-look by a simple slide-in installation within surrounding countertops and cabinets. This range features a Self-Cleaning oven, which delivers a high concentrated heat with the touch of a button that conveniently cleans the oven cavity and eliminates the need to scrub baked-on food and spills. The dual element bake alternates the upper broiling element and the lower baking element for even heating and optimal baking results. The exclusive Precise Air true European convection system uses an innovative fan that rotates one way, then reverses direction to allow heated air to circulate evenly around food. Plus, a third heating element surrounds the fan and delivers consistent heat for true European convection.

- Total oven capacity of 6.6 cu. ft. in a 30-inch space
- Extension gliding roller rack
- Bridge element
- Features bake / warm / storage drawer
- Self-cleaning function saves time and labour
- Smooth cooktop surface

Specifications

Dimensions

Assembled Depth (in inches)	26.50	Assembled Height (in inches)
Assembled Weight (In LBS)	199	Assembled Width (in inches)
Item Depth	26.5	Item Height
Item Weight	199	Item Width
Primary Oven Capacity (cu. ft.)	5.6	Secondary Oven Capacity (cu. ft.)

Details

Bridge Element	Yes	Broiler Location	Drawer
----------------	-----	------------------	--------

Certified	Yes	Cleaning Type	Self Cleaning
Clock	Yes	Colour / Finish	Stainless Steel
Colour Family	Stainless Steel	Continuous Grates	N/A
Convection	Yes	Cooktop Features	Minuterie auto
Cooktop Surface Type	Smooth Surface	Country of Origin	MX-Mexico
Delay Start	Yes	Digital Display	Yes
Digital Temperature Display	Yes	Drawer	Storage/Oven
ENERGY STAR Certified	No	Element 1 (In.)	6
Element 2 (In.)	7	Element 3 (In.)	7
Element 4 (In.)	6/9/12	Element 5 (In.)	Bridge (2)
Fuel Type Ranges	Electric	Grate Material	N/A
Griddle Option	No	Handle Color	Stainless Steel
Hot Surface Indicator Light	Yes	Ignition Type	N/A
Labour	1 Year Limited	Number of Burners	6
Number of Oven Racks	3	Number of Ovens	2
Oven Control Type	Touchpad	Parts	1 year
Range Control Type	Knobs	Range Type	Slide-in
Self Cleaning	Yes	Simmer Element	No
Style	Slide-In	Surface Type	Smooth Top
The Home Depot Exclusive	No	UPC Code (no spaces or dashes)	48834005377

KUENBURG GLEN
LOT 311
- SLIDE-IN-RANGE - Pg 2