



CONSTRUCTION SUMMARY

Kleinburg Glen - 44L - 1 - 25-2 Elev.B HUDSON
CARPET

| | |
|------------------|--|
| Inv.1,035 | 1 - 2ND FLOOR CARPET: UPG Underpad - Master Bedroom / Bedroom 2 / Bedroom 3 |
| Line15090 | Note: |
| 6Dec16 / 18Jan17 | |
| Inv.1,035 | 1 - 2ND FLOOR CARPET: UPG to Costa Rica - Master Bedroom / Bedroom 2 / Bedroom 3 |
| Line15089 | Note: |
| 6Dec16 / 18Jan17 | |

CENTRAL VAC AND WIRING

| | |
|------------------|--|
| Inv.731 | 1 - FAMILY ROOM: CONDUIT PIPE - FOR TELEVISION - ABOVE FIREPLACE APPROX 66" AFF NEXT TO CABLE AND 110V RECEPTACLE. TERMINATING LEFT OF FIREPLACE AT STANDARD HEIGHT. PLEASE SEE FLOORPLAN FOR LOCATION |
| Line9866 | Note: |
| 9Aug16 / 11Nov16 | |
| Inv.731 | 1 - CONDUIT PIPE - FROM ATTIC TO ELECTRICAL PANEL - Please run a straight run from Electrical Panel to Attic |
| Line9886 | Note: |
| 9Aug16 / 11Nov16 | |
| Inv.731 | 1 - KITCHEN: INSTALL VAC PAN UNDER KITCHEN SINK |
| Line9889 | Note: |
| 9Aug16 / 11Nov16 | |
| Inv.731 | 2 - BEDROOM 2 & 3: ADD RG6 CABLE TO BOTH BEDROOMS AT STANDARD HEIGHT. PLEASE SEE FLOORPLAN FOR LOCATION |
| Line9894 | Note: |
| 9Aug16 / 11Nov16 | |

CERAMIC

| | |
|------------------|--|
| Inv.1,035 | 1 - MASTER ENSUITE FLOOR TILE: UPG 4 |
| Line15066 | Note: Floor / Tub Face / Tub Deck / Tub Splash |
| 6Dec16 / 18Jan17 | |
| Inv.1,035 | 1 - MASTER ENSUITE WALL TILE: UPG 2 |
| Line15071 | Note: Installed Vertically Stacked |
| 6Dec16 / 18Jan17 | |
| Inv.1,035 | 1 - MAIN BATH FLOOR TILE: UPG 4 |
| Line15074 | Note: |
| 6Dec16 / 18Jan17 | |
| Inv.1,035 | 1 - LAUNDRY FLOOR TILE: UPG 4 |
| Line15082 | Note: |
| 6Dec16 / 18Jan17 | |

DRYWALL

| | |
|------------------|---|
| Inv.731 | 1 - SMOOTH CEILINGS - (2 - Story Design) SECOND FLOOR |
| Line9902 | Note: |
| 9Aug16 / 11Nov16 | |

ELECTRICAL

Kleinburg Glen - 44L - 1 - 25-2 Elev.B HUDSON

| | |
|------------------|--|
| Inv.731 | 1 - KITCHEN: 110V WALL RECEPTACLE ON DEDICATED CIRCUIT - GAS FIRED APPLIANCE - FOR AUX. EQUIPMENT - NOT A STOVE PLUG.TO ACCOMMODATE FUTURE GAS RANGE |
| Line9860 | Note: |
| 9Aug16 / 11Nov16 | |
| Inv.731 | 1 - KITCHEN: 110V WALL RECEPTACLE ON DEDICATED CIRCUIT - FOR MICROWAVE - MICROWAVE NOT INCLUDED. FOR FUTURE WALL OVEN/MICRO COMBO. PLEASE SEE FLOORPLAN FOR LOCATION |
| Line9862 | Note: |
| 9Aug16 / 11Nov16 | |
| Inv.731 | 1 - KITCHEN: 220V WALL RECEPTICAL ON DEDICATED CIRCUIT - FOR 4 WIRE BUILT - IN WALL OVEN - FOR FUTURE WALL OVEN/MICRO COMBO. PLEASE SEE FLOORPLAN FOR LOCATION |
| Line9861 | Note: |
| 9Aug16 / 11Nov16 | |
| Inv.731 | 1 - KITCHEN: RELOCATE FRIDGE TO DISHWASHER LOCATION. PLEASE SEE FLOORPLAN FOR LOCATION. |
| Line9864 | Note: |
| 9Aug16 / 11Nov16 | |
| Inv.731 | 1 - KITCHEN: 110V WALL RECEPTACLE ON NORMAL CIRCUIT - AT ISLAND UNDER BREAKFAST BAR, LEFT OF SINK. PLEASE SEE FLOORPLAN FOR LOCATION |
| Line9865 | Note: |
| 9Aug16 / 11Nov16 | |
| Inv.731 | 1 - FAMILY ROOM: 110V WALL RECEPTACLE ON NORMAL CIRCUIT - APPROX 66" AFF NEXT TO CABLE AND CONDUIT. PLEASE SEE FLOORPLAN FOR LOCATION |
| Line9867 | Note: |
| 9Aug16 / 11Nov16 | |
| Inv.731 | 1 - 200 AMP ELECTRICAL SERVICE |
| Line9895 | Note: |
| 9Aug16 / 11Nov16 | |
| Inv.731 | 1 - KITCHEN: ROUGH - IN CEILING OUTLET & SWITCH (WITH COVER PLATE) - DOES NOT INCLUDE FIXTURE - OVER ISLAND. |
| Line9897 | Note: |
| 9Aug16 / 11Nov16 | |
| Inv.731 | 1 - KITCHEN: ROUGH - IN CEILING OUTLET ON SAME SWITCH AS OTHER CEILING ISLAND ROUGH-IN - DOES NOT INCLUDE FIXTURE - OVER ISLAND. PLEASE SEE FLOORPLAN FOR LOCATION |
| Line9898 | Note: |
| 9Aug16 / 11Nov16 | |
| Inv.731 | 1 - KITCHEN CABINET STRIP VALANCE LIGHTS (UNDER CABINETS) - ROUGH - IN - DOES NOT INCLUDE (AND REQUIRES) KITCHEN UPGRADE PRICING |
| Line9901 | Note: |
| 9Aug16 / 11Nov16 | |
| Inv.731 | 1 - KITCHEN: RELOCATE DISHWASHER AND SINK TO ISLAND. DISHWASHER ON RIGHT SIDE OF SINK. PLEASE SEE FLOORPLAN FOR LOCATION |
| Line13812 | Note: |
| 9Aug16 / 11Nov16 | |
| Inv.1,035 | 1 - KITCHEN - Purchasers request to NOT INSTALL builder's standard hood fan and standard cabinets above stove. DELETE. Do not supply, install, and/or credit. Purchasers are installing their own hood fan after closing. |
| Line15907 | Note: Purchasers accept and acknowledge that the exhaust fan duct hole may be off-centered with stove in kitchen due to purchasers installing their own hood fan after closing. The vendor is exempt. Please leave 36" opening for future 30" Chimney Hood |
| 6Dec16 / 18Jan17 | |

EXTERIOR COLOURS

Kleinburg Glen - 44L - 1 - 25-2 Elev.B HUDSON

| | |
|------------------|-------------------------------|
| Inv.731 | 1 - EXTERIOR COLOUR PACKAGE 1 |
| Line13805 | Note: |
| 9Aug16 / 11Nov16 | |

FIREPLACE AND MANTLE

| | |
|------------------|---|
| Inv.1,035 | 1 - FIREPLACE: UPG Add Hearth to fireplace Mantle |
| Line15920 | Note: |
| 6Dec16 / 18Jan17 | |

FRAMING

| | |
|------------------|---|
| Inv.731 | 1 - MANDOOR - GARAGE TO HOUSE - AS PER PLAN AND GRADE PERMITING |
| Line13807 | Note: AS PER APS |
| 9Aug16 / 11Nov16 | |

| | |
|------------------|--|
| Inv.731 | 1 - MAIN FLOOR: EXTENDED HEIGHT ARCHWAY (PRICE PER DOORWAY) - INCLUDE FRAMING NOTE |
| Line13809 | Note: |
| 9Aug16 / 11Nov16 | |

| | |
|------------------|---|
| Inv.731 | 1 - STANDARD DOOR EXTENDED HEIGHT 96 INCH (PRICE PER DOOR) - GROUND FLOOR 2 STOREY MODELS |
| Line13810 | Note: |
| 9Aug16 / 11Nov16 | |

GLASS AND MIRROR

| | |
|------------------|---|
| Inv.731 | 1 - MASTER ENSUITE: CONVERT FRAMED SHOWER TO 10MM FRAMLESS SHOWER ENCLOSURE WITH DOOR AND 10MM SIDE PANEL |
| Line9923 | Note: |
| 9Aug16 / 11Nov16 | |

GRANITE MARBLE QUARTZ

| | |
|------------------|---|
| Inv.1,035 | 1 - KITCHEN COUNTERTOP: UPG 3 Caesarstone |
| Line15018 | Note: |
| 6Dec16 / 18Jan17 | |

| | |
|------------------|--|
| Inv.1,035 | 1 - KITCHEN COUNTERTOP EDGE: UPG 2, 4cm FZ40 |
| Line15019 | Note: See spec sheet attached |
| 6Dec16 / 18Jan17 | |

| | |
|------------------|--------------------------------------|
| Inv.1,035 | 1 - MASTER ENSUITE COUNTERTOP: UPG 4 |
| Line15069 | Note: |
| 6Dec16 / 18Jan17 | |

| | |
|------------------|--|
| Inv.1,035 | 1 - MASTER ENSUITE COUNTERTOP EDGE: UPG 4CM FZ40 |
| Line15070 | Note: |
| 6Dec16 / 18Jan17 | |

| | |
|------------------|---------------------------------|
| Inv.1,035 | 1 - MAIN BATH COUNTERTOP: UPG 4 |
| Line15077 | Note: |
| 6Dec16 / 18Jan17 | |

| | |
|------------------|---|
| Inv.1,035 | 1 - MAIN BATH COUNTERTOP EDGE: UPG 4CM FZ40 |
| Line15078 | Note: |
| 6Dec16 / 18Jan17 | |

HARDWOOD

Kleinburg Glen - 44L - 1 - 25-2 Elev.B HUDSON

| | |
|------------------|--|
| Inv.1,035 | 1 - MAIN FLOOR: UPG 3 Hardwood Family Room / Living/Dining Room / Lower Landing: |
| Line15014 | Note: |
| 6Dec16 / 18Jan17 | |
| Inv.1,035 | 1 - 2ND FLOOR: UPG 3 Hardwood Upper Hallway |
| Line15015 | Note: |
| 6Dec16 / 18Jan17 | |

HVAC

| | |
|------------------|---|
| Inv.731 | 1 - KITCHEN: GAS LINE ROUGH - GROUND FLOOR. TO ACCOMMODATE FUTURE GAS RANGE |
| Line9859 | Note: |
| 9Aug16 / 11Nov16 | |
| Inv.731 | 1 - TANKLESS HWT CONNECTION - HWT ON RENTAL BASIS / TANK NOT INCLUDED |
| Line9915 | Note: |
| 9Aug16 / 11Nov16 | |
| Inv.731 | 1 - HUMIDIFIER: WB3 - 12 (UP TO 2,000 SQ.FT.) |
| Line9916 | Note: |
| 9Aug16 / 11Nov16 | |

INTERIOR TRIM AND DOORS

| | |
|------------------|---|
| Inv.731 | 2 - MAIN FLOOR: EXTENDED HEIGHT ARCHWAY (PRICE PER DOORWAY) - INCLUDE FRAMING NOTE |
| Line9876 | Note: |
| 9Aug16 / 11Nov16 | |
| Inv.731 | 4 - STANDARD DOOR EXTENDED HEIGHT 96 INCH (PRICE PER DOOR) - GROUND FLOOR 2 STOREY MODELS |
| Line9877 | Note: |
| 9Aug16 / 11Nov16 | |

KITCHEN AND BATH CABINetry

| | |
|------------------|--|
| Inv.731 | 1 - KITCHEN: INSTALL VAC PAN UNDER KITCHEN SINK |
| Line13813 | Note: |
| 9Aug16 / 11Nov16 | |
| Inv.1,035 | 1 - KITCHEN CABINetry: UPG 2 |
| Line15020 | Note: |
| 6Dec16 / 18Jan17 | |
| Inv.1,035 | 1 - KITCHEN CABINetry: UPG Stain, Graphite |
| Line15021 | Note: |
| 6Dec16 / 18Jan17 | |
| Inv.1,035 | 1 - KITCHEN: Add Base Corner Folding Door |
| Line15022 | Note: |
| 6Dec16 / 18Jan17 | |
| Inv.1,035 | 1 - KITCHEN: UPG Add Built in Wall Oven & Microwave and Cooktop (Maple Door) |
| Line15024 | Note: See Kitchen Drawing for location |
| 6Dec16 / 18Jan17 | |
| Inv.1,035 | 1 - KITCHEN CABINetry: Add Fridge Gable to either side of Fridge. |
| Line15025 | Note: Fridge Relocated left of window. See Kitchen Drawing for location |
| 6Dec16 / 18Jan17 | |

Kleinburg Glen - 44L - 1 - 25-2 Elev.B HUDSON

| | |
|------------------|--|
| Inv.1,035 | 1 - MASTER ENSUITE CABINETRY: UPG 2 |
| Line15067 | Note: |
| 6Dec16 / 18Jan17 | |
| Inv.1,035 | 1 - MASTER ENSUITE CABINETRY: UPG STAIN Graphite |
| Line15068 | Note: |
| 6Dec16 / 18Jan17 | |
| Inv.1,035 | 1 - MAIN BATH CABINETRY: UPG 2 |
| Line15080 | Note: |
| 6Dec16 / 18Jan17 | |
| Inv.1,035 | 1 - MAIN BATH: UPG STAIN Graphite |
| Line15081 | Note: |
| 6Dec16 / 18Jan17 | |
| Inv.1,035 | 1 - KITCHEN: Add soft close hinges to all doors & drawers throughout kitchen |
| Line15908 | Note: |
| 6Dec16 / 18Jan17 | |
| Inv.1,035 | 1 - KITCHEN: UPG Hardware to handles |
| Line15909 | Note: |
| 6Dec16 / 18Jan17 | |
| Inv.1,035 | 1 - MASTER ENSUITE: UPG Hardware to Vanity |
| Line15910 | Note: |
| 6Dec16 / 18Jan17 | |
| Inv.1,035 | 1 - MAIN BATH: UPG Hardware to Vanity |
| Line15911 | Note: |
| 6Dec16 / 18Jan17 | |
| Inv.1,035 | 1 - KITCHEN: Add Light Valance to base perimeter of Upper Cabinets |
| Line15912 | Note: |
| 6Dec16 / 18Jan17 | |
| Inv.1,035 | 1 - KITCHEN: Add Pots & pans Drawer under cooktop. 2 Deep Drawers - At drop in cooktop - Top drawer is false (no drawer) |
| Line15913 | Note: Please see kitchen drawing for location |
| 6Dec16 / 18Jan17 | |

MISC.

| | |
|------------------|--|
| Inv.731 | 1 - Purchaser has attended a Structural appointment at the Decor Centre & has DECLINED any additional upgrades and accepts and acknowledges that there will be no further structural changes/additions/deletions to be made upon signing on August 9, 2016. |
| Line9920 | Note: |
| 9Aug16 / 11Nov16 | |
| Inv.731 | 1 - Purchasers are aware & accepts that ANY changes made to upgrades after signing this Purchasers Extra Form are subject to a minimum administration fee of \$500. PLUS a 10% holdback fee. |
| Line9921 | Note: |
| 9Aug16 / 11Nov16 | |
| Inv.731 | 1 - BONUS PACKAGE: \$5,000.00 (INCLUDING TAXES) WORTH OF UPGRADES FROM GOLD PARK HOMES DÉCOR CENTRE IS BEING APPLIED TOWARD THE STRUCTURAL APPOINTMENT. PURCHASER HAS A REMAINING AMOUNT OF \$00 (INCLUDING TAXES) TO BE USED TOWARD THE COLOUR APPOINTMENT. |
| Line9922 | Note: |
| 9Aug16 / 11Nov16 | |

Kleinburg Glen - 44L - 1 - 25-2 Elev.B HUDSON

| | |
|------------------|---|
| Inv.731 | 1 - BALANCE AFTER CREDIT: \$16,244.00 PAID IN FULL BY CHEQUE. |
| Line9924 | Note: |
| 9Aug16 / 11Nov16 | |
| Inv.1,035 | 1 - Purchaser has attended a Colour appointment at the Decor Centre & has DECLINED any additional upgrades and accepts and acknowledges that there will be no further structural changes/additions/deletions to be made upon signing. |
| Line15921 | Note: |
| 6Dec16 / 18Jan17 | |
| Inv.1,035 | 1 - Purchasers are aware & accepts that ANY changes made to upgrades after signing this Purchasers Extra Form are subject to a minimum administration fee of \$500. PLUS a 10% holdback fee. |
| Line15922 | Note: |
| 6Dec16 / 18Jan17 | |
| Inv.1,035 | 1 - Purchaser request that all upgrades from this purchaser's extras form to be added to the purchase price. Purchaser is aware that upgrades will be processed only after the builder receives approval letter from the bank. |
| Line15923 | Note: |
| 6Dec16 / 18Jan17 | |
| Inv.1,035 | 1 - Purchaser Accepts Standard Appliance Openings: Fridge - 37-1/2"W x 73-1/2" High Approx. Dishwasher - 24" W Approx |
| Line15924 | Note: |
| 6Dec16 / 18Jan17 | |
| Inv.1,035 | 1 - TOTAL: \$49,092.17 50% DEPOSIT \$ 24,546.09 Paid by Credit Card 50% Applied to Mortgage |
| Line15925 | Note: |
| 6Dec16 / 18Jan17 | |

PAINTING

| | |
|------------------|--|
| Inv.1,035 | 1 - STAIRS & RAILINGS: UPG - Stain Colour Guinness |
| Line15023 | Note: |
| 6Dec16 / 18Jan17 | |

PLUMBING

| | |
|------------------|--|
| Inv.731 | 2 - KITCHEN: RELOCATE DISHWASHER AND SINK TO ISLAND. DISHWASHER ON RIGHT SIDE OF SINK. PLEASE SEE FLOORPLAN FOR LOCATION |
| Line9863 | Note: |
| 9Aug16 / 11Nov16 | |
| Inv.731 | 1 - MASTER ENSUITE: TRENCH DRAIN APPROX 6 INCH SQUARE - TILED DRAIN - ACO 37239 |
| Line9904 | Note: |
| 9Aug16 / 11Nov16 | |
| Inv.731 | 1 - KITCHEN: RELOCATE FRIDGE TO DISHWASHER LOCATION. PLEASE SEE FLOORPLAN FOR LOCATION. |
| Line13811 | Note: |
| 9Aug16 / 11Nov16 | |
| Inv.1,035 | 3 - MASTER ENSUITE & MAIN BATH: UPG Vanity Sinks - Contrac Camden 16" Square Undermount |
| Line15914 | Note: Includes Polished cut out for upgraded Caesarstone countertop. See spec sheet attached |
| 6Dec16 / 18Jan17 | |

Kleinburg Glen - 44L - 1 - 25-2 Elev.B HUDSON

| | |
|------------------|--|
| Inv.1,035 | 2 - MASTER ENSUITE & MAIN BATH: UPG Shower Faucet and Tub/Shower Faucet to Delta Addison #T14492 |
| Line15917 | Note: See spec sheet attached |
| 6Dec16 / 18Jan17 | |
| Inv.1,035 | 3 - MASTER ENSUITE & MAIN BATH: UPG Vanity Faucet to Delta Addison Single hole #592-DST Chrome |
| Line15916 | Note: See spec sheet attached |
| 6Dec16 / 18Jan17 | |
| Inv.1,035 | 1 - KITCHEN: UPG Kitchen Sink to Blanco Quatrus R15 U Super Single 401518 |
| Line15918 | Note: See spec sheet attached |
| 6Dec16 / 18Jan17 | |

STAIRS AND RAILINGS

| | |
|------------------|---|
| Inv.1,035 | 1 - STAIRS & RAILINGS: UPG Handrail to V-Groove * Euroline 2 pickets with Pewter Colour |
| Line15919 | Note: |
| 6Dec16 / 18Jan17 | |

WINDOWS - BASEMENT

| | |
|------------------|--|
| Inv.731 | 2 - BASEMENT WINDOWS - UPGRADE EXISTING BASEMENT WINDOW TO 46 INCH X 32 INCH - MAY REQUIRE INSTALLATION OF WINDOW WELL |
| Line9906 | Note: To be colour matched |
| 9Aug16 / 11Nov16 | |
| Inv.731 | 2 - BASEMENT: COLOUR MATCH BOTH UPGRADED WINDOWS |
| Line9908 | Note: |
| 9Aug16 / 11Nov16 | |

WINDOWS AND DOORS

| | |
|------------------|--|
| Inv.731 | 2 - MAIN FLOOR: ADD GARDEN DOORS WITH CLEAR GLASS AND MINI BLINDS IN LIEU OF SLIDERS AT REAR OF HOUSE. |
| Line9883 | Note: |
| 9Aug16 / 11Nov16 | |
| Inv.731 | 1 - MAN DOOR GARAGE TO HOUSE - OPTIONAL - IF GRADE PERMITS |
| Line13806 | Note: AS PER APS |
| 9Aug16 / 11Nov16 | |

Scheduled Closing Date: December-19-16

Purchaser: Soterios Galineas

Property: 44L

Telephone Res. / Bus: (416) 836-7151

Project: Burkshire Holdings Inc.

Decor Advisor: Laura Lofaro

Model and Elevation: 25-2 Elev.B HUDSON

Layout Changes: ☐ Yes ☐ No Sketch Attached: ☐ Yes ☐ No Exterior Colour Scheme:

1. Cabinetry

| | Style and Colour | Counter | Hardware |
|---|--------------------------|--|----------------------|
| Kitchen / Breakfast | *Florentine Mple.Graphit | *Caesarstone 6270 Atlantic Salt *Edge FZ40 | *CH-51 |
| Laundry Room | <input type="text"/> | <input type="text"/> | <input type="text"/> |
| Powder Room | <input type="text"/> | <input type="text"/> | <input type="text"/> |
| <input type="text"/> | <input type="text"/> | <input type="text"/> | <input type="text"/> |
| Master Ensuite Bathroom | *Florentine Mple.Graphit | *Caesarstone 4230 Shitake *Edge FZ40 | *CH-51 |
| Second Ensuite Bathroom (If Applicable) | <input type="text"/> | <input type="text"/> | <input type="text"/> |
| Main Bath | *Florentine Mple.Graphit | *Caesarstone 4230 Shitake *Edge FZ40 | *CH-51 |
| Dishwasher Cabinet | <input type="text"/> | | |

Comment

* Kitchen Countertop / Master Ensuite EDGE - UPG 4cm - FZ40

2. Floor Tile

| | Selection | Grout | Threshold |
|---|------------------------------------|----------------------|----------------------|
| Entrance Vestibule | *17.7x17.7 Must Polished Dove Grey | <input type="text"/> | <input type="text"/> |
| Main Hall | *17.7x17.7 Must Polished Dove Grey | <input type="text"/> | <input type="text"/> |
| Kitchen / Breakfast | *17.7x17.7 Must Polished Dove Grey | <input type="text"/> | <input type="text"/> |
| Laundry Room | *17.7x17.7 Must Polished Taupe | <input type="text"/> | <input type="text"/> |
| Powder Room | *17.7x17.7 Must Polished Dove Grey | <input type="text"/> | <input type="text"/> |
| | <input type="text"/> | <input type="text"/> | <input type="text"/> |
| Master Ensuite Bathroom | *17.7x17.7 Must Polished Taupe | <input type="text"/> | <input type="text"/> |
| Second Ensuite Bathroom (If Applicable) | <input type="text"/> | <input type="text"/> | <input type="text"/> |
| Lower Landing (If Applicable) | See Hardwood | <input type="text"/> | <input type="text"/> |
| Main Bath | *17.7x17.7 Must Polished Taupe | <input type="text"/> | <input type="text"/> |

Comment

Master Ensuite Floor / Tub Face / Tub Deck / Tub Splash - *17.7x17.7 Must Polished Taupe

3. Wall Tile

| | Selection | Listello/Inserts | Describe |
|---|------------------------|---|----------------------|
| | <input type="text"/> | <input type="radio"/> Yes <input checked="" type="radio"/> No | <input type="text"/> |
| Master Ensuite Bathroom | | | |
| Tub Deck | *See floor tile | <input type="radio"/> Yes <input checked="" type="radio"/> No | <input type="text"/> |
| Shower Stall | *8x24 Sacramento Beige | <input type="radio"/> Yes <input checked="" type="radio"/> No | <input type="text"/> |
| Bathroom Walls | N/A | <input type="radio"/> Yes <input checked="" type="radio"/> No | <input type="text"/> |
| Second Ensuite Bathroom (If Applicable) | N/A | <input type="radio"/> Yes <input checked="" type="radio"/> No | <input type="text"/> |
| Main Bath | 8x10 Venus Ivory | <input type="radio"/> Yes <input checked="" type="radio"/> No | <input type="text"/> |

Kitchen Backsplash

☐ Yes ☒ No

Backsplash Behind Fridge

Comment

Master Shower Wall - Installed in a vertically stacked pattern

Purchaser: Soterios Galineas

Property: 44L

Telephone Res. / Bus: (416) 836-7151

Project: Burkshire Holdings Inc.

Decor Advisor: Laura Lofaro

Model and Elevation: 25-2 Elev.B HUDSON

4. Plumbing Fixtures

| | | | | |
|--------------------------|--------------------------|--------------------------|--------------------------|--------------------------|
| <input type="checkbox"/> | Second Ensuite | <input type="checkbox"/> | Powder Room | <input type="checkbox"/> |
| Master Ensuite Bathroom | <input type="checkbox"/> | Other Room - Specify | <input type="checkbox"/> | Other Washroom |
| <input type="text"/> | | | | |

Comment

*Master Ensuite & Main Bath Vanity Sinks: Contrac Camden 16" Square Undermount
 *Master Ensuite & Main Bath Vanity Faucets: Delta Addison Single hole #592-DST Chrome
 *Master Ensuite & Main Bath Shower & Tub/Shower Faucet: Delta Addison #T14492
 *Kitchen Sink: Blanco Quatrus R15 U Super Single 401518

5. Hardwood Flooring

| | Type and Stain | | Type and Stain |
|-------------------------------|--------------------------------|----------------------|--------------------------------|
| Main Hall | N/A | Upper Landing | *Preverco HrdMple GuinnessNuan |
| Kitchen / Breakfast | N/A | Upper Hall | *Preverco HrdMple GuinnessNuan |
| Living Room | *Preverco HrdMple GuinnessNuan | Master Bedroom | N/A |
| Dining Room | *Preverco HrdMple GuinnessNuan | Bedroom #2 | N/A |
| Family Room | *Preverco HrdMple GuinnessNuan | Bedroom #3 | N/A |
| Den/Library | N/A | Bedroom #4 | N/A |
| Entrance Vestibule | N/A | Bedroom #5 | N/A |
| Lower Landing (If Applicable) | *Preverco HrdMple GuinnessNuan | Other Room - Specify | N/A |
| | | <input type="text"/> | |

Comment

*Preverco Hard Maple Guinness Nuance 5-1/4"

6. Carpeting

| | Upgrade | Description |
|-------------------------------|--------------------------|--|
| Main Hall | <input type="checkbox"/> | N/A |
| Living Room | <input type="checkbox"/> | N/A |
| Dining Room | <input type="checkbox"/> | N/A |
| Family Room | <input type="checkbox"/> | N/A |
| Den/Library | <input type="checkbox"/> | N/A |
| Upper Hall | <input type="checkbox"/> | N/A |
| Master Bedroom | <input type="checkbox"/> | *Costa Rica Berber 13013 Sebastien Beige |
| Bedroom #2 | <input type="checkbox"/> | *Costa Rica Berber 13013 Sebastien Beige |
| Bedroom #3 | <input type="checkbox"/> | *Costa Rica Berber 13013 Sebastien Beige |
| Bedroom #4 | <input type="checkbox"/> | N/A |
| Bedroom #5 | <input type="checkbox"/> | N/A |
| <input type="text"/> | <input type="checkbox"/> | <input type="text"/> |
| Upper Landing (If Applicable) | <input type="checkbox"/> | N/A |
| Lower Landing (If Applicable) | <input type="checkbox"/> | N/A |

| | | |
|------------------|-------------------------------------|--------------------------|
| Upgrade Underpad | Type *12mm Superpad in each area | Area N/A |
| Carpet on Stairs | Capped N/A | Runner - *Upgrade N/A |

Comment



Scheduled Closing Date: December-19-16

Purchaser: Soterios Galineas

Property: 44L

Telephone Res. / Bus: (416) 836-7151

Project: Burkshire Holdings Inc.

Decor Advisor: Laura Lofaro

Model and Elevation: 25-2 Elev.B HUDSON

7. Fireplace

| | Living Room | | | Family Room | | | Other Room - Specify | | |
|----------------|-----------------------|-----------------------|-----------------------|-----------------------|----------------------------------|-----------------------|-----------------------|-----------------------|-----------------------|
| | Purchased | As Per Plan | N/A | Purchased | As Per Plan | N/A | Purchased | As Per Plan | N/A |
| | <input type="radio"/> | <input type="radio"/> | <input type="radio"/> | <input type="radio"/> | <input checked="" type="radio"/> | <input type="radio"/> | <input type="radio"/> | <input type="radio"/> | <input type="radio"/> |
| Fireplace Type | | | | STD | | | | | |
| Mantle Type | | | | STD Cast Stone | | | | | |
| Colour / Stain | | | | STD | | | | | |
| Surround | | | | STD | | | | | |
| Hearth | | | | *Add Hearth | | | | | |

Comment

8. Trim Carpentry

Interior Doors STD Front Door Glass Inserts STD Door Handles STD
Interior Trim STD

Comment

9. Plaster Mouldings and Medallions

| | | | | | |
|--------------------|-----|--|----------------------|-----|--|
| Entrance Vestibule | N/A | | Kitchen/Breakfast | N/A | |
| Main Hall | N/A | | Den/Library | N/A | |
| Living Room | N/A | | Lower Landing | N/A | |
| Dining Room | N/A | | Other Room - Specify | N/A | |
| Family Room | N/A | | | | |

Comment

10. Railings and Spindles

Railing Package *Euroline 2 with V-Groove Handrail
Railing Colour *Preverco Guinness
Stringer / Riser *Preverco Guinness
Spindle Colour *Pewter
Treads *Preverco Guinness
Oak Stairs ☒ Yes ☐ No

Comment

11. Wall Paint

| | | | |
|---------------------|-----------------------------|----------------|--|
| Main & Upper Hall | | Master Bedroom | |
| Living Room | | Bedroom #2 | |
| Dining Room | | Bedroom #3 | |
| Kitchen / Breakfast | | Bedroom #4 | |
| Family Room | | Bedroom #5 | |
| Powder Room | | Master Ensuite | |
| Laundry Room | | | |
| Den/Library | | Second Ensuite | |
| Trim Paint | White | | |
| Comment | Smooth Ceilings First Floor | | |

Warm Grey Throughout

Scheduled Closing Date: December-19-16

Purchaser: Soterios Galineas

Property: 44L

Telephone Res. / Bus: (416) 836-7151

Project: Burkshire Holdings Inc.

Decor Advisor: Laura Lofaro

Model and Elevation: 25-2 Elev.B HUDSON

12. Electrical

Plugs and Switches ☒ White ☐ Ivory

Hood Fan ☐ White ☐ Ivory

Appliances

Built in Cooktop

Built in Oven

Gas Stove

Microwave

☒ Yes ☐ No

☒ Yes ☐ No

☒ Yes ☐ No

☒ Yes ☐ No

Comment

Above Kitchen Cabinet Light ☐ Yes ☒ No

Below Kitchen Cabinet Light ☒ Yes ☐ No

13. Heating and Air Conditioning

Air Conditioning

Gas Provisions Dryer

Comment

Gas Provisions Stove

Gas Provisions Barbecue

14. Additional Comments

15. Disclaimers and Notes

- 1) Colours of all materials are as close as possible to builder's selection, but not necessarily identical due to variances in manufacturing.
- 2) Any extras listed above are null and void unless accompanied by a separate invoice/amendment. Said invoice must be paid in full.
- 3) The Purchaser acknowledges that after Interior Colour Selection form is signed and dated, no further changes will be permitted other than re-selection due to unavailability. Purchaser's Initials
- 4) The Purchaser acknowledges reading and accepting the "Gold Park Homes Decor Centre Disclaimers" form. This document contains other miscellaneous disclaimers.

This Interior Colour Selection is final and approved by:

Signature:

Date:

 Jan 9/17

Elevation A • 1,898 sq.ft.

Elevation B • 1,898 sq.ft.

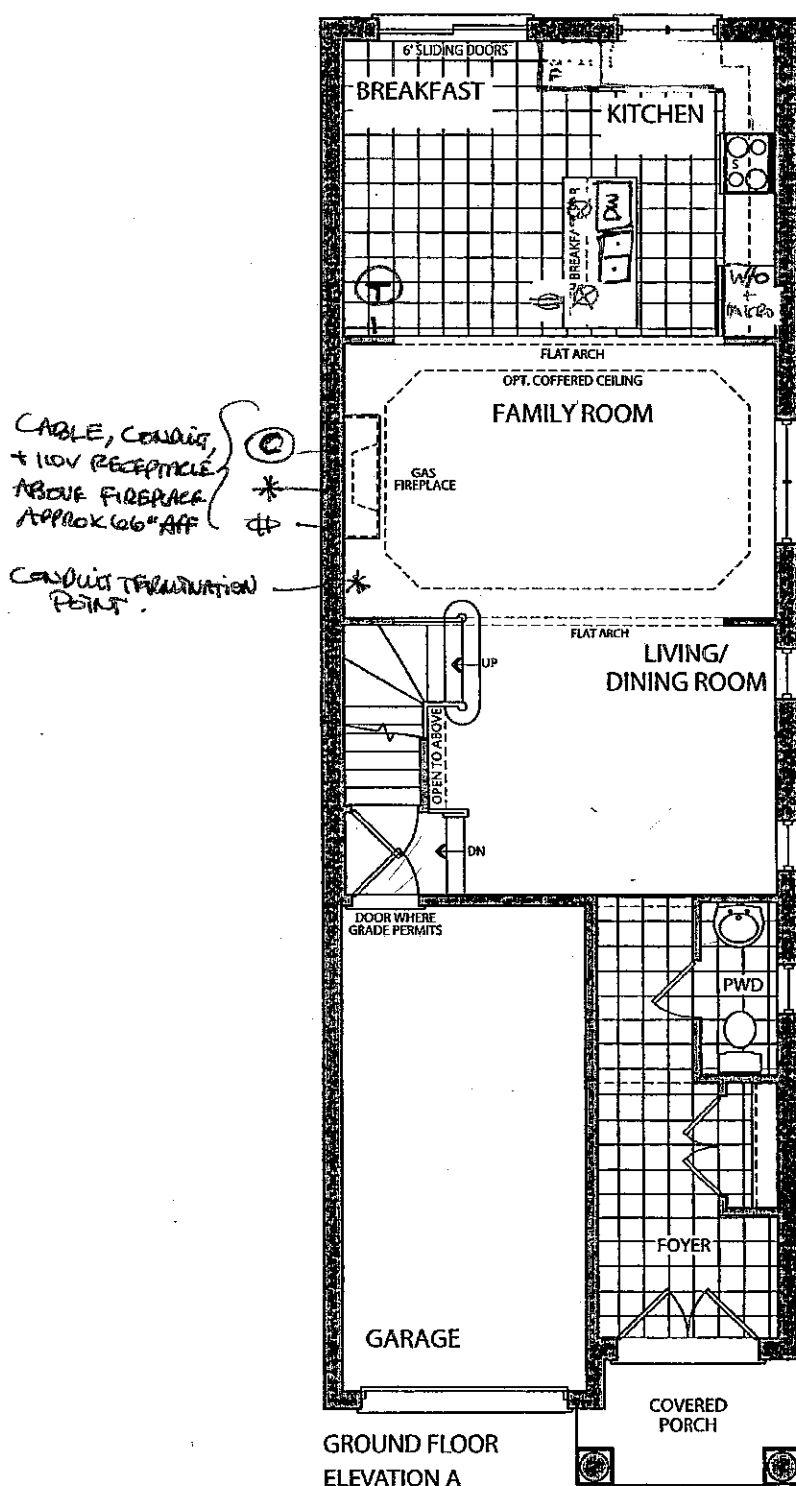

CABLE, CONDUIT
+ 110V RECEPTACLE
ABOVE FIREPLACE
APPROX 106" AFF

CONDUIT TERMINATION
POINT

- RELOCATE SINK + DN TO ISLAND
- RELOCATE FRIDGE, LEFT OF WINDOW
- ADD 220V + 110V DEDICATED FOR FUTURE WALL OVEN/MICRO COMBO
- ADD GAS LINE + 110V DEDICATED FOR GAS RANGE.
- ADD 110V TO ISLAND UNDER BREAKFAST BAR
- 2 CEILING OUTLETS OVER ISLAND.
- UNDER CABINET LIGHTING ROUGH-IN

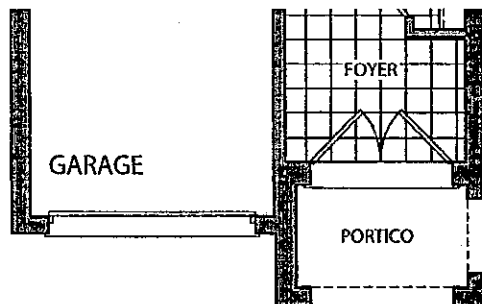

EXTEND ARCHWAYS +
DOOR HEIGHTS

- ⊙ - CABLE
- * - CONDUIT
- Ⓣ - TELEPHONE
- Ⓢ - 110V RECEPTACLE
- ⊗ - CEILING OUTLETS

STRUCTURAL
LOT 44L

AUGUST 9, 2016

COLOURS

JAN 9, 2017

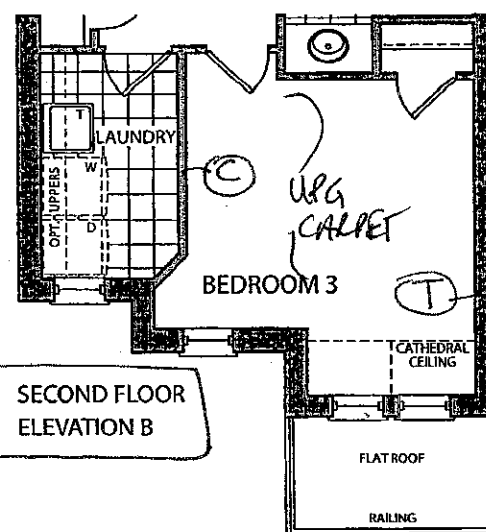
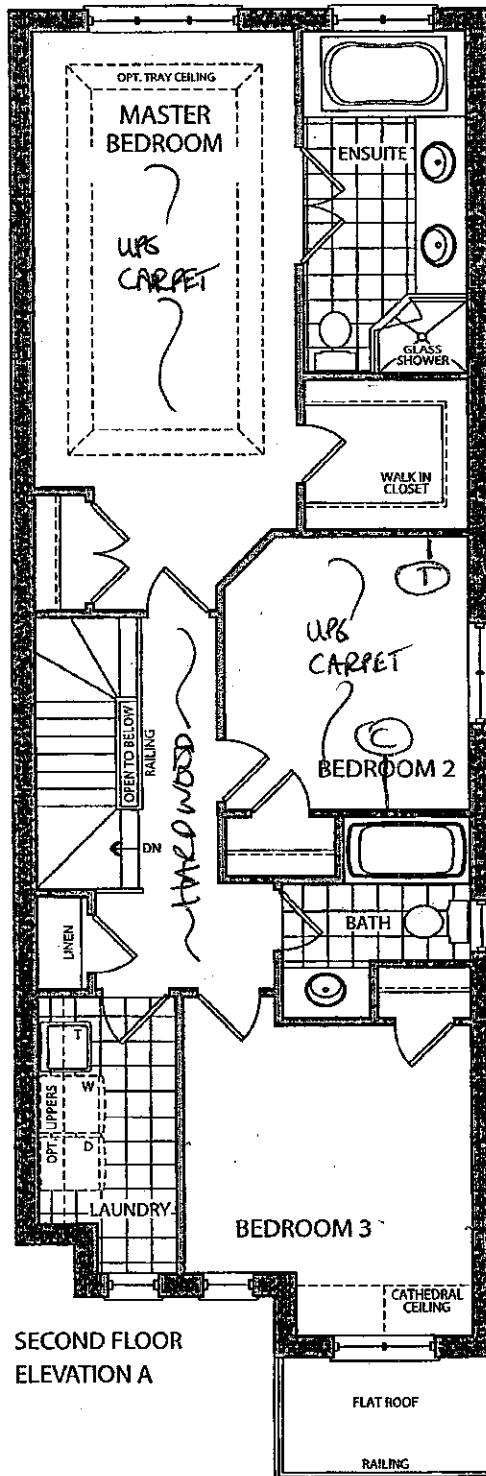

SMOOTH CEILING

STRUCTURAL
LOT 44 L

AUGUST 9, 2016
COLOURS

JAN 9, 2017

Elevation A • 1,898 sq.ft.

Elevation B • 1,898 sq.ft.

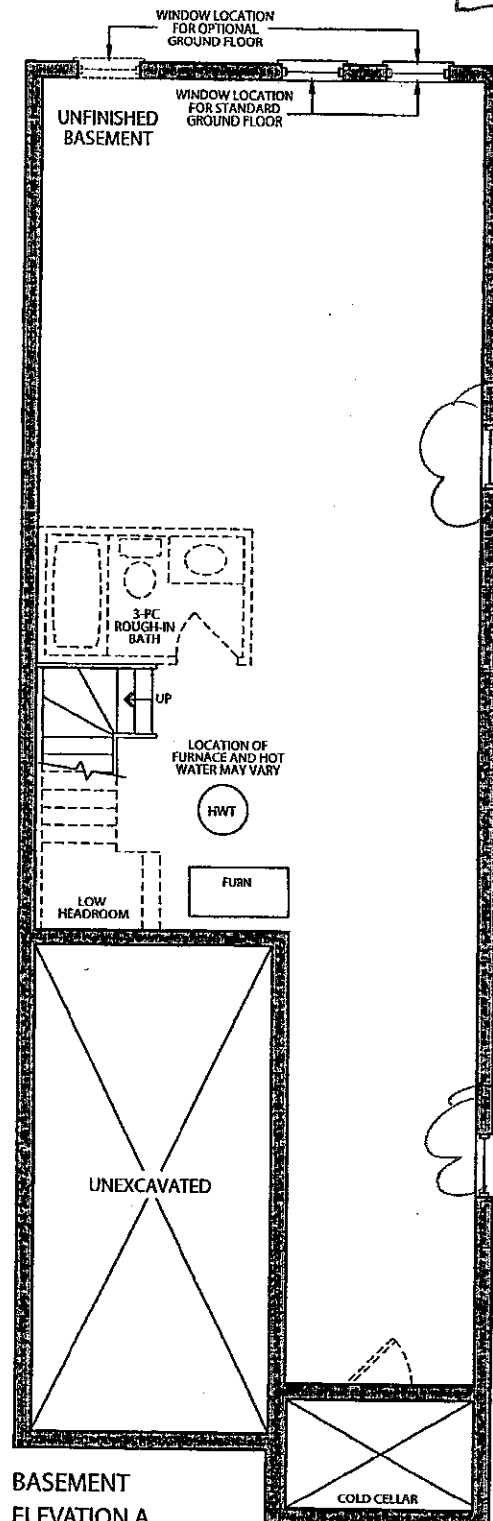

UPGRADE TO
46" x 32"
COLOUR MATCHED.

BASEMENT
ELEVATION A

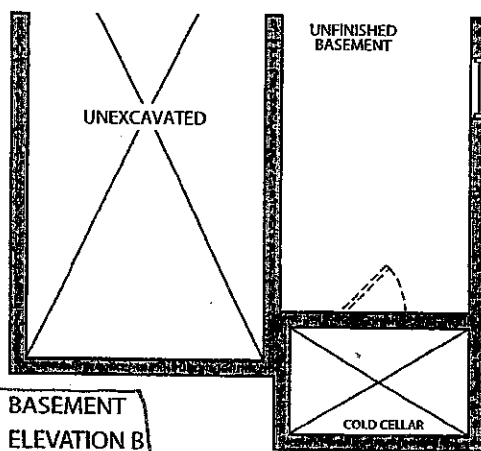

BASEMENT
ELEVATION B

STRUCTURAL
LOT 44L

AUGUST 9, 2016
COLOURS

JAN 9, 2017

CORTINA

78 Regina Road Woodbridge ON L4L 8L6
905-264-6464

DARK STAIN INFORMATION

Builder GOLD PARK HOMES Project KLEINBURG GLEN Lot # 44L

Cortina Kitchens offers a wide variety of finishes, applied to oak and maple products. The subject finishes include the spray stains **Cocoa**, **Espresso**, **Graphite** as well as wiping stain **Ebony**.

Due to the very dark stains applied on natural maple and oak doors and joints, several characteristics are important to be noted when purchasing these products.

1. Shadow lines may be visible at the interior profile edges of a door or drawer front. If movement occurs shadow lines may increase or decrease, depending on the style and/or size of a door or drawer front.
2. Variation and unevenness may be visible in the finish.
3. Hairline cracks at the joints are created over time due to the nature of natural wood, caused by usage, humidity, or dryness. They tend to be more visible to darker stains, than lighter wood stains.

Please be advised that Cortina Kitchens will not replace doors nor parts that exhibit the above characteristics associated with this finish. These characteristics are not avoidable and are a result of the natural characteristics of wood and wood veneer, and the characteristics of darker stains on wood.

Thank you for your understanding.

I am well informed of this information, and agree to the purchase of any of the subject finishes listed above.

Purchaser: 

Date: JAN 9, 2017

GOLDPARK

WORTH MORE™

Attention: Building Department

Re: Lot # 44L

This is to acknowledge that as the purchaser of the above noted lot, I have asked Gold Park Homes not to install the standard builder's kitchen exhaust hood, as I will be installing my own unit after closing.

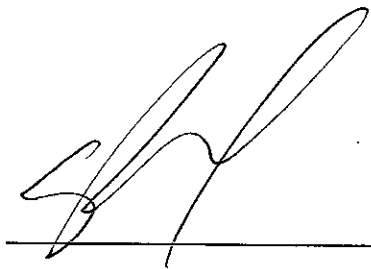

Purchaser

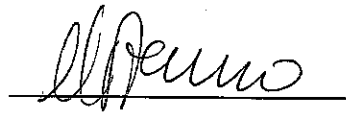

Vendor

Dated this 9th day of January, 2017.

- Standard 2CM & 3CM
- ◐ Upgrade 1 2CM & 3CM
- ◑ Upgrade 1 4 CM
- Upgrade 2

20mm (3/4") Profiles



30mm (1-1/4") Profiles

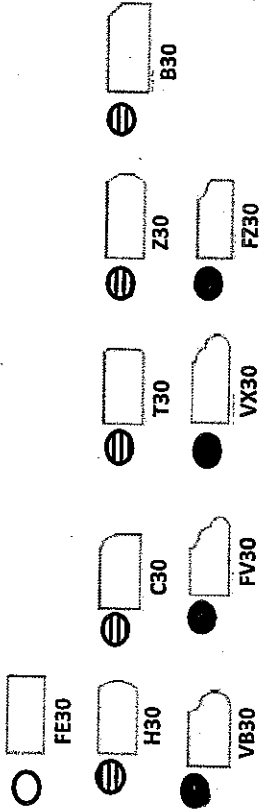

40mm (1-1/2") Profiles

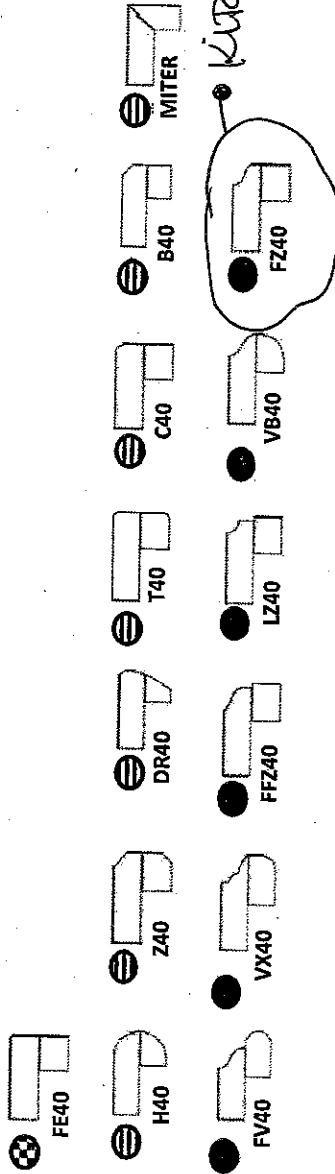

Note: All colours may not be available in 30mm at time ordered. Vendor reserves the right to use 40 mm edges (by lamination process).

*Mitre edge is available in Upgrade 1 for an overall thickness of 2". All other Mitre edge options will be an Upgrade 2 Edge.

KG - Lot 44L



JAN 9, 2017

KIRKEN, MASTER ENSUITE, MAIN BATH

CORTINA

70 Regina Road, Woodbridge, Ontario L4L 8L6
Tel: 905-264-0404 Fax: 905-264-0684
www.CortinaKitchens.com

QUOTATION

Date: 28/06/16

| | | |
|-----------------------------|-------------------------|-------------|
| Trade Name: Gold Park Homes | Site location: | Model: 25-2 |
| Address: | Project: Kleinburg Glen | Phase: |

This layout has been explained to the purchaser by Cortina Kitchens Inc. and is understood by the purchaser.

* RELOCATE
DW/SINK/
FRIDGE *

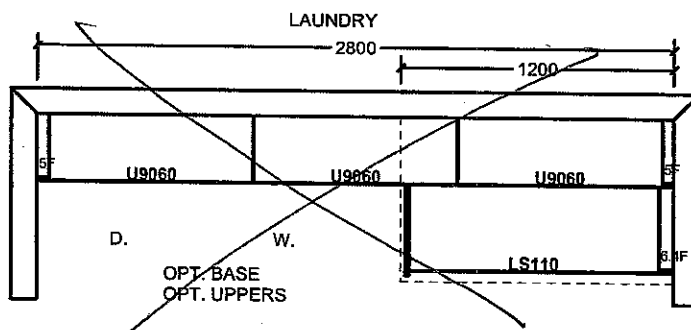
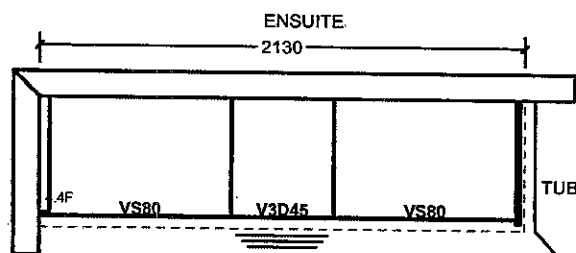
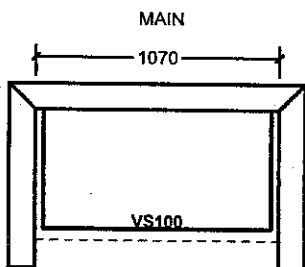
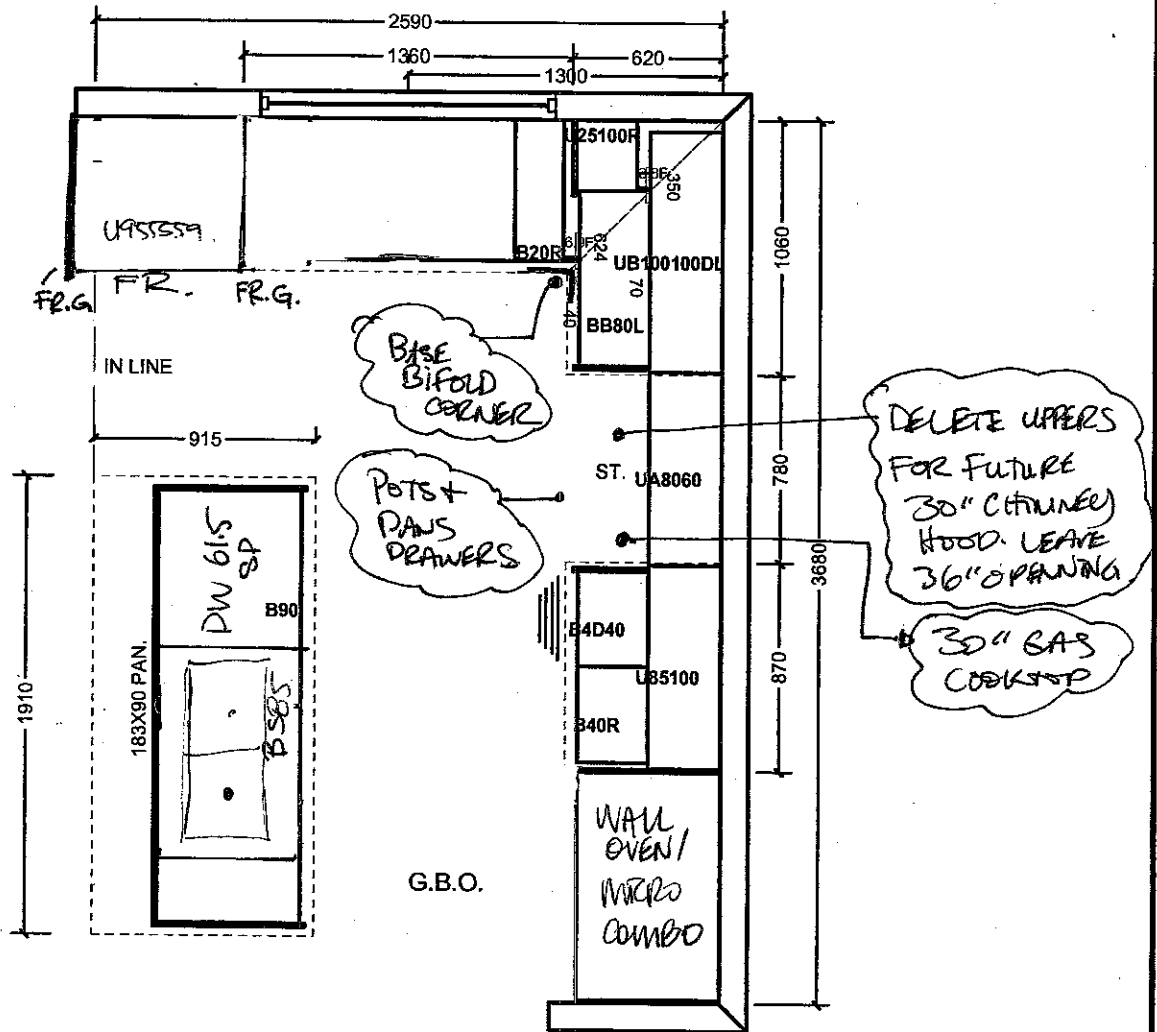

All prices subject to confirmation from head office.
This quotation is subject to the terms & conditions set out

ACCEPTED DATE: JAN 9, 2017

All agreements are contingent upon strikes, accidents, and delays beyond our control.
Please provide our installer with template for sinkholes or \$150.00 will be charged for callback.

LOT 44L

Item A. Wood grain and colour are characteristics of the product. We cannot guarantee that such grain and colour will always match.
Item B. Cortina Kitchens Inc. reserves the right to alter dimensions and make technical changes without notice.

UPGRADE HARDWARE

UPGRADE HARDWARE



CH-32



CH-38



CH-44

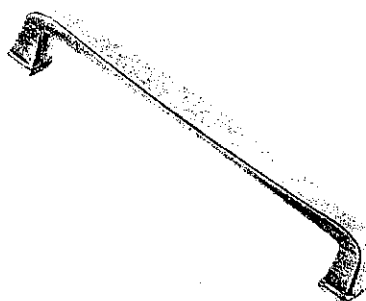

CH-45

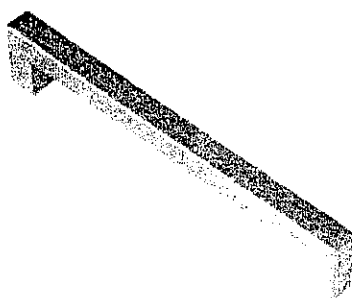

CH-46

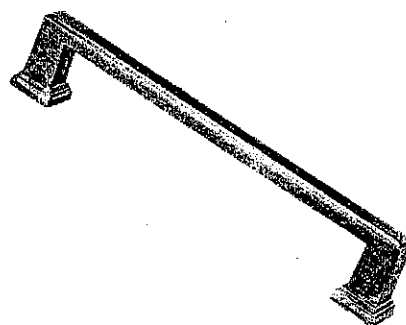

CH-47

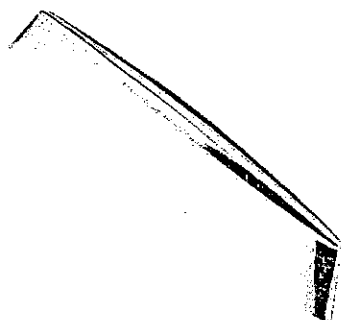

CH-48

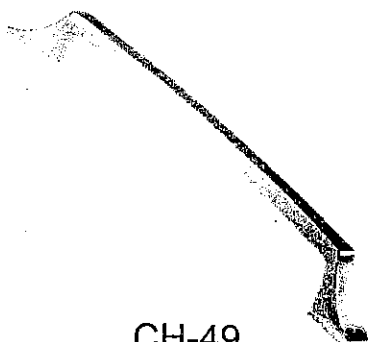

CH-49

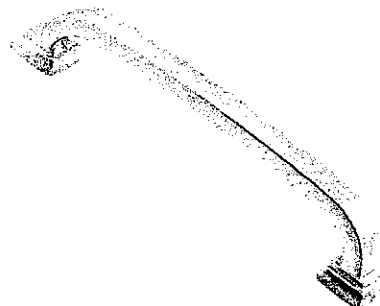

CH-50

→ KITCHEN / MASTER ENSUITE /
MAIN BATH

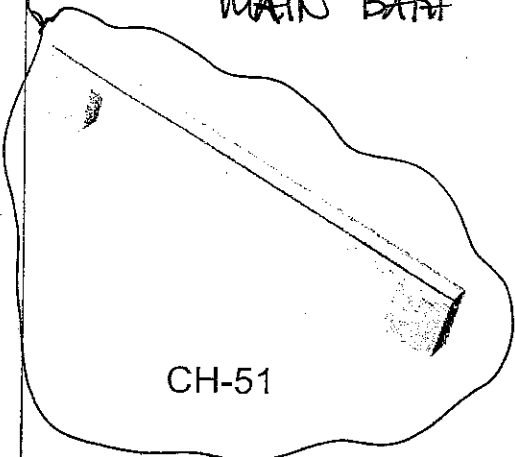

CH-51

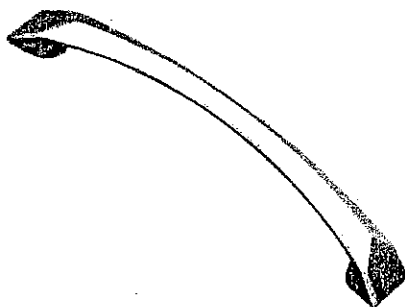

CH-52

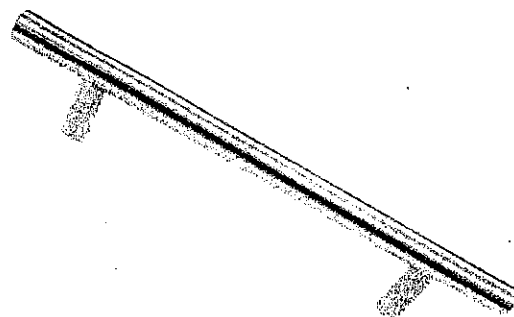

CH-53

*NOTES:

- IMAGES ARE FOR QUICK REFERENCE PURPOSES ONLY
- ACTUAL SIZES AND FINISHES AS PER HARDWARE
- SAMPLE BOARD PROVIDED TO DECOR CENTRE

KLEINBURG GLEN
LOT 44L

Ⓞ
JAN 9, 2017

Camden

4210CHY 16" Square Undermount Sink

2016 décor center catalogue

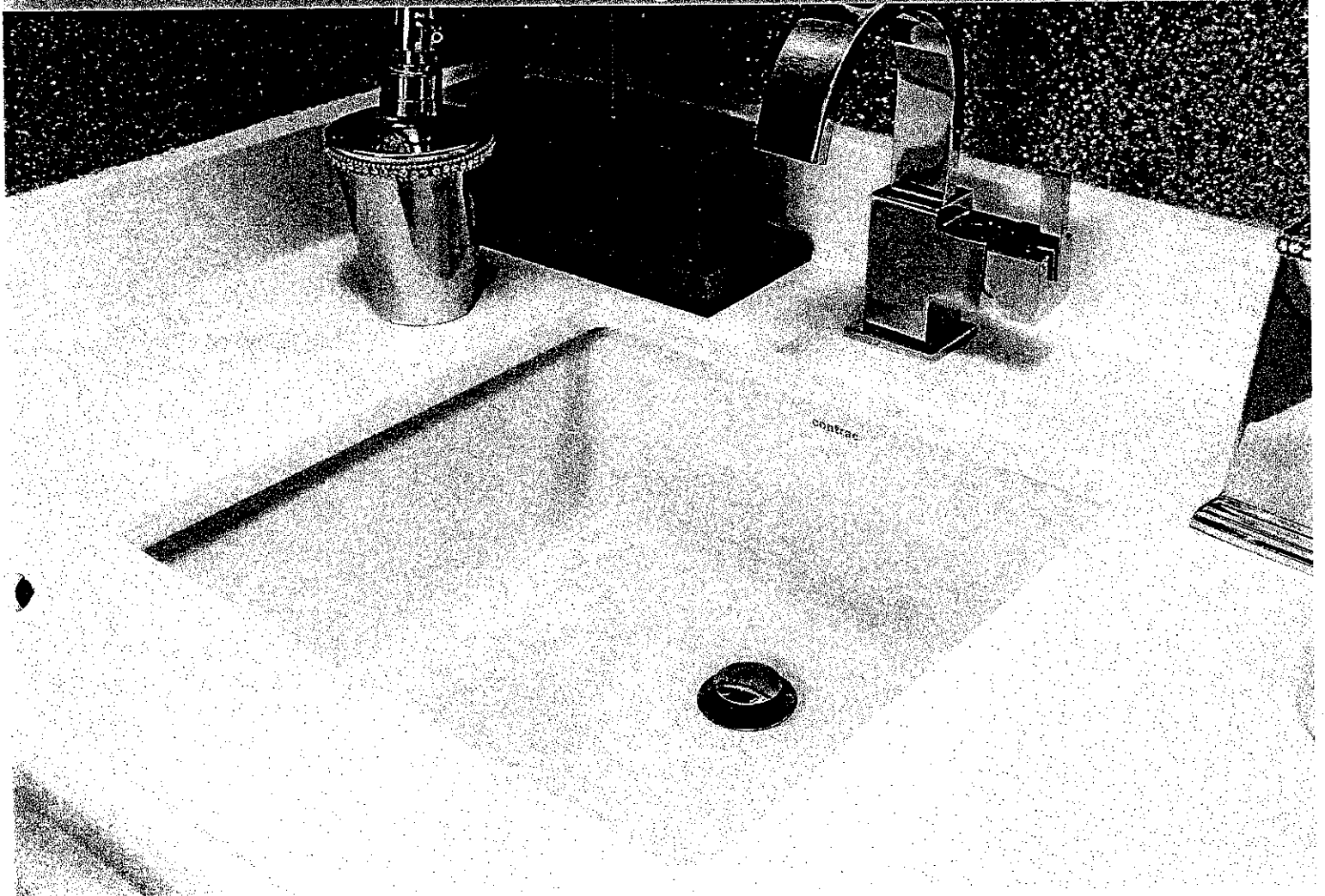

FEATURES

Vitreous china
Front overflow hole
Template and mounting hardware supplied
Overall dimensions (W x D x H):
(OD) 16" x 16" x 7½"
(ID) 13⅞" x 13⅞" x 5½"

CERTIFICATIONS

IAPMO cUPC
ASME A112.19.2 / CSA B45.1-2008

COLOUR

Soft white

LOT No.:

44L

ROOM:

MASTER ENSUITE X2

MAIN BATH X1

DATE:

JAN 9, 2017

SIGNATURE:

GOLDPARK
WORTH MORE

Kleinsburg
SINCE 1872

This site uses cookies. By continuing to browse the site you are agreeing to our use of cookies.
Find out more here

SAMSUNG CANADA ANNOUNCES RETURN PROCESS FOR GALAXY NOTE7 DEVICES
OFFICIAL ANNOUNCEMENT

Home / Home Appliances / Cooking Appliances / All Cooking Appliances / NA30K6550TS Gas Cooktop With 22K BTU Dual ...

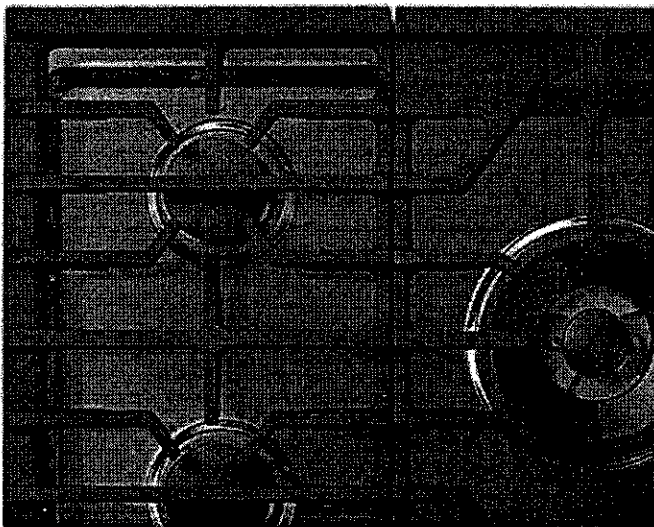
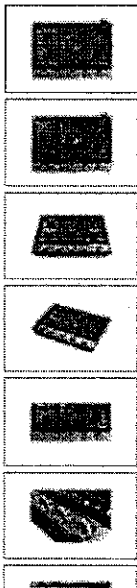

NA30K6550TS/AA
NA30K6550TS Gas Cooktop with 22K BTU Dual Burner, 56000 BTU

- Powerful heat with precise control
- Remote & convenient cooktop monitoring
- One-touch control of both cooktop & hood

WHERE TO BUY

| | | |
|------------------|-------------|--------------|
| 5 EA | 56000 B... | 762 x 79.... |
| Number of Burner | Total Power | Net (WxHxD) |

Powerful heat with
precise control

K6 LOT 44L

JAN 9. 2017

NA30K6550TS Gas Cooktop with 22K BTU Dual Burner, 56...

BENEFITS SPECS REVIEWS SUPPORT COMPARE

WHERE TO BU

HIDE ALL SPECS



SAMSUNG NA30K6550TS GAS COOKTOP

Materials/Finishes

Model Type Install
30 inch built-in gas cooktop

Control Method
Illuminated Knobs

Power/Ratings

Total Power
56000 BTU

Power Level
Low-Med-High

Burner - Left Front
9500 BTU

Burner - Left Rear
9500 BTU

Burner - Right Front
13000 BTU

Burner - Right Rear
5000 BTU, Precise Simmer

Burner - Center Front
19000 BTU, Dual

Power Supply
120 V / 60 Hz, 1 A

Features

Grate
Cast Iron (3 pcs)

Surface
Stainless

Simmer/Melt
Yes

Cooktop

Number of Burner
5 EA

Fuel Type
Natural Gas (factory set)

Accessories

WOK grate
No

Griddle
Aluminum Griddle

LP Conversion Kit
Yes

K6. lot
44L

Smart

Wi-Fi Connectivity
Yes

Auto Connectivity (with Hood)
No

Weights/Dimensions

Package (WxHxD)
880 x 270 x 650 mm

Cutout (WxHxD)
W 723.9 x D 498.5 mm

Net (WxHxD)
762 x 79.3 x 533 mm

Weight (Gross)
36.5 kg

Weight (Net)
30.2 kg

Loading Quantity (20/40ft)
168 / 360

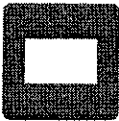

K6. lot#44L



JAN 9, 2017



or obligation, in specifications, availability and models. Samsung Electronics Canada Inc. will not be responsible for typographical errors or omissions. All trademarks are property of their respective owners.

JAN 9, 2017



Whirlpool Gold® 5
Combination Micrc
Oven with True Cc
Cooking

4.0

11 Reviews | Write a Rev



AVAILABLE COLOR OF



Monochromatic Stainless Steel - 1

- OVERVIEW
- FEATURES
- SPECIFICATIONS
- RATINGS & REVIEWS
- MANUALS

Configuration and Overview

Fuel Type

Electric

Oven Cooking System

Convection

Oven Capacity

5.0

Oven Cooking System

Convection

Oven Features

KG LOT # 442



JAN 9, 2017

DIMENSIONS. WHIRLPOOL GOLD 5.0 COMBINATION MICROWAVE WALL OVEN.

Depth

26 7/16

Height

42 9/16

Width

30

Cutout Depth

24

Cutout Height

41 5/16

Cutout Width

28 1/2

K6-44L

(1) Compared to previous Rapid Preheat option.

MSRP is Manufacturer's Suggested Retail Price and may not necessarily be the price at which the product is sold in the consumer's area. Dealer alone determines actual price.

® Registered trademark/TM Trademark of Whirlpool, U.S.A. © 2017 Whirlpool Corporation. All Rights Reserved. All other trademarks are owned by their respective companies.

K6- Lot 44L



JAN 9, 2017

BLANCO QUATRUS™ R15 Undermount

BLANCO QUATRUS™ R15
U 1 1/4

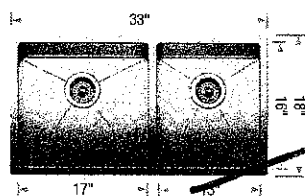

Sink
Specifications

Undermount
Minimum Cabinet Size*
36" (915 mm)
Bowl Depth
9" (230 mm)
Cubed Weight
55 lb. (25 kg)

Model
N°

401520

Installed
Price**

\$ 1684.70

Optional
Accessories

| | | |
|--------|-------------------|-----------|
| 406451 | Grid (LB) | \$ 235.75 |
| 406450 | Grid (SB) | \$ 211.60 |
| 406345 | Ash Cutting Board | \$ 313.95 |
| 406344 | Workstation | \$ 161.00 |
| 517666 | CapFlow™ | \$ 36.80 |
| 230694 | Magnetic Caddy | \$ 112.70 |

Installed
Price**

BLANCO QUATRUS™ R15 U 2

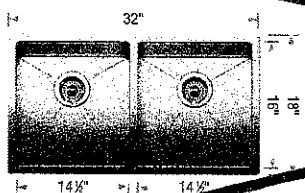

Sink
Specifications

Undermount
Minimum Cabinet Size*
36" (915 mm)
Bowl Depth
9" (230 mm)
Cubed Weight
55 lb. (25 kg)

Model
N°

401519

Installed
Price**

\$ 1492.70

Optional
Accessories

| | | |
|--------|-------------------|-----------|
| 406454 | Grid | \$ 211.60 |
| 406345 | Ash Cutting Board | \$ 313.95 |
| 406344 | Workstation | \$ 161.00 |
| 517666 | CapFlow™ | \$ 36.80 |
| 230694 | Magnetic Caddy | \$ 112.70 |

Installed
Price**

BLANCO QUATRUS™ R15
U SUPER SINGLE

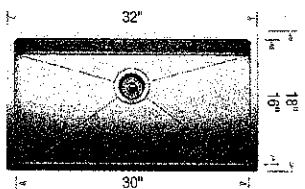

Sink
Specifications

Undermount
Minimum Cabinet Size*
36" (915 mm)
Bowl Depth
9" (230 mm)
Cubed Weight
55 lb. (25 kg)

Model
N°

401518

Installed
Price**

\$ 1007.40

Optional
Accessories

| | | |
|--------|-------------------|-----------|
| 406347 | Super Single Grid | \$ 224.25 |
| 406346 | Elevated Grid | \$ 195.50 |
| 406345 | Ash Cutting Board | \$ 313.95 |
| 406344 | Workstation | \$ 161.00 |
| 517666 | CapFlow™ | \$ 36.80 |
| 230694 | Magnetic Caddy | \$ 112.70 |

Installed
Price**

LOT No.: 44L

ROOM: KITCHEN

DATE: JAN 9. 2017

SIGNATURE:

Kleinburg
CLEAN

GOLDPARK
WORTH MORE™

* Depending on cabinet construction, a different cabinet size may be required. Consult the cabinet manufacturer.

** Installed price subject to change.

Addison™ Collection

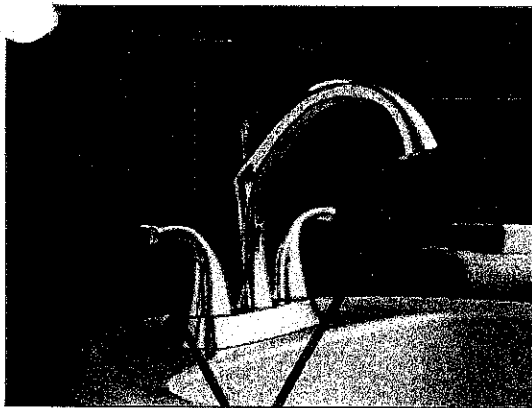

Lavatory 4" Centreset

Chrome Finish
2592-MPU-DST

Brilliance® Stainless Finish
2592-SSMPU-DST

Champagne Bronze™ Finish
2592-CZMPU-DST

Applies to faucets shown above

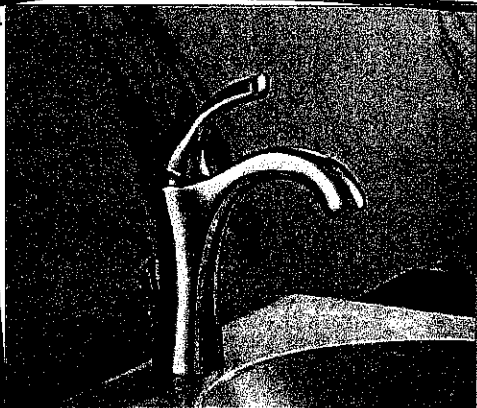

Lavatory
Single or three holes with plate

Chrome Finish
592-DST

Brilliance® Stainless Finish
592-SS-DST

Champagne Bronze™ Finish
592-CZ-DST



Vessel Lavatory

Chrome Finish
792-DST

Brilliance® Stainless Finish
792-SS-DST

Champagne Bronze™ Finish
792-CZ-DST

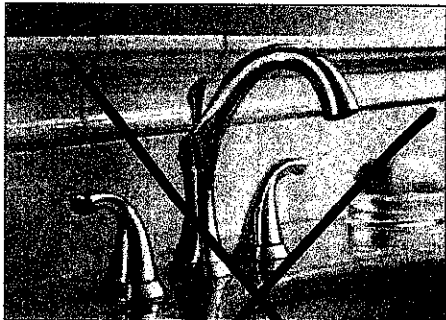

Lavatory Widespread with pop up
3592LF

Brilliance® Stainless Finish
3592LF-SS

Champagne Bronze™ Finish
3592LF-CZ

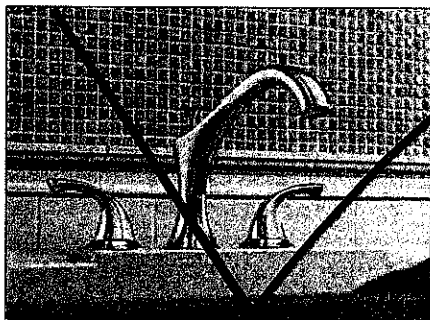

Roman Tub 3 Piece
T2792 / R2709

Brilliance® Stainless Finish
T2792-SS / R2709

Champagne Bronze™ Finish
T2792-CZ / # R2709

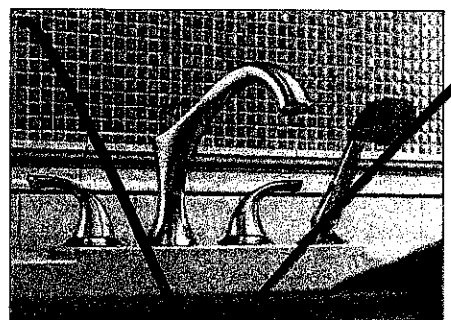

Roman Tub 4 Piece
T4792 / R4716

Brilliance® Stainless Finish
T4792-SS / R4716

Champagne Bronze™ Finish
T4792-CZ / R4716

Shown in Chrome



KLEINBURG GLEN

LOT 44L

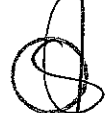

JAN. 9. 2017

MASTER ENSUITE x2
MAIN BATH x1

Addison™ Collection

Pressure Balance

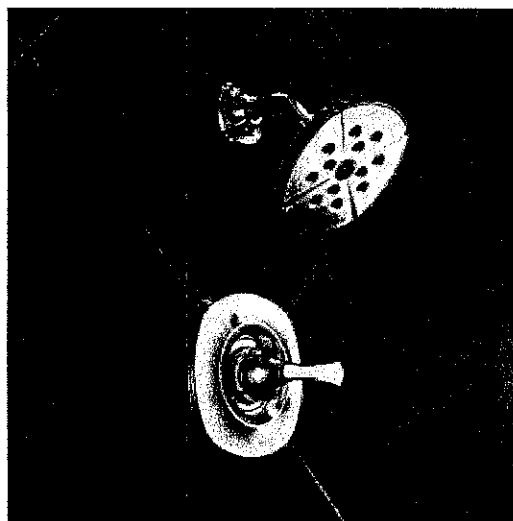

Shower, 2.0 GPM

Chrome Finish
T14292

Brilliance® Stainless Finish
T14292-SS

Champagne Bronze™
Finish
T14292-CZ

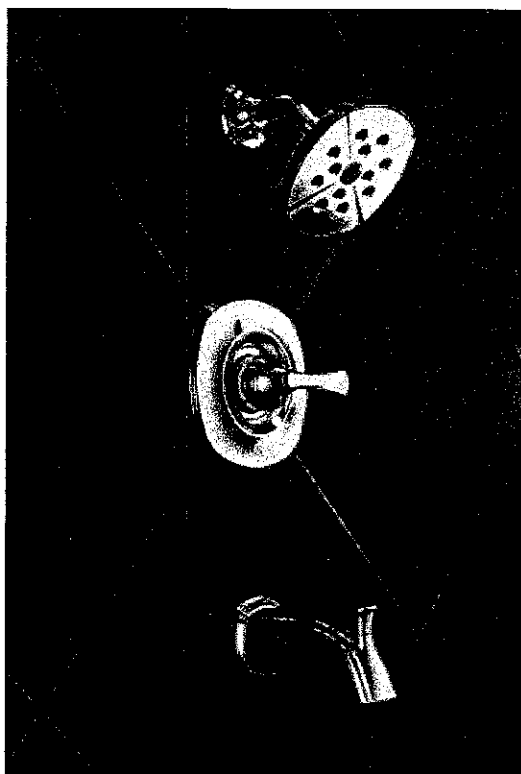

Tub & Shower, 2.0 GPM

Chrome Finish
T14492

Brilliance® Stainless Finish
T14492-SS

Champagne Bronze™ Finish
T14492-CZ

MASER ENSUITE
+
MAIN BATH

Dual Function Pressure Balance

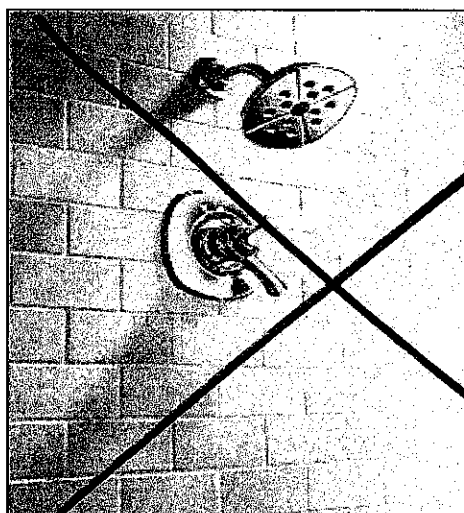

Shower, 2.0 GPM

Chrome Finish
T17292

Brilliance® Stainless
Finish
T17292-SS

Champagne Bronze™
Finish
T17292-CZ

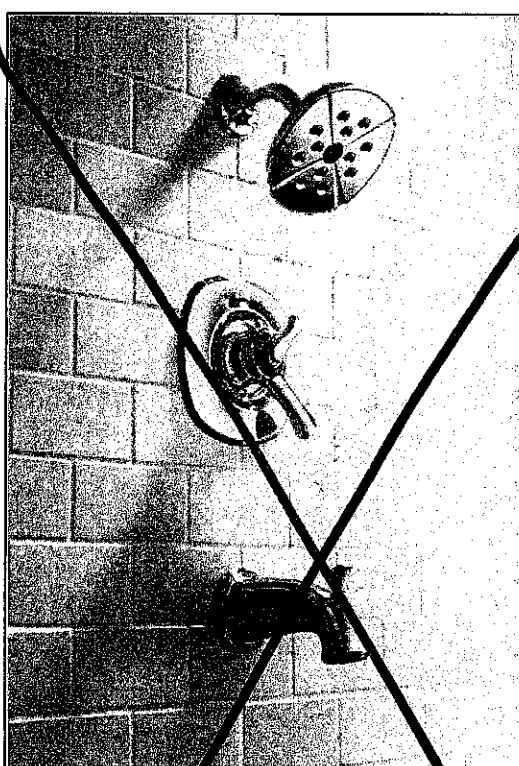

Tub & Shower, 2.0 GPM

Chrome Finish
T17492

Brilliance® Stainless Finish
T17492-SS

Champagne Bronze™ Finish
T17492-CZ

Shown in Chrome



KLEINBURG GLEN
LOT 44L



JAN 9, 2017
MASER ENSUITE +
MAIN BATH