



CONSTRUCTION SUMMARY

Kleinburg Glen - 74 - 1 - 38-4 Elev.B BRIDGEPORT
CENTRAL VAC AND WIRING

Inv.740	1 - GREAT ROOM: CONDUIT PIPE - FOR TELEVISION - CENTERED TO ROOM. APPROX 54" AFF TERMINATING STRAIGHT DOWN AT STANDARD HEIGHT NEXT TO CABLE. PLEASE SEE FLOORPLAN FOR LOCATION
Line10038	Note:
10Aug16 / 11Nov16	
Inv.740	1 - MASTER BEDROOM: CONDUIT PIPE - FOR TELEVISION - APPROX 54" AFF. NEXT TO STD CABLE. TERMINATING STRAIGHT DOWN AT STD HEIGHT. PLEASE SEE FLOORPLAN FOR LOCATION
Line10040	Note:
10Aug16 / 11Nov16	
Inv.740	1 - CONDUIT PIPE - FROM ATTIC TO ELECTRICAL PANEL - PLEASE RUN A STRAIGHT RUN FROM ELECTRICAL PANEL TO ATTIC
Line10045	Note:
10Aug16 / 11Nov16	

CERAMIC

Inv.1,151	1 - KITCHEN: UPG 1 Backsplash wall tile - Including behind chimney hood fan
Line17034	Note:
31Jan17 / 11Apr17	
Inv.1,151	1 - MAIN FLOOR TILE: UPG 2 Foyer / Powder Room / Kitchen
Line17029	Note: Layed in a straight stacked pattern. See floorplan for tile direction
31Jan17 / 11Apr17	

DRYWALL

Inv.740	1 - SMOOTH CEILINGS - (2 - Story Design) 2ND FLOOR
Line10052	Note:
10Aug16 / 11Nov16	

ELECTRICAL

Inv.740	1 - KITCHEN: 110V WALL RECEPTACLE ON NORMAL CIRCUIT - LEFT SIDE OF ISLAND. PLEASE SEE FLOORPLAN FOR LOCATION
Line10032	Note:
10Aug16 / 11Nov16	
Inv.740	1 - KITCHEN: RELOCATE STANDARD KITCHEN LIGHT TO CENTERED OVER ISLAND
Line10033	Note:
10Aug16 / 11Nov16	
Inv.740	1 - KITCHEN: 110V WALL RECEPTACLE ON DEDICATED CIRCUIT - FOR FUTURE GAS FIRED APPLIANCE - FOR AUX. EQUIPMENT - NOT A STOVE PLUG. PURCHASER TO SUPPLY AND INSTALL GAS LINE AT OWN EXPENSE AND WARRANTY AFTER CLOSING.
Line10034	Note:
10Aug16 / 11Nov16	
Inv.740	1 - KITCHEN CABINET STRIP VALANCE LIGHTS (UNDER CABINETS) - ROUGH - IN - DOES NOT INCLUDE (AND REQUIRES) KITCHEN UPGRADE PRICING
Line10035	Note:
10Aug16 / 11Nov16	
Inv.740	1 - GREAT ROOM: 110V WALL RECEPTACLE ON NORMAL CIRCUIT - FOR FUTURE TV. CENTERED TO ROOM APPROX 54" AFF. PLEASE SEE FLOOR PLAN FOR LOCATION
Line10039	Note:
10Aug16 / 11Nov16	

Kleinburg Glen - 74 - 1 - 38-4 Elev.B BRIDGEPORT

Inv.740	1 - MASTER BEDROOM: 110V WALL RECEPTACLE ON NORMAL CIRCUIT - APPROX 54" AFF. FOR FUTURE TV NEXT TO STD CABLE AND CONDUIT.
Line10041	Note:
10Aug16 / 11Nov16	

Inv.740	1 - MASTER ENSUITE: UPGRADE TO JET TUB - UPG1 ONLY
Line13846	Note:
10Aug16 / 11Nov16	

EXTERIOR COLOURS

Inv.740	1 - EXTERIOR COLOUR PACKAGE 2
Line13849	Note:
10Aug16 / 11Nov16	

FIREPLACE AND MANTLE

Inv.1,151	1 - FIREPLACE: UPG to add Hearth to Base of Fireplace
Line17045	Note:
31Jan17 / 11Apr17	

FRAMING

Inv.740	1 - MAIN FLOOR-STANDARD DOOR EXTENDED HEIGHT 96 INCH (PRICE PER DOOR) - GROUND FLOOR 2 STOREY MODELS
Line13848	Note:
10Aug16 / 11Nov16	

Inv.740	1 - MAIN FLOOR- EXTENDED HEIGHT ARCHWAY (PRICE PER DOORWAY)
Line13847	Note:
10Aug16 / 11Nov16	

GLASS AND MIRROR

Inv.740	1 - MASTER ENSUITE: CONVERT FRAMED SHOWER TO 10MM FRAMLESS SHOWER ENCLOSURE WITH DOOR AND 10MM SIDE PANEL
Line10044	Note:
10Aug16 / 11Nov16	

HARDWOOD

Inv.1,151	1 - MAIN FLOOR HARDWOOD: UPG 1 - Main Hall / Den / Dining Room / Great Room / Lower Landing / Upper Landing
Line17030	Note:
31Jan17 / 11Apr17	

Inv.1,151	1 - SECOND FLOOR HARDWOOD: UPG 1 - Upper Hall
Line17031	Note:
31Jan17 / 11Apr17	

Inv.1,151	1 - INSTALL PREVERCO 4-1/4" RED OAK ON LANDINGS
Line20854	Note:
31Jan17 / 11Apr17	

Inv.1,151	1 - FIREPLACE: UPG to add Hearth to Base of Fireplace
Line20855	Note:
31Jan17 / 11Apr17	

HVAC

Kleinburg Glen - 74 - 1 - 38-4 Elev.B BRIDGEPORT

Inv.740	1 - KITCHEN: UPGRADE VENTING FOR STOVE TO 8 INCH PIPE EXTERIOR WALL CENTERED OVER OVEN TO ACCOMMODATE FOR FUTURE CHIMNEY STYLE HOOD FAN
Line10030	Note:
10Aug16 / 11Nov16	

Inv.740	1 - HUMIDIFIER: WB3 - 17 (UP TO 3,000 SQ.FT.)
Line10046	Note:
10Aug16 / 11Nov16	

INTERIOR TRIM AND DOORS

Inv.740	4 - MAIN FLOOR- EXTENDED HEIGHT ARCHWAY (PRICE PER DOORWAY)
Line10047	Note:
10Aug16 / 11Nov16	

Inv.740	8 - MAIN FLOOR-STANDARD DOOR EXTENDED HEIGHT 96 INCH (PRICE PER DOOR) - GROUND FLOOR 2 STOREY MODELS
Line10048	Note:
10Aug16 / 11Nov16	

KITCHEN AND BATH CABINETRY

Inv.1,151	1 - LAUNDRY: UPG Add Upper Cabinets to Laundry - Standard Cabinetry Line
Line17036	Note:
31Jan17 / 11Apr17	

Inv.1,151	1 - KITCHEN: UPG Cabinet Stain colour to Cocoa
Line17021	Note:
31Jan17 / 11Apr17	

Inv.1,151	1 - KITCHEN: UPG Modify cabinets to accommodate slide-in range
Line17022	Note:
31Jan17 / 11Apr17	

Inv.1,151	1 - KITCHEN: Add 4foot double door deep pantry in "opt. Desk" area. See floorplan for location
Line17023	Note:
31Jan17 / 11Apr17	

Inv.1,151	1 - KITCHEN: Delete upper cabinets and finish sides for future 30" chimney hood fan. Please leave 36" opening
Line17024	Note:
31Jan17 / 11Apr17	

Inv.1,151	1 - KITCHEN: UPG Stain Cocoa to New Pantry area
Line17025	Note:
31Jan17 / 11Apr17	

Inv.1,151	2 - KITCHEN: Add 2 full gables on either side of New Pantry
Line17026	Note:
31Jan17 / 11Apr17	

Inv.1,151	1 - KITCHEN: Add Furring panel & Crown moulding to upper cabinets complete to ceiling
Line17027	Note:
31Jan17 / 11Apr17	

Inv.1,151	1 - KITCHEN: Add furring panel & crown moulding to New Pantry area
Line17028	Note:
31Jan17 / 11Apr17	

Kleinburg Glen - 74 - 1 - 38-4 Elev.B BRIDGEPORT

Inv.1,151	1 - KITCHEN: UPG Add Light Valance to upper cabinets
Line17033	Note:
31Jan17 / 11Apr17	
Inv.1,151	3 - KITCHEN: UPG - Add 1 long top drawer right of cooktop and 1 top drawer left of cooktop
Line17037	Note:
31Jan17 / 11Apr17	

MISC.

Inv.740	1 - Purchaser has attended a Structural appointment at the Decor Centre & has DECLINED any additional upgrades and accepts and acknowledges that there will be no further structural changes/additions/deletions to be made upon signing on August 10, 2016.
Line10049	Note:
10Aug16 / 11Nov16	
Inv.740	1 - Purchasers are aware & accepts that ANY changes made to upgrades after signing this Purchasers Extra Form are subject to a minimum administration fee of \$500. PLUS a 10% holdback fee.
Line10050	Note:
10Aug16 / 11Nov16	
Inv.740	1 - Purchasers are aware & accepts that ANY changes made to upgrades after signing this Purchasers Extra Form are subject to a minimum administration fee of \$500. PLUS a 10% holdback fee.
Line10051	Note:
10Aug16 / 11Nov16	
Inv.740	1 - BALANCE AFTER CREDIT: \$10,094.10 PAID BY CREDIT CARD.
Line10053	Note:
10Aug16 / 11Nov16	
Inv.1,151	1 - Purchaser has attended a Colour appointment at the Decor Centre & has DECLINED any additional upgrades and accepts and acknowledges that there will be no further structural changes/additions/deletions to be made upon signing.
Line17040	Note:
31Jan17 / 11Apr17	
Inv.1,151	1 - Purchasers are aware & accepts that ANY changes made to upgrades after signing this Purchasers Extra Form are subject to a minimum administration fee of \$500. PLUS a 10% holdback fee.
Line17041	Note:
31Jan17 / 11Apr17	
Inv.1,151	1 - KITCHEN - Purchasers request to NOT INSTALL builder's standard hood fan and standard cabinets above stove. DELETE. Do not supply, install, and/or credit. Purchasers are installing their own hood fan after closing.
Line17042	Note: Purchasers accept and acknowledge that the exhaust fan duct hole may be off-centered with stove in kitchen due to purchasers installing their own hood fan after closing. The vendor is exempt.
31Jan17 / 11Apr17	
Inv.1,151	1 - Fridge - 37-1/2"W x 73-1/2" High Approx. Range - 30-1/2"D x 31-1/2"W Approx. Dishwasher - 24" W Approx.
Line17043	Note:
31Jan17 / 11Apr17	
Inv.1,151	1 - TOTAL: \$28,480.52 Paid by Credit Card & Cheque
Line17044	Note:
31Jan17 / 11Apr17	

PAINTING

Kleinburg Glen - 74 - 1 - 38-4 Elev.B BRIDGEPORT

Inv.1,151	1 - STAIRS & RAILINGS: UPG Stain colour to Preverco Komodo
Line17032	Note:
31Jan17 / 11Apr17	

PLUMBING

Inv.740	1 - MUD ROOM: HOSE BIB - EXTRA HOSE BIB WITH HOT AND COLD WATER VALVE. PLEASE SEE FLOORPLAN FOR LOCATION
Line10031	Note:
10Aug16 / 11Nov16	

Inv.740	1 - MASTER ENSUITE: UPGRADE TO JET TUB - UPG1 ONLY
Line10042	Note:
10Aug16 / 11Nov16	

PLUMBING FIXTURES

Inv.1,151	2 - MASTER ENSUITE VANITY SINKS: x2 Contrac Minuet
Line17035	Note:
31Jan17 / 11Apr17	

STAIRS AND RAILINGS

Inv.1,151	1 - STAIRS & RAILINGS: UPG to Euroline 1 with V-Groove handrail
Line17038	Note:
31Jan17 / 11Apr17	

TRIM AND DOORS

Inv.1,151	1 - MAIN FLOOR TRIM: UPG 1 on 1st floor only
Line17039	Note:
31Jan17 / 11Apr17	

WINDOWS - BASEMENT

Inv.740	1 - BASEMENT WINDOWS - UPGRADE EXISTING BASEMENT WINDOW TO 53 INCH X 16 INCH - MAY REQUIRE INSTALLATION OF WINDOW WELL. PLEASE SEE FLOORPLAN FOR LOCATION
Line10036	Note:
10Aug16 / 11Nov16	

Inv.740	1 - BASEMENT UPGRAGED WINDOW TO BE COLOUR MATCHED
Line10037	Note:
10Aug16 / 11Nov16	

Scheduled Closing Date: February-01-17

Purchasers: Yvonne Kharag & Lionel Kharag

Property: 74

Telephone Res. / Bus: (647) 932-2327

Project: Burkshire Holdings Inc.

Decor Advisor: Laura Lofaro

Model and Elevation: 38-4 Elev.B BRIDGEPORT

Layout Changes: ☐ Yes ☐ No Sketch Attached: ☐ Yes ☐ No Exterior Colour Scheme:

1. Cabinetry

	Style and Colour	Counter	Hardware
Kitchen / Breakfast	Siena Oak *Cocoa	Granite Pol. Grigio Sardo STD Edge FE20	CS1-16
Laundry Room	*P400 PVC Mystic	N/A	CS1-16
Powder Room	N/A		
Master Ensuite Bathroom	Siena Oak Greystone	Wilsonart Pearl Soapstone 4886-38	CS1-18
Second Ensuite Bathroom (If Applicable)	Siena Oak Greystone	Wilsonart Pearl Soapstone 4886-38	CS1-10
Twin Ensuite	Toscana PVC Mystic	Wilsonart Smoky Topaz 4589K-07	CS1-22
Dishwasher Cabinet			

Comment

2. Floor Tile

	Selection	Grout	Threshold
Entrance Vestibule	*12x24 Antikas Series Grigio (Grey)		
Main Hall	N/A		
Kitchen / Breakfast	*12x24 Antikas Series Grigio (Grey)		
Laundry Room	13x13 Costa Matte White		
Powder Room	*12x24 Antikas Series Grigio (Grey)		
	Mud Room: 13x13 Costa Matte White		
Master Ensuite Bathroom	13x13 Costa Matte White		
Second Ensuite Bathroom (If Applicable)	13x13 Carrara Series White/Grey		
Lower Landing (If Applicable)	N/A		
Twin Ensuite	13x13 Venus Series Ivory		

Comment

Master Ensuite: Floor / Tub Skirt / Tub Deck

3. Wall Tile

	Selection	Listello/Inserts	Describe
		<input type="radio"/> Yes <input checked="" type="radio"/> No	
Master Ensuite Bathroom			
Tub Deck	TUBSplash: 8x10 WeaveTenderGre	<input type="radio"/> Yes <input checked="" type="radio"/> No	
Shower Stall	8x10 Weave Tender Grey	<input type="radio"/> Yes <input checked="" type="radio"/> No	
Bathroom Walls	N/A	<input type="radio"/> Yes <input checked="" type="radio"/> No	
Second Ensuite Bathroom (If Applicable)	8x10 Weave White	<input type="radio"/> Yes <input checked="" type="radio"/> No	
Twin Ensuite	8x10 Venus Ivory	<input type="radio"/> Yes <input checked="" type="radio"/> No	

Kitchen Backsplash

☒ Yes ☐ No

Backsplash Behind Fridge

Comment

*OntHexGlossyTendGrey11.9x10.7

*Kitchen Backsplash Ontario Hex Glossy Tender Grey 11.9x10.7 Code: OD.ON.TGR.02.HEX.GL. Backsplash behind chimney hood.

46

Scheduled Closing Date: February-01-17

Purchasers: Yvonne Kharag & Lionel Kharag

Property: 74

Telephone Res. / Bus: (647) 932-2327

Project: Burkshire Holdings Inc.

Decor Advisor: Laura Lofaro

Model and Elevation: 38-4 Elev.B BRIDGEPORT

4. Plumbing Fixtures

Master Ensuite Bathroom Second Ensuite Powder Room
Other Room - Specify Other Washroom

Comment

Master Ensuite: UPG Vanity Sinks Contrac Minuet x2 CODE:13-0024-W
Everywhere else standard

5. Hardwood Flooring

	Type and Stain		Type and Stain
Main Hall	*Preverco RedOak Komodo 4-1/4"	Upper Landing	*Preverco RedOak Komodo 4-1/4"
Kitchen / Breakfast	N/A	Upper Hall	*Preverco RedOak Komodo 4-1/4"
Living Room	N/A	Master Bedroom	N/A
Dining Room	*Preverco RedOak Komodo 4-1/4"	Bedroom #2	N/A
Family Room	N/A	Bedroom #3	N/A
Den/Library	*Preverco RedOak Komodo 4-1/4"	Bedroom #4	N/A
Entrance Vestibule	N/A	Bedroom #5	N/A
Lower Landing (If Applicable)	*Preverco RedOak Komodo 4-1/4"	Other Room - Specify	*Preverco RedOak Komodo 4-1/4"
		Great Room	

Comment

6. Carpeting

	Upgrade	Description
Main Hall	<input type="checkbox"/>	N/A
Living Room	<input type="checkbox"/>	N/A
Dining Room	<input type="checkbox"/>	N/A
Family Room	<input type="checkbox"/>	N/A
Den/Library	<input type="checkbox"/>	N/A
Upper Hall	<input type="checkbox"/>	N/A
Master Bedroom	<input type="checkbox"/>	T15
Bedroom #2	<input type="checkbox"/>	T15
Bedroom #3	<input type="checkbox"/>	T15
Bedroom #4	<input type="checkbox"/>	T15
Bedroom #5	<input type="checkbox"/>	N/A
	<input type="checkbox"/>	N/A
Upper Landing (If Applicable)	<input type="checkbox"/>	N/A
Lower Landing (If Applicable)	<input type="checkbox"/>	N/A

	Type	Area
Upgrade Underpad	N/A	
	Capped	Runner - *Upgrade
Carpet on Stairs	N/A	

Comment

9/12

Purchasers: Yvonne Kharag & Lionel Kharag

Property: 74

Telephone Res. / Bus: (647) 932-2327

Project: Burkshire Holdings Inc.

Decor Advisor: Laura Lofaro

Model and Elevation: 38-4 Elev.B BRIDGEPORT

7. Fireplace

	Living Room			Family Room			Other Room - Specify Great Room		
	Purchased	As Per Plan	N/A	Purchased	As Per Plan	N/A	Purchased	As Per Plan	N/A
Fireplace Type	<input type="radio"/>	<input type="radio"/>	<input type="radio"/>	<input type="radio"/>	<input type="radio"/>	<input type="radio"/>	<input type="radio"/>	<input checked="" type="radio"/>	<input type="radio"/>
Mantle Type							STD Gas		
Colour / Stain							STD		
Surround							STD		
Hearth							*Add Hearth		

Comment

8. Trim Carpentry

Interior Doors	STD	Front Door Glass Inserts	STD	Door Handles	STD
Interior Trim	UPG 1 on Main Floor / STD on Second Floor				

Comment

*96" Doors ordered at Structural

9. Plaster Mouldings and Medallions

Entrance Vestibule	N/A		Kitchen/Breakfast	N/A	
Main Hall	N/A		Den/Library	N/A	
Living Room	N/A		Lower Landing	N/A	
Dining Room	N/A		Other Room - Specify	N/A	
Family Room	N/A				

Comment

10. Railings and Spindles

Railing Package	*Euroline 1 with V-Groove Handrail		
Railing Colour	*Preverco Komodo	Spindle Colour	Black
Stringer / Riser	*Preverco Komodo	Treads	*Preverco Komodo
Comment		Oak Stairs	<input checked="" type="radio"/> Yes <input type="radio"/> No

Comment

11. Wall Paint

Main & Upper Hall		Master Bedroom	
Living Room		Bedroom #2	
Dining Room		Bedroom #3	
Kitchen / Breakfast		Bedroom #4	
Family Room		Bedroom #5	
Powder Room		Master Ensuite	
Laundry Room			
Den/Library		Second Ensuite	
Trim Paint	White	Thru-Out	Warm Grey

Comment Smooth Ceilings First Floor

4/10

Scheduled Closing Date: February-01-17

Purchasers: Yvonne Kharag & Lionel Kharag

Property: 74

Telephone Res. / Bus: (647) 932-2327

Project: Burkshire Holdings Inc.

Decor Advisor: Laura Lofaro

Model and Elevation: 38-4 Elev.B BRIDGEPORT

12. Electrical

Plugs and Switches ☒ White ☐ Ivory

Hood Fan ☐ White ☐ Ivory

Appliances

Built in Cooktop

☐ Yes ☒ No

Built in Oven

☐ Yes ☒ No

Gas Stove

☒ Yes ☐ No

Microwave

☐ Yes ☒ No

Above Kitchen Cabinet Light ☐ Yes ☒ No

Below Kitchen Cabinet Light ☒ Yes ☐ No

Comment

*Chimney Hood fan - Purchaser to supply & install own hood at own expense and warranty after closing

*Gas line to be supplied and installed by purchaser at own expense and warranty after closing

13. Heating and Air Conditioning

Air Conditioning

Gas Provisions Stove

Gas Provisions Dryer

Gas Provisions Barbecue

Comment

14. Additional Comments

15. Disclaimers and Notes

- 1) Colours of all materials are as close as possible to builder's selection, but not necessarily identical due to variances in manufacturing.
- 2) Any extras listed above are null and void unless accompanied by a separate invoice/amendment. Said invoice must be paid in full.
- 3) The Purchaser acknowledges that after Interior Colour Selection form is signed and dated, no further changes will be permitted other than re-selection due to unavailability.  Purchaser's Initials
- 4) The Purchaser acknowledges reading and accepting the "Gold Park Homes Decor Centre Disclaimers" form. This document contains other miscellaneous disclaimers.

This Interior Colour Selection is final and approved by:

Signature: _____ Date: _____ Signature: _____ Date: _____

13-0024-W

Minuet

rectangular vessel lavatory



Finish

Soft white vitreous china
Nano easy clean glaze



Overflow
Rear



Template
Supplied



Faucet drilling
Single hole



Dimensions

19" (W) x 15 1/4" (D) x 6 1/4" (H)

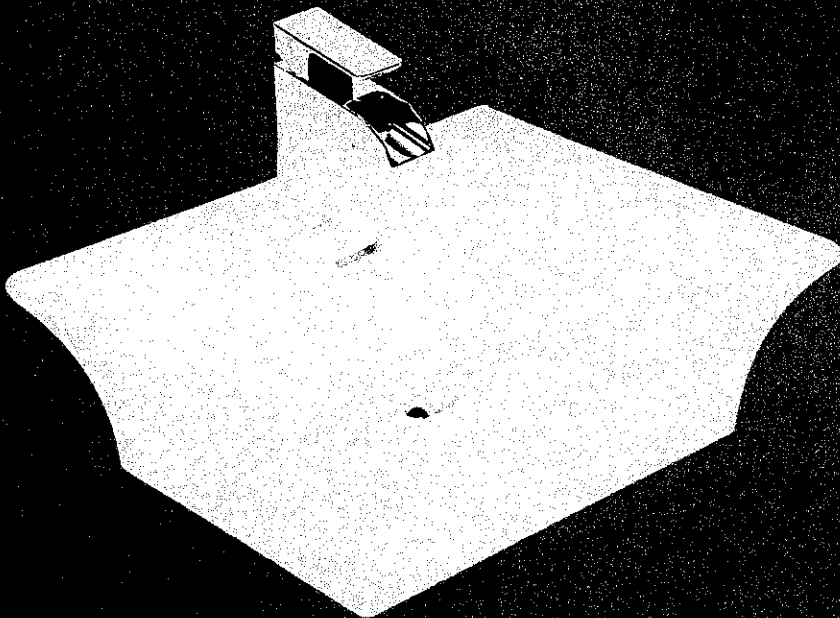

www.foremostcanada.com

K6-74



JAN. 31. 2017

NX58H9500WS

5.8 cu. ft. Slide-in Gas Range with Intuitive Controls

Features

- Slide-in Design
- 5 Gas Burners
 - Right Front: Dual 18K BTU
 - Left Front: 15K BTU
 - Right Rear: 5K BTU
 - Left Rear: 9.5K BTU
 - Center: 9.5K BTU (Oval)
- Large Oven Capacity – 5.8 cu. ft.
- Guiding Light Controls
- Cast Iron 3 Piece Grates
- Reversible Cast Iron Griddle
- Wok Grate
- True Convection Oven (3-Fan)
- Temperature Probe
- Warming Drawer (3 Levels)
- Grate Indicator Marks
- Healthy Cook Options

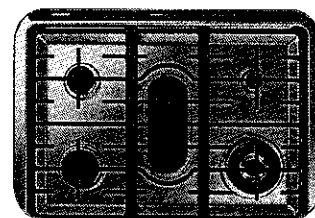
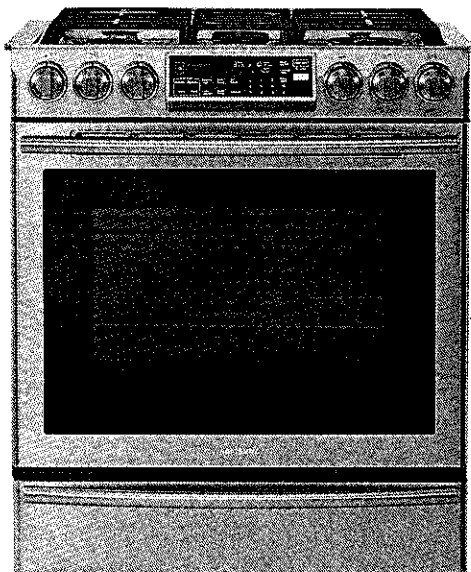

Power/Flexible Cooktop

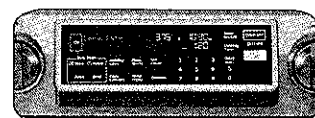

Guiding Light Controls

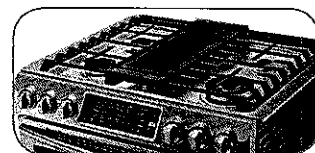

Cast Iron Reversible Griddle

Convenience

- Auto Oven Light
- Sabbath Mode
- Delay Start
- Auto Shut-Off Option
- Child Safety Lock
- Self Clean
- 3 Favorite Cook Presets
- 4 Healthy Cook Presets
- 3 Chrome Oven Racks, including 1 Split Rack

Available Color



Stainless Steel

Signature Features

POWERFUL/FLEXIBLE COOKTOP

- True dual-power burner allows for even heat distribution and reduced cooking time, plus the convenience of a large oval burner.

GUIDING-LIGHT CONTROLS

- Intuitive controls offer simple, step-by-step instructions for choosing cooking options.
- Only illuminates cooking options that are able to be selected and goes from left to right eliminating back and forth.
- Control temperature and time settings, select cooking functions and program your favorite recipes.

TRUE CONVECTION

- Heated fan system is great for baking and broiling because temperature is distributed thoroughly and food cooks evenly.

REVERSIBLE CAST IRON GRIDDLE

- Reversible griddle provides the flexibility of cooking on flat or grilled surface, while the Cast Iron provides even cooking.

GRATE INDICATOR MARKS

- Indicator marks located on the grates allow cookware to be ideally placed for precise cooking.



Ranked "Highest in Customer Satisfaction with Ranges, Cooktops and Ovens."*

—J.D. Power

SAMSUNG

KG-74.

CIA

JAN. 31. 2017

NX58H9500WS

5.8 cu. ft. Slide-in Gas Range with Intuitive Controls

INSTALLING YOUR RANGE

30" minimum clearance between the top of the cooking surface and the bottom of an unprotected wood or metal cabinet; or 24" minimum when the bottom of the wood or metal cabinet is protected by not less than 1/4" flame retardant millboard covered with not less than no.28 MSG sheet steel, 0.015" stainless steel, 0.024" aluminum or 0.020" copper.

** 18" minimum between the countertop and the adjacent cabinet bottom.

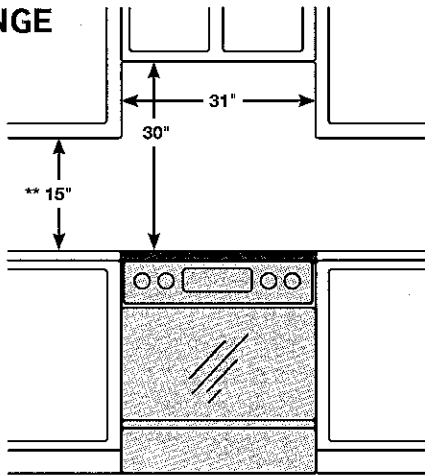

IMPORTANT: To eliminate the risk of burns or fire caused by reaching over heated surface units, cabinet storage space located above the surface units should be avoided. If cabinet storage is to be provided, the risk can be reduced by installing a range hood that projects horizontally a minimum of 5" beyond the bottom of the cabinets.

Dimensions

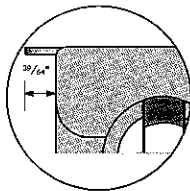
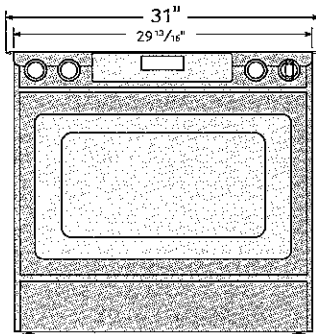

Glass cooktop overlaps and sits on top of your kitchen countertop to give a built-in look. Cut out space for the range is 29 13/16".

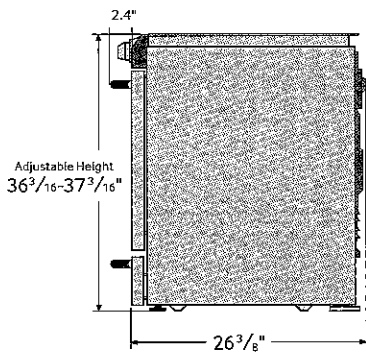

Total Power (BTU)
57,000 BTU

Power Source
120 V/60 Hz

Black Enamel 5 Burner Cooktop

- Right Front: 18000 BTU – Dual
- Left Front: 15000 BTU
- Right Rear: 5000 BTU
- Left Rear: 9500 BTU
- Center Rear: 9500 BTU – Oval

Oven

- Bake: 150°F - 550°F
- Convection Bake: 150°F - 550°F
- Bake Burner: 18000 BTU
- Broil Burner: 16000 BTU
- Variable Broil: Low/Hi (375°F - 480°F)
- Convection Roast: 150°F - 550°F
- Sabbath Mode

Warming Drawer

- Capacity: 0.7 cu. ft.
- Heating Performance: 600 W
- Temperature Settings: 3 Level

Warranty

One (1) Year All Parts and Labor
Five (5) Years Gas Cooktop

Product Dimensions & Weight (WxHxD)

Actual Oven Dimensions:
25" x 21 1/8" x 19"

Outside Dimensions:
29 13/16" x 36 3/16-37 3/16" (Adjustable) x 26 3/8"

Weight: 202 lbs.

Shipping Dimensions & Weight (WxHxD)

Dimensions:
32 7/8" x 43 11/16" x 30 1/8"

Weight: 225 lbs.

Color	Model #	UPC Code
Stainless Steel	NX58H9500WS	887276032047

SAMSUNG

*Samsung received the highest numerical score for ranges, cooktops and ovens in the proprietary J.D. Power 2014 Kitchen Appliance Study™. Study based on 151,380 total responses measuring 17 ranges, cooktops and oven brands and measures opinions of consumers about their new appliance purchased in the past 24 months. Proprietary study results are based on experiences and perceptions of consumers surveyed in January-March 2014. Your experiences may vary. Visit jdpower.com.

Actual color may vary. Design, specifications, and color availability are subject to change without notice. Not metric. Weights and measurements are approximate.

©2014 Samsung Electronics America, Inc. 25 Challenger Road, Ridgefield Park, NJ 07660. Tel: 800-SAMSUNG, samsung.com. Samsung is a registered trademark of Samsung Electronics Co., Ltd.

K6-74

46

JAN. 31. 2017

70 Regina Road, Woodbridge, Ontario L4L 8L6
Tel: 905-284-8484 Fax 905-284-0884
www.CortinaKitchens.com

Date: 28/06/16

This layout has been explained to the purchaser by Cortina Kitchens Inc. and is understood by the purchaser.

Hand-drawn kitchen layout diagram with dimensions and annotations. The diagram shows a kitchen area with various cabinets, drawers, and appliances. Dimensions are provided for overall size and individual components. Annotations include handwritten notes and labels for specific parts.

Dimensions:

- Overall width: 3960
- Overall height: 2740
- Top section width: 2030
- Top section height: 920
- Bottom section width: 2974
- Bottom section height: 1750
- Left section height: 2820
- Right section height: 1070
- Top section width (left): 1520
- Top section width (right): 2030
- Bottom section width (left): 360
- Bottom section width (middle): 50
- Bottom section width (right): 360

Annotations and Labels:

- US5024230R
- US10024230
- 4 ADJ. SH.
- OPT. PANTRY
- 4 FT DOUBLE DOOR PANTRY
- SDDV110
- OPT. DESK
- IN LINE
- 1 LONG TOP DRAWER
- 196X90 PAN.
- EL. PL. 6x8.5
- SP. DW. 61.5
- BS85
- B4D40
- 77 x 90 PAN.
- 30" SLIDE-IN RANGE
- UA8040 ST.
- 1 TOP DRAWER (STO)
- B40L
- JB10510DL
- BB90R
- B90
- B90
- FR.G.
- FR.
- U955559
- U85100
- U85100
- U90100
- G.B.O.

Item A. Wood grain and colour are characteristics of the product. We cannot guarantee that such grain and colour will always match.
Item B. Cortina Kitchens Inc. reserves the right to alter dimensions and make technical changes without notice.

Lot 74.

⑩ M. Khanaq

Date: 28/06/16

Trade Name: Gold Park Homes

Site location:

Model: 38-4

Address:

Project: Kleinburg Glen

Phase:

This layout has been explained to the purchaser by Cortina Kitchens Inc. and is understood by the purchaser.

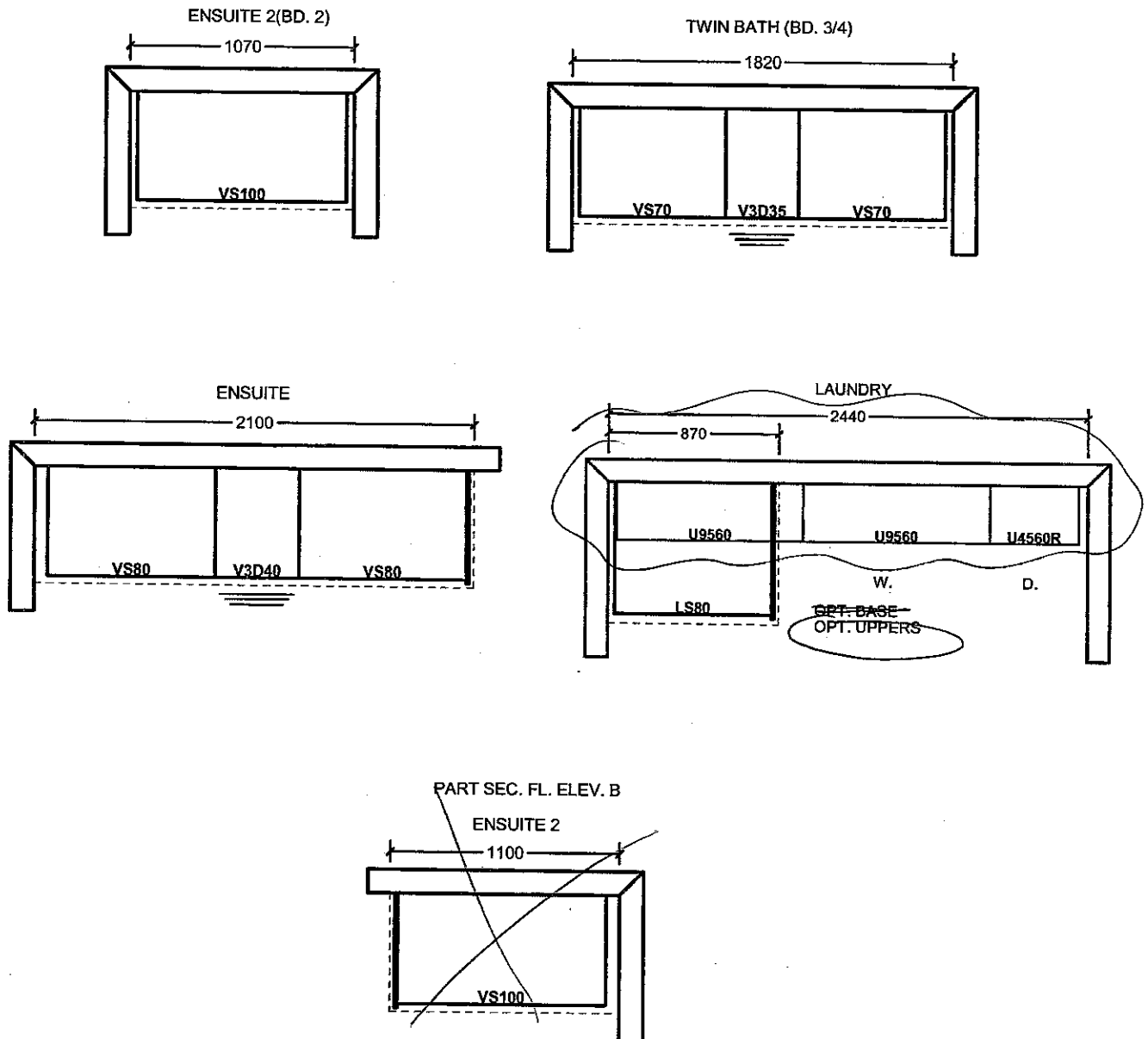

All prices subject to confirmation from head office.
This quotation is subject to the terms & conditions set out

ACCEPTED DATE: JAN. 31, 2017

All agreements are contingent upon strikes, accidents, and delays beyond our control.
Please provide our installer with template for sinkholes or \$150.00 will be charged for callback.

Item A. Wood grain and colour are characteristics of the product. We cannot guarantee that such grain and colour will always match.
Item B. Cortina Kitchens Inc. reserves the right to alter dimensions and make technical changes without notice.

LOT 74

CORTINA

KITCHENS INC.

10 Regina Road Woodbridge ON L4L 8L6
905-264-6464

DARK STAIN INFORMATION

Builder: BOWPARK HOMES Project: KWENBURG GLEN Lot #: 74

Cortina Kitchens offers a wide variety of finishes, applied to oak and maple products. The subject finishes include the spray stains Cocoa Espresso, Graphite as well as wiping stain **Ebony**.

Due to the very dark stains applied on natural maple and oak doors and joints, several characteristics are important to be noted when purchasing these products.

1. Shadow lines may be visible at the interior profile edges of a door or drawer front. If movement occurs shadow lines may increase or decrease, depending on the style and/or size of a door or drawer front.
2. Variation and unevenness may be visible in the finish.
3. Hairline cracks at the joints are created over time due to the nature of natural wood, caused by usage, humidity, or dryness. They tend to be more visible to darker stains, than lighter wood stains.

Please be advised that Cortina Kitchens will not replace doors nor parts that exhibit the above characteristics associated with this finish. These characteristics are not avoidable and are a result of the natural characteristics of wood and wood veneer, and the characteristics of darker stains on wood.

Thank you for your understanding.

I am well informed of this information, and agree to the purchase of any of the subject finishes listed above.

Purchaser: _____

[Signature]

Date: _____

Jan - 31, 2017

CORTINA

KITCHENS INC.

70 Regina Road Woodbridge ON L4L 8L6
905-264-6464

INFORMATION - PVC DOORS

Builder: Gold Park Homes Project: KUENBURG GLEN Lot # 74

All cabinets with PVC (Thermofoil) Doors come with melamine gables, panels and kick. The doors, crown moulding and light valance are PVC wrapped. Open shelves incorporated in design will only be available with melamine interiors. There will be variations in colour shades between the PVC parts (doors, crown and Light valance) and the melamine parts (open shelves, Gables, Panels and Kick) due to the difference in material.

Furring Panel with crown moulding to the ceiling is not available on all PVC door styles due to subtle variations in colour shades between the PVC parts (moulding) and the melamine parts (furring panel) due to the difference in material. Grain directions in wood grain pattern melamine, vary between the furring panel, crown moulding (horizontal) and the PVC doors (vertical).

Thank you for your understanding.

I am well informed of this information, and agree to the purchase of the above.

Purchaser: J. Phang

Date: JAN. 31. 2017

STANDARD HARDWARE

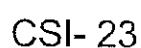
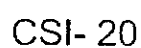
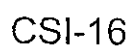
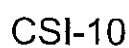

- IMAGES ARE FOR QUICK REFERENCE PURPOSES ONLY
- ACTUAL SIZES AND FINISHES AS PER HARDWARE
SAMPLE BOARD PROVIDED TO DECOR CENTRE

K6-74

○
JAN. 31. 2017

- Standard 2CM & 3CM
- ⊖ Upgrade 1 2CM & 3CM
- ⊗ Upgrade 1 4 CM
- Upgrade 2

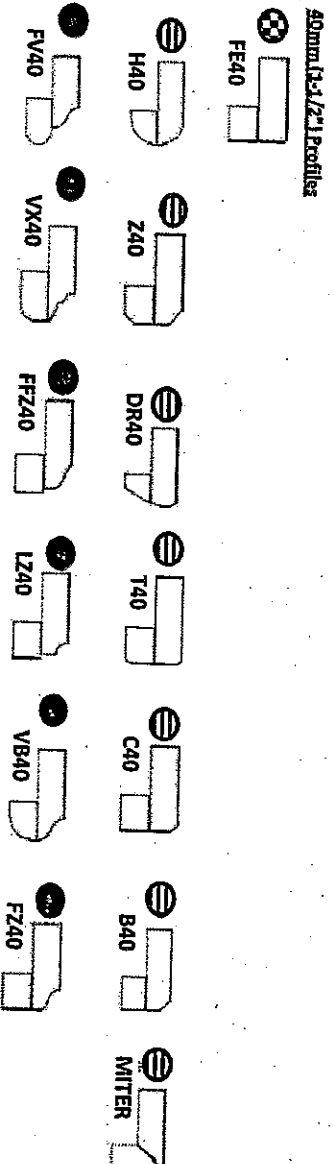
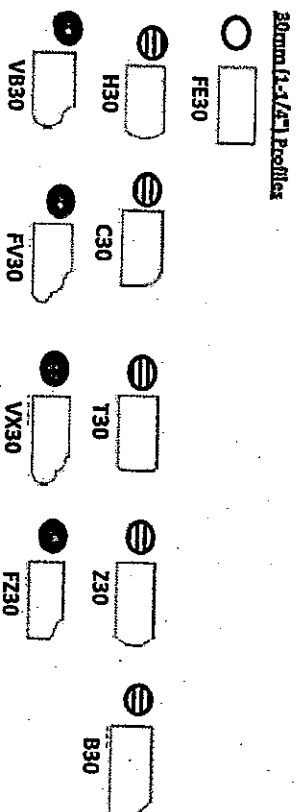
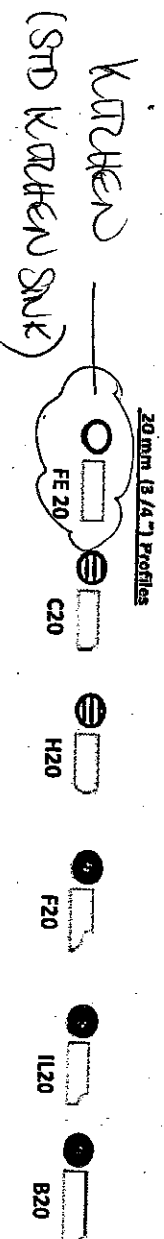

Note: All colours may not be available in 30mm at time ordered. Vendor reserves the right to use 40 mm edges (by lamination process).

*Mitre edge is available in Upgrade 1 for an overall thickness of 2". All other Mitre edge options will be an Upgrade 2 Edge.

K6-74

UP

JAN. 31. 2017



Attention: Building Department

Re: Lot # 74-KG.

This is to acknowledge that as the purchaser of the above noted lot, I have asked Gold Park Homes not to install the standard builder's kitchen exhaust hood. I will be installing my own unit after closing at my own expense and warranty. I also accept that the venting location will be as per the standard range hood.

Purchaser

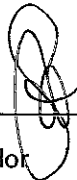
Vendor

Purchaser

Dated this 31st day of JANUARY, 20 17.

Elevation A • 2,778 sq.ft.

Elevation B • 2,817 sq.ft.

TILE DIRECTION: FOYER/KITCHEN/POWDER RM.

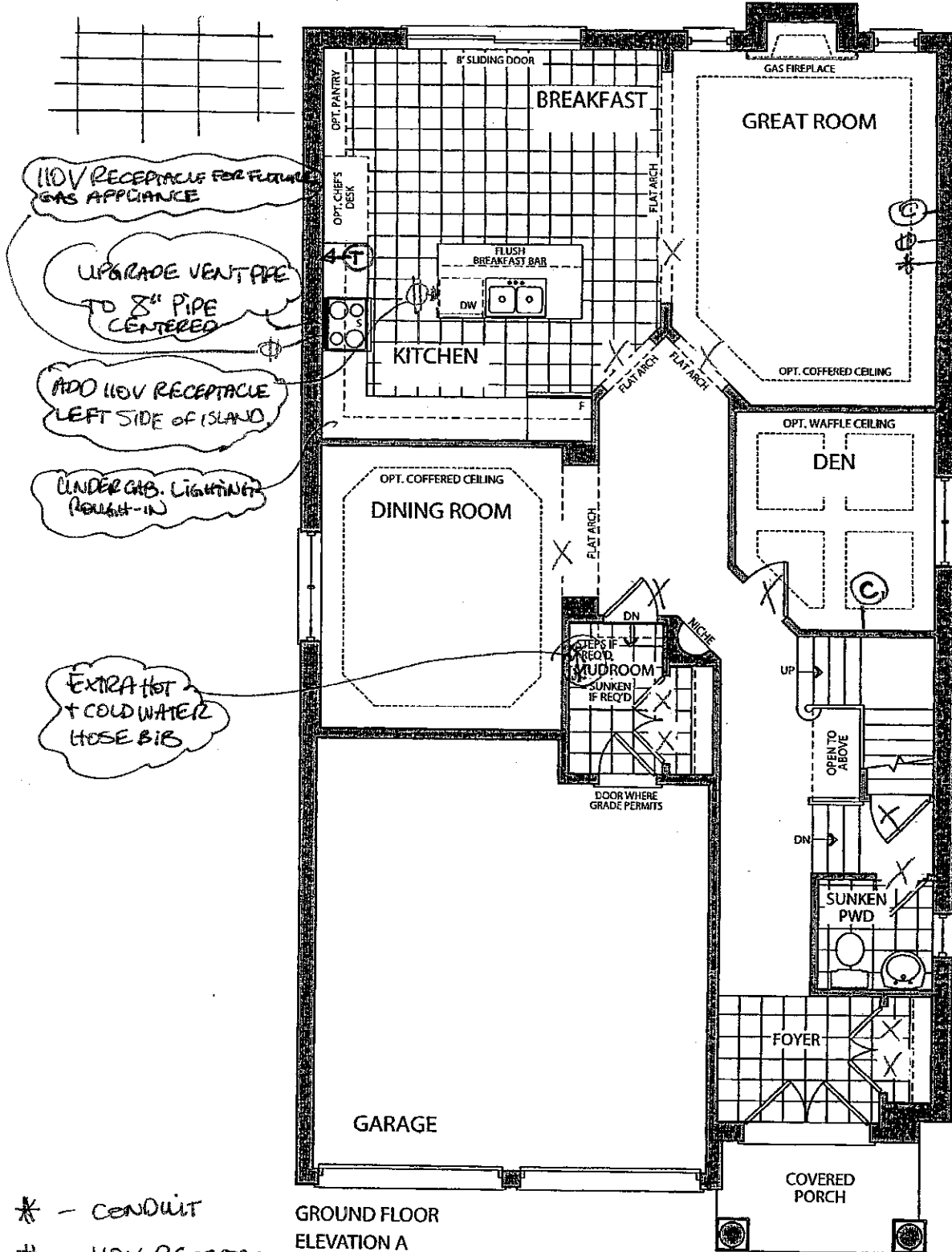

CABLE, 110V REC. + CONDUIT PIPE APPROX 5LH AFF FOR FUTURE WALL MOUNTED TV.

- * - CONDUIT
- Ⓢ - 110V RECEPTACLE
- Ⓢ - CABLE
- Ⓢ - TELEPHONE
- X - EXTEND DOOR HEIGHTS + ARCHWAYS

GROUND FLOOR
ELEVATION A

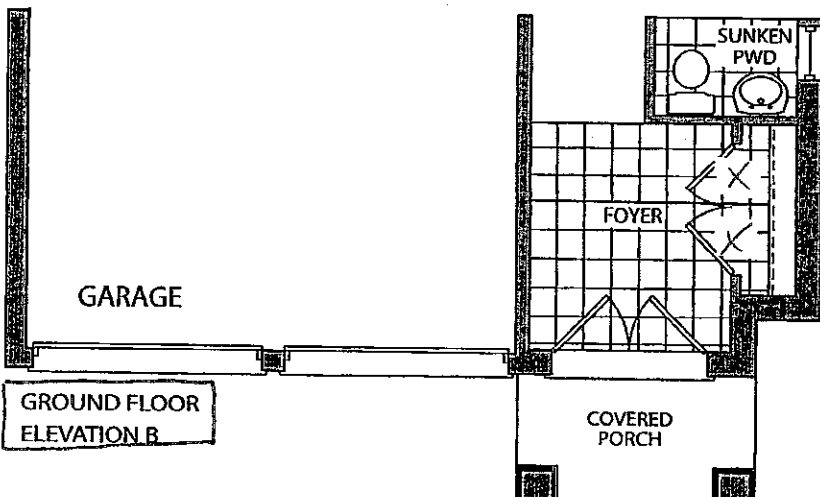

GROUND FLOOR
ELEVATION B

COLOURS



JAN. 31. 2017

STRUCTURAL

LOT 74



AUG. 10. 2016

CABLE, 110V RECEPTACLE +
CONDUIT APPROX 54" AFF
FOR FUTURE WALL MOUNTED TV

Elevation A • 2,778 sq.ft.

Elevation B • 2,817 sq.ft.

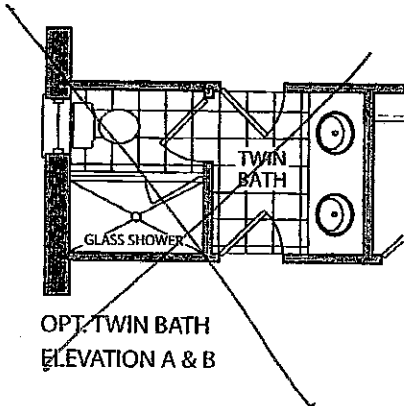
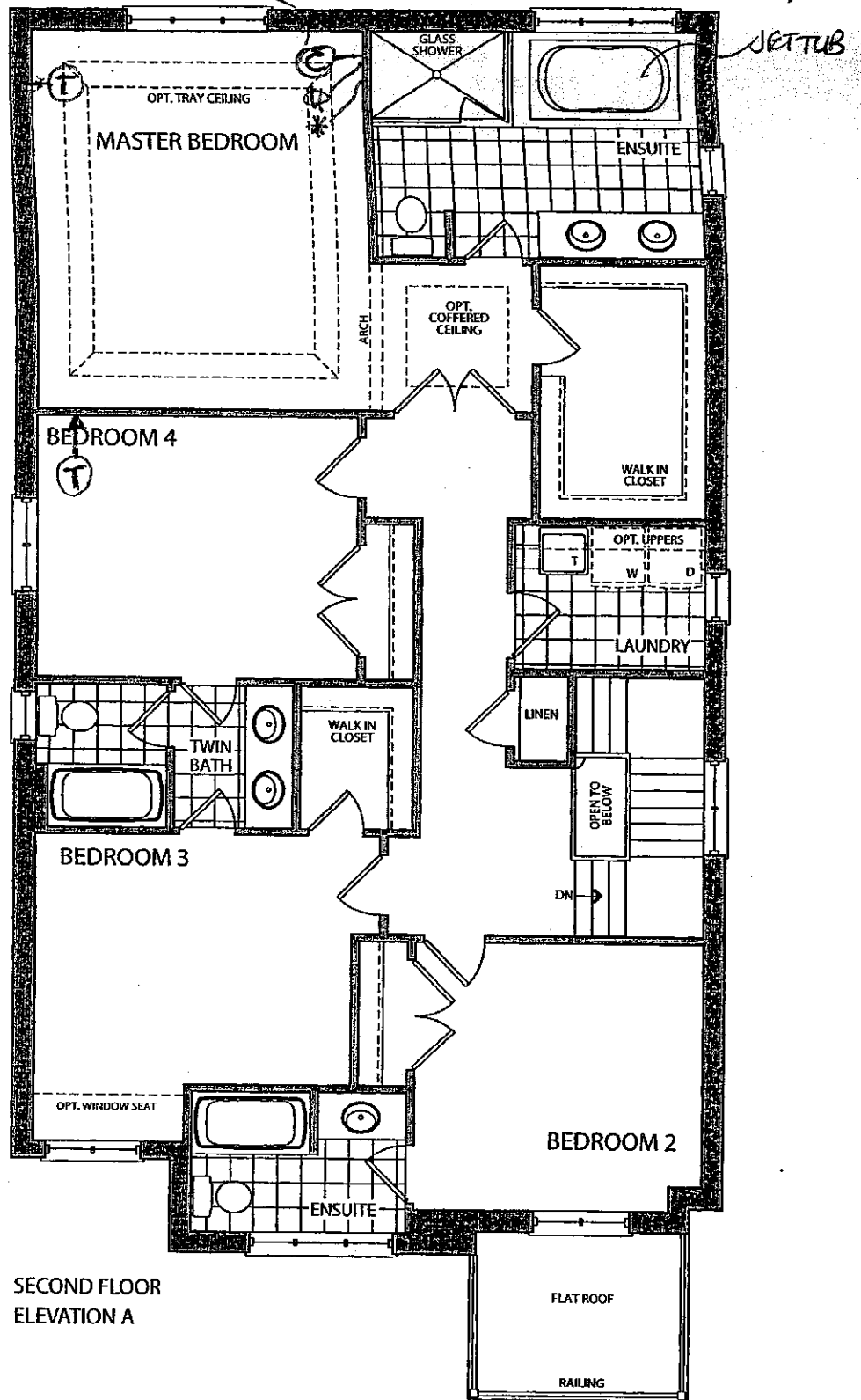

SECOND FLOOR
ELEVATION A

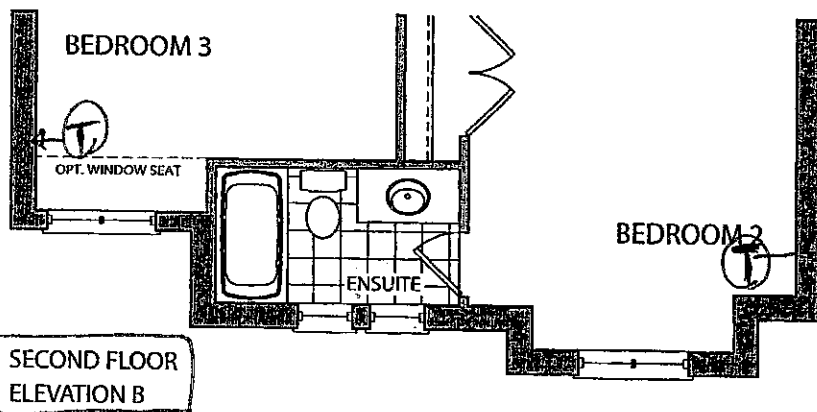

SECOND FLOOR
ELEVATION B

Colours

48

JAN. 31. 2017

STRUCTURAL
LOT 74

48 48

AUG. 10. 2016

Elevation A • 2,778 sq.ft.

Elevation B • 2,817 sq.ft.

UPS. WINDOW TO 53"X16"
TO BE COLOUR MATCHED

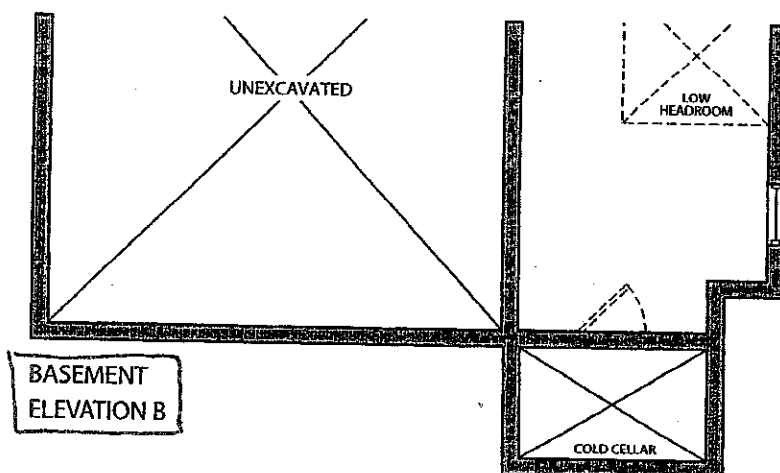
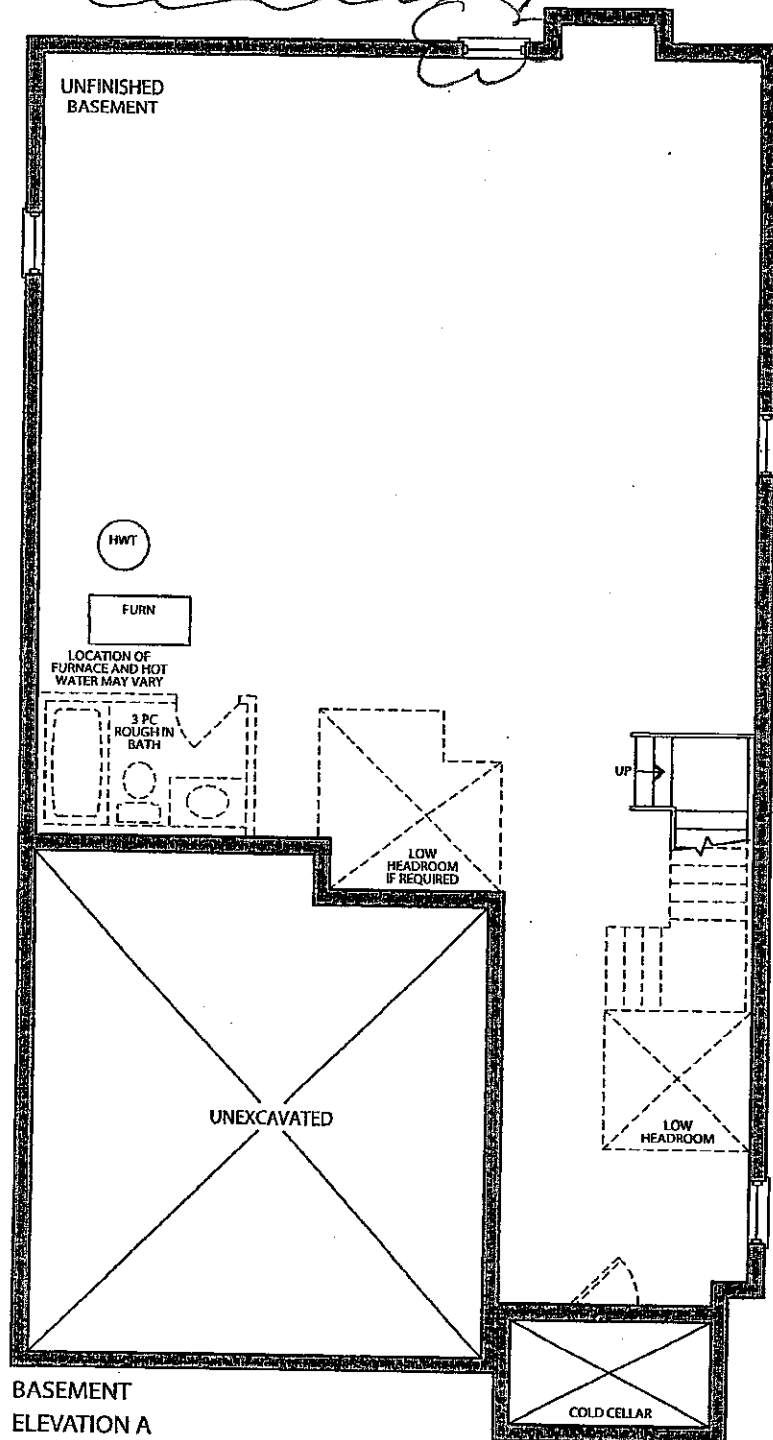

Colours



JAN. 31. 2017

STRUCTURAL

LOT 74



AUG. 10. 2016