



CONSTRUCTION SUMMARY

Kleinburg Glen - 83R - 1 - 25-2 Elev.B HUDSON  
CENTRAL VAC AND WIRING

|                   |                                                                                                                                                             |
|-------------------|-------------------------------------------------------------------------------------------------------------------------------------------------------------|
| Inv.784           | 1 - FAMILY ROOM: CONDUIT PIPE - FOR TELEVISION - Locate approx. 66" A.F.F. above fireplace, terminating right of fireplace by cable. See plan for location. |
| Line11125         | Note:                                                                                                                                                       |
| 25Aug16 / 14Nov16 |                                                                                                                                                             |
| Inv.784           | 1 - FAMILY ROOM: ROUGH - IN FIBER OPTIC CABLE - HOME RUN TO ELECTRICAL PANEL - Locate right of fireplace. See plan for location.                            |
| Line11126         | Note:                                                                                                                                                       |
| 25Aug16 / 14Nov16 |                                                                                                                                                             |

CERAMIC

|                   |                                                                                                                                                                           |
|-------------------|---------------------------------------------------------------------------------------------------------------------------------------------------------------------------|
| Inv.1,141         | 1 - FOYER / POWDER ROOM FLOOR TILE: Upgrade 5 - Timeless 24x24" polished - laid in striaght, stacked pattern.                                                             |
| Line16868         | Note:                                                                                                                                                                     |
| 30Jan17 / 10Apr17 |                                                                                                                                                                           |
| Inv.1,141         | 1 - MASTER ENSUITE FLOOR TILE: Upgrade 4 - 12x24" polished - laid in straight, stacked pattern. - See plan for tile direction                                             |
| Line16869         | Note:                                                                                                                                                                     |
| 30Jan17 / 10Apr17 |                                                                                                                                                                           |
| Inv.1,141         | 1 - MASTER ENSUITE WALL TILE - SHOWER WALL + TUB SKIRT/DECK/SPLASH: Upgrade 1 - 2x8" CDC bright. Lay in horizontal stacked pattern, see sketch for tile direction at tub. |
| Line16870         | Note:                                                                                                                                                                     |
| 30Jan17 / 10Apr17 |                                                                                                                                                                           |
| Inv.1,141         | 1 - LAUNDRY ROOM FLOOR TILE: Upgrade 4 - 12x24" polished - laid in straight, stacked pattern. - See plan for tile direction                                               |
| Line16873         | Note:                                                                                                                                                                     |
| 30Jan17 / 10Apr17 |                                                                                                                                                                           |
| Inv.1,298         | 1 - MASTER ENSUITE: *DELETE* ITEM 9 FROM ORDER PE-1.141 (FLOOR TILE) - LAYOUT HAS BEEN REVISED                                                                            |
| Line20347         | Note:                                                                                                                                                                     |
| 4Apr17 / 10Apr17  |                                                                                                                                                                           |
| Inv.1,298         | 1 - MASTER ENSUITE: *DELETE* ITEM 10 FROM ORDER PE.1.141 (WALL TILE) - LAYOUT HAS BEEN REVISED                                                                            |
| Line20348         | Note:                                                                                                                                                                     |
| 4Apr17 / 10Apr17  |                                                                                                                                                                           |
| Inv.1,298         | 1 - MASTER ENSUITE: *REVISE LAYOUT* MOVE TOILET TO BY WINDOW AND INCREASE SHOWER TO FULL WIDTH OF BATHROOM - SEE PLAN FOR LOCATION.                                       |
| Line20349         | Note:                                                                                                                                                                     |
| 4Apr17 / 10Apr17  |                                                                                                                                                                           |
| Inv.1,298         | 1 - MASTER ENSUITE: UPGRADE 4 FLOOR TILE - 12X24" LAID IN STRAIGHT, STACKED PATTERN. SEE PLAN FOR TILE DIRECTION.                                                         |
| Line20350         | Note:                                                                                                                                                                     |
| 4Apr17 / 10Apr17  |                                                                                                                                                                           |
| Inv.1,298         | 1 - MASTER ENSUITE: UPGRADE 1 WALL TILE - 2X8" LAID IN HORIZONTAL, STACKED PATTERN.                                                                                       |
| Line20351         | Note:                                                                                                                                                                     |
| 4Apr17 / 10Apr17  |                                                                                                                                                                           |

ELECTRICAL

Kleinburg Glen - 83R - 1 - 25-2 Elev.B HUDSON

|                   |                                                                                                                      |
|-------------------|----------------------------------------------------------------------------------------------------------------------|
| Inv.784           | 1 - FAMILY ROOM: 110V WALL RECEPTACLE ON NORMAL CIRCUIT Locate approx. 66" A.F.F. above fireplace.                   |
| Line11127         | Note:                                                                                                                |
| 25Aug16 / 14Nov16 |                                                                                                                      |
| Inv.784           | 1 - KITCHEN: 110V WALL RECEPTACLE ON DEDICATED CIRCUIT - GAS FIRED APPLIANCE - FOR AUX. EQUIPMENT - NOT A STOVE PLUG |
| Line11129         | Note:                                                                                                                |
| 25Aug16 / 14Nov16 |                                                                                                                      |

EXTERIOR COLOURS

|                   |                               |
|-------------------|-------------------------------|
| Inv.784           | 1 - EXTERIOR COLOUR PACKAGE 9 |
| Line13877         | Note:                         |
| 25Aug16 / 14Nov16 |                               |

FRAMING

|                   |                                                                                                                                                |
|-------------------|------------------------------------------------------------------------------------------------------------------------------------------------|
| Inv.784           | 3 - MAIN FLOOR: FRAME MAIN FLOOR ARCHES AT 96 INCH. See plan for location.                                                                     |
| Line11130         | Note:                                                                                                                                          |
| 25Aug16 / 14Nov16 |                                                                                                                                                |
| Inv.1,298         | 1 - ATTENTION**MASTER ENSUITE: *REVISE LAYOUT* MOVE TOILET TO BY WINDOW AND INCREASE SHOWER TO FULL WIDTH OF BATHROOM - SEE PLAN FOR LOCATION. |
| Line20822         | Note:                                                                                                                                          |
| *NEW              |                                                                                                                                                |
| 4Apr17 / 10Apr17  |                                                                                                                                                |

HARDWOOD

|                   |                                                                                             |
|-------------------|---------------------------------------------------------------------------------------------|
| Inv.1,141         | 1 - LIVING / DINING / FAMILY ROOM HARDWOOD: Upgrade 5 - Vintage 5" White Oak Hand Scraped   |
| Line16866         | Note:                                                                                       |
| 30Jan17 / 10Apr17 |                                                                                             |
| Inv.1,141         | 1 - KITCHEN HARDWOOD: Upgrade 5 - Vintage 5" White Oak Hand Scraped                         |
| Line16867         | Note:                                                                                       |
| 30Jan17 / 10Apr17 |                                                                                             |
| Inv.1,261         | 1 - UPPER HALL: Upgrade 5 hardwood floor - VINTAGE 3/4 x 5" White Oak Hand Scraped 'Gotham' |
| Line19449         | Note:                                                                                       |
| 21Mar17 / 10Apr17 |                                                                                             |

HVAC

|                   |                                            |
|-------------------|--------------------------------------------|
| Inv.784           | 1 - KITCHEN: GAS LINE ROUGH - GROUND FLOOR |
| Line11128         | Note:                                      |
| 25Aug16 / 14Nov16 |                                            |

INTERIOR TRIM AND DOORS

|                   |                                                                   |
|-------------------|-------------------------------------------------------------------|
| Inv.784           | 3 - MAIN FLOOR: EXTENDED HEIGHT ARCHWAY (PRICE PER DOORWAY) - 96" |
| Line11131         | Note:                                                             |
| 25Aug16 / 14Nov16 |                                                                   |

KITCHEN AND BATH CABINETRY

|                   |                                                        |
|-------------------|--------------------------------------------------------|
| Inv.1,141         | 1 - KITCHEN CABINETRY: Upgrade 3 profile (pvc lacquer) |
| Line16858         | Note:                                                  |
| 30Jan17 / 10Apr17 |                                                        |

## Kleinburg Glen - 83R - 1 - 25-2 Elev.B HUDSON

|                   |                                                                                                                                                          |
|-------------------|----------------------------------------------------------------------------------------------------------------------------------------------------------|
| Inv.1,141         | 1 - KITCHEN CABINETRY: Cabinetry Slide-in stove prep                                                                                                     |
| Line16859         | Note:                                                                                                                                                    |
| 30Jan17 / 10Apr17 |                                                                                                                                                          |
| Inv.1,141         | 1 - KITCHEN CABINETRY: Delete uppers above range, finish sides of cabinets. Leave approx. 36" between uppers for future 30" chimney-style hood fan.      |
| Line16861         | Note:                                                                                                                                                    |
| 30Jan17 / 10Apr17 |                                                                                                                                                          |
| Inv.1,141         | 1 - KITCHEN CABINETRY: Raise cabinets 3/4 for hardwood flooring in kitchen                                                                               |
| Line16864         | Note:                                                                                                                                                    |
| 30Jan17 / 10Apr17 |                                                                                                                                                          |
| Inv.1,141         | 1 - KITCHEN CABINETRY: Do *NOT* install hardware, do not drill holes.                                                                                    |
| Line16865         | Note: *kitchen only*                                                                                                                                     |
| 30Jan17 / 10Apr17 |                                                                                                                                                          |
| Inv.1,298         | 1 - MASTER ENSUITE: *REVISE LAYOUT* MOVE TOILET TO BY WINDOW AND INCREASE SHOWER TO FULL WIDTH OF BATHROOM - SEE PLAN FOR LOCATION. REQUIRES ADDED GABLE |
| Line20825         | Note: <b>*NEW</b>                                                                                                                                        |
| 4Apr17 / 10Apr17  |                                                                                                                                                          |

## MISC.

|                   |                                                                                                                                                                                                                                                                   |
|-------------------|-------------------------------------------------------------------------------------------------------------------------------------------------------------------------------------------------------------------------------------------------------------------|
| Inv.784           | 1 - Purchaser has attended a Structural appointment at the Decor Centre & has DECLINED any additional upgrades and accepts and acknowledges that there will be no further structural changes/additions/deletions to be made upon signing on September 8, 2016.    |
| Line11132         | Note:                                                                                                                                                                                                                                                             |
| 25Aug16 / 14Nov16 |                                                                                                                                                                                                                                                                   |
| Inv.784           | 1 - Purchasers are aware & accepts that ANY changes made to upgrades after signing this Purchasers Extra Form are subject to a minimum administration fee of \$500. PLUS a 10% holdback fee.                                                                      |
| Line11133         | Note:                                                                                                                                                                                                                                                             |
| 25Aug16 / 14Nov16 |                                                                                                                                                                                                                                                                   |
| Inv.784           | 1 - BONUS PACKAGE: \$5,000.00 (INCLUDING TAXES) WORTH OF UPGRADES FROM GOLD PARK HOMES DÉCOR CENTRE IS BEING APPLIED TOWARD THE STRUCTURAL APPOINTMENT. PURCHASER HAS A REMAINING AMOUNT OF \$2451.85 (INCLUDING TAXES) TO BE USED TOWARD THE COLOUR APPOINTMENT. |
| Line11134         | Note:                                                                                                                                                                                                                                                             |
| 25Aug16 / 14Nov16 |                                                                                                                                                                                                                                                                   |
| Inv.1,141         | 1 - Purchaser has attended a Colour appointment at the Decor Centre & has DECLINED any additional upgrades and accepts and acknowledges that there will be no further changes/additions/deletions to be made upon signing on January 30 2017.                     |
| Line16874         | Note:                                                                                                                                                                                                                                                             |
| 30Jan17 / 10Apr17 |                                                                                                                                                                                                                                                                   |
| Inv.1,141         | 1 - Purchasers are aware & accepts that ANY changes made to upgrades after signing this Purchasers Extra Form are subject to a minimum administration fee of \$500. PLUS a 10% holdback fee.                                                                      |
| Line16875         | Note:                                                                                                                                                                                                                                                             |
| 30Jan17 / 10Apr17 |                                                                                                                                                                                                                                                                   |
| Inv.1,141         | 1 - STAIRCASE - The purchaser was advised and therefore accepts and acknowledges that the wood species of the staircase and flooring chosen do not match. This difference may result in a stain colour variance.                                                  |
| Line16876         | Note: The purchaser agrees that the vendor is to be exempt from any and all claims by the purchaser regarding this colour variance.                                                                                                                               |
| 30Jan17 / 10Apr17 |                                                                                                                                                                                                                                                                   |

Kleinburg Glen - 83R - 1 - 25-2 Elev.B HUDSON

|                   |                                                                                                                                                                                                                           |
|-------------------|---------------------------------------------------------------------------------------------------------------------------------------------------------------------------------------------------------------------------|
| Inv.1,141         | 1 - KITCHEN - Purchasers request to NOT INSTALL builder's standard hood fan and standard cabinets above stove. DELETE. Do not supply, install, and/or credit. Purchasers are installing their own hood fan after closing. |
| Line16877         | Note: Purchasers accept and acknowledge that the exhaust fan duct hole may be off-centered with stove in kitchen due to purchasers installing their own hood fan after closing. The vendor is exempt.                     |
| 30Jan17 / 10Apr17 |                                                                                                                                                                                                                           |

PAINTING

|                   |                                                                        |
|-------------------|------------------------------------------------------------------------|
| Inv.1,141         | 1 - MAIN STAIRS: Stain stairs 'Vintage Pewter'                         |
| Line16872         | Note: Stairs will not match hardwood floors in colour/texture/species. |
| 30Jan17 / 10Apr17 |                                                                        |

PLUMBING

|                  |                                                                                                                                     |
|------------------|-------------------------------------------------------------------------------------------------------------------------------------|
| Inv.1,298        | 1 - MASTER ENSUITE: *REVISE LAYOUT* MOVE TOILET TO BY WINDOW AND INCREASE SHOWER TO FULL WIDTH OF BATHROOM - SEE PLAN FOR LOCATION. |
| Line20823        | Note:                                                                                                                               |
| *NEW             |                                                                                                                                     |
| 4Apr17 / 10Apr17 |                                                                                                                                     |

|                  |                                              |
|------------------|----------------------------------------------|
| Inv.1,298        | 1 - ATTENTION: STRUCTURAL CHANGE: DELETE TUB |
| Line20824        | Note:                                        |
| *NEW             |                                              |
| 4Apr17 / 10Apr17 |                                              |

STAIRS AND RAILINGS

|                   |                                        |
|-------------------|----------------------------------------|
| Inv.1,141         | 1 - MAIN STAIRS: Euroline 1 + V Groove |
| Line16871         | Note:                                  |
| 30Jan17 / 10Apr17 |                                        |

Purchasers: Olga Ferro & Fausto Ferro

Property: 83R

Telephone Res. / Bus: (416) 788-8900

Project: Burkshire Holdings Inc.

Decor Advisor: Yolande Somerville

Model and Elevation: 25-2 Elev.B HUDSON

Layout Changes: ☒ Yes ☐ No

Sketch Attached: ☒ Yes ☐ No

Exterior Colour Scheme:

### 1. Cabinetry

|                                         | Style and Colour           | Counter                           | Hardware |
|-----------------------------------------|----------------------------|-----------------------------------|----------|
| Kitchen / Breakfast                     | *aston pvclacq 'wht matt   | Granite: Grigio Sardo Edge: FE-20 | *NONE    |
| Laundry Room                            | n/a                        | n/a                               | n/a      |
| Powder Room                             | n/a                        | n/a                               | n/a      |
| n/a                                     | n/a                        | n/a                               | n/a      |
| Master Ensuite Bathroom                 | varese pvc 'crystal white' | P-Lam # P-344-LM 'Inukshuk Grey'  | cs1-23   |
| Second Ensuite Bathroom (If Applicable) | n/a                        | n/a                               | n/a      |
| Main Bathroom                           | P-400 pvc 'mystic'         | P-Lam #4925K-07 'Calcutta Marble' | cs1-23   |
| Dishwasher Cabinet                      | n/a                        |                                   |          |

Comment

### 2. Floor Tile

|                                         | Selection                           | Grout | Threshold |
|-----------------------------------------|-------------------------------------|-------|-----------|
| Entrance Vestibule                      | *24x24" Himalaya polished 'Grey'    | n/a   | n/a       |
| Main Hall                               | n/a                                 | n/a   | n/a       |
| Kitchen / Breakfast                     | n/a                                 | n/a   | n/a       |
| Laundry Room                            | *12x24" Carrara X pol. 'White/Grey' | n/a   | n/a       |
| Powder Room                             | *24x24" Himalaya polished 'Grey'    | n/a   | n/a       |
| Main Bathroom                           | *12x24" Carrara X pol. 'White/Grey' | n/a   | n/a       |
| Master Ensuite Bathroom                 | *12x24" Timeless pol. 'Dark Grey'   | n/a   | n/a       |
| Second Ensuite Bathroom (If Applicable) | n/a                                 | n/a   | n/a       |
| Lower Landing (If Applicable)           | n/a                                 | n/a   | n/a       |
| n/a                                     | n/a                                 | n/a   | n/a       |

Comment

Grout lines as small as possible, please!

### 3. Wall Tile

|                                         | Selection                | Listello/Inserts                                              | Describe             |
|-----------------------------------------|--------------------------|---------------------------------------------------------------|----------------------|
| M. Ens Tub skirt/splash                 | *2x8" CDC 'Taupe' Bright | <input type="radio"/> Yes <input checked="" type="radio"/> No | <input type="text"/> |
| Master Ensuite Bathroom                 |                          |                                                               |                      |
| Tub Deck                                | *2x8" CDC 'Taupe' Bright | <input type="radio"/> Yes <input checked="" type="radio"/> No | <input type="text"/> |
| Shower Stall                            | *2x8" CDC 'Taupe' Bright | <input type="radio"/> Yes <input checked="" type="radio"/> No | <input type="text"/> |
| Bathroom Walls                          | n/a                      | <input type="radio"/> Yes <input checked="" type="radio"/> No | <input type="text"/> |
| Second Ensuite Bathroom (If Applicable) | n/a                      | <input type="radio"/> Yes <input checked="" type="radio"/> No | <input type="text"/> |
| Main Bathroom                           | 8x10" Weave 'White'      | <input type="radio"/> Yes <input checked="" type="radio"/> No | <input type="text"/> |

Kitchen Backsplash ☐ Yes ☒ No

Backsplash Behind Fridge

Comment

Agents: Olga Ferro & Fausto Ferro

Property: 83R

Phone Res. / Bus: (416) 788-8900

Project: Burkshire Holdings Inc.

For Advisor: Yolande Somerville

Model and Elevation: 25-2 Elev.B HUDSON

#### 4. Plumbing Fixtures

Master Ensuite Bathroom ☐ Second Ensuite ☐ Powder Room ☐  
Other Room - Specify ☐ Other Washroom ☐

Comment

Standard Plumbing thru out

#### 5. Hardwood Flooring

|                               | Type and Stain                    |                      | Type and Stain                       |
|-------------------------------|-----------------------------------|----------------------|--------------------------------------|
| Main Hall                     | n/a                               | Upper Landing        | n/a                                  |
| Kitchen / Breakfast           | "Vintage 5" Hand Scraped 'Gotham' | Upper Hall           | <del>n/a</del> - VINTAGE 5" 'GOTHAM' |
| Living Room                   | "Vintage 5" Hand Scraped 'Gotham' | Master Bedroom       | n/a HAND SCRAPED                     |
| Dining Room                   | "Vintage 5" Hand Scraped 'Gotham' | Bedroom #2           | n/a                                  |
| Family Room                   | "Vintage 5" Hand Scraped 'Gotham' | Bedroom #3           | n/a                                  |
| Den/Library                   | n/a                               | Bedroom #4           | n/a                                  |
| Entrance Vestibule            | n/a                               | Bedroom #5           | n/a                                  |
| Lower Landing (If Applicable) | n/a                               | Other Room - Specify | n/a                                  |

Comment

Hardwood Selection: Vintage 3/4 x 5" White Oak Hand Scraped 'Gotham'

#### 6. Carpeting

|                               | Upgrade                  | Description         |
|-------------------------------|--------------------------|---------------------|
| Main Hall                     | <input type="checkbox"/> | n/a                 |
| Living Room                   | <input type="checkbox"/> | n/a                 |
| Dining Room                   | <input type="checkbox"/> | n/a                 |
| Family Room                   | <input type="checkbox"/> | n/a                 |
| Den/Library                   | <input type="checkbox"/> | n/a                 |
| Upper Hall                    | <input type="checkbox"/> | <del>T-04</del> N/A |
| Master Bedroom                | <input type="checkbox"/> | T-04                |
| Bedroom #2                    | <input type="checkbox"/> | T-04                |
| Bedroom #3                    | <input type="checkbox"/> | T-04                |
| Bedroom #4                    | <input type="checkbox"/> | n/a                 |
| Bedroom #5                    | <input type="checkbox"/> | n/a                 |
|                               | <input type="checkbox"/> | n/a                 |
| Upper Landing (If Applicable) | <input type="checkbox"/> | n/a                 |
| Lower Landing (If Applicable) | <input type="checkbox"/> | n/a                 |

|                  | Type          | Area                     |
|------------------|---------------|--------------------------|
| Upgrade Underpad | n/a           | n/a                      |
| Carpet on Stairs | Capped<br>n/a | Runner - "Upgrade<br>n/a |

Comment

Standard Carpet + Standard Underpad on 2nd floor - BEDROOMS.

Purchasers: Olga Ferro & Fausto Ferro  
Telephone Res. / Bus: (416) 788-8900  
Decor Advisor: Yolande Somerville

Property: 83R  
Project: Burkshire Holdings Inc.  
Model and Elevation: 25-2 Elev.B HUDSON

7. Fireplace

|                | Living Room           |                       |                                  | Family Room            |                                  |                       | Other Room - Specify  |                       |                                  |
|----------------|-----------------------|-----------------------|----------------------------------|------------------------|----------------------------------|-----------------------|-----------------------|-----------------------|----------------------------------|
|                | Purchased             | As Per Plan           | N/A                              | Purchased              | As Per Plan                      | N/A                   | Purchased             | As Per Plan           | N/A                              |
| Fireplace Type | <input type="radio"/> | <input type="radio"/> | <input checked="" type="radio"/> | <input type="radio"/>  | <input checked="" type="radio"/> | <input type="radio"/> | <input type="radio"/> | <input type="radio"/> | <input checked="" type="radio"/> |
| Mantle Type    |                       |                       |                                  | Standard Gas           |                                  |                       |                       |                       |                                  |
| Colour / Stain |                       |                       |                                  | Standard Mediterranean |                                  |                       |                       |                       |                                  |
| Surround       |                       |                       |                                  | Standard               |                                  |                       |                       |                       |                                  |
| Hearth         |                       |                       |                                  | None                   |                                  |                       |                       |                       |                                  |
| Comment        | <div></div>           |                       |                                  |                        |                                  |                       |                       |                       |                                  |

8. Trim Carpentry

|                |             |                          |          |              |          |
|----------------|-------------|--------------------------|----------|--------------|----------|
| Interior Doors | Standard    | Front Door Glass Inserts | Standard | Door Handles | Standard |
| Interior Trim  | Standard    |                          |          |              |          |
| Comment        | <div></div> |                          |          |              |          |

9. Plaster Mouldings and Medallions

|                    |             |  |                      |      |  |
|--------------------|-------------|--|----------------------|------|--|
| Entrance Vestibule |             |  | Kitchen/Breakfast    |      |  |
| Main Hall          |             |  | Den/Library          |      |  |
| Living Room        |             |  | Lower Landing        |      |  |
| Dining Room        |             |  | Other Room - Specify | none |  |
| Family Room        |             |  | Thru Out             |      |  |
| Comment            | <div></div> |  |                      |      |  |

10. Railings and Spindles

|                  |                        |                                                               |                   |
|------------------|------------------------|---------------------------------------------------------------|-------------------|
| Railing Package  | *Euroline 1 + V Groove |                                                               |                   |
| Railing Colour   | *Vintage 'Pewter'      | Spindle Colour                                                | *Black            |
| Stringer / Riser | *Vintage 'Pewter'      | Treads                                                        | *Vintage 'Pewter' |
| Comment          | <div></div>            |                                                               |                   |
|                  | Oak Stairs             | <input checked="" type="radio"/> Yes <input type="radio"/> No |                   |

11. Wall Paint

|                     |                                                                  |                |           |
|---------------------|------------------------------------------------------------------|----------------|-----------|
| Main & Upper Hall   |                                                                  | Master Bedroom |           |
| Living Room         |                                                                  | Bedroom #2     |           |
| Dining Room         |                                                                  | Bedroom #3     |           |
| Kitchen / Breakfast |                                                                  | Bedroom #4     |           |
| Family Room         |                                                                  | Bedroom #5     |           |
| Powder Room         |                                                                  | Master Ensuite |           |
| Laundry Room        |                                                                  |                |           |
| Den/Library         |                                                                  | Second Ensuite |           |
| Trim Paint          |                                                                  | Thru Out       | Warm Grey |
| Comment             | Smooth Ceilings First Floor <input type="checkbox"/> <div></div> |                |           |



Scheduled Closing Date: Monday, February 13, 2017

Purchasers: Olga Ferro & Fausto Ferro

Property: 83R

Telephone Res. / Bus: (416) 788-8900

Project: Burkshire Holdings Inc.

Decor Advisor: Yolande Somerville

Model and Elevation: 25-2 Elev.B HUDSON

## 12. Electrical

Plugs and Switches ☒ White ☐ Ivory

Hood Fan ☐ White ☐ Ivory

Appliances

Built in Cooktop

Built in Oven

Gas Stove

Microwave

☐ Yes ☒ No

☐ Yes ☒ No

☒ Yes ☐ No

☐ Yes ☒ No

Comment

\*Chimney-style hood fan

Above Kitchen Cabinet Light ☐ Yes ☒ No

Below Kitchen Cabinet Light ☐ Yes ☒ No

## 13. Heating and Air Conditioning

Air Conditioning

Gas Provisions Stove

Gas Provisions Dryer

Gas Provisions Barbecue

Comment

Standard Gas BBQ Line

## 14. Additional Comments

## 15. Disclaimers and Notes

- Colours of all materials are as close as possible to builder's selection, but not necessarily identical due to variances in manufacturing.
- Any extras listed above are null and void unless accompanied by a separate invoice/amendment. Said invoice must be paid in full.
- The Purchaser acknowledges that after Interior Colour Selection form is signed and dated, no further changes will be permitted other than re-selection due to unavailability. \_\_\_\_\_ Purchaser's Initials
- The Purchaser acknowledges reading and accepting the "Gold Park Homes Decor Centre Disclaimers" form. This document contains other miscellaneous disclaimers.

This Interior Colour Selection is final and approved by:

Signature: \_\_\_\_\_

Date: \_\_\_\_\_

Signature: \_\_\_\_\_

Date: \_\_\_\_\_



Elevation A • 1,898 sq.ft.

Elevation B • 1,898 sq.ft.

No Phone  
in  
Kitchen

Hardwood  
in  
Kitchen

66" AFF

LEGEND

⊙ 96" Arch

⊕ ELECTRICAL OUTLET

▲ ⊕ CABLE

▲ ⊕ PHONE

▲ ⊕ FIBER OPTIC

\* CONDUIT

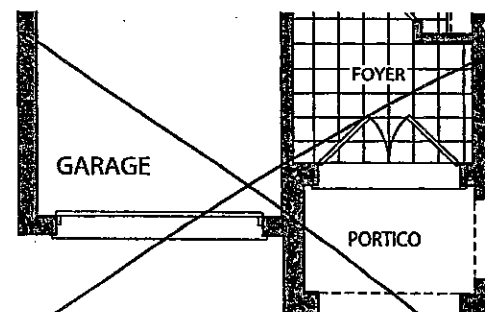
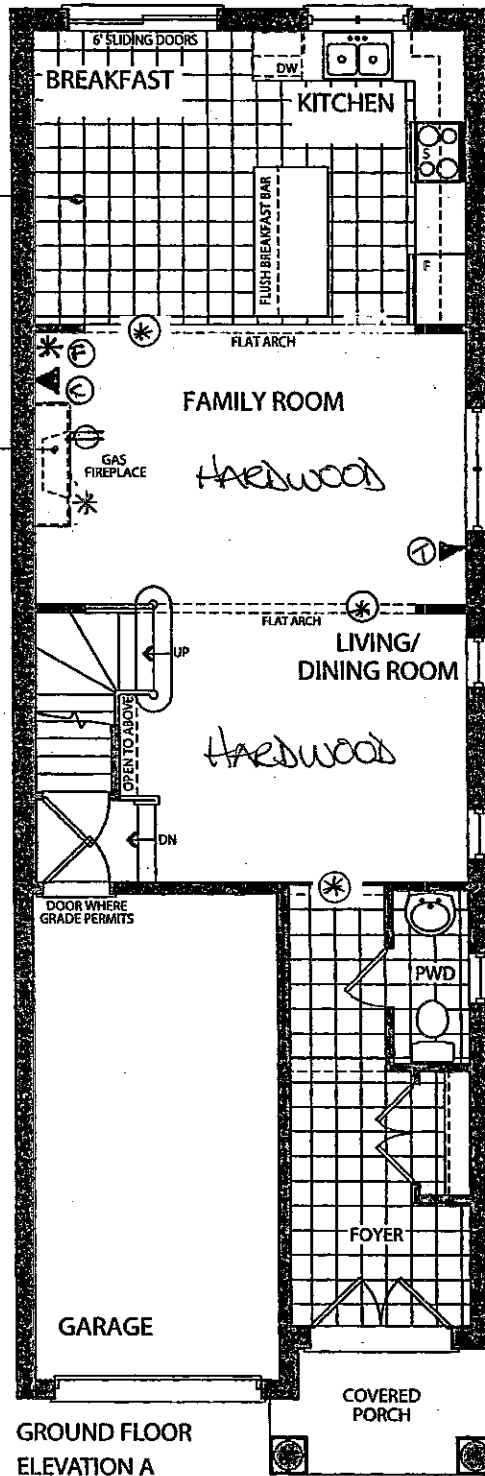

KG-83R  
JAN. 30 2017

SEPT 8 2016  
LOT 83R

⊕ ⊕



# the Hudson

Elevation A • 1,898 sq.ft.

Elevation B • 1,898 sq.ft.

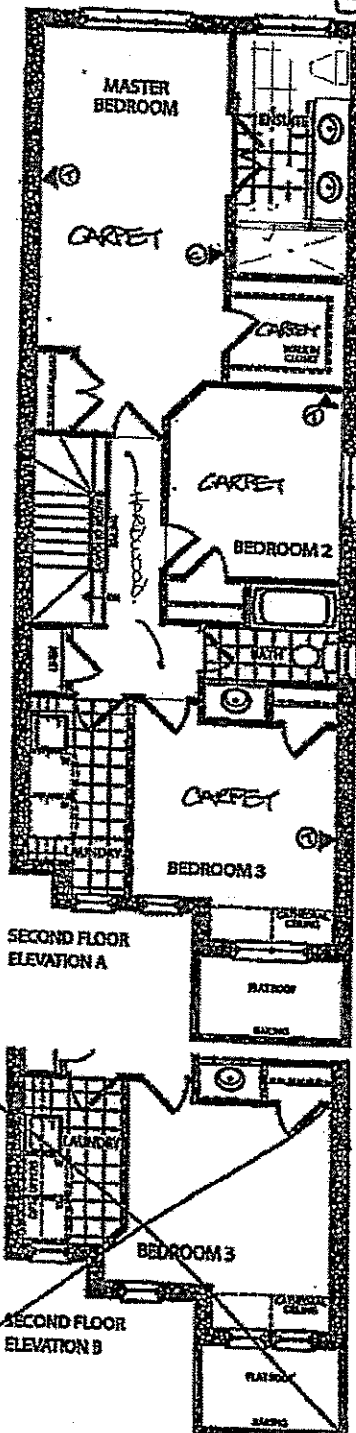

FLOOR  
Tile Direction  
Half walk with Glass floor.

\*REVISED LAYOUT\*  
APRIL 4 2017

Tile  
Direction

TILE  
Direction

SECOND FLOOR  
ELEVATION A

SECOND FLOOR  
ELEVATION B

SEPT 8 2016  
LOT 832

KG - 832  
JAN. 30 2017

Prices, figures, illustrations, sizes, features and finishes are subject to change without notice. EAGE Areas and dimensions are approximate and actual usable floor space may vary from the noted area. Layout may be reverse of the unit purchased. E.S.D.E.

**GOLDPARK**  
HOMES

Elevation A • 1,898 sq.ft.

Elevation B • 1,898 sq.ft.

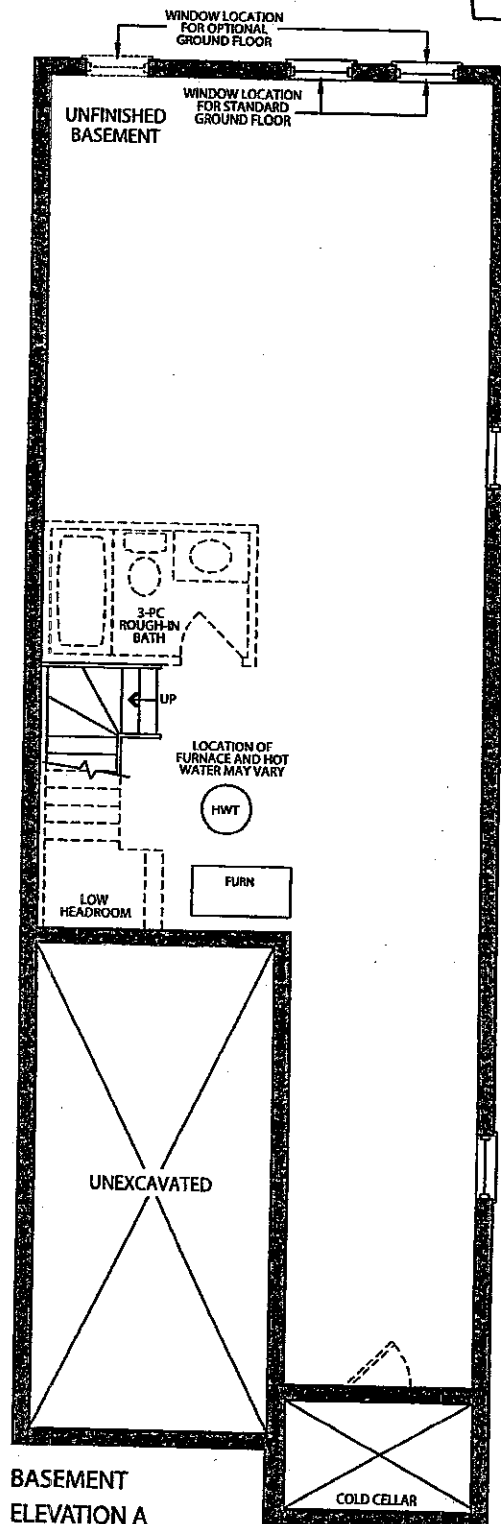

BASEMENT  
ELEVATION A

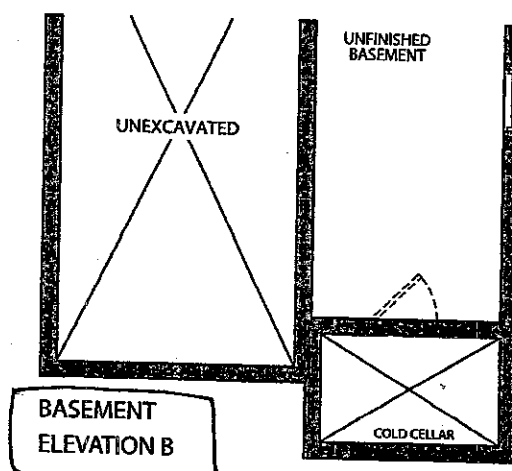

BASEMENT  
ELEVATION B

SEPT 8 2016

LOT 83 R



KG-83R

JAN 30 2017

*[Signature]*

CORTINA

70 Regina Road, Woodbridge, Ontario L4L 8L6  
Tel: 905-284-8464 Fax: 905-284-0664  
www.CortinaKitchens.com

KG-83R

JAN. 30 2017

QUOTATION

Date: 28/06/16

Trade Name: Gold Park Homes

Site location:

Model: 25-2

Address:

Project: Kleinburg Glen

Phase:

This layout has been explained to the purchaser by Cortina Kitchens Inc. and is understood by the purchaser.

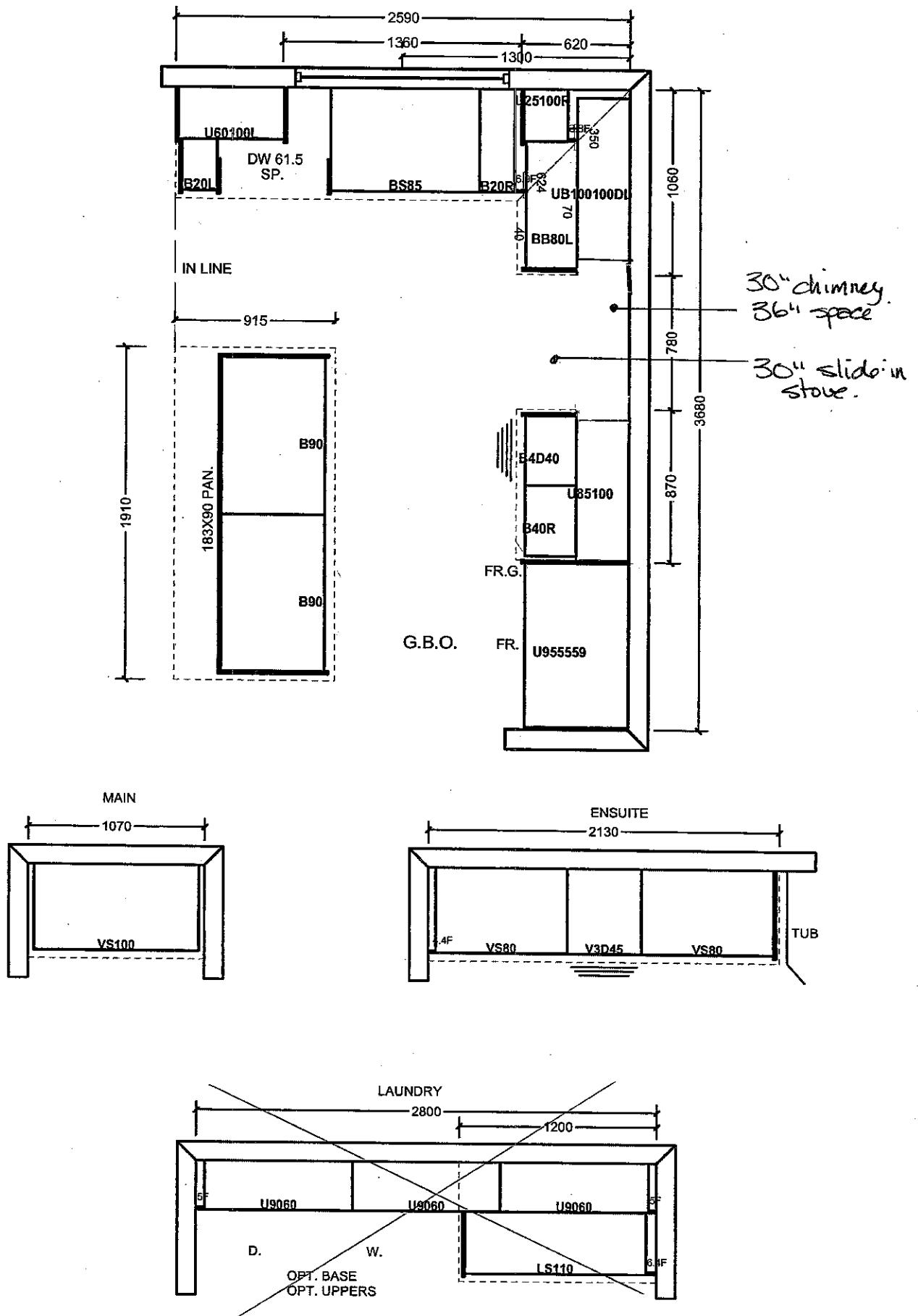

All prices subject to confirmation from head office.  
This quotation is subject to the terms & conditions set out

All agreements are contingent upon strikes, accidents, and delays beyond our control.  
Please provide our installer with template for sinkholes or \$150.00 will be charged for callback.

ACCEPTED DATE: \_\_\_\_\_

Item A. Wood grain and colour are characteristics of the product. We cannot guarantee that such grain and colour will always match.  
Item B. Cortina Kitchens Inc. reserves the right to alter dimensions and make technical changes without notice.

- Standard 2CM & 3CM
- Upgrade 1 2CM & 3CM
- Upgrade 1.4 CM
- Upgrade 2

20mm (3/4") Profiles



30mm (1 1/4") Profiles

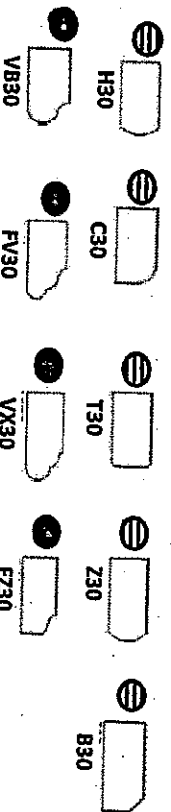

40mm (1 1/2") Profiles

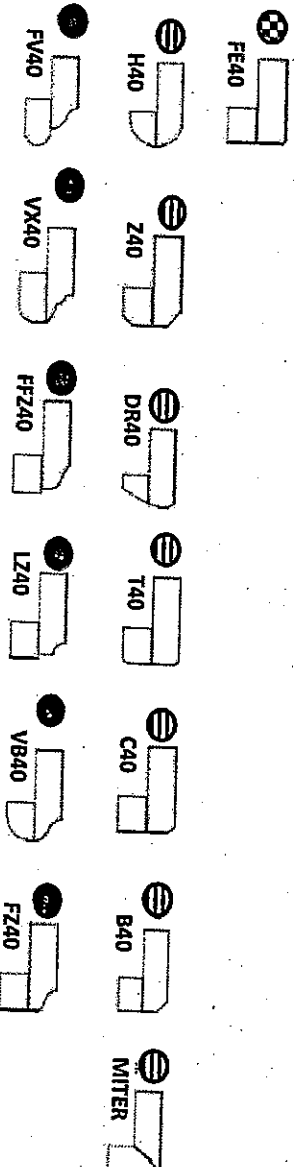

Note: All colours may not be available in 30mm at time ordered. Vendor reserves the right to use 40 mm edges (by lamination process).

\*Mitre edge is available in Upgrade 1 for an overall thickness of 2". All other Mitre edge options will be an Upgrade 2 Edge.

\*SINK & FAUCET

KG-83R  
JAN 30 2017

## STANDARD HARDWARE

RG-83R

JAN 30 2017



STANDARD HARDWARE

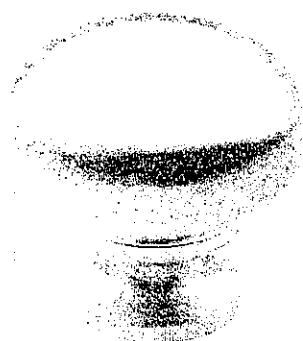

CSI-6



CSI-10

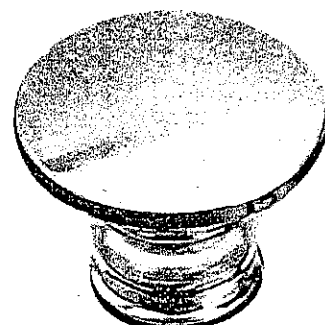

CSI-14

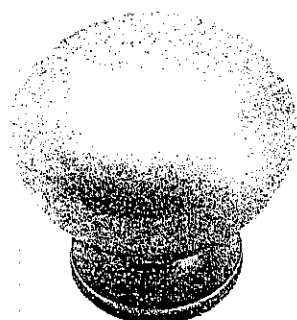

CSI-16

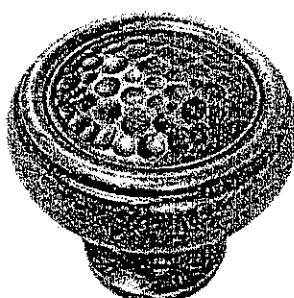

CSI-18

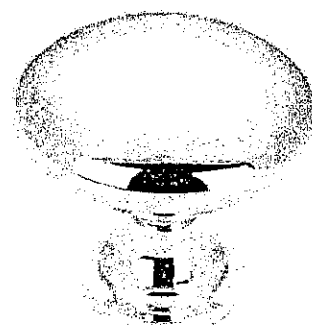

CSI-19

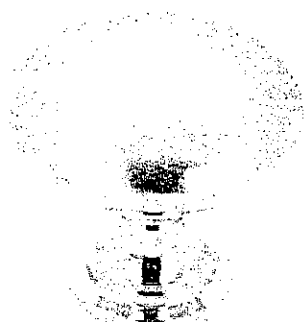

CSI-20

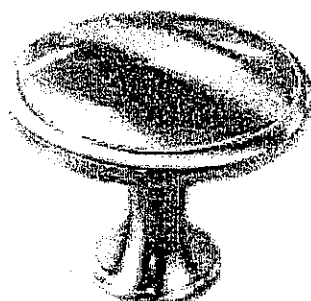

CSI-21

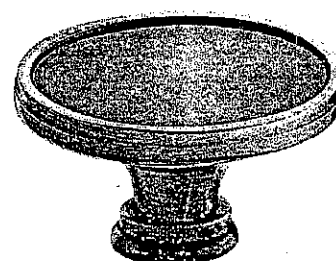

CSI-22

MASTER ENSUITE  
+  
MAIN

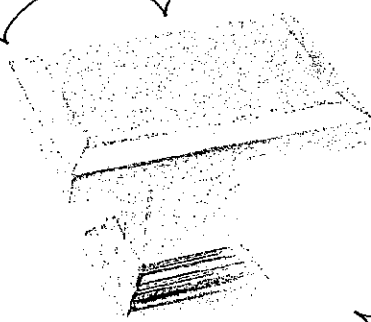

CSI-23

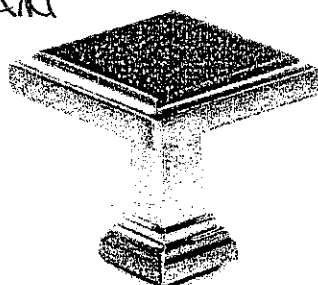

CSI-24

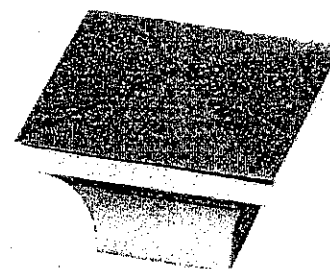

CSI-25

## \*NOTES:

- IMAGES ARE FOR QUICK REFERENCE PURPOSES ONLY
- ACTUAL SIZES AND FINISHES AS PER HARDWARE SAMPLE BOARD PROVIDED TO DECOR CENTRE

# CORTINA

KITCHENS INC.

70 Regina Road Woodbridge ON L4L 8L6  
905-264-6464

## INFORMATION - PVC DOORS

Builder. Gold Park Homes Project..... Lot # 83R

All cabinets with PVC (Thermofoil) Doors come with melamine gables, panels and kick. The doors, crown moulding and light valance are PVC wrapped. Open shelves incorporated in design will only be available with melamine interiors. There will be variations in colour shades between the PVC parts (doors, crown and Light valance) and the melamine parts (open shelves, Gables, Panels and Kick) due to the difference in material.

Furring Panel with crown moulding to the ceiling is not available on all PVC door styles due to subtle variations in colour shades between the PVC parts (moulding) and the melamine parts (furring panel) due to the difference in material. Grain directions in wood grain pattern melamine, vary between the furring panel, crown moulding (horizontal) and the PVC doors (vertical).

Thank you for your understanding.

---

I am well informed of this information, and agree to the purchase of the above.

Purchaser:  

Date: JAN 30 2017

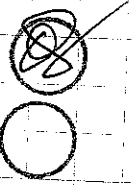
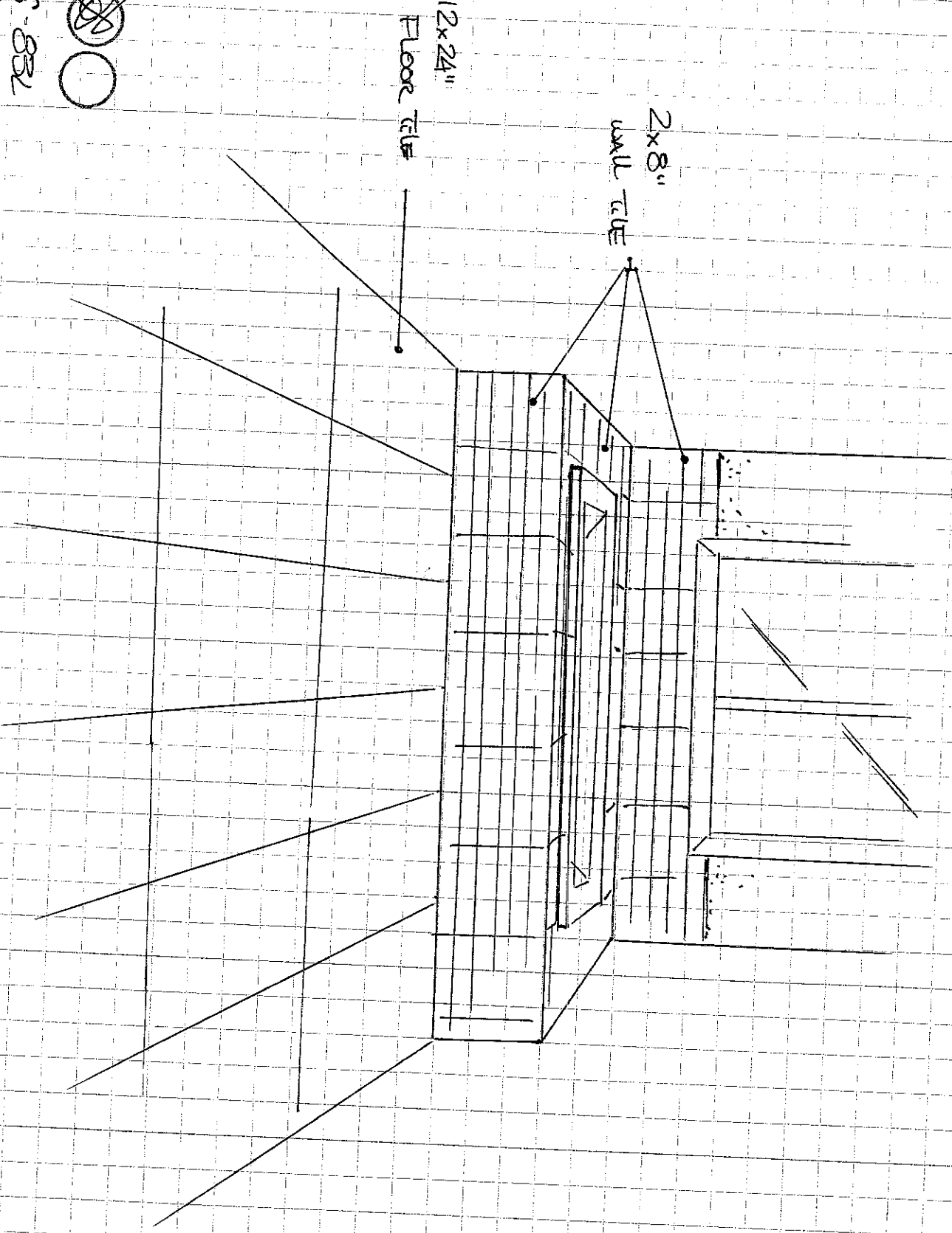

KG-832  
MASTER  
JAN 30  
2017  
INSULITE  
TUB-TILE  
DIRECTION.



# CORTINA

KITCHENS INC.

70 Regina Road, Woodbridge, ON L4L 8L6  
Tel:(905) 264-6464 Fax:(905) 264-0664

December, 2008

## POLICY MEMO FOR BUILDERS

### DRILLING FOR KNOB AND HANDLE HARDWARE

Builder: GOLD PARK

Project: KLEINBURG

Lot #: 83R

Date: JAN 30 2017

Cortina Kitchens' cabinetry doors and drawer fronts will be drilled to accept a standard knob or handle selected from Cortina's hardware boards. This drilling comes standard with the order, and is done ONLY in our shop, not on the job site.



For those not wanting Cortina's standard drilling, the following applies:

No holes to be drilled on the doors and drawer fronts should be specified in writing on the order. If while in production, Cortina Kitchens misses this request, Cortina Kitchens and the Builder will not be held responsible to replace any or all doors and drawer fronts affected, and the customer agrees to accept the product as is. No hardware will be supplied or credited by Cortina Kitchens. No charge will apply for this request.

---

I, \_\_\_\_\_, have read and agree to the above information.

Customer Signature:

Date:

\_\_\_\_\_



# GOLDPARK

WORTH MORE™

Attention: Building Department

Re: Lot # 83R

This is to acknowledge that as the purchaser of the above noted lot, I have asked Gold Park Homes not to install the standard builder's kitchen exhaust hood, as I will be installing my own unit after closing.

   
Purchaser

\_\_\_\_\_  
Vendor

Dated this 30<sup>th</sup> day of JANUARY, 20 17.