

**Brampton Encore - 126 - 1 - 41-6 Elev.A VERDI OPT - GAF1 AND SFA3**  
**CENTRAL VAC AND WIRING**

Inv.637	1 - TELEPHONE AND CABLE ROUGH-IN LOCATIONS
Line8080	Note: NOTE: STANDARD CAT 5 HAS BEEN MOVED FROM BED #4, INTO THE DEN. SEE SKETCH
7Jul16 / 15Nov16	
Inv.637	1 - DEN: INSTALL RG 6 ROUGH-IN DEN. SEE SKETCH
Line8094	Note:
7Jul16 / 15Nov16	
Inv.637	1 - GROUND FLOOR-REC ROOM: INSTALL RG 6 ROUGH-IN REC ROOM. SEE SKETCH
Line8095	Note:
7Jul16 / 15Nov16	
Inv.637	1 - FAMILY ROOM: INSTALL CONDUIT PIPE- FOR TELEVISION- IN FAMILY ROOM, SEE SKETCH
Line8096	Note:
7Jul16 / 15Nov16	
Inv.637	1 - KITCHEN: INSTALL VAC PAN UNDER KITCHEN SINK
Line8098	Note:
7Jul16 / 15Nov16	
Inv.637	1 - GROUND FLOOR-MAN DOOR: INSTALL ROUGH-IN FOR EXTRA SECURITY KEY PAD BY MAN DOOR.
Line8099	Note:
7Jul16 / 15Nov16	
Inv.637	1 - FAMILY ROOM: INSTALL ROUGH-IN FIBER OPTIC CABLE- HOME RUN TO ELECTRICAL PANEL- IN FAMILY ROOM
Line8100	Note:
7Jul16 / 15Nov16	
Inv.637	1 - ATTIC: INSTALL CONDUIT PIPE- FROM ATTIC TO ELECTRICAL PANEL- MUST SPECIFY LOCATION AND TERMINATION POINT. CLOSE TO THE FRONT OF THE HOUSE
Line8101	Note:
7Jul16 / 15Nov16	
Inv.637	1 - MASTER BEDROOM: INSTALL ROUGH-IN FOR EXTRA SECURITY KEY PAD, IN MASTER BEDROOM
Line8140	Note:
7Jul16 / 15Nov16	

**CERAMIC**

Inv.1,204	1 - FOYER: INSTALL Floor Upgrade 4 Foyer Vestibule Floor
Line17907	Note:
22Feb17 / 10Apr17	
Inv.1,204	1 - KITCHEN: INSTALL Floor Upgrade 4 Kitchen and Breakfast Floor
Line17908	Note:
22Feb17 / 10Apr17	
Inv.1,204	1 - LAUNDRY ROOM: INSTALL Floor Upgrade 4 Laundry Room Floor on Main
Line17909	Note:
22Feb17 / 10Apr17	
Inv.1,204	1 - POWDER ROOM: INSTALL Floor Upgrade 4 Powder Room Floor
Line17910	Note:
22Feb17 / 10Apr17	

**Brampton Encore - 126 - 1 - 41-6 Elev.A VERDI OPT - GAF1 AND SFA3**

Inv.1,204	1 - TWIN BATH: INSTALL Floor Upgrade 4 Bath 3 4 Floor
Line17911	Note:
22Feb17 / 10Apr17	
Inv.1,204	1 - TWIN BATH: INSTALL Floor Upgrade 4 Bath 3 4 Shower with Ceiling
Line17912	Note:
22Feb17 / 10Apr17	
Inv.1,204	1 - MASTER ENSUITE: INSTALL Floor Upgrade 4 Ensuite Bath Floor
Line17913	Note:
22Feb17 / 10Apr17	
Inv.1,204	1 - MASTER ENSUITE: INSTALL Floor Upgrade 4 Ensuite Bath Shower with Ceiling
Line17914	Note:
22Feb17 / 10Apr17	
Inv.1,204	1 - TWIN BATH: INSTALL Floor Upgrade 2 Bath 3 4 Shower Stall Floor
Line19665	Note:
22Feb17 / 10Apr17	
Inv.1,204	1 - MASTER ENSUITE: INSTALL Floor Upgrade 2 Ensuite Bath Shower Stall Floor
Line19666	Note:
22Feb17 / 10Apr17	
Inv.1,204	1 - GROUND FLOOR- BAR AREA: INSTALL STANDARD TILE IN BAR AREA, AS SHOWN, IN LIEU OF STANDARD CARPET.
Line19668	Note:
22Feb17 / 10Apr17	

**ELECTRICAL**

Inv.637	1 - FAMILY ROOM: INSTALL 110V WALL RECEPTACLE ON DEDICATED CIRCUIT - ABOVE FIREPLACE SEE SKETCH
Line8097	Note:
7Jul16 / 15Nov16	
Inv.637	1 - KITCHEN: INSTALL 110V WALL RECEPTACLE ON DEDICATED CIRCUIT - FOR MICROWAVE - MICROWAVE NOT INCLUDED. SEE SKETCH. PURCHASER MUST BUY APPROPRIATE CABINETRY AT THE TIME OF COLOURS.
Line8102	Note:
7Jul16 / 15Nov16	
Inv.637	1 - BASEMENT: INSTALL 200 AMP ELECTRICAL SERVICE
Line8103	Note:
7Jul16 / 15Nov16	
Inv.637	1 - LIVING ROOM: INSTALL ADDITIONAL STANDARD FIXTURE WITH SWITCH - IN LIVING ROOM. SEE SKETCH. IN ADDITION TO BUILDER'S STANDARD SWITCH CONTROLLED RECEPTICAL
Line8104	Note:
7Jul16 / 15Nov16	
Inv.637	1 - LIVING ROOM: INSTALL ROUGH - IN FOR WALL OUTLET ( SCONCE) & SWITCH (WITH COVER PLATE) - DOES NOT INCLUDE FIXTURE - IN LIVING ROOM, SEVEN (7) ABOVE FINISHED FLOOR. SEE SKETCH.
Line8105	Note:
7Jul16 / 15Nov16	

**Brampton Encore - 126 - 1 - 41-6 Elev.A VERDI OPT - GAF1 AND SFA3**

Inv.637	1 - GROUND FLOOR-REC ROOM: INSTALL 220V WALL RECEPTICAL ON DEDICATED CIRCUIT-FOR FUTURE OVEN -
	MOVE LOCATION OF ELECTRICAL FOR FRIDGE . SEE SKETCH
Line8114	Note: TO BE APPROVED BY CONSTRUCTION
7Jul16 / 15Nov16	

**EXTERIOR COLOURS**

Inv.637	1 - EXTERIOR COLOUR PACKAGE 9
Line14075	Note:
7Jul16 / 15Nov16	

**FIREPLACE AND MANTLE**

Inv.1,204	1 - FAMILY ROOM- FIREPLACE: INSTALL Wall Mounted Thermostat. Does Not Include Fireplace
Line19528	Note:
22Feb17 / 10Apr17	
Inv.1,204	1 - FAMILY ROOM- FIREPLACE: INSTALL Variable Speed Fan Kit. Does Not Include Fireplace
Line19529	Note:
22Feb17 / 10Apr17	

**FORMING**

Inv.637	1 - BASEMENT: INSTALL COLD CELLAR
Line8106	Note:
7Jul16 / 15Nov16	
Inv.637	1 - EXTERIOR: INSTALL SIDE DOOR- HOME TO EXTERIOR- AS PER PLAN AND GRADE PERMITTING
Line8108	Note:
7Jul16 / 15Nov16	
Inv.637	1 - EXTERIOR/BACK YARD: INSTALL BACK DOOR- GARAGE TO EXTERIOR- AS PER PLAN AND GRADE PERMITTING
Line8109	Note:
7Jul16 / 15Nov16	

**FRAMING**

Inv.637	1 - GARAGE: INSTALL MANDOOR - GARAGE TO HOUSE- AS PER PLAN AND GRADE PERMITTING
Line8107	Note: GIVEN IN AGREEMENT OF PURCHASE AND SALE
7Jul16 / 15Nov16	
Inv.637	1 - OPTIONAL LAUNDRY
Line14066	Note:
7Jul16 / 15Nov16	
Inv.637	1 - OPTIONAL GROUND FLOOR
Line14067	Note:
7Jul16 / 15Nov16	
Inv.637	1 - MAIN FLOOR: INSTALL FOUR (X4) STANDARD DOOR EXTENDED HEIGHT 96" (PRICE PER DOOR) MAIN FLOOR 3 STOREY MODELS - TO GO IN CLOSETS, POWDER ROOM, AND LAUNDRY
Line14073	Note:
7Jul16 / 15Nov16	

**Brampton Encore - 126 - 1 - 41-6 Elev.A VERDI OPT - GAF1 AND SFA3**

Inv.637	1 - MAIN FLOOR-DEN: INSTALL ONE (X1) STANDARD FRENCH DOOR EXTENDED HEIGHT 96" (PRICE PER DOOR) MAIN FLOOR 3 STOREY MODELS - TO GO IN DEN
Line14074	Note:
7Jul16 / 15Nov16	

**GLASS AND MIRROR**

Inv.637	1 - MASTER BEDROOM: CONVERT FRAMED SHOWER TO 10MM FRAMLESS SHOWER ENCLOSURE WITH DOOR AND 10MM SIDE PANEL IN MASTER ENSUITE
Line8110	Note:
7Jul16 / 15Nov16	
Inv.637	1 - TWIN ENSUITE: CONVERT FRAMED SHOWER TO 10MM FRAMLESS SHOWER ENCLOSURE WITH DOOR AND 10MM SIDE PANEL, IN TWIN ENSUITE (BED 3/4)
Line8137	Note:
7Jul16 / 15Nov16	

**GRANITE MARBLE QUARTZ**

Inv.1,204	1 - KITCHEN: INSTALL 2 CM GRP 1 Optional Flush BBar
Line17925	Note:
22Feb17 / 10Apr17	
Inv.1,204	1 - KITCHEN: INSTALL 4 CM PROFILE UPG 1 Optional Flush BBar
Line19525	Note:
22Feb17 / 10Apr17	
Inv.1,204	1 - KITCHEN: INSTALL 4 CM PROFILE UPG 1 Kitchen with Island no BBar
Line19524	Note:
22Feb17 / 10Apr17	
Inv.1,204	1 - KITCHEN COUNTER: INSTALL CONTINUOUS COUNTER FOR SLIDE-IN RANGE
Line19737	Note:
22Feb17 / 10Apr17	

**HARDWOOD**

Inv.1,204	1 - DINING ROOM: INSTALL PREVERCO 4 1/4" ENGINEERED RED OAK IN CAPPUCCINO, Upgrade 1 LEVEL S Dining
Line17915	Note:
22Feb17 / 10Apr17	
Inv.1,204	1 - FAMILY ROOM: INSTALL PREVERCO 4 1/4" ENGINEERED RED OAK IN CAPPUCCINO, Upgrade 1 LEVEL S Family
Line17916	Note:
22Feb17 / 10Apr17	
Inv.1,204	1 - DEN: INSTALL PREVERCO 4 1/4" ENGINEERED RED OAK IN CAPPUCCINO, Upgrade 1 LEVEL S Den
Line17917	Note:
22Feb17 / 10Apr17	
Inv.1,204	1 - LIVING ROOM: INSTALL PREVERCO 4 1/4" ENGINEERED RED OAK IN CAPPUCCINO, Upgrade 1 LEVEL S Living
Line17918	Note:
22Feb17 / 10Apr17	
Inv.1,204	1 - MAIN HALL: INSTALL PREVERCO 4 1/4" ENGINEERED RED OAK IN CAPPUCCINO, Upgrade 1 LEVEL S Main Hall
Line17919	Note:
22Feb17 / 10Apr17	

**Brampton Encore - 126 - 1 - 41-6 Elev.A VERDI OPT - GAF1 AND SFA3**

Inv.1,204	1 - UPPER HALL: INSTALL PREVERCO 4 1/4" ENGINEERED RED OAK IN CAPPUCCINO, Upgrade 1 LEVEL S Upper Hall
Line17920	Note:
22Feb17 / 10Apr17	

**HVAC**

Inv.637	1 - KITCHEN: INSTALL GAS LINE ROUGH - MAIN FLOOR - (3 STOREY MODELS), FOR STOVE
Line8113	Note:
7Jul16 / 15Nov16	

**INTERIOR TRIM AND DOORS**

Inv.1,204	2 - MAIN FLOOR-LIVING ROOM: INSTALL Each 8 Inch Fluted Column 9 Foot With Three Quarter Inch MDF Base Apron (All Columns MUST Match Throughout)- IN LIEU OF STANDARD COLUMNS
Line19744	Note:
22Feb17 / 10Apr17	

Inv.637	4 - MAIN FLOOR: INSTALL FOUR (X4) STANDARD DOOR EXTENDED HEIGHT 96" (PRICE PER DOOR) MAIN FLOOR 3 STOREY MODELS - TO GO IN CLOSETS, POWDER ROOM, AND LAUNDRY
Line8120	Note:
7Jul16 / 15Nov16	

Inv.637	1 - MAIN FLOOR-DEN: INSTALL ONE (X1) STANDARD FRENCH DOOR EXTENDED HEIGHT 96" (PRICE PER DOOR) MAIN FLOOR 3 STOREY MODELS - TO GO IN DEN
Line8123	Note:
7Jul16 / 15Nov16	

Inv.1,204	1 - MAIN FLOOR ONLY: INSTALL 1ST UPGRADE TRIM -BB & Casing Package 1 MF
Line17921	Note: GROUND FLOOR AND 2ND FLOOR TO REMAIN STANDARD
22Feb17 / 10Apr17	

**KITCHEN AND BATH CABINETRY**

Inv.1,204	2 - KITCHEN: INSTALL Oak PVC 94 Pull out Out Drawers Base MICROWAVE Pantry.
	ONLY THE BOTTOM 2 SHELVES ARE TO BECOME PULLOUTS. THE TOP SHELF WILL REMAIN STATIONARY.
Line19738	Note:
22Feb17 / 10Apr17	

Inv.1,204	1 - KITCHEN: INSTALL Oak PVC 86 Pull out spice door 2 level single door with two level with Multi tech tracks attached to door (BESIDE POT AND PAN)
Line19740	Note:
22Feb17 / 10Apr17	

Inv.1,204	1 - ENSUITE 2: INSTALL Handles Main Vanity
Line19741	Note:
22Feb17 / 10Apr17	

Inv.1,204	1 - Handles Master Ensuite
Line19742	Note:
22Feb17 / 10Apr17	

Inv.1,204	1 - TWIN BATH: INSTALL Handles Twin Bathbd34
Line19743	Note:
22Feb17 / 10Apr17	

Inv.1,204	1 - KITCHEN: INSTALL Handles Kitchen
Line17926	Note:
22Feb17 / 10Apr17	

**Brampton Encore - 126 - 1 - 41-6 Elev.A VERDI OPT - GAF1 AND SFA3**

Inv.1,204	1 - KITCHEN: INSTALL Oak PVC 104 Slide in stove enclosure with countertop by others
Line17927	Note:
22Feb17 / 10Apr17	
Inv.1,204	1 - KITCHEN: INSTALL Oak PVC 87 Pot and Pan Drawers 2 deep drawers and one shallow top drawer 60 70 80 90 cm wide
Line17929	Note:
22Feb17 / 10Apr17	
Inv.1,204	3 - KITCHEN: INSTALL Oak PVC 94 Pull out Out Drawers Base Pantry.
	ONLY THE BOTTOM 3 SHELVES ARE TO BECOME PULLOUTS. THE TOP SHELF WILL REMAIN STATIONARY.
Line17930	Note:
22Feb17 / 10Apr17	
Inv.1,204	1 - KITCHEN: INSTALL Oak PVC 145 Waste Basket 2 bins with lids pull out attached to door
Line17931	Note:
22Feb17 / 10Apr17	
Inv.1,204	1 - KITCHEN: DELETE CABINETS ABOVE STOVE FOR FUTURE CHIMNEY STYLE FAN.
Line19535	Note:
22Feb17 / 10Apr17	
Inv.1,204	1 - KITCHEN: Add 30cm deep base cabinet to back of island in standard line
Line19661	Note:
22Feb17 / 10Apr17	
Inv.1,204	1 - KITCHEN: Reduce double door pantry to a single door pantry approx. 50cm wide, shift fridge and existing base and upper towards pantry, and add 1.5 feet of cabinetry at end of fridge wall to accommodate a tall cabinet for built-in steam oven
Line19662	Note:
22Feb17 / 10Apr17	

**MISC.**

Inv.1,204	1 - Purchasers are aware & accepts that ANY changes made to upgrades after signing this Purchasers Extra Form are subject to a minimum administration fee of \$500. PLUS a 10% holdback fee
Line19746	Note:
22Feb17 / 10Apr17	
Inv.637	1 - DO NOT INSTALL GROUND FLOOR-VENTING FOR FUTURE STOVE
	NOT APPROVED BY CONSTRUCTION
Line8115	Note: REFUND ISSUED ON PE:986
7Jul16 / 15Nov16	
Inv.637	1 - BONUS PACKAGE: \$10,000.00 (INCLUDING TAXES) WORTH OF UPGRADES FROM GOLD PARK HOMES DÉCOR CENTRE IS BEING APPLIED TOWARD THE STRUCTURAL APPOINTMENT. PURCHASER HAS A REMAINING AMOUNT OF \$00 (INCLUDING TAXES) TO BE USED TOWARD THE COLOUR APPOINTMENT
Line8131	Note:
7Jul16 / 15Nov16	
Inv.637	1 - Purchaser has attended a Structural appointment at the Decor Centre & has DECLINED any additional upgrades and accepts and acknowledges that there will be no further structural changes/additions/deletions to be made upon signing on July 7, 2016
Line8132	Note:
7Jul16 / 15Nov16	

**Brampton Encore - 126 - 1 - 41-6 Elev.A VERDI OPT - GAF1 AND SFA3**

Inv.637	1 - Purchasers are aware & accepts that ANY changes made to upgrades after signing this Purchasers Extra Form are subject to a minimum administration fee of \$500. PLUS a 10% holdback fee
Line8133	Note:
7Jul16 / 15Nov16	
Inv.986	1 - REFUND FOR GF VENT- NOT APPROVED BY CONSTRUCTION
Line14071	Note:
15Nov16 / 10Apr17	
Inv.1,204	1 - 2ND FLOOR BEDROOMS: INSTALL LOCKS ON ALL BEDROOM DOORS ON SECOND FLOOR. BED 2, 3, 4 AND MASTER BDRM
Line19530	Note:
22Feb17 / 10Apr17	
Inv.1,204	1 - GROUND FLOOR-REC ROOM ENTRANCE- INSTALL LOCK WITH TWO (X2) KEYS
Line19531	Note:
22Feb17 / 10Apr17	
Inv.1,204	1 - SIDE DOOR ENTRANCE- INSTALL LOCK WITH TWO (X2) KEYS
Line19532	Note:
22Feb17 / 10Apr17	
Inv.1,204	1 - GARAGE- DOOR FROM GARAGE TO BACK YARD- INSTALL LOCK FROM INSIDE GARAGE
Line19533	Note:
22Feb17 / 10Apr17	
Inv.1,204	1 - GARAGE MAN DOOR- TO LOCK FROM GARAGE AND GROUND FLOOR (BOTH SIDES).
Line19534	Note:
22Feb17 / 10Apr17	
Inv.1,204	1 - Purchaser has attended a Colour appointment at the Decor Centre & has DECLINED any additional upgrades and accepts and acknowledges that there will be no further structural changes/additions/deletions to be made upon signing on March 23, 2017
Line19745	Note:
22Feb17 / 10Apr17	

**PAINTING**

Inv.1,204	1 - STAIRCASE: Stain Staircases 3 Storey Model (Euroline Pickets Charged Separately)
Line17922	Note:
22Feb17 / 10Apr17	

**PLUMBING**

Inv.637	1 - KITCHEN: INSTALL ROUGH-IN - WATERLINE FOR FRIDGE
Line8125	Note:
7Jul16 / 15Nov16	
Inv.637	1 - EXTERIOR/KITCHEN: INSTALL HOSE BIB - EXTRA EXTERIOR HOSE BIB- COLD ONLY, ON DECK OUTSIDE OF KITCHEN, IF POSSIBLE. TO BE APPROVED BY CONSTRUCTION
Line8126	Note:
7Jul16 / 15Nov16	

**PLUMBING FIXTURES**

Inv.1,204	1 - KITCHEN: INSTALL UPGRADED KITCHEN UNDERMOUNT SINK-
BLANCO QUATRUS U 1-3/4 KITCHEN SINK #401244 (STAINLESS)	
Line19526	Note:
22Feb17 / 10Apr17	

**Brampton Encore - 126 - 1 - 41-6 Elev.A VERDI OPT - GAF1 AND SFA3**

Inv.1,204	1 - KITCHEN: INSTALL SOAP DISPENSER  DELTA: #RP 1002 CHROME FINISH
Line19527	Note:
22Feb17 / 10Apr17	

**STAIRS AND RAILINGS**

Inv.1,204	1 - STAIRCASE: INSTALL 1 34 Inch LOTUS Non Fluted
Line17923	Note:
22Feb17 / 10Apr17	
Inv.1,204	1 - STAIRCASE: INSTALL V Groove Handrail
Line17924	Note:
22Feb17 / 10Apr17	

**WINDOWS - BASEMENT**

Inv.637	1 - BASEMENT: INSTALL ONE (X1) BASEMENT WINDOWS - UPGRADE EXISTING BASEMENT WINDOW TO 46 INCH X 32 INCH - MAY REQUIRE INSTALLATION OF WINDOW WELL. SEE SKETCH
Line8111	Note:
7Jul16 / 15Nov16	
Inv.637	2 - BASEMENT: INSTALL TWO (X2) BASEMENT WINDOWS - UPGRADE EXISTING BASEMENT WINDOW TO 30 INCH X 24 INCH - MAY REQUIRE INSTALLATION OF WINDOW WELL. SEE SKETCH
Line8112	Note:
7Jul16 / 15Nov16	

**WINDOWS AND DOORS**

Inv.637	1 - GARAGE: INSTALL MANDOOR - GARAGE TO HOUSE- AS PER PLAN AND GRADE PERMITTING
Line14065	Note:
7Jul16 / 15Nov16	
Inv.637	1 - EXTERIOR: INSTALL SIDE DOOR- HOME TO EXTERIOR- AS PER PLAN AND GRADE PERMITTING
Line14068	Note:
7Jul16 / 15Nov16	
Inv.637	1 - EXTERIOR/BACK YARD: INSTALL BACK DOOR- GARAGE TO EXTERIOR- AS PER PLAN AND GRADE PERMITTING
Line14069	Note:
7Jul16 / 15Nov16	



Scheduled Closing Date:

Purchaser: Amitkumar Yoges Shah

Property: 126 of Plan -

Telephone Res. / Bus: (647) 473-2227

Project: Fieldwalk Investments Inc.

Decor Advisor: Terri Parisani

Model and Elevation: 41-6 Elev.A VERDI OPT - GAF1 AND SFA

Layout Changes: ☒ Yes ☐ No Sketch Attached: ☒ Yes ☐ No Exterior Colour Scheme: 

## 1. Cabinetry

	Style and Colour	Counter	Hardware
Kitchen / Breakfast	Varese(pvc)ChocoMaple	Grigio Sardo Granite **Edge: H40	*CH-53
Laundry Room	-		
Powder Room	-		
TWIN BATH	Varese(pvc) Mystic	4925K-07 Calcutta Marble Laminate	*CH-53
Master Ensuite Bathroom	Varese(pvc)ChocoMaple	4925K-07 Calcutta Marble Laminate	*CH-53
Second Ensuite Bathroom (If Applicable)	Varese(pvc)AntiqWhite	4921K-52 Madura Garnet Laminate	*CH-53
NANNY ENSUITE	Varese(pvc)AntiqWhite	4921K-52 Madura Garnet Laminate	cs1-14
Dishwasher Cabinet	-		

## Comment

GROUND FLOOR BAR: CABINET: Varese(pvc)Mystic COUNTER: 4931K-52 White Juperana HARDWARE: CS1-21

## 2. Floor Tile

	Selection	Grout	Threshold
Entrance Vestibule	*Upg.4 Volkas White Polished 12 x24	N/A	N/A
Main Hall	-	N/A	N/A
Kitchen / Breakfast	*Upg.4 Volkas White Polished 12 x24	N/A	N/A
Laundry Room	*Upg.4 Volkas White Polished 12 x24	N/A	N/A
Powder Room	*Upg.4 Volkas White Polished 12 x24	N/A	N/A
TWIN BATH	*Upg.4 Volkas White Polished 12 x24	N/A	N/A
Master Ensuite Bathroom	*Upg.4 Volkas White Polished 12 x24	N/A	N/A
Second Ensuite Bathroom (If Applicable)	New Reeds Taupe 13 x 13	N/A	N/A
Lower Landing (If Applicable)	-		
NANNY ENSUITE	New Reeds Taupe 13 x 13	N/A	N/A

## Comment

\*GROUND FLOOR HALL & GROUND FLOOR BAR AREA: SERPENTINE BEYAZ 13 X 13  
MASTER ENSUITE SHOWER STALL FLOOR: \*UPG.2, ALLURE SERIES 2 X 2 POLISHED, SMOKE (W/ DARKEST STANDARD GROUT)  
TWIN BATH SHOWER STALL FLOOR: \*UPG.2, ALLURE SERIES 2 X 2 POLISHED, SMOKE (W/ DARKEST STANDARD GROUT)

## 3. Wall Tile

	Selection	Listello/Inserts	Describe
TWIN BATH	*Upg4 Volkas Wht Polished 12x24	<input type="radio"/> Yes <input checked="" type="radio"/> No	
Master Ensuite Bathroom			
Tub Deck	-	<input type="radio"/> Yes <input checked="" type="radio"/> No	
Shower Stall	*Upg4 Volkas Wht Polished 12x24	<input type="radio"/> Yes <input checked="" type="radio"/> No	
Bathroom Walls	-	<input type="radio"/> Yes <input checked="" type="radio"/> No	
Second Ensuite Bathroom (If Applicable)	Weave Ivory 8 x 10	<input type="radio"/> Yes <input checked="" type="radio"/> No	
NANNY ENSUITE	Weave Ivory 8 x 10	<input type="radio"/> Yes <input checked="" type="radio"/> No	
Kitchen Backsplash	<input type="radio"/> Yes <input checked="" type="radio"/> No	Backsplash Behind Fridge	

## Comment

Scheduled Closing Date:

Purchaser: Amitkumar Yoges Shah

Property: 126 of Plan -

Telephone Res. / Bus: (647) 473-2227

Project: Fieldwalk Investments Inc.

Decor Advisor: Terri Parisani

Model and Elevation: 41-6 Elev.A VERDI OPT - GAF1 AND SFA

#### 4. Plumbing Fixtures

<input type="text"/>	Second Ensuite	<input type="text"/>	Powder Room	<input type="text"/>	
Master Ensuite Bathroom	<input type="text"/>	Other Room - Specify	<input type="text"/>	Other Washroom	<input type="text"/>

Comment

ALL PLUMBING TO REMAIN STANDARD THROUGHOUT

#### 5. Hardwood Flooring

	Type and Stain		Type and Stain
Main Hall	*Upg.1 Preverco 4 1/4"Cappuccino	Upper Landing	<input type="text"/>
Kitchen / Breakfast	<input type="text"/>	Upper Hall	*Upg.1 Preverco 4 1/4"Cappuccino
Living Room	*Upg.1 Preverco 4 1/4"Cappuccino	Master Bedroom	<input type="text"/>
Dining Room	*Upg.1 Preverco 4 1/4"Cappuccino	Bedroom #2	<input type="text"/>
Family Room	*Upg.1 Preverco 4 1/4"Cappuccino	Bedroom #3	<input type="text"/>
Den/Library	*Upg.1 Preverco 4 1/4"Cappuccino	Bedroom #4	<input type="text"/>
Entrance Vestibule	<input type="text"/>	Bedroom #5	<input type="text"/>
Lower Landing (If Applicable)	<input type="text"/>	Other Room - Specify	<input type="text"/>

Comment

ALL HARDWOOD TO BE ENGINEERED RED OAK

#### 6. Carpeting

	Upgrade	Description
Main Hall	<input type="checkbox"/>	<input type="text"/>
Living Room	<input type="checkbox"/>	<input type="text"/>
Dining Room	<input type="checkbox"/>	<input type="text"/>
Family Room	<input type="checkbox"/>	<input type="text"/>
Den/Library	<input type="checkbox"/>	<input type="text"/>
Upper Hall	<input type="checkbox"/>	<input type="text"/>
Master Bedroom	<input type="checkbox"/>	T-07
Bedroom #2	<input type="checkbox"/>	T-07
Bedroom #3	<input type="checkbox"/>	T-07
Bedroom #4	<input type="checkbox"/>	T-07
Bedroom #5	<input type="checkbox"/>	<input type="text"/>
GROUND FLOOR	<input type="checkbox"/>	T-07
Upper Landing (If Applicable)	<input type="checkbox"/>	<input type="text"/>
Lower Landing (If Applicable)	<input type="checkbox"/>	<input type="text"/>

Upgrade Underpad	Type STANDARD	Area <input type="text"/>
Carpet on Stairs	Capped <input type="text"/>	Runner - *Upgrade <input type="text"/>

Comment

Scheduled Closing Date:

Purchaser: Amitkumar Yoges Shah

Property: 126 of Plan -

Telephone Res. / Bus: (647) 473-2227

Project: Fieldwalk Investments Inc.

Decor Advisor: Terri Parisani

Model and Elevation: 41-6 Elev.A VERDI OPT - GAF1 AND SFA

## 7. Fireplace

	Living Room			Family Room			Other Room - Specify		
	Purchased	As Per Plan	N/A	Purchased	As Per Plan	N/A	Purchased	As Per Plan	N/A
Fireplace Type	<input type="radio"/>	<input type="radio"/>	<input checked="" type="radio"/>	<input type="radio"/>	<input checked="" type="radio"/>	<input type="radio"/>	<input type="radio"/>	<input type="radio"/>	<input checked="" type="radio"/>
Mantle Type				STANDARD					
Colour / Stain				NF-24					
Surround				WHITE PAINT-GRADE					
Hearth				NERO MARQUINA					
Comment									

## 8. Trim Carpentry

Interior Doors	STANDARD	Front Door Glass Inserts	STANDARD	Door Handles	STANDARD
Interior Trim	*1ST UPGRADE ON MAIN FLOOR ONLY				
Comment	GROUND FLOOR AND SECOND FLOOR TO HAVE STANDARD TRIM				

## 9. Plaster Mouldings and Medallions

Entrance Vestibule	N/A		Kitchen/Breakfast	N/A	
Main Hall	N/A		Den/Library	N/A	
Living Room	N/A		Lower Landing	N/A	
Dining Room	N/A		Other Room - Specify	N/A	
Family Room	N/A				
Comment					

## 10. Railings and Spindles

Railing Package	*LOTUS WITH V-GROOVE HANDRAIL		
Railing Colour	*CAPPUCCINO RED OAK	Spindle Colour	*CAPPUCCINO RED OAK
Stringer / Riser	*CAPPUCCINO RED OAK	Treads	*CAPPUCCINO RED OAK
Comment	Oak Stairs	<input checked="" type="radio"/> Yes	<input type="radio"/> No

## 11. Wall Paint

Main & Upper Hall	WARM GREY	Master Bedroom	WARM GREY
Living Room	WARM GREY	Bedroom #2	WARM GREY
Dining Room	WARM GREY	Bedroom #3	WARM GREY
Kitchen / Breakfast	WARM GREY	Bedroom #4	WARM GREY
Family Room	WARM GREY	Bedroom #5	WARM GREY
Powder Room	WARM GREY	Master Ensuite	WARM GREY
Laundry Room	WARM GREY	TWIN BATH	WARM GREY
Den/Library	WARM GREY	Second Ensuite	WARM GREY
Trim Paint	WHITE	GROUND FLOOR	WARM GREY
Comment	Smooth Ceilings First Floor		

Scheduled Closing Date:

Purchaser: Amitkumar Yoges Shah

Property: 126 of Plan -

Telephone Res. / Bus: (647) 473-2227

Project: Fieldwalk Investments Inc.

Decor Advisor: Terri Parisani

Model and Elevation: 41-6 Elev.A VERDI OPT - GAF1 AND SFA

## 12. Electrical

Plugs and Switches ☒ White ☐ Ivory

Hood Fan ☐ White ☐ Ivory

Appliances Built in Cooktop

Comment

DELETE STANDARD HOOD FAN

Built in Oven

☐ Yes ☒ No

Above Kitchen Cabinet Light ☐ Yes ☒ No

Below Kitchen Cabinet Light ☐ Yes ☒ No

Gas Stove

☒ Yes ☐ No

Microwave

☒ Yes ☐ No

## 13. Heating and Air Conditioning

Air Conditioning

Gas Provisions Dryer

Comment

GAS LINE FOR STOVE PURCHASED  
GAS LINE FOR BBQ IS STANDARD

Gas Provisions Stove

Gas Provisions Barbecue

## 14. Additional Comments

## 15. Disclaimers and Notes

- 1) Colours of all materials are as close as possible to builder's selection, but not necessarily identical due to variances in manufacturing.
- 2) Any extras listed above are null and void unless accompanied by a separate invoice/amendment. Said invoice must be paid in full.
- 3) The Purchaser acknowledges that after Interior Colour Selection form is signed and dated, no further changes will be permitted other than re-selection due to unavailability. \_\_\_\_\_ Purchaser's Initials
- 4) The Purchaser acknowledges reading and accepting the "Gold Park Homes Decor Centre Disclaimers" form. This document contains other miscellaneous disclaimers.

This Interior Colour Selection is final and approved by:

Signature: \_\_\_\_\_

Date: March 23, 2017

Telephone — (T)  
Cable — (C)  
Electrical — (E)

**The  
Verdi  
41' SERIES**

**Elevation A • 3,940 sq.ft. | Elevation B • 3,940 sq.ft.**

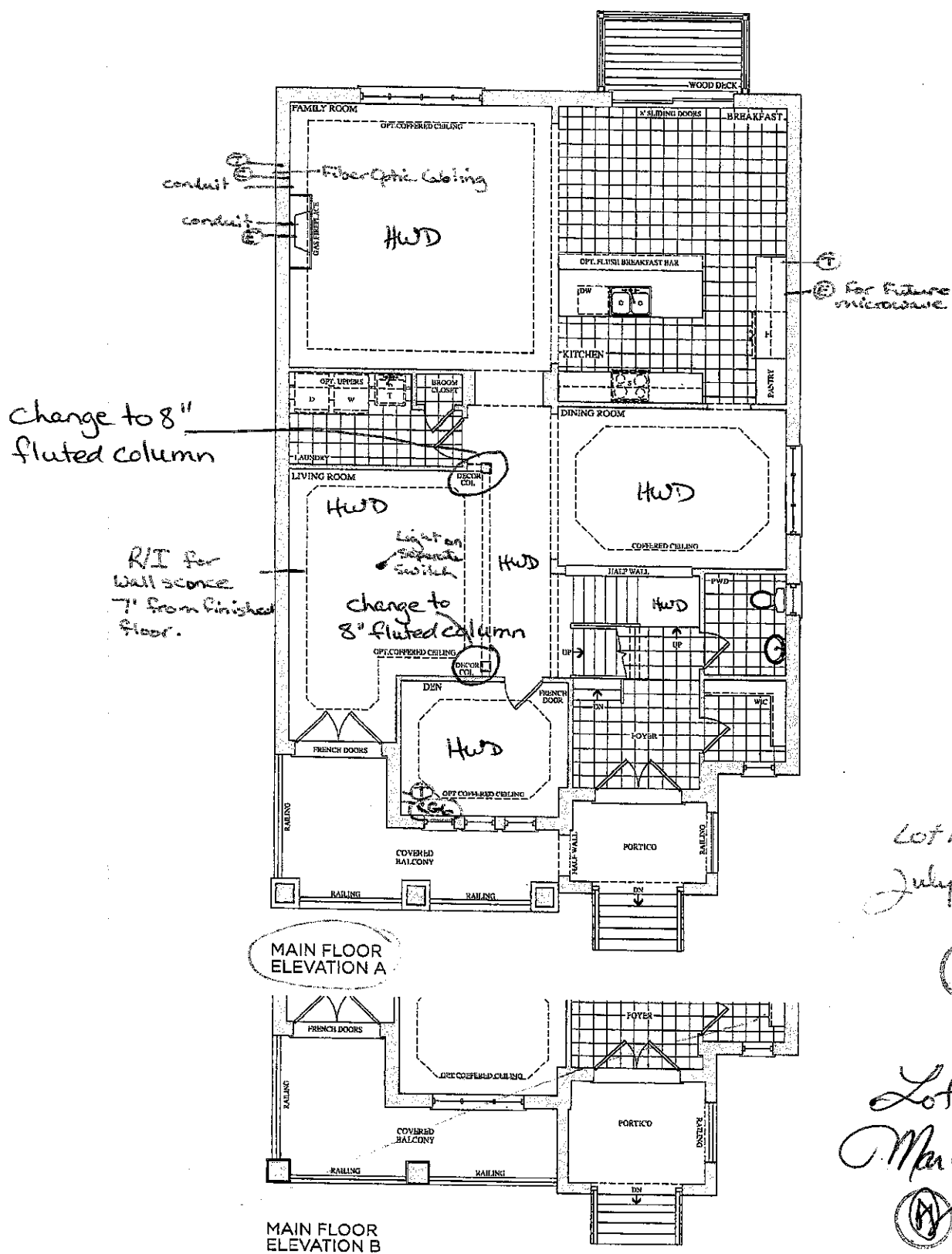

Lot 126

July 7, 1945

① ②

Lot 126  
Mar 23, 17



Prices, figures, illustrations, sizes, features and finishes are subject to change without notice. E.&O.E. Areas and dimensions are approximate and actual usable floor space may vary from the stated area. Layout may be reverse of the unit purchased. E. & O.E.

**GOLD PARK HOMES**

**The Verdi**  
**41' SERIES**

Elevation A • 3,940 sq.ft. | Elevation B • 3,940 sq.ft.

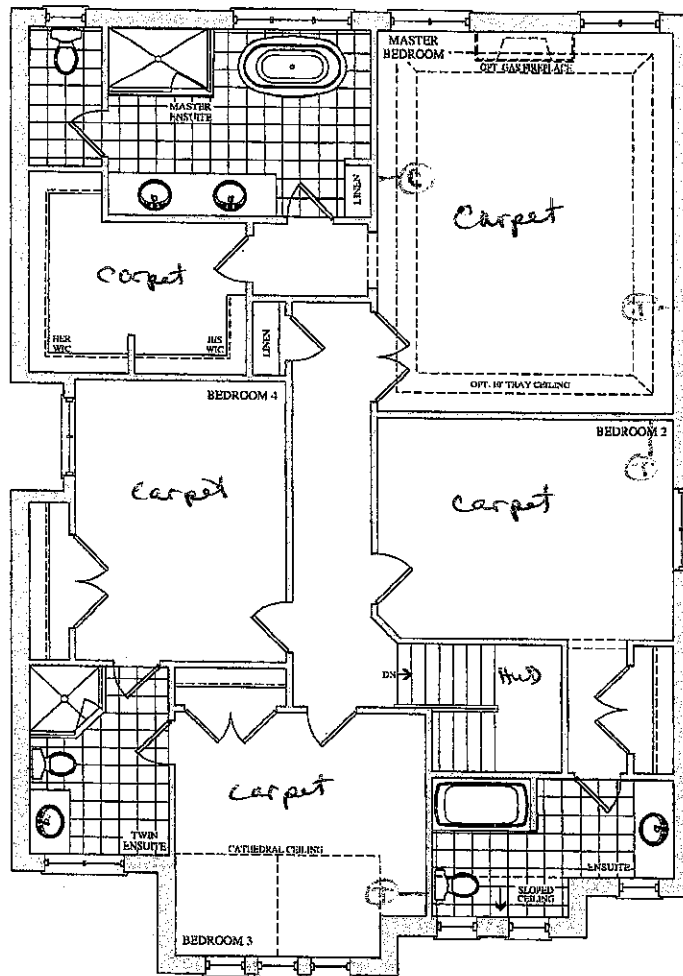

SECOND FLOOR  
ELEVATION A

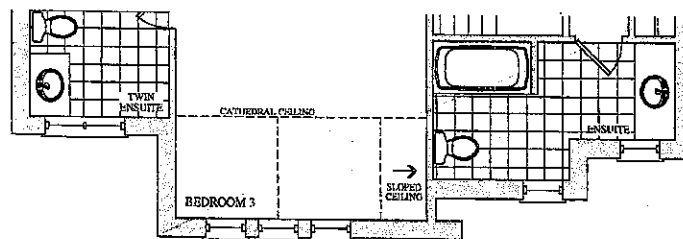

SECOND FLOOR  
ELEVATION B

Lot 126  
July 7, 16

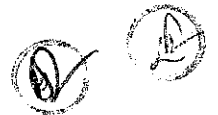

Lot 126  
Mar 23, 17



Telephone—(T)  
Cable—(C)

**The  
Verdi  
41' SERIES**

**Elevation A • 3,940 sq.ft. | Elevation B • 3,940 sq.ft.**

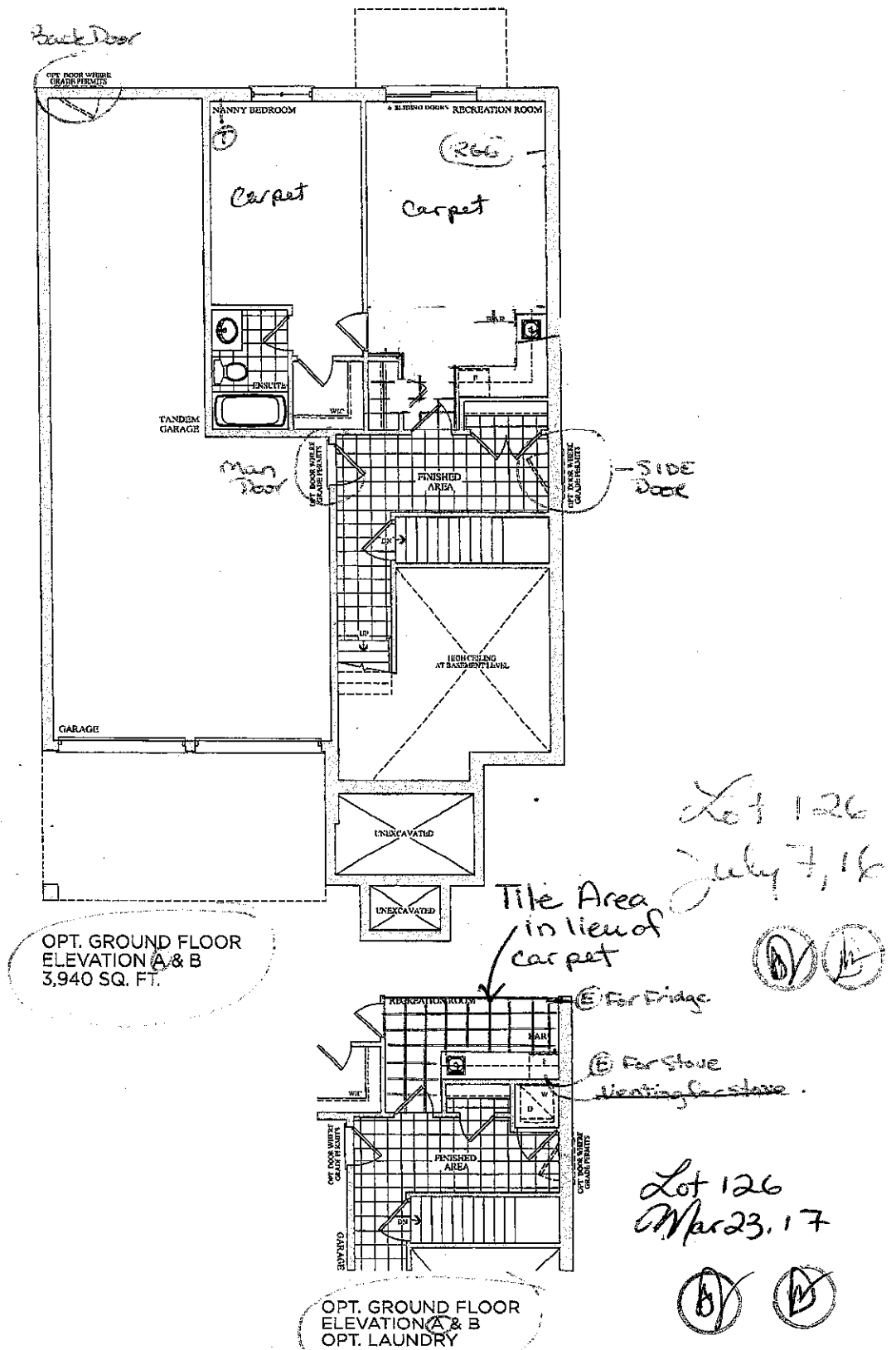

Prices, figures, illustrations, sizes, features and finishes are subject to change without notice. E.&O.E. Areas and dimensions are approximate and actual usable floor space may vary from the stated area. Layout may be reverse of the unit purchased. E. & O. E.

**GOLD PARK HOMES**

<b>CORTINA</b> <small>75 Rogers Road, Woodbridge, Ontario L4L 0A2  Tel: 905.364.4454 Fax: 905.364.4554  www.CortinaKitchens.com</small>		<b>QUOTATION</b> Date: 23/06/16
Trade Name: Gold Park Homes	Site location: Brampton	Model: 41-6
Address:	Project: Encore	Phase:

This layout has been explained to the purchaser by Cortina Kitchens Inc. and is understood by the purchaser.

**KITCHEN**

2900

OPT. FLUSH BREAKFAST BAR

B95 B90 B95

SP. DW 01.5

ELPL 04.3

65X90 PAN. 915 65X90 PAN.

Spice Drawer

Pot & Pan Drawer

Slide-In stove ST.

B50R B4D45

U60100R U60100L U3000 U60100R U60100L

1050 730 1070

2900

Hand-drawn sketch of a kitchen pantry unit. The unit is a tall, narrow cabinet with a built-in microwave at the top. Below the microwave are two pull-out shelves. The bottom section of the unit consists of three pull-out shelves. The top shelf of this section is to be standard, while the two shelves below it are to be pull-out. The unit is labeled with dimensions and notes.

Dimensions and labels:

- Top shelf: 80 242 91
- Microwave: 45 55 54
- Shelf below microwave: 45 55 54
- Bottom section (pull-out shelves): 50 242 91
- Overall height: 3350
- Notes:
  - Pantry w/ Built-in Microwave
  - Two pull-out shelves below microwave
  - Bottom 3 shelves to be pullout shelves
  - Top shelf to be standard

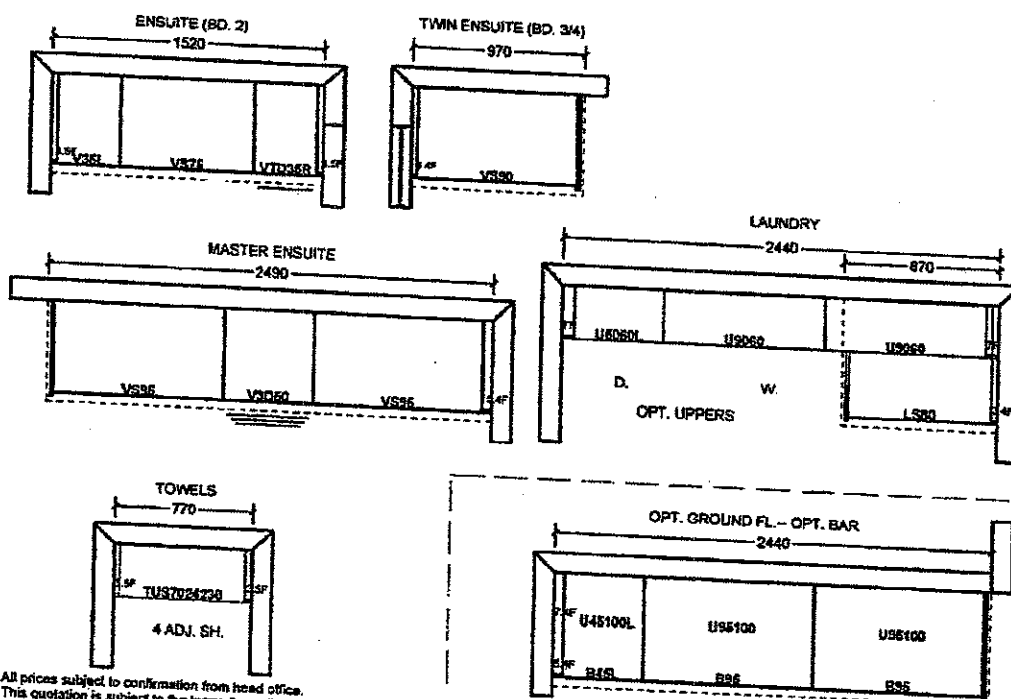

All prices subject to confirmation from head office.  
This quotation is subject to the terms & conditions set  
out

ACCEPTED DATE:

All agreements are contingent upon strikes, accidents, and delays beyond our control. Please provide our installer with template for sinkholes or \$150.00 will be charged for callback.

Item 8. Wood grain and colour are characteristics of the product. We cannot guarantee that each grain and colour will always match.  
Item 9. Cordco Kitchens Inc. reserves the right to alter dimensions and make technical changes without notice.

Lot 126  
Mar. 23, 17





GOLDPARK  
HOMES



Granite, Marble,  
Engineered Surfaces

Lot 126  
Order 23, 17

- Standard 2CM & 3CM
- Upgrade 1 2CM & 3CM
- Upgrade 1 4 CM
- Upgrade 2

29mm (3/4") Profiles



30mm (1 1/4") Profiles

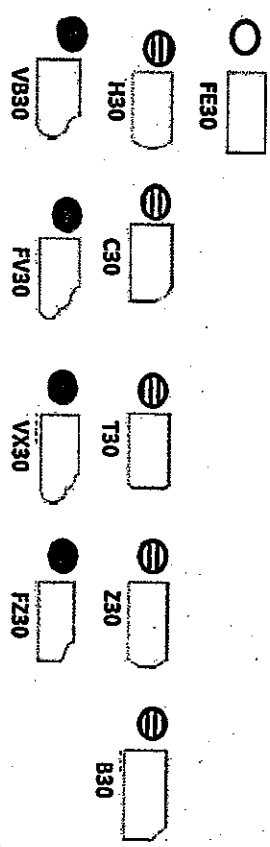

40mm (1 1/2") Profiles

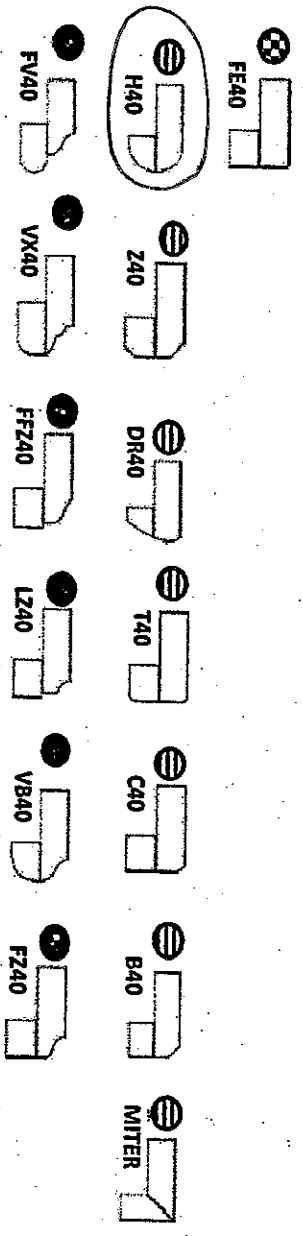

Note: All colours may not be available in 30mm at time ordered. Vendor reserves the right to use 40 mm edges (by lamination process).

\*Mitre edge is available in Upgrade 1 for an overall thickness of 2". All other Mitre edge options will be an Upgrade 2 Edge.

Kitchen

## STANDARD HARDWARE

Lot 126

Mar. 23, 17

STANDARD HARDWARE



CSI-6

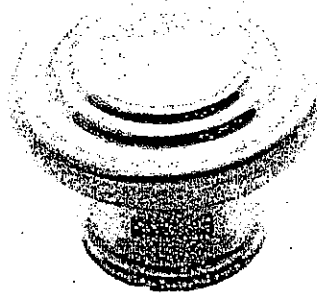

CSI-10

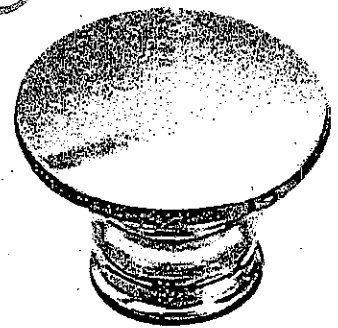

CSI-14

Bar

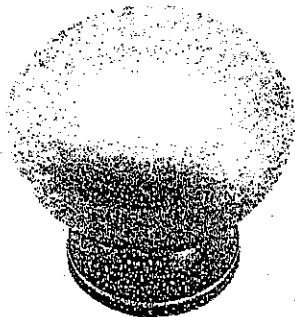

CSI-16



CSI-18

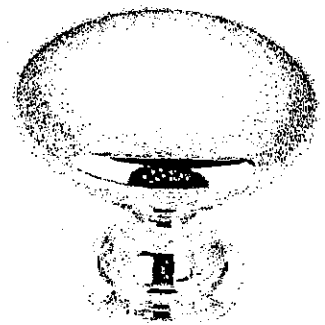

CSI-19

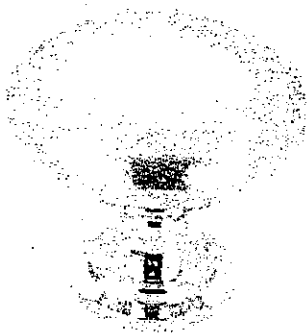

CSI-20

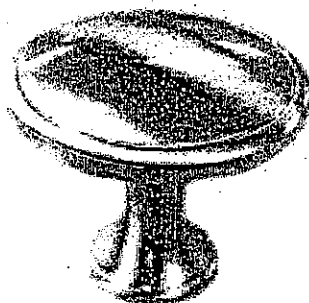

CSI-21

Nanny



CSI-22

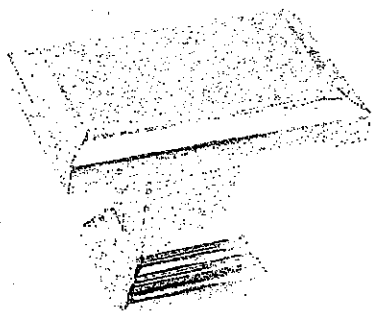

CSI-23

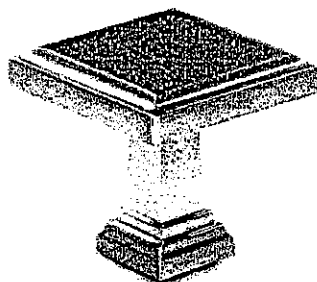

CSI-24

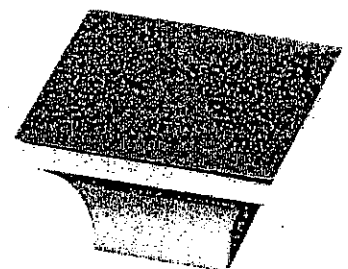

CSI-25

## \*NOTES:

- IMAGES ARE FOR QUICK REFERENCE PURPOSES ONLY
- ACTUAL SIZES AND FINISHES AS PER HARDWARE SAMPLE BOARD PROVIDED TO DECOR CENTRE

## UPGRADE HARDWARE

Mar. 23, 17



UPGRADE HARDWARE



CH-32



CH-38

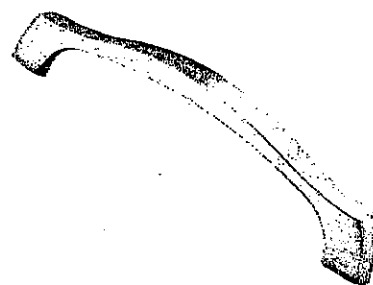

CH-44

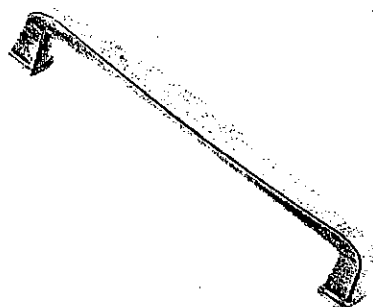

CH-45

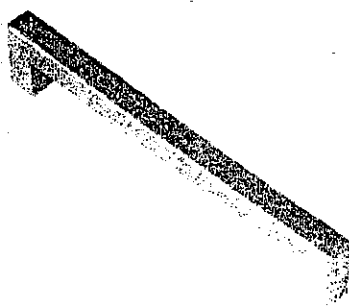

CH-46

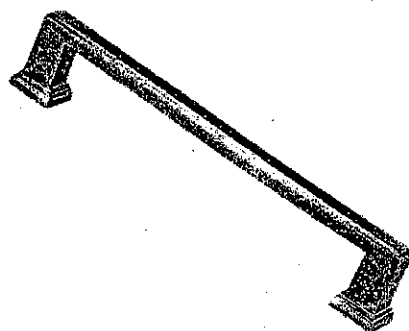

CH-47

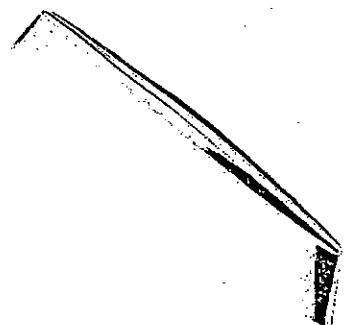

CH-48

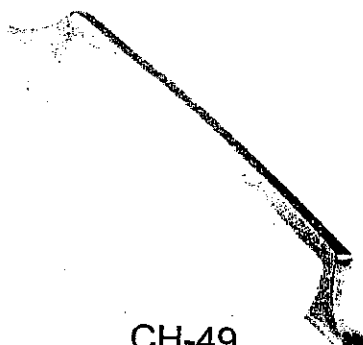

CH-49

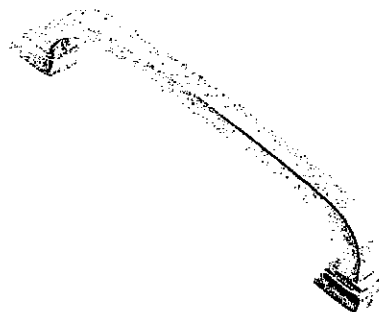

CH-50

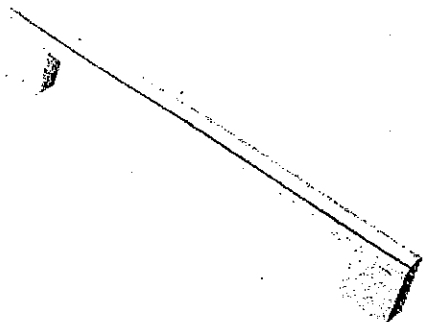

CH-51

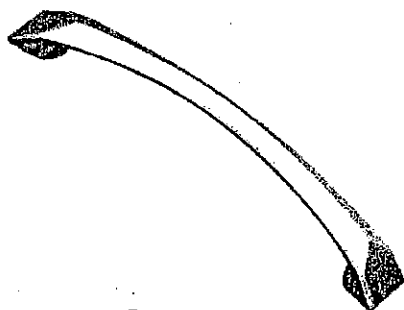

CH-52

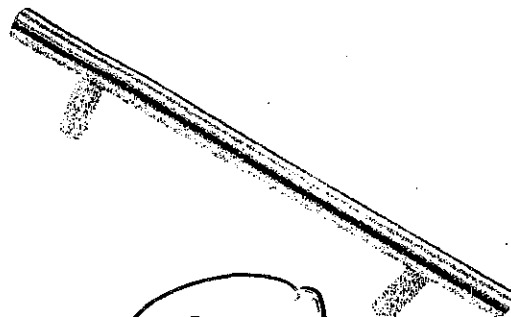

CH-53

Kitchen  
Ens. 2  
Twin  
master

## \*NOTES:

- IMAGES ARE FOR QUICK REFERENCE PURPOSES ONLY
- ACTUAL SIZES AND FINISHES AS PER HARDWARE SAMPLE BOARD PROVIDED TO DECOR CENTRE

# CORTINA

## UPGRADE HARDWARE

Lot 126

Mar. 23, 17

MODIFIED: 19/05/16 fd

UPGRADE HARDWARE



CH-32



CH-38



CH-44

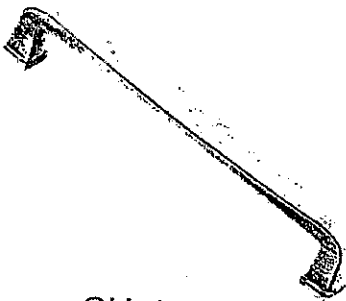

CH-45

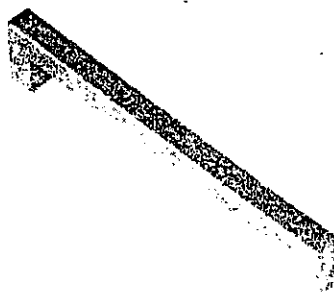

CH-46

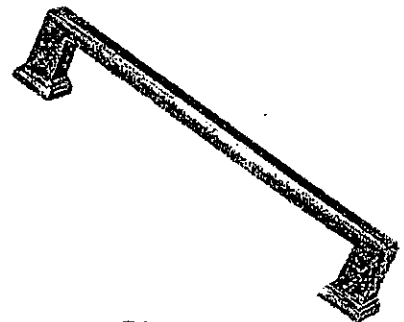

CH-47

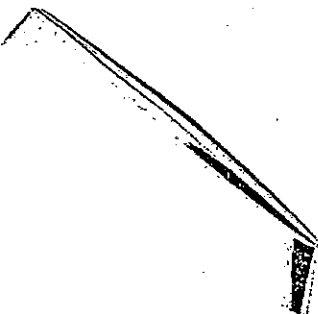

CH-48

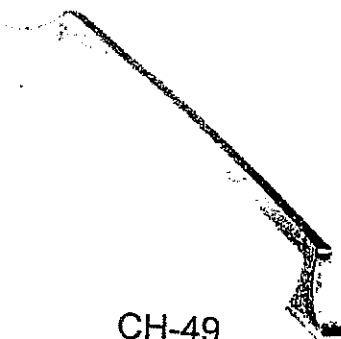

CH-49



CH-50

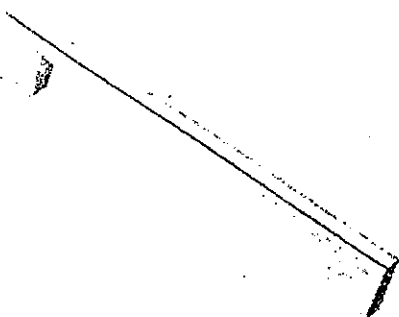

CH-51

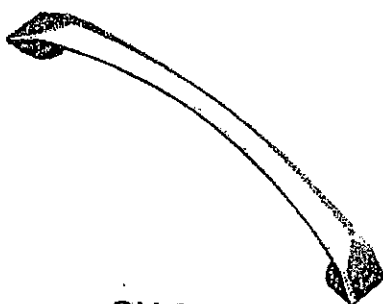

CH-52

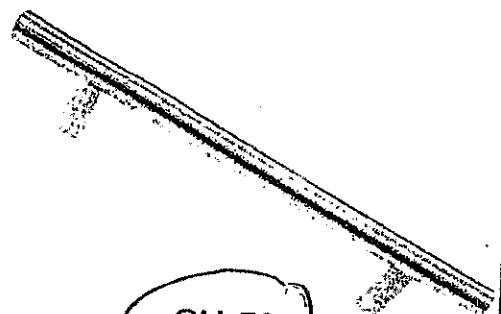

CH-53

Kitchen  
Ens. 2  
Twin  
Master

### \*NOTES:

- IMAGES ARE FOR QUICK REFERENCE PURPOSES ONLY
- ACTUAL SIZES AND FINISHES AS PER HARDWARE SAMPLE BOARD PROVIDED TO DECOR CENTRE

# GOLDPARK

WORTH MORE™

Attention: Building Department

Re: Lot # 126

This is to acknowledge that as the purchaser of the above noted lot, I have asked Gold Park Homes not to install the standard builder's kitchen exhaust hood. I will be installing my own unit after closing at my own expense and warranty. I also accept that the venting location will be as per the standard range hood.



Purchaser

Vendor

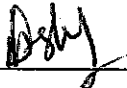

Purchaser

Dated this 23 day of March, 2017.

# CORTINA

KITCHENS INC.

70 Regina Road Woodbridge ON L4L 8L6  
905-264-6464

## INFORMATION - PVC DOORS

Builder Gold Park Homes Project Encore Lot # 126

All cabinets with PVC (Thermofoil) Doors come with melamine gables, panels and kick. The doors, crown moulding and light valance are PVC wrapped. Open shelves incorporated in design will only be available with melamine interiors. There will be variations in colour shades between the PVC parts (doors, crown and Light valance) and the melamine parts (open shelves, Gables, Panels and Kick) due to the difference in material.

Furring Panel with crown moulding to the ceiling is not available on all PVC door styles due to subtle variations in colour shades between the PVC parts (moulding) and the melamine parts (furring panel) due to the difference in material. Grain directions in wood grain pattern melamine, vary between the furring panel, crown moulding (horizontal) and the PVC doors (vertical).

Thank you for your understanding.

I am well informed of this information, and agree to the purchase of the above.

Purchaser: \_\_\_\_\_

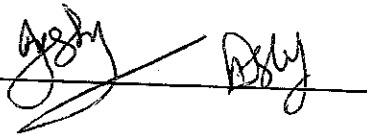

Date: \_\_\_\_\_

03/23/17

## Kitchen – Soap Dispensers



Soap Dispenser

Chrome Finish  
# RP1001

Arctic™ Stainless Finish  
# RP1001AR

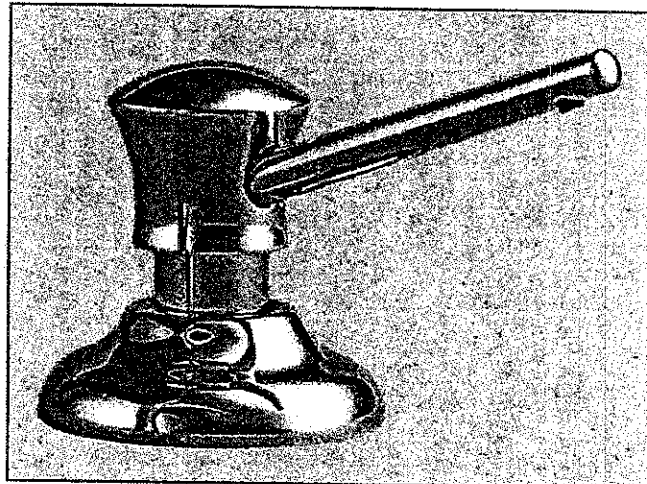

Soap Dispenser

Chrome Finish  
# RP1002

Arctic™ Stainless Finish  
# RP1002AR

Champagne Bronze™ Finish  
# RP1002CZ

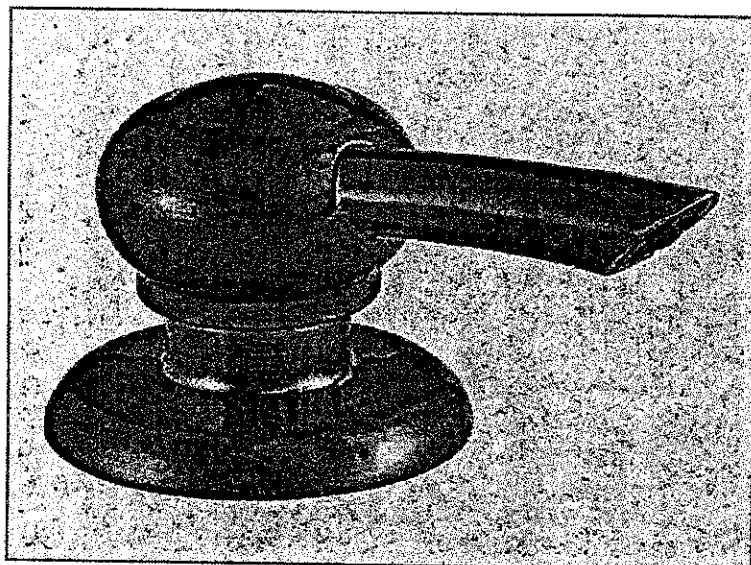

Soap Dispenser

Chrome Finish  
# RP50813

Arctic™ Stainless Finish  
# RP50813AR

Champagne Bronze™ Finish  
# RP50813CZ



Lot 126  
Mar. 23, 17



Lot 126



PLUMBING UPGRADES

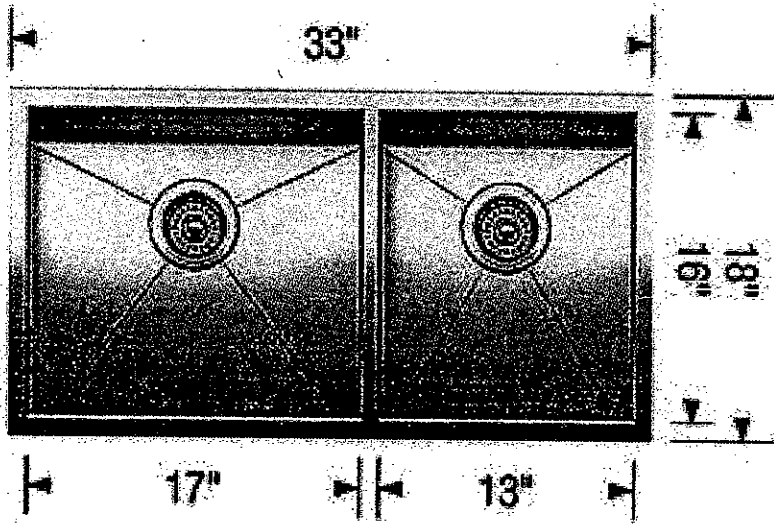
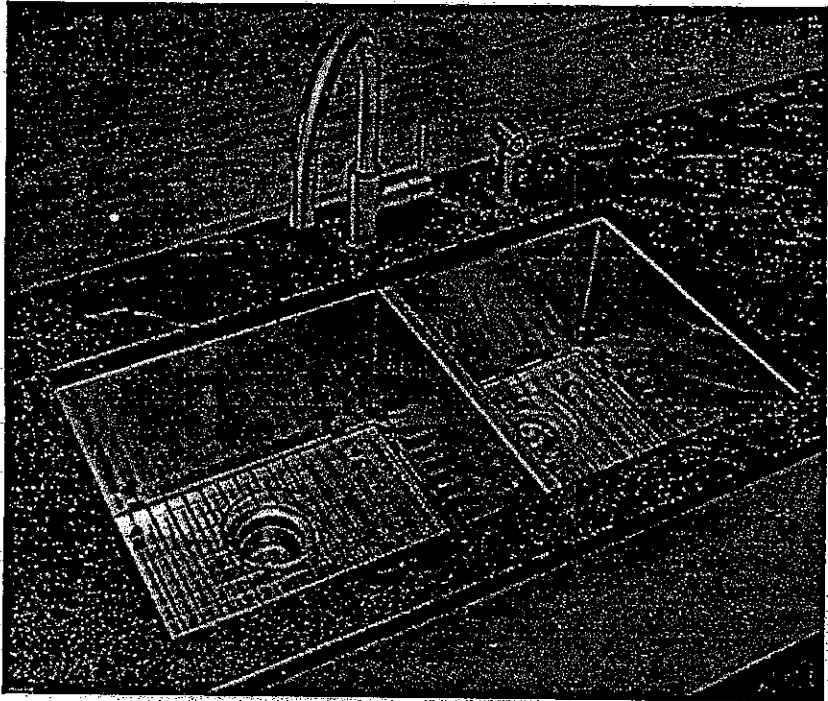

Blanco Quatrus U 1-3/4 kitchen sink #401244 (stainless)

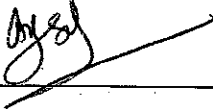

LOT #  
126  
Encore

ROOM: Kitchen	SIGNATURE: 
DATE: 03/23/17	SIGNATURE: 



Lot 126



## **WALL MOUNTED RANGE HOODS USER INSTRUCTIONS**

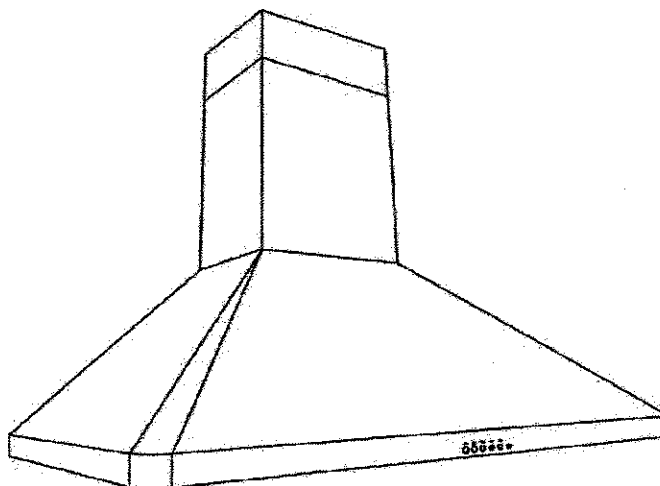

### **Model - Rapido Chef**

We recommend to put working gloves on to perform the installation as some edges may be sharp.

#### **IMPORTANT SAFETY INSTRUCTIONS**

Carefully read the following important information regarding installation safety and maintenance.

Keep these instructions for future reference.

6/22/2012

### Venting Requirements:

- Vent system must terminate to the outside (roof or side wall).
- DO NOT terminate the vent system in an attic or other enclosed area.
- DO NOT use 4" (10.2 cm) laundry-type wall caps.
- Use metal/aluminum vent only. Rigid metal/aluminum vent is recommended.
- DO NOT use plastic vent.
- Always keep the duct clean to ensure proper airflow.
- Calculate the following figures before installation:
  1. Distance from the floor to the ceiling.
  2. Distance between the floor to the countertop/stove
  3. Distance between the cooking surface to the range hood (recommend 24" to 30") minimum of 36" is required for gas stove top
  4. Height of hood and duct cover

#### For the most efficient & quiet operation:

- A distance of 24" to 30" is recommended between stove top and the bottom of range hood. 30" minimum is required for gas stove tops.
- It is recommended that the range hood be vented vertically through the roof through 6" (15.3 cm) or bigger round metal/aluminum vent work.
- The size of the vent should be uniform.
- Use no more than three 90° elbows.
- Make sure there is a minimum of 24" (61 cm) of straight vent between the elbows if more than one elbow is used.
- DO NOT install two elbows together.
- The length of vent system and number of elbows should be kept to a minimum to provide efficient performance.
- The vent system must have a damper. If roof or wall cap has a damper, DO NOT use damper (if supplied) on top of the range hood.
- Use silver tape or duct tape to seal all joints in the vent system.
- Use caulking to seal exterior wall or roof opening around the cap.

### Height & Clearance:

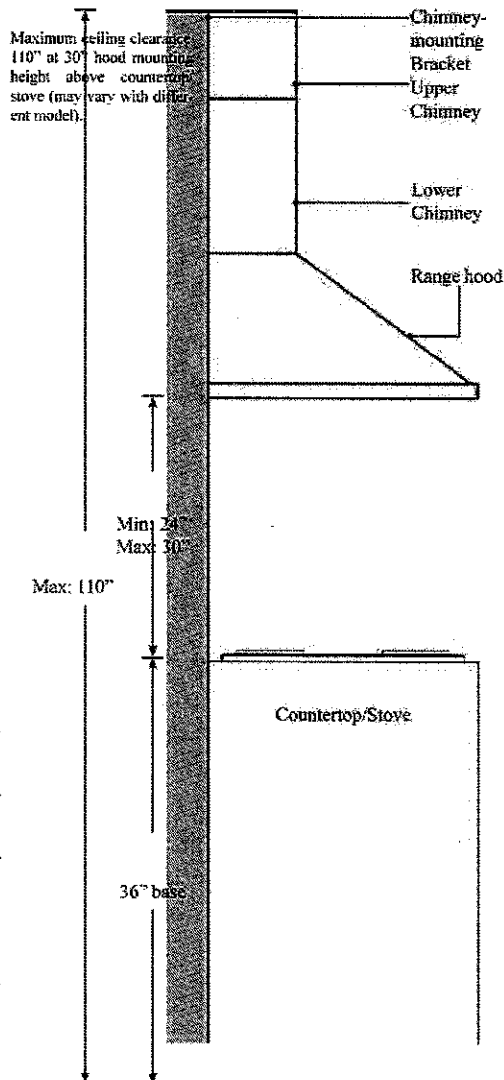

**IMPORTANT:**

- A minimum of 6" round (standard for this range hood) or 3-1/4 x 10" rectangular duct (purchased separately) must be used to maintain maximum airflow efficiency.
- Use the Flexible Duct Tube supplied with the range hood or use a rigid type metal/aluminum duct tube (follow the building codes in your area). When connecting the duct tube to the Flange, you may need to insert a 6" crimped-in connector in between the duct tube and the Flange. This is available at your local hardware store, if not, you can use a pipe crimper. Please ensure that the back draft flaps can open to allow for maximum airflow.
- Please use *Duct Run Calculation* below to compute total available duct run when using elbows, transitions and caps.
- ALWAYS, when possible, reduce the number of transitions and turns. If long duct run is required, increase duct size from 6" to 7" or 8". If a reducer is used, install a long reducer instead of a pancake reducer. Reducing duct size will restrict airflow and decrease airflow, thus reduce duct size as far away from opening as possible.
- If turns or transitions are required; install as far away from opening and as far apart, between 2, as possible.
- Minimum mount height between stove top to hood bottom should be no less than 24-inch for electric cook tops and minimum of 30" for gas stove tops and no higher than 30 inch for electric cook tops.
- It is important to install the hood at the proper mounting height. Hoods mounted too low could result in heat damage and fire hazard; while hoods mounted too high will be hard to reach and will loose its performance and efficiency.
- If available, also refer to stove top manufacturer's height clearance requirements and recommended hood mounting height above range.

**Minimum Duct Size:**

- Round - 6" minimum
- Rectangular - 3-1/4 x 10" minimum (requires a 6" to 3-1/4x10" adaptor, not supplied)

**Calculating Vent System Length:**

To calculate the length of the system you need, deduct the equivalent feet for each vent piece used in the system from the recommended maximum duct run.

<b>Duct Run Calculation:</b>	
<b>Recommended maximum run</b>	
6" or 3-1/4 x 10" duct	50 ft
<b>Vent piece deduction</b>	
Each 90° elbow used	9 ft
Each 45° elbow used	5 ft
Each 6" to 3-1/4 x 10" transition used	7 ft
Side wall cap with damper	0 ft
Roof cap	0 ft

**Duct Run Calculation example:**

One roof cap, two 90° elbow, and one 45° elbow used:

$$0\text{ft} + 9\text{ft} + 9\text{ft} + 5\text{ft} = 23\text{ft used.}$$

Deduct 23ft from 50ft, 27ft maximum available for straight duct run.

- Overall without Chimney:**

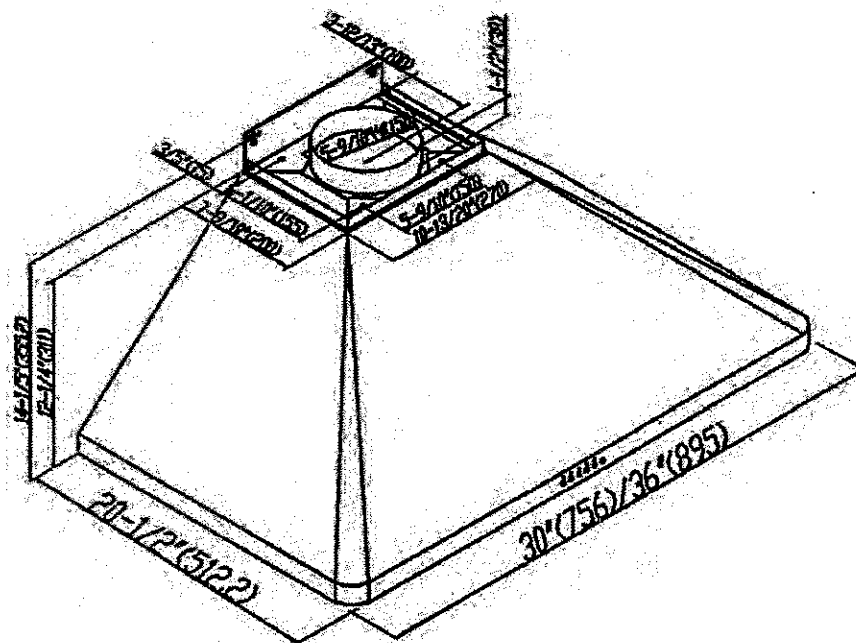

# ANCONA

Rapido Chef II 30 & 36

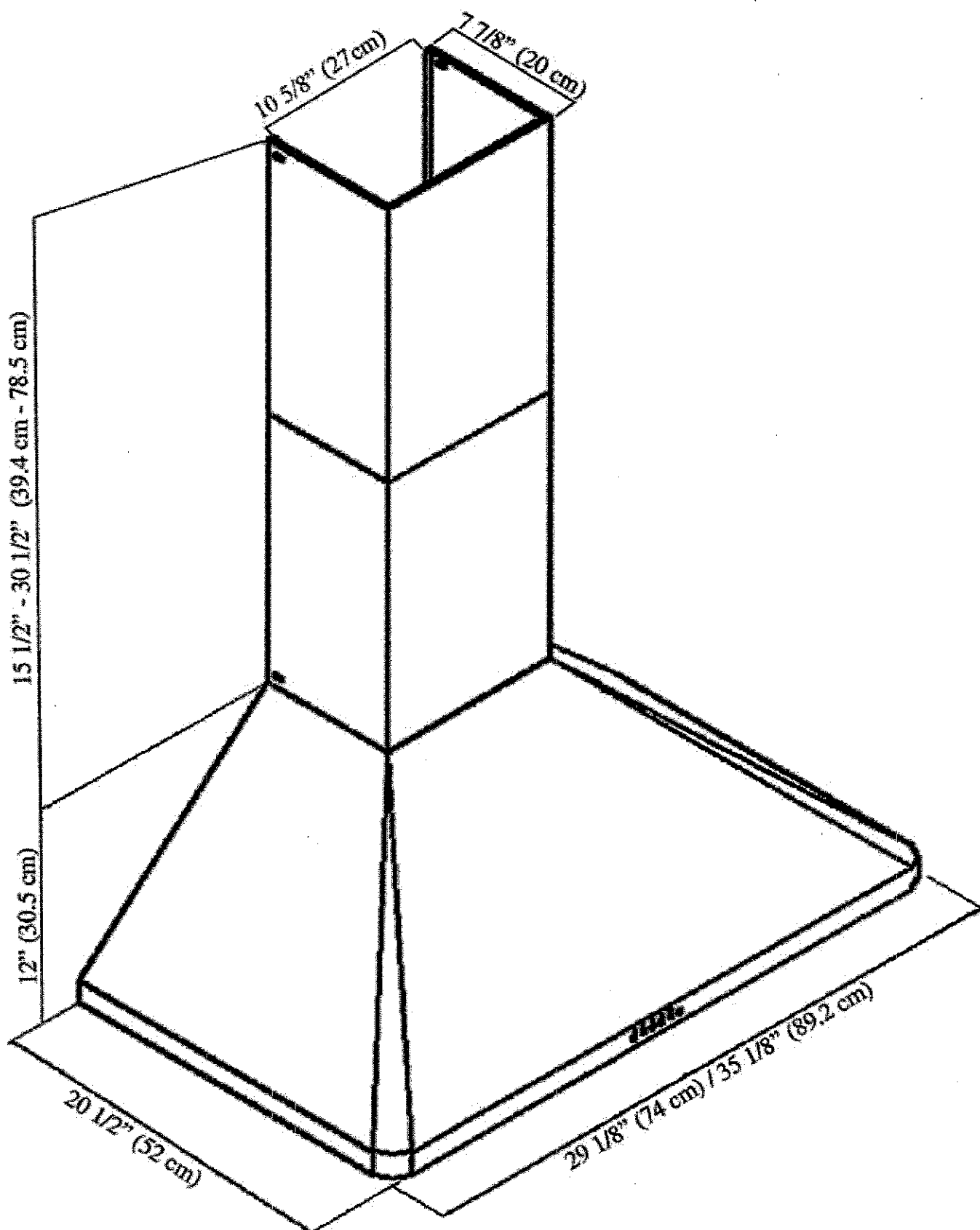

Lot 126

27" Standard Installation



**BOSCH**

## Microwaves

**HMB57152UC**

**Built-In Microwave Oven  
500 Series - Stainless Steel**

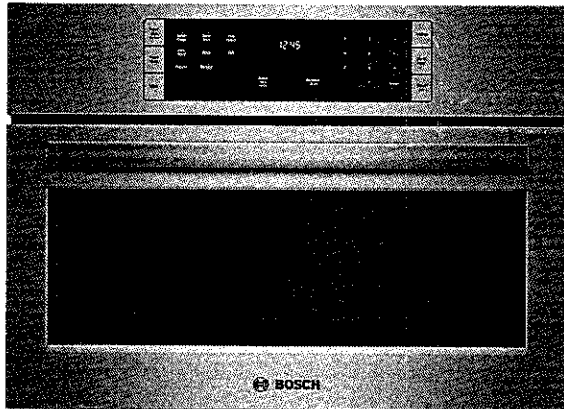

### Built-In Microwave Design Matched for Use in Combination with Bosch Wall Oven

- 1.6 cu. ft. Large cooking interior adds the flexibility for a variety of meal options.
- Built For Speed and Convenience With 950 Watts of Microwave Cooking Power
- Convenient Automatic Sensor Programs Simplify Cooking for Great Results Every Time
- White Colored LCD Matches Bosch Wall Ovens

#### Technical Data

Max. Microwave power (W) :	950
Number of Power Levels :	10
Turntable :	Yes
Turntable diameter (in) :	14 1/8"
Turntable diameter (mm) :	360
Heating type :	Microwave
Cavity material :	Stainless steel
Door opening :	Handle
Clock / Timer :	Yes
Included accessories :	1 x grid high, 1 x grid flat
UPC code :	825225924173
Product color :	Stainless steel
Watts (W) :	1750
Current (A) :	15
Volts (V) :	120
Frequency (Hz) :	60
Approval certificates :	CUL, UL
Power cord length (in) :	43"
Power cord length (cm) :	109
Plug type :	Nema5-15P
Required cutout size (HxWxD) (in) :	19 1/4" x 25 1/2 x 19 1/4"
Required cutout size (HxWxD) (mm) :	488 x 648 x 488
Overall appliance dimensions (HxWxD) (in) :	19 5/8" x 26 3/4 x 19 5/8"
Overall appliance dimensions (HxWxD) (mm) :	498 x 680 x 498
Product packaging dimensions (HxWxD) (in) :	22.63 x 26.29 x 30.39
Net weight (lbs) :	75
Net weight (kg) :	34.0
Gross weight (lbs) :	83
Gross weight (kg) :	38.0

#### Included accessories

1 x grid high  
1 x grid flat



**BOSCH**

## **Microwaves**

### **HMB57152UC**

#### **Built-In Microwave Oven 500 Series - Stainless Steel**

#### **Built-In Microwave Design Matched for Use in Combination with Bosch Wall Oven**

---

##### **Design**

- Built-In Microwave For Use With Bosch Wall Ovens
- Recessed Glass Turntable

##### **Performance**

- 950 Watt Microwave Power
- 10 Microwave Power Levels

##### **Efficiency**

- Large Cooking Interior Gives You Flexibility to Cook Various Dishes
- More Even Cooking From Center to Crust

##### **Convenience**

- Keep Warm Program
- Automatic Sensor Programs Simplify Cooking for Great Results
- Popcorn Program - Get Fully "Popped" Popcorn Simply by Entering the Bag Size
- Timer with Cook Time and Delay Start Function

**Microwaves**

**HMB57152UC**  
**Built-In Microwave Oven**  
**500 Series - Stainless Steel**

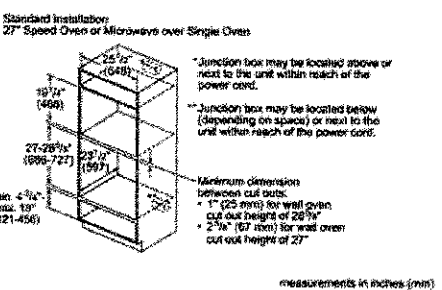
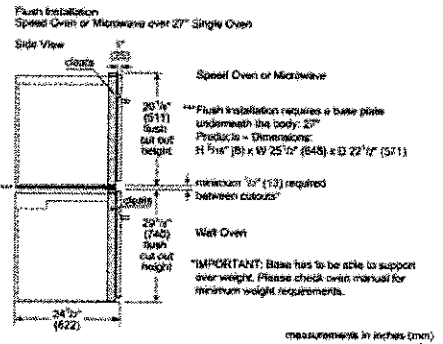
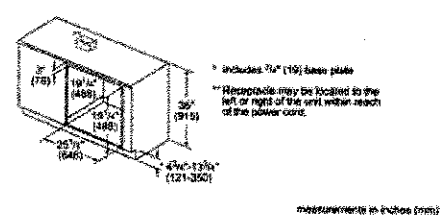
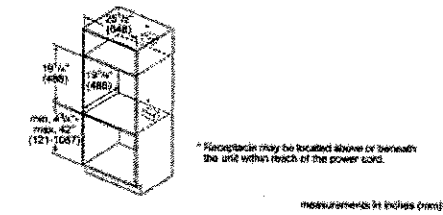
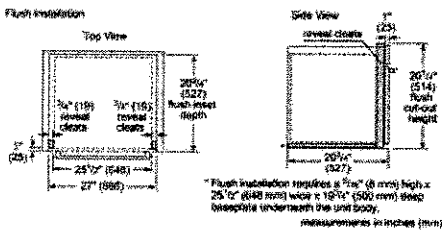
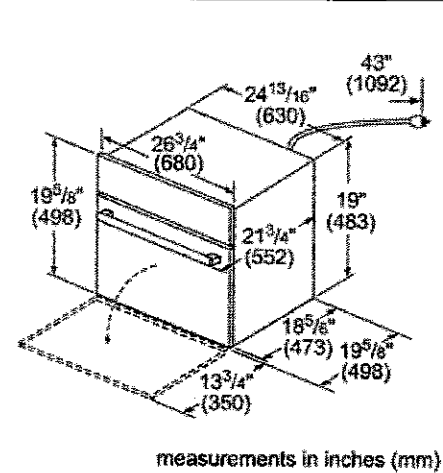



Lot 126  
Mar. 23, 17  
Ⓟ Ⓟ

# Whirlpool® 30" (76.2 cm) Slide-in Gas Range

## PRODUCT MODEL NUMBERS

WEG730H0D      WEG760H0D      WEG745H0F

## GAS SUPPLY REQUIREMENTS

### Gas supply line:

- Provide a gas supply line of  $\frac{3}{4}$ " (1.9 cm) rigid pipe to the range location. A smaller size pipe on longer runs may result in insufficient gas supply. With LP gas, piping or tubing size can be  $\frac{1}{2}$ " (1.3 cm) minimum. Usually, LP gas suppliers determine the size and materials used in the system.

**NOTE:** Pipe-joint compounds that resist the action of LP gas must be used. Do not use TEFLON®† tape.

### Flexible metal appliance connector:

- If local codes permit, a new CSA design-certified, 4 to 5 ft (122 to 152.4 cm) long,  $\frac{1}{2}$ " (1.3 cm) or  $\frac{3}{4}$ " (1.9 cm) I.D., flexible metal appliance connector may be used for connecting range to the gas supply line.



- A  $\frac{1}{2}$ " (1.3 cm) male pipe thread is needed for connection to the female pipe threads of the inlet to the appliance pressure regulator.

- Do not kink or damage the flexible metal tubing when moving the range.

- Must include a shutoff valve:

The supply line must be equipped with a manual shutoff valve. This valve should be located in the same room but external to the range opening, such as an adjacent cabinet. It should be in a location that allows ease of opening and closing. Do not block access to shutoff valve. The valve is for turning on or shutting off gas to the range.

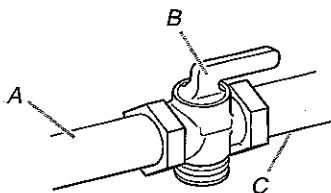

A. Gas supply line  
B. Shutoff valve "open" position  
C. To range

## Gas Pressure Regulator

The gas pressure regulator supplied with this range must be used. The inlet pressure to the regulator should be as follows for proper operation:

Natural gas:

Minimum pressure: 5" WCP

Maximum pressure: 14" WCP

LP gas:

Minimum pressure: 11" WCP

Maximum pressure: 14" WCP

Contact local gas supplier if you are not sure about the inlet pressure.

## PRODUCT DIMENSIONS

This manual covers several models. Your model may appear different from the models depicted. Dimensions given are maximum dimensions across all models.

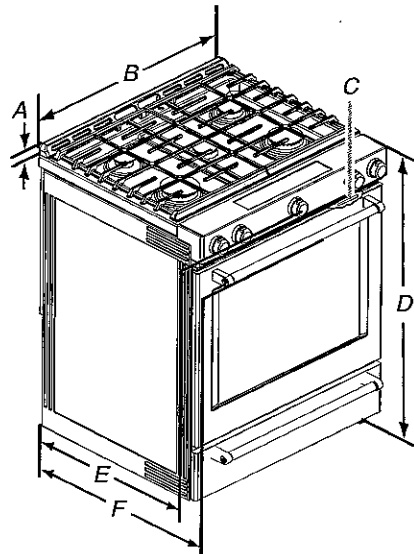

A.  $1\frac{1}{8}$ " (3.0 cm) height from cooktop to top of vent

B.  $29\frac{1}{8}$ " (75.9 cm)

C. Model/serial number plate (located behind the oven door on the top right-hand side of the oven frame)

D.  $36\frac{1}{8}$ " (91.4 cm) height to top of cooktop edge with leveling legs screwed all the way in\*

E.  $28\frac{5}{8}$ " (71.9 cm) max. depth from front of console to back of range.

F.  $28\frac{7}{8}$ " (73.3 cm) max. depth from handle to back of range.

**IMPORTANT:** Range must be level after installation. Follow the instructions in the "Level Range" section. Using the cooktop as a reference for leveling the range is not recommended.

\* Range can be raised approximately 1" (2.5 cm) by adjusting the leveling legs.

## Type of Gas

### Natural gas:

- This range is factory set for use with Natural gas. See "Gas Conversions" section. The model/serial rating plate located behind the control panel has information on the types of gas that can be used. If the types of gas listed do not include the type of gas available, check with the local gas supplier.

### LP gas conversion:

Conversion must be done by a qualified service technician. No attempt shall be made to convert the appliance from the gas specified on the model/serial rating plate for use with a different gas without consulting the serving gas supplier. See "Gas Conversions" section.

†TEFLON is a registered trademark of Chemours.

## ELECTRICAL REQUIREMENTS

**IMPORTANT:** The range must be electrically grounded in accordance with local codes and ordinances, or in the absence of local codes, with the National Electrical Code, ANSI/NFPA 70 or Canadian Electrical Code, CSA C22.1.

If codes permit and a separate ground wire is used, it is recommended that a qualified electrical installer determine that the ground path is adequate.

- A 120 volt, 60 Hz., AC only, 15-amp fused, electrical circuit is required. A time-delay fuse or circuit breaker is also recommended. It is recommended that a separate circuit serving only this range be provided.
- Electronic ignition systems operate within wide voltage limits, but proper grounding and polarity are necessary. Check that the outlet provides 120-volt power and is correctly grounded.

## CABINET OPENING DIMENSIONS

Cabinet opening dimensions shown are for 25" (64.0 cm) countertop depth, 24" (61.0 cm) base cabinet depth and 36" (91.4 cm) countertop height.

**IMPORTANT:** If installing a range hood or microwave hood combination above the range, follow the range hood or microwave hood combination installation instructions for dimensional clearances above the cooktop surface.

Range may be installed next to combustible walls with zero clearance.

**NOTE:** When installed in a slide-in cutout, the front of oven door may protrude beyond the base cabinet.

- A. 18" (45.7 cm) upper side cabinet to countertop
- B. 13" (33 cm) max. upper cabinet depth
- C. 30" (76.2 cm) min. opening width
- D. For minimum clearance to top of cooktop, see NOTE\*.
- E. 30" (76.2 cm) min. opening width
- F. 3" (7.6 cm) min. clearance from both sides of range to side wall or other combustible material.
- G. The shaded area is recommended for installation of rigid gas pipe and grounded outlet.
- H. 13<sup>1</sup>/<sub>8</sub>" (33.3 cm)
- I. 7<sup>1</sup>/<sub>16</sub>" (19.5 cm)
- J. 4<sup>13</sup>/<sub>16</sub>" (12.2 cm)
- K. 3<sup>1</sup>/<sub>16</sub>" (9.4 cm) or measurement of N, whichever is greater
- L. 12" (30.5 cm)
- M. Cabinet door or hinges should not extend into the cutout.
- N. Remaining counter depth should not exceed 2<sup>1</sup>/<sub>4</sub>" (5.7 cm)

\* **NOTE:** 24" (61.0 cm) minimum when bottom of wood or metal cabinet is shielded by not less than 1/4" (0.64 cm) flame retardant millboard covered with not less than No. 28 MSG sheet steel, 0.015" (0.4 mm) stainless steel, 0.024" (0.6 mm) aluminum or 0.020" (0.5 mm) copper.

