

Brampton Encore - 128 - 1 - 41-6 Elev.B VERDI OPT - GFA1 AND SFA3
CENTRAL VAC AND WIRING

Inv.626	1 - TELEPHONE AND CABLE ROUGH-IN LOCATIONS
Line7909	Note:
6Jul16 / 15Nov16	
Inv.626	1 - FAMILY ROOM: INSTALL CONDUIT PIPE- FOR TELEVISION- ABOVE FIREPLACE, SEE SKETCH
Line7910	Note:
6Jul16 / 15Nov16	
Inv.626	1 - FAMILY ROOM: INSTALL ROUGH-IN WIRING FOR ONE PAIR OF SPEAKERS - IN FAMILY ROOM, SEE SKETCH
Line7912	Note:
6Jul16 / 15Nov16	

CERAMIC

Inv.1,167	1 - FOYER: INSTALL Floor Upgrade 5 Foyer Vestibule Floor
Line18333	Note:
6Feb17 / 24Mar17	
Inv.1,167	1 - KITCHEN: INSTALL Floor Upgrade 5 Kitchen and Breakfast Floor
Line18334	Note:
6Feb17 / 24Mar17	
Inv.1,167	1 - POWDER ROOM: INSTALL Floor Upgrade 5 Powder Room Floor
Line18335	Note:
6Feb17 / 24Mar17	
Inv.1,167	1 - MASTER ENSUITE: INSTALL Floor Upgrade 5 Ensuite Bath Floor
Line18336	Note:
6Feb17 / 24Mar17	
Inv.1,167	1 - MASTER ENSUITE: INSTALL Floor Upgrade 4 Ensuite Bath Shower with Ceiling
Line18337	Note:
6Feb17 / 24Mar17	

ELECTRICAL

Inv.626	1 - FAMILY ROOM: INSTALL 110V WALL RECEPTACLE ON DEDICATED CIRCUIT - ABOVE FIREPLACE SEE SKETCH
Line7911	Note:
6Jul16 / 15Nov16	
Inv.626	1 - KITCHEN: RELOCATE FRIDGE AND STOVE IN KITCHEN. SEE ATTACHED FLOOR PLAN
Line11977	Note:
6Jul16 / 15Nov16	
Inv.626	1 - KITCHEN: INSTALL 220V WALL RECEPTICAL ON DEDICATED CIRCUIT- FOR 4 WIRE BUILT-IN WALL OVEN - SEE SKETCH
Line11976	Note:
6Jul16 / 15Nov16	
Inv.1,167	1 - STRUCTURAL:
KITCHEN: INSTALL 110V WALL RECEPTACLE ON DEDICATED CIRCUIT-FOR HOOD FAN ABOVE STOVE. SEE SKETCH	
Line18284	Note:
6Feb17 / 24Mar17	

Brampton Encore - 128 - 1 - 41-6 Elev.B VERDI OPT - GFA1 AND SFA3

Inv.1,167	1 - **RELOCATE:** KITCHEN: INSTALL 110V WALL RECEPTACLE ON DEDICATED CIRCUIT - FOR MICROWAVE - MICROWAVE NOT INCLUDED **NOW TO GO IN ISLAND. SEE SKETCH
Line18286	Note:
6Feb17 / 24Mar17	
Inv.1,167	1 - DELETE: ITEM #4 ON PE626 KITCHEN: INSTALL 220V WALL RECEPTICAL ON DEDICATED CIRCUIT- FOR 4 WIRE BUILT-IN WALL OVEN - MUST SPECIFY LOCATION
Line18328	Note: PURCHASER IS NOT BUYING A WALL OVEN UNIT.
6Feb17 / 24Mar17	
Inv.1,167	1 - CLIENT TO SUPPLY AND INSTALL THEIR OWN RANGEHOOD AFTER CLOSING.
Line19812	Note:
6Feb17 / 24Mar17	
Inv.1,274	1 - KITCHEN: INSTALL 110V WALL RECEPTACLE ON DEDICATED CIRCUIT - GAS FIRED APPLIANCE - FOR AUX. EQUIPMENT - NOT A STOVE PLUG
Line19814	Note:
24Mar17 / 7Apr17	

EXTERIOR COLOURS

Inv.626	1 - EXTERIOR COLOUR PACKAGE 3
Line14039	Note:
6Jul16 / 15Nov16	

FIREPLACE AND MANTLE

Inv.1,167	1 - FAMILY ROOM: INSTALL Cabinet NF6-Does Not Include Fireplace
Line18347	Note:
6Feb17 / 24Mar17	

FRAMING

Inv.626	1 - KITCHEN: RELOCATE FRIDGE AND STOVE IN KITCHEN. SEE ATTACHED FLOOR PLAN
Line14034	Note:
6Jul16 / 15Nov16	
Inv.626	1 - KITCHEN: RELOCATE SINK AND DISHWASHER IN KITCHEN. SEE ATTACHED FLOOR PLAN
Line14037	Note:
6Jul16 / 15Nov16	
Inv.626	1 - MAN DOOR GARAGE TO HOUSE - OPTIONAL - IF GRADE PERMITS
Line14041	Note:
6Jul16 / 15Nov16	
Inv.984	1 - OPTIONAL GROUND FLOOR
Line14043	Note:
15Nov16 / 15Nov16	
Inv.984	1 - OPTIONAL LAUNDRY
Line14044	Note:
15Nov16 / 15Nov16	

GRANITE MARBLE QUARTZ

Brampton Encore - 128 - 1 - 41-6 Elev.B VERDI OPT - GFA1 AND SFA3

Inv.1,167	1 - KITCHEN: INSTALL ADDITIONAL 2 FEET OF GRANITE ON FRIDGE WALL WHERE BASE CABINETS WERE ADDED.
Line18330	Note:
6Feb17 / 24Mar17	
Inv.1,167	1 - KITCHEN: INSTALL 2 CM GRP 2 Optional Flush BBar
Line18331	Note:
6Feb17 / 24Mar17	
Inv.1,167	1 - KITCHEN: INSTALL 2 CM GRP 2 Kitchen with Island no BBar
Line18332	Note:
6Feb17 / 24Mar17	

HARDWOOD

Inv.1,167	1 - DINING ROOM: INSTALL PREVERCO 4 1/4" ENGINEERED RED OAK IN KOMODO, Upgrade 1 LEVEL S IN Dining
Line18338	Note:
6Feb17 / 24Mar17	
Inv.1,167	1 - DEN: INSTALL PREVERCO 4 1/4" ENGINEERED RED OAK IN KOMODO, Upgrade 1 LEVEL S IN Den
Line18339	Note:
6Feb17 / 24Mar17	
Inv.1,167	1 - FAMILY ROOM: INSTALL PREVERCO 4 1/4" ENGINEERED RED OAK IN KOMODO, Upgrade 1 LEVEL S IN Family
Line18340	Note:
6Feb17 / 24Mar17	
Inv.1,167	1 - LIVING ROOM: INSTALL PREVERCO 4 1/4" ENGINEERED RED OAK IN KOMODO, Upgrade 1 LEVEL S IN Living
Line18341	Note:
6Feb17 / 24Mar17	
Inv.1,167	1 - MAIN HALL: INSTALL PREVERCO 4 1/4" ENGINEERED RED OAK IN KOMODO, Upgrade 1 LEVEL S IN Main Hall
Line18342	Note:
6Feb17 / 24Mar17	
Inv.1,167	1 - UPPER HALL: INSTALL PREVERCO 4 1/4" ENGINEERED RED OAK IN KOMODO, Upgrade 1 LEVEL S IN Upper Hall
Line18343	Note:
6Feb17 / 24Mar17	

HVAC

Inv.1,167	1 - CLIENT TO SUPPLY AND INSTALL THEIR OWN RANGEHOOD AFTER CLOSING. PLEASE SEE APPLIANCE SPECS FOR DUCT LOCATION
Line19810	Note:
6Feb17 / 24Mar17	
Inv.1,274	1 - KITCHEN: INSTALL GAS LINE ROUGH - MAIN FLOOR - (3 STOREY MODELS) FOR STOVE
Line19813	Note:
24Mar17 / 7Apr17	
Inv.1,274	1 - KITCHEN: PLEASE SUPPLY 10" RANGE HOOD DUCT. CLIENT TO PURCHASE AND INSTALL RANGE HOOD AFTER CLOSING. PLEASE SEE SPECS FOR DETAILS AND LOCATION
Line19815	Note:
24Mar17 / 7Apr17	

KITCHEN AND BATH CABINETRY

Brampton Encore - 128 - 1 - 41-6 Elev.B VERDI OPT - GFA1 AND SFA3

Inv.626	1 - KITCHEN: CHANGE KITCHEN LAYOUT, ADDING CABINETRY WHERE NEEDED. SEE ATTACHED FLOOR PLAN
Line11979	Note: *DOES NOT INCLUDE CHARGE FOR BUILT-IN WALL OVEN UNIT OR ADDITIONAL GRANITE, IF NEEDED
6Jul16 / 15Nov16	
Inv.626	1 - KITCHEN: RELOCATE FRIDGE AND STOVE IN KITCHEN. SEE ATTACHED FLOOR PLAN
Line14035	Note:
6Jul16 / 15Nov16	
Inv.626	1 - KITCHEN: RELOCATE SINK AND DISHWASHER IN KITCHEN. SEE ATTACHED FLOOR PLAN
Line14036	Note:
6Jul16 / 15Nov16	
Inv.1,167	1 - KITCHEN: INSTALL UPG 2 GRP IIIA Kitchen
Line17152	Note:
6Feb17 / 24Mar17	
Inv.1,167	1 - KITCHEN: INSTALL Spray Stain Kitchen
Line17153	Note:
6Feb17 / 24Mar17	
Inv.1,167	1 - KITCHEN: INSTALL MAPLE FRIDGE / FREEZER DOOR PANELS
Line18579	Note:
6Feb17 / 24Mar17	
Inv.1,167	1 - KITCHEN: ADJUST CABINET OPENING FOR 48" STOVE
Line18283	Note:
6Feb17 / 24Mar17	
Inv.1,167	1 - KITCHEN: INSTALL Oak PVC 97 Base cabinet for under counter microwave open shelf with matching interior or panel with
	TO GO IN ISLAND. SEE SKETCH
Line18329	Note:
6Feb17 / 24Mar17	
Inv.1,167	1 - KITCHEN: INSTALL MAPLE DISHWASHER DOOR PANEL
Line18578	Note:
6Feb17 / 24Mar17	
Inv.1,167	1 - KITCHEN: ADJUST CABINET ABOVE 48" STOVE, AS PER THE REQUIREMENTS NEEDED FOR PURCHASER'S HOOD FAN
Line18580	Note:
6Feb17 / 24Mar17	
Inv.1,167	1 - **RELOCATE:**
	KITCHEN: INSTALL 110V WALL RECEPTACLE ON DEDICATED CIRCUIT - FOR MICROWAVE - MICROWAVE NOT INCLUDED
	**NOW TO GO IN ISLAND. SEE SKETCH
Line19811	Note:
6Feb17 / 24Mar17	

MISC.

Inv.626	1 - Purchasers are aware & accepts that ANY changes made to upgrades after signing this Purchasers Extra Form are subject to a minimum administration fee of \$500. PLUS a 10% holdback fee
Line11981	Note:
6Jul16 / 15Nov16	

Brampton Encore - 128 - 1 - 41-6 Elev.B VERDI OPT - GFA1 AND SEA3

Inv.626	1 - Purchaser has attended a Structural appointment at the Decor Centre & has DECLINED any additional upgrades and accepts and acknowledges that there will be no further structural changes/additions/deletions to be made upon signing on September 26, 2016
Line11980	Note:
6Jul16 / 15Nov16	
Inv.626	1 - BONUS PACKAGE: \$7345.00 (INCLUDING TAXES) WORTH OF UPGRADES FROM GOLD PARK HOMES DÉCOR CENTRE IS BEING APPLIED TOWARD THE STRUCTURAL APPOINTMENT. PURCHASER HAS A REMAINING AMOUNT OF \$2655.00 (INCLUDING TAXES) TO BE USED TOWARD THE COLOUR APPOINTMENT
Line11982	Note:
6Jul16 / 15Nov16	
Inv.1,167	1 - Purchaser has attended a Colour appointment at the Decor Centre & has DECLINED any additional upgrades and accepts and acknowledges that there will be no further structural changes/additions/deletions to be made upon signing on March 7, 2017
Line18581	Note:
6Feb17 / 24Mar17	
Inv.1,167	1 - Purchasers are aware & accepts that ANY changes made to upgrades after signing this Purchasers Extra Form are subject to a minimum administration fee of \$500. PLUS a 10% holdback fee
Line18582	Note:
6Feb17 / 24Mar17	
Inv.1,167	1 - BONUS PACKAGE: \$2655.00 (INCLUDING TAXES) WORTH OF UPGRADES FROM GOLD PARK HOMES DÉCOR CENTRE IS BEING APPLIED TOWARD THE COLOUR APPOINTMENT
Line18592	Note:
6Feb17 / 24Mar17	
Inv.1,274	1 - Purchasers are aware & accepts that ANY changes made to upgrades after signing this Purchasers Extra Form are subject to a minimum administration fee of \$500. PLUS a 10% holdback fee
Line20465	Note:
24Mar17 / 7Apr17	

PAINTING

Inv.1,167	1 - STAIRCASE: Stain Staircases 3 Storey Model (Euroline Pickets Charged Separately)
Line18344	Note:
6Feb17 / 24Mar17	

PLUMBING

Inv.626	1 - BASEMENT: INSTALL ROUGH-IN - 3PC BASEMENT ROUGH-IN, AS PER SKETCH
Line7914	Note:
6Jul16 / 15Nov16	
Inv.626	1 - KITCHEN: RELOCATE SINK AND DISHWASHER IN KITCHEN. SEE ATTACHED FLOOR PLAN
Line11978	Note:
6Jul16 / 15Nov16	

STAIRS AND RAILINGS

Inv.1,167	1 - STAIRCASE: INSTALL EUROLINE R 6 Black
Line18345	Note:
6Feb17 / 24Mar17	
Inv.1,167	1 - STAIRCASE: INSTALL V Groove Handrail
Line18346	Note:
6Feb17 / 24Mar17	

WINDOWS - BASEMENT

Brampton Encore - 128 - 1 - 41-6 Elev.B VERDI OPT - GFA1 AND SFA3

Inv.626	3 - BASEMENT: INSTALL THREE (X3) BASEMENT WINDOWS - UPGRADE EXISTING BASEMENT WINDOW TO 30 INCH X 24 INCH - MAY REQUIRE INSTALLATION OF WINDOW WELL
Line7913	Note:
6Jul16 / 15Nov16	

WINDOWS AND DOORS

Inv.626	1 - MAN DOOR GARAGE TO HOUSE - OPTIONAL - IF GRADE PERMITS
Line13113	Note: AS PER APS
6Jul16 / 15Nov16	

Scheduled Closing Date:

Purchaser: Harpreet Kaur Ghotra
Telephone Res. / Bus: (905) 460-0130 / (647) 402-0130
Decor Advisor: Terri Parisani

Property: 128 of Plan -
Project: Fieldwalk Investments Inc.
Model and Elevation: 41-6 Elev.B VERDI OPT - GFA1 AND SFA

Layout Changes: ☒ Yes ☐ No Sketch Attached: ☒ Yes ☐ No Exterior Colour Scheme:

1. Cabinetry

	Style and Colour	Counter	Hardware
Kitchen / Breakfast	*Upg.2Varese(mpl)Coco	*Upg.2 Andino White Granite Edge: FE20	NONE
Laundry Room			
Powder Room			
TWIN BATH	Toscana(pvc)VanillaStix	4932K-52 Golden Juperana Laminate	NONE
Master Ensuite Bathroom	Toscana(pvc) Mystic	6696-46 Carrara Bianco Laminate	NONE
Second Ensuite Bathroom (If Applicable)	Toscana(pvc)WhtCrystal	8830-58 Elemental Concrete Laminate	NONE
NANNY ENSUITE	Toscana(pvc)WhtCrystal	4589K-07 Smokey Topez Laminate	NONE
Dishwasher Cabinet			

Comment

GROUND FLOOR BAR: CABINET: Toscana(pvc)WhtCrystal COUNTER: 4589K-07 Smokey Topez Laminate HARDWARE: NONE

2. Floor Tile

	Selection	Grout	Threshold
Entrance Vestibule	*Upg.5 TimelessSeriesLtGrey Polished24x24	N/A	N/A
Main Hall			
Kitchen / Breakfast	*Upg.5 TimelessSeriesLtGrey Polished24x24	N/A	N/A
Laundry Room	Serpentine Beyaz 13 x 13	N/A	N/A
Powder Room	*Upg.5 TimelessSeriesLtGrey Polished24x24	N/A	N/A
TWIN BATH	Serpentine Taupe 13 x 13	N/A	N/A
Master Ensuite Bathroom	*Upg.5 TimelessSeriesLtGrey Polished24x24	N/A	N/A
Second Ensuite Bathroom (If Applicable)	Serpentine Grey 13 x 13	N/A	N/A
Lower Landing (If Applicable)		N/A	N/A
NANNY ENSUITE	New Reeds Brown 13 x 13	N/A	N/A

Comment

GROUND FLOOR HALL: New Reeds Brown 13 x 13

3. Wall Tile

	Selection	Listello/Inserts	Describe
TWIN BATH	Serpentine Taupe 8 X 10	<input type="radio"/> Yes <input checked="" type="radio"/> No	
Master Ensuite Bathroom			
Tub Deck		<input type="radio"/> Yes <input checked="" type="radio"/> No	
Shower Stall	*Upg.4 TimelessLtGreyPol 12 x 24	<input type="radio"/> Yes <input checked="" type="radio"/> No	
Bathroom Walls		<input type="radio"/> Yes <input checked="" type="radio"/> No	
Second Ensuite Bathroom (If Applicable)	Serpentine Grey 8 x 10	<input type="radio"/> Yes <input checked="" type="radio"/> No	
NANNY ENSUITE	New Reeds Brown 8 x 10	<input type="radio"/> Yes <input checked="" type="radio"/> No	

Kitchen Backsplash ☐ Yes ☒ No Backsplash Behind Fridge

Comment

Scheduled Closing Date:

Purchaser: Harpreet Kaur Ghotra
Telephone Res. / Bus: (905) 460-0130 / (647) 402-0130
Decor Advisor: Terri Parisani

Property: 128 of Plan -
Project: Fieldwalk Investments Inc.
Model and Elevation: 41-6 Elev.B VERDI OPT - GFA1 AND SFA

4. Plumbing Fixtures

Second Ensuite

Powder Room

Master Ensuite Bathroom

Other Room - Specify

Other Washroom

Comment

ALL FIXTURES TO REMAIN STANDARD THROUGHOUT

5. Hardwood Flooring

	Type and Stain		Type and Stain
Main Hall	<input type="text"/> *Upg.1 Preverco 4 1/4" Komodo	Upper Landing	<input type="text"/>
Kitchen / Breakfast	<input type="text"/>	Upper Hall	<input type="text"/> *Upg.1 Preverco 4 1/4" Komodo
Living Room	<input type="text"/> *Upg.1 Preverco 4 1/4" Komodo	Master Bedroom	<input type="text"/>
Dining Room	<input type="text"/> *Upg.1 Preverco 4 1/4" Komodo	Bedroom #2	<input type="text"/>
Family Room	<input type="text"/> *Upg.1 Preverco 4 1/4" Komodo	Bedroom #3	<input type="text"/>
Den/Library	<input type="text"/> *Upg.1 Preverco 4 1/4" Komodo	Bedroom #4	<input type="text"/>
Entrance Vestibule	<input type="text"/>	Bedroom #5	<input type="text"/>
Lower Landing (If Applicable)	<input type="text"/>	Other Room - Specify	<input type="text"/>

Comment

ALL HARDWOOD IS 4 1/4" ENGINEERED RED OAK

6. Carpeting

	Upgrade	Description
Main Hall	<input type="checkbox"/>	<input type="text"/>
Living Room	<input type="checkbox"/>	<input type="text"/>
Dining Room	<input type="checkbox"/>	<input type="text"/>
Family Room	<input type="checkbox"/>	<input type="text"/>
Den/Library	<input type="checkbox"/>	<input type="text"/>
Upper Hall	<input type="checkbox"/>	<input type="text"/>
Master Bedroom	<input type="checkbox"/>	<input type="text"/> T-15
Bedroom #2	<input type="checkbox"/>	<input type="text"/> T-15
Bedroom #3	<input type="checkbox"/>	<input type="text"/> T-15
Bedroom #4	<input type="checkbox"/>	<input type="text"/> T-15
Bedroom #5	<input type="checkbox"/>	<input type="text"/>
<input type="text"/> GROUND FLOOR	<input type="checkbox"/>	<input type="text"/> T-15
Upper Landing (If Applicable)	<input type="checkbox"/>	<input type="text"/>
Lower Landing (If Applicable)	<input type="checkbox"/>	<input type="text"/>

Upgrade Underpad

Type
STANDARD

Area

Carpet on Stairs

Capped

Runner - *Upgrade

Comment

Scheduled Closing Date:

Purchaser: Harpreet Kaur Ghotra
Telephone Res. / Bus: (905) 460-0130 / (647) 402-0130
Decor Advisor: Terri Parisani

Property: 128 of Plan -

Project: Fieldwalk Investments Inc.

Model and Elevation: 41-6 Elev.B VERDI OPT - GFA1 AND SFA

7. Fireplace

	Living Room			Family Room			Other Room - Specify		
	Purchased	As Per Plan	N/A	Purchased	As Per Plan	N/A	Purchased	As Per Plan	N/A
Fireplace Type	<input type="radio"/>	<input type="radio"/>	<input checked="" type="radio"/>	<input type="radio"/>	<input checked="" type="radio"/>	<input type="radio"/>	<input type="radio"/>	<input type="radio"/>	<input checked="" type="radio"/>
Mantle Type				*UPGRADE					
Colour / Stain				NF-6					
Surround				WHITE PAINT-GRADE					
Hearth				BIANCO CARRARA					
				NONE					

Comment

8. Trim Carpentry

Interior Doors STANDARD Front Door Glass Inserts STANDARD Door Handles STANDARD
Interior Trim STANDARD

Comment

9. Plaster Mouldings and Medallions

Entrance Vestibule	N/A		Kitchen/Breakfast	N/A	
Main Hall	N/A		Den/Library	N/A	
Living Room	N/A		Lower Landing	N/A	
Dining Room	N/A		Other Room - Specify	N/A	
Family Room	N/A				

Comment

10. Railings and Spindles

Railing Package *EUROLINE 6 WITH V-GROOVE HANDRAIL
Railing Colour *KOMODO RED OAK Spindle Colour BLACK
Stringer / Riser *KOMODO RED OAK Treads *KOMODO RED OAK
Oak Stairs ☒ Yes ☐ No

Comment

STAIN STAIR LANDINGS TO MATCH STAIR STAIN

11. Wall Paint

Main & Upper Hall	WARM GREY	Master Bedroom	WARM GREY
Living Room	WARM GREY	Bedroom #2	WARM GREY
Dining Room	WARM GREY	Bedroom #3	WARM GREY
Kitchen / Breakfast	WARM GREY	Bedroom #4	WARM GREY
Family Room	WARM GREY	Bedroom #5	WARM GREY
Powder Room	WARM GREY	Master Ensuite	WARM GREY
Laundry Room	WARM GREY	TWIN BATH	WARM GREY
Den/Library	WARM GREY	Second Ensuite	WARM GREY
Trim Paint	WHITE	GROUND FLOOR	WARM GREY
Comment	Smooth Ceilings First Floor		

Scheduled Closing Date:

Purchaser: Harpreet Kaur Ghotra
Telephone Res. / Bus: (905) 460-0130 / (647) 402-0130
Decor Advisor: Terri Parisani

Property: 128 of Plan -
Project: Fieldwalk Investments Inc.
Model and Elevation: 41-6 Elev.B VERDI OPT - GFA1 AND SFA

12. Electrical

Plugs and Switches ☒ White ☐ Ivory
Hood Fan ☐ White ☐ Ivory
Appliances Built in Cooktop Built in Oven Gas Stove Microwave
☐ Yes ☒ No ☐ Yes ☒ No ☒ Yes ☐ No ☒ Yes ☐ No
Comment

PURCHASER TO SUPPLY THIER OWN HOOD FAN

13. Heating and Air Conditioning

Air Conditioning Gas Provisions Stove
Gas Provisions Dryer Gas Provisions Barbecue

Comment

GAS LINE FOR STOVE WAS PURCHASED
GAS LINE FOR BBQ IS STANDARD

14. Additional Comments

15. Disclaimers and Notes

- Colours of all materials are as close as possible to builder's selection, but not necessarily identical due to variances in manufacturing.
- Any extras listed above are null and void unless accompanied by a separate invoice/amendment. Said invoice must be paid in full.
- The Purchaser acknowledges that after Interior Colour Selection form is signed and dated, no further changes will be permitted other than re-selection due to unavailability. Bz Purchaser's Initials
- The Purchaser acknowledges reading and accepting the "Gold Park Homes Decor Centre Disclaimers" form. This document contains other miscellaneous disclaimers.

This Interior Colour Selection is final and approved by:

Signature: Harpreet Kaur Ghotra Date: 7-Mar-17

CORTINA

KITCHENS INC.
70 Regina Road, Woodbridge, Ontario L4L 8L5
Tel: 905-284-6464 Fax: 905-284-0584
www.CortinaKitchens.com

Lot 128 - Revised

Mar. 7, 17



QUOTATION

Date: July 30/16

Trade Name: Gold Park Homes

Site location: Brampton

Model: 41-6 VERDI

Address:

Project: Encore LOT 128

Phase:

This layout has been explained to the purchaser by Cortina Kitchens Inc. and is understood by the purchaser.

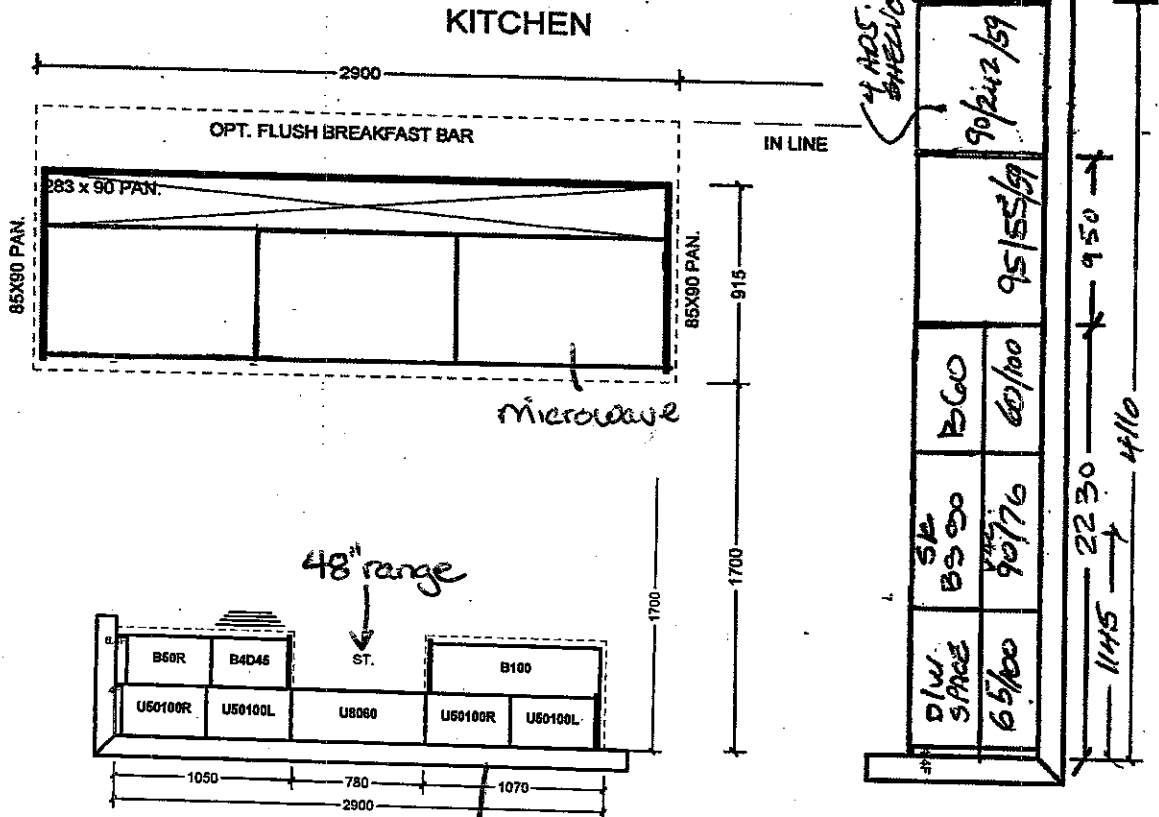

Revert to original layout on this stove wall.

* No knobs to be installed throughout

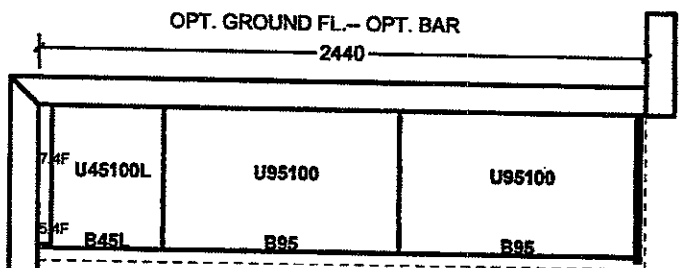
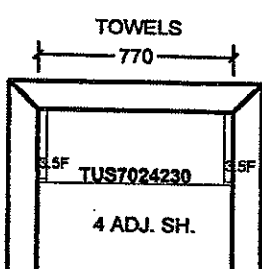
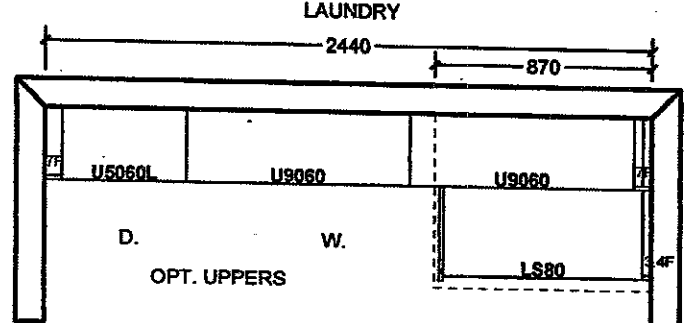
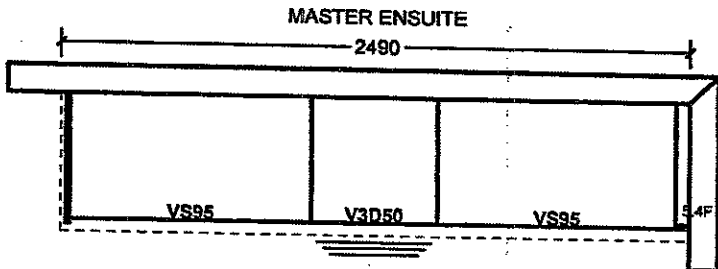
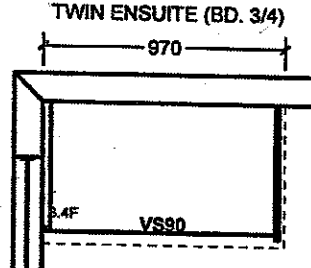
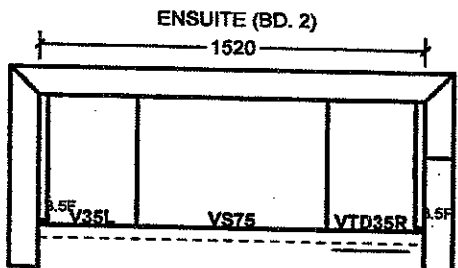

All prices subject to confirmation from head office. This quotation is subject to the terms & conditions set out

ACCEPTED DATE:

All agreements are contingent upon strikes, accidents, and delays beyond our control. Please provide our installer with template for sinkholes or \$150.00 will be charged for callback.

Item A. Wood grain and colour are characteristics of the product. We cannot guarantee that such grain and colour will always match.
Item B. Cortina Kitchens Inc. reserves the right to alter dimensions and make technical changes without notice.

Elevation A • 3,940 sq.ft. | Elevation B • 3,940 sq.ft.

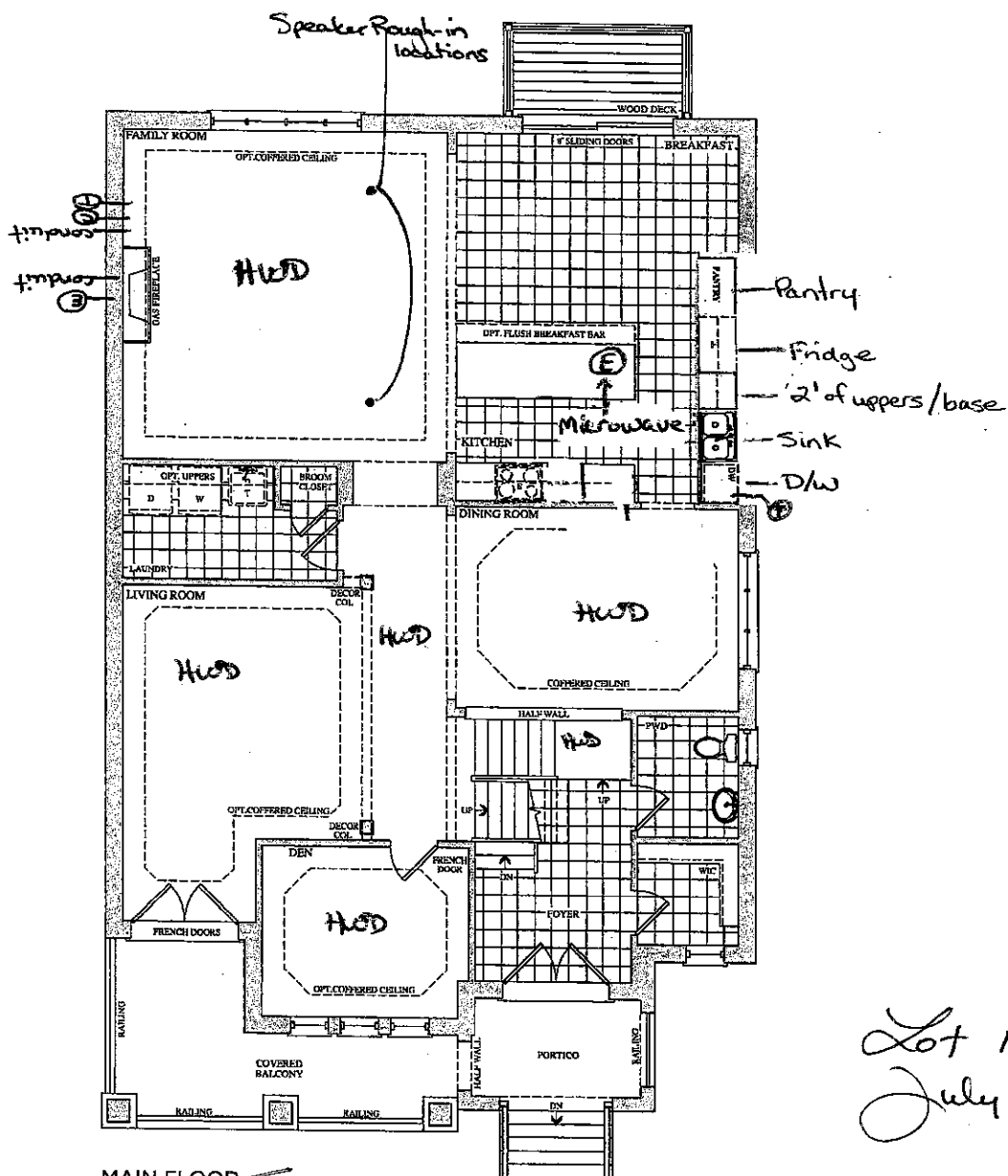

~~MAIN FLOOR
ELEVATION A~~

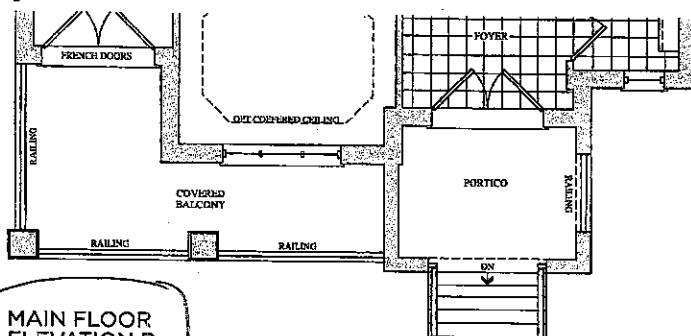

MAIN FLOOR
ELEVATION B

Lot 128
July 6, 116

Lot 128
Mar. 7, 17

Prices, figures, illustrations, sizes, features and finishes are subject to change without notice. E.&O.E. Areas and dimensions are approximate and actual usable floor space may vary from the stated area. Layout may be reverse of the unit purchased. E. & O.E.

GOLDPARK
HOMES

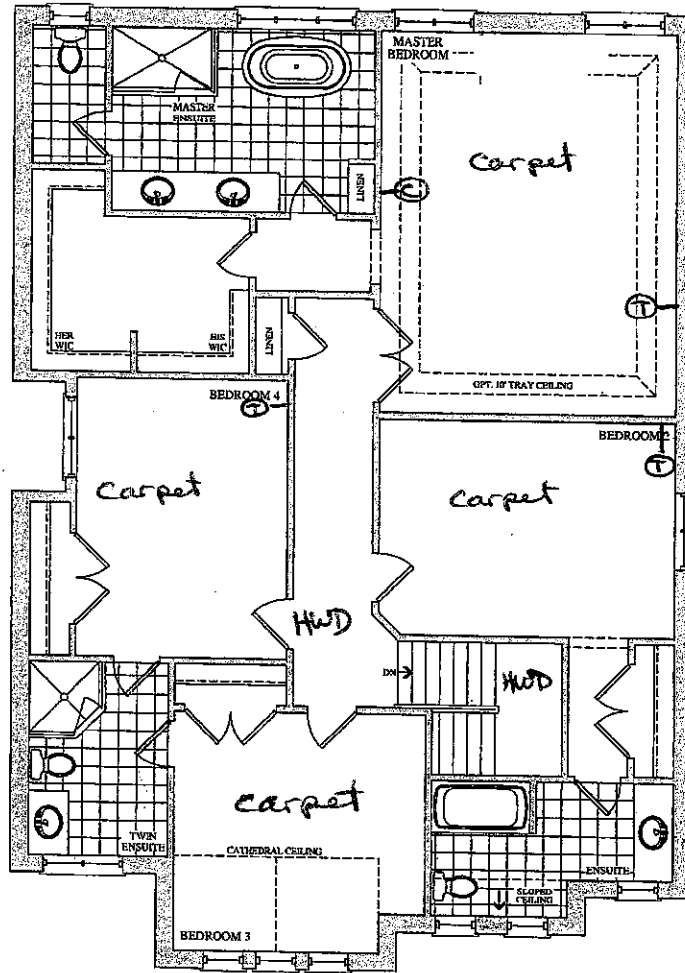

SECOND FLOOR
ELEVATION A

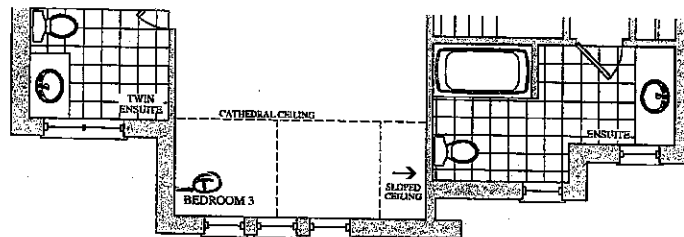

SECOND FLOOR
ELEVATION B

Lot 128
July 6, 16



Lot 128
Apr. 7, 17



Telephone — (T)
Cable — (C)

The
Verdi
41' SERIES

Elevation A • 3,940 sq.ft. | Elevation B • 3,940 sq.ft.

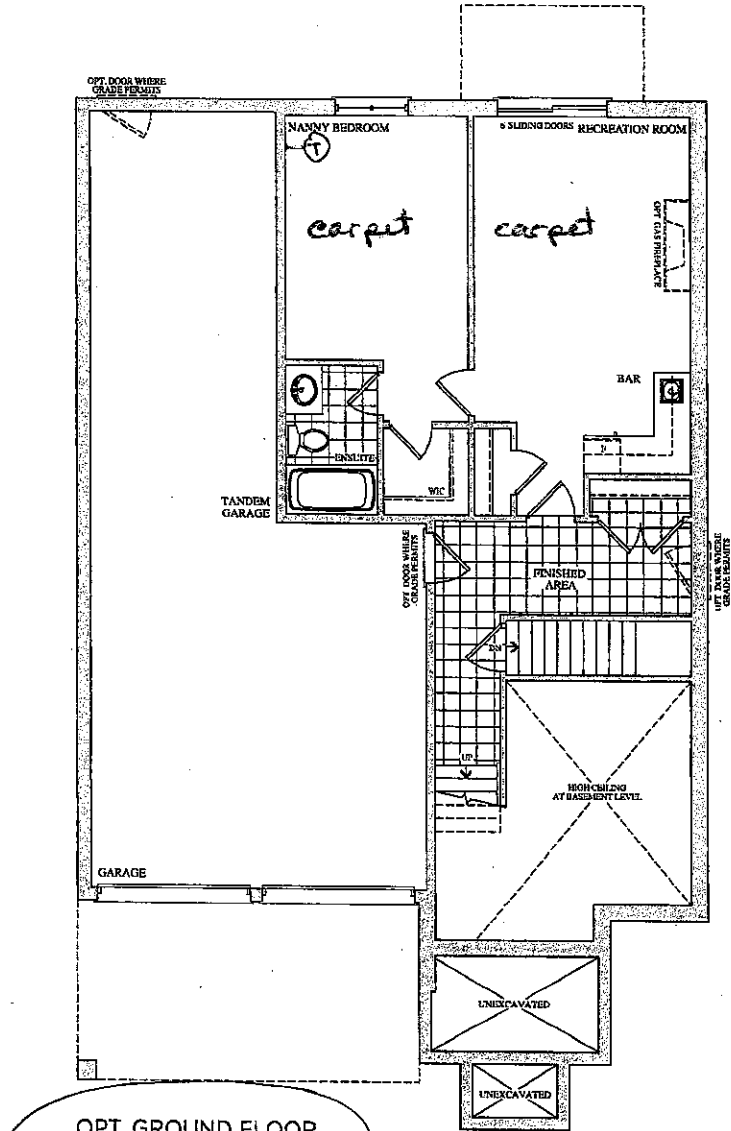

OPT. GROUND FLOOR
ELEVATION A & B
3,940 SQ. FT.

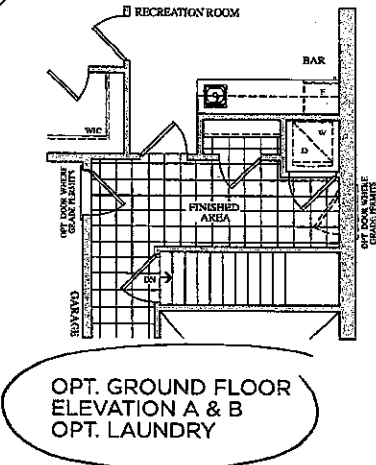

OPT. GROUND FLOOR
ELEVATION A & B
OPT. LAUNDRY

Lot 128
July 8, 16

(2)

Lot 128
Apr. 7, 17

(2)

Prices, figures, illustrations, sizes, features and finishes are subject to change without notice. E.&O.E. Areas and dimensions are approximate and actual usable floor space may vary from the stated area. Layout may be reverse of the unit purchased. E. & O.E.

CORTINA

KITCHENS INC.

70 Regina Road, Woodbridge, ON L4L 8L6
Tel: (905) 264-6464 Fax: (905) 264-0664

December, 2008

POLICY MEMO FOR BUILDERS

DRILLING FOR KNOB AND HANDLE HARDWARE

Builder: Gold Park Homes Project: Encore Brampton
Lot #: 128 Date: Mar. 7, 17

Cortina Kitchens' cabinetry doors and drawer fronts will be drilled to accept a standard knob or handle selected from Cortina's hardware boards. This drilling comes standard with the order, and is done ONLY in our shop, not on the job site.

For those not wanting Cortina's standard drilling, the following applies:

No holes to be drilled on the doors and drawer fronts should be specified in writing on the order. If while in production, Cortina Kitchens misses this request, Cortina Kitchens and the Builder will not be held responsible to replace any or all doors and drawer fronts affected, and the customer agrees to accept the product as is. No hardware will be supplied or credited by Cortina Kitchens. No charge will apply for this request.

I, Harpreet Ghotra, have read and agree to the above information.

Customer Signature: Harpreet Kaur Ghotra
Date: 07-March-2017



Granite, Marble,
Engineered Surfaces

207128
Mar 7, 17

- Standard 2CM @ 9CM
- ⊖ Upgrade 1 2CM @ 3CM
- ⊗ Upgrade 1 4 CM
- Upgrade 2

20mm (3/4") Profiles



Kitchen

20mm (1-1/4") Profiles

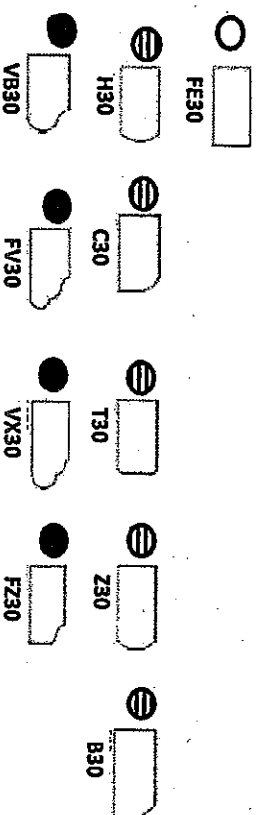

40mm (1-1/2") Profiles

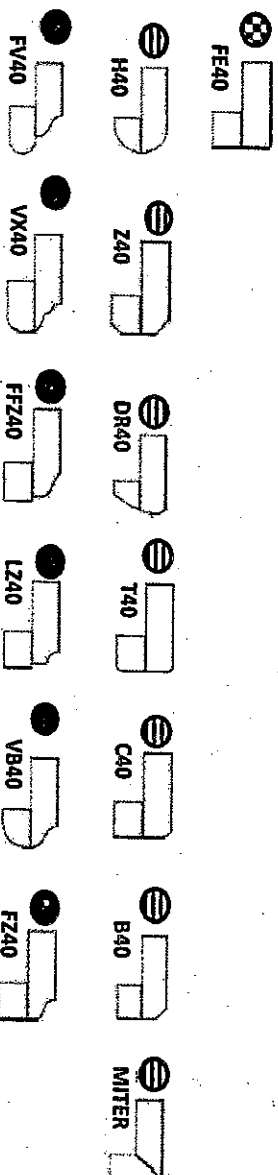

Note: All colours may not be available in 30mm at time ordered. Vendor reserves the right to use 40 mm edges (by lamination process).

*Mitre edge is available in Upgrade 1 for an overall thickness of 2". All other Mitre edge options will be an Upgrade 2 Edge.

Lot 128

T36IT800NP 36-INCH FLUSH CUSTOM FRENCH DOOR BOTTOM FREEZER

FREEDOM® COLLECTION

Thermador 
REAL INNOVATIONS FOR REAL COOKS®

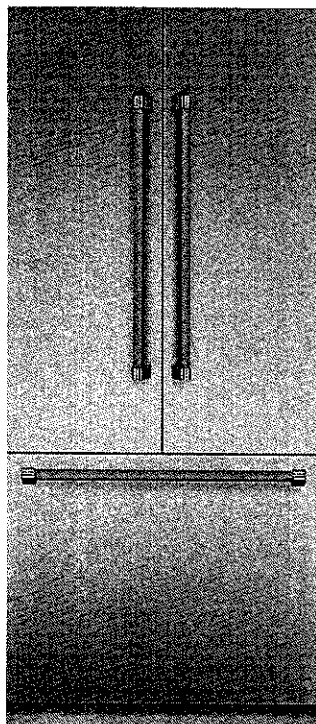

FEATURES & BENEFITS

- Freedom® Hinge enables true flush design
- Full-height door—true cabinet integration without exposed venting grille
- All-LED sidewall and theater lighting
- Brightspace interior design
- Accepts custom or stainless steel panel kit panels

TEMPERATURE RANGES

Refrigeration	35°F (2°C) to 46°F (8°C)
Adjustable Temperature Drawer	32°F (0°C) to 37°F (3°C)
Deli Drawer	Just above 32°F (0°C)
SuperCool	35.5°F (2°C) for approximately 9 hours
Energy Saving (Economy) Mode	Refrigerator: 45°F (7°C) Freezer: 3°F (-16°C)
Freezer	-9°F (-23°C) to 7°F (-14°C)
SuperFreeze®	-9°F (-23°C) for approximately 52 hours

SEE PAGE 2 FOR OPTIONAL ACCESSORIES

GENERAL PROPERTIES

Panel Ready	Yes
Lighting	All-LED Sidewall and Theater Lighting
Full Width Shelves - Refrigerator	3
Adjustable Shelves - Refrigerator	2
Shelf Material - Refrigerator	Glass Shelves w/Metal Trim
Full Extension Drawers at 90° Door Opening Angle	Yes
Humidity Control Drawer	Yes
Door Bins - Refrigerator	6
Gallon Door Bins	2
Defrost Process - Freezer	Frost-Free
Freezer Drawers	1
Ice Maker	Yes
Door Open Alarm	Yes
SuperCool	Yes
SuperFreeze®	Yes
Special Modes	Sabbath, Economy, Vacation

CAPACITY

Total Unit Gross Capacity (cu. ft.) - AHAM	20 cu. ft.
Refrigerator Gross Capacity (cu. ft.)	14 cu. ft.
Freezer Gross Capacity (cu. ft.)	6 cu. ft.

TECHNICAL DETAILS

Watts (W)	588 W
Current (A)	15 A
Volts (V)	120 V
Frequency (Hz)	60 Hz
Power Cord Length (in.)	78 3/4"
Plug Type	120V 3-Wire

DIMENSIONS & WEIGHT

Appliance Dimensions (H x W x D) (in.)	84" x 35 3/4" x 24"
Required Cutout Size (H x W x D) (in.)	84" x 36" x 24 3/4"
Net / Gross Weight (lbs)	454 / 496 lbs

EFFICIENCY

ENERGY STAR® Qualified	Yes
Annual Energy Consumption	590 kWh

WARRANTY

Limited, Entire Appliance, Parts and Labor on Any Part of the Refrigerator that Fails Because of a Manufacturing Defect	2 Year
Limited Warranty for Sealed Refrigeration System*; Parts And Labor	3rd to 6th Year
Limited Warranty for Sealed Refrigeration System*; Parts Only	7th to 12th Year

* Sealed refrigeration system includes compressor, evaporator, condenser, dryer / strainer and connection tubing

T36IT800NP

36-INCH FLUSH CUSTOM FRENCH DOOR

BOTTOM FREEZER

FREEDOM® COLLECTION



ACCESSORIES (OPTIONAL)

Stainless Steel Panel Options:

TFL36IT800 - Flat Stainless Steel Panel Kit

TCH36IT800 - Chiseled Stainless Steel Panel Kit

Handle Options:

PR36HNDL10 - 36" Professional Handle

MS36HNDL10 - 36" Masterpiece® Handle

FRAMEKIT10 - Freedom® Frame Kit

HEATRKIT10 - Freedom® Heater Kit

Filters:

REPLFLTR10 - Freedom® Water Filter

SCRNFLTR10 - Filter By-Pass

CUTOUT DIMENSIONS

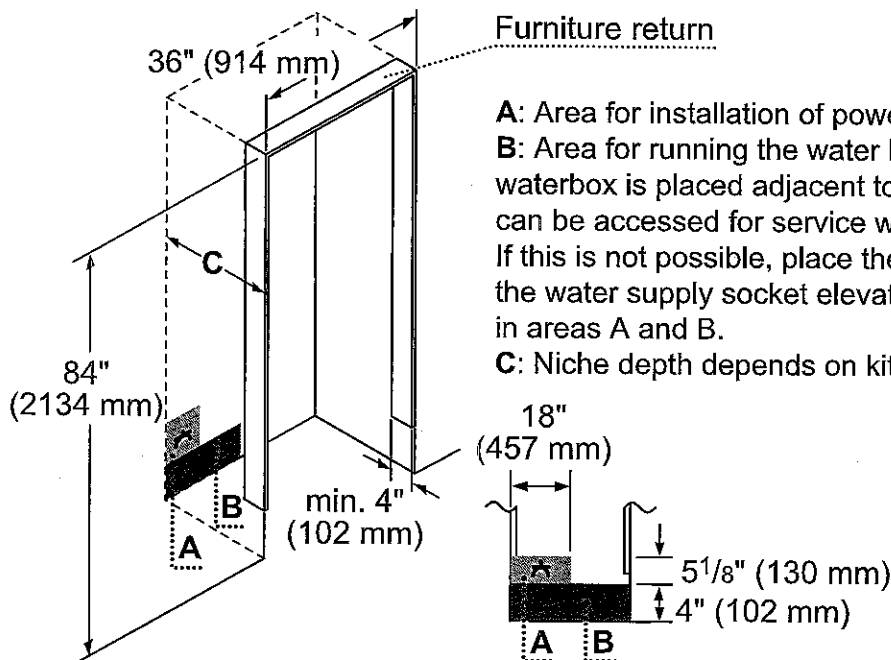

FREEDOM® COLLECTION



Technical drawing of the front view of a rectangular structure. The overall width is 36" (914 mm). The top horizontal edges are 1/8" (3 mm) thick. The overall height is 24" (610 mm). The distance from the top edge to the base of the structure is 9 1/4" (235 mm). The base of the structure is 20 15/16" (530 mm) high. The base is supported by two angled legs. The distance from the centerline to the outer edge of the base is 17 13/16" (452 mm). The angle between the legs is 90°. The angle between the leg and the base is 115°.

* Depends on the thickness of the furniture door.
3/4" (19 mm) is relevant for the stainless steel door.
(special Accessory).

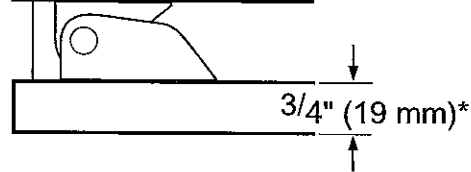

Technical drawings of the refrigerator showing front and side views with dimensions in inches and millimeters.

Front View Dimensions:

- Top width: $35\frac{3}{4}"$ (908 mm)
- Top depth: $24"^{**}$ (610 mm)
- Right height: $79\frac{7}{8}"$ (2029 mm)
- Left height: $84"$ (2134 mm)
- Bottom depth: $35\frac{3}{4}"$ (908 mm)
- Bottom width: $24"^{**}$ (610 mm)
- Bottom height: $4"$ (102 mm)
- Top depth (inner): $21\frac{13}{16}" - 4\frac{3}{16}"$ (72-106 mm)
- Top height (inner): $7\frac{1}{8}"$ (181 mm)

Side View Dimensions:

- Top width: $17\frac{13}{16}"$ (452 mm)
- Top width: $17\frac{13}{16}"$ (452 mm)
- Right height: $51\frac{3}{8}"$ (1304 mm)
- Bottom height: $1\frac{1}{8}"$ (3 mm)
- Bottom height: $28\frac{7}{16}"$ (722 mm)
- Bottom width: $35\frac{3}{4}"$ (908 mm)
- Bottom width: $4"$ (102 mm)
- Bottom height: $4"$ (102 mm)
- Variable water connection at the appliance

11 / 15

DWHD440MPR EMERALD® 4-PROGRAM DISHWASHER CUSTOM PANEL

Lot 128

Thermador ★
REAL INNOVATIONS FOR REAL COOKS®

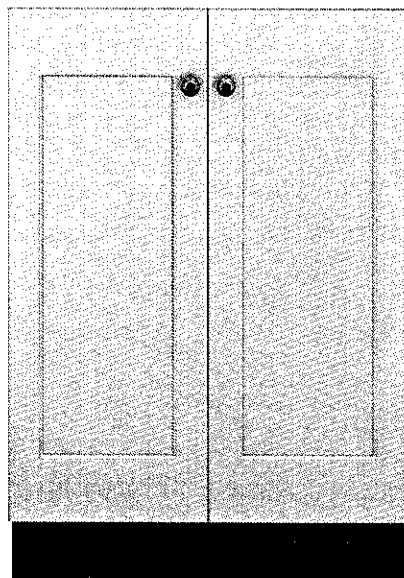

Also Available In:

DWHD440MFP - Flat Stainless Steel Panel
with Professional Series Handle

DWHD440MFM - Flat Stainless Steel Panel
with Masterpiece® Series Handle

FEATURES & BENEFITS

- Sens-A-Wash® measures water cleanliness and adjusts wash cycle
- Three stage advanced filtration recirculates water for sparkling results
- Accommodates 15 plate settings for your dinner parties
- Extra Dry Option ensures perfectly dry dishes and sanitizes 99.9% of bacteria
- Impressively Quiet®-48 dBA for peaceful kitchen experience

ACCESSORIES (OPTIONAL)

Dishwasher Supply and Drainage Hose Extension 76 3/4"	SGZ1010UC
Dishwasher 3-Prong Power Cord 66 7/8"	SMZPC002UC
Dishwasher Accessory Kit	SMZ5000
Fine Silverware Carafe	SMZ5002UC
24" Stainless Steel Chiseled Door with Masterpiece Handle	DWHDZJCMD
24" Stainless Steel Chiseled Door with Professional Handle	DWHDZJCPD



Accessory Kit includes Extra-Tall-Item Sprinkler,
Vase / Bottle Holder, 3 Plastic Item Clips and
Small Item Basket

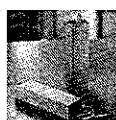

Fine
Silverware
Carafe

GENERAL PROPERTIES

Number Of Wash Cycles	4
Number Of Options	4
dBA	48
Third Rack	N/A
Rack Adjustability	Rackmatic 3-Stage
Tub Material	Stainless Steel
Control Type	Buttons
Concealed Heating Element	Yes
Leak Protection System	N/A
Water Softener	No
Five-Level Wash	Yes
Childlock	No

EFFICIENCY

Water Usage Per Cycle (g)	2.9 g
Energy Efficiency Class	Tier 1
ENERGY STAR® Qualified	Yes
Total Annual Energy Consumption (kWh)	269 kWh
Total Annual Water Consumption (g)	624 g

CAPACITY

Number Of Place Settings	15
--------------------------	----

TECHNICAL DETAILS

Watts (W)	1,300 W
Current (A)	12 A
Volts (V)	120 V
Frequency (Hz)	60 Hz
Power Cord Length (in)	47 1/4"
Minimum Water Pressure (lb/sin)	14
Max. Temperature for Water Intake	120° F
Length Inlet Hose (in)	53"
Length Outlet Hose (in)	67"

DIMENSIONS & WEIGHT

Overall Appliance Dimensions (HxWxD) (in)	33 7/8" x 23 9/16" x 23 1/16"
Required Cutout Size (HxWxD) (in)	33 7/8" x 23 5/8" x 24"
Adjustable Feet	Yes
Net Weight (lbs)	83 lbs

WARRANTY

Full Warranty, Entire Appliance, Parts and Labor	2 Year
Limited Warranty for Microprocessor or Printed Circuit Board; Parts Only	3rd to 5th Year
Limited Warranty for Racks (Does Not Include Rack Components); Parts Only	3rd to 5th Year
Limited Warranty for Rust-through On Inner Tub Liner; Parts Only	Lifetime

DWHD440MPR
EMERALD® 4-PROGRAM DISHWASHER
CUSTOM PANEL



DISHWASHER & CUTOUT DIMENSIONS

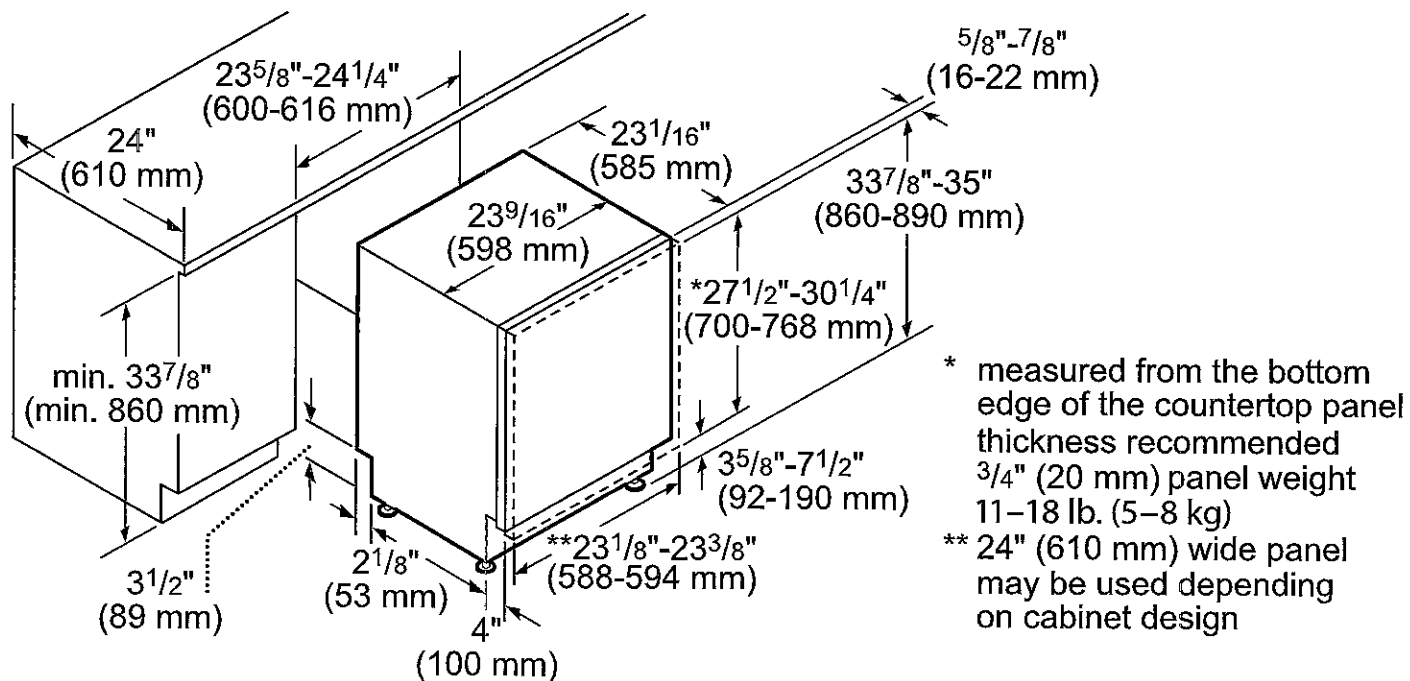

measurements in inches and mm

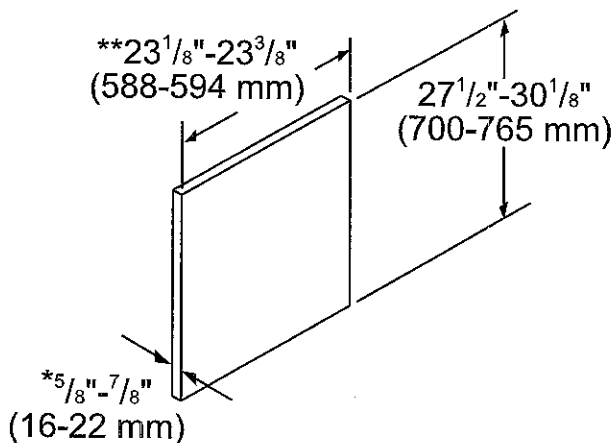

- * thickness recommended 3/4" (20 mm), panel weight 11-18 lb. (5-8 kg)
- ** 24" (610 mm) wide panel may be used depending on cabinet design

measurements in inches and mm

These warranties give you specific legal rights and you may have other rights that vary from state to state. Full warranty and limited warranty from date of installation. For complete warranty details, refer to your Use & Care manual, or ask your dealer.

Specifications are for planning purposes only. Refer to installation instructions and consult your countertop supplier prior to making counter opening. Consult with a heating and ventilation engineer for your specific ventilation requirements. For the most detailed information, refer to installation instructions accompanying product or write to Thermador indicating the model number. Specifications are correct at time of printing. Thermador reserves the right to change product specifications or design without notice. Some models are certified for use in Canada. Thermador is not responsible for products that are transported from the U.S. for use in Canada.

Lot 128

PH48GS 27-INCH DEPTH WALL HOOD (48-INCH WIDTH)

PROFESSIONAL SERIES

Thermador ★
REAL INNOVATIONS FOR REAL COOKS®

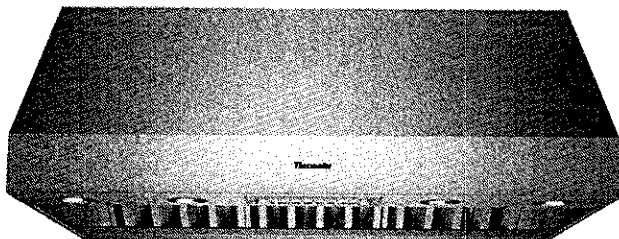

42-inch model PH42GS shown

FEATURES & BENEFITS

- Three fan speeds
- Auto function senses heat from the cooking surface and adjusts fan speeds
- Powerfully Quiet ventilation systems
- Extended capture area ensures removal of smoke and odor
- Built-in 'Clean Filter' reminder light illuminates after 40 hours of operation
- 27" depth hood is a perfect companion to the Pro Grand Professional Range
- Delayed shut-off tackles lingering odors for up to 10 minutes
- Dimmer lighting – for a soft lighting effect
- Two infrared keep-hot lamps hold food warm until serving time

ACCESSORIES (OPTIONAL)

25 ft. Blower Connector Cable - EXTNCB25

For use with the following Inline and Remote Blowers: VTR630P, VTR1030P, VTR1330P, VTI610P, VTI1010P

Roofplates

RFPLT600P - For use with 600 CFM Remote Blower VTR630P

RFPLT1000P - For use with 1000 CFM Remote Blower VTR1030P and 1300 CFM Blower VTR1330P

48" W, 6" H Stainless Steel Duct Cover	DC48US
48" W, 12" H Stainless Steel Duct Cover	DCT48US
Roof Jack and Transition	RJ310
10" Wall Cap	WC10

GENERAL PROPERTIES

Operating Mode	Ducted
Maximum CFM	N/A
Number of Speed Settings	3-Stage
Motor Location	Blower (Sold Separately)
Number Of Lights	4
Bulb Type	40 W - G9 Base
Total Power Of The Lamps (W)	160 W
Damper Included	Yes
Grease Filter Material	Washable Stainless Steel
Grease Filter Type	Commercial-Style Baffle

TECHNICAL DETAILS

Watts (W)	N/A
Current (A)	15; 20 A
Volts (V)	120 V
Frequency (Hz)	60 HZ
Plug Type	120V-3 Prong

DIMENSIONS & WEIGHT

Overall Appliance Dimensions (Width Of Canopy Included) (HxWxD) (in)	18" x 47 15/16" x 27"
Required Distance Above Cooktop / Range Cooking Surface	30" / 30"
Diameter of Air Duct (in) Top	10"
Diameter of Air Duct (in) Back	10"
Net Weight (lbs)	98 lbs

ACCESSORIES (REQUIRED)

Blower (Sold Separately)

BLOWER OPTIONS

Remote Blower (Mounted to Roof or External Wall)	VTR630P - 600 CFM
	VTR1030P - 1000 CFM
	VTR1330P - 1300 CFM
Inline Blower (Mounted Between Kitchen and External Wall)	VTI610P - 600 CFM
	VTI1010P - 1000 CFM
Integrated Blower (Mounted in Hood)	VTN630N - 600 CFM
	VTN1030N - 1000 CFM

WARRANTY

Limited Warranty Parts And Labor	2 Year
----------------------------------	--------

PH48GS
27-INCH DEPTH WALL HOOD (48-INCH WIDTH)
PROFESSIONAL SERIES



HOOD DIMENSIONS

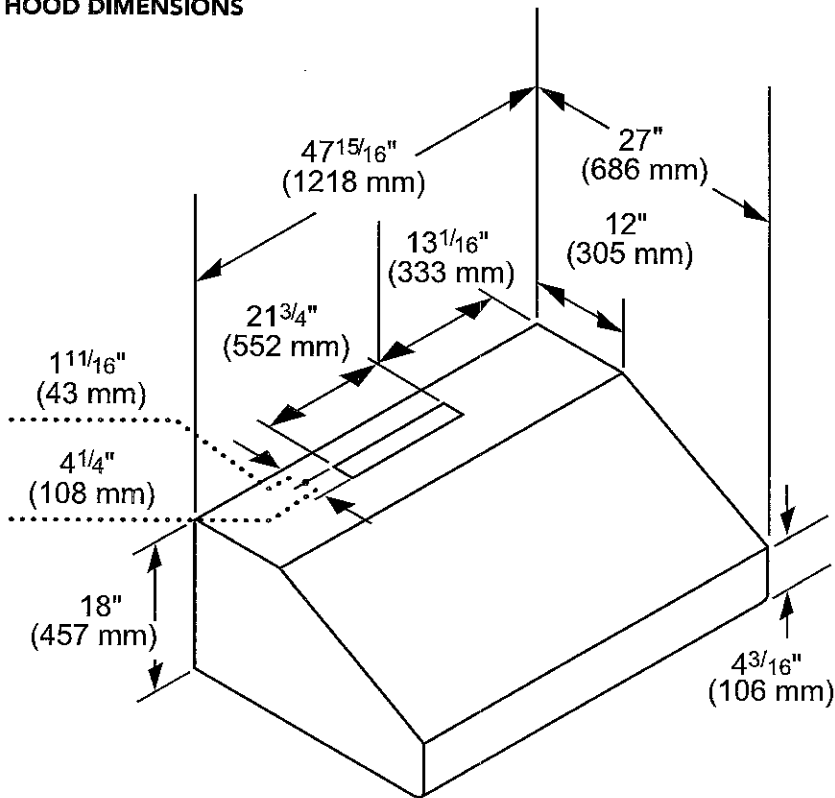

measurements in inches and mm

OPTIONAL ACCESSORIES

48" WIDE DUCT COVER
DC48US 6" HIGH
DCT48US 12" HIGH

Stainless steel duct cover for wall hood applications

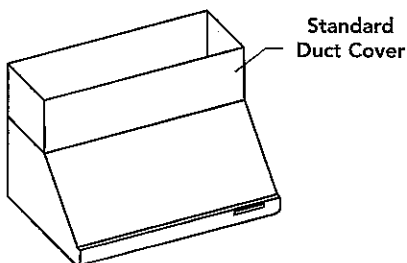

PH48GS

27-INCH DEPTH WALL HOOD (48-INCH WIDTH)

PROFESSIONAL SERIES



REMOTE BLOWERS (MOUNTED TO ROOF OR EXTERNAL WALL)

VTR630P-600 CFM

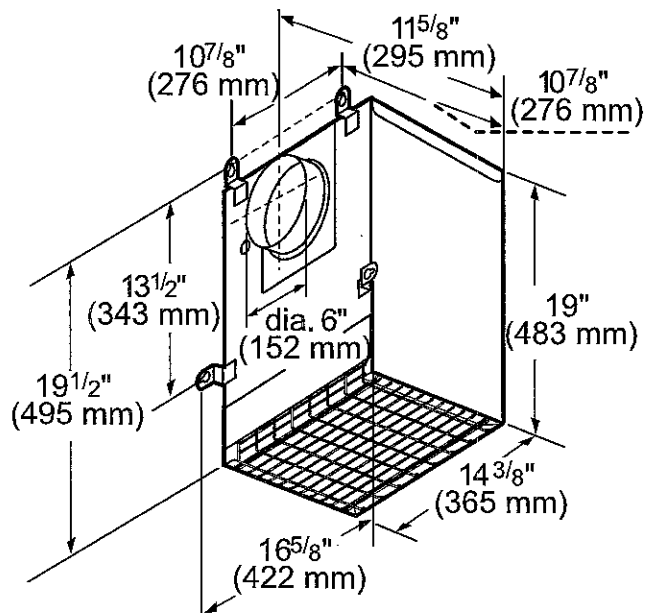

measurements in inches and mm

VTR1030P-1000 CFM

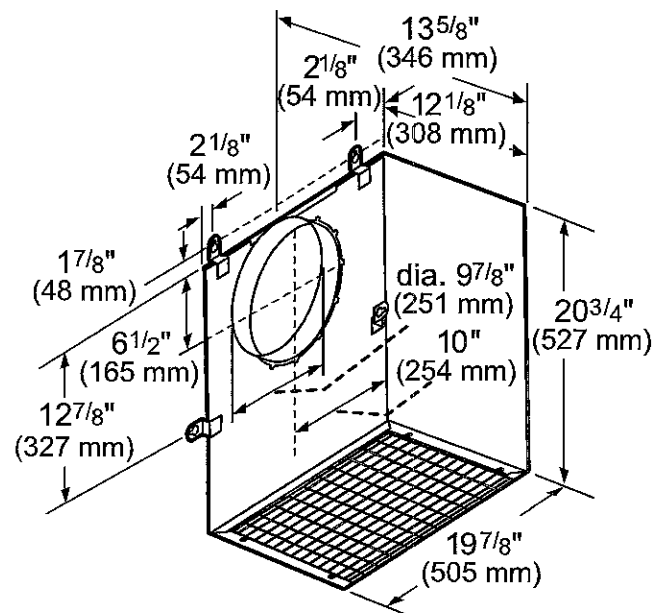

measurements in inches and mm

VTR1330P-1300 CFM

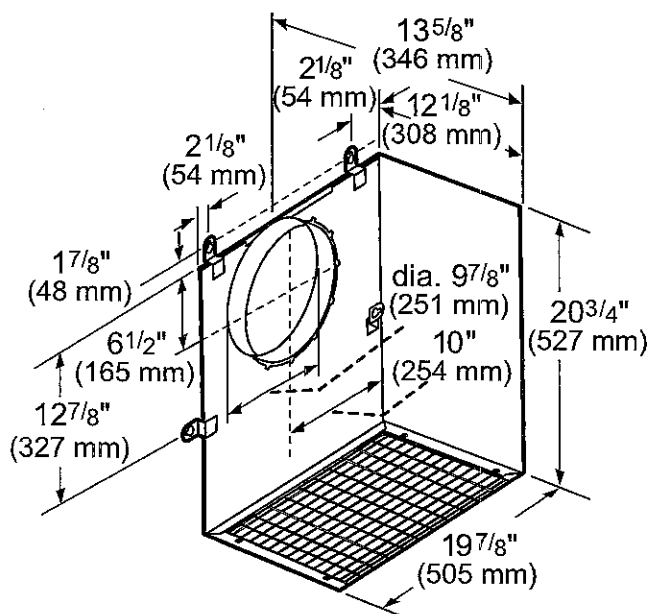

measurements in inches and mm

PH48GS
27-INCH DEPTH WALL HOOD (48-INCH WIDTH)
 PROFESSIONAL SERIES



INLINE BLOWERS (MOUNTED BETWEEN KITCHEN AND EXTERNAL WALL)

VTI610P-600 CFM

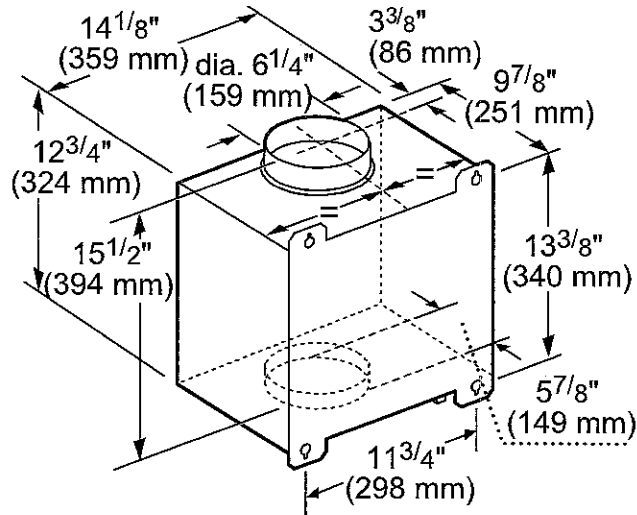

measurements in inches and mm

VTI1010P-1000 CFM

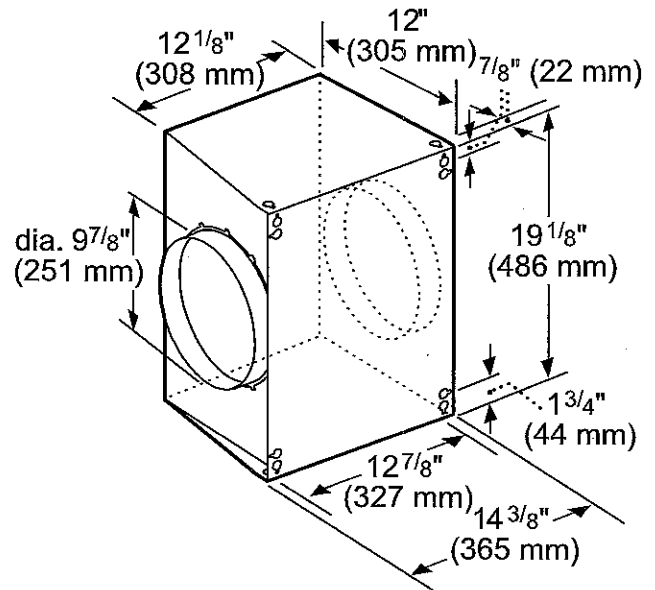

measurements in inches and mm

INTEGRATED BLOWERS (MOUNTED IN HOOD)

VTN630N-600 CFM

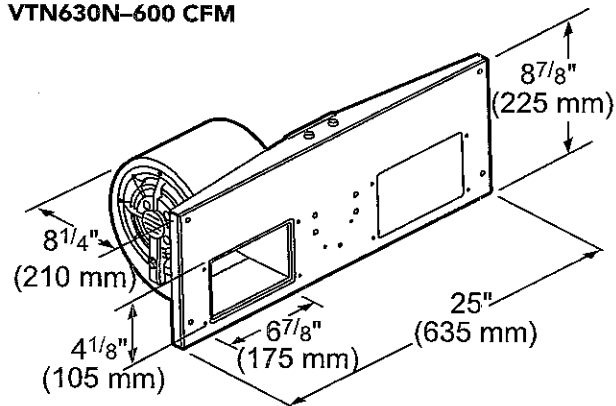

measurements in inches and mm

VTN1030N-1000 CFM

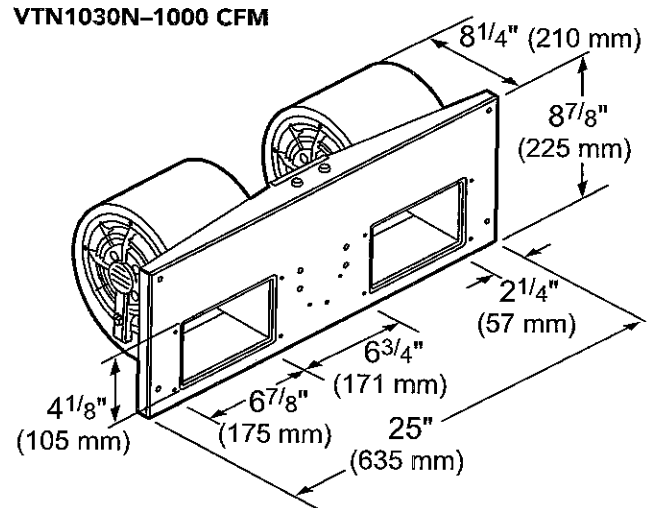

PH48GS 27-INCH DEPTH WALL HOOD (48-INCH WIDTH) PROFESSIONAL SERIES



REMOTE BLOWER ACCESSORIES

ROOFPLATE-RFPLT600P

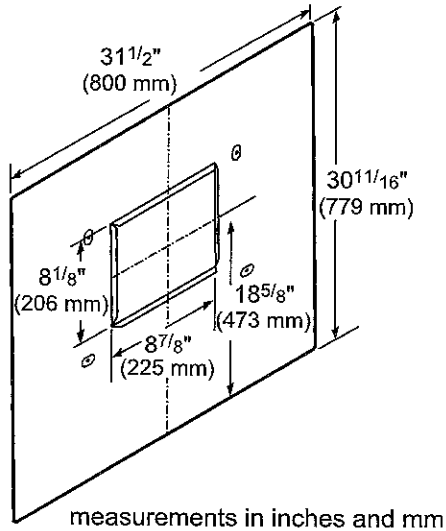

ROOFPLATE-RFPLT1000P

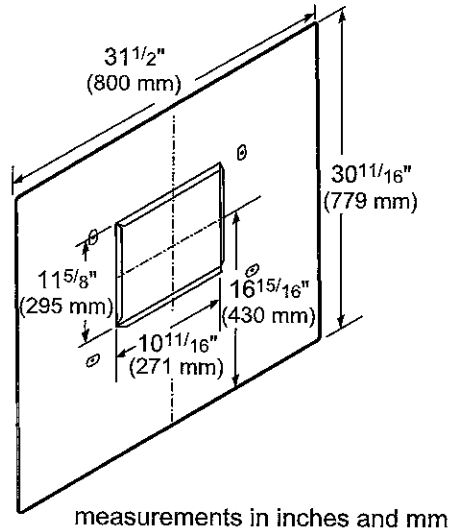

EXTNCB25

25 ft. Blower Connector Cable for use with the following Inline and Remote blowers: VTR630P, VTR1030P, VTR1330P, VT1610P, VT11010P

ROOF JACK & TRANSITION

ROOF JACK-RJ310

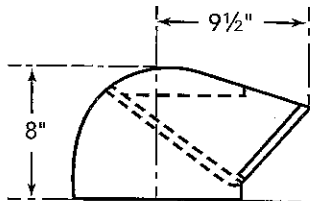

TRANSITION

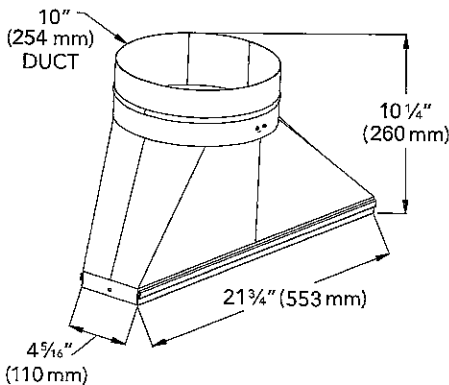

WALL CAPS

10-INCH WALL CAP-WC10

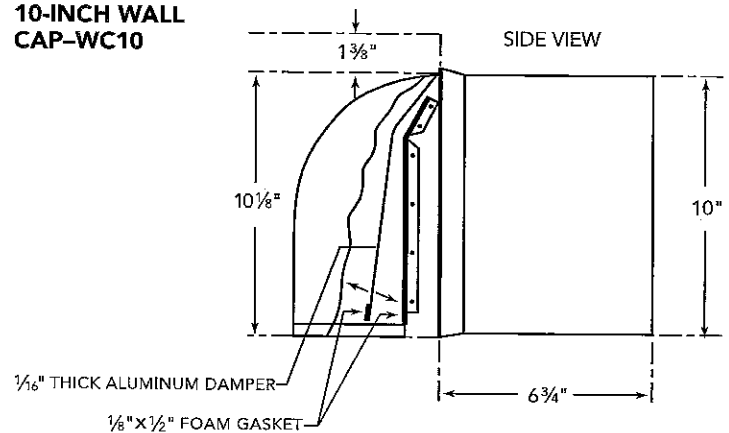

These warranties give you specific legal rights and you may have other rights that vary from state to state. Full warranty and limited warranty from date of installation. For complete warranty details, refer to your Use & Care manual, or ask your dealer.

Specifications are for planning purposes only. Refer to installation instructions and consult your countertop supplier prior to making counter opening. Consult with a heating and ventilation engineer for your specific ventilation requirements. For the most detailed information, refer to installation instructions accompanying product or write to Thermador indicating the model number. Specifications are correct at time of printing. Thermador reserves the right to change product specifications or design without notice. Some models are certified for use in Canada. Thermador is not responsible for products that are transported from the U.S. for use in Canada.

PRG486NLH 48-INCH GAS PRO HARMONY® RANGE WITH GRILL

PROFESSIONAL SERIES, STANDARD-DEPTH, PORCELAIN COOKTOP SURFACE

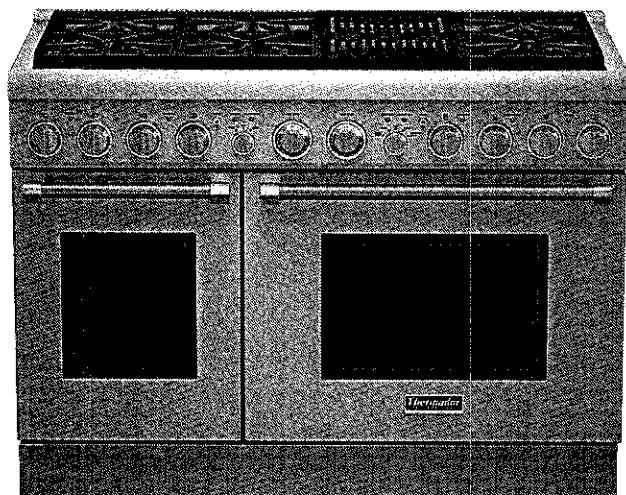

Also Available:
PRL486NLH - LP

FEATURES & BENEFITS

- ★ Exclusive, patented Star® Burner—most even heating, unsurpassed flame coverage
- ★ QuickClean Base® designed for easy surface cleaning
- ★ Precision simmering capabilities as low as 100°F (375 BTU) with 2 ExtraLow® Simmer burners
 - Professional style, continuous cast iron grates
 - Truly Flush Mounted™, 24" standard cabinet depth

TECHNICAL DETAILS

Circuit Breaker (A)	20 A
Volts (V)	120 V
Frequency (Hz)	60 Hz
Plug Type	120V-3 Prong
Power Cord Length (in)	72"
Energy Source	Gas
Gas Type	Natural Gas 15 mbar (USA)
Alternative Gas Type	Liquid Gas 27.5 mbar (USA)

SEE PAGE 2 FOR OPTIONAL ACCESSORIES

GENERAL PROPERTIES

Oven Capacity	4.4 / 2.3 cu. ft.
Cooking Modes - Main / Large Cavity	Bake, Convection Bake, Broil, Extended Bake
Cooking Modes - Small Cavity	Bake, Broil
Programs	Sabbath Function (Main)
Cleaning Type	N/A
Type of Grate	Continuous Cast Iron
Controls	Metal Knobs
Sealed Burners	Yes

OVEN PERFORMANCE

Bake Power	23,500 BTU (Lg) / 15,000 BTU (Sm) (NG)
Broil Power	20,000 BTU (Lg) / 7,500 BTU (Sm) / (NG)
Convection Power	N/A

BURNER PERFORMANCE

Total Number of Cooktop Burners	6 + Grill
Power of Front Left Burner BTU	18,000 and XLO (NG)
Power of Back Left Burner BTU	18,000 and XLO (NG)
Power of Back Center Burner BTU	18,000 (NG)
Power of Front Center Burner BTU	18,000 (NG)
Power of Center 12" Electric Griddle (W)	N/A
Power of Center 12" Electric Grill (W)	1,630 W
Power of Far Right 12" Electric Griddle (W)	N/A
Power of Back Right Burner BTU	18,000 (NG)
Power of Front Right Burner BTU	18,000 (NG)

DIMENSIONS & WEIGHT

Overall Appliance Dimensions (HxWxD) (in)	35 7/8" - 36 3/4" x 47 7/8" x 24 3/4"
Required Cutout Size (HxWxD) (in)	35 7/8" - 36 3/4" x 48" x 24"
Adjustable Range Height (in.)	7/8"
Net Weight (lbs)	540 lbs

ACCESSORIES (INCLUDED)

1 X Island Trim, 3 X Full Access Telescopic Racks, 2 X Telescopic Rack – Small, 1 X Broiler Pan, 1 X Broiler Pan Small

WARRANTY

Limited Warranty, Entire Appliance, Parts and Labor	2 Year
---	--------

★ THERMADOR EXCLUSIVE

PRG486NLH 48-INCH GAS PRO HARMONY® RANGE WITH GRILL

PROFESSIONAL SERIES, STANDARD-DEPTH, PORCELAIN COOKTOP SURFACE



ACCESSORIES (OPTIONAL)



PABRICKBKN
Black Ceramic Briquettes
with Basket



PAGRIDDLEN
Griddle for Indoor
Electric Grill



PA12LCVRN
12" Pro Grill Cover for
Indoor Electric Grill



PA12CHPBLK
12" Cutting Board



PWOKRINGHC
Wok Ring



PA48GLBH
9" Low Backguard



PAKNOBLUNH
Blue Knob Pro Harmony Kit



PAGRIDDLE
Griddle

48-INCH RANGE DIMENSIONS

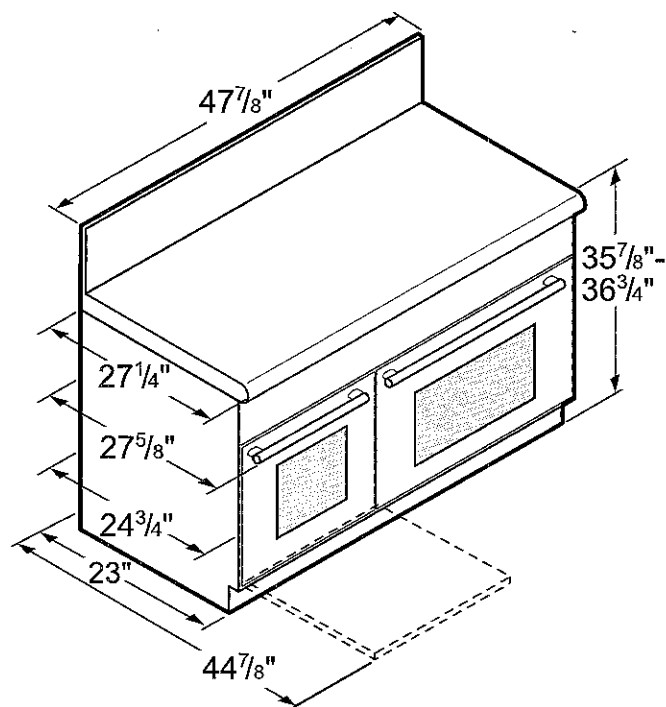

48-INCH RANGE CUTOUT DIMENSIONS

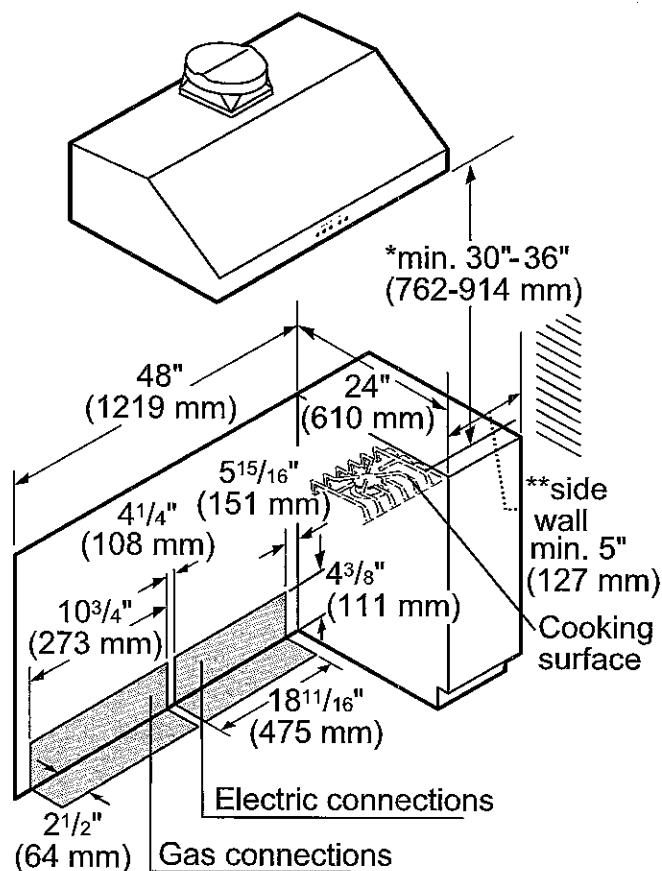

* 30" (762 mm) minimum clearance above cooking surface to non-combustible surface. Minimum clearance above cooking surface to combustible surface is 36" (914 mm).

** 5" (127 mm) minimum clearance from sides of the cooker, above the cooking surface, to combustible side walls.

Note: Most hoods contain combustible components that must be considered when planning the installation.

measurements in inches

PRG486NLH 48-INCH GAS PRO HARMONY® RANGE WITH GRILL

PROFESSIONAL SERIES, STANDARD-DEPTH, PORCELAIN COOKTOP SURFACE



48-INCH RANGE CUTOUT DIMENSIONS

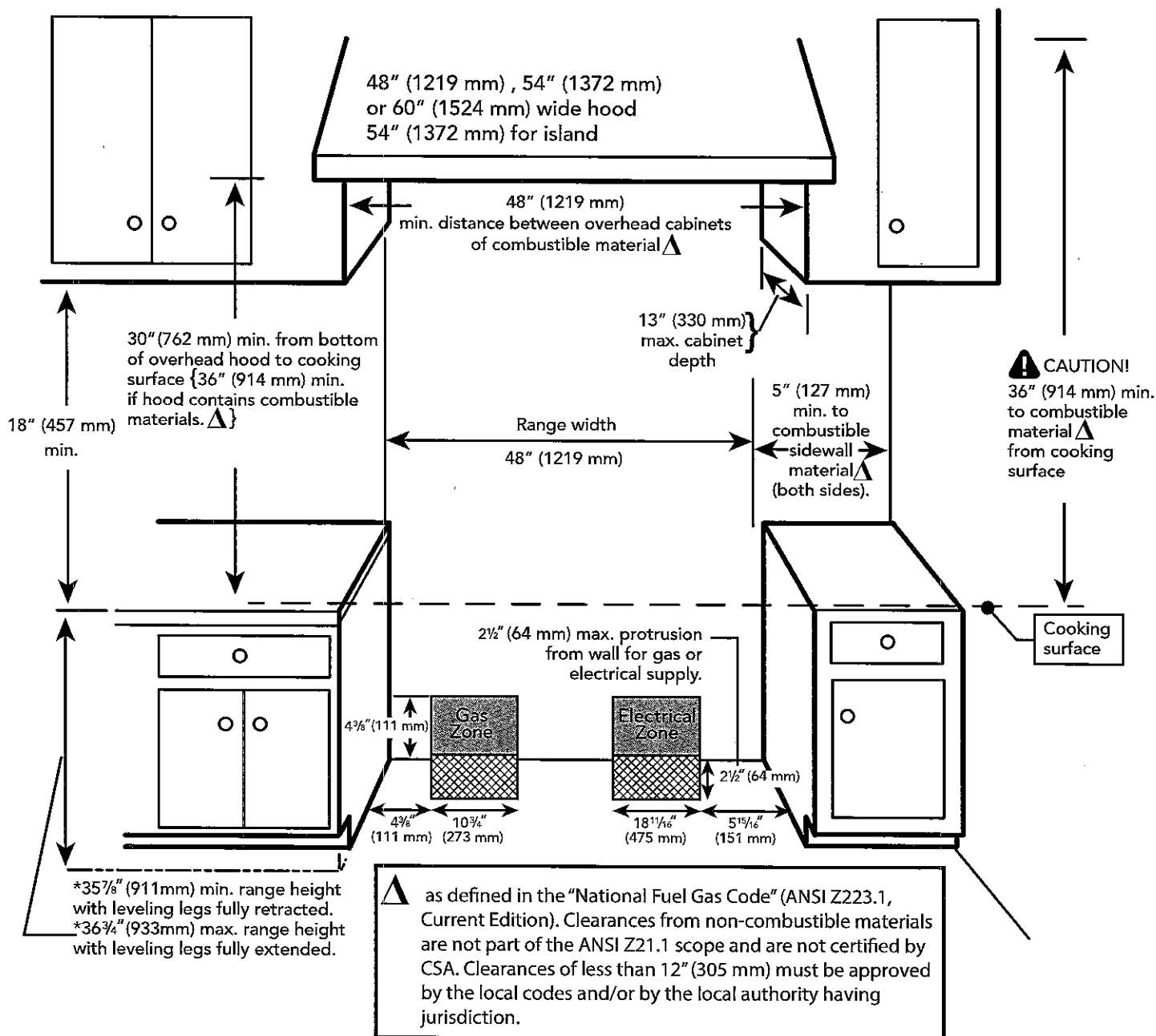

PRG486NLH 48-INCH GAS PRO HARMONY® RANGE WITH GRILL

PROFESSIONAL SERIES, STANDARD-DEPTH, PORCELAIN COOKTOP SURFACE



48-INCH RANGE DIMENSIONS AND CLEARANCE REQUIREMENTS WITH "LOW BACK"

NOTE: A 36-inch minimum clearance is required between the top of the cooking surface and the bottom of an unprotected cabinet. A 30-inch clearance can be used when the bottom of the wood or metal cabinet is protected by not less than 1/4 inch of a flame retardant material covered with not less than No. 28 MSG sheet steel, 0.015 inch (0.4 mm) thick stainless steel, 0.024 inch (0.6 mm) aluminum, or 0.020 inch (0.5 mm) thick copper.

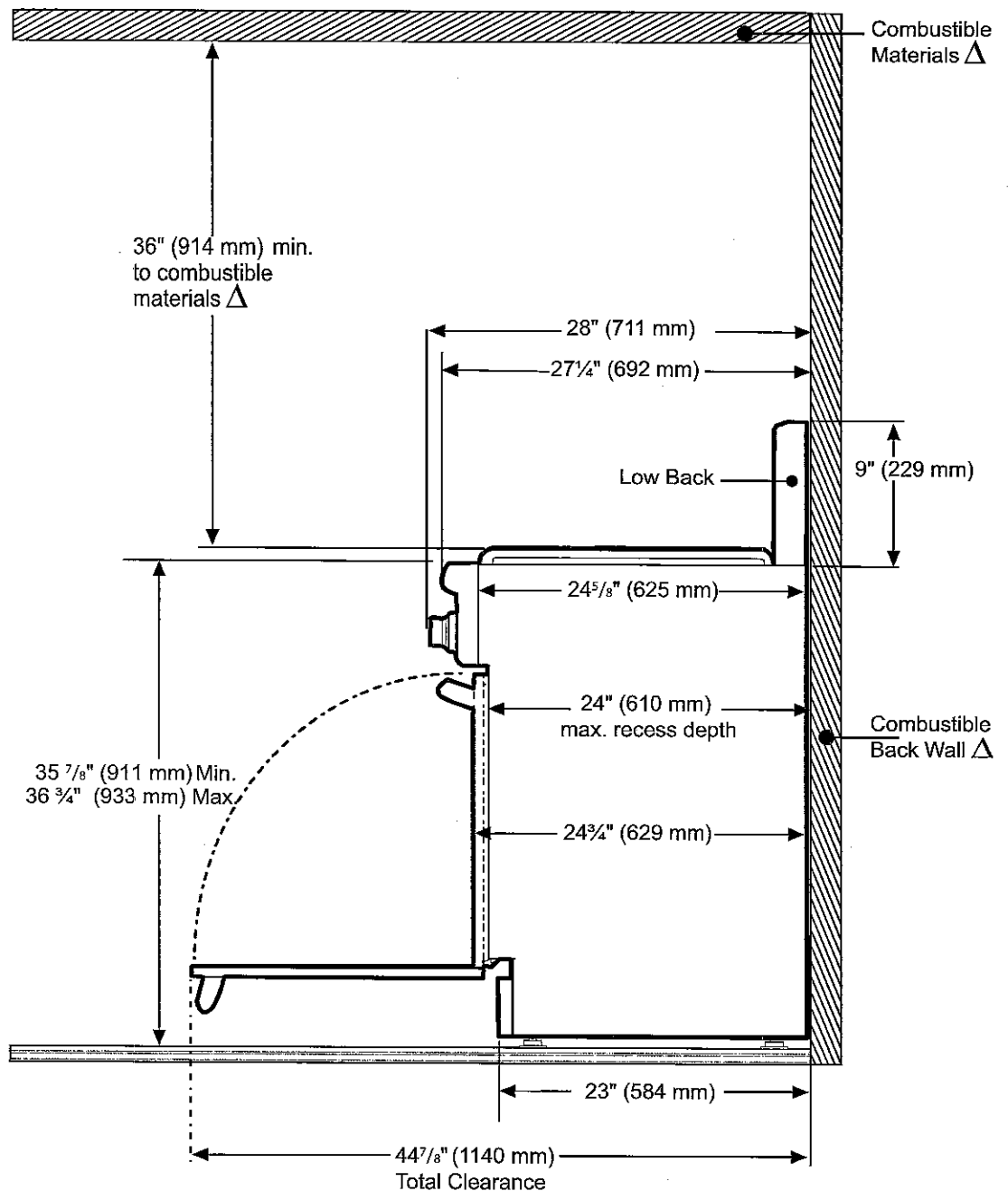

△ As defined in the "National Fuel Gas Code" (ANSI Z223.1, Current Edition). Clearances from non-combustible materials are not part of the ANSI Z21.1 scope and are not certified by CSA. Clearances of less than 12" (305 mm) must be approved by the local codes and/or by the local authority having jurisdiction.

PRG486NLH 48-INCH GAS PRO HARMONY® RANGE WITH GRILL

PROFESSIONAL SERIES, STANDARD-DEPTH, PORCELAIN COOKTOP SURFACE



48-INCH RANGE DIMENSIONS AND CLEARANCE REQUIREMENTS WITH "FLUSH ISLAND TRIM"

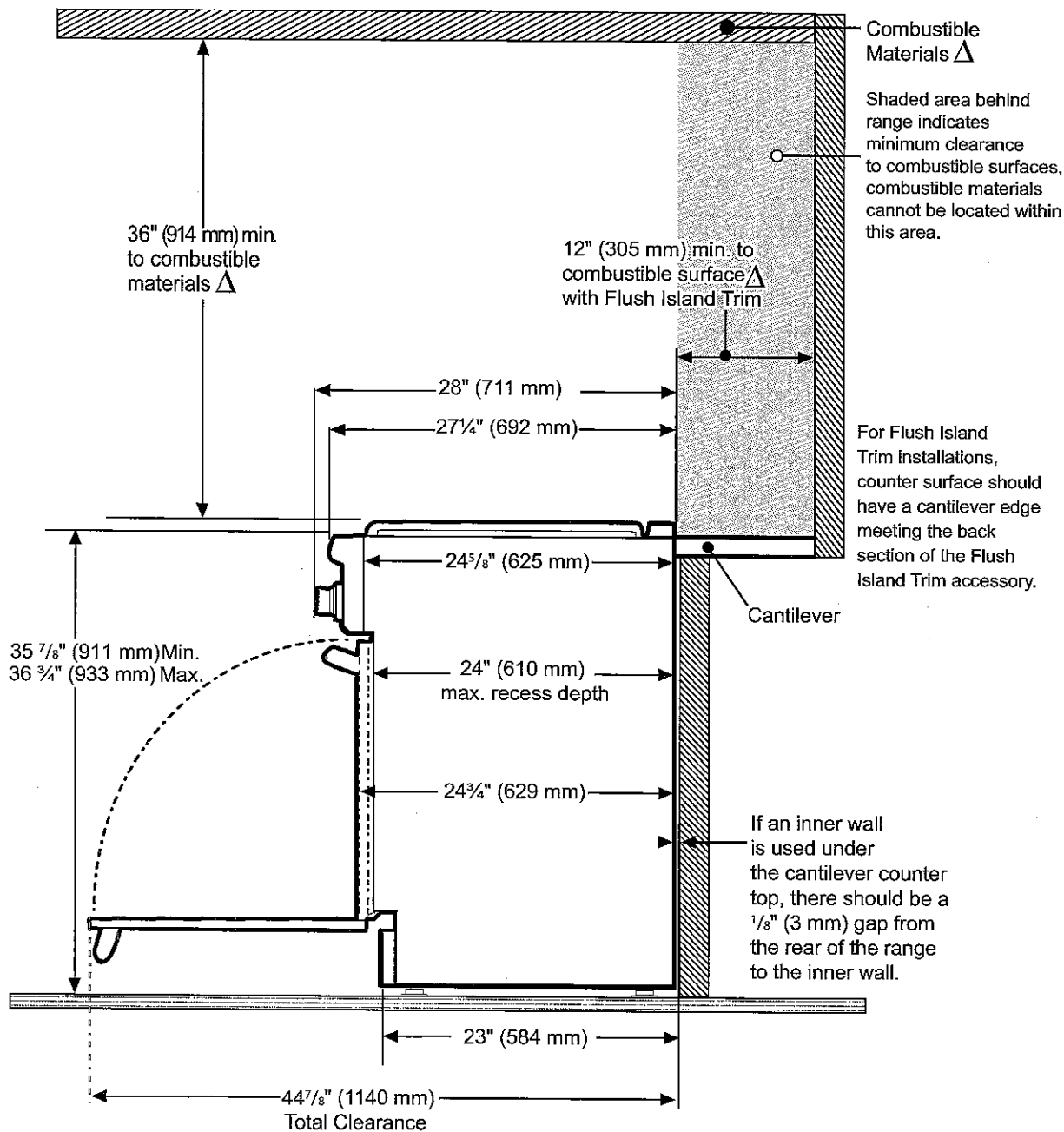

Δ As defined in the "National Fuel Gas Code" (ANSI Z223.1, Current Edition). Clearances from non-combustible materials are not part of the ANSI Z21.1 scope and are not certified by CSA. Clearances of less than 12" (305 mm) must be approved by the local codes and/or by the local authority having jurisdiction.

These warranties give you specific legal rights and you may have other rights that vary from state to state. Full warranty and limited warranty from date of installation. For complete warranty details, refer to your Use & Care manual, or ask your dealer.

Specifications are for planning purposes only. Refer to installation instructions and consult your countertop supplier prior to making counter opening. Consult with a heating and ventilation engineer for your specific ventilation requirements. For the most detailed information, refer to installation instructions accompanying product or write to Thermador indicating the model number. Specifications are correct at time of printing. Thermador reserves the right to change product specifications or design without notice. Some models are certified for use in Canada. Thermador is not responsible for products that are transported from the U.S. for use in Canada.

1 800 735 4328 | USA THERMADOR.COM | CANADA THERMADOR.CA | ©2015 BSH HOME APPLIANCES CORPORATION. ALL RIGHTS RESERVED.

MD24JS

24-INCH MICRODRAWER® MICROWAVE

MASTERPIECE® & PROFESSIONAL SERIES

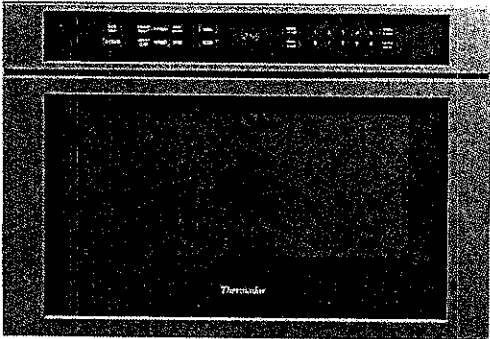

FEATURES & BENEFITS

- Spacious 1.2 cu. ft. Interior fits a 20 oz. cup or a 13" x 9" pan
- 950 watts microwave power and 10 power levels
- Sensor cooking programs measure humidity and adjust cooking level and cooking time
- Touch "open" and "close"
- Perfect flush installation and hidden vent

GENERAL PROPERTIES	
Cavity Color	White
Max. Microwave Power (W)	950 W
CAPACITY	
Cavity Capacity (cu. ft.)	1.2 cu. ft.
Turntable Diameter (in.)	N/A
TECHNICAL DETAILS	
Watts (W)	1,500 W
Circuit Breaker (A)	15 A
Volts (V)	120 V
Frequency (Hz)	60 Hz
Plug Type	120V-3 Prong
Power Cord Length (in.)	48"
DIMENSIONS & WEIGHT	
Overall Appliance Dimensions (HxWxD) (in.)	16 5/16" x 23 7/8" x 23 3/8"
Required Cutout Size (HxWxD) (in.)	14 13/16" x 22 1/8" x 23 1/2"
Net Weight (Lbs)	81 lbs
ACCESSORIES (INCLUDED)	
N/A	
WARRANTY	
Limited Warranty, Entire Appliance, Parts and Labor	2 Year

MD24JS
24-INCH MICRODRAWER® MICROWAVE
MASTERPIECE® & PROFESSIONAL SERIES



PRODUCT DIMENSIONS

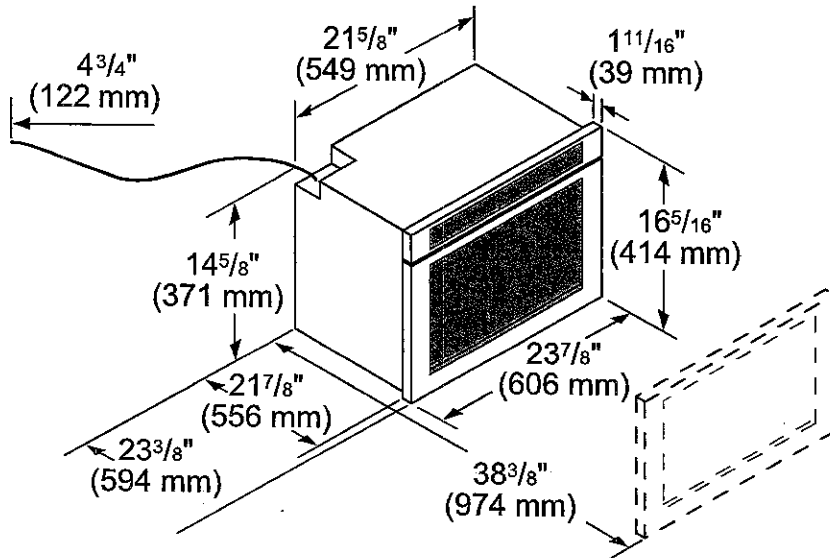

MD24JS 24-INCH MICRODRAWER® MICROWAVE

MASTERPIECE® & PROFESSIONAL SERIES



STANDARD INSTALLATION

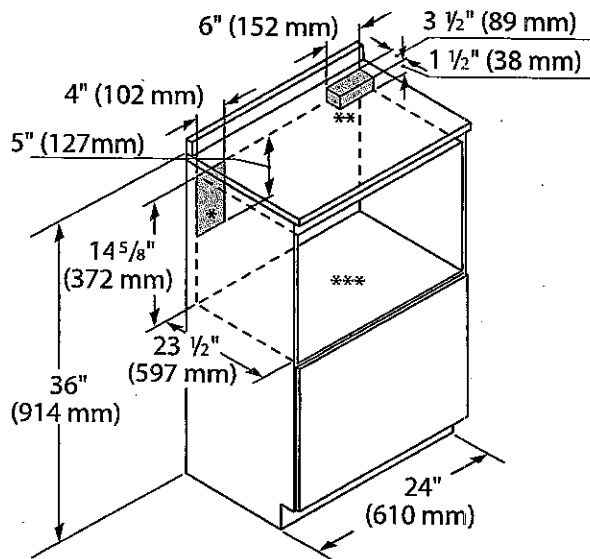

Frontview cut out

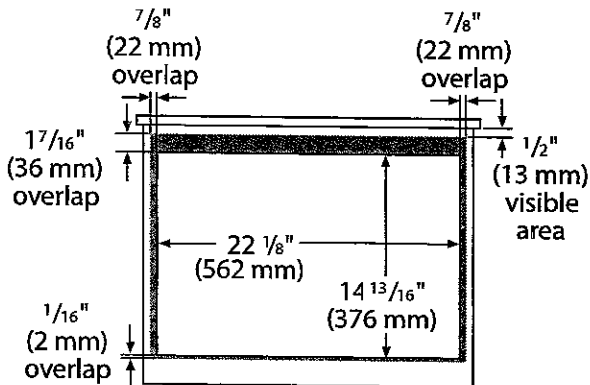

- * Suggested location of electrical outlet
- ** Anti-Tip Block
- *** Base should support up to 100 lbs

FLUSH INSTALLATION

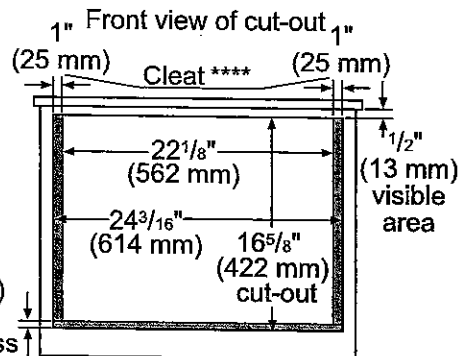
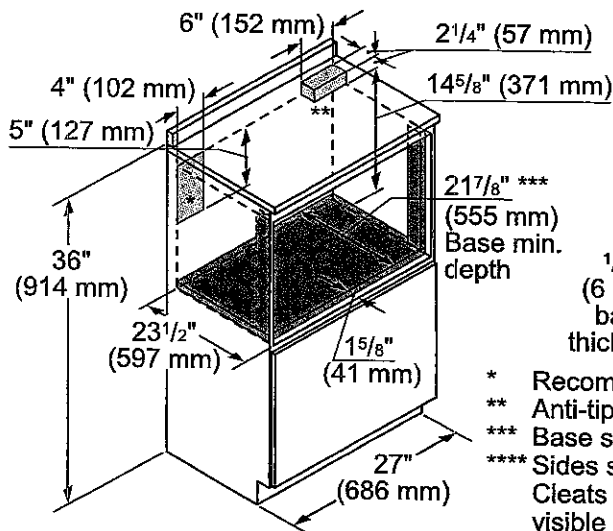

- * Recommended location of electrical outlet
- ** Anti-tip block
- *** Base should support up to 100 lbs
- **** Sides should be finished and extend back to cleat. Cleats should also be finished, as they may be visible after installation.

These warranties give you specific legal rights and you may have other rights that vary from state to state. Full warranty and limited warranty from date of installation. For complete warranty details, refer to your Use & Care manual, or ask your dealer.

Specifications are for planning purposes only. Refer to installation instructions and consult your countertop supplier prior to making counter opening. Consult with a heating and ventilation engineer for your specific ventilation requirements. For the most detailed information, refer to installation instructions accompanying product or write to Thermador indicating the model number. Specifications are correct at time of printing. Thermador reserves the right to change product specifications or design without notice. Some models are certified for use in Canada. Thermador is not responsible for products that are transported from the U.S. for use in Canada.