

Brampton Encore - 74 - 1 - 41-1 Elev.A STRAUSS OPT - SFA1

CENTRAL VAC AND WIRING

Inv.560	1 - TELEPHONE AND CABLE ROUGH-IN LOCATIONS
Line6828	Note:
13Jun16 / 16Nov16	
Inv.560	1 - FAMILY ROOM: INSTALL CONDUIT PIPE- FOR TELEVISION- MUST SPECIFY LOCATION AND TERMINATION POINT, TO GO ABOVE FIREPLACE. SEE SKETCH
Line6829	Note:
13Jun16 / 16Nov16	

CERAMIC

Inv.560	1 - OPTIONAL ENSUITE BEDROOM 2- SHOWER IN LIEU OF TUB
Line14140	Note:
13Jun16 / 16Nov16	
Inv.1,130	1 - MASTER ENSUTIE: INSTALL Floor Upgrade 2 Ensuite Bath Floor
Line16660	Note:
25Jan17 / 24Mar17	

ELECTRICAL

Inv.560	1 - FAMILY ROOM: INSTALL 110V WALL RECEPTACLE ON DEDICATED CIRCUIT - ABOVE FIREPLACE. SEE SKETCH
Line6830	Note:
13Jun16 / 16Nov16	
Inv.560	1 - OPTIONAL ENSUITE BEDROOM 2- SHOWER IN LIEU OF TUB
Line14142	Note:
13Jun16 / 16Nov16	

EXTERIOR COLOURS

Inv.560	1 - EXTERIOR COLOUR PACKAGE 7
Line14138	Note:
13Jun16 / 16Nov16	

FORMING

Inv.560	1 - EXTERIOR: INSTALL SIDE DOOR- HOME TO EXTERIOR- AS PER PLAN AND GRADE PERMITTING
Line6832	Note:
13Jun16 / 16Nov16	

FRAMING

Inv.560	1 - GARAGE: INSTALL MANDOOR - GARAGE TO HOUSE- AS PER PLAN AND GRADE PERMITTING
Line6831	Note: GIVEN IN AGREEMENT OF PURCHASE AND SALE
13Jun16 / 16Nov16	
Inv.560	1 - OPTIONAL ENSUITE BEDROOM 2- SHOWER IN LIEU OF TUB
Line14139	Note:
13Jun16 / 16Nov16	

GRANITE MARBLE QUARTZ

Inv.1,130	1 - KITCHEN: INSTALL 2 CM GRP 1 Optional Flush BBar
Line16664	Note:
25Jan17 / 24Mar17	

Brampton Encore - 74 - 1 - 41-1 Elev.A STRAUSS OPT - SFA1

HARDWOOD

Inv.1,130	1 - DINING ROOM: INSTALL PREVERCO 4 1/4" ENGINEERED RED OAK IN CAPPUCCINO Upgrade 1 LEVEL I Dining
Line16654	Note:
25Jan17 / 24Mar17	
Inv.1,130	1 - FAMILY ROOM: INSTALL PREVERCO 4 1/4" ENGINEERED RED OAK IN CAPPUCCINO Upgrade 1 LEVEL I Family
Line16655	Note:
25Jan17 / 24Mar17	
Inv.1,130	1 - MAIN HALL: INSTALL PREVERCO 4 1/4" ENGINEERED RED OAK IN CAPPUCCINO Upgrade 1 LEVEL I Main Hall
Line16656	Note:
25Jan17 / 24Mar17	

MISC.

Inv.560	1 - BONUS PACKAGE: \$2785.45 (INCLUDING TAXES) WORTH OF UPGRADES FROM GOLD PARK HOMES DÉCOR CENTRE IS BEING APPLIED TOWARD THE STRUCTURAL APPOINTMENT. PURCHASER HAS A REMAINING AMOUNT OF \$7214.55 (INCLUDING TAXES) TO BE USED TOWARD THE COLOUR APPOINTMENT
Line6833	Note:
13Jun16 / 16Nov16	
Inv.560	1 - Purchaser has attended a Structural appointment at the Decor Centre & has DECLINED any additional upgrades and accepts and acknowledges that there will be no further structural changes/additions/deletions to be made upon signing on June 13, 2016
Line6834	Note:
13Jun16 / 16Nov16	
Inv.560	1 - Purchasers are aware & accepts that ANY changes made to upgrades after signing this Purchasers Extra Form are subject to a minimum administration fee of \$500. PLUS a 10% holdback fee
Line6835	Note:
13Jun16 / 16Nov16	
Inv.1,130	1 - BONUS PACKAGE: \$7214.55 (INCLUDING TAXES) WORTH OF UPGRADES FROM GOLD PARK HOMES DÉCOR CENTRE IS BEING APPLIED TOWARD THE COLOUR APPOINTMENT
Line16661	Note:
25Jan17 / 24Mar17	
Inv.1,130	1 - Purchaser has attended a Colour appointment at the Decor Centre & has DECLINED any additional upgrades and accepts and acknowledges that there will be no further structural changes/additions/deletions to be made upon signing on January 25, 2017
Line16662	Note:
25Jan17 / 24Mar17	
Inv.1,130	1 - Purchasers are aware & accepts that ANY changes made to upgrades after signing this Purchasers Extra Form are subject to a minimum administration fee of \$500. PLUS a 10% holdback fee
Line16663	Note:
25Jan17 / 24Mar17	

PAINTING

Inv.1,130	1 - STAIRCASE: Stain Staircase 2 Storey Model (Euroline Pickets Charged Separately)
Line16657	Note:
25Jan17 / 24Mar17	

PLUMBING

Inv.560	1 - OPTIONAL ENSUITE BEDROOM 2- SHOWER IN LIEU OF TUB
Line14141	Note:
13Jun16 / 16Nov16	



CONSTRUCTION SUMMARY

Brampton Encore - 74 - 1 - 41-1 Elev.A STRAUSS OPT - SFA1
STAIRS AND RAILINGS

Inv.1,130	1 - STAIRCASE: INSTALL EUROLINE 2 Black
Line16658	Note:
25Jan17 / 24Mar17	
Inv.1,130	1 - STAIRCASE: INSTALL V Groove Handrail
Line16659	Note:
25Jan17 / 24Mar17	

WINDOWS AND DOORS

Inv.560	1 - GARAGE: INSTALL MANDOOR - GARAGE TO HOUSE- AS PER PLAN AND GRADE PERMITTING
Line14136	Note:
13Jun16 / 16Nov16	
Inv.560	1 - EXTERIOR: INSTALL SIDE DOOR- HOME TO EXTERIOR- AS PER PLAN AND GRADE PERMITTING
Line14137	Note:
13Jun16 / 16Nov16	

Scheduled Closing Date:

Purchaser: Talwinder Singh Mandeir
Telephone Res. / Bus: (905) 456-6760 / (416) 887-5560
Decor Advisor: Terri Parisani

Property: 74 of Plan -
Project: Fieldwalk Investments Inc.
Model and Elevation: 41-1 Elev.A STRAUSS OPT - SFA1

Layout Changes: ☐ Yes ☒ No
Sketch Attached: ☒ Yes ☐ No
Exterior Colour Scheme:

1. Cabinetry

Cabinetry	Style and Colour	Counter	Hardware
Kitchen / Breakfast	Venice(pvc)ItalianWalnut	Grigio Sardo Granite Edge: FE20	cs1-10
Laundry Room			
Powder Room			
TWIN BATH	P400(pvc)Mystic	7735-58 Portico Marble Laminate	cs1-20
Master Ensuite Bathroom	Venice(pvc)ChocoMaple	6697-44 Argento Romano Laminate	cs1-23
Second Ensuite Bathroom (If Applicable)	P400(pvc)Mystic	4925K-07 Calcatta Marble Laminate	cs1-18
Dishwasher Cabinet			
Comment			

2. Floor Tile

1001 Tile	Selection	Grout	Threshold
Entrance Vestibule	Serpentine Beyaz 13 x 13	N/A	N/A
Main Hall			
Kitchen / Breakfast	Serpentine Beyaz 13 x 13	N/A	N/A
Laundry Room	Serpentine Beyaz 13 x 13	N/A	N/A
Powder Room	Serpentine Beyaz 13 x 13	N/A	N/A
TWIN BATH	New Reeds Brown 13 x 13	N/A	N/A
Master Ensuite Bathroom	*Upg.2 Antika Series Bianco 18 x 18	N/A	N/A
Second Ensuite Bathroom (If Applicable)	Costa Matte White, 13 x 13	N/A	N/A
Lower Landing (If Applicable)		N/A	N/A
Comment			

3. Wall Tile

Wall Tile	Selection	Listello/Inserts	Describe
TWIN BATH	Weave White 8 x 10	<input type="radio"/> Yes <input checked="" type="radio"/> No	
Master Ensuite Bathroom			
Tub Deck	Weave Tender Grey 8 x 10	<input type="radio"/> Yes <input checked="" type="radio"/> No	
Shower Stall	Weave Tender Grey 8 x 10	<input type="radio"/> Yes <input checked="" type="radio"/> No	
Bathroom Walls	Weave Tender Grey 8 x 10	<input type="radio"/> Yes <input checked="" type="radio"/> No	
Second Ensuite Bathroom (If Applicable)	Venus Series Grey	<input type="radio"/> Yes <input checked="" type="radio"/> No	
		<input type="radio"/> Yes <input type="radio"/> No	
Kitchen Backsplash	<input type="radio"/> Yes <input checked="" type="radio"/> No	Backsplash Behind Fridge	
Comment			

Scheduled Closing Date:

Purchaser: Talwinder Singh Mandeir
Telephone Res. / Bus: (905) 456-6760 / (416) 887-5560
Decor Advisor: Terri Parisani

Property: 74 of Plan -
Project: Fieldwalk Investments Inc.
Model and Elevation: 41-1 Elev.A STRAUSS OPT - SFA1

4. Plumbing Fixtures

	Second Ensuite		Powder Room	
Master Ensuite Bathroom		Other Room - Specify		Other Washroom

Comment

ALL FIXTURES TO REMAIN STANDARD THROUGHOUT

5. Hardwood Flooring

	Type and Stain		Type and Stain
Main Hall	*Upg.1,Preverco,4 1/4"Cappuccino	Upper Landing	
Kitchen / Breakfast		Upper Hall	
Living Room		Master Bedroom	
Dining Room	*Upg.1,Preverco,4 1/4"Cappuccino	Bedroom #2	
Family Room	*Upg.1,Preverco,4 1/4"Cappuccino	Bedroom #3	
Den/Library		Bedroom #4	
Entrance Vestibule		Bedroom #5	
Lower Landing (If Applicable)		Other Room - Specify	

Comment

6. Carpeting

	Upgrade	Description
Main Hall	<input type="checkbox"/>	
Living Room	<input type="checkbox"/>	
Dining Room	<input type="checkbox"/>	
Family Room	<input type="checkbox"/>	
Den/Library	<input type="checkbox"/>	
Upper Hall	<input type="checkbox"/>	T-04
Master Bedroom	<input type="checkbox"/>	T-04
Bedroom #2	<input type="checkbox"/>	T-04
Bedroom #3	<input type="checkbox"/>	T-04
Bedroom #4	<input type="checkbox"/>	T-04
Bedroom #5	<input type="checkbox"/>	
	<input type="checkbox"/>	
Upper Landing (If Applicable)	<input type="checkbox"/>	
Lower Landing (If Applicable)	<input type="checkbox"/>	

Upgrade Underpad	Type STANDARD	Area
Carpet on Stairs	Capped	Runner - *Upgrade

Comment

Scheduled Closing Date:

Purchaser: Talwinder Singh Mandeir
Telephone Res. / Bus: (905) 456-6760 / (416) 887-5560
Decor Advisor: Terri Parisani

Property: 74 of Plan -
Project: Fieldwalk Investments Inc.
Model and Elevation: 41-1 Elev.A STRAUSS OPT - SFA1

7. Fireplace

	Living Room			Family Room			Other Room - Specify		
	Purchased	As Per Plan	N/A	Purchased	As Per Plan	N/A	Purchased	As Per Plan	N/A
Fireplace Type	<input type="radio"/>	<input type="radio"/>	<input checked="" type="radio"/>	<input type="radio"/>	<input checked="" type="radio"/>	<input type="radio"/>	<input type="radio"/>	<input type="radio"/>	<input checked="" type="radio"/>
Mantle Type				STANDARD					
Colour / Stain				NF-24					
Surround				WHITE PAINT-GRADE MANTL					
Hearth				PERLATO ROYALE					
Comment									

8. Trim Carpentry

Interior Doors	STANDARD	Front Door Glass Inserts	STANDARD	Door Handles	STANDARD
Interior Trim	STANDARD				
Comment					

9. Plaster Mouldings and Medallions

Entrance Vestibule	N/A		Kitchen/Breakfast	N/A	
Main Hall	N/A		Den/Library	N/A	
Living Room	N/A		Lower Landing	N/A	
Dining Room	N/A		Other Room - Specify		
Family Room	N/A				
Comment					

10. Railings and Spindles

Railing Package	*EUROLINE 2 WITH V-GROOVE HANDRAIL		
Railing Colour	*CAPPUCCINO, RED OAK	Spindle Colour	BLACK
Stringer / Riser	*CAPPUCCINO, RED OAK	Treads	*CAPPUCCINO, RED OAK
Comment	Oak Stairs <input checked="" type="radio"/> Yes <input type="radio"/> No		
STAIR LANDINGS TO BE STAINED TO MATCH STAIRS			

11. Wall Paint

Main & Upper Hall	WARM GREY	Master Bedroom	WARM GREY
Living Room	WARM GREY	Bedroom #2	WARM GREY
Dining Room	WARM GREY	Bedroom #3	WARM GREY
Kitchen / Breakfast	WARM GREY	Bedroom #4	WARM GREY
Family Room	WARM GREY	Bedroom #5	WARM GREY
Powder Room	WARM GREY	Master Ensuite	WARM GREY
Laundry Room	WARM GREY	TWIN BATH	WARM GREY
Den/Library	WARM GREY	Second Ensuite	WARM GREY
Trim Paint	WHITE		
Comment	Smooth Ceilings First Floor		

Scheduled Closing Date:

Purchaser: Talwinder Singh Mandeir
Telephone Res. / Bus: (905) 456-6760 / (416) 887-5560
Decor Advisor: Terri Parisani

Property: 74 of Plan -
Project: Fieldwalk Investments Inc.
Model and Elevation: 41-1 Elev.A STRAUSS OPT - SFA1

12. Electrical

Plugs and Switches ☒ White ☐ Ivory

Hood Fan ☐ White ☐ Ivory

Appliances Built in Cooktop

☐ Yes ☒ No

Built in Oven

☐ Yes ☒ No

Above Kitchen Cabinet Light ☐ Yes ☒ No

Below Kitchen Cabinet Light ☐ Yes ☒ No

Gas Stove

☐ Yes ☒ No

Microwave

☐ Yes ☒ No

Comment

STANDARD HOOD FAN: STAINLESS STEEL

13. Heating and Air Conditioning

Air Conditioning

Gas Provisions Stove

Gas Provisions Dryer

Gas Provisions Barbecue

Comment

GAS LINE FOR BBQ IS STANDARD

14. Additional Comments

15. Disclaimers and Notes

- 1) Colours of all materials are as close as possible to builder's selection, but not necessarily identical due to variances in manufacturing.
- 2) Any extras listed above are null and void unless accompanied by a separate invoice/amendment. Said invoice must be paid in full.
- 3) The Purchaser acknowledges that after Interior Colour Selection form is signed and dated, no further changes will be permitted other than re-selection due to unavailability. _____ Purchaser's Initials
- 4) The Purchaser acknowledges reading and accepting the "Gold Park Homes Decor Centre Disclaimers" form. This document contains other miscellaneous disclaimers.

This Interior Colour Selection is final and approved by:

Signature: Talwinder Mandeir Date: Jan-25-2017

The
Strauss
41' SERIES

Elevation A • 2,607 sq.ft. | Elevation B • 2,625 sq.ft.

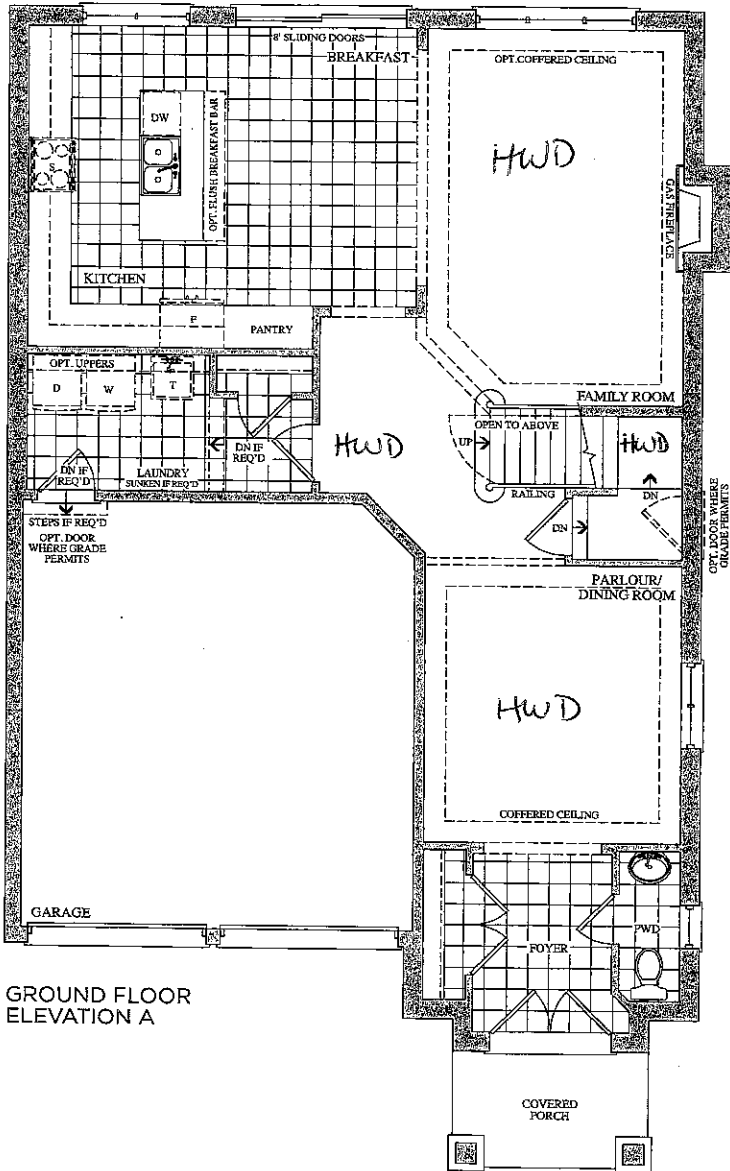

GROUND FLOOR
ELEVATION A

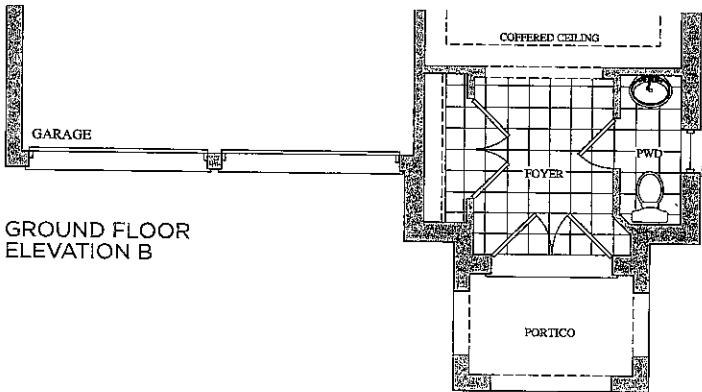

GROUND FLOOR
ELEVATION B

Lot 74
Jan 25, 17

T.M.

Prices, figures, illustrations, sizes, features and finishes are subject to change without notice. E.&O.E. Areas and dimensions are approximate and actual usable floor space may vary from the stated area. Layout may be reverse of the unit purchased. E. & O.E.

The
Strauss
41' SERIES

Elevation A • 2,607 sq.ft. | Elevation B • 2,625 sq.ft.

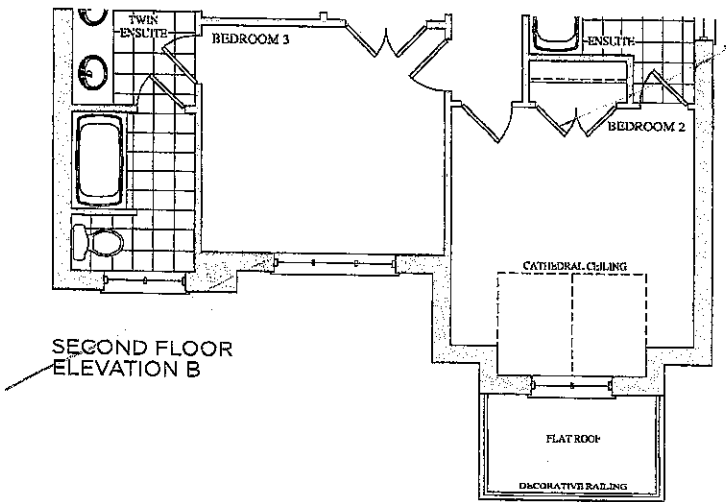
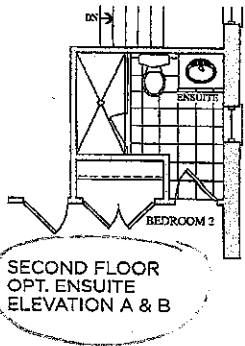
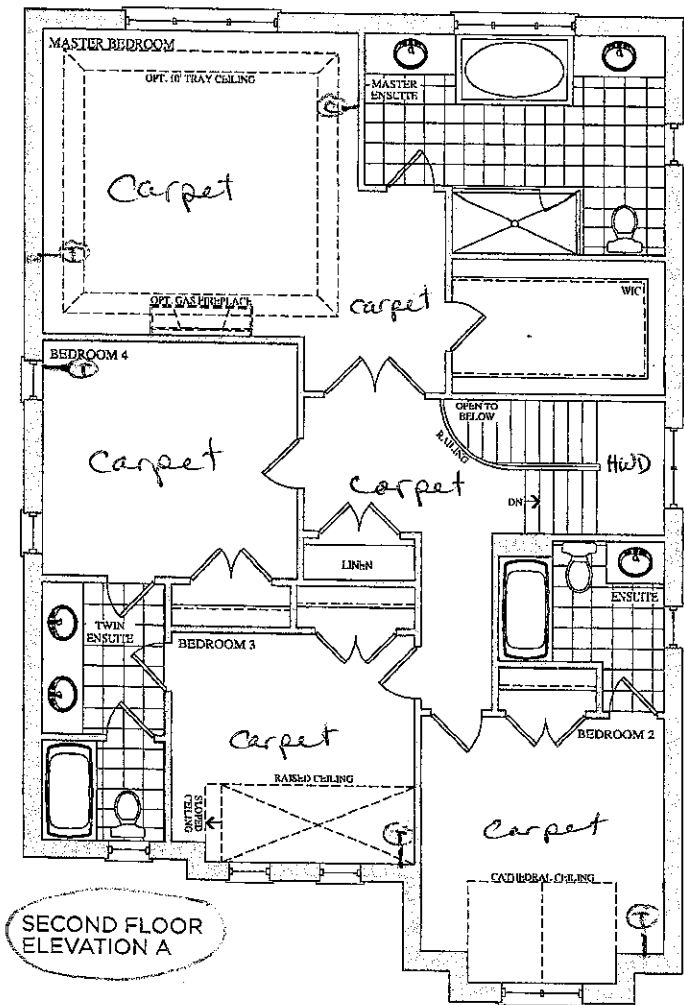

Lot 74
June 13, 16
R.M.

Lot 74
Jan 25, 17
T.M.

Prices, figures, illustrations, sizes, features and finishes are subject to change without notice. E.&O.E. Areas and dimensions are approximate and actual usable floor space may vary from the stated area. Layout may be reverse of the unit purchased. E. & O.E.

CORTINA

KITCHENS INC.

70 Regina Road Woodbridge ON L4L 8L6
905-264-6464

INFORMATION - PVC DOORS

Builder: Gold Park Homes Project: Encore Lot #: 74

All cabinets with PVC (Thermofoil) Doors come with melamine gables, panels and kick. The doors, crown moulding and light valance are PVC wrapped. Open shelves incorporated in design will only be available with melamine interiors. There will be variations in colour shades between the PVC parts (doors, crown and Light valance) and the melamine parts (open shelves, Gables, Panels and Kick) due to the difference in material.

Furring Panel with crown moulding to the ceiling is not available on all PVC door styles due to subtle variations in colour shades between the PVC parts (moulding) and the melamine parts (furring panel) due to the difference in material. Grain directions in wood grain pattern melamine, vary between the furring panel, crown moulding (horizontal) and the PVC doors (vertical).

Thank you for your understanding.

I am well informed of this information, and agree to the purchase of the above.

Purchaser: Talwinder Mondia

Date: Jan-25-2017



CSI-6

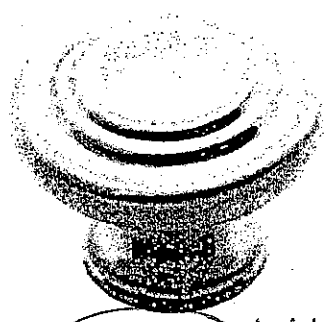

CSI-10 Kitchen

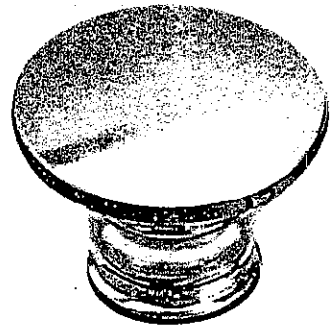

CSI-14

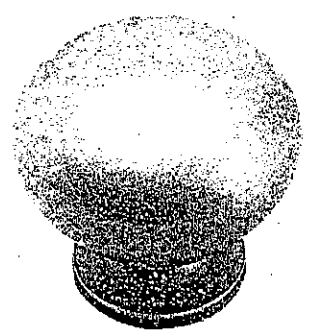

CSI-16

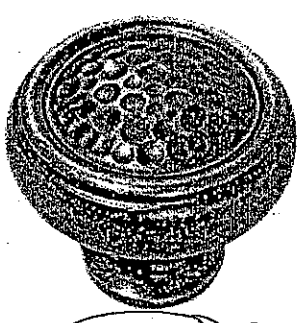

CSI-18 Ens. 2

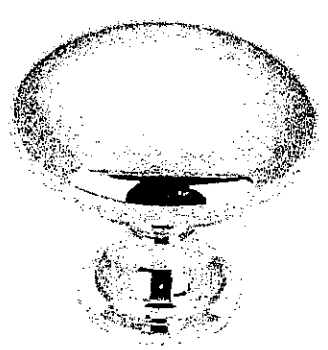

CSI-19

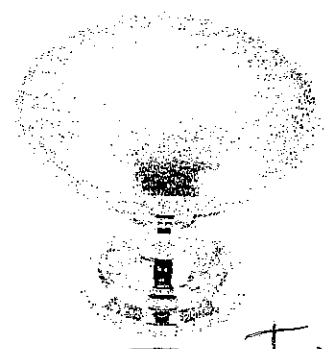

CSI-20 Twin

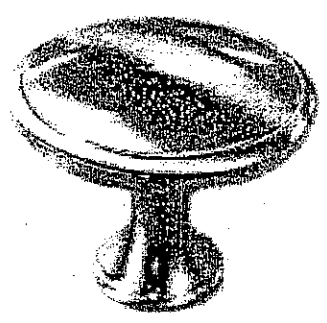

CSI-21



CSI-22



CSI-23 master

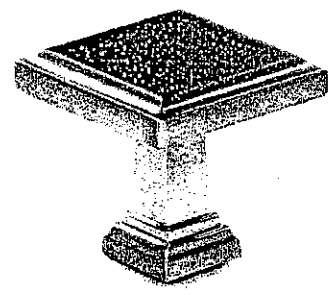

CSI-24

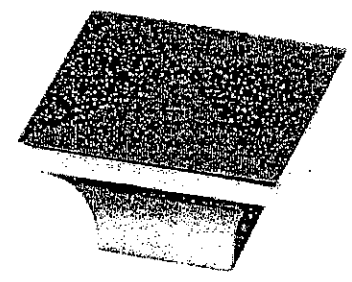

CSI-25

*NOTES:

- IMAGES ARE FOR QUICK REFERENCE PURPOSES ONLY
- ACTUAL SIZES AND FINISHES AS PER HARDWARE
- SAMPLE BOARD PROVIDED TO DECOR CENTRE



Granite, Marble,
Engineered Surfaces

20174
Jan 25, 17



- Standard 2CM & 3CM
- ⊖ Upgrade 1 2CM & 3CM
- ⊕ Upgrade 1 4 CM
- Upgrade 2

20mm (3/4") Profiles

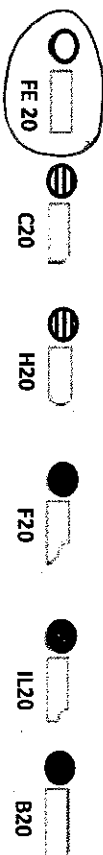

Kitchen

30mm (1-1/4") Profiles

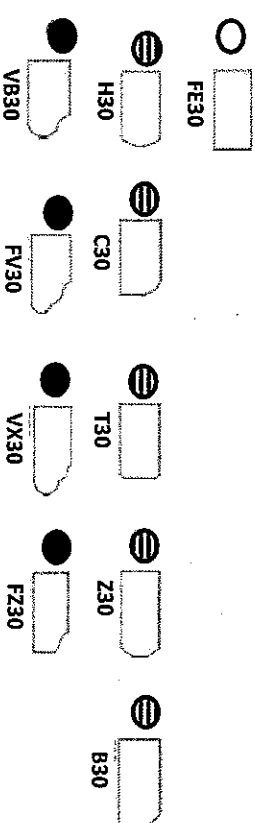

40mm (1-1/2") Profiles

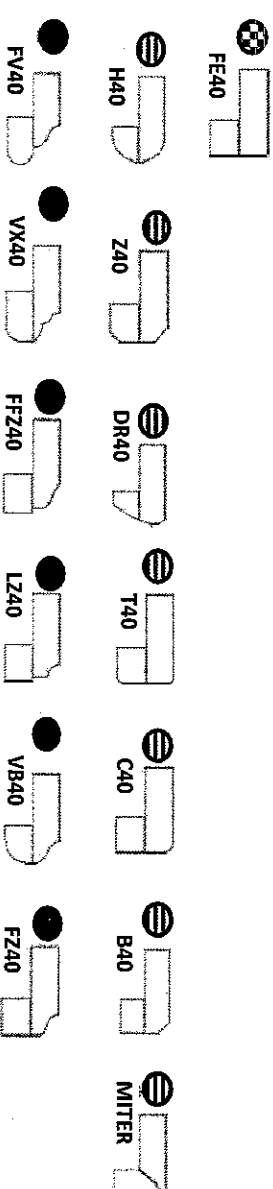

Note: All colours may not be available in 30mm at time ordered. Vendor reserves the right to use 40 mm edges (by lamination process).

*Mitre edge is available in Upgrade 1 for an overall thickness of 2". All other Mitre edge options will be an Upgrade 2 Edge.

Trade Name: Gold Park Homes	Site location: Brampton	Model: 41-4
Address:	Project: Encore	Phase:

This layout has been explained to the purchaser by Cortina Kitchens Inc. and is understood by the purchaser.

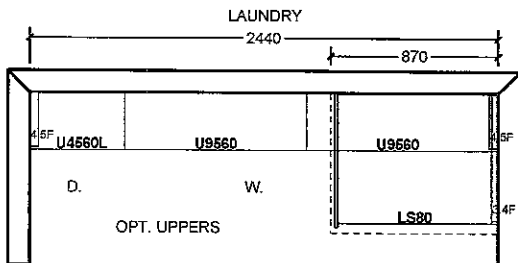
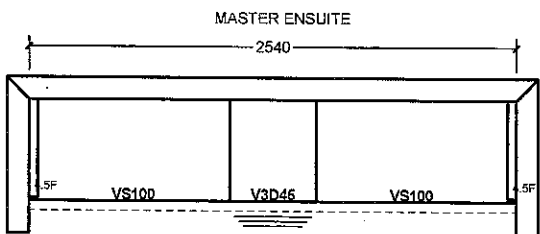
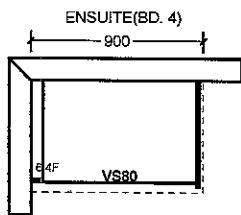
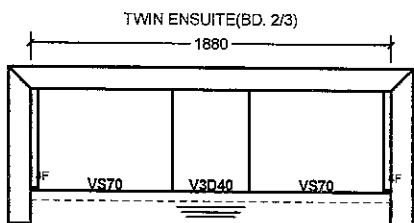
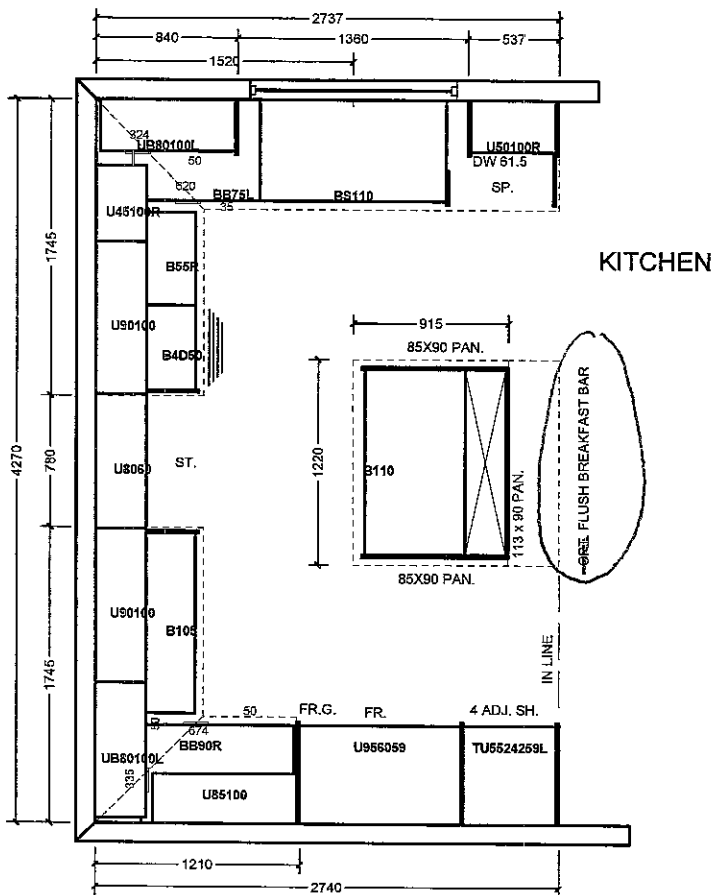

All prices subject to confirmation from head office.
This quotation is subject to the terms & conditions set out

All agreements are contingent upon strikes, accidents, and delays beyond our control.
Please provide our installer with template for sinkholes or \$150.00 will be charged for callback.

ACCEPTED DATE: _____

Item A. Wood grain and colour are characteristics of the product. We cannot guarantee that such grain and colour will always match.
Item B. Cortina Kitchens Inc. reserves the right to alter dimensions and make technical changes without notice.

Lot 74
Jan. 25, 17
T.M