

Brampton Encore - 129 - 1 - 41-1 Elev.A STRAUSS
CENTRAL VAC AND WIRING

Inv.651	1 - TELEPHONE AND CABLE ROUGH-IN LOCATIONS
Line8274	Note:
12Jul16 / 15Nov16	
Inv.651	1 - FAMILY ROOM: INSTALL CONDUIT PIPE- FOR TELEVISION- ABOVE FIREPLACE
Line8275	Note:
12Jul16 / 15Nov16	

CERAMIC

Inv.651	1 - ENSUITE (BED #2): INSTALL SHOWER IN LIEU OF TUB- INCLUDES FRAMED GLASS SHOWER ENCLOSURE-
Line14023	Note:
12Jul16 / 15Nov16	
Inv.1,169	1 - KITCHEN: INSTALL UPGRADE 2 FLOOR TILE IN KITCHEN/BREAKFAST AREA
Line17209	Note:
7Feb17 / 15Mar17	
Inv.1,169	1 - FOYER: INSTALL UPGRADE 2 FLOOR TILE IN FOYER
Line17210	Note:
7Feb17 / 15Mar17	
Inv.1,169	1 - POWDER ROOM: INSTALL UPGRADE 2 FLOOR TILE IN POWDER ROOM
Line17211	Note:
7Feb17 / 15Mar17	
Inv.1,169	1 - TWIN BATH: INSTALL UPGRADE 1 FLOOR TILE IN TWIN BATH
Line17212	Note:
7Feb17 / 15Mar17	

ELECTRICAL

Inv.651	1 - FAMILY ROOM: INSTALL 110V WALL RECEPTACLE ON DEDICATED CIRCUIT - ABOVE FIREPLACE. SEE SKETCH
Line8276	Note:
12Jul16 / 15Nov16	
Inv.651	1 - KITCHEN: INSTALL KITCHEN CABINET STRIP VALANCE LIGHTS (UNDER CABINETS) - ROUGH - IN - DOES NOT INCLUDE (AND REQUIRES) KITCHEN UPGRADE PRICING
Line8277	Note:
12Jul16 / 15Nov16	

EXTERIOR COLOURS

Inv.651	1 - EXTERIOR COLOUR PACKAGE 4
Line14025	Note:
12Jul16 / 15Nov16	

FRAMING

Inv.651	1 - ENSUITE (BED #2): INSTALL SHOWER IN LIEU OF TUB- INCLUDES FRAMED GLASS SHOWER ENCLOSURE-
Line8282	Note:
12Jul16 / 15Nov16	
Inv.651	1 - GARAGE: INSTALL MANDOOR - GARAGE TO HOUSE- AS PER PLAN AND GRADE PERMITING
Line8278	Note: GIVEN IN AGREEMENT OF PURCHASE AND SALE
12Jul16 / 15Nov16	

Brampton Encore - 129 - 1 - 41-1 Elev.A STRAUSS

Inv.651	1 - MAIN FLOOR: INSTALL SIX (X6) STANDARD DOORS EXTENDED HEIGHT 96" (PRICE PER DOOR)- GROUND FLOOR 2 STOREY MODELS. ON CLOSETS, POWDER ROOM, BASEMENT AND LAUNDRY. SEE SKETCH
Line14024	Note:
12Jul16 / 15Nov16	

GRANITE MARBLE QUARTZ

Inv.1,169	1 - KITCHEN: INSTALL FLUSH COUNTER TOP ON BREAKFAST BAR
Line17213	Note:
7Feb17 / 15Mar17	
Inv.1,169	1 - KITCHEN: INSTALL GRANITE FOR SLIDE-IN STOVE
Line17215	Note:
7Feb17 / 15Mar17	

HARDWOOD

Inv.1,169	1 - DINING ROOM: INSTALL PREVERCO ENGINEERED 4 1/4" IN KOMODO Upgrade 1 LEVEL S Dining
Line17203	Note:
7Feb17 / 15Mar17	
Inv.1,169	1 - FAMILY ROOM: INSTALL PREVERCO ENGINEERED 4 1/4" IN KOMODO IN FAMILY ROOM
Line17204	Note:
7Feb17 / 15Mar17	
Inv.1,169	1 - MAIN HALL: INSTALL PREVERCO ENGINEERED 4 1/4" IN KOMODO IN MAIN HALL
Line17205	Note:
7Feb17 / 15Mar17	
Inv.1,169	1 - UPPER HALL: INSTALL PREVERCO ENGINEERED 4 1/4" IN KOMODO IN UPPER HALL
Line17227	Note:
7Feb17 / 15Mar17	

INTERIOR TRIM AND DOORS

Inv.651	6 - MAIN FLOOR: INSTALL SIX (X6) STANDARD DOORS EXTENDED HEIGHT 96" (PRICE PER DOOR)- GROUND FLOOR 2 STOREY MODELS. ON CLOSETS, POWDER ROOM, BASEMENT AND LAUNDRY. SEE SKETCH
Line8284	Note:
12Jul16 / 15Nov16	

KITCHEN AND BATH CABINETRY

Inv.1,169	1 - KITCHEN: INSTALL Oak PVC 104 Slide in stove enclosure with countertop by others
Line17214	Note:
7Feb17 / 15Mar17	
Inv.1,169	1 - KITCHEN: INSTALL Oak PVC 59 Upper Corner Diagonal 100cm h
Line17216	Note:
7Feb17 / 15Mar17	
Inv.1,169	1 - KITCHEN: INSTALL Oak PVC 84 Base Corner Folding Door B C F D
Line17217	Note:
7Feb17 / 15Mar17	
Inv.1,169	1 - KITCHEN: INSTALL UPG 1 GRP III Opt Light Valance
Line17221	Note:
7Feb17 / 15Mar17	

Brampton Encore - 129 - 1 - 41-1 Elev.A STRAUSS

Inv.1,169	1 - KITCHEN: INSTALL UPG 1 GRP III Opt Furring Panel
Line17222	Note:
7Feb17 / 15Mar17	
Inv.1,169	1 - KITCHEN: INSTALL UPG 1 GRP III Opt Crown Moulding
Line17223	Note:
7Feb17 / 15Mar17	

MISC.

Inv.651	1 - BONUS PACKAGE: \$7898.70 (INCLUDING TAXES) WORTH OF UPGRADES FROM GOLD PARK HOMES DÉCOR CENTRE IS BEING APPLIED TOWARD THE STRUCTURAL APPOINTMENT. PURCHASER HAS A REMAINING AMOUNT OF \$7101.30 (INCLUDING TAXES) TO BE USED TOWARD THE COLOUR APPOINTMENT
Line8286	Note:
12Jul16 / 15Nov16	
Inv.651	1 - Purchaser has attended a Structural appointment at the Decor Centre & has DECLINED any additional upgrades and accepts and acknowledges that there will be no further structural changes/additions/deletions to be made upon signing on July 12, 2016
Line8287	Note:
12Jul16 / 15Nov16	
Inv.651	1 - Purchasers are aware & accepts that ANY changes made to upgrades after signing this Purchasers Extra Form are subject to a minimum administration fee of \$500. PLUS a 10% holdback fee
Line8288	Note:
12Jul16 / 15Nov16	
Inv.1,169	1 - BONUS PACKAGE: \$6445.90 (INCLUDING TAXES) WORTH OF UPGRADES FROM GOLD PARK HOMES DÉCOR CENTRE IS BEING APPLIED TOWARD THE COLOUR APPOINTMENT
Line17224	Note:
7Feb17 / 15Mar17	
Inv.1,169	1 - Purchaser has attended a Colour appointment at the Decor Centre & has DECLINED any additional upgrades and accepts and acknowledges that there will be no further structural changes/additions/deletions to be made upon signing on February 7, 2017
Line17225	Note:
7Feb17 / 15Mar17	
Inv.1,169	1 - Purchasers are aware & accepts that ANY changes made to upgrades after signing this Purchasers Extra Form are subject to a minimum administration fee of \$500. PLUS a 10% holdback fee
Line17226	Note:
7Feb17 / 15Mar17	

PAINTING

Inv.1,169	1 - STAIRCASE: Stain Staircase 2 Storey Model (Euroline Pickets Charged Separately)
Line17206	Note:
7Feb17 / 15Mar17	

PLUMBING

Inv.651	1 - BASEMENT: INSTALL ROUGH-IN - 3PC BASEMENT ROUGH-IN
Line8285	Note:
12Jul16 / 15Nov16	
Inv.651	1 - ENSUITE (BED #2): INSTALL SHOWER IN LIEU OF TUB- INCLUDES FRAMED GLASS SHOWER ENCLOSURE-
Line14022	Note:
12Jul16 / 15Nov16	

STAIRS AND RAILINGS

Brampton Encore - 129 - 1 - 41-1 Elev.A STRAUSS

Inv.1,169	1 - STAIRCASE: INSTALL Railing 1 3 4 Inch LOTUS Non Fluted
Line17207	Note:
7Feb17 / 15Mar17	
Inv.1,169	1 - STAIRCASE: INSTALL Railing V Groove Handrail
Line17208	Note:
7Feb17 / 15Mar17	

WINDOWS - BASEMENT

Inv.651	2 - BASEMENT: INSTALL TWO (X2) BASEMENT WINDOWS - UPGRADE EXISTING BASEMENT WINDOW TO 30 INCH X 24 INCH - MAY REQUIRE INSTALLATION OF WINDOW WELL. SEE SKETCH
Line9037	Note:
12Jul16 / 15Nov16	

WINDOWS AND DOORS

Inv.651	1 - GARAGE: INSTALL MANDOOR - GARAGE TO HOUSE- AS PER PLAN AND GRADE PERMITING
Line14020	Note:
12Jul16 / 15Nov16	

Scheduled Closing Date:

Purchasers: BAC DUONG & CHU J LIN

Property: 129 of Plan -

Telephone Res. / Bus: (905) 216-3883 / (416) 993-7175

Project: Fieldwalk Investments Inc.

Decor Advisor: Terri Parisani

Model and Elevation: 41-1 Elev.A STRAUSS

Layout Changes: ☒ Yes ☐ No Sketch Attached: ☒ Yes ☐ No Exterior Colour Scheme:

1. Cabinetry

	Style and Colour	Counter	Hardware
Kitchen / Breakfast	Siena (oak) Slate	Crema Caramel Granite Edge: FE20	cs1-23
Laundry Room	<input type="text"/>	<input type="text"/>	<input type="text"/>
Powder Room	<input type="text"/>	<input type="text"/>	<input type="text"/>
TWIN BATH	Toscana(pvc)AntiqWhite	4588K-07 Kalahari Topez Laminate	cs1-25
Master Ensuite Bathroom	Toscana(pvc) Mystic	1877K-52 Autumn Carnival Laminate	cs1-25
Second Ensuite Bathroom (If Applicable)	Toscana(pvc) Mystic	6697-46 Argento Romano Laminate	cs1-25
<input type="text"/>	<input type="text"/>	<input type="text"/>	<input type="text"/>
Dishwasher Cabinet	<input type="text"/>		

Comment

2. Floor Tile

	Selection	Grout	Threshold
Entrance Vestibule	*Upg.2 Nepal Brown, 12 x 24	N/A	N/A
Main Hall	<input type="text"/>	<input type="text"/>	<input type="text"/>
Kitchen / Breakfast	*Upg.2 Nepal Brown, 12 x 24	N/A	N/A
Laundry Room	Serpentine Krem 13 x 13	N/A	N/A
Powder Room	*Upg.2 Nepal Brown, 12 x 24	N/A	N/A
TWIN BATH	*Upg.1 Venus Brown 13 x 13	N/A	N/A
Master Ensuite Bathroom	Serpentine Krem 13 x 13	N/A	N/A
Second Ensuite Bathroom (If Applicable)	New Reeds Brown 13 x 13	N/A	N/A
Lower Landing (If Applicable)	<input type="text"/>	<input type="text"/>	<input type="text"/>
<input type="text"/>	<input type="text"/>	<input type="text"/>	<input type="text"/>

Comment

3. Wall Tile

	Selection	Listello/Inserts	Describe
TWIN BATH	Venus Brown 8 x 10	<input type="radio"/> Yes <input checked="" type="radio"/> No	<input type="text"/>
Master Ensuite Bathroom			
Tub Deck	Venus Ivory 8 x 10	<input type="radio"/> Yes <input checked="" type="radio"/> No	<input type="text"/>
Shower Stall	Venus Ivory 8 x 10	<input type="radio"/> Yes <input checked="" type="radio"/> No	<input type="text"/>
Bathroom Walls	Venus Ivory 8 x 10	<input type="radio"/> Yes <input checked="" type="radio"/> No	<input type="text"/>
Second Ensuite Bathroom (If Applicable)	Serpentine Syrak 8 x 10	<input type="radio"/> Yes <input checked="" type="radio"/> No	<input type="text"/>
<input type="text"/>	<input type="text"/>	<input type="radio"/> Yes <input type="radio"/> No	<input type="text"/>

Kitchen Backsplash

☐ Yes ☒ No

Backsplash Behind Fridge

Comment

Scheduled Closing Date:

Purchasers: BAC DUONG & CHU J LIN

Property: 129 of Plan -

Telephone Res. / Bus: (905) 216-3883 / (416) 993-7175

Project: Fieldwalk Investments Inc.

Decor Advisor: Terri Parisani

Model and Elevation: 41-1 Elev.A STRAUSS

4. Plumbing Fixtures

Master Ensuite Bathroom Second Ensuite Powder Room
Other Room - Specify Other Washroom

Comment

ALL FIXTURES ARE STANDARD THROUGHOUT

5. Hardwood Flooring

	Type and Stain		Type and Stain
Main Hall	*Upg.1 Preverco 4 1/4" Komodo	Upper Landing	<input type="text"/>
Kitchen / Breakfast	<input type="text"/>	Upper Hall	**Upg.1 Preverco 4 1/4" Komodo
Living Room	<input type="text"/>	Master Bedroom	<input type="text"/>
Dining Room	*Upg.1 Preverco 4 1/4" Komodo	Bedroom #2	<input type="text"/>
Family Room	*Upg.1 Preverco 4 1/4" Komodo	Bedroom #3	<input type="text"/>
Den/Library	<input type="text"/>	Bedroom #4	<input type="text"/>
Entrance Vestibule	<input type="text"/>	Bedroom #5	<input type="text"/>
Lower Landing (If Applicable)	<input type="text"/>	Other Room - Specify	<input type="text"/>

Comment

ALL HARDWOOD IS ENGINEERED RED OAK

6. Carpeting

	Upgrade	Description
Main Hall	<input type="checkbox"/>	<input type="text"/>
Living Room	<input type="checkbox"/>	<input type="text"/>
Dining Room	<input type="checkbox"/>	<input type="text"/>
Family Room	<input type="checkbox"/>	<input type="text"/>
Den/Library	<input type="checkbox"/>	<input type="text"/>
Upper Hall	<input type="checkbox"/>	<input type="text"/>
Master Bedroom	<input type="checkbox"/>	T-18
Bedroom #2	<input type="checkbox"/>	T-18
Bedroom #3	<input type="checkbox"/>	T-18
Bedroom #4	<input type="checkbox"/>	T-18
Bedroom #5	<input type="checkbox"/>	<input type="text"/>
<input type="text"/>	<input type="checkbox"/>	<input type="text"/>
Upper Landing (If Applicable)	<input type="checkbox"/>	<input type="text"/>
Lower Landing (If Applicable)	<input type="checkbox"/>	<input type="text"/>

Upgrade Underpad	Type STANDARD	Area <input type="text"/>
Carpet on Stairs	Capped <input type="text"/>	Runner - *Upgrade <input type="text"/>

Comment

Scheduled Closing Date:

Purchasers: BAC DUONG & CHU J LIN

Property: 129 of Plan -

Telephone Res. / Bus: (905) 216-3883 / (416) 993-7175

Project: Fieldwalk Investments Inc.

Decor Advisor: Terri Parisani

Model and Elevation: 41-1 Elev.A STRAUSS

7. Fireplace

	Living Room			Family Room			Other Room - Specify		
	Purchased	As Per Plan	N/A	Purchased	As Per Plan	N/A	Purchased	As Per Plan	N/A
Fireplace Type	<input type="radio"/>	<input type="radio"/>	<input checked="" type="radio"/>	<input type="radio"/>	<input checked="" type="radio"/>	<input type="radio"/>	<input type="radio"/>	<input type="radio"/>	<input checked="" type="radio"/>
Mantle Type				STANDARD					
Colour / Stain				NF-23					
Surround				WHITE PAINT-GRADE					
Hearth				PERLATO ROYALE					
Comment				NONE					

8. Trim Carpentry

Interior Doors	STANDARD	Front Door Glass Inserts	STANDARD	Door Handles	STANDARD
Interior Trim	STANDARD				
Comment					

9. Plaster Mouldings and Medallions

Entrance Vestibule	N/A		Kitchen/Breakfast	N/A	
Main Hall	N/A		Den/Library	N/A	
Living Room	N/A		Lower Landing	N/A	
Dining Room	N/A		Other Room - Specify		
Family Room	N/A				
Comment					

10. Railings and Spindles

Railing Package	*LOTUS WITH V-GROOVE HANDRAIL		
Railing Colour	*KOMODO RED OAK	Spindle Colour	*KOMODO RED OAK
Stringer / Riser	*KOMODO RED OAK	Treads	*KOMODO RED OAK
Comment	OAK STAIRS <input checked="" type="radio"/> Yes <input type="radio"/> No		

STAIN STAIR LANDINGS TO MATCH STAIRCASE

11. Wall Paint

Main & Upper Hall	OYSTER	Master Bedroom	OYSTER
Living Room	OYSTER	Bedroom #2	OYSTER
Dining Room	OYSTER	Bedroom #3	OYSTER
Kitchen / Breakfast	OYSTER	Bedroom #4	OYSTER
Family Room	OYSTER	Bedroom #5	OYSTER
Powder Room	OYSTER	Master Ensuite	OYSTER
Laundry Room	OYSTER	TWIN BATH	OYSTER
Den/Library	OYSTER	Second Ensuite	OYSTER
Trim Paint	WHITE		
Comment	Smooth Ceilings First Floor		

Scheduled Closing Date:

Purchasers: BAC DUONG & CHU J LIN

Property: 129 of Plan -

Telephone Res. / Bus: (905) 216-3883 / (416) 993-7175

Project: Fieldwalk Investments Inc.

Decor Advisor: Terri Parisani

Model and Elevation: 41-1 Elev.A STRAUSS

12. Electrical

Plugs and Switches ☒ White ☐ Ivory

Hood Fan ☐ White ☐ Ivory

Appliances Built in Cooktop

☐ Yes ☒ No

Built in Oven

☐ Yes ☒ No

Above Kitchen Cabinet Light ☐ Yes ☒ No

Below Kitchen Cabinet Light ☒ Yes ☐ No

Gas Stove

☒ Yes ☐ No

Microwave

☐ Yes ☒ No

Comment

STANDARD HOOD FAN: STAINLESS STEEL

13. Heating and Air Conditioning

Air Conditioning

Gas Provisions Dryer

Gas Provisions Stove

Gas Provisions Barbecue

Comment

GAS LINE FOR STOVE PURCHASED
GAS LINE FOR BBQ IS STANDARD

14. Additional Comments

15. Disclaimers and Notes

- 1) Colours of all materials are as close as possible to builder's selection, but not necessarily identical due to variances in manufacturing.
- 2) Any extras listed above are null and void unless accompanied by a separate invoice/amendment. Said invoice must be paid in full.
- 3) The Purchaser acknowledges that after Interior Colour Selection form is signed and dated, no further changes will be permitted other than re-selection due to unavailability. Purchaser's Initials
- 4) The Purchaser acknowledges reading and accepting the "Gold Park Homes Decor Centre Disclaimers" form. This document contains other miscellaneous disclaimers.

This Interior Colour Selection is final and approved by:

Signature:

Date:

Signature:

Date:

Scheduled Closing Date:

Purchasers: BAC DUONG & CHU J LIN

Property: 129 of Plan -

Telephone Res. / Bus: (905) 216-3883 / (416) 993-7175

Project: Fieldwalk Investments Inc.

Decor Advisor: Terri Parisani

Model and Elevation: 41-1 Elev.A STRAUSS

Layout Changes: ☒ Yes ☐ No Sketch Attached: ☒ Yes ☐ No Exterior Colour Scheme:

1. Cabinetry

	Style and Colour	Counter	Hardware
Kitchen / Breakfast	<input type="text" value="Siena (oak) Slate"/>	<input type="text" value="Crema Caramel Granite Edge: FE20"/>	<input type="text" value="cs1-23"/>
Laundry Room	<input type="text"/>	<input type="text"/>	<input type="text"/>
Powder Room	<input type="text"/>	<input type="text"/>	<input type="text"/>
TWIN BATH	<input type="text" value="Toscana(pvc)AntiqWhite"/>	<input type="text" value="4588K-07 Kalahari Topez Laminate"/>	<input type="text" value="cs1-25"/>
Master Ensuite Bathroom	<input type="text" value="Toscana(pvc) Mystic"/>	<input type="text" value="1877K-52 Autumn Carnival Laminate"/>	<input type="text" value="cs1-25"/>
Second Ensuite Bathroom (If Applicable)	<input type="text" value="Toscana(pvc) Mystic"/>	<input type="text" value="6697-46 Argento Romano Laminate"/>	<input type="text" value="cs1-25"/>
<input type="text"/>	<input type="text"/>	<input type="text"/>	<input type="text"/>
Dishwasher Cabinet	<input type="text"/>		

Comment

2. Floor Tile

	Selection	Grout	Threshold
Entrance Vestibule	<input type="text" value="*Upg.2 Nepal Brown, 12 x 24"/>	<input type="text" value="N/A"/>	<input type="text" value="N/A"/>
Main Hall	<input type="text"/>	<input type="text"/>	<input type="text"/>
Kitchen / Breakfast	<input type="text" value="*Upg.2 Nepal Brown, 12 x 24"/>	<input type="text" value="N/A"/>	<input type="text" value="N/A"/>
Laundry Room	<input type="text" value="Serpentine Krem 13 x 13"/>	<input type="text" value="N/A"/>	<input type="text" value="N/A"/>
Powder Room	<input type="text" value="*Upg.2 Nepal Brown, 12 x 24"/>	<input type="text" value="N/A"/>	<input type="text" value="N/A"/>
TWIN BATH	<input type="text" value="*Upg.1 Venus Brown 13 x 13"/>	<input type="text" value="N/A"/>	<input type="text" value="N/A"/>
Master Ensuite Bathroom	<input type="text" value="Serpentine Krem 13 x 13"/>	<input type="text" value="N/A"/>	<input type="text" value="N/A"/>
Second Ensuite Bathroom (If Applicable)	<input type="text" value="New Reeds Brown 13 x 13"/>	<input type="text" value="N/A"/>	<input type="text" value="N/A"/>
Lower Landing (If Applicable)	<input type="text"/>	<input type="text"/>	<input type="text"/>
<input type="text"/>	<input type="text"/>	<input type="text"/>	<input type="text"/>

Comment

3. Wall Tile

	Selection	Listello/Inserts	Describe
TWIN BATH	<input type="text" value="Venus Brown 8 x 10"/>	<input type="radio"/> Yes <input checked="" type="radio"/> No	<input type="text"/>
Master Ensuite Bathroom			
Tub Deck	<input type="text" value="Venus Ivory 8 x 10"/>	<input type="radio"/> Yes <input checked="" type="radio"/> No	<input type="text"/>
Shower Stall	<input type="text" value="Venus Ivory 8 x 10"/>	<input type="radio"/> Yes <input checked="" type="radio"/> No	<input type="text"/>
Bathroom Walls	<input type="text" value="Venus Ivory 8 x 10"/>	<input type="radio"/> Yes <input checked="" type="radio"/> No	<input type="text"/>
Second Ensuite Bathroom (If Applicable)	<input type="text" value="Serpentine Syrak 8 x 10"/>	<input type="radio"/> Yes <input checked="" type="radio"/> No	<input type="text"/>
<input type="text"/>	<input type="text"/>	<input type="radio"/> Yes <input type="radio"/> No	<input type="text"/>

Kitchen Backsplash

☐ Yes ☒ No

Backsplash Behind Fridge

Comment

Scheduled Closing Date:

Purchasers: BAC DUONG & CHU J LIN
Telephone Res. / Bus: (905) 216-3883 / (416) 993-7175
Decor Advisor: Terri Parisani

Property: 129 of Plan -
Project: Fieldwalk Investments Inc.
Model and Elevation: 41-1 Elev.A STRAUSS

4. Plumbing Fixtures

<input type="text"/>	Second Ensuite	<input type="text"/>	Powder Room	<input type="text"/>	
Master Ensuite Bathroom	<input type="text"/>	Other Room - Specify	<input type="text"/>	Other Washroom	<input type="text"/>

Comment

ALL FIXTURES ARE STANDARD THROUGHOUT

5. Hardwood Flooring

	Type and Stain		Type and Stain
Main Hall	*Upg.1 Preverco 4 1/4" Komodo	Upper Landing	-
Kitchen / Breakfast	-	Upper Hall	**Upg.1 Preverco 4 1/4" Komodo
Living Room	-	Master Bedroom	-
Dining Room	*Upg.1 Preverco 4 1/4" Komodo	Bedroom #2	-
Family Room	*Upg.1 Preverco 4 1/4" Komodo	Bedroom #3	-
Den/Library	-	Bedroom #4	-
Entrance Vestibule	-	Bedroom #5	-
Lower Landing (If Applicable)	-	Other Room - Specify	<input type="text"/>

Comment

ALL HARDWOOD IS ENGINEERED RED OAK

6. Carpeting

	Upgrade	Description
Main Hall	<input type="checkbox"/>	-
Living Room	<input type="checkbox"/>	-
Dining Room	<input type="checkbox"/>	-
Family Room	<input type="checkbox"/>	-
Den/Library	<input type="checkbox"/>	-
Upper Hall	<input type="checkbox"/>	-
Master Bedroom	<input type="checkbox"/>	T-18
Bedroom #2	<input type="checkbox"/>	T-18
Bedroom #3	<input type="checkbox"/>	T-18
Bedroom #4	<input type="checkbox"/>	T-18
Bedroom #5	<input type="checkbox"/>	-
<input type="text"/>	<input type="checkbox"/>	-
Upper Landing (If Applicable)	<input type="checkbox"/>	-
Lower Landing (If Applicable)	<input type="checkbox"/>	-

Upgrade Underpad	Type STANDARD	Area	<input type="text"/>
Carpet on Stairs	Capped	Runner - *Upgrade	<input type="text"/>

Comment

Scheduled Closing Date:

Purchasers: BAC DUONG & CHU J LIN
Telephone Res. / Bus: (905) 216-3883 / (416) 993-7175
Decor Advisor: Terri Parisani

Property: 129 of Plan -
Project: Fieldwalk Investments Inc.
Model and Elevation: 41-1 Elev.A STRAUSS

7. Fireplace

	Living Room			Family Room			Other Room - Specify		
	Purchased	As Per Plan	N/A	Purchased	As Per Plan	N/A	Purchased	As Per Plan	N/A
Fireplace Type	<input type="radio"/>	<input type="radio"/>	<input checked="" type="radio"/>	<input type="radio"/>	<input checked="" type="radio"/>	<input type="radio"/>	<input type="radio"/>	<input type="radio"/>	<input checked="" type="radio"/>
Mantle Type				STANDARD					
Colour / Stain				NF-23					
Surround				WHITE PAINT-GRADE					
Hearth				PERLATO ROYALE					
Comment				NONE					

8. Trim Carpentry

Interior Doors	STANDARD	Front Door Glass Inserts	STANDARD	Door Handles	STANDARD
Interior Trim	STANDARD				
Comment					

9. Plaster Mouldings and Medallions

Entrance Vestibule	N/A		Kitchen/Breakfast	N/A	
Main Hall	N/A		Den/Library	N/A	
Living Room	N/A		Lower Landing	N/A	
Dining Room	N/A		Other Room - Specify		
Family Room	N/A				
Comment					

10. Railings and Spindles

Railing Package	*LOTUS WITH V-GROOVE HANDRAIL		
Railing Colour	*KOMODO RED OAK	Spindle Colour	*KOMODO RED OAK
Stringer / Riser	*KOMODO RED OAK	Treads	*KOMODO RED OAK
Comment	Oak Stairs <input checked="" type="radio"/> Yes <input type="radio"/> No		
STAIN STAIR LANDINGS TO MATCH STAIRCASE			

11. Wall Paint

Main & Upper Hall	OYSTER	Master Bedroom	OYSTER
Living Room	OYSTER	Bedroom #2	OYSTER
Dining Room	OYSTER	Bedroom #3	OYSTER
Kitchen / Breakfast	OYSTER	Bedroom #4	OYSTER
Family Room	OYSTER	Bedroom #5	OYSTER
Powder Room	OYSTER	Master Ensuite	OYSTER
Laundry Room	OYSTER	TWIN BATH	OYSTER
Den/Library	OYSTER	Second Ensuite	OYSTER
Trim Paint	WHITE		
Comment	Smooth Ceilings First Floor		

Scheduled Closing Date:

Purchasers: BAC DUONG & CHU J LIN

Property: 129 of Plan -

Telephone Res. / Bus: (905) 216-3883 / (416) 993-7175

Project: Fieldwalk Investments Inc.

Decor Advisor: Terri Parisani

Model and Elevation: 41-1 Elev.A STRAUSS

12. Electrical

Plugs and Switches

☒ White ☐ Ivory

Hood Fan

☐ White ☐ Ivory

Appliances

Built in Cooktop

☐ Yes ☒ No

Built in Oven

☐ Yes ☒ No

Gas Stove

☒ Yes ☐ No

Microwave

☐ Yes ☒ No

Above Kitchen Cabinet Light

☐ Yes ☒ No

Below Kitchen Cabinet Light

☒ Yes ☐ No

Comment

STANDARD HOOD FAN: STAINLESS STEEL

13. Heating and Air Conditioning

Air Conditioning

Gas Provisions Stove

Gas Provisions Dryer

Gas Provisions Barbecue

Comment

GAS LINE FOR STOVE PURCHASED
GAS LINE FOR BBQ IS STANDARD

14. Additional Comments

15. Disclaimers and Notes

- 1) Colours of all materials are as close as possible to builder's selection, but not necessarily identical due to variances in manufacturing.
- 2) Any extras listed above are null and void unless accompanied by a separate invoice/amendment. Said invoice must be paid in full.
- 3) The Purchaser acknowledges that after Interior Colour Selection form is signed and dated, no further changes will be permitted other than re-selection due to unavailability. Purchaser's Initials
- 4) The Purchaser acknowledges reading and accepting the "Gold Park Homes Decor Centre Disclaimers" form. This document contains other miscellaneous disclaimers.

This Interior Colour Selection is final and approved by:

Signature: Chu J Lin

Date: Feb. 7

Signature: Brian D

Date: Feb 7 / 17

Telephone — (T)
Cable — (C)
Electrical — (E)

The
Strauss
41' SERIES

Elevation A • 2,607 sq.ft. | Elevation B • 2,625 sq.ft.

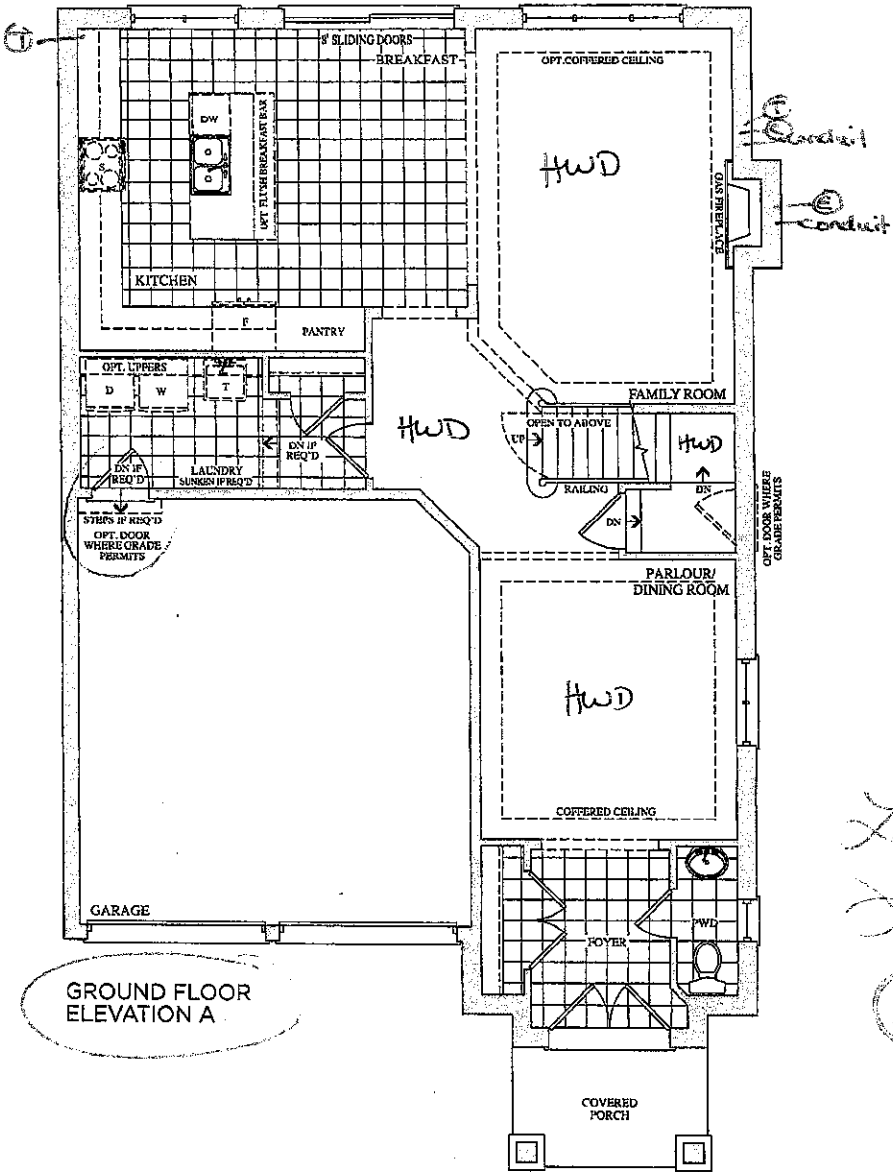

GROUND FLOOR
ELEVATION A

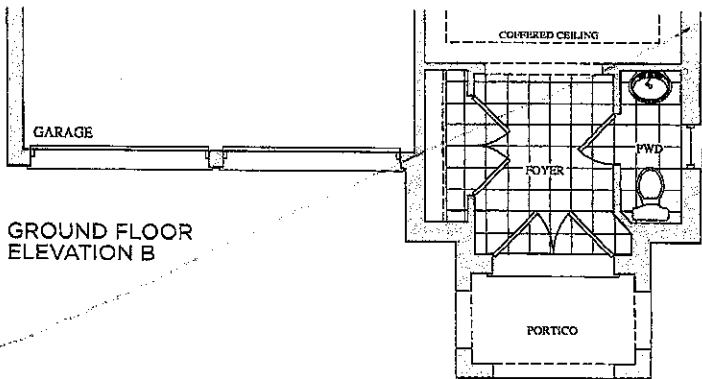

GROUND FLOOR
ELEVATION B

Lot 129
July 12, 16

(B.D) (C.L)

Lot 129
Feb. 7, 14

(B.D) (C.L)

Prices, figures, illustrations, sizes, features and finishes are subject to change without notice. E.&O.E. Areas and dimensions are approximate and actual usable floor space may vary from the stated area. Layout may be reverse of the unit purchased. E. & O.E.

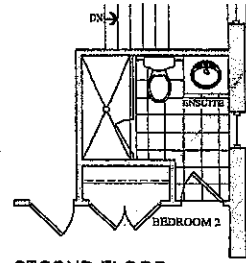
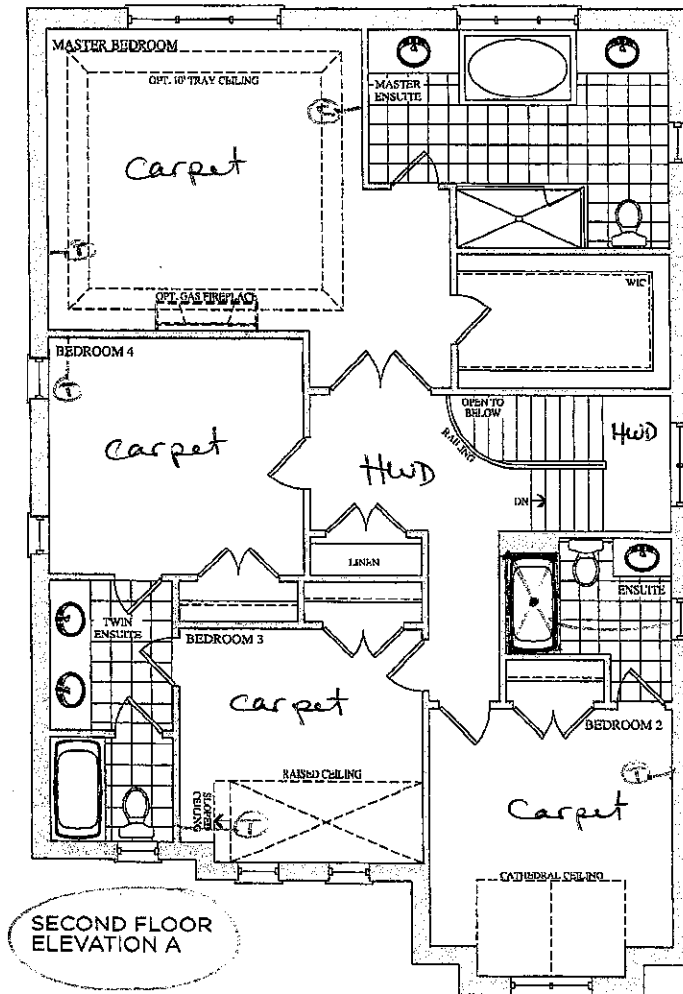

SECOND FLOOR
OPT. ENSUITE
ELEVATION A & B

Delete tub, install
framed shower w/ pot
light.

Lot 129
July 12, 16

B.D. C.L.

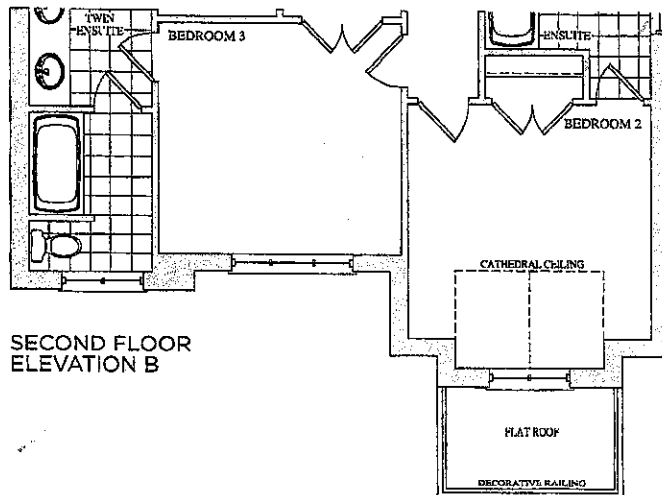

Lot 129
Feb. 7, 17

B.D. C.L.

Trade Name: Gold Park Homes

Site location: Brampton

Model: 41-1

Address:

Project: Encore

Phase:

This layout has been explained to the purchaser by Cortina Kitchens Inc. and is understood by the purchaser.

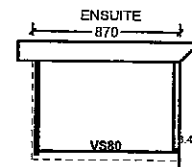
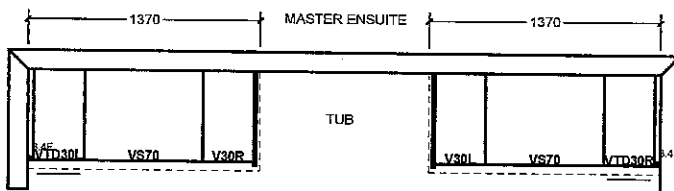
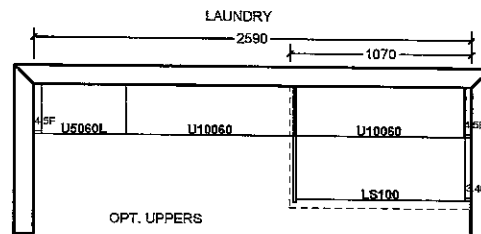
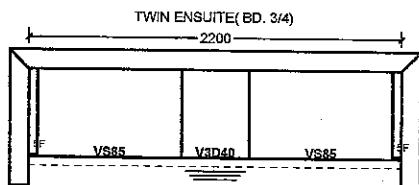
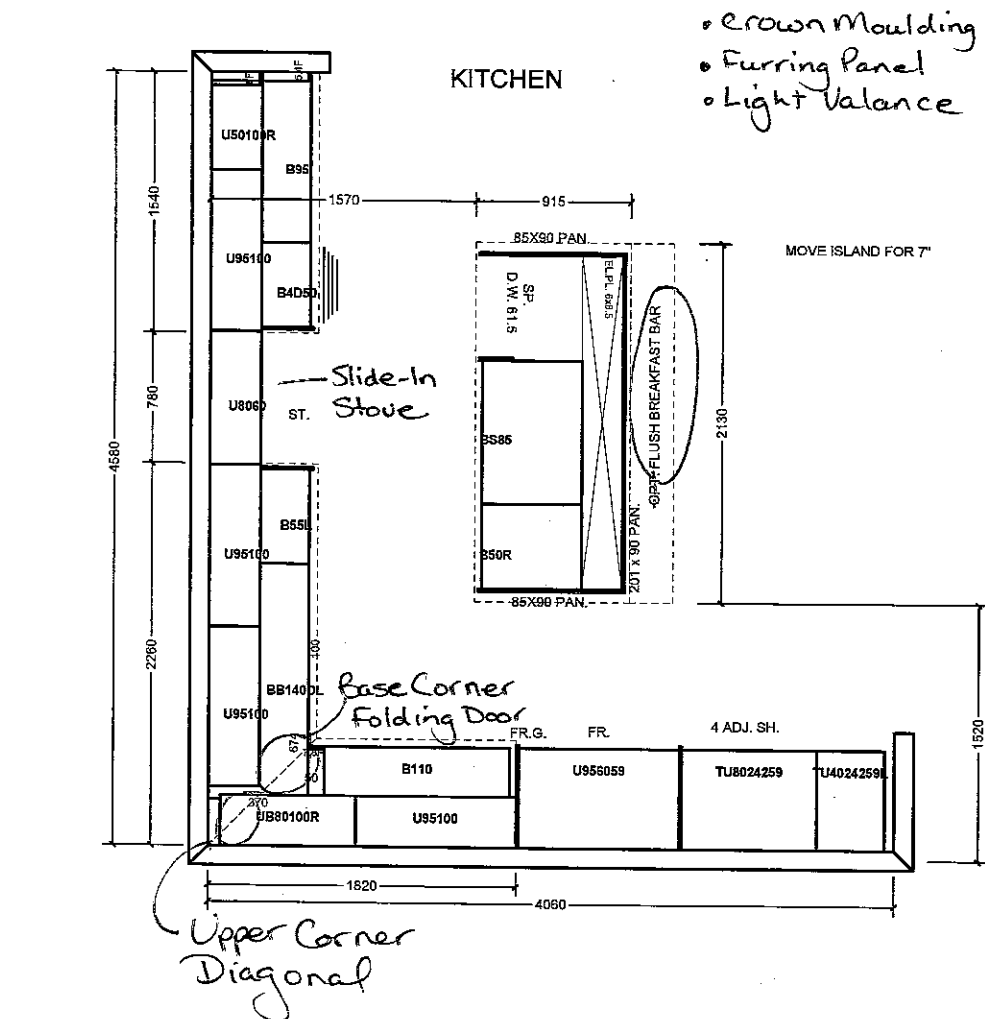

All prices subject to confirmation from head office.
This quotation is subject to the terms & conditions set out

All agreements are contingent upon strikes, accidents, and delays beyond our control.
Please provide our installer with template for sinkholes or \$150.00 will be charged for callback.

ACCEPTED DATE: _____

Item A. Wood grain and colour are characteristics of the product. We cannot guarantee that such grain and colour will always match.
Item B. Cortina Kitchens Inc. reserves the right to alter dimensions and make technical changes without notice.

Lot 129
Feb. 7, 17



Lot 129
Feb. 7, 17



CSI-6

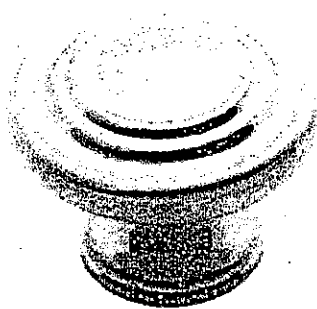

CSI-10

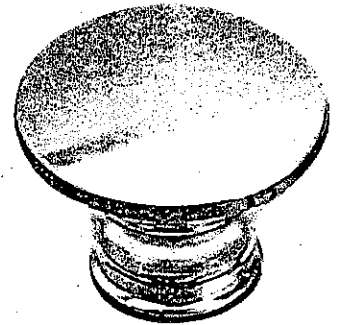

CSI-14

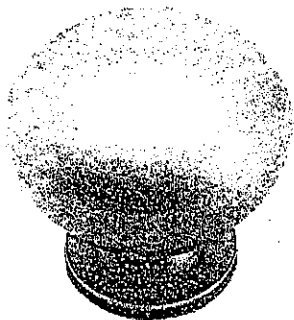

CSI-16

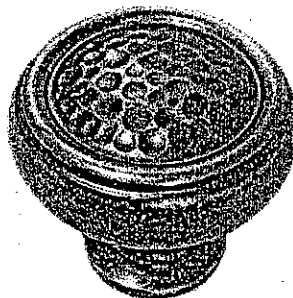

CSI-18

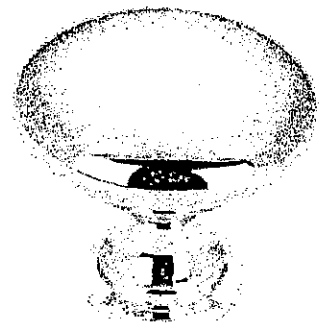

CSI-19

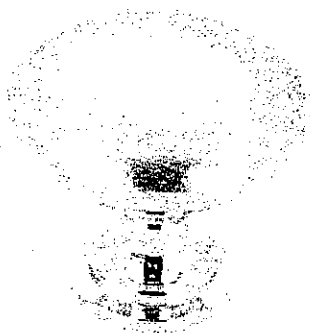

CSI-20

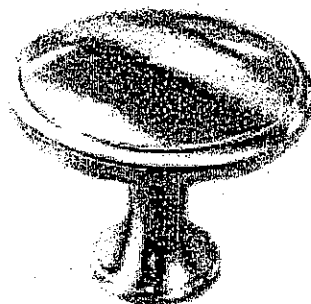

CSI-21



CSI-22

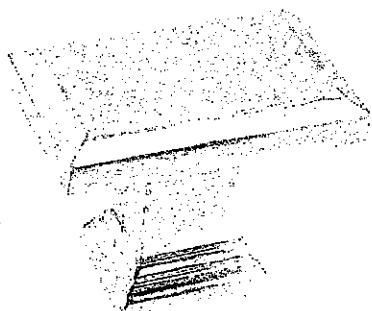

CSI-23

Kitchen

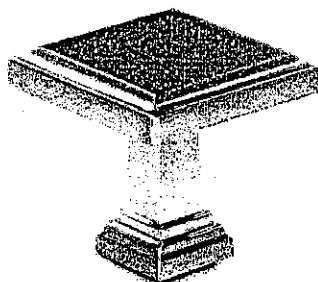

CSI-24

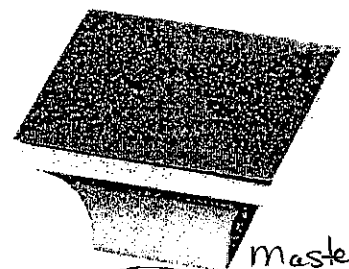

CSI-25

Master
Twin
Ens. 2

*NOTES:

- IMAGES ARE FOR QUICK REFERENCE PURPOSES ONLY
- ACTUAL SIZES AND FINISHES AS PER HARDWARE
- SAMPLE BOARD PROVIDED TO DECOR CENTRE

GOLDPARK
H D M E S



Granite, Marble,
Engineered Surfaces

- Standard 2CM & 3CM
- ⊖ Upgrade 1 2CM & 3CM
- ⊗ Upgrade 1 4 CM
- Upgrade 2

20mm (3/4") Profiles

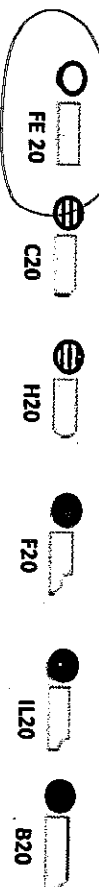

30mm (1-1/4") Profiles

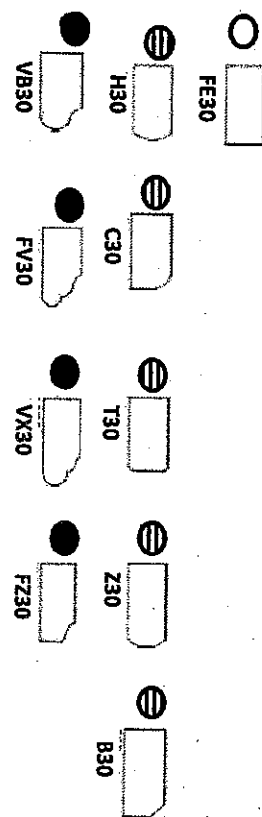

40mm (1-1/2") Profiles

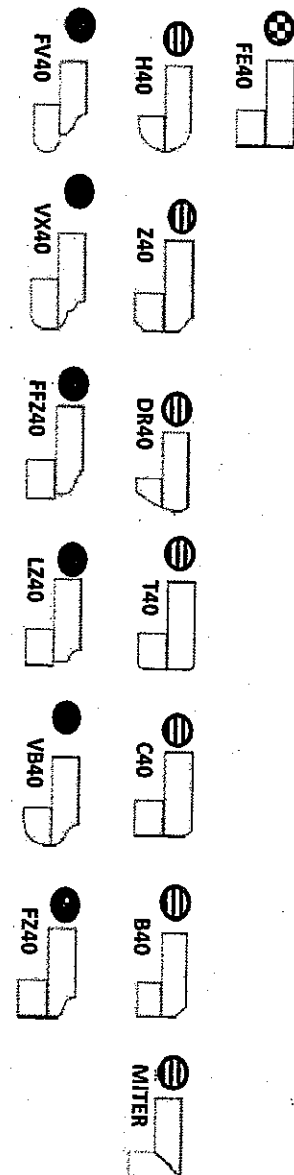

Note: All colours may not be available in 30mm at time ordered. Vendor reserves the right to use 40 mm edges (by lamination process).

*Mitre edge is available in Upgrade 1 for an overall thickness of 2". All other Mitre edge options will be an Upgrade 2 Edge.

kitchen

207129
Feb. 7, 17



FRIGIDAIRE

Lot 129
Encore

Slide-In Ranges

FFES3025P S/W/B

30" Electric

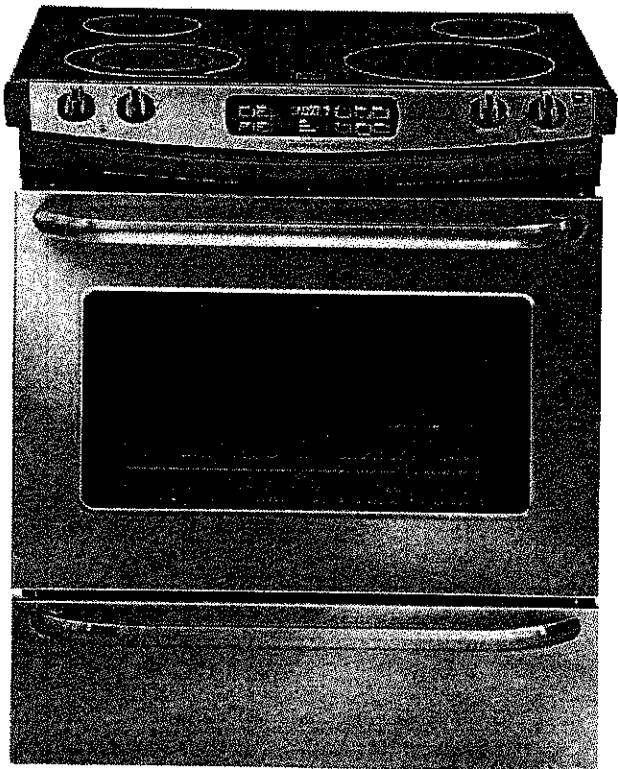

Signature Features

Large Capacity

Our large capacity oven gives you room to cook more at once.

Extra-Large Element

With our extra-large 12" element, you have more flexibility to fit larger pots and pans.

Even Baking Technology

Our even baking technology ensures even baking every time.

One-Touch Self-Clean

Your oven cleans itself—so you don't have to. Self-clean options available in 2- and 3-hour cycles.

Product Dimensions

Height (Max.)	36-5/8"
Width	30"
Depth	28-5/16"

More Easy-To-Use Features

- Built with American Pride**
Appliances that are high-performing, more accessible, and more innovative than ever—designed, built, and engineered in the U.S.A.
- SpaceWise® Expandable Elements**
Flexible elements expand to meet your cooking needs—big or small.
- Extra-Large Window**
Check on the status of your dish without having to open the oven door.
- Ready-Select® Controls**
Easily control your cooking temperature with our easy-to-use controls.
- Store-More™ Storage Drawer**
With the Store-More™ Storage Drawer, you will have extra space to store your cookware.
- Oven Rack Handles**
Oven racks are designed with space for you to easily pull out the racks, even when wearing an oven mitt.
- Delay Clean**
Set the oven to begin cleaning on your schedule.
- A.D.A. Compliant**
When properly installed, this model is A.D.A.-qualified based on the United States Access Board's A.D.A./A.B.A. Accessibility Guidelines and the Department of Justice's 2010 A.D.A. Standards for Accessible Design.



Available In:



Elements	Size	Watts
Right Front	12"	2,700
Right Rear	6"	1,200
Left Front	6 / 9"	1,400 / 3,000
Left Rear	7"	1,500

frigidaire.com

Features	
Oven Control/Timing System	Ready-Select® Controls
Surface Type	Black Ceramic Glass (S), Color-Coordinated Ceramic Glass (W/B)
Window	Extra-Large
Exterior Door Finish	Stainless Steel (S), Color-Coordinated (W/B)
Handle Design	Stainless Steel (S), Color-Coordinated (W/B)
Exterior Finish (Side Panels)	Black (S), Color-Coordinated (W/B)
Convection System	
Oven Cleaning System	Self-Clean
Drawer Functionality	Storage
Oven Controls	
Bake	Yes
Broil	Variable
Keep Warm	
Add-a-Minute	
Delay Start	Yes
Self-Clean/Clean Options	Yes/2, 3 Hours
Steam Clean	
Delay Clean	2, 3 Hours (Scroll Thru)
Kitchen Timer	Yes
Timed Cook Option	Yes
Auto Oven Shut-Off	12 Hours
Cooktop Features	
Right Front Element (Watts)	12" - 2,700
Right Rear Element (Watts)	6" - 1,200
Left Front Element (Watts)	6"/9" - 1,400/3,000
Left Rear Element (Watts)	7" - 1,500
Center Element (Watts)	
Hot Surface Indicator Light	Yes
Coil Cooktop/Drip Bowls	
Oven Features	
Capacity (Cu. Ft.)	4.6
Oven Light	1
Hidden Bake Element	
Rack Configuration	2 Handle Racks
Baking System	Even Baking Technology
Broiling System	Vari-Broil™ Hi/Low
Bake Element/Broil Element (Watts)	2,750/3,400
Optional Accessories	
Rear Filler Kit - Stainless Steel (S)/ White (W)/Black (B)	(S) PN# 901193-001S (W) PN# 901193-9011 (B) PN# 901193-9010
Side Panel Kit - Stainless Steel (S)/ White (W)/Black (B)	(S) PN# 903074-901S (W) PN# A01S29902 (B) PN# A01S29901
Backguard Kit - Stainless Steel (S)/ White (W)/Black (B)	(S) PN# 903046-901S (W) PN# 903046-9011 (B) PN# 903046-9010
Side Trim Kit - Stainless Steel (S)/ White (W)/Black (B)	(S) PN# 903075-901S (W) PN# 903075-9011 (B) PN# 903075-9010
Certifications	
A.D.A. Compliant¹	Yes
Sabbath Mode (Star-K® Certified)	
Specifications	
Oven Interior (H x W x D)	17-1/2" x 24-1/8" x 18-3/4"
Power Supply Connection Location	Left Bottom Rear
Voltage Rating	240V/208V/60 Hz
Connected Load (kW Rating) @ 240/208 Volts	11.6/8.9 kW
Amps @ 240/208 Volts	49.1/42.8
Minimum Circuit Required (Amps)	40
Shipping Weight (Approx.)	200 Lbs.

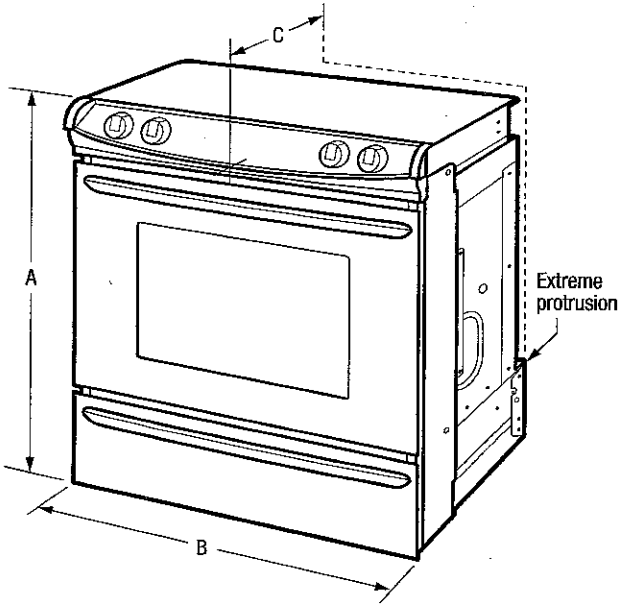

NOTE: For planning purposes only. Always consult local and national electric codes. Refer to Product Installation Guide for detailed installation instructions on the web at frigidaire.com.



Product Dimensions		Cutout Dimensions	
A-Height (Min./Max.)	35-3/4"/36-5/8"	Height (Min./Max.)	35-7/8"/36-5/8"
B-Width	30"	Width (Min./Max.)	29-15/16"/30-1/16"*
C-Depth	28-5/16"	Depth (Min./Max.)	21-3/4"/22-1/8"***
Depth with Door Open 90°	47-9/16"	*Cutout and countertop cutout width should match. **24" with optional backguard installed.	

¹When properly installed, this model is A.D.A.-qualified based on the United States Access Board's A.D.A./A.B.A. Accessibility Guidelines and the Department of Justice's 2010 A.D.A. Standards for Accessible Design.

Accessories information available on the web at frigidaire.com

FRIGIDAIRE

USA • 10200 David Taylor Drive • Charlotte, NC 28262 • 1-800-FRIGIDAIRE • frigidaire.com
CANADA • 5855 Terry Fox Way • Mississauga, ON L5V 3E4 • 1-800-265-8352 • frigidaire.ca

FFES3025P 10/16

© 2016 Electrolux Home Products, Inc.

Specifications
subject to change.

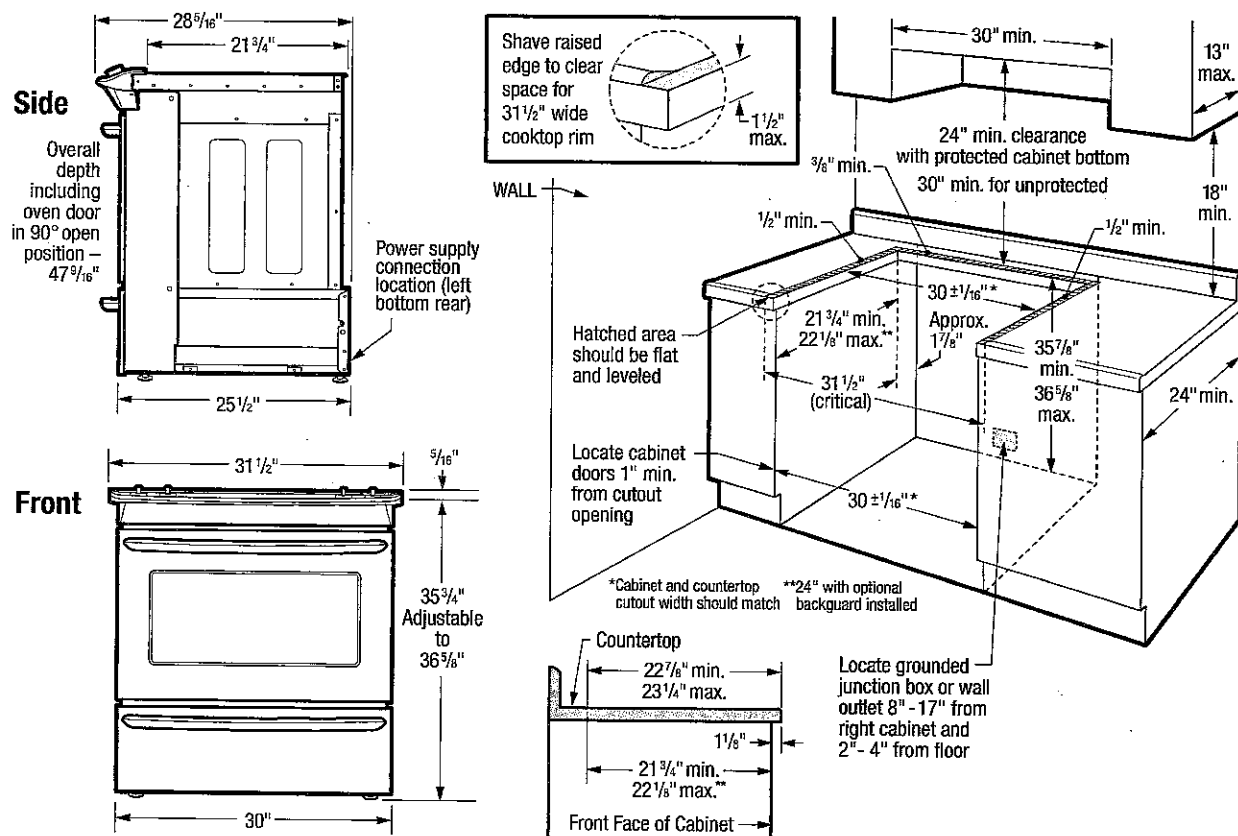

Slide-In Range Specifications

- Product Shipping Weight (approx.) – 200 Lbs.
- Single phase 3- or 4-wire cable, 120/240 or 120/208 Volt, 60 Hertz, fused on both sides of line with ground. *(If local code permits, range may be connected by hard-wiring or by means of power supply cord kit.)*
- Connected Load (kW Rating) @ 240/208 Volts = 11.8/8.9 kW
- Amps @ 240/208 Volts = 49.1/42.8 Amps
- Recommended Circuit Breaker – 50 Amps (40 Amps minimum)
- Always consult local and national electric codes.
- Make sure wall coverings around range can withstand heat generated by range.
- Linoleum or any other synthetic floor covering located beneath range, must be capable of withstanding minimum heat of 90° F above room temperature without shrinking, warping or discoloring. Insulating pad or 1/4"-thick plywood required between range and a carpeted floor.
- Countertop MUST be level in all directions and adjustable range height at least 1/16" greater than tallest cabinet height, to ensure metal rangetop flange will fit properly on countertop edge.
- When installing optional Backguard Kit, cutout depth of 21-3/4" minimum/22-1/8" maximum needs increased to 24".
- Overhead cabinetry should not exceed a 13" maximum depth.
- Absolute minimum horizontal distance between overhead cabinets installed to either side of appliance must be no less than maximum width of appliance.
- Allow 24" minimum clearance between rangetop and bottom of cabinet when bottom of wood or metal cabinet is protected by not less than 1/4" flame-retardant millboard covered with not less than No. 28 MSG sheet steel, 0.015" stainless steel, 0.024" aluminum or 0.020" copper. Allow 30" minimum clearance when cabinet is unprotected.
- To reduce risk of fire when using overhead cabinetry, install range hood that projects horizontally a recommended minimum of 5" beyond bottom of cabinets.

Countertop Preparation

Rangetop's side flanges overlap countertop cutout edges - for detailed preparation instructions, refer to product installation guide on the web.

- **Flat Square-Finish Countertops** - require no preparation since range top's flange lays directly on countertop edge.
- **Formed Front-Edged Countertops** - require front molded edge to be shaved flat 3/4" from each front corner of opening.
- **Tile Countertops** - may need trim cut back 3/4" from each front corner of opening and/or rounded edge flattened.
- For existing cutout width greater than 30-1/16" reduce the 3/4" overlap dimension; for cutout width of 29", replace actual side trim panels with smaller side trim panels, available with optional Side Trim Kit (refer to detailed kit installation instructions).

Note: For planning purposes only. Refer to Product Installation Guide on the web at frigidaire.com for detailed instructions.

Optional Accessories

- Rear Filler Kit: Stainless Steel - (PN# 901193-901S), White - (PN# 901193-901I), Black - (PN# 901193-901O).
- Side Panel Kit: Stainless Steel - (PN# 903074-901S), White - (PN# A01529902), Black - (PN# A01529901).
- Backguard Kit: Stainless Steel - (PN# 903046-901S), White - (PN# 903046-901I), Black - (PN# 903046-901O).
- Side Trim Kit: Stainless Steel - (PN# 903075-901S), White - (PN# 903075-901I), Black - (PN# 903075-901O).

