

Kleinburg Glen - 61 - 1 - 42-3 Elev.B CARLTON
CERAMIC

Inv.1,103	1 - ENSUTTE 2 SHOWER: DO *not* DROP CEILING ABOVE SHOWER - Shower jambs to be applied to ceiling. Price includes taller glass fixed panels and taller, full height glass door (for future steam shower). Price per Sergio Jan 26 2017
Line18133	Note:
16Jan17 / 24Feb17	
Inv.1,103	1 - MASTER ENSUITE SHOWER: DO *not* DROP CEILING ABOVE SHOWER - Shower jambs to be applied to ceiling. Price includes taller glass fixed panels and taller, full height glass door (for future steam shower). Price per Sergio Jan 26 2017
Line18134	Note:
16Jan17 / 24Feb17	
Inv.1,103	1 - KITCHEN FLOOR TILE: Upgrade 5 - 24x24" Regal Polished
Line16628	Note:
16Jan17 / 24Feb17	
Inv.1,103	1 - Thru out: Grout lines as small as possible, please!
Line16629	Note:
16Jan17 / 24Feb17	
Inv.1,103	1 - POWDER ROOM: Upgrade 5 - 24x24" Regal polished
Line16631	Note:
16Jan17 / 24Feb17	
Inv.1,103	1 - MASTER ENSUITE: Upgrade 4 floor tile - 18x18" Must polished - laid in straight, stacked pattern
Line16639	Note:
16Jan17 / 24Feb17	
Inv.1,103	1 - ENSUITE 2: SHOWER WALL TILE - upgrade 1 - 4x16" CDC- laid in horizontal, stacked pattern.
Line16648	Note:
16Jan17 / 24Feb17	
Inv.1,103	1 - TWIN BATH: TUB/SHOWER WALL TILE - upgrade 1 - 2X8" CDC- laid in horizontal, stacked pattern.
Line16713	Note:
16Jan17 / 24Feb17	

DRYWALL

Inv.1,103	1 - MASTER ENSUITE SHOWER: DO *not* DROP CEILING ABOVE SHOWER - Shower jambs to be applied to ceiling. Price includes taller glass fixed panels and taller, full height glass door (for future steam shower). Price per Sergio Jan 26 2017
Line18136	Note: *PURCHASER HAS RAINSHOWER HEAD
16Jan17 / 24Feb17	
Inv.602	1 - SMOOTH CEILINGS - (2 - Story Design) 2ND FLOOR
Line7392	Note:
23Jun16 / 13Oct16	

ELECTRICAL

Inv.1,103	1 - Add potlight built-in to cabinet, price includes cut outs and 1 transformer
Line18131	Note:
16Jan17 / 24Feb17	
Inv.602	1 - 200 AMP ELECTRICAL SERVICE
Line7390	Note:
23Jun16 / 13Oct16	

Kleinburg Glen - 61 - 1 - 42-3 Elev.B CARLTON

Inv.602	1 - KITCHEN: Single pole switch for puck lights in upper cabinets
Line9492	Note:
23Jun16 / 13Oct16	
Inv.602	1 - KITCHEN: ROUGH - IN CEILING OUTLET ON SAME SWITCH - DOES NOT INCLUDE FIXTURE - Locate above island, on same switch as standard light. See plan for location.
Line9490	Note:
23Jun16 / 13Oct16	
Inv.602	1 - KITCHEN: Install a 110V WALL RECEPTACLE ON DEDICATED CIRCUIT - FOR future 600+cfm hood fan.
Line7409	Note:
23Jun16 / 13Oct16	
Inv.602	1 - KITCHEN: 240v / 50a Outlet for future micro/oven combo unit.
Line9486	Note:
23Jun16 / 13Oct16	
Inv.602	1 - KITCHEN: 110V WALL RECEPTACLE ON DEDICATED CIRCUIT - GAS FIRED APPLIANCE - FOR AUX. EQUIPMENT - NOT A STOVE PLUG
Line9487	Note:
23Jun16 / 13Oct16	
Inv.602	1 - KITCHEN: RELOCATE STANDARD FIXTURE - Locate above island, see plan for location.
Line9489	Note:
23Jun16 / 13Oct16	
Inv.602	2 - KITCHEN: KITCHEN CABINET INTERIOR CABINET LIGHT - EACH PUCK LIGHT - DOES NOT INCLUDE (AND REQUIRES) KITCHEN UPGRADE PRICING -locate 1 in each upper cabinet either side of cook top.
Line9491	Note:
23Jun16 / 13Oct16	
Inv.602	1 - MASTER ENSUITE: RELOCATE STANDARD FIXTURE - Locate above sink
Line9716	Note:
23Jun16 / 13Oct16	
Inv.602	1 - REAR EXTERIOR: ADDITIONAL EXTERIOR COACH LIGHT ON SAME SWITCH (BUILDER STANDARD FIXTURE) - In addition to builders standard light, add 1 light - locate 1 on either side of double doors - See plan for location.
Line9541	Note:
23Jun16 / 13Oct16	
Inv.602	1 - MASTER ENSUITE: ROUGH - IN WALL OUTLET ON SAME SWITCH - DOES NOT INCLUDE FIXTURE - LOCATE approx. center above sink. See plan for location.
Line9715	Note:
23Jun16 / 13Oct16	
Inv.1,103	1 - KITCHEN: Add 110V WALL RECEPTACLE ON NORMAL CIRCUIT - for future wine fridge. See plan for location.
Line17970	Note:
16Jan17 / 24Feb17	

EXTERIOR COLOURS

Inv.602	1 - EXTERIOR COLOUR PACKAGE 2
Line12599	Note:
23Jun16 / 13Oct16	

FRAMING

Kleinburg Glen - 61 - 1 - 42-3 Elev.B CARLTON

Inv.1,103	1 - GREAT ROOM: Standard Fireplace to be centered on wall.
Line17980	Note:
16Jan17 / 24Feb17	
Inv.1,137	1 - MAIN FLOOR: Remove side windows, reframe and install taller windows
Line18849	Note:
26Jan17 / 13Mar17	
Inv.602	1 - MAIN FLOOR CEILING 10FT- INCLUDES: TALLER FRONT DOOR WITH TRANSOM, TALLER FRONT AND REAR ELEVATION WINDOWS OR WITH TRANSOM, EXTRA TALL FLAT ARCHES, 8' TALL INTERIOR DOORS, WITH KITCHEN CROWN AND FURRING PANEL,
Line7391	Note:
23Jun16 / 13Oct16	
Inv.602	1 - OPTIONAL 10 FOOT TRAY CEILING - MASTER BEDROOM
Line9496	Note:
23Jun16 / 13Oct16	
Inv.602	1 - KITCHEN: *REDUCE* BULKHEADS AS MUCH AS POSSIBLE. TO ALLOW FOR FUTURE FURRING PANEL AND CROWN MOULDING TO HIDE BULKHEADS. (all cabinets to be same height)
Line9485	Note:
23Jun16 / 13Oct16	
Inv.602	1 - STANDARD DOOR EXTENDED HEIGHT 96 INCH (PRICE PER DOOR) - SECOND FLOOR 2 STOREY 38 FOOT AN 42 FOOT MODELS ONLY
Line12597	Note:
23Jun16 / 13Oct16	
Inv.602	1 - UPPER HALL & MASTER BEDROOM: Increase Archway to 8' height (PRICE PER DOORWAY) See plan for location.
Line12598	Note:
23Jun16 / 13Oct16	
Inv.1,103	1 - MASTER ENSUITE SHOWER: DO *not* DROP CEILING ABOVE SHOWER - Shower jambs to be applied to ceiling. Price includes taller glass fixed panels and taller, full height glass door (for future steam shower). Price per Sergio Jan 26 2017
Line16710	Note:
16Jan17 / 24Feb17	
Inv.1,103	1 - KITCHEN NOTE: **DELETE** BULKHEAD thru out kitchen. Cabinetry to be stacked to ceiling at cooktop. Cabinets will touch ceiling above pantry wall.
Line16748	Note:
16Jan17 / 24Feb17	
Inv.1,103	1 - ENSUITE 2 SHOWER: DO *not* DROP CEILING ABOVE SHOWER - Shower jambs to be applied to ceiling. Price includes taller glass fixed panels and taller, full height glass door (for future steam shower). Price per Sergio Jan 26 2017
Line17889	Note:
16Jan17 / 24Feb17	

GLASS AND MIRROR

Inv.1,103	1 - ENSUITE 2 SHOWER: DO *not* DROP CEILING ABOVE SHOWER - Shower jambs to be applied to ceiling. Price includes taller glass fixed panels and taller, full height glass door (for future steam shower). Price per Sergio Jan 26 2017
Line18132	Note:
16Jan17 / 24Feb17	
Inv.1,103	1 - MASTER ENSUITE SHOWER: DO *not* DROP CEILING ABOVE SHOWER - Shower jambs to be applied to ceiling. Price includes taller glass fixed panels and taller, full height glass door (for future steam shower). Price per Sergio Jan 26 2017
Line18135	Note:
16Jan17 / 24Feb17	

Kleinburg Glen - 61 - 1 - 42-3 Elev.B CARLTON

Inv.602	1 - CONVERT FRAMED SHOWER TO 10MM FRAMELESS SHOWER ENCLOSURE WITH DOOR AND 10MM SIDE PANEL
Line7395	Note:
23Jun16 / 13Oct16	

HARDWOOD

Inv.1,103	1 - GREAT ROOM / DEN / LIVING/DINING HARDWOOD FLOOR: 3/4 x 3-1/2" Vintage Red Oak (Smooth)
Line16632	Note:
16Jan17 / 24Feb17	
Inv.1,103	1 - UPPER HALL HARDWOOD FLOOR: 3/4 x 3-1/2" Vintage Red Oak (Smooth)
Line16633	Note:
16Jan17 / 24Feb17	

HVAC

Inv.1,137	1 - *DELETE* ITEM #13 from order PE-502-1 **do not install 10" duct, homeowner bought hood fan thru Cortina kitchens - it is not required.
Line18508	Note:
26Jan17 / 13Mar17	
Inv.602	1 - TANKLESS HWT CONNECTION - HWT ON RENTAL BASIS / TANK NOT INCLUDED
Line7405	Note:
23Jun16 / 13Oct16	
Inv.602	1 - KITCHEN: GAS LINE ROUGH - GROUND FLOOR (for future gas cook top)
Line9488	Note:
23Jun16 / 13Oct16	
Inv.602	1 - KITCHEN: UPGRADE VENTING FOR STOVE TO 10" INCH PIPE EXTERIOR WALL
Line7410	Note:
23Jun16 / 13Oct16	

INTERIOR TRIM AND DOORS

Inv.602	2 - UPPER HALL & MASTER BEDROOM: Increase Archway to 8' height (PRICE PER DOORWAY) See plan for location.
Line7400	Note:
23Jun16 / 13Oct16	
Inv.602	18 - STANDARD DOOR EXTENDED HEIGHT 96 INCH (PRICE PER DOOR) - SECOND FLOOR 2 STOREY 38 FOOT AN 42 FOOT MODELS ONLY
Line7406	Note:
23Jun16 / 13Oct16	
Inv.602	1 - MAIN FLOOR CEILING 10FT- INCLUDES: TALLER FRONT DOOR WITH TRANSOM, TALLER FRONT AND REAR ELEVATION WINDOWS OR WITH TRANSOM, EXTRA TALL FLAT ARCHES, 8' TALL INTERIOR DOORS, WITH KITCHEN CROWN AND FURRING PANEL,
Line12595	Note:
23Jun16 / 13Oct16	
Inv.1,103	1 - MAIN FLOOR + 2ND FLOOR: Upgrade package 2
Line16650	Note:
16Jan17 / 24Feb17	

KITCHEN AND BATH CABINETRY

Kleinburg Glen - 61 - 1 - 42-3 Elev.B CARLTON

Inv.602	1 - MAIN FLOOR CEILING 10FT- INCLUDES: TALLER FRONT DOOR WITH TRANSOM, TALLER FRONT AND REAR ELEVATION WINDOWS OR WITH TRANSOM, EXTRA TALL FLAT ARCHES, 8' TALL INTERIOR DOORS, WITH KITCHEN CROWN AND FURRING PANEL,
Line12593	Note:
23Jun16 / 13Oct16	
Inv.1,103	1 - KITCHEN CABINETRY: Upgrade 4 profile (maple) Price includes spray stain premium
Line16136	Note:
16Jan17 / 24Feb17	
Inv.1,103	1 - KITCHEN CABINETRY: Stacked uppers *Cooktop Wall *
Line16618	Note:
16Jan17 / 24Feb17	
Inv.1,103	6 - KITCHEN CABINETRY: Plain, Clear Glass doors in upper stacked cabinets *Note: interior of cabinets to be standard white finish)
Line16619	Note: Cooktop wall only!
16Jan17 / 24Feb17	
Inv.1,103	1 - KITCHEN CABINETRY: L-shaped hood canopy, complete with 600cfm fan.-36"wide
Line16621	Note: Cabinet to be 40cm deep + 40cm deep stacked upper - per Paolo Feb 23 2017
16Jan17 / 24Feb17	
Inv.1,103	1 - KITCHEN CABINETRY: Double appliance cabinet for built-in wall ovens, complete with bottom drawer (standard appliance installation, not flush)
Line16622	Note:
16Jan17 / 24Feb17	
Inv.1,103	3 - KITCHEN CABINETRY: Pots and Pans drawers (1 shallow top drawer + 2 deep drawers) *top drawer is false at cooktop
Line16623	Note:
16Jan17 / 24Feb17	
Inv.1,103	1 - KITCHEN CABINETRY: Panel-ready fridge - door overlay (2 doors) **hardware to be supplied by homeowner & must be on site at time of installation**
Line16624	Note:
16Jan17 / 24Feb17	
Inv.1,103	1 - KITCHEN CABINETRY: Leave minimum 24" space for backsplash
Line16625	Note:
16Jan17 / 24Feb17	
Inv.1,103	1 - KITCHEN CABINETRY: Adjust cabinets for 36" cooktop
Line16627	Note:
16Jan17 / 24Feb17	
Inv.1,103	1 - POWDER ROOM CABINETRY: Upgrade 2 profile (maple)
Line16634	Note:
16Jan17 / 24Feb17	
Inv.1,103	1 - MASTER ENSUITE CABINETRY: Upgrade 2 profile (maple) (price includes spray stain premium)
Line16638	Note:
16Jan17 / 24Feb17	
Inv.1,103	3 - MASTER ENSUITE: Raise vanity to 36"
Line16641	Note:
16Jan17 / 24Feb17	
Inv.1,103	1 - ENSUITE 2 CABINETRY: Upgrade: spray stain premium
Line16647	Note:
16Jan17 / 24Feb17	

Kleinburg Glen - 61 - 1 - 42-3 Elev.B CARLTON

Inv.1,103	1 - TWIN BATH CABINETRY: Upgrade to spray stain premium
Line16649	Note:
16Jan17 / 24Feb17	
Inv.1,103	1 - KITCHEN CABINETRY: Built-in fridge (regular installation)
Line16673	Note:
16Jan17 / 24Feb17	
Inv.1,103	1 - KITCHEN CABINETRY: Add potlight built-in to cabinet, price includes cut outs and 1 transformer
Line16747	Note:
16Jan17 / 24Feb17	
Inv.1,103	2 - KITCHEN CABINETRY: Clear glass door with matching interior - 1 on either side of hood fan.
Line16746	Note:
16Jan17 / 24Feb17	
Inv.1,103	1 - KITCHEN CABINETRY: Stacked uppers above pantry wall (no glass)
Line17888	Note:
16Jan17 / 24Feb17	
Inv.1,103	1 - KITCHEN: Do NOT install hardware, do not drill holes for kitchen cabinetry.
Line17890	Note:
16Jan17 / 24Feb17	
Inv.1,103	1 - KITCHEN CABINETRY: Add soft-close hardware in kitchen
Line17905	Note:
16Jan17 / 24Feb17	
Inv.1,103	1 - KITCHEN CABINETRY: Leave space for future wine fridge. See plan for location.
Line17972	Note:
16Jan17 / 24Feb17	
Inv.1,103	1 - KITCHEN: Add pull out waste/recycle cabinet with 2 bins in island. See plan for location.
Line17977	Note:
16Jan17 / 24Feb17	
Inv.1,103	1 - KITCHEN: Upgrade standard shallow pantry to deep pantry.
Line17978	Note:
16Jan17 / 24Feb17	
Inv.1,103	1 - KITCHEN: Add pull-out spice beside pantry. See plan for location.
Line17979	Note:
16Jan17 / 24Feb17	

MISC.

Inv.1,137	1 - BASEMENT: Adjust credit for basement windows (should have credited \$290, only credited \$250)
Line18275	Note:
26Jan17 / 13Mar17	
Inv.602	1 - THRU OUT: *DELETE* ACCESSORIES THRU OUT - INSTALL STANDARD MIRRORS THRU OUT.
Line9497	Note:
23Jun16 / 13Oct16	
Inv.602	1 - MASTER ENSUITE: DELETE ARCH BY TUB
Line9495	Note:
23Jun16 / 13Oct16	

Kleinburg Glen - 61 - 1 - 42-3 Elev.B CARLTON

Inv.602	1 - Purchaser has attended a Structural appointment at the Decor Centre & has DECLINED any additional upgrades and accepts and acknowledges that there will be no further structural changes/additions/deletions to be made upon signing on August 2, 2016.
Line9537	Note:
23Jun16 / 13Oct16	
Inv.602	1 - Purchasers are aware & accepts that ANY changes made to upgrades after signing this Purchasers Extra Form are subject to a minimum administration fee of \$500. PLUS a 10% holdback fee.
Line9538	Note:
23Jun16 / 13Oct16	
Inv.602	1 - BONUS PACKAGE: \$10,000.00 (INCLUDING TAXES) WORTH OF UPGRADES FROM GOLD PARK HOMES DÉCOR CENTRE IS BEING *DEFERRED* THE COLOURS APPOINTMENT. PURCHASER HAS A REMAINING AMOUNT OF \$10,000 (INCLUDING TAXES) TO BE USED TOWARD THE COLOUR APPOINTMENT.
Line9539	Note:
23Jun16 / 13Oct16	
Inv.1,103	1 - *CREDIT* rear basement window credit due to WOB condition.
Line16749	Note:
16Jan17 / 24Feb17	
Inv.1,103	1 - Purchasers are aware & accepts that ANY changes made to upgrades after signing this Purchasers Extra Form are subject to a minimum administration fee of \$500. PLUS a 10% holdback fee.
Line16715	Note:
16Jan17 / 24Feb17	
Inv.1,103	1 - Purchaser has attended a Colour appointment at the Decor Centre & has DECLINED any additional upgrades and accepts and acknowledges that there will be no further changes/additions/deletions to be made upon signing on January 26 2017.
Line16714	Note:
16Jan17 / 24Feb17	

PAINTING

Inv.1,103	1 - MAIN STAIRS: Stain stairs to match hardwood, as close as possible. Note, price includes landings stained on site.
Line16653	Note:
16Jan17 / 24Feb17	

PLUMBING

Inv.602	1 - KITCHEN: ROUGH - IN - WATERLINE FOR FRIDGE
Line7402	Note:
23Jun16 / 13Oct16	
Inv.602	1 - MASTER ENSUITE: ROUGH - IN FOR RAINSHOWER HEAD - SHOWER HEAD NOT INCLUDED AND MUST BE PURCHASED
Line7403	Note:
23Jun16 / 13Oct16	
Inv.602	1 - MASTER ENSUITE: Plumbing wall in shower to be on bedroom wall, see plan for location.
Line9714	Note:
23Jun16 / 13Oct16	
Inv.1,103	1 - MASTER ENSUITE AND ENSUITE 2: DELETE TOE TESTER on standard shower faucet
Line17891	Note:
16Jan17 / 24Feb17	

Kleinburg Glen - 61 - 1 - 42-3 Elev.B CARLTON

Inv.1,103	1 - MASTER ENSUITE: Install standard shower head from ceiling (in lieu of upgraded rain shower head) with standard control valve (please delete toe-tester). Homeowner to delete/alter all tile and plumbing to master ensuite shower after closing.
Line17906	Note: Purchaser accepts and acknowledges that warranty is void on Master Ensuite plumbing.
16Jan17 / 24Feb17	

PLUMBING FIXTURES

Inv.1,103	1 - MASTER ENSUITE: Upgrade free-standing tub to Mirolin Brook #CF2002
Line16642	Note:
16Jan17 / 24Feb17	

Inv.1,103	1 - MASTER ENSUITE TUB FILLER: Delta Arzo 3 piece tub filler #T2786/R2709 (chrome)
Line16646	Note:
16Jan17 / 24Feb17	

STAIRS AND RAILINGS

Inv.1,103	1 - MAIN STAIRS: Euroline 2 + V Groove
Line16651	Note:
16Jan17 / 24Feb17	

WINDOWS - BASEMENT

Inv.602	5 - BASEMENT WINDOWS - UPGRADE EXISTING BASEMENT WINDOW TO 30 INCH X 24 INCH - MAY REQUIRE INSTALLATION OF WINDOW WELL- ONLY 4 WINDOWS UPG
Line7397	Note: REFUND FOR ONE REAR WINDOW UPG-DUE TO WOB CONDITION PE:875
23Jun16 / 13Oct16	

Inv.602	1 - BASEMENT WINDOWS - EXTRA BASEMENT WINDOW 30 INCH X 24 INCH - MAY REQUIRE INSTALLATION OF WINDOW WELL
Line9713	Note:
23Jun16 / 13Oct16	

WINDOWS AND DOORS

Inv.1,137	1 - MAIN FLOOR: Remove side windows, reframe and install taller windows
Line18488	Note: As per Bruno Pricing by Martina
26Jan17 / 13Mar17	

Inv.602	1 - MAIN FLOOR CEILING 10FT- INCLUDES: TALLER FRONT DOOR WITH TRANSOM, TALLER FRONT AND REAR ELEVATION WINDOWS OR WITH TRANSOM, EXTRA TALL FLAT ARCHES, 8' TALL INTERIOR DOORS, WITH KITCHEN CROWN AND FURRING PANEL,
Line12594	Note:
23Jun16 / 13Oct16	

Purchaser: Pearl Mingle

Property: 61

Telephone Res. / Bus: (416) 274-6267

Project: Burkshire Holdings Inc.

Decor Advisor: Yolande Somerville

Model and Elevation: 42-3 Elev.B CARLTON

Layout Changes: ☐ Yes ☒ No Sketch Attached: ☒ Yes ☐ No Exterior Colour Scheme:

1. Cabinetry

	Style and Colour	Counter	Hardware
Kitchen / Breakfast	*hampton maple 'cocoa'	Granite: Crema Caramel Edge: FE-20	*none
Laundry Room	n/a	n/a	n/a
Powder Room	*florentine maple 'cocoa'	P-Lam #7264-58 'Limestone'	cs1-22
n/a	n/a	n/a	n/a
Master Ensuite Bathroom	*florentine maple 'cocoa'	P-Lam #7267-58 'Concrete Stone'	cs1-21
Second Ensuite Bathroom (If Applicable)	siena oak 'cocoa'	P-Lam #7267-58 'Concrete Stone'	cs1-24
Twin 3/4	siena oak 'cocoa'	P-Lam #7264-58 'Concrete Stone'	cs1-23
Dishwasher Cabinet	n/a		
Comment			

2. Floor Tile

	Selection	Grout	Threshold
Entrance Vestibule	13x13" Venus 'Ivory'	n/a	n/a
Main Hall	n/a	n/a	n/a
Kitchen / Breakfast	24x24" Regal polished 'Taupe'	n/a	n/a
Laundry Room	13x13" Venus 'Ivory'	n/a	n/a
Powder Room	24x24" Regal polished 'Taupe'	n/a	n/a
Mud Room	13x13" Venus 'Ivory'	n/a	n/a
Master Ensuite Bathroom	18x18" Must 'Ivory'	n/a	n/a
Second Ensuite Bathroom (If Applicable)	13x13" Carrara 'White/Grey'	n/a	n/a
Lower Landing (If Applicable)	n/a	n/a	n/a
Twin Bathroom	13x13" New Reeds 'Taupe'	n/a	n/a

Comment

Grout lines as small as possible!

3. Wall Tile

	Selection	Listello/Inserts	Describe
Master Ensuite Bathroom		<input type="radio"/> Yes <input checked="" type="radio"/> No	
Tub Deck	n/a	<input type="radio"/> Yes <input checked="" type="radio"/> No	
Shower Stall	8x10" Weave 'White'	<input type="radio"/> Yes <input checked="" type="radio"/> No	
Bathroom Walls	n/a	<input type="radio"/> Yes <input checked="" type="radio"/> No	
Second Ensuite Bathroom (If Applicable)	*4x16" CDC 'Tender Grey' Bright	<input type="radio"/> Yes <input checked="" type="radio"/> No	
Twin Bathroom	*2x8" CDC 'Taupe' Bright	<input type="radio"/> Yes <input checked="" type="radio"/> No	
Kitchen Backsplash	<input type="radio"/> Yes <input checked="" type="radio"/> No	Backsplash Behind Fridge	none
Comment			

Purchaser: Pearl Mingle
Telephone Res. / Bus: (416) 274-6267
Decor Advisor: Yolande Somerville

Property: 61
Project: Burkshire Holdings Inc.
Model and Elevation: 42-3 Elev.B CARLTON

4. Plumbing Fixtures

Master Ensuite Bathroom Second Ensuite Powder Room
Other Room - Specify Other Washroom

Comment

Standard Thru out, except Master Ensuite
Note: No toe tester in Master or Ensuite 2 shower!

5. Hardwood Flooring

	Type and Stain		Type and Stain
Main Hall	n/a	Upper Landing	n/a
Kitchen / Breakfast	n/a	Upper Hall	*3-1/2" Vintage Baroque (smooth)
Living Room	*3-1/2" Vintage Baroque (smooth)	Master Bedroom	n/a
Dining Room	*3-1/2" Vintage Baroque (smooth)	Bedroom #2	n/a
Family Room	*3-1/2" Vintage Baroque (smooth)	Bedroom #3	n/a
Den/Library	*3-1/2" Vintage Baroque (smooth)	Bedroom #4	n/a
Entrance Vestibule	n/a	Bedroom #5	n/a
Lower Landing (If Applicable)	n/a	Other Room - Specify	<input type="text"/>

Comment

Hardwood Selection: Vintage 3/4 x 3-1/2" Red Oak smooth 'Baroque'

6. Carpeting

	Upgrade	Description
Main Hall	<input type="checkbox"/>	n/a
Living Room	<input type="checkbox"/>	n/a
Dining Room	<input type="checkbox"/>	n/a
Family Room	<input type="checkbox"/>	n/a
Den/Library	<input type="checkbox"/>	n/a
Upper Hall	<input type="checkbox"/>	n/a
Master Bedroom	<input type="checkbox"/>	T-15
Bedroom #2	<input type="checkbox"/>	T-15
Bedroom #3	<input type="checkbox"/>	T-15
Bedroom #4	<input type="checkbox"/>	T-15
Bedroom #5	<input type="checkbox"/>	n/a
<input type="text"/>	<input type="checkbox"/>	<input type="text"/>
Upper Landing (If Applicable)	<input type="checkbox"/>	n/a
Lower Landing (If Applicable)	<input type="checkbox"/>	n/a

Upgrade Underpad Type Area
Capped Runner - *Upgrade
Carpet on Stairs

Comment

Standard Carpet and Standard Underpad in bedrooms

L.R.

Purchaser: Pearl Mingle

Property: 61

Telephone Res. / Bus: (416) 274-6267

Project: Burkshire Holdings Inc.

Decor Advisor: Yolande Somerville

Model and Elevation: 42-3 Elev.B CARLTON

7. Fireplace

	Living Room			Family Room			Other Room - Specify		
	Purchased	As Per Plan	N/A	Purchased	As Per Plan	N/A	Purchased	As Per Plan	N/A
Fireplace Type	<input type="radio"/>	<input type="radio"/>	<input checked="" type="radio"/>	<input type="radio"/>	<input checked="" type="radio"/>	<input type="radio"/>	<input type="radio"/>	<input type="radio"/>	<input checked="" type="radio"/>
Mantle Type				Standard Gas					
Colour / Stain				Standard Mediterranean					
Surround				Standard					
Hearth				none					
Comment									

8. Trim Carpentry

Interior Doors	*Standard	Front Door Glass Inserts	Standard	Door Handles	Standard
Interior Trim	*Upgrade package 2				
Comment	*96" tall doors thru out - standard profile				

9. Plaster Mouldings and Medallions

Entrance Vestibule			Kitchen/Breakfast		
Main Hall			Den/Library		
Living Room			Lower Landing		
Dining Room			Other Room - Specify	none	
Family Room			Thru out		
Comment					

10. Railings and Spindles

Railing Package	*Euroline 2 + V Groove		
Railing Colour	*Vintage 'Baroque'	Spindle Colour	*Black
Stringer / Riser	*Vintage 'Baroque'	Treads	*Vintage 'Baroque'
Comment		Oak Stairs	<input type="radio"/> Yes <input checked="" type="radio"/> No

11. Wall Paint

Main & Upper Hall		Master Bedroom	
Living Room		Bedroom #2	
Dining Room		Bedroom #3	
Kitchen / Breakfast		Bedroom #4	
Family Room		Bedroom #5	
Powder Room		Master Ensuite	
Laundry Room		Second Ensuite	
Den/Library		Thru Out	Warm Grey
Trim Paint			
Comment	Smooth Ceilings First Floor		



INTERIOR COLOUR SCHEME

*** NOTE: This is not an approved document. Document must be locked ***

Scheduled Closing Date: Thursday, November 03, 2016

Purchaser: Pearl Mingle

Property: 61

Telephone Res. / Bus: (416) 274-6267

Project: Burkshire Holdings Inc.

Decor Advisor: Yolande Somerville

Model and Elevation: 42-3 Elev.B CARLTON

12. Electrical

Plugs and Switches ☒ White ☐ Ivory

Hood Fan ☐ White ☐ Ivory

Appliances Built in Cooktop

☒ Yes ☐ No

Built in Oven

☒ Yes ☐ No

Above Kitchen Cabinet Light ☐ Yes ☒ No

Below Kitchen Cabinet Light ☒ Yes ☐ No

Gas Stove

☒ Yes ☐ No

Microwave

☒ Yes ☐ No

Comment

13. Heating and Air Conditioning

Air Conditioning

Gas Provisions Dryer

Gas Provisions Stove

Gas Provisions Barbecue

Comment

Standard Gas BBQ Line

14. Additional Comments

15. Disclaimers and Notes

- 1) Colours of all materials are as close as possible to builder's selection, but not necessarily identical due to variances in manufacturing.
- 2) Any extras listed above are null and void unless accompanied by a separate invoice/amendment. Said invoice must be paid in full.
- 3) The Purchaser acknowledges that after Interior Colour Selection form is signed and dated, no further changes will be permitted other than re-selection due to unavailability. _____ Purchaser's Initials
- 4) The Purchaser acknowledges reading and accepting the "Gold Park Homes Decor Centre Disclaimers" form. This document contains other miscellaneous disclaimers.

This Interior Colour Selection is final and approved by:

Signature: 

Date: _____

Elevation A • 3,354 sq.ft.

✓ Elevation B • 3,361 sq.ft.

LOT 61

AUGUST 2, 2016

PM

KG-61

JANUARY 24

2017

PM

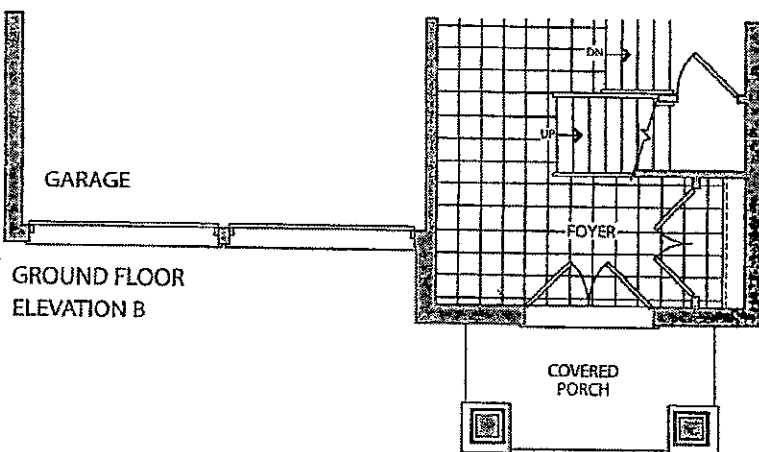
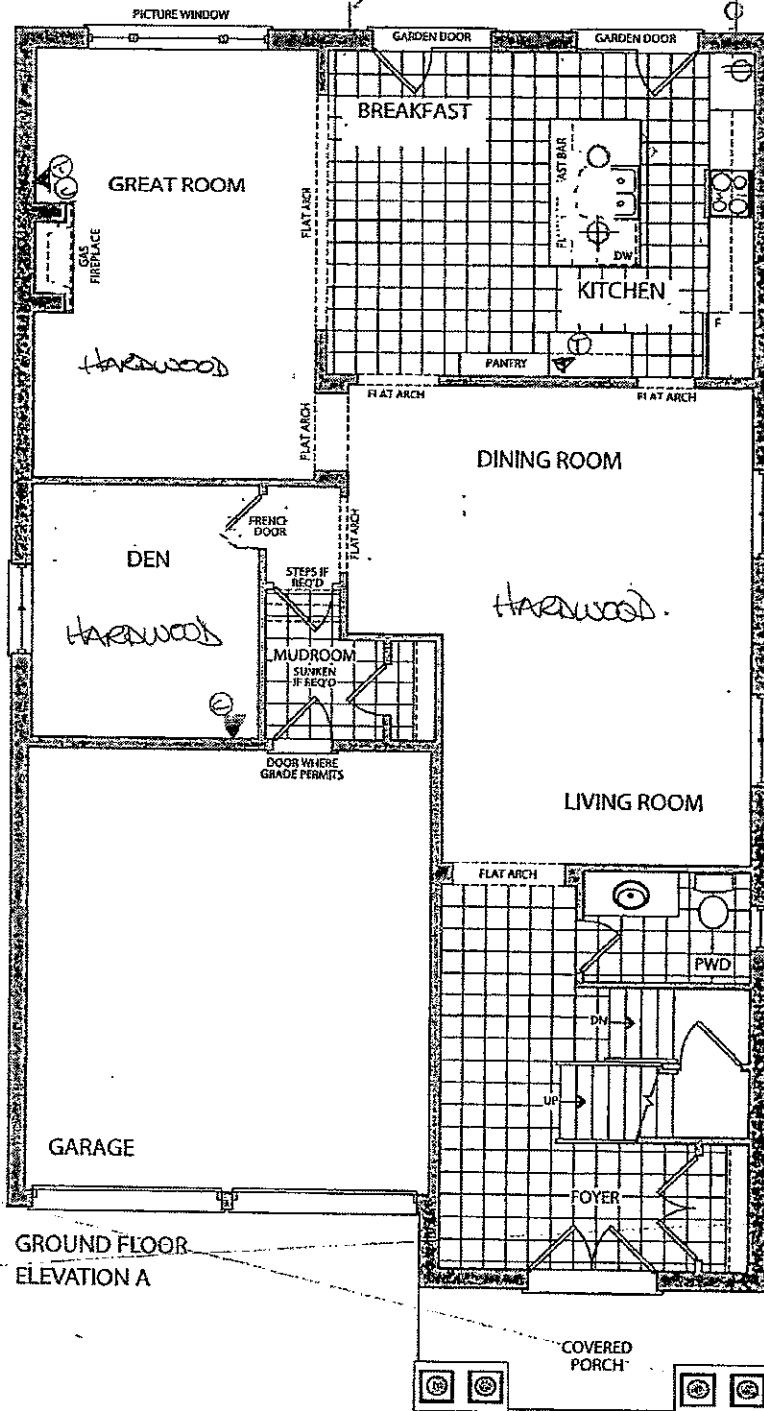

Prices, figures, illustrations, sizes, features and finishes are subject to change without notice. E.&O.E. Areas and dimensions are approximate and actual usable floor space may vary from the stated area. Layout may be reverse of the unit purchased. E. & O.E.

LG-61

AUGUST 2 2016

PM

JAN. 26 2017
KG-61

PM

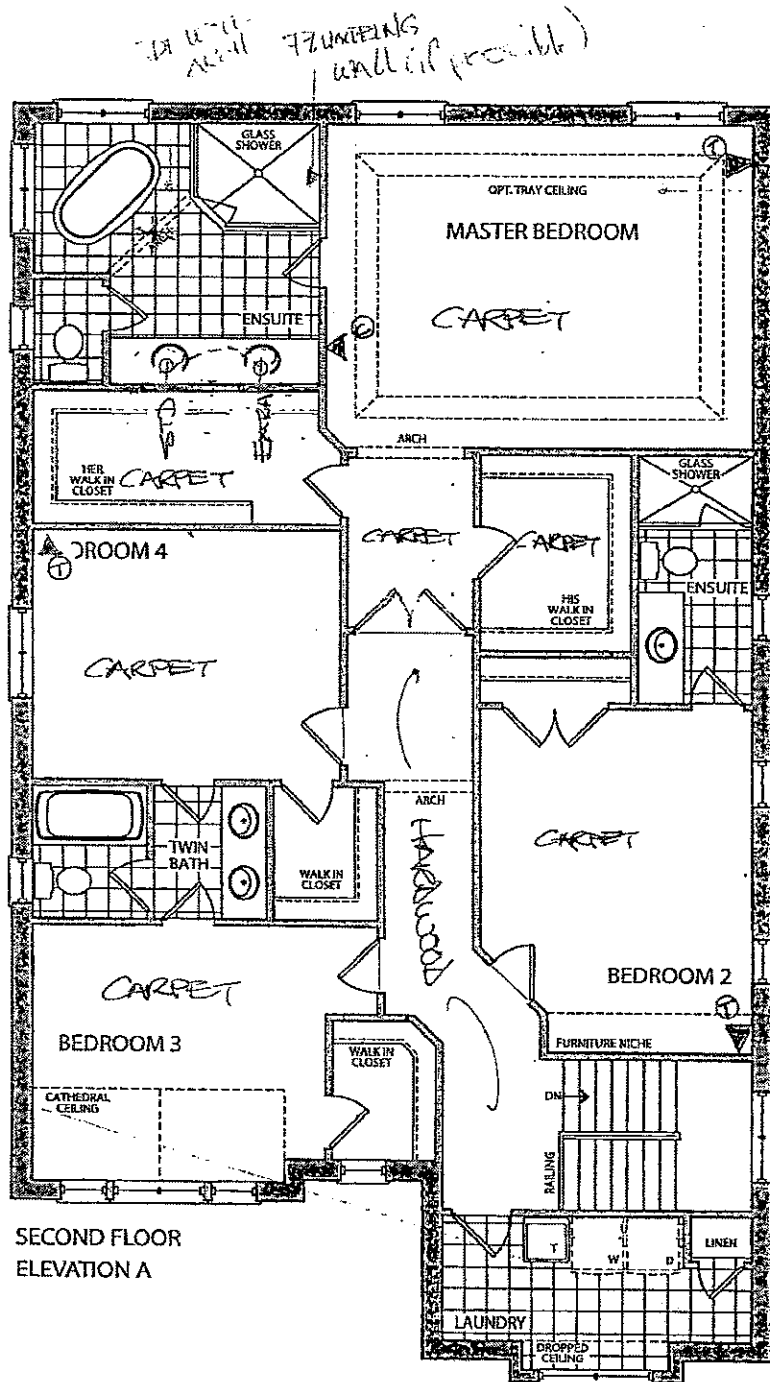

SECOND FLOOR
ELEVATION A

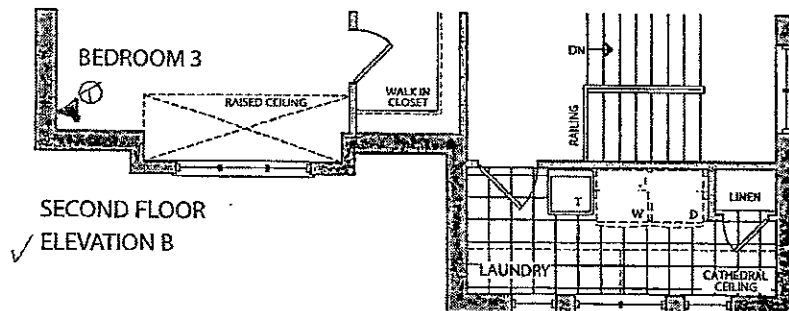

SECOND FLOOR
ELEVATION B

—Elevation A • 3,354 sq.ft.—

✓Elevation B • 3,361 sq.ft.

lot 61

AUGUST 2 2016

(PM)

ADD:
30x24" →

KG-61 (PM)

JANUARY 24 2017

URG
30x24"

URG.
30x24"

* DAILY COOK
— MINUTE.

URG.
30x24"

URG.
30x24"

URG.
30x24"

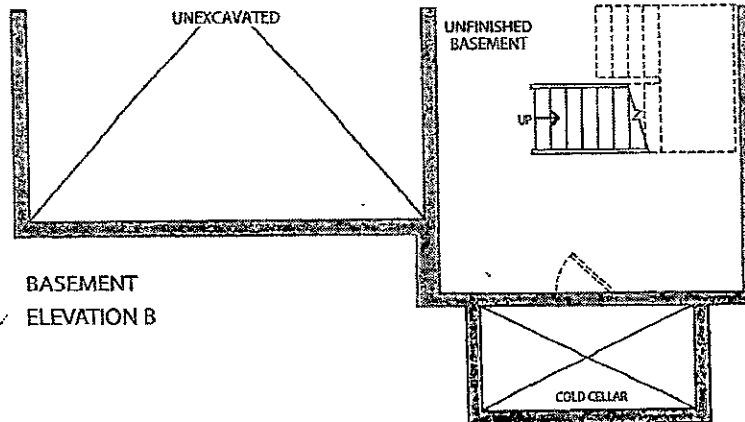
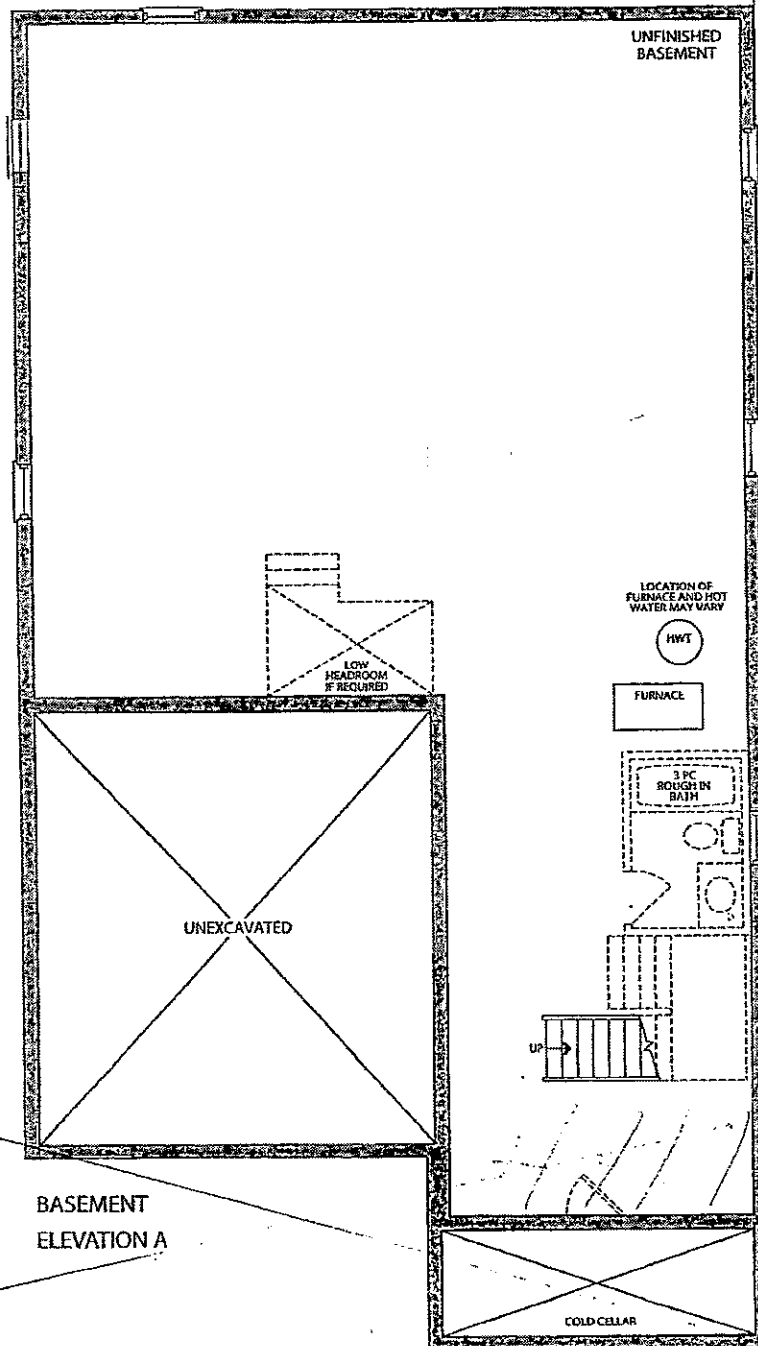

Prices, figures, illustrations, sizes, features and finishes are subject to change without notice. C.&O.E. Areas and dimensions are approximate and actual usable floor space may vary from the stated area. Layout may be reverse of the unit purchased. E. & O.E.

CORTINA

70 Regina Road, Woodbridge, Ontario L4L 8L6
Tel: 905-264-0404 Fax: 905-264-0884
www.CortinaKitchens.com

KG-61

JANUARY 26 2017

P.M.

QUOTATION

Date: 29/06/16

Trade Name: Gold Park Homes

Site location:

Model: 42-3

Address:

Project: Kleinburg Glen

Phase:

This layout has been explained to the purchaser by Cortina Kitchens Inc. and is understood by the purchaser.

* STACKED UPPIERS
AT FRIDGE WALL ONLY (see sketch).

* GLASS DOORS AT STACKED UPPIERS. (see sketch)

* OPEN ABOVE PANTRY WALL

* 10' CEILING

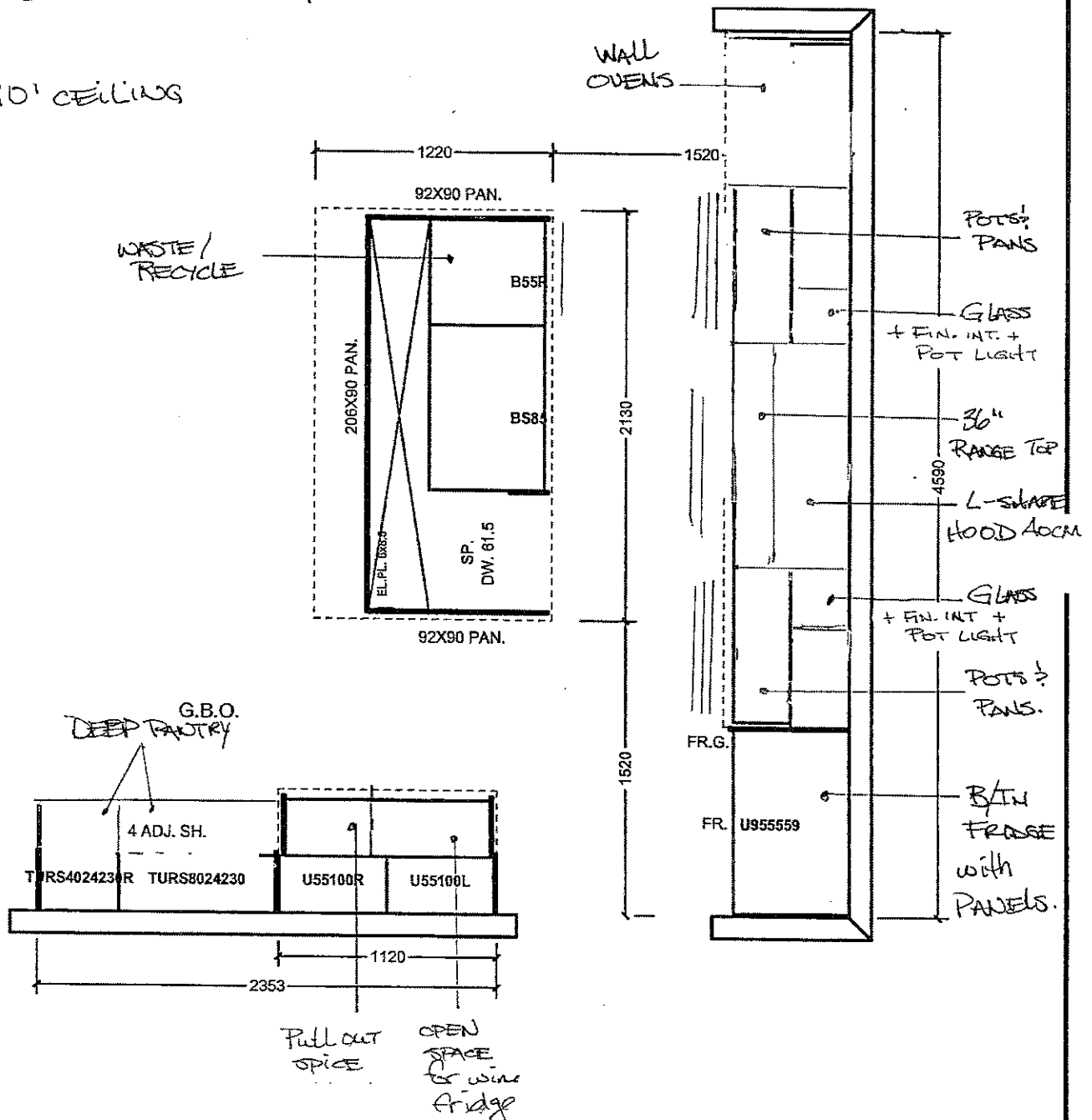

All prices subject to confirmation from head office.
This quotation is subject to the terms & conditions set out

ACCEPTED DATE: _____

All agreements are contingent upon strikes, accidents, and delays beyond our control.
Please provide our installer with template for sinkholes or \$150.00 will be charged for callback.

Item A. Wood grain and colour are characteristics of the product. We cannot guarantee that such grain and colour will always match.
Item B. Cortina Kitchens Inc. reserves the right to alter dimensions and make technical changes without notice.

CORTINA

70 Regina Road, Woodbridge, Ontario L4L 8L8
Tel: 905-294-0454 Fax: 905-294-0984
www.CortinaKitchens.com

KG-61

JAN 26 2017



QUOTATION

Date: 29/06/16

Trade Name: Gold Park Homes

Site location:

Model: 42-3

Address:

Project: Kleinburg Glen

Phase:

This layout has been explained to the purchaser by Cortina Kitchens Inc. and is understood by the purchaser.

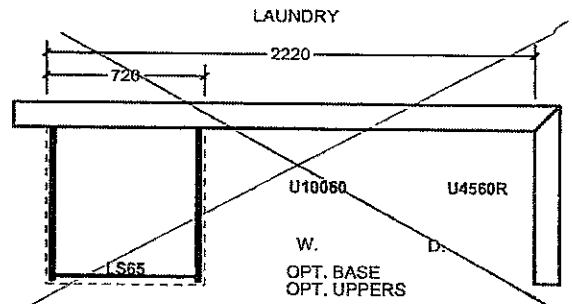
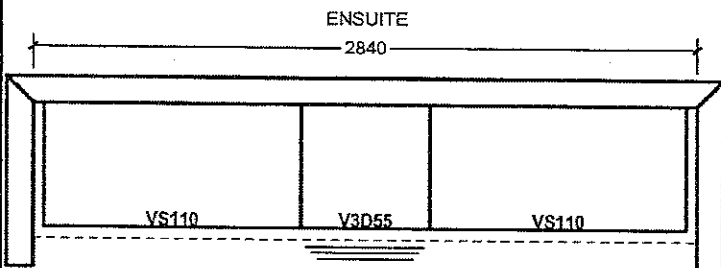
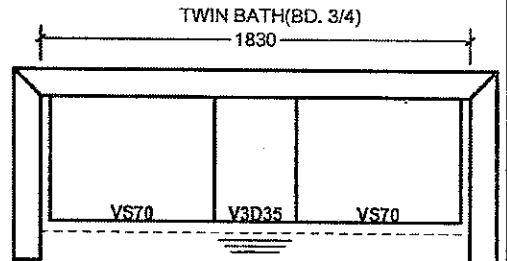
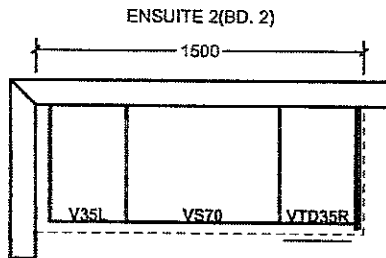
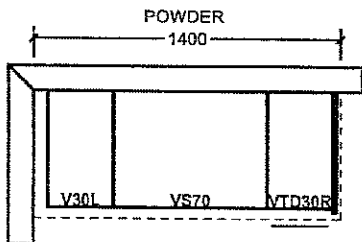

OPT. SECOND FLOOR

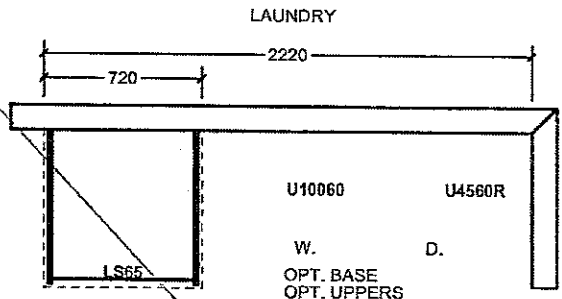
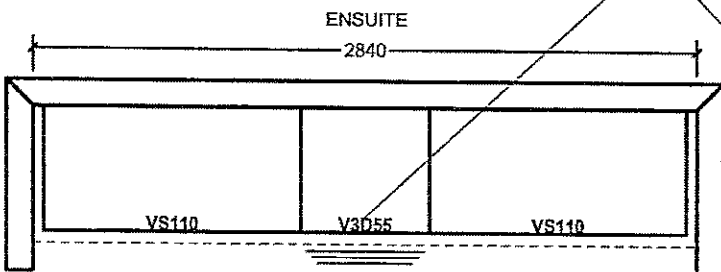
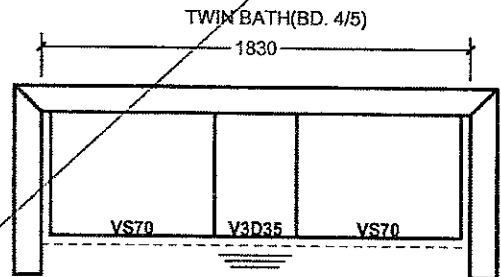
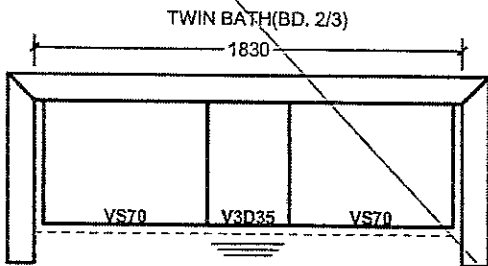

All prices subject to confirmation from head office.
This quotation is subject to the terms & conditions set out

ACCEPTED DATE: _____

All agreements are contingent upon strikes, accidents, and delays beyond our control.
Please provide our installer with template for sinkholes or \$150.00 will be charged for callback.

Item A. Wood grain and colour are characteristics of the product. We cannot guarantee that such grain and colour will always match.
Item B. Cortina Kitchens Inc. reserves the right to alter dimensions and make technical changes without notice.

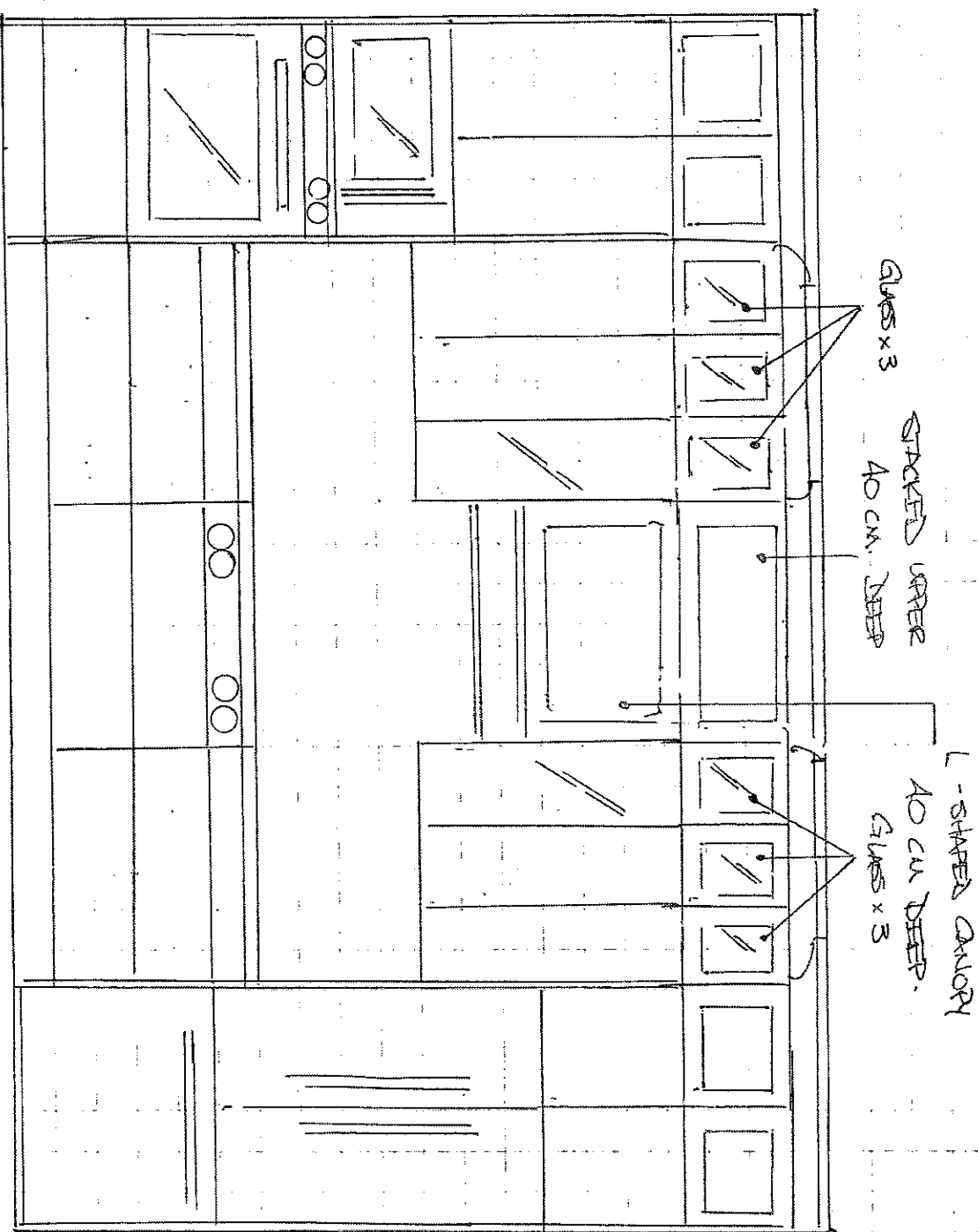

KG-61

KITCHEN ELEVATION - RANGE / FRIDGE / OVEN WALL

JAN 26 2017

PH

DEAD END
W/USE
FRIDGE

WINE
BALLAST
SPACE

STACKED
UPPERS (NO GLASS)

DEEP TRAY

KG-61

KITCHEN ELEVATION - TRAY

* REVISION *

1.2.

JAN 26 2017

1/2

FEB 21 2017

CORTINA

KITCHENS INC.

70 Regina Road, Woodbridge, ON L4L 8L6
Tel:(905) 264-6464 Fax:(905) 264-0664

December, 2008

POLICY MEMO FOR BUILDERS

DRILLING FOR KNOB AND HANDLE HARDWARE

Builder: GOLD PARK

Project: KLEINBURG

Lot #: 61

Date: FEB 21 2017

Cortina Kitchens' cabinetry doors and drawer fronts will be drilled to accept a standard knob or handle selected from Cortina's hardware boards. This drilling comes standard with the order, and is done ONLY in our shop, not on the job site.

For those not wanting Cortina's standard drilling, the following applies:

No holes to be drilled on the doors and drawer fronts should be specified in writing on the order. If while in production, Cortina Kitchens misses this request, Cortina Kitchens and the Builder will not be held responsible to replace any or all doors and drawer fronts affected, and the customer agrees to accept the product as is. No hardware will be supplied or credited by Cortina Kitchens. No charge will apply for this request.

I, _____, have read and agree to the above information.

Customer Signature:

(L.R.) [Signature]

Date:

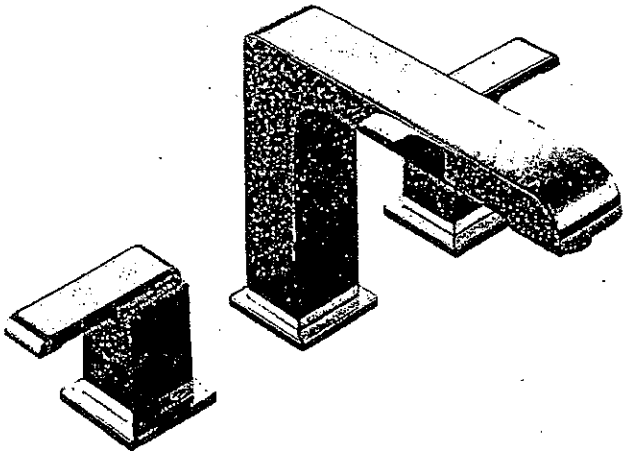

FEB 21 2017

Arzo® Collection

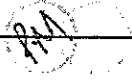

Roman Tub - 3 Piece

Chrome Finish
T2786 / # R2709

LOT No.: 61	
ROOM: MASTER ENSUITE	
DATE: JAN. 26 2016	SIGNATURE: 
	GOLDPARK <small>WORTH MORE</small>

* MASTER ENSUITE
LAV IS STANDARD

CORTINA

MODIFIED: 19/05/16 fd

STANDARD HARDWARE

KG-61
JAN. 26 2017

PA

STANDARD HARDWARE

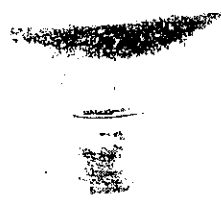

CSI-6

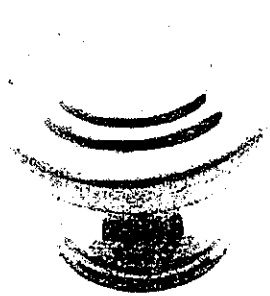

CSI-10



CSI-14



CSI-16



CSI-18

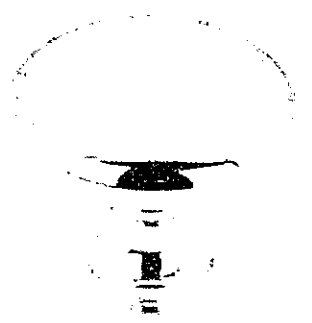

CSI-19

MASTER
ENSUITE

POWDER ROOM
KITCHEN



CSI-20

TWIN
BATH.

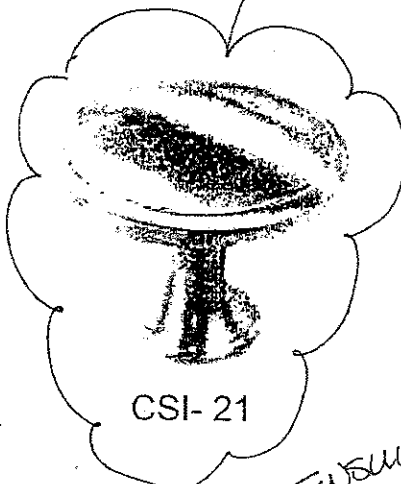

CSI-21

ENSUITE
2.

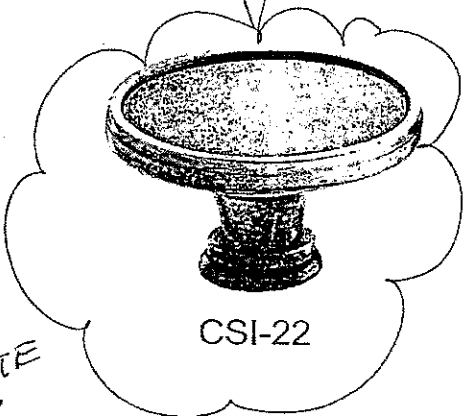

CSI-22

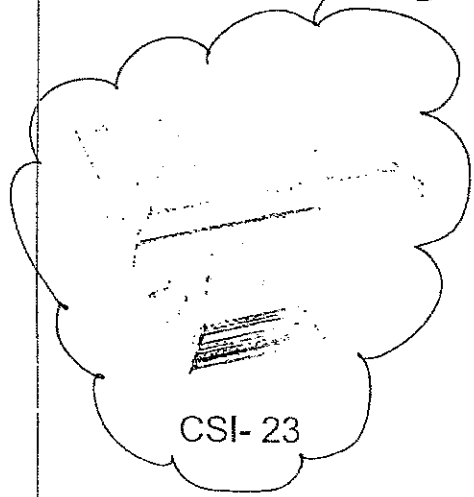

CSI-23

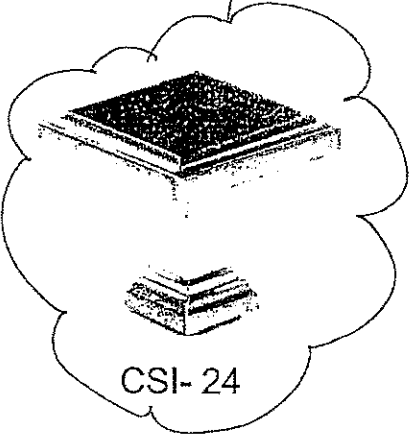

CSI-24

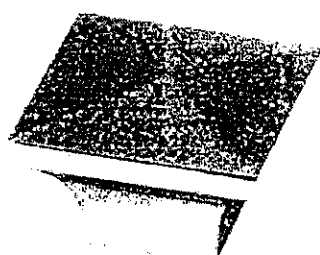

CSI-25

*NOTES:
- IMAGES ARE FOR QUICK REFERENCE PURPOSES ONLY
- ACTUAL SIZES AND FINISHES AS PER HARDWARE
SAMPLE BOARD PROVIDED TO DECOR CENTRE

* KITCHEN - NO
HARDWARE *

- Standard 2CM & 3CM
- ◐ Upgrade 1 2CM & 3CM
- ◑ Upgrade 1 4 CM
- Upgrade 2

20mm (3/4") Profiles



30mm (1 1/4") Profiles

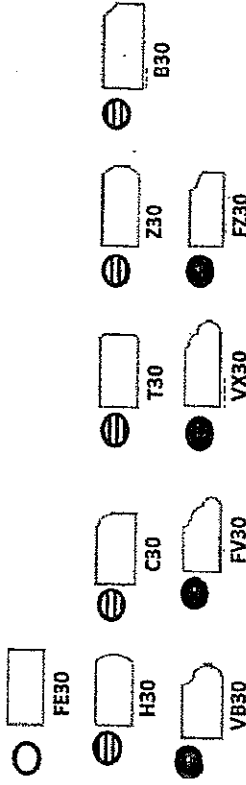

40mm (1 1/2") Profiles

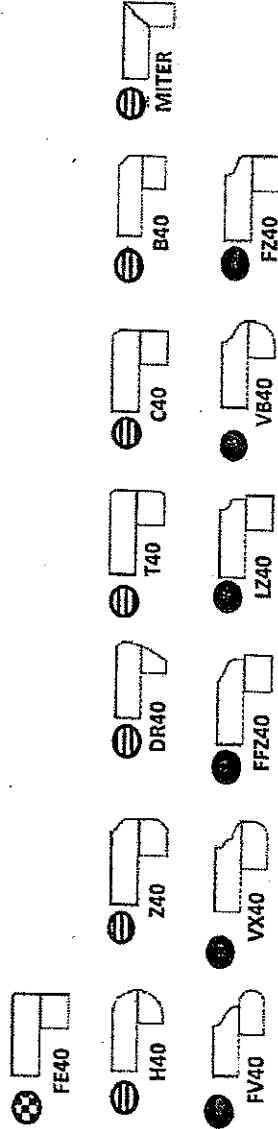

Note: All colours may not be available in 30mm at time ordered. Vendor reserves the right to use 40 mm edges (by lamination process).

*Mitre edge is available in Upgrade 1 for an overall thickness of 2". All other Mitre edge options will be an Upgrade 2 Edge.

JAN. 26 2017

KG-61

* STANDARD SINK & FAUCET

Lot 61

PEARL MINGLE

FRIDGE
Panel Ready

T36IT800NP
36-INCH FLUSH CUSTOM FRENCH DOOR
BOTTOM FREEZER
FREEDOM® COLLECTION

Thermador★
REAL INNOVATIONS FOR REAL COOKS®

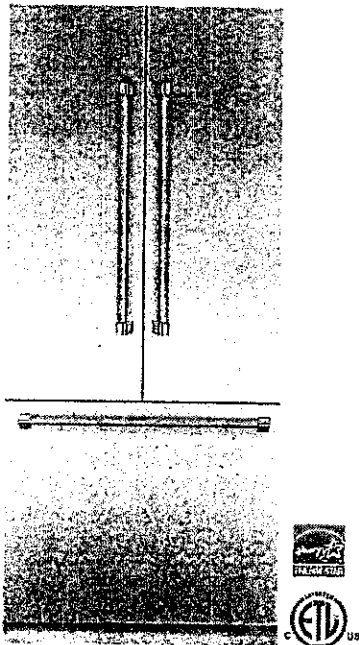

FEATURES & BENEFITS

- Freedom® Hinge enables true flush design
- Full-height door-true cabinet integration without exposed venting grille
- All-LED sidewall and theater lighting
- Brightspace interior design
- Accepts custom or stainless steel panel kit panels

TEMPERATURE RANGES

Refrigeration	35°F (2°C) to 46°F (8°C)
Adjustable Temperature Drawer	32°F (0°C) to 37°F (3°C)
Deli Drawer	Just above 32°F (0°C)
SuperCool	35.5°F (2°C) for approximately 9 hours
Energy Saving (Economy) Mode	Refrigerator: 45°F (7°C) Freezer: 3°F (-16°C)
Freezer	-9°F (-23°C) to 7°F (-14°C)
SuperFreeze®	-9°F (-23°C) for approximately 52 hours

SEE PAGE 2 FOR OPTIONAL ACCESSORIES

GENERAL PROPERTIES

Panel Ready	Yes
Lighting	All-LED Sidewall and Theater Lighting
Full Width Shelves - Refrigerator	3
Adjustable Shelves - Refrigerator	2
Shelf Material - Refrigerator	Glass Shelves w/Metal Trim
Full Extension Drawers at 90° Door Opening Angle	Yes
Humidity Control Drawer	Yes
Door Bins - Refrigerator	6
Gallon Door Bins	2
Defrost Process - Freezer	Frost-Free
Freezer Drawers	1
Ice Maker	Yes
Door Open Alarm	Yes
SuperCool	Yes
SuperFreeze®	Yes
Special Modes	Sabbath, Economy, Vacation

CAPACITY

Total Unit Gross Capacity (cu. ft.) - AHAM	20 cu. ft.
Refrigerator Gross Capacity (cu. ft.)	14 cu. ft.
Freezer Gross Capacity (cu. ft.)	6 cu. ft.

TECHNICAL DETAILS

Watts (W)	588 W
Current (A)	15 A
Volts (V)	120 V
Frequency (Hz)	60 Hz
Power Cord Length (in.)	78 3/4"
Plug Type	120V 3-Wire

DIMENSIONS & WEIGHT

Appliance Dimensions (H x W x D) (in.)	84" x 35 3/4" x 24"
Required Cutout Size (H x W x D) (in.)	84" x 36" x 24 3/4"
Net / Gross Weight (lbs)	454 / 496 lbs

EFFICIENCY

ENERGY STAR® Qualified	Yes
Annual Energy Consumption	590 kWh

WARRANTY

Limited, Entire Appliance, Parts and Labor on Any Part of the Refrigerator that Fails Because of a Manufacturing Defect	2 Year
Limited Warranty for Sealed Refrigeration System*; Parts And Labor	3rd to 6th Year
Limited Warranty for Sealed Refrigeration System*; Parts Only	7th to 12th Year

* Sealed refrigeration system includes compressor, evaporator, condenser, dryer / strainer and connection tubing

61

T36IT800NP
36-INCH FLUSH CUSTOM FRENCH DOOR
BOTTOM FREEZER
 FREEDOM® COLLECTION



ACCESSORIES (OPTIONAL)

Stainless Steel Panel Options:	
TFL36IT800	- Flat Stainless Steel Panel Kit
TCH36IT800	- Chiseled Stainless Steel Panel Kit
Handle Options:	
PR36HNDL10	- 36" Professional Handle
MS36HNDL10	- 36" Masterpiece® Handle
FRAMEKIT10	- Freedom® Frame Kit
HEATRKIT10	- Freedom® Heater Kit
Filters:	
REPLFLTR10	- Freedom® Water Filter
SCRNFLTR10	- Filter By-Pass

CUTOUT DIMENSIONS

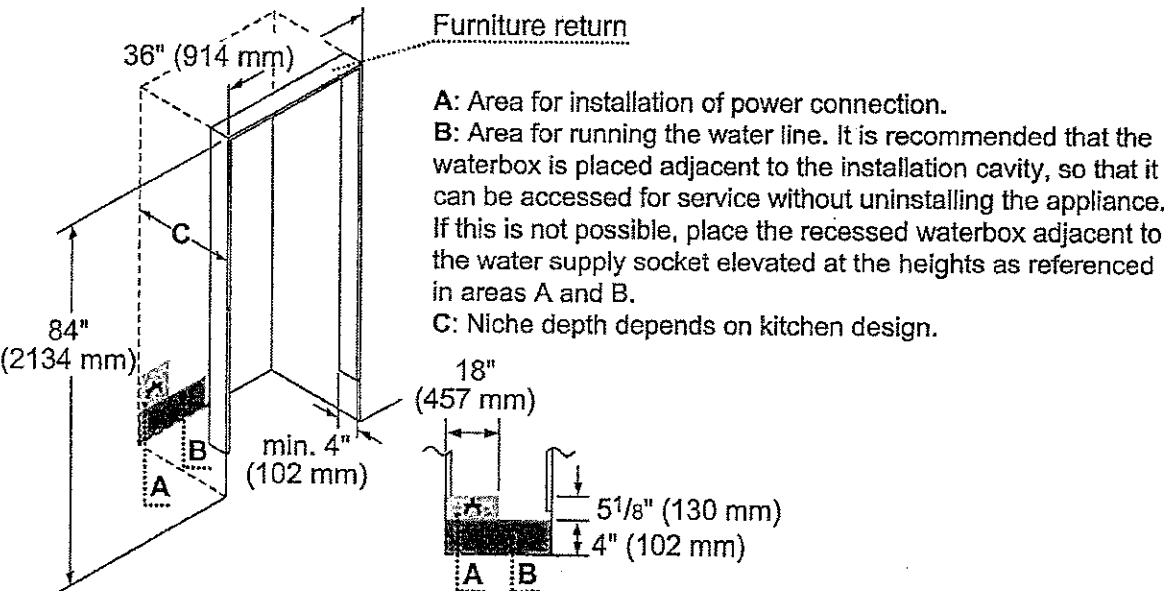

61

T36IT800NP
36-INCH FLUSH CUSTOM FRENCH DOOR
BOTTOM FREEZER
FREEDOM® COLLECTION



TOP VIEW CLEARANCE

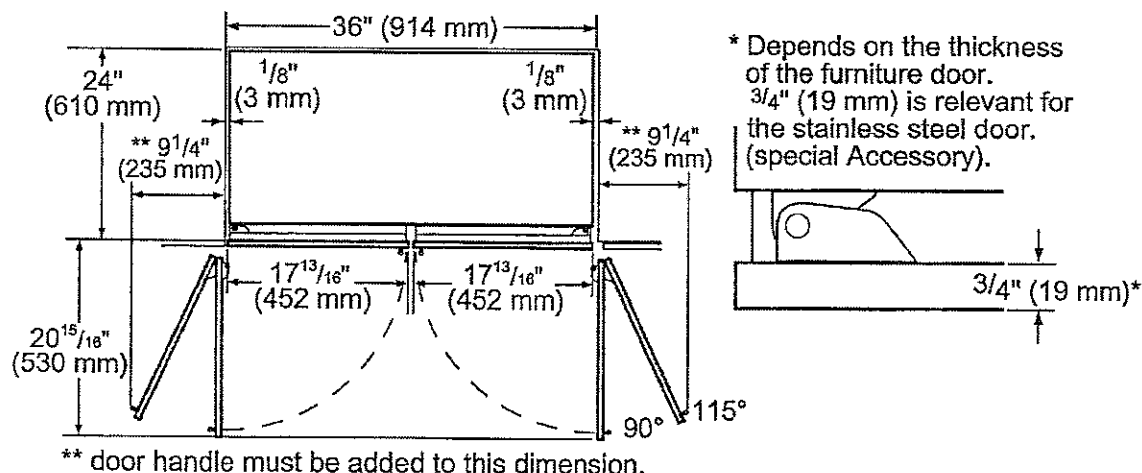

PANEL DIMENSIONS

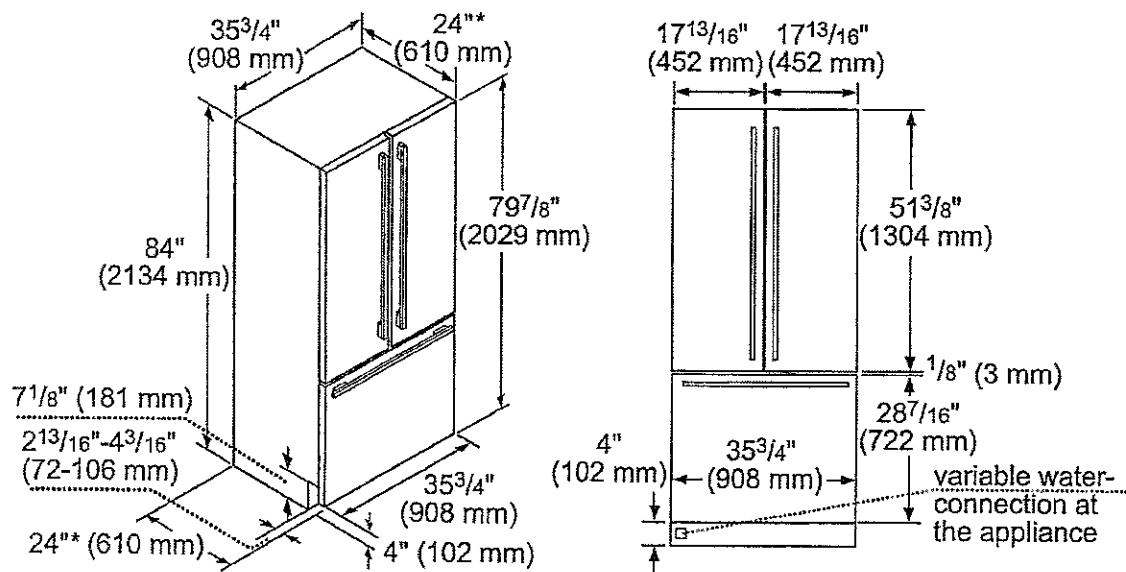

*Excludes thickness of door panel. If standard panel with 3/4" thickness is mounted, total depth is 24 3/4".

These warranties give you specific legal rights and you may have other rights that vary from state to state. Full warranty and limited warranty from date of installation. For complete warranty details, refer to your Use & Care manual, or ask your dealer.

Specifications are for planning purposes only. Refer to Installation instructions and consult your countertop supplier prior to making counter opening. Consult with a heating and ventilation engineer for your specific ventilation requirements. For the most detailed information, refer to installation instructions accompanying product or write to Thermador indicating the model number. Specifications are correct at time of printing. Thermador reserves the right to change product specifications or design without notice. Some models are certified for use in Canada. Thermador is not responsible for products that are transported from the U.S. for use in Canada.

1 800 735 4328 | USA THERMADOR.COM | CANADA THERMADOR.CA | ©2015 BSH HOME APPLIANCES CORPORATION. ALL RIGHTS RESERVED.

61

MEDMC301JS
30-INCH DOUBLE COMBINATION BUILT-IN OVEN
MASTERPIECE® SERIES



2

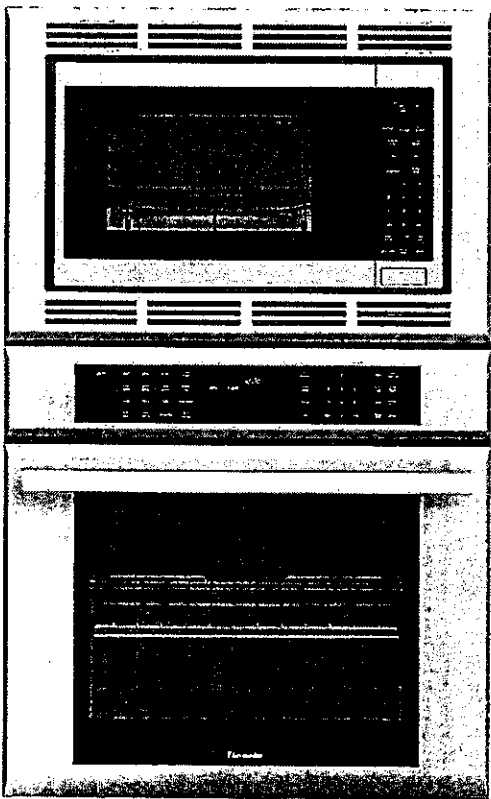

FEATURES & BENEFITS

- ★ - SoftClose® door ensures ultra smooth closing of the oven door
- ★ - Fastest preheat in the luxury segment (around 7 minutes)
- ★ - Superfast 2-hour self clean mode-fastest on the market
 - 2 Full Access® telescopic racks
 - No preheat Speed Convection mode

ACCESSORIES (OPTIONAL)

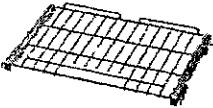

TLSCPRCK30
30-Inch Oven Telescopic Rack

GENERAL PROPERTIES

Modes – Upper Cavity	See MCES for Microwave Features
Modes – Lower Cavity	(18) Bake, Roast, True Convection, Convection Bake, Convection Roast, No Preheat Speed Convection, Warm, EasyCook®, Broil, Convection Broil, Pizza, Proof, Dehydrate, Cook Control™ Probe, Self Clean, Sabbath, Favorites, Fast Preheat
Warming Drawer	N/A
Cleaning Type – Lower Cavity	Self Clean
Telescopic Rack(s)	2
Illumination Type – Upper & Lower Cavity	Halogen with SoftLight Function
Interior Lights – Upper & Lower Cavity	1 / 3

OVEN PERFORMANCE

Microwave Power	1,000 W
Bake / Broil Element Wattages – Lower Cavity	2,000 / 3,600 W
Convection Element Wattages – Lower Cavity	2,000 W
Warming Drawer Wattage	N/A

TECHNICAL DETAILS

Watts (W)	10,200 W
Circuit Breaker (A)	50 A
Volts (V); Frequency (Hz)	240V/208V/60 Hz
Plug Type	Fixed Connection, No Plug
Conduit	66" Flexible 4-Wire
Energy Source	Electric

DIMENSIONS & WEIGHT

Overall Appliance Dimensions (HxWxD) (in)	50" x 29 3/4" x 23 7/8"
Required Cutout Size (HxWxD) (in)	49 1/2" x 28 1/2" x 24"
Microwave Cavity Size (cu. ft.)	1.5 cu. ft.
Oven Cavity Size – Upper / Lower Cavity (cu. ft.)	4.7 cu. ft.
Warming Drawer Cavity Size (cu. ft.)	N/A
Overall Oven Interior Dimensions (HxWxD) (in)	17 7/8" x 25" x 17 7/8"
Usable Oven Interior Dimensions (HxWxD) (in)	12 3/4" x 22 3/4" x 17 1/4"
Net Weight (lbs)	250 lbs

ACCESSORIES (INCLUDED)

Upper Cavity: 1 Oven Rack, 1 Ceramic Glass Tray, 1 Roller Ring Lower Cavity: 2 Telescopic and 1 Standard Oven Rack, Temperature Probe, Broiler Pan

WARRANTY

Limited Warranty Parts and Labor	2 Year
----------------------------------	--------

* Valid for wall oven

★ THERMADOR EXCLUSIVE

61

MEDMC301JS
30-INCH DOUBLE COMBINATION BUILT-IN OVEN
MASTERPIECE® SERIES



30-INCH DOUBLE COMBINATION OVEN WITH MICROWAVE

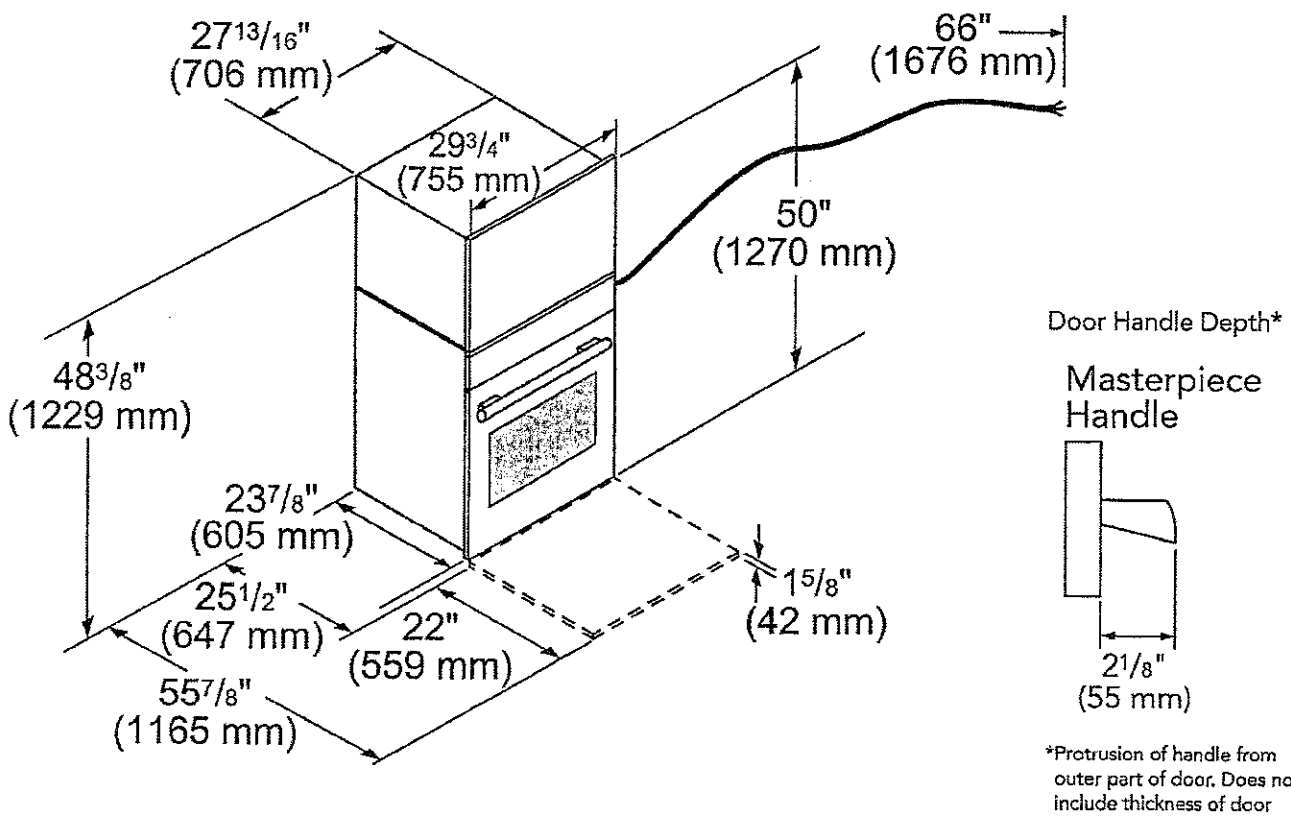

61

MEDMC301JS
30-INCH DOUBLE COMBINATION BUILT-IN OVEN
MASTERPIECE® SERIES



30-INCH DOUBLE COMBINATION OVEN WITH MICROWAVE

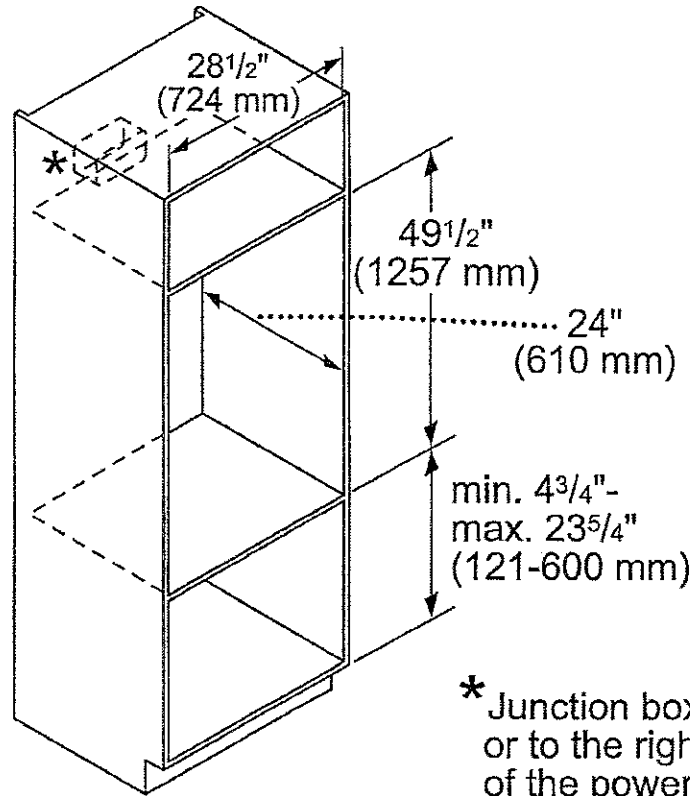

These warranties give you specific legal rights and you may have other rights that vary from state to state. Full warranty and limited warranty from date of installation. For complete warranty details, refer to your Use & Care manual, or ask your dealer.

Specifications are for planning purposes only. Refer to installation instructions and consult your countertop supplier prior to making counter opening. Consult with a heating and ventilation engineer for your specific ventilation requirements. For the most detailed information, refer to installation instructions accompanying product or write to Thermador indicating the model number. Specifications are correct at time of printing. Thermador reserves the right to change product specifications or design without notice. Some models are certified for use in Canada. Thermador is not responsible for products that are transported from the U.S. for use in Canada.

61

4



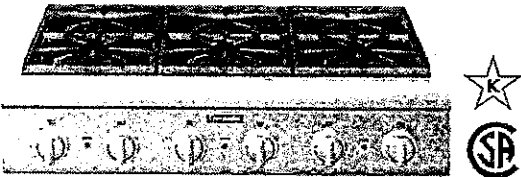

PCG366G
36-INCH GAS RANGETOP
PROFESSIONAL SERIES, PORCELAIN COOKTOP SURFACE



FEATURES & BENEFITS

- ★ - Patented Pedestal Star® Burner with QuickClean Base® designed for easy surface cleaning and superior heat spread for any size pan
- ★ - Precision simmering capabilities as low as 100°F (375 BTU) with 2 ExtraLow® Simmer burners
 - 18,000 BTU (NG) Star® Burners
 - Star-K certified
 - Restaurant style metal knobs

ACCESSORIES (OPTIONAL)

-  **PAGRIDDLE**
Griddle
-  **PA12CHPBLK**
12" Cutting Board
-  **PWOKRINGHC**
Wok Ring
-  **PA36GLBC**
12" Low Backguard
-  **PAKNOBLUNH**
Blue Knob Kit
-  **PALPKITHN**
LP Conversion Kit

GENERAL PROPERTIES

Controls	Metal Knobs
Sealed Burners	Yes
Grate Material	Cast Iron

BURNER PERFORMANCE

Total Number of Cooktop Burners	6
Power of Front Left Burner (NG)	18,000 and XLO
Power of Back Left Burner (NG)	18,000 and XLO
Power of Back Center Burner (NG)	18,000
Power of Front Center Burner (NG)	18,000
Power of Center 12" Electric Griddle (W)	N/A
Power of Center 12" Electric Grill (W)	N/A
Power of Back Right Burner (NG)	18,000
Power of Front Right Burner (NG)	18,000

TECHNICAL DETAILS

Circuit Breaker (A)	10 A
Volts (V)	120 V
Frequency (Hz)	60 Hz
Plug Type	120V-3 Prong
Power Cord Length (in)	72"
Energy Source	Gas
Gas Type	Natural Gas 15 mbar (USA)
Alternative Gas Type	LP 27.4 mbar (USA)
Convertible To LP (Kit Required)	Yes

DIMENSIONS & WEIGHT

Overall Appliance Dimensions (H* <i>x</i> W <i>x</i> D) (in)	10 7/16" x 35 15/16" x 25 13/16"
Required Cutout Size (H <i>x</i> W <i>x</i> D) (in)	7 11/16" x 35 1/8" x 22 13/16"
Minimum Distance From Rear Wall (in)	12" min to combustible surface with Flush Island Trim
Net Weight (lbs)	142 lbs

ACCESSORIES (INCLUDED)

1 x Island Trim

WARRANTY

Limited Warranty, Entire Appliance, Parts and Labor	2 Year
---	--------

*Height Includes Gas Connection

★ THERMADOR EXCLUSIVE

61

PCG366G
36-INCH GAS RANGETOP
 PROFESSIONAL SERIES, PORCELAIN COOKTOP SURFACE



36-INCH RANGETOP AND CUTOUT DIMENSIONS

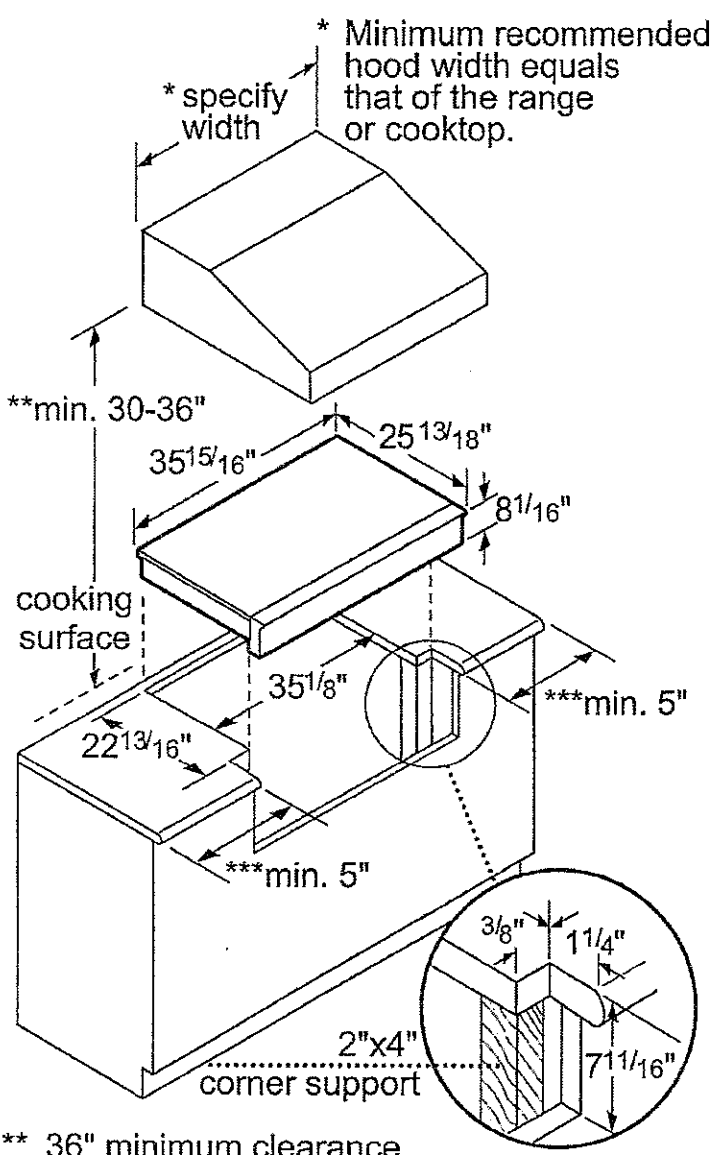

** 36" minimum clearance from cooking surface to combustible surfaces.

***5" minimum clearance from cooking surface to combustible side wall.

Note: Most hoods contain combustible components that must be considered when planning the installation.

measurements in inches

61

PCG366G
36-INCH GAS RANGETOP
PROFESSIONAL SERIES, PORCELAIN COOKTOP SURFACE



36-INCH RANGETOP CLEARANCE REQUIREMENTS

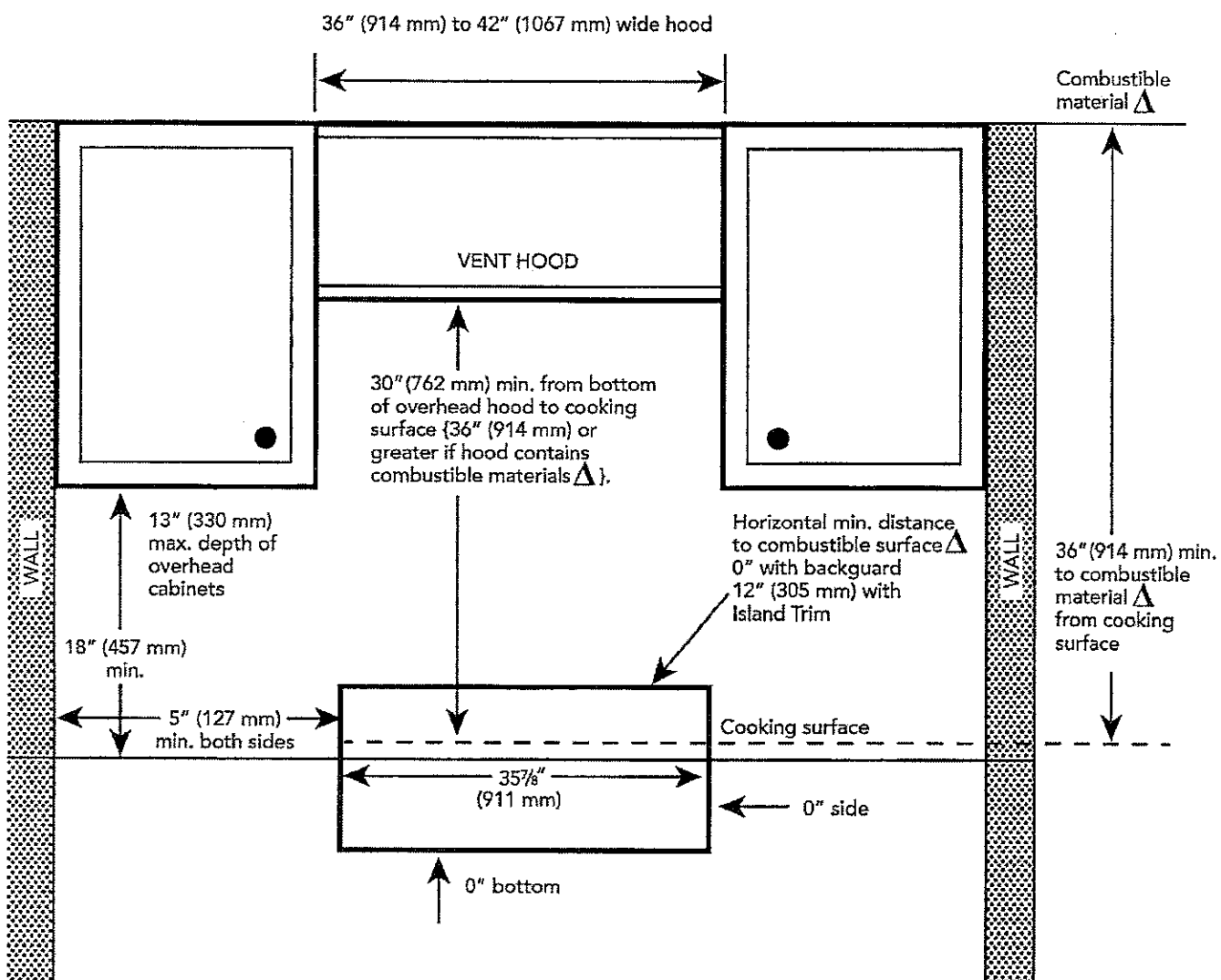

Δ as defined in the "National Fuel Gas Code" (ANSI Z223.1, Current Edition). Clearances from non-combustible materials are not part of the ANSI Z223.1 scope and are not certified by CSA. Clearances of less than 12" (305 mm) must be approved by the local codes and/or by the local authority having jurisdiction.

Clearances Requirements

NOTE: A 36-inch minimum clearance is required between the top of the cooking surface and the bottom of an unprotected cabinet. A 30-inch clearance can be used when the bottom of the wood or metal cabinet is protected by not less than 1/4 inch of a flame retardant material covered with not less than No. 28 MSG sheet steel, 0.015 inch (0.4 mm) thick stainless steel, 0.024 inch (0.6 mm) aluminum, or 0.020 inch (0.5 mm) thick copper.

6d

PCG366G
36-INCH GAS RANGETOP
PROFESSIONAL SERIES, PORCELAIN COOKTOP SURFACE



ELECTRICAL AND GAS LOCATIONS

The gas and electrical supply must be located in an area that is accessible without requiring removal of the rangetop. The appliance electrical power cord and gas pipe connection are located on the left rear underside of the rangetop.

The junction box must be located within 3 feet (~900 mm) of the rangetop connection.

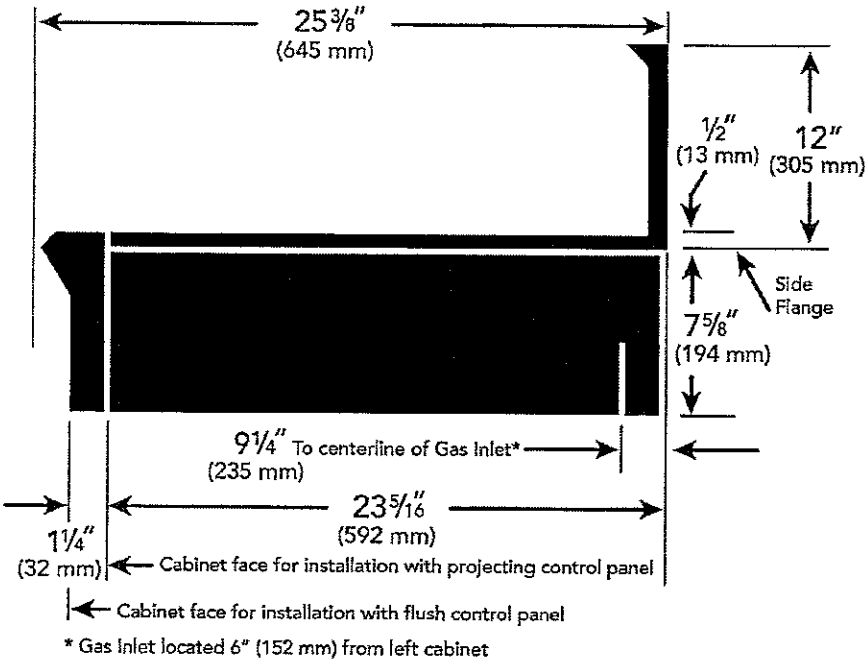

NATURAL GAS REQUIREMENTS:

Inlet Connection: 1/2" NPT (min. 3/4" dia. flex line)
Supply Pressure: 6" min. to 14" max. water column (14.9 mb to 34.9 mb)
Manifold Pressure: 5" water column (12.5 mb)

PROPANE GAS REQUIREMENTS:

Inlet Connection: 1/2" NPT (min. 3/4" dia. flex line)
Supply Pressure: 11" min. to 14" max. water column (27.4 mb to 34.9 mb)
Manifold Pressure: 10" water column (24.9 mb)

These warranties give you specific legal rights and you may have other rights that vary from state to state. Full warranty and limited warranty from date of installation. For complete warranty details, refer to your Use & Care manual, or ask your dealer.

Specifications are for planning purposes only. Refer to installation instructions and consult your countertop supplier prior to making counter opening. Consult with a heating and ventilation engineer for your specific ventilation requirements. For the most detailed information, refer to installation instructions accompanying product or write to Thermador indicating the model number. Specifications are correct at time of printing. Thermador reserves the right to change product specifications or design without notice. Some models are certified for use in Canada. Thermador is not responsible for products that are transported from the U.S. for use in Canada.

1 800 735 4328 | USA THERMADOR.COM | CANADA THERMADOR.CA | ©2015 BSH HOME APPLIANCES CORPORATION. ALL RIGHTS RESERVED.

61

GE Monogram® Wine Reserve

ZDWR240HBS

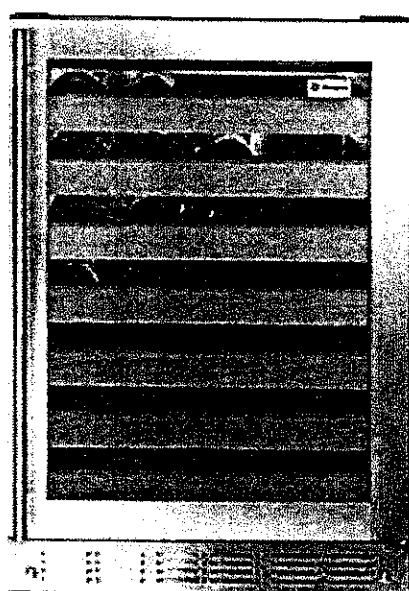

SPECIFICATIONS

Overall Width	23 1/2" (59.7 cm)
Overall Height	33 7/8" (86 cm)
Overall Depth	23 3/8" (59.4 cm)
Door Clearance	9 3/8" (23.8 cm) @ 110° 2" (5.1 cm) @ 90° 23 1/4" (60.6) door length
Overall Capacity	5.5 cu. ft.
Minimum Cabinet Width	23 3/4" (60.3 cm)
Minimum Cabinet Depth	24" (60.9 cm)
Cutout Width	23 3/4" (60.3 cm)
Cutout Height	34 1/2" (87.7 cm) Min 35" (89 cm) Max
Electrical Requirements	1.2 A
Voltz/Hertz/Amps	120 V, 60 Hz, 15 or 20 amp circuit
Shipping Weight	146 lb (66 kg)

ATTENTION ELECTRICIAN:

A 115 volt 60Hz, 15 or 20 amp power supply is required. An individual properly grounded branch circuit or circuit breaker is recommended. Install a properly grounded 3-prong electrical receptacle recessed into the back wall.

OVERALL DIMENSIONS

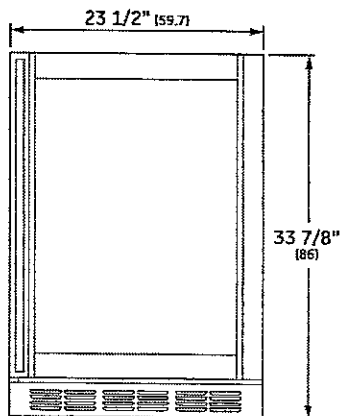

FRONT VIEW

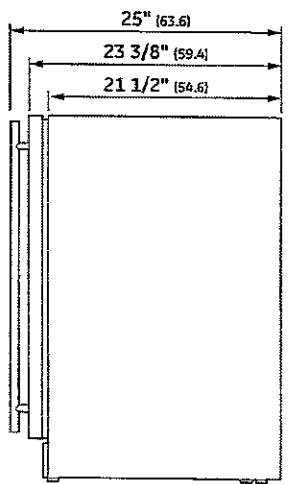

SIDE VIEW

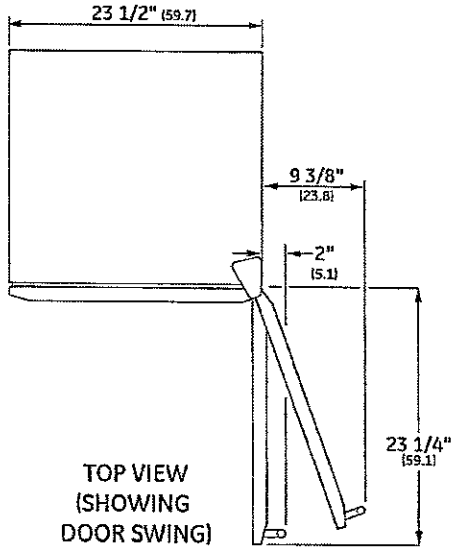

TOP VIEW
(SHOWING
DOOR SWING)

Dimensions in parentheses are in centimeters unless otherwise noted.
Actual product dimension may vary due to manufacturing tolerances.



61

GE Monogram® Wine Reserve

ZDWR240HBS

INSTALLATION

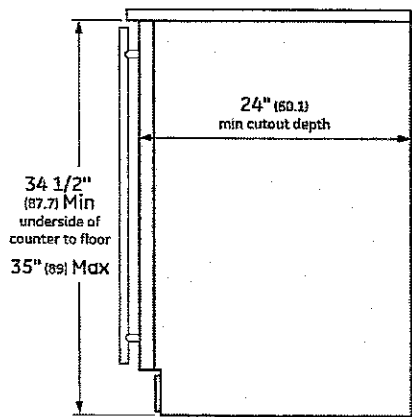

FLUSH CUTOUT INSTALLATION
SIDE VIEW

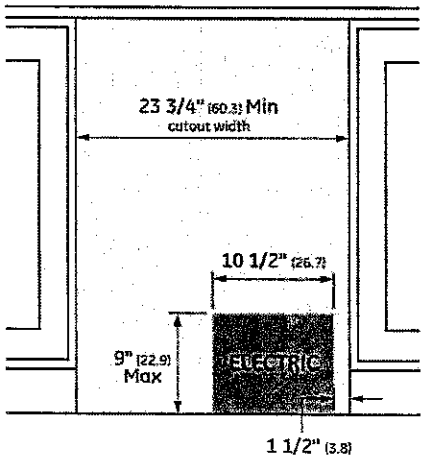

INSTALLATION CUTOUT
FRONT VIEW

NOTES

- The cutout depth must be 24"
- The cutout dimensions shown allow for a full door swing and access to the pull-out racks when installed as a built-in.
- The wine reserve can be free-standing.
- Note: If installing between frameless cabinets, a 1/2" wide filler strip or side panel may be required. The filler strip will act as a spacer between the door case and adjacent cabinet and will prevent interference with cabinet door swing. The width of the opening must include filler panels.
- Wine reserve is vented at the front toekick to allow built-in undercounter installation.

GE Monogram® Wine Reserve

61
ZDWR240HBS

FEATURES AND BENEFITS

Adjustable Temperature Control - Maintains a consistent temperature

Adjustable Temperature Control - Maintains a consistent temperature

Red or white wine temperature setting - Maintain the ideal temperature for aging or serving wine

LED Temperature Display - Allows you to monitor the temperature at a glance

Full-extension sliding wine racks - Positions bottles either horizontally or vertically to maximize space

Unfinished heart-of-cherry wood wine shelf fronts - Can be finished to complement surrounding cabinetry

UV resistant, tempered glass door - Affords a full view of wine reserve contents

Flush Installation - Allows near-seamless integration with surrounding cabinetry

Reversible Door Swing - Easily reversed to left or right door swing as needed

Stainless steel tubular handle - Designed to coordinate with other Monogram appliances

Soft Interior Lighting - Automatically illuminates when the door is open, but can be activated by an internal on/off switch

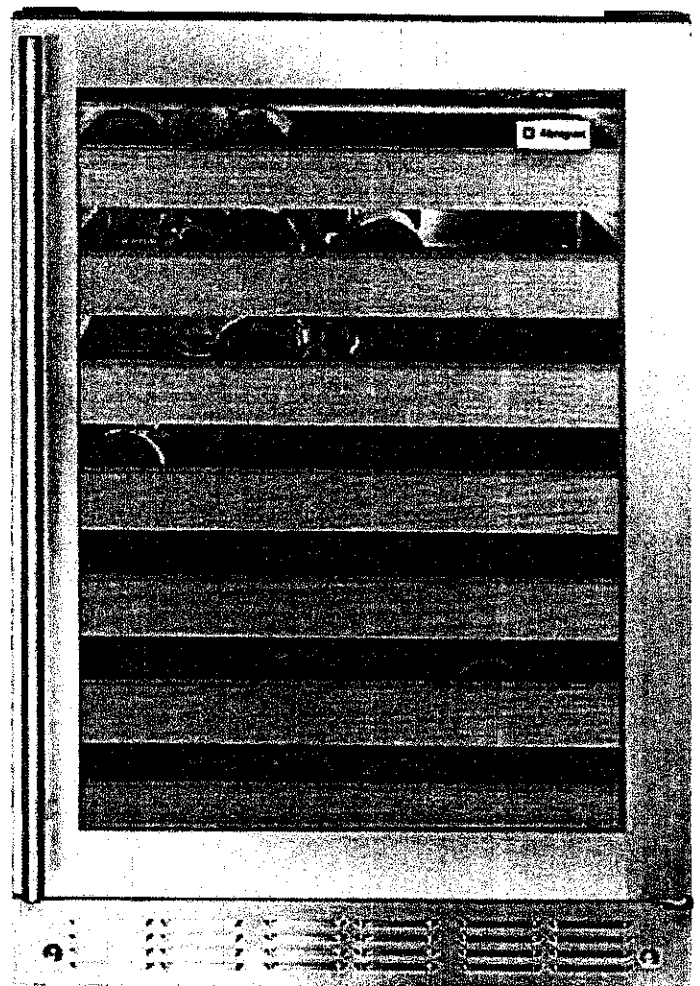

ZDWR240HBS - wine reserve with digital controls

