



CONSTRUCTION SUMMARY

Brampton Encore - 12 - 1 - 38-6 Elev.A SCARLATTI
CENTRAL VAC AND WIRING

Inv.516	1 - TELEPHONE AND CABLE ROUGH-IN LOCATIONS
Line6216	Note:
25May16 / 26Sep16	
Inv.516	1 - KITCHEN: INSTALL VAC PAN UNDER KITCHEN SINK
Line6217	Note:
25May16 / 26Sep16	
Inv.516	1 - BEDROOM #2: INSTALL RG 6 ROUGH-IN IN BED #2. SEE SKETCH
Line6218	Note:
25May16 / 26Sep16	

CERAMIC

Inv.1,109	1 - FOYER: INSTALL Floor Upgrade 4 Foyer Vestibule Main Hall Floor
Line16183	Note:
17Jan17 / 28Feb17	
Inv.1,109	1 - KITCHEN: INSTALL Floor Upgrade 4 Kitchen Floor No Breakfast
Line16184	Note:
17Jan17 / 28Feb17	
Inv.1,109	1 - POWDER ROOM: INSTALL Floor Upgrade 4 Powder Room Floor
Line16185	Note:
17Jan17 / 28Feb17	
Inv.1,109	1 - MASTER ENSUITE: Floor Upgrade 2 Ensuite Bath Floor
Line16187	Note:
17Jan17 / 28Feb17	
Inv.1,109	1 - MASTER ENSUITE: INSTALL Wall Upgrade 2 Ensuite Bath 2 Rows
Line16188	Note:
17Jan17 / 28Feb17	
Inv.1,109	1 - MASTER ENSUITE: INSTALL Wall Upgrade 2 Ensuite Bath Shower Ceiling
Line16189	Note:
17Jan17 / 28Feb17	
Inv.1,109	1 - MASTER ENSUITE: INSTALL Wall Upgrade 2 Ensuite Bath Shower Walls
Line16190	Note:
17Jan17 / 28Feb17	
Inv.1,109	1 - MASTER ENSUITE: INSTALL Wall Upgrade 2 Ensuite Bath Tub Deck Face
Line16191	Note:
17Jan17 / 28Feb17	
Inv.1,109	1 - MASTER ENSUITE: INSTALL Wall Upgrade 2 Ensuite Bath Tub Deck Top
Line16192	Note:
17Jan17 / 28Feb17	
Inv.1,109	1 - TWIN BATH: INSTALL Floor Upgrade 2 Bath 3 4 Floor
Line16193	Note:
17Jan17 / 28Feb17	
Inv.1,109	1 - TWIN BATH: INSALL Wall Upgrade 2 Bath 3 4 Tub with Ceiling
Line16199	Note:
17Jan17 / 28Feb17	

ELECTRICAL

Inv.516	1 - KITCHEN: INSTALL 220V WALL RECEPTICAL ON DEDICATED CIRCUIT- FOR 4 WIRE BUILT-IN WALL OVEN - FOR FUTURE MICROWAVE/WALL OVEN UNIT. PURCHASER IS AWARE THAT THEY MUST BUY THE APPROPRIATE CABINETRY AT THE TIME OF COLOURS. SEE SKETCH
Line6219	Note:
25May16 / 26Sep16	
Inv.516	1 - 110V WALL RECEPTACLE ON DEDICATED CIRCUIT - FOR MICROWAVE - MICROWAVE NOT INCLUDED. FOR FUTURE MICROWAVE/WALL OVEN UNIT. PURCHASER IS AWARE THAT THEY MUST BUY THE APPROPRIATE CABINETRY AT THE TIME OF COLOURS. SEE SKETCH
Line6220	Note:
25May16 / 26Sep16	
Inv.516	1 - LIVING ROOM: INSTALL ADDITIONAL STANDARD FIXTURE WITH SWITCH - IN LIVING ROOM. SEE SKETCH
Line6221	Note: IN ADDITION TO BUILDER'S STANDARD SWITCH CONTROLLED RECEPTICAL
25May16 / 26Sep16	
Inv.1,109	1 - KITCHEN CABINETRY: **NOTE: ELECTRICAL WAS PURCHASED FOR BUILT-IN WALL OVEN/MICROWAVE UNIT, HOWEVER CABINETRY EXTRAS WERE NOT PURCHASED. ELECTRICAL WILL BE INSTALLED AND ACCESSIBLE IN STANDARD CABINETS.
Line18287	Note:
17Jan17 / 28Feb17	

EXTERIOR COLOURS

Inv.516	1 - EXTERIOR COLOUR PACKAGE 9
Line11919	Note:
25May16 / 26Sep16	

FORMING

Inv.516	1 - EXTERIOR: INSTALL SIDE DOOR- HOME TO EXTERIOR- AS PER PLAN AND GRADE PERMITTING
Line6223	Note: GRADING DOES NOT PERMIT PER SITING DATED AUGUST 2, 2016 - CREDIT DUE TO PURCHASER
25May16 / 26Sep16	

FRAMING

Inv.516	1 - GARAGE: INSTALL MANDOOR - GARAGE TO HOUSE- AS PER PLAN AND GRADE PERMITTING
GIVEN IN AGREEMENT OF PURCHASE AND SALE	
Line6222	Note: GRADING PERMITS AS PER SITING DATED AUGUST 2, 2016
25May16 / 26Sep16	

HVAC

Inv.516	1 - KITCHEN: INSTALL GAS LINE ROUGH - MAIN FLOOR - (3 STOREY MODELS) FOR
Line6225	Note:
25May16 / 26Sep16	

KITCHEN AND BATH CABINETRY

Brampton Encore - 12 - 1 - 38-6 Elev.A SCARLATTI

Inv.1,109	1 - KITCHEN CABINETRY: **NOTE: ELECTRICAL WAS PURCHASED FOR BUILT-IN WALL OVEN/MICROWAVE UNIT, HOWEVER CABINETRY EXTRAS WERE NOT PURCHASED. ELECTRICAL WILL BE INSTALLED AND ACCESSIBLE IN STANDARD CABINETS.
Line16182	Note:
17Jan17 / 28Feb17	
Inv.1,109	3 - MASTER ENSUITE: Oak PVC 156 36 Inch 90cm tall vanity cabinets price per cabinet box in lieu of standard height THREE (X3 BOXES IN MASTER VANITY)
Line16198	Note:
17Jan17 / 28Feb17	

MISC.

Inv.516	1 - BONUS PACKAGE: \$8571.05 (INCLUDING TAXES) WORTH OF UPGRADES FROM GOLD PARK HOMES DÉCOR CENTRE IS BEING APPLIED TOWARD THE STRUCTURAL APPOINTMENT. PURCHASER HAS A REMAINING AMOUNT OF \$6428.95 (INCLUDING TAXES) TO BE USED TOWARD THE COLOUR APPOINTMENT
Line8251	Note:
25May16 / 26Sep16	
Inv.516	1 - Purchaser has attended a Structural appointment at the Decor Centre & has DECLINED any additional upgrades and accepts and acknowledges that there will be no further structural changes/additions/deletions to be made upon signing on July 12, 2016
Line8252	Note:
25May16 / 26Sep16	
Inv.516	1 - Purchasers are aware & accepts that ANY changes made to upgrades after signing this Purchasers Extra Form are subject to a minimum administration fee of \$500. PLUS a 10% holdback fee
Line8253	Note:
25May16 / 26Sep16	
Inv.861	1 - GRADING DOES NOT PERMIT SIDE DOOR PER SITING DATED AUGUST 2, 2016 - CREDIT DUE TO PURCHASER
Line11920	Note:
26Sep16 / 28Feb17	
Inv.1,109	1 - BONUS PACKAGE: \$6428.95 (INCLUDING TAXES) WORTH OF UPGRADES FROM GOLD PARK HOMES DÉCOR CENTRE IS BEING APPLIED TOWARD THE COLOUR APPOINTMENT
Line16195	Note:
17Jan17 / 28Feb17	
Inv.1,109	1 - Purchaser has attended a Colour appointment at the Decor Centre & has DECLINED any additional upgrades and accepts and acknowledges that there will be no further structural changes/additions/deletions to be made upon signing on January 17, 2017
Line16196	Note:
17Jan17 / 28Feb17	
Inv.1,109	1 - Purchasers are aware & accepts that ANY changes made to upgrades after signing this Purchasers Extra Form are subject to a minimum administration fee of \$500. PLUS a 10% holdback fee
Line16197	Note:
17Jan17 / 28Feb17	

PLUMBING

Inv.516	1 - KITCHEN: INSTALL ROUGH-IN - WATERLINE FOR FRIDGE
Line6226	Note:
25May16 / 26Sep16	
Inv.516	1 - BASEMENT: INSTALL ROUGH-IN - 3PC BASEMENT ROUGH-IN, AS PER PLAN
Line6227	Note:
25May16 / 26Sep16	

WINDOWS - BASEMENT

Brampton Encore - 12 - 1 - 38-6 Elev.A SCARLATTI

Inv.516	2 - BASEMENT: INSTALL TWO (X2) BASEMENT WINDOWS - UPGRADE EXISTING BASEMENT WINDOW TO 46 INCH X 32 INCH EGRESS - MAY REQUIRE INSTALLATION OF WINDOW WELL. TO BE APPROVED BY CONSTRUCTION
Line6224	Note:
25May16 / 26Sep16	

Scheduled Closing Date:

Purchasers: NASIRUDDIN M ALAM & NOWRIN NASRIN TU Property: 12 of Plan -

Telephone Res. / Bus: (647) 933-1450 / (416) 460-7751

Project: Fieldwalk Investments Inc.

Decor Advisor: Terri Parisani

Model and Elevation: 38-6 Elev.A SCARLATTI

Layout Changes: ☐ Yes ☒ No Sketch Attached: ☒ Yes ☐ No Exterior Colour Scheme:

1. Cabinetry

	Style and Colour	Counter	Hardware
Kitchen / Breakfast	Venice(pvc)ChocoMaple	Rosa Beta Granite Edge: FE-20	cs1-24
Laundry Room	<input type="text"/>	<input type="text"/>	<input type="text"/>
Powder Room	<input type="text"/>	<input type="text"/>	<input type="text"/>
TWIN BATH	Venice(pvc)WhiteCrystal	4926K-07 Black Alicante Laminate	cs1-24
Master Ensuite Bathroom	Venice(pvc)WhiteCrystal	4926K-07 Black Alicante Laminate	cs1-24
Second Ensuite Bathroom (If Applicable)	Venice(pvc)WhiteCrystal	4926K-07 Black Alicante Laminate	cs1-24
<input type="text"/>	<input type="text"/>	<input type="text"/>	<input type="text"/>
Dishwasher Cabinet	<input type="text"/>		
Comment	<input type="text"/>		

2. Floor Tile

Room Title	Selection	Grout	Threshold
Entrance Vestibule	*Upg.4 Must Polished Ivory 18 x 18	N/A	N/A
Main Hall			
Kitchen / Breakfast	*Upg.4 Must Polished Ivory 18 x 18	N/A	N/A
Laundry Room	New Reeds Silver 13 x 13	N/A	N/A
Powder Room	*Upg.4 Must Polished Ivory 18 x 18	N/A	N/A
TWIN BATH	*Upg.2 New Byzantine Pentellic Grey12x24	N/A	N/A
Master Ensuite Bathroom	*Upg.2 New Byzantine Azzuro 12x24	N/A	N/A
Second Ensuite Bathroom (If Applicable)	New Reeds Silver 13 x 13	N/A	N/A
Lower Landing (If Applicable)			
		N/A	N/A
Comment			
GROUND FLOOR HALL: New Reeds Silver 13 x 13			

3. Wall Tile

Wall Tile	Selection	Listello/Inserts	Describe
TWIN BATH	<div>*Upg.2 Zenith Grey 12 x 24</div>	<div><input type="radio"/> Yes <input checked="" type="radio"/> No</div>	<div>**SEE NOTES BELOW</div>
Master Ensuite Bathroom			
Tub Deck	<div>*Upg.2 Allure Anthracite 12 x 24</div>	<div><input type="radio"/> Yes <input checked="" type="radio"/> No</div>	<div>**SEE NOTES BELOW</div>
Shower Stall	<div>*Upg.2 Allure Anthracite 12 x 24</div>	<div><input type="radio"/> Yes <input checked="" type="radio"/> No</div>	<div>**SEE NOTES BELOW</div>
Bathroom Walls	<div>*Upg.2 Allure Anthracite 12 x 24</div>	<div><input type="radio"/> Yes <input checked="" type="radio"/> No</div>	<div>**SEE NOTES BELOW</div>
Second Ensuite Bathroom (If Applicable)	<div>Reflection Espresso (Dk Brown)</div>	<div><input type="radio"/> Yes <input checked="" type="radio"/> No</div>	<div></div>
GROUND FL ENSUITE	<div></div>	<div><input type="radio"/> Yes <input checked="" type="radio"/> No</div>	<div></div>
Kitchen Backsplash	<div><input type="radio"/> Yes <input checked="" type="radio"/> No</div>	Backsplash Behind Fridge	<div></div>
Comment	<div></div>		
<div>**TWIN BATH AND MASTER ENSUITE WALL TILES: PLEASE INSTALL HORIZONTALLY, STACKED. THE FLOORS CAN BE AT THE DESCRETION OF THE INSTALLER/</div>			

Scheduled Closing Date:

Purchasers: NASIRUDDIN M ALAM & NOWRIN NASRIN TU Property: 12 of Plan -

Telephone Res. / Bus: (647) 933-1450 / (416) 460-7751

Project: Fieldwalk Investments Inc.

Decor Advisor: Terri Parisani

Model and Elevation: 38-6 Elev.A SCARLATTI

4. Plumbing Fixtures

<input type="text"/>	Second Ensuite	<input type="text"/>	Powder Room	<input type="text"/>	
Master Ensuite Bathroom	<input type="text"/>	Other Room - Specify	<input type="text"/>	Other Washroom	<input type="text"/>

Comment

ALL PLUMBING IS STANDARD THROUGHOUT

5. Hardwood Flooring

	Type and Stain		Type and Stain
Main Hall	STD. PREVERCO, NATURAL	Upper Landing	STD. PREVERCO, NATURAL
Kitchen / Breakfast	<input type="text"/>	Upper Hall	<input type="text"/>
Living Room	STD. PREVERCO, NATURAL	Master Bedroom	<input type="text"/>
Dining Room	STD. PREVERCO, NATURAL	Bedroom #2	<input type="text"/>
Family Room	STD. PREVERCO, NATURAL	Bedroom #3	<input type="text"/>
Den/Library	<input type="text"/>	Bedroom #4	<input type="text"/>
Entrance Vestibule	<input type="text"/>	Bedroom #5	<input type="text"/>
Lower Landing (If Applicable)	<input type="text"/>	Other Room - Specify	<input type="text"/>
		BREAKFAST AREA	STD. PREVERCO, NATURAL

Comment

ALL HARDWOOD IS IN RED OAK

6. Carpeting

	Upgrade	Description
Main Hall	<input type="checkbox"/>	<input type="text"/>
Living Room	<input type="checkbox"/>	<input type="text"/>
Dining Room	<input type="checkbox"/>	<input type="text"/>
Family Room	<input type="checkbox"/>	<input type="text"/>
Den/Library	<input type="checkbox"/>	<input type="text"/>
Upper Hall	<input type="checkbox"/>	T-04
Master Bedroom	<input type="checkbox"/>	T-04
Bedroom #2	<input type="checkbox"/>	T-04
Bedroom #3	<input type="checkbox"/>	T-04
Bedroom #4	<input type="checkbox"/>	T-04
Bedroom #5	<input type="checkbox"/>	<input type="text"/>
GROUND FLOOR	<input type="checkbox"/>	T-04
Upper Landing (If Applicable)	<input type="checkbox"/>	<input type="text"/>
Lower Landing (If Applicable)	<input type="checkbox"/>	<input type="text"/>

Upgrade Underpad	Type STANDARD	Area <input type="text"/>
Carpet on Stairs	Capped <input type="text"/>	Runner - *Upgrade <input type="text"/>

Comment

Scheduled Closing Date:

Purchasers: NASIRUDDIN M ALAM & NOWRIN NASRIN TU Property: 12 of Plan -

Telephone Res. / Bus: (647) 933-1450 / (416) 460-7751 Project: Fieldwalk Investments Inc.

Decor Advisor: Terri Parisani Model and Elevation: 38-6 Elev.A SCARLATTI

7. Fireplace

	Living Room			Family Room			Other Room - Specify		
	Purchased	As Per Plan	N/A	Purchased	As Per Plan	N/A	Purchased	As Per Plan	N/A
	<input type="radio"/>	<input type="radio"/>	<input checked="" type="radio"/>	<input type="radio"/>	<input checked="" type="radio"/>	<input type="radio"/>	<input type="radio"/>	<input type="radio"/>	<input checked="" type="radio"/>
Fireplace Type	<input type="text"/>			STANDARD			<input type="text"/>		
Mantle Type	<input type="text"/>			NF-23			<input type="text"/>		
Colour / Stain	<input type="text"/>			WHITE PAINT-GRADE			<input type="text"/>		
Surround	<input type="text"/>			TRAVERTINO CLASSICO			<input type="text"/>		
Hearth	<input type="text"/>			NONE			<input type="text"/>		
Comment	<input type="text"/>								

8. Trim Carpentry

Interior Doors	<input type="text" value="STANDARD"/>	Front Door Glass Inserts	<input type="text" value="STANDARD"/>	Door Handles	<input type="text" value="STANDARD"/>
Interior Trim	<input type="text" value="STANDARD"/>				
Comment	<input type="text"/>				

9. Plaster Mouldings and Medallions

Entrance Vestibule	<input type="text" value="N/A"/>	<input type="text"/>	Kitchen/Breakfast	<input type="text" value="N/A"/>	<input type="text"/>
Main Hall	<input type="text" value="N/A"/>	<input type="text"/>	Den/Library	<input type="text" value="N/A"/>	<input type="text"/>
Living Room	<input type="text" value="N/A"/>	<input type="text"/>	Lower Landing	<input type="text" value="N/A"/>	<input type="text"/>
Dining Room	<input type="text" value="N/A"/>	<input type="text"/>	Other Room - Specify	<input type="text" value="N/A"/>	<input type="text"/>
Family Room	<input type="text" value="N/A"/>	<input type="text"/>			
Comment	<input type="text"/>				

10. Railings and Spindles

Railing Package	<input type="text" value="STANDARD"/>		
Railing Colour	<input type="text" value="NATURAL RED OAK"/>	Spindle Colour	<input type="text" value="NATURAL RED OAK"/>
Stringer / Riser	<input type="text" value="NATURAL RED OAK"/>	Treads	<input type="text" value="NATURAL RED OAK"/>
Comment	Oak Stairs	<input checked="" type="radio"/> Yes <input type="radio"/> No	
<input type="text"/>			

11. Wall Paint

Main & Upper Hall	<input type="text" value="COOL WHITE"/>	Master Bedroom	<input type="text" value="COOL WHITE"/>
Living Room	<input type="text" value="COOL WHITE"/>	Bedroom #2	<input type="text" value="COOL WHITE"/>
Dining Room	<input type="text" value="COOL WHITE"/>	Bedroom #3	<input type="text" value="COOL WHITE"/>
Kitchen / Breakfast	<input type="text" value="COOL WHITE"/>	Bedroom #4	<input type="text" value="COOL WHITE"/>
Family Room	<input type="text" value="COOL WHITE"/>	Bedroom #5	<input type="text" value="COOL WHITE"/>
Powder Room	<input type="text" value="COOL WHITE"/>	Master Ensuite	<input type="text" value="COOL WHITE"/>
Laundry Room	<input type="text" value="COOL WHITE"/>	TWIN BATH	<input type="text" value="COOL WHITE"/>
Den/Library	<input type="text" value="COOL WHITE"/>	Second Ensuite	<input type="text" value="COOL WHITE"/>
Trim Paint	<input type="text" value="WHITE"/>	GROUND FLOOR	<input type="text" value="COOL WHITE"/>
Comment	Smooth Ceilings First Floor	<input type="text"/>	
<input type="text"/>			

Scheduled Closing Date:

Purchasers: NASIRUDDIN M ALAM & NOWRIN NASRIN TU Property: 12 of Plan -

Telephone Res. / Bus: (647) 933-1450 / (416) 460-7751

Project: Fieldwalk Investments Inc.

Decor Advisor: Terri Parisani

Model and Elevation: 38-6 Elev.A SCARLATTI

12. Electrical

Plugs and Switches ☒ White ☐ Ivory

Hood Fan ☐ White ☐ Ivory

Appliances Built in Cooktop

☐ Yes ☒ No

Built in Oven

☐ Yes ☒ No

Above Kitchen Cabinet Light ☐ Yes ☒ No

Below Kitchen Cabinet Light ☐ Yes ☒ No

Gas Stove

☒ Yes ☐ No

Microwave

☐ Yes ☒ No

Comment

13. Heating and Air Conditioning

Air Conditioning

Gas Provisions Dryer

Gas Provisions Stove

Gas Provisions Barbecue

Comment

GAS LINE FOR STOVE PURCHASED
GAS LINE FOR BBQ GIVEN STANDARD

14. Additional Comments

15. Disclaimers and Notes

- 1) Colours of all materials are as close as possible to builder's selection, but not necessarily identical due to variances in manufacturing.
- 2) Any extras listed above are null and void unless accompanied by a separate invoice/amendment. Said invoice must be paid in full.
- 3) The Purchaser acknowledges that after Interior Colour Selection form is signed and dated, no further changes will be permitted other than re-selection due to unavailability. Purchaser's Initials
- 4) The Purchaser acknowledges reading and accepting the "Gold Park Homes Decor Centre Disclaimers" form. This document contains other miscellaneous disclaimers.

This Interior Colour Selection is final and approved by:

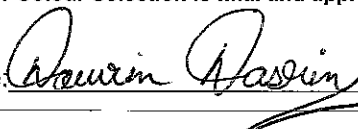
Signature: 

Date: JAN 17 / 17

Signature: 

Date: Jan 17, 2017

Telephone — (T)
Cable — (C)
Electrical — (E)

The Scarlatti

38' SERIES

Elevation A • 3,591 sq.ft. | Elevation B • 3,578 sq.ft.

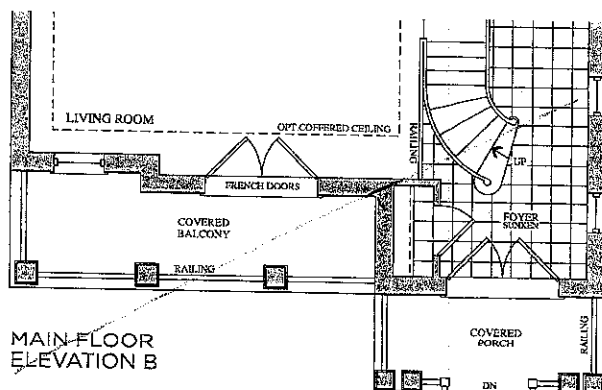
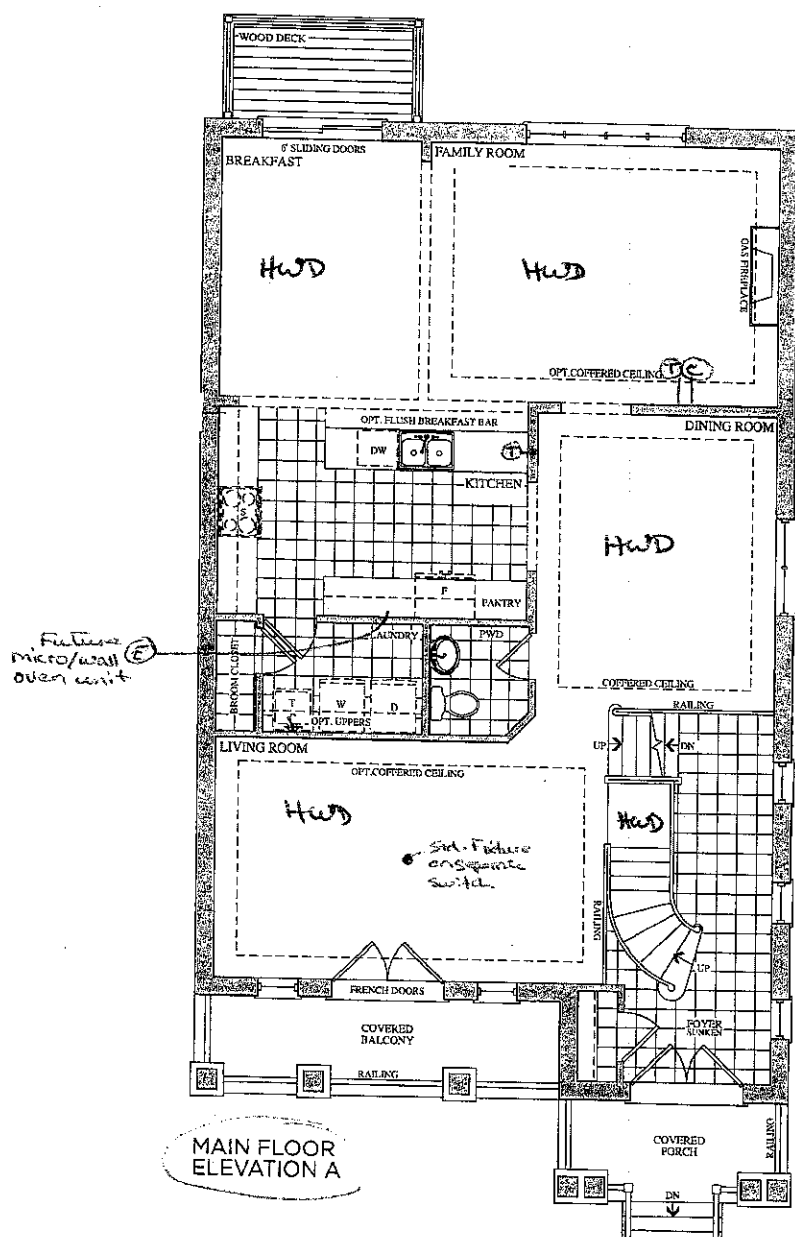

Lot 12
July 12, 1916

Lot 12
Jan 17, 17

NA NT

Prices, figures, illustrations, sizes, features and finishes are subject to change without notice. E.&O.E. Areas and dimensions are approximate and actual usable floor space may vary from the stated area. Layout may be reverse of the unit purchased. E. & O.E.

GOLDPARK
HOMES

**The
Scarlatti**
38' SERIES

Elevation A • 3,591 sq.ft. | Elevation B • 3,578 sq.ft.

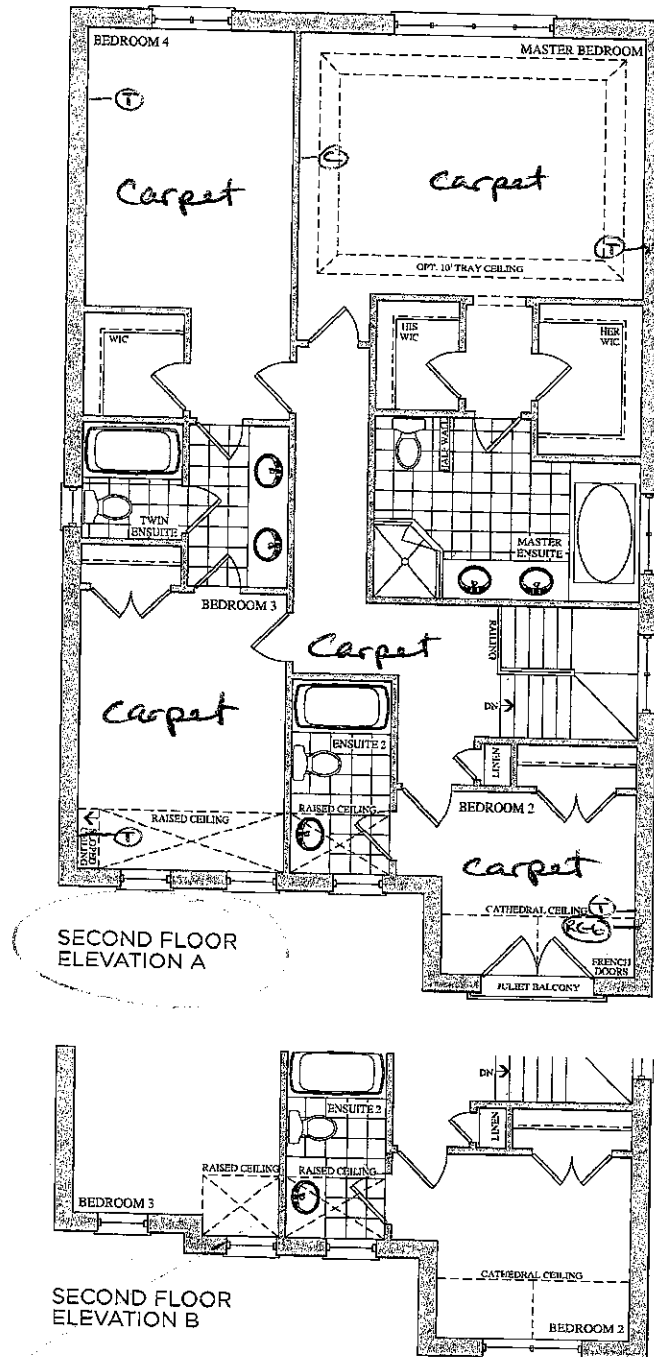

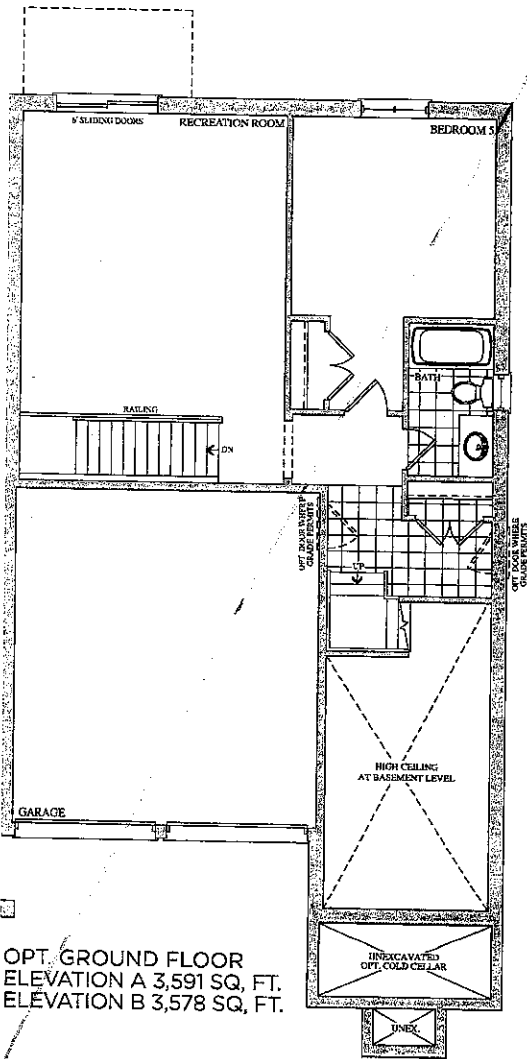
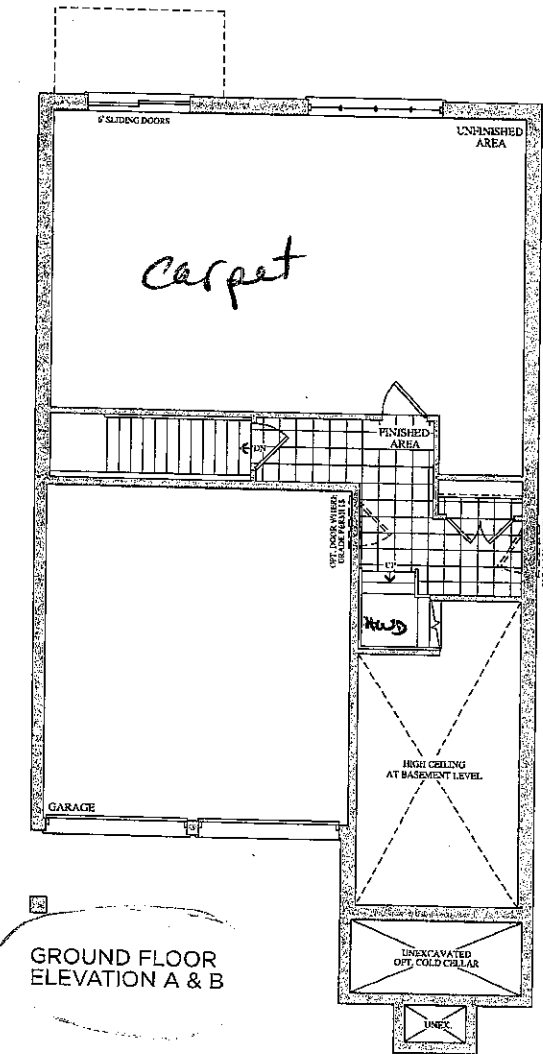

Lot 12
Jan 17, 17
NA
NT

Lot 13
July 12, 12
OO

Prices, figures, illustrations, sizes, features and finishes are subject to change without notice. E.&O.E. Areas and dimensions are approximate and actual usable floor space may vary from the stated area. Layout may be reverse of the unit purchased. E. & O.E.

GOLDPARK
HOMES

CORTINA

KITCHENS INC.

70 Regina Road Woodbridge ON L4L 8L6
905-264-6464

INFORMATION - PVC DOORS

Builder: Gold Park Homes Project: Encore Lot #: 12

All cabinets with PVC (Thermofoil) Doors come with melamine gables, panels and kick. The doors, crown moulding and light valance are PVC wrapped. Open shelves incorporated in design will only be available with melamine interiors. There will be variations in colour shades between the PVC parts (doors, crown and Light valance) and the melamine parts (open shelves, Gables, Panels and Kick) due to the difference in material.

Furring Panel with crown moulding to the ceiling is not available on all PVC door styles due to subtle variations in colour shades between the PVC parts (moulding) and the melamine parts (furring panel) due to the difference in material. Grain directions in wood grain pattern melamine, vary between the furring panel, crown moulding (horizontal) and the PVC doors (vertical).

Thank you for your understanding.

I am well informed of this information, and agree to the purchase of the above.

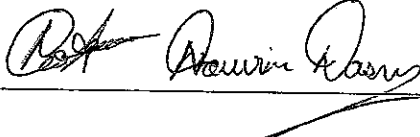
Purchaser:  Date: Jan 17, 2017

Date: 06/23/16

Trade Name: Gold Park Homes

Site location: Brampton

Model: 38-6

Address:

Project: Encore

Phase:

This layout has been explained to the purchaser by Cortina Kitchens Inc. and is understood by the purchaser.

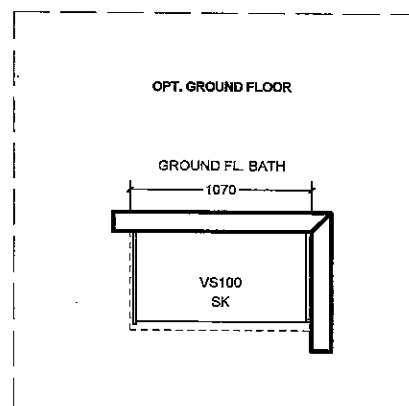
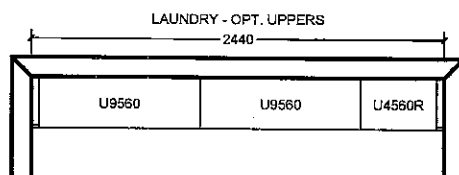
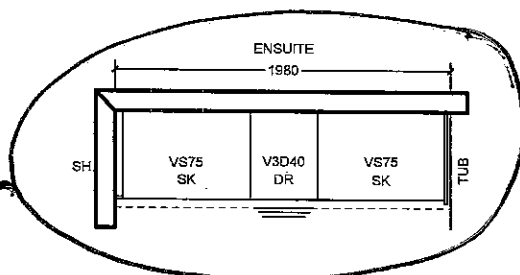
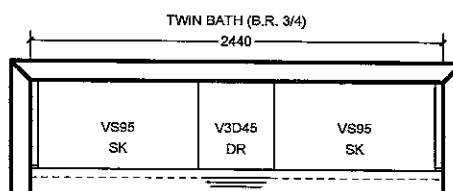
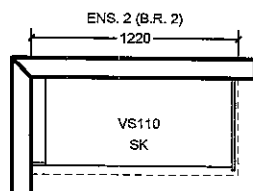
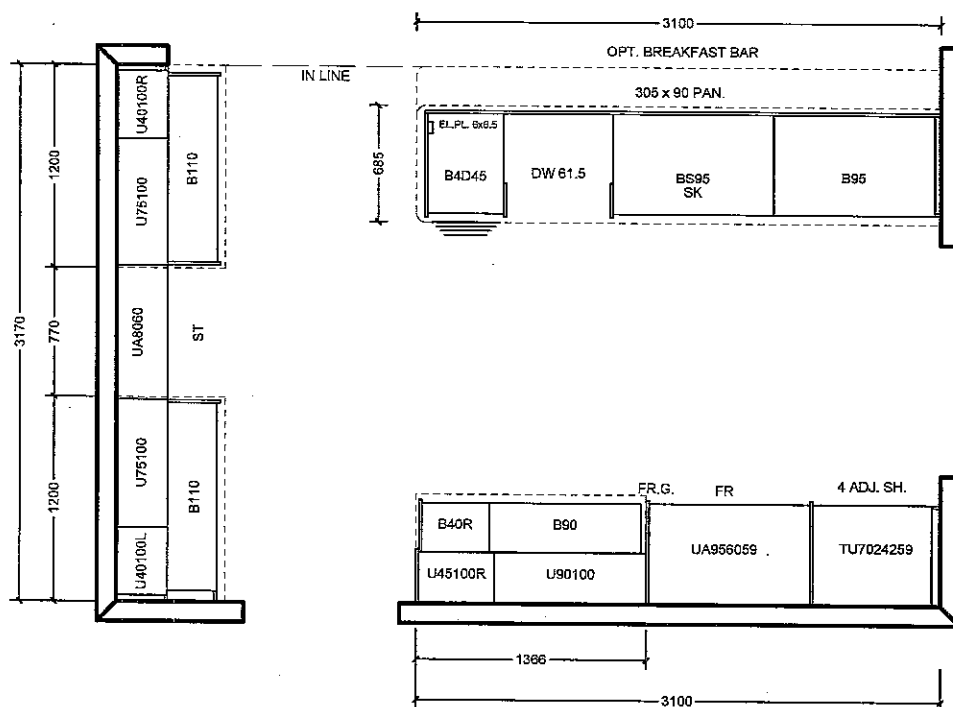

All prices subject to confirmation from head office.
This quotation is subject to the terms & conditions set out
in Cortina's Agreement of Purchase and Sale

All agreements are contingent upon strikes, accidents, and delay beyond our control.
Please provide our installer with template for sinkholes or \$150.00 will be charged for callback.

ACCEPTED DATE: _____

CUSTOMER SIGNATURE

SALESPERSON SIGNATURE

CORTINA HEAD OFFICE APPROVAL

ITEM A. Wood grain and colour are characteristics of the product, we cannot guarantee that such grain and colour will always match
ITEM B. Cortina Kitchens reserves the right to alter dimensions and make technical changes without notice.

Raise cabinet height in master ensuite
Vanity.

Lot 12
Jan 17/17

NA NT



Granite, Marble,
Engineered Surfaces

2 of 12

- Standard 2CM & 3CM
- ⊖ Upgrade 1 2CM & 3CM
- ⊕ Upgrade 1 4 CM
- Upgrade 2

20mm (3/4") Profiles



Kitchen

30mm (1-1/4") Profiles

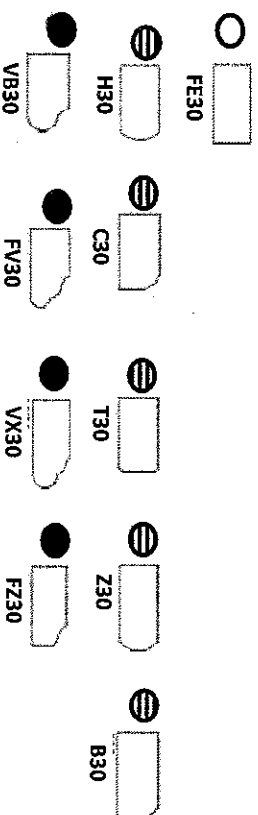

40mm (1-1/2") Profiles

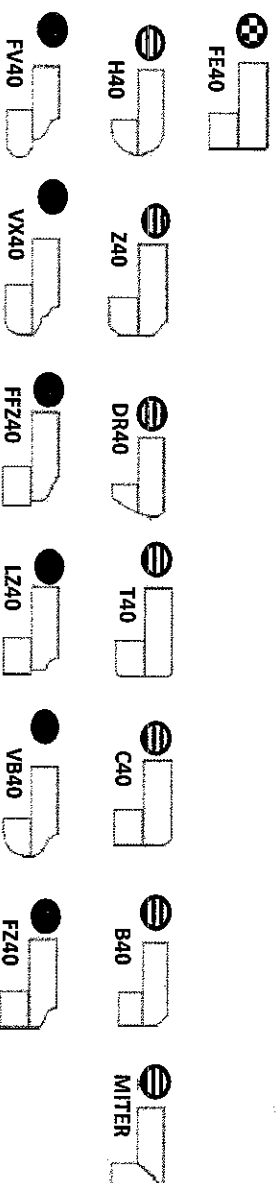

Note: All colours may not be available in 30mm at time ordered. Vendor reserves the right to use 40 mm edges (by lamination process).

*Mitre edge is available in Upgrade 1 for an overall thickness of 2". All other Mitre edge options will be an Upgrade 2 Edge.



STANDARD HARDWARE

STANDARD HARDWARE



CSI-6



CSI-10



CSI-14

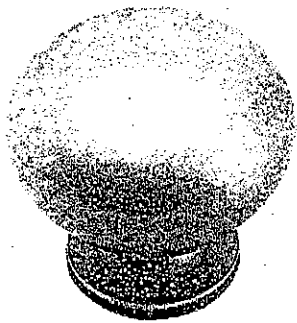

CSI-16

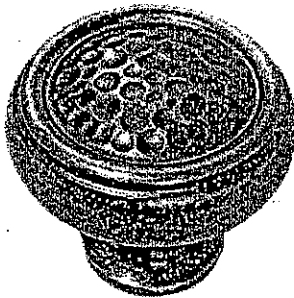

CSI-18

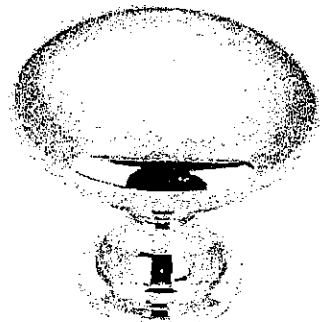

CSI-19

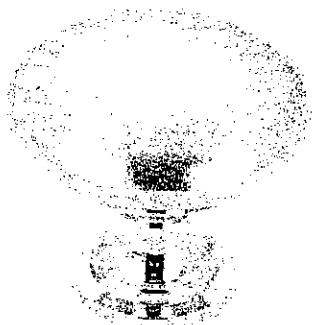

CSI-20

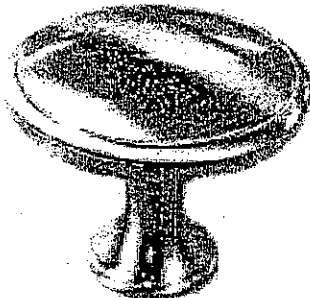

CSI-21



CSI-22

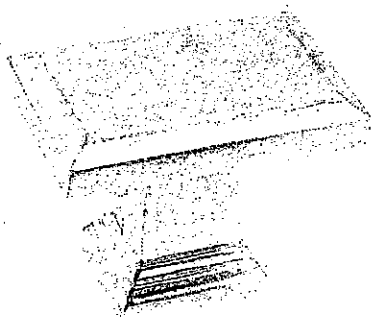

CSI-23

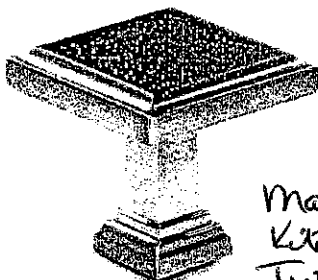

CSI-24

Master
Kitchen
Twin
Ens. 2

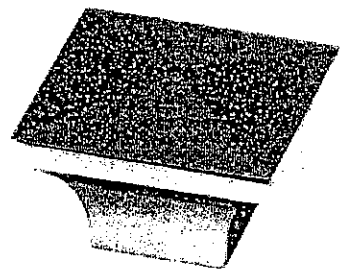

CSI-25

***NOTES:**

- IMAGES ARE FOR QUICK REFERENCE PURPOSES ONLY
- ACTUAL SIZES AND FINISHES AS PER HARDWARE SAMPLE BOARD PROVIDED TO DECOR CENTRE