

Brampton Encore - 67 - 1 - 41-5 Elev.A BRAHMS OPT - GFA1
CENTRAL VAC AND WIRING

Inv.497	1 - TELEPHONE AND CABLE ROUGH-IN LOCATIONS
Line6030	Note:
16May16 / 23Sep16	
Inv.497	1 - BEDROOM #2: INSTALL RG 6 ROUGH-IN IN BEDROOM #2
Line6031	Note:
16May16 / 23Sep16	
Inv.497	1 - GROUND FLOOR REC ROOM: INSTALL RG 6 ROUGH-IN IN REC ROOM
Line6032	Note:
16May16 / 23Sep16	
Inv.497	2 - FAMILY ROOM: INSTALL ROUGH-IN WIRING FOR TWO PAIRS OF SPEAKERS - IN FAMILY ROOM. SEE SKETCH
Line6033	Note:
16May16 / 23Sep16	
Inv.497	1 - FAMILY ROOM: INSTALL CAT 6 WIRING - UPGRADE AN OUTLET TO CAT 6- IN FAMILY ROOM. SEE SKETCH
Line6034	Note:
16May16 / 23Sep16	
Inv.497	1 - CONDUIT PIPE- FROM ATTIC TO ELECTRICAL PANEL- MUST SPECIFY LOCATION AND TERMINATION POINT
Line6035	Note:
16May16 / 23Sep16	

ELECTRICAL

Inv.497	1 - KITCHEN: INSTALL 110V WALL RECEPTACLE ON DEDICATED CIRCUIT - FOR MICROWAVE - MICROWAVE NOT INCLUDED. FOR FUTURE MICROWAVE/WALL OVEN UNIT. PURCHASER IS AWARE THAT THEY MUST BUY THE APPROPRIATE CABINETRY AT THE TIME OF COLOURS
Line6202	Note:
16May16 / 23Sep16	
Inv.497	1 - BASEMENT: INSTALL 200 AMP ELECTRICAL SERVICE
Line6203	Note:
16May16 / 23Sep16	
Inv.497	1 - KITCHEN: INSTALL 220V WALL RECEPTICAL ON DEDICATED CIRCUIT- FOR 4 WIRE BUILT-IN WALL OVEN - FOR FUTURE MICROWAVE/WALL OVEN UNIT. PURCHASER IS AWARE THAT THEY MUST BUY THE APPROPRIATE CABINETRY AT THE TIME OF COLOURS
Line6206	Note:
16May16 / 23Sep16	
Inv.497	1 - LIVING/DINING ROOM: RELOCATE STANDARD FIXTURE - TO THE CENTRE OF THE ROOM. SEE SKETCH
Line6207	Note: IN ADDITION TO THE BUILDER'S STANDARD SWITCH CONTROLLED RECEPTACLE
16May16 / 23Sep16	

EXTERIOR COLOURS

Inv.497	1 - EXTERIOR COLOUR PACKAGE 8
Line11878	Note:
16May16 / 23Sep16	

FORMING

Brampton Encore - 67 - 1 - 41-5 Elev.A BRAHMS OPT - GFA1

Inv.497	1 - EXTERIOR: INSTALL SIDE DOOR- HOME TO EXTERIOR- AS PER PLAN AND GRADE PERMITTING
Line6205	Note: GRADE DOES NOT PERMIT PER SITING DATED JUNE 30, 2016 CREDIT OWED TO PURCHASER
16May16 / 23Sep16	
Inv.856	1 - GRADE DOES NOT PERMIT PER SITING DATED JUNE 30, 2016 CREDIT OWED TO PURCHASER
Line11880	Note:
23Sep16 / 28Feb17	

GRANITE MARBLE QUARTZ

Inv.1,070	1 - KITCHEN: INSTALL CONTINUOUS COUNTERTOP FOR 36" COOKTOP
Line15733	Note:
21Dec16 / 28Feb17	
Inv.1,070	1 - KITCHEN: INSTALL 2 CM GRP 1 Optional Flush BBar
Line15735	Note:
21Dec16 / 28Feb17	
Inv.1,070	1 - MASTER ENSUTIE: INSTALL 2 CM GRP 1 Master Ensuite
Line15736	Note:
21Dec16 / 28Feb17	
Inv.1,070	1 - ENSUITE 2 (BED #4): INSTALL 2 CM GRP 1 Optional Ensuite 4
Line15737	Note:
21Dec16 / 28Feb17	
Inv.1,070	1 - TWIN BATH: INSTALL 2 CM GRP 1 Twin Bath
Line15738	Note:
21Dec16 / 28Feb17	

HARDWOOD

Inv.1,070	1 - DEN: PREVERCO PRO, RED OAK, IN CAPPUCCINO. Upgrade 1 LEVEL S Den
Line15723	Note:
21Dec16 / 28Feb17	
Inv.1,070	1 - FAMILY ROOM: PREVERCO PRO, RED OAK, IN CAPPUCCINO. Upgrade 1 LEVEL S Family
Line15724	Note:
21Dec16 / 28Feb17	
Inv.1,070	1 - LIVING ROOM: PREVERCO PRO, RED OAK, IN CAPPUCCINO. Upgrade 1 LEVEL S Living
Line15725	Note:
21Dec16 / 28Feb17	
Inv.1,070	1 - MAIN HALL: PREVERCO PRO, RED OAK, IN CAPPUCCINO. Upgrade 1 LEVEL S Main Hall
Line15726	Note:
21Dec16 / 28Feb17	
Inv.1,070	1 - LANDINGS: PREVERCO PRO, RED OAK, IN CAPPUCCINO. Upgrade 1 LEVEL S Landings
Line15727	Note:
21Dec16 / 28Feb17	
Inv.1,070	1 - UPPER HALL: PREVERCO PRO, RED OAK, IN CAPPUCCINO. Upgrade 1 LEVEL S Upper Hall
Line15728	Note:
21Dec16 / 28Feb17	

HVAC

Brampton Encore - 67 - 1 - 41-5 Elev.A BRAHMS OPT - GFA1

Inv.497	1 - KITCHEN: INSTALL GAS LINE ROUGH - MAIN FLOOR - (3 STOREY MODELS) FOR STOVE
Line6210	Note:
16May16 / 23Sep16	

KITCHEN AND BATH CABINETRY

Inv.1,070	1 - KITCHEN: INSTALL Oak PVC 112 Built in wall oven and microwave and cooktop with countertop by others 242cm
Line15730	Note:
21Dec16 / 28Feb17	
Inv.1,070	1 - KITCHEN: INSTALL Oak PVC 158 Overlay Gable Pantry 61x220 61x242 FOR WALL OVEN
Line15731	Note:
21Dec16 / 28Feb17	
Inv.1,070	1 - KITCHEN: DELETE CABINET ABOVE STOVE. PURCHASER TO PROVIDE FAN AFTER CLOSING
Line15732	Note:
21Dec16 / 28Feb17	
Inv.1,070	1 - KITCHEN: ADJUST BASE AND UPPER CABINETRY TO ACCOMODATE 36" COOKTOP
Line15734	Note:
21Dec16 / 28Feb17	
Inv.1,070	2 - KITCHEN: INSTALL TWO (X2) Oak PVC 50 Matching Interior Single Door cabinet 100cm h
Line15742	Note:
21Dec16 / 28Feb17	
Inv.1,070	2 - KITCHEN: INSTALL TWO (X2) Oak PVC 26 White Etched glass Std White interior 100cm h
Line15752	Note:
21Dec16 / 28Feb17	

MISC.

Inv.497	1 - BONUS PACKAGE: \$8757.50 (INCLUDING TAXES) WORTH OF UPGRADES FROM GOLD PARK HOMES DÉCOR CENTRE IS BEING APPLIED TOWARD THE STRUCTURAL APPOINTMENT. PURCHASER HAS A REMAINING AMOUNT OF \$1242.50 (INCLUDING TAXES) TO BE USED TOWARD THE COLOUR APPOINTMENT
Line6212	Note:
16May16 / 23Sep16	
Inv.497	1 - Purchaser has attended a Structural appointment at the Decor Centre & has DECLINED any additional upgrades and accepts and acknowledges that there will be no further structural changes/additions/deletions to be made upon signing on May 25, 2016
Line6213	Note:
16May16 / 23Sep16	
Inv.497	1 - Purchaser request that all upgrades from this purchaser's extras form to be added to the purchase price. Purchaser is aware that upgrades will be processed only after the builder receives approval letter from the bank
Line6214	Note:
16May16 / 23Sep16	
Inv.497	1 - MODEL 41-5 ELEVATION A AND PURCHASER BOUGHT THE OPTIONAL GROUND FLOOR
Line11879	Note:
16May16 / 23Sep16	
Inv.1,070	1 - STAIRCASE - The purchaser is advised and therefore accepts and acknowledges that the stain of the staircase and flooring chosen cannot be an exact match, as the hardwood is prefinished at the factory
Line15748	Note:
21Dec16 / 28Feb17	

Brampton Encore - 67 - 1 - 41-5 Elev.A BRAHMS OPT - GFA1

Inv.1,070	1 - DELETE HOODFAN & CABINETS ABOVE STOVE: KITCHEN - Purchasers request to NOT INSTALL builder's standard hood fan and standard cabinets above stove. DELETE. Do not supply, install, and/or credit. Purchasers are installing their own hood fan after closin
Line15747	Note: Purchasers accept and acknowledge that the exhaust fan duct hole may be off-centered with stove in kitchen due to purchasers installing their own hood fan after closing. The vendor is exempt
21Dec16 / 28Feb17	
Inv.1,070	1 - GRANITE WAIVER Due to the many variables that can affect the pattern, colour and/or design and "pitting" of natural products, granite installed will not be identical to the samples displayed.
Line15749	Note: Every effort is made to provide granite counter tops as close as possible but the vendor is not responsible for results which differ from the sample displayed. All countertop surfaces may have seems & product pattern & shade can change in areas containing seems.
21Dec16 / 28Feb17	
Inv.1,070	1 - Purchaser has attended a Colour appointment at the Decor Centre & has DECLINED any additional upgrades and accepts and acknowledges that there will be no further structural changes/additions/deletions to be made upon signing on December 21, 2016
Line15750	Note:
21Dec16 / 28Feb17	
Inv.1,070	1 - Purchasers are aware & accepts that ANY changes made to upgrades after signing this Purchasers Extra Form are subject to a minimum administration fee of \$500. PLUS a 10% holdback fee
Line15751	Note:
21Dec16 / 28Feb17	

PAINTING

Inv.1,070	1 - STAIRCASES: Stain Staircases 3 Storey Model (Euroline Pickets Charged Separately)
Line15729	Note:
21Dec16 / 28Feb17	

PLUMBING

Inv.497	1 - KITCHEN: INSTALL ROUGH-IN - WATERLINE FOR FRIDGE
Line6211	Note:
16May16 / 23Sep16	
Inv.1,070	2 - MASTER ENSUITE: INSTALL TWO (X2) UNDERMOUNT SINKS CALVIN 19 1/4" OVAL #4220CFY
Line15743	Note:
21Dec16 / 28Feb17	
Inv.1,070	2 - TWIN BATH: INSTALL TWO (X2) UNDERMOUNT SINKS CALVIN 19 1/4" OVAL #4220CFY
Line15744	Note:
21Dec16 / 28Feb17	
Inv.1,070	1 - ENSUITE 2: INSTALL UNDERMOUNT SINK CALVIN 19 1/4" OVAL #4220CFY
Line15745	Note:
21Dec16 / 28Feb17	

STAIRS AND RAILINGS

Inv.1,070	1 - STAIRCASE: INSTALL EUROLINE 1 Black
Line15739	Note:
21Dec16 / 28Feb17	

Brampton Encore - 67 - 1 - 41-5 Elev.A BRAHMS OPT - GFA1

Inv.1,070	1 - STAIRCASE: INSTALL V Groove Handrail
Line15740	Note:
21Dec16 / 28Feb17	

WINDOWS - BASEMENT

Inv.497	2 - BASEMENT: INSTALL TWO (X2) BASEMENT WINDOWS - UPGRADE EXISTING BASEMENT WINDOW TO 30 INCH X 24 INCH - MAY REQUIRE INSTALLATION OF WINDOW WELL
Line6208	Note:
16May16 / 23Sep16	
Inv.497	1 - BASEMENT: INSTALL ONE (X1) BASEMENT WINDOWS - UPGRADE EXISTING BASEMENT WINDOW TO 46 INCH X 32 INCH EGRESS - MAY REQUIRE INSTALLATION OF WINDOW WELL
Line6209	Note:
16May16 / 23Sep16	

Scheduled Closing Date: November-16-16

Purchasers: SANJEEV SHARMA & GEETU SHARMA

Property: 67 of Plan -

Telephone Res. / Bus: (905) 230-6380

Project: Fieldwalk Investments Inc.

Decor Advisor: Terri Parisani

Model and Elevation: 41-5 Elev.A BRAHMS OPT - GFA1

Layout Changes: ☒ Yes ☐ NoSketch Attached: ☒ Yes ☐ NoExterior Colour Scheme:

1. Cabinetry

	Style and Colour	Counter	Hardware
Kitchen / Breakfast	Varese(pvc)ItalianWalnut	Rosa Beta Granite Edge: C30	cs1-24
Laundry Room	-		
Powder Room	-		
TWIN BATH	Varese(pvc)ChocoMaple	*Upg.1 Tan Brown Granite Edge: C30	cs1-21
Master Ensuite Bathroom	Varese(pvc)ChocoMaple	*Upg.1 Sapphire Brown/Blue Granit Edge:C30	cs1-23
Second Ensuite Bathroom (If Applicable)	Varese(pvc)ChocoMaple	*Upg.1 Tan Brown Granite Edge: C30	cs1-21
NANNY ENSUITE	Varese(pvc)ItalianWalnut	4595K-52 Bahia Granite Laminate	cs1-21
Dishwasher Cabinet	-		

Comment

BAR: CABINET: Varese(pvc)ItalianWalnut COUNTER:4595K-52 Bahia Granite Laminate HARDWARE: cs1-24

2. Floor Tile

	Selection	Grout	Threshold
Entrance Vestibule	Reflex White, 13 x 13	N/A	N/A
Main Hall	-	N/A	N/A
Kitchen / Breakfast	Reflex White, 13 x 13	N/A	N/A
Laundry Room	Serpentine Beyaz, 13 x 13	N/A	N/A
Powder Room	New Reeds Brown, 13 x 13	N/A	N/A
TWIN BATH	New Reeds Silver, 13 x 13	N/A	N/A
Master Ensuite Bathroom	Reflex White, 13 x 13	N/A	N/A
Second Ensuite Bathroom (If Applicable)	Serpentine Beyaz, 13 x 13	N/A	N/A
Lower Landing (If Applicable)	-	N/A	N/A
NANNY ENSUITE	Serpentine Beyaz, 13 x 13	N/A	N/A

Comment

GROUND FLOOR HALL: Serpentine Beyaz, 13 x 13

3. Wall Tile

	Selection	Listello/Inserts	Describe
TWIN BATH	New Reeds Brown 8 x 10	<input type="radio"/> Yes <input checked="" type="radio"/> No	
Master Ensuite Bathroom			
Tub Deck	-	<input type="radio"/> Yes <input checked="" type="radio"/> No	
Shower Stall	Reflection White 8 x 10	<input type="radio"/> Yes <input checked="" type="radio"/> No	
Bathroom Walls	-	<input type="radio"/> Yes <input checked="" type="radio"/> No	
Second Ensuite Bathroom (If Applicable)	Serpentine Grey, 8 x 10	<input type="radio"/> Yes <input checked="" type="radio"/> No	
NANNY ENSUITE	Serpentine Grey, 8 x 10	<input type="radio"/> Yes <input checked="" type="radio"/> No	

Kitchen Backsplash ☐ Yes ☒ NoBacksplash Behind Fridge

Comment

Purchasers: SANJEEV SHARMA & GEETU SHARMA

Property: 67 of Plan -

Telephone Res. / Bus: (905) 230-6380

Project: Fieldwalk Investments Inc.

Decor Advisor: Terri Parisani

Model and Elevation: 41-5 Elev.A BRAHMS OPT - GFA1

4. Plumbing Fixtures

<input type="text"/>	Second Ensuite	<input type="text"/>	Powder Room	<input type="text"/>
Master Ensuite Bathroom	<input type="text"/>	Other Room - Specify	<input type="text"/>	Other Washroom
Comment	<input type="text"/>			

ALL FIXTURES TO REMAIN AS STANDARD

5. Hardwood Flooring

Main Hall	Type and Stain *Upg1. Preverco Pro, Cappuccino	Upper Landing	Type and Stain *Upg1. Preverco Pro, Cappuccino
Kitchen / Breakfast	<input type="text"/>	Upper Hall	*Upg1. Preverco Pro, Cappuccino
Living Room	*Upg1. Preverco Pro, Cappuccino	Master Bedroom	<input type="text"/>
Dining Room	*Upg1. Preverco Pro, Cappuccino	Bedroom #2	<input type="text"/>
Family Room	*Upg1. Preverco Pro, Cappuccino	Bedroom #3	<input type="text"/>
Den/Library	*Upg1. Preverco Pro, Cappuccino	Bedroom #4	<input type="text"/>
Entrance Vestibule	<input type="text"/>	Bedroom #5	<input type="text"/>
Lower Landing (If Applicable)	<input type="text"/>	Other Room - Specify	<input type="text"/>

Comment

6. Carpeting

Main Hall	<input type="checkbox"/>	Description	<input type="text"/>
Living Room	<input type="checkbox"/>		<input type="text"/>
Dining Room	<input type="checkbox"/>		<input type="text"/>
Family Room	<input type="checkbox"/>		<input type="text"/>
Den/Library	<input type="checkbox"/>		<input type="text"/>
Upper Hall	<input type="checkbox"/>		<input type="text"/>
Master Bedroom	<input type="checkbox"/>	T-12	<input type="text"/>
Bedroom #2	<input type="checkbox"/>	T-12	<input type="text"/>
Bedroom #3	<input type="checkbox"/>	T-12	<input type="text"/>
Bedroom #4	<input type="checkbox"/>	T-12	<input type="text"/>
Bedroom #5	<input type="checkbox"/>		<input type="text"/>
GROUND FLOOR	<input type="checkbox"/>	T-12	<input type="text"/>
Upper Landing (If Applicable)	<input type="checkbox"/>		<input type="text"/>
Lower Landing (If Applicable)	<input type="checkbox"/>		<input type="text"/>

Upgrade Underpad	Type STANDARD	Area <input type="text"/>
Carpet on Stairs	Capped <input type="text"/>	Runner - *Upgrade NONE

Comment

Purchasers: SANJEEV SHARMA & GEETU SHARMA

Property: 67 of Plan -

Telephone Res. / Bus: (905) 230-6380

Project: Fieldwalk Investments Inc.

Decor Advisor: Terri Parisani

Model and Elevation: 41-5 Elev.A BRAHMS OPT - GFA1

7. Fireplace

	Living Room			Family Room			Other Room - Specify		
	Purchased	As Per Plan	N/A	Purchased	As Per Plan	N/A	Purchased	As Per Plan	N/A
Fireplace Type	<input type="radio"/>	<input type="radio"/>	<input checked="" type="radio"/>	<input type="radio"/>	<input checked="" type="radio"/>	<input type="radio"/>	<input type="radio"/>	<input type="radio"/>	<input checked="" type="radio"/>
Mantle Type				STANDARD					
Colour / Stain				NF-20					
Surround				WHITE PAINT-GRADE					
Hearth				NERO MARQUINA					
Comment									

8. Trim Carpentry

Interior Doors	STANDARD	Front Door Glass Inserts	STANDARD	Door Handles	STANDARD
Interior Trim	STANDARD				
Comment					

9. Plaster Mouldings and Medallions

Entrance Vestibule	N/A		Kitchen/Breakfast	N/A	
Main Hall	N/A		Den/Library	N/A	
Living Room	N/A		Lower Landing	N/A	
Dining Room	N/A		Other Room - Specify		
Family Room	N/A				
Comment					

10. Railings and Spindles

Railing Package	*EUROLINE 1 WITH V-GROOVE HANDRAIL		
Railing Colour	*CAPPUCCINO RED OAK	Spindle Colour	BLACK
Stringer / Riser	*CAPPUCCINO RED OAK	Treads	*CAPPUCCINO RED OAK
Comment			
	Oak Stairs	<input checked="" type="radio"/> Yes	<input type="radio"/> No

11. Wall Paint

Main & Upper Hall	COOL WHITE	Master Bedroom	COOL WHITE
Living Room	COOL WHITE	Bedroom #2	COOL WHITE
Dining Room	COOL WHITE	Bedroom #3	COOL WHITE
Kitchen / Breakfast	COOL WHITE	Bedroom #4	COOL WHITE
Family Room	COOL WHITE	Bedroom #5	COOL WHITE
Powder Room	COOL WHITE	Master Ensuite	COOL WHITE
Laundry Room	COOL WHITE	TWIN BATH	COOL WHITE
Den/Library	COOL WHITE	Second Ensuite	COOL WHITE
Trim Paint	WHITE	GROUND FLOOR	COOL WHITE
Comment	Smooth Ceilings First Floor		

Purchasers: SANJEEV SHARMA & GEETU SHARMA

Property: 67 of Plan -

Telephone Res. / Bus: (905) 230-6380

Project: Fieldwalk Investments Inc.

Decor Advisor: Terri Parisani

Model and Elevation: 41-5 Elev.A BRAHMS OPT - GFA1

12. Electrical

Plugs and Switches ☒ White ☐ Ivory

Hood Fan ☐ White ☐ Ivory

Appliances Built in Cooktop

☒ Yes ☐ No

Built in Oven

☒ Yes ☐ No

Above Kitchen Cabinet Light ☐ Yes ☒ No

Below Kitchen Cabinet Light ☐ Yes ☒ No

Gas Stove

☒ Yes ☐ No

Microwave

☒ Yes ☐ No

Comment

DELETE STANDARD HOOD FAN

13. Heating and Air Conditioning

Air Conditioning

Gas Provisions Stove

Gas Provisions Dryer

Gas Provisions Barbecue

Comment

GAS LINE FOR STOVE PURCHASED
GAS LINE FOR BBQ STANDARD

14. Additional Comments

15. Disclaimers and Notes

- Colours of all materials are as close as possible to builder's selection, but not necessarily identical due to variances in manufacturing.
- Any extras listed above are null and void unless accompanied by a separate invoice/amendment. Said invoice must be paid in full.
- The Purchaser acknowledges that after Interior Colour Selection form is signed and dated, no further changes will be permitted other than re-selection due to unavailability. Purchaser's Initials
- The Purchaser acknowledges reading and accepting the "Gold Park Homes Decor Centre Disclaimers" form. This document contains other miscellaneous disclaimers.

This Interior Colour Selection is final and approved by:

Signature: Geetu Sharma

Date: Dec 21-16

Signature: Sanjeev Sharma

Date: Dec 21, 2016

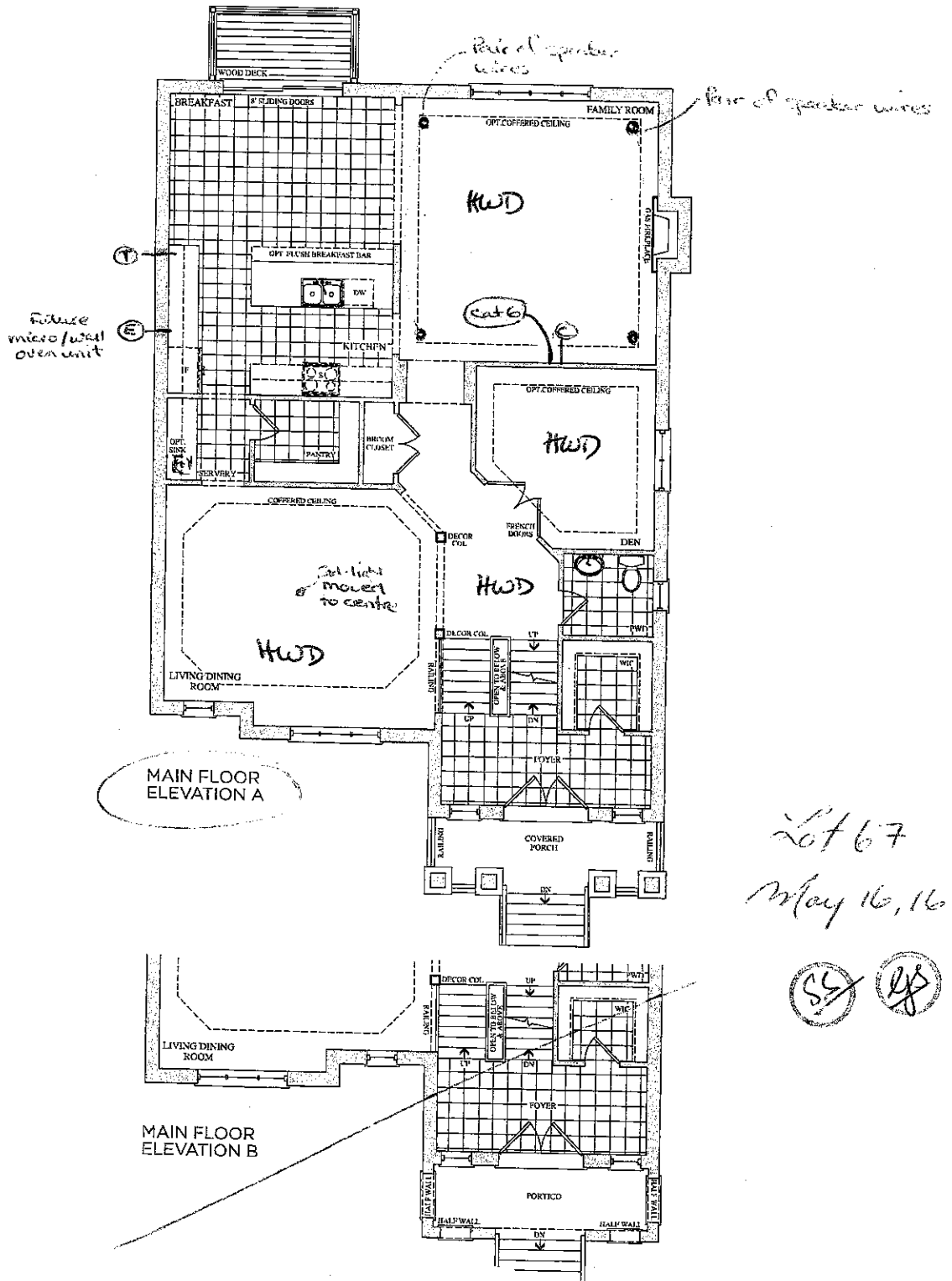

Prices, figures, illustrations, sizes, features and finishes are subject to change, without notice. E.S.O.L. Areas and dimensions are approximate and actual usable floor space may vary from the stated area. Layout may be reverse of the unit purchased. E. & O.E.

GOLDPARK
HOMES

Lot 63
Dec. 21, 16

SS RS

The Brahms 41' SERIES

Elevation A • 4,038 sq.ft. | Elevation B • 4,038 sq.ft.

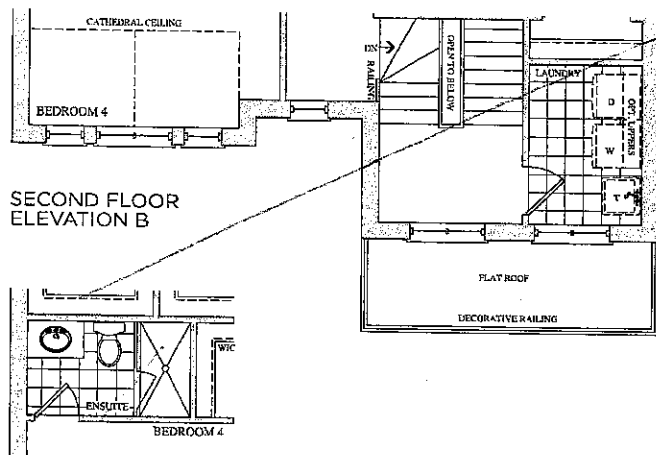
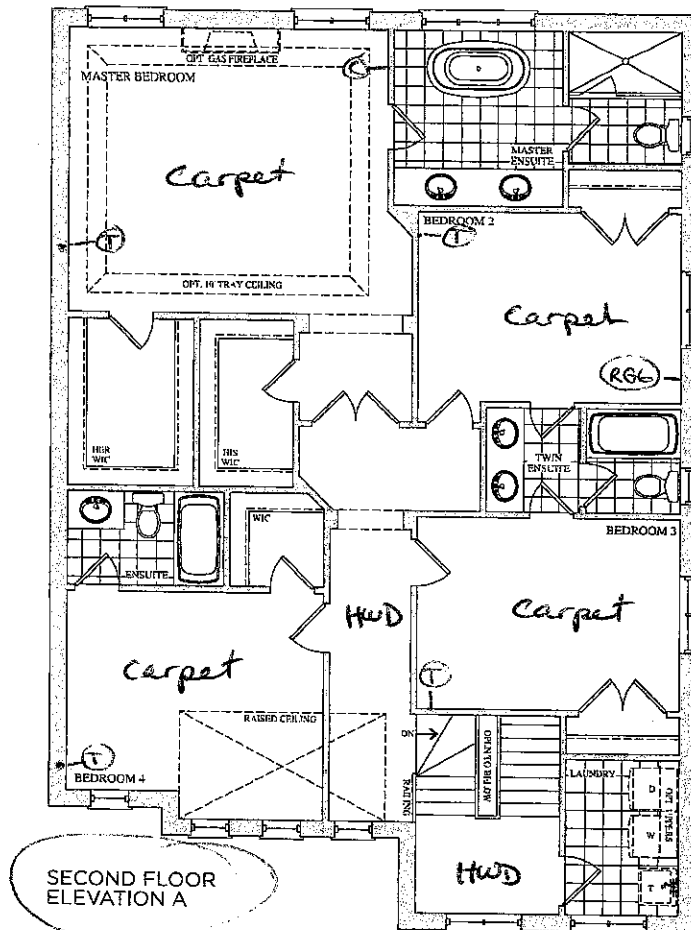

SECOND FLOOR
ELEVATION A & B
OPT. ENSUITE

Lot 67
May 16, 2016

SS (circled) LPS (circled)

Prices, figures, illustrations, sizes, features and finishes are subject to change without notice. E.&O.E. Areas and dimensions are approximate and actual usable floor space may vary from the stated area. Layout may be reverse of the unit purchased. E. & O.E.

GOLDPARK
HOMES

Lot 67
Dec. 21, 16

SS (circled) LPS (circled)

The Brahms 41' SERIES

Elevation A • 4,038 sq.ft. | Elevation B • 4,038 sq.ft.

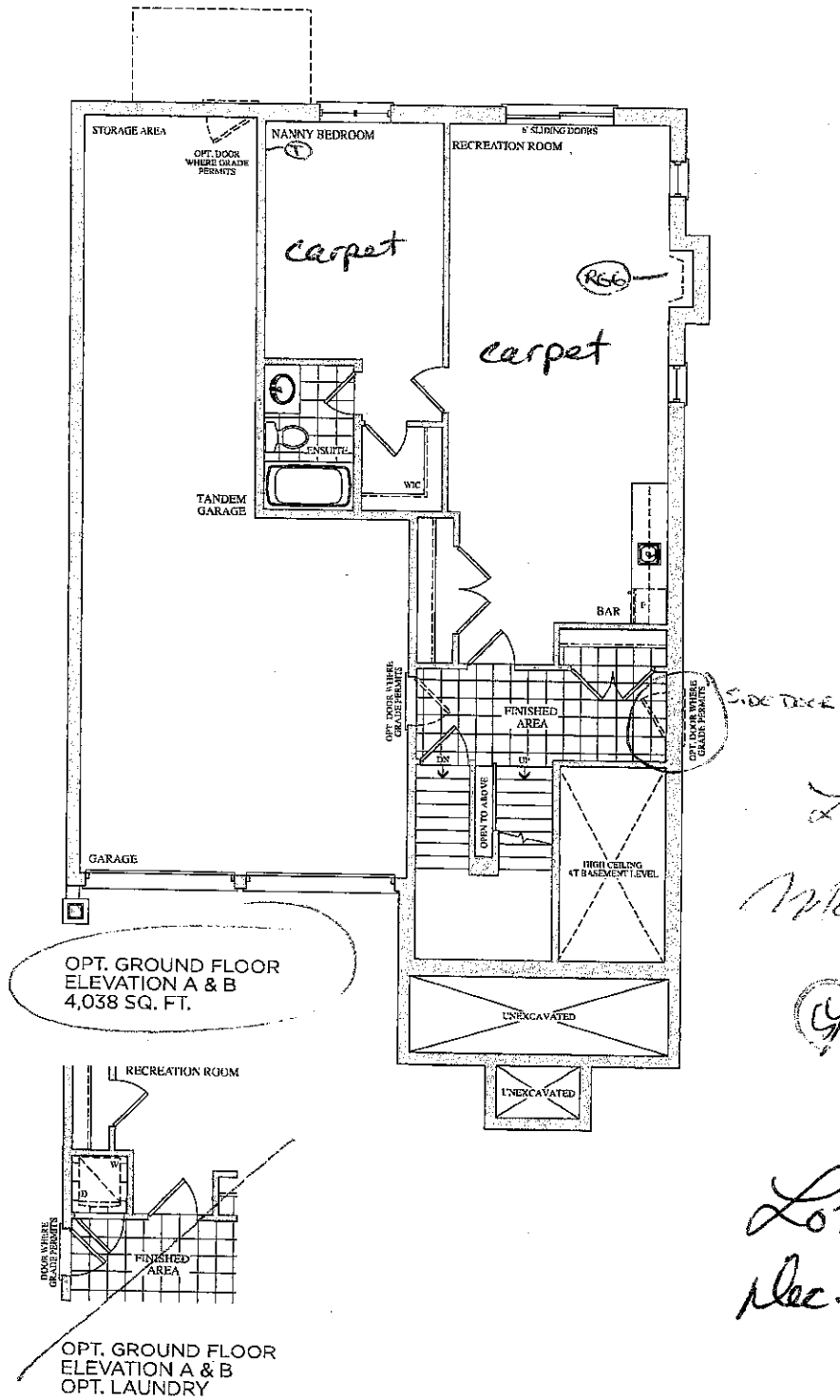

Lot 67
May 16, 16
(y) (gs)

Lot 67
Dec. 21, 16

cs gjs

Prices, figures, illustration's sizes, features and finishes are subject to change without notice. L&O.L. Areas and dimensions are approximate and actual usable floor space may vary from the stated area. Layout may be reverse of the unit purchased. E. & O.E.

COLDPARK
HOMES

CORTINA

KITCHENS INC.

70 Regina Road Woodbridge ON L4L 8L6
905-264-6464

INFORMATION - PVC DOORS

Builder Gold Park Homes Project Encore Lot # 67

All cabinets with PVC (Thermofoil) Doors come with melamine gables, panels and kick. The doors, crown moulding and light valance are PVC wrapped. Open shelves incorporated in design will only be available with melamine interiors. There will be variations in colour shades between the PVC parts (doors, crown and Light valance) and the melamine parts (open shelves, Gables, Panels and Kick) due to the difference in material.

Furring Panel with crown moulding to the ceiling is not available on all PVC door styles due to subtle variations in colour shades between the PVC parts (moulding) and the melamine parts (furring panel) due to the difference in material. Grain directions in wood grain pattern melamine, vary between the furring panel, crown moulding (horizontal) and the PVC doors (vertical).

Thank you for your understanding.

I am well informed of this information, and agree to the purchase of the above.

Purchaser:

Geetu Chahal
Geetu Chahal

Date:

Dec-21-2016

GOLDPARK

WORTH MORE™

Attention: Building Department

Re: Lot # 67

This is to acknowledge that as the purchaser of the above noted lot, I have asked Gold Park Homes not to install the standard builder's kitchen exhaust hood, as I will be installing my own unit after closing.

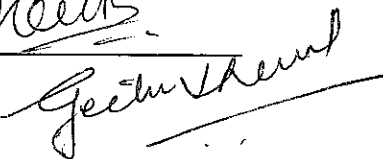
Purchaser 

Vendor

Dated this 21st day of December, 2016.

Date: 23/06/16

Trade Name: Gold Park Homes

Site location: Brampton

Model: 41-5

Address:

Project: Encore

Phase:

This layout has been explained to the purchaser by Cortina Kitchens Inc. and is understood by the purchaser.

KITCHEN

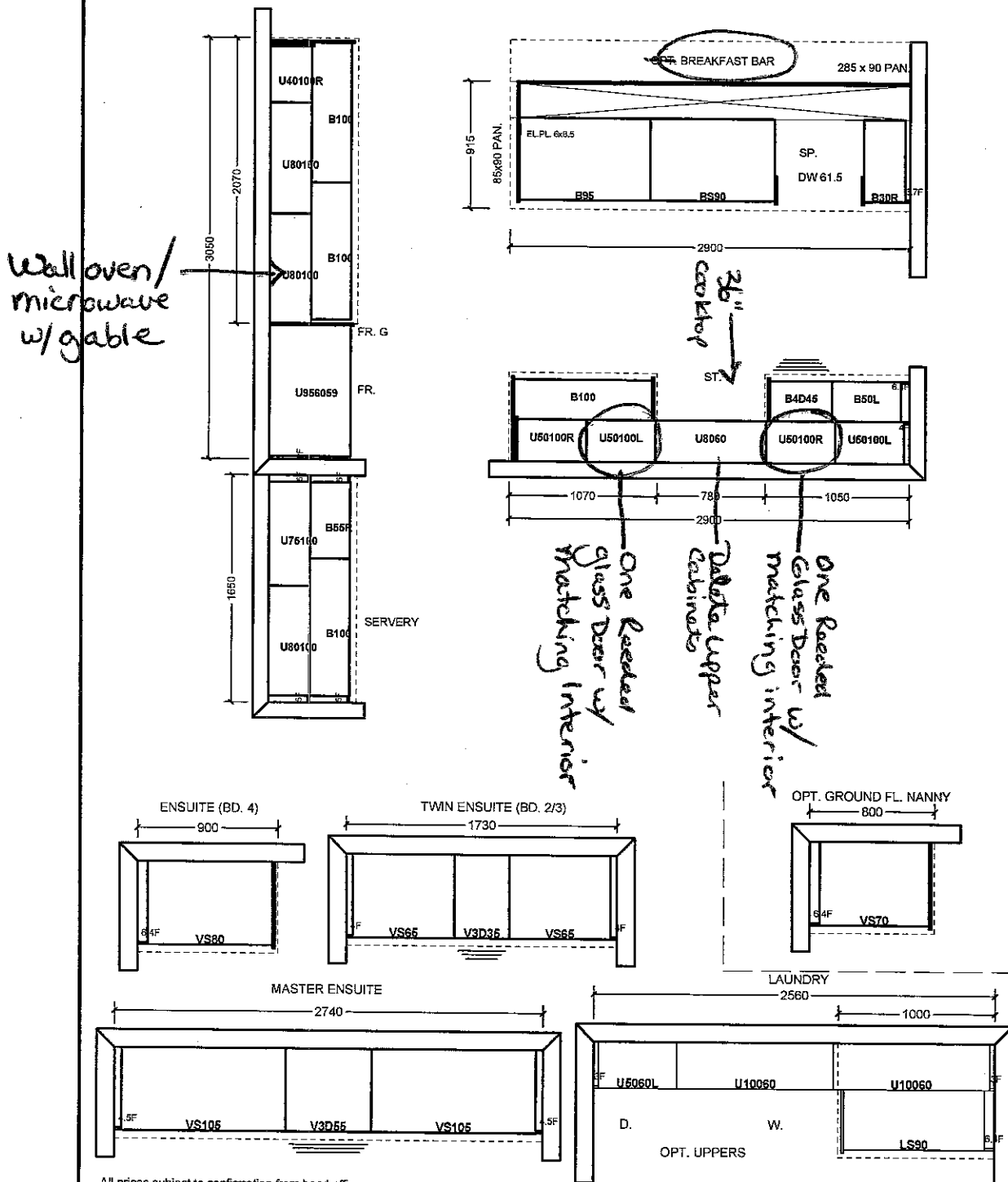

All prices subject to confirmation from head office.
This quotation is subject to the terms & conditions set out

ACCEPTED DATE: _____

All agreements are contingent upon strikes, accidents, and delays beyond our control.
Please provide our installer with template for sinkholes or \$150.00 will be charged for callback.

Item A. Wood grain and colour are characteristic of the product. We cannot guarantee that such grain and colour will always match.
Item B. Cortina Kitchens Inc. reserves the right to alter dimensions and make technical changes without notice.

Lot 67
Dec-21, 16

CS



Lot 67
Dec. 21, 16

Calvin

19 1/4" Oval
4220CFY Undermount Sink

2016 décor center catalogue

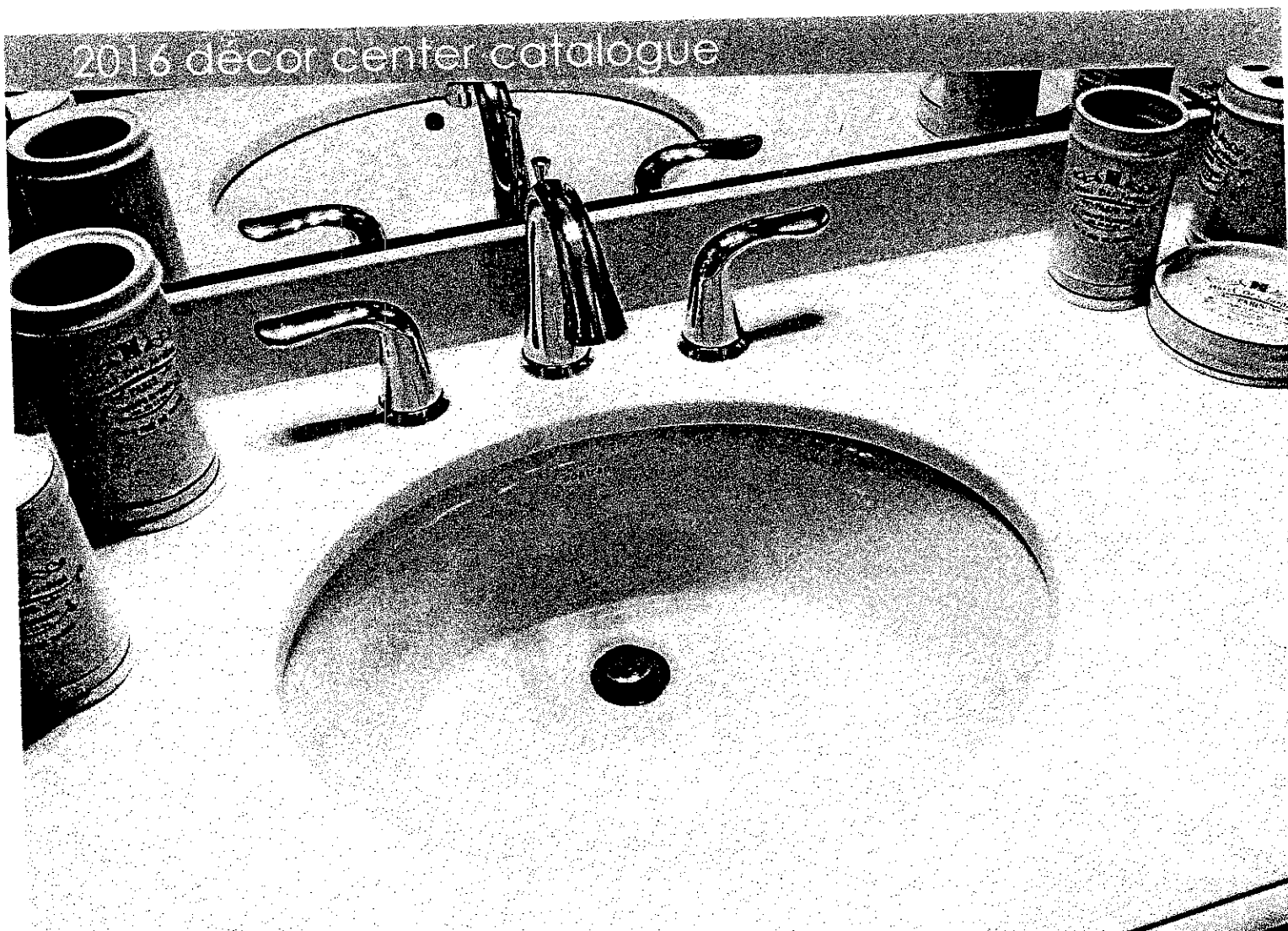

FEATURES

Vitreous china
Front overflow hole
Template and mounting hardware supplied
Overall dimensions (W x D x H):
(OD): 19 1/4" x 16 1/8" x 7 7/8"
(ID): 17" x 13 3/4" x 5 3/4"

CERTIFICATIONS

IAPMO cUPC
ASME A112.19.2 / CSA B45.1-2008

COLOUR

Soft white

contrac.
www.contrac.ca

The images shown are a representation of the finish and color, and may not reflect every characteristic possible.

Issued: Feb. 2016

For - Master Ens x 2
Twin Bath x 2
Ensuite 2 x 1

ME21H706MQS

2.1 cu. ft. Over-the-Range Microwave

(OTR)

NOTE: — This Over-the-Range microwave will be installed over the wall oven.
② It will be used as microwave only and not as OTR

Features

- Smart Multi Sensor
- Ceramic Enamel Interior
- Extra-Large 2.1 cu. ft. Capacity
- 1000 Watts Cooking Power
- 400 CFM Ventilation System
- LED Cooktop Lighting
- Simple Clean Filter
- Charcoal/Grease Vent Filter
- 10 Power Levels
- Sensor Cook
- Two-Stage Programmable Cooking
- Smart & 1 Pound Defrost
- Auto Cook
- Chrome Rack
- Touch Control
- LED Display

Convenience

- Clock (12hr/24hr) with Daylight Savings Time Adjustment
- Kitchen Timer
- End Signal
- Interior Light: Halogen
- Cooktop Lighting (LED): High/Low/Off
- Vent Fan Control: On/Off/Delay Off
- Child Safety Lock
- Sound On/Off
- Eco Mode (Reduces Standby Power)

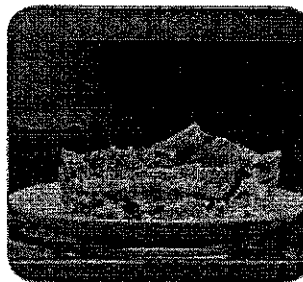
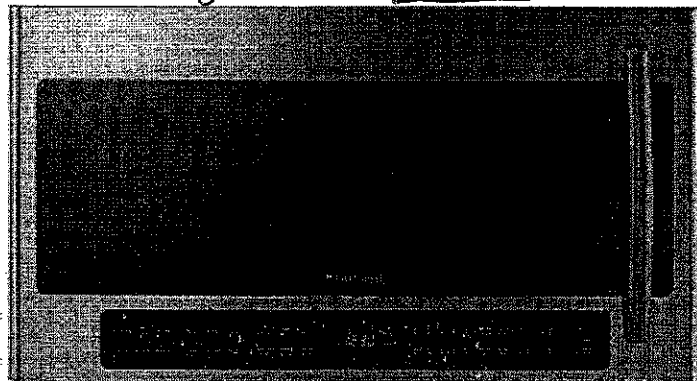

Smart Multi Sensor

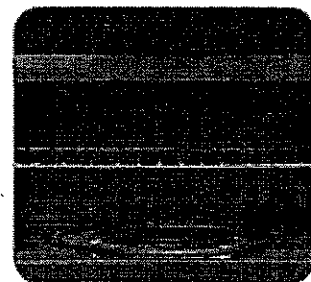

Ceramic Enamel Interior

Available Colors



Stainless Steel
(shown)



Black Stainless

Signature Features

SMART MULTI SENSOR

- Smart Multi Sensor automatically senses the temperature of foods at the rate of 3 times per sec and controls its heating level and time to make the foods the desired condition without overcooking.

CERAMIC ENAMEL INTERIOR

- Scratch-resistant and easy-to-clean interior.
- Effortlessly remove grease or oil from surfaces and protect against scratches that occur from daily use.

LED COOKTOP LIGHT

- More energy efficient and significantly brighter than halogen or incandescent bulbs.
- LED Bulbs last longer, requiring less frequent replacement.
- Evenly distributes a soft, bright light across your cooktop.

SIMPLE CLEAN FILTER

- Convenient, easy-to-access location is simple to eject with one touch and helps you remember when to clean the filter.

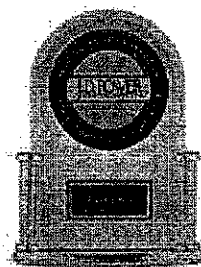

Ranked "Highest in Customer Satisfaction with Over the Range Microwaves."*

—J.D. Power

SAMSUNG

ME21H706MQS

2.1 cu. ft. Over-the-Range Microwave

*NOTE: This unit will be installed over the wall oven.
(2) It will be used as Microwave only and not as OTR.*

Dimensions

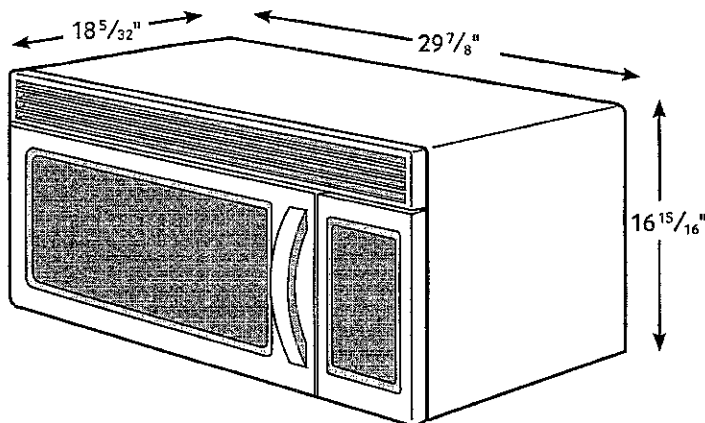

Specifications

- Oven Cavity: 2.1 cu. ft.
- Power Output: 1000 W
- Power Consumption: 17000 W/14.5 A
- Power Source: 120 V/60 Hz
- Control Method: Digital (Membrane Touch)
- Display: LED
- Cooking Control: 10 Power Levels Including Defrost
- Cooking Timer: Digital, up to 99 Minutes, 99 Seconds
- Microwave Distribution System: Rotating Turntable + Stirrer
- Glass Turntable Diameter: 14 3/16"
- Chrome Rack (1)
- Vent Fan: 400 CFM
- Vent Fan Control: On/Off/Delay Off
- Cooktop Lighting: High/Low/Off
- Halogen Interior Light

Installing your Microwave

- This microwave oven is designed for adaptation to the following three types of ventilation:

- A. Outside Top Exhaust (Vertical Duct)
- B. Recirculating (Non-Vented Ductless)
- C. Outside Back Exhaust (Horizontal Duct)

- The space between the cabinets must be 30" wide and free of obstructions.
- This microwave oven is for installation over ranges up to 36" wide.
- The microwave must be level. Use a level to make sure the cabinet bottom is level. If the cabinets have a front overhang only, with no back or side frame, install the mounting plate down the same distance as the front overhang depth. This will keep the microwave level.

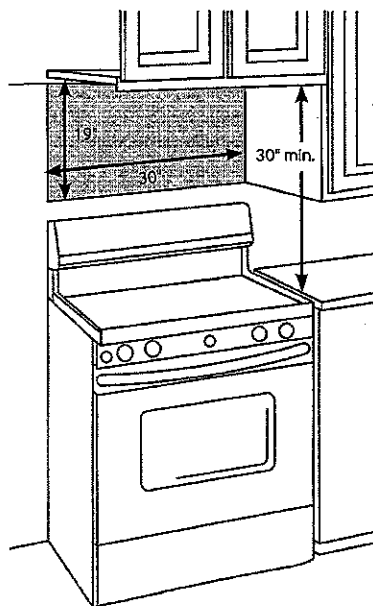

Warranty

One (1) Year All Parts and Labor
Ten (10) Years Parts on Magnetron

Product Dimensions & Weight (WxHxD)

Cavity Dimensions:
22 1/8" x 10 13/16" x 14 27/32"

Outside Net Dimensions:
29 7/8" x 16 15/16" x 18 5/32"

Weight: 59.2 lbs.

Shipping Dimensions & Weight (WxHxD)

Dimensions:
33 3/8" x 19 13/32" x 20 3/4"

Weight: 65.9 lbs.

Color	Model #	UPC Code
Stainless Steel	ME21H706MQS	887276046044
Black Stainless	ME21H706MQG	887276118222

FOR EASIER INSTALLATION AND PERSONAL SAFETY, WE RECOMMEND THAT TWO PEOPLE INSTALL THIS MICROWAVE OVEN. IMPORTANT: Do not grip or use handle during installation.

NOTE: If your cabinet is metal, use the nylon grommet around the power cord hole to prevent cutting of the cord.

NOTE: We recommend using filler blocks if the cabinet front hangs below the cabinet bottom shelf.

IMPORTANT: If filler blocks are not used, case damage may occur from over tightening screws.

NOTE: When mounting the microwave oven, thread power cord through hole in bottom of top cabinet. Do not pinch cord or lift oven by pulling cord.

SAMSUNG

Samsung received the highest numerical score for over-the-range microwaves in the proprietary ADI Power 2014 Model Appliance Study. Study based on 1,538 total responses measuring 45 over-the-range microwave brands and measures opinions of consumers about their new appliance purchased in the past 24 months. Proprietary study results are based on experiences and perceptions of consumers surveyed in January-March 2014. Your experience may vary. Visit adi.power.com

Actual color may vary. Design, color, features and availability are subject to change without notice.

Non-static weights and measurements are approximate.

© 2014 Samsung Electronics America, Inc. 85 Challenger Road, Ridgefield Park, NJ 07663. 1-800-SAMSUNG. Samsung.com

Samsung is a registered trademark of Samsung Electronics Co., Ltd.

NV51K7770SS

5.1 cu. ft. Single Wall Oven

Features

- 6 Oven Modes including Steam Bake and Steam Roast
- 5.1 cu. ft. Capacity
- Gourmet Cook
- Dual Convection
- WiFi Connectivity
- WiFi-Enabled Temperature Probe
- Signature LED Lights
- Soft-Close Door
- 3 Heavy-Duty Racks including a Gliding Rack
- Blue LED Illuminated Knobs
- Broil Element
- Smart Control Key
- 6 Rack Positions
- Drop-Down Door Design
- LED Display

Convenience

- Hidden Heating Element
- Rapid Preheat
- Sabbath Mode
- Hybrid and Self Clean
- Delay Start
- Proofing
- Warming Mode
- Kitchen Timer
- Child Safety Lock
- Convection Conversion

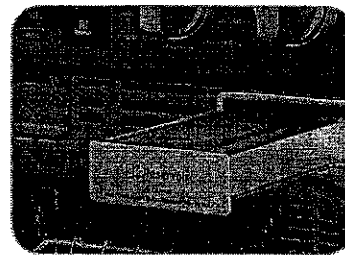
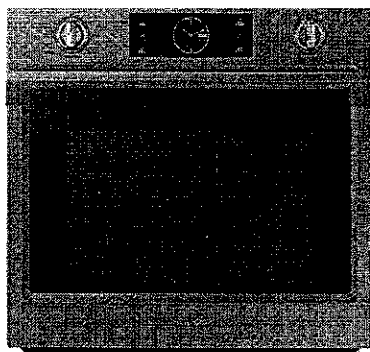

Steam Cook



Flex Duo™

Available Colors



Stainless Steel (shown)



Black Stainless Steel

Signature Features

STEAM COOK

- Delivers moisture at precise times for a crisp, browned outside and tender inside.

DIGITAL-ANALOG CONTROLS

- The ultimate interface, a combination of analog knobs and a digital touch screen.

FLEX DUO™

- Cook two dishes at different temperatures simultaneously with the Smart Divider.

SAMSUNG

NV51K7770SS

5.1 cu. ft. Single Wall Oven

Cabinet Dimensions

Single Oven Installed in Cabinet

*Junction Box

**Allow a minimum of 22" for clearance to adjacent corners, drawers, walls, etc. when door is open.

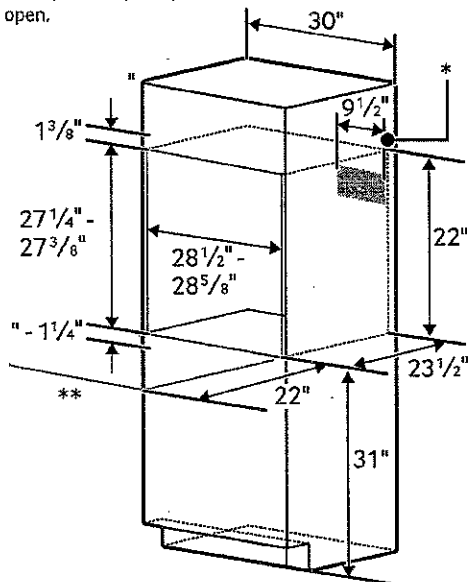

Convection Wall Oven

- Hidden Bake Element
- Bake: 175°F–550°F
- Convection Bake: 175°F–550°F
- Convection Roast: 175°F–550°F
- Broil: Low-High
- Steam Bake: 230°F–550°F
- Steam Roast: 230°F–550°F
- Proofing
- Sabbath Mode

Warranty

One (1) Year All Parts and Labor

Product Dimensions & Weight (WxHxD)

Outside (Max) Wall Oven Dimensions:

28 3/4" x 27 3/8" x 24 7/16"

Wall Oven Cut-Out Dimensions:

28 1/2" x 27 1/4" x 23 1/2"

Weight: 149.9 lbs.

Shipping Dimensions & Weight (WxHxD)

Dimensions:

33 1/2" x 33 3/4" x 29 13/16"

Weight: 176.4 lbs.

Color	Model #	UPC Code
Stainless Steel	NV51K7770SS	887276181691
Black Stainless Steel	NV51K7770SG	887276181752

Product Dimensions

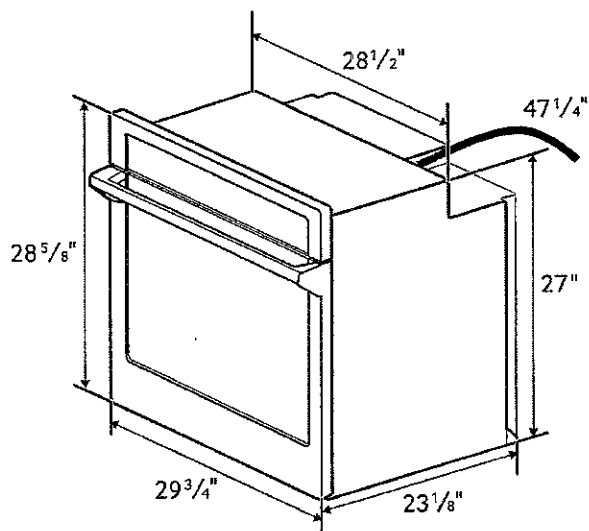

KW RATING	
240V	6.2
208V	4.7
BREAKER SIZE	
240V	30 Amps
208V	30 Amps

SAMSUNG

© 2016 Samsung Electronics America, Inc. All rights reserved. Samsung and the Samsung logo are registered trademarks of Samsung Electronics Co., Ltd. in the U.S. and other countries. Samsung may vary design specifications and product availability without notice. Dimensions and measurements are approximate.

36" RANGE HOOD

NK36K7000WS

36" Range Hood



Stainless Steel
(Shown)



Black Stainless Steel

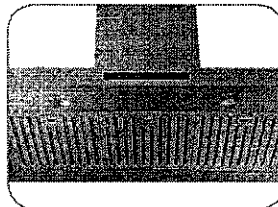
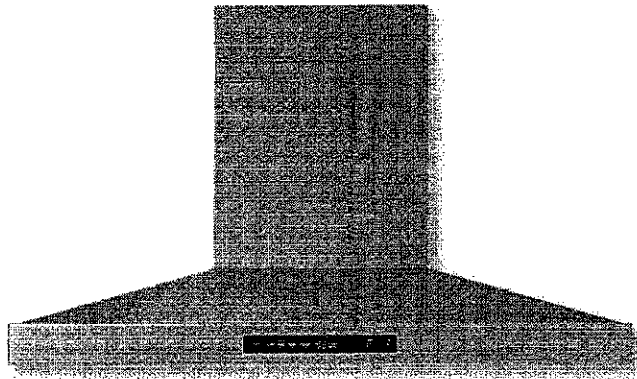

Baffle Filter

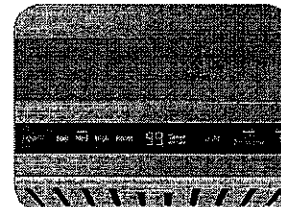

WiFi Monitoring

Features

- 600 CFM Ventilation System
- 4 Fan Speeds including Booster
- Wall-Mounted Chimney Style
- Digital Touch Control
- Exterior Venting

Convenience

- LED Lighting

Signature Features

Bluetooth Connected Hood

- Automatically sync the fans and the lights with the burners through Bluetooth.¹

¹Only on select Samsung cooktops.

Baffle Filter

- Dishwasher-safe metal filters help keep the air clean by drawing grease and odor through the hood.

WiFi Monitoring

- Control the connected hood vent and LED lights remotely from your smartphone.²

²Only when synced with select Samsung cooktops. Available on android and IOS. WiFi connection required.

SAMSUNG

36" RANGE HOOD

NK36K7000WS

36" Range Hood

Venting Methods

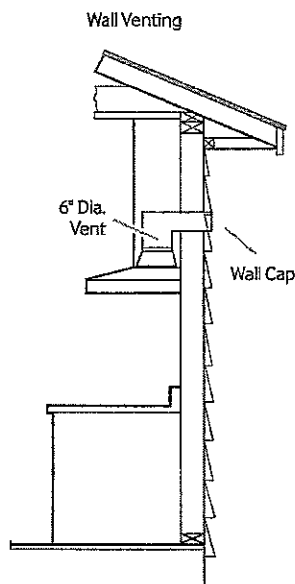
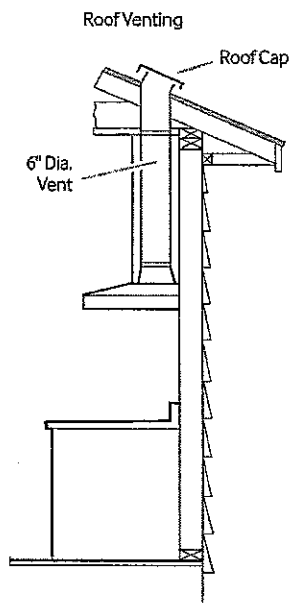

Total Power

- 220 W

Power Source

- 120 V/60 Hz

Range Hood

- 36," Stainless Steel Chimney Hood
- Vent Fan: 600 CFM
- Front-Centered, Touch Control
- 4 Fan Speeds: 3 Step, 1 Booster
- Hood Connectivity Control
- Bluetooth On/Off Control
- Mobile Monitoring: Fan Speed, Lighting On/Off, Power Control
- Removable Baffle Filter
- LED Lighting

Warranty

One (1) Year All Parts and Labour

Dimensions and Clearance

Refer to installation manual for more details.

** For Vented Installation

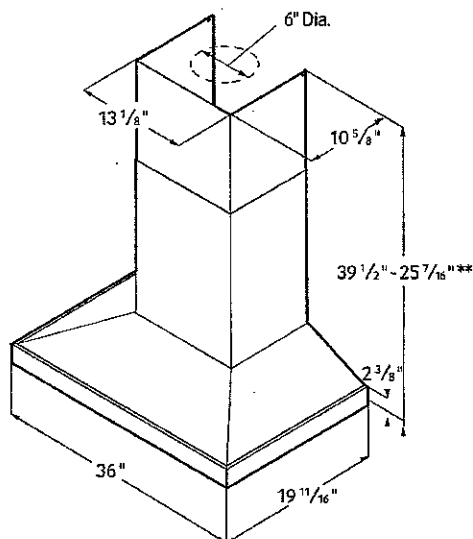

COLOUR	MODEL #	UPC CODE
Stainless Steel	NK36K7000WS	887276182988
Black Stainless	NK36K7000WG	887276182971

PLEASE VISIT SAMSUNG.COM FOR OUR LATEST UPDATES.

Actual colour may vary. Design, specifications, and colour availability are subject to change without notice.
Non-metric weights and measurements are approximate.

© 2016 Samsung Electronics Canada Inc. All rights reserved. Samsung is a registered trademark of Samsung Electronics Co., Ltd., used with permission.

SAMSUNG

RF28JBEDBSR

28 cu. ft. 4-Door French Door Refrigerator with Food ShowCase Fridge Door

Features

- Large Capacity – 28 cu. ft.
- Food ShowCase Fridge Door
- Metal Cooling
- Ice Master Ice Maker in the Refrigerator
- High-Efficiency LED Lighting
- External Filtered Water and Ice Dispenser
- FlexZone™ Drawer with Metal Cooling, 4 Temperature Control Settings and Smart Divider
- Twin Cooling Plus®
- ENERGY STAR®-Compliant
- Power Freeze and Power Cool Options
- EZ-Open Handle™ on Freezer Door and FlexZone™ Drawer
- Two Humidity-Controlled Crispers
- Tempered Glass Spill-Proof Shelves
- Gallon Door Bin

Convenience

- CoolTight Door
- Dispenser Light
- Door Alarm
- Water Filter Indicator
- Child Lock



ENERGY STAR®-Rated:
CEE Tier 1: More Efficient
720 kWh/yr



Ranked "Highest in Customer Satisfaction with French Door Refrigerators, in a Tie."*

—J.D. Power

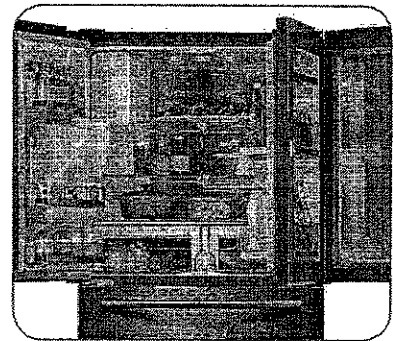
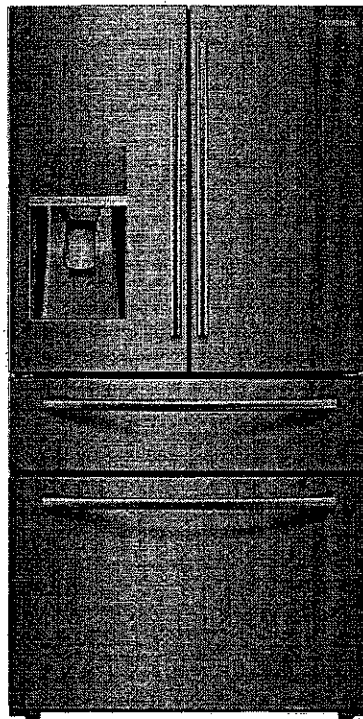

Food ShowCase Fridge Door

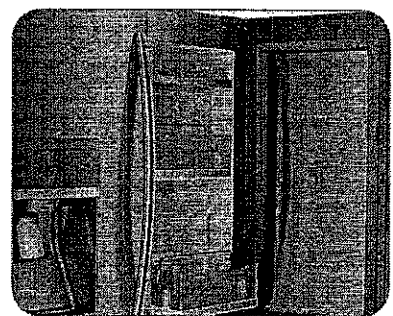

Metal Cooling

Available Colors



Stainless Steel



Black Stainless

Signature Features

FOOD SHOWCASE WITH METAL COOLING

- Innovative door-in-door design gives easy access to on-the-go items such as drinks and condiments.
- Stainless steel paneling locks in cold and seals in freshness while maintaining consistent temperature throughout the refrigerator.

FLEXZONE™ DRAWER WITH METAL COOLING

- Metal Cooling cools food faster.¹
- Counter-height drawer is optimized for family organization with easy access for kids.
- Adjustable Smart Divider and four customizable temperature control settings from Chill to Soft Freeze.

¹Compared to Samsung refrigerator with plastic cooling plate.

LARGE CAPACITY

- Our 28 cu. ft. extra-large-capacity Four-Door French Door has enough room to fit up to 28 bags of groceries.²

²Grocery comparison based on each cubic foot of usable space equalling one paper bag.

SAMSUNG

RF28JBEDBSR

28 cu. ft. 4-Door French Door Refrigerator with Food ShowCase Fridge Door

Installing Your Refrigerator

1. Measure the height, width and depth of the opening, making sure to include baseboards, molding, tile, countertop overhang, etc. Check to be sure there is enough room to open the door (consider walls, islands or other obstacles when measuring).
2. Refer to illustration below to determine dimensions.
3. Allow 2" of clearance on hinge side of refrigerator when installing next to a wall where handle may make contact.
4. Allow 1" minimum clearance at rear for proper air circulation and water/electrical connections. Allow a 3/8" minimum clearance at sides and top for ease of installation.
5. Ensure each door and entryway in the home is wide enough for the refrigerator to be moved through easily.

Please note: The following dimension and cutout information is for planning purposes only. For complete installation details consult manual packed with product, or download manual online at samsung.com.

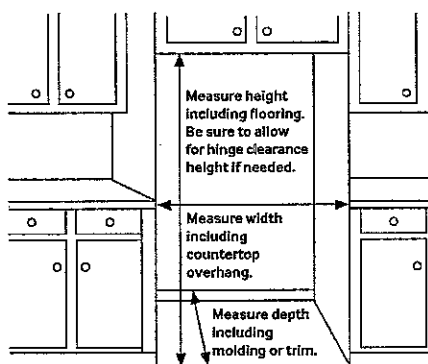

Dimensions

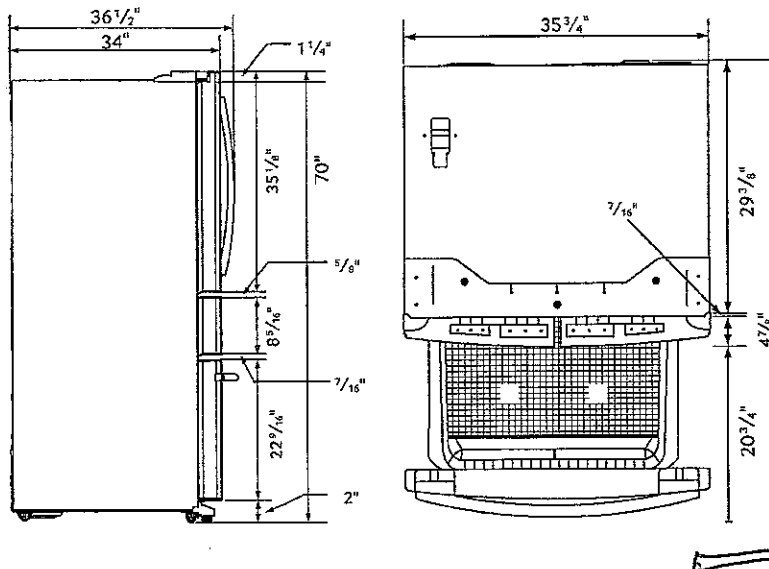

Total Capacity: 27.8 cu. ft.

Refrigerator: 15.7 cu. ft.

- Food ShowCase Fridge Door
- 5 Tempered Glass Spill-Proof Shelves
 - 1 Slide-In, 1 Slide-Out, 1 Foldable Half, 2 Fixed
- 2 Humidity Controlled Crispers
- 6 Door Bins
 - Right Door: 1 Gallon Bin, 1 Slide-Out, 1 Regular Bin
 - Left Door: 3 Regular Bins
- High-Efficiency Top and Side LED Lighting

FlexZone™ Drawer: 3.8 cu. ft.

- EZ-Open Handle™
- 4 Temperature Settings with Smart Divider:
 - Meat/Fish (29°F)
 - Cold Drinks (33°F)
 - Deli/Snacks (37°F)
 - Wine/Party Dishes (42°F)

Freezer: 8.3 cu. ft.

- EZ-Open Handle™
- 1 Drawer Divider
- High-Efficiency LED Lighting

Accessories

Water Filter: HAF-CIN

Warranty

One (1) Year Parts and Labor on Refrigerator

Five (5) Years Parts and Labor on Sealed Refrigeration System Only*

Ten (10) Years Parts and Five (5) Years Labor on Digital Inverter Compressor

*Compressor, evaporator, condenser, drier, connecting tubing

Product Dimensions & Weight

Dimensions (WxHxD with hinges, handles and doors):

35 3/4" x 70" x 36 1/2"

Dimensions (WxHxD without hinges and door):

35 3/4" x 68 7/8" x 29 3/8"

Dimensions (WxHxD with hinge and door, no handle):

35 3/4" x 70" x 34"

Weight: 390.2 lbs.

Shipping Dimensions & Weight (WxHxD)

Dimensions: 38 1/4" x 75 3/4" x 36 1/4"

Weight: 416.7 lbs.

Color	Model #	UPC Code
Stainless Steel	RF28JBEDBSR	887276142364
Black Stainless	RF28JBEDBSG	887276142357

SAMSUNG

Samsung received the highest numerical score for French door refrigerator in the proprietary 2014 Kitchen Appliance Study. Study based on 15,330 total responses measuring 10 key refrigerator attributes. Only Samsung experienced a 100% increase in new appliance purchases in the past 24 months. Proprietary study results are based on a nationwide survey of consumers surveyed January-March 2014. Your experience may vary. Visit www.samsung.com.

Actual color may vary. Design specifications and color availability is subject to change without notice. Dimensions and weight are approximate and may vary by model. ©2014 Samsung Electronics America, Inc. 85 Challenge Road, Basking Ridge, NJ 07005. 1-800-SAMSUNG. Samsung and Samsung logo are registered trademarks of Samsung Electronics Co., Ltd.

DW80J7550US

Samsung Dishwasher

Features

- WaterWall™ System
- Zone Booster
- Quiet Operation: 44dBA
- Express Cycle: 60 Minutes
- Half-Load Cycle: Lower Rack
- One-Touch Adjustable Racking System
- ENERGY STAR® rated: 258 kWh/Year
- Hidden Heating Element
- Triple Filtration System
- Electronic Touch Sensor
- 3 Spray Wash Arms (Upper, Middle, Lower)
- 5 Wash Cycles and 5 Wash Options
- Fan Condensing Drying System
- 2-Piece Silverware Basket
- Stainless Steel Interior

Convenience

- Child Lock
- Rinse Refill Indicator
- Last Cycle Memory
- Four Sensors (Digital Water Leakage, Water Fill, Overflow, Turbidity)

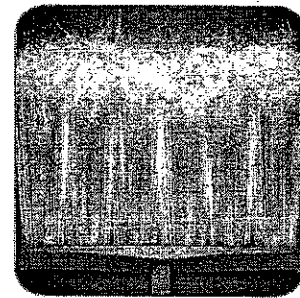
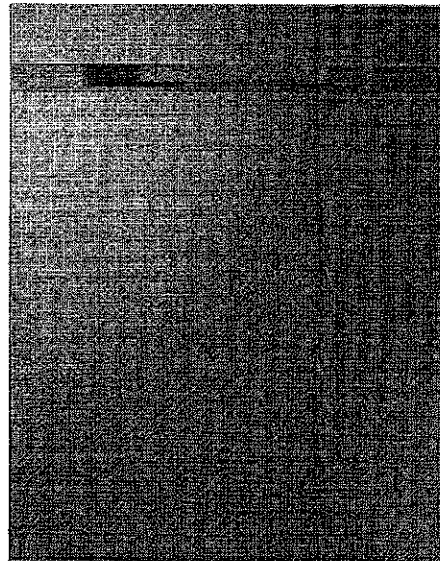

WaterWall™ System

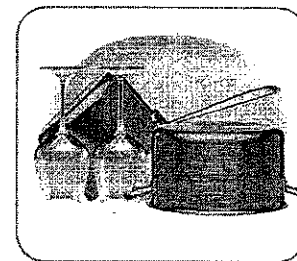

Zone Booster

Available Colors



Stainless Steel



Black Stainless Steel



White

Signature Features

WATERWALL™ SYSTEM

- Powerful wall of water cleans hard-to-reach places.
- Ensures more even, thorough washing performance than conventional rotary-spraying systems.

ZONE BOOSTER

- Offers flexibility to wash all types of dishes in one load.
- Select to wash right or left zone on the bottom rack.
- Lower temperature and pressure for delicates.

EXPRESS 60

- Clean dishes with greater speed and efficiency with a 60 minute cycle.
- Ideal for lighter loads of cups, cutlery, bowls and plates.

QUIET SOUND

- Quietest in its class.*
- Removable, flexible tray for easy loading and unloading.

* Based on MSRP.

SAMSUNG

DW80J7550US

Samsung Dishwasher

Installing Your Dishwasher

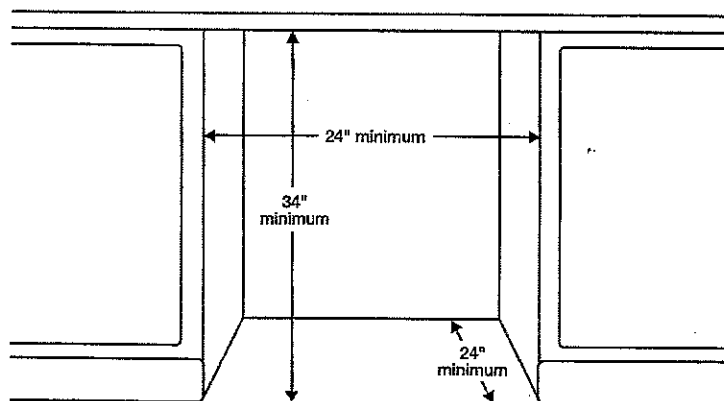

Dimensions

Side View

Rear View

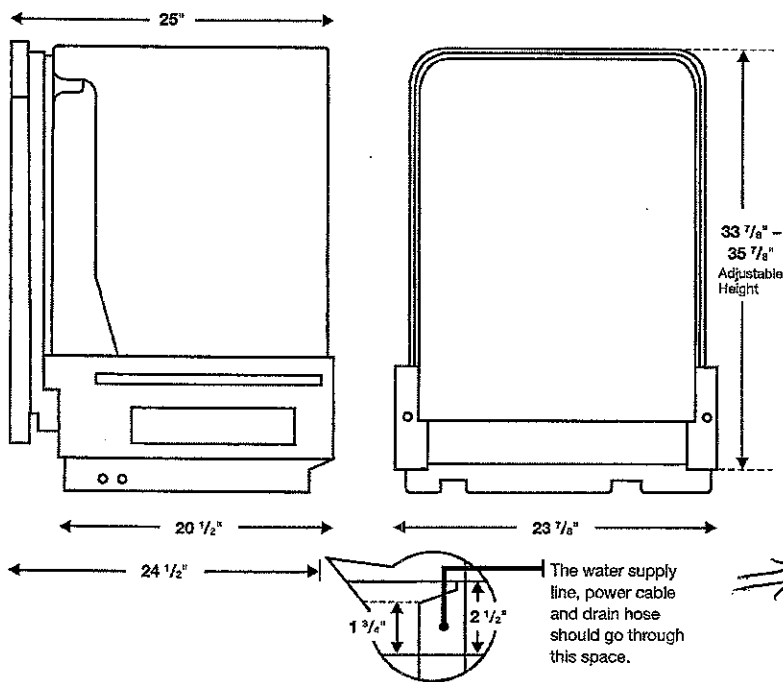

Performance

- 5 Wash Cycles: Auto, Normal, Heavy, Delicate, Express 60
- 5 Options: Half-Load Wash, Targeted Wash, Sanitize (Anti-Bacterial-NSF), Dry+, Delay Start
- 4 Control Buttons: Sound off, Child Lock, Start & Pause, Cancel and Drain
- 3 Filter System
- Hidden Heat Element
- Stainless Steel Interior Tub

Convenience Features

- Child Lock
- Digital Water Leakage Sensor.
- One-Touch Adjustable Racking System
- Nylon Racking
- 2 Piece Silverware Basket
- Upper Rack: 2 Cup Shelves, 3 Adjustable Tines
- Lower Rack: 6 Fold Down Tine

Warranty

Five (5) Years Limited on Linear Motion Parts, Printed Circuit Board and Interior Nylon Racks. Lifetime Limited Warranty on Stainless Steel Door Liner and Tub for Leakage.

Product Dimensions & Weight (WxHxD)

Dimensions:
24" x 33 7/8" x 24 2/3" (27" with handle)

Weight: 101 lbs.

Shipping Dimensions & Weight (WxHxD)

Dimensions:
26 1/16" x 34 27/32" x 29 1/8"

Weight: 108 lbs.

Color

Stainless Steel

Black Stainless Steel

White

Model

DW80J7550US

DW80J7550UG

DW80J7550UW

UPC Code

887276090092

887276117775

887276096391

SAMSUNG

Actual color may vary. Design, specifications, and color availability are subject to change without notice.
Note: All weight and measurements are approximate.
© 2015 Samsung Electronics America, Inc. 65 Chilton Road, Ridgefield Park, NJ 07668-1640. SAMSUNG, samsung.com
Samsung is a registered trademark of Samsung Electronics Co., Ltd.

Materials/Finishes

COOKTOP 36"

Model Type Install

36 inch built-in gas
cooktop

Total Power

59000 BTU

Burner - Left Front

9500 BTU

Burner - Right Front

13000 BTU

Burner - Center Front

22000 BTU, Dual Brass

Features

Grate

Cast Iron (3pcs)

Simmer/Melt

Yes

Number of Burner

5 EA

Accessories

WOK grate

Yes

Control Method

Illuminated Knobs

Power/Ratings

Power Level

Low-Med-High

Burner - Left Rear

9500 BTU

Burner - Right Rear

5000 BTU, Precise
Simmer

Power Supply

120 V / 60 Hz, 1 A

Surface

Black Stainless +
Enamel

Cooktop

Fuel Type

Natural Gas (factory set)

Griddle

Cast Iron Griddle

SAMSUNG
MODEL #

NA36K7750
TG

LP Conversion Kit

Yes

Smart**Wi-Fi Connectivity**

Yes

**Auto Connectivity
(with Hood)**

Yes

Weights/Dimensions**Package (WxHxD)**

1030 x 270 x 650 mm

Cutout (WxHxD)

W 860.4 x D 485.8 mm

Net (WxHxD)

914.4 x 79.3 x 533 mm

Weight (Gross)

43.7 kg

Weight (Net)

38.2 kg

Loading Quantity**(20/40ft)**

152 / 328

HIDE ALL SPECS

WF50K7500AV

Samsung Front-Load Washer

5.0 cu. ft. Capacity

Features

- AddWash™
- Super Speed
- PowerFoam™
- Steam Wash
- VRT Plus™
- Smart Home Ready
- Self Clean+
- Smart Care
- Swirl Drum Design
- Direct Drive Motor
- 1300 RPM Maximum Spin Speed
- 14 Preset Wash Cycles
- 13 Options

Convenience

- Child Lock
- Door Lock
- Dispenser Trays: Prewash, Main Wash, Softener, Bleach



ENERGY STAR®-rated:

CEE Tier 3

IMEF = 2.92

IWF = 2.9

105 kWh/yr

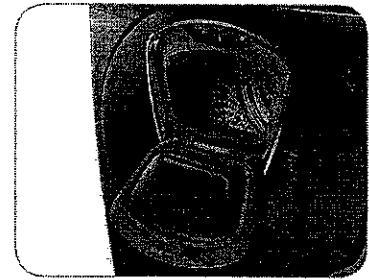
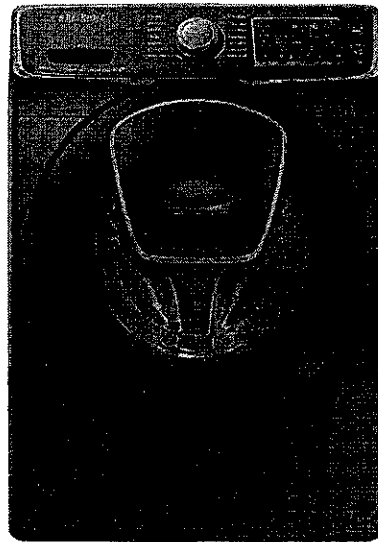

AddWash™

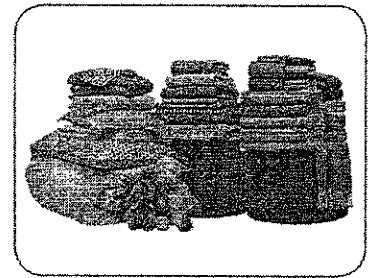

5.0 cu. ft. Capacity

Available Colors:



Black Stainless Steel



White

Signature Features

AddWash™

- Conveniently add in forgotten laundry after the cycle has begun with the AddWash™ door.
- Save time and energy by not doing an additional load of laundry.

5.0 CU. FT. CAPACITY

- Largest 27" Front Load Washer in the industry¹ lets you wash over 3 laundry baskets in a single load.²
- 5.0 cu. ft. capacity gets more laundry done in less time.

¹Based on US DOE/EPA listing.

²Based on an 8-lb. load of laundry.

SUPER SPEED

- Breakthrough technology provides a 50% faster and thorough wash cycle.
- Wash a full load in only 30 minutes.³

³Normal 1-hour wash can be completed in as little as 30 minutes as compared to WF511 washer without Super Speed. Based on DOE standard's average of 7.5 loads per week.

SAMSUNG

WF50K7500AV

Samsung Front-Load Washer

Dimensions

REQUIRED DIMENSIONS FOR INSTALLATION WITH PEDESTAL:

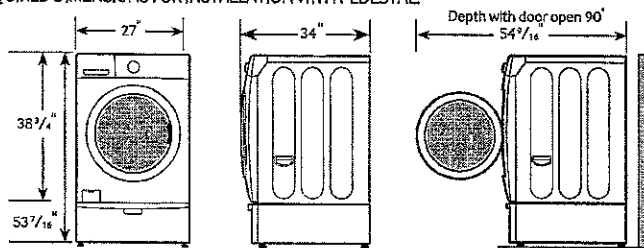

Installation Specifications

If the washer and dryer are installed together or the dryer alone, the closet front must have two unobstructed air openings for a combined minimum total area of 72 in.² (see stacked build below). Your washer alone does not require a specific air opening.

1. Alcove or closet installation

MINIMUM CLEARANCES FOR CLOSET AND ALCOVE INSTALLATIONS:

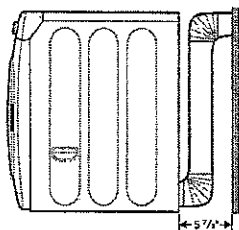
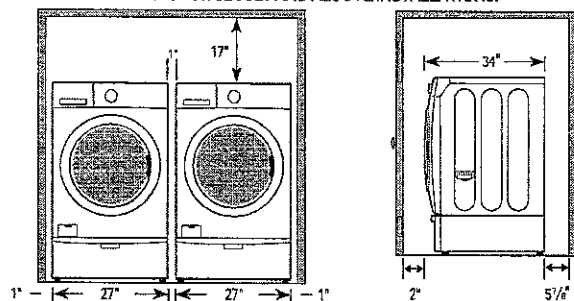

When installing with matching dryer, if the exhaust duct is installed at the rear of the dryer, the rear must have at least 5 7/8 inch clearance.

2. With stacked washer and dryer

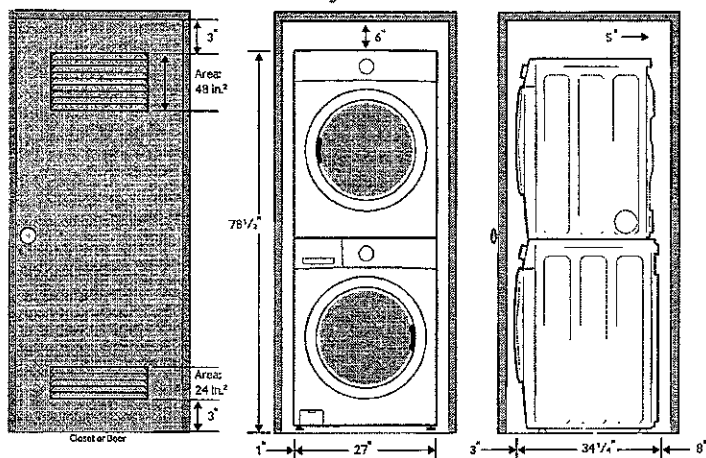

5.0 cu. ft. Capacity

14 Preset Wash Cycles:

Eco Cold, Normal, Heavy Duty, Permanent Press, Sanitize, Allergen, Bedding, Deep Steam, Whites, Active Wear, Delicates, Wool, Quick Wash, Rinse and Spin

13 Options:

Super Speed, Steam, Self Clean+, Delay End, My Cycle, Prewash, Extra Rinse, Extra Spin, Spin Only, Sound, Child Lock, Smart Care, Drum Light

5 Temperature Settings:

Extra Hot, Hot, Warm, Eco Warm, Cold

5 Spin Settings:

Extra High, High, Medium, Low, No Spin

5 Soil Settings:

Heavy, Heavy Medium, Normal, Low Medium, Light

Dispenser Trays:

Prewash, Main Wash, Softener, Bleach

Warranty

One (1) Year Parts and Labor

One (1) Year Control Board

Three (3) Years Stainless Steel Drum

Ten (10) Years Direct Drive Motor

Product Dimensions & Weight (WxHxD)

Dimensions: 27" x 38 3/4" x 34"

Weight: 238 lbs

Shipping Dimensions & Weight (WxHxD)

Dimensions: 29 3/8" x 42 15/16" x 36 3/16"

Weight: 244 lbs

Color

Black Stainless Steel

White

Model

WF50K7500AV

WF50K7500AW

UPC Code

887276135557

887276135564

Matching Dryer (Electric/Gas)

Black Stainless Steel

White

Black Stainless Steel

White

DV50K7500EV

DV50K7500EW

DV50K7500GV

DV50K7500GW

887276135946

887276135960

887276135977

887276135984

Optional Stacking Kit

Sold separately

SKK-7A

887276146423

SAMSUNG

Actual color may vary. Design, specifications, and compatibility are subject to change without notice. No warranty. Dimensions and measurements are approximate.

© 2016 Samsung Electronics America, Inc. 485 Challenger Road, Ridgefield, PA 15076-0000. Tel: 888-SAMSUNG, samsung.com. Samsung is a registered trademark of Samsung Electronics Co., Ltd.

DV50K7500EV

Samsung Front-Load Electric Dryer

7.5 cu. ft. Capacity

Features

- ENERGY STAR® 2016 Certified
- Multi-Steam Technology:
 - Steam Refresh
 - Steam Wrinkle Away
 - Steam Sanitize
- Vent Sensor™
- Stainless Steel Drum
- Eco Dry Technology
- Smart Home Ready
- Smart Care
- Sensor Dry
- 14 Preset Drying Cycles
- 12 Options
- 5 Temperature Settings
- 4-Way Venting
- Dual Heaters
- Dryer Rack
- Dryer Drum Light
- Reversible See-Through Door

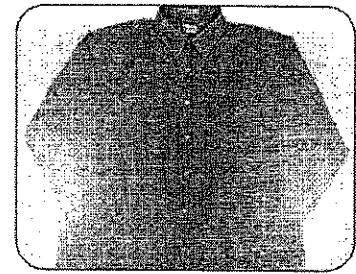
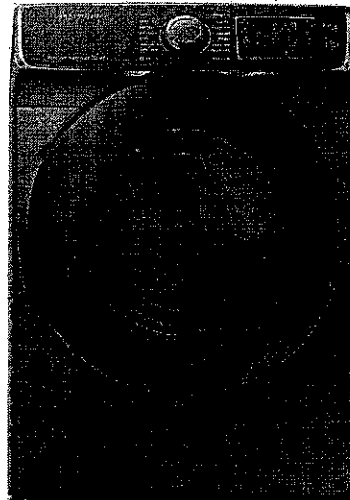

Multi-Steam Technology

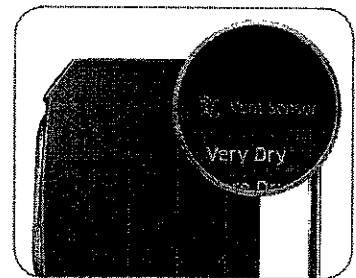

Vent Sensor

Convenience

- Child Lock
- My Cycle Option
- Filter Check Indicator

Available Colors:



Black Stainless Steel



White

Signature Features

ENERGY STAR® 2016 CERTIFIED

- Meets strict energy-consumption requirements.

MULTI-STEAM TECHNOLOGY

- Helps remove wrinkles and odors, and freshens clothes so you can spend less time ironing and less money at the dry cleaners.

VENT SENSOR™

- Detects duct blockages and reminds you to clean your vent.
- Conveniently allows you to forward these alerts to your smartphone.

SAMSUNG

DV50K7500EV

Samsung Front-Load Electric Dryer

Dimensions

REQUIRED DIMENSIONS FOR INSTALLATION WITH PEDESTAL:

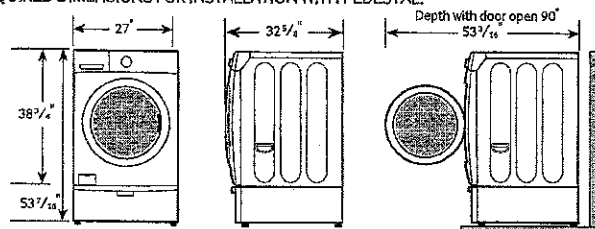

Installation Specifications

If the washer and dryer are installed together or the dryer alone, the closet front must have two unobstructed air openings for a combined minimum total area of 72 in.² (see stacked build below). Your washer alone does not require a specific air opening.

1. Alcove or closet installation

MINIMUM CLEARANCES FOR CLOSET AND ALCOVE INSTALLATIONS:

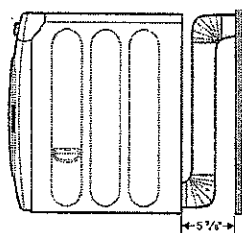
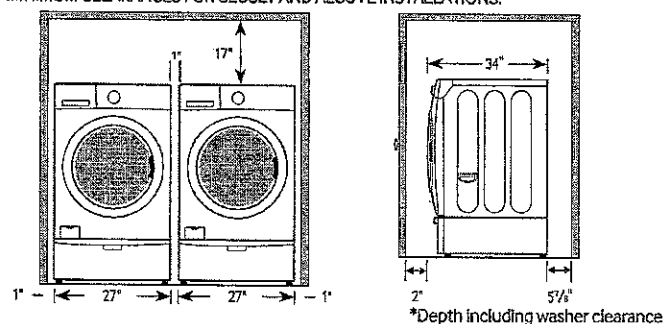

If the exhaust duct is installed at the rear of the dryer, the rear must have at least 5 7/8 inch clearance.

2. With stacked washer and dryer

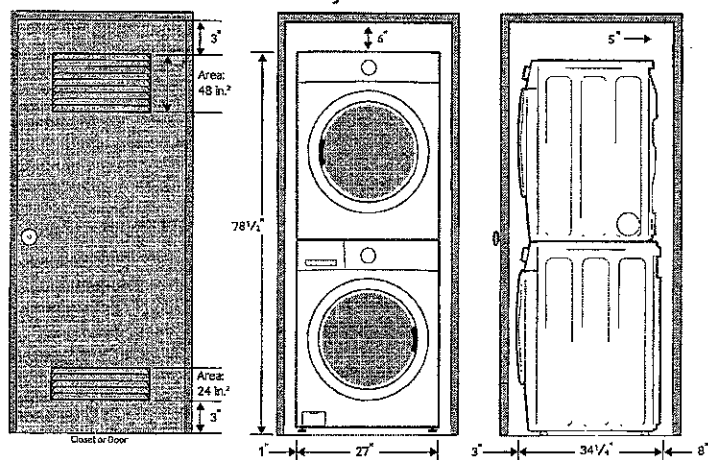

7.5 cu. ft. Capacity DOE

4-Way Venting

14 Preset Dry Cycles:

Steam Refresh, Steam Wrinkle Away, Steam Sanitize, Eco Normal, Normal, Heavy Duty, Permanent Press, Active Wear, Bedding, Delicates, Wool, Time Dry, Air Fluff, Quick Dry

12 Options:

Mixed Load Bell, Wrinkle Prevent, Anti-Static, My Cycle, Rack Dry, Adjust Time (Up), Adjust Time (Down), Eco Dry, Sound, Child Lock, Smart Care, Drum Light

5 Temperature Settings:

High, Medium, Medium Low, Low, Extra Low

5 Dry Levels:

Very Dry, More Dry, Normal Dry, Less Dry, Damp Dry

Warranty

One (1) Year Parts and Labor

One (1) Year Control Board

Product Dimensions & Weight (WxHxD)

Dimensions: 27" x 38 3/4" x 32 5/8"

Weight: 126 lbs

Shipping Dimensions & Weight (WxHxD)

Dimensions: 29 3/8" x 42 3/8" x 34 11/16"

Weight: 134 lbs

Electric

Black Stainless Steel
White

Model

DV50K7500EV
DV50K7500EW

UPC Code

887276135946
887276135960

Gas

Black Stainless Steel
White

Model

DV50K7500GV
DV50K7500GW

UPC Code

887276135977
887276135984

Matching Washer

Black Stainless Steel
White

WF50K7500AV
WF50K7500AW

887276135557
887276135564

Optional Stacking Kit

Sold separately

SKK-7A

887276146423

Optional Side Vent Kit

Sold separately

DV-2A/XAA

887276146416

SAMSUNG

Actual color may vary. Design, specifications, and color availability are subject to change without notice. All dimensions and measurements are approximate.

The Enterprise and Galaxy are registered trademarks of Samsung Electronics Co., Ltd. in the U.S. and other countries. Samsung is a registered trademark of Samsung Electronics Co., Ltd.

© 2013 Samsung Electronics America, Inc. All rights reserved. Under the terms of the Samsung Electronics Co., Ltd. license, Samsung is a registered trademark of Samsung Electronics Co., Ltd.