

**Brampton Encore - 66 - 1 - 41-5 Elev.B BRAHMS OPT - GFA1**

**CARPET**

Inv.1,110	1 - BEDROOM #2: INSTALL City View Berber Bed 2
Line16226	Note:
18Jan17 / 28Feb17	
Inv.1,110	1 - BEDROOM #3: INSTALL City View Berber Bed 3
Line16227	Note:
18Jan17 / 28Feb17	
Inv.1,110	1 - BEDROOM #4: INSTALL City View Berber Bed 4
Line16228	Note:
18Jan17 / 28Feb17	
Inv.1,110	1 - MASTER BEDROOM: INSTALL City View Berber Master Bed
Line16229	Note:
18Jan17 / 28Feb17	
Inv.1,110	1 - UPPER HALL: INSTALL City View Berber Upper Hall
Line16230	Note:
18Jan17 / 28Feb17	

**CENTRAL VAC AND WIRING**

Inv.554	1 - TELEPHONE AND CABLE ROUGH-IN LOCATIONS
Line6731	Note:
9Jun16 / 23Sep16	
Inv.554	1 - GROUND FLOOR-REC ROOM: INSTALL RG 6 ROUGH-IN IN GROUND FLOOR REC ROOM. SEE SKETCH
Line6732	Note:
9Jun16 / 23Sep16	
Inv.554	1 - FAMILY ROOM: INSTALL CONDUIT PIPE- FOR TELEVISION- MUST SPECIFY LOCATION AND TERMINATION POINT, ABOVE FIREPLACE
Line6734	Note:
9Jun16 / 23Sep16	
Inv.554	1 - FAMILY ROOM: INSTALL ROUGH-IN FIBER OPTIC CABLE- HOME RUN TO ELECTRICAL PANEL- MUST SPECIFY LOCATION IN ROOM IN FAMILY ROOM, SEE SEKTCH
Line6741	Note:
9Jun16 / 23Sep16	

**CERAMIC**

Inv.554	1 - MASTER ENSUITE: INSTALL SHOWER STALL SEAT IN MASTER ENSUITE SHOWER STALL
Line11871	Note:
9Jun16 / 23Sep16	
Inv.1,110	1 - LAUNDRY ROOM: INSTALL Floor Upgrade 1 Laundry Room Floor on 2nd
Line16215	Note:
18Jan17 / 28Feb17	
Inv.1,110	1 - KITCHEN: INSTALL Floor Upgrade 5 Kitchen and Breakfast Floor with Servery
Line16216	Note:
18Jan17 / 28Feb17	
Inv.1,110	1 - FOYER: INSTALL Floor Upgrade 5 Foyer Vestibule Floor
Line16217	Note:
18Jan17 / 28Feb17	

Brampton Encore - 66 - 1 - 41-5 Elev.B BRAHMS OPT - GFA1

Inv.1,110	1 - GROUND FLOOR HALL: INSTALL Floor Upgrade 5 Garage Entrance Landing Floor
Line16218	Note:
18Jan17 / 28Feb17	
Inv.1,110	1 - POWDER ROOM: INSTALL Floor Upgrade 5 Powder Room Floor
Line16219	Note:
18Jan17 / 28Feb17	
Inv.1,110	1 - TWIN BATH: INSTALL Floor Upgrade 4 Bath 2 3 Floor
Line16220	Note:
18Jan17 / 28Feb17	
Inv.1,110	1 - TWIN BATH: INSTALL Floor Upgrade 4 Bath 2 3 Tub with Ceiling
Line16221	Note:
18Jan17 / 28Feb17	
Inv.1,110	1 - MASTER ENSUITE: INSTALL Floor Upgrade 4 Ensuite Bath Floor
Line16222	Note:
18Jan17 / 28Feb17	
Inv.1,110	1 - ENSUITE 2: INSTALL Floor Upgrade 4 Bath 4 Floor
Line16224	Note:
18Jan17 / 28Feb17	
Inv.1,110	1 - ENSUITE 2: INSTALL Floor Upgrade 4 Bath 4 Tub with Ceiling
Line16225	Note:
18Jan17 / 28Feb17	
Inv.1,110	1 - MASTER ENSUITE: INSTALL Floor Upgrade 4 Ensuite Bath Shower with Ceiling
Line16234	Note:
18Jan17 / 28Feb17	
Inv.1,110	1 - NANNY ENSUITE: INSTALL Floor Upgrade 2 Nanny Bath Floor
Line16235	Note:
18Jan17 / 28Feb17	

DRYWALL

Inv.554	1 - SECOND FLOOR: INSTALL SMOOTH CEILINGS - (3-Story Design) ON SECOND FLOOR
Line6759	Note:
9Jun16 / 23Sep16	
Inv.554	1 - ENSUITE 2 (BED #4): INSTALL SHOWER IN LIEU OF TUB- INCLUDES FRAMED GLASS SHOWER ENCLOSURE- TO GO IN ENSUITE #2, OFF BED #4
Line11872	Note:
9Jun16 / 23Sep16	

ELECTRICAL

Inv.554	1 - FAMILY ROOM: INSTALL 110V WALL RECEPTACLE ON DEDICATED CIRCUIT - ABOVE FIREPLACE SEE SKETCH
Line6735	Note:
9Jun16 / 23Sep16	
Inv.554	1 - KITCHEN: INSTALL 220V WALL RECEPTICAL ON DEDICATED CIRCUIT- FOR 4 WIRE BUILT-IN WALL OVEN - FOR FUTURE MICROWAVE/WALL OVEN UNIT. SEE SKETCH. PURCHASER IS AWARE THAT THEY MUST BUY THE APPROPRIATE CABINETRY AT THE TIME OF COLOURS
Line6746	Note:
9Jun16 / 23Sep16	

**Brampton Encore - 66 - 1 - 41-5 Elev.B BRAHMS OPT - GFA1**

Inv.554	1 - KITCHEN: INSTALL 110V WALL RECEPTACLE ON DEDICATED CIRCUIT - FOR MICROWAVE - MICROWAVE NOT INCLUDED. FOR FUTURE MICROWAVE/WALL OVEN UNIT. SEE SKETCH. PURCHASER IS AWARE THAT THEY MUST BUY THE APPROPRIATE CABINETRY AT THE TIME OF COLOURS
Line6747	Note:
9Jun16 / 23Sep16	
Inv.554	1 - BASEMENT: INSTALL 200 AMP ELECTRICAL SERVICE
Line6749	Note:
9Jun16 / 23Sep16	
Inv.554	1 - LIVING ROOM: INSTALL ROUGH - IN CEILING OUTLET ON SAME SWITCH AS DINING ROOM LIGHT- DOES NOT INCLUDE FIXTURE - MUST SPECIFY LOCATION. SEE SKETCH
Line6751	Note:
9Jun16 / 23Sep16	
Inv.554	1 - KITCHEN: INSTALL KITCHEN CABINET STRIP VALANCE LIGHTS (UNDER CABINETS) - ROUGH - IN - DOES NOT INCLUDE (AND REQUIRES) KITCHEN UPGRADE PRICING
Line6756	Note:
9Jun16 / 23Sep16	
Inv.554	1 - ENSUITE 2 (BED #4): INSTALL SHOWER IN LIEU OF TUB- INCLUDES FRAMED GLASS SHOWER ENCLOSURE- TO GO IN ENSUITE #2, OFF BED #4
Line11873	Note:
9Jun16 / 23Sep16	
Inv.1,110	1 - VALANCE: ROUGH-IN ONLY NOTE: ROUGH-IN ELECTRICAL WAS PURCHASED FOR A UNDER CABINET LIGHT VALANCE, HOWEVER, CABINETRY EXTRAS WERE NOT PURCHASED. ELECTRICAL WILL BE INSTALLED AND ACCESSIBLE UNDER STANDARD CABINETS.
Line18285	Note:
18Jan17 / 28Feb17	

**EXTERIOR COLOURS**

Inv.554	1 - EXTERIOR COLOUR PACKAGE 6
Line11868	Note:
9Jun16 / 23Sep16	

**FORMING**

Inv.554	1 - EXTERIOR: INSTALL SIDE DOOR- HOME TO EXTERIOR- AS PER PLAN AND GRADE PERMITTING
Line6758	Note: GRADE DOES NOT PERMIT - CREDIT DUE - PER SITING DATED AUGUST 2, 2016
9Jun16 / 23Sep16	
Inv.554	1 - EXTERIOR-BACK YARD: INSTALL BACK DOOR- GARAGE TO EXTERIOR- AS PER PLAN AND GRADE PERMITTING
Line6766	Note: GRADE DOES NOT PERMIT - CREDIT DUE - PER SITING DATED AUGUST 2, 2016
9Jun16 / 23Sep16	

**FRAMING**

Inv.554	1 - GARAGE: INSTALL MANDOOR - GARAGE TO HOUSE- AS PER PLAN AND GRADE PERMITTING
Line6757	Note: GIVEN IN AGREEMENT OF PURCHASE AND SALE
9Jun16 / 23Sep16 GRADE DOES NOT PERMIT - NO CREDIT DUE	
Inv.554	1 - FAMILY ROOM: INSTALL OPTIONAL COFFERED CEILING - FAMILY ROOM (PER ROOM AS PER PLAN)
Line6760	Note:
9Jun16 / 23Sep16	

**Brampton Encore - 66 - 1 - 41-5 Elev.B BRAHMS OPT - GFA1**

Inv.554	1 - MASTER ENSUITE: INSTALL SHOWER STALL SEAT IN MASTER ENSUITE SHOWER STALL
Line6761	Note:
9Jun16 / 23Sep16	
Inv.554	1 - ENSUITE 2 (BED #4): INSTALL SHOWER IN LIEU OF TUB- INCLUDES FRAMED GLASS SHOWER ENCLOSURE- TO GO IN ENSUITE #2, OFF BED #4
Line6762	Note:
9Jun16 / 23Sep16	
Inv.554	1 - MAIN FLOOR: INSTALL FIVE (X5) STANDARD DOORS EXTENDED HEIGHT 96" (PRICE PER DOOR) MAIN FLOOR 3 STOREY MODELS - INCLUDE FRAMING NOTE. FOR CLOSETS, POWDER ROOM, AND PANTRY. SEE SKETCH
Line11874	Note:
9Jun16 / 23Sep16	
Inv.554	1 - MAIN FLOOR - DEN: INSTALL TWO (X2) STANDARD FRENCH DOORS EXTENDED HEIGHT 96" (PRICE PER DOOR) MAIN FLOOR 3 STOREY MODELS - TO GO IN DEN. SEE SKETCH
Line11875	Note:
9Jun16 / 23Sep16	

**GARAGE DOORS**

Inv.554	2 - GARAGE: INSTALL INSULATION KIT - STANDARD GARAGE DOORS - EACH HOUSE REQUIRES 2 INSULATION KITS- PER DOOR PRICE
Line6763	Note:
9Jun16 / 23Sep16	

**HVAC**

Inv.554	1 - GAS LINE ROUGH - MAIN FLOOR - (3 STOREY MODELS) FOR STOVE
Line6771	Note:
9Jun16 / 23Sep16	
Inv.554	1 - TANKLESS HWT CONNECTION - HWT ON RENTAL BASIS / TANK NOT INCLUDED
Line6772	Note:
9Jun16 / 23Sep16	

**INTERIOR TRIM AND DOORS**

Inv.554	5 - MAIN FLOOR: INSTALL FIVE (X5) STANDARD DOORS EXTENDED HEIGHT 96" (PRICE PER DOOR) MAIN FLOOR 3 STOREY MODELS - INCLUDE FRAMING NOTE. FOR CLOSETS, POWDER ROOM, AND PANTRY. SEE SKETCH
Line6773	Note:
9Jun16 / 23Sep16	
Inv.554	2 - MAIN FLOOR - DEN: INSTALL TWO (X2) STANDARD FRENCH DOORS EXTENDED HEIGHT 96" (PRICE PER DOOR) MAIN FLOOR 3 STOREY MODELS - TO GO IN DEN. SEE SKETCH
Line6774	Note:
9Jun16 / 23Sep16	

**KITCHEN AND BATH CABINETRY**

Inv.554	1 - KITCHEN: INSTALL KITCHEN CABINET STRIP VALANCE LIGHTS (UNDER CABINETS) - ROUGH - IN - DOES NOT INCLUDE (AND REQUIRES) KITCHEN UPGRADE PRICING
Line11870	Note:
9Jun16 / 23Sep16	

Brampton Encore - 66 - 1 - 41-5 Elev.B BRAHMS OPT - GFA1

Inv.1,110	1 - KITCHEN CABINETRY: NOTE: ELECTRICAL WAS PURCHASED FOR A BUILT-IN WALL OVEN/ MICROWAVE UNIT, HOWEVER, CABINETRY EXTRAS WERE NOT PURCHASED. ELECTRICAL WILL BE INSTALLED AND ACCESSIBLE IN STANDARD CABINETS.
Line16213	Note:
18Jan17 / 28Feb17	
Inv.1,110	1 - KITCHEN CABINETRY- VALANCE: ROUGH-IN ONLY NOTE: ELECTRICAL WAS PURCHASED FOR A UNDER CABINET LIGHT VALANCE, HOWEVER, CABINETRY EXTRAS WERE NOT PURCHASED. ELECTRICAL WILL BE INSTALLED AND ACCESSIBLE UNDER STANDARD CABINETS.
Line16214	Note:
18Jan17 / 28Feb17	

MISC.

Inv.554	1 - BONUS PACKAGE: \$15,000.00 (INCLUDING TAXES) WORTH OF UPGRADES FROM GOLD PARK HOMES DÉCOR CENTRE IS BEING APPLIED TOWARD THE STRUCTURAL APPOINTMENT. PURCHASER HAS A REMAINING AMOUNT OF \$00 (INCLUDING TAXES) TO BE USED TOWARD THE COLOUR APPOINTMENT
Line6779	Note:
9Jun16 / 23Sep16	
Inv.554	1 - Purchaser has attended a Structural appointment at the Decor Centre & has DECLINED any additional upgrades and accepts and acknowledges that there will be no further structural changes/additions/deletions to be made upon signing on June 9, 2016
Line6780	Note:
9Jun16 / 23Sep16	
Inv.554	1 - Purchasers are aware & accepts that ANY changes made to upgrades after signing this Purchasers Extra Form are subject to a minimum administration fee of \$500. PLUS a 10% holdback fee
Line6781	Note:
9Jun16 / 23Sep16	
Inv.554	1 - MODEL IS 41.5 ELEVATION B AND PURCHASED WITH THE OPTIONAL GROUND FLOOR
Line11869	Note:
9Jun16 / 23Sep16	
Inv.855	2 - CREDIT TO PURCHASER AS SIDE DOOR NOT AVAILABLE PER GRADE AND ALSO REAR DOOR NOT AVAILABLE PER GRADE
Line11877	Note:
23Sep16 / 28Feb17	
Inv.1,110	1 - Purchaser has attended a Colour appointment at the Decor Centre & has DECLINED any additional upgrades and accepts and acknowledges that there will be no further structural changes/additions/deletions to be made upon signing on January 18, 2017
Line16232	Note:
18Jan17 / 28Feb17	
Inv.1,110	1 - Purchasers are aware & accepts that ANY changes made to upgrades after signing this Purchasers Extra Form are subject to a minimum administration fee of \$500. PLUS a 10% holdback fee
Line16233	Note:
18Jan17 / 28Feb17	

PLUMBING

Inv.554	1 - MASTER ENSUITE: INSTALL ROUGH-IN FOR RAINSHOWER HEAD- SHOWER HEAD NOT INCLUDED AND MUST BE PURCHASED AT THE TIME OF COLOURS
Line6776	Note:
9Jun16 / 23Sep16	
Inv.554	1 - KITCHEN: INSTALL ROUGH-IN - WATERLINE FOR FRIDGE
Line6777	Note:
9Jun16 / 23Sep16	

Brampton Encore - 66 - 1 - 41-5 Elev.B BRAHMS OPT - GFA1

Inv.554	2 - GARAGE/EXTERIOR: INSTALL TWO (X2) HOSE BIBS - STANDARD TO UPGRADED WITH HOT AND COLD WATER VALVE
Line6778	TO GO IN GARAGE AND BACK YARD, AS PER PLAN
	Note:
9Jun16 / 23Sep16	
Inv.554	1 - MASTER ENSUITE: INSTALL WATER SERVICE - INCREASE WATER SERVICE TO 3/4" IN MASTER ENSUITE
Line6782	
	Note:
9Jun16 / 23Sep16	
Inv.554	1 - ROUGH-IN - 3PC BASEMENT ROUGH-IN
Line6783	
	Note:
9Jun16 / 23Sep16	
Inv.554	1 - ENSUITE #2 (BED #4) : INSTALL WATER SERVICE - INCREASE WATER SERVICE TO 3/4" IN ENSUITE #2, OFF BED #4
Line6784	
	Note:
9Jun16 / 23Sep16	
Inv.1,110	1 - MASTER ENSUITE:
	*INSTALL RAIN SHOWER HEAD WITH EXTENDED ARM:
	RAINCAN, 8" WIDE #RP70172
	6" CEILING MOUNT ARM #RP61058
Line16231	
	Note:
18Jan17 / 28Feb17	

WINDOWS - BASEMENT

Inv.554	3 - BASEMENT: INSTALL THREE (X3) BASEMENT WINDOWS - UPGRADE EXISTING BASEMENT WINDOW TO 46 INCH X 32 INCH - MAY REQUIRE INSTALLATION OF WINDOW WELL. TO BE APPROVED BY CONSTRUCTION
Line6770	
	Note:
9Jun16 / 23Sep16	

Scheduled Closing Date: November-15-16

Purchaser: SARBJIT KAUR BRAR

Property: 66 of Plan -

Telephone Res. / Bus: (905) 488-8436

Project: Fieldwalk Investments Inc.

Decor Advisor: Terri Parisani

Model and Elevation: 41-5 Elev.B BRAHMS OPT - GFA1

Layout Changes: ☐ Yes ☒ NoSketch Attached: ☒ Yes ☐ NoExterior Colour Scheme: 

## 1. Cabinetry

	Style and Colour	Counter	Hardware
Kitchen / Breakfast	Carrara(pvc)WhiteCrysta	Grigio Sardo Granite Edge: FE20	cs1-24
Laundry Room	-		
Powder Room	-		
TWIN BATH	Carrara(pvc)WhiteCrysta	6697-46 Argento Romano Laminate	cs1-25
Master Ensuite Bathroom	Carrara(pvc)VanillaStix	4595K-52 Bahia Granite Laminate	cs1-22
Second Ensuite Bathroom (If Applicable)	Carrara(pvc)WhiteCrysta	4886-38 Pearl Soapstone Laminate	cs1-10
NANNY ENSUITE	Carrara(pvc)WhiteCrysta	4589K-07 Smokey Topez Laminate	cs1-10
Dishwasher Cabinet	-		

## Comment

GROUND FLOOR BAR: CABINET: Carrara(pvc)WhiteCrystal COUNTER: 4589K-07 Smokey Topez Laminate HARDWARE:cs1-10

## 2. Floor Tile

	Selection	Grout	Threshold
Entrance Vestibule	*Upg. 5 CarraraX Series White Polished24x24	N/A	N/A
Main Hall	-		
Kitchen / Breakfast	*Upg. 5 CarraraX Series White Polished24x24	N/A	N/A
Laundry Room	*Upg. 1 New Byzantine Azzuro 13 x 13	N/A	N/A
Powder Room	*Upg. 5 CarraraX Series White Polished24x24	N/A	N/A
TWIN BATH	*Upg.4 Shell Regal White Polished 12 x 24	N/A	N/A
Master Ensuite Bathroom	*Upg.4 Regal Shell White Polished 12 x 12	N/A	N/A
Second Ensuite Bathroom (If Applicable)	*Upg.4 CarraraX Series White Polished12x24	N/A	N/A
Lower Landing (If Applicable)	-	N/A	N/A
NANNY ENSUITE	*Upg.2 New Byzantine Azzuro 12 x 24	N/A	N/A

## Comment

GROUND FLOOR HALL: \*Upg. 5 CarraraX Series White Polished24x24

NOTE: PLEASE TILE UNDER KITCHEN CABINETS

## 3. Wall Tile

	Selection	Listello/Inserts	Describe
TWIN BATH	*Shell Regal White Polished12x24	<input type="radio"/> Yes <input checked="" type="radio"/> No	
Master Ensuite Bathroom			
Tub Deck	-	<input type="radio"/> Yes <input checked="" type="radio"/> No	
Shower Stall	*Upg3 Niagara Falls Ivory 12x24	<input type="radio"/> Yes <input checked="" type="radio"/> No	
Bathroom Walls	-	<input type="radio"/> Yes <input checked="" type="radio"/> No	
Second Ensuite Bathroom (If Applicable)	*CarraraXSeries WhitePolished12x24	<input type="radio"/> Yes <input checked="" type="radio"/> No	
NANNY ENSUITE	Weave White 8 x 10	<input type="radio"/> Yes <input checked="" type="radio"/> No	

Kitchen Backsplash ☐ Yes ☒ NoBacksplash Behind Fridge 

## Comment

Purchaser: SARBJIT KAUR BRAR

Property: 66 of Plan -

Telephone Res. / Bus: (905) 488-8436

Project: Fieldwalk Investments Inc.

Decor Advisor: Terri Parisani

Model and Elevation: 41-5 Elev.B BRAHMS OPT - GFA1

4. Plumbing Fixtures

<input type="checkbox"/>	Second Ensuite	<input type="checkbox"/>	Powder Room	<input type="checkbox"/>	
Master Ensuite Bathroom	<input type="checkbox"/>	Other Room - Specify	<input type="checkbox"/>	Other Washroom	<input type="checkbox"/>
Comment					

PLUMBING TO REMAIN STANDARD THROUGHOUT.  
\*\*MASTER ENSUITE SHOWER HEAD AND ARM IS UPGRADED. SEE INVOICE

5. Hardwood Flooring

	Type and Stain		Type and Stain
Main Hall	STD. PREVERCO, NATURAL	Upper Landing	STD. PREVERCO, NATURAL
Kitchen / Breakfast	<input type="text"/>	Upper Hall	<input type="text"/>
Living Room	STD. PREVERCO, NATURAL	Master Bedroom	<input type="text"/>
Dining Room	STD. PREVERCO, NATURAL	Bedroom #2	<input type="text"/>
Family Room	STD. PREVERCO, NATURAL	Bedroom #3	<input type="text"/>
Den/Library	STD. PREVERCO, NATURAL	Bedroom #4	<input type="text"/>
Entrance Vestibule	<input type="text"/>	Bedroom #5	<input type="text"/>
Lower Landing (If Applicable)	<input type="text"/>	Other Room - Specify	<input type="text"/>

Comment  
ALL HARDWOOD IS RED OAK

6. Carpeting

	Upgrade	Description
Main Hall	<input type="checkbox"/>	<input type="text"/>
Living Room	<input type="checkbox"/>	<input type="text"/>
Dining Room	<input type="checkbox"/>	<input type="text"/>
Family Room	<input type="checkbox"/>	<input type="text"/>
Den/Library	<input type="checkbox"/>	<input type="text"/>
Upper Hall	<input type="checkbox"/>	*Upg.1 Cityview Berber #721 Creamer
Master Bedroom	<input type="checkbox"/>	*Upg.1 Cityview Berber #721 Creamer
Bedroom #2	<input type="checkbox"/>	*Upg.1 Cityview Berber #721 Creamer
Bedroom #3	<input type="checkbox"/>	*Upg.1 Cityview Berber #721 Creamer
Bedroom #4	<input type="checkbox"/>	*Upg.1 Cityview Berber #721 Creamer
Bedroom #5	<input type="checkbox"/>	<input type="text"/>
Entire Ground Floor	<input type="checkbox"/>	STANDARD T-15 (INCLUDES NANNY BEDROOM)
Upper Landing (If Applicable)	<input type="checkbox"/>	<input type="text"/>
Lower Landing (If Applicable)	<input type="checkbox"/>	<input type="text"/>

Upgrade Underpad	Type STANDARD	Area <input type="text"/>
Carpet on Stairs	Capped <input type="text"/>	Runner - *Upgrade <input type="text"/>

Comment  
\* UPGRADE CARPET THROUGHOUT UPSTAIRS HALL AND BEDROOMS.  
\*STANDARD CARPET ON GROUND FLOOR LEVEL, IN ALL NON-TILED AREAS



Purchaser: SARBJIT KAUR BRAR

Property: 66 of Plan -

Telephone Res. / Bus: (905) 488-8436

Project: Fieldwalk Investments Inc.

Decor Advisor: Terri Parisani

Model and Elevation: 41-5 Elev.B BRAHMS OPT - GFA1

7. Fireplace

	Living Room			Family Room			Other Room - Specify		
	Purchased	As Per Plan	N/A	Purchased	As Per Plan	N/A	Purchased	As Per Plan	N/A
Fireplace Type	<input type="radio"/>	<input type="radio"/>	<input checked="" type="radio"/>	<input type="radio"/>	<input checked="" type="radio"/>	<input type="radio"/>	<input type="radio"/>	<input type="radio"/>	<input checked="" type="radio"/>
Mantle Type				STANDARD					
Colour / Stain				NF-20					
Surround				WHITE PAINT-GRADE					
Hearth				BIANCO CARRARA					
Comment				NONE					
<div></div>									

8. Trim Carpentry

Interior Doors	STANDARD	Front Door Glass Inserts	STANDARD	Door Handles	STANDARD
Interior Trim	STANDARD				
Comment	<div></div>				

9. Plaster Mouldings and Medallions

Entrance Vestibule	N/A		Kitchen/Breakfast	N/A	
Main Hall	N/A		Den/Library	N/A	
Living Room	N/A		Lower Landing	N/A	
Dining Room	N/A		Other Room - Specify	N/A	
Family Room	N/A				
Comment	<div></div>				

10. Railings and Spindles

Railing Package	STANDARD		
Railing Colour	NATURAL, RED OAK	Spindle Colour	NATURAL, RED OAK
Stringer / Riser	NATURAL, RED OAK	Treads	NATURAL, RED OAK
Comment	<div></div>		Oak Stairs <input checked="" type="radio"/> Yes <input type="radio"/> No

11. Wall Paint

Main & Upper Hall	COOL WHITE	Master Bedroom	COOL WHITE
Living Room	COOL WHITE	Bedroom #2	COOL WHITE
Dining Room	COOL WHITE	Bedroom #3	COOL WHITE
Kitchen / Breakfast	COOL WHITE	Bedroom #4	COOL WHITE
Family Room	COOL WHITE	Bedroom #5	
Powder Room	COOL WHITE	Master Ensuite	COOL WHITE
Laundry Room	COOL WHITE	TWIN BATH	COOL WHITE
Den/Library	COOL WHITE	Second Ensuite	COOL WHITE
Trim Paint	WHITE	GROUND FLOOR	COOL WHITE
Comment	Smooth Ceilings First Floor		<div></div>

Scheduled Closing Date: November-15-16

Purchaser: SARBJIT KAUR BRAR

Property: 66 of Plan -

Telephone Res. / Bus: (905) 488-8436

Project: Fieldwalk Investments Inc.

Decor Advisor: Terri Parisani

Model and Elevation: 41-5 Elev.B BRAHMS OPT - GFA1

12. Electrical

Plugs and Switches

☒ White ☐ Ivory

Hood Fan

☐ White ☐ Ivory

Appliances

Built in Cooktop

☐ Yes ☒ No

Built in Oven

☐ Yes ☒ No

Gas Stove

☒ Yes ☐ No

Microwave

☐ Yes ☒ No

Above Kitchen Cabinet Light

☐ Yes ☒ No

Below Kitchen Cabinet Light

☒ Yes ☐ No

Comment

\*NOTE: PURCHASER IS NOT PURCHASING CABINETRY TO ACCOMODATE THE ELECTRICAL THAT WAS PURCHASED AT THE STRUCTURAL APPOINTMENT. SEE INVOICE

13. Heating and Air Conditioning

Air Conditioning

Gas Provisions Dryer

Gas Provisions Stove

Gas Provisions Barbecue

Comment

GAS LINE FOR STOVE PURCHASED  
GAS LINE FOR BBQ IS STANDARD

14. Additional Comments

15. Disclaimers and Notes

- 1) Colours of all materials are as close as possible to builder's selection, but not necessarily identical due to variances in manufacturing.
- 2) Any extras listed above are null and void unless accompanied by a separate invoice/amendment. Said invoice must be paid in full.
- 3) The Purchaser acknowledges that after Interior Colour Selection form is signed and dated, no further changes will be permitted other than re-selection due to unavailability. Purchaser's Initials
- 4) The Purchaser acknowledges reading and accepting the "Gold Park Homes Decor Centre Disclaimers" form. This document contains other miscellaneous disclaimers.

This Interior Colour Selection is final and approved by:

Signature: Sarbjit Brar Date: Jan 18, 2017

# The Brahms

## 41' SERIES

Elevation A • 4,038 sq.ft. | Elevation B • 4,038 sq.ft.

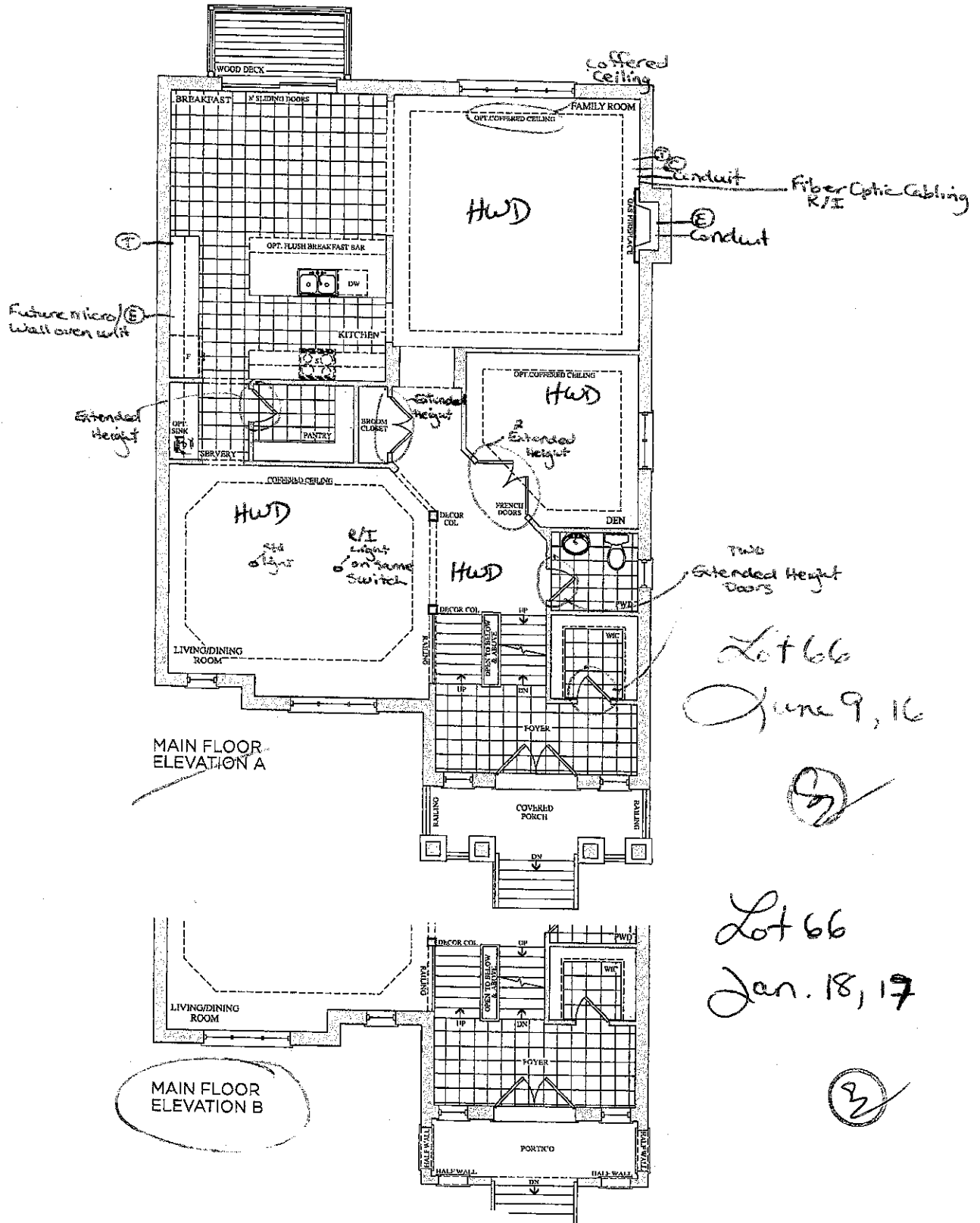

Prices, figures, illustrations, sizes, features and finishes are subject to change without notice. E.&O.E. Areas and dimensions are approximate and actual usable floor space may vary from the stated area. Layout may be reverse of the unit purchased. E. & O.E.

**GOLD PARK**  
HOMES

2nd Floor  
• Smooth Ceilings

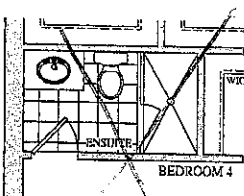
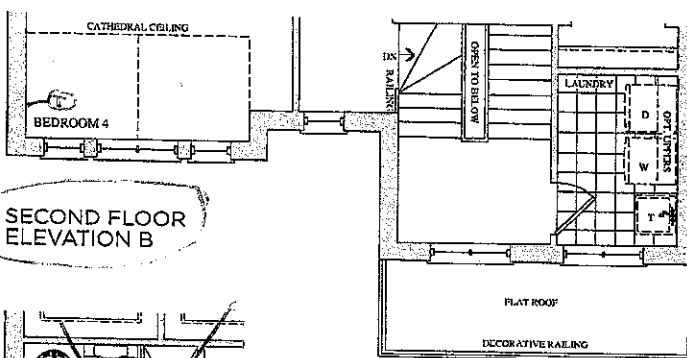
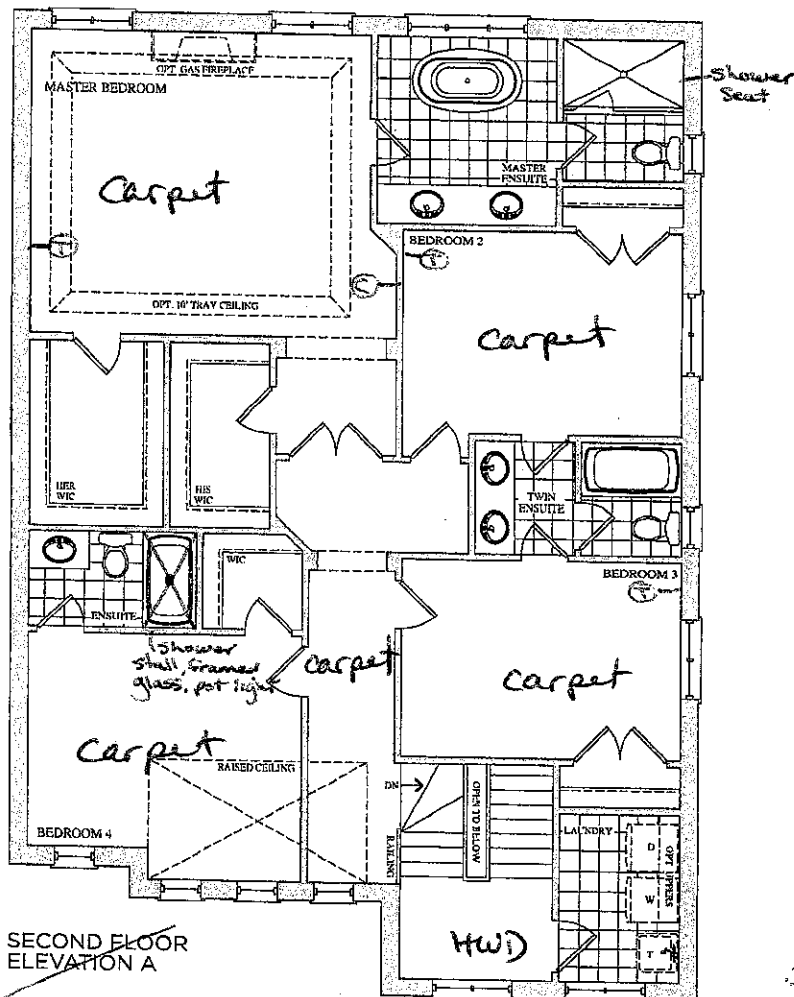

Lot 66  
June 9, 16

(5.2)

Lot 66  
Jan 18, 17

(2)

Telephone — (T)  
Cable — (C)

The  
Brahms  
41' SERIES

Elevation A • 4,038 sq.ft. | Elevation B • 4,038 sq.ft.

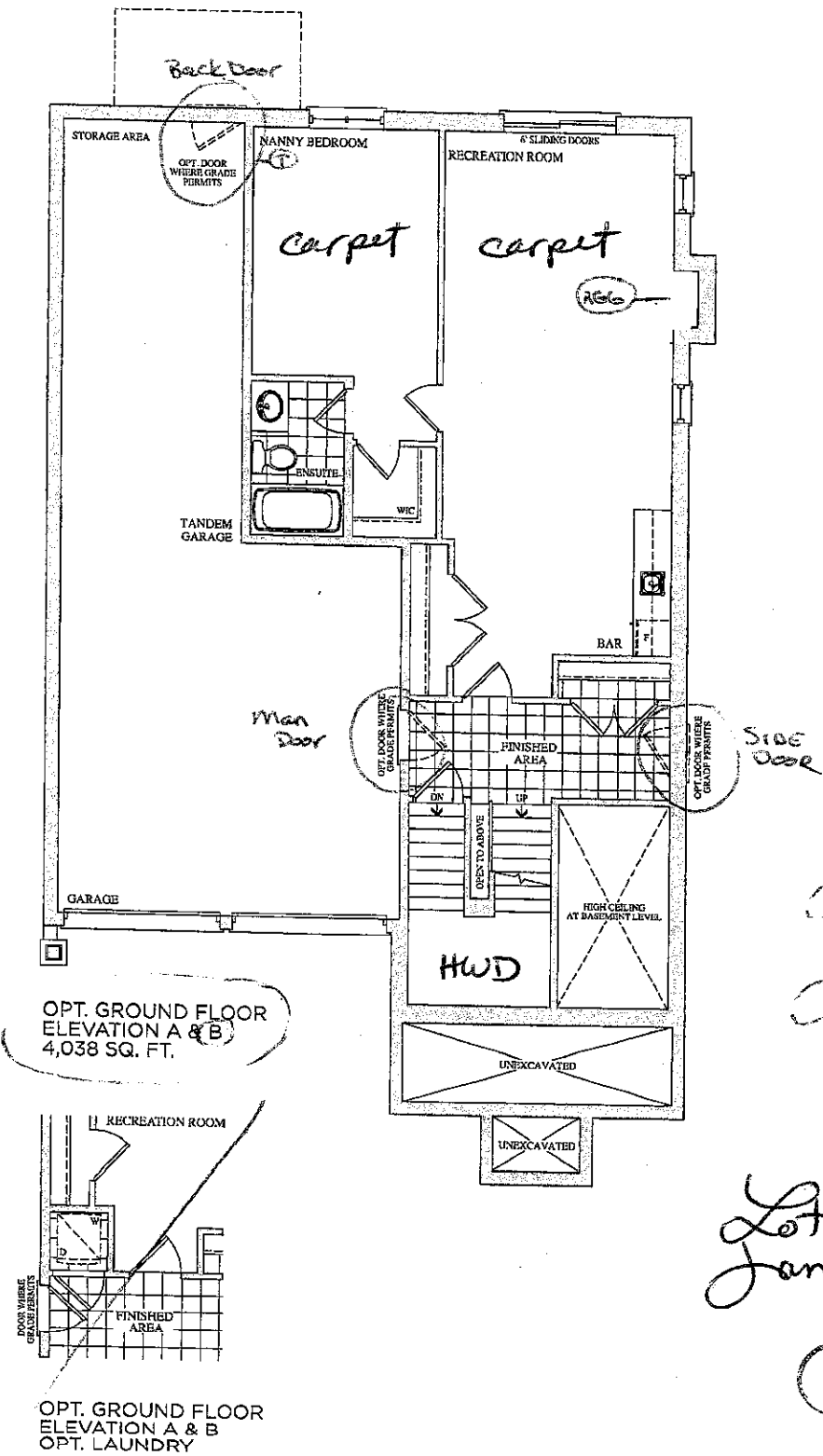

Prices, figures, illustrations, sizes, features and finishes are subject to change without notice. E & O.E. Areas and dimensions are approximate and actual usable floor space may vary from the stated area. Layout may be reverse of the unit purchased. E. & O.E.

# CORTINA

KITCHENS INC.

70 Regina Road Woodbridge ON L4L 8L6  
905-264-6464

902

## INFORMATION - PVC DOORS

Builder: Gold Park Homes Project: Encore Lot #: 66

All cabinets with PVC (Thermofoil) Doors come with melamine gables, panels and kick. The doors, crown moulding and light valance are PVC wrapped. Open shelves incorporated in design will only be available with melamine interiors. There will be variations in colour shades between the PVC parts (doors, crown and Light valance) and the melamine parts (open shelves, Gables, Panels and Kick) due to the difference in material.

Furring Panel with crown moulding to the ceiling is not available on all PVC door styles due to subtle variations in colour shades between the PVC parts (moulding) and the melamine parts (furring panel) due to the difference in material. Grain directions in wood grain pattern melamine, vary between the furring panel, crown moulding (horizontal) and the PVC doors (vertical).

Thank you for your understanding.

---

I am well informed of this information, and agree to the purchase of the above.

Purchaser: Sergij Brar

Date: Jan 18, 2017



CSI-6

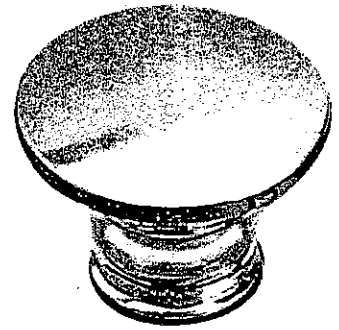

CSI-10

Ens. 2  
Nanny  
Bar

CSI-14

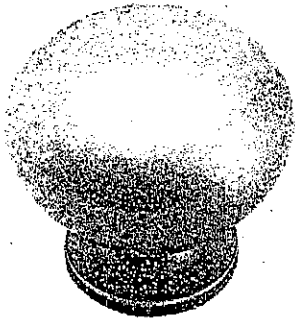

CSI-16

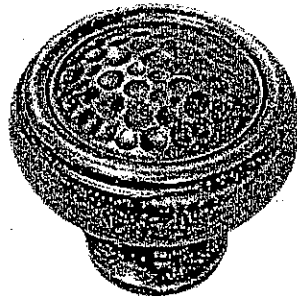

CSI-18

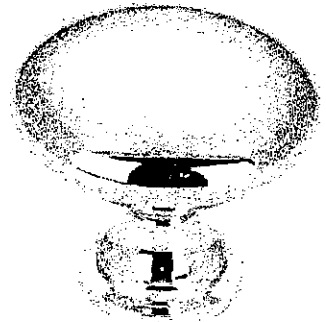

CSI-19

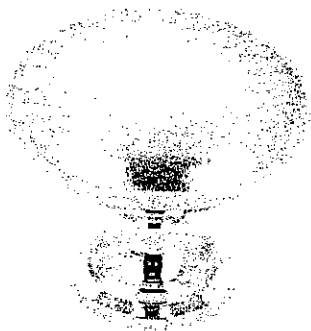

CSI-20

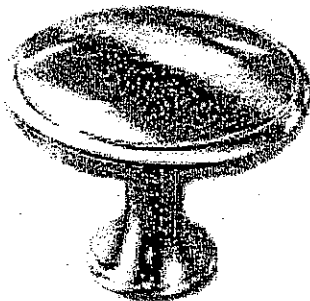

CSI-21



CSI-22

Master

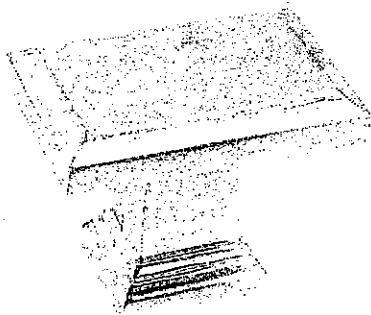

CSI-23

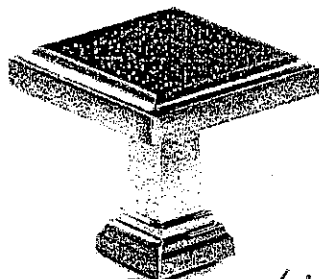

CSI-24

Kitchen

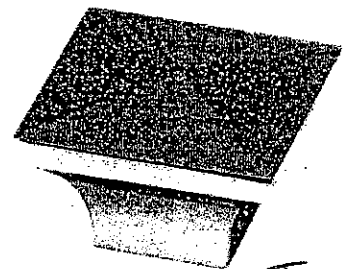

CSI-25

Twin

## \*NOTES:

- IMAGES ARE FOR QUICK REFERENCE PURPOSES ONLY
- ACTUAL SIZES AND FINISHES AS PER HARDWARE SAMPLE BOARD PROVIDED TO DECOR CENTRE

Lot 66  
Jan. 18, 17



**GOLDPARK**  
HOMES



Granite, Marble,  
Engineered Surfaces

- Standard 2CM & 3CM
- ◐ Upgrade 1 2CM & 3CM
- ◑ Upgrade 1 4 CM
- Upgrade 2

**20 mm (3/4") Profiles**

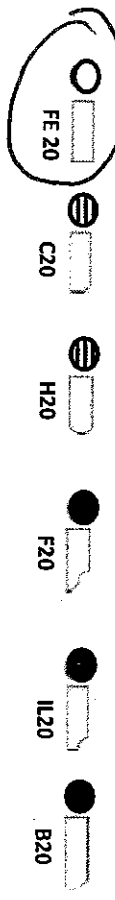

**30mm (1-1/4") Profiles**

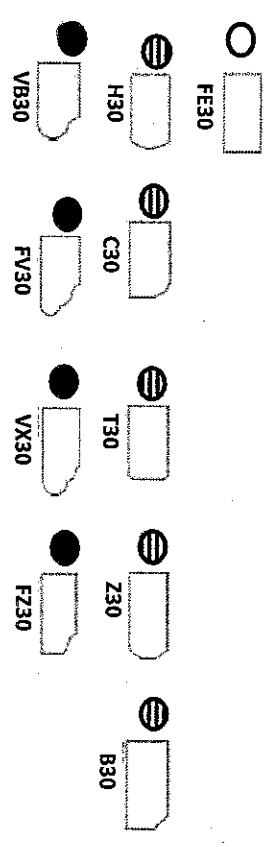

**40mm (1-1/2") Profiles**

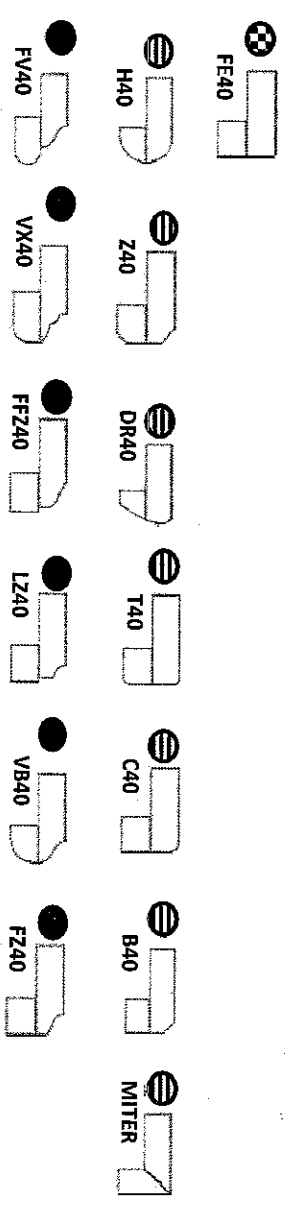

Note: All colours may not be available in 30mm at time ordered. Vendor reserves the right to use 40 mm edges (by lamination process).

\*Mitre edge is available in Upgrade 1 for an overall thickness of 2". All other Mitre edge options will be an Upgrade 2 Edge.



Trade Name: Gold Park Homes

Site location: Brampton

Model: 41-5

Address:

Project: Encore

Phase:

This layout has been explained to the purchaser by Cortina Kitchens Inc. and is understood by the purchaser.

## KITCHEN

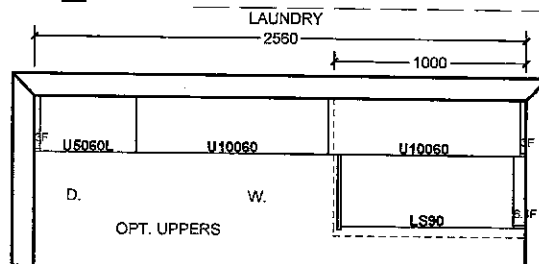
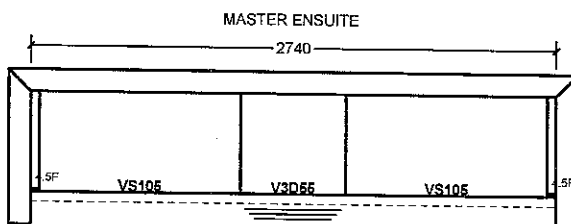
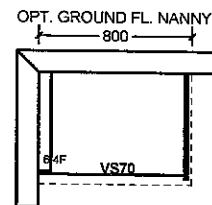
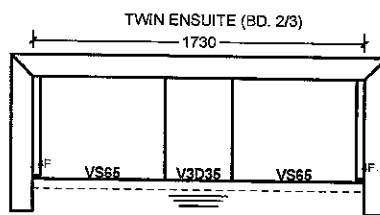
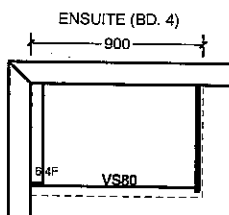
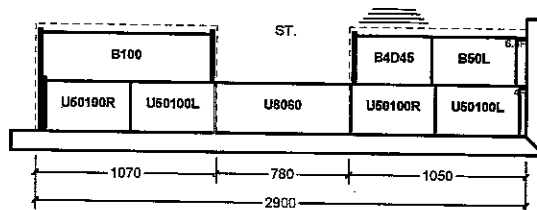
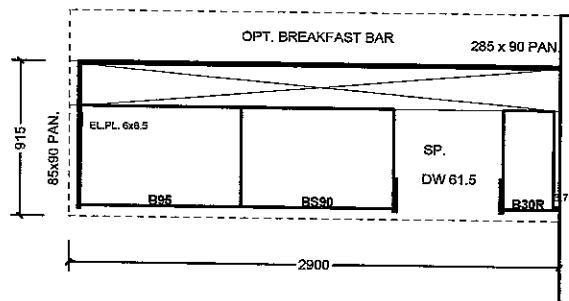
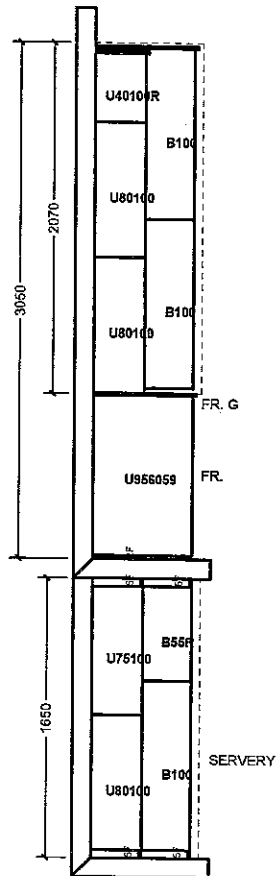

All prices subject to confirmation from head office.  
This quotation is subject to the terms & conditions set out

ACCEPTED DATE: \_\_\_\_\_

All agreements are contingent upon strikes, accidents, and delays beyond our control.  
Please provide our installer with template for sinkholes or \$150.00 will be charged for callback.

Item A: Wood grain and colour are characteristics of the product. We cannot guarantee that such grain and colour will always match.  
Item B: Cortina Kitchens Inc. reserves the right to alter dimensions and make technical changes without notice.

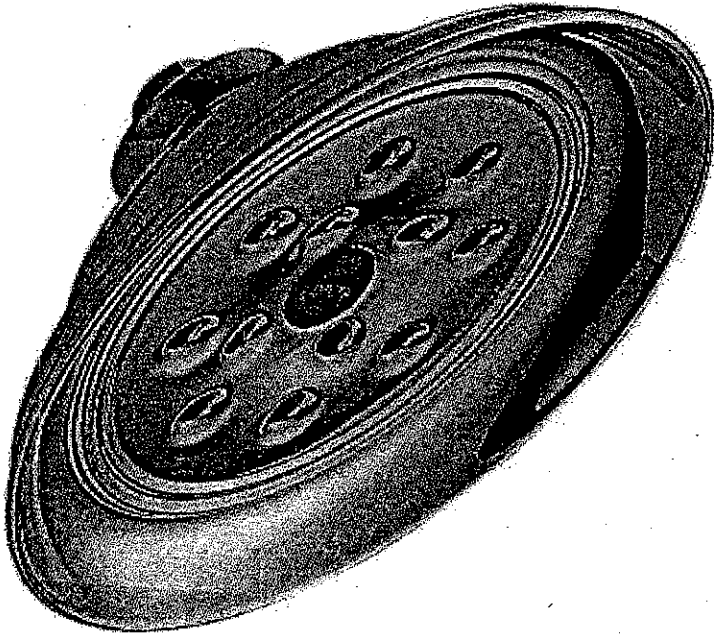

RainCan Head 8" - RP70172

Shower Head  
8" wide

\$ 175.00

+ 6" ceiling mount arm  
\$ 90.00

6" Ceiling mount arm - RP61058

Lot 66

Jan. 18, 17

