

Brampton Encore - 20 - 1 - 38-3 Elev.A HAYDN
CENTRAL VAC AND WIRING

Inv.546	1 - TELEPHONE AND CABLE ROUGH-IN LOCATIONS
Line6632	Note:
7Jun16 / 27Sep16	
Inv.546	1 - FAMILY ROOM: INSTALL CONDUIT PIPE- FOR TELEVISION- MUST SPECIFY LOCATION AND TERMINATION POINT, ABOVE FIREPLACE
Line6634	Note:
7Jun16 / 27Sep16	
Inv.546	1 - BEDROOM #2: INSTALL RG 6 ROUGH-IN IN BED #2. SEE SKETCH
Line6636	Note:
7Jun16 / 27Sep16	
Inv.546	1 - BEDROOM #3: INSTALL RG 6 ROUGH-IN IN BED #3. SEE SKETCH
Line6637	Note:
7Jun16 / 27Sep16	
Inv.546	1 - BEDROOM #4: INSTALL RG 6 ROUGH-IN IN BED #4. SEE SKETCH
Line6638	Note:
7Jun16 / 27Sep16	
Inv.546	1 - KITCHEN: INSTALL VAC PAN UNDER KITCHEN SINK
Line6639	Note:
7Jun16 / 27Sep16	

CERAMIC

Inv.1,142	1 - FOYER: INSTALL Floor Upgrade 4 Foyer Vestibule Floor
Line16887	Note:
30Jan17 / 24Feb17	
Inv.1,142	1 - POWDER ROOM: INSTALL Floor Upgrade 4 Powder Room Floor
Line16888	Note:
30Jan17 / 24Feb17	

ELECTRICAL

Inv.546	1 - FAMILY ROOM: INSTALL 110V WALL RECEPTACLE ON DEDICATED CIRCUIT -ABOVE FIREPLACE SEE SKETCH
Line6635	Note:
7Jun16 / 27Sep16	
Inv.546	1 - KITCHEN: INSTALL KITCHEN CABINET STRIP VALANCE LIGHTS (UNDER CABINETS) - ROUGH - IN - DOES NOT INCLUDE (AND REQUIRES) KITCHEN UPGRADE PRICING
Line6640	Note:
7Jun16 / 27Sep16	
Inv.1,142	1 - KITCHEN: DELETE UPPER CABINETS ABOVE STOVE. PURCHASER TO SUPPLY THEIR OWN FAN AFTER CLOSING
Line18130	Note:
30Jan17 / 24Feb17	

EXTERIOR COLOURS

Inv.546	1 - EXTERIOR COLOUR PACKAGE 7
Line12039	Note:
7Jun16 / 27Sep16	

FORMING

Brampton Encore - 20 - 1 - 38-3 Elev.A HAYDN

Inv.546	1 - EXTERIOR: INSTALL SIDE DOOR- HOME TO EXTERIOR- AS PER PLAN AND GRADE PERMITTING
Line6642	Note: GRADING DOES NOT PERMIT PER SITING DATED AUGUST 2, 2016 - CREDIT DUE TO PURCHASER
7Jun16 / 27Sep16	

FRAMING

Inv.546	1 - GARAGE: INSTALL MANDOOR - GARAGE TO HOUSE- AS PER PLAN AND GRADE PERMITTING
Line6641	Note: GIVEN IN AGREEMENT OF PURCHASE AND SALE
7Jun16 / 27Sep16 GRADING PERMITS PER SITING DATED AUGUST 2, 2016	

GRANITE MARBLE QUARTZ

Inv.1,142	1 - KITCHEN: INSTALL 2 CM GRP 1 Optional Flush BBar
Line16882	Note:
30Jan17 / 24Feb17	

HVAC

Inv.546	1 - KITCHEN: INSTALL GAS LINE ROUGH - MAIN FLOOR FOR STOVE
Line6644	Note:
7Jun16 / 27Sep16	
Inv.546	1 - BASEMENT: INSTALL TANKLESS HWT CONNECTION - HWT ON RENTAL BASIS / TANK NOT INCLUDED
Line6645	Note:
7Jun16 / 27Sep16	

INTERIOR TRIM AND DOORS

Inv.1,142	1 - MAIN FLOOR: INSTALL BB & Casing Package 1 MAIN FLOOR ONLY
Line16886	Note: **NOTE: SECOND FLOOR TO REMAIN STANDARD
30Jan17 / 24Feb17	

KITCHEN AND BATH CABINETRY

Inv.546	1 - KITCHEN: INSTALL KITCHEN CABINET STRIP VALANCE LIGHTS (UNDER CABINETS) - ROUGH - IN - DOES NOT INCLUDE (AND REQUIRES) KITCHEN UPGRADE PRICING
Line12038	Note:
7Jun16 / 27Sep16	
Inv.1,142	1 - KITCHEN: INSTALL Oak PVC 87 Pot and Pan Drawers 2 deep drawers and one shallow top drawer 60 70 80 90 cm wide
Line16881	Note:
30Jan17 / 24Feb17	
Inv.1,142	1 - KITCHEN: INSTALL UPG 1 GRP III Opt Light Valance
Line16879	Note:
30Jan17 / 24Feb17	
Inv.1,142	1 - KITCHEN: DELETE UPPER CABINETS ABOVE STOVE. PURCHASER TO SUPPKY THEIR OWN FAN AFTER CLOSING
Line16880	Note:
30Jan17 / 24Feb17	
Inv.1,142	1 - KITCHEN: INSTALL Handles Kitchen
Line16883	Note:
30Jan17 / 24Feb17	

MISC.

Brampton Encore - 20 - 1 - 38-3 Elev.A HAYDN

Inv.546	1 - BONUS PACKAGE: \$7130.30 (INCLUDING TAXES) WORTH OF UPGRADES FROM GOLD PARK HOMES DÉCOR CENTRE IS BEING APPLIED TOWARD THE STRUCTURAL APPOINTMENT. PURCHASER HAS A REMAINING AMOUNT OF \$2869.70 (INCLUDING TAXES) TO BE USED TOWARD THE COLOUR APPOINTMENT
Line6648	Note:
7Jun16 / 27Sep16	
Inv.546	1 - Purchaser has attended a Structural appointment at the Decor Centre & has DECLINED any additional upgrades and accepts and acknowledges that there will be no further structural changes/additions/deletions to be made upon signing on June 7, 2016
Line6649	Note:
7Jun16 / 27Sep16	
Inv.546	1 - Purchasers are aware & accepts that ANY changes made to upgrades after signing this Purchasers Extra Form are subject to a minimum administration fee of \$500. PLUS a 10% holdback fee
Line6650	Note:
7Jun16 / 27Sep16	
Inv.1,142	1 - BONUS PACKAGE: \$2869.70 (INCLUDING TAXES) WORTH OF UPGRADES FROM GOLD PARK HOMES DÉCOR CENTRE IS BEING APPLIED TOWARD THE COLOUR APPOINTMENT
Line16889	Note:
30Jan17 / 24Feb17	
Inv.1,142	1 - Purchaser has attended a Colour appointment at the Decor Centre & has DECLINED any additional upgrades and accepts and acknowledges that there will be no further structural changes/additions/deletions to be made upon signing on January 30, 2017
Line16890	Note:
30Jan17 / 24Feb17	
Inv.1,142	1 - Purchasers are aware & accepts that ANY changes made to upgrades after signing this Purchasers Extra Form are subject to a minimum administration fee of \$500. PLUS a 10% holdback fee.
Line16891	Note:
30Jan17 / 24Feb17	

PLUMBING

Inv.546	1 - ROUGH-IN - WATERLINE FOR FIRDGE
Line6647	Note:
7Jun16 / 27Sep16	

STAIRS AND RAILINGS

Inv.1,142	1 - STAIRCASE: INSTALL 1 34 Inch LOTUS Non Fluted
Line16884	Note:
30Jan17 / 24Feb17	
Inv.1,142	1 - STAIRCASE: INSTALL V Groove Handrail
Line16885	Note:
30Jan17 / 24Feb17	

WINDOWS - BASEMENT

Inv.546	3 - BASEMENT: INSTALL THREE (X3) BASEMENT WINDOWS - UPGRADE EXISTING BASEMENT WINDOW TO 30 INCH X 16 INCH. SEE SKETCH
Line6643	Note: WINDOW AT ROUGH-IN LOCATION TO REMAIN STANDARD SIZE
7Jun16 / 27Sep16	

Scheduled Closing Date:

Purchasers:

KWABENA BREFO-MENSAH & ANN BREFO-MI

Property: 20 of Plan -

Telephone Res. / Bus:

(905) 846-2380 / (647) 381-1244

Project: Fieldwalk Investments Inc.

Decor Advisor:

Terri Parisani

Model and Elevation: 38-3 Elev.A HAYDN

Layout Changes:

☒ Yes
 ☐ No

Sketch Attached:

☒ Yes
 ☐ No

Exterior Colour Scheme:

1. Cabinetry

Cabinetry	Style and Colour	Counter	Hardware
Kitchen / Breakfast	Carrara(pvc)VanillaStix	Crema Caramel Granite Edge: FE20	*CH-44
Laundry Room			
Powder Room			
TWIN BATH	Varese(pvc)Mystic	4595K-52 Bahia Granite Laminate	cs1-16
Master Ensuite Bathroom	Toscana(pvc)AntiqWhite	4595K-52 Bahia Granite Laminate	cs1-14
Second Ensuite Bathroom (If Applicable)	Toscana(pvc)AntiqWhite	1875K-52 Summer Carnival	cs1-22
Dishwasher Cabinet			
Comment			

2. Floor Tile

Room Title	Selection	Grout	Threshold
Entrance Vestibule	*Upg.4, Must Polished 12 x 24	N/A	N/A
Main Hall			
Kitchen / Breakfast	New Reeds Taupe 13 x 13	N/A	N/A
Laundry Room	New Reeds Silver 13 x 13	N/A	N/A
Powder Room	*Upg.4, Must Polished 12 x 24	N/A	N/A
TWIN BATH	Serpentine Syrak 13 x 13	N/A	N/A
Master Ensuite Bathroom	Serpentine Syrak 13 x 13	N/A	N/A
Second Ensuite Bathroom (If Applicable)	Reflex Taupe 13 x 13	N/A	N/A
Lower Landing (If Applicable)			
Comment			

3. Wall Tile

Wall Tile	Selection	Listello/inserts	Describe
TWIN BATH	<div>Venus Grey 8 x 10</div>	<div><input type="radio"/> Yes <input checked="" type="radio"/> No</div>	<div></div>
Master Ensuite Bathroom			
Tub Deck	<div>Venus Brown 8 x 10</div>	<div><input type="radio"/> Yes <input checked="" type="radio"/> No</div>	<div></div>
Shower Stall	<div>Venus Brown 8 x 10</div>	<div><input type="radio"/> Yes <input checked="" type="radio"/> No</div>	<div></div>
Bathroom Walls	<div>Venus Brown 8 x 10</div>	<div><input type="radio"/> Yes <input checked="" type="radio"/> No</div>	<div></div>
Second Ensuite Bathroom (If Applicable)	<div>Weave Ivory 8 x 10</div>	<div><input type="radio"/> Yes <input checked="" type="radio"/> No</div>	<div></div>
<div></div>	<div></div>	<div><input type="radio"/> Yes <input checked="" type="radio"/> No</div>	<div></div>
Kitchen Backsplash	<div><input type="radio"/> Yes <input checked="" type="radio"/> No</div>	Backsplash Behind Fridge	<div></div>
Comment	<div></div>		
<div></div>			

Scheduled Closing Date:

Purchasers: KWABENA BREFO-MENSAH & ANN BREFO-MI Property: 20 of Plan -

Telephone Res. / Bus: (905) 846-2380 / (647) 381-1244

Project: Fieldwalk Investments Inc.

Decor Advisor: Terri Parisani

Model and Elevation: 38-3 Elev.A HAYDN

4. Plumbing Fixtures

	<input type="text"/>	Second Ensuite	<input type="text"/>	Powder Room	<input type="text"/>
Master Ensuite Bathroom	<input type="text"/>	Other Room - Specify	<input type="text"/>	Other Washroom	<input type="text"/>

Comment

ALL FIXTURES TO REMAIN AS STANDARD THROUGHOUT

5. Hardwood Flooring

	Type and Stain		Type and Stain
Main Hall	<input type="text" value="STD. NATURAL PREVERCO"/>	Upper Landing	<input type="text" value="STD. NATURAL PREVERCO"/>
Kitchen / Breakfast	<input type="text"/>	Upper Hall	<input type="text"/>
Living Room	<input type="text"/>	Master Bedroom	<input type="text"/>
Dining Room	<input type="text" value="STD. NATURAL PREVERCO"/>	Bedroom #2	<input type="text"/>
Family Room	<input type="text" value="STD. NATURAL PREVERCO"/>	Bedroom #3	<input type="text"/>
Den/Library	<input type="text"/>	Bedroom #4	<input type="text"/>
Entrance Vestibule	<input type="text"/>	Bedroom #5	<input type="text"/>
Lower Landing (If Applicable)	<input type="text"/>	Other Room - Specify	<input type="text"/>

Comment

6. Carpeting

	Upgrade	Description
Main Hall	<input type="checkbox"/>	<input type="text"/>
Living Room	<input type="checkbox"/>	<input type="text"/>
Dining Room	<input type="checkbox"/>	<input type="text"/>
Family Room	<input type="checkbox"/>	<input type="text"/>
Den/Library	<input type="checkbox"/>	<input type="text"/>
Upper Hall	<input type="checkbox"/>	<input type="text" value="T-15"/>
Master Bedroom	<input type="checkbox"/>	<input type="text" value="T-15"/>
Bedroom #2	<input type="checkbox"/>	<input type="text" value="T-15"/>
Bedroom #3	<input type="checkbox"/>	<input type="text" value="T-15"/>
Bedroom #4	<input type="checkbox"/>	<input type="text" value="T-15"/>
Bedroom #5	<input type="checkbox"/>	<input type="text"/>
<input type="text"/>	<input type="checkbox"/>	<input type="text"/>
Upper Landing (If Applicable)	<input type="checkbox"/>	<input type="text"/>
Lower Landing (If Applicable)	<input type="checkbox"/>	<input type="text"/>

Upgrade Underpad	Type <input type="text" value="STANDARD"/>	Area <input type="text"/>
Carpet on Stairs	Capped <input type="text"/>	Runner - *Upgrade <input type="text"/>

Comment

Scheduled Closing Date:

Purchasers: KWABENA BREFO-MENSAH & ANN BREFO-MI
Telephone Res. / Bus: (905) 846-2380 / (647) 381-1244
Decor Advisor: Terri Parisani

Property: 20 of Plan -
Project: Fieldwalk Investments Inc.
Model and Elevation: 38-3 Elev.A HAYDN

7. Fireplace

	Living Room			Family Room			Other Room - Specify		
	Purchased	As Per Plan	N/A	Purchased	As Per Plan	N/A	Purchased	As Per Plan	N/A
	<input type="radio"/>	<input type="radio"/>	<input checked="" type="radio"/>	<input type="radio"/>	<input checked="" type="radio"/>	<input type="radio"/>	<input type="radio"/>	<input type="radio"/>	<input checked="" type="radio"/>
Fireplace Type				STANDARD					
Mantle Type				NF-23					
Colour / Stain				WHITE PAINT-GRADE					
Surround				PERLATO ROYALE					
Hearth				NONE					
Comment	<div></div>								

8. Trim Carpentry

Interior Doors	STANDARD	Front Door Glass Inserts	STANDARD	Door Handles	STANDARD
Interior Trim	1ST FLOOR: 1ST UPGRADE, 2ND FLOOR: STANDARD				
Comment	<div></div>				

9. Plaster Mouldings and Medallions

Entrance Vestibule	N/A		Kitchen/Breakfast	N/A	
Main Hall	N/A		Den/Library	N/A	
Living Room	N/A		Lower Landing	N/A	
Dining Room	N/A		Other Room - Specify		
Family Room	N/A				
Comment	<div></div>				

10. Railings and Spindles

Railing Package	LOTUS WITH V-GROOVE HANDRAIL		
Railing Colour	NATURAL RED OAK	Spindle Colour	NATURAL RED OAK
Stringer / Riser	NATURAL RED OAK	Treads	NATURAL RED OAK
Comment	Oak Stairs	<input checked="" type="radio"/> Yes <input type="radio"/> No	
<div></div>			

11. Wall Paint

Main & Upper Hall	WARM GREY	Master Bedroom	WARM GREY
Living Room	WARM GREY	Bedroom #2	WARM GREY
Dining Room	WARM GREY	Bedroom #3	WARM GREY
Kitchen / Breakfast	WARM GREY	Bedroom #4	WARM GREY
Family Room	WARM GREY	Bedroom #5	WARM GREY
Powder Room	WARM GREY	Master Ensuite	WARM GREY
Laundry Room	WARM GREY	TWIN BATH	WARM GREY
Den/Library	WARM GREY	Second Ensuite	WARM GREY
Trim Paint	WHITE		
Comment	Smooth Ceilings First Floor		
<div></div>			

Scheduled Closing Date:

Purchasers: KWABENA BREFO-MENSAH & ANN BREFO-MI Property: 20 of Plan -

Telephone Res. / Bus: (905) 846-2380 / (647) 381-1244

Project: Fieldwalk Investments Inc.

Decor Advisor: Terri Parisani

Model and Elevation: 38-3 Elev.A HAYDN

12. Electrical

Plugs and Switches ☒ White ☐ Ivory

Hood Fan ☐ White ☐ Ivory

Appliances Built in Cooktop

☐ Yes ☒ No

Built in Oven

☐ Yes ☒ No

Above Kitchen Cabinet Light ☐ Yes ☒ No

Below Kitchen Cabinet Light ☒ Yes ☐ No

Gas Stove

☐ Yes ☒ No

Microwave

☐ Yes ☒ No

Comment

DELETE STANDARD HOOD FAN.

13. Heating and Air Conditioning

Air Conditioning

Gas Provisions Stove

Gas Provisions Dryer

Gas Provisions Barbecue

Comment

GAS LINE FOR BBQ IS STANDARD

14. Additional Comments

15. Disclaimers and Notes

- 1) Colours of all materials are as close as possible to builder's selection, but not necessarily identical due to variances in manufacturing.
- 2) Any extras listed above are null and void unless accompanied by a separate invoice/amendment. Said invoice must be paid in full.
- 3) The Purchaser acknowledges that after Interior Colour Selection form is signed and dated, no further changes will be permitted other than re-selection due to unavailability. Purchaser's Initials
- 4) The Purchaser acknowledges reading and accepting the "Gold Park Homes Decor Centre Disclaimers" form. This document contains other miscellaneous disclaimers.

This Interior Colour Selection is final and approved by:

Signature:

Date: 30/01/2017

Signature:

Date: Jan 30/2017

Scheduled Closing Date:

Purchasers: KWABENA BREFO-MENSAH & ANN BREFO-MI Property: 20 of Plan -

Telephone Res. / Bus: (905) 846-2380 / (647) 381-1244

Project: Fieldwalk Investments Inc.

Decor Advisor: Terri Parisani

Model and Elevation: 38-3 Elev.A HAYDN

Layout Changes: ☒ Yes ☐ No Sketch Attached: ☒ Yes ☐ No Exterior Colour Scheme:

1. Cabinetry

	Style and Colour	Counter	Hardware
Kitchen / Breakfast	Carrara(pvc)VanillaStix	Crema Caramel Granite Edge: FE20	*CH-44
Laundry Room	<input type="text"/>	<input type="text"/>	<input type="text"/>
Powder Room	<input type="text"/>	<input type="text"/>	<input type="text"/>
TWIN BATH	Varese(pvc)Mystic	4595K-52 Bahia Granite Laminate	cs1-16
Master Ensuite Bathroom	Toscana(pvc)AntiqWhite	4595K-52 Bahia Granite Laminate	cs1-14
Second Ensuite Bathroom (If Applicable)	Toscana(pvc)AntiqWhite	1875K-52 Summer Carnival	cs1-22
<input type="text"/>	<input type="text"/>	<input type="text"/>	<input type="text"/>
Dishwasher Cabinet	<input type="text"/>		
Comment	<input type="text"/>		

2. Floor Tile

	Selection	Grout	Threshold
Entrance Vestibule	*Upg.4, Must Polished 12 x 24	N/A	N/A
Main Hall	<input type="text"/>	<input type="text"/>	<input type="text"/>
Kitchen / Breakfast	New Reeds Taupe 13 x 13	N/A	N/A
Laundry Room	New Reeds Silver 13 x 13	N/A	N/A
Powder Room	*Upg.4, Must Polished 12 x 24	N/A	N/A
TWIN BATH	Serpentine Syrak 13 x 13	N/A	N/A
Master Ensuite Bathroom	Serpentine Syrak 13 x 13	N/A	N/A
Second Ensuite Bathroom (If Applicable)	Reflex Taupe 13 x 13	N/A	N/A
Lower Landing (If Applicable)	<input type="text"/>	<input type="text"/>	<input type="text"/>
<input type="text"/>	<input type="text"/>	<input type="text"/>	<input type="text"/>
Comment	<input type="text"/>		

3. Wall Tile

	Selection	Listello/Inserts	Describe
TWIN BATH	Venus Grey 8 x 10	<input type="radio"/> Yes <input checked="" type="radio"/> No	<input type="text"/>
Master Ensuite Bathroom			
Tub Deck	Venus Brown 8 x 10	<input type="radio"/> Yes <input checked="" type="radio"/> No	<input type="text"/>
Shower Stall	Venus Brown 8 x 10	<input type="radio"/> Yes <input checked="" type="radio"/> No	<input type="text"/>
Bathroom Walls	Venus Brown 8 x 10	<input type="radio"/> Yes <input checked="" type="radio"/> No	<input type="text"/>
Second Ensuite Bathroom (If Applicable)	Weave Ivory 8 x 10	<input type="radio"/> Yes <input checked="" type="radio"/> No	<input type="text"/>
<input type="text"/>	<input type="text"/>	<input type="radio"/> Yes <input checked="" type="radio"/> No	<input type="text"/>
Kitchen Backsplash	<input type="radio"/> Yes <input checked="" type="radio"/> No	Backsplash Behind Fridge	<input type="text"/>
Comment	<input type="text"/>		

Scheduled Closing Date:

Purchasers: KWABENA BREFO-MENSAH & ANN BREFO-MI Property: 20 of Plan -

Telephone Res. / Bus: (905) 846-2380 / (647) 381-1244

Project: Fieldwalk Investments Inc.

Decor Advisor: Terri Parisani

Model and Elevation: 38-3 Elev.A HAYDN

4. Plumbing Fixtures

<input type="text"/>	Second Ensuite	<input type="text"/>	Powder Room	<input type="text"/>	
Master Ensuite Bathroom	<input type="text"/>	Other Room - Specify	<input type="text"/>	Other Washroom	<input type="text"/>

Comment

ALL FIXTURES TO REMAIN AS STANDARD THROUGHOUT

5. Hardwood Flooring

	Type and Stain		Type and Stain
Main Hall	STD. NATURAL PREVERCO	Upper Landing	STD. NATURAL PREVERCO
Kitchen / Breakfast	-	Upper Hall	-
Living Room	-	Master Bedroom	-
Dining Room	STD. NATURAL PREVERCO	Bedroom #2	-
Family Room	STD. NATURAL PREVERCO	Bedroom #3	-
Den/Library	-	Bedroom #4	-
Entrance Vestibule	-	Bedroom #5	-
Lower Landing (If Applicable)	-	Other Room - Specify	-

Comment

6. Carpeting

	Upgrade	Description
Main Hall	<input type="checkbox"/>	-
Living Room	<input type="checkbox"/>	-
Dining Room	<input type="checkbox"/>	-
Family Room	<input type="checkbox"/>	-
Den/Library	<input type="checkbox"/>	-
Upper Hall	<input type="checkbox"/>	T-15
Master Bedroom	<input type="checkbox"/>	T-15
Bedroom #2	<input type="checkbox"/>	T-15
Bedroom #3	<input type="checkbox"/>	T-15
Bedroom #4	<input type="checkbox"/>	T-15
Bedroom #5	<input type="checkbox"/>	-
<input type="text"/>	<input type="checkbox"/>	-
Upper Landing (If Applicable)	<input type="checkbox"/>	-
Lower Landing (If Applicable)	<input type="checkbox"/>	-

Upgrade Underpad	Type	Area
	STANDARD	<input type="text"/>
Carpet on Stairs	Capped	Runner - *Upgrade
	<input type="text"/>	<input type="text"/>

Comment

Scheduled Closing Date:

Purchasers: KWABENA BREFO-MENSAH & ANN BREFO-MI Property: 20 of Plan -

Telephone Res. / Bus: (905) 846-2380 / (647) 381-1244

Project: Fieldwalk Investments Inc.

Decor Advisor: Terri Parisani

Model and Elevation: 38-3 Elev.A HAYDN

7. Fireplace

Living Room

Purchased

As Per Plan

N/A

Family Room

Purchased

As Per Plan

N/A

Other Room - Specify

Purchased

As Per Plan

N/A

Fireplace Type

STANDARD

Mantle Type

NF-23

Colour / Stain

WHITE PAINT-GRADE

Surround

PERLATO ROYALE

Hearth

NONE

Comment

8. Trim Carpentry

Interior Doors STANDARD

Front Door Glass Inserts STANDARD

Door Handles STANDARD

Interior Trim 1ST FLOOR: 1ST UPGRADE, 2ND FLOOR: STANDARD

Comment

9. Plaster Mouldings and Medallions

Entrance Vestibule

N/A

Kitchen/Breakfast

N/A

Main Hall

N/A

Den/Library

N/A

Living Room

N/A

Lower Landing

N/A

Dining Room

N/A

Other Room - Specify

Family Room

N/A

Comment

10. Railings and Spindles

Railing Package LOTUS WITH V-GROOVE HANDRAIL

Railing Colour NATURAL RED OAK

Spindle Colour NATURAL RED OAK

Stringer / Riser NATURAL RED OAK

Treads NATURAL RED OAK

Comment

Oak Stairs Yes No

11. Wall Paint

Main & Upper Hall WARM GREY

Master Bedroom WARM GREY

Living Room WARM GREY

Bedroom #2 WARM GREY

Dining Room WARM GREY

Bedroom #3 WARM GREY

Kitchen / Breakfast WARM GREY

Bedroom #4 WARM GREY

Family Room WARM GREY

Bedroom #5 WARM GREY

Powder Room WARM GREY

Master Ensuite WARM GREY

Laundry Room WARM GREY

TWIN BATH WARM GREY

Den/Library WARM GREY

Second Ensuite WARM GREY

Trim Paint WHITE

Comment Smooth Ceilings First Floor

Scheduled Closing Date:

Purchasers: KWABENA BREFO-MENSAH & ANN BREFO-MI Property: 20 of Plan -

Telephone Res. / Bus: (905) 846-2380 / (647) 381-1244

Project: Fieldwalk Investments Inc.

Decor Advisor: Terri Parisani

Model and Elevation: 38-3 Elev.A HAYDN

12. Electrical

Plugs and Switches ☒ White ☐ Ivory

Hood Fan ☐ White ☐ Ivory

Appliances Built in Cooktop

☐ Yes ☒ No

Built in Oven

☐ Yes ☒ No

Gas Stove

☐ Yes ☒ No

Microwave

☐ Yes ☒ No

Above Kitchen Cabinet Light ☐ Yes ☒ No

Below Kitchen Cabinet Light ☒ Yes ☐ No

Comment

DELETE STANDARD HOOD FAN.

13. Heating and Air Conditioning

Air Conditioning

Gas Provisions Stove

Gas Provisions Dryer

Gas Provisions Barbecue

Comment

GAS LINE FOR BBQ IS STANDARD

14. Additional Comments

15. Disclaimers and Notes

- 1) Colours of all materials are as close as possible to builder's selection, but not necessarily identical due to variances in manufacturing.
- 2) Any extras listed above are null and void unless accompanied by a separate invoice/amendment. Said invoice must be paid in full.
- 3) The Purchaser acknowledges that after Interior Colour Selection form is signed and dated, no further changes will be permitted other than re-selection due to unavailability. _____ Purchaser's Initials
- 4) The Purchaser acknowledges reading and accepting the "Gold Park Homes Decor Centre Disclaimers" form. This document contains other miscellaneous disclaimers.

This Interior Colour Selection is final and approved by:

Signature: _____

Date: 30/01/2017

Signature: _____

Date: Jan 28/2017

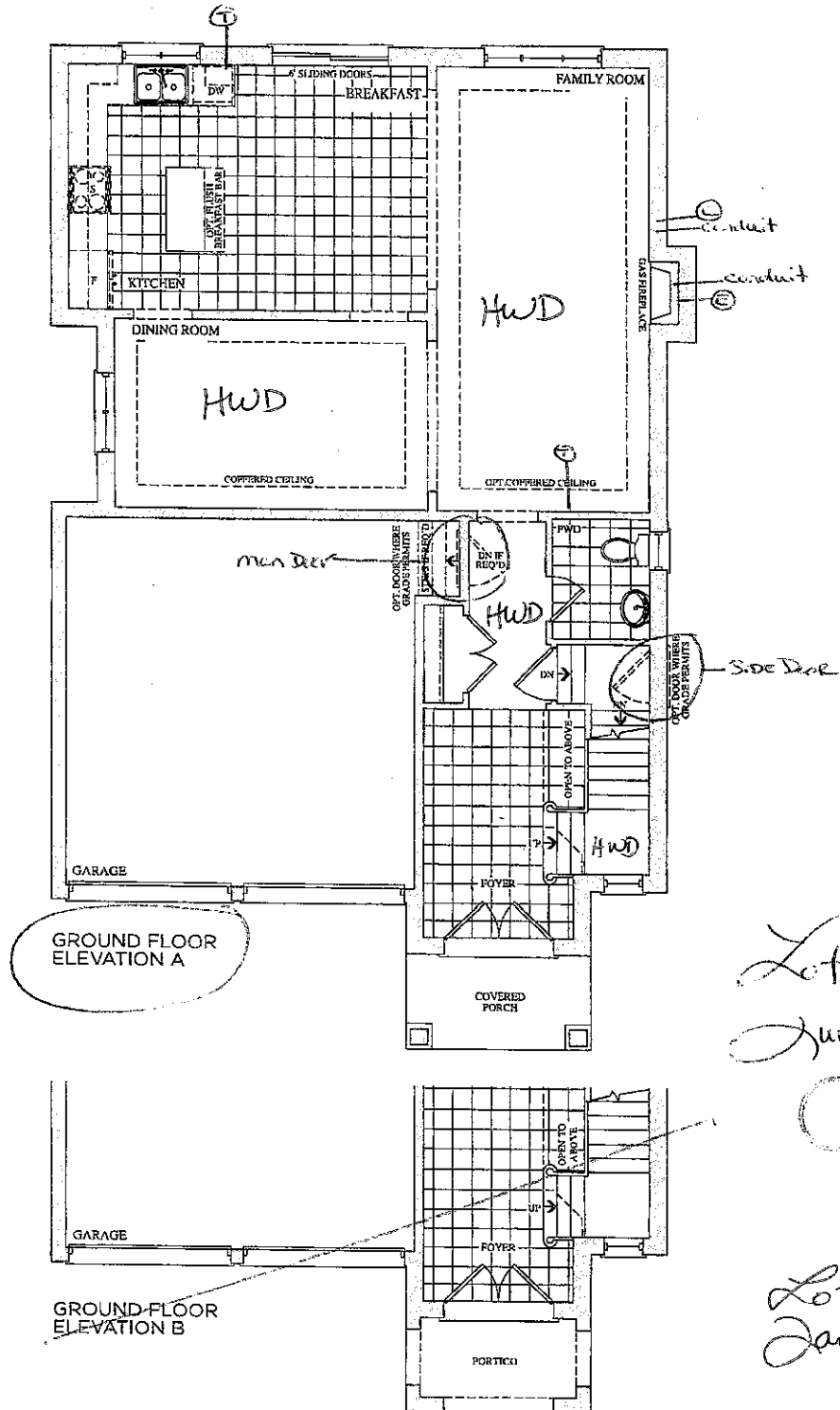

Lot 20
June 6, 16

Lot 20
Jan. 30, 17



The Haydn 38' SERIES

Elevation A • 2,454 sq.ft. | Elevation B • 2,448 sq.ft.

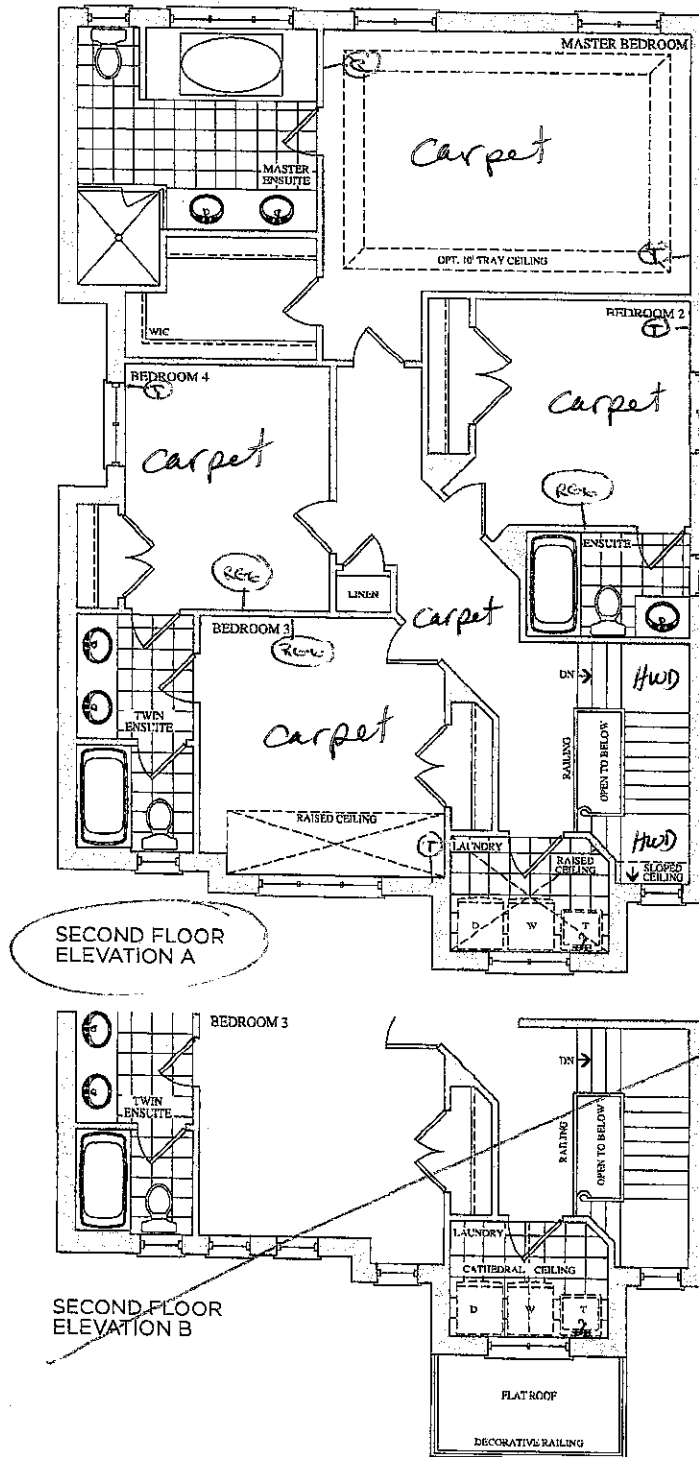

Lot 20
June 6, 16

Lot 20
Jan. 30, 17

ICBM

ABM

Prices, figures, illustrations, sizes, features and finishes are subject to change without notice. E.&O.E. Areas and dimensions are approximate and actual usable floor space may vary from the stated area. Layout may be reverse of the unit purchased. E. & O.E.

OLD PARK HOMES

Trade Name: Gold Park Homes	Site location: Brampton	Model: 38-3
Address:	Project: Encore	Phase:

This layout has been explained to the purchaser by Cortina Kitchens Inc. and is understood by the purchaser.

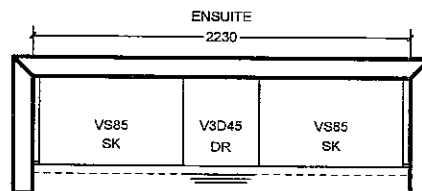
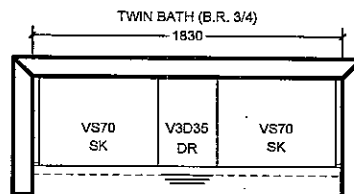
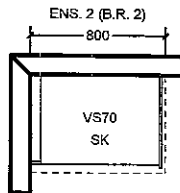
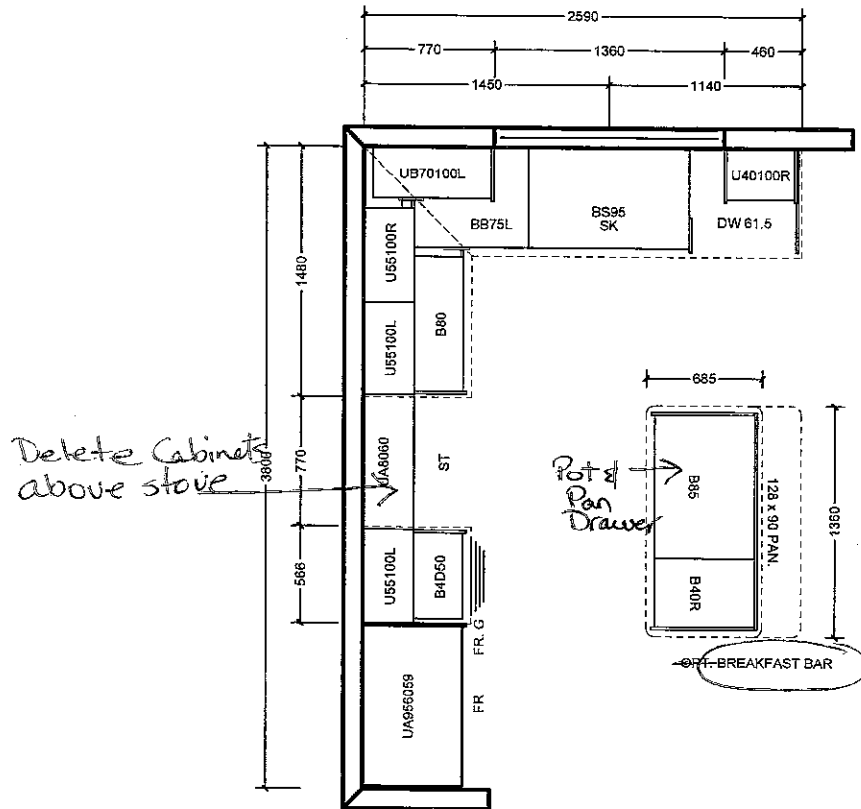

All prices subject to confirmation from head office.
This quotation is subject to the terms & conditions set out
in Cortina's Agreement of Purchase and Sale

All agreements are contingent upon strikes, accidents, and delay beyond our control. Please provide our installer with template for sinkholes or \$150.00 will be charged for callback.

ACCEPTED DATE: _____

CUSTOMER SIGNATURE

SALESPERSON SIGNATURE _____

CORTINA HEAD OFFICE APPROVAL:

ITEM A. Wood grain and colour are characteristics of the product, we cannot guarantee that such grain and colour will always match
ITEM B. Cortina Kitchens reserves the right to alter dimensions and make technical changes without notice.

Lot 20
Jan 30, 17



CORTINA

KITCHENS INC.

70 Regina Road Woodbridge ON L4L 8L6
905-264-6464

INFORMATION - PVC DOORS

Builder..Gold Park Homes Project..Encore..... Lot #..20.....

All cabinets with PVC (Thermofoil) Doors come with melamine gables, panels and kick. The doors, crown moulding and light valance are PVC wrapped. Open shelves incorporated in design will only be available with melamine interiors. There will be variations in colour shades between the PVC parts (doors, crown and Light valance) and the melamine parts (open shelves, Gables , Panels and Kick) due to the difference in material.

Furring Panel with crown moulding to the ceiling is not available on all PVC door styles due to subtle variations in colour shades between the PVC parts (moulding) and the melamine parts (furring panel) due to the difference in material. Grain directions in wood grain pattern melamine , vary between the furring panel, crown moulding (horizontal) and the PVC doors (vertical).

Thank you for your understanding.

I am well informed of this information, and agree to the purchase of the above.

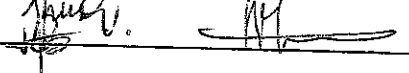
Purchaser: 

Date: Jan 30/2017



Attention: Building Department

Re: Lot # 20

This is to acknowledge that as the purchaser of the above noted lot, I have asked Gold Park Homes not to install the standard builder's kitchen exhaust hood. I will be installing my own unit after closing at my own expense and warranty. I also accept that the venting location will be as per the standard range hood.

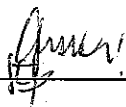

Purchaser

Vendor

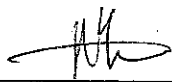

Purchaser

Dated this 30th day of January, 20 17.

UPGRADE HARDWARE

Jan 30, 17



UPGRADE HARDWARE



CH-32

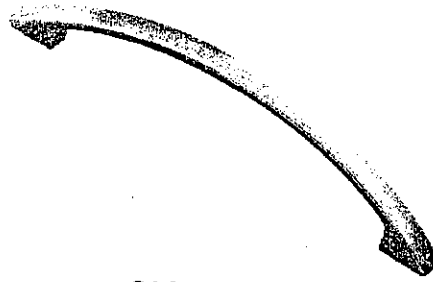

CH-38



CH-44

Kitchen

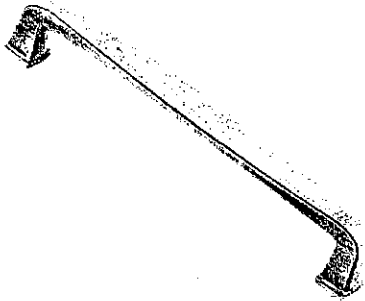

CH-45

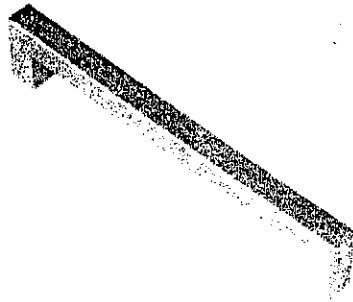

CH-46

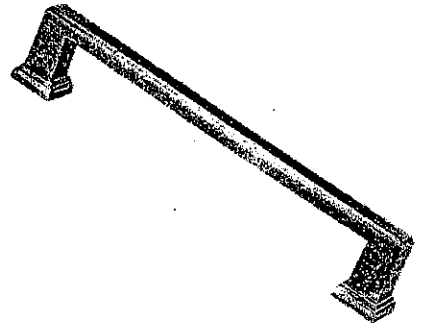

CH-47

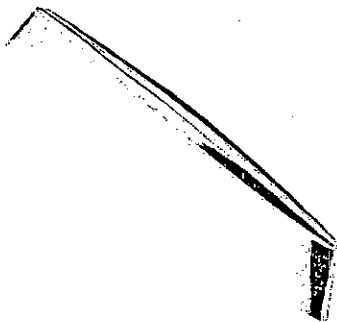

CH-48

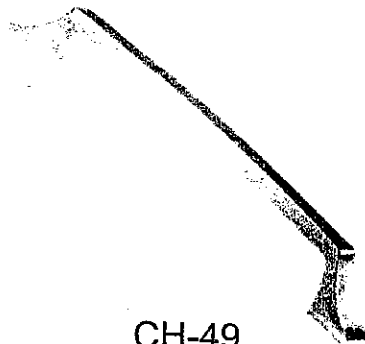

CH-49

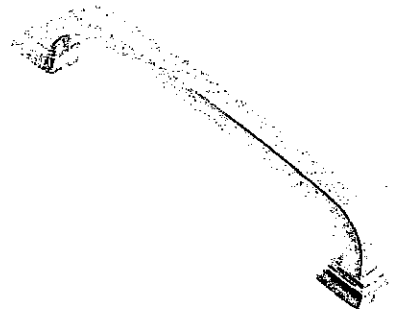

CH-50

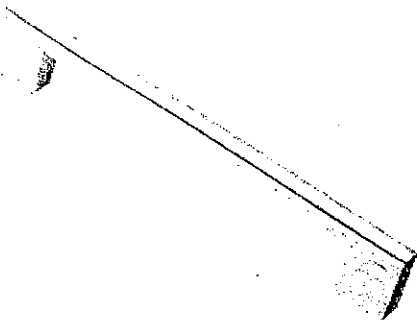

CH-51

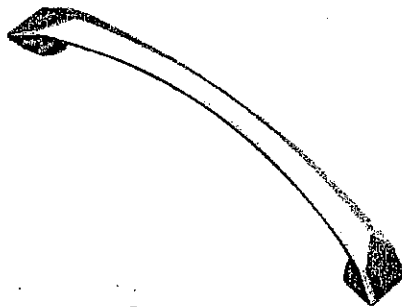

CH-52



CH-53

*NOTES:

- IMAGES ARE FOR QUICK REFERENCE PURPOSES ONLY
- ACTUAL SIZES AND FINISHES AS PER HARDWARE SAMPLE BOARD PROVIDED TO DECOR CENTRE

STANDARD HARDWARE

Lot 20
Jan 30, 2017



STANDARD HARDWARE



CSI-6

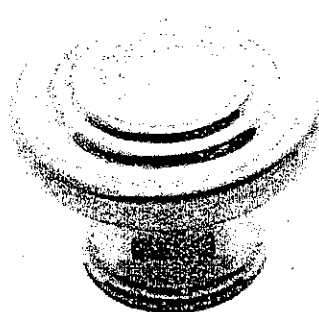

CSI-10

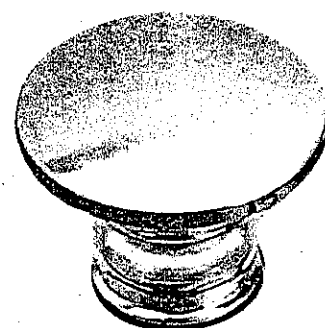
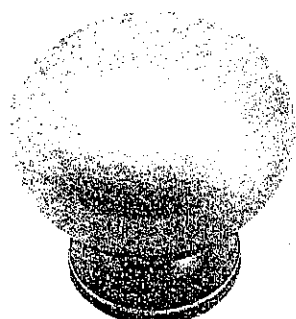
CSI-14 *master*CSI-16 *Twin*

CSI-18

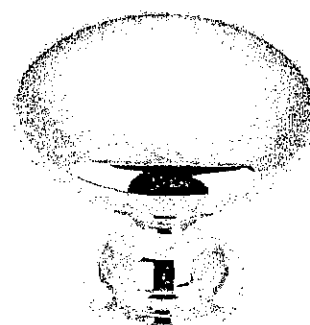

CSI-19

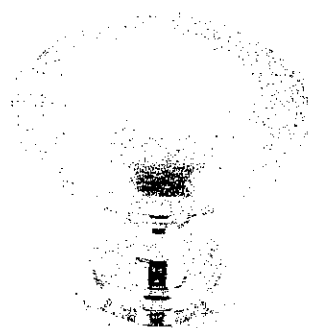

CSI-20

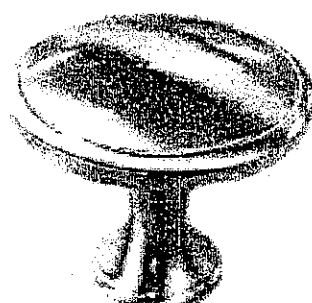

CSI-21

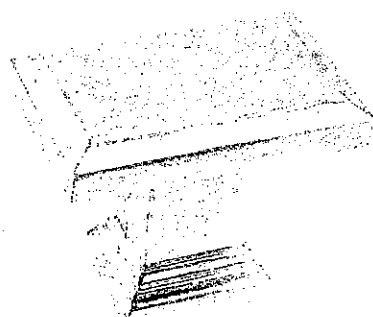
CSI-22 *Ens.2*

CSI-23

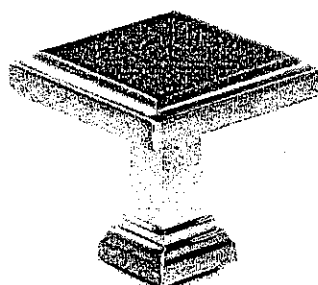

CSI-24

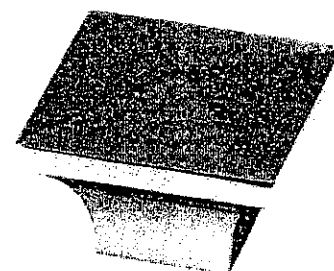

CSI-25

***NOTES:**

- IMAGES ARE FOR QUICK REFERENCE PURPOSES ONLY
- ACTUAL SIZES AND FINISHES AS PER HARDWARE
- SAMPLE BOARD PROVIDED TO DECOR CENTRE

GOLDPARK
HOMES



Granite, Marble,
Engineered Surfaces

201.20
Jan 30, 17

(10mm) (A12N)

- Standard 2CM & 3CM
- Upgrade 1 2CM & 3CM
- Upgrade 1 4 CM
- Upgrade 2

20 mm (3/4") Profiles



Kitchen

30mm (1-1/4") Profiles

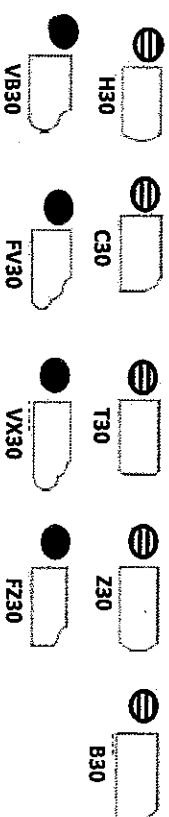

40mm (1-1/2") Profiles

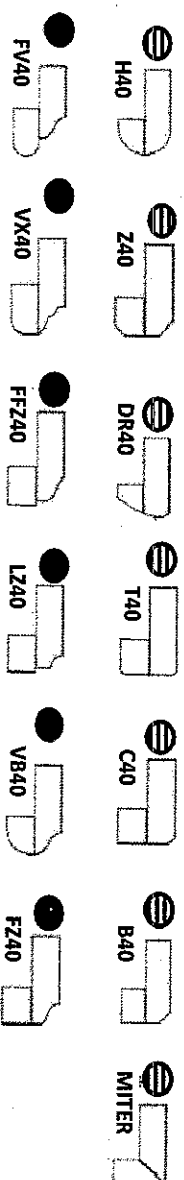

Note: All colours may not be available in 30mm at time ordered. Vendor reserves the right to use 40 mm edges (by lamination process).

*Mitre edge is available in Upgrade 1 for an overall thickness of 2". All other Mitre edge options will be an Upgrade 2 Edge.