

**Brampton Encore - 31 - 1 - 38-6 Elev.B SCARLATTI OPT- GFA1**  
**CENTRAL VAC AND WIRING**

Inv.590	1 - TELEPHONE AND CABLE ROUGH-IN LOCATIONS
Line7216	Note:
20Jun16 / 29Sep16	
Inv.590	1 - FAMILY ROOM: INSTALL CONDUIT PIPE- FOR TELEVISION- MUST SPECIFY LOCATION AND TERMINATION POINT, ABOVE FIREPLACE. SEE SKETCH
Line7217	Note:
20Jun16 / 29Sep16	

**CERAMIC**

Inv.1,173	1 - KITCHEN: INSTALL Floor Upgrade 4 Kitchen Floor No Breakfast
Line17291	Note:
9Feb17 / 24Feb17	
Inv.1,173	1 - FOYER: INSTALL Floor Upgrade 4 Foyer Vestibule Main Hall Floor
Line17292	Note:
9Feb17 / 24Feb17	

**CROWN MOULDING**

Inv.590	1 - FAMILY ROOM: INSTALL WAFFLE CEILING IN FAMILY ROOM ONLY. MODEL # T-164
Line12057	Note:
20Jun16 / 29Sep16	

**DRYWALL**

Inv.590	1 - MASTER ENSUITE: DELETE HALF WALL BESIDE TOILET, TURN TOILET AND EXTEND THE GLASS SHOWER. NOTE SHOWER FAUCET LOCATION. SEE SKETCH
Line12058	Note:
20Jun16 / 29Sep16	

**ELECTRICAL**

Inv.590	1 - FAMILY ROOM: INSTALL 110V WALL RECEPTACLE ON DEDICATED CIRCUIT - ABOVE FIREPLACE. SEE SKETCH
Line7218	Note:
20Jun16 / 29Sep16	
Inv.590	1 - KITCHEN: INSTALL 220V WALL RECEPTICAL ON DEDICATED CIRCUIT- FOR 4 WIRE BUILT-IN WALL OVEN - FOR FUTURE MICRO/WALL OVEN UNIT. SEE SKETCH. PURCHASER IS AWARE THAT THEY MUST BUY THE APPROPRIATE CABINETRY AT THE TIME OF COLOURS.
Line7220	Note:
20Jun16 / 29Sep16	
Inv.590	1 - KITCHEN: INSTALL 110V WALL RECEPTACLE ON DEDICATED CIRCUIT - FOR MICROWAVE - MICROWAVE NOT INCLUDED. FOR FUTURE MICRO/WALL OVEN UNIT. SEE SKETCH. PURCHASER IS AWARE THAT THEY MUST BUY THE APPROPRIATE CABINETRY AT THE TIME OF COLOURS
Line7221	Note:
20Jun16 / 29Sep16	
Inv.590	1 - MASTER BEDROOM: INSTALL UPGRADE TO 3 - WAY SWITCH (2 SWITCHES) - SECOND SWITCH TO BE BESIDE BED. SEE SKETCH
Line7222	Note:
20Jun16 / 29Sep16	

Brampton Encore - 31 - 1 - 38-6 Elev.B SCARLATTI OPT- GFA1

Inv.590	1 - KITCHEN: INSTALL KITCHEN CABINET STRIP VALANCE LIGHTS (UNDER CABINETS) - ROUGH - IN - DOES NOT INCLUDE (AND REQUIRES) KITCHEN UPGRADE PRICING
Line12052	Note:
20Jun16 / 29Sep16	
Inv.590	1 - LIVING ROOM: INSTALL ROUGH - IN CEILING OUTLET ON SEPERATE SWITCH - DOES NOT INCLUDE FIXTURE - IN LIVING ROOM. IN ADDITION TO BUILDER'S STANDARD SWITCH CONTROLLED RECEPTICAL. SEE SKETCH
Line12055	Note:
20Jun16 / 29Sep16	
Inv.590	1 - KITCHEN: INSTALL ROUGH - IN CEILING OUTLET ON SEPERATE SWITCH - DOES NOT INCLUDE FIXTURE - IN KITCHEN. IN ADDITION TO BUILDER'S STANDARD LIGHT
Line12056	Note:
20Jun16 / 29Sep16	
Inv.1,173	1 - DELETE HOODFAN & CABINETS ABOVE STOVE: KITCHEN - Purchasers request to NOT INSTALL builder's standard hood fan and standard cabinets above stove. DELETE. Do not supply, install, and/or credit. Purchasers are installing their own hood fan after closin
Line17306	Note: Purchasers accept and acknowledge that the exhaust fan duct hole may be off-centered with stove in kitchen due to purchasers installing their own hood fan after closing. The vendor is exempt
9Feb17 / 24Feb17	

EXTERIOR COLOURS

Inv.590	1 - EXTERIOR COLOUR PACKAGE 6
Line12163	Note:
20Jun16 / 29Sep16	

FRAMING

Inv.590	1 - MASTER ENSUITE: DELETE HALF WALL BESIDE TOILET, TURN TOILET AND EXTEND THE GLASS SHOWER. NOTE SHOWER FAUCET LOCATION. SEE SKETCH
Line12161	Note:
20Jun16 / 29Sep16	
Inv.590	1 - MASTER ENSUITE: INSTALL SHOWER STALL SEAT
Line12061	Note:
20Jun16 / 29Sep16	
Inv.590	1 - MAIN FLOOR: INSTALL FOUR (X4) STANDARD DOOR EXTENDED HEIGHT 96" (PRICE PER DOOR) MAIN FLOOR 3 STOREY MODELS - TO GO IN CLOSETS, POWDER ROOM AND LAUNDRY ROOM. SEE SKETCH
Line12160	Note:
20Jun16 / 29Sep16	

GLASS AND MIRROR

Inv.590	1 - MASTER ENSUITE: CONVERT FRAMED SHOWER TO 10MM FRAMLESS SHOWER ENCLOSURE WITH DOOR AND 10MM SIDE PANEL
Line12060	Note:
20Jun16 / 29Sep16	
Inv.590	1 - MASTER ENSUITE: DELETE HALF WALL BESIDE TOILET, TURN TOILET AND EXTEND THE GLASS SHOWER. NOTE SHOWER FAUCET LOCATION. SEE SKETCH
Line12162	Note:
20Jun16 / 29Sep16	

GRANITE MARBLE QUARTZ

Inv.1,173	1 - KITCHEN: INSTALL 2 CM GRP 2 Kitchen with Island
Line17293	Note:
9Feb17 / 24Feb17	

Brampton Encore - 31 - 1 - 38-6 Elev.B SCARLATTI OPT- GFA1

Inv.1,173	1 - KITCHEN: INSTALL 2 CM GRP 2 Optional Flush BBar
Line17294	Note:
9Feb17 / 24Feb17	
Inv.1,173	1 - KITCHEN: INSTALL 4 CM PROFILE STANDARD Kitchen with Island no BBar
Line17295	Note:
9Feb17 / 24Feb17	
Inv.1,173	1 - KITCHEN: INSTALL 4 CM PROFILE STANDARD Optional Flush BBar
Line17296	Note:
9Feb17 / 24Feb17	
Inv.1,173	1 - KITCHEN: INSTALL CONTINUOUS COUNTERTOP FOR COOKTOP
Line17305	Note:
9Feb17 / 24Feb17	

HARDWOOD

Inv.1,173	1 - DINING ROOM: INSTALL 4 1/4" PREVERCO RED OAK IN CAPPUCCINO Upgrade 1 LEVEL S Dining
Line17284	Note:
9Feb17 / 24Feb17	
Inv.1,173	1 - FAMILY ROOM: INSTALL 4 1/4" PREVERCO RED OAK IN CAPPUCCINO IN Family
Line17285	Note:
9Feb17 / 24Feb17	
Inv.1,173	1 - LIVING ROOM: INSTALL 4 1/4" PREVERCO RED OAK IN CAPPUCCINO IN Living
Line17286	Note:
9Feb17 / 24Feb17	
Inv.1,173	1 - BREAKFAST AREA: INSTALL 4 1/4" PREVERCO RED OAK IN CAPPUCCINO IN BREAKFAST AREA
Line17287	Note:
9Feb17 / 24Feb17	

HVAC

Inv.590	1 - KITCHEN: INSTALL GAS LINE ROUGH - MAIN FLOOR - (3 STOREY MODELS), FOR STOVE
Line7232	Note:
20Jun16 / 29Sep16	

INTERIOR TRIM AND DOORS

Inv.590	4 - MAIN FLOOR: INSTALL FOUR (X4) STANDARD DOOR EXTENDED HEIGHT 96" (PRICE PER DOOR) MAIN FLOOR 3 STOREY MODELS - TO GO IN CLOSETS, POWDER ROOM AND LAUNDRY ROOM. SEE SKETCH
Line12054	Note:
20Jun16 / 29Sep16	

KITCHEN AND BATH CABINETRY

Inv.1,173	1 - KITCHEN: INSTALL Handles Kitchen
Line17297	Note:
9Feb17 / 24Feb17	
Inv.1,173	4 - BREAKFAST AREA: INSTALL FOUR (X4) OAK PVC STD 175 Pantry double door 30cm deep 242 cm high. TO GO THE LENGTH OF THE BREAKFAST AREA. SEE FLOOR PLAN
Line17298	Note:
9Feb17 / 24Feb17	

**Brampton Encore - 31 - 1 - 38-6 Elev.B SCARLATTI OPT- GFA1**

Inv.1,173	1 - BREAKFAST AREA: INSTALL Oak PVC 158 Overlay Gable Pantry 61x220 61x242 FOR NEW PANTRY
Line17299	Note:
9Feb17 / 24Feb17	
Inv.1,173	1 - KITCHEN: INSTALL Oak PVC 112 Built in wall oven and microwave and cooktop with countertop by others 242cm
Line17300	Note:
9Feb17 / 24Feb17	
Inv.1,173	1 - KITCHEN: INSSTALL Oak PVC 158 Overlay Gable Pantry 61x220 61x242, FOR WALL OVEN UNIT
Line17301	Note:
9Feb17 / 24Feb17	
Inv.1,173	1 - KITCHEN: INSTALL Oak PVC 87 Pot and Pan Drawers 2 deep drawers and one shallow top drawer 60 70 80 90 cm wide. TO GO UNDER COOKTOP. NOTE, TOP DRAWER IS NON-OPERATIONAL
Line17302	Note:
9Feb17 / 24Feb17	
Inv.1,173	1 - KITCHEN: INSTALL UPG 1 GRP III Opt Light Valance
Line17303	Note:
9Feb17 / 24Feb17	
Inv.1,173	1 - KITCHEN: DELETE CABINETS ABOVE STOVE. PURCHASER TO SUPPLY THEIR OWN FAN
Line17304	Note:
9Feb17 / 24Feb17	

**MISC.**

Inv.590	1 - BONUS PACKAGE: \$10,000.00 (INCLUDING TAXES) WORTH OF UPGRADES FROM GOLD PARK HOMES DÉCOR CENTRE IS BEING APPLIED TOWARD THE STRUCTURAL APPOINTMENT.
Line12062	Note:
20Jun16 / 29Sep16	
Inv.590	1 - Purchaser has attended a Structural appointment at the Decor Centre & has DECLINED any additional upgrades and accepts and acknowledges that there will be no further structural changes/additions/deletions to be made upon signing on September 28, 2016
Line12063	Note:
20Jun16 / 29Sep16	
Inv.590	1 - Purchasers are aware & accepts that ANY changes made to upgrades after signing this Purchasers Extra Form are subject to a minimum administration fee of \$500. PLUS a 10% holdback fee
Line12064	Note:
20Jun16 / 29Sep16	
Inv.1,173	1 - GRANITE WAIVER Due to the many variables that can affect the pattern, colour and/or design and "pitting" of natural products, granite installed will not be identical to the samples displayed. Every effort is made to provide granite counter tops
Line17307	Note: close as possible but the vendor is not responsible for results which differ from the sample displayed
9Feb17 / 24Feb17	
Inv.1,173	1 - Purchaser has attended a Colour appointment at the Decor Centre & has DECLINED any additional upgrades and accepts and acknowledges that there will be no further structural changes/additions/deletions to be made upon signing on February 9, 2017
Line17308	Note:
9Feb17 / 24Feb17	
Inv.1,173	1 - Purchasers are aware & accepts that ANY changes made to upgrades after signing this Purchasers Extra Form are subject to a minimum administration fee of \$500. PLUS a 10% holdback fee
Line17309	Note:
9Feb17 / 24Feb17	

Brampton Encore - 31 - 1 - 38-6 Elev.B SCARLATTI OPT- GFA1

PAINTING

Inv.1,173	1 - STAIRCASE: Stain Staircases 3 Storey Model (Euroline Pickets Charged Separately)
Line17288	Note:
9Feb17 / 24Feb17	

PLUMBING

Inv.590	1 - KITCHEN: INSTALL ROUGH-IN - WATERLINE FOR FRIDGE
Line7226	Note:
20Jun16 / 29Sep16	
Inv.590	1 - BASEMENT: INSTALL ROUGH-IN - 3PC BASEMENT ROUGH-IN, AS PER PLAN
Line7227	Note:
20Jun16 / 29Sep16	
Inv.590	1 - MASTER ENSUITE: DELETE HALF WALL BESIDE TOILET, TURN TOILET AND EXTEND THE GLASS SHOWER. NOTE SHOWER FAUCET LOCATION. SEE SKETCH
Line12059	Note:
20Jun16 / 29Sep16	

STAIRS AND RAILINGS

Inv.1,173	1 - STAIRCASE: INSTALL EUROLINE 1 Black
Line17289	Note:
9Feb17 / 24Feb17	
Inv.1,173	1 - STAIRCASE: INSTALL V Groove Handrail
Line17290	Note:
9Feb17 / 24Feb17	

WINDOWS - BASEMENT

Inv.590	4 - BASEMENT: INSTALL FOUR (X4) BASEMENT WINDOWS - UPGRADE EXISTING BASEMENT WINDOW TO 30 INCH X 24 INCH - MAY REQUIRE INSTALLATION OF WINDOW WELL
Line7231	Note:
20Jun16 / 29Sep16	

WINDOWS AND DOORS

Inv.590	1 - BREAKFAST AREA: INSTALL GARDEN DOORS IN LIEU OF PATIO SLIDERS- 6FT X 80 INCH WITH GRILLED GLASS
Line12053	Note:
20Jun16 / 29Sep16	

Scheduled Closing Date:

Purchasers: Piyush Vora & Archana P Vora  
Telephone Res. / Bus: (289) 997-4656 / (416) 302-3332  
Decor Advisor: Terri Parisani

Property: 31 of Plan -  
Project: Fieldwalk Investments Inc.  
Model and Elevation: 38-6 Elev.B SCARLATTI OPT- GFA1

Layout Changes: ☒ Yes ☐ No      Sketch Attached: ☒ Yes ☐ No      Exterior Colour Scheme:

1. Cabinetry

	Style and Colour	Counter	Hardware
Kitchen / Breakfast	Varese(pvc)AntiqWhite	*Upg.2 #9141 CeasarStone *Edge: C-40	*CH-53
Laundry Room			
Powder Room			
TWIN BATH	Varese(pvc)VanillaStix	4588K-07 Kalahari Topaz Laminate	cs1-22
Master Ensuite Bathroom	Varese(pvc)Mystic	P-948-CA Hiverna Laminate	cs1-23
Second Ensuite Bathroom (If Applicable)	Varese(pvc)Silver	6897-46 Argento Romano Laminate	cs1-18
GROUND FL ENSUITE	Carrara(pvc)Mystic	7264-58 Lime Stone Laminate	cs1-25
Dishwasher Cabinet			

Comment

2. Floor Tile

	Selection	Grout	Threshold
Entrance Vestibule	*Upg.4, Regal Shell White Polished 12 x 24	N/A	N/A
Main Hall			
Kitchen / Breakfast	*Upg.4 Must Polished, Taupe 18 x 18	N/A	N/A
Laundry Room	Serpentine Taupe 13 x 13	N/A	N/A
Powder Room	New Reeds Grey 13 x 13	N/A	N/A
TWIN BATH	Reflex Espresso 13 x 13	N/A	N/A
Master Ensuite Bathroom	Serpentine Syrak 13 x 13	N/A	N/A
Second Ensuite Bathroom (If Applicable)	Serpentine Grey 13 x 13	N/A	N/A
Lower Landing (If Applicable)			
GROUND FL ENSUITE	Serpentine Krem 13 x 13	N/A	N/A

Comment

3. Wall Tile

	Selection	Listello/Inserts	Describe
TWIN BATH	Reflection White 8 x 10	<input type="radio"/> Yes <input checked="" type="radio"/> No	
Master Ensuite Bathroom			
Tub Deck	Serpentine Syrak 8 x 10	<input type="radio"/> Yes <input checked="" type="radio"/> No	
Shower Stall	Serpentine Syrak 8 x 10	<input type="radio"/> Yes <input checked="" type="radio"/> No	
Bathroom Walls	Serpentine Syrak 8 x 10	<input type="radio"/> Yes <input checked="" type="radio"/> No	
Second Ensuite Bathroom (If Applicable)	Venus Anthracite 8 x 10	<input type="radio"/> Yes <input checked="" type="radio"/> No	
GROUND FL ENSUITE	Serpentine Krem 8 x 10	<input type="radio"/> Yes <input checked="" type="radio"/> No	

Kitchen Backsplash ☐ Yes ☒ No      Backsplash Behind Fridge

Comment

Scheduled Closing Date:

Purchasers: Piyush Vora & Archana P Vora  
Telephone Res. / Bus: (289) 997-4656 / (416) 302-3332  
Decor Advisor: Terri Parisani

Property: 31 of Plan -  
Project: Fieldwalk Investments Inc.  
Model and Elevation: 38-6 Elev.B SCARLATTI OPT- GFA1

4. Plumbing Fixtures

Second Ensuite

Powder Room

Master Ensuite Bathroom

Other Room - Specify

Other Washroom

Comment

ALL FIXTURES TO REMAIN STANDARD THROUGHOUT

5. Hardwood Flooring

Type and Stain

Main Hall

\*Upg.1 Preverco Pro, Cappuccino

Type and Stain

Upper Landing

\*Upg.1 Preverco Pro, Cappuccino

Kitchen / Breakfast

-

Upper Hall

-

Living Room

\*Upg.1 Preverco Pro, Cappuccino

Master Bedroom

-

Dining Room

\*Upg.1 Preverco Pro, Cappuccino

Bedroom #2

-

Family Room

\*Upg.1 Preverco Pro, Cappuccino

Bedroom #3

-

Den/Library

-

Bedroom #4

-

Entrance Vestibule

-

Bedroom #5

-

Lower Landing (If Applicable)

-

Other Room - Specify

BREAKFAST AREA

\*Upg.1 Preverco Pro, Cappuccino

Comment

6. Carpeting

	Upgrade	Description
Main Hall	<input type="checkbox"/>	-
Living Room	<input type="checkbox"/>	-
Dining Room	<input type="checkbox"/>	-
Family Room	<input type="checkbox"/>	-
Den/Library	<input type="checkbox"/>	-
Upper Hall	<input type="checkbox"/>	T-07
Master Bedroom	<input type="checkbox"/>	T-07
Bedroom #2	<input type="checkbox"/>	T-07
Bedroom #3	<input type="checkbox"/>	T-07
Bedroom #4	<input type="checkbox"/>	T-07
Bedroom #5	<input type="checkbox"/>	T-07
GROUND FLOOR	<input type="checkbox"/>	T-07
Upper Landing (If Applicable)	<input type="checkbox"/>	-
Lower Landing (If Applicable)	<input type="checkbox"/>	T-07 (BASEMENT)

Upgrade Underpad

Type

STANDARD

Area

Carpet on Stairs

Capped

T-07

Runner - \*Upgrade

N/A

Comment

CARPET ON STAIRS FROM GROUND FLOOR TO BASEMENT

Scheduled Closing Date:

Purchasers: Piyush Vora & Archana P Vora  
Telephone Res. / Bus: (289) 997-4656 / (416) 302-3332  
Decor Advisor: Terri Parisani

Property: 31 of Plan -  
Project: Fieldwalk Investments Inc.  
Model and Elevation: 38-6 Elev.B SCARLATTI OPT- GFA1

7. Fireplace

	Living Room			Family Room			Other Room - Specify		
	Purchased	As Per Plan	N/A	Purchased	As Per Plan	N/A	Purchased	As Per Plan	N/A
	<input type="radio"/>	<input type="radio"/>	<input checked="" type="radio"/>	<input type="radio"/>	<input checked="" type="radio"/>	<input type="radio"/>	<input type="radio"/>	<input type="radio"/>	<input checked="" type="radio"/>
Fireplace Type	<input type="text"/>			STANDARD			<input type="text"/>		
Mantle Type	<input type="text"/>			NF-24			<input type="text"/>		
Colour / Stain	<input type="text"/>			WHITE PAINT-GRADE			<input type="text"/>		
Surround	<input type="text"/>			NERO MARQUINA			<input type="text"/>		
Hearth	<input type="text"/>			NONE			<input type="text"/>		
Comment	<input type="text"/>								

8. Trim Carpentry

Interior Doors	<input type="text" value="STANDARD"/>	Front Door Glass Inserts	<input type="text" value="STANDARD"/>	Door Handles	<input type="text" value="STANDARD"/>
Interior Trim	<input type="text" value="STANDARD"/>				
Comment	<input type="text"/>				

9. Plaster Mouldings and Medallions

Entrance Vestibule	<input type="text" value="N/A"/>	<input type="text"/>	Kitchen/Breakfast	<input type="text" value="N/A"/>	<input type="text"/>
Main Hall	<input type="text" value="N/A"/>	<input type="text"/>	Den/Library	<input type="text" value="N/A"/>	<input type="text"/>
Living Room	<input type="text" value="N/A"/>	<input type="text"/>	Lower Landing	<input type="text" value="N/A"/>	<input type="text"/>
Dining Room	<input type="text" value="N/A"/>	<input type="text"/>	Other Room - Specify	<input type="text" value="N/A"/>	<input type="text"/>
Family Room	<input type="text" value="N/A"/>	<input type="text"/>			
Comment	<input type="text"/>				

10. Railings and Spindles

Railing Package	<input type="text" value="EUROLINE 1 WITH V-GROOVE HANDRAIL"/>		
Railing Colour	<input type="text" value="*CAPPUCCINO"/>	Spindle Colour	<input type="text" value="*CAPPUCCINO"/>
Stringer / Riser	<input type="text" value="*CAPPUCCINO"/>	Treads	<input type="text" value="*CAPPUCCINO"/>
Comment	Oak Stairs <input checked="" type="radio"/> Yes <input type="radio"/> No		
<input type="text" value="*STAIRS FROM GROUND FLOOR TO BASEMENT ARE CARPETED"/>			

11. Wall Paint

Main & Upper Hall	<input type="text" value="WARM GREY"/>	Master Bedroom	<input type="text" value="WARM GREY"/>
Living Room	<input type="text" value="WARM GREY"/>	Bedroom #2	<input type="text" value="WARM GREY"/>
Dining Room	<input type="text" value="WARM GREY"/>	Bedroom #3	<input type="text" value="WARM GREY"/>
Kitchen / Breakfast	<input type="text" value="WARM GREY"/>	Bedroom #4	<input type="text" value="WARM GREY"/>
Family Room	<input type="text" value="WARM GREY"/>	Bedroom #5	<input type="text" value="WARM GREY"/>
Powder Room	<input type="text" value="WARM GREY"/>	Master Ensuite	<input type="text" value="WARM GREY"/>
Laundry Room	<input type="text" value="WARM GREY"/>	TWIN BATH	<input type="text" value="WARM GREY"/>
Den/Library	<input type="text" value="WARM GREY"/>	Second Ensuite	<input type="text" value="WARM GREY"/>
Trim Paint	<input type="text" value="WHITE"/>	GROUND FLOOR	<input type="text" value="WARM GREY"/>
Comment	Smooth Ceilings First Floor <input type="text"/>		
<input type="text"/>			



Scheduled Closing Date:

Purchasers: Piyush Vora & Archana P Vora  
Telephone Res. / Bus: (289) 997-4656 / (416) 302-3332  
Decor Advisor: Terri Parisani

Property: 31 of Plan -  
Project: Fieldwalk Investments Inc.  
Model and Elevation: 38-6 Elev.B SCARLATTI OPT- GFA1

12. Electrical

Plugs and Switches ☒ White ☐ Ivory

Hood Fan ☐ White ☐ Ivory

Appliances Built in Cooktop

☒ Yes ☐ No

Built in Oven

☒ Yes ☐ No

Above Kitchen Cabinet Light ☐ Yes ☒ No

Below Kitchen Cabinet Light ☒ Yes ☐ No

Gas Stove

☒ Yes ☐ No

Microwave

☒ Yes ☐ No

Comment

DELETE STANDARD HOOD FAN. PURCHASER TO SUPPLY AFTER CLOSING

13. Heating and Air Conditioning

Air Conditioning

Gas Provisions Stove

Gas Provisions Dryer

Gas Provisions Barbecue

Comment

GAS LINE FOR STOVE PURCHASED  
GAS LINE FOR BBQ STANDARD

14. Additional Comments

15. Disclaimers and Notes

- 1) Colours of all materials are as close as possible to builder's selection, but not necessarily identical due to variances in manufacturing.
- 2) Any extras listed above are null and void unless accompanied by a separate invoice/amendment. Said invoice must be paid in full.
- 3) The Purchaser acknowledges that after Interior Colour Selection form is signed and dated, no further changes will be permitted other than re-selection due to unavailability. Purchaser's Initials
- 4) The Purchaser acknowledges reading and accepting the "Gold Park Homes Decor Centre Disclaimers" form. This document contains other miscellaneous disclaimers.

This Interior Colour Selection is final and approved by:

Signature:

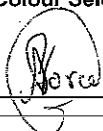

Date:

9th Feb 2017

Signature:



Date:

9th Feb 2017

Scheduled Closing Date:

Purchasers: Piyush Vora &amp; Archana P Vora

Property: 31 of Plan -

Telephone Res. / Bus: (289) 997-4656 / (416) 302-3332

Project: Fieldwalk Investments Inc.

Decor Advisor: Terri Parisani

Model and Elevation: 38-6 Elev.B SCARLATTI OPT- GFA1

Layout Changes: ☒ Yes ☐ NoSketch Attached: ☒ Yes ☐ NoExterior Colour Scheme: 

## 1. Cabinetry

	Style and Colour	Counter	Hardware
Kitchen / Breakfast	Varese(pvc)AntiqWhite	*Upg.2 #9141 CeasarStone *Edge: C-40	*CH-53
Laundry Room	-		
Powder Room	-		
TWIN BATH	Varese(pvc)VanillaStix	4588K-07 Kalahari Topaz Laminate	cs1-22
Master Ensuite Bathroom	Varese(pvc)Mystic	P-948-CA Hiverna Laminate	cs1-23
Second Ensuite Bathroom (If Applicable)	Varese(pvc)Silver	6897-46 Argento Romano Laminate	cs1-18
GROUND FL ENSUITE	Carrara(pvc)Mystic	7264-58 Lime Stone Laminate	cs1-25
Dishwasher Cabinet			

Comment

## 2. Floor Tile

	Selection	Grout	Threshold
Entrance Vestibule	*Upg.4, Regal Shell White Polished 12 x 24	N/A	N/A
Main Hall	-		
Kitchen / Breakfast	*Upg.4 Must Polished, Taupe 18 x 18	N/A	N/A
Laundry Room	Serpentine Taupe 13 x 13	N/A	N/A
Powder Room	New Reeds Grey 13 x 13	N/A	N/A
TWIN BATH	Reflex Espresso 13 x 13	N/A	N/A
Master Ensuite Bathroom	Serpentine Syrak 13 x 13	N/A	N/A
Second Ensuite Bathroom (If Applicable)	Serpentine Grey 13 x 13	N/A	N/A
Lower Landing (If Applicable)	-		
GROUND FL ENSUITE	Serpentine Krem 13 x 13	N/A	N/A

Comment

## 3. Wall Tile

	Selection	Listello/Inserts	Describe
TWIN BATH	Reflection White 8 x 10	<input type="radio"/> Yes <input checked="" type="radio"/> No	
Master Ensuite Bathroom			
Tub Deck	Serpentine Syrak 8 x 10	<input type="radio"/> Yes <input checked="" type="radio"/> No	
Shower Stall	Serpentine Syrak 8 x 10	<input type="radio"/> Yes <input checked="" type="radio"/> No	
Bathroom Walls	Serpentine Syrak 8 x 10	<input type="radio"/> Yes <input checked="" type="radio"/> No	
Second Ensuite Bathroom (If Applicable)	Venus Anthracite 8 x 10	<input type="radio"/> Yes <input checked="" type="radio"/> No	
GROUND FL ENSUITE	Serpentine Krem 8 x 10	<input type="radio"/> Yes <input checked="" type="radio"/> No	

Kitchen Backsplash ☐ Yes ☒ NoBacksplash Behind Fridge 

Comment

Scheduled Closing Date:

Purchasers: Piyush Vora & Archana P Vora  
Telephone Res. / Bus: (289) 997-4656 / (416) 302-3332  
Decor Advisor: Terri Parisani

Property: 31 of Plan -  
Project: Fieldwalk Investments Inc.  
Model and Elevation: 38-6 Elev.B SCARLATTI OPT- GFA1

4. Plumbing Fixtures

Second Ensuite

Powder Room

Master Ensuite Bathroom

Other Room - Specify

Other Washroom

Comment

ALL FIXTURES TO REMAIN STANDARD THROUGHOUT

5. Hardwood Flooring

Type and Stain

\*Upg.1 Preverco Pro, Cappuccino

Main Hall

Type and Stain

\*Upg.1 Preverco Pro, Cappuccino

Upper Landing

Type and Stain

-

Kitchen / Breakfast

Type and Stain

\*Upg.1 Preverco Pro, Cappuccino

Living Room

Type and Stain

\*Upg.1 Preverco Pro, Cappuccino

Dining Room

Type and Stain

\*Upg.1 Preverco Pro, Cappuccino

Family Room

Type and Stain

-

Den/Library

Type and Stain

-

Entrance Vestibule

Type and Stain

-

Lower Landing (If Applicable)

Type and Stain

\*Upg.1 Preverco Pro, Cappuccino

Other Room - Specify

Type and Stain

\*Upg.1 Preverco Pro, Cappuccino

BREAKFAST AREA

Comment

6. Carpeting

Upgrade

☐

Description

-

Main Hall

Upgrade

☐

Description

-

Living Room

Upgrade

☐

Description

-

Dining Room

Upgrade

☐

Description

-

Family Room

Upgrade

☐

Description

-

Den/Library

Upgrade

☐

Description

T-07

Upper Hall

Upgrade

☐

Description

T-07

Master Bedroom

Upgrade

☐

Description

T-07

Bedroom #2

Upgrade

☐

Description

T-07

Bedroom #3

Upgrade

☐

Description

T-07

Bedroom #4

Upgrade

☐

Description

T-07

Bedroom #5

Upgrade

☐

Description

T-07

GROUND FLOOR

Upgrade

☐

Description

-

Upper Landing (If Applicable)

Upgrade

☐

Description

T-07 (BASEMENT)

Lower Landing (If Applicable)

Type

STANDARD

Area

Upgrade Underpad

Capped

T-07

Runner - \*Upgrade

N/A

Carpet on Stairs

Comment

CARPET ON STAIRS FROM GROUND FLOOR TO BASEMENT

Scheduled Closing Date:

Purchasers: Piyush Vora & Archana P Vora  
Telephone Res. / Bus: (289) 997-4656 / (416) 302-3332  
Decor Advisor: Terri Parisani

Property: 31 of Plan -  
Project: Fieldwalk Investments Inc.  
Model and Elevation: 38-6 Elev.B SCARLATTI OPT- GFA1

7. Fireplace

	Living Room			Family Room			Other Room - Specify		
	Purchased	As Per Plan	N/A	Purchased	As Per Plan	N/A	Purchased	As Per Plan	N/A
	<input type="radio"/>	<input type="radio"/>	<input checked="" type="radio"/>	<input type="radio"/>	<input checked="" type="radio"/>	<input type="radio"/>	<input type="radio"/>	<input type="radio"/>	<input checked="" type="radio"/>
Fireplace Type				STANDARD					
Mantle Type				NF-24					
Colour / Stain				WHITE PAINT-GRADE					
Surround				NERO MARQUINA					
Hearth				NONE					
Comment									

8. Trim Carpentry

Interior Doors	STANDARD	Front Door Glass Inserts	STANDARD	Door Handles	STANDARD
Interior Trim	STANDARD				
Comment					

9. Plaster Mouldings and Medallions

Entrance Vestibule	N/A		Kitchen/Breakfast	N/A	
Main Hall	N/A		Den/Library	N/A	
Living Room	N/A		Lower Landing	N/A	
Dining Room	N/A		Other Room - Specify	N/A	
Family Room	N/A				
Comment					

10. Railings and Spindles

Railing Package	*EUROLINE 1 WITH V-GROOVE HANDRAIL		
Railing Colour	*CAPPUCCINO	Spindle Colour	*CAPPUCCINO
Stringer / Riser	*CAPPUCCINO	Treads	*CAPPUCCINO
Comment	Oak Stairs <input checked="" type="radio"/> Yes <input type="radio"/> No		
*STAIRS FROM GROUND FLOOR TO BASEMENT ARE CARPETED			

11. Wall Paint

Main & Upper Hall	WARM GREY	Master Bedroom	WARM GREY
Living Room	WARM GREY	Bedroom #2	WARM GREY
Dining Room	WARM GREY	Bedroom #3	WARM GREY
Kitchen / Breakfast	WARM GREY	Bedroom #4	WARM GREY
Family Room	WARM GREY	Bedroom #5	WARM GREY
Powder Room	WARM GREY	Master Ensuite	WARM GREY
Laundry Room	WARM GREY	TWIN BATH	WARM GREY
Den/Library	WARM GREY	Second Ensuite	WARM GREY
Trim Paint	WHITE	GROUND FLOOR	WARM GREY
Comment	Smooth Ceilings First Floor		

Scheduled Closing Date:

Purchasers: Piyush Vora & Archana P Vora  
Telephone Res. / Bus: (289) 997-4656 / (416) 302-3332  
Decor Advisor: Terri Parisani

Property: 31 of Plan -  
Project: Fieldwalk Investments Inc.  
Model and Elevation: 38-6 Elev.B SCARLATTI OPT- GFA1

12. Electrical

Plugs and Switches ☒ White ☐ Ivory   
Hood Fan ☐ White ☐ Ivory  
Appliances Built in Cooktop Built in Oven Gas Stove Microwave  
☒ Yes ☐ No ☒ Yes ☐ No ☒ Yes ☐ No ☒ Yes ☐ No  
Above Kitchen Cabinet Light ☐ Yes ☒ No  
Below Kitchen Cabinet Light ☒ Yes ☐ No

Comment

DELETE STANDARD HOOD FAN. PURCHASER TO SUPPLY AFTER CLOSING

13. Heating and Air Conditioning

Air Conditioning   
Gas Provisions Dryer   
Gas Provisions Stove   
Gas Provisions Barbecue

Comment

GAS LINE FOR STOVE PURCHASED  
GAS LINE FOR BBQ STANDARD

14. Additional Comments

15. Disclaimers and Notes

- Colours of all materials are as close as possible to builder's selection, but not necessarily identical due to variances in manufacturing.
- Any extras listed above are null and void unless accompanied by a separate invoice/amendment. Said invoice must be paid in full.
- The Purchaser acknowledges that after Interior Colour Selection form is signed and dated, no further changes will be permitted other than re-selection due to unavailability. \_\_\_\_\_ Purchaser's Initials
- The Purchaser acknowledges reading and accepting the "Gold Park Homes Decor Centre Disclaimers" form. This document contains other miscellaneous disclaimers.

This Interior Colour Selection is final and approved by:

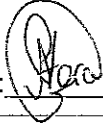
Signature:  Date: 9<sup>th</sup> Feb 2017 Signature:  Date: Feb 9<sup>th</sup> 2017

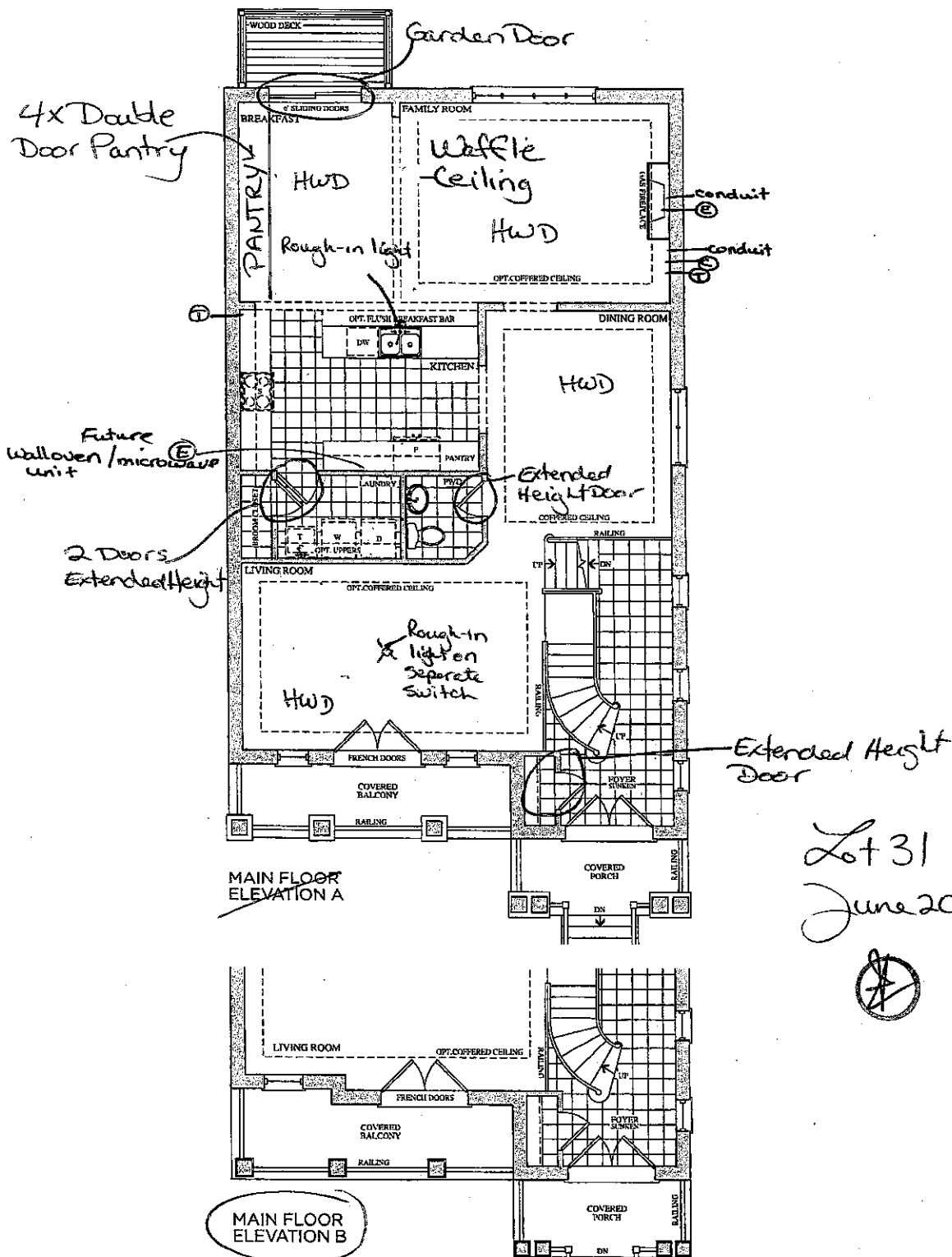

Lot 31  
June 20, 16



Lot 31  
Feb. 9, 17

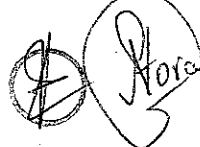

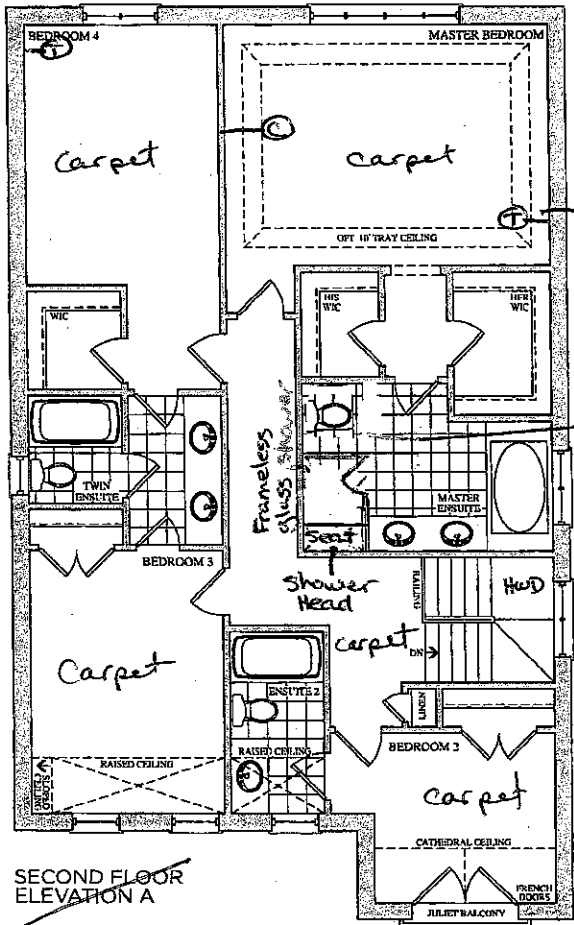

SECOND FLOOR  
ELEVATION A

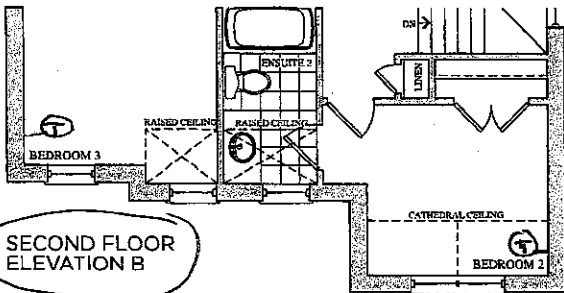

SECOND FLOOR  
ELEVATION B

Lot 31  
Sept 28, 16  
Ⓢ

Prices, figures, illustrations, sizes, features and finishes are subject to change without notice. E.A.O.L. Areas and dimensions are approximate and actual usable floor space may vary from the stated area. Layout may be reverse of the unit purchased. E. & O.E.

GOLDPARK  
HOMES

Lot 31  
Feb. 9, 17  
Ⓢ

Ⓢ

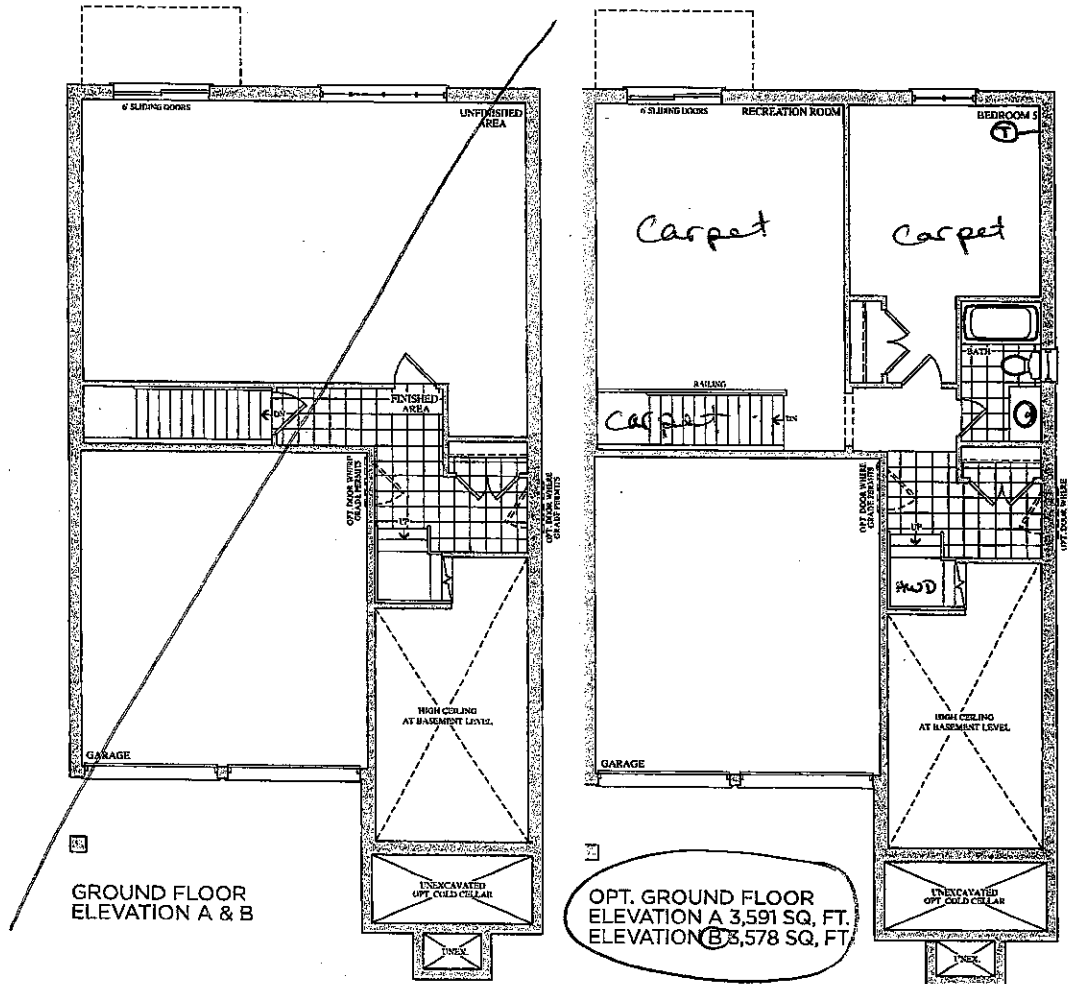

Lot 31  
Sept 28, 16



Prices, figures, illustrations, sizes, features and finishes are subject to change without notice. E.&O.E. Areas and dimensions are approximate and actual usable floor space may vary from the stated area. Layout may be reverse of the unit purchased. E. & O.E.

GOLDPARK  
HOMES

Lot 31  
Feb. 9, 17





Date: 06/23/16

Trade Name: Gold Park Homes	Site location: Brampton	Model: 38-6
Address:	Project: Encore	Phase:

This layout has been explained to the purchaser by Cortina Kitchens Inc. and is understood by the purchaser.

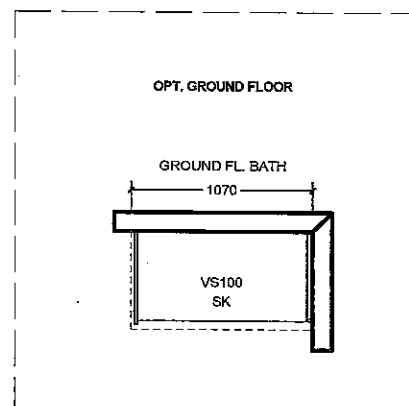
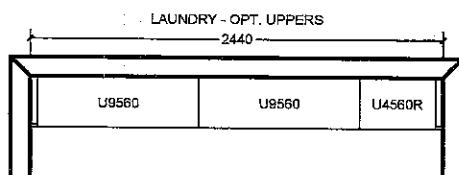
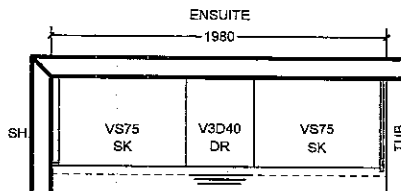
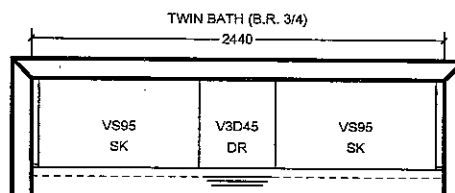
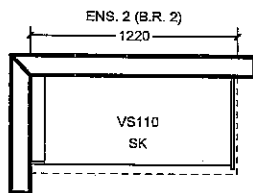
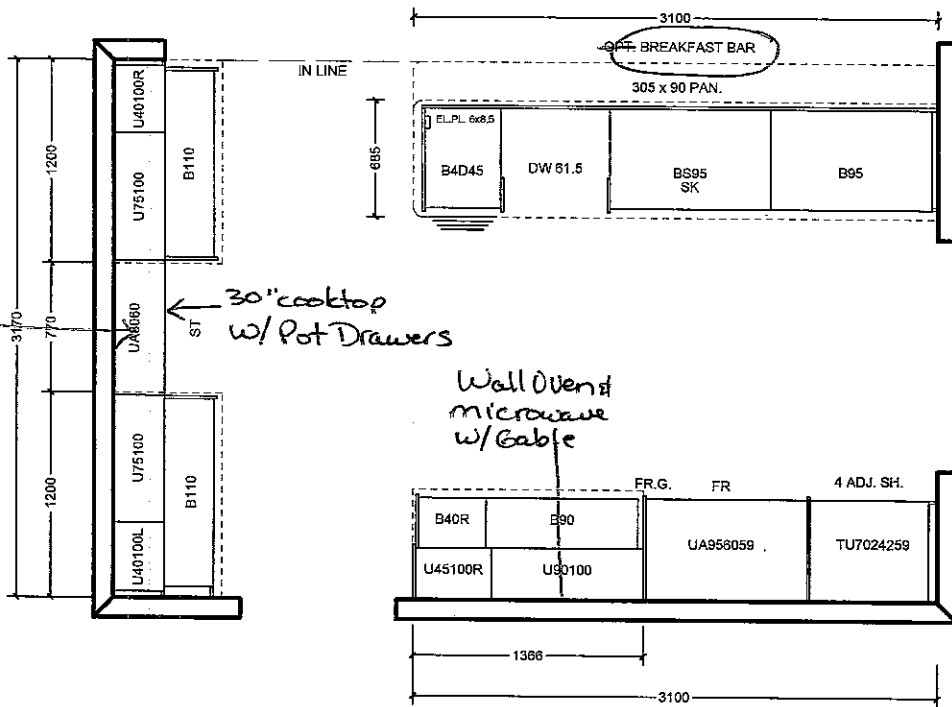

All prices subject to confirmation from head office.  
This quotation is subject to the terms & conditions set out  
in Cortina's Agreement of Purchase and Sale

All agreements are contingent upon strikes, accidents, and delay beyond our control.  
Please provide our installer with template for sinkholes or \$150.00 will be charged for callback.

ACCEPTED DATE: \_\_\_\_\_

CUSTOMER SIGNATURE \_\_\_\_\_

SALESPERSON SIGNATURE \_\_\_\_\_

CORTINA HEAD OFFICE APPROVAL \_\_\_\_\_

ITEM A. Wood grain and colour are characteristics of the product, we cannot guarantee that such grain and colour will always match.  
ITEM B. Cortina Kitchens reserves the right to alter dimensions and make technical changes without notice.

**\*Note** - Pantry to go in breakfast area -  
4 x Double Door Pantry 30cm deep, 242cm high.  
see floor plan.

Lot 31  
Feb. 9, 17

*[Handwritten signature]*

## STANDARD HARDWARE

STANDARD HARDWARE



CSI-6

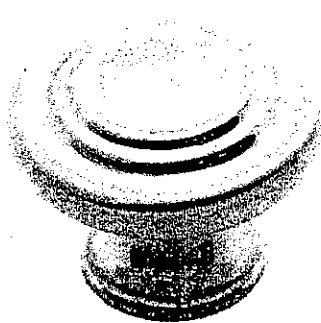

CSI-10



CSI-14

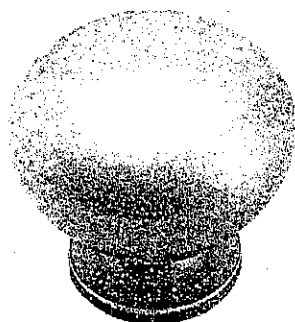

CSI-16

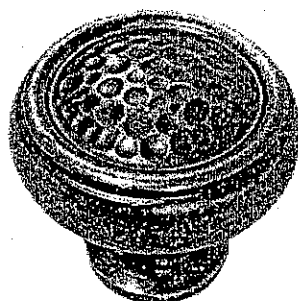

CSI-18 Ens. 2

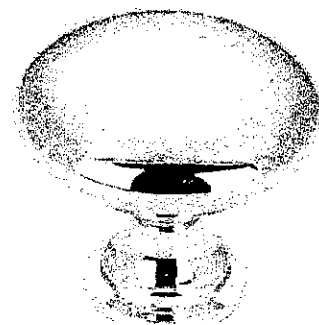

CSI-19

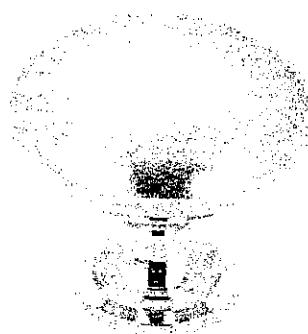

CSI-20



CSI-21



CSI-22 Twin

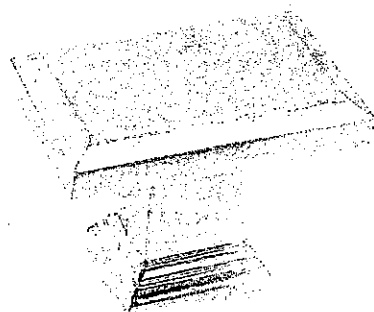

CSI-23

master

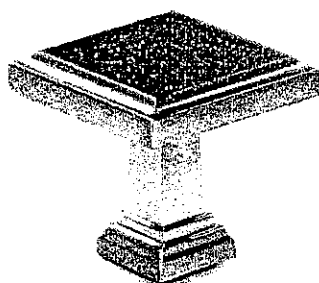

CSI-24

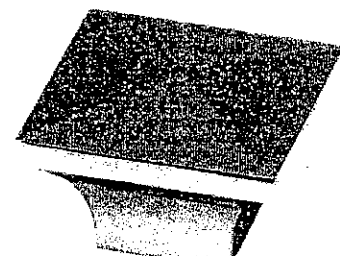

CSI-25

Ground Floor

## \*NOTES:

- IMAGES ARE FOR QUICK REFERENCE PURPOSES ONLY
- ACTUAL SIZES AND FINISHES AS PER HARDWARE SAMPLE BOARD PROVIDED TO DECOR CENTRE

## UPGRADE HARDWARE

UPGRADE HARDWARE



CH-32



CH-38



CH-44

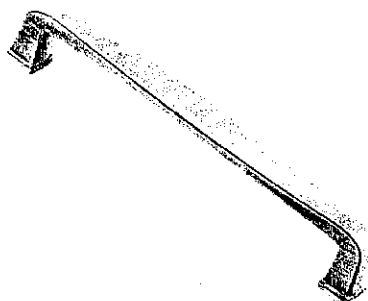

CH-45

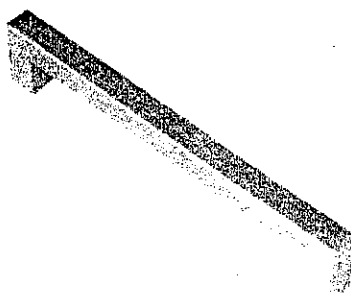

CH-46

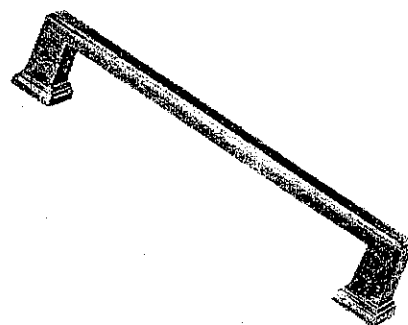

CH-47

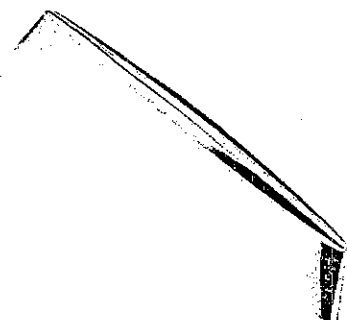

CH-48

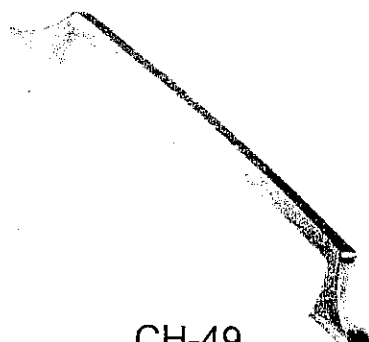

CH-49



CH-50

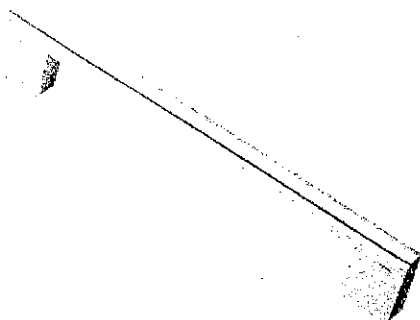

CH-51

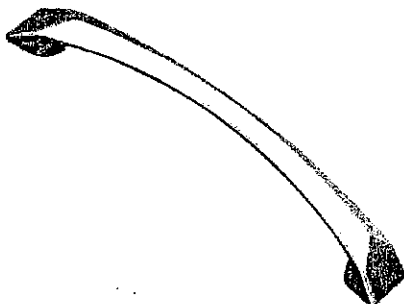

CH-52

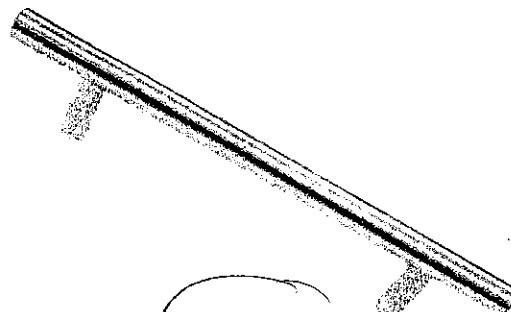

CH-53

Kitchen

**\*NOTES:**

- IMAGES ARE FOR QUICK REFERENCE PURPOSES ONLY
- ACTUAL SIZES AND FINISHES AS PER HARDWARE SAMPLE BOARD PROVIDED TO DECOR CENTRE

# CORTINA

KITCHENS INC.

70 Regina Road Woodbridge ON L4L 8L6  
905-264-6464

## INFORMATION - PVC DOORS

Builder: Gold Park Homes Project: Encore Lot #: 31

All cabinets with PVC (Thermofoil) Doors come with melamine gables, panels and kick. The doors, crown moulding and light valance are PVC wrapped. Open shelves incorporated in design will only be available with melamine interiors. There will be variations in colour shades between the PVC parts (doors, crown and Light valance) and the melamine parts (open shelves, Gables, Panels and Kick) due to the difference in material.

Furring Panel with crown moulding to the ceiling is not available on all PVC door styles due to subtle variations in colour shades between the PVC parts (moulding) and the melamine parts (furring panel) due to the difference in material. Grain directions in wood grain pattern melamine, vary between the furring panel, crown moulding (horizontal) and the PVC doors (vertical).

Thank you for your understanding.

---

I am well informed of this information, and agree to the purchase of the above.

Purchaser:  

Date: 9th Feb 2017

# GOLDPARK

WORTH MORE™

Attention: Building Department

Re: Lot # 31

This is to acknowledge that as the purchaser of the above noted lot, I have asked Gold Park Homes not to install the standard builder's kitchen exhaust hood. I will be installing my own unit after closing at my own expense and warranty. I also accept that the venting location will be as per the standard range hood.

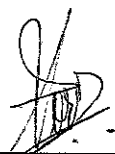
  
\_\_\_\_\_  
Purchaser

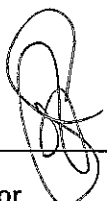
  
\_\_\_\_\_  
Vendor

  
\_\_\_\_\_  
Purchaser

Dated this 09 day of Feb, 2017.



Granite, Marble,  
Engineered Surfaces

- Standard 2CM & 3CM
- ⊖ Upgrade 1 2CM & 3CM
- ⊗ Upgrade 1 4 CM
- Upgrade 2

20mm (3/4") Profiles



30mm (1 1/4") Profiles

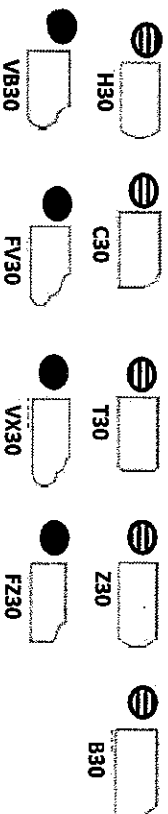

40mm (1 1/2") Profiles

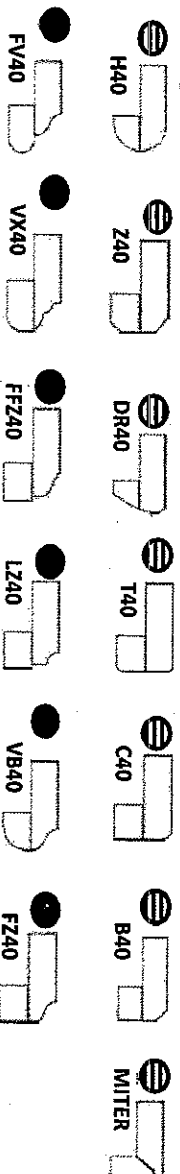

Note: All colours may not be available in 30mm at time ordered. Vendor reserves the right to use 40 mm edges (by lamination process).

\*Mitre edge is available in Upgrade 1 for an overall thickness of 2". All other Mitre edge options will be an Upgrade 2 Edge.

20131  
Feb. 9, 17  
Nerv