

Kleinburg Glen - 34R - 1 - 25-2 Elev.A HUDSON OPT- GFA1

APPLIANCES

Inv.1,198	1 - Purchaser Accepts Standard Appliance Openings: Fridge - 37-1/2"W x 73-1/2" High Approx. Range - 30-1/2"D x 31-1/2"W Approx. Dishwasher - 24" W Approx.
Line17790	Note:
19Feb17 / 23Feb17	

CARPET

Inv.1,198	1 - MASTER BEDROOM / BEDROOM 2 / BEDROOM 3 - Upgrade underpad to '12mm superpad'
Line17786	Note:
19Feb17 / 23Feb17	

CENTRAL VAC AND WIRING

Inv.719	1 - CONDUIT PIPE - FROM ATTIC TO ELECTRICAL PANEL - Locate in center of attic.
Line9719	Note:
2Aug16 / 7Nov16	

CERAMIC

Inv.719	1 - THRU OUT: DO *NOT* INSTALL ACCESSORIES, INSTALL MIRRORS AS PER STANDARD
Line12416	Note:
2Aug16 / 7Nov16	

Inv.1,198	1 - FOYER FLOOR TILE: Upgrade 5 - 24x24" polished - lay in straight, stacked pattern. Grout lines as small as possible!
Line17773	Note:
19Feb17 / 23Feb17	

Inv.1,198	1 - POWDER ROOM FLOOR TILE: Upgrade 5 - 24x24" polished - lay in straight, stacked pattern. Grout lines as small as possible!
Line17774	Note:
19Feb17 / 23Feb17	

Inv.1,198	1 - MASTER ENSUITE FLOOR TILE: UPGRADE 5 - 24X24" POLISHED -laid in straight, stacked pattern.
Line17779	Note:
19Feb17 / 23Feb17	

Inv.1,198	1 - MASTER ENSUITE WALL TILE: Upgrade 2 - Crystalo glass mosaic
Line17780	Note:
19Feb17 / 23Feb17	

Inv.1,198	1 - MAIN BATH FLOOR TILE: UPGRADE 5 - 24X24" POLISHED -laid in straight, stacked pattern.
Line17781	Note:
19Feb17 / 23Feb17	

Inv.1,198	1 - MAIN BATH WALL TILE: Upgrade 2 -cristallo glass mosaic
Line17782	Note:
19Feb17 / 23Feb17	

DRYWALL

Inv.719	1 - SMOOTH CEILINGS - (2 - Story Design) 2ND FLOOR
Line9732	Note:
2Aug16 / 7Nov16	

Kleinburg Glen - 34R - 1 - 25-2 Elev.A HUDSON OPT- GFA1

Inv.719	1 - SECOND FLOOR CEILING 9 FOOT - 25 FOOT MODELS ONLY- 96" SECOND FLOOR DOORS AND ARCHES, TALLER FRONT AND REAR 2ND FLOOR WINDOWS
Line13504	Note:
2Aug16 / 7Nov16	

ELECTRICAL

Inv.719	1 - KITCHEN: 110V WALL RECEPTACLE ON DEDICATED CIRCUIT - GAS FIRED APPLIANCE - FOR AUX. EQUIPMENT - NOT A STOVE PLUG
Line9720	Note:
2Aug16 / 7Nov16	

Inv.719	1 - KITCHEN: 110V WALL RECEPTACLE ON DEDICATED CIRCUIT - FOR future 600+ cfm hood fan
Line9724	Note:
2Aug16 / 7Nov16	

Inv.719	1 - KITCHEN CABINET STRIP VALANCE LIGHTS (UNDER CABINETS) - ROUGH - IN - DOES NOT INCLUDE (AND REQUIRES) KITCHEN UPGRADE PRICING
Line9725	Note:
2Aug16 / 7Nov16	

Inv.719	2 - MASTER ENSUITE: ROUGH - IN WALL OUTLET ON SAME SWITCH - DOES NOT INCLUDE FIXTURE - ADD on either side of vanity, see plan for location.
Line9730	Note:
2Aug16 / 7Nov16	

Inv.719	1 - KITCHEN: RELOCATE STANDARD FIXTURE - MOVE TO ABOVE ISLAND, SEE PLAN FOR LOCATION.
Line9727	Note:
2Aug16 / 7Nov16	

Inv.719	1 - KITCHEN: ROUGH - IN CEILING OUTLET ON SAME SWITCH - DOES NOT INCLUDE FIXTURE - Locate above island, use same switch as standard ceiling light.
Line9728	Note:
2Aug16 / 7Nov16	

Inv.719	1 - POWDER ROOM: ROUGH - IN CEILING OUTLET ON SAME SWITCH - DOES NOT INCLUDE FIXTURE - Locate in approx. center of room. In addition to standard vanity light, add a ceiling light using same switch.
Line9729	Note:
2Aug16 / 7Nov16	

Inv.1,198	1 - **ATTENTION** KITCHEN: *DELETE* from order PE.719.1 -110V WALL RECEPTACLE ON DEDICATED CIRCUIT - GAS FIRED APPLIANCE - FOR AUX. EQUIPMENT - NOT A STOVE PLUG *do not install*
Line17770	Note:
19Feb17 / 23Feb17	

EXTERIOR COLOURS

Inv.719	1 - EXTERIOR COLOUR PACKAGE 4
Line13400	Note:
2Aug16 / 7Nov16	

FRAMING

Inv.719	1 - KITCHEN: REDUCE BULKHEADS TO ALLOW FOR FUTURE FURRING PANEL AND CROWN MOULDING TO CEILING.
Line9735	Note:
2Aug16 / 7Nov16	

Kleinburg Glen - 34R - 1 - 25-2 Elev.A HUDSON OPT- GFA1

Inv.719	1 - SECOND FLOOR CEILING 9 FOOT - 25 FOOT MODELS ONLY- 96" SECOND FLOOR DOORS AND ARCHES, TALLER FRONT AND REAR 2ND FLOOR WINDOWS
Line9736	Note:
2Aug16 / 7Nov16	
Inv.719	8 - MAIN FLOOR: FRAME MAIN FLOOR ARCHES & DOORS AT 96 INCH - ADDED WITH THE ADDITION OF TALLER INTERIOR DOORS
Line9738	Note:
2Aug16 / 7Nov16	
Inv.719	1 - BEDROOM 3/LAUNDRY: *REMOVE* DOOR FROM HALLWAY, REMOVE WALL BETWEEN BEDROOM 3 AND 2ND FLOOR LAUNDRY CREATING 1 BIG BEDROOM, STANDARD FINISHES INCLUDING CARPET.
Line9743	Note:
2Aug16 / 7Nov16	
Inv.719	1 - OPTIONAL GROUND FLOOR
Line13401	Note:
2Aug16 / 7Nov16	
Inv.719	1 - MASTER BEDROOM: *DELETE* Reach-in closet.
Line13500	Note:
2Aug16 / 7Nov16	
Inv.719	1 - MAN DOOR GARAGE TO HOUSE - OPTIONAL - IF GRADE PERMITS
Line13506	Note:
2Aug16 / 7Nov16	
Inv.1,198	1 - MASTER ENSUITE: UPGRADE TO FREE STANDING TUB - UPG1 ONLY
Line17988	Note:
19Feb17 / 23Feb17	

GLASS AND MIRROR

Inv.1,198	1 - MASTERE ENSUITE: CONVERT FRAMED SHOWER TO 10MM FRAMLESS SHOWER ENCLOSURE WITH DOOR AND 10MM SIDE PANEL
Line17791	Note:
19Feb17 / 23Feb17	

HARDWOOD

Inv.1,198	1 - UPPER HALL HARDWOOD: Upgrade to 'standard' red oak natural
Line17778	Note:
19Feb17 / 23Feb17	

HVAC

Inv.719	1 - KITCHEN: UPGRADE VENTING FOR STOVE TO 8 INCH PIPE EXTERIOR WALL
Line9722	Note:
2Aug16 / 7Nov16	
Inv.719	1 - KITCHEN: GAS LINE ROUGH - GROUND FLOOR
Line9721	Note:
2Aug16 / 7Nov16	
Inv.719	1 - 2nd FLOOR LAUNDRY: Move washer/dryer and tub to basement
Line12414	Note:
2Aug16 / 7Nov16	

Kleinburg Glen - 34R - 1 - 25-2 Elev.A HUDSON OPT- GFA1

Inv.1,198	1 - **ATTENTION** KITCHEN: *DELETE* from order PE.719.1 GAS LINE ROUGH - GROUND FLOOR *do not install*
Line17769	Note:
19Feb17 / 23Feb17	

INTERIOR TRIM AND DOORS

Inv.719	1 - MASTER BEDROOM: *DELETE* Reach-in closet.
Line9731	Note:
2Aug16 / 7Nov16	
Inv.719	3 - MAIN FLOOR: EXTENDED HEIGHT ARCHWAY (PRICE PER DOORWAY) - 96"
Line9739	Note:
2Aug16 / 7Nov16	
Inv.719	4 - MAIN FLOOR: STANDARD DOOR EXTENDED HEIGHT 96 INCH (PRICE PER DOOR) - GROUND FLOOR 2 STOREY MODELS
Line9740	Note:
2Aug16 / 7Nov16	
Inv.719	1 - BEDROOM 3/LAUNDRY: *REMOVE* DOOR FROM HALLWAY, REMOVE WALL BETWEEN BEDROOM 3 AND 2ND FLOOR LAUNDRY CREATING 1 BIG BEDROOM, STANDARD FINISHES INCLUDING CARPET
Line12415	Note:
2Aug16 / 7Nov16	
Inv.719	1 - SECOND FLOOR CEILING 9 FOOT - 25 FOOT MODELS ONLY- 96" SECOND FLOOR DOORS AND ARCHES, TALLER FRONT AND REAR 2ND FLOOR WINDOWS
Line13396	Note:
2Aug16 / 7Nov16	
Inv.719	1 - SECOND FLOOR CEILING 9 FOOT - 25 FOOT MODELS ONLY- 96" SECOND FLOOR DOORS AND ARCHES, TALLER FRONT AND REAR 2ND FLOOR WINDOWS
Line13501	Note:
2Aug16 / 7Nov16	
Inv.1,198	12 - THRU OUT: Upgrade interior door handles to "modern square' brushed finish
Line17792	Note:
19Feb17 / 23Feb17	
Inv.1,198	1 - TRIM THRU OUT: Upgrade package 2
Line17783	Note:
19Feb17 / 23Feb17	

MISC.

Inv.719	1 - Purchaser has attended a Structural appointment at the Decor Centre & has DECLINED any additional upgrades and accepts and acknowledges that there will be no further structural changes/additions/deletions to be made upon signing on August 2, 2016.
Line9744	Note:
2Aug16 / 7Nov16	
Inv.719	1 - Purchasers are aware & accepts that ANY changes made to upgrades after signing this Purchasers Extra Form are subject to a minimum administration fee of \$500. PLUS a 10% holdback fee.
Line9745	Note:
2Aug16 / 7Nov16	
Inv.719	1 - BONUS PACKAGE: \$5,000.00 (INCLUDING TAXES) WORTH OF UPGRADES FROM GOLD PARK HOMES DÉCOR CENTRE IS BEING APPLIED TOWARD THE STRUCTURAL APPOINTMENT. PURCHASER HAS A REMAINING AMOUNT OF \$00 (INCLUDING TAXES) TO BE USED TOWARD THE COLOUR APPOINTMENT.
Line9746	Note:
2Aug16 / 7Nov16	

Kleinburg Glen - 34R - 1 - 25-2 Elev.A HUDSON OPT- GFA1

Inv.1,198	1 - Purchaser has attended a Colour appointment at the Decor Centre & has DECLINED any additional upgrades and accepts and acknowledges that there will be no further changes/additions/deletions to be made upon signing on February 19 2017.
Line17787	Note:
19Feb17 / 23Feb17	

Inv.1,198	1 - Purchasers are aware & accepts that ANY changes made to upgrades after signing this Purchasers Extra Form are subject to a minimum administration fee of \$500. PLUS a 10% holdback fee.
Line17788	Note:
19Feb17 / 23Feb17	

PAINTING

Inv.719	1 - SECOND FLOOR CEILING 9 FOOT - 25 FOOT MODELS ONLY- 96" SECOND FLOOR DOORS AND ARCHES, TALLER FRONT AND REAR 2ND FLOOR WINDOWS
Line13502	Note:
2Aug16 / 7Nov16	

PLUMBING

Inv.719	1 - 2nd FLOOR LAUNDRY: Move washer/dryer and tub to basement
Line9742	Note:
2Aug16 / 7Nov16	

Inv.1,198	1 - MASTER ENSUITE: UPGRADE TO FREE STANDING TUB - UPG1 ONLY
Line17771	Note:
19Feb17 / 23Feb17	

STAIRS AND RAILINGS

Inv.1,198	1 - MAIN STAIRS: Euroline 2 + V Groove
Line17784	Note:
19Feb17 / 23Feb17	

WINDOWS AND DOORS

Inv.719	1 - GARAGE MAN DOOR: Upgrade to 96" metal door from house to garage.
Line9741	Note:
2Aug16 / 7Nov16	

Inv.719	1 - SECOND FLOOR CEILING 9 FOOT - 25 FOOT MODELS ONLY- 96" SECOND FLOOR DOORS AND ARCHES, TALLER FRONT AND REAR 2ND FLOOR WINDOWS
Line13397	Note:
2Aug16 / 7Nov16	

Inv.719	1 - SECOND FLOOR CEILING 9 FOOT - 25 FOOT MODELS ONLY- 96" SECOND FLOOR DOORS AND ARCHES, TALLER FRONT AND REAR 2ND FLOOR WINDOWS
Line13503	Note:
2Aug16 / 7Nov16	

Inv.719	1 - MAN DOOR GARAGE TO HOUSE - OPTIONAL - IF GRADE PERMITS
Line13505	Note: AS PER APS
2Aug16 / 7Nov16	

Purchaser: Linda Ricci
Telephone Res. / Bus: (416) 414-6677
Decor Advisor: Yolande Somerville

Property: 34R
Project: Burkshire Holdings Inc.
Model and Elevation: 25-2 Elev.A HUDSON OPT- GFA1

Layout Changes: ☒ Yes ☐ No Sketch Attached: ☒ Yes ☐ No Exterior Colour Scheme:

1. Cabinetry

	Style and Colour	Counter	Hardware
Kitchen / Breakfast	p-400 pvc 'mystic'	Granite: Grigio Sardo Edge: FE-20	cs1-24
Laundry Room	n/a	n/a	n/a
Powder Room	n/a	n/a	n/a
n/a			
Master Ensuite Bathroom	p-400 pvc 'white crystal'	P-Lam #4926k-07 'Black Alicante'	cs1-23
Second Ensuite Bathroom (If Applicable)	n/a	n/a	n/a
Main Bathroom	p-400 pvc 'white crystal'	P-Lam #6697-46 'Argento Romano'	cs1-23
Dishwasher Cabinet	n/a		

Comment

Standard Appliance Openings!

2. Floor Tile

	Selection	Grout	Threshold
Entrance Vestibule	*24x24" Arya pol. 'White/Grey'	n/a	n/a
Main Hall	n/a	n/a	n/a
Kitchen / Breakfast	13X13" Reflection 'White'	n/a	n/a
Laundry Room	n/a	n/a	n/a
Powder Room	*24x24" Arya pol. 'White/Grey'	n/a	n/a
	n/a	n/a	n/a
Master Ensuite Bathroom	*24x24" Arya pol. 'White/Grey'	n/a	n/a
Second Ensuite Bathroom (If Applicable)	n/a	n/a	n/a
Lower Landing (If Applicable)	n/a	n/a	n/a
Main Bathroom	*24x24" Arya pol. 'White/Grey'	n/a	n/a

Comment

Grout lines as small as possible, please!

3. Wall Tile

	Selection	Listello/Inserts	Describe
		<input type="radio"/> Yes <input checked="" type="radio"/> No	
Master Ensuite Bathroom			
Tub Deck	n/a	<input type="radio"/> Yes <input checked="" type="radio"/> No	
Shower Stall	*Crystalloglass'superwhite' mat/glos	<input type="radio"/> Yes <input checked="" type="radio"/> No	
Bathroom Walls	n/a	<input type="radio"/> Yes <input checked="" type="radio"/> No	
Second Ensuite Bathroom (If Applicable)	n/a	<input type="radio"/> Yes <input checked="" type="radio"/> No	
Main Bathroom	*Crystalloglass'superwhite' mat/glos	<input type="radio"/> Yes <input checked="" type="radio"/> No	

Kitchen Backsplash

☐ Yes ☒ No

Backsplash Behind Fridge

n/a

Comment

Scheduled Closing Date: Monday, January 30, 2017

Purchaser: Linda Ricci
Telephone Res. / Bus: (416) 414-6677
Decor Advisor: Yolande Somerville

Property: 34R
Project: Burkshire Holdings Inc.
Model and Elevation: 25-2 Elev.A HUDSON OPT- GFA1

4. Plumbing Fixtures

<input type="checkbox"/>	Second Ensuite	<input type="checkbox"/>	Powder Room	<input type="checkbox"/>	
Master Ensuite Bathroom	<input type="checkbox"/>	Other Room - Specify	<input type="checkbox"/>	Other Washroom	<input type="checkbox"/>

Comment

Standard Thru Out

5. Hardwood Flooring

	Type and Stain		Type and Stain
Main Hall	standard red oak 'natural	Upper Landing	n/a
Kitchen / Breakfast	n/a	Upper Hall	*standard red oak 'natural
Living Room	standard red oak 'natural	Master Bedroom	n/a
Dining Room	standard red oak 'natural	Bedroom #2	n/a
Family Room	standard red oak 'natural	Bedroom #3	n/a
Den/Library	n/a	Bedroom #4	n/a
Entrance Vestibule	n/a	Bedroom #5	n/a
Lower Landing (If Applicable)	n/a	Other Room - Specify	

Comment

Hardwood Selection: Preverco 3/4 x 4-1/4" Red Oak 'Natural'

6. Carpeting

	Upgrade	Description
Main Hall	<input type="checkbox"/>	n/a
Living Room	<input type="checkbox"/>	n/a
Dining Room	<input type="checkbox"/>	n/a
Family Room	<input type="checkbox"/>	n/a
Den/Library	<input type="checkbox"/>	n/a
Upper Hall	<input type="checkbox"/>	n/a
Master Bedroom	<input type="checkbox"/>	T-04
Bedroom #2	<input type="checkbox"/>	T-04
Bedroom #3	<input type="checkbox"/>	T-04
Bedroom #4	<input type="checkbox"/>	n/a
Bedroom #5	<input type="checkbox"/>	n/a
Former laundry	<input type="checkbox"/>	T-04
Upper Landing (If Applicable)	<input type="checkbox"/>	n/a
Lower Landing (If Applicable)	<input type="checkbox"/>	n/a

Upgrade Underpad	Type *Superpad 12mm	Area Bedrooms
Carpet on Stairs	Capped n/a	Runner - *Upgrade n/a

Comment

Note: Laundry has moved to basement

Purchaser: Linda Ricci
Telephone Res. / Bus: (416) 414-6677
Decor Advisor: Yolande Somerville

Property: 34R
Project: Burkshire Holdings Inc.
Model and Elevation: 25-2 Elev.A HUDSON OPT- GFA1

7. Fireplace

	Living Room			Family Room			Other Room - Specify		
	Purchased	As Per Plan	N/A	Purchased	As Per Plan	N/A	Purchased	As Per Plan	N/A
Fireplace Type	<input type="radio"/>	<input type="radio"/>	<input checked="" type="radio"/>	<input type="radio"/>	<input checked="" type="radio"/>	<input type="radio"/>	<input type="radio"/>	<input type="radio"/>	<input checked="" type="radio"/>
Mantle Type				Standard Gas					
Colour / Stain				Standard					
Surround				None					
Hearth				None					
Comment	<div></div>								

8. Trim Carpentry

Interior Doors Front Door Glass Inserts Door Handles

Interior Trim

Comment

*Standard door profile, but 96" thru out

*Upgrade interior door hardware to "Square" lever - brushed finish

9. Plaster Mouldings and Medallions

Entrance Vestibule	<input type="text"/>	<input type="text"/>	Kitchen/Breakfast	<input type="text"/>	<input type="text"/>
Main Hall	<input type="text"/>	<input type="text"/>	Den/Library	<input type="text"/>	<input type="text"/>
Living Room	<input type="text"/>	<input type="text"/>	Lower Landing	<input type="text"/>	<input type="text"/>
Dining Room	<input type="text"/>	<input type="text"/>	Other Room - Specify	<input type="text" value="none"/>	<input type="text"/>
Family Room	<input type="text"/>	<input type="text"/>	Thru out	<input type="text"/>	<input type="text"/>
Comment	<div></div>				

10. Railings and Spindles

Railing Package

Railing Colour

Stringer / Riser

Spindle Colour

Treads

Oak Stairs ☒ Yes ☐ No

Comment

11. Wall Paint

Main & Upper Hall	<input type="text"/>	Master Bedroom	<input type="text"/>
Living Room	<input type="text"/>	Bedroom #2	<input type="text"/>
Dining Room	<input type="text"/>	Bedroom #3	<input type="text"/>
Kitchen / Breakfast	<input type="text"/>	Bedroom #4	<input type="text"/>
Family Room	<input type="text"/>	Bedroom #5	<input type="text"/>
Powder Room	<input type="text"/>	Master Ensuite	<input type="text"/>
Laundry Room	<input type="text"/>		<input type="text"/>
Den/Library	<input type="text"/>	Second Ensuite	<input type="text"/>
Trim Paint	<input type="text"/>	Thru Out	<input type="text" value="Warm Grey"/>
Comment	Smooth Ceilings First Floor <input type="text"/>		

Scheduled Closing Date: Monday, January 30, 2017

Purchaser: Linda Ricci
Telephone Res. / Bus: (416) 414-6677
Decor Advisor: Yolande Somerville

Property: 34R
Project: Burkshire Holdings Inc.
Model and Elevation: 25-2 Elev.A HUDSON OPT- GFA1

12. Electrical

Plugs and Switches ☒ White ☐ Ivory
Hood Fan ☐ White ☐ Ivory
Appliances Built in Cooktop Built in Oven Gas Stove Microwave
☐ Yes ☒ No ☐ Yes ☒ No ☐ Yes ☒ No ☐ Yes ☒ No
Above Kitchen Cabinet Light ☐ Yes ☒ No
Below Kitchen Cabinet Light ☒ Yes ☐ No

Comment
Standard Stainless Steel Hood Fan

13. Heating and Air Conditioning

Air Conditioning Gas Provisions Stove
Gas Provisions Dryer Gas Provisions Barbecue

Comment
Standard Gas Fireplace

14. Additional Comments

15. Disclaimers and Notes

- 1) Colours of all materials are as close as possible to builder's selection, but not necessarily identical due to variances in manufacturing.
- 2) Any extras listed above are null and void unless accompanied by a separate invoice/amendment. Said invoice must be paid in full.
- 3) The Purchaser acknowledges that after Interior Colour Selection form is signed and dated, no further changes will be permitted other than re-selection due to unavailability. _____ Purchaser's Initials
- 4) The Purchaser acknowledges reading and accepting the "Gold Park Homes Decor Centre Disclaimers" form. This document contains other miscellaneous disclaimers.

This Interior Colour Selection is final and approved by:

Signature:  Date: _____

CORTINA

KITCHENS INC.

70 Regina Road Woodbridge ON L4L 8L6
905-264-6464

INFORMATION - PVC DOORS

Builder: Gold Park Homes Project..... Lot # 34R

All cabinets with PVC (Thermofoil) Doors come with melamine gables, panels and kick. The doors, crown moulding and light valance are PVC wrapped. Open shelves incorporated in design will only be available with melamine interiors. There will be variations in colour shades between the PVC parts (doors, crown and Light valance) and the melamine parts (open shelves, Gables, Panels and Kick) due to the difference in material.

Furring Panel with crown moulding to the ceiling is not available on all PVC door styles due to subtle variations in colour shades between the PVC parts (moulding) and the melamine parts (furring panel) due to the difference in material. Grain directions in wood grain pattern melamine, vary between the furring panel, crown moulding (horizontal) and the PVC doors (vertical).

Thank you for your understanding.

I am well informed of this information, and agree to the purchase of the above.

Purchaser: 

Date: Feb 19 2017

GOLDPARK
HOMES

Kleinburg

**Granite, Marble,
Engineered Surfaces**

- Standard 2CM & 3CM
- ⊖ Upgrade 1 2CM & 3CM
- ⊗ Upgrade 1 4 CM
- Upgrade 2

KG-3AR

Feb. 19 2017



20mm (3/4") Profiles

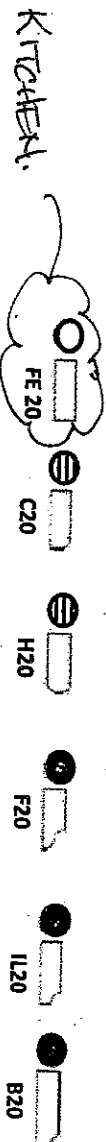

30mm (1 1/8") Profiles

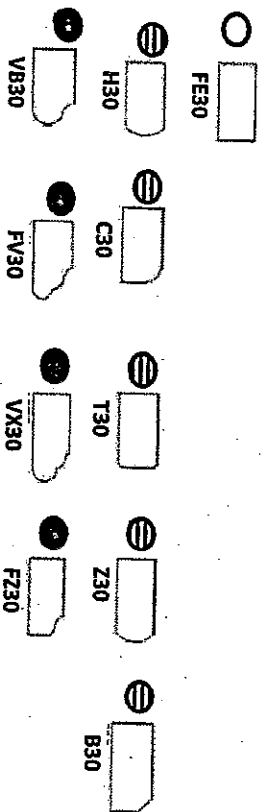

40mm (1 1/2") Profiles

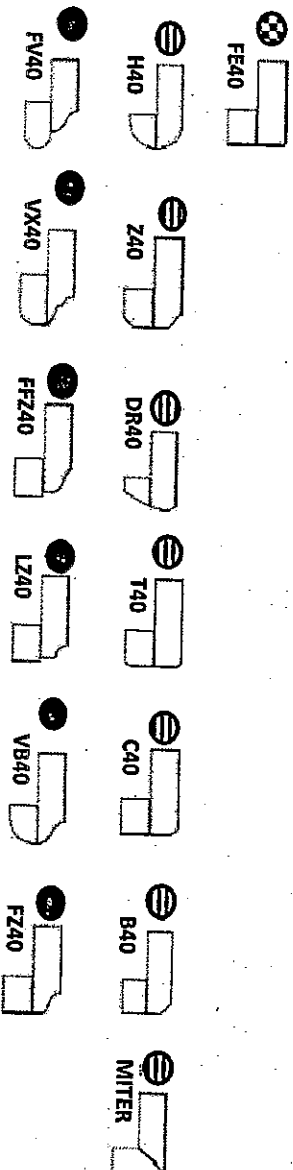

Note: All colours may not be available in 30mm at time ordered. Vendor reserves the right to use 40 mm edges (by lamination process).

*Mitre edge is available in Upgrade 1 for an overall thickness of 2". All other Mitre edge options will be an Upgrade 2 Edge.

*STD SINK & FAUCET.



CSI-6



CSI-10

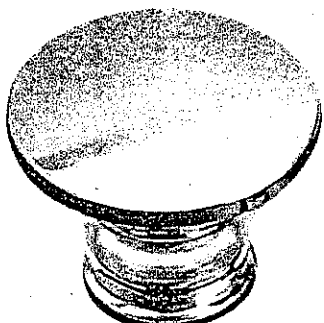

CSI-14

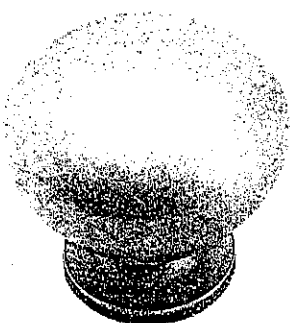

CSI-16



CSI-18

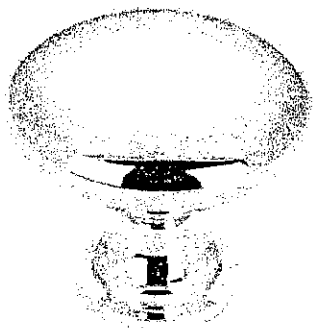

CSI-19



CSI-20



CSI-21



CSI-22

MASTER
+
MAIN BATH

KITCHEN

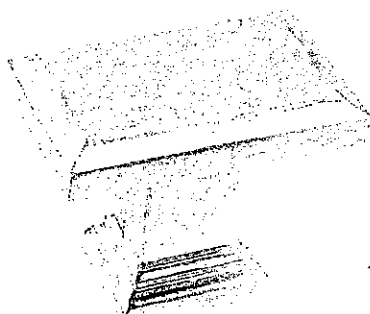

CSI-23

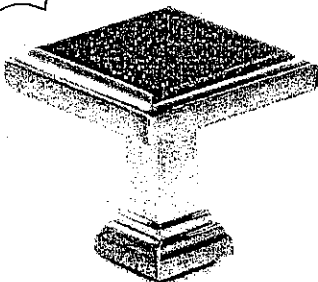

CSI-24

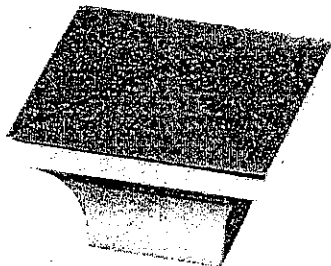

CSI-25

***NOTES:**

- IMAGES ARE FOR QUICK REFERENCE PURPOSES ONLY
- ACTUAL SIZES AND FINISHES AS PER HARDWARE SAMPLE BOARD PROVIDED TO DECOR CENTRE

Elevation A • 1,898 sq.ft.

Elevation B • 1,898 sq.ft.

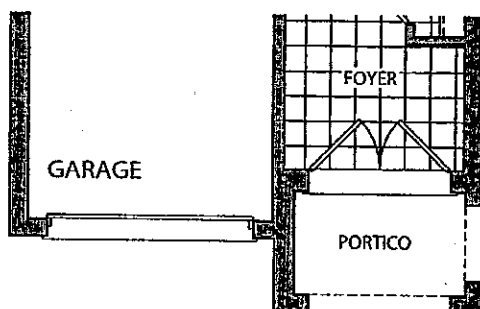
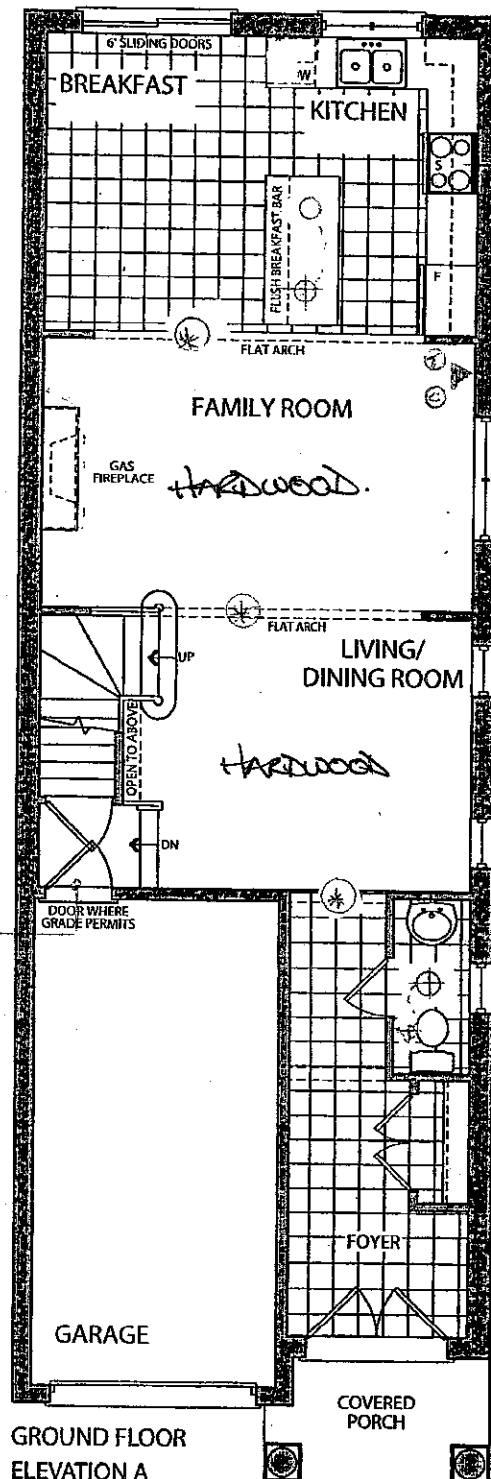

GROUND FLOOR
ELEVATION B

GROUND FLOOR
ELEVATION A

*NO FIRE IN KITCHEN!

~~GAS LINE: 1" DUCT~~
~~8" DUCT~~
~~BEHIND~~

16" METAL
DOOR

96" DOORS
+ ARCHES

KG-34R
FEB 19 2017

34R
AUG 2 2016

Elevation A • 1,898 sq.ft.

Elevation B • 1,898 sq.ft.

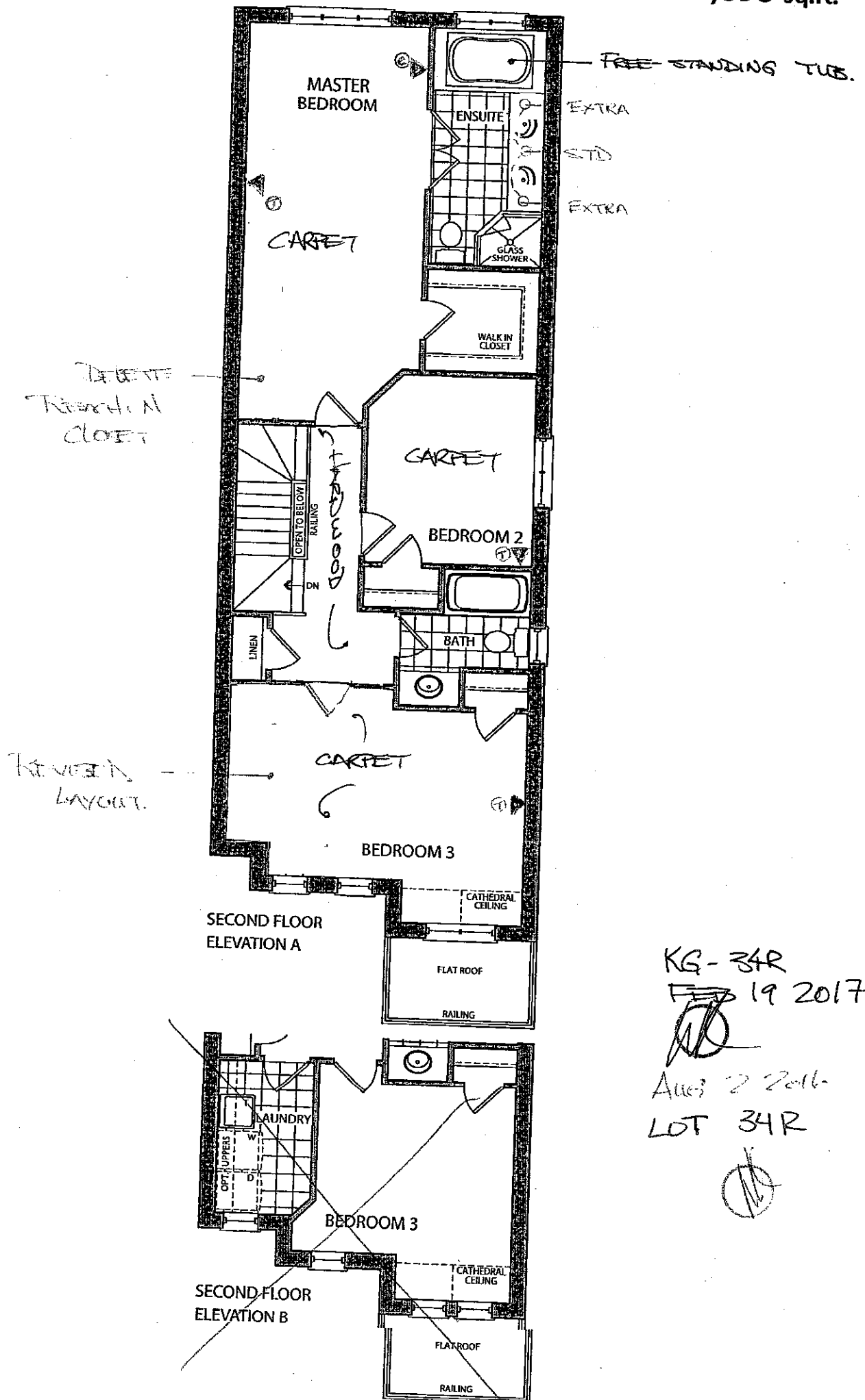

KG-34R
Feb 19 2017

Aug 2 2016
LOT 34R