

Kleinburg Glen - 92 - 1 - 38-5 Elev.B ROSEMONT

CERAMIC

Inv.1,147	1 - FOYER / LAUNDRY / POWDER / KITCHEN FLOOR TILE: Upgrade 2 - 12x24" Antikos - laid in straight, stacked pattern. See plan for tile direction.
Line16966	Note:
31Jan17 / 22Feb17	
Inv.1,147	1 - MASTER ENSUITE FLOOR TILE: Upgrade 2 12x24" New Byzantine - laid in straight, stacked pattern - see plan for tile direction.
Line16970	Note:
31Jan17 / 22Feb17	

DRYWALL

Inv.610	1 - SMOOTH CEILINGS - (2 - Story Design) 2ND FLOOR
Line7527	Note:
27Jun16 / 18Oct16	

EXTERIOR COLOURS

Inv.610	1 - EXTERIOR COLOUR PACKAGE 8
Line12768	Note:
27Jun16 / 18Oct16	

FRAMING

Inv.610	1 - MAIN FLOOR CEILING 10FT- INCLUDES: TALLER FRONT DOOR WITH TRANSOM, TALLER FRONT AND REAR ELEVATION WINDOWS OR WITH TRANSOM, EXTRA TALL FLAT ARCHES, 8' TALL INTERIOR DOORS, WITH KITCHEN CROWN AND FURRING PANEL
Line7528	Note:
27Jun16 / 18Oct16	
Inv.610	19 - SECOND FLOOR: FRAME 2ND FLOOR DOORS AT 96 INCH - ADDED WITH THE ADDITION OF TALLER INTERIOR DOORS
Line7530	Note:
27Jun16 / 18Oct16	

HARDWOOD

Inv.1,147	1 - GREAT ROOM / DINING ROOM / DEN / MAIN HALL HARDWOOD FLOOR: Upgrade 1 - Preverco red oak smooth 3/4 x 4-1/4"
Line16967	Note:
31Jan17 / 22Feb17	
Inv.1,147	1 - UPPER HALL HARDWOOD FLOOR: Upgrade 1 - Preverco red oak smooth 3/4 x 4-1/4"
Line16968	Note:
31Jan17 / 22Feb17	
Inv.1,147	1 - MASTER BEDROOM / BEDROOM 2 / BEDROOM 3 / BEDROOM 4 HARDWOOD FLOOR: Upgrade 1 - Preverco red oak smooth 3/4 x 4-1/4"
Line16969	Note:
31Jan17 / 22Feb17	

INTERIOR TRIM AND DOORS

Inv.610	18 - 19 STANDARD DOOR EXTENDED HEIGHT 96 INCH (PRICE PER DOOR) - SECOND FLOOR 2 STOREY 38 FOOT AN 42 FOOT MODELS ONLY- 19 DOORS TOTAL.
Line7533	Note: SEE INVOICE PE: TO BE CHARGED FOR MISSING DOOR AT COLOUR APPT
27Jun16 / 18Oct16	

Kleinburg Glen - 92 - 1 - 38-5 Elev.B ROSEMONT

Inv.610	1 - MAIN FLOOR CEILING 10FT- INCLUDES: TALLER FRONT DOOR WITH TRANSOM, TALLER FRONT AND REAR ELEVATION WINDOWS OR WITH TRANSOM, EXTRA TALL FLAT ARCHES, 8' TALL INTERIOR DOORS, WITH KITCHEN CROWN AND FURRING PANEL
Line12425	Note:
27Jun16 / 18Oct16	

KITCHEN AND BATH CABINETRY

Inv.610	1 - MAIN FLOOR CEILING 10FT- INCLUDES: TALLER FRONT DOOR WITH TRANSOM, TALLER FRONT AND REAR ELEVATION WINDOWS OR WITH TRANSOM, EXTRA TALL FLAT ARCHES, 8' TALL INTERIOR DOORS, WITH KITCHEN CROWN AND FURRING PANEL
Line12426	Note:
27Jun16 / 18Oct16	
Inv.1,147	1 - KITCHEN CABINETRY: Slide-in stove prep
Line16965	Note:
31Jan17 / 22Feb17	

MISC.

Inv.610	1 - Purchaser has attended a Structural appointment at the Decor Centre & has DECLINED any additional upgrades and accepts and acknowledges that there will be no further structural changes/additions/deletions to be made upon signing on June 27, 2016
Line7539	Note:
27Jun16 / 18Oct16	
Inv.610	1 - Purchasers are aware & accepts that ANY changes made to upgrades after signing this Purchasers Extra Form are subject to a minimum administration fee of \$500. PLUS a 10% holdback fee.
Line7541	Note:
27Jun16 / 18Oct16	
Inv.610	1 - BONUS PACKAGE: \$7,500.00 (INCLUDING TAXES) WORTH OF UPGRADES FROM GOLD PARK HOMES DÉCOR CENTRE IS BEING APPLIED TOWARD THE STRUCTURAL APPOINTMENT. PURCHASER HAS A REMAINING AMOUNT OF \$00 (INCLUDING TAXES) TO BE USED TOWARD THE COLOUR APPOINTMENT.
Line7542	Note:
27Jun16 / 18Oct16	
Inv.1,147	1 - Purchaser has attended a Colour appointment at the Decor Centre & has DECLINED any additional upgrades and accepts and acknowledges that there will be no further changes/additions/deletions to be made upon signing on January 31 2017.
Line16973	Note:
31Jan17 / 22Feb17	
Inv.1,147	1 - Purchasers are aware & accepts that ANY changes made to upgrades after signing this Purchasers Extra Form are subject to a minimum administration fee of \$500. PLUS a 10% holdback fee.
Line16974	Note:
31Jan17 / 22Feb17	
Inv.1,147	1 - Purchaser Accepts Standard Appliance Openings: Fridge - 37-1/2"W x 73-1/2" High Approx. Range - 30-1/2"D x 31-1/2"W Approx. Dishwasher - 24" W Approx.
Line16975	Note:
31Jan17 / 22Feb17	

PAINTING

Inv.1,147	1 - MAIN STAIRS: Stain stairs to match hardwood, as close as possible.
Line16972	Note:
31Jan17 / 22Feb17	

STAIRS AND RAILINGS

Kleinburg Glen - 92 - 1 - 38-5 Elev.B ROSEMONT

Inv.1,147	1 - MAIN STAIRS: Euroline 1 + V Groove
Line16971	Note:
31Jan17 / 22Feb17	

WINDOWS - BASEMENT

Inv.610	3 - BASEMENT WINDOWS - UPGRADE EXISTING BASEMENT WINDOW TO 30 INCH X 24 INCH - MAY REQUIRE INSTALLATION OF WINDOW WELL
Line7697	Note:
27Jun16 / 18Oct16	

WINDOWS AND DOORS

Inv.610	1 - MAIN FLOOR CEILING 10FT- INCLUDES: TALLER FRONT DOOR WITH TRANSOM, TALLER FRONT AND REAR ELEVATION WINDOWS OR WITH TRANSOM, EXTRA TALL FLAT ARCHES, 8' TALL INTERIOR DOORS, WITH KITCHEN CROWN AND FURRING PANEL
Line12424	Note:
27Jun16 / 18Oct16	

Purchasers: Giovanni Roma & Cosimo Figliomeni

Property: 92

Telephone Res. / Bus: (905) 850-7625

Project: Burkshire Holdings Inc.

Decor Advisor: Yolande Somerville

Model and Elevation: 38-5 Elev.B ROSEMONT

Layout Changes: ☐ Yes ☒ No

Sketch Attached: ☒ Yes ☐ No

Exterior Colour Scheme:

1. Cabinetry

	Style and Colour	Counter	Hardware
Kitchen / Breakfast	varese pvc 'antq white'	Granite: Crema Caramel FE20	cs1-16
Laundry Room	n/a	n/a	n/a
Powder Room	n/a	n/a	n/a
Twin Bathroom	varese pvc 'mystic'	P-Lam #P-344-LM 'Inukshuk Grey'	cs1-18
Master Ensuite Bathroom	siena oak 'greystone'	P-Lam #8830-58 'Elemental Concrete'	cs1-23
Second Ensuite Bathroom (If Applicable)	varese pvc 'crystal white'	P-Lam #4926k-07 'Black Alicante'	cs1-18
n/a	n/a	n/a	n/a
Dishwasher Cabinet	n/a		

Comment

2. Floor Tile

	Selection	Grout	Threshold
Entrance Vestibule	*12x24" Antikas 'Beige'	n/a	n/a
Main Hall	n/a	n/a	n/a
Kitchen / Breakfast	*12x24" Antikas 'Beige'	n/a	n/a
Laundry Room	*12x24" Antikas 'Beige'	n/a	n/a
Powder Room	*12x24" Antikas 'Beige'	n/a	n/a
Twin Bathroom	13x13" Serpentine 'Beyaz-White'	n/a	n/a
Master Ensuite Bathroom	*12x24" New Byzantine 'Azzuro Blue'	n/a	n/a
Second Ensuite Bathroom (If Applicable)	13x13" Serpentine 'Grey'	n/a	n/a
Lower Landing (If Applicable)	n/a	n/a	n/a
n/a	n/a	n/a	n/a

Comment

Grout lines as small as possible, please!

3. Wall Tile

	Selection	Listello/Inserts	Describe
M. Ens. Tub Skirt/Splas	8x10" Weave 'White'	<input type="radio"/> Yes <input checked="" type="radio"/> No	<input type="text"/>
Master Ensuite Bathroom			
Tub Deck	8x10" Weave 'White'	<input type="radio"/> Yes <input checked="" type="radio"/> No	<input type="text"/>
Shower Stall	8x10" Weave 'White'	<input type="radio"/> Yes <input checked="" type="radio"/> No	<input type="text"/>
Bathroom Walls	n/a	<input type="radio"/> Yes <input checked="" type="radio"/> No	<input type="text"/>
Second Ensuite Bathroom (If Applicable)	8x10" Weave 'White'	<input type="radio"/> Yes <input checked="" type="radio"/> No	<input type="text"/>
Twin Bathroom	8x10" Weave 'White'	<input type="radio"/> Yes <input checked="" type="radio"/> No	<input type="text"/>

Kitchen Backsplash ☐ Yes ☒ No

Backsplash Behind Fridge

Comment

C.F. Ro

Scheduled Closing Date: Tuesday, November 01, 2016

Purchasers: Giovanni Roma & Cosimo Figliomeni

Property: 92

Telephone Res. / Bus: (905) 850-7625

Project: Burkshire Holdings Inc.

Decor Advisor: Yolande Somerville

Model and Elevation: 38-5 Elev.B ROSEMONT

4. Plumbing Fixtures

<input type="checkbox"/>	Second Ensuite	<input type="checkbox"/>	Powder Room	<input type="checkbox"/>	
Master Ensuite Bathroom	<input type="checkbox"/>	Other Room - Specify	<input type="checkbox"/>	Other Washroom	<input type="checkbox"/>
<input type="text"/>					

Comment

Standard Thru out

5. Hardwood Flooring

	Type and Stain		Type and Stain
Main Hall	<input type="text" value="*Preverco Red Oak 'Komodo'"/>	Upper Landing	<input type="text" value="n/a"/>
Kitchen / Breakfast	<input type="text" value="n/a"/>	Upper Hall	<input type="text" value="*Preverco Red Oak 'Komodo'"/>
Living Room	<input type="text" value="*Preverco Red Oak 'Komodo'"/>	Master Bedroom	<input type="text" value="*Preverco Red Oak 'Komodo'"/>
Dining Room	<input type="text" value="*Preverco Red Oak 'Komodo'"/>	Bedroom #2	<input type="text" value="*Preverco Red Oak 'Komodo'"/>
Family Room	<input type="text" value="*Preverco Red Oak 'Komodo'"/>	Bedroom #3	<input type="text" value="*Preverco Red Oak 'Komodo'"/>
Den/Library	<input type="text" value="*Preverco Red Oak 'Komodo'"/>	Bedroom #4	<input type="text" value="*Preverco Red Oak 'Komodo'"/>
Entrance Vestibule	<input type="text" value="n/a"/>	Bedroom #5	<input type="text" value="n/a"/>
Lower Landing (If Applicable)	<input type="text" value="n/a"/>	Other Room - Specify	<input type="text" value="n/a"/>

Comment

Hardwood Selection: Preverco Red Oak smooth - 3/4 x 4-1/4" 'Komodo'

6. Carpeting

	Upgrade	Description
Main Hall	<input type="checkbox"/>	<input type="text" value="n/a"/>
Living Room	<input type="checkbox"/>	<input type="text" value="n/a"/>
Dining Room	<input type="checkbox"/>	<input type="text" value="n/a"/>
Family Room	<input type="checkbox"/>	<input type="text" value="n/a"/>
Den/Library	<input type="checkbox"/>	<input type="text" value="n/a"/>
Upper Hall	<input type="checkbox"/>	<input type="text" value="n/a"/>
Master Bedroom	<input type="checkbox"/>	<input type="text" value="n/a"/>
Bedroom #2	<input type="checkbox"/>	<input type="text" value="n/a"/>
Bedroom #3	<input type="checkbox"/>	<input type="text" value="n/a"/>
Bedroom #4	<input type="checkbox"/>	<input type="text" value="n/a"/>
Bedroom #5	<input type="checkbox"/>	<input type="text" value="n/a"/>
<input type="text"/>	<input type="checkbox"/>	<input type="text" value="n/a"/>
Upper Landing (If Applicable)	<input type="checkbox"/>	<input type="text" value="n/a"/>
Lower Landing (If Applicable)	<input type="checkbox"/>	<input type="text" value="n/a"/>

Upgrade Underpad	Type <input type="text" value="n/a"/>	Area <input type="text" value="n/a"/>
Carpet on Stairs	Capped <input type="text" value="n/a"/>	Runner - *Upgrade <input type="text" value="n/a"/>

Comment

CF RG

Purchasers: Giovanni Roma & Cosimo Figliomeni

Property: 92

Telephone Res. / Bus: (905) 850-7625

Project: Burkshire Holdings Inc.

Decor Advisor: Yolande Somerville

Model and Elevation: 38-5 Elev.B ROSEMONT

7. Fireplace

Living Room			Family Room			Other Room - Specify		
Purchased	As Per Plan	N/A	Purchased	As Per Plan	N/A	Purchased	As Per Plan	N/A
<input type="radio"/>	<input type="radio"/>	<input checked="" type="radio"/>	<input type="radio"/>	<input checked="" type="radio"/>	<input type="radio"/>	<input type="radio"/>	<input type="radio"/>	<input checked="" type="radio"/>

Fireplace Type	<input type="text"/>	Standard Gas	<input type="text"/>
Mantle Type	<input type="text"/>	Standard Mediterranean	<input type="text"/>
Colour / Stain	<input type="text"/>	Standard	<input type="text"/>
Surround	<input type="text"/>	None	<input type="text"/>
Hearth	<input type="text"/>	None	<input type="text"/>

Comment

8. Trim Carpentry

Interior Doors	*Standard	Front Door Glass Inserts	Standard	Door Handles	Standard
Interior Trim	Standard				

Comment

*Standard Door profile, but 96"

9. Plaster Mouldings and Medallions

Entrance Vestibule	<input type="text"/>	<input type="text"/>	Kitchen/Breakfast	<input type="text"/>	<input type="text"/>
Main Hall	<input type="text"/>	<input type="text"/>	Den/Library	<input type="text"/>	<input type="text"/>
Living Room	<input type="text"/>	<input type="text"/>	Lower Landing	<input type="text"/>	<input type="text"/>
Dining Room	<input type="text"/>	<input type="text"/>	Other Room - Specify	none	<input type="text"/>
Family Room	<input type="text"/>	<input type="text"/>	Thru Out	<input type="text"/>	<input type="text"/>

Comment

10. Railings and Spindles

Railing Package	*Euroline 1 + V Groove		
Railing Colour	*Komodo	Spindle Colour	*Black
Stringer / Riser	*Komodo	Treads	*Komodo
Comment	Oak Stairs	<input checked="" type="radio"/> Yes	<input type="radio"/> No

Comment

11. Wall Paint

Main & Upper Hall	<input type="text"/>	Master Bedroom	<input type="text"/>
Living Room	<input type="text"/>	Bedroom #2	<input type="text"/>
Dining Room	<input type="text"/>	Bedroom #3	<input type="text"/>
Kitchen / Breakfast	<input type="text"/>	Bedroom #4	<input type="text"/>
Family Room	<input type="text"/>	Bedroom #5	<input type="text"/>
Powder Room	<input type="text"/>	Master Ensuite	<input type="text"/>
Laundry Room	<input type="text"/>	Second Ensuite	<input type="text"/>
Den/Library	<input type="text"/>	Thru Out	Warm Grey
Trim Paint	<input type="text"/>		

Comment Smooth Ceilings First Floor

C.F. RG

Purchasers: Giovanni Roma & Cosimo Figliomeni

Property: 92

Telephone Res. / Bus: (905) 850-7625

Project: Burkshire Holdings Inc.

Decor Advisor: Yolande Somerville

Model and Elevation: 38-5 Elev.B ROSEMONT

12. Electrical

Plugs and Switches ☒ White ☐ Ivory

Hood Fan ☐ White ☐ Ivory

Appliances Built in Cooktop

☐ Yes ☒ No

Built in Oven

☐ Yes ☒ No

Above Kitchen Cabinet Light ☐ Yes ☒ No

Below Kitchen Cabinet Light ☐ Yes ☒ No

Gas Stove

☐ Yes ☒ No

Microwave

☐ Yes ☒ No

Comment

Standard Stainless Steel Hood Fan

13. Heating and Air Conditioning

Air Conditioning

Gas Provisions Dryer

Comment

Standard Gas BBQ Line

Gas Provisions Stove

Gas Provisions Barbecue

14. Additional Comments

15. Disclaimers and Notes

- Colours of all materials are as close as possible to builder's selection, but not necessarily identical due to variances in manufacturing.
- Any extras listed above are null and void unless accompanied by a separate invoice/amendment. Said invoice must be paid in full.
- The Purchaser acknowledges that after Interior Colour Selection form is signed and dated, no further changes will be permitted other than re-selection due to unavailability. _____ Purchaser's Initials
- The Purchaser acknowledges reading and accepting the "Gold Park Homes Decor Centre Disclaimers" form. This document contains other miscellaneous disclaimers.

This Interior Colour Selection is final and approved by:

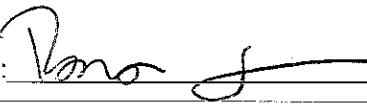
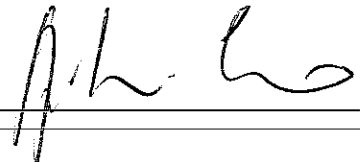
Signature:  Date: _____ Signature:  Date: _____



Elevation B • 2,861 sq.ft.

TILE PATTERN

TILE PATTERN.

TILE PATTERN.

The image displays two architectural floor plans, labeled 'GROUND FLOOR ELEVATION A' and 'GROUND FLOOR ELEVATION B', showing the layout of a house with various rooms and features.

GROUND FLOOR ELEVATION A:

- Rooms and Features:** BREAKFAST (with 8' SLIDING DOOR), KITCHEN (with DW, BREAKFAST BAR, and PANTRY), DINING ROOM (with HARDWOOD), GREAT ROOM (with GAS FIREPLACE and HARDWOOD), DEN (with HARDWOOD), LAUNDRY (with SUNKEN IF REQ'D and DN STEPS IF REQ'D), GARAGE (with DOOR WHERE GRADE PERMITS), and Foyer (with UP and DOWN stairs).
- Handwritten Notes:** 'HARDWOOD' is written in the Great Room, Dining Room, and Den. 'HARDWOOD' is also written with arrows pointing to the walls in the Foyer area.
- Other Labels:** 'COVERED PORCH' is shown at the bottom right.

GROUND FLOOR ELEVATION B:

- Rooms and Features:** GARAGE, Foyer (with UP and DOWN stairs), and PORTICO.
- Other Labels:** 'OPEN TO ABOVE' is written near the Foyer stairs.

KG-92
Jan 31 2017
RG CF

GOLDPARK
LTD

Elevation A • 2,861 sq.ft.

Elevation B • 2,861 sq.ft.

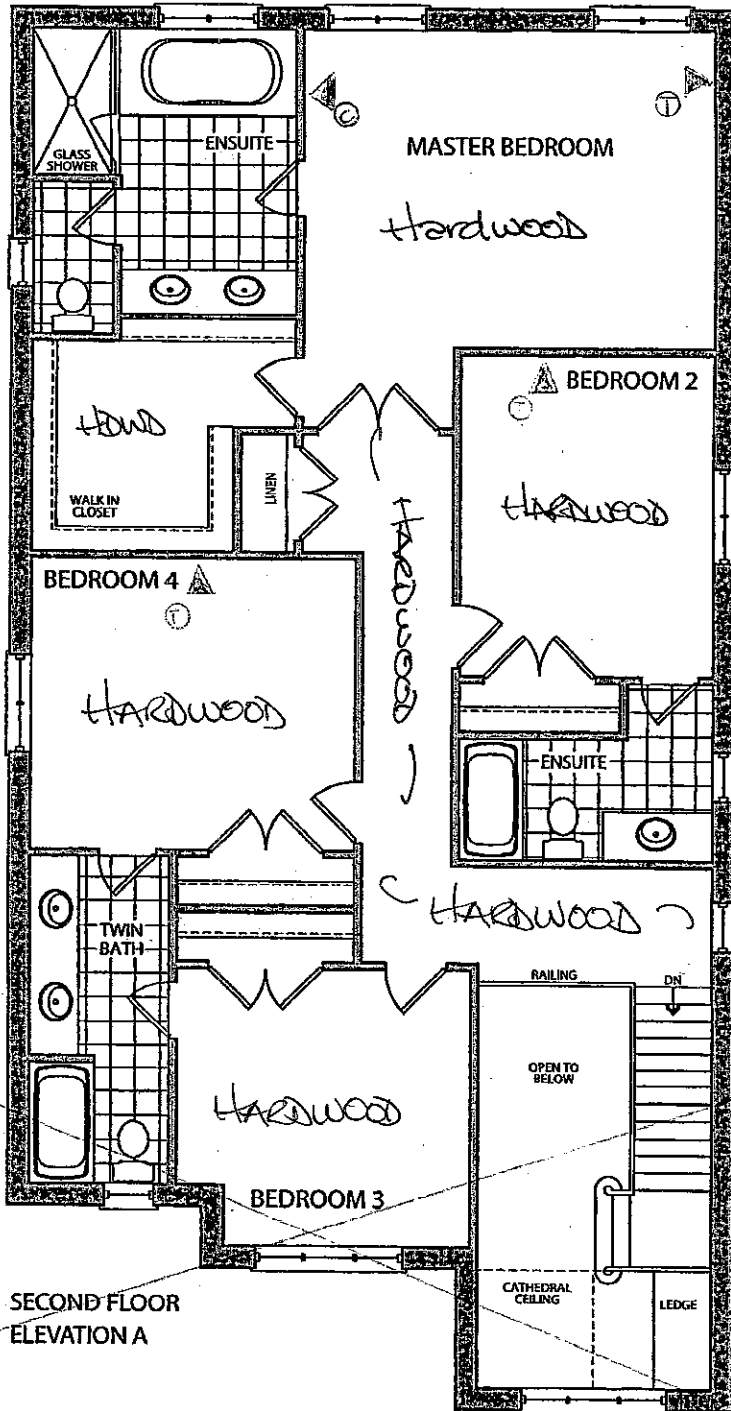
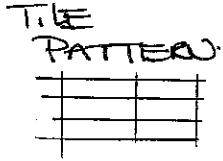

SECOND FLOOR
ELEVATION A

LOT 92
JUNE 3, 2016
RG FB

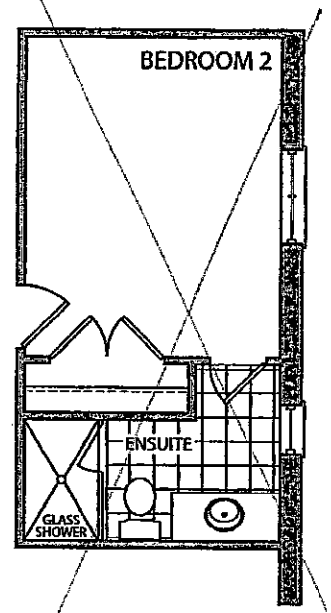

OPT. ENSUITE
ELEVATION A & B

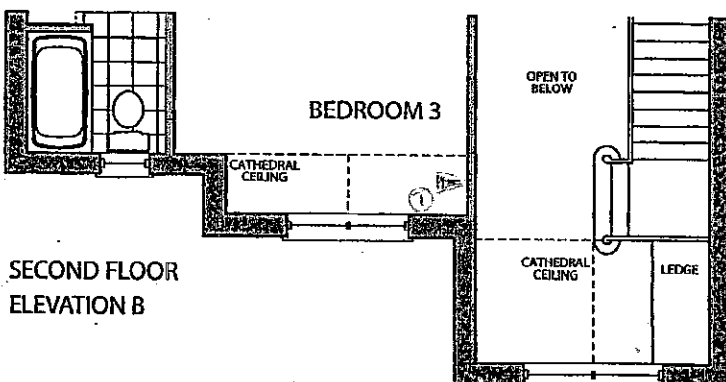

SECOND FLOOR
ELEVATION B

KG-92
Jan 31 2017

RG CF

Elevation A • 2,861 sq.ft.

✓ Elevation B • 2,861 sq.ft.

LOT 92

JUNE 30 2016

(RG) (FC)

RG - 92
Jan 31 2017 *

(RG) (CF)

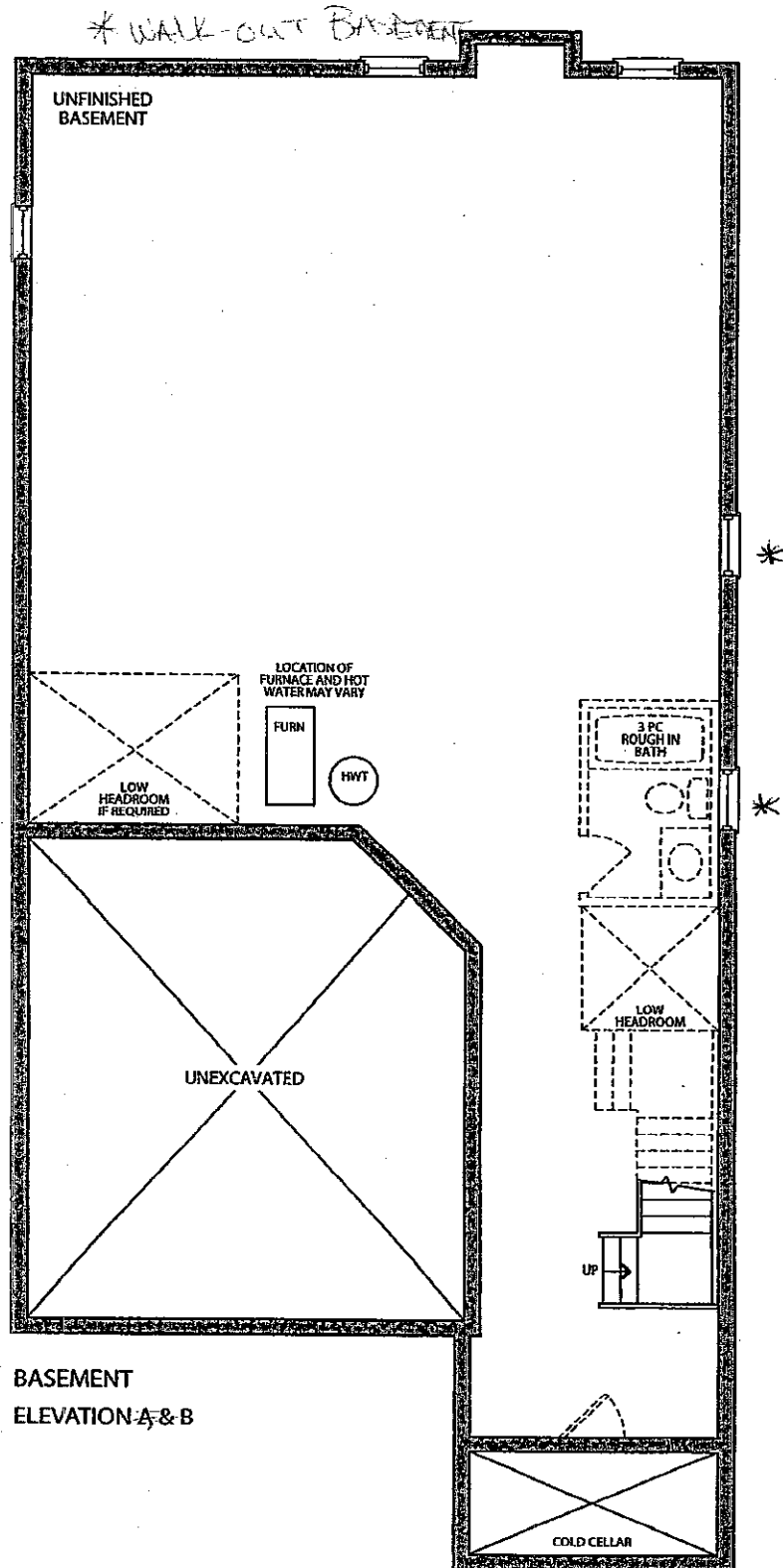

* LARGER.

24' x 30'

CORTINA

70 Regina Road, Woodbridge, Ontario L4L 8L6
Tel: 905-294-8464 Fax: 905-294-0664
www.CortinaKitchens.com

KG-92

JAN. 31 2017

RG PA

QUOTATION

Date: 28/06/16

Trade Name: Gold Park Homes

Site location:

Model: 38-5

Address:

Project: Kleinburg Glen

Phase:

This layout has been explained to the purchaser by Cortina Kitchens Inc. and is understood by the purchaser.

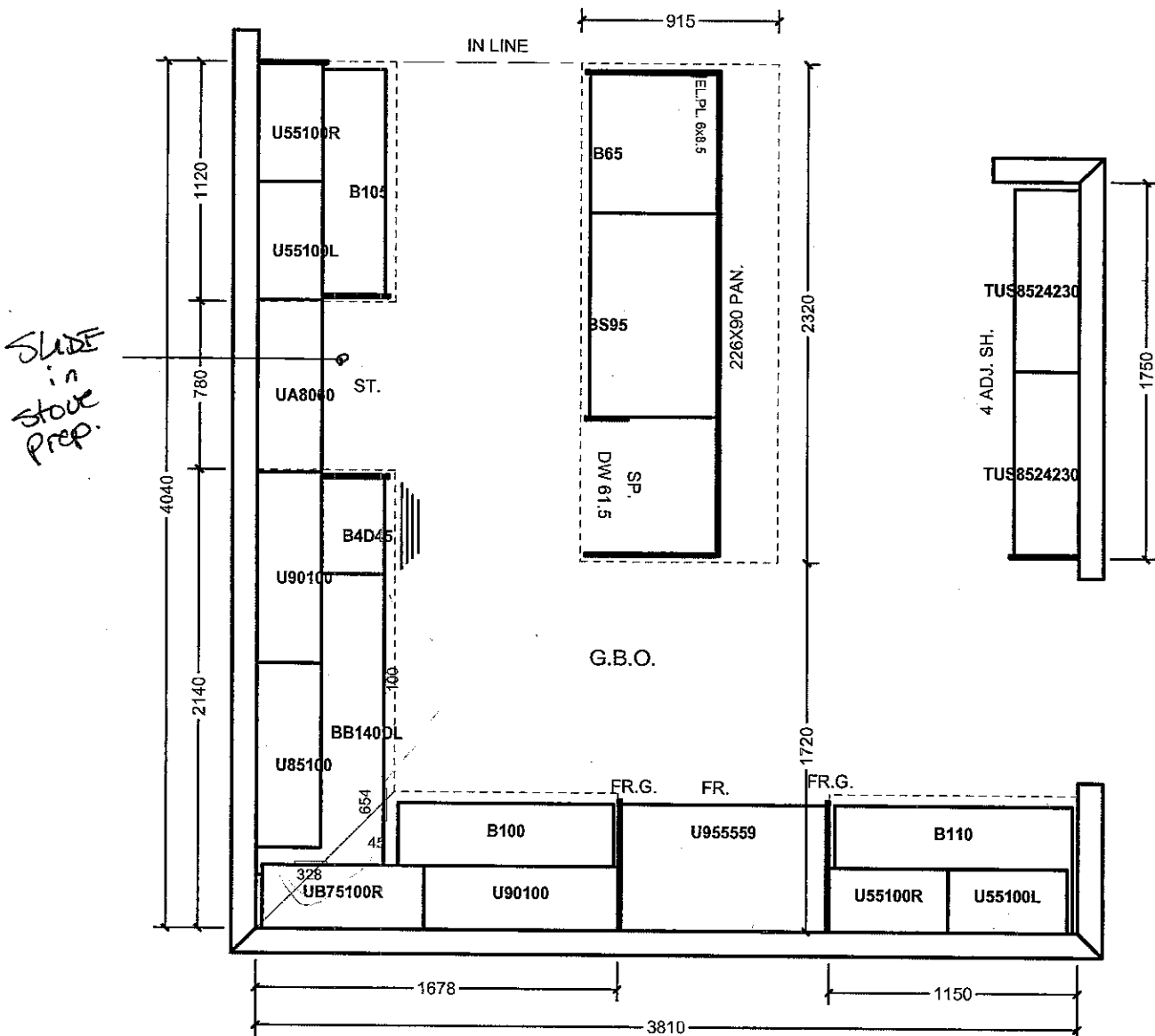

All prices subject to confirmation from head office.
This quotation is subject to the terms & conditions set out

ACCEPTED DATE: _____

All agreements are contingent upon strikes, accidents, and delays beyond our control.
Please provide our installer with template for sinkholes or \$150.00 will be charged for callback.

Item A. Wood grain and colour are characteristics of the product. We cannot guarantee that such grain and colour will always match.
Item B. Cortina Kitchens Inc. reserves the right to alter dimensions and make technical changes without notice.

CORTINA

70 Regina Road, Woodbridge, Ontario L4L 8L8
Tel: 905-294-6484 Fax: 905-294-0684
www.CortinaKitchens.com

KG-92

Jan 31 2017

REC

QUOTATION

Date: 28/06/16

Trade Name: Gold Park Homes

Site location:

Model: 38-5

Address:

Project: Kleinburg Glen

Phase:

This layout has been explained to the purchaser by Cortina Kitchens Inc. and is understood by the purchaser.

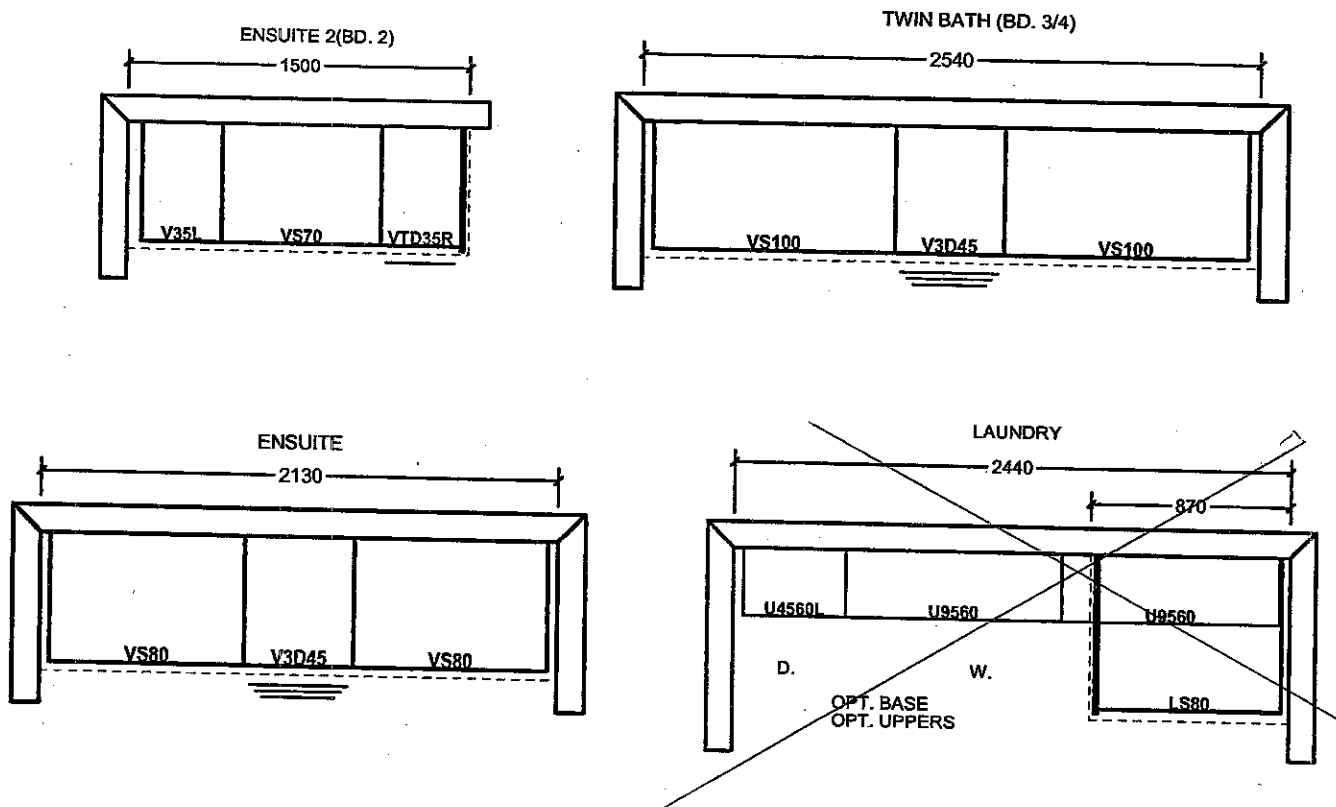

OPT. SECOND FLOOR

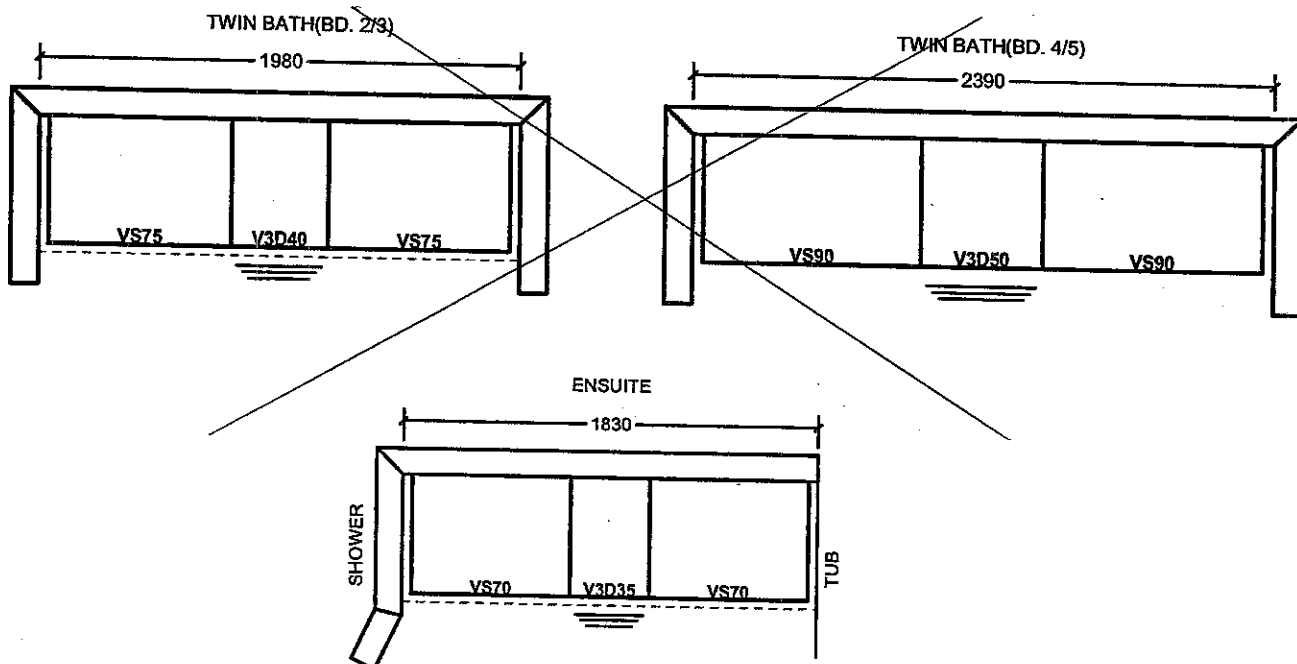

All prices subject to confirmation from head office.
This quotation is subject to the terms & conditions set out

ACCEPTED DATE: _____

All agreements are contingent upon strikes, accidents, and delays beyond our control.
Please provide our installer with template for sinkholes or \$150.00 will be charged for callback.

Item A. Wood grain and colour are characteristics of the product. We cannot guarantee that such grain and colour will always match.
Item B. Cortina Kitchens Inc. reserves the right to alter dimensions and make technical changes without notice.

CORTINA

MODIFIED: 19/05/16 fd

STANDARD HARDWARE

KG-92

JAN 31 2017

RG

CF

STANDARD HARDWARE

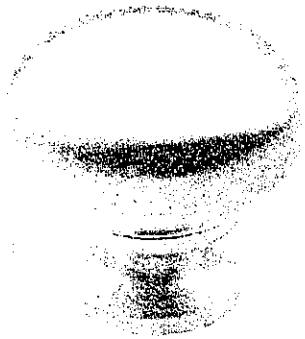

CSI-6



CSI-10



CSI-14

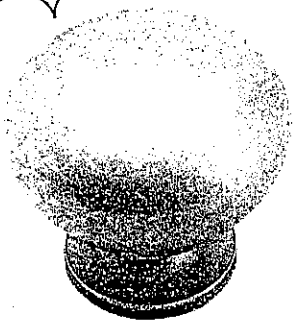

CSI-16

KITCHEN.

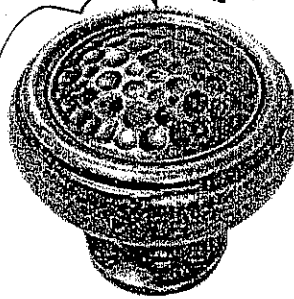

CSI-18

ENSUITE 2
+ TWIN.

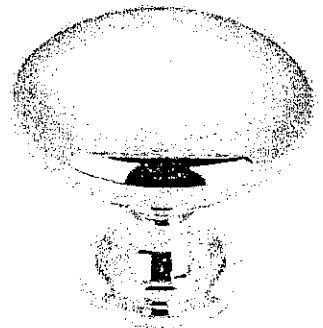

CSI-19



CSI-20

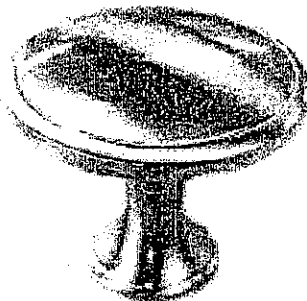

CSI-21



CSI-22

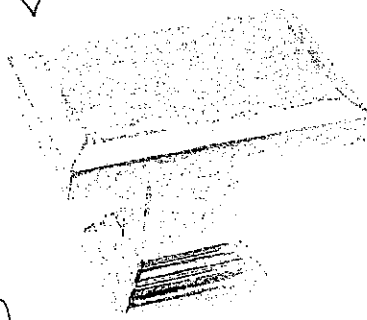

CSI-23

MASTER
ENSUITE

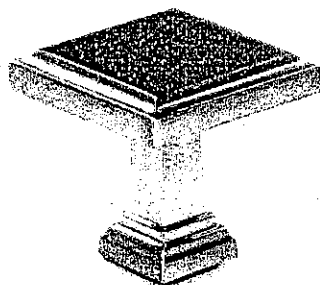

CSI-24

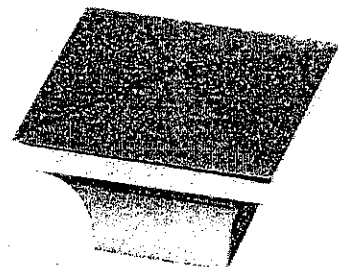

CSI-25

*NOTES:

- IMAGES ARE FOR QUICK REFERENCE PURPOSES ONLY
- ACTUAL SIZES AND FINISHES AS PER HARDWARE SAMPLE BOARD PROVIDED TO DECOR CENTRE

GOLDPARK
HOMES

Kleinfur
GmbH

Granite, Marble,
Engineered Surfaces

- Standard 2CM & 3CM
- ⊗ Upgrade 1 2CM & 3CM
- ⊗ Upgrade 1 4 CM
- Upgrade 2

20mm (3/4") Profiles

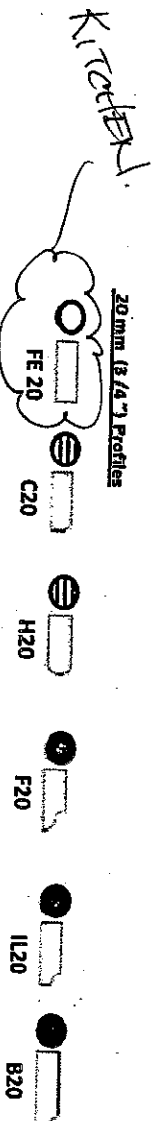

30mm (1 1/4") Profiles

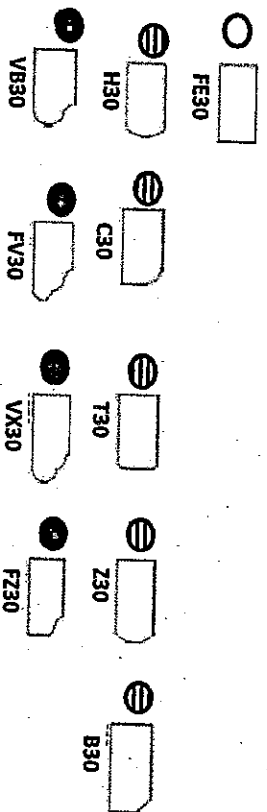

40mm (1 1/2") Profiles

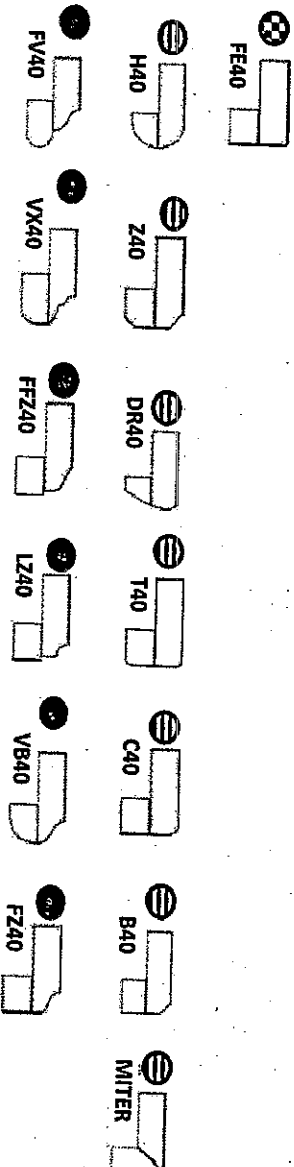

Note: All colours may not be available in 30mm at time ordered. Vendor reserves the right to use 40 mm edges (by lamination process).

*Mitre edge is available in Upgrade 1 for an overall thickness of 2". All other Mitre edge options will be an Upgrade 2 Edge.

*STO SINK & FAUCET

KG-92
JAN 31 2017 (26) (6P)

CORTINA

KITCHENS INC.

70 Regina Road Woodbridge ON L4L 8L6
905-264-6464

INFORMATION - PVC DOORS

Builder: Gold Park Homes Project: Kleinburg Lot # 92

All cabinets with PVC (Thermofoil) Doors come with melamine gables, panels and kick. The doors, crown moulding and light valance are PVC wrapped. Open shelves incorporated in design will only be available with melamine interiors. There will be variations in colour shades between the PVC parts (doors, crown and Light valance) and the melamine parts (open shelves, Gables, Panels and Kick) due to the difference in material.

Furring Panel with crown moulding to the ceiling is not available on all PVC door styles due to subtle variations in colour shades between the PVC parts (moulding) and the melamine parts (furring panel) due to the difference in material. Grain directions in wood grain pattern melamine, vary between the furring panel, crown moulding (horizontal) and the PVC doors (vertical).

Thank you for your understanding.

I am well informed of this information, and agree to the purchase of the above.

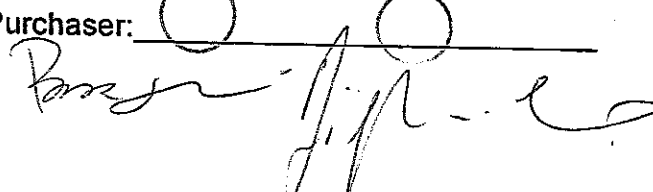
Purchaser: 

Date: JAN 31 2017