

Brampton Encore - 95 - 1 - 41-6 Elev.A VERDI
CENTRAL VAC AND WIRING

Inv.415	1 - GROUND FLOOR: INSTALL RG 6 ROUGH-IN - ADDITIONAL ROUGH-IN TO GO ON GROUND FLOOR. SEE SKETCH FOR LOCATION
Line4949	Note:
11Apr16 / 26Apr16	
Inv.415	1 - KITCHEN: INSTALL VAC PAN UNDER KITCHEN SINK ROUGH-IN ONLY
Line4950	Note:
11Apr16 / 26Apr16	

CERAMIC

Inv.839	1 - GROUND FLOOR ENSUITE: INSTALL Floor Upgrade 4 GROUND FLOOR ENSUITE Floor
Line11660	Note:
21Sep16 / 26Sep16	
Inv.839	1 - FOYER: INSTALL Floor Upgrade 4 Foyer Vestibule Floor
Line11661	Note:
21Sep16 / 26Sep16	
Inv.839	1 - POWDER ROOM: INSTALL Floor Upgrade 4 Powder Room Floor
Line11662	Note:
21Sep16 / 26Sep16	
Inv.839	1 - TWIN BATH: INSTALL Floor Upgrade 4 Bath 3 4 Floor
Line11663	Note:
21Sep16 / 26Sep16	
Inv.839	1 - ENSUITE 2: INSTALL Floor Upgrade 4 Bath 2 Floor
Line11664	Note:
21Sep16 / 26Sep16	

ELECTRICAL

Inv.415	1 - Telephone and cable rough-in locations. See sketch. Locations may vary slightly due to joist locations
Line4948	Note: Purchaser moved standard phone location from the kitchen to the Ground floor instead
11Apr16 / 26Apr16	
Inv.415	1 - KITCHEN: INSTALL 110V WALL RECEPTACLE ON DEDICATED CIRCUIT - FOR MICROWAVE - MICROWAVE NOT INCLUDED. SEE SKETCH FOR LOCATION
Line4951	Note:
11Apr16 / 26Apr16	
Inv.415	1 - KITCHEN: INSTALL 220V WALL RECEPTICAL ON DEDICATED CIRCUIT- FOR 4 WIRE BUILT-IN WALL OVEN - SEE SKETCH FOR LOCATION
Line4952	Note:
11Apr16 / 26Apr16	
Inv.415	1 - LIVING ROOM: INSTALL ROUGH - IN CEILING OUTLET ON SAME SWITCH - DOES NOT INCLUDE FIXTURE - SEE SKETCH.
Line4953	Note:
11Apr16 / 26Apr16	
Inv.415	1 - KITCHEN: KITCHEN CABINET STRIP VALANCE LIGHTS (UNDER CABINETS) - ROUGH - IN ONLY- DOES NOT INCLUDE (AND REQUIRES) KITCHEN UPGRADE PRICING
Line4954	Note:
11Apr16 / 26Apr16	

Brampton Encore - 95 - 1 - 41-6 Elev.A VERDI

Inv.839	1 - PURCHASER BOUGHT ELECTRICAL FOR BUILT-IN OVEN/MICRO AND ROUGH-IN ELECTRICAL FOR VALANCE LIGHTING.
	WE WILL BE INSTALLING A STANDARD KITCHEN, BUT ELECTRICAL WILL REMAIN
	NO CREDIT FOR ELECTRICAL WORK PREVIOUSLY PURCHASED
Line11654	Note: THEY WILL BE GOING WITH A STANDARD KITCHEN WITH US AND REPLACING IT AFTER CLOSING
21Sep16 / 26Sep16	

EXTERIOR COLOURS

Inv.415	1 - EXTERIOR COLOUR PACKAGE 6
Line5465	Note:
11Apr16 / 26Apr16	

FORMING

Inv.415	1 - EXTERIOR: INSTALL SIDE DOOR- HOME TO EXTERIOR- AS PER PLAN AND GRADE PERMITTING
Line4957	Note:
11Apr16 / 26Apr16	
Inv.503	1 - DELETE:
	EXTERIOR: SIDE DOOR- HOME TO EXTERIOR- AS PER PLAN AND GRADE PERMITTING
Line6104	Note: GRADE DOES NOT PERMIT
18May16 / 19May16	

FRAMING

Inv.415	1 - DEN: INSTALL EXTENDED HEIGHT 96" FRENCH DOOR IN LIEU STANDARD HEIGHT FRENCH DOOR. (PRICE PER DOOR) MAIN FLOOR 3 STOREY MODELS - INCLUDE FRAMING NOTE
Line5231	Note:
11Apr16 / 26Apr16	
Inv.415	1 - LIVING ROOM: INSTALL OPTIONAL COFFERED CEILING - LIVING ROOM (PER ROOM AS PER PLAN)
Line4956	Note:
11Apr16 / 26Apr16	
Inv.415	1 - MAIN FLOOR: EXTEND HEIGHT OF THREE (3) STANDARD DOORS TO 96" (PRICE PER DOOR) MAIN FLOOR 3 STOREY MODELS - INCLUDE FRAMING NOTE. TO GO ON CLOSET, POWDER ROOM AND LAUNDRY ROOM.
Line5230	Note:
11Apr16 / 26Apr16	
Inv.415	1 - GROUND FLOOR: INSTALL COMPLETE- 3PC BASEMENT WASHROOM ON GROUND FLOOR. VENDOR TO DETERMINE LOCATION
Line5234	Note:
11Apr16 / 26Apr16	

GRANITE MARBLE QUARTZ

Inv.839	1 - KITCHEN: INSTALL 2 CM GRP 1 Optional Raised BBar
Line11727	Note:
21Sep16 / 26Sep16	
Inv.1,162	1 - Homeowner decided and to proceed with a standard kitchen island and requests a refund to be adjusted on closing. CREDIT- 2 CM GRP 1 Optional Raised BBar
Line17120	Note:
3Feb17 / 3Feb17	

Brampton Encore - 95 - 1 - 41-6 Elev.A VERDI

HVAC

Inv.415	1 - KITCHEN: INSTALL GAS LINE ROUGH - MAIN FLOOR - (3 STOREY MODELS) FOR STOVE IN KITCHEN
Line4959	Note:
11Apr16 / 26Apr16	

INTERIOR TRIM AND DOORS

Inv.415	3 - MAIN FLOOR: EXTEND HEIGHT OF THREE (3) STANDARD DOORS TO 96" (PRICE PER DOOR) MAIN FLOOR 3 STOREY MODELS - INCLUDE FRAMING NOTE. TO GO ON CLOSET, POWDER ROOM AND LAUNDRY ROOM.
Line4960	Note:
11Apr16 / 26Apr16	

Inv.415	1 - DEN: INSTALL EXTENDED HEIGHT 96" FRENCH DOOR IN LIEU STANDARD HEIGHT FRENCH DOOR. (PRICE PER DOOR) MAIN FLOOR 3 STOREY MODELS - INCLUDE FRAMING NOTE
Line5190	Note:
11Apr16 / 26Apr16	

KITCHEN AND BATH CABINETRY

Inv.839	1 - PURCHASER BOUGHT ELECTRICAL FOR BUILT-IN OVEN/MICRO AND ROUGH-IN ELECTRICAL FOR VALANCE LIGHTING.
WE WILL BE INSTALLING A STANDARD KITCHEN, BUT ELECTRICAL WILL REMAIN	
NO CREDIT FOR ELECTRICAL WORK PREVIOUSLY PURCHASED	
Line11653	Note: THEY WILL BE GOING WITH A STANDARD KITCHEN WITH US AND REPLACING IT AFTER CLOSING
21Sep16 / 26Sep16	

Inv.839	1 - MASTER ENSUITE: INSTALL Handles Master Ensuite
Line11656	Note:
21Sep16 / 26Sep16	

Inv.839	1 - TWIN BATH: INSTALL Handles Twin Bathbd34
Line11657	Note:
21Sep16 / 26Sep16	

Inv.839	1 - ENSUITE 2: INSTALL Handles Ens 2bd2
Line11658	Note:
21Sep16 / 26Sep16	

Inv.839	1 - GROUND FLOOR ENSUITE: INSTALL Handles IN GROUND FLOOR ENSUITE
Line11659	Note:
21Sep16 / 26Sep16	

MISC.

Inv.415	1 - BONUS PACKAGE: \$10,000.00 (INCLUDING TAXES) WORTH OF UPGRADES FROM GOLD PARK HOMES DÉCOR CENTRE IS BEING APPLIED TOWARD THE STRUCTURAL APPOINTMENT.
Line5192	Note:
11Apr16 / 26Apr16	

Inv.415	1 - Purchaser has attended a Structural appointment at the Decor Centre & has DECLINED any additional upgrades and accepts and acknowledges that there will be no further structural changes/additions/deletions to be made upon signing on April 18,2016
Line5193	Note:
11Apr16 / 26Apr16	

Brampton Encore - 95 - 1 - 41-6 Elev.A VERDI

Inv.415	1 - Purchasers are aware & accepts that ANY changes made to upgrades after signing this Purchasers Extra Form are subject to a minimum administration fee of \$500. PLUS a 10% holdback fee
Line5194	Note:
11Apr16 / 26Apr16	
Inv.503	1 - Purchasers are aware & accepts that ANY changes made to upgrades after signing this Purchasers Extra Form are subject to a minimum administration fee of \$500. PLUS a 10% holdback fee
Line6106	Note:
18May16 / 19May16	
Inv.839	1 - Purchaser has attended a Colour appointment at the Decor Centre & has DECLINED any additional upgrades and accepts and acknowledges that there will be no further structural changes/additions/deletions to be made upon signing on September 21, 2016
Line11665	Note:
21Sep16 / 26Sep16	
Inv.839	1 - Purchasers are aware & accepts that ANY changes made to upgrades after signing this Purchasers Extra Form are subject to a minimum administration fee of \$500. PLUS a 10% holdback fee
Line11666	Note:
21Sep16 / 26Sep16	

PLUMBING

Inv.415	1 - KITCHEN: INSTALL ROUGH-IN - WATERLINE FOR FRIDGE
Line4961	Note:
11Apr16 / 26Apr16	
Inv.415	1 - BASEMENT: INSTALL ROUGH-IN - 3PC BASEMENT ROUGH-IN, AS PER PLAN
Line4962	Note:
11Apr16 / 26Apr16	
Inv.415	1 - GROUND FLOOR: INSTALL COMPLETE- 3PC BASEMENT WASHROOM ON GROUND FLOOR. VENDOR TO DETERMINE LOCATION
Line4963	Note:
11Apr16 / 26Apr16	
Inv.415	1 - BASEMENT: INSTALL ROUGH-IN LAUNDRY WITHOUT TUB, IN BASEMENT. INCLUDES ELECTRICAL FOR WASHER AND DRYER, VENTING AND PLUMBING.
Line4964	Note:
11Apr16 / 26Apr16	

WINDOWS - BASEMENT

Inv.415	3 - BASEMENT: UPGRADE THREE (3) BASEMENT WINDOWS - UPGRADE EXISTING BASEMENT WINDOW TO 30 INCH X 24 INCH - MAY REQUIRE INSTALLATION OF WINDOW WELL
Line5191	Note:
11Apr16 / 26Apr16	

WINDOWS AND DOORS

Inv.415	1 - GARAGE: INSTALL MAN DOOR GARAGE TO HOUSE - OPTIONAL - IF GRADE PERMITS
Line4958	Note:
11Apr16 / 26Apr16	

Purchasers: Sajeev Baby & Nicey Matthew

Property: 95 of Plan -

Telephone Res. / Bus: (905) 820-1849

Project: Fieldwalk Investments Inc.

Decor Advisor: Terri Parisani

Model and Elevation: 41-6 Elev.A VERDI

Layout Changes: ☐ Yes ☒ No Sketch Attached: ☒ Yes ☐ No Exterior Colour Scheme:

1. Cabinetry

	Style and Colour	Counter	Hardware
Kitchen / Breakfast	Varese(pvc)Choc.Maple	Crema Caramel Granite Edge: C-20	cs1-25
Laundry Room	-		
Powder Room	-		
TWIN BATH	Varese(pvc)Choc.Maple	6696-46 Carrara Bianco Laminate	*CH-49
Master Ensuite Bathroom	Varese(pvc)Choc.Maple	6696-46 Carrara Bianco Laminate	*CH-49
Second Ensuite Bathroom (If Applicable)	Varese(pvc)Choc.Maple	6696-46 Carrara Bianco Laminate	*CH-49
GROUND FL ENSUITE	Varese(pvc)Choc.Maple	6696-46 Carrara Bianco Laminate	*CH-49
Dishwasher Cabinet	N/A		

Comment

2. Floor Tile

	Selection	Grout	Threshold
Entrance Vestibule	*Upg.4 CarraraXSeries White,Polished12x24	N/A	N/A
Main Hall	-	N/A	N/A
Kitchen / Breakfast	Serpentine Krem, 13 x 13	N/A	N/A
Laundry Room	Serpentine Krem, 13 x 13	N/A	N/A
Powder Room	*Upg.4 CarraraXSeries White,Polished12x24	N/A	N/A
TWIN BATH	*Upg.4 CarraraXSeries White,Polished12x24	N/A	N/A
Master Ensuite Bathroom	*Upg.4 CarraraXSeries White,Polished12x24	N/A	N/A
Second Ensuite Bathroom (If Applicable)	*Upg.4 CarraraXSeries White,Polished12x24	N/A	N/A
Lower Landing (If Applicable)	-		
GROUND FL ENSUITE	*Upg.4 CarraraXSeries White,Polished12x24	N/A	N/A

Comment

GROUND FLOOR HALL: Serpentine Krem, 13 x 13

3. Wall Tile

	Selection	Listello/Inserts	Describe
TWIN BATH	Weave White, 8 x 10	<input type="radio"/> Yes <input checked="" type="radio"/> No	
Master Ensuite Bathroom			
Tub Deck	-	<input type="radio"/> Yes <input checked="" type="radio"/> No	
Shower Stall	Serpentine Krem 8 x 10	<input type="radio"/> Yes <input checked="" type="radio"/> No	
Bathroom Walls	-	<input type="radio"/> Yes <input checked="" type="radio"/> No	
Second Ensuite Bathroom (If Applicable)	Weave White, 8 x 10	<input type="radio"/> Yes <input checked="" type="radio"/> No	
GROUND FL ENSUITE	Weave White, 8 x 10	<input type="radio"/> Yes <input checked="" type="radio"/> No	

Kitchen Backsplash ☐ Yes ☒ No

Backsplash Behind Fridge

Comment

Scheduled Closing Date: Tuesday, October 04, 2016

Purchasers: Sajeev Baby & Nicey Matthew

Property: 95 of Plan -

Telephone Res. / Bus: (905) 820-1849

Project: Fieldwalk Investments Inc.

Decor Advisor: Terri Parisani

Model and Elevation: 41-6 Elev.A VERDI

4. Plumbing Fixtures

<input type="checkbox"/>	Second Ensuite	<input type="checkbox"/>	Powder Room	<input type="checkbox"/>	
Master Ensuite Bathroom	<input type="checkbox"/>	Other Room - Specify	<input type="checkbox"/>	Other Washroom	<input type="checkbox"/>

Comment

STANDARD PLUMBING FIXTURES THROUGHOUT HOUSE

5. Hardwood Flooring

	Type and Stain		Type and Stain
Main Hall	PROVERCO, 4 1/4" NATURAL	Upper Landing	PROVERCO, 4 1/4" NATURAL
Kitchen / Breakfast	-	Upper Hall	-
Living Room	PROVERCO, 4 1/4" NATURAL	Master Bedroom	-
Dining Room	PROVERCO, 4 1/4" NATURAL	Bedroom #2	-
Family Room	PROVERCO, 4 1/4" NATURAL	Bedroom #3	-
Den/Library	PROVERCO, 4 1/4" NATURAL	Bedroom #4	-
Entrance Vestibule	-	Bedroom #5	-
Lower Landing (If Applicable)	-	Other Room - Specify	-

Comment

6. Carpeting

	Upgrade	Description
Main Hall	<input type="checkbox"/>	-
Living Room	<input type="checkbox"/>	-
Dining Room	<input type="checkbox"/>	-
Family Room	<input type="checkbox"/>	-
Den/Library	<input type="checkbox"/>	-
Upper Hall	<input type="checkbox"/>	T-06
Master Bedroom	<input type="checkbox"/>	T-06
Bedroom #2	<input type="checkbox"/>	T-06
Bedroom #3	<input type="checkbox"/>	T-06
Bedroom #4	<input type="checkbox"/>	T-06
Bedroom #5	<input type="checkbox"/>	
GROUND FLOOR	<input type="checkbox"/>	T-06
Upper Landing (If Applicable)	<input type="checkbox"/>	-
Lower Landing (If Applicable)	<input type="checkbox"/>	-

Upgrade Underpad	Type STANDARD	Area
Carpet on Stairs	Capped N/A	Runner - *Upgrade N/A

Comment

Scheduled Closing Date: Tuesday, October 04, 2016

Purchasers: Sajeew Baby & Nicey Matthew

Property: 95 of Plan -

Telephone Res. / Bus: (905) 820-1849

Project: Fieldwalk Investments Inc.

Decor Advisor: Terri Parisani

Model and Elevation: 41-6 Elev.A VERDI

7. Fireplace

	Living Room			Family Room			Other Room - Specify		
	Purchased	As Per Plan	N/A	Purchased	As Per Plan	N/A	Purchased	As Per Plan	N/A
Fireplace Type	<input type="radio"/>	<input type="radio"/>	<input checked="" type="radio"/>	<input type="radio"/>	<input checked="" type="radio"/>	<input type="radio"/>	<input type="radio"/>	<input type="radio"/>	<input checked="" type="radio"/>
Mantle Type				STANDARD					
Colour / Stain				NF-20					
Surround				WHITE PAINT-GRADE					
Hearth				CREMA MARFIL					
				NONE					

Comment

8. Trim Carpentry

Interior Doors	STD-Extended	Front Door Glass Inserts	STANDARD	Door Handles	STANDARD
Interior Trim	STANDARD				

Comment

9. Plaster Mouldings and Medallions

Entrance Vestibule	N/A		Kitchen/Breakfast	N/A	
Main Hall	N/A		Den/Library	N/A	
Living Room	N/A		Lower Landing	N/A	
Dining Room	N/A		Other Room - Specify		
Family Room	N/A				

Comment

10. Railings and Spindles

Railing Package	STANDARD		
Railing Colour	NATURAL	Spindle Colour	NATURAL
Stringer / Riser	NATURAL	Treads	NATURAL
		Oak Stairs	<input checked="" type="radio"/> Yes <input type="radio"/> No

Comment

11. Wall Paint

Main & Upper Hall	BIRCH WHITE	Master Bedroom	BIRCH WHITE
Living Room	BIRCH WHITE	Bedroom #2	BIRCH WHITE
Dining Room	BIRCH WHITE	Bedroom #3	BIRCH WHITE
Kitchen / Breakfast	BIRCH WHITE	Bedroom #4	BIRCH WHITE
Family Room	BIRCH WHITE	Bedroom #5	BIRCH WHITE
Powder Room	BIRCH WHITE	Master Ensuite	BIRCH WHITE
Laundry Room	BIRCH WHITE	TWIN BATH	BIRCH WHITE
Den/Library	BIRCH WHITE	Second Ensuite	BIRCH WHITE
Trim Paint	WHITE	GROUND FLOOR	BIRCH WHITE

Comment

Smooth Ceilings First Floor

Purchasers: Sajeev Baby & Nicey Matthew

Property: 95 of Plan -

Telephone Res. / Bus: (905) 820-1849

Project: Fieldwalk Investments Inc.

Decor Advisor: Terri Parisani

Model and Elevation: 41-6 Elev.A VERDI

12. Electrical

Plugs and Switches ☒ White ☐ Ivory Above Kitchen Cabinet Light ☐ Yes ☒ No
Hood Fan ☐ White ☐ Ivory Below Kitchen Cabinet Light ☒ Yes ☐ No
Appliances Built in Cooktop Built in Oven Gas Stove Microwave
☐ Yes ☒ No ☐ Yes ☒ No ☒ Yes ☐ No ☐ Yes ☒ No

Comment

PURCHASER BOUGHT ELECTRICAL FOR BUILT-IN OVEN/MICRO AND ROUGH-IN ELECTRICAL FOR VALANCE LIGHTING. THEY WILL BE GOING WITH A STANDARD KITCHEN WITH US AND REPLACING IT AFTER CLOSING

STANDARD HOOD FAN: STAINLESS STEEL

13. Heating and Air Conditioning

Air Conditioning Gas Provisions Stove
Gas Provisions Dryer Gas Provisions Barbecue

Comment

PURCHASER BOUGHT GAS LINE FOR STOVE
GAS LINE FOR BBQ IS STANDARD

14. Additional Comments

15. Disclaimers and Notes

- Colours of all materials are as close as possible to builder's selection, but not necessarily identical due to variances in manufacturing.
- Any extras listed above are null and void unless accompanied by a separate invoice/amendment. Said invoice must be paid in full.
- The Purchaser acknowledges that after Interior Colour Selection form is signed and dated, no further changes will be permitted other than re-selection due to unavailability. Purchaser's Initials _____
- The Purchaser acknowledges reading and accepting the "Gold Park Homes Decor Centre Disclaimers" form. This document contains other miscellaneous disclaimers.

This Interior Colour Selection is final and approved by:

Signature: Nicey Mathew Date: Sep 21, 2016 Signature: Nicey Mathew Date: Sep 21, 2016

Trade Name: Gold Park Homes	Site location: Brampton	Model: 41-6
Address:	Project: Encore	Phase:

This layout has been explained to the purchaser by Cortina Kitchens Inc. and is understood by the purchaser.

KITCHEN

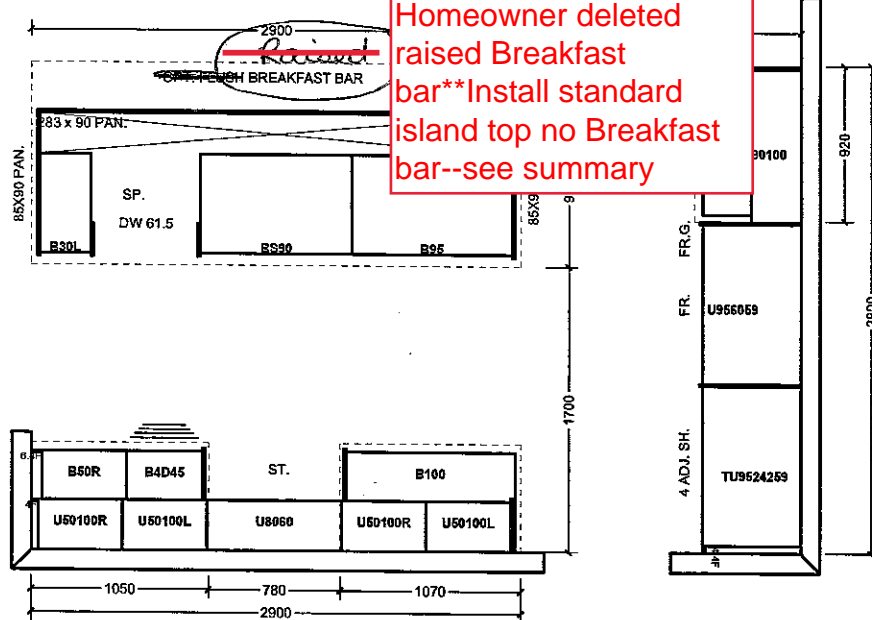

ENSUITE (BD. 2)

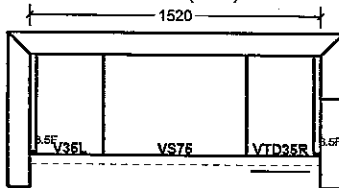

TWIN ENSUITE (BD. 3/4)

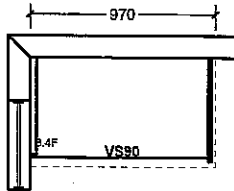

MASTER ENSUITE

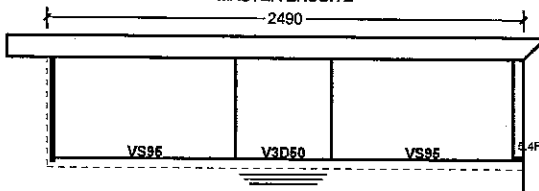

LAUNDRY

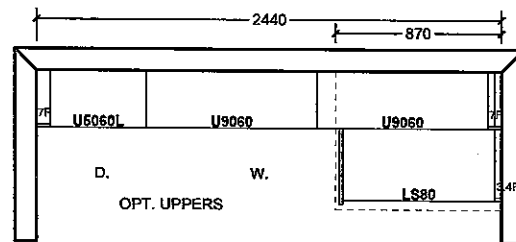

TOWELS

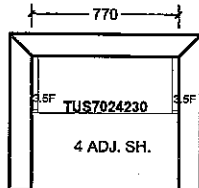

OPT. GROUND FL- OPT. BAR

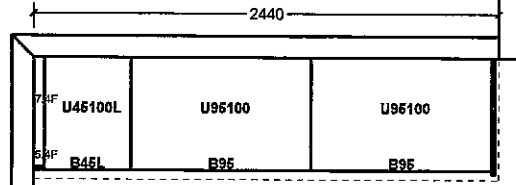

All prices subject to confirmation from head office.
This quotation is subject to the terms & conditions set out

ACCEPTED DATE: _____

All agreements are contingent upon strikes, accidents, and delays beyond our control.
Please provide our installer with template for sinkholes or \$150.00 will be charged for callback.

Item A. Wood grain and colour are characteristics of the product. We cannot guarantee that such grain and colour will always match.
Item B. Cortina Kitchens Inc. reserves the right to alter dimensions and make technical changes without notice.

* Build Standard
Kitchen

Lot 95
Sept 21, 16



Telephone — (T)
 cable — (C)
 Electrical — (E)

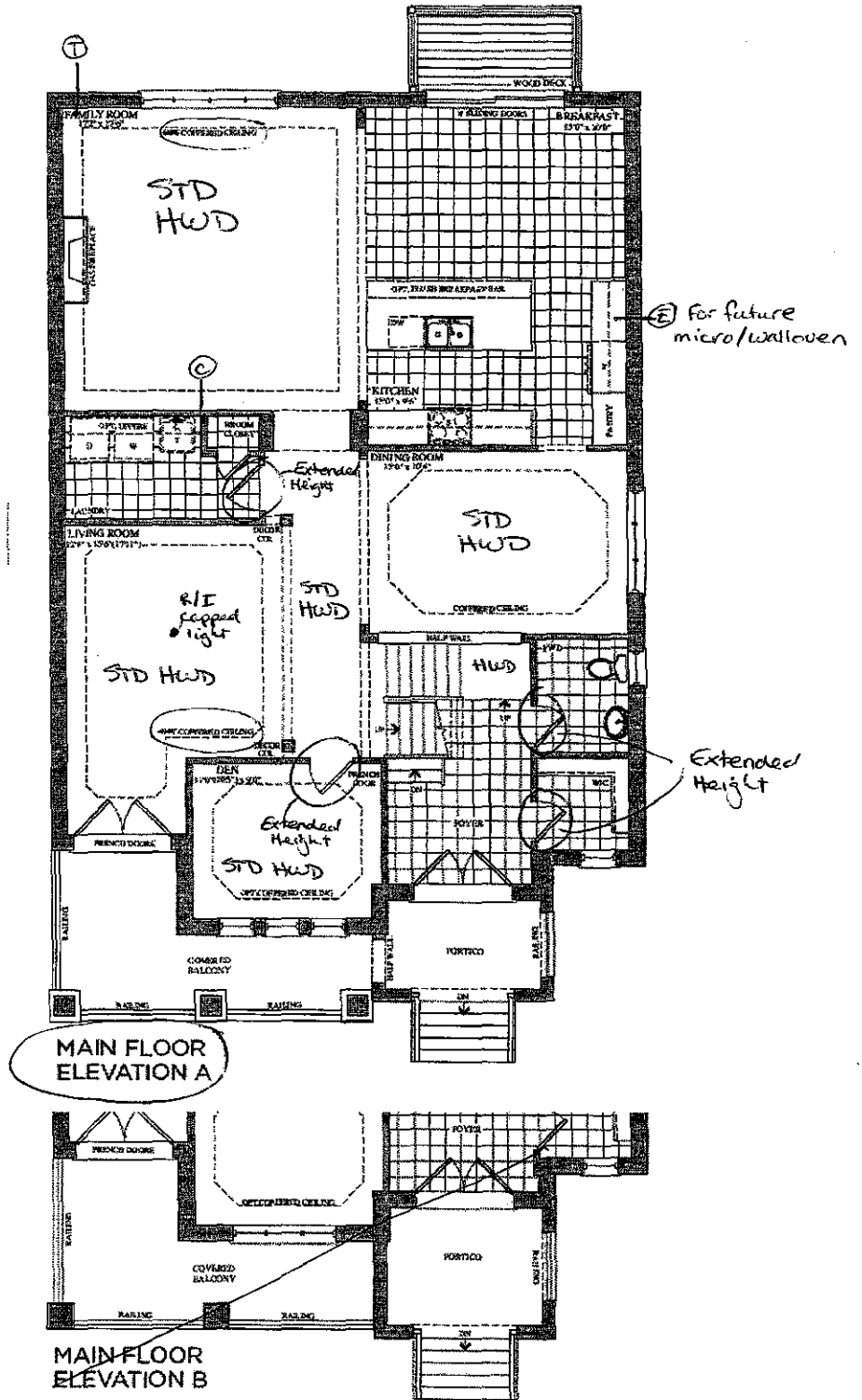

GOLDPARK
 REALTY

Lot 95
 Sept 21, 16

Lot 95
 April 18, 2016



Telephone — (T)
Cable — (C)

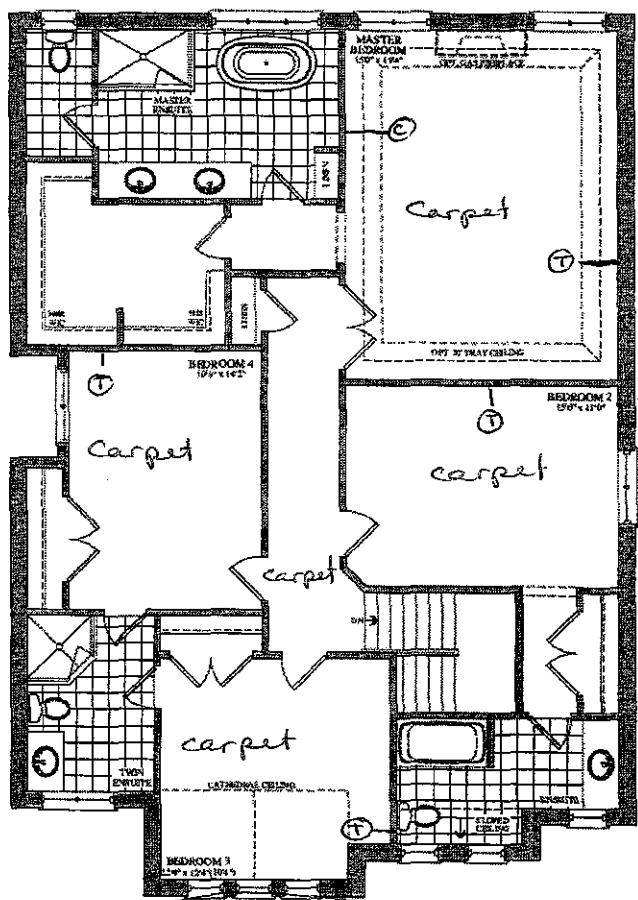

SECOND FLOOR
ELEVATION A

The Verdi 41' SERIES
Elevation A • 3,409 sq.ft.

Elevation B • 3,409 sq.ft.

goldpeak

Goldpeak is a registered trademark of Goldpeak Inc. All other trademarks are the property of their respective owners.

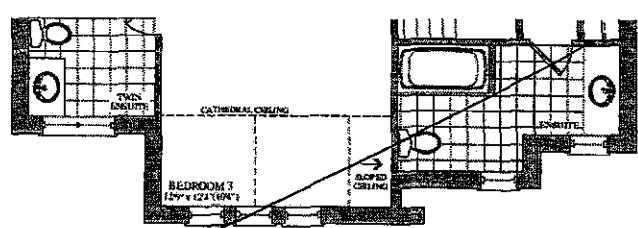

SECOND FLOOR
ELEVATION B

Lot 95
Sept, 21, 16



Lot 95
April 18, 2016

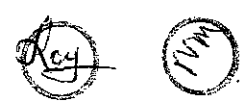

Telephone — (T)
 Cable — (C)

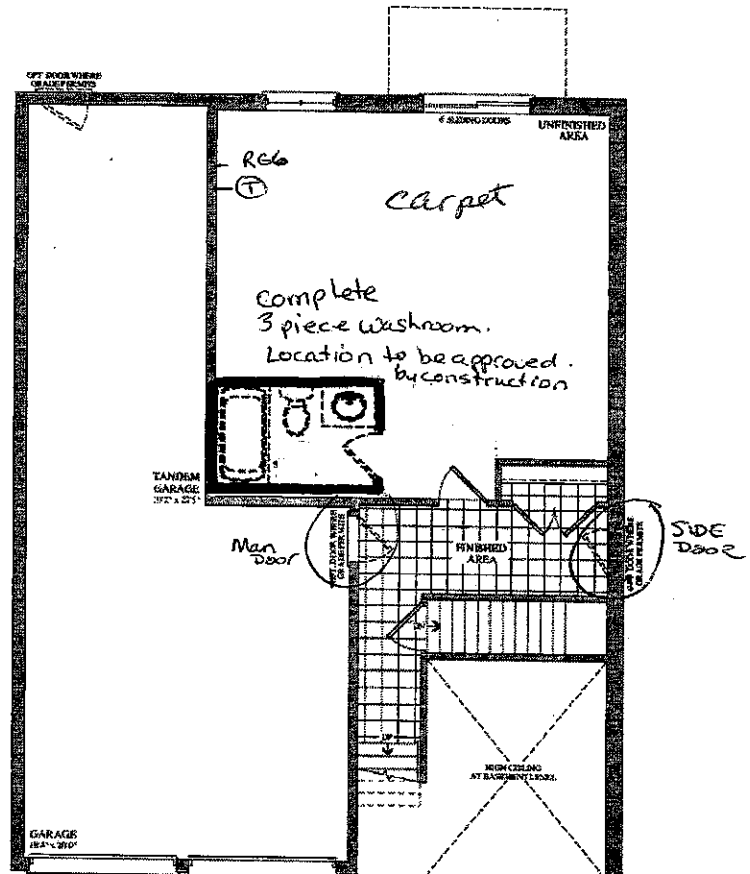

GROUND FLOOR ELEVATION A

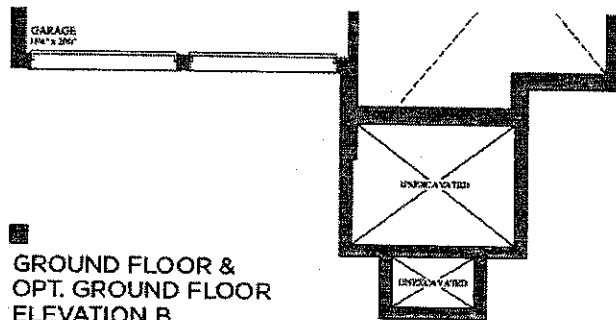

GROUND FLOOR & OPT. GROUND FLOOR ELEVATION B

The Verdi 41' SERIES

Elevation A • 3,409 sq.ft.



Elevation B • 3,409 sq.ft.



GOLD PARK

The Verdi 41' Series is a registered trademark of Gold Park Homes, Inc. All other trademarks are the property of their respective owners. © 2016

Lot 95
 Sept 21, 18



Lot 95
 April 18, 2016



CORTINA

KITCHENS INC.

70 Regina Road Woodbridge ON L4L 8L6
905-264-6464

INFORMATION - PVC DOORS

Builder... Gold Park Homes Project... Encore Lot #... 95

All cabinets with PVC (Thermofoil) Doors come with melamine gables, panels and kick. The doors, crown moulding and light valance are PVC wrapped. Open shelves incorporated in design will only be available with melamine interiors. There will be variations in colour shades between the PVC parts (doors, crown and Light valance) and the melamine parts (open shelves, Gables, Panels and Kick) due to the difference in material.

Furring Panel with crown moulding to the ceiling is not available on all PVC door styles due to subtle variations in colour shades between the PVC parts (moulding) and the melamine parts (furring panel) due to the difference in material. Grain directions in wood grain pattern melamine, vary between the furring panel, crown moulding (horizontal) and the PVC doors (vertical).

Thank you for your understanding.

I am well informed of this information, and agree to the purchase of the above.

X Purchaser: _____

Date: _____

X

STANDARD HARDWARE

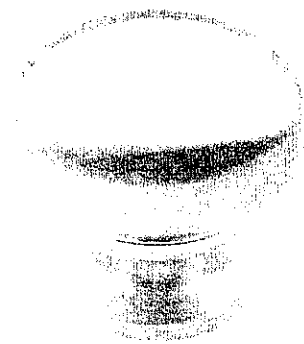

CSI-6

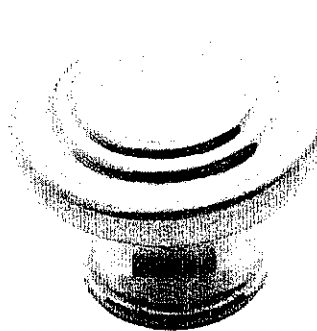

CSI-10



CSI-14



CSI-16



CSI-18

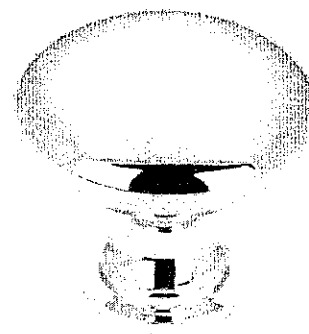

CSI-19

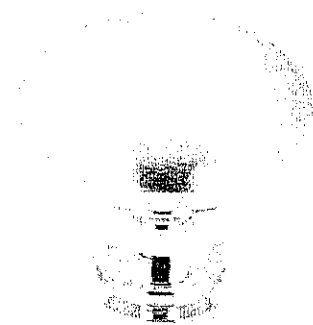

CSI-20

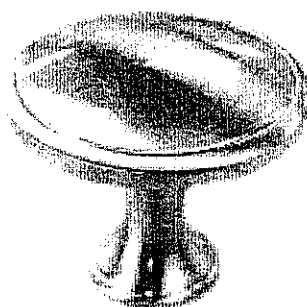

CSI-21



CSI-22

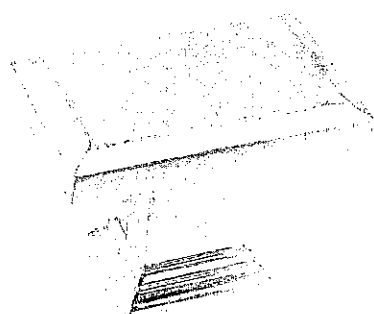

CSI-23

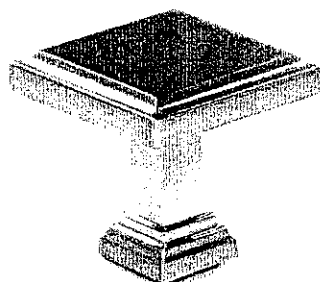

CSI-24

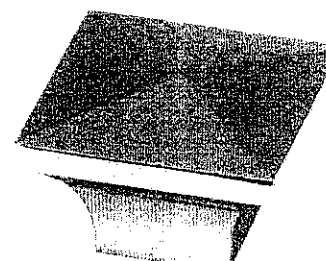

CSI-25

*Kitchen****NOTES:**

- IMAGES ARE FOR QUICK REFERENCE PURPOSES ONLY
- ACTUAL SIZES AND FINISHES AS PER HARDWARE SAMPLE BOARD PROVIDED TO DECOR CENTRE

UPGRADE HARDWARE



UPGRADE HARDWARE

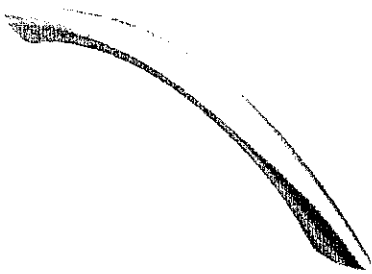

CH-32



CH-38

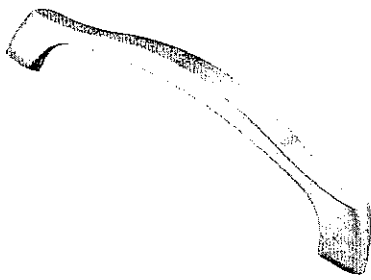

CH-44

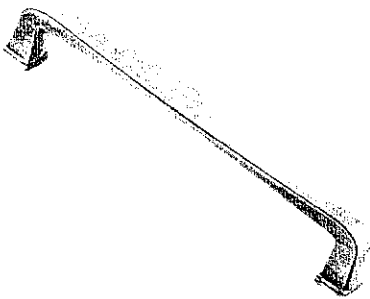

CH-45

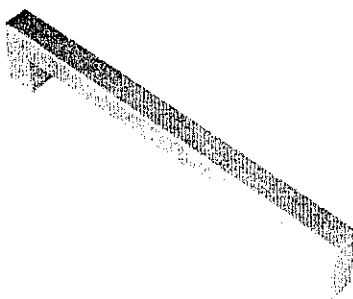

CH-46

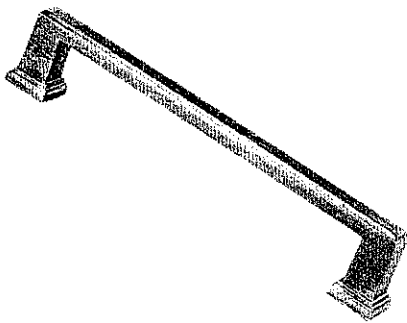

CH-47

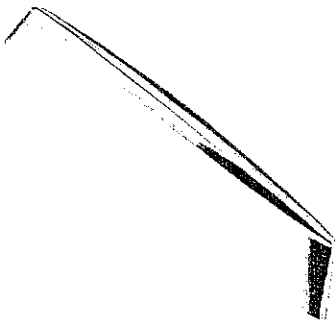

CH-48

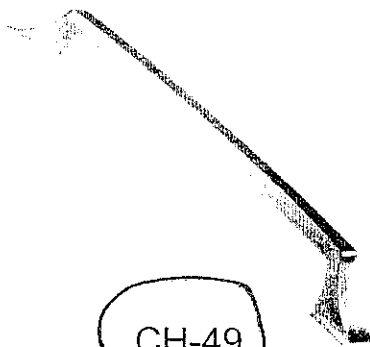

CH-49

Twin Bath
Master Ens.
Ens. # 2
Ground Floor Ens.



CH-50

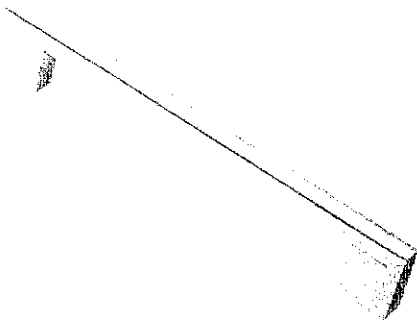

CH-51

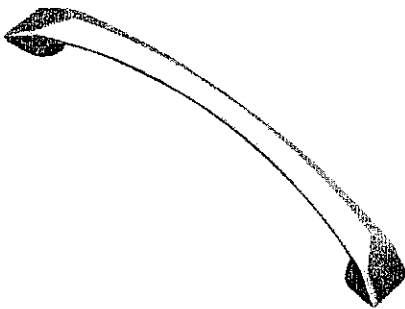

CH-52

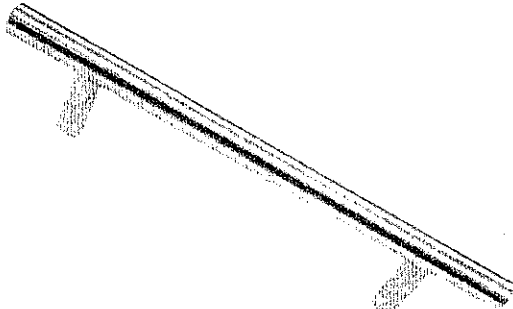

CH-53

*NOTES:

- IMAGES ARE FOR QUICK REFERENCE PURPOSES ONLY
- ACTUAL SIZES AND FINISHES AS PER HARDWARE
- SAMPLE BOARD PROVIDED TO DECOR CENTRE