

Kleinburg Glen - 47L - 1 - 25-9 Elev.B SOMERSET

ELECTRICAL

| | |
|-------------------|---|
| Inv.772 | 1 - KITCHEN: Single pole switch for rough-in pendant lights above peninsula. See plan for location. |
| Line10310 | Note: |
| 22Aug16 / 11Nov16 | |
| Inv.772 | 2 - KITCHEN: ROUGH - IN CEILING OUTLET ON SAME SWITCH - DOES NOT INCLUDE FIXTURE - Locate 2 on same switch - above peninsula (in addition to builder's standard ceiling light) See plan for location. |
| Line10309 | Note: |
| 22Aug16 / 11Nov16 | |
| Inv.772 | 1 - FAMILY ROOM: 110V WALL RECEPTACLE ON NORMAL CIRCUIT - Locate approx. 60" A.F.F. above fireplace. |
| Line10311 | Note: |
| 22Aug16 / 11Nov16 | |

EXTERIOR COLOURS

| | |
|-------------------|-------------------------------|
| Inv.772 | 1 - EXTERIOR COLOUR PACKAGE 9 |
| Line13784 | Note: |
| 22Aug16 / 11Nov16 | |

FRAMING

| | |
|-------------------|---|
| Inv.772 | 1 - MAIN FLOOR: FRAME MAIN FLOOR ARCH AT 96 INCH |
| Line10316 | Note: |
| 22Aug16 / 11Nov16 | |
| Inv.772 | 1 - MANDOOR - GARAGE TO HOUSE - AS PER PLAN AND GRADE PERMITING |
| Line13785 | Note: |
| 22Aug16 / 11Nov16 | |

HARDWOOD

| | |
|------------------|--|
| Inv.1,082 | 1 - SECOND FLOOR HALLWAY: UPG to Standard Natural Hardwood |
| Line15877 | Note: |
| 9Jan17 / 20Jan17 | |
| Inv.1,082 | 1 - SECOND FLOOR Bedroom 2 / Bedroom 3: UPG To Standard Natural Hardwood |
| Line15880 | Note: Master to stay STD Carpet. |
| 9Jan17 / 20Jan17 | |

INTERIOR TRIM AND DOORS

| | |
|-------------------|---|
| Inv.772 | 1 - MAIN FLOOR: EXTENDED HEIGHT ARCHWAY (PRICE PER DOORWAY) - 96" |
| Line10317 | Note: |
| 22Aug16 / 11Nov16 | |

MISC.

| | |
|-------------------|--|
| Inv.772 | 1 - Purchaser has attended a Structural appointment at the Decor Centre & has DECLINED any additional upgrades and accepts and acknowledges that there will be no further structural changes/additions/deletions to be made upon signing on August 22, 2016. |
| Line10313 | Note: |
| 22Aug16 / 11Nov16 | |
| Inv.772 | 1 - Purchasers are aware & accepts that ANY changes made to upgrades after signing this Purchasers Extra Form are subject to a minimum administration fee of \$500. PLUS a 10% holdback fee. |
| Line10314 | Note: |
| 22Aug16 / 11Nov16 | |

Kleinburg Glen - 47L - 1 - 25-9 Elev.B SOMERSET

| | |
|-------------------|---|
| Inv.772 | 1 - BONUS PACKAGE: \$5,000.00 (INCLUDING TAXES) WORTH OF UPGRADES FROM GOLD PARK HOMES DÉCOR CENTRE IS BEING APPLIED TOWARD THE STRUCTURAL APPOINTMENT. PURCHASER HAS A REMAINING AMOUNT OF \$3598.80 (INCLUDING TAXES) TO BE USED TOWARD THE COLOUR APPOINTMENT. |
| Line10315 | Note: |
| 22Aug16 / 11Nov16 | |
| Inv.1,082 | 1 - Purchasers are aware & accepts that ANY changes made to upgrades after signing this Purchasers Extra Form are subject to a minimum administration fee of \$500. PLUS a 10% holdback fee. |
| Line15882 | Note: |
| 9Jan17 / 20Jan17 | |
| Inv.1,082 | 1 - Purchaser has attended a Colour appointment at the Decor Centre & has DECLINED any additional upgrades and accepts and acknowledges that there will be no further structural changes/additions/deletions to be made upon signing. |
| Line15881 | Note: |
| 9Jan17 / 20Jan17 | |
| Inv.1,082 | 1 - Purchaser Accepts Standard Appliance Openings: Fridge - 37-1/2"W x 73-1/2" High Approx. Range - 30-1/2"D x 31-1/2"W Approx. Dishwasher - 24" W Approx |
| Line15883 | Note: |
| 9Jan17 / 20Jan17 | |
| Inv.1,082 | 1 - REMAINING BONUS PACKAGE OF: \$3,598.80 (INCLUDING TAXES) WORTH OF UPGRADES FROM GOLD PARK HOMES DÉCOR CENTRE IS BEING APPLIED TOWARD THE COLOUR APPOINTMENT. PURCHASER HAS A REMAINING AMOUNT OF \$00 (INCLUDING TAXES) |
| Line15884 | Note: |
| 9Jan17 / 20Jan17 | |
| Inv.1,082 | 1 - TOTAL: \$4,045.40 TOTAL AFTER REMAINING CREDIT OF \$3,598.80: \$446.60. Paid by Credit Card |
| Line15885 | Note: |
| 9Jan17 / 20Jan17 | |

WINDOWS - BASEMENT

| | |
|-------------------|--|
| Inv.772 | 2 - BASEMENT WINDOWS - UPGRADE EXISTING BASEMENT WINDOW TO 30 INCH X 24 INCH - MAY REQUIRE INSTALLATION OF WINDOW WELL |
| Line10312 | Note: |
| 22Aug16 / 11Nov16 | |

WINDOWS AND DOORS

| | |
|-------------------|--|
| Inv.772 | 1 - MAN DOOR GARAGE TO HOUSE - OPTIONAL - IF GRADE PERMITS |
| Line13786 | Note: |
| 22Aug16 / 11Nov16 | |

Purchasers: Lixu Qin & Yunxue Chen

Property: 47L

Telephone Res. / Bus: (226) 979-3618

Project: Burkshire Holdings Inc.

Decor Advisor: Laura Lofaro

Model and Elevation: 25-9 Elev.B SOMERSET

Layout Changes: ☐ Yes ☐ No

Sketch Attached: ☐ Yes ☐ No

Exterior Colour Scheme:

1. Cabinetry

| | Style and Colour | Counter | Hardware |
|---|----------------------|--|----------|
| Kitchen / Breakfast | Toscana PVC AntWhite | Crema Caramel Granite Pol. STD FE20 Edge | CS1-20 |
| Laundry Room | N/A | | |
| Powder Room | N/A | | |
| | | | |
| Master Ensuite Bathroom | Toscana PVC AntWhite | Wilsonart Autumn Carnival 1877K-52 | CS1-20 |
| Second Ensuite Bathroom (If Applicable) | N/A | | |
| Main Bath | Toscana PVC AntWhite | Wilsonart Autumn Carnival 1877K-52 | CS1-20 |
| Dishwasher Cabinet | N/A | | |

Comment

2. Floor Tile

| | Selection | Grout | Threshold |
|---|------------------------|-------|-----------|
| Entrance Vestibule | 12x12 Sacramento Beige | | |
| Main Hall | | | |
| Kitchen / Breakfast | 12x12 Sacramento Beige | | |
| Laundry Room | 12x12 Sacramento Beige | | |
| Powder Room | 12x12 Sacramento Beige | | |
| | | | |
| Master Ensuite Bathroom | 12x12 Sacramento Beige | | |
| Second Ensuite Bathroom (If Applicable) | N/A | | |
| Lower Landing (If Applicable) | N/A | | |
| Main Bath | 12x12 Sacramento Beige | | |

Comment

3. Wall Tile

| | Selection | Listello/Inserts | Describe |
|---|------------------|---|----------|
| | | <input type="radio"/> Yes <input checked="" type="radio"/> No | |
| Master Ensuite Bathroom | | | |
| Tub Deck | 8x10 Weave Ivory | <input type="radio"/> Yes <input checked="" type="radio"/> No | |
| Shower Stall | 8x10 Weave Ivory | <input type="radio"/> Yes <input checked="" type="radio"/> No | |
| Bathroom Walls | N/A | <input type="radio"/> Yes <input checked="" type="radio"/> No | |
| Second Ensuite Bathroom (If Applicable) | N/A | <input type="radio"/> Yes <input checked="" type="radio"/> No | |
| Main Bath | 8x10 Weave Ivory | <input type="radio"/> Yes <input checked="" type="radio"/> No | |

Kitchen Backsplash ☐ Yes ☒ No

Backsplash Behind Fridge

Comment

Purchasers: Lixu Qin & Yunxue Chen

Property: 47L

Telephone Res. / Bus: (226) 979-3618

Project: Burkshire Holdings Inc.

Decor Advisor: Laura Lofaro

Model and Elevation: 25-9 Elev.B SOMERSET

4. Plumbing Fixtures

Master Ensuite Bathroom Second Ensuite Powder Room
Other Room - Specify Other Washroom

Comment

STD Throughout

5. Hardwood Flooring

| | Type and Stain | | Type and Stain |
|-------------------------------|---------------------------------|----------------------|----------------------------------|
| Main Hall | Preverco Red Oak Natural-EI Pro | Upper Landing | *Preverco Red Oak Natural-EI Pro |
| Kitchen / Breakfast | N/A | Upper Hall | *Preverco Red Oak Natural-EI Pro |
| Living Room | N/A | Master Bedroom | SEE CARPET |
| Dining Room | N/A | Bedroom #2 | *Preverco Red Oak Natural-EI Pro |
| Family Room | Preverco Red Oak Natural-EI Pro | Bedroom #3 | *Preverco Red Oak Natural-EI Pro |
| Den/Library | N/A | Bedroom #4 | N/A |
| Entrance Vestibule | N/A | Bedroom #5 | N/A |
| Lower Landing (If Applicable) | N/A | Other Room - Specify | <input type="text"/> |

Comment

6. Carpeting

| | Upgrade | Description |
|-------------------------------|--------------------------|----------------------|
| Main Hall | <input type="checkbox"/> | N/A |
| Living Room | <input type="checkbox"/> | N/A |
| Dining Room | <input type="checkbox"/> | N/A |
| Family Room | <input type="checkbox"/> | N/A |
| Den/Library | <input type="checkbox"/> | N/A |
| Upper Hall | <input type="checkbox"/> | N/A |
| Master Bedroom | <input type="checkbox"/> | T07 |
| Bedroom #2 | <input type="checkbox"/> | N/A |
| Bedroom #3 | <input type="checkbox"/> | N/A |
| Bedroom #4 | <input type="checkbox"/> | N/A |
| Bedroom #5 | <input type="checkbox"/> | N/A |
| <input type="text"/> | <input type="checkbox"/> | <input type="text"/> |
| Upper Landing (If Applicable) | <input type="checkbox"/> | N/A |
| Lower Landing (If Applicable) | <input type="checkbox"/> | <input type="text"/> |

| | Type | Area |
|------------------|---------------|---|
| Upgrade Underpad | N/A | <input type="text"/> |
| Carpet on Stairs | Capped N/A | Runner - *Upgrade <input type="text"/> |

Comment

Purchasers: Lixu Qin & Yunxue Chen

Property: 47L

Telephone Res. / Bus: (226) 979-3618

Project: Burkshire Holdings Inc.

Decor Advisor: Laura Lofaro

Model and Elevation: 25-9 Elev.B SOMERSET

7. Fireplace

| | Living Room | | | Family Room | | | Other Room - Specify | | |
|----------------|-----------------------|-----------------------|-----------------------|-----------------------|----------------------------------|-----------------------|-----------------------|-----------------------|-----------------------|
| | Purchased | As Per Plan | N/A | Purchased | As Per Plan | N/A | Purchased | As Per Plan | N/A |
| Fireplace Type | <input type="radio"/> | <input type="radio"/> | <input type="radio"/> | <input type="radio"/> | <input checked="" type="radio"/> | <input type="radio"/> | <input type="radio"/> | <input type="radio"/> | <input type="radio"/> |
| Mantle Type | | | | STD Gas | | | | | |
| Colour / Stain | | | | STD Cast Stone | | | | | |
| Surround | | | | STD | | | | | |
| Hearth | | | | STD | | | | | |
| Comment | | | | Declined | | | | | |
| <div></div> | | | | | | | | | |

8. Trim Carpentry

| | | | | | |
|----------------|-------------|--------------------------|-----|--------------|-----|
| Interior Doors | STD | Front Door Glass Inserts | STD | Door Handles | STD |
| Interior Trim | STD | | | | |
| Comment | <div></div> | | | | |

9. Plaster Mouldings and Medallions

| | | | | | |
|--------------------|-------------|--|----------------------|-----|--|
| Entrance Vestibule | N/A | | Kitchen/Breakfast | N/A | |
| Main Hall | N/A | | Den/Library | N/A | |
| Living Room | N/A | | Lower Landing | N/A | |
| Dining Room | N/A | | Other Room - Specify | v | |
| Family Room | N/A | | | | |
| Comment | <div></div> | | | | |

10. Railings and Spindles

| | | |
|------------------|-------------|---|
| Railing Package | STD | |
| Railing Colour | Natural | Spindle Colour |
| Stringer / Riser | Natural | Treads |
| Comment | <div></div> | |
| | Oak Stairs | <input checked="" type="radio"/> Yes <input type="radio"/> No |

11. Wall Paint

| | | | |
|---------------------|-----------------------------|----------------|------------|
| Main & Upper Hall | | Master Bedroom | |
| Living Room | | Bedroom #2 | |
| Dining Room | | Bedroom #3 | |
| Kitchen / Breakfast | | Bedroom #4 | |
| Family Room | | Bedroom #5 | |
| Powder Room | | Master Ensuite | |
| Laundry Room | | | |
| Den/Library | | Second Ensuite | |
| Trim Paint | | Thru-Out | Cool White |
| Comment | <div></div> | | |
| | Smooth Ceilings First Floor | | |

Purchasers: Lixu Qin & Yunxue Chen

Property: 47L

Telephone Res. / Bus: (226) 979-3618

Project: Burkshire Holdings Inc.

Decor Advisor: Laura Lofaro

Model and Elevation: 25-9 Elev.B SOMERSET

12. Electrical

Plugs and Switches ☒ White ☐ Ivory

Hood Fan ☐ White ☐ Ivory

Appliances

Built in Cooktop

Built in Oven

Gas Stove

Microwave

☐ Yes ☒ No

☐ Yes ☒ No

☐ Yes ☒ No

☐ Yes ☒ No

Comment

SS Hood Fan

Above Kitchen Cabinet Light ☐ Yes ☐ No

Below Kitchen Cabinet Light ☐ Yes ☒ No

13. Heating and Air Conditioning

Air Conditioning

Gas Provisions Stove

Gas Provisions Dryer

Gas Provisions Barbecue

Comment

14. Additional Comments

15. Disclaimers and Notes

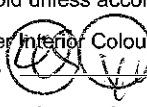
- Colours of all materials are as close as possible to builder's selection, but not necessarily identical due to variances in manufacturing.
- Any extras listed above are null and void unless accompanied by a separate invoice/amendment. Said invoice must be paid in full.
- The Purchaser acknowledges that after Interior Colour Selection form is signed and dated, no further changes will be permitted other than re-selection due to unavailability.  Purchaser's Initials
- The Purchaser acknowledges reading and accepting the "Gold Park Homes Decor Centre Disclaimers" form. This document contains other miscellaneous disclaimers.

This Interior Colour Selection is final and approved by:

Signature: Lixu Qin Date: Jan. 9th. 2017 Signature: Yunxue Chen Date: Jan. 9 2017

Elevation A • 1,794 sq.ft.

Elevation B • 1,794 sq.ft.

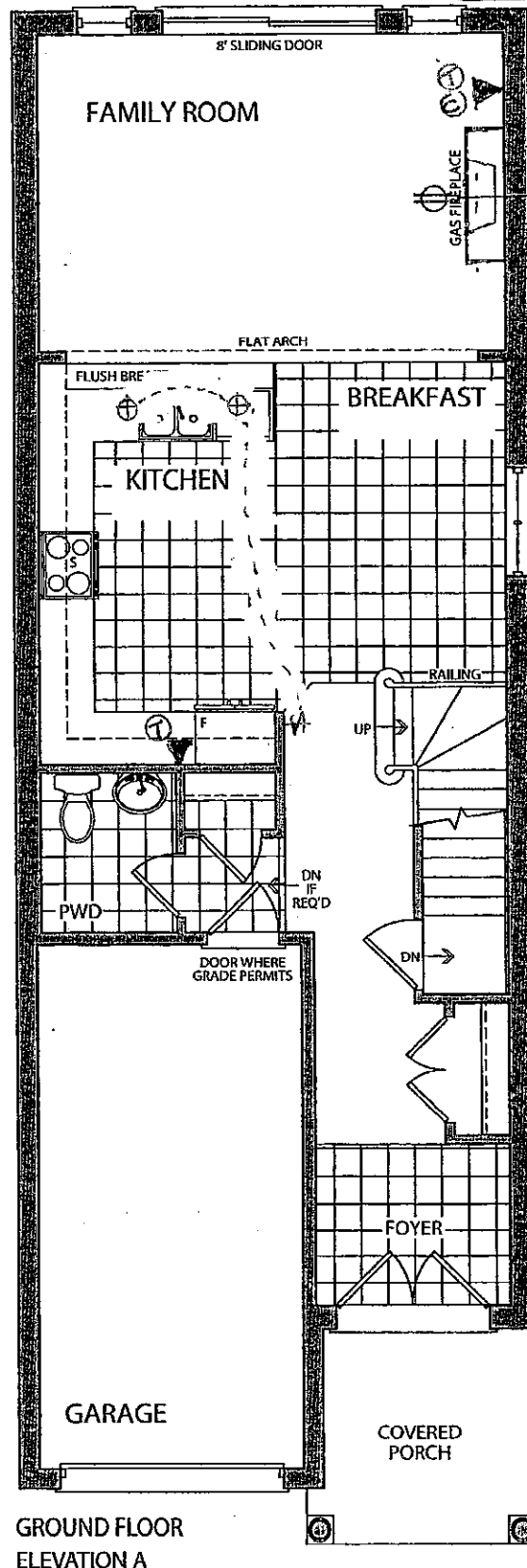

GROUND FLOOR
ELEVATION A

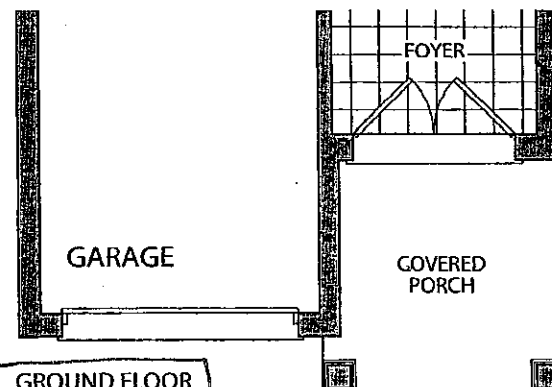

GROUND FLOOR
ELEVATION B

STRUCTURAL
AUG. 22 2016
LOT 47L

(K) (LQ)

COVERS

(LQ) (fj)

JAN 9. 2017

Elevation A • 1,794 sq.ft.

Elevation B • 1,794 sq.ft.

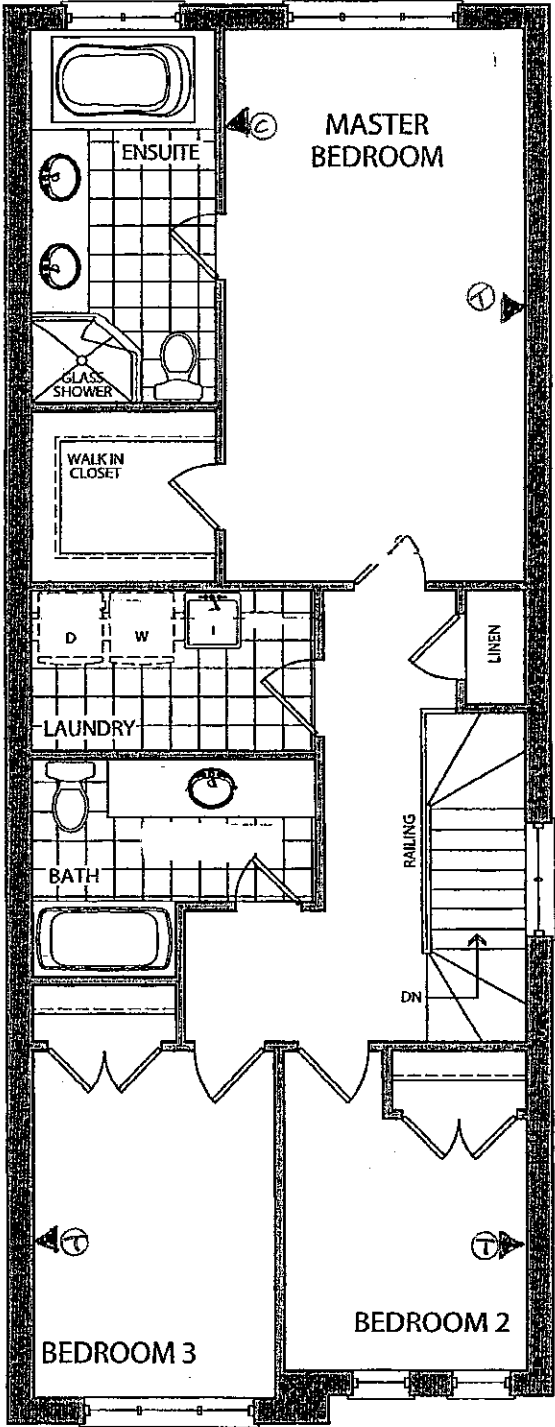

SECOND FLOOR
ELEVATION A

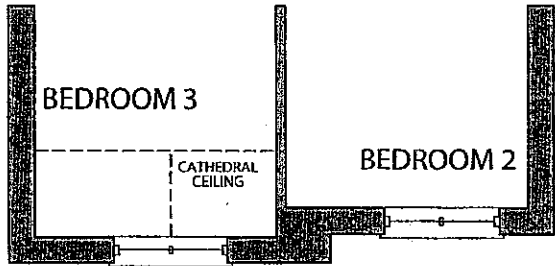

SECOND FLOOR
ELEVATION B

STRUCTURAL
Aug 22 2016
LOT 47L

COLOURS
Jan. 9. 2017

Prices, figures, illustrations, sizes, features and finishes are subject to change without notice. E.&O.E. Areas and dimensions are approximate and actual usable floor space may vary from the stated area. Layout may be reverse of the unit purchased. E. & O.E.

Elevation A • 1,794 sq.ft.

Elevation B • 1,794 sq.ft.

*WALK-OUT
BASEMENT

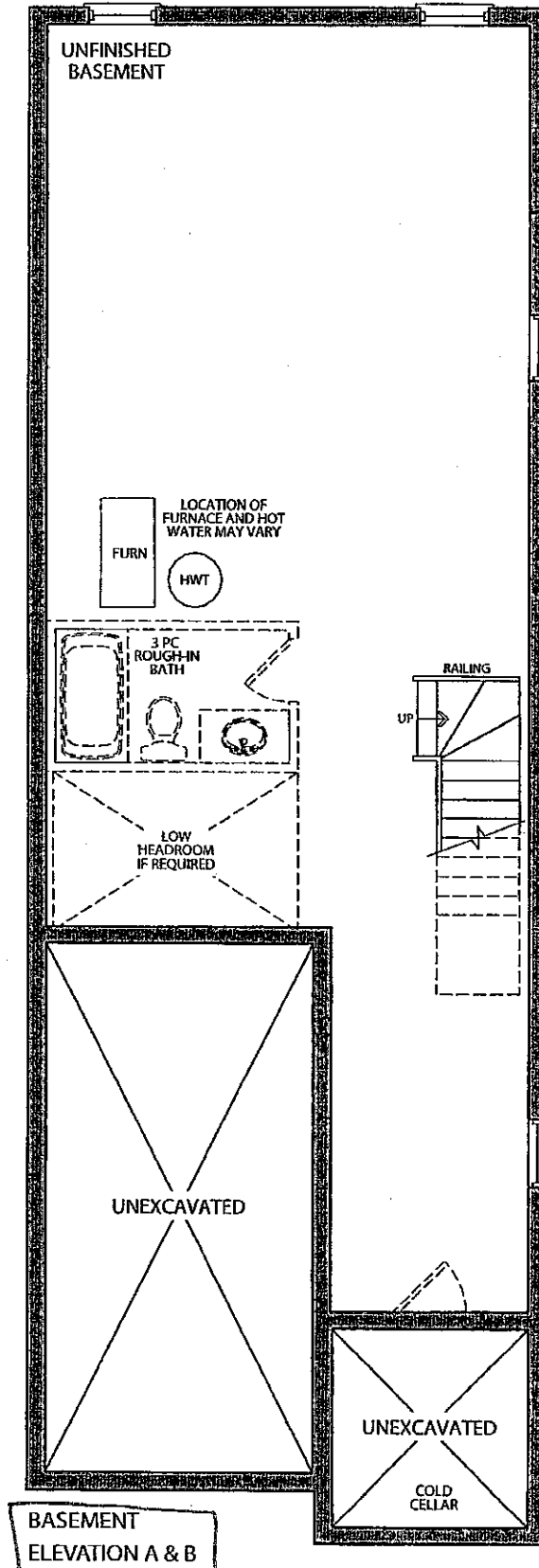

UPG:
24x30"

UPG:
24x30" STRUCTURAL

AUGUST 22 2016
LOT 47L

KC LQ

COLOURS

LQ JC

JAN. 9. 2017

CORTINA

KITCHENS INC.

70 Regina Road Woodbridge ON L4L 8L6
905-264-6464

INFORMATION - PVC DOORS

Builder: Gold Park Homes Project: KENNEDY GLEN Lot #: 47L

All cabinets with PVC (Thermofoil) Doors come with melamine gables, panels and kick. The doors, crown moulding and light valance are PVC wrapped. Open shelves incorporated in design will only be available with melamine interiors. There will be variations in colour shades between the PVC parts (doors, crown and Light valance) and the melamine parts (open shelves, Gables, Panels and Kick) due to the difference in material.

Furring Panel with crown moulding to the ceiling is not available on all PVC door styles due to subtle variations in colour shades between the PVC parts (moulding) and the melamine parts (furring panel) due to the difference in material. Grain directions in wood grain pattern melamine, vary between the furring panel, crown moulding (horizontal) and the PVC doors (vertical).

Thank you for your understanding.

I am well informed of this information, and agree to the purchase of the above.

Purchaser: Lion Qin

Date: JAN. 9. 2017

Purchaser: Yunqin Chen

Date: Jan 9. 2017

Trade Name: Gold Park Homes

Site location: Kleinburg

Model: 25-9

Address:

Project: Huntington& Nashville

Phase:

This layout has been explained to the purchaser by Cortina Kitchens Inc. and is understood by the purchaser.

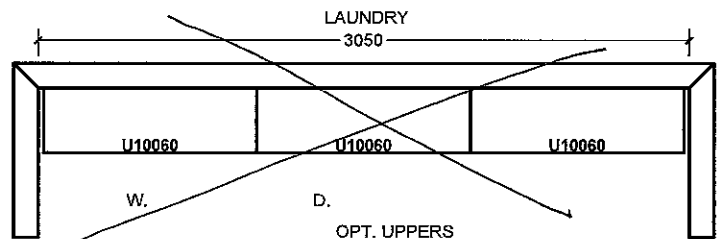
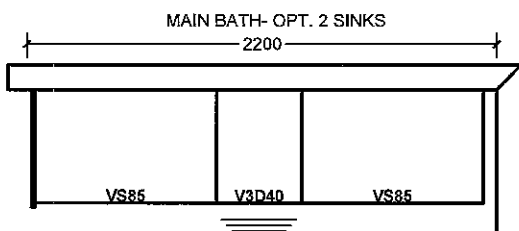
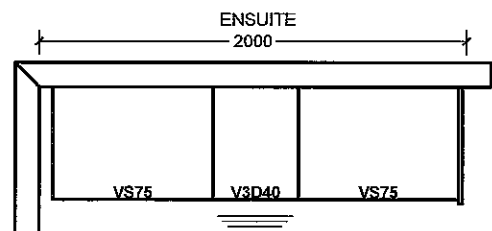
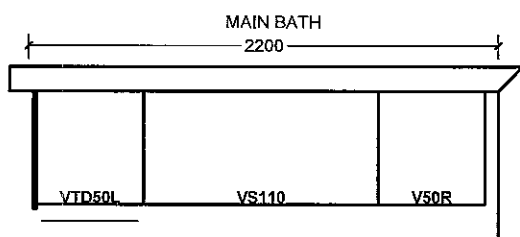
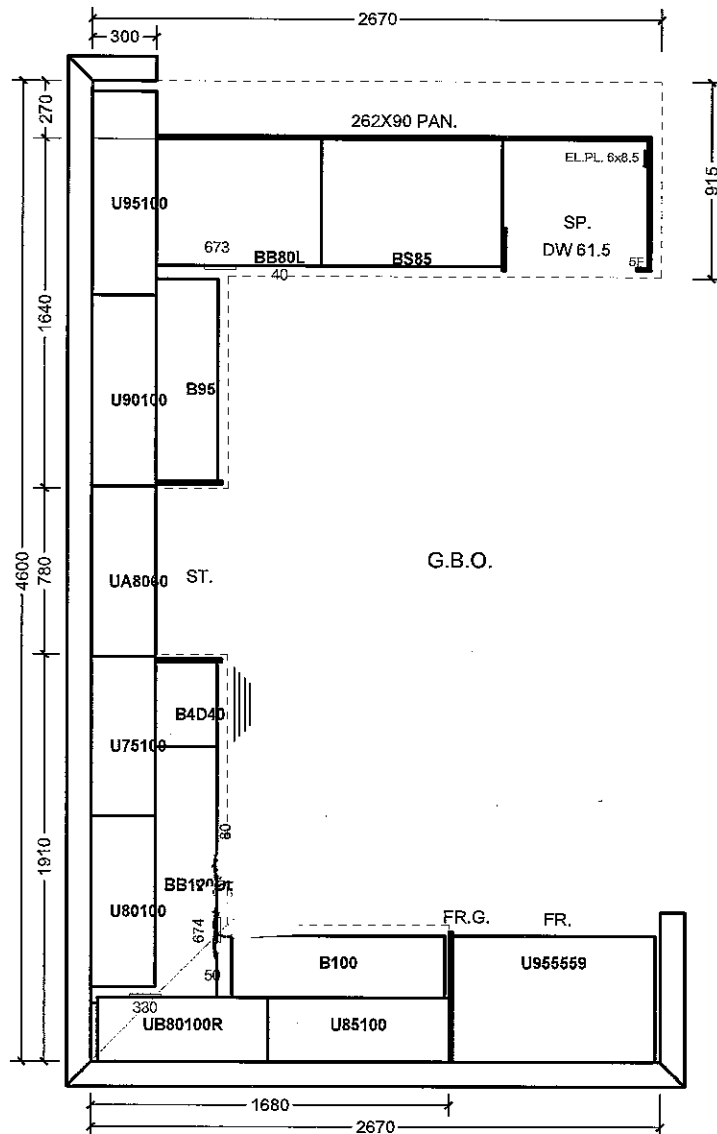

All prices subject to confirmation from head office.
This quotation is subject to the terms & conditions set out

All agreements are contingent upon strikes, accidents, and delays beyond our control.
Please provide our installer with template for sinkholes or \$150.00 will be charged for callback.

ACCEPTED DATE: JAN 9, 2017

[Signature]

LOT 47L

[Signature]

Item A. Wood grain and colour are characteristics of the product. We cannot guarantee that such grain and colour will always match.
Item B. Cortina Kitchens Inc. reserves the right to alter dimensions and make technical changes without notice.

STANDARD HARDWARE

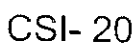
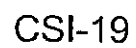
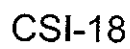
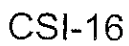
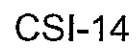
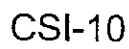
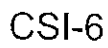

KIRCHEN, WÄSST ER SÜNDE,
MAN BÄTT

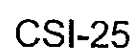
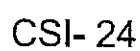
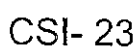
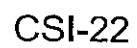
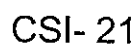

- IMAGES ARE FOR QUICK REFERENCE PURPOSES ONLY
- ACTUAL SIZES AND FINISHES AS PER HARDWARE
SAMPLE BOARD PROVIDED TO DECOR CENTRE

K6-LOT 47L

49

JAN 9. 2017

- Standard 2CM & 3CM
- ◐ Upgrade 1 2CM & 3CM
- ◑ Upgrade 1 4 CM
- Upgrade 2

20mm (3/4") Profiles



20mm (3/4") Profiles

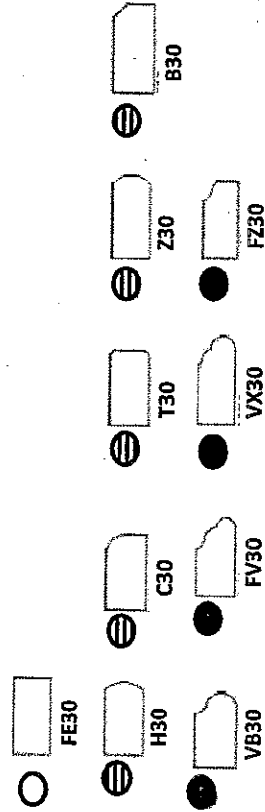

40mm (1 1/2") Profiles

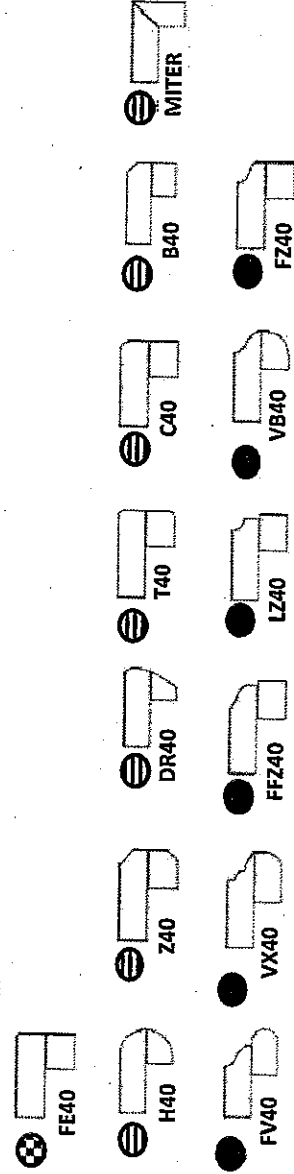

Note: All colours may not be available in 30mm at time ordered. Vendor reserves the right to use 40 mm edges (by lamination process).

*Mitre edge is available in Upgrade 1 for an overall thickness of 2". All other Mitre edge options will be an Upgrade 2 Edge.

K6-LOT47L

20 42

JAN-9-2017