

Kleinburg Glen - 13 - 1 - 42-1 Elev.A ROYALTON
CENTRAL VAC AND WIRING

Inv.536	1 - LAUNDRY ROOM- Install an additional key pad ROUGH - IN FOR EXTRA SECURITY KEY PAD (See Sketch)
Line6483	Note:
3Jun16 / 7Nov16	
Inv.536	1 - GREAT ROOM- Install a CONDUIT PIPE - FOR TELEVISION - from Great Room to basement for future TV above fireplace, approx. 60" A.F.F., see plan for location
Line6492	Note:
3Jun16 / 7Nov16	

CERAMIC

Inv.536	1 - BATHROOMS THRU OUT - Do *NOT* install Mirrors or Accessories (towel bars, soap holders, etc)
Line6811	Note:
3Jun16 / 7Nov16	
Inv.1,063	1 - KITCHEN FLOOR TILE: Upgrade 5 - 24x24" Glossy
Line15567	Note:
19Dec16 / 18Jan17	
Inv.1,063	1 - POWDER ROOM FLOOR TILE: Upgrade 5 - 24x24" Glossy
Line15568	Note:
19Dec16 / 18Jan17	
Inv.1,063	1 - FOYER FLOOR TILE: Upgrade 5 - 24x24" Glossy
Line15569	Note:
19Dec16 / 18Jan17	
Inv.1,063	1 - ENSUITE 2 FLOOR TILE: Upgrade 2 12x24" laid in straight, stacked pattern.
Line15575	Note:
19Dec16 / 18Jan17	
Inv.1,063	1 - ENSUITE 2 WALL TILE: Upgrade 1 wall tile - 4x16" laid in vertical stacked pattern. See sketch for tile pattern.
Line15576	Note:
19Dec16 / 18Jan17	
Inv.1,063	1 - ENSUITE 2 SHOWER WALL ACCENT TILE: Install 1 band of 4 rows accent tile approx. 66" A.F.F. See sketch for location.
Line15577	Note: Yahly Glass/marble/Shell
19Dec16 / 18Jan17	
Inv.1,063	1 - TWIN BATHROOM FLOOR TILE: Upgrade 2 - 12x24" laid in straight, stacked pattern.
Line15578	Note:
19Dec16 / 18Jan17	
Inv.1,063	1 - TWIN BATHROOM WALL TILE: Upgrade 1 wall tile - 4x16" laid in horizontal stacked pattern.
Line15579	Note:
19Dec16 / 18Jan17	
Inv.1,063	1 - TWIN BATHROOM TUB WALL ACCENT TILE: Install 1 (horizontal) band of 1 row of accent tile (accent tile to be laid as 'soldier'-vertical style) Locate approx. 66" A.F.F. See sketch for location.
Line15580	Note:
19Dec16 / 18Jan17	
Inv.1,063	1 - MASTER ENSUITE FLOOR TILE: Upgrade 5 tile - 24x24" Glossy
Line15581	Note: Grout lines as small as possible, please!
19Dec16 / 18Jan17	

Kleinburg Glen - 13 - 1 - 42-1 Elev.A ROYALTON

Inv.1,063	1 - MASTER ENSUITE SHOWER FLOOR TILE: Upgrade 1 Ceramic Hex
Line15582	Note:
19Dec16 / 18Jan17	
Inv.1,063	1 - MASTER ENSUITE SHOWER WALL TILE: Upgrade 1 tile - 4x16" laid in horizontal, stacked pattern.
Line15583	Note:
19Dec16 / 18Jan17	

ELECTRICAL

Inv.536	1 - GREAT ROOM-Install a 110V WALL RECEPTACLE ON NORMAL CIRCUIT - MUST SPECIFY LOCATION above fireplace for future TV, approx. 60" A.F.F. See plan for location
Line6494	Note:
3Jun16 / 7Nov16	
Inv.536	1 - KITCHEN- In addition to the builders standard ceiling light, Install a ROUGH - IN CEILING OUTLET & SWITCH (WITH COVER PLATE) Centred above the island - DOES NOT INCLUDE FIXTURE, see plan for location
Line6495	Note:
3Jun16 / 7Nov16	
Inv.536	1 - POWDER ROOM: ADDITIONAL STANDARD CEILING FIXTURE ON SAME SWITCH **DELETE** BUILDER'S STANDARD VANITY SCENCE AND INSTALL THIS FIXTURE USING STANDARD SWITCH.
Line7634	Note:
3Jun16 / 7Nov16	
Inv.536	1 - GREAT ROOM - Install a ROUGH - IN CEILING OUTLET & SWITCH (WITH COVER PLATE) - DOES NOT INCLUDE FIXTURE - Add 1 capped ceiling outlet in corner, approx. 36" from each wall, see plan for location
Line6509	Note:
3Jun16 / 7Nov16	
Inv.536	1 - 220V WALL RECEPTICAL ON DEDICATED CIRCUIT - FOR 4 WIRE BUILT - IN WALL OVEN - MUST SPECIFY LOCATION
Line7624	Note:
3Jun16 / 7Nov16	
Inv.536	1 - 200 AMP ELECTRICAL SERVICE
Line7638	Note:
3Jun16 / 7Nov16	
Inv.677	1 - KITCHEN: 240v WALL RECEPTICAL ON DEDICATED CIRCUIT - FOR 4 WIRE BUILT-IN WALL OVEN.
Line8844	Note:
19Jul16 / 17Jan17	
Inv.677	-1 - *DELETE* 220V WALL RECEPTICAL ON DEDICATED CIRCUIT - FOR 4 WIRE BUILT - IN WALL OVEN (DELETE ITEM FROM ORDER #PE-536-1, DATED JUNE 28 2016)
Line8842	Note:
19Jul16 / 17Jan17	
Inv.677	1 - 110V WALL RECEPTACLE ON DEDICATED CIRCUIT - GAS FIRED APPLIANCE - FOR AUX. EQUIPMENT - NOT A STOVE PLUG
Line8845	Note:
19Jul16 / 17Jan17	

EXTERIOR COLOURS

Inv.536	1 - EXTERIOR COLOUR PACKAGE 1
Line13489	Note:
3Jun16 / 7Nov16	

Kleinburg Glen - 13 - 1 - 42-1 Elev.A ROYALTON
FIREPLACE

Inv.1,063	1 - FAMILY ROOM: Add raised hearth to standard fireplace mantle
Line15592	Note:
19Dec16 / 18Jan17	

FRAMING

Inv.536	1 - GREAT ROOM / DINING ROOM - Create approx. 42x96" opening in shared wall, complete with standard trim. See plan and sketch for location. (Approved by Stacey & Sergio June 6 2016.)
Line6565	Note:
3Jun16 / 7Nov16	
Inv.536	8 - FRAME MAIN FLOOR DOORS AT 96 INCH - ADDED WITH THE ADDITION OF TALLER INTERIOR DOORS
Line7629	Note:
3Jun16 / 7Nov16	
Inv.536	1 - MAIN FLOOR & 2ND FLOOR: FRAME ARCHWAYS TO 96"
Line7633	Note:
3Jun16 / 7Nov16	
Inv.536	1 - MAN DOOR GARAGE TO HOUSE - OPTIONAL - IF GRADE PERMITS
Line13491	Note: AS PER APS
3Jun16 / 7Nov16	

GLASS AND MIRROR

Inv.536	1 - MASTER ENSUITE- CONVERT FRAMED SHOWER TO 10MM FRAMLESS SHOWER ENCLOSURE WITH DOOR AND 10MM SIDE PANEL
Line6502	Note:
3Jun16 / 7Nov16	
Inv.536	1 - BATHROOMS THRU OUT - Do *NOT* install Mirrors or Accessories (towel bars, soap holders, etc)
Line12391	Note:
3Jun16 / 7Nov16	
Inv.536	1 - BATHROOMS THRU OUT - Do *NOT* install Mirrors or Accessories (towel bars, soap holders, etc)
Line13493	Note:
3Jun16 / 7Nov16	

GRANITE MARBLE QUARTZ

Inv.1,063	1 - KITCHEN STONE COUNTER TOP: Upgrade 3 Caesar Stone (price includes cooktop cut)
Line15562	Note:
19Dec16 / 18Jan17	
Inv.1,063	1 - KITCHEN STONE COUNTER TOP: Upgrade Edge to FE-40
Line15563	Note:
19Dec16 / 18Jan17	

HARDWOOD

Inv.1,063	1 - GREAT ROOM / DINING ROOM / DEN / MAIN HALL / LANDINGS: Upgrade 3 hardwood - Preverco Ash 3/4 x 4-1/4" Brushed finish
Line15571	Note:
19Dec16 / 18Jan17	
Inv.1,063	1 - UPPER HALL / MASTER BEDROOM / BEDROOM 2 / BEDROOM 3 / BEDROOM 4: Upgrade 3 hardwood - Preverco Ash 3/4 x 4-1/4" Brushed finish
Line15572	Note:
19Dec16 / 18Jan17	

HVAC

Inv.536	1 - KITCHEN- Install a GAS LINE ROUGH for future gas cooktop, see plan for location
Line6498	Note:
3Jun16 / 7Nov16	

INTERIOR TRIM AND DOORS

Inv.536	8 - MAIN FLOOR: STANDARD DOOR EXTENDED HEIGHT 96 INCH (PRICE PER DOOR) MAIN FLOOR 3 STOREY MODELS - INCLUDE FRAMING NOTE
Line7632	Note:
3Jun16 / 7Nov16	

Inv.536	4 - MAIN FLOOR: EXTENDED HEIGHT ARCHWAY (PRICE PER DOORWAY) - 96" tall
Line7630	Note:
3Jun16 / 7Nov16	

Inv.536	1 - 2ND FLOOR: EXTENDED HEIGHT ARCHWAY (PRICE PER DOORWAY) - 96" tall
Line7631	Note:
3Jun16 / 7Nov16	

Inv.536	1 - GREAT ROOM / DINING ROOM - Create approx. 42x96" opening in shared wall, complete with standard trim. See plan and sketch for location. (Approved by Stacey & Sergio June 6 2016.)
Line13492	Note:
3Jun16 / 7Nov16	

Inv.1,063	1 - MAIN FLOOR: Package 1 on main floor only (standard on 2nd floor)
Line15794	Note:
19Dec16 / 18Jan17	

KITCHEN AND BATH CABINETRY

Inv.1,063	1 - KITCHEN CABINETRY: Upgrade 6 cabinet profile - mdf
Line15545	Note:
19Dec16 / 18Jan17	

Inv.1,063	1 - KITCHEN CABINETRY: Two-tone kitchen - island a different colour
Line15546	Note:
19Dec16 / 18Jan17	

Inv.1,063	1 - KITCHEN CABINETRY: Accommodate for built-in fridge (standard installation, not flush)
Line15547	Note:
19Dec16 / 18Jan17	

Inv.1,063	1 - KITCHEN CABINETRY: Adjust cabinetry for 36" cooktop
Line15548	Note:
19Dec16 / 18Jan17	

Inv.1,063	1 - KITCHEN CABINETRY: Delete cabinet above cooktop, finish sides of cabinets for future chimney-style hood fan. Leave approx. 42" between uppers above 36" cooktop for future 36" hood fan.
Line15549	Note:
19Dec16 / 18Jan17	

Inv.1,063	1 - KITCHEN CABINETRY: Pots and Pans drawers below cooktop - top drawer is false + 2 deep drawers below.
Line15550	Note:
19Dec16 / 18Jan17	

Kleinburg Glen - 13 - 1 - 42-1 Elev.A ROYALTON

Inv.1,063	1 - KITCHEN CABINETRY: Cabinetry Crown + Furring Panel
Line15551	Note:
19Dec16 / 18Jan17	
Inv.1,063	1 - KITCHEN CABINETRY: Double appliance cabinet with drawer below (locate at end of cabinets near breakfast area, see plan for location)
Line15552	Note:
19Dec16 / 18Jan17	
Inv.1,063	1 - KITCHEN CABINETRY: Base Corner Folding Door
Line15553	Note:
19Dec16 / 18Jan17	
Inv.1,063	1 - KITCHEN CABINETRY: Upper corner diagonal door
Line15554	Note:
19Dec16 / 18Jan17	
Inv.1,063	2 - KITCHEN CABINETRY: Top drawer - 1 large drawer (price same as 2 drawers)
Line15556	Note:
19Dec16 / 18Jan17	
Inv.1,063	1 - KITCHEN CABINETRY: Upgrade hardware (door handles)
Line15558	Note:
19Dec16 / 18Jan17	
Inv.1,063	1 - KITCHEN ISLAND: Upgraded island detailing - decorative posts, furniture kick and wainscot panelling - see attached sketch (special pricing per Sergio Dec 22)
Line15560	Note:
19Dec16 / 18Jan17	
Inv.1,063	1 - LAUNDRY ROOM: Install optional upper cabinets - standard level
Line15574	Note:
19Dec16 / 18Jan17	

MISC.

Inv.536	1 - Purchasers are aware & accepts that ANY changes made to upgrades after signing this Purchasers Extra Form are subject to a minimum administration fee of \$500. PLUS a 10% holdback fee.
Line7636	Note:
3Jun16 / 7Nov16	
Inv.536	1 - Purchaser has attended a Structural appointment at the Decor Centre & has DECLINED any additional upgrades and accepts and acknowledges that there will be no further structural changes/additions/deletions to be made upon signing on June 28, 2016
Line7635	Note:
3Jun16 / 7Nov16	
Inv.536	1 - BONUS PACKAGE: \$10,000.00 (INCLUDING TAXES) WORTH OF UPGRADES FROM GOLD PARK HOMES DÉCOR CENTRE IS BEING APPLIED TOWARD THE STRUCTURAL APPOINTMENT. PURCHASER HAS A REMAINING AMOUNT OF \$00 (INCLUDING TAXES) TO BE USED TOWARD THE COLOUR APPOINTMENT
Line7637	Note:
3Jun16 / 7Nov16	
Inv.677	1 - Purchasers are aware & accepts that ANY changes made to upgrades after signing this Purchasers Extra Form are subject to a minimum administration fee of \$500. PLUS a 10% holdback fee.
Line8846	Note:
19Jul16 / 17Jan17	

Kleinburg Glen - 13 - 1 - 42-1 Elev.A ROYALTON

Inv.1,063	1 - Purchaser has attended a Colour appointment at the Decor Centre & has DECLINED any additional upgrades and accepts and acknowledges that there will be no further changes/additions/deletions to be made upon signing on December 19, 2016.
Line15593	Note:
19Dec16 / 18Jan17	
Inv.1,063	1 - Purchasers are aware & accepts that ANY changes made to upgrades after signing this Purchasers Extra Form are subject to a minimum administration fee of \$500. PLUS a 10% holdback fee.
Line15594	Note:
19Dec16 / 18Jan17	
Inv.1,063	1 - STAIRCASE - The purchaser was advised and therefore accepts and acknowledges that the wood species of the staircase and flooring chosen do not match. This difference may result in a stain colour variance.
Line15595	Note: The purchaser agrees that the vendor is to be exempt from any and all claims by the purchaser regarding this colour variance.
19Dec16 / 18Jan17	

PAINTING

Inv.1,063	1 - MAIN STAIRS: Stain stairs 'Generation Cobalt' Note: Stairs will not match hardwood floors in colour, texture or species.
Line15591	Note:
19Dec16 / 18Jan17	

PLUMBING

Inv.536	1 - KITCHEN- Install a ROUGH - IN - WATERLINE FOR FRIDGE
Line6496	Note:
3Jun16 / 7Nov16	
Inv.1,063	1 - MASTER ENSUITE: 4-piece Roman Tub Filler #T4716LP/H20/R4716
Line15588	Note:
19Dec16 / 18Jan17	
Inv.1,063	1 - KITCHEN SINK: Upgrade to rectangular single bowl Blanco Quatrus Super Single + Bottom Grid #401248/406347
Line15598	Note:
19Dec16 / 18Jan17	

STAIRS AND RAILINGS

Inv.1,063	1 - MAIN STAIRS: *Custom Package* Square Newell Post (2-1/2") + Oak Pickets (1-3/4") (Approved by Sergio Dec 22)
Line15590	Note:
19Dec16 / 18Jan17	

WINDOWS AND DOORS

Inv.536	1 - MAN DOOR GARAGE TO HOUSE - OPTIONAL - IF GRADE PERMITS
Line13490	Note: AS PER APS
3Jun16 / 7Nov16	

Scheduled Closing Date: September-13-16

Purchasers: Manhal Odishou & Tania Albina Odishou

Property: 13

REVISED

Telephone Res. / Bus: (416) 879-5233

Project: Burkshire Holdings Inc.

Decor Advisor: Yolande Somerville

Model and Elevation: 42-1 Elev.A ROYALTON

Layout Changes: ☐ Yes ☒ NoSketch Attached: ☒ Yes ☐ No

Exterior Colour Scheme:

1. Cabinetry

	Style and Colour	Counter	Hardware
Kitchen / Breakfast	*manchst mdf crem mat	*Caesar Stone 'Organic White' *Edge: FE-40	*CH-44
Laundry Room	*varese pvc 'mystic	n/a	cs1-24
Powder Room	n/a	n/a	n/a
Kitchen *ISLAND*	*manchest mpl greyston	same	n/a
Master Ensuite Bathroom	toscana pvc 'crystal whit	P-Lam #4926k-07'Black Alicant'	cs1-24
Second Ensuite Bathroom (If Applicable)	varese pvc 'crystal white'	P-Lam #P-345LM 'Inukshuk Taupe'	cs1-14
Twin Bathroom	varese pvc 'crystal white'	P-Lam #4886-38 'Pearl Soapstone'	cs1-14
Dishwasher Cabinet	n/a		

Comment

2. Floor Tile

	Selection	Grout	Threshold
Entrance Vestibule	*24x24" Timeless Glossy 'Light Grey'	n/a	n/a
Main Hall	n/a	n/a	n/a
Kitchen / Breakfast	*24x24" Timeless Glossy 'Light Grey'	n/a	n/a
Laundry Room	13x13" Serpentine 'Beyaz-White'	n/a	n/a
Powder Room	*24x24" Timeless Glossy 'Light Grey'	n/a	n/a
		n/a	n/a
Master Ensuite Bathroom	*24x24" Arya 'White/grey Glossy'	n/a	n/a
Second Ensuite Bathroom (If Applicable)	*12x24" Allure 'Grey'	n/a	n/a
Lower Landing (If Applicable)	n/a	n/a	n/a
Twin Bathroom	*12x24" Allure 'Grey'	n/a	n/a

Comment

Grout lines as small as possible, please!!

3. Wall Tile

	Selection	Listello/Inserts	Describe
M. Ens. Shower Floor	*Ontario Hex 'Snow White'	<input checked="" type="radio"/> Yes <input type="radio"/> No	
Master Ensuite Bathroom			
Tub Deck	n/a	<input type="radio"/> Yes <input checked="" type="radio"/> No	
Shower Stall	*4x12" Chess 'White'	<input type="radio"/> Yes <input checked="" type="radio"/> No	
Bathroom Walls	n/a	<input type="radio"/> Yes <input checked="" type="radio"/> No	
Second Ensuite Bathroom (If Applicable)	*4x16" CDC 'Siver Grey' bright	<input checked="" type="radio"/> Yes <input type="radio"/> No	Yahli white blend glass/marble/pearl
Twin Bathroom	*4x16" CDC 'Sterling Grey' bright	<input checked="" type="radio"/> Yes <input type="radio"/> No	Marmara marble mos. stacked

Kitchen Backsplash ☐ Yes ☒ No

Backsplash Behind Fridge

n/a

Comment

none

Purchasers: Manhal Odishou & Tania Albina Odishou

Property: 13

Telephone Res. / Bus: (416) 879-5233

Project: Burkshire Holdings Inc.

Decor Advisor: Yolande Somerville

Model and Elevation: 42-1 Elev.A ROYALTON

4. Plumbing Fixtures

<input type="text"/>	Second Ensuite	<input type="text"/>	Powder Room	<input type="text"/>
Master Ensuite Bathroom	<input type="text"/>	Other Room - Specify	<input type="text"/>	Other Washroom
<input type="text"/>				

Comment

Standard thru out except:
Kitchen sink
Master tub faucet

5. Hardwood Flooring

	Type and Stain		Type and Stain
Main Hall	<input 'komodo'"="" ash="" brush="" type="text" value="*3/4 x 4-1/4"/>	Upper Landing	<input 'komodo'"="" ash="" brush="" type="text" value="*3/4 x 4-1/4"/>
Kitchen / Breakfast	<input type="text" value="n/a"/>	Upper Hall	<input 'komodo'"="" ash="" brush="" type="text" value="*3/4 x 4-1/4"/>
Living Room	<input type="text" value="n/a"/>	Master Bedroom	<input 'komodo'"="" ash="" brush="" type="text" value="*3/4 x 4-1/4"/>
Dining Room	<input 'komodo'"="" ash="" brush="" type="text" value="*3/4 x 4-1/4"/>	Bedroom #2	<input 'komodo'"="" ash="" brush="" type="text" value="*3/4 x 4-1/4"/>
Family Room	<input 'komodo'"="" ash="" brush="" type="text" value="*3/4 x 4-1/4"/>	Bedroom #3	<input 'komodo'"="" ash="" brush="" type="text" value="*3/4 x 4-1/4"/>
Den/Library	<input 'komodo'"="" ash="" brush="" type="text" value="*3/4 x 4-1/4"/>	Bedroom #4	<input 'komodo'"="" ash="" brush="" type="text" value="*3/4 x 4-1/4"/>
Entrance Vestibule	<input type="text" value="n/a"/>	Bedroom #5	<input type="text" value="n/a"/>
Lower Landing (If Applicable)	<input 'komodo'"="" ash="" brush="" type="text" value="*3/4 x 4-1/4"/>	Other Room - Specify	<input type="text" value="n/a"/>

Comment

Hardwood Selection: Preverco Ash Brushed Finish 3/4 x 4-1/4" 'Komodo'
Note: Stairs will not match in colour, finish or species

6. Carpeting

	Upgrade	Description
Main Hall	<input type="checkbox"/>	<input type="text"/>
Living Room	<input type="checkbox"/>	<input type="text"/>
Dining Room	<input type="checkbox"/>	<input type="text"/>
Family Room	<input type="checkbox"/>	<input type="text"/>
Den/Library	<input type="checkbox"/>	<input type="text"/>
Upper Hall	<input type="checkbox"/>	<input type="text"/>
Master Bedroom	<input type="checkbox"/>	<input type="text"/>
Bedroom #2	<input type="checkbox"/>	<input type="text"/>
Bedroom #3	<input type="checkbox"/>	<input type="text"/>
Bedroom #4	<input type="checkbox"/>	<input type="text"/>
Bedroom #5	<input type="checkbox"/>	<input type="text"/>
Thru out	<input type="checkbox"/>	<input type="text" value="none"/>
Upper Landing (If Applicable)	<input type="checkbox"/>	<input type="text"/>
Lower Landing (If Applicable)	<input type="checkbox"/>	<input type="text"/>

Upgrade Underpad	Type <input type="text"/>	Area <input type="text"/>
Carpet on Stairs	Capped <input type="text"/>	Runner - *Upgrade <input type="text"/>

Comment

No Carpet Thru out

Purchasers: Manhal Odishou & Tania Albina Odishou
Telephone Res. / Bus: (416) 879-5233
Decor Advisor: Yolande Somerville

Property: 13
Project: Burkshire Holdings Inc.
Model and Elevation: 42-1 Elev.A ROYALTON

7. Fireplace

	Living Room			Family Room			Other Room - Specify		
	Purchased	As Per Plan	N/A	Purchased	As Per Plan	N/A	Purchased	As Per Plan	N/A
Fireplace Type	<input type="radio"/>	<input type="radio"/>	<input checked="" type="radio"/>	<input type="radio"/>	<input checked="" type="radio"/>	<input type="radio"/>	<input type="radio"/>	<input type="radio"/>	<input checked="" type="radio"/>
Mantle Type				Standard Gas					
Colour / Stain				Standard Mediterranean					
Surround				Standard					
Hearth				none					
Comment				*Raised					
<div></div>									

8. Trim Carpentry

Interior Doors **Front Door Glass Inserts** **Door Handles**

Interior Trim

Comment
*Standard door profile - 96" on main floor

9. Plaster Mouldings and Medallions

Entrance Vestibule	<input type="text"/>	<input type="text"/>	Kitchen/Breakfast	<input type="text"/>	<input type="text"/>
Main Hall	<input type="text"/>	<input type="text"/>	Den/Library	<input type="text"/>	<input type="text"/>
Living Room	<input type="text"/>	<input type="text"/>	Lower Landing	<input type="text"/>	<input type="text"/>
Dining Room	<input type="text"/>	<input type="text"/>	Other Room - Specify	<input type="text" value="none"/>	<input type="text"/>
Family Room	<input type="text"/>	<input type="text"/>	Thru out	<input type="text"/>	<input type="text"/>
Comment <div></div>					

10. Railings and Spindles

Railing Package

Railing Colour **Spindle Colour**

Stringer / Riser **Treads**

Comment **Oak Stairs** ☒ Yes ☐ No

11. Wall Paint

Main & Upper Hall	<input type="text"/>	Master Bedroom	<input type="text"/>
Living Room	<input type="text"/>	Bedroom #2	<input type="text"/>
Dining Room	<input type="text"/>	Bedroom #3	<input type="text"/>
Kitchen / Breakfast	<input type="text"/>	Bedroom #4	<input type="text"/>
Family Room	<input type="text"/>	Bedroom #5	<input type="text"/>
Powder Room	<input type="text"/>	Master Ensuite	<input type="text"/>
Laundry Room	<input type="text"/>	Second Ensuite	<input type="text"/>
Den/Library	<input type="text"/>	Thru Out	<input type="text" value="Warm Grey"/>
Trim Paint	<input type="text"/>		
Comment	Smooth Ceilings First Floor <input type="text"/>		

(Handwritten signature)

Scheduled Closing Date: September-13-16

Purchasers: Manhal Odishou & Tania Albina Odishou

Property: 13

Telephone Res. / Bus: (416) 879-5233

Project: Burkshire Holdings Inc.

Decor Advisor: Yolande Somerville

Model and Elevation: 42-1 Elev.A ROYALTON

12. Electrical

Plugs and Switches ☒ White ☐ Ivory

Hood Fan ☐ White ☐ Ivory

Appliances Built in Cooktop

☒ Yes ☐ No

Built in Oven

☒ Yes ☐ No

Above Kitchen Cabinet Light ☐ Yes ☒ No

Below Kitchen Cabinet Light ☐ Yes ☒ No

Gas Stove

☒ Yes ☐ No

Microwave

☒ Yes ☐ No

Comment

Chimney-hood fan after closing

13. Heating and Air Conditioning

Air Conditioning

Gas Provisions Dryer

Comment

Standard Gas BBQ Line

Gas Provisions Stove

Gas Provisions Barbecue

14. Additional Comments

15. Disclaimers and Notes

- 1) Colours of all materials are as close as possible to builder's selection, but not necessarily identical due to variances in manufacturing.
- 2) Any extras listed above are null and void unless accompanied by a separate invoice/amendment. Said invoice must be paid in full.
- 3) The Purchaser acknowledges that after Interior Colour Selection form is signed and dated, no further changes will be permitted other than re-selection due to unavailability. Purchaser's Initials
- 4) The Purchaser acknowledges reading and accepting the "Gold Park Homes Decor Centre Disclaimers" form. This document contains other miscellaneous disclaimers.

This Interior Colour Selection is final and approved by:

Signature:

Date:

Signature:

Date:

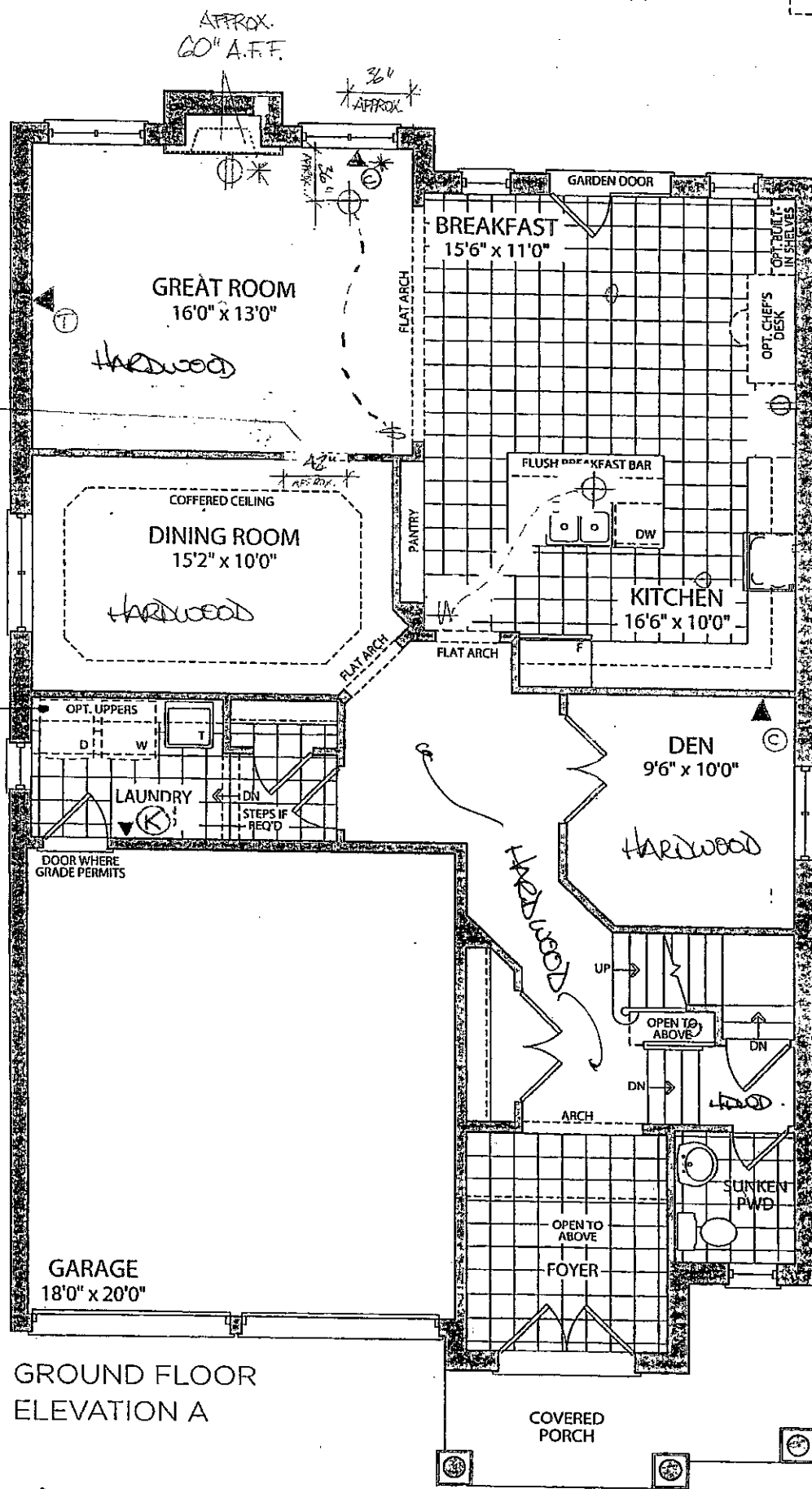

GROUND FLOOR ELEVATION A

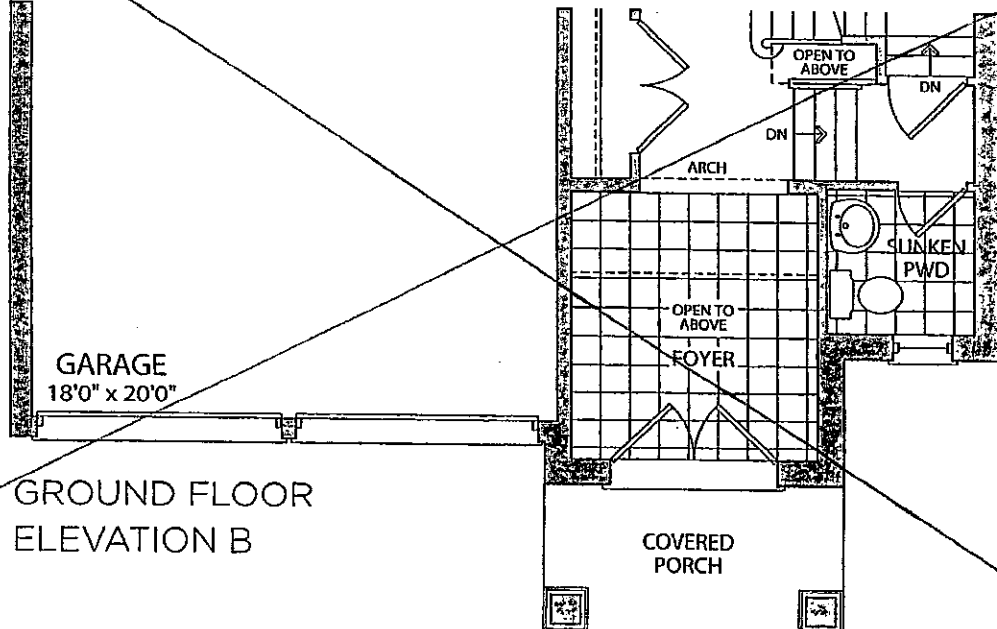

GROUND FLOOR ELEVATION B

KG-13
Dec. 22 2016

ROYALTON A
LOT 13
JUNE 28 2016

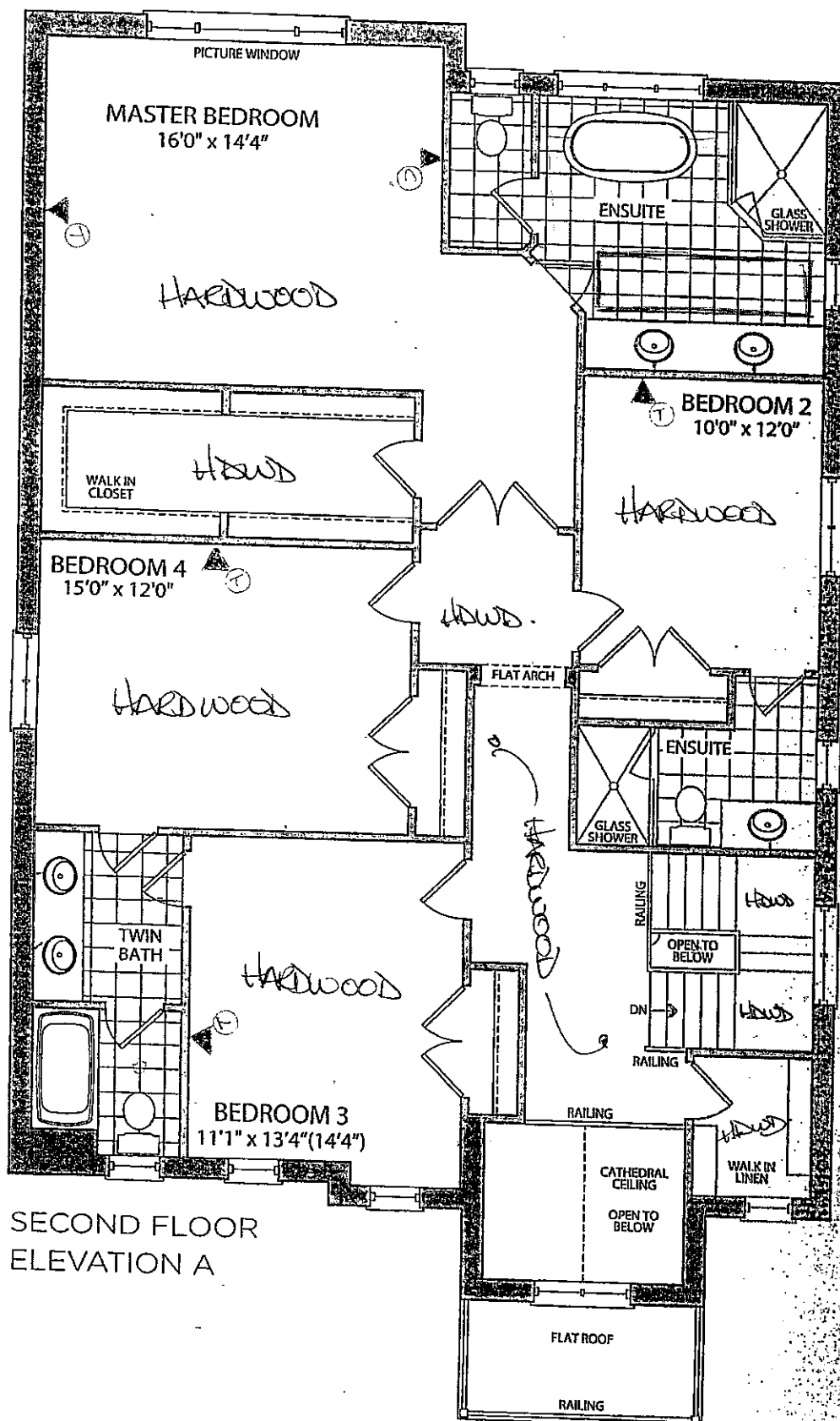

SECOND FLOOR
ELEVATION A

ROYALTON A

LOT 13

JUNE 28 2016

① ②

KG-13

DEC 28 2016

① ②

LEGEND

* 2" CONDUIT

⊕ ELECTRICAL OUTLET

▲Ⓚ KEY PAD ROUGH IN

✦ SINGLE POLE SWITCH

▲ⓔ GAS LINE

▲Ⓣ PHONE

▲ⓐ CABLE

⊕ ROUGH IN CAPPED CEILING OUTLET



the Royalton



Elevation A • 3,016 sq.ft.



Elevation B • 3,043 sq.ft.

GOLDPARK
HOMES

Prices, figures, illustrations, sizes, features and finishes are subject to change without notice. E.&O.E. Areas and dimensions are approximate and actual usable floor space may vary from the stated area. Layout may be reverse of the unit purchased. E. & O.E.

42

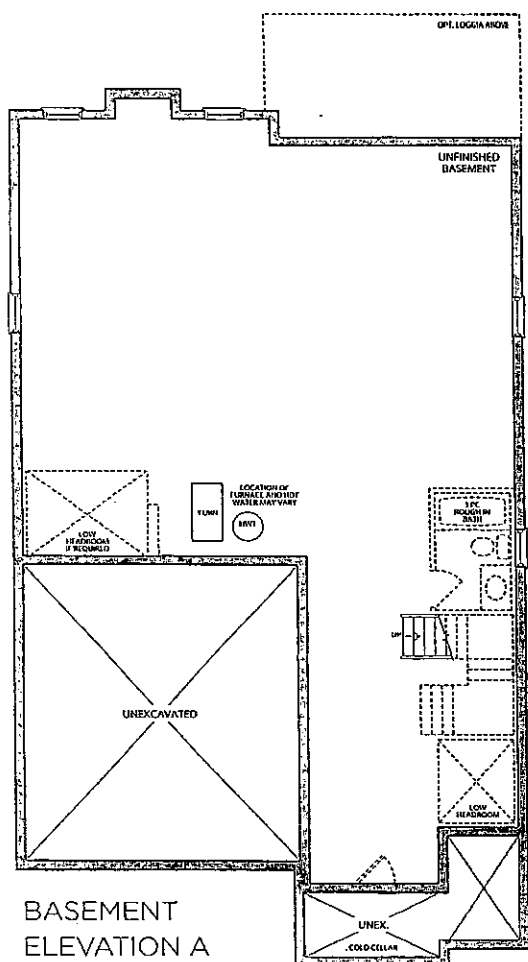

BASEMENT
ELEVATION A

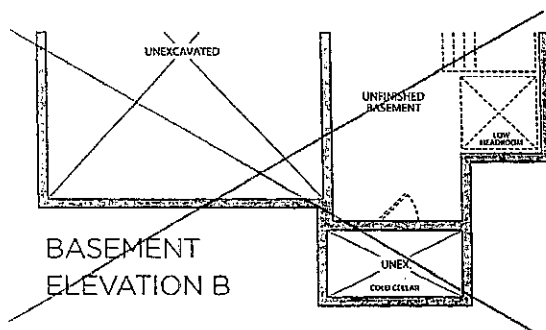

BASEMENT
ELEVATION B

ROYALTON A

LOT 13

JUNE 28 2016

① ⑩

KG-13

Dec 22 2016

KG-13

KG-13
Dec 22 2016

QUOTATION

Date: 14/10/16

Trade Name: Gold Park Homes	Site location: Kleinburg	Model: 42-1
Address:	Project: Kleinburg Glen	Phase:

This layout has been explained to the purchaser by Cortina Kitchens Inc. and is understood by the purchaser.

* CROWN MOULDINGS
+ FURRING PANEL

* UPGRADED ISLAND DETAIL

* 36" COOK TOP

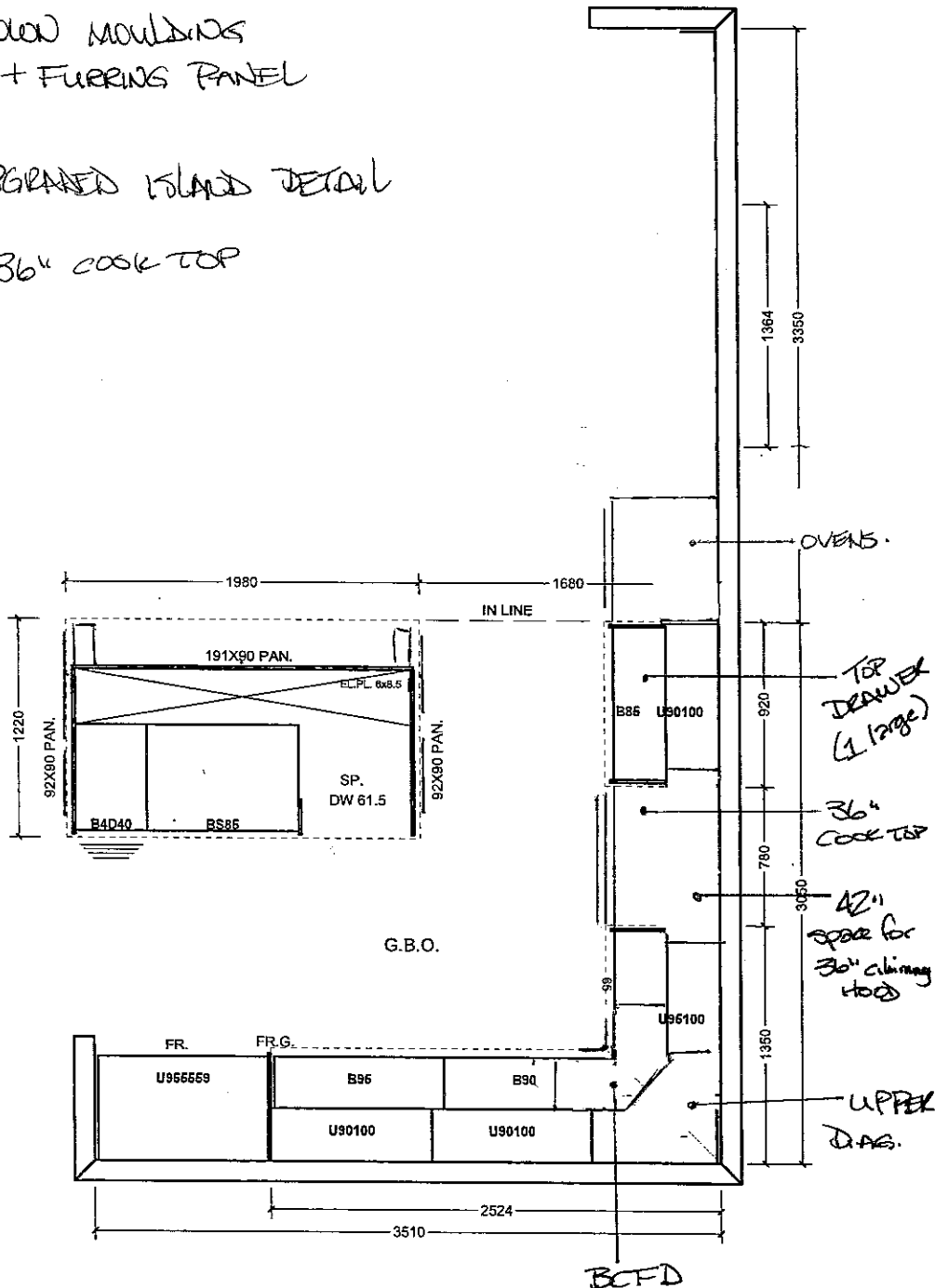

All prices subject to confirmation from head office.
This quotation is subject to the terms & conditions set out

ACCEPTED DATE: _____

All agreements are contingent upon strikes, accidents, and delays beyond our control.
Please provide our installer with template for sinkholes or \$150.00 will be charged for callback.

ⓑ

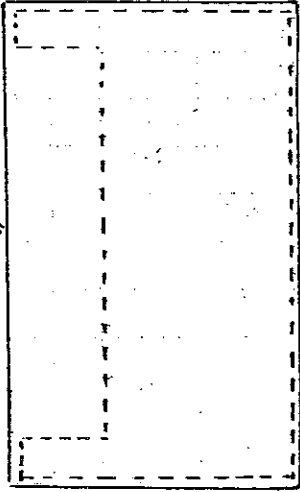

Ⓐ

PLAN - ISLAND

QUARTZ TOP (by others)

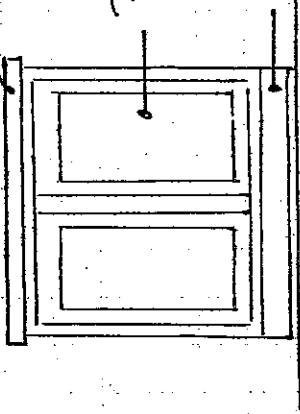

POST + DUNNYPANIEL

FURNITURE KICK

A - ELEVATION - ISLAND END

KLEINBURG SLEN.

LOT 13.

KITCHEN ISLAND.

UPGRADE 4 MAPLE

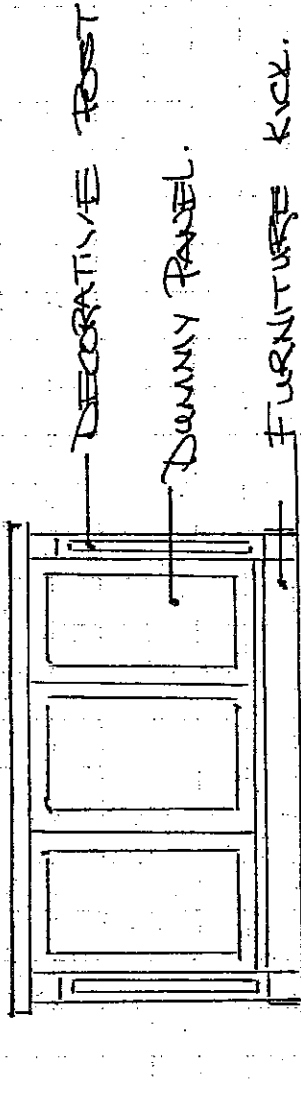

DECORATIVE POST

DUNNYPANIEL

FURNITURE KICK

B - ELEVATION - ISLAND REAR (BREAKFAST BAR SIDE)

KG-13

Dec. 22 2016

CORTINA

KITCHENS INC.
70 Regina Road, Woodbridge, Ontario L4L 8L8
Tel: 905-234-9984 Fax: 905-264-9984
www.CortinaKitchens.com

KG-13

Dec 22 2016

QUOTATION

Date: 14/10/16

Trade Name: Gold Park Homes

Site location: Kleinburg

Model: 42-1

Address:

Project: Kleinburg Glen

Phase:

This layout has been explained to the purchaser by Cortina Kitchens Inc. and is understood by the purchaser.

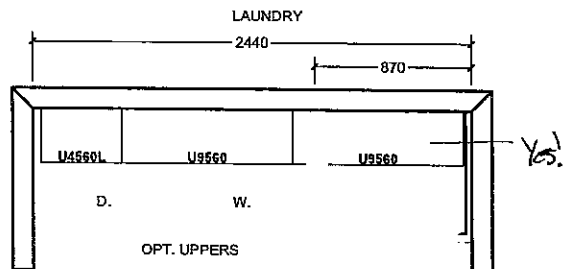
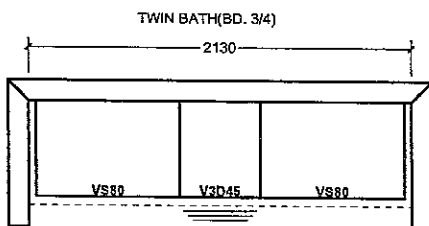
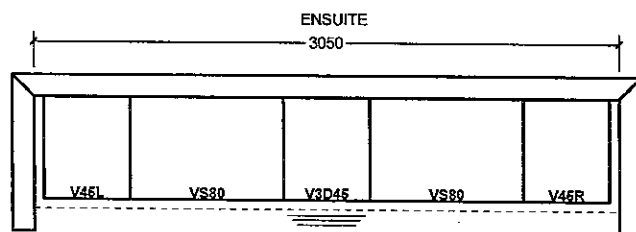
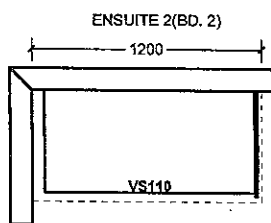

OPT. 5 BED. SECOND FLOOR

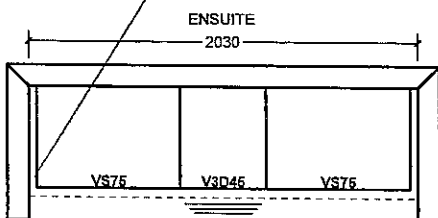
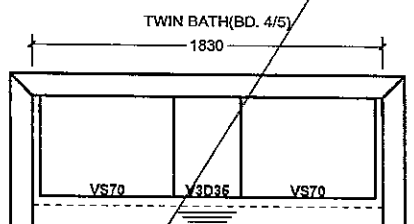
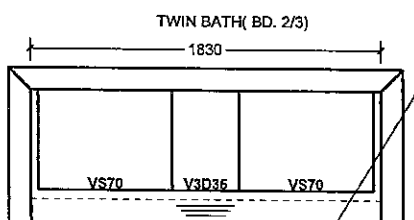

PART OPT. 5 BED. SECOND FLOOR

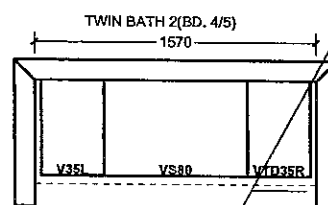

PART SECOND FL. ELV. B

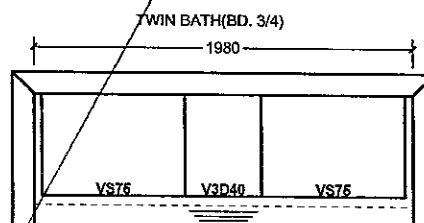

All prices subject to confirmation from head office.
This quotation is subject to the terms & conditions set out

ACCEPTED DATE: _____

All agreements are contingent upon strikes, accidents, and delays beyond our control.
Please provide our installer with template for sinkholes or \$150.00 will be charged for callback.

Item A. Wood grain and colour are characteristics of the product. We cannot guarantee that such grain and color will always match.
Item B. Cortina Kitchens Inc. reserves the right to alter dimensions and make technical changes without notice.

Granite, Marble,
Engineered Surfaces

- Standard 2CM & 3CM
- ⊖ Upgrade 1 2CM & 3CM
- ⊗ Upgrade 1 4 CM
- Upgrade 2

20 mm (3/4") Profiles



30mm (1-1/4") Profiles

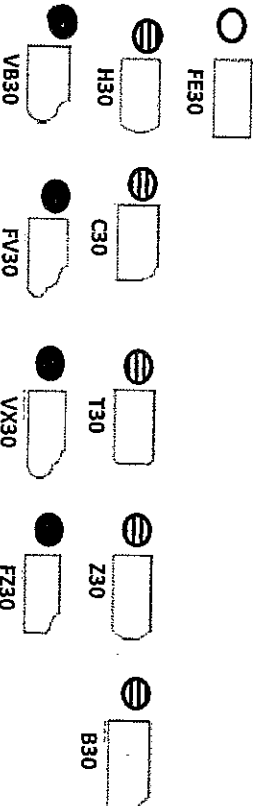

KITCHEN

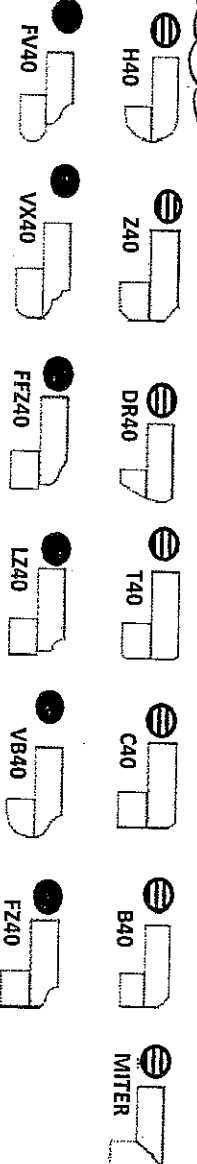

Note: All colours may not be available in 30mm at time ordered. Vendor reserves the right to use 40 mm edges (by lamination process).

* Mitre edge is available in Upgrade 1 for an overall thickness of 2". All other Mitre edge options will be an Upgrade 2 Edge.

* Upgrade Suck

+

STD. FAUCET

KG-13
Dec. 22 2016

**BLANCO QUATRUS™
U SUPER SINGLE**

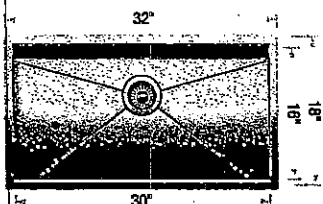

**Sink
Specifications**

Undermount
Minimum Cabinet Size*
 36" (915 mm)
Bowl Depth
 9" (230 mm)
Cubed Weight
 55 lb. (25 kg)

**Model
N°**

401248 ✓

**Optional
Accessories**

406347 ✓ Super Single Grid
 406346 Elevated Grid
 406345 Ash Cutting Board
 406344 Workstation
 517686 CapFlow™
 230694 Magnetic Caddy

SINK + GRID

LOT No.: 13

ROOM: KITCHEN

DATE: Dec 22 2016

SIGNATURE:

GOLDPARK
WORTH MORE

Kleinburg
OLEN

UPGRADE HARDWARE

KG-13
Dec 22 2016

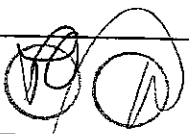

UPGRADE HARDWARE



CH-32



CH-38

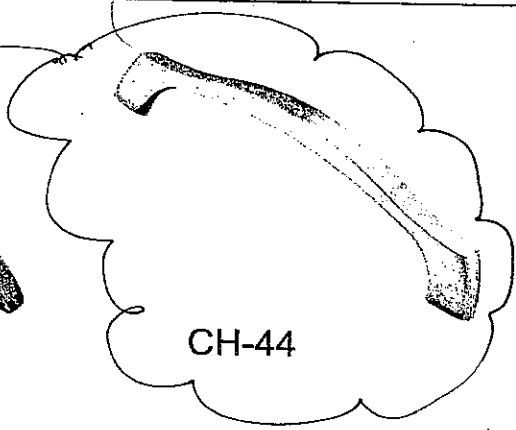

CH-44

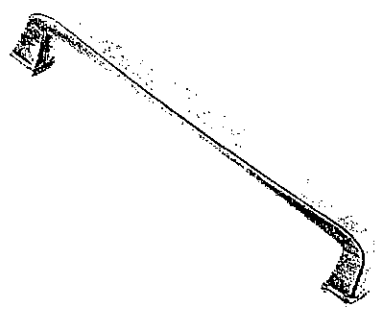

CH-45

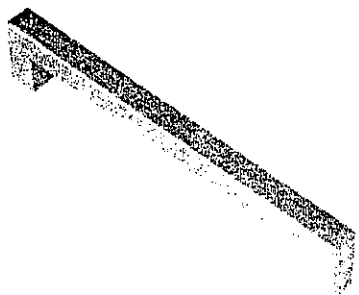

CH-46

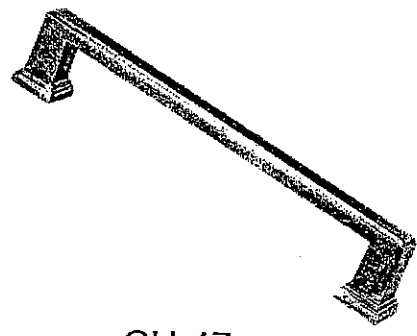

CH-47

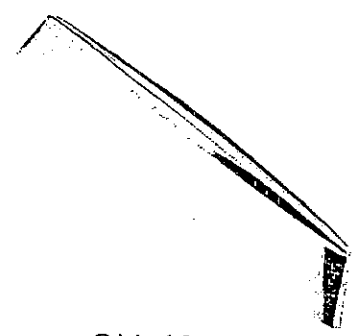

CH-48

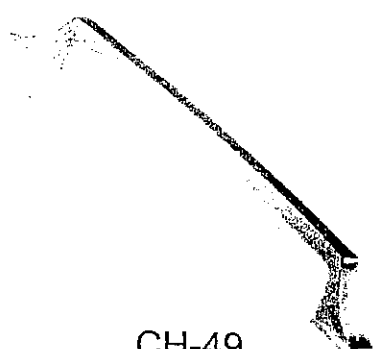

CH-49



CH-50

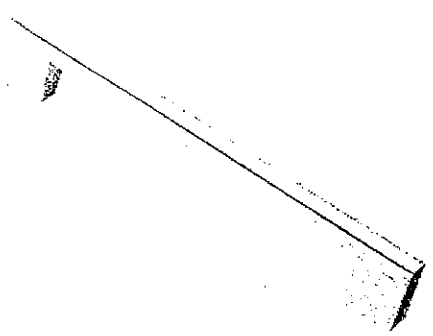

CH-51

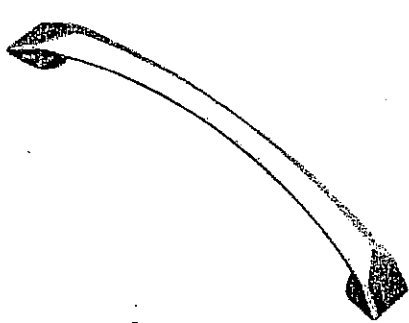

CH-52

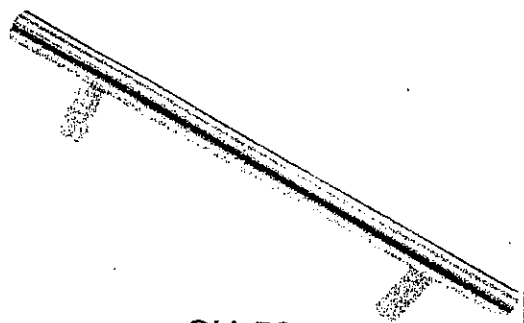

CH-53

***NOTES:**
- IMAGES ARE FOR QUICK REFERENCE PURPOSES ONLY
- ACTUAL SIZES AND FINISHES AS PER HARDWARE
SAMPLE BOARD PROVIDED TO DECOR CENTRE

STANDARD HARDWARE

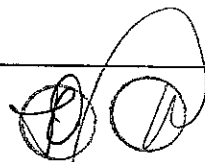
KG-13
Dec 22 2016

CSI-6



CSI-10

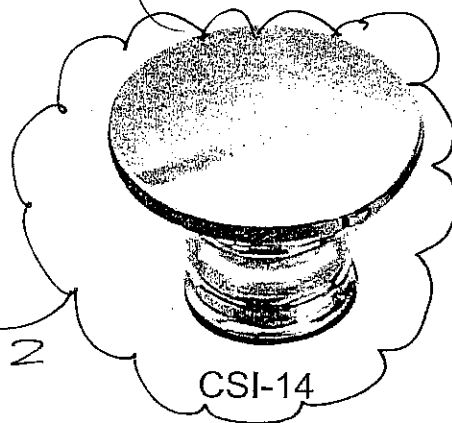

CSI-14

Evo 2
+
Twin

CSI-16



CSI-18

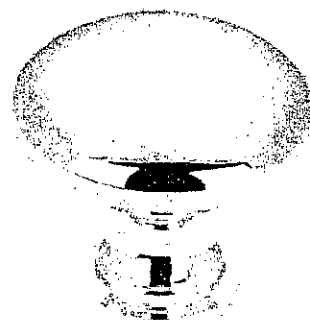

CSI-19



CSI-20

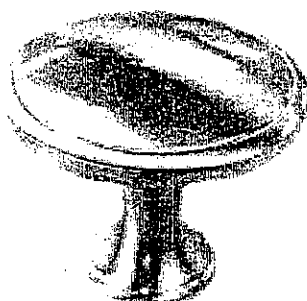

CSI-21



CSI-22

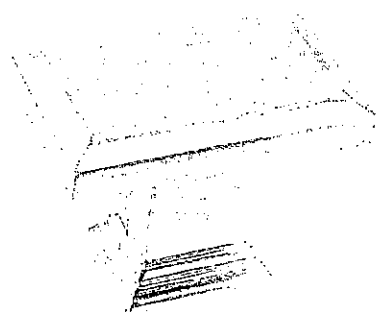

CSI-23

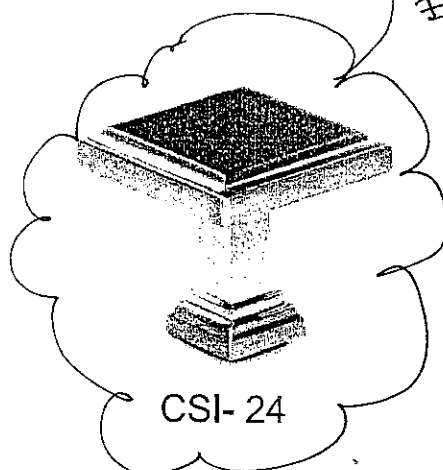

CSI-24

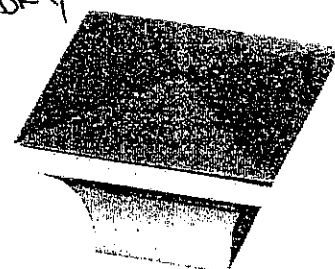
MASTER
EN SUITE
+
LAUNDRY

CSI-25

*NOTES:

- IMAGES ARE FOR QUICK REFERENCE PURPOSES ONLY
- ACTUAL SIZES AND FINISHES AS PER HARDWARE
- SAMPLE BOARD PROVIDED TO DECOR CENTRE

GOLDPARK

WORTH MORE™

Attention: Building Department

Re: Lot # 13

This is to acknowledge that as the purchaser of the above noted lot, I have asked Gold Park Homes not to install the standard builder's kitchen exhaust hood, as I will be installing my own unit after closing.

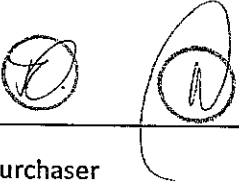
Purchaser
Vendor

Dated this 22nd day of December, 20 16.

CORTINA

KITCHENS INC.

70 Regina Road Woodbridge ON L4L 8L6
905-264-6464

INFORMATION - PVC DOORS

Builder: Gold Park Homes Project: Kleinburg Lot # 13

All cabinets with PVC (Thermofoil) Doors come with melamine gables, panels and kick. The doors, crown moulding and light valance are PVC wrapped. Open shelves incorporated in design will only be available with melamine interiors. There will be variations in colour shades between the PVC parts (doors, crown and Light valance) and the melamine parts (open shelves, Gables, Panels and Kick) due to the difference in material.

Furring Panel with crown moulding to the ceiling is not available on all PVC door styles due to subtle variations in colour shades between the PVC parts (moulding) and the melamine parts (furring panel) due to the difference in material. Grain directions in wood grain pattern melamine, vary between the furring panel, crown moulding (horizontal) and the PVC doors (vertical).

Thank you for your understanding.

I am well informed of this information, and agree to the purchase of the above.

Purchaser: _____

(Signature)

(Signature)

Date: _____

Dec 22 2016