

Brampton Encore - 37 - 1 - 38-6 Elev.B SCARLATTI
CARPET

Inv.1,074	1 - BEDROOM 2: INSTALL City View Berber Bed 2
Line15805	Note:
22Dec16 / 13Jan17	
Inv.1,074	1 - BEDROOM 3: INSTALL City View Berber Bed 3
Line15806	Note:
22Dec16 / 13Jan17	
Inv.1,074	1 - BEDROOM 4: INSTALL City View Berber Bed 4
Line15807	Note:
22Dec16 / 13Jan17	
Inv.1,074	1 - MASTER BEDROOM: INSTALL City View Berber Master Bed
Line15809	Note:
22Dec16 / 13Jan17	
Inv.1,074	1 - GROUND FLOOR REC ROOM: INSTALL City View Berber Rec Room at GF
Line15810	Note:
22Dec16 / 13Jan17	

CENTRAL VAC AND WIRING

Inv.607	1 - FAMILY ROOM: INSTALL CONDUIT PIPE- FOR TELEVISION- MUST SPECIFY LOCATION AND TERMINATION POINT, ABOVE FIREPLACE. SEE SKETCH
Line7468	Note:
27Jun16 / 20Sep16	
Inv.607	1 - ATTIC: INSTALL CONDUIT PIPE- FROM ATTIC TO ELECTRICAL PANEL- MUST SPECIFY LOCATION AND TERMINATION POINT, NEAR FRONT OF HOUSE
Line7470	Note:
27Jun16 / 20Sep16	
Inv.1,074	1 - **STRUCTURAL: KITCHEN:
	INSTALL VAC PAN UNDER KITCHEN SINK
Line15815	Note:
22Dec16 / 13Jan17	

CERAMIC

Inv.1,074	1 - FOYER: INSTALL Floor Upgrade 2 Foyer Vestibule Main Hall Floor
Line15802	Note:
22Dec16 / 13Jan17	
Inv.1,074	1 - KITCHEN: INSTALL: Floor Upgrade 2 Kitchen Floor No Breakfast
Line15803	Note:
22Dec16 / 13Jan17	
Inv.1,074	1 - POWDER ROOM; INSTALL Floor Upgrade 2 Powder Room Floor
Line15804	Note:
22Dec16 / 13Jan17	

ELECTRICAL

Inv.607	1 - TELEPHONE AND CABLE ROUGH-IN LOCATIONS
Line7467	Note:
27Jun16 / 20Sep16	

Brampton Encore - 37 - 1 - 38-6 Elev.B SCARLATTI

Inv.607	1 - FAMILY ROOM: INSTALL 110V WALL RECEPTACLE ON DEDICATED CIRCUIT - ABOVE FIREPLACE. SEE SKETCH
Line7469	Note:
27Jun16 / 20Sep16	
Inv.607	1 - LIVING ROOM: INSTALL ADDITIONAL STANDARD FIXTURE WITH SWITCH - SEE SKETCH
Line7474	Note:
27Jun16 / 20Sep16	
Inv.607	4 - EXTERIOR: INSTALL FOUR (X4) POT LIGHT: 4 INCH LINE VOLTAGE POT LIGHT - (EXTERIOR) -EACH. SEE SKETCH
Line7475	Note:
27Jun16 / 20Sep16	
Inv.1,074	2 - **STRUCTURAL: KITCHEN: INSTALL TWO (X2) 220V WALL RECEPTICAL ON DEDICATED CIRCUIT- FOR 4 WIRE BUILT-IN WALL OVEN - MUST SPECIFY LOCATION. FOR WALL OVEN/MICROWAVE UNIT
Line15791	Note:
22Dec16 / 13Jan17	
Inv.1,074	1 - **STRUCTURAL: KITCHEN: INSTALL :KITCHEN CABINET STRIP VALANCE LIGHTS (UNDER CABINETS) - ROUGH - IN - DOES NOT INCLUDE (AND REQUIRES) KITCHEN UPGRADE PRICING
Line15814	Note:
22Dec16 / 13Jan17	
Inv.1,074	1 - DELETE HOODFAN & CABINETS ABOVE STOVE: KITCHEN - Purchasers request to NOT INSTALL builder's standard hood fan and standard cabinets above stove. DELETE. Do not supply, install, and/or credit. Purchasers are installing their own hood fan after closin
Line15825	Note: Purchasers accept and acknowledge that the exhaust fan duct hole may be off-centered with stove in kitchen due to purchasers installing their own hood fan after closing. The vendor is exempt
22Dec16 / 13Jan17	
Inv.1,074	1 - KITCHEN: INSTALL 110V WALL RECEPTACLE ON DEDICATED CIRCUIT - GAS FIRED APPLIANCE - FOR AUX. EQUIPMENT - NOT A STOVE PLUG
Line15830	Note:
22Dec16 / 13Jan17	

EXTERIOR COLOURS

Inv.607	1 - EXTERIOR COLOUR PACKAGE 8
Line11538	Note:
27Jun16 / 20Sep16	

FORMING

Inv.607	1 - EXTERIOR: INSTALL SIDE DOOR- HOME TO EXTERIOR- AS PER PLAN AND GRADE PERMITTING
Line7477	Note:
27Jun16 / 20Sep16	

FRAMING

Inv.607	1 - GARAGE: INSTALL MANDOOR - GARAGE TO HOUSE- AS PER PLAN AND GRADE PERMITTING
Line7476	Note: GIVEN IN AGREEMENT OF PURCHASE AND SALE
27Jun16 / 20Sep16	

GRANITE MARBLE QUARTZ

Brampton Encore - 37 - 1 - 38-6 Elev.B SCARLATTI

Inv.1,074	1 - KITCHEN: INSTALL 2 CM GRP 2 Kitchen with Island
Line15812	Note:
22Dec16 / 13Jan17	
Inv.1,074	1 - KITCHEN: INSTALL 2 CM GRP 2 Optional Flush BBar
Line15813	Note:
22Dec16 / 13Jan17	
Inv.1,074	1 - KITCHEN: INSTALL A CONTINUOUS COUNTER TOP FOR A 36" COOKTOP
Line15821	Note:
22Dec16 / 13Jan17	

HARDWOOD

Inv.1,074	1 - DINING ROOM: INSTALL PREVERCO PRO IN CAPPUCCINO Upgrade 1 LEVEL S Dining
Line15784	Note:
22Dec16 / 13Jan17	
Inv.1,074	1 - LIVING ROOM: INSTALL PREVERCO PRO IN CAPPUCCINO Upgrade 1 LEVEL S Living
Line15786	Note:
22Dec16 / 13Jan17	
Inv.1,074	1 - UPPER HALL: INSTALL PREVERCO PRO IN CAPPUCCINO Upgrade 1 LEVEL S Upper Hall
Line15788	Note:
22Dec16 / 13Jan17	
Inv.1,074	1 - FAMILY ROOM: INSTALL PREVERCO PRO IN CAPPUCCINO Upgrade 1 LEVEL S Family
Line15785	Note:
22Dec16 / 13Jan17	
Inv.1,074	1 - LANDINGS: INSTALL PREVERCO PRO IN CAPPUCCINO Upgrade 1 LEVEL S Landings
Line15787	Note:
22Dec16 / 13Jan17	
Inv.1,074	1 - BREAKFAST AREA: INSTALL PREVERCO PRO IN CAPPUCCINO Upgrade 1 LEVEL S BREAKFAST AREA
Line15831	Note:
22Dec16 / 13Jan17	

HVAC

Inv.607	1 - KITCHEN: INSTALL GAS LINE ROUGH - MAIN FLOOR - (3 STOREY MODELS), FOR STOVE
Line7481	Note:
27Jun16 / 20Sep16	

KITCHEN AND BATH CABINETRY

Inv.1,074	1 - KITCHEN: INSTALL Oak PVC 112 Built in wall oven and microwave and cooktop with countertop by others 242cm
Line15817	Note:
22Dec16 / 13Jan17	
Inv.1,074	1 - KITCHEN: INSTALL Oak PVC 158 Overlay Gable Pantry 61x220 61x242 FOR WALL OVEN UNIT
Line15818	Note:
22Dec16 / 13Jan17	
Inv.1,074	1 - KITCHEN: DELETE CABINETRY ABOVE STOVE
Line15819	Note:
22Dec16 / 13Jan17	

Brampton Encore - 37 - 1 - 38-6 Elev.B SCARLATTI

Inv.1,074	1 - KITCHEN: ADJUST CABINETS TO ACCOMODATE A 36" COOKTOP
Line15820	Note:
22Dec16 / 13Jan17	
Inv.1,074	1 - KITCHEN: INSTALL Spray Stain Kitchen
Line15822	Note:
22Dec16 / 13Jan17	
Inv.1,074	1 - MASTER: INSTALL Spray Stain Master Ensuite
Line15823	Note:
22Dec16 / 13Jan17	
Inv.1,074	1 - KITCHEN: INSTALL UPG 1 GRP III Opt Light Valance
Line15832	Note:
22Dec16 / 13Jan17	

MISC.

Inv.607	1 - BONUS PACKAGE: \$10,000.00 (INCLUDING TAXES) WORTH OF UPGRADES FROM GOLD PARK HOMES DÉCOR CENTRE IS BEING APPLIED TOWARD THE STRUCTURAL APPOINTMENT. PURCHASER HAS A REMAINING AMOUNT OF \$00 (INCLUDING TAXES) TO BE USED TOWARD THE COLOUR APPOINTMENT
Line7498	Note:
27Jun16 / 20Sep16	
Inv.607	1 - Purchaser has attended a Structural appointment at the Decor Centre & has DECLINED any additional upgrades and accepts and acknowledges that there will be no further structural changes/additions/deletions to be made upon signing on June 27, 2016
Line7499	Note:
27Jun16 / 20Sep16	
Inv.607	1 - Purchasers are aware & accepts that ANY changes made to upgrades after signing this Purchasers Extra Form are subject to a minimum administration fee of \$500. PLUS a 10% holdback fee
Line7500	Note:
27Jun16 / 20Sep16	
Inv.1,074	1 - STAINING
STAIRCASE - The purchaser is advised and therefore accepts and acknowledges that the stain of the staircase and flooring chosen cannot be an exact match, as the hardwood is prefinished at the factory	
Line15824	Note:
22Dec16 / 13Jan17	
Inv.1,074	1 - GRANITE WAIVER
Due to the many variables that can affect the pattern, colour and/or design and "pitting" of natural products, granite installed will not be identical to the samples displayed. Every effort is made to provide granite counter tops as clos	
Line15826	Note:
22Dec16 / 13Jan17	
Inv.1,074	1 - ELECTRICAL FOR APPLIANCES:
*PLEASE NOTE: PRICE ABOVE MAY CHANGE. PURCHASER(S) TO PROVIDE PROPER APPLIANCE SPECIFICATIONS TO PRICE APPLICABLE ELECTRICAL ACCORDINGLY	
Line15827	Note:
22Dec16 / 13Jan17	
Inv.1,074	1 - Purchaser has attended a Colour appointment at the Decor Centre & has DECLINED any additional upgrades and accepts and acknowledges that there will be no further structural changes/additions/deletions to be made upon signing on December 22, 2016
Line15828	Note:
22Dec16 / 13Jan17	

Brampton Encore - 37 - 1 - 38-6 Elev.B SCARLATTI

Inv.1,074	1 - Purchasers are aware & accepts that ANY changes made to upgrades after signing this Purchasers Extra Form are subject to a minimum administration fee of \$500. PLUS a 10% holdback fee
Line15829	Note:
22Dec16 / 13Jan17	

PAINTING

Inv.1,074	1 - STAIRCASE: Stain Staircases 3 Storey Model (Euroline Pickets Charged Separately)
Line15801	Note:
22Dec16 / 13Jan17	

PLUMBING

Inv.607	1 - KITCHEN: INSTALL ROUGH-IN - WATERLINE FOR FRIDGE
Line7486	Note:
27Jun16 / 20Sep16	
Inv.607	1 - BASEMENT: INSTALL ROUGH-IN - 3PC BASEMENT ROUGH-IN, AS PER PLAN
Line7487	Note:
27Jun16 / 20Sep16	
Inv.607	1 - GARAGE: INSTALL HOSE BIB - STANDARD TO UPGRADED WITH HOT AND COLD WATER VALVE. FOR THE HOSE BIB IN GARAGE.
Line7488	Note: REAR HOSE BIB TO REMAIN STANDARD
27Jun16 / 20Sep16	

STAIRS AND RAILINGS

Inv.1,074	1 - STARCASE: INSTALL EUROLINE 1 Black
	RAILING TO REMAIN STANDARD
Line15816	Note:
22Dec16 / 13Jan17	

WINDOWS - BASEMENT

Inv.607	1 - BASEMENT: INSTALL ONE (X1) BASEMENT WINDOWS - UPGRADE EXISTING BASEMENT WINDOW TO 53 INCH X 16 INCH - MAY REQUIRE INSTALLATION OF WINDOW WELL. SEE SKETCH
Line7479	Note:
27Jun16 / 20Sep16	
Inv.607	2 - BASEMENT: INSTALL TWO (X2) BASEMENT WINDOWS - UPGRADE EXISTING BASEMENT WINDOW TO 30 INCH X 24 INCH - MAY REQUIRE INSTALLATION OF WINDOW WELL. SEE SEKTCH
Line7480	Note:
27Jun16 / 20Sep16	

Scheduled Closing Date:

Purchasers: RAJVIR PARMAR & MANPREET KALKAT

Property: 37 of Plan -

Telephone Res. / Bus:

Project: Fieldwalk Investments Inc.

Decor Advisor: Terri Parisani

Model and Elevation: 38-6 Elev.B SCARLATTI

Layout Changes: ☒ Yes ☐ NoSketch Attached: ☒ Yes ☐ NoExterior Colour Scheme:

1. Cabinetry

	Style and Colour	Counter	Hardware
Kitchen / Breakfast	Siena (oak) *Cocoa	*Upg.2 Bianco Antico Edge: FE 20	cs1-6
Laundry Room	<input type="text"/>	<input type="text"/>	<input type="text"/>
Powder Room	<input type="text"/>	<input type="text"/>	<input type="text"/>
TWIN BATH	Varese(pvc)AntiquWhite	4588K-07 Kalahari Topez Laminate	cs1-14
Master Ensuite Bathroom	Siena (oak) *Cocoa	6729-46 Paloma Bisque Laminate	cs1-6
Second Ensuite Bathroom (If Applicable)	Siena (oak) Slate	6698-58 Paloma Polar Laminate	cs1-25
<input type="text"/>	<input type="text"/>	<input type="text"/>	<input type="text"/>
Dishwasher Cabinet	<input type="text"/>		
Comment	<input type="text"/>		

2. Floor Tile

	Selection	Grout	Threshold
Entrance Vestibule	*Upg.2, New Byzantine Cream 18 x 18	N/A	N/A
Main Hall	<input type="text"/>	N/A	N/A
Kitchen / Breakfast	*Upg.2, Champions Series White 18 x 18	N/A	N/A
Laundry Room	Reflex White 13 x 13	N/A	N/A
Powder Room	*Upg.2, Champions Series White 18 x 18	N/A	N/A
TWIN BATH	Reflex Espresso 13 x 13	N/A	N/A
Master Ensuite Bathroom	Reflex Bone, 13 x 13	N/A	N/A
Second Ensuite Bathroom (If Applicable)	Costa Matte, White 13 x 13	N/A	N/A
Lower Landing (If Applicable)	<input type="text"/>	<input type="text"/>	<input type="text"/>
<input type="text"/>	<input type="text"/>	<input type="text"/>	<input type="text"/>
Comment	<input type="text"/>		

GROUND FLOOR HALL: Costa Matte, White 13 x 13

3. Wall Tile

	Selection	Listello/Inserts	Describe
TWIN BATH	Weave Ivory 8 x 10	<input type="radio"/> Yes <input checked="" type="radio"/> No	<input type="text"/>
Master Ensuite Bathroom			
Tub Deck	Reflection Bone 8 x 10	<input type="radio"/> Yes <input checked="" type="radio"/> No	<input type="text"/>
Shower Stall	Reflection Bone 8 x 10	<input type="radio"/> Yes <input checked="" type="radio"/> No	<input type="text"/>
Bathroom Walls	Reflection Bone 8 x 10	<input type="radio"/> Yes <input checked="" type="radio"/> No	<input type="text"/>
Second Ensuite Bathroom (If Applicable)	Weave Tender Grey 8 x 10	<input type="radio"/> Yes <input checked="" type="radio"/> No	<input type="text"/>
<input type="text"/>	<input type="text"/>	<input type="radio"/> Yes <input checked="" type="radio"/> No	<input type="text"/>
Kitchen Backsplash	<input type="radio"/> Yes <input checked="" type="radio"/> No	Backsplash Behind Fridge	<input type="text"/>
Comment	<input type="text"/>		

Scheduled Closing Date:

Purchasers:
RAJVIR PARMAR & MANPREET KALKAT

Property:
37 of Plan -

Telephone Res. / Bus:

Project:
Fieldwalk Investments Inc.

Decor Advisor:
Terri Parisani

Model and Elevation:
38-6 Elev.B SCARLATTI

4. Plumbing Fixtures

Second Ensuite

Powder Room

Master Ensuite Bathroom

Other Room - Specify

Other Washroom

Comment

FIXTURES TO REMAIN STANDARD THROUGHOUT

5. Hardwood Flooring

Type and Stain

*Upg.1 Preverco Pro Cappuccino

Main Hall

Type and Stain

*Upg.1 Preverco Pro Cappuccino

Upper Landing

Kitchen / Breakfast

Type and Stain

*Upg.1 Preverco Pro Cappuccino

Upper Hall

*Upg.1 Preverco Pro Cappuccino

Living Room

Dining Room

*Upg.1 Preverco Pro Cappuccino

Master Bedroom

Bedroom #2

*Upg.1 Preverco Pro Cappuccino

Family Room

Bedroom #3

Den/Library

Bedroom #4

Entrance Vestibule

Bedroom #5

Lower Landing (If Applicable)

Other Room - Specify
BREAKFAST AREA

*Upg.1 Preverco Pro Cappuccino

Comment

ALL HARDWOOD IS RED OAK

6. Carpeting

	Upgrade	Description
Main Hall	<input type="checkbox"/>	
Living Room	<input type="checkbox"/>	
Dining Room	<input type="checkbox"/>	
Family Room	<input type="checkbox"/>	
Den/Library	<input type="checkbox"/>	
Upper Hall	<input type="checkbox"/>	
Master Bedroom	<input type="checkbox"/>	Upg. 1, Cityview 786 Gentle Doe
Bedroom #2	<input type="checkbox"/>	Upg. 1, Cityview 786 Gentle Doe
Bedroom #3	<input type="checkbox"/>	Upg. 1, Cityview 786 Gentle Doe
Bedroom #4	<input type="checkbox"/>	Upg. 1, Cityview 786 Gentle Doe
Bedroom #5	<input type="checkbox"/>	
GROUND FLOOR	<input type="checkbox"/>	Upg. 1, Cityview 786 Gentle Doe
Upper Landing (If Applicable)	<input type="checkbox"/>	
Lower Landing (If Applicable)	<input type="checkbox"/>	

Upgrade Underpad

Type

STANDARD

Area

Carpet on Stairs

Capped

NONE

Runner - *Upgrade

NONE

Comment

Scheduled Closing Date:

Purchasers: RAJVIR PARMAR & MANPREET KALKAT

Property: 37 of Plan -

Telephone Res. / Bus:

Project: Fieldwalk Investments Inc.

Decor Advisor: Terri Parisani

Model and Elevation: 38-6 Elev.B SCARLATTI

7. Fireplace

	Living Room			Family Room			Other Room - Specify		
	Purchased	As Per Plan	N/A	Purchased	As Per Plan	N/A	Purchased	As Per Plan	N/A
Fireplace Type	<input type="radio"/>	<input type="radio"/>	<input checked="" type="radio"/>	<input type="radio"/>	<input checked="" type="radio"/>	<input type="radio"/>	<input type="radio"/>	<input type="radio"/>	<input checked="" type="radio"/>
Mantle Type				STANDARD					
Colour / Stain				NF-24					
Surround				WHITE PAINT-GRADE					
Hearth				NERO MARQUINO					
Comment				NONE					

8. Trim Carpentry

Interior Doors	STANDARD	Front Door Glass Inserts	STANDARD	Door Handles	STANDARD
Interior Trim	STANDARD				
Comment					

9. Plaster Mouldings and Medallions

Entrance Vestibule	N/A		Kitchen/Breakfast	N/A	
Main Hall	N/A		Den/Library	N/A	
Living Room	N/A		Lower Landing	N/A	
Dining Room	N/A		Other Room - Specify	N/A	
Family Room	N/A				
Comment					

10. Railings and Spindles

Railing Package	*EUROLINE 1 *WITH STANDARD HANDRAIL		
Railing Colour	*CAPPUCCINO, RED OAK	Spindle Colour	BLACK
Stringer / Riser	*CAPPUCCINO, RED OAK	Treads	*CAPPUCCINO, RED OAK
Comment	Oak Stairs <input checked="" type="radio"/> Yes <input type="radio"/> No		

11. Wall Paint

Main & Upper Hall	OYSTER	Master Bedroom	OYSTER
Living Room	OYSTER	Bedroom #2	OYSTER
Dining Room	OYSTER	Bedroom #3	OYSTER
Kitchen / Breakfast	OYSTER	Bedroom #4	OYSTER
Family Room	OYSTER	Bedroom #5	
Powder Room	OYSTER	Master Ensuite	OYSTER
Laundry Room	OYSTER	TWIN BATH	OYSTER
Den/Library	OYSTER	Second Ensuite	OYSTER
Trim Paint	WHITE	GROUND FLOOR	OYSTER
Comment	Smooth Ceilings First Floor		

Scheduled Closing Date:

Purchasers: RAJVIR PARMAR & MANPREET KALKAT

Property: 37 of Plan -

Telephone Res. / Bus:

Project: Fieldwalk Investments Inc.

Decor Advisor: Terri Parisani

Model and Elevation: 38-6 Elev.B SCARLATTI

12. Electrical

Plugs and Switches ☒ White ☐ Ivory

Hood Fan ☐ White ☐ Ivory

Appliances Built in Cooktop

☒ Yes ☐ No

Built in Oven

☒ Yes ☐ No

Above Kitchen Cabinet Light ☐ Yes ☒ No

Below Kitchen Cabinet Light ☒ Yes ☐ No

Gas Stove

☒ Yes ☐ No

Microwave

☒ Yes ☐ No

Comment

DELETE STANDARD HOOD FAN

13. Heating and Air Conditioning

Air Conditioning

Gas Provisions Dryer

Comment

GAS LINE PURCHASED FOR STOVE
GAS LINE FOR BBQ IS STANDARD

Gas Provisions Stove

Gas Provisions Barbecue

14. Additional Comments

15. Disclaimers and Notes

- Colours of all materials are as close as possible to builder's selection, but not necessarily identical due to variances in manufacturing.
- Any extras listed above are null and void unless accompanied by a separate invoice/amendment. Said invoice must be paid in full.
- The Purchaser acknowledges that after Interior Colour Selection form is signed and dated, no further changes will be permitted other than re-selection due to unavailability. Purchaser's Initials
- The Purchaser acknowledges reading and accepting the "Gold Park Homes Decor Centre Disclaimers" form. This document contains other miscellaneous disclaimers.

This Interior Colour Selection is final and approved by:

Signature: Manpreet Kalkat Date: Dec 22/16 Signature: Rajvir Parmar Date: Dec 22, 2016

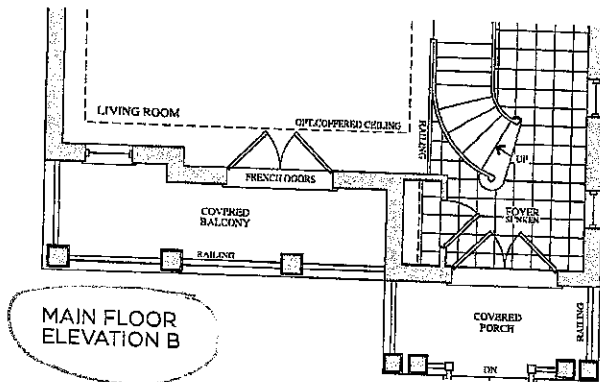
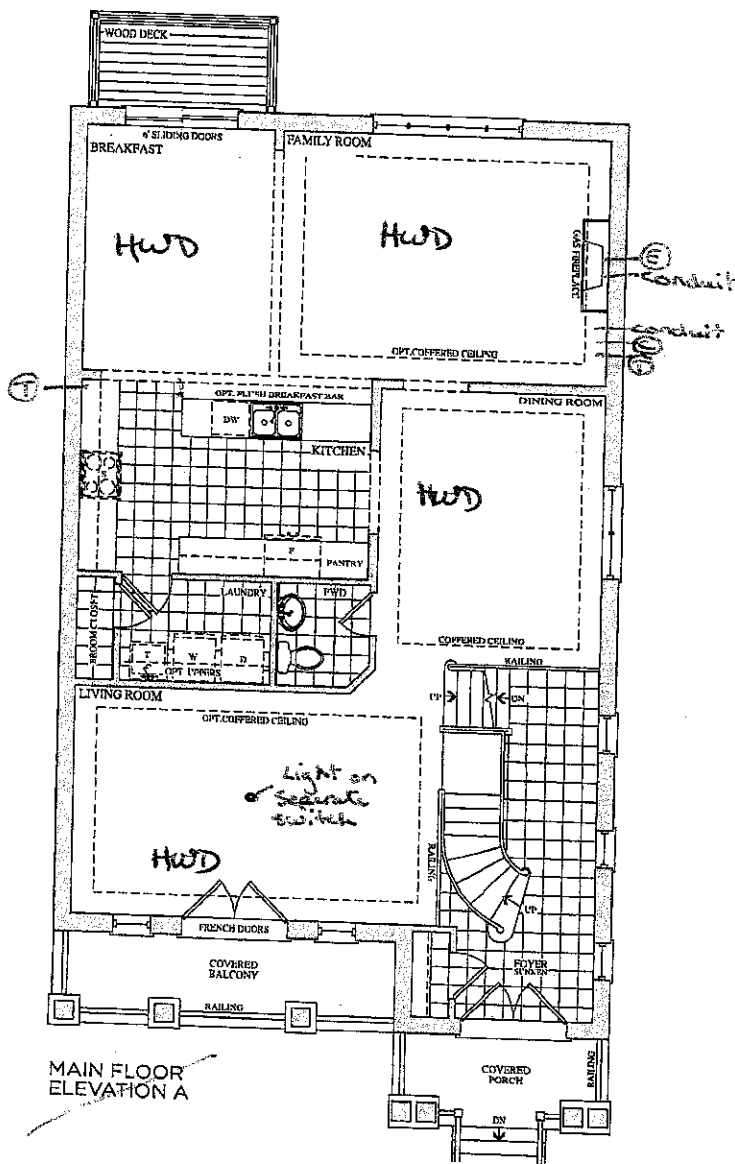

Lot 37
June 27, 16

Lot 37
Dec. 22, 16

Prices, figures, illustrations, sizes, features and finishes are subject to change without notice. E.O.E. Areas and dimensions are approximate and actual usable floor space may vary from the stated area. Layout may be reverse of the unit purchased. E. & O.E.

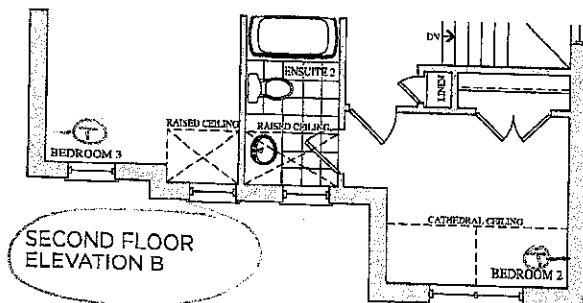
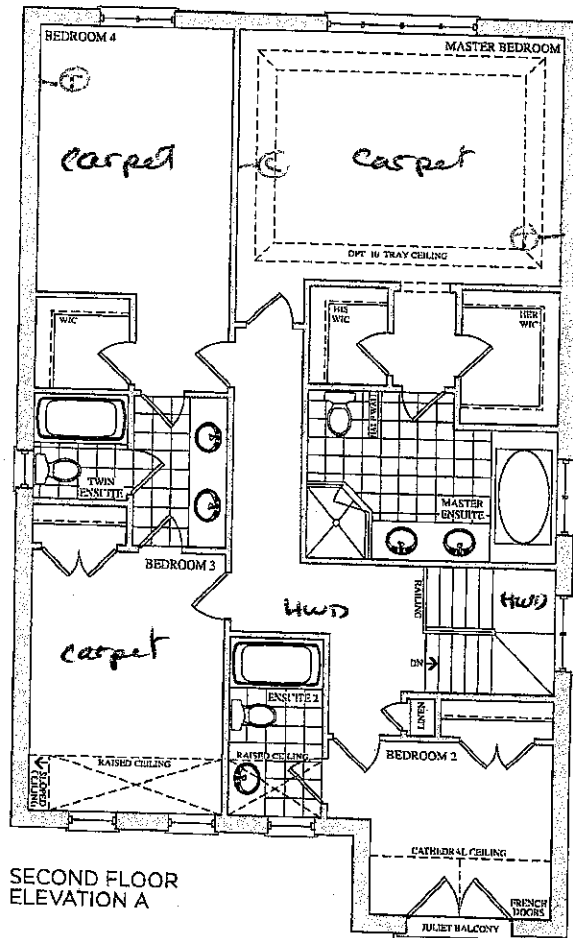

Lot 37

June 27, 16

(RS)

Lot 37

Dec. 22, 16

(RS)

(ML)

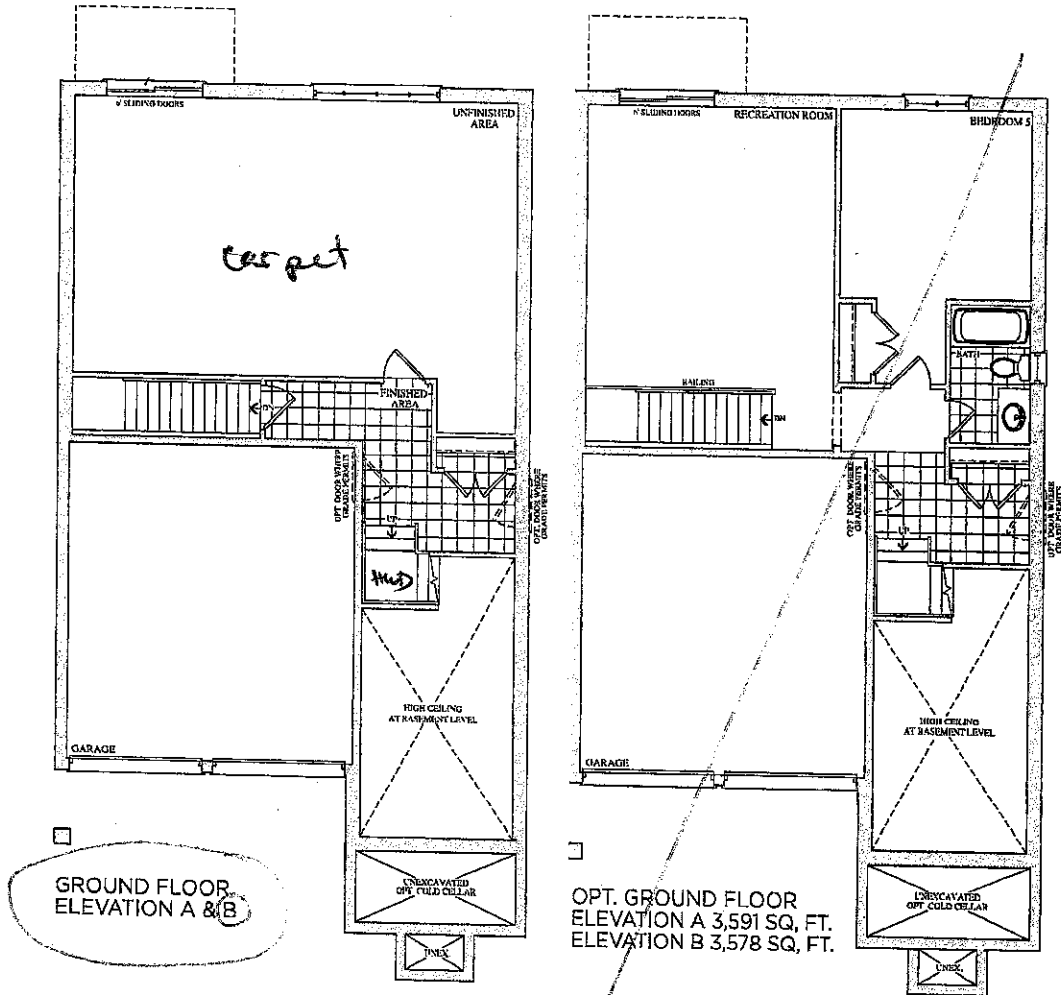

Lot 37
June 27, 16
(B)

Prices, figures, illustrations, sizes, features and finishes are subject to change without notice. E.&O.E. Areas and dimensions are approximate and actual usable floor space may vary from the stated area. Layout may be reverse of the unit purchased. E. & O.E.

GOLD PARK
HOMES

Lot 37
Dec. 22, 16

(RS) (ML)

GOLDPARK
WORTH MORE™

Attention: Building Department

Re: Lot # 37

This is to acknowledge that as the purchaser of the above noted lot, I have asked Gold Park Homes not to install the standard builder's kitchen exhaust hood, as I will be installing my own unit after closing.

Purchaser Manpreet Kaur

Vendor

Dated this 22 day of Dec, 2016.

CORTINA

70 Regina Road Woodbridge ON L4L 8L6
905-264-6464

DARK STAIN INFORMATION

Builder Gold Park Homes... Project Encore..... Lot # 37.....

Cortina Kitchens offers a wide variety of finishes, applied to oak and maple products. The subject finishes include the spray stains **Cocoa** , **Espresso** , **Graphite** as well as wiping stain **Ebony**.

Due to the very dark stains applied on natural maple and oak doors and joints, several characteristics are important to be noted when purchasing these products.

1. Shadow lines may be visible at the interior profile edges of a door or drawer front. If movement occurs shadow lines may increase or decrease, depending on the style and/or size of a door or drawer front.
2. Variation and unevenness may be visible in the finish.
3. Hairline cracks at the joints are created over time due to the nature of natural wood, caused by usage, humidity, or dryness. They tend to be more visible to darker stains, than lighter wood stains.

Please be advised that Cortina Kitchens will not replace doors nor parts that exhibit the above characteristics associated with this finish. These characteristics are not avoidable and are a result of the natural characteristics of wood and wood veneer, and the characteristics of darker stains on wood.

Thank you for your understanding.

I am well informed of this information, and agree to the purchase of any of the subject finishes listed above.

Purchaser:

Ryan Sun
Naynait Kattar

Date:

Dec 24 2016



CSI-6

Kitchen Master

CSI-10

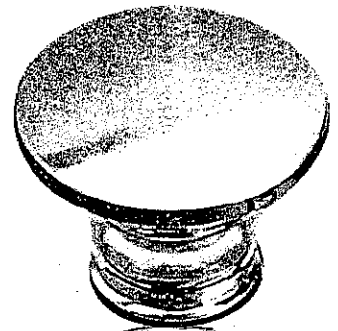

CSI-14

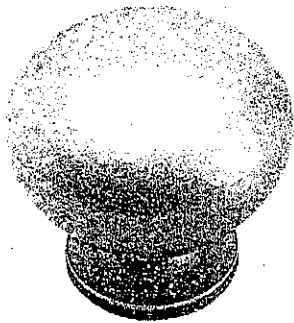
Twin

CSI-16

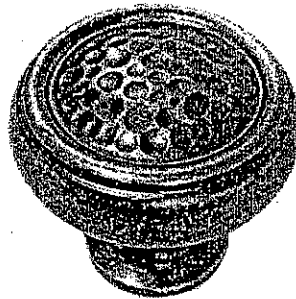

CSI-18

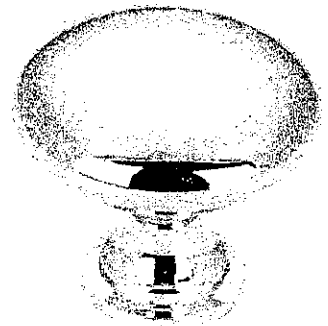

CSI-19

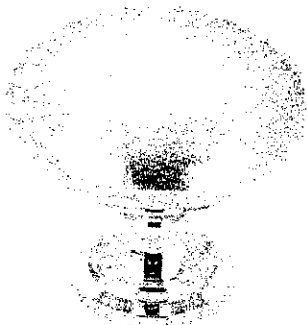

CSI-20

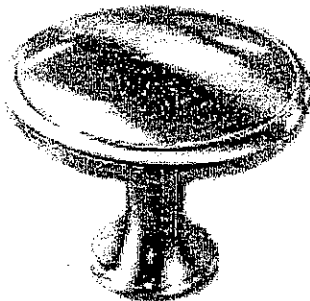

CSI-21



CSI-22

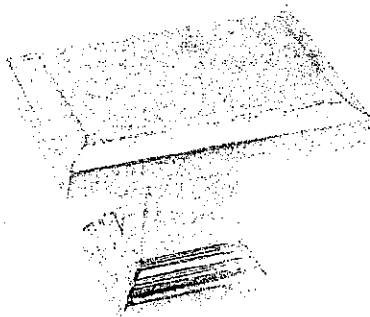

CSI-23

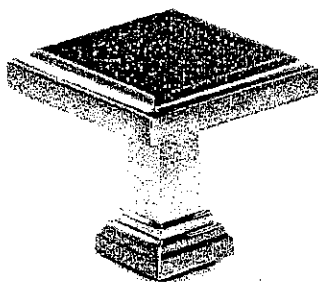

CSI-24

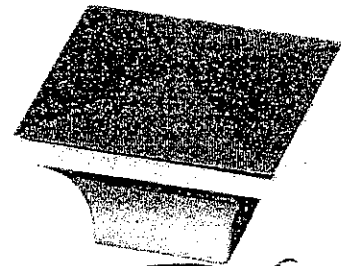

CSI-25

*Ens. 2****NOTES:**

- IMAGES ARE FOR QUICK REFERENCE PURPOSES ONLY
- ACTUAL SIZES AND FINISHES AS PER HARDWARE SAMPLE BOARD PROVIDED TO DECOR CENTRE

Date: 06/23/16

Trade Name: Gold Park Homes	Site location: Brampton	Model: 38-6
Address:	Project: Encore	Phase:

This layout has been explained to the purchaser by Cortina Kitchens Inc. and is understood by the purchaser.

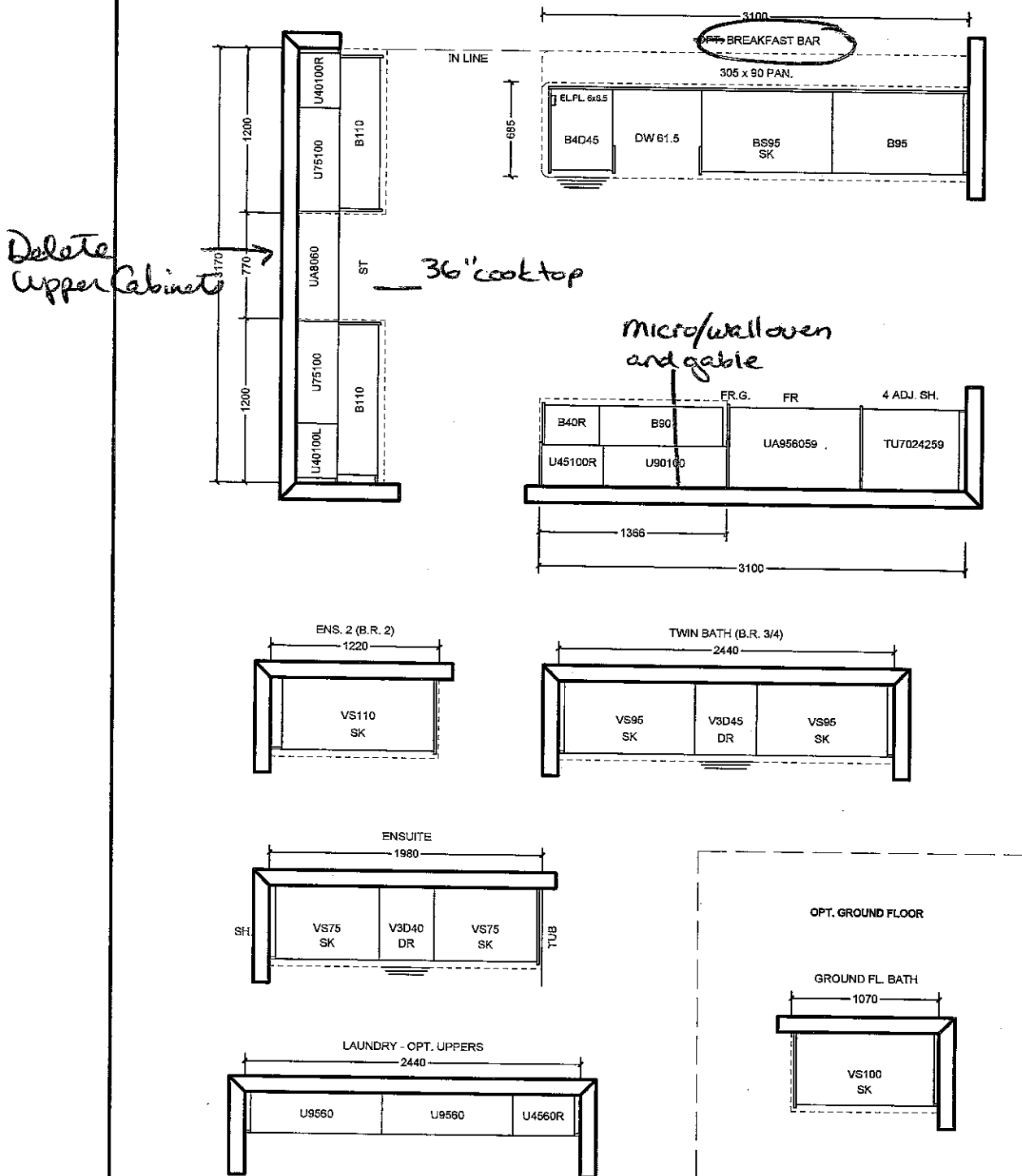

All prices subject to confirmation from head office.
This quotation is subject to the terms & conditions set out
in Cortina's Agreement of Purchase and Sale

All agreements are contingent upon strikes, accidents, and delay beyond our control.
Please provide our installer with template for sinkholes or \$150.00 will be charged for callback.

ACCEPTED DATE: _____

CUSTOMER SIGNATURE _____

SALESPERSON SIGNATURE _____

CORTINA HEAD OFFICE APPROVAL _____

ITEM A. Wood grain and colour are characteristics of the product, we cannot guarantee that such grain and colour will always match
ITEM B. Cortina Kitchens reserves the right to alter dimensions and make technical changes without notice.

Lot 37
Dec. 22, 16

RS

MB

Lot 37

JENN-AIR® DETAILED PLANNING DIMENSIONS

1 of 2

36" GAS COOKTOP
JGC1536B – 36" x 4³/₁₆" x 21"

PRODUCT DIMENSIONS

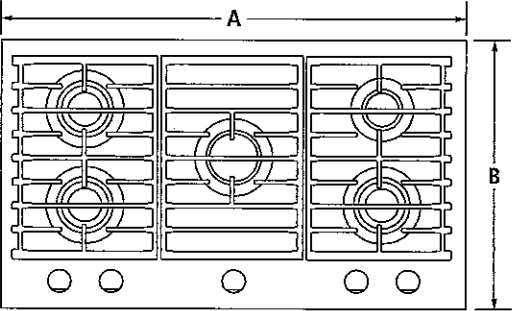

TOP VIEW

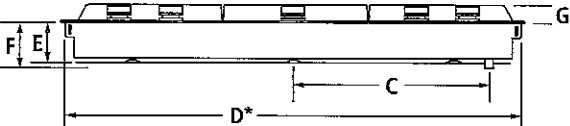

FRONT VIEW

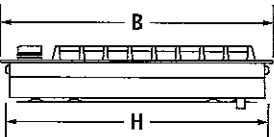

SIDE VIEW

MODEL #		JGC1536B	
		in	cm
A	Overall width	36	91.4
B	Depth of cooktop	21	53.3
C	Center of cooktop to center of gas inlet	15 ³ / ₁₆	38.5
D*	Width of recessed cooktop	35 ⁵ / ₁₆	74.5
E	Height of recessed cooktop	3 ³ / ₁₆	8.1
F	Height from gas inlet to countertop	4 ³ / ₁₆	10.6
G	Height with grates	1 ¹ / ₄	3.1
H	Depth of recessed cooktop	20 ⁵ / ₁₆	51.6

*Measured from tab to tab. Tabs should not be bent during installation.

IMPORTANT: Dimensional specifications are provided for planning purposes only.
Do not make any cutouts based on this information. Refer to the Installation Guide *before* selecting cabinetry, verifying electrical/gas connections, making cutouts or beginning installation.
All Jenn-Air® appliances are appropriately UL, CUL or CSA approved.

JENN-AIR® DETAILED PLANNING DIMENSIONS

36" GAS COOKTOP
JGC1536B – 36" x 4³/₁₆" x 21"

OPENING/CLEARANCE DIMENSIONS

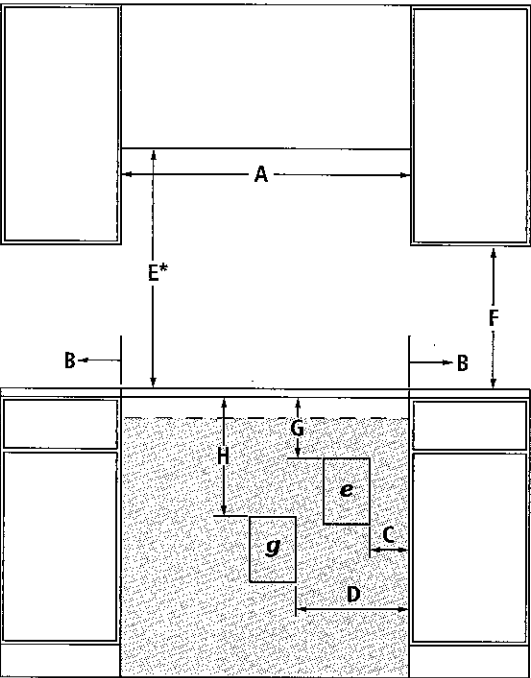

FRONT VIEW

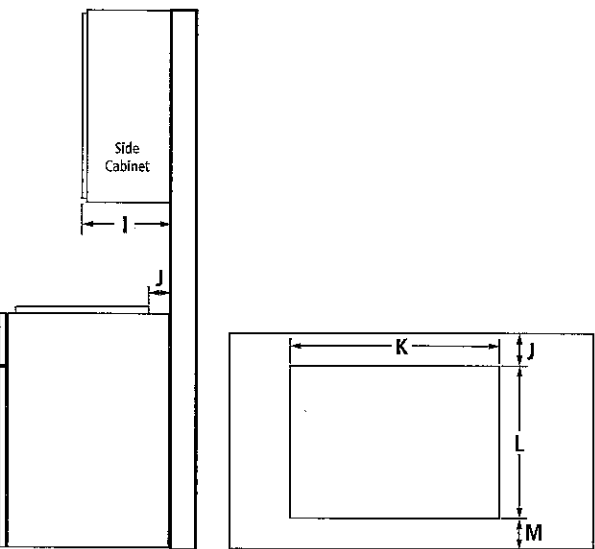

SIDE VIEW

TOP VIEW – CUTOUT

MODEL #		JGC1536B	
		in	cm
A	Width of combustable area above cooking surface (min.)	36	91.4
B	Width from cooktop to fixed wall or other combustable material (min.)	6	15.2
C	Width to outer edge of electrical outlet (recommended)	9	22.9
D	Width to gas supply line location (recommended)	12	30.5
E*	Height to bottom of uncovered wood or metal cabinet above cooking surface (min.)	30	76.2
F	Height to bottom of uncovered wood or metal cabinet (min.)	18	45.7
G	Height to top edge of electrical outlet (recommended)	9	22.9
H	Height to gas supply line location (recommended)	18	45.7
I	Depth of upper cabinet (recommended)	13	33.0
J	Depth from cutout to wall (min.)	2 ⁵ / ₁₆	5.9
K	Width of cutout	35 ³ / ₁₆	89.9
L	Depth of cutout	20 ³ / ₁₆	51.8
M	Depth from cutout to front of countertop	2 ⁵ / ₁₆	5.9
e	Recommended electrical access location		
g	Recommended gas supply line location		

*Dimension can be reduced by 6" (15.2 cm) when bottom of wood or metal cabinet is covered by not less than 1/4" (0.6 cm) flame retardant millboard covered with not less than No. 28 MSG sheet metal, 0.015" (0.4 mm) stainless steel, 0.024" (0.6 mm) aluminum or 0.020" (0.5 mm) copper. If installing a hood or microwave hood combination above the cooktop, follow the hood or microwave hood combination instructions for dimensional clearances above the cooking surface.

GAS REQUIREMENTS

Natural Gas

This cooktop is factory-set for use with natural gas.

LP Gas Conversion

Conversion must be done by a qualified service technician. To convert to LP gas, use an LP gas conversion kit.

ELECTRICAL REQUIREMENTS

120 volt, 60 Hz, AC only, 15-amp fused, electrical circuit is required. A time-delay fuse or dedicated circuit is recommended.

LOCATION REQUIREMENTS

- To ensure cooktop base clearance, cabinet side walls need to be wider than the cutout.
- If cabinet has a drawer, allow a 4" (10.2 cm) minimum clearance between countertop and top of drawer. Drawer depth may need to be shortened to avoid interfering with the regulator.

IMPORTANT: Dimensional specifications are provided for planning purposes only. Do not make any cutouts based on this information. Refer to the Installation Guide before selecting cabinetry, verifying electrical/gas connections, making cutouts or beginning installation. All Jenn-Air® appliances are appropriately UL, CUL or CSA approved.

Standard Application

JENN-AIR® DETAILED PLANNING DIMENSIONS

30" SINGLE WALL OVENS

JJW3430D, JJW2430D – 30" x 29⁷/₁₆" x 25⁵/₁₆"

PRODUCT DIMENSIONS

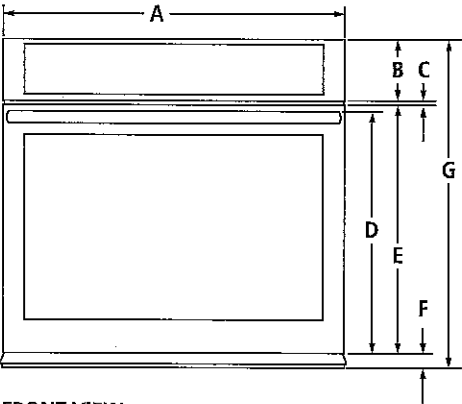

FRONT VIEW

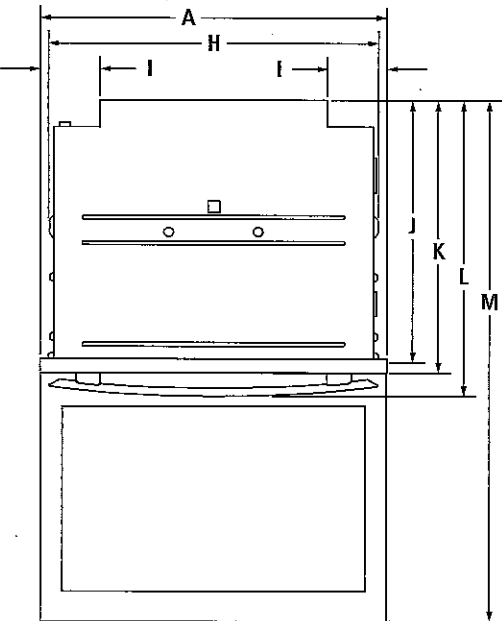

TOP VIEW

MODEL #		JJW3430D JJW2430D	
		in	cm
A	Overall width	30	76.2
	Pro-Style® Stainless or Euro-Style Stainless		
	Floating Glass	29 ¹⁵ / ₁₆	76.1
B	Height of control panel	5 ¹ / ₂	14.0
C	Space between control panel and door	7 ¹ / ₁₆	1.1
D	Height to top of handle		
	Pro-Style® Stainless	21 ¹¹ / ₁₆	55.0
	Euro-Style (color-coordinating)	21 ⁷ / ₁₆	54.4
E	Height of door	22 ¹ / ₁₆	56.2
F	Height of trim	1 ¹ / ₁₆	4.3
G	Overall height	29 ⁷ / ₁₆	75.8
H	Width of recessed oven	28 ⁷ / ₁₆	72.2
I	Width of conduit channel	3 ⁵ / ₁₆	8.8
J	Depth of recessed oven	23 ³ / ₁₆	58.7
K	Depth with door	24 ³ / ₁₆	61.8
L	Depth with handle		
	Pro-Style® Stainless	26 ⁵ / ₁₆	66.9
	Euro-Style (color-coordinating)	25 ⁵ / ₁₆	64.3
M	Depth with door fully open	45 ³ / ₁₆	115.3

IMPORTANT: Dimensional specifications are provided for planning purposes only.
Do not make any cutouts based on this information. Refer to the Installation Guide *before* selecting cabinetry, verifying electrical/gas connections, making cutouts or beginning installation.
All Jenn-Air® appliances are appropriately UL, CUL or CSA approved.

JENN-AIR® DETAILED PLANNING DIMENSIONS

30" SINGLE WALL OVENS

JJW3430D, JJW2430D – 30" x 29⁷/₈" x 25⁵/₁₆"

DIMENSIONS AS INSTALLED

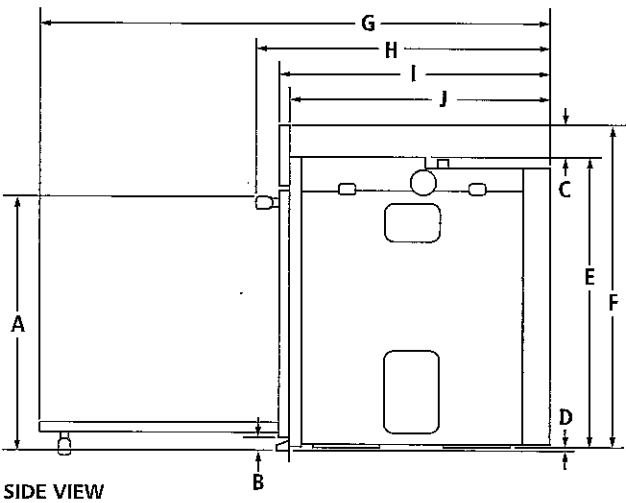

MODEL #		JJW3430D JJW2430D	
		in	cm
A	Height to top of handle Pro-Style® Stainless	22 ³ / ₄	57.8
	Euro-Style (color-coordinating)	22 ¹ / ₁₆	57.3
B	Height of trim extending below cutout	1 ¹ / ₈	2.9
C	Height from top of recessed oven to top of control panel JJW3430D	2 ¹ / ₂	6.3
	JJW2430D	2 ¹⁵ / ₁₆	7.4
D	Height from bottom of recessed oven foot to bottom of oven vent	³ / ₁₆	0.5
E	Height of recessed oven	26 ³ / ₄	67.9
F	Height to top of control panel	29 ⁷ / ₈	75.8
G	Depth with door fully open	45 ⁵ / ₈	115.3
H	Depth with handle Pro-Style® Stainless	26 ⁵ / ₁₆	66.9
	Euro-Style (color-coordinating)	25 ⁵ / ₁₆	64.3
I	Depth with door	24 ⁵ / ₁₆	61.8
J	Depth of recessed oven	23 ¹ / ₁₆	58.6

IMPORTANT: Dimensional specifications are provided for planning purposes only.
Do not make any cutouts based on this information. Refer to the Installation Guide before selecting cabinetry, verifying electrical/gas connections, making cutouts or beginning installation.
All Jenn-Air® appliances are appropriately UL, CUL or CSA approved.

JENN-AIR® DETAILED PLANNING DIMENSIONS

30" SINGLE WALL OVENS

JJW3430D, JJW2430D – 30" x 29⅞" x 25⅝"

OPENING/CLEARANCE DIMENSIONS

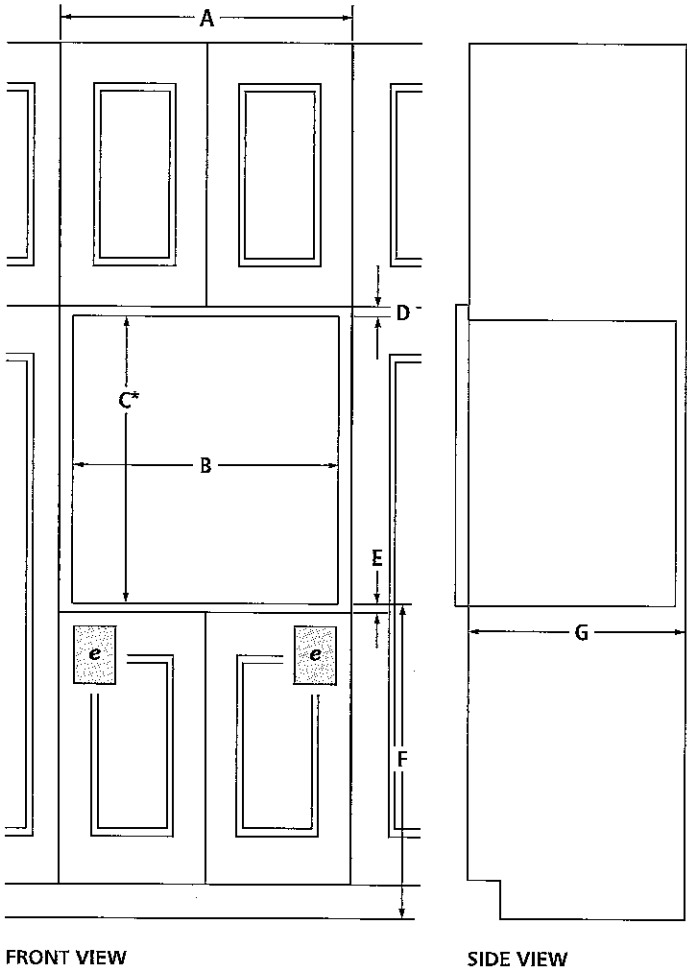

MODEL #		JJW3430D JJW2430D	
		in	cm
A	Width of cabinet (min.)	30	76.2
B	Width of cutout	28½	72.4
C*	Height of cutout (recommended)	28	71.2
D	Top of cutout to bottom of upper cabinet door (min.)	2⅝	5.5
E	Bottom of cutout to top of lower cabinet door (min.)	1½	3.8
F	Bottom of cutout to floor	32	81.3
G	Depth of cutout (min.)	24	61.0
H	Top of countertop to bottom of cutout (min.)	30⅝	76.7
I	Top of cutout to underside of countertop (min.)	1½	3.8
J	Bottom of cutout to floor	4⅝	11.0
e	Recommended junction box location		

*Will fit cutout height from 26⅝" (68.4 cm) to 29⅞" (74.8 cm).

ELECTRICAL REQUIREMENTS

240 volt, 20-amp fused, grounded circuit is required. A dedicated circuit is required.

The length of conduit provided is for serviceability. Do not cut the conduit. The junction box should be located 3" (7.6 cm) maximum below the support surface. Drill a 1" (2.5 cm) minimum diameter hole in the right rear or left rear corner of the support surface for access to the junction box.

NOTE: For under counter installation, the junction box should be located in the adjacent right or left cabinet. Drill a 1" (2.5 cm) minimum diameter hole in an upper corner of the side wall for access to the junction box.

CABINET REQUIREMENTS

NOTE: When using under counter installation, check cabinet manufacturer's specifications to verify fit.

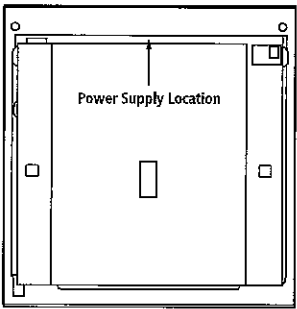
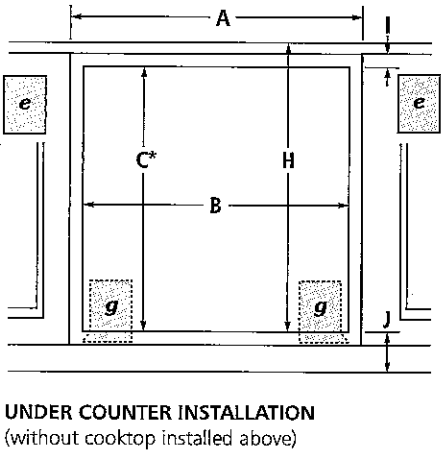

IMPORTANT: Dimensional specifications are provided for planning purposes only. Do not make any cutouts based on this information. Refer to the Installation Guide before selecting cabinetry, verifying electrical/gas connections, making cutouts or beginning installation. All Jenn-Air® appliances are appropriately UL, CUL or CSA approved.

Std.
Application

JENN-AIR® DETAILED PLANNING DIMENSIONS

4 of 4

30" SINGLE WALL OVENS – FLUSH INSTALLATION

JJW3430D, JJW2430D – 30" x 29⁷/₈" x 24⁵/₁₆" (depth without handle)

OPENING/CLEARANCE DIMENSIONS

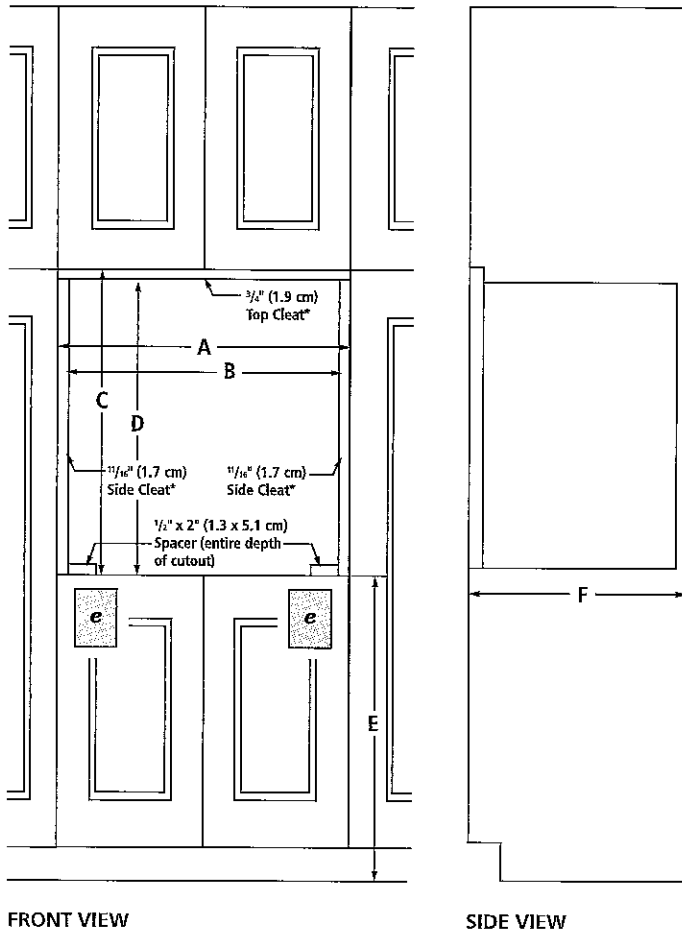

FRONT VIEW

SIDE VIEW

MODEL #		JJW3430D JJW2430D	
		in	cm
A	Width of flush inset cutout (min.)	30 ¹ / ₄	76.8
B	Width of opening (min.)	28 ⁷ / ₈	73.3
C	Height of flush inset cutout (min.)	30 ⁷ / ₁₆	77.3
D	Height of opening (min.)	29 ¹ / ₁₆	75.4
E	Bottom of cutout to floor	4 ⁷ / ₁₆ -32	11.7-81.3
F	Depth of cutout (min.)	25	63.5
G	Bottom of cutout to floor for under counter	4 ¹ / ₁₆	10.3
e	Recommended junction box location		

ELECTRICAL REQUIREMENTS

240 volt, 20-amp fused, grounded circuit is required. A dedicated circuit is required.

The length of conduit provided is for serviceability. Do not cut the conduit. The junction box should be located 3" (7.6 cm) maximum below the support surface. Drill a 1" (2.5 cm) minimum diameter hole in the right rear or left rear corner of the support surface for access to the junction box.

NOTE: For under counter installation, the junction box should be located in the adjacent right or left cabinet. Drill a 1" (2.5 cm) minimum diameter hole in an upper corner of the side wall for access to the junction box.

FLUSH INSTALLATION REQUIREMENTS

A 25" (63.5 cm) minimum cutout depth is required.

These dimensions will result in a 1/4" (0.6 cm) reveal on the top, a 1/4" (0.6 cm) reveal on the sides and a 1/8" (0.3 cm) reveal on the bottom of the wall oven.

The front face of the cleats and spacers will be visible and should be treated as a finished surface.

CABINET REQUIREMENTS

NOTE: When using under counter installation, check cabinet manufacturer's specifications to verify fit.

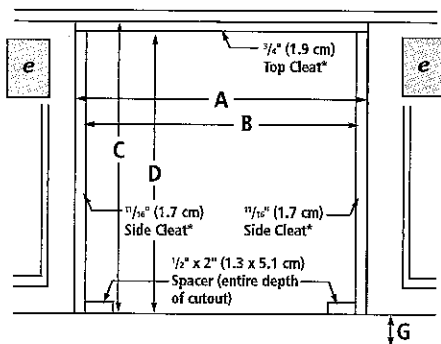

UNDER COUNTER INSTALLATION
(without cooktop installed above)

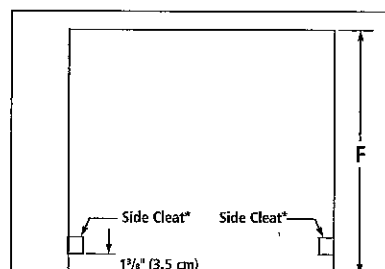

TOP VIEW

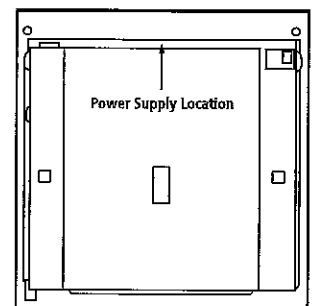

BACK VIEW

* Cleats and spacers must be recessed 1³/₈" (3.5 cm) from the front of the cabinet.

IMPORTANT: Dimensional specifications are provided for planning purposes only.
Do not make any cutouts based on this information. Refer to the Installation Guide *before* selecting cabinetry, verifying electrical/gas connections, making cutouts or beginning installation.
All Jenn-Air® appliances are appropriately UL, CUL or CSA approved.

JENN-AIR®

8660BdZw1015

Sol. Application

JENN-AIR® DETAILED PLANNING DIMENSIONS

BUILT-IN MICROWAVE OVENS

JMC2430D – 29¾" x 19⅞" x 24¾"

JMC2427D – 26¾" x 19⅞" x 24⅞"

PRODUCT DIMENSIONS

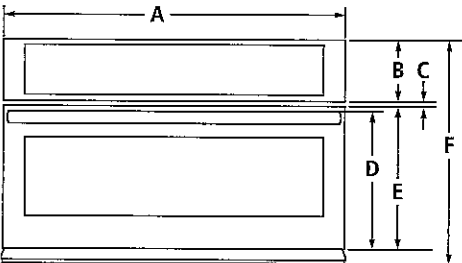

FRONT VIEW

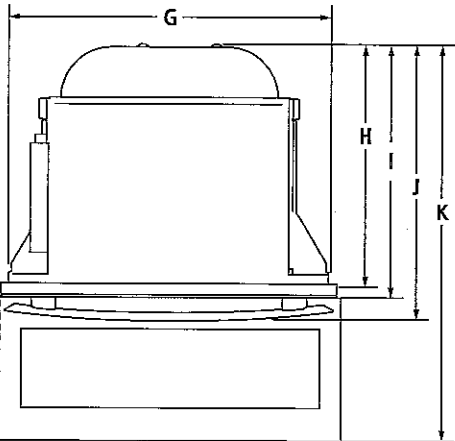

TOP VIEW

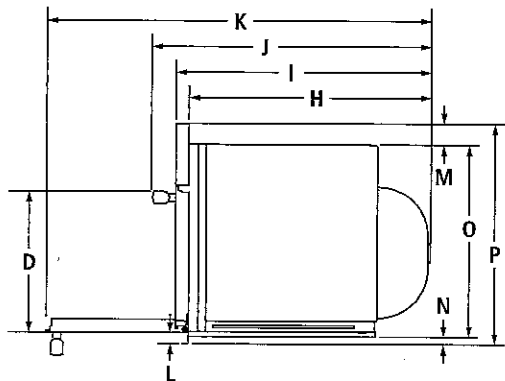

SIDE VIEW

MODEL #		JMC2430D		JMC2427D	
		in	cm	in	cm
A	Overall width	29¾	75.6	26¾	68.0
B	Height of control panel	5½	14.0	5½	14.0
C	Space between control panel and door				
	Pro-Style® Stainless	⅞	1.1	—	—
	Euro-Style Stainless	⅞	1.1	⅞	1.1
	Black Floating Glass	½	1.2	—	—
D	Height to top of handle				
	Pro-Style® Stainless	12¾	31.4	—	—
	Euro-Style Stainless	12¾	31.0	12¾	31.0
	Black Floating Glass	12¾	31.0	—	—
E	Height of door	12¾	32.3	12¾	32.3
F	Overall height	19⅞	50.3	19⅞	50.3
G	Width of recessed oven	28¾	72.1	25¾	64.5
H	Depth of recessed oven	21½	54.6	21½	54.6
I	Depth with door				
	Pro-Style® Stainless	22⅞	57.7	—	—
	Euro-Style Stainless	22⅞	57.7	22⅞	57.5
	Black Floating Glass	22⅞	57.5	—	—
J	Depth with handle				
	Pro-Style® Stainless	25¾	64.4	—	—
	Euro-Style Stainless	24¾	62.9	24⅞	62.8
	Black Floating Glass	24⅞	62.8	—	—
K	Depth with door fully open				
	Pro-Style® Stainless	34¾	87.4	—	—
	Euro-Style Stainless	34¾	87.4	34¾	87.4
	Black Floating Glass	34½	87.6	—	—
L	Height of trim				
	Pro-Style® Stainless	1⅞	2.9	—	—
	Euro-Style Stainless	1⅞	2.9	1¾	3.0
	Black Floating Glass	1¾	3.0	—	—
M	Height from top of recessed oven to top of control panel	1⅞	5.0	1⅞	5.0
N	Height from bottom of recessed oven to bottom of trim	⅞	1.6	⅞	1.6
O	Height of recessed oven	17¾	44.1	17¾	44.1
P	Height to top of control panel	19⅞	48.8	19¾	48.8

IMPORTANT: Dimensional specifications are provided for planning purposes only.
Do not make any cutouts based on this information. Refer to the Installation Guide before selecting cabinetry, verifying electrical/gas connections, making cutouts or beginning installation. All Jenn-Air® appliances are appropriately UL, CUL or CSA approved.



JENN-AIR® DETAILED PLANNING DIMENSIONS

BUILT-IN MICROWAVE OVENS

JMC2430D – 29¾" x 19⅞" x 24¾"
JMC2427D – 26¾" x 19⅞" x 24⅞"

OPENING/CLEARANCE DIMENSIONS

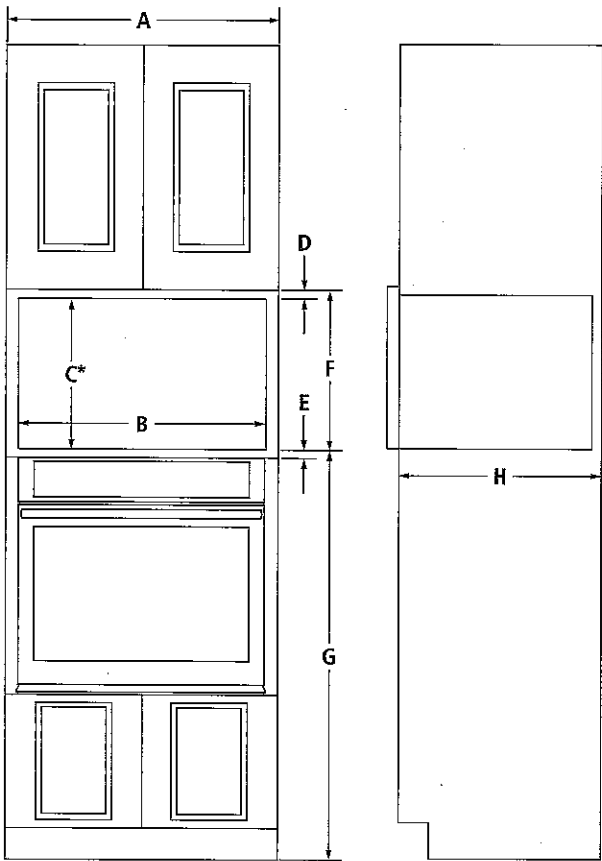

FRONT VIEW – INSTALLATION OVER SINGLE OVEN

SIDE VIEW

Approved models: JJW3430D, JJW2430D, JJW2427D

MODEL #		JMC2430D		JMC2427D	
		in	cm	in	cm
A	Width of cabinet (min.)	30	76.2	27	68.6
B	Width of cutout	28½	72.4	25½	64.8
C*	Height of cutout	17⅞-17¾	44.1-45.1	17⅞-17¾	44.1-45.1
D	Top of cutout to bottom of upper cabinet (min.)	2⅜	5.5	2⅜	5.5
E	Bottom of cutout to top of single oven (min.)	1	2.5	1	2.5
	Bottom of cutout to top of cabinet door (min.)	1½	3.8	1½	3.8
F	Bottom of cutout to bottom of upper cabinet door	19⅞	50.3	19⅞	50.3
G	Bottom of cutout to floor (recommended)	40	101.6	40	101.6
H	Depth of cutout (min.)	21⅞	55.5	21⅞	55.5

*Optional spacer kits are available for a cutout height of 19"-19⅜" (48.3-50.2 cm).

ELECTRICAL REQUIREMENTS

240 volt, 20-amp fused, grounded circuit is required. A dedicated circuit is recommended.

The length of conduit provided is for serviceability. Do not cut the conduit. The junction box should be located 3" (7.6 cm) maximum below the support surface. Drill a 1" (2.5 cm) minimum diameter hole in the left rear corner of the support surface for access to the junction box.

If the junction box is on the rear wall behind the oven, it must be recessed and located in any corner of the cabinet.

LOCATION REQUIREMENTS

Support structure must be able to support 90 lb (41.0 kg) including microwave oven and contents.

IMPORTANT: Dimensional specifications are provided for planning purposes only. Do not make any cutouts based on this information. Refer to the Installation Guide before selecting cabinetry, verifying electrical/gas connections, making cutouts or beginning installation. All Jenn-Air® appliances are appropriately UL, CUL or CSA approved.

JENN-AIR® DETAILED PLANNING DIMENSIONS

BUILT-IN MICROWAVE OVENS – FLUSH INSTALLATION

JMC2430D – 29¾" x 19⅞" x 22⅛" (depth without handle)

JMC2427D – 26¾" x 19⅞" x 22⅝" (depth without handle)

OPENING/CLEARANCE DIMENSIONS

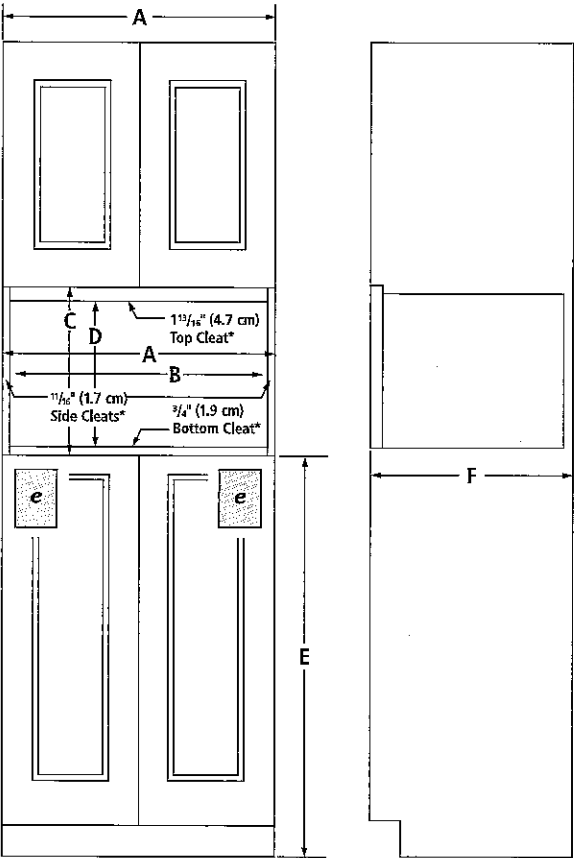

FRONT VIEW

SIDE VIEW

MODEL #		JMC2430D		JMC2427D	
		in	cm		
A	Width of flush inset cutout (min.)	30¼	76.8	27¼	69.2
B	Width of opening (min.)	28⅞	70.8	25⅞	65.7
C	Height of flush inset cutout (min.)	20⅜	51.3	20⅜	51.3
D	Height of opening (min.)	17⅞	44.7	17⅞	44.7
E	Bottom of cutout to floor	40	101.6	40	101.6
F	Depth of cutout (min.)	23¼	59.0	23¼	59.0
e	Recommended junction box location				

ELECTRICAL REQUIREMENTS

240 volt, 20-amp fused, grounded circuit is required. A dedicated circuit is recommended.

The length of conduit provided is for serviceability. Do not cut the conduit. The junction box should be located 3" (7.6 cm) maximum below the support surface. Drill a 1" (2.5 cm) minimum diameter hole in the left rear corner of the support surface for access to the junction box.

FLUSH INSTALLATION REQUIREMENTS

A 23¼" (59.0 cm) minimum cutout depth is required.

These dimensions will result in a ¼" (0.6 cm) reveal on the top, a ½" (0.6 cm) reveal on the sides and a ⅞" (0.3 cm) reveal on the bottom of the microwave oven.

The front face of the cleats and platform will be visible and should be treated as a finished surface.

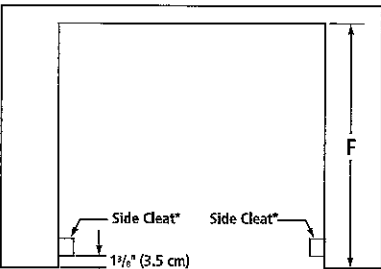

TOP VIEW

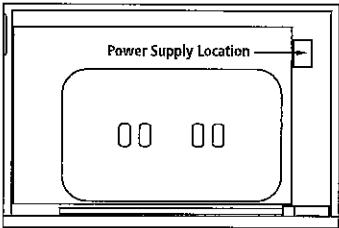

BACK VIEW

*Cleats and platform must be recessed 1⅜" (3.5 cm) from the front of the cabinet.

IMPORTANT: Dimensional specifications are provided for planning purposes only. Do not make any cutouts based on this information. Refer to the Installation Guide before selecting cabinetry, verifying electrical/gas connections, making cutouts or beginning installation. All Jenn-Air® appliances are appropriately UL, CUL or CSA approved.



8673AdZw1115

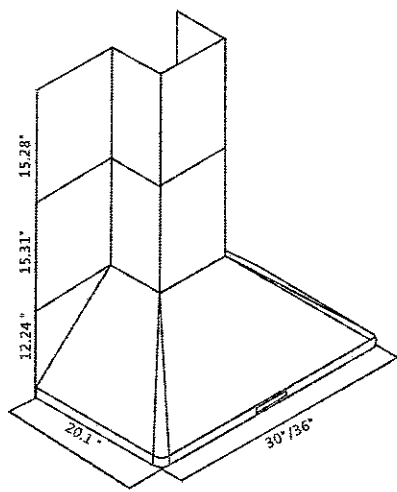

Product Description

Wall Mounted Range Hood

- Mounting version: Wall Mount
- Voltage: 120V @ 60 Hz (USA & Canada Standard)
- Speeds: 3 Speeds
- Airflow Max: 720 CFM
- Noise Level: Low Speed: 45dB to Max Speed: 62dB
- Motor: 360W Ultra Quiet Dual Chamber Motor
- Keypad: Digital Touch Sensitive Controls
- Lighting: 2 x 3.5W LED lights
- Venting Size: 6-in round duct vent
- Filters: Dishwasher Safe Stainless Steel Baffle Filters
- Material: Heavy Duty 19 Gauge Brushed Stainless Steel
- Features: Ultra-Slim
- Warranty: 1 year parts
- Amperage: 12A
- Wattage: 360W

Finish: Stainless Steel

Materials: Stainless Steel

Listing: ETL Listed

Warranty: 1 Year

Dimensions & Weights

Width: 3 feet 4 inches

Length: 29.875 - 35.875 inches

Height: 20.1 inches

On Mon, Dec 19, 2016 at 10:06 AM, Terri Parisani <TParisani@goldparkhomes.com> wrote:

Hi,

JENN-AIR® DETAILED PLANNING DIMENSIONS

1 of 3

69" STANDARD-DEPTH FRENCH DOOR REFRIGERATOR WITH ICE & WATER DISPENSER

JFX2897DR – 35⁵/₁₆" x 70¹/₈" x 35⁷/₁₆"

PRODUCT DIMENSIONS

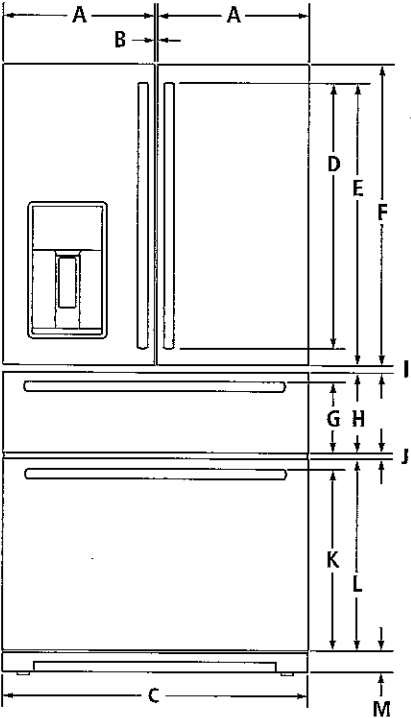

FRONT VIEW

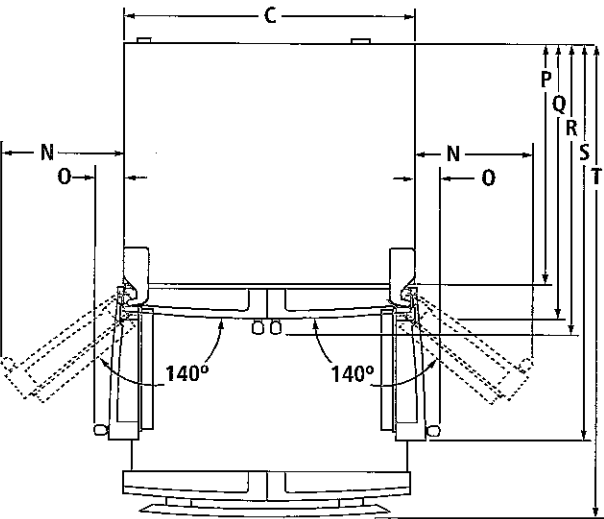

TOP VIEW

MODEL #		JFX2897DR	
		in	cm
A	Width of each door	17 ⁷ / ₈	45.4
B	Space between doors	³ / ₈	0.9
C	Overall width	35 ⁵ / ₁₆	90.5
D	Height of door handles		
	Pro-Style® Stainless	26	66.0
	Euro-Style Stainless	30 ¹ / ₂	77.5
E	Height to top of door handles		
	Pro-Style® Stainless	30 ³ / ₈	77.2
	Euro-Style Stainless	32 ¹ / ₂	82.5
F	Height of doors	34 ¹ / ₁₆	88.4
G	Height to top of upper drawer handle		
	Pro-Style® Stainless	8 ³ / ₈	21.1
	Euro-Style Stainless	8 ¹ / ₄	21.0
H	Height of upper drawer	9 ¹ / ₁₆	24.0
I	Space between doors and drawer	¹ / ₂	1.3
J	Space between drawers	¹ / ₂	1.3
K	Height to top of lower drawer handle		
	Pro-Style® Stainless	20 ⁹ / ₁₆	52.3
	Euro-Style Stainless	20 ⁵ / ₈	52.5
L	Height of lower drawer	21 ¹ / ₄	55.2
M	Height of grille	2 ¹ / ₂	6.4
N	Width from side of refrigerator to handle – door fully open 140°		
	Pro-Style® Stainless	14 ¹ / ₂	36.9
	Euro-Style Stainless	13 ¹ / ₄	33.5
O	Width from side of refrigerator to handle – door open 90°		
	Pro-Style® Stainless	3 ³ / ₈	9.9
	Euro-Style Stainless	2 ¹ / ₄	5.7
P	Depth without doors	29 ⁹ / ₁₆	75.1
Q	Depth with doors	33 ³ / ₄	85.7
R	Depth with handles		
	Pro-Style® Stainless	36	91.4
	Euro-Style Stainless	35 ⁷ / ₁₆	90.0
S	Depth with doors open 90°	48 ⁹ / ₁₆	123.4
T	Depth with upper drawer fully open	56 ¹ / ₁₆	144.6

IMPORTANT: Dimensional specifications are provided for planning purposes only. Do not make any cutouts based on this information. Refer to the Installation Guide before selecting cabinetry, verifying electrical/gas connections, making cutouts or beginning installation. All Jenn-Air® appliances are appropriately UL, CUL or CSA approved.

JENN-AIR® DETAILED PLANNING DIMENSIONS

69" STANDARD-DEPTH FRENCH DOOR REFRIGERATOR WITH ICE & WATER DISPENSER

JFX2897DR – 35⁵/₁₆" x 70¹/₈" x 35⁷/₁₆"

DIMENSIONS AS INSTALLED

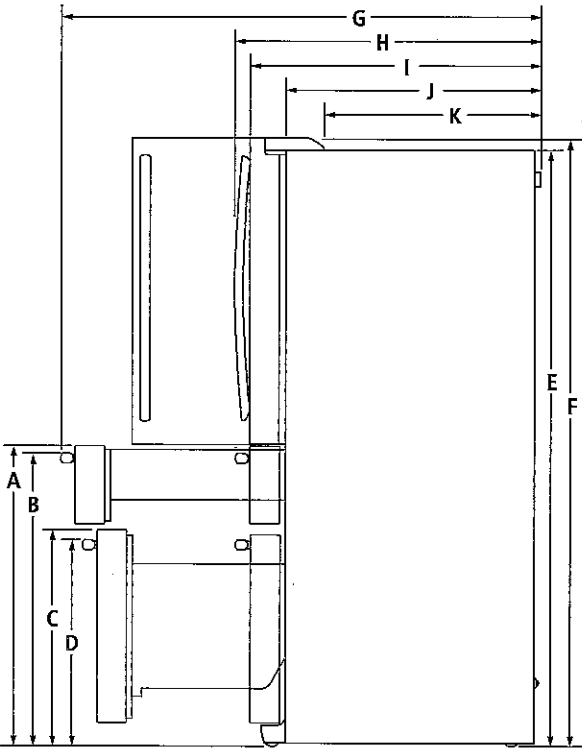

SIDE VIEW

MODEL #		JFX2897DR	
		in	cm
A	Height to top of upper drawer (min.)	34 ¹ / ₁₆	88.1
B	Height to top of upper drawer handle (min.)		
	Pro-Style® Stainless	33 ⁹ / ₁₆	85.2
	Euro-Style Stainless	33 ¹ / ₂	85.0
C	Height to top of lower drawer (min.)	24 ³ / ₄	62.8
D	Height to top of lower drawer handle (min.)		
	Pro-Style® Stainless	23 ⁵ / ₁₆	60.0
	Euro-Style Stainless	23 ³ / ₈	59.5
E	Height of recessed refrigerator (min.)	68 ¹ / ₁₆	174.4
F	Height to top of doors (min.)	70 ¹ / ₈	178.1
G	Depth with upper drawer fully open including drawer handle (min.)		
	Pro-Style® Stainless	56 ⁷ / ₁₆	143.4
	Euro-Style Stainless	54 ³ / ₄	139.1
H	Depth with handles (min.)		
	Pro-Style® Stainless	36	91.4
	Euro-Style Stainless	35 ⁷ / ₁₆	90.0
I	Depth with doors (min.)	33 ³ / ₄	85.7
J	Depth without doors (min.)	29 ⁵ / ₁₆	75.2
K	Depth to back of hinges (min.)	24 ¹³ / ₁₆	63.0

IMPORTANT: Dimensional specifications are provided for planning purposes only.
Do not make any cutouts based on this information. Refer to the Installation Guide *before* selecting cabinetry, verifying electrical/gas connections, making cutouts or beginning installation.
All Jenn-Air® appliances are appropriately UL, CUL or CSA approved.

JENN-AIR® DETAILED PLANNING DIMENSIONS

69" STANDARD-DEPTH FRENCH DOOR REFRIGERATOR WITH ICE & WATER DISPENSER

JFX2897DR – 35⅞" x 70⅞" x 35⅞"

OPENING/CLEARANCE DIMENSIONS

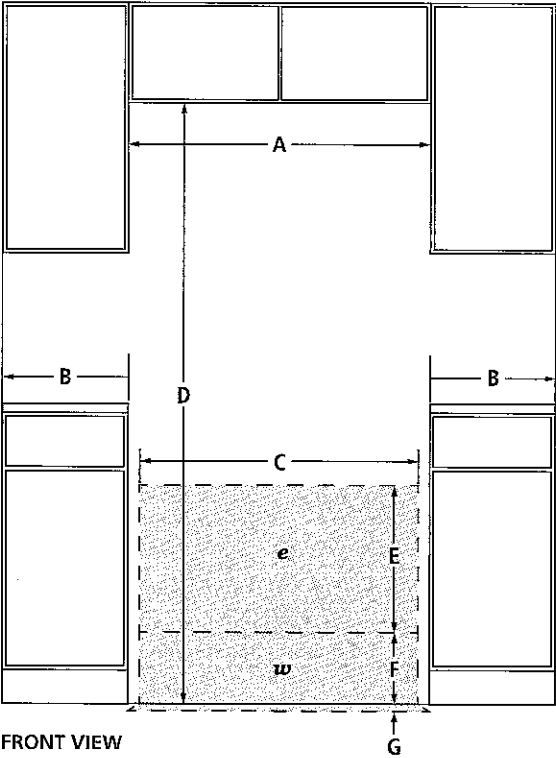

MODEL #		JFX2897DR	
		in	cm
A	Width (min.)	36⅞	93.7
B	Minimum width from side of refrigerator to fixed wall – door open 90° (full access to remove bins)	2¼	5.7
	Minimum width from side of refrigerator to fixed wall – door fully open 140°	13¾	34.8
C	Width of recommended electrical/ water installation area	34	86.4
D	Height (min.)	70⅞	178.0
E	Height of recommended electrical installation area (min.-max.)	10-24	25.4-61.0
F	Height of recommended water installation area	10	25.4
G	Depth of recommended water installation area	1	2.5
H	Water line location – distance from side	2½	6.3
I	Water line location – distance from bottom	7⅞	18.7
e	Recommended electrical connection location		
w	Recommended water connection location		

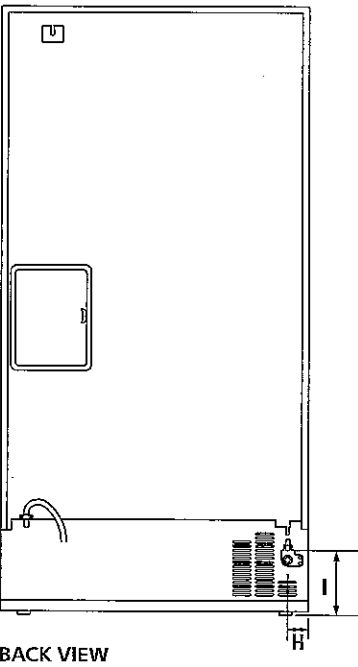

ELECTRICAL REQUIREMENTS

115 volt, 60 Hz, AC only, 15- or 20-amp fused, grounded circuit is required. A dedicated circuit is recommended. Use an outlet that cannot be turned off by a switch.

Minimum length of power cord is 60" (152.0 cm). Do not use an extension cord.

WATER PRESSURE REQUIREMENTS

A cold water supply with water pressure between 30 and 120 psi (207 and 827 kPa) is required to operate the water dispenser and ice maker. Call a licensed, qualified plumber with any questions about the water pressure.

Reverse Osmosis Water Supply

IMPORTANT: The pressure of the water coming out of a reverse osmosis system going to the water inlet valve of the refrigerator needs to be between 30 and 120 psi (207 and 827 kPa).

If a reverse osmosis water filtration system is connected to the cold water supply, the water pressure to the reverse osmosis system needs to be a minimum of 40 to 60 psi (276 to 414 kPa).

IMPORTANT: Dimensional specifications are provided for planning purposes only. Do not make any cutouts based on this information. Refer to the Installation Guide before selecting cabinetry, verifying electrical/gas connections, making cutouts or beginning installation. All Jenn-Air® appliances are appropriately UL, CUL or CSA approved.

