

Kleinburg Glen - 44R - 1 - 25-1 Elev.B RIVERSTONE OPT- GFA1
CENTRAL VAC AND WIRING

Inv.638	1 - LAUNDRY ROOM: ROUGH - IN FOR EXTRA SECURITY KEY PAD
Line8116	Note:
7Jul16 / 11Nov16	

ELECTRICAL

Inv.638	1 - KITCHEN: RELOCATE STANDARD FIXTURE - Locate above island, see plan for location.
Line8117	Note:
7Jul16 / 11Nov16	

Inv.638	1 - KITCHEN: ROUGH - IN CEILING OUTLET ON SAME SWITCH - DOES NOT INCLUDE FIXTURE - Locate above island, use same switch as standard ceiling light. See plan for location.
Line8118	Note:
7Jul16 / 11Nov16	

Inv.638	1 - KITCHEN: ROUGH - IN CEILING OUTLET & SWITCH (WITH COVER PLATE) - DOES NOT INCLUDE FIXTURE - See plan for location.
Line8121	Note:
7Jul16 / 11Nov16	

Inv.638	1 - FAMILY ROOM: RELOCATE STANDARD FIXTURE, SEE PLAN FOR LOCATION
Line8124	Note:
7Jul16 / 11Nov16	

Inv.638	1 - FAMILY ROOM: ROUGH - IN CEILING OUTLET ON SAME SWITCH - DOES NOT INCLUDE FIXTURE - Use same switch as standard light. See plan for location.
Line8127	Note:
7Jul16 / 11Nov16	

Inv.638	1 - FAMILY ROOM: 110V WALL RECEPTACLE ON NORMAL CIRCUIT - Locate above fireplace, approx. 60" A.F.F.. See plan for location.
Line8128	Note:
7Jul16 / 11Nov16	

Inv.638	1 - MAIN BATHROOM: Add a ROUGH - IN CEILING OUTLET ON SAME SWITCH as standard vanity light - DOES NOT INCLUDE FIXTURE - See plan for location.
Line8129	Note:
7Jul16 / 11Nov16	

EXTERIOR COLOURS

Inv.638	1 - EXTERIOR COLOUR PACKAGE 9
Line13787	Note:
7Jul16 / 11Nov16	

FRAMING

Inv.966	1 - OPTIONAL GROUND FLOOR
Line13794	Note:
11Nov16 / 11Nov16	

GRANITE MARBLE QUARTZ

Inv.1,061	1 - MASTER ENSUITE COUNTERTOP: UPG 1 Marble Countertop
Line15529	Note: STD FE20 Edge. STD Sink. See spec sheet attached
19Dec16 / 12Jan17	

Inv.1,061	1 - KITCHEN COUNTERTOP Edge: UPG 2
Line15530	Note: F20 Edge. See spec sheet attached
19Dec16 / 12Jan17	

HARDWOOD

Inv.1,061	1 - 2ND FLOOR HARDWOOD: UPG Standard Hardwood in Upper Hallway
Line15527	Note:
19Dec16 / 12Jan17	

HVAC

Inv.638	1 - HUMIDIFIER: WB3 - 12 (UP TO 2,000 SQ.FT.)
Line8130	Note:
7Jul16 / 11Nov16	

KITCHEN AND BATH CABINETRY

Inv.1,061	1 - KITCHEN: UPG Add Light Valance to Upper Cabinets
Line15531	Note:
19Dec16 / 12Jan17	

MISC.

Inv.638	1 - BONUS PACKAGE: \$5,000.00 (INCLUDING TAXES) WORTH OF UPGRADES FROM GOLD PARK HOMES DÉCOR CENTRE IS BEING APPLIED TOWARD THE STRUCTURAL APPOINTMENT. PURCHASER HAS A REMAINING AMOUNT OF \$3316.60 (INCLUDING TAXES) TO BE USED TOWARD THE COLOUR APPOINTMENT.
Line8134	Note:
7Jul16 / 11Nov16	
Inv.638	1 - Purchasers are aware & accepts that ANY changes made to upgrades after signing this Purchasers Extra Form are subject to a minimum administration fee of \$500. PLUS a 10% holdback fee.
Line8135	Note:
7Jul16 / 11Nov16	
Inv.638	1 - Purchaser has attended a Structural appointment at the Decor Centre & has DECLINED any additional upgrades and accepts and acknowledges that there will be no further structural changes/additions/deletions to be made upon signing on July 7, 2016.
Line8136	Note:
7Jul16 / 11Nov16	
Inv.1,061	1 - Purchaser has attended a Colour appointment at the Decor Centre & has DECLINED any additional upgrades and accepts and acknowledges that there will be no further structural changes/additions/deletions to be made upon signing.
Line15533	Note:
19Dec16 / 12Jan17	
Inv.1,061	1 - Purchasers are aware & accepts that ANY changes made to upgrades after signing this Purchasers Extra Form are subject to a minimum administration fee of \$500. PLUS a 10% holdback fee.
Line15534	Note:
19Dec16 / 12Jan17	
Inv.1,061	1 - REMAINING BONUS PACKAGE: \$3316.60 (INCLUDING TAXES) WORTH OF UPGRADES FROM GOLD PARK HOMES DÉCOR CENTRE IS BEING APPLIED TOWARD THE DECOR APPOINTMENT. PURCHASER HAS A REMAINING AMOUNT OF \$00 (INCLUDING TAXES).
Line15535	Note:
19Dec16 / 12Jan17	
Inv.1,061	1 - Purchaser Accepts Standard Appliance Openings: Fridge - 37-1/2"W x 73-1/2" High Approx. Range - 30-1/2"D x 31-1/2"W Approx. Dishwasher - 24" W Approx
Line15536	Note:
19Dec16 / 12Jan17	



CONSTRUCTION SUMMARY

Kleinburg Glen - 44R - 1 - 25-1 Elev.B RIVERSTONE OPT- GFA1

Inv.1,061	1 - TOTAL AFTER BONUS: \$175.10
	Paid by Credit Card.
Line15537	Note:
19Dec16 / 12Jan17	

Purchaser: Yuri Nagaev
Telephone Res. / Bus: (647) 991-2992
Decor Advisor: Laura Lofaro

Property: 44R
Project: Burkshire Holdings Inc.
Model and Elevation: 25-1 Elev.B RIVERSTONE OPT- GFA1

Layout Changes: ☐ Yes ☐ No Sketch Attached: ☐ Yes ☐ No Exterior Colour Scheme:

1. Cabinetry

	Style and Colour	Counter	Hardware
Kitchen / Breakfast	Varese PVC AntWhite	Crema Caramel *UPG2 Edge F20	CS1-25
Laundry Room	N/A		
Powder Room	N/A		
Master Ensuite Bathroom	Varese PVC ChocMaple	*Marble Pol. Perlato Royal STD FE20 Edge	CS1-24
Second Ensuite Bathroom (If Applicable)	N/A		
Main Bath	Varese PVC ChocMaple	Wilsonart Kalahari Topaz 4588K-07	CS1-24
Dishwasher Cabinet	N/A		

Comment

2. Floor Tile

	Selection	Grout	Threshold
Entrance Vestibule	12x12 Sacramento Beige		
Main Hall	N/A		
Kitchen / Breakfast	12x12 Sacramento Beige		
Laundry Room	12x12 Sacramento Beige		
Powder Room	12x12 Sacramento Beige		
Master Ensuite Bathroom	13x13 Serpentine Taupe		
Second Ensuite Bathroom (If Applicable)	N/A		
Lower Landing (If Applicable)	N/A		
Main Bath	13x13 Serpentine Taupe		

Comment

3. Wall Tile

	Selection	Listello/Inserts	Describe
		<input type="radio"/> Yes <input checked="" type="radio"/> No	
Master Ensuite Bathroom			
Tub Deck	8x10 Weave Taupe	<input type="radio"/> Yes <input checked="" type="radio"/> No	
Shower Stall	8x10 Weave Taupe	<input type="radio"/> Yes <input checked="" type="radio"/> No	
Bathroom Walls	N/A	<input type="radio"/> Yes <input checked="" type="radio"/> No	
Second Ensuite Bathroom (If Applicable)	N/A	<input type="radio"/> Yes <input checked="" type="radio"/> No	
Main Bath	8x10 Serpentine Taupe	<input type="radio"/> Yes <input checked="" type="radio"/> No	

Kitchen Backsplash ☐ Yes ☒ No

Backsplash Behind Fridge

Comment

IN

Scheduled Closing Date: December-20-16

Purchaser: Yuri Nagaev
Telephone Res. / Bus: (647) 991-2992
Decor Advisor: Laura Lofaro

Property: 44R
Project: Burkshire Holdings Inc.
Model and Elevation: 25-1 Elev.B RIVERSTONE OPT- GFA1

4. Plumbing Fixtures

<input type="checkbox"/>	Second Ensuite	<input type="checkbox"/>	Powder Room	<input type="checkbox"/>
Master Ensuite Bathroom <input type="checkbox"/>	Other Room - Specify	<input type="checkbox"/>	Other Washroom	<input type="checkbox"/>

Comment

STD Throughout

5. Hardwood Flooring

Main Hall	Type and Stain Preverco Red Oak Natural-EI Pro	Upper Landing	Type and Stain N/A
Kitchen / Breakfast	N/A	Upper Hall	Preverco Red Oak Natural-EI Pro
Living Room	N/A	Master Bedroom	N/A
Dining Room	N/A	Bedroom #2	N/A
Family Room	Preverco Red Oak Natural-EI Pro	Bedroom #3	N/A
Den/Library	N/A	Bedroom #4	N/A
Entrance Vestibule	N/A	Bedroom #5	N/A
Lower Landing (If Applicable)	N/A	Other Room - Specify	N/A

Comment

6. Carpeting

	Upgrade	Description
Main Hall	<input type="checkbox"/>	N/A
Living Room	<input type="checkbox"/>	N/A
Dining Room	<input type="checkbox"/>	N/A
Family Room	<input type="checkbox"/>	N/A
Den/Library	<input type="checkbox"/>	N/A
Upper Hall	<input type="checkbox"/>	N/A
Master Bedroom	<input type="checkbox"/>	T15
Bedroom #2	<input type="checkbox"/>	T15
Bedroom #3	<input type="checkbox"/>	T15
Bedroom #4	<input type="checkbox"/>	N/A
Bedroom #5	<input type="checkbox"/>	N/A
<input type="checkbox"/>	<input type="checkbox"/>	N/A
Upper Landing (If Applicable)	<input type="checkbox"/>	N/A
Lower Landing (If Applicable)	<input type="checkbox"/>	N/A

Upgrade Underpad	Type N/A	Area
Carpet on Stairs	Capped N/A	Runner - *Upgrade

Comment

IN

Purchaser: Yuri Nagaev
Telephone Res. / Bus: (647) 991-2992
Decor Advisor: Laura Lofaro

Property: 44R
Project: Berkshire Holdings Inc.
Model and Elevation: 25-1 Elev.B RIVERSTONE OPT- GFA1

7. Fireplace

Living Room			Family Room			Other Room - Specify		
Purchased	As Per Plan	N/A	Purchased	As Per Plan	N/A	Purchased	As Per Plan	N/A
<input type="radio"/>	<input type="radio"/>	<input type="radio"/>	<input type="radio"/>	<input checked="" type="radio"/>	<input type="radio"/>	<input type="radio"/>	<input type="radio"/>	<input type="radio"/>

Fireplace Type	<input type="text"/>	STD	<input type="text"/>
Mantle Type	<input type="text"/>	STD Cast Stone	<input type="text"/>
Colour / Stain	<input type="text"/>	STD	<input type="text"/>
Surround	<input type="text"/>	STD	<input type="text"/>
Hearth	<input type="text"/>	Declined	<input type="text"/>

Comment

8. Trim Carpentry

Interior Doors	STD	Front Door Glass Inserts	STD	Door Handles	STD
Interior Trim	STD				

Comment

9. Plaster Mouldings and Medallions

Entrance Vestibule	N/A	<input type="text"/>	Kitchen/Breakfast	N/A	<input type="text"/>
Main Hall	N/A	<input type="text"/>	Den/Library	N/A	<input type="text"/>
Living Room	N/A	<input type="text"/>	Lower Landing	N/A	<input type="text"/>
Dining Room	N/A	<input type="text"/>	Other Room - Specify	N/A	<input type="text"/>
Family Room	N/A	<input type="text"/>			

Comment

10. Railings and Spindles

Railing Package	STD		
Railing Colour	Natural Oak	Spindle Colour	Natural Oak
Stringer / Riser	Natural Oak	Treads	Natural Oak
Comment	Oak Stairs	<input checked="" type="radio"/> Yes	<input type="radio"/> No

11. Wall Paint

Main & Upper Hall	<input type="text"/>	Master Bedroom	<input type="text"/>
Living Room	<input type="text"/>	Bedroom #2	<input type="text"/>
Dining Room	<input type="text"/>	Bedroom #3	<input type="text"/>
Kitchen / Breakfast	<input type="text"/>	Bedroom #4	<input type="text"/>
Family Room	<input type="text"/>	Bedroom #5	<input type="text"/>
Powder Room	<input type="text"/>	Master Ensuite	<input type="text"/>
Laundry Room	<input type="text"/>		<input type="text"/>
Den/Library	<input type="text"/>	Second Ensuite	<input type="text"/>
Trim Paint	White		<input type="text"/>

Comment Smooth Ceilings First Floor

Warm Grey Throughout



Scheduled Closing Date: December-20-16

Purchaser: Yuri Nagaev
Telephone Res. / Bus: (647) 991-2992
Decor Advisor: Laura Lofaro

Property: 44R
Project: Burkshire Holdings Inc.
Model and Elevation: 25-1 Elev.B RIVERSTONE OPT- GFA1

12. Electrical

Plugs and Switches ☒ White ☐ Ivory

Hood Fan ☐ White ☐ Ivory

Appliances

Built in Cooktop

☐ Yes ☒ No

Built in Oven

☐ Yes ☒ No

Above Kitchen Cabinet Light ☐ Yes ☒ No

Below Kitchen Cabinet Light ☐ Yes ☒ No

Gas Stove

☐ Yes ☒ No

Microwave

☐ Yes ☒ No

Comment

SS Hood Fan

13. Heating and Air Conditioning

Air Conditioning

Gas Provisions Dryer

Comment

Gas Provisions Stove

Gas Provisions Barbecue

14. Additional Comments

15. Disclaimers and Notes

- 1) Colours of all materials are as close as possible to builder's selection, but not necessarily identical due to variances in manufacturing.
- 2) Any extras listed above are null and void unless accompanied by a separate invoice/amendment. Said invoice must be paid in full.
- 3) The Purchaser acknowledges that after Interior Colour Selection form is signed and dated, no further changes will be permitted other than re-selection due to unavailability.  Purchaser's Initials
- 4) The Purchaser acknowledges reading and accepting the "Gold Park Homes Decor Centre Disclaimers" form. This document contains other miscellaneous disclaimers.

This Interior Colour Selection is final and approved by:

Signature: 

Date: Dec. 19, 2016

(I.N) STRUCTURAL

LOT 44R

July 7 2016

COLOURS

LOT 442

(I.N)

DEC. 19. 2016

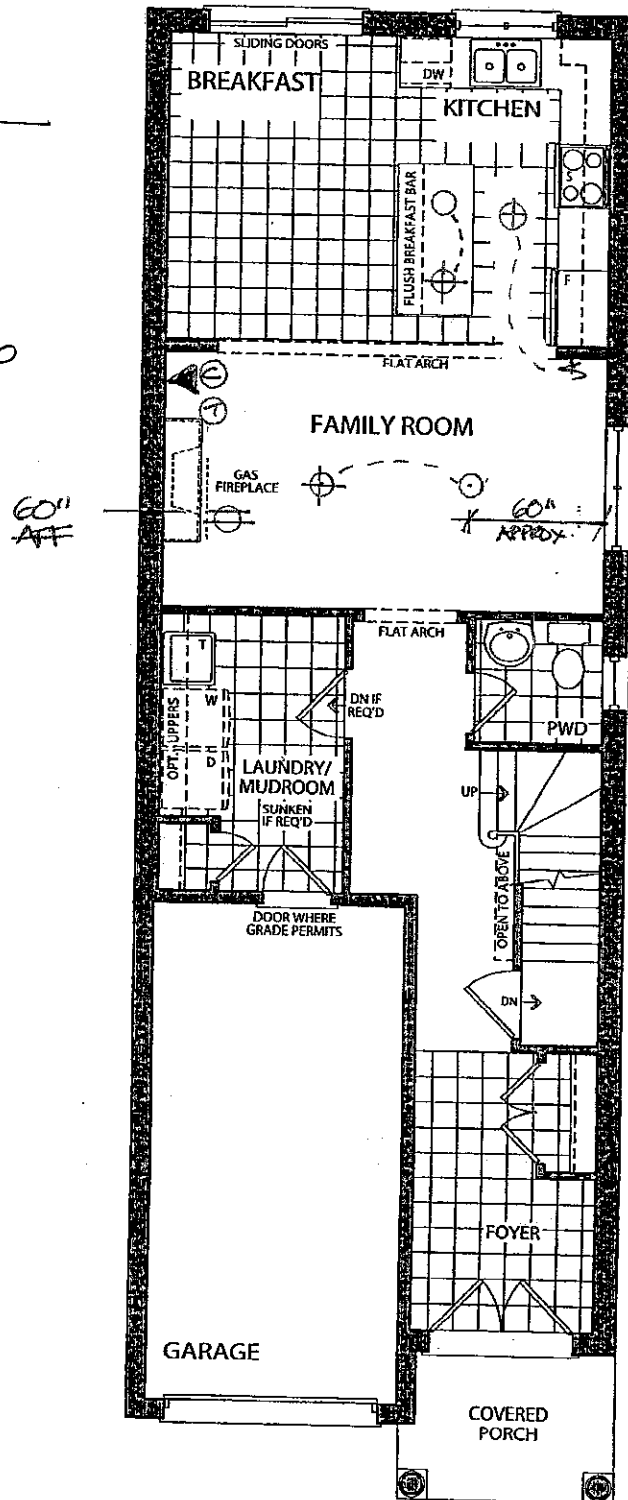

OPT. GROUND FLOOR
ELEVATION A

Elevation A • 1,849 sq.ft.

✓ Elevation B • 1,849 sq.ft.

IN Structural

Lot 44R

July 7 2016

Colours

IN

Dec. 19/16

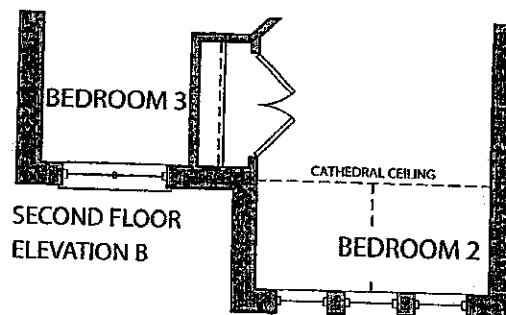
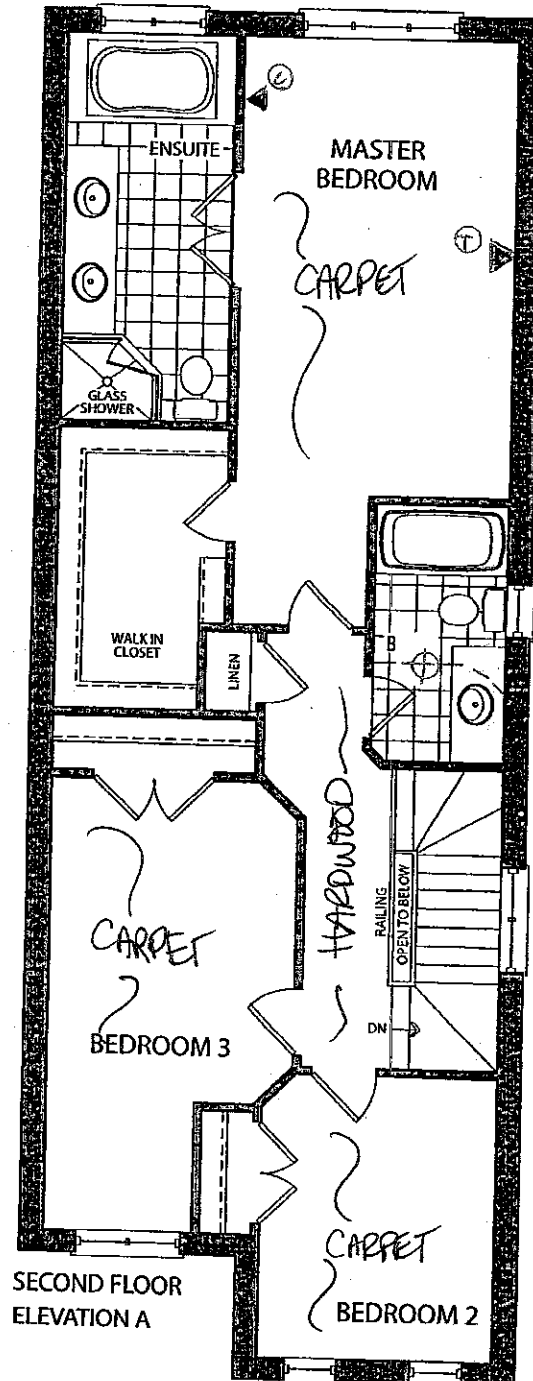

Elevation A • 1,849 sq.ft.

Elevation B • 1,849 sq.ft.

Structural
LOT 44-R

July 7 2016

IN

CLAUKE

IN DEC. 19, 2016

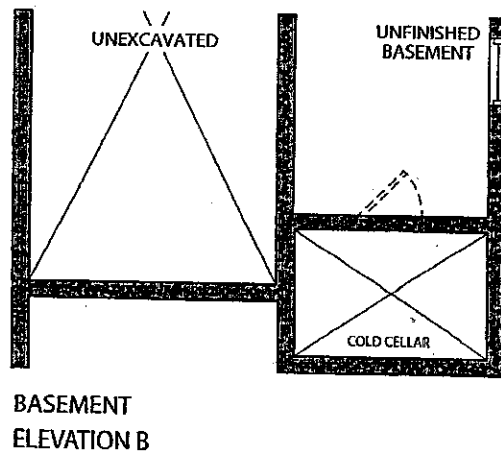
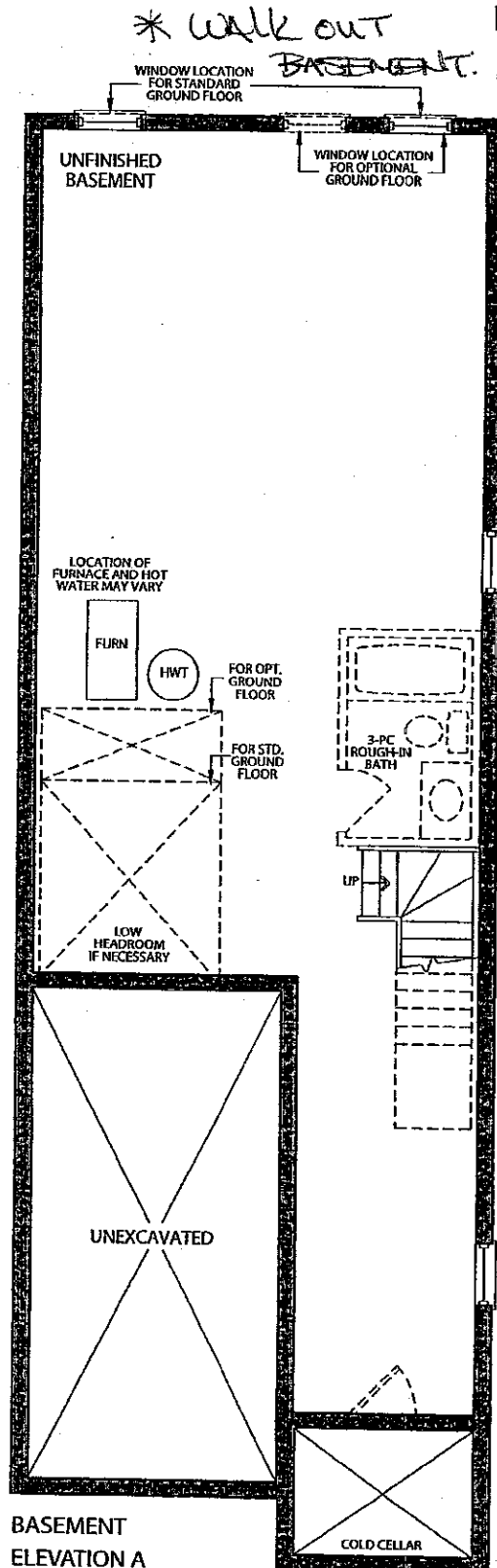

CORTINA

KITCHENS INC.

70 Regina Road Woodbridge ON L4L 8L6
905-264-6464

INFORMATION - PVC DOORS

Builder Gold Park Homes Project KLEINBURG GLEN Lot # 442

All cabinets with PVC (Thermofoil) Doors come with melamine gables, panels and kick. The doors, crown moulding and light valance are PVC wrapped. Open shelves incorporated in design will only be available with melamine interiors. There will be variations in colour shades between the PVC parts (doors, crown and Light valance) and the melamine parts (open shelves, Gables, Panels and Kick) due to the difference in material.

Furring Panel with crown moulding to the ceiling is not available on all PVC door styles due to subtle variations in colour shades between the PVC parts (moulding) and the melamine parts (furring panel) due to the difference in material. Grain directions in wood grain pattern melamine, vary between the furring panel, crown moulding (horizontal) and the PVC doors (vertical).

Thank you for your understanding.

I am well informed of this information, and agree to the purchase of the above.

Purchaser: 

Date: DEC. 19. 2016

Trade Name: Gold Park Homes

Site location:

Model: 25-1

Address:

Project: Kleinburg Glen

Phase:

This layout has been explained to the purchaser by Cortina Kitchens Inc. and is understood by the purchaser.

LIGHT VALANCE

OPT. GROUND FLOOR KITCHEN

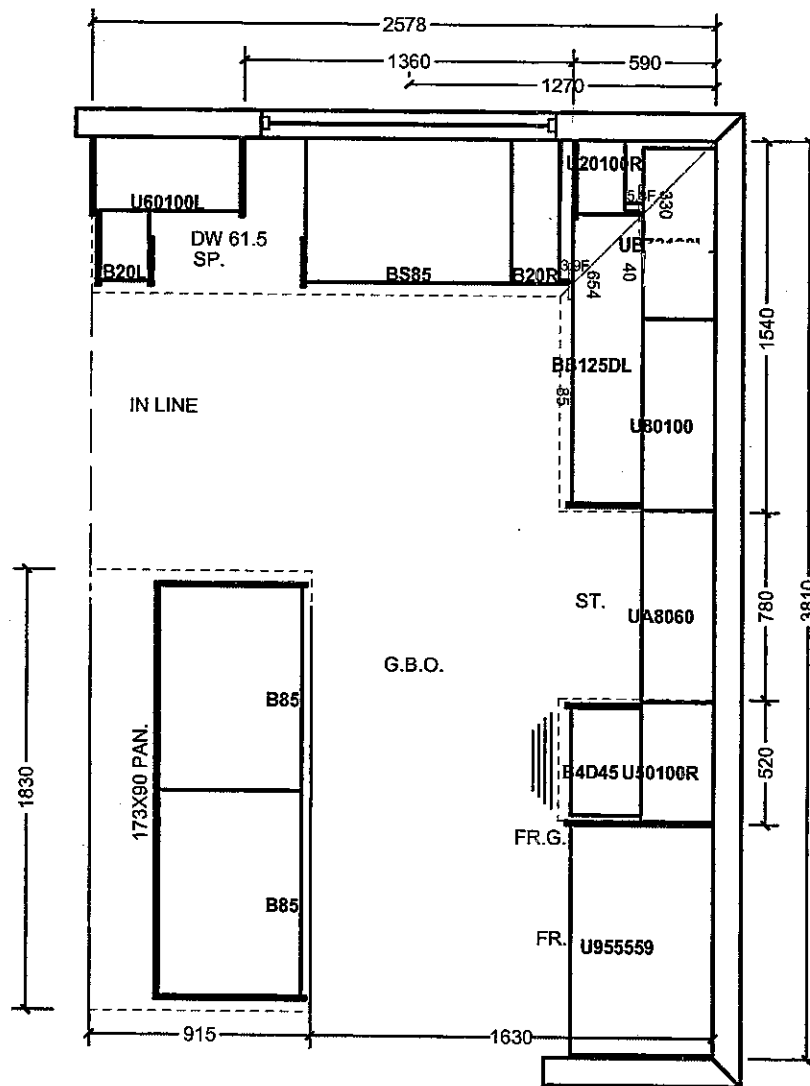

*NOT ENOUGH SPACE FOR FRIDGE TO OPEN

All prices subject to confirmation from head office.
This quotation is subject to the terms & conditions set outAll agreements are contingent upon strikes, accidents, and delays beyond our control.
Please provide our installer with template for sinkholes or \$150.00 will be charged for callback.

ACCEPTED DATE: DEC. 19. 2016

Lot 44R

X IN

Trade Name: Gold Park Homes	Site location:	Model: 25-1
Address:	Project: Kleinburg Glen	Phase:

This layout has been explained to the purchaser by Cortina Kitchens Inc. and is understood by the purchaser.

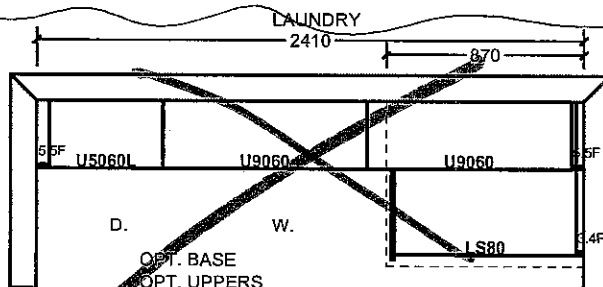
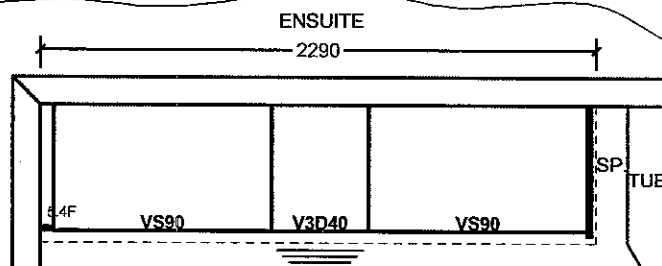
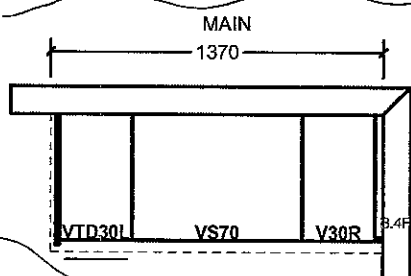
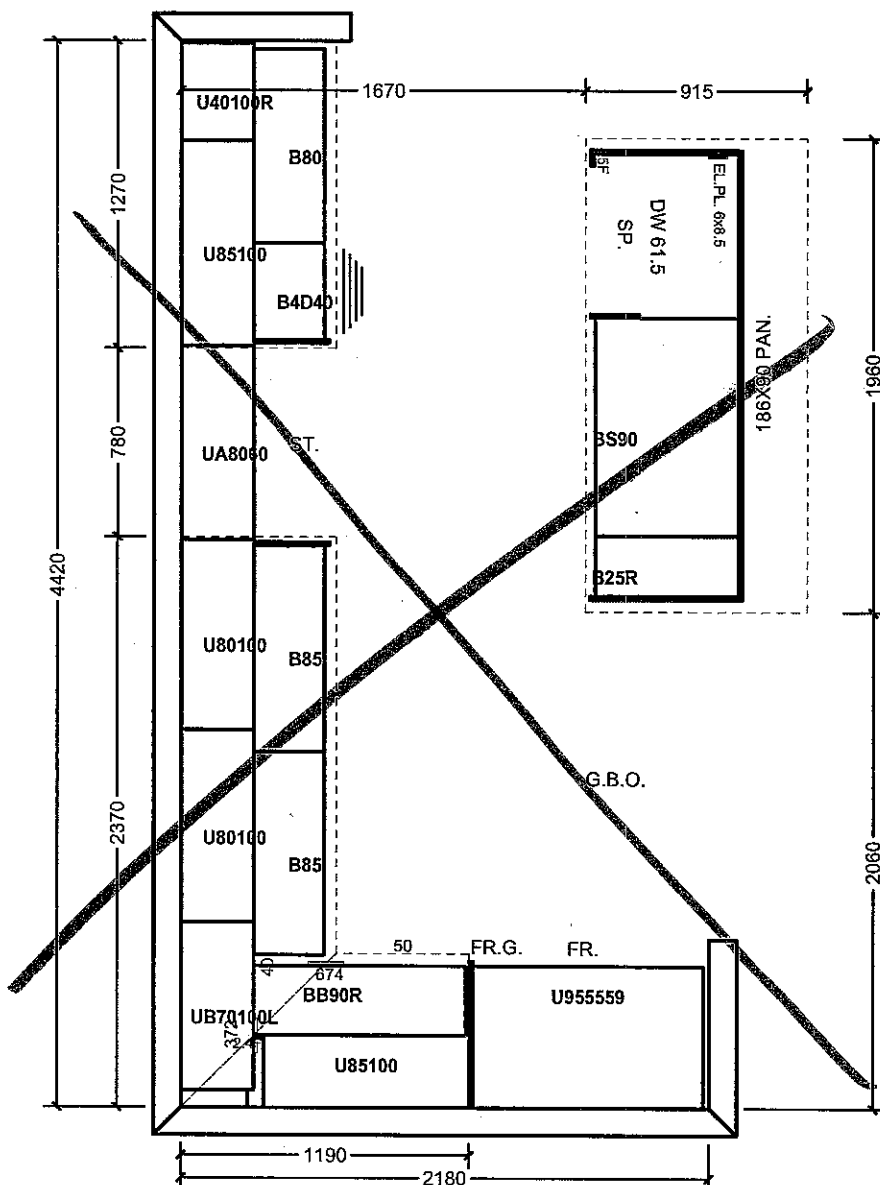

All prices subject to confirmation from head office.
This quotation is subject to the terms & conditions set out

ACCEPTED DATE: Dec. 19, 2016

All agreements are contingent upon strikes, accidents, and delays beyond our control. Please provide our installer with template for sinkholes or \$150.00 will be charged for callback.

LOT 442

X IN

- Standard 2CM & 3CM
- ⊖ Upgrade 1 2CM & 3CM
- ⊗ Upgrade 1 4 CM
- Upgrade 2

20mm (3/4") Profiles

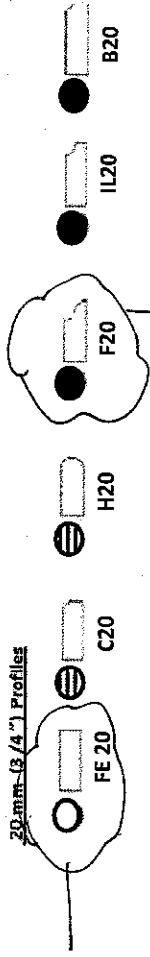

30mm (1-1/4") Profiles

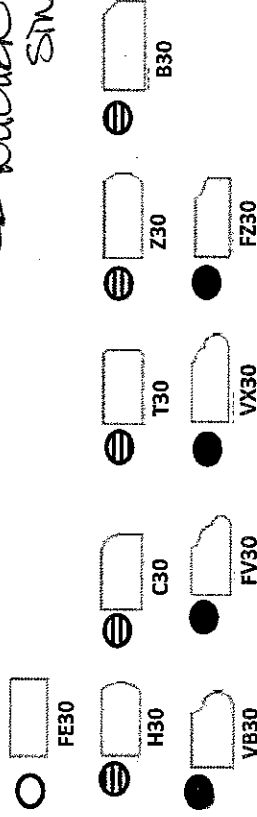

40mm (1-1/2") Profiles

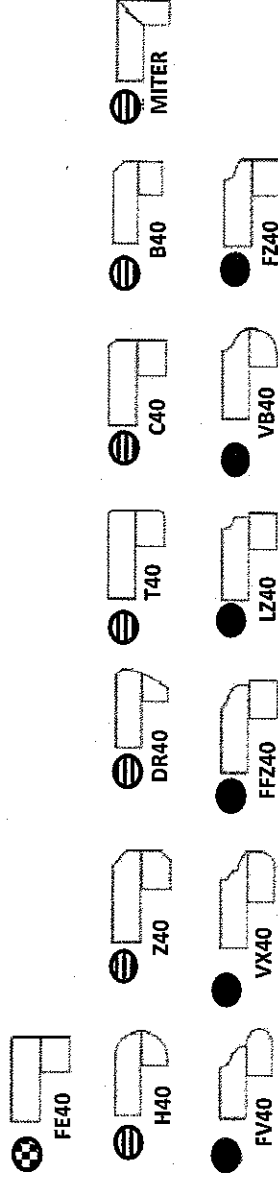

Note: All colours may not be available in 30mm at time ordered. Vendor reserves the right to use 40 mm edges (by lamination process).

*Mitre edge is available in Upgrade 1 for an overall thickness of 2". All other Mitre edge options will be an Upgrade 2 Edge.

KG-44R

(ZN)

DEC. 19.2016

STANDARD HARDWARE

STANDARD HARDWARE



CSI-6

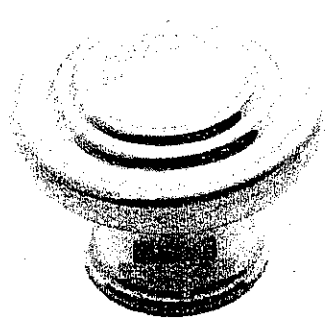

CSI-10



CSI-14



CSI-16



CSI-18

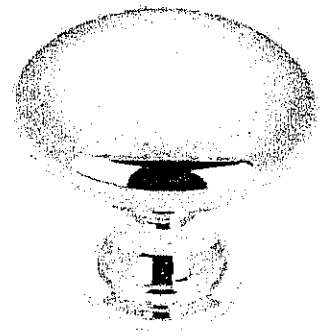

CSI-19

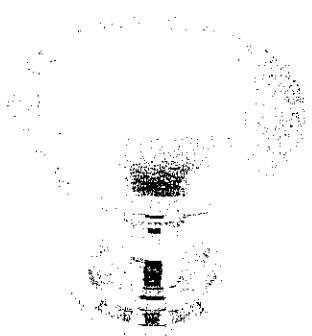

CSI-20

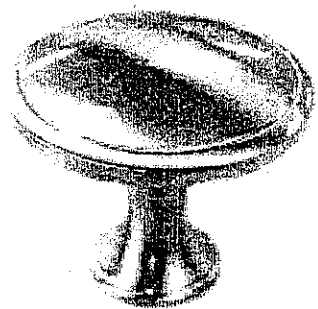

CSI-21



CSI-22

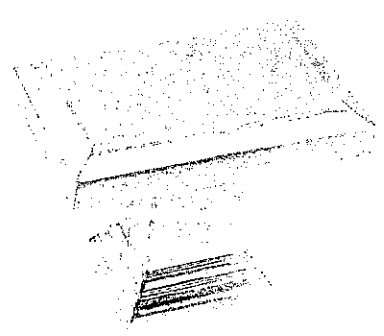

CSI-23

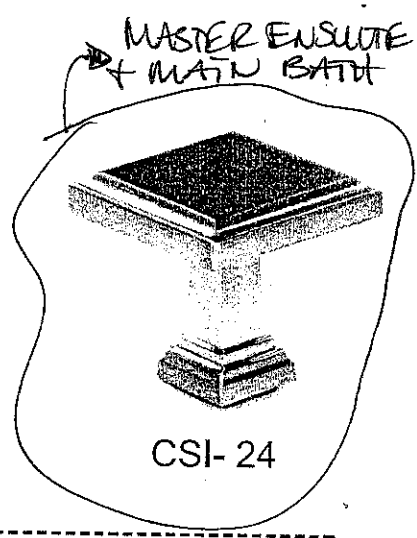

CSI-24

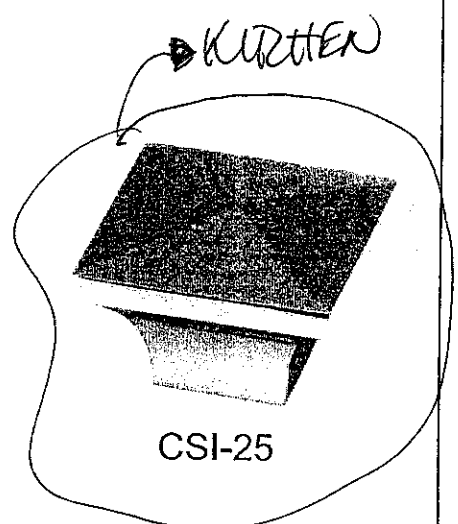

CSI-25

***NOTES:**
- IMAGES ARE FOR QUICK REFERENCE PURPOSES ONLY
- ACTUAL SIZES AND FINISHES AS PER HARDWARE
SAMPLE BOARD PROVIDED TO DECOR CENTRE

KLEINBURG GLEN
LOT 44R
IN
DEC. 19.2016