

Kleinburg Glen - 82L - 1 - 25-9 Elev.A SOMERSET OPT- GFA1

APPLIANCES

Inv.1,055	1 - Purchaser Accepts Standard Appliance Openings: Fridge - 37-1/2"W x 73-1/2" High Approx. Range - 30-1/2"D x 31-1/2"W Approx. Dishwasher - 24" W Approx.
Line15406	Note:
13Dec16 / 20Dec16	

CARPET

Inv.1,055	1 - FOYER / KITCHEN / MUD ROOM / POWDER ROOM FLOOR TILE: Upgrade 2 - 12x24" -Laid in straight, stacked pattern. See plan for tile direction.
Line15399	Note:
13Dec16 / 20Dec16	

CENTRAL VAC AND WIRING

Inv.722	1 - FAMILY ROOM: CONDUIT PIPE - FOR TELEVISION - Locate approx. 60" A.F.F. above the fireplace, terminating left of fireplace beside cable location. See plan for location.
Line9779	Note:
4Aug16 / 11Nov16	

ELECTRICAL

Inv.722	1 - KITCHEN: 110V WALL RECEPTACLE ON NORMAL CIRCUIT - Locate approx. 60" above fireplace. see plan for location.
Line9780	Note:
4Aug16 / 11Nov16	
Inv.722	1 - KITCHEN: RELOCATE STANDARD FIXTURE - to above island, see plan for location.
Line9781	Note:
4Aug16 / 11Nov16	
Inv.722	1 - KITCHEN: ROUGH - IN CEILING OUTLET ON SAME SWITCH - DOES NOT INCLUDE FIXTURE - Locate above island, using same switch as standard light. See plan for location.
Line9782	Note:
4Aug16 / 11Nov16	

EXTERIOR COLOURS

Inv.722	1 - EXTERIOR COLOUR PACKAGE 7
Line13861	Note:
4Aug16 / 11Nov16	

FRAMING

Inv.722	1 - MAIN FLOOR: FRAME MAIN FLOOR ARCH AT 96 INCH
Line9784	Note:
4Aug16 / 11Nov16	
Inv.969	1 - OPTIONAL GROUND FLOOR
Line13862	Note:
11Nov16 / 11Nov16	

HARDWOOD

Inv.1,055	1 - MAIN HALL / FAMILY ROOM HARDWOOD FLOOR: Upgrade 1 - Preverco Red Oak (smooth) 3/4 x 4-1/4"
Line15400	Note:
13Dec16 / 20Dec16	

INTERIOR TRIM AND DOORS

Kleinburg Glen - 82L - 1 - 25-9 Elev.A SOMERSET OPT- GFA1

Inv.722	1 - MAIN FLOOR: EXTENDED HEIGHT ARCHWAY (PRICE PER DOORWAY) - 96"
Line9785	Note:
4Aug16 / 11Nov16	

MISC.

Inv.722	1 - Purchaser has attended a Structural appointment at the Decor Centre & has DECLINED any additional upgrades and accepts and acknowledges that there will be no further structural changes/additions/deletions to be made upon signing on August 4, 2016.
Line9786	Note:
4Aug16 / 11Nov16	

Inv.722	1 - Purchasers are aware & accepts that ANY changes made to upgrades after signing this Purchasers Extra Form are subject to a minimum administration fee of \$500. PLUS a 10% holdback fee.
Line9787	Note:
4Aug16 / 11Nov16	

Inv.722	1 - BONUS PACKAGE: \$5,000.00 (INCLUDING TAXES) WORTH OF UPGRADES FROM GOLD PARK HOMES DÉCOR CENTRE IS BEING APPLIED TOWARD THE STRUCTURAL APPOINTMENT. PURCHASER HAS A REMAINING AMOUNT OF \$4186.40 (INCLUDING TAXES) TO BE USED TOWARD THE COLOUR APPOINTMENT.
Line9788	Note:
4Aug16 / 11Nov16	

Inv.1,055	1 - Purchaser has attended a Colour appointment at the Decor Centre & has DECLINED any additional upgrades and accepts and acknowledges that there will be no further changes/additions/deletions to be made upon signing on December 13, 2016.
Line15403	Note:
13Dec16 / 20Dec16	

Inv.1,055	1 - Purchasers are aware & accepts that ANY changes made to upgrades after signing this Purchasers Extra Form are subject to a minimum administration fee of \$500. PLUS a 10% holdback fee.
Line15404	Note:
13Dec16 / 20Dec16	

Inv.1,055	1 - STAIRCASE - The purchaser was advised and therefore accepts and acknowledges that the stain of the staircase and flooring chosen do not match. This difference might result in an undesirable colour variance.
Line15405	Note: The purchaser agrees that the vendor is to be exempt from any and all claims by the purchaser regarding this colour variance.
13Dec16 / 20Dec16	

PAINTING

Inv.1,055	1 - MAIN STAIRS: Stain stairs to match hardwood, as close as possible.
Line15402	Note:
13Dec16 / 20Dec16	

Purchaser: Peiwen Wu

Property: 82L

Telephone Res. / Bus: (416) 400-9307

Project: Burkshire Holdings Inc.

Decor Advisor: Yolande Somerville

Model and Elevation: 25-9 Elev.A SOMERSET OPT- GFA1

Layout Changes: ☐ Yes ☒ No

Sketch Attached: ☒ Yes ☐ No

Exterior Colour Scheme:

1. Cabinetry

	Style and Colour	Counter	Hardware
Kitchen / Breakfast	Varese pvc 'wht crystal'	Granite: Grigio Sardo Edge: FE-20	cs1-23
Laundry Room	n/a	n/a	n/a
Powder Room	n/a	n/a	n/a
n/a			
Master Ensuite Bathroom	Varese pvc 'Mystic'	P-Lam: #P-344-LM 'Inukshuk Grey'	cs1-23
Second Ensuite Bathroom (If Applicable)	n/a		
Main Bathroom	Varese pvc 'wht crystal'	P-Lam: #P-344-LM 'Inukshuk Grey'	cs1-23
Dishwasher Cabinet	n/a		

Comment

2. Floor Tile

	Selection	Grout	Threshold
Entrance Vestibule	*12x24" New Byzantium 'Pentellic Grey'	n/a	n/a
Main Hall	n/a	n/a	n/a
Kitchen / Breakfast	*12x24" New Byzantium 'Pentellic Grey'	n/a	n/a
Laundry Room	13x13" Carrara 'White/Grey'	n/a	n/a
Powder Room	*12x24" New Byzantium 'Pentellic Grey'	n/a	n/a
Mud Room	*12x24" New Byzantium 'Pentellic Grey'	n/a	n/a
Master Ensuite Bathroom	13x13" Carrara 'White/Grey'	n/a	n/a
Second Ensuite Bathroom (If Applicable)	n/a	n/a	n/a
Lower Landing (If Applicable)	n/a	n/a	n/a
Main Bathroom	13x13" Carrara 'White/Grey'	n/a	n/a

Comment

3. Wall Tile

	Selection	Listello/Inserts	Describe
M. Ens Tub skirt/splash	8x10" Weave 'White'	<input type="radio"/> Yes <input checked="" type="radio"/> No	
Master Ensuite Bathroom			
Tub Deck	8x10" Weave 'White'	<input type="radio"/> Yes <input checked="" type="radio"/> No	
Shower Stall	8x10" Weave 'White'	<input type="radio"/> Yes <input checked="" type="radio"/> No	
Bathroom Walls	n/a	<input type="radio"/> Yes <input checked="" type="radio"/> No	
Second Ensuite Bathroom (If Applicable)	n/a	<input type="radio"/> Yes <input checked="" type="radio"/> No	
Main Bathroom	8x10" Weave 'White'	<input type="radio"/> Yes <input checked="" type="radio"/> No	

Kitchen Backsplash ☐ Yes ☒ No

Backsplash Behind Fridge

Comment

WJH

Purchaser: Peiwen Wu
Telephone Res. / Bus: (416) 400-9307
Decor Advisor: Yolande Somerville

Property: 82L
Project: Berkshire Holdings Inc.
Model and Elevation: 25-9 Elev.A SOMERSET OPT- GFA1

4. Plumbing Fixtures

Master Ensuite Bathroom Second Ensuite Powder Room
Other Room - Specify Other Washroom

Comment

Standard Thru out

5. Hardwood Flooring

	Type and Stain		Type and Stain
Main Hall	*Preverco Red Oak 'Komodo'	Upper Landing	n/a
Kitchen / Breakfast	n/a	Upper Hall	n/a
Living Room	n/a	Master Bedroom	n/a
Dining Room	n/a	Bedroom #2	n/a
Family Room	*Preverco Red Oak 'Komodo'	Bedroom #3	n/a
Den/Library	n/a	Bedroom #4	n/a
Entrance Vestibule	n/a	Bedroom #5	n/a
Lower Landing (If Applicable)	n/a	Other Room - Specify	<input type="text"/>

Comment

*Hardwood selection: 3/4 x 4-1/4" Preverco Red Oak 'Komodo' (smooth)

6. Carpeting

	Upgrade	Description
Main Hall	<input type="checkbox"/>	n/a
Living Room	<input type="checkbox"/>	n/a
Dining Room	<input type="checkbox"/>	n/a
Family Room	<input type="checkbox"/>	n/a
Den/Library	<input type="checkbox"/>	n/a
Upper Hall	<input type="checkbox"/>	n/a
Master Bedroom	<input type="checkbox"/>	T-15
Bedroom #2	<input type="checkbox"/>	T-15
Bedroom #3	<input type="checkbox"/>	T-15
Bedroom #4	<input type="checkbox"/>	n/a
Bedroom #5	<input type="checkbox"/>	n/a
<input type="text"/>	<input type="checkbox"/>	n/a
Upper Landing (If Applicable)	<input type="checkbox"/>	n/a
Lower Landing (If Applicable)	<input type="checkbox"/>	n/a

Upgrade Underpad	Type n/a	Area n/a
Carpet on Stairs	Capped n/a	Runner - *Upgrade n/a

Comment

Standard carpet and underpad in upper hall and bedrooms

Wu

Purchaser: Peiwen Wu

Property: 82L

Telephone Res. / Bus: (416) 400-9307

Project: Burkshire Holdings Inc.

Decor Advisor: Yolande Somerville

Model and Elevation: 25-9 Elev.A SOMERSET OPT- GFA1

7. Fireplace

	Living Room			Family Room			Other Room - Specify		
	Purchased	As Per Plan	N/A	Purchased	As Per Plan	N/A	Purchased	As Per Plan	N/A
Fireplace Type	<input type="radio"/>	<input type="radio"/>	<input checked="" type="radio"/>	<input type="radio"/>	<input checked="" type="radio"/>	<input type="radio"/>	<input type="radio"/>	<input type="radio"/>	<input checked="" type="radio"/>
Mantle Type				Standard Gas					
Colour / Stain				Standard					
Surround				none					
Hearth				none					
Comment									

8. Trim Carpentry

Interior Doors	Standard	Front Door Glass Inserts	Standard	Door Handles	Standard
Interior Trim	Standard				
Comment					

9. Plaster Mouldings and Medallions

Entrance Vestibule			Kitchen/Breakfast		
Main Hall			Den/Library		
Living Room			Lower Landing		
Dining Room			Other Room - Specify	none	
Family Room			Thru Out		
Comment					

10. Railings and Spindles

Railing Package	Standard Oak	
Railing Colour	*Komodo	Spindle Colour
Stringer / Riser	*Komodo	Treads
Comment		
	Oak Stairs	<input checked="" type="radio"/> Yes <input type="radio"/> No

11. Wall Paint

Main & Upper Hall		Master Bedroom	
Living Room		Bedroom #2	
Dining Room		Bedroom #3	
Kitchen / Breakfast		Bedroom #4	
Family Room		Bedroom #5	
Powder Room		Master Ensuite	
Laundry Room			
Den/Library		Second Ensuite	
Trim Paint		Thru Out	Warm Grey
Comment	Smooth Ceilings First Floor		

Wu

Scheduled Closing Date: Thursday, March 16, 2017

Purchaser: Peiwen Wu

Property: 82L

Telephone Res. / Bus: (416) 400-9307

Project: Burkshire Holdings Inc.

Decor Advisor: Yolande Somerville

Model and Elevation: 25-9 Elev.A SOMERSET OPT- GFA1

12. Electrical

Plugs and Switches

☒ White ☐ Ivory

Hood Fan

☐ White ☐ Ivory

Appliances

Built in Cooktop

☐ Yes ☒ No

Built in Oven

☐ Yes ☒ No

Gas Stove

☐ Yes ☒ No

Microwave

☐ Yes ☒ No

Above Kitchen Cabinet Light

☐ Yes ☒ No

Below Kitchen Cabinet Light

☐ Yes ☒ No

Comment

Standard Stainless Steel Hood Fan

13. Heating and Air Conditioning

Air Conditioning

Gas Provisions Dryer

Gas Provisions Stove

Gas Provisions Barbecue

Comment

Standard Gas BBQ Line

14. Additional Comments

15. Disclaimers and Notes

- 1) Colours of all materials are as close as possible to builder's selection, but not necessarily identical due to variances in manufacturing.
- 2) Any extras listed above are null and void unless accompanied by a separate invoice/amendment. Said invoice must be paid in full.
- 3) The Purchaser acknowledges that after Interior Colour Selection form is signed and dated, no further changes will be permitted other than re-selection due to unavailability. Purchaser's Initials
- 4) The Purchaser acknowledges reading and accepting the "Gold Park Homes Decor Centre Disclaimers" form. This document contains other miscellaneous disclaimers.

This Interior Colour Selection is final and approved by:

Signature: Wendy Wu Date:

Elevation A • 1,794 sq.ft.

Elevation B • 1,794 sq.ft.

No PLANE
in KITCHEN.



Tile Direction

Tile Direction

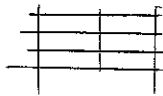

Tile
Direction

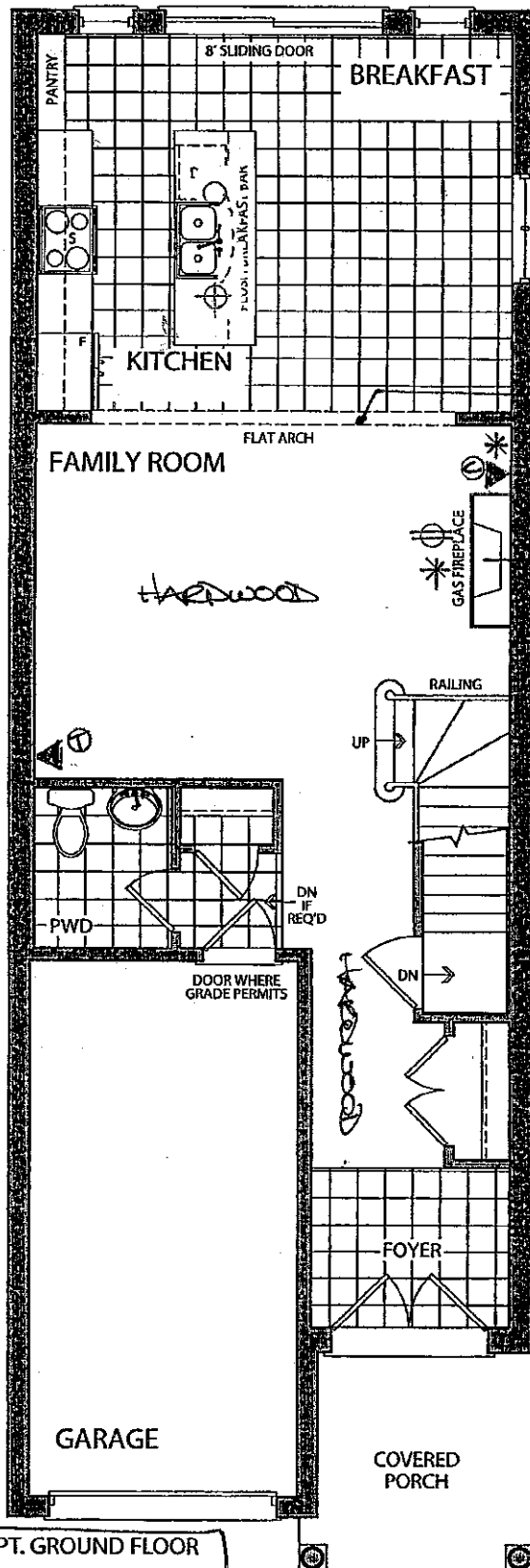

OPT. GROUND FLOOR
ELEVATION A

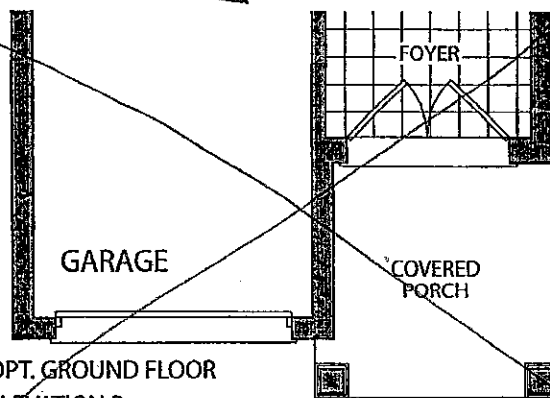

OPT. GROUND FLOOR
ELEVATION B

August 4 2016

LOT 82L

Wm

KG-82L

Dec 13 2016

Elevation A • 1,794 sq.ft.

Elevation B • 1,794 sq.ft.

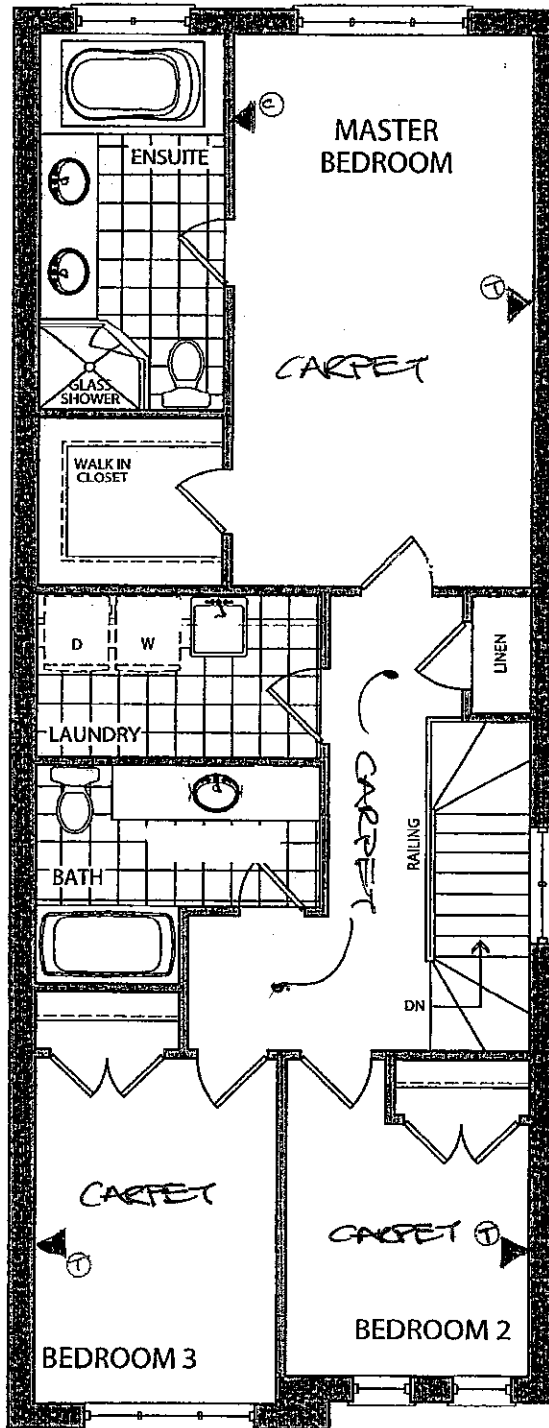

SECOND FLOOR
ELEVATION A

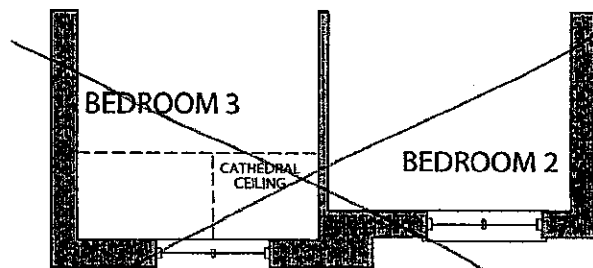

SECOND FLOOR
ELEVATION B

August 4/16

LOT 82L

urgh (K) 2016

KG-82L
Dec 13 2016

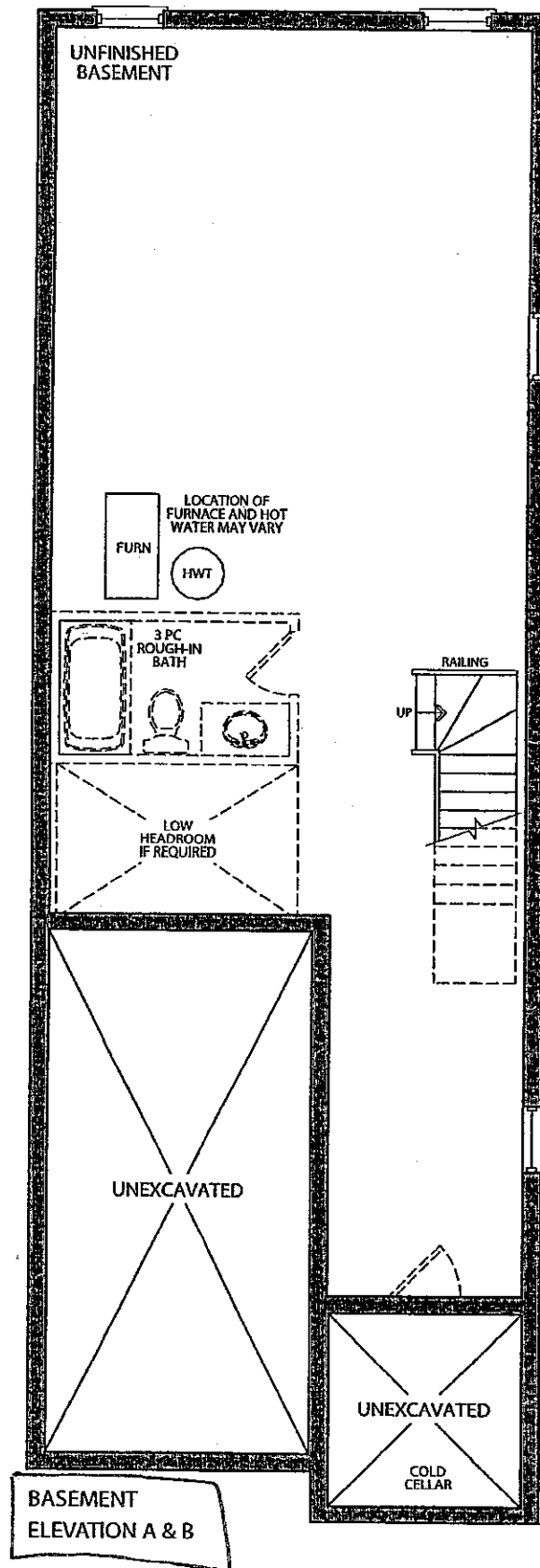

Wider

KG-82L
Dec. 13 2016

August 4 2016

LOT 82L

Wider

CORTINA

KITCHENS INC.

70 Regina Road Woodbridge ON L4L 8L6
905-264-6464

INFORMATION - PVC DOORS

Builder..Gold Park Homes Project...Kleinburg Lot #...82L.....

All cabinets with PVC (Thermofoil) Doors come with melamine gables, panels and kick. The doors, crown moulding and light valance are PVC wrapped. Open shelves incorporated in design will only be available with melamine interiors. There will be variations in colour shades between the PVC parts (doors, crown and Light valance) and the melamine parts (open shelves, Gables , Panels and Kick) due to the difference in material.

Furring Panel with crown moulding to the ceiling is not available on all PVC door styles due to subtle variations in colour shades between the PVC parts (moulding) and the melamine parts (furring panel) due to the difference in material. Grain directions in wood grain pattern melamine , vary between the furring panel, crown moulding (horizontal) and the PVC doors (vertical).

Thank you for your understanding.

I am well informed of this information, and agree to the purchase of the above.

Purchaser

Wah

Date:

Dec 13 2016

KG-82L
Dec. 13 2016

WWu

Trade Name: Gold Park Homes	Site location: Kleinburg	Model: 25-9
Address:	Project: Huntington & Nashville	Phase:

This layout has been explained to the purchaser by Cortina Kitchens Inc. and is understood by the purchaser.

OPT. GR. FLOOR

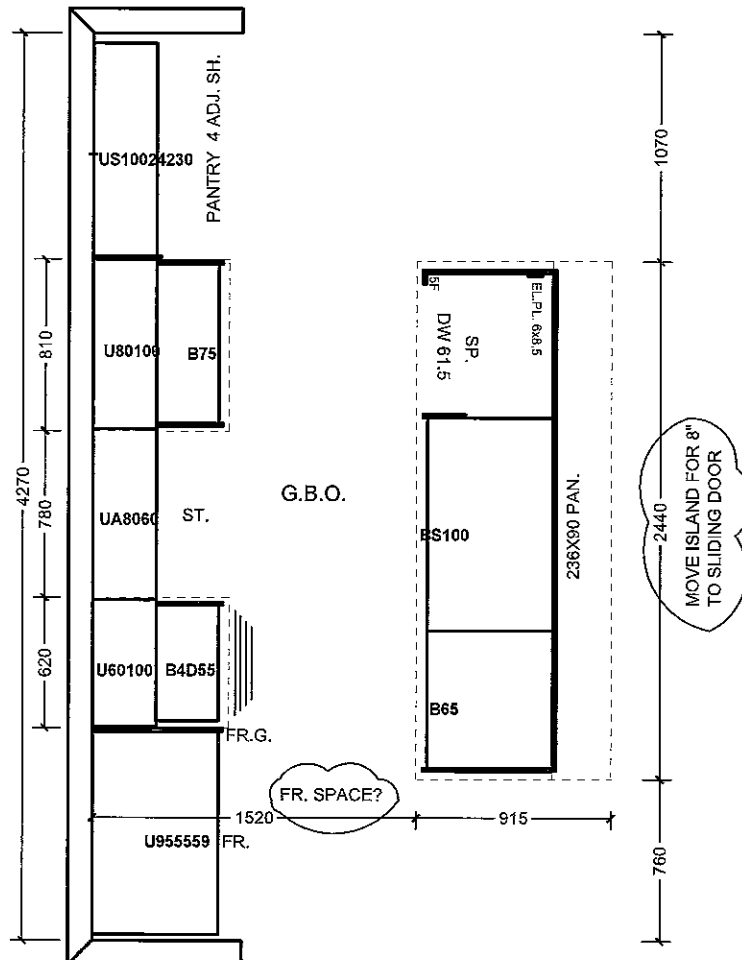

***STANDARD APPLIANCE OPENINGS!**

All prices subject to confirmation from head office.
This quotation is subject to the terms & conditions set out

ACCEPTED DATE: _____

All agreements are contingent upon strikes, accidents, and delays beyond our control.
Please provide our installer with template for sinkholes or \$150.00 will be charged for callback.

Item A. Wood grain and colour are characteristics of the product. We cannot guarantee that such grain and colour will always match.
Item B. Cortina Kitchens Inc. reserves the right to alter dimensions and make technical changes without notice.

Phase:

Item A. Wood grain and colour are characteristics of the product. We cannot guarantee that such grain and colour will always match.
Item B. Cortina Kitchens Inc. reserves the right to alter dimensions and make technical changes without notice.

KG-82L
Dec 13 2016 

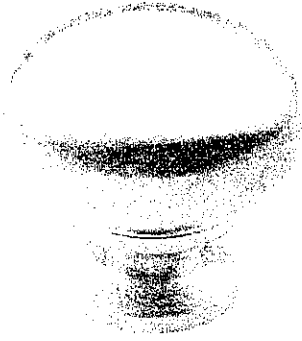

CSI-6

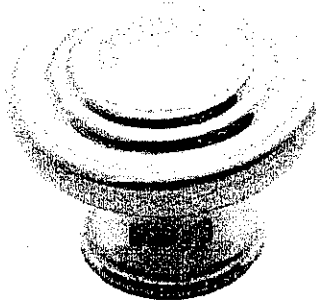

CSI-10

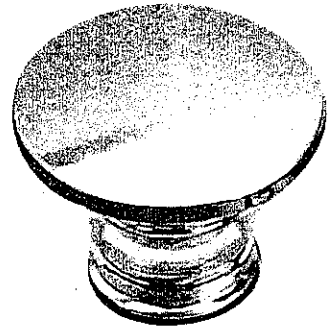

CSI-14

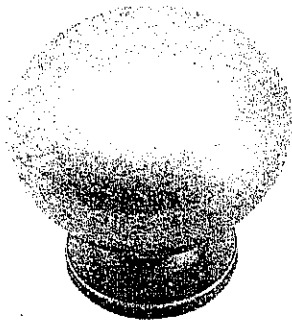

CSI-16

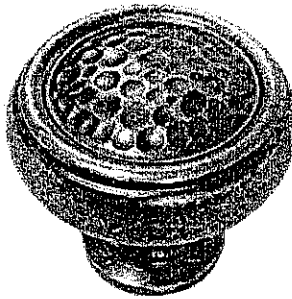

CSI-18

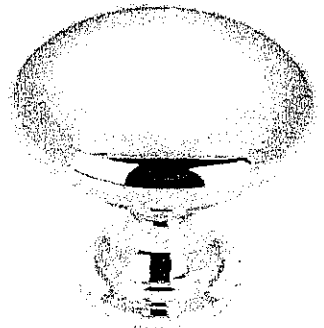

CSI-19

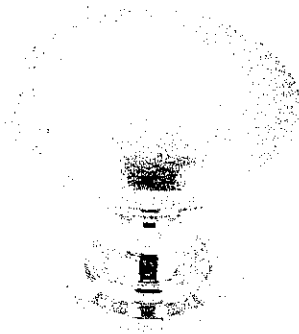

CSI-20

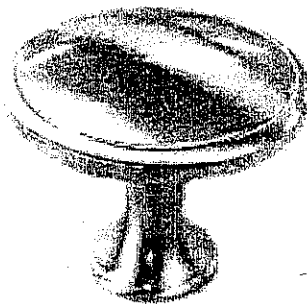

CSI-21

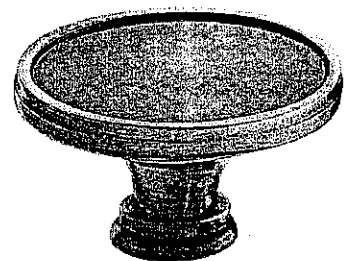

CSI-22

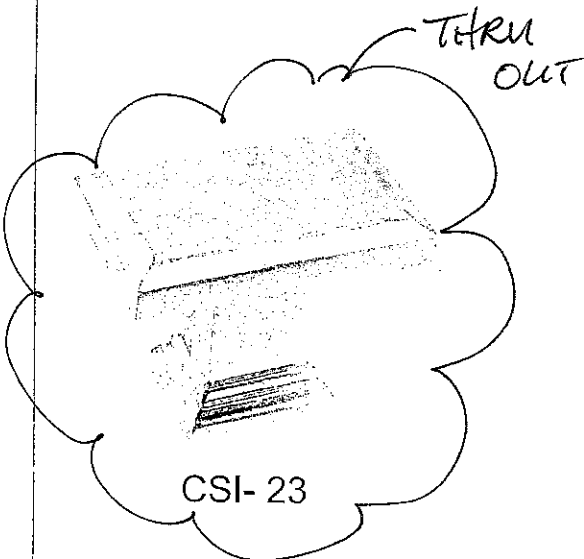

CSI-23

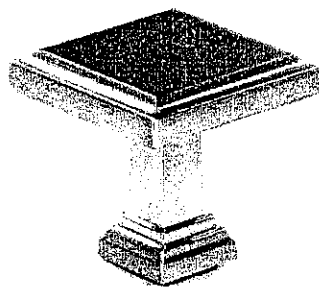

CSI-24

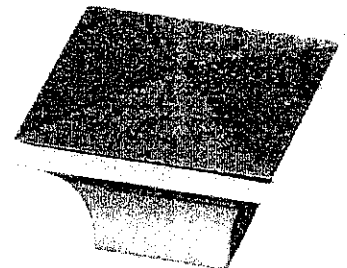

CSI-25

***NOTES:**

- IMAGES ARE FOR QUICK REFERENCE PURPOSES ONLY
- ACTUAL SIZES AND FINISHES AS PER HARDWARE SAMPLE BOARD PROVIDED TO DECOR CENTRE

- Standard 2CM & 3CM
- ⊖ Upgrade 1 2CM & 3CM
- ⊗ Upgrade 1 4 CM
- Upgrade 2

20mm (3/4") Profiles

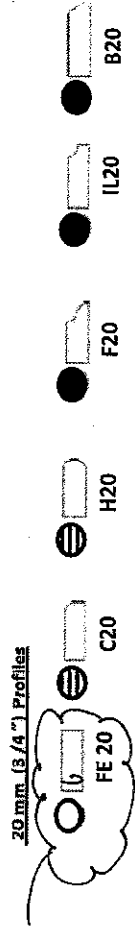

30mm (1-1/4") Profiles

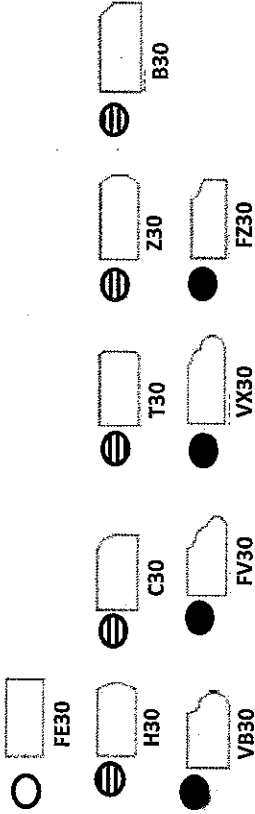

40mm (1-1/2") Profiles

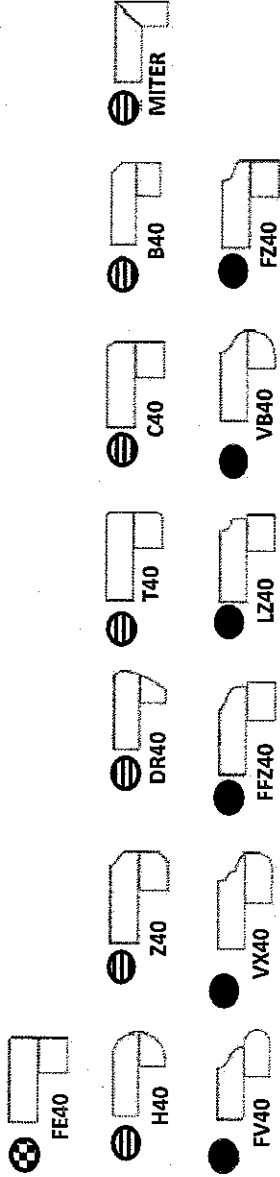

Note: All colours may not be available in 30mm at time ordered. Vendor reserves the right to use 40 mm edges (by lamination process).

*Mitre edge is available in Upgrade 1 for an overall thickness of 2". All other Mitre edge options will be an Upgrade 2 Edge.

KG-82L
Dec. 13 2016

STD KITCHEN SINK