

Kleinburg Glen - 50L - 1 - 25-1 Elev.B RIVERSTONE OPT- GFA1

APPLIANCES

Inv.1,036	1 - Purchaser Accepts Standard Appliance Openings: Fridge - 37-1/2"W x 73-1/2" High Approx. Range - 30-1/2"D x 31-1/2"W Approx. Dishwasher - 24" W Approx
Line15041	Note:
6Dec16 / 20Dec16	

DRYWALL

Inv.694	1 - 2nd FLOOR: SMOOTH CEILINGS - (2 - Story Design) 2ND FLOOR
Line9225	Note:
26Jul16 / 10Nov16	

ELECTRICAL

Inv.694	1 - KITCHEN: RELOCATE STANDARD FIXTURE - See plan for location.
Line9201	Note:
26Jul16 / 10Nov16	
Inv.694	1 - KITCHEN: ROUGH - IN CEILING OUTLET & SWITCH (WITH COVER PLATE) - DOES NOT INCLUDE FIXTURE - Locate above island, see plan for location. (in addition to builders standard ceiling light)
Line9202	Note:
26Jul16 / 10Nov16	
Inv.694	1 - KITCHEN: 110V WALL RECEPTACLE ON DEDICATED CIRCUIT - FOR MICROWAVE - MICROWAVE & CABINETRY CUSTOMIZATION NOT INCLUDED. Locate above stove for future OTR.
Line9209	Note:
26Jul16 / 10Nov16	
Inv.694	1 - GREAT ROOM: 110V WALL RECEPTACLE ON NORMAL CIRCUIT - Locate approx. 66" A.F.F. above fireplace for future tv.
Line9215	Note:
26Jul16 / 10Nov16	
Inv.694	1 - MASTER WIC: ADDITIONAL STANDARD FIXTURE WITH SWITCH - See plan for location. In addition to buider's standard light.
Line9219	Note:
26Jul16 / 10Nov16	

EXTERIOR COLOURS

Inv.694	1 - EXTERIOR COLOUR PACKAGE 4
Line13687	Note:
26Jul16 / 10Nov16	

FRAMING

Inv.694	2 - MAIN FLOOR: FRAME MAIN FLOOR ARCHES AT 96 INCH
Line9228	Note:
26Jul16 / 10Nov16	
Inv.694	1 - OPTIONAL GROUND FLOOR
Line13688	Note:
26Jul16 / 10Nov16	

GRANITE MARBLE QUARTZ

Kleinburg Glen - 50L - 1 - 25-1 Elev.B RIVERSTONE OPT- GFA1

Inv.1,036	1 - KITCHEN COUNTERTOP EDGE: UPG 4cm FE40
Line15028	Note:
6Dec16 / 20Dec16	

HARDWOOD

Inv.1,036	1 - MAIN FLOOR HARDWOOD Hallway / Family Room : UPG 1
Line15026	Note:
6Dec16 / 20Dec16	
Inv.1,036	1 - 2ND FLOOR HARDWOOD: Upper Hallway UPG 1
Line15034	Note:
6Dec16 / 20Dec16	
Inv.1,036	1 - MAIN FLOOR KITCHEN FLOOR: Hardwood UPG 1
Line15035	Note:
6Dec16 / 20Dec16	

INTERIOR TRIM AND DOORS

Inv.694	2 - MAIN FLOOR: EXTENDED HEIGHT ARCHWAY (PRICE PER DOORWAY) - 96"
Line9229	Note:
26Jul16 / 10Nov16	

KITCHEN AND BATH CABINETRY

Inv.1,036	1 - KITCHEN: Homeowner declined OTR Customization from Structural order. STD Hoodfan to be installed
Line15030	Note:
6Dec16 / 20Dec16	
Inv.1,036	1 - KITCHEN: UPG Raise Kitchen to accommodate for Hardwood
Line15036	Note:
6Dec16 / 20Dec16	

MISC.

Inv.694	1 - Purchaser has attended a Structural appointment at the Decor Centre & has DECLINED any additional upgrades and accepts and acknowledges that there will be no further structural changes/additions/deletions to be made upon signing on July 26, 2016.
Line9230	Note:
26Jul16 / 10Nov16	
Inv.694	1 - Purchasers are aware & accepts that ANY changes made to upgrades after signing this Purchasers Extra Form are subject to a minimum administration fee of \$500. PLUS a 10% holdback fee.
Line9232	Note:
26Jul16 / 10Nov16	
Inv.694	1 - BONUS PACKAGE: \$5,000.00 (INCLUDING TAXES) WORTH OF UPGRADES FROM GOLD PARK HOMES DÉCOR CENTRE IS BEING APPLIED TOWARD THE STRUCTURAL APPOINTMENT. PURCHASER HAS A REMAINING AMOUNT OF \$00 (INCLUDING TAXES) TO BE USED TOWARD THE COLOUR APPOINTMENT.
Line9233	Note:
26Jul16 / 10Nov16	
Inv.1,036	1 - Purchaser has attended a Colour appointment at the Decor Centre & has DECLINED any additional upgrades and accepts and acknowledges that there will be no further structural changes/additions/deletions to be made upon signing.
Line15037	Note:
6Dec16 / 20Dec16	

Kleinburg Glen - 50L - 1 - 25-1 Elev.B RIVERSTONE OPT- GFA1

Inv.1,036	1 - Purchasers are aware & accepts that ANY changes made to upgrades after signing this Purchasers Extra Form are subject to a minimum administration fee of \$500. PLUS a 10% holdback fee.
Line15038	Note:
6Dec16 / 20Dec16	
Inv.1,036	1 - Purchaser request that all upgrades from this purchaser's extras form to be added to the purchase price. Purchaser is aware that upgrades will be processed only after the builder receives approval letter from the bank.
Line15039	Note:
6Dec16 / 20Dec16	
Inv.1,036	1 - STAIRCASE - The purchaser was advised and therefore accepts and acknowledges that the stain of the staircase and flooring chosen do not match. This difference might result in an undesirable colour variance.
Line15040	Note: The purchaser agrees that the vendor is to be exempt from any and all claims by the purchaser regarding this colour variance.
6Dec16 / 20Dec16	
Inv.1,036	1 - TOTAL \$10,994.90 50% Deposit by Credit Card \$5,497.45 50% On Closing \$5,497.45
Line15045	Note:
6Dec16 / 20Dec16	

PAINTING

Inv.1,036	1 - STAIRS & RAILINGS: UPG Stain Colour to Cappuccino
Line15027	Note:
6Dec16 / 20Dec16	

Purchaser: Galina Kasyanik

Property: 50L

Telephone Res. / Bus: (647) 244-0107

Project: Burkshire Holdings Inc.

Decor Advisor: Laura Lofaro

Model and Elevation: 25-1 Elev.B RIVERSTONE OPT- GFA1

Layout Changes: ☐ Yes ☐ No

Sketch Attached: ☐ Yes ☐ No

Exterior Colour Scheme:

### 1. Cabinetry

	Style and Colour	Counter	Hardware
Kitchen / Breakfast	Varese PVC VanillaStix	Granite Pol. Crema Caramel *Edge FE40	CS1-20
Laundry Room	N/A		
Powder Room	N/A		
Master Ensuite Bathroom	Varese PVC ChocMple	Formica Paloma Bisque 6729-46	CS1-20
Second Ensuite Bathroom (If Applicable)			
Main Bath	Varese PVC ChocMple	Formica Paloma Bisque 6729-46	CS1-20
Dishwasher Cabinet			

Comment

### 2. Floor Tile

	Selection	Grout	Threshold
Entrance Vestibule	12x12 Sacramento Beige		
Main Hall	*See Hardwood		
Kitchen / Breakfast	*See Hardwood		
Laundry Room	12x12 Sacramento Beige		
Powder Room	12x12 Sacramento Beige		
Master Ensuite Bathroom	12x12 Sacramento Beige		
Second Ensuite Bathroom (If Applicable)	N/A		
Lower Landing (If Applicable)	N/A		
Main Bath	12x12 Sacramento Beige		

Comment

### 3. Wall Tile

	Selection	Listello/Inserts	Describe
		<input type="radio"/> Yes <input checked="" type="radio"/> No	
Master Ensuite Bathroom			
Tub Deck	8x10 Reflection Bone	<input type="radio"/> Yes <input checked="" type="radio"/> No	
Shower Stall	8x10 Reflection Bone	<input type="radio"/> Yes <input checked="" type="radio"/> No	
Bathroom Walls		<input type="radio"/> Yes <input checked="" type="radio"/> No	
Second Ensuite Bathroom (If Applicable)		<input type="radio"/> Yes <input checked="" type="radio"/> No	
Main Bath	8x10 Reflection Bone	<input type="radio"/> Yes <input checked="" type="radio"/> No	

Kitchen Backsplash

☐ Yes ☒ No

Backsplash Behind Fridge

Comment

Purchaser: Galina Kasyanik

Property: 50L

Telephone Res. / Bus: (647) 244-0107

Project: Burkshire Holdings Inc.

Decor Advisor: Laura Lofaro

Model and Elevation: 25-1 Elev.B RIVERSTONE OPT- GFA1

#### 4. Plumbing Fixtures

<input type="text"/>	Second Ensuite	<input type="text"/>	Powder Room	<input type="text"/>
Master Ensuite Bathroom	<input type="text"/>	Other Room - Specify	<input type="text"/>	Other Washroom
<input type="text"/>		<input type="text"/>		

Comment

STD Throughout

#### 5. Hardwood Flooring

	Type and Stain		Type and Stain
Main Hall	<input type="text" value="*Preverco RedOak Capp. 4-1/4"/>	Upper Landing	<input type="text" value="N/A"/>
Kitchen / Breakfast	<input type="text" value="N/A"/>	Upper Hall	<input type="text" value="*Preverco RedOak Capp. 4-1/4"/>
Living Room	<input type="text" value="N/A"/>	Master Bedroom	<input type="text" value="N/A"/>
Dining Room	<input type="text" value="N/A"/>	Bedroom #2	<input type="text" value="N/A"/>
Family Room	<input type="text" value="*Preverco RedOak Capp. 4-1/4"/>	Bedroom #3	<input type="text" value="N/A"/>
Den/Library	<input type="text" value="N/A"/>	Bedroom #4	<input type="text" value="N/A"/>
Entrance Vestibule	<input type="text" value="N/A"/>	Bedroom #5	<input type="text" value="N/A"/>
Lower Landing (If Applicable)	<input type="text" value="N/A"/>	Other Room - Specify	<input type="text"/>

Comment

\*Preverco Red Oak Cappucino 4-1/4"

#### 6. Carpeting

	Upgrade	Description
Main Hall	<input type="checkbox"/>	<input type="text" value="N/A"/>
Living Room	<input type="checkbox"/>	<input type="text" value="N/A"/>
Dining Room	<input type="checkbox"/>	<input type="text" value="N/A"/>
Family Room	<input type="checkbox"/>	<input type="text" value="N/A"/>
Den/Library	<input type="checkbox"/>	<input type="text" value="N/A"/>
Upper Hall	<input type="checkbox"/>	<input type="text" value="N/A"/>
Master Bedroom	<input type="checkbox"/>	<input type="text" value="T15"/>
Bedroom #2	<input type="checkbox"/>	<input type="text" value="T15"/>
Bedroom #3	<input type="checkbox"/>	<input type="text" value="T15"/>
Bedroom #4	<input type="checkbox"/>	<input type="text" value="N/A"/>
Bedroom #5	<input type="checkbox"/>	<input type="text" value="N/A"/>
<input type="text"/>	<input type="checkbox"/>	<input type="text"/>
Upper Landing (If Applicable)	<input type="checkbox"/>	<input type="text" value="N/A"/>
Lower Landing (If Applicable)	<input type="checkbox"/>	<input type="text" value="N/A"/>

Upgrade Underpad	Type <input type="text" value="N/A"/>	Area <input type="text"/>
Carpet on Stairs	Capped <input type="text" value="N/A"/>	Runner - *Upgrade <input type="text"/>

Comment

Purchaser: Galina Kasyanik

Property: 50L

Telephone Res. / Bus: (647) 244-0107

Project: Burkshire Holdings Inc.

Decor Advisor: Laura Lofaro

Model and Elevation: 25-1 Elev.B RIVERSTONE OPT- GFA1

## 7. Fireplace

Living Room			Family Room			Other Room - Specify		
Purchased	As Per Plan	N/A	Purchased	As Per Plan	N/A	Purchased	As Per Plan	N/A
<input type="radio"/>	<input type="radio"/>	<input type="radio"/>	<input type="radio"/>	<input checked="" type="radio"/>	<input type="radio"/>	<input type="radio"/>	<input type="radio"/>	<input type="radio"/>

Fireplace Type	<input type="text"/>	STD	<input type="text"/>
Mantle Type	<input type="text"/>	STD	<input type="text"/>
Colour / Stain	<input type="text"/>	STD	<input type="text"/>
Surround	<input type="text"/>	STD	<input type="text"/>
Hearth	<input type="text"/>	DECLINED	<input type="text"/>

Comment

## 8. Trim Carpentry

Interior Doors	STD	Front Door Glass Inserts	STD	Door Handles	STD
Interior Trim	STD				

Comment

## 9. Plaster Mouldings and Medallions

Entrance Vestibule	N/A	<input type="text"/>	Kitchen/Breakfast	N/A	<input type="text"/>
Main Hall	N/A	<input type="text"/>	Den/Library	N/A	<input type="text"/>
Living Room	N/A	<input type="text"/>	Lower Landing	N/A	<input type="text"/>
Dining Room	N/A	<input type="text"/>	Other Room - Specify	N/A	<input type="text"/>
Family Room	N/A	<input type="text"/>			

Comment

## 10. Railings and Spindles

Railing Package	STD		
Railing Colour	Preverco Cappuccino Pro	Spindle Colour	Preverco Cappuccino Pro
Stringer / Riser	Preverco Cappuccino Pro	Treads	Preverco Cappuccino Pro
Comment	Oak Stairs	<input checked="" type="radio"/> Yes	<input type="radio"/> No

Comment

## 11. Wall Paint

Main & Upper Hall	<input type="text"/>	Master Bedroom	<input type="text"/>
Living Room	<input type="text"/>	Bedroom #2	<input type="text"/>
Dining Room	<input type="text"/>	Bedroom #3	<input type="text"/>
Kitchen / Breakfast	<input type="text"/>	Bedroom #4	<input type="text"/>
Family Room	<input type="text"/>	Bedroom #5	<input type="text"/>
Powder Room	<input type="text"/>	Master Ensuite	<input type="text"/>
Laundry Room	<input type="text"/>		<input type="text"/>
Den/Library	<input type="text"/>	Second Ensuite	<input type="text"/>
Trim Paint	White		<input type="text"/>
Comment	Smooth Ceilings First Floor		<input type="text"/>

Birch White Throughout

Scheduled Closing Date: November-17-16

Purchaser: Galina Kasyanik

Property: 50L

Telephone Res. / Bus: (647) 244-0107

Project: Burkshire Holdings Inc.

Decor Advisor: Laura Lofaro

Model and Elevation: 25-1 Elev.B RIVERSTONE OPT- GFA1

12. Electrical

Plugs and Switches ☒ White ☐ Ivory

Hood Fan ☐ White ☐ Ivory

Appliances Built in Cooktop

☐ Yes ☒ No

Built in Oven

☐ Yes ☒ No

Above Kitchen Cabinet Light ☐ Yes ☒ No

Below Kitchen Cabinet Light ☐ Yes ☒ No

Gas Stove

☐ Yes ☒ No

Microwave

☐ Yes ☐ No

Comment

SS Hood. Purchaser Declined Kitchen Cabinet Adjustment for OTR. Electrical ordered for OTR. Homeowner to adjust cabinets at own expense and warranty after closing.

13. Heating and Air Conditioning

Air Conditioning

Gas Provisions Stove

Gas Provisions Dryer

Gas Provisions Barbecue

Comment

14. Additional Comments

15. Disclaimers and Notes

- 1) Colours of all materials are as close as possible to builder's selection, but not necessarily identical due to variances in manufacturing.
- 2) Any extras listed above are null and void unless accompanied by a separate invoice/amendment. Said invoice must be paid in full.
- 3) The Purchaser acknowledges that after Interior Colour Selection form is signed and dated, no further changes will be permitted other than re-selection due to unavailability. MK Purchaser's Initials
- 4) The Purchaser acknowledges reading and accepting the "Gold Park Homes Decor Centre Disclaimers" form. This document contains other miscellaneous disclaimers.

This Interior Colour Selection is final and approved by:

Signature: MKasy

Date: Dec 6 2016

Elevation A • 1,849 sq.ft.

Elevation B • 1,849 sq.ft.

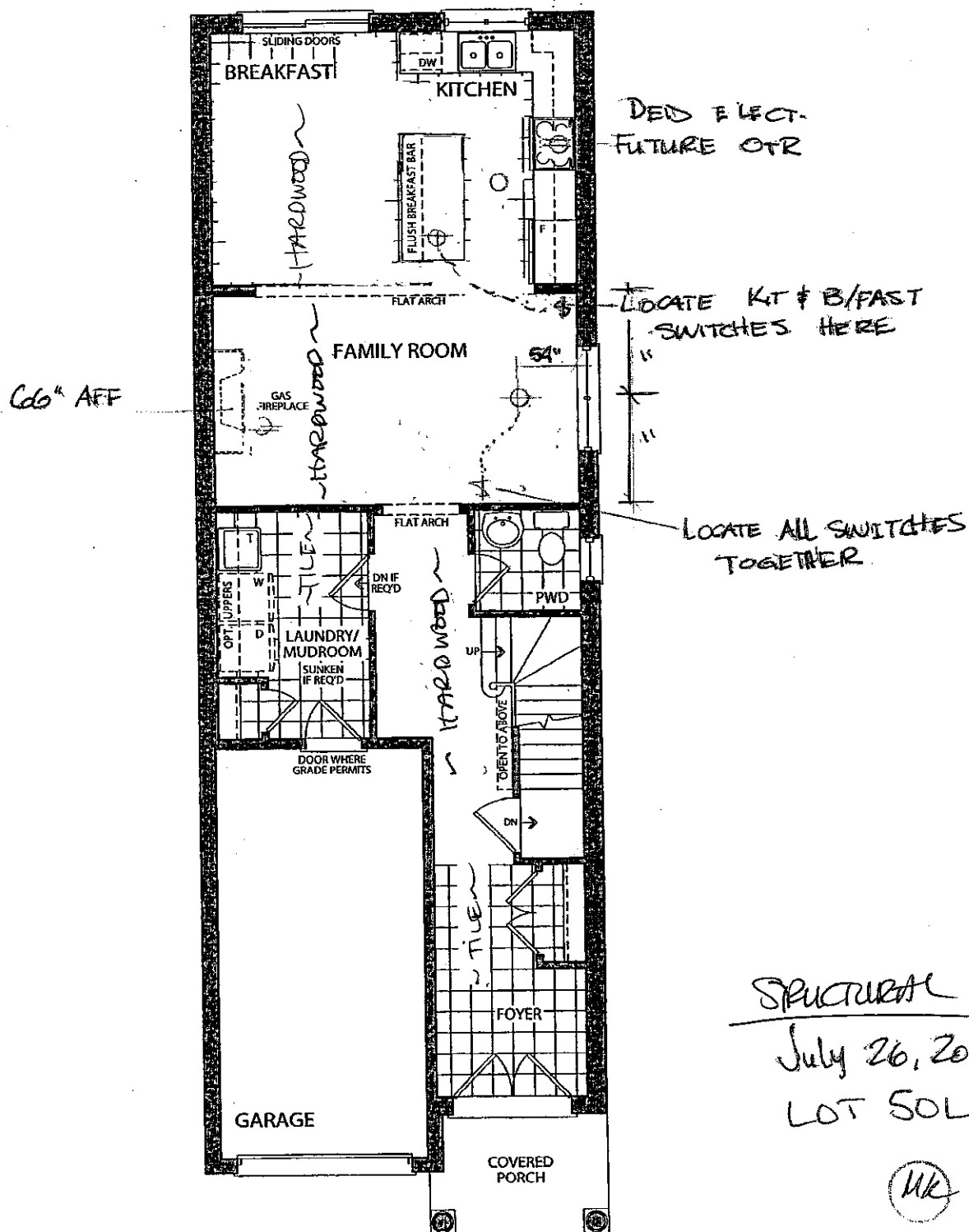

OPT. GROUND FLOOR  
ELEVATION A

STRUCTURAL

July 26, 2016  
LOT 50L

(MK)

DECOR

(MK)

December 6,  
2016



# the Riverstone

Elevation A • 1,849 sq.ft.  
Elevation B • 1,849 sq.ft.

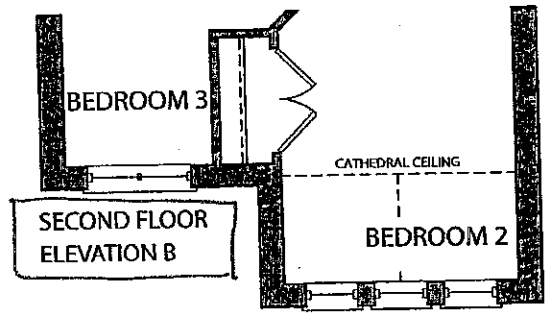
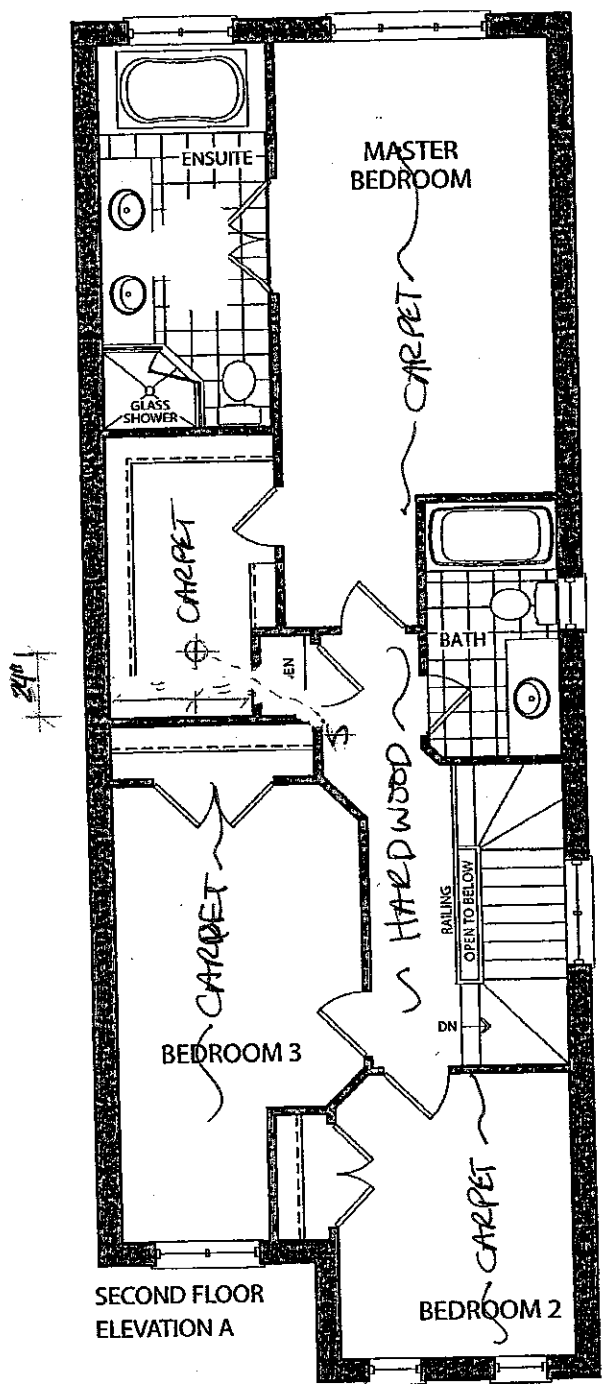

STRUCTURAL

July 26, 2016  
LOT 50L

MA

COLOURS

MA

Dec 6, 2016

Prices, figures, illustrations, sizes, features and finishes are subject to change without notice. E.&O.E. Areas and dimensions are approximate and actual usable floor space may vary from the stated area. Layout may be reverse of the unit purchased. E. & O.E.

Elevation A • 1,849 sq.ft.

Elevation B • 1,849 sq.ft.

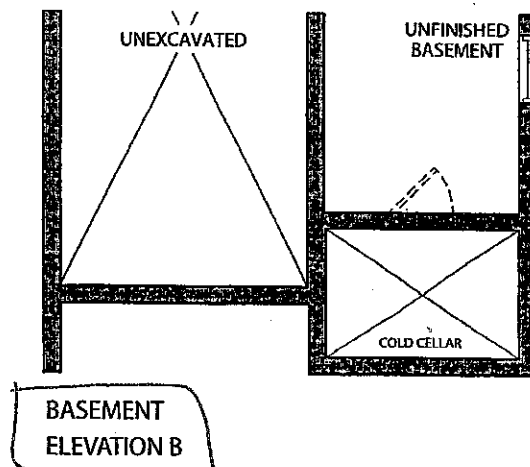
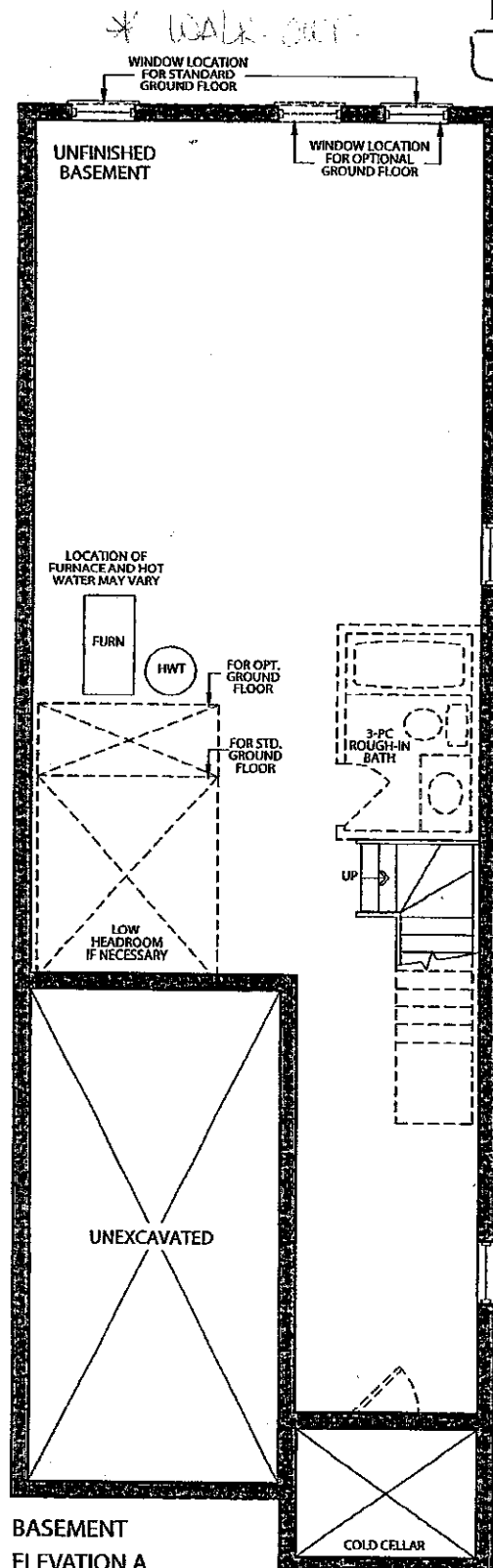

STRUCTURAL

July 26, 2016

LOT 50L

MA

CONCRETE

MA

Dec 6, 2016

# CORTINA

KITCHENS INC.

70 Regina Road Woodbridge ON L4L 8L6  
905-264-6464

## INFORMATION - PVC DOORS

Builder: Gold Park Homes Project: KLEINBURG GREEN Lot #: 50L

All cabinets with PVC (Thermofoil) Doors come with melamine gables, panels and kick. The doors, crown moulding and light valance are PVC wrapped. Open shelves incorporated in design will only be available with melamine interiors. There will be variations in colour shades between the PVC parts (doors, crown and Light valance) and the melamine parts (open shelves, Gables, Panels and Kick) due to the difference in material.

Furring Panel with crown moulding to the ceiling is not available on all PVC door styles due to subtle variations in colour shades between the PVC parts (moulding) and the melamine parts (furring panel) due to the difference in material. Grain directions in wood grain pattern melamine, vary between the furring panel, crown moulding (horizontal) and the PVC doors (vertical).

Thank you for your understanding.

---

I am well informed of this information, and agree to the purchase of the above.

Purchaser: M. Kasey

Date: Dec 6, 2016

Trade Name: Gold Park Homes	Site location:	Model: 25-1
Address:	Project: Kleinburg Glen	Phase:

This layout has been explained to the purchaser by Cortina Kitchens Inc. and is understood by the purchaser.

OPT. GROUND FLOOR KITCHEN

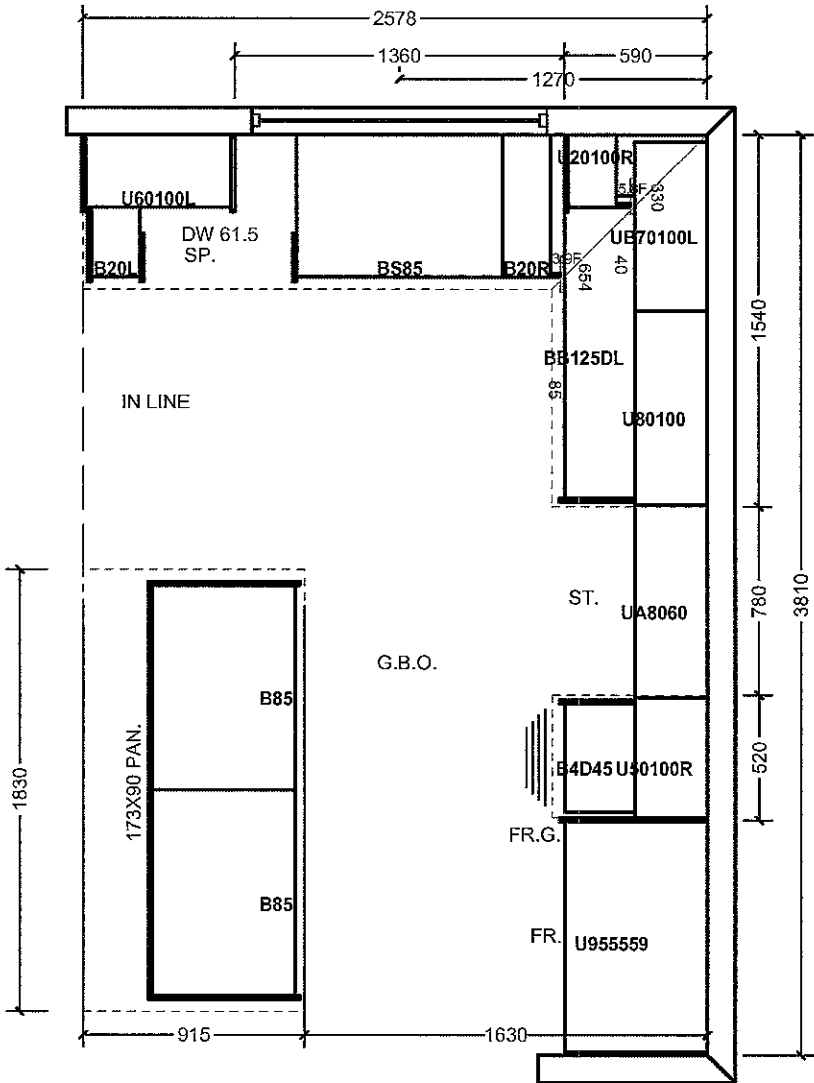

\*NOT ENOUGH SPACE FOR FRIDGE TO OPEN

All prices subject to confirmation from head office.  
This quotation is subject to the terms & conditions set out

ACCEPTED DATE: Dec. 6. 2016

All agreements are contingent upon strikes, accidents, and delays beyond our control.  
Please provide our installer with template for sinkholes or \$150.00 will be charged for callback.

Lot 50L

Inkasey

Item A. Wood grain and colour are characteristics of the product. We cannot guarantee that such grain and colour will always match.  
Item B. Cortina Kitchens Inc. reserves the right to alter dimensions and make technical changes without notice.

Trade Name: Gold Park Homes

Site location:

Model: 25-1

Address:

Project: Kleinburg Glen

Phase:

This layout has been explained to the purchaser by Cortina Kitchens Inc. and is understood by the purchaser.

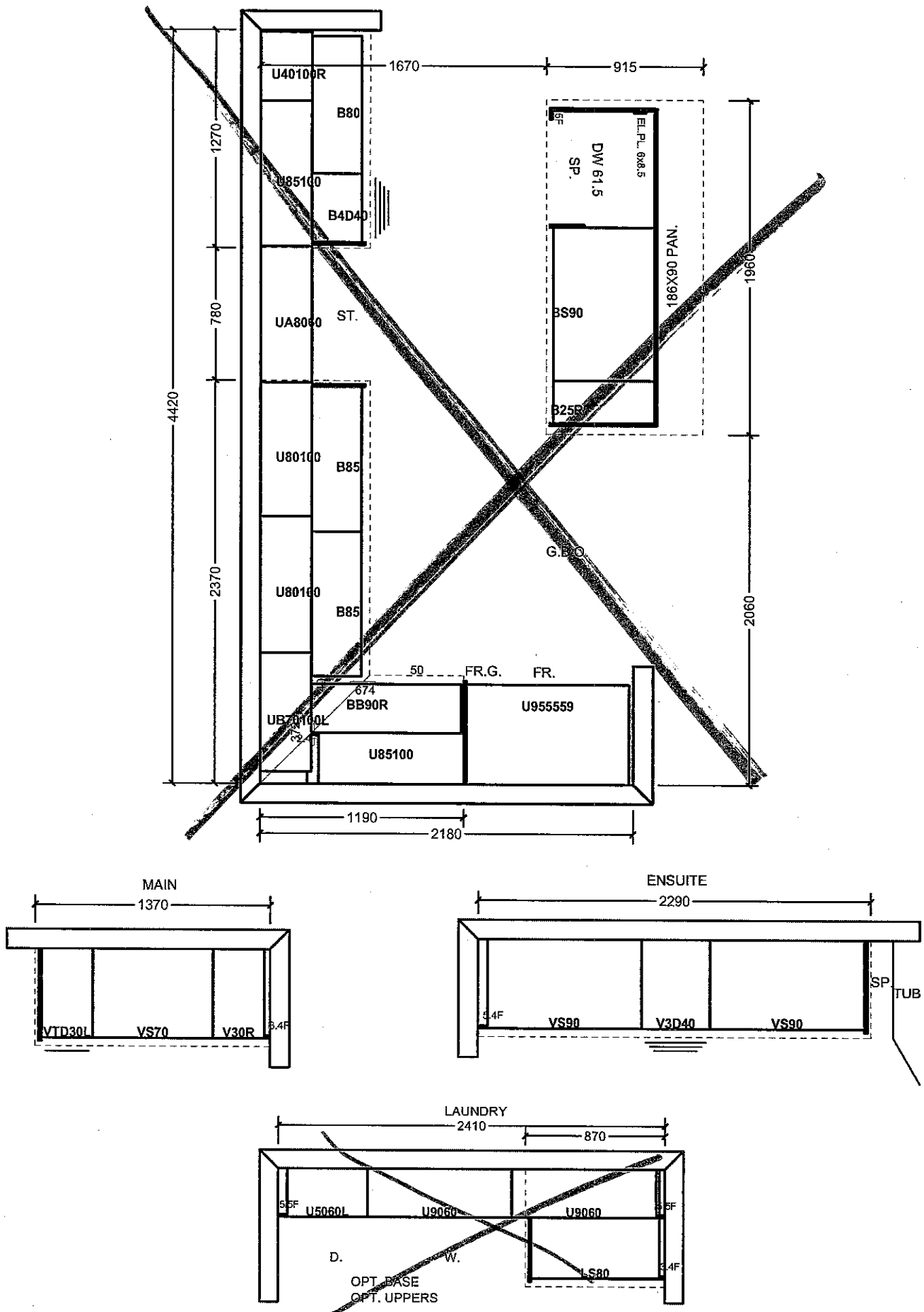

All prices subject to confirmation from head office.  
This quotation is subject to the terms & conditions set out

ACCEPTED DATE: DEC. 6. 2016

All agreements are contingent upon strikes, accidents, and delays beyond our control.  
Please provide our installer with template for sinkholes or \$150.00 will be charged for callback.

Lot 50L

*MyKasey*

















Item A. Wood grain and colour are characteristics of the product. We cannot guarantee that such grain and colour will always match.  
Item B. Cortina Kitchens Inc. reserves the right to alter dimensions and make technical changes without notice.

## Granite, Marble, Quartz (Edge Profiles)

Standard & Upgrade Profiles  
Offered with a 2 cm Surface

Standard	Upgrade
----------	---------

Standard & Upgrade Profiles  
Offered with a 3 cm Surface

	Standard	Upgrade
FD30		
FD30		
FD30		
FD30		
FD30		
FD30		
FD30		
FD30		

Standard

4 mm Upgrade 1 & 2 Profiles Offered with a 2 cm Surface

**Upgrade 1.**

**Note:** All colours may not be available in 30mm at time ordered. Vendor reserves the right to use 40mm edges (by limitation process).

STD KUTHER SINK

KLEINBURG BLEU

50507



STANDARD HARDWARE

STANDARD HARDWARE



CSI-6

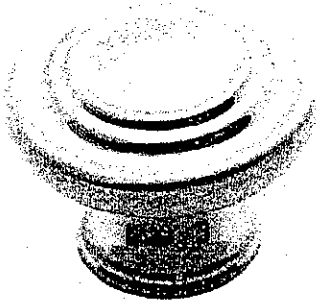

CSI-10



CSI-14



CSI-16

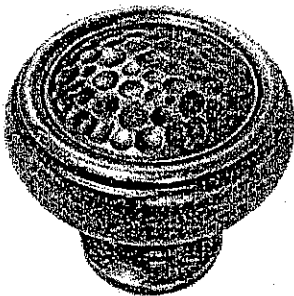

CSI-18

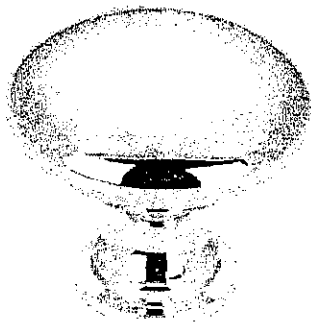

CSI-19

→ KIRCHEN/  
MAIN BATH & MASTER ENSUITE

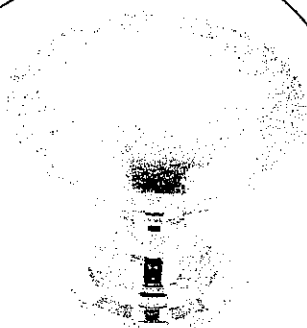

CSI- 20

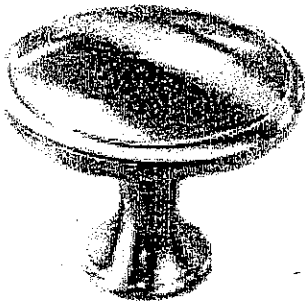

CSI- 21



CSI-22

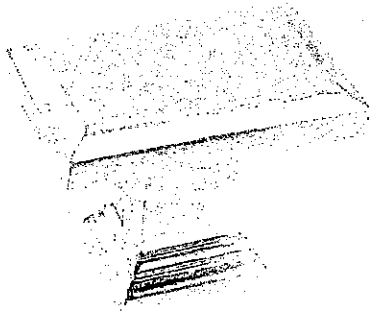

CSI- 23

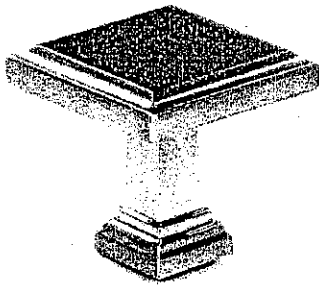

CSI- 24

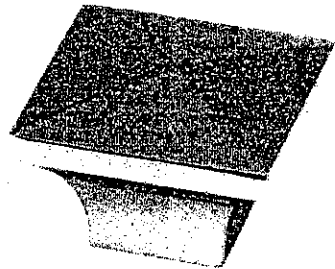

CSI-25

\*NOTES:

- IMAGES ARE FOR QUICK REFERENCE PURPOSES ONLY
- ACTUAL SIZES AND FINISHES AS PER HARDWARE
- SAMPLE BOARD PROVIDED TO DECOR CENTRE

KLEINBURG GLEN  
LOT 50L

DEC. 6. 2016