

Kleinburg Glen - 46R - 1 - 25-2 Elev.A HUDSON

APPLIANCES

Inv.1,029	1 - Purchaser Accepts Standard Appliance Openings: Fridge - 37-1/2"W x 73-1/2" High Approx. Range - 30-1/2"D x 31-1/2"W Approx. Dishwasher - 24" W Approx
Line14874	Note:
4Dec16 / 20Dec16	

CENTRAL VAC AND WIRING

Inv.705	2 - BEDROOM 2 & 3: ADD RG6 CABLE TO BOTH BEDROOMS. PLEASE SEE FLOORPLAN FOR LOCATIONS.
Line9419	Note:
27Jul16 / 10Nov16	

ELECTRICAL

Inv.705	1 - KITCHEN: 110V WALL RECEPTACLE ON DEDICATED CIRCUIT - FOR MICROWAVE - MICROWAVE NOT INCLUDED. TO ISLAND UNDERCOUNTER. RIGHT SIDE. PLEASE SEE FLOORPLAN FOR LOCATION
Line9415	Note:
27Jul16 / 10Nov16	

EXTERIOR COLOURS

Inv.705	1 - EXTERIOR COLOUR PACKAGE 7
Line13728	Note:
27Jul16 / 10Nov16	

FRAMING

Inv.705	1 - MAIN FLOOR: EXTENDED HEIGHT ARCHWAY (PRICE PER DOORWAY)
Line13729	Note:
27Jul16 / 10Nov16	
Inv.705	1 - MAIN FLOOR: STANDARD DOOR EXTENDED HEIGHT 96 INCH (PRICE PER DOOR) - GROUND FLOOR 2 STOREY MODELS
Line13730	Note:
27Jul16 / 10Nov16	
Inv.705	1 - MANDOOR - GARAGE TO HOUSE - AS PER PLAN AND GRADE PERMITING
Line13734	Note: AS PER APS
27Jul16 / 10Nov16	

HARDWOOD

Inv.1,029	1 - MAIN FLOOR: Living/Dining / Family Room / Lower Landing - UPG 5
Line14859	Note:
4Dec16 / 20Dec16	
Inv.1,029	1 - 2ND FLOOR: Upper Hallway - UPG 5
Line14860	Note:
4Dec16 / 20Dec16	

HVAC

Inv.705	1 - FAMILY ROOM: DELETE FIREPLACE FROM FAMILY ROOM AS PER PURCHASERS REQUEST.
Line9418	Note:
27Jul16 / 10Nov16	

Kleinburg Glen - 46R - 1 - 25-2 Elev.A HUDSON
INTERIOR TRIM AND DOORS

Inv.705	2 - MAIN FLOOR: EXTENDED HEIGHT ARCHWAY (PRICE PER DOORWAY)
Line9416	Note:
27Jul16 / 10Nov16	
Inv.705	4 - MAIN FLOOR: STANDARD DOOR EXTENDED HEIGHT 96 INCH (PRICE PER DOOR) - GROUND FLOOR 2 STOREY MODELS
Line9417	Note:
27Jul16 / 10Nov16	

KITCHEN AND BATH CABINETRY

Inv.1,029	1 - KITCHEN: Base Cabinet for under coutner microwave - open shelf with matching interior and drawer below
Line14861	Note:
4Dec16 / 20Dec16	
Inv.1,029	1 - KITCHEN: Add Furring Panel
Line14863	Note:
4Dec16 / 20Dec16	
Inv.1,029	1 - KITCHEN: Purchasers request to NOT INSTALL builder's standard hood fan and standard cabinets above stove. DELETE. Do not supply, install, and/or credit. Purchasers are installing their own hood fan after closing.
Line14862	Note: With Finished Sides. Purchasers accept and acknowledge that the exhaust fan duct hole may be off-centered with stove in kitchen due to purchasers installing their own hood fan after closing. The vendor is exempt.
4Dec16 / 20Dec16	
Inv.1,029	1 - KITCHEN: Add Crown Moulding
Line14864	Note:
4Dec16 / 20Dec16	
Inv.1,029	1 - KITCHEN: UPG Handles
Line14865	Note:
4Dec16 / 20Dec16	

MISC.

Inv.705	1 - BONUS PACKAGE: \$5,000.00 (INCLUDING TAXES) WORTH OF UPGRADES FROM GOLD PARK HOMES DÉCOR CENTRE IS BEING APPLIED TOWARD THE STRUCTURAL APPOINTMENT. PURCHASER HAS A REMAINING AMOUNT OF \$2,949.05 (INCLUDING TAXES) TO BE USED TOWARD THE COLOUR APPOINTMENT.
Line9422	Note:
27Jul16 / 10Nov16	
Inv.705	1 - Purchasers are aware & accepts that ANY changes made to upgrades after signing this Purchasers Extra Form are subject to a minimum administration fee of \$500. PLUS a 10% holdback fee.
Line9421	Note:
27Jul16 / 10Nov16	
Inv.705	1 - Purchaser has attended a Structural appointment at the Decor Centre & has DECLINED any additional upgrades and accepts and acknowledges that there will be no further structural changes/additions/deletions to be made upon signing on July 27, 2016.
Line9420	Note:
27Jul16 / 10Nov16	
Inv.1,029	1 - Purchaser has attended a Colour appointment at the Decor Centre & has DECLINED any additional upgrades and accepts and acknowledges that there will be no further structural changes/additions/deletions to be made upon signing.
Line14868	Note:
4Dec16 / 20Dec16	

Kleinburg Glen - 46R - 1 - 25-2 Elev.A HUDSON

Inv.1,029	1 - Purchasers are aware & accepts that ANY changes made to upgrades after signing this Purchasers Extra Form are subject to a minimum administration fee of \$500. PLUS a 10% holdback fee.
Line14869	Note:
4Dec16 / 20Dec16	
Inv.1,029	1 - BALANCE OF BONUS PACKAGE: \$2,949.05 (INCLUDING TAXES) WORTH OF UPGRADES FROM GOLD PARK HOMES DÉCOR CENTRE IS BEING APPLIED TOWARD THE COLOUR APPOINTMENT. PURCHASER HAS A REMAINING AMOUNT OF \$00 (INCLUDING TAXES).
Line14870	Note:
4Dec16 / 20Dec16	
Inv.1,029	1 - Purchaser request that all upgrades from this purchaser's extras form to be added to the purchase price. Purchaser is aware that upgrades will be processed only after the builder receives approval letter from the bank.
Line14871	Note:
4Dec16 / 20Dec16	
Inv.1,029	1 - STAIRCASE - The purchaser was advised and therefore accepts and acknowledges that the wood species of the staircase and flooring chosen do not match. This difference may result in a stain colour variance.
Line14872	Note: The purchaser agrees that the vendor is to be exempt from any and all claims by the purchaser regarding this colour variance.
4Dec16 / 20Dec16	
Inv.1,029	1 - STAIRCASE - The purchaser was advised and therefore accepts and acknowledges that the stain of the staircase and flooring chosen do not match. This difference might result in an undesirable colour variance.
Line14873	Note: The purchaser agrees that the vendor is to be exempt from any and all claims by the purchaser regarding this colour variance.
4Dec16 / 20Dec16	
Inv.1,029	1 - BALANCE AFTER CREDIT: \$13,390.75 50% DEPOSIT: \$6695.38 50% APPLIED TO MORTGAGE: \$6695.38
Line14875	Note:
4Dec16 / 20Dec16	

PAINTING

Inv.1,029	1 - STAIRS: UPG Stain Colour Preverco Vienna
Line14858	Note:
4Dec16 / 20Dec16	

STAIRS AND RAILINGS

Inv.1,029	1 - STAIRS & RAILINGS: UPG Euroline 1 with V-Groove handrail
Line14867	Note:
4Dec16 / 20Dec16	

TRIM AND DOORS

Inv.1,029	1 - MAIN FLOOR: UPG 1 Trim on Main floor only
Line14866	Note:
4Dec16 / 20Dec16	

WINDOWS AND DOORS

Inv.705	1 - MAN DOOR GARAGE TO HOUSE - OPTIONAL - IF GRADE PERMITS
Line13733	Note: AS PER APS
27Jul16 / 10Nov16	

Purchaser: Tal Krasnopolsky

Property: 46R

Telephone Res. / Bus: (416) 832-4666

Project: Burkshire Holdings Inc.

Decor Advisor: Laura Lofaro

Model and Elevation: 25-2 Elev.A HUDSON

Layout Changes: ☐ Yes ☐ No Sketch Attached: ☐ Yes ☐ No Exterior Colour Scheme:

1. Cabinetry

	Style and Colour	Counter	Hardware
Kitchen / Breakfast	Venice PVC AntiqueWht	Granite Pol. Crema Caramel STD FE20 Edge	CH-47
Laundry Room	<input type="text"/>	<input type="text"/>	<input type="text"/>
Powder Room	<input type="text"/>	<input type="text"/>	<input type="text"/>
<input type="text"/>	<input type="text"/>	<input type="text"/>	<input type="text"/>
Master Ensuite Bathroom	Toscana PVC VanillStix	Wilsonart Autumn Carnival 1877K-52	CS1-18
Second Ensuite Bathroom (If Applicable)	<input type="text"/>	<input type="text"/>	<input type="text"/>
Main Bath	Toscana PVC Mystic	Wilsonart Winter Carnival 1874K-52	CS1-18
Dishwasher Cabinet	<input type="text"/>		

Comment

2. Floor Tile

	Selection	Grout	Threshold
Entrance Vestibule	13x13 Venus Series Ivory	<input type="text"/>	<input type="text"/>
Main Hall	13x13 Venus Series Ivory	<input type="text"/>	<input type="text"/>
Kitchen / Breakfast	13x13 Venus Series Ivory	<input type="text"/>	<input type="text"/>
Laundry Room	13x13 Serpentine Taupe	<input type="text"/>	<input type="text"/>
Powder Room	13x13 Venus Series Ivory	<input type="text"/>	<input type="text"/>
<input type="text"/>	<input type="text"/>	<input type="text"/>	<input type="text"/>
Master Ensuite Bathroom	13x13 Serpentine Taupe	<input type="text"/>	<input type="text"/>
Second Ensuite Bathroom (If Applicable)	N/A	<input type="text"/>	<input type="text"/>
Lower Landing (If Applicable)	N/A	<input type="text"/>	<input type="text"/>
Main Bath	13x13 Serpentine Taupe	<input type="text"/>	<input type="text"/>

Comment

Master Ensuite: Tub Deck / Tub Face / Tub Splash: 13x13 Serpentine Taupe

3. Wall Tile

	Selection	Listello/Inserts	Describe
	<input type="text"/>	<input type="radio"/> Yes <input checked="" type="radio"/> No	<input type="text"/>
Master Ensuite Bathroom			
Tub Deck	See Floor Tile	<input type="radio"/> Yes <input checked="" type="radio"/> No	<input type="text"/>
Shower Stall	8x10 Weave Taupe	<input type="radio"/> Yes <input checked="" type="radio"/> No	<input type="text"/>
Bathroom Walls	<input type="text"/>	<input type="radio"/> Yes <input checked="" type="radio"/> No	<input type="text"/>
Second Ensuite Bathroom (If Applicable)	N/A	<input type="radio"/> Yes <input checked="" type="radio"/> No	<input type="text"/>
Main Bath	8x10 Weave Taupe	<input type="radio"/> Yes <input checked="" type="radio"/> No	<input type="text"/>

Kitchen Backsplash ☐ Yes ☒ No

Backsplash Behind Fridge

Comment

V.V.

Purchaser: Tal Krasnopolsky

Property: 46R

Telephone Res. / Bus: (416) 832-4666

Project: Burkshire Holdings Inc.

Decor Advisor: Laura Lofaro

Model and Elevation: 25-2 Elev.A HUDSON

4. Plumbing Fixtures

<input type="checkbox"/>	Second Ensuite	<input type="checkbox"/>	Powder Room	<input type="checkbox"/>
Master Ensuite Bathroom	<input type="checkbox"/>	Other Room - Specify	<input type="checkbox"/>	Other Washroom
<input type="text"/>				

Comment

STD. PLUMBING THROUGHOUT

V.K.

5. Hardwood Flooring

	Type and Stain		Type and Stain
Main Hall	<input type="text" value="See Tile"/>	Upper Landing	<input <="" td="" type="text" value="*Preverco White Oak Vienna 7"/>
Kitchen / Breakfast	<input type="text" value="See Tile"/>	Upper Hall	<input <="" td="" type="text" value="*Preverco White Oak Vienna 7"/>
Living Room	<input <="" td="" type="text" value="*Preverco White Oak Vienna 7"/> <td>Master Bedroom</td> <td><input type="text"/></td>	Master Bedroom	<input type="text"/>
Dining Room	<input <="" td="" type="text" value="*Preverco White Oak Vienna 7"/> <td>Bedroom #2</td> <td><input type="text"/></td>	Bedroom #2	<input type="text"/>
Family Room	<input <="" td="" type="text" value="*Preverco White Oak Vienna 7"/> <td>Bedroom #3</td> <td><input type="text"/></td>	Bedroom #3	<input type="text"/>
Den/Library	<input type="text" value="N/A"/>	Bedroom #4	<input type="text"/>
Entrance Vestibule	<input type="text" value="See Tile"/>	Bedroom #5	<input type="text"/>
Lower Landing (If Applicable)	<input <="" td="" type="text" value="*Preverco White Oak Vienna 7"/> <td>Other Room - Specify</td> <td><input type="text"/></td>	Other Room - Specify	<input type="text"/>

Comment

Hardwood - Preverco White Oak Vienna Variation with Knots - Brushed - 7"

6. Carpeting

	Upgrade	Description
Main Hall	<input type="checkbox"/>	<input type="text" value="N/A"/>
Living Room	<input type="checkbox"/>	<input type="text" value="N/A"/>
Dining Room	<input type="checkbox"/>	<input type="text" value="N/A"/>
Family Room	<input type="checkbox"/>	<input type="text" value="N/A"/>
Den/Library	<input type="checkbox"/>	<input type="text" value="N/A"/>
Upper Hall	<input type="checkbox"/>	<input type="text" value="N/A"/>
Master Bedroom	<input type="checkbox"/>	<input type="text" value="T15"/>
Bedroom #2	<input type="checkbox"/>	<input type="text" value="T15"/>
Bedroom #3	<input type="checkbox"/>	<input type="text" value="T15"/>
Bedroom #4	<input type="checkbox"/>	<input type="text" value="N/A"/>
Bedroom #5	<input type="checkbox"/>	<input type="text" value="N/A"/>
<input type="text"/>	<input type="checkbox"/>	<input type="text" value="N/A"/>
Upper Landing (If Applicable)	<input type="checkbox"/>	<input type="text" value="N/A"/>
Lower Landing (If Applicable)	<input type="checkbox"/>	<input type="text" value="N/A"/>

Upgrade Underpad	Type <input type="text" value="N/A"/>	Area <input type="text" value="N/A"/>
Carpet on Stairs	Capped <input type="text" value="N/A"/>	Runner - *Upgrade <input type="text" value="N/A"/>

Comment

V.K.

Scheduled Closing Date: December-07-16

Purchaser: Tal Krasnopolsky
Telephone Res. / Bus: (416) 832-4666
Decor Advisor: Laura Lofaro

Property: 46R
Project: Burkshire Holdings Inc.
Model and Elevation: 25-2 Elev.A HUDSON

7. Fireplace

	Living Room			Family Room			Other Room - Specify		
	Purchased	As Per Plan	N/A	Purchased	As Per Plan	N/A	Purchased	As Per Plan	N/A
Fireplace Type	<input type="radio"/>	<input type="radio"/>	<input type="radio"/>	<input type="radio"/>	<input type="radio"/>	<input type="radio"/>	<input type="radio"/>	<input type="radio"/>	<input type="radio"/>
Mantle Type				N/A					
Colour / Stain				N/A					
Surround				N/A					
Hearth				N/A					

Comment

Fireplace deleted at Structurals

8. Trim Carpentry

Interior Doors Front Door Glass Inserts Door Handles
Interior Trim

Comment

Extended Doors ordered at Structurals

9. Plaster Mouldings and Medallions

Entrance Vestibule	<input type="text" value="N/A"/>	<input type="text"/>	Kitchen/Breakfast	<input type="text" value="N/A"/>	<input type="text"/>
Main Hall	<input type="text" value="N/A"/>	<input type="text"/>	Den/Library	<input type="text" value="N/A"/>	<input type="text"/>
Living Room	<input type="text" value="N/A"/>	<input type="text"/>	Lower Landing	<input type="text" value="N/A"/>	<input type="text"/>
Dining Room	<input type="text" value="N/A"/>	<input type="text"/>	Other Room - Specify	<input type="text" value="N/A"/>	<input type="text"/>
Family Room	<input type="text" value="N/A"/>	<input type="text"/>			

Comment

10. Railings and Spindles

Railing Package
Railing Colour Spindle Colour
Stringer / Riser Treads
Oak Stairs ☒ Yes ☐ No

Comment

11. Wall Paint

Main & Upper Hall	<input type="text"/>	Master Bedroom	<input type="text"/>
Living Room	<input type="text"/>	Bedroom #2	<input type="text"/>
Dining Room	<input type="text"/>	Bedroom #3	<input type="text"/>
Kitchen / Breakfast	<input type="text"/>	Bedroom #4	<input type="text"/>
Family Room	<input type="text"/>	Bedroom #5	<input type="text"/>
Powder Room	<input type="text"/>	Master Ensuite	<input type="text"/>
Laundry Room	<input type="text"/>		<input type="text"/>
Den/Library	<input type="text"/>	Second Ensuite	<input type="text"/>
Trim Paint	<input type="text" value="White"/>		<input type="text"/>
Comment	Smooth Ceilings First Floor <input type="text"/>		<input type="text"/>

Warm Grey

V.V.

Scheduled Closing Date: December-07-16

Purchaser: Tal Krasnopolsky

Property: 46R

Telephone Res. / Bus: (416) 832-4666

Project: Burkshire Holdings Inc.

Decor Advisor: Laura Lofaro

Model and Elevation: 25-2 Elev.A HUDSON

12. Electrical

Plugs and Switches ☒ White ☐ Ivory

Hood Fan ☐ White ☐ Ivory

Appliances

Built in Cooktop

Built in Oven

Gas Stove

Microwave

☐ Yes ☒ No

☐ Yes ☒ No

☐ Yes ☒ No

☒ Yes ☐ No

Comment

No SS Hood Fan. -Chimney hood installed at own expense and warranty after closing.

Above Kitchen Cabinet Light ☐ Yes ☒ No

Below Kitchen Cabinet Light ☐ Yes ☒ No

13. Heating and Air Conditioning

Air Conditioning

Gas Provisions Stove

Gas Provisions Dryer

Gas Provisions Barbecue

Comment

14. Additional Comments

15. Disclaimers and Notes

- 1) Colours of all materials are as close as possible to builder's selection, but not necessarily identical due to variances in manufacturing.
- 2) Any extras listed above are null and void unless accompanied by a separate invoice/amendment. Said invoice must be paid in full.
- 3) The Purchaser acknowledges that after Interior Colour Selection form is signed and dated, no further changes will be permitted other than re-selection due to unavailability. V.N. Purchaser's Initials
- 4) The Purchaser acknowledges reading and accepting the "Gold Park Homes Decor Centre Disclaimers" form. This document contains other miscellaneous disclaimers.

This Interior Colour Selection is final and approved by:

Signature: 

Date: 04/12/2016

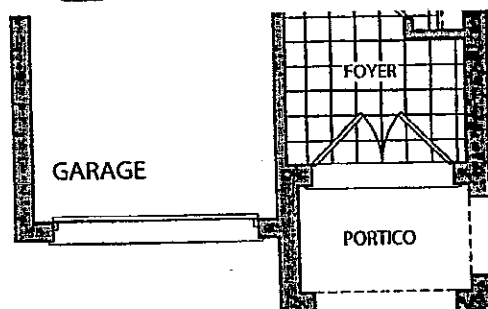
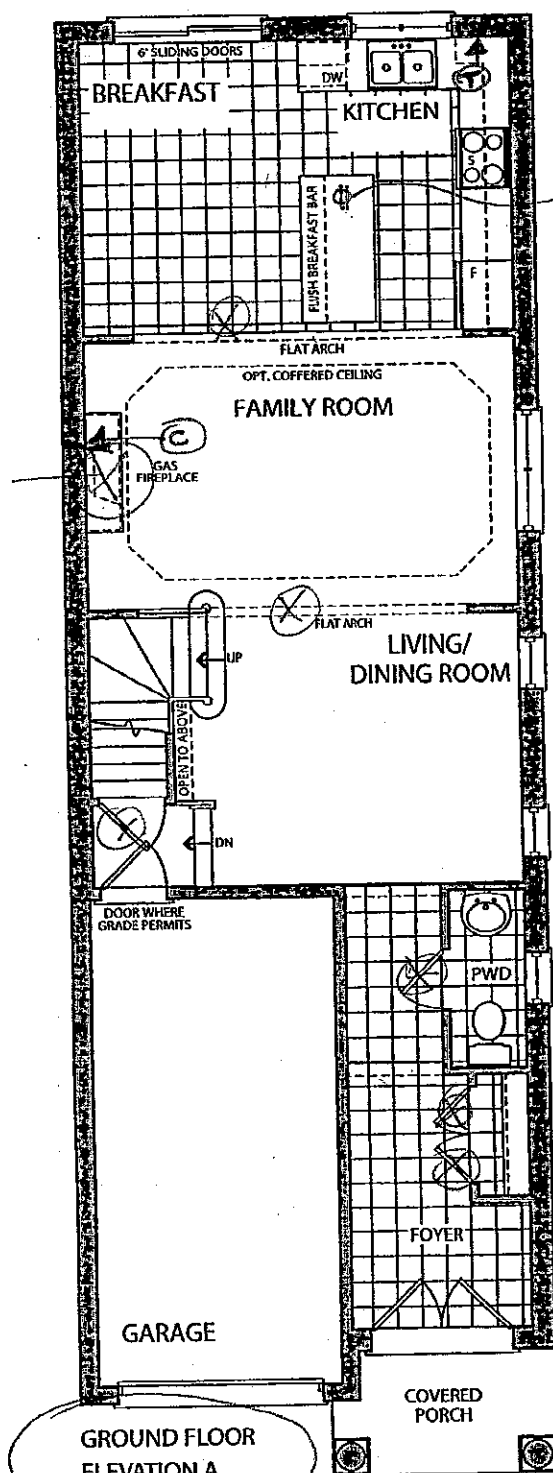

- Ⓢ - CABLE
- Ⓣ - TELEPHONE
- ⓧ - EXTENDED ARCHWAYS + DOOR HEIGHTS

STRUCTURAL
LOT 462

V.H.

July 28, 2016
COLOURS

V.H. 04/12/2016

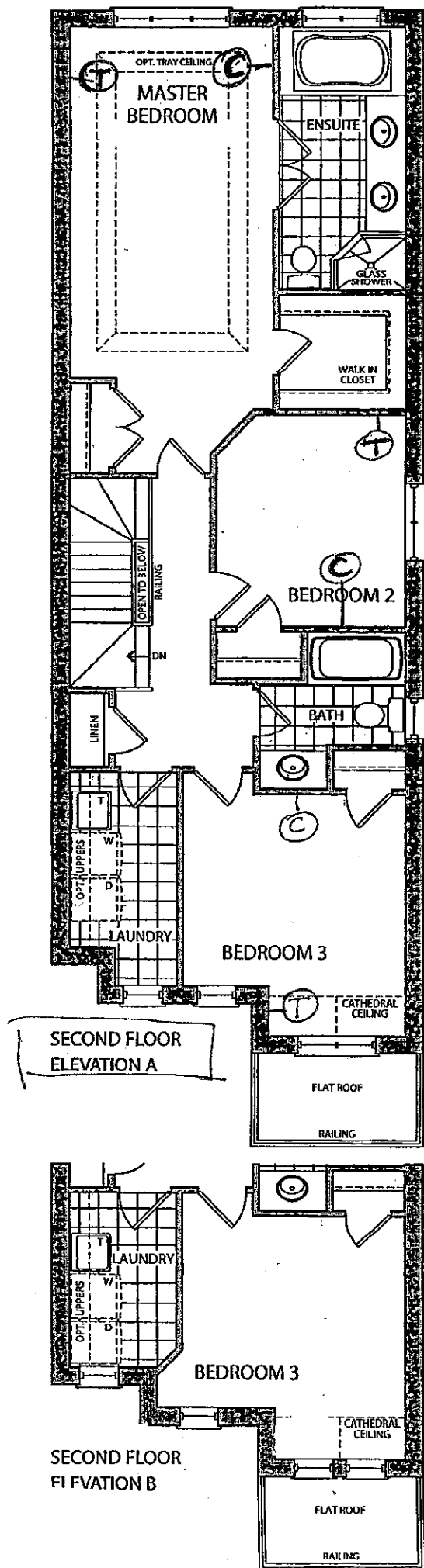

STRUCTURAL
LOT 46 R

(V.H.)

JULY 28, 2016

COVERS

V.H. 04/12/2016

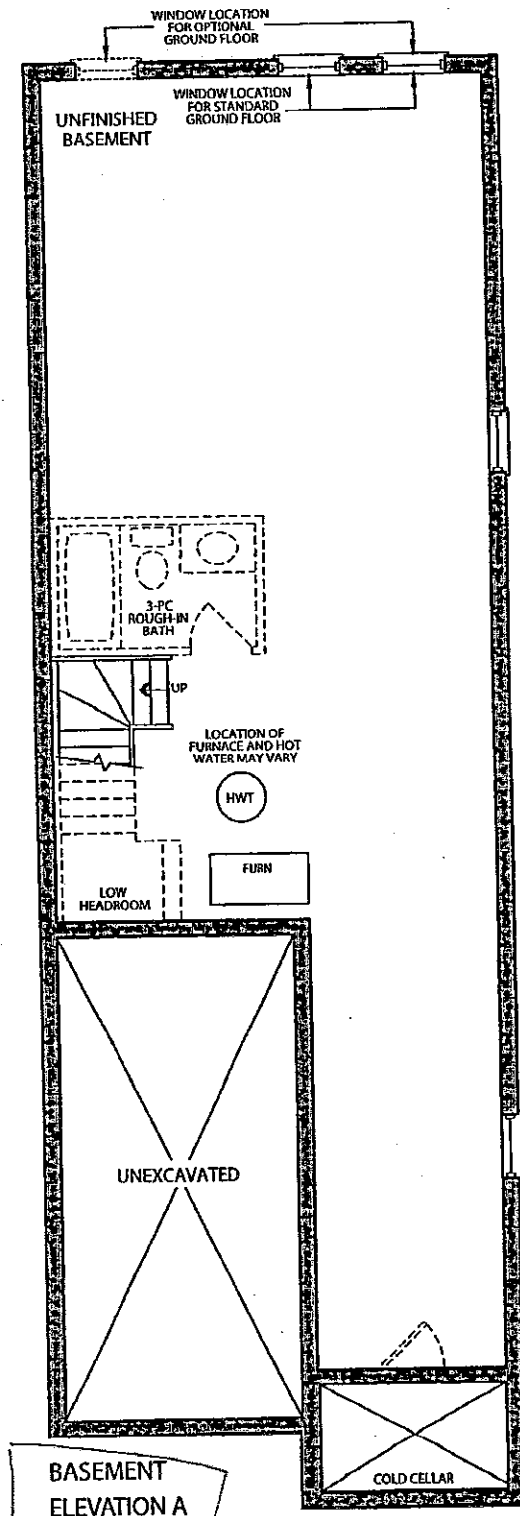

BASEMENT
ELEVATION A

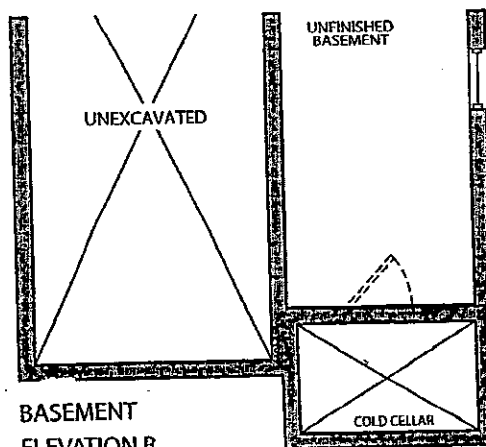

BASEMENT
ELEVATION B

STRUCTURAL
LOT 46R

V.K.

JULY 28, 2016
COLOURS

V.K. 04/12/2016

GOLDPARK
HOMES

CORTINA

KITCHENS INC.

70 Regina Road Woodbridge ON L4L 8L6
905-264-6464

INFORMATION - PVC DOORS

Builder..Gold Park Homes Project...KLEINBURG GREEN Lot #...416R

All cabinets with PVC (Thermofoil) Doors come with melamine gables, panels and kick. The doors, crown moulding and light valance are PVC wrapped. Open shelves incorporated in design will only be available with melamine interiors. There will be variations in colour shades between the PVC parts (doors, crown and Light valance) and the melamine parts (open shelves, Gables , Panels and Kick) due to the difference in material.

Furring Panel with crown moulding to the ceiling is not available on all PVC door styles due to subtle variations in colour shades between the PVC parts (moulding) and the melamine parts (furring panel) due to the difference in material. Grain directions in wood grain pattern melamine , vary between the furring panel, crown moulding (horizontal) and the PVC doors (vertical).

Thank you for your understanding.

I am well informed of this information, and agree to the purchase of the above.

Purchaser: 

Date: 04/12/2016

STANDARD HARDWARE

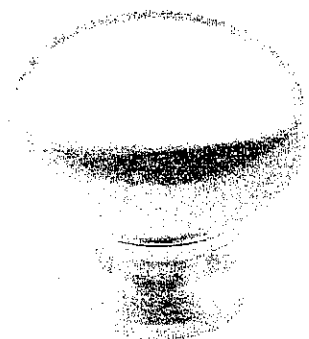

CSI-6



CSI-10



CSI-14



CSI-16



CSI-18

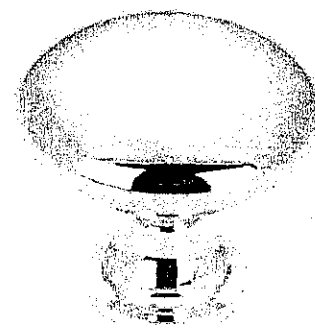

CSI-19

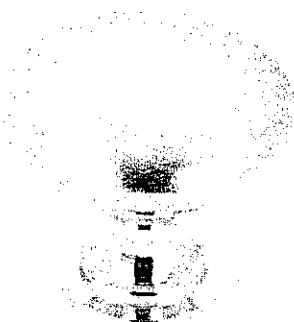

CSI-20

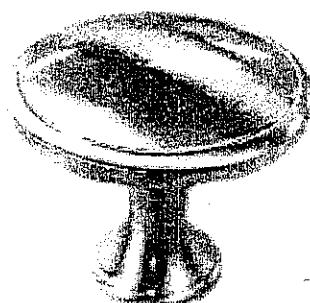

CSI-21

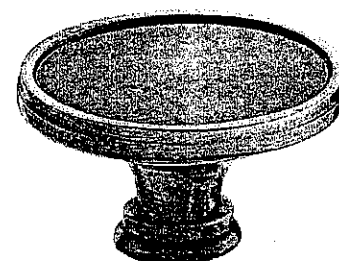

CSI-22

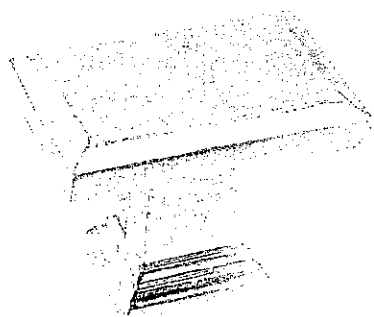

CSI-23

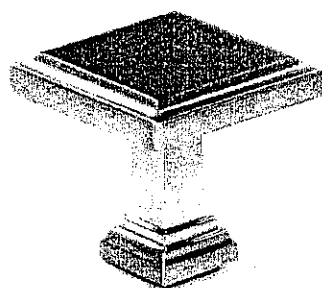

CSI-24

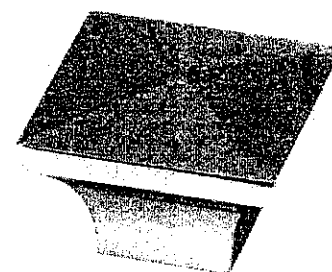

CSI-25

***NOTES:**

- IMAGES ARE FOR QUICK REFERENCE PURPOSES ONLY
- ACTUAL SIZES AND FINISHES AS PER HARDWARE SAMPLE BOARD PROVIDED TO DECOR CENTRE

KLEINBURG GLEN
Lot 46R
V.V.
DEC. 4. 2010.

UPGRADE HARDWARE



CH-32

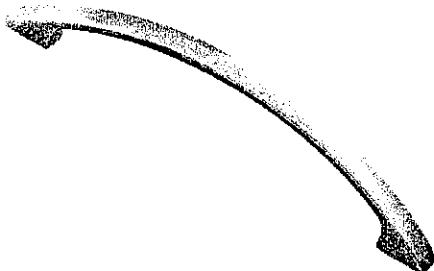

CH-38

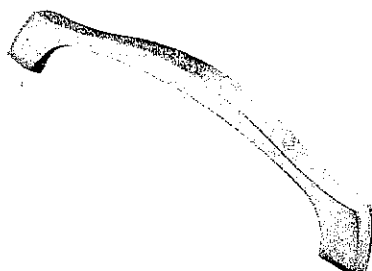

CH-44

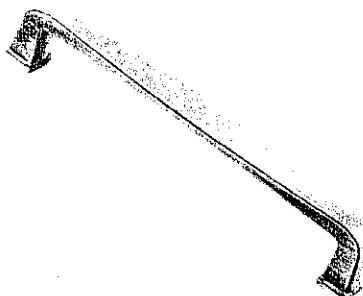

CH-45

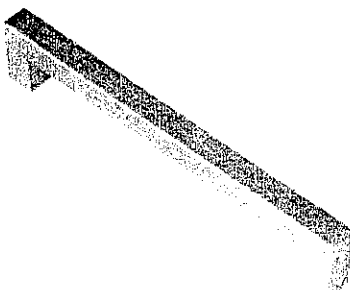

CH-46

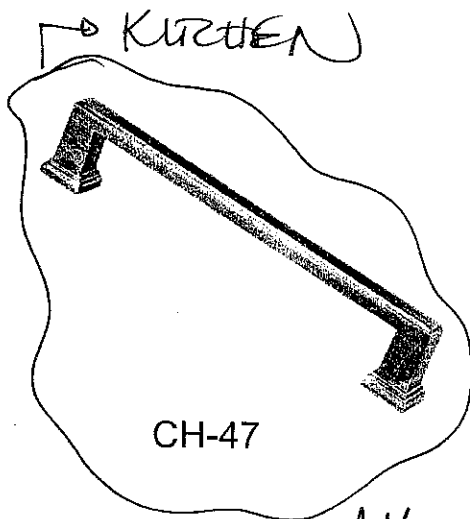

CH-47

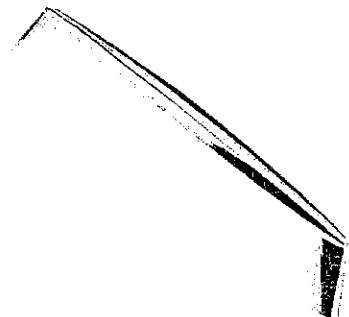

CH-48

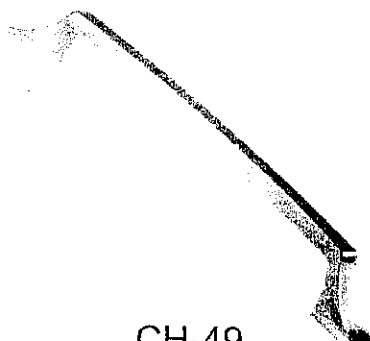

CH-49



CH-50

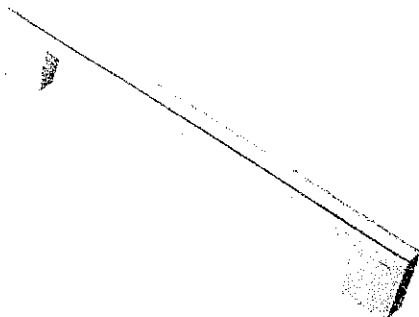

CH-51

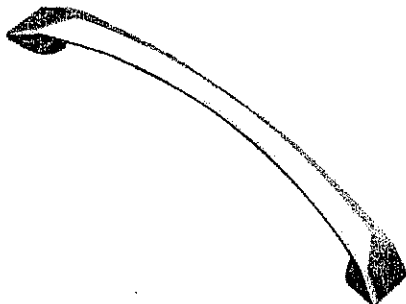

CH-52

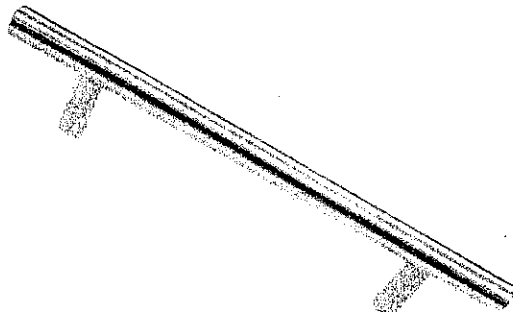

CH-53

*NOTES:

- IMAGES ARE FOR QUICK REFERENCE PURPOSES ONLY
- ACTUAL SIZES AND FINISHES AS PER HARDWARE
- SAMPLE BOARD PROVIDED TO DECOR CENTRE

KLEINBURG GLEN
LOT 46R
V.H.

DEC. 4. 2016

CORTINA

70 Regina Road, Woodbridge, Ontario L4L 8L8
Tel: 905-284-8464 Fax: 905-284-0884
www.CortinaKitchens.com

QUOTATION

Date: 28/06/16

Trade Name: Gold Park Homes

Site location:

Model: 25-2

Address:

Project: Kleinburg Glen

Phase:

This layout has been explained to the purchaser by Cortina Kitchens Inc. and is understood by the purchaser.

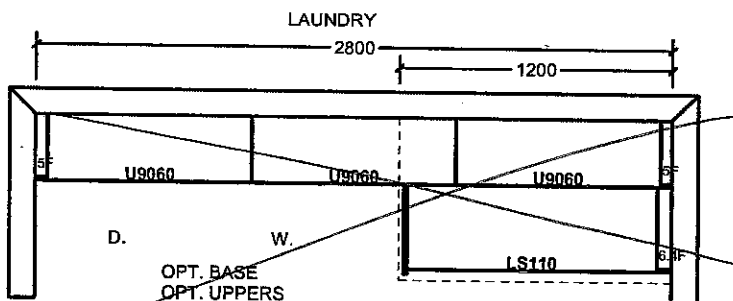
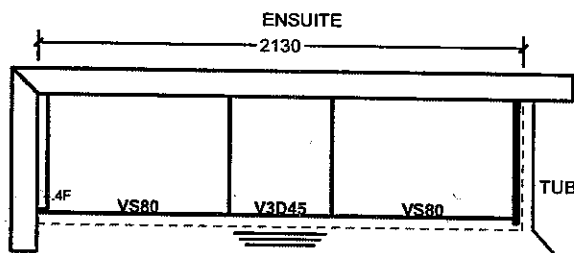
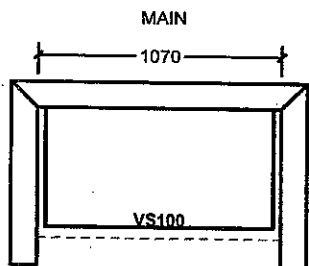
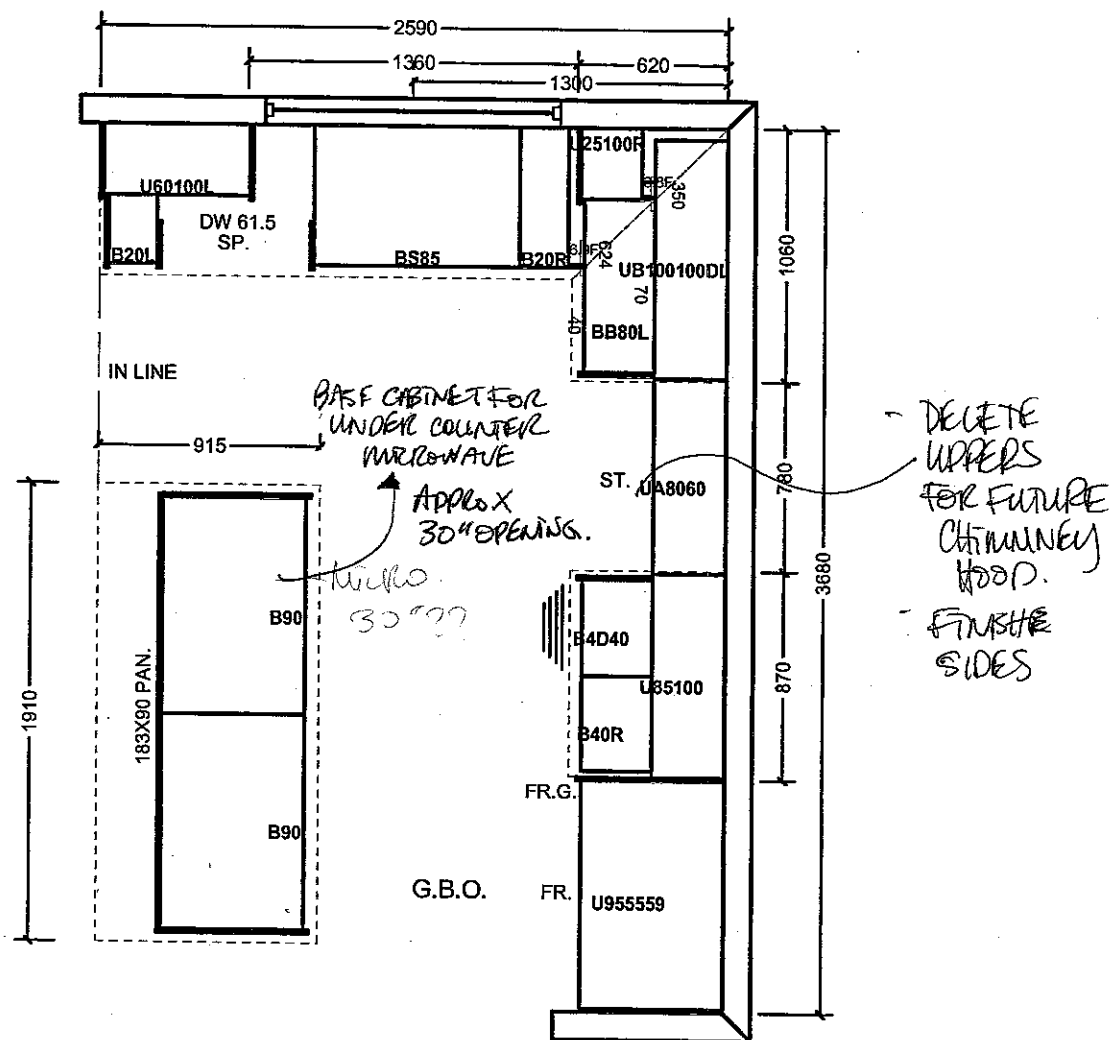

All prices subject to confirmation from head office.
This quotation is subject to the terms & conditions set out

ACCEPTED DATE: DEC. 4, 2016

All agreements are contingent upon strikes, accidents, and delays beyond our control.
Please provide our installer with template for sinkholes or \$150.00 will be charged for callback.

Item A. Wood grain and colour are characteristics of the product. We cannot guarantee that such grain and colour will always match.
Item B. Cortina Kitchens Inc. reserves the right to alter dimensions and make technical changes without notice.

LOT 46R

V.N.

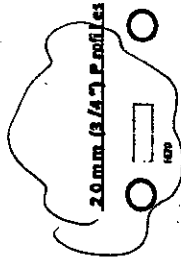

20mm (3/4") Profiles

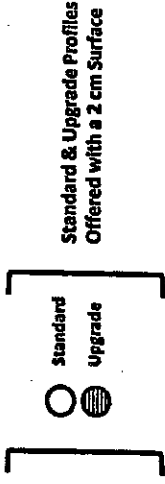

Standard & Upgrade Profiles
Offered with a 2 cm Surface

30mm (1 1/4") Profiles

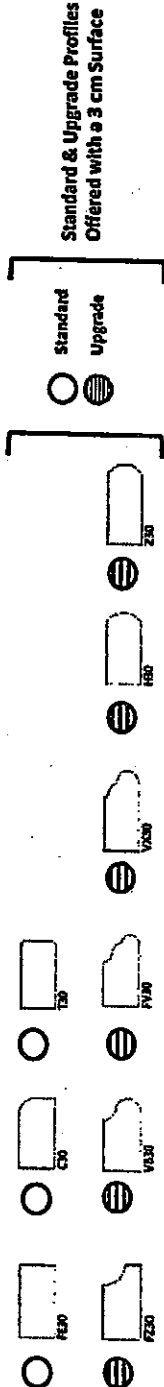

Standard & Upgrade Profiles
Offered with a 3 cm Surface

40mm (1 1/2") Profiles

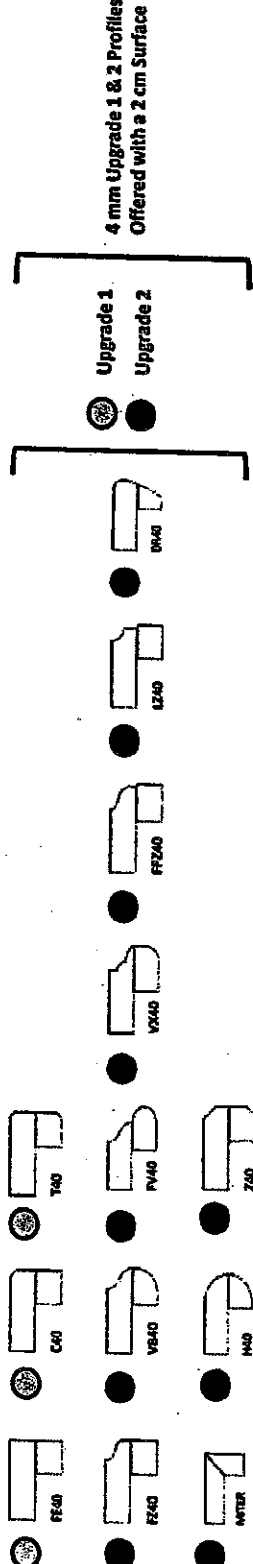

4 mm Upgrade 1 & 2 Profiles
Offered with a 2 cm Surface

Note: All colours may not be available in 30mm at time ordered.
Vendor reserves the right to use 40mm edges (by limitation process).

KUENBURG, GREN
LOT 4602

V.N.

DEC. 4. 2016

KITCHEN
— STD SINK —